

Sales Selection Sheet
Checklist

1 of 54

LOT 7140 Model: 39-3611 B The Beechfield

PURCHASERS: SASIREKA SASITHARAN/

VENDOR: Heathwood Homes (Whitby) Limited

GREAT ROOM WAFFLE CEILING
BUILT-IN KITCHEN LAYOUT
OPTIONAL SEVERY SINK

- ☐ WOB
- ☐ DECK

UPGRADED / MODIFIED ELEVATION

- ☐ CORNER UPGRADE
- ☐ REAR UPGRADE

CEILING UPGRADE - SMOOTH

- ☒ MAIN FLOOR (STD)
- ☒ SECOND FLOOR WITH RESILIENCE CHANEL
- ☒ LOWER LEVEL

ADDITIONAL ROUGH-INS

- ☒ 200 AMP SERVICE (STD)
- ☒ WET BAR ROUGH-IN
- ☒ HUMIDIFIER (STD)
- ☒ AIR CONDITIONING (STD)

GAS ROUGH-IN

- ☒ STOVE
- ☐ DRYER
- ☐ BBQ
- ☐ ADDITIONAL GAS FIREPLACE

KITCHEN HOODFAN VENTING SIZE

- ☒ 6 IN ROUND DUCT (STD WITH APPLIANCE PACKAGE)
- ☐ 7 IN ROUND DUCT

FULL LOWER LEVEL STAIRS	All Oak
UPPER LOWER LEVEL STAIRS	N/A
LOWER LOWER LEVEL STAIRS	N/A
MAIN STAIRS	All Oak

May 15/24

Date

Signature on file

Purchaser:

May 15/24

Date

BRENDA LUKER

Decor Consultant:

Date

Purchaser:

-05- 15 2024

Date

myRover

Heathwood Homes (Whitby) Limited

Approved

Locked Date:

Customer Colours

SASIREKA SASITHARAN/
Project: Country Lane
Unit: 7140, Phase: 7
Model: 39-3611 B The Beechfield

2 of 54
Created: 1/8/2024 10:02:28

Locked:
Closed:

Kitchen/Breakfast

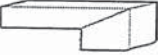
Cabinet Colour/Style	9526	Classic II-TRINITY HG LUMMIA-HG NORTHWIND 771 ***UPG***	
Island Cabinet Colour/Style	9526	Classic II-TRINITY HG LUMMIA-HG NORTHWIND 771 ***UPG***	
Cabinet Hardware	7676	12843-HARDWARE ***STD***	
Countertop	7873	Group 5 -Quartz-Caesarstone-BIANCO DRIFT # 6131-3/4 inch with built-up edge	
Island Countertop	7873	Group 5 -Quartz-Caesarstone-BIANCO DRIFT # 6131-3/4 inch with built-up edge	
Countertop Edge	4005	DOUBLE MITRE 1 1/2 INCH***STD IN KITCHEN ONLY***	
			
Sink	9493	BLANCO QUATRUS U 1 SUPER SINGLE 401248 (min cabinet 36 in)	PG 30
Crumb Vac Color	9483	Vacuum-Crumb Vac (Dust Pan)-Black	
HoodFan	9414	AVN-368CS-AVG 36 inch STAINLESS STEEL CHIMNEY WALL MOUNTED HOODFAN	PG 43-44
Backsplash	1111	N/A *****	
Backsplash Grout	1111	N/A *****	
Backsplash Tile Pattern	1111	N/A *****	

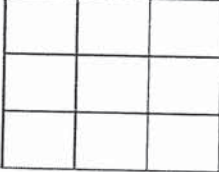
Flooring	8248	OV.CX.WHT.2424.PL-Carrara X-White Polished-24 x 24 ***6***	
Floor Tile Grout	9837	Grout-Warm Grey #5093 ***STD***	
Floor Tile Pattern	3000	STANDARD SQUARE ***STD***	
			

- Purchasers have been advised: standard fridge opening is a minimum 37 3/8 x 73 3/8 inches. Ice Waterline Rough-In is included.
- Standard stove opening is 30 inches and standard dishwasher opening is 24 inches. Any gas stove will require backsplash or stainless steel backing to avoid fire hazards.
- Purchasers acknowledge: Heathwood Homes and its contractors will not be responsible for any kitchen cabinet changes due to appliances dimension changes after sign-off.

Comment

Walk in Pantry

Flooring	8248	OV.CX.WHT.2424.PL-Carrara X-White Polished-24 x 24 ***6***	
Floor Tile Grout	9837	Grout-Warm Grey #5093 ***STD***	
Floor Tile Pattern	3000	STANDARD SQUARE ***STD***	
			

55

Customer Colours

SASIREKA SASITHARAN/
Project: Country Lane
Unit: 7140, Phase: 7
Model: 39-3611 B The Beechfield

3 of 54
Created: 1/8/2024 10:02:28

Locked:
Closed:

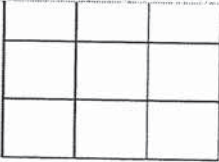

Comment

Servery

Cabinet Colour/Style	9526	Classic II-TRINITY HG LUMMIA-HG NORTHWIND 771 ***UPG***
Cabinet Hardware	7676	12843-HARDWARE ***STD***
Opt. Cabinet Colour/Style - Uppers	9526	Classic II-TRINITY HG LUMMIA-HG NORTHWIND 771 ***UPG***
Opt. Cabinet Hardware - Uppers	7676	12843-HARDWARE ***STD***
Countertop	7873	Group 5 -Quartz-Caesarstone-BIANCO DRIFT # 6131-3/4 inch with built-up edge
Countertop Edge	4005	DOUBLE MITRE 1 1/2 INCH ***STD IN KITCHEN ONLY***



Opt. Sink	9502	Plumbing-KINDRED Sink Collection - Reginox NS1813U/7 Stainless Steel Single Bowl Undermount Sink
Opt. Backsplash	1111	N/A *****
Opt. Backsplash Grout	1111	N/A *****
Opt. Backsplash Tile Pattern	1111	N/A *****

Flooring	8248	OV.CX.WHT.2424.PL-Carrara X-White Polished-24 x 24 ***6***
Floor Tile Grout	9837	Grout-Warm Grey #5093 ***STD***
Floor Tile Pattern	3000	STANDARD SQUARE ***STD***

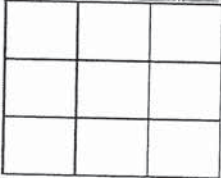

Comment

Foyer

Flooring	8248	OV.CX.WHT.2424.PL-Carrara X-White Polished-24 x 24 ***6***
Floor Tile Grout	9837	Grout-Warm Grey #5093 ***STD***
Floor Tile Pattern	3000	STANDARD SQUARE ***STD***

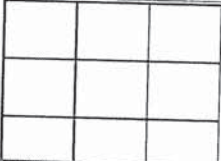

55

Customer Colours

SASIREKA SASITHARAN/
Project: Country Lane
Unit: 7140, Phase: 7
Model: 39-3611 B The Beechfield

4 of 54

666

Created: 1/8/2024 10:02:28

Locked:

Closed:

Comment

Powder Room

Flooring	8248	OV.CX.WHT.2424.PL-Carrara X-White Polished-24 x 24 ***6***
Floor Tile Grout	9837	Grout-Warm Grey #5093 ***STD***
Floor Tile Pattern	3000	STANDARD SQUARE ***STD***

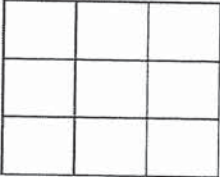

Plumbing Fixture (Colour)	1737	Plumbing Fixtures-WHITE ***STD***
---------------------------	------	-----------------------------------

Comment

Dining Room and Hall

Flooring	9011	Red Oak PEARL-Vintage Red Oak Sculpted-PEWTER-3/4 inch X 5 inch ***STD***
----------	------	---

Comment

Great Room

Flooring	9011	Red Oak PEARL-Vintage Red Oak Sculpted-PEWTER-3/4 inch X 5 inch ***STD***
----------	------	---

Comment

Great Room Fireplace

Type	8869	Majestic MERC32 ***STD***
Mantle	1435	NF 15-Paint Grade Mantle- Flat (Per Plan)-WHITE ***STD***
Surround (STD)	8873	3 pc- 4 inch Marble Surround-Nero Marquina ***STD***

PG 29

- Purchasers have been advised: heat from the FP can damage TV above a FP and items placed on mantle.

- Heathwood and its contractors will not be liable for any damage on items placed/@installed above a FP after closing.

Comment

LOWER LEVEL STANDARD ELECTRICAL FIREPLACE NF 15 MANTLE NO SURROUND

Living Room

Flooring	9011	Red Oak PEARL-Vintage Red Oak Sculpted-PEWTER-3/4 inch X 5 inch ***STD***
----------	------	---

Comment

5.5

Customer Colours

SASIREKA SASITHARAN/
Project: Country Lane
Unit: 7140, Phase: 7
Model: 39-3611 B The Beechfield

5 of 54

66

Created: 1/8/2014 10:12:25

Locked:

Closed:

Study

Flooring

9011

Red Oak PEARL-Vintage Red Oak Sculpted-PEWTER-3/4 inch X 5 inch ***STD***

Comment

9011

Mud Room

Flooring

9255

TR.SP.WHITE.1313 SEMPRE White Matte 13 x 13 ***STD***

Floor Tile Grout

9837

Grout-Warm Grey #5093 ***STD***

Floor Tile Pattern

3000

STANDARD SQUARE ***STD***

Opt. Bench Cabinet Colour/Style

1111

N/A *****

Opt. Bench Cabinet Hardware

1111

N/A *****

Comment

Main Hall

Flooring

9011

Red Oak PEARL-Vintage Red Oak Sculpted-PEWTER-3/4 inch X 5 inch ***STD***

Comment

Upper Hall

Flooring

9011

Red Oak PEARL-Vintage Red Oak Sculpted-PEWTER-3/4 inch X 5 inch ***STD***

Comment

Master Bedroom

Flooring

9250

DY 14253-Dynasty Tex-PROVINCIAL WHITE-40 oz Poly***STD***

Comment

Bedroom 2

Flooring

9250

DY 14253-Dynasty Tex-PROVINCIAL WHITE-40 oz Poly***STD***

Comment

Bedroom 3

Flooring

9250

DY 14253-Dynasty Tex-PROVINCIAL WHITE-40 oz

Comment

5

Customer Colours

SASIREKA SASITHARAN/
Project: Country Lane
Unit: 7140, Phase: 7
Model: 39-3611 B The Beechfield

6 of 54
Created: 2/8/2014 10:12:15

Locked:
Closed:

Poly***STD***

Comment

Bedroom 4

Flooring

9250

DY 14253-Dynasty Tex-PROVINCIAL WHITE-40 oz
Poly***STD***

Comment

Master Ensuite

Cabinet Colour/Style

6247

Viking III-CAMDEN-SHALE GREY CL-MAPLE ***STD***

Cabinet Hardware

2076

181-HARDWARE ***STD***

Countertop

8902

Group 5-Quartz-Caesarstone-GEORGIAN BLUFF-3/4 inch
with built-up edge ***6***

Countertop Edge

4007

GROUP 2 TO 7 - DOUBLE MITRE 1 1/2 INCH ***3***

Floor Tile

9056

OV.ET.IGY.2424.PL-Eterna-Imperial Grey Polished-24 x 24
6

Floor Tile Grout

9837

Grout-Warm Grey #5093 ***STD***

Floor Tile Pattern

3000

STANDARD SQUARE ***STD***

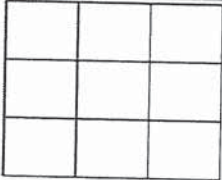

Shower Wall Tile

9431

TH.LT.DGR.1016.GL-Lindt Glossy-Dark Grey-10 x 16 UPG
1 ***UPG***

Shower Wall Tile Grout

9836

Grout-Eggshell #5220 ***STD***

Shower Wall Tile Pattern

3090

VERTICAL STACKED ***STD***



Shower Floor Tile

8665

OD.ON.TPE.0202.MT.N-Ontario Series Mosaic-Taupe
Matte-2 x 2 ***1***

Shower Floor Tile Grout

9840

Grout-Pearl Gray #5019 ***STD***

Shower Floor Tile Pattern

3000

STANDARD SQUARE ***STD***

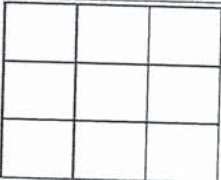

Shower Jamb(s) and Sill(s)

8925

Shower Jamb / Sill-Sky Grey (Light Grey) ***STD***

Plumbing Fixture (colour)

1737

Plumbing Fixtures-WHITE ***STD***

Comment

55

Customer Colours

SASIREKA SASITHARAN/
Project: Country Lane
Unit: 7140, Phase: 7
Model: 39-3611 B The Beechfield

7 of 54
Created: 2/8/2024 10:02:25
Locked:
Closed:

Shared Ensuite

Cabinet Colour/Style	9157	Viking III-SIMCOE-MOONLIGHT-3DL ***STD***
Cabinet Hardware	2076	181-HARDWARE ***STD***
Countertop	8595	Group 2-Quartz-Caesarstone-OCEAN FOAM #6141-3/4 inch with built-up edge ***3***
Countertop Edge	4007	GROUP 2 TO 7 - DOUBLE MITRE 1 1/2 INCH ***3***
Floor Tile	8860	MC.MR.TPE.10HEX-Merino-Taupe-10 inch HEX ***7***
Floor Tile Grout	9840	Grout-Pearl Gray #5019 ***STD***
Floor Tile Pattern	1111	N/A *****

Wall Tile	5420	QT.SP.DGR.0810-Splendour-Dark Grey-8 inch x 10 inch ***STD***
Wall Tile Grout	9836	Grout-Eggshell #5220 ***STD***
Wall Tile Pattern	3090	VERTICAL STACKED ***STD***
Opt. Shower Floor Tile	1111	N/A *****
Opt. Shower Floor Tile Grout	1111	N/A *****
Opt. Shower Floor Tile Pattern	1111	N/A *****

Opt. Shower Jamb(s) and Sill(s)	1111	N/A *****
Plumbing Fixture (colour)	1737	Plumbing Fixtures-WHITE ***STD***
Comment		

Ensuite 2

Cabinet Colour/Style	9111	Viking III-SIMCOE ORCHID 3DL ***STD***
Cabinet Hardware	2076	181-HARDWARE ***STD***
Countertop	9814	Group 2-Quartz-Caesarstone-ASHEN MARBLE # 7512-3/4 inch B/U MITERED EDGE ***2***
Countertop Edge	4010	GROUP 1 - SINGLE POLISHED STRAIGHT EDGE 3/4 INCH ***1***
Floor Tile	8838	OV.ET.WHT.1224.PL-Eterna-Carrara White Polished-12 x 24 See Tile Direction on Sketch Page ***5***
Floor Tile Grout	9827	Grout-Warm Gray #5002 ***STD***

54

5

Customer Colours

SASIREKA SASITHARAN/
Project: Country Lane
Unit: 7140, Phase: 7
Model: 39-3611 B The Beechfield

Created: 27/01/2024 10:02:25

Locked:

Closed:

Floor Tile Grout	9837	Grout-Warm Grey #5093	STD
Floor Tile Pattern	3050	SIDE TO SIDE ***STD***	
		<div></div>	
Shower Wall Tile	9440	TH.CT.LGR.0812.GL-Construct-Light Grey Glossy-8 x 12 UPG 1 ***UPG***	
Shower Wall Tile Grout	9836	Grout-Eggshell #5220 ***STD***	
Shower Wall Tile Pattern	3090	VERTICAL STACKED ***STD***	
		<div></div>	
Shower Floor Tile	8661	OD.ON.SWT.0202.MT.N-Ontario Series Mosaic-Snow White Matte-2 x 2 ***STD***	
Shower Floor Tile Grout	9836	Grout-Eggshell #5220 ***STD***	
Shower Floor Tile Pattern	3000	STANDARD SQUARE ***STD***	
		<div></div>	
Shower Jamb(s) and Sill(s)	8923	Shower Jamb / Sill-Thassos White ***STD***	
Plumbing Fixture (colour)	1737	Plumbing Fixtures-WHITE ***STD***	
Comment			

Laundry Room

Flooring	8228	GE.NA.TPE.1313-New Albion-Taupe-13 x 13 ***STD***	
Floor Tile Grout	9837	Grout-Warm Grey #5093 ***STD***	
Floor Tile Pattern	3000	STANDARD SQUARE ***STD***	
		<div></div>	
Opt. Cabinet Colour/Style - Uppers	1111	N/A *****	
Opt. Cabinet Hardware - Uppers	1111	N/A *****	
Opt. Cabinet Colour/Style - Base	9111	VIKING III SIMCOE ORCHID 3DL ***UPG***	
Opt. Cabinet Hardware - Base	2076	181-HARDWARE ***STD***	
Comment	WITH STANDARD PALOMO POLAR ETCHINGS 6698-45 FORMICA COUNTERTOP AND STANDARD DROP IN SINK AND FAUCET		

Lower Level Recreation Room

Flooring	9250	DY 14253 -Dynasty Tex-PROVINCIAL WHITE-40 oz Poly***STD***	
Comment	LOWER LEVEL STANDARD ELECTRICAL FIREPLACE NF 15 MANTLE NO SURROUND		

Customer Colours

SASIREKA SASITHARAN/
Project: Country Lane
Unit: 7140, Phase: 7
Model: 39-3611 B The Beechfield

9 of 54

665

Created: 9/8/2024 10:02:25

Locked:

Closed:

LOWER LEVEL STANDARD ELECTRICAL FIREPLACE NF 15 MANTLE NO SURROUND

PG 29

Lower Level Bedroom

Flooring	9250	DY 14253 -Dynasty Tex-PROVINCIAL WHITE-40 oz Poly***STD***
Comment		

Lower Level Bathroom

Cabinet Colour/Style	9533	Viking III-TRINITY LPL-FREE SPIRIT L580K ***STD***									
Cabinet Hardware	2076	181-HARDWARE ***STD***									
Countertop	8796	6698-46-Countertop-PALOMA POLAR ETCHINGS FINISH-Formica ***STD***									
Countertop Edge	1111	N/A *****									
Floor Tile	5490	GE.LR.GRY.1313-La Riserva-Grey-13 x 13 ***STD***									
Floor Tile Grout	9837	Grout-Warm Grey #5093 ***STD***									
Floor Tile Pattern	3000	STANDARD SQUARE ***STD***									
		<table><tr><td></td><td></td><td></td></tr><tr><td></td><td></td><td></td></tr><tr><td></td><td></td><td></td></tr></table>									
Wall Tile	5442	GE.NA.GRY.0810-New Albion-Grey-8 x 10 ***STD***									
Wall Tile Grout	9836	Grout-Eggshell #5220 ***STD***									
Wall Tile Pattern	3090	VERTICAL STACKED ***STD***									
		<table><tr><td></td><td></td><td></td><td></td></tr><tr><td></td><td></td><td></td><td></td></tr></table>									
Opt. Shower Floor Tile	1111	N/A *****									
Opt. Shower Floor Tile Grout	1111	N/A *****									
Opt. Shower Floor Tile Pattern	1111	N/A *****									

Opt. Shower Jamb(s) and Sill(s)	1111	N/A *****
Plumbing Fixture (colour)	1737	Plumbing Fixtures-WHITE ***STD***
Comment		

Main Stairs

Type	1712	Oak Stairs ***STD***
------	------	----------------------

55

Customer Colours

SASIREKA SASITHARAN/
Project: Country Lane
Unit: 7140, Phase: 7
Model: 39-3611 B The Beechfield

Created: 2/8/2024 10:02:28
Locked:
Closed:

Colour	7922	Eclipse (Pewter) STAIN TO COMPLIMENT HARDWOOD AND WILL VARY FROM FLOORING ***99***
Handrail/Pickets/Posts Type	8148	Single Collar Alt. Plain w/ Shoes with 3 1/2 Square/Cap Post(s)-BLACK ***STD***
Handrail/Pickets/Posts Colour	7922	Eclipse (Pewter) STAIN TO COMPLIMENT HARDWOOD AND WILL VARY FROM FLOORING ***99***
Custom Stain/Paint	1111	N/A *****
Landing(s)	9011	Red Oak PEARL-Vintage Red Oak Sculpted-PEWTER-3/4 inch X 5 inch ***STD***
Opt. Carpet Runner	1111	N/A *****
Comment		

Lower Level Stairs

Type	1712	Oak Stairs ***STD***
Colour	7922	Eclipse (Pewter) STAIN TO COMPLIMENT HARDWOOD AND WILL VARY FROM FLOORING ***99***
Handrail/Pickets/Posts Type	8148	Single Collar Alt. Plain w/ Shoes with 3 1/2 Square/Cap Post(s)-BLACK ***STD***
Handrail/Pickets/Posts Colour	7922	Eclipse (Pewter) STAIN TO COMPLIMENT HARDWOOD AND WILL VARY FROM FLOORING ***99***
Custom Stain/Paint	1111	N/A *****
Landing(s)	9011	Red Oak PEARL-Vintage Red Oak Sculpted-PEWTER-3/4 inch X 5 inch ***STD***
Opt. Carpet Runner	1111	N/A *****
Comment		

Throughout

Switches and Plug	5796	Decora White Switches and Plugs ***STD***
Thresholds	2232	Metal Thresholds ***STD***
Underpad	1079	500 Series-Underpad ***STD***
Trim Size	8704	5 1/4 inch Baseboard and 3 inch Integrated Backbend Casings ***UPG*** / ***STD in Singles***
Trim - Paint Colour	1716	Trim-WHITE ***STD***
Walls - Paint Colour	1717	22-Wall-WARM GREY ***STD***
Comment		

Purchaser:

SASIREKA SASITHARAN

Date

Decor Consultant



Date

Customer Colours

SASIREKA SASITHARAN/
Project: Country Lane
Unit: 7140, Phase: 7
Model: 39-3611 B The Beechfield

11 of 54

Created: 2/8/2024 10:02:25
Locked:
Closed:

Purchaser:			
	Date	Country Lane	Date Approved
			
			-05- 15 2024



CONSTRUCTION SUMMARY

Lot: 7140
Model: 39-3611 B The Beechfield
Project/Phase: Country Lane / 7

Offer Worksheet	Supply and Install Central Air Conditioning Note:
Offer Worksheet	Two Men and a Truck Credit of One Thousand Dollars (\$1000.00) for moving services only, Into your Heathwood Home (No Cash Value) The Credit is Non-Transferable and cannot be combined with any other offer. - Singles Note:
Offer Worksheet	Classic Collection: Five Appliances: SS Fridge, Stove, Dishwasher: White Front Loader Washer/Dryer (Singles) Note:
Offer Worksheet	ADDED BY AMENDMENT - The Purchaser(s) acknowledge that they have NOT been referred by an existing Heathwood Homeowner and therefor are not entitled to a referral fee under Heathwood Homes Referral program. Note:



CONSTRUCTION SUMMARY

Lot: 7140
Model: 39-3611 B The Beechfield
Project/Phase: Country Lane / 7

APPLIANCES

Invoice	Qty.	Description
1666 389,736 02Aug24 **	1.0	KITCHEN - GRANITE - GRANITE CUTOUT w/ STRAIGHT EDGE POLISH TO ACCOMMODATE COOK TOP SKETCH # 2 SEE COOKTOP SPECS
1666 390,078 02Aug24	1.0	KITCHEN - AVN-368CS-AVG 36 inch STAINLESS STEEL CHIMNEY WALL MOUNTED HOODFAN ***UPG*** SEE SPECS CABINETRY-delete stove uppers; ELECTRICAL-Notify; HEATING/AIR CONDITIONING-Duct Size remains 6

CABINETRY

Invoice	Qty.	Description
1666 389,736 02Aug24 **	1.0	KITCHEN - GRANITE - GRANITE CUTOUT w/ STRAIGHT EDGE POLISH TO ACCOMMODATE COOK TOP SKETCH # 2 SEE COOKTOP SPECS
1666 389,832 02Aug24 **	1.0	SERVERY ONLY - PLUMBING - BAR SINK - COMPLETE BAR SINK FOR SERVERY INCLUDES PLUMBING ROUGH-IN AND MOEN ALIGN BAR PREP FAUCET (MODEL: 5965) AND REGINOX NS1813U/7 UNDERMOUNT SINK (INCLUDING GRANITE SINK CUTOUT/POLISH) - SKETCH # 3 SEE SPECS CONCRETE AND DRAIN-CONNECT WITH EXISTING STACK; GRANITE-See Specs for Bar Sink
1666 389,219 02Aug24	1.0	Kitchen - Cabinetry - CLASSIC II - Kitchen - UPG
1666 389,227 02Aug24	1.0	KITCHEN - Cabinetry - CLASSIC II - Opt. Built-Ins - UPG SKETCH # 3 DRYWAL-Notify; FRAMING-Modify Bulkhead; GRANITE-delete partial countertop due to Built-in; PAINTING-
1666 389,224 02Aug24	1.0	Servery - Cabinetry - CLASSIC II - Opt. Servery Uppers - UPG DRYWAL-Notify; FRAMING-Modify Bulkhead; PAINTING-Notify
1666 02Aug24 NoCat	1.0	KITCHEN - INSTALL BUILT IN OVEN/MICRO TO BESIDE FRIDGE SEE SKETCH # 3
1666 389,866 02Aug24 **	1.0	KITCHEN - PLUMBING - KITCHEN SINK UPGRADE - BLANCO QUATRUS U 1 SUPER SINGLE 401248 (MIN CABINET 36 IN) SEE SPEC CABINETRY-upgraded kitchen sink; GRANITE-upgraded kitchen sink
1666 389,271 02Aug24 **	1.0	Master Ensuite - Granite - Countertop upgrade with 4” backsplash - 3/4” GROUP 5 with double edge - Master Ensuite - UPG CABINETRY-delete std countertop; GRANITE-see upgraded single hole faucet and undermount sink
1666 389,257 02Aug24 **	1.0	Ensuite 2 - Granite - Countertop upgrade with 4” backsplash - 3/4” GROUP 2 with double edge - Ensuite 2 - UPG CABINETRY-delete std countertop; GRANITE-see upgraded single hole faucet and undermount sink
1666 389,258 02Aug24 **	1.0	Shared Bathroom - Granite - Countertop upgrade with 4” backsplash - 3/4” GROUP 2 with double edge - Shared Bathroom - UPG CABINETRY-delete std countertop; GRANITE-see upgraded single hole faucet and undermount sink



CONSTRUCTION SUMMARY

Lot: 7140
Model: 39-3611 B The Beechfield
Project/Phase: Country Lane / 7

CABINETRY

Invoice	Qty.	Description
1666 390,078 02Aug24 **	1.0	KITCHEN - AVN-368CS-AVG 36 inch STAINLESS STEEL CHIMNEY WALL MOUNTED HOODFAN ***UPG*** SEE SPECS CABINETRY-delete stove uppers; ELECTRICAL-Notify; HEATING/AIR CONDITIONING-Duct Size remains 6
1666 390,313 02Aug24	1.0	- CABINETRY-15B-45CM WIDE PULL-OUT DOOR BASE CABINET WASTE/RECYCLE CENTRE WITH SOFT-CLOSE ([2] 35L BINS) (AVAILABLE ONLY WITH 45CM WIDE CABINET) CLASSIC INSTALL IN ISLAND SKETCH # 3
1666 390,370 02Aug24	1.0	SHARED BATHROOM - CABINETRY-15D-VANITY BANK OF DRAWERS (3) (MAX. WIDTH 55CM) VIKING BETWEEN SINKS SKETCH # 4 AND 5
1666 390,370 02Aug24	2.0	ENSUITE 2 - CABINETRY-15D-VANITY BANK OF DRAWERS (3) (MAX. WIDTH 55CM) VIKING EACH SIDE OF SINK SKETCH # 4 AND 5



CONSTRUCTION SUMMARY

Lot: 7140
Model: 39-3611 B The Beechfield
Project/Phase: Country Lane / 7

CERAMICS

Invoice	Qty.	Description
1666 391,141 02Aug24	1.0	FOYER - CERAMICS - FOYER FLOOR - UG 6
1666 391,144 02Aug24	1.0	KITCHEN/SERVERY/BREAKFAST - CERAMICS - KITCHEN/BREAKFAST/SERVERY/PANTRY FLOOR - UG 6
1666 391,142 02Aug24	1.0	POWDER ROOM - CERAMICS - POWDER FLOOR - UG 6
1666 391,147 02Aug24	1.0	MASTER ENSUITE - CERAMICS - PRINCIPAL BATH FLOOR - UG 6
1666 390,620 02Aug24	1.0	- CERAMICS - PRINCIPAL SHOWER SHOWER FLOOR - UG 1
1666 391,042 02Aug24	1.0	ENSUITE 2 - CERAMICS - MAIN BATH 2 FLOOR - UG 5
1666 390,618 02Aug24	1.0	ENSUITE 2 - CERAMICS - MAIN BATH 2 WALL - UG 1
1666 391,249 02Aug24	1.0	SHARED BATHROOM - CERAMICS - MAIN/SHRD BATH FLOOR - UG 7
1666 390,619 02Aug24	1.0	MASTER ENSUITE - CERAMICS - PRINCIPAL SHOWER WALL - UG 1
1666 02Aug24 NoCat	1.0	KITCHEN - DELETE STD BACKSPLASH - AS PER PURCHASER REQUEST

CONCRETE AND DRAIN

Invoice	Qty.	Description
1666 389,832 02Aug24 **	1.0	SERVERY ONLY - PLUMBING - BAR SINK - COMPLETE BAR SINK FOR SERVERY INCLUDES PLUMBING ROUGH-IN AND MOEN ALIGN BAR PREP FAUCET (MODEL: 5965) AND REGINOX NS1813U/7 UNDERMOUNT SINK (INCLUDING GRANITE SINK CUTOUT/POLISH) - SKETCH # 3 SEE SPECS CONCRETE AND DRAIN-CONNECT WITH EXISTING STACK; GRANITE-See Specs for Bar Sink
1666 389,561 02Aug24 **	1.0	FINISHED BASEMENT FAMILY (REC) ROOM - PLUMBING - OPTIONAL EXTRA - ROUGH- IN FOR FUTURE WET BAR - SKETCH # 1 CONCRETE AND DRAIN-Additional Stack



CONSTRUCTION SUMMARY

Lot: 7140
Model: 39-3611 B The Beechfield
Project/Phase: Country Lane / 7

DRYWALL

Invoice	Qty.	Description
1666 389,227 02Aug24 **	1.0	KITCHEN - Cabinetry - CLASSIC II - Opt. Built-Ins - UPG SKETCH # 3 DRYWAL-Notify; FRAMING-Modify Bulkhead; GRANITE-delete partial countertop due to Built-in; PAINTING-
1666 389,224 02Aug24 **	1.0	Servery - Cabinetry - CLASSIC II - Opt. Servery Uppers - UPG DRYWAL-Notify; FRAMING-Modify Bulkhead; PAINTING-Notify
1666 389,245 02Aug24	1.0	- Drywall - Smooth Ceilings - Second Floor - UPG ELECTRICAL-Drop electrical boxes; PAINTING-Paint smooth ceiling
1666 389,244 02Aug24	1.0	- Drywall - Smooth Ceilings - Basement - UPG PAINTING-Paint smooth ceiling
1666 389,287 02Aug24 **	1.0	GREAT ROOM - Waffle Ceiling - Install Waffle Ceiling. Coffered ceiling is standard - GREAT ROOM - UPG SKETCH # 2 DRYWALL-Standard Smooth Ceiling inside waffles;FRAMING-Strap Ceiling for Potlights;PAINTING-Paint mou (6)



CONSTRUCTION SUMMARY

Lot: 7140
Model: 39-3611 B The Beechfield
Project/Phase: Country Lane / 7

ELECTRICAL

Invoice	Qty.	Description
1666 389,736 02Aug24 **	1.0	KITCHEN - GRANITE - GRANITE CUTOUT w/ STRAIGHT EDGE POLISH TO ACCOMMODATE COOK TOP SKETCH # 2 SEE COOKTOP SPECS
1666 389,800 02Aug24 **	1.0	KITCHEN - HEATING/AIR - ROUGH-IN GAS LINE FOR GAS STOVE AT MAIN FLOOR (SEE SPECS) (HOOK-UP NOT INCLUDED) LEAVE STANDARD 120 VOLT ELECTRICAL OUTLET ON A SEPARATE CIRCUIT. * SPECIFY IF STANDARD 220V WILL STAY OR BE RELOCATED STANDARD 240 V 40 AMP RELOCATED TO B/i MICRO/OVEN LOCATION BESIDE FRIDGE ELECTRICAL-Notify SKETCH # 3 SEE COOKTOP SPECS
1666 390,528 02Aug24	1.0	KITCHEN - ELECTRICAL-RELOCATION OF SWITCHES/LIGHTS (MUST SPECIFY LOCATION)-NOTE: PLUGS CANNOT BE RELOCATED- MUST PURCHASE ADDITIONAL OUTLET. RELOCATE STD 220V PLUG TO BUILT IN OVEN / MICRO LOCATION BESIDE FRIDGE SKETCH # 3
1666 389,245 02Aug24 **	1.0	- Drywall - Smooth Ceilings - Second Floor - UPG ELECTRICAL-Drop electrical boxes; PAINTING-Paint smooth ceiling
1666 390,528 02Aug24	1.0	KITCHEN - ELECTRICAL-RELOCATION OF SWITCHES/LIGHTS (MUST SPECIFY LOCATION)-NOTE: PLUGS CANNOT BE RELOCATED- MUST PURCHASE ADDITIONAL OUTLET. RELOCATE STD KITCHEN LIGHT TO OVER ISLAND SKETCH # 2
1666 390,496 02Aug24	2.0	KITCHEN - ELECTRICAL-CEILING ROUGH-IN (CAPPED) 2 ADDITIONAL OVER ISLAND SKETCH # 2
1666 390,519 02Aug24	4.0	- ELECTRICAL-OUTLET-EXTRA WALL INTERIOR OUTLET ON EXISTING CIRCUIT (DOES NOT INCLUDE KITCHEN OUTLETS) GREAT RM - 1 X OVER FIREPLACE APPROX 70" +/- FROM FF DINING RM - 2 - INSTALL APPROX 66" FF LIVING RM - 1 - INSTALL APPROX 66" FF SEE SKETCH # 2
1666 390,495 02Aug24	1.0	- ELECTRICAL-CAR CHARGER-ADDITIONAL OUTLET 30AMP/240V 2 POLE BREAKER AND FEMALE OUTLET FOR FUTURE ELECTRICAL CAR CHARGER, PLEASE SPECIFY LOCATION SKETCH # 2
1666 390,078 02Aug24 **	1.0	KITCHEN - AVN-368CS-AVG 36 inch STAINLESS STEEL CHIMNEY WALL MOUNTED HOODFAN ***UPG*** SEE SPECS CABINETRY-delete stove uppers; ELECTRICAL-Notify; HEATING/AIR CONDITIONING-Duct Size remains 6
1666 395,461 02Aug24	1.0	- CLASSIC COLLECTION SCHEDULE A - Choice of 20 LED (3000K) pot lights in finished areas (Second Floor Potlight(s) Require Smooth Ceiling) DRYWALL-Drywall Ceiling cutouts for potlights FRAMING-Frame to accommodate potlights 4 X KITCHEN - 1 SWITCH - RELOCATE STD TO OVER ISLAND 4 X BRKFST - 1 SWITCH - DO NOT DELETE STD LIGHT 6 X GREAT RM - 1 SWITCH 4 X DINING RM - 1 SWITCH - DO NOT DELETE STD LIGHT 2 X HALLWAY IN FRONT IN FRONT OF STAIRS - 1 SWITCH - DELETE STD LIGHT SKETCH # 2



CONSTRUCTION SUMMARY

Lot: 7140
Model: 39-3611 B The Beechfield
Project/Phase: Country Lane / 7

FRAMING

Invoice	Qty.	Description
1666 389,227 02Aug24 **	1.0	KITCHEN - Cabinetry - CLASSIC II - Opt. Built-Ins - UPG SKETCH # 3 DRYWAL-Notify; FRAMING-Modify Bulkhead; GRANITE-delete partial countertop due to Built-in; PAINTING-
1666 389,224 02Aug24 **	1.0	Servery - Cabinetry - CLASSIC II - Opt. Servery Uppers - UPG DRYWAL-Notify; FRAMING-Modify Bulkhead; PAINTING-Notify
1666 389,287 02Aug24 **	1.0	GREAT ROOM - Waffle Ceiling - Install Waffle Ceiling. Coffered ceiling is standard - GREAT ROOM - UPG SKETCH # 2 DRYWALL-Standard Smooth Ceiling inside waffles;FRAMING-Strap Ceiling for Potlights;PAINTING-Paint mou (6)



CONSTRUCTION SUMMARY

Lot: 7140
Model: 39-3611 B The Beechfield
Project/Phase: Country Lane / 7

GRANITE

Invoice	Qty.	Description
1666 389,736 02Aug24	1.0	KITCHEN - GRANITE - GRANITE CUTOUT w/ STRAIGHT EDGE POLISH TO ACCOMMODATE COOK TOP SKETCH # 2 SEE COOKTOP SPECS
1666 389,832 02Aug24 **	1.0	SERVERY ONLY - PLUMBING - BAR SINK - COMPLETE BAR SINK FOR SERVERY INCLUDES PLUMBING ROUGH-IN AND MOEN ALIGN BAR PREP FAUCET (MODEL: 5965) AND REGINOX NS1813U/7 UNDERMOUNT SINK (INCLUDING GRANITE SINK CUTOUT/POLISH) - SKETCH # 3 SEE SPECS CONCRETE AND DRAIN-CONNECT WITH EXISTING STACK; GRANITE-See Specs for Bar Sink
1666 389,227 02Aug24 **	1.0	KITCHEN - Cabinetry - CLASSIC II - Opt. Built-Ins - UPG SKETCH # 3 DRYWAL-Notify; FRAMING-Modify Bulkhead; GRANITE-delete partial countertop due to Built-in; PAINTING-
1666 389,866 02Aug24 **	1.0	KITCHEN - PLUMBING - KITCHEN SINK UPGRADE - BLANCO QUATRUS U 1 SUPER SINGLE 401248 (MIN CABINET 36 IN) SEE SPEC CABINETRY-upgraded kitchen sink; GRANITE-upgraded kitchen sink
1666 389,738 02Aug24	5.0	- GRANITE - GRANITE CUTOUT WITH STRAIGHT EDGE POLISH TO ACCOMMODATE UNDER MOUNT VANITY SINK MST ENSUITE X 2 ENS 2 SHARED X 2 SEE SINK SPECS
1666 389,271 02Aug24	1.0	Master Ensuite - Granite - Countertop upgrade with 4” backsplash - 3/4” GROUP 5 with double edge - Master Ensuite - UPG CABINETRY-delete std countertop; GRANITE-see upgraded single hole faucet and undermount sink
1666 389,822 02Aug24 **	5.0	- PLUMBING - AMERICAN STANDARD - SINK - UNDERMOUNT SINK - BOXE - WHITE - MODEL 0315 000 020 MST ENSUITE X 2; ENS 2; SHARED X 2 SEE SPEC GRANITE-See Specs
1666 389,270 02Aug24	1.0	Kitchen/Servery - Granite - Countertop - 3/4” GROUP 5 with double edge - Kitchen/Servery - UPG
1666 389,257 02Aug24	1.0	Ensuite 2 - Granite - Countertop upgrade with 4” backsplash - 3/4” GROUP 2 with double edge - Ensuite 2 - UPG CABINETRY-delete std countertop; GRANITE-see upgraded single hole faucet and undermount sink
1666 389,258 02Aug24	1.0	Shared Bathroom - Granite - Countertop upgrade with 4” backsplash - 3/4” GROUP 2 with double edge - Shared Bathroom - UPG CABINETRY-delete std countertop; GRANITE-see upgraded single hole faucet and undermount sink



CONSTRUCTION SUMMARY

Lot: 7140
Model: 39-3611 B The Beechfield
Project/Phase: Country Lane / 7

HEATING / AIR CONDITIONING

Invoice	Qty.	Description
1666 389,800 02Aug24	1.0	KITCHEN - HEATING/AIR - ROUGH-IN GAS LINE FOR GAS STOVE AT MAIN FLOOR (SEE SPECS) (HOOK-UP NOT INCLUDED) LEAVE STANDARD 120 VOLT ELECTRICAL OUTLET ON A SEPARATE CIRCUIT. * SPECIFY IF STANDARD 220V WILL STAY OR BE RELOCATED STANDARD 240 V 40 AMP RELOCATED TO B/i MICRO/OVEN LOCATION BESIDE FRIDGE ELECTRICAL-Notify SKETCH # 3 SEE COOKTOP SPECS
1666 390,078 02Aug24 **	1.0	KITCHEN - AVN-368CS-AVG 36 inch STAINLESS STEEL CHIMNEY WALL MOUNTED HOODFAN ***UPG*** SEE SPECS CABINETRY-delete stove uppers; ELECTRICAL-Notify; HEATING/AIR CONDITIONING-Duct Size remains 6

PAINTING

Invoice	Qty.	Description
1666 389,227 02Aug24 **	1.0	KITCHEN - Cabinetry - CLASSIC II - Opt. Built-Ins - UPG SKETCH # 3 DRYWAL-Notify; FRAMING-Modify Bulkhead; GRANITE-delete partial countertop due to Built-in; PAINTING-
1666 389,224 02Aug24 **	1.0	Servery - Cabinetry - CLASSIC II - Opt. Servery Uppers - UPG DRYWAL-Notify; FRAMING-Modify Bulkhead; PAINTING-Notify
1666 389,245 02Aug24 **	1.0	- Drywall - Smooth Ceilings - Second Floor - UPG ELECTRICAL-Drop electrical boxes; PAINTING-Paint smooth ceiling
1666 389,244 02Aug24 **	1.0	- Drywall - Smooth Ceilings - Basement - UPG PAINTING-Paint smooth ceiling
1666 389,287 02Aug24 **	1.0	GREAT ROOM - Waffle Ceiling - Install Waffle Ceiling. Coffered ceiling is standard - GREAT ROOM - UPG SKETCH # 2 DRYWALL-Standard Smooth Ceiling inside waffles;FRAMING-Strap Ceiling for Potlights;PAINTING-Paint mou (6)



CONSTRUCTION SUMMARY

Lot: 7140
Model: 39-3611 B The Beechfield
Project/Phase: Country Lane / 7

PLUMBING

Invoice	Qty.	Description
1666 389,832 02Aug24	1.0	SERVERY ONLY - PLUMBING - BAR SINK - COMPLETE BAR SINK FOR SERVERY INCLUDES PLUMBING ROUGH-IN AND MOEN ALIGN BAR PREP FAUCET (MODEL: 5965) AND REGINOX NS1813U/7 UNDERMOUNT SINK (INCLUDING GRANITE SINK CUTOUT/POLISH) - SKETCH # 3 SEE SPECS CONCRETE AND DRAIN-CONNECT WITH EXISTING STACK; GRANITE-See Specs for Bar Sink
1666 389,866 02Aug24	1.0	KITCHEN - PLUMBING - KITCHEN SINK UPGRADE - BLANCO QUATRUS U 1 SUPER SINGLE 401248 (MIN CABINET 36 IN) SEE SPEC CABINETRY-upgraded kitchen sink; GRANITE-upgraded kitchen sink
1666 389,822 02Aug24	5.0	- PLUMBING - AMERICAN STANDARD - SINK - UNDERMOUNT SINK - BOXE - WHITE - MODEL 0315 000 020 MST ENSUITE X 2; ENS 2; SHARED X 2 SEE SPEC GRANITE-See Specs
1666 389,561 02Aug24	1.0	FINISHED BASEMENT FAMILY (REC) ROOM - PLUMBING - OPTIONAL EXTRA - ROUGH- IN FOR FUTURE WET BAR - SKETCH # 1 CONCRETE AND DRAIN-Additional Stack

WAFFLE CEILING

Invoice	Qty.	Description
1666 389,287 02Aug24	1.0	GREAT ROOM - Waffle Ceiling - Install Waffle Ceiling. Coffered ceiling is standard - GREAT ROOM - UPG SKETCH # 2 DRYWALL-Standard Smooth Ceiling inside waffles;FRAMING-Strap Ceiling for Potlights;PAINTING-Paint mou (6)



Sales Selection Sheet
Country Lane

22 of 54

PURCHASER: SASIREKA SASITHARAN

TEL:

LOT / UNIT 7140	PHASE 7	MODEL 39-3611 B The Beechfield	
--------------------	------------	-----------------------------------	--

- 1. This Sales Selection Sheet when properly executed forms part of our Agreement of Purchase and Sale.
- 2. All extras and upgrades listed above are subject to Construction Progress and Architectural and Municipal requirements.
- 3. In the event the Vendor is unable to incorporate the work approved above in the construction of the house for any reason whatsoever, the Vendor will not be liable to the Purchaser in any way. The monies paid for any changes or optional extras not proceeded with shall be returned to the Purchaser, without interest. The cost of options or extras is non-refundable in all other circumstances. If for any reason whatsoever the Agreement of Purchase and Sale is not completed, the total cost of work approved above will be retained by the Vendor.
- 4. The Vendor reserves the right to substitute above materials and equipment with that of equal or better quality.
- 5. Purchaser acknowledges that items may not be exactly as shown. Variations from the Vendor's samples may occur in finished materials due to normal production processes. Vendor is not responsible for shade difference which may occur from different dye lots or wood grains. Variations from the Vendor's samples will occur with natural materials such as wood, marble, granite, hardwood and brick.
- 6. The Vendor reserves the right to select Grout & Thresholds that best suits the Tile selected.
- 7. Selections will not be processed unless signed by Heathwood Homes Head Office.
- 8. The selections made on this schedule are final and cannot be changed once submitted.
- 9. The Purchaser has checked and acknowledges the accuracy of this schedule.

Payment Summary

Paid By	Amount
Total Payment:	

PURCHASER:

Signature on file

15-May-24

SASIREKA SASITHARAN

DATE

BRENDA LUKER

15-May-24

Decor Consultant

DATE

-05-15 2024

myRosen

Date Approved

Heathwood Homes (Whitby) Limited



39-3611 ELEV. B

Sketch #1

The Beechfield

SMOOTH
CEILING

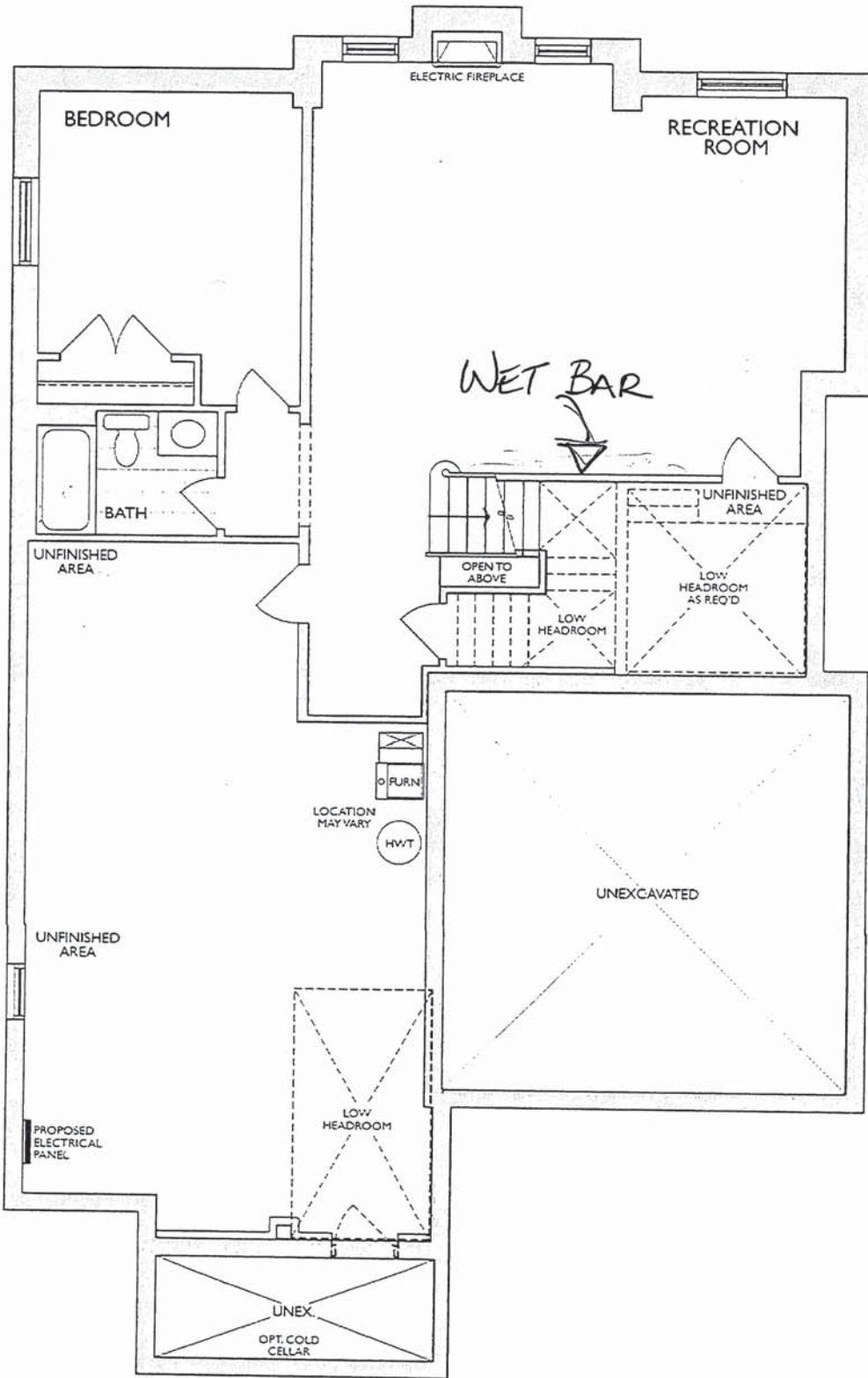

FINISHED LOWER LEVEL
ELEV. B

55

* Floor plan may vary due to grading conditions.



39-3611 ELEV. B

Sketch #2 The Beechfield

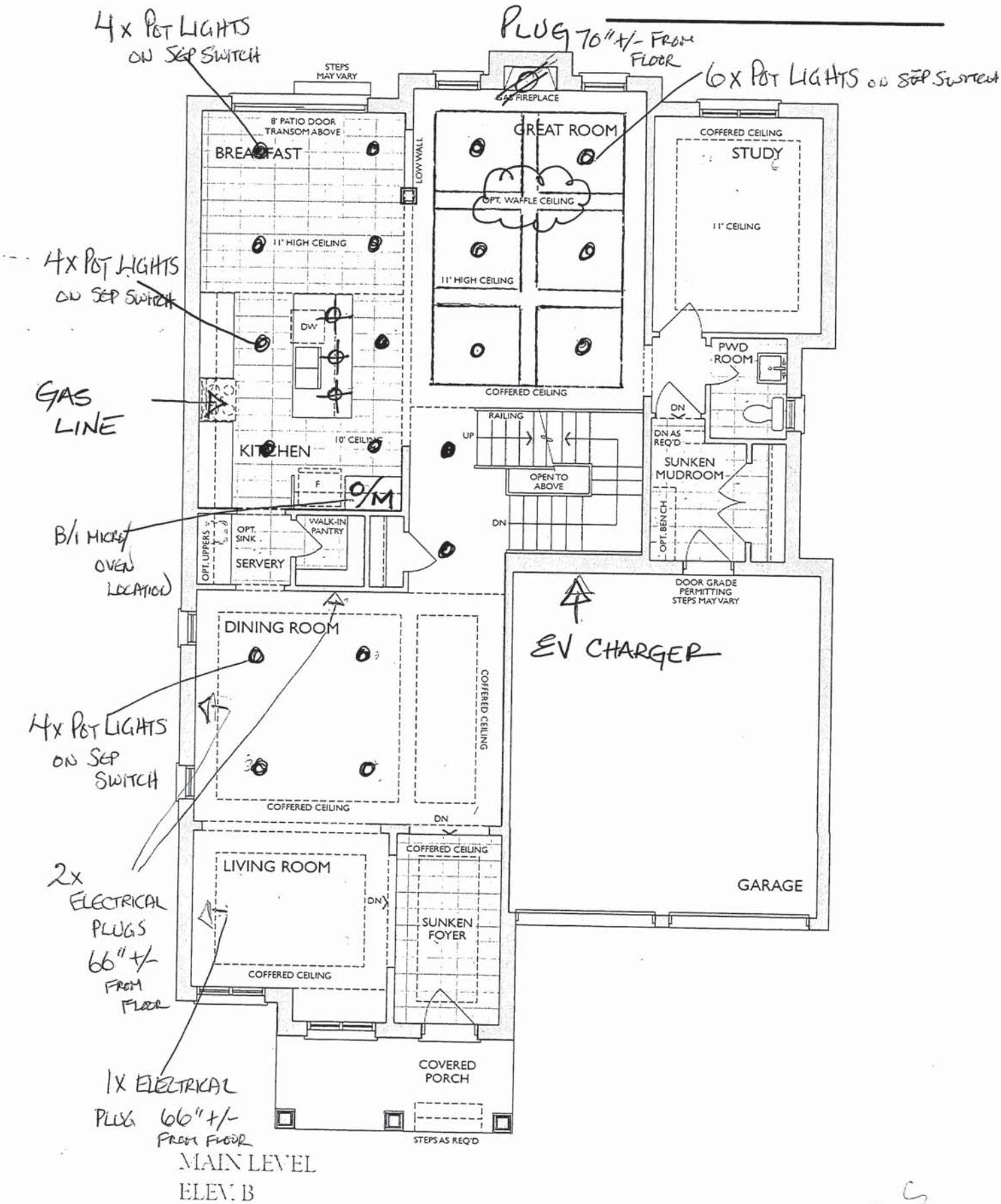

* Floor plan may vary due to grading conditions.



Heathwood Homes
Country Lane, Whitby

Model:
39-3611 (4505)
The Classic Series

- Standard Features:
- Tandem Box Soft Close Drawers
 - Blumotion Hinges for Doors
 - Crown Moulding & fascia
 - Top Drawer Construction
 - Deep Fridge Upper w/Deep Panel
 - Tall upper Cabinets

Drawn By: Sepideh B
Date: July 12, 2023
Revision:
Scale: Not To Scale

Approved By Builder:

Date:

25 of 54

Sketch #35

Project: Country Lane
Unit: 7140, Phase: 7
Model: 39-3611 B The Beechfield

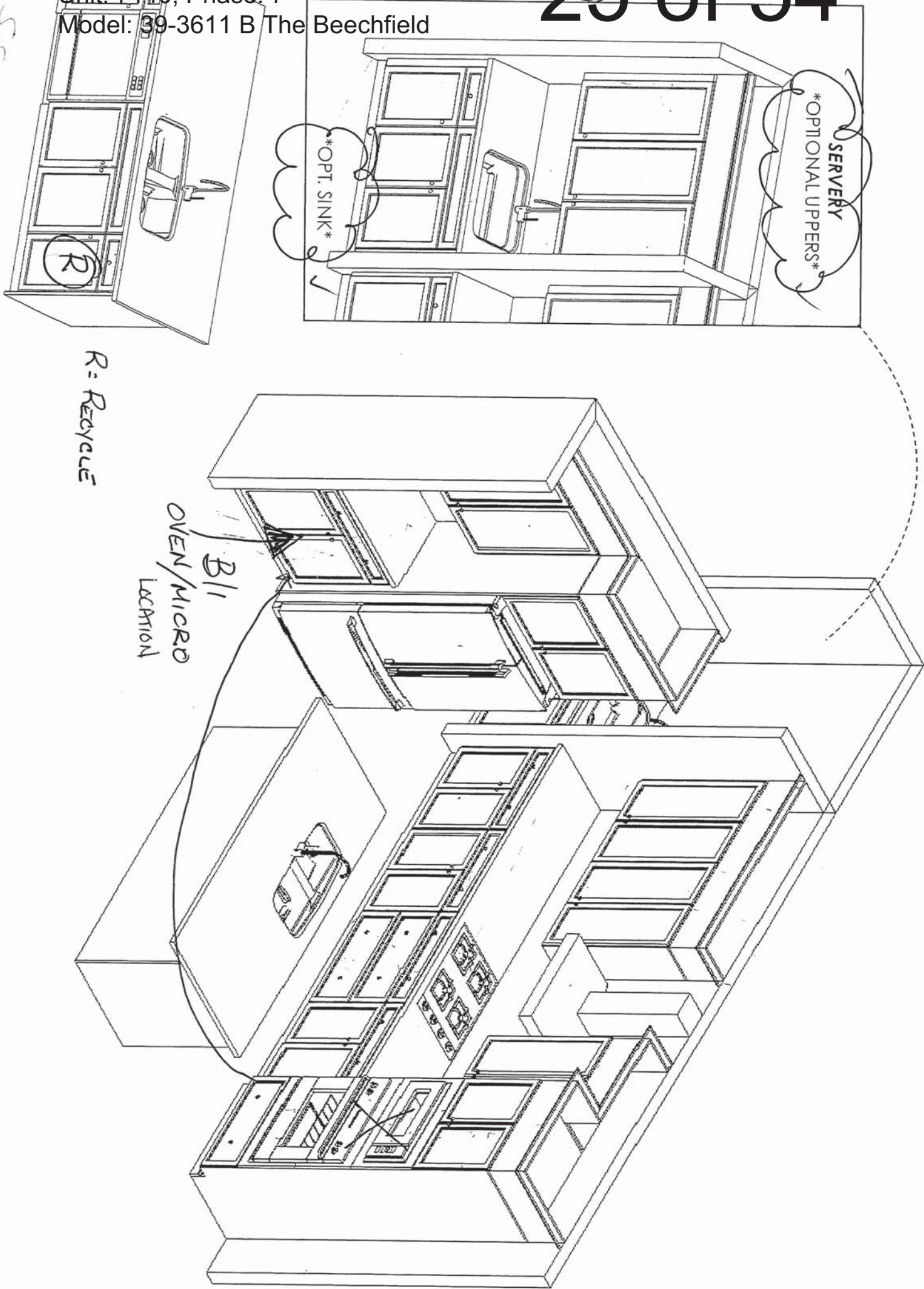

R = Recycle

B/I
OVEN/MICRO
LOCATION

This sketch is for DESIGN PURPOSES ONLY – It is not meant to be an exact rendition.



39-3611 ELEV. B

The Beechfield

Sketch #4

SMOOTH
CEILING

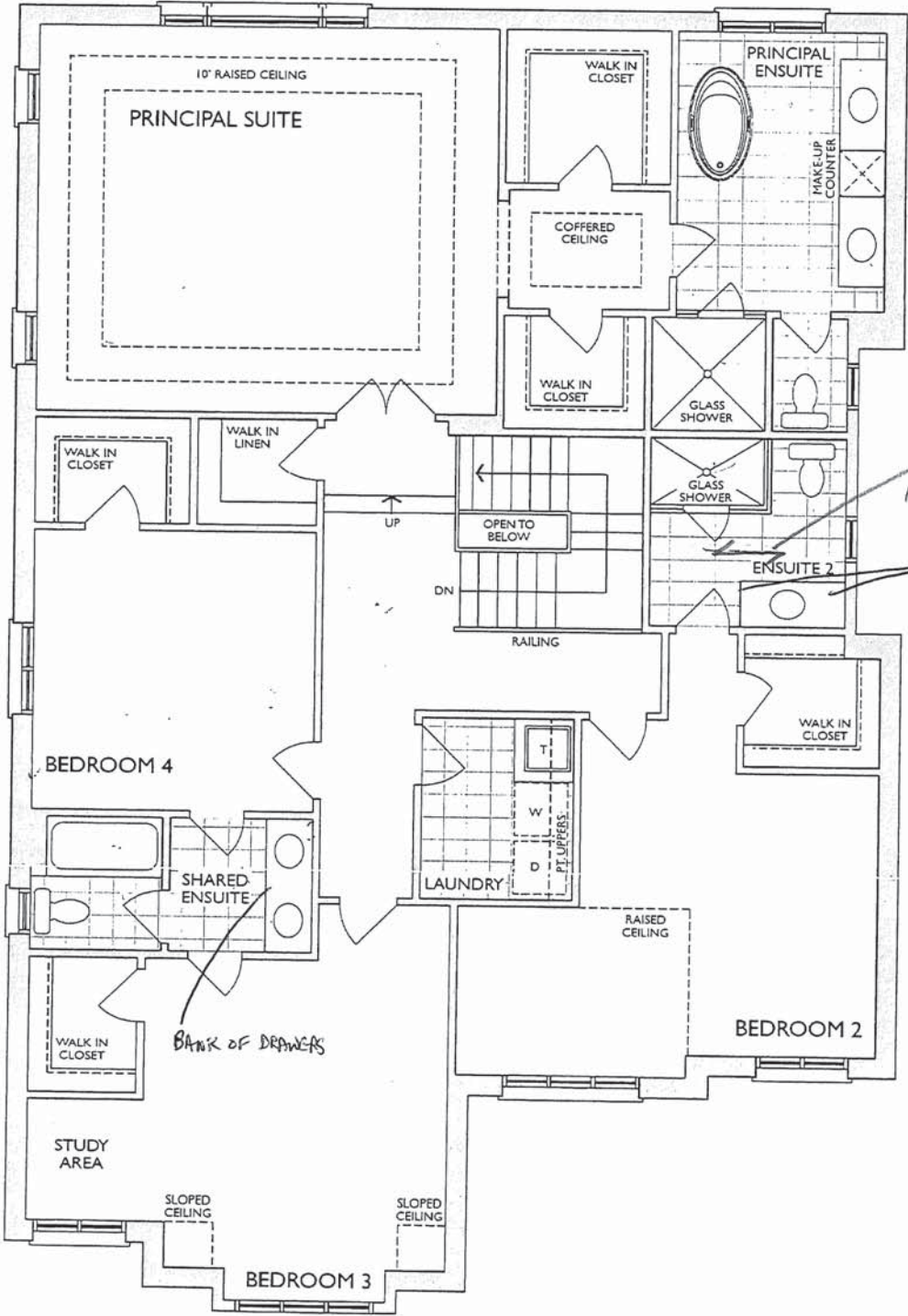

SECOND LEVEL
ELEV. B

55

* Floor plan may vary due to grading conditions.

Sketch #5

MASTER ENSUITE
2nd FLR

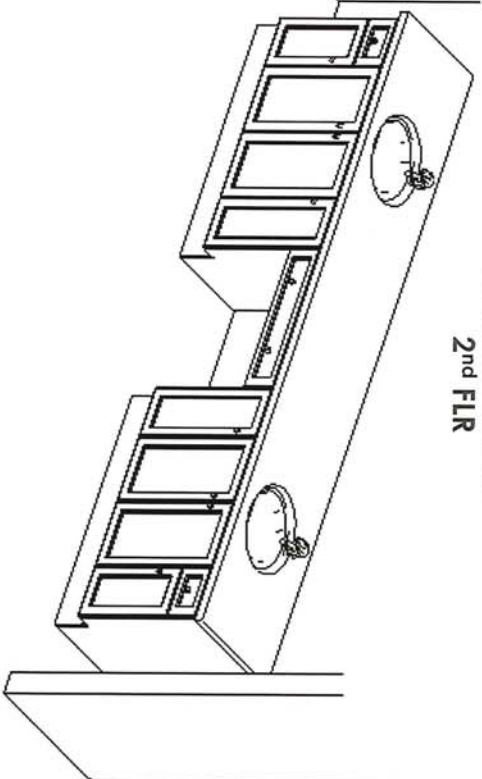

MAIN/SHARED BATH
2nd FLR

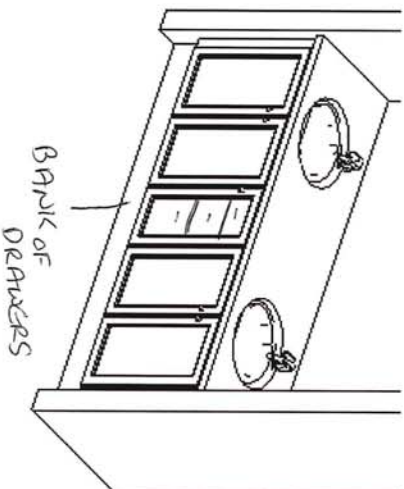

ENSUITE 2
2nd FLR

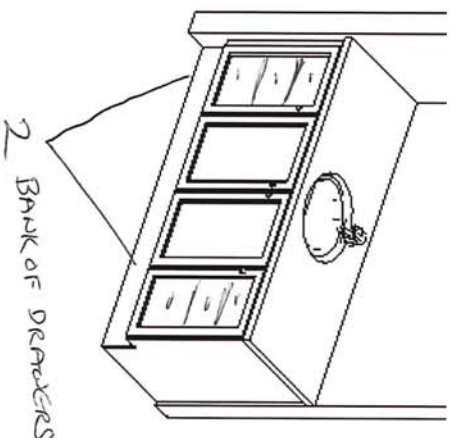

LAUNDRY
2nd FLR

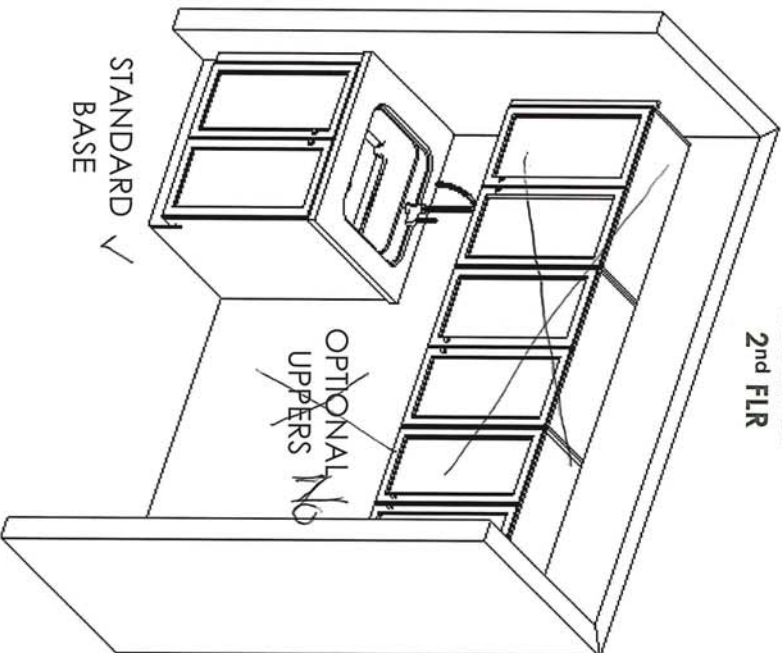

BASEMENT
BATH

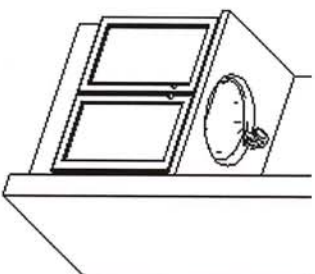

This sketch is for DESIGN PURPOSES ONLY – It is not meant to be an exact rendition.



F R E N D E L
K I T C H E N S L I M I T E D
1350 Sheppard Drive, Mississauga, ON L4W 1G5

HEATHWOOD HOMES
COUNTRY LANE, WHITBY
TRADITIONS
MODEL: 39-3611 (4505)
THE CLASSIC SERIES

Standard Features:

- Blum Metabox Drawers
- Blum Clip On Hinges
- Top Drawer in Master Ensuite

Drawn By: Sepideh B
Date: April 8, 2024
Revision:
Scale: Not To Scale

Approved By Builder:

Date:

18" Wide cabinet : B17-45cm wide pull-out door base cabinet waste/recycle centre with soft-close ([2] 35L bins per unit) (available only with 45cm wide cabinet)



Euro-Cargo Recycling Center

Make your life easier with the Euro-Cargo sliding waste bin. Full-extension slides give you complete access to your bins. The integrated lid remains fixed inside your cabinet, and once the system is closed, the lid covers the bins to prevent odors from escaping.

Product # 3614100 [View list](#)

Total Capacity **76 l**

76 l

93 l

Interior Dimensions Required - Width **412 to 418 mm**

412 to 418 mm

462 to 468 mm

562 to 568 mm

Bin Quantity **2**

2

4

Bin Capacity **2 x 38 liters**

2 x 38 L + 2 x 8.5 L

2 x 38 liters

24" wide cabinet : B18-60cm wide pull-out door base cabinet waste/recycle centre with soft-close ([4] bins total, including [2] 35L) (available only with 60cm or 24" wide cabinet)

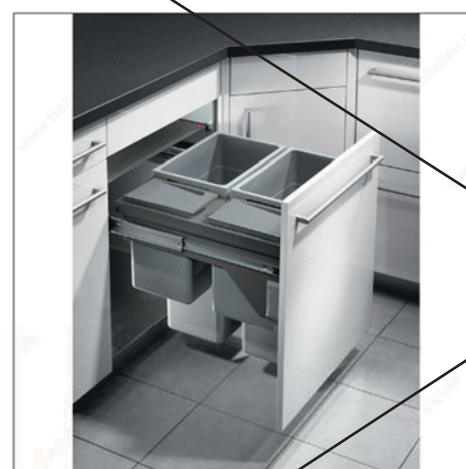

Euro-Cargo Recycling Center

Make your life easier with the Euro-Cargo sliding waste bin. Full-extension slides give you complete access to your bins. The integrated lid remains fixed inside your cabinet, and once the system is closed, the lid covers the bins to prevent odors from escaping.

Product # 361460100 [View list](#)

Total Capacity **93 l**

76 l

93 l

Interior Dimensions Required - Width **562 to 568 mm**

412 to 418 mm

462 to 468 mm

562 to 568 mm

Bin Quantity **4**

2

4

Bin Capacity **2 x 38 L + 2 x 8.5 L**

2 x 38 L + 2 x 8.5 L

2 x 38 liters



NFAS NF15 Mantel

- GREAT ROOM
RECREATION ROOM

S-S



Sink Specifications

Colour	SKU
brushed finish	401248

Design and planning tips

- Min cabinet size: 36 in (915 mm)
- Bowl Depth: 9 in (230.0 mm)

Specifications:
Installation clips, Sink template, Installation instructions, 3 ½" (90 mm) stainless steel strainer

Depending on cabinet construction, a different cabinet size may be required. Consult the cabinet manufacturer.
Codes/Standards: ASME A112.19.3-2017/ CSA B45.4-17

Optional Accessories

Elevated Grid	406346
Workstation	406344
CapFlow Strainer Cover	517666
Ash Cutting Board	406345
Sink Grid	402125

QUATRUS U 1 SUPER SINGLE
Stainless steel brushed finish

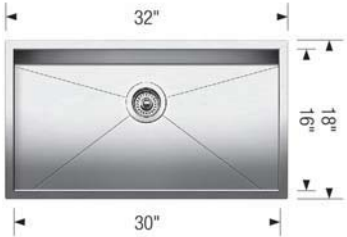

Warranty
Limited lifetime warranty on all sinks and faucets. One-year warranty on all accessories and soap dispensers.

Code/Standards Compliance
BLANCO sinks and faucets are third-party tested and certified to CSA, cUPC, ANSI/ASME, IAPMO and NSF standards and listed by applicable certification bodies. For more information on individual product listings, contact our office or listing organization.

 Need support? Learn more by watching our sink & faucet How-to videos:
<https://www.blanco.com/ca-en/support/how-to-videos/how-to-videos-for-sinks/>

	BLANCO Canada Inc 100 Corporation Drive Brampton ON L6S 6B5	Tel & Fax Tel: 905-494-2400 Toll free: 1-877-425-2626 Fax: 905-494-2425 Toll free: 1-877-825-2626
---	---	---

While BLANCO strives to provide accurate information, all images and dimensions in this document are intended for reference only and are subject to change at any time without notice. This document is not intended for use as an installation guide. For technical installation details, refer to installation instructions provided with the product. BLANCO assumes no responsibility for the use of superseded or voided specifications.



There is more than 1 version of this model.
Page down to identify the version you have.

FAUCET DESCRIPTION

- Reflex™ pulldown system offers smooth operation, easy movement and secure docking
- Power Clean™ spray technology
- Metal construction with various finishes identified by suffix
- Duralock™ connect installation
- Pulldown spray with 68" braided hose
- Flexible supply lines with 3/8" compression fittings
- High arc spout provides height and reach to fill or clean large pots while pulldown wand provides the maneuverability for cleaning or rinsing
- 360° rotating spout
- Faucet designed for handle to be mounted on right side only

OPERATION

- Lever style handle
- Temperature controlled by 100° arc of handle travel
- Operates with less than 5 lbs. of force
- Operates in stream or spray mode in the pullout or retracted position

FLOW

- Flow is limited to 1.5 gpm (5.7 L/min) max at 60 psi

CARTRIDGE

- 1255™ Duralast™ cartridge

STANDARDS

- Third party certified to IAPMO Green, ASME A112.18.1/CSA B125.1 and all applicable requirements therein including NSF 61/9G & 372
- Meets CalGreen and Georgia SB370 requirements
- Complies with California Proposition 65 and with the Federal Safe Drinking Water Act
- The backflow protection system in the device consists of two independently operating check valves, a primary and a secondary which prevent backflow

- ADA  for lever handle

WARRANTY

- Lifetime limited warranty against leaks, drips and finish defects to the original homeowner
- 10 year limited warranty when used in a multifamily installation
- 5 year limited warranty when used in a commercial installation

Visit www.moen.com/support for complete details and limitations

Specifications

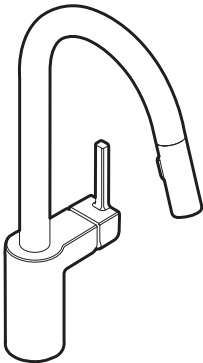

ALIGN™
Single Handle High Arc
Pulldown Kitchen Faucet

Models: 7565 series

NOTE: THIS FAUCET IS DESIGNED TO BE INSTALLED
THROUGH 1 HOLE, 1-1/2" (38mm) MIN. DIA.
(OPTIONAL 3-HOLE ESCUTCHEON 141002 AVAILABLE)

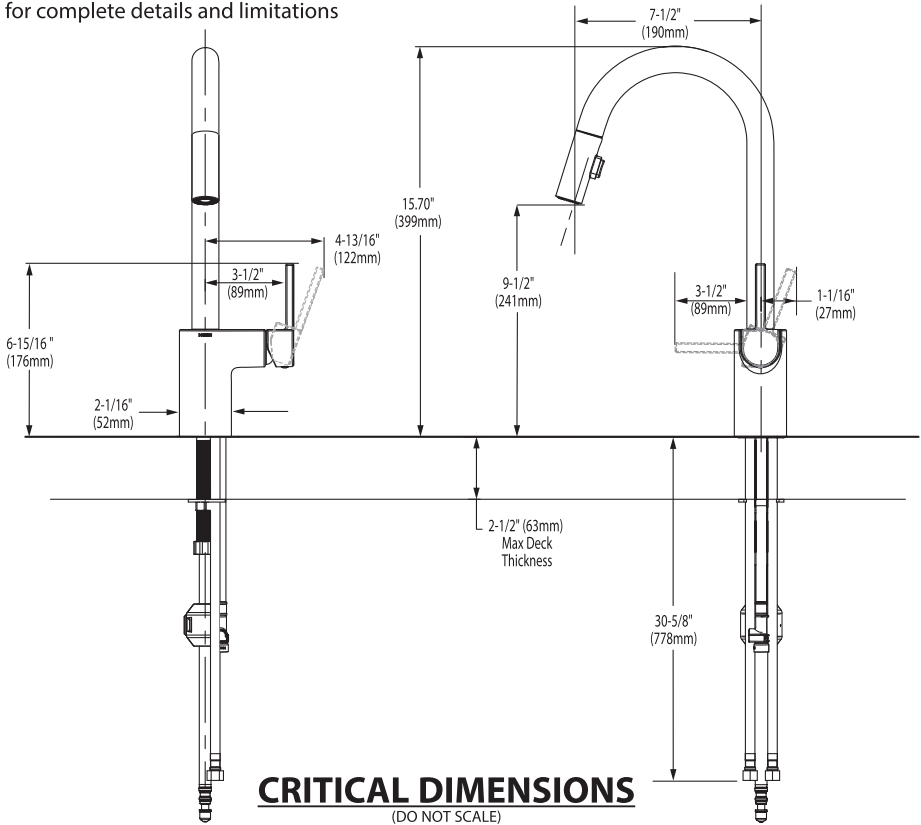

Stainless Steel | 122.0264.714

FAMILY : Sinks | SERIES : Reginox | MODEL : NS1813U-7 | FINISH : Stainless Steel | INSTALLATION TYPE : Undermount |
PRODUCT LINE : Prep / Bar

SREVERY SINK
(UNDERMOUONT)

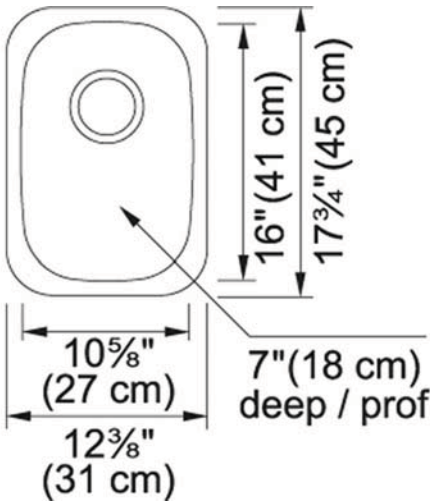

TECHNICAL DATA	
Width overall	17 3/4"
Length overall	12 3/8"
Width of large bowl	16"
Length of large bowl	10 5/8"
Depth of large bowl	7"
Cabinet Size	15"
Number of Bowls	1
Waste Outlet Diameter	3 1/2"
Cut-Out Template	Yes
Faucet Hole	0
Type of Material	18 Gauge Stainless Steel
Surface Finish	SILK
Special feature	Rear Drain Waste Hole Location
Waste Kit Included	Yes

SREVERY FAUCET

MOEN®

Specifications

There is more than 1 version of this model.
Page down to identify the version you have.

FAUCET DESCRIPTION

- Reflex™ pulldown system offers smooth operation, easy movement and secure docking
- Power Clean™ spray technology
- Metal construction with various finishes identified by suffix
- Duralock™ quick connect
- Pulldown spray with 68" braided hose
- Flexible supply lines with 3/8" compression fittings
- High arc spout provides the perfect height and reach for prep sinks while the pulldown feature provides maneuverability for food preparation tasks
- 360° rotating spout provides ability to install handle on either side
- Faucet designed for handle to be mounted on right side

OPERATION

- Lever style handle
- Temperature controlled by 100° arc of handle travel
- Operates with less than 5 lbs. of force
- Operates in stream or spray mode in the pullout or retracted position

FLOW

- Flow is limited to 1.5 gpm (5.7 L/min) max at 60 psi

CARTRIDGE

- 1255™ Duralast™ cartridge for Single-Handle Faucets

STANDARDS

- Third party certified to IAPMO Green, ASME A112.18.1/CSA B125.1 and all applicable requirements referenced therein including NSF 61/9G & 372
- Meets CalGreen and Georgia SB370 requirements
- Complies with California Proposition 65 and with the Federal Safe Drinking Water Act
- The backflow protection system in the device consists of two independently operating check valves, a primary and a secondary which prevent backflow

- ADA  for lever handle

WARRANTY

- Lifetime limited warranty against leaks, drips and finish defects to the original homeowner
 - 10 year limited warranty when used in a multifamily installation
 - 5 year limited warranty when used in a commercial installation
- Visit www.moen.com/support for complete details and limitations

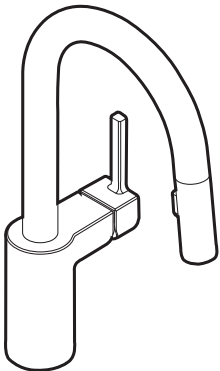

ALIGN™
Single Handle High Arc
Pulldown Prep/Bar Faucet

Models: 5965 series

NOTE: THIS FAUCET IS DESIGNED TO BE INSTALLED
THROUGH 1 HOLE, 1-1/2" (38mm) MIN. DIA.
(OPTIONAL 3-HOLE ESCUTCHEON 141002 AVAILABLE)

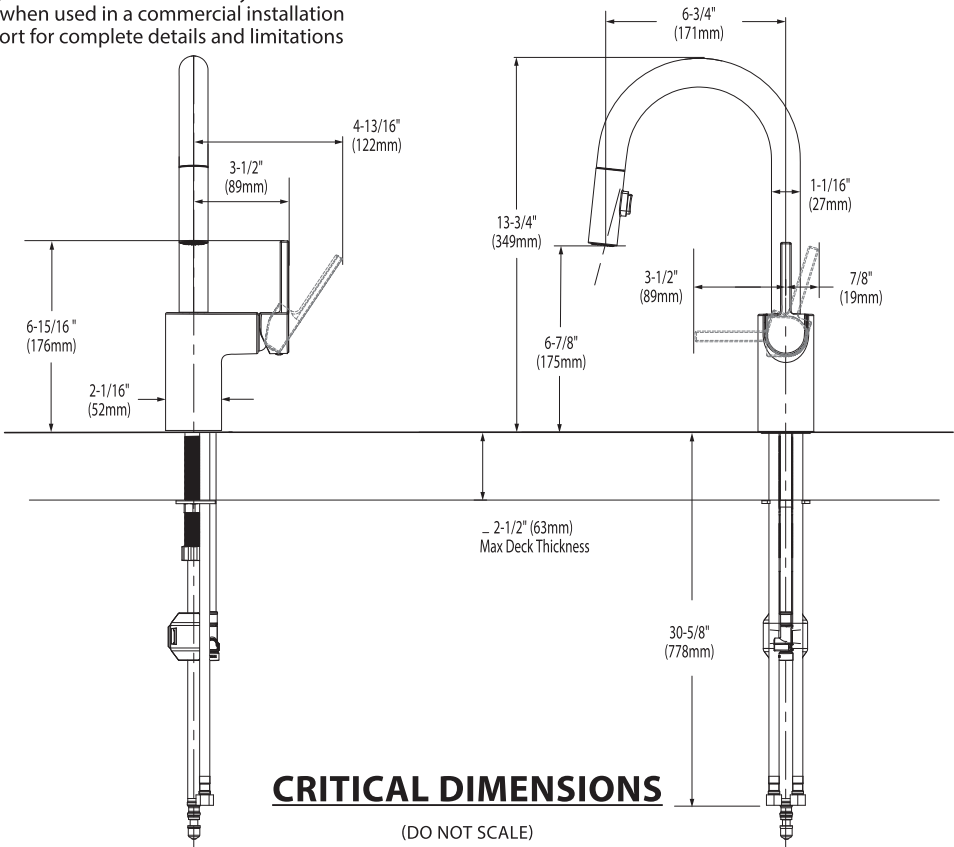

CRITICAL DIMENSIONS

(DO NOT SCALE)



 **BARRIER FREE (ABOVE COUNTER OR DROP-IN ONLY)**

**BOULEVARD®
PEDESTAL SINK**
VITREOUS CHINA

BOULEVARD® PEDESTAL SINK

- STD
- ☐

~~0641.800~~

~~Faucet holes on 8" (203mm) centers (Illustrated)~~
- ☐

0641.400

Faucet holes on 4" (102mm) centers
- ☐

~~0641.100~~

~~Center hole only~~

- Classic styled rectangular pedestal lavatory
 - Vitreous china
 - Rear overflow
 - Supplied with mounting kit
 - Right Height® for greater comfort during use
 - Faucet ledge with large deck area (faucet not included)
 - **Design coordinates with Boulevard® Toilet**
 - Basin has flat bottom to also allow use as an **above counter** sink or a **drop-in** sink (with u-shaped cut out)

Nominal Dimensions:
24" x 19" x 35-1/2"
(610 x 483 x 902mm)

- ☐

0641.008

Pedestal top-8" (203mm) centers
- ☐

0641.004

Pedestal top-4" (102mm) centers
- ☐

0641.001

Pedestal top-center hole only
- ☐

0010.000

Pedestal only

Bowl sizes:
17" (432mm) wide,
12-1/2" (318mm) front to back,
5" (127mm) deep

**Compliance Certifications -
Meets or Exceeds the Following Specifications:**
• ASME A112.19.2 - 2008/CSA B45.1-08



SEE REVERSE FOR ROUGHING-IN DIMENSIONS

- To Be Specified:
- ☐ Color:

☐ White

☐ Linen
- ☐ Faucet Finish:
- ☐ Supplies:
- ☐ 1-1/4" Trap:
- ☐ Nipple:

* See faucet section for additional models available

**BOULEVARD®
PEDESTAL SINK**
VITREOUS CHINA



BARRIER FREE (ABOVE COUNTER OR DROP-IN ONLY)

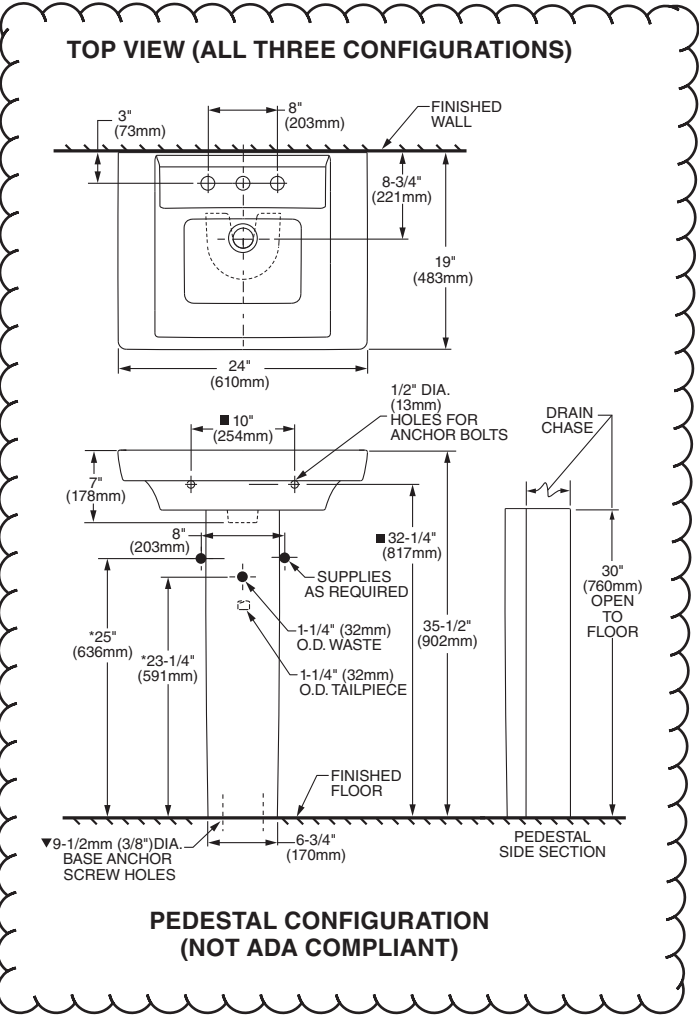

ABOVE COUNTER CONFIGURATION

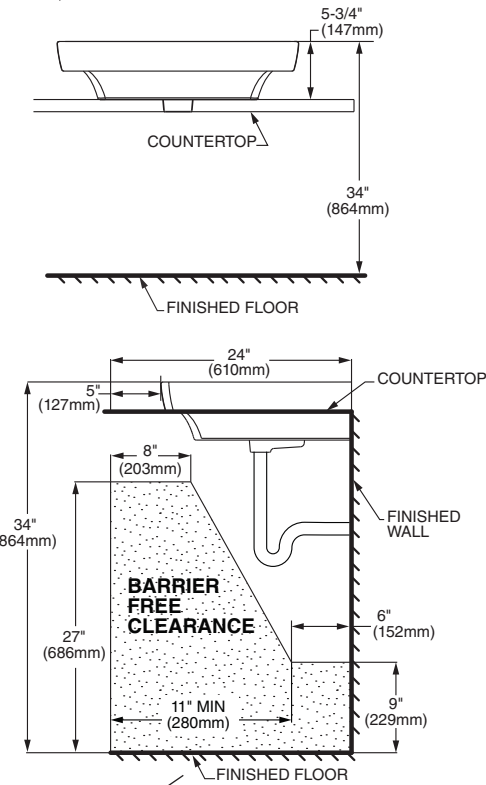

ABOVE COUNTER AND DROP-IN SINK CONFIGURATIONS MEET THE AMERICANS WITH DISABILITIES ACT GUIDELINES AND ANSI A117.1 ACCESSIBLE AND USABLE BUILDINGS AND FACILITIES - CHECK LOCAL CODES.
Top of sink installed at 34" (864mm) height from finished floor.
Sink installed 5" (127mm) minimum from front edge of countertop.
Provide 27" (686mm) knee clearance area.

NOTES:
* DIMENSIONS SHOWN FOR LOCATION OF SUPPLIES AND "P" TRAPS ARE SUGGESTED.
▼ PEDESTAL ANCHORING SCREWS NOT INCLUDED.
■ SUITABLE FOR REINFORCEMENT ONLY. ACTUAL DIMENSIONS MUST BE TAKEN FROM FIXTURE.
FITTING NOT INCLUDED AND MUST BE ORDERED SEPARATELY.
PROVIDE SUITABLE REINFORCEMENT FOR ALL WALL SUPPORTS.
INSTALLATION INSTRUCTIONS SUPPLIED WITH LAVATORY.

IMPORTANT: Dimensions of fixtures are nominal and may vary within the range of tolerance established by ANSI Standard A112.19.2. These measurements are subject to change or cancellation. No responsibility is assumed for use of superseded or voided pages.

PRINCIPAL ENSUITE X 2
SHARED BATHROOM X 2
ENSUITE 2 X 1

American Standard

Style That Works Better

 BARRIER FREE

BOXE
UNDERCOUNTER SINK
VITREOUS CHINA

BOXE UNDERCOUNTER SINK

- Vitreous china
- Rectangular undercounter mount sink with rectangular interior and flat bottom design bowl
- Unglazed rim
- Front overflow
- Supplied with template
- Meets OBC requirement when sink is installed with overflow to the rear
- Mounting clips available separately (P031006000) (Faucet not included)

 **0315 000 Unglazed Rim**
508 x 406mm (20" x 16")

Bowl size:
438mm (17-1/4") wide,
337mm (13-1/4") front to back,
127mm (5") deep



COMPLIANCE CERTIFICATIONS –
Meets or exceeds the following Specifications:
• ASME A112.19.2M for Vitreous China Fixtures.
• CAN/CSA B45 Series.

To Be Specified

- ☐ Colour: ☐ White
- ☐ Faucet*:
- ☐ Faucet Finish:
- ☐ Supplies & Stops:
- ☐ Trap 1-1/4" (32 mm):

* See faucet section for additional models available

 • Countertop 864mm (34") from finished floor. Sink installed 102mm (4") from front edge of countertop. Countertop thickness to be 25mm (1") maximum.
MEETS THE AMERICAN DISABILITIES ACT GUIDELINES AND ANSI A117.1 ACCESSIBLE AND USEABLE BUILDINGS AND FACILITIES - CHECK LOCAL CODES.

NOTES:
WE RECOMMEND USING SINK AS A TEMPLATE TO DETERMINE PROPER CONTOUR. CUT COUNTERTOP 38MM (1-1/2") INSIDE SINK CONTOUR. FAUCETS NOT INCLUDED AND MUST BE ORDERED SEPARATELY.
* DIMENSIONS SHOWN FOR LOCATION OF SUPPLIES AND "P" TRAP ARE SUGGESTED.
▼ UNDERCOUNTER MOUNTING KIT SUPPLIED SEPARATELY.
IMPORTANT: Dimensions of fixtures are nominal and may vary within the range of tolerances established by ANSI Standard A112.19.2.
These measurements are subject to change or cancellation. No responsibility is assumed for use of superseded or voided pages.

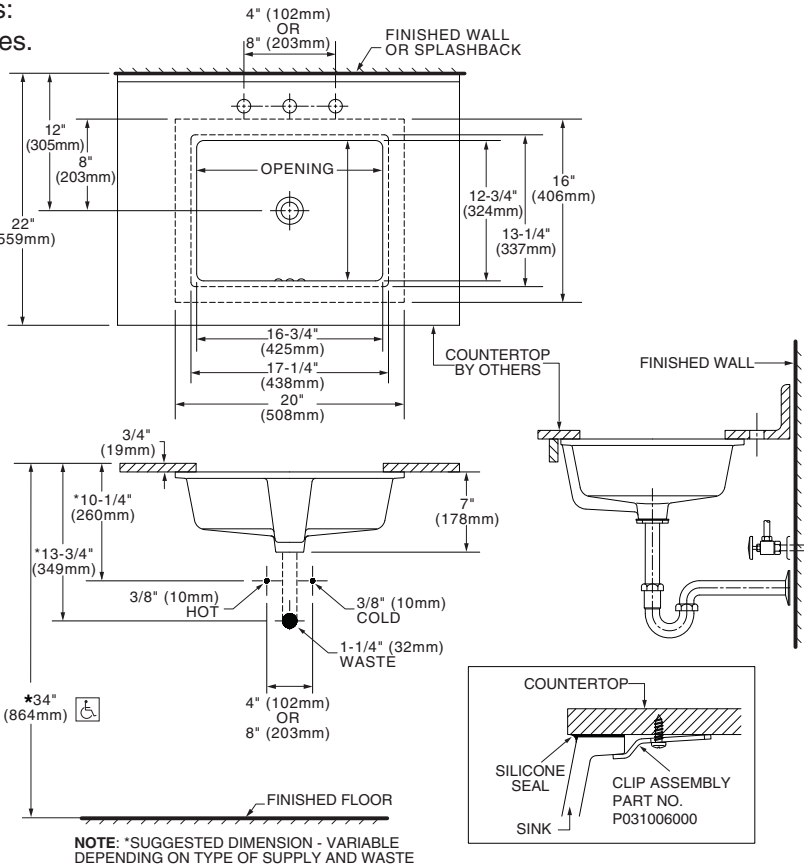

* To comply with ADA standards, overflow hole must face back.



COLONY™
COUNTERTOP SINK
VITREOUS CHINA

COLONY COUNTERTOP SINK

- Vitreous china
- Self-rimming
- Front overflow
- Supplied with template
- Faucet deck
(Faucet shown not included)



- ☐ 0346 803
Faucet holes on 203mm (8") centres
- ☒ 0346 403 (Illustrated)
Faucet holes on 102mm (4") centres
- ☐ 0346 001
Centre hole only

Nominal Dimensions:
521 x 448mm (20-1/2" x 17-5/8")

Bowl sizes:
422mm (16-5/8") wide, 279mm (11") front to back, 143mm (5-5/8") deep

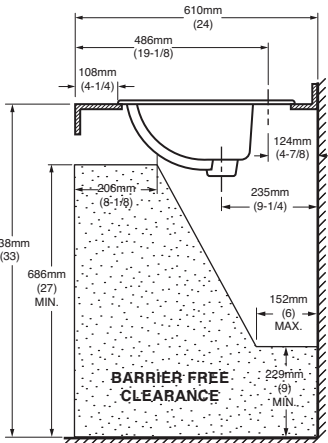
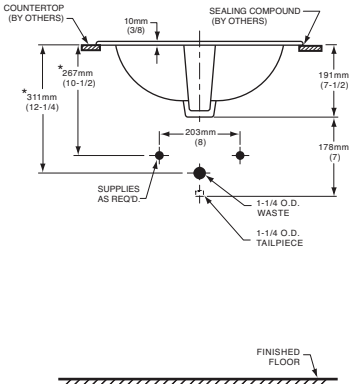
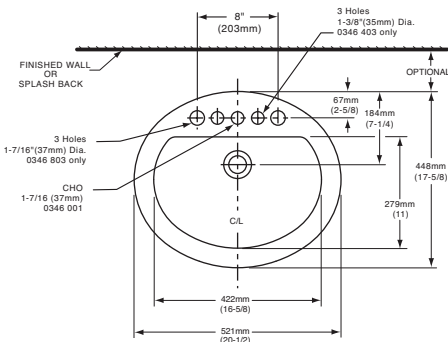

COMPLIANCE CERTIFICATIONS –
Meets or exceeds the following Specifications:
• ASME A112.19.2M for Vitreous China Fixtures.
• CAN/CSA B45 Series.

- To Be Specified
- ☐ Colour: ☐ White ☐ Bone ☐ Silver Gray ☐ Linen
 - ☐ Faucet*:
 - ☐ Faucet Finish:
 - ☐ Supplies & Stops:
 - ☐ Trap 1-1/4" (32 mm):

NOTES:
* DIMENSIONS SHOWN FOR LOCATION OF SUPPLIES AND "P" TRAP ARE SUGGESTED. FOR COUNTERTOP CUTOUT AND INSTALLATION INSTRUCTIONS USE TEMPLATE SUPPLIED WITH SINK.
FAUCETS NOT INCLUDED AND MUST BE ORDERED SEPARATELY.
IMPORTANT: Dimensions of fixtures are nominal and may vary within the range of tolerances established by ANSI Standard A112.19.2.
These measurements are subject to change or cancellation. No responsibility is assumed for use of superseded or voided pages.

* See faucet section for additional models available



DEMI™
Product Specification Sheet



Two Piece Freestanding Collection

CF2007	Two Piece Freestanding Soaker
Size:	60" x 32" x 22" 1524 mm x 813 mm x 559 mm

PRODUCT FEATURES & BENEFITS

- Vacuum formed acrylic reinforced with fiberglass
- Scratch, stain and fade resistant high gloss finish
- Installation friendly two piece design
- Accepts deck mounted faucet
- Includes integral pop up drain and rectangular overflow
- Includes levelling feet

TWO PIECE ASSEMBLY

FRONT VIEW

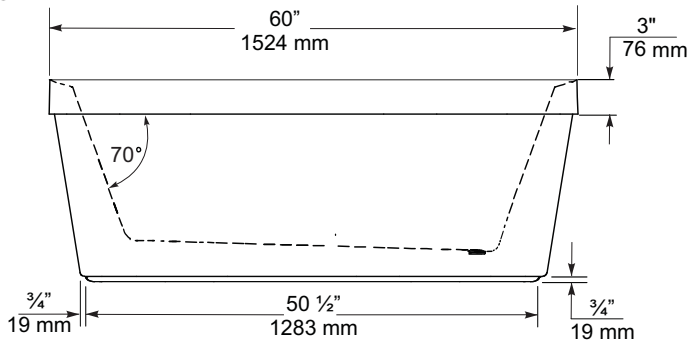

END VIEW

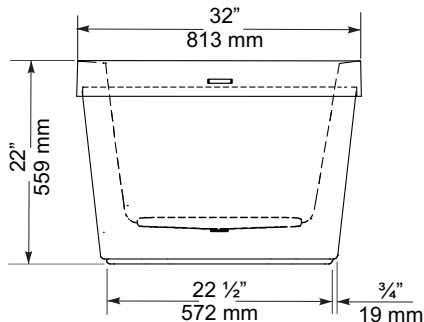

TOP VIEW

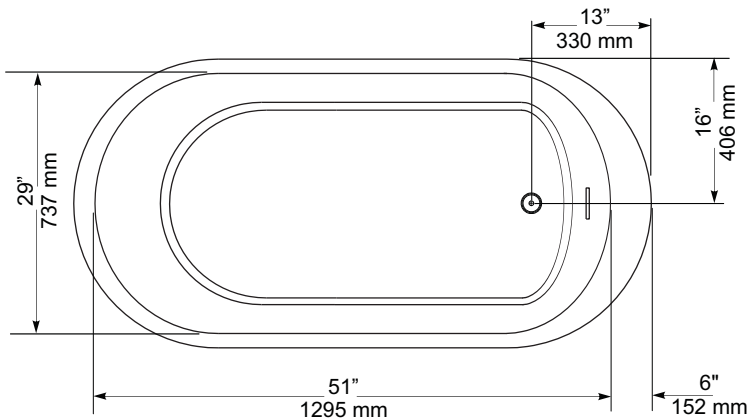

GENERAL SPECIFICATIONS		
Average Weight	90 lb	41 kg
Bathing Well at bottom	43"x 20"	1092 x 508 mm
Capacity Drain to Overflow		195 litres
Water Depth Drain to Overflow	16"	406 mm
Drain Opening (dia.)	2"	51 mm
Overflow Opening	2 1/4"x 1/2"	57 x 13 mm
Drain to Floor Clearance	3 1/4"	83 mm

NOTES: Please confirm measurements on actual product to ensure proper identification. Bathtub to be installed on the floor supported by 5 self levelling feet. Adjust if required to level the bathtub for adequate drainage. Refer to installation instructions for additional information.

IMPORTANT: Dimensions of fixtures are nominal and may vary ± 1/4" (6 mm). Weight may vary ± 5 lb (2.3 kg). Drawing is not to scale. These measurements are subject to change at manufacturer's discretion.

Compliance Certifications -
Meets or Exceeds the following Specifications:
• CAN/CSA - B45 Series





FloWise™ DUAL FLUSH
ELONGATED TOILET
VITREOUS CHINA

FloWise™ DUAL FLUSH ELONGATED TOILET

- 2476 216
 - Vitreous china
 - Low-consumption Dual Flush
 - Full flush 6.0 Lpf/1.3 gpf,
 - Partial flush 3.0 Lpf/0.66 gpf.
 - Elongated wash down bowl
 - Internal trapway fully-glazed, 2-1/4" (57mm) ballpass
 - Concealed trapway bowl
 - Chrome-plated top mounted push button actuator
 - Easy to clean sanitary dam on bowl
 - Includes Elongated Slow Close Seat
 - 100% factory flush tested
 - 2 bolt caps

Separate Component Parts:

- 3067 316 Elongated Bowl with Slow Close Seat
- 4035 216 Unlined Tank



- 2476 516 Same as above with Lined tank
 - 3067 316 Elongated Bowl
 - 4035 516 Lined Tank

Nominal Dimensions:
794 x 432 x 765mm
(31-1/4" x 17" x 30-1/8")

- Compliance Certifications -
Meets or Exceeds the Following Specifications:
- ASME A112.19.2M (and 19.6M)
 - CAN/CSA B45 series

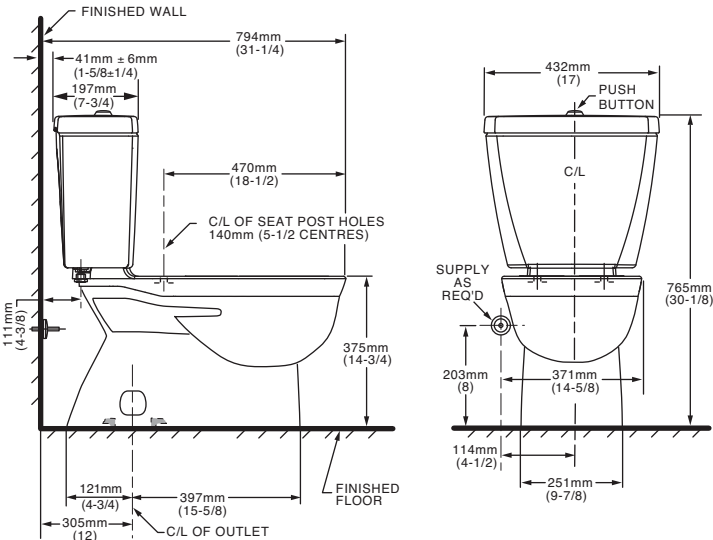

NOTES:
THIS TOILET IS DESIGNED TO ROUGH-IN AT A MINIMUM DIMENSION OF 305MM (12") FROM FINISHED WALL TO C/L OF OUTLET.
SUPPLY NOT INCLUDED WITH FIXTURE AND MUST BE ORDERED SEPARATELY.
* DIMENSION SHOWN FOR LOCATION OF SUPPLY IS SUGGESTED.
FOR ADDITIONAL INFORMATION REFER TO INSTALLATION INSTRUCTIONS SUPPLIED.
IMPORTANT: Dimensions of fixtures are nominal and may vary within the range of tolerance established by ANSI Standard A112.19.2
These measurements are subject to change or cancellation. No responsibility is assumed for use of superseded or voided pages.

- To Be Specified
- Colour: 020 White
 - Supply with stop:

UPGRADED VALUE ADDED FEATURES AT NO EXTRA CHARGE



Specifications

DESCRIPTION

- Metal construction with various finishes identified by suffix
- 16" long 3/8" tubing connections
- Includes metal or 50/50 pop-up type waste assembly where noted

OPERATION

- Pivot action lever style handle
- Temperature controlled through 180° degree arc of handle travel

FLOW

- Flow is limited to 1.5 gpm max (5.7L/min) at 60 psi

CARTRIDGE

- 1225 cartridge design
- Nonmetallic/nonferrous and stainless steel material
- Can accommodate reversed piping and back to back installations

STANDARDS

- Third party certified to WaterSense®, CSA B-125.1, ASME A112.18.1 and all applicable requirements referenced therein including NSF61/9
- Complies with California Proposition 65 and with the Federal Safe Drinking Water Act

- **ADA**  for lever handle

WARRANTY

- Lifetime limited warranty against leaks, drips and finish defects to the original consumer purchaser
- 5 year warranty if used in commercial installations

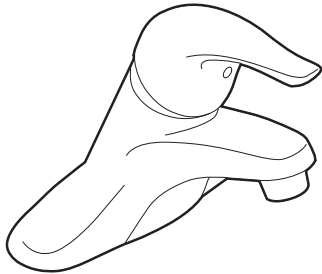

CHATEAU®
Single-Handle Lavatory Faucet

with Metal Waste Assembly

Model: L4625 series

L4631BC

Bulk Packed (12 per carton):

L64624 series

with 50/50 Waste Assembly

Bulk Packed (12 per carton):

L64625 series

Less Waste

Bulk Packed (12 per carton):

L64600 series

NOTE: THIS FAUCET IS DESIGNED TO BE
INSTALLED THRU 3-1" DIA. HOLES, 2" ON CENTER

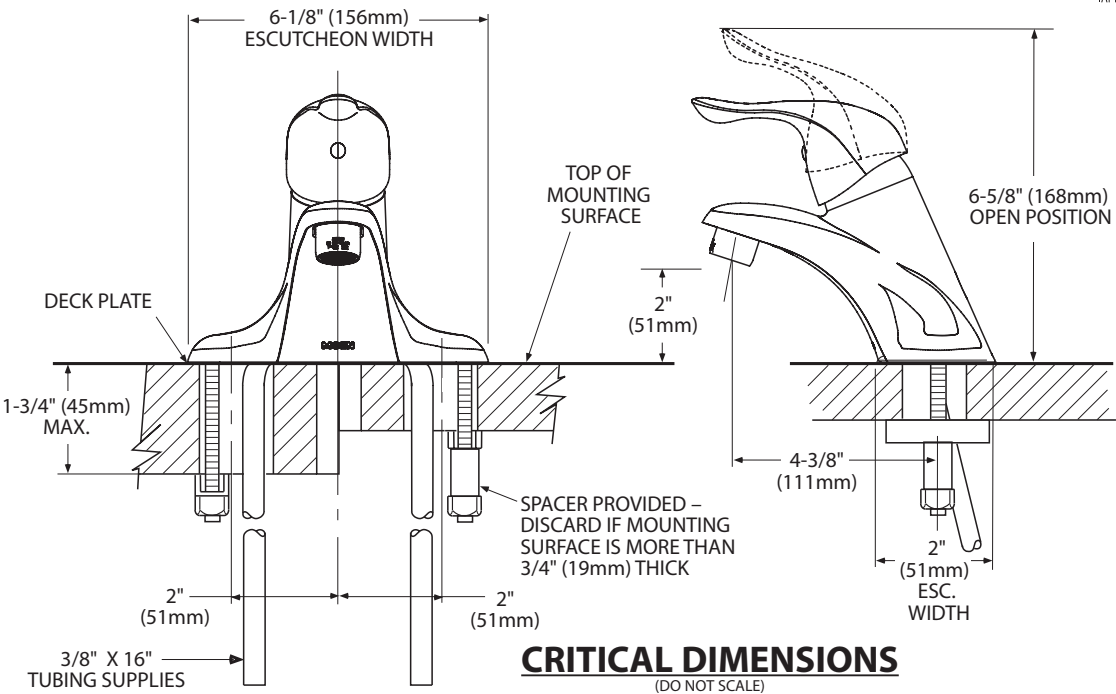



Buy it for looks. Buy it for life.®

There is more than 1 version of this model.
Page down to identify the version you have.

DESCRIPTION

- Metal construction with various finishes identified by suffix
- Includes non-metalic showerhead, arm, flange and non-metalic diverter tub spout

OPERATION

- Handle operates counterclockwise through a 270° arc with off at 6 o'clock and maximum hot at the 9 o'clock position. Shut off in clockwise direction
- Adjustable temperature limit stop to control maximum hot water temperature
- Pressure balancing mechanism maintains selected discharge temperature to ± 3°

FLOW

- Showerhead is limited to 2.5 gpm (9.5 L/min) at 80 psi
- EP suffix models are limited to 1.75 gpm (6.6 L/min) at 80 psi
- NH suffix models contain no showerhead

CARTRIDGE

- 1222 cartridge design
- Accommodates back to back installations
- Nonmetallic/nonferrous and stainless steel material

STANDARDS

- Third party certified to meet ASME A112.18.1/CSA B125.1 and all applicable requirements referenced therein
- EP suffix models are third party certified to WaterSense®

- ADA  for lever handle

WARRANTY

- Lifetime limited warranty against leaks, drips and finish defects to the original consumer purchaser
- 5 year warranty if used in commercial installations

Specifications

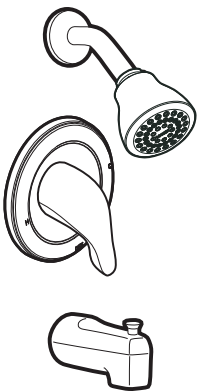

CHATEAU® POSI-TEMP®
Single-Handle Tub/Shower Trim Kit

Models: TL181 series - valve trim only
(Bulk Packed 12 per carton)
TL182 series - shower trim only
(Bulk Packed 12 per carton)
TL183 series - tub/shower trim
(Bulk Packed 12 per carton)

Valves: 62300 series
2500 series

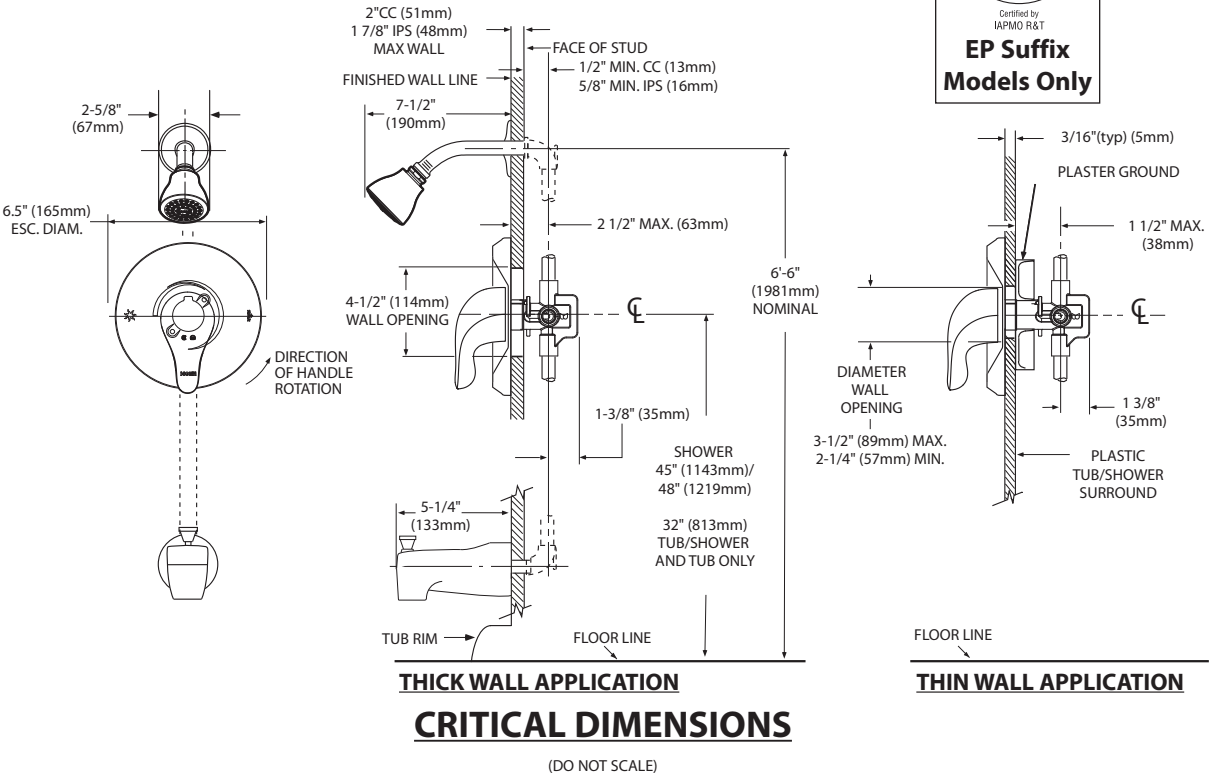



Specifications

DESCRIPTION

- Metal construction with various finishes identified by suffix

OPERATION

- Lever style handles with hot and cold color indicator
- Rotate hot side handle counterclockwise to open (clockwise to close) and the cold side handle (clockwise to open) and (counterclockwise to close)

STANDARDS

- Third party certified to: ASME A112.18.1/CSA B-125.1, and all applicable requirements referenced therein

- ADA  for lever handles

WARRANTY

- Lifetime limited warranty against leaks, drips and finish defects to the original homeowner
 - 10 year limited warranty when used in a multi-family installation
 - 5 year limited warranty when used in a commercial installation
- Visit www.moen.com/support for complete details and limitations

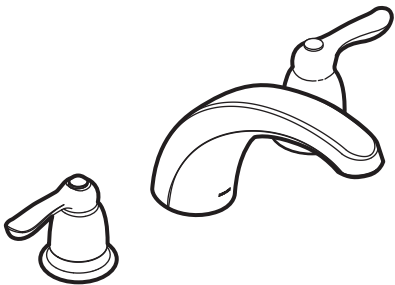

CHATEAU®
Two-Handle Garden Tub Trim

Models: T994 series

Valves: 4792, 4793, 4794, 4796, 4797, 4798

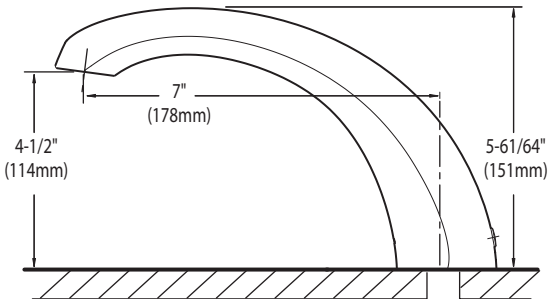
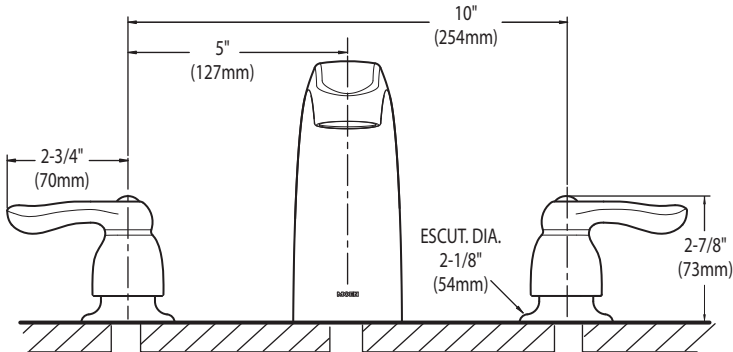

CRITICAL DIMENSIONS
(DO NOT SCALE)



AVN-368CS

36" Wall mount hood - professional design

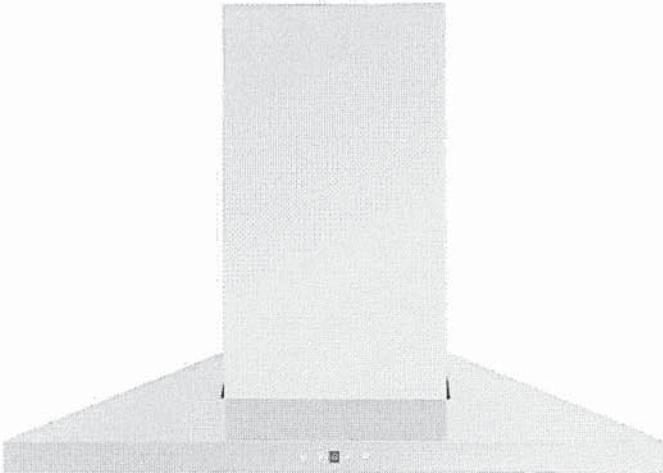

Selected Model	
Model number	AVN-368CS
Dimensions	
Dimensions	35 1/2" (W) x 19 3/4" (D) x 7 1/2" (H)
Exterior Appearance	
Stainless steel grade	201
Features	
Control	Soft touch with LED display
Lighting	2 bulbs, 3W LED (bulbs included)
Blower type	860 CFM, 6-Speed
Blower performance	Speed 1, 0.7 sones
	Speed 6, 6.5 sones
Filter type	2 Stainless steel baffle filters (included)
Duct transition	6" Round (Top)
Ducting	Ducted
Electrical Requirements	
Electrical requirements	120V / 60Hz / 2.7 Amps
Accessories (optionnal)	
Optional duct covers	AD-884S (884mm, AVN-AVH compatible)
Warranty	
1-year Warranty	Parts and labour, in-home service

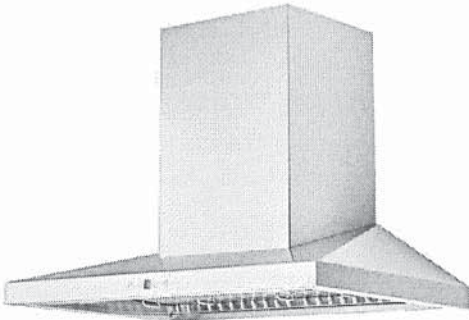

Dimensions

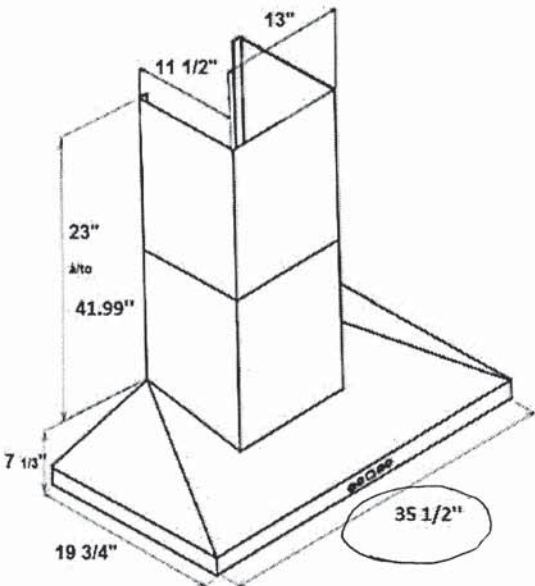
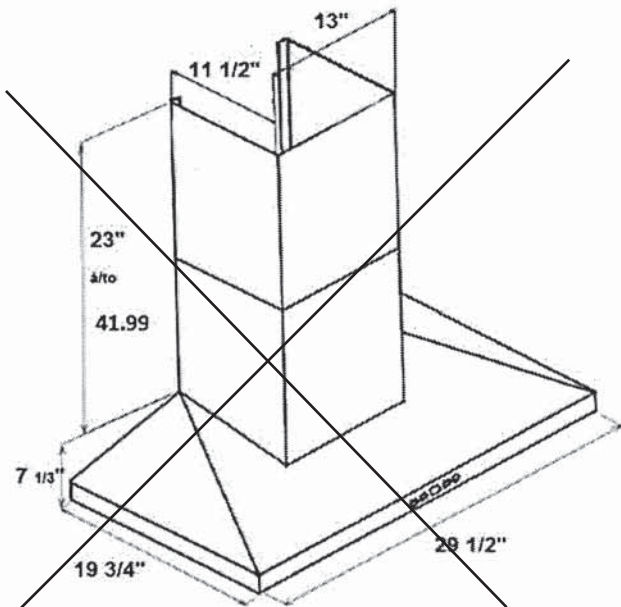

Installation

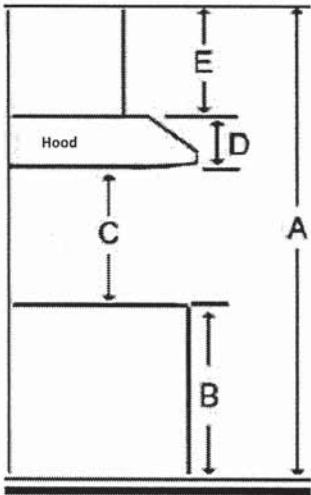

A	Floor to ceiling height	variable
B	Floor to counter top height (standard)	36"
C	Recommended height between cooking surface and bottom of the hood	28" to 30"
D	Hood height	7 1/3"
E	Chimney height	19" to 41.99"

Duct transition

Top 6" round

The information contained herein is based on sources that we believe to be reliable, but is not guaranteed by us, may be incomplete and/or may change without notice.

HOME APPLIANCES



LG REFRIGERATION

LRYKC2606_

26 cu. ft. Counter Depth MAX Refrigerator

- Industry's Largest 26 cu. ft. Counter Depth Capacity
- Mirror InstaView® with Door in Door
- Pocket Handle Design with Welcome Light
- Industry's First 3 Built-in Ice maker
- Market First 4 Types of Ice
- Cool Guard with Premium Backlit Lighting

AVAILABLE COLORS



PRINTPROOF™ STAINLESS STEEL



PRINTPROOF™ BLACK STAINLESS STEEL



Proactive Smart Alerts to Keep Your Appliances Running Smoothly

- Preventative Alerts help you stay a step ahead of potential issues to find proactive solutions before problems arise.
- Avoid preventable repairs and service calls with real-time diagnostics for a hassle-free experience.
- Integrated within LG's ThinQ app—a smart home hub for managing your smart devices and appliances.

ThinQ Care

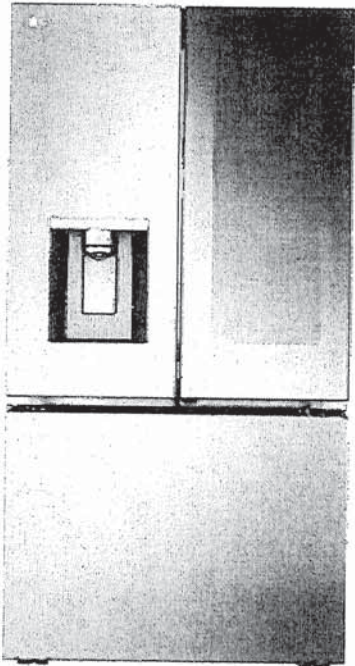

CAPACITY

Refrigerator (cu. ft.)	16.9 cu. ft.
Freezer (cu. ft.)	8.6 cu. ft.
Total Capacity (cu. ft.)	25.5 cu. ft.

ENERGY

ENERGY STAR® Qualified	Yes
Energy Consumption (kWh/Year)	699

WATER & ICE SYSTEM

Ice & Water Dispenser	Yes
Water Dispenser UVnano	Yes
In-door Ice maker	Yes (1)
In-door Ice maker Ice Type	Cubed / Crushed
In-door Ice maker Daily Production	3.0 / 3.3 (IcePlus) lbs.
In-door Ice maker Storage Capacity	3.0 lbs.
No. Freezer Ice maker	Yes (2)
Freezer Ice maker Ice Type	Craft & Mini Cubed
Freezer Ice maker Daily Production	3 or 6 ea & 1.5 / 1.7 (IcePlus) lbs.
Freezer Ice maker Storage Capacity	27 ea / 4.0 lbs.
Ice Plus	Yes
Filteration System	1 stage
Filter	LT1000P
Dispenser Light Decoration	Yes

COOLING

Compressor Type	Smart Inverter
Evaporator	Yes (1)
Multi Air Flow Cooling	Yes
Temperature Sensors	3

Refrigerant

Low GWP, Zero ODP and More Energy Efficient Refrigerant (R600a / 57g / 2.01oz)

CONVENIENCE

Display Type	Smooth Touch Control / White LED
Temperature Controls	Electronic/Digital
Door Alarm	Yes
Child Lock	Yes
Auto Closing Door Hinge	Yes
Sabbath Mode	Yes
ADA Compliant	Yes

REFRIGERATOR

No. of Shelves	4 split (3 Fixed + 1 Retractable)
Shelf Construction	Spill Protector/Tempered Glass
Shelf Trim	Metallic Décor
No. of Crisper Bins	2
Pantry (Glide N Serve)	Yes (Temp. Control)
Cool Guard	Yes
Fresh Air Filter	Yes
Light	Yes
Light (Back lit lighting)	Yes

REFRIGERATOR DOOR

InstaView®	Yes
InstaView® Dimension (WxH)	11 3/4" x 30 3/4"
Door-in-Door®	Yes
No. of Bins	4 (Left Door), 4 (Right Door)
Door Shape	Flat
Handle Type	Pocket
Handle Light	Yes

FREEZER

Door Type	Pull Drawer
Handle Type	Smart Pull™ Handle
Drawers / Shelves	3-Tier Organization
Freezer Light	LED Lighting

Upper
Lower

SMART TECHNOLOGY

Smart Diagnosis	Yes
Wi-Fi	Yes
ThinQ®	Yes
ThinQ® Care	Yes

MATERIALS AND FINISHES

Hidden Hinges	Yes
---------------	-----

All Available Colors

Insulation

DIMENSIONS/CLEARANCES/WEIGHTS

Product (W x H x D)	35 3/4" x 70 1/4" x 31 5/8"
Width	35 3/4"
Height (to Top of Hinge)	70 1/4"
Depth (with Handles)	29 1/8"
Width (Door Open 90° without Handle)	40"
Width (Door Open 90° with Handle)	44 7/8"
Width (Door Fully Open without Handle)	56 3/4"
Height (to Top of Case)	68 7/8"
Depth without Door	24 3/4"
Depth without Handles	29 1/8"
Depth (to Hinge Cover)	18 1/4"
Depth (Total with Door Open)	43 5/8"
Depth (Draw Open Fully without Handle)	48 7/8"
Installation Clearance	Sides 1/8", Top 1", Back 2"
Carton Dimensions (WxHxD)	38" x 72" x 31"
Weight (Unit/Carton)	291 lbs. / 313 lbs.

LIMITED WARRANTY

Parts & Labor	1 Year
Sealed System (Parts & Labor)	5 Years
Compressor (Parts & Labor)	5 Years
Linear Compressor (Parts & Labor)	6 - 10 Years

UPC CODES

LRYKC2606S (PrintProof™ Stainless Steel)	195174034828
LRYKC2606D (PrintProof™ Black Stainless Steel)	195174037669

NA36N7755TS

SAMSUNG

36" Gas Cooktop

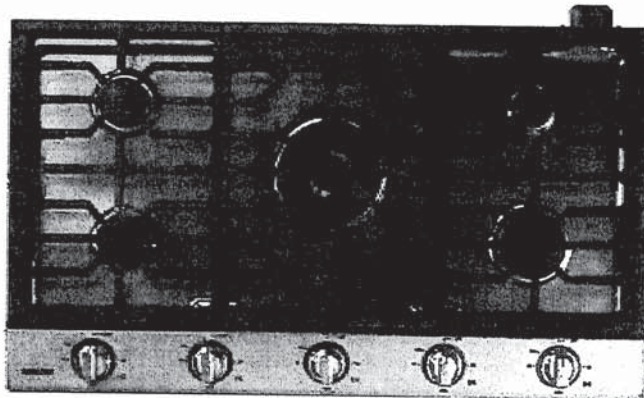

Signature Features

22K True Dual-Power Burner

- Two independent heating burners offer intense heat and precise control to quickly boil water or temper chocolate.

Analog Controls with Digital Wi-Fi and Bluetooth® Technology

- The ultimate combination of analog comfort and digital technology delivers exceptional cooking performance.

Cast Iron Griddle

- Cook breakfast, grill sandwiches, or sauté vegetables on the removable griddle.

Available Colors



Stainless Steel (shown)



Fingerprint Resistant
Black Stainless Steel



22K True Dual-Power Burner

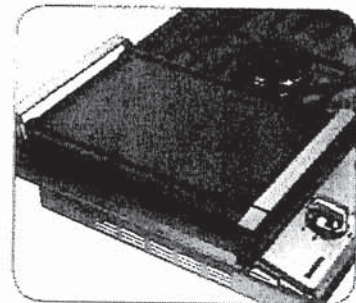

Cast Iron Griddle

Features

- Bluetooth® Connected to Hood
- Blue LED Lights
- Wi-Fi Connectivity
- Powerful Cooktop
 - Right Front: 13K BTU
 - Left Front: 9.5K BTU
 - Right Rear: 5K BTU
 - Left Rear: 9.5K BTU
 - Center: True Dual, 22K BTU (Brass)

- Cast Iron 3-Piece Grates
- Sealed Burners
- Burner On/Off Monitoring
- ADA Compliant

Convenience

- Wok Grate
- LP Conversion Kit



ADA Compliant

S.S

NA36N7755TS

SAMSUNG

36" Gas Cooktop

Installation Requirements

Countertop cut-out and minimum clearance dimensions:

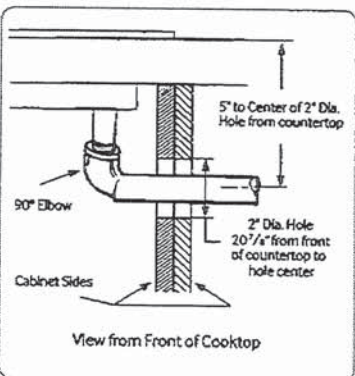
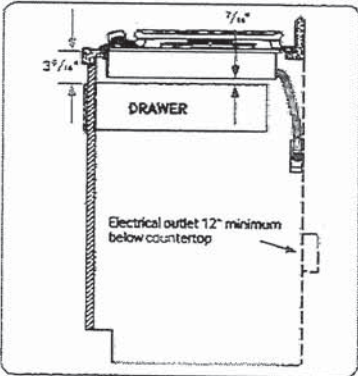
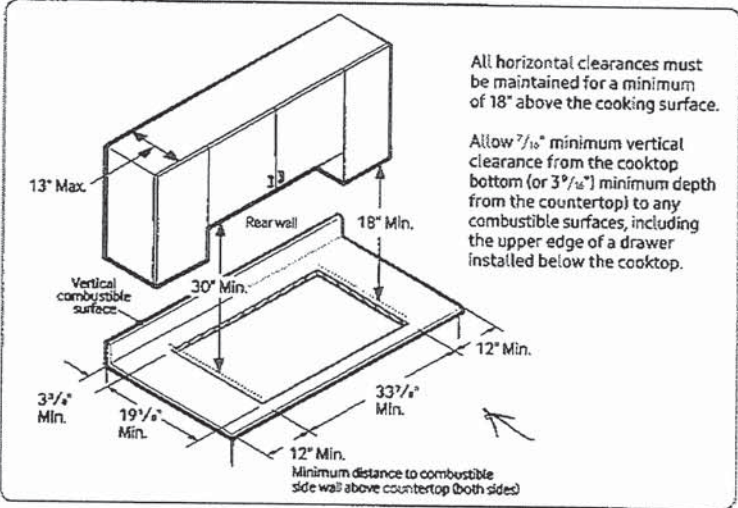

Total Power (BTU)
59K

Power Source
120V / 60 Hz / 1A

Gas Cooktop (BTU)
• Right Front: 13K
• Left Front: 9.5K
• Right Rear: 5K Simmer
• Left Rear: 9.5K
• Center: 22K (True Dual)

Warranty
One (1) Year All Parts and Labor

Product Dimensions & Weight (WxHxD)
Outside (Max) Cooktop Dimensions:
36" x 5 41/72" x 22 1/3"

Cooktop Cut-Out Dimensions:
33 7/8" x 3 1/8" x 19 1/8"

Weight: 87.7 lbs. (88.4 lbs. Fingerprint Resistant Black Stainless Steel)

Shipping Dimensions & Weight (WxHxD)
Dimensions: 40 9/16" x 10 5/8" x 25 5/8"
Weight: 95.9 lbs. (97.2 lbs. Fingerprint Resistant Black Stainless Steel)

Color	Model #	UPC Code
Stainless Steel	NA36N7755TS	887276281766
Fingerprint Resistant Black Stainless Steel	NA36N7755TG	887276281759

Installing Over a Single Oven

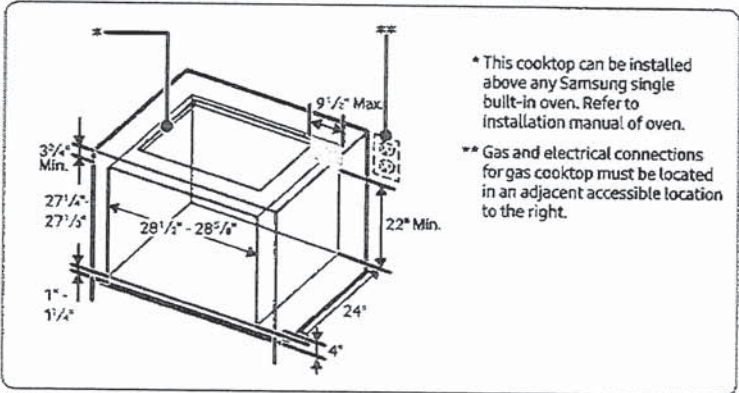

Cooktop Dimensions

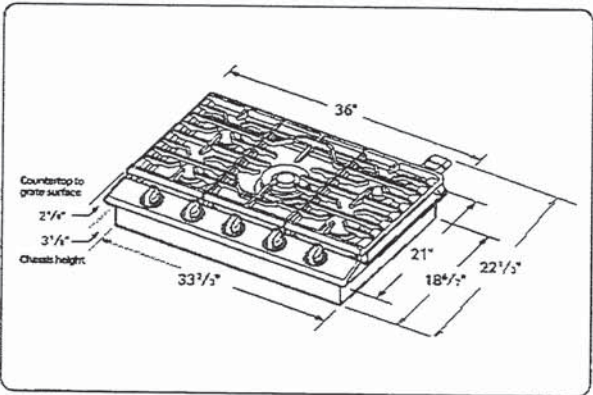



HOME APPLIANCES

LG COOKING

WCEP6423_

1.7 / 4.7 cu. ft. Smart Combination Wall Oven with Convection, Air Fry and EasyClean®

KEY FEATURES

- 6.4 cu. ft. Large Capacity
- ThinQ® Technology with ThinQ Care
- Convection Technology with Air Fry
- EasyClean® and Self Clean
- SmoothTouch® Glass Controls
- WideView™ Window

AVAILABLE COLORS

- PrintProof® STAINLESS STEEL
- PrintProof® BLACK STAINLESS STEEL

SMART APPLIANCE

ThinQ Care

- Proactive Smart Alerts to Keep Your Appliances Running Smoothly**
- Preventative Alerts help you stay a step ahead of potential issues to find proactive solutions before problems arise.
 - Avoid preventable repairs and service calls with real-time diagnostics for a hassle-free experience.
 - Integrated within LG's ThinQ app—a smart home hub for managing your smart devices and appliances.

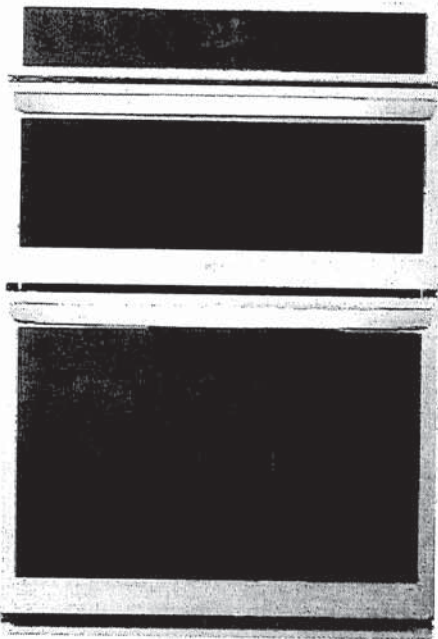

PRODUCT FEATURES

SUMMARY

Type	Combination Wall Oven
Total Oven Capacity (cu. ft.)	6.4 (1.7 Upper / 4.7 Lower)
Available Colors	PrintProof® Stainless Steel / PrintProof® Black Stainless Steel
PrintProof® Finish	Yes
UPPER OVEN FEATURES	
Capacity (cu. ft.)	1.7
Interior	Stainless Steel
Speed Oven	No
Convection Technology	Yes
Microwave Power Output	950W
Convection Element Power	1500W
Broil Element Power	1200W
Bake Element Power	375W
Air Fry	Yes
Dehydrate	No
Defrost Presets	Meat, Poultry, Fish, Bread
Oven Modes	Auto Cook, Broil, Convection Bake, Defrost, Melt, Microwave, Popcorn, Proof, Sensor Cook, Soften, Warm, Air Fry, Dehydrate
Sensor Cook	Beverage, Casserole, Chicken, Pasta, Pizza, Dinner Plate, Rice, Soup, Vegetable
Auto Cook	Bacon, Bagels, Baked Potatoes, Brownie, Canned Vegetable, Cod Fillets, Corn Dog, Fresh Vegetable, Frozen Chicken Wings, Frozen Fries, Frozen Chicken Nuggets, Frozen Pizza, Frozen Soft Pretzels, Frozen Vegetable, Garlic Bread, Hamburger, Lamb chops, Meat Loaf, Nachos, Oatmeal Pork Chops, Quinoa, Ribeye Steak, Rice, Salmon Steak, Sausage, Sirloin Steak, Tenderloin
Soften	Butter, Cream Cheese, Frosting, Ice Cream
Melt	Butter, Caramel, Cheese, Chocolate, Marshmallow

LOWER OVEN FEATURES

Capacity (cu. ft.)	4.7
EasyClean®	Yes (10mins)
Self Clean	Yes (3, 4, 5 hours)
Convection Type	Fan Convection
Convection Conversion	No
Bake Element Power	2500W
Variable Warm	Yes (High, Med, Low)
Broil Element Power	2,500W inner / 1,500W outer
Variable Broil	Yes (Full, Center / Low, Med, High)
Number of Rack Position	5
12 hrs. Auto Shut-off	Yes
InstaView®	No
Air Fry	Yes
Steam Assist	No
Oven Modes	Air Fry / Convection Bake / Convection Roast / Bake / Broil / Frozen Meal / Warm / Proof / Favorite
Maintenance Modes	EasyClean® / Self Clean
CONTROL	
Oven Control Type	SmoothTouch™ Glass Controls
Display	LED Display
Language	English
Clock	12 hr or 24 hr
Temperature Unit of Measure	Fahrenheit / Celsius
Certified Sabbath Mode	Yes
SMART FEATURES	
ThinQ® (Wi-Fi Enabled)	Yes
Check & Control	Yes
Voice Control	Yes (Google, Alexa)
Smart Recipe (3rd Party Recipe App)	SideChef
ThinQ Care	Yes
SmartDiagnosis™	Yes

ACCESSORIES

Glass Tray (Upper Oven)	Yes
Metal Tray (Upper Oven)	Yes
Rack (Upper Oven)	Yes
Temperature probe	No
Heavy Duty Rack	Yes (2)
Air Fry Tray	Yes
POWER/RATINGS	
Amp at 240V	40A
kW at 240V	7.8kW
Required Power Supply	120 / 240 VAC, 120 / 208 VAC
DIMENSIONS & WEIGHT	
Product Dimensions (WxHxD)	29 3/4" x 43 13/16" x 23 3/8"
Standard Cut-out Dimensions (WxHxD)	*Min. 28 1/2" x 43 7/16" x 24" **Max. 28 5/8" x 43 1/2" x 24"
Flush Cut-out Dimensions (WxHxD)	30" x 44" x 25"
Shipping Dimensions (WxHxD)	33" x 50" x 30"
Product Weight (lbs.)	192 lbs.
Shipping Weight (lbs.)	225 lbs.
LIMITED WARRANTY	
Parts & Labor	1 Year
UPC CODES	
WCEP6423F (PrintProof® Stainless Steel)	048231344753
WCEP6423D (PrintProof® Black Stainless Steel)	048231345323

40 AMPS

Dimensions and Clearances

Measure the current cutout dimensions and compare them to the cutout dimensions shown below. Little or no cabinet work may be necessary. The image may differ from the actual model.

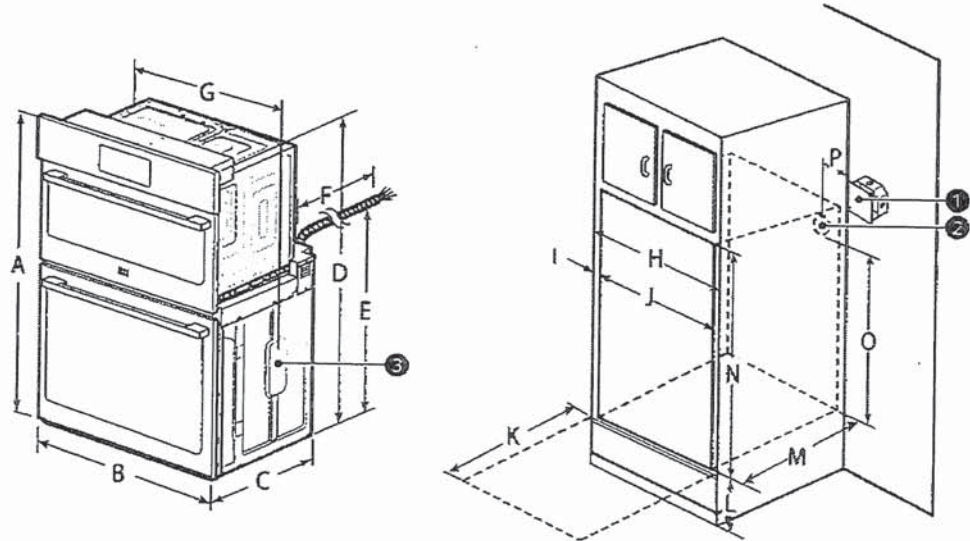

List		Dimensions
A	Height	43 13/16" (111.3 cm)
B	Width	29 3/4" (75.5 cm)
C	Depth	23 3/8" (59.3 cm)
D	Height (standard installation)	43 3/16" (109.7 cm)
E	Height (power cord)	25 7/8" (65.6 cm)
F	Length (power cord)	60" (152.4 cm)
G	Width (standard installation)	28 7/16" (72.2 cm)
H	Cabinet width	30" (76.2 cm)
I	Overlap of oven	1" (2.5 cm)
J	Cutout width	28 1/2" Min. (72.4 cm) 28 5/8" Max. (72.7 cm)
K	Depth of open door	23" (58.4 cm)
L	Cutout location from floor	12" (30.5 cm)
M	Cutout depth	24" Min. (61.0 cm)
N	Cutout height	43 7/16" Min. (110.3 cm) 43 1/2" Max. (110.5 cm)
O	Height of conduit opening from floor of cutout	39 27/32" (101.2 cm)
P	Distance of conduit opening from side of cabinet	5" (12.7 cm)

S.S.



HOME APPLIANCES

LG DISHWASHERS

LDFN4542_
Front Control Dishwasher with Quadwash™

KEY FEATURES

- QuadWash™ System
- 3rd Rack
- 15 Place Settings
- EasyRack™ Plus
- Dynamic Dry™
- NeveRust™ Stainless Steel Tub
- LoDecibel™ Operation (48 dB)
- NFC Tag On Technology
- NSF Certified
- Available in PrintProof™ Black Stainless Steel, PrintProof™ Stainless Steel, black, and White

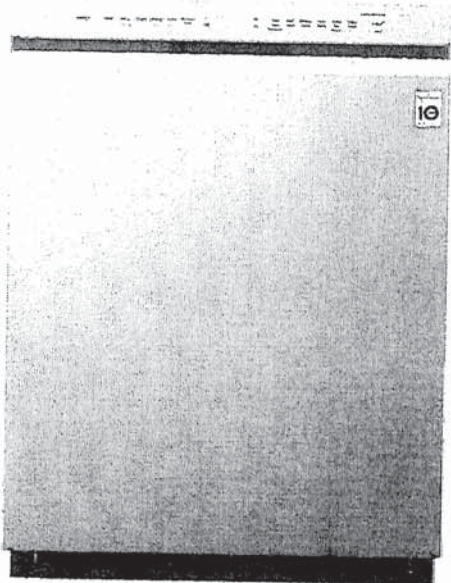

PRODUCT FEATURES

CAPACITY	
Total Place Settings	15
Upper Rack Dish Height Limit	9.0"
Lower Rack Dish Height Limit	12.5"
RACKS AND BASKETS	
Cutlery Baskets	Yes
Fold Down Tines	Yes (Half Fold on Upper & Half Fold on Lower)
BPA-Free Nylon Coated Racks and Tines	Yes
Rack Handle	Yes (Upper)
EasyRack™ Plus System	Yes
Height Adjustable Upper Rack	Yes
3rd Rack (Fixed)	Yes
STYLE AND DESIGN	
Control Panel Location	Front Control
Electronic Controls	Fully Integrated Control Panel
Tub Material	NeveRust™ Stainless Steel
Handle	Pocket Handle
All Available Colors	PrintProof™ Stainless Steel, PrintProof™ Black Stainless Steel, White, Black
Fingerprint Resistant	Yes
FEATURES	
QuadWash®	Yes
Inverter Direct Drive Motor	Yes
LoDecibel™ Quiet Operation	48dB
Number of Wash Cycles	9 (Auto, Heavy, Delicate, Normal, Turbo, Download Cycle, Machine Clean, Rinse, Express)
Number of Options	8 (Dual Zone, Half Load, Energy Saver, High Temp, Extra Dry, Delay Start, Control Lock, Night Dry)
Number of Spray Arms	3 (Top, Upper, Lower)
SenseClean™ Wash System	Yes
Vario Wash	Yes
Detergent and Rinse-Aid Dispenser	Yes
Drying System	Dynamic Dry
End of Cycle Indicator	Yes (Beeper + END indication on display)
Hidden Water Heater	Yes
Safety Float Switch (Leaks)	Yes
Soil (Turbidity) Sensor	Yes
Tub Insulation (Damping Sheet, Sound Absorbing Material (felt), Base)	Yes
BPA-Free Nylon Coated Racks and Tines	Yes
Anti-Bacterial Treatment (Sump, Inner / Outer filter, Drain pump case, Drain hose)	Yes
Balanced Door	Yes
3-Stage Filtration System	Yes

SMART FEATURES	
NFC Tag On	Yes
CERTIFICATIONS	
NSF® Certified	Yes
POWER RATINGS	
ENERGY STAR® Qualified	Yes
CEE Tier	1
Energy Use (kWh/Year)	258 kWh/Year
Water Factor (WF)	2.9
DIMENSIONS / CLEARANCES / WEIGHT	
Product Dimensions (in) (W x H x D)	23 3/4" x 33 5/8" x 24 5/8"
Product Weight (lbs)	75 lbs
Depth with Door Closed with Handle (in)	24 5/8"
Depth with Door Open (in)	49 1/4"
Carton Dimensions (in) (W x H x D)	28" x 34 7/8" x 29 5/8"
Shipping Weight with Carton (lbs)	88.2 lbs
LIMITED WARRANTY	
Labor	1 Year
Parts	1 Year
Control Board and Rack Parts	5 Years
Direct Drive Motor	10 Years
Stainless Steel Door Liner or Tub	Lifetime
UPC CODES	
LDFN4542S (PrintProof™ Stainless Steel)	048231341943
LDFN4542D (PrintProof™ Black Stainless Steel)	048231342001
LDFN4542B (Black)	048231341981
LDFN4542W (White)	048231341998

© 2020 LG Electronics USA, Inc. All rights reserved. "LG Life's Good" is a registered trademark of LG Corp. All other product and brand names are trademarks or registered trademarks of their respective owners. Design, features and specifications are subject to change without notice. Non-metric weights and measurements are approximate. Some features may require Internet access. Content and services may vary by product and are subject to change without notice. 1/28/20

5.5

DETAILED PLANNING DIMENSION

WHIRLPOOL® FRONT LOAD WASHER WITH INTUITIVE CONTROLS - 4.3 cu ft

ELECTRICAL REQUIREMENTS

WARNING: To reduce the risk of fire, electric shock, or injury to persons, read the IMPORTANT SAFETY INSTRUCTIONS and INSTALLATION INSTRUCTIONS, located in your appliance's Owner's Manual, before installing and operating this appliance.

Electrical Requirements	
WFW560CHW	4.3 cu ft DOE (US)/5.0 cu ft IEC (CAN)
Minimum Circuit Amperage Rating	15 A
Maximum Ampere Draw	10.36 A
Operating Voltage	120 V AC only
Operating Frequency	60 Hz

PRODUCT DIMENSIONS

WFW560CHW	4.3 cu ft DOE (US)/5.0 cu ft IEC (CAN)			
Unit of Measurement	in (minimum)	mm (minimum)	in (maximum)	mm (maximum)
Height (with feet) (A)	38 ^{5⁄8}	981	40	1016
Product Width (B)	27	686	-	-

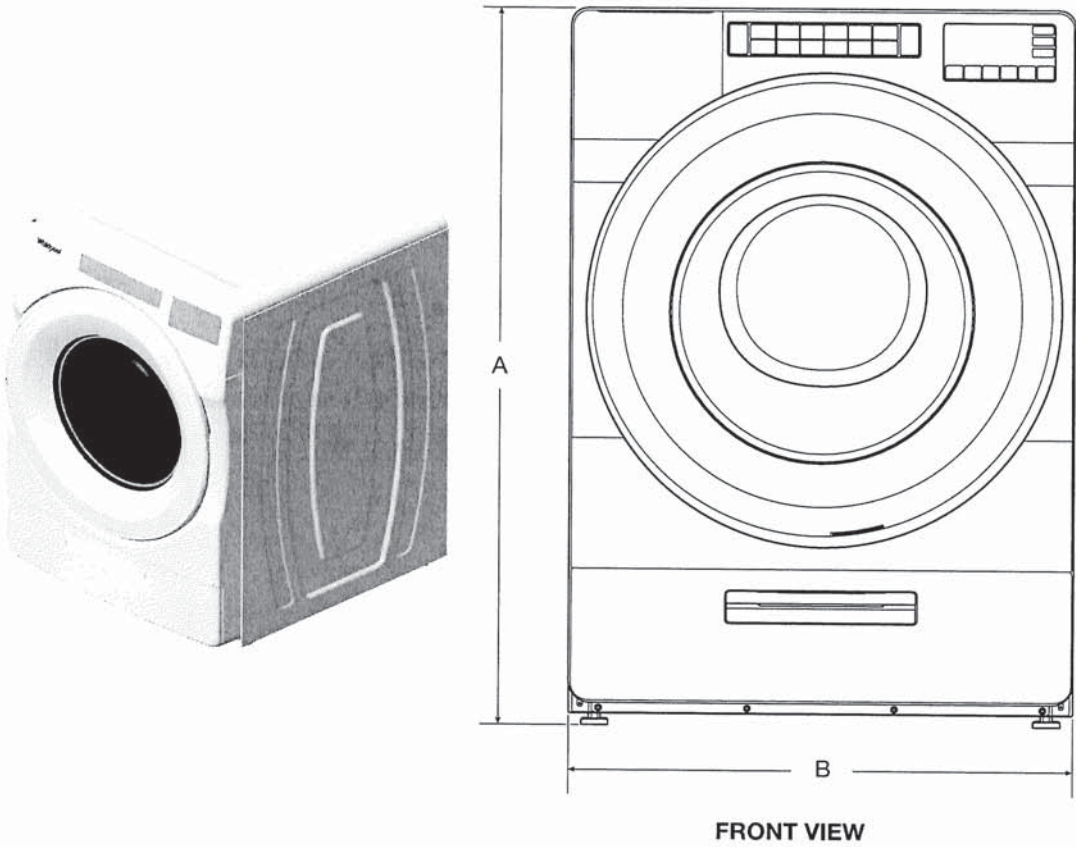

FRONT VIEW

IMPORTANT: Dimensional specifications are provided for planning purposes only.



DETAILED PLANNING DIMENSION

3 of 15

WHIRLPOOL® FRONT LOAD WASHER WITH INTUITIVE CONTROLS - 4.3 cu ft

PRODUCT DIMENSIONS

WFW560CHW	4.3 cu ft DOE (US)/5.0 cu ft IEC (CAN)			
Unit of Measurement	in (minimum)	mm (minimum)	in (maximum)	mm (maximum)
Door Width (C)	25 ¹ / ₁₆	652	-	-
Product Depth (D)	31 ¹ / ₁₆	802	-	-
Product Depth with Door Open (E)	54 ⁷ / ₈	1393	-	-
Door Height (F)	25 ¹ / ₁₆	652	-	-
Height to Bottom of Door (G)	9 ¹ / ₂	241	-	-

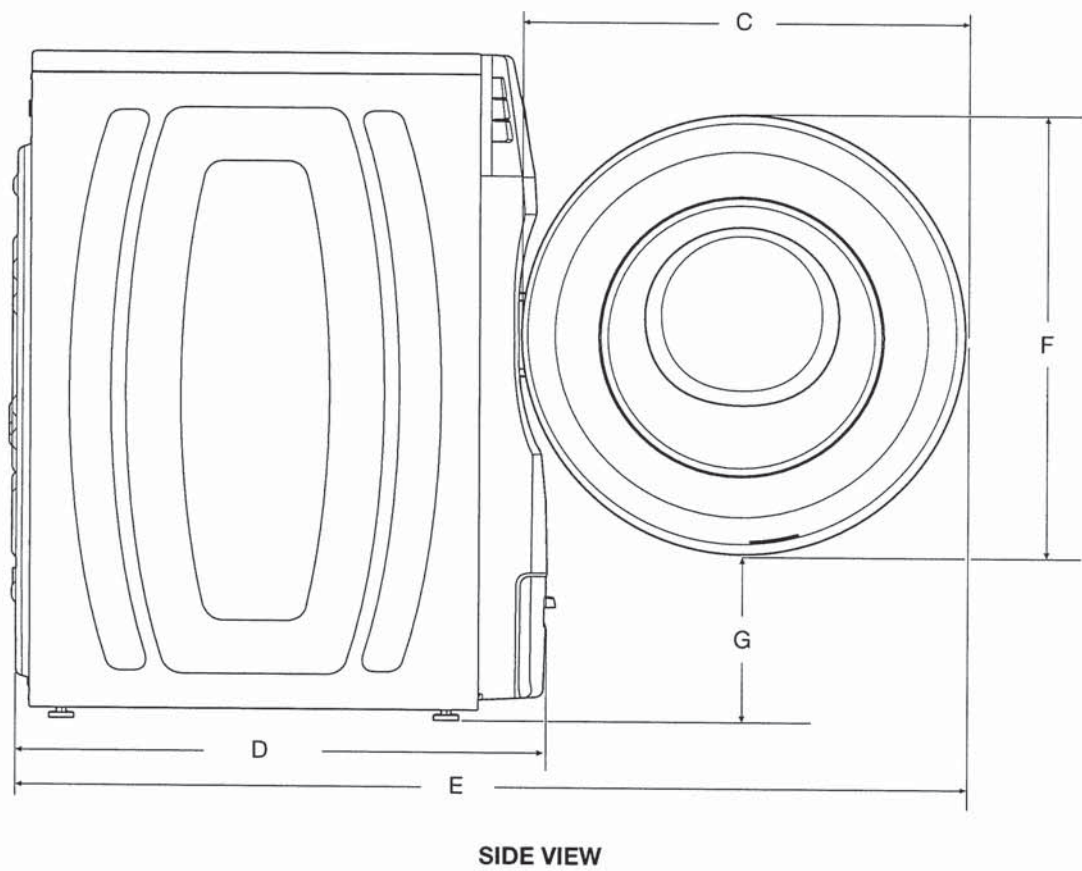

IMPORTANT: Dimensional specifications are provided for planning purposes only.



DETAILED PLANNING DIMENSION

4 of 15

WHIRLPOOL® FRONT LOAD WASHER WITH INTUITIVE CONTROLS - 4.3 cu ft

PRODUCT DIMENSIONS

WFW560CHW	4.3 cu ft DOE (US)/5.0 cu ft IEC (CAN)			
Unit of Measurement	in (minimum)	mm (minimum)	in (maximum)	mm (maximum)
Position of Power Cord (H)	35 ⁵ / ₁₆	897	-	-
Power Cord Length	72	1830	-	-
Position of Water Inlet Valves (I)	35 ⁵ / ₁₆	897	-	-
Position of Drain Hose (J)	8	205	-	-
Drain Hose Length	52	1321	-	-
Diameter of Drain Hose	1	26	-	-

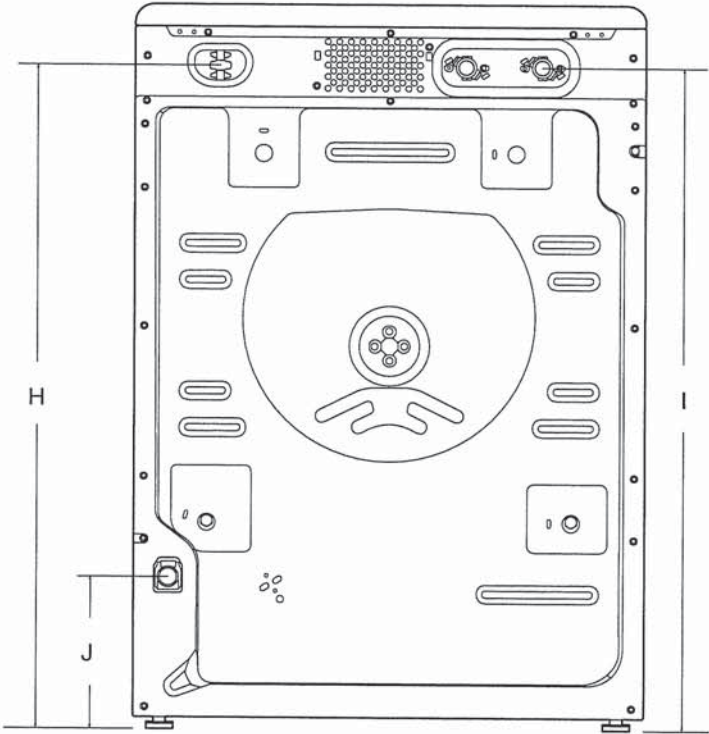

BACK VIEW

IMPORTANT: Dimensional specifications are provided for planning purposes only.



WHIRLPOOL DRYER Model #: YWED5620HW

Whirlpool Brand Canada English | Washer and Dryers | Dryers | Electric Dryers | YWED5620HW

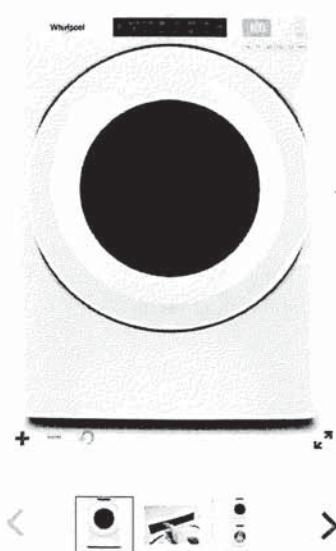

7.4 cu. ft. Front Load Electric
Dryer with Intuitive Touch
Controls

Whirlpool® 7.4 cu. ft. Front Load Electric Dryer with Intuitive Touch Controls
Model #: YWED5620HW

Dimensions

Depth	78.74 cm, 31.0 in
Depth With Door Open 90 Degree	138.43 cm, 54-1/2 in
Height	98.42 cm, 38-3/4 in
Width	68.58 cm, 27.0 in

Configuration and Overview

Fuel Type	Electric
-----------	----------

Cycles and Options

Cycle Time Remaining	Yes
Lint Filter Indicator	No
Number of Dryer Cycles	36
Number of Dryness Levels	3

Ventilation System

Long Vent	No
Maximum Vent Length	64
Venting Direction	Left, Right, Bottom, Rear

Electrical

Hz	60
Power Cord Included	Yes