

Sales Selection Sheet
Checklist

1 of 38

LOT 3185B-9 Model: 20-1790 A The Dunmore

PURCHASERS: Manmohan, S BINDRA/Sunita Bindra

VENDOR: Heathwood Homes (Huron) Limited

WALK OUT BASEMENT

OPTIONAL DOUBLE SINKS IN MASTER ENSUITE BATHROOM

- ☒ FINISHED BASEMENT
- ☐ COLD CELLAR

UPGRADED / MODIFIED ELEVATION

- ☐ CORNER UPGRADE
- ☐ REAR UPGRADE

CEILING UPGRADE - SMOOTH

- ☐ MAIN FLOOR
- ☐ SECOND FLOOR
- ☐ BASEMENT

ADDITIONAL ROUGH-INS

- ☐ 200 AMP SERVICE
- ☐ WET BAR ROUGH-IN
- ☐ HUMIDIFIER
- ☒ AIR CONDITIONING

GAS ROUGH-IN

- ☒ STOVE
- ☐ DRYER
- ☐ BBQ
- ☐ ADDITIONAL FIREPLACE

KITCHEN: HOODFAN VENTING SIZE

- ☒ 6 IN ROUND DUCT
- ☐ 7 IN ROUND DUCT

FULL BASEMENT STAIRS:	N/A
UPPER BASEMENT STAIRS:	All Oak
LOWER BASEMENT STAIRS:	Carpet Grade
MAIN STAIRS:	All Oak
MEDIA STAIRS (if applicable):	N/A
LOFT STAIRS (if applicable):	N/A

March 9, 2022 Signature on file

DatePurchaser:

DatePurchaser:

March 9, 2022 SONIA SHARIF

DateDecor Consultant:

March 9, 2022 MARILYN ROSEN

Date ApprovedHeathwood Homes (Huron) Limited

Locked Date:

Customer Colours

Manmohan, S BINDRA/Sunita Bindra
Project: Wallaceton
Unit: 3185B-9, Phase: 3
Model: 20-1790 A The Dunmore

2 of 38



414

Created: 12/19/2021 20:19:35

Locked:

Closed:

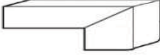
Kitchen

Cabinet Colour/Style	9166	Viking III-CHARLESTON-ORCHID-3DL ***STD***	
Countertop	8595	Group 2-Quartz-Caesarstone-OCEAN FOAM #6141-3/4 inch with built-up edge ***2***	
Countertop Edge	4005	DOUBLE MITRE 1 1/2 INCH ***UPG***	
Cabinet Hardware	2086	9677-HARDWARE ***STD***	
Island Cabinet Colour/Style	9168	Viking III-CHARLESTON-MOONLIGHT-3DL ***STD***	
Island Countertop	8595	Group 2-Quartz-Caesarstone-OCEAN FOAM #6141-3/4 inch with built-up edge ***2***	
Backsplash	8103	OD.ON.SWT.02.HEX.MT-ONTARIO HEXAGON MATTE-SNOW WHITE ***2***	
Backsplash Grout	2225	Grout-(27) Silver ***STD***	
Backsplash Tile Pattern	3110	HORIZONTAL HEX ***STD***	 <div>changed to SCB50030 due to original selection on back order - same size</div>
HoodFan	9393	SCB51930-CYCLONE 30 inch CANOPY CHIMNEY HOODFAN-SS	PG 32
Appliance	9393	Purchasers have been advised: standard fridge opening is a minimum 37 3/8 x 73 3/8". Ice Waterline Rough-In is included.	
Appliance	9393	Standard stove opening is 30" and standard dishwasher opening is 24". Any gas stove will require backsplash or stainless steel backing to avoid fire hazards.	
Appliance	9393	Purchasers acknowledge: Heathwood Homes and its contractors will not be responsible for any kitchen cabinet changes due to appliances dimension changes after	
Comment			

Kitchen/Breakfast

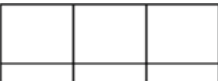
Flooring	9393	TR.SP.WHITE.1313 SEMPRE White Matte 13	
Floor Tile Grout	2225	Grout-(27) Silver ***STD***	
Floor Tile Pattern	3000	STANDARD SQUARE ***STD***	

Customer Colours

Manmohan, S BINDRA/Sunita Bindra
Project: Wallaceton
Unit: 3185B-9, Phase: 3
Model: 20-1790 A The Dunmore

Created: 12/19/2021 20:19:35

Locked:

Closed:

Comment

Foyer

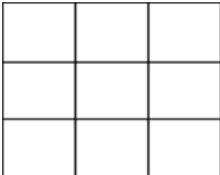
Flooring	3000	TR.SP.WHITE.1313 SEMPRE White Matte 13
Floor Tile Grout	2225	Grout-(27) Silver ***STD***
Floor Tile Pattern	3000	STANDARD SQUARE ***STD*** 
Comment		

Laundry Room

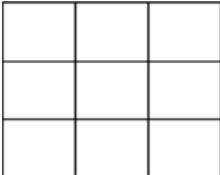
Flooring	3000	TR.SP.WHITE.1313 SEMPRE White Matte 13
Floor Tile Grout	2225	Grout-(27) Silver ***STD***
Floor Tile Pattern	3000	STANDARD SQUARE ***STD*** 
Comment		

Laundry Room Opt.

Cabinet - Uppers	1111	N/A *****
Cabinet Hardware	1111	N/A *****
Comment		

Mud Room

Flooring	1111	TR.SP.WHITE.1313 SEMPRE White Matte 13
----------	------	--

Customer Colours

Manmohan, S BINDRA/Sunita Bindra
Project: Wallaceton
Unit: 3185B-9, Phase: 3
Model: 20-1790 A The Dunmore

4 of 38
Created: 12/19/2021 20:19:35
Locked:
Closed:

Floor Tile Grout	2225	Grout-(27) Silver ***STD***
Floor Tile Pattern	3000	STANDARD SQUARE ***STD*** <div><div></div><div></div><div></div><div></div><div></div><div></div><div></div><div></div><div></div></div>
Comment		

Powder Room

Flooring	3000	TR.SP.WHITE.1313 SEMPRE White Matte 13
Floor Tile Grout	2225	Grout-(27) Silver ***STD***
Floor Tile Pattern	3000	STANDARD SQUARE ***STD*** <div><div></div><div></div><div></div><div></div><div></div><div></div><div></div><div></div><div></div></div>
Plumbing Fixture (Colour)	1737	Plumbing Fixtures-WHITE ***STD***
Comment		

Hall

Flooring	7502	Red Oak Pearl-Vintage Engineered-PEWTER/ECLIPSE-3/4 inch x 3 1/4 inch
Comment		

Dining Room

Flooring	7502	Red Oak Pearl-Vintage Engineered-PEWTER/ECLIPSE-3/4 inch x 3 1/4 inch
Comment		

Great Room

Flooring	7502	Red Oak Pearl-Vintage Engineered-PEWTER/ECLIPSE-3/4 inch x 3 1/4 inch
Comment		

Manmohan, S BINDRA/Sunita Bindra
Project: Wallaceton
Unit: 3185B-9, Phase: 3
Model: 20-1790 A The Dunmore

Created: 12/19/2021 20:19:35

Locked:

Closed:

Upper Hall

Flooring	7502	Red Oak Pearl-Vintage Engineered-PEWTER/ECLIPSE-3/4 inch x 3 1/4 inch ***3***
Comment		

Finished Basement (Rec) Room/Hall

Flooring	9248	DY 89418 -Dynasty Tex-BLACK ICE-40 oz Poly***STD***
Comment		

Master Bedroom

Flooring	9248	DY 89418 -Dynasty Tex-BLACK ICE-40 oz Poly***STD ***
Comment		

Bedroom 2

Flooring	9248	DY 89418 -Dynasty Tex-BLACK ICE-40 oz Poly***STD ***
Comment		

Bedroom 3

Flooring	9248	DY 89418 -Dynasty Tex-BLACK ICE-40 oz Poly***STD ***
Comment		

Master Ensuite

Cabinet Colour/Style	9111	VIKING III SIMCOE ORCHID 3DL ***STD***
Countertop	8826	4926K-07-Countertop-BLACK ALICANTE-Wilsonart ***STD***

Customer Colours

Manmohan, S BINDRA/Sunita Bindra
Project: Wallaceton
Unit: 3185B-9, Phase: 3
Model: 20-1790 A The Dunmore

6 of 38
Created: 12/19/2021 20:19:35
Locked:
Closed:

Countertop Edge	1111	N/A *****
Cabinet Hardware	2086	9677-HARDWARE ***STD***
Floor Tile	2086	GE.BY.AZR.1313 New Byzantine Azzuro 13
Floor Tile Grout	2225	Grout-(27) Silver ***STD***
Floor Tile Pattern	3000	STANDARD SQUARE ***STD*** <div><div></div><div></div><div></div><div></div><div></div><div></div><div></div><div></div><div></div></div>
Shower Floor Tile	8661	OD.ON.SWT.0202.MT.N-Ontario Series Mosaic-Snow White Matte-2 x 2 ***STD***
Shower Floor Tile Grout	2226	Grout-(00) White ***STD***
Shower Floor Tile Pattern	3000	STANDARD SQUARE ***STD*** <div><div></div><div></div><div></div><div></div><div></div><div></div><div></div><div></div><div></div></div>
Shower Wall Tile	5411	QT.SP.WHT.0810-Splendour-White-8 inch x 10 inch ***STD***
Shower Wall Tile Grout	2226	Grout-(00) White ***STD***
Shower Wall Tile Pattern	3070	HORIZONTAL STACKED ***STD*** <div><div></div><div></div><div></div><div></div><div></div><div></div></div>
Shower Jamb(s) and Sill(s)	8923	Shower Jamb / Sill-Thassos White ***STD***
Plumbing Fixture (colour)	1737	Plumbing Fixtures-WHITE ***STD***
Comment		

Main Bathroom

Cabinet Colour/Style	9157	Viking III-SIMCOE-MOONLIGHT-3DL ***STD***
Countertop	8796	6698-46-Countertop-PALOMA POLAR ETCHINGS FINISH-Formica ***STD***
Countertop Edge	1111	N/A *****

Customer Colours

Manmohan, S BINDRA/Sunita Bindra
Project: Wallaceton
Unit: 3185B-9, Phase: 3
Model: 20-1790 A The Dunmore

7 of 38

414

Created: 12/19/2021 20:19:35

Locked:

Closed:

Cabinet Hardware	2086	9677-HARDWARE ***STD***
Flooring	2086	TR.SP.WHITE.1313 SEMPRE White Matte 13
Floor Tile Grout	2225	Grout-(27) Silver ***STD***
Floor Tile Pattern	3000	STANDARD SQUARE ***STD*** <div><div></div><div></div><div></div><div></div><div></div><div></div><div></div><div></div><div></div></div>
Wall Tile	8833	QT.UW.WHT.0810-Uniwall-White-8 x 10 ***STD***
Wall Tile Grout	2226	Grout-(00) White ***STD***
Main Bathroom Tile Pattern	3070	HORIZONTAL STACKED ***STD*** <div><div></div><div></div><div></div><div></div><div></div><div></div></div>
Plumbing Fixture (Colour)	1737	Plumbing Fixtures-WHITE ***STD***
Comment		

Finished Basement Bathroom

Cabinet Colour/Style	6265	Viking III-MANCHESTER-SHALE GREY CL-MAPLE ***STD***
Countertop	8801	P-344 LM-Countertop-INUKSHUK GREY-Arborite ***STD***
Countertop Edge	1111	N/A *****
Cabinet Hardware	2086	9677-HARDWARE ***STD***
Flooring	8623	GE.CM.GRY.1313-Corte Milia-Grey-13 x 13 ***STD***
Floor Tile Grout	2225	Grout-(27) Silver ***STD***
Floor Tile Pattern	3000	STANDARD SQUARE ***STD*** <div><div></div><div></div><div></div><div></div><div></div><div></div><div></div><div></div><div></div></div>
Shower Floor Tile	8664	OD.ON.TGR.0202.MT.N-Ontario Series Mosaic-Tender Grey Matte-2 x 2 ***1***

Customer Colours

Manmohan, S BINDRA/Sunita Bindra
Project: Wallaceton
Unit: 3185B-9, Phase: 3
Model: 20-1790 A The Dunmore

8 of 38
Created: 12/19/2021 20:19:35
Locked:
Closed:

Shower Floor Tile Grout	2226	Grout-(00) White ***STD***
Shower Floor Tile Pattern	3000	STANDARD SQUARE ***STD*** <div><div></div><div></div><div></div><div></div><div></div><div></div><div></div><div></div><div></div></div>
Shower Wall Tile	9025	QT.UW.TGR.0810-Uniwall-Tender Grey-8 x 10 ***STD***
Shower Wall Tile Grout	2226	Grout-(00) White ***STD***
Shower Wall Tile Pattern	3070	HORIZONTAL STACKED ***STD*** <div><div></div><div></div><div></div><div></div><div></div><div></div></div>
Shower Jamb(s)	8923	Shower Jamb / Sill-Thassos White ***STD***
Plumbing Fixture (Colour)	1737	Plumbing Fixtures-WHITE ***STD***
Comment		

Great Room Fireplace

Type	8865	Dimplex-Electric Fireplace-PF3033HL ***STD***	
Mantle	8891	NF-17-Paint Grade Mantle- Cabinet (Per Plan)-WHITE ***STD***	PG 21
Surround Opt.	1111	N/A *****	
Disclaimer	1111	Purchasers have been advised: heat from the FP can damage TV above a FP and items placed on mantle.	
Disclaimer	1111	Heathwood and its contractors will not be liable for any damage on items placed/installed above a FP after closing.	
Comment			

Basement Stairs

Type	1714	Carpet Grade Stairs ***STD BASEMENT STAIRS***
Colour	1111	N/A *****
Carpet Runner	1111	N/A *****
Handrail/Pickets/Post Type	9119	Handrail only on closed walls (one or two sides per building code) ***STD***

Customer Colours

Manmohan, S BINDRA/Sunita Bindra
Project: Wallaceton
Unit: 3185B-9, Phase: 3
Model: 20-1790 A The Dunmore

9 of 38
Created: 12/19/2021 20:19:35
Locked:
Closed:

Building Code, STD		
Handrail/Pickets/Post Colours	1728	Oak Grade-Stain handrail,oak pickets,stringers,treads,risers
Carpet	9248	DY 89418 -Dynasty Tex-BLACK ICE-40 oz Poly***STD***
Custom Stain/Paint	1111	N/A *****
Comment		

Basement Stairs Landings (Upper and Lo

Flooring	7502	Red Oak Pearl-Vintage Engineered-PEWTER/ECLIPSE-3/4 inch x 3 1/4 inch ***3***
Comment		

Main Stairs

Type	1712	Oak Stairs ***STD MAIN STAIRS***
Colour	7922	Eclipse (Pewter) STAIN TO COMPLIMENT HARDWOOD AND WILL VARY FROM FLOORING ***99***
Carpet Runner	1111	N/A *****
Handrail/Pickets/Posts Type	7652	1 5/16 inch Square pickets with 3 1/2" Square/Cap Post(s)-ALL OAK ***STD***
Handrail/Pickets/Posts Colour	1728	Oak Grade-Stain handrail,oak pickets,stringers,treads,risers
Custom Stain/Paint	1111	N/A *****
Comment		

Main Stairs Landing(s)

Flooring	7502	Red Oak Pearl-Vintage Engineered-PEWTER/ECLIPSE-3/4 inch x 3 1/4 inch
Comment		

Throughout

10 of 38

Created: 12/19/2021 20:18:35

Created: 12/19/2021 20:49:35
Locked:
Closed:

Purchaser: _____
Manmohan, S BINDRA **Date** **Decor Consultant** **Date**

Purchaser: _____
Sunita Bindra _____ Date _____ Wallace-ton _____ Date Approved _____



CONSTRUCTION SUMMARY

Lot: 3185B-9
Model: 20-1790 A The Dunmore
Project/Phase: Wallaceton / 3

Offer	Five Appliances: SS Fridge, Stove, Dishwasher: White Front Loader Washer/Dryer - Townhomes
Worksheet	Note: UPGRADE APPLIANCES SEE SPECS 34-38



CONSTRUCTION SUMMARY

Lot: 3185B-9
Model: 20-1790 A The Dunmore
Project/Phase: Wallaceton / 3

ALUMINUM

Invoice	Qty.	Description
989 09Mar22 ** NoCat	1	- THIS IS A WALK OUT BASEMENT LOT WITH A JULIETTE RAILING ACROSS MAIN FLOOR SLIDING PATIO DOOR.

APPLIANCES

Invoice	Qty.	Description
989 313,484 09Mar22	1	- APPLIANCES - CYCLONE 30 INCH WALL MOUNT CHIMNEY HOOD SS - SCB51930 CABINETRY - delete stove uppers; ELECTRICAL - delete std range hood; HEATING/AIR CONDITIONING - Delete change to 6"

CABINETRY

Invoice	Qty.	Description
989 313,768 09Mar22	1	KITCHEN - 11A-Upper angle corner per unit Viking SKETCH #'S 2 AND 3
989 314,040 09Mar22	1	KITCHEN - 30H-Wall cabinet with shelf for microwave (finished interior) (opening 24 InchW x 13 3/4 InchH x 17 InchD) Viking SKETCH #'S 2 AND 3
989 306,565 09Mar22	1	KITCHEN - CABINETRY - OPT DEEP FRIDGE UPPER & GABLES - KITCHEN (ALL DOOR STYLES) SKETCH #'S 2 AND 3
989 313,796 09Mar22	1	KITCHEN - 12B-Pots and pans drawers (width min. 60cm/max. 90cm) (size subject to floor plan) Viking SKETCH #'S 2 AND 3
989 313,484 09Mar22 **	1	- APPLIANCES - CYCLONE 30 INCH WALL MOUNT CHIMNEY HOOD SS - SCB51930 CABINETRY - delete stove uppers; ELECTRICAL - delete std range hood; HEATING/AIR CONDITIONING - Delete change to 6"
989 314,124 09Mar22	1	- 40J-Two-tone colour/style selection for island (must be of equal or lower level to main selection) Viking
989 334,723 09Mar22 **	1	MASTER ENSUITE - PLUMBING - OPTION FROM ONE SINK TO DOUBLE SINKS INCLUDING STD CHATEAU FAUCET OVERMOUNT COLONY SINK ONE EXTRA VANITY LIGHT AND CABINET CONVERSION 2D VIKING SKETCH # 4 CABINETRY-2D Convert Cabinetry Viking; Eletrical-Additional Vanity Light

CARPET

Invoice	Qty.	Description
989 311,568 09Mar22 **	1	UPPER HALL - HARDWOOD - VINTAGE - 3-1/4 INCH RED OAK ENGINEERED - UPPER HALL - UPG CARPET - delete std CARPET; INTERIOR TRIM - supply and install quarter rounds; PAINTING - paint quarter



CONSTRUCTION SUMMARY

Lot: 3185B-9
Model: 20-1790 A The Dunmore
Project/Phase: Wallaceton / 3

CERAMICS

Invoice	Qty.	Description
989 308,527 09Mar22	1	Basement Bathroom - CERAMICS - SHOWER FLOOR - BASEMENT BATHROOM - UPGRADE 1
989 308,448 09Mar22	1	Kitchen - CERAMICS - BACKSPLASH - KITCHEN - UPGRADE 2
989 314,179 09Mar22	1	- CERAMICS - ADDITIONAL BACKSPLASH DUE TO INSTALL CHIMENEY HOODFAN IN KITCHEN - KITCHEN - UPGRADE 2

CONCRETE AND DRAIN

Invoice	Qty.	Description
989 09Mar22 ** NoCat	1	- THIS IS A WALK OUT BASEMENT LOT WITH A JULIETTE RAILING ACROSS MAIN FLOOR SLIDING PATIO DOOR.

DECK

Invoice	Qty.	Description
989 09Mar22 ** NoCat	1	- THIS IS A WALK OUT BASEMENT LOT WITH A JULIETTE RAILING ACROSS MAIN FLOOR SLIDING PATIO DOOR.



CONSTRUCTION SUMMARY

Lot: 3185B-9
Model: 20-1790 A The Dunmore
Project/Phase: Wallaceton / 3

ELECTRICAL

Invoice	Qty.	Description
989 314,229 09Mar22	1	KITCHEN - ELECTRICAL - EXTRA WALL INTERIOR OUTLET (120V/15A) ON A SEPARATE CIRCUIT (ON ARCFault) MICROWAVE SHELF SEE SKETCH #S 2 AND 3
989 314,232 09Mar22	1	GREAT ROOM - ELECTRICAL - EXTRA WALL INTERIOR OUTLET ON EXISTING CIRCUIT (DOES NOT INCLUDE KITCHEN OUTLETS) +/- TO BE CENTERED ABOVE FIREPLACE- +/- 70" FROM FLOOR SKETCH # 3
989 314,224 09Mar22	2	- ELECTRICAL - CEILING ROUGH-IN (CAPPED) 1) GREAT ROOM - TO BE CENTERED +/- IN ROOM ON EXISTING SWITCH 2) ABOVE CENTERED ABOVE ISLAND +/- ON SEPARATE SWITCH SEE SKETCH # 2
989 314,340 09Mar22 **	1	KITCHEN - HEATING/AIR - ROUGH-IN GAS LINE FOR GAS STOVE AT MAIN FLOOR (SEE SPECS) (HOOK-UP NOT INCLUDED) LEAVE STANDARD 120 VOLT ELECTRICAL OUTLET ON A SEPARATE CIRCUIT. * STANDARD 220V WILL STAY ELECTRICAL - notification
989 313,484 09Mar22 **	1	- APPLIANCES - CYCLONE 30 INCH WALL MOUNT CHIMNEY HOOD SS - SCB51930 CABINETRY - delete stove uppers; ELECTRICAL - delete std range hood; HEATING/AIR CONDITIONING - Du change to 6"
989 334,723 09Mar22 **	1	MASTER ENSUITE - PLUMBING - OPTION FROM ONE SINK TO DOUBLE SINKS INCLUDING STD CHATEAU FAUCET OVERMOUNT COLONY SINK ONE EXTRA VANITY LIGHT AND CABINET CONVERSION 2D VIKING SKETCH # 4 CABINETRY-2D Convert Cabinetry Viking; Eletrical-Additional Vanity Light
989 314,223 09Mar22	1	KITCHEN - ELECTRICAL - ADDITIONAL SWITCH FOR CAPPED CEILING OVER THE ISLAND -LOCATE WITH STANDARD KITCHEN LIGHT SWITCH

EXTERIOR BRICK

Invoice	Qty.	Description
989 09Mar22 ** NoCat	1	- THIS IS A WALK OUT BASEMENT LOT WITH A JULIETTE RAILING ACROSS MAIN FLOOR SLIDING PATIO DOOR.

EXTERIOR CAULKING

Invoice	Qty.	Description
989 09Mar22 ** NoCat	1	- THIS IS A WALK OUT BASEMENT LOT WITH A JULIETTE RAILING ACROSS MAIN FLOOR SLIDING PATIO DOOR.

EXTERIOR RAILINGS

Invoice	Qty.	Description
989 09Mar22 ** NoCat	1	- THIS IS A WALK OUT BASEMENT LOT WITH A JULIETTE RAILING ACROSS MAIN FLOOR SLIDING PATIO DOOR.



CONSTRUCTION SUMMARY

Lot: 3185B-9
Model: 20-1790 A The Dunmore
Project/Phase: Wallaceton / 3

FORMING

Invoice	Qty.	Description
989 09Mar22 ** NoCat	1	- THIS IS A WALK OUT BASEMENT LOT WITH A JULIETTE RAILING ACROSS MAIN FLOOR SLIDING PATIO DOOR.

FRAMING

Invoice	Qty.	Description
989 09Mar22 ** NoCat	1	- THIS IS A WALK OUT BASEMENT LOT WITH A JULIETTE RAILING ACROSS MAIN FLOOR SLIDING PATIO DOOR.

GRANITE

Invoice	Qty.	Description
989 310,903 09Mar22	1	Kitchen / Island - GRANITE - COUNTERTOP - 3/4 INCH GROUP 2 WITH MITRE EDGE - KITCHEN / ISLAND - UPG

HARDWOOD

Invoice	Qty.	Description
989 311,568 09Mar22	1	UPPER HALL - HARDWOOD - VINTAGE - 3-1/4 INCH RED OAK ENGINEERED - UPPER HALL - UPG CARPET - delete std CARPET; INTERIOR TRIM - supply and install quarter rounds; PAINTING - paint quarter

HEATING / AIR CONDITIONING

Invoice	Qty.	Description
989 314,340 09Mar22	1	KITCHEN - HEATING/AIR - ROUGH-IN GAS LINE FOR GAS STOVE AT MAIN FLOOR (SEE SPECS) (HOOK-UP NOT INCLUDED) LEAVE STANDARD 120 VOLT ELECTRICAL OUTLET ON A SEPARATE CIRCUIT. * STANDARD 220V WILL STAY ELECTRICAL - notification
989 313,484 09Mar22 **	1	- APPLIANCES - CYCLONE 30 INCH WALL MOUNT CHIMNEY HOOD SS - SCB51930 CABINETRY - delete stove uppers; ELECTRICAL - delete std range hood; HEATING/AIR CONDITIONING - Du change to 6"
989 09Mar22 ** NoCat	1	- THIS IS A WALK OUT BASEMENT LOT WITH A JULIETTE RAILING ACROSS MAIN FLOOR SLIDING PATIO DOOR.

INTERIOR TRIM AND DOORS

Invoice	Qty.	Description
989 311,568 09Mar22 **	1	UPPER HALL - HARDWOOD - VINTAGE - 3-1/4 INCH RED OAK ENGINEERED - UPPER HALL - UPG CARPET - delete std CARPET; INTERIOR TRIM - supply and install quarter rounds; PAINTING - paint quarter
989 09Mar22 ** NoCat	1	- THIS IS A WALK OUT BASEMENT LOT WITH A JULIETTE RAILING ACROSS MAIN FLOOR SLIDING PATIO DOOR.



CONSTRUCTION SUMMARY

Lot: 3185B-9
Model: 20-1790 A The Dunmore
Project/Phase: Wallaceton / 3

LUMBER

Invoice	Qty.	Description
989 09Mar22 ** NoCat	1	- THIS IS A WALK OUT BASEMENT LOT WITH A JULIETTE RAILING ACROSS MAIN FLOOR SLIDING PATIO DOOR.

PAINTING

Invoice	Qty.	Description
989 311,568 09Mar22 **	1	UPPER HALL - HARDWOOD - VINTAGE - 3-1/4 INCH RED OAK ENGINEERED - UPPER HALL - UPG CARPET - delete std CARPET; INTERIOR TRIM - supply and install quarter rounds; PAINTING - paint quarter

PLUMBING

Invoice	Qty.	Description
989 334,723 09Mar22	1	MASTER ENSUITE - PLUMBING - OPTION FROM ONE SINK TO DOUBLE SINKS INCLUDING STD CHATEAU FAUCET OVERMOUNT COLONY SINK ONE EXTRA VANITY LIGHT AND CABINET CONVERSION 2D VIKING SKETCH # 4 CABINETRY-2D Convert Cabinetry Viking; Eletrical-Additional Vanity Light

STEEL

Invoice	Qty.	Description
989 09Mar22 ** NoCat	1	- THIS IS A WALK OUT BASEMENT LOT WITH A JULIETTE RAILING ACROSS MAIN FLOOR SLIDING PATIO DOOR.

STRUCTURED WIRING

Invoice	Qty.	Description
989 314,546 09Mar22	2	FINISHED BASEMENT FAMILY (REC) ROOM - STRUCTURED WIRING - RELOCATION OF TV/PHONE 1) BASEMENT- RELOCATE PHONE LINE 2) BASEMENT- RELOCATE CABLE TV SEE SKETCH # 1

WINDOWS

Invoice	Qty.	Description
989 09Mar22 ** NoCat	1	- THIS IS A WALK OUT BASEMENT LOT WITH A JULIETTE RAILING ACROSS MAIN FLOOR SLIDING PATIO DOOR.

SKETCH #1
20-1790 ELEV. A
WOB

THE DUNMORE
ELEVATION A | 2,242 SQ. FT.
Includes 452 sq. ft. of Finished Lower Level
WALLACETON
EST. 1870

RELOCATE
PHONE LINE
AND CABLE TV

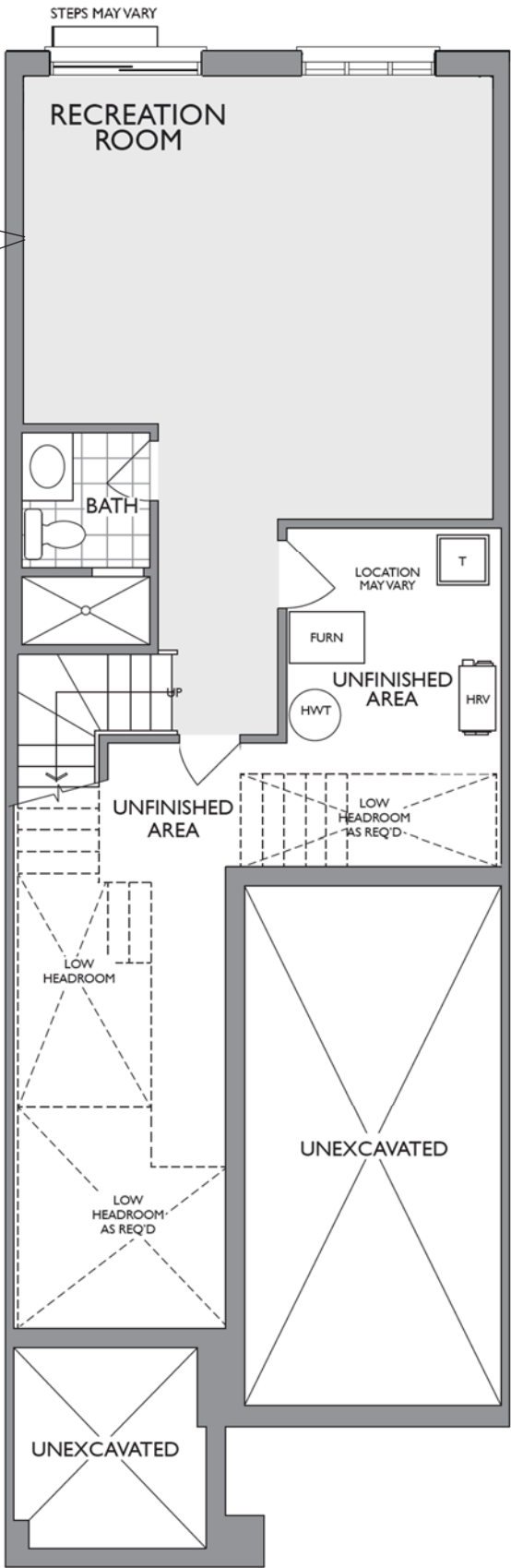

LOWER LEVEL
ELEVATION A

SKETCH #2
20-1790 ELEV. A
WOB

THE DUNMORE
ELEVATION A | 2,242 SQ. FT.
Includes 452 sq. ft. of Finished Lower Level
WALLACETON
EST. 1870

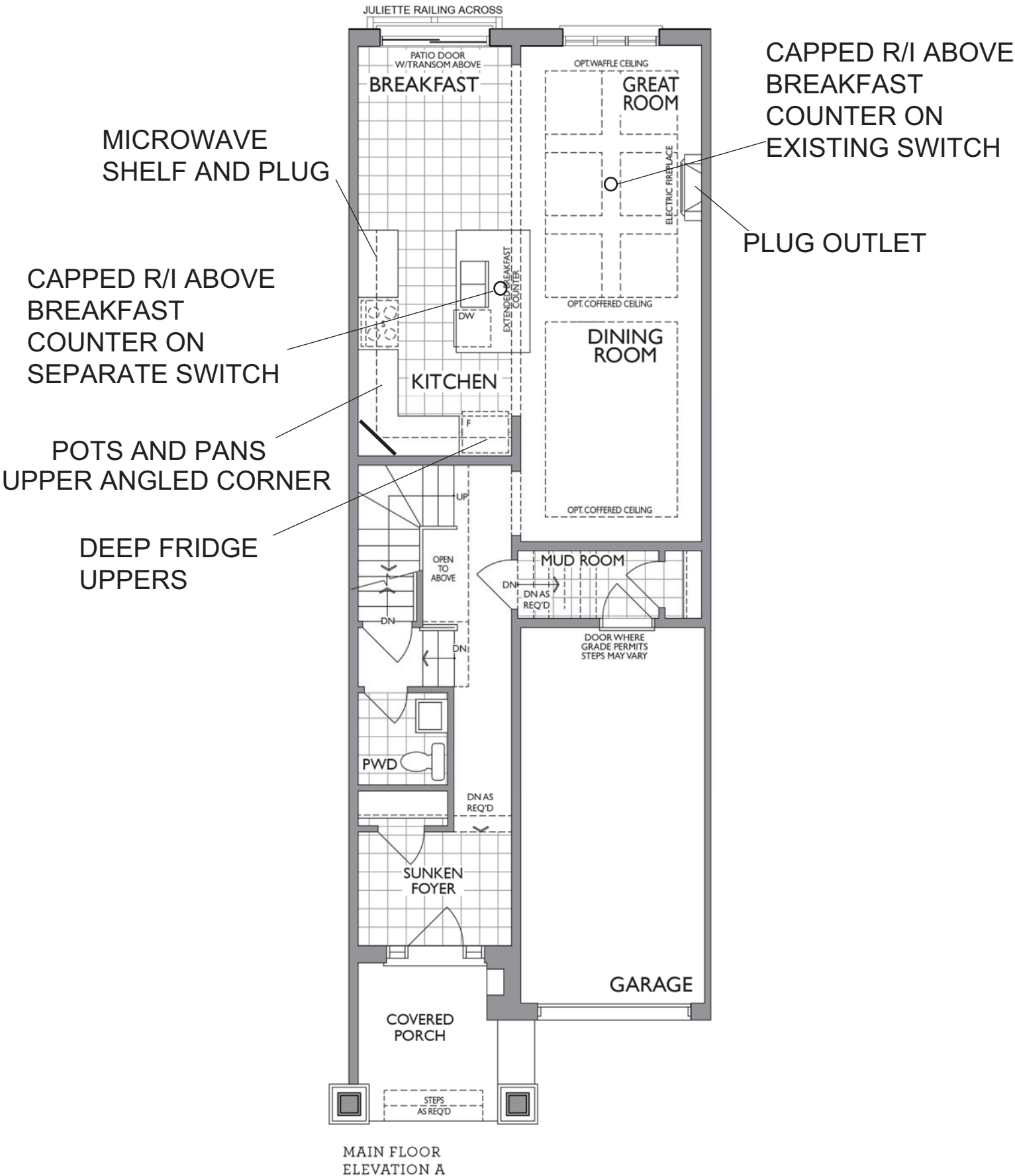

Project: Wallaceton
Unit: 3185B-9, Phase: 3
Model: 20-1790 A The Dunmore

KITCHEN
(GROUND FLOOR)

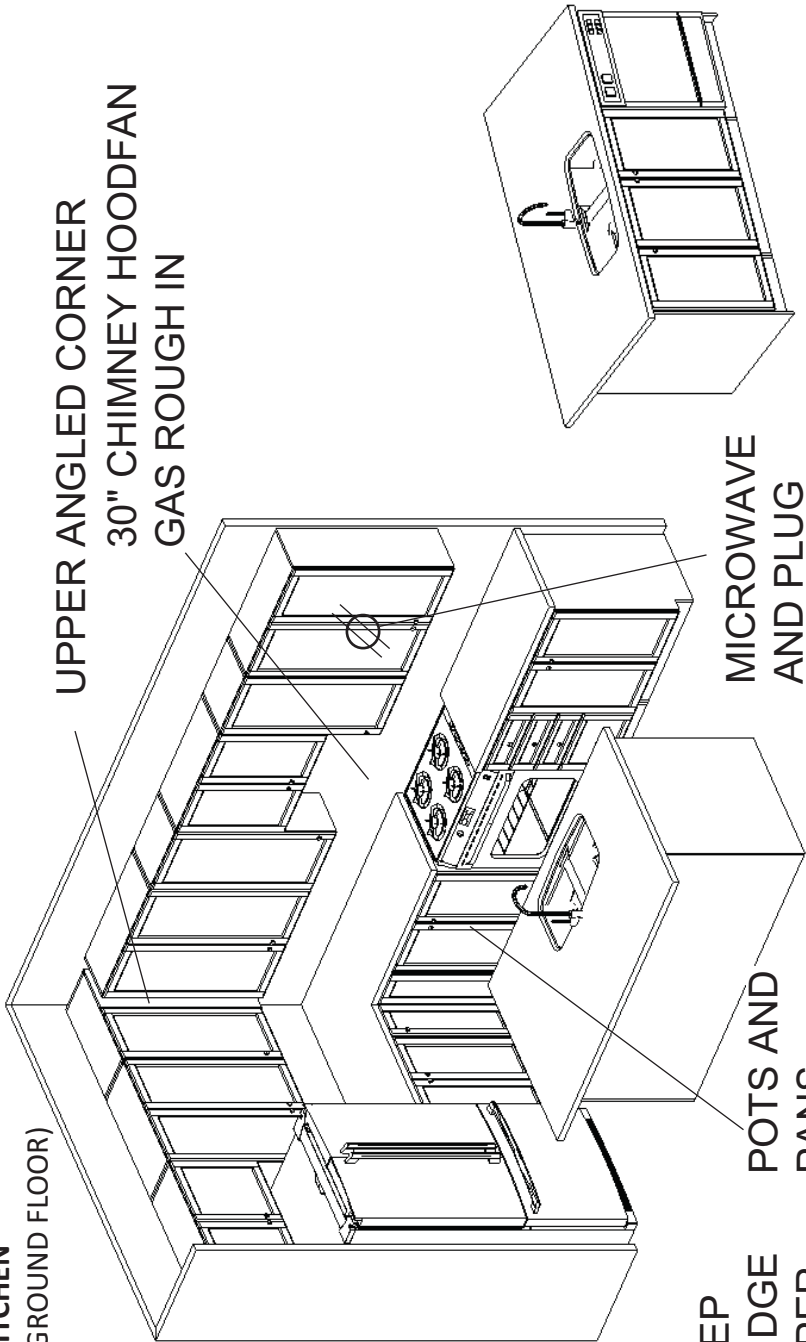

UPPER ANGLED CORNER
30" CHIMNEY HOODFAN
GAS ROUGH IN

MICROWAVE
AND PLUG

DEEP
FRIDGE
UPPER
POTS AND
PANS

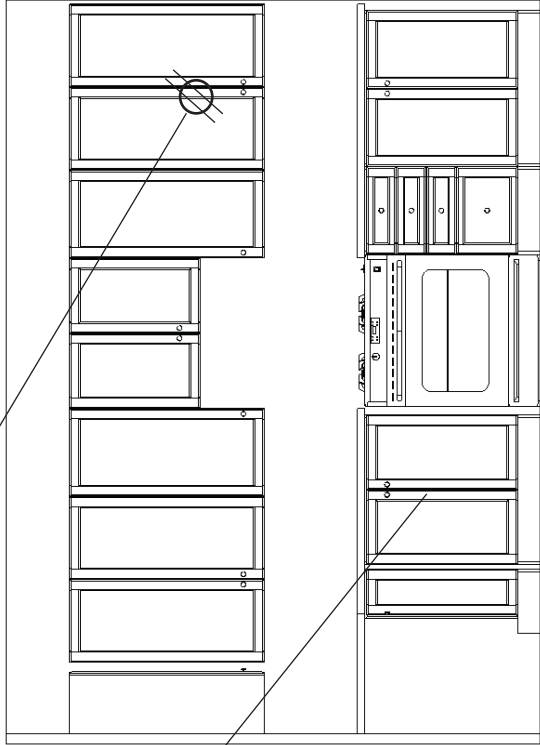
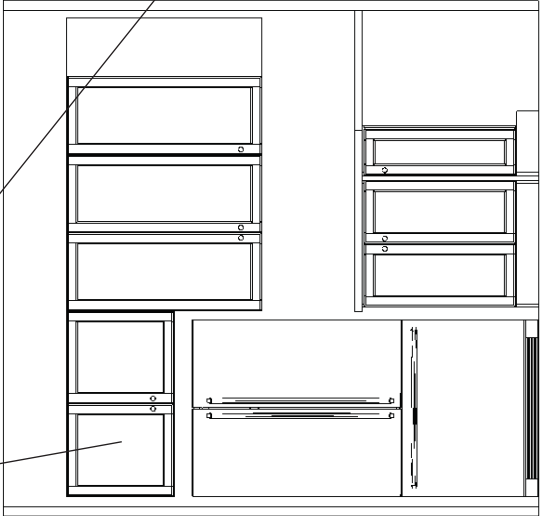

OPTIONAL DOUBLE SINKS

MASTER ENSUITE
(2ND FLR)

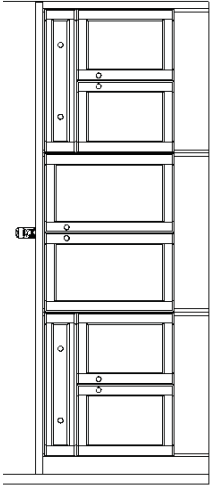

MAIN BATH
(2ND FLR)

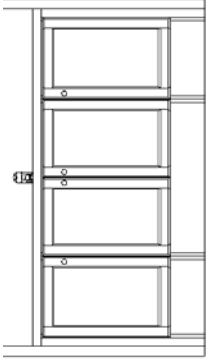

OPT. LAUNDRY UPPERS
(2ND FLR)

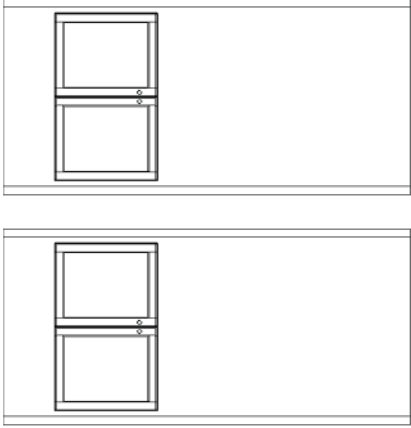

STD. BASEMENT BATH

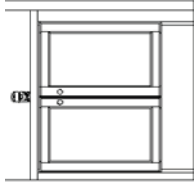

HEATHWOOD HOMES
WALLACETON, KITCHENER, ON
MODEL: 20-1790 (2004)

STANDARD CONTRACT INCLUDES:

Appliance Openings

- Hood Opening: 30"W Std. hood
- Fridge Opening: 37 3/8 "W X 73 1/8"H
- 30cm deep cabinet over fridge
- Stove Opening: 30" Freestanding
- Dishwasher Opening: 24"

Standard Kitchens Scope:

- 100cm H wall cabinets
- Std. Blumotion Hinges- **soft close**
- Std. Metabox Drawers- **not soft close**
- Min 40cm W drawer
- Base pie cut corner cabinets
- Backing on all cabinets
- Countertop by others
- Upgrade applied paneled fridge & dishwashers supply only (appliances hardware by others)

Standard Vanity & Laundry Scope:

- Powder by others, pedestal
- All vanities include laminate counter
- Std. Blum Hinges- **not soft close**
- Metabox Drawers- **not soft close**
- Master Ensuite: Top drawers (Full height doors at sink)
- Mains: Full height doors (top drawers added if Masters can't accommodate)
- Optional laundry base & wall cabinets

SKETCH #4
20-1790 ELEV. A
WOB

THE DUNMORE
ELEVATION A | 2,242 SQ. FT.
Includes 452 sq. ft. of Finished Lower Level
WALLACETON
EST. 1870

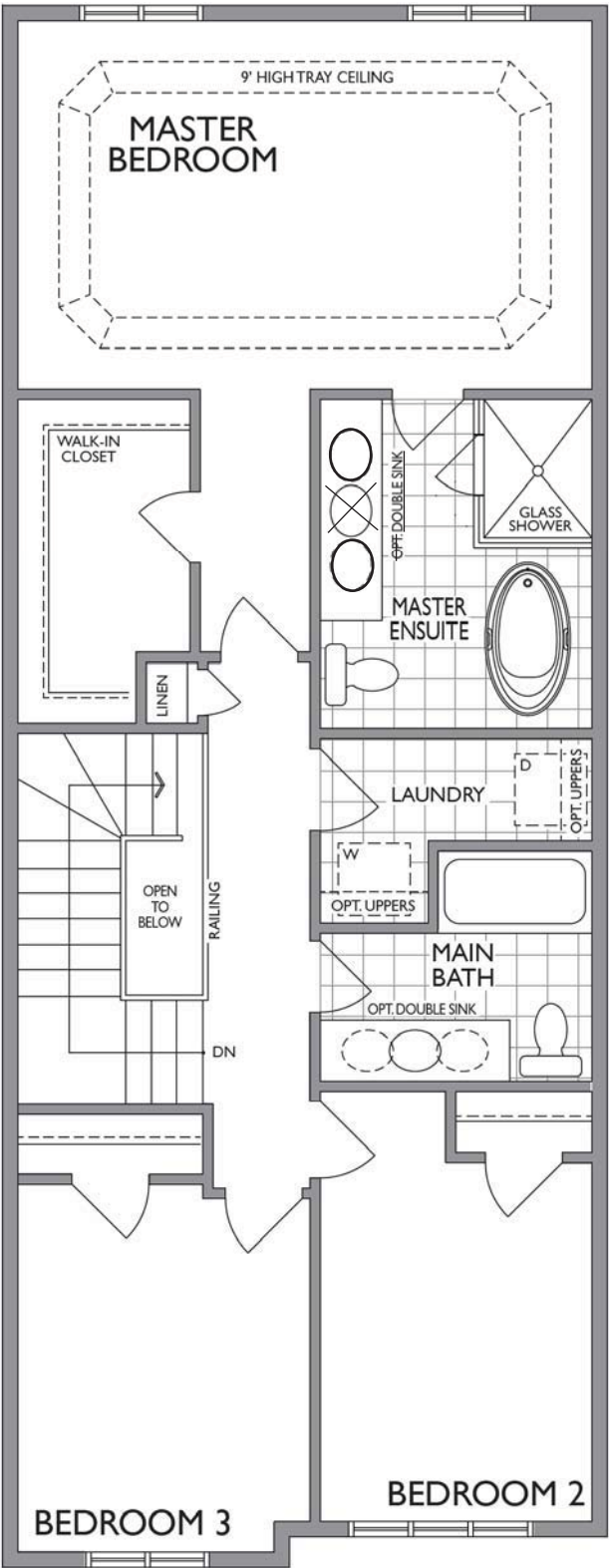

OPTIONAL
DOUBLE SINKS

SECOND FLOOR
ELEVATION A



NFAS NF17 Mantel CABINET

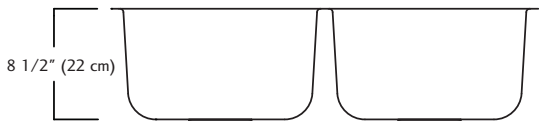
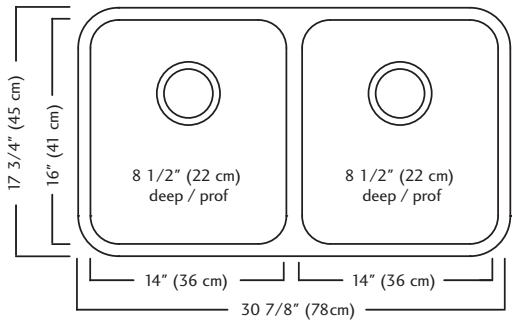

ND1831UA/9 SPECIFICATION

Model ND1831UA/9 is a double (two equal size) bowl undermount sink manufactured by Franke Kindred Canada Limited from 18 gauge stainless steel. Product has silk finished rims and linear brush finished bowls. Sink is fully undercoated. Basket strainer waste fittings (3 1/2", 89 mm) are included. Sink is backed with a limited lifetime warranty.

- O.D. 17 3/4" x 30 7/8" x 8 1/2" (45 x 78 x 22 cm)
- **Recommended for minimum 36" cabinet**



Specifications

FAUCET DESCRIPTION

- Reflex™ pulldown system offers smooth operation, easy movement and secure docking
- Power Clean™ spray technology
- Metal construction with various finishes identified by suffix
- Quick connect installation
- Pulldown spray with 68" braided hose
- Flexible supply lines with 3/8" compression fittings
- High arc spout provides height and reach to fill or clean large pots while pulldown wand provides the maneuverability for cleaning or rinsing
- 360° rotating spout
- Faucet designed for handle to be mounted on right side only

OPERATION

- Lever style handle
- Temperature controlled by 100° arc of handle travel
- Operates with less than 5 lbs. of force
- Operates in stream or spray mode in the pullout or retracted position

FLOW

- Flow is limited to 1.5 gpm (5.7 L/min) max at 60 psi

CARTRIDGE

- 1255™ Duralast™ cartridge

STANDARDS

- Third party certified to IAPMO Green, ASME A112.18.1/CSA B125.1 and all applicable requirements therein including NSF 61/9G & 372
- Meets CalGreen and Georgia SB370 requirements
- Complies with California Proposition 65 and with the Federal Safe Drinking Water Act
- The backflow protection system in the device consists of two independently operating check valves, a primary and a secondary which prevent backflow

- ADA  for lever handle

WARRANTY

- Lifetime limited warranty against leaks, drips and finish defects to the original homeowner
 - 10 year limited warranty when used in a multifamily installation
 - 5 year limited warranty when used in a commercial installation
- Visit www.moen.com/support for complete details and limitations

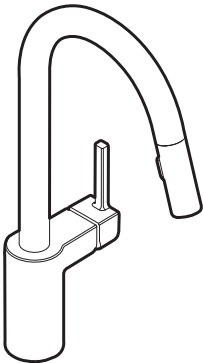

ALIGN™
Single Handle High Arc
Pulldown Kitchen Faucet

Models: 7565 series

NOTE: THIS FAUCET IS DESIGNED TO BE INSTALLED
THROUGH 1 HOLE, 1-1/2" (38mm) MIN. DIA.
(OPTIONAL 3-HOLE ESCUTCHEON 141002 AVAILABLE)

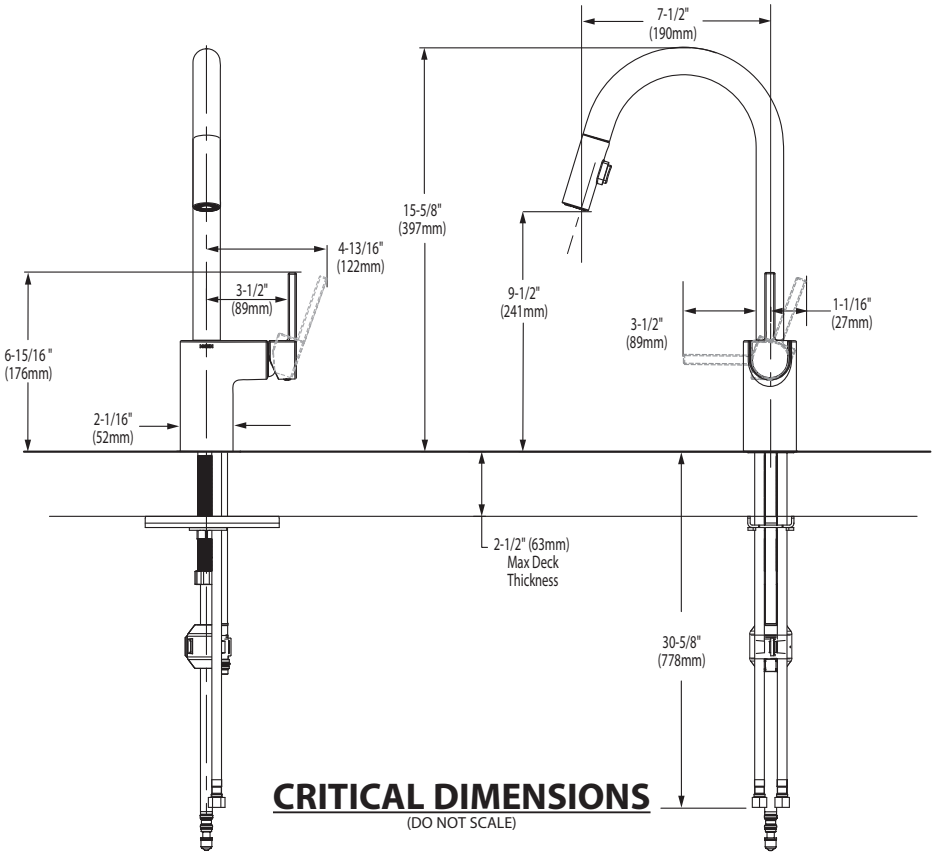

FOR MORE INFORMATION CALL: 1-800-BUY-MOEN
www.moen.com



 **BARRIER FREE (ABOVE COUNTER OR DROP-IN ONLY)**

**BOULEVARD®
PEDESTAL SINK**
VITREOUS CHINA

BOULEVARD® PEDESTAL SINK

- STD
- ☐

~~0641.800~~

~~Faucet holes on 8" (203mm) centers (Illustrated)~~
- ☐

0641.400

Faucet holes on 4" (102mm) centers
- ☐

~~0641.100~~

~~Center hole only~~

• Classic styled rectangular pedestal lavatory

• Vitreous china

• Rear overflow

• Supplied with mounting kit

• Right Height® for greater comfort during use

• Faucet ledge with large deck area (faucet not included)

• **Design coordinates with Boulevard® Toilet**

• Basin has flat bottom to also allow use as an **above counter** sink or a **drop-in** sink (with u-shaped cut out)

Nominal Dimensions:
24" x 19" x 35-1/2"
(610 x 483 x 902mm)

- ☐

0641.008

Pedestal top-8" (203mm) centers
- ☐

0641.004

Pedestal top-4" (102mm) centers
- ☐

0641.001

Pedestal top-center hole only
- ☐

0010.000

Pedestal only

Bowl sizes:
17" (432mm) wide,
12-1/2" (318mm) front to back,
5" (127mm) deep

**Compliance Certifications -
Meets or Exceeds the Following Specifications:**
• ASME A112.19.2 - 2008/CSA B45.1-08



SEE REVERSE FOR ROUGHING-IN DIMENSIONS

To Be Specified:

- ☐ Color:

☐ White

☐ Linen
- ☐ Faucet Finish:
- ☐ Supplies:
- ☐ 1-1/4" Trap:
- ☐ Nipple:

* See faucet section for additional models available



**BOULEVARD®
PEDESTAL SINK**
VITREOUS CHINA

BARRIER FREE (ABOVE COUNTER OR DROP-IN ONLY)

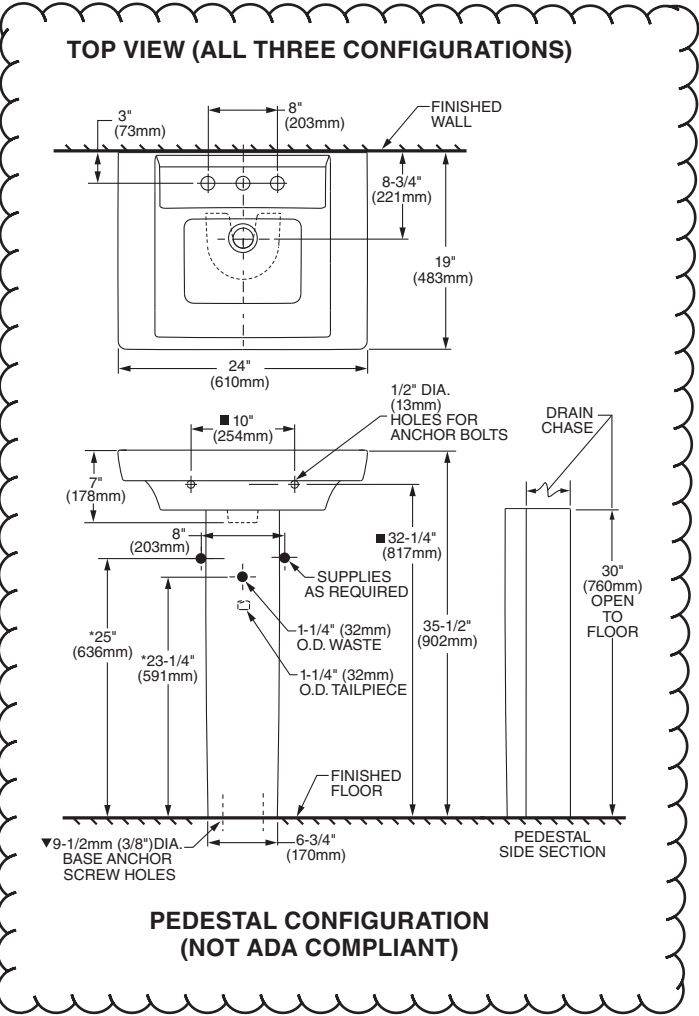

ABOVE COUNTER CONFIGURATION

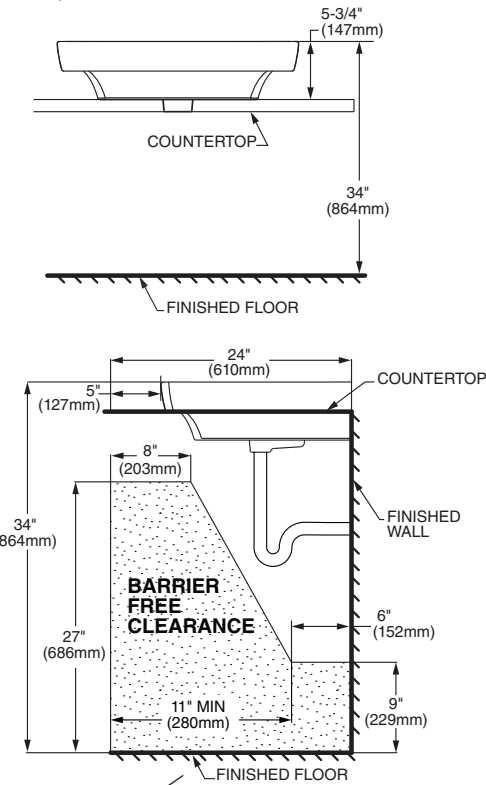

ABOVE COUNTER AND DROP-IN SINK CONFIGURATIONS MEET THE AMERICANS WITH DISABILITIES ACT GUIDELINES AND ANSI A117.1 ACCESSIBLE AND USABLE BUILDINGS AND FACILITIES - CHECK LOCAL CODES.
Top of sink installed at 34" (864mm) height from finished floor.
Sink installed 5" (127mm) minimum from front edge of countertop.
Provide 27" (686mm) knee clearance area.

NOTES:
* DIMENSIONS SHOWN FOR LOCATION OF SUPPLIES AND "P" TRAPS ARE SUGGESTED.
▼ PEDESTAL ANCHORING SCREWS NOT INCLUDED.
■ SUITABLE FOR REINFORCEMENT ONLY. ACTUAL DIMENSIONS MUST BE TAKEN FROM FIXTURE.
FITTING NOT INCLUDED AND MUST BE ORDERED SEPARATELY.
PROVIDE SUITABLE REINFORCEMENT FOR ALL WALL SUPPORTS.
INSTALLATION INSTRUCTIONS SUPPLIED WITH LAVATORY.

IMPORTANT: Dimensions of fixtures are nominal and may vary within the range of tolerance established by ANSI Standard A112.19.2
These measurements are subject to change or cancellation. No responsibility is assumed for use of superseded or voided pages.



COLONY™
COUNTERTOP SINK
VITREOUS CHINA

COLONY COUNTERTOP SINK

- Vitreous china
- Self-rimming
- Front overflow
- Supplied with template
- Faucet deck
(Faucet shown not included)



- ☐ 0346 803
Faucet holes on 203mm (8") centres
- STD** ☐ 0346 403 (Illustrated)
Faucet holes on 102mm (4") centres
- ☐ 0346 001
Centre hole only

Nominal Dimensions:
521 x 448mm (20-1/2" x 17-5/8")

Bowl sizes:
422mm (16-5/8") wide, 279mm (11") front to back, 143mm (5-5/8") deep

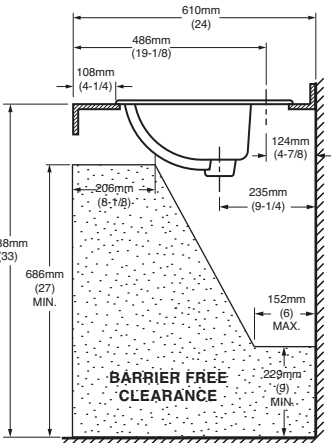
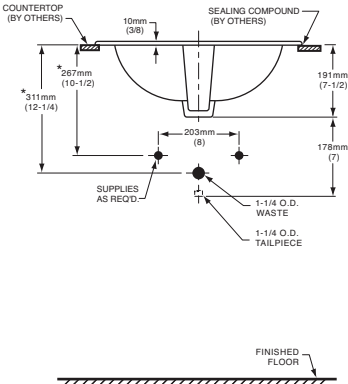
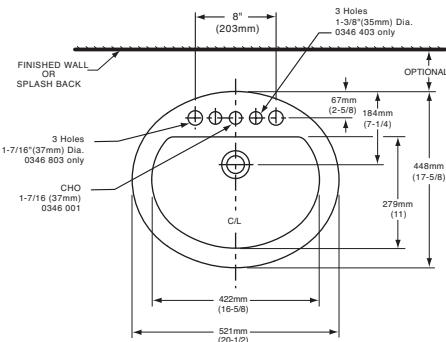

COMPLIANCE CERTIFICATIONS –
Meets or exceeds the following Specifications:
• ASME A112.19.2M for Vitreous China Fixtures.
• CAN/CSA B45 Series.

- To Be Specified
- ☐ Colour: ☐ White ☐ Bone ☐ Silver Gray
☐ Linen
- ☐ Faucet*:
- ☐ Faucet Finish:
- ☐ Supplies & Stops:
- ☐ Trap 1-1/4" (32 mm):

NOTES:
★ DIMENSIONS SHOWN FOR LOCATION OF SUPPLIES AND "P" TRAP ARE SUGGESTED. FOR COUNTERTOP CUTOUT AND INSTALLATION INSTRUCTIONS USE TEMPLATE SUPPLIED WITH SINK.
FAUCETS NOT INCLUDED AND MUST BE ORDERED SEPARATELY.
IMPORTANT: Dimensions of fixtures are nominal and may vary within the range of tolerances established by ANSI Standard A112.19.2.
These measurements are subject to change or cancellation. No responsibility is assumed for use of superseded or voided pages.

* See faucet section for additional models available



Specifications

DESCRIPTION

- Metal construction with various finishes identified by suffix
- 16" long 3/8" tubing connections
- Includes metal or 50/50 pop-up type waste assembly where noted

OPERATION

- Pivot action lever style handle
- Temperature controlled through 180° degree arc of handle travel

FLOW

- Flow is limited to 1.5 gpm max (5.7L/min) at 60 psi

CARTRIDGE

- 1225 cartridge design
- Nonmetallic/nonferrous and stainless steel material
- Can accommodate reversed piping and back to back installations

STANDARDS

- Third party certified to WaterSense®, CSA B-125.1, ASME A112.18.1 and all applicable requirements referenced therein including NSF61/9
- Complies with California Proposition 65 and with the Federal Safe Drinking Water Act

- **ADA**  for lever handle

WARRANTY

- Lifetime limited warranty against leaks, drips and finish defects to the original consumer purchaser
- 5 year warranty if used in commercial installations

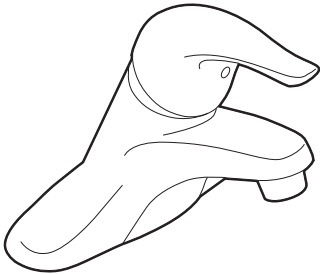

CHATEAU®
Single-Handle Lavatory Faucet

with Metal Waste Assembly

Model: L4625 series
L4631BC

Bulk Packed (12 per carton):
L64624 series

with 50/50 Waste Assembly

Bulk Packed (12 per carton):
L64625 series

Less Waste

Bulk Packed (12 per carton):
L64600 series

NOTE: THIS FAUCET IS DESIGNED TO BE
INSTALLED THRU 3-1" DIA. HOLES, 2" ON CENTER

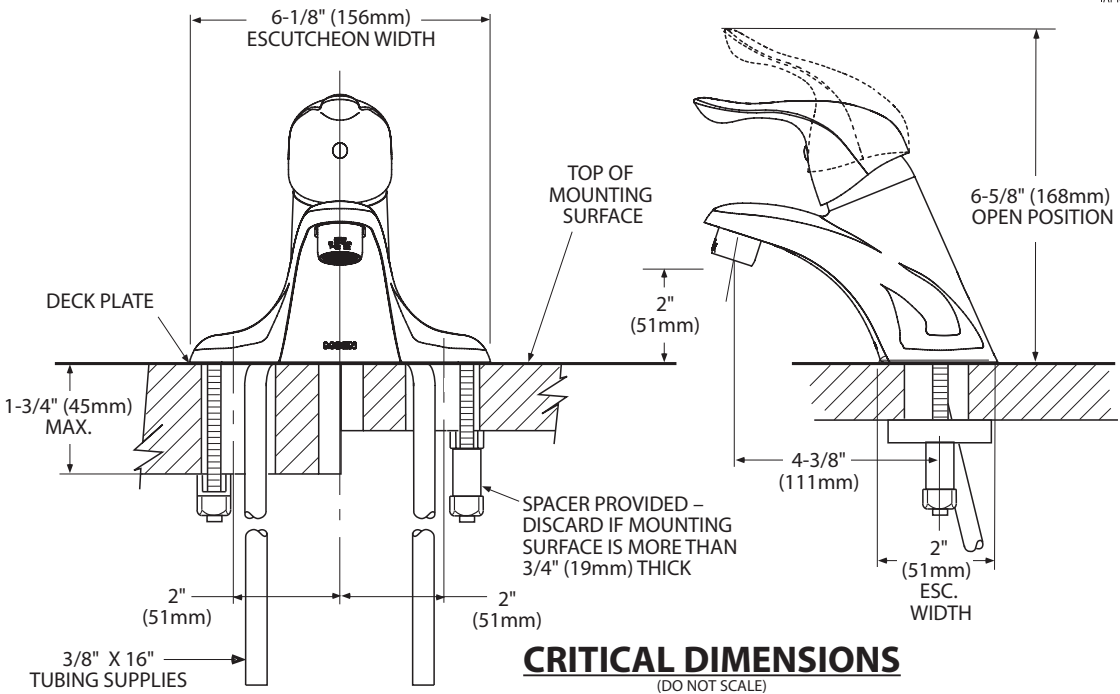



Buy it for looks. Buy it for life.®

There is more than 1 version of this model.
Page down to identify the version you have.

DESCRIPTION

- Metal construction with various finishes identified by suffix
- Includes non-metalic showerhead, arm, flange and non-metalic diverter tub spout

OPERATION

- Handle operates counterclockwise through a 270° arc with off at 6 o'clock and maximum hot at the 9 o'clock position. Shut off in clockwise direction
- Adjustable temperature limit stop to control maximum hot water temperature
- Pressure balancing mechanism maintains selected discharge temperature to ± 3°

FLOW

- Showerhead is limited to 2.5 gpm (9.5 L/min) at 80 psi
- EP suffix models are limited to 1.75 gpm (6.6 L/min) at 80 psi
- NH suffix models contain no showerhead

CARTRIDGE

- 1222 cartridge design
- Accommodates back to back installations
- Nonmetallic/nonferrous and stainless steel material

STANDARDS

- Third party certified to meet ASME A112.18.1/CSA B125.1 and all applicable requirements referenced therein
- EP suffix models are third party certified to WaterSense®

- ADA  for lever handle

WARRANTY

- Lifetime limited warranty against leaks, drips and finish defects to the original consumer purchaser
- 5 year warranty if used in commercial installations

Specifications



CHATEAU® POSI-TEMP®
Single-Handle Tub/Shower Trim Kit

Models: TL181 series - valve trim only
(Bulk Packed 12 per carton)
TL182 series - shower trim only
(Bulk Packed 12 per carton)
TL183 series - tub/shower trim
(Bulk Packed 12 per carton)

Valves: 62300 series
2500 series

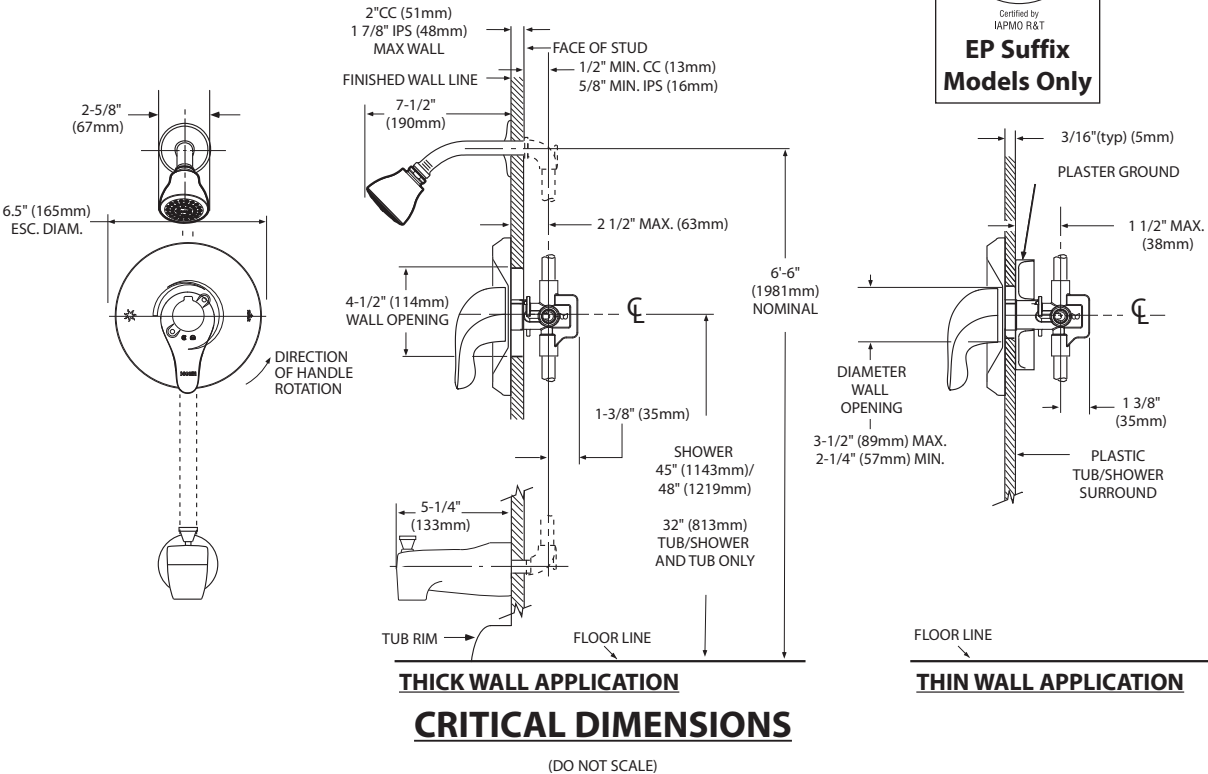



Specifications

DESCRIPTION

- Metal construction with various finishes identified by suffix

OPERATION

- Lever style handles with hot and cold color indicator
- Rotate hot side handle counterclockwise to open (clockwise to close) and the cold side handle (clockwise to open) and (counterclockwise to close)

STANDARDS

- Third party certified to: ASME A112.18.1/CSA B-125.1, and all applicable requirements referenced therein

- ADA  for lever handles

WARRANTY

- Lifetime limited warranty against leaks, drips and finish defects to the original homeowner
 - 10 year limited warranty when used in a multi-family installation
 - 5 year limited warranty when used in a commercial installation
- Visit www.moen.com/support for complete details and limitations

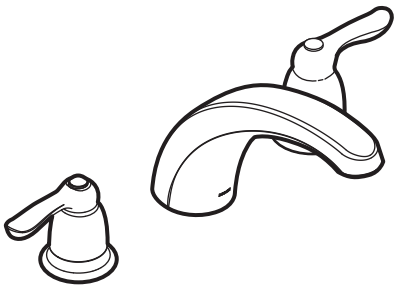

CHATEAU®
Two-Handle Garden Tub Trim

Models: T994 series

Valves: 4792, 4793, 4794, 4796, 4797, 4798

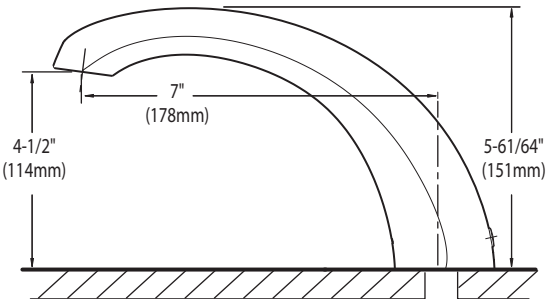
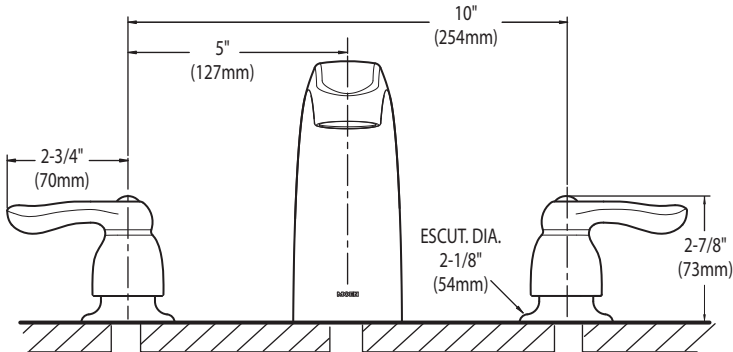

CRITICAL DIMENSIONS
(DO NOT SCALE)



DEMI™
Product Specification Sheet



CF2007	Two Piece Freestanding Soaker
Size:	60" x 32" x 22" 1524 mm x 813 mm x 559 mm

PRODUCT FEATURES & BENEFITS

- Vacuum formed acrylic reinforced with fiberglass
- Scratch, stain and fade resistant high gloss finish
- Installation friendly two piece design
- Accepts deck mounted faucet
- Includes integral pop up drain and rectangular overflow
- Includes levelling feet

TWO PIECE ASSEMBLY

FRONT VIEW

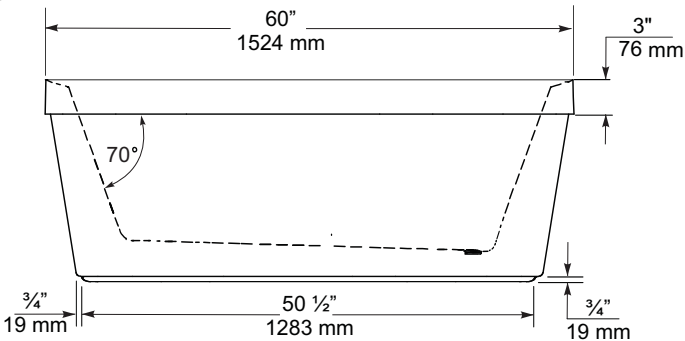

END VIEW

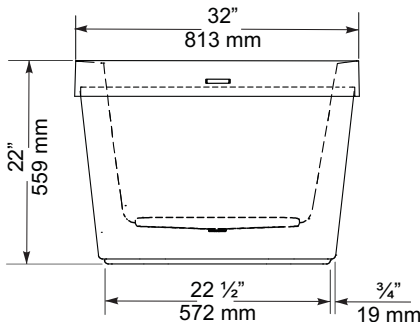

TOP VIEW

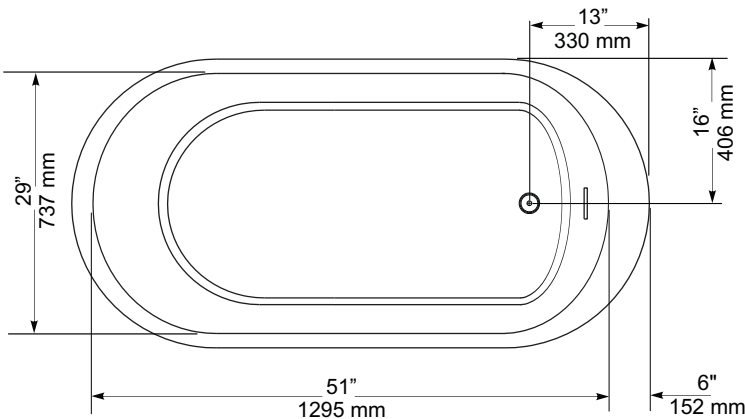

GENERAL SPECIFICATIONS		
Average Weight	90 lb	41 kg
Bathing Well at bottom	43"x 20"	1092 x 508 mm
Capacity Drain to Overflow		195 litres
Water Depth Drain to Overflow	16"	406 mm
Drain Opening (dia.)	2"	51 mm
Overflow Opening	2 1/4"x 1/2"	57 x 13 mm
Drain to Floor Clearance	3 1/4"	83 mm

NOTES: Please confirm measurements on actual product to ensure proper identification. Bathtub to be installed on the floor supported by 5 self levelling feet. Adjust if required to level the bathtub for adequate drainage. Refer to installation instructions for additional information.

IMPORTANT: Dimensions of fixtures are nominal and may vary ± 1/4" (6 mm). Weight may vary ± 5 lb (2.3 kg). Drawing is not to scale. These measurements are subject to change at manufacturer's discretion.

Compliance Certifications -
Meets or Exceeds the following Specifications:
• CAN/CSA - B45 Series



60 Shorncliffe Rd., Toronto, Ontario M8Z 5K1
Telephone: 416.231.9030 Fax: 416.231.0929
www.mirolin.com

© 2018 Mirolin Industries Corp.

Customer Service: 416.231.5790
Canada, U.S.A.: 800.MIROLIN(647-6546)
Fax, Canada: 800.463.2236

R0084162
25 Sep. 2018



FloWise™ DUAL FLUSH
ELONGATED TOILET
VITREOUS CHINA

FloWise™ DUAL FLUSH ELONGATED TOILET

- ☐ 2476 216
- Vitreous china
 - Low-consumption Dual Flush
Full flush 6.0 Lpf/1.3 gpf,
Partial flush 3.0 Lpf/0.66 gpf.
 - Elongated wash down bowl
 - Internal trapway fully-glazed,
2-1/4" (57mm) ballpass
 - Concealed trapway bowl
 - Chrome-plated top mounted
push button actuator
 - Easy to clean sanitary dam on bowl
 - Includes Elongated Slow Close Seat
 - 100% factory flush tested
 - 2 bolt caps

Separate Component Parts:

- ☐ 3067 316 Elongated Bowl with Slow Close Seat
- ☐ 4035 216 Unlined Tank



- ☐ 2476 516 Same as above with Lined tank
- ☐ 3067 316 Elongated Bowl
- ☐ 4035 516 Lined Tank

Nominal Dimensions:
794 x 432 x 765mm
(31-1/4" x 17" x 30-1/8")

- Compliance Certifications -
Meets or Exceeds the Following Specifications:
- ASME A112.19.2M (and 19.6M)
 - CAN/CSA B45 series

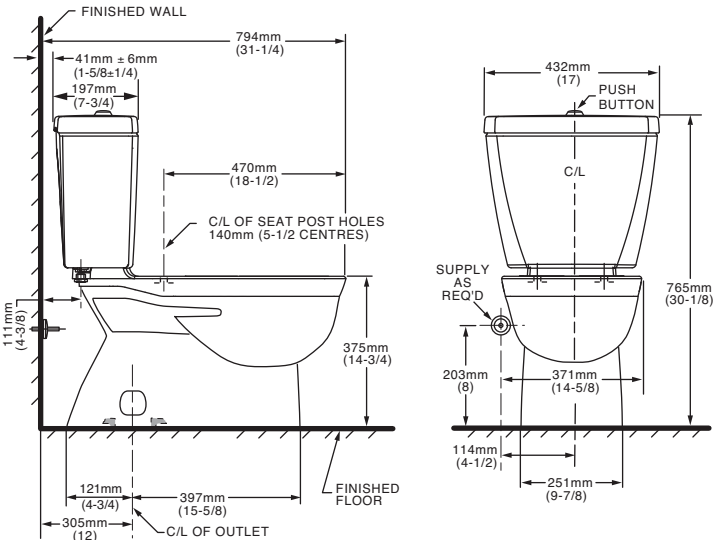

- To Be Specified
- ☐ Colour: 020 White
- ☐ Supply with stop:

NOTES:
THIS TOILET IS DESIGNED TO ROUGH-IN AT A MINIMUM DIMENSION OF 305MM (12") FROM FINISHED WALL TO C/L OF OUTLET.
SUPPLY NOT INCLUDED WITH FIXTURE AND MUST BE ORDERED SEPARATELY.
* DIMENSION SHOWN FOR LOCATION OF SUPPLY IS SUGGESTED.
FOR ADDITIONAL INFORMATION REFER TO INSTALLATION INSTRUCTIONS SUPPLIED.
IMPORTANT: Dimensions of fixtures are nominal and may vary within the range of tolerance established by ANSI Standard A112.19.2
These measurements are subject to change or cancellation. No responsibility is assumed for use of superseded or voided pages.

UPGRADED VALUE ADDED FEATURES AT NO EXTRA CHARGE

changed to SCB50030 due to original selection on back order - same size

SC(B)519 | ALITO Collection



Baffle Filter

Wall Mount

Strong and sturdy with attractive lines and an imposing frame, the SC(B)519 is fitted with a time-delay OFF feature up to nine minutes, a 550 CFM fan, two bright front mounted LED lights and a digital three-speed push button control panel.

Green Features



3 Speed Push Button Control Panel



Long-Lasting LED Lights



Time-Delay OFF Feature



Grease Cup



Model	Colour	Ducting	Filters	Size	CFM
-------	--------	---------	---------	------	-----

SCB51930	Stainless Steel	6"	Baffle	30"	550
SCB51936	Stainless Steel	6"	Baffle	36"	550

SC(B)519 | ALITO Collection



Features

- Wall mount range hood
- 6” round duct adapter
- Non-stick aluminum fan blades
- 3 speed push button control
- 2 LED lights (2 x 1.4W, 4000K)
- Quick release aluminum mesh filters
- Standard chimney fits up to 9 ft. ceiling
- Up to 9 minutes time-delay OFF feature
- Plug-in connection

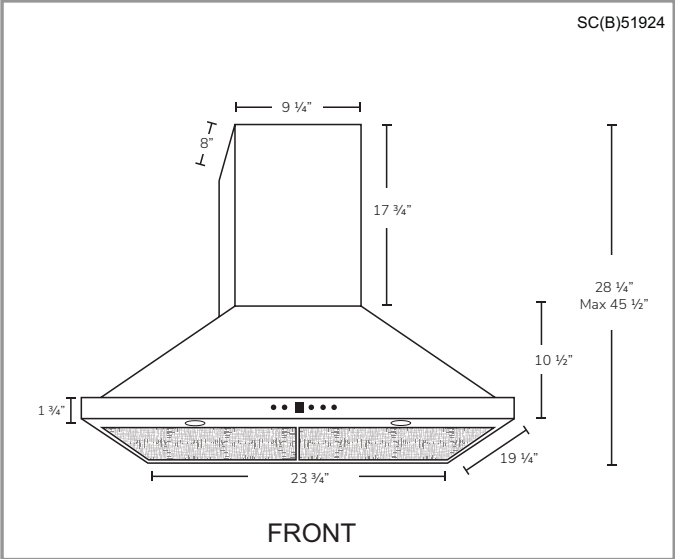
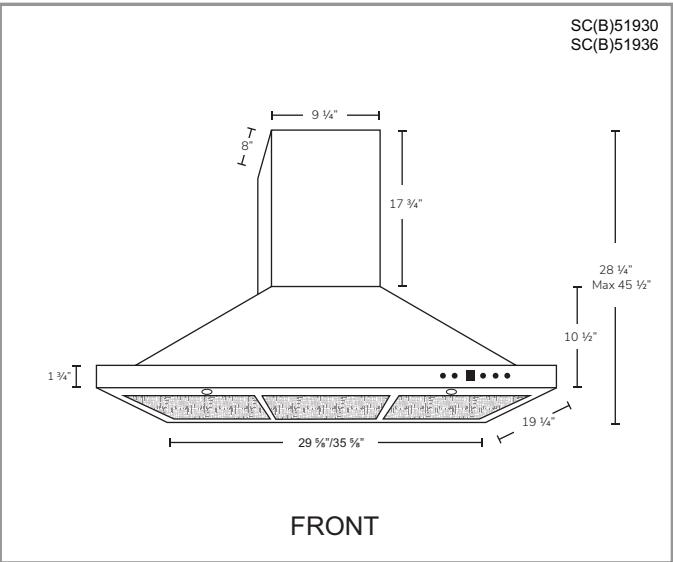

Options

- Filters:

SCB519 - Quick Release Stainless Steel Baffle Filters
- Chimney Flues:
A1.CH10 - short (7'-8' ceilings)
A1.CH18 - standard (8'-9' ceilings)
A1.CH30 - extended (9'-11' ceilings)
- Widths: 24", 30", 36"

Specifications

- | | | |
|--|--|--|
| <ul style="list-style-type: none">▪ Air Flow Volume: 550 CFM▪ Electrical Connection: 120 V/60 Hz▪ Power Consumption: 300 Watts | <ul style="list-style-type: none">▪ Current: 2.5 Amps▪ Fan Speed: 1599 RPM▪ Fan Type: Centrifugal Blower | <ul style="list-style-type: none">▪ Finishes: Stainless Steel▪ Ducting: 6" Round▪ Noise Level: Min. 2 Sones
Max. 6 Sones |
|--|--|--|





HOME APPLIANCES

LG REFRIGERATION

LFXC22526
22 cu.ft. Counter Depth 3-Door French Door Refrigerator

- Smudge Resistant Finish
- 10 Year Warranty on Inverter Linear Compressor
- Slim SpacePlus® Ice System
- Dual Ice Maker in freezer
- Door Cooling+
- Glide N' Serve Pantry Drawer
- SmartThinQ® - WiFi Connectivity
- Fresh Air Filter
- Flat Duct design
- SmartPull™ Handle
- ENERGY STAR®

Enjoy new ways to control your home with LG smart appliances

- Get an alert when kids forget to close the door
- Make more ice while you're at work
- Works with the LG SmartThinQ®app

works with the Google Assistant

WORKS WITH alexa

CAPACITY	
Refrigerator (cu.ft.)	14.8
Freezer (cu.ft.)	7.3
Total Capacity (cu.ft.)	22.1
ENERGY	
Energy Consumption (kWh/Year)	665
ENERGY STAR® Qualified	Yes
WATER & ICE SYSTEM	
Ice & Water Dispenser	Yes
Dispenser Type	Integrated Tall
Ice System	Slim SpacePlus®
Dual Ice Maker	Installed
Dispenser Light	Yes
Water Filter	LT1000P
COOLING	
Inverter Linear Compressor	Yes
Multi-Air Flow	Yes
Temperature Sensors	6
Fresh Air Filter	Yes
CONVENIENCE	
Display Type	Membrane / White LED
Temperature Controls	Electronic/Digital
Door Alarm	Yes
LoDecibel™ Quiet Operation	Yes
REFRIGERATOR	
No. of Shelves	4 Split
Cantilevered Shelves	Hybrid Cantilevered
Shelf Construction	Spill Protector™ Tempered Glass
Crisper Bins	2 Humidity Crispers
Glide N' Serve Pantry Drawer	Yes
Refrigerator Light	Ceiling LED
REFRIGERATOR DOOR	
No. of Bins	6 Total
Door Bin Construction	1 Piece (Clear)
Door Cooling+	Yes



FREEZER	
Door Type	Pull Drawer
Drawers	2-Tier Organization
DuraBase™ Solid Drawer Base	Yes
Drawer Divider	Yes
Freezer Light	LED Lighting
Freezer Handle	SmartPull™ Handle
SmartThinQ® SMART FEATURES	
Wi-Fi Enabled	Yes
SmartDiagnosis	Yes
MATERIALS AND FINISHES	
Contour Door	Yes
Hidden Hinges	Yes
Smudge Resistant Finish	Yes
Handles	Matching Commercial
Available Colours	Smudge Resistant Stainless Steel
DIMENSIONS/CLEARANCES/WEIGHTS	
Depth with Handles	31 1/4"
Depth without Handles	28 3/4"
Depth without Door	24 3/4"
Depth (Total with Door Open)	43 1/2"
Height to Top of Case	68 3/8"
Height to Top of Door Hinge	69 3/4"
Width	35 3/4"
Width (Door Open 90° with Handle)	44 1/4"
Width (Door Open 90° without Handle)	39 1/4"
Door Edge Clearance with Handle	4 1/2"
Door Edge Clearance without Handle	1 3/4"
Installation Clearance	Sides 1/8", Top 1", Back 2"
Weight (Unit/Carton)	271 lbs. / 301 lbs.
Carton Dimensions (WxHxD)	38" x 73" x 36"
WARRANTY	
Part & Labour	1 Year
Sealed System	5 Years
Inverter Linear Compressor	10 Years
UPC CODES	
LFXC22526S (Smudge Resistant Stainless Steel)	048231797238
LFXC22526D (Smudge Resistant Black Stainless Steel)	048231797245

35 of 38



LRGL5825_

5.8 cu ft. Smart Wi-Fi Enabled True Convection
InstaView™ Gas Range with Air Fry

ThinQ® Technology with Proactive Customer Care

PRINTPROOF™ BLACK STAINLESS STEEL

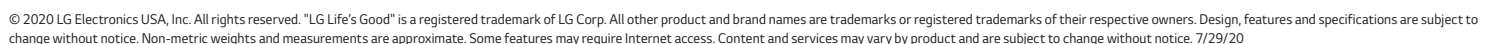

HOME APPLIANCES

LG DISHWASHERS



LDTSS5552_
Top Control Dishwasher with Quadwash™

- QuadWash™
- TrueSteam® with Sanitization
- Dynamic Dry™ Enhanced with TrueSteam®
- PrintProof™ Finish
- 3rd Rack
- LoDecibel™ Operation (46 dB)
- Top Control Panel With LED Display
- LG ThinQ® Technology



CAPACITY	
Total Place Settings	15
Upper Rack Dish Height Limit	7.1"
Lower Rack Dish Height Limit	12.5"
RACKS AND BASKETS	
Cutlery Baskets	Yes
Fold Down Tines	Yes (Half Fold on Upper & Half Fold on Lower)
BPA-Free Nylon Coated Racks and Tines	Yes
Rack Handle	Yes (Upper)
EasyRack™ Plus System	Yes
Height Adjustable Upper Rack	Yes
STYLE AND DESIGN	
Control Panel Location	Top Control
Electronic Controls	Fully Integrated Control Panel
Tub Material	NeveRust™ Stainless Steel
Handle	Towel Bar Handle
All Available Colors	PrintProof™ Stainless Steel, PrintProof™ Black Stainless Steel
Fingerprint Resistant	Yes
FEATURES	
TrueSteam™	Yes
QuadWash™	Yes
SenseClean Wash System	Yes
Vario Wash	Yes
Number of Spray Arms	3 (Top, Upper, Lower)
Detergent and Rinse-Aid Dispenser	Yes
Drying System	Dynamic Dry
End of Cycle Indicator	Yes (Beeper + END indication on display)
Hidden Water Heater	Yes
Safety Float Switch (Leaks)	Yes
Soil (Turbidity) Sensor	Yes
DirectDrive Motor™	Yes
LoDecibel Quiet Operation	46 dBA
Tub Insulation	Damping Sheet, Sound Absorbing Material (felt), Base
BPA-Free Nylon Coated Racks and Tines	Yes
Anti-Bacterial Treatment (Sump, Inner / Outer filter, Drain pump case, Drain hose)	Yes
Balanced Door	Yes

SMART FEATURES	
Wifi	Yes
POWER RATINGS	
ENERGY STAR® Qualified	Yes
CEE Tier	1
Energy Use (kWh/Year)	258 kWh/Year
Water Factor (WF)	2.9
DIMENSIONS / CLEARANCES / WEIGHT	
Product Dimensions (in) (W x H x D)	23 3/4" x 33 5/8" x 24 5/8"
Product Weight (lbs)	87.3 lbs
Depth with Door Closed with Handle (in)	24 5/8"
Depth with Door Open (in)	49 1/4"
Carton Dimensions (in) (W x H x D)	28 1/32" x 34 7/8" x 29 5/8"
Shipping Weight with Carton (lbs)	99.4 lbs
LIMITED WARRANTY	
Labor	1 Year
Parts	1 Year
Control Board and Rack Parts	5 Years
Direct Drive Motor	10 Years
Stainless Steel Door Liner or Tub	Lifetime
UPC CODES	
LDTSS5552S (PrintProof™ Stainless Steel)	048231342346
LDTSS5552D (PrintProof™ Black Stainless Steel)	048231342568

WHIRLPOOL WASHER Model #: WFW5620HW

Whirlpool Brand Canada English | Washer and Dryers | Washers | Front Load Washers | WFW5620HW



5.2 cu. ft. I.E.C. Closet-Depth
Front Load Washer with
Load & Go™ Dispenser

Whirlpool 5.2 cu. ft. I.E.C. Closet-Depth Front Load Washer with Load & Go™ Dispenser
Model #: WFW5620HW

Dimensions

Depth	80.17 cm, 31-9/16 in
Depth With Door Open 90 Degree	143.51 cm, 56-1/2 in
Minimum Height	98.11 cm, 38-5/8 in
Width	68.58 cm, 27.0 in

Appearance

LCD Touch Screen	No
Window	Yes

Details

Drum Material	Stainless Steel
---------------	-----------------

Cycles and Options

Number of Wash Cycles	37
-----------------------	----

Electrical

Hz	60
Power Cord Included	Yes

WHIRLPOOL DRYER Model #: YWED5620HW

Whirlpool Brand Canada English | Washer and Dryers | Dryers | Electric Dryers | YWED5620HW



7.4 cu. ft. Front Load Electric
Dryer with Intuitive Touch
Controls



7.4 cu. ft. Front Load Electric Dryer with Intuitive Touch Controls

Model #: YWED5620HW

Dimensions

Depth	78.74 cm, 31.0 in
Depth With Door Open 90 Degree	138.43 cm, 54-1/2 in
Height	98.42 cm, 38-3/4 in
Width	68.58 cm, 27.0 in

Configuration and Overview

Fuel Type	Electric
-----------	----------

Cycles and Options

Cycle Time Remaining	Yes
Lint Filter Indicator	No
Number of Dryer Cycles	36
Number of Dryness Levels	3

Ventilation System

Long Vent	No
Maximum Vent Length	64
Venting Direction	Left, Right, Bottom, Rear

Electrical

Hz	60
Power Cord Included	Yes