

**Sales Selection Sheet
Checklist**

1 of 33

LOT 3186A-4 Model: 20-1606 B The Grassfield

PURCHASERS: N, M TANVEER/

VENDOR: Heathwood Homes (Huron) Limited

FINISHED BASEMENT

COLD CELLAR

UPGRADED / MODIFIED ELEVATION

CORNER UPGRADE

REAR UPGRADE

CEILING UPGRADE - SMOOTH

MAIN FLOOR

SECOND FLOOR

BASEMENT

ADDITIONAL ROUGH-INS

200 AMP SERVICE

WET BAR ROUGH-IN

HUMIDIFIER

AIR CONDITIONING

GAS ROUGH-IN

STOVE

DRYER

BBQ

ADDITIONAL FIREPLACE

KITCHEN: HOODFAN VENTING SIZE

6 IN ROUND DUCT

7 IN ROUND DUCT

FULL BASEMENT STAIRS:	N/A
UPPER BASEMENT STAIRS:	All Oak
LOWER BASEMENT STAIRS:	Carpet Grade
MAIN STAIRS:	All Oak
MEDIA STAIRS (if applicable):	N/A
LOFT STAIRS (if applicable):	N/A

Mar 29, 2022 Signature on file

 Date Purchaser:

Mar 29, 2022 IRIT SALEM

 Date Decor Consultant:

 Date Purchaser:

Mar 29, 2022 MARILYN ROSEN

 Date Approved Heathwood Homes (Huron) Limited

Locked Date:

Customer Colours

N, M TANVEER/
 Project: Wallaceton
 Unit: 3186A-4, Phase: 3
 Model: 20-1606 B The Grassfield

Locked:
 Closed:

Kitchen

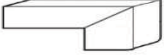
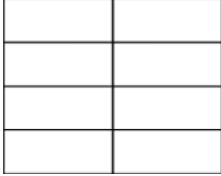
Cabinet Colour/Style	6825	Classic Plus-BOSTON-WINTER WHITE-PAINT MDF ***UPG***	
Countertop	8595	Group 2-Quartz-Caesarstone-OCEAN FOAM #6141-3/4 inch with built-up edge ***2***	
Countertop Edge	4005	DOUBLE MITRE 1 1/2 INCH ***UPG***	
Cabinet Hardware	9152	12829 MB BLACK-HARDWARE ***2***	
Island Cabinet Colour/Style	9185	Classic Plus-BOSTON-MOONLIGHT-PAINT MDF ***UPG***	
Island Countertop	8595	Group 2-Quartz-Caesarstone-OCEAN FOAM #6141-3/4 inch with built-up edge ***2***	
Backsplash	5721	QT.CD.ARW.0306.BR-Colour and Dimension Bright-Arctic White-3 x 6 ***1***	
Backsplash Grout	7704	Grout-(19) Pearl Gray ***STD***	
Backsplash Tile Pattern	3070	HORIZONTAL STACKED ***STD***	
HoodFan	9393	SCB51930-CYCLONE 30 inch CANOPY CHIMNEY HOODFAN-SS	32-33
Appliances	9393	Purchasers have been advised: standard fridge opening is a minimum 37 3/8 x 73 3/8". Ice Waterline Rough-In is included.	
Appliances	9393	Standard stove opening is 30" and standard dishwasher opening is 24". Any gas stove will require backsplash or stainless steel backing to avoid fire hazards.	
Appliances	9393	Purchasers acknowledge: Heathwood Homes and its contractors will not be responsible for any kitchen cabinet changes due to appliances dimension changes after	
Comment	NO APPLIANCE PACKAGE		

Kitchen/Breakfast

Flooring		 Pearl OPHELIA 2/4 inch x 5 inch ***5***	
		SEE REVISED PG. 34 FOR NEW FLOORING	
Floor Tile Grout	1111	N/A *****	
Floor Tile Pattern	1111	N/A *****	

Customer Colours

N, M TANVEER/
Project: Wallaceton
Unit: 3186A-4, Phase: 3
Model: 20-1606 B The Grassfield

Created: 11/11/2021 12:19:22

Locked:

Closed:

Comment

Foyer

Flooring

9242

OV.ET.VLK.1224.PL-ETERNA VOLKAS POLISHED12X24 S 2
Tile Direction Sketch **5**

Floor Tile Grout

2225

Grout-(27) Silver ***STD***

Floor Tile Pattern

3050

SIDE TO SIDE ***STD***

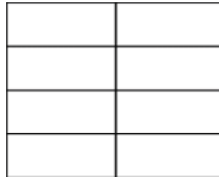

Comment

Laundry Room

Flooring

5494

GE.NA.GRY.1313-New Albion-Grey-13 x 13 ***STD***

Floor Tile Grout

2225

Grout-(27) Silver ***STD***

Floor Tile Pattern

3000

STANDARD SQUARE ***STD***

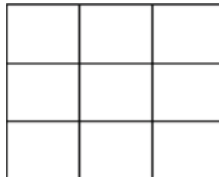

Comment

Mud Room

Flooring

9242

OV.ET.VLK.1224.PL-ETERNA VOLKAS POLISHED12X24 S 2
Tile Direction Sketch **5**

Floor Tile Grout

2225

Grout-(27) Silver ***STD***

Floor Tile Pattern

3050

SIDE TO SIDE ***STD***

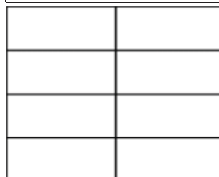

Comment

Customer Colours

N, M TANVEER/
Project: Wallaceton
Unit: 3186A-4, Phase: 3
Model: 20-1606 B The Grassfield

Created: 11/11/2021 12:19:22

Locked:

Closed:

Powder Room

Flooring 9242 OV.ET.VLK.1224.PL-ETERNA VOLKAS POLISHED12X24 S 2
Tile Direction Sketch **5**

Floor Tile Grout 2225 Grout-(27) Silver ***STD***

Floor Tile Pattern 3050 SIDE TO SIDE ***STD***

Plumbing Fixture (Colour) 1737 Plumbing Fixtures-WHITE ***STD***

Comment

Hall

Flooring 9242 OV.ET.VLK.1224.PL-ETERNA VOLKAS POLISHED12X24 S 2
Tile Direction Sketch **5**

Grout 2225 Grout-(27) Silver ***STD***

Floor Tile Pattern 3050 SIDE TO SIDE ***STD***

Comment

Great Room

Flooring ~~9242 OV.ET.VLK.1224.PL-ETERNA VOLKAS POLISHED12X24 S 2~~

SEE REVISED PG. 34 FOR NEW FLOORING

Comment

Upper Hall

Flooring 9248 DY 89418 -Dynasty Tex-BLACK ICE-40 oz Poly***STD ***

Comment

N, M TANVEER/
 Project: Wallaceton
 Unit: 3186A-4, Phase: 3
 Model: 20-1606 B The Grassfield

Created: 11/11/2021 12:19:22

Locked:

Closed:

Finished Basement (Rec) Room/Hall

Flooring DY 89418 -Dynasty Tex-BLACK ICE-40 oz Poly***STD***

Comment

Master Bedroom

Flooring DY 89418 -Dynasty Tex-BLACK ICE-40 oz Poly***STD ***

Comment

Bedroom 2

Flooring DY 89418 -Dynasty Tex-BLACK ICE-40 oz Poly***STD ***

Comment

Bedroom 3

Flooring DY 89418 -Dynasty Tex-BLACK ICE-40 oz Poly***STD ***

Comment

Master Ensuite

Cabinet Colour/Style Viking III-SIMCOE-MOONLIGHT-3DL ***STD***

Countertop 6698-46-Countertop-PALOMA POLAR ETCHINGS
FINISH-Formica ***STD***

Countertop Edge N/A *****

Cabinet Hardware 135-HARDWARE ***STD***

Floor Tile UN.BL.BIA.1224-Biel-Bianco (White)-12 x 24 See Tile
Direction on Sketch Page ***2***

S 4

Floor Tile Grout Grout-(27) Silver ***STD***

N, M TANVEER/
 Project: Wallaceton
 Unit: 3186A-4, Phase: 3
 Model: 20-1606 B The Grassfield

Created: 11/11/2021 12:19:22

Locked:

Closed:

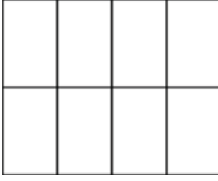
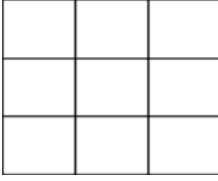
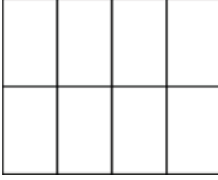
Floor Tile Pattern	3040	FRONT TO BACK ***STD*** 
Shower Floor Tile	8661	OD.ON.SWT.0202.MT.N-Ontario Series Mosaic-Snow White Matte-2 x 2 ***STD***
Shower Floor Tile Grout	2226	Grout-(00) White ***STD***
Shower Floor Tile Pattern	3000	STANDARD SQUARE ***STD*** 
Shower Wall Tile	5420	QT.SP.DGR.0810-Splendour-Dark Grey-8 inch x 10 inch ***STD***
Shower Wall Tile Grout	2226	Grout-(00) White ***STD***
Shower Wall Tile Pattern	3090	VERTICAL STACKED ***STD*** 
Shower Jamb(s) and Sill(s)	8923	Shower Jamb / Sill-Thassos White ***STD***
Plumbing Fixture (colour)	1737	Plumbing Fixtures-WHITE ***STD***
Comment	<div style="border: 1px solid black; height: 30px;"></div>	

Main Bathroom

Cabinet Colour/Style	9157	Viking III-SIMCOE-MOONLIGHT-3DL ***STD***
Countertop	8796	6698-46-Countertop-PALOMA POLAR ETCHINGS FINISH-Formica ***STD***
Countertop Edge	1111	N/A *****
Cabinet Hardware	7672	135-HARDWARE ***STD***
Flooring	5494	GE.NA.GRY.1313-New Albion-Grey-13 x 13 ***STD***
Floor Tile Grout	2225	Grout-(27) Silver ***STD***
Floor Tile Pattern	3000	STANDARD SQUARE ***STD*** 

Customer Colours

N, M TANVEER/
 Project: Wallaceton
 Unit: 3186A-4, Phase: 3
 Model: 20-1606 B The Grassfield

Created: 11/11/2021 12:19:22
 Locked:
 Closed:



Wall Tile 5420 QT.SP.DGR.0810-Splendour-Dark Grey-8 inch x 10 inch
 STD

Wall Tile Grout 2226 Grout-(00) White ***STD***

Main Bathroom Tile Pattern 3070 HORIZONTAL STACKED ***STD***

Plumbing Fixture (Colour)

Comment

Finished Basement Bathroom

Cabinet Colour/Style 9157 Viking III-SIMCOE-MOONLIGHT-3DL ***STD***

Countertop 8796 6698-46-Countertop-PALOMA POLAR ETCHINGS
 FINISH-Formica ***STD***

Countertop Edge 1111 N/A *****

Cabinet Hardware 7672 135-HARDWARE ***STD***

Flooring 5494 GE.NA.GRY.1313-New Albion-Grey-13 x 13 ***STD***

Floor Tile Grout 2225 Grout-(27) Silver ***STD***

Floor Tile Pattern 3000 STANDARD SQUARE ***STD***

Shower Floor Tile 8661 OD.ON.SWT.0202.MT.N-Ontario Series Mosaic-Snow
 White Matte-2 x 2 ***STD***

Shower Floor Tile Grout 2226 Grout-(00) White ***STD***

Shower Floor Tile Pattern 3000 STANDARD SQUARE ***STD***

Shower Wall Tile 5420 QT.SP.DGR.0810-Splendour-Dark Grey-8 inch x 10 inch
 STD

Customer Colours

N, M TANVEER/
 Project: Wallaceton
 Unit: 3186A-4, Phase: 3
 Model: 20-1606 B The Grassfield

Created: 11/11/2021 12:19:22

Locked:

Closed:

Shower Wall Tile Grout

Shower Wall Tile Pattern

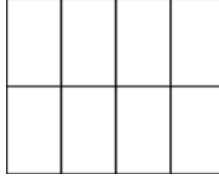

Shower Jamb(s)

Plumbing Fixture (Colour)

Comment

Great Room Fireplace

Type

Mantle

PG 21

Surround Opt.

Disclaimer

Disclaimer

Comment

Basement Stairs

Type

Colour

Carpet Runner

Handrail/Pickets/Post Type

Handrail/Pickets/Post Colours

Carpet

Custom Stain/Paint

Comment

Customer Colours

N, M TANVEER/
 Project: Wallaceton
 Unit: 3186A-4, Phase: 3
 Model: 20-1606 B The Grassfield

Created: 11/11/2021 12:19:22

Locked:

Closed:

Comment

Basement Stairs Landings (Upper and Lo

Flooring Red Oak-Vintage 5 inch Pre-Sanded Smooth Unfinished Red Oak-Unfinished-3/4 inch x 5 inch ***4***

Comment

Main Stairs

Type Oak Stairs ***STD MAIN STAIRS***

Colour Sambucca STAIN TO COMPLIMENT HARDWOOD AND WILL VARY FROM FLOORING ***99***

Carpet Runner N/A *****

Handrail/Pickets/Posts Type 1 5/16 inch Square pickets with 3 1/2" Square/Cap Post(s)-ALL OAK ***STD***

Handrail/Pickets/Posts Colour Oak Grade-Stain handrail,oak pickets,stringers,treads,rises

Custom Stain/Paint N/A *****

Comment

Main Stairs Landing(s)

Flooring Red Oak-Vintage 5 inch Pre-Sanded Smooth Unfinished Red Oak-Unfinished-3/4 inch x 5 inch ***1***

Comment

Throughout

Walls - Paint Colour 22-Wall-WARM GREY ***STD***

Underpad 600 Series-Underpad ***UPG***

Thresholds Metal Thresholds ***STD***

Switches and Plug Decora White Switches and Plugs ***STD***

Trim Size 4 1/4 Baseboard and 2 3/4 Casings ***STD***

Trim Colour Trim WHITE ***STD***

Customer Colours

N, M TANVEER/
Project: Wallaceton
Unit: 3186A-4, Phase: 3
Model: 20-1606 B The Grassfield

Created: 11/11/2021 12:19:22

Locked:

Closed:

Trim - Paint Colour | 1716 | Trim-WHITE ""STD""

Comment

[Empty comment box]

Purchaser:

N, M TANVEER

Date

Decor Consultant

Date

Purchaser:

Date

Wallaceton

Date Approved



CONSTRUCTION SUMMARY

Lot: 3186A-4
Model: 20-1606 B The Grassfield
Project/Phase: Wallaceton / 3

Offer	The Purchaser(s) acknowledge that they have NOT been referred by an existing Heathwood Homeowner and therefor are not entitled to a referral fee under Heathwood Homes Referral program.
Worksheet	Note:



CONSTRUCTION SUMMARY

Lot: 3186A-4
Model: 20-1606 B The Grassfield
Project/Phase: Wallaceton / 3

ADMIN FEE

Invoice	Qty.	Description
944 29Mar22 NoCat	-1	- PROMO_ FIVE THOUSAND DOLLARS (\$5,000.00)

APPLIANCES

Invoice	Qty.	Description
944 313,484 29Mar22	1	KITCHEN - APPLIANCES - CYCLONE 30 INCH WALL MOUNT CHIMNEY HOOD SS - SCB51930

CABINETRY

Invoice	Qty.	Description
944 313,484 29Mar22 **	1	KITCHEN - APPLIANCES - CYCLONE 30 INCH WALL MOUNT CHIMNEY HOOD SS - SCB51930
944 313,765 29Mar22	1	KITCHEN - 11A-Upper angle corner per unit Classic SKETCH # 3
944 314,121 29Mar22	1	KITCHEN - 40J-Two-tone colour/style selection for island (must be of equal or lower level to main selection) Classic
944 313,585 29Mar22	1	KITCHEN - 03G-Cabinet hardware upgrade II display board-Per Kitchen Classic
944 314,037 29Mar22	1	KITCHEN - 30H-Wall cabinet with shelf for microwave (finished interior) (opening 24 InchW x 13 3/4 InchH x 17 InchD) Classic SEE SKETCH # 2 AND 3
944 313,621 29Mar22	1	KITCHEN - 04H-66cm deep fridge enclosure (counter depth) with (1) wall ([1] 66cm deep gable and [1] 66cm deep cabinet) (This is not a zero clearance enclosure. Standard heights and widths will be used.) Classic SKETCH # 3
944 311,531 29Mar22 **	1	KITCHEN/BREAKFAST - HARDWOOD - VINTAGE - 5 INCH RED OAK SCULPTED - KITCHEN / BREAKFAST - UPG (INCLUDES RAISED CABINET) CABINETRY - Raise Cabinet; CERAMICS - delete std ceramics
944 306,497 29Mar22	1	KITCHEN - CABINETRY - CLASSIC PLUS - KITCHEN - UPG



CONSTRUCTION SUMMARY

Lot: 3186A-4
Model: 20-1606 B The Grassfield
Project/Phase: Wallaceton / 3

CARPET

Invoice	Qty.	Description
944 307,500 29Mar22	1	BEDROOM 2 - CARPET - 600 SERIES UNDERPAD - BEDROOM 2 - UPGRADE 4
944 307,501 29Mar22	1	BEDROOM 3 - CARPET - 600 SERIES UNDERPAD - BEDROOM 3 - UPGRADE 4
944 307,502 29Mar22	1	MASTER BEDROOM - CARPET - 600 SERIES UNDERPAD - MASTER BEDROOM - UPGRADE 4
944 307,503 29Mar22	1	FINISHED BASEMENT FAMILY (REC) ROOM/HALL - CARPET - 600 SERIES UNDERPAD - RECREATION ROOM AND BASEMENT STAIRS - UPGRADE 4
944 307,504 29Mar22	1	UPPER HALL - CARPET - 600 SERIES UNDERPAD - UPPER HALL - UPGRADE 4



CONSTRUCTION SUMMARY

Lot: 3186A-4
Model: 20-1606 B The Grassfield
Project/Phase: Wallaceton / 3

CERAMICS

Invoice	Qty.	Description
944 308,321 29Mar22	1	FOYER - CERAMICS - FLOOR - FOYER - UPGRADE 5
944 308,358 29Mar22	1	MAIN HALL - CERAMICS - FLOOR - MAIN HALL - UPGRADE 5
944 308,365 29Mar22	1	MUD ROOM - CERAMICS - FLOOR - MUD ROOM - UPGRADE 5
944 308,372 29Mar22	1	POWDER ROOM - CERAMICS - FLOOR - POWDER ROOM - UPGRADE 5
944 308,311 29Mar22	1	MASTER ENSUITE - CERAMICS - FLOOR - ENSUITE MASTER - UPGRADE 2
944 308,295 29Mar22	1	KITCHEN - CERAMICS - BACKSPLASH - KITCHEN - UPGRADE 1
944 314,178 29Mar22	1	KITCHEN - CERAMICS - ADDITIONAL BACKSPLASH DUE TO INSTALL CHIMNEY HOODFAN IN KITCHEN - KITCHEN - UPGRADE 1
944 311,531 29Mar22 **	1	KITCHEN/BREAKFAST - HARDWOOD - VINTAGE - 5 INCH RED OAK SCULPTED - KITCHEN / BREAKFAST - UPG (INCLUDES RAISED CABINET) CABINETRY - Raise Cabinet; CERAMICS - delete std ceramics



CONSTRUCTION SUMMARY

Lot: 3186A-4
Model: 20-1606 B The Grassfield
Project/Phase: Wallaceton / 3

ELECTRICAL

Invoice	Qty.	Description
944 313,484 29Mar22 **	1	KITCHEN - APPLIANCES - CYCLONE 30 INCH WALL MOUNT CHIMNEY HOOD SS - SCB51930
944 314,340 29Mar22 **	1	KITCHEN - HEATING/AIR - ROUGH-IN GAS LINE FOR GAS STOVE AT MAIN FLOOR (SEE SPECS) (HOOK-UP NOT INCLUDED) LEAVE STANDARD 120 VOLT ELECTRICAL OUTLET ON A SEPARATE CIRCUIT. * STANDARD 220V WILL STAY SKETCH # 2 AND 3 ELECTRICAL - notification
944 314,229 29Mar22	1	KITCHEN - ELECTRICAL - EXTRA WALL INTERIOR OUTLET (120V/15A) ON A SEPARATE CIRCUIT (ON ARCFULT) FOR MICROWAVE SHELF SEE SKETCH # 2 AND 3
944 314,224 29Mar22	2	- ELECTRICAL - CEILING ROUGH-IN (CAPPED) GREAT ROOM 1X IN THE CENTRE OF THE ROOM- USE EXISTING SWITCH PLUG KITCHEN 1X TO BE INSTALLED ABOVE THE BREAKFASRT BAR - USE SEPARATE SWITCH SEE SKECH # 2
944 314,223 29Mar22	1	KITCHEN - ELECTRICAL - ADDITIONAL SWITCH SEE SKETCH # 2
944 314,232 29Mar22	1	GREAT ROOM - ELECTRICAL - EXTRA WALL INTERIOR OUTLET ON EXISTING CIRCUIT (DOES NOT INCLUDE KITCHEN OUTLETS) TO BE INSTALLED 70" +/- FROM FLOOR CENTERED ABOVE THE FIRE PLACE SEE SKETCH # 2

GRANITE

Invoice	Qty.	Description
944 310,872 29Mar22	1	- GRANITE - COUNTERTOP - 3/4 INCH GROUP 2 WITH MITRE EDGE - KITCHEN / ISLAND - UPG



CONSTRUCTION SUMMARY

Lot: 3186A-4
Model: 20-1606 B The Grassfield
Project/Phase: Wallaceton / 3

HARDWOOD

Invoice	Qty.	Description
944 311,531 29Mar22	1	KITCHEN/BREAKFAST - HARDWOOD - VINTAGE - 5 INCH RED OAK SCULPTED - KITCHEN / BREAKFAST - UPG (INCLUDES RAISED CABINET) CABINETRY - Raise Cabinet; CERAMICS - delete std ceramics
944 311,532 29Mar22	1	MAIN STAIRS LANDING(S) - HARDWOOD - VINTAGE - 5 INCH RED OAK SCULPTED - LANDING(S) TO 2ND FLOOR - UPG HARDWOOD - Supply and Install smooth UNFINISHED pre-sanded red oak at stair landing(s)
944 311,533 29Mar22	1	- HARDWOOD - VINTAGE - 5 INCH RED OAK SCULPTED - LANDING(S) TO BSMT - UPG HARDWOOD - Supply and Install smooth UNFINISHED pre-sanded red oak at stair landing(s)
944 311,530 29Mar22	1	GREAT ROOM - HARDWOOD - VINTAGE - 5 INCH RED OAK SCULPTED - GREAT ROOM - UPG
944 314,352 29Mar22 **	2	- PAINT - STAIN STAIR LANDING IN SAMBUCCA. LANDING UNDER 25 SQ.FT. EACH HARDWOOD - Supply and Install smooth UNFINISHED pre-sanded red oak at stair landing(s)

HEATING / AIR CONDITIONING

Invoice	Qty.	Description
944 313,484 29Mar22 **	1	KITCHEN - APPLIANCES - CYCLONE 30 INCH WALL MOUNT CHIMNEY HOOD SS - SCB51930
944 314,340 29Mar22	1	KITCHEN - HEATING/AIR - ROUGH-IN GAS LINE FOR GAS STOVE AT MAIN FLOOR (SEE SPECS) (HOOK-UP NOT INCLUDED) LEAVE STANDARD 120 VOLT ELECTRICAL OUTLET ON A SEPARATE CIRCUIT. * STANDARD 220V WILL STAY SKETCH # 2 AND 3 ELECTRICAL - notification

PAINTING

Invoice	Qty.	Description
944 314,352 29Mar22	2	- PAINT - STAIN STAIR LANDING IN SAMBUCCA. LANDING UNDER 25 SQ.FT. EACH HARDWOOD - Supply and Install smooth UNFINISHED pre-sanded red oak at stair landing(s)

THE GRASSFIELD

SKETCH #1

ELEVATION B | 1,986 SQ. FT.

Includes 380 sq. ft. of Finished Lower Level

WALLACETON
EST. 1870

20-1606 ELEV. B

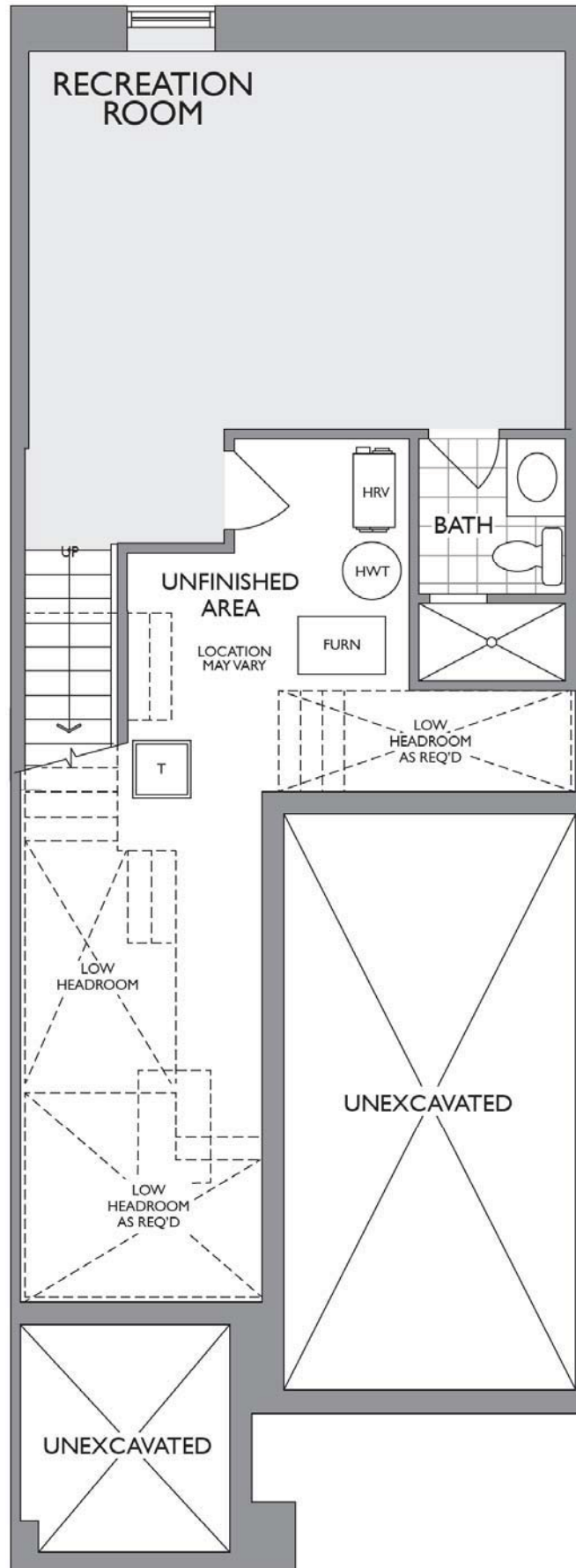

THE GRASSFIELD

ELEVATION B | 1,986 SQ. FT.

Includes 380 sq. ft. of Finished Lower Level

WALLACETON

EST. 1870

SKETCH #2

20-1606 ELEV. B

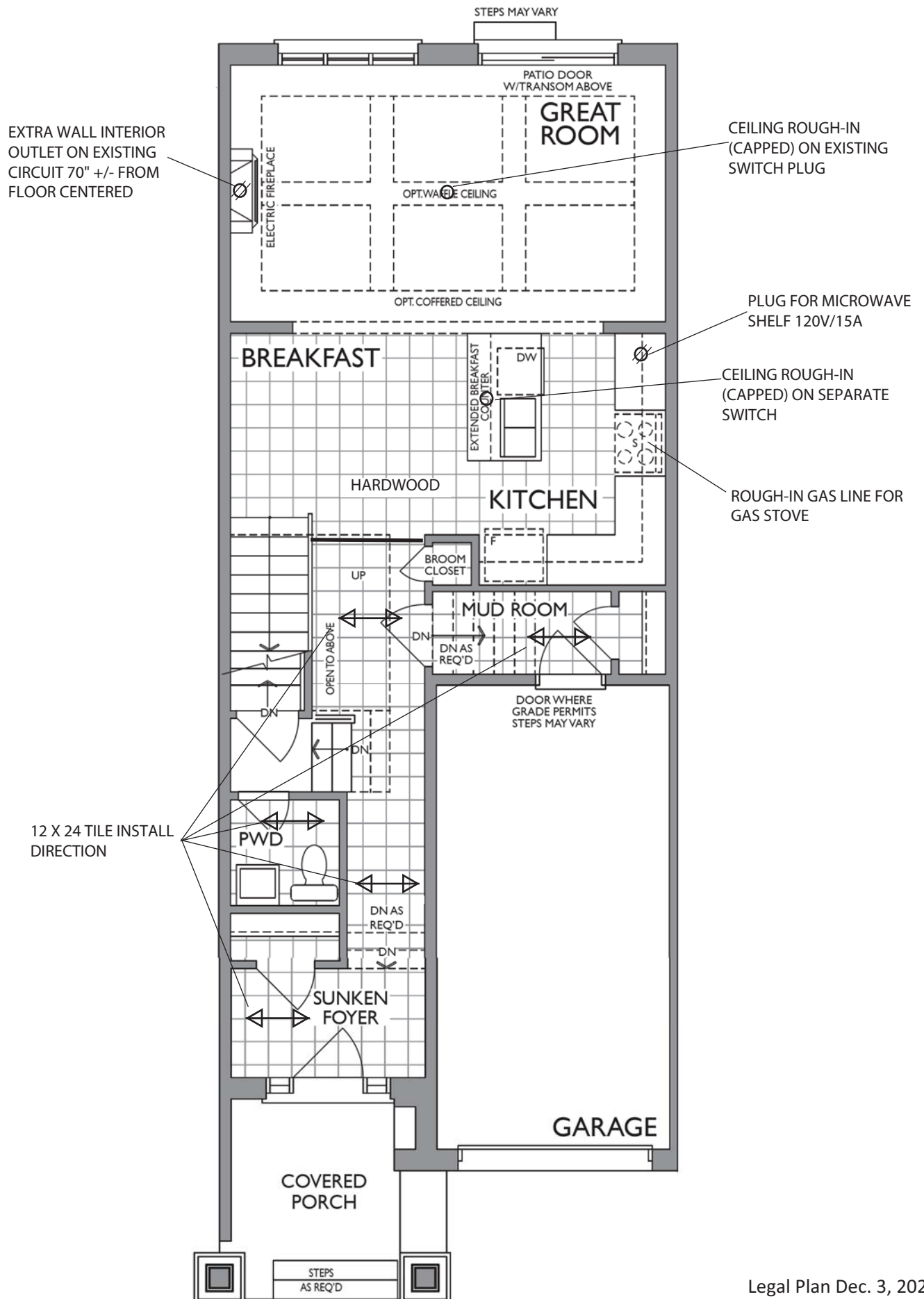



Project: Wallaceon
 Unit: 3186A-4, Phase: 3
 Model: 20-1606 B The Grassfield

**HEATHWOOD HOMES
 WALLACETON, KITCHENER, ON
 MODEL: 20-1606 (2003)**

STANDARD CONTRACT INCLUDES:

Appliance Openings

- Hood Opening: 30"W Std. hood
- Fridge Opening: 37 3/8 "W X 73 7/8"H
- 30cm deep cabinet over fridge
- Stove Opening: 30" Freestanding
- Dishwasher Opening: 24"

Standard Kitchens Scope:

- 100cm H wall cabinets
- Std. Blumotion Hinges- **soft close**
- Std. Metabox Drawers- **not soft close**
- Min 40cm W drawer
- Base pie cut corner cabinets
- Backing on all cabinets
- Countertop by others
- Upgrade applied paneled fridge & dishwashers supply only (appliance hardware by others)

Standard Vanity & Laundry Scope:

- Powder by others, pedestal
- All vanities include laminate counter
- Std. Blum Hinges- **not soft close**
- Tandem Box Drawers- **soft close**
- Master Ensuite: Top drawers (Full height doors at sink)
- Mains: Full height doors (top drawers added if Masters can't accommodate)
- Optional laundry base & wall cabinets

THIS DRAWING IS FOR DESIGN PURPOSES ONLY.
 IT IS NOT AN EXACT RENDITION.

STD. BASEMENT BATH

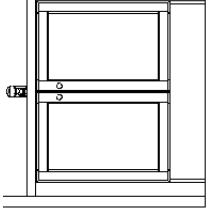

**MASTER ENSUITE
 (2ND FLR)**

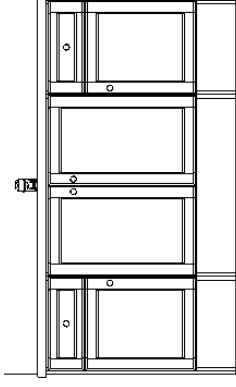

**MAIN BATH
 (2ND FLR)**

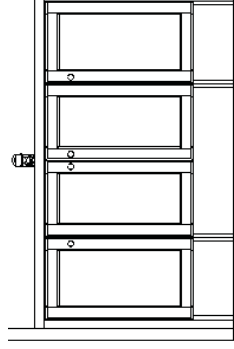

Project: Wallaceon
 Unit: 3186A-4, Phase: 3
 Model: 20-1606 B The Grassfield

**KITCHEN
 (GROUND FLOOR)**

UPPER ANGLE CORNER
 DEEP FRIDGE UPPERS

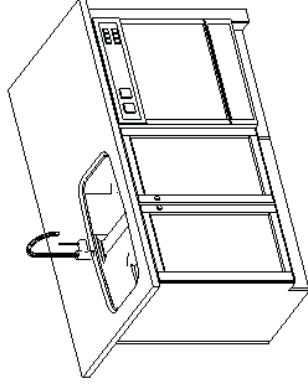

- 30" CHIMNEY
 HOODFAN
 - GAS ROUGH-IN

MICROWAVE SHELF & PLUG

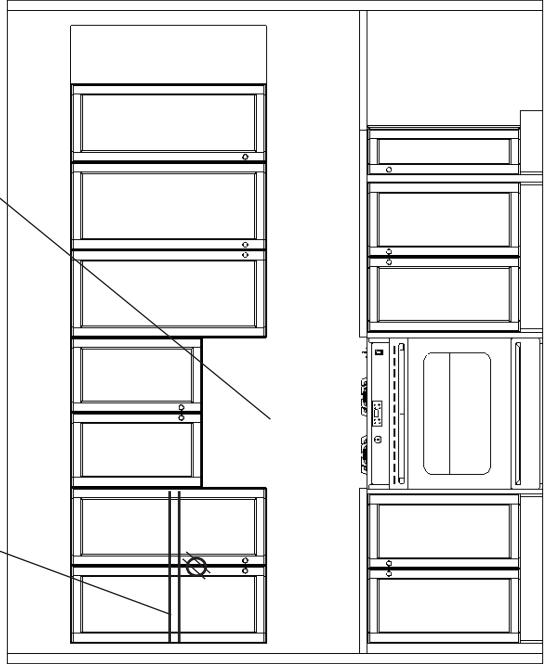
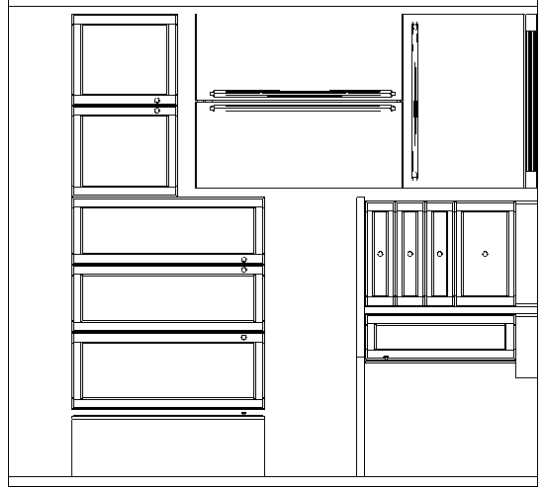

THE GRASSFIELD

ELEVATION B | 1,986 SQ. FT.

Includes 380 sq. ft. of Finished Lower Level

WALLACETON
EST. 1870

SKETCH #4

20-1606 ELEV. B

12 X 24 TILE INSTALL
DIRECTION

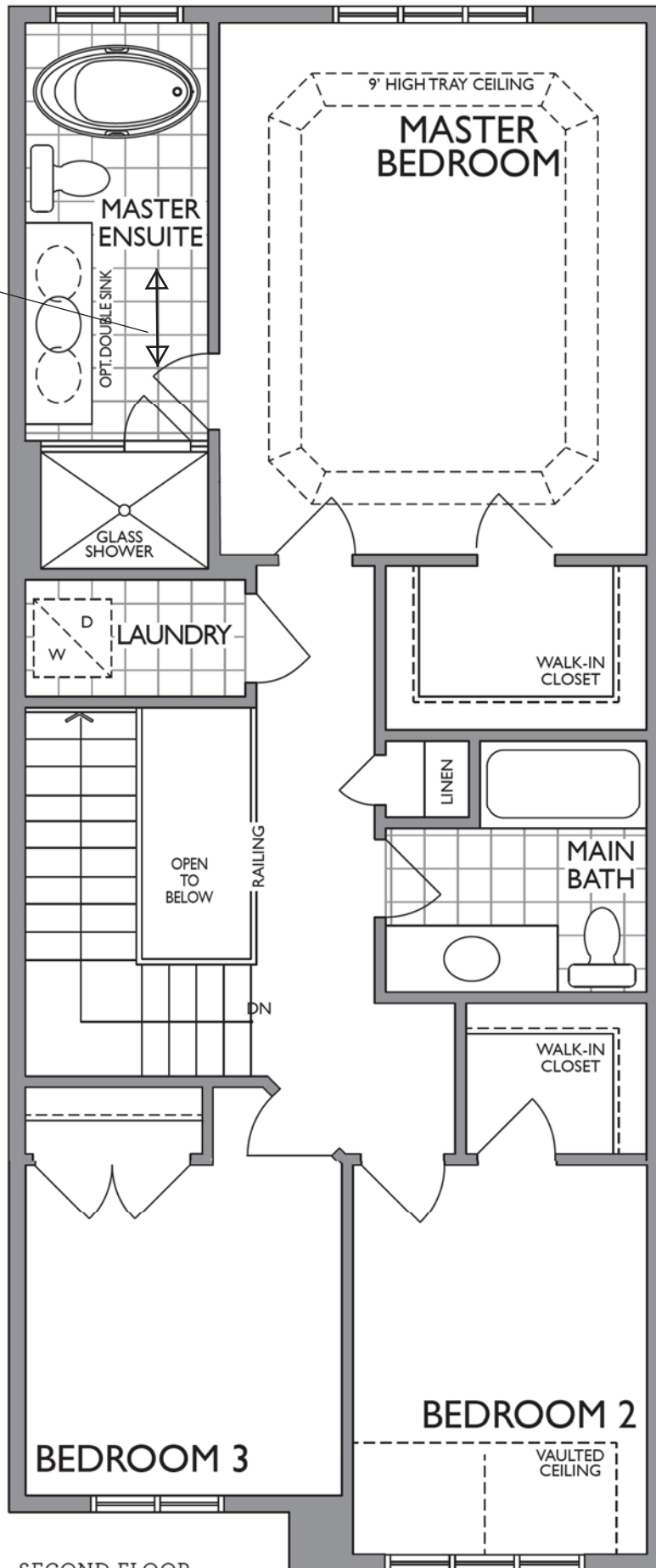

SECOND FLOOR
ELEVATION B



NFAS NF17 Mantel CABINET

Reginox

ND1831UA/9



Optional Accessories

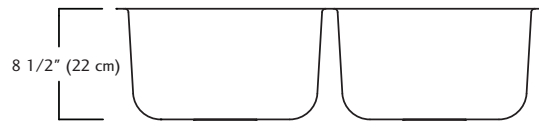
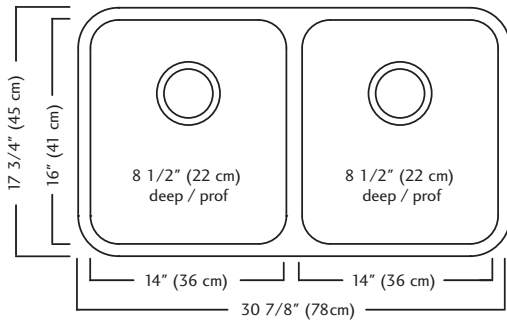
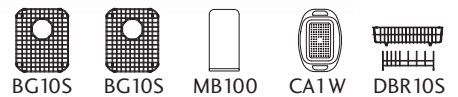

ND1831UA/9 SPECIFICATION

Model ND1831UA/9 is a double (two equal size) bowl undermount sink manufactured by Franke Kindred Canada Limited from 18 gauge stainless steel. Product has silk finished rims and linear brush finished bowls. Sink is fully undercoated. Basket strainer waste fittings (3 1/2", 89 mm) are included. Sink is backed with a limited lifetime warranty.

- O.D. 17 3/4" x 30 7/8" x 8 1/2" (45 x 78 x 22 cm)
- **Recommended for minimum 36" cabinet**

Franke Kindred Canada Limited
 P.O. Box 190, 1000 Franke Kindred Road, Midland, Ontario, Canada, L4R 4K9 Phone: 866-687-7465 Fax: 800-361-8408



Specifications

FAUCET DESCRIPTION

- Reflex™ pulldown system offers smooth operation, easy movement and secure docking
- Power Clean™ spray technology
- Metal construction with various finishes identified by suffix
- Quick connect installation
- Pulldown spray with 68" braided hose
- Flexible supply lines with 3/8" compression fittings
- High arc spout provides height and reach to fill or clean large pots while pulldown wand provides the maneuverability for cleaning or rinsing
- 360° rotating spout
- Faucet designed for handle to be mounted on right side only

OPERATION

- Lever style handle
- Temperature controlled by 100° arc of handle travel
- Operates with less than 5 lbs. of force
- Operates in stream or spray mode in the pullout or retracted position

FLOW

- Flow is limited to 1.5 gpm (5.7 L/min) max at 60 psi

CARTRIDGE

- 1255™ Duralast™ cartridge

STANDARDS

- Third party certified to IAPMO Green, ASME A112.18.1/CSA B125.1 and all applicable requirements therein including NSF 61/9G & 372
- Meets CalGreen and Georgia SB370 requirements
- Complies with California Proposition 65 and with the Federal Safe Drinking Water Act
- The backflow protection system in the device consists of two independently operating check valves, a primary and a secondary which prevent backflow

- ADA  for lever handle

WARRANTY

- Lifetime limited warranty against leaks, drips and finish defects to the original homeowner
 - 10 year limited warranty when used in a multifamily installation
 - 5 year limited warranty when used in a commercial installation
- Visit www.moen.com/support for complete details and limitations

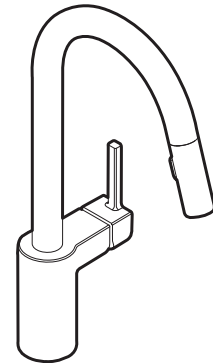

ALIGN™
**Single Handle High Arc
 Pulldown Kitchen Faucet**

Models: 7565 series

NOTE: THIS FAUCET IS DESIGNED TO BE INSTALLED THROUGH 1 HOLE, 1-1/2" (38mm) MIN. DIA. (OPTIONAL 3-HOLE ESCUTCHEON 141002 AVAILABLE)

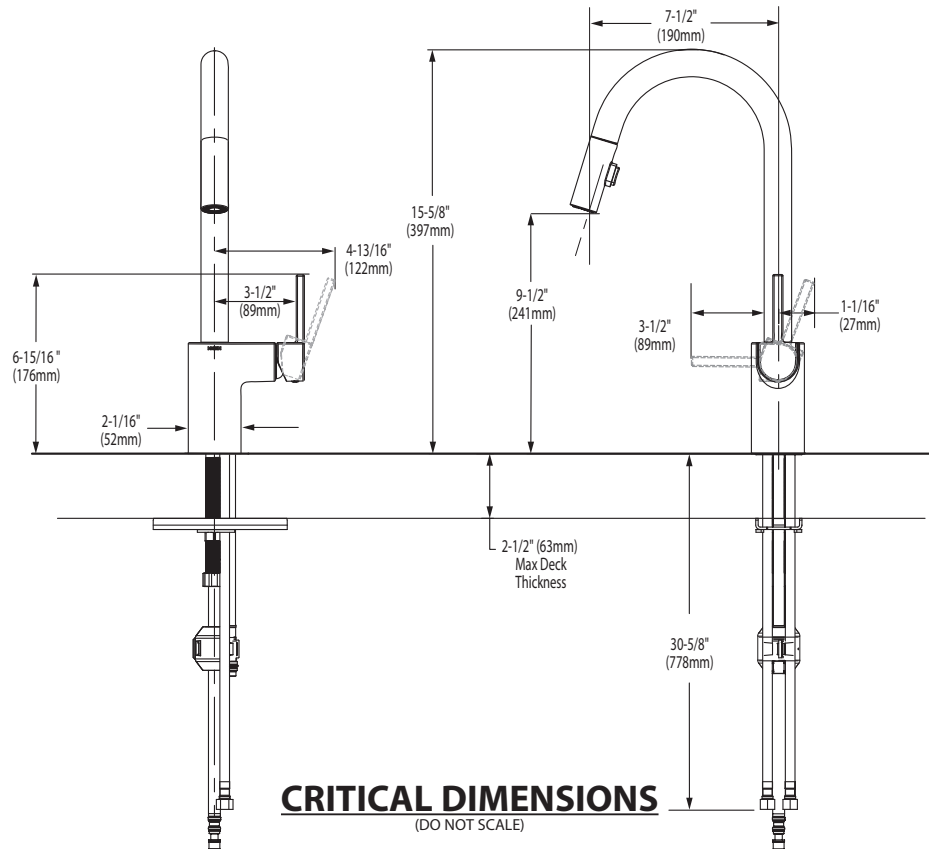

FOR MORE INFORMATION CALL: 1-800-BUY-MOEN

www.moen.com



 BARRIER FREE (ABOVE COUNTER OR DROP-IN ONLY)

BOULEVARD®
PEDESTAL SINK
VITREOUS CHINA

BOULEVARD® PEDESTAL SINK

- ~~0641.800 Faucet holes on 8" (203mm) centers (Illustrated)~~
- STD** **0641.400** Faucet holes on 4" (102mm) centers
- ~~0641.100 Center hole only~~
- Classic styled rectangular pedestal lavatory
 - Vitreous china
 - Rear overflow
 - Supplied with mounting kit
 - Right Height® for greater comfort during use
 - Faucet ledge with large deck area (faucet not included)
 - **Design coordinates with Boulevard® Toilet**
 - Basin has flat bottom to also allow use as an **above counter** sink or a **drop-in** sink (with u-shaped cut out)

Nominal Dimensions:

24" x 19" x 35-1/2"
(610 x 483 x 902mm)

- 0641.008** Pedestal top-8" (203mm) centers
- 0641.004** Pedestal top-4" (102mm) centers
- 0641.001** Pedestal top-center hole only
- 0010.000** Pedestal only

Bowl sizes:

17" (432mm) wide,
12-1/2" (318mm) front to back,
5" (127mm) deep

Compliance Certifications -

Meets or Exceeds the Following Specifications:

- ASME A112.19.2 - 2008/CSA B45.1-08



SEE REVERSE FOR ROUGHING-IN DIMENSIONS

To Be Specified:

- Color: White Linen
- Faucet Finish:
- Supplies:
- 1-1/4" Trap:
- Nipple:

* See faucet section for additional models available



**BOULEVARD®
 PEDESTAL SINK
 VITREOUS CHINA**

BARRIER FREE (ABOVE COUNTER OR DROP-IN ONLY)

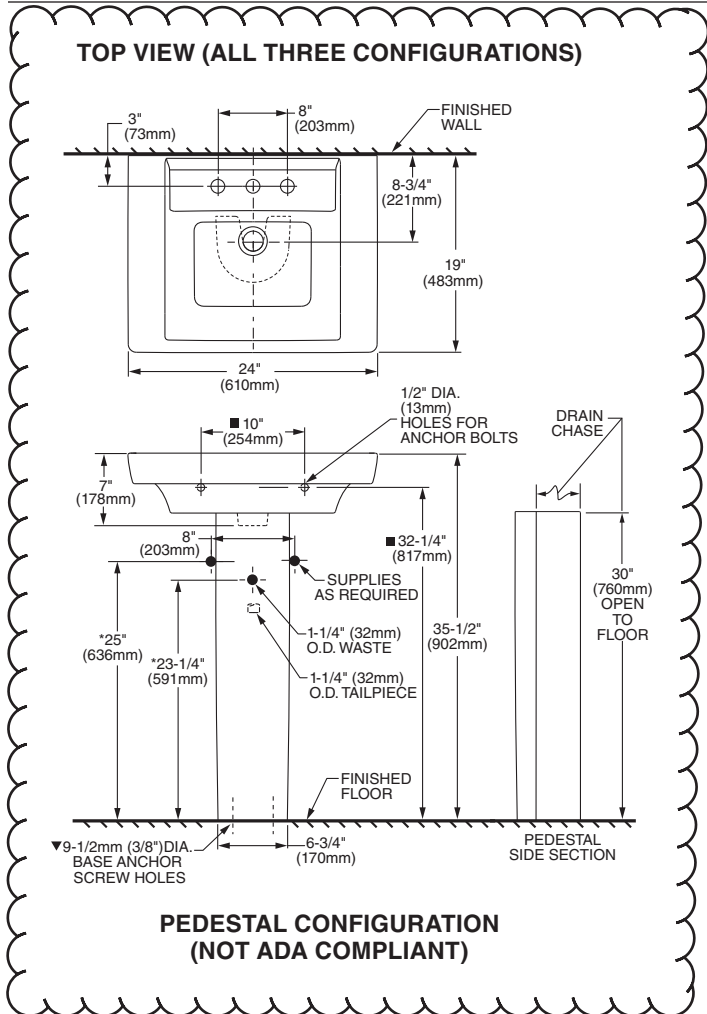

ABOVE COUNTER CONFIGURATION

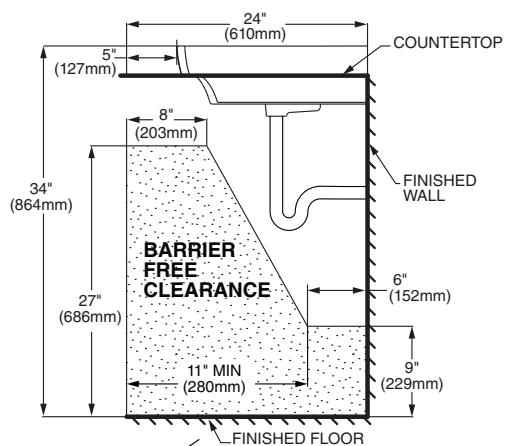
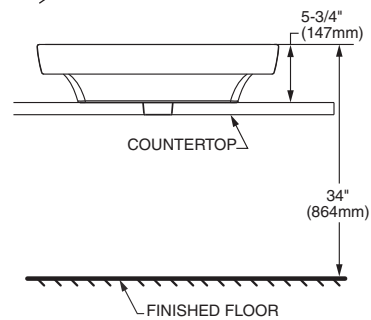

DROP-IN SINK CONFIGURATION

ABOVE COUNTER AND DROP-IN SINK CONFIGURATIONS MEET THE AMERICANS WITH DISABILITIES ACT GUIDELINES AND ANSI A117.1 ACCESSIBLE AND USABLE BUILDINGS AND FACILITIES - CHECK LOCAL CODES.
 Top of sink installed at 34" (864mm) height from finished floor.
 Sink installed 5" (127mm) minimum from front edge of countertop.
 Provide 27" (686mm) knee clearance area.

NOTES:
 * DIMENSIONS SHOWN FOR LOCATION OF SUPPLIES AND "P" TRAPS ARE SUGGESTED.
 ▼ PEDESTAL ANCHORING SCREWS NOT INCLUDED.
 ■ SUITABLE FOR REINFORCEMENT ONLY. ACTUAL DIMENSIONS MUST BE TAKEN FROM FIXTURE.
 FITTING NOT INCLUDED AND MUST BE ORDERED SEPARATELY.
 PROVIDE SUITABLE REINFORCEMENT FOR ALL WALL SUPPORTS.
 INSTALLATION INSTRUCTIONS SUPPLIED WITH LAVATORY.

IMPORTANT: Dimensions of fixtures are nominal and may vary within the range of tolerance established by ANSI Standard A112.19.2. These measurements are subject to change or cancellation. No responsibility is assumed for use of superseded or voided pages.



BARRIER FREE

**COLONY™
 COUNTERTOP SINK**
 VITREOUS CHINA

COLONY COUNTERTOP SINK

- Vitreous china
- Self-rimming
- Front overflow
- Supplied with template
- Faucet deck
 (Faucet shown not included)



0346 803

Faucet holes on 203mm (8") centres

STD **0346 403** (Illustrated)

Faucet holes on 102mm (4") centres

0346 001

Centre hole only

Nominal Dimensions:

521 x 448mm (20-1/2" x 17-5/8")

Bowl sizes:

422mm (16-5/8") wide, 279mm (11") front to back, 143mm (5-5/8") deep

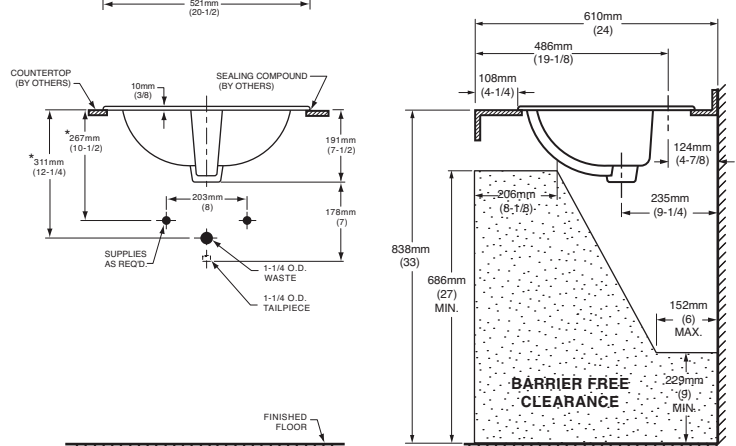
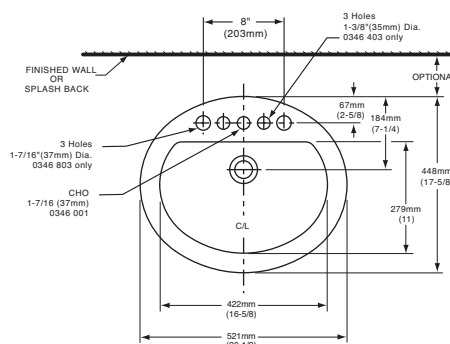

COMPLIANCE CERTIFICATIONS –

Meets or exceeds the following Specifications:

- ASME A112.19.2M for Vitreous China Fixtures.
- CAN/CSA B45 Series.

To Be Specified

- Colour: White Bone Silver Gray Linen
- Faucet*:
- Faucet Finish:
- Supplies & Stops:
- Trap 1-1/4" (32 mm):

NOTES:

* DIMENSIONS SHOWN FOR LOCATION OF SUPPLIES AND "P" TRAP ARE SUGGESTED. FOR COUNTERTOP CUTOUT AND INSTALLATION INSTRUCTIONS USE TEMPLATE SUPPLIED WITH SINK. FAUCETS NOT INCLUDED AND MUST BE ORDERED SEPARATELY. IMPORTANT: Dimensions of fixtures are nominal and may vary within the range of tolerances established by ANSI Standard A112.19.2. These measurements are subject to change or cancellation. No responsibility is assumed for use of superseded or voided pages.

* See faucet section for additional models available



DEMI™ Product Specification Sheet

Two Piece Freestanding Collection



CF2007 Two Piece Freestanding Soaker

Size: 60" x 32" x 22"
 1524 mm x 813 mm x 559 mm

PRODUCT FEATURES & BENEFITS

- Vacuum formed acrylic reinforced with fiberglass
- Scratch, stain and fade resistant high gloss finish
- Installation friendly two piece design
- Accepts deck mounted faucet
- Includes integral pop up drain and rectangular overflow
- Includes levelling feet

TWO PIECE ASSEMBLY

FRONT VIEW

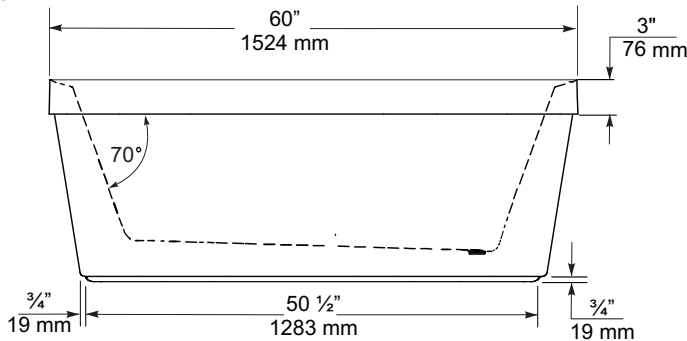

END VIEW

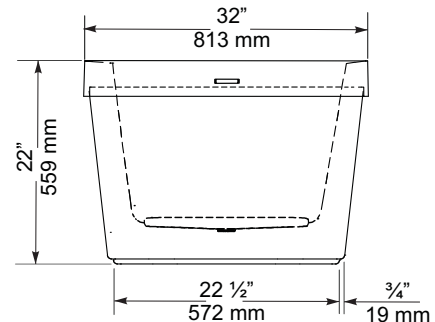

TOP VIEW

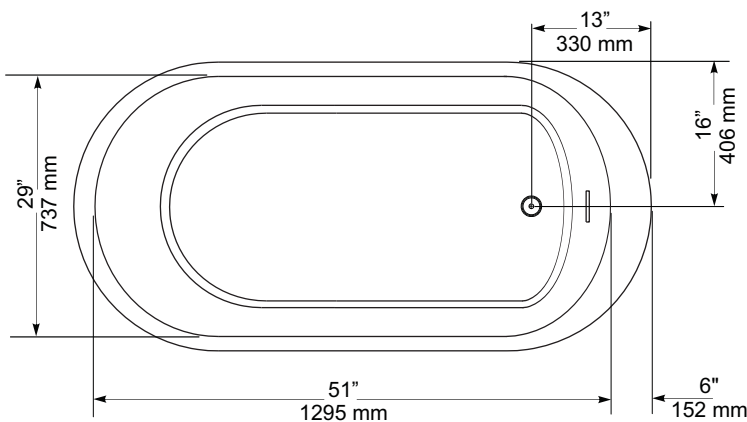

GENERAL SPECIFICATIONS

Average Weight	90 lb	41 kg
Bathing Well at bottom	43" x 20"	1092 x 508 mm
Capacity Drain to Overflow		195 litres
Water Depth Drain to Overflow	16"	406 mm
Drain Opening (dia.)	2"	51 mm
Overflow Opening	2 1/4" x 1/2"	57 x 13 mm
Drain to Floor Clearance	3 1/4"	83 mm

NOTES: Please confirm measurements on actual product to ensure proper identification. Bathtub to be installed on the floor supported by 5 self levelling feet. Adjust if required to level the bathtub for adequate drainage. Refer to installation instructions for additional information.

IMPORTANT: Dimensions of fixtures are nominal and may vary ± 1/4" (6 mm). Weight may vary ± 5 lb (2.3 kg). Drawing is not to scale. These measurements are subject to change at manufacturer's discretion.

Compliance Certifications -

Meets or Exceeds the following Specifications:

- CAN/CSA - B45 Series



60 Shorncliffe Rd., Toronto, Ontario M8Z 5K1
 Telephone: 416.231.9030 Fax: 416.231.0929
 www.mirolin.com

Customer Service: 416.231.5790
 Canada, U.S.A.: 800.MIROLIN(647-6546)
 Fax, Canada: 800.463.2236

R0084162
 25 Sep. 2018

American Standard
 Style That Works Better

FloWise™ DUAL FLUSH ELONGATED TOILET

VITREOUS CHINA

FloWise™ DUAL FLUSH ELONGATED TOILET

2476 216

- Vitreous china
- Low-consumption Dual Flush
 Full flush 6.0 Lpf/1.3 gpf,
 Partial flush 3.0 Lpf/0.66 gpf.
- Elongated wash down bowl
- Internal trapway fully-glazed,
 2-1/4" (57mm) ballpass
- Concealed trapway bowl
- Chrome-plated top mounted
 push button actuator
- Easy to clean sanitary dam on bowl
- Includes Elongated Slow Close Seat
- 100% factory flush tested
- 2 bolt caps

Separate Component Parts:

- 3067 316** Elongated Bowl with Slow Close Seat
- 4035 216** Unlined Tank



2476 516 Same as above with Lined tank

- 3067 316** Elongated Bowl
- 4035 516** Lined Tank

Nominal Dimensions:
 794 x 432 x 765mm
 (31-1/4" x 17" x 30-1/8")

- Compliance Certifications -
 Meets or Exceeds the Following Specifications:**
- ASME A112.19.2M (and 19.6M)
 - CAN/CSA B45 series

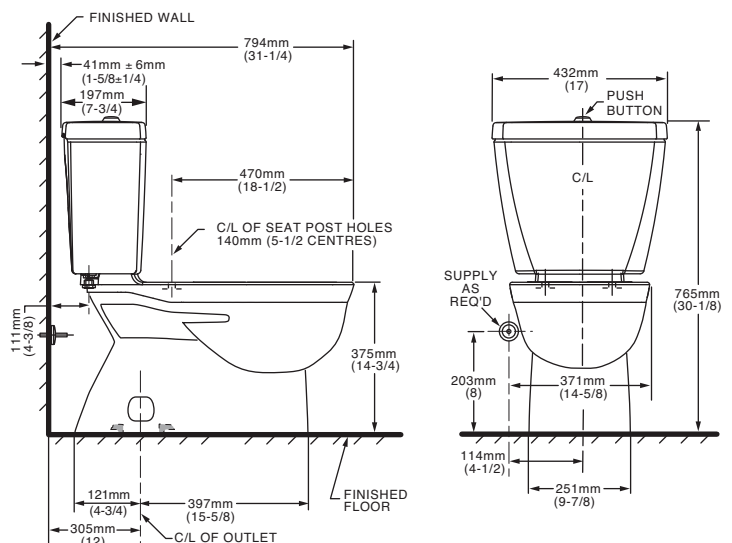

- To Be Specified
- Colour: 020 White
 - Supply with stop:

NOTES:
 THIS TOILET IS DESIGNED TO ROUGH-IN AT A MINIMUM DIMENSION OF 305MM (12") FROM FINISHED WALL TO C/L OF OUTLET.
 SUPPLY NOT INCLUDED WITH FIXTURE AND MUST BE ORDERED SEPARATELY.
 * DIMENSION SHOWN FOR LOCATION OF SUPPLY IS SUGGESTED.
 FOR ADDITIONAL INFORMATION REFER TO INSTALLATION INSTRUCTIONS SUPPLIED.
 IMPORTANT: Dimensions of fixtures are nominal and may vary within the range of tolerance established by ANSI Standard A112.19.2
 These measurements are subject to change or cancellation. No responsibility is assumed for use of superseded or voided pages.

UPGRADED VALUE ADDED FEATURES AT NO EXTRA CHARGE



Specifications

DESCRIPTION

- Metal construction with various finishes identified by suffix
- 16" long 3/8" tubing connections
- Includes metal or 50/50 pop-up type waste assembly where noted

OPERATION

- Pivot action lever style handle
- Temperature controlled through 180° degree arc of handle travel

FLOW

- Flow is limited to 1.5 gpm max (5.7L/min) at 60 psi

CARTRIDGE

- 1225 cartridge design
- Nonmetallic/nonferrous and stainless steel material
- Can accommodate reversed piping and back to back installations

STANDARDS

- Third party certified to WaterSense®, CSA B-125.1, ASME A112.18.1 and all applicable requirements referenced therein including NSF61/9
- Complies with California Proposition 65 and with the Federal Safe Drinking Water Act

- **ADA**  for lever handle

WARRANTY

- Lifetime limited warranty against leaks, drips and finish defects to the original consumer purchaser
- 5 year warranty if used in commercial installations

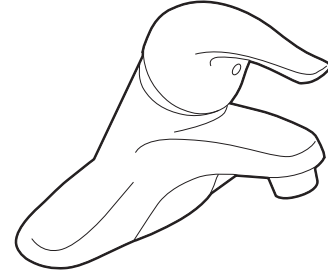

CHATEAU® Single-Handle Lavatory Faucet

with Metal Waste Assembly

Model: L4625 series

L4631BC

Bulk Packed (12 per carton):

L64624 series

with 50/50 Waste Assembly

Bulk Packed (12 per carton):

L64625 series

Less Waste

Bulk Packed (12 per carton):

L64600 series

NOTE: THIS FAUCET IS DESIGNED TO BE INSTALLED THRU 3-1" DIA. HOLES, 2" ON CENTER

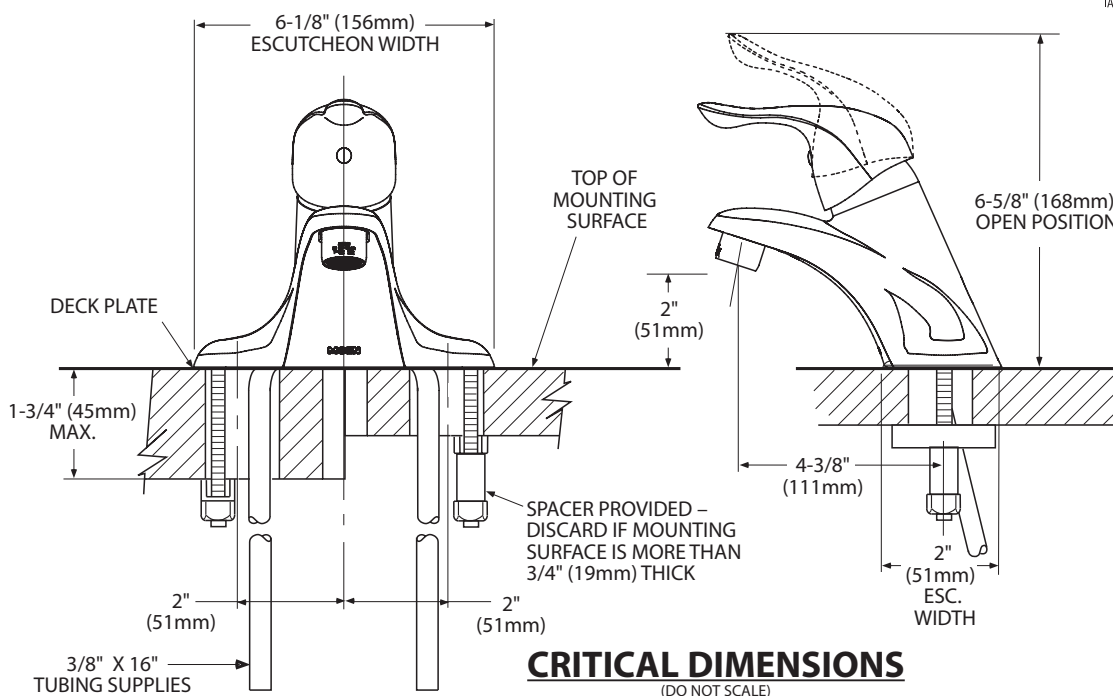



Buy it for looks. Buy it for life.®

*There is more than 1 version of this model.
 Page down to identify the version you have.*

DESCRIPTION

- Metal construction with various finishes identified by suffix
- Includes non-metallic showerhead, arm, flange and non-metallic diverter tub spout

OPERATION

- Handle operates counterclockwise through a 270° arc with off at 6 o'clock and maximum hot at the 9 o'clock position. Shut off in clockwise direction
- Adjustable temperature limit stop to control maximum hot water temperature
- Pressure balancing mechanism maintains selected discharge temperature to ± 3°

FLOW

- Showerhead is limited to 2.5 gpm (9.5 L/min) at 80 psi
- EP suffix models are limited to 1.75 gpm (6.6 L/min) at 80 psi
- NH suffix models contain no showerhead

CARTRIDGE

- 1222 cartridge design
- Accommodates back to back installations
- Nonmetallic/nonferrous and stainless steel material

STANDARDS

- Third party certified to meet ASME A112.18.1/CSA B125.1 and all applicable requirements referenced therein
- EP suffix models are third party certified to WaterSense®

- **ADA** for lever handle

WARRANTY

- Lifetime limited warranty against leaks, drips and finish defects to the original consumer purchaser
- 5 year warranty if used in commercial installations

Specifications



**CHATEAU® POSI-TEMP®
 Single-Handle Tub/Shower Trim Kit**

- Models:** TL181 series - valve trim only
 (Bulk Packed 12 per carton)
 TL182 series - shower trim only
 (Bulk Packed 12 per carton)
 TL183 series - tub/shower trim
 (Bulk Packed 12 per carton)

- Valves:** 62300 series
 2500 series

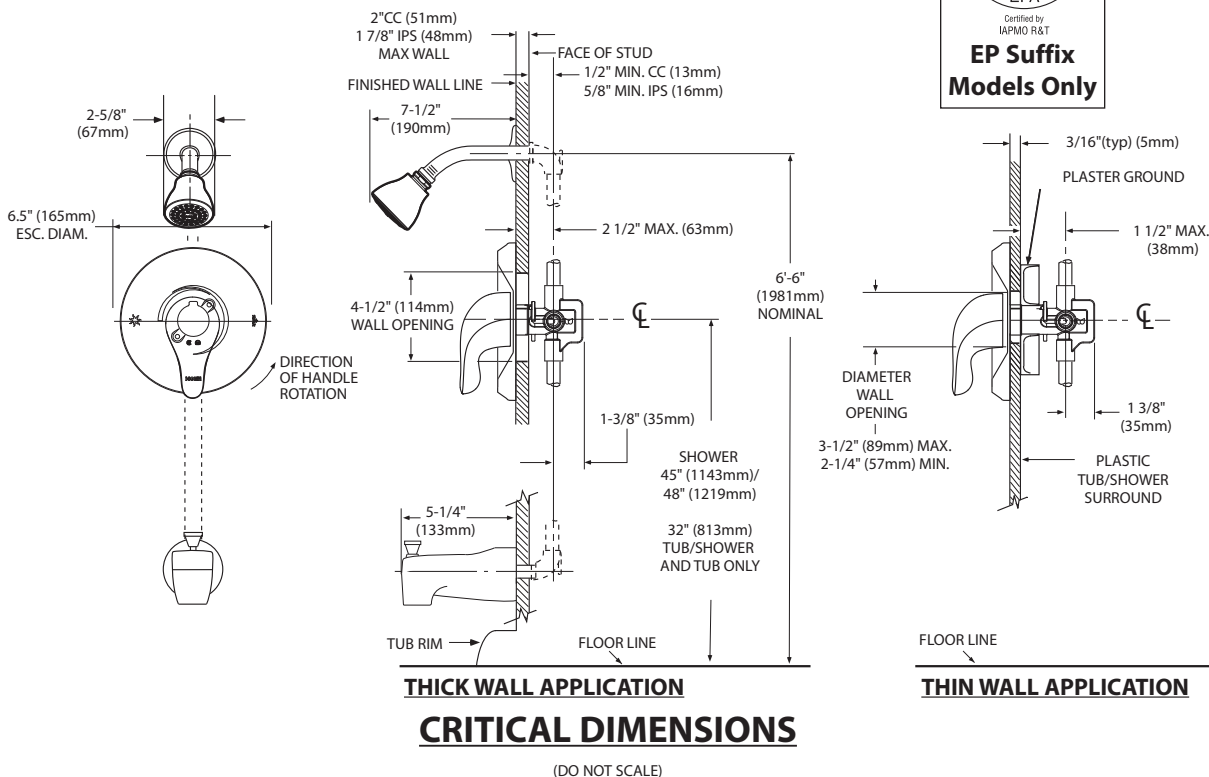



Specifications

DESCRIPTION

- Metal construction with various finishes identified by suffix

OPERATION

- Lever style handles with hot and cold color indicator
- Rotate hot side handle counterclockwise to open (clockwise to close) and the cold side handle (clockwise to open) and (counterclockwise to close)

STANDARDS

- Third party certified to: ASME A112.18.1/CSA B-125.1, and all applicable requirements referenced therein

- ADA  for lever handles

WARRANTY

- Lifetime limited warranty against leaks, drips and finish defects to the original homeowner
 - 10 year limited warranty when used in a multi-family installation
 - 5 year limited warranty when used in a commercial installation
- Visit www.moen.com/support for complete details and limitations

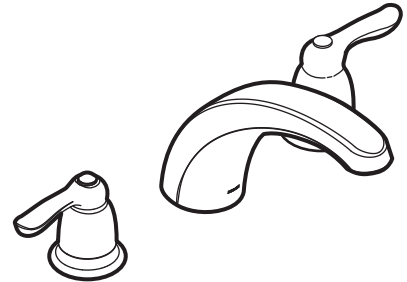

CHATEAU® Two-Handle Garden Tub Trim

Models: T994 series

Valves: 4792, 4793, 4794, 4796, 4797, 4798

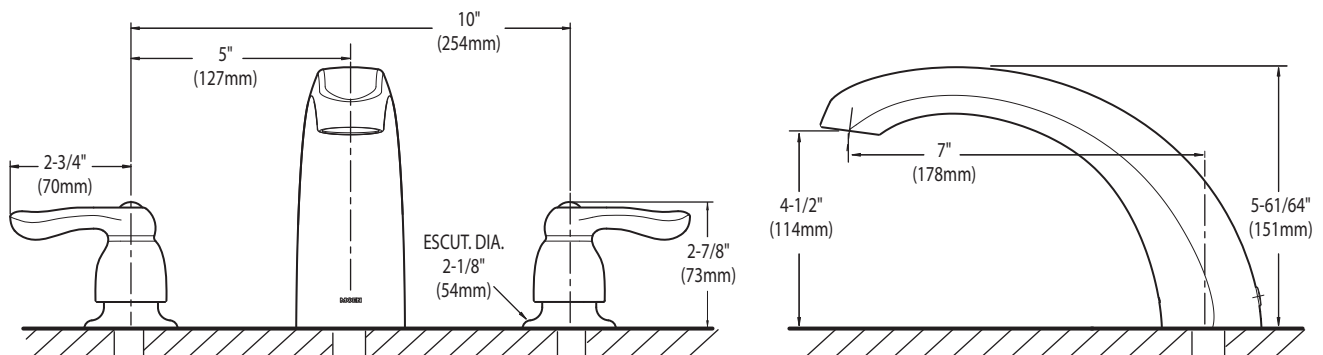

CRITICAL DIMENSIONS

(DO NOT SCALE)

SC(B)519 | ALITO Collection



Wall Mount

Strong and sturdy with attractive lines and an imposing frame, the SC(B)519 is fitted with a time-delay OFF feature up to nine minutes, a 550 CFM fan, two bright front mounted LED lights and a digital three-speed push button control panel.

Green Features



3 Speed Push Button Control Panel



Long-Lasting LED Lights



Time-Delay OFF Feature



Grease Cup



Model	Colour	Ducting	Filters	Size	CFM
-------	--------	---------	---------	------	-----

SCB51930	Stainless Steel	6"	Baffle	30"	550
----------	-----------------	----	--------	-----	-----

Cyclone Range Hoods Inc.

1361 Huntingwood Drive, Unit 16. Toronto, ON. M1S 3J1. Canada.

Toll Free: 1-888-293-5662 Tel: (416) 293-0933 Fax: (416) 293-4793 Website: www.CycloneRangeHoods.com

SC(B)519 | ALITO Collection



Features

- Wall mount range hood
- 6" round duct adapter
- Non-stick aluminum fan blades
- 3 speed push button control
- 2 LED lights (2 x 1.4W, 4000K)
- Quick release aluminum mesh filters
- Standard chimney fits up to 9 ft. ceiling
- Up to 9 minutes time-delay OFF feature
- Plug-in connection

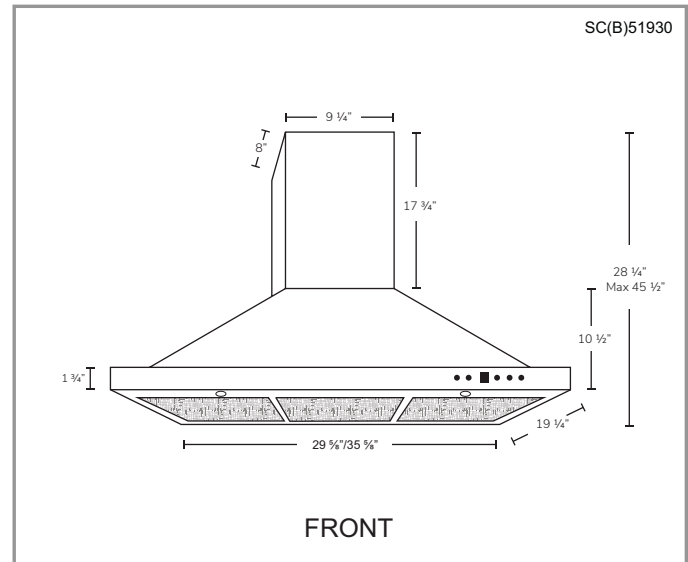

Options

- Filters:

SCB519 - Quick Release Stainless Steel Baffle Filters

- Chimney Flues:
 - A1.CH10 - short (7'-8' ceilings)
 - A1.CH18 - standard (8'-9' ceilings)
 - A1.CH30 - extended (9'-11' ceilings)
- Widths: 24", 30", 36"

Specifications

- Air Flow Volume: 550 CFM
- Electrical Connection: 120 V/60 Hz
- Power Consumption: 300 Watts

- Current: 2.5 Amps
- Fan Speed: 1599 RPM
- Fan Type: Centrifugal Blower

- Finishes: Stainless Steel
- Ducting: 6" Round
- Noise Level: Min. 2 Sones
Max. 6 Sones

