

Sales Selection Sheet
Checklist

1 of 43

LOT 695-3 Model: 20-1841 A ARLINGTON

PURCHASERS: DOOHAN, D POWELL/

VENDOR: Heathwood Homes (Whitby) Limited

- ☐ WOB
- ☐ DECK
- ☐ FINISHED BASEMENT
- ☐ COLD CELLAR

UPGRADED / MODIFIED ELEVATION

- ☐ CORNER UPGRADE
- ☒ REAR UPGRADE
- ☐ SIDE UPGRADE

CEILING UPGRADE - SMOOTH

- ☐ MAIN FLOOR
- ☐ SECOND FLOOR
- ☐ BASEMENT
- ☐ LOWER LEVEL

ADDITIONAL ROUGH-INS

- ☒ 200 AMP SERVICE (STD 200AMP TOWNS)
- ☐ WET BAR ROUGH-IN
- ☐ HUMIDIFIER
- ☒ AIR CONDITIONING (SITE STD)

GAS ROUGH-IN

- ☐ STOVE
- ☐ DRYER
- ☐ BBQ
- ☐ ADDITIONAL FIREPLACE

KITCHEN: HOODFAN VENTING SIZE

- ☒ 6 IN ROUND DUCT
- ☐ 7 IN ROUND DUCT (STD FOR TOWNS)

FULL BASEMENT STAIRS:	Paint Grade
UPPER BASEMENT STAIRS:	N/A
LOWER LEVEL STAIRS:	All Oak
LOWER BASEMENT STAIRS:	N/A
MAIN STAIRS:	All Oak
MEDIA STAIRS (if applicable):	N/A
LOFT STAIRS (if applicable):	N/A

Sept 20/22
Date

Purchaser:

Signature
on file

Sept 20/22
Date

Decor Consultant:

IRIT SALEM

Date

Purchaser:

-09- 20 2022

Date



Heathwood Homes (Whitby) Limited

mKozens

DOOHAN, D POWELL/
Project: Country Lane
Unit: 695-3, Phase: 6
Model: 20-1841 A ARLINGTON

Created: 7/25/2012 08:26:46
Locked:
Closed:

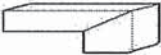
Kitchen

Cabinet Colour/Style	9111	Viking III-SIMCOE ORCHID 3DL ***STD***	
Island Cabinet Colour/Style	9111	Viking III-SIMCOE ORCHID 3DL ***STD***	
Cabinet Hardware	9148	12817 SB GOLD-HARDWARE ***2***	
Countertop	9121	MSI Quartz GROUP 1 ICED WHITE 3/4 inch with double mitre edge ***1***	
Island Countertop	9121	MSI Quartz GROUP 1 ICED WHITE 3/4 inch with double mitre edge ***1***	
Countertop Edge	4005	DOUBLE MITRE 1 1/2 INCH ***UPG***	
Sink	9487	Plumbing-KINDRED Kitchen Sink Collection - Reginox ND1831 U/9-Double (equal size) Bowl Undermount Sink (or equivalent)-Stainless Steel	PG 19
Crumb Vac Color	9482	Vacuum-Crumb Vac (Dust Pan)-White	
HoodFan	9904	YWMH31017HZ-Whirlpool Over-The-Range Microwave Hood Combination-SS-30 inch	PG 27-29
Opt. Backsplash	9473	KD.OC.SMK.2,5 X 10-Oceani Series-Smoke Glossy-2,5 x 10 UPG 3 ***UPG***	
Opt. Backsplash Grout	7704	Grout-(19) Pearl Gray ***STD***	
Opt. Backsplash Tile Pattern	3100	HERRINGBONE ***UPG***	
Flooring	9358	Red Oak Pearl-Vintage Engineered-TITANIUM-3/4 inch x 3 1/4 inch ***UPG***	
Floor Tile Grout	1111	N/A *****	
Floor Tile Pattern	1111	N/A *****	

- Purchasers have been advised: standard fridge opening is a minimum 37 3/8 x 73 3/8 inches. Ice Waterline Rough-In is included.
- Standard stove opening is 30 inches and standard dishwasher opening is 24 inches. Any gas stove will require backsplash or stainless steel backing to avoid fire hazards.
- Purchasers acknowledge: Heathwood Homes and its contractors will not be responsible for any kitchen cabinet changes due to appliances dimension changes after sign-off.

Comment

Foyer

Flooring	9115	OV.ET.MGR.1224.PL Eterna Series Medium Grey 12x24 Polished See Tile Direction	S 3
Floor Tile Grout	2220	Grout-(11) Sahara Beige ***UPG***	
Floor Tile Pattern	3050	SIDE TO SIDE ***STD***	

Customer Colours

DOOHAN, D POWELL/
Project: Country Lane
Unit: 695-3, Phase: 6
Model: 20-1841 A ARLINGTON

Locked:
Closed:

Comment

Powder Room

Flooring	8075	NY.RG.JBK.1224.PL-Regal Polished-Jet Black-12 x 24 See 53 Tile Direction on Sketch 3 Page ***4***
Floor Tile Grout	7704	Grout-(19) Pearl Gray ***STD***
Floor Tile Pattern	3050	SIDE TO SIDE ***STD***

Plumbing Fixture (Colour)	1737	Plumbing Fixtures-WHITE ***STD***
Comment		

Dining Room

Flooring	9358	Red Oak Pearl-Vintage Engineered-TITANIUM-3/4 inch x 3 1/4 inch ***STD***
Comment		

Great Room

Flooring	9358	Red Oak Pearl-Vintage Engineered-TITANIUM-3/4 inch x 3 1/4 inch ***STD***
Comment		

Great Room Fireplace

Type	8865	Dimplex-Electric Fireplace-PF3033HL ***STD***
Mantle	1439	NF 17-Paint Grade Mantle-Flat Wall-WHITE ***STD*** CABINET
Opt. Surround	1111	N/A *****

- Purchasers have been advised: heat from the FP can damage TV above a FP and items placed on mantle.

- Heathwood and its contractors will not be liable for any damage on items placed/@installed above a FP after closing.

Comment

Upper Hall

Flooring	9358	Red Oak Pearl-Vintage Engineered-TITANIUM-3/4 inch x 3 1/4 inch ***STD***
Comment		

Customer Colours

DOOHAN, D POWELL/
Project: Country Lane
Unit: 695-3, Phase: 6
Model: 20-1841 A ARLINGTON

Locked:
Closed:

Master Bedroom

Flooring	9245	DY 87354-Dynasty Tex-OVERCAST-40 oz Poly***STD***
Comment		

Bedroom 2

Flooring	9245	DY 87354-Dynasty Tex-OVERCAST-40 oz Poly***STD***
Comment		

Bedroom 3

Flooring	9245	DY 87354-Dynasty Tex-OVERCAST-40 oz Poly***STD***
Comment		

Master Ensuite

Cabinet Colour/Style	9158	Viking III-SIMCOE-NAVY BLUE-3DL ?***STD***								
Cabinet Hardware	7672	135-HARDWARE ***STD***								
Countertop	8796	6698-46-Countertop-PALOMA POLAR ETCHINGS FINISH-Formica ***STD***								
Countertop Edge	1111	N/A *****								
Floor Tile	8838	OV.ET.WHT.1224.PL-Eterna-Carrara White Polished-12 x 24 See Tile Direction on Sketch 4 Page ***5***								
Floor Tile Grout	2225	Grout-(27) Silver ***STD***								
Floor Tile Pattern	3040	FRONT TO BACK ***STD*** <table><tr><td></td><td></td><td></td><td></td></tr><tr><td></td><td></td><td></td><td></td></tr></table>								
Shower Wall Tile	9020	QT.WV.WHT.0810-Weave-White-8 x 10 ***STD***								
Shower Wall Tile Grout	2226	Grout-(00) White ***STD***								
Shower Wall Tile Pattern	3070	HORIZONTAL STACKED ***STD*** <table><tr><td></td><td></td></tr><tr><td></td><td></td></tr><tr><td></td><td></td></tr><tr><td></td><td></td></tr></table>								
Shower Floor Tile	8661	OD.ON.SWT.0202.MT.N-Ontario Series Mosaic-Snow White Matte-2 x 2 ***STD***								

Handwritten signature

Customer Colours

DOOHAN, D POWELL/
Project: Country Lane
Unit: 695-3, Phase: 6
Model: 20-1841 A ARLINGTON

Locked:
Closed:

White Mastic 2 x 2 STD											
Shower Floor Tile Grout	2226	Grout-(00) White ***STD***									
Shower Floor Tile Pattern	3000	STANDARD SQUARE ***STD***									
<table><tr><td></td><td></td><td></td></tr><tr><td></td><td></td><td></td></tr><tr><td></td><td></td><td></td></tr></table>											
Shower Jamb(s) and Sill(s)	8923	Shower Jamb / Sill-Thassos White ***STD***									
Plumbing Fixture (colour)	1737	Plumbing Fixtures-WHITE ***STD***									
Comment											

Main Bathroom

Cabinet Colour/Style	9157	Viking III-SIMCOE-MOONLIGHT-3DL ?***STD***								
Cabinet Hardware	7672	135-HARDWARE ***STD***								
Countertop	8796	6698-46-Countertop-PALOMA POLAR ETCHINGS FINISH-Formica ***STD***								
Countertop Edge	1111	N/A *****								
Floor Tile	8913	UN.BL.BIA.1224-Biel-Bianco (White)-12 x 24 See Tile Direction on Sketch 4 Page ***2***								
Floor Tile Grout	2225	Grout-(27) Silver ***STD***								
Floor Tile Pattern	3050	SIDE TO SIDE ***STD***								
<table><tr><td></td><td></td></tr><tr><td></td><td></td></tr><tr><td></td><td></td></tr><tr><td></td><td></td></tr></table>										
Wall Tile	9022	QT.WV.TGR.0810-Weave-Tender Grey-8 x 10 ***STD***								
Wall Tile Grout	2226	Grout-(00) White ***STD***								
Wall Tile Pattern	3070	HORIZONTAL STACKED ***STD***								
<table><tr><td></td><td></td></tr><tr><td></td><td></td></tr><tr><td></td><td></td></tr><tr><td></td><td></td></tr></table>										
Opt. Shower Floor Tile	1111	N/A *****								
Opt. Shower Floor Tile Grout	1111	N/A *****								
Opt. Shower Floor Tile Pattern	1111	N/A *****								
Opt. Shower Jamb(s) and Sill(s)	1111	N/A *****								
Plumbing Fixture (colour)	1737	Plumbing Fixtures-WHITE ***STD***								
Comment										

MP

Customer Colours

DOOHAN, D POWELL/
Project: Country Lane
Unit: 695-3, Phase: 6
Model: 20-1841 A ARLINGTON

Locked:
Closed:

Lower Level Family Room

Flooring	9245	DY 87354-Dynasty Tex-OVERCAST-40 oz Poly***STD***
Comment		

Lower Level Laundry Mud Room

Flooring	9245	TR.SP.WHITE.1313 SEMPRE White Matte 13									
Floor Tile Grout	2225	Grout-(27) Silver ***STD***									
Floor Tile Pattern	3000	STANDARD SQUARE ***STD***									
		<table><tr><td></td><td></td><td></td></tr><tr><td></td><td></td><td></td></tr><tr><td></td><td></td><td></td></tr></table>									
Opt. Cabinet Colour/Style - Uppers	1111	N/A *****									
Opt. Cabinet Hardware - Uppers	1111	N/A *****									
Opt. Cabinet Colour/Style - Base	1111	N/A *****									
Opt. Cabinet Hardware - Base	1111	N/A *****									
Opt. Countertop	1111	N/A *****									
Opt. Countertop Edge	1111	N/A *****									

- Optional Bedroom 4 Layout Laundry Rough in Relocated to Unfinished Basement (No Opt. Cabinet)

Comment	
---------	--

Opt. Lower Level Bedroom 4

Flooring	1111	N/A *****
Comment		

Opt. Lower Level Bedroom 4 Hallway

Flooring	1111	N/A *****
Comment		

Opt. Lower Level Bedroom 4 Mud Room

Flooring	1111	N/A *****
Floor Tile Grout	1111	N/A *****

Handwritten signature

Customer Colours

DOOHAN, D POWELL/
Project: Country Lane
Unit: 695-3, Phase: 6
Model: 20-1841 A ARLINGTON

Created: 12/25/2022 08:26:46

Locked:

Closed:

Floor Tile Grout	1111	N/A
Floor Tile Pattern	1111	N/A *****

Comment

Opt. Lower Level Bedroom 4 Bathroom

Cabinet Colour/Style	1111	N/A *****
Cabinet Hardware	1111	N/A *****
Countertop	1111	N/A *****
Countertop Edge	1111	N/A *****
Floor Tile	1111	N/A *****
Floor Tile Grout	1111	N/A *****
Floor Tile Pattern	1111	N/A *****

Wall Tile	1111	N/A *****
Wall Tile Grout	1111	N/A *****
Wall Tile Pattern	1111	N/A *****

Opt. Shower Floor Tile	1111	N/A *****
Opt. Shower Floor Tile Grout	1111	N/A *****
Opt. Shower Floor Tile Pattern	1111	N/A *****

Opt. Shower Jamb(s) and Sill(s)	1111	N/A *****
Plumbing Fixture (colour)	1111	N/A *****
Comment		

Lower Level and Main Stairs

Type	1712	Oak Stairs ?***STD***
Colour	7040	San Juan STAIN TO COMPLEMENT HARDWOOD AND



Customer Colours

DOOHAN, D POWELL/
Project: Country Lane
Unit: 695-3, Phase: 6
Model: 20-1841 A ARLINGTON

Locked:
Closed:

Colour	7940	Sambucca STAIN TO COMPLIMENT HARDWOOD AND WILL VARY FROM FLOORING ***99***
Handrail/Pickets/Posts Type	8148	Single Collar Alt. Plain w/ Shoes with 3 1/2" Square/Cap Post(s)-BLACK ***2***
Handrail/Pickets/Posts Colour	7940	Sambucca STAIN TO COMPLIMENT HARDWOOD AND WILL VARY FROM FLOORING ***99***
Custom Stain/Paint	1111	N/A *****
Landing(s)	9059	Red Oak-Vintage 3 1/4 inch Pre-Sanded Smooth Unfinished Red Oak-Unfinished-3/4 inch x 3 1/4inch
Opt. Carpet Runner	1111	N/A *****
Comment		

Basement Stairs

Type	1713	Paint Grade Stairs ***STD BASEMENT STAIR ***
Comment		

Throughout

Switches and Plug	5796	Decora White Switches and Plugs ***STD***
Thresholds	2232	Metal Thresholds ***STD***
Underpad	1079	500 Series-Underpad ***STD***
Trim Size	8705	4 1/4 Baseboard and 2 3/4 Casings ***STD***
Trim - Paint Colour	1716	Trim-WHITE ***STD***
Walls - Paint Colour	1717	22-Wall-WARM GREY ***STD***
Comment		

Purchaser:  3/4 26 2022 Date Decor Consultant  July 26. 22 Date
DOOHAN, D POWELL

Purchaser: _____ Date  Country Lane  -09- 2 n 2022 Date Approved





CONSTRUCTION SUMMARY

Lot: 695-3
Model: 20-1841 A ARLINGTON
Project/Phase: Country Lane / 6

Offer Worksheet	Five Appliances: SS Fridge, Stove, Dishwasher: White Front Loader Washer/Dryer ? Townhomes Note:
Offer Worksheet	The Purchaser(s) have been referred by Lot 50-3 and will receive \$500 towards D?cor Upgrades (No Cash Value) and The Heathwood Homeowner that has referred the purchaser(s) in this agreement noted here will receive 30 days after the closing date a cheque Note:
Offer Worksheet	Five Thousand Dollars (\$5,000) at D?cor. (No Cash Value) - Townhomes Note:
Offer Worksheet	Two Men and a Truck Credit of One Thousand Dollars (\$1000.00) for moving services only, Into your Heathwood Home (No Cash Value) The Credit is Non-Transferable and cannot be combined with any other offer. Note:



CONSTRUCTION SUMMARY

Lot: 695-3
Model: 20-1841 A ARLINGTON
Project/Phase: Country Lane / 6

ADMIN FEE

Invoice	Qty.	Description
---------	------	-------------

ADMIN FEE - REFERRAL

Invoice	Qty.	Description
---------	------	-------------

APPLIANCES

Invoice	Qty.	Description
---------	------	-------------

1132 335,505 20Sep22	1	- APPLIANCES - WHIRLPOOL OTR SS - YWMH31017HZ CABINETRY-Notify; ELECTRICAL-delete std range hood; HEATING/AIR CONDITIONING-Duct Size change
----------------------------	---	---

CABINETRY

Invoice	Qty.	Description
---------	------	-------------

1132 335,975 20Sep22	1	KITCHEN - CABINETRY-H04-66cm deep fridge enclosure (counter depth) with (1) wall ([1] 66cm deep gable and [1] 66cm deep cabinet) (this is not a zero clearance enclosure) (standard heights and widths will be used) VIKING SKETCH # 3 DRYWAL-Notify; FRAMING-Modify Bulkhead; PAINTING-Notify
1132 335,943 20Sep22	1	KITCHEN - CABINETRY-C04-Pantry 66cm deep in lieu of upper/base per foot (counter depth) VIKING SKETCH # 3 DRYWAL-Notify; FRAMING-Modify Bulkhead (66cm deep); PAINTING-Notify
1132 335,964 20Sep22	1	- CABINETRY-G01-Upgrade hardware for kitchen in a CONDO, TOWNHOUSE & SEMI-DETACHED model (stacked upper hardware is an additional charge see line G04 if applicable) VIKING
1132 335,505 20Sep22 **	1	- APPLIANCES - WHIRLPOOL OTR SS - YWMH31017HZ CABINETRY-Notify; ELECTRICAL-delete std range hood; HEATING/AIR CONDITIONING-Duct Size change
1132 336,090 20Sep22 **	1	Kitchen - Hardwood - 3-1/4 in Vintage NSS Red Oak - Kitchen - UPG CABINETRY-Raise Cabinet; CERAMICS-Delete Std Ceramics
1132 335,871 20Sep22 **	1	MASTER ENSUITE - PLUMBING - OPTION FROM ONE SINK TO DOUBLE SINKS INCLUDING ONE ADDITIONAL STD CHATEAU FAUCET OVERMOUNT COLONY SINK ONE EXTRA VANITY LIGHT AND CABINET CONVERSION 2D VIKING SKETCH # 4 CABINETRY-2D Convert Cabinetry Viking; ELECTRICAL-Additional Vanity Light



CONSTRUCTION SUMMARY

Lot: 695-3
Model: 20-1841 A ARLINGTON
Project/Phase: Country Lane / 6

CERAMICS

Invoice	Qty.	Description
1132 339,139 20Sep22	1	Kitchen Optional Backsplash - Ceramics - Install in Specified Pattern - Kitchen Optional Backsplash - UPG
1132 336,090 20Sep22 **	1	Kitchen - Hardwood - 3-1/4 in Vintage NSS Red Oak - Kitchen - UPG CABINETRY-Raise Cabinet; CERAMICS-Delete Std Ceramics
1132 339,099 20Sep22	1	Foyer Floor - Ceramics - Upgrade 5 Tile - Foyer Floor - UPG
1132 339,057 20Sep22	1	Main Bath Floor - Ceramics - Upgrade 2 Tile - Main Bath Floor - UPG
1132 339,075 20Sep22	1	Powder Room Floor - Ceramics - Upgrade 4 Tile - Powder Room Floor - UPG
1132 339,094 20Sep22	1	Master Ensuite Floor - Ceramics - Upgrade 5 Tile - Master Ensuite Floor - UPG
1132 339,138 20Sep22	1	Foyer Floor - Ceramics - Upgrade Grout - Foyer Floor - UPG
1132 339,061 20Sep22	1	Kitchen Optional Backsplash - Ceramics - Upgrade 3 Tile - Kitchen Optional Backsplash - UPG

DRYWALL

Invoice	Qty.	Description
1132 335,975 20Sep22 **	1	KITCHEN - CABINETRY-H04-66cm deep fridge enclosure (counter depth) with (1) wall ([1] 66cm deep gable and [1] 66cm deep cabinet) (this is not a zero clearance enclosure) (standard heights and widths will be used) VIKING SKETCH # 3 DRYWAL-Notify; FRAMING-Modify Bulkhead; PAINTING-Notify
1132 335,943 20Sep22 **	1	KITCHEN - CABINETRY-C04-Pantry 66cm deep in lieu of upper/base per foot (counter depth) VIKING SKETCH # 3 DRYWAL-Notify; FRAMING-Modify Bulkhead (66cm deep); PAINTING-Notify



CONSTRUCTION SUMMARY

Lot: 695-3
Model: 20-1841 A ARLINGTON
Project/Phase: Country Lane / 6

ELECTRICAL

Invoice	Qty.	Description
1132 335,505 20Sep22 **	1	- APPLIANCES - WHIRLPOOL OTR SS - YWMH31017HZ CABINETRY-Notify; ELECTRICAL-delete std range hood; HEATING/AIR CONDITIONING-Duct Size change t
1132 335,570 20Sep22	2	THROUGHOUT - ELECTRICAL - CEILING ROUGH-IN (CAPPED) 1X ABOVE THE BREAKFAST BAR- USE SEPARATE SWITCH 1X IN THE CENTER OF THE GREAT ROOM-USE EXISTING SWITCH PLUG SEE SKETCH # 3
1132 335,569 20Sep22	1	KITCHEN - ELECTRICAL - ADDITIONAL SWITCH TO BE USED FOR THE R/I CAP LIGHT ABOVE THE BREAKFAST BAR SEE SKETCH # 3
1132 335,578 20Sep22	1	GREAT ROOM - ELECTRICAL - EXTRA WALL INTERIOR OUTLET ON EXISTING CIRCUIT (DOES NOT INCLUDE KITCHEN OUTLETS) TO BE INSTALL ABOVE THE CENTRE OF THE FIRE PLACE 70" +/- FROM FLOOR SEE SKSETCH # 3
1132 335,871 20Sep22 **	1	MASTER ENSUITE - PLUMBING - OPTION FROM ONE SINK TO DOUBLE SINKS INCLUDING ONE ADDITIONAL STD CHATEAU FAUCET OVERMOUNT COLONY SINK ONE EXTRA VANITY LIGHT AND CABINET CONVERSION 2D VIKING SKETCH # 4 CABINETRY-2D Convert Cabinetry Viking; ELECTRICAL-Additional Vanity Light

FRAMING

Invoice	Qty.	Description
1132 335,975 20Sep22 **	1	KITCHEN - CABINETRY-H04-66cm deep fridge enclosure (counter depth) with (1) wall ([1] 66cm deep gable and [1] 66cm deep cabinet) (this is not a zero clearance enclosure) (standard heights and widths will be used) VIKING SKETCH # 3 DRYWAL-Notify; FRAMING-Modify Bulkhead; PAINTING-Notify
1132 335,943 20Sep22 **	1	KITCHEN - CABINETRY-C04-Pantry 66cm deep in lieu of upper/base per foot (counter depth) VIKING SKETCH # 3 DRYWAL-Notify; FRAMING-Modify Bulkhead (66cm deep); PAINTING-Notify

GLASS PRODUCTS / MIRRORS

Invoice	Qty.	Description
1132 338,681 20Sep22	1	Master Ensuite - GLASS PRODUCTS / MIRRORS - Upgrade to Frameless clear glass with D-Ring Handle in chrome - Master Ensuite - UPG

GRANITE

Invoice	Qty.	Description
1132 337,876 20Sep22	1	Kitchen - Granite - Countertop - 3/4” GROUP 1 with double edge - Kitchen - UPG



CONSTRUCTION SUMMARY

Lot: 695-3
Model: 20-1841 A ARLINGTON
Project/Phase: Country Lane / 6

HARDWOOD

Invoice	Qty.	Description
1132 335,692 20Sep22 **	1	- PAINT - STAIN STAIR LANDING IN SAMBUCCA. LANDING UNDER 25 SQ.FT. EACH HARDWOOD-Supply and Install smooth UNFINISHED pre-sanded red oak at stair landing(s)
1132 336,090 20Sep22	1	Kitchen - Hardwood - 3-1/4 in Vintage NSS Red Oak - Kitchen - UPG CABINETRY-Raise Cabinet; CERAMICS-Delete Std Ceramics
1132 335,691 20Sep22 **	1	- PAINT - STAIN STAIR LANDING IN SAMBUCCA. LANDING OVER 25 SQ.FT. EACH HARDWOOD-Supply and Install smooth UNFINISHED pre-sanded red oak at stair landing(s)

HEATING / AIR CONDITIONING

Invoice	Qty.	Description
1132 335,505 20Sep22 **	1	- APPLIANCES - WHIRLPOOL OTR SS - YWMH31017HZ CABINETRY-Notify; ELECTRICAL-delete std range hood; HEATING/AIR CONDITIONING-Duct Size change 1

MODIFIED ELEVATION

Invoice	Qty.	Description
1492 09Jun23 NoCat	1	- REAR UPGRADE

PAINTING

Invoice	Qty.	Description
1132 335,975 20Sep22 **	1	KITCHEN - CABINETRY-H04-66cm deep fridge enclosure (counter depth) with (1) wall ([1] 66cm deep gable and [1] 66cm deep cabinet) (this is not a zero clearance enclosure) (standard heights and widths will be used) VIKING SKETCH # 3 DRYWAL-Notify; FRAMING-Modify Bulkhead; PAINTING-Notify
1132 335,943 20Sep22 **	1	KITCHEN - CABINETRY-C04-Pantry 66cm deep in lieu of upper/base per foot (counter depth) VIKING SKETCH # 3 DRYWAL-Notify; FRAMING-Modify Bulkhead (66cm deep); PAINTING-Notify
1132 335,692 20Sep22	1	- PAINT - STAIN STAIR LANDING IN SAMBUCCA. LANDING UNDER 25 SQ.FT. EACH HARDWOOD-Supply and Install smooth UNFINISHED pre-sanded red oak at stair landing(s)
1132 335,691 20Sep22	1	- PAINT - STAIN STAIR LANDING IN SAMBUCCA. LANDING OVER 25 SQ.FT. EACH HARDWOOD-Supply and Install smooth UNFINISHED pre-sanded red oak at stair landing(s)

PLUMBING

Invoice	Qty.	Description
1132 335,871 20Sep22	1	MASTER ENSUITE - PLUMBING - OPTION FROM ONE SINK TO DOUBLE SINKS INCLUDING ONE ADDITIONAL STD CHATEAU FAUCET OVERMOUNT COLONY SINK ONE EXTRA VANITY LIGHT AND CABINET CONVERSION 2D VIKING SKETCH # 4 CABINETRY-2D Convert Cabinetry Viking; ELECTRICAL-Additional Vanity Light

The Arlington

ELEVATION A & B: 1,841 SQ. FT.

THE TRAILS OF
COUNTRY LANE

Sketch #1

20-1841 ELEV. A

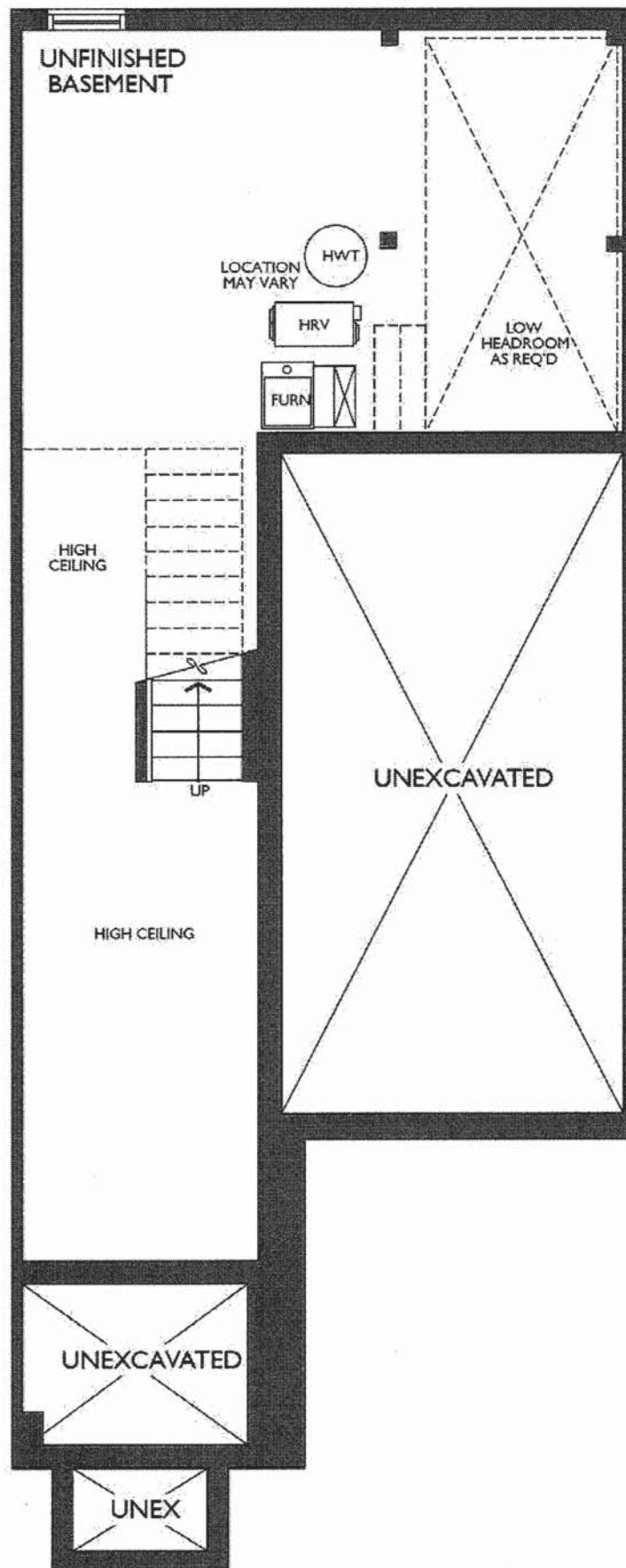

BASEMENT
ELEVATION A & B

RP

15 of 43

THE TRAILS OF COUNTRY LANE

20-1841 ELEV. A



The Arlington

ELEVATION A & B: 1,841 SQ. FT.
THE TRAILS OF
COUNTRY LANE

Sketch #3

20-1841 ELEV. A

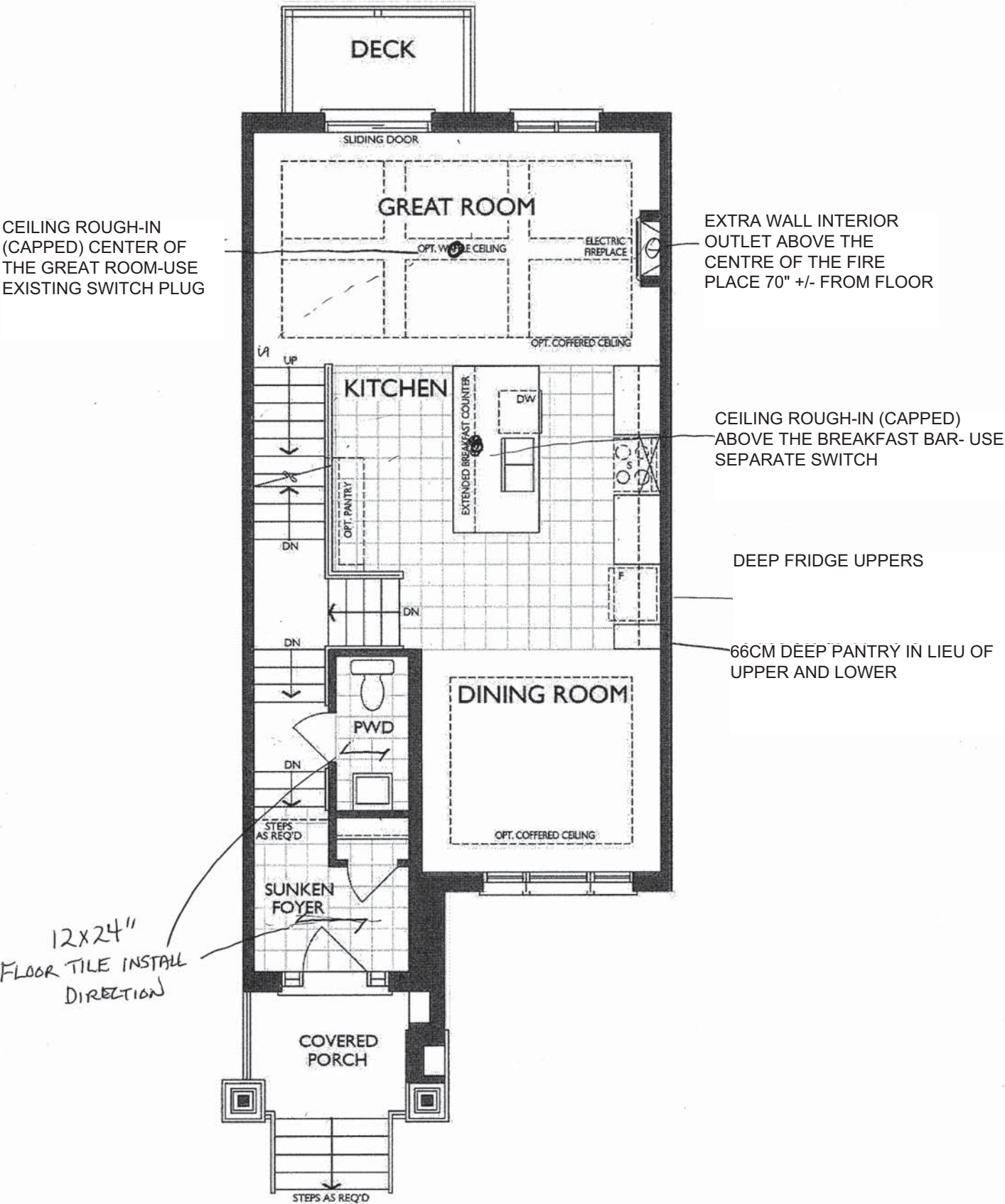

MAIN LEVEL
ELEVATION A

The Arlington

Sketch #4 ELEVATION A & B: 1,841 SQ. FT.

20-1841 ELEV. A

THE TRAILS OF
COUNTRY LANE

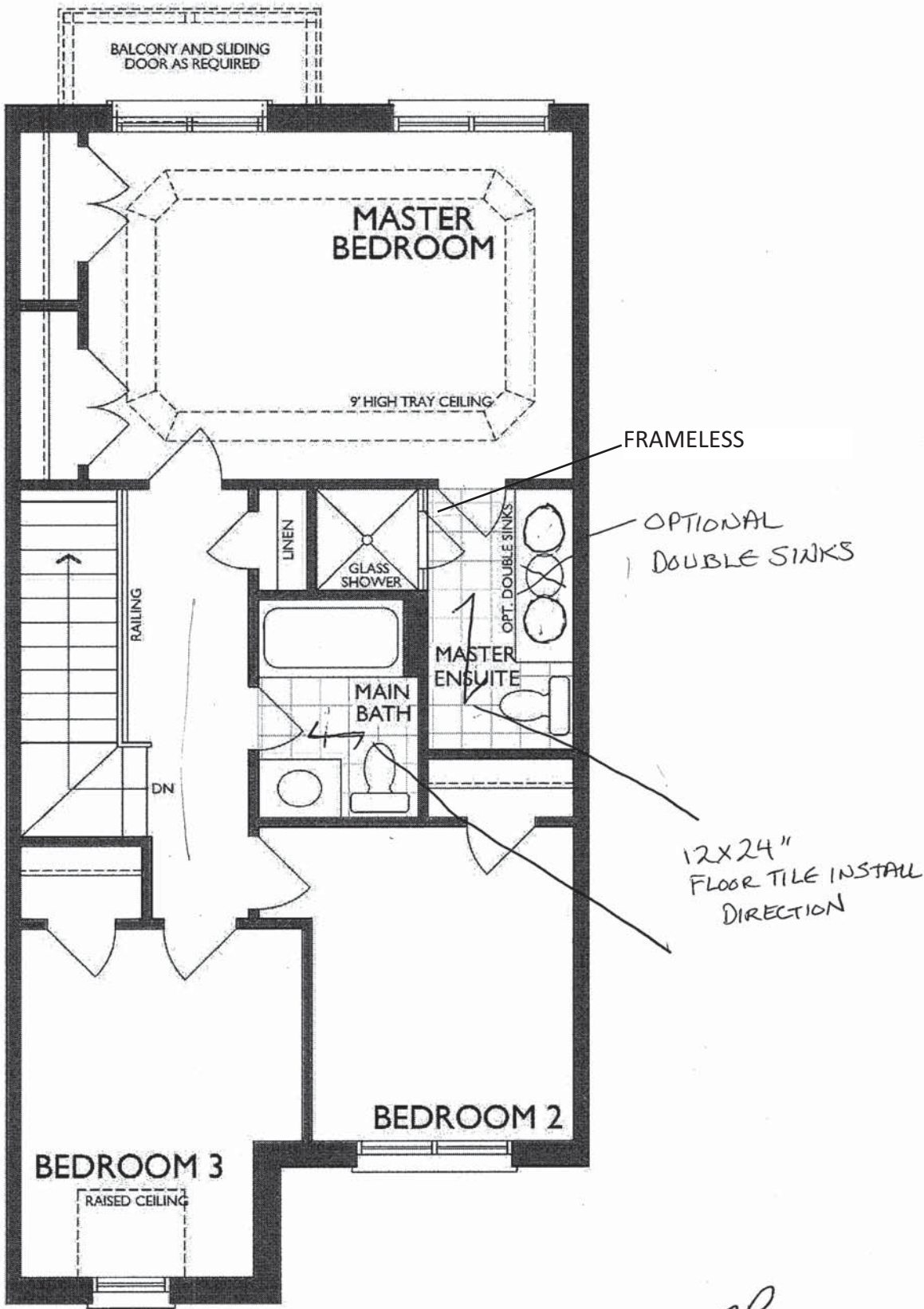

UPPER LEVEL
ELEVATION A

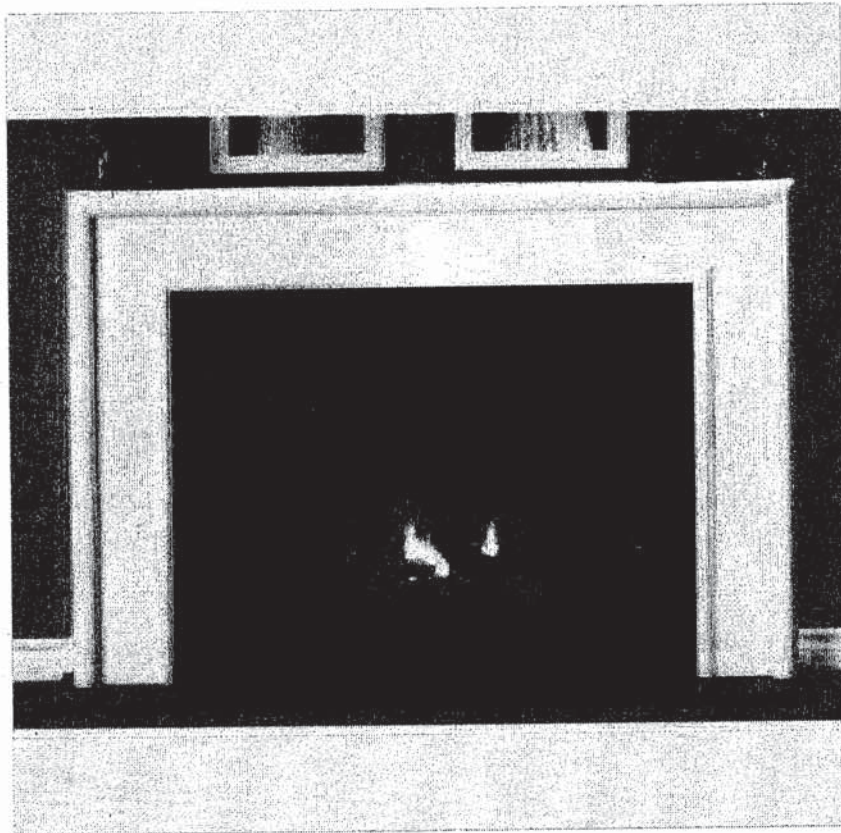

NFAS NF17 Mantel - Cabinet

SP

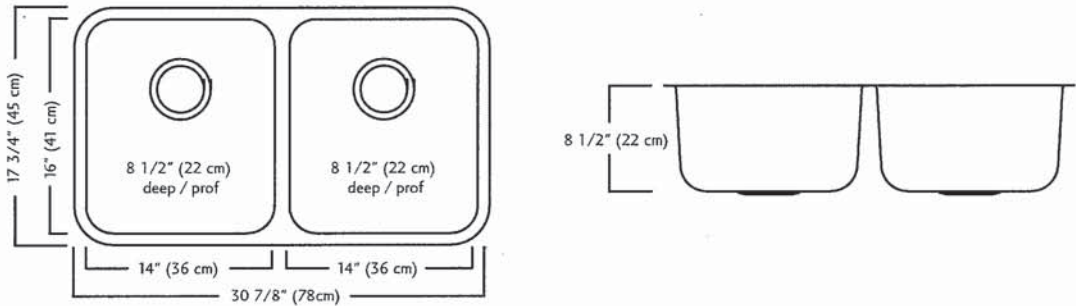
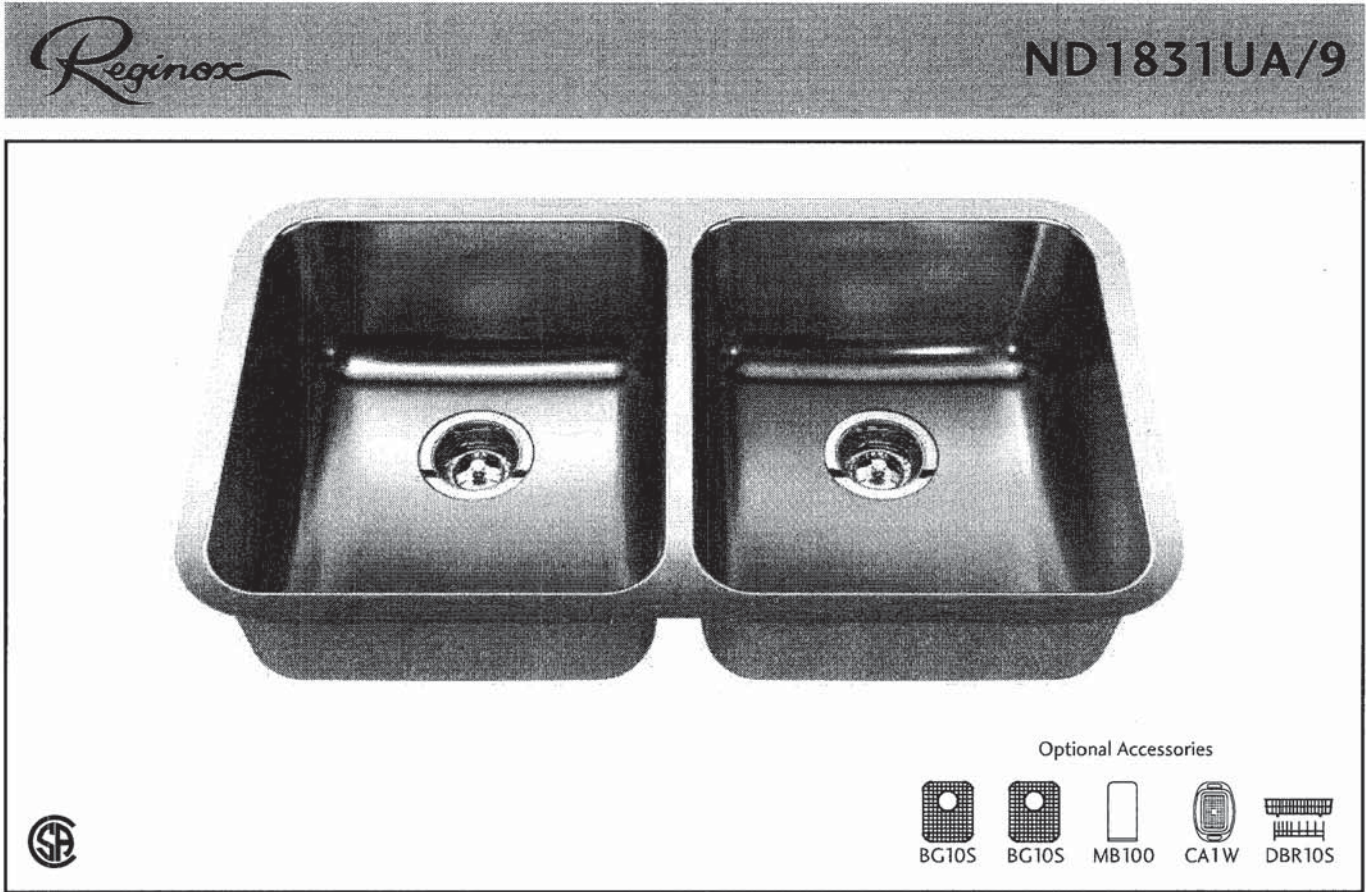

ND1831UA/9 SPECIFICATION

Model ND1831UA/9 is a double (two equal size) bowl undermount sink manufactured by Franke Kindred Canada Limited from 18 gauge stainless steel. Product has silk finished rims and linear brush finished bowls. Sink is fully undercoated. Basket strainer waste fittings (3 1/2", 89 mm) are included. Sink is backed with a limited lifetime warranty.

- O.D. 17 3/4" x 30 7/8" x 8 1/2" (45 x 78 x 22 cm)
- Recommended for minimum 36" cabinet

Franke Kindred Canada Limited
P.O. Box 190, 1000 Franke Kindred Road, Midland, Ontario, Canada, L4R 4K9 Phone: 866-687-7465 Fax: 800-361-8408

MOEN®

Specifications

FAUCET DESCRIPTION

- Reflex™ pulldown system offers smooth operation, easy movement and secure docking
- Power Clean™ spray technology
- Metal construction with various finishes identified by suffix
- Quick connect installation
- Pulldown spray with 68" braided hose
- Flexible supply lines with 3/8" compression fittings
- High arc spout provides height and reach to fill or clean large pots while pulldown wand provides the maneuverability for cleaning or rinsing
- 360° rotating spout
- Faucet designed for handle to be mounted on right side only

OPERATION

- Lever style handle
- Temperature controlled by 100° arc of handle travel
- Operates with less than 5 lbs. of force
- Operates in stream or spray mode in the pullout or retracted position

FLOW

- Flow is limited to 1.5 gpm (5.7 L/min) max at 60 psi

CARTRIDGE

- 1255™ Duralast™ cartridge

STANDARDS

- Third party certified to IAPMO Green, ASME A112.18.1/CSA B125.1 and all applicable requirements therein including NSF 61/9G & 372
- Meets CalGreen and Georgia SB370 requirements
- Complies with California Proposition 65 and with the Federal Safe Drinking Water Act
- The backflow protection system in the device consists of two independently operating check valves, a primary and a secondary which prevent backflow

- ADA  for lever handle

WARRANTY

- Lifetime limited warranty against leaks, drips and finish defects to the original homeowner
 - 10 year limited warranty when used in a multifamily installation
 - 5 year limited warranty when used in a commercial installation
- Visit www.moen.com/support for complete details and limitations

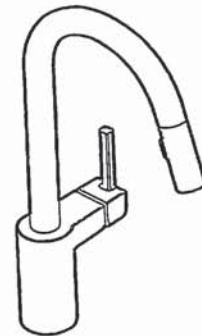

ALIGN™
Single Handle High Arc
Pulldown Kitchen Faucet

Models: 7565 series

NOTE: THIS FAUCET IS DESIGNED TO BE INSTALLED
THROUGH 1 HOLE, 1-1/2" (38mm) MIN. DIA.
(OPTIONAL 3-HOLE ESCUTCHEON 141002 AVAILABLE)

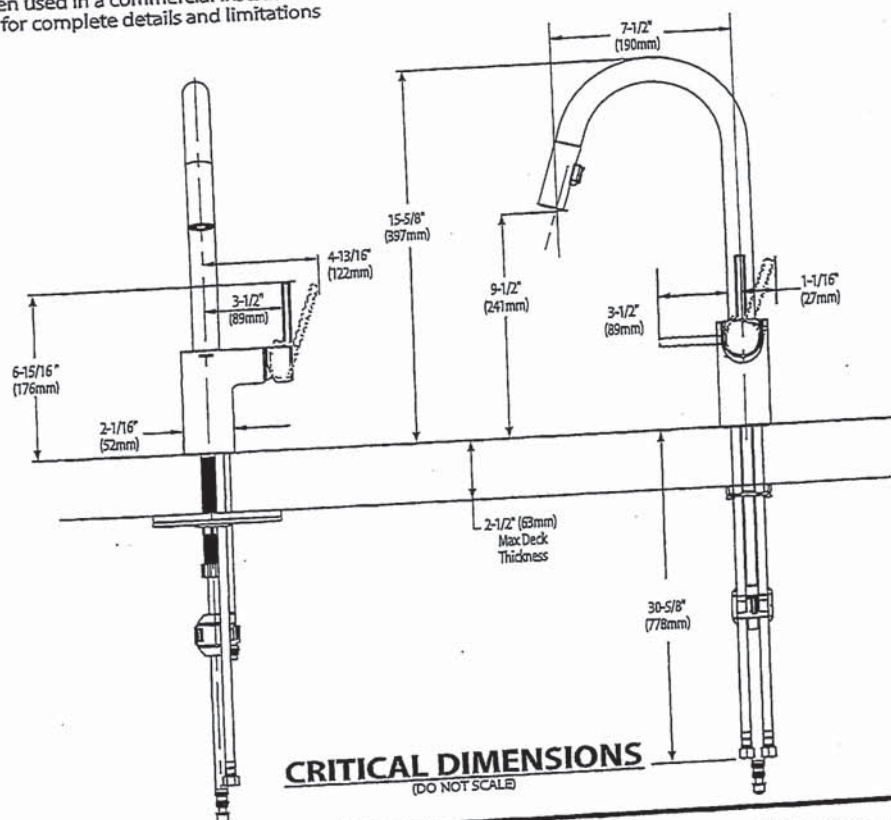

FOR MORE INFORMATION CALL: 1-800-BUY-MOEN
www.moen.com



BARRIER FREE (ABOVE COUNTER OR DROP-IN ONLY)

BOULEVARD® PEDESTAL SINK

STD ☒ ~~0641.800~~ Faucet holes on 8" (203mm) centers (illustrated)
☒ **0641.400** Faucet holes on 4" (102mm) centers

- ☒ ~~0641.100~~ Center hole only
- Classic styled rectangular pedestal lavatory
 - Vitreous china
 - Rear overflow
 - Supplied with mounting kit
 - Right Height® for greater comfort during use
 - Faucet ledge with large deck area (faucet not included)
 - **Design coordinates with Boulevard® Toilet**
 - Basin has flat bottom to also allow use as an above counter sink or a drop-in sink (with u-shaped cut out)

Nominal Dimensions:

24" x 19" x 35-1/2"
(610 x 483 x 902mm)

- ☐ **0641.008** Pedestal top-8" (203mm) centers
☐ **0641.004** Pedestal top-4" (102mm) centers
☐ **0641.001** Pedestal top-center hole only
☐ **0010.000** Pedestal only

Bowl sizes:

17" (432mm) wide,
12-1/2" (318mm) front to back,
5" (127mm) deep

Compliance Certifications -

Meets or Exceeds the Following Specifications:

- ASME A112.19.2 - 2008/CSA B45.1-08

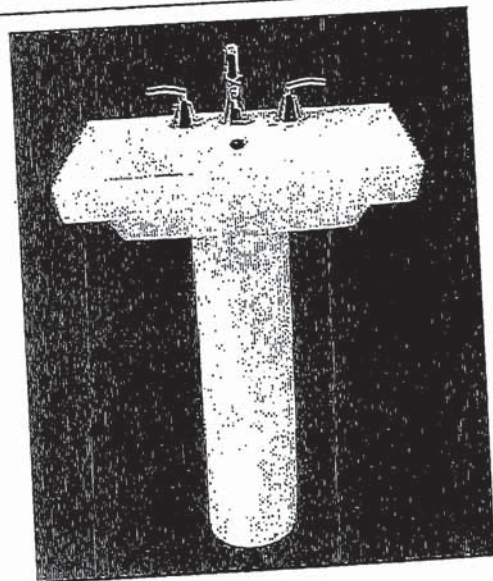

SEE REVERSE FOR ROUGHING-IN DIMENSIONS

To Be Specified:

- ☐ Color: ☐ White ☐ Linen
☐ Faucet Finish:
☐ Supplies:
☐ 1-1/4" Trap:
☐ Nipple:

* See faucet section for additional models available



**BOULEVARD®
PEDESTAL SINK**
VITREOUS CHINA

BARRIER FREE (ABOVE COUNTER OR DROP-IN ONLY)

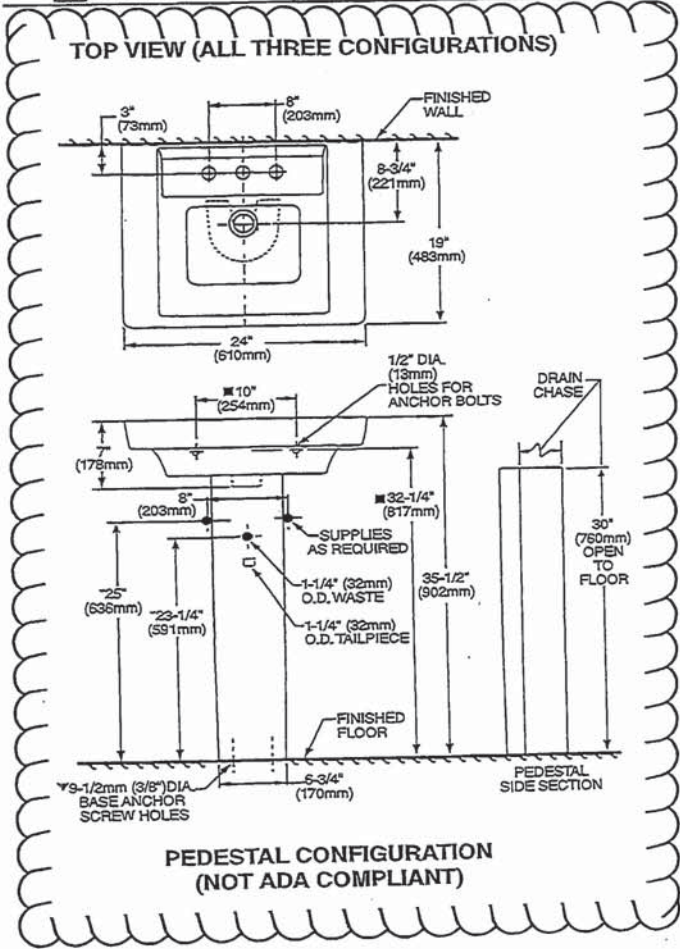

ABOVE COUNTER CONFIGURATION

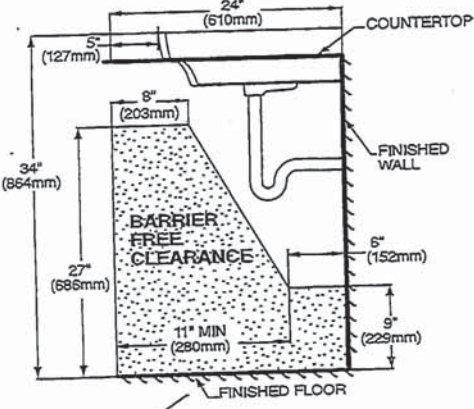
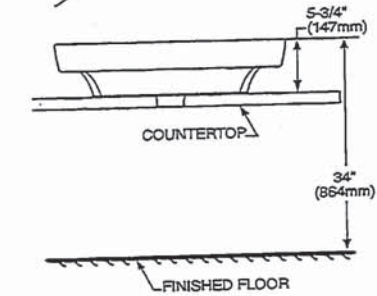

ABOVE COUNTER AND DROP-IN SINK CONFIGURATIONS MEET THE AMERICANS WITH DISABILITIES ACT GUIDELINES AND ANSI A117.1 ACCESSIBLE AND USABLE BUILDINGS AND FACILITIES - CHECK LOCAL CODES.
Top of sink installed at 34" (864mm) height from finished floor.
Sink installed 5" (127mm) minimum from front edge of countertop.
Provide 27" (686mm) knee clearance area.

NOTES:
* DIMENSIONS SHOWN FOR LOCATION OF SUPPLIES AND "P" TRAPS ARE SUGGESTED.
▼ PEDESTAL ANCHORING SCREWS NOT INCLUDED.
■ SUITABLE FOR REINFORCEMENT ONLY. ACTUAL DIMENSIONS MUST BE TAKEN FROM FIXTURE.
FITTING NOT INCLUDED AND MUST BE ORDERED SEPARATELY.
PROVIDE SUITABLE REINFORCEMENT FOR ALL WALL SUPPORTS.
INSTALLATION INSTRUCTIONS SUPPLIED WITH LAVATORY.

IMPORTANT: Dimensions of fixtures are nominal and may vary within the range of tolerance established by ANSI Standard A112.19.2
These measurements are subject to change or cancellation. No responsibility is assumed for use of superseded or voided pages.

American Standard

 BARRIER FREE

COLONY COUNTERTOP SINK

- Vitreous china
- Self-rimming
- Front overflow
- Supplied with template
- Faucet deck
- (Faucet shown not included)

☐ 0346 803

Faucet holes on 203mm (8") centres

STD ☒ 0346 403 (Illustrated)

Faucet holes on 102mm (4") centres

☐ 0346 001

Centre hole only

Nominal Dimensions:

521 x 448mm (20-1/2" x 17-5/8")

Bowl sizes:

422mm (16-5/8") wide, 279mm (11") front to back, 143mm (5-5/8") deep

COMPLIANCE CERTIFICATIONS –

Meets or exceeds the following Specifications:

- ASME A112.19.2M for Vitreous China Fixtures.
- CAN/CSA B45 Series.

To Be Specified

☐ Colour: ☐ White ☐ Bone ☐ Silver Gray
☐ Linen

☐ Faucet*:

☐ Faucet Finish:

☐ Supplies & Stops:

☐ Trap 1-1/4" (32 mm):

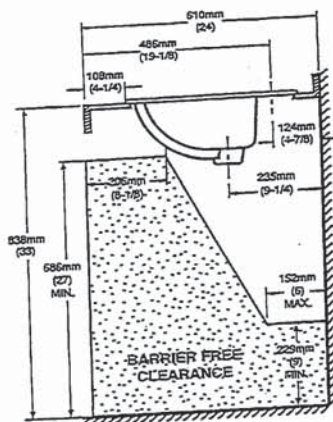
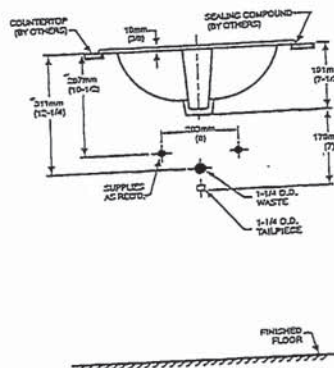
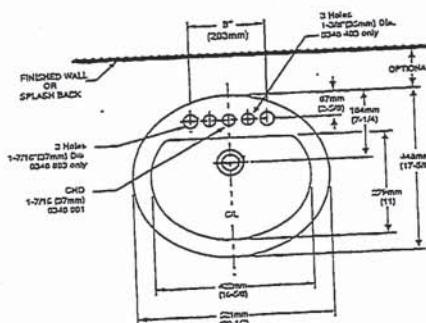
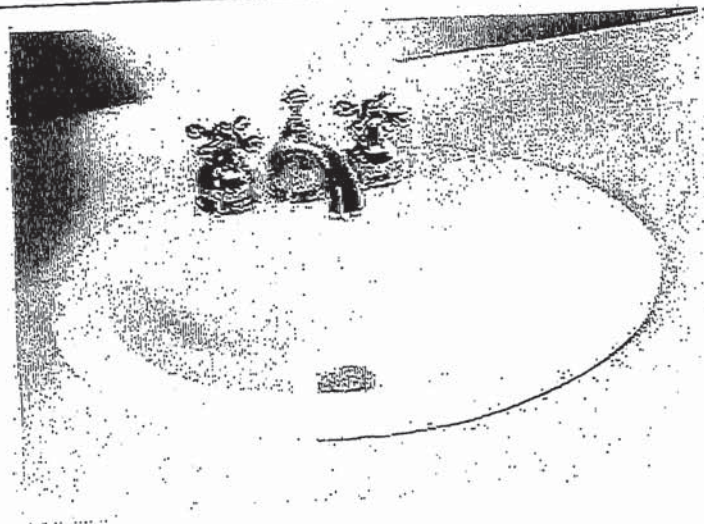

NOTES:
* DIMENSIONS SHOWN FOR LOCATION OF SUPPLIES AND "P" TRAP ARE SUGGESTED.
FOR COUNTERTOP CUTOUT AND INSTALLATION INSTRUCTIONS USE TEMPLATE
SUPPLIED WITH SINK.
FAUCETS NOT INCLUDED AND MUST BE ORDERED SEPARATELY.
IMPORTANT: Dimensions of fixtures are nominal and may vary within the range of tolerances
established by ANSI Standard A112.19.2.
These measurements are subject to change or cancellation. No responsibility is assumed for use
of superseded or voided pages.

* See faucet section for additional models available

BAS-198

© 2000 American Standard Inc.

01/07

VITREOUS CHINA

08/08

MOEN®

Specifications

DESCRIPTION

- Metal construction with various finishes identified by suffix
- 16" long 3/8" tubing connections
- Includes metal or 50/50 pop-up type waste assembly where noted

OPERATION

- Pivot action lever style handle
- Temperature controlled through 180° degree arc of handle travel

FLOW

- Flow is limited to 1.5 gpm max (5.7L/min) at 60 psi

CARTRIDGE

- 1225 cartridge design
- Nonmetallic/nonferrous and stainless steel material
- Can accommodate reversed piping and back to back installations

STANDARDS

- Third party certified to WaterSense®, CSA B-125.1, ASME A112.18.1 and all applicable requirements referenced therein including NSF61/9
- Complies with California Proposition 65 and with the Federal Safe Drinking Water Act

- ADA  for lever handle

WARRANTY

- Lifetime limited warranty against leaks, drips and finish defects to the original consumer purchaser
- 5 year warranty if used in commercial installations

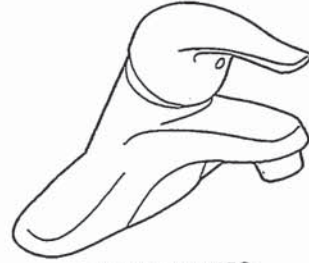

CHATEAU®
Single-Handle Lavatory Faucet

with Metal Waste Assembly
Model: L4625 series
L4631BC

Bulk Packed (12 per carton):
L64624 series

with 50/50 Waste Assembly
Bulk Packed (12 per carton):
L64625 series

Less Waste
Bulk Packed (12 per carton):
L64600 series

NOTE: THIS FAUCET IS DESIGNED TO BE
INSTALLED THRU 3-1" DIA. HOLES, 2" ON CENTER

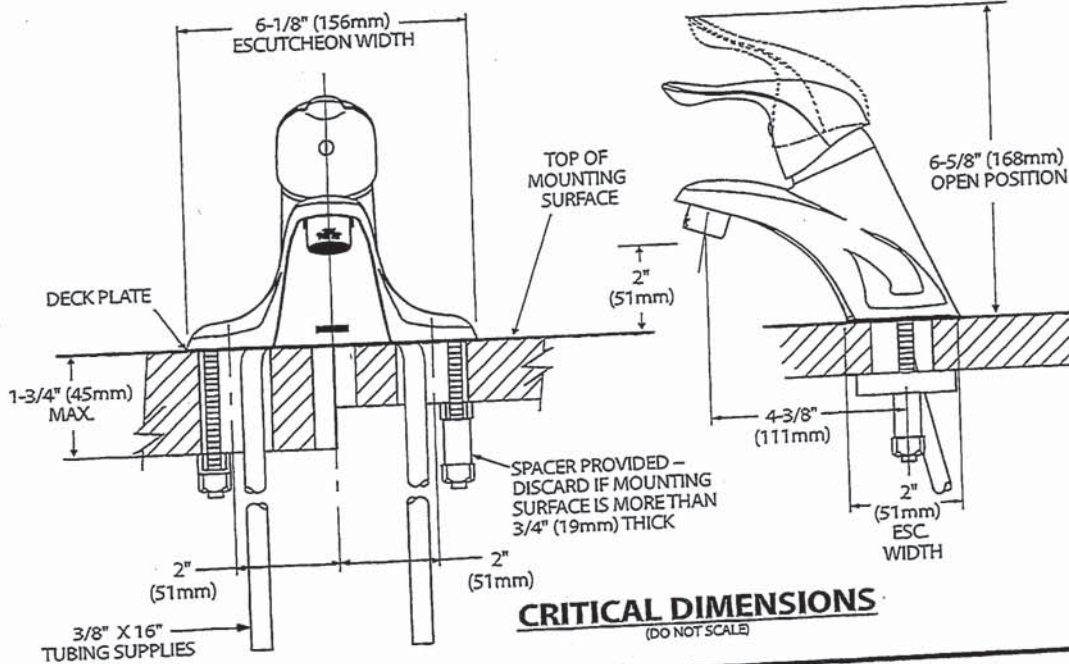

FOR MORE INFORMATION CALL: 1-800-BUY-MOEN
www.moen.com

Rev 8/15

mf



Buy it for looks. Buy it for life.®

There is more than 1 version of this model.
Page down to identify the version you have.

DESCRIPTION

- Metal construction with various finishes identified by suffix
- Includes non-metallic showerhead, arm, flange and non-metallic diverter tub spout

OPERATION

- Handle operates counterclockwise through a 270° arc with off at 6 o'clock and maximum hot at the 9 o'clock position. Shut off in clockwise direction
- Adjustable temperature limit stop to control maximum hot water temperature
- Pressure balancing mechanism maintains selected discharge temperature to $\pm 3^\circ$

FLOW

- Showerhead is limited to 2.5 gpm (9.5 L/min) at 80 psi
- EP suffix models are limited to 1.75 gpm (6.6 L/min) at 80 psi
- NH suffix models contain no showerhead.

CARTRIDGE

- 1222 cartridge design
- Accommodates back to back installations
- Nonmetallic/nonferrous and stainless steel material

STANDARDS

- Third party certified to meet ASME A112.18.1/CSA B125.1 and all applicable requirements referenced therein
- EP suffix models are third party certified to WaterSense®
- ADA ♿ for lever handle

WARRANTY

- Lifetime limited warranty against leaks, drips and finish defects to the original consumer purchaser
- 5 year warranty if used in commercial installations

Specifications



CHATEAU® POSI-TEMP® Single-Handle Tub/Shower Trim Kit

Models: TL181 series - valve trim only
(Bulk Packed 12 per carton)
TL182 series - shower trim only
(Bulk Packed 12 per carton)
TL183 series - tub/shower trim
(Bulk Packed 12 per carton)

Valves: 62300 series
2500 series

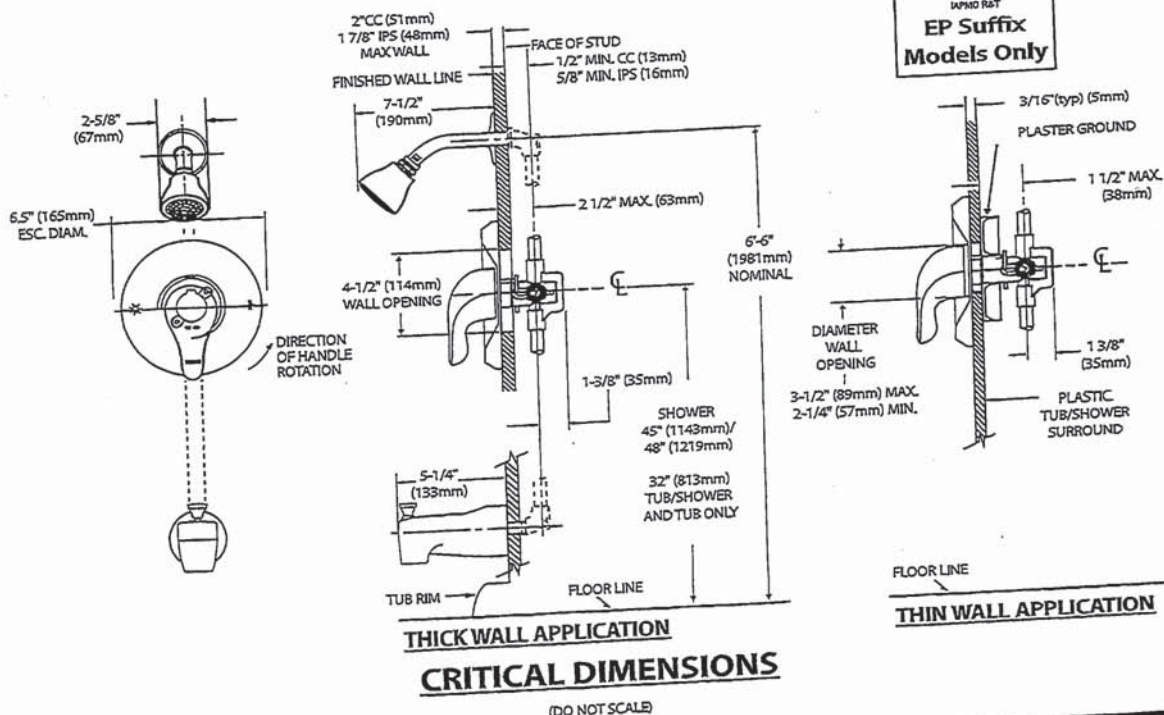

FOR MORE INFORMATION CALL: 1-800-BUY-MOEN
www.moen.com

TL183sp: Rev. 5/13

WMH31017H
OVER-THE-RANGE MICROWAVE



DISHWASHER-SAFE TURNTABLE PLATE

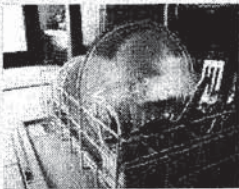

Clean up spills on the turntable by simply putting it in the dishwasher.

2-SPEED, 300 CFM MOTOR CLASS*



Match the right amount of ventilation to the dish being prepared and quickly get rid of cooking odors with two different fan speed settings.

MICROWAVE PRESETS



Get just the right amount of heat and time, whether you're cooking or defrosting, with specific preset options.

OTHER FEATURES

- Add 30 seconds option
- Electronic touch controls
- Adjustable cooktop lighting



White (W)



Black (B)



Fingerprint Resistant Stainless Steel (Z)



Silver (S)

MODEL	WMH31017HW	WMH31017HB	WMH31017HZ	WMH31017HS
Max height (in)	17-1/8"	17-1/8"	17-1/8"	17-1/8"
Width (in)	29-15/16"	29-15/16"	29-15/16"	29-15/16"
Depth (in)	15-9/16"	15-9/16"	15-9/16"	15-9/16"

Whirlpool®

*Performance varies based on installation.
©/™ ©2018 Whirlpool. All rights reserved. 1/18. WC170107A

VENTING DESIGN SPECIFICATIONS

This section is intended for architectural designer and builder/contractor reference only.

NOTES:

- Vent materials needed for installation are not provided with microwave hood combination.
- We do not recommend using a flexible metal vent.
- To avoid possible product damage, be sure to vent air outside, unless using recirculation installation. Do not vent exhaust air into concealed spaces, such as spaces within walls or ceilings, attics, crawl spaces, or garages.

For optimal venting installation, we recommend:

- Using roof or wall caps that have backdraft dampers
- Using a rigid metal vent
- Using the most direct route by minimizing the length of the vent and number of elbows to provide efficient performance
- Using uniformly sized vents
- Using duct tape to seal all joints in the vent system
- Using caulking compound to seal exterior wall or roof opening around cap
- Not installing 2 elbows together for optimal hood performance

If venting through the wall, be sure that there is proper clearance within the wall for the damper to open fully.

If venting through the roof, and rectangular-to-round transition is used, be sure there are at least 3" (7.6 cm) of clearance between the top of the microwave oven and the transition piece. See "Rectangular-to-Round Transition" illustration.

Rectangular-to-Round Transition

NOTE: The minimum 3" (7.6 cm) clearance must exist between the top of the microwave oven and the rectangular to round transition piece so that the damper can open freely and fully.

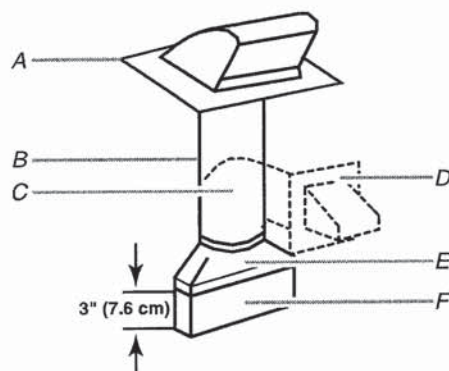

- A. Roof cap
- B. 6" (15.2 cm) min. diameter round vent
- C. Elbow (for wall venting only)
- D. Wall cap
- E. 3 1/4" x 10" to 6" (8.3 x 25.4 cm to 15.2 cm) rectangular to round transition piece
- F. Vent extension piece, at least 3" (7.6 cm) high

Recommended Standard Fittings

The following length equivalents are for use when figuring vent length. See the examples in "Recommended Vent Length".

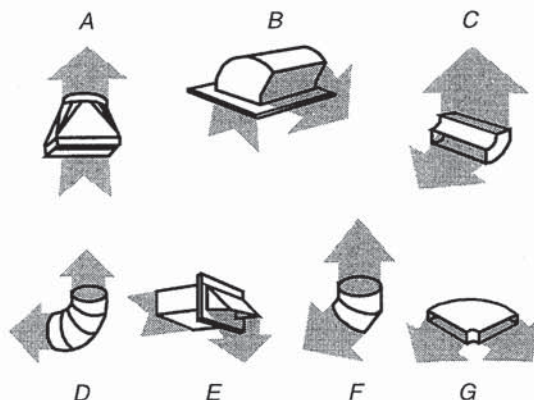

- A. Rectangular-to-round transition piece: 3 1/4" x 10" to 6" = 5 ft (8.3 x 25.4 cm to 15.2 cm = 1.5 m)
- B. Roof cap: 3 1/4" x 10" = 24 ft (8.3 x 25.4 cm = 7.3 m)
- C. 90° elbow: 3 1/4" x 10" = 25 ft (8.3 x 25.4 cm = 7.6 m)
- D. 90° elbow: 6" = 10 ft (15.2 cm = 3 m)
- E. Wall cap: 3 1/4" x 10" = 40 ft (8.3 x 25.4 cm = 12.2 m)
- F. 45° elbow: 6" = 5 ft (15.2 cm = 1.5 m)
- G. 90° flat elbow: 3 1/4" x 10" = 10 ft (8.3 x 25.4 cm = 3 m)

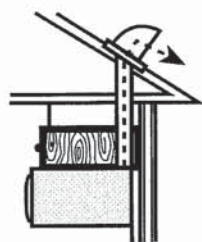

Roof venting



Roof cap

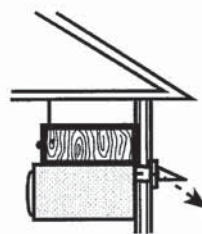

Wall venting



Wall cap

Recommended Vent Length

A 3¼" x 10" (8.3 x 25.4 cm) rectangular or 6" (15.2 cm) round vent should be used.

The total length of the vent system including straight vent, elbow(s), transitions, and wall or roof caps must not exceed the equivalent of 140 ft (42.7 m) for either type of vent. See the "Recommended Standard Fittings" section for equivalent lengths.

For best performance, use no more than three 90° elbows.

To calculate the length of the system you need, add the equivalent lengths of each vent piece used in the system. See the following examples:

3¼" x 10" (8.3 x 25.4 cm) vent system = 73 ft (22.2 m) total

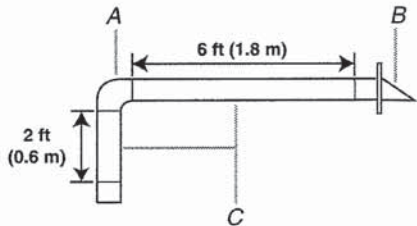

- A. One 3¼" x 10" (8.3 x 25.4 cm) 90° elbow = 25 ft (7.6 m)
- B. 1 wall cap = 40 ft (12.2 m)
- C. 2 ft (0.6 m) + 6 ft (1.8 m) straight = 8 ft (2.4 m)

6" (15.2 cm) vent system = 73 ft (22.2 m) total

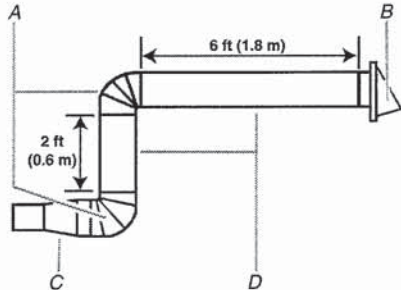

- A. Two 90° elbows = 20 ft (6.1 m)
- B. 1 wall cap = 40 ft (12.2 m)
- C. 1 rectangular-to-round transition piece = 5 ft (1.5 m)
- D. 2 ft (0.6 m) + 6 ft (1.8 m) straight = 8 ft (2.4 m)

If the existing vent is round, a rectangular-to-round transition piece must be used. In addition, a rectangular 3" (7.6 cm) extension vent between the damper assembly and rectangular-to-round transition piece must be installed to keep the damper from sticking.

Whirlpool® 21 cu. ft. Top-Freezer Refrigerator
WRT541SZD

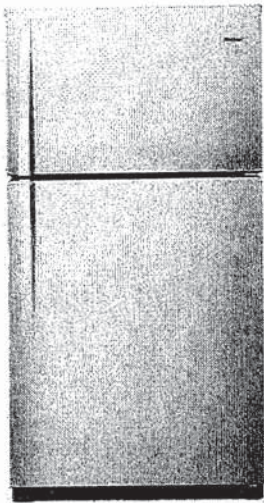

Fingerprint-Resistant Stainless
WRT541SZDZ

Also available in:

- White WRT541SZDW
- Black WRT541SZDB
- Monochromatic Stainless Steel WRT541SZDM

Key Features & Benefits

- Frameless Glass Shelves**
Store more items on wall-to-wall shelves for greater storage flexibility.
- Flexi-Slide™ Bin**
Make space for tall items with the bin that quickly and easily moves side to side.
- Humidity-Controlled Crispers**
Store fruits and vegetables in their ideal environment.

Capacity	
Total Capacity	21 cu. ft.
Refrigerator Capacity	15 cu. ft.
Freezer Capacity	6 cu. ft.
General Features & Properties	
EZ Connect Icemaker Kit	
LED Interior Lighting	
ENERGY STAR® Certified	
Electronic Temperature Controls	
Freezer Temperature Controls	
Clear Door Bins	
Adjustable Door Bins	
Quiet Cooling	
Fingerprint Resistant	
Electrical Details	
Amps	6.5
Volts	115
Certifications	
ADA Compliant	Yes
ENERGY STAR® Certified	Yes

Technical Details	
Refrigerator Type	Top-Freezer
Number of Doors	2
Number of Interior Refrigerator Shelves	3
Number of Refrigerator Door Bins	1 Fixed, 4 Adjustable
Number of Interior Freezer Shelves	1
Number of Freezer Door Bins	2 Fixed
Lighting Type	LED
Ice Maker	Optional
Ice Maker Location	Freezer
Dispenser Type	N/A
Dimensions	
Product Dimensions (H x W x D)	66-1/4" x 32-3/4" x 34"
Depth with Door Open 90°	62-1/4"
Cutout Dimensions	Allow extra 1/2" on sides and top Allow extra 1" on rear
Reference Material	
Dimension Guide	
Use & Care Guide	
Energy Guide	
Warranty	

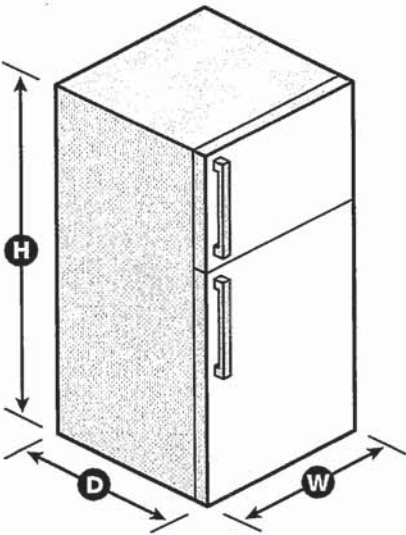

GARAGE RIGHT
HINGES ON RIGHT
HANDLE ON LEFT.

NOTE: Dimensions are for planning purposes only. For complete details, see Installation Instructions packed with product. Specifications subject to change without notice.
©/™ © 2020. All rights reserved. Printed in the U.S.A. D200052XXC. WRT541SZDSPECSHEETV01.

Whirlpool® Top Mount Refrigerator

PRODUCT MODEL NUMBERS

WRT311FZD WRT541SZD
WRT511SZD

Electrical: A 115-volt, 60-Hz, AC-only, 15- or 20-amp fused, grounded electrical supply is required. It is recommended that a separate circuit serving only your refrigerator be provided. Use an outlet that cannot be turned off by a switch. Do not use an extension cord.

NOTE: Before performing any type of installation, cleaning, or removing a light bulb, turn the control (Thermostat, Refrigerator or Freezer Control depending on the model) to OFF and then disconnect the refrigerator from the electrical source. When you are finished, reconnect the refrigerator to the electrical source and reset the control (Thermostat, Refrigerator or Freezer Control depending on the model) to the desired setting. See "Using the Controls."

Water: A cold water supply with water pressure between 30 and 120 psi (207 and 827 kPa) is required to operate ice maker and water dispenser. If you have questions about your water pressure, call a licensed, qualified plumber.

IMPORTANT: The pressure of the water coming out of a reverse osmosis system going to the water inlet valve of the refrigerator needs to be between 30 and 120 psi (207 and 827 kPa).

Reverse Osmosis Water Supply: If a reverse osmosis water filtration system is connected to your cold water supply, the water pressure to the reverse osmosis system needs to be a minimum of 40 to 60 psi (276 to 414 kPa).

PRODUCT DIMENSIONS

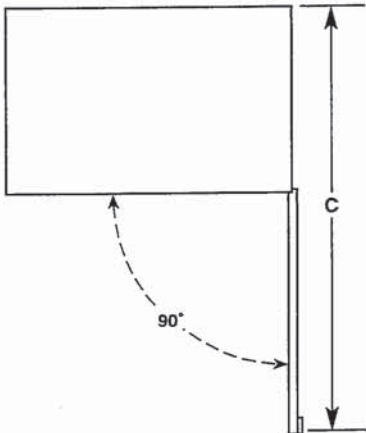
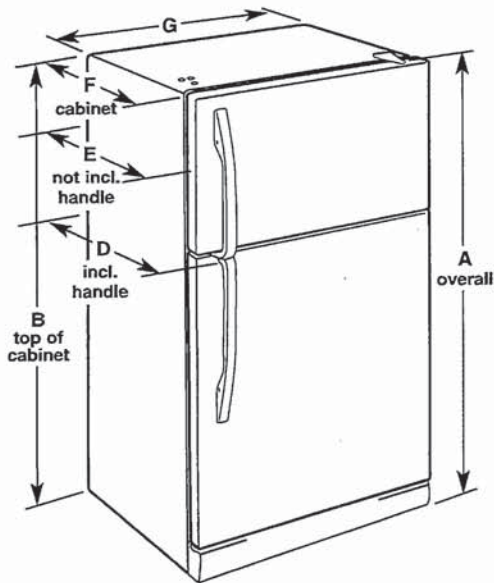

Model Number	Model Size	Reversible Door	Height - Overall "A"	Height - Top of Cabinet "B"	Depth - Door Open 90° "C"	Depth - With Handles "D"	Depth - Without Handles "E"	Depth - Cabinet Only "F"	Width - Cabinet "G"
WRT311FZD	20.5 cu. ft.	Yes	66¼" (168.3 cm)	65½" (166.4 cm)	62¼" (158.1 cm)	32¾" (83.5 cm)	30¾" (77.8 cm)	28½" (72.4 cm)	32¾" (83.2 cm)
WRT511SZD WRT541SZD	21.3 cu. ft.	Yes	66¼" (168.3 cm)	65½" (166.4 cm)	62¼" (158.1 cm)	34" (86.4 cm)	32½" (82.3 cm)	28½" (72.4 cm)	32¾" (83.2 cm)

LOCATION REQUIREMENTS

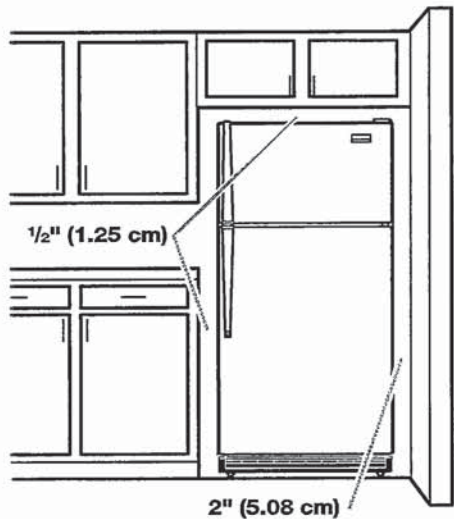

To ensure proper ventilation for your refrigerator, allow for a ½" (1.25 cm) space on each and between overhead cabinets and refrigerator top. Allow at least 1" (2.5 cm) between back of cabinet and the wall. If your refrigerator has an ice maker, make sure you leave some extra space at the back for the water line connections.

If you are installing your refrigerator next to a fixed wall, leave 2" (5 cm) minimum on the hinge side (depending on your model) to allow for the door to swing open.

NOTE: This refrigerator is intended for use in a location where the temperature ranges from a minimum of 55°F (13°C) to a maximum of 110°F (43°C). The preferred room temperature range for optimum performance, which reduces electricity usage and provides superior cooling, is between 60°F (15°C) and 90°F (32°C). It is recommended that you do not install the refrigerator near a heat source, such as an oven or radiator.



5.3 cu. ft. Whirlpool® electric range with Frozen Bake™ technology

YWFE515S0JS

This Whirlpool® electric range with a dual element stove top helps you get dinner to the table. Skip preheating for favorites like pizza with Frozen Bake™ technology. This self cleaning oven also prevents cooked food from getting cold with the Keep Warm setting. Closed door broiling helps keep the kitchen comfortable.



Top Features

- FlexHeat™ Dual Radiant Element**
Get two elements in one with a 6" inner ring that's great for smaller pots and pans and a 9" expandable outer ring that makes room for larger cookware.
- Frozen Bake™ technology**
Skip preheating and cook frozen favorites like pizza in fewer steps with preprogrammed settings that automatically adjust cooking times for you.
- Keep Warm setting**
Keep dishes from getting cold with this setting that delivers low heat to the oven.
- Closed Door Broiling**
Maintain the optimal cooking temperature for food while still keeping the kitchen comfortable and cool using this broiling temperature management system that helps prevent overheating.

Dimensions	
Depth	27 3/4
Height	36
Width	29 7/8

Exterior	
Handle Type	Reach-Through Handle

Configuration and Overview	
Range Type	Freestanding
Fuel Type	Electric
Size (IN, inches)	30

Features	
Hot Surface Indicator Light	Yes
Heating Element On Indicator Light	Yes
Power On Indicator Light	No
Griddle	NA
Automatic Convection Conversion Temperature Adjust	No
Power Outage Compatible	No

Exterior	
Door Removable	Yes
Drawer Type	Storage Drawer
Oven Door	Glass Window
Oven Window Size	Extra Large
Handle Color	Stainless Steel
Handle Material	Metal

- Available Finishes/Colours
- YWFE515S0JB Black
 - YWFE515S0JS Stainless Steel
 - YWFE515S0JW White

- Manuals & Literature:
- [Installation Instructions](#)
 - [Use and Care](#)
 - [Warranty](#)

WHIRLPOOL 30" (76.0 CM) FREESTANDING ELECTRIC RANGES
Model YWFE515S0JS

Product Dimensions

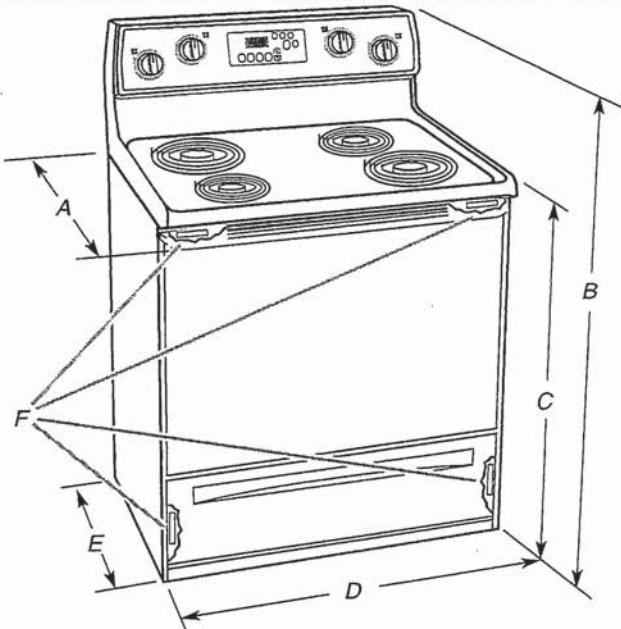

- A. 27³/₄" (70.5 cm) max. depth with handle
- B. 46⁷/₈" (119.1 cm) overall height (max.) with leveling legs screwed all the way in*
- C. 36" (91.4 cm) cooktop height (max.) with leveling legs screwed all the way in*
- D. 29⁷/₈" (75.9 cm) width
- E. 25⁵/₁₆" (64.3 cm) depth - back of range to front of cooktop**
- F. Model/serial/rating plate (located on the frame behind a top corner of the door or either side of the drawer)

IMPORTANT: Range must be level after installation. Follow the instructions in the "Level Range" section. Using the cooktop as a reference for leveling the range is not recommended.

*Range can be raised approximately 1" (2.5 cm) by adjusting the leveling legs.

**Front of door and drawer may extend further forward depending on styling.

Cabinet Dimensions

Cabinet opening dimensions shown are for 25" (64.0 cm) countertop depth, 24" (61.0 cm) base cabinet depth and 36" (91.4 cm) countertop height.

IMPORTANT: If installing a range hood or microwave hood combination above the cooking surface, follow the range hood or microwave hood combination installation instructions for dimensional clearances above the cooktop surface.

A freestanding range may be installed next to combustible walls with zero clearance.

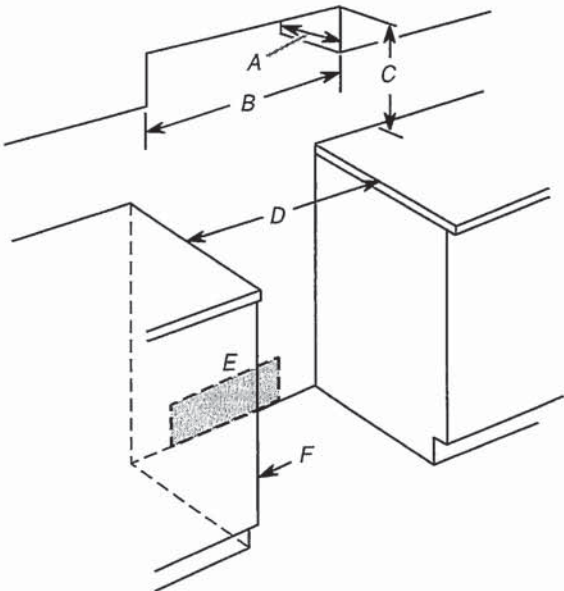

- A. 13" (33.0 cm) max. upper cabinet depth
- B. 30" (76.2 cm) min. opening width
- C. For minimum clearance to top of cooktop, see NOTE*
- D. 30" (76.2 cm) min. opening width
- E. Outlet - 8" (20.3 cm) to 22" (55.9 cm) from either cabinet, 7" (17.8 cm) max. from floor.
- F. Cabinet door or hinges should not extend into the cutout.

***NOTE:** 24" (61.0 cm) minimum when bottom of wood or metal cabinet is covered by not less than 1/4" (6.4 mm) flame retardant millboard covered with not less than No. 28 MSG sheet steel, 0.015" (0.4 mm) stainless steel, 0.024" (0.6 mm) aluminum or 0.020" (0.5 mm) copper.

30" (76.2 cm) minimum clearance between the top of the cooking platform and the bottom of an uncovered wood or metal cabinet.

18

WHIRLPOOL 30" (76.0 CM) FREESTANDING ELECTRIC RANGES
Model YWFE515S0JS

Electrical Requirements - Canada Only

⚠ WARNING



Electrical Shock Hazard
Electrically ground range.
Failure to do so can result in death, fire, or electrical shock.

If codes permit and a separate ground wire is used, it is recommended that a qualified electrical installer determine that the ground path is adequate and wire gauge are in accordance with local codes.

Be sure that the electrical connection and wire size are adequate and in conformance with CSA Standard C22.1, Canadian Electrical Code, Part 1 - latest edition, and all local codes and ordinances.

A copy of the above code standards can be obtained from:

Canadian Standards Association
178 Rexdale Blvd.
Toronto, ON M9W 1R3 CANADA

- Check with a qualified electrical installer if you are not sure the range is properly grounded.

Range Rating*		Specified Rating of Power Supply Cord Kit and Circuit Protection
120/240 V	120/208 V	Amps
8.8 - 16.5 KW	7.8 - 12.5 KW	40 or 50**
16.6 - 22.5 KW	12.6 - 18.5 KW	50

*The NEC calculated load is less than the total connected load listed on the model/serial/rating plate.

**If connecting to a 50 A circuit, use a 50 A rated cord with kit. For 50 A rated cord kits, use kits that specify use with a nominal 1 3/8" (3.5 cm) diameter connection opening.

- A time-delay fuse or circuit breaker is recommended.
- This range is equipped with a CSA International Certified Power Cord intended to be plugged into a standard 14-50R wall receptacle. Be sure the wall receptacle is within reach of range's final location.



- Do not use an extension cord.

INSTALLATION INSTRUCTIONS

Unpack Range

⚠ WARNING

Excessive Weight Hazard
Use two or more people to move and install range.
Failure to do so can result in back or other injury.

1. Remove shipping materials, tape and film from range.
2. Remove oven racks and parts package from inside oven.
3. Do not remove the shipping base at this time.

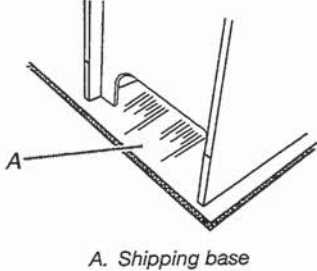

4. On Ranges Equipped with a Storage Drawer:
- Remove the storage drawer. See the "Storage Drawer" section. Use a 1/4" (6.4 mm) drive ratchet to lower the rear leveling legs one-half turn. Use a wrench or pliers to lower front leveling legs one-half turn.

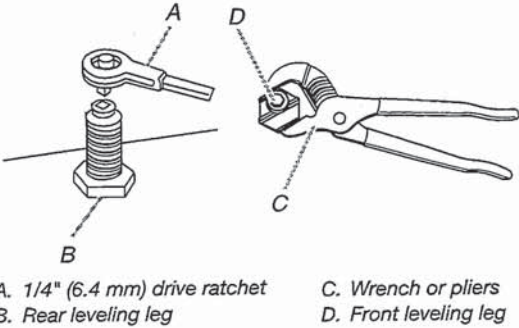

On Ranges Equipped with a Warming Drawer or Premium Storage Drawer:

On ranges equipped with a warming drawer or premium storage drawer, the rear legs cannot be accessed by removing the warming drawer or premium storage drawer. It will be necessary to adjust the rear legs from outside the range. Use wrench or pliers to lower the front and rear leveling legs one half turn.

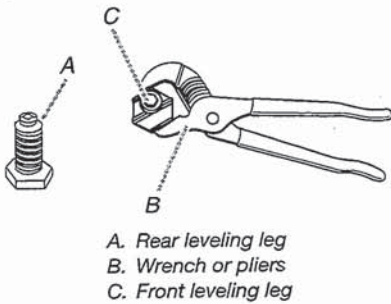

MP

WHIRLPOOL 30" (76.0 CM) FREESTANDING ELECTRIC RANGES Model YWFE515S0JS

Install Anti-Tip Bracket

⚠ WARNING



Tip Over Hazard

A child or adult can tip the range and be killed.

Install anti-tip bracket to floor or wall per installation instructions.

Slide range back so rear range foot is engaged in the slot of the anti-tip bracket.

Re-engage anti-tip bracket if range is moved.

Do not operate range without anti-tip bracket installed and engaged.

Failure to follow these instructions can result in death or serious burns to children and adults.

1. Remove the anti-tip bracket from where it is taped inside the storage drawer or warming drawer.
2. Determine which mounting method to use: floor or wall.
If you have a stone or masonry floor, you can use the wall mounting method. If you are installing the range in a mobile home, you must secure the range to the floor.
3. Determine and mark centerline of the cutout space. The mounting can be installed on either the left-side or right-side of the cutout. Position mounting bracket against the wall in the cutout so that the V-notch of the bracket is $12\frac{9}{16}$ " (31.9 cm) from centerline as shown.

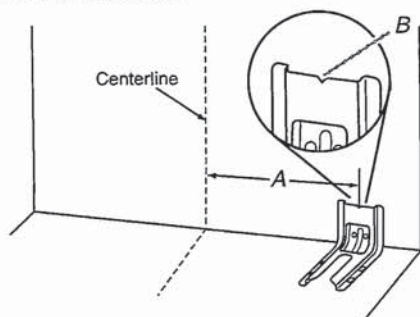

A. $12\frac{9}{16}$ " (31.9 cm)
B. Bracket V-notch

4. Drill two $\frac{1}{8}$ " (3 mm) holes that correspond to the bracket holes of the determined mounting method. See the following illustrations.

Floor Mounting

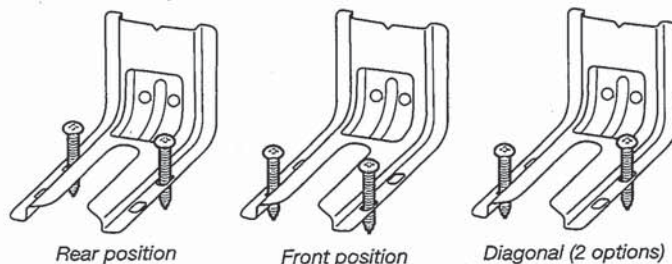

Wall Mounting

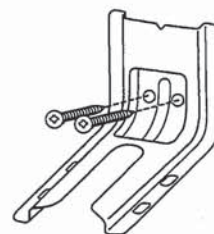

5. Using the Phillips screwdriver, mount anti-tip bracket to the wall or floor with the two #12 x $1\frac{5}{8}$ " (4.1 cm) screws provided.
6. Move range close enough to opening to allow for final electrical connections. Remove shipping base, cardboard or hardboard from under range.
7. Move range into its final location, making sure rear leveling leg slides into anti-tip bracket.

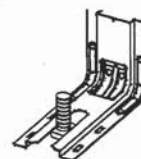

8. Move range forward onto shipping base, cardboard or hardboard to continue installing the range using the following installation instructions.

NP

Whirlpool®

55 dBA* Front Control Dishwasher
WDF330PAH

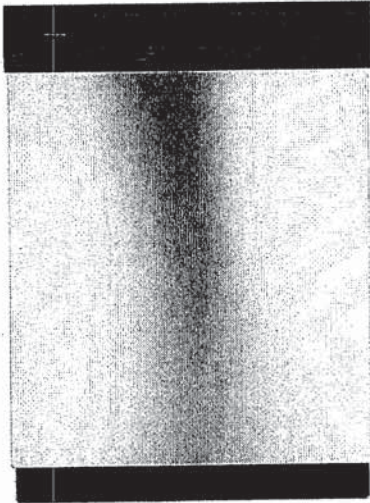

Stainless Steel
WDF330PAHS

Also available in:

- ☐ White
- WDF330PAHW
- ☒ Black
- WDF330PAHB

Key Features & Benefits

- 1-Hour Wash Cycle**

Clean dishes in half the time so your plates, pans and glasses are thoroughly cleaned up and taken care of in just an hour.**
- Soil Sensor**

Determines how dirty dishes are and adjusts the Normal cycle as needed to make sure dishes come out clean.
- Normal Cycle**

Use for normal amounts of food soil to clean up leftover messes from your day-to-day meals.

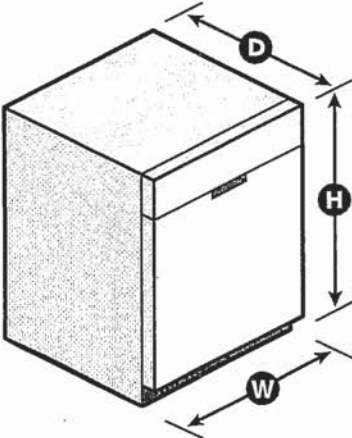

Capacity	
Total Place Settings	13
General Features & Properties	
Heavy Cycle	
High Temperature Wash Option	
Heated Dry Option	
ENERGY STAR® Certified	
Industry's Best Selling Dishwasher Brand†	
Designed, Engineered and Assembled in the U.S.A. with American Pride	
Electrical Details	
Amps	10
Volts	120
Hz	60
Certifications	
ENERGY STAR® Certified	Yes

Technical Details	
Dishwasher Type	Built-in
Control Location	Front
Control Type	Push Button
Number of Wash Cycles	3
Number of Options	4
dBA*	55
Number of Racks	2
Tub Material	Plastic
Wash System	Filter
Wash System Type	Removable Filter
Number of Wash Arms	2

Dimensions	
Product Dimensions (H x W x D)	34-1/2" x 23-7/8" x 24-1/2"
Depth with Door Open 90°	49-1/2"

Reference Material	
Dimension Guide	
Install Guide	
Use & Care Guide	
Energy Guide	
Warranty	

*Per IEC standards. **Compared to Normal cycle with lightly soiled loads. †Based on 12-month average of sales. TraQline 2018. NOTE: Dimensions are for planning purposes only. For complete details, see Installation Instructions packed with product. Specifications subject to change without notice.
©/™ © 2020. All rights reserved. Printed in the U.S.A. D200052XXA. WDF330PAHSPECSHEETV01.

Handwritten signature or mark.



Undercounter Dishwasher

PRODUCT MODEL NUMBERS

WDF110PAB	WDF320PAD	WDT710PAH
WDF111PAB	WDF330PAH	WDT720PAD
WDF120PAF	WDF331PAH	WDT730PAH
WDF121PAF	WDF520PAD	WDT735PAG
WDF130PAH	WDF540PAD	WDT735PAH
WDF131PAH	WDF545PAF	

DRAIN REQUIREMENTS

- A new drain hose is supplied with your dishwasher. If drain hose is not long enough, use a new drain hose with a maximum length of 12 ft (3.7 m) that meets all current AHAM/ IAPMO test standards, is resistant to heat and detergent, and fits the 1" (25 mm) drain connector of the dishwasher. See the "Tools and Parts" section at the front of the guide for part details and orders.
- Make sure to connect drain hose to waste tee or disposer inlet above drain trap in house plumbing and 20" (508 mm) minimum above the floor. It is recommended that the drain hose either be looped up and securely fastened to the underside of the counter or be connected to an air gap.
- Make sure to use an air gap if the drain hose is connected to house plumbing lower than 20" (508 mm) above subfloor or floor.

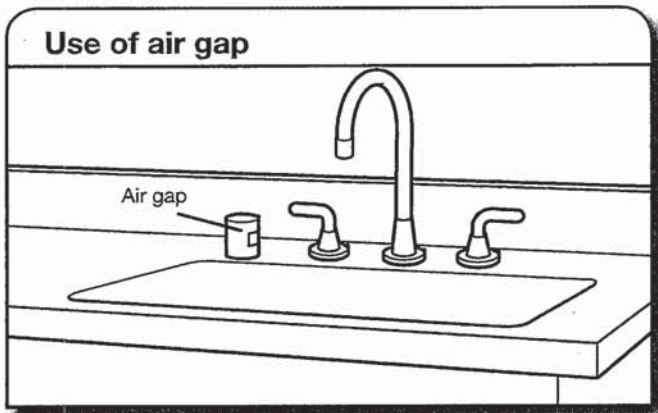

- If required, the air gap should be installed in accordance with the air gap installation instructions. When you are connecting the air gap, a rubber hose (not provided) will be needed to connect to the waste tee or disposer inlet.
- Use 1/2" minimum I.D. drain line fittings.

WATER SUPPLY REQUIREMENTS

- This dishwasher has a water heating feature and also requires a connection to a hot water supply line.
 - A hot water line with 20 to 120 psi (138 to 862 kPa) water pressure can be verified by a licensed plumber.
 - 120°F (49°C) water at dishwasher
 - 3/8" O.D. copper tubing with compression fitting or flexible braided water supply line. See the "Tools and Parts" section at the front of the guide for part details and orders.
- NOTE:** 1/2" minimum plastic tubing is not recommended.
- A 90° elbow with 3/4" hose connection with rubber washer. See the "Tools and Parts" section at the front of the guide for part details and orders.
 - Do not solder within 6" (152 mm) of the water inlet valve.
 - If installed in new construction, make sure the house water supply lines have been flushed prior to connecting the dishwasher to remove any debris that may exist in the supply line.

NOTE: If replacing an existing dishwasher, it is recommended to install a new water line (see the "Tools and Parts" section at the front of the guide for part details) and drain hose (supplied) with the new dishwasher.

ELECTRICAL REQUIREMENTS

You Must Have:

- 120-volt, 60 Hz, AC-only, 15- or 20-amp, fused electrical supply
- Copper wire only
- A maximum of 2 field wiring supply conductors (12 AWG largest size) plus 1 grounding conductor are permitted in the terminal box.

We Recommend:

- A time-delay fuse or circuit breaker
- A separate circuit

If Connecting Dishwasher with a Power Cord:

- Use a UL Listed power cord kit marked for use with dishwasher. See the "Tools and Parts" section at the front of the guide for part details and orders.
- Plug into a grounded 3 prong outlet. Outlet must meet all local codes and ordinances.

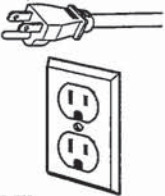

If Connecting Dishwasher with Direct Wiring:

- Use flexible, armored, or nonmetallic sheathed copper wire with grounding wire that meets the wiring requirements for your home and local codes and ordinances.
- Use a UL Listed/CSA Approved metallic strain relief.



Because Whirlpool Corporation policy includes a continuous commitment to improve our products, we reserve the right to change materials and specifications without notice.

Dimensions are for planning purposes only. For complete details, see Installation Instructions packed with product. Specifications subject to change without notice.

mb

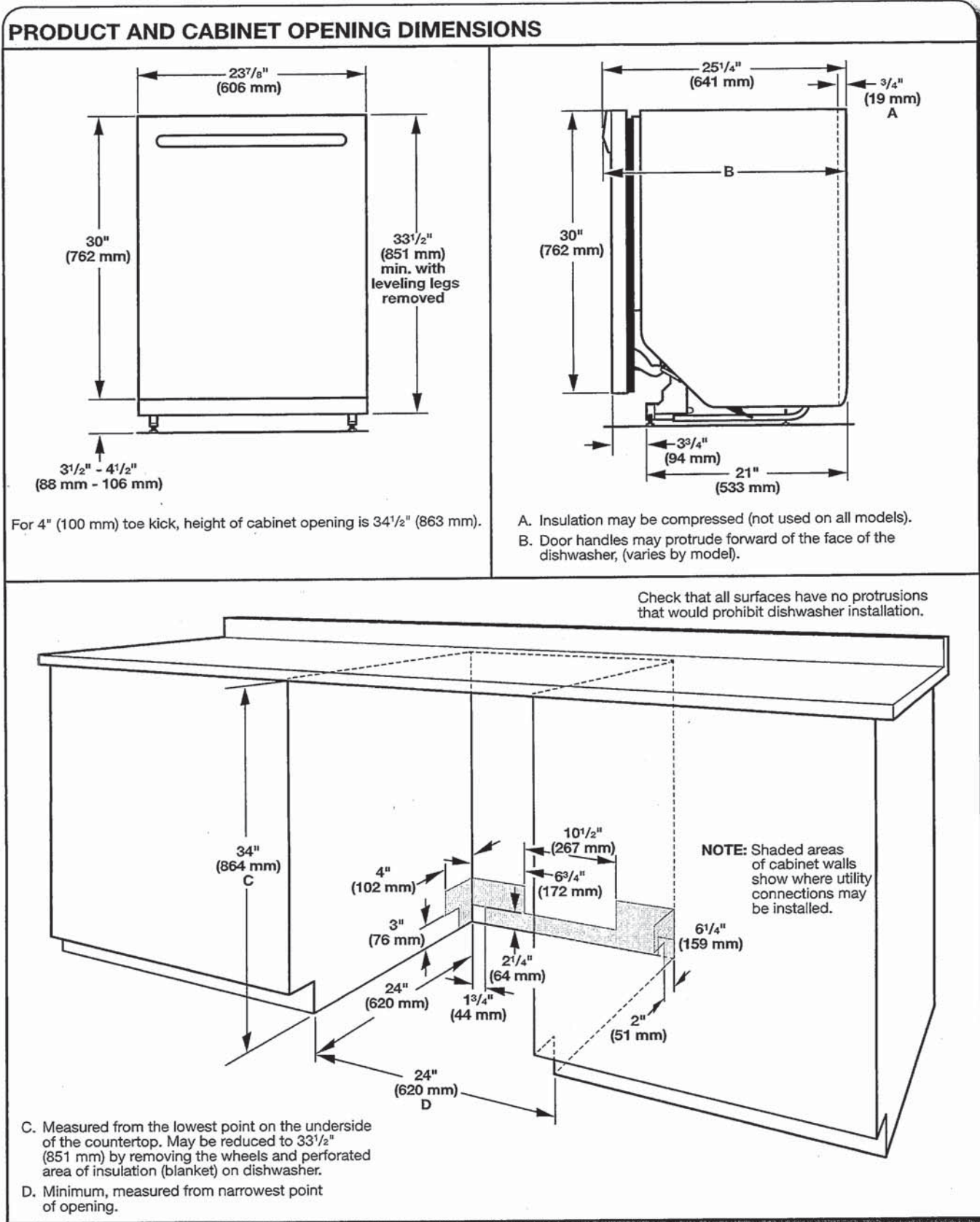

Because Whirlpool Corporation policy includes a continuous commitment to improve our products, we reserve the right to change materials and specifications without notice.

Dimensions are for planning purposes only. For complete details, see Installation Instructions packed with product. Specifications subject to change without notice.

mp

DETAILED PLANNING DIMENSION

2 of 15

WHIRLPOOL® FRONT LOAD WASHER WITH INTUITIVE CONTROLS - 4.3 cu ft

ELECTRICAL REQUIREMENTS

WARNING: To reduce the risk of fire, electric shock, or injury to persons, read the IMPORTANT SAFETY INSTRUCTIONS and INSTALLATION INSTRUCTIONS, located in your appliance's Owner's Manual, before installing and operating this appliance.

Electrical Requirements	
WFW560CHW	4.3 cu ft DOE (US)/5.0 cu ft IEC (CAN)
Minimum Circuit Amperage Rating	15 A
Maximum Ampere Draw	10.36 A
Operating Voltage	120 V AC only
Operating Frequency	60 Hz

PRODUCT DIMENSIONS

WFW560CHW		4.3 cu ft DOE (US)/5.0 cu ft IEC (CAN)		
Unit of Measurement	in (minimum)	mm (minimum)	in (maximum)	mm (maximum)
Height (with feet) (A)	38 $\frac{5}{8}$	981	40	1016
Product Width (B)	27	686	-	-

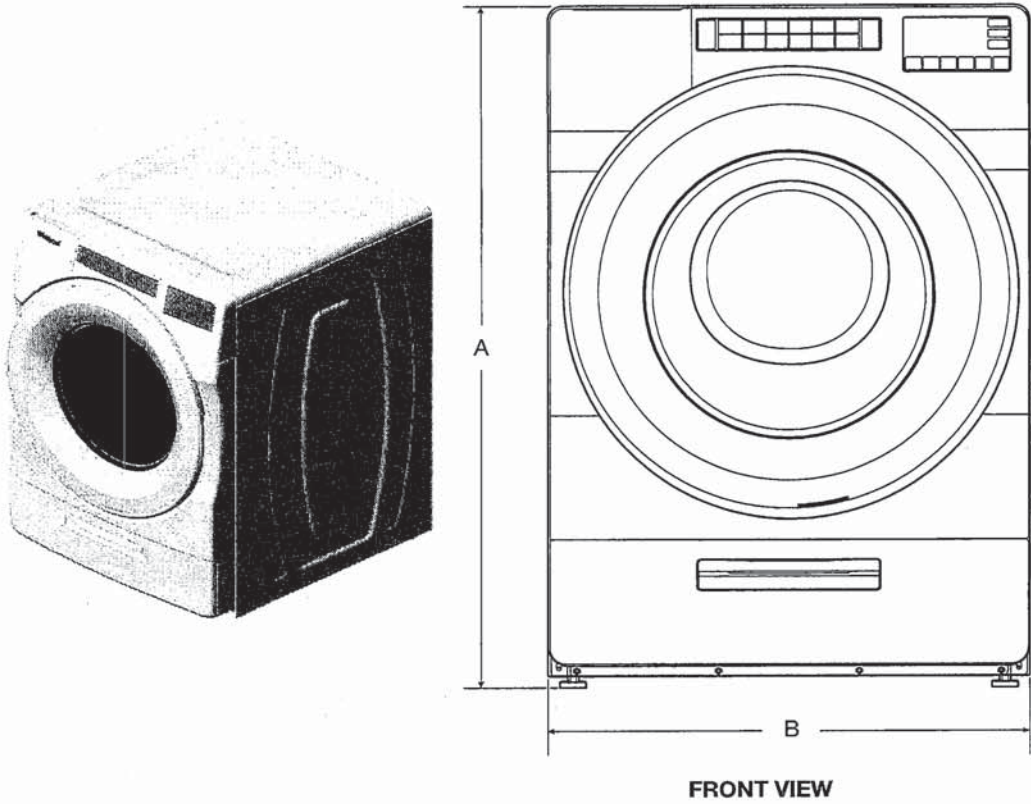

FRONT VIEW

IMPORTANT: Dimensional specifications are provided for planning purposes only.



DETAILED PLANNING DIMENSION

3 of 15

WHIRLPOOL® FRONT LOAD WASHER WITH INTUITIVE CONTROLS - 4.3 cu ft

PRODUCT DIMENSIONS

WFW560CHW		4.3 cu ft DOE (US)/5.0 cu ft IEC (CAN)		
Unit of Measurement	in (minimum)	mm (minimum)	in (maximum)	mm (maximum)
Door Width (C)	25 ¹¹ / ₁₆	652	-	-
Product Depth (D)	31 ⁹ / ₁₆	802	-	-
Product Depth with Door Open (E)	54 ⁷ / ₈	1393	-	-
Door Height (F)	25 ¹¹ / ₁₆	652	-	-
Height to Bottom of Door (G)	9 ¹ / ₂	241	-	-

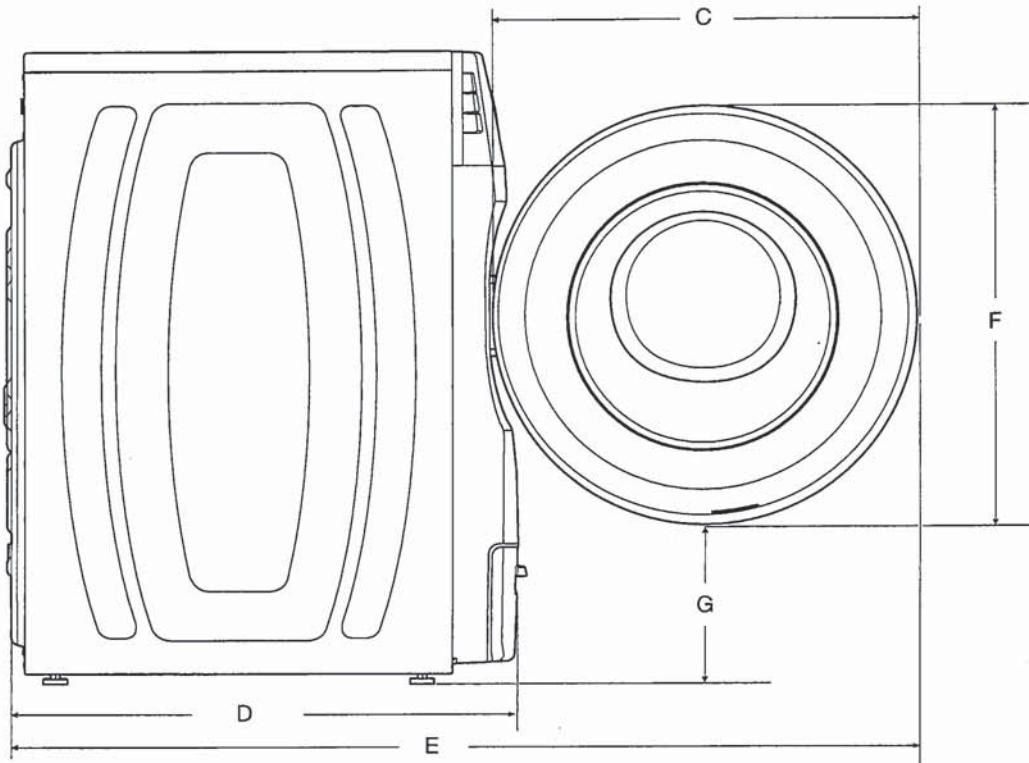

SIDE VIEW

IMPORTANT: Dimensional specifications are provided for planning purposes only.



Handwritten signature or initials.

DETAILED PLANNING DIMENSION

4 of 15

WHIRLPOOL® FRONT LOAD WASHER WITH INTUITIVE CONTROLS - 4.3 cu ft

PRODUCT DIMENSIONS

Unit of Measurement	4.3 cu ft DOE (US)/5.0 cu ft IEC (CAN)			
	in (minimum)	mm (minimum)	in (maximum)	mm (maximum)
Position of Power Cord (H)	35 ⁵ / ₁₆	897	-	-
Power Cord Length	72	1830	-	-
Position of Water Inlet Valves (I)	35 ⁵ / ₁₆	897	-	-
Position of Drain Hose (J)	8	205	-	-
Drain Hose Length	52	1321	-	-
Diameter of Drain Hose	1	26	-	-

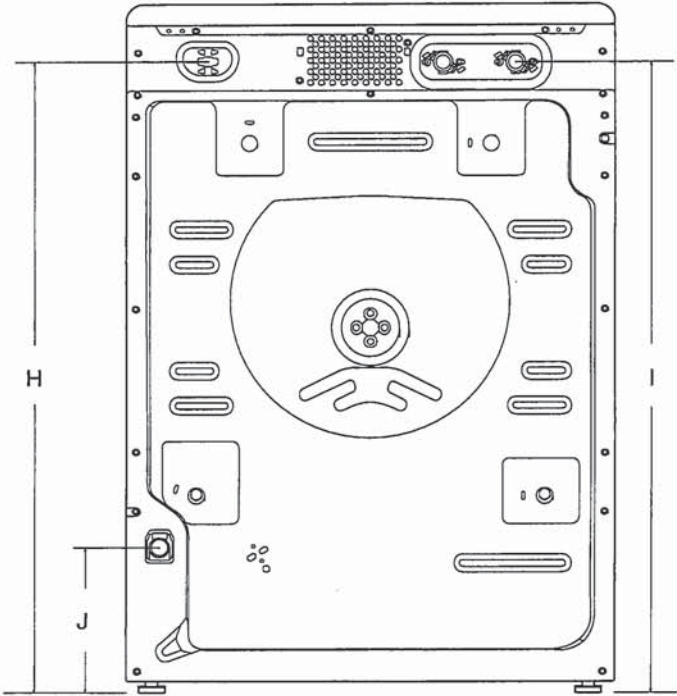

BACK VIEW

IMPORTANT: Dimensional specifications are provided for planning purposes only.



[Handwritten signature]

DETAILED PLANNING DIMENSION

5 of 15

WHIRLPOOL® FRONT LOAD WASHER WITH INTUITIVE CONTROLS - 4.3 cu ft

All Dimensions show recommended spacing allowed, except for closet door ventilation openings which are minimum required. This washer has been tested for installation with spacing of 0" (0 mm) clearance on the sides. Consider allowing more space for ease of installation and servicing, and spacing for companion appliances and clearances for walls, doors, and floor moldings. Add spacing of 1" (25 mm) on all sides of washer to reduce noise transfer. If a closet door or louvered door is installed, top and bottom air openings in door are required.

*For additional details (or information) specific to your model, refer to your Quick Start Guide.

CUSTOM UNDER COUNTER INSTALLATION

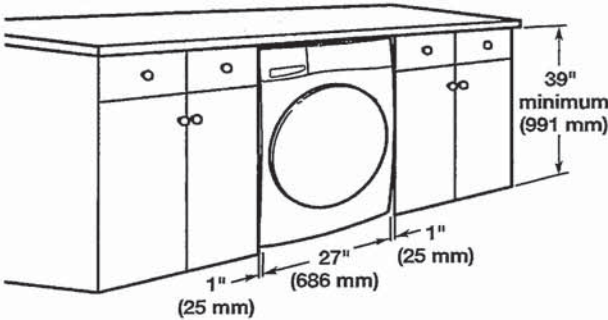

RECESSED AREA OR CLOSET INSTALLATION

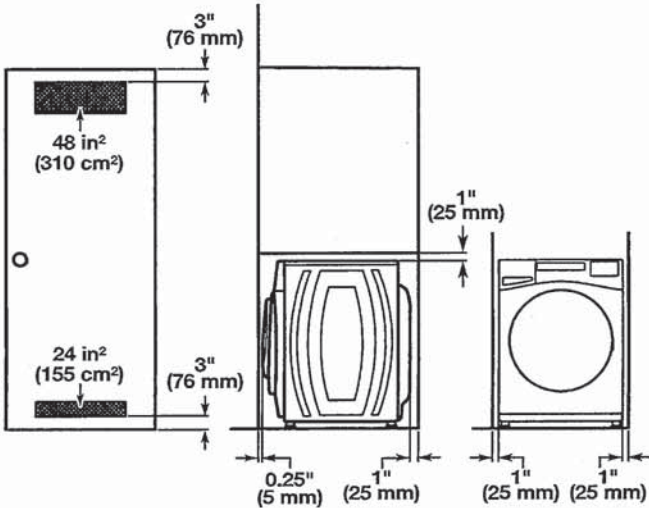

NOTE: All 27" wide washers should have 19" clearance, while all 29" wide washers should have 22" clearance.

IMPORTANT: Dimensional specifications are provided for planning purposes only.



A handwritten signature in the bottom right corner of the page.

WHIRLPOOL DRYER Model #: YWED5620HW

Whirlpool Brand Canada English | Washer and Dryers | Dryers | Electric Dryers | YWED5620HW

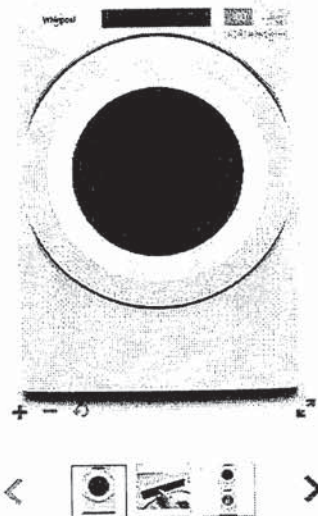

Define
Your Style
Available in select
models.

7.4 cu. ft. Front Load Electric
Dryer with Intuitive Touch
Controls



7.4 cu. ft. Front Load Electric Dryer with Intuitive Touch Controls

Model #: YWED5620HW

Dimensions

Depth	78.74 cm, 31.0 in
Depth With Door Open 90 Degree	138.43 cm, 54-1/2 in
Height	98.42 cm, 38-3/4 in
Width	68.58 cm, 27.0 in

Configuration and Overview

Fuel Type	Electric
-----------	----------

Cycles and Options

Cycle Time Remaining	Yes
Lint Filter Indicator	No
Number of Dryer Cycles	36
Number of Dryness Levels	3

Ventilation System

Long Vent	No
Maximum Vent Length	64
Venting Direction	Left, Right, Bottom, Rear

Electrical

Hz	60
Power Cord Included	Yes

Handwritten signature