

Sales Selection Sheet
Checklist

1 of 41

LOT 371 Model: 28-2897 B THE KINGSMERE

PURCHASERS: Lovely Bhagchandani/Saket Jhamnani

VENDOR: Heathwood Homes (Huron) Limited

- ☐ WOB
- ☐ DECK
- ☐ FINISHED BASEMENT
- ☐ COLD CELLAR

UPGRADED / MODIFIED ELEVATION

- ☐ CORNER UPGRADE
- ☐ REAR UPGRADE
- ☐ SIDE UPGRADE

CEILING UPGRADE - SMOOTH

- ☐ MAIN FLOOR
- ☐ SECOND FLOOR
- ☐ BASEMENT

ADDITIONAL ROUGH-INS

- ☒ 200 AMP SERVICE (STD IN SINGLES)
- ☐ WET BAR ROUGH-IN
- ☐ HUMIDIFIER
- ☒ AIR CONDITIONING (SITE STD)

GAS ROUGH-IN

- ☒ STOVE
- ☐ DRYER
- ☐ BBQ
- ☐ ADDITIONAL FIREPLACE

KITCHEN: HOODFAN VENTING SIZE

- ☒ 6 IN ROUND DUCT
- ☐ 7 IN ROUND DUCT

FULL BASEMENT STAIRS:	N/A
UPPER BASEMENT STAIRS:	All Oak
LOWER LEVEL STAIRS:	Paint Grade
MAIN STAIRS:	All Oak
MEDIA STAIRS (if applicable):	N/A
LOFT STAIRS (if applicable):	N/A

APRIL 12/23
Date Purchaser: *Signature*
on file

APRIL 12/23
Date Decor Consultant: SONIA SHARIF

Date Purchaser:

~~04-12-2023~~
-04-12-2023
Date Approved: *Signature*
Heathwood Homes (Huron) Limited

Locked Date:

Customer Colours

Lovely Bhagchandani/Saket Jhamnani
Project: Wallaceton
Unit: 371, Phase: 3
Model: 28-2897 B THE KINGSMERE

Created: 11/3/2022 13:05:54
Locked:
Closed:

Kitchen

Cabinet Colour/Style	9111	Viking III-SIMCOE ORCHID 3DL ***STD***
Island Cabinet Colour/Style	9158	Viking III-SIMCOE-NAVY BLUE-3DL ***STD***
Cabinet Hardware	7667	12881-HARDWARE ***STD***
Countertop	9069	MSI Quartz GROUP 1 ICED WHITE ***STD***
Island Countertop	9069	MSI Quartz GROUP 1 ICED WHITE ***STD***
Countertop Edge	4010	SINGLE POLISHED STRAIGHT EDGE 3/4 INCH ***STD***

- Please note some islands may require a seam as per manufacturer and fabricator discretions.

Sink	9487	Plumbing-KINDRED Kitchen Sink Collection - Reginox ND1831 U/9-Double (equal size) Bowl Undermount Sink (or equivalent)-Stainless Steel	PG 21
HoodFan	9394	SCB51936-CYCLONE 36 inch CANOPY CHIMNEY HOODFAN-SS	PG 32-33
Backsplash	1111	N/A *****	
Backsplash Grout	1111	N/A *****	
Backsplash Tile Pattern	1111	N/A *****	

Flooring	9106	GE.MD.WHT.1818.MT Madison Series White Matte 18 X 18 Matte ***1***
Floor Tile Grout	2225	Grout-(27) Silver ***STD***
Floor Tile Pattern	3000	STANDARD SQUARE ***STD***

- Purchasers have been advised: standard fridge opening is a minimum 37 3/8 x 73 3/8 inches. Ice Waterline Rough-In is included.

- Standard stove opening is 30 inches and standard dishwasher opening is 24 inches. Any gas stove will require backsplash or stainless steel backing to avoid fire hazards.

- Purchasers acknowledge: Heathwood Homes and its contractors will not be responsible for any kitchen cabinet changes due to appliances dimension changes after sign-off.

Comment

Landing and Broom Closet

Flooring	9106	GE.MD.WHT.1818.MT Madison Series White Matte 18 X 18 Matte ***1***
Floor Tile Grout	2225	Grout-(27) Silver ***STD***
Floor Tile Pattern	3000	STANDARD SQUARE ***STD***

L.B. SJ

Customer Colours

Lovely Bhagchandani/Saket Jhamnani
Project: Wallaceton
Unit: 371, Phase: 3
Model: 28-2897 B THE KINGSMERE

Created: 11/9/2022 13:05:54
Locked:
Closed:



Comment

Foyer

Flooring	9106	GE.MD.WHT.1818.MT Madison Series White Matte 18 X 18 Matte ***1***
Floor Tile Grout	9106	Grout-(27) Silver ***STD***
Floor Tile Pattern	9106	STANDARD SQUARE ***STD***

Comment

Powder Room

Flooring	9106	GE.MD.WHT.1818.MT Madison Series White Matte 18 X 18 Matte ***1***
Floor Tile Grout	9106	Grout-(27) Silver ***STD***
Floor Tile Pattern	9106	STANDARD SQUARE ***STD***

Plumbing Fixture (Colour)	9106	Plumbing Fixtures-WHITE ***STD***
---------------------------	------	-----------------------------------

Comment

Dining Room

Flooring	9106	Red Oak Pearl-Vintage Engineered-GRYPHON/IRONGATE-3/4 inch x 3 1/4 inch
----------	------	---

Comment

Main Hall

Flooring	9106	Red Oak Pearl-Vintage Engineered-GRYPHON/IRONGATE-3/4 inch x 3 1/4 inch
----------	------	---

Comment

Great/Breakfast

Flooring	9106	Red Oak Pearl-Vintage Engineered-GRYPHON/IRONGATE-3/4 inch x 3 1/4 inch
----------	------	---

L.B SJ

Lovely Bhagchandani/Saket Jhamnani
Project: Wallaceton
Unit: 371, Phase: 3
Model: 28-2897 B THE KINGSMERE

Created: 11/07/2022 13:05:54
Locked:
Closed:

Comment

Great Room Fireplace

Type	9106	Majestic MERC32 ***STD***
Mantle	9106	NF-17-Paint Grade Mantle- Cabinet (Per Plan)-WHITE ***STD***
Surround (Opt.)	1111	N/A *****

PG 20

- Purchasers have been advised: heat from the FP can damage TV above a FP and items placed on mantle.
- Heathwood and its contractors will not be liable for any damage on items placed/@installed above a FP after closing.

Comment

Mud Room / Laundry

Flooring	9437	TH.CT.WHT.1212.MT-Construct-White Matte-12 x 12 STD ***STD***
Floor Tile Grout	2225	Grout-(27) Silver ***STD***
Floor Tile Pattern	3000	STANDARD SQUARE ***STD*** <div><div></div><div></div><div></div><div></div><div></div><div></div><div></div><div></div><div></div></div>
Opt. Cabinet Colour/Style - Uppers	1111	N/A *****
Opt. Cabinet Hardware - Uppers	1111	N/A *****
Opt. Cabinet Colour/Style - Base	1111	N/A *****
Opt. Cabinet Hardware - Base	1111	N/A *****
Opt. Countertop	1111	N/A *****
Opt. Countertop Edge	1111	N/A *****

Comment

Upper Hall

Flooring	9505	84558-MINOTAUR-BEACH SHELL-40 oz Poly ***STD***
----------	------	---

Comment

Master Bedroom

Flooring	9505	84558-MINOTAUR-BEACH SHELL-40 oz Poly ***STD***
----------	------	---

Comment

LB.SJ

Lovely Bhagchandani/Saket Jhamnani
Project: Wallaceton
Unit: 371, Phase: 3
Model: 28-2897 B THE KINGSMERE

Created: 11/9/2022 13:05:54
Locked:
Closed:

Bedroom 2

Flooring	9505	84558-MINOTAUR-BEACH SHELL-40 oz Poly ***STD***
----------	------	---

Comment	
---------	--

Bedroom 3

Flooring	9505	84558-MINOTAUR-BEACH SHELL-40 oz Poly ***STD***
----------	------	---

Comment	
---------	--

Bedroom 4 (Reg. Second Floor)

Flooring	9505	84558-MINOTAUR-BEACH SHELL-40 oz Poly ***STD***
----------	------	---

Comment	
---------	--

Family Room (Opt. Second Floor)

Flooring	1111	N/A *****
----------	------	-----------

Comment	
---------	--

Bedroom 5

Flooring	9505	84558-MINOTAUR-BEACH SHELL-40 oz Poly ***STD***
----------	------	---

Comment	
---------	--

Master Ensuite

Cabinet Colour/Style	9505	Viking III-MUSKOKA-MOONLIGHT-3DL ***STD***
----------------------	------	--

Cabinet Hardware	9505	135-HARDWARE ***STD***
------------------	------	------------------------

Countertop	9069	MSI Quartz GROUP 1 ICED WHITE ***STD***
------------	------	---

Countertop Edge	4010	SINGLE POLISHED STRAIGHT EDGE 3/4 INCH ***STD***
-----------------	------	--

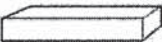

Floor Tile	9071	GE.BY.AZR.1313 New Byzantine Azzuro 13x13 ***STD***
------------	------	---

Floor Tile Grout	9071	Grout-(27) Silver ***STD***
------------------	------	-----------------------------

Floor Tile Pattern	9071	STANDARD SQUARE ***STD***
--------------------	------	---------------------------

L.B. 50

Lovely Bhagchandani/Saket Jhamnani
Project: Wallaceeton
Unit: 371, Phase: 3
Model: 28-2897 B THE KINGSMERE

Created: 11/09/2022 13:05:04
Locked:
Closed:



Shower Wall Tile	9020	QT.WV.WHT.0810-Weave-White-8 x 10 ***STD***
Shower Wall Tile Grout	9020	Grout-(00) White ***STD***
Shower Wall Tile Pattern	3090	VERTICAL STACKED ***STD*** <div><div></div><div></div><div></div><div></div><div></div><div></div><div></div><div></div></div>
Shower Floor Tile	8661	OD.ON.SWT.0202.MT.N-Ontario Series Mosaic-Snow White Matte-2 x 2 ***STD***
Shower Floor Tile Grout	8661	Grout-(00) White ***STD***
Shower Floor Tile Pattern	3000	STANDARD SQUARE ***STD*** <div><div></div><div></div><div></div><div></div><div></div><div></div><div></div><div></div></div>
Shower Jamb(s) and Sill(s)	3000	Shower Jamb / Sill-Thassos White ***STD***
Plumbing Fixture (colour)	3000	Plumbing Fixtures-WHITE ***STD***
Comment		

Shared Ensuite

Cabinet Colour/Style	3000	Viking III-MUSKOKA-NAVY BLUE-3DL ***STD***
Cabinet Hardware	3000	135-HARDWARE ***STD***
Countertop	3000	6698-46-Countertop-PALOMA POLAR ETCHINGS FINISH-Formica ***STD***
Countertop Edge	1111	N/A *****
Floor Tile	9071	GE.BY.AZR.1313 New Byzantine Azzuro 13x13 ***STD***
Floor Tile Grout	9071	Grout-(27) Silver ***STD***
Floor Tile Pattern	9071	STANDARD SQUARE ***STD***
Shower Wall Tile	9020	QT.WV.WHT.0810-Weave-White-8 x 10 ***STD***
Shower Wall Tile Grout	2226	Grout-(00) White ***STD***
Shower Wall Tile Pattern	3090	VERTICAL STACKED ***STD*** <div><div></div><div></div><div></div><div></div><div></div><div></div><div></div><div></div></div>

L.B. SJ

Lovely Bhagchandani/Saket Jhamnani
Project: Wallaceeton
Unit: 371, Phase: 3
Model: 28-2897 B THE KINGSMERE

Created: 11/07/2022 13:05:54
Locked:
Closed:

Shower Floor Tile	8661	OD.ON.SWT.0202.MT.N-Ontario Series Mosaic-Snow White Matte-2 x 2 ***STD***									
Shower Floor Tile Grout	8661	Grout-(00) White ***STD***									
Shower Floor Tile Pattern	3000	STANDARD SQUARE ***STD***									
		<table><tr><td></td><td></td><td></td></tr><tr><td></td><td></td><td></td></tr><tr><td></td><td></td><td></td></tr></table>									
Shower Jamb(s) and Sill(s)	3000	Shower Jamb / Sill-Thassos White ***STD***									
Plumbing Fixture (colour)	3000	Plumbing Fixtures-WHITE ***STD***									
Comment											

Ensuite 4 (Reg. Second Floor)

Cabinet Colour/Style	9538	Viking II-TRINITY LPL-STAINLESS ***STD***									
Cabinet Hardware	9538	135-HARDWARE ***STD***									
Countertop	9538	6698-46-Countertop-PALOMA POLAR ETCHINGS FINISH-Formica ***STD***									
Countertop Edge	1111	N/A *****									
Floor Tile	9071	GE.BY.AZR.1313 New Byzantine Azzuro 13x13 ***STD***									
Floor Tile Grout	9071	Grout-(27) Silver ***STD***									
Floor Tile Pattern	3000	STANDARD SQUARE ***STD***									
		<table><tr><td></td><td></td><td></td></tr><tr><td></td><td></td><td></td></tr><tr><td></td><td></td><td></td></tr></table>									
Wall Tile	3000	QT.SP.WHT.0810-Splendour-White-8 inch x 10 inch ***STD***									
Wall Tile Grout	3000	Grout-(00) White ***STD***									
Wall Tile Pattern	3090	VERTICAL STACKED ***STD***									
		<table><tr><td></td><td></td><td></td><td></td></tr><tr><td></td><td></td><td></td><td></td></tr></table>									
Opt. Shower Floor Tile	1111	N/A *****									
Opt. Shower Floor Tile Grout	1111	N/A *****									
Opt. Shower Floor Tile Pattern	1111	N/A *****									
Opt. Shower Jamb(s) and Sill(s)	1111	Shower Jamb / Sill-Thassos White ***STD***									
Plumbing Fixture (colour)	1111	Plumbing Fixtures-WHITE ***STD***									
Comment											

LB. SJ

Lovely Bhagchandani/Saket Jhamnani
Project: Wallaceon
Unit: 371, Phase: 3
Model: 28-2897 B THE KINGSMERE

Created: 11/07/2022 13:05:54
Locked:
Closed:

Ensuite 5

Cabinet Colour/Style	9538	Viking II-TRINITY LPL-STAINLESS ***STD***
Cabinet Hardware	9538	135-HARDWARE ***STD***
Countertop	9538	6698-46-Countertop-PALOMA POLAR ETCHINGS FINISH-Formica ***STD***
Countertop Edge	1111	N/A *****

Floor Tile	9071	GE.BY.AZR.1313 New Byzantine Azzuro 13x13 ***STD***
Floor Tile Grout	9071	Grout-(27) Silver ***STD***
Floor Tile Pattern	3000	STANDARD SQUARE ***STD***

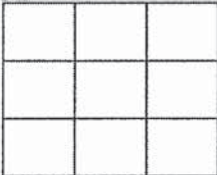

Wall Tile	3000	QT.SP.WHT.0810-Splendour-White-8 inch x 10 inch ***STD***
Wall Tile Grout	3000	Grout-(00) White ***STD***
Wall Tile Pattern	3090	VERTICAL STACKED ***STD***

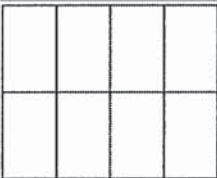

Opt. Shower Floor Tile	1111	N/A *****
Opt. Shower Floor Tile Grout	1111	N/A *****
Opt. Shower Floor Tile Pattern	1111	N/A *****

Opt. Shower Jamb(s) and Sill(s)	1111	Shower Jamb / Sill-Thassos White ***STD***
Plumbing Fixture (colour)	1111	Plumbing Fixtures-WHITE ***STD***
Comment		

Lower Level Recreation Room (Opt. Finish)

Flooring	1111	N/A *****
Comment		

Lower Level Bathroom (Opt. Finished Bas

Cabinet Colour/Style	1111	N/A *****
----------------------	------	-----------

Customer Colours

Lovely Bhagchandani/Saket Jhamnani
Project: Wallaceeton
Unit: 371, Phase: 3
Model: 28-2897 B THE KINGSMERE

Created: 11/09/2022 13:05:34
Locked:
Closed:

Cabinet Hardware	1111	N/A *****
Countertop	1111	N/A *****
Countertop Edge	1111	N/A *****
Floor Tile	1111	N/A *****
Floor Tile Grout	1111	N/A *****
Floor Tile Pattern	1111	N/A *****
Wall Tile	1111	N/A *****
Wall Tile Grout	1111	N/A *****
Wall Tile Pattern	1111	N/A *****
Opt. Shower Floor Tile	1111	N/A *****
Opt. Shower Floor Tile Grout	1111	N/A *****
Opt. Shower Floor Tile Pattern	1111	N/A *****
Opt. Shower Jamb(s) and Sill(s)	1111	N/A *****
Plumbing Fixture (colour)	1111	N/A *****
Comment		

Main Stairs

Type	1111	Oak Stairs ***STD MAIN STAIRS***
Colour	7912	Irongate (Gryphon) STAIN TO COMPLIMENT HARDWOOD AND WILL VARY FROM FLOORING
Handrail/Pickets/Posts Type	7912	1 5/16 inch Square pickets with 3 1/2" Square/Cap Post(s)-ALL OAK ***STD***
Handrail/Pickets/Posts Colour	7912	Irongate (Gryphon) STAIN TO COMPLIMENT HARDWOOD AND WILL VARY FROM FLOORING
Custom Stain/Paint	1111	N/A *****
Landing(s)	1111	Red Oak Pearl-Vintage Engineered-GRYPHON/IRONGATE-3/4 inch x 3 1/4 inch
Opt. Carpet Runner	1111	N/A *****
Comment		

L.B. SJ

Customer Colours

Lovely Bhagchandani/Saket Jhamnani
Project: Wallaceton
Unit: 371, Phase: 3
Model: 28-2897 B THE KINGSMERE

Created: 11/9/2022 13:05:54
Locked:
Closed:

Comment

Lower Level Stairs

Type	1713	Paint Grade Stairs ***STD UNFINISHED BASEMENT STAIRS
Colour	1111	N/A *****
Handrail/Pickets/Posts Type	1111	N/A *****
Handrail/Pickets/Posts Colour	1111	N/A *****
Custom Stain/Paint	1111	N/A *****
Landing(s)	1111	N/A *****
Opt. Carpet Runner	1111	N/A *****
Comment		

Throughout

Switches and Plug	1111	Decora White Switches and Plugs ***STD***
Thresholds	1111	Metal Thresholds ***STD***
Underpad	1111	500 Series-Underpad ***STD***
Trim Size	1111	4 1/4 Baseboard and 2 3/4 Casings ***STD***
Trim - Paint Colour	1111	Trim-WHITE ***STD***
Walls - Paint Colour	1111	22-Wall-WARM GREY ***STD***
Comment		

Purchaser:



2/17/2023



Feb. 17/23

Lovely Bhagchandani

Date

Decor Consultant

Date

Purchaser:



2/17/2023



03-24-2023

Saket Jhamnani

Date

Wallaceton

Date Approved



CONSTRUCTION SUMMARY

Lot: 371
Model: 28-2897 B THE KINGSMERE
Project/Phase: Wallaceton / 3

Offer Worksheet	Ten Thousand Dollars (\$10,000) At D?cor. (No Cash Value) Singles Note:
Offer Worksheet	The Purchaser(s) acknowledge that they have NOT been referred by an existing Heathwood Homeowner and therefor are not entitled to a referral fee under Heathwood Homes Referral program. Note:



CONSTRUCTION SUMMARY

Lot: 371
Model: 28-2897 B THE KINGSMERE
Project/Phase: Wallaceton / 3

ADMIN FEE

Invoice	Qty.	Description
---------	------	-------------

APPLIANCES

Invoice	Qty.	Description
1207 313,486 19Jun23	1	- APPLIANCES - CYCLONE 36 INCH WALL MOUNT CHIMNEY HOOD SS - SCB51936 CABINETRY-delete stove uppers; ELECTRICAL-delete std range hood; HEATING/AIR CONDITIONING-Duct change to 6 in

CABINETRY

Invoice	Qty.	Description
1207 343,575 19Jun23	1	KITCHEN - CABINETRY - OPT. BUILT IN - VIKING II/III - UPG SKETCH # 3 DRYWAL-Notify; FRAMING-Modify Bulkhead; GRANITE-delete partial countertop due to Built-in; PAINTING-
1207 314,124 19Jun23	1	KITCHEN - L01-Two-tone colour/style selection for island (must be of equal or lower level to main selection) Viking SKETCH # 3
1207 313,486 19Jun23 **	1	- APPLIANCES - CYCLONE 36 INCH WALL MOUNT CHIMNEY HOOD SS - SCB51936 CABINETRY-delete stove uppers; ELECTRICAL-delete std range hood; HEATING/AIR CONDITIONING-Duct change to 6 in

CERAMICS

Invoice	Qty.	Description
1207 345,189 19Jun23	1	- CERAMICS - FOYER FLOOR - UPG 1
1207 345,190 19Jun23	1	- CERAMICS - POWDER FLOOR - UPG 1
1207 345,192 19Jun23	1	- CERAMICS - KITCHEN - UPG 1

DRYWALL

Invoice	Qty.	Description
1207 343,575 19Jun23 **	1	KITCHEN - CABINETRY - OPT. BUILT IN - VIKING II/III - UPG SKETCH # 3 DRYWAL-Notify; FRAMING-Modify Bulkhead; GRANITE-delete partial countertop due to Built-in; PAINTING-



CONSTRUCTION SUMMARY

Lot: 371
Model: 28-2897 B THE KINGSMERE
Project/Phase: Wallaceton / 3

ELECTRICAL

Invoice	Qty.	Description
1207 314,242 19Jun23	1	KITCHEN - ELECTRICAL - RELOCATION OF SWITCHES/LIGHTS (MUST SPECIFY LOCATION) - NOTE: PLUGS CANNOT BE RELOCATED- MUST PURCHASE ADDITIONAL OUTLET. RELOCATE STOVE PLUG FOR WALL OVEN SKETCH # 3
1207 314,224 19Jun23	1	KITCHEN - ELECTRICAL - CEILING ROUGH-IN (CAPPED) INCLUDING SWITCH R/I CAPPED LIGHT +/- CENTERED ABOVE BREAKFAST COUNTER ON SEPARATE SWITCH SKETCH # 2
1207 314,224 19Jun23	1	GREAT ROOM - ELECTRICAL - CEILING ROUGH-IN (CAPPED) INCLUDING SWITCH R/I CAPPED CEILING LIGHT +/- CENTERED IN GREAT ROOM ON SEPARATE SWITCH SKETCH # 2
1207 314,242 19Jun23	1	- ELECTRICAL - RELOCATION OF SWITCHES/LIGHTS (MUST SPECIFY LOCATION) - NOTE: PLUGS CANNOT BE RELOCATED- MUST PURCHASE ADDITIONAL OUTLET. RELOCATE LIGHT FIXTURE FROM SECOND FLOOR ABOVE STAIRCASE TO +/- CENTERED IN OPEN TO ABOVE CEILING SEE SKETCH # 4
1207 314,340 19Jun23 **	1	KITCHEN - HEATING/AIR - ROUGH-IN GAS LINE FOR GAS STOVE AT MAIN FLOOR (SEE SPECS) (HOOK-UP NOT INCLUDED) LEAVE STANDARD 120 VOLT ELECTRICAL OUTLET ON A SEPARATE CIRCUIT. * SPECIFY IF STANDARD 220V WILL STAY OR BE RELOCATED STANDARD 240V TO BE RELOCATED TO BUILT-IN MICRO/OVEN LOCATION SKETCH # 3 ELECTRICAL-Notify
1207 313,486 19Jun23 **	1	- APPLIANCES - CYCLONE 36 INCH WALL MOUNT CHIMNEY HOOD SS - SCB51936 CABINETRY-delete stove uppers; ELECTRICAL-delete std range hood; HEATING/AIR CONDITIONING-Duct change to 6 in
1207 314,232 19Jun23	1	GREAT ROOM - ELECTRICAL - EXTRA WALL INTERIOR OUTLET ON EXISTING CIRCUIT (DOES NOT INCLUDE KITCHEN OUTLETS) +/- TO BE CENTERED ABOVE THE FIREPLACE, +/- 70" FROM FLOOR SKETCH # 2

FRAMING

Invoice	Qty.	Description
1207 343,575 19Jun23 **	1	KITCHEN - CABINETRY - OPT. BUILT IN - VIKING II/III - UPG SKETCH # 3 DRYWAL-Notify; FRAMING-Modify Bulkhead; GRANITE-delete partial countertop due to Built-in; PAINTING-

GRANITE

Invoice	Qty.	Description
1207 343,575 19Jun23 **	1	KITCHEN - CABINETRY - OPT. BUILT IN - VIKING II/III - UPG SKETCH # 3 DRYWAL-Notify; FRAMING-Modify Bulkhead; GRANITE-delete partial countertop due to Built-in; PAINTING-
1508 314,277 30Jun23	1	- GRANITE - GRANITE CUTOUT WITH STRAIGHT EDGE POLISH TO ACCOMMODATE BUILT IN LAYOUT COOK TOP



CONSTRUCTION SUMMARY

Lot: 371
Model: 28-2897 B THE KINGSMERE
Project/Phase: Wallaceton / 3

HEATING / AIR CONDITIONING

Invoice	Qty.	Description
1207 314,340 19Jun23	1	KITCHEN - HEATING/AIR - ROUGH-IN GAS LINE FOR GAS STOVE AT MAIN FLOOR (SEE SPECS) (HOOK-UP NOT INCLUDED) LEAVE STANDARD 120 VOLT ELECTRICAL OUTLET ON A SEPARATE CIRCUIT. * SPECIFY IF STANDARD 220V WILL STAY OR BE RELOCATED STANDARD 240V TO BE RELOCATED TO BUILT-IN MICRO/OVEN LOCATION SKETCH # 3 ELECTRICAL-Notify
1207 313,486 19Jun23 **	1	- APPLIANCES - CYCLONE 36 INCH WALL MOUNT CHIMNEY HOOD SS - SCB51936 CABINETRY-delete stove uppers; ELECTRICAL-delete std range hood; HEATING/AIR CONDITIONING-Duct change to 6 in

PAINTING

Invoice	Qty.	Description
1207 343,575 19Jun23 **	1	KITCHEN - CABINETRY - OPT. BUILT IN - VIKING II/III - UPG SKETCH # 3 DRYWAL-Notify; FRAMING-Modify Bulkhead; GRANITE-delete partial countertop due to Built-in; PAINTING-

THE KINGSMERE

ELEVATION B | 2,888 SQ. FT.

922 sq. ft. of opt. finished Lower Level

WALLACETON
EST. 1870

28-2897 ELEV. B

Sketch #1

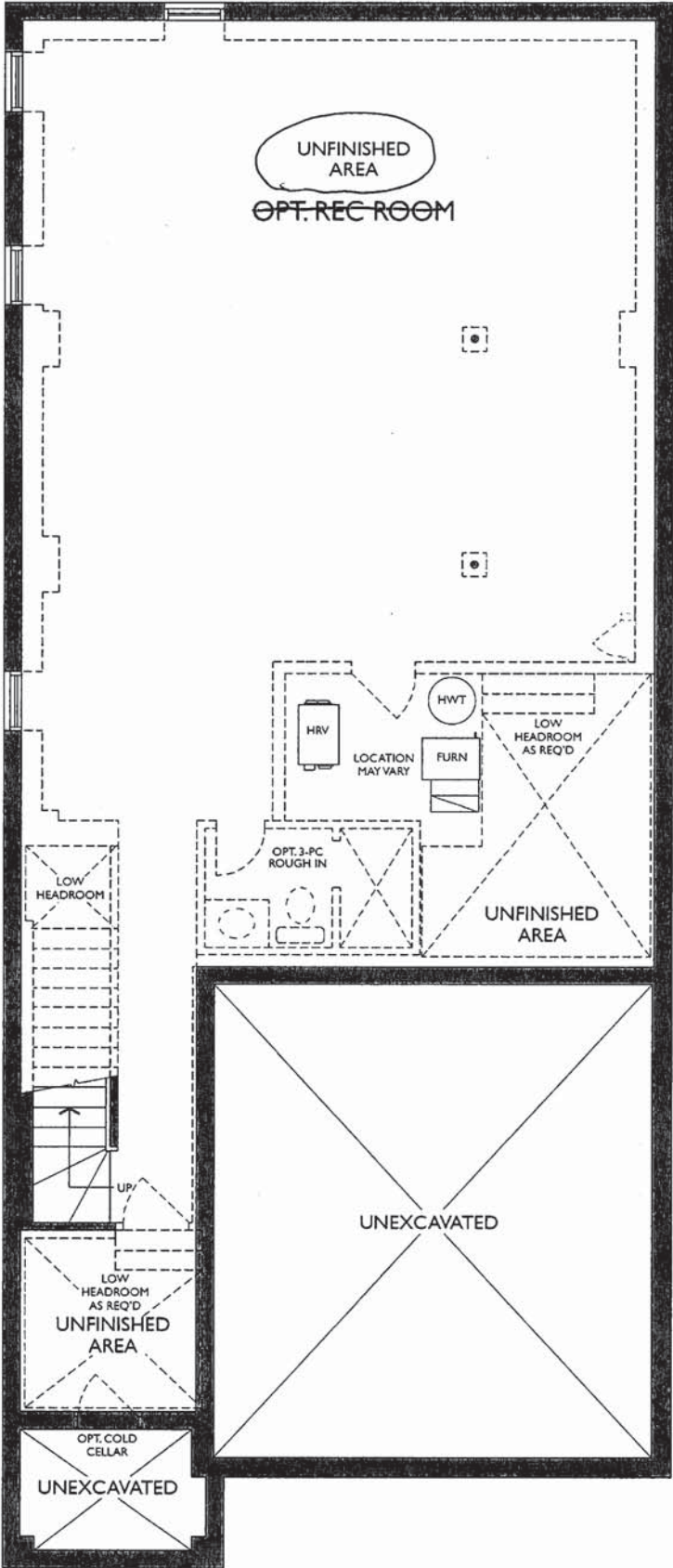

LOWER LEVEL
ELEVATION A & B

L.B. SJ

Sketch # 2

922 sq. ft. of opt. finished Lower Level

WALLACETON

EST. 1870



L.B.

UPGRADE KITCHEN - BUILT-IN APPLIANCES:
-36" COOKTOP POTS & PANS
-30" WALL OVEN
36" CHIMNEY
hood fan

17 of 41

Project: Wallaceton
Unit: 371, Phase: 3
Model: 28-2897-B THE KINGSMERE

9/20/2022

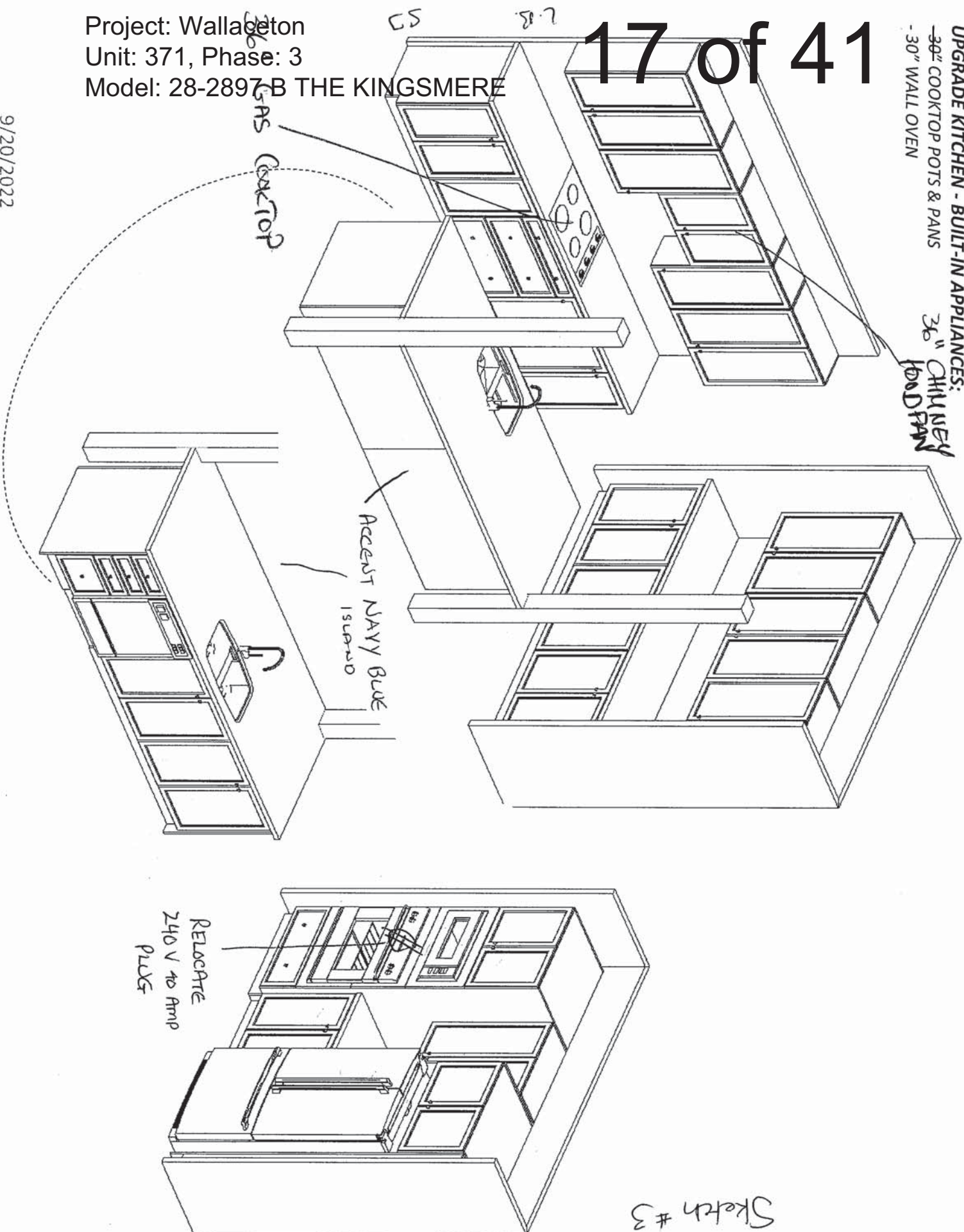

F R E N D E L
K I T C H E N S L I M I T E D
1350 Showman Drive, Mississauga, ON L4W 1C5

HEATHWOOD HOMES
WALLACETON, KITCHENER ON
MODEL: 28-2897 (3404)

STANDARD CONTRACT INCLUDES:

Appliance Openings

- Hood Opening: 30"W Builder hood
- Fridge Opening: 37 3/8 "W X 73 3/8"
- Fridge cabinet & gables: 66cm Deep
- Stove Opening: 30" Freestanding
- Dishwasher Opening: 24"

Standard Kitchens Scope:

- 100cm H wall cabinets
- Std. Blumotion Hinges- **soft close**
- Std. Metabox Drawers- **not soft close**
- Min 40cm W drawer
- Base pie cut corner cabinets
- Backing on all cabinets
- Countertop by others
- Upgrade applied paneled fridge & dishwashers supply only (appliance hardware by others)

Standard Vanity & Laundry Scope:

- Powder by others, pedestal
- Master Ens. - Top by others
- Remaining vanities inc. laminate top
- Std. Blum Hinges- **not soft close**
- Std. Metabox Drawers- **not soft close**
- Master Ens: Top drawers(Sink Full height)
- Mains: Full height doors (top drawers added if Masters can't accommodate)
- Optional laundry base & wall cabinets

THIS DRAWING IS FOR DESIGN PURPOSES ONLY.
IT IS NOT AN EXACT REPRESENTATION.

THE KINGSMERE

ELEVATION B | 2,888 SQ. FT.
922 sq. ft. of opt. finished Lower Level

WALLACETON
EST. 1870

Sketch #4

28-2897 ELEV. B

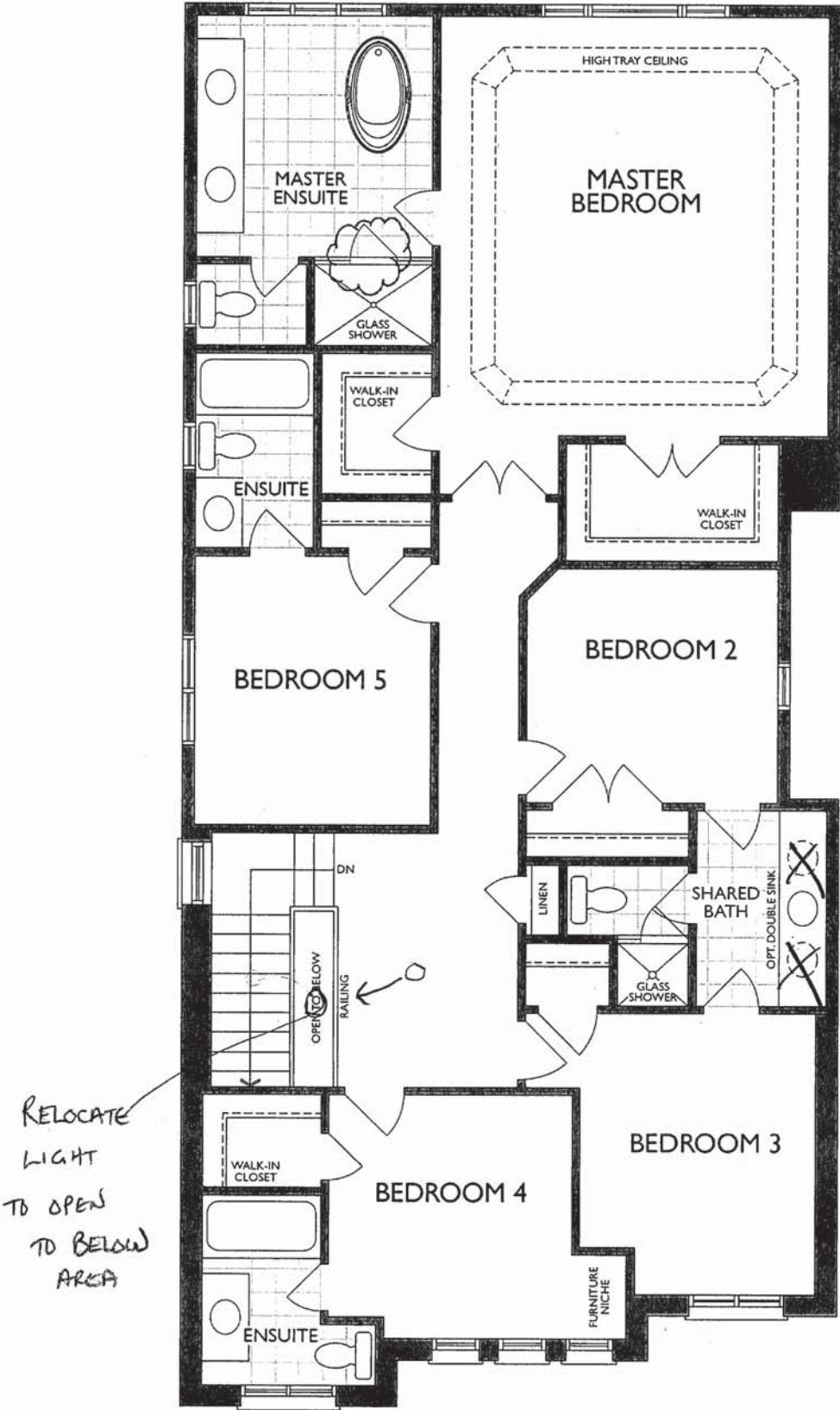

SECOND FLOOR
ELEVATION B

*Master Ensuite Shower Door Swing Changed

L.B.

SJ

(3404) STANDARD 2ND FLOOR

MASTER ENSUITE

(2ND FLR - ELEV: A, B, C)

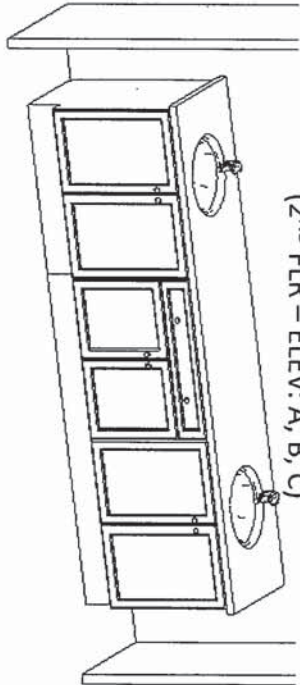

ENSUITE 3

(2ND FLR - ELEV: A, B, C)

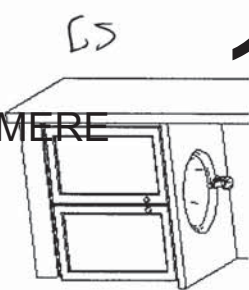

SHARED ENSUITE

(2ND FLR - ELEV: A, B, C)

(OPT. DBL SINK)

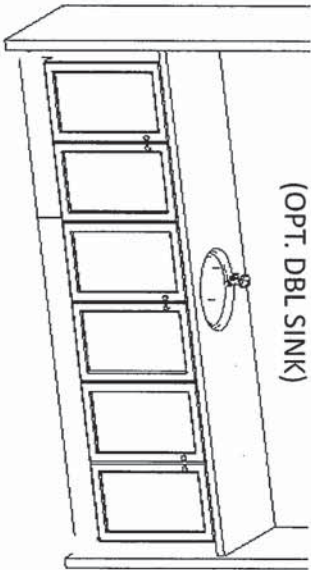

LAUNDRY

(GROUND FLOOR)

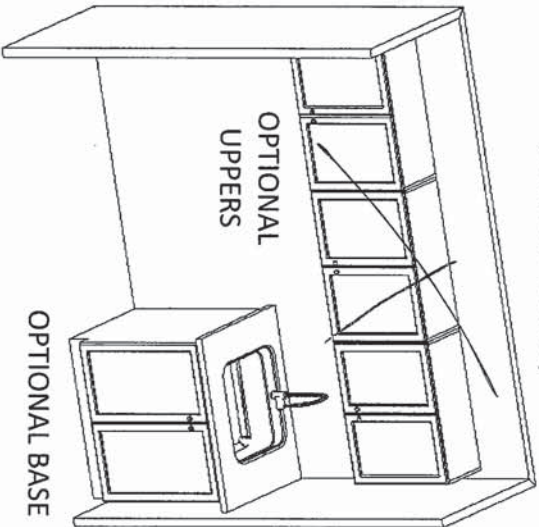

ENSUITE 2

(2ND FLR - ELEV: A)

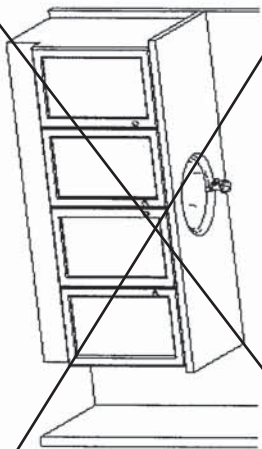

(2ND FLR - ELEV: B, C)

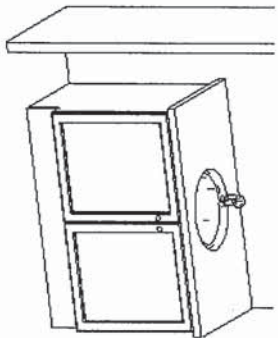

OR

OPT. BASEMENT BATH

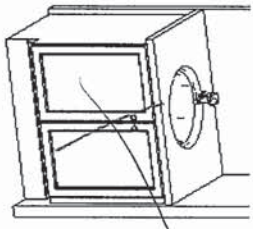

Sketch # 5



F R E N D E L
K I T C H E N S L I M I T E D
1350 Shawson Drive, Mississauga, ON L4W 1C5

HEATHWOOD HOMES
WALLACETON, KITCHENER ON
MODEL: 28-2897 (3404)

STANDARD CONTRACT INCLUDES:

Appliance Openings

- Hood Opening: 30"W Builder hood
- Fridge Opening: 37 3/8 "W X 73 3/8"
- Fridge cabinet & gables: 66cm Deep
- Stove Opening: 30" Freestanding
- Dishwasher Opening: 24"

Standard Kitchens Scope:

- 100cm H wall cabinets
- Std. Blumotion Hinges- **soft close**
- Std. Metabox Drawers- **not soft close**
- Min 40cm W drawer
- Base pie cut corner cabinets
- Backing on all cabinets
- Countertop by others
- Upgrade applied paneled fridge & dishwashers supply only (appliance hardware by others)

Standard Vanity & Laundry Scope:

- Powder by others, pedestal
- Master Ens. - Top by others
- Remaining vanities inc. laminate top
- Std. Blum Hinges- **not soft close**
- Std. Metabox Drawers- **not soft close**
- Master Ens: Top drawers(Sink Full height)
- Mains: Full height doors (top drawers added if Masters can't accommodate)
- Optional laundry base & wall cabinets

THIS DRAWING IS FOR DESIGN PURPOSES ONLY.
IT IS NOT AN EXACT REPRESENTATION.

Project: Wallaceton
Unit: 371, Phase: 3
Model: 28-2897 B THE KINGSMERE

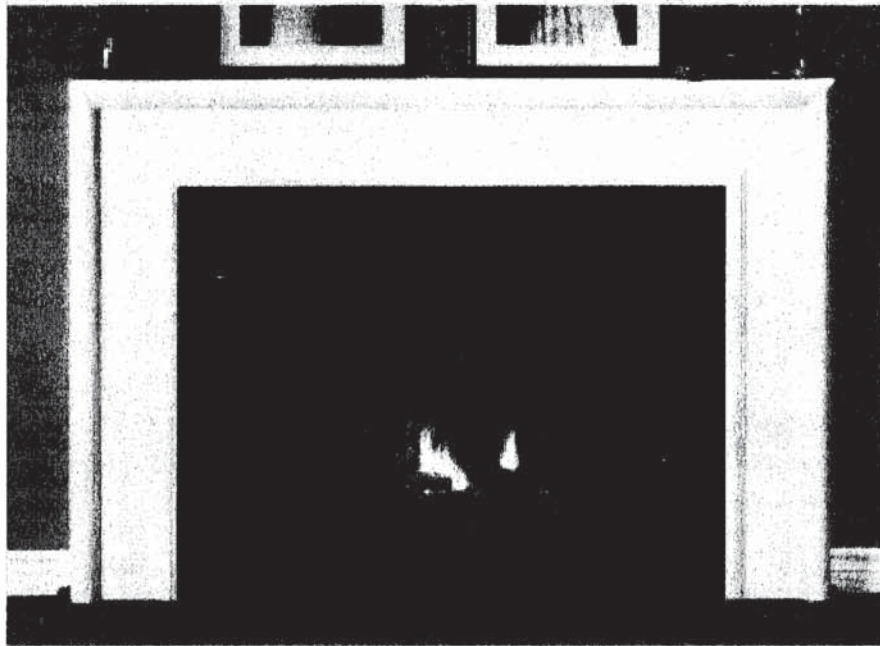

NEAS NF17 Mantel - CABINET

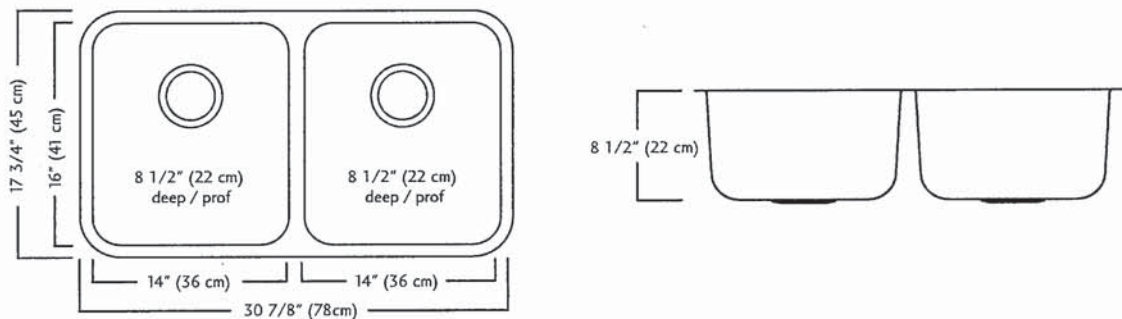

ND1831UA/9 SPECIFICATION

Model ND1831UA/9 is a double (two equal size) bowl undermount sink manufactured by Franke Kindred Canada Limited from 18 gauge stainless steel. Product has silk finished rims and linear brush finished bowls. Sink is fully undercoated. Basket strainer waste fittings (3 1/2", 89 mm) are included. Sink is backed with a limited lifetime warranty.

- O.D. 17 3/4" x 30 7/8" x 8 1/2" (45 x 78 x 22 cm)
- Recommended for minimum 36" cabinet

Franke Kindred Canada Limited
P.O. Box 190, 1000 Franke Kindred Road, Midland, Ontario, Canada, L4R 4K9 Phone: 866-687-7465 Fax: 800-361-8408

SJ
L.B.

MOEN®

Specifications

FAUCET DESCRIPTION

- Reflex™ pulldown system offers smooth operation, easy movement and secure docking
- Power Clean™ spray technology
- Metal construction with various finishes identified by suffix
- Quick connect installation
- Pulldown spray with 68" braided hose
- Flexible supply lines with 3/8" compression fittings
- High arc spout provides height and reach to fill or clean large pots while pulldown wand provides the maneuverability for cleaning or rinsing
- 360° rotating spout
- Faucet designed for handle to be mounted on right side only

OPERATION

- Lever style handle
- Temperature controlled by 100° arc of handle travel
- Operates with less than 5 lbs. of force
- Operates in stream or spray mode in the pullout or retracted position

FLOW

- Flow is limited to 1.5 gpm (5.7 L/min) max at 60 psi

CARTRIDGE

- 1255™ Duralast™ cartridge

STANDARDS

- Third party certified to IAPMO Green, ASME A112.18.1/CSA B125.1 and all applicable requirements therein including NSF 61/9G & 372
- Meets CalGreen and Georgia SB370 requirements
- Complies with California Proposition 65 and with the Federal Safe Drinking Water Act
- The backflow protection system in the device consists of two independently operating check valves, a primary and a secondary which prevent backflow

- **ADA**  for lever handle

WARRANTY

- Lifetime limited warranty against leaks, drips and finish defects to the original homeowner
 - 10 year limited warranty when used in a multifamily installation
 - 5 year limited warranty when used in a commercial installation
- Visit www.moen.com/support for complete details and limitations

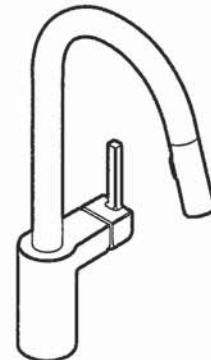

ALIGN™
Single Handle High Arc
Pulldown Kitchen Faucet

Models: 7565 series

NOTE: THIS FAUCET IS DESIGNED TO BE INSTALLED
THROUGH 1 HOLE, 1-1/2" (38mm) MIN. DIA.
(OPTIONAL 3-HOLE ESCUTCHEON 141002 AVAILABLE)

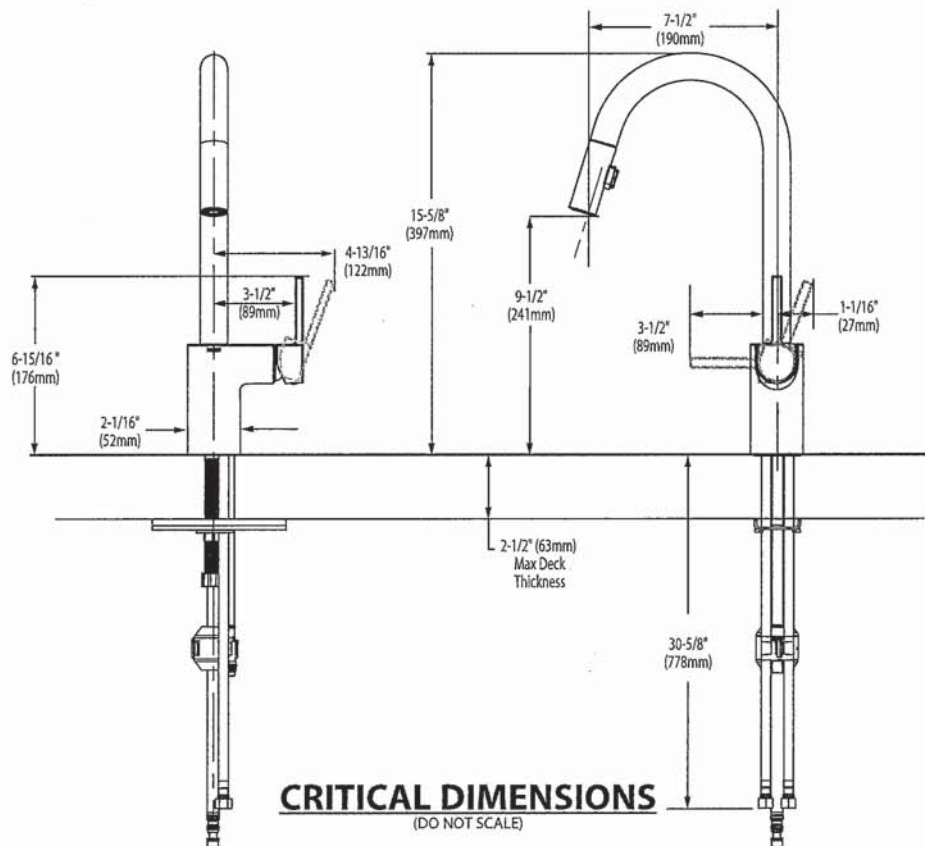

SJ
L.B.



 **BARRIER FREE (ABOVE COUNTER OR DROP-IN ONLY)**

**BOULEVARD®
PEDESTAL SINK**
VITREOUS CHINA

BOULEVARD® PEDESTAL SINK

- STD ☒ **0641.400** Faucet holes on 4" (102mm) centers
- ☐ **0641.800** Faucet holes on 8" (203mm) centers (Illustrated)
- ☐ **0641.100** Center hole only
- Classic styled rectangular pedestal lavatory
 - Vitreous china
 - Rear overflow
 - Supplied with mounting kit
 - Right Height® for greater comfort during use
 - Faucet ledge with large deck area (faucet not included)
 - **Design coordinates with Boulevard® Toilet**
 - Basin has flat bottom to also allow use as an **above counter** sink or a **drop-in** sink (with u-shaped cut out)

Nominal Dimensions:

24" x 19" x 35-1/2"
(610 x 483 x 902mm)

- ☐ **0641.008** Pedestal top-8" (203mm) centers
- ☐ **0641.004** Pedestal top-4" (102mm) centers
- ☐ **0641.001** Pedestal top-center hole only
- ☐ **0010.000** Pedestal only

Bowl sizes:

17" (432mm) wide,
12-1/2" (318mm) front to back,
5" (127mm) deep

Compliance Certifications -

Meets or Exceeds the Following Specifications:

- ASME A112.19.2 - 2008/CSA B45.1-08

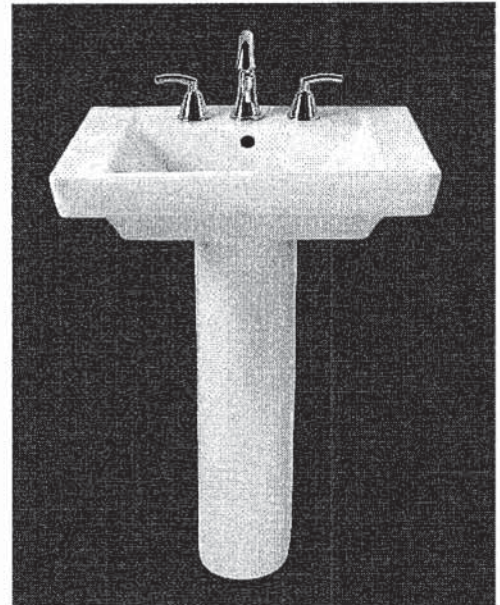

SEE REVERSE FOR ROUGHING-IN DIMENSIONS

To Be Specified:

- ☐ Color: ☐ White ☐ Linen
- ☐ Faucet Finish:
- ☐ Supplies:
- ☐ 1-1/4" Trap:
- ☐ Nipple:

* See faucet section for additional models available

SJ
L.B.

Master Ensuite

American Standard

Style That Works Better

 BARRIER FREE

OVALYN™
UNDERCOUNTER SINK
VITREOUS CHINA

OVALYN™ UNDERCOUNTER SINK

- Classic oval undermount sink
- Made from vitreous china
- Front overflow
- Supplied with mounting kit (047194-0070A) and template

☐ **0495.221 Unglazed rim**

435 x 359mm
(17-1/8" x 14-1/8")

☐ **0495.300 Glazed underside**

Bowl size:

382mm (15-1/16") wide
306mm (12-1/16") front to back
140mm (5-1/2") deep

☐ **0496.221 Unglazed rim**

489 x 413mm
(19-1/4" x 16-1/4")

☐ **0496.300 Glazed underside**

Bowl size:

432mm (17") wide
356mm (14") front to back
140mm (5-1/2") deep

☐ **0497.221 Unglazed rim**

546 x 441mm
(21-1/2" x 17-3/8")

☐ **0497.300 Glazed underside**

Bowl size:

483mm (19") wide
391mm (15-3/8") front to back
140mm (5-1/2") deep

Compliance Certifications -

Meets or Exceeds the Following Specifications:

- ASME A112.19.2M for Vitreous China Fixtures
- CAN/CSA B45 series

To Be Specified:

- ☐ Color: ☐ White ☐ Bone ☐ Linen
☐ Silver ☐ Fawn Beige ☐ Black
- ☐ Faucet*:
☐ Faucet Finish:
☐ Supplies:
☐ 1-1/4" Trap:

* See faucet section for additional models available

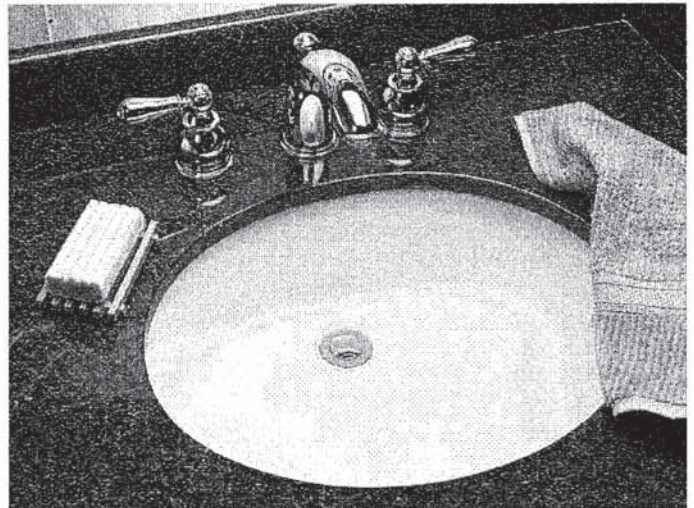

STD Master Ensuite Undermount SINGLES

X 2

SEE REVERSE FOR ROUGHING-IN DIMENSIONS

SJ
L.B.

American Standard

Style That Works Better

 BARRIER FREE

OVALYN™
UNDERCOUNTER SINK
VITREOUS CHINA

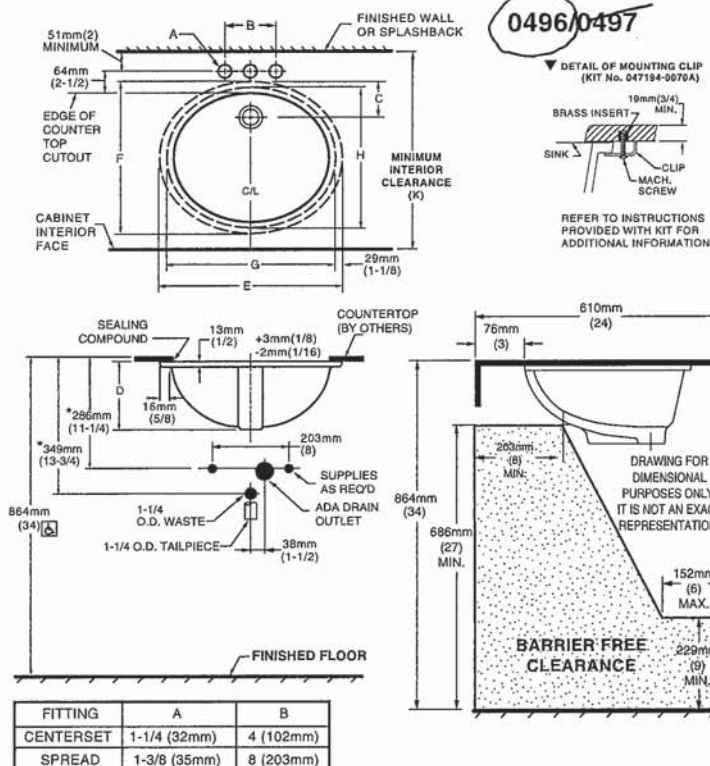

NOTES:
* DIMENSIONS SHOWN FOR LOCATION OF SUPPLIED AND "P" TRAP ARE SUGGESTED.
▼ UNDERCOUNTER MOUNTING KIT SUPPLIED WITH SINK.
PLEASE NOTE MINIMUM INTERIOR CLEARANCE DIMENSION (K). FITTINGS NOT INCLUDED AND MUST BE ORDERED SEPARATELY. USE ENCLOSED TEMPLATE FOR COUNTERTOP CUTOUT SEALING COMPOUND SUPPLIED BY OTHERS.

IMPORTANT: Dimensions of fixtures are nominal and may vary within the range of tolerances established by ANSI Standard A112.19.2. These measurements are subject to change or cancellation. No responsibility is assumed for use of superseded or voided pages.

 **MEETS THE AMERICANS WITH DISABILITIES ACT GUIDELINES AND ANSI A117.1 ACCESSIBLE AND USEABLE BUILDINGS AND FACILITIES - CHECK LOCAL CODES.**

Countertop 864mm (34") from finished floor. Lavatory installed 76mm (3") from front edge of countertop. Countertop thickness to be 25mm (1") maximum.

CAT. NO.	E	F	G	H	C	D	J	K
0496.221	489mm (19-1/4)	413mm (16-1/4)	432mm (17)	356mm (14)	103mm (4-1/16)	182mm (7-3/16)	16mm (5/8)	500mm (19-11/16)
0497.221	546mm (21-1/2)	441mm (17-3/8)	483mm (19)	391mm (15-3/8)	95mm (3-3/4)	191mm (7-1/2)	19mm (3/4)	534mm (21-1/16)

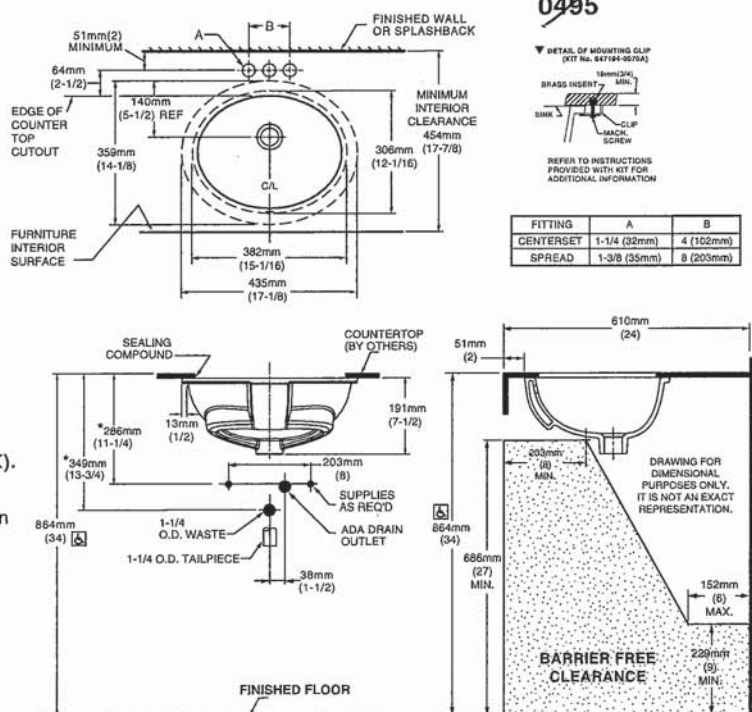

NOTES:
USE ENCLOSED TEMPLATE FOR COUNTER TOP CUTOUT. FITTINGS NOT INCLUDED WITH FIXTURE AND MUST BE ORDERED SEPARATELY.
* DIMENSIONS SHOWN FOR LOCATION OF SUPPLIED AND "P" TRAP ARE SUGGESTED.
▼ UNDERCOUNTER MOUNTING KIT SUPPLIED WITH SINK.
PLEASE NOTE MINIMUM INTERIOR CLEARANCE DIMENSION (K). SEALING COMPOUND SUPPLIED BY OTHERS.

IMPORTANT: Dimensions of fixtures are nominal and may vary within the range of tolerances established by ANSI Standard A112.19.2. These measurements are subject to change or cancellation. No responsibility is assumed for use of superseded or voided pages

 **MEETS THE AMERICANS WITH DISABILITIES ACT GUIDELINES AND ANSI A117.1 ACCESSIBLE AND USEABLE BUILDINGS AND FACILITIES - CHECK LOCAL CODES.**

Countertop 864mm (34") from finished floor. Lavatory installed 51mm (2") from front edge of countertop. Countertop thickness to be 25mm (1") maximum.

57
L.B.



COLONY™
COUNTERTOP SINK
VITREOUS CHINA

COLONY COUNTERTOP SINK

- Vitreous china
- Self-rimming
- Front overflow
- Supplied with template
- Faucet deck
(Faucet shown not included)

- ☐ 0346 803
Faucet holes on 203mm (8") centres
- ☒ 0346 403 (Illustrated)
Faucet holes on 102mm (4") centres
- ☐ 0346 001
Centre hole only

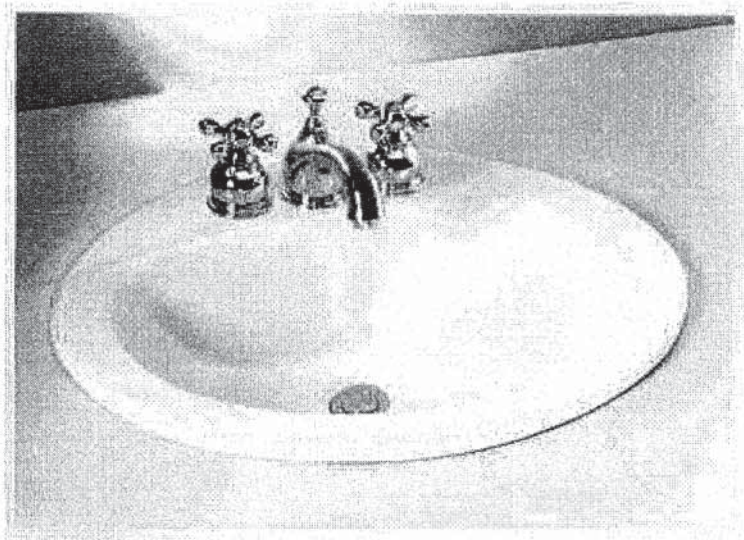

Nominal Dimensions:
521 x 448mm (20-1/2" x 17-5/8")

Bowl sizes:
422mm (16-5/8") wide, 279mm (11") front to back, 143mm (5-5/8") deep

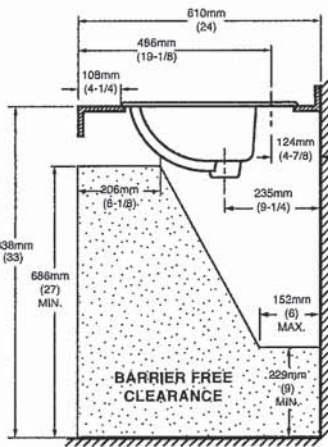
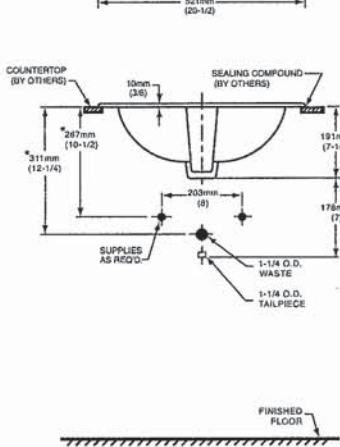
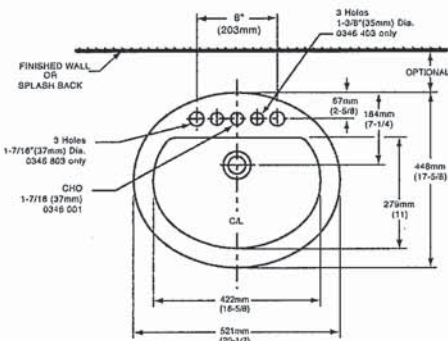

COMPLIANCE CERTIFICATIONS –
Meets or exceeds the following Specifications:
• ASME A112.19.2M for Vitreous China Fixtures.
• CAN/CSA B45 Series.

- To Be Specified
- ☐ Colour: ☐ White ☐ Bone ☐ Silver Gray ☐ Linen
 - ☐ Faucet*:
 - ☐ Faucet Finish:
 - ☐ Supplies & Stops:
 - ☐ Trap 1-1/4" (32 mm):

NOTES:
* DIMENSIONS SHOWN FOR LOCATION OF SUPPLIES AND "P" TRAP ARE SUGGESTED. FOR COUNTERTOP CUTOUT AND INSTALLATION INSTRUCTIONS USE TEMPLATE SUPPLIED WITH SINK. FAUCETS NOT INCLUDED AND MUST BE ORDERED SEPARATELY. IMPORTANT: Dimensions of fixtures are nominal and may vary within the range of tolerances established by ANSI Standard A112.19.2. These measurements are subject to change or cancellation. No responsibility is assumed for use of superseded or voided pages.

* See faucet section for additional models available

SJ
L.B.



DEMI™
Product Specification Sheet

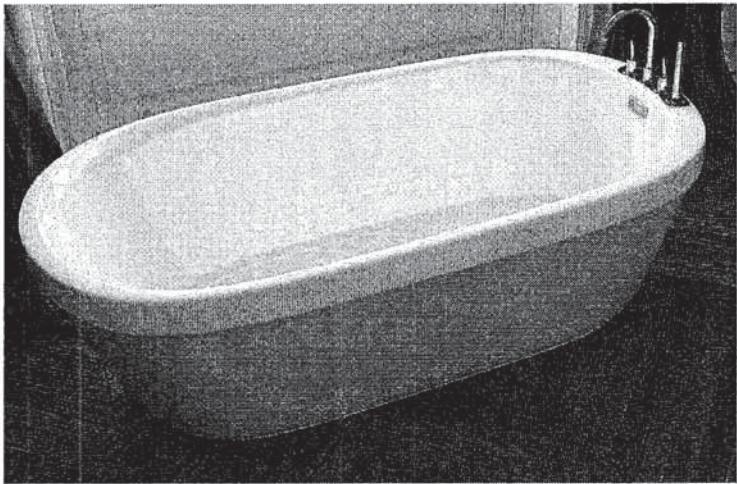

Two Piece Freestanding Collection

CF2007	Two Piece Freestanding Soaker
Size:	60" x 32" x 22" 1524 mm x 813 mm x 559 mm

PRODUCT FEATURES & BENEFITS

- Vacuum formed acrylic reinforced with fiberglass
- Scratch, stain and fade resistant high gloss finish
- Installation friendly two piece design
- Accepts deck mounted faucet
- Includes integral pop up drain and rectangular overflow
- Includes levelling feet

TWO PIECE ASSEMBLY

FRONT VIEW

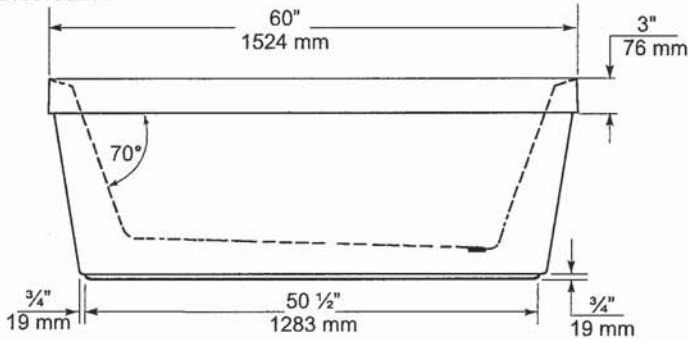

END VIEW

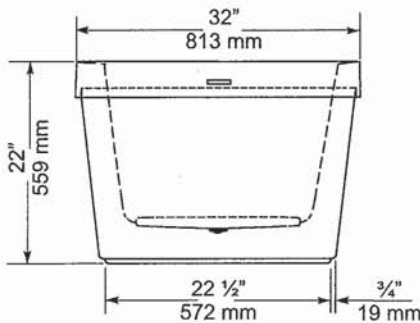

TOP VIEW

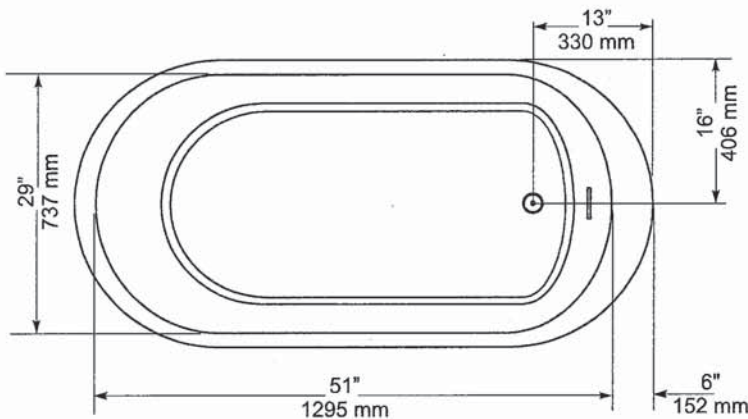

GENERAL SPECIFICATIONS		
Average Weight	90 lb	41 kg
Bathing Well at bottom	43"x 20"	1092 x 508 mm
Capacity Drain to Overflow		195 litres
Water Depth Drain to Overflow	16"	406 mm
Drain Opening (dia.)	2"	51 mm
Overflow Opening	2 1/4"x 1 1/2"	57 x 13 mm
Drain to Floor Clearance	3 1/4"	83 mm

NOTES: Please confirm measurements on actual product to ensure proper identification. Bathtub to be installed on the floor supported by 5 self levelling feet. Adjust if required to level the bathtub for adequate drainage. Refer to installation instructions for additional information.

IMPORTANT: Dimensions of fixtures are nominal and may vary ± 1/4" (6 mm). Weight may vary ± 5 lb (2.3 kg). Drawing is not to scale. These measurements are subject to change at manufacturer's discretion.

Compliance Certifications -
Meets or Exceeds the following Specifications:
• CAN/CSA - B45 Series



53
L.B.

American Standard
Style That Works Better

FloWise™ DUAL FLUSH
ELONGATED TOILET
VITREOUS CHINA

FloWise™ DUAL FLUSH ELONGATED TOILET

- 2476 216
 - Vitreous china
 - Low-consumption Dual Flush
 - Full flush 6.0 Lpf/1.3 gpf,
 - Partial flush 3.0 Lpf/0.66 gpf.
 - Elongated wash down bowl
 - Internal trapway fully-glazed,
 - 2-1/4" (57mm) ballpass
 - Concealed trapway bowl
 - Chrome-plated top mounted
 - push button actuator
 - Easy to clean sanitary dam on bowl
 - Includes Elongated Slow Close Seat
 - 100% factory flush tested
 - 2 bolt caps

Separate Component Parts:

- 3067 316 Elongated Bowl with Slow Close Seat
- 4035 216 Unlined Tank

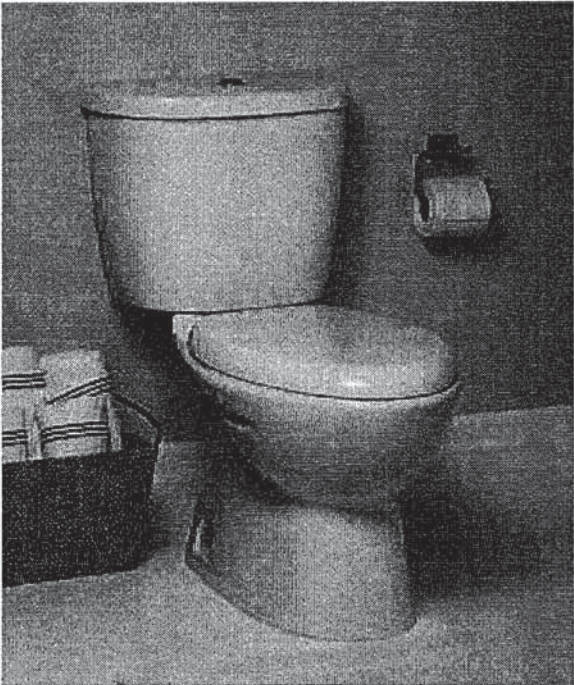

- 2476 516 Same as above with Lined tank
 - 3067 316 Elongated Bowl
 - 4035 516 Lined Tank

Nominal Dimensions:
794 x 432 x 765mm
(31-1/4" x 17" x 30-1/8")

Compliance Certifications -
Meets or Exceeds the Following Specifications:

- ASME A112.19.2M (and 19.6M)
- CAN/CSA B45 series

- To Be Specified
- Colour: 020 White
 - Supply with stop:

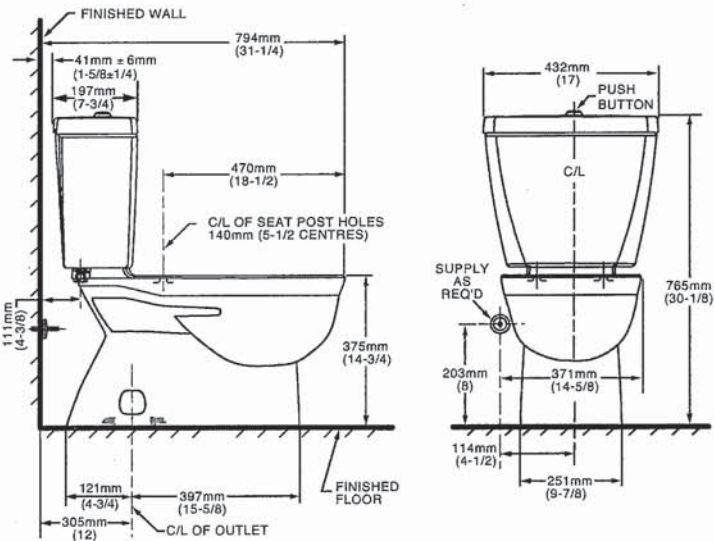

NOTES:
THIS TOILET IS DESIGNED TO ROUGH-IN AT A MINIMUM DIMENSION OF 305MM (12") FROM FINISHED WALL TO C/L OF OUTLET.
SUPPLY NOT INCLUDED WITH FIXTURE AND MUST BE ORDERED SEPARATELY.
* DIMENSION SHOWN FOR LOCATION OF SUPPLY IS SUGGESTED.
FOR ADDITIONAL INFORMATION REFER TO INSTALLATION INSTRUCTIONS SUPPLIED.
IMPORTANT: Dimensions of fixtures are nominal and may vary within the range of tolerance established by ANSI Standard A112.19.2
These measurements are subject to change or cancellation. No responsibility is assumed for use of superseded or voided pages.

UPGRADED VALUE ADDED FEATURES AT NO EXTRA CHARGE

57
L.B.

MOEN®

Specifications

DESCRIPTION

- Metal construction with various finishes identified by suffix
- 16" long 3/8" tubing connections
- Includes metal or 50/50 pop-up type waste assembly where noted

OPERATION

- Pivot action lever style handle
- Temperature controlled through 180° degree arc of handle travel

FLOW

- Flow is limited to 1.5 gpm max (5.7L/min) at 60 psi

CARTRIDGE

- 1225 cartridge design
- Nonmetallic/nonferrous and stainless steel material
- Can accommodate reversed piping and back to back installations

STANDARDS

- Third party certified to WaterSense®, CSA B-125.1, ASME A112.18.1 and all applicable requirements referenced therein including NSF61/9
- Complies with California Proposition 65 and with the Federal Safe Drinking Water Act
- **ADA**  for lever handle

WARRANTY

- Lifetime limited warranty against leaks, drips and finish defects to the original consumer purchaser
- 5 year warranty if used in commercial installations



CHATEAU®
Single-Handle Lavatory Faucet

with Metal Waste Assembly

Model: L4625 series

L4631BC

Bulk Packed (12 per carton):

L64624 series

with 50/50 Waste Assembly

Bulk Packed (12 per carton):

L64625 series

Less Waste

Bulk Packed (12 per carton):

L64600 series

NOTE: THIS FAUCET IS DESIGNED TO BE
INSTALLED THRU 3-1" DIA. HOLES, 2" ON CENTER

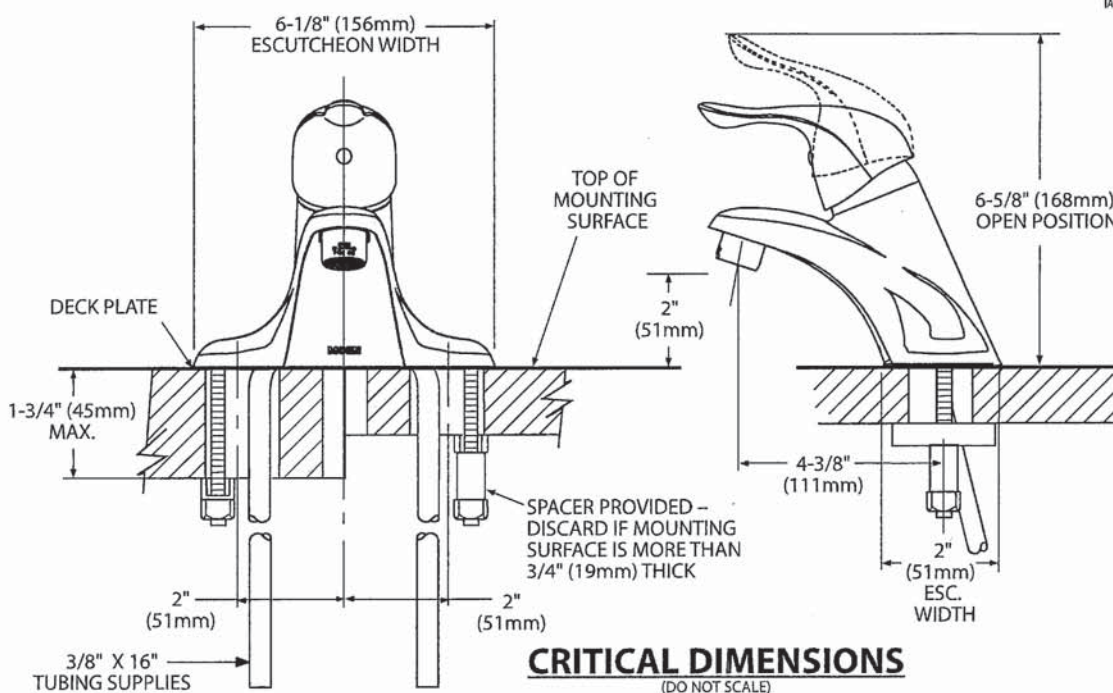

Rev 8/15

FOR MORE INFORMATION CALL: 1-800-BUY-MOEN

www.moen.com



Buy it for looks. Buy it for life.®

There is more than 1 version of this model.
Page down to identify the version you have.

DESCRIPTION

- Metal construction with various finishes identified by suffix
- Includes non-metallic showerhead, arm, flange and non-metallic diverter tub spout

OPERATION

- Handle operates counterclockwise through a 270° arc with off at 6 o'clock and maximum hot at the 9 o'clock position. Shut off in clockwise direction
- Adjustable temperature limit stop to control maximum hot water temperature
- Pressure balancing mechanism maintains selected discharge temperature to $\pm 3^\circ$

FLOW

- Showerhead is limited to 2.5 gpm (9.5 L/min) at 80 psi
- EP suffix models are limited to 1.75 gpm (6.6 L/min) at 80 psi
- NH suffix models contain no showerhead

CARTRIDGE

- 1222 cartridge design
- Accommodates back to back installations
- Nonmetallic/nonferrous and stainless steel material

STANDARDS

- Third party certified to meet ASME A112.18.1/CSA B125.1 and all applicable requirements referenced therein
- EP suffix models are third party certified to WaterSense®
- ADA  for lever handle

WARRANTY

- Lifetime limited warranty against leaks, drips and finish defects to the original consumer purchaser
- 5 year warranty if used in commercial installations

Specifications



CHATEAU® POSI-TEMP® Single-Handle Tub/Shower Trim Kit

Models: TL181 series - valve trim only
(Bulk Packed 12 per carton)
TL182 series - shower trim only
(Bulk Packed 12 per carton)
TL183 series - tub/shower trim
(Bulk Packed 12 per carton)

Valves: 62300 series
2500 series

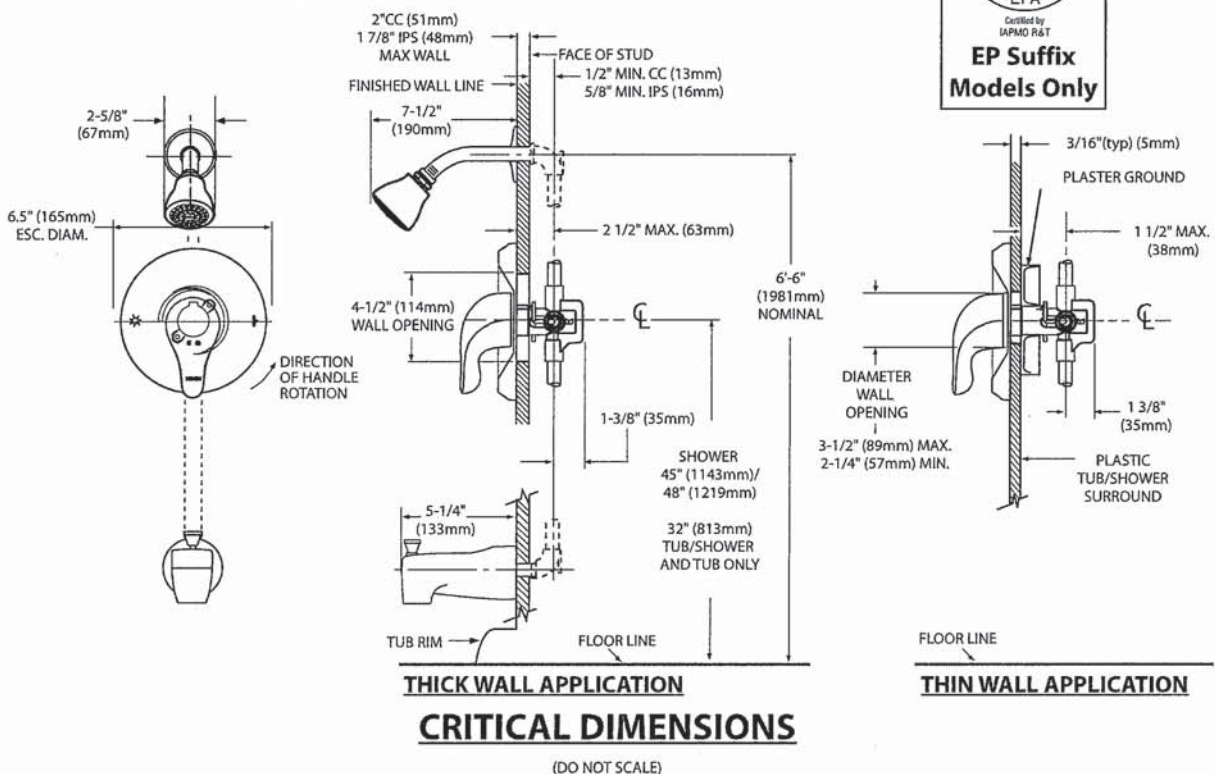

SJ
2.12

MOEN®

Specifications

DESCRIPTION

- Metal construction with various finishes identified by suffix

OPERATION

- Lever style handles with hot and cold color indicator
- Rotate hot side handle counterclockwise to open (clockwise to close) and the cold side handle (clockwise to open) and (counterclockwise to close)

STANDARDS

- Third party certified to: ASME A112.18.1/CSA B-125.1, and all applicable requirements referenced therein

- **ADA**  for lever handles

WARRANTY

- Lifetime limited warranty against leaks, drips and finish defects to the original homeowner
 - 10 year limited warranty when used in a multi-family installation
 - 5 year limited warranty when used in a commercial installation
- Visit www.moen.com/support for complete details and limitations

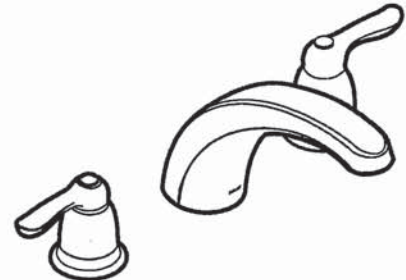

CHATEAU®

Two-Handle Garden Tub Trim

Models: T994 series

Valves: 4792, 4793, 4794, 4796, 4797, 4798

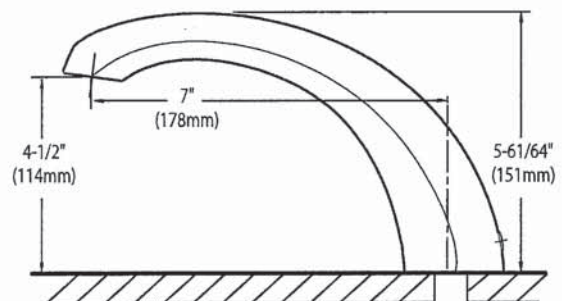
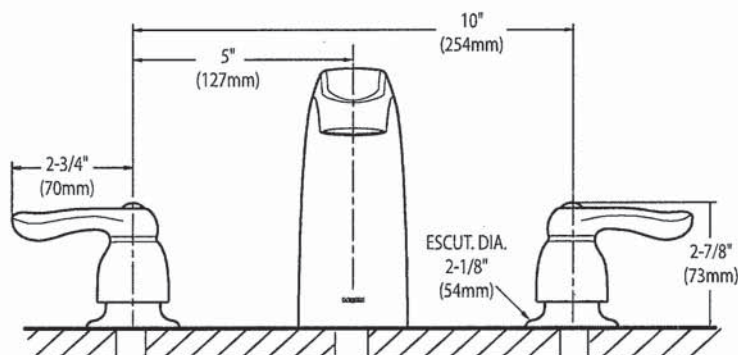

CRITICAL DIMENSIONS

(DO NOT SCALE)

SC(B)519 | ALITO Collection

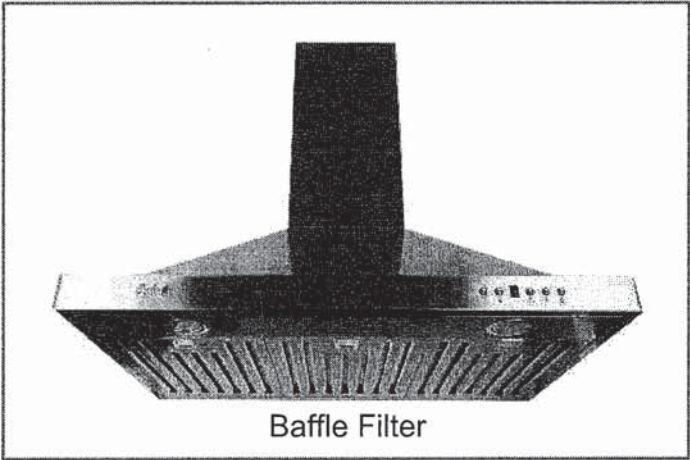

Baffle Filter

Wall Mount

Strong and sturdy with attractive lines and an imposing frame, the SC(B)519 is fitted with a time-delay OFF feature up to nine minutes, a 550 CFM fan, two bright front mounted LED lights and a digital three-speed push button control panel.

Green Features



3 Speed Push Button Control Panel



Long-Lasting LED Lights



Time-Delay OFF Feature



Grease Cup

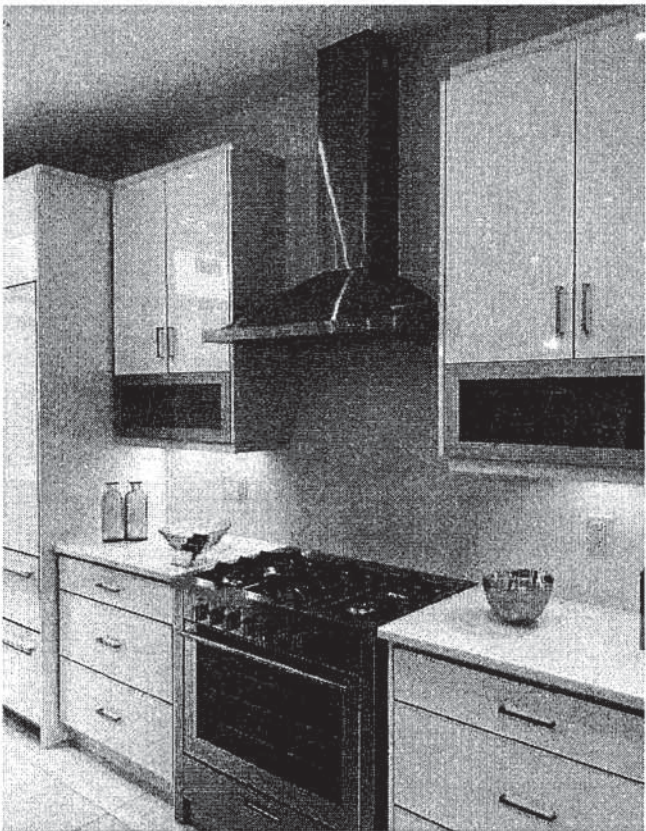

Model	Colour	Ducting	Filters	Size	CFM
SCB51930	Stainless Steel	6"	Baffle	30"	550
SCB51936	Stainless Steel	6"	Baffle	36"	550

Cyclone Range Hoods Inc.

1361 Huntingwood Drive, Unit 16, Toronto, ON, M1S 3J1, Canada.

Toll Free: 1-888-293-5662 Tel: (416) 293-0933 Fax: (416) 293-4793 Website: www.CycloneRangeHoods.com

SC(B)519 | ALITO Collection



Features

- Wall mount range hood
- 6" round duct adapter
- Non-stick aluminum fan blades
- 3 speed push button control
- 2 LED lights (2 x 1.4W, 4000K)
- Quick release aluminum mesh filters
- Standard chimney fits up to 9 ft. ceiling
- Up to 9 minutes time-delay OFF feature
- Plug-in connection

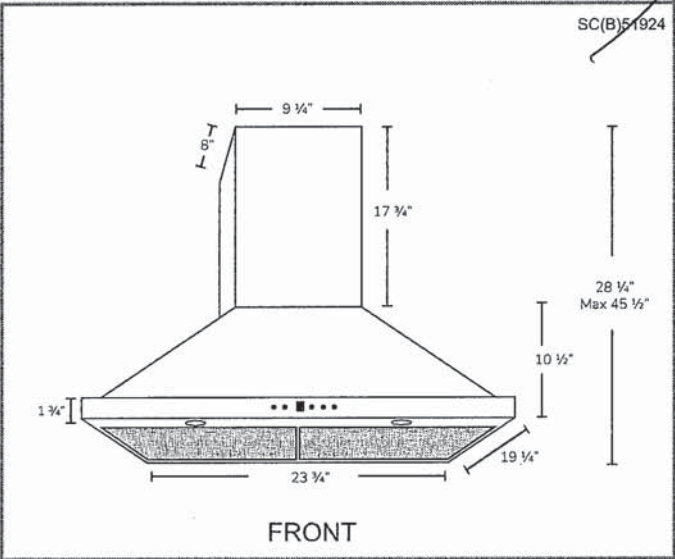
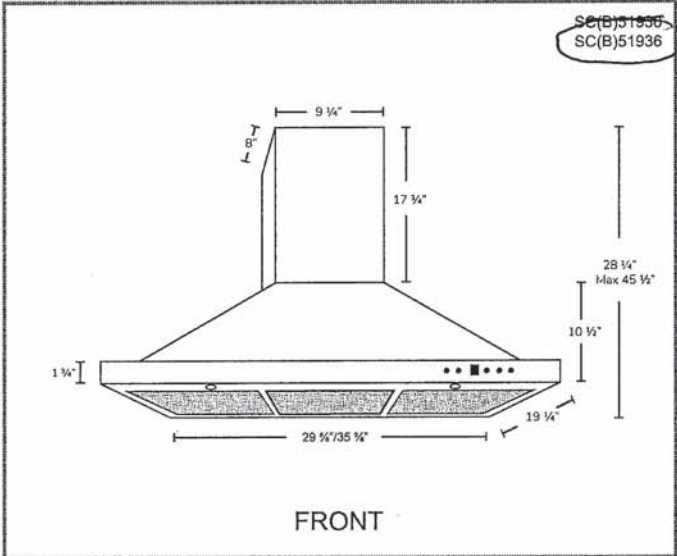

Options

- Filters:

SCB519 - Quick Release Stainless Steel Baffle Filters
- Chimney Flues:
A1.CH10 - short (7'-8' ceilings)
A1.CH18 - standard (8'-9' ceilings)
A1.CH30 - extended (9'-11' ceilings)
- Widths: 24", 30", 36"

Specifications

- | | | |
|--|--|--|
| <ul style="list-style-type: none">• Air Flow Volume: 550 CFM• Electrical Connection: 120 V/60 Hz• Power Consumption: 300 Watts | <ul style="list-style-type: none">• Current: 2.5 Amps• Fan Speed: 1599 RPM• Fan Type: Centrifugal Blower | <ul style="list-style-type: none">• Finishes: Stainless Steel• Ducting: 6" Round• Noise Level: Min. 2 Sones
Max. 6 Sones |
|--|--|--|



36" Gas Cooktop

800 Series – Stainless Steel NGM8656UC



NGM8656UC
Stainless Steel

Also available in:
Black w/Black NGM8646UC
Stainless
Knobs

Bosch gas cooktops are engineered to perform precisely, offering high heat and low simmer options for optimal cooking flexibility.

Features & Benefits
Powerful 19,000 BTU burner for boiling, searing and stir-frying
OptiSim® Burner – simmer delicate sauces and melt chocolate without scorching
Electronic re-ignition will automatically re-ignite the burner in case the flame goes out
Continuous grates make moving heavy pots easier
Distinctive red LED light indicates burners are on

General Properties	
Knob material	Metal
Sealed burners	Yes
Grate material	Cast iron
Element Performance	
Total BTU load (NG / LP)	58,500 / 47,300
Power of front left burner (NG / LP)	12,000 / 9,100
Power of back left burner (NG / LP)	10,000 / 9,100
Power of center burner (NG / LP)	19,000 / 15,000
Power of back right burner (NG / LP)	5,500 / 5,000
Power of front right burner (NG / LP)	12,000 / 9,100
Technical Details	
Watts	360 W
Circuit breaker	15 A
Volts	120 V
Frequency	60 Hz
Plug type	3 prong
Power cord length	60"
Energy source	Gas
Convertible to LP (kit required)	Yes



Dimensions & Weight	
Overall appliance dimensions (HxWxD)	3 13/16" x 37" x 21 1/4"
Required cutout size (HxWxD)	3 13/16" x 34 15/16" x 19 1/8"
Minimum distance from counter front	1 7/8"
Minimum distance from rear wall	3"
Net weight	39 lbs
Accessories – Included	
Included	LP conversion kit
Accessories – Optional	



HEZ298102
Wok ring



HEZ27751
Cooktop control knob kit, black stainless steel

† To be fully ADA compliant, these units must be installed according to ADA guidelines. Please check current ADA requirements for guidance on installation.

Accessories: To purchase Bosch accessories, cleaners & parts please visit www.bosch-home.com/us/store or call 1-800-944-2904 (Mon to Fri 5 am to 6 pm PST, Sat 6 am to 3 pm PST).

Notes: All height, width and depth dimensions are shown in inches. BSH reserves the absolute and unrestricted right to change product materials and specifications, at any time, without notice. Consult the product's installation instructions for final dimensional data and other details prior to making cutout.

Warranties: Please see Use & Care manual or Bosch website for statement of limited warranty.

For more information on our entire line of products, go to www.bosch-home.com/us or call 1-800-944-2904

© BSH Home Appliances Corporation. All rights reserved. Bosch is a registered trademark of Robert Bosch GmbH.

36" Gas Cooktop

800 Series – Stainless Steel NGM8656UC



Installation Details

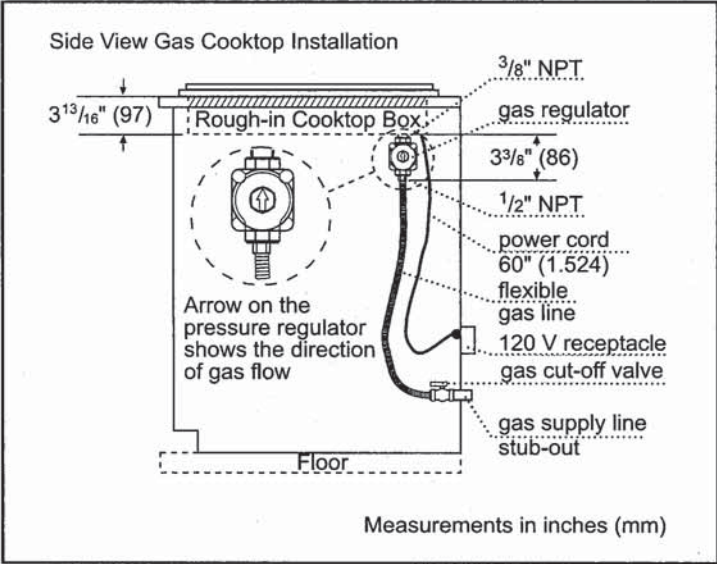
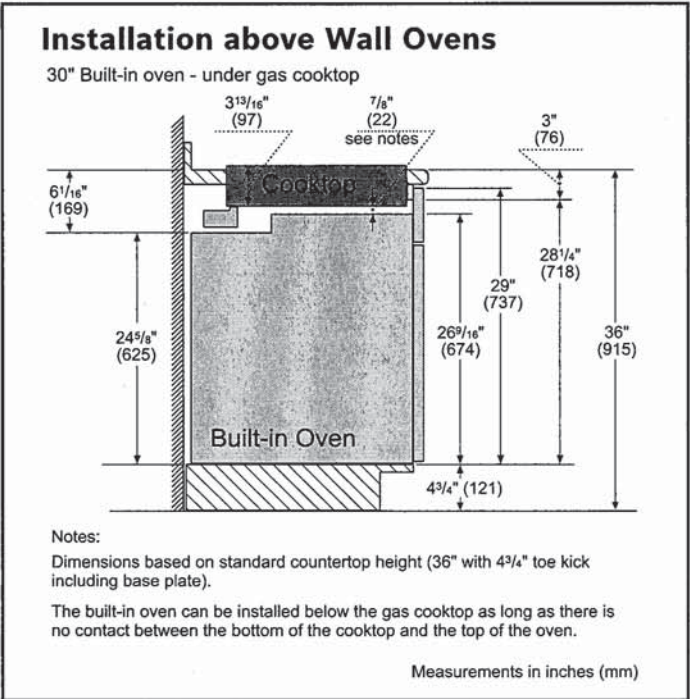
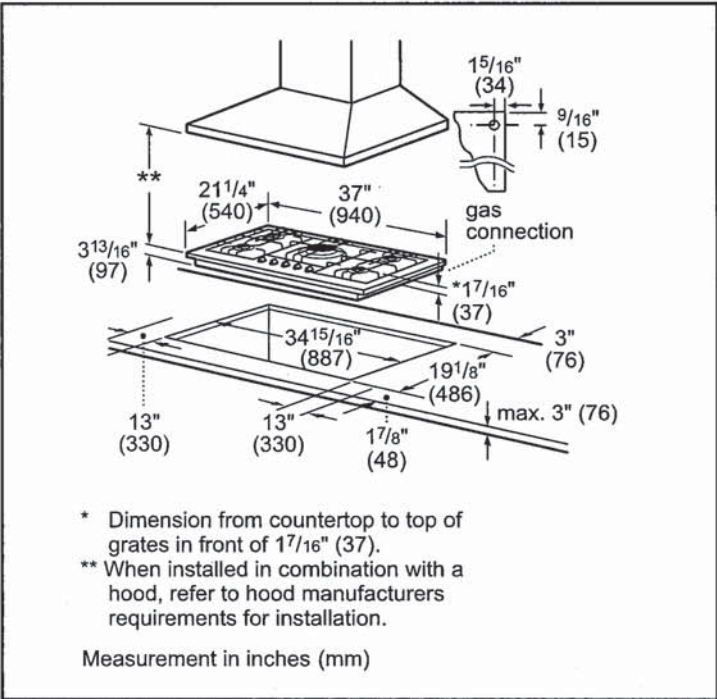

Accessories: To purchase Bosch accessories, cleaners & parts please visit www.bosch-home.com/us/store or call 1-800-944-2904 (Mon to Fri 5 am to 6 pm PST, Sat 6 am to 3 pm PST).

Notes: All height, width and depth dimensions are shown in inches. BSH reserves the absolute and unrestricted right to change product materials and specifications, at any time, without notice. Consult the product's installation instructions for final dimensional data and other details prior to making cutout.

Warranties: Please see Use & Care manual or Bosch website for statement of limited warranty.

For more information on our entire line of products, go to www.bosch-home.com/us or call 1-800-944-2904

© BSH Home Appliances Corporation. All rights reserved. Bosch is a registered trademark of Robert Bosch GmbH.

36" Gas Cooktop

800 Series – Stainless Steel NGM8656UC



Installation Details

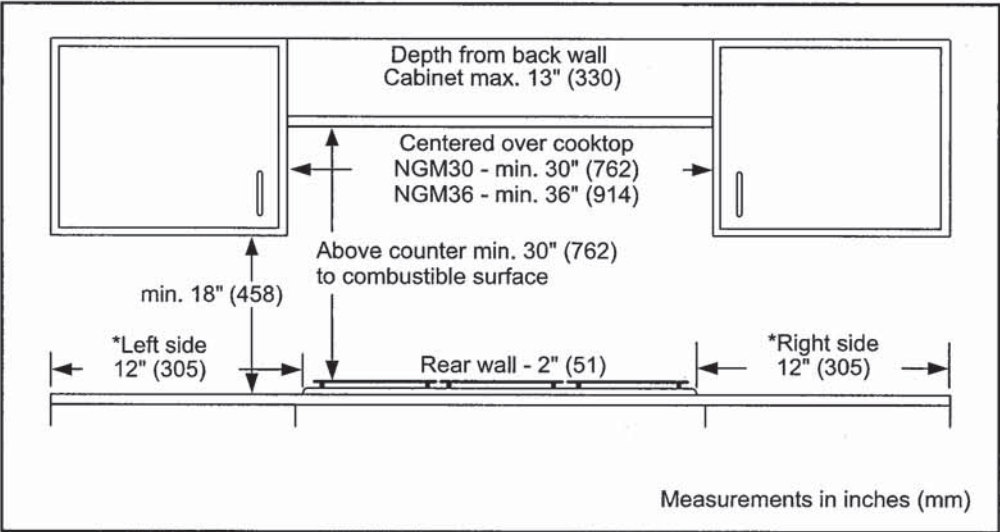

Accessories: To purchase Bosch accessories, cleaners & parts please visit www.bosch-home.com/us/store or call 1-800-944-2904 (Mon to Fri 5 am to 6 pm PST, Sat 6 am to 3 pm PST).

Notes: All height, width and depth dimensions are shown in inches. BSH reserves the absolute and unrestricted right to change product materials and specifications, at any time, without notice. Consult the product's installation instructions for final dimensional data and other details prior to making cutout.

Warranties: Please see Use & Care manual or Bosch website for statement of limited warranty.

For more information on our entire line of products, go to www.bosch-home.com/us or call 1-800-944-2904

© BSH Home Appliances Corporation. All rights reserved. Bosch is a registered trademark of Robert Bosch GmbH.

36" Gas Cooktop

800 Series – Stainless Steel NGM8656UC



Bosch Cooktop over Built-In Oven Approved Combination Guide

The following **OVENS, COOKTOPS AND DRAWERS**
are approved to be installed in combination and the installation has been certified by CSA.

Built-in ovens		Cooktops		
Conventional ovens (1)	Steam ovens	Induction	Electric	Gas (1) *
HBL5351UC, HBL5354UC	HSLP451UC, HSLP454UC	NIT5068UC	NET8068UC	NGM8046UC
HBL5451UC, HBL5344UC		NIT5668UC, NIT5469UC	NET8068SUC	NGM5656UC
HBL8443UC, HBL5454UC		NIT8068UC, NIT8068SUC	NET8668UC	NGMP656UC
HBL8453UC, HBL8444UC		NIT8668UC, NIT8668SUC	NET8668SUC	NGM8656UC
HBL8451UC, HBL8444LUC		NITP068UC, NITP068SUC	NETP068SUC	NGM8646UC
HBL8463UC, HBL8444RUC		NITP668UC, NITP668SUC	NETP668SUC	NGM5656UC
HBL8461UC, HBL8454UC		NIT8069UC, NIT8069SUC	NEM5066UC	NGMP056UC
HBL8442UC, HBLP454UC		NIT8669UC, NIT8669SUC	NEM5666UC	NGM8056UC
HBLP451UC, HBLP454LUC		NITP069UC, NITP069SUC		Gas (2) *
HBLP451LUC, HBLP454RUC		NITP669UC, NITP669SUC		NGM5456UC
HBLP451RUC, HBN8454UC				Gas (3) *
HBN5451UC, HBN8451UC				NGMP077UC
Conventional ovens (2)				NGMP677UC
HBE5451UC				NGM8657UC
Conventional ovens (3)				NGM8057UC
HBE5452UC				

The following **OVENS, COOKTOPS AND DRAWERS**
are approved by BSH Home Appliances Corporation to be installed in combination. These products, identified in the table below, may be installed in combination. The suitability of the combination has not been evaluated by CSA.

Built-in ovens		Cooktops		
Conventional ovens (2)	Speed oven (1)	Induction (1)	Electric (1)	Gas (1) *
HBE5453UC	HMCP0252UC, HMCP0254UC	NIT5068UC	NET8068UC	NGM8046UC
Built-In microwave	HMC80242UC, HMC80244UC	NIT5668UC, NIT5469UC	NET8068SUC	NGM5656UC
HMB57152UC	HMC80252UC, HMC80254UC	NIT8068UC, NIT8068SUC	NET8668UC	NGMP656UC
HMB50162UC	HMC87152UC, HMC87154UC	NIT8668UC, NIT8668SUC	NET8668SUC	NGM8656UC
HMB50152UC	HMC80152UC, HMC50154UC	NITP068UC, NITP068SUC	NETP068SUC	NGM8646UC
HMB87154UC		NITP668UC, NITP668SUC	NETP668SUC	NGM5656UC
HMB50154UC		NIT8069UC, NIT8069SUC	NEM5066UC	NGMP056UC
Storage drawer	Speed oven (2)	NIT8669UC, NIT8669SUC	NEM5666UC	NGM8056UC
HSD5051UC	HMC54151UC	NITP069UC, NITP069SUC		Gas (2) *
Drawer microwave	HMC54152UC	NITP669UC, NITP669SUC		NGM5456UC
HMD8053UC	HMC54154UC			Gas (3) *
HMD8451UC				NGMP077UC
Warming drawers				NGMP677UC
HWD5051UC				NGM8657UC
HWD5751UC				NGM8057UC

*Gas cooktops may require a 3/8" street elbow (not provided) at the regulator outlet for installation above built-in oven.
COOKTOPS that are not listed above must be approved under local codes and/or by the local authority having jurisdiction.
Please note: For the latest updates to the approved oven/cooktop combination refer to the website listed in your appliance's installation instructions.

Accessories: To purchase Bosch accessories, cleaners & parts please visit www.bosch-home.com/us/store or call 1-800-944-2904 (Mon to Fri 5 am to 6 pm PST, Sat 6 am to 3 pm PST).
Notes: All height, width and depth dimensions are shown in inches. BSH reserves the absolute and unrestricted right to change product materials and specifications, at any time, without notice. Consult the product's installation instructions for final dimensional data and other details prior to making cutout.
Warranties: Please see Use & Care manual or Bosch website for statement of limited warranty.
For more information on our entire line of products, go to www.bosch-home.com/us or call 1-800-944-2904
© BSH Home Appliances Corporation. All rights reserved. Bosch is a registered trademark of Robert Bosch GmbH.

36" Gas Cooktop

800 Series – Stainless Steel NGM8656UC



Cooktop over built-in oven combination installation
Refer to the product installation guide for all other measurements.

Oven installation requirements				Cooktop installation requirements (wall spacing)				
When installing an oven or oven with a drawer in combination with a cooktop, a minimum distance between the cabinet floor and countertop (B) is required. Reference the table for dimensions. Refer to the oven installation guide for all other measurements.								
Oven type	A Inches (mm)	B min. Inches (mm)	C max. Inches (mm)	Gas cooktop (1) min. Inches (mm)	Gas cooktop (2) min. Inches (mm)	Gas cooktop (3) min. Inches (mm)	Electric cooktop	Induction cooktop
Conventional oven (1)	28 1/4 (718)	31 1/4 (794)	4 3/4 (121)	D: 24 (610) E: 24 (610)	D: 3 (76) E: 4 (102)	D: 24 (610) E: 24 (610)	Reference Product Installation Instructions	
Conventional oven (2)	23 (584)	27 3/4 (705)	8 1/4 (210)	D: 24 (610) E: 24 (610)	D: 3 (76) E: 4 (102)	D: 24 (610) E: 24 (610)	Reference Product Installation Instructions	
Conventional oven (3)	23 1/16 (585)	27 13/16 (707)	8 3/16 (208)	D: 24 (610) E: 24 (610)	D: 3 (76) E: 4 (102)	D: 24 (610) E: 24 (610)	Reference Product Installation Instructions	
Steam oven	19 1/4 (488)	23 3/8 (594)	12 5/8 (321)	D: 24 (610) E: 24 (610)	D: 3 (76) E: 4 (102)	D: 24 (610) E: 24 (610)	Reference Product Installation Instructions	
Steam oven with 4" storage drawer								
Speed oven (2)	17 3/4 (450)	22 1/2 (572)	13 1/2 (343)	D: 24 (610) E: 24 (610)	D: 3 (76) E: 4 (102)	Reference Product Installation Instructions		
Microwave speed oven (1)	19 1/4 (488)	24 (609)	12 (306)	D: 24 (610) E: 24 (610)	D: 3 (76) E: 4 (102)	Reference Product Installation Instructions		
Microwave speed oven (1) with warming drawer	28 1/4 (718)	31 1/4 (794)	4 3/4 (121)	D: 24 (610) E: 24 (610)	D: 3 (76) E: 4 (102)	Reference Product Installation Instructions		
Drawer microwave	14 13/16 (376)	20 (508)	16 (406)	D: 24 (610) E: 24 (610)	D: 3 (76) E: 4 (102)	Reference Product Installation Instructions		

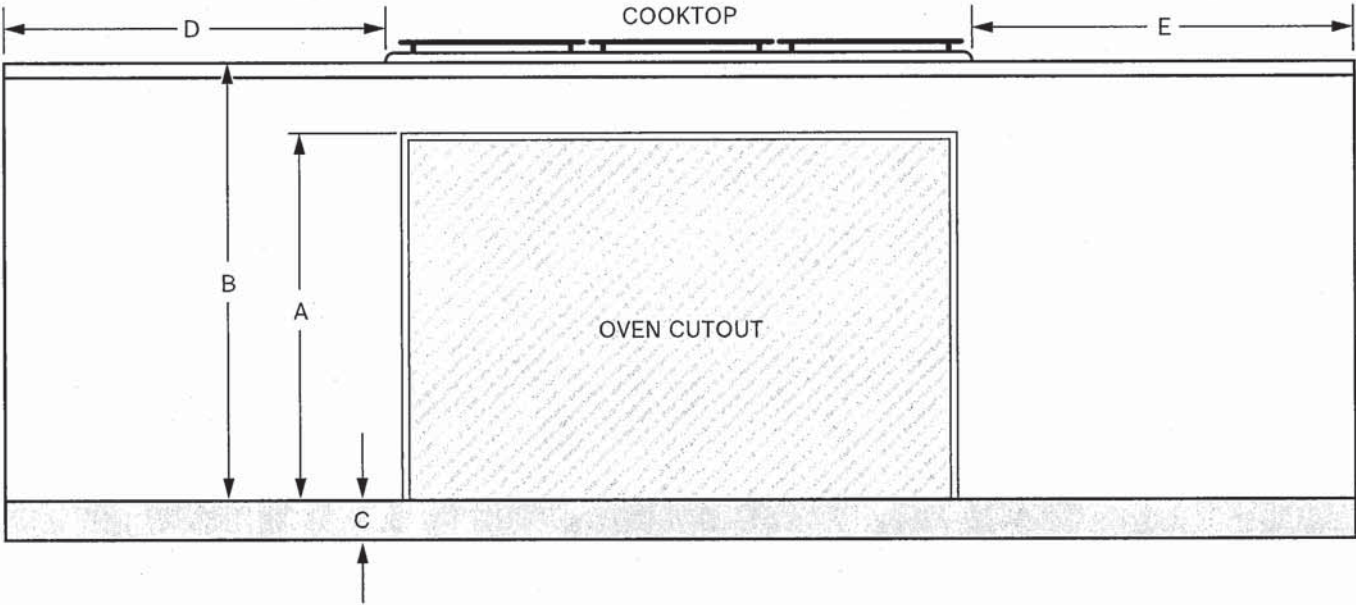

Accessories: To purchase Bosch accessories, cleaners & parts please visit www.bosch-home.com/us/store or call 1-800-944-2904 (Mon to Fri 5 am to 6 pm PST, Sat 6 am to 3 pm PST).

Notes: All height, width and depth dimensions are shown in inches. BSH reserves the absolute and unrestricted right to change product materials and specifications, at any time, without notice. Consult the product's installation instructions for final dimensional data and other details prior to making cutout.

Warranties: Please see Use & Care manual or Bosch website for statement of limited warranty.

For more information on our entire line of products, go to www.bosch-home.com/us or call 1-800-944-2904

© BSH Home Appliances Corporation. All rights reserved. Bosch is a registered trademark of Robert Bosch GmbH.



800 Series, Combination Oven, 30",
Stainless steel
HBL87M53UC

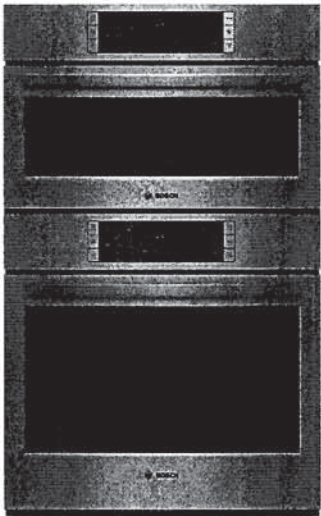

Included accessories

x oven racks /lower
x temperature probe /lower

Optional accessories

HEZTR301 : Telescopic Oven Rack 30"

Bosch microwave combination ovens
create an all-in-one cooking center with an
upper microwave and a Genuine European
Convection oven below

- Home Connect: home appliances with smart connectivity for an easier everyday life.

Technical Data

Cooking mode :	Microwave
Cooking method second cavity :	
3rd element convection, Convection Bake, Convection Broil, Convection Roast, Dough proving setting, Pizza setting, Small area grill, Top/bottom heating, Top heating, 1/3 bottom heat., Variable small-area grill, Warming	
Integrated Cleaning system :	No
Number of interior lights :	1
Included accessories :	
x oven racks /lower, x temperature probe	
Bake Element Wattages cavity 1 (W) :	600
Broil Element Wattages cavity 1 (W) :	1750
Convection Element Wattages cavity 1 (W) :	1700
Microwave Wattages (W) :	1000
UPC code :	825225960164
Product color :	Stainless steel
Energy source :	Electric
Watts (W) :	7975
Current (A) :	40
Volts (V) :	208-240
Frequency (Hz) :	60
Approval certificates :	CSA
Power cord length (in) :	50"
Power cord length (cm) :	127.0
Appliance Dimensions (h x w x d) (cm) :	124.4 x 75.5 x 62.2
Required cutout size (HxWxD) (in) :	48 5/8" x 28 1/2" x 23 1/2"
Overall appliance dimensions (HxWxD) (in) :	49" x 29 3/4" x 24 1/2"
Overall appliance dimensions (HxWxD) (mm) :	1244 x 755 x 622
Product packaging dimensions (HxWxD) (in) :	55 3/4" x 34" x 31 1/2"
Product packaging dimensions (HxWxD) (mm) :	1441 x 787 x 863
:	328
Net weight (kg) :	148.768
Gross weight (lbs) :	328.000
Gross weight (kg) :	148.8



BOSCH

**800 Series, Combination Oven, 30",
Stainless steel
HBL87M53UC**

**Bosch microwave combination ovens
create an all-in-one cooking center with an
upper microwave and a Genuine European
Convection oven below**

Design

- Bosch wall ovens can be installed flush for a sleek timeless design, or proud for a more traditional look
- Touch control with SteelTouch™ buttons makes operating the oven easier
- Bosch wall ovens are compatible with most existing cutouts

Performance

- Lower oven's convection multi-rack mode gives uniform baking results even when using all 3 racks simultaneously
- Family or guests late to dinner? Keep food warm in the lower oven without overcooking until ready to serve by using the warm mode
- Lower oven's proof mode maintains a low temperature to proof yeast doughs for an even and faster rise compared to being left on the countertop
- Closed-door broiling prevents intense heat from escaping the lower oven - offering rich, even browning on tender cuts of meat and perfectly toasted casseroles
- Lower oven comes with 2 standard racks and 1 telescopic rack that gives easier accessibility for large or heavy dishes
- Dampened hinges softly guide the lower oven's QuietClose door shut. It's premium engineering that you'll appreciate each time you close your oven

Efficiency

- Download Bosch Home Connect application and control the lower wall oven with your smart phone or tablet

Convenience

- 1 light in the upper microwave and 2 lights in the lower oven gives visibility in the cavity so you can see the cooking progress
- Large oven window lets you monitor the cooking progress without opening the oven door to maintain a consistent oven temperature
- Keep your home safe by avoiding accidental or unsupervised use of your wall oven with the panel lock feature

Capacity

- With capacities of 1.6 cu. ft upper microwave and 4.6 cu. ft. lower oven allows enough space to cook everyday meals or for a crowd



800 Series, Combination Oven, 30",
Stainless steel
HBL87M53UC

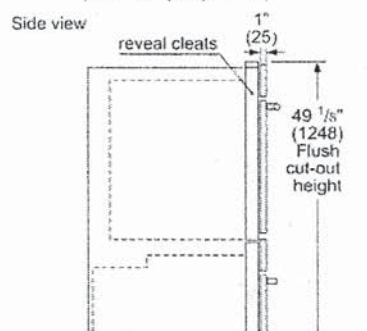
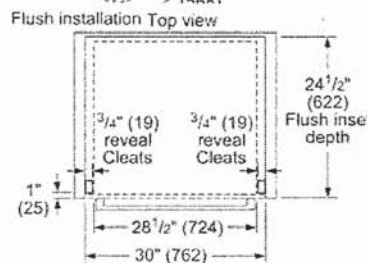
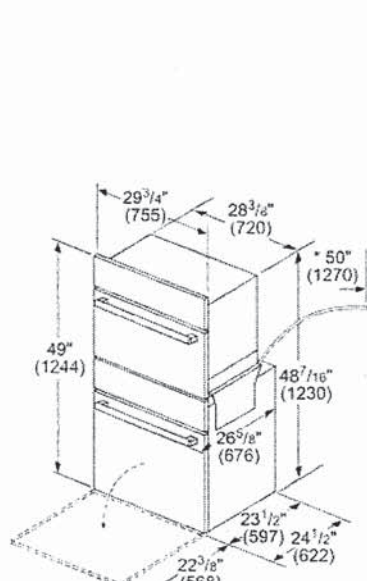

Standard Installation
Combination oven over storage or warming drawer

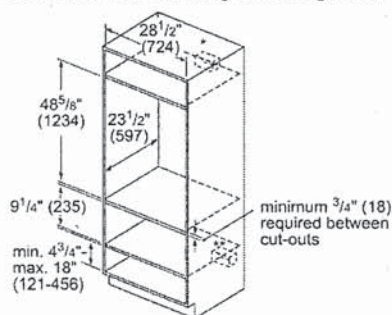

* Wall oven junction box may be located above or to the right or left of the unit within reach of the power cable.

** Electrical hook-up may be located below (depending on space) or next to the drawer within reach of the power cable.

measurements in inches (mm)

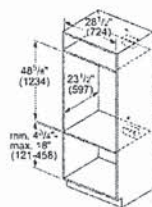

* Junction box may be installed above, below, or to the left or right of the unit within reach of the power cable.

measurements in inches (mm)

Flush installation
Combination oven over storage or warming drawer
Side view

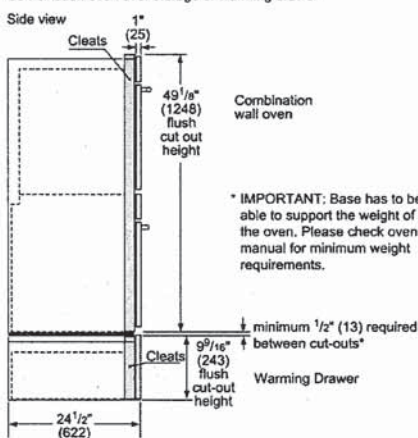

measurements in inches (mm)