

PRE-Sales Selection Sheet  
Checklist

1 of 43

LOT 3185A-7 Model: 20-1790 END B The Dunmore

PURCHASERS: MASOODA, A SHAHBAZI

VENDOR: Heathwood Homes (Huron) Limited

WALK OUT BASEMENT LOT WITH JULIETTE RAILING ACROSS MAIN FLOOR SLIDING PATIO DOOR

- ☒ FINISHED BASEMENT  
☐ COLD CELLAR

UPGRADED / MODIFIED ELEVATION

- ☐ CORNER UPGRADE  
☐ REAR UPGRADE

CEILING UPGRADE - SMOOTH

- ☐ MAIN FLOOR  
☐ SECOND FLOOR  
☐ BASEMENT

ADDITIONAL ROUGH-INS

- ☐ 200 AMP SERVICE  
☐ WET BAR ROUGH-IN  
☐ HUMIDIFIER  
☒ AIR CONDITIONING

GAS ROUGH-IN

- ☐ STOVE  
☐ DRYER  
☐ BBQ  
☐ ADDITIONAL FIREPLACE

KITCHEN: HOODFAN VENTING SIZE

- ☒ 6 IN ROUND DUCT  
☐ 7 IN ROUND DUCT

FULL BASEMENT STAIRS:

N/A

UPPER BASEMENT STAIRS:

All Oak

LOWER BASEMENT STAIRS:

Carpet Grade

MAIN STAIRS:

All Oak

MEDIA STAIRS (if applicable):

N/A

LOFT STAIRS (if applicable):

N/A

3):

Nov 29/21  
Date

Purchaser:

*Signature on file*

Nov 29/21  
Date

Decor Consultant:

TINA LEFUR

APPROVED

Date

Purchaser:

-11- 29 2021

Date

Heathwood Homes (Huron) Limited

*Signature*

Locked Date:

Approved

MASOODA, A SHAHBAZ/  
Project: Wallaceton  
Unit: 3185A-7, Phase: 3  
Model: 20-1790 END B The Dunmore

Created: 10/18/2021 17:14:23  
Locked:  
Closed:

2 of 43

Kitchen

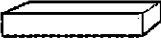
Cabinet Colour/Style	9156	Viking III-SIMCOE-RAIN CLOUD-3DL ***STD***
Countertop	9069	MSI Quartz GROUP 1 ICED WHITE ***STD***
Countertop Edge	4010	SINGLE POLISHED STRAIGHT EDGE 3/4 INCH ***STD*** 
Cabinet Hardware	7667	12881-HARDWARE ***STD***
Island Cabinet Colour/Style	9156	Viking III-SIMCOE-RAIN CLOUD-3DL ***STD***
Island Countertop	9069	MSI Quartz GROUP 1 ICED WHITE ***STD***
Backsplash	1111	N/A *****
Backsplash Grout	1111	N/A *****
Backsplash Tile Pattern	1111	N/A *****

HoodFan	9904	YWMH31017HZ-Whirlpool Over-The-Range Microwave Hood Combination-SS-30 inch SPEC PAGES 29-31
Appliance	0	Purchasers have been advised: standard fridge opening is a minimum 37 3/8 x 73 3/8". Ice Waterline Rough-In is included.
Appliance	0	Standard stove opening is 30" and standard dishwasher opening is 24". Any gas stove will require backsplash or stainless steel backing to avoid fire hazards.
Appliance	0	Purchasers acknowledge: Heathwood Homes and its contractors will not be responsible for any kitchen cabinet changes due to appliances dimension changes after

Comment

Kitchen/Breakfast

Flooring	9106	GE.MD.WHT.1818.MT Madison Series White Matte 18
Floor Tile Grout	2225	Grout-(27) Silver ***STD***
Floor Tile Pattern	3000	STANDARD SQUARE ***STD*** 

MASOODA, A SHAHBAZ/  
Project: Wallaceton  
Unit: 3185A-7, Phase: 3  
Model: 20-1790 END B The Dunmore

Created: 10/18/2021 17:14:23  
Locked:  
Closed:

3 of 43



Comment

Foyer

Flooring9106GE.MD.WHT.1818.MT Madison Series White Matte 18

Floor Tile Grout2225Grout-(27) Silver \*\*\*STD\*\*\*

Floor Tile Pattern3000STANDARD SQUARE \*\*\*STD\*\*\*

Comment

Laundry Room

Flooring9255TR.SP.WHITE.1313 SEMPRE White Matte 13

Floor Tile Grout2225Grout-(27) Silver \*\*\*STD\*\*\*

Floor Tile Pattern3000STANDARD SQUARE \*\*\*STD\*\*\*

Comment

Laundry Room Opt.

Cabinet - Uppers1111N/A \*\*\*\*\*

Cabinet Hardware1111N/A \*\*\*\*\*

Comment

Mud Room

Flooring9106GE.MD.WHT.1818.MT Madison Series White Matte 18



MASOODA, A SHAHBAZ/  
Project: Wallaceton  
Unit: 3185A-7, Phase: 3  
Model: 20-1790 END B The Dunmore

Created: 10/18/2021 17:14:23  
Locked:  
Closed:

4 of 43



Floor Tile Grout 2225 Grout-(27) Silver \*\*\*STD\*\*\*

Floor Tile Pattern 3000 STANDARD SQUARE \*\*\*STD\*\*\*

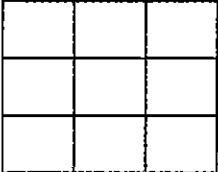

Comment

Powder Room

Flooring 9106 GE.MD.WHT.1818.MT Madison Series White Matte 18

Floor Tile Grout 2225 Grout-(27) Silver \*\*\*STD\*\*\*

Floor Tile Pattern 3000 STANDARD SQUARE \*\*\*STD\*\*\*

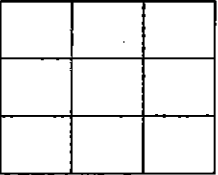

Plumbing Fixture (Colour) 1737 Plumbing Fixtures-WHITE \*\*\*STD\*\*\*

Comment

Hall

Flooring 7502 Red Oak Pearl-Vintage Engineered-ECLIPSE-3/4 inch x 3 1/4 inch \*\*\*STD\*\*\*

Comment

Dining Room

Flooring 7502 Red Oak Pearl-Vintage Engineered-ECLIPSE-3/4 inch x 3 1/4 inch \*\*\*STD\*\*\*

Comment

Great Room

Flooring 7502 Red Oak Pearl-Vintage Engineered-ECLIPSE-3/4 inch x 3 1/4 inch \*\*\*STD\*\*\*

Comment



MASOODA, A SHAHBAZ/  
Project: Wallaceton  
Unit: 3185A-7, Phase: 3  
Model: 20-1790 END B The Dunmore

Created: 10/18/2021 17:14:23  
Locked:  
Closed:

5 of 43

Upper Hall

Flooring 1737 Red Oak Pearl-Vintage Engineered-ECLIPSE-3/4 inch x 3 1/4 inch \*\*\*3\*\*\*

Comment

Finished Basement (Rec) Room/Hall

Flooring 9248 DY 89418 -Dynasty Tex-BLACK ICE-40 oz Poly\*\*\*STD\*\*\*

Comment

Master Bedroom

Flooring 9248 DY 89418 -Dynasty Tex-BLACK ICE-40 oz Poly\*\*\*STD \*\*\*

Comment

Bedroom 2

Flooring 9248 DY 89418 -Dynasty Tex-BLACK ICE-40 oz Poly\*\*\*STD \*\*\*

Comment

Bedroom 3

Flooring 9248 DY 89418 -Dynasty Tex-BLACK ICE-40 oz Poly\*\*\*STD \*\*\*

Comment

Master Ensuite

Cabinet Colour/Style 9111 VIKING III SIMCOE ORCHID 3DL \*\*\*STD\*\*\*

Countertop 8826 4926K-07-Countertop-BLACK ALICANTE-Wilsonart \*\*\*STD\*\*\*

MASOODA, A SHAHBAZ/  
Project: Wallaceton  
Unit: 3185A-7, Phase: 3  
Model: 20-1790 END B The Dunmore

Created: 10/18/2021 17:14:23  
Locked:  
Closed:

6 of 43



Countertop Edge	1111	N/A *****
Cabinet Hardware	7672	135-HARDWARE ***STD***
Floor Tile	9255	TR.SP.WHITE.1313 SEMPRE White Matte 13
Floor Tile Grout	2225	Grout-(27) Silver ***STD***
Floor Tile Pattern	3000	STANDARD SQUARE ***STD*** <div><div></div><div></div><div></div><div></div><div></div><div></div><div></div><div></div><div></div></div>
Shower Floor Tile	8661	OD.ON.SWT.0202.MT.N-Ontario Series Mosaic-Snow White Matte-2 x 2 ***STD***
Shower Floor Tile Grout	2226	Grout-(00) White ***STD***
Shower Floor Tile Pattern	3000	STANDARD SQUARE ***STD*** <div><div></div><div></div><div></div><div></div><div></div><div></div><div></div><div></div><div></div></div>
Shower Wall Tile	9020	QT.WV.WHT.0810-Weave-White-8 x 10 ***STD***
Shower Wall Tile Grout	2226	Grout-(00) White ***STD***
Shower Wall Tile Pattern	3070	HORIZONTAL STACKED ***STD*** <div><div></div><div></div><div></div><div></div><div></div><div></div></div>
Shower Jamb(s) and Sill(s)	8923	Shower Jamb / Sill-Thassos White ***STD***
Plumbing Fixture (colour)	1737	Plumbing Fixtures-WHITE ***STD***
Comment		

Main Bathroom

Cabinet Colour/Style	9111	VIKING III SIMCOE ORCHID 3DL ***STD***
Countertop	8826	4926K-07-Countertop-BLACK ALICANTE-Wilsonart ***STD***
Countertop Edge	1111	N/A *****



MASOODA, A SHAHBAZ/  
Project: Wallaceton  
Unit: 3185A-7, Phase: 3  
Model: 20-1790 END B The Dunmore

Created: 10/18/2021 17:14:23  
Locked:  
Closed:

7 of 43

Cabinet Hardware	7672	135-HARDWARE ***STD***									
Flooring	9255	TR.SP.WHITE.1313 SEMPRE White Matte 13									
Floor Tile Grout	2225	Grout-(27) Silver ***STD***									
Floor Tile Pattern	3000	STANDARD SQUARE ***STD*** <table><tr><td></td><td></td><td></td></tr><tr><td></td><td></td><td></td></tr><tr><td></td><td></td><td></td></tr></table>									
Wall Tile	9020	QT.WV.WHT.0810-Weave-White-8 x 10 ***STD***									
Wall Tile Grout	2226	Grout-(00) White ***STD***									
Main Bathroom Tile Pattern	3070	HORIZONTAL STACKED ***STD*** <table><tr><td></td><td></td></tr><tr><td></td><td></td></tr><tr><td></td><td></td></tr><tr><td></td><td></td></tr></table>									
Plumbing Fixture (Colour)	1737	Plumbing Fixtures-WHITE ***STD***									
Comment											

Finished Basement Bathroom

Cabinet Colour/Style	9111	VIKING III SIMCOE ORCHID 3DL ***STD***									
Countertop	8826	4926K-07-Countertop-BLACK ALICANTE-Wilsonart ***STD***									
Countertop Edge	1111	N/A *****									
Cabinet Hardware	7672	135-HARDWARE ***STD***									
Flooring	9255	TR.SP.WHITE.1313 SEMPRE White Matte 13									
Floor Tile Grout	2225	Grout-(27) Silver ***STD***									
Floor Tile Pattern	3000	STANDARD SQUARE ***STD*** <table><tr><td></td><td></td><td></td></tr><tr><td></td><td></td><td></td></tr><tr><td></td><td></td><td></td></tr></table>									
Shower Floor Tile	8661	OD.ON.SWT.0202.MT.N-Ontario Series Mosaic-Snow White Matte-2 x 2 ***STD***									

MASOODA, A SHAHBAZ/  
Project: Wallaceton  
Unit: 3185A-7, Phase: 3  
Model: 20-1790 END B The Dunmore

Created: 10/18/2021 17:14:23  
Locked:  
Closed:

8 of 43



Shower Floor Tile Grout	2226	Grout-(00) White ***STD***									
Shower Floor Tile Pattern	3000	STANDARD SQUARE ***STD*** <table><tr><td></td><td></td><td></td></tr><tr><td></td><td></td><td></td></tr><tr><td></td><td></td><td></td></tr></table>									
Shower Wall Tile	9020	QT.WV.WHT.0810-Weave-White-8 x 10 ***STD***									
Shower Wall Tile Grout	2226	Grout-(00) White ***STD***									
Shower Wall Tile Pattern	3070	HORIZONTAL STACKED ***STD*** <table><tr><td></td><td></td></tr><tr><td></td><td></td></tr><tr><td></td><td></td></tr><tr><td></td><td></td></tr></table>									
Shower Jamb(s)	8923	Shower Jamb / Sill-Thassos White ***STD***									
Plumbing Fixture (Colour)	1737	Plumbing Fixtures-WHITE ***STD***									
Comment											

Great Room Fireplace

Type	8865	Dimplex-Electric Fireplace-PF3033HL ***STD***
Mantle	8891	NF-17-Paint Grade Mantle- Cabinet (Per Plan)-WHITE ***STD*** PAGE 18
Surround Opt.	1111	N/A *****
Disclaimer	0	Purchasers have been advised: heat from the FP can damage TV above a FP and items placed on mantle.
Disclaimer	0	Heathwood and its contractors will not be liable for any damage on items placed/installed above a FP after closing.
Comment		

Basement Stairs

Type	1714	Carpet Grade Stairs ***STD BASEMENT STAIRS***
Colour	7922	Eclipse (Pewter) STAIN TO COMPLIMENT HARDWOOD AND WILL VARY FROM FLOORING ***99***
Carpet Runner	1111	N/A *****
Handrail/Pickets/Post Type	7652	1 5/16 inch Square pickets with 3 1/2" Square/Cap Post(s)-ALL OAK ***STD***





Customer Colours

324

MASOODA, A SHAHBAZ/  
Project: Wallaceton  
Unit: 3185A-7, Phase: 3  
Model: 20-1790 END B The Dunmore

Created: 10/18/2021 17:14:23  
Locked:  
Closed:

9 of 43

			Post(s)-ALL OAK ***STD***
Handrail/Pickets/Post Colours	1729	Carpet Grade-Stain handrail, pickets, stringers, nosing _pos	
Carpet	9248	DY 89418 -Dynasty Tex-BLACK ICE-40 oz Poly***STD***	
Custom Stain/Paint	1111	N/A *****	
Comment			

Basement Stairs Landings (Upper and Lower)

Flooring	7502	Red Oak Pearl-Vintage Engineered-ECLIPSE-3/4 inch x 3 1/4 inch ***3***
Comment		

Main Stairs

Type	1712	Oak Stairs ***STD MAIN STAIRS***
Colour	7922	Eclipse (Pewter) STAIN TO COMPLIMENT HARDWOOD AND WILL VARY FROM FLOORING ***99***
Carpet Runner	1111	N/A *****
Handrail/Pickets/Posts Type	7652	1 5/16 inch Square pickets with 3 1/2" Square/Cap Post(s)-ALL OAK ***STD***
Handrail/Pickets/Posts Colour	1728	Oak Grade-Stain handrail,oak pickets,stringers,treads,risers
Custom Stain/Paint	1111	N/A *****
Comment		

Main Stairs Landing(s)

Flooring	7502	Red Oak Pearl-Vintage Engineered-ECLIPSE-3/4 inch x 3 1/4 inch ***STD***
Comment		

Throughout

## 324

Created: 10/18/2021 17:14:23

Locked:

**Closed:**

Walls - Paint Colour	1717	22-Wall-WARM GREY ***STD***
Underpad	1079	500 Series-Underpad ***STD***
Thresholds	2232	Metal Thresholds ***STD***
Switches and Plug	5796	Decora White Switches and Plugs ***STD***
Trim Size	8705	4 ¼ Baseboard and 2 ¾ Casings ***STD***
Trim - Paint Colour	1716	Trim-WHITE ***STD***

**Comment**

Purchaser: MASOODA, A SHAHBAZ

Date \_\_\_\_\_

~~Decor Consultant~~

Date \_\_\_\_\_

**Purchaser:**

Date \_\_\_\_\_

## Wallaceton

**Date Approved**



CONSTRUCTION SUMMARY

11 OF 43

Lot: 3185A-7

Model: 20-1790 END B The Dunmore

Project/Phase: Wallaceton / 3

Offer Worksheet	SCHEDULE X: ITEM #5 ADJUSTMENTS (e) AND (f) COMBINED TO BE CAPPED AT \$5,000 Note:
Offer Worksheet	Five Appliances: SS Fridge, Stove, Dishwasher: White Front Loader Washer/Dryer - Townhomes Note:
Offer Worksheet	The Purchaser(s) acknowledge that they have NOT been referred by an existing Heathwood Homeowner and therefor are not entitled to a referral fee under Heathwood Homes Referral program Note:



CONSTRUCTION SUMMARY

12 of 43

Lot: 3185A-7

Model: 20-1790 END B The Dunmore  
Project/Phase: Wallaceton / 3

ALUMINUM

Invoice	Qty.	Description
871 09Dec21 ** NoCat	1	- WALK OUT BASEMENT LOT WITH JULIETTE RAILING ACROSS MAIN FLOOR SLIDING PATIO DOOR AS PER AMENDMENT DATED OCTOBER 20/21

APPLIANCES

Invoice	Qty.	Description
871 313,492 09Dec21	1	- APPLIANCES - WHIRLPOOL OTR SS - YWMH31017HZ  SPEC PAGES 29-31 Cabinetry - Upg Range Hood; Electrical - Credit Std Range Hood; Heating - Duct Size change;

CABINETRY

Invoice	Qty.	Description
871 313,492 09Dec21 **	1	- APPLIANCES - WHIRLPOOL OTR SS - YWMH31017HZ  SPEC PAGES 29-31 Cabinetry - Upg Range Hood; Electrical - Credit Std Range Hood; Heating - Duct Size change;
871 313,624 09Dec21	1	KITCHEN - 04H-66cm deep fridge enclosure (counter depth) with (1) wall ([1] 66cm deep gable and [1] 66cm deep cabinet) (This is not a zero clearance enclosure. Standard heights and widths will be used.) Viking  SKETCH # 3

CARPET

Invoice	Qty.	Description
871 311,748 09Dec21 **	1	UPPER HALL - HARDWOOD - VINTAGE - 3-1/4 INCH RED OAK ENGINEERED - UPPER HALL - UPG  Carpet - delete std carpet; Interior Trim - supply and install quarter rounds; Painting - paint quarter rounds

CERAMICS

Invoice	Qty.	Description
871 308,915 09Dec21	1	- CERAMICS - FLOOR - KITCHEN - UPGRADE 1
871 308,900 09Dec21	1	FOYER - CERAMICS - FLOOR - FOYER - UPGRADE 1
871 308,943 09Dec21	1	POWDER ROOM - CERAMICS - FLOOR - POWDER ROOM - UPGRADE 1
871 308,936 09Dec21	1	MUD ROOM - CERAMICS - FLOOR - MUD ROOM - UPGRADE 1



CONSTRUCTION SUMMARY

13A 43  
OF

Lot: 3185A-7  
Model: 20-1790 END B The Dunmore  
Project/Phase: Wallaceton / 3

CONCRETE AND DRAIN

Invoice	Qty.	Description
871	1	- WALK OUT BASEMENT LOT WITH JULIETTE RAILING ACROSS MAIN FLOOR SLIDING PATIO DOOR AS PER AMENDMENT DATED OCTOBER 20/21
09Dec21 ** NoCat		

DECK

Invoice	Qty.	Description
871	1	- WALK OUT BASEMENT LOT WITH JULIETTE RAILING ACROSS MAIN FLOOR SLIDING PATIO DOOR AS PER AMENDMENT DATED OCTOBER 20/21
09Dec21 ** NoCat		

ELECTRICAL

Invoice	Qty.	Description
871 313,492 09Dec21 **	1	- APPLIANCES - WHIRLPOOL OTR SS - YWMH31017HZ  SPEC PAGES 29-31 Cabinetry - Upg Range Hood; Electrical - Credit Std Range Hood; Heating - Duct Size change;
871 314,224 09Dec21	1	KITCHEN - ELECTRICAL - CEILING ROUGH-IN (CAPPED)  TO BE CENTERED +/- ABOVE BREAKFAST BAR ON ISLAND. SKETCH # 2
871 314,232 09Dec21	1	GREAT ROOM - ELECTRICAL - EXTRA WALL INTERIOR OUTLET ON EXISTING CIRCUIT (DOES NOT INCLUDE KITCHEN OUTLETS)  TO BE CENTERED ABOVE FIREPLACE 70" +/- FROM FLOOR SKETCH # 2

EXTERIOR BRICK

Invoice	Qty.	Description
871 09Dec21 ** NoCat	1	- WALK OUT BASEMENT LOT WITH JULIETTE RAILING ACROSS MAIN FLOOR SLIDING PATIO DOOR AS PER AMENDMENT DATED OCTOBER 20/21

EXTERIOR CAULKING

Invoice	Qty.	Description
871 09Dec21 ** NoCat	1	- WALK OUT BASEMENT LOT WITH JULIETTE RAILING ACROSS MAIN FLOOR SLIDING PATIO DOOR AS PER AMENDMENT DATED OCTOBER 20/21

EXTERIOR RAILINGS

Invoice	Qty.	Description
871 09Dec21 ** NoCat	1	- WALK OUT BASEMENT LOT WITH JULIETTE RAILING ACROSS MAIN FLOOR SLIDING PATIO DOOR AS PER AMENDMENT DATED OCTOBER 20/21

FORMING

Invoice	Qty.	Description
871 09Dec21 ** NoCat	1	- WALK OUT BASEMENT LOT WITH JULIETTE RAILING ACROSS MAIN FLOOR SLIDING PATIO DOOR AS PER AMENDMENT DATED OCTOBER 20/21



CONSTRUCTION SUMMARY

13B OF 43

Lot: 3185A-7  
Model: 20-1790 END B The Dunmore  
Project/Phase: Wallaceton / 3

FRAMING

Invoice	Qty.	Description
871 09Dec21 ** NoCat	1	- WALK OUT BASEMENT LOT WITH JULIETTE RAILING ACROSS MAIN FLOOR SLIDING PATIO DOOR AS PER AMENDMENT DATED OCTOBER 20/21

GLASS PRODUCTS / MIRRORS

Invoice	Qty.	Description
871 310,747 09Dec21	1	MASTER ENSUITE - MIRRORS/GLASS PRODUCTS - UPGRADE TO FRAMELESS CLEAR GLASS WITH D-RING HANDLE IN CHROME - ENSUITE MASTER SKETCH # 4

HARDWOOD

Invoice	Qty.	Description
871 311,748 09Dec21	1	UPPER HALL - HARDWOOD - VINTAGE - 3-1/4 INCH RED OAK ENGINEERED - UPPER HALL - UPG  Carpet - delete std carpet; Interior Trim - supply and install quarter rounds; Painting - paint quarter rounds

HEATING / AIR CONDITIONING

Invoice	Qty.	Description
871 313,492 09Dec21 **	1	- APPLIANCES - WHIRLPOOL OTR SS - YWMH31017HZ  SPEC PAGES 29-31 Cabinetry - Upg Range Hood; Electrical - Credit Std Range Hood; Heating - Duct Size change;
871 09Dec21 ** NoCat	1	- WALK OUT BASEMENT LOT WITH JULIETTE RAILING ACROSS MAIN FLOOR SLIDING PATIO DOOR AS PER AMENDMENT DATED OCTOBER 20/21

INTERIOR TRIM AND DOORS

Invoice	Qty.	Description
871 311,748 09Dec21 **	1	UPPER HALL - HARDWOOD - VINTAGE - 3-1/4 INCH RED OAK ENGINEERED - UPPER HALL - UPG  Carpet - delete std carpet; Interior Trim - supply and install quarter rounds; Painting - paint quarter rounds
871 09Dec21 ** NoCat	1	- WALK OUT BASEMENT LOT WITH JULIETTE RAILING ACROSS MAIN FLOOR SLIDING PATIO DOOR AS PER AMENDMENT DATED OCTOBER 20/21

LUMBER

Invoice	Qty.	Description
871 09Dec21 ** NoCat	1	- WALK OUT BASEMENT LOT WITH JULIETTE RAILING ACROSS MAIN FLOOR SLIDING PATIO DOOR AS PER AMENDMENT DATED OCTOBER 20/21

PAINTING

Invoice	Qty.	Description
871 311,748 09Dec21 **	1	UPPER HALL - HARDWOOD - VINTAGE - 3-1/4 INCH RED OAK ENGINEERED - UPPER HALL - UPG  Carpet - delete std carpet; Interior Trim - supply and install quarter rounds; Painting - paint quarter rounds



CONSTRUCTION SUMMARY

13<sup>C</sup> OF 43

Lot: 3185A-7

Model: 20-1790 END B The Dunmore

Project/Phase: Wallaceton / 3

STEEL

Invoice	Qty.	Description
871	1	- WALK OUT BASEMENT LOT WITH JULIETTE RAILING ACROSS MAIN FLOOR SLIDING PATIO DOOR AS PER AMENDMENT DATED OCTOBER 20/21
09Dec21 ** NoCat		

WINDOWS

Invoice	Qty.	Description
871	1	- WALK OUT BASEMENT LOT WITH JULIETTE RAILING ACROSS MAIN FLOOR SLIDING PATIO DOOR AS PER AMENDMENT DATED OCTOBER 20/21
09Dec21 ** NoCat		

UK 3 WALLACETON  
LOT 3185A-7  
20-1790 ELEV B END WOB  
THE DUNMORE

14 of 43

THE DUNMORE

ELEVATION B ~ END | 2,325 SQ. FT.

Includes 461 sq. ft. of Finished Lower Level

WOB

Sketch #1

WALLACETON  
EST. 1870

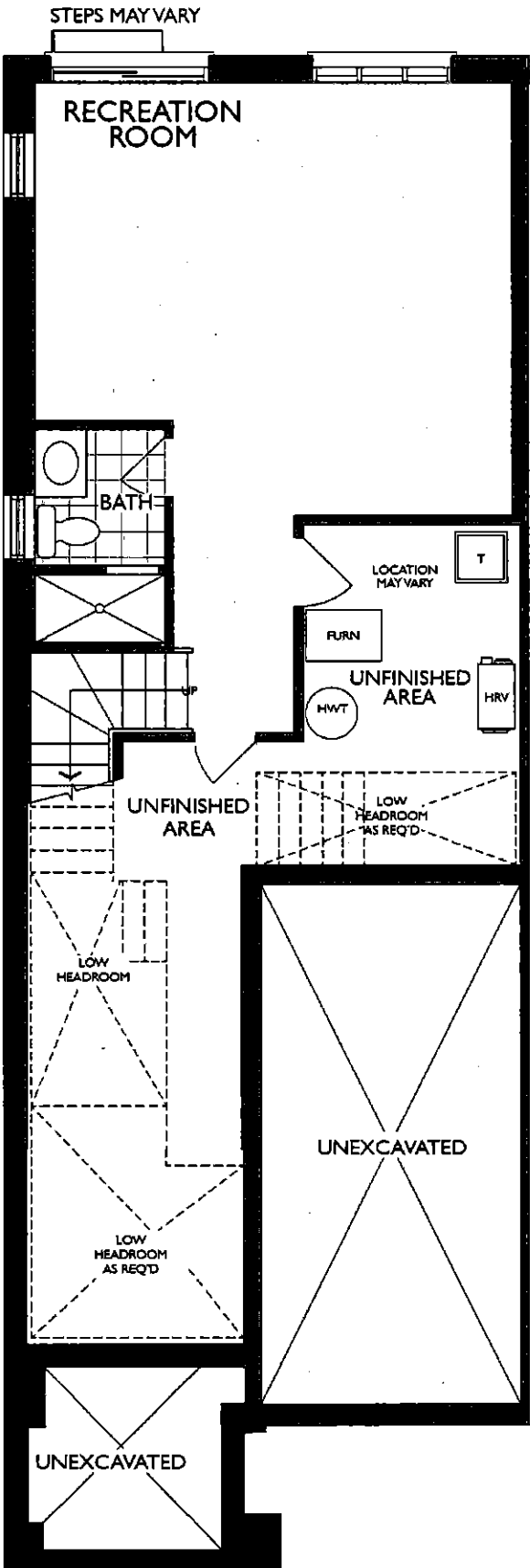

LOWER LEVEL  
ELEVATION B - END



UK 3 WALLACETON  
LOT 3185A-7  
20-1790 ELEV B END WOB  
THE DUNMORE

15 of 43

THE DUNMORE

ELEVATION B ~ END | 2,325 SQ. FT.

Includes 461 sq. ft. of Finished Lower Level

20-1790 ELEV. B END

WOB

Sketch #2 WALLACETON

EST. 1870

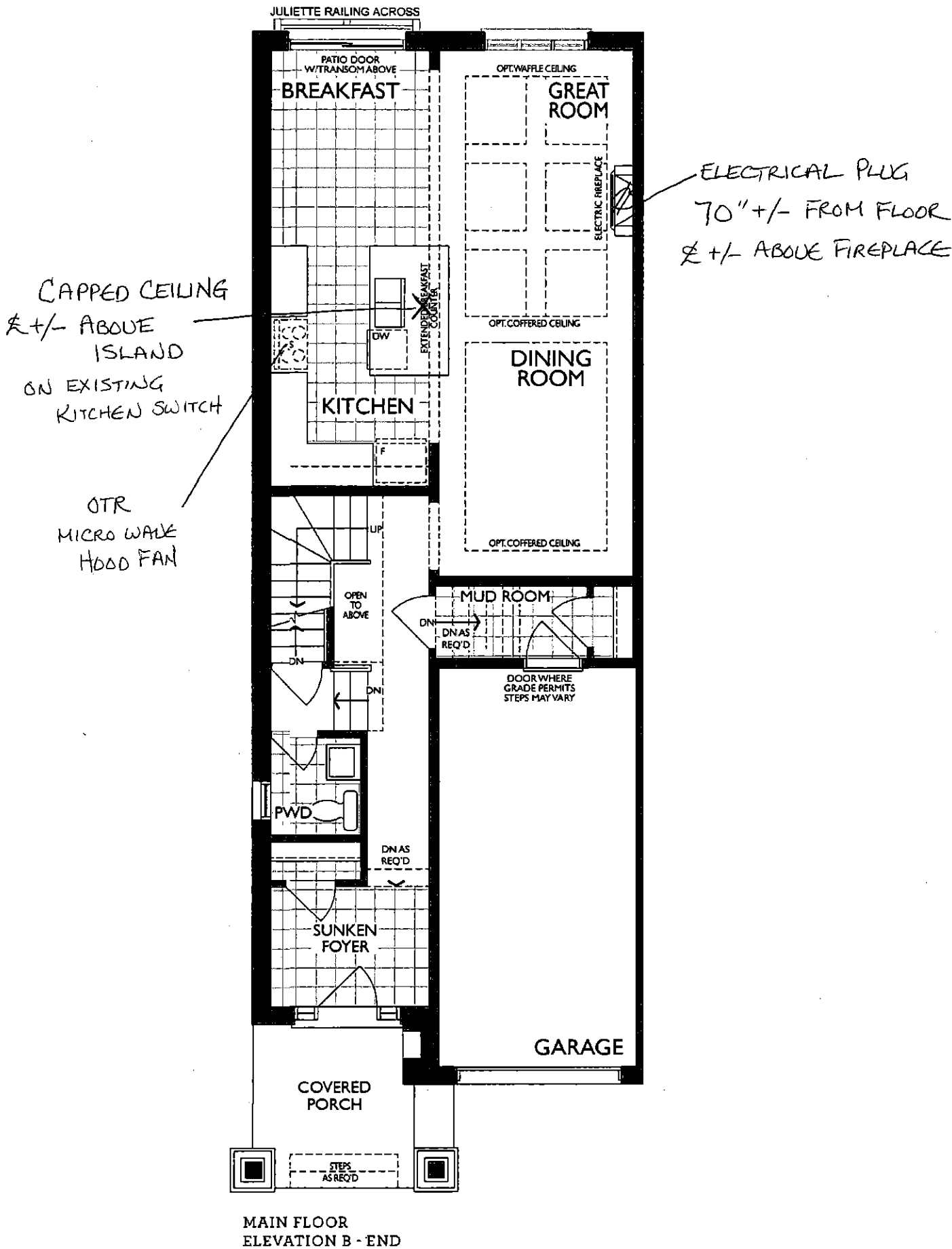

2/12/2021

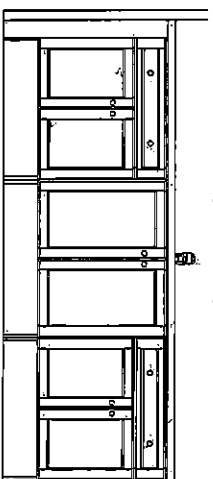
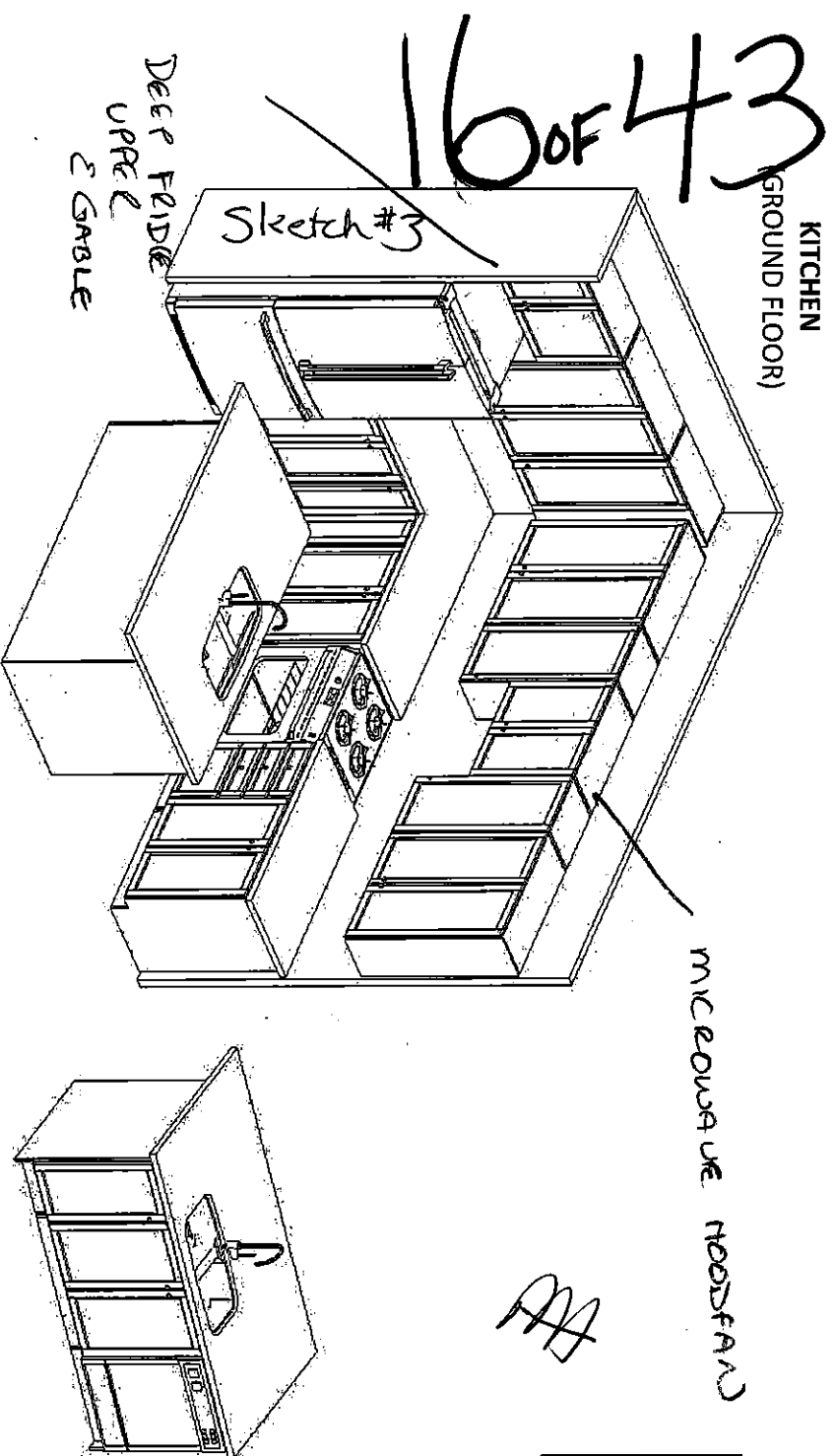
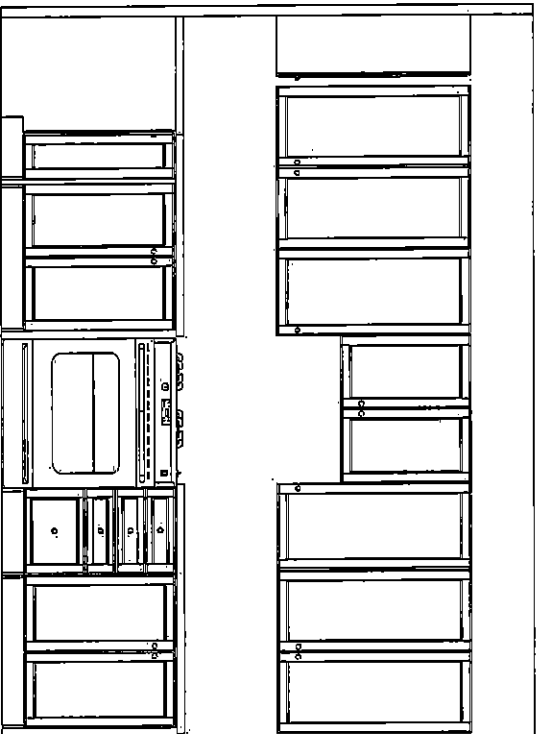
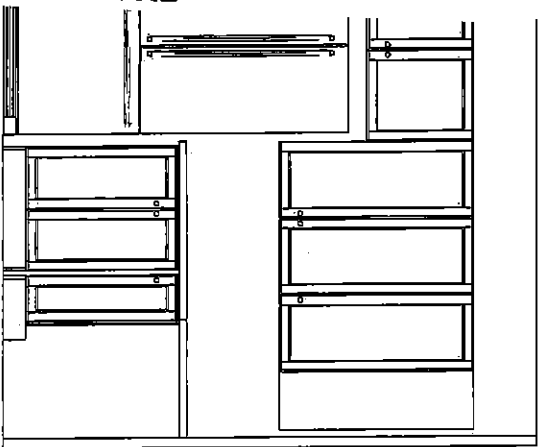

MASTER ENSUITE  
(2ND FLR)

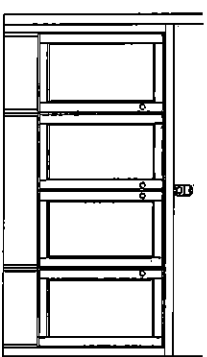

MAIN BATH  
(2ND FLR)

OPT. LAUNDRY UPPIERS  
(2ND FLR)

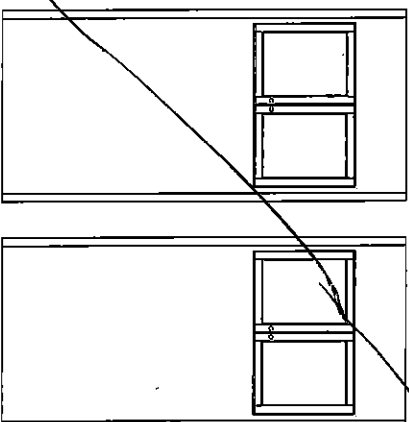

STD. BASEMENT BATH

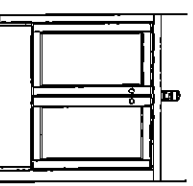

F R E N D L E  
K I T C H E N S , L I M I T E D  
1330 Birchmont Drive, Mississauga ON L4W 1G5

HEATHWOOD HOMES  
WALLACETON, KITCHENER ON  
MODEL: 20-1790 (2004)

STANDARD CONTRACT INCLUDES:

Appliance Openings

- Hood Opening: 30"W Std. hood
- Fridge Opening: 37 3/8 "W X 73 3/8" H
- 30cm deep cabinet over fridge
- Stove Opening: 30" Freestanding
- Dishwasher Opening: 24"

Standard Kitchens Scope:

- 100cm H wall cabinets
- Std. Blumotion Hinges- **soft close doors**
- Std. Metabox Drawers- **not soft close**
- Min 40cm W drawer
- Base pie cut corner cabinets
- Backing on all cabinets
- Countertop by others
- Upgrade applied paneled fridge & dishwashers supply only (appliance hardware by others)

Standard Vanity & Laundry Scope:

- Powder by others, pedestal
- All vanities include laminate counter
- Std. Blumotion Hinges- **not soft close**
- Tandem Box Drawers- **soft close**
- Master Ensuite: Top drawers (Full height doors at sink)
- Mains: Full height doors (top drawers added if Masters can't accommodate)
- Optional laundry base & wall cabinets

UK 3 WALLACETON  
LOT 3185A-7  
20-1790 END ELEV B WOB  
THE DUNMORE

17 of 43

20-1790 ELEV. B END

THE DUNMORE

ELEVATION B - END | 2,325 SQ. FT.

Includes 461 sq. ft. of Finished Lower Level

WOB

Sketch #4 WALLACETON  
EST. 1870

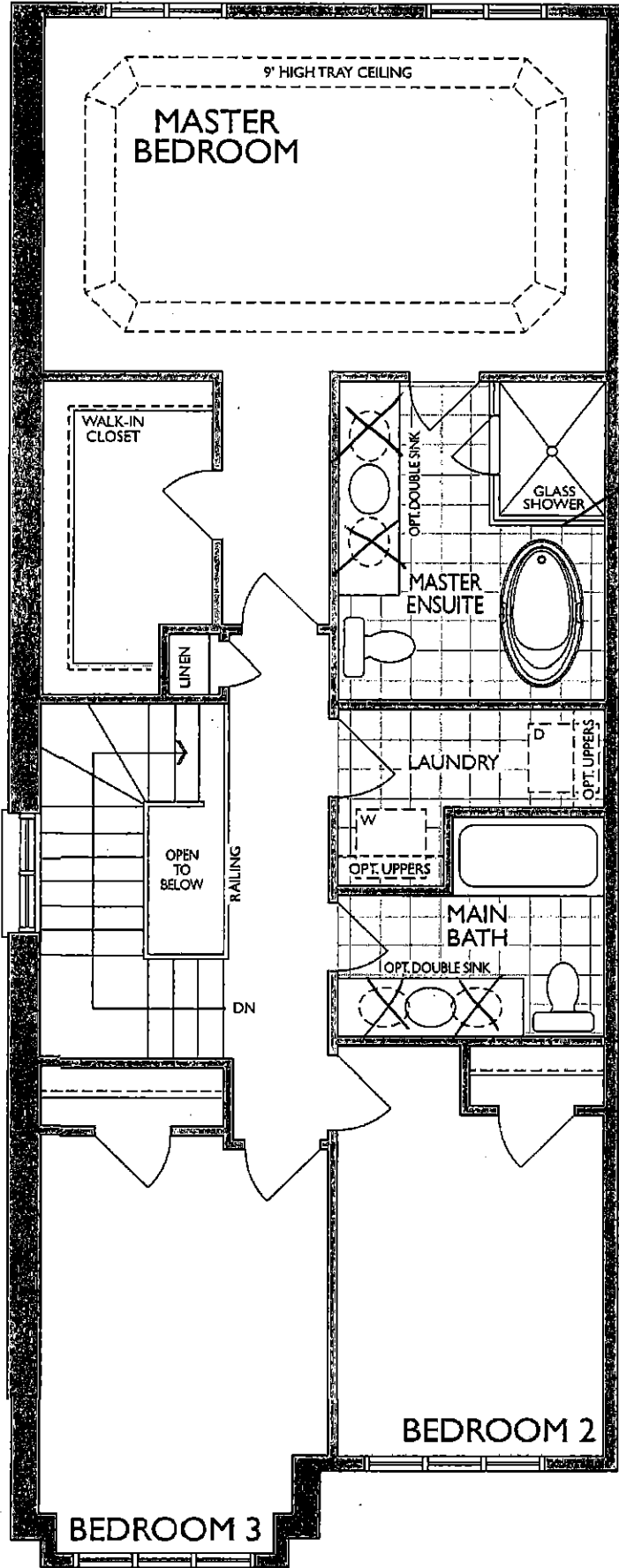

SECOND FLOOR  
ELEVATION B - END

UK 3 WALLACETON  
LOT 3185A-7  
20-1790 END ELEV B WOB  
THE DUNMORE

18 of 43

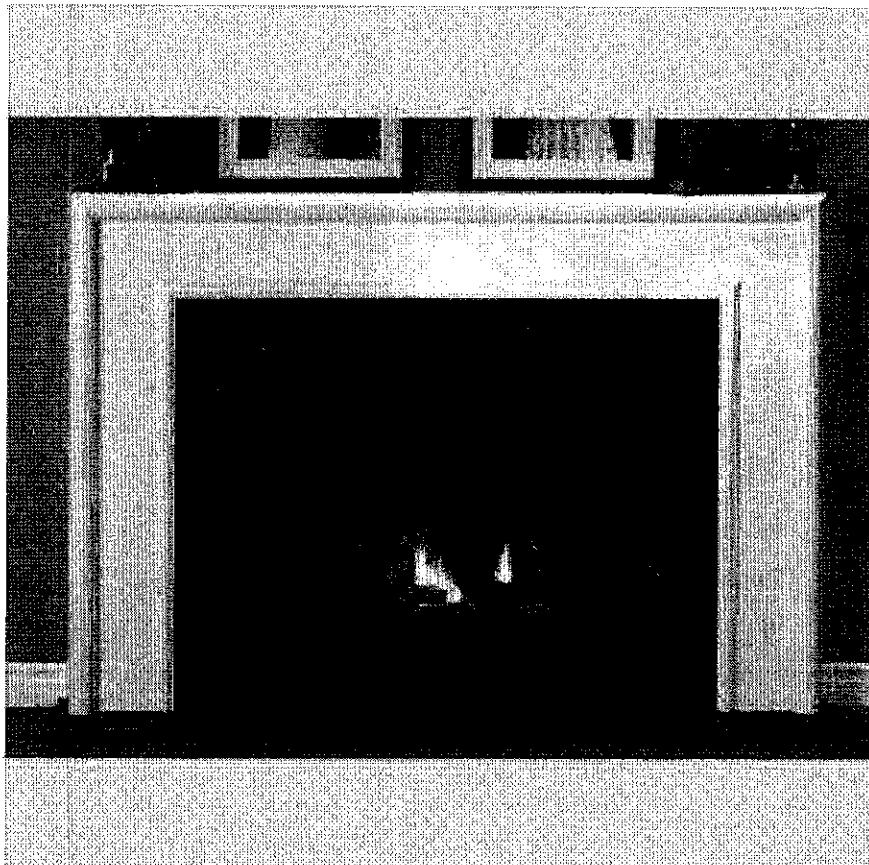

**NEAS NE17 Mantel**

AA

UK 3 WALLACETON  
LOT 3185A-7  
20-1790 END ELEV B WOB  
THE DUNMORE

19 of 43

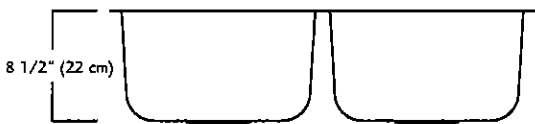
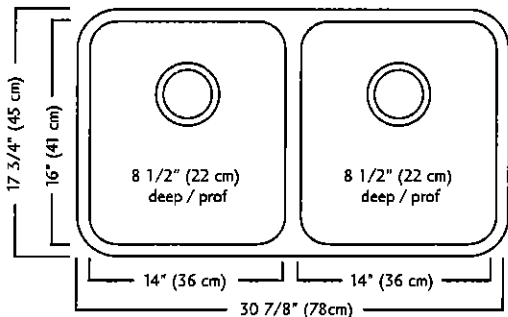
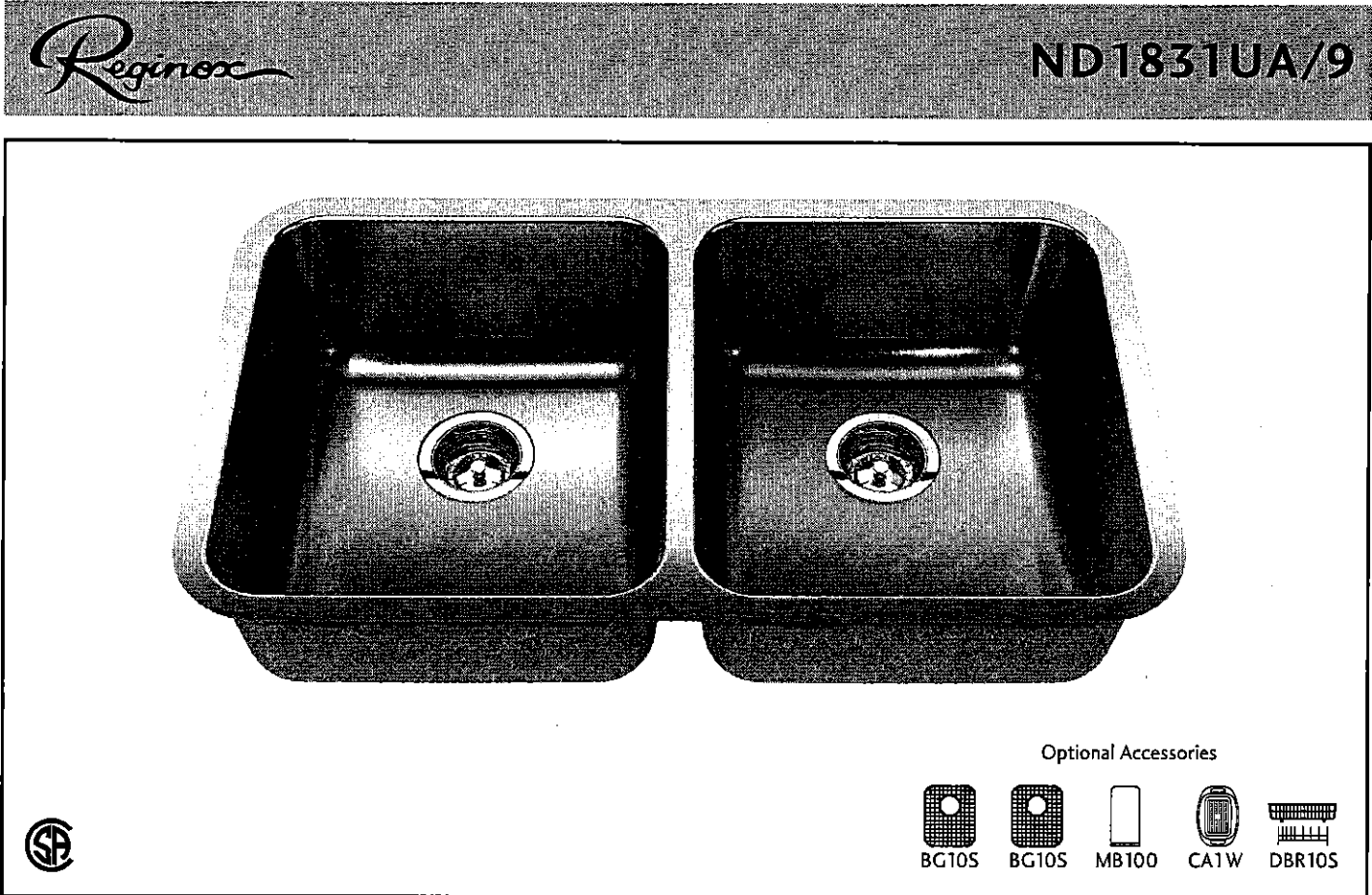

ND1831UA/9 SPECIFICATION

Model ND1831UA/9 is a double (two equal size) bowl undermount sink manufactured by Franke Kindred Canada Limited from 18 gauge stainless steel. Product has silk finished rims and linear brush finished bowls. Sink is fully undercoated. Basket strainer waste fittings (3 1/2", 89 mm) are included. Sink is backed with a limited lifetime warranty.

- O.D. 17 3/4" x 30 7/8" x 8 1/2" (45 x 78 x 22 cm)
- Recommended for minimum 36" cabinet

Franke Kindred Canada Limited  
P.O. Box 190, 1000 Franke Kindred Road, Midland, Ontario, Canada, L4R 4K9 Phone: 866-687-7465 Fax: 800-361-8408

AAA

UK 3 WALLACETON  
LOT 3185A-7  
20-1790 END ELEV B WOB  
THE DUNMORE

20 of 43

MOEN®

There is more than 1 version of this model.  
Page down to identify the version you have.

FAUCET DESCRIPTION

- Reflex™ pulldown system offers smooth operation, easy movement and secure docking
- Power Clean™ spray technology
- Metal construction with various finishes identified by suffix
- Duralock™ connect installation
- Pulldown spray with 68" braided hose
- Flexible supply lines with 3/8" compression fittings
- High arc spout provides height and reach to fill or clean large pots while pulldown wand provides the maneuverability for cleaning or rinsing
- 360° rotating spout
- Faucet designed for handle to be mounted on right side only

OPERATION

- Lever style handle
- Temperature controlled by 100° arc of handle travel
- Operates with less than 5 lbs. of force
- Operates in stream or spray mode in the pullout or retracted position

FLOW

- Flow is limited to 1.5 gpm (5.7 L/min) max at 60 psi

CARTRIDGE

- 1255™ Duralast™ cartridge

STANDARDS

- Third party certified to IAPMO Green, ASME A112.18.1/CSA B125.1 and all applicable requirements therein including NSF 61/9G & 372
- Meets CalGreen and Georgia SB370 requirements
- Complies with California Proposition 65 and with the Federal Safe Drinking Water Act
- The backflow protection system in the device consists of two independently operating check valves, a primary and a secondary which prevent backflow

- ADA  for lever handle

WARRANTY

- Lifetime limited warranty against leaks, drips and finish defects to the original homeowner
  - 10 year limited warranty when used in a multifamily installation
  - 5 year limited warranty when used in a commercial installation
- Visit [www.moen.com/support](http://www.moen.com/support) for complete details and limitations

Specifications

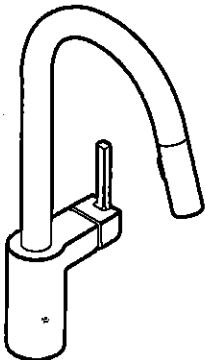

**ALIGN™**  
**Single Handle High Arc**  
**Pulldown Kitchen Faucet**

Models: 7565 series

**NOTE:** THIS FAUCET IS DESIGNED TO BE INSTALLED  
THROUGH 1 HOLE, 1-1/2" (38mm) MIN. DIA.  
(OPTIONAL 3-HOLE ESCUTCHEON 141002 AVAILABLE)

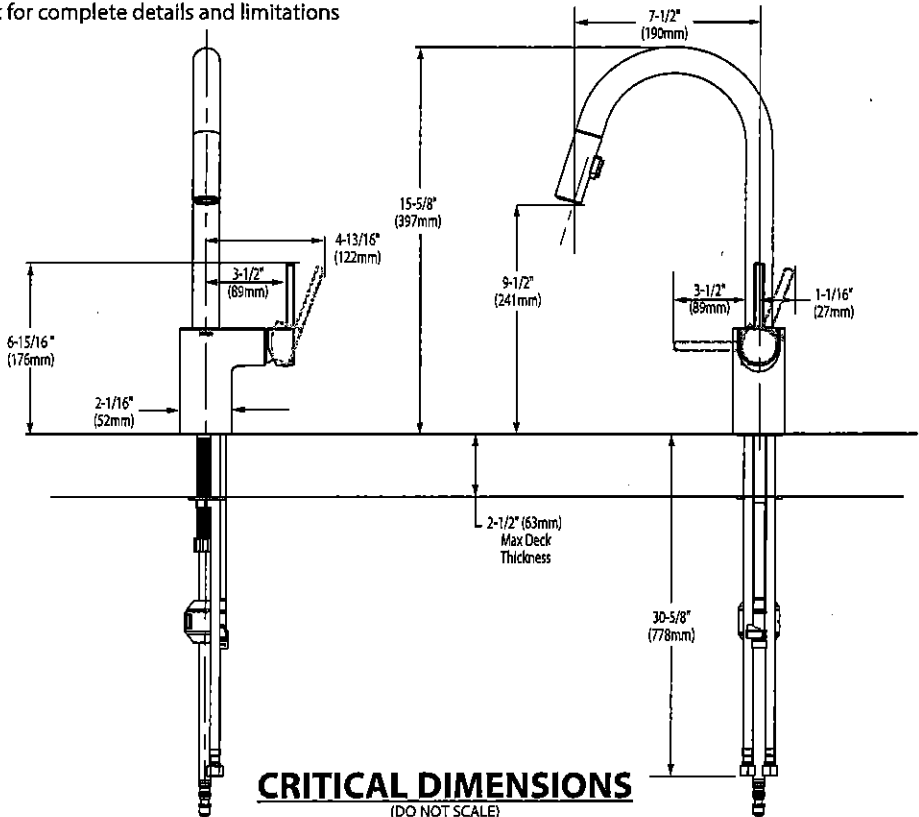

MA

UK 3 WALLACETON  
LOT 3185A-7  
20-1790 END ELEV B WOB  
THE DUNMORE

21 of 43



**BARRIER FREE (ABOVE COUNTER OR DROP-IN ONLY)**

**BOULEVARD®  
PEDESTAL SINK**  
VITREOUS CHINA

**BOULEVARD® PEDESTAL SINK**

- ☐ 0641.800 Faucet holes on 8" (203mm) centers (Illustrated)
- ☒ 0641.400 Faucet holes on 4" (102mm) centers
- ☐ 0641.100 Center hole only
  - Classic styled rectangular pedestal lavatory
  - Vitreous china
  - Rear overflow
  - Supplied with mounting kit
  - Right Height® for greater comfort during use
  - Faucet ledge with large deck area (faucet not included)
  - **Design coordinates with Boulevard® Toilet**
  - Basin has flat bottom to also allow use as an **above counter** sink or a **drop-in** sink (with u-shaped cut out)

**Nominal Dimensions:**  
24" x 19" x 35-1/2"  
(610 x 483 x 902mm)

- ☐ 0641.008 Pedestal top-8" (203mm) centers
- ☐ 0641.004 Pedestal top-4" (102mm) centers
- ☐ 0641.001 Pedestal top-center hole only
- ☐ 0010.000 Pedestal only

**Bowl sizes:**  
17" (432mm) wide,  
12-1/2" (318mm) front to back,  
5" (127mm) deep

**Compliance Certifications -  
Meets or Exceeds the Following Specifications:**  
• ASME A112.19.2 - 2008/CSA B45.1-08

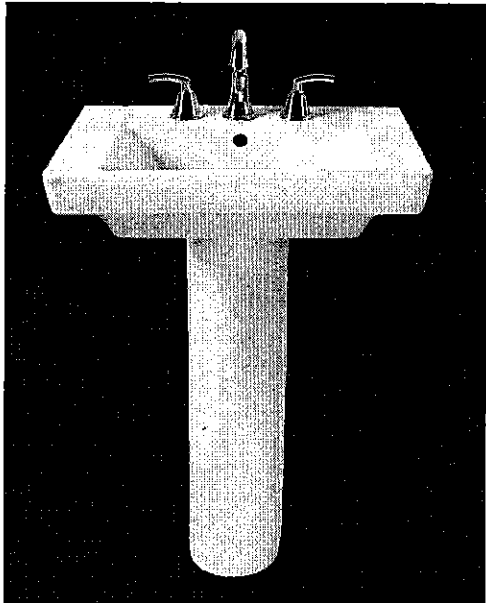

SEE REVERSE FOR ROUGHING-IN DIMENSIONS

<p><b>To Be Specified:</b></p> <p><input type="checkbox"/> Color: <input type="checkbox"/> White <input type="checkbox"/> Linen</p> <p><input type="checkbox"/> Faucet Finish:</p> <p><input type="checkbox"/> Supplies:</p> <p><input type="checkbox"/> 1-1/4" Trap:</p> <p><input type="checkbox"/> Nipple:</p>
---

\* See faucet section for additional models available

MA

UK 3 WALLACETON  
LOT 3185A-7  
20-1790 END ELEV B WOB  
THE DUNMORE

22 of 43



BARRIER FREE (ABOVE COUNTER OR DROP-IN ONLY)

**BOULEVARD®**  
**PEDESTAL SINK**  
VITREOUS CHINA

TOP VIEW (ALL THREE CONFIGURATIONS)

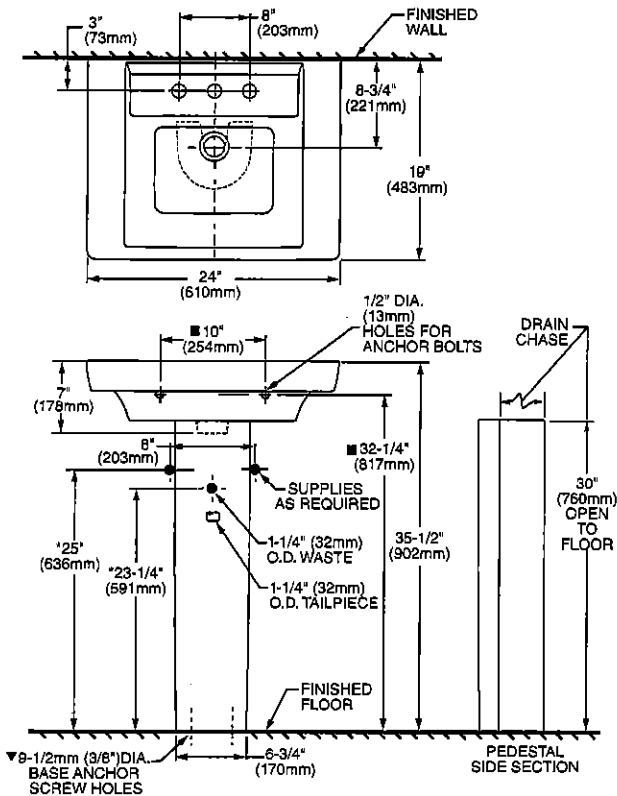

PEDESTAL CONFIGURATION  
(NOT ADA COMPLIANT)

ABOVE COUNTER CONFIGURATION

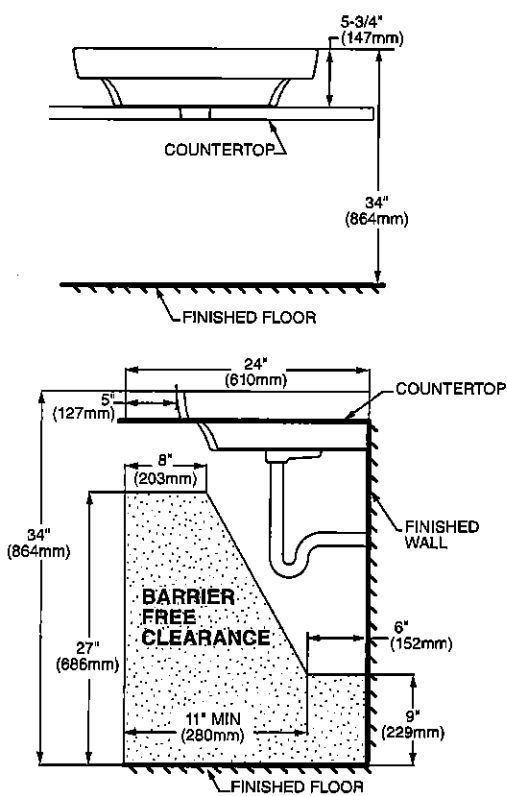

DROP-IN SINK CONFIGURATION



**ABOVE COUNTER AND DROP-IN SINK CONFIGURATIONS**  
**MEET THE AMERICANS WITH DISABILITIES ACT GUIDELINES**  
**AND ANSI A117.1 ACCESSIBLE AND USABLE**  
**BUILDINGS AND FACILITIES - CHECK LOCAL CODES.**  
Top of sink installed at 34" (864mm) height from finished floor.  
Sink installed 5" (127mm) minimum from front edge of countertop.  
Provide 27" (686mm) knee clearance area.

**NOTES:**  
\* DIMENSIONS SHOWN FOR LOCATION OF SUPPLIES AND "P" TRAPS ARE SUGGESTED.  
▼ PEDESTAL ANCHORING SCREWS NOT INCLUDED.  
■ SUITABLE FOR REINFORCEMENT ONLY. ACTUAL DIMENSIONS MUST BE TAKEN FROM FIXTURE.  
FITTING NOT INCLUDED AND MUST BE ORDERED SEPARATELY.  
PROVIDE SUITABLE REINFORCEMENT FOR ALL WALL SUPPORTS.  
INSTALLATION INSTRUCTIONS SUPPLIED WITH LAVATORY.

**IMPORTANT:** Dimensions of fixtures are nominal and may vary within the range of tolerance established by ANSI Standard A112.19.2  
These measurements are subject to change or cancellation. No responsibility is assumed for use of superseded or voided pages.

MA



UK 3 WALLACETON  
LOT 3185A-7  
20-1790 END ELEV B WOB  
THE DUNMORE

23 of 43

American Standard

 BARRIER FREE

COLONY™  
COUNTERTOP SINK  
VITREOUS CHINA

COLONY COUNTERTOP SINK

- Vitreous china
- Self-rimming
- Front overflow
- Supplied with template
- Faucet deck  
(Faucet shown not included)

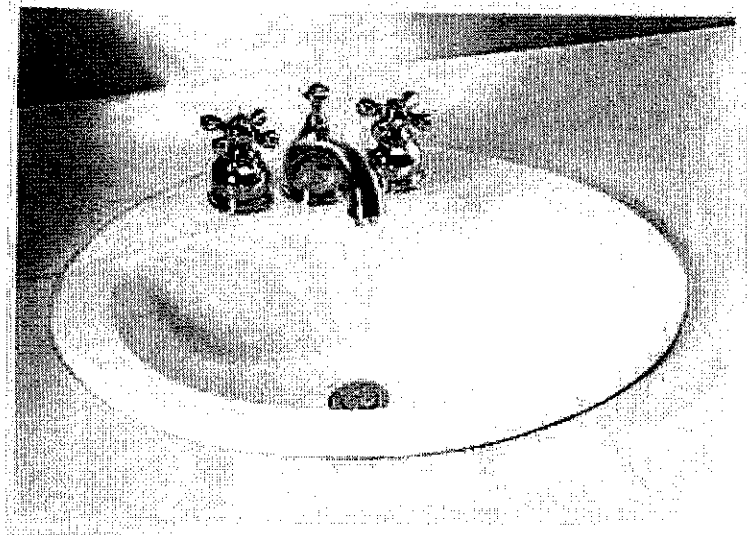

- ☐ 0346 803  
Faucet holes on 203mm (8") centres
- ☒ 0346 403 (Illustrated)  
Faucet holes on 102mm (4") centres
- ☐ 0346 001  
Centre hole only

Nominal Dimensions:  
521 x 448mm (20-1/2" x 17-5/8")

Bowl sizes:  
422mm (16-5/8") wide, 279mm (11") front to back, 143mm (5-5/8") deep

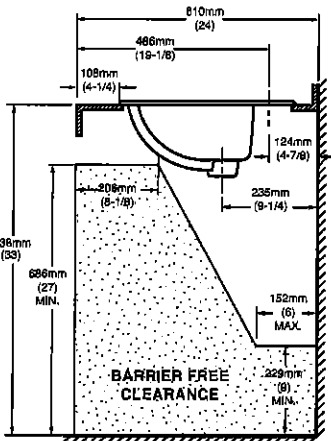
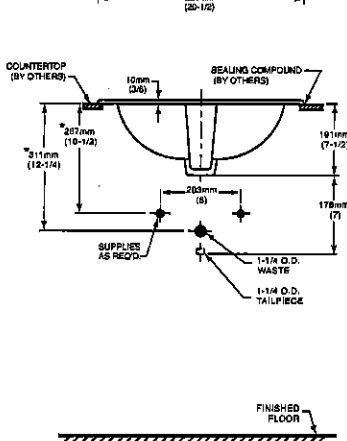
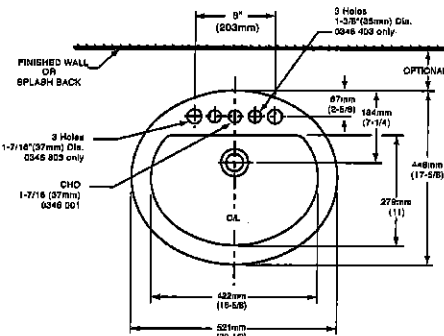

COMPLIANCE CERTIFICATIONS –  
Meets or exceeds the following Specifications:  
• ASME A112.19.2M for Vitreous China Fixtures.  
• CAN/CSA B45 Series.

- To Be Specified
- ☐ Colour: ☐ White ☐ Bone ☐ Silver Gray  
☐ Linen
- ☐ Faucet\*:
- ☐ Faucet Finish:
- ☐ Supplies & Stops:
- ☐ Trap 1-1/4" (32 mm):

NOTES:  
\* DIMENSIONS SHOWN FOR LOCATION OF SUPPLIES AND "P" TRAP ARE SUGGESTED.  
FOR COUNTERTOP CUTOUT AND INSTALLATION INSTRUCTIONS USE TEMPLATE  
SUPPLIED WITH SINK.  
FAUCETS NOT INCLUDED AND MUST BE ORDERED SEPARATELY.  
IMPORTANT: Dimensions of fixtures are nominal and may vary within the range of tolerances  
established by ANSI Standard A112.19.2.  
These measurements are subject to change or cancellation. No responsibility is assumed for use  
of superseded or voided pages.

\* See faucet section for additional models available

MA

UK 3 WALLACETON  
LOT 3185A-7  
20-1790 END ELEV B WOB  
THE DUNMORE

24 OF 43



DEMI™  
Product Specification Sheet

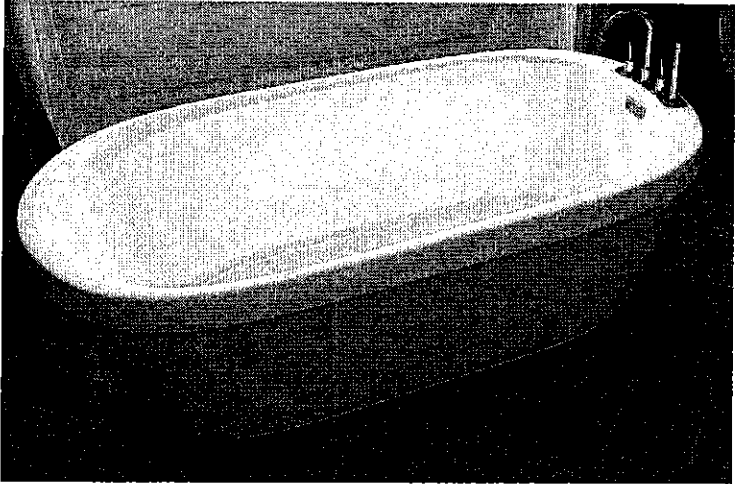

Two Piece Freestanding Collection

CF2007	Two Piece Freestanding Soaker
Size:	60" x 32" x 22" 1524 mm x 813 mm x 559 mm

PRODUCT FEATURES & BENEFITS

- Vacuum formed acrylic reinforced with fiberglass
- Scratch, stain and fade resistant high gloss finish
- Installation friendly two piece design
- Accepts deck mounted faucet
- Includes integral pop up drain and rectangular overflow
- Includes levelling feet

TWO PIECE ASSEMBLY

FRONT VIEW

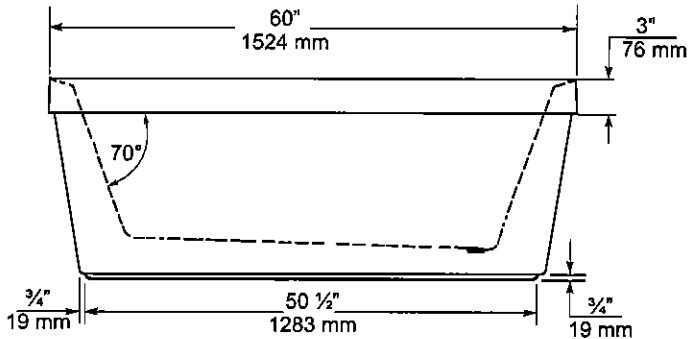

END VIEW

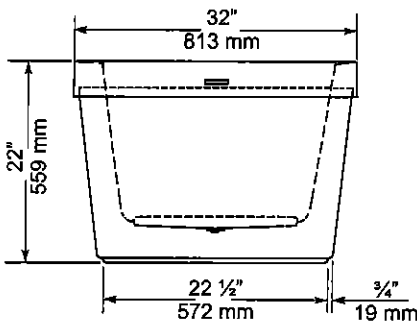

TOP VIEW

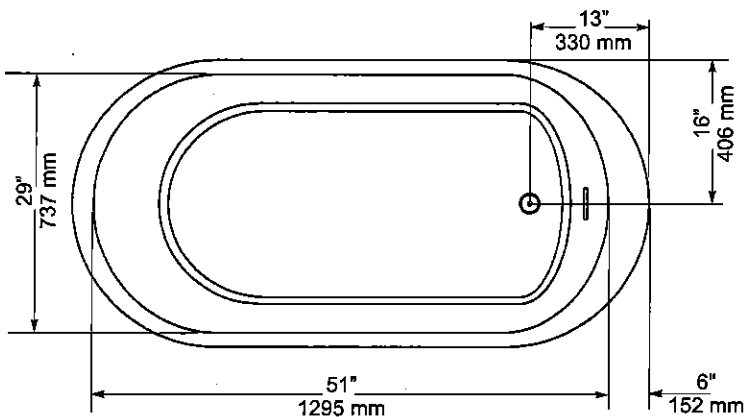

GENERAL SPECIFICATIONS		
Average Weight	90 lb	41 kg
Bathing Well at bottom	43"x 20"	1092 x 508 mm
Capacity Drain to Overflow		195 litres
Water Depth Drain to Overflow	16"	406 mm
Drain Opening (dia.)	2"	51 mm
Overflow Opening	2 1/4"x 1/2"	57 x 13 mm
Drain to Floor Clearance	3 1/4"	83 mm

**NOTES:** Please confirm measurements on actual product to ensure proper identification. Bathtub to be installed on the floor supported by 5 self levelling feet. Adjust if required to level the bathtub for adequate drainage. Refer to installation instructions for additional information.

**IMPORTANT:** Dimensions of fixtures are nominal and may vary ± 1/4" (6 mm). Weight may vary ± 5 lb (2.3 kg). Drawing is not to scale. These measurements are subject to change at manufacturer's discretion.

Compliance Certifications -  
Meets or Exceeds the following Specifications:  
• CAN/CSA - B45 Series



MM

UK 3 WALLACETON  
LOT 3185A-7  
20-1790 END ELEV B WOB  
THE DUNMORE

25 of 43

American Standard  
Style That Works Better

FloWise™ DUAL FLUSH  
ELONGATED TOILET  
VITREOUS CHINA

FloWise™ DUAL FLUSH ELONGATED TOILET

- 2476 216
  - Vitreous china
  - Low-consumption Dual Flush
    - Full flush 6.0 Lpf/1.3 gpf,
    - Partial flush 3.0 Lpf/0.66 gpf.
  - Elongated wash down bowl
  - Internal trapway fully-glazed,  
2-1/4" (57mm) ballpass
  - Concealed trapway bowl
  - Chrome-plated top mounted  
push button actuator
  - Easy to clean sanitary dam on bowl
  - Includes Elongated Slow Close Seat
  - 100% factory flush tested
  - 2 bolt caps

Separate Component Parts:

- 3067 316 Elongated Bowl with Slow Close Seat
- 4035 216 Unlined Tank

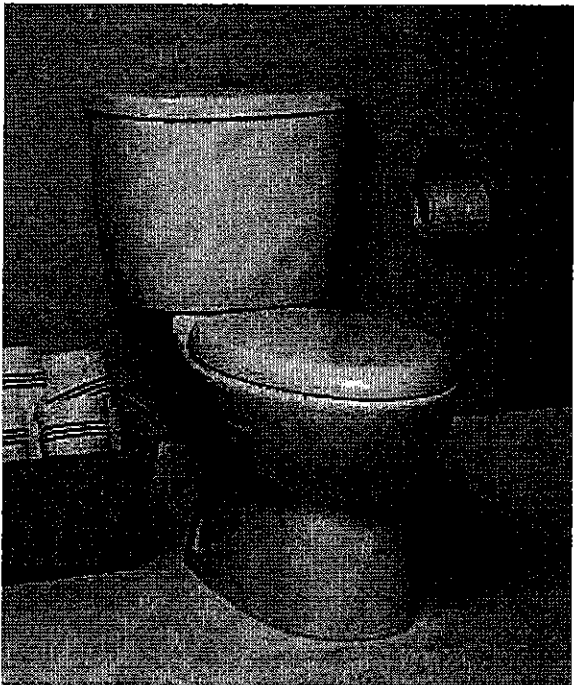

- 2476 516 Same as above with Lined tank
  - 3067 316 Elongated Bowl
  - 4035 516 Lined Tank

Nominal Dimensions:  
794 x 432 x 765mm  
(31-1/4" x 17" x 30-1/8")

Compliance Certifications -  
Meets or Exceeds the Following Specifications:

- ASME A112.19.2M (and 19.6M)
- CAN/CSA B45 series

- To Be Specified
- Colour: 020 White
  - Supply with stop:

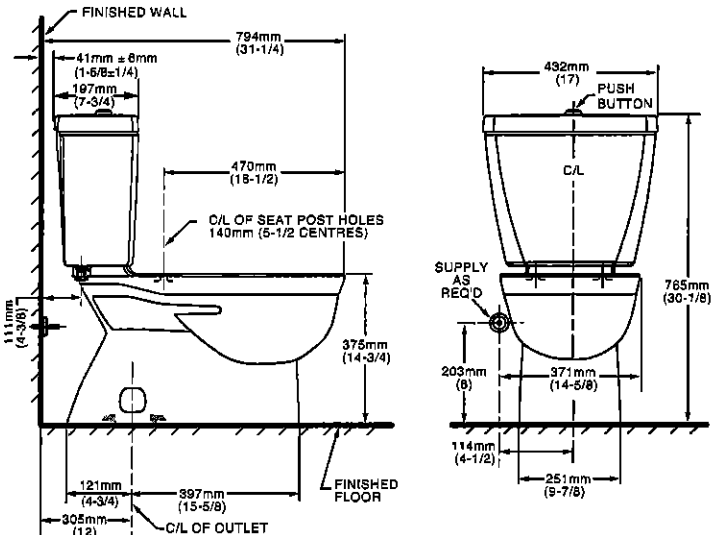

NOTES:  
THIS TOILET IS DESIGNED TO ROUGH-IN AT A MINIMUM DIMENSION OF 305MM (12") FROM FINISHED WALL TO C/L OF OUTLET.  
SUPPLY NOT INCLUDED WITH FIXTURE AND MUST BE ORDERED SEPARATELY.  
\* DIMENSION SHOWN FOR LOCATION OF SUPPLY IS SUGGESTED.  
FOR ADDITIONAL INFORMATION REFER TO INSTALLATION INSTRUCTIONS SUPPLIED.  
IMPORTANT: Dimensions of fixtures are nominal and may vary within the range of tolerance established by ANSI Standard A112.19.2  
These measurements are subject to change or cancellation. No responsibility is assumed for use of superseded or voided pages.

UPGRADED VALUE ADDED FEATURES AT NO EXTRA CHARGE

AD

UK 3 WALLACETON  
LOT 3185A-7  
20-1790 END ELEV B WOB  
THE DUNMORE

26 of 43

MOEN®

Specifications

There is more than 1 version of this model.  
Page down to identify the version you have.

DESCRIPTION

- Metal construction with various finishes identified by suffix
- Flexible supplies with 3/8" compression fittings
- Includes metal or 50/50 pop-up type waste assembly where noted

OPERATION

- Pivot action lever style handle
- Temperature controlled through 100° degree arc of handle travel

FLOW

- Water usage is limited to these maximum flow rates as indicated by the corresponding product markings
- ° 1.2 gpm max (4.5L/min) at 60 psi
- ° 1.5 gpm max (5.7L/min) at 60 psi

CARTRIDGE

- 1255™ Duralast™ cartridge
- Nonmetallic/nonferrous and stainless steel material

STANDARDS

- Third party certified to WaterSense®, ASME A112.18.1/CSA B125.1 and all applicable requirements referenced therein
- Certified to NSF 61/9 & 372
- Products marked with 1.2 gpm are compliant with California water efficiency regulations
- Complies with California Proposition 65 and with the Federal Safe Drinking Water Act

- **ADA**  for lever handle

WARRANTY

- Lifetime limited warranty against leaks, drips and finish defects to the original consumer purchaser
- 5 year warranty if used in commercial installations

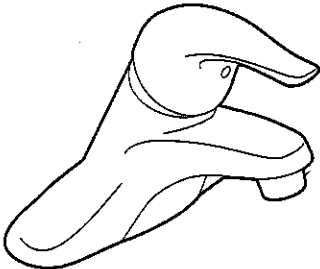

**CHATEAU®**  
Single-Handle Lavatory Faucet

with Metal Waste Assembly

Model: L4625 series  
L4631BC

**Bulk Packed (12 per carton):**  
L64624 series

with 50/50 Waste Assembly

**Bulk Packed (12 per carton):**  
L64625 series

Less Waste  
**Bulk Packed (12 per carton):**  
L64600 series

**NOTE:** THIS FAUCET IS DESIGNED TO BE  
INSTALLED THRU 3-1" DIA. HOLES, 2" ON CENTER

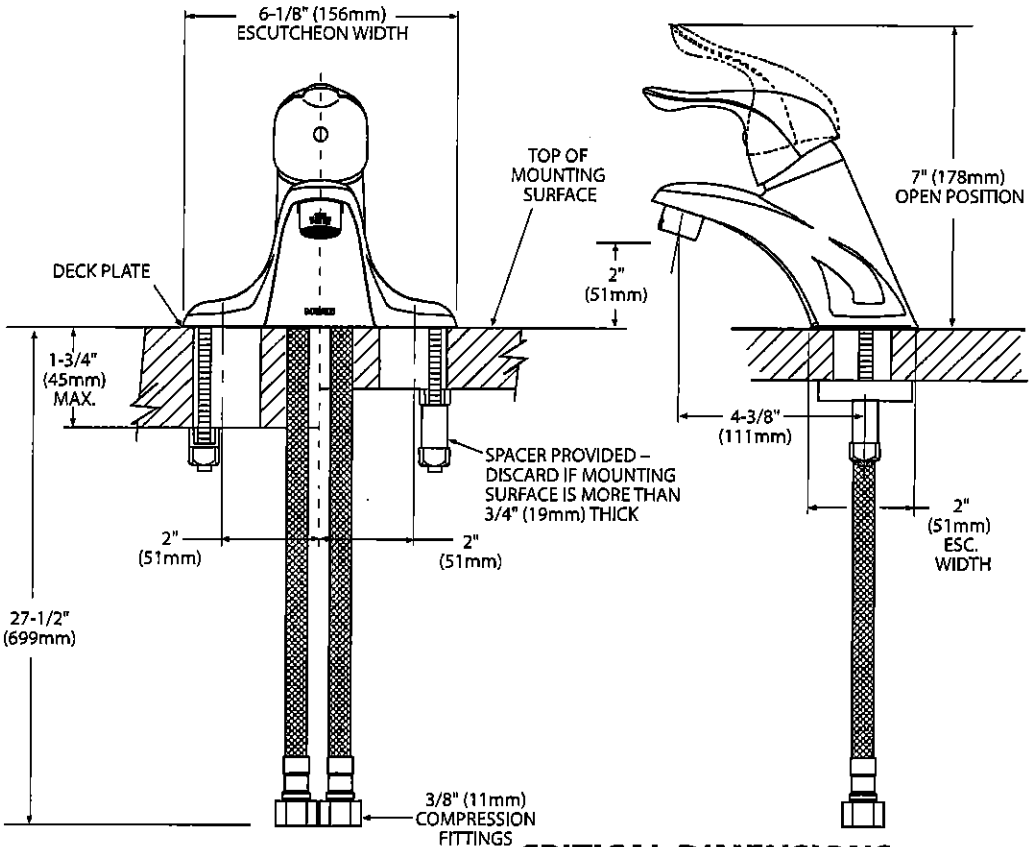

**CRITICAL DIMENSIONS**  
(DO NOT SCALE)

AM

UK 3 WALLACETON  
LOT 3185A-7  
20-1790 END ELEV B WOB  
THE DUNMORE

27 of 43



Buy it for looks. Buy it for life.®

There is more than 1 version of this model.  
Page down to identify the version you have.

DESCRIPTION

- Metal construction with various finishes identified by suffix
- Includes non-metallic showerhead, arm, flange and non-metallic diverter tub spout

OPERATION

- Handle operates counterclockwise through a 270° arc with off at 6 o'clock and maximum hot at the 9 o'clock position. Shut off in clockwise direction
- Adjustable temperature limit stop to control maximum hot water temperature
- Pressure balancing mechanism maintains selected discharge temperature to ± 3°

FLOW

- Showerhead is limited to 2.5 gpm (9.5 L/min) at 80 psi
- EP suffix models are limited to 1.75 gpm (6.6 L/min) at 80 psi
- NH suffix models contain no showerhead

CARTRIDGE

- 1222 cartridge design
- Accommodates back to back installations
- Nonmetallic/nonferrous and stainless steel material

STANDARDS

- Third party certified to meet ASME A112.18.1/CSA B125.1 and all applicable requirements referenced therein
- EP suffix models are third party certified to WaterSense®

- ADA  for lever handle

WARRANTY

- Lifetime limited warranty against leaks, drips and finish defects to the original consumer purchaser
- 5 year warranty if used in commercial installations

Specifications

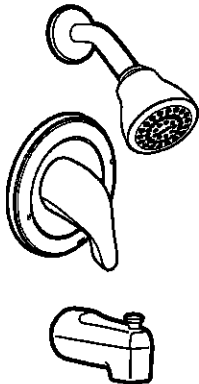

CHATEAU® POSI-TEMP®  
Single-Handle Tub/Shower Trim Kit

Models: TL181 series - valve trim only  
(Bulk Packed 12 per carton)  
TL182 series - shower trim only  
(Bulk Packed 12 per carton)  
TL183 series - tub/shower trim  
(Bulk Packed 12 per carton)

Valves: 62300 series  
2500 series

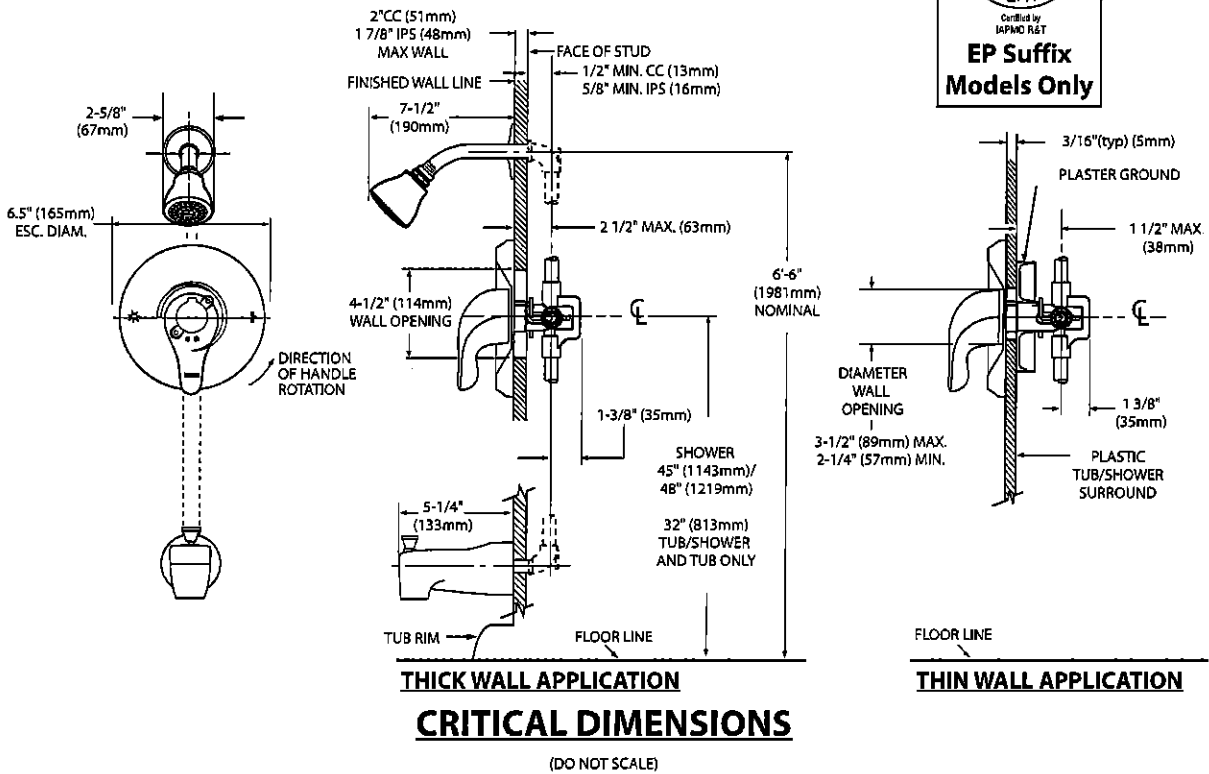
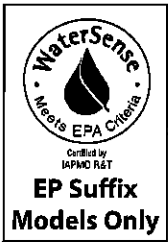

UK 3 WALLACETON  
LOT 3185A-7  
20-1790 END ELEV B WOB  
THE DUNMORE

28 of 43

MOEN®

Specifications

DESCRIPTION

- Metal construction with various finishes identified by suffix

OPERATION

- Lever style handles with hot and cold color indicator
- Rotate hot side handle counterclockwise to open (clockwise to close) and the cold side handle (clockwise to open) and (counterclockwise to close)

STANDARDS

- Third party certified to: ASME A112.18.1/CSA B-125.1, and all applicable requirements referenced therein
- ADA  for lever handles

WARRANTY

- Lifetime limited warranty against leaks, drips and finish defects to the original homeowner
  - 10 year limited warranty when used in a multi-family installation
  - 5 year limited warranty when used in a commercial installation
- Visit [www.moen.com/support](http://www.moen.com/support) for complete details and limitations

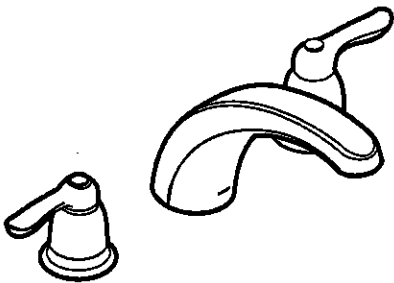

CHATEAU®  
Two-Handle Garden Tub Trim

Models: T994 series

Valves: 4792, 4793, 4794, 4796, 4797, 4798

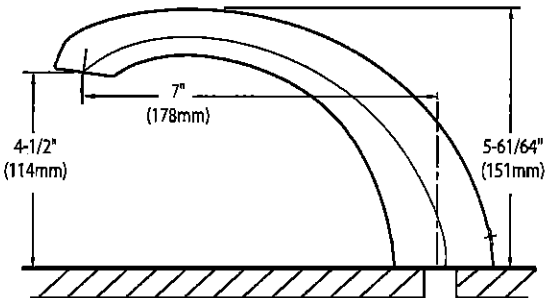
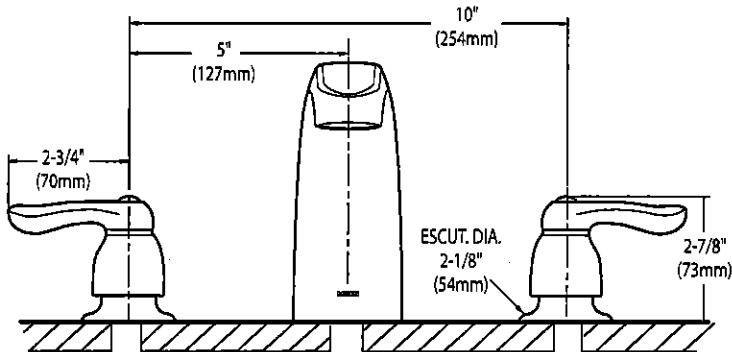

CRITICAL DIMENSIONS

(DO NOT SCALE)

AA

UK 3 WALLACETON  
LOT 3185A-7  
20-1790 END ELEV B WOB  
THE DUNMORE

29 of 43

WMH31017H  
OVER-THE-RANGE MICROWAVE

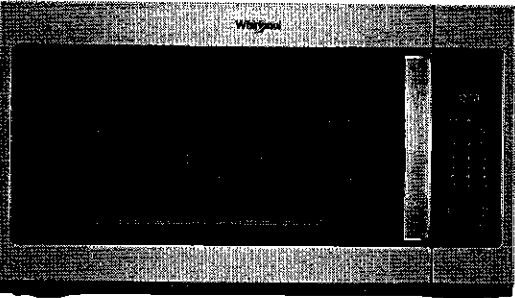

DISHWASHER-SAFE TURNTABLE PLATE



Clean up spills on the turntable by simply putting it in the dishwasher.

2-SPEED 300 CFM MOTOR CLASS\*



Match the right amount of ventilation to the dish being prepared and quickly get rid of cooking odors with two different fan speed settings.

MICROWAVE PRESETS



Get just the right amount of heat and time, whether you're cooking or defrosting, with specific preset options.

OTHER FEATURES

- Add 30 seconds option
- Electronic touch controls
- Adjustable cooktop lighting

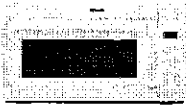

White  
(W)



Black  
(B)



Fingerprint Resistant  
Stainless Steel (Z)



Silver  
(S)

MODEL	WMH31017HW	WMH31017HB	WMH31017HZ	WMH31017HS
Max height (in)	17-1/8"	17-1/8"	17-1/8"	17-1/8"
Width (in)	29-15/16"	29-15/16"	29-15/16"	29-15/16"
Depth (in)	15-9/16"	15-9/16"	15-9/16"	15-9/16"

Whirlpool®

\*Performance varies based on installation.

©/™ ©2018 Whirlpool. All rights reserved. 1/18. WC170107A

MA

UK 3 WALLACETON  
LOT 3185A-7  
20-1790 END ELEV B WOB  
THE DUNMORE

30 of 43

VENTING DESIGN SPECIFICATIONS

This section is intended for architectural designer and builder/contractor reference only.

NOTES:

- Vent materials needed for installation are not provided with microwave hood combination.
- We do not recommend using a flexible metal vent.
- To avoid possible product damage, be sure to vent air outside, unless using recirculation installation. Do not vent exhaust air into concealed spaces, such as spaces within walls or ceilings, attics, crawl spaces, or garages.

For optimal venting installation, we recommend:

- Using roof or wall caps that have backdraft dampers
- Using a rigid metal vent
- Using the most direct route by minimizing the length of the vent and number of elbows to provide efficient performance
- Using uniformly sized vents
- Using duct tape to seal all joints in the vent system
- Using caulking compound to seal exterior wall or roof opening around cap
- Not installing 2 elbows together for optimal hood performance

If venting through the wall, be sure that there is proper clearance within the wall for the damper to open fully.

If venting through the roof, and rectangular-to-round transition is used, be sure there are at least 3" (7.6 cm) of clearance between the top of the microwave oven and the transition piece. See "Rectangular-to-Round Transition" illustration.

Rectangular-to-Round Transition

NOTE: The minimum 3" (7.6 cm) clearance must exist between the top of the microwave oven and the rectangular to round transition piece so that the damper can open freely and fully.

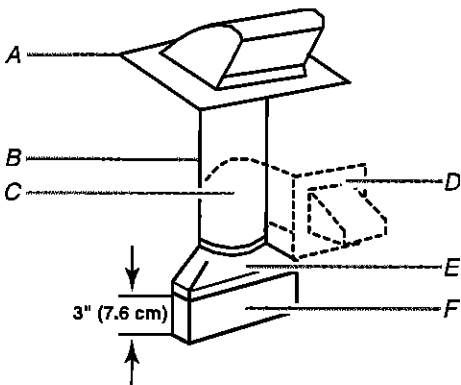

- A. Roof cap
- B. 6" (15.2 cm) min. diameter round vent
- C. Elbow (for wall venting only)
- D. Wall cap
- E. 3 1/4" x 10" to 6" (8.3 x 25.4 cm to 15.2 cm) rectangular to round transition piece
- F. Vent extension piece, at least 3" (7.6 cm) high

Recommended Standard Fittings

The following length equivalents are for use when figuring vent length. See the examples in "Recommended Vent Length".

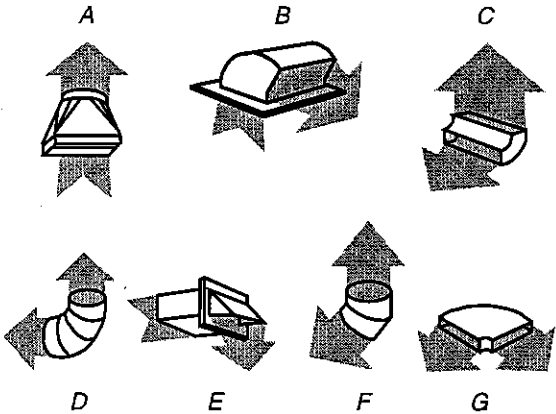

- A. Rectangular-to-round transition piece: 3 1/4" x 10" to 6" = 5 ft (8.3 x 25.4 cm to 15.2 cm = 1.5 m)
- B. Roof cap: 3 1/4" x 10" = 24 ft (8.3 x 25.4 cm = 7.3 m)
- C. 90° elbow: 3 1/4" x 10" = 25 ft (8.3 x 25.4 cm = 7.6 m)
- D. 90° elbow: 6" = 10 ft (15.2 cm = 3 m)
- E. Wall cap: 3 1/4" x 10" = 40 ft (8.3 x 25.4 cm = 12.2 m)
- F. 45° elbow: 6" = 5 ft (15.2 cm = 1.5 m)
- G. 90° flat elbow: 3 1/4" x 10" = 10 ft (8.3 x 25.4 cm = 3 m)

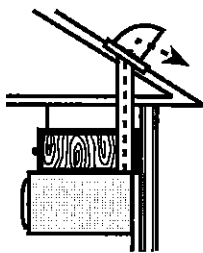

Roof venting

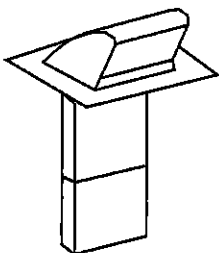

Roof cap

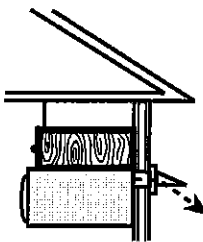

Wall venting

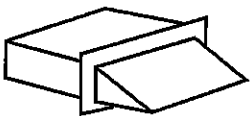

Wall cap

MA



31 of 43

Recommended Vent Length

A 3 1/4" x 10" (8.3 x 25.4 cm) rectangular or 6" (15.2 cm) round vent should be used.

The total length of the vent system including straight vent, elbow(s), transitions, and wall or roof caps must not exceed the equivalent of 140 ft (42.7 m) for either type of vent. See the "Recommended Standard Fittings" section for equivalent lengths.

For best performance, use no more than three 90° elbows.

To calculate the length of the system you need, add the equivalent lengths of each vent piece used in the system. See the following examples:

3 1/4" x 10" (8.3 x 25.4 cm) vent system = 73 ft (22.2 m) total

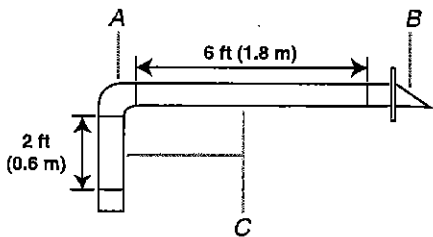

- A. One 3 1/4" x 10" (8.3 x 25.4 cm) 90° elbow = 25 ft (7.6 m)
- B. 1 wall cap = 40 ft (12.2 m)
- C. 2 ft (0.6 m) + 6 ft (1.8 m) straight = 8 ft (2.4 m)

6" (15.2 cm) vent system = 73 ft (22.2 m) total

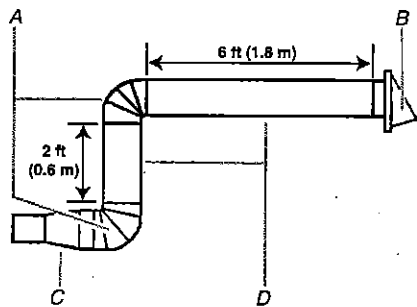

- A. Two 90° elbows = 20 ft (6.1 m)
- B. 1 wall cap = 40 ft (12.2 m)
- C. 1 rectangular-to-round transition piece = 5 ft (1.5 m)
- D. 2 ft (0.6 m) + 6 ft (1.8 m) straight = 8 ft (2.4 m)

If the existing vent is round, a rectangular-to-round transition piece must be used. In addition, a rectangular 3" (7.6 cm) extension vent between the damper assembly and rectangular-to-round transition piece must be installed to keep the damper from sticking.

MA

UK 3 WALLACETON  
LOT 3185A-7  
20-1790 END ELEV B WOB  
THE DUNMORE

32 of 43



21 cu. ft. Top-Freezer Refrigerator  
WRT541SZD

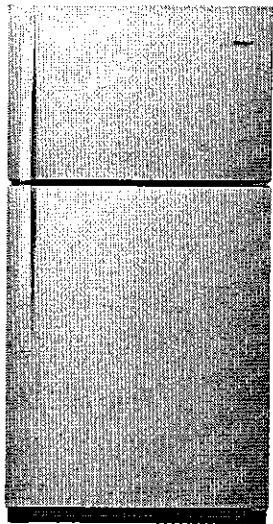

Fingerprint-Resistant Stainless  
WRT541SZDZ

Also available in:

- White WRT541SZDW
- Black WRT541SZDB
- Monochromatic Stainless Steel WRT541SZDM

Key Features & Benefits

- Frameless Glass Shelves**  
Store more items on wall-to-wall shelves for greater storage flexibility.
- Flexi-Slide™ Bin**  
Make space for tall items with the bin that quickly and easily moves side to side.
- Humidity-Controlled Crispers**  
Store fruits and vegetables in their ideal environment.

Capacity	
Total Capacity	21 cu. ft.
Refrigerator Capacity	15 cu. ft.
Freezer Capacity	6 cu. ft.
General Features & Properties	
EZ Connect Icemaker Kit	
LED Interior Lighting	
ENERGY STAR® Certified	
Electronic Temperature Controls	
Freezer Temperature Controls	
Clear Door Bins	
Adjustable Door Bins	
Quiet Cooling	
Fingerprint Resistant	
Electrical Details	
Amps	6.5
Volts	115
Certifications	
ADA Compliant	Yes
ENERGY STAR® Certified	Yes

Technical Details	
Refrigerator Type	Top-Freezer
Number of Doors	2
Number of Interior Refrigerator Shelves	3
Number of Refrigerator Door Bins	1 Fixed, 4 Adjustable
Number of Interior Freezer Shelves	1
Number of Freezer Door Bins	2 Fixed
Lighting Type	LED
Ice Maker	Optional
Ice Maker Location	Freezer
Dispenser Type	N/A

Dimensions	
Product Dimensions (H x W x D)	66-1/4" x 32-3/4" x 34"
Depth with Door Open 90°	62-1/4"
Cutout Dimensions	Allow extra 1/2" on sides and top Allow extra 1" on rear

- Reference Material
- [Dimension Guide](#)
- [Use & Care Guide](#)
- [Energy Guide](#)
- [Warranty](#)

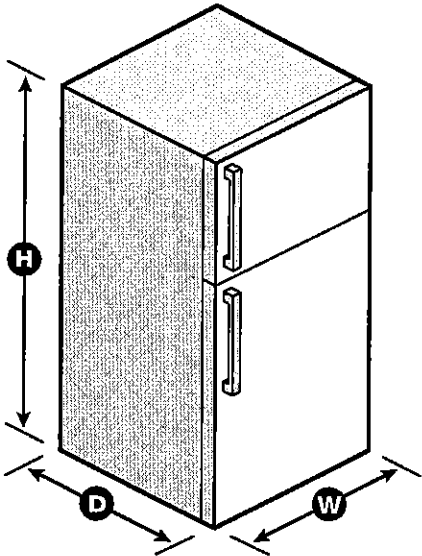

NOTE: Dimensions are for planning purposes only. For complete details, see Installation Instructions packed with product. Specifications subject to change without notice.

©/™ © 2020. All rights reserved. Printed in the U.S.A. D200052XXC. WRT541SZDSPECSHEETV01.

MM

UK 3 WALLACETON  
LOT 3185A-7  
20-1790 END ELEV B WOB  
THE DUNMORE

33 of 43

Whirlpool® Top Mount Refrigerator

PRODUCT MODEL NUMBERS

WRT311FZD      WRT541SZD  
WRT511SZD

**Electrical:** A 115-volt, 60-Hz, AC-only, 15- or 20-amp fused, grounded electrical supply is required. It is recommended that a separate circuit serving only your refrigerator be provided. Use an outlet that cannot be turned off by a switch. Do not use an extension cord.

**NOTE:** Before performing any type of installation, cleaning, or removing a light bulb, turn the control (Thermostat, Refrigerator or Freezer Control depending on the model) to OFF and then disconnect the refrigerator from the electrical source. When you are finished, reconnect the refrigerator to the electrical source and reset the control (Thermostat, Refrigerator or Freezer Control depending on the model) to the desired setting. See "Using the Controls."

**Water:** A cold water supply with water pressure between 30 and 120 psi (207 and 827 kPa) is required to operate ice maker and water dispenser. If you have questions about your water pressure, call a licensed, qualified plumber.

**IMPORTANT:** The pressure of the water coming out of a reverse osmosis system going to the water inlet valve of the refrigerator needs to be between 30 and 120 psi (207 and 827 kPa).

**Reverse Osmosis Water Supply:** If a reverse osmosis water filtration system is connected to your cold water supply, the water pressure to the reverse osmosis system needs to be a minimum of 40 to 60 psi (276 to 414 kPa).

PRODUCT DIMENSIONS

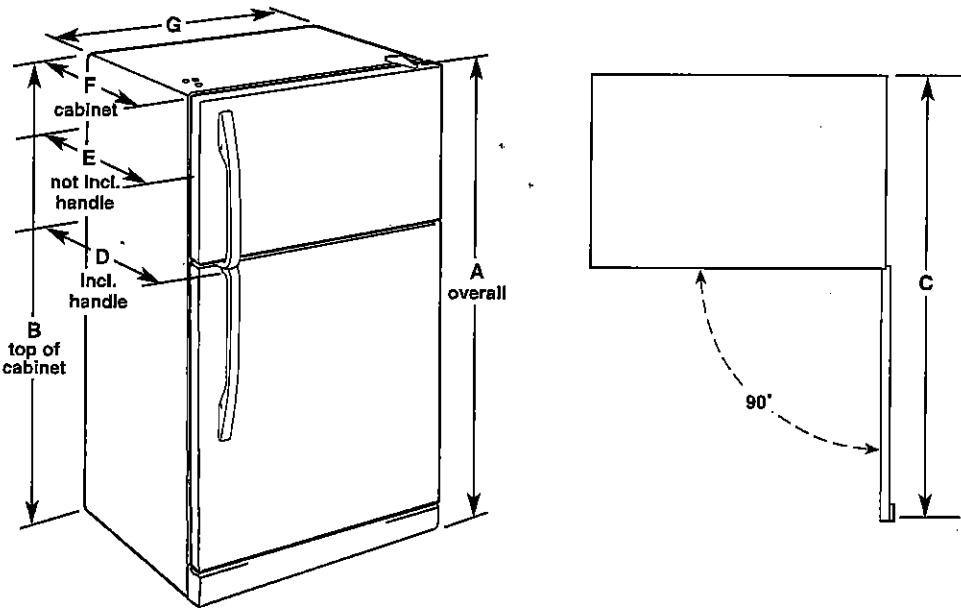

Model Number	Model Size	Reversible Door	Height - Overall "A"	Height - Top of Cabinet "B"	Depth - Door Open 90° "C"	Depth - With Handles "D"	Depth - Without Handles "E"	Depth - Cabinet Only "F"	Width - Cabinet "G"
WRT311FZD	20.5 cu. ft.	Yes	66¼" (168.3 cm)	65½" (166.4 cm)	62¼" (158.1 cm)	32¾" (83.5 cm)	30¾" (77.8 cm)	28½" (72.4 cm)	32¾" (83.2 cm)
WRT511SZD WRT541SZD	21.3 cu. ft.	Yes	66¼" (168.3 cm)	65½" (166.4 cm)	62¼" (158.1 cm)	34" (86.4 cm)	32½" (82.3 cm)	28½" (72.4 cm)	32¾" (83.2 cm)

LOCATION REQUIREMENTS

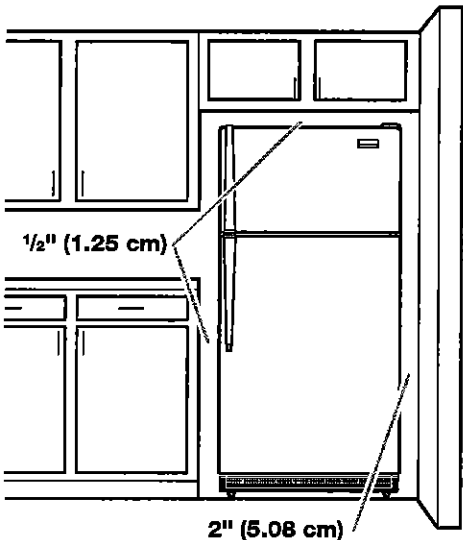

To ensure proper ventilation for your refrigerator, allow for a ½" (1.25 cm) space on each and between overhead cabinets and refrigerator top. Allow at least 1" (2.5 cm) between back of cabinet and the wall. If your refrigerator has an ice maker, make sure you leave some extra space at the back for the water line connections.

If you are installing your refrigerator next to a fixed wall, leave 2" (5 cm) minimum on the hinge side (depending on your model) to allow for the door to swing open.

**NOTE:** This refrigerator is intended for use in a location where the temperature ranges from a minimum of 55°F (13°C) to a maximum of 110°F (43°C). The preferred room temperature range for optimum performance, which reduces electricity usage and provides superior cooling, is between 60°F (15°C) and 90°F (32°C). It is recommended that you do not install the refrigerator near a heat source, such as an oven or radiator.

AA

UK 3 WALLACETON  
LOT 3185A-7  
20-1790 END ELEV B WOB  
THE DUNMORE

34 OF 43

Refrigerator Door Swing Verification

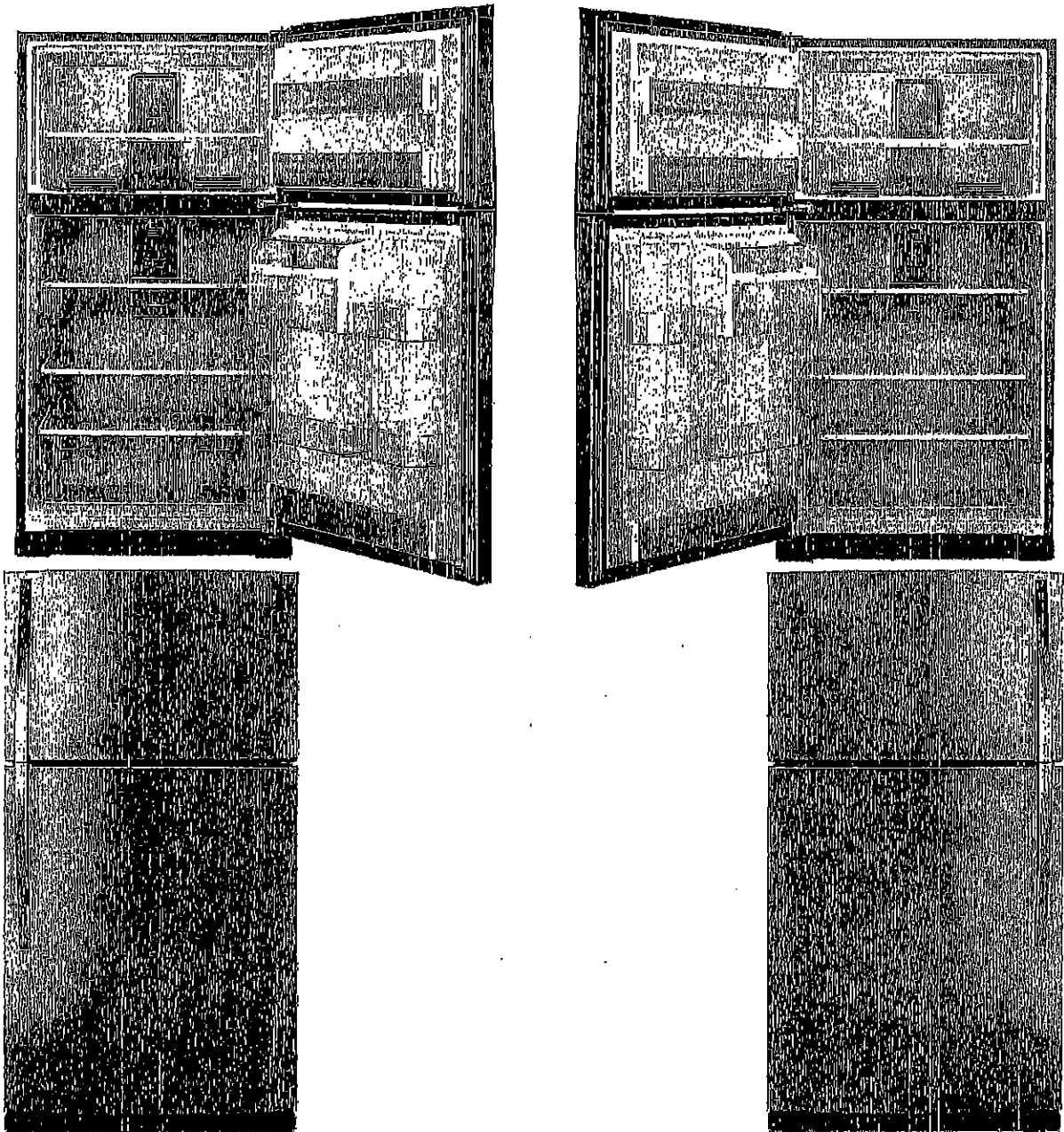

When facing the refrigerator

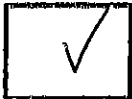

RIGHT HAND  
DOOR OPENING

- Hinges on right
- Handle on left

*mp*  
INITIAL

LEFT HAND  
DOOR OPENING

- Hinges on left
- Handle on right



INITIAL

GARAGE LEFT

- Please check and INITIAL your door swing selection.

UK 3 WALLACETON  
LOT 3185A-7  
20-1790 END ELEV B WOB  
THE DUNMORE

35 of 43



5.3 cu. ft. Whirlpool® electric range with Frozen Bake™ technology

YWFE515S0JS

This Whirlpool® electric range with a dual element stove top helps you get dinner to the table. Skip preheating for favorites like pizza with Frozen Bake™ technology. This self cleaning oven also prevents cooked food from getting cold with the Keep Warm setting. Closed door broiling helps keep the kitchen comfortable.

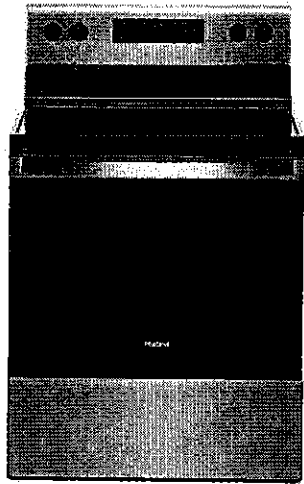

Available Finishes/Colours

- YWFE515S0JB  
Black
- YWFE515S0JS  
Stainless Steel
- YWFE515S0JW  
White

Manuals & Literature:

- [Installation Instructions](#)
- [Use and Care](#)
- [Warranty](#)

Top Features

- FlexHeat™ Dual Radiant Element**  
Get two elements in one with a 6" inner ring that's great for smaller pots and pans and a 9" expandable outer ring that makes room for larger cookware.
- Frozen Bake™ technology**  
Skip preheating and cook frozen favorites like pizza in fewer steps with preprogrammed settings that automatically adjust cooking times for you.
- Keep Warm setting**  
Keep dishes from getting cold with this setting that delivers low heat to the oven.
- Closed Door Broiling**  
Maintain the optimal cooking temperature for food while still keeping the kitchen comfortable and cool using this broiling temperature management system that helps prevent overheating.

Dimensions

Depth	27 3/4
Height	36
Width	29 7/8

Exterior

Handle Type	Reach-Through Handle
-------------	----------------------

Configuration and Overview

Range Type	Freestanding
Fuel Type	Electric
Size (IN, inches)	30

Features

Hot Surface Indicator Light	Yes
Heating Element On Indicator Light	Yes
Power On Indicator Light	No
Griddle	NA
Automatic Convection Conversion Temperature Adjust	No
Power Outage Compatible	No

Exterior

Door Removable	Yes
Drawer Type	Storage Drawer
Oven Door	Glass Window
Oven Window Size	Extra Large
Handle Color	Stainless Steel
Handle Material	Metal

Because Whirlpool Corporation policy includes a continuous commitment to improve our products, we reserve the right to change materials and specifications without notice. Dimensions are for planning purposes only. For complete details, see Installation Instructions packed with product. Specifications subject to change without notice.

Handwritten signature

UK 3 WALLACETON  
LOT 3185A-7  
20-1790 END ELEV B WOB  
THE DUNMORE

36 of 43

WHIRLPOOL 30" (76.0 CM) FREESTANDING ELECTRIC RANGES  
Model YWFE515S0JS

Product Dimensions

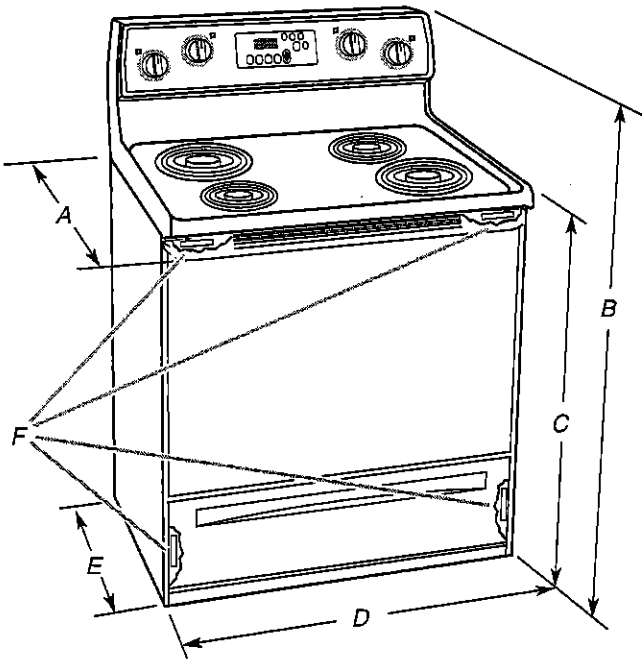

- A. 27<sup>3</sup>/<sub>4</sub>" (70.5 cm) max. depth with handle
- B. 46<sup>7</sup>/<sub>8</sub>" (119.1 cm) overall height (max.) with leveling legs screwed all the way in\*
- C. 36" (91.4 cm) cooktop height (max.) with leveling legs screwed all the way in\*
- D. 29<sup>7</sup>/<sub>8</sub>" (75.9 cm) width
- E. 25<sup>5</sup>/<sub>8</sub>" (64.3 cm) depth - back of range to front of cooktop\*\*
- F. Model/serial/rating plate (located on the frame behind a top corner of the door or either side of the drawer)

**IMPORTANT:** Range must be level after installation. Follow the instructions in the "Level Range" section. Using the cooktop as a reference for leveling the range is not recommended.

\*Range can be raised approximately 1" (2.5 cm) by adjusting the leveling legs.

\*\*Front of door and drawer may extend further forward depending on styling.

Cabinet Dimensions

Cabinet opening dimensions shown are for 25" (64.0 cm) countertop depth, 24" (61.0 cm) base cabinet depth and 36" (91.4 cm) countertop height.

**IMPORTANT:** If installing a range hood or microwave hood combination above the cooking surface, follow the range hood or microwave hood combination installation instructions for dimensional clearances above the cooktop surface.

A freestanding range may be installed next to combustible walls with zero clearance.

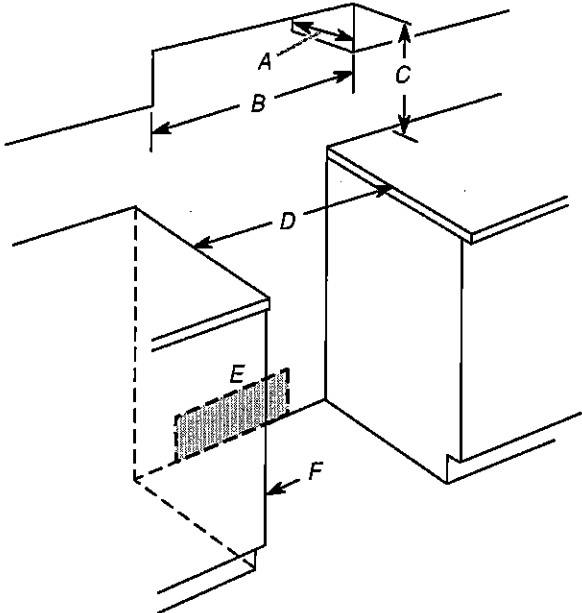

- A. 13" (33.0 cm) max. upper cabinet depth
- B. 30" (76.2 cm) min. opening width
- C. For minimum clearance to top of cooktop, see NOTE\*
- D. 30" (76.2 cm) min. opening width
- E. Outlet - 8" (20.3 cm) to 22" (55.9 cm) from either cabinet, 7" (17.8 cm) max. from floor.
- F. Cabinet door or hinges should not extend into the cutout.

**\*NOTE:** 24" (61.0 cm) minimum when bottom of wood or metal cabinet is covered by not less than 1/4" (6.4 mm) flame retardant millboard covered with not less than No. 28 MSG sheet steel, 0.015" (0.4 mm) stainless steel, 0.024" (0.6 mm) aluminum or 0.020" (0.5 mm) copper.  
30" (76.2 cm) minimum clearance between the top of the cooking platform and the bottom of an uncovered wood or metal cabinet.

MA

UK 3 WALLACETON  
LOT 3185A-7  
20-1790 END ELEV B WOB  
THE DUNMORE

37 of 43

WHIRLPOOL 30" (76.0 CM) FREESTANDING ELECTRIC RANGES  
Model YWFE515S0JS

Electrical Requirements - Canada Only

**⚠ WARNING**



**Electrical Shock Hazard**  
Electrically ground range.  
Failure to do so can result in death, fire, or electrical shock.

If codes permit and a separate ground wire is used, it is recommended that a qualified electrical installer determine that the ground path is adequate and wire gauge are in accordance with local codes.  
Be sure that the electrical connection and wire size are adequate and in conformance with CSA Standard C22.1, Canadian Electrical Code, Part 1 - latest edition, and all local codes and ordinances.

A copy of the above code standards can be obtained from:  
Canadian Standards Association  
178 Rexdale Blvd.  
Toronto, ON M9W 1R3 CANADA

- Check with a qualified electrical installer if you are not sure the range is properly grounded.

Range Rating*		Specified Rating of Power Supply Cord Kit and Circuit Protection
120/240 V	120/208 V	Amps
8.8 - 16.5 KW	7.8 - 12.5 KW	40 or 50**
16.6 - 22.5 KW	12.6 - 18.5 KW	50

\*The NEC calculated load is less than the total connected load listed on the model/serial/rating plate.

- \*\*If connecting to a 50 A circuit, use a 50 A rated cord with kit. For 50 A rated cord kits, use kits that specify use with a nominal 1 3/8" (3.5 cm) diameter connection opening.
- A time-delay fuse or circuit breaker is recommended.
- This range is equipped with a CSA International Certified Power Cord intended to be plugged into a standard 14-50R wall receptacle. Be sure the wall receptacle is within reach of range's final location.



- Do not use an extension cord.

INSTALLATION INSTRUCTIONS

Unpack Range

**⚠ WARNING**

**Excessive Weight Hazard**  
Use two or more people to move and install range.  
Failure to do so can result in back or other injury.

1. Remove shipping materials, tape and film from range.
2. Remove oven racks and parts package from inside oven.
3. Do not remove the shipping base at this time.

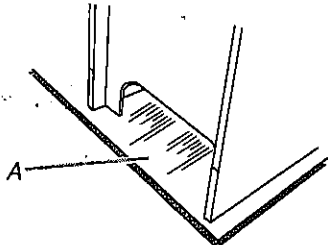

A. Shipping base

4. On Ranges Equipped with a Storage Drawer:

Remove the storage drawer. See the "Storage Drawer" section. Use a 1/4" (6.4 mm) drive ratchet to lower the rear leveling legs one-half turn. Use a wrench or pliers to lower front leveling legs one-half turn.

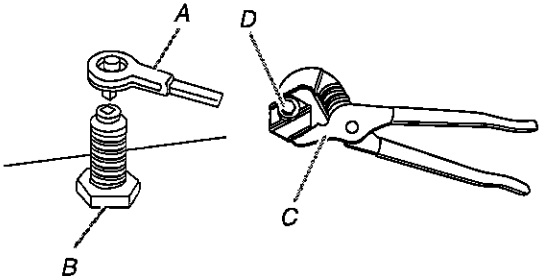

A. 1/4" (6.4 mm) drive ratchet  
B. Rear leveling leg  
C. Wrench or pliers  
D. Front leveling leg

On Ranges Equipped with a Warming Drawer or Premium Storage Drawer:

On ranges equipped with a warming drawer or premium storage drawer, the rear legs cannot be accessed by removing the warming drawer or premium storage drawer. It will be necessary to adjust the rear legs from outside the range. Use wrench or pliers to lower the front and rear leveling legs one half turn.

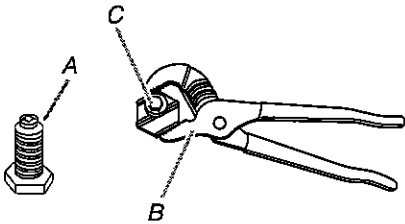

A. Rear leveling leg  
B. Wrench or pliers  
C. Front leveling leg

MA

UK 3 WALLACETON  
LOT 3185A-7  
20-1790 END ELEV B WOB  
THE DUNMORE

38 of 43

WHIRLPOOL 30" (76.0 CM) FREESTANDING ELECTRIC RANGES  
Model YWFE515S0JS

Install Anti-Tip Bracket

**WARNING**

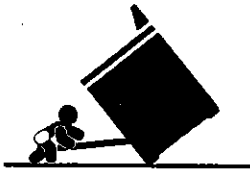

**Tip Over Hazard**

A child or adult can tip the range and be killed.

Install anti-tip bracket to floor or wall per installation instructions.

Slide range back so rear range foot is engaged in the slot of the anti-tip bracket.

Re-engage anti-tip bracket if range is moved.

Do not operate range without anti-tip bracket installed and engaged.

Failure to follow these instructions can result in death or serious burns to children and adults.

1. Remove the anti-tip bracket from where it is taped inside the storage drawer or warming drawer.
2. Determine which mounting method to use: floor or wall.  
If you have a stone or masonry floor, you can use the wall mounting method. If you are installing the range in a mobile home, you must secure the range to the floor.
3. Determine and mark centerline of the cutout space. The mounting can be installed on either the left-side or right-side of the cutout. Position mounting bracket against the wall in the cutout so that the V-notch of the bracket is 12<sup>9</sup>/<sub>16</sub>" (31.9 cm) from centerline as shown.

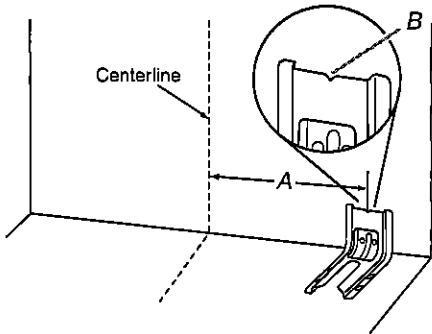

A. 12<sup>9</sup>/<sub>16</sub>" (31.9 cm)  
B. Bracket V-notch

4. Drill two 1/8" (3 mm) holes that correspond to the bracket holes of the determined mounting method. See the following illustrations.

**Floor Mounting**

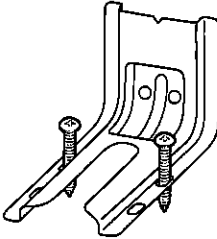

Rear position

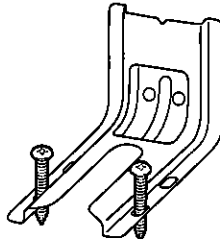

Front position

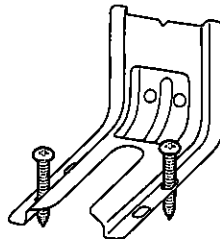

Diagonal (2 options)

**Wall Mounting**

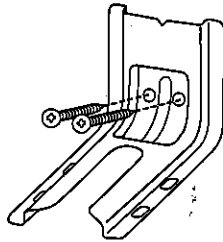

5. Using the Phillips screwdriver, mount anti-tip bracket to the wall or floor with the two #12 x 1<sup>5</sup>/<sub>8</sub>" (4.1 cm) screws provided.
6. Move range close enough to opening to allow for final electrical connections. Remove shipping base, cardboard or hardboard from under range.
7. Move range into its final location, making sure rear leveling leg slides into anti-tip bracket.
8. Move range forward onto shipping base, cardboard or hardboard to continue installing the range using the following installation instructions.

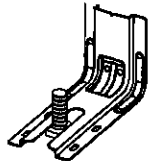

*Handwritten signature or mark.*



UK 3 WALLACETON  
LOT 3185A-7  
20-1790 END ELEV B WOB  
THE DUNMORE

39 OF 43

Whirlpool®

53 dBA\* Front Control Dishwasher  
WDF540PAD

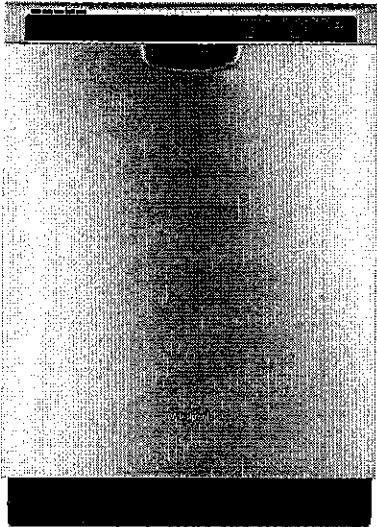

Monochromatic Stainless Steel  
WDF540PADM

Also available in:

- ☐ White
- WDF540PADW
- ☒ Black
- WDF540PADB

Key Features & Benefits

- Sensor Cycle**

Automatically get the right wash and dry settings for each load with two sensors that measure temperature, soil level and load size during prewash and the wash cycle.
- 1-Hour Wash Cycle**

Clean the dishes you need fast with a cycle that thoroughly takes care of plates, pans and glasses in just an hour.\*\*
- Cycle Memory**

Quickly start your dishwasher with one button. It automatically remembers the last cycle you picked so it's stored and ready to go.

Capacity	
Total Place Settings	15
General Features & Properties	
Soil Sensor	
In-Door Silverware Basket	
Sani Rinse Option	
Normal Cycle	
Heavy Cycle	
High Temperature Wash Option	
Heated Dry Option	
ENERGY STAR® Certified	
Industry's Best Selling Dishwasher Brand†	
Electrical Details	
Amps	15
Volts	120
Hz	60
Certifications	
ENERGY STAR® Certified	Yes

Technical Details	
Dishwasher Type	Built-in
Control Location	Front
Control Type	Electronic
Number of Wash Cycles	5
Number of Options	5
dBA*	53
Number of Racks	2
Tub Material	Plastic
Wash System	Filter
Wash System Type	Removable Filter
Number of Wash Arms	3
Dimensions	
Product Dimensions (H x W x D)	34-1/2" x 23-7/8" x 24-1/2"
Depth with Door Open 90°	49-1/2"
Reference Material	
<a href="#">Dimension Guide</a>	
<a href="#">Install Guide</a>	
<a href="#">Use &amp; Care Guide</a>	
<a href="#">Energy Guide</a>	
<a href="#">Warranty</a>	

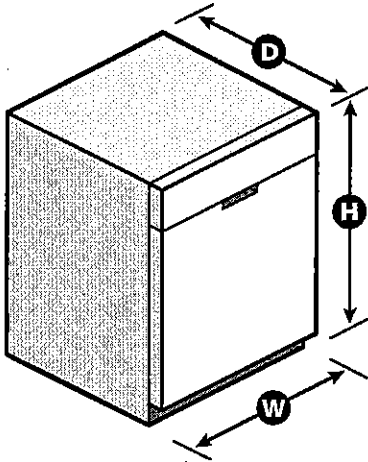

\*Per IEC standards. \*\*Compared to Normal cycle with lightly soiled loads. †Based on 12-month average of unit sales. TraQline 2018. NOTE: Dimensions are for planning purposes only. For complete details, see Installation Instructions packed with product. Specifications subject to change without notice. ©/™ © 2020. All rights reserved. Printed in the U.S.A. D200052XXA. WDF540PADSPEC SHEET V01.

AM

40 of 43

UK 3 WALLACETON  
LOT 3185A-7  
20-1790 END ELEV B WOB  
THE DUNMORE

**Whirlpool®** Undercounter Dishwasher

**PRODUCT MODEL NUMBERS**

WDF110PAB	WDF310PLA	WDF530PSY
WDF111PAB	WDF320PAD	WDF540PAD
WDF120PAF	WDF510PAY	WDF730PAY
WDF121PAF	WDF520PAD	WDT710PAY
WDF310PAA	WDF530PAY	WDT720PAD
WDF310PCA	WDF530PLY	WDT770PAY

**Electrical Requirements:** 120-volt, 60-Hz, AC only, 15- or 20-amp, fused electrical supply. Copper wire only. A time delay fuse or circuit breaker and separate circuit is recommended.

**If direct wiring dishwasher:** Use flexible, armored, or nonmetallic, sheathed copper wire with grounding wire that meets the wiring requirements for your home and local codes and ordinances. Use a UL listed or CSA approved conduit connector.

**If connecting dishwasher with a power supply cord:** Use Power Supply Cord Kit (Part No. 4317824) marked for use with dishwashers. Follow the kit instructions for installing the power supply cord. Power supply cord must plug into a grounded 3 prong, outlet, located in the cabinet next to the dishwasher opening. Outlet must meet all local codes and ordinances.

**Water Supply Requirements:** A hot water line with 20 to 120 psi (138 to 862 kPa) water pressure. Water temperature must be 120°F (49°C) water at dishwasher. Use 3/8" O.D. copper tubing with compression fitting or flexible braided water supply line (1/2" minimum plastic tubing is not recommended). Use a 90° elbow with 1/4"N.P.T. external pipe threads on one end. Do not solder within 6" (15.2 cm) from water inlet valve.

**Drain Requirements:** A new drain hose is supplied with your dishwasher. If this is not long enough, use a new drain hose with a maximum length of 12' (3.7 m) (Part No. 3385556) that meets all current AHAM/IAPMO test standards, is resistant to heat and detergent, and fits the 1" (2.5 cm) drain connector of the dishwasher.

Make sure to connect the drain hose to waste tee or disposer inlet above drain trap in house plumbing and 20" (50.8 cm) minimum above the floor. It is recommended that the drain hose either be looped up and securely fastened to the underside of the counter or be connected to an air gap.

Make sure to use an air gap if the drain hose is connected to house plumbing lower than 20" (50.8 cm) above subfloor or floor.

Use 1/2" (1.3 cm) minimum I.D. drain line fittings. If required, the air gap should be installed in accordance with the air gap installation instructions. When connecting the air gap, a rubber hose (not provided) will be needed to connect to the waste tee or disposer inlet.

**PRODUCT DIMENSIONS**

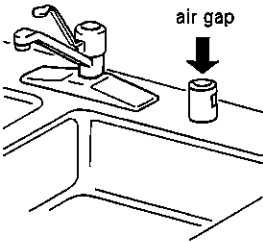
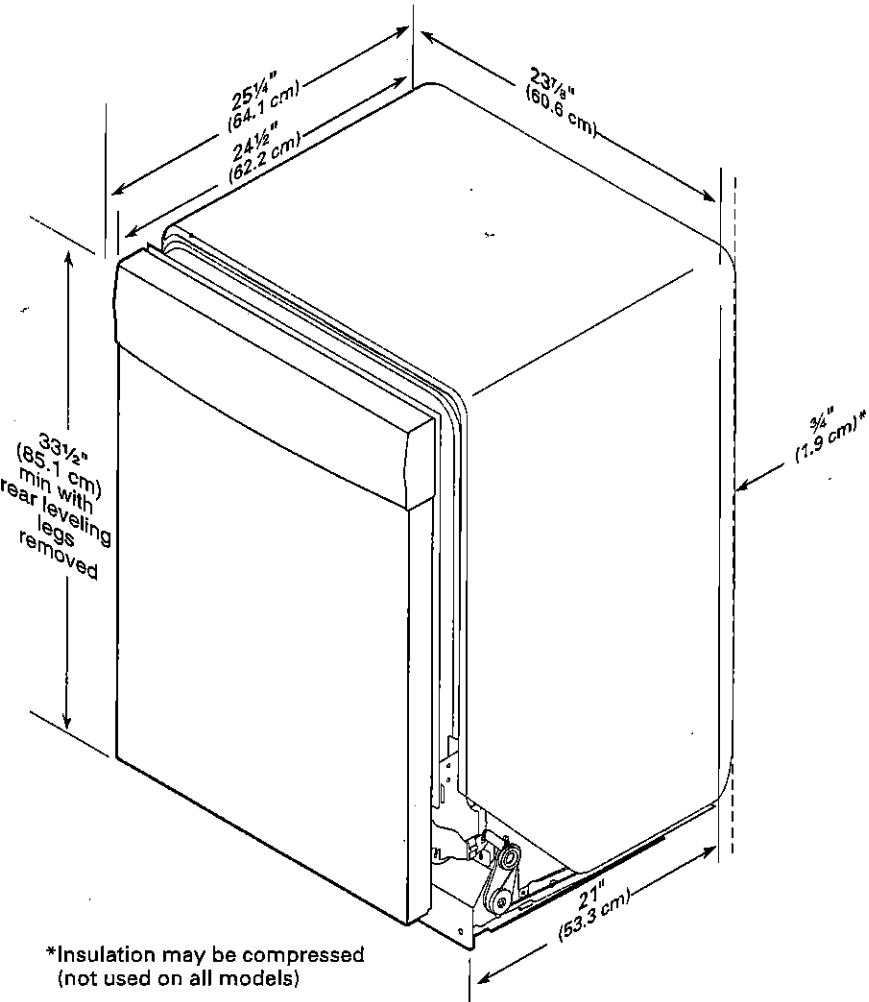

AM

UK 3 WALLACETON  
LOT 3185A-7  
20-1790 END ELEV B WOB  
THE DUNMORE

41 of 43

CABINET CUTOUT DIMENSIONS

NOTE: Shaded areas of cabinet walls show where utility connections may be installed.

- \*Measure from the lowest point on the underside of the countertop. May be reduced to 33½" (85.1 cm) by removing the rear leveling legs from dishwasher.
- \*\*Minimum, measured from narrowest point of opening.

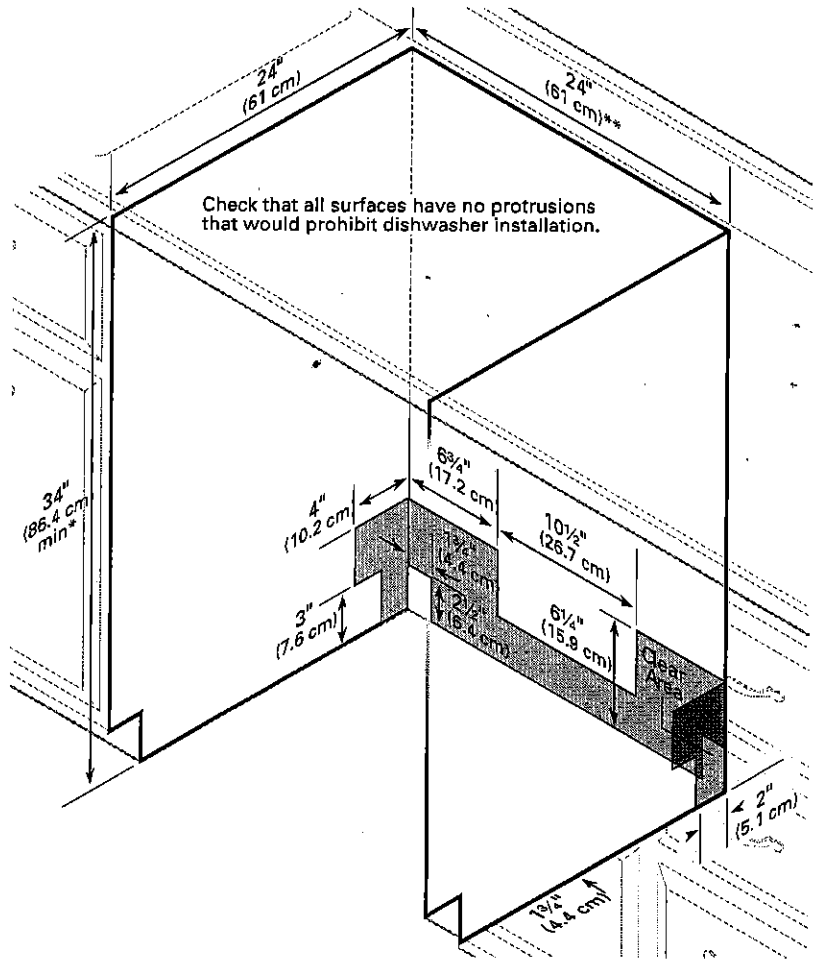

mm

UK 3 WALLACETON  
LOT 3185A-7  
20-1790 END ELEV B WOB  
THE DUNMORE

42 of 43

WHIRLPOOL WASHER Model #: WFW5620HW

Whirlpool Brand Canada English | Washer and Dryers | Washers | Front Load Washers | WFW5620HW

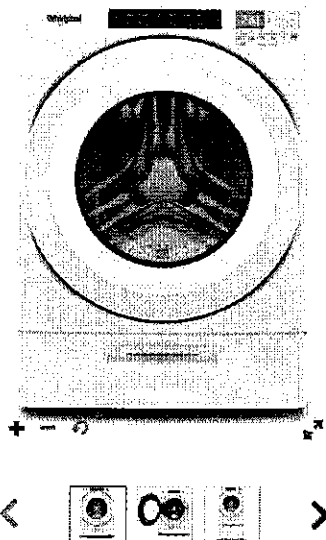

5.2 cu. ft. I.E.C. Closet-Depth  
Front Load Washer with  
Load & Go™ Dispenser

**Whirlpool** 5.2 cu. ft. I.E.C. Closet-Depth Front Load Washer with Load & Go™ Dispenser  
Model #: WFW5620HW

Dimensions

Depth	80.17 cm, 31-9/16 in
Depth With Door Open 90 Degree	143.51 cm, 56-1/2 in
Minimum Height	98.11 cm, 38-5/8 in
Width	68.58 cm, 27.0 in

Appearance

LCD Touch Screen	No
Window	Yes

Details

Drum Material	Stainless Steel
---------------	-----------------

Cycles and Options

Number of Wash Cycles	37
-----------------------	----

Electrical

Hz	60
Power Cord Included	Yes

*[Handwritten signature]*

UK 3 WALLACETON  
LOT 3185A-7  
20-1790 END ELEV B WOB  
THE DUNMORE

43 OF 43

WHIRLPOOL DRYER Model #: YWED5620HW

Whirlpool Brand Canada English | Washers and Dryers | Dryers | Electric Dryers | YWED5620HW

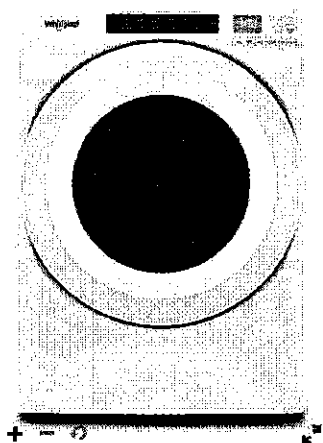

7.4 cu. ft. Front Load Electric  
Dryer with Intuitive Touch  
Controls

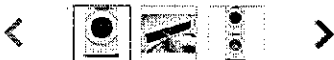

Whirlpool® 7.4 cu. ft. Front Load Electric Dryer with Intuitive Touch Controls

Model #: YWED5620HW

Dimensions

Depth	78.74 cm, 31.0 in
Depth With Door Open 90 Degree	138.43 cm, 54-1/2 in
Height	98.42 cm, 38-3/4 in
Width	68.58 cm, 27.0 in

Configuration and Overview

Fuel Type	Electric
-----------	----------

Cycles and Options

Cycle Time Remaining	Yes
Lint Filter Indicator	No
Number of Dryer Cycles	36
Number of Dryness Levels	3

Ventilation System

Long Vent	No
Maximum Vent Length	64
Venting Direction	Left, Right, Bottom, Rear

Electrical

Hz	60
Power Cord Included	Yes

M