

PRE-Sales Selection Sheet
Checklist

1 OF 41

LOT 3185A-5 Model: 20-1456 B The Hampton

PURCHASERS: NAVJOT SINGH BINDRA/GURSIMRAN KAUR

VENDOR: Heathwood Homes (Huron) Limited

WALK OUT BASEMENT

OPTIONAL DOUBLE SINKS IN MASTER ENSUITE BATHROOM

- ☒ FINISHED BASEMENT
- ☐ COLD CELLAR

UPGRADED / MODIFIED ELEVATION

- ☐ CORNER UPGRADE
- ☐ REAR UPGRADE

CEILING UPGRADE - SMOOTH

- ☐ MAIN FLOOR
- ☐ SECOND FLOOR
- ☐ BASEMENT

ADDITIONAL ROUGH-INS

- ☐ 200 AMP SERVICE
- ☐ WET BAR ROUGH-IN
- ☐ HUMIDIFIER
- ☒ AIR CONDITIONING

GAS ROUGH-IN

- ☐ STOVE
- ☐ DRYER
- ☐ BBQ
- ☐ ADDITIONAL FIREPLACE

KITCHEN: HOODFAN VENTING SIZE

- ☒ 6 IN ROUND DUCT
- ☐ 7 IN ROUND DUCT

FULL BASEMENT STAIRS:	N/A
UPPER BASEMENT STAIRS:	All Oak
LOWER BASEMENT STAIRS:	Carpet Grade
MAIN STAIRS:	All Oak
MEDIA STAIRS (if applicable):	N/A
LOFT STAIRS (if applicable):	N/A

DEC 7/21
Date

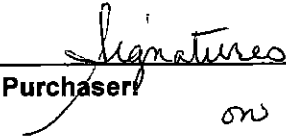
Purchaser

on file

DEC 7/21
Date

TINA LEFUR
Decor Consultant

APPROVED

-12- 0 6 2021
Date

Heathwood Homes (Huron) Limited

Locked Date:

Approved

NAVJOT SINGH BINDRA/GURSIMRAN KAUR
Project: Wallaceton
Unit: 3185A-5, Phase: 3
Model: 20-1456 B The Hampton

Created: 10/23/2021 13:59
Locked:
Closed:

2 of 41

Kitchen

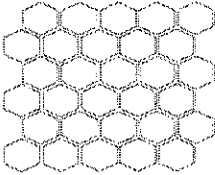
Cabinet Colour/Style	9111	VIKING III SIMCOE ORCHID 3DL ***STD***
Countertop	9069	MSI Quartz GROUP 1 ICED WHITE ***STD***
Countertop Edge	4005	DOUBLE MITRE 1 1/2 INCH ***UPG*** 
Cabinet Hardware	7667	12881-HARDWARE ***STD***
Island Cabinet Colour/Style	9111	VIKING III SIMCOE ORCHID 3DL ***STD***
Island Countertop	9069	MSI Quartz GROUP 1 ICED WHITE ***STD***
Backsplash	8103	OD.ON.SWT.02.HEX.MT-ONTARIO HEXAGON MATTE-SNOW WHITE ***2***
Backsplash Grout	2226	Grout-(00) White ***STD***
Backsplash Tile Pattern	3120	VERTICAL HEX ***STD*** 
HoodFan	9904	YWMH31017HZ-Whirlpool Over-The-Range Microwave Hood Combination-SS-30 inch PAGES 30-32
Appliance	9904	Purchasers have been advised: standard fridge opening is a minimum 37 3/8 x 73 3/8". Ice Waterline Rough-In is included.
Appliance	9904	Standard stove opening is 30" and standard dishwasher opening is 24". Any gas stove will require backsplash or stainless steel backing to avoid fire hazards.
Appliance	9904	Purchasers acknowledge: Heathwood Homes and its contractors will not be responsible for any kitchen cabinet changes due to appliances dimension changes after
Comment		

Kitchen/Breakfast

Flooring	9904	Red Oak Pearl-Vintage Engineered-ECLIPSE-3/4 inch x 3 1/4 inch ***8***
Floor Tile Grout	1111	N/A *****
Floor Tile Pattern	1111	N/A *****

NAVJOT SINGH BINDRA/GURSIMRAN KAUR
Project: Wallaceton
Unit: 3185A-5, Phase: 3
Model: 20-1456 B The Hampton

Created: 10/22/2021 13:59
Locked:
Closed:

3 of 41

Comment

Hall

Flooring

1111

Red Oak Pearl-Vintage Engineered-ECLIPSE-3/4 inch x 3 1/4 inch ***STD***

Comment

Foyer

Flooring

9243

OV.ET.VLK.2424.MT-ETERNA VOLKAS MATTE 24X24 ***6***

Floor Tile Grout

7705

Grout-(01) Alabaster ***UPG***

Floor Tile Pattern

3000

STANDARD SQUARE ***STD***

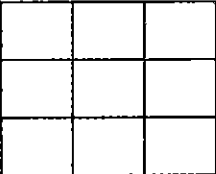

Comment

Mud Room

Flooring

3000

GE.BY.AZR.1313 New Byzantine Azzuro 13

Floor Tile Grout

2225

Grout-(27) Silver ***STD***

Floor Tile Pattern

3000

STANDARD SQUARE ***STD***

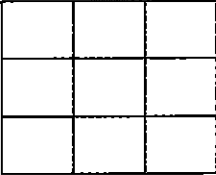

Comment

Powder Room

Flooring

9241

OV.ET.VLK.1224.MT-ETERNA VOLKAS MATTE 12X24
Tile Direction on Sketch **5**

SKETCH # 2 PAGE 17

Floor Tile Grout

7705

Grout-(01) Alabaster ***UPG***

NAVJOT SINGH BINDRA/GURSIMRAN KAUR
Project: Wallaceton
Unit: 3185A-5, Phase: 3
Model: 20-1456 B The Hampton

Created: 10/22/2021 13:59:
Locked:
Closed:

Handwritten marks: "4 of 4" and a large "41" with a vertical line.

Floor Tile Grout (1700) Grout (01) Alabaster Grout

Floor Tile Pattern	3050	SIDE TO SIDE ***STD***

Plumbing Fixture (Colour)	1737	Plumbing Fixtures-WHITE ***STD***
---------------------------	------	-----------------------------------

Comment	
---------	--

Great Room

Flooring	1737	Red Oak Pearl-Vintage Engineered-ECLIPSE-3/4 inch x 3 1/4 inch ***STD***
----------	------	--

Comment	
---------	--

Upper Hall

Flooring	1737	Red Oak Pearl-Vintage Engineered-ECLIPSE-3/4 inch x 3 1/4 inch ***3***
----------	------	--

Comment	
---------	--

Finished Basement (Rec) Room/Hall

Flooring	9246	DY 84558 -Dynasty Tex-BEACH SHELL-40 oz Poly***STD***
----------	------	---

Comment	
---------	--

Master Bedroom

Flooring	9246	DY 84558 -Dynasty Tex-BEACH SHELL-40 oz Poly***STD***
----------	------	---

Comment	
---------	--

Bedroom 2

Flooring	9246	DY 84558 -Dynasty Tex-BEACH SHELL-40 oz Poly***STD***
----------	------	---

Customer Colours

332

NAVJOT SINGH BINDRA/GURSIMRAN KAUR
Project: Wallaceton
Unit: 3185A-5, Phase: 3
Model: 20-1456 B The Hampton

Created: 10/22/2024 13:59:00
Locked:
Closed:

5 of 41

Comment	
---------	--

Bedroom 3

Flooring	9246	DY 84558 -Dynasty Tex-BEACH SHELL-40 oz Poly***STD***
Comment		

Master Ensuite

Cabinet Colour/Style	9156	Viking III-SIMCOE-RAIN CLOUD-3DL ***STD***									
Countertop	8822	4924-38-Countertop-WHITE CARRARA-Wilsonart ***STD***									
Countertop Edge	1111	N/A *****									
Cabinet Hardware	7672	135-HARDWARE ***STD***									
Floor Tile	8913	UN.BL.BIA.1224-Biel-Bianco (White)-12 x 24 See Tile Direction on Sketch 4 Page 19 ***2***									
Floor Tile Grout	2225	Grout-(27) Silver ***STD***									
Floor Tile Pattern	3040	FRONT TO BACK ***STD*** <table><tr><td></td><td></td><td></td><td></td></tr><tr><td></td><td></td><td></td><td></td></tr></table>									
Shower Floor Tile	8688	OD.QU.BLK.0202.FS-Quebec Series Unglazed Mosaic-Black FS-1.89 x 1.89 ***2***									
Shower Floor Tile Grout	7704	Grout-(19) Pearl Gray ***STD***									
Shower Floor Tile Pattern	3000	STANDARD SQUARE ***STD*** <table><tr><td></td><td></td><td></td></tr><tr><td></td><td></td><td></td></tr><tr><td></td><td></td><td></td></tr></table>									
Shower Wall Tile	9020	QT.WV.WHT.0810-Weave-White-8 x 10 ***STD***									
Shower Wall Tile Grout	2226	Grout-(00) White ***STD***									
Shower Wall Tile Pattern	3070	HORIZONTAL STACKED ***STD*** <table><tr><td></td><td></td></tr><tr><td></td><td></td></tr><tr><td></td><td></td></tr></table>									

NAVJOT SINGH BINDRA/GURSIMRAN KAUR
Project: Wallaceon
Unit: 3185A-5, Phase: 3
Model: 20-1456 B The Hampton

Created: 10/22/2021 13:59
Locked:
Closed:

6 of 41



Shower Jamb(s) and Sill(s) 8923 Shower Jamb / Sill-Thassos White ***STD***

Plumbing Fixture (colour) 1737 Plumbing Fixtures-WHITE ***STD***

Comment

Main Bathroom

Cabinet Colour/Style 9156 Viking III-SIMCOE-RAIN CLOUD-3DL ***STD***

Countertop 8822 4924-38-Countertop-WHITE CARRARA-Wilsonart ***STD***

Countertop Edge 1111 N/A *****

Cabinet Hardware 7672 135-HARDWARE ***STD***

Flooring 7672 GE.MD.WHT.1818.MT Madison Series White Matte 18

Floor Tile Grout 2225 Grout-(27) Silver ***STD***

Floor Tile Pattern 3000 STANDARD SQUARE ***STD***

Tub Wall Tile 9020 QT.WV.WHT.0810-Weave-White-8 x 10 ***STD***

Tub Wall Tile Grout 2226 Grout-(00) White ***STD***

Tub Wall Tile Pattern 3070 HORIZONTAL STACKED ***STD***

Plumbing Fixture (Colour) 1737 Plumbing Fixtures-WHITE ***STD***

Comment

Finished Basement Bathroom

Cabinet Colour/Style 9157 Viking III-SIMCOE-MOONLIGHT-3DL ***STD***

Countertop 8822 4924-38-Countertop-WHITE CARRARA-Wilsonart

NAVJOT SINGH BINDRA/GURSIMRAN KAUR
Project: Wallaceton
Unit: 3185A-5, Phase: 3
Model: 20-1456 B The Hampton

Created: 10/22/2021 13:56
Locked:
Closed:

7 of 41

STD

Countertop Edge	1111	N/A *****									
Cabinet Hardware	7672	135-HARDWARE ***STD***									
Flooring	7672	GE.BY.AZR.1313 New Byzantine Azzuro 13									
Floor Tile Grout	2225	Grout-(27) Silver ***STD***									
Floor Tile Pattern	3000	STANDARD SQUARE ***STD*** <table><tr><td></td><td></td><td></td></tr><tr><td></td><td></td><td></td></tr><tr><td></td><td></td><td></td></tr></table>									
Shower Floor Tile	8661	OD.ON.SWT.0202.MT.N-Ontario Series Mosaic-Snow White Matte-2 x 2 ***STD***									
Shower Floor Tile Grout	2226	Grout-(00) White ***STD***									
Shower Floor Tile Pattern	3000	STANDARD SQUARE ***STD*** <table><tr><td></td><td></td><td></td></tr><tr><td></td><td></td><td></td></tr><tr><td></td><td></td><td></td></tr></table>									
Wall Tile	9020	QT.WV.WHT.0810-Weave-White-8 x 10 ***STD***									
Wall Tile Grout	2226	Grout-(00) White ***STD***									
Wall Tile Pattern	3070	HORIZONTAL STACKED ***STD*** <table><tr><td></td><td></td></tr><tr><td></td><td></td></tr><tr><td></td><td></td></tr><tr><td></td><td></td></tr></table>									
Shower Jamb(s)	8923	Shower Jamb / Sill-Thassos White ***STD***									
Plumbing Fixture (Colour)	1737	Plumbing Fixtures-WHITE ***STD***									
Comment											

Great Room Fireplace

Type	8865	Dimplex-Electric Fireplace-PF3033HL ***STD***
Mantle	8891	NF-17-Paint Grade Mantle- Cabinet (Per Plan)-WHITE ***STD*** PAGE 20
Surround Opt.	1111	N/A *****

Customer Colours

332

NAVJOT SINGH BINDRA/GURSIMRAN KAUR
Project: Wallaceton
Unit: 3185A-5, Phase: 3
Model: 20-1456 B The Hampton

Created: 10/22/2021 13:59:1
Locked:
Closed:

8 of 41

Disclaimers	1111	Purchasers have been advised: heat from the FP can damage TV above a FP and items placed on mantle.
Disclaimers	1111	Heathwood and its contractors will not be liable for any damage on items placed/installed above a FP after closing.
Comment		

Basement Stairs

Type	1714	Carpet Grade Stairs ***STD BASEMENT STAIRS***
Colour	1111	N/A *****
Carpet Runner	1111	N/A *****
Handrail/Pickets/Post Type	9119	Handrail only on closed walls (one or two sides per building code) ***STD***
Handrail/Pickets/Post Colours	1729	Carpet Grade-Stain handrail, pickets, stringers, nosing_pos
Carpet	9246	DY 84558 -Dynasty Tex-BEACH SHELL-40 oz Poly***STD***
Custom Stain/Paint	1111	N/A *****
Comment		

Basement Stairs Landing(s)

Flooring	1111	Red Oak Pearl-Vintage Engineered-ECLIPSE-3/4 inch x 3 1/4 inch ***3***
Comment		

Main Stairs

Type	1712	Oak Stairs ***STD MAIN STAIRS***
Colour	7922	Eclipse (Pewter) STAIN TO COMPLIMENT HARDWOOD AND WILL VARY FROM FLOORING ***99***
Carpet Runner	1111	N/A *****
Handrail/Pickets/Posts Type	7652	1 5/16 inch Square pickets with 3 1/2" Square/Cap Post(s)-ALL OAK ***STD***

Customer Colours

332

NAVJOT SINGH BINDRA/GURSIMRAN KAUR
Project: Wallaceton
Unit: 3185A-5, Phase: 3
Model: 20-1456 B The Hampton

Created: 10/22/2021 13:59:04
Locked:
Closed:

9 of 41

Handrail/Pickets/Posts Colour 1728 Oak Grade-Stain handrail,oak pickets,stringers,treads,risers

Custom Stain/Paint 1111 N/A *****

Comment

Main Stairs Landing(s)

Flooring 1111 Red Oak Pearl-Vintage Engineered-ECLIPSE-3/4 inch x 3 1/4 inch ***STD***

Comment

Throughout

Walls - Paint Colour 1717 22-Wall-WARM GREY ***STD***

Underpad 1079 500 Series-Underpad ***STD***

Thresholds 2232 Metal Thresholds ***STD***

Switches and Plug 5796 Decora White Switches and Plugs ***STD***

Trim Size 8705 4 1/4 Baseboard and 2 3/4 Casings ***STD***

Trim - Paint Colour 1716 Trim-WHITE ***STD***

Comment

Purchaser: NAVJOT SINGH BINDRA 11/25/21 Date Decor Consultant TINA LEFUR 11/25/21 Date

Purchaser: GURSIMRAN KAUR 11/25/21 Date Wallaceton mRozen -12- 06 2021 Date Approved



CONSTRUCTION SUMMARY

10 of 41

Lot: 3185A-5
Model: 20-1456 B The Hampton
Project/Phase: Wallaceton / 3

Offer Worksheet	SCHEDULE X: ITEM #5 ADJUSTMENTS (e) AND (f) COMBINED TO BE CAPPED AT \$5,000 Note:
Offer Worksheet	Five Appliances: SS Fridge, Stove, Dishwasher: White Front Loader Washer/Dryer - Townhomes Note:
Offer Worksheet	The Purchaser(s) acknowledge that they have NOT been referred by an existing Heathwood Homeowner and therefor are not entitld to a referral fee under Heathwood Homes Referral program Note:



CONSTRUCTION SUMMARY

11 of 41

Lot: 3185A-5

Model: 20-1456 B The Hampton

Project/Phase: Wallaceton / 3

ALUMINUM

Invoice Qty. Description

959	1	- WALK OUT BASEMENT LOT WITH JULIETTE RAILING ACROSS MAIN FLOOR SLIDING PATIO DOOR AS PER AMENDMENT DATED OCTOBER 22, 2021
06Dec21 ** NoCat		

APPLIANCES

Invoice Qty. Description

880 313,492 07Dec21	1	KITCHEN - APPLIANCES - WHIRLPOOL OTR SS - YWMH31017HZ SPEC PAGES 30-32 Cabinetry - Upg range hood; Electrical - delete std range hood; Heating/Air - Duct Size change to 6in
---------------------------	---	---

CABINETRY

Invoice Qty. Description

880 313,768 07Dec21	1	KITCHEN - 11A-Upper angle corner per unit Viking SKETCH # 3
880 313,624 07Dec21	1	KITCHEN - 04H-66cm deep fridge enclosure (counter depth) with (1) wall ([1] 66cm deep gable and [1] 66cm deep cabinet) (This is not a zero clearance enclosure. Standard heights and widths will be used.) Viking SKETCH # 3
880 311,439 07Dec21 **	1	KITCHEN/BREAKFAST - HARDWOOD - VINTAGE - 3-1/4 INCH RED OAK ENGINEERED - KITCHEN / BREAKFAST - UPG (INCLUDES RAISED CABINET) Cabinetry - Raise Cabinet; Ceramics - delete std ceramics
880 07Dec21 ** NoCat	1	MASTER ENSUITE - PLUMBING - OPTION FROM ONE SINK TO DOUBLE SINKS INCLUDING STD CHATEAU FAUCET OVERMOUNT COLONY SINK ONE EXTRA VANITY LIGHT AND CABINET CONVERSION 2D VIKING SKETCH # 4 Cabinetry - 2D Cabinet Conversion; Electrical - Additional Vanity Light
880 313,492 07Dec21 **	1	KITCHEN - APPLIANCES - WHIRLPOOL OTR SS - YWMH31017HZ SPEC PAGES 30-32 Cabinetry - Upg range hood; Electrical - delete std range hood; Heating/Air - Duct Size change to 6in
880 313,796 07Dec21	1	KITCHEN - 12B-Pots and pans drawers (width min. 60cm/max. 90cm) (size subject to floor plan) Viking SKETCH # 3

CARPET

Invoice Qty. Description

880 311,441 07Dec21 **	1	UPPER HALL - HARDWOOD - VINTAGE - 3-1/4 INCH RED OAK ENGINEERED - UPPER HALL - UPG Carpet - delete std carpet; Interior Trim - supply and install quarter rounds; Painting - paint quarter rounds
---------------------------------	---	---



CONSTRUCTION SUMMARY

12 of 41

Lot: 3185A-5
Model: 20-1456 B The Hampton
Project/Phase: Wallaceton / 3

CERAMICS

Invoice	Qty.	Description
880 311,439 07Dec21 **	1	KITCHEN/BREAKFAST - HARDWOOD - VINTAGE - 3-1/4 INCH RED OAK ENGINEERED - KITCHEN / BREAKFAST - UPG (INCLUDES RAISED CABINET) Cabinetry - Raise Cabinet; Ceramics - delete std ceramics
880 308,004 07Dec21	1	FOYER - CERAMICS - FLOOR - FOYER - UPGRADE 6
880 308,046 07Dec21	1	POWDER ROOM - CERAMICS - FLOOR - POWDER ROOM - UPGRADE 5
880 307,978 07Dec21	1	KITCHEN - CERAMICS - BACKSPLASH - KITCHEN - UPGRADE 2
880 308,062 07Dec21	1	- CERAMICS - SHOWER FLOOR - ENSUITE MASTER - UPGRADE 2
880 307,993 07Dec21	1	MASTER ENSUITE - CERAMICS - FLOOR - ENSUITE MASTER - UPGRADE 2
880 308,021 07Dec21	1	MAIN BATHROOM - CERAMICS - FLOOR - MAIN BATHROOM - UPGRADE 1
880 308,051 07Dec21	1	FOYER - CERAMICS - FLOOR GROUT - FOYER - GROUT
880 308,055 07Dec21	1	POWDER ROOM - CERAMICS - FLOOR GROUT - POWDER ROOM - GROUT

CONCRETE AND DRAIN

Invoice	Qty.	Description
959 06Dec21 ** NoCat	1	- WALK OUT BASEMENT LOT WITH JULIETTE RAILING ACROSS MAIN FLOOR SLIDING PATIO DOOR AS PER AMENDMENT DATED OCTOBER 22, 2021

DECK

Invoice	Qty.	Description
959 06Dec21 ** NoCat	1	- WALK OUT BASEMENT LOT WITH JULIETTE RAILING ACROSS MAIN FLOOR SLIDING PATIO DOOR AS PER AMENDMENT DATED OCTOBER 22, 2021



CONSTRUCTION SUMMARY

13 of 41
Lot: 3185A-5
Model: 20-1456 B The Hampton
Project/Phase: Wallaceton / 3

ELECTRICAL

Invoice Qty. Description

880 314,224 07Dec21	1	KITCHEN - ELECTRICAL - CEILING ROUGH-IN (CAPPED) TO BE CENTERED +/- ABOVE THE ISLAND IN THE KITCHEN SKETCH # 2
880 314,232 07Dec21	1	GREAT ROOM - ELECTRICAL - EXTRA WALL INTERIOR OUTLET ON EXISTING CIRCUIT (DOES NOT INCLUDE KITCHEN OUTLETS) TO BE CENTERED +/- ABOVE THE FIREPLACE 70" +/- FROM THE FLOOR SKETCH # 2
880 07Dec21 ** NoCat	1	MASTER ENSUITE - PLUMBING - OPTION FROM ONE SINK TO DOUBLE SINKS INCLUDING STD CHATEAU FAUCET OVERMOUNT COLONY SINK ONE EXTRA VANITY LIGHT AND CABINET CONVERSION 2D VIKING SKETCH # 4 Cabinetry - 2D Cabinet Conversion; Electrical - Additional Vanity Light
880 313,492 07Dec21 **	1	KITCHEN - APPLIANCES - WHIRLPOOL OTR SS - YWMH31017HZ SPEC PAGES 30-32 Cabinetry - Upg range hood; Electrical - delete std range hood; Heating/Air - Duct Size change to 6in

EXTERIOR BRICK

Invoice Qty. Description

959 06Dec21 ** NoCat	1	- WALK OUT BASEMENT LOT WITH JULIETTE RAILING ACROSS MAIN FLOOR SLIDING PATIO DOOR AS PER AMENDMENT DATED OCTOBER 22, 2021
----------------------------	---	--

EXTERIOR CAULKING

Invoice Qty. Description

959 06Dec21 ** NoCat	1	- WALK OUT BASEMENT LOT WITH JULIETTE RAILING ACROSS MAIN FLOOR SLIDING PATIO DOOR AS PER AMENDMENT DATED OCTOBER 22, 2021
----------------------------	---	--

EXTERIOR RAILINGS

Invoice Qty. Description

959 06Dec21 ** NoCat	1	- WALK OUT BASEMENT LOT WITH JULIETTE RAILING ACROSS MAIN FLOOR SLIDING PATIO DOOR AS PER AMENDMENT DATED OCTOBER 22, 2021
----------------------------	---	--

FORMING

Invoice Qty. Description

959 06Dec21 ** NoCat	1	- WALK OUT BASEMENT LOT WITH JULIETTE RAILING ACROSS MAIN FLOOR SLIDING PATIO DOOR AS PER AMENDMENT DATED OCTOBER 22, 2021
----------------------------	---	--

FRAMING

Invoice Qty. Description

959 06Dec21 ** NoCat	1	- WALK OUT BASEMENT LOT WITH JULIETTE RAILING ACROSS MAIN FLOOR SLIDING PATIO DOOR AS PER AMENDMENT DATED OCTOBER 22, 2021
----------------------------	---	--



CONSTRUCTION SUMMARY

14 of 41
Lot: 3185A-5
Model: 20-1456 B The Hampton
Project/Phase: Wallaceton / 3

GLASS PRODUCTS / MIRRORS

Invoice	Qty.	Description
880 310,741 07Dec21	1	MASTER ENSUITE - MIRRORS/GLASS PRODUCTS - UPGRADE TO FRAMELESS CLEAR GLASS WITH D-RING HANDLE IN CHROME - OPTIONAL ENSUITE MASTER

GRANITE

Invoice	Qty.	Description
880 310,801 07Dec21	1	KITCHEN - GRANITE - COUNTERTOP - 3/4 INCH GROUP 1 WITH MITRE EDGE - KITCHEN / ISLAND - UPG

HARDWOOD

Invoice	Qty.	Description
880 311,439 07Dec21	1	KITCHEN/BREAKFAST - HARDWOOD - VINTAGE - 3-1/4 INCH RED OAK ENGINEERED - KITCHEN / BREAKFAST - UPG (INCLUDES RAISED CABINET) Cabinetry - Raise Cabinet; Ceramics - delete std ceramics
880 311,441 07Dec21	1	UPPER HALL - HARDWOOD - VINTAGE - 3-1/4 INCH RED OAK ENGINEERED - UPPER HALL - UPG Carpet - delete std carpet; Interior Trim - supply and install quarter rounds; Painting - paint quarter rounds

HEATING / AIR CONDITIONING

Invoice	Qty.	Description
959 06Dec21 ** NoCat	1	- WALK OUT BASEMENT LOT WITH JULIETTE RAILING ACROSS MAIN FLOOR SLIDING PATIO DOOR AS PER AMENDMENT DATED OCTOBER 22, 2021
880 313,492 07Dec21 **	1	KITCHEN - APPLIANCES - WHIRLPOOL OTR SS - YWMH31017HZ SPEC PAGES 30-32 Cabinetry - Upg range hood; Electrical - delete std range hood; Heating/Air - Duct Size change to 6in

INTERIOR TRIM AND DOORS

Invoice	Qty.	Description
959 06Dec21 ** NoCat	1	- WALK OUT BASEMENT LOT WITH JULIETTE RAILING ACROSS MAIN FLOOR SLIDING PATIO DOOR AS PER AMENDMENT DATED OCTOBER 22, 2021
880 311,441 07Dec21 **	1	UPPER HALL - HARDWOOD - VINTAGE - 3-1/4 INCH RED OAK ENGINEERED - UPPER HALL - UPG Carpet - delete std carpet; Interior Trim - supply and install quarter rounds; Painting - paint quarter rounds

LUMBER

Invoice	Qty.	Description
959 06Dec21 ** NoCat	1	- WALK OUT BASEMENT LOT WITH JULIETTE RAILING ACROSS MAIN FLOOR SLIDING PATIO DOOR AS PER AMENDMENT DATED OCTOBER 22, 2021



CONSTRUCTION SUMMARY

15 of 41

Lot: 3185A-5
Model: 20-1456 B The Hampton
Project/Phase: Wallaceton / 3

PAINTING

Invoice	Qty.	Description
880 311,441 07Dec21 **	1	UPPER HALL - HARDWOOD - VINTAGE - 3-1/4 INCH RED OAK ENGINEERED - UPPER HALL - UPG Carpet - delete std carpet; Interior Trim - supply and install quarter rounds; Painting - paint quarter rounds

PLUMBING

Invoice	Qty.	Description
880 07Dec21 NoCat	1	MASTER ENSUITE - PLUMBING - OPTION FROM ONE SINK TO DOUBLE SINKS INCLUDING STD CHATEAU FAUCET OVERMOUNT COLONY SINK ONE EXTRA VANITY LIGHT AND CABINET CONVERSION 2D VIKING SKETCH # 4 Cabinetry - 2D Cabinet Conversion; Electrical - Additional Vanity Light

STEEL

Invoice	Qty.	Description
959 06Dec21 ** NoCat	1	- WALK OUT BASEMENT LOT WITH JULIETTE RAILING ACROSS MAIN FLOOR SLIDING PATIO DOOR AS PER AMENDMENT DATED OCTOBER 22, 2021

WINDOWS

Invoice	Qty.	Description
959 06Dec21 ** NoCat	1	- WALK OUT BASEMENT LOT WITH JULIETTE RAILING ACROSS MAIN FLOOR SLIDING PATIO DOOR AS PER AMENDMENT DATED OCTOBER 22, 2021

UK 3 WALLACETON
LOT 3185A-5
20-1456 ELEV B
THE HAMPTON

16 of 41

THE HAMPTON

20-1456 ELEV. B

ELEVATION B | 1,800 SQ. FT.

Includes 329 sq. ft. of Finished Lower Level

WOB

Sketch #1 WALLACETON

EST. 1870

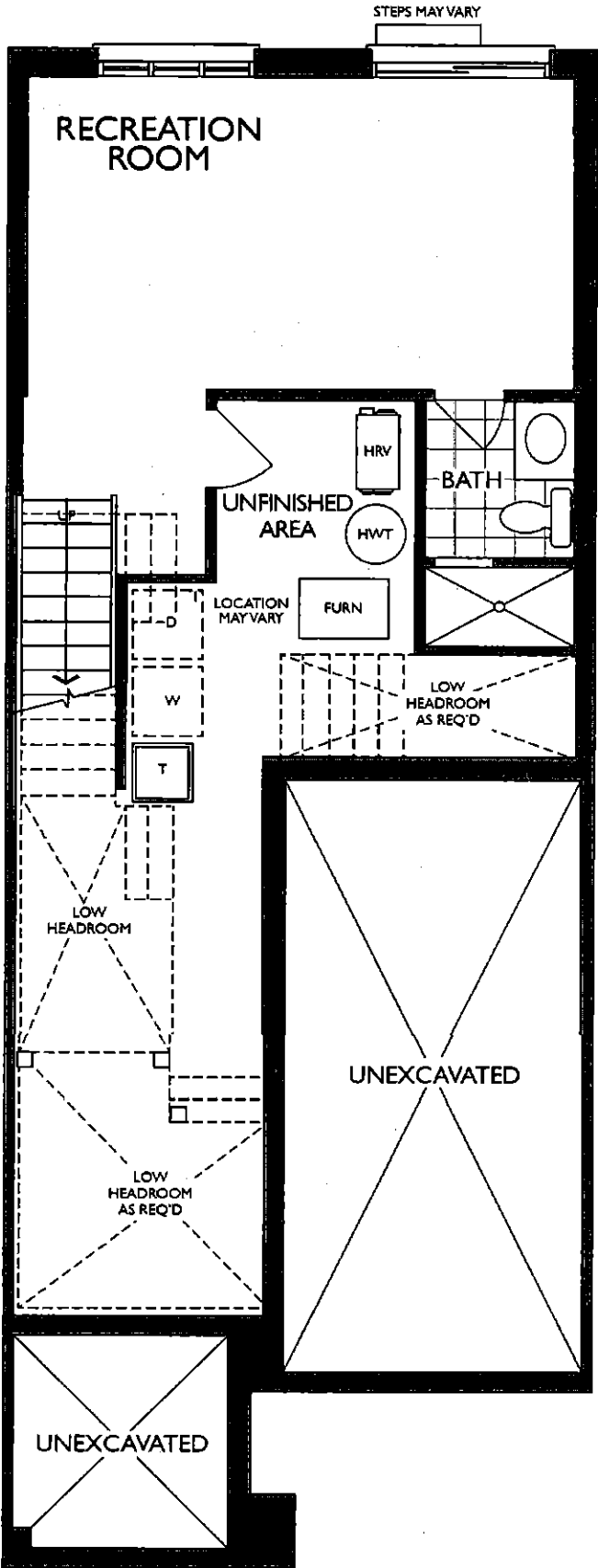

LOWER LEVEL
ELEVATION B

UK 3 WALLACETON
LOT 3185A-5
20-1456 ELEV B
THE HAMPTON

17 of 141

THE HAMPTON

20-1456 ELEV. B

ELEVATION B | 1,800 SQ. FT.

Includes 329 sq. ft. of Finished Lower Level

WOB

Sketch #2 WALLACETON
EST. 1870

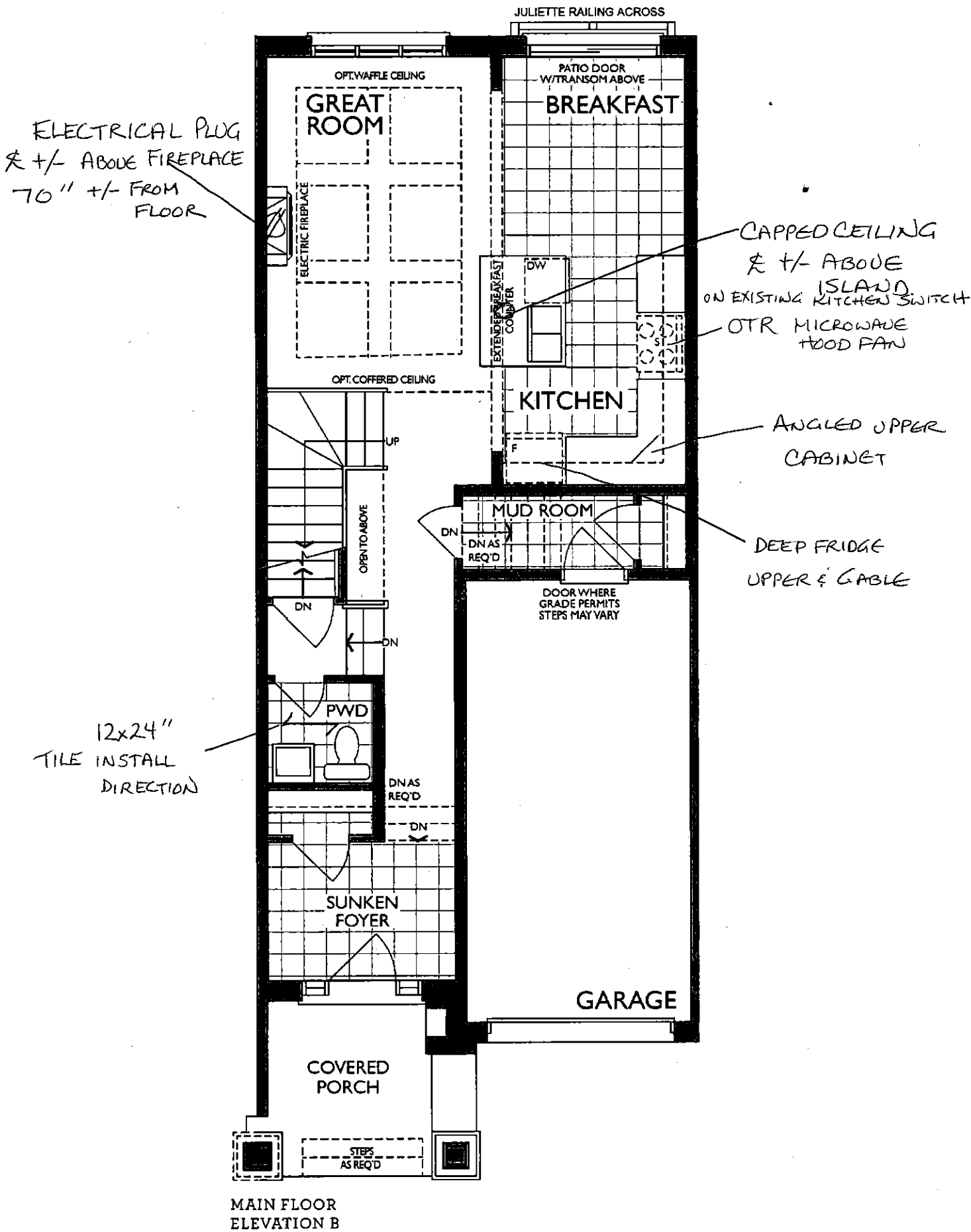

KITCHEN

(GROUND FLOOR)

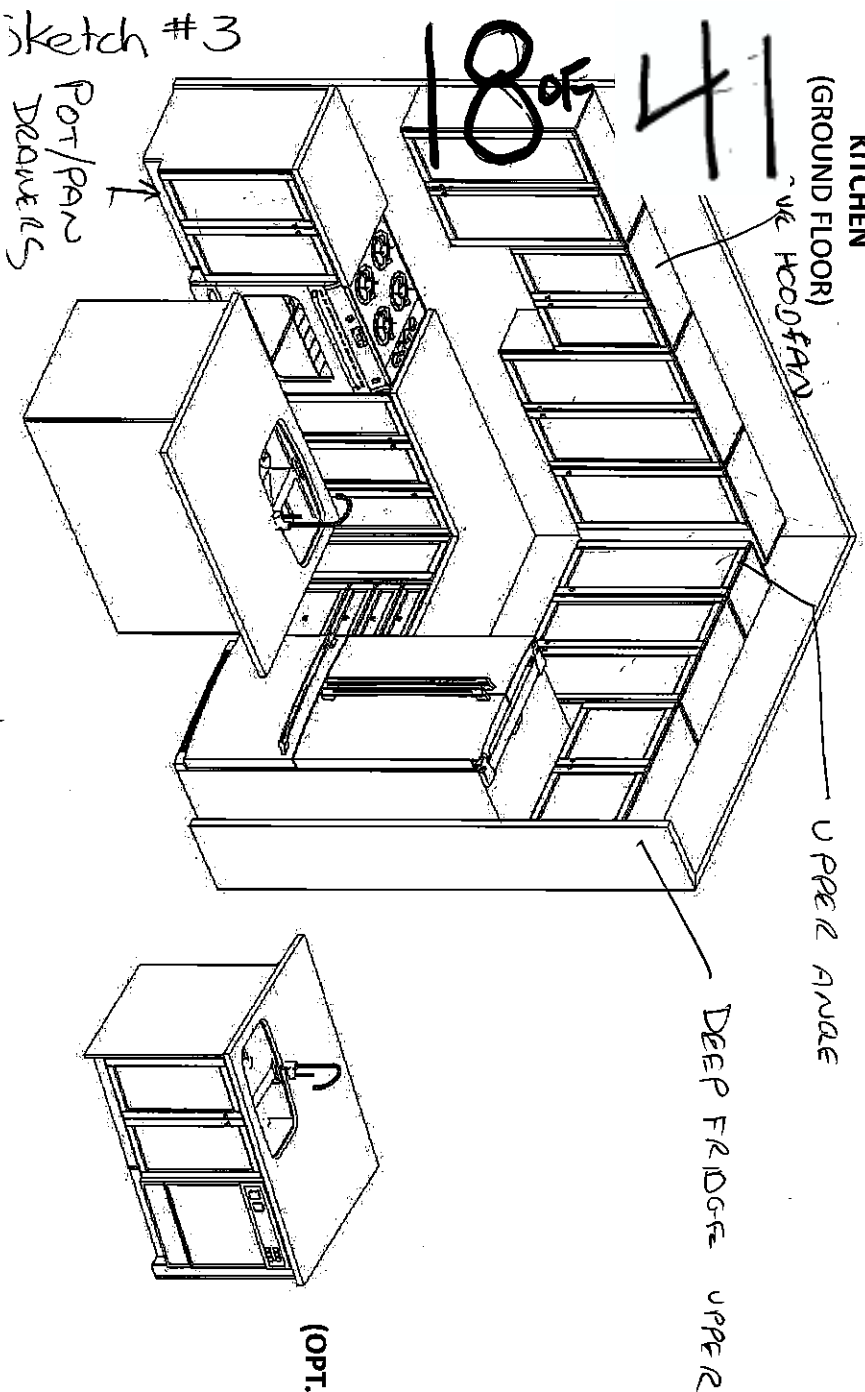

STD. BASEMENT BATH

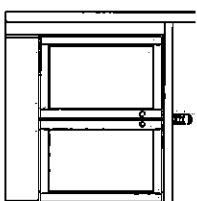

MASTER ENSUITE

(OPT. MASTER ENSUITE SAME SIZE & DIRECTION)

(2ND FLR)

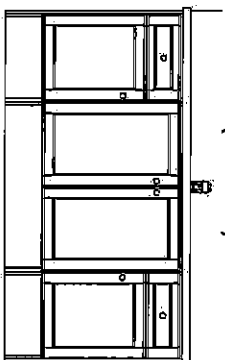

MAIN BATH

(2ND FLR)

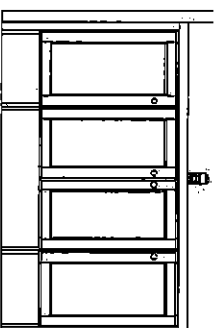

F R E N D E L
K I T C H E N S , L I M I T E D
1350 Shawson Drive, Mississauga, ON L4W 1C5

HEATHWOOD HOMES
WALLACETON, KITCHENER ON
MODEL: 20-1456 (2002)

STANDARD CONTRACT INCLUDES:

Appliance Openings

- Hood Opening: 30"W Std. hood
- Fridge Opening: 37 3/8 "W X 73 3/8" H
- 30cm deep cabinet over fridge
- Stove Opening: 30" Freestanding
- Dishwasher Opening: 24"

Standard Kitchens Scope:

- 100cm H wall cabinets
- Std. Blumotion Hinges- **soft close doors**
- Std. Metabox Drawers- **not soft close**
- Min 40cm W drawer
- Base pie cut corner cabinets
- Backing on all cabinets
- Countertop by others
- Upgrade applied paneled fridge & dishwashers supply only (appliance hardware by others)

Standard Vanity & Laundry Scope:

- Powder by others, pedestal
- All vanities include laminate counter
- Std. Blumotion Hinges- **not soft close**
- Tandem Box Drawers- **soft close**
- Master Ensuite: Top drawers (Full height doors at sink)
- Mains: Full height doors (top drawers added if Masters can't accommodate)
- Optional laundry base & wall cabinets

UK 3 WALLACETON
LOT 3185A-5
20-1456 ELEV B
THE HAMPTON

'12/2021

[Handwritten signature]

THIS DRAWING IS FOR DESIGN PURPOSES ONLY.
IT IS NOT AN EXACT REPRESENTATION.

UK 3 WALLACETON
LOT 3185A-5
20-1456 ELEV B
THE HAMPTON

19 of 41

20-1456 ELEV. B

WOB

THE HAMPTON

ELEVATION B | 1,800 SQ. FT.

Includes 329 sq. ft. of Finished Lower Level

WALLACETON
EST. 1870

Sketch #4

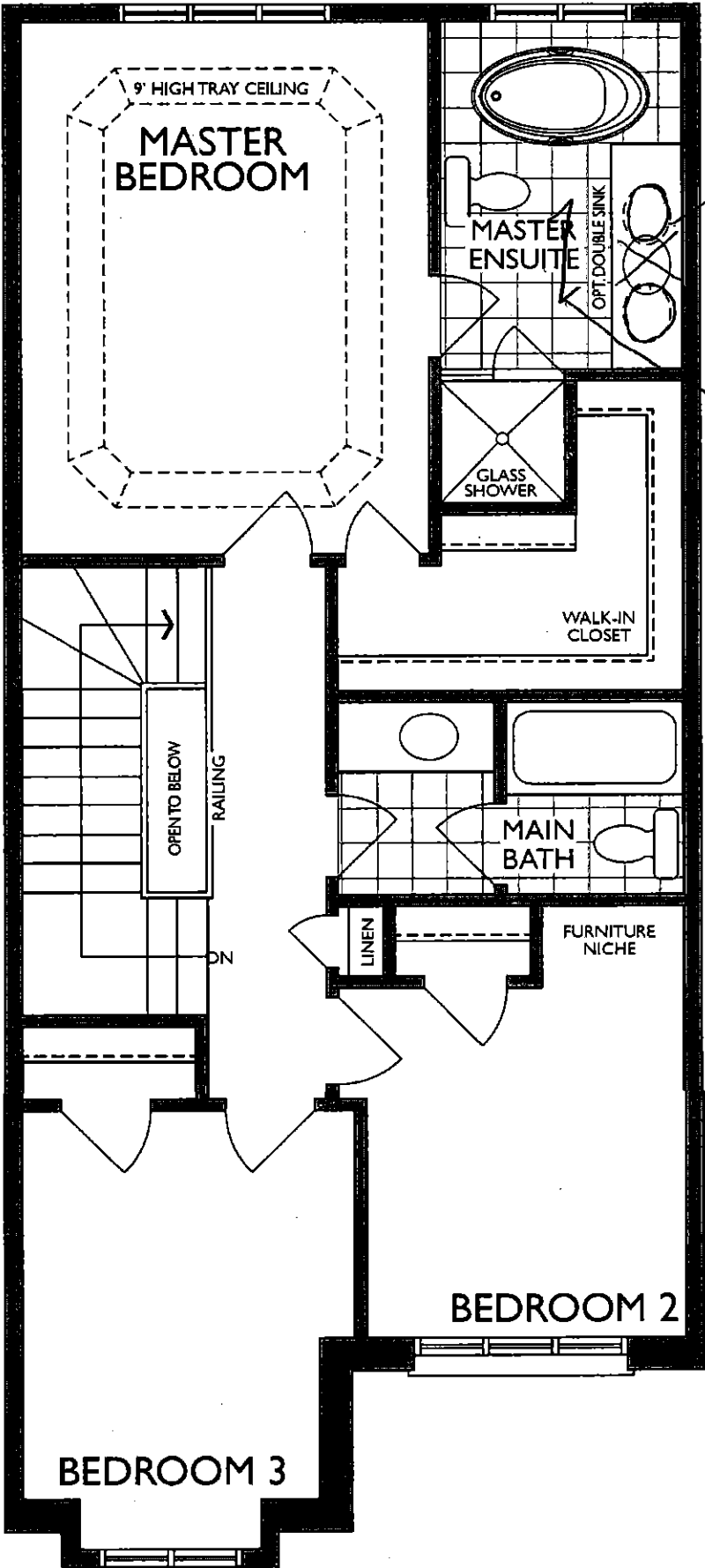

UK 3 WALLACETON
LOT 3185A-5
20-1456 ELEV B
THE HAMPTON

20 of 41

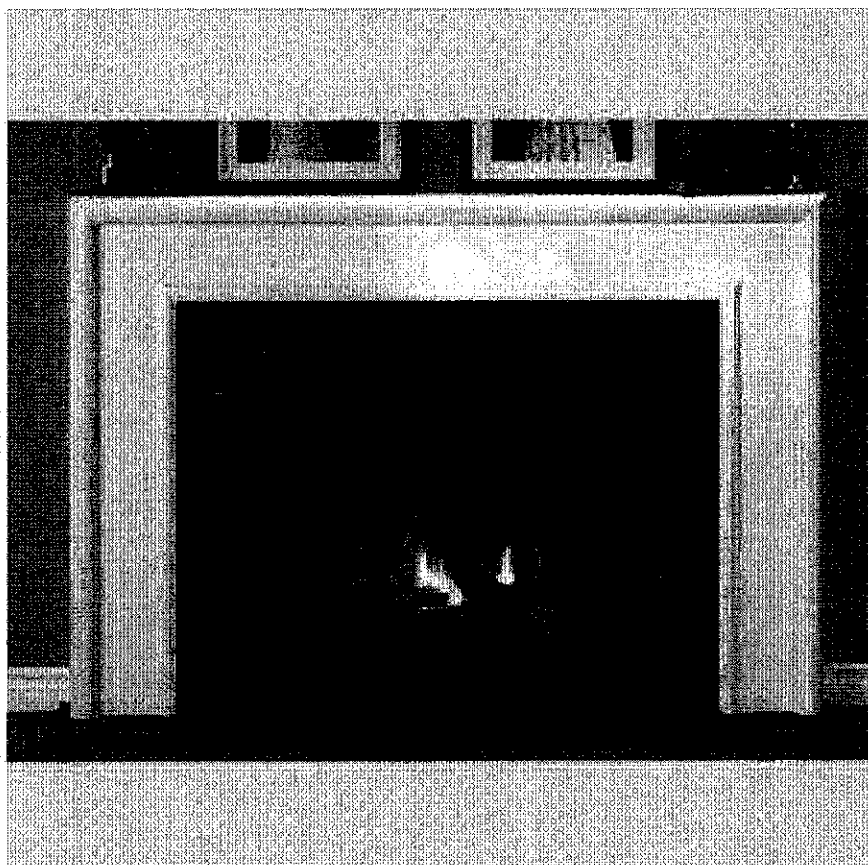

NEAS NF17 Mantel - CABINET

Net
\$

UK 3 WALLACETON
LOT 3185A-5
20-1456 ELEV B
THE HAMPTON

21 of 41

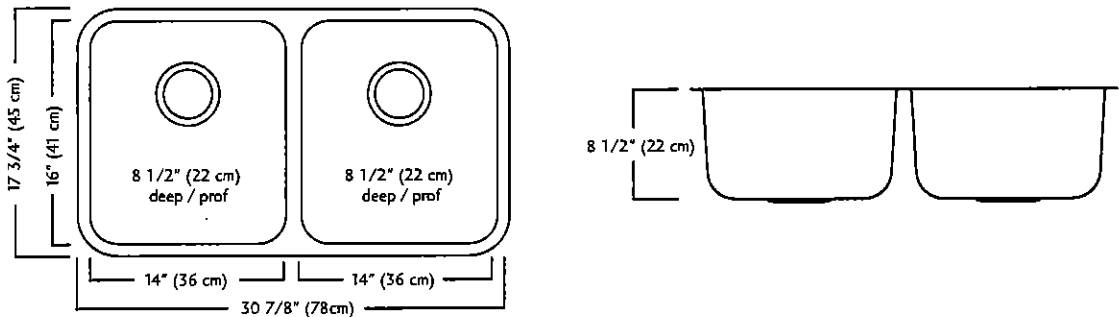
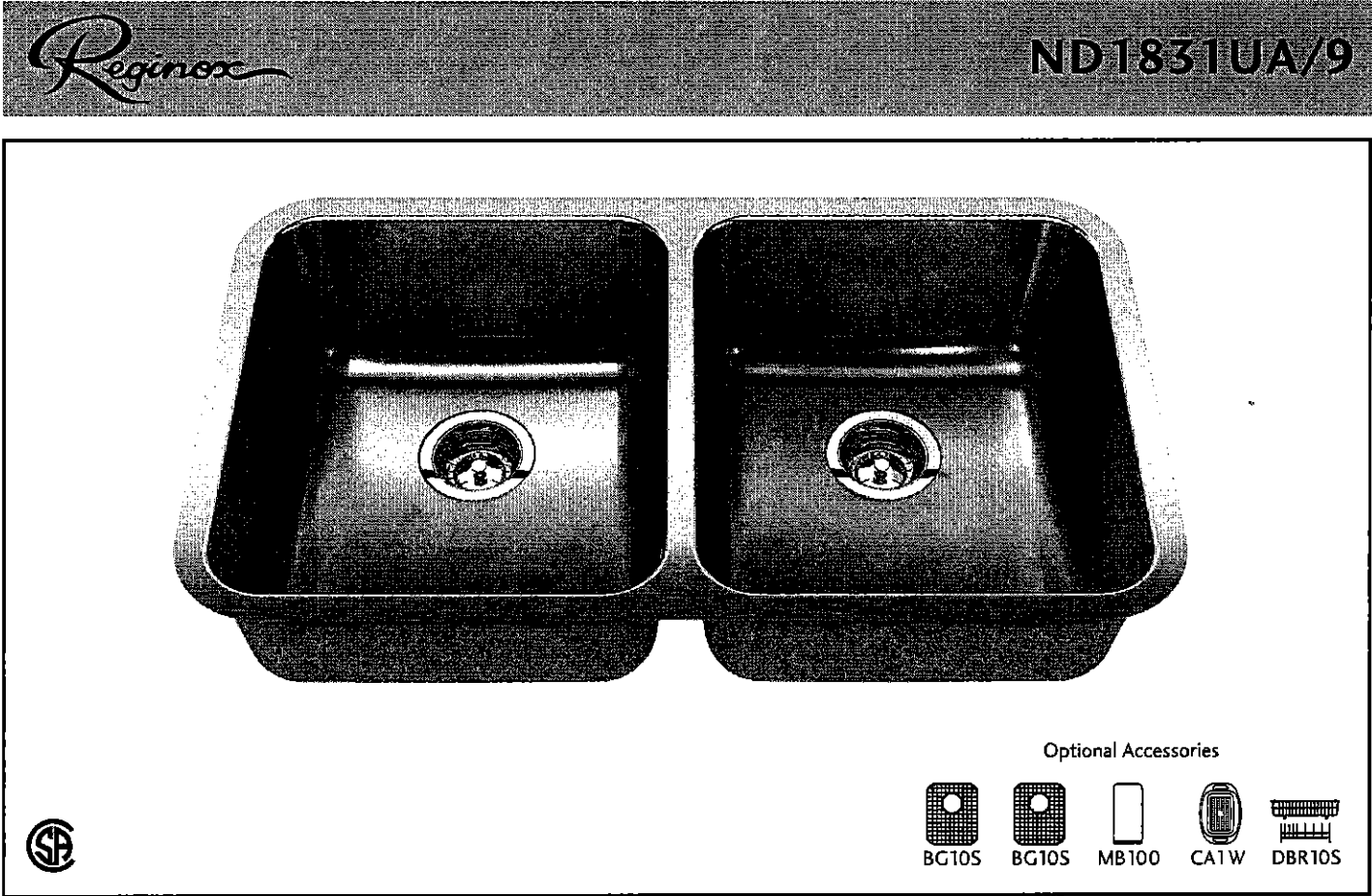

ND1831UA/9 SPECIFICATION

Model ND1831UA/9 is a double (two equal size) bowl undermount sink manufactured by Franke Kindred Canada Limited from 18 gauge stainless steel. Product has silk finished rims and linear brush finished bowls. Sink is fully undercoated. Basket strainer waste fittings (3 1/2", 89 mm) are included. Sink is backed with a limited lifetime warranty.

- O.D. 17 3/4" x 30 7/8" x 8 1/2" (45 x 78 x 22 cm)
- Recommended for minimum 36" cabinet

Franke Kindred Canada Limited
P.O. Box 190, 1000 Franke Kindred Road, Midland, Ontario, Canada, L4R 4K9 Phone: 866-687-7465 Fax: 800-361-8408

[Handwritten signature]

UK 3 WALLACETON
LOT 3185A-5
20-1456 ELEV B
THE HAMPTON

22 of 41

MOEN®

There is more than 1 version of this model.
Page down to identify the version you have.

FAUCET DESCRIPTION

- Reflex™ pulldown system offers smooth operation, easy movement and secure docking
- Power Clean™ spray technology
- Metal construction with various finishes identified by suffix
- Duralock™ connect installation
- Pulldown spray with 68" braided hose
- Flexible supply lines with 3/8" compression fittings
- High arc spout provides height and reach to fill or clean large pots while pulldown wand provides the maneuverability for cleaning or rinsing
- 360° rotating spout
- Faucet designed for handle to be mounted on right side only

OPERATION

- Lever style handle
- Temperature controlled by 100° arc of handle travel
- Operates with less than 5 lbs. of force
- Operates in stream or spray mode in the pullout or retracted position

FLOW

- Flow is limited to 1.5 gpm (5.7 L/min) max at 60 psi

CARTRIDGE

- 1255™ Duralast™ cartridge

STANDARDS

- Third party certified to IAPMO Green, ASME A112.18.1/CSA B12.5.1 and all applicable requirements therein including NSF 61/9G & 372
- Meets CalGreen and Georgia SB370 requirements
- Complies with California Proposition 65 and with the Federal Safe Drinking Water Act
- The backflow protection system in the device consists of two independently operating check valves, a primary and a secondary which prevent backflow

- ADA ♿ for lever handle

WARRANTY

- Lifetime limited warranty against leaks, drips and finish defects to the original homeowner
 - 10 year limited warranty when used in a multifamily installation
 - 5 year limited warranty when used in a commercial installation
- Visit www.moen.com/support for complete details and limitations

Specifications

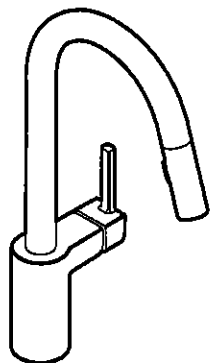

ALIGN™
Single Handle High Arc
Pulldown Kitchen Faucet

Models: 7565 series

NOTE: THIS FAUCET IS DESIGNED TO BE INSTALLED
THROUGH 1 HOLE, 1-1/2" (38mm) MIN. DIA.
(OPTIONAL 3-HOLE ESCUTCHEON 141002 AVAILABLE)

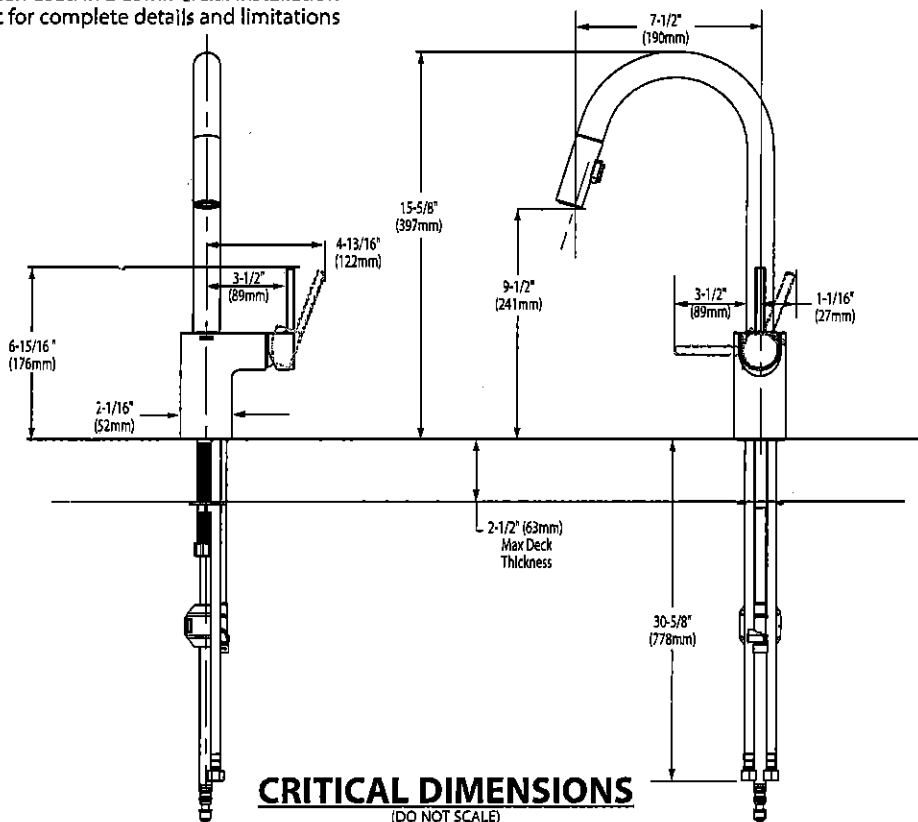

Handwritten signatures and initials at the bottom right of the page.

UK 3 WALLACETON
LOT 3185A-5
20-1456 ELEV B
THE HAMPTON

23 of 41

*American
Standard*

☐ BARRIER FREE (ABOVE COUNTER OR DROP-IN ONLY)

**BOULEVARD®
PEDESTAL SINK**
VITREOUS CHINA

BOULEVARD® PEDESTAL SINK

- STD ☐ 0641.800 Faucet holes on 8" (203mm) centers (Illustrated)
- ☒ 0641.400 Faucet holes on 4" (102mm) centers
- ☐ 0641.100 Center hole only
- Classic styled rectangular pedestal lavatory
 - Vitreous china
 - Rear overflow
 - Supplied with mounting kit
 - Right Height® for greater comfort during use
 - Faucet ledge with large deck area (faucet not included)
 - **Design coordinates with Boulevard® Toilet**
 - Basin has flat bottom to also allow use as an **above counter sink** or a **drop-in sink** (with u-shaped cut out)

Nominal Dimensions:

24" x 19" x 35-1/2"
(610 x 483 x 902mm)

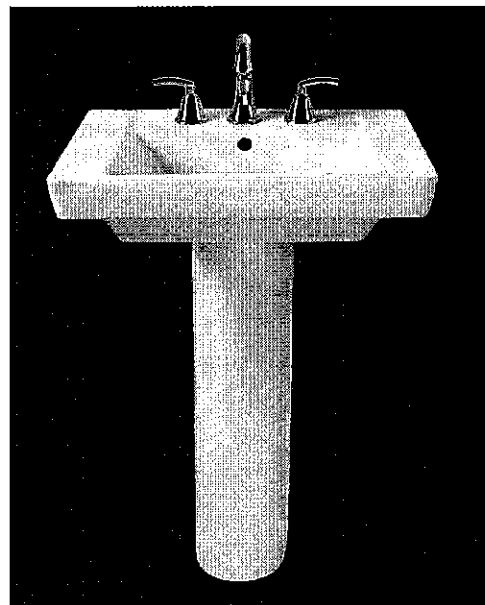

- ☐ 0641.008 Pedestal top-8" (203mm) centers
- ☐ 0641.004 Pedestal top-4" (102mm) centers
- ☐ 0641.001 Pedestal top-center hole only
- ☐ 0010.000 Pedestal only

SEE REVERSE FOR ROUGHING-IN DIMENSIONS

Bowl sizes:

17" (432mm) wide,
12-1/2" (318mm) front to back,
5" (127mm) deep

Compliance Certifications -

Meets or Exceeds the Following Specifications:

- ASME A112.19.2 - 2008/CSA B45.1-08

To Be Specified:

- ☐ Color: ☐ White ☐ Linen
- ☐ Faucet Finish:
- ☐ Supplies:
- ☐ 1-1/4" Trap:
- ☐ Nipple:

* See faucet section for additional models available

[Handwritten signature]

UK 3 WALLACETON
LOT 3185A-5
20-1456 ELEV B
THE HAMPTON

24 of 41

American Standard

 **BARRIER FREE**

**COLONY™
COUNTERTOP SINK**
VITREOUS CHINA

COLONY COUNTERTOP SINK

- Vitreous china
- Self-rimming
- Front overflow
- Supplied with template
- Faucet deck
(Faucet shown not included)

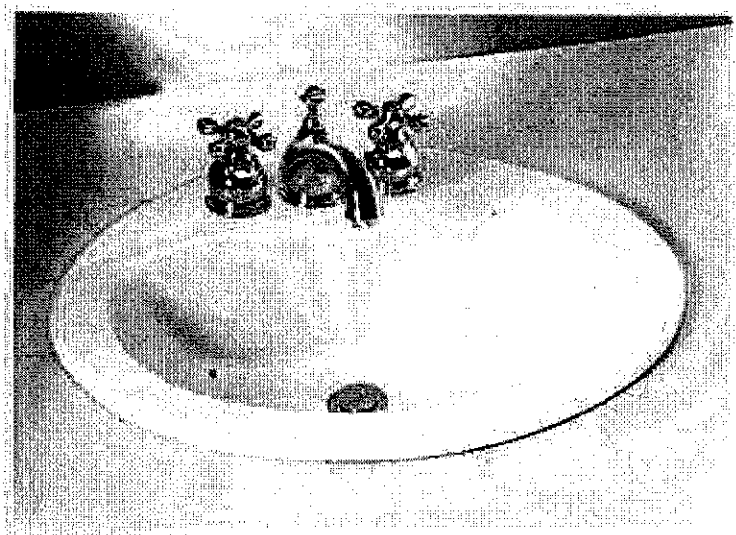

- ☐ **0346 803**
Faucet holes on 203mm (8") centres
- ☒ **0346 403 (Illustrated)**
Faucet holes on 102mm (4") centres
- ☐ **0346 001**
Centre hole only

Nominal Dimensions:
521 x 448mm (20-1/2" x 17-5/8")

Bowl sizes:
422mm (16-5/8") wide, 279mm (11") front to
back, 143mm (5-5/8") deep

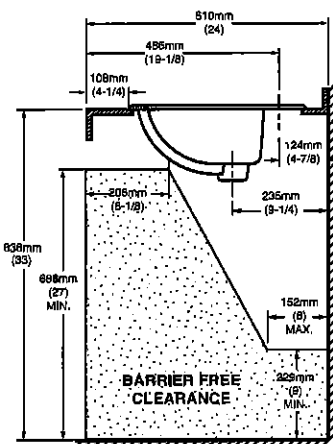
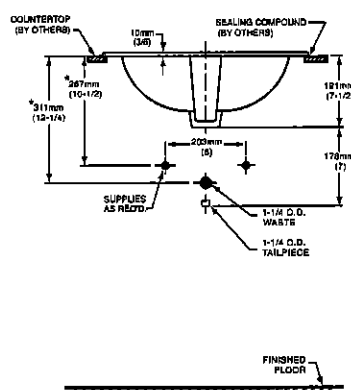
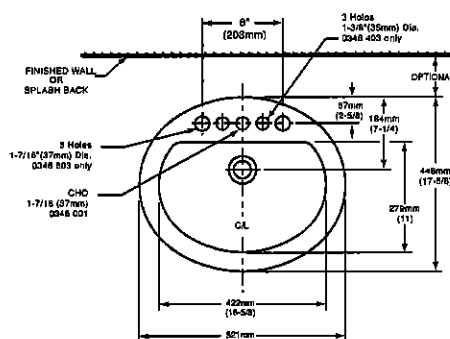

COMPLIANCE CERTIFICATIONS –
Meets or exceeds the following Specifications:
• ASME A112.19.2M for Vitreous China Fixtures.
• CAN/CSA B45 Series.

To Be Specified

- ☐ Colour: ☐ White ☐ Bone ☐ Silver Gray
☐ Linen
- ☐ Faucet*:
- ☐ Faucet Finish:
- ☐ Supplies & Stops:
- ☐ Trap 1-1/4" (32 mm):

NOTES:
* DIMENSIONS SHOWN FOR LOCATION OF SUPPLIES AND "P" TRAP ARE SUGGESTED.
FOR COUNTERTOP CUTOUT AND INSTALLATION INSTRUCTIONS USE TEMPLATE
SUPPLIED WITH SINK.
FAUCETS NOT INCLUDED AND MUST BE ORDERED SEPARATELY.
IMPORTANT: Dimensions of fixtures are nominal and may vary within the range of tolerances
established by ANSI Standard A112.19.2.
These measurements are subject to change or cancellation. No responsibility is assumed for use
of superseded or voided pages.

* See faucet section for additional models available

BAS-198

© 2000 American Standard Inc.

01/07

Handwritten signature

UK 3 WALLACETON
LOT 3185A-5
20-1456 ELEV B
THE HAMPTON

25 of 41



DEMI™
Product Specification Sheet

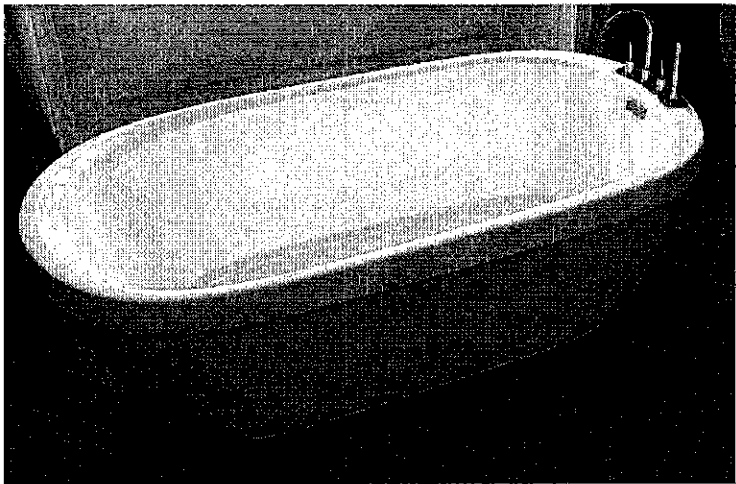

Two Piece Freestanding Collection

CF2007	Two Piece Freestanding Soaker
Size:	60" x 32" x 22" 1524 mm x 813 mm x 559 mm

PRODUCT FEATURES & BENEFITS

- Vacuum formed acrylic reinforced with fiberglass
- Scratch, stain and fade resistant high gloss finish
- Installation friendly two piece design
- Accepts deck mounted faucet
- Includes integral pop up drain and rectangular overflow
- Includes levelling feet

TWO PIECE ASSEMBLY

FRONT VIEW

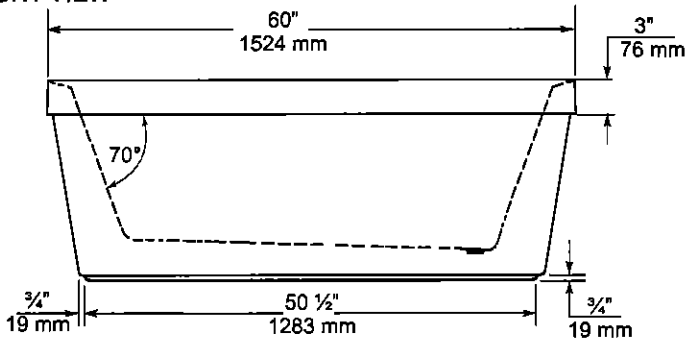

END VIEW

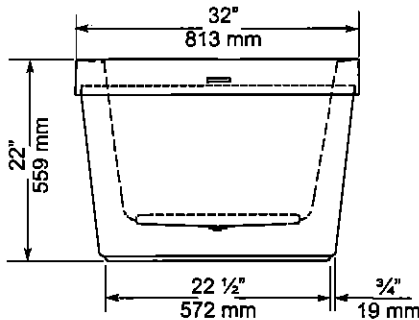

TOP VIEW

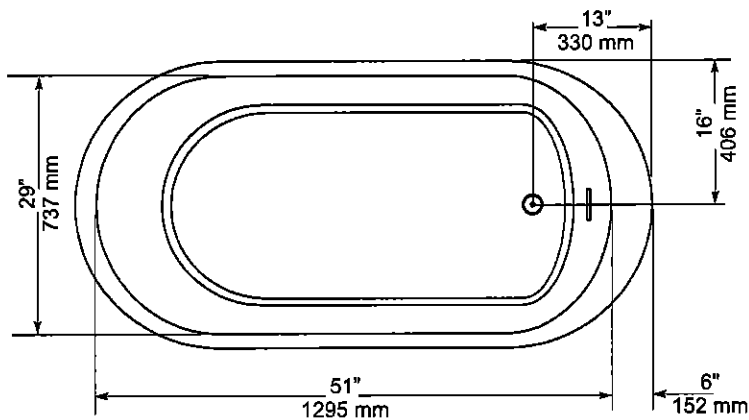

GENERAL SPECIFICATIONS		
Average Weight	90 lb	41 kg
Bathing Well at bottom	43"x 20"	1092 x 508 mm
Capacity Drain to Overflow		195 litres
Water Depth Drain to Overflow	16"	406 mm
Drain Opening (dia.)	2"	51 mm
Overflow Opening	2 1/4"x 1/2"	57 x 13 mm
Drain to Floor Clearance	3 1/4"	83 mm

NOTES: Please confirm measurements on actual product to ensure proper identification. Bathtub to be installed on the floor supported by 5 self levelling feet. Adjust if required to level the bathtub for adequate drainage. Refer to installation instructions for additional information.

IMPORTANT: Dimensions of fixtures are nominal and may vary ± 1/4" (6 mm). Weight may vary ± 5 lb (2.3 kg). Drawing is not to scale. These measurements are subject to change at manufacturer's discretion.

Compliance Certifications -
Meets or Exceeds the following Specifications:
• CAN/CSA - B45 Series



[Handwritten signature]

UK 3 WALLACETON
LOT 3185A-5
20-1456 ELEV B
THE HAMPTON

26 of 41

American Standard
Style That Works Better

FloWise™ DUAL FLUSH
ELONGATED TOILET
VITREOUS CHINA

FloWise™ DUAL FLUSH ELONGATED TOILET

- 2476 216
 - Vitreous china
 - Low-consumption Dual Flush
 - Full flush 6.0 Lpf/1.3 gpf,
 - Partial flush 3.0 Lpf/0.66 gpf.
 - Elongated wash down bowl
 - Internal trapway fully-glazed, 2-1/4" (57mm) ballpass
 - Concealed trapway bowl
 - Chrome-plated top mounted push button actuator
 - Easy to clean sanitary dam on bowl
 - Includes Elongated Slow Close Seat
 - 100% factory flush tested
 - 2 bolt caps

Separate Component Parts:

- 3067 316 Elongated Bowl with Slow Close Seat
- 4035 216 Unlined Tank

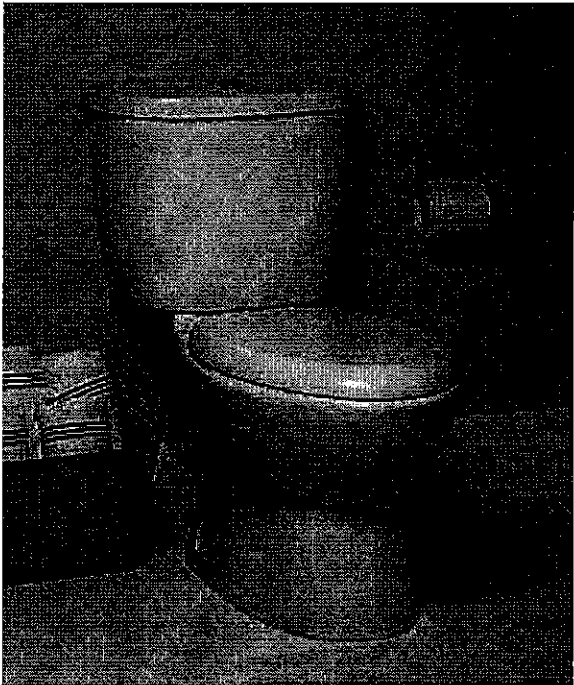

- 2476 516 Same as above with Lined tank
 - 3067 316 Elongated Bowl
 - 4035 516 Lined Tank

Nominal Dimensions:
794 x 432 x 765mm
(31-1/4" x 17" x 30-1/8")

- Compliance Certifications -
Meets or Exceeds the Following Specifications:
- ASME A112.19.2M (and 19.6M)
 - CAN/CSA B45 series

To Be Specified

- Colour: 020 White
- Supply with stop:

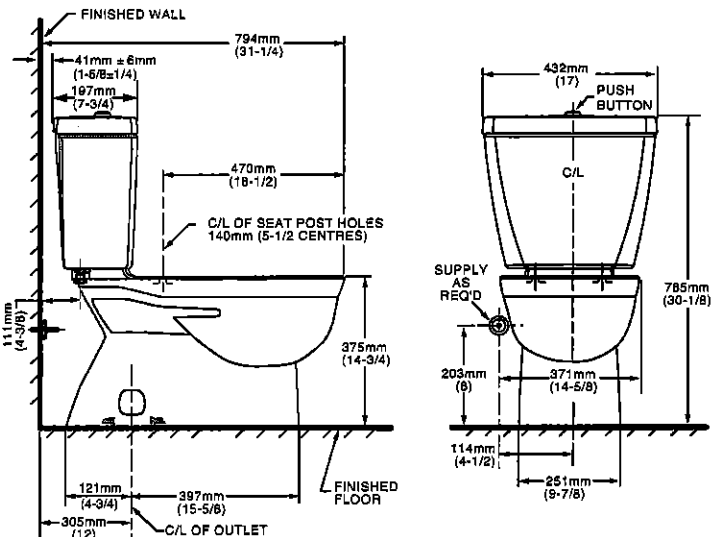

NOTES:
THIS TOILET IS DESIGNED TO ROUGH-IN AT A MINIMUM DIMENSION OF 305MM (12") FROM FINISHED WALL TO C/L OF OUTLET.
SUPPLY NOT INCLUDED WITH FIXTURE AND MUST BE ORDERED SEPARATELY.
* DIMENSION SHOWN FOR LOCATION OF SUPPLY IS SUGGESTED.
FOR ADDITIONAL INFORMATION REFER TO INSTALLATION INSTRUCTIONS SUPPLIED.
IMPORTANT: Dimensions of fixtures are nominal and may vary within the range of tolerance established by ANSI Standard A112.19.2
These measurements are subject to change or cancellation. No responsibility is assumed for use of superseded or voided pages.

UPGRADED VALUE ADDED FEATURES AT NO EXTRA CHARGE

[Handwritten signature]

UK 3 WALLACETON
LOT 3185A-5
20-1456 ELEV B
THE HAMPTON

27 of 41

MOEN®

Specifications

There is more than 1 version of this model.
Page down to identify the version you have.

DESCRIPTION

- Metal construction with various finishes identified by suffix
- Flexible supplies with 3/8" compression fittings
- Includes metal or 50/50 pop-up type waste assembly where noted

OPERATION

- Pivot action lever style handle
- Temperature controlled through 100° degree arc of handle travel

FLOW

- Water usage is limited to these maximum flow rates as indicated by the corresponding product markings
 - ° 1.2 gpm max (4.5L/min) at 60 psi
 - ° 1.5 gpm max (5.7L/min) at 60 psi

CARTRIDGE

- 1255™ Duralast™ cartridge.
- Nonmetallic/nonferrous and stainless steel material

STANDARDS

- Third party certified to WaterSense®, ASME A112.18.1/CSA B125.1 and all applicable requirements referenced therein
- Certified to NSF 61/9 & 372
- Products marked with 1.2 gpm are compliant with California water efficiency regulations
- Complies with California Proposition 65 and with the Federal Safe Drinking Water Act

- **ADA**  for lever handle

WARRANTY

- Lifetime limited warranty against leaks, drips and finish defects to the original consumer purchaser
- 5 year warranty if used in commercial installations

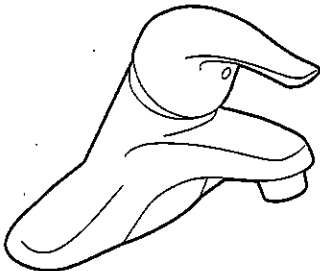

CHATEAU®
Single-Handle Lavatory Faucet

with Metal Waste Assembly

Model: L4625 series
L4631BC

Bulk Packed (12 per carton):
L64624 series

with 50/50 Waste Assembly

Bulk Packed (12 per carton):
L64625 series

Less Waste

Bulk Packed (12 per carton):
L64600 series

NOTE: THIS FAUCET IS DESIGNED TO BE
INSTALLED THRU 3-1" DIA. HOLES, 2" ON CENTER

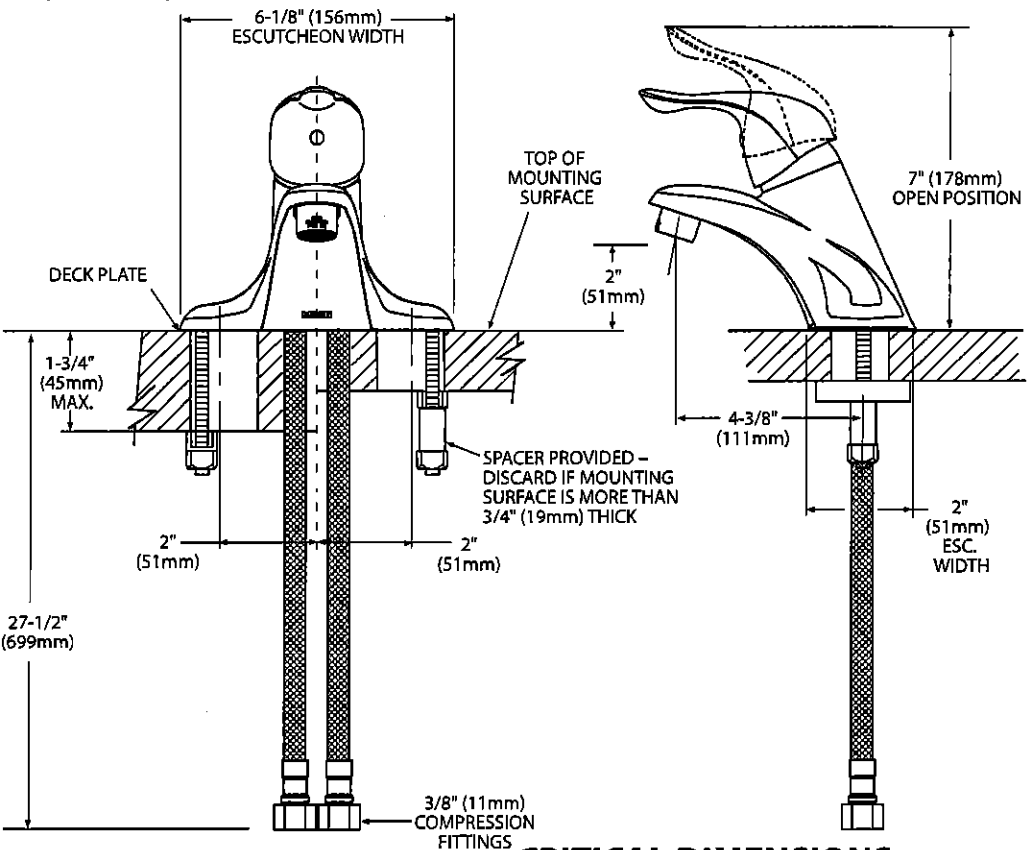

CRITICAL DIMENSIONS
(DO NOT SCALE)



UK 3 WALLACETON
LOT 3185A-5
20-1456 ELEV B
THE HAMPTON

28 of 41



Buy it for looks. Buy it for life.®

There is more than 1 version of this model.
Page down to identify the version you have.

DESCRIPTION

- Metal construction with various finishes identified by suffix
- Includes non-metallic showerhead, arm, flange and non-metallic diverter tub spout

OPERATION

- Handle operates counterclockwise through a 270° arc with off at 6 o'clock and maximum hot at the 9 o'clock position. Shut off in clockwise direction
- Adjustable temperature limit stop to control maximum hot water temperature
- Pressure balancing mechanism maintains selected discharge temperature to ± 3°

FLOW

- Showerhead is limited to 2.5 gpm (9.5 L/min) at 80 psi
- EP suffix models are limited to 1.75 gpm (6.6 L/min) at 80 psi
- NH suffix models contain no showerhead

CARTRIDGE

- 1222 cartridge design
- Accommodates back to back installations
- Nonmetallic/nonferrous and stainless steel material

STANDARDS

- Third party certified to meet ASME A112.18.1/CSA B125.1 and all applicable requirements referenced therein
- EP suffix models are third party certified to WaterSense®
- ADA ♿ for lever handle

WARRANTY

- Lifetime limited warranty against leaks, drips and finish defects to the original consumer purchaser
- 5 year warranty if used in commercial installations

Specifications

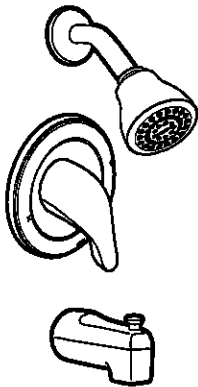

CHATEAU® POSI-TEMP®
Single-Handle Tub/Shower Trim Kit

Models: TL181 series - valve trim only
(Bulk Packed 12 per carton)
TL182 series - shower trim only
(Bulk Packed 12 per carton)
TL183 series - tub/shower trim
(Bulk Packed 12 per carton)

Valves: 62300 series
2500 series

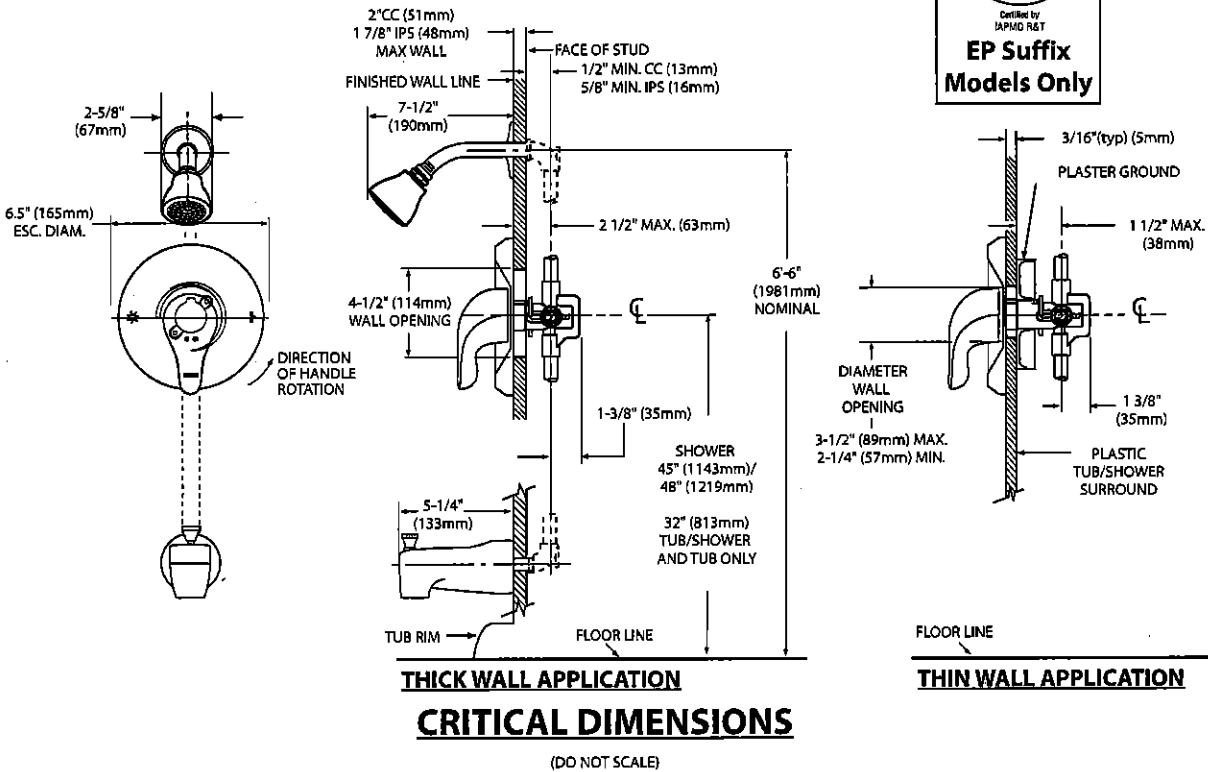
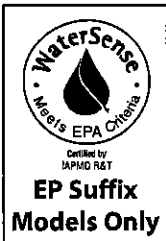

Handwritten signature

UK 3 WALLACETON
LOT 3185A-5
20-1456 ELEV B
THE HAMPTON

29 of 41

MOEN®

Specifications

DESCRIPTION

- Metal construction with various finishes identified by suffix

OPERATION

- Lever style handles with hot and cold color indicator
- Rotate hot side handle counterclockwise to open (clockwise to close) and the cold side handle (clockwise to open) and (counterclockwise to close)

STANDARDS

- Third party certified to: ASME A112.18.1/CSA B-125.1, and all applicable requirements referenced therein
- ADA ♿ for lever handles

WARRANTY

- Lifetime limited warranty against leaks, drips and finish defects to the original homeowner
 - 10 year limited warranty when used in a multi-family installation
 - 5 year limited warranty when used in a commercial installation
- Visit www.moen.com/support for complete details and limitations

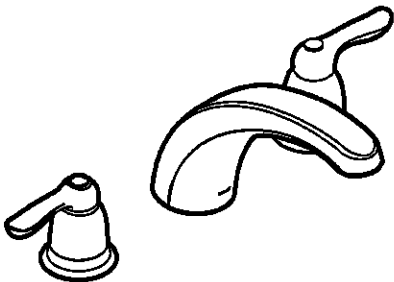

CHATEAU®
Two-Handle Garden Tub Trim

Models: T994 series

Valves: 4792, 4793, 4794, 4796, 4797, 4798

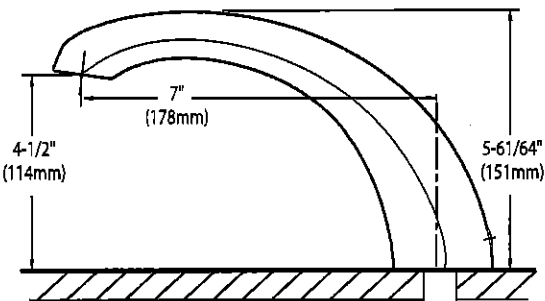
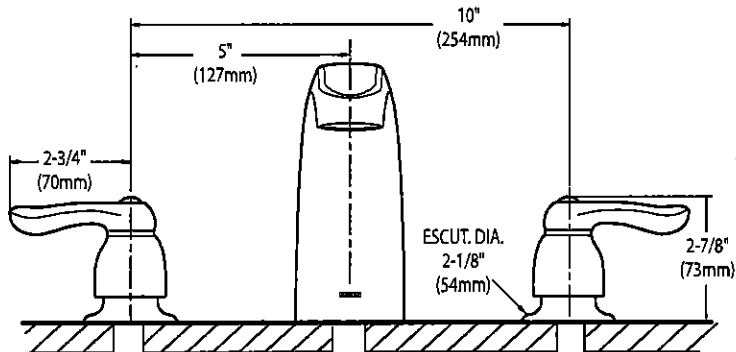

CRITICAL DIMENSIONS

(DO NOT SCALE)

[Handwritten signature]

UK 3 WALLACETON
LOT 3185A-5
20-1456 ELEV B
THE HAMPTON

30 of 41

WMH31017H
OVER-THE-RANGE MICROWAVE

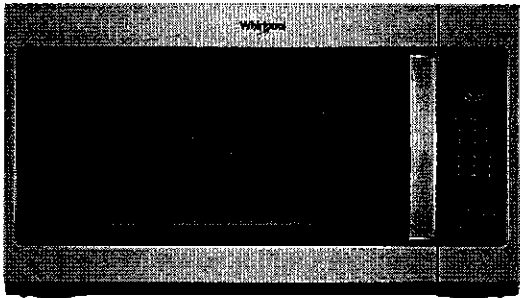

DISHWASHER-SAFE TURNTABLE PLATE

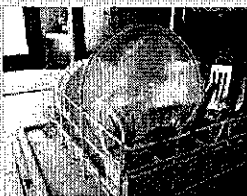

Clean up spills on the turntable by simply putting it in the dishwasher.

2-SPEED, 300 CFM MOTOR CLASS*



Match the right amount of ventilation to the dish being prepared and quickly get rid of cooking odors with two different fan speed settings.

MICROWAVE PRESETS

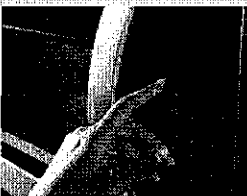

Get just the right amount of heat and time, whether you're cooking or defrosting, with specific preset options.

OTHER FEATURES

- Add 30 seconds option
- Electronic touch controls
- Adjustable cooktop lighting



White (W)



Black (B)



Fingerprint Resistant Stainless Steel (Z)



Silver (S)

MODEL	WMH31017HW	WMH31017HB	WMH31017HZ	WMH31017HS
Max height (in)	17-1/8"	17-1/8"	17-1/8"	17-1/8"
Width (in)	29-15/16"	29-15/16"	29-15/16"	29-15/16"
Depth (in)	15-9/16"	15-9/16"	15-9/16"	15-9/16"

Whirlpool®

*Performance varies based on installation.
®/™ ©2018 Whirlpool. All rights reserved. 1/18. WC170107A

[Handwritten signature]

VENTING DESIGN SPECIFICATIONS

This section is intended for architectural designer and builder/contractor reference only.

NOTES:

- Vent materials needed for installation are not provided with microwave hood combination.
- We do not recommend using a flexible metal vent.
- To avoid possible product damage, be sure to vent air outside, unless using recirculation installation. Do not vent exhaust air into concealed spaces, such as spaces within walls or ceilings, attics, crawl spaces, or garages.

For optimal venting installation, we recommend:

- Using roof or wall caps that have backdraft dampers
- Using a rigid metal vent
- Using the most direct route by minimizing the length of the vent and number of elbows to provide efficient performance
- Using uniformly sized vents
- Using duct tape to seal all joints in the vent system
- Using caulking compound to seal exterior wall or roof opening around cap
- Not installing 2 elbows together for optimal hood performance

If venting through the wall, be sure that there is proper clearance within the wall for the damper to open fully.

If venting through the roof, and rectangular-to-round transition is used, be sure there are at least 3" (7.6 cm) of clearance between the top of the microwave oven and the transition piece. See "Rectangular-to-Round Transition" illustration.

Rectangular-to-Round Transition

NOTE: The minimum 3" (7.6 cm) clearance must exist between the top of the microwave oven and the rectangular to round transition piece so that the damper can open freely and fully.

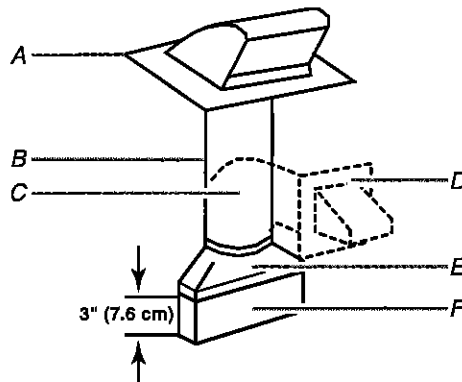

- A. Roof cap
- B. 6" (15.2 cm) min. diameter round vent
- C. Elbow (for wall venting only)
- D. Wall cap
- E. 3 1/4" x 10" to 6" (8.3 x 25.4 cm to 15.2 cm) rectangular to round transition piece
- F. Vent extension piece, at least 3" (7.6 cm) high

Recommended Standard Fittings

The following length equivalents are for use when figuring vent length. See the examples in "Recommended Vent Length".

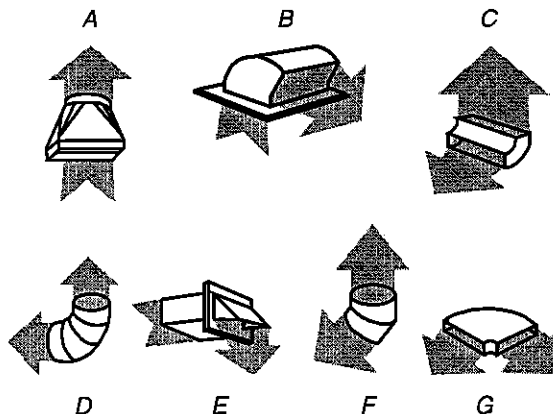

- A. Rectangular-to-round transition piece: 3 1/4" x 10" to 6" = 5 ft (8.3 x 25.4 cm to 15.2 cm = 1.5 m)
- B. Roof cap: 3 1/4" x 10" = 24 ft (8.3 x 25.4 cm = 7.3 m)
- C. 90° elbow: 3 1/4" x 10" = 25 ft (8.3 x 25.4 cm = 7.6 m)
- D. 90° elbow: 6" = 10 ft (15.2 cm = 3 m)
- E. Wall cap: 3 1/4" x 10" = 40 ft (8.3 x 25.4 cm = 12.2 m)
- F. 45° elbow: 6" = 5 ft (15.2 cm = 1.5 m)
- G. 90° flat elbow: 3 1/4" x 10" = 10 ft (8.3 x 25.4 cm = 3 m)

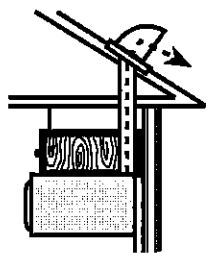

Roof venting

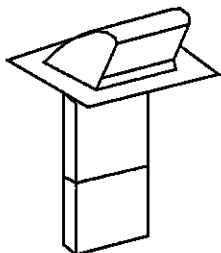

Roof cap

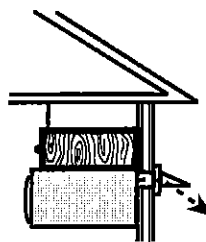

Wall venting



Wall cap

[Handwritten signature]

Recommended Vent Length

A 3¼" x 10" (8.3 x 25.4 cm) rectangular or 6" (15.2 cm) round vent should be used.

The total length of the vent system including straight vent, elbow(s), transitions, and wall or roof caps must not exceed the equivalent of 140 ft (42.7 m) for either type of vent. See the "Recommended Standard Fittings" section for equivalent lengths.

For best performance, use no more than three 90° elbows.

To calculate the length of the system you need, add the equivalent lengths of each vent piece used in the system. See the following examples:

3¼" x 10" (8.3 x 25.4 cm) vent system = 73 ft (22.2 m) total

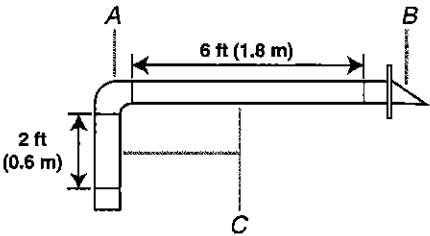

- A. One 3¼" x 10" (8.3 x 25.4 cm) 90° elbow = 25 ft (7.6 m)
- B. 1 wall cap = 40 ft (12.2 m)
- C. 2 ft (0.6 m) + 6 ft (1.8 m) straight = 8 ft (2.4 m)

6" (15.2 cm) vent system = 73 ft (22.2 m) total

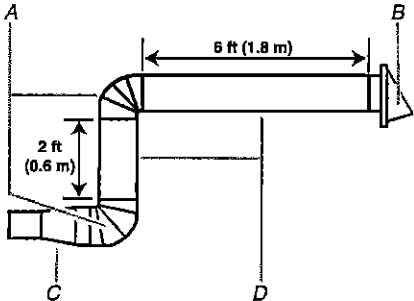

- A. Two 90° elbows = 20 ft (6.1 m)
- B. 1 wall cap = 40 ft (12.2 m)
- C. 1 rectangular-to-round transition piece = 5 ft (1.5 m)
- D. 2 ft (0.6 m) + 6 ft (1.8 m) straight = 8 ft (2.4 m)

If the existing vent is round, a rectangular-to-round transition piece must be used. In addition, a rectangular 3" (7.6 cm) extension vent between the damper assembly and rectangular-to-round transition piece must be installed to keep the damper from sticking.

[Handwritten signatures]

UK3 WALLACETON
LOT 3185A-5
20-1456 ELEV B
THE HAMPTON

33 of 41

HOME APPLIANCES

LG REFRIGERATION

LFCC22426S

23 cu.ft. Counter Depth 3-Door French Door Refrigerator

- Counter Depth
- PrintProof Finish™
- Smart Cooling™ System
- Door Cooling +
- SmartDiagnosis™
- LoDecibel™ Quiet Operation
- ENERGY STAR® Qualified

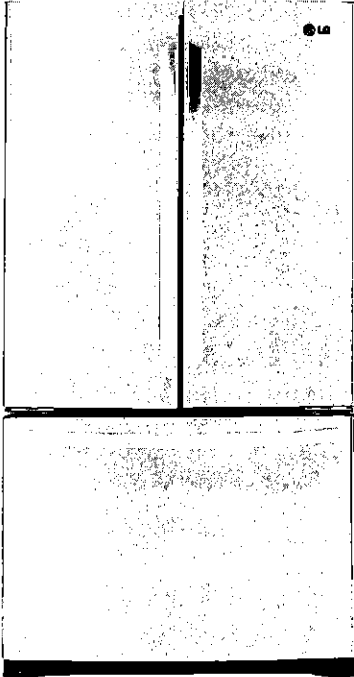

CAPACITY	
Refrigerator (cu.ft.)	15.50
Freezer (cu.ft.)	7.30
Total Capacity (cu.ft.)	22.8
ENERGY	
Energy Consumption (kWh/Year)	595
ENERGY STAR® Qualified	Yes
WATER & ICE SYSTEM	
Daily Ice Production (lbs)	2.5 lbs
IcePlus™ Production (lbs)	2.7 lbs
Ice Storage Capacity (lbs)	4.0 lbs
Ice System	Factory Installed Ice Maker
Water Filter	LT1000P
COOLING	
Linear Compressor	Yes
Smart Cooling™ System	Yes
Multi-Air Flow™ System	Yes
Temperature Sensors	5
Fresh Air Filter	Yes
CONVENIENCE	
Display Type	Membrane / White LED
Temperature Controls	Electronic/Digital
Auto Closing Door Hinge	Yes
LoDecibel™ Quiet Operation	Yes
REFRIGERATOR	
No. of Shelves	4 Split
Cantilevered Shelves	Hybrid Cantilevered
Shelf Construction	Spill Protector™ Tempered Glass
Crisper Bins	2 Humidity Crispers
Glide N' Serve™ Drawer	Yes
Refrigerator Light	Celling LED (Frameless)
REFRIGERATOR DOOR	
No. of Bins	6 Total (2 Adjustable Gallon Sized)
Door Bin Construction	1 Piece (Clear)
FREEZER	
Door Type	Pull Drawer
Drawers	2-Tier Organization
DuraBase™ Solid Drawer Base	Yes
Drawer Divider	Yes
Freezer Light	LED Lighting
Freezer Handle	SmartPull™ Handle

SMART FEATURES	
SmartDiagnosis™	Yes
wi-fi Enabled	No
MATERIALS AND FINISHES	
Contour Door	Yes
Hidden Hinges	Yes
Fingerprint & Smudge Resistant Exterior	Yes
Handles	Matching Commercial
All Available Colors	PrintProof™ Stainless Steel
DIMENSIONS/CLEARANCES/WEIGHTS	
Depth with Handles	31 1/4"
Depth without Handles	28 3/4"
Depth without Door	24 3/4"
Depth (Total with Door Open)	43 1/2"
Height to Top of Case	68 3/8"
Height to Top of Door Hinge	69 3/4"
Width	35 3/4"
Width (Door Open 90° with Handle)	44 1/4"
Width (Door Open 90° without Handle)	39 1/4"
Door Edge Clearance with Handle	4 1/2"
Door Edge Clearance without Handle	1 1/3"
Installation Clearance	Sides 1/8", Top 1", Back 2"
Weight (Unit/Carton)	259 lbs. / 289 lbs.
Carton Dimensions (WxHxD)	38" x 73" x 37"
LIMITED WARRANTY	
Parts & Labor	1 Year
Sealed System (Parts & Labor)	5 Years
Compressor (Parts & Labor)	5 Years
Linear Compressor (Parts Only)	6-10 Years
UPC CODES	
LFCC22426S (PrintProof™ Stainless Steel)	048231797252

UK 3 WALLACETON
LOT 3185A-5
20-1456 ELEV B
THE HAMPTON

34 of 41



5.3 cu. ft. Whirlpool® electric range with Frozen Bake™ technology

YWFE515S0JS

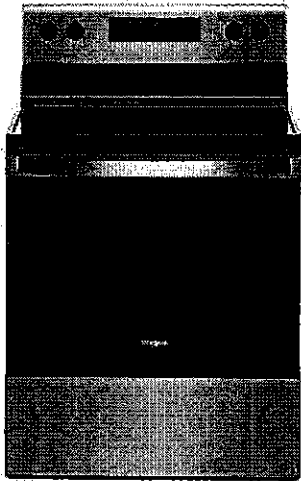

This Whirlpool® electric range with a dual element stove top helps you get dinner to the table. Skip preheating for favorites like pizza with Frozen Bake™ technology. This self cleaning oven also prevents cooked food from getting cold with the Keep Warm setting. Closed door broiling helps keep the kitchen comfortable.



Available Finishes/Colours

- YWFE515S0JB
Black
- YWFE515S0JS
Stainless Steel
- YWFE515S0JW
White

Manuals & Literature:

-  [Installation Instructions](#)
-  [Use and Care](#)
-  [Warranty](#)

Top Features

- FlexHeat™ Dual Radiant Element**
Get two elements in one with a 6" inner ring that's great for smaller pots and pans and a 9" expandable outer ring that makes room for larger cookware.
- Frozen Bake™ technology**
Skip preheating and cook frozen favorites like pizza in fewer steps with preprogrammed settings that automatically adjust cooking times for you.
- Keep Warm setting**
Keep dishes from getting cold with this setting that delivers low heat to the oven.
- Closed Door Broiling**
Maintain the optimal cooking temperature for food while still keeping the kitchen comfortable and cool using this broiling temperature management system that helps prevent overheating.

Dimensions	
Depth	27 3/4
Height	36
Width	29 7/8

Exterior	
Handle Type	Reach-Through Handle

Configuration	
Installation Type	Freestanding
Power Source	Electric
Control Type	30

Features	
Hot Surface Indicator Light	Yes
Heating Element On Indicator Light	Yes
Power On Indicator Light	No
Griddle	NA
Automatic Convection Conversion Temperature Adjust	No
Power Outage Compatible	No

Exterior	
Door Removable	Yes
Drawer Type	Storage Drawer
Oven Door	Glass Window
Oven Window Size	Extra Large
Handle Color	Stainless Steel
Handle Material	Metal

UK 3 WALLACETON
LOT 3185A-5
20-1456 ELEV B
THE HAMPTON

35 of 41

WHIRLPOOL 30" (76.0 CM) FREESTANDING ELECTRIC RANGES
Model YWFE515S0JS

Product Dimensions

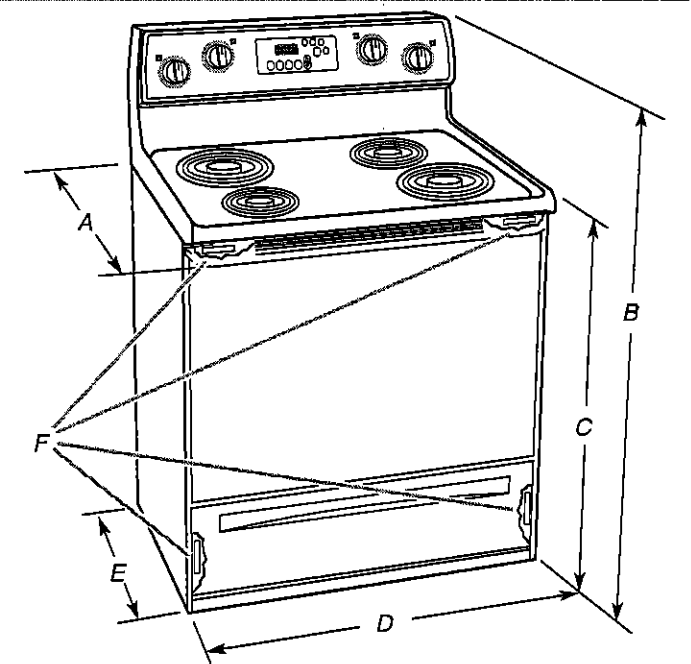

- A. 27³/₈" (70.5 cm) max. depth with handle
- B. 46⁷/₈" (119.1 cm) overall height (max.) with leveling legs screwed all the way in*
- C. 36" (91.4 cm) cooktop height (max.) with leveling legs screwed all the way in*
- D. 29⁷/₈" (75.9 cm) width
- E. 25⁵/₁₆" (64.3 cm) depth - back of range to front of cooktop**
- F. Model/serial/rating plate (located on the frame behind a top corner of the door or either side of the drawer)

IMPORTANT: Range must be level after installation. Follow the instructions in the "Level Range" section. Using the cooktop as a reference for leveling the range is not recommended.

*Range can be raised approximately 1" (2.5 cm) by adjusting the leveling legs.

**Front of door and drawer may extend further forward depending on styling.

Cabinet Dimensions

Cabinet opening dimensions shown are for 25" (64.0 cm) countertop depth, 24" (61.0 cm) base cabinet depth and 36" (91.4 cm) countertop height.

IMPORTANT: If installing a range hood or microwave hood combination above the cooking surface, follow the range hood or microwave hood combination installation instructions for dimensional clearances above the cooktop surface.

A freestanding range may be installed next to combustible walls with zero clearance.

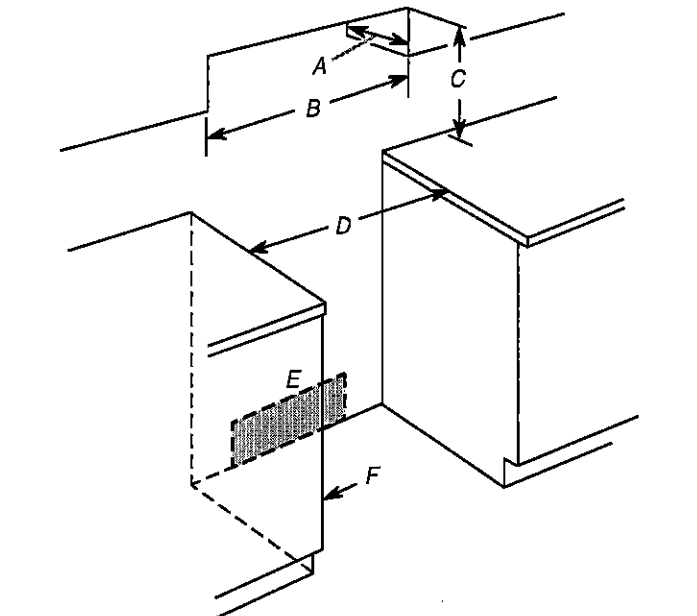

- A. 13" (33.0 cm) max. upper cabinet depth
- B. 30" (76.2 cm) min. opening width
- C. For minimum clearance to top of cooktop, see NOTE*
- D. 30" (76.2 cm) min. opening width
- E. Outlet - 8" (20.3 cm) to 22" (55.9 cm) from either cabinet; 7" (17.8 cm) max. from floor.
- F. Cabinet door or hinges should not extend into the cutout.

***NOTE:** 24" (61.0 cm) minimum when bottom of wood or metal cabinet is covered by not less than 1/4" (6.4 mm) flame retardant millboard covered with not less than No. 28 MSG sheet steel, 0.015" (0.4 mm) stainless steel, 0.024" (0.6 mm) aluminum or 0.020" (0.5 mm) copper.

30" (76.2 cm) minimum clearance between the top of the cooking platform and the bottom of an uncovered wood or metal cabinet.

Handwritten signatures and initials.

UK 3 WALLACETON
LOT 3185A-5
20-1456 ELEV B
THE HAMPTON

36 of 41

WHIRLPOOL 30" (76.0 CM) FREESTANDING ELECTRIC RANGES
Model YWFE515S0JS

Electrical Requirements - Canada Only

⚠ WARNING



Electrical Shock Hazard

Electrically ground range.

Failure to do so can result in death, fire, or electrical shock.

If codes permit and a separate ground wire is used, it is recommended that a qualified electrical installer determine that the ground path is adequate and wire gauge are in accordance with local codes.

Be sure that the electrical connection and wire size are adequate and in conformance with CSA Standard C22.1, Canadian Electrical Code, Part 1 - latest edition, and all local codes and ordinances.

A copy of the above code standards can be obtained from:
Canadian Standards Association
178 Rexdale Blvd.
Toronto, ON M9W 1R3 CANADA

- Check with a qualified electrical installer if you are not sure the range is properly grounded.

Range Rating*		Specified Rating of Power Supply Cord Kit and Circuit Protection
120/240 V	120/208 V	Amps
8.8 - 16.5 KW	7.8 - 12.5 KW	40 or 50**
16.6 - 22.5 KW	12.6 - 18.5 KW	50

*The NEC calculated load is less than the total connected load listed on the model/serial/rating plate.

**If connecting to a 50 A circuit, use a 50 A rated cord with kit. For 50 A rated cord kits, use kits that specify use with a nominal 1 3/8" (3.5 cm) diameter connection opening.

- A time-delay fuse or circuit breaker is recommended.
- This range is equipped with a CSA International Certified Power Cord intended to be plugged into a standard 14-50R wall receptacle. Be sure the wall receptacle is within reach of range's final location.

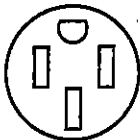

- Do not use an extension cord.

INSTALLATION INSTRUCTIONS

Unpack Range

⚠ WARNING

Excessive Weight Hazard

Use two or more people to move and install range.
Failure to do so can result in back or other injury.

1. Remove shipping materials, tape and film from range.
2. Remove oven racks and parts package from inside oven.
3. Do not remove the shipping base at this time.

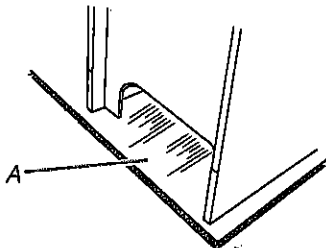

A. Shipping base

4. On Ranges Equipped with a Storage Drawer:

Remove the storage drawer. See the "Storage Drawer" section. Use a 1/4" (6.4 mm) drive ratchet to lower the rear leveling legs one-half turn. Use a wrench or pliers to lower front leveling legs one-half turn.

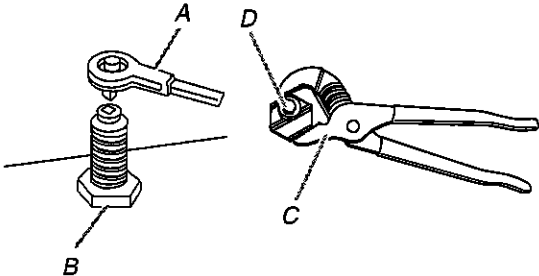

A. 1/4" (6.4 mm) drive ratchet
B. Rear leveling leg
C. Wrench or pliers
D. Front leveling leg

On Ranges Equipped with a Warming Drawer or Premium Storage Drawer:

On ranges equipped with a warming drawer or premium storage drawer, the rear legs cannot be accessed by removing the warming drawer or premium storage drawer. It will be necessary to adjust the rear legs from outside the range. Use wrench or pliers to lower the front and rear leveling legs one half turn.

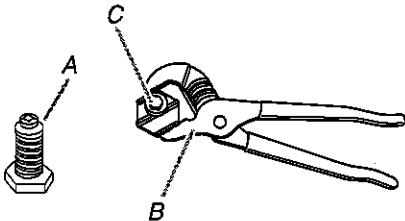

A. Rear leveling leg
B. Wrench or pliers
C. Front leveling leg

Handwritten signatures and initials.

WHIRLPOOL 30" (76.0 CM) FREESTANDING ELECTRIC RANGES
Model YWFE515S0JS

Install Anti-Tip Bracket

WARNING



Tip Over Hazard

A child or adult can tip the range and be killed.

Install anti-tip bracket to floor or wall per installation instructions.

Slide range back so rear range foot is engaged in the slot of the anti-tip bracket.

Re-engage anti-tip bracket if range is moved.

Do not operate range without anti-tip bracket installed and engaged.

Failure to follow these instructions can result in death or serious burns to children and adults.

1. Remove the anti-tip bracket from where it is taped inside the storage drawer or warming drawer.
2. Determine which mounting method to use: floor or wall.
If you have a stone or masonry floor, you can use the wall mounting method. If you are installing the range in a mobile home, you must secure the range to the floor.
3. Determine and mark centerline of the cutout space. The mounting can be installed on either the left-side or right of the cutout. Position mounting bracket against the wall cutout so that the V-notch of the bracket is 12⁹/₁₆" (31.9 cm) from centerline as shown.

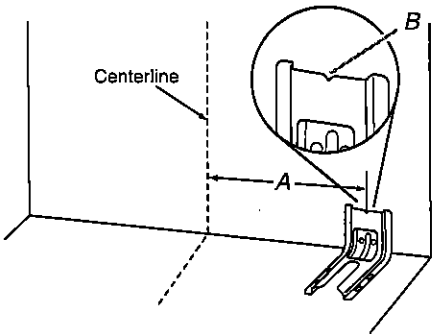

A. 12⁹/₁₆" (31.9 cm)
B. Bracket V-notch

4. Drill two 1/8" (3 mm) holes that correspond to the bracket holes of the determined mounting method. See the following illustrations.

Floor Mounting

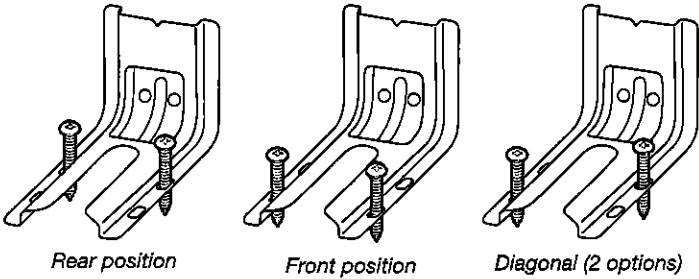

Wall Mounting

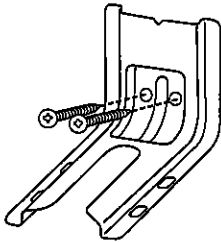

5. Using the Phillips screwdriver, mount anti-tip bracket to the wall or floor with the two #12 x 1⁵/₈" (4.1 cm) screws provided.
6. Move range close enough to opening to allow for final electrical connections. Remove shipping base, cardboard or hardboard from under range.
7. Move range into its final location, making sure rear leveling leg slides into anti-tip bracket.
8. Move range forward onto shipping base, cardboard or hardboard to continue installing the range using the following installation instructions.

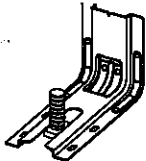

Handwritten signature or initials.

UK3 WALLACETON
LOT 3185A-5
20-1456 ELEV B
THE HAMPTON

38 of 41

WDF560SAFM



Undercounter Dishwasher

PRODUCT MODEL NUMBERS

WDF560SAF
WDF760SAD
WDF770SAF
WDT750SAH
WDT765SAH
WDT780SAE
WDT920SAD

WDT970SAH
WDT975SAH
WDT995SAF
WDTA70SAH
WDTA75SAH
WDTA75SAH

DRAIN REQUIREMENTS

- A new drain hose is supplied with your dishwasher.
If drain hose is not long enough, use a new drain hose with a maximum length of 12 ft (3.7 m) that meets all current AHAM/IAPMO test standards, is resistant to heat and detergent, and fits the 1" (25 mm) drain connector of the dishwasher.
NOTE: Do not connect multiple drain hoses together.
- Make sure to connect drain hose to waste tee or disposer inlet above drain trap in house plumbing and 20" (508 mm) minimum above the floor. It is recommended that the drain hose either be looped up and securely fastened to the underside of the counter or be connected to an air gap.
- Make sure to use an air gap if the drain hose is connected to house plumbing lower than 20" (508 mm) above subfloor or floor.

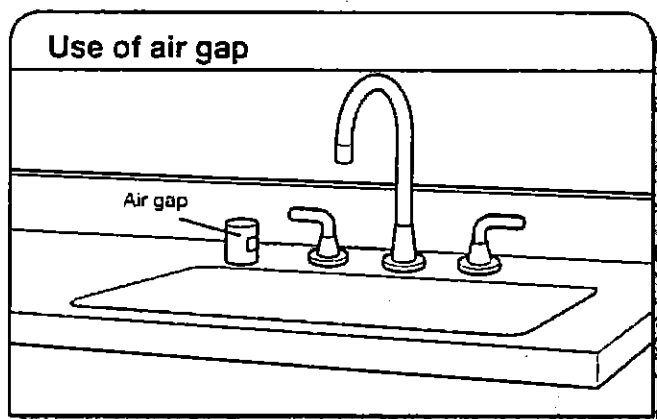

- If required, the air gap should be installed in accordance with the air gap installation instructions. When you are connecting the air gap, a rubber hose (not provided) will be needed to connect to the waste tee or disposer inlet.
- Use 1/2" minimum I.D. drain line fittings.

WATER SUPPLY REQUIREMENTS

- This dishwasher has a water heating feature and also requires a connection to a hot water supply line.
- A hot water line with 20 to 120 psi (138 to 862 kPa) water pressure can be verified by a licensed plumber.
- 120°F (49°C) water at dishwasher
- 3/4" O.D. copper tubing with compression fitting or flexible braided water supply line. See the "Tools and Parts" section at the front of the guide for part details and orders.
NOTE: 1/2" minimum plastic tubing is not recommended.
- A 90° elbow with 3/4" hose connection with rubber washer.
- Do not solder within 6" (152 mm) of the water inlet valve.
- If installed in new construction, make sure the house water supply lines have been flushed prior to connecting the dishwasher to remove any debris that may exist in the supply line.

NOTE: If replacing an existing dishwasher, it is recommended to install a new water line (see the "Tools and Parts" section at the front of the guide for part details) and drain hose (supplied) with the new dishwasher.

ELECTRICAL REQUIREMENTS

- 120-volt, 60 Hz, AC-only, 15- or 20-amp, fused electrical supply
- Copper wire only
- A maximum of 2 field wiring supply conductors (12 AWG largest size) plus 1 grounding conductor are permitted in the terminal box.

We Recommend:

- A time-delay fuse or circuit breaker
- A separate circuit

If Connecting Dishwasher with a Power Cord:

- Use UL Listed power cord kit marked for use with dishwasher. See the "Tools and Parts" section at the front of the guide for part details and orders.
- Plug into a grounded 3 prong outlet. Outlet must meet all local codes and ordinances.

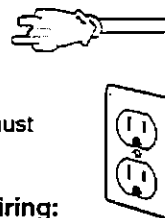

If Connecting Dishwasher with Direct Wiring:

- Use flexible, armored, or nonmetallic sheathed copper wire with grounding wire that meets the wiring requirements for your home and local codes and ordinances.
- Use a UL Listed/CSA Approved metallic strain relief. See the "Tools and Parts" section at the front of the guide for part details and orders.



39 of 41

Product and Cabinet Opening Dimensions

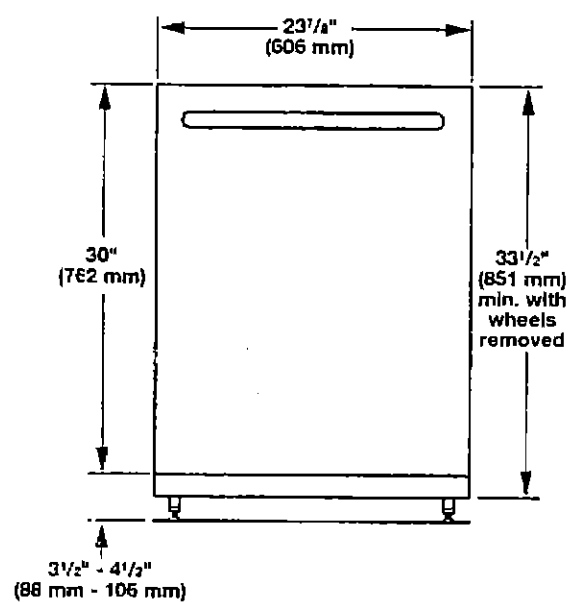

For 4" (100 mm) toe kick, height of cabinet opening is 34 1/2" (863 mm).

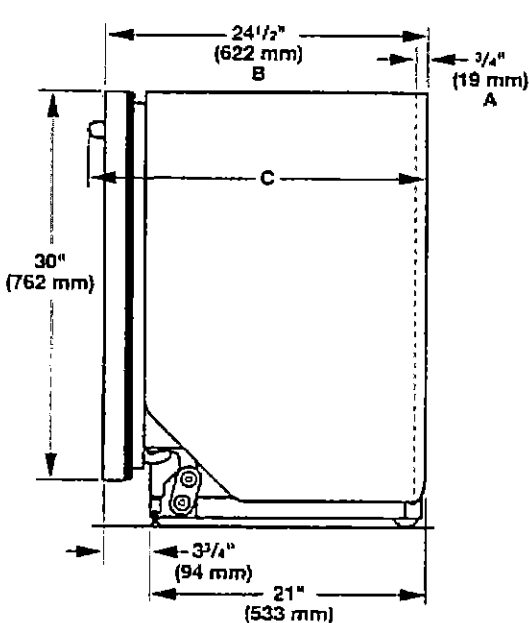

- A. Insulation may be compressed (not used on all models).
B. For panel-ready models, dishwasher depth is 24" (610 mm), not including the 3/4" (19 mm) custom door panel.
C. Door handles may protrude forward of the face of the dishwasher, varies by model.

Check that all surfaces have no protrusions that would prohibit dishwasher installation.

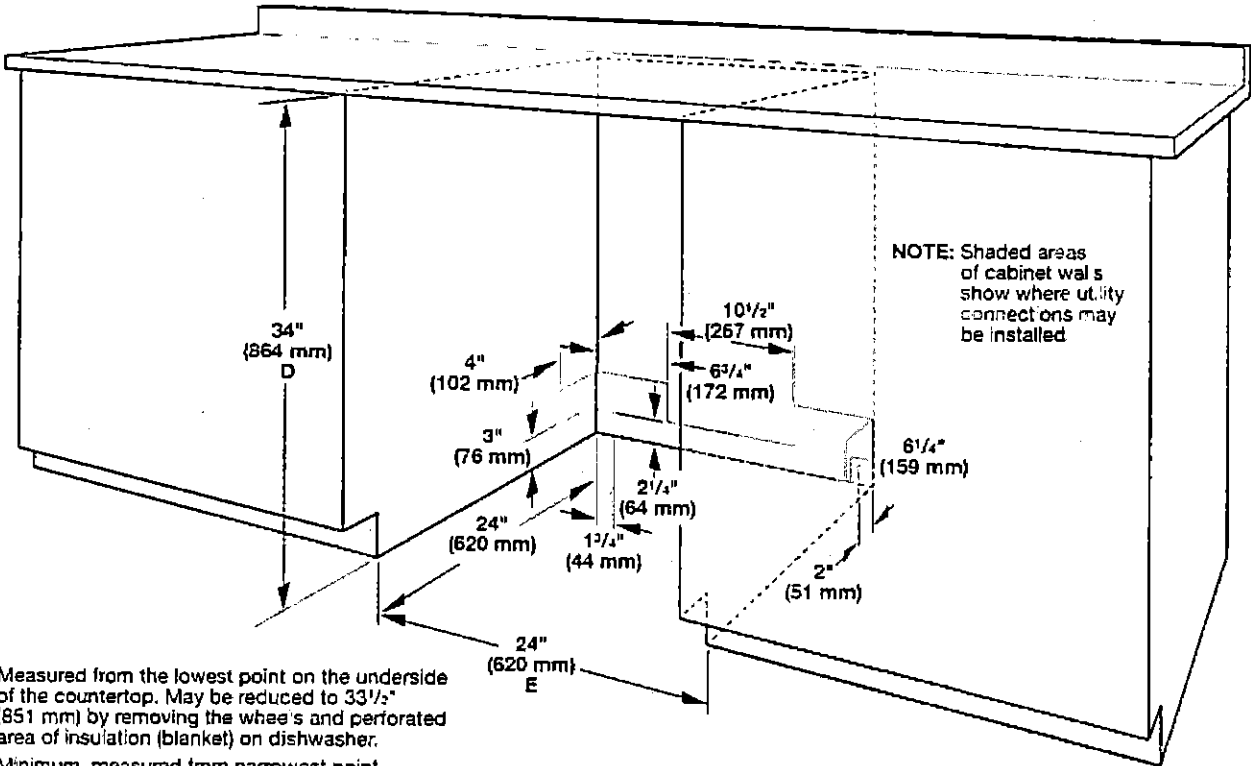

NOTE: Shaded areas of cabinet walls show where utility connections may be installed

- D. Measured from the lowest point on the underside of the countertop. May be reduced to 33 1/2" (851 mm) by removing the wheels and perforated area of insulation (blanket) on dishwasher.
E. Minimum, measured from narrowest point of opening

UK 3 WALLACETON
LOT 3185A-5
20-1456 ELEV B
THE HAMPTON

40 of 41

WHIRLPOOL WASHER Model #: WFW5620HW

Whirlpool Brand Canada English | Washer and Dryers | Washers | Front Load Washers | WFW5620HW

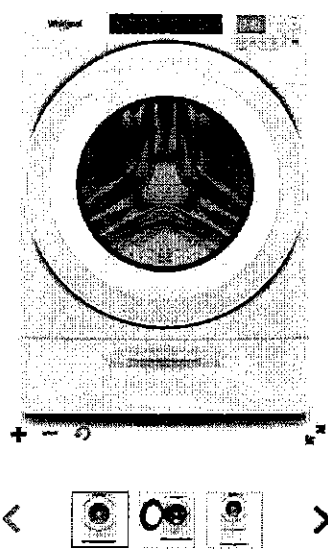

5.2 cu. ft. I.E.C. Closet-Depth
Front Load Washer with
Load & Go™ Dispenser

Whirlpool® 5.2 cu. ft. I.E.C. Closet-Depth Front Load Washer with Load & Go™ Dispenser
Model #: WFW5620HW

Dimensions

Depth	80.17 cm, 31-9/16 in
Depth With Door Open 90 Degree	143.51 cm, 56-1/2 in
Minimum Height	98.11 cm, 38-5/8 in
Width	68.58 cm, 27.0 in

Appearance

LCD Touch Screen	No
Window	Yes

Details

Drum Material	Stainless Steel
---------------	-----------------

Cycles and Options

Number of Wash Cycles	37
-----------------------	----

Electrical

Hz	60
Power Cord Included	Yes

Handwritten signatures.

UK 3 WALLACETON
LOT 3185A-5
20-1456 ELEV B
THE HAMPTON

41 OF 41

WHIRLPOOL DRYER Model #: YWED5620HW

Whirlpool Brand Canada English | Washer and Dryers | Dryers | Electric Dryers | YWED5620HW

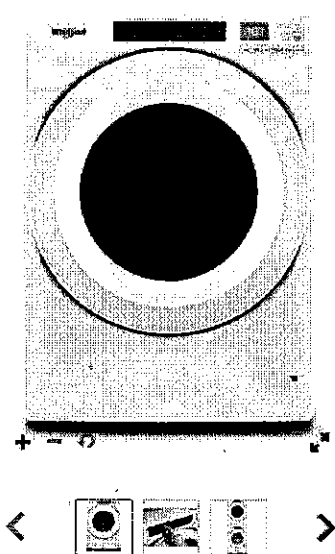

7.4 cu. ft. Front Load Electric
Dryer with Intuitive Touch
Controls

Whirlpool® 7.4 cu. ft. Front Load Electric Dryer with Intuitive Touch Controls

Model #: YWED5620HW

Dimensions

Depth	78.74 cm, 31.0 in
Depth With Door Open 90 Degree	138.43 cm, 54-1/2 in
Height	98.42 cm, 38-3/4 in
Width	68.58 cm, 27.0 in

Configuration and Overview

Fuel Type	Electric
-----------	----------

Cycles and Options

Cycle Time Remaining	Yes
Lint Filter Indicator	No
Number of Dryer Cycles	36
Number of Dryness Levels	3

Ventilation System

Long Vent	No
Maximum Vent Length	64
Venting Direction	Left, Right, Bottom, Rear

Electrical

Hz	60
Power Cord Included	Yes

Handwritten signature and initials.