

PRE-Sales Selection Sheet Checklist

1 of 37

LOT 312 Model: 33-3344 A The Windsor
PURCHASERS: QAIS HAZRATY/
VENDOR: Heathwood Homes (Huron) Limited

- FINISHED BASEMENT
- COLD CELLAR

UPGRADED / MODIFIED ELEVATION

- CORNER UPGRADE
- REAR UPGRADE

CEILING UPGRADE - SMOOTH

- MAIN FLOOR
- SECOND FLOOR
- BASEMENT

ADDITIONAL ROUGH-INS

- 200 AMP SERVICE
- WET BAR ROUGH-IN
- HUMIDIFIER
- AIR CONDITIONING

GAS ROUGH-IN

- STOVE
- DRYER
- BBQ
- ADDITIONAL FIREPLACE

KITCHEN: HOODFAN VENTING SIZE

- 6 IN ROUND DUCT
- 7 IN ROUND DUCT

FULL BASEMENT STAIRS:	All Oak
UPPER BASEMENT STAIRS:	N/A
LOWER BASEMENT STAIRS:	N/A
MAIN STAIRS:	All Oak
MEDIA STAIRS (if applicable):	N/A
LOFT STAIRS (if applicable):	N/A

6/1/2021
 Date Purchaser: Qais Hazraty

JUNE 1/21
 Date Decor Consultant: [Signature]

APPROVED

Date Purchaser:

-06-14 2021
 Date Approved: [Signature]
 Heathwood Homes (Huron) Limited

Locked Date:

2 of 37

	Sales Selection Sheet Wallaceston	TEL:
PURCHASER: QAIS HAZRATY		

LOT / UNIT 312	PHASE 2	MODEL 33-3344 A The Windsor
-------------------	------------	--------------------------------

It is herein understood and agreed between the undersigned parties hereto that the following changes shall be made to the above mentioned Agreement of Purchase and Sale in accordance with the agreement and except for such changes noted below, all other terms and conditions in the Agreement of Purchase and Sale shall remain as stated herein: It is further understood that and agreed that all changes and additions shall be installed as per builder's specifications, location and available selections. The Purchaser hereby agrees to purchase the following extras:

ADMIN FEE

1	- SCHEDULE "E" TEN THOUSAND DOLLARS (\$10,000.00) AT DECOR (NO CASH VALUE) - SINGLED	Qty: 1	
60,928	Note:		

Sub Total
HST
Total

1. This Sales Selection Sheet when properly executed forms part of our Agreement of Purchase and Sale.
2. All extras and upgrades listed above are subject to Construction Progress and Architectural and Municipal requirements.
3. In the event the Vendor is unable to incorporate the work approved above in the construction of the house for any reason whatsoever, the Vendor will not be liable to the Purchaser in any way. The monies paid for any changes or optional extras not proceeded with shall be returned to the Purchaser, without interest. The cost of options or extras is non-refundable in all other circumstances. If for any reason whatsoever the Agreement of Purchase and Sale is not completed, the total cost of work approved above will be retained by the Vendor.
4. The Vendor reserves the right to substitute above materials and equipment with that of equal or better quality.
5. Purchaser acknowledges that items may not be exactly as shown. Variations from the Vendor's samples may occur in finished materials due to normal production processes. Vendor is not responsible for shade difference which may occur from different dye lots or wood grains. Variations from the Vendor's samples will occur with natural materials such as wood, marble, granite, hardwood and brick.
6. The Vendor reserves the right to select Grout & Thresholds that best suits the Tile selected.
7. Selections will not be processed unless signed by Heathwood Homes Head Office.
8. The selections made on this schedule are final and cannot be changed once submitted.
9. The Purchaser has checked and acknowledges the accuracy of this schedule.

Payment Summary	
<u>Paid By</u>	<u>Amount</u>
<u>Total Payment:</u>	

PURCHASER:	DocuSigned by: <i>Qais Hazraty</i> QAIS HAZRATY	14-May-21 DATE	DocuSigned by:  Decor Consultant	14-May-21 DATE
------------	---	-------------------	---	-------------------

APPROVED

-06-14-2021
 Date Approved  Heathwood Homes (Huron) Limited

TAX#:1

PREPARED BY: Irit Salem

PE 820-1

Slinvoice.rpt 28may19

Customer Colours

QAIS HAZRATY/
 Project: Wallaceton
 Unit: 312, Phase: 2
 Model: 33-3344 A The Windsor

Created: 4/12/2021 10:47:46

Locked:

Closed:

3 of 37

Kitchen

Cabinet Colour/Style	6825	Classic Plus-BOSTON-WINTER WHITE-PAINT MDF ***UPG***
Countertop	9069	MSI Quartz GROUP 1 ICED WHITE ***STD***
Countertop Edge	4010	SINGLE POLISHED STRAIGHT EDGE 3/4 INCH ***STD*** 
Cabinet Hardware	9144	12877 BN NICKEL-HARDWARE ***2***
Island Cabinet Colour/Style	6825	Classic Plus-BOSTON-WINTER WHITE-PAINT MDF ***UPG***
Island Countertop		
Backsplash	1111	N/A *****
Backsplash Grout	1111	N/A *****
Backsplash Tile Pattern	1111	N/A *****

HoodFan	1111	AV1308 Air King 30 <i>PAGE 29</i>
---------	------	--

- Purchasers have been advised: standard fridge opening is a minimum 37 3/8 x 73 3/8 inches. Ice Waterline Rough-In is included.
- Standard stove opening is 30 inches and standard dishwasher opening is 24 inches. Any gas stove will require backsplash or stainless steel backing to avoid fire hazards.
- Purchasers acknowledge: Heathwood Homes and its contractors will not be responsible for any kitchen cabinet changes due to appliances dimension changes after sign-off.

Comment

Kitchen / Breakfast

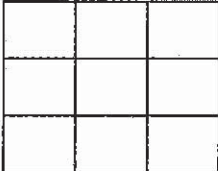
Flooring	1111	TR.SP.WHITE.1313 SEMPRE White Matte 13
Floor Tile Grout	2225	Grout-(27) Silver ***STD***
Floor Tile Pattern	3000	STANDARD SQUARE ***STD*** 

Comment

Servery

Cabinet Colour/Style	6825	Classic Plus-BOSTON-WINTER WHITE-PAINT MDF ***UPG***
Countertop	9069	MSI Quartz GROUP 1 ICED WHITE ***STD***
Countertop Edge	4010	SINGLE POLISHED STRAIGHT EDGE 3/4 INCH ***STD***

91

Customer Colours

304

QAIS HAZRATY/
 Project: Wallaceton
 Unit: 312, Phase: 2
 Model: 33-3344 A The Windsor

Created: 4/12/2021 10:47:46

Locked:

Closed:

4 of 37



Cabinet Hardware	9144	12877 BN NICKEL-HARDWARE ***2***
Backsplash	1111	N/A *****
Backsplash Grout	1111	N/A *****
Backsplash Tile Pattern	1111	N/A *****

Flooring	1111	TR.SP.WHITE.1313 SEMPRE White Matte 13
----------	------	--

Comment

Cabinet

Cabinet Hardware	9144	12877 BN NICKEL-HARDWARE ***2***
------------------	------	----------------------------------

Comment

Foyer

Flooring	8248	OV.CX.WHT.2424.PL-Carrara X-White Polished-24 x 24 ***6***
----------	------	---

Floor Tile Grout	2225	Grout-(27) Silver ***STD***
------------------	------	-----------------------------

Floor Tile Pattern	3000	STANDARD SQUARE ***STD***
--------------------	------	---------------------------



Comment

Laundry Room

Flooring	9106	GE.MD.WHT.1818.MT Madison Series White Matte 18
----------	------	---

Floor Tile Grout	7705	Grout-(01) Alabaster ***UPG***
------------------	------	--------------------------------

Floor Tile Pattern	3000	STANDARD SQUARE ***STD***
--------------------	------	---------------------------

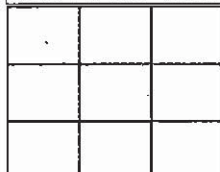

Comment

all

QAIS HAZRATY/
 Project: Wallaceton
 Unit: 312, Phase: 2
 Model: 33-3344 A The Windsor

Created: 4/12/2024 10:47:46

Locked:

Closed:

5 of 37

Laundry Room Opt. Upper Cabinets

Cabinet - Uppers	1111	N/A *****
Cabinet Hardware		
Comment		

Mud Room

Flooring	9106	GE.MD.WHT.1818.MT Madison Series White Matte 18									
Floor Tile Grout	7705	Grout-(01) Alabaster ***UPG***									
Floor Tile Pattern	3000	STANDARD SQUARE ***STD***									
		<table border="1"> <tr><td></td><td></td><td></td></tr> <tr><td></td><td></td><td></td></tr> <tr><td></td><td></td><td></td></tr> </table>									
Comment											

Powder Room

Flooring	8248	OV.CX.WHT.2424.PL-Carrara X-White Polished-24 x 24 ***6***									
Floor Tile Grout	2225	Grout-(27) Silver ***STD***									
Floor Tile Pattern	3000	STANDARD SQUARE ***STD***									
		<table border="1"> <tr><td></td><td></td><td></td></tr> <tr><td></td><td></td><td></td></tr> <tr><td></td><td></td><td></td></tr> </table>									
Plumbing Fixture (Colour)	1737	Plumbing Fixtures-WHITE ***STD***									
Comment											

Dining Room/Hall

Flooring	7498	Red Oak Pearl-Vintage Engineered-IRONGATE-3/4 inch x 3 1/4 inch ***STD***
Comment		

Great Room

Flooring	7498	Red Oak Pearl-Vintage Engineered-IRONGATE-3/4 inch x 3 1/4 inch ***STD***
Comment		

Great Room Fireplace

Type	8869	Majestic MERC32 ***STD***
Mantle	1439	NF 17-Paint Grade Mantle-Flat Wall-WHITE ***STD***

OR

QAIS HAZRATY/
Project: Wallaceon
Unit: 312, Phase: 2
Model: 33-3344 A The Windsor

Created: 4/12/2021 10:47:46

Locked:

Closed:

6 of 37

Surround Opt. N/A *****

- Purchasers have been advised: heat from the FP can damage TV above a FP and items placed on mantle.

- Heathwood and its contractors will not be liable for any damage on items placed/installed above a FP after closing.

Comment

Office

Flooring Red Oak Pearl-Vintage Engineered-IRONGATE-3/4 inch x 3 1/4 inch ***3***

Comment

Main Floor Hall

Flooring Red Oak Pearl-Vintage Engineered-IRONGATE-3/4 inch x 3 1/4 inch ***STD***

Comment

Upper Hall

Flooring DY 89418 -Dynasty Tex-BLACK ICE-40 oz Poly***STD***

Comment

Master Bedroom

Flooring DY 89418 -Dynasty Tex-BLACK ICE-40 oz Poly***STD***

Comment

Bedroom 2

Flooring DY 89418 -Dynasty Tex-BLACK ICE-40 oz Poly***STD***

Comment

Bedroom 3

Flooring DY 89418 -Dynasty Tex-BLACK ICE-40 oz Poly***STD***

Comment

CA

QAIS HAZRATY/
 Project: Wallaceton
 Unit: 312, Phase: 2
 Model: 33-3344 A The Windsor

Created: 4/12/2021 10:47:46

Locked:

Closed:

7 OF 37

Bedroom 4

Flooring	9248	DY 89418 -Dynasty Tex-BLACK ICE-40 oz Poly***STD***
Comment		

Opt. Bedroom 5

Flooring	1111	N/A *****
Comment		

Media Room

Flooring	9248	DY 89418 -Dynasty Tex-BLACK ICE-40 oz Poly***STD***
Comment		

Master Ensuite

Cabinet Colour/Style	9120	VIKING III-GEORGIAN-ORCHID 3DL***STD***
Countertop	9069	MSI Quartz GROUP 1 ICED WHITE ***STD***
Countertop Edge	4010	GROUP 1 - SINGLE POLISHED STRAIGHT EDGE 3/4 INCH ***1***
Cabinet Hardware	7667	12881-HARDWARE ***STD***
Floor Tile	8244	OV.CX.WHT.1224.PL-Carrara X-White Polished-12 x 24 See Tile Direction on Sketch 4 Page 22 ***5***
Floor Tile Grout	2225	Grout-(27) Silver ***STD***
Floor Tile Pattern	3050	SIDE TO SIDE ***STD***
Shower Floor Tile	8661	OD.ON.SWT.0202.MT.N-Ontario Series Mosaic-Snow White Matte-2 x 2 ***STD***
Shower Floor Tile Grout	2226	Grout-(00) White ***STD***
Shower Floor Tile Pattern	3000	STANDARD SQUARE ***STD***
Shower Wall Tile	9020	QT.WV.WHT.0810-Weave-White-8 x 10 ***STD***
Shower Wall Tile Grout	2226	Grout-(00) White ***STD***
Shower Wall Tile Pattern	3070	HORIZONTAL STACKED ***STD***

911

QAIS HAZRATY/
 Project: Wallaceton
 Unit: 312, Phase: 2
 Model: 33-3344 A The Windsor

Created: 4/12/2021 10:47:46

Locked:

Closed:

8 of 37

Shower Jamb(s) and Sill(s)	8923	Shower Jamb / Sill-Thassos White ***STD***
Plumbing Fixture (colour)	1737	Plumbing Fixtures-WHITE ***STD***
Comment		

Ensuite 2

Cabinet Colour/Style	9163	Viking II-GEORGIAN-RAIN CLOUD-3DL ***STD***
Countertop	8796	6698-46-Countertop-PALOMA POLAR ETCHINGS FINISH-Formica ***STD***
Countertop Edge	1111	N/A *****

Cabinet Hardware	7667	12881-HARDWARE ***STD***
Floor Tile	8244	OV.CX.WHT.1224.PL-Carrara X-White Polished-12 x 24 See Tile Direction on Sketch 4 Page 22 ***5***
Floor Tile Grout	2225	Grout-(27) Silver ***STD***
Floor Tile Pattern	3040	FRONT TO BACK ***STD***

S4P22

Plumbing Fixture (colour)	1737	Plumbing Fixtures-WHITE ***STD***
Shower Floor Tile	8661	OD.ON.SWT.0202.MT.N-Ontario Series Mosaic-Snow White Matte-2 x 2 ***STD***
Shower Floor Tile Grout	2226	Grout-(00) White ***STD***
Shower Floor Tile Pattern	3000	STANDARD SQUARE ***STD***

Shower Wall Tile	9020	QT.WV.WHT.0810-Weave-White-8 x 10 ***STD***
Shower Wall Tile Grout	2226	Grout-(00) White ***STD***
Shower Wall Tile Pattern	3070	HORIZONTAL STACKED ***STD***

Shower Jamb(s) and Sill(s)	8923	Shower Jamb / Sill-Thassos White ***STD***
Comment		

Opt. Shared Ensuite

Cabinet Colour/Style	9120	VIKING III-GEORGIAN-ORCHID 3DL ***STD***
----------------------	------	--

QAIS HAZRATY/
 Project: Wallaceton
 Unit: 312, Phase: 2
 Model: 33-3344 A The Windsor

Created: 4/12/2021 10:47:46

Locked:

Closed:

9 of 37

Countertop	8796	6698-46-Countertop-PALOMA POLAR ETCHINGS FINISH-Formica ***STD***								
Countertop Edge	1111	N/A *****								
Cabinet Hardware	7667	12881-HARDWARE ***STD***								
Floor Tile	8244	OV.CX.WHT.1224.PL-Carrara X-White Polished-12 x 24 See Tile Direction on Sketch 4 Page 22 ***5***								
Floor Tile Grout	2225	Grout-(27) Silver ***STD***								
Floor Tile Pattern	3040	FRONT TO BACK ***STD*** <table border="1" style="width: 100px; height: 60px; margin: 5px;"> <tr><td></td><td></td><td></td><td></td></tr> <tr><td></td><td></td><td></td><td></td></tr> </table>								
Wall Tile	9020	QT.WV.WHT.0810-Weave-White-8 x 10 ***STD***								
Wall Tile Grout	2226	Grout-(00) White ***STD***								
Wall Tile Pattern	3070	HORIZONTAL STACKED ***STD*** <table border="1" style="width: 100px; height: 60px; margin: 5px;"> <tr><td></td><td></td></tr> <tr><td></td><td></td></tr> <tr><td></td><td></td></tr> <tr><td></td><td></td></tr> </table>								
Plumbing Fixture (colour)	1737	Plumbing Fixtures-WHITE ***STD***								
Comment										

Finished Basement Foyer

Flooring	9248	DY 89418 -Dynasty Tex-BLACK ICE-40 oz Poly***STD***
Comment		

Opt. Finished Basement (Rec) Room/Hall

Flooring	1111	N/A *****
Comment		

Opt. Finished Basement Bathroom

Cabinet Colour/Style	1111	N/A *****
Countertop	1111	N/A *****
Countertop Edge	1111	N/A *****
Cabinet Hardware	1111	N/A *****
Flooring	1111	N/A *****

QA

Customer Colours

304

QAIS HAZRATY/
 Project: Wallaceton
 Unit: 312, Phase: 2
 Model: 33-3344 A The Windsor

Created: 4/12/2021 10:47:46

Locked:

Closed:

10 of 37

Floor Tile Grout	1111	N/A *****
Floor Tile Pattern	1111	N/A *****

Shower Floor Tile	1111	N/A *****
Shower Floor Tile Grout	1111	N/A *****
Shower Floor Tile Pattern		

Shower Wall Tile	1111	N/A *****
Shower Wall Tile Grout	1111	N/A *****
Shower Wall Tile Pattern	1111	N/A *****

Shower Jamb(s)	1111	N/A *****
Plumbing Fixture (Colour)	1111	N/A *****
Comment		

Main Stairs

Type	1712	Oak Stairs ***STD MAIN STAIRS***
Colour	7912	Irongate (Gryphon) STAIN TO COMPLIMENT HARDWOOD AND WILL VARY FROM FLOORING
Carpet Runner	1111	N/A *****
Handrail/Pickets/Post Type	8148	Single Collar Alt. Plain w/ Shoes with 3 1/2" Square/Cap Post(s)-BLACK ***2***
Handrail/Pickets/Posts Colour	7912	Irongate (Gryphon) STAIN TO COMPLIMENT HARDWOOD AND WILL VARY FROM FLOORING
Custom Stain/Paint	1111	N/A *****
Comment		

Main Stairs Landing(s)

Flooring	7498	Red Oak Pearl-Vintage Engineered-IRONGATE-3/4 inch x 3 1/4 inch ***STD***
Comment		

OK

QAIS HAZRATY/
 Project: Wallaceton
 Unit: 312, Phase: 2
 Model: 33-3344 A The Windsor

Created: 4/12/2021 10:47:46

Locked:

Closed:

11 of 37

Basement Stairs

Type	1712	Oak Stairs ***1 BASEMENT STAIRS***
Colour	7912	Irongate (Gryphon) STAIN TO COMPLIMENT HARDWOOD AND WILL VARY FROM FLOORING
Carpet Runner	1111	N/A *****
Handrail/Pickets/Post Type	8148	Single Collar Alt. Plain w/ Shoes with 3 1/2" Square/Cap Post(s)-BLACK ***2***
Handrail/Pickets/Post Colours	7912	Irongate (Gryphon) STAIN TO COMPLIMENT HARDWOOD AND WILL VARY FROM FLOORING
Carpet	1111	N/A *****
Custom Stain/Paint	1111	N/A *****
Comment		

Handrail/Pickets/Post Colour

Basement Stairs Landing(s)

Flooring	7498	Red Oak Pearl-Vintage Engineered-IRONGATE-3/4 inch x 3 1/4 inch ***STD***
Comment		

Throughout

Underpad	1079	500 Series-Underpad ***STD***
Thresholds	2232	Metal Thresholds ***STD***
Switches and Plug	5796	Decora White Switches and Plugs ***STD***
Trim Size	8705	4 1/4 Baseboard and 2 3/4 Casings ***STD***
Trim - Paint Colour	1716	Trim-WHITE ***STD***
Comment		

Walls - Paint Colour

Walls - Paint Colour	1717	22-Wall-WARM GREY ***STD***
Comment		

Purchaser: See next page
 QAIS HAZRATY *for signature*

JUNE 1/21
 Date

[Signature]
 Decor Consultant

Date

QA

QAIS HAZRATY/
Project: Wallaceton
Unit: 312, Phase: 2
Model: 33-3344 A The Windsor

Created: 4/12/2021 10:47:46

Locked:

Closed:

12 of 37

Purchaser:



Date

Wallaceton

M. Roer

APPROVED

05-14-2021

AK



Sales Selection Sheet

Wallaceton

13 of 37

PURCHASER: QAIS HAZRATY

TEL:

LOT / UNIT 312	PHASE 2	MODEL 33-3344 A The Windsor	
-------------------	------------	--------------------------------	--

It is herein understood and agreed between the undersigned parties hereto that the following changes shall be made to the above mentioned Agreement of Purchase and Sale in accordance with the agreement and except for such changes noted below, all other terms and conditions in the Agreement of Purchase and Sale shall remain as stated herein: It is further understood that and agreed that all changes and additions shall be installed as per builder's specifications, location and available selections. The Purchaser hereby agrees to purchase the following extras:

ADMIN FEE

1	- PROMO- SCHEDULE E	Qty: (1)
60,371	Note:	

APPLIANCES

2	- SEE SPECS FOR BUILT-IN 36" GAS COOKTOP AND DOUBLE WALL OVENS PAGES 30-37	Qty: 1
60,372	Note:	

CABINETRY Additional item on R-SSS page 40

3 204,893 60,339	KITCHEN - CABINETRY - CLASSIC PLUS - KITCHEN - UPG Note:	Qty: 1
4 204,944 60,340	KITCHEN - CABINETRY - CLASSIC PLUS - OPT. SERVERY UPPERS - UPG Note: SKETCH # 3 PAGE 21	Qty: 1
5 189,306 60,341	KITCHEN - CABINETRY - CLASSIC PLUS KITCHEN BUILT IN - KITCHEN - UPGRADE 4 Note: KITCHEN BUILT IN 2 WALL OVENS SEE SKETCH # 3 PAGE 21 SPECS PAGES 30-37	Qty: 1
6 189,234 60,343	- CABINETRY - 02J-DUMMY DOOR FOR BASE FINISHED ENDS (EACH) - UPGRADE 2 Note: TO BE INSTALLED ON EACH END SIDE OF THE ISLAND SKETCH # 3 PAGE 21	Qty: 4
7 189,236 60,344	KITCHEN - CABINETRY - 19B-45CM WIDE PULL-OUT DOOR BASE CABINET WASTE/RECYCLE CENTRE WITH SOFT-CLOSE ([2] 35L BINS) (AVAILABLE ONLY WITH 45CM WIDE CABINET) ; PRICE ALL THE SAME FOR ALL LINES - KITCHEN Note: WITH A TOP DRAWER TO BE INSTALLED BESIDE THE SINK SEE SKETCH # 3 PAGE 21	Qty: 1
8 189,315 60,348	SERVERY ONLY - CABINETRY - 09J-CROWN MOULDING (PER 8' LENGTH PRICE) (FOR CLARIFICATION OF STYLES, SEE MOULDING MATRIX) ; PRICE ALL THE SAME FOR ALL LINES - KITCHEN Note:	Qty: 1
9 189,006 60,350	KITCHEN - CABINETRY - 12B-POTS AND PANS DRAWERS (WIDTH MIN. 60CM/MAX. 90CM) (SIZE SUBJECT TO FLOOR PLAN) - UPGRADE 2 Note: POTS AND PANS DRAWERS SEE SKETCH # 3 PAGE 21	Qty: 7

Initials: MR

TAX#:1

PREPARED BY: Irit Salem

PE 806-1

SlInvoice.rpt 28may19



Sales Selection Sheet

Wallaceton

14 of 37
TEL:

PURCHASER: QAIS HAZRATY

LOT / UNIT	PHASE	MODEL
312	2	33-3344 A The Windsor

CABINERY

10 189,091 60,353	KITCHEN - CABINERY - 09C-INTERIOR PULL-OUT DRAWER FOR SINGLE-DOOR PANTRY (EACH) (59CM OR 66CM DEEP, MAX. [4] Note: TO BE INSTALLED IN THE PANTRY SEE SKETCH # 3 PAGE 21	Qty: 3
*11 189,133 60,481	MASTER ENSUITE - CABINERY - 13D-VANITY TOWEL DRAWERS ([2] DRAWERS) (WIDTH MIN. 60CM/MAX. 90CM) (SIZE SUBJECT TO FLOOR PLAN) - UPGRADE Note: MASTER BATHROOM IN LIEU OF MAKE UP DRAWER (2 DEEP DRAWERS) SKETCH #'S 4 AND 5 PAGES 22 AND 23	Qty: 1
*12 189,031 60,485	KITCHEN - CABINERY - 23B-BASE ISLAND WITH PANEL PER FOOT (27" DEEP)- UPGRADE 2 Note: EXTEND THE ISLAND 2' 8" (WITH ADDED BACK PANEL) SKETCH # 3 PAGE 21	Qty: 3
13 188,998 60,487	KITCHEN - CABINERY - 10B-UPGRADE LEVELS 1-4, 5-7 DRAWERS FROM METABOX TO TANDEMBOX PER DRAWER. BD X 4, BPP X Note: SOFT CLOSE DRAWERS (7x3 pot and pan drawers, 2 under cooktop, 1 under built in wall oven, 1 in the top waste drawe.	Qty: 25
14 204,964 60,489	KITCHEN - CABINERY - OPT CROWN STD HEIGHT - KITCHEN - UPG Note:	Qty: 1
15 60,581	KITCHEN - CABINERY - 03C-PANTRY 66CM DEEP PER FOOT (COUNTER DEPTH) - UPGRADE 2 Note: TO BE INSTALLED AT THE END OF THE KITCHEN BESIDE THE FRIDGE LOWER AND MIDDLE DOOR OF PANTRY TO OPERATE AS ONE, UPPER DOOR TO BE OPEN SEPARATELY SEE SKETCH # 3 PAGE 21	Qty: 2
16 189,300 60,596	- CABINERY - 03G-CABINET HARDWARE UPGRADE II DISPLAY BOARD; PER KITCHEN ; PRICE ALL THE SAME FOR ALL Note:	Qty: 1
17 189,288 60,597	- CABINERY - 03D-INCREASE VANITY TO KITCHEN HEIGHT 3' OR LESS (90CM HIGH, MAINTAINS VANITY DEPTH) ; PRICE ALL THE SAME FOR ALL LINES - KITCHEN Note: MAIN BATHROOM SHARED BATHROOM	Qty: 2
*18 189,288 60,681	MASTER ENSUITE - CABINERY - 03D-INCREASE VANITY TO KITCHEN HEIGHT 3' OR MORE (90CM HIGH, MAINTAINS VANITY DEPTH) ; PRICE ALL THE SAME FOR ALL LINES - Note:	Qty: 2
*19 188,977 60,930	KITCHEN - CABINERY - 01B-BASE CABINET PER FOOT - UPGRADE 2 Note: TO BE INSTALL IN LIEU OF FRIDGE LOCATION SEE SKETCH # 3 PAGE 21	Qty: 3

CABINERY / ELECTRICAL



Sales Selection Sheet

Wallaceton

15 of 37

TEL:

PURCHASER: QAIS HAZRATY

LOT / UNIT 312	PHASE 2	MODEL 33-3344 A The Windsor	
-------------------	------------	--------------------------------	--

CABINETY / ELECTRICAL

20 60,373	KITCHEN - RELOCATE MOVE THE ISLAND 1' TOWARDS THE GREAT ROOM AND 1' TOWARDS THE BREAKFAST ROOM TO BE 4' +/- BETWEEN THE ISLAND AND COOKTOP WALL AND 4' +/- BETWEEN ISLAND AND BUILT IN WALL OVEN- DELETE STANDARD BANK OF DRAWER- SEE POT AND PAN DRAWER UPGRADES Note: RELOCATE FRIDGE TO THE END OF CABINETS BESIDE PANTRY ,RELOCATE 2 STD UPPERS (BESIDE STD. HOODFAN) TO THE STD. FRIDGE LOCATION, KEEP STD. 30" UPPER CABINET ABOVE COOKTOP FASTENED TO BACK WALL ONLY LEAVE 60" OPENING ABOVE COOKTOP FOR FUTURE HOODFAN TO BE DONE AFTER CLOSING SEE SKETCH # 3 PAGE 21	Qty: 1
21 60,598	MASTER ENSUITE - DUPLICATE CHARGE - SEE REVISED SSS PAGES 38 AND 39 FOR CREDIT ON CLOSING Note: CABINETY - 03D-INCREASE VANITY TO KITCHEN HEIGHT 3' OR LESS (90CM HIGH, MAINTAINS VANITY DEPTH) ; PRICE ALL THE SAME FOR ALL LINES - KITCHEN	Qty: 2

CERAMICS

22 204,764 60,682	ENSUITE 2 - CERAMICS - FLOOR - ENSUITE 2 - UPGRADE 5 Note:	Qty: 1
23 204,772 60,683	MASTER BEDROOM - CERAMICS - FLOOR - ENSUITE MASTER - UPGRADE 5 Note:	Qty: 1
24 204,717 60,684	FOYER - CERAMICS - FLOOR - FOYER - UPGRADE 6 Note:	Qty: 1
25 204,728 60,685	MUD ROOM - CERAMICS - FLOOR - GARAGE ENTRY / MUD ROOM - UPGRADE 1 Note:	Qty: 1
26 204,725 60,686	POWDER ROOM - CERAMICS - FLOOR - POWDER ROOM - UPGRADE 6 Note:	Qty: 1
27 204,756 60,687	SHARED BATHROOM - CERAMICS - FLOOR - SHARED ENSUITE - UPGRADE 5 Note:	Qty: 1
28 204,811 60,688	LAUNDRY ROOM - CERAMICS - FLOOR GROUT - LAUNDRY ROOM - GROUT Note:	Qty: 1
29 204,809 60,689	MUD ROOM - CERAMICS - FLOOR GROUT - GARAGE ENTRY / MUD ROOM - GROUT Note:	Qty: 1

Initials: MX

TAX#:1

PREPARED BY: Irit Salem

PE 806-3

Slinvoice.rpt 28may19



Sales Selection Sheet
Wallaceton

16 of 37
TEL:

PURCHASER: QAIS HAZRATY

LOT / UNIT 312	PHASE 2	MODEL 33-3344 A The Windsor
-------------------	------------	--------------------------------

CERAMICS

30 204,744 60,690	LAUNDRY ROOM - CERAMICS - FLOOR - LAUNDRY ROOM - UPGRADE 1 Note:	Qty: 1
-------------------------	--	--------

DRYWALL

31 205,412 60,600	- DRYWALL - DRYWALL - SMOOTH CEILING IN MAIN FLOOR - MAINFLOOR - UPG Note:	Qty: 1
-------------------------	--	--------

ELECTRICAL **Additional item on R-SSS page 40**

32 189,450 60,334	- ELECTRICAL - CEILING ROUGH-IN (CAPPED) Note: 2X GREAT ROOM - 1- USE STD SWITCH PLUG. 1 USE SEPARATE SWITCH 1X KITCHEN - 1 USE SAME SWITCH AS STD. KITCHEN LIGHT 1X IN THE KITCHEN ABOVE THE BREAKFAST BAR USE SEPARATE SWITCH 2X MAIN STAIRS LANDING - USE SEPARATE 3 WAY SWITCH 1X POWDER ROOM - USE SEPARATE SWITCH 1X UPPER BASEMENT STAIRS - USE EXISTING SWITCH SEE SKETCH # 2 PAGE 20	Qty: 8
33 189,451 60,335	- ELECTRICAL - ADDITIONAL SWITCH Note: POWDER ROOM, GREAT ROOM AND KITCHEN SKETCH # 2 PAGE 20	Qty: 3
34 189,422 60,336	- ELECTRICAL - EXTERIOR FIXTURE COMPLETE; SIDE/REAR COACH LIGHT Note: USE SWITCH TOGETHER WITH EXISTING EXTERIOR LIGHT SKETCH # 2 PAGE 20	Qty: 3
35 189,449 60,337	GREAT ROOM - ELECTRICAL - EXTRA WALL INTERIOR OUTLET ON EXISTING CIRCUIT (DOES NOT INCLUDE KITCHEN OUTLETS) Note: TO BE INSTALLED ABOVE THE FIRE PLACE 70" FROM FLOOR SKETCH # 2 PAGE 20	Qty: 1
36 189,417 60,382	KITCHEN - ELECTRICAL - RELOCATION OF SWITCHES/LIGHTS (MUST SPECIFY LOCATION) - NOTE: PLUGS CANNOT BE RELOCATED- MUST PURCHASE ADDITIONAL OUTLET. Note: RELOCATE STD. STOVE ELECTRICAL TO THE NEW WALL OVEN LOCATION (SEE ELECTRICAL FOR DOUBLE OVEN) SKETCH # 3 PAGE 21	Qty: 1
37 189,440 60,383	KITCHEN - ELECTRICAL - EXTRA WALL INTERIOR OUTLET (120V/15A) ON A SEPARATE CIRCUIT (ON ARCFULT) Note: EXTRA ELECTRICAL OUTLET-TO BE INSTALLED ON THE ISLAND SEE SKETCH # 2 PAGE 20	Qty: 1
*38 189,451 60,384	- ELECTRICAL - ADDITIONAL SWITCH DUPLICATE CHARGE SEE REVISED SSS PAGES 38 AND 39 FOR CREDIT ON CLOSING Note: GREAT ROOM POWDER ROOM AND KITCHEN	Qty: 3

GRANITE

Initials: K

TAX#:1

PREPARED BY: Irit Salem

PE 806-4



Sales Selection Sheet

Wallaceton

17 of 37

PURCHASER: QAIS HAZRATY

TEL:

LOT / UNIT 312	PHASE 2	MODEL 33-3344 A The Windsor	
-------------------	------------	--------------------------------	--

GRANITE

*39 189,461 60,367	KITCHEN - GRANITE - ADDITIONAL COUNTERTOP PER SQ.FT. -STD Note: TO BE USED FOR THE EXTENTION OF THE ISLAND (2'.8") STD.GRANITE WILL HAVE A SEAM SKETCH # 3 PAGE 21	Qty: 6
*40 189,461 60,388	KITCHEN - GRANITE - ADDITIONAL COUNTERTOP PER SQ.FT. - STD Note: TO BE USED IN LIEU OF FRIDGE LOCATION STD.GRANITE WILL HAVE A SEAM SKETCH # 3 PAGE 20	Qty: 8
41 189,464 60,586	- GRANITE - GRANITE CUTOUT W/ STRAIGHT EDGE POLISH TO ACCOMMODATE COOK TOP Note: SKETCH # 3 PAGE 21 36" COOKTOP SPECS PAGES 30-34	Qty: 1

HEATING / AIR

*42 189,474 60,375	KITCHEN - HEATING/AIR - ROUGH-IN GAS LINE FOR GAS STOVE AT MAIN FLOOR (SEE SPECS) (HOOK-UP NOT INCLUDED) LEAVE STANDARD 120 VOLT ELECTRICAL OUTLET ON A SEPARATE CIRCUIT. * STANDARD 220V WILL BE RELOCATED TO BUILT-IN WALL OVENS Note: SKETCH # 3 PAGE 21 SPECS PAGES 30-34	Qty: 1
43 189,471 60,601	- HEATING/AIR - HUMIDIFIER LENNOX HCWB3-17 FROM 2,001 TO 4,000 SQ.FT. (INCLUDING BASEMENT) Note:	Qty: 1

INTERIOR RAILINGS

*44 204,887 60,385	- INTERIOR RAILINGS - BLACK METAL - SINGLE COLLAR ALT. PLAIN W/ SHOES WITH 3 1/2" SQUARE/CAP POST(S) AS PER PLAN - UPG Note:	Qty: 1
--------------------------	---	--------

INTERIOR TRIM AND DOORS

*45 189,477 60,381	- INTERIOR TRIM - UPG. 6-8' STANDARD DOOR TO 8' DOOR INCLUDING HARDWARE Note: POWDER, ROOM, FOYER, OFFICE AND MUDROOM SEE SKETCH # PAGE#	Qty: 4
--------------------------	---	--------

MIRRORS/GLASS PRODUCTS

46 204,888 60,376	ENSUITE 2 - MIRRORS/GLASS PRODUCTS - UPGRADE TO FRAMELESS CLEAR GLASS WITH D-RING HANDLE IN CHROME - ENSUITE 2 - UPG Note:	Qty: 1
47 204,889 60,377	MASTER ENSUITE - MIRRORS/GLASS PRODUCTS - UPGRADE TO FRAMELESS CLEAR GLASS WITH D-RING HANDLE IN CHROME - ENSUITE MASTER - UPG Note:	Qty: 1

MODIFICATIONS

Initials: PK

TAX#:1

PREPARED BY: Irit Salem

PE 806-5

S\invoice.rpt 28may19

 HEATHWOOD	Sales Selection Sheet Wallaceston	18 OF 37
PURCHASER: QAIS HAZRATY		TEL:

LOT / UNIT 312	PHASE 2	MODEL 33-3344 A The Windsor
-------------------	------------	--------------------------------

MODIFICATIONS

48	GREAT ROOM -	Qty: 1
60,374	Note: DRY WALL BOX ABOVE FIRE PLACE SEE SKECT <u>2</u> PAGE# <u>20</u>	

STRUCTURED WIRING

49	GREAT ROOM - STRUCTURED WIRING - CONDUIT PIPE TO ABOVE FIREPLACE ROUGH-IN	Qty: 1
189,787		
60,386	Note: TO BE INSTALLED IABOVE THEH FIRE PLACE 70" FROM FLOOR SEE SKETCH # <u>2</u> PAGE# <u>20</u>	

Sub Total
HST
Total

1. This Sales Selection Sheet when properly executed forms part of our Agreement of Purchase and Sale.
2. All extras and upgrades listed above are subject to Construction Progress and Architectural and Municipal requirements.
3. In the event the Vendor is unable to incorporate the work approved above in the construction of the house for any reason whatsoever, the Vendor will not be llable to the Purchaser in any way. The monies paid for any changes or optional extras not proceeded with shall be returned to the Purchaser, without interest. The cost of options or extras is non-refundable in all other circumstances. If for any reason whatsoever the Agreement of Purchase and Sale is not completed, the total cost of work approved above will be retained by the Vendor.
4. The Vendor reserves the right to substitute above materials and equipment with that of equal or better quality.
5. Purchaser acknowledges that items may not be exactly as shown. Variations from the Vendor's samples may occur in finished materials due to normal production processes. Vendor is not responsible for shade difference which may occur from different dye lots or wood grains. Variations from the Vendor's samples will occur with natural materials such as wood, marble, granite, hardwood and brick.
6. The Vendor reserves the right to select Grout & Thresholds that best suits the Tile selected.
7. Selections will not be processed unless signed by Heathwood Homes Head Office.
8. The selections made on this schedule are final and cannot be changed once submitted.
9. The Purchaser has checked and acknowledges the accuracy of this schedule.

Payment Summary	
<u>Paid By</u>	<u>Amount</u>
<u>Total Payment:</u>	

PURCHASER: Qais Hazraty 25-May-21 DATE Decor Consultant 25-May-21 DATE

QAIS HAZRATY 0A5FDCE4AC... CCF9682580AB40B...

APPROVED

m Rosen

Date Approved Heathwood Homes (Huron) Limited

TAX#: 1

PREPARED BY: Irit Salem

PE 806-6

SInvoice.rpt 28may19

UK-75 WALLACE TON
LOT 312
33-3344 W.O.B ELEV. B
THE WINDSOR

19 of 37

Sketch #1

33-3344 ELEV. A WOB

THE WINDSOR

ELEVATION A | 3,607 SQ. FT.
Including 263 sq. ft. of finished Lower Level
701 sq. ft. of opt. finished Lower Level
WALLACETON
EST. 1870

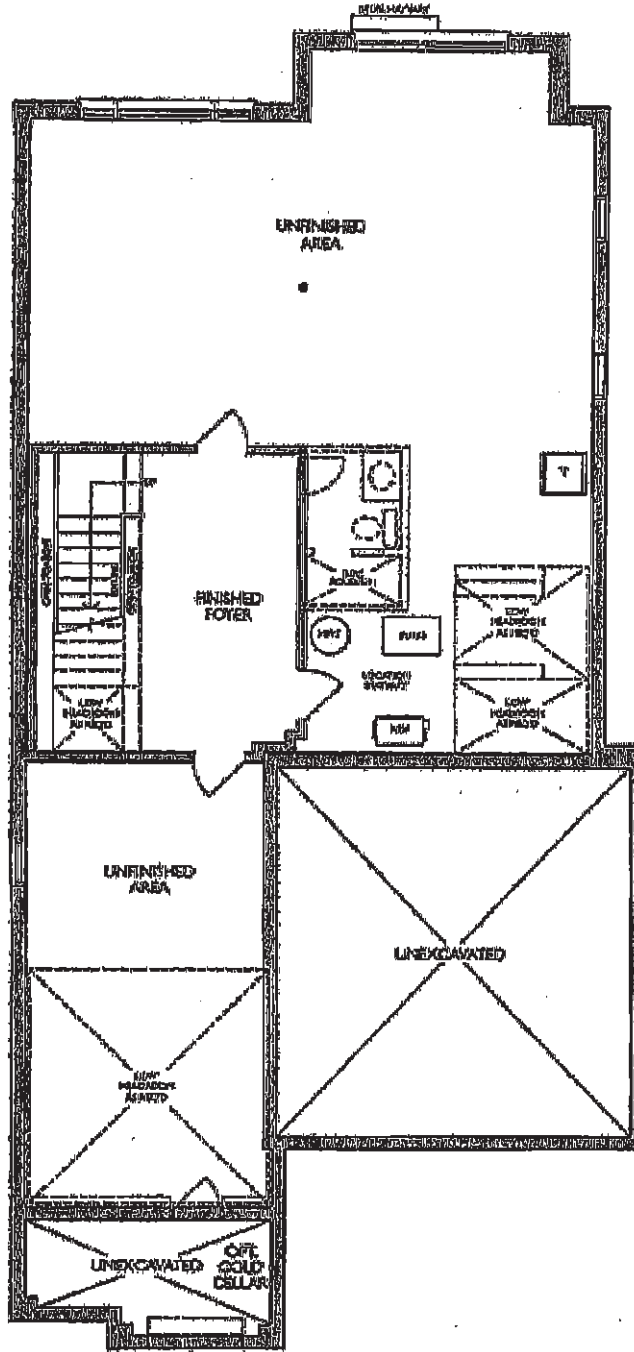

LOWER LEVEL
ELEVATION A

Legal Plan Nov 28, 2020

DS
QH

UK-75 WALLACETON
LOT 312
33-3344 W.O.B ELEV. B
THE WINDSOR

20 of 37

Sketch #2

THE WINDSOR

33-3344 ELEV. A WOB

ELEVATION A | 3,607 SQ. FT.
Including 263 sq. ft. of finished Lower Level
701 sq. ft. of opt. finished Lower Level
WALLACETON
EST. 1870

Lot 312

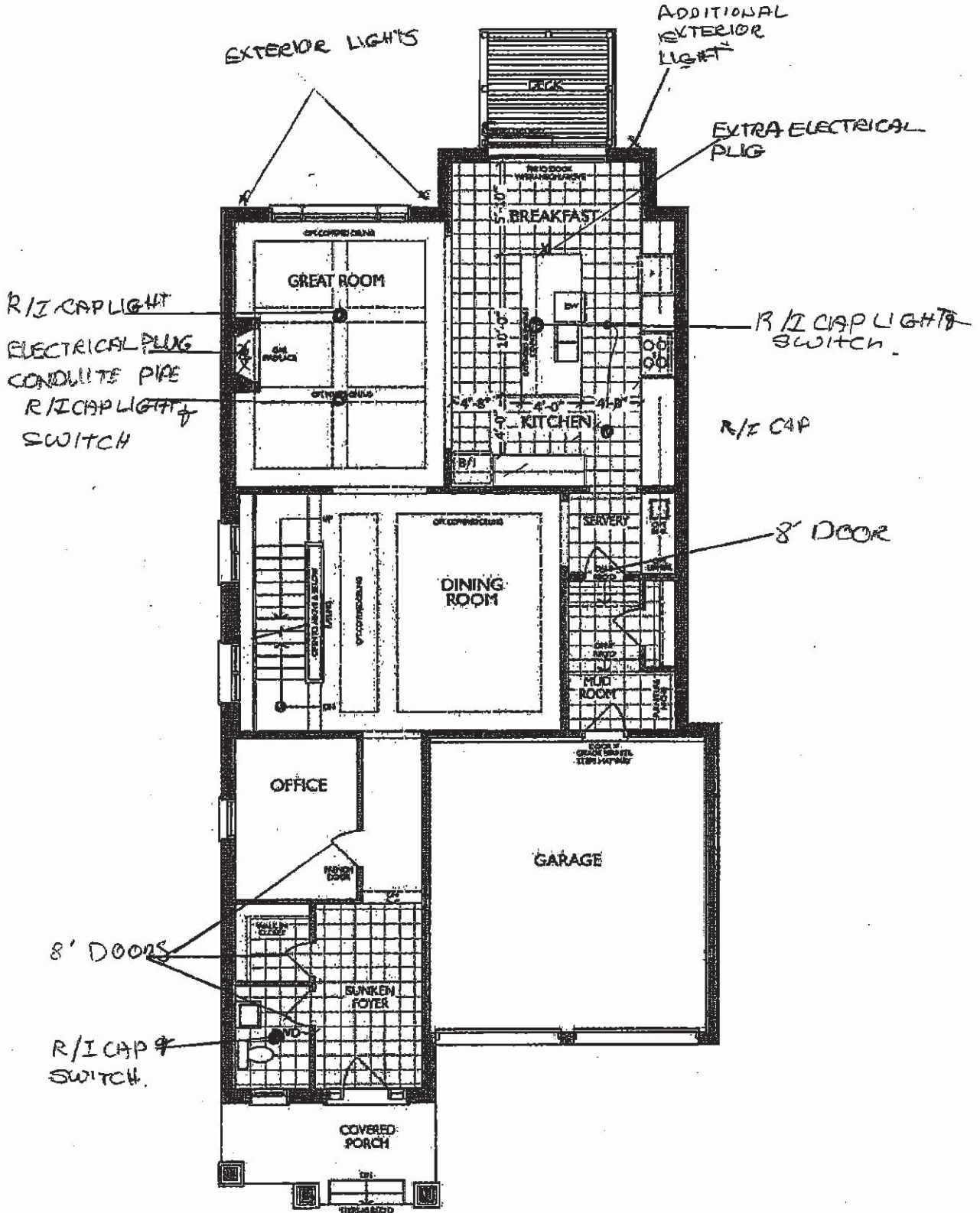

MAIN FLOOR
ELEVATION A

DS
QH

UK-75 WALLACETON
 LOT 312
 33-3344 W.O.B ELEV. A
 THE WINDSOR

21 of 37

Sketch #3



FRENDEL
KITCHENS LIMITED
Established 1954

HEATHWOOD HOMES
WALLACETON KITCHEN ON
MODEL 33-3344 (1003)

STANDARD CONTRACT INCLUDES:

Appliance Openings

- Floor: 30" W Builder Model
- Fridge Opening: 37 3/8" W X 73 3/8" H
- Fridge cabinet & tables: 66cm Deep
- Cooktop: 30" W - Tall Wall Oven: 30" W
- Dishwasher Opening: 24"

Standard Kitchen's Scope:

- 106cm H wall cabinets
- 3rd. Blumotion hinges - soft close doors
- 3rd. Metabox Drawers - not soft close
- 100cm W drawer
- Base pull out corner cabinets
- Backing on all cabinets
- Countertop by others
- Upstage applied paneled sides & dishwashers supply only (appliance hardware by others)

THIS DRAWING IS FOR INFORMATION ONLY. IT IS NOT AN EXACT REPRODUCTION.

LOT SPECIFIC LAYOUT: LOT 312

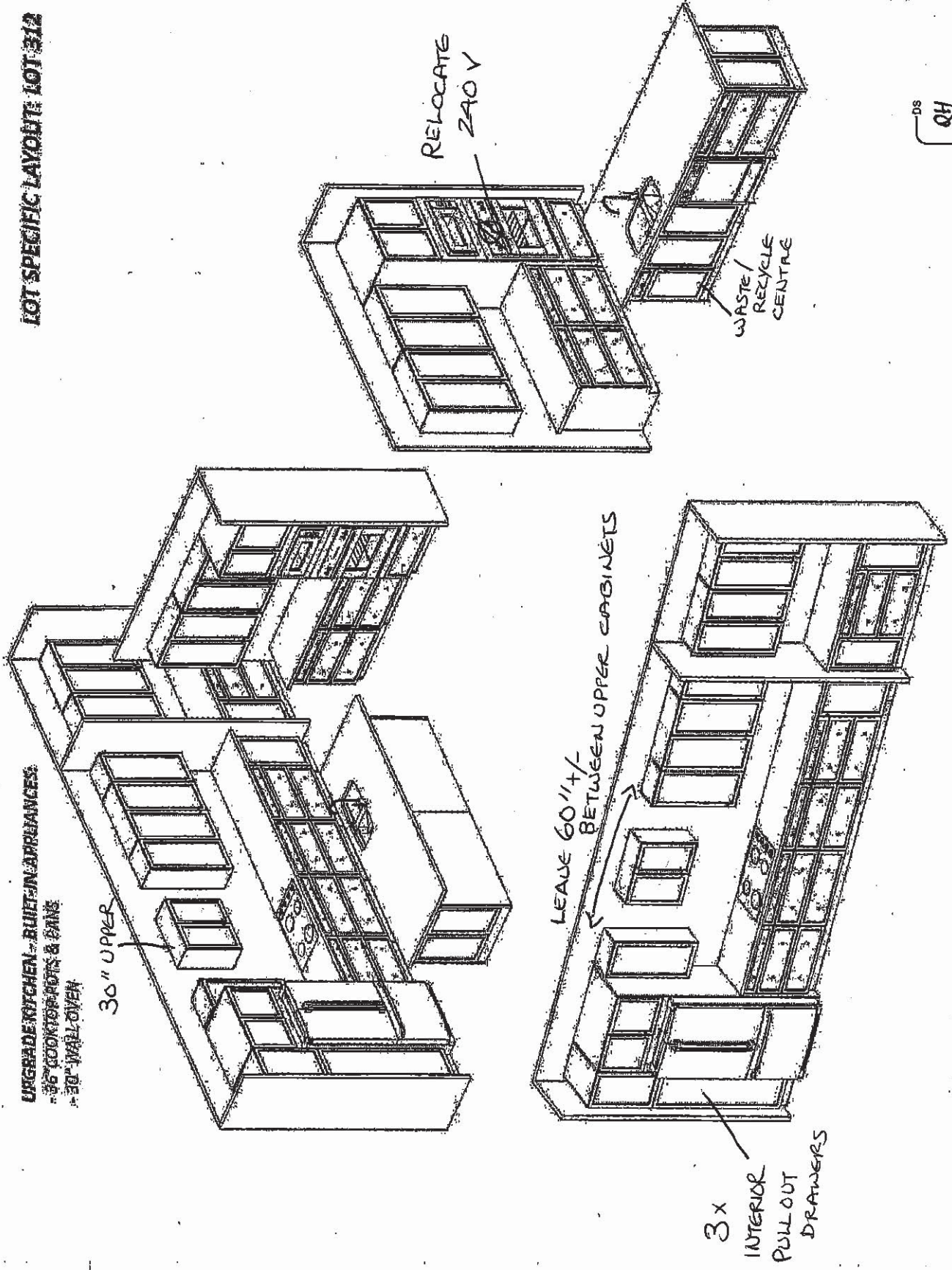

DS
QH

UPGRADE KITCHEN - BLUE/NEUTRAL FINISHES

- 36" COOKTOP SLOTS & PANES
- 30" WALL OVEN

30" Upper

LEAVE 60 1/4" BETWEEN UPPER CABINETS

3x INTERIOR PULL OUT DRAWERS

UK-75 WALLACETON
LOT 312
33-3344 W.O.B ELEV. B
THE WINDSOR

22 of 37

Sketch # 4

THE WINDSOR

33-3344 ELEV. A WOB

ELEVATION A | 3,607 SQ. FT.
Including 263 sq. ft. of finished Lower Level
701 sq. ft. of opt. finished Lower Level
WALLACETON
B.S.T. 1870

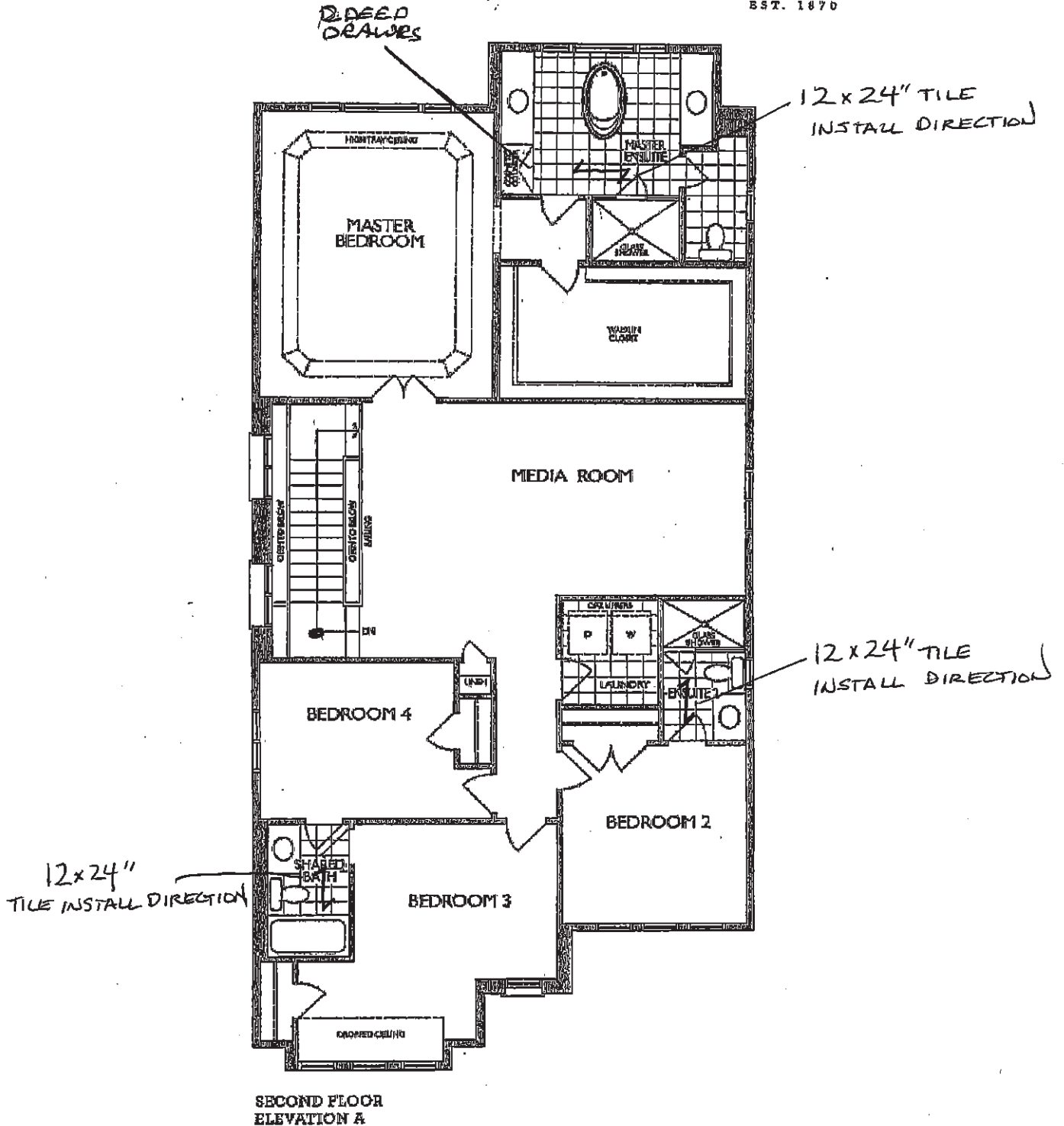

SECOND FLOOR
ELEVATION A

Legal Plan Nov 28, 2020

DS
QH

UK-75 WALLACETON
LOT 312
33-3344 W.O.B ELEV. B
THE WINDSOR

23 of 37

Sketch # 5
MASTER BATHROOM

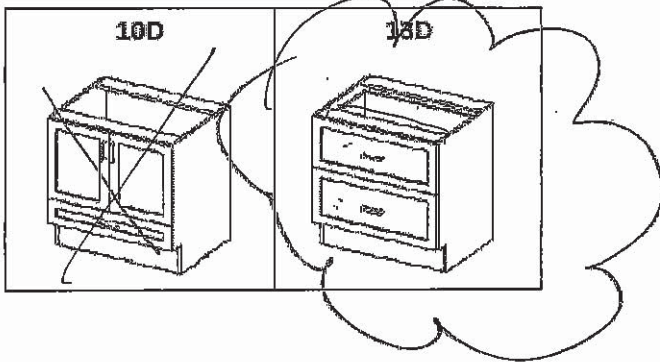

[Bei Liu]

UK-75 WALLACETON
LOT 312
33-3344 W.O.B ELEV. A
THE WINDSOR

24 of 37

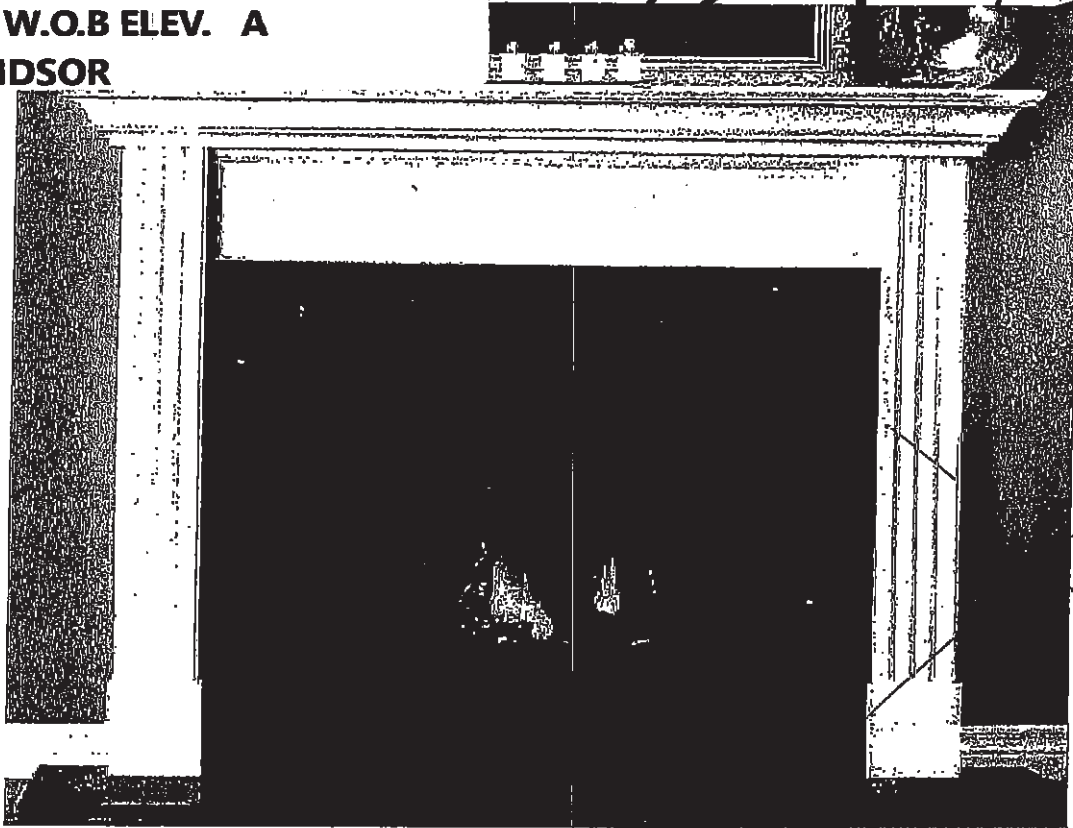

STANDARD NF 15 Mantel

Clean apron finish with fluted legs

WHITE PAINT GRADE FINISH

(PICTURE SHOWN WITH UPGRADE SURROUND AND HEARTH -PRICED SEPARATELY)



CABINET

STANDARD NF 17 Mantel

WHITE PAINT GRADE FINISH

(PICTURE SHOWN WITH UPGRADE SURROUND AND HEARTH -PRICED SEPARATELY)

ll

UK-75 WALLACETON
 LOT 312
 33-3344 W.O.B ELEV. A
 THE WINDSOR

25 of 37

STANDARD KITCHEN SINK

ND1831UA/9

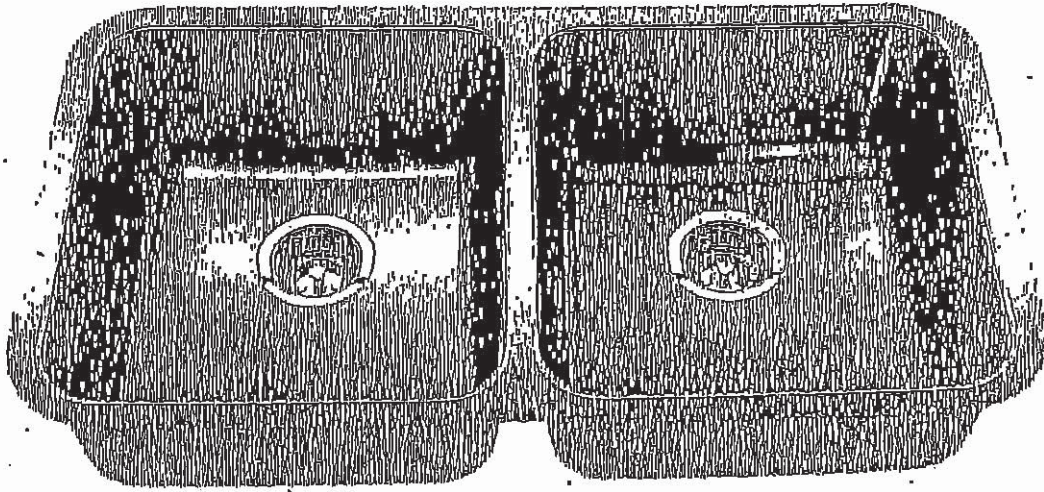

Optional Accessories

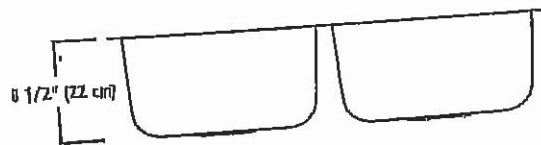
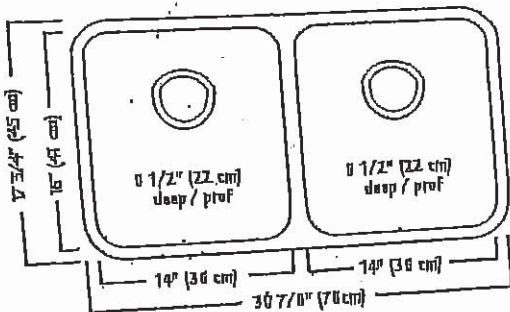

ND1831UA/9 SPECIFICATION

Model ND1831UA/9 is a double (two equal size) bowl undermount sink manufactured by Franke Kindred Canada Limited from 18 gauge stainless steel. Product has silk finished rims and linear brush finished bowls. Sink is fully undercoated. Basket strainer waste fittings (3 1/2", 89 mm) are included. Sink is backed with a limited lifetime warranty.

- * O.D. 17 3/4" x 30 7/8" x 1 1/2" (45 x 78 x 22 cm)
- * Recommended for minimum 36" cabinet

Franke Kindred Canada Limited
 P.O. Box 190, 1000 Franke Kindred Road, Midland, Ontario, Canada, L4R 4K9 Phone: 866-687-7465 Fax: 800-361-8408

Franke Kindred Canada Limited

Printed in Canada

1117

Kiy
 at

UK-75 WALLACETON
LOT 312
33-3344 W.O.B ELEV. A
THE WINDSOR

26 of 37

STANDARD KITCHEN FAUCET

Align

Modern

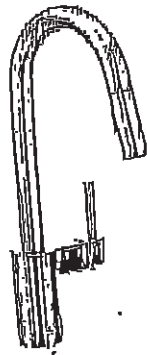

Single Handle Pull-Down Kitchen
Faucet#
Model 7565+

Key

at

UK-75 WALLACETON
LOT 312
33-3344 W.O.B ELEV. A
THE WINDSOR

27 of 37

Chateau

Transitional

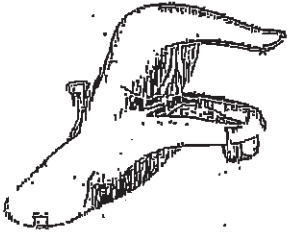

Lavatory Faucet with Pop-Up Drain
Model L4621†

VANITY SINKS AND PEDESTAL



Posi-Temp® Pressure Balancing Tub/Shower
Model 62320 / TL183†

OR

Posi-Temp Valve and Tub/Shower Trim
with Eco-Performance Easy Clean® XL
Model 62320 / TL183EP†
(TL183EP not available in BC)

SHOWER AND 5" TUB FAUCETS



2 Handle Roman Tub with 9" Spout
Model 4796 / T990†

FREESTANDING TUB FAUCETS

UK-75 WALLACETON
 LOT 312
 33-3344 W.O.B ELEV. A
 THE WINDSOR

28 of 37



Buy it for looks. Buy it for life.®

There is more than 1 version of this model.
 Page down to identify the version you have.

DESCRIPTION

- Metal construction with various finishes identified by suffix
- 1/2" IPS connections
- Includes metal or 50/50 pop-up type waste assembly where noted

OPERATION

- Pivot action lever style handle
- Temperature controlled through 100° degree arc of handle travel

FLOW

- Water usage is limited to these maximum flow rates as indicated by the corresponding product markings
 - 1.2 gpm max (4.5L/mln) at 60 psi
 - 1.5 gpm max (5.7L/mln) at 60 psi

CARTRIDGE

- 1255™ Duralast™ cartridge
- Nonmetallic/nonferrous and stainless steel material

STANDARDS

- Third party certified to WaterSense®, ASME A112.18.1/CSA B125.1 and all applicable requirements referenced therein
- Certified to NSF 61/9 & 372
- Products marked with 1.2 gpm are compliant with California water efficiency regulations
- Complies with California Proposition 65 and with the Federal Safe Drinking Water Act

- ADA ♿ for lever handle

WARRANTY

- Lifetime limited warranty against leaks, drips and finish defects to the original consumer purchaser
- 5 year warranty if used in commercial installations

Specifications

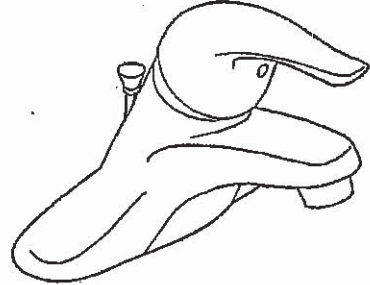

CHATEAU®
 Single-Handle Lavatory Faucet

with Metal Waste Assembly
 Models: L4621 series

Bulk Pack Models (12 Per Carton):
 L64620 series

with 50/50 Waste Assembly
Bulk Pack Model (12 Per Carton): L64621 series

Less Waste
 Model: L4601 series

Bulk Pack Model (12 Per Carton):
 L64601 series

**NOTE: THIS FAUCET IS DESIGNED TO BE
 INSTALLED THRU 3-1" DIA. HOLES, 2" ON CENTER**

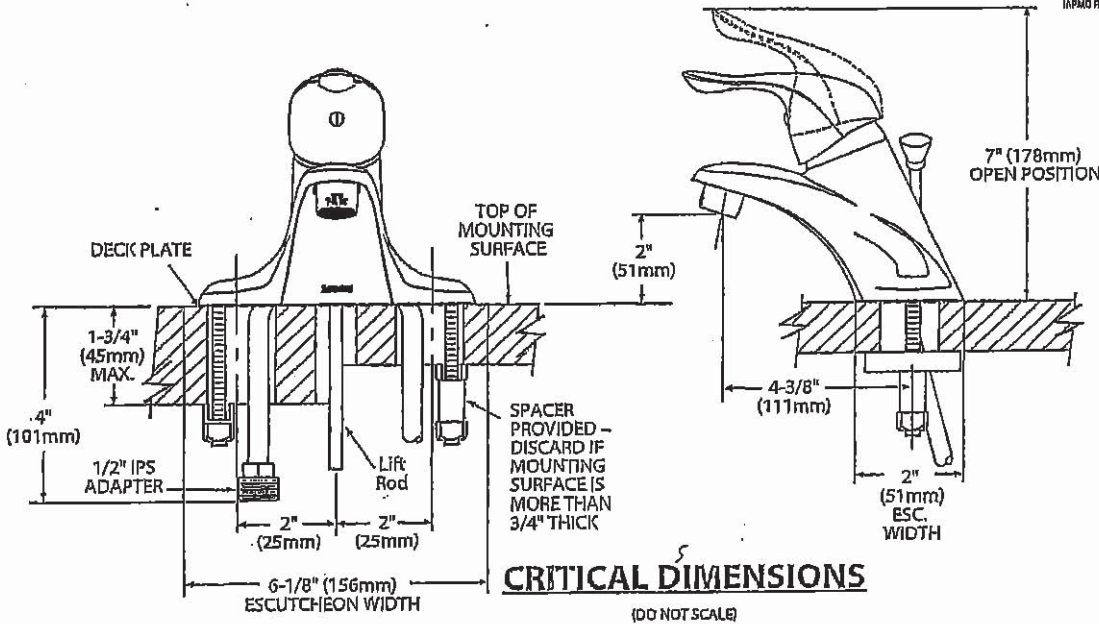

Rev. 1/16

FOR MORE INFORMATION CALL: 1-800-BUY-MOEN

www.moen.com

AN

UK-75 WALLACETON
 LOT 312
 33-3344 W.O.B ELEV. B
 THE WINDSOR

29 of 37



SPECIFICATIONS
AV SERIES
 RANGE HOODS

HVI 2100 CERTIFIED 180 CFM/7.0 Sones @ 0.10" SP. Horizontal
 180 CFM/7.5 Sones @ 0.10" SP. Vertical

Dimensions

Overall bottom projection - 18³/₈"
 Overall top projection - 12"
 Height - 6"
 Available widths: 21", 24", 30", 36" & 42"

Hood Body

Stainless Steel: 24 gauge, grade 430 stainless steel.
 Painted: 23 gauge cold rolled commercial grade (CRCQ) steel, auto welded, coated with a baked enamel finish.

Motor

2 speed, single coil, thermally protected, permanently lubricated.
 Rated 120 volts, 60 hz. Complete w/lt 200°C lead wires.

Lighting

Single 60 watt cook light capacity (bulb not included).

Ducting Options

Horizontal ducting: 3¹/₄"x10" (duct adapter and damper included).
 Vertical ducting: 3¹/₄"x10" (duct adapter and damper included).
 Vertical ducting: 7" round (duct adapter and damper not included).
 Ductless: removable front vent (charcoal filter not included).

Fan Blade

One piece polymeric, electronically balanced blade. 6⁵/₈" diameter with 5 paddles.

Electrical connection

Hood top - 7/8" knockout hole for use with 1/2" cable clamp
 Hood back - 7/8" knockout hole for use with 1/2" cable clamp

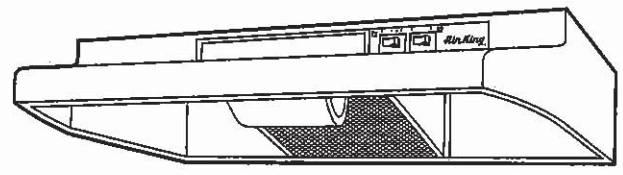

AV SERIES

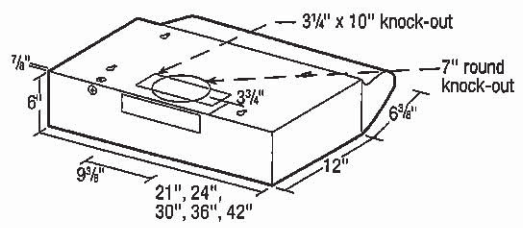

Filters

UL rated, class 2 filter.
 Grease Filter: RF35 - 8⁷/₈"x10³/₈" (included).
 Charcoal Filter: RF34 (not included).
 Combo Grease/Charcoal: RF55 (not included).

Available Finishes

White, Biscuit, Almond, Black & Stainless Steel.

EXPANDED PERFORMANCE

Air Flow - CFM	Static Pressure (inches of w.g.)						Sones @ .1 SP	Fan Speed RPM	Power Watts	Apms
	0	0.05	0.1	0.15	0.2	0.25				
Vertical Ducting High	246	232	218	203	181	147	7.5	2973	87.0	2.1
Horizontal Ducting High	225	210	180	175	155	120	7.0	3024	87.0	2.1

PROJECT				ARCHITECT					
LOCATION				ENGINEER					
CONTRACTOR				SUBMITTED BY			DATE		
FAN NUMBER	MODEL NUMBER	CFM	IN W.C.	RPM	WATTS	AMPS	SONES	QTY	OPTIONAL EQUIPMENT & REMARKS



Air King: 820 Lincoln Avenue
 West Chester, Pennsylvania 19380-4466
 Tel: (610) 692-7400 • 877-304-3785
 Fax: (610) 696-8048

Canada:
 Brampton, Ontario
 Tel: 905-456-2033
 Fax: (905) 456-1015

Specifications subject to change without notice.

Updated 2-18

STANDARD 30" HOODFAN
 TO 30" UPPER CABINETS AFFIXED
 TO WALL AT BACK OF CABINETS
 TO BE CHANGED BY PURCHASER
 AFTER CLOSING

UK-75 WALLACETON**LOT 312****33-3344 W.O.B ELEV. A**

30 of 37

36" Gas Cooktop

800 Series – Stainless Steel NGM8657UC

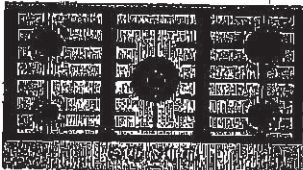
BOSCH
 Invented for life

NGM8657UC
 Stainless Steel

The stainless steel gas cooktop with FlameSelect® – achieve consistent cooking results thanks to nine precisely defined power levels.

Features & Benefits

FlameSelect® – allows for a precise adjustment of the flame size with nine defined power levels

Dual flame power burner with two heat options, quickly boil water or maintain a precise simmer

Heavy-duty grates can be easily and quickly cleaned in the dishwasher

OptiSim® burner – simmer delicate sauces and melt chocolate without scorching

Low profile stainless steel cooking surface is easily accessible and quick to clean

General Properties	
No. of burners	5
Knob color	Stainless steel appearance
Control location	Front center
Sealed burners	Yes
Gas valves	Five 9-level step valves
Ignition system	Electric, thermocouple safety control
Cooktop surface material	Stainless steel
Grate material	Cast iron
Grate features	Continuous grates, dishwasher safe

Element Performance	
Total BTU load (NG / LP)	41,400 / 40,100
Power of front left burner (NG / LP) OptiSim®	3,400 / 3,400 BTU
Power of back left burner (NG / LP)	6,000 / 6,000 BTU
Power of center burner (NG / LP) Dual-flame	17,000 / 15,700 BTU
Power of back right burner (NG / LP)	9,000 / 9,000 BTU
Power of front right burner (NG / LP)	6,000 / 6,000 BTU

Technical Details	
Circuit breaker	15 A
Volts	120 V
Frequency	60 Hz
Plug type	3-prong
Power cord length	40"
Fuel type	Natural Gas (factory set)
Convertible to LP (kit required)	Yes

Dimensions & Weight	
Overall appliance dimensions (HxWxD)	2-23/64" x 36" x 20-1/2"
Required cutout size (HxWxD)	1-1/4" x 35-1/2" x 19-5/16"
Minimum distance from counter front	1-7/8"
Minimum distance from rear wall	3"
Net weight	42 lbs

Accessories – Included	
Included	LP conversion kit, OptiSim® cap

Accessories – Optional	

HEZ298107
 Wok ring

HEZ27754
 FlameSelect® 800 Series metal control knob kit, stainless steel

† To be fully ADA compliant, these units must be installed according to ADA guidelines. Please check current ADA requirements for guidance on installation.

Accessories: To purchase Bosch accessories, cleaners & parts please visit www.bosch-home.com/us/store or call 1-800-944-2904 (Mon to Fri 5 am to 6 pm PST, Sat 8 am to 3 pm PST).
 Notes: All height, width and depth dimensions are shown in inches. BSH reserves the absolute and unrestricted right to change product materials and specifications, at any time, without notice. Consult the product's installation instructions for final dimensional data and other details prior to making cutout.

Warranties: Please see Use & Care manual or Bosch website for statement of limited warranty.

For more information on our entire line of products, go to www.bosch-home.com/us or call 1-800-944-2904

© BSH Home Appliances Corporation. All rights reserved. Bosch is a registered trademark of Robert Bosch GmbH.

UK-75 WALLACETON

LOT 312

33-3344 W.O.B ELEV. A

THE WINDSOR

31 OF 37

36" Gas Cooktop

800 Series – Stainless Steel NGM8657UC



Installation Details

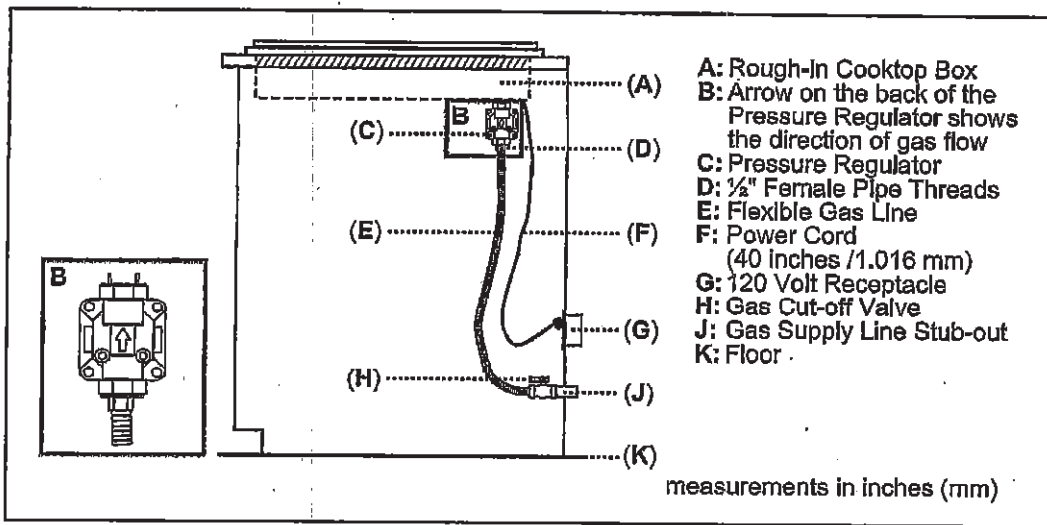
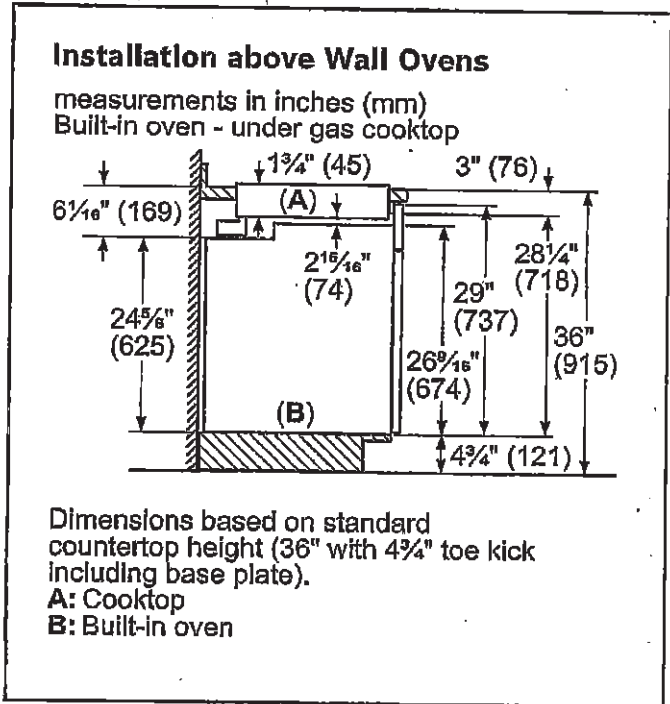
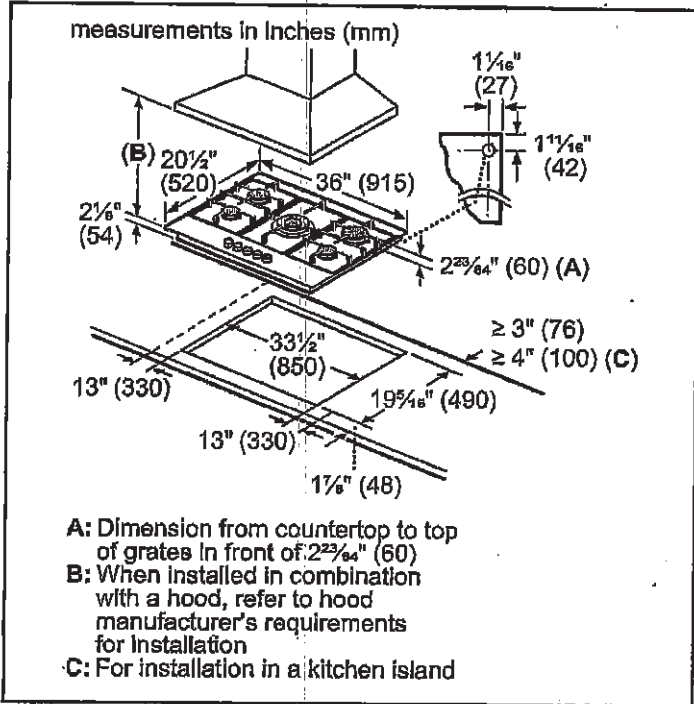

Accessories: To purchase Bosch accessories, cleaners & parts please visit www.bosch-home.com/us/store or call 1-800-944-2904 (Mon to Fri 5 am to 6 pm PST, Sat 6 am to 3 pm PST).
Notes: All height, width and depth dimensions are shown in inches. BSH reserves the absolute and unrestricted right to change product materials and specifications, at any time, without notice. Consult the product's installation instructions for final dimensional data and other details prior to making cutout.
Warranties: Please see Use & Care manual or Bosch website for statement of limited warranty.

For more information on our entire line of products, go to www.bosch-home.com/us or call 1-800-944-2904
© BSH Home Appliances Corporation. All rights reserved. Bosch is a registered trademark of Robert Bosch GmbH.



UK-75 WALLACETON

LOT 312

33-3344 W.O.B ELEV. A

THE WINDSOR

32 of 37

36" Gas Cooktop

800 Series – Stainless Steel NGM8657UC



Installation Details

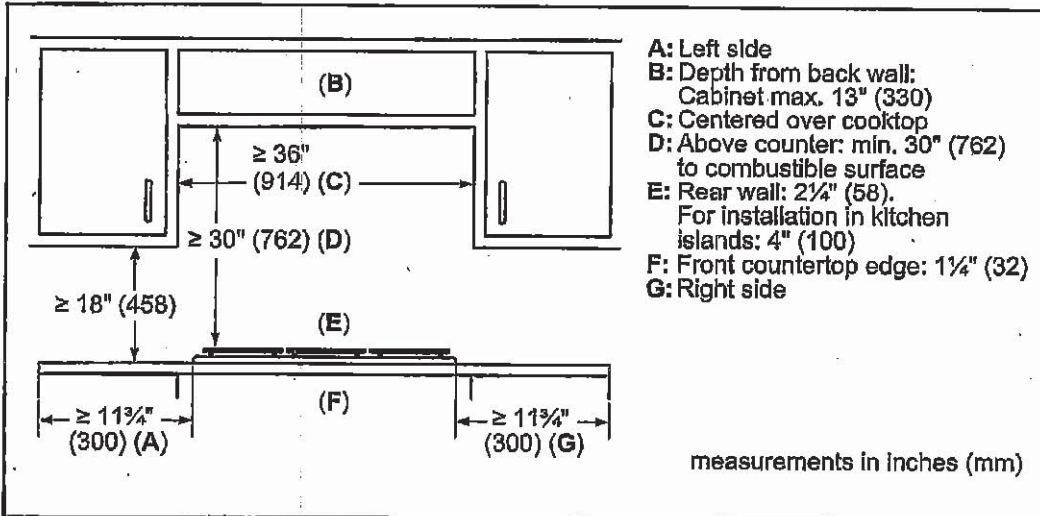

Accessories: To purchase Bosch accessories, cleaners & parts please visit www.bosch-home.com/us/store or call 1-800-944-2904 (Mon to Fri 5 am to 6 pm PST, Sat 6 am to 3 pm PST).

Notes: All height, width and depth dimensions are shown in inches. BSH reserves the absolute and unrestricted right to change product materials and specifications, at any time, without notice. Consult the product's installation instructions for final dimensional data and other details prior to making cutout.

Warranties: Please see Use & Care manual or Bosch website for statement of limited warranty.

For more information on our entire line of products, go to www.bosch-home.com/us or call 1-800-944-2904

© BSH Home Appliances Corporation. All rights reserved. Bosch is a registered trademark of Robert Bosch GmbH.



UK-75 WALLACETON
LOT 312
33-3344 W.O.B ELEV. A
THE WINDSOR

33 of 37

36" Gas Cooktop

800 Series – Stainless Steel NGM8657UC



Bosch Cooktop over Built-In Oven Approved Combination Guide

The following **Ovens, COOKTOPS AND DRAWERS** are approved to be installed in combination and the installation has been certified by CSA.

Built-in ovens		Cooktops		
Conventional ovens (1)	Steam ovens	Induction	Electric	Gas (1) *
HBL5351UC, HBL5354UC	HSLP451UC, HSLP454UC	NIT5068UC	NET8068UC	NGM8046UC
HBL5451UC, HBL5444UC		NIT5668UC, NIT5469UC	NET8068SUC	NGM8656UC
HBL8443UC, HBL5454UC		NIT8068UC, NIT8068SUC	NET8668UC	NGMP656UC
HBL8453UC, HBL8444UC		NIT8668UC, NIT8668SUC	NET8668SUC	NGM8656UC
HBL8451UC, HBL8444UC		NITP068UC, NITP068SUC	NETP068SUC	NGMB646UC
HBL8463UC, HBL8444UC		NITP668UC, NITP668SUC	NETP668SUC	NGM8656UC
HBL8461UC, HBL8454UC		NIT8069UC, NIT8069SUC	NEM5066UC	NGMP056UC
HBL8442UC, HBLP454UC		NIT8669UC, NIT8669SUC	NEM5666UC	NGM8056UC
HBLP451UC, HBLP454UC		NITP069UC, NITP069SUC		Gas (2) *
HBLP4511UC, HBLP4541UC		NITP668UC, NITP668SUC		NGM8456UC
HBLP451RUC, HBN8454UC				Gas (3) *
HBN5451UC, HBN8451UC				NGMP077UC
Conventional ovens (2)				NGMP677UC
HBE5451UC				NGM8657UC
Conventional ovens (3)				NGM8057UC
HBE5452UC				

The following **Ovens, COOKTOPS AND DRAWERS** are approved by BSH Home Appliances Corporation to be installed in combination. These products, identified in the table below, may be installed in combination. The suitability of the combination has not been evaluated by CSA.

Built-in ovens		Cooktops		
Conventional ovens (2)	Speed oven (1)	Induction (1)	Electric (1)	Gas (1) *
HBE5453UC	HMCP0252UC, HMCP0254UC	NIT5068UC	NET8068UC	NGM8046UC
Built-In microwave	HMC80242UC, HMC80244UC	NIT5668UC, NIT5469UC	NET8068SUC	NGM8656UC
HMB57152UC	HMC80252UC, HMC80254UC	NIT8068UC, NIT8068SUC	NET8668UC	NGMP656UC
HMB50162UC	HMC87152UC, HMC87154UC	NIT8668UC, NIT8668SUC	NET8668SUC	NGM8656UC
HMB50152UC	HMC80152UC, HMC50154UC	NITP068UC, NITP068SUC	NETP068SUC	NGMB646UC
HMB87154UC		NITP668UC, NITP668SUC	NETP668SUC	NGM8656UC
HMB50154UC		NIT8069UC, NIT8069SUC	NEM5066UC	NGMP056UC
Storage drawer	Speed oven (2)	NIT8669UC, NIT8669SUC	NEM5666UC	NGM8056UC
HSD5051UC	HMC54151UC	NITP069UC, NITP069SUC		Gas (2) *
Drawer microwave	HMC54152UC	NITP669UC, NITP669SUC		NGM8456UC
HMD8053UC	HMC54154UC			Gas (3) *
HMB8451UC				NGMP077UC
Warming drawers				NGMP677UC
HWD5051UC				NGM8657UC
HWD5751UC				NGM8057UC

*Gas cooktops may require a 3/8" street elbow (not provided) at the regulator outlet for installation above built-in oven.
 COOKTOPS that are not listed above must be approved under local codes and/or by the local authority having jurisdiction.
 Please note: For the latest updates to the approved oven/cooktop combination refer to the website listed in your appliance's Installation Instructions.

Accessories: To purchase Bosch accessories, cleaners & parts please visit www.bosch-home.com/us/store or call 1-800-944-2904 (Mon to Fri 5 am to 6 pm PST, Sat 6 am to 3 pm PST).
 Notes: All height, width and depth dimensions are shown in inches. BSH reserves the absolute and unrestricted right to change product materials and specifications, at any time, without notice. Consult the product's Installation Instructions for final dimensional data and other details prior to making cutout.
 Warranties: Please see Use & Care manual or Bosch website for statement of limited warranty.
 For more information on our entire line of products, go to www.bosch-home.com/us or call 1-800-944-2904
 © BSH Home Appliances Corporation. All rights reserved. Bosch is a registered trademark of Robert Bosch GmbH.

DB
 RH

UK-75 WALLACETON
LOT 312
33-3344 W.O.B ELEV. A
THE WINDSOR

34 of 37

36" Gas Cooktop

800 Series - Stainless Steel NGM8657UC



Cooktop over built-in oven combination Installation
 Refer to the product Installation guide for all other measurements.

Oven installation requirements				Cooktop installation requirements (wall spacing)				
When installing an oven or oven with a drawer in combination with a cooktop, a minimum distance between the cabinet floor and countertop (B) is required. Reference the table for dimensions. Refer to the oven installation guide for all other measurements.								
Oven type	A Inches (mm)	B min. Inches (mm)	C max. Inches (mm)	Gas cooktop (1) min. Inches (mm)	Gas cooktop (2) min. Inches (mm)	Gas cooktop (3) min. Inches (mm)	Electric cooktop	Induction cooktop
Conventional oven (1)	28 1/4 (718)	31 1/4 (794)	4 3/4 (121)	D: 24 (610) E: 24 (610)	D: 3 (76) E: 4 (102)	D: 24 (610) E: 24 (610)	Reference Product Installation Instructions	
Conventional oven (2)	23 (584)	27 9/4 (705)	8 1/4 (210)	D: 24 (610) E: 24 (610)	D: 3 (76) E: 4 (102)	D: 24 (610) E: 24 (610)	Reference Product Installation Instructions	
Conventional oven (3)	23 1/16 (585)	27 13/16 (707)	8 3/16 (208)	D: 24 (610) E: 24 (610)	D: 3 (76) E: 4 (102)	D: 24 (610) E: 24 (610)	Reference Product Installation Instructions	
Steam oven	19 1/4 (488)	23 3/8 (594)	2 5/8 (32)	D: 24 (610) E: 24 (610)	D: 3 (76) E: 4 (102)	D: 24 (610) E: 24 (610)	Reference Product Installation Instructions	
Steam oven with 4" storage drawer								
Speed oven (2)	17 3/4 (450)	22 1/2 (572)	13 1/2 (343)	D: 24 (610) E: 24 (610)	D: 3 (76) E: 4 (102)	Reference Product Installation Instructions		
Microwave speed oven (1)	19 1/4 (488)	24 (609)	12 (306)	D: 24 (610) E: 24 (610)	D: 3 (76) E: 4 (102)	Reference Product Installation Instructions		
Microwave speed oven (1) with warming drawer	28 1/4 (718)	31 1/4 (794)	4 3/4 (121)	D: 24 (610) E: 24 (610)	D: 3 (76) E: 4 (102)	Reference Product Installation Instructions		
Drawer microwave	14 13/16 (376)	20 (508)	16 (406)	D: 24 (610) E: 24 (610)	D: 3 (76) E: 4 (102)	Reference Product Installation Instructions		

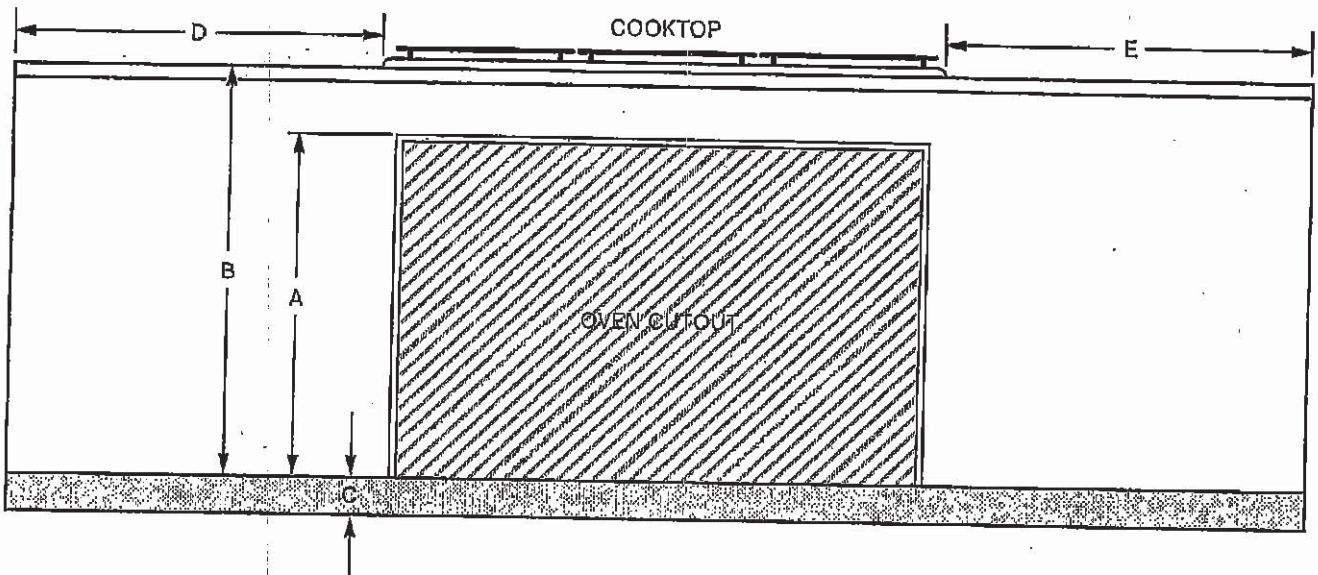

Accessories: To purchase Bosch accessories, cleaners & parts please visit www.bosch-home.com/us/store or call 1-800-944-2904 (Mon to Fri 5 am to 6 pm PST, Sat 6 am to 3 pm PST).
Notes: All height, width and depth dimensions are shown in inches. BSH reserves the absolute and unrestricted right to change product materials and specifications, at any time, without notice. Consult the product's Installation Instructions for final dimensional data and other details prior to making cutout.
Warranties: Please see Use & Care manual or Bosch website for statement of limited warranty.
 For more information on our entire line of products, go to www.bosch-home.com/us or call 1-800-944-2904
 © BSH Home Appliances Corporation. All rights reserved. Bosch is a registered trademark of Robert Bosch GmbH.

DS
QH

UK-75 WALLACETON

LOT 312

33-3344 W.O.B ELEV. A

THE WINDSOR

35 of 37

30" Double Wall Oven

800 Series – Stainless Steel HBL8651UC

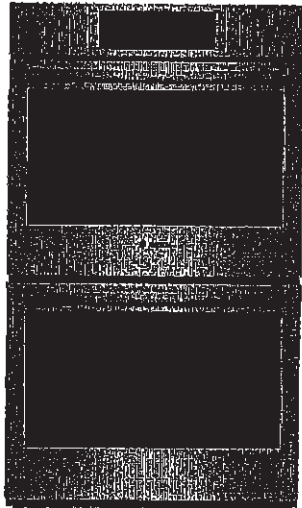

HBL8651UC
Stainless Steel

Also available in:

Black HBL8661UC

Black Stainless HBL8642UC
Steel

**The Bosch wall oven
installs flush and features
a QuietClose® door.**

Features & Benefits

Dampened hinges softly and quietly guide the QuietClose® door shut.

A full-extension telescopic rack offers safe access to the oven cavity.

Touch control with SteelTouch™ buttons makes operating the oven easier.

The wall oven is designed to be installed flush with cabinetry.

Bosch wall ovens are compatible with most competitors' cutouts.

General Properties	
Cooking modes – upper cavity	Bake, Variable Broil (hi & low), Roast, Warm, Sabbath, Proof Dough, Convection Bake, Convection Broil, Convection Roast, Pizza, Multi-Rack, Genuine European Convection, Convection Conversion, Temperature Probe, Fast Preheat
Cooking modes – lower cavity	Bake, Variable Broil (hi & low), Roast, Warm, Sabbath
Cleaning type – upper & lower cavity	Self Clean
Telescopic rack	1
Illumination type – upper & lower cavity	Halogen
Interior lights – upper cavity	2
Interior lights – lower cavity	1

Oven Performance	
Bake / Broil element wattages – upper & lower cavity	2,400 / 3,800 W
Convection element wattages – upper cavity	2,000 W
Technical Details	
Watts (W)	8,495 W
Volts (V), Frequency (Hz), Circuit breaker (A)	240 / 208 V, 60 Hz, 40 A
Power cord length (in); Plug type	50", Fixed connection, no plug
Energy source	Electric
Dimensions & Weight	
Overall appliance dimensions (HxWxD) (in)	52 1/16" x 29 3/4" x 24 1/2"
Required cutout size – Standard (HxWxD) (in)	49 3/4" x 51 1/2" x 28 1/2" x 23 1/2"
Required cutout size – Flush (HxWxD) (in)	52 3/16" x 40" x 24 1/2"
Oven cavity size (cu. ft.)	4.6
Overall oven interior dimensions (HxWxD) (in)	17 13/16" x 24 1/8" x 18"
Usable oven interior dimensions (HxWxD) (in)	12 5/16" x 23 1/4" x 15 1/4"
Net weight (lbs)	261 lbs
Accessories—Included	
Included	Upper Oven: 1 Telescopic and 2 Standard Oven Racks; Temperature Probe; Lower Oven: 2 Standard Oven Racks
Accessories—Optional	



HEZTR301
30" Telescopic Rack

Accessories: To purchase Bosch accessories, cleaners & parts please visit www.bosch-home.com/us/store or call 1-800-944-2904 (Mon to Fri 8 am to 6 pm PST, Sat 8 am to 3 pm PST).
Notes: All height, width and depth dimensions are shown in inches. BSH reserves the absolute and unrestricted right to change product materials and specifications, at any time, without notice. Consult the product's installation instructions for final dimensional data and other details prior to making cutout.
Warranties: Please see Use & Care manual or Bosch website for statement of limited warranty.
 For more information on our entire line of products, go to www.bosch-home.com/us or call 1-800-944-2904
 © BSH Home Appliances Corporation. All rights reserved. Bosch is a registered trademark of Robert Bosch GmbH.

DS
QH

UK-75 WALLACETON

LOT 312

33-3344 W.O.B ELEV. A

THE WINDSOR

36 of 37

30" Double Wall Oven

800 Series - Stainless Steel HBL8651UC



Installation Details

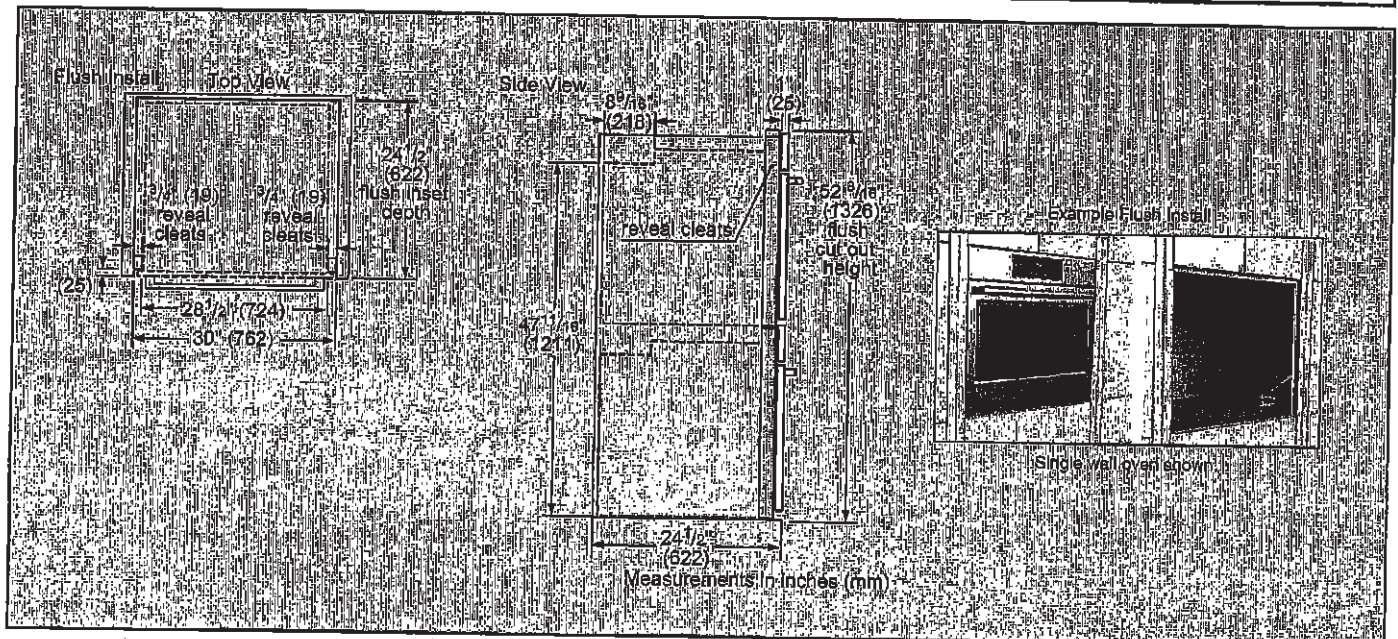
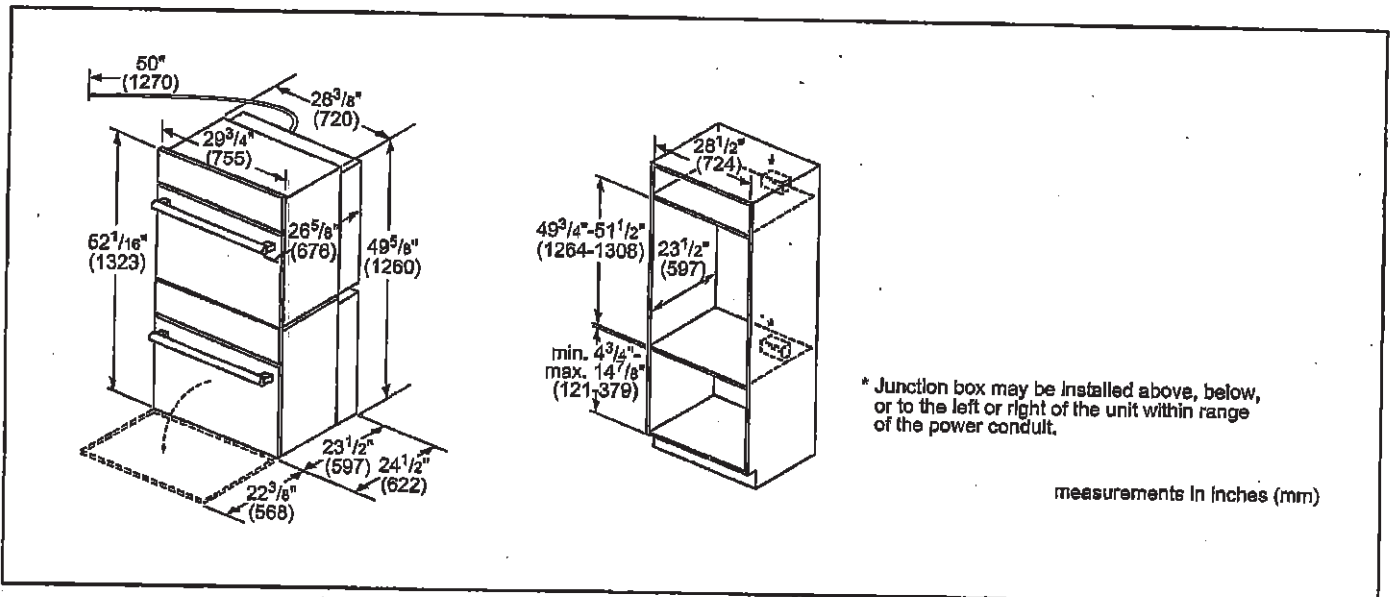

Accessories: To purchase Bosch accessories, cleaners & parts please visit www.bosch-home.com/us/store or call 1-800-944-2904 (Mon to Fri 5 am to 6 pm PST, Sat 6 am to 3 pm PST).

Notes: All height, width and depth dimensions are shown in inches. BSH reserves the absolute and unrestricted right to change product materials and specifications, at any time, without notice. Consult the product's installation instructions for final dimensional data and other details prior to making cutout.

Warranties: Please see Use & Care manual or Bosch website for statement of limited warranty.

For more information on our entire line of products, go to www.bosch-home.com/us or call 1-800-944-2904

© BSH Home Appliances Corporation. All rights reserved. Bosch is a registered trademark of Robert Bosch GmbH.



UK-75 WALLACETON

LOT 312

33-3344 W.O.B ELEV. A

THE WINDSOR

37 OF 37

30" Double Wall Oven

800 Series – Stainless Steel HBL8651UC



Installation Details

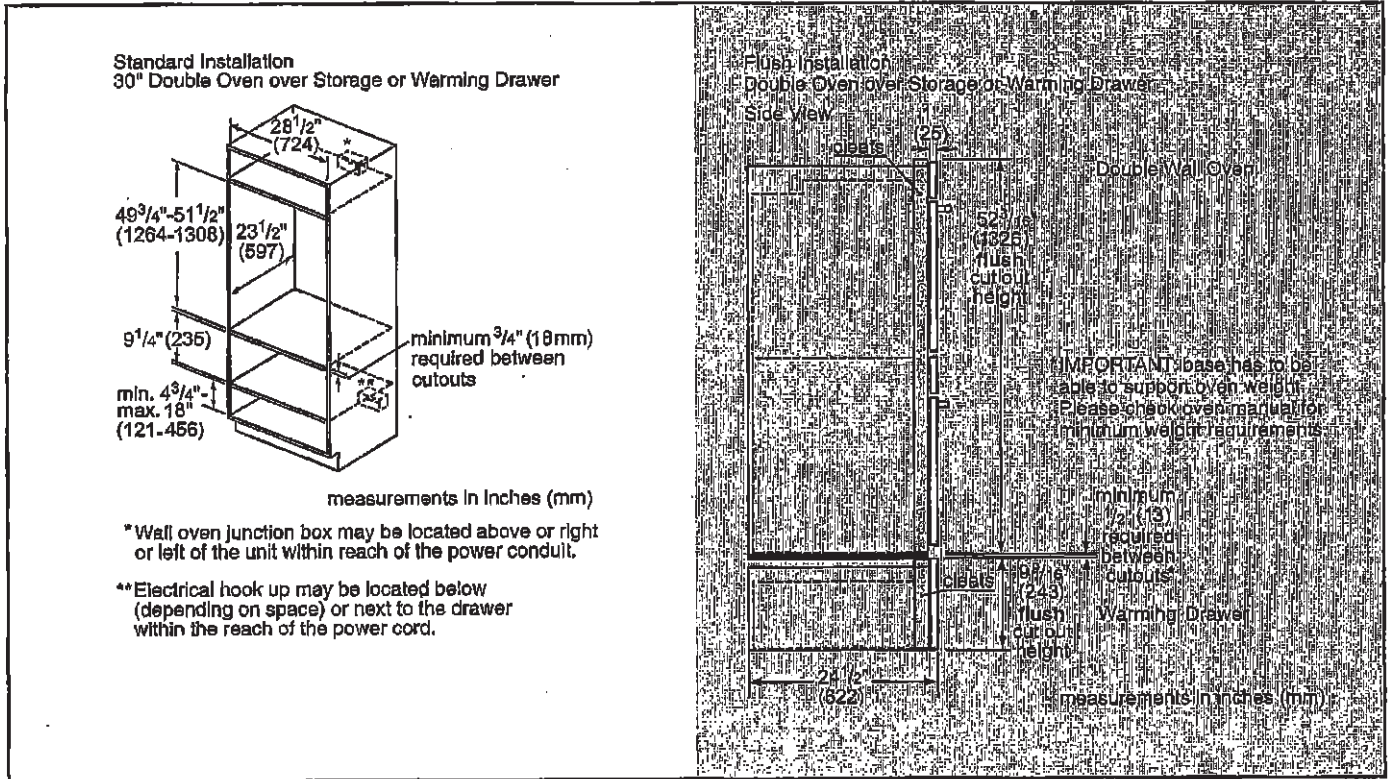

Accessories: To purchase Bosch accessories, cleaners & parts please visit www.bosch-home.com/us/store or call 1-800-944-2904 (Mon to Fri 5 am to 6 pm PST, Sat 6 am to 3 pm PST).

Notes: All height, width and depth dimensions are shown in inches. BSH reserves the absolute and unrestricted right to change product materials and specifications, at any time, without notice. Consult the product's installation instructions for final dimensional data and other details prior to making cutout.

Warranties: Please see Use & Care manual or Bosch website for statement of limited warranty.

For more information on our entire line of products, go to www.bosch-home.com/us or call 1-800-944-2904

© BSH Home Appliances Corporation. All rights reserved. Bosch is a registered trademark of Robert Bosch GmbH.

