

**PRE-Sales Selection Sheet
Checklist**

1 of 56

LOT 228 Model: 33-3344 B The Windsor PURCHASERS: VICTORIA, ANNE LEGG/KATHRYN, ELIZABETH ADAMS VENDOR: Heathwood Homes (Huron) Limited
--

OPTIONAL WAFFLE CEILING IN GREAT ROOM (INCLUDES COFFER)
SIDE UPGRADE

- FINISHED BASEMENT
- COLD CELLAR

UPGRADED / MODIFIED ELEVATION

- CORNER UPGRADE
- REAR UPGRADE

CEILING UPGRADE - SMOOTH

- MAIN FLOOR
- SECOND FLOOR
- BASEMENT

ADDITIONAL ROUGH-INS

- 200 AMP SERVICE
- WET BAR ROUGH-IN
- HUMIDIFIER
- AIR CONDITIONING

GAS ROUGH-IN

- STOVE
- DRYER
- BBQ
- ADDITIONAL FIREPLACE

KITCHEN: HOODFAN VENTING SIZE

- 6 IN ROUND DUCT
- 7 IN ROUND DUCT

FULL BASEMENT STAIRS:	All Oak
UPPER BASEMENT STAIRS:	N/A
LOWER BASEMENT STAIRS:	N/A
MAIN STAIRS:	All Oak
MEDIA STAIRS (if applicable):	N/A
LOFT STAIRS (if applicable):	N/A

March 21/21 _____
Date Purchaser: *Signature*
on file

March 21/21 _____
Date Decor Consultant: IRIT SALEM

Date Purchaser:

APPROVED

-03- 23 2021 _____
Date Heathwood Homes (Huron) Limited

Signature
Approved

Locked Date:



Sales Selection Sheet

Wallaceton

2 of 56

PURCHASERS: VICTORIA, ANNE LEGG and KATHRYN, ELIZABETH ADAMS

TEL:

LOT / UNIT 228	PHASE 2	MODEL 33-3344 B The Windsor	
-------------------	------------	--------------------------------	--

It is herein understood and agreed between the undersigned parties hereto that the following changes shall be made to the above mentioned Agreement of Purchase and Sale in accordance with the agreement and except for such changes noted below, all other terms and conditions in the Agreement of Purchase and Sale shall remain as stated herein: It is further understood that and agreed that all changes and additions shall be installed as per builder's specifications, location and available selections. The Purchaser hereby agrees to purchase the following extras:

ADMIN FEE

1	- SCHEDULE "E" TEN THOUSAND DOLLARS (\$10,000.00) AT DECOR (NO CASH VALUE) -SINGLES	Qty: 1	
55,016	Note:		

Sub Total
HST
Total

1. This Sales Selection Sheet when properly executed forms part of our Agreement of Purchase and Sale.
2. All extras and upgrades listed above are subject to Construction Progress and Architectural and Municipal requirements.
3. In the event the Vendor is unable to incorporate the work approved above in the construction of the house for any reason whatsoever, the Vendor will not be liable to the Purchaser in any way. The monies paid for any changes or optional extras not proceeded with shall be returned to the Purchaser, without interest. The cost of options or extras is non-refundable in all other circumstances. If for any reason whatsoever the Agreement of Purchase and Sale is not completed, the total cost of work approved above will be retained by the Vendor.
4. The Vendor reserves the right to substitute above materials and equipment with that of equal or better quality.
5. Purchaser acknowledges that items may not be exactly as shown. Variations from the Vendor's samples may occur in finished materials due to normal production processes. Vendor is not responsible for shade difference which may occur from different dye lots or wood grains. Variations from the Vendor's samples will occur with natural materials such as wood, marble, granite, hardwood and brick.
6. The Vendor reserves the right to select Grout & Thresholds that best suits the Tile selected.
7. Selections will not be processed unless signed by Heathwood Homes Head Office.
8. The selections made on this schedule are final and cannot be changed once submitted.
9. The Purchaser has checked and acknowledges the accuracy of this schedule.

Payment Summary	
<u>Paid By</u>	<u>Amount</u>
<u>Total Payment:</u>	

PURCHASER: Signatures on _____ 05-Mar-21 _____ IRIT SALEM 05-Mar-21
VICTORIA, ANNE LEGG DATE Decor Consultant DATE

PURCHASER: file _____ 05-Mar-21 **APPROVED** _____
KATHRYN, ELIZABETH ADAMS DATE DATE

02-23-2021
Date Approved Heathwood Homes (Huron) Limited

TAX#:1
PREPARED BY: Irit Salem
PE 783-1
SInvoice.rpt 28may19

VICTORIA, ANNE LEGG/KATHRYN, ELIZABETH ADAMS
 Project: Wallaceton
 Unit: 228, Phase: 2
 Model: 33-3344 B The Windsor

Created: 2/24/2021 11:35:46

Locked:

Closed:

3 of 56

Kitchen

Cabinet Colour/Style	9157	Viking III-SIMCOE-MOONLIGHT-3DL ***STD***
Countertop	8901	Group 5-Quartz-Caesarstone-MOORLAND FOG-3/4 inch with built-up edge ***5***
Countertop Edge	4005	DOUBLE MITRE 1 1/2 INCH ***UPG***
Cabinet Hardware	7667	12881-HARDWARE ***STD***
Island Cabinet Colour/Style	9157	Viking III-SIMCOE-MOONLIGHT-3DL ***STD***
Island Countertop	8901	Group 5-Quartz-Caesarstone-MOORLAND FOG-3/4 inch with built-up edge ***5***
Backsplash	8642	WB.PR.TGR.1212.GL-Penny Rounds-Tender Grey Glossy-12 x 12 ***4***
Backsplash Grout	2225	Grout-(27) Silver ***STD***
Backsplash Tile Pattern	1111	N/A *****

HoodFan	8896	SCB51436-CYCLONE 36 inch STAINLESS CANOPY CHIMNEY HOODFAN-STAINLESS STEEL ***Upg*** SPEC PAGE 33
---------	------	---

Comment

Servery Opt. Uppers

Cabinet	9157	Viking III-SIMCOE-MOONLIGHT-3DL ***STD***
Cabinet Hardware	7667	12881-HARDWARE ***STD***

Comment

Kitchen / Breakfast

Flooring	8496	Red Oak UVF-Vintage Red Oak Solid Sculpted Character UVF-SAND DUNE-3/4 inch X 5 inch ***9***
Floor Tile Grout	1111	N/A *****
Floor Tile Pattern	1111	N/A *****

Comment

Foyer

Flooring	8842	OV.ET.BON.1224.PL-Eterna-Bone Polished-12 x 24 See Tile Direction on Sketch 2 Page 21 ***5***
----------	------	---

V8-ka

Customer Colours

296

VICTORIA, ANNE LEGG/KATHRYN, ELIZABETH ADAMS
 Project: Wallaceton
 Unit: 228, Phase: 2
 Model: 33-3344 B The Windsor

Created: 2/24/2021 11:35:46

Locked:

Closed:

4 of 56

Floor Tile Grout	7707	Grout-(39) Ivory ***UPG***
Floor Tile Pattern	3050	SIDE TO SIDE ***STD***

Comment

Laundry Room

Flooring	8261	TR.ST.BYZ.1313-Serpentine-Beyaz/White-13x13 See Tile Line Pattern on Sketch 4 Page 23 ***STD***
Floor Tile Grout	7705	Grout-(01) Alabaster ***UPG***
Floor Tile Pattern	3000	STANDARD SQUARE ***STD***

Comment

Laundry Room Opt.

Cabinet - Uppers	1111	N/A *****
Cabinet Hardware	1111	N/A *****

Comment

Mud Room

Flooring	1111	GE.SU.GRY.1313 Sauble Grey 13
Floor Tile Grout	2220	Grout-(11) Sahara Beige ***UPG***
Floor Tile Pattern	3000	STANDARD SQUARE ***STD***

Comment

Powder Room

Flooring	8842	OV.ET.BON.1224.PL-Eterna-Bone Polished-12 x 24 See Tile Direction on Sketch 2 Page 21 ***5***
Floor Tile Grout	7707	Grout-(39) Ivory ***UPG***
Floor Tile Pattern	3050	SIDE TO SIDE ***STD***

187A

VICTORIA, ANNE LEGG/KATHRYN, ELIZABETH ADAMS
Project: Wallaceton
Unit: 228, Phase: 2
Model: 33-3344 B The Windsor

Created: 2/24/2021 11:35:46

Locked:

Closed:

5 of 56

Plumbing Fixture (Colour)	1737	Plumbing Fixtures-WHITE ***STD***
Comment		

Dining Room / Hall / OFFICE

Flooring	8496	Red Oak UVF-Vintage Red Oak Solid Sculpted Character UVF-SAND DUNE-3/4 inch X 5 inch ***1***
Comment	AND OFFICE FLOOR	

Great Room

Flooring	8496	Red Oak UVF-Vintage Red Oak Solid Sculpted Character UVF-SAND DUNE-3/4 inch X 5 inch ***1***
Comment		

Upper Hall

Flooring	9247	DY 16611-Dynasty Tex-SANDY BEIGE-40 oz Poly***STD***
Comment		

Opt. Finished Basement (Rec) Room/Hall

Flooring	9247	DY 16611-Dynasty Tex-SANDY BEIGE-40 oz Poly***STD***
Comment		

Master Bedroom

Flooring	9247	DY 16611-Dynasty Tex-SANDY BEIGE-40 oz Poly***STD***
Comment		

Bedroom 2

Flooring	9247	DY 16611-Dynasty Tex-SANDY BEIGE-40 oz Poly***STD***
Comment		

Bedroom 3

Page 3 of 3		
-------------	--	--

Vista

Customer Colours

296

VICTORIA, ANNE LEGG/KATHRYN, ELIZABETH ADAMS
 Project: Wallaceton
 Unit: 228, Phase: 2
 Model: 33-3344 B The Windsor

Created: 2/24/2021 11:35:46

Locked:

Closed:

6 of 56

Flooring	9247	DY 16611-Dynasty Tex-SANDY BEIGE-40 oz Poly***STD***
Comment		

Bedroom 4		
Flooring	9247	DY 16611-Dynasty Tex-SANDY BEIGE-40 oz Poly***STD***
Comment		

Ensuite 2		
Cabinet Colour/Style	6265	Viking III-MANCHESTER-SHALE GREY CL-MAPLE ***STD***
Countertop	9069	MSI Quartz GROUP 1 ICED WHITE ***1***
Countertop Edge	1111	N/A *****
Cabinet Hardware	7672	135-HARDWARE ***STD***
Floor Tile	8261	TR.ST.BYZ.1313-Serpentine-Beyaz/White-13x13 See Tile Line Pattern on Sketch 4 Page 23 ***STD***
Floor Tile Grout	7705	Grout-(01) Alabaster ***UPG***
Floor Tile Pattern	3000	STANDARD SQUARE ***STD***

Plumbing Fixture (colour)	1737	Plumbing Fixtures-WHITE ***STD***
Shower Floor Tile	8642	WB.PR.TGR.1212.GL-Penny Rounds-Tender Grey Glossy-12 x 12 ***6***
Shower Floor Tile Grout	7705	Grout-(01) Alabaster ***UPG***
Shower Floor Tile Pattern	1111	N/A *****

Shower Wall Tile	9022	QT.WV.TGR.0810-Weave-Tender Grey-8 x 10 ***STD***
Shower Wall Tile Grout	7705	Grout-(01) Alabaster ***UPG***
Shower Wall Tile Pattern	3090	VERTICAL STACKED ***STD***

Shower Jamb(s) and Sill(s)	8923	Shower Jamb / Sill-Thassos White ***STD***
Comment	ENSUITE 2	

vt aka

VICTORIA, ANNE LEGG/KATHRYN, ELIZABETH ADAMS
 Project: Wallaceton
 Unit: 228, Phase: 2
 Model: 33-3344 B The Windsor

Created: 2/24/2021 11:35:46

Locked:

Closed:

7 of 56

Master Ensuite

Cabinet Colour/Style	6265	Viking III-MANCHESTER-SHALE GREY CL-MAPLE ***STD***
Countertop	9069	MSI Quartz GROUP 1 ICED WHITE ***STD***
Countertop Edge	4010	GROUP 1 - SINGLE POLISHED STRAIGHT EDGE 3/4 INCH ***1***
Cabinet Hardware	7672	135-HARDWARE ***STD***
Floor Tile	7672	GE.MD.LGR.1818.MT Madison Series Light Grey Matte 18
Floor Tile Grout	7705	Grout-(01) Alabaster ***UPG***
Floor Tile Pattern	3000	STANDARD SQUARE ***STD***

Shower Floor Tile	8643	WB.PR.TPE.1212.GL-Penny Rounds-Taupe Glossy-12 x 12 ***6***
Shower Floor Tile Grout	2220	Grout-(11) Sahara Beige ***UPG***
Shower Floor Tile Pattern	1111	N/A *****

Shower Wall Tile	9022	QT.WV.TGR.0810-Weave-Tender Grey-8 x 10 ***STD***
Shower Wall Tile Grout	7705	Grout-(01) Alabaster ***UPG***
Shower Wall Tile Pattern	3090	VERTICAL STACKED ***STD***

Shower Jamb(s) and Sill(s)	8923	Shower Jamb / Sill-Thassos White ***STD***
Plumbing Fixture (colour)	1737	Plumbing Fixtures-WHITE ***STD***
Comment	PENNY ROUND TAUPÉ GLOSSY 1212 LISTELLO UPG 4 (8643) 12" WIDE WITH UPG. SAHARA BEIGE BEIGE GROUT	

Shared Ensuite

Cabinet Colour/Style	6265	Viking III-MANCHESTER-SHALE GREY CL-MAPLE ***STD***
Countertop	8822	4924-38-Countertop-WHITE CARRARA-Wilsonart ***STD***
Countertop Edge	1111	N/A *****
Cabinet Hardware	7672	135-HARDWARE ***STD***
Flooring	8261	TR.ST.BYZ.1313-Serpentine-Beyaz/White-13x13 See Tile Line Pattern on Sketch 4 Page 23 ***STD***

vt ka

Customer Colours

296

VICTORIA, ANNE LEGG/KATHRYN, ELIZABETH ADAMS
 Project: Wallaceon
 Unit: 228, Phase: 2
 Model: 33-3344 B The Windsor

Created: 2/24/2021 11:35:46

Locked:

Closed:

8 of 56

Floor Tile Grout	7705	Grout-(01) Alabaster ***UPG***
Floor Tile Pattern	3000	STANDARD SQUARE ***STD***

Wall Tile	9020	QT.WV.WHT.0810-Weave-White-8 x 10 ***STD***
Wall Tile Grout	2226	Grout-(00) White ***STD***
Shared Ensuite Floor Tile Pattern	3090	VERTICAL STACKED ***STD***

Plumbing Fixture (Colour)	1737	Plumbing Fixtures-WHITE ***STD***
Comment		

Opt. Finished Basement Bathroom

Shower Floor Tile	8661	OD.ON.SWT.0202.MT.N-Ontario Series Mosaic-Snow White Matte-2 x 2 ***STD***
Shower Floor Tile Grout	2226	Grout-(00) White ***STD***
Shower Floor Tile Pattern	3000	STANDARD SQUARE ***STD***

Shower Wall Tile	9022	QT.WV.TGR.0810-Weave-Tender Grey-8 x 10 ***STD***
Shower Wall Tile Grout	7705	Grout-(01) Alabaster ***UPG***
Shower Wall Tile Pattern	3090	VERTICAL STACKED ***STD***

Shower Jamb(s)	8923	Shower Jamb / Sill-Thassos White ***STD***
Cabinet Colour/Style	6265	Viking III-MANCHESTER-SHALE GREY CL-MAPLE ***STD***
Countertop	8822	4924-38-Countertop-WHITE CARRARA-Wilsonart ***STD***
Countertop Edge	1111	N/A *****

Cabinet Hardware	7672	135-HARDWARE ***STD***
Flooring	8261	TR.ST.BYZ.1313-Serpentine-Beyaz/White-13x13 See Tile Line Pattern on Sketch Page 26 ***STD***
Floor Tile Grout	7705	Grout-(01) Alabaster ***UPG***
Floor Tile Pattern	3000	STANDARD SQUARE ***STD***

vs ka

VICTORIA, ANNE LEGG/KATHRYN, ELIZABETH ADAMS
 Project: Wallaceton
 Unit: 228, Phase: 2
 Model: 33-3344 B The Windsor

Created: 2/24/2021 11:35:46

Locked:

Closed:

9 of 56

Plumbing Fixture (Colour)	1737	Plumbing Fixtures-WHITE ***STD***
Comment		

Great Room Fireplace

Type	8869	Majestic MERC32 ***STD***
Mantle	7735	NF 8-Paint Grade Mantle-WHITE ***Upg*** PAGE 24
Surround Opt.	1111	N/A *****
Comment	DRY WALL ABOVE FIRPLACE TO CEILING	

Basement Stairs

Type	1712	Oak Stairs ***STD MAIN STAIRS***
Colour	7940	Sambucca STAIN TO COMPLIMENT HARDWOOD AND WILL VARY FROM FLOORING ***99***
Carpet Runner	1111	N/A *****
Handrail/Pickets/Post Type	8148	Single Collar Alt. Plain w/ Shoes with 3 1/2" Square/Cap Post(s)-BLACK ***2***
Handrail/Pickets/Post Colours	7761	Oak Grade-Stain handrail, stringers, treads, risers, nosing post
Carpet	1111	N/A *****
Custom Stain/Paint	1111	N/A *****
Comment		

Basement Stairs Landing(s)

Flooring	8906	Red Oak-Vintage 5 inch Pre-Sanded Smooth Unfinished Red Oak-Unfinished-3/4 inch x 5 inch ***4***
Comment	STAIN SAMBUCCA	

Main Stairs

Type	1712	Oak Stairs ***STD MAIN STAIRS***
Colour	7940	Sambucca STAIN TO COMPLIMENT HARDWOOD AND WILL VARY FROM FLOORING ***99***
Carpet Runner	1111	N/A *****
Handrail/Pickets/Posts Type	8148	Single Collar Alt. Plain w/ Shoes with 3 1/2" Square/Cap Post(s)-BLACK ***2***
Handrail/Pickets/Posts Colour	1111	N/A *****

VK
 ka

VICTORIA, ANNE LEGG/KATHRYN, ELIZABETH ADAMS
 Project: Wallaceton
 Unit: 228, Phase: 2
 Model: 33-3344 B The Windsor

Created: 2/24/2021 11:35:46

Locked:

Closed:

10 of 56

Custom Stain/Paint	1111	N/A *****
Comment		

Main Stairs Landing(s)		
Flooring	8906	Red Oak-Vintage 5 inch Pre-Sanded Smooth Unfinished Red Oak-Unfinished-3/4 inch x 5 inch ***4***
Comment	STAIN SAMBUCCA	

Throughout		
Walls - Paint Colour	1717	22-Wall-WARM GREY ***STD***
Underpad	1079	500 Series-Underpad ***STD***
Thresholds	2232	Metal Thresholds ***STD***
Switches and Plug	5796	Decora White Switches and Plugs ***STD***
Trim Size	8705	4 1/4 Baseboard and 2 3/4 Casings ***STD***
Trim - Paint Colour	1716	Trim-WHITE ***STD***
Comment		

Purchaser: Victoria Legg 03/19/2021 IRIT SALEM March 19/21
 VICTORIA, ANNE LEGG Date Decor Consultant Date
APPROVED

Purchaser: Kathryn Adams 03/19/2021 M. Rosen March 19/21
 KATHRYN, ELIZABETH ADAM Date Wallaceton Date Approved



Sales Selection Sheet

Wallaceton

11 of 56

PURCHASERS: VICTORIA, ANNE LEGG and KATHRYN, ELIZABETH ADAMS

TEL:

LOT / UNIT 228	PHASE 2	MODEL 33-3344 B The Windsor	
-------------------	------------	--------------------------------	--

It is herein understood and agreed between the undersigned parties hereto that the following changes shall be made to the above mentioned Agreement of Purchase and Sale in accordance with the agreement and except for such changes noted below, all other terms and conditions in the Agreement of Purchase and Sale shall remain as stated herein: It is further understood that and agreed that all changes and additions shall be installed as per builder's specifications, location and available selections. The Purchaser hereby agrees to purchase the following extras:

APPLIANCES

1	- SCB511436 CYCLONE 36" SS	Qty: 1
54,954	Note: CYCLONE 36" CHIMNEY HOOD FAN SS SPEC PAGE 33	
2	- BUILT-IN APPLIANCES	Qty: 1
55,038	Note: SEE SPEC. PAGE#S 34-56	

CABINERY Additional item see R-SSS page 59

3	KITCHEN - CABINERY - OPT LIGHT VALANCE (INCLUDE LIGHTING) - KITCHEN - UPG	Qty: 1
205,350		
54,905	Note:	
4	- CABINERY - VIKING II/III - OPT. SERVERY UPPERS - UPG	Qty: 1
205,327		
54,906	Note: Sketch # 3 Page 22	
5	- CABINERY - VIKING I/II/III KITCHEN BUILT IN - KITCHEN - STANDARD SERIES	Qty: 1
189,047		
54,907	Note: SEE SKETCH # 3 PAGE# 22	
6	- CABINERY - 32H-BASE CABINET FOR UNDER-COUNTER MICROWAVE WITH DRAWER BELOW (FINISHED INTERIOR) (SUPPLY SPECS) - UPGRADE 1	Qty: 1
189,216		
54,911	Note: SEE SPEC # SKETCH # 3 PAGE 22 PAGE# 42 AND 43	
7	- CABINERY - 19B-45CM WIDE PULL-OUT DOOR BASE CABINET WASTE/RECYCLE CENTRE WITH SOFT-CLOSE (2) 35L BINS) (AVAILABLE ONLY WITH 45CM WIDE CABINET) ; PRICE ALL THE SAME FOR ALL LINES - KITCHEN	Qty: 1
189,236		
54,914	Note: WITH TOP DRAWER- TO BE INSTALLED IN THE ISLAND BESIDE THE SINK SEE SKETCH # 3 PAGE# 22	
*8	SERVERY ONLY - CABINERY - SERVERY OPT LIGHT VALANCE (INCLUDE LIGHTING) - KITCHEN - UPG	Qty: 1
205,350		
54,978	Note:	
*9	- CABINERY -OPTIONAL -PANTRY 30CM DEEP - UPGRADE 1	Qty: 1
189,069		
54,992	Note: OPTIONAL 30 CM DEEP PANTRY Sketch # 2 AND 3 PAGES 21 AND 22	
10	- CABINERY - 12B-POTS AND PANS DRAWERS (WIDTH MIN. 60CM/MAX. 90CM) (SIZE SUBJECT TO FLOOR PLAN) - UPGRADE 1	Qty: 2
189,00E		
55,027	Note: TO BE INSTALLED ON EACH SIDE OF THE COOKTOP SEE SKETCH # 3 PAGE# 22	

Initials: VJ KA

TAX#:1

PREPARED BY: Bei Liu

PE 769-1



Sales Selection Sheet

Wallaceton

12 of 56

PURCHASERS: VICTORIA, ANNE LEGG and KATHRYN, ELIZABETH ADAMS

TEL:

LOT / UNIT 228	PHASE 2	MODEL 33-3344 B The Windsor
-------------------	------------	--------------------------------

CABINETRY

11 189,315 55,034	- CABINETRY - 09J-CROWN MOULDING (PER 8' LENGTH PRICE) (FOR CLARIFICATION OF STYLES, SEE MOULDING MATRIX) ; PRICE ALL THE SAME FOR ALL LINES - KITCHEN Note: FOR THE SERVERY	Qty: 1
12 205,351 55,035	- CABINETRY - OPT CROWN STD HEIGHT - KITCHEN - UPG Note:	Qty: 1
13 189,233 55,036	- CABINETRY - 02J-DUMMY DOOR FOR BASE FINISHED ENDS (EACH) - UPGRADE 1 Note: TO BE INSTALLED ON THE BACK OF THE ISLAND\SEE SKETCH # 3 PAGE 22	Qty: 4

CABINETRY / ELECTRICAL

14 54,913	KITCHEN/BREAKFAST - Note: RELOCATE STD. BANK OF DRAWERS - TO BE BESIDE THE FRIDGE (DUE TO WASTE DRAWER) SEE SKETCH # 3 PAGE# 22	Qty: 1
--------------	--	--------

CERAMICS

15 205,182 54,955	- CERAMICS - BACKSPLASH - KITCHEN - UPGRADE 4 Note:	Qty: 1
16 189,372 54,956	- CERAMICS - ADDITIONAL BACKSPLASH DUE TO INSTALL CHIMENEY HOODFAN IN KITCHEN - KITCHEN - UPGRADE 4 Note:	Qty: 1
17 205,174 54,957	- CERAMICS - BACKSPLASH - SERVERY - UPGRADE 4 Note:	Qty: 1
18 205,103 54,958	- CERAMICS - FLOOR - FOYER - UPGRADE 5 Note:	Qty: 1
19 205,111 54,959	- CERAMICS - FLOOR - POWDER ROOM - UPGRADE 5 Note:	Qty: 1
20 205,20C 54,960	- CERAMICS - FLOOR GROUT - ENSUITE 2 - GROUT Note:	Qty: 1
21 205,201 54,961	- CERAMICS - FLOOR GROUT - ENSUITE MASTER - GROUT Note:	Qty: 1

Initials: VJ TA

TAX#:1

PREPARED BY: Bei Liu

PE 769-2

Invoice.rpt 28may19



Sales Selection Sheet

Wallaceton

13 of 56

PURCHASERS: VICTORIA, ANNE LEGG and KATHRYN, ELIZABETH ADAMS

TEL:

LOT / UNIT 228	PHASE 2	MODEL 33-3344 B The Windsor	
-------------------	------------	--------------------------------	--

CERAMICS

22 205,198 54,963	- CERAMICS - FLOOR GROUT - LAUNDRY ROOM - GROUT Note:	Qty: 1
23 205,202 54,964	- CERAMICS - FLOOR GROUT - OPT. FINISHED BASEMENT BATHROOM - GROUT Note:	Qty: 1
24 205,195 54,965	- CERAMICS - FLOOR GROUT - POWDER ROOM - GROUT Note:	Qty: 1
25 205,199 54,966	- CERAMICS - FLOOR GROUT - SHARED ENSUITE - GROUT Note:	Qty: 1
26 205,084 54,968	- CERAMICS - SHOWER FLOOR - ENSUITE 2 - UPGRADE 6 Note:	Qty: 1
27 205,09C 54,969	- CERAMICS - SHOWER FLOOR - ENSUITE MASTER - UPGRADE 6 Note:	Qty: 1
28 205,191 54,970	- CERAMICS - SHOWER FLOOR GROUT - ENSUITE 2 - GROUT Note:	Qty: 1
29 205,192 54,971	- CERAMICS - SHOWER FLOOR GROUT - ENSUITE MASTER - GROUT Note:	Qty: 1
30 205,188 54,972	- CERAMICS - SHOWER WALL AND CEILING GROUT - ENSUITE 2 - GROUT Note:	Qty: 1
31 205,189 54,973	- CERAMICS - SHOWER WALL AND CEILING GROUT - ENSUITE MASTER - GROUT Note:	Qty: 1
32 205,19C 54,974	- CERAMICS - SHOWER WALL AND CEILING GROUT - OPT. FINISHED BASEMENT BATHROOM - GROUT Note:	Qty: 1
*33 189,355 55,002	- CERAMICS - 12" OF LISTELLO * INDICATE SIZE ON SSS - UPGRADE 4 Note: MASTER SHOWER 12" LISTELLO ON 3 SIDES 5" FROM FLOOR SEE SKETCH# 4 PAGE# 23	Qty: 28

Initials: VJ TA

TAX#:1

PREPARED BY: Bei Liu

PE 769-3

SInvoice.rpt 28may19



Sales Selection Sheet

Wallaceton

14 of 56

PURCHASERS: VICTORIA, ANNE LEGG and KATHRYN, ELIZABETH ADAMS

TEL:

LOT / UNIT 228	PHASE 2	MODEL 33-3344 B The Windsor
-------------------	------------	--------------------------------

CERAMICS

34 205,155 55,020	- CERAMICS - FLOOR - ENSUITE MASTER - UPGRADE 1 Note:	Qty: 1
35 205,196 55,028	- CERAMICS - FLOOR GROUT - GARAGE ENTRY / MUD ROOM - GROUT Note:	Qty: 1
36 205,194 55,029	- CERAMICS - FLOOR GROUT - FOYER - GROUT Note:	Qty: 1

DRYWALL

37 55,003	- WALL ABOVE THE FIRE PLACE <i>SKETCH # 2 PAGE 21</i> Note: GRET ROOM -BUILT OUT THE BOX TO CEILING FOR FIRE PLACE	Qty: 1
--------------	--	--------

ELECTRICAL Additional item see R-SSS page 57 & 59

38 189,448 54,933	- ELECTRICAL - POTLIGHT BUNDLE - 8 X 4 INCH SLIM RECESSED LED DOWNLIGHT WHITE TRIM (3000K)MODEL DWS4303 INCLUDES 2 SWITCHES BASEMENT (SEE LINE VOLTAGE FOR MAIN FLOOR) Note: REC ROOM; 6 POT LIGHT USE STD. SWITCH (RELOCATE STD. LIGHT) 1 POT LIGHT IN UPPER BASEMENT LANDING USE SAME STD. SWITCH AS MAIN HALL WAY 1 POT LIGHT IN THE MAIN FLOOR SERVERY - USE SAME SWITCH AS KITCHEN POT LIGHT SEE SKETCH # 1 AND 2 PAGE# 20 AND 21	Qty: 1
39 189,44E 54,934	- ELECTRICAL - POTLIGHT BUNDLE - 8 X T477GR-W 4 INCH LINE VOLTAGE POTLIGHTS INCLUDES 2 SWITCHESMAIN FLOOR (SEE SLIM LINE FOR BASEMENT) Note: DINING ROOM - 4 POT LIGHT ON SEPARATE SWITCH GREAT ROOM - 6 POT LIGHT ON SEPARATE SWITCH KITCHEN 6 POT LIGHT - USE SEPARATE SWITCH <i>RELOCATE 2X STANDARD KITCHEN LIGHTS ABOVE ISLAND</i> SEE SKETCH # 2 PAGE# 21	Qty: 2
40 189,44C 54,938	- ELECTRICAL - EXTRA WALL INTERIOR OUTLET (120V/15A) ON A SEPARATE CIRCUIT (ON ARCFULT) Note: KITCHEN: TO BE USED FOR THE BASE MICROWAVE <i>SPEC PAGES 42 AND 43</i> SEE SKETCH # 3 PAGE# 22	Qty: 1
41 189,44E 54,939	- ELECTRICAL - EXTRA WALL INTERIOR OUTLET ON EXISTING CIRCUIT (DOES NOT INCLUDE KITCHEN OUTLETS) Note: GREAT ROOM - TO BE INSTALLED ABOVE THE FIRE PLACE 70"+ FROM FLOOR SEE SKETCH# 2 PAGE# 21	Qty: 1
42 189,417 54,940	- ELECTRICAL - RELOCATION OF SWITCHES/LIGHTS (MUST SPECIFY LOCATION) - NOTE: PLUGS CANNOT BE RELOCATED- MUST PURCHASE ADDITIONAL OUTLET. <i>SPECS PAGES 39-41</i> Note: KITCHEN- RELOCATE STD. STOVE TO WALL OVEN LOCATION SEE SKETCH # 3 PAGE# 22	Qty: 1

Initials: VL AK

TAX#:1

PREPARED BY: Bei Liu

PE 769-4



Sales Selection Sheet

Wallaceton

15 of 56

PURCHASERS: VICTORIA, ANNE LEGG and KATHRYN, ELIZABETH ADAMS

TEL:

LOT / UNIT 228	PHASE 2	MODEL 33-3344 B The Windsor
-------------------	------------	--------------------------------

ELECTRICAL

Added exterior outlet and fixture see Rev-SSS pgs 57-58

*43 189,417	- ELECTRICAL - RELOCATION OF LIGHTS (MUST SPECIFY LOCATION) - NOTE: PLUGS CANNOT BE RELOCATED- MUST PURCHASE ADDITIONAL OUTLET.	Qty: 3
54,949	Note: RECROOM - RELOCATE STD, REC ROOM LIGHT TO BE ON TO THE LOWER BASEMENT STAIRS LANDING 65" FROM FLOOR, USE EXISTING 3 WAY SWITCH FOR FUTURE SCONES RELOCATE BASEMENT REC ROOM LIGHT TO BE ON MAIN STAIRS ALNDING WALL 65" FROM FLOOR - USE STD. HALL WAY LIGHT SWITCH. SERVRY LIGHT TO BE RELOCATED TO THE OFFICE - USE EXISTING SWITCH SEE SKETCH # 1 AND 2 PAGE# 20 AND 21	
44 189,450	- ELECTRICAL - CEILING ROUGH-IN (CAPPED)	Qty: 3
54,952	Note: 2 FAMILY ROOM ON SECOND FLOOR SEPARATE SWITCH -2' FROM WALLS 1 ABOVE CENTRE OF STAIRS SEPARATE SWITCH (SWITCH ON LOWER FLOOR) TO SECOND FLOOR SEE SKETCH # 4 PAGE# 23 AND SKETCH # 2 PAGE 21 FOR SWITCH LOCATION	
45 54,991	- DECORA DIMMER SWITCH WITH ON AND OFF (120V) SINGLE POLE Note: TO BE INSTALLED FOR THE POT LIGHT ; REC ROOM, GREAT ROOM/ MASTER BEDROOM ,OFFICE, FAMILY ROOM CAP LIGHT SEE SKETCH #1,2,4 PAGE# 20, 21 AND 23	Qty: 5
46 189,448	- ELECTRICAL - EXTRA WALL INTERIOR OUTLET ON EXISTING CIRCUIT (DOES NOT INCLUDE KITCHEN OUTLETS) (TOTAL OF 5)	Qty: 4
54,994	Note: 3- UNFINISHED BASMENT NOTE: 1X BEDROOM 3 1 REC ROOM SKETCH # 4 PAGE 23 SEE SKETCH# 1 PAGE # 20	
47 189,451	- ELECTRICAL - ADDITIONAL SWITCH LOCATE BY REAR PATIO DOOR	Qty: 1
54,997	Note: EXTERIOR : TO BE USED FOR EXTERIOR CAP LIGHT (FUTURE MOTION LIGHT) SEE SKETCH # 2 PAGE# 21 BOTH	
*48 189,450	- ELECTRICAL - ROUGH-IN (CAPPED)	Qty: 2
54,998	Note: EXTERIOR TO BE USED FOR FUTURE MOTION LIGHT SEE SKETCH # 2 PAGE# 21	
49 189,430	SHARED BATHROOM - ELECTRICAL - ADDITIONAL SHOWER LIGHT (COMPLETE) INCLUDING SWITCH; 10 1/2" ROUND FROSTED WHITE GLASS	Qty: 1
55,019	Note: SHARED BATHROOM TUB SKETCH # 4 PAGE 23	

FIREPLACE AND MANTLE

50 55,037	GREAT ROOM FIREPLACE - OPT. BLOWER FAN KIT Note:	Qty: 1
--------------	---	--------

GRANITE

51 205,208	- GRANITE - COUNTERTOP - 3/4" GROUP 5 WITH MITRE EDGE - KITCHEN / ISLAND - UPG	Qty: 1
54,920	Note:	

Initials: VL KA

TAX#:1

PREPARED BY: Bei Liu

PE 769-5

S\invoice.rpt 28may19



Sales Selection Sheet

Wallaceton

16 of 56

PURCHASERS: VICTORIA, ANNE LEGG and KATHRYN, ELIZABETH ADAMS

TEL:

LOT / UNIT 228	PHASE 2	MODEL 33-3344 B The Windsor
-------------------	------------	--------------------------------

GRANITE

52 205,227 54,921	- GRANITE - COUNTERTOP WITH 4" BACKSPLASH - 3/4" GROUP 1 - ENSUITE 2 - UPG Note:	Qty: 1
53 189,464 54,922	- GRANITE - GRANITE CUTOUT W/ STRAIGHT EDGE POLISH TO ACCOMMODATE COOK TOP Note: COOKTOP SPECS PAGES 36-38	Qty: 1

HARDWOOD

54 205,360 54,925	- HARDWOOD - 5" RED OAK SCULPTED - DINING ROOM - UPG Note:	Qty: 1
55 205,356 54,926	- HARDWOOD - 5" RED OAK SCULPTED - GREAT ROOM - UPG Note:	Qty: 1
*56 205,406 54,927	- HARDWOOD - 5" RED OAK SCULPTED - KITCHEN / SERVERY / BREAKFAST - UPG Note:	Qty: 1
57 205,376 54,928	- HARDWOOD - 5" RED OAK SCULPTED - LANDING(S) TO 2ND FLOOR - UPG Note:	Qty: 1
58 205,372 54,929	- HARDWOOD - 5" RED OAK SCULPTED - LANDING(S) TO BSMT - UPG Note:	Qty: 1
59 205,364 54,930	- HARDWOOD - 5" RED OAK SCULPTED - MAIN HALL - UPG Note:	Qty: 1
60 205,368 54,931	- HARDWOOD - 5" RED OAK SCULPTED - OFFICE - UPG Note:	Qty: 1

HEATING / AIR

61 189,474 54,912	- HEATING/AIR - ROUGH-IN GAS LINE FOR GAS STOVE AT MAIN FLOOR (SEE SPECS) (HOOK-UP NOT INCLUDED) LEAVE STANDARD 120 VOLT ELECTRICAL OUTLET ON A SEPARATE CIRCUIT. * SPECIFY IF STANDARD 220V WILL STAY OR BE RELOCATED Note: FOR B/I OVENS SKETCH # 3 PAGE 22 GAS COOKTOP SPECS PAGES 36-38	Qty: 1
-------------------------	---	--------

INTERIOR RAILINGS

*62 205,274 54,947	- INTERIOR RAILINGS - BLACK METAL - SINGLE COLLAR ALT. PLAIN W/ SHOES WITH 3 1/2" SQUARE/CAP POST(S) AS PER PLAN - MAIN AND BASEMENT STAIR - UPG Note:	Qty: 1
--------------------------	---	--------

Initials: VJ KA

TAX#:1

PREPARED BY: Bei Liu

PE 769-6



Sales Selection Sheet

Wallaceton

17 of 56

PURCHASERS: VICTORIA, ANNE LEGG and KATHRYN, ELIZABETH ADAMS

TEL:

LOT / UNIT 228	PHASE 2	MODEL 33-3344 B The Windsor
-------------------	------------	--------------------------------

MIRRORS/GLASS PRODUCTS

63 205,275 54,923	- MIRRORS/GLASS PRODUCTS - UPGRADE TO FRAMELESS CLEAR GLASS WITH D-RING HANDLE IN CHROME - ENSUITE 2 - UPG Note:	Qty: 1
64 205,276 54,924	- MIRRORS/GLASS PRODUCTS - UPGRADE TO FRAMELESS CLEAR GLASS WITH D-RING HANDLE IN CHROME - ENSUITE MASTER - UPG Note:	Qty: 1

MODIFICATIONS

65 55,015	- PROMO Note:	Qty: (1)
--------------	----------------------	----------

PAINTING

66 191,830 54,953	- PAINT - STAIN STAIR LANDING IN SAMBUCCA. LANDING UNDER 25 SQ.FT. EACH Note:	Qty: 4
-------------------------	--	--------

PLUMBING

67 189,613 54,890	- PLUMBING - BAR SINK - COMPLETE BAR SINK FOR SERVERY INCLUDES PLUMBING ROUGH-IN AND MOEN ALIGN BAR PR EP FAUCET (MODEL: 5965) AND REGINOX NS1813U/7 UNDERMOUNT SINK (INCLUDING GRANITE SINK CUTOUT/POLISH) - Note: SKETCH #3 PAGE 22 SPECS PAGES 27 AND 28	Qty: 1
68 189,722 54,917	- PLUMBING - KITCHEN SINK UPGRADE - BLANCO KITCHEN SINK QUATRUS U 1 MAXI #401248 (32 INCH X 18 INCH) Note: SPEC PAGE 25	Qty: 1
69 189,618 55,022	- PLUMBING - MOEN -KYVOS - LAV SINGLE HANDLE FAUCET WITH PUSH-BUTTON DRAIN - CHROME (MODEL: 6781) - Note: MASTER AND ENSUITE 2 BATHROOM SPEC PAGE 29	Qty: 3
70 189,620 55,023	- PLUMBING - MOEN -KYVOS - POSI-TEMP PRESSURE BALANCED TUB/SHOWER ECO-PERFORMANCE CHROME (MODEL: T2783 EP/62320) - Note: MASTER BATHROOM SPEC PAGE 30	Qty: 1

SECURITY Additional item see R-SSS page 62

71 189,773 54,901	- SECURITY - SECURITY CAMERA ROUGH-IN Note: 1- FRONT PORCH 1- BACK 1- SIDE OF HOUSE SEE SKETCH# 2 PAGE# 21	Qty: 3
-------------------------	--	--------

Initials: *VL* *KA*

TAX#:1

PREPARED BY: Bei Liu

PE 769-7



Sales Selection Sheet

Wallaceton

18 of 56

PURCHASERS: VICTORIA, ANNE LEGG and KATHRYN, ELIZABETH ADAMS

TEL:

LOT / UNIT 228	PHASE 2	MODEL 33-3344 B The Windsor
-------------------	------------	--------------------------------

SECURITY

72 189,774	MUD ROOM - SECURITY - SECURITY KEY PAD ROUGH-IN	Qty: 1
54,902	Note: TO BE INSTALLED IN THE MUD ROOM SEE SKETCH# 2 PAGE# 21	

STRUCTURED WIRING Additional item see R-SSS page 62

73 189,776	BEDROOM 2- STRUCTURED WIRING - TV CABLE LINE ROUGH-IN RG 6	Qty: 1
54,903	Note: BEDROOM 2 SEE SKETCH# 4 PAGE# 23	
74 189,776	- STRUCTURED WIRING - TV CABLE LINE ROUGH-IN RG 6	Qty: 2
54,904	Note: 1-FAMILY ROOM (SECOND FLOOR) 1- OFFICE SEE SKETCH# 2,4 PAGE# 21 AND 23	
75 189,775	- STRUCTURED WIRING - RELOCATION OF TV/PHONE	Qty: 2
54,932	Note: GREAT ROOM- - RELOCATE STD. R// CABLE TO BE ABOVE THE FIRE PLACE 70"+- FROM FLOOR KITCHEN - RELOCATE STD. R// PHONE SEE SKETCH# 2 PAGE# 21	
*76 189,775	- STRUCTURED WIRING - RELOCATION OF TV	Qty: 1
54,935	Note: FINISHED RECROOM- RELOCATE STD.R// CABLE SEE SKETCH# 1 PAGE# 20	

WAFFLE CEILING

77 54,977	GREAT ROOM - SKETCH # 2 PAGE 21	Qty: 1
	Note: GREAT ROOM - WAFFLE CEILING INCLUDES COFFERED CEILING	

Sub Total
HST
Total

Initials: VL Ka

TAX#:1

PREPARED BY: Bei Liu

PE 769-8

Invoice.rpt 28may19



Sales Selection Sheet

Wallaceton

19 of 56

PURCHASERS: VICTORIA, ANNE LEGG and KATHRYN, ELIZABETH ADAMS

TEL:

LOT / UNIT 228	PHASE 2	MODEL 33-3344 B The Windsor	
-------------------	------------	--------------------------------	--

1. This Sales Selection Sheet when properly executed forms part of our Agreement of Purchase and Sale.
2. All extras and upgrades listed above are subject to Construction Progress and Architectural and Municipal requirements.
3. In the event the Vendor is unable to incorporate the work approved above in the construction of the house for any reason whatsoever, the Vendor will not be liable to the Purchaser in any way. The monies paid for any changes or optional extras not proceeded with shall be returned to the Purchaser, without interest. The cost of options or extras is non-refundable in all other circumstances. If for any reason whatsoever the Agreement of Purchase and Sale is not completed, the total cost of work approved above will be retained by the Vendor.
4. The Vendor reserves the right to substitute above materials and equipment with that of equal or better quality.
5. Purchaser acknowledges that items may not be exactly as shown. Variations from the Vendor's samples may occur in finished materials due to normal production processes. Vendor is not responsible for shade difference which may occur from different dye lots or wood grains. Variations from the Vendor's samples will occur with natural materials such as wood, marble, granite, hardwood and brick.
6. The Vendor reserves the right to select Grout & Thresholds that best suits the Tile selected.
7. Selections will not be processed unless signed by Heathwood Homes Head Office.
8. The selections made on this schedule are final and cannot be changed once submitted.
9. The Purchaser has checked and acknowledges the accuracy of this schedule.

Payment Summary	
Paid By	Amount
Total Payment:	

PURCHASER:

Victoria Anne Legg
VICTORIA, ANNE LEGG

19-Mar-21
DATE

Rachel
Decor Consultant

19-Mar-21
DATE

PURCHASER:

Kathryn Adams
KATHRYN, ELIZABETH ADAMS

19-Mar-21
DATE

APPROVED

23-23-2021

Date Approved Heathwood Homes (Huron) Limited

M. Rosen

PAID BY AMENDMENT
WITH DEPOSIT OF
\$ 23,770.00 PAID BY VISA MARCH 19/21

TAX#:1

PREPARED BY: Bei Liu

PE 769-9

SInvoice.rpt 28may19

UK Lot 228 Upgraded Rear and Side Elevation

UK-75 WALLACETON
LOT 228
33-3344 ELEV. B
THE WINDSOR

20 of 56
THE WINDSOR

Sketch #1

ELEVATION B | 3,596 SQ. FT.
Including 263 sq. ft. of finished Lower Level

701 sq. ft. of opt. finished Lower Level

33-3345 ELEV. B

RELOCATED REC ROOM LIGHT
&
ADDITIONAL ELECTRICAL PLUG STD HEIGHT.

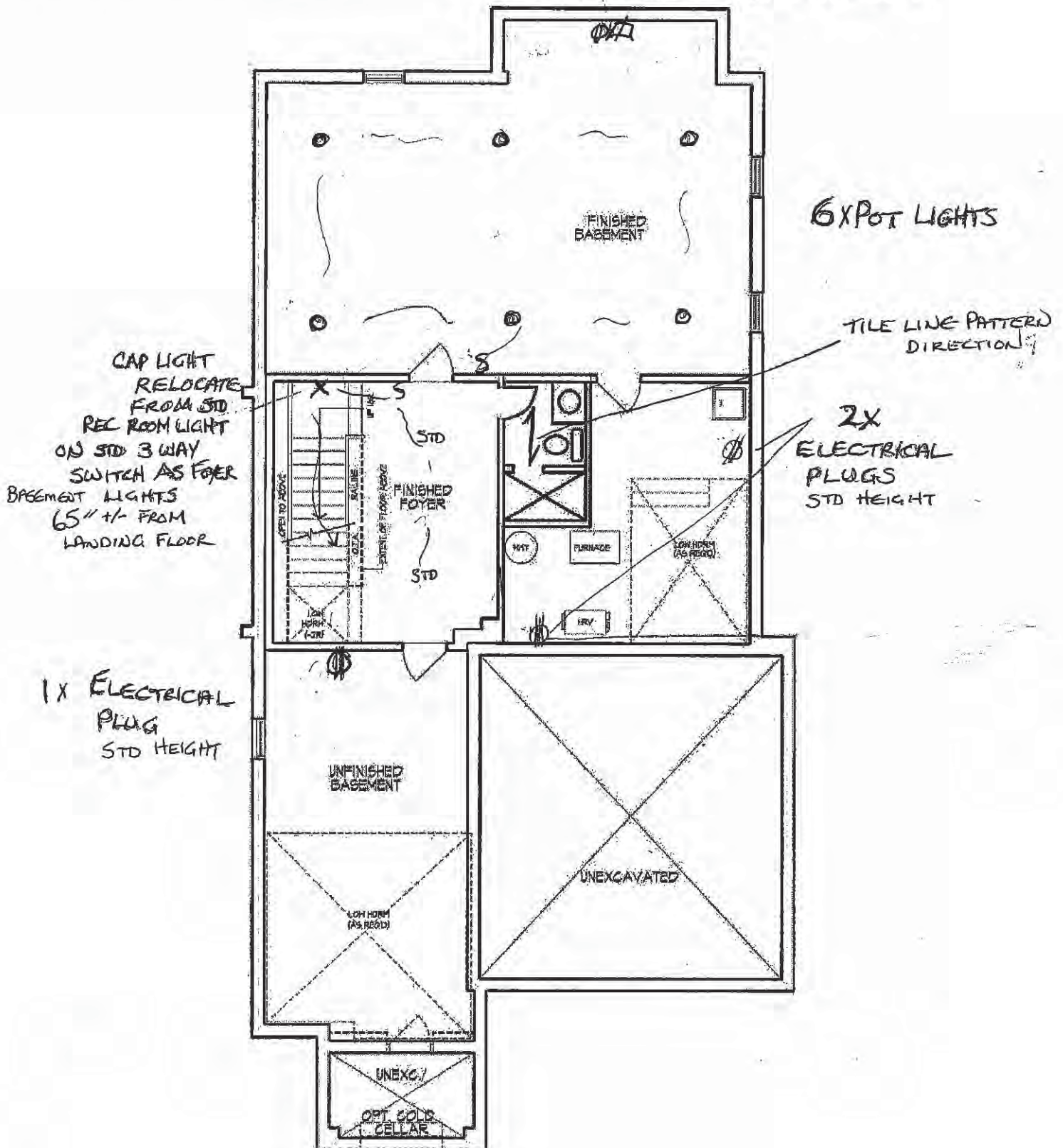

BASEMENT PLAN, ELEV. 'A' LOT (2)28

Basement Plan – Elev. B Lot 228

to
V1

UK Lot 228 Upgraded Rear and Side Elevation

21 of 56

Sketch #2

THE WINDSOR

ELEVATION B | 3,596 SQ. FT.
Including 263 sq. ft. of finished Lower Level

701 sq. ft. of opt. finished Lower Level

33-3345 ELEV. B

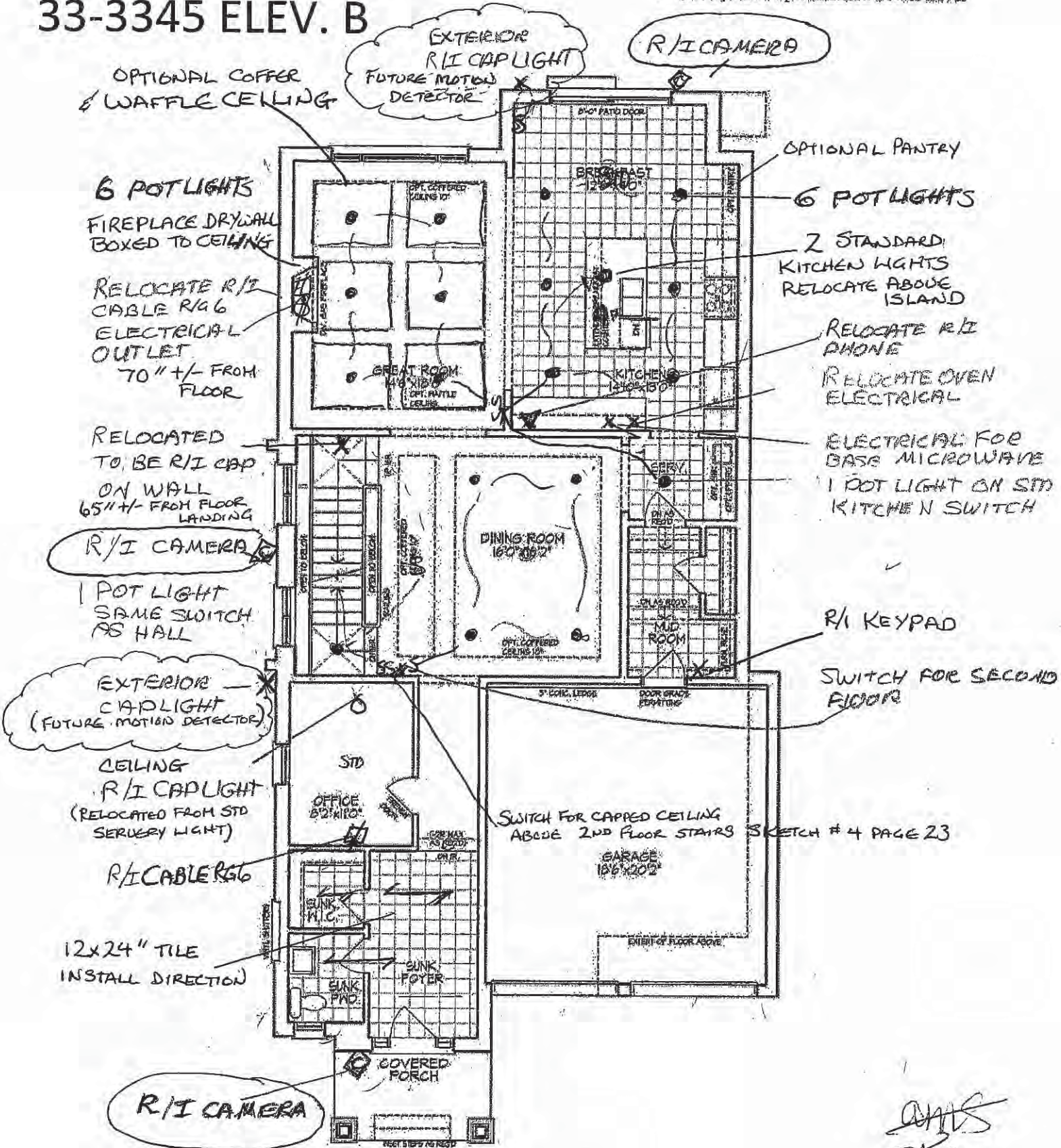

Ground Floor Plan – Elev. B Lot 228

ANS
JR

VJ

UK-75 WALLACETON
 LOT 228
 33-3344 ELEV. B
 THE WINDSOR

2/12/2021

22 of 56

UPGRADE KITCHEN - BUILT-IN APPLIANCES:
 -30" COOKTOP POTS & PANS
 -30" WALL OVEN

Sketch #3

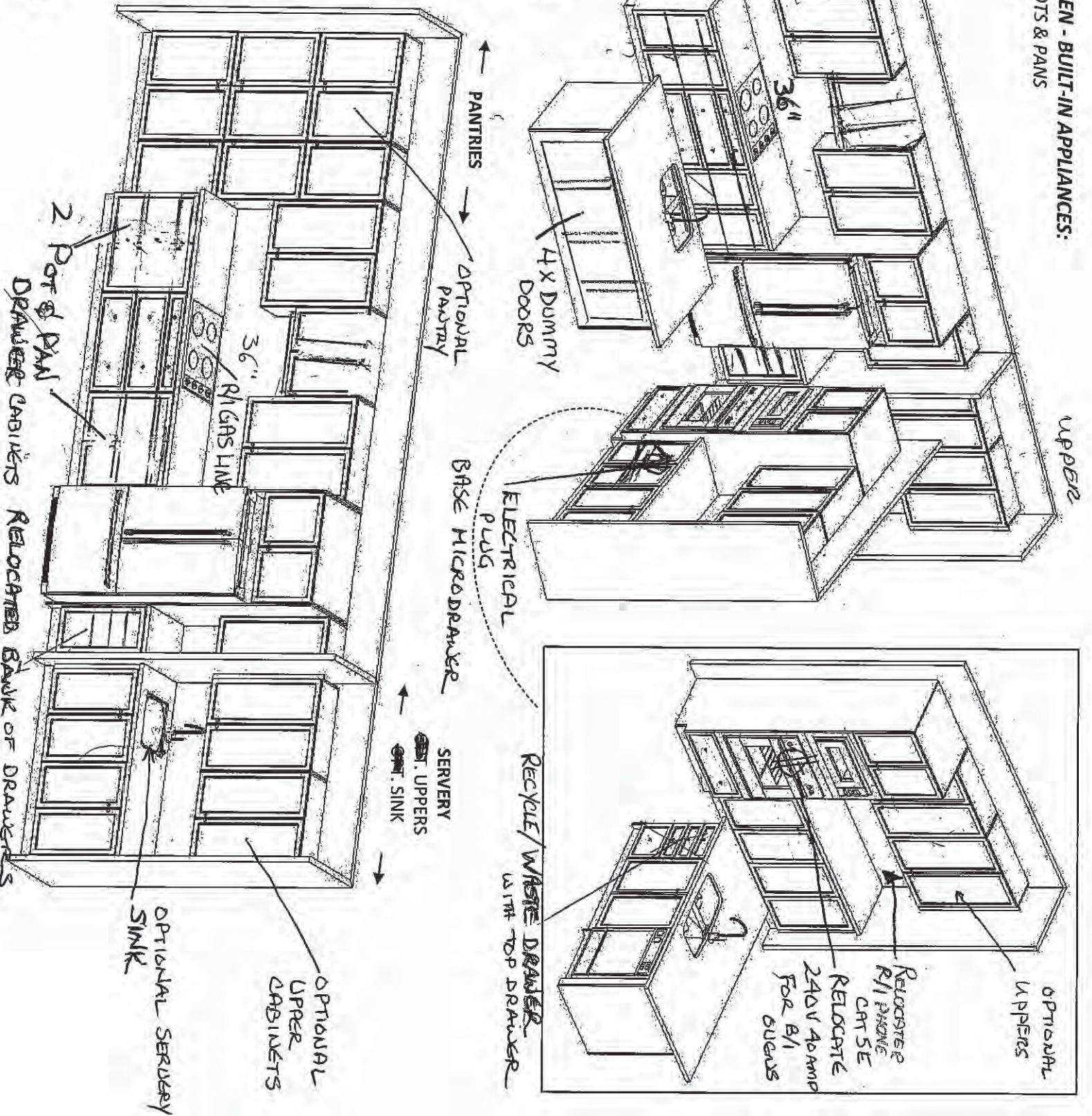

FRENDEL
 KITCHENS LIMITED
 1990 Sturminster Drive, Mississauga, ON L4W 1G3

HEATHWOOD HOMES
 WALLACETON, KITCHENER ON
 MODEL: 33-3344 (4003)

STANDARD CONTRACT INCLUDES:

Appliance Openings

- Hood: 30"W builder hood
- Fridge Opening: 37 3/8 "W X 73 3/8"
- Fridge cabinet & gables: 66cm Deep
- Cooktop: 30"W - Tall Wall Oven: 30"W
- Dishwasher Opening: 24"

Standard Kitchens Scope:

- 100cm H wall cabinets
- Std. Blumotion Hinges- **soft close doors**
- Std. Metabox Drawers- **not soft close**
- Min 40cm W drawer
- Base pie cut corner cabinets
- Backing on all cabinets
- Countertop by others
- Upgrade applied paneled fridge & dishwashers supply only (appliance hardware by others)

THIS DRAWING IS FOR DESIGN PURPOSES ONLY. IT IS NOT AN EXACT RENDITION.

UK Lot 228 Upgraded Rear and Side Elevation

UK-75 WALLACETON
LOT 228
33-3344 ELEV. B
THE WINDSOR

23 of 56
THE WINDSOR

ELEVATION B | 3,596 SQ. FT.
Including 263 sq. ft. of finished Lower Level

33-3345 ELEV. B

Sketch #4

701 sq. ft. of opt. finished Lower Level

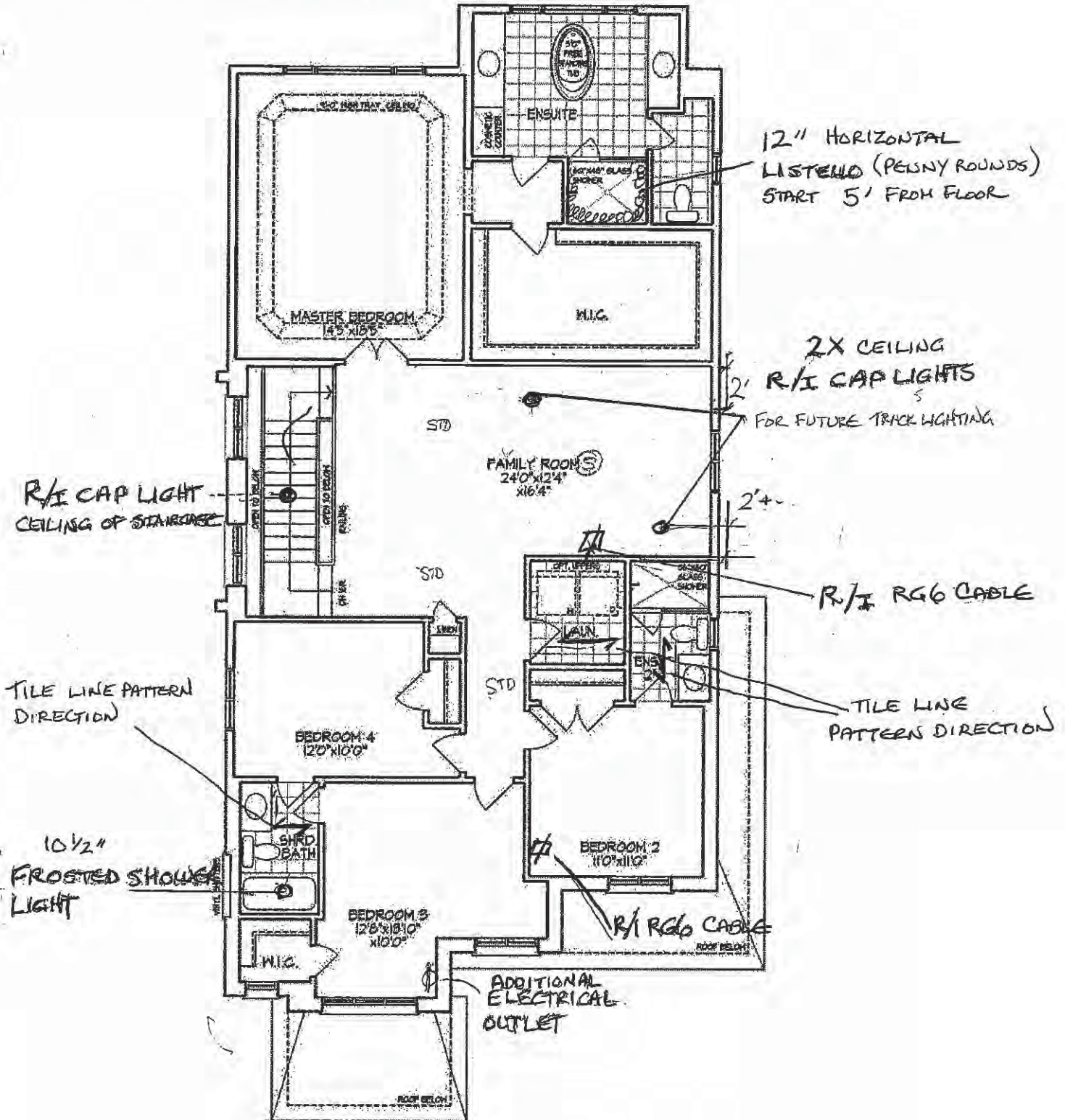

Second Floor Plan – Elev. B Lot 228

VJ KQ

UK-75 WALLACETON
LOT 228
33-3344 ELEV. B
THE WINDSOR

24 OF 56

UPGRADE MANTLE SINGLES

36" FIREPLACES

NF 8 Mantel
WHITE PAINT GRADE FINISH

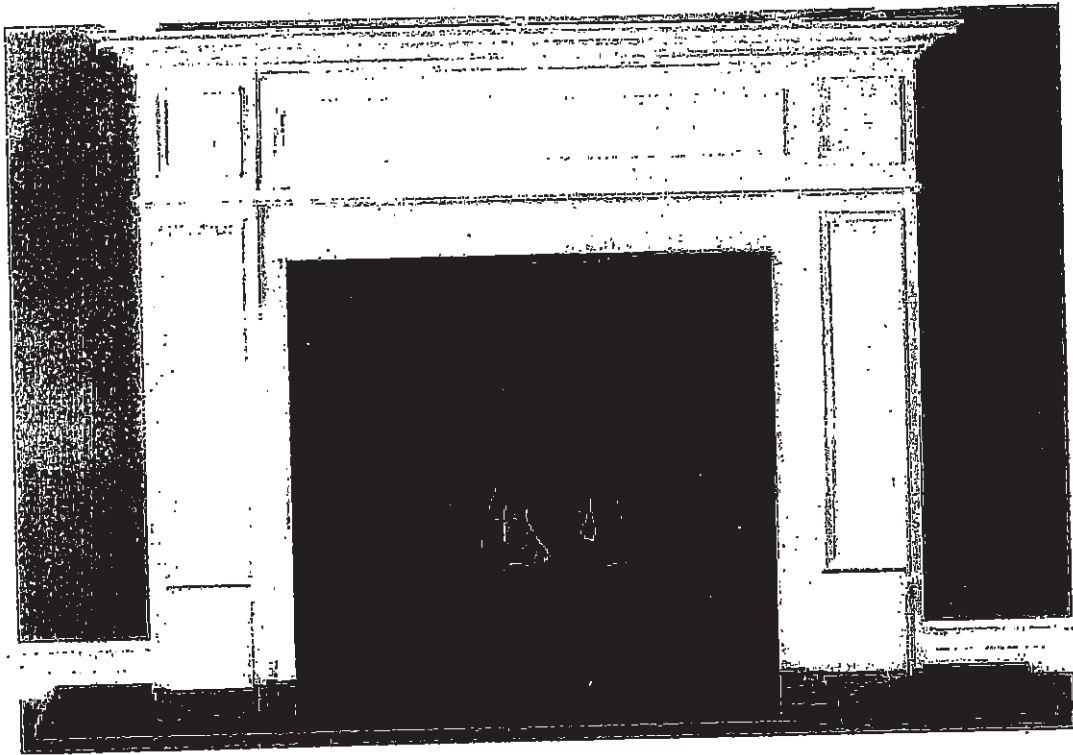

Kathryn Adams
KA

VA

UK-75 WALLACETON
 LOT 228
 33-3344 ELEV. B
 THE WINDSOR

25 of 56

BLANCO

**BLANCO QUATRUS U Maxi
 Stainless Steel
 Undermount Sink**

This new German-engineered sink from BLANCO features a 9-inch bowl depth and zero-radius bowl corners. Made of durable 18 gauge stainless steel.

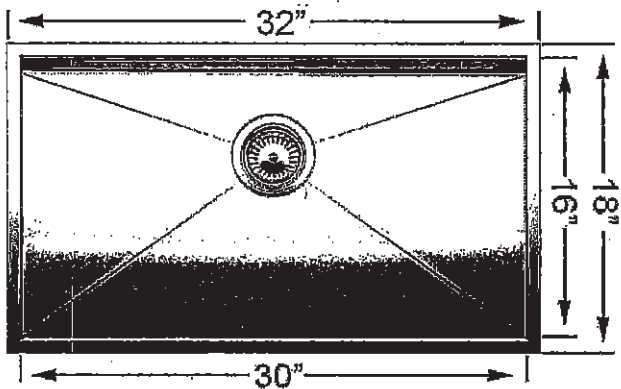
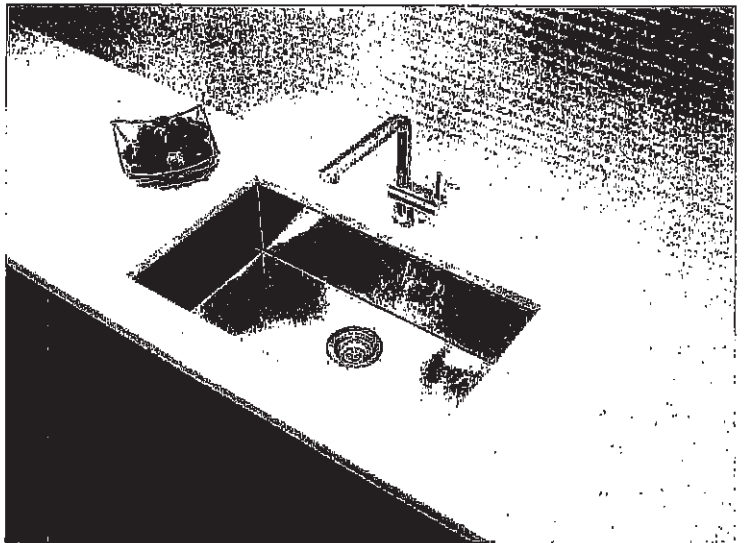

Model No.	Bowl Depth	
	Main	Secondary
401248	9" (230 mm)	

Material
 Durable 18 gauge stainless steel
 Brushed finish

Specifications
 Minimum Cabinet Size: 33" (840 mm)
 Undermount installation
 Rear positioned drain hole for maximum usable bowl and cabinet storage space
 Zero-radius corners and x-pattern drain grooves
 Sound deadening system included
 Template included
 3 1/2" stainless steel strainer included
 Limited Lifetime Warranty

Accessories	
Stainless Steel Grid	223192

VJ
 ka

UK-75 WALLACETON
LOT 228
33-3344 ELEV. B
THE WINDSOR

26 of 56

STANDARD KITCHEN FAUCET

Align

Modern

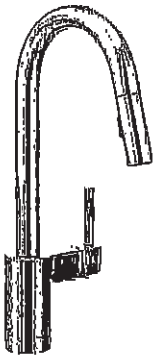

Single Handle Pull-Down Kitchen
Faucet*

Model 7565†

Ha vj

UK-75 WALLACETON
LOT 228
33-3344 ELEV B
THE WINDSOR

Optional Servery Sink

27 of 56

Reginox

NS1813U/7

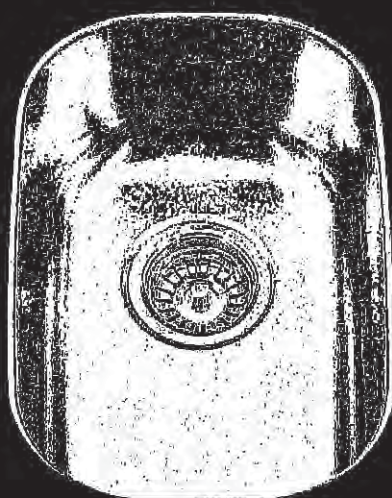

Optional Accessory
BG35S

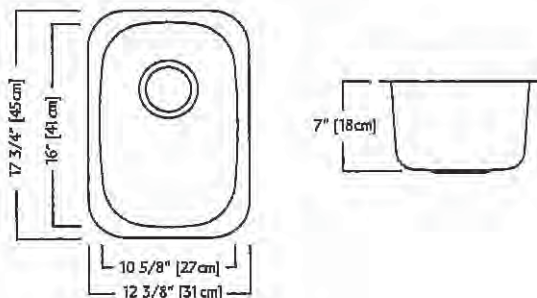

NS1813U/7 SPECIFICATION

Model NS1813U/7 is a single bowl, undermount sink manufactured for Franke Kindred Canada Limited from 18 gauge, 18-10 stainless steel. Product has mirror finished rim and satin finished bowl. Sink is fully undercoated. Basket strainer waste fitting (3 1/2", 89 mm) is included. Sink is backed with a limited buyer lifetime warranty.

- O.D. 17 3/4" x 12 3/8" x 7" (45 x 31 x 18 cm)
- Recommended for minimum 15" cabinet

Franke Kindred Canada Limited
P.O. Box 190, 1000 Franke Kindred Road, Midland, Ontario, Canada, L4R 4K9 Phone: 866-687-7465 Fax: 800-361-8408

UK-75 WALLACETON
 LOT 228
 33-3344 ELEV B
 THE WINDSOR

28 of 56

Align®

Traditional | Transitional | Modern

From intimate galley kitchens to large gourmet workstations,
 Align faucets bring a refreshed modern look to your home.



MotionSense™ Hands-Free Single Handle Pulldown Kitchen Faucet *
 Not Available in BL or BG
 Model 7565E

Chrome
 Other



Single Handle Pulldown Kitchen Faucet *
 Available in BG

Model 7565

Chrome
 Other

STANDARD
 KITCHEN FAUCET

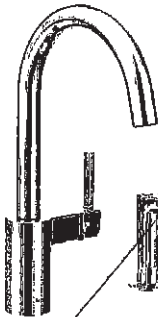

Single Handle Kitchen Faucet with Side Spray *
 Not Available in BL or BG

Model 7165

Chrome
 Other

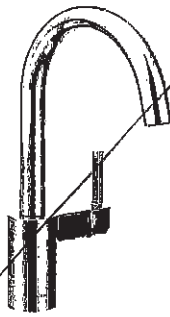

Single Handle Kitchen Faucet *
 Not Available in BL or BG

Model 7365

Chrome
 Other



Single Handle Pulldown Bar/Prep Faucet *
 Available in BG

Model 5965

Chrome
 Other

SERVERY
 FAUCET

FINISH OPTIONS:



C SRS BL BG

To order, combine the model number with one of these finish letter(s):
 Spot Resist™ Stainless [SRS], Matte Black [BL] & Brushed Gold [BG]
 To order Chrome (C) model, use model number only.
 For Chrome MotionSense, order 7565EC.

* Deckplate sold separately - 141002 series

UK-75 WALLACETON
LOT 228
33-3344 ELEV. B
THE WINDSOR

29 of 56

ENS. 2 + MASTER ENSUITE x 2

Kyvos™

Traditional | Transitional | Modern

The geometric, square edges paired with the flat handle offer a bold feel that elevates contemporary bathroom interiors.

X 3

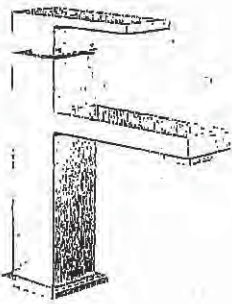

**Single Handle
Lav Faucet
with Push-Button Drain**

Model 6781

Chrome

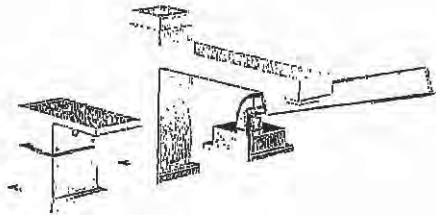

**One Handle Roman Tub Faucet
with Hand Shower**

Model T907 / 4791

Chrome



Tub Drain Half Kit Available



FINISH OPTIONS:



C

- Deckplate sold separately - 193148 series

VJ
Ker

UK-75 WALLACETON
LOT 228
33-3344 ELEV. B
THE WINDSOR

30 of 56

Master Bathroom

Kyvos™

Traditional | Transitional | Modern

The geometric, square edges paired with the flat handle offer a bold feel that elevates contemporary bathroom interiors.

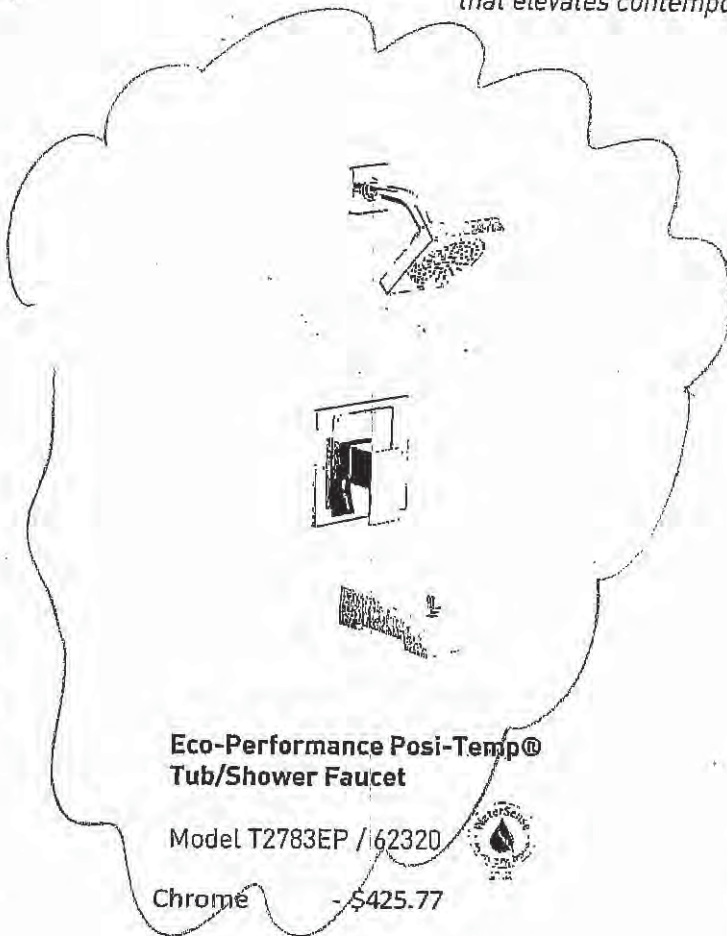

**Eco-Performance Posi-Temp®
Tub/Shower Faucet**

Model T2783EP / 62320

Chrome - \$425.77

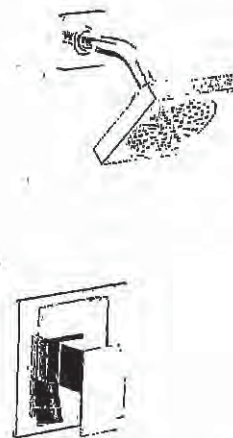

**Eco-Performance Posi-Temp®
Shower Only**

Model T2782EP / 62320

Chrome - \$341.82



FINISH OPTIONS:



C

UK-75 WALLACETON
LOT 228
33-3344 ELEV. B
THE WINDSOR

31 of 56

Chateau

Transitional

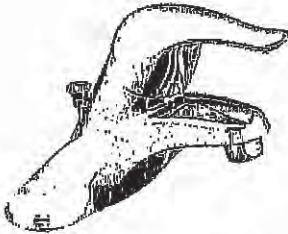

Lavatory Faucet with Pop-Up Drain
Model L4621†

VANITY SINKS AND PEDESTAL

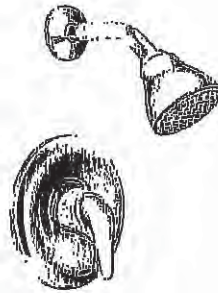

Posi-Temp® Pressure Balancing Tub/Shower
Model 62320 / TL183†

OR

Posi-Temp Valve and Tub/Shower Trim
with Eco-Performance Easy Clean® XL

Model 62320 / TL183EP†

(TL183EP not available in BC)

SHOWER AND 5' TUB FAUCETS



2 Handle Roman Tub with 9" Spout
Model 4796 / T990†

FREESTANDING TUB FAUCETS

VK
Ka

UK-75 WALLACETON
 LOT 228
 33-3344 ELEV. B
 THE WINDSOR

32 of 56



Buy it for looks. Buy it for life.®

There is more than 1 version of this model.
 Page down to identify the version you have.

DESCRIPTION

- Metal construction with various finishes identified by suffix
- 1/2" IPS connections
- Includes metal or 50/50 pop-up type waste assembly where noted

OPERATION

- Pivot action lever style handle
- Temperature controlled through 100° degree arc of handle travel

FLOW

- Water usage is limited to these maximum flow rates as indicated by the corresponding product markings
 - 1.2 gpm max (4.5L/min) at 60 psi
 - 1.5 gpm max (5.7L/min) at 60 psi

CARTRIDGE

- 1255™ Duralast™ cartridge
- Nonmetallic/nonferrous and stainless steel material

STANDARDS

- Third party certified to WaterSense®, ASME A112.18.1/CSA B125.1 and all applicable requirements referenced therein
- Certified to NSF 61/9 & 372
- Products marked with 1.2 gpm are compliant with California water efficiency regulations
- Complies with California Proposition 65 and with the Federal Safe Drinking Water Act
- ADA ♿ for lever handle

WARRANTY

- Lifetime limited warranty against leaks, drips and finish defects to the original consumer purchaser
- 5 year warranty if used in commercial installations

Specifications

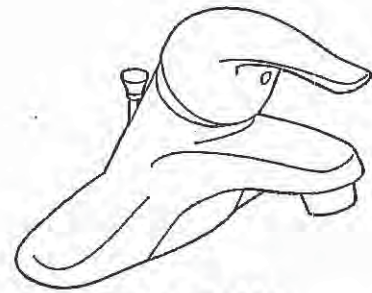

**CHATEAU®
 Single-Handle Lavatory Faucet**

with Metal Waste Assembly
 Models: L4621 series

Bulk Pack Models (12 Per Carton):
 L64620 series

with 50/50 Waste Assembly
Bulk Pack Model (12 Per Carton): L64621 series

Less Waste
 Model: L4601 series

Bulk Pack Model (12 Per Carton):
 L64601 series

**NOTE: THIS FAUCET IS DESIGNED TO BE
 INSTALLED THRU 3-1" DIA. HOLES, 2" ON CENTER**

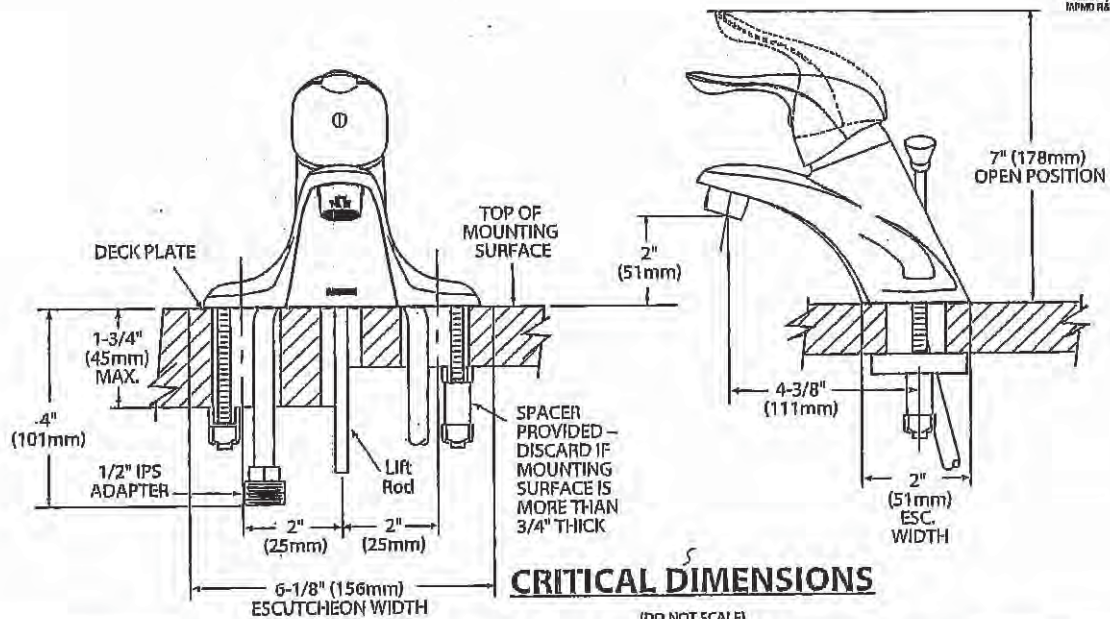

Rev. 1/16

FOR MORE INFORMATION CALL: 1-800-BUY-MOEN
 www.moen.com

VK
 HCA

Cyclone[®]

51436 Canopy Hood Collection

a statement of strength and power as the stainless steel frame gleams under your kitchen lights. It has baffle filters, two bright LED lights in each bay, a three speed control panel, and a quiet, powerful fan. The bold design and strong stainless steel frame making the fan will make this machine the focus of your kitchen. Fitted with time-delay "OFF" options up to nine hours.

- Capacity: 550 CFM
- Material: Stainless Steel
- Dimensions: W: 36" H: 44.5" D: 19.5"
- Electrical Connection: 120V/60Hz
- Power Consumption: 200 watts
- Speed: 1254 RPM
- Options: Min. at 2 and Max at 6" Round (Top Only)

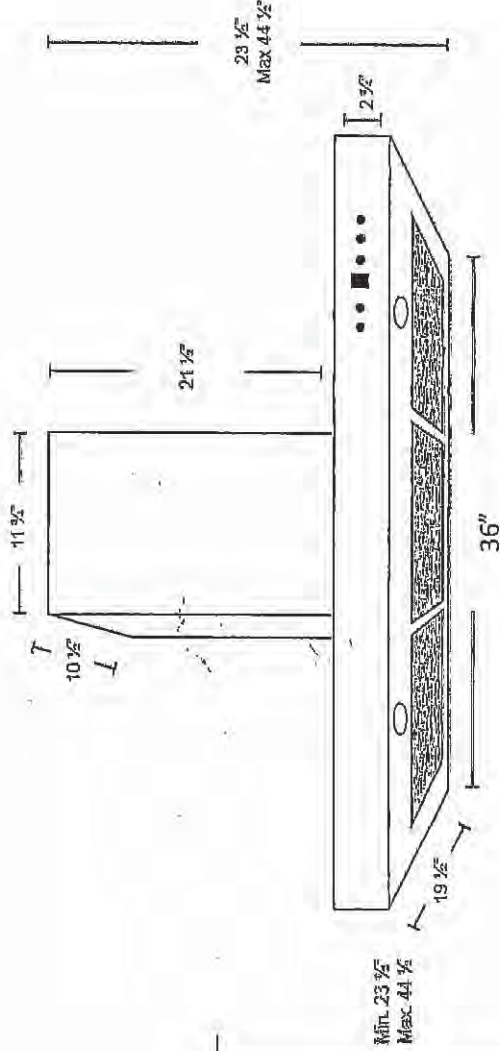
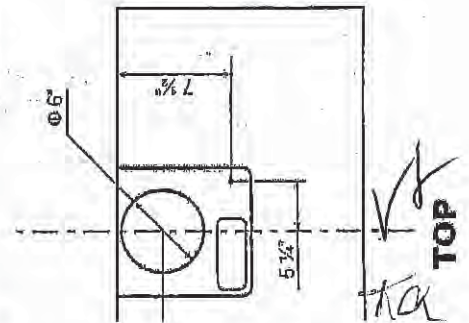
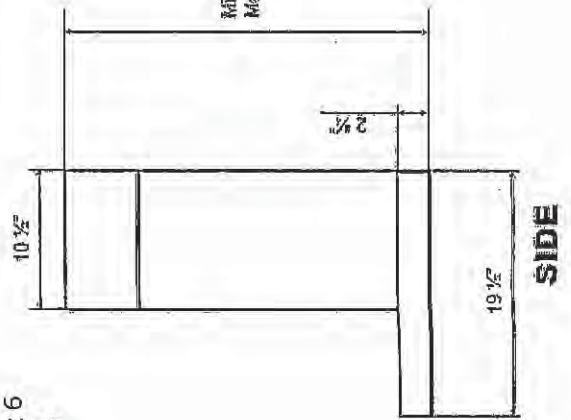
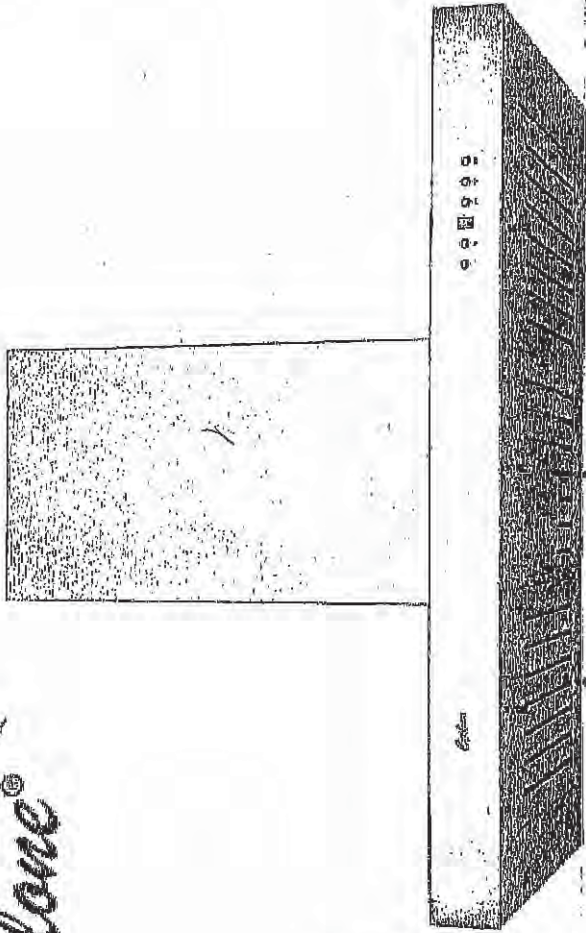

UK-75 WALLACETON
 LOT 228
 33-3344 ELEV. B
 THE WINDSOR

34 of 56

36" Counter-Depth 4-Door Refrigerator

800 Series – Stainless Steel B36CL80SNS

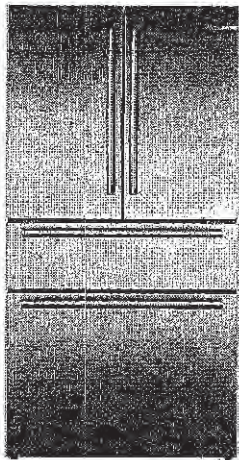

B36CL80SNS
 Stainless Steel

Introducing the revolutionary, new FarmFresh System™, with four freshness technologies designed to work together to keep your food fresher, longer. Enjoy less food waste, new innovative features and more thoughtful design.

Features & Benefits

VitaFreshPro™ provides pre-programmed freshness settings to optimize temperature and humidity to keep meat, fish, and produce fresher, longer.

Interior Water Dispenser is thoughtfully placed inside for refreshing water at the touch of a button or a push of a nozzle.

FlexBar™ utilizes typically unused space in the upper refrigerator cavity.

General Properties	
Full 72" height and true counter depth for built-in appearance	Yes
Lighting	Recessed LED light bars
Number of compressors/evaporators	2 / 2
Defrost process refrigerator section	Frost-free
Number of shelves – refrigerator	5
Adjustable shelves – refrigerator	4 half-width
Shelf material – refrigerator	Tempered glass
Type of shelves – refrigerator	Frameless split shelves with metal trim
Flexible storage bar	FlexBar™
Gallon storage bins	3
Humidity control compartments	2
Full width temp. & humidity controlled drawer	VitaFreshPro™
Ice maker	Yes
Water filter	UltraClarityPro™
Internal water dispenser	Yes
Touch control panel	Yes
AirFresh® filter	Yes
FreshProtect™ ethylene filter	Yes
MultiAirFlow™	Yes
Stainless steel back wall	Yes
Defrost process freezer section	Automatic
Number of drawers – freezer	3
Wi-Fi enabled	Yes, Home Connect™ app

Capacity	
Total capacity (cu. ft.)	20.5
Refrigerator capacity (cu. ft.)	14.5
Freezer capacity (cu. ft.)	6
Technical Details	
Current (A)	15 A
Volts (V)	115 V
Frequency (Hz)	60 Hz
Power cord length (in.)	91
Plug type	120V-3 prong
Dimensions & Weight	
Appliance dimensions with hinges, handles and doors (H x W x D) (in.)	72" x 35 5/8" x 31 1/8"
Appliance dimensions without hinges and doors (H x W x D) (in.)	71 1/2" x 35 5/8" x 24"***
Appliance dimensions with hinges and doors, no handles (H x W x D) (in.)	72" x 35 5/8" x 28 3/4"
Required cutout size (H x W x D) (in.)	72" x 36" x 25"
Net weight (lbs)	350 lbs
Efficiency	
Energy consumption (kWh/yr)	568
ENERGY STAR® qualified	Yes – Tier 1
Accessories	
UltraClarityPro™ Water Filter: BORPLFTR50	
FreshProtect™ Ethylene Filter Kit: BOETHSCV10	
FreshProtect™ Ethylene Filter Refill: BOFRSRF	
FlexBar™ Bottle Holder: BOFLEXBOTL	
FlexBar™ Deep Shelf: BOFLEXLGSB	
FlexBar™ Shallow Shelf: BOFLEXSMBS	
FlexBar™ Egg Tray: BOFLEXEGG	

*When leveling legs are fully extended, add 5/8" to overall height, total 72 5/8".
 **The cutout depth of 25" includes the required 1" airflow. The electrical covers on the back of unit do not require additional depth.

Accessories: To purchase Bosch accessories, cleaners & parts please visit www.bosch-home.com/us/store or call 1-800-944-2904 (Mon to Fri 5 am to 6 pm PST, Sat 6 am to 3 pm PST).
Notes: All height, width and depth dimensions are shown in inches. BSH reserves the absolute and unrestricted right to change product materials and specifications, at any time, without notice. Consult the product's installation instructions for final dimensional data and other details prior to making cutout.
Warranties: Please see Use & Care manual or Bosch website for statement of limited warranty.

For more information on our entire line of products, go to www.bosch-home.com/us or call 1-800-944-2904
 © BSH Home Appliances Corporation. All rights reserved. Bosch is a registered trademark of Robert Bosch GmbH.



Handwritten initials: VJ, KA

UK-75 WALLACETON
 LOT 228
 33-3344 ELEV. B
 THE WINDSOR

35 of 56

36" Counter-Depth 4-Door Refrigerator

800 Series – Stainless Steel B36CL80SNS



Installation Details

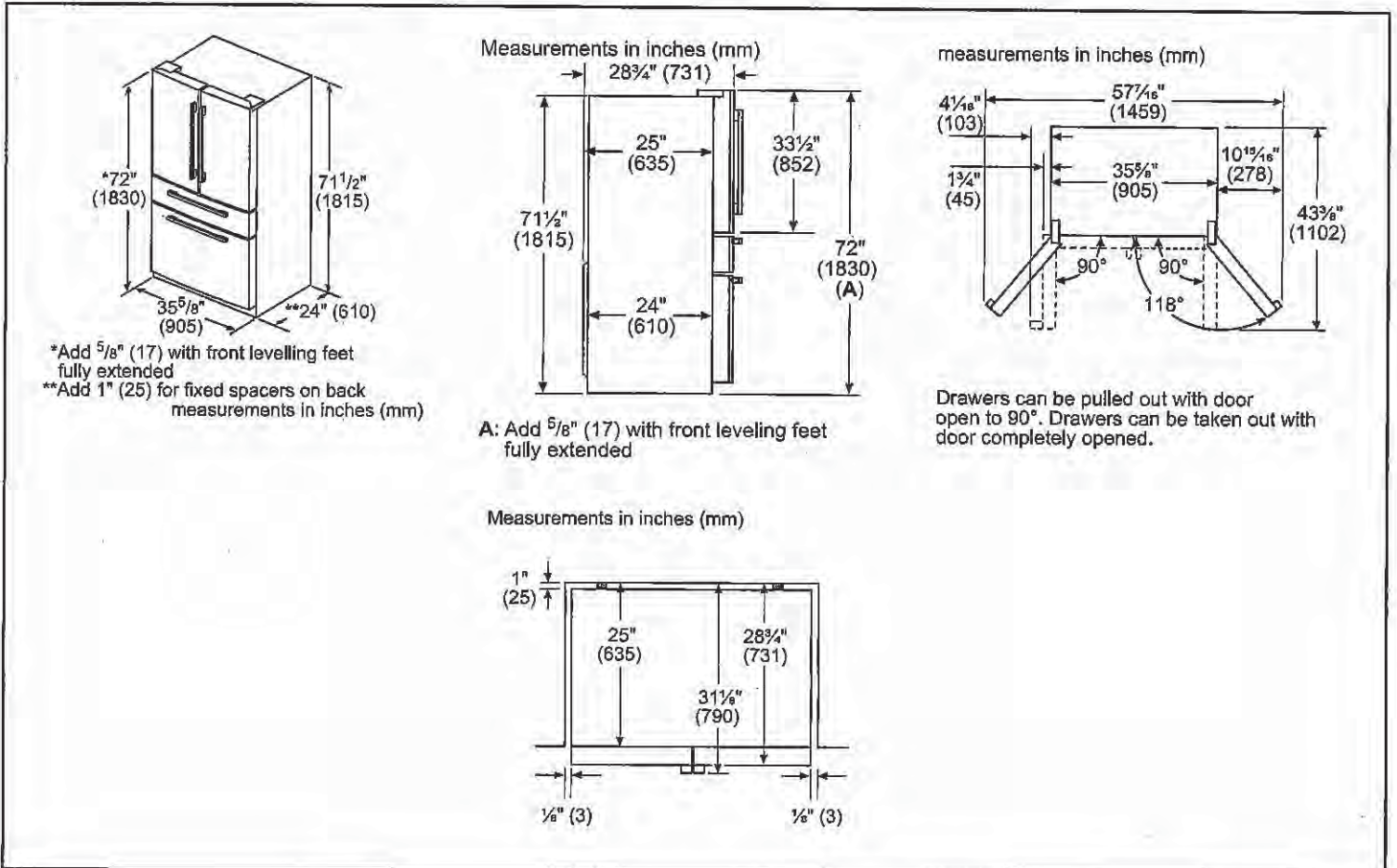

Drawers can be pulled out with door open to 90°. Drawers can be taken out with door completely opened.

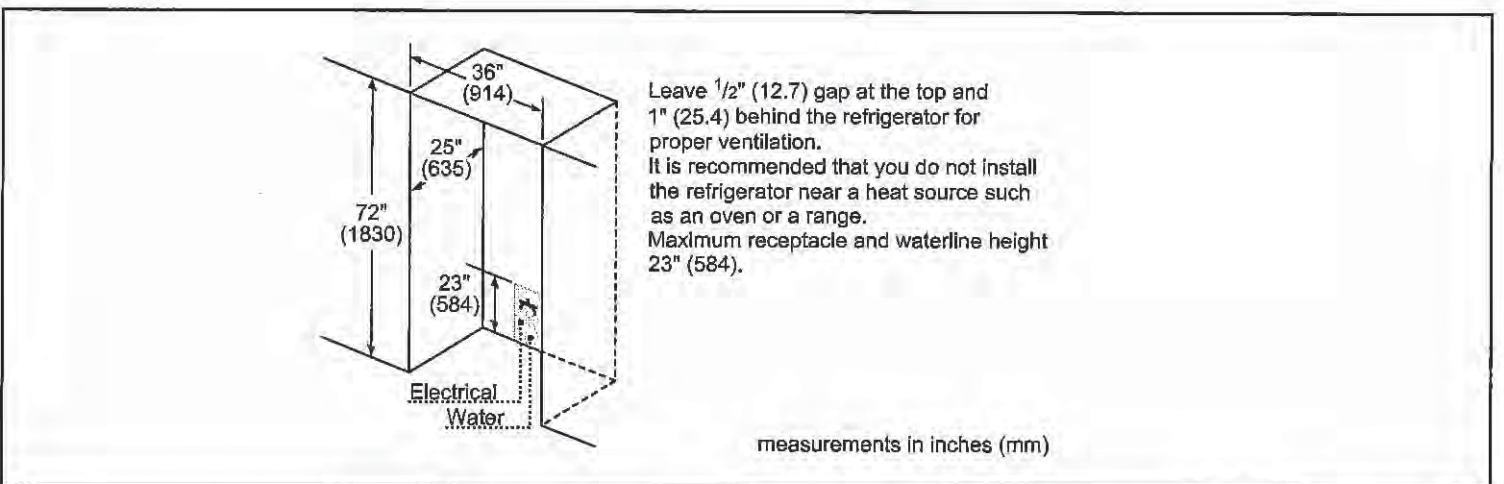

Accessories: To purchase Bosch accessories, cleaners & parts please visit www.bosch-home.com/us/store or call 1-800-944-2904 (Mon to Fri 5 am to 6 pm PST, Sat 6 am to 3 pm PST).

Notes: All height, width and depth dimensions are shown in inches. BSH reserves the absolute and unrestricted right to change product materials and specifications, at any time, without notice. Consult the product's installation instructions for final dimensional data and other details prior to making cutout.

Warranties: Please see Use & Care manual or Bosch website for statement of limited warranty.

For more information on our entire line of products, go to www.bosch-home.com/us or call 1-800-944-2904

© BSH Home Appliances Corporation. All rights reserved. Bosch is a registered trademark of Robert Bosch GmbH.

VF
KA

UK-75 WALLACETON
 LOT 228
 33-3344 ELEV. B
 THE WINDSOR

36 of 56

36" Gas Cooktop

Benchmark® Series – Stainless Steel NGMP656UC

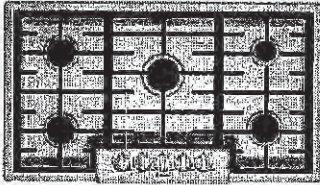

NGMP656UC
 Stainless Steel

The 36" Benchmark® Series gas cooktop features a dual-stacked burner that delivers both a low simmer and high heat flame.

Features & Benefits

Dual stacked burner designed for faster boil time (20,000 BTUs) and a low simmer

OptiSim® Burner – simmer delicate sauces and melt chocolate without scorching

Electronic re-ignition will automatically re-ignite the burner in case the flame goes out

Continuous grates make moving heavy pots easier

Distinctive red LED light indicates burners are on

General Properties	
Knob material	Metal
Sealed burners	Yes
Grate material	Cast iron
Element Performance	
Total BTU load (NG / LP)	59,500 / 47,300
Power of front left burner (NG / LP)	12,000 / 9,100
Power of back left burner (NG / LP)	10,000 / 9,100
Power of center burner (NG / LP)	20,000 / 15,000
Power of back right burner (NG / LP)	5,500 / 5,000
Power of front right burner (NG / LP)	12,000 / 9,100
Technical Details	
Watts	360 W
Circuit breaker	15 A
Volts	120 V
Frequency	60 Hz
Plug type	3 prong
Power cord length	60"
Energy source	Gas
Convertible to LP (kit required)	Yes

Dimensions & Weight	
Overall appliance dimensions (HxWxD)	3 13/16" x 37" x 21 1/4"
Required cutout size (HxWxD)	3 13/16" x 34 15/16" x 19 1/8"
Minimum distance from counter front	1 7/8"
Minimum distance from rear wall	3"
Net weight	39 lbs
Accessories – Included	
Included	LP conversion kit
Accessories – Optional	



HEZ298102
 Wok ring



HEZGR301
 Griddle



Accessories: To purchase Bosch accessories, cleaners & parts please visit www.bosch-home.com/us/store or call 1-800-944-2904 (Mon to Fri 5 am to 6 pm PST, Sat 6 am to 3 pm PST).
Notes: All height, width and depth dimensions are shown in inches. BSH reserves the absolute and unrestricted right to change product materials and specifications, at any time, without notice. Consult the product's installation instructions for final dimensional data and other details prior to making cutout.
Warranties: Please see Use & Care manual or Bosch website for statement of limited warranty.
For more information on our entire line of products, go to www.bosch-home.com/us or call 1-800-944-2904
 © BSH Home Appliances Corporation. All rights reserved. Bosch is a registered trademark of Robert Bosch GmbH.

Handwritten initials/signature.

UK-75 WALLACETON
 LOT 228
 33-3344 ELEV. B
 THE WINDSOR

37 of 56

36" Gas Cooktop

Benchmark® Series – Stainless Steel NGMP656UC



Installation Details

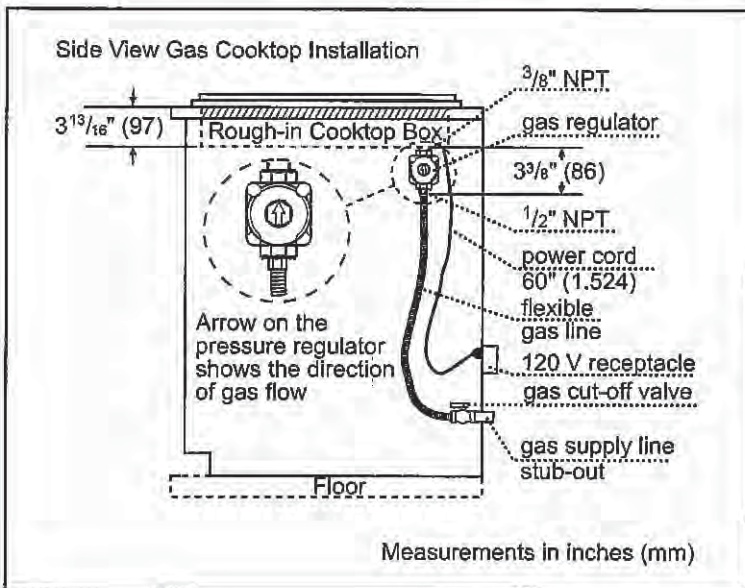
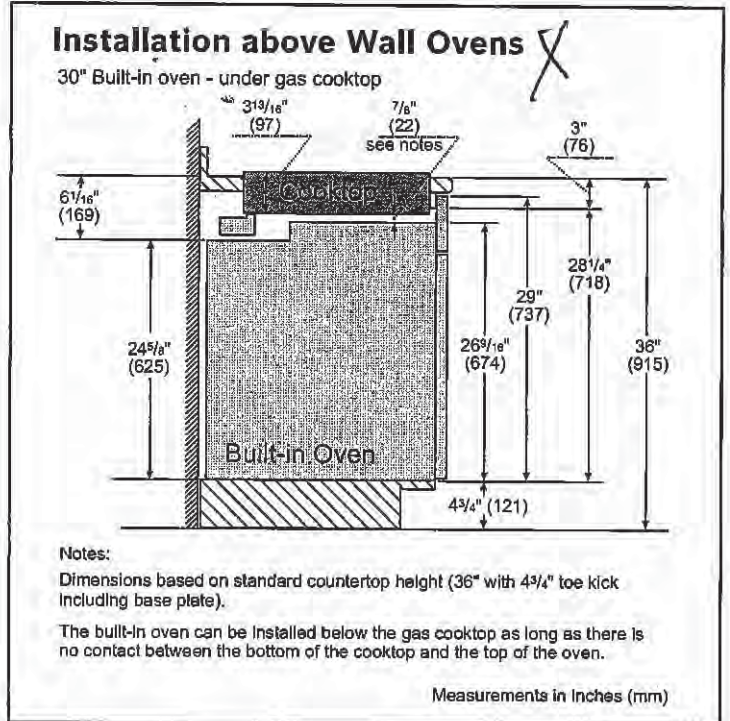
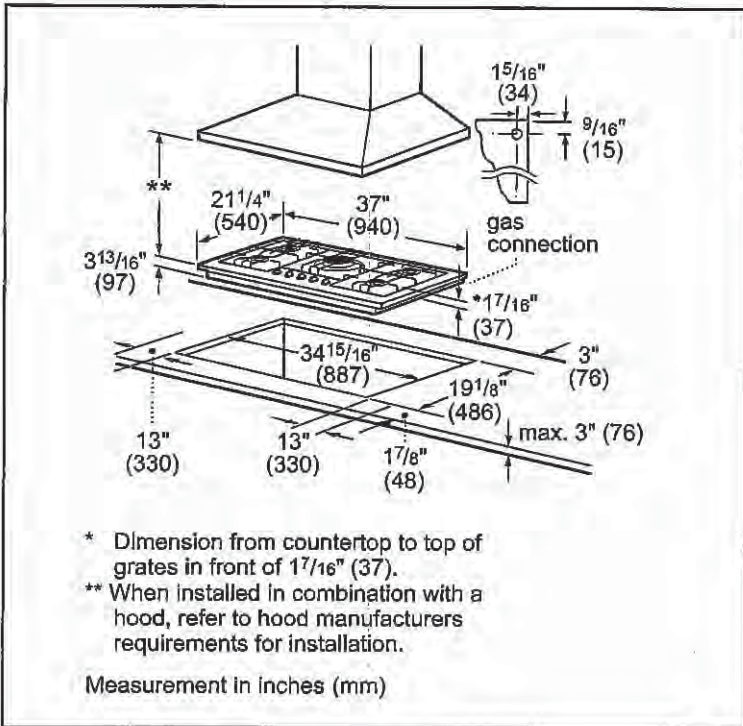

Accessories: To purchase Bosch accessories, cleaners & parts please visit www.bosch-home.com/us/store or call 1-800-944-2904 (Mon to Fri 5 am to 6 pm PST, Sat 6 am to 3 pm PST).
Notes: All height, width and depth dimensions are shown in inches. BSH reserves the absolute and unrestricted right to change product materials and specifications, at any time, without notice. Consult the product's installation instructions for final dimensional data and other details prior to making cutout.
Warranties: Please see Use & Care manual or Bosch website for statement of limited warranty.
For more information on our entire line of products, go to www.bosch-home.com/us or call 1-800-944-2904
 © BSH Home Appliances Corporation. All rights reserved. Bosch is a registered trademark of Robert Bosch GmbH.

07/18

VK
ka

UK-75 WALLACETON
LOT 228
33-3344 ELEV. B
THE WINDSOR

38 of 56

36" Gas Cooktop

Benchmark® Series – Stainless Steel NGMP656UC



Installation Details

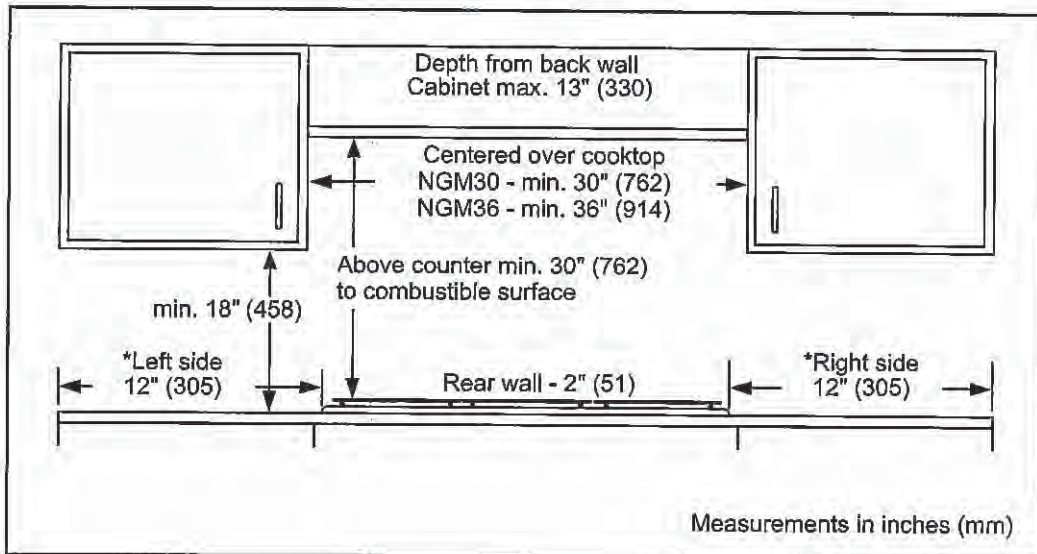

Accessories: To purchase Bosch accessories, cleaners & parts please visit www.bosch-home.com/us/store or call 1-800-944-2904 (Mon to Fri 5 am to 6 pm PST, Sat 6 am to 3 pm PST).

Notes: All height, width and depth dimensions are shown in inches. BSH reserves the absolute and unrestricted right to change product materials and specifications, at any time, without notice. Consult the product's installation instructions for final dimensional data and other details prior to making cutout.

Warranties: Please see Use & Care manual or Bosch website for statement of limited warranty.

For more information on our entire line of products, go to www.bosch-home.com/us or call 1-800-944-2904

© BSH Home Appliances Corporation. All rights reserved. Bosch is a registered trademark of Robert Bosch GmbH.

07/18

KA
VZ

UK-75 WALLACETON
 LOT 228
 33-3344 ELEV. B
 THE WINDSOR

39 of 56

30" Double Wall Oven Right Swing Door

Benchmark® Series – Stainless Steel HBLP651RUC

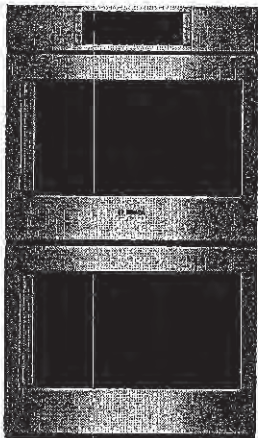

HBLP651RUC
 Stainless Steel

The Bosch wall oven features a SideOpening door for easier cavity access and a high-resolution TFT user interface

Features & Benefits

SideOpening door offers better ergonomic access to the oven cavity.

The color TFT control panel with SteelTouch™ buttons is easy to use.

A full-extension telescopic rack offers safe access to the oven cavity.

The wall oven is designed to be installed flush with cabinetry.

Bosch wall ovens are compatible with most competitors' cutouts.

General Properties	
Cooking modes – upper cavity	Bake, Variable Broil (hi & low), Roast, Warm, Sabbath, Proof Dough, Convection Bake, Convection Broil, Convection Roast, Pizza, Multi Rack, Genuine European Convection, Convection Conversion, AutoProbe, Fast Preheat, EcoChef, Speed Convection (Frozen Foods)
Cooking modes – lower cavity	Identical to Upper Cavity (Exception: Lower Cavity Does not Feature Temperature Probe and EcoChef)
Cleaning type – upper cavity	Self Clean
Cleaning type – lower cavity	Self Clean
Telescopic rack	1
Illumination type – upper / lower cavity	Halogen
Interior lights – upper cavity	2
Interior lights – lower cavity	2



Oven Performance	
Bake / broil element wattages – upper cavity	2,400 / 3,800 W
Convection element wattages – upper cavity	2,000 W
Bake / broil element wattages – lower cavity	2,400 / 3,800 W
Convection element wattages – lower cavity	2,000 W
Technical Details	
Watts (W)	9,125 W
Circuit breaker (A)	40 A
Volts (V)	240 / 208 V
Frequency (Hz)	60 Hz
Power cord length (in)	50"
Plug type	Fixed Connection, No Plug
Energy source	Electric
Dimensions & Weight	
Overall appliance dimensions (HxWxD) (in)	52 1/16" x 29 3/4" x 24 1/2"
Required cutout size (HxWxD) (in)	49 3/4" – 51 1/2" x 28 1/2" x 23 1/2"
Oven cavity size – lower cavity (cu. ft.)	4.6
Overall oven interior dimensions (HxWxD)(in)	17 13/16" x 24 1/8" x 18"
Usable oven interior dimensions (HxWxD)(in)	12 5/16" x 23 1/4" x 15 1/4"
Net weight (lbs)	261 lbs

Accessories—Included
 Upper Oven: 1 Telescopic and 2 Standard Oven Racks, Temperature Probe, Broiler Pan
 Lower Oven: 3 Standard Oven Racks

Accessories—Optional



HEZTR301
 30" Telescopic Rack

For help and assistance with Bosch accessories please visit: www.bosch-eshop.com/eshop/bosch/us or call 1-800-944-2904 Mon-Fri 5am to 6pm PST Sat 6am to 3pm PST
 Notes: All height, width and depth dimensions are shown in inches. BSH reserves the absolute and unrestricted right to change product materials and specifications, at any time, without notice. Consult the product's installation instructions for final dimensional data and other details prior to making cutout. Applicable product warranty can be found in accompanying product literature or you may contact your account manager for further details.
 Warranties: Bosch warrants that the Product is free from defects in materials and workmanship for a period of three hundred and sixty-five (365) days from the date of purchase. The foregoing timeline begins to run upon the date of purchase, and shall not be stalled, tolled, extended, or suspended, for any reason whatsoever. This Product is also warranted to be free from cosmetic defects in material and workmanship (such as scratches of stainless steel, paint/porcelain blemishes, chip, dents, or other damage) to the finish of the Product, for a period of thirty (30) days from the date of purchase or closing date for new construction. This cosmetic warranty excludes slight color variations due to inherent differences in painted and porcelain parts, as well as differences caused by kitchen lighting, product location, or other similar factors. This cosmetic warranty specifically excludes any display, floor, "As Is", or "B" stock appliances.
 For more information on our entire line of products, go to www.bosch-home.com/us or call 1-800-944-2904
 © BSH Home Appliances Corporation. All rights reserved. Bosch is a registered trademark of Robert Bosch GmbH.

VJ
 KA

UK-75 WALLACETON
 LOT 228
 33-3344 ELEV. B
 THE WINDSOR

40 of 56

30" Double Wall Oven Right Swing Door

Benchmark® Series – Stainless Steel HBLP651RUC



Installation Details

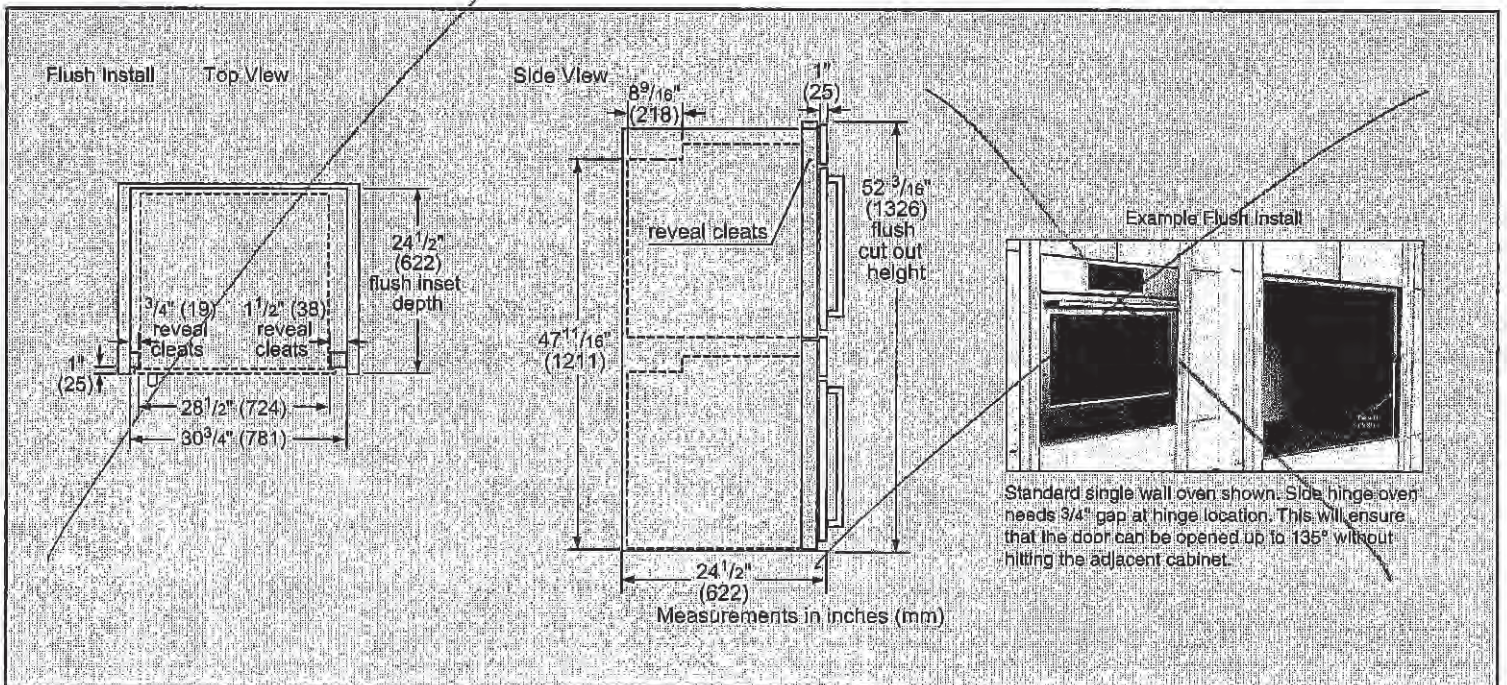
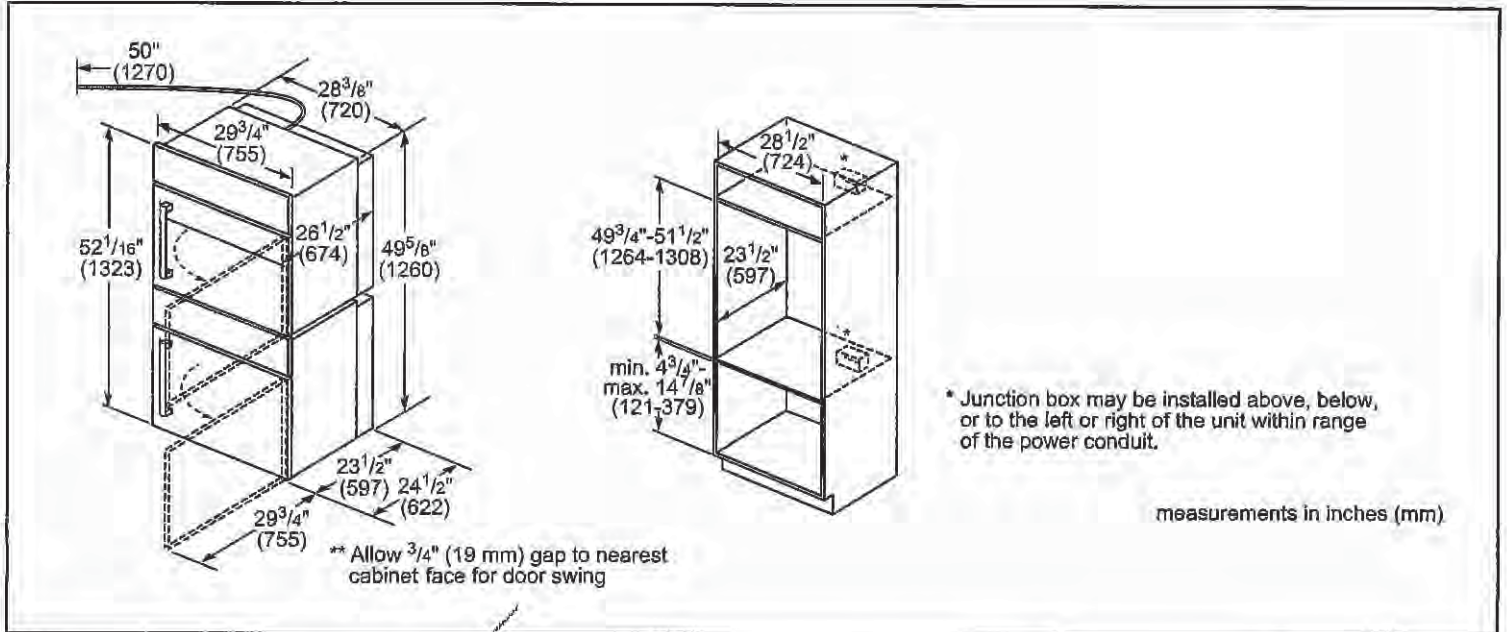

For help and assistance with Bosch accessories please visit: www.bosch-eshop.com/eshop/bosch/us or call 1-800-944-2904 Mon-Fri 5am to 6pm PST Sat 6am to 3pm PST

Notes: All height, width and depth dimensions are shown in inches. BSH reserves the absolute and unrestricted right to change product materials and specifications, at any time, without notice. Consult the product's Installation Instructions for final dimensional data and other details prior to making cutout. Applicable product warranty can be found in accompanying product literature or you may contact your account manager for further details.

Warranties: Bosch warrants that the Product is free from defects in materials and workmanship for a period of three hundred and sixty-five (365) days from the date of purchase. The foregoing timeline begins to run upon the date of purchase, and shall not be stalled, tolled, extended, or suspended, for any reason whatsoever. This Product is also warranted to be free from cosmetic defects in material and workmanship (such as scratches of stainless steel, paint/porcelain blemishes, chip, dents, or other damage) to the finish of the Product, for a period of thirty (30) days from the date of purchase or closing date for new construction. This cosmetic warranty excludes slight color variations due to inherent differences in painted and porcelain parts, as well as differences caused by kitchen lighting, product location, or other similar factors. This cosmetic warranty specifically excludes any display, floor, "As Is", or "B" stock appliances.

For more information on our entire line of products, go to www.bosch-home.com/us or call 1-800-944-2904

© BSH Home Appliances Corporation. All rights reserved. Bosch is a registered trademark of Robert Bosch GmbH.

09/15

✓
KCA

30" Double Wall Oven Right Swing Door

Benchmark® Series – Stainless Steel HBLP651RUC



Installation Details

Standard

The ovens will overlap the cutout resulting in a 1/2" (13mm) spacing between the products

IMPORTANT: The spacing between cutouts applies when installing any Bosch 30" or 27" single, double, combination and 27"/30" compact oven in a side-by-side installation.

If another product is installed adjacent to the side hinge we recommend to increase each distance by an additional 1/4" (6mm) to leave room for the door to open and close freely.

Side-by-Side Installation

Flush

Standard Installation
 30" Double Oven over Storage or Warming Drawer

measurements in inches (mm)

* Wall oven junction box may be located above or right or left of the unit within reach of the power conduit.

** Electrical hook up may be located below (depending on space) or next to the drawer within the reach of the power cord.

Flush Installation
 Double Oven over Storage or Warming Drawer
 Side View

measurements in inches (mm)

*IMPORTANT: base has to be able to support oven weight. Please check oven manual for minimum weight requirements.

For help and assistance with Bosch accessories please visit: www.bosch-eshop.com/eshop/bosch/us or call 1-800-944-2904 Mon-Fri 5am to 6pm PST Sat 6am to 3pm PST

Notes: All height, width and depth dimensions are shown in inches. BSH reserves the absolute and unrestricted right to change product materials and specifications, at any time, without notice. Consult the product's installation instructions for final dimensional data and other details prior to making cutout. Applicable product warranty can be found in accompanying product literature or you may contact your account manager for further details.

Warranties: Bosch warrants that the Product is free from defects in materials and workmanship for a period of three hundred and sixty-five (365) days from the date of purchase. The foregoing timeline begins to run upon the date of purchase, and shall not be stalled, tolled, extended, or suspended, for any reason whatsoever. This Product is also warranted to be free from cosmetic defects in material and workmanship (such as scratches of stainless steel, paint/porcelain blemishes, chip, dents, or other damage) to the finish of the Product, for a period of thirty (30) days from the date of purchase or closing date for new construction. This cosmetic warranty excludes slight color variations due to inherent differences in painted and porcelain parts, as well as differences caused by kitchen lighting, product location, or other similar factors. This cosmetic warranty specifically excludes any display, floor, "As Is", or "B" stock appliances.

For more information on our entire line of products, go to www.bosch-home.com/us or call 1-800-944-2904

© BSH Home Appliances Corporation. All rights reserved. Bosch is a registered trademark of Robert Bosch GmbH.

VF
 TA

UK-75 WALLACETON
 LOT 228
 33-3344 ELEV. B
 THE WINDSOR

42 of 56

SHARP

SMD2477ASC

24-INCH MICROWAVE DRAWER® OVEN

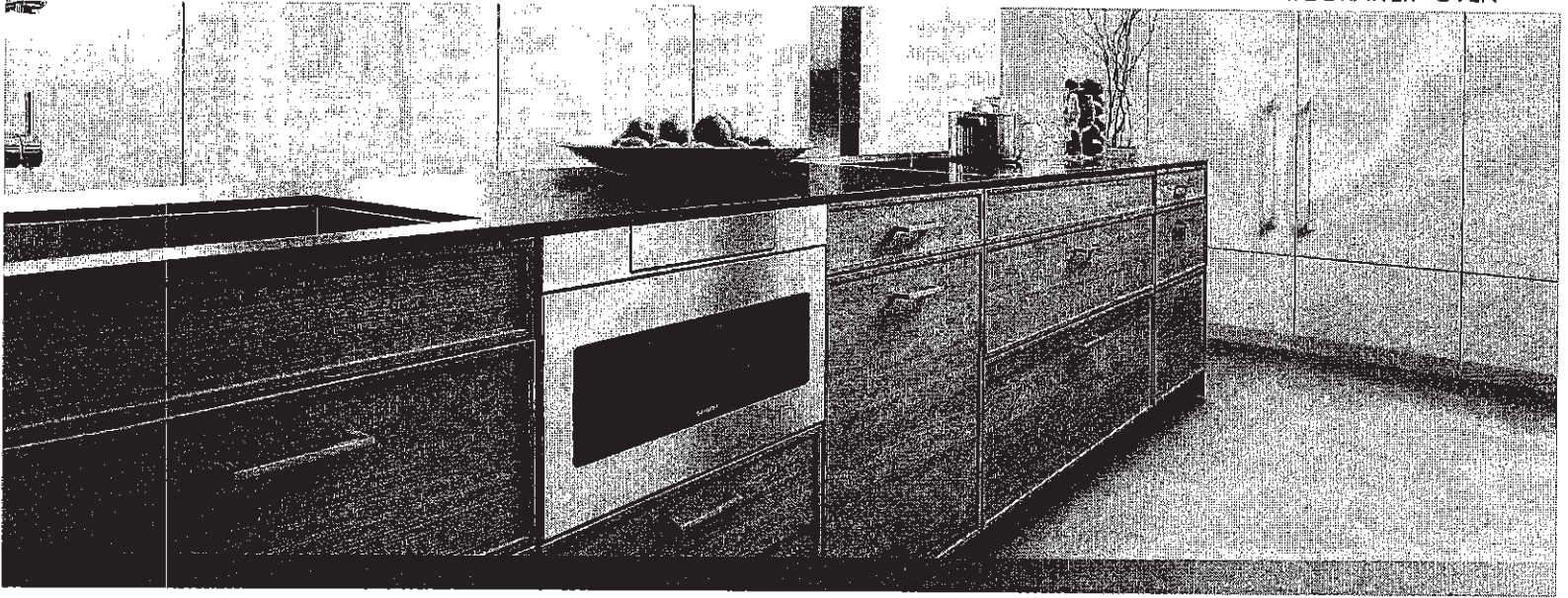

TAKE YOUR MICROWAVE TO A BETTER PLACE

It's your kitchen, your design and your lifestyle. Sharp's Microwave Drawer Oven allows you to focus on the design elements you prefer by removing the microwave from sightlines and enabling more design versatility. The Microwave Drawer offers flexible placement options below an island, peninsula, or standard cabinetry, and can also be installed adjacent to your wall oven. The Microwave Drawer allows you to showcase your design savvy and create a kitchen that flows with your lifestyle.

Sharp introduces the next generation of this successful appliance—model SMD2477ASC - a 24" microwave drawer with a simpler and a sleeker design to match more built-in appliances.

Design Flexibility

Sharp's Microwave Drawer product expands the option for microwave placement in almost any kitchen plan— it's a perfect choice for open-plan kitchens, islands, peninsulas, and a great addition to wet bars, family rooms and home theatres.

Location and Counter Space Saving

You may place the drawer under a counter, cooktop or wall oven or above a warming drawer without a built-in kit, additional trim or venting. Sharp microwave drawer provides the best solution for a cleaner, uncluttered counter space.

SHARP's Exclusive AutoTouch™ System

Sharp's exclusive AutoTouch™ system allows you to open and close the drawer automatically at one-finger operation by pressing a button on the control panel.

New Hidden Control Panel

The new SMD2477ASC model features a hidden control panel which gives a more integrated look and feel within the kitchen. The new tall control panel, angled at 45° degrees, is easy to see, easy to access and easy to use.

Specifications

TECHNICAL SPECIFICATIONS

Size	24" wide
Microwave Capacity	1.2 cu.ft
Microwave Power	950 watts
Control Panel	Digital LCD Display
Control Type	Hidden Control Panel
Drawer Opening	AutoTouch™ System
Power Level	11
Sensor Cook, Reheat, Popcorn Settings	13
Reheat Auto Settings	2
Defrost Auto Settings	6
Keep Warm Setting	Yes, up to 30 min.
Melt / Soften / Settings	Yes
Beverage Setting	Yes
Programmable Stages	Yes, 4
Digital Clock	Yes
Kitchen Timer	Yes
Child Lock	Yes
+30 sec	Yes
Interior Oven Light	Yes

TECHNICAL SPECIFICATIONS CONTINUED

Demonstration Mode	Yes
Built-in Ready	Yes
Available Colour	Stainless Steel
Accessory	SKMD24F0AS
DIMENSIONS/WEIGHT(inches/lbs.)	
Cut-out Dimension	22 1/8" x 15 9/16"
Product Dimension	23 7/8" x 23 1/64" x 15 7/8"
Box Dimension	29.8" w x 27.9" x 21.9"
Net Weight	74 lb.
Gross Weight	85.8 lb.
POWER/SAFETY	
Power / Ratings	120V, 60Hz
Ratings	1.67Kw, 14.5Amps
Safety Compliance	FCC, DHHS, cUL
WARRANTY/UPC	
Warranty	1 year parts & labour with In-home service; 4 additional years for magnetron tube only
UPC	074000619944

5-03-2016

KA V8

UK-75 WALLACETON
LOT 228
33-3344 ELEV. B
THE WINDSOR

43 of 56

SHARP

SMD2477ASC

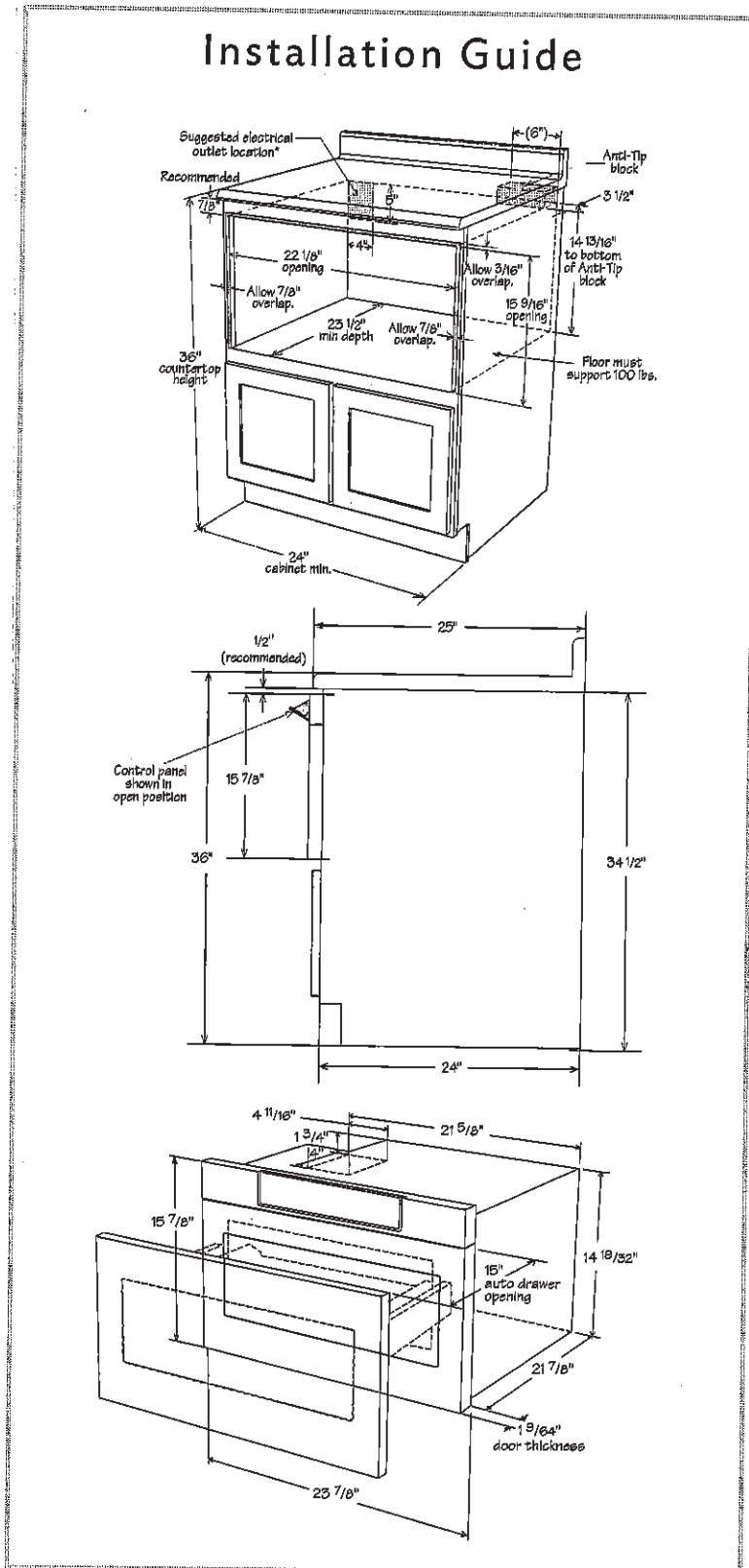

© 2016 Sharp Electronics Corporation. All rights reserved.
Product specification and design are subject to change without notice.

SHARP ELECTRONICS OF CANADA LTD.
335 Britannia Road East, MISSISSAUGA, ONTARIO, L4Z 1W9
www.sharp.ca

ka v8

UK-75 WALLACETON
 LOT 228
 33-3344 ELEV. B
 THE WINDSOR

44 of 56

24" Bar Handle Dishwasher

500 Series – Stainless Steel SHXM65Z55N

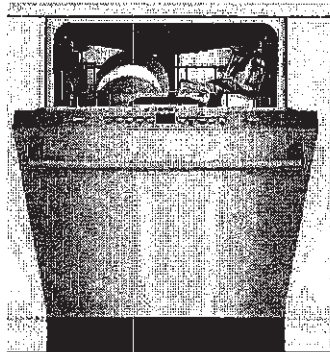

SHXM65Z55N
 Stainless Steel

All-new AutoAir™ option automatically releases the door at the end of the cycle to let moisture escape and fresh air in for drier dishes.

Features & Benefits

44 dBA: dishwasher runs quietly so your kitchen conversations aren't interrupted.

The Flexible 3rd Rack * with fold down sides adds 30% more* loading area, perfect for utensils and ramekins.

The EasyGlide™ rack system provides a smooth glide for easier loading & unloading on the upper rack.

The AquaStop® leak protection system contains leaks through a precisely engineered system. If a leak occurs, the system contains it by shutting down operation and pumping out water. So you have the ultimate peace of mind whether you are away or at home.

General Properties	
Number of wash cycles	5
Number of options	5
dBA	44
Third rack	Flexible 3rd Rack
Rack adjustability	Rackmatic®
Tub material	Stainless Steel
Control type	Buttons
Concealed water heating element	Yes
Leak protection system	24/7 AquaStop®
Water softener	No
Five-level wash	Yes
ChildLock	No
Special features	InfoLight®, AutoAir™ Option

Efficiency	
Water usage per cycle	3.5
Energy efficiency class	Tier 1
ENERGY STAR® qualified	Yes
Total annual energy consumption (kWh)	269
Total annual water consumption (g)	623.5

Capacity	
Number of place settings	16

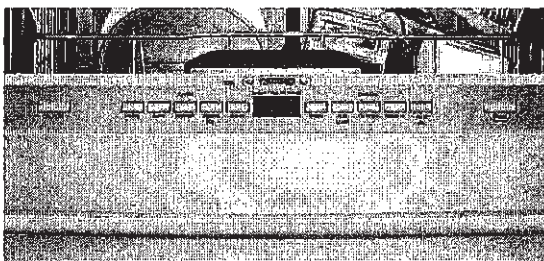

*Compared to a Bosch dishwasher with 2 racks.

Accessories: To purchase Bosch accessories, cleaners & parts please visit www.bosch-home.com/us/store or call 1-800-944-2904 (Mon to Fri 5 am to 6 pm PST, Sat 6 am to 3 pm PST).
Notes: All height, width and depth dimensions are shown in inches. BSH reserves the absolute and unrestricted right to change product materials and specifications, at any time, without notice. Consult the product's installation instructions for final dimensional data and other details prior to making cutout.
Warranties: Please see Use & Care manual or Bosch website for statement of limited warranty.

For more information on our entire line of products, go to www.bosch-home.com/us or call 1-800-944-2904
 © BSH Home Appliances Corporation. All rights reserved. Bosch is a registered trademark of Robert Bosch GmbH.

Technical Details	
Watts (W)	1440 W
Current (A)	12 Amps
Volts (V)	120 V
Frequency (Hz)	60 Hz
Power cord length	67"
- Install length from corner of unit	45"
Minimum water pressure (lb/sin)	14
Length outlet hose (in)	79"

Dimensions & Weight	
Overall appliance dimensions (HxWxD) (in)	33 7/8" x 23 9/16" x 23 3/4"
Required cutout size (HxWxD) (in)	33 7/8" x 23 5/8" x 24"
Adjustable feet	Yes
Net weight (lbs)	91 lbs

Accessories—Optional	
Junction Box	SMZPCJB1UC
Bosch Dishwasher Water Supply Hose	SMZSH002UC
Drain Hose Extension Kit	SGZ1010UC
Dishwasher Accessory Kit	SMZ5000
Anti-Tarnish Silverware Cassette	SMZ5002UC
Edge Protector	SMZEP001UC

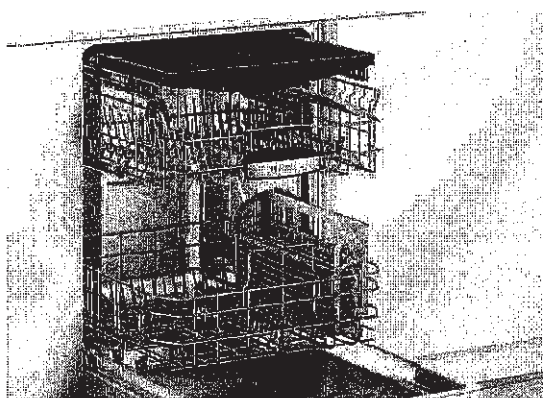

VJ
 KA

UK-75 WALLACETON
 LOT 228
 33-3344 ELEV. B
 THE WINDSOR

45 of 56

24" Bar Handle Dishwasher

500 Series – Stainless Steel SHXM65Z55N



Installation Details

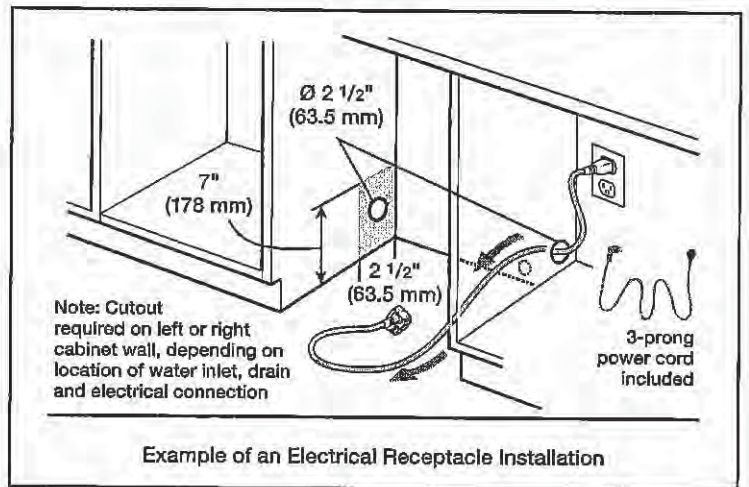
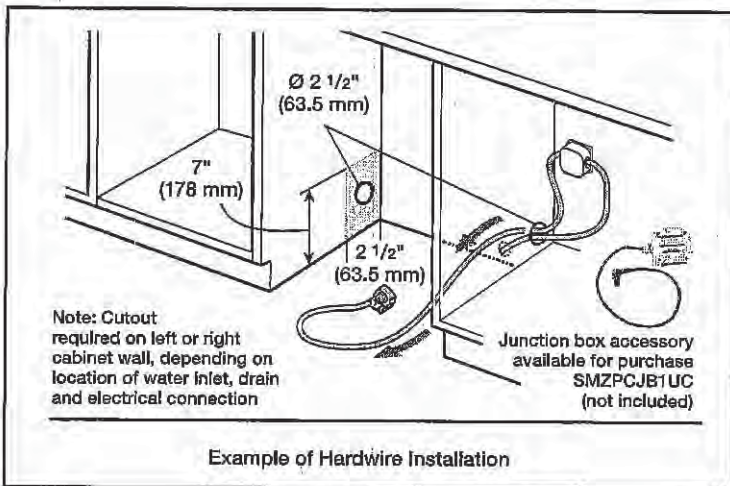
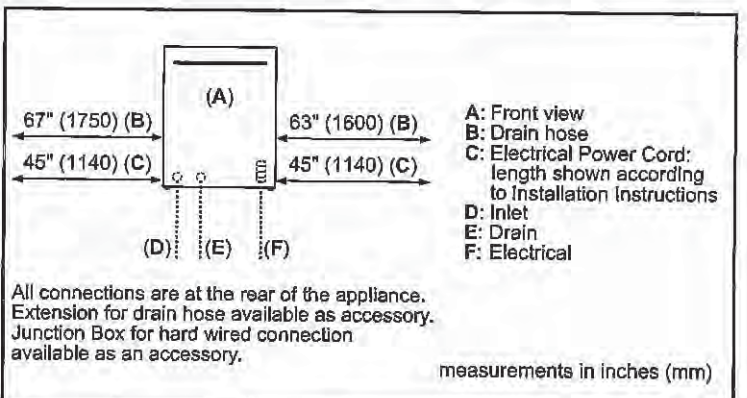
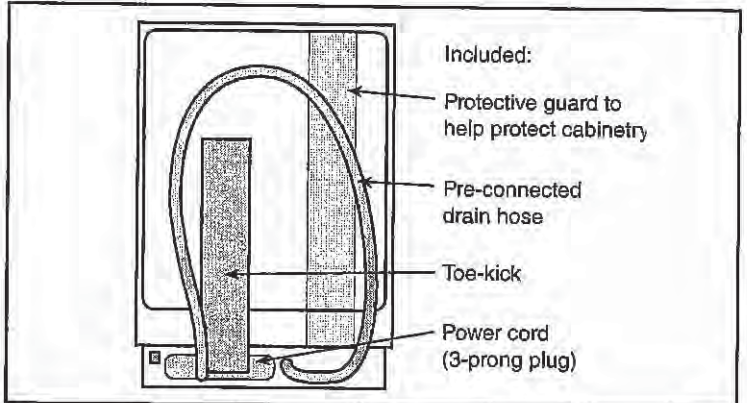
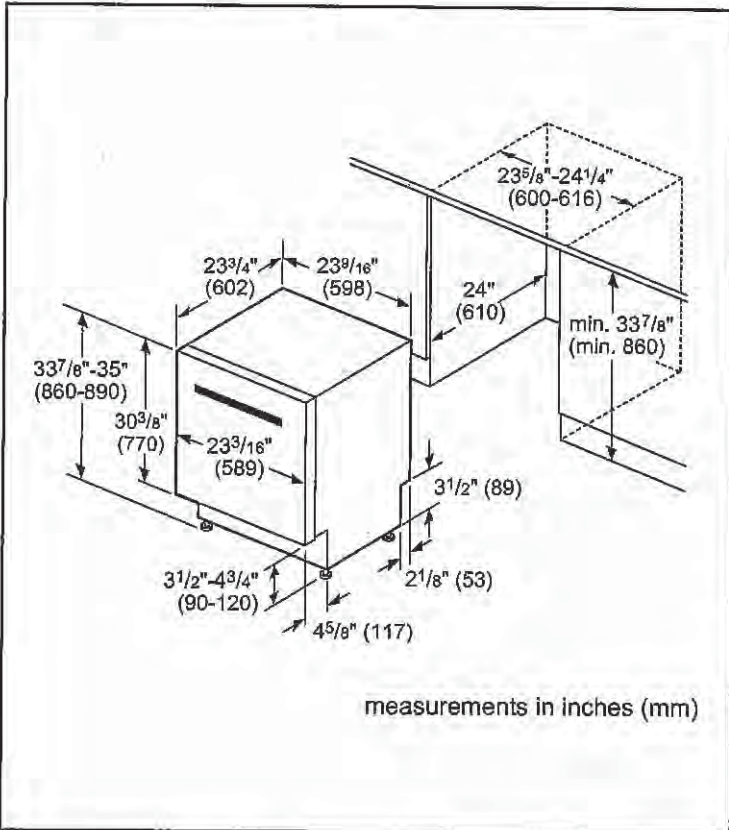

Accessories: To purchase Bosch accessories, cleaners & parts please visit www.bosch-home.com/us/store or call 1-800-944-2904 (Mon to Fri 5 am to 6 pm PST, Sat 6 am to 3 pm PST).
Notes: All height, width and depth dimensions are shown in inches. BSH reserves the absolute and unrestricted right to change product materials and specifications, at any time, without notice. Consult the product's installation instructions for final dimensional data and other details prior to making cutout.
Warranties: Please see Use & Care manual or Bosch website for statement of limited warranty.
For more information on our entire line of products, go to www.bosch-home.com/us or call 1-800-944-2904
 © BSH Home Appliances Corporation. All rights reserved. Bosch is a registered trademark of Robert Bosch GmbH.

✓
 KA

UK-75 WALLACETON
LOT 228
33-3344 ELEV. B
THE WINDSOR

46 of 56

24" Bar Handle Dishwasher

500 Series – Stainless Steel SHXM65Z55N



Installation Details

Note: Plumbing installations will vary - refer to local codes. Drain hose included is 79" (201 cm) and can be extended to a maximum of 155 3/4" (396 cm).

Always use the approved drain hose extension kit (SGZ1010UC).

Ensure a portion of the drain hose is raised between min. 33" (84 cm) and max. 43" (110 cm) above the cabinet floor.

Accessories: To purchase Bosch accessories, cleaners & parts please visit www.bosch-home.com/us/store or call 1-800-944-2904 (Mon to Fri 5 am to 6 pm PST, Sat 6 am to 3 pm PST).

Notes: All height, width and depth dimensions are shown in inches. BSH reserves the absolute and unrestricted right to change product materials and specifications, at any time, without notice. Consult the product's installation instructions for final dimensional data and other details prior to making cutout.

Warranties: Please see Use & Care manual or Bosch website for statement of limited warranty.

For more information on our entire line of products, go to www.bosch-home.com/us or call 1-800-944-2904

© BSH Home Appliances Corporation. All rights reserved. Bosch is a registered trademark of Robert Bosch GmbH.

05/19

VK
KA

UK-75 WALLACETON
 LOT 228
 33-3344 ELEV. B
 THE WINDSOR

47 of 56

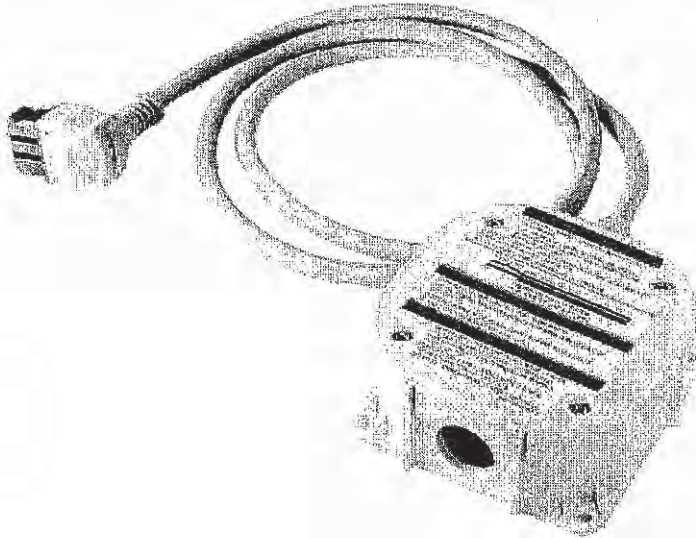

Features

	Accessory
Brand	Bosch
Product name / series name	
SKU	SMZPCJB1UC
Internal article number	000000000011031987
EAN code	4242005156078
Product packaging dimensions (HxWxD) (in)	
	1
	1
Quantity per packing unit	
Standard number of units per pallet	
UPC code	825225958826
	MCSA03192704_SMZPCJB1UC_- _11031987_- _junction_box_kit_def

Technical Specification

Notes: All height, width and depth dimensions are shown in inches. *Please refer to installation instructions prior to making cutout. BSH reserves the absolute and unrestricted right to change product materials and specifications, at any time, without notice. Consult the product's installation instructions for final dimensional data and other details. Applicable product warranty can be found in a accompanying product literature or you may contact your account manager for further details.

For more information on our entire line of products, go to boschappliances.com or call 1-800-944-2904.
 Copyright ©2020 BSH Home Appliances Corporation. All rights reserved. Bosch is a registered trademark of Robert Bosch GmbH.

Litho Date: 10/2020

VJ
 KA

UK-75 WALLACETON
 LOT 228
 33-3344 ELEV. B
 THE WINDSOR

48 of 56



HOME APPLIANCES

LG LAUNDRY

WM4500HBA

5.0 cu.ft. Front Load Washer with TurboWash™ 360° and Built-In Intelligence

- 5.0 cu. ft. Mega Capacity
- TurboWash™ 360° Technology
- AI Fabric Sensor/ Smart Pairing™
- ezDispense™ Automatic Dispenser
- AAFA Certified LG washer
- LG ThinQ® Technology / Proactive Customer Care
- ColdWash™ Technology
- Direct Drive Motor 10-Year Limited Warranty
- ENERGY STAR® Certified
- Closet Depth
- NeveRust™ Stainless Steel Tub and Lifters

AVAILABLE COLORS

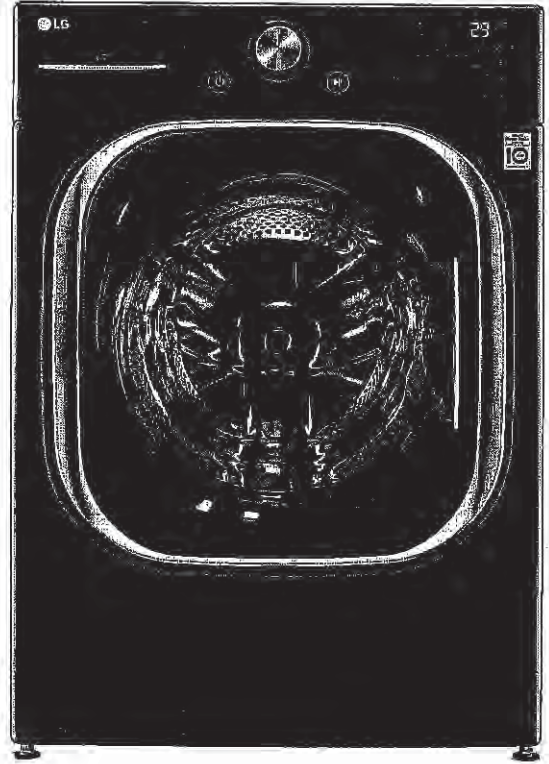

Enjoy new ways to control your home with LG smart appliances

- Use the ThinQ® app to start the laundry while you're out
- Get alerts when the cycle is finished
- With Smart Pairing™, the washer can tell the dryer to select a compatible drying cycle

LG ThinQ®



SUMMARY		No. of Spin Speeds		MATERIALS AND FINISHES	
Type	Front Load Washer	Spin Speeds	5	NeveRust™ Stainless Steel Drum	Yes
Capacity (cu.ft.)	5.0 cu. ft.	Max RPM	1300	Cabinet	PCM
Matching Electric Dryer	DLEX4500B	Water Levels	Load Sensing	Control Panel	Plastic
Matching Gas Dryer	DLGX4501B	No. of Soil Levels	5	Top Plate	Painted
Color	Black Steel (B)	FABRIC CARE FEATURES		Door / Rlm	Glass/Chrome
APPEARANCE		AI DD™	Yes	Door Cover	Dark Black Tinted Square Cover
Hard Buttons	Yes	TurboWash™ 360 Technology	Yes	All Available Colors	Black Steel (B)
Touch Buttons	Yes	Steam Technology	Yes	CERTIFICATION	
Dial-A-Cycle™	Yes	Allergiene™ Cycle	Yes	AAFA	Yes
ENERGY		Sanitary Cycle	Yes	POWER SOURCE	
ENERGY STAR® Most Efficient 2019	Yes	ColdWash™ Option	Yes	Ratings	UL Listed
ENERGY STAR® Qualified	Yes	SenseClean™ System	Yes	Electrical Requirements	120V, 10 Amps
CEE Tier	Advanced	CONVENIENCE FEATURES		Type	Electric
IMEF	3.1	TrueBalance™ Anti-Vibration System	Yes	OPTIONS/ACCESSORIES	
IWF	2.9	4 Tray Dispenser	ezDispense cartridge (Detergent, Softener), Main Wash, Bleach (cup)	Pedestal	WDP4B
WASH PROGRAMS		LoDeclat™ Quiet Operation	Yes	Pedestal (WxHxD)	27 x 14 1/8 x 30 3/4 (50 9/16 D with door open)
No. of Programs	14	End of Cycle Signal	Yes	LG Sidekick™ Pedestal Washer	WD100CB
Wash Programs	Normal, Heavy Duty, Bedding, Sanitary, Allergiene™, Bright White, Tub Clean, Delicates, Perm. Press, Sportswear, Towels, Speed Wash, Rinse+Spin, Downloaded	LoadSense	Yes	LG Sidekick™ Pedestal Washer (WxHxD)	27 x 14 1/8 x 30 3/4 (50 9/16 D with door open)
WASH OPTIONS		Child Lock	Yes	Stacking Kit	KSTK1
No. of Dptions	15	Auto Suds Removal	Yes	DIMENSIONS	
Options	TurboWash®, Steam, Fresh Care, Pre-wash, Remote Start, Delay Wash, Wi-Fi, Add Item, Extra Rinse, Control Lock, Drum Light, ColdWash, Spin Only, Detergent Level, Softener Level	Leveling Legs	4 Adjustable Legs	Product (WxHxD)	27" x 39" x 33 1/4"
WASH DETAILS		Easy Loading TITub™	Yes	Depth with Door Open	(53 1/4" D with door open)
No. of Wash/Rinse Temps	5	ThinQ® TECHNOLOGY		Carton (WxHxD)	29 23/32" x 43 4/32" x 33 28/32"
Wash/Rinse Temps	Extra Hot, Hot, Warm, Cold, Tap Cold	SmartDiagnosis™ (v3.0)	Yes	Weight (Product/Carton)	201.5 / 215.2 lbs
		Wi-Fi	Yes	LIMITED WARRANTY	
		Remote Start and Cycle Monitor	Yes	Parts and Labor	1 Year
		Energy Monitoring	Yes	Direct Drive Motor	10 Years
		MOTOR AND AGITATOR		Drum	3 Years
		Motor Type	Inverter Direct Drive Motor	UPC CODES	
		Axis	Horizontal	WM4500HBA (Black Steel)	048231026772

© 2020 LG Electronics USA, Inc. All rights reserved. "LG Life's Good" is a registered trademark of LG Corp. All other product and brand names are trademarks or registered trademarks of their respective owners. Design, features and specifications are subject to change without notice. Non-metric weights and measurements are approximate. Some features may require Internet access. Content and services may vary by product and are subject to change without notice. 7/22/20

ka
vj

10 INSTALLATION

⚠ WARNING

- Certain internal parts are intentionally not grounded and may present a risk of electric shock only during servicing. Service personnel- Do not contact the following parts while the appliance is energized: pump, valve, motor, control board.

Tools Needed



- 1 Pliers
- 2 Flat-Blade Screwdriver
- 3 Level

Choosing the Proper Location

Check the following requirements for the install location before installing the washer.

- Allow for sufficient space between the walls and the washer for installation.
- Make sure that the floor is clean, dry and free of dust, dirt, water and oil so the leveling feet cannot slide easily. Leveling feet that can move or slide on the floor can contribute to excess vibration and noise.
- If the floor has too much flex, reinforce it to make it more rigid. If the floor is not solid, it may cause severe vibration and noise.
- If a drain pan must be used, take extra care to follow the instructions provided with the drain pan and make sure the leveling feet are adjusted for firm and even contact with the pan. Use of drain pans and failure to properly level the washer may result in increased vibration and noise during operation.

Power Outlet

- The power outlet must be within **60 inches (1.5 m)** of either side of the washer.
- Position the washer so that the outlet and plug are easily accessible.
- Do not overload the outlet with more than one appliance.
- The outlet must be grounded in accordance with current electrical wiring codes and regulations.
- Use a time-delay fuse or circuit breaker.

- It is the personal responsibility and obligation of the washer owner to have a proper outlet installed by a qualified electrician.

Flooring

- To minimize noise and vibration, install the washer on a level, solidly constructed floor capable of supporting the washer without flexing or bouncing.
- The washer must be installed on firm flooring to minimize vibration during the spin cycle. Concrete flooring is best, but a wood floor is sufficient, provided it is built to FHA standards.
- The floor under the washer must not slope more than 1 inch (2.5 cm) from front to back or side to side.
- Installing on carpeting and soft tile surfaces is not recommended.
- Never install the washer on a platform or weakly supported structure.

Floor Installation

To ensure sufficient clearance for water inlet hoses, drain hose and airflow, allow minimum clearances of at least **1 inch (2.5 cm)** at the sides and **4 inches (10 cm)** behind the washer. Be sure to allow for wall, door, or floor moldings that may increase the required clearances.

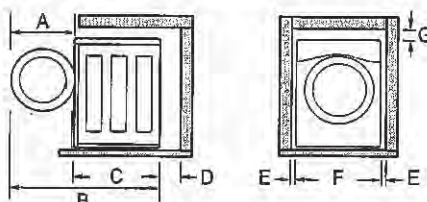

Dimensions and Clearances	
A	24 3/4" (62.6 cm)
B	57 3/4" (146.6 cm)
C	33 1/4" (84 cm)
D	4" (10 cm)
E	1" (2.5 cm)

Ka
VH

Dimensions and Clearances	
F	27" (70 cm)
G	1/4" (0.5 cm)

Stacking or Pedestal Installation

The washer can be stacked under a dryer or on top of a pedestal or pedestal washer.

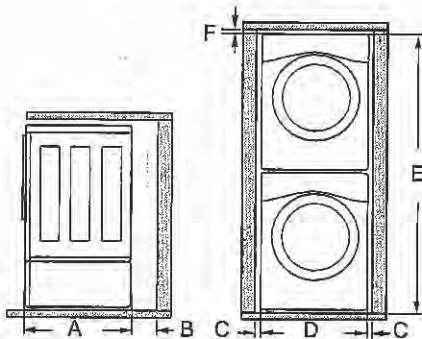

Dimensions and Clearances	
A	33 1/4" (84 cm)
B	4" (10 cm)
C	1" (0.5 cm)
D	27" (70 cm)
E	77 1/2" (196.8 cm)
F	1/4" (0.5 cm)

NOTE

- Refer to the instructions packaged with the optional pedestal kit before stacking appliance on pedestal.
- Do not use a drain pan with a pedestal or pedestal washer installation as it can block the drawer. Using a drain pan may result in increased vibration and noise during operation.

Unpacking and Removing Shipping Material

Remove all shipping materials from the washer for proper operation and inspect it for shipping damage.

CAUTION

- Failure to remove shipping materials can cause excessive noise and vibration.

Unpacking Shipping Material

* This feature is only available on some models.

Lift the washer off the foam base.

- After removing the carton and shipping material, lift the washer off the foam base.
- Make sure the plastic drum support 1* comes off with the base and is not stuck to the bottom of the washer.
- If you must lay the washer down to remove the carton base 2, always protect the side of the washer and lay it carefully on its side. Do not lay the washer on its front or back.

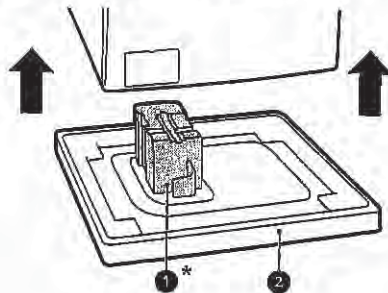

Removing Shipping Material

- Remove the bolt assemblies.
 - Starting with the bottom two shipping bolts 3, use the included wrench to fully loosen all 4 shipping bolts by turning them counterclockwise.
 - Remove the bolt assemblies (bolts and retainers) by wiggling them slightly while pulling them out.

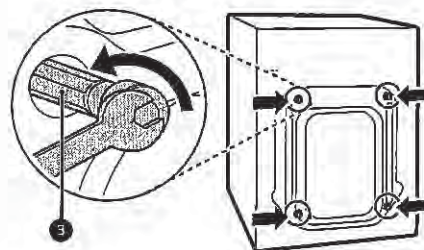

- Install the hole caps.
 - Locate the hole caps 4 included in the accessory pack or attached to the back of

ka
vr

UK-75 WALLACETON
 LOT 228
 33-3344 ELEV. B
 THE WINDSOR

51 of 56

HOME APPLIANCES

LG LAUNDRY

DLEX4500B / DLGX4501B

7.4 cu.ft. Front Load Dryer with TurboSteam™ and Built-In Intelligence



- 7.4 cu. ft. Ultra Large Capacity
- TurboSteam™ Technology
- AI Fabric Sensor/ Smart Pairing™
- LG ThinQ® Technology / Proactive Customer Care
- FlowSense™ Duct Clogging and Lint Filter Indicators
- ENERGY STAR® Certified
- Closet Depth
- LoDecibel™ Quiet Operation
- Reversible Door
- Wrinkle Care Option

AVAILABLE COLORS



BLACK STEEL

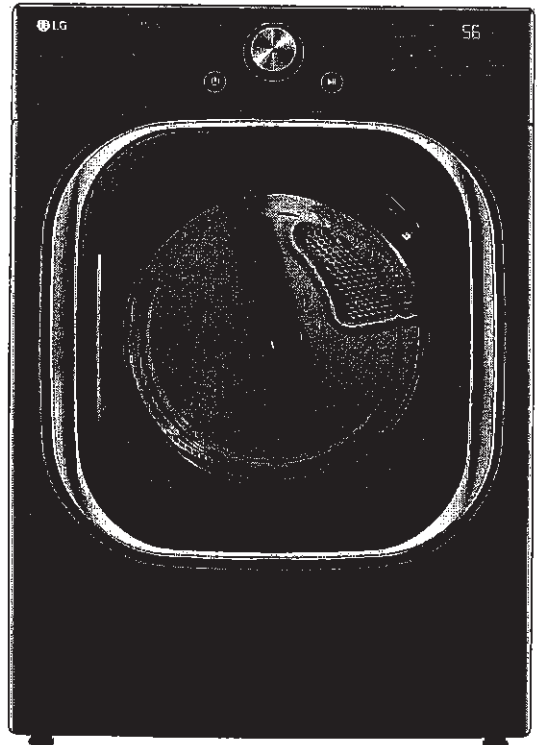

Enjoy new ways to control your home with LG smart appliances

- Use the ThinQ® app to start the laundry while you're out
- Get alerts when the cycle is finished
- With Smart Pairing™, the washer can tell the dryer to select a compatible drying cycle

LG ThinQ®



SUMMARY		FABRIC CARE FEATURES		POWER SOURCE	
Type	Front Load Dryer	AI Dry	Yes	Ratings	CSA Listed
Capacity	7.4 cu. Ft.	Sensor Dry	Yes	Electrical Requirements	120V, 15 Amps (Gas) / 240V 30 Amps (Electric)
Matching Washer	WM4500HBA	Precise Temperature Control with Variable Heater	Yes	Type	Electric, Gas
Sensor Dry	Yes	Steam	TurboSteam™	BTU Rating	10,000 Feet
Steam	Yes	CONVENIENCE FEATURES		OPTIONS	
Color	Black Steel (B)	3 Minute Installation Check	Yes	LP Conversion Kit	383EEL3002D
APPEARANCE		LoDecibel™ Quiet Operation	Yes	Side Venting Kit	383EEL9001B
Intelligent Electronic Controls with LED Display	Yes	End of Cycle Signal	Yes	Pedestal	WDP4B
Dial-A-Cycle™	Yes	Drum Light	Yes	Pedestal (WxHxD)	27 x 14 1/8 x 30 3/4 (50 1/2 D with door open)
Touch Buttons	Yes	Reversible Door	Yes	DIMENSIONS (ELECTRIC)	
DRYER PROGRAMS		FlowSense™ Duct Clogging Indicator	Yes	Product (WxHxD)	27" x 38 11/16" x 29 3/4"
No. of Programs	14	Wrinkle Care Option	Yes	Depth with Door Open	51"
Programs (Sensor Dry)	Normal, Heavy Duty, Bedding, Small Load, Anti Bacterial, Steam-Sanitary™, SteamFresh™, Perm Press, Delicates, Sportswear, Towels, Speed Dry (Manual Dry), Air Dry (Manual Dry), Downloaded	Child Lock	Yes	Carton (WxHxD)	29 1/2" x 42 1/4" x 31 1/4"
No. of Options	12	Venting Option	Electric: 4 Way Venting / Gas: 3 Way Venting	Weight (Product)	136 lbs
Options	More Time, Less Time, Damp Dry Signal, Wrinkle Care, Control Lock, Wi-Fi, Energy Saver, TurboSteam™, Reduce Static, Remote Start, Drum Light, Signal	4 Adjustable Legs	Yes	Weight (Carton)	155 lbs
Temperature Settings	High, Med-High, Medium, Low, Ultra Low	Remaining Time Display/Status Indicator(s)	Yes	DIMENSIONS (GAS)	
Drying Levels	Very Dry, More Dry, Normal Dry, Less Dry, Damp Dry	ThinQ™ TECHNOLOGY		Product (WxHxD)	27" x 38 11/16" x 29 3/4"
Manual Dry Times	60 min., 50 min., 40 min., 30 min., 20 min., More Time/Less Time	SmartDiagnosis™ (v3.0)	Yes	Depth with Door Open	51"
		Wi-Fi	Yes	Carton (WxHxD)	29 1/2" x 42 1/4" x 31 1/4"
		Remote Start and Cycle Monitor	Yes	Weight (Product)	139.4 lbs
		Energy Monitoring	Yes (Wi-Fi)	Weight (Carton)	158.4 lbs
		ENERGY		LIMITED WARRANTY	
		ENERGY STAR® Certified	Yes	Parts & Labor	1 Year
		CEF	Electric: 3.94 / Gas: 3.49	Drum	10 Years
		MATERIALS AND FINISHES		UPC CODES	
		NeveRust® Stainless Steel Drum	Yes	DLEX4500B (Black Steel)	048231026789
		Tub Rear	Painted	DLGX4501B (Black Steel)	048231026796
		Cabinet	Painted Steel	WM4500HBA (Black Steel)	048231026772
		Door	Dark Black Tinted Square Cover		
		All Available Colors	Black Steel (B)		

© 2020 LG Electronics USA, Inc. All rights reserved. "LG Life's Good" is a registered trademark of LG Corp. All other product and brand names are trademarks or registered trademarks of their respective owners. Design, features and specifications are subject to change without notice. Non-metric weights and measurements are approximate. Some features may require Internet access. Content and services may vary by product and are subject to change without notice. 7/22/20

ka
vt

UK-75 WALLACETON
LOT 228
33-3344 ELEV. B
THE WINDSOR

52 of 56

Installation Location Requirements

WARNING

- Read all installation instructions completely before installing and operating your dryer! It is important that you review this entire manual before installing and using your dryer. Detailed instructions concerning electrical connections, gas connections, and exhaust requirements are provided on the following pages.

ENGLISH

The installation requires:

- A location that allows for proper exhaust installation. A gas dryer must be exhausted to the outdoors. See Venting the Dryer.
- A grounded electrical outlet located within 2 ft. (61 cm) of either side of the dryer. See Connecting Electric Dryers.
- A sturdy floor to support the total dryer weight of 200 lb (90.7 kg). The combined weight of a companion appliance should also be considered.
- No other fuel-burning appliance can be installed in the same closet as a dryer.
- Additional clearances might be required for wall, door and floor moldings.
- Companion appliance spacing should also be considered.

NOTE

- The floor must be level, with a maximum slope of 1 inch (2.5 cm) under the entire dryer. Clothes may not tumble properly, and automatic sensor cycles may not operate correctly if the dryer is not level.
- For garage installation, you will need to place the dryer at least 18 inches (45.7 cm) above the floor. The standard pedestal height is 15 inches (38 cm). You will need 18 inches (45.7 cm) from the garage floor to the bottom of the dryer.
- Do not operate your dryer at temperatures below 45 °F (7 °C). At lower temperatures, the dryer might not shut off at the end of an automatic cycle. This can result in longer drying times.
- The dryer must not be installed or stored in an area where it will be exposed to water and/or weather.
- Check code requirements that limit, or do not permit, installation of the dryer in garages, closets, mobile homes or sleeping quarters. Contact your local building inspector.

Start

12 INSTALLATION

Clearances

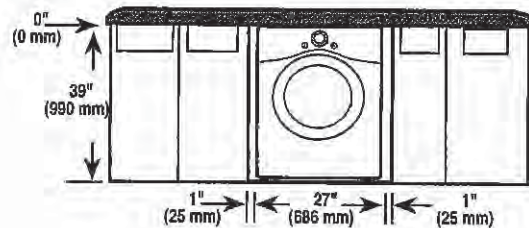
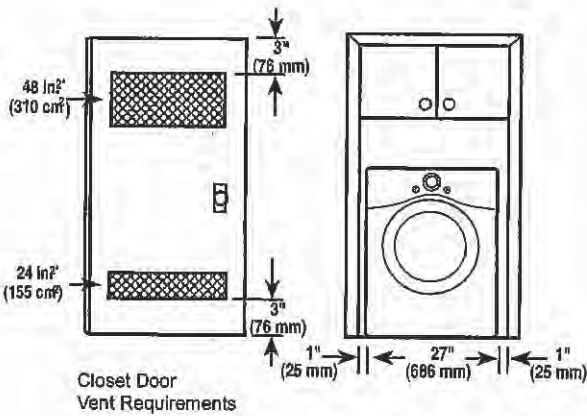
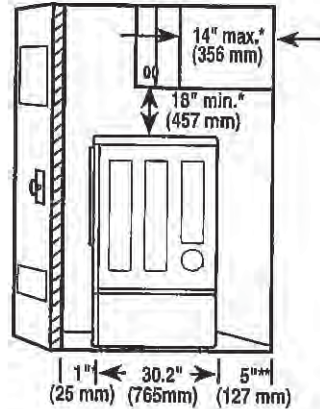
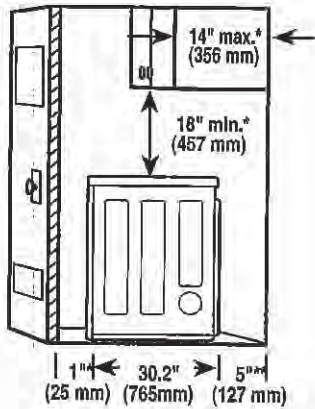

Installation Spacing for Recessed Area or Closet Installation

The following clearances are recommended for this dryer. This dryer has been tested for clearances of 1 inch (2.5 cm) on the sides and rear. Recommended clearances should be considered for the following reasons:

- Additional clearances should be considered for ease of installation and servicing.
- Additional clearances should be considered on all sides of the dryer to reduce noise transfer. For closet installation, with a door, minimum ventilation openings in the top and bottom of the door are required. Louvered doors with equivalent ventilation openings are acceptable.

Closet Ventilation Requirements

Closets with doors must have both an upper and lower vent to prevent heat and moisture buildup in the closet. One upper vent opening with a minimum opening of 48 sq. in. (310 cm²) must be installed no lower than 6 feet above the floor. One lower vent opening with a minimum opening of 24 sq. in. (155 cm²) must be installed no more than one foot above the floor. Install vent grills in the door or cut down the door at the top and bottom to form openings. Louvered doors with equivalent ventilation openings are also acceptable.

NOTE

- There should be at least a little space around the dryer (or any other appliance) to eliminate the transfer of vibration from one appliance to another. If there is enough vibration, it could cause appliances to make noise or come into contact, causing paint damage and further increasing noise.

ka vt

UK-75 WALLACETON
 LOT 228
 33-3344 ELEV. B
 THE WINDSOR

54 of 56

Installation Spacing for Recessed Area or Closet, with Stacked Washer and Dryer

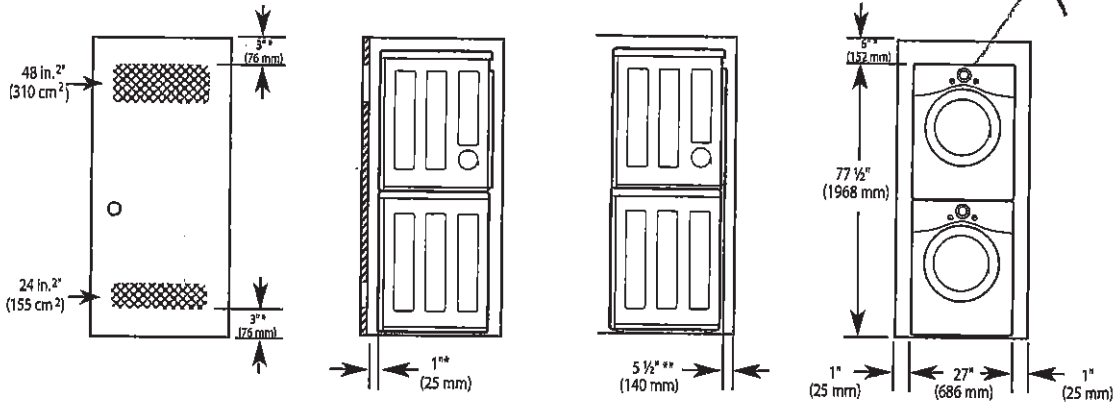

ENGLISH

* Required spacing

** For side or bottom venting, 2-inch (5.1 cm) of spacing is allowed.

Installation Spacing for Cabinet

For cabinet installation with a door, minimum ventilation openings in the top of the cabinet are required.

* Required spacing

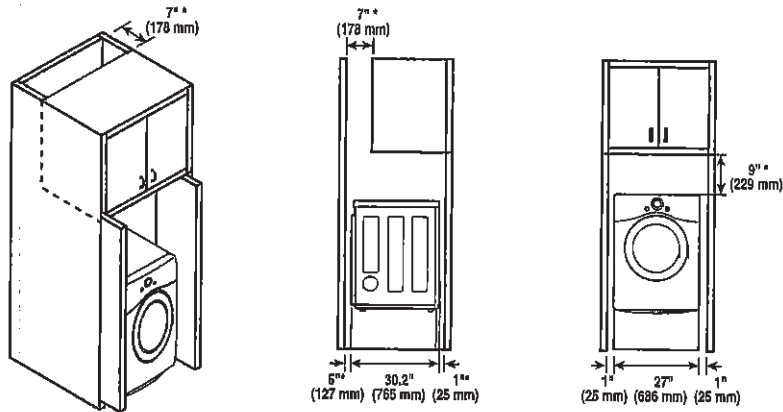

V2
ka

55 of 56

18 INSTALLATION

Venting the Dryer

⚠ WARNING

To reduce the risk of fire or explosion, electric shock, property damage, injury to persons or death when using this appliance, follow basic safety precautions, including the following:

- Do not crush or collapse ductwork.
- Do not allow ductwork to rest on or contact sharp objects.
- If connecting to existing ductwork, make sure it is suitable and clean before installing the dryer.
- Venting must conform to local building codes.
- Gas dryers MUST exhaust to the outdoors.
- Use only 4-inch (10.2 cm) rigid, semi-rigid or flexible metal ductwork inside the dryer cabinet and for venting outside.
- To reduce the risk of fire, combustion, or accumulation of combustible gases, DO NOT exhaust dryer air into an enclosed and unventilated area, such as an attic, wall, ceiling, crawl space, chimney, gas vent, or concealed space of a building.
- To reduce the risk of fire, DO NOT exhaust the dryer with plastic or thin foil ducting.
- The exhaust duct must be 4-inch (10.2 cm) in diameter with no obstructions. The exhaust duct should be kept as short as possible. Make sure to clean any old ducts before installing your new dryer.
- Rigid, semi-rigid or flexible metal ducting is recommended for use between the dryer and the wall. All non-rigid metal transition duct must be UL-listed. Use of other materials for transition duct could affect drying time.
- DO NOT use sheet metal screws or other fasteners which extend into the duct that could catch lint and reduce the efficiency of the exhaust system. Secure all joints with duct tape.
- Do not exceed the recommended duct length limitations noted in the chart. Failure to follow these instructions may result in extended drying times, fire or death.

⚠ WARNING

- Ductwork is not provided with the dryer. You should obtain the necessary ductwork locally. The vent hood should have hinged dampers to prevent backdraft when the dryer is not in use.
- The total length of flexible metal duct must not exceed 8 ft. (2.4 m).

Ductwork

Wall Cap Type	Number of 90° Elbows	Maximum length of 4-inch diameter rigid metal duct
 a: 4" (10.2 cm)	0	65 ft. (19.8 m)
	1	55 ft. (16.8 m)
	2	47 ft. (14.3 m)
	3	36 ft. (11.0 m)
 b: 2.5" (6.35 cm)	0	55 ft. (16.8 m)
	1	47 ft. (14.3 m)
	2	41 ft. (12.5 m)
	3	30 ft. (9.1 m)
 b: 2.5" (6.35 cm)	4	22 ft. (6.7 m)

NOTE

- Deduct 6 ft. (1.8 m) for each additional elbow. Do not use more than four 90° elbows.
- In Canada, only those foil-type flexible ducts, if any, specifically identified for use with the appliance by the manufacturer should be used. In the United States, only those foil-type flexible ducts, if any, specifically identified for use with the appliance by the manufacturer and that comply with the Outline for Clothes Dryer Transition Duct, Subject 2158A, should be used.

VJ
Ka

UK-75 WALLACETON
LOT 228
33-3344 ELEV. B
THE WINDSOR

56^{OF} 56

Routing and Connecting Ductwork

NOTE

Follow the guidelines below to maximize drying performance and reduce lint buildup and condensation in the ductwork. Ductwork and fittings are NOT included and must be purchased separately.

- Use 4-inch (10.2 cm) diameter rigid, semi-rigid or flexible metal ductwork.
- The exhaust duct run should be as short as possible.
- Use as few elbow joints as possible.
- The male end of each section of exhaust duct must point away from the dryer.
- Use duct tape on all duct joints.
- Insulate ductwork that runs through unheated areas in order to reduce condensation and lint buildup on duct surfaces.
- Incorrect or inadequate exhaust systems are not covered by the dryer warranty. Dryer failures or service required because of such exhaust systems will not be covered by the dryer warranty.

Correct Venting

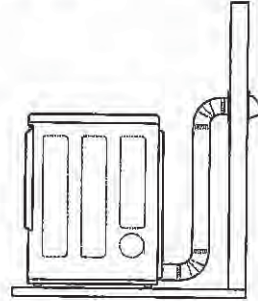

Incorrect Venting

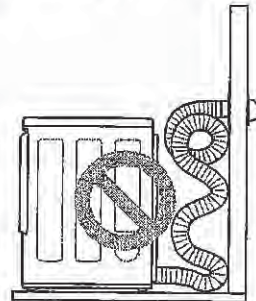

ENGLISH

VJ
KA