

PRE-Sales Selection Sheet
Checklist

1 of 50

LOT 302 Model: 33-2969 B The Hartwell

PURCHASERS: BASSAM CHABAN/HALIMEH QASSEM

VENDOR: Heathwood Homes (Huron) Limited

COFFERED CEILING -DINING ROOM

WAFFLE CEILING-GREAT ROOM

WOB SIDE AND REAR UPGRADE

- ☐ FINISHED BASEMENT
- ☐ COLD CELLAR

UPGRADED / MODIFIED ELEVATION

- ☐ CORNER UPGRADE
- ☒ REAR UPGRADE

CEILING UPGRADE - SMOOTH

- ☒ MAIN FLOOR
- ☒ SECOND FLOOR
- ☐ BASEMENT

ADDITIONAL ROUGH-INS

- ☒ 200 AMP SERVICE
- ☐ WET BAR ROUGH-IN
- ☒ HUMIDIFIER
- ☒ AIR CONDITIONING

GAS ROUGH-IN

- ☒ STOVE
- ☐ DRYER
- ☒ BBQ
- ☐ ADDITIONAL FIREPLACE

KITCHEN: HOODFAN VENTING SIZE

- ☒ 6 IN ROUND DUCT
- ☐ 7 IN ROUND DUCT

FULL BASEMENT STAIRS:

N/A

UPPER BASEMENT STAIRS:

All Oak

LOWER BASEMENT STAIRS:

Paint Grade

MAIN STAIRS:

All Oak

MEDIA STAIRS (if applicable):

N/A

LOFT STAIRS (if applicable):

N/A

May 31/21
Date Purchaser:

file

May 31/21
Date Decor Consultant:

IRIT SALEM

Date Purchaser:

- APPROVED -

May 31/21

Date

Heathwood Homes (Huron) Limited

M. Rosen

Approved

Locked Date:



Sales Selection Sheet
Wallaceton

2 of 50

PURCHASERS: BASSAM CHABAN and HALIMEH QASSEM

TEL: BUS.: 519-572-2624

LOT / UNIT	PHASE	MODEL	
302	2	33-2969 B The Hartwell	

It is herein understood and agreed between the undersigned parties hereto that the following changes shall be made to the above mentioned Agreement of Purchase and Sale in accordance with the agreement and except for such changes noted below, all other terms and conditions in the Agreement of Purchase and Sale shall remain as stated herein: It is further understood that and agreed that all changes and additions shall be installed as per builder's specifications, location and available selections. The Purchaser hereby agrees to purchase the following extras:

ADMIN FEE

1	- SCHEDULE "E": TEN THOUSAND DOLLARS (\$10,000.00) AT DECOR (NO CASH VALUE) - SINGLES	Qty: 1	
60,546	Note:		

Sub Total
HST
Total

1. This Sales Selection Sheet when properly executed forms part of our Agreement of Purchase and Sale.
2. All extras and upgrades listed above are subject to Construction Progress and Architectural and Municipal requirements.
3. In the event the Vendor is unable to incorporate the work approved above in the construction of the house for any reason whatsoever, the Vendor will not be liable to the Purchaser in any way. The monies paid for any changes or optional extras not proceeded with shall be returned to the Purchaser, without interest. The cost of options or extras is non-refundable in all other circumstances. If for any reason whatsoever the Agreement of Purchase and Sale is not completed, the total cost of work approved above will be retained by the Vendor.
4. The Vendor reserves the right to substitute above materials and equipment with that of equal or better quality.
5. Purchaser acknowledges that items may not be exactly as shown. Variations from the Vendor's samples may occur in finished materials due to normal production processes. Vendor is not responsible for shade difference which may occur from different dye lots or wood grains. Variations from the Vendor's samples will occur with natural materials such as wood, marble, granite, hardwood and brick.
6. The Vendor reserves the right to select Grout & Thresholds that best suits the Tile selected.
7. Selections will not be processed unless signed by Heathwood Homes Head Office.
8. The selections made on this schedule are final and cannot be changed once submitted.
9. The Purchaser has checked and acknowledges the accuracy of this schedule.

Payment Summary

<u>Paid By</u>	<u>Amount</u>
----------------	---------------

Total Payment:

PURCHASER:

Signatures on file
BASSAM CHABAN

31-May-21
DATE

IRIT SALEM
Decor Consultant

31-May-21
DATE

PURCHASER:

HALIMEH QASSEM

31-May-21
DATE

- APPROVED -

Date Approved *mRosen* Heathwood Homes (Huron) Limited

TAX#:1

PREPARED BY: Irit Salem

PE 811-1

Sinvoice.rpt 28may19

BASSAM CHABAN/HALIMEH QASSEM
Project: Wallaceton
Unit: 302, Phase: 2
Model: 33-2969 B The Hartwell

Created: 4/6/2021 10:59:23
Locked:
Closed:

3 of 50

Kitchen

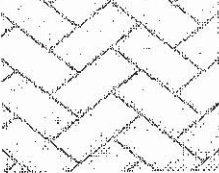
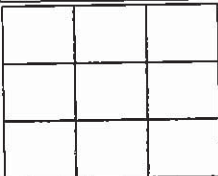
Cabinet Colour/Style	6823	Classic Plus-BOSTON-MACADEMIA-PAINT MDF ***UPG***
Countertop	7888	Group 6-Quartz- Caesarstone-ALPINE MIST # 5110-3/4 inch with built-up edge ***6***
Countertop Edge	4005	DOUBLE MITRE 1 1/2 INCH ***UPG*** 
Cabinet Hardware	9146	12877 MB BLACK-HARDWARE ***2***
Island Cabinet Colour/Style	6861	Classic II-BOSTON-CAVIAR CL-MAPLE ***3***
Island Countertop	7888	Group 6-Quartz- Caesarstone-ALPINE MIST # 5110-3/4 inch with built-up edge ***6***
Backsplash	7888	OV.ET.MGR.1X3.PL.HER Eterna Series Medium Grey 1
Backsplash Grout	2220	Grout-(11) Sahara Beige ***UPG***
Backsplash Tile Pattern	3100	HERRINGBONE ***UPG*** 
HoodFan	3100	KVWB606HBS KITCHEN AID 36 SPEC PAGE 45
Flooring	9244	OV.ET.VLK.2424.PL-ETERNA VOLKAS POLISHED 24X24 ***6***
Floor Tile Grout	7705	Grout-(01) Alabaster ***UPG***
Floor Tile Pattern	3000	STANDARD SQUARE ***STD*** 

- Purchasers have been advised: standard fridge opening is a minimum 37 3/8 x 73 3/8 inches. Ice Waterline Rough-In is included.
- Standard stove opening is 30 inches and standard dishwasher opening is 24 inches. Any gas stove will require backsplash or stainless steel backing to avoid fire hazards.
- Purchasers acknowledge: Heathwood Homes and its contractors will not be responsible for any kitchen cabinet changes due to appliances dimension changes after sign-off.

Comment

Servery

Cabinet Colour/Style	6823	Classic Plus-BOSTON-MACADEMIA-PAINT MDF ***UPG***
Countertop	7888	Group 6-Quartz- Caesarstone-ALPINE MIST # 5110-3/4 inch with built-up edge ***6***
Countertop Edge	4005	DOUBLE MITRE 1 1/2 INCH ***UPG*** 
Cabinet Hardware	9146	12877 MB BLACK-HARDWARE ***2***

BE. 49

BASSAM CHABAN/HALIMEH QASSEM
Project: Wallaceton
Unit: 302, Phase: 2
Model: 33-2969 B The Hartwell

Created: 4/6/2021 10:59:23
Locked:
Closed:

4 of 50

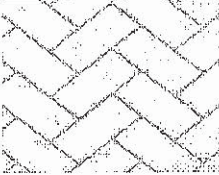
Backsplash	9146	OV.ET.MGR.1X3.PL.HER Eterna Series Medium Grey 1
Backsplash Grout	2220	Grout-(11) Sahara Beige ***UPG***
Backsplash Tile Pattern	3100	HERRINGBONE ***UPG***
		
Flooring	9244	OV.ET.VLK.2424.PL-ETERNA VOLKAS POLISHED 24X24 ***6***
Comment		

Cabinet		
Cabinet Hardware	1111	N/A *****
Comment		

Foyer		
Flooring	9244	OV.ET.VLK.2424.PL-ETERNA VOLKAS POLISHED 24X24 ***6***
Floor Tile Grout	7705	Grout-(01) Alabaster ***UPG***
Floor Tile Pattern	3000	STANDARD SQUARE ***STD***
		
Comment		

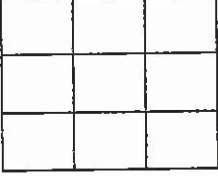
Laundry Room		
Flooring	9244	OV.ET.VLK.2424.PL-ETERNA VOLKAS POLISHED 24X24 ***6***
Floor Tile Grout	7705	Grout-(01) Alabaster ***UPG***
Floor Tile Pattern	3000	STANDARD SQUARE ***STD***
		
Comment		

Laundry Room Opt. Upper Cabinets		
Cabinet - Uppers	9111	VIKING III SIMCOE ORCHID 3DL ***1***
Cabinet Hardware	7667	12881-HARDWARE ***STD***

Bc 49

BASSAM CHABAN/HALIMEH QASSEM
Project: Wallaceton
Unit: 302, Phase: 2
Model: 33-2969 B The Hartwell

Created: 4/6/2021 10:59:23
Locked:
Closed:

5 of 50

Comment

Mud Room

Flooring9244OV.ET.VLK.2424.PL-ETERNA VOLKAS POLISHED 24X24
6

Floor Tile Grout7705Grout-(01) Alabaster ***UPG***

Floor Tile Pattern3000STANDARD SQUARE ***STD***

Comment

Powder Room

Flooring9244OV.ET.VLK.2424.PL-ETERNA VOLKAS POLISHED 24X24
6

Floor Tile Grout7705Grout-(01) Alabaster ***UPG***

Floor Tile Pattern3000STANDARD SQUARE ***STD***

Plumbing Fixture (Colour)1737Plumbing Fixtures-WHITE ***STD***

Comment

Dining Room

Flooring9064White Oak UVF-Vintage Northern Solid Sawn : White Oak :
Sculpted UVF-APOLLO-3/4 inch x 5 inch ***2***

Comment

Great Room

Flooring9064White Oak UVF-Vintage Northern Solid Sawn : White Oak :
Sculpted UVF-APOLLO-3/4 inch x 5 inch ***2***

Comment

Great Room Fireplace

Type8869Majestic MERC32 ***STD***

Mantle1439NF 17-Paint Grade Mantle-Flat Wall-WHITE ***STD***

Surround Opt.1111N/A *****

- Purchasers have been advised: heat from the FP can damage TV above a FP and items placed on mantle.

Bc LA 9

BASSAM CHABAN/HALIMEH QASSEM
Project: Wallaceton
Unit: 302, Phase: 2
Model: 33-2969 B The Hartwell

Created: 4/6/2021 10:59:23
Locked:
Closed:

6 of 50

- Heathwood and its contractors will not be liable for any damage on items placed/installed above a FP after closing.

Comment WITH BUILT UP DRY WALL ABOVE

Office

Flooring 9064 White Oak UVF-Vintage Northern Solid Sawn : White Oak :
Sculpted UVF-APOLLO-3/4 inch x 5 inch ***2***

Comment

Main Floor Hall

Flooring 9064 White Oak UVF-Vintage Northern Solid Sawn : White Oak :
Sculpted UVF-APOLLO-3/4 inch x 5 inch ***2***

Comment

Upper Hall

Flooring 9064 White Oak UVF-Vintage Northern Solid Sawn : White Oak :
Sculpted UVF-APOLLO-3/4 inch x 5 inch ***5***

Comment

Master Bedroom

Flooring 9064 White Oak UVF-Vintage Northern Solid Sawn : White Oak :
Sculpted UVF-APOLLO-3/4 inch x 5 inch ***5***

Comment

Bedroom 2

Flooring 9064 White Oak UVF-Vintage Northern Solid Sawn : White Oak :
Sculpted UVF-APOLLO-3/4 inch x 5 inch ***5***

Comment

Bedroom 3

Flooring 9064 White Oak UVF-Vintage Northern Solid Sawn : White Oak :
Sculpted UVF-APOLLO-3/4 inch x 5 inch ***5***

Comment

Bedroom 4

Flooring 9064 White Oak UVF-Vintage Northern Solid Sawn : White Oak :
Sculpted UVF-APOLLO-3/4 inch x 5 inch ***5***

Bc 149

BASSAM CHABAN/HALIMEH QASSEM
Project: Wallaceton
Unit: 302, Phase: 2
Model: 33-2969 B The Hartwell

Created: 4/6/2021 10:59:23
Locked:
Closed:

7 of 50

Comment	
---------	--

Opt. Bedroom 5

Flooring	1111	N/A *****
Comment		

Media Room

Flooring	9064	White Oak UVF-Vintage Northern Solid Sawn : White Oak : Sculpted UVF-APOLLO-3/4 inch x 5 inch ***5***
Comment		

Master Ensuite

Cabinet Colour/Style	9111	VIKING III SIMCOE ORCHID 3DL ***STD***									
Countertop	9111	Group 7-Quartz-Caesarstone-CALCATTÀ NUVO #5131 3/4									
Countertop Edge	4007	GROUP 2 TO 7 - DOUBLE MITRE 1 1/2 INCH ***3***									
Cabinet Hardware	9146	12877 MB BLACK-HARDWARE ***2***									
Floor Tile	9116	OV.ET.MGR.2424.PL Eterna Series Medium Grey 24x24 ***6***									
Floor Tile Grout	2220	Grout-(11) Sahara Beige ***UPG***									
Floor Tile Pattern	3000	STANDARD SQUARE ***STD***									
		<table><tr><td></td><td></td><td></td></tr><tr><td></td><td></td><td></td></tr><tr><td></td><td></td><td></td></tr></table>									
Shower Floor Tile	3000	OV.ET.MGR.02.HEX.PL Eterna Series Medium Grey 2									
Shower Floor Tile Grout	2220	Grout-(11) Sahara Beige ***UPG***									
Shower Floor Tile Pattern	1111	N/A *****									
Shower Wall Tile	9116	OV.ET.MGR.2424.PL Eterna Series Medium Grey 24x24 ***6***									
Shower Wall Tile Grout	2220	Grout-(11) Sahara Beige ***UPG***									
Shower Wall Tile Pattern	3000	STANDARD SQUARE ***STD***									
		<table><tr><td></td><td></td><td></td></tr><tr><td></td><td></td><td></td></tr><tr><td></td><td></td><td></td></tr></table>									

BC it 9



BASSAM CHABAN/HALIMEH QASSEM
Project: Wallaceton
Unit: 302, Phase: 2
Model: 33-2969 B The Hartwell

Created: 4/6/2021 10:59:23
Locked:
Closed:

8 of 50

Shower Jamb(s) and Sill(s)	8923	Shower Jamb / Sill-Thassos White ***STD***
Plumbing Fixture (colour)	1737	Plumbing Fixtures-WHITE ***STD***
Comment	SHOWER CEILING THE SAME AS FLOOR.OV.ET.MRG.02.HEX SERIES MEDIUM GREY 2	

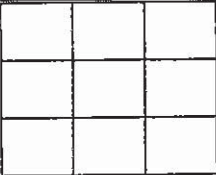
Main Bathroom

Cabinet Colour/Style	9157	Viking III-SIMCOE-MOONLIGHT-3DL ***STD***
Countertop	7874	Group 5-Quartz-Caesarstone-PURE WHITE # 1141-3/4 inch with built-up edge ***6***
Countertop Edge	4007	GROUP 2 TO 7 - DOUBLE MITRE 1 1/2 INCH ***3***
Cabinet Hardware	9146	12877 MB BLACK-HARDWARE ***2***
Flooring	8248	OV.CX.WHT.2424.PL-Carrara X-White Polished-24 x 24 ***6***
Floor Tile Grout	7705	Grout-(01) Alabaster ***UPG***
Floor Tile Pattern	3000	STANDARD SQUARE ***STD***
		
Wall Tile	8248	OV.CX.WHT.2424.PL-Carrara X-White Polished-24 x 24 ***7***
Wall Tile Grout	2226	Grout-(00) White ***STD***
Main Bathroom Tile Pattern	3000	STANDARD SQUARE ***STD***
		
Plumbing Fixture (Colour)	1737	Plumbing Fixtures-WHITE ***STD***
Comment		

Shared Bathroom

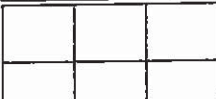
Cabinet Colour/Style	6319	Viking III-MANCHESTER-CAVIAR CL-MAPLE ***STD***
Countertop	7885	Group 6-Quartz- Caesarstone-FROSTY CARRINA # 5141-3/4 inch with built-up edge ***7***
Countertop Edge	4007	GROUP 2 TO 7 - DOUBLE MITRE 1 1/2 INCH ***3***
Cabinet Hardware	7667	12881-HARDWARE ***STD***
Flooring	8130	NY.RG.JBK.2424.PL-Regal Polished-Jet Black-24 x 24 ***6***
Floor Tile Grout	2221	Grout-(47) Charcoal ***UPG***
Floor Tile Pattern	3000	STANDARD SQUARE ***STD***
		

BASSAM CHABAN/HALIMEH QASSEM
Project: Wallaceton
Unit: 302, Phase: 2
Model: 33-2969 B The Hartwell

Created: 4/6/2021 10:59:23
Locked:
Closed:

9 of 50

Shower Floor Tile	8109	OD.ON.BLK.02.HEX.MT-ONTARIO HEXAGON MATTE-BLACK ***2***
Shower Floor Tile Grout	2221	Grout-(47) Charcoal ***UPG***
Shower Floor Tile Pattern	1111	N/A *****
Wall Tile	8130	NY.RG.JBK.2424.PL-Regal Polished-Jet Black-24 x 24 ***7***
Wall Tile Grout	2221	Grout-(47) Charcoal ***UPG***
Shower Wall Tile Pattern	3000	STANDARD SQUARE ***STD***
Shower Jamb(s)	8927	Shower Jamb / Sill-Moonlight Black ***Upg***
Plumbing Fixture (Colour)	1737	Plumbing Fixtures-WHITE ***STD***
Comment	SHOWER CEILING TILE: OD.ON.BLK 02. HEX.MT ONTARIO HEXAGON MATTE BLACK- 2	

Opt. Finished Basement (Rec) Room/Hall

Flooring	1111	N/A *****
Comment		

Opt. Finished Basement Bathroom

Cabinet Colour/Style	1111	N/A *****
Countertop	1111	N/A *****
Countertop Edge	1111	N/A *****
Cabinet Hardware	1111	N/A *****
Flooring	1111	N/A *****
Floor Tile Grout	1111	N/A *****
Floor Tile Pattern	1111	N/A *****
Shower Floor Tile	1111	N/A *****
Shower Floor Tile Grout	1111	N/A *****

Bc 149

BASSAM CHABAN/HALIMEH QASSEM
Project: Wallaceton
Unit: 302, Phase: 2
Model: 33-2969 B The Hartwell

Created: 4/6/2021 10:59:23
Locked:
Closed:

10 of 50

Shower Floor Tile Pattern	1111	N/A *****
Shower Wall Tile	1111	N/A *****
Shower Wall Tile Grout	1111	N/A *****
Shower Wall Tile Pattern	1111	N/A *****
Shower Jamb(s)	1111	N/A *****
Plumbing Fixture (Colour)	1111	N/A *****
Comment		

Main Stairs

Type	1712	Oak Stairs ***STD MAIN STAIRS***
Colour	7940	Sambucca STAIN TO COMPLIMENT HARDWOOD AND WILL VARY FROM FLOORING ***99***
Carpet Runner	9252	DY 16787 -Dynasty Tex-MYSTIC BEIGE-40 oz Poly***STD***
Handrail/Pickets/Posts Type	8148	Single Collar Alt. Plain w/ Shoes with 3 1/2" Square/Cap Post(s)-BLACK ***2***
Handrail/Pickets/Posts Colour	1111	N/A *****
Custom Stain/Paint	1111	N/A *****
Comment		

Main Stairs Landing(s)

Flooring	8906	Red Oak-Vintage 5 inch Pre-Sanded Smooth Unfinished Red Oak-Unfinished-3/4 inch x 5 inch ***1***
Comment	STAIN SAMBUCCA	

Basement Stairs

Type	1713	Paint Grade Stairs ***STD BASEMENT STAIR ***
Colour	1111	N/A *****
Carpet Runner	1111	N/A *****
Handrail/Pickets/Post Type	1111	N/A *****

Bc H 9

BASSAM CHABAN/HALIMEH QASSEM
Project: Wallaceton
Unit: 302, Phase: 2
Model: 33-2969 B The Hartwell

Created: 4/6/2021 10:59:23
Locked:
Closed:

11 of 50



Handrail/Pickets/Post Colours	1111	N/A *****
Carpet	1111	N/A *****
Custom Stain/Paint	1111	N/A *****
Comment		

Handrail/Pickets/Post Colour		
Basement Stairs Landing(s)		
Flooring	8906	Red Oak-Vintage 5 inch Pre-Sanded Smooth Unfinished Red Oak-Unfinished-3/4 inch x 5 inch ***1***
Comment	STAIN SAMBUCCA	

Throughout		
Underpad	1080	300 Series-Underpad ***UPG***
Thresholds	2232	Metal Thresholds ***STD***
Switches and Plug	5796	Decora White Switches and Plugs ***STD***
Trim Size	8705	4 1/4 Baseboard and 2 3/4 Casings ***STD***
Trim - Paint Colour	1716	Trim-WHITE ***STD***
Comment		

Walls - Paint Colour		
Walls - Paint Colour	1717	22-Wall-WARM GREY ***STD***
Comment		

Purchaser:		Date		Date
	BASSAM CHABAN		Decor Consultant	May 10, 21

Purchaser:		Date		Date Approved
	HALIMEH QASSEM		Wallaceton	05-31-21

- APPROVED -



Sales Selection Sheet

Wallaceton

12 of 50

TEL: BUS.: 519-572-2624

PURCHASERS: BASSAM CHABAN and HALIMEH QASSEM

LOT / UNIT
302PHASE
2MODEL
33-2969 B The Hartwell

It is herein understood and agreed between the undersigned parties hereto that the following changes shall be made to the above mentioned Agreement of Purchase and Sale in accordance with the agreement and except for such changes noted below, all other terms and conditions in the Agreement of Purchase and Sale shall remain as stated herein: It is further understood that and agreed that all changes and additions shall be installed as per builder's specifications, location and available selections. The Purchaser hereby agrees to purchase the following extras:

ADMIN FEE

1	- promo SCHEDULE E	Qty: (1)
60,413	Note:	

APPLIANCES

2	KITCHEN - KVWB606HBS KITCHEN AID 36" CHIMNY HOOD FAN BLK/SS	Qty: 1
56,141	Note: 36" CHIMNY HOOD FAN BLK/SS SPEC PAGE 45	
3	-	Qty: 1
60,414	Note: APPLAINCES SEE SPEC# PAGE# 46-50	

CABINETRY

4	KITCHEN - CABINETRY - 03G-CABINET HARDWARE UPGRADE II DISPLAY BOARD; PER KITCHEN ; PRICE ALL THE SAME FOR ALL	Qty: 1
189,30C		
56,038	Note:	
*5	KITCHEN - CABINETRY - CLASSIC PLUS- KITCHEN - UPG	Qty: 1
207,712		
56,039	Note:	
6	KITCHEN - CABINETRY - 12B-POTS AND PANS DRAWERS (WIDTH MIN. 60CM/MAX. 90CM) (SIZE SUBJECT TO FLOOR PLAN) - UPGRADE 2	Qty: 2
189,00E		
56,042	Note: SEE SKETCH # 3 PAGE# 27	
*7	KITCHEN - CABINETRY - 22A-GLASS DOOR (EACH) (SMOKE GLASS) (UNFINISHED CABINET INTERIOR) ; PRICE ALL THE SAME FOR ALL LINES - KITCHEN	Qty: 2
189,07C		
56,043	Note: SEE SKETCH # 3 PAGE# 27	
*8	- CABINETRY - CLASSIC PLUS- OPT. Servery Uppers - UPG	Qty: 1
207,774		
56,048	Note: SKETCH # 3 PAGE 27	
9	MASTER ENSUITE - CABINETRY - 12D-VANITY BANK OF DRAWERS (60CM TO 90CM WIDE) - UPGRADE 1	Qty: 1
189,12E		
56,049	Note: MASTER BATHROOM SKETCH # 5 PAGE 29	
10	MAIN BATHROOM - CABINETRY - 12D-VANITY BANK OF DRAWERS (60CM TO 90CM WIDE) - UPGRADE 1	Qty: 1
189,12E		
56,050	Note: MAIN BATHROOM SKETCH # 5 PAGE 29	

Page 1 of 13

Initials: Bc H 9

TAX#:1

PREPARED BY: Irit Salem

PE 786-1

SInvoice.rpt 28may19



Sales Selection Sheet
Wallaceton

3 of 50
TEL: BUS.: 519-572-2624

PURCHASERS: BASSAM CHABAN and HALIMEH QASSEM

LOT / UNIT 302	PHASE 2	MODEL 33-2969 B The Hartwell	
-------------------	------------	---------------------------------	--

CABINETRY

11 189,079 56,081	KITCHEN - CABINETRY - 04C-PANTRY 66CM DEEP IN LIEU OF UPPER/BASE PER FOOT (COUNTER DEPTH) - UPGRADE 2 Note: LOWER 2 CABINETS TO BE ONE PANNLE CABINET TOP CABINET TO BE SEPARATE OPENING TO BE INSTALLED BESIDE THE FRIDGE SEE SKETCH # 3 PAGE# 27	Qty: 3
12 189,236 56,082	- CABINETRY - 19B-45CM WIDE PULL-OUT DOOR BASE CABINET WASTE/RECYCLE CENTRE WITH SOFT-CLOSE ([2] 35L BINS) (AVAILABLE ONLY WITH 45CM WIDE CABINET) ; PRICE ALL THE SAME FOR ALL LINES - KITCHEN Note: TO BE INSTALLED IN THE ISLAND SEE SKETCH # 3 PAGE# 27	Qty: 1
13 207,783 56,118	KITCHEN - CABINETRY - OPT LIGHT VALANCE (INCLUDE LIGHTING) - KITCHEN - UPG Note:	Qty: 1
14 207,760 56,121	LAUNDRY ROOM - CABINETRY - VIKING II/III - OPT. Laundry Room Uppers - STANDARD SERIES Note: SKETCH # 4 PAGE 28	Qty: 1
*15 207,782 56,140	SERVERY ONLY - CABINETRY - OPT LIGHT VALANCE INC. LIGHT - SERVRY- UPG Note:	Qty: 1
16 189,325 56,148	KITCHEN - CABINETRY - 40J-TWO-TONE COLOUR/STYLE SELECTION FOR ISLAND (MUST BE OF EQUAL OR LOWER LEVEL TO MAIN Note:	Qty: 1
17 189,217 57,206	KITCHEN/BREAKFAST - CABINETRY - 32H-BASE CABINET FOR UNDER-COUNTER MICROWAVE WITH DRAWER BELOW (FINISHED INTERIOR) (SUPPLY SPECS) - UPGRADE 2 SKETCH #3 PAGE 27 Note: SEE SPEC# PAGE# 49 AND 50	Qty: 1
*18 189,301 57,207	- CABINETRY - 03G-CABINET HARDWARE UPGRADE II DISPLAY BOARD; PER VANITY ; PRICE ALL THE SAME FOR ALL LINES - Note: MASTER AND MAIN BATHROOM	Qty: 2
19 207,784 60,438	KITCHEN - CABINETRY - OPT CROWN STD HEIGHT - KITCHEN - UPG Note:	Qty: 1
20 189,315 60,439	SERVERY ONLY - CABINETRY - 09J-CROWN MOULDING (PER 8' LENGTH PRICE) (FOR CLARIFICATION OF STYLES, SEE MOULDING MATRIX) ; PRICE ALL THE SAME FOR ALL LINES - KITCHEN Note:	Qty: 1

CABINETRY / ELECTRICAL

21 56,083	SERVERY ONLY - OPENING FOR BEVERAGE FRIDGE Note: SERVERY SKETCH#3 PAGE 27 SPEC PAGE 48	Qty: 1
------------------	--	--------

Initials: BC HQ



Sales Selection Sheet
Wallaceton

14 of 50
TEL: BUS.: 519-572-2624

PURCHASERS: BASSAM CHABAN and HALIMEH QASSEM

LOT / UNIT 302	PHASE 2	MODEL 33-2969 B The Hartwell	
-------------------	------------	---------------------------------	--

CABINETRY / ELECTRICAL

22	- RELOCATE STD. BANK OF DRAWERS	Qty: 1	
56,084	Note: KITCHEN SKETCH # 3 PAGE 27		

Carpet

*23 207,700	- Carpet - CARPET RUNNER - DYNASTY 400Z POLY - Main Stair - UPG UP TO THE BASAMENT DOOR	Qty: 1	
60,422	Note: NOT TO BE INSTALL ON THE LANDING (5)		
24 207,703	- Carpet - CARPET RUNNER - 600 SERIES UNDERPAD - Main Stair - UPG	Qty: 1	
60,440	Note: NOT TO INSTLLRD ON TH ELANDING		

CERAMICS

25 189,405	KITCHEN - CERAMICS - ADDITIONAL BACKSPLASH DUE TO INSTALL CHIMENEY HOODFAN IN KITCHEN - KITCHEN - UPGRADE 7	Qty: 1	
56,070	Note:		
26 207,614	KITCHEN - Ceramics - BACKSPLASH - Opt. Kitchen - Upgrade 7	Qty: 1	
56,071	Note:		
27 207,621	KITCHEN - Ceramics - BACKSPLASH - Opt. Servery - Upgrade 7	Qty: 1	
56,072	Note:		
28 207,640	KITCHEN - Ceramics - BACKSPLASH GROUT - Opt. Kitchen - Grout	Qty: 1	
56,073	Note:		
29 207,639	SERVERY ONLY - Ceramics - BACKSPLASH GROUT - Opt. Servery - Grout	Qty: 1	
56,074	Note:		
30 207,566	KITCHEN - Ceramics - FLOOR - Kitchen / Breakfast - Upgrade 6	Qty: 1	
56,085	Note:		
31 207,574	LAUNDRY ROOM - Ceramics - FLOOR - Laundry Room - Upgrade 6	Qty: 1	
56,086	Note:		
32 207,542	FOYER - Ceramics - FLOOR - Foyer - Upgrade 6	Qty: 1	
56,087	Note:		

Initials: BC HS

TAX#:1

PREPARED BY: Irit Salem

PE 786-3

SlInvoice.rpt 28may19



Sales Selection Sheet

Wallaceton

15 of 50

PURCHASERS: BASSAM CHABAN and HALIMEH QASSEM

TEL: BUS.: 519-572-2624

LOT / UNIT
302

PHASE
2

MODEL
33-2969 B The Hartwell

Ceramics

33 207,558 56,088	MUD ROOM - Ceramics - FLOOR - Garage Entry / Mud Room - Upgrade 6 Note:	Qty: 1
34 207,55C 56,089	POWDER ROOM - Ceramics - FLOOR - Powder Room - Upgrade 6 Note:	Qty: 1
35 207,52E 56,091	MASTER ENSUITE - Ceramics - SHOWER FLOOR - Ensuite Master - Upgrade 7 Note: INCL. CEILING TILE TO BE THE SAME AS SHOWER FLOOR	Qty: 1
36 207,598 56,092	SHARED BATHROOM - Ceramics - FLOOR - Shared Ensuite - Upgrade 6 Note:	Qty: 1
37 207,52C 56,093	SHARED BATHROOM - Ceramics - SHOWER FLOOR - Shared Ensuite - Upgrade 2 Note: CEILING TILE TO BE THE SAME AS FLOOR	Qty: 1
*38 207,471 56,094	SHARED BATHROOM - Ceramics - SHOWER WALL . - Shared Ensuite - Upgrade 6 - Shared Ensuite - Upgrade 6 Note:	Qty: 1
39 207,59C 56,095	MAIN BATHROOM - Ceramics - FLOOR - Main Bath - Upgrade 6 Note:	Qty: 1
40 207,48E 56,096	MAIN BATHROOM - Ceramics - TUB WALL - INSTALL FLOOR TILE ON WALL - Main Bath - Upgrade 6 Note:	Qty: 1
41 207,637 56,097	MASTER ENSUITE - Ceramics - FLOOR GROUT - Ensuite Master - Grout Note:	Qty: 1
42 207,63C 56,098	FOYER - Ceramics - FLOOR GROUT - Foyer - Grout Note:	Qty: 1
43 207,632 56,099	MUD ROOM - Ceramics - FLOOR GROUT - Garage Entry / Mud Room - Grout Note:	Qty: 1
44 207,633 56,100	KITCHEN - Ceramics - FLOOR GROUT - Kitchen / Breakfast - Grout Note:	Qty: 1

Initials: Bc H 2

TAX#:1

PREPARED BY: Irit Salem

PE 786-4

S\invoice.rpt 28may19



Sales Selection Sheet

Wallaceton

16 of 50

PURCHASERS: BASSAM CHABAN and HALIMEH QASSEM

TEL: BUS.: 519-572-2624

LOT / UNIT
302

PHASE
2

MODEL
33-2969 B The Hartwell

Ceramics

45 207,634 56,101	LAUNDRY ROOM - Ceramics - FLOOR GROUT - Laundry Room - Grout Note:	Qty: 1
46 207,636 56,102	MAIN BATHROOM - Ceramics - FLOOR GROUT - Main Bath - Grout Note:	Qty: 1
47 207,631 56,103	POWDER ROOM - Ceramics - FLOOR GROUT - Powder Room - Grout Note:	Qty: 1
48 207,635 56,104	SHARED BATHROOM - Ceramics - FLOOR GROUT - Shared Ensuite - Grout Note:	Qty: 1
49 207,628 56,105	MASTER ENSUITE - Ceramics - SHOWER FLOOR GROUT - Ensuite Master - Grout Note:	Qty: 1
50 207,627 56,106	SHARED BATHROOM - Ceramics - SHOWER FLOOR GROUT - Shared Ensuite - Grout Note:	Qty: 1
51 207,626 56,107	MASTER ENSUITE - Ceramics - SHOWER WALL AND CEILING GROUT - Ensuite Master - Grout Note:	Qty: 1
52 207,624 56,108	- Ceramics - SHOWER WALL AND CEILING GROUT - Shared Ensuite - Grout Note:	Qty: 1
*53 207,501 56,145	MASTER ENSUITE - Ceramics - SHOWER WALL INSTALL FLOOR TILE ON WALL - Ensuite Master - Upgrade 6 Note: ONLY WALLS FLOOR TILE TO BE ON THE CEILIGN	Qty: 1
54 207,582 56,146	MASTER ENSUITE - Ceramics - FLOOR - Ensuite Master - Upgrade 6 Note:	Qty: 1
*55 189,414 60,441	SHARED BATHROOM - CERAMICS - UPGRADED SHOWER JAMB/SILL COLOUR MOONLIGHT BLACK #8927 Note: SHARED BATHROOM	Qty: 1

COFFERED CEILING

Initials: Bc HT

TAX#:1

PREPARED BY: Irit Salem

PE 786-5

SInvoice.rpt 28may19



Sales Selection Sheet

Wallaceton

17 of 50

PURCHASERS: BASSAM CHABAN and HALIMEH QASSEM

TEL: BUS.: 519-572-2624

LOT / UNIT
302

PHASE
2

MODEL
33-2969 B The Hartwell

COFFERED CEILING

56 207,851 56,052	- COFFERED CEILING - COFFERED CEILING - OPT. COFFERED CEILING - DINING ROOM - UPG Note:	Qty: 1
-----------------------------	---	--------

DRYWALL

57 207,854 56,051	- DRYWALL - DRYWALL - SMOOTH CEILING IN MAIN FLOOR - MAINFLOOR - UPG Note:	Qty: 1
58 207,853 60,445	- DRYWALL - DRYWALL - SMOOTH CEILING IN 2ND FLOR WITH RESILIENT CHANNEL - 2ND FLOOR - UPG Note:	Qty: 1

ELECTRICAL

59 189,426 56,109	- ELECTRICAL - 4" EXTERIOR POTLIGHT IN SOFFIT (120 VOLT NON-INSULATED) MODEL #2550WH Note: INCL. SWITCH USE SECOND FLOOR SOFFIT LIGHT ON ONE SWITCH (INSTALL LIGHT IN THE CORNERS OF EACH SECTION) MAIN FLOOR USE THE SAME SWITCH AS STD. EXTERIOR POT LIGHT SEE SKETCH # 2 PAGE # 26 FOR 2 ON PORCH SKETCH # 6 PAGE 30 SECOND FLOOR SOF	Qty: 10
60 189,445 56,110	- ELECTRICAL - POTLIGHT BUNDLE - 8 X T477GR-W 4 INCH LINE VOLTAGE POTLIGHTS INCLUDES 2 SWITCHESMAIN FLOOR (SEE SLIM LINE FOR BASEMENT) Note: 6X IN GRAT ROOM- USE SEPARATE SWITCH 2X HALL WAY - SEPARATE SWITCH - KEEP AND CENTRED STD. LIGHT 4X DINING ROOM- USE SEPARATE SWITCH - KEEP STD. LIGHT 4X HOME OFFICE - USE SEPARATE SWITCH - KEEP STD. LIGHT 6X KITCHEN - USE SEPARATE SWITCH 2X HALL WAY - USES SEPARATE SWITCH - KEEP AND CENTRED STD. LIGHT SEE SKETCH # 2 PAGE# 26	Qty: 3
*61 189,417 56,112	KITCHEN - ELECTRICAL - RELOCATION OF LIGHTS (MUST SPECIFY LOCATION) - NOTE: PLUGS CANNOT BE RELOCATED- MUST PURCHASE ADDITIONAL OUTLET. Note: RELOCATE STD. KITCHEN 2 LIGHT TO BE ABOVE THE ISLAND- USE STD. KITCHEN SWITCH SKETCH # 2 PAGE 26	Qty: 2
62 189,445 56,113	- ELECTRICAL - EXTRA WALL INTERIOR OUTLET ON EXISTING CIRCUIT (DOES NOT INCLUDE KITCHEN OUTLETS) Note: FOYER , SERVERY, GREAT ROOM, MEDIA ROOM SEE SKETCH # 2 PAGE# 26	Qty: 4
63 189,430 56,115	MAIN BATHROOM - ELECTRICAL - ADDITIONAL SHOWER LIGHT (COMPLETE) INCLUDING SWITCH; 10 1/2" ROUND FROSTED WHITE GLASS Note: MAIN BATHROOM	Qty: 1
64 189,428 56,116	KITCHEN - ELECTRICAL - 1 PUCKLIGHT INCLUDING ROUGH-IN AND ONE SWITCH Note: TO BE USED FOR THE GLASS CABINETS IN THE KITCHEN SEE SKETCH # 3 PAGE# 27	Qty: 2

Initials: Bc Hg

TAX#:1

PREPARED BY: Irit Salem

PE 786-6

SInvoice.rpt 28may19



Sales Selection Sheet

Wallaceton

18 of 50

PURCHASERS: BASSAM CHABAN and HALIMEH QASSEM

TEL: BUS.: 519-572-2624

LOT / UNIT	PHASE	MODEL
302	2	33-2969 B The Hartwell

ELECTRICAL

65 189,42C	- ELECTRICAL - REINFORCE CELING BOX TO HOLD A LIGHT FIXTURE UP TO 75LBS	Qty: 1
56,119	Note: UPPER HALL WAY (OPEN TO BELOW) SKETCH # 4 Page 28	
*66 189,424	- ELECTRICAL - OUTLET WATERPROOF (G.F.I.) ON AN EXISTING CIRCUIT	Qty: 4
56,125	Note: MASTER BATHROOM (WATER CLOSET) MAIN BATHROOM, SHARED BATHROOM, POWEDER ROOM, SEE SKETCH # 284 PAGE# 26 AND 28	
67 189,44C	KITCHEN - ELECTRICAL - EXTRA WALL INTERIOR OUTLET (120V/15A) ON A SEPARATE CIRCUIT (ON ARCAFAULT)	Qty: 2
56,126	Note: TO BE USED FOR THE BEVRIDGE FRIDGE AND MICROWAVE DRAWER SEE SKETCH # 3 PAGE# 27	
68 189,45C	MASTER ENSUITE - ELECTRICAL - CEILING ROUGH-IN (CAPPED)	Qty: 1
60,427	Note: TO BE INSTALLED ABOVE THE TUB - USE SEPARATE SWITCH SEE SKETCH # 4 PAGE# 28	
69 189,451	MASTER ENSUITE - ELECTRICAL - ADDITIONAL SWITCH	Qty: 1
60,429	Note: TO BE USED FOR THE R/I CAP LIGHT SEE SKETCH \$ 4 PAGE# 28	
70 189,422	- ELECTRICAL - EXTERIOR FIXTURE COMPLETE; SIDE/REAR COACH LIGHT	Qty: 1
60,437	Note: TO BE INSTALLED ON MAIN FLOOR LEVEL USE SWITCH TO BE TOGETHER WITH STD. EXTERIOR LIGHT SEE SKETCH # 2 PAGE# 26	
71 189,422	- ELECTRICAL - EXTERIOR FIXTURE COMPLETE; SIDE/REAR COACH LIGHT	Qty: 1
60,447	Note: TO BE INSTALED ON THE BASAMNT LEVEL ON SAME SWITCH AS STD. LIGHT SEE SKETCH # 1 PAGE# 25	
72 189,424	- ELECTRICAL - EXTERIOR OUTLET WATERPROOF (G.F.I.) ON AN EXISTING CIRCUIT	Qty: 1
60,448	Note: TO HBE INSTALLED ON EXTERIOR MAIN FLOOR LEVEL SEE SKETCH # 2 PAGE# 26	
*73 189,425	- ELECTRICAL - EXTERIOR OUTLET WATERPROOF (G.F.I.) ON A SEPARATE CIRCUIT	Qty: 1
60,449	Note: TO BE INSTALLRD IN THE BASEMENT LEVEL SEE SKETCH # 1 PAGE# 25	
74 189,449	BEDROOM 3 - ELECTRICAL - EXTRA WALL INTERIOR OUTLET ON EXISTING CIRCUIT (DOES NOT INCLUDE KITCHEN OUTLETS)	Qty: 1
60,677	Note: TO BE INSTALLED 52" FROM FLOOR SEE SKETCH # 4 PAGE# 28	

SEE CLARIFICATION IN R-SSS PG. 51

Initials: Bc 14 9

TAX#:1

PREPARED BY: Irit Salem

PE 786-7

SInvoice.rpt 28may19



Sales Selection Sheet

Wallaceton

19 of 50

PURCHASERS: BASSAM CHABAN and HALIMEH QASSEM

TEL: BUS.: 519-572-2624

LOT / UNIT	PHASE	MODEL	
302	2	33-2969 B The Hartwell	

ELECTRICAL

75	KITCHEN - STD. KITCHEN ELECTRICAL PLUG	Qty: 1
60,678	Note: STD. KITCHEN ELECTRICAL OUTLET ONE ISLAND TO BE INSTALLED ON THE BACK OF THE ISLAND IN THE CORNER CLOSE TO COUNTER TOP (DUE TO WATERFALL GRANITE) SEE SKETCH # 3 PAGE# 27	

GARAGE DOORS

76	- GARAGE DOORS - AUTOMATIC GARAGE DOOR OPENER COMES WITH ONE REMOTE AND ONE INTERIOR OPERATING BUTTON	Qty: 2
189,454		
57,210	Note:	

GLASS PRODUCTS / MIRRORS

77	- DELETE ALL MIRRORS THROUGHOUT THE HOUSE	Qty: 1
60,511	Note:	

Granite

78	KITCHEN - Granite - COUNTERTOP - 3/4" GROUP 6 WITH MITRE EDGE - Kitchen / Island - UPG	Qty: 1
207,645		
56,075	Note:	
79	MASTER ENSUITE - Granite - COUNTERTOP WITH 4" BACKSPLASH - 3/4" GROUP 7 WITH MITRE EDGE - Ensuite Master - UPG	Qty: 1
207,653		
56,076	Note:	
80	MAIN BATHROOM - Granite - COUNTERTOP WITH 4" BACKSPLASH - 3/4" GROUP 5 WITH MITRE EDGE - Main Bath - UPG	Qty: 1
207,667		
56,077	Note:	
81	SHARED BATHROOM - Granite - COUNTERTOP WITH 4" BACKSPLASH - 3/4" GROUP 6 WITH MITRE EDGE - Shared Ensuite - UPG	Qty: 1
207,660		
56,078	Note:	
82	- GRANITE - GRANITE CUTOUT W/ STRAIGHT EDGE POLISH TO ACCOMMODATE UNDER MOUNT VANITY SINK	Qty: 3
189,463		
56,079	Note: MAIN BATHROOM, AND SHARED BATHROOM SINK SPECS PAGE 38	
83	KITCHEN - GRANITE - DRILL ADDITIONAL HOLE ON COUNTERTOP FOR FUTURE WATER SOAP DISPENSER	Qty: 1
189,466		
60,640	Note: DRILL 1" HOLE BESIDE E KITCHEN SINK SEE SKETCH # 3 PAGE# 27 ADD PAGE 34	
*84	KITCHEN - Granite - COUNTERTOP GROUP WATER FALL 6 Island - UPG	Qty: 1
207,645		
60,665	Note: ISLAND WATER FALL ON BOTH SIDES SKETCH #3 PAGE 27	

HARDWOOD

Page 8 of 13

Initials: Bc H 9

TAX#:1

PREPARED BY: Irit Salem

PE 786-8

S\invoice.rpt 28may19



Sales Selection Sheet

Wallaceton

20 of 50

PURCHASERS: BASSAM CHABAN and HALIMEH QASSEM

TEL: BUS.: 519-572-2624

LOT / UNIT 302	PHASE 2	MODEL 33-2969 B The Hartwell	
-------------------	------------	---------------------------------	--

HARDWOOD

85 207,822 56,054	BEDROOM 2 - HARDWOOD - 5" WHITE OAK UVF OIL - BEDROOM 2 - UPG Note:	Qty: 1
86 207,827 56,055	BEDROOM 3 - HARDWOOD - 5" WHITE OAK UVF OIL - BEDROOM 3 - UPG Note:	Qty: 1
87 207,832 56,056	BEDROOM 4 - HARDWOOD - 5" WHITE OAK UVF OIL - BEDROOM 4 - UPG Note:	Qty: 1
88 207,796 56,057	DINING ROOM - HARDWOOD - 5" WHITE OAK UVF OIL - DINING ROOM - UPG Note:	Qty: 1
89 207,800 56,058	- HARDWOOD - 5" WHITE OAK UVF OIL - DINING ROOM HALL - UPG Note:	Qty: 1
*90 207,837 56,059	- HARDWOOD - 5" WHITE OAK UVF OIL - FAMILY/ BED 5 - UPG Note:	Qty: 1
91 207,788 56,060	GREAT ROOM - HARDWOOD - 5" WHITE OAK UVF OIL - GREAT ROOM - UPG Note:	Qty: 1
92 207,792 56,061	- HARDWOOD - 5" WHITE OAK UVF OIL - GREAT ROOM HALL - UPG Note:	Qty: 1
93 207,812 56,062	- HARDWOOD - 5" WHITE OAK UVF OIL - HOME OFFICE - UPG Note:	Qty: 1
94 207,808 56,063	- HARDWOOD - 5" WHITE OAK UVF OIL - Landing(S) To 2nd Floor - UPG Note:	Qty: 1
95 207,804 56,064	- HARDWOOD - 5" WHITE OAK UVF OIL - Landing(S) To Bsmt - UPG Note:	Qty: 1
96 207,819 56,068	MASTER BEDROOM - HARDWOOD - 5" WHITE OAK SCULPTED - MASTER BEDROOM - UPG Note:	Qty: 1

Initials: BC HA

TAX#:1

PREPARED BY: Irit Salem

PE 786-9

SInvoice.rpt 28may19



Sales Selection Sheet

Wallaceton

21 of 50

PURCHASERS: BASSAM CHABAN and HALIMEH QASSEM

TEL: BUS.: 519-572-2624

LOT / UNIT	PHASE	MODEL	
302	2	33-2969 B The Hartwell	

HARDWOOD

97 207,844 56,069	UPPER HALL - HARDWOOD - 5" WHITE OAK SCULPTED - UPPER HALL - UPG Note:	Qty: 1
-----------------------------	--	--------

HEATING / AIR

*98 189,474 56,065	KITCHEN - HEATING/AIR - ROUGH-IN GAS LINE FOR GAS STOVE AT MAIN FLOOR (SEE SPECS) (HOOK-UP NOT INCLUDED) LEAVE STANDARD 120 VOLT ELECTRICAL OUTLET ON A SEPARATE CIRCUIT. STANDARD 220V WILL STAY Note: SKETCH #3 PAGE 27 STOVE SPEC PAGE 47	Qty: 1
99 189,471 60,415	- HEATING/AIR - HUMIDIFIER LENNOX HCWB3-17 FROM 2,001 TO 4,000 SQ.FT. (INCLUDING BASEMENT) Note:	Qty: 1
100 189,472 60,423	- HEATING/AIR - ROUGH-IN GAS LINE FOR BBQ AT MAIN FLOOR UP TO 40' (QUICK CONNECT NOT INCLUDED); ELECTRICAL OUTLET PRICED SEPARATELY IF REQUIRED Note: SKETCH #2 PAGE 26	Qty: 1

Interior Railings

101 207,706 56,120	- Interior Railings - BLACK METAL - SINGLE COLLAR ALT. PLAIN W/ SHOES WITH 3 1/2" SQUARE/CAP POST(S) AS PER PLAN - Main Stair - UPG Note: BLACK METAL -	Qty: 1
------------------------------	---	--------

INTERIOR TRIM AND DOORS

*102 189,476 60,424	- INTERIOR TRIM - UPG 6-8' STANDARD SINGLE 8' DOOR Note: FOYER CLOSET, POWDER ROOM SKETCH #2 PAGE 26	Qty: 2
-------------------------------	--	--------

MIRRORS/GLASS PRODUCTS

*103 207,708 56,122	- MIRRORS/GLASS PRODUCTS - UPGRADE TO FRAMELESS CLEAR GLASS WITH D-RING HANDLE IN BLACK - Ensuite Master - UPG Note: BLACK	Qty: 1
*104 207,709 56,123	SHARED BATHROOM - MIRRORS/GLASS PRODUCTS - UPGRADE TO FRAMELESS CLEAR GLASS WITH D-RING HANDLE IN BRUSHED - GOLD Note: BRUSHED GOLD	Qty: 1

MODIFICATIONS

105 57,208	- WALL OPENING BETWEEN HOME OFFICE AND DINING ROOM Note: 5' +- OPENING WITH DROPED ARCH SEE SKETCH # 2 PAGE# 26	Qty: 1
-------------------	--	--------



Sales Selection Sheet

Wallaceton

22 of 50

PURCHASERS: BASSAM CHABAN and HALIMEH QASSEM

TEL: BUS.: 519-572-2624

LOT / UNIT	PHASE	MODEL
302	2	33-2969 B The Hartwell

MODIFICATIONS

106	- DELETE DOOR FROM HALL WAY TO OFFICE AND MAKE OPENING BIGGER BY 1' TOWARDS THE FOYER	Qty: 1
60,637	Note: HOME OFFICE ; DELETE DOOR FROM HOME OFFICE, MODIFED OPENING TO 8' HIGH X 3 1/2 WIDE SKETCH # 2 PAGE 26	

PAINTING

107	- PAINT - STAIN STAIR LANDING IN SAMBUCCA. LANDING UNDER 25 SQ.FT. EACH	Qty: 3
191,83C		
56,067	Note:	

PLUMBING

108	MASTER ENSUITE MAIN BATH - PLUMBING - OPTION FROM ONE SINK TO DOUBLE SINKS INCLUDING STD CHATEAU FAUCET, STD COLONY SINK, INCLU INCLUDING CABINET CONVERSION 2D VIKING AND ONE EXTRA VANITY LIGHT	Qty: 1
189,689		
56,127	Note: SKETCH # 4 AND 5 PAGES 28 AND 29	
109	KITCHEN - PLUMBING - KITCHEN SINK UPGRADE - BLANCO KITCHEN SINK PRECIS U SUPER SINGLE (32 INCH X 19 INCH) UND ERMOUNT 1 LARGE BOWL 9-1/2 INCH DEEP - COLOUR: ANTHRACITE MODEL#400890	Qty: 1
189,713		
56,129	Note: SPEC PAGE 34	
*110	MASTER ENSUITE - PLUMBING - MOEN -ALIGN - LAV SINGLE HANDLE FAUCET WITH LIFT ROD DRAIN - MATTE BLACK (MODEL: 6190BL)	Qty: 2
189,593		
56,131	Note: MASTER BATHROOM (SPEC PAGE 39	
*111	MASTER BEDROOM - PLUMBING - MOEN -ALIGN - 3 PIECE ROMAN TUB - MATTE BLACK (MODEL: 9796/T393BL) -	Qty: 1
189,576		
56,133	Note: MASTER BATHROOM TUB SPEC PAGE 39	
*112	- PLUMBING - MOEN -RIZON - LAV - SINGLE HANDLE FAUCET MATTE BLACK (MODEL: 6900BL) -	Qty: 3
189,626		
56,135	Note: MAIN BATH . AND POWDER ROOM SPEC PAGE 43	
*113	SHARED BATHROOM - PLUMBING - MOEN -ALIGN - LAV SINGLE HANDLE FAUCET WITH LIFT ROD DRAIN - BRUSHED GOLD (MODEL: 6190BG) -	Qty: 1
189,589		
56,137	Note: SHARED BATHROOM SPEC PAGE 41	
*114	SHARED BATHROOM - PLUMBING - MOEN -ALIGN - POSI-TEMP WITH 3 FUNCTION DIVERTER VALVE, SLIDE BAR WITH HAND HELD AND SHOW ERHEAD (LESS TUB SPOUT) BRUSHED GOLD (MODEL: 62320/3372/T4191/T2192EP/3887EP/A725) -	Qty: 1
189,607		
56,138	Note: SPEC PAGE 42	
*115	MAIN BATHROOM - PLUMBING - MOEN -RIZON - POSI-TEMP WITH 3 FUNCTION DIVERTER VALVE, SLIDE BAR WITH HAND HELD, SHOWERH EAD AND TUB SPOUT MATTE BLACK (MODEL: 62320/3372/128284/T4171/T2813EP/3669EP/A725) -	Qty: 1
189,636		
60,411	Note: SPEC PAGE 44	
*116	MASTER ENSUITE - PLUMBING - MOEN -ALIGN - POSI-TEMP WITH 3 FUNCTION DIVERTER VALVE, SLIDE BAR WITH HAND HELD AND SHOW ERHEAD (LESS TUB SPOUT) MATTE BLACK (MODEL: 62320/3372/T4191/T2192EP/3887EP/A725) -	Qty: 1
189,609		
60,426	Note: SPEC PAGE 40	

Initials: Bc HA 9

TAX#:1

PREPARED BY: Irit Salem

PE 786-11

SInvoice.rpt 28may19



Sales Selection Sheet

Wallaceton

23 of 50

PURCHASERS: BASSAM CHABAN and HALIMEH QASSEM

TEL: BUS.: 519-572-2624

LOT / UNIT	PHASE	MODEL	
302	2	33-2969 B The Hartwell	

PLUMBING

117 189,546 60,434	- PLUMBING - AMERICAN STANDARD - SINK OPTIONS - UNDERMOUNT SINK - STUDIO - WHITE - MODEL 0614 000 020 Note: 2 IN MAIN BATHROOM AND SHARED BATHROOM <i>SPEC PAGE 38</i>	Qty: 3
*118 189,546 60,435	MASTER ENSUITE - PLUMBING - AMERICAN STANDARD - SINK OPTIONS - UNDERMOUNT SINK - STUDIO - WHITE - MODEL 0614 000 020 Note: <i>SPEC PAGE 38</i>	Qty: 2
119 189,510 60,436	KITCHEN - PLUMBING - MOEN - SOAP DISPENSERS - MATTE BLACK (MODEL: 3942BL) - <i>SPEC PAGES 36 AND 37</i> Note: KITCHEN SEES SKETCH # <i>3</i> <i>PAGE 27</i> AND <i>PAGE 34</i> SINK SPEC	Qty: 1
*120 189,666 60,638	- PLUMBING - SEPARATE WATER BYPASS FROM KITCHEN TO WATER SUPPLY IN BASEMENT Note: FOR FUTURE WATER FILTRATION SYSTEM SEE SKETCH # <i>3</i> <i>PAGE# 27</i>	Qty: 1

SECURITY

121 60,676	- SECURITY SYSTEM R/I - 3 DOOR CONTRACTS Note: 3 DOOR CONTRACTS SEE SKETCH # <i>7, 8</i> <i>PAGES 31 AND 32</i>	Qty: 3
-----------------------	--	--------

STRUCTURED WIRING

122 189,776 60,432	- STRUCTURED WIRING - RELOCATION OF TV/PHONE Note: GREAT ROOM RELOCATE STD. R/I CABLE TO BE 70" ABOVE THE FIRE PLACE HOME OFFICE; RELOCATE STD. R/I FROM THE KITCHEN TO THE HOME OFFICE SEE SKETCH # <i>2</i> <i>PAGE# 26</i>	Qty: 2
123 189,776 60,639	- STRUCTURED WIRING - TV CABLE LINE ROUGH-IN RG 6 SEE CLARIFICATION IN R-SSS PG. 55 Note: TO BE INSTALLED IN BEDROOMS 2,3,4, MEDIA ROOM - BESIDE ELECTRICAL OUTLET SEE SKETCH # <i>4</i> <i>PAGE# 28</i>	Qty: 4
124 189,783 60,673	GREAT ROOM - STRUCTURED WIRING - ROUGH-IN SURROUND SOUND 5.1 DELETED AS PER R-SSS PG. 55 Note: SEE SKETCH # <i>7</i> <i>PAGE# 31</i>	Qty: 1
125 189,792 60,674	- STRUCTURED WIRING - DATA LINE ROUGH-IN CAT6 Note: CAT 6 CABLES SEE SKETCH # <i>7, 8</i> <i>PAGE# 31 AND 32</i>	Qty: 18
*126 189,782 60,675	- STRUCTURED WIRING - ROUGH-IN MOTORIZED BLINDS 16/2 <i>SKETCH # 7, 8 PAGES 31 AND 32</i> Note: ROUGH-IN MOTORIZED BLINDS 16/2 - 18 WINDOWS CABLE RUN	Qty: 18

WAFFLE CEILING

Initials: *Bc* *HA*



Sales Selection Sheet
Wallaceton

24 of 50

PURCHASERS: BASSAM CHABAN and HALIMEH QASSEM

TEL: BUS.: 519-572-2624

LOT / UNIT 302	PHASE 2	MODEL 33-2969 B The Hartwell	
-------------------	------------	---------------------------------	--

WAFFLE CEILING

127 207,852 56,053	- WAFFLE CEILING - WAFFLE CEILING - OPT. WAFFLE CEILING - GREAT ROOM - GREAT ROOM - UPG Note: SKETCH # 2 PAGE 26	Qty: 1
------------------------------	---	--------

Sub Total
HST
Total

- 1. This Sales Selection Sheet when properly executed forms part of our Agreement of Purchase and Sale.
- 2. All extras and upgrades listed above are subject to Construction Progress and Architectural and Municipal requirements.
- 3. In the event the Vendor is unable to incorporate the work approved above in the construction of the house for any reason whatsoever, the Vendor will not be liable to the Purchaser in any way. The monies paid for any changes or optional extras not proceeded with shall be returned to the Purchaser, without interest. The cost of options or extras is non-refundable in all other circumstances. If for any reason whatsoever the Agreement of Purchase and Sale is not completed, the total cost of work approved above will be retained by the Vendor.
- 4. The Vendor reserves the right to substitute above materials and equipment with that of equal or better quality.
- 5. Purchaser acknowledges that items may not be exactly as shown. Variations from the Vendor's samples may occur in finished materials due to normal production processes. Vendor is not responsible for shade difference which may occur from different dye lots or wood grains. Variations from the Vendor's samples will occur with natural materials such as wood, marble, granite, hardwood and brick.
- 6. The Vendor reserves the right to select Grout & Thresholds that best suits the Tile selected.
- 7. Selections will not be processed unless signed by Heathwood Homes Head Office.
- 8. The selections made on this schedule are final and cannot be changed once submitted.
- 9. The Purchaser has checked and acknowledges the accuracy of this schedule.

Payment Summary	
<u>Paid By</u>	<u>Amount</u>
<u>Total Payment:</u>	

PURCHASER: 
BASSAM CHABAN

06-May-21
DATE

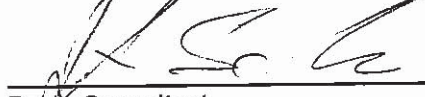
Decor Consultant

06-May-21
DATE

PURCHASER: 
HALIMEH QASSEM

06-May-21
DATE

- APPROVED -

Date Approved Heathwood Homes (Huron) Limited

UK-75 WALLACETON
LOT 302
33-2969 WOB ELEV B
THE HARTWELL

25 of 50

THE HARTWELL

ELEVATION A | 2,969 SQ. FT.

918 sq. ft. of opt. finished Lower Level

WALLACETON

BST. 1870

SKETCH #1

33-2969 ELEV. A WOB

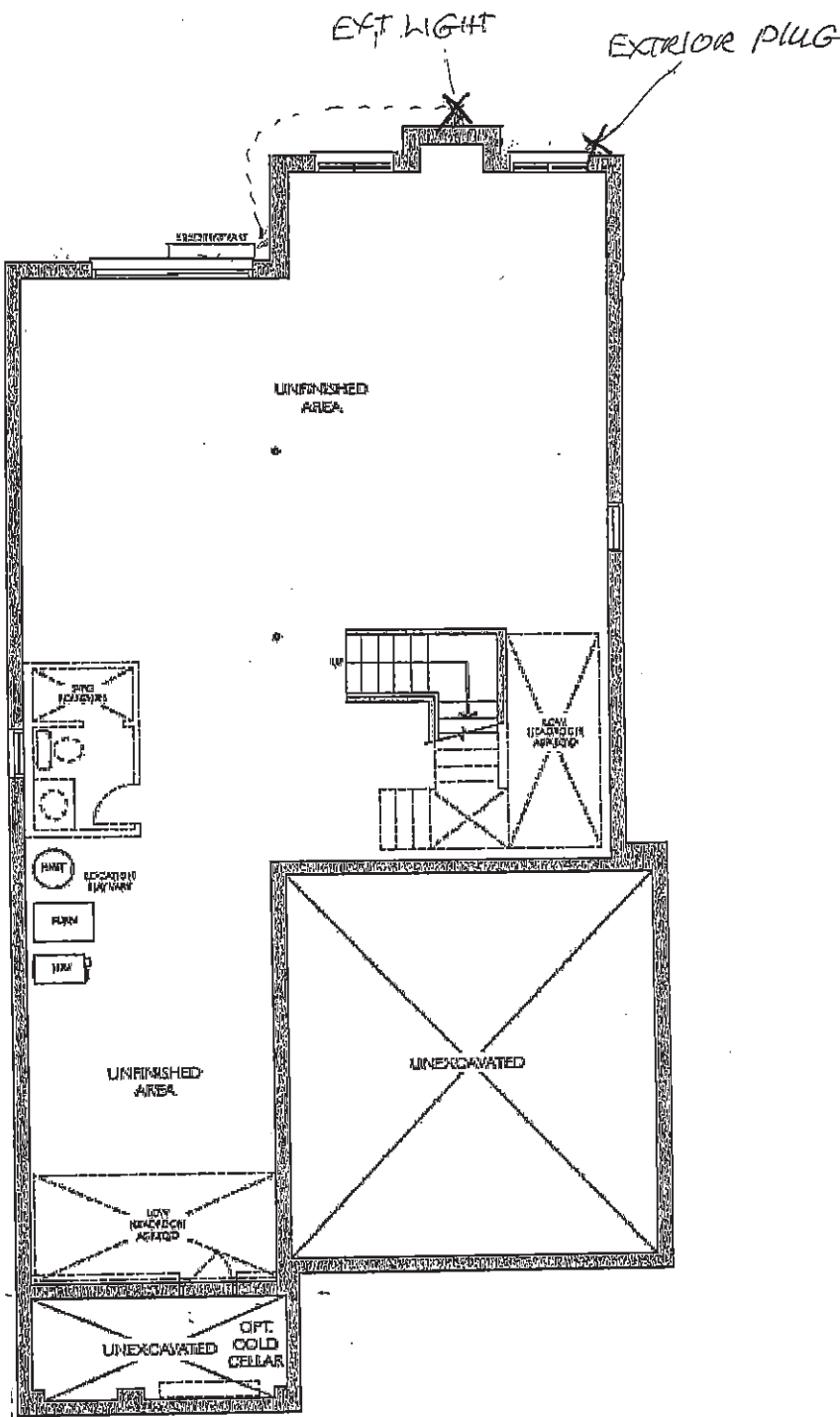

LOWER LEVEL
ELEVATION A

Legal Plan Nov 18, 2020

H 2

Bc

26 of 50

THE HARTWELL

918 sq. ft. of opt. finished Lower Level

EXTERIOR
LIGHT

WALLACETON
EST. 1870

EST. 1870

PLUG +
RELOCATE
R/X CABLE

EXTERIOR
PLUG

6 For 1 LIGHT &
SWITCH

2 POT LIGHT
SWITCH

OPEN WALL TO
5' +/-

ELECTRICAL PLUG

~~MAIN FLOOR
ELEVATION B~~

Legal Plan Nov 18, 2020

B.C.

49

UK-75 WALLACETON
LOT 302
33-2969 WOB ELEV B
THE HARTWELL

UK-75 WALLACETON
LOT 302
33-2969 WOB ELEV. B
THE HARTWELL

HEATHWOOD H
WALLACETON, KITCI
MODEL: 33-2969

STANDARD CONTRACT INCL

Appliance Openings

- Hood: 30"W Builder hood
- Fridge Opening: 37 3/8 "v
- Fridge cabinet & gables:
- Stove Opening: 30" Frees
- Dishwasher Opening: 24"

Standard Kitchens Scope:

- 100cm H wall cabinets
- Std. Blumotion Hinges- soft close doors
- Std. Metabox Drawers- not soft close
- Min 40cm W drawer
- Base pie cut corner cabinets
- Backing on all cabinets
- Countertop by others
- Upgrade applied paneled fridge & dishwashers supply only (appliance hardware by others)

27 of 50

THIS DRAWING IS FOR DESIGN PURPOSES ONLY.
IT IS NOT AN EXACT REPRESENTATION.

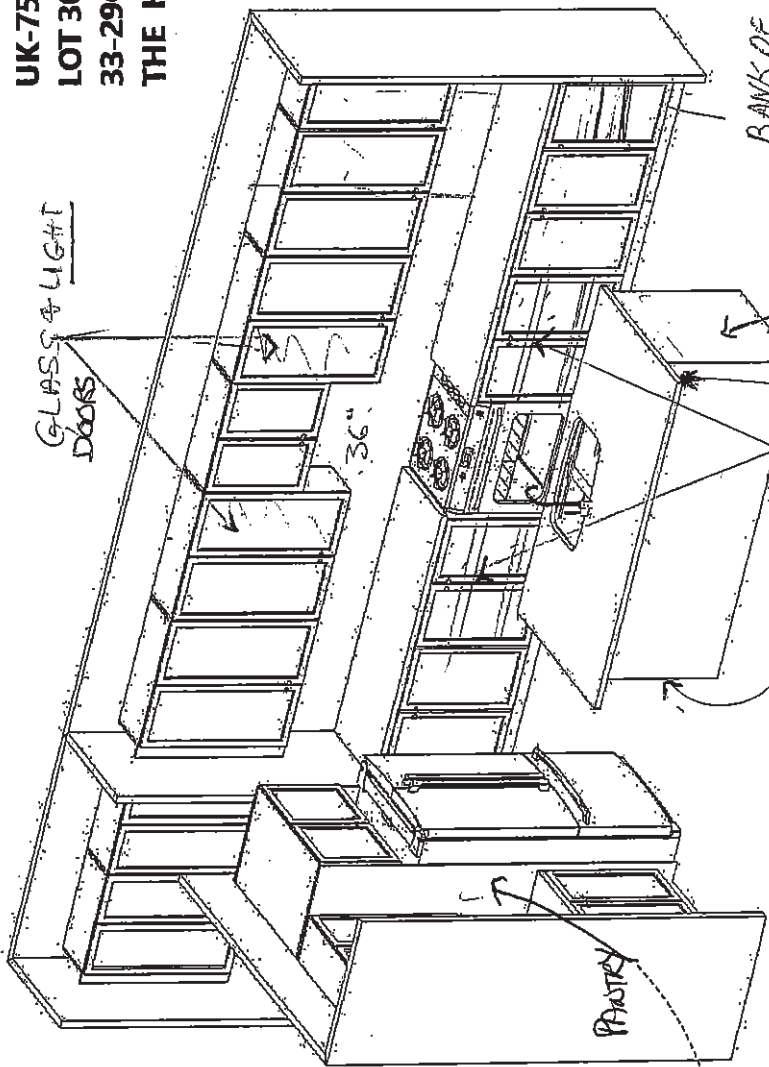

Sketch #3

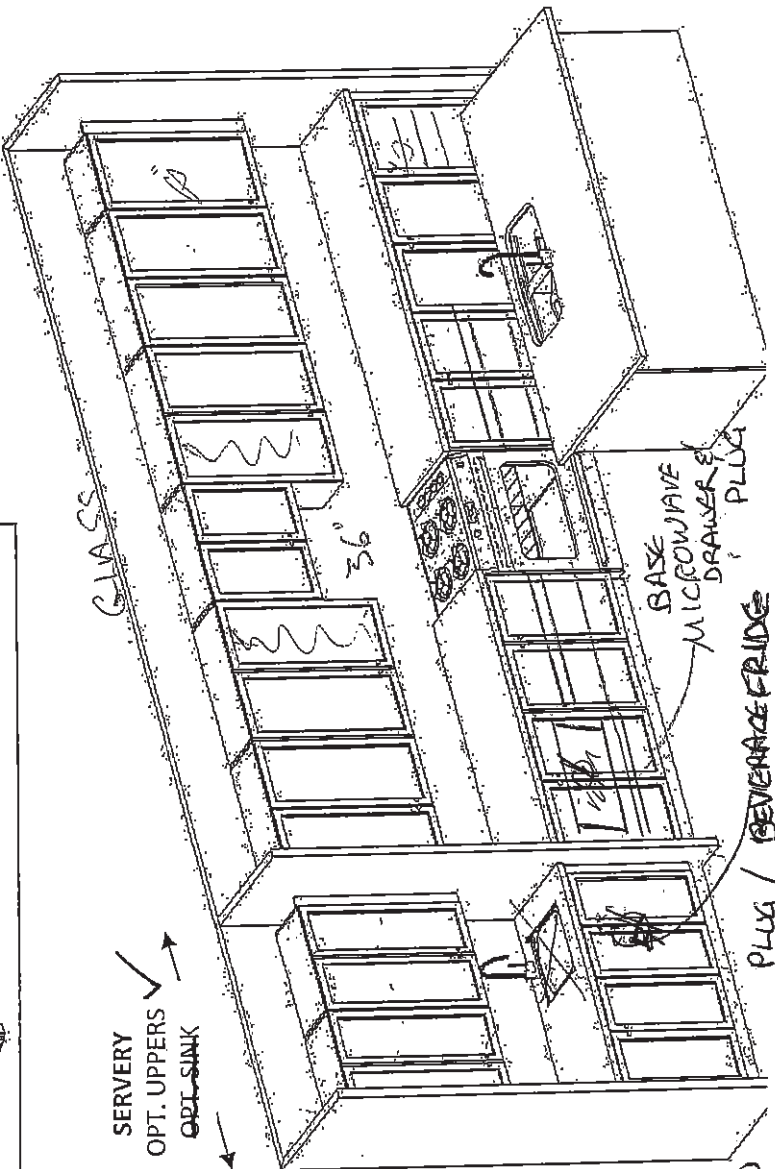
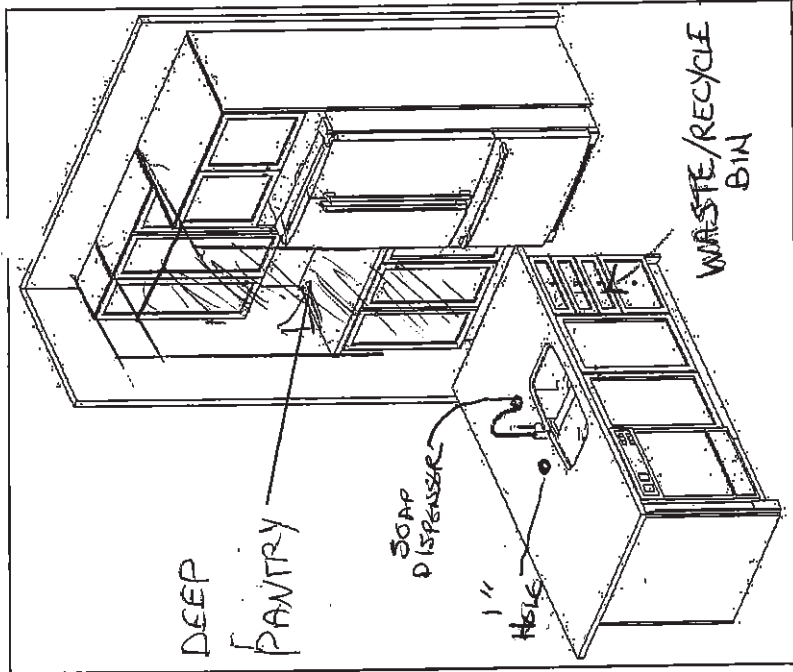

Bc H 2

UK-75 WALLACETON
LOT 302
33-2969 WOB ELEV. B
THE HARTWELL

28 of 50

Sketch #4 THE HARTWELL

ELEVATION B | 2,962 SQ. FT.
918 sq. ft. of opt. finished Lower Level
WALLACETON
EST. 1870

33-2969 ELEV. B WOB

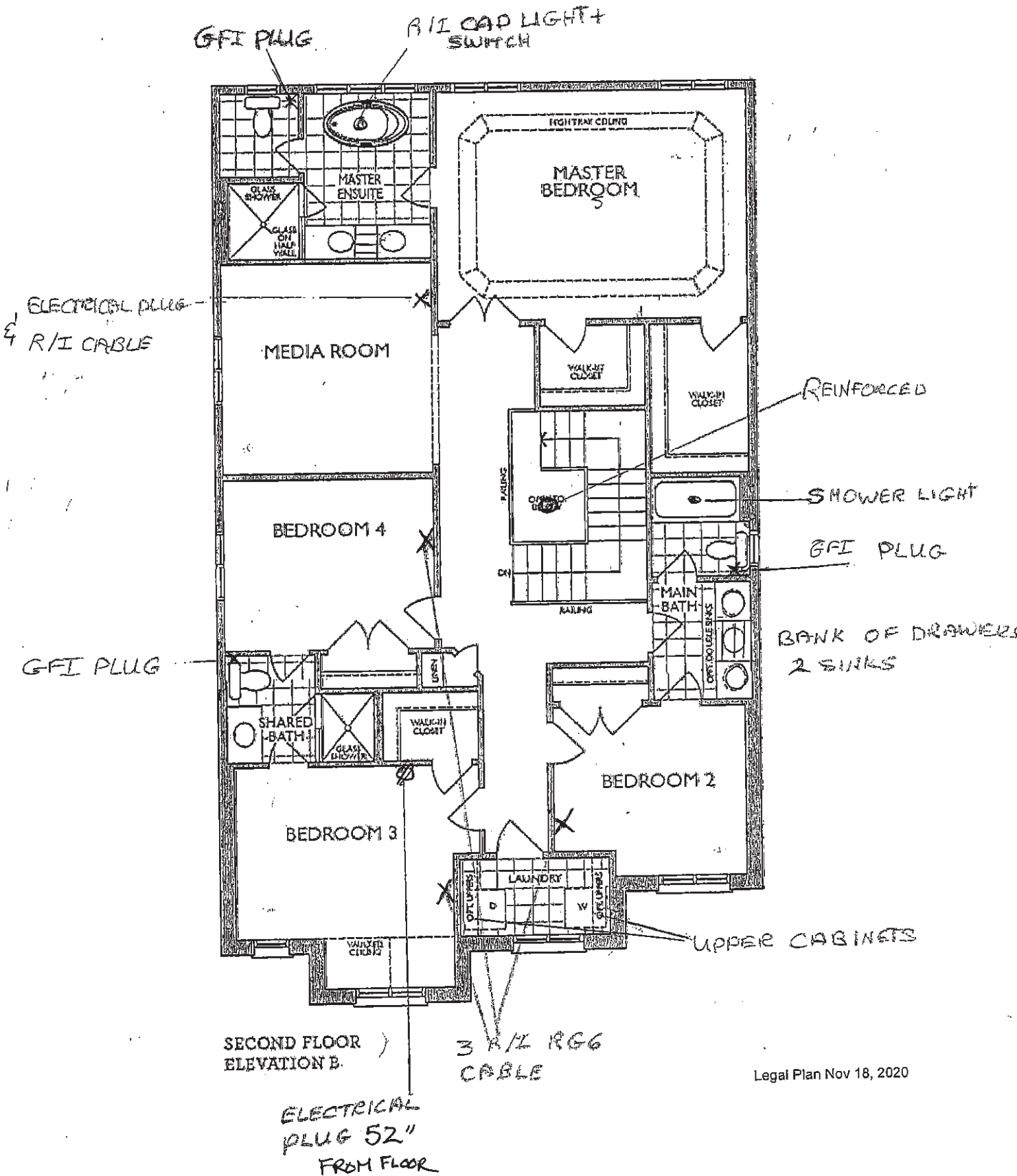

Legal Plan Nov 18, 2020

H 9 B.C



FRENDEL
KITCHEN'S LIMITED
1330 Shawnee Drive, Massillon, OH 44861

HEATHWOOD HOMES
WALLACETON, KITCHENER ON
MODEL: 33-2969 (4001)

STANDARD CONTRACT INCLUDES:

Standard Vanity & Laundry Scope:

- Powder by others, pedestal
- Master Ens. - Top by others
- Remaining vanities inc. laminate top
- Std. Blumotion Hinges- **not soft close**
- Std. Metabox Drawers- **not soft close**
- Master Ens: Top drawers (Sink Full height)
- Mains: Full height doors (top drawers added if Masters can't accommodate)
- Optional laundry base & wall cabinets

29 of 50

Sketch #5

THIS DRAWING IS FOR DESIGN PURPOSES ONLY.
IT IS NOT AN EXACT REPRESENTATION.

UK-75 WALLACETON
LOT 302
33-2969 WOB ELEV B
THE HARTWELL

MASTER ENSUITE
(2ND FLR)

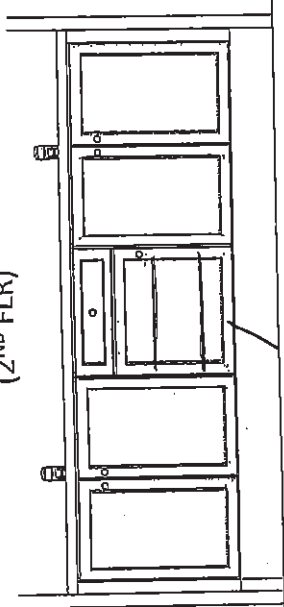

VANITY BANK
OF DRAWERS

2 SINKS
MAIN BATH
(2ND FLR)

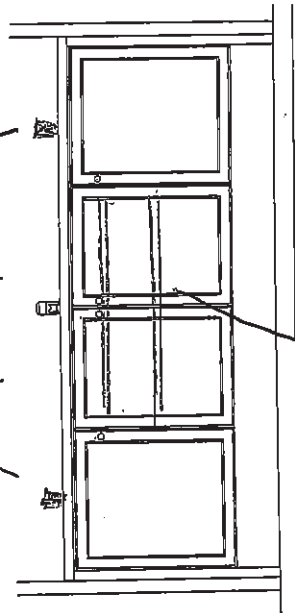

VANITY BANK
OF DRAWERS

SHARED BATH
(2ND FLR)

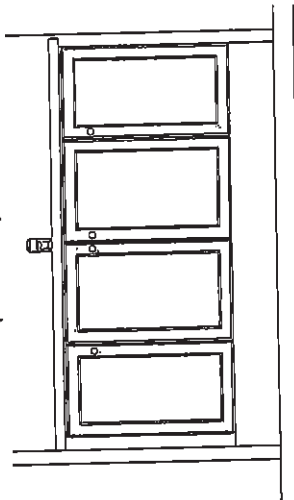

OPT. LAUNDRY UPPERS
(2ND FLR)

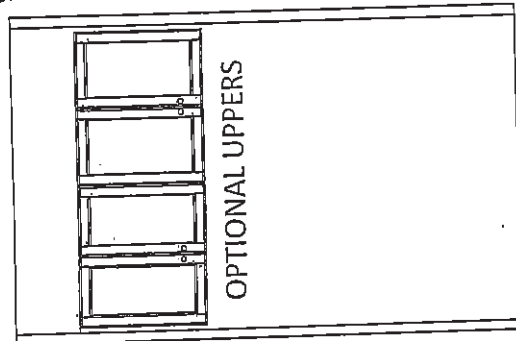

OPTIONAL UPPERS

OPT. BASEMENT BATH
OR LOWER BATH

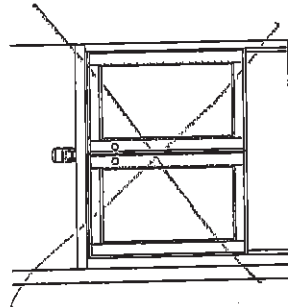

1 x 9

Bc

2/12/2021

UK-75 WALLACETON
LOT 302
33-2969 WOB ELEV B
THE HARTWELL

30 of 50

8 POT LIGHT
ON 1 SWITCH

2 POT LIGHT
ON 1 SWITCH

Sketch #6

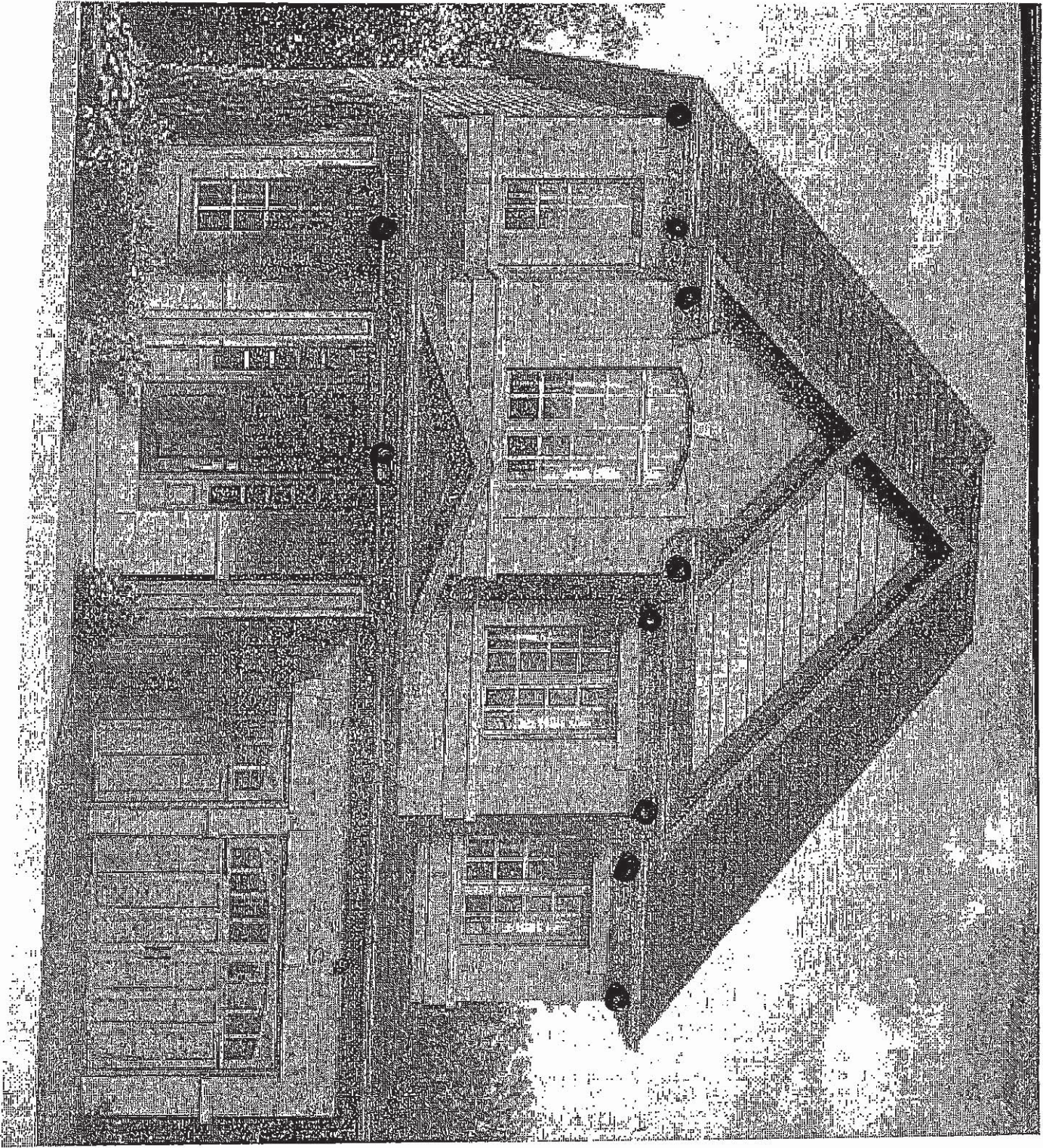

X79

Bc

31 OF 50

Sketch #7



UK-75 WALLACETON
LOT 302
33-2969 WOB ELEV. B
THE HARTWELL

32 of 50

Sketch #8

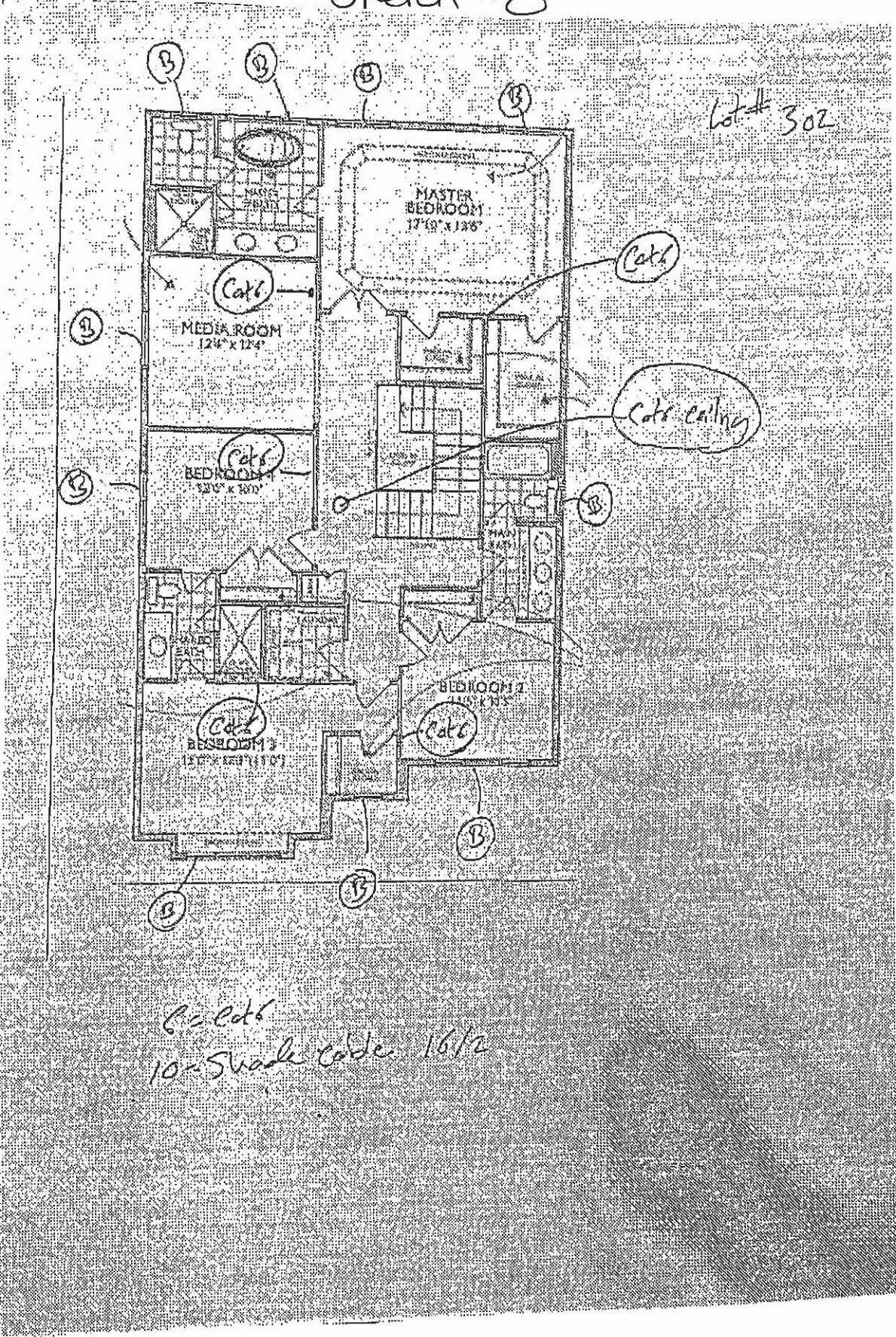

6 = Cat
10 = Shade cable 16/2

Bc HQ

UK-75 WALLACETON
LOT 302
33-2969 WOB ELEV B
THE HARTWELL



STANDARD NF 15 Mantel

Clean apron finish with fluted legs

WHITE PAINT GRADE FINISH

(PICTURE SHOWN WITH UPGRADE SURROUND AND HEARTH -PRICED SEPARATELY)



STANDARD NF 17 Mantel

WHITE PAINT GRADE FINISH

(PICTURE SHOWN WITH UPGRADE SURROUND AND HEARTH -PRICED SEPARATELY)

HP

BC







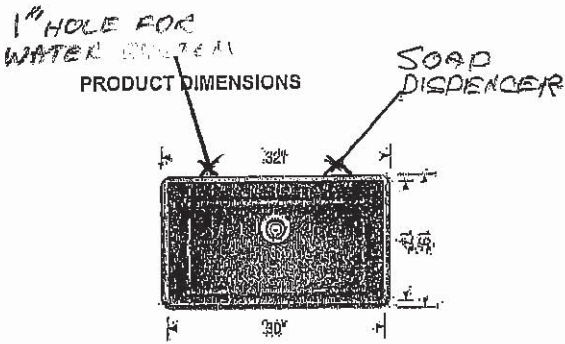
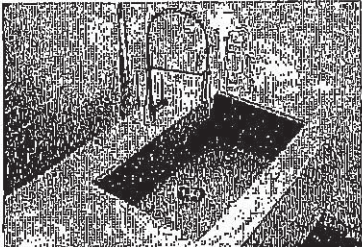

UK-75 WALLACETON
LOT 302
33-2969 WOB ELEV. B
THE HARTWELL

34 of 50

Product Specification Sheet

PRECIS U SUPER SINGLE
SILGRANIT®



PRECIS U SUPER SINGLE	Colour Finish	Model No.	FEATURES / SPECIFICATIONS
	White	401820	<ul style="list-style-type: none">• Precis kitchen sinks are made in Canada and Germany• Extra-large bowl size is ideal for busy families• Made of SILGRANIT, a high-quality granite composite• Heat, scratch and stain resistant• Non-porous surface is anti-bacterial and easy to clean <p>DESIGN AND PLANNING TIPS:</p> <p>Cabinet Size: 36" (915 mm) Bowl depth: 9 1/2" (240 mm) To protect from damage, this model should be shipped on a pallet</p>
	Truffle	401143	
	Metallic Gray	401683	
	Concrete Gray	402266	
	Cinder	401397	
	Café	400889	
	Biscuit	401819	
	Anthracite	400890	

WARRANTY

Limited Lifetime warranty

Code/Standards Compliance

BLANCO sinks and faucets are third-party tested and certified to CSA, cUPC, ANSI/ASME and NSF standards and listed by applicable certification bodies. For more information on individual product listings, contact our office or listing organization.

BLANCO CANADA
100 Corporation Drive
Brampton, ON L6S 6B5

Tel: 905 494 2400
Fax: 905 494 2425
www.blancocanada.com

Toll Free: 1 877 425 2626
Toll Free: 1 877 825 2626

© 2016 BLANCO CANADA

179 B.C

UK-75 WALLACETON
LOT 302
33-2969 WOB ELEV. B
THE HARTWELL

35 of 50

KITCHEN FAUCET

Align

Modern

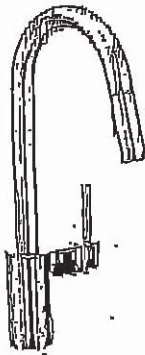

Single Handle Pull-Down Kitchen
Faucet*

Model 7565†

BL- BLACK

179

B.C

UK-75 WALLACETON
LOT 302
33-2969 WOB ELEV. B
THE HARTWELL

36 of 50

Soap or Lotion Dispensers

Traditional | Transitional | Modern

*However you define your faucet's style,
you can assure a coordinated look with Moen soap dispensers.*

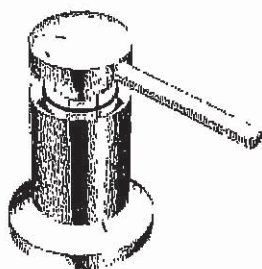

**Soap or Lotion
Dispenser**

Model 3942
Not available in ORB

Chrome

Other

BLACK

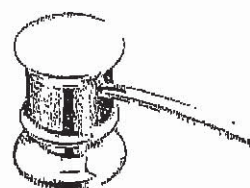

**Soap or Lotion
Dispenser**

Model 3944
Available in BL
Not available in W

Chrome

Other

FINISH OPTIONS:

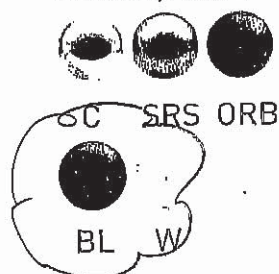

To order, combine the model number with one of these finish letter(s):
LifeShine® Classic Stainless (CSL), Spot Resist™ Stainless (SRS),
Oil Rubbed Bronze (ORB), Matte Black (BL) & Glacier (W).
To order Chrome (C) model, use model number only.

49

B.C.



Buy it for looks. Buy it for life.®

UK-75 WALLACETON
LOT 302
33-2969 WOB ELEV. B
THE HARTWELL

Specifications
37 of 50

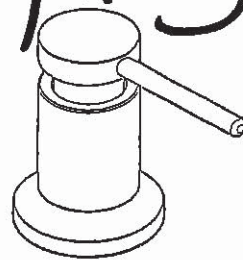

LIQUID DISPENSER

Model: 3942 series

DESCRIPTION

- Available in various finishes identified by suffix

OPERATION

- Press down, pump action

STANDARDS

- Designed and manufactured to comply with the requirements of: CSA B15.1 and ASME A112.18.1 and all requirements referenced therein

WARRANTY

- Lifetime limited warranty against manufacturing and finish defects to the original consumer purchaser
- 5 year warranty if used in commercial installations

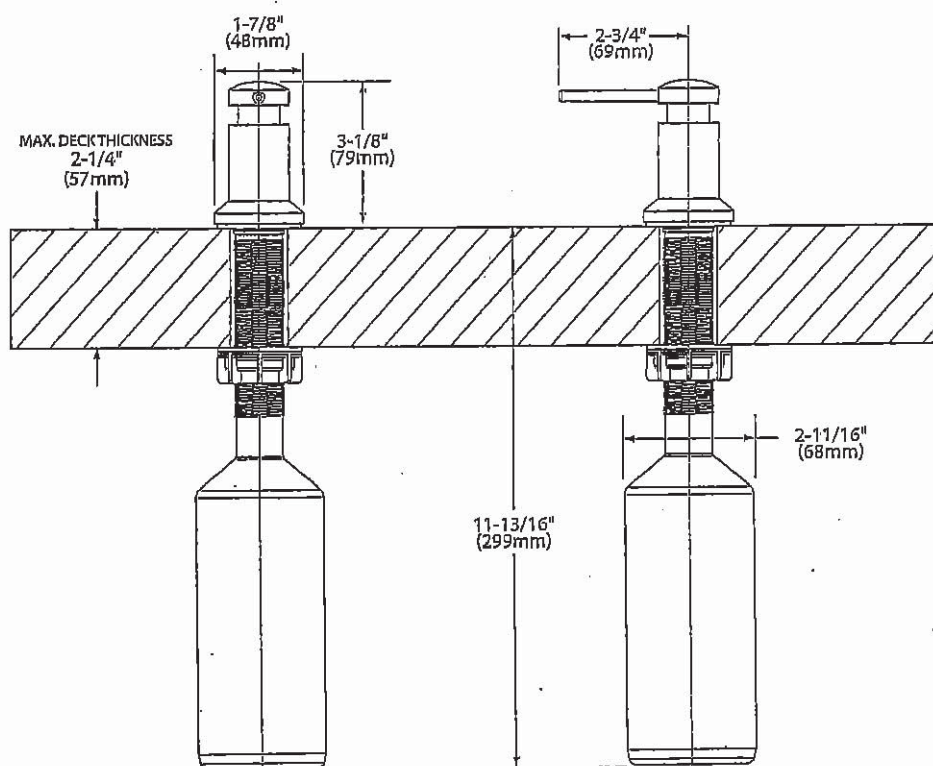

NOTE: DESIGNED TO BE INSTALLED THROUGH 1 HOLE 1-1/8" DIAMETER

CRITICAL DIMENSIONS

(DO NOT SCALE)

179

B.C

UK-75 WALLACETON
LOT 302
33-2969 WOB ELEV. B
THE HARTWELL

38 of 50

American Standard
Style That Works Better

BOULEVARD™
UNDERCOUNTER SINK
VITREOUS CHINA

BOULEVARD™ UNDERCOUNTER SINK

- Rectangular under mount sink with unique tapered interior bowl
- Made from vitreous china
- Unglazed rim
- Front overflow
- Supplied with mounting kit (047-194-0070A) and template

- ☐ 0610.000 Unglazed Rim
514 x 406mm
(20-1/4" x 16")
- ☐ 0610.300 Glazed underside

Bowl Size:
432mm (17") wide
330mm (13") front to back
152mm (6") deep

- Compliance Certifications -
Meets or Exceeds the
Following Specifications:
- ASME A112.19.2M for Vitreous China Fixtures.
 - CAN/CSA B45 series

To Be Specified:

- ☐ Color: ☐ White ☐ Bone
☐ Linen ☐ Black
- ☐ Faucet*:
- ☐ Faucet Finish:
- ☐ Supplies:
- ☐ 1-1/4" Trap:

* See faucet section for additional models available

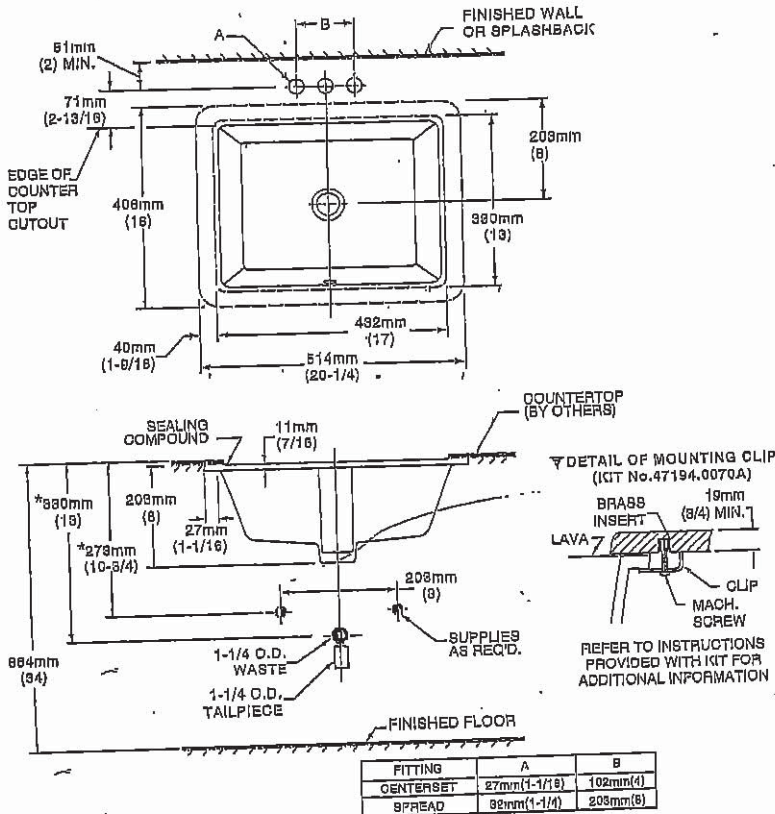
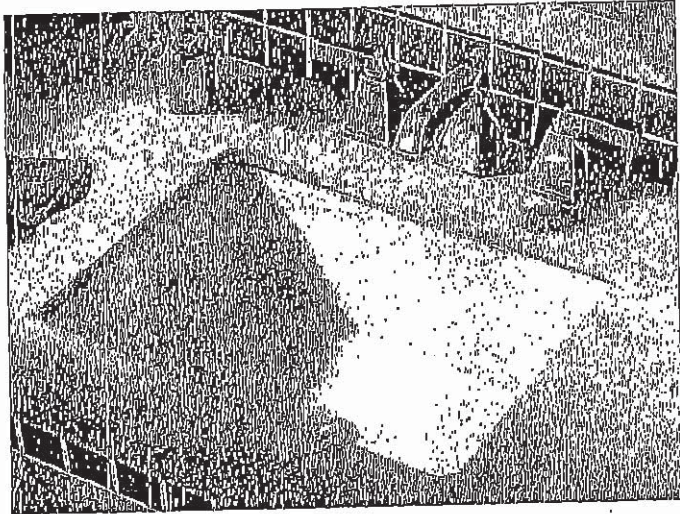

NOTES:
WE RECOMMEND USING BASIN AS A TEMPLATE TO DETERMINE PROPER CONTOUR. CUT COUNTERTOP 38MM (1-1/2") INSIDE BASIN CONTOUR.
* DIMENSIONS SHOWN FOR LOCATION OF SUPPLIED AND "P" TRAP ARE SUGGESTED.
▼ UNDERCOUNTER MOUNTING KIT SUPPLIED WITH SINK.
FITTINGS NOT INCLUDED WITH FIXTURE AND MUST BE ORDERED SEPARATELY.
SEALING COMPOUND SUPPLIED BY OTHERS.

IMPORTANT: Dimensions of fixtures are nominal and may vary within the range of tolerances established by ANSI Standard A112.19.2. These measurements are subject to change or cancellation. No responsibility is assumed for use of superseded or voided pages.

J47

Revised 2/08

H Q Bc

H Q Bc

MASTER BATHROOM

Align®

Traditional | Transitional | Modern

From large, open master baths to minimalist powder rooms, Align faucets and accessories bring a refreshed modern look to your home.



Single Handle Vessel Lav Faucet with Push-Button Drain without Overflow

NEW! Available in BG
 Not Available in BL
 Chrome
 Other
 Model 6192 / 140780

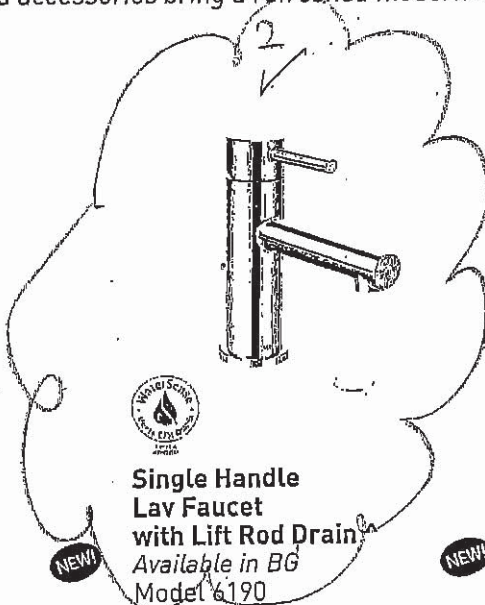

Single Handle Lav Faucet with Lift Rod Drain
 Available in BG
 Model 6190

NEW!
 Chrome
 Other BLACK

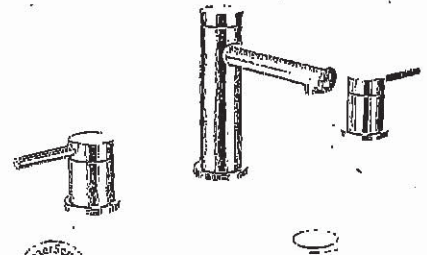

Two Handle Adjustable Widespread (8" - 16") Lav Faucet with Lift Rod Drain
 Available in BG
 Model T6193 / 69000

NEW!
 Chrome
 Other

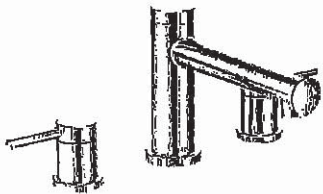

NEW!
Two Handle Roman Tub Faucet
 Available in BG
 Model T393 / 4796

Chrome
 Other

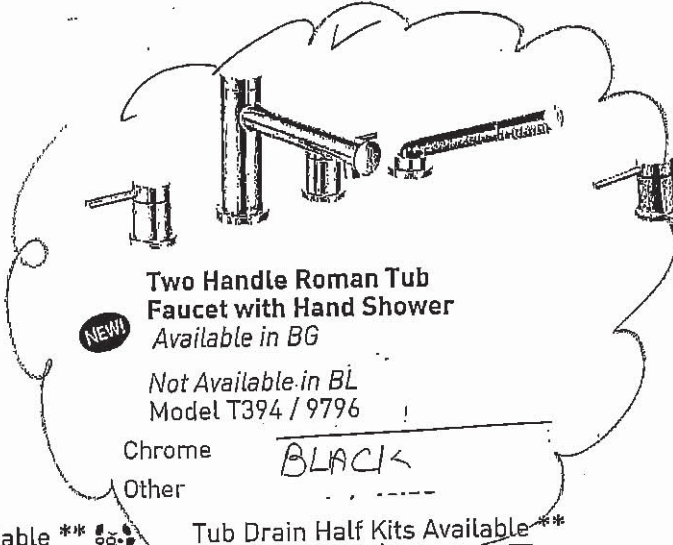

Two Handle Roman Tub Faucet with Hand Shower
 Available in BG
 Not Available in BL
 Model T394 / 9796

Chrome
 Other BLACK



Two Handle Bidet Faucet
 Not Available in BL or BG
 Model T5191 / 9265

Chrome
 Other

Tub Drain Half Kits Available **
 Chrome
 Other

Tub Drain Half Kits Available **
 Chrome
 Other

FINISH OPTIONS:

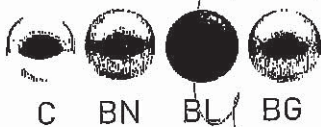

C BN BL BG

To order, combine the model number with one of these finish letter(s):
 LifeShine® Brushed Nickel (BN), Matte Black (BL) & Brushed Gold (BG)
 To order Chrome (C) model, use model number only.
 ^ Deckplate included - Deckplate sold separately - 172666 series
 ** T90331 / 140680

UK-75 WALLACETON
LOT 302
33-2969 WOB ELEV. B
THE HARTWELL

40 of 50

MASTER BATHROOM

Align®

Traditional | Transitional | Modern

From large, open master baths to minimalist powder rooms, Align faucets and accessories bring a refreshed modern look to your home.

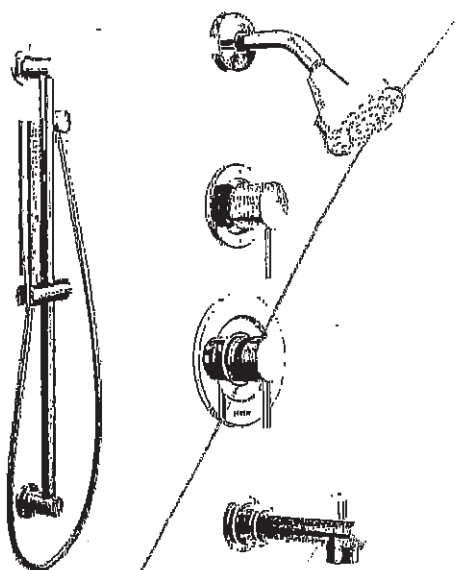

Posi-Temp® Tub/Shower Faucet with 3 Function Transfer Valve/Trim and Slide Bar with Hand Shower *
Available in BL & BG

Model T2193EP / 3372 / 128284 / T4191 / 62320 / 3887EP / A725

Chrome
Other

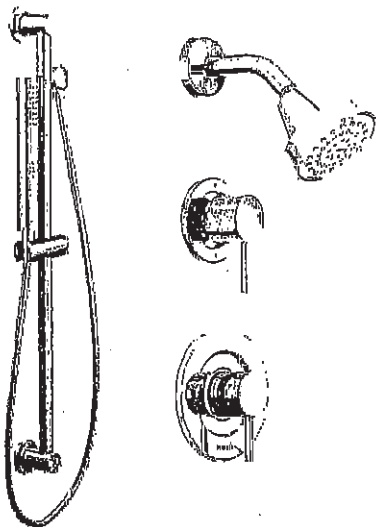

Posi-Temp® Shower Only with 3 Function Transfer Valve/Trim and Slide Bar with Hand Shower *
Available in BL & BG

Model T2192EP / 3372 / T4191 / 62320 / 3887EP / A725

Chrome
Other

~~Black~~

FINISH OPTIONS:



To order, combine the model number with one of these finish letter(s):
LifeShine® Brushed Nickel (BN), Matte Black (BL) & Brushed Gold (BG)
To order Chrome (C) model, use model number only.
* Please see vertical spa guide for installation #700106

H 9

Bc

UK-75 WALLACETON
 LOT 302
 33-2969 WOB ELEV. B
 THE HARTWELL

41 of 50

SHARED BATHROOM

Align®

Traditional | Transitional | Modern

From large, open master baths to minimalist powder rooms, Align faucets and accessories bring a refreshed modern look to your home.



Single Handle Vessel Lav
 Faucet with Push-Button
 Drain without Overflow

NEW! Available in BG
 Not Available in BL
 Chrome
 Other
 Model 6192 / 140780

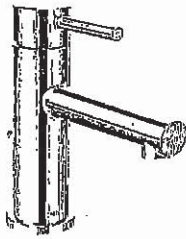

Single Handle
 Lav Faucet
 with Lift Rod Drain ^
 Available in BG
 Model 6190

NEW!

Chrome
 Other

BRUSHED
 GOLD

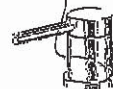

Two Handle Adjustable
 Widespread (8" - 16") Lav Faucet
 with Lift Rod Drain
 Available in BG
 Model T6193 / 69000

NEW!

Chrome
 Other

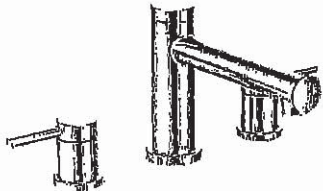

Two Handle
 Roman Tub Faucet
 Available in BG
 Model T393 / 4796

NEW!

Chrome
 Other

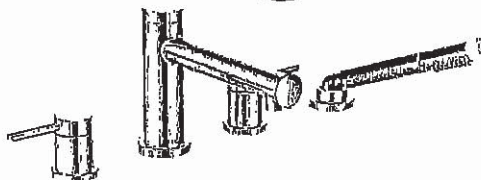

Two Handle Roman Tub
 Faucet with Hand Shower
 Available in BG
 Not Available in BL
 Model T394 / 9796

NEW!

Chrome
 Other

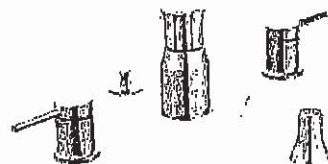

Two Handle
 Bidet Faucet
 Not Available in BL or BG
 Model T5191 / 9265

Chrome
 Other

Tub Drain Half Kits Available **
 Chrome
 Other

Tub Drain Half Kits Available **
 Chrome
 Other

FINISH OPTIONS:

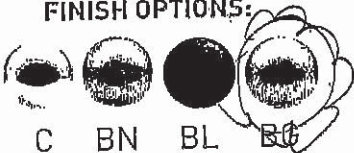

To order, combine the model number with one of these finish letter(s):
 LifeShine® Brushed Nickel (BN), Matte Black (BL) & Brushed Gold (BG)
 To order Chrome (C) model, use model number only.
 ^ Deckplate included ~ Deckplate sold separately - 172666 series
 ** T90331 / 140680

29

Bc

UK-75 WALLACETON
LOT 302
33-2969 WOB ELEV. B
THE HARTWELL

42 of 50

SHARED BATHROOM

Align®

Traditional | Transitional | Modern

From large, open master baths to minimalist powder rooms, Align faucets and accessories bring a refreshed modern look to your home.

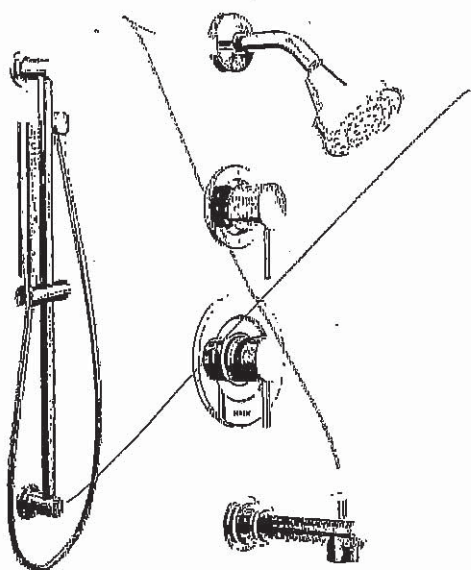

**Posi-Temp® Tub/Shower Faucet
with 3 Function Transfer Valve/Trim
and Slide Bar with Hand Shower ***

NEW!

Available in BL & BG

Model T2193EP / 3372 / 128284 / T4191 /
62320 / 3887EP / A725

Chrome
Other

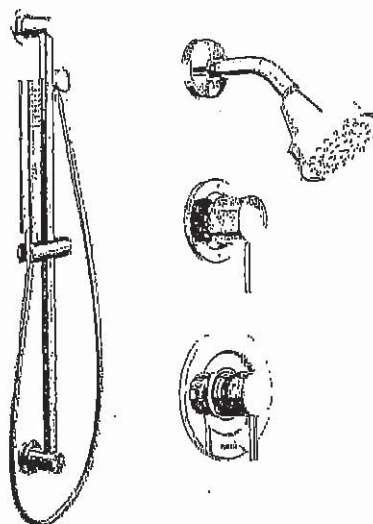

**Posi-Temp® Shower Only
with 3 Function Transfer Valve/Trim
and Slide Bar with Hand Shower ***

NEW!

Available in BL & BG

Model T2192EP / 3372 / T4191 / 62320 /
3887EP / A725

Chrome
Other

BRUSHED GOLD

FINISH OPTIONS:

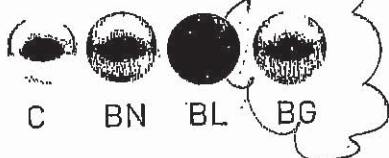

To order, combine the model number with one of these finish letter(s):
LifeShine® Brushed Nickel (BN), Matte Black (BL) & Brushed Gold (BG)
To order Chrome (C) model, use model number only.
* Please see vertical spa guide for installation #700106

14 9

Bc

POWDER & MAIN BATHROOM (2)

Rizon™

Traditional | Transitional | Modern

Polished smooth with clean, horizontal lines, the Rizon collection features a modern style with simple edges and soft curves.

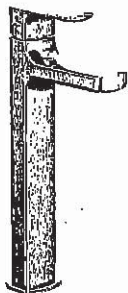

Single Handle Vessel Lav Faucet with Push-Button Drain without Overflow ±
 Not available in BL
 Model 6911 / 140780

Chrome
 Other

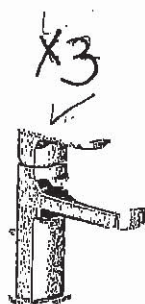

Single Handle Lav Faucet with Lift Rod Drain -
 Available in BL*
 Model 6900

Chrome

Other

BL BLACK

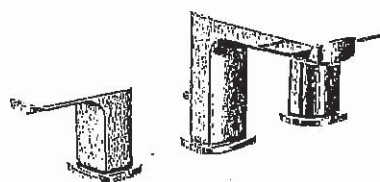

Two Handle Adjustable Widespread (8" - 16") Lav Faucet with Lift Rod Drain
 Available in BL*
 Model T6920 / 69000

Chrome
 Other



NEW!

Two Handle Roman Tub Faucet
 Available in BL*
 Model T935 / 4796

Chrome
 Other

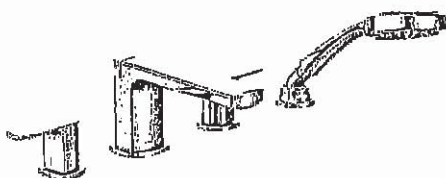

Two Handle Roman Tub Faucet with Hand Shower
 Not available in BL
 Model T936 / 9796

Chrome
 Other

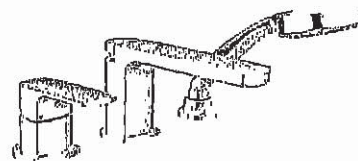

One Handle Roman Tub Faucet with Hand Shower
 Not available in BL
 Model T937 / 4791

Chrome



Tub Drain Half Kits Available**



Chrome

Other

FINISH OPTIONS:

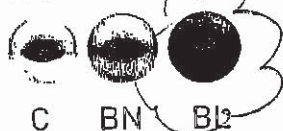

To order, combine the model number with one of these finish letter(s):
 LifeShine® Brushed Nickel (BN) & Matte Black (BL)
 To order Chrome (C) model, use model number only.

- Deckplate sold separately - 165006 series ± Single hole installation only
 ** T90331 / 140680
 * BL Finish Ships Q2

H 9

BL

UK-75 WALLACETON
LOT 302
33-2969 WOB ELEV. B
THE HARTWELL

44 of 50

MAIN BATHROOM

Rizon™

Traditional | Transitional | Modern

Polished smooth with clean, horizontal lines, the Rizon collection features a modern style with simple edges and soft curves.

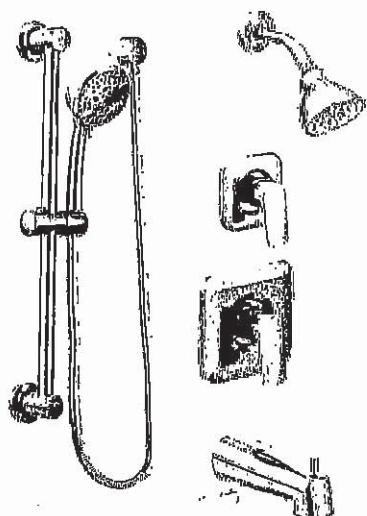

**Posi-Temp® Tub/Shower Faucet
with 3 Function Transfer Valve/Trim
and Slide Bar with Hand Shower ***

Available in BL*

Model T2813EP / 3372 / 128284 / 62320 /
T2081 / 3669EP / A725

Chrome

Other

BLACK

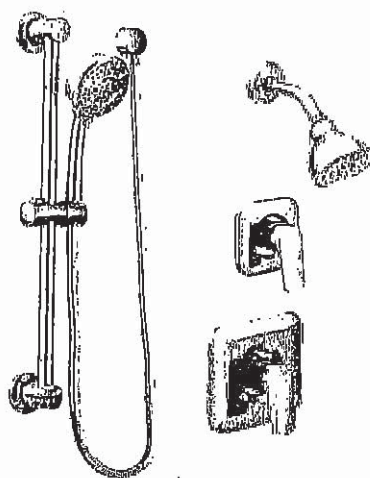

**Posi-Temp® Shower Only
with 3 Function Transfer Valve/Trim
and Slide Bar with Hand Shower ***

Available in BL*

Model T2812EP / 3372 / T2081 / 62320 /
3669EP / A725

Chrome

Other

FINISH OPTIONS:

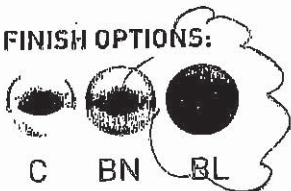

To order, combine the model number with one of these finish letter(s):
LifeShine® Brushed Nickel (BN) & Matte Black (BL)
To order Chrome (C) model, use model number only.

- Please see vertical spa guide for installation #700106
- * BL Finish Ships Q2

H9

BC

45 of 50



FOR THE WAY IT'S MADE.
FOR THE WAY IT'S WORKS.

MODEL: KVWB606DBS COLOUR: BLACK STAINLESS
36-In. Width | Wall-Mount Canopy | 600 CFM Motor

This 3-speed vent hood has power to effectively vent an output of up to 65K BTUs. Auto speed sensing keeps the vent at the proper fan speed by sensing the amount of heat coming from the cooktop. This 36-inch wall-mount canopy hood has both LED and halogen lights to brighten almost any work area.

PRODUCT FEATURES

- 600 CFM/65K BTU Threshold
- Allows installation over any KitchenAid regular 36-inch range or cooktop, and some commercial-style cooking surfaces with outputs up to 65K BTU
- Perimeter Ventilation
- Increases ventilation system efficiency by pulling air from the edges of the hood and speeding up the movement of air at the center, allowing it to efficiently handle up to a 65K BTU total output
- Auto Speed Setting
- Takes the guesswork out of protecting cabinets from steam, grease, and moisture by automatically adjusting fan speed to ventilation needs depending on the heat being produced
- LED Task Lights
- Provide extra lighting over the cooking surface to help in the cooking process
- Halogen Night Lights
- Enhances the style of the ventilation system by providing soft, accent lighting in the kitchen

H9 Bc

PERFORMANCE

Duct Outlet Type Round
Duct Outlet Size 6"

ELECTRICAL

15amp, 60 Hz, 120 V.

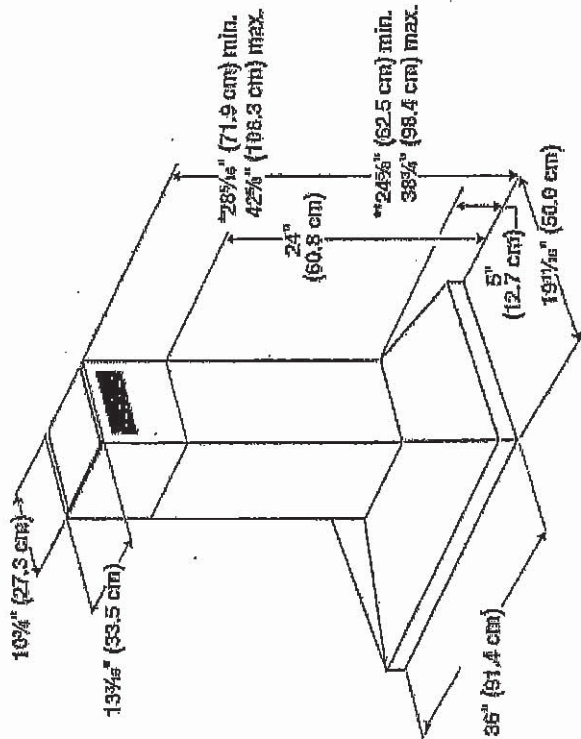
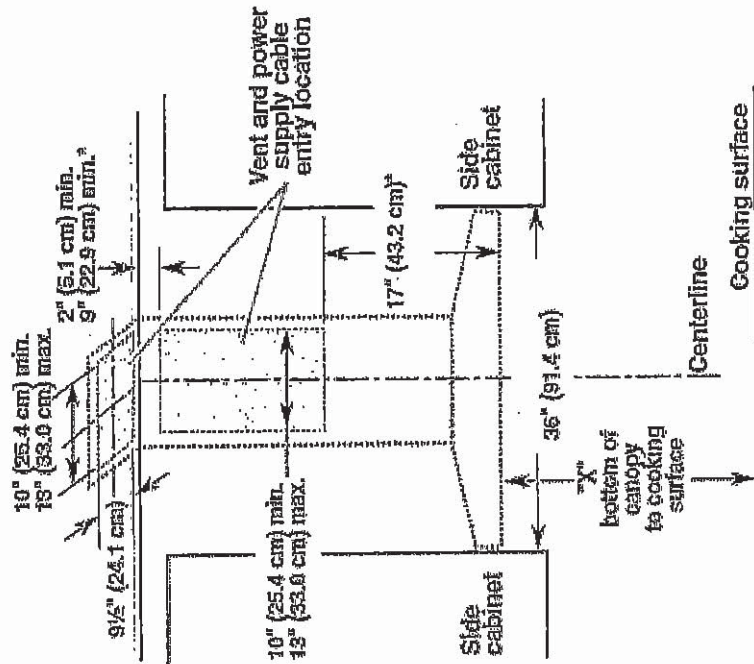

*For non-vented (recirculating) installations

**For vented installations

*For non-vented (recirculating) installations

IMPORTANT:

- Minimum distance "X": 24" (61.0 cm) from electric cooking surface.
- Minimum distance "X": 27" (68.6 cm) from gas cooking surfaces.
- Suggested maximum distance "X": 36" (91.4 cm)

UK-75 WALLACETON
LOT 302
33-2969 WOB ELEV. B
THE HARTWELL

46 of 50

KitchenAid®

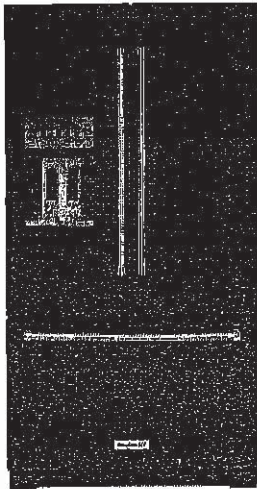

26.8 cu. ft. 36-Inch Width Standard Depth
French Door Refrigerator with Exterior Ice and
Water

KRFF507HBS

This 26.8 cu. ft. french door refrigerator helps fresh produce stay that way with the ExtendFresh™ Temperature Management System. A pull-out tray accommodates large platters with ease, while a FreshChill™ Temperature-Controlled Full-Width Pantry lets you optimize temperature and airflow for the specific food you're storing.

Top Features

PrintShield™ Finish
Resists smudges and fingerprints. The specialized coating for stainless steel is easy to clean with just water and a soft cloth, so you can spend more time cooking and less time cleaning up.

ExtendFresh™ Temperature Management System
Separately monitors the temperatures in the refrigerator and freezer through a sensor located in each to help ensure fresh fruit juices don't become frozen and prawns avoid freezer burn.

Pull Out Tray
Provides an ideal space to store large platters of appetizers and then access them with ease to keep you in the creative flow. It resists moisture and stains, and is removable for easy cleanup.

FreshChill™ Temperature-Controlled Full-Width Pantry
Provides a manual temperature setting that lets you maintain the freshness of ingredients as varied as a whole salmon or large eggplants. It gives you total control over the amount of cool air that enters the drawer.





Dimensions

Depth	36 5/8
Height	69 7/8
Width	35 11/16

Available Finishes/Colours

-  KRFF507HBS
Black Stainless
Steel with
PrintShield™ Finish
-  KRFF507HPS.
Stainless Steel with
PrintShield™ #8482;
Finish

Manuals & Literature:

-  [Dimension Guide](#)
-  [Energy Guide](#)
-  [Use and Care](#)
-  [Warranty](#)

179

BC



UK-75 WALLACETON
LOT 302
33-2969 WOB ELEV. B
THE HARTWELL

47 of 50

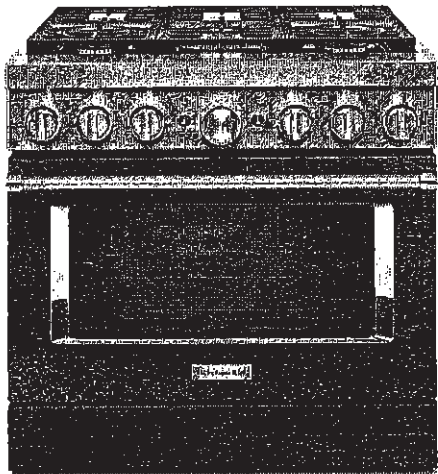
KitchenAid®



Available Finishes/Colours

- | | |
|--|--|
|  KFDC506JAV
Matte Avocado |  KFDC506JBK
Imperial Black ✓ |
|  KFDC506JIB
Ink Blue |  KFDC506JMB
Misty Blue |
|  KFDC506JMH
Matte Milkshake |  KFDC506JPA
Passion Red |

4 Additional finishes/colours available.

Manuals & Literature:

- | | |
|--|---|
|  Dimension Guide |  Installation Instructions |
|  Use and Care |  Warranty |

KitchenAid® 36" Smart Commercial-Style Dual Fuel Range with 6 Burners

KFDC506JBK

Expand your skills with a 36-inch KitchenAid® Commercial Style Range with 6 burners. This dual fuel range combines a gas cooktop with the even baking of an electric oven. Two 20,000 BTU Ultra Power™ Dual-Flame Burners offer the power and precision to successfully sear, simmer, stir-fry and sauté. Even-Heat™ True Convection helps you achieve more consistent baking and roasting.

Top Features	
Dual Fuel Range Satisfies the needs of the most demanding cooks by combining the precise control of a gas cooking surface with the even baking, roasting and broiling of an electric oven.	
Even-Heat™ True Convection Features a unique bow-tie design with heating element and fan that circulates hot air throughout the entire oven, providing consistent temperatures for crisp, flaky baked goods, juicy, well-browned roasts and flavorful, caramelized vegetables.	
Two 20,000 BTU Ultra Power™ Dual-Flame Burners Give you precise control of powerful highs, steady lows and the wide range of temperatures in between. The versatile, dual-flame design lets you sear, sauté, simmer and sizzle, all on the same burner.	
Smart Appliance Lets you control the oven with your Google Assistant device* to stay hands on or hands off. Use the KitchenAid™ App to preheat, proof, bake and roast, save custom cooking instructions for favorite recipes and more.	
Dimensions	
Height	36
Width	35 7/8

Because Whirlpool Corporation policy includes a continuous commitment to improve our products, we reserve the right to change materials and specifications without notice. Dimensions are for planning purposes only. For complete details, see Installation Instructions packed with product. Specifications subject to change without notice.

Handwritten notes: "H 9" and "BC"

UK-75 WALLACETON
LOT 302
33-2969 WOB ELEV. B
THE HARTWELL

48 of 50

KitchenAid®

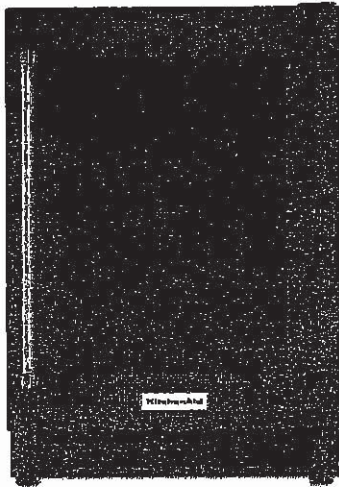

24" Undercounter Refrigerator with Glass Door and Metal Trim Shelves

KURR304EBS

This 5.1 cu. ft. capacity Stainless Steel Undercounter Refrigerator has more than ample space for wine and all other entertaining needs. Its Proximity-activated interior LED lighting helps illuminate items so they can be found without opening the door. Activated by approaching the unit, these lights switch on only as needed.

Top Features

5.1 Cu. Ft. Capacity
Provides more than ample space for wine and all other entertaining needs.

Auto-Light Interior LED lighting
Is proximity-activated making it easy to find items inside the unit without having to open the door. One or two rows of LED top-mounted lights slowly illuminate when approaching the unit, and gradually turn off when not needed.





UV-Protected Thermal Glass Door
Filters UV rays to help protect wine and other beverages from premature aging.

Professionally-Inspired Design
Combines a bold blend of professionally-inspired styling with sleek touches for the home. This beautiful specialty refrigeration unit features Satin Textured Handles and the KitchenAid® Badge, a symbol of uncompromised quality.

Available Finishes/Colours

- **KURR304EBS**
Black Stainless Steel with PrintShield™ Finish
- **KURR304ESS**
Stainless Steel

Manuals & Literature:

-  [Dimension Guide](#)
-  [Energy Guide](#)
-  [Use and Care](#)
-  [Warranty](#)

Dimensions	
Depth	26 3/4
Height	35 1/8
Width	23 3/4

At-A-Glance Volume And Shelf Area	
Bottle Capacity	46
Refrigerator Volume (Cu Ft)	5.10

Controls	
Auto Defrost	Yes
Control Type	Electronic
Cooling On/Off	Yes
Ice Maker On/Off	No
Number of Temperature Controlled Zones	1

Controls	
Temperature Range	32F to 42F
Verrouillage des commandes	Yes
Door Ajar/Open Alarm	Yes
Control Location	Interior Top Front
Water Filter Indicator/Reset	No
Control Lockout	Yes
Max Cool/Fast Cool	No

Appearance	
Window	Yes
Cabinet Finish	Textured

TEPPERMAN'S
Jay Oliquino
joliquino@teppermans.com

1415 Huron Rd
Kitchener, ON N2R 0L3
(519) 279-7810 x 4065

Because Whirlpool Corporation policy includes a continuous commitment to improve our products, we reserve the right to change materials and specifications without notice. Dimensions are for planning purposes only. For complete details, see Installation Instructions packed with product. Specifications subject to change without notice.

173

Bc

UK-75 WALLACETON
LOT 302
33-2969 WOB ELEV. B
THE HARTWELL

49 of 50

SHARP
Be Original.

SMD2477AHC
24-INCH MICROWAVE DRAWER® OVEN

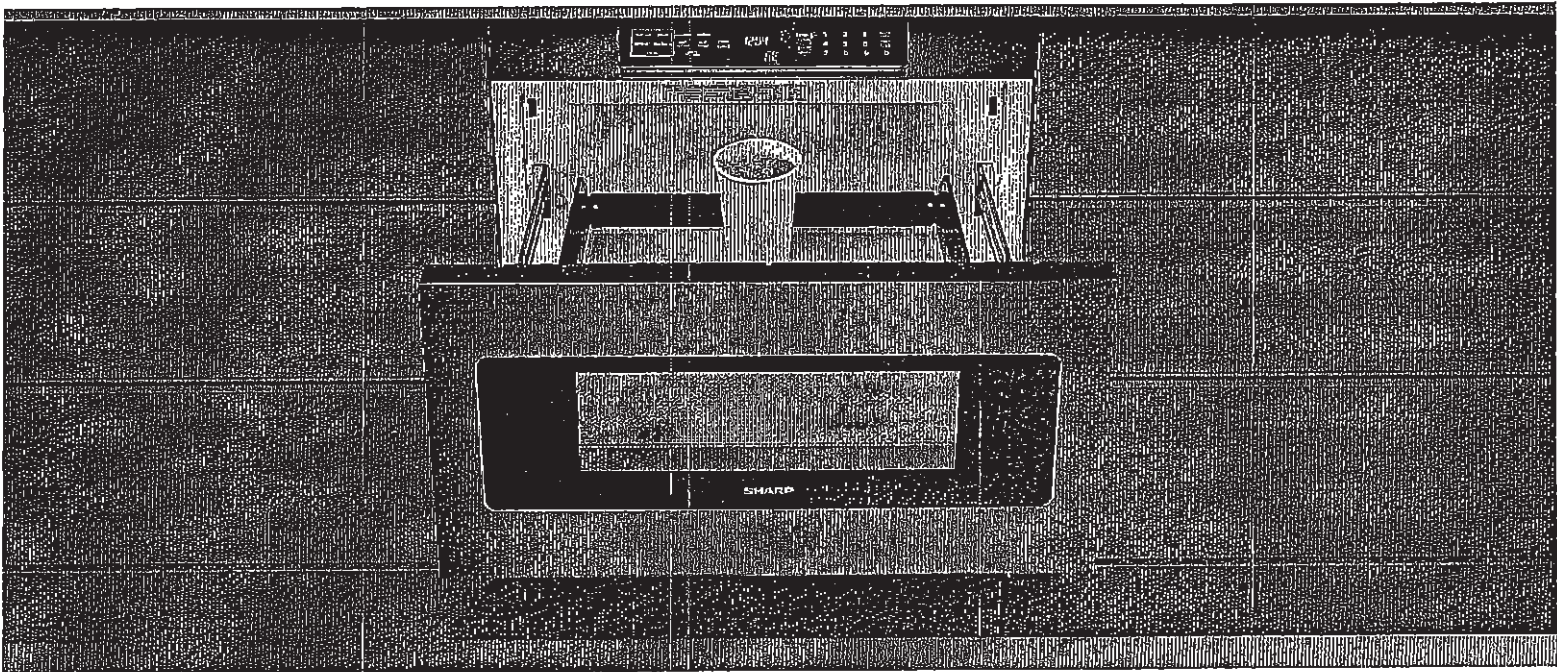

DESIGNED FOR YOUR DREAM KITCHEN

Sharp's Black Stainless Microwave Drawer's rich, elegant finish is an absolute show-stopper for your dream kitchen. As a complimentary appliance in a black stainless kitchen, or a stunning design statement in any kitchen, the Sharp Black Stainless Microwave Drawer allows you to showcase your design savvy and create a kitchen that flows with your lifestyle. It is built to match but designed to stand out.

Design Flexibility

Sharp's Microwave Drawer product expands the option for microwave placement in almost any kitchen plan—it's a perfect choice for open-plan kitchens, islands, peninsulas, and a great addition to wet bars, family rooms and home theatres.

Location and Counter Space Saving

You may place the drawer under a counter, cooktop or wall oven or above a warming drawer without a built-in kit, additional trim or venting. Sharp microwave drawer provides the best solution for a cleaner, uncluttered counter space.

SHARP's Exclusive AutoTouch™ System

Sharp's exclusive AutoTouch™ system allows you to open and close the drawer automatically at one-finger operation by pressing a button on the control panel.

Hidden Control Panel

The new SMD2477AHC model features a hidden control panel which gives a more integrated look and feel within the kitchen. The new tall control panel, angled at 45° degrees, is easy to see, easy to access and easy to use.

Specifications

TECHNICAL SPECIFICATIONS	
Size	24" wide
Microwave Capacity	1.2 cu.ft
Microwave Power	950 watts
Control Panel	Digital LCD Display
Control Type	Hidden Control Panel
Drawer Opening	AutoTouch™ System
Power Level	11
Sensor Cook, Reheat, Popcorn Settings	13
Reheat Auto Settings	2
Defrost Auto Settings	6
Keep Warm Setting	Yes, up to 30 min.
Melt / Soften / Settings	Yes
Beverage Setting	Yes
Programmable Stages	Yes, 4
Digital Clock	Yes
Kitchen Timer	Yes
Child Lock	Yes
+30 sec	Yes
Interior Oven Light	Yes

TECHNICAL SPECIFICATIONS CONTINUED	
Demonstration Mode	Yes
Built-in Ready	Yes
Finish	Black Stainless Steel
DIMENSIONS/WEIGHT(Inches/lbs.)	
Cut-out Dimension	22 1/8" x 15 9/16"
Product Dimension	23 7/8" x 23 1/64" x 15 7/8"
Box Dimension	29.8" w x 27.9" x 21.9"
Net Weight	74 lb.
Gross Weight	85.8 lb.
POWER/SAFETY	
Power / Ratings	120V, 60Hz
Ratings	1.67Kw, 14.5Amps
Safety Compliance	FCC, DHHS, cUL
WARRANTY/UPC	
Warranty	1 year parts & labour with In-home service; 4 additional years for magnetron tube only
UPC	074000620568

179

Bc

UK-75 WALLACETON
LOT 302
33-2969 WOB ELEV. B
THE HARTWELL

50 of 50

SHARP
Be Original.

SMD2477AHC

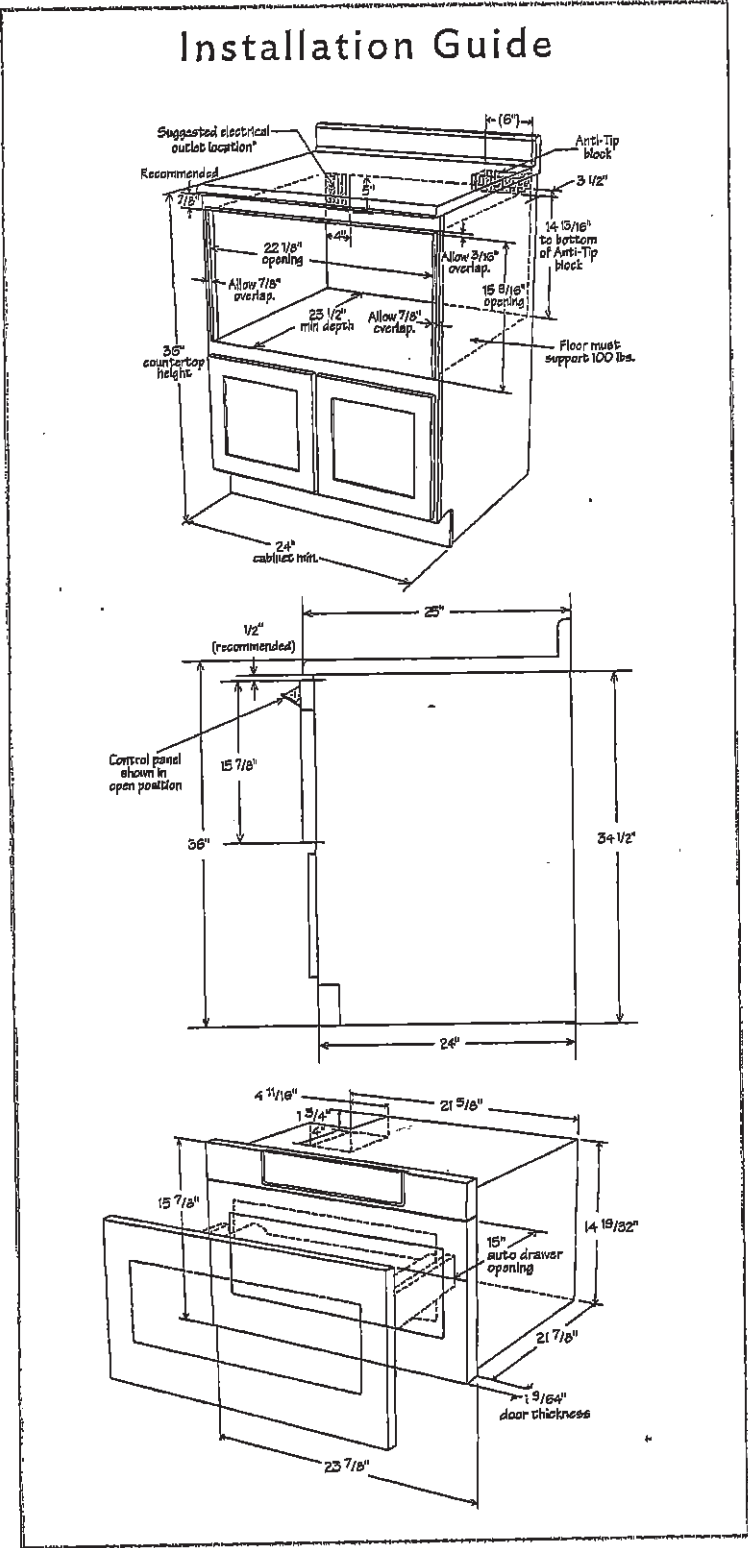

49

Bc