



12-Jul-21

# PRE-Sales Selection Sheet CHECKLIST

11 of 41  
C2

LOT	050-6	REVISED	20-2447-EN ELEV A THE BARRINGTON
PURCHASERS: ALEXANDER PINATSI		CONTACT NO: 647-523-7876	
JENNA ELIZABETH PINATSI		647-997-6440	
VENDOR: HEATHWOOD HOMES (WHITBY) LIMITED - PHASE 4			

- ☐ FINISHED BASEMENT
- ☐ COLD CELLAR

UPGRADED / MODIFIED ELEVATION

- ☐ CORNER UPGRADE
- ☐ SIDE UPGRADE
- ☐ REAR UPGRADE

- ☐ WALK OUT DECK
- ☐ WALK OUT BASEMENT

CEILING UPGRADE - SMOOTH

- ☒ MAIN FLOOR
- ☐ SECOND FLOOR

- ☐ BASEMENT

ADDITIONAL ROUGH-INS

- ☒ 200 AMP SERVICE
- ☐ WET BAR ROUGH IN

- ☐ HUMIDIFIER
- ☒ AIRCON

GAS ROUGH-IN

- ☒ STOVE
- ☒ BBQ

- ☐ DRYER
- ☐ ADDITIONAL FIREPLACE

HOODFAN VENTING

- ☐ 6" ROUND DUCT
- ☒ 7" ROUND DUCT

REVISED

FULL BASEMENT STAIRS:	<u>PAINT GRADE</u>
UPPER BASEMENT STAIRS:	<u>N/A</u>
LOWER BASEMENT STAIRS:	<u>N/A</u>
STAIRS TO LOWER LEVEL:	<u>ALL OAK</u>
STAIRS TO UPPER LEVEL:	<u>N/A</u>
MAIN STAIRS:	<u>ALL OAK</u>
MEDIA STAIRS (if applicable):	<u>N/A</u>

July 6/21  
Date  
Signature on  
Purchaser  
file

July 6/21  
Date  
TINA LEFUR  
D cor Consultant  
APPROVED

Date  
Purchaser

-07- 12 2021  
Date Approved  
HEATHWOOD HOMES (WHITBY)  
LIMITED - PHASE 4



12-Jul-21

# Interior Finishing Selection Sheet

12 of 11

LOT 050-6

20-2447-EN ELEV A THE BARRINGTON

PURCHASERS: ALEXANDER PINATSI

CONTACT NO: 647-523-7876

JENNA ELIZABETH PINATSI

647-997-6440

VENDOR: HEATHWOOD HOMES (WHITBY) LIMITED - PHASE 4

## Appliances

6-34 Kitchen HoodFan

## Cabinetry

1-9166 Kitchen Cabinet Colour/Style

3-2086 Kitchen Cabinet Hardware

25-9158 Main Bathroom Cabinet Colour/Style

29-7672 Main Bathroom Cabinet Hardware

28-8796 Main Bathroom Countertop

20-9156 Master Ensuite Cabinet Colour/Style

22-7672 Master Ensuite Cabinet Hardware

21-8796 Master Ensuite Countertop

414-9157 Powder Room Lower Level Cabinet Colour/Style

416-7672 Powder Room Lower Level Cabinet Hardware

415-8796 Powder Room Lower Level Countertop

## Carpet

37-9247 Bedroom 2 Flooring

38-9247 Bedroom 3 Flooring

14-9247 Family Room Flooring

367-9247 Lower Level Hall Flooring

36-9247 Master Bedroom Flooring

52-1079 Throughout Underpad

## Ceramics

16-9257 Foyer Flooring

## UPG

☐ Air King Under Cabinet Range Hood (Standard for Towns Only)  
STAINLESS STEEL AV1308 STD 30" PAGE 29

☐ CHARLESTON ORCHID Viking III STD 3DL 9167 - CHARLESTON  
RAIN CLOUD FOR ISLAND

☐ HARDWARE 9677 STD

☐ SIMCOE NAVY BLUE Viking III STD 3DL

☐ HARDWARE 135 STD

☐ Countertop PALOMA POLAR ETCHINGS FINISH 6698-46  
Formica

☐ SIMCOE RAIN CLOUD Viking III STD 3DL

☐ HARDWARE 135 STD

☐ Countertop PALOMA POLAR ETCHINGS FINISH 6698-46  
Formica

☐ SIMCOE MOONLIGHT Viking III STD 3DL

☐ HARDWARE 135 STD

☐ Countertop PALOMA POLAR ETCHINGS FINISH 6698-46  
Formica

☐ Dynasty Tex 40 oz Poly SANDY BEIGE DY 16611 STD

☐ Dynasty Tex 40 oz Poly SANDY BEIGE DY 16611 STD

☐ Dynasty Tex 40 oz Poly SANDY BEIGE DY 16611 STD

☐ Dynasty Tex 40 oz Poly SANDY BEIGE DY 16611 STD

☐ Dynasty Tex 40 oz Poly SANDY BEIGE DY 16611 STD

☐ Underpad 500 Series STD

☐ CARRARA White / Grey GE.CR.WHIT.1313.MT STD 13 x 13

1. The Purchaser acknowledges these selections are subject to the terms and conditions of the applicable Agreement of Purchase and Sale.
2. The Purchaser acknowledges that the Vendor accepts no responsibility in the event the Vendor is unable to supply a selection. The Purchaser agrees to reselect from the currently available selections immediately upon request.
3. The Vendor reserves the right to substitute above materials and equipment with that of equal or better quality.
4. Purchaser acknowledges that items may not be exactly as shown. Variations from the Vendor's samples may occur in finished materials due to normal production processes. Vendor is not responsible for shade difference which may occur from different dye lots or wood grains. Variations from the Vendor's samples will occur with natural materials such as wood, marble, granite, hardwood and brick.
5. The Vendor reserves the right to select Grout & Thresholds that best suits the Tile selected.
6. Selections will not be processed unless signed by Heathwood Homes Head Office.
7. The colour selections made on the Colour Chart are final and cannot be changed once submitted.
8. The Purchaser has checked and acknowledges the accuracy of this Colour Chart.

Date

Purchaser

Date

Purchaser

Date

Décor Consultant

Date Approved

HEATHWOOD HOMES (WHITBY)  
LIMITED - PHASE 4



09-Jun-21

# Interior Finishing Selection Sheet

3 of 11

LOT 050-6

20-2447-EN ELEV A THE BARRINGTON

PURCHASERS: ALEXANDER PINATSIS  
JENNA ELIZABETH PINATSIS

CONTACT NO: 647-523-7876  
647-997-6440

VENDOR: HEATHWOOD HOMES (WHITBY) LIMITED - PHASE 4

UPG

## Ceramics

17-2225 Foyer Grout

4-5721 Kitchen Backsplash

5-2226 Kitchen Backsplash Grout

348-9257 Laundry Mud Room Flooring

349-2225 Laundry Mud Room Grout

30-9257 Main Bathroom Flooring

31-2225 Main Bathroom Grout

112-9020 Main Bathroom Tub Wall Tile

113-2226 Main Bathroom Tub Wall Tile Grout

23-9257 Master Ensuite Floor Tile

24-2225 Master Ensuite Floor Tile Grout

73-8665 Master Ensuite Shower Floor Tile

74-2226 Master Ensuite Shower Floor Tile Grout

147-8923 Master Ensuite Shower Jamb(s) and Sill(s)

104-8833 Master Ensuite Shower Wall Tile

105-2226 Master Ensuite Shower Wall Tile Grout

32-9257 Powder Room Flooring

33-2225 Powder Room Grout

369-9257 Powder Room Lower Level Flooring

370-2225 Powder Room Lower Level Grout

53-2232 Throughout Thresholds

☐ Grout (27) Silver STD

☒ Colour and Dimension Bright Arctic White  
QT.CD.ARW.0306.BR UPG\_1 3 x 6 INSTALL IN SUBWAY  
PATTERN

☐ Grout (00) White STD

☐ CARRARA White / Grey GE.CR.WHIT.1313.MT STD 13 x 13

☐ Grout (27) Silver STD

☐ CARRARA White / Grey GE.CR.WHIT.1313.MT STD 13 x 13

☐ Grout (27) Silver STD

☐ Weave White QT.WV.WHT.0810 STD 8 x 10 INSTALL  
STACKED HORIZONTALLY

☐ Grout (00) White STD

☐ CARRARA White / Grey GE.CR.WHIT.1313.MT STD 13 x 13

☐ Grout (27) Silver STD

☒ Ontario Series Mosaic Taupe Matte OD.ON.TPE.0202.MT.N  
UPG 1 2 x 2

☐ Grout (00) White STD

☐ Shower Jamb / Sill Thassos White STD

☐ Uniwall White QT.UW.WHT.0810 STD 8 x 10 INSTALL  
STACKED HORIZONTALLY

☐ Grout (00) White STD

☐ CARRARA White / Grey GE.CR.WHIT.1313.MT STD 13 x 13

☐ Grout (27) Silver STD

☐ CARRARA White / Grey GE.CR.WHIT.1313.MT STD 13 x 13

☐ Grout (27) Silver STD

☐ Metal Thresholds STD

## Electrical

1. The Purchaser acknowledges these selections are subject to the terms and conditions of the applicable Agreement of Purchase and Sale.
2. The Purchaser acknowledges that the Vendor accepts no responsibility in the event the Vendor is unable to supply a selection. The Purchaser agrees to reselect from the currently available selections immediately upon request.
3. The Vendor reserves the right to substitute above materials and equipment with that of equal or better quality.
4. Purchaser acknowledges that items may not be exactly as shown. Variations from the Vendor's samples may occur in finished materials due to normal production processes. Vendor is not responsible for shade difference which may occur from different dye lots or wood grains. Variations from the Vendor's samples will occur with natural materials such as wood, marble, granite, hardwood and brick.
5. The Vendor reserves the right to select Grout & Thresholds that best suits the Tile selected.
6. Selections will not be processed unless signed by Heathwood Homes Head Office.
7. The colour selections made on the Colour Chart are final and cannot be changed once submitted.
8. The Purchaser has checked and acknowledges the accuracy of this Colour Chart.

Date

Purchaser

Date

Décor Consultant

Date

Purchaser

Date Approved

HEATHWOOD HOMES (WHITBY)  
LIMITED - PHASE 4



09-Jun-21

# Interior Finishing Selection Sheet

OF

LOT 050-6

20-2447-EN ELEV A THE BARRINGTON

PURCHASERS: ALEXANDER PINATSI  
JENNA ELIZABETH PINATSI

CONTACT NO: 647-523-7876  
647-997-6440

VENDOR: HEATHWOOD HOMES (WHITBY) LIMITED - PHASE 4

UPG

## Electrical

90-5796 Throughout Switches and Plug

☐ Decora White Switches and Plugs STD

## Fireplace

136-8891 Great Room Fireplace Mantle

☐ Paint Grade Mantle- Cabinet (Per Plan) WHITE NF-17 STD

135-8865 Great Room Fireplace Type

☐ Dimplex FP3033HL Electric Fireplace

## Granite

2-9069 Kitchen Countertop

☐ MSI Quartz ICED WHITE Group 1 STD 3/4"

## Hardwood

11-9359 Great Room Flooring

☐ Vintage Pioneered Solid Collection Select V : Red Oak Pearl  
BARISTA Red Oak Pearl 3/4" X 3 1/4"

7-9359 Kitchen/Breakfast Flooring

☒ Vintage Pioneered Solid Collection Select V : Red Oak Pearl  
BARISTA Red Oak Pearl 3/4" X 3 1/4"

12-9359 Living Room Flooring

☐ Vintage Pioneered Solid Collection Select V : Red Oak Pearl  
BARISTA Red Oak Pearl 3/4" X 3 1/4"

98-9359 Main Hall Flooring

☐ Vintage Pioneered Solid Collection Select V : Red Oak Pearl  
BARISTA Red Oak Pearl 3/4" X 3 1/4"

78-9059 Stair Landing to Lower Level Flooring

☒ Red Oak-Vintage 3 1/4 inch Pre-Sanded Smooth Unfinished Red  
Oak-Unfinished-3/4 inch x 3 1/4inch Red Oak 3/4" x 3 1/4"

77-9059 Stair Landing to Upper Level Flooring

☒ Red Oak-Vintage 3 1/4 inch Pre-Sanded Smooth Unfinished Red  
Oak-Unfinished-3/4 inch x 3 1/4inch Red Oak 3/4" x 3 1/4"

35-9359 Upper Hall Flooring

☐ Vintage Pioneered Solid Collection Select V : Red Oak Pearl  
BARISTA Red Oak Pearl 3/4" X 3 1/4"

## Interior Railings

49-8148 Stairs to Lower Level Handrail/Pickets/Posts Type

☐ Single Collar Alt. Plain w/ Shoes with 3 1/2" Square/Cap Post(s)  
BLACK METAL STD

43-8148 Stairs to Upper Level Handrail/Pickets/Posts Type

☐ Single Collar Alt. Plain w/ Shoes with 3 1/2" Square/Cap Post(s)  
BLACK METAL STD

## Interior Stairs

116-1713 Basement Stairs Type

☐ Paint Grade Stairs STD

45-1712 Stairs to Lower Level Type

☐ Oak Stairs UPG\_1

39-1712 Stairs to Upper Level Type

☐ Oak Stairs UPG\_1

1. The Purchaser acknowledges these selections are subject to the terms and conditions of the applicable Agreement of Purchase and Sale.
2. The Purchaser acknowledges that the Vendor accepts no responsibility in the event the Vendor is unable to supply a selection. The Purchaser agrees to reselect from the currently available selections immediately upon request.
3. The Vendor reserves the right to substitute above materials and equipment with that of equal or better quality.
4. Purchaser acknowledges that items may not be exactly as shown. Variations from the Vendor's samples may occur in finished materials due to normal production processes. Vendor is not responsible for shade difference which may occur from different dye lots or wood grains. Variations from the Vendor's samples will occur with natural materials such as wood, marble, granite, hardwood and brick.
5. The Vendor reserves the right to select Grout & Thresholds that best suits the Tile selected.
6. Selections will not be processed unless signed by Heathwood Homes Head Office.
7. The colour selections made on the Colour Chart are final and cannot be changed once submitted.
8. The Purchaser has checked and acknowledges the accuracy of this Colour Chart.

Date

Purchaser

Date

Décor Consultant

Date

Purchaser

Date Approved

HEATHWOOD HOMES (WHITBY)  
LIMITED - PHASE 4



09-Jun-21

# Interior Finishing Selection Sheet

15 of 11

LOT 050-6

20-2447-EN ELEV A THE BARRINGTON

PURCHASERS: ALEXANDER PINATSI  
JENNA ELIZABETH PINATSI

CONTACT NO: 647-523-7876  
647-997-6440

VENDOR: HEATHWOOD HOMES (WHITBY) LIMITED - PHASE 4

UPG

## Interior Trim

91-9374 Throughout Trim Size

☐ 4 1/4" Baseboards and 2 3/4" Integrated Backbend Casings  
STD

## Painting

46-7761 Stairs to Lower Level Colour

☐ Stain handrail, stringers, treads, risers, nosing & posts. (Metal pickets) STAIRS TO BE STAINED SAMBUCCA

40-7761 Stairs to Upper Level Colour

☐ Stain handrail, stringers, treads, risers, nosing & posts. (Metal pickets) STAIRS TO BE STAINED SAMBUCCA

240-1716 Throughout Trim - Paint Colour

☐ Trim WHITE STD

51-1717 Throughout Walls - Paint Colour

☐ Wall WARM GREY 22 STD

## Plumbing

266-1737 Main Bathroom Plumbing Fixture (Colour)

☐ Plumbing Fixtures WHITE STD

149-1737 Master Ensuite Plumbing Fixture (colour)

☐ Plumbing Fixtures WHITE STD

34-1737 Powder Room Plumbing Fixture (Colour)

☐ Plumbing Fixtures WHITE STD

371-1737 Powder Room Lower Level Plumbing Fixture (Colour)

☐ Plumbing Fixtures WHITE STD

1. The Purchaser acknowledges these selections are subject to the terms and conditions of the applicable Agreement of Purchase and Sale.
2. The Purchaser acknowledges that the Vendor accepts no responsibility in the event the Vendor is unable to supply a selection. The Purchaser agrees to reselect from the currently available selections immediately upon request.
3. The Vendor reserves the right to substitute above materials and equipment with that of equal or better quality.
4. Purchaser acknowledges that items may not be exactly as shown. Variations from the Vendor's samples may occur in finished materials due to normal production processes. Vendor is not responsible for shade difference which may occur from different dye lots or wood grains. Variations from the Vendor's samples will occur with natural materials such as wood, marble, granite, hardwood and brick.
5. The Vendor reserves the right to select Grout & Thresholds that best suits the Tile selected.
6. Selections will not be processed unless signed by Heathwood Homes Head Office.
7. The colour selections made on the Colour Chart are final and cannot be changed once submitted.
8. The Purchaser has checked and acknowledges the accuracy of this Colour Chart.

Date

Purchaser

APPROVED

Date

Décor Consultant

Date

Purchaser

Date Approved

HEATHWOOD HOMES (WHITBY)  
LIMITED - PHASE 4



# Sales Selection Sheet

06-Jul-21

LOT 050-6

20-2447-EN ELEV A THE BARRINGTON

PURCHASERS: ALEXANDER PINATSI  
JENNA ELIZABETH PINATSI

CONTACT NO: 647-523-7876  
647-997-6440

VENDOR: HEATHWOOD HOMES (WHITBY) LIMITED - PHASE 4

HST #

It is herein understood and agreed between the undersigned parties hereto that the following changes shall be made to the above mentioned Agreement of Purchase and Sale in accordance with the agreement and except for such changes noted below, all other terms and conditions in the Agreement of Purchase and Sale shall remain as stated herein: It is further understood that and agreed that all changes and additions shall be installed as per builder's specifications, location and available selections. The Purchaser hereby agrees to purchase the following extras:

## Cabinetry

- |      |   |                |        |
|------|---|----------------|--------|
| 1347 | <b>Optional Extras</b>  |                | Qty: 1 |
|      | 40J- Two-tone colour/style selection for island (must be of equal or lower level to main selection) Before June 1, 2021 VIKING        |                |        |
| 1338 | <b>Optional Extras</b>  | <b>KITCHEN</b> | Qty: 1 |
|      | 30H- Wall cabinet with shelf for microwave (finished interior) (opening 24"W x 13 3/4"H x 17"D) * electrical priced separately Viking |                |        |
|      | SEE SKETCH # 7  | PAGE 20        | FOR    |
|      | LOCATION  |                |        |
| 1552 | <b>Optional Upgrade</b>   | <b>KITCHEN</b> | Qty: 1 |
|      | Optional Valance (Trim Only) VIKING I/II/III  |                |        |

## Ceramics

- |      |                |                                    |        |
|------|----------------|------------------------------------|--------|
| 1928 |                | <b>Kitchen Optional Backsplash</b> | Qty: 1 |
|      | Upgrade 1 Tile |                                    |        |
| 1919 |                | <b>M. Ensuite Shower Floor</b>     | Qty: 1 |
|      | Upgrade 1 Tile |                                    |        |

## Fireplace

- |    |  |  |        |
|----|--|--|--------|
| 81 |  |  | Qty: 1 |
|    | Purchasers have been advised: heat from the FP can damage TV above a FP and items placed on mantle. Purchasers acknowledge: Heathwood Homes and its contractors will not be liable for any damage on items placed/installed above a FP after closing |  |        |

1. This Sales Selection Sheet when properly executed forms part of our Agreement of Purchase and Sale.
2. All extras and upgrades listed above are subject to Construction Progress and Architectural and Municipal requirements.
3. In the event the Vendor is unable to incorporate the work approved above in the construction of the house for any reason whatsoever, the Vendor will not be liable to the Purchaser in any way. The monies paid for any changes or optional extras not proceeded with shall be returned to the Purchaser, without interest. The cost of options or extras is non-refundable in all other circumstances. If for any reason whatsoever the Agreement of Purchase and Sale is not completed, the total cost of work approved above will be retained by the Vendor.
4. The Vendor reserves the right to substitute above materials and equipment with that of equal or better quality.
5. Purchaser acknowledges that items may not be exactly as shown. Variations from the Vendor's samples may occur in finished materials due to normal production processes. Vendor is not responsible for shade difference which may occur from different dye lots or wood grains. Variations from the Vendor's samples will occur with natural materials such as wood, marble, granite, hardwood and brick.
6. The Vendor reserves the right to select Grout & Thresholds that best suits the Tile selected.
7. Selections will not be processed unless signed by Heathwood Homes Head Office.
8. The selections made on this schedule are final and cannot be changed once submitted.
9. The Purchaser has checked and acknowledges the accuracy of this schedule.

Date

Purchaser

Date APPROVED

Décor Consultant

Date

Purchaser

Date Approved

HEATHWOOD HOMES (WHITBY)  
LIMITED - PHASE 4



Sales Selection Sheet  
OF

06-Jul-21

LOT 050-6

20-2447-EN ELEV A THE BARRINGTON

PURCHASERS: ALEXANDER PINATSI  
JENNA ELIZABETH PINATSI

CONTACT NO: 647-523-7876  
647-997-6440

VENDOR: HEATHWOOD HOMES (WHITBY) LIMITED - PHASE 4

HST #

It is herein understood and agreed between the undersigned parties hereto that the following changes shall be made to the above mentioned Agreement of Purchase and Sale in accordance with the agreement and except for such changes noted below, all other terms and conditions in the Agreement of Purchase and Sale shall remain as stated herein. It is further understood that and agreed that all changes and additions shall be installed as per builder's specifications, location and available selections. The Purchaser hereby agrees to purchase the following extras:

Hardwood

1173

Vintage

KIT/BRK

Qty: 1

3-1/4" Red Oak Select-V

Painting

531

Optional Extras - PAINT / STAIN - Custom

Qty: 2

Stain stair landing less than 25sq/ft in sambucca. For stair with metal pickets only.  
5" (Unfinished Pre-sanded) smooth hardwood will be installed and to be stained in sambucca to match the stairs

Plumbing

277

STANDARD Kitchen Sink Option

KITCHEN

SINGLE

Qty: 1

KINDRED Kitchen Sink Collection - Reginox NS19300 1651 UA/9 Stainless Kitchen Sink (equal size) Bowl Undermount Sink (or equivalent)

PAGE 23

1. This Sales Selection Sheet when properly executed forms part of our Agreement of Purchase and Sale.
2. All extras and upgrades listed above are subject to Construction Progress and Architectural and Municipal requirements.
3. In the event the Vendor is unable to incorporate the work approved above in the construction of the house for any reason whatsoever, the Vendor will not be liable to the Purchaser in any way. The monies paid for any changes or optional extras not proceeded with shall be returned to the Purchaser, without interest. The cost of options or extras is non-refundable in all other circumstances. If for any reason whatsoever the Agreement of Purchase and Sale is not completed, the total cost of work approved above will be retained by the Vendor.
4. The Vendor reserves the right to substitute above materials and equipment with that of equal or better quality.
5. Purchaser acknowledges that items may not be exactly as shown. Variations from the Vendor's samples may occur in finished materials due to normal production processes. Vendor is not responsible for shade difference which may occur from different dye lots or wood grains. Variations from the Vendor's samples will occur with natural materials such as wood, marble, granite, hardwood and brick.
6. The Vendor reserves the right to select Grout & Thresholds that best suits the Tile selected.
7. Selections will not be processed unless signed by Heathwood Homes Head Office.
8. The selections made on this schedule are final and cannot be changed once submitted.
9. The Purchaser has checked and acknowledges the accuracy of this schedule.

Date

Purchaser

Date

APPROVED

Décor Consultant

Date

Purchaser

-07- 12 2021

Date Approved

HEATHWOOD HOMES (WHITBY)  
LIMITED - PHASE 4

C2 COUNTRY LANE  
LOT 50-6  
20-2447 END ELEV A  
THE BARRINGTON

18 of 41

# The Barrington

20-2447 END ELEV. A

Sketch #5

ELEVATION A & B END:  
2,504 SQ FT

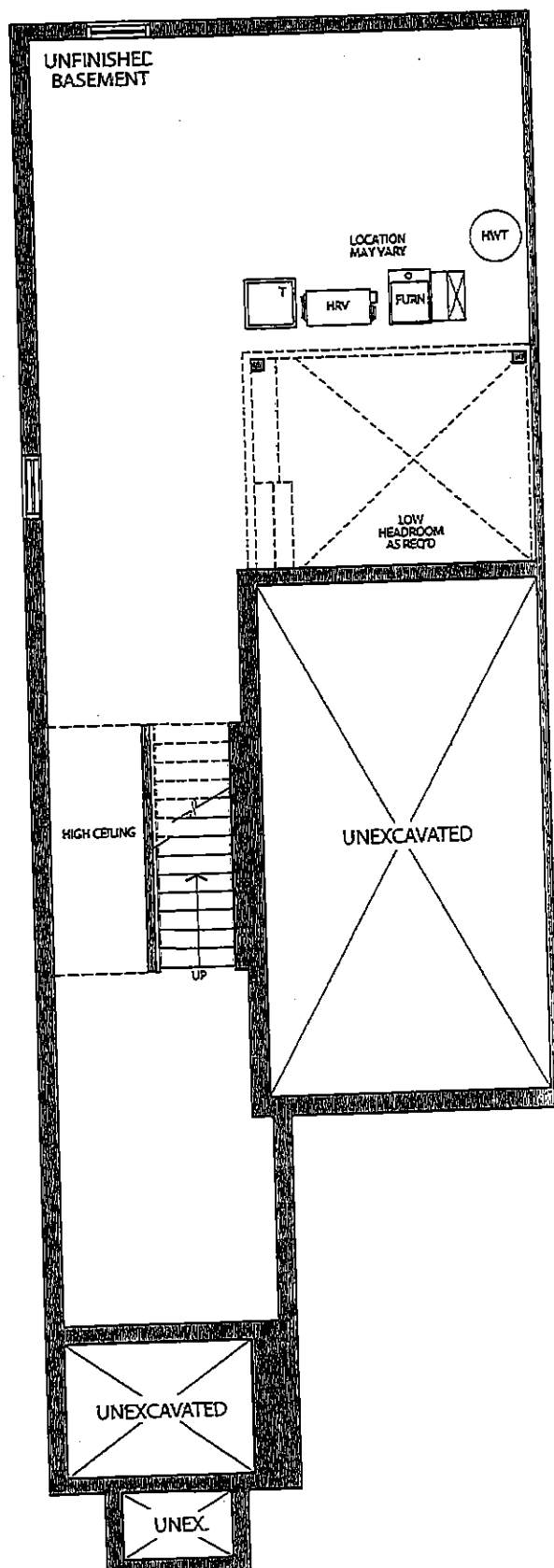

ELEVATION A & B  
END  
BASEMENT



C2 COUNTRY LANE  
LOT 50-6  
20-2447 END ELEV A  
THE BARRINGTON

19 of 41

# The Barrington

20-2447 END ELEV. A Sketch #6

ELEVATION A & B END:  
2,504 SQ FT

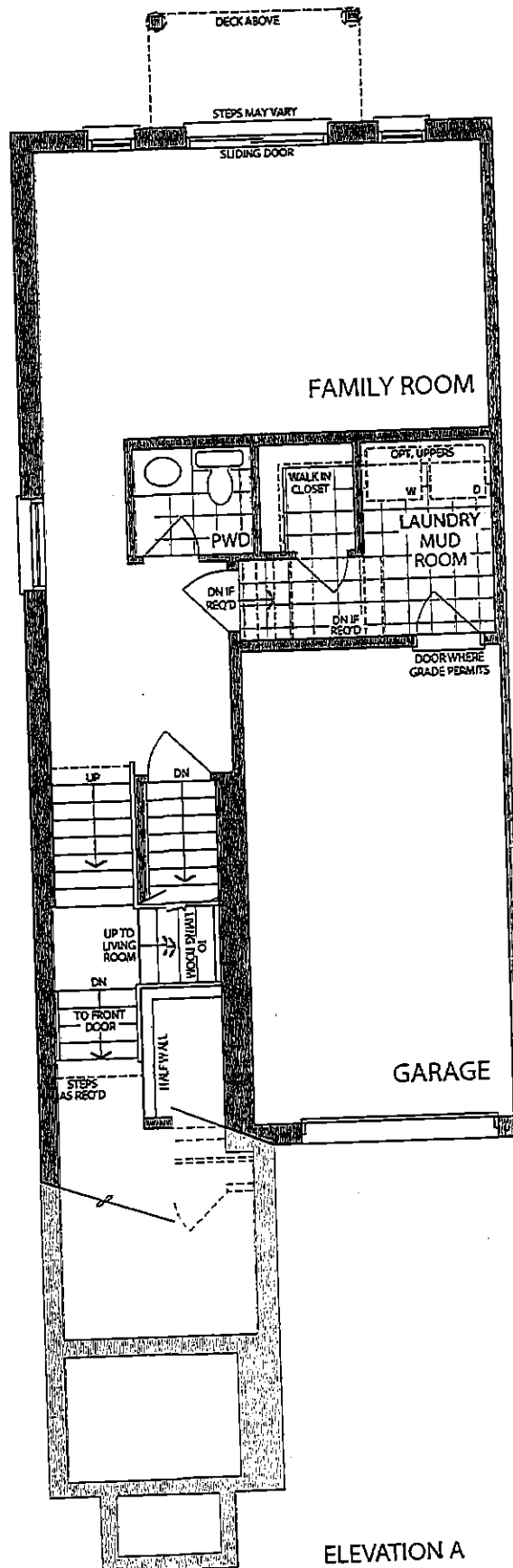

ELEVATION A  
INTERIOR END  
LOWER LEVEL

JP

C2 COUNTRY LANE  
LOT 50-6  
20-2447 END ELEV A  
THE BARRINGTON

20 of 41  
The Barrington

20-2447 END ELEV. A

Sketch #7

ELEVATION A & B END:  
2,504 SQ FT

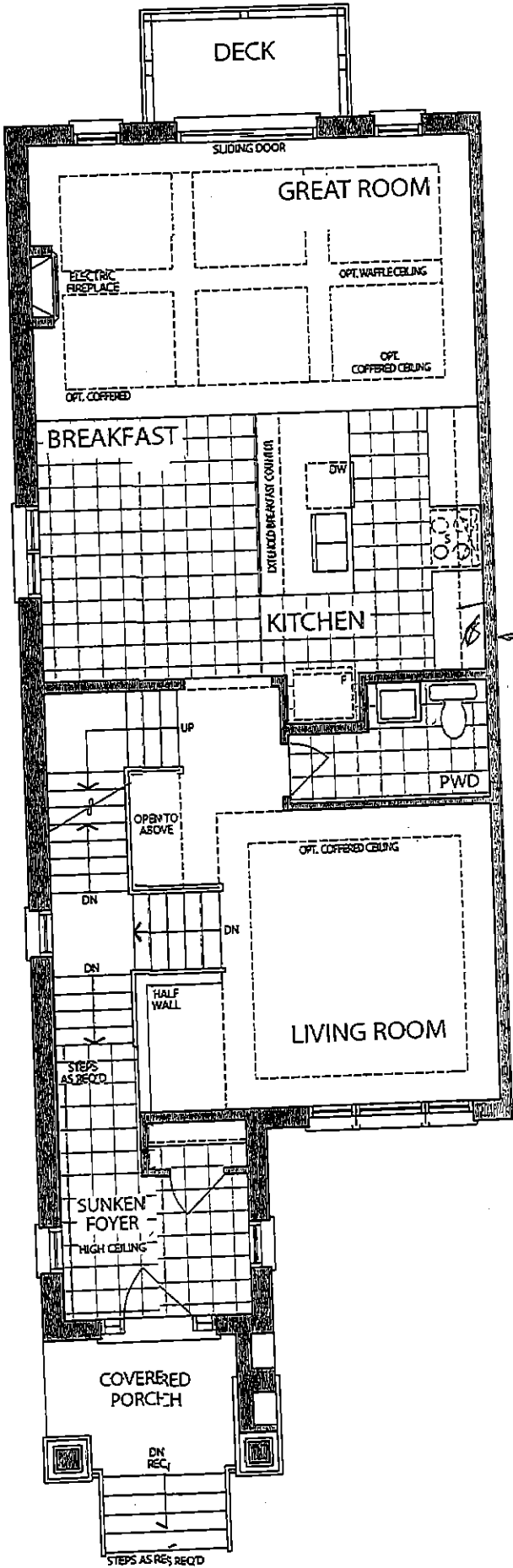

MAIN LEVEL  
INTERIOR END  
ELEVATION A

C2 COUNTRY LANE  
LOT 50-6  
20-2447 END ELEV A  
THE BARRINGTON

21 of 41

# The Barrington

20-2447 END ELEV. A *Sketch #8*

ELEVATION A & B END:  
2,504 SQ FT

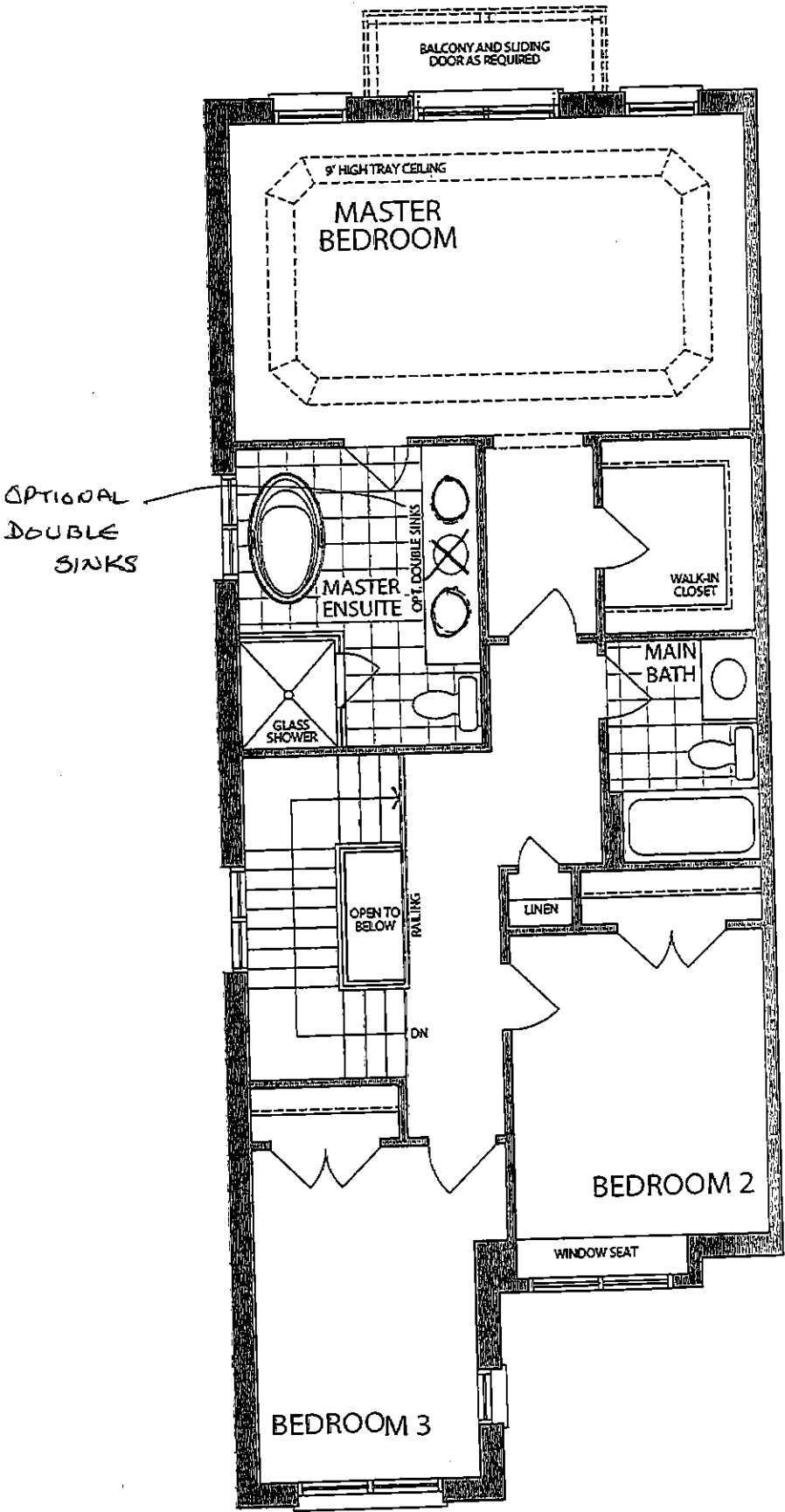

UPPER LEVEL  
INTERIOR END  
ELEVATION A

C2 COUNTRY LANE  
LOT 50-6  
20-2447 END ELEV A  
THE BARRINGTON

22 of 41

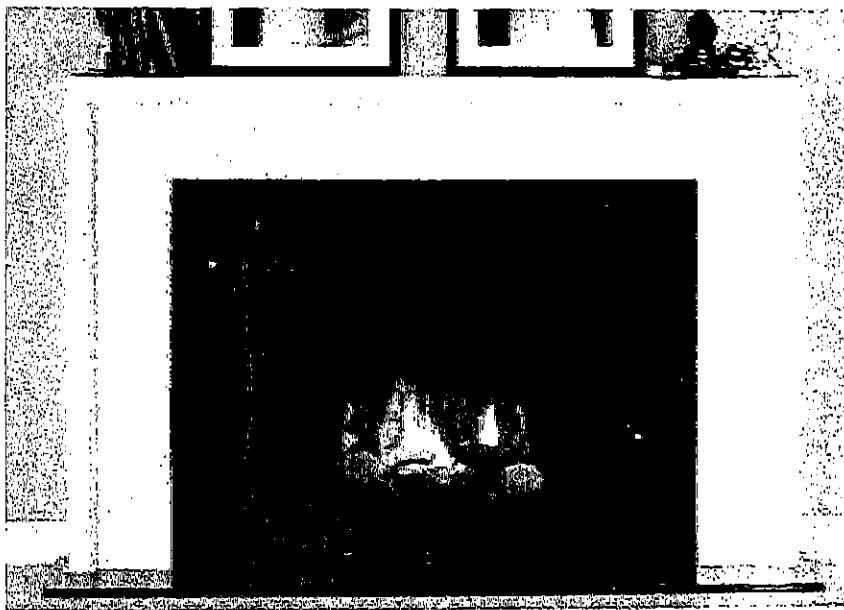

CABINET

NEAS NF17 Mantel

JF

C2 COUNTRY LANE  
LOT 50-6  
20-2447 END ELEV A  
THE BARRINGTON

23 OF 41

Stainless Steel | 122.0264.716

FAMILY : Sinks | SERIES : Reginox | MODEL : NS1930U/9 | FINISH : Stainless Steel | INSTALLATION TYPE : Undermount

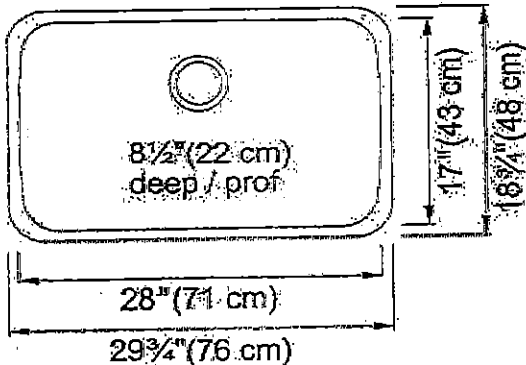
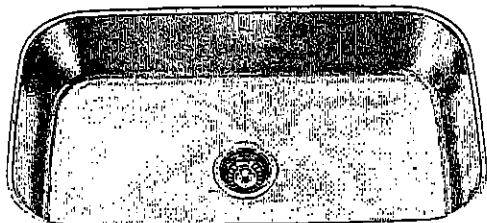

TECHNICAL DATA	
Width overall	18 3/4"
Length overall	29 3/4"
Width of large bowl	17"
Length of large bowl	28"
Depth of large bowl	8 1/2"
Cabinet Size	36"
Number of Bowls	1
Waste Outlet Diameter	3 1/2"
Cut-Out Template	Yes
Faucet Hole	None
Type of Material	18 Gauge Stainless Steel
Surface Finish	SILK
Special feature	Rear Drain Waste Hole Location
Waste Kit Included	YES

JP

C2 COUNTRY LANE  
LOT 50-6  
20-2447 END ELEV A  
THE BARRINGTON

24 of 41

STANDARD KITCHEN FAUCET

Align

Modern

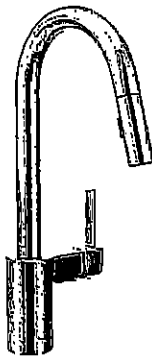

Single Handle Pull-Down Kitchen  
Faucet\*

Model 7565†

JP

C2 COUNTRY LANE  
LOT 50-6  
20-2447 END ELEV A  
THE BARRINGTON

25 of 41

*American  
Standard*

**BOULEVARD®  
PEDESTAL SINK**  
VITREOUS CHINA

**BOULEVARD® PEDESTAL SINK**

- ☐ 0641.800 Faucet holes on 8" (203mm) centers (Illustrated)
- \* ☒ 0641.400 Faucet holes on 4" (102mm) centers
- ☐ 0641.100 Center hole only
  - Classic styled rectangular pedestal lavatory
  - Vitreous china
  - Rear overflow
  - Supplied with mounting kit
  - Right Height® for greater comfort during use
  - Faucet ledge with large deck area (faucet not included)
  - Design coordinates with Boulevard® Toilet
  - Basin has flat bottom to also allow use as an above counter sink or a drop-in sink (with u-shaped cut out)

**Nominal Dimensions:**

24" x 19" x 35-1/2"  
(610 x 483 x 902mm)

- ☐ 0641.008 Pedestal top-8" (203mm) centers
- ☐ 0641.004 Pedestal top-4" (102mm) centers
- ☐ 0641.001 Pedestal top-center hole only
- ☐ 0010.000 Pedestal only

**Bowl sizes:**

17" (432mm) wide,  
12-1/2" (318mm) front to back,  
5" (127mm) deep

**Compliance Certifications -**

**Meets or Exceeds the Following Specifications:**

- ASME A112.19.2 - 2008/CSA B45.1-08

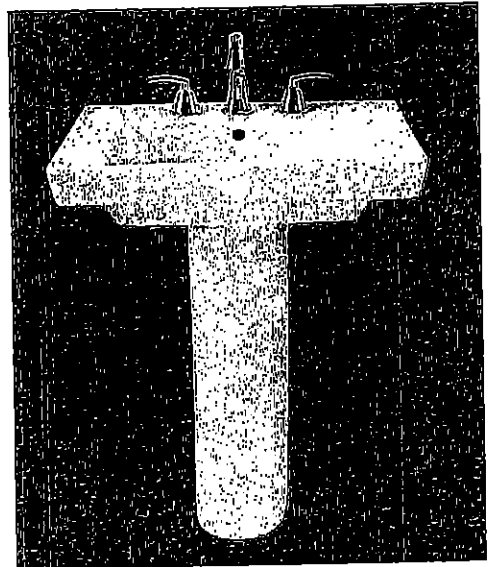

SEE REVERSE FOR ROUGHING-IN DIMENSIONS

**To Be Specified:**

- ☐ Color: ☐ White ☐ Linen
- ☐ Faucet Finish:
- ☐ Supplies:
- ☐ 1-1/4" Trap:
- ☐ Nipple:

\* See faucet section for additional models available

*JP*



C2 COUNTRY LANE  
LOT 50-6  
20-2447 END ELEV A  
THE BARRINGTON

26 of 41

COLONY™  
COUNTERTOP SINK  
VITREOUS CHINA

### COLONY COUNTERTOP SINK

- Vitreous china
- Self-rimming
- Front overflow
- Supplied with template
- Faucet deck
- (Faucet shown not included)

- ☒ 0346 803  
Faucet holes on 203mm (8") centres
- ☐ 0346 403 (Illustrated)  
Faucet holes on 102mm (4") centres
- ☐ 0346 001  
Centre hole only

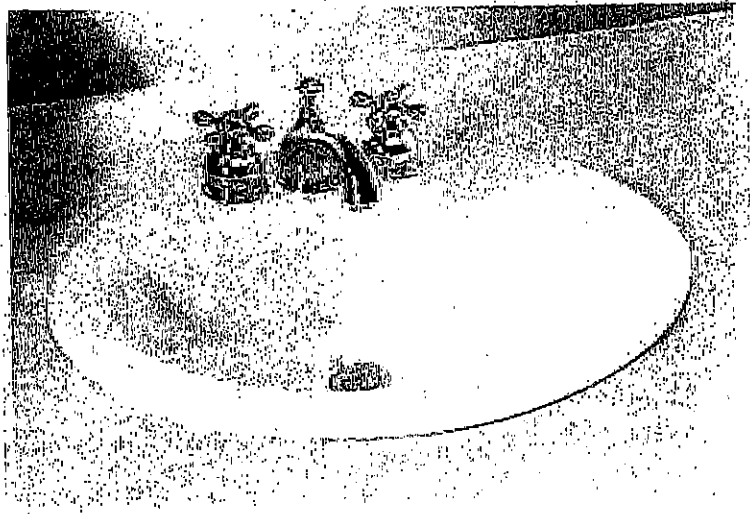

Nominal Dimensions:  
521 x 448mm (20-1/2" x 17-5/8")

Bowl sizes:  
422mm (16-5/8") wide, 279mm (11") front to  
back, 143mm (5-5/8") deep

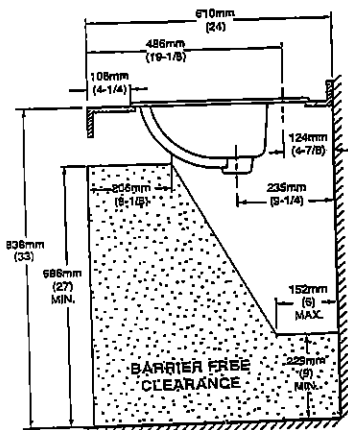
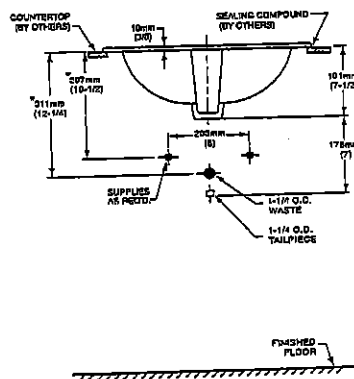
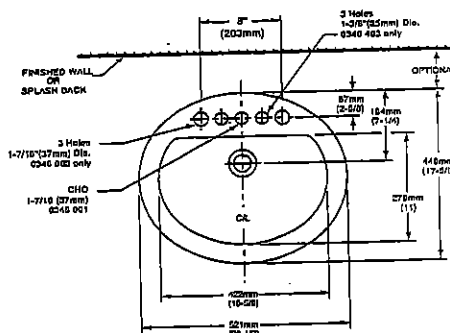

COMPLIANCE CERTIFICATIONS –  
Meets or exceeds the following Specifications:  
• ASME A112.19.2M for Vitreous China Fixtures.  
• CAN/CSA B45 Series.

#### To Be Specified

- ☐ Colour: ☒ White ☐ Bone ☐ Silver Gray  
☐ Linen
- ☐ Faucet\*:
- ☐ Faucet Finish:
- ☐ Supplies & Stops:
- ☐ Trap 1-1/4" (32 mm):

NOTES:  
\* DIMENSIONS SHOWN FOR LOCATION OF SUPPLIES AND "P" TRAP ARE SUGGESTED.  
FOR COUNTERTOP CUTOUT AND INSTALLATION INSTRUCTIONS USE TEMPLATE  
SUPPLIED WITH SINK.  
FAUCETS NOT INCLUDED AND MUST BE ORDERED SEPARATELY.  
IMPORTANT: Dimensions of fixtures are nominal and may vary within the range of tolerances  
established by ANSI Standard A112.19.2.  
These measurements are subject to change or cancellation. No responsibility is assumed for use  
of superseded or voided pages.

\* See faucet section for additional models available

R



C2 COUNTRY LANE  
LOT 50-6  
20-2447 END ELEV A  
THE BARRINGTON

27 of 41



Demi CF2007

JP

C2 COUNTRY LANE  
LOT 50-6  
20-2447 END ELEV A  
THE BARRINGTON

28 of 41

## Chateau

Transitional

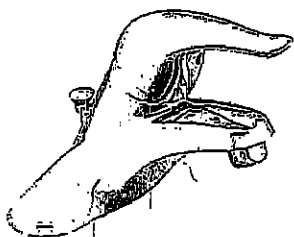

Lavatory Faucet with Pop-Up Drain  
Model L4621†

VANITY SINKS AND PEDESTAL



Posi-Temp® Pressure Balancing Tub/Shower  
Model 62320 / TL183†

OR

Posi-Temp Valve and Tub/Shower Trim  
with Eco-Performance Easy Clean® XL

Model 62320 / TL183EP†

(TL183EP not available in BC)

SHOWER AND 5' TUB FAUCETS



2 Handle Roman Tub with 9" Spout  
Model 4796 / T990†

FREESTANDING TUB FAUCETS

JP

C2 COUNTRY LANE  
LOT 50-6  
20-2447 END ELEV A  
THE BARRINGTON

29 of 41



SPECIFICATIONS  
**AV SERIES**  
RANGE HOODS

**HVI** 2100  
CERTIFIED 180 CFM/7.0 Sones @ 0.10" SP. Horizontal  
180 CFM/7.5 Sones @ 0.10" SP. Vertical

• **Dimensions**

Overall bottom projection - 18<sup>3</sup>/<sub>8</sub>"  
Overall top projection - 12"  
Height - 6"  
Available widths: 21", 24", 30", 36" & 42"

• **Hood Body**

Stainless Steel: 24 gauge, grade 430 stainless steel.  
Painted: 23 gauge cold rolled commercial grade (CRCQ) steel, auto welded, coated with a baked enamel finish.

• **Motor**

2 speed, single coil, thermally protected, permanently lubricated.  
Rated 120 volts, 60 hz. Complete with 200°C lead wires.

• **Lighting**

Single 60 watt cook light capacity (bulb not included).

• **Ducting Options**

Horizontal ducting: 3<sup>1</sup>/<sub>4</sub>"x10" (duct adapter and damper included).  
Vertical ducting: 3<sup>1</sup>/<sub>4</sub>"x10" (duct adapter and damper included).  
Vertical ducting: 7" round (duct adapter and damper not included).  
Ductless: removable front vent (charcoal filter not included).

• **Fan Blade**

One piece polymeric, electronically balanced blade. 6<sup>5</sup>/<sub>8</sub>" diameter with 5 paddles.

• **Electrical connection**

Hood top - 7/8" knockout hole for use with 1/2" cable clamp  
Hood back - 7/8" knockout hole for use with 1/2" cable clamp

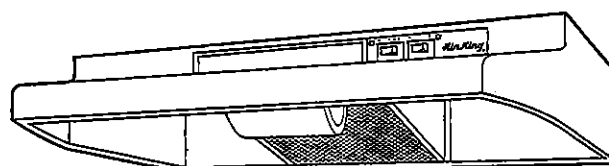

**AV SERIES**

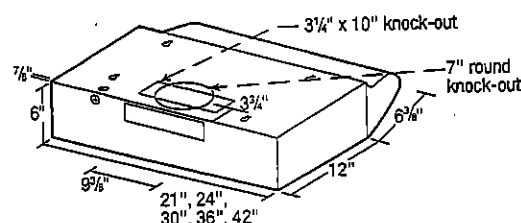

• **Filters**

UL rated, class 2 filter.  
Grease Filter: RF35 - 8<sup>7</sup>/<sub>8</sub>"x10<sup>3</sup>/<sub>8</sub>" (included).  
Charcoal Filter: RF34 (not included).  
Combo Grease/Charcoal: RF55 (not included).

• **Available Finishes**

White, Biscuit, Almond, Black & Stainless Steel.

EXPANDED PERFORMANCE										
Air Flow - CFM	Static Pressure (inches of w.g.)						Sones @ .1 SP	Fan Speed RPM	Power Watts	Apms
	0	0.05	0.1	0.15	0.2	0.25				
Vertical Ducting High	246	232	218	203	181	147	7.5	2973	87.0	2.1
Horizontal Ducting High	225	210	180	175	155	120	7.0	3024	87.0	2.1

PROJECT							ARCHITECT			
LOCATION							ENGINEER			
CONTRACTOR							SUBMITTED BY		DATE	
FAN NUMBER	MODEL NUMBER	CFM	IN W.C.	RPM	WATTS	AMPS	SONES	QTY	OPTIONAL EQUIPMENT & REMARKS	



Air King: 820 Lincoln Avenue  
West Chester, Pennsylvania 19380-4466  
Tel: (610) 692-7400 • 877-304-3785  
Fax: (610) 696-8048

Canada:  
Brampton, Ontario  
Tel: 905-456-2033  
Fax: (905) 456-1015

Updated 2-18

Specifications subject to change without notice.

JP

C2 COUNTRY LANE  
LOT 50-6  
20-2447 END ELEV A  
THE BARRINGTON

30 of 41

Whirlpool® Bottom Mount Refrigerator

PRODUCT MODEL NUMBERS

- WRF532SMB  
WRF535SMB
- WRF535SWB  
WRF540CWB

**Electrical:** A 115-volt, 60-HZ, AC-only, 15- or 20-amp fused, grounded electrical supply is required. It is recommended that a separate circuit serving only your refrigerator be provided. Use an outlet that cannot be turned off by a switch. Do not use an extension cord.

**NOTE:** Before performing any type of installation, cleaning, or removing a light bulb, turn the control (Thermostat, Refrigerator or Freezer Control depending on the model) to OFF and then disconnect the refrigerator from the electrical source. When you are finished, reconnect the refrigerator to the electrical source and reset the control (Thermostat, Refrigerator or Freezer Control depending on the model) to the desired setting. See "Using the Controls."

**Water:** A cold water supply with water pressure between 30 and 120 psi (207 and 827 kPa) is required to operate the ice maker and water dispenser. If you have questions about your water pressure, call a licensed, qualified plumber.

**IMPORTANT:** The pressure of the water coming out of a reverse osmosis system going to the water inlet valve of the refrigerator needs to be between 35 and 120 psi (241 and 827 kPa).

**Reverse Osmosis Water Supply:** If a reverse osmosis water filtration system is connected to your cold water supply, the water pressure to the reverse osmosis system needs to be a minimum of 40 to 60 psi (276 to 414 kPa).

PRODUCT DIMENSIONS

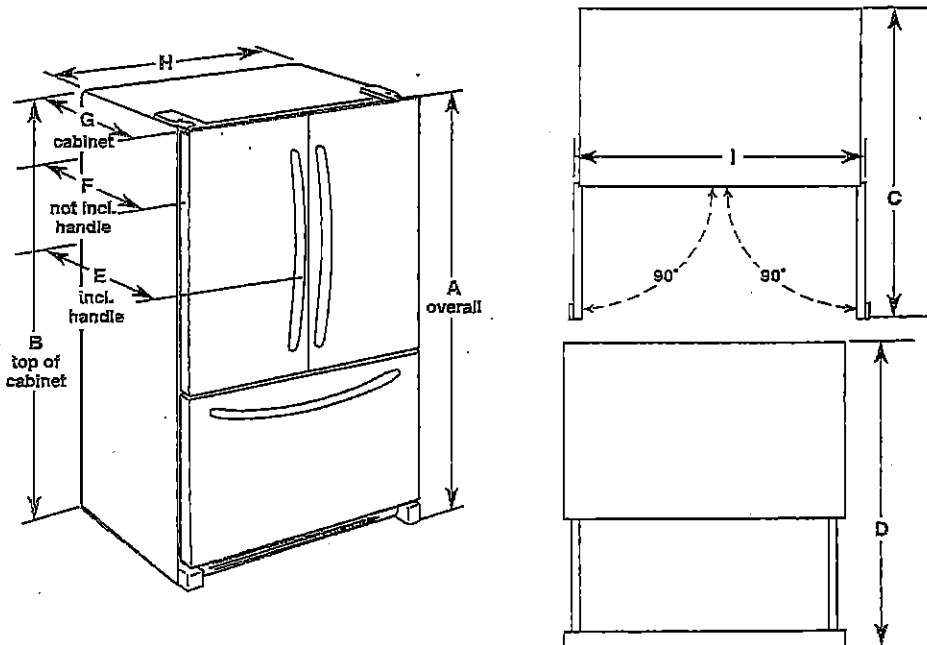

Model Number/Size	Height - Overall "A"	Height - Top of Cabinet "B"	Depth - Doors Open 90° "C"	Depth - Drawer Open "D"	Depth - With Handles "E"	Depth - Without Handles "F"	Depth - Cabinet Only "G"	Width - Cabinet "H"	Width - Door Open 90° "I"
WRF535SWB 25.2 cu. ft.	70 1/4" (178.1 cm)	68 3/4" (174.8 cm)	48 1/4" (122.1 cm)	53 1/4" (135 cm)	35 1/4" (90 cm)	32 1/4" (83.7 cm)	29 1/2" (74 cm)	35 1/4" (90.5 cm)	43 3/4" (110.2 cm)
WRF535SMB 25.2 cu. ft.	70 1/4" (178.1 cm)	68 3/4" (174.8 cm)	48 1/4" (122.1 cm)	53 1/4" (135 cm)	35 1/4" (90 cm)	32 1/4" (83.7 cm)	29 1/2" (74 cm)	35 1/4" (90.5 cm)	43 3/4" (110.2 cm)
WRF532SMB 22.1 cu. ft.	70 1/4" (178.1 cm)	68 3/4" (174.8 cm)	47 1/4" (119.5 cm)	52 1/4" (132.4 cm)	34 1/4" (87.5 cm)	31 1/4" (81.1 cm)	28 1/2" (71.4 cm)	32 1/4" (82.9 cm)	42 3/4" (107.6 cm)
WRF540CWB 20 cu. ft.	70 1/4" (178.1 cm)	68 3/4" (174.8 cm)	46" (121.9 cm)	44 1/4" (113.0 cm)	29 3/4" (74.6 cm)	28" (71.1 cm)	24 1/4" (61.3 cm)	35 1/4" (90.5 cm)	39 3/4" (100.0 cm)

LOCATION REQUIREMENTS

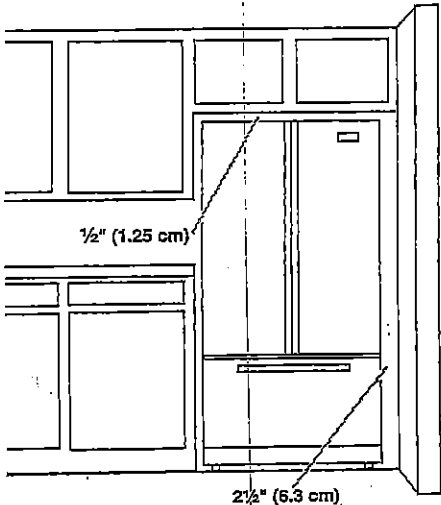

To ensure proper ventilation for your refrigerator, allow for a 1/2" (1.25 cm) space on each side and at the top. Allow for 1" (2.54 cm) of space behind the refrigerator. If your refrigerator has an ice maker, make sure you leave some extra space at the back for the water line connections.

If you are installing your refrigerator next to a fixed wall, leave 2 1/2" (6.3 cm) minimum on the hinge side (some models require more) to allow for the door to swing open.

**NOTE:** This refrigerator is intended for use in a location where the temperature ranges from a minimum of 55°F (13°C) to a maximum of 110°F (43°C). The preferred room temperature range for optimum performance, which reduces electricity usage and provides superior cooling, is between 60°F (15°C) and 90°F (32°C). It is recommended that you do not install the refrigerator near a heat source, such as an oven or radiator.

Because Whirlpool Corporation policy includes a continuous commitment to improve our products, we reserve the right to change materials and specifications without notice.

Dimensions are for planning purposes only. For complete details, see Installation Instructions packed with product. Specifications subject to change without notice.

Ref. W10597594B  
10/1/14

JF

C2 COUNTRY LANE  
LOT 50-6  
20-2447 END ELEV A  
THE BARRINGTON

31 of 41

Whirlpool

FRONT CONTROL  
GAS RANGES

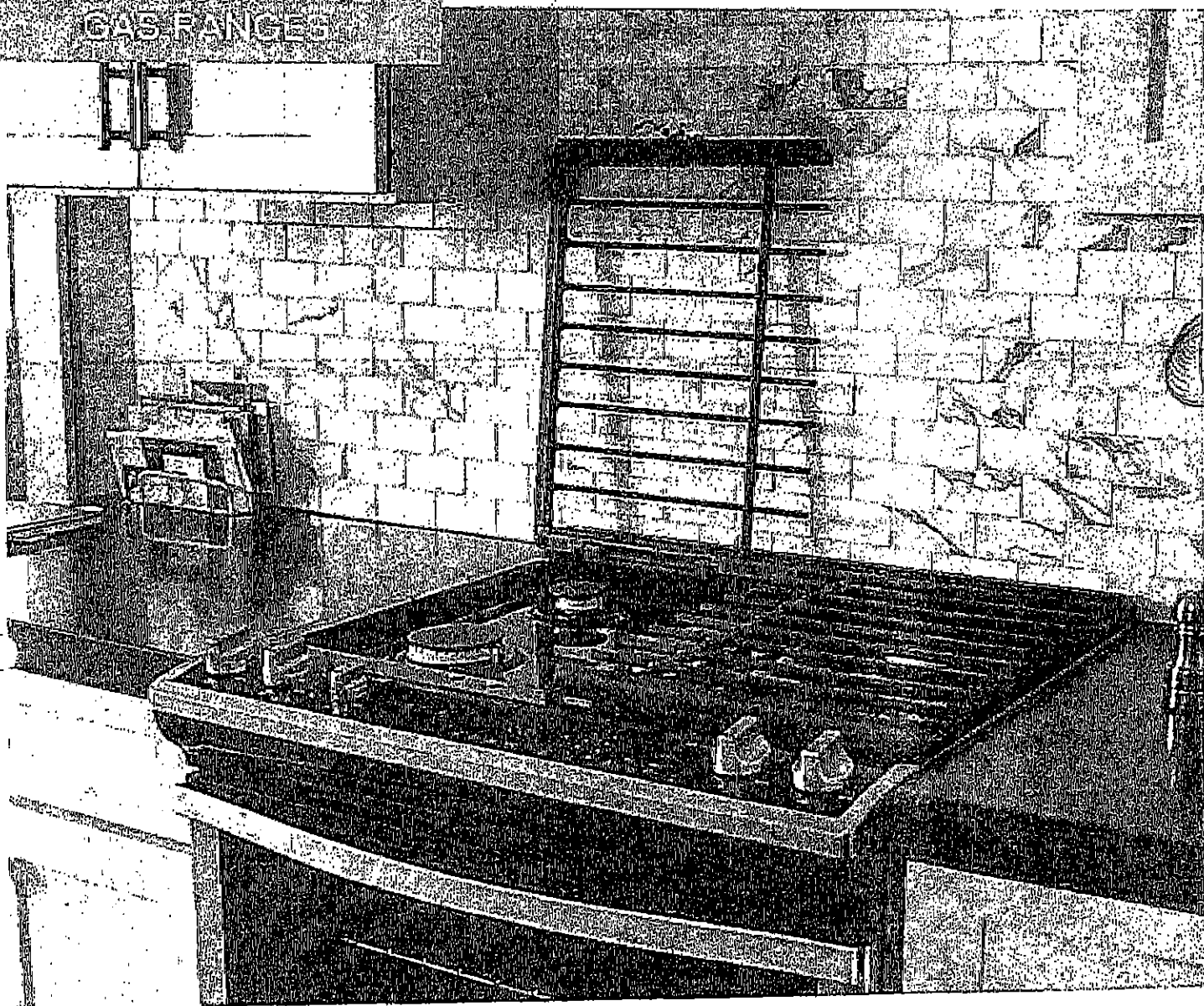

## FEATURING



### TimeSaver™ system

The TimeSaver™ system's Frozen Bake Technology allows you to skip preheating for favorites like pizza, lasagna, chicken nuggets, fries or pies so you can cook frozen foods faster.\*



### HeatRight™ system

The HeatRight™ system's True convection helps you to cook food faster\*\* with a rear fan and third heating element to circulate hot air over, under, and around food.



### CompleteClean™ system

The CompleteClean™ system's EZ-2-Lift™ hinged grates give you quick access to spills on the cooktop. The industry first hinged design allows you to wipe up under them without removing them entirely. For a more thorough clean, the grates are also dishwasher-safe.

# Every day, care.

From the #1 Selling Appliance brand in the USA†

AF

C2 COUNTRY LANE  
LOT 50-6  
20-2447 END ELEV A  
THE BARRINGTON

32 of 41

## Front Control Gas Ranges

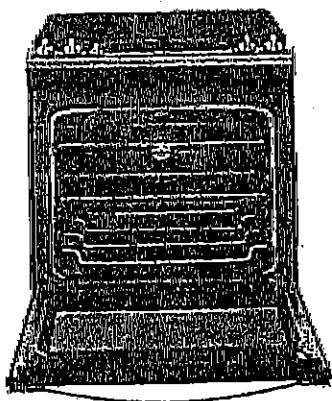
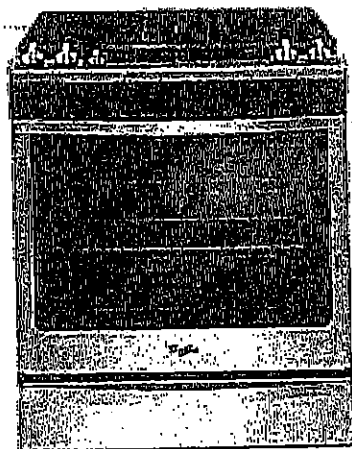

WEG745HOF

30" Freestanding Range - 5.8 cu. ft.



**TimeSaver™ system**  
• Frozen Bake™ Technology



**HeatRight™ system**  
• True Convection  
• Convection Conversion  
• AccuSimmer™ burner  
• Center Oval burner  
• Temperature Sensor



**CompleteClean System**  
• EZ-Lift™ Hinged Grates  
• AquaLift™ Self-cleaning Technology  
• Dishwasher-safe knobs



**ReadySet™ system**  
• (2) SpeedHeat™ burners  
• Rapid Preheat  
• Keep Warm  
• Delay Cook

### Available colors



S  
Stainless  
Steel



H  
White



G  
Black

### PRODUCT DIMENSIONS

The manual shows several models. Your model may appear different from the model shown. Dimensions given are approximate. Dimensions are in inches.

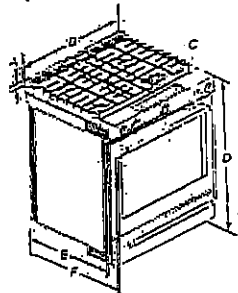

- A. 35 1/2" (903 mm) height from floor to top of cooktop
- B. 29 1/2" (750 mm) depth from front of cooktop to back of range
- C. 29 1/2" (750 mm) depth from front of cooktop to back of range
- D. 29 1/2" (750 mm) depth from front of cooktop to back of range
- E. 29 1/2" (750 mm) depth from front of cooktop to back of range
- F. 29 1/2" (750 mm) depth from front of cooktop to back of range

**IMPORTANT:** Range must be level after installation. Follow the instructions in the "Level Range" section. Using the screws as a reference for leveling the range is not recommended.

\*Range can be raised up to 1/2" (12.5 mm) by adjusting the leveling legs.

Type of Gas

Natural gas

The range is factory set for use with Natural gas. See "Gas Conversion" section.

The manufacturer's rating plate located behind the control panel has information on the type of gas that can be used. If the type of gas is not listed, consult the type of gas available where you live for the correct gas.

LP gas conversions

Conversion must be done by a qualified service technician. Do not attempt to do this yourself. Conversion from the gas supplied on the model's rating plate to use with a different gas without consulting the service technician is not recommended.

### CABINET OPENING DIMENSIONS

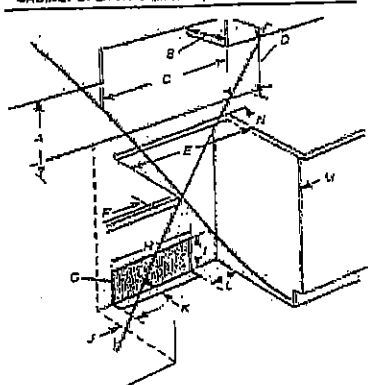

**IMPORTANT:** If installing a range into a cabinet, make sure the cabinet is level. The range may be installed in a cabinet that is not level. The range may be installed in a cabinet that is not level. The range may be installed in a cabinet that is not level.

NOTE: When installed in a cabinet, the front of the range must be level.

NOTE: When installed in a cabinet, the front of the range must be level.

NOTE: When installed in a cabinet, the front of the range must be level.

NOTE: When installed in a cabinet, the front of the range must be level.

NOTE: When installed in a cabinet, the front of the range must be level.

NOTE: When installed in a cabinet, the front of the range must be level.

NOTE: When installed in a cabinet, the front of the range must be level.

NOTE: When installed in a cabinet, the front of the range must be level.

NOTE: When installed in a cabinet, the front of the range must be level.

NOTE: When installed in a cabinet, the front of the range must be level.

NOTE: When installed in a cabinet, the front of the range must be level.

### ACCESSORIES & REPLACEMENT PARTS

- Part number 8273888A Anti-Tip Kit for Range
- Part number 4378577 Brick Baking Stone
- Part number 4396923 Porcelain Broiler Pan & Grid
- Part number W10123240 Premium Broil Pan & Roasting Rack
- Part number 8009 Appliance Light Bulb - 40 Watt



\*Compared to a traditional preheat and bake cycle for pizza, nuggets/fries, pies and lasagna. \*\*Compared to the multi-bake cycle on the same model. †Based on 12-month average of unit sales. Refrigeration, Cooking, Dishwashers, and Laundry appliances. Trusline, 2014.

©2016 Whirlpool. All rights reserved. 5715 Form No. W1010059B

R

C2 COUNTRY LANE  
LOT 50-6  
20-2447 END ELEV A  
THE BARRINGTON

33 of 41

# Whirlpool® 30" (76.2 cm) Slide-in Gas Range

## PRODUCT MODEL NUMBERS

WEG760H0D

WEG760H0D

WEG745H0F

## GAS SUPPLY REQUIREMENTS

### Gas supply line:

- Provide a gas supply line of  $\frac{3}{4}$ " (1.9 cm) rigid pipe to the range location. A smaller size pipe on longer runs may result in insufficient gas supply. With LP gas, piping or tubing size can be  $\frac{1}{2}$ " (1.3 cm) minimum. Usually, LP gas suppliers determine the size and materials used in the system.

NOTE: Pipe-joint compounds that resist the action of LP gas must be used. Do not use TEFLON® tape.

### Flexible metal appliance connector:

- If local codes permit, a new CSA design-certified, 4 to 5 ft (122 to 152.4 cm) long,  $\frac{1}{2}$ " (1.3 cm) or  $\frac{3}{4}$ " (1.9 cm) I.D., flexible metal appliance connector may be used for connecting range to the gas supply line.



- A  $\frac{1}{2}$ " (1.3 cm) male pipe thread is needed for connection to the female pipe threads of the inlet to the appliance pressure regulator.

- Do not kink or damage the flexible metal tubing when moving the range.

- Must include a shutoff valve:

The supply line must be equipped with a manual shutoff valve. This valve should be located in the same room but external to the range opening, such as an adjacent cabinet. It should be in a location that allows ease of opening and closing. Do not block access to shutoff valve. The valve is for turning on or shutting off gas to the range.

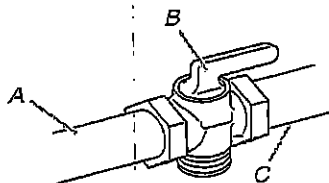

A. Gas supply line  
B. Shutoff valve "open" position  
C. To range

## Gas Pressure Regulator

The gas pressure regulator supplied with this range must be used. The inlet pressure to the regulator should be as follows for proper operation:

### Natural gas:

Minimum pressure: 5" WCP  
Maximum pressure: 14" WCP

### LP gas:

Minimum pressure: 11" WCP  
Maximum pressure: 14" WCP

Contact local gas supplier if you are not sure about the inlet pressure.

## PRODUCT DIMENSIONS

This manual covers several models. Your model may appear different from the models depicted. Dimensions given are maximum dimensions across all models.

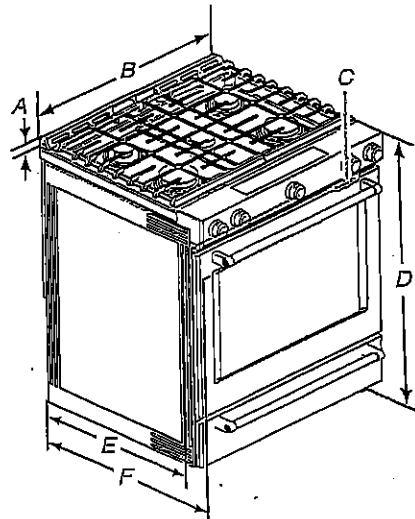

- A.  $1\frac{1}{16}$ " (3.0 cm) height from cooktop to top of vent
- B.  $29\frac{1}{8}$ " (75.9 cm)
- C. Model/serial number plate (located behind the oven door on the top right-hand side of the oven frame)
- D. 36" (91.4 cm) height to top of cooktop edge with leveling legs screwed all the way in\*

- E.  $28\frac{1}{8}$ " (71.9 cm) max. depth from front of console to back of range.
- F.  $28\frac{1}{8}$ " (73.3 cm) max. depth from handle to back of range.

**IMPORTANT:** Range must be level after installation. Follow the instructions in the "Level Range" section. Using the cooktop as a reference for leveling the range is not recommended.

\* Range can be raised approximately 1" (2.5 cm) by adjusting the leveling legs.

## Type of Gas

### Natural gas:

- This range is factory set for use with Natural gas. See "Gas Conversions" section. The model/serial rating plate located behind the control panel has information on the types of gas that can be used. If the types of gas listed do not include the type of gas available, check with the local gas supplier.

### LP gas conversion:

Conversion must be done by a qualified service technician. No attempt shall be made to convert the appliance from the gas specified on the model/serial rating plate for use with a different gas without consulting the serving gas supplier. See "Gas Conversions" section.

®TEFLON is a registered trademark of Chemours.

C2 COUNTRY LANE  
LOT 50-6  
20-2447 END ELEV A  
THE BARRINGTON

34.3.41

# Whirlpool® Undercounter Dishwasher

## PRODUCT MODEL NUMBERS

WDF110PAB	WDF310PLA	WDF530PSY
WDF111PAB	WDF320PAD	WDF540PAD
WDF120PAF	WDF310PAY	WDF730PAY
WDF121PAF	WDF520PAD	WDT710PAY
WDF310PAA	WDF530PAY	WDT720PAD
WDF310PCA	WDF530PLY	WDT770PAY

**Electrical Requirements:** 120-volt, 60-Hz, AC only, 15- or 20-amp. fused electrical supply. Copper wire only. A time delay fuse or circuit breaker and separate circuit is recommended.

**If direct wiring dishwasher:** Use flexible, armored, or nonmetallic, sheathed copper wire with grounding wire that meets the wiring requirements for your home and local codes and ordinances. Use a UL listed or CSA approved conduit connector.

**If connecting dishwasher with a power supply cord:** Use Power Supply Cord Kit (Part No. 4317824) marked for use with dishwashers. Follow the kit instructions for installing the power supply cord.

Power supply cord must plug into a grounded 3 prong, outlet, located in the cabinet next to the dishwasher opening. Outlet must meet all local codes and ordinances.

**Water Supply Requirements:** A hot water line with 20 to 120 psi (138 to 862 kPa) water pressure. Water temperature must be 120°F (49°C) water at dishwasher. Use 3/8" O.D. copper tubing with compression fitting or flexible braided water supply line (1/2" minimum plastic tubing is not recommended). Use a 90° elbow with 3/4" N.P.T. external pipe threads on one end. Do not solder within 6" (15.2 cm) from water inlet valve.

**Drain Requirements:** A new drain hose is supplied with your dishwasher. If this is not long enough, use a new drain hose with a maximum length of 12' (3.7 m) (Part No. 3385556) that meets all current AHAM/IAPMO test standards, is resistant to heat and detergent, and fits the 1" (2.5 cm) drain connector of the dishwasher.

Make sure to connect the drain hose to waste tee or disposer inlet above drain trap in house plumbing and 20" (50.8 cm) minimum above the floor. It is recommended

that the drain hose either be looped up and securely fastened to the underside of the counter or be connected to an air gap.

Make sure to use an air gap if the drain hose is connected to house plumbing lower than 20" (50.8 cm) above subfloor or floor.

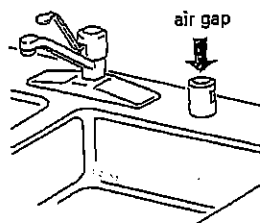

Use 1/2" (1.3 cm) minimum I.D. drain line fittings.

If required, the air gap should be installed in accordance with the air gap installation instructions. When connecting the air gap, a rubber hose (not provided) will be needed to connect to the waste tee or disposer inlet.

## PRODUCT DIMENSIONS

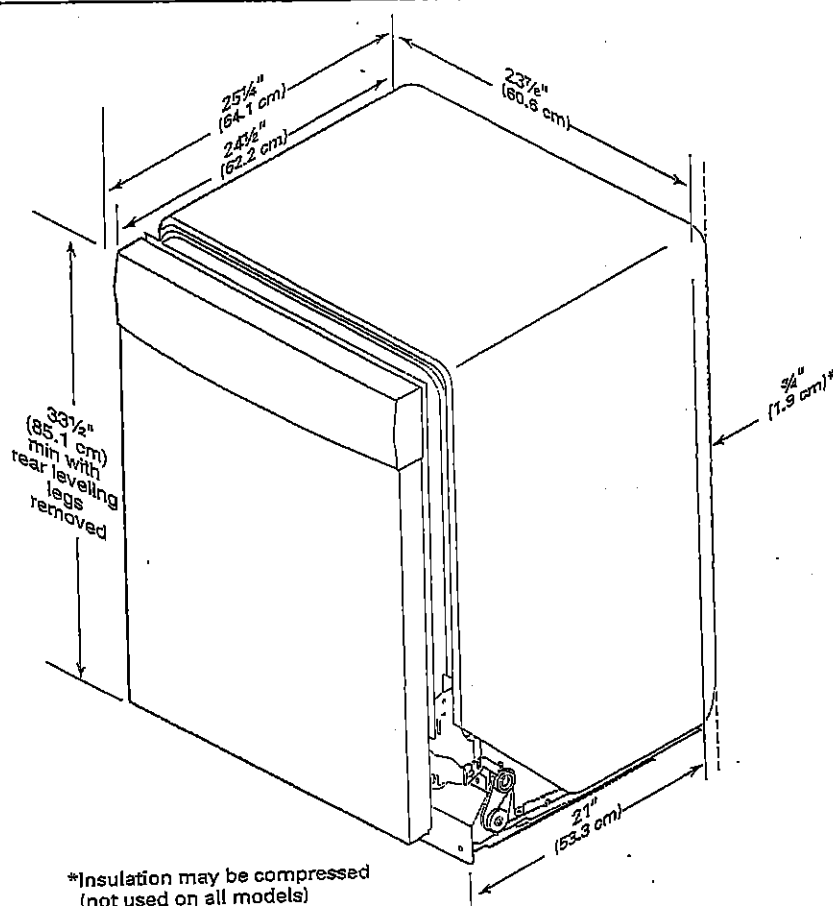

\*Insulation may be compressed (not used on all models)

Because Whirlpool Corporation policy includes a continuous commitment to improve our products, we reserve the right to change materials and specifications without notice.

Dimensions are for planning purposes only. For complete details, see installation instructions packed with product. Specifications subject to change without notice.

Page 1 of 2  
W10435040C-D-WH  
5/1/16

JP



C2 COUNTRY LANE  
LOT 50-6  
20-2447 END ELEV A  
THE BARRINGTON

35 of 41

CABINET CUTOUT DIMENSIONS

WDF320PAD

NOTE: Shaded areas of cabinet walls show where utility connections may be installed.

\*Measure from the lowest point on the underside of the countertop. May be reduced to 33½" (85.1 cm) by removing the rear leveling legs from dishwasher.

\*\*Minimum, measured from narrowest point of opening.

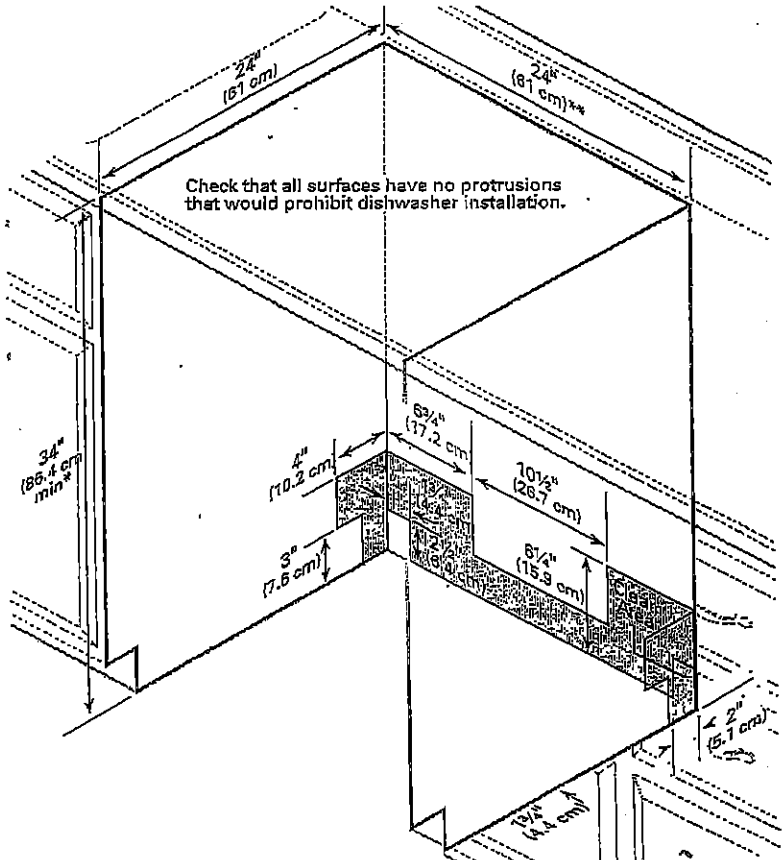

JD

C2 COUNTRY LANE  
LOT 50-6  
20-2447 END ELEV A  
THE BARRINGTON

36 of 41

WHIRLPOOL WASHER Model #: WFW5620HW

Whirlpool Brand Canada English | Washer and Dryers | Washers | Front Load Washers | WFW5620HW

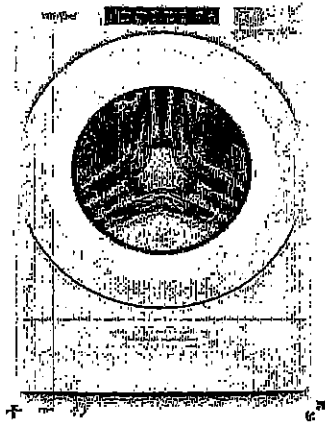

5.2 cu. ft. I.E.C. Closet-Depth  
Front Load Washer with  
Load & Go™ Dispenser



Whirlpool

5.2 cu. ft. I.E.C. Closet-Depth Front Load Washer with Load & Go™  
Dispenser

Model #: WFW5620HW

Dimensions

Depth	80.17 cm, 31-9/16 in
Depth With Door Open 90 Degree	143.51 cm, 56-1/2 in
Minimum Height	98.11 cm, 38-5/8 in
Width	68.58 cm, 27.0 in

Appearance

LCD Touch Screen	No
Window	Yes

Details

Drum Material	Stainless Steel
---------------	-----------------

Cycles and Options

Number of Wash Cycles	37
-----------------------	----

Electrical

Hz	60
Power Cord Included	Yes

JR

C2 COUNTRY LANE  
 LOT 50-6  
 20-2447 END ELEV A  
 THE BARRINGTON

37 of 41

WHIRLPOOL WASHER Model #: WFW5620HW

## LOCATION REQUIREMENTS

Proper installation is your responsibility.

### You will need:

- A water heater set to 120°F (49°C).
- A grounded electrical outlet located within 6 ft (1.8 m) of power cord on back of washer.
- Hot and cold water faucets located within 4 ft (1.2 m) of hot and cold water fill valves on washer, and water pressure of 20–100 psi (137.9–689.6 kPa).
- A level floor with maximum slope of 1" (25 mm) under entire washer. Installing on carpet or surfaces with foam backing is not recommended.
- Floor must support washer's total weight (with water and load) of 315 lbs (143 kgs).

**IMPORTANT:** Do not install, store, or operate washer where it will be exposed to weather or in temperatures below 32°F (0°C). Water remaining in washer after use may cause damage in low temperatures. See "Washer Care" in your Use and Care Guide for winterizing information.

### Whirlpool Models\*

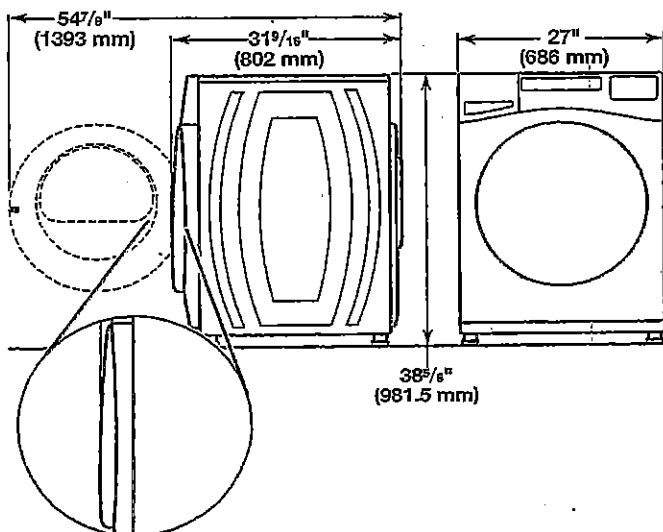
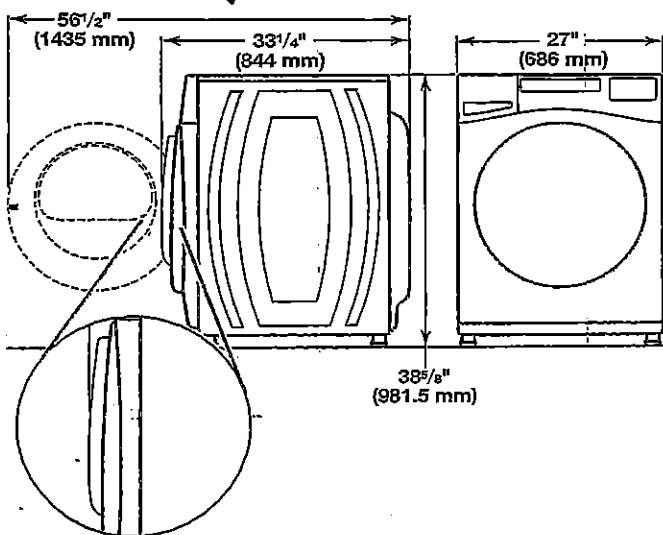

\*For additional details (or information) specific to your model, refer to the 'Dimensions' listed for your model at [www.whirlpool.com](http://www.whirlpool.com).

### Maytag Models

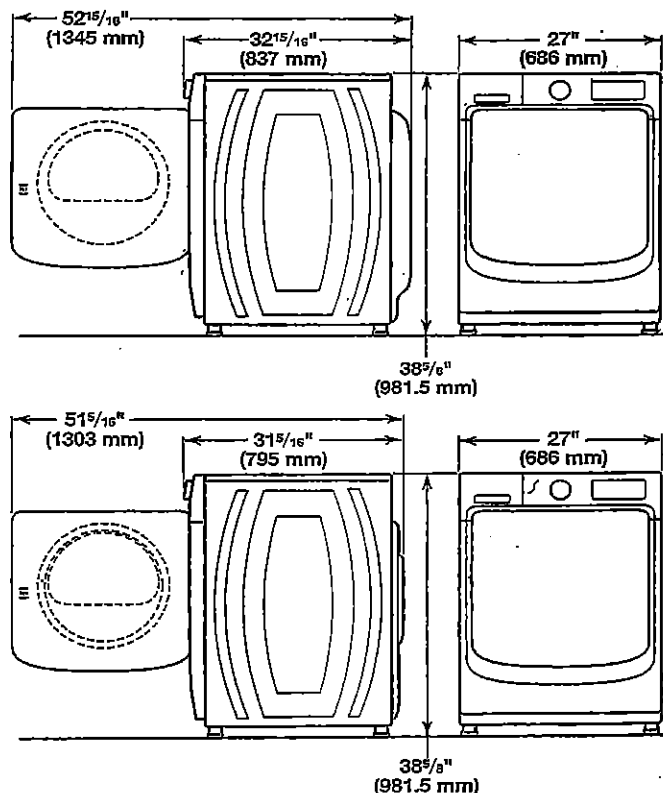

All dimensions show minimum spacing allowed. For each arrangement, consider allowing more space for ease of installation and servicing, and spacing for companion appliances and clearances for walls, doors, and floor moldings.

Space must be large enough to allow door to fully open. Add spacing of 1" (25 mm) on all sides of washer to reduce noise transfer. If a closet door or louvered door is installed, top and bottom air openings in door are required.

### Recessed area or closet installation (stacked washer and dryer):

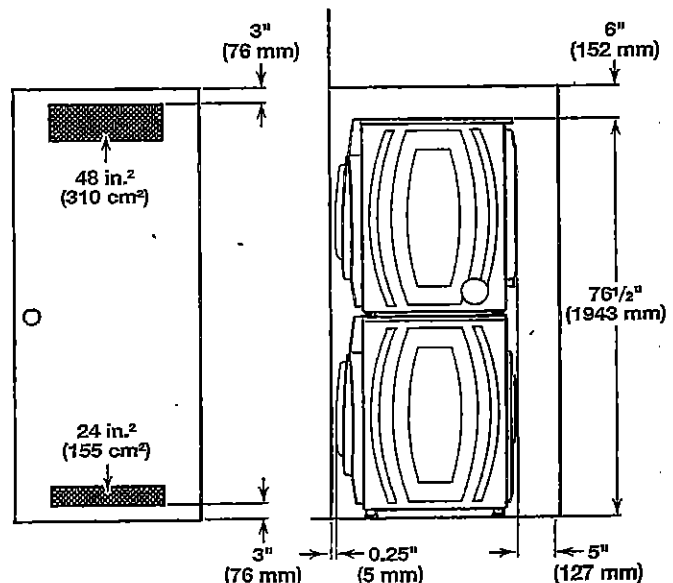

C2 COUNTRY LANE  
 LOT 50-6  
 20-2447 END ELEV A  
 THE BARRINGTON

38 of 41

WHIRLPOOL WASHER Model #: WFW5620HW

Custom under-counter installation:

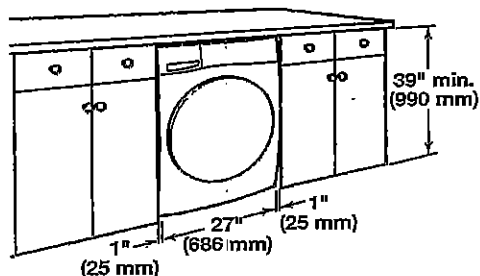

Recessed area or closet installation:

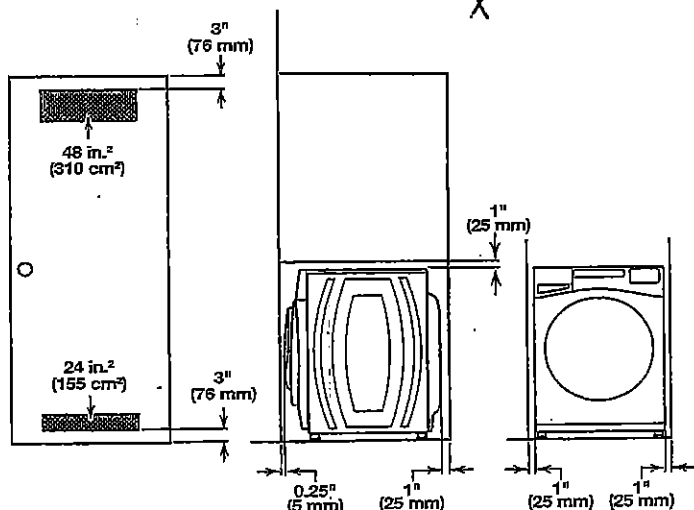

Custom cabinet installation:

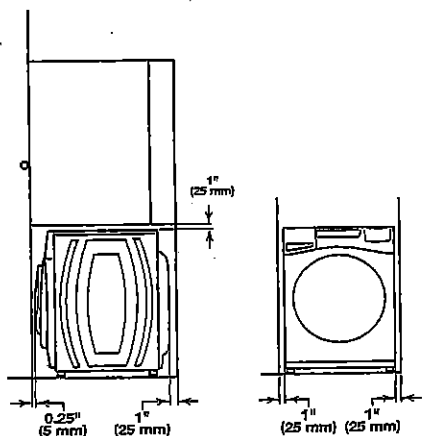

DRAIN SYSTEM

The drain system can be installed using a floor drain, wall standpipe, or laundry tub. Select the method you need.

**IMPORTANT:** To avoid siphoning, only 4.5" (114 mm) of drain hose should be inside standpipe. Always secure drain hose with cable tie.

Floor standpipe drain system

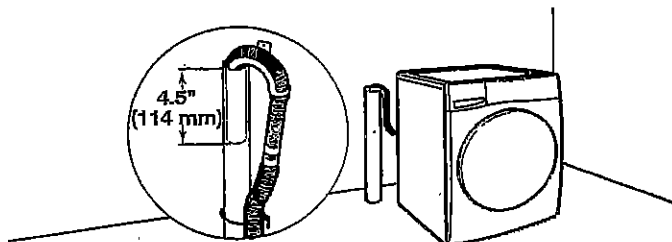

Minimum diameter for a standpipe drain: 2" (51 mm). Minimum carry-away capacity: 17 gal. (64 L) per minute. A 1/4" (6 mm) diameter to 1" (25 mm) diameter Standpipe Adapter Kit is available (Part Number 3363920). Top of standpipe must be at least 30" (762 mm) high; install no higher than 96" (2.44 m) from bottom of washer. If you have an overhead sewer and need to pump higher than 96" (2.44 m), a sump pump and associated hardware are needed. See "Alternate parts."

Wall standpipe drain system

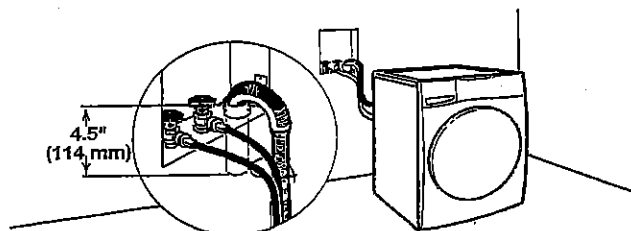

See requirements for floor standpipe drain system.

Laundry tub drain system

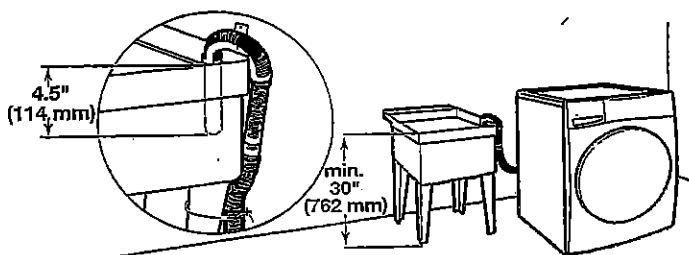

Minimum capacity: 20 gal. (76 L). Top of laundry tub must be at least 30" (762 mm) above floor; install no higher than 96" (2.44 m) from bottom of washer.

C2 COUNTRY LANE  
LOT 50-6  
20-2447 END ELEV A  
THE BARRINGTON

39 of 41

WHIRLPOOL DRYER Model #: YWED5620HW

Whirlpool Brand Canada English | Washer and Dryers | Dryers | Electric Dryers | YWED5620HW

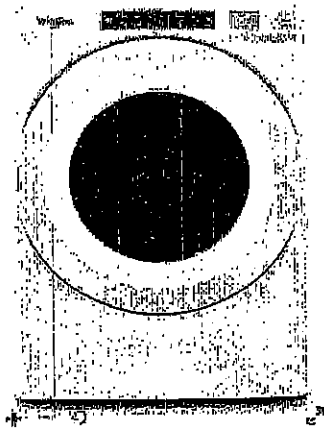

7.4 cu. ft. Front Load Electric  
Dryer with Intuitive Touch  
Controls



**Whirlpool** 7.4 cu. ft. Front Load Electric Dryer with Intuitive Touch Controls  
Model #: YWED5620HW

Dimensions

Depth	78.74 cm, 31.0 in
Depth With Door Open 90 Degree	138.43 cm, 54-1/2 in
Height	98.42 cm, 38-3/4 in
Width	68.58 cm, 27.0 in

Configuration and Overview

Fuel Type	Electric
-----------	----------

Cycles and Options

Cycle Time Remaining	Yes
Lint Filter Indicator	No
Number of Dryer Cycles	36
Number of Dryness Levels	3

Ventilation System

Long Vent	No
Maximum Vent Length	64
Venting Direction	Left, Right, Bottom, Rear

Electrical

Hz	60
Power Cord Included	Yes

P

C2 COUNTRY LANE  
LOT 50-6  
20-2447 END ELEV A  
THE BARRINGTON

40 of 41

WHIRLPOOL DRYER Model #: YWED5620HW

#### Back view:

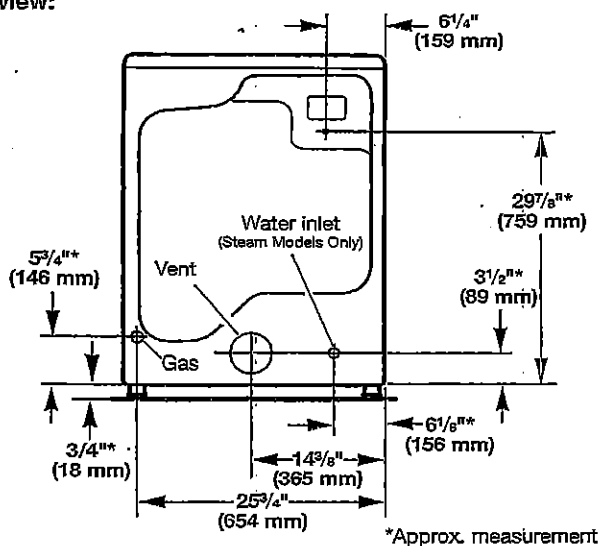

**NOTE:** Most installations require a minimum of 5" (127 mm) clearance behind dryer for exhaust vent with elbow. See "Venting Requirements."

#### Installation Clearances

For each arrangement, consider allowing more space for ease of installation and servicing, spacing for companion appliances, and clearances for walls, doors, and floor moldings. Space must be large enough to allow door to fully open. Add spacing on all sides of dryer to reduce noise transfer. If a closet door or louvered door is installed, top and bottom air openings in door are required.

Check code requirements. Some codes limit, or do not permit, installation of the dryer in garages, closets, mobile homes, or sleeping quarters. Contact your local building inspector.

**NOTE:** No other fuel-burning appliance can be installed in the same closet as a dryer.

#### Installation spacing for recessed area or closet installation

All dimensions show recommended and minimum spacing allowed.

- Additional spacing should be considered for ease of installation and servicing.
- Additional clearances might be required for wall, door, floor moldings, dryer venting, and gas line.
- Additional spacing should be considered on all sides of the dryer to reduce noise transfer.
- For closet installation with a door, minimum ventilation openings in the top and bottom of the door are required. Louvered doors with equivalent ventilation openings are acceptable.
- Companion appliance spacing should also be considered.

#### Recommended installation clearances (dryer only):

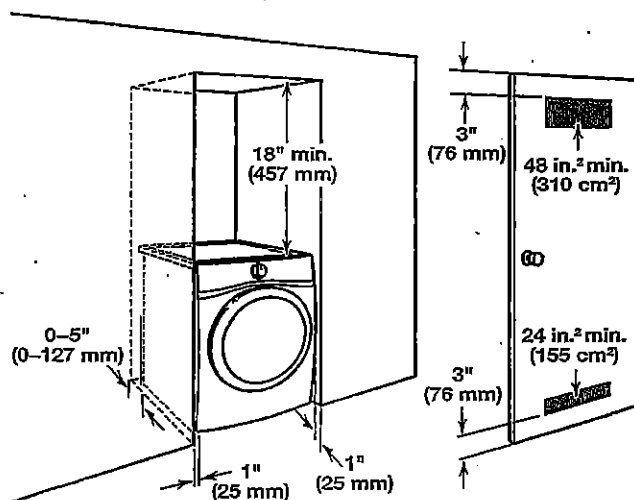

0" (0 mm) rear spacing is allowed for straight back venting only. For steam models only, inlet hose must not be kinked.

#### Custom under-counter installation:

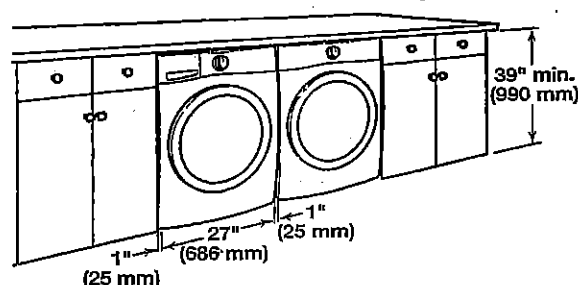

#### Mobile home - Additional installation requirements:

This dryer is suitable for mobile home installations. The installation must conform to the Manufactured Home Construction and Safety Standard, Title 24 CFR, Part 3280 (formerly the Federal Standard for Mobile home construction and Safety, Title 24, HUD Part 280) or Standard CAN/CSA-Z240 MH.

#### Mobile home installations require:

- Metal exhaust system hardware, available for purchase from your dealer. For further information, see "Assistance or Service" in your Use and Care Guide.
- Special provisions must be made in mobile homes to introduce outside air into dryer. Openings (such as a nearby window) should be at least twice as large as dryer exhaust opening.

#### For mobile home installation of gas dryers:

- Mobile Home Installation Hold-down Kit Part Number 346764 is available to order. For further information, see "Assistance or Service" in your Use and Care Guide.

2

C2 COUNTRY LANE  
LOT 50-6  
20-2447 END ELEV A  
THE BARRINGTON

41 OF 41

WHIRLPOOL DRYER Model #: YWED5620HW

Additional parts may be required, depending on your installation. Check local codes. Check existing electrical supply and venting. Read "Electrical Requirements" and "Venting Requirements" before purchasing parts.

**If using a power supply cord:**

Use a UL Listed power supply cord kit marked for use with clothes dryers. The kit should contain:

- A UL Listed 30 amp power supply cord, rated 120/240 volt minimum. The cord should be type SRD or SRDT and be at least 4 ft. (1.22 m) long. The wires that connect to the dryer must end in ring terminals or spade terminals with upturned ends.
- A UL Listed strain relief.

**Optional Equipment (not supplied with dryer):**

Refer to your Use and Care Guide for information about accessories available for your dryer.

**LOCATION REQUIREMENTS**

Check code requirements. Some codes limit, or do not permit, installing dryer in garages, closets, mobile homes, or sleeping quarters. Contact your local building inspector.

**⚠ WARNING**



**Explosion Hazard**

Keep flammable materials and vapors, such as gasoline, away from dryer.

Place dryer at least 18 inches (460 mm) above the floor for a garage installation.

Failure to do so can result in death, explosion, or fire.

**You will need:**

- A location allowing for proper exhaust installation. See "Venting Requirements."
- A separate 15 or 20 amp circuit for a gas dryer or 30 amp circuit for an electric dryer.
- If using power supply cord, a grounded electrical outlet located within 2 ft. (610 mm) of either side of dryer. See "Electrical Requirements."
- Floor must support dryer weight of 200 lbs. (90.7 kg). Also consider weight of companion appliance.
- Cold water faucets located within 4 ft. (1.2 m) of the water fill valves, and water pressure of 20–120 psi (138–827 kPa). You may use your washer's water supply by purchasing the necessary parts noted in "Parts needed."
- Level floor with maximum slope of 1" (25 mm) under entire dryer. If slope is greater than 1" (25 mm), install Extended Dryer Feet Kit, Part Number 279810. If not level, clothes may not tumble properly and automatic sensor cycles may not operate correctly.
- For garage installation, place dryer at least 18" (460 mm) above floor. If using a pedestal, you will need 18" (460 mm) to bottom of dryer.
- The dryer must not be installed or stored in an area where it will be exposed to water and/or weather.

**IMPORTANT:** Do not operate, install, or store dryer where it will be exposed to water, weather, or at temperatures below 40°F (4°C). Lower temperatures may cause dryer not to shut off at end of automatic sensor cycles, resulting in longer drying times.

**DRYER DIMENSIONS**

Front view:

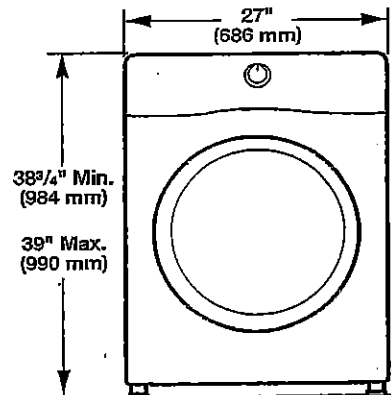

Side view:

Whirlpool Models ✓

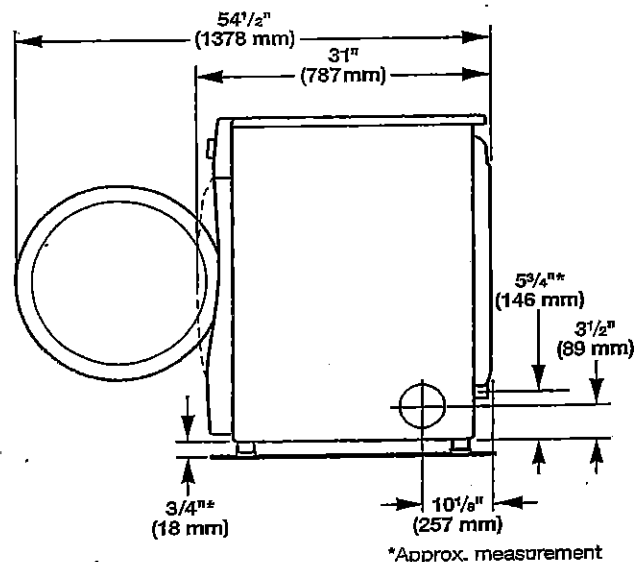

\*Approx. measurement

Maytag Models

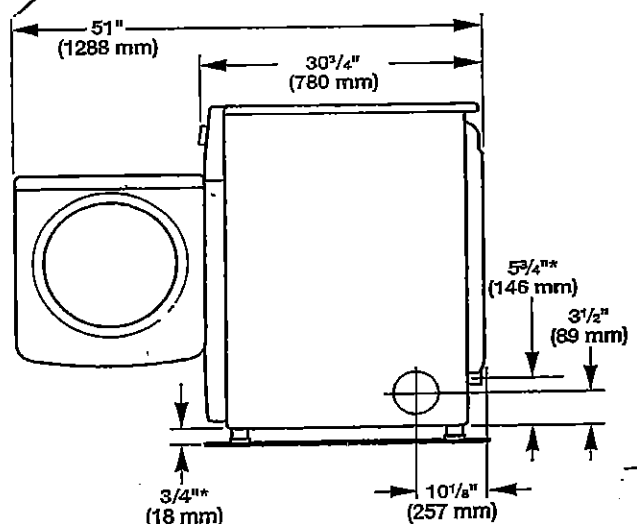

\*Approx. measurement

JP