



02-Jul-21

Interior Finishing Selection Sheet

10 OF 42

LOT 049-6

20-2447-EN ELEV B THE BARRINGTON

PURCHASERS: ROXANNE L. SERRA

CONTACT NO: 289-404-3836

VENDOR: HEATHWOOD HOMES (WHITBY) LIMITED - PHASE 4

UPG

Appliances

6-9117 Kitchen HoodFan

☒ CYCLONE 30" STAINLESS CHIMNEY/CANOPY HOODFAN
STAINLESS STEEL SCB51930 UPG 30" PAGES 27-28

Cabinetry

1-9111 Kitchen Cabinet Colour/Style

3-2098 Kitchen Cabinet Hardware

25-9156 Main Bathroom Cabinet Colour/Style

29-2086 Main Bathroom Cabinet Hardware

28-8827 Main Bathroom Countertop

20-9156 Master Ensuite Cabinet Colour/Style

22-2086 Master Ensuite Cabinet Hardware

21-8827 Master Ensuite Countertop

414-9156 Powder Room Lower Level Cabinet Colour/Style

416-2086 Powder Room Lower Level Cabinet Hardware

415-8827 Powder Room Lower Level Countertop

☐ SIMCOE ORCHID VIKING III STD 3DL

☐ HARDWARE 12801 STD

☐ SIMCOE RAIN CLOUD Viking III STD 3DL

☐ HARDWARE 9677 STD

☐ Countertop CALCUTTA MARBLE 4925K-07 Wilsonart

☐ SIMCOE RAIN CLOUD Viking III STD 3DL

☐ HARDWARE 9677 STD

☐ Countertop CALCUTTA MARBLE 4925K-07 Wilsonart

☐ SIMCOE RAIN CLOUD Viking III STD 3DL

☐ HARDWARE 9677 STD

☐ Countertop CALCUTTA MARBLE 4925K-07 Wilsonart

Carpet

37-9245 Bedroom 2 Flooring

38-9245 Bedroom 3 Flooring

14-9245 Family Room Flooring

367-9245 Lower Level Hall Flooring

36-9245 Master Bedroom Flooring

52-1079 Throughout Underpad

☐ Dynasty Tex 40 oz Poly OVERCAST DY 87354 STD

☐ Dynasty Tex 40 oz Poly OVERCAST DY 87354 STD

☐ Dynasty Tex 40 oz Poly OVERCAST DY 87354 STD

☐ Dynasty Tex 40 oz Poly OVERCAST DY 87354 STD

☐ Dynasty Tex 40 oz Poly OVERCAST DY 87354 STD

☐ Underpad 500 Series STD

Ceramics

16-8913 Foyer Flooring

17-2225 Foyer Grout

☒ Biel Bianco (White) UN.BL.BIA.1224 UPG_2 12 x 24 TO BE
INSTALLED SIDE TO SIDE SKETCH # 7 PAGE 18

☐ Grout (27) Silver STD

1. The Purchaser acknowledges these selections are subject to the terms and conditions of the applicable Agreement of Purchase and Sale.
2. The Purchaser acknowledges that the Vendor accepts no responsibility in the event the Vendor is unable to supply a selection. The Purchaser agrees to reselect from the currently available selections immediately upon request.
3. The Vendor reserves the right to substitute above materials and equipment with that of equal or better quality.
4. Purchaser acknowledges that items may not be exactly as shown. Variations from the Vendor's samples may occur in finished materials due to normal production processes. Vendor is not responsible for shade difference which may occur from different dye lots or wood grains. Variations from the Vendor's samples will occur with natural materials such as wood, marble, granite, hardwood and brick.
5. The Vendor reserves the right to select Grout & Thresholds that best suits the Tile selected.
6. Selections will not be processed unless signed by Heathwood Homes Head Office.
7. The colour selections made on the Colour Chart are final and cannot be changed once submitted.
8. The Purchaser has checked and acknowledges the accuracy of this Colour Chart.

July 2, 2021 
Date Purchaser

July 2, 2021 
Date APPROVED - Décor Consultant

Date Purchaser

Date Approved HEATHWOOD HOMES (WHITBY)
LIMITED - PHASE 4



02-Jul-21

Interior Finishing Selection Sheet

LOT 049-6

20-2447-EN ELEV B THE BARRINGTON

PURCHASERS: ROXANNE L. SERRA

CONTACT NO: 289-404-3836

VENDOR: HEATHWOOD HOMES (WHITBY) LIMITED - PHASE 4

Ceramics

UPG

4-5721 Kitchen Backsplash
5-2226 Kitchen Backsplash Grout
7-8913 Kitchen/Breakfast Flooring
8-2225 Kitchen/Breakfast Grout
348-9257 Laundry Mud Room Flooring
349-2225 Laundry Mud Room Grout
30-9106 Main Bathroom Flooring
31-2225 Main Bathroom Grout
112-5411 Main Bathroom Tub Wall Tile
113-2226 Main Bathroom Tub Wall Tile Grout
23-9106 Master Ensuite Floor Tile
24-2225 Master Ensuite Floor Tile Grout
73-8661 Master Ensuite Shower Floor Tile
74-2226 Master Ensuite Shower Floor Tile Grout
147-8923 Master Ensuite Shower Jamb(s) and Sill(s)
104-5411 Master Ensuite Shower Wall Tile
105-2226 Master Ensuite Shower Wall Tile Grout
32-8913 Powder Room Flooring
33-2225 Powder Room Grout
369-9257 Powder Room Lower Level Flooring

- ☒ Colour and Dimension Bright Arctic White
QT.CD.ARW.0306.BR UPG_1 3 x 6 TO BE INSTALLED IN A
BRICK DESIGN
- ☐ Grout (00) White STD
- ☒ Biel Bianco (White) UN.BL.BIA.1224 UPG_2 12 x 24 TO BE
INSTALLED SIDE TO SIDE SKETCH # 7 PAGE 18
- ☐ Grout (27) Silver STD
- ☐ CARRARA White / Grey GE.CR.WHIT.1313.MT STD 13 x 13
- ☐ Grout (27) Silver STD
- ☒ Madison Series White Matte GE.MD.WHT.1818.MT UPG 1
18" X 18" Matte
- ☐ Grout (27) Silver STD
- ☐ Splendour White QT.SP.WHT.0810 Std 8" x 10" TO BE
INSTALLED VERTICALLY
- ☐ Grout (00) White STD
- ☒ Madison Series White Matte GE.MD.WHT.1818.MT UPG 1
18" X 18" Matte
- ☐ Grout (27) Silver STD
- ☐ Ontario Series Mosaic Snow White Matte
OD.ON.SWT.0202.MT.N STD 2 x 2
- ☐ Grout (00) White STD
- ☐ Shower Jamb / Sill Thassos White STD
- ☐ Splendour White QT.SP.WHT.0810 Std 8" x 10" TO BE
INSTALLED VERTICALLY
- ☐ Grout (00) White STD
- ☒ Biel Bianco (White) UN.BL.BIA.1224 UPG_2 12 x 24 TO BE
INSTALLED SIDE TO SIDE SKETCH # 7 PAGE 18
- ☐ Grout (27) Silver STD
- ☐ CARRARA White / Grey GE.CR.WHIT.1313.MT STD 13 x 13

1. The Purchaser acknowledges these selections are subject to the terms and conditions of the applicable Agreement of Purchase and Sale.
2. The Purchaser acknowledges that the Vendor accepts no responsibility in the event the Vendor is unable to supply a selection. The Purchaser agrees to reselect from the currently available selections immediately upon request.
3. The Vendor reserves the right to substitute above materials and equipment with that of equal or better quality.
4. Purchaser acknowledges that items may not be exactly as shown. Variations from the Vendor's samples may occur in finished materials due to normal production processes. Vendor is not responsible for shade difference which may occur from different dye lots or wood grains. Variations from the Vendor's samples will occur with natural materials such as wood, marble, granite, hardwood and brick.
5. The Vendor reserves the right to select Grout & Thresholds that best suits the Tile selected.
6. Selections will not be processed unless signed by Heathwood Homes Head Office.
7. The colour selections made on the Colour Chart are final and cannot be changed once submitted.
8. The Purchaser has checked and acknowledges the accuracy of this Colour Chart.

July 2, 2021

Date

R. Serra

Purchaser

July 2, 2021

Date

APPROVED

07-07-2021

Décor Consultant

Date

Purchaser

Date Approved

HEATHWOOD HOMES (WHITBY)
LIMITED - PHASE 4



02-Jul-21

Interior Finishing Selection Sheet

LOT 049-6

20-2447-EN ELEV B THE BARRINGTON

PURCHASERS: ROXANNE L. SERRA

CONTACT NO: 289-404-3836

VENDOR: HEATHWOOD HOMES (WHITBY) LIMITED - PHASE 4

UPG

Ceramics

370-2225 Powder Room Lower Level Grout

53-2232 Throughout Thresholds

Electrical

90-5796 Throughout Switches and Plug

Fireplace

136-8891 Great Room Fireplace Mantle

135-8865 Great Room Fireplace Type

Granite

2-9121 Kitchen Countertop

Hardwood

11-7498 Great Room Flooring

12-7498 Living Room Flooring

98-7498 Main Hall Flooring

78-7498 Stair Landing to Lower Level Flooring

77-7498 Stair Landing to Upper Level Flooring

35-7498 Upper Hall Flooring

Interior Railings

49-8148 Stairs to Lower Level Handrail/Pickets/Posts Type

43-8148 Stairs to Upper Level Handrail/Pickets/Posts Type

Interior Stairs

116-1713 Basement Stairs Type

☐ Grout (27) Silver STD

☐ Metal Thresholds STD

☐ Decora White Switches and Plugs STD

☐ Paint Grade Mantle- Cabinet (Per Plan) WHITE NF-17 STD

☐ Dimplex FP3033HL Electric Fireplace

☐ MSI Quartz ICED WHITE Group 1 UPG 3/4" with Mitered Edge

☐ Vintage Northern Solid Sawn Engineered Select V : Red Oak Pearl GRYPHON Red Oak Pearl 3/4" x 3 1/4"

☐ Vintage Northern Solid Sawn Engineered Select V : Red Oak Pearl GRYPHON Red Oak Pearl 3/4" x 3 1/4"

☐ Vintage Northern Solid Sawn Engineered Select V : Red Oak Pearl GRYPHON Red Oak Pearl 3/4" x 3 1/4"

☐ Vintage Northern Solid Sawn Engineered Select V : Red Oak Pearl GRYPHON Red Oak Pearl 3/4" x 3 1/4"

☐ Vintage Northern Solid Sawn Engineered Select V : Red Oak Pearl GRYPHON Red Oak Pearl 3/4" x 3 1/4"

☐ Vintage Northern Solid Sawn Engineered Select V : Red Oak Pearl GRYPHON Red Oak Pearl 3/4" x 3 1/4"

☐ Single Collar Alt. Plain w/ Shoes with 3 1/2" Square/Cap Post(s) BLACK METAL STD

☐ Single Collar Alt. Plain w/ Shoes with 3 1/2" Square/Cap Post(s) BLACK METAL STD

☐ Paint Grade Stairs STD

1. The Purchaser acknowledges these selections are subject to the terms and conditions of the applicable Agreement of Purchase and Sale.
2. The Purchaser acknowledges that the Vendor accepts no responsibility in the event the Vendor is unable to supply a selection. The Purchaser agrees to reselect from the currently available selections immediately upon request.
3. The Vendor reserves the right to substitute above materials and equipment with that of equal or better quality.
4. Purchaser acknowledges that items may not be exactly as shown. Variations from the Vendor's samples may occur in finished materials due to normal production processes. Vendor is not responsible for shade difference which may occur from different dye lots or wood grains. Variations from the Vendor's samples will occur with natural materials such as wood, marble, granite, hardwood and brick.
5. The Vendor reserves the right to select Grout & Thresholds that best suits the Tile selected.
6. Selections will not be processed unless signed by Heathwood Homes Head Office.
7. The colour selections made on the Colour Chart are final and cannot be changed once submitted.
8. The Purchaser has checked and acknowledges the accuracy of this Colour Chart.

July 2, 2021

Date

R. Serra

Purchaser

July 2, 2021

Date

APPROVED
-07-07-2021

Décor Consultant

M. Rosen

Date

Purchaser

Date Approved HEATHWOOD HOMES (WHITBY)
LIMITED - PHASE 4



02-Jul-21

Interior Finishing Selection Sheet

LOT 049-6

20-2447-EN ELEV B THE BARRINGTON

PURCHASERS: ROXANNE L. SERRA

CONTACT NO: 289-404-3836

VENDOR: HEATHWOOD HOMES (WHITBY) LIMITED - PHASE 4

Interior Stairs

45-1712 Stairs to Lower Level Type

39-1712 Stairs to Upper Level Type

Interior Trim

91-9374 Throughout Trim Size

Painting

46-7761 Stairs to Lower Level Colour

50-7761 Stairs to Lower Level Handrail/Pickets/Posts Colour

40-7761 Stairs to Upper Level Colour

44-7761 Stairs to Upper Level Handrail/Pickets/Posts Colour

240-1716 Throughout Trim - Paint Colour

51-1717 Throughout Walls - Paint Colour

Plumbing

266-1737 Main Bathroom Plumbing Fixture (Colour)

149-1737 Master Ensuite Plumbing Fixture (colour)

34-1737 Powder Room Plumbing Fixture (Colour)

371-1737 Powder Room Lower Level Plumbing Fixture (Colour)

UPG

☐ Oak Stairs UPG_1

☐ Oak Stairs UPG_1

☐ 4 1/4" Baseboards and 2 3/4" Integrated Backbend Casings STD

☐ Stain handrail, stringers, treads,risers, nosing & posts. (Metal pickets) STAIN TO COMPLIMENT Red Oak Pearl GRYPHON SHADE WILL VARY

☐ Stain handrail, stringers, treads,risers, nosing & posts. (Metal pickets) STAIN TO COMPLIMENT Red Oak Pearl GRYPHON SHADE WILL VARY

☐ Stain handrail, stringers, treads,risers, nosing & posts. (Metal pickets) STAIN TO COMPLIMENT Red Oak Pearl GRYPHON SHADE WILL VARY

☐ Stain handrail, stringers, treads,risers, nosing & posts. (Metal pickets) STAIN TO COMPLIMENT Red Oak Pearl GRYPHON SHADE WILL VARY

☐ Trim WHITE STD

☐ Wall WARM GREY 22 STD

☐ Plumbing Fixtures WHITE STD

☐ Plumbing Fixtures WHITE STD

☐ Plumbing Fixtures WHITE STD

☐ Plumbing Fixtures WHITE STD

1. The Purchaser acknowledges these selections are subject to the terms and conditions of the applicable Agreement of Purchase and Sale.
2. The Purchaser acknowledges that the Vendor accepts no responsibility in the event the Vendor is unable to supply a selection. The Purchaser agrees to reselect from the currently available selections immediately upon request.
3. The Vendor reserves the right to substitute above materials and equipment with that of equal or better quality.
4. Purchaser acknowledges that items may not be exactly as shown. Variations from the Vendor's samples may occur in finished materials due to normal production processes. Vendor is not responsible for shade difference which may occur from different dye lots or wood grains. Variations from the Vendor's samples will occur with natural materials such as wood, marble, granite, hardwood and brick.
5. The Vendor reserves the right to select Grout & Thresholds that best suits the Tile selected.
6. Selections will not be processed unless signed by Heathwood Homes Head Office.
7. The colour selections made on the Colour Chart are final and cannot be changed once submitted.
8. The Purchaser has checked and acknowledges the accuracy of this Colour Chart.

July 2, 2021
Date

Purchaser

July 2, 21
Date

Décor Consultant

Date

Purchaser

Date Approved

HEATHWOOD HOMES (WHITBY)
LIMITED - PHASE 4



02-Jul-21

Sales Selection Sheet
of 2

LOT	049-6	20-2447-EN ELEV B THE BARRINGTON
PURCHASERS: ROXANNE L. SERRA		CONTACT NO: 289-404-3836
VENDOR: HEATHWOOD HOMES (WHITBY) LIMITED - PHASE 4		HST #

It is herein understood and agreed between the undersigned parties hereto that the following changes shall be made to the above mentioned Agreement of Purchase and Sale in accordance with the agreement and except for such changes noted below, all other terms and conditions in the Agreement of Purchase and Sale shall remain as stated herein: It is further understood that and agreed that all changes and additions shall be installed as per builder's specifications, location and available selections. The Purchaser hereby agrees to purchase the following extras:

Appliances

2171	Cyclone 30" Wall Mount Chimney Hood SS SCB51930	KITCHEN	Qty: 1
	PAGES 27-28		

Cabinetry

1544	Optional Upgrade Optional Valance (Trim Only) VIKING I/II/III	KITCHEN	Qty: 1
------	--	---------	--------

Ceramics

1907	Upgrade 2 Tile	Foyer Floor	Qty: 1
1911	Upgrade 2 Tile	Kit/Brk Floor	Qty: 1
1966	Optional Extras Supply and install additional backsplash due to chimney hoodfan installation Upgrade 1	Kitchen	Qty: 1
1915	Upgrade 1 Tile	Kitchen Optional Backsplash	Qty: 1
1912	Upgrade 2 Tile	M. Ensuite Floor	Qty: 1
1908	Upgrade 2 Tile	M.Flr.Pow Floor	Qty: 1

1. This Sales Selection Sheet when properly executed forms part of our Agreement of Purchase and Sale.
2. All extras and upgrades listed above are subject to Construction Progress and Architectural and Municipal requirements.
3. In the event the Vendor is unable to incorporate the work approved above in the construction of the house for any reason whatsoever, the Vendor will not be liable to the Purchaser in any way. The monies paid for any changes or optional extras not proceeded with shall be returned to the Purchaser, without interest. The cost of options or extras is non-refundable in all other circumstances. If for any reason whatsoever the Agreement of Purchase and Sale is not completed, the total cost of work approved above will be retained by the Vendor.
4. The Vendor reserves the right to substitute above materials and equipment with that of equal or better quality.
5. Purchaser acknowledges that items may not be exactly as shown. Variations from the Vendor's samples may occur in finished materials due to normal production processes. Vendor is not responsible for shade difference which may occur from different dye lots or wood grains. Variations from the Vendor's samples will occur with natural materials such as wood, marble, granite, hardwood and brick.
6. The Vendor reserves the right to select Grout & Thresholds that best suits the Tile selected.
7. Selections will not be processed unless signed by Heathwood Homes Head Office.
8. The selections made on this schedule are final and cannot be changed once submitted.
9. The Purchaser has checked and acknowledges the accuracy of this schedule.

Date	Purchaser	Date	APPROVED	Décor Consultant
Date	Purchaser	Date Approved	HEATHWOOD HOMES (WHITBY) LIMITED - PHASE 4	



02-Jul-21

Sales Selection Sheet
OF 2

LOT	049-6	20-2447-EN ELEV B THE BARRINGTON
PURCHASERS: ROXANNE L. SERRA		CONTACT NO: 289-404-3836
VENDOR: HEATHWOOD HOMES (WHITBY) LIMITED - PHASE 4		HST #

It is herein understood and agreed between the undersigned parties hereto that the following changes shall be made to the above mentioned Agreement of Purchase and Sale in accordance with the agreement and except for such changes noted below, all other terms and conditions in the Agreement of Purchase and Sale shall remain as stated herein: It is further understood that and agreed that all changes and additions shall be installed as per builder's specifications, location and available selections. The Purchaser hereby agrees to purchase the following extras:

1913	Upgrade 2 Tile	Main Bth Floor	Qty: 1
<div>Granite</div>			
867	Optional Upgrade Countertop 3/4" GROUP 1 with double edge	Kitchen	Qty: 1
<div>Mirrors/Glass Products</div>			
549	Shower Upgrade Upgrade to Frameless clear glass with D-Ring Handle in chrome	Master Ensuite	Qty: 1
<div>Plumbing</div>			
279	STANDARD Kitchen Sink Option KINDRED Kitchen Sink Collection - Reginox ND1827RU/9 Stainless Kitchen Double (Large bowl/ Full Bowl) Undermount Sink (or equivalent)	KITCHEN	Qty: 1

PAGE 21

- 1. This Sales Selection Sheet when properly executed forms part of our Agreement of Purchase and Sale.
- 2. All extras and upgrades listed above are subject to Construction Progress and Architectural and Municipal requirements.
- 3. In the event the Vendor is unable to incorporate the work approved above in the construction of the house for any reason whatsoever, the Vendor will not be liable to the Purchaser in any way. The monies paid for any changes or optional extras not proceeded with shall be returned to the Purchaser, without interest. The cost of options or extras is non-refundable in all other circumstances. If for any reason whatsoever the Agreement of Purchase and Sale is not completed, the total cost of work approved above will be retained by the Vendor.
- 4. The Vendor reserves the right to substitute above materials and equipment with that of equal or better quality.
- 5. Purchaser acknowledges that items may not be exactly as shown. Variations from the Vendor's samples may occur in finished materials due to normal production processes. Vendor is not responsible for shade difference which may occur from different dye lots or wood grains. Variations from the Vendor's samples will occur with natural materials such as wood, marble, granite, hardwood and brick.
- 6. The Vendor reserves the right to select Grout & Thresholds that best suits the Tile selected.
- 7. Selections will not be processed unless signed by Heathwood Homes Head Office.
- 8. The selections made on this schedule are final and cannot be changed once submitted.
- 9. The Purchaser has checked and acknowledges the accuracy of this schedule.

July 2, 2021		July 2, 2021	
Date	Purchaser	Date	Décor Consultant
		APPROVED	
		07-07-2021	
Date	Purchaser	Date Approved	HEATHWOOD HOMES (WHITBY) LIMITED - PHASE 4

C2 COUNTRY LANE
LOT 49-6
20-2447 EN ELEV B
THE BARRINGTON

16 of 42

The Barrington

20-2447 END ELEV. B Sketch #5 ELEVATION A & B END:
2,504 SQ FT

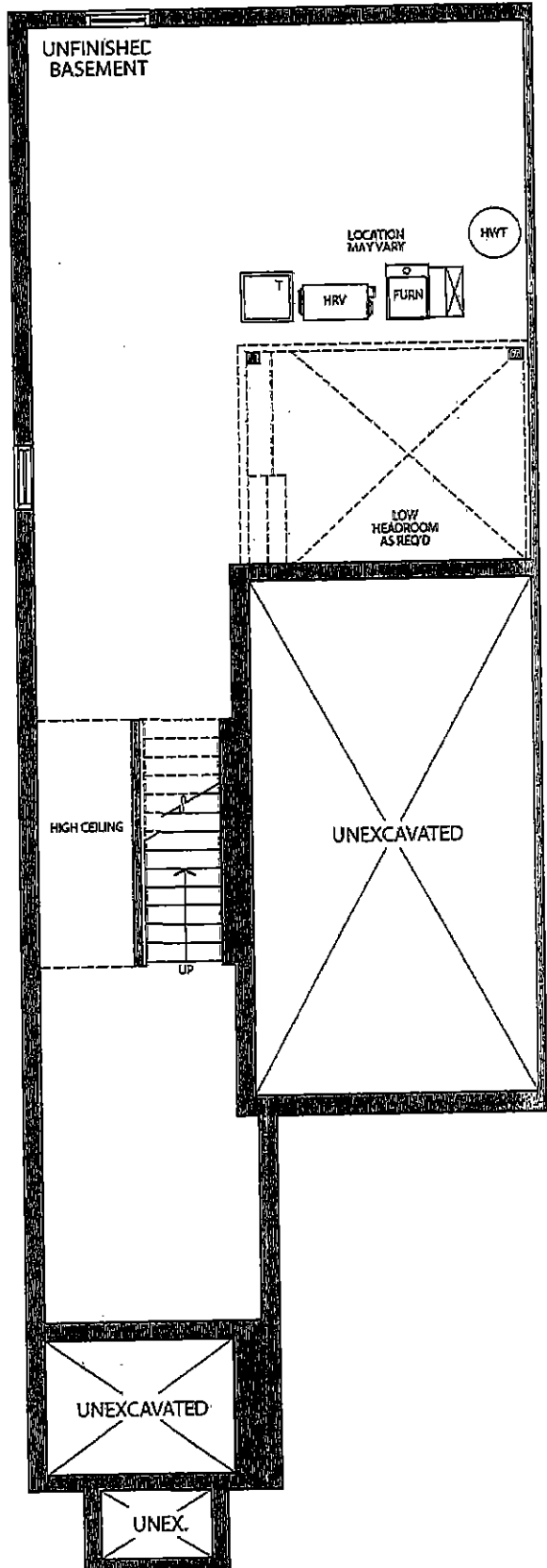

ELEVATION A & B
END
BASEMENT

RF

C2 COUNTRY LANE
LOT 49-6
20-2447 EN ELEV B
THE BARRINGTON

17 of 42
The Barrington

20-2447 END ELEV. B

Sketch #6

ELEVATION A & B END:
2,504 SQ FT

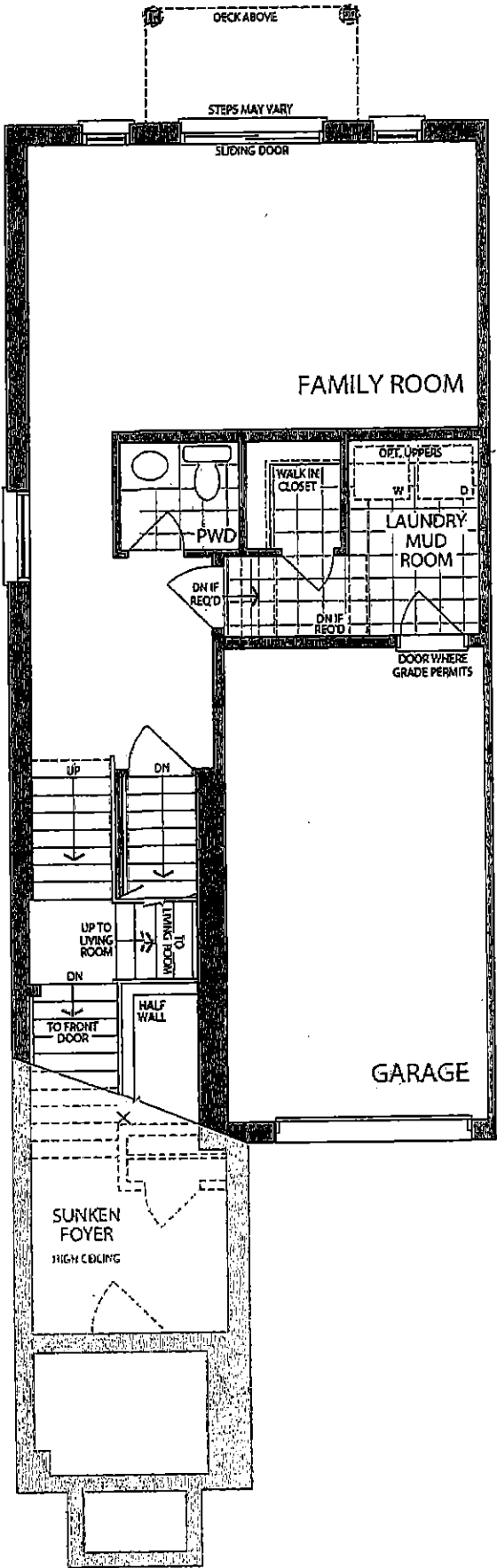

LOWER LEVEL
ELEVATION B END

Rf

C2 COUNTRY LANE
LOT 49-6
20-2447 EN ELEV B
THE BARRINGTON

18 of 42

The Barrington

20-2447 END ELEV. B

Sketch #7

ELEVATION A & B END:
2,504 SQ FT

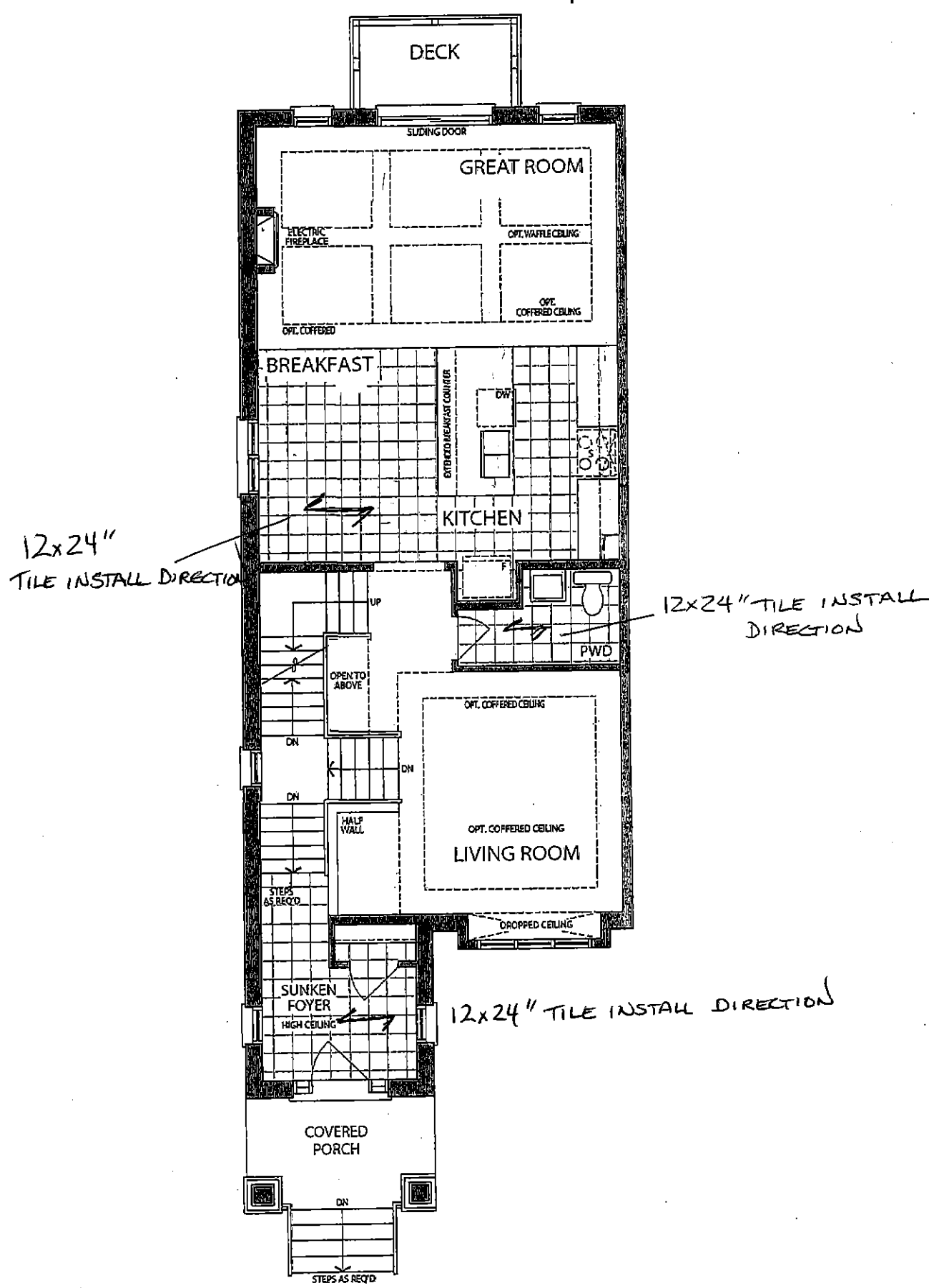

MAIN LEVEL
ELEVATION B END

RF

C2 COUNTRY LANE
LOT 49-6
20-2447 EN ELEV B
THE BARRINGTON

19 of 42

The Barrington

20-2447 END ELEV. B Sketch #8 ELEVATION A & B END:
2,504 SQ FT

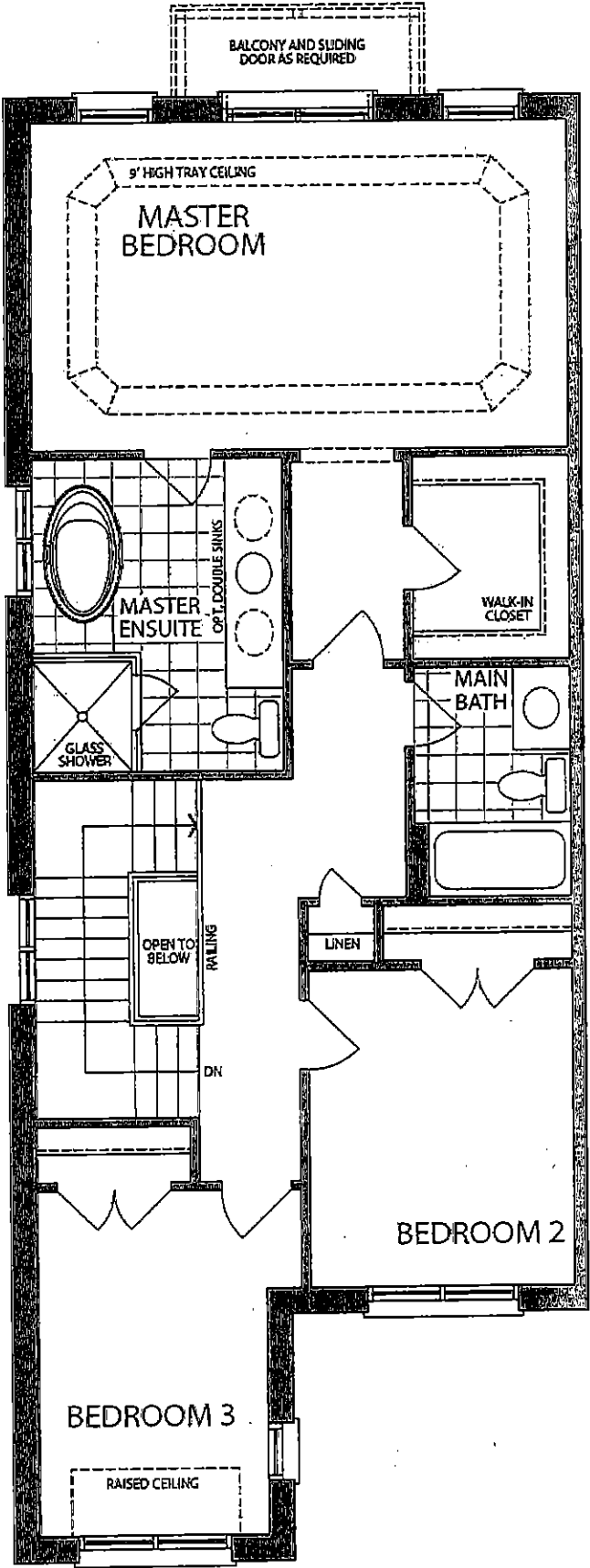

UPPER LEVEL
ELEVATION B END

RF

C2 COUNTRY LANE
LOT 49-6
20-2447 EN ELEV B
THE BARRINGTON

20 of 42

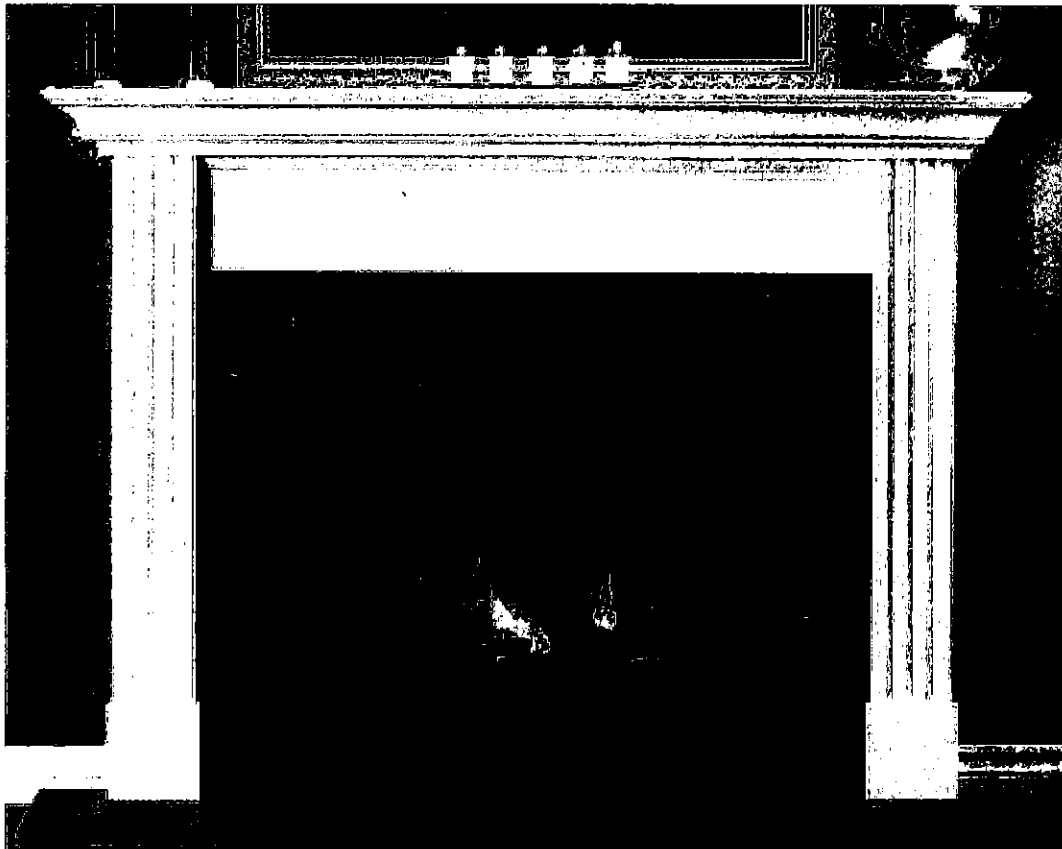

STANDARD NF 15 Mantel

Clean apron finish with fluted legs

WHITE PAINT GRADE FINISH

(PICTURE SHOWN WITH UPGRADE SURROUND AND HEARTH -PRICED SEPARATELY)

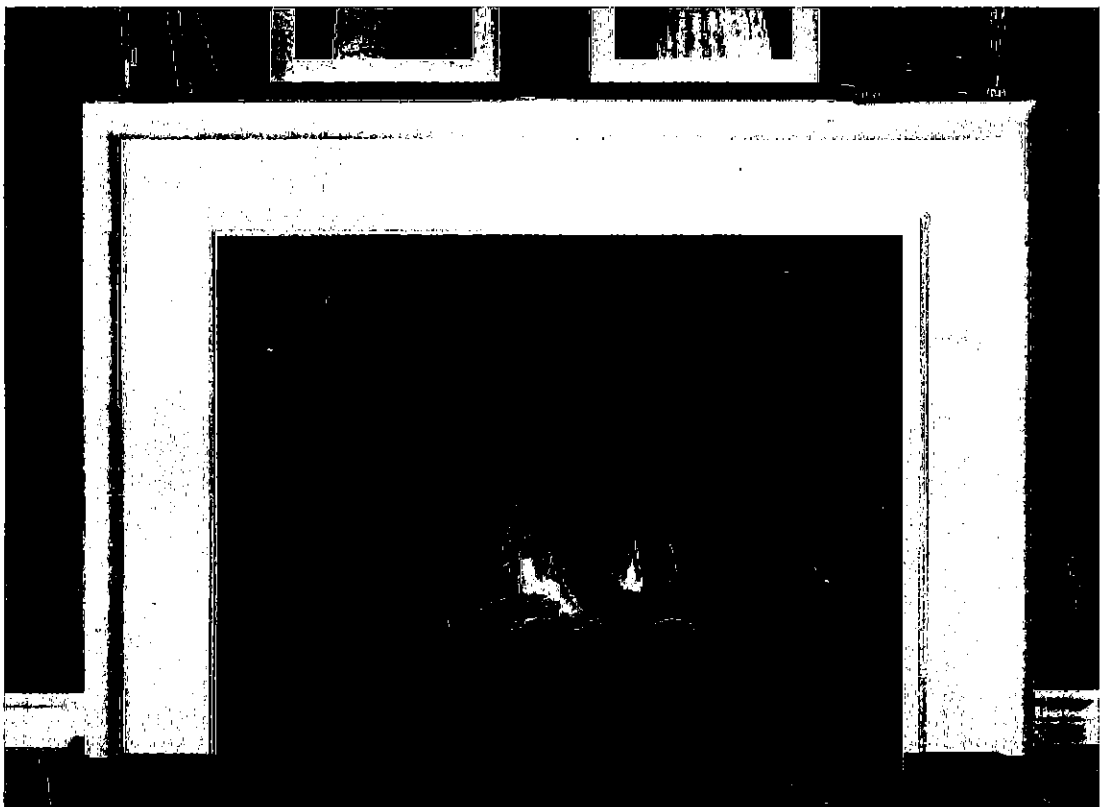

CABINET

STANDARD NF 17 Mantel

WHITE PAINT GRADE FINISH

(PICTURE SHOWN WITH UPGRADE SURROUND AND HEARTH -PRICED SEPARATELY)

C2 COUNTRY LANE
LOT 49-6
20-2447 EN ELEV B
THE BARRINGTON

21 of 42

Stainless Steel | 122.0264.711

FAMILY : Sinks | SERIES : Reginox | MODEL : NDC1932RU/9 | FINISH : Stainless Steel | INSTALLATION TYPE : Undermount

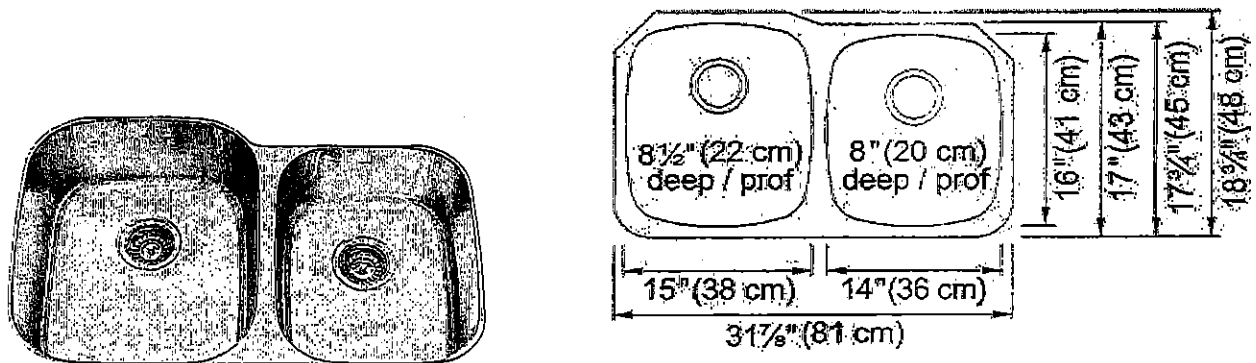

TECHNICAL DATA	
Width overall	18 3/4"
Length overall	37 13/16"
Width of large bowl	17"
Length of large bowl	15"
Depth of large bowl	8 1/2"
Width of small bowl	16"
Length of small bowl	14"
Depth of small bowl	8"
Cabinet Size	36"
Number of Bowls	2
Waste Outlet Diameter	3 1/2"
Cut-Out Template	Yes
Faucet Hole	None
Type of Material	18 Gauge Stainless Steel
Surface Finish	SILK

RP

C2 COUNTRY LANE
LOT 49-6
20-2447 EN ELEV B
THE BARRINGTON

22 of 42

STANDARD KITCHEN FAUCET

Align

Modern

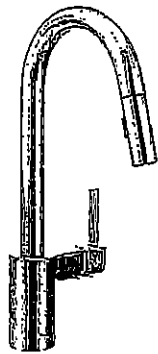

Single Handle Pull-Down Kitchen
Faucet*

Model 7565†

52

C2 COUNTRY LANE
LOT 49-6
20-2447 EN ELEV B
THE BARRINGTON

23 of 42

American
Standard

BOULEVARD®
PEDESTAL SINK
VITREOUS CHINA

BOULEVARD® PEDESTAL SINK

- ☐ 0641.800 Faucet holes on 8" (203mm) centers (Illustrated)-
- ✶ ☐ 0641.400 Faucet holes on 4" (102mm) centers
- ☐ 0641.100 Center hole only
 - Classic styled rectangular pedestal lavatory
 - Vitreous china
 - Rear overflow
 - Supplied with mounting kit
 - Right Height® for greater comfort during use
 - Faucet ledge with large deck area (faucet not included)
 - Design coordinates with Boulevard® Toilet
 - Basin has flat bottom to also allow use as an above counter sink or a drop-in sink (with u-shaped cut out)

Nominal Dimensions:

24" x 19" x 35-1/2"
(610 x 483 x 902mm)

- ☐ 0641.008 Pedestal top-8" (203mm) centers
- ☐ 0641.004 Pedestal top-4" (102mm) centers
- ☐ 0641.001 Pedestal top-center hole only
- ☐ 0010.000 Pedestal only

Bowl sizes:

17" (432mm) wide,
12-1/2" (318mm) front to back,
5" (127mm) deep

Compliance Certifications -

Meets or Exceeds the Following Specifications:

- ASME A112.19.2 - 2008/CSA B45.1-08

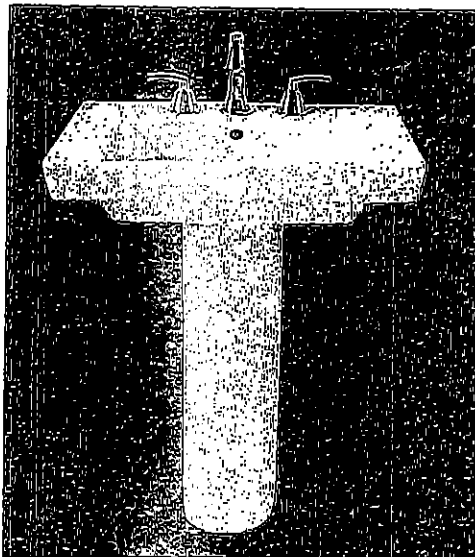

SEE REVERSE FOR ROUGHING-IN DIMENSIONS

To Be Specified:

- ☐ Color: ☐ White ☐ Linen
- ☐ Faucet Finish:
- ☐ Supplies:
- ☐ 1-1/4" Trap:
- ☐ Nipple:

* See faucet section for additional models available

C2 COUNTRY LANE
LOT 49-6
20-2447 EN ELEV B
THE BARRINGTON

24 of 42

American Standard

 BARRIER FREE

COLONY™
COUNTERTOP SINK
VITREOUS CHINA

COLONY COUNTERTOP SINK

- Vitreous china
 - Self-rimming
 - Front overflow
 - Supplied with template
 - Faucet deck
- (Faucet shown not included)

- ☒ 0346 803
Faucet holes on 203mm (8") centres
- ☐ 0346 403 (Illustrated)
Faucet holes on 102mm (4") centres
- ☐ 0346 001
Centre hole only

Nominal Dimensions:
521 x 448mm (20-1/2" x 17-5/8")

Bowl sizes:
422mm (16-5/8") wide, 279mm (11") front to back, 143mm (5-5/8") deep

COMPLIANCE CERTIFICATIONS –
Meets or exceeds the following Specifications:
• ASME A112.19.2M for Vitreous China Fixtures.
• CAN/CSA B45 Series.

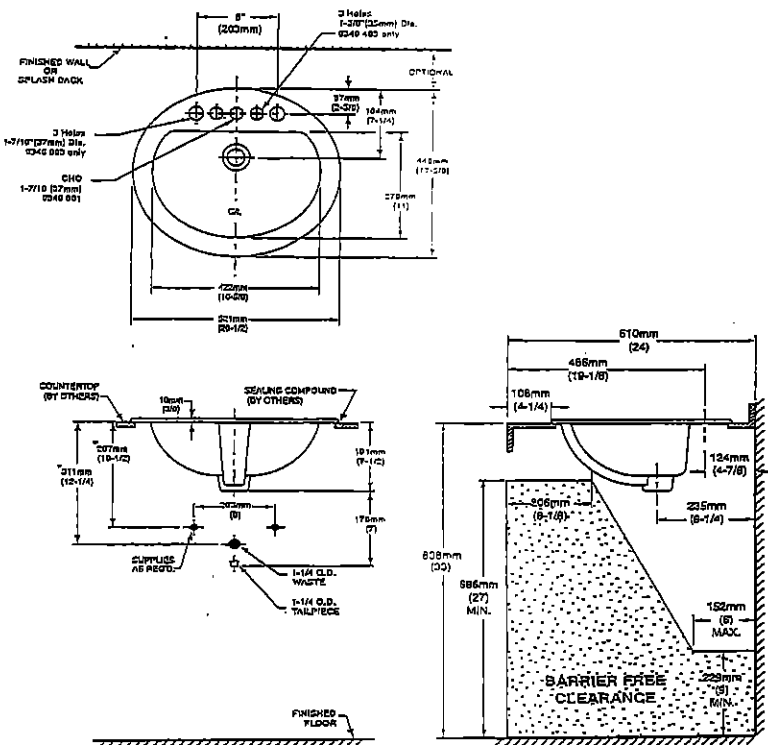
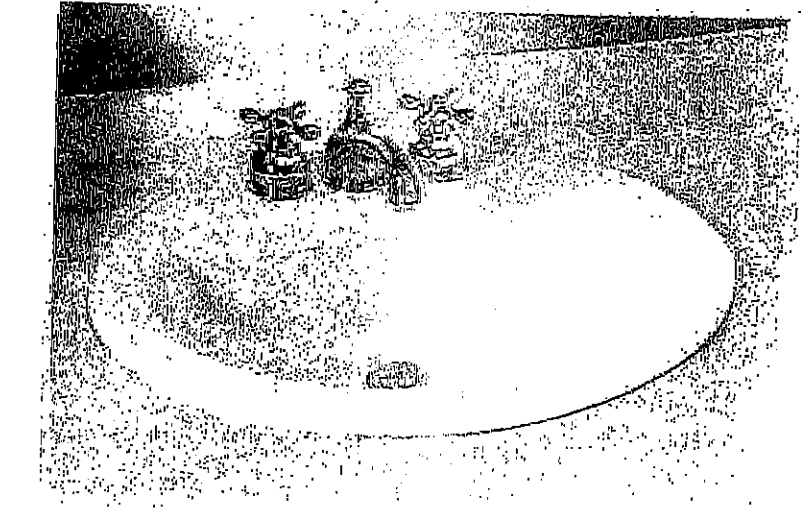

- To Be Specified
- ☐ Colour: ☒ White ☐ Bone ☐ Silver Gray
☐ Linen
- ☐ Faucet*:
- ☐ Faucet Finish:
- ☐ Supplies & Stops:
- ☐ Trap 1-1/4" (32 mm):

NOTES:
* DIMENSIONS SHOWN FOR LOCATION OF SUPPLIES AND "P" TRAP ARE SUGGESTED. FOR COUNTERTOP CUTOUT AND INSTALLATION INSTRUCTIONS USE TEMPLATE SUPPLIED WITH SINK.
FAUCETS NOT INCLUDED AND MUST BE ORDERED SEPARATELY.
IMPORTANT: Dimensions of fixtures are nominal and may vary within the range of tolerances established by ANSI Standard A112.19.2.
These measurements are subject to change or cancellation. No responsibility is assumed for use of superseded or voided pages.

* See faucet section for additional models available

C2 COUNTRY LANE
LOT 49-6
20-2447 EN ELEV B
THE BARRINGTON

25 of 42



Demi CP2007

[Handwritten signature]

C2 COUNTRY LANE
LOT 49-6
20-2447 EN ELEV B
THE BARRINGTON

26 of 42

Chateau

Transitional

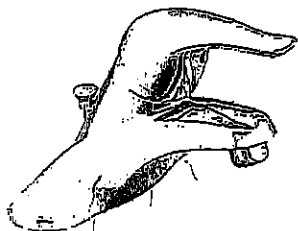

Lavatory Faucet with Pop-Up Drain
Model L4621+

VANITY SINKS AND PEDESTAL

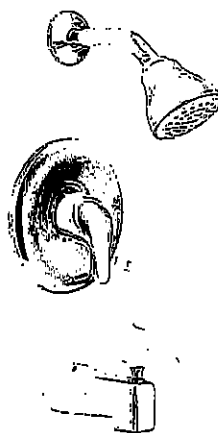

Posi-Temp® Pressure Balancing Tub/Shower
Model 62320 / TL183+

OR

Posi-Temp Valve and Tub/Shower Trim
with Eco-Performance Easy Clean® XL

Model 62320 / TL183EP+

(TL183EP not available in BC)

SHOWER AND 5' TUB FAUCETS



2 Handle Roman Tub with 9" Spout
Model 4796 / T990+

FREESTANDING TUB FAUCETS

C2 COUNTRY LANE
LOT 49-6
20-2447 EN ELEV B
THE BARRINGTON

27 of 42

SC(B)519 | ALITO Collection

Cyclone®
Breathe Better

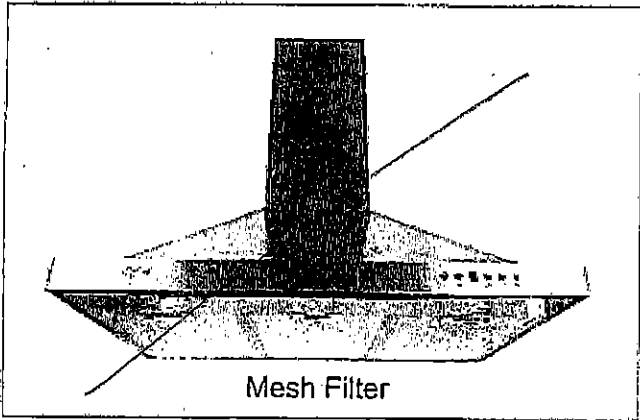

Mesh Filter

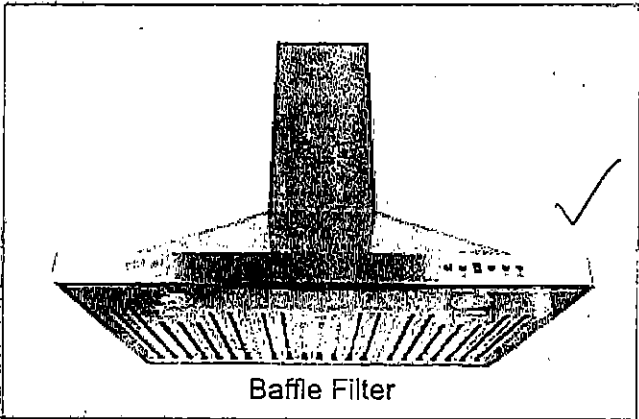

Baffle Filter

Wall Mount

Strong and sturdy with attractive lines and an imposing frame, the SC(B)519 is fitted with a time-delay OFF feature up to nine minutes, a 550 CFM fan, two bright front mounted LED lights and a digital three-speed push button control panel.

Green Features



3 Speed Push Button
Control Panel



Long-Lasting
LED Lights



Time-Delay
OFF Feature



Grease Cup

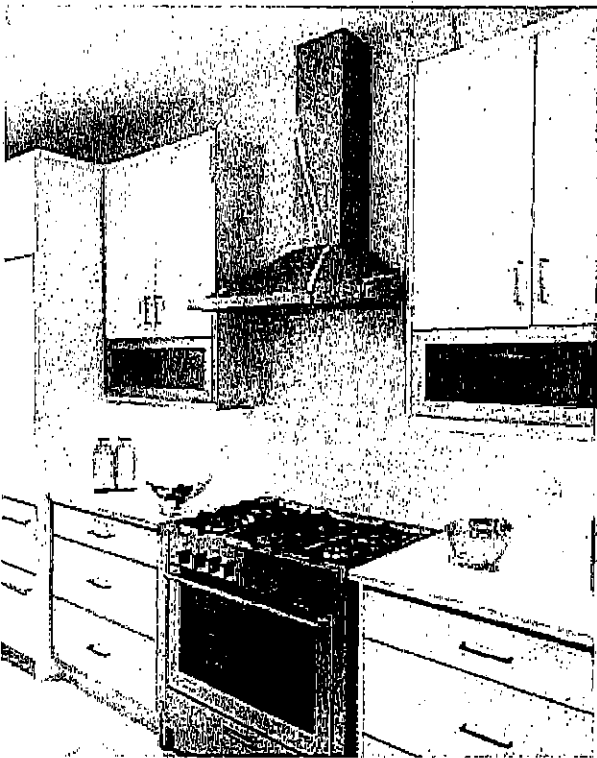

Model	Colour	Ducting	Filters	Size	CFM
SCB51924	Stainless Steel	6"	Mesh	24"	550
SCB51930	Stainless Steel	6"	Mesh	30"	550
SCB51936	Stainless Steel	6"	Mesh	36"	550
SCB51924	Stainless Steel	6"	Baffle	24"	550
SCB51930	Stainless Steel	6"	Baffle	30"	550
SCB51936	Stainless Steel	6"	Baffle	36"	550

Cyclone Range Hoods Inc.

1361 Huntingwood Drive, Unit 16, Toronto, ON, M1S 3J1, Canada.

Toll Free: 1-888-293-5662 Tel: (416) 293-0933 Fax: (416) 293-4793 Website: www.CycloneRangeHoods.com

C2 COUNTRY LANE
LOT 49-6
20-2447 EN ELEV B
THE BARRINGTON

28 of 42

SC(B)519 | ALITO Collection

Cyclone[®]
Breathe Better

Features

- Wall mount range hood
- 6" round duct adapter
- Non-stick aluminum fan blades
- 3 speed push button control
- 2 LED lights (2 x 1.4W, 4000K)
- Quick release aluminum mesh filters
- Standard chimney fits up to 9 ft. ceiling
- Up to 9 minutes time-delay OFF feature
- Plug-in connection

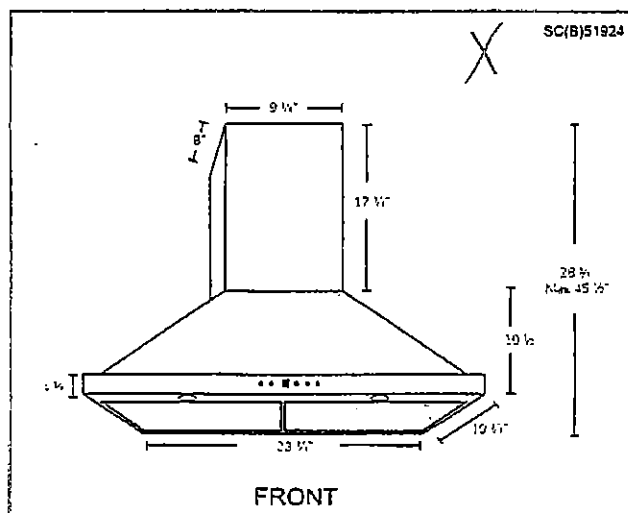
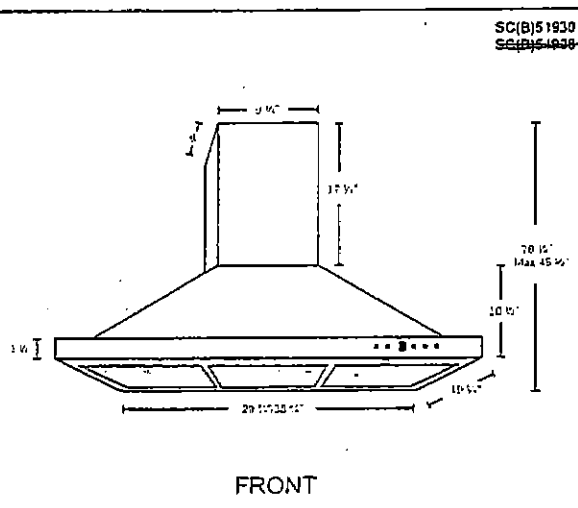

Options

- Filters:
 - SC519 - Quick Release Aluminum Mesh Filters
 - SCB519 - Quick Release Stainless Steel Baffle Filters
- Chimney Flues:
 - A1.CH10 - short (7'-8' ceilings)
 - A1.CH18 - standard (8'-9' ceilings)
 - A1.CH30 - extended (9'-11' ceilings)
- Widths: 24", 30", 36"

Specifications

- | | | |
|--------------------------------------|--------------------------------|---|
| • Air Flow Volume: 550 CFM | • Current: 2.5 Amps | • Finishes: Stainless Steel |
| • Electrical Connection: 120 V/60 Hz | • Fan Speed: 1599 RPM | • Ducting: 6" Round |
| • Power Consumption: 300 Watts | • Fan Type: Centrifugal Blower | • Noise Level: Min. 2 Sones
Max. 6 Sones |



Toronto • Vancouver • Boston
www.CycloneRangeHoods.com

C2 COUNTRY LANE
LOT 49-6
20-2447 EN ELEV B
THE BARRINGTON

29 of 42

Whirlpool® Top Mount Refrigerator

PRODUCT MODEL NUMBERS

WRT311FZD
WRT511SZD

WRT541SZD

PRODUCT DIMENSIONS

Electrical: A 115-volt, 60-Hz, AC-only, 15- or 20-amp fused, grounded electrical supply is required. It is recommended that a separate circuit serving only your refrigerator be provided. Use an outlet that cannot be turned off by a switch. Do not use an extension cord.

NOTE: Before performing any type of installation, cleaning, or removing a light bulb, turn the control (Thermostat, Refrigerator or Freezer Control depending on the model) to OFF and then disconnect the refrigerator from the electrical source. When you are finished, reconnect the refrigerator to the electrical source and reset the control (Thermostat, Refrigerator or Freezer Control depending on the model) to the desired setting. See "Using the Controls."

Water: A cold water supply with water pressure between 30 and 120 psi (207 and 827 kPa) is required to operate ice maker and water dispenser. If you have questions about your water pressure, call a licensed, qualified plumber.

IMPORTANT: The pressure of the water coming out of a reverse osmosis system going to the water inlet valve of the refrigerator needs to be between 30 and 120 psi (207 and 827 kPa).

Reverse Osmosis Water Supply: If a reverse osmosis water filtration system is connected to your cold water supply, the water pressure to the reverse osmosis system needs to be a minimum of 40 to 60 psi (276 to 414 kPa).

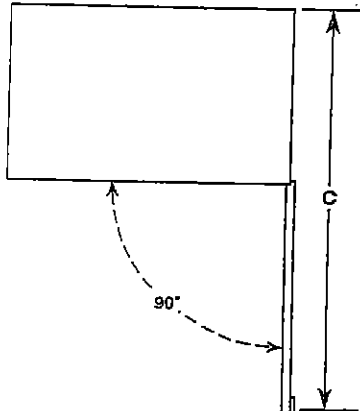
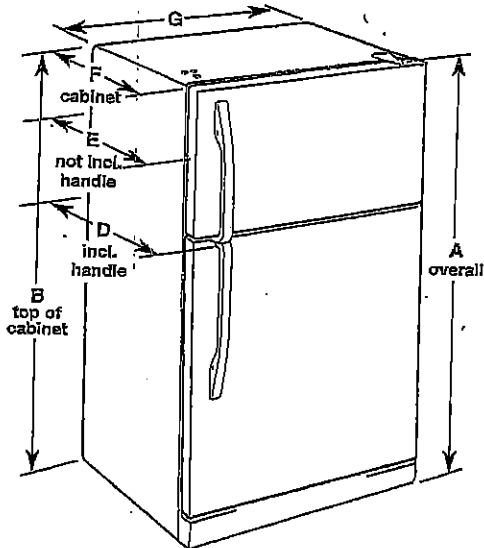

Model Number	Model Size	Reversible Door	Height - Overall "A"	Height - Top of Cabinet "B"	Depth - Door Open 90° "C"	Depth - With Handles "D"	Depth - Without Handles "E"	Depth - Cabinet Only "F"	Width - Cabinet "G"
WRT311FZD	20.5 cu. ft.	Yes	66 1/4" (168.3 cm)	65 1/2" (166.4 cm)	62 1/4" (158.1 cm)	32 1/2" (83.5 cm)	30 3/8" (77.8 cm)	28 1/2" (72.4 cm)	32 3/4" (83.2 cm)
WRT511SZD WRT541SZD	21.3 cu. ft.	Yes	66 1/4" (168.3 cm)	65 1/2" (166.4 cm)	62 1/4" (158.1 cm)	34" (86.4 cm)	32 1/2" (82.3 cm)	28 1/2" (72.4 cm)	32 3/4" (83.2 cm)

LOCATION REQUIREMENTS

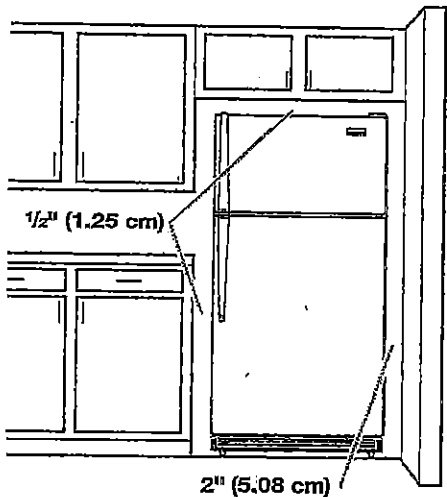

To ensure proper ventilation for your refrigerator, allow for a 1/2" (1.25 cm) space on each end and between overhead cabinets and refrigerator top. Allow at least 1" (2.5 cm) between back of cabinet and the wall. If your refrigerator has an ice maker, make sure you leave some extra space at the back for the water line connections.

If you are installing your refrigerator next to a fixed wall, leave 2" (5 cm) minimum on the hinge side (depending on your model) to allow for the door to swing open.

NOTE: This refrigerator is intended for use in a location where the temperature ranges from a minimum of 55°F (13°C) to a maximum of 110°F (43°C). The preferred room temperature range for optimum performance, which reduces electricity usage and provides superior cooling, is between 60°F (15°C) and 90°F (32°C). It is recommended that you do not install the refrigerator near a heat source, such as an oven or radiator.

Because Whirlpool Corporation policy includes a continuous commitment to improve our products, we reserve the right to change materials and specifications without notice.

Dimensions are for planning purposes only. For complete details, see Installation Instructions packed with product. Specifications subject to change without notice.

Ref. W10674106
10/29/14

SP

C2 COUNTRY LANE
LOT 49-6
20-2447 EN ELEV B
THE BARRINGTON

30 of 42

Refrigerator Door Swing Verification

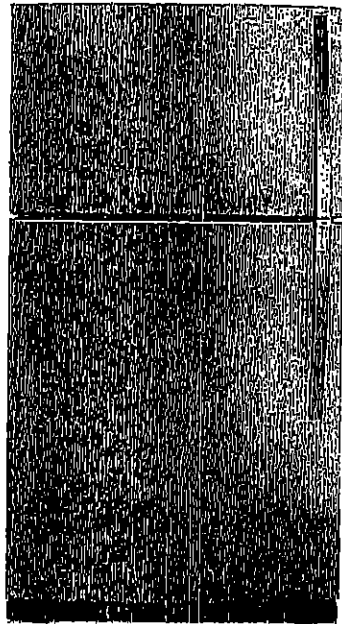
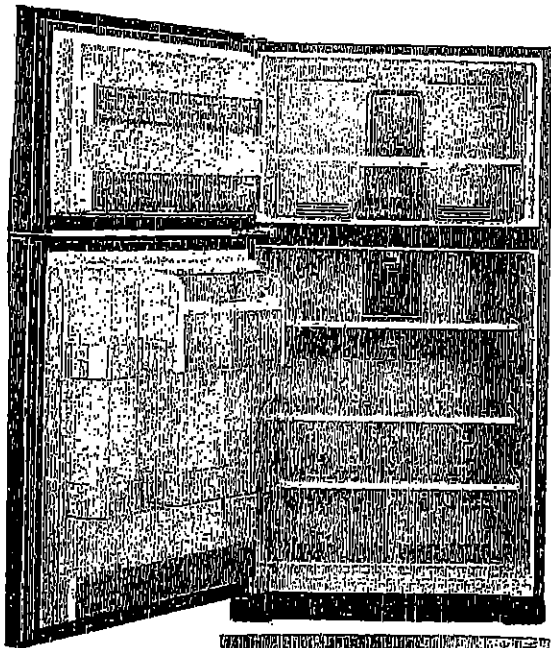
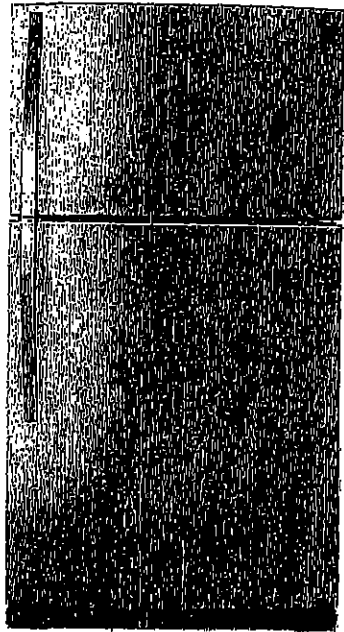
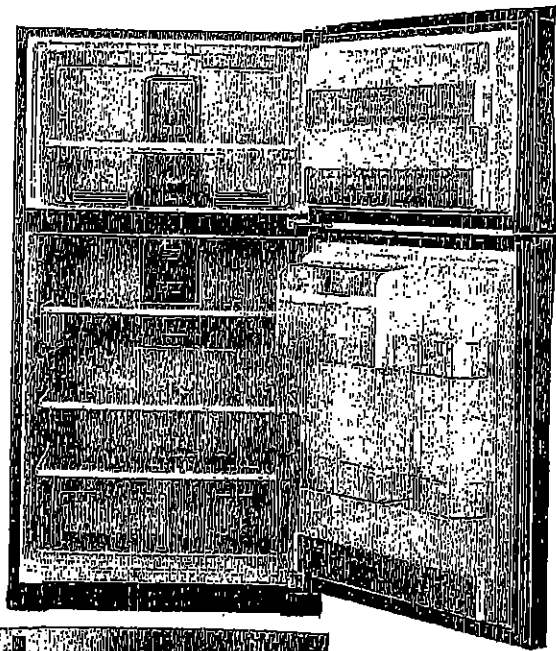

When facing the refrigerator



RIGHT HAND
DOOR OPENING

- Hinges on right
- Handle on left

INITIAL

LEFT HAND
DOOR OPENING

- Hinges on left
- Handle on right

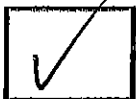

INITIAL

Please check and INITIAL your door swing selection.

C2 COUNTRY LANE
LOT 49-6
20-2447 EN ELEV B
THE BARRINGTON

31 of 42

WHIRLPOOL 30" (76.0 CM) FREESTANDING ELECTRIC RANGES
Model YWFE515S0JS

5.3 cu. ft. Whirlpool® electric range with Frozen
Bake™ technology

YWFE515S0JS



Home > Kitchen Appliances > Cooking Appliances > Ranges > Single Oven Ranges > YWFE515S0JS

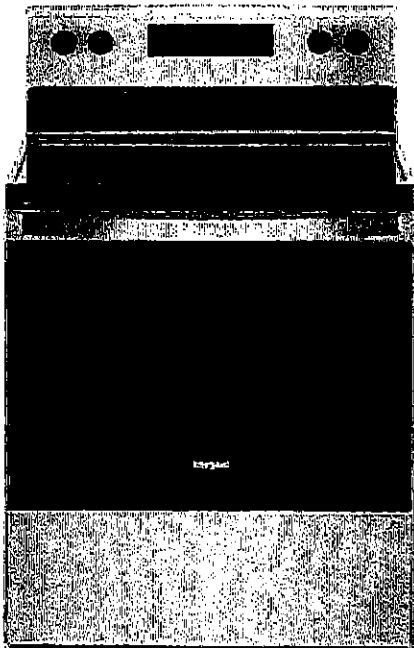

12 21



C2 COUNTRY LANE
LOT 49-6
20-2447 EN ELEV B
THE BARRINGTON

32 of 42

WHIRLPOOL 30" (76.0 CM) FREESTANDING ELECTRIC RANGES
Model YWFE515S0JS

Product Dimensions

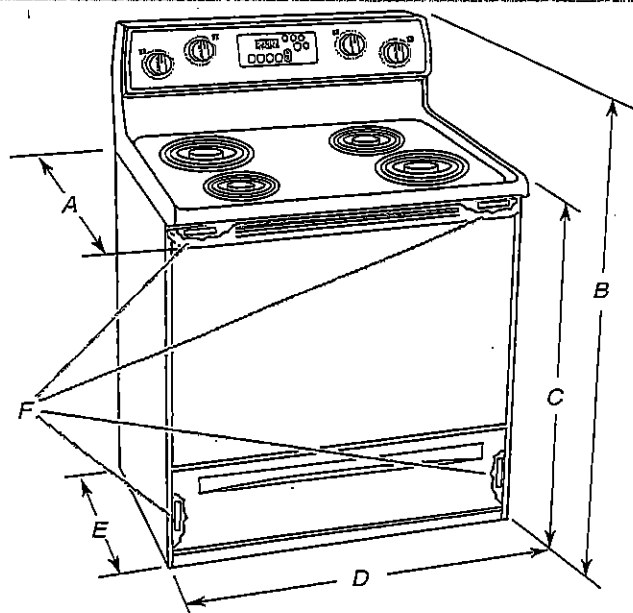

- A. 27³/₄" (70.5 cm) max. depth with handle
- B. 46⁷/₈" (119.1 cm) overall height (max.) with leveling legs screwed all the way in*
- C. 36" (91.4 cm) cooktop height (max.) with leveling legs screwed all the way in*
- D. 29⁷/₈" (75.9 cm) width
- E. 25⁵/₁₆" (64.3 cm) depth - back of range to front of cooktop**
- F. Model/serial/rating plate (located on the frame behind a top corner of the door or either side of the drawer)

IMPORTANT: Range must be level after installation. Follow the instructions in the "Level Range" section. Using the cooktop as a reference for leveling the range is not recommended.

*Range can be raised approximately 1" (2.5 cm) by adjusting the leveling legs.

**Front of door and drawer may extend further forward depending on styling.

Cabinet Dimensions

Cabinet opening dimensions shown are for 25" (64.0 cm) countertop depth, 24" (61.0 cm) base cabinet depth and 36" (91.4 cm) countertop height.

IMPORTANT: If installing a range hood or microwave hood combination above the cooking surface, follow the range hood or microwave hood combination installation instructions for dimensional clearances above the cooktop surface.

A freestanding range may be installed next to combustible walls with zero clearance.

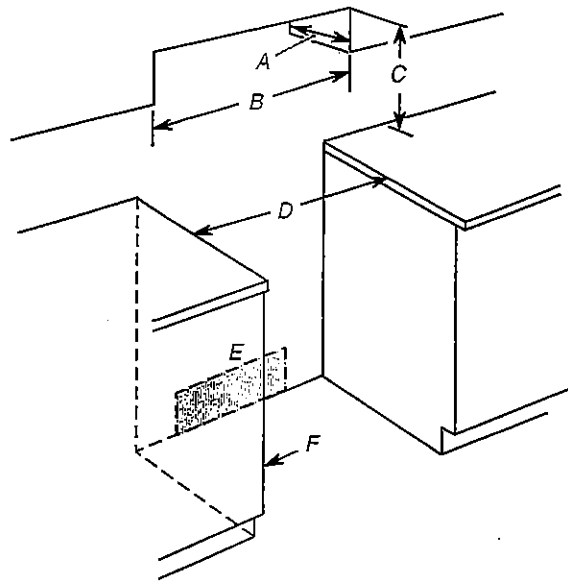

- A. 13" (33.0 cm) max. upper cabinet depth
- B. 30" (76.2 cm) min. opening width
- C. For minimum clearance to top of cooktop, see NOTE*
- D. 30" (76.2 cm) min. opening width
- E. Outlet - 8" (20.3 cm) to 22" (55.9 cm) from either cabinet, 7" (17.8 cm) max. from floor.
- F. Cabinet door or hinges should not extend into the cutout.

*NOTE: 24" (61.0 cm) minimum when bottom of wood or metal cabinet is covered by not less than 1/4" (6.4 mm) flame retardant millboard covered with not less than No. 28 MSG sheet steel, 0.015" (0.4 mm) stainless steel, 0.024" (0.6 mm) aluminum or 0.020" (0.5 mm) copper.

30" (76.2 cm) minimum clearance between the top of the cooking platform and the bottom of an uncovered wood or metal cabinet.

RF

JAN 28/20

C2 COUNTRY LANE
 LOT 49-6
 20-2447 EN ELEV B
 THE BARRINGTON

33 of 42

WHIRLPOOL 30" (76.0 CM) FREESTANDING ELECTRIC RANGES
 Model YWFE515S0JS

Install Anti-Tip Bracket

⚠ WARNING



Tip Over Hazard

A child or adult can tip the range and be killed.
 Install anti-tip bracket to floor or wall per installation instructions.
 Slide range back so rear range foot is engaged in the slot of the anti-tip bracket.
 Re-engage anti-tip bracket if range is moved.
 Do not operate range without anti-tip bracket installed and engaged.
 Failure to follow these instructions can result in death or serious burns to children and adults.

1. Remove the anti-tip bracket from where it is taped inside the storage drawer or warming drawer.
2. Determine which mounting method to use: floor or wall.
 If you have a stone or masonry floor, you can use the wall mounting method. If you are installing the range in a mobile home, you must secure the range to the floor.
3. Determine and mark centerline of the cutout space. The mounting can be installed on either the left-side or right-side of the cutout. Position mounting bracket against the wall in the cutout so that the V-notch of the bracket is 12⁹/₁₆" (31.9 cm) from centerline as shown.

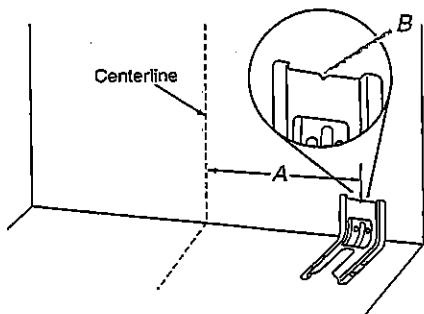

A. 12⁹/₁₆" (31.9 cm)
 B. Bracket V-notch

4. Drill two 1/8" (3 mm) holes that correspond to the bracket holes of the determined mounting method. See the following illustrations.

Floor Mounting

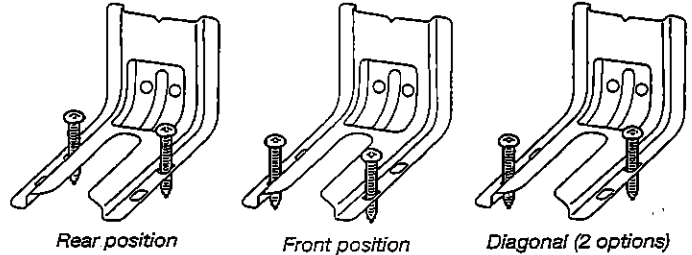

Wall Mounting

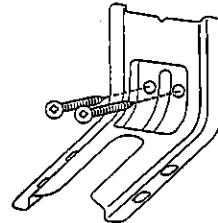

5. Using the Phillips screwdriver, mount anti-tip bracket to the wall or floor with the two #12 x 1⁵/₈" (4.1 cm) screws provided.
6. Move range close enough to opening to allow for final electrical connections. Remove shipping base, cardboard or hardboard from under range.
7. Move range into its final location, making sure rear leveling leg slides into anti-tip bracket.

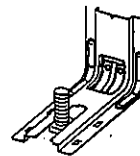

8. Move range forward onto shipping base, cardboard or hardboard to continue installing the range using the following installation instructions.

42

C2 COUNTRY LANE
LOT 49-6
20-2447 EN ELEV B
THE BARRINGTON

34 of 42

Whirlpool® Dishwasher with ENERGY STAR® qualification



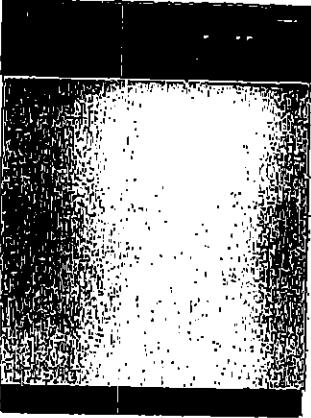



WDF310PAAS
Black-on-Stainless

OTHER AVAILABLE COLORS

 Black
Model: WDF310PAAB

 Biscuit-on-Biscuit
Model: WDF310PAAT

 White
Model: WDF310PAAW

 Universal Silver
Model: WDF310PAAD



DIMENSIONS		KEY FEATURES:
Maximum Height	34 1/2 Inches	ENERGY STAR® Qualified No One Has Fewer Repairs 17 Years In A Row Resource - Efficient Wash System CEE Tier 1 qualified Tall Tub Design White Plastic Interior Quiet Partner(TM) I Sound Package Auto Soil Sensor Electronic Controls 3 Automatic Cycles 1-Hour Wash Cycle Heavy Wash Cycle Normal Cycle 4 Options High Temperature Wash System Heated Dry Option 4 Hour Delay Wash Option 4-Tier SheerClean Direct Feed Wash System Control Lock Vinyl Racks In-Rack Silverware Basket
Minimum Height	33 1/2 Inches	
Height	34 1/2 Inches	
Depth	24 1/2 Inches	
Width	23 7/8 Inches	
Dimensions shown are for planning purposes only. For complete information, see Installation Instructions packaged with product.		
ELECTRICAL		
15 Amps Amps. 60 Hz. 120 V. 15,		
Before purchasing this appliance, read important information about its estimated annual energy consumption or energy efficiency rating that is available from your dealer.		

R2

C2 COUNTRY LANE
LOT 49-6
20-2447 EN ELEV B
THE BARRINGTON

35^{3,4} OF 42

Whirlpool® Undercounter Dishwasher

PRODUCT MODEL NUMBERS

WDF110PAB	WDE310PLA	WDF530PSY
WDF111PAB	WDF320PAD	WDF540PAD
WDF120PAF	WDF510PAY	WDF730PAY
WDF121PAF	WDF520PAD	WDT710PAY
WDF310PAA	WDF530PAY	WDT720PAD
WDF310PCA	WDF530FLY	WDT770PAY

Electrical Requirements: 120-volt, 60-Hz, AC only, 15- or 20-amp. fused electrical supply. Copper wire only. A time delay fuse or circuit breaker and separate circuit is recommended.

If direct wiring dishwasher: Use flexible, armored, or nonmetallic, sheathed copper wire with grounding wire that meets the wiring requirements for your home and local codes and ordinances. Use a UL listed or CSA approved conduit connector.



If connecting dishwasher with a power supply cord: Use Power Supply Cord Kit (Part No. 4317824) marked for use with dishwashers. Follow the kit instructions for installing the power supply cord.



Power supply cord must plug into a grounded 3 prong, outlet, located in the cabinet next to the dishwasher opening. Outlet must meet all local codes and ordinances.

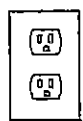

Water Supply Requirements: A hot water line with 20 to 120 psi (138 to 862 kPa) water pressure. Water temperature must be 120°F (49°C) water at dishwasher. Use 3/8" O.D. copper tubing with compression fitting or flexible braided water supply line (1/2" minimum plastic tubing is not recommended). Use a 90° elbow with 3/4" N.P.T. external pipe threads on one end. Do not solder within 6" (15.2 cm) from water inlet valve.

Drain Requirements: A new drain hose is supplied with your dishwasher. If this is not long enough, use a new drain hose with a maximum length of 12' (3.7 m) (Part No. 3385556) that meets all current AHAM/IAPMO test standards, is resistant to heat and detergent, and fits the 1" (2.5 cm) drain connector of the dishwasher.

Make sure to connect the drain hose to waste tee or disposer inlet above drain trap in house plumbing and 20" (50.8 cm) minimum above the floor. It is recommended

that the drain hose either be looped up and securely fastened to the underside of the counter or be connected to an air gap.

Make sure to use an air gap if the drain hose is connected to house plumbing lower than 20" (50.8 cm) above subfloor or floor.

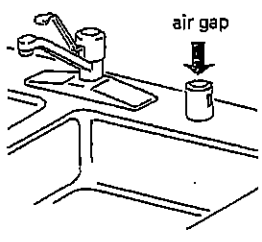

Use 1/2" (1.3 cm) minimum I.D. drain line fittings.

If required, the air gap should be installed in accordance with the air gap installation instructions. When connecting the air gap, a rubber hose (not provided) will be needed to connect to the waste tee or disposer inlet.

PRODUCT DIMENSIONS

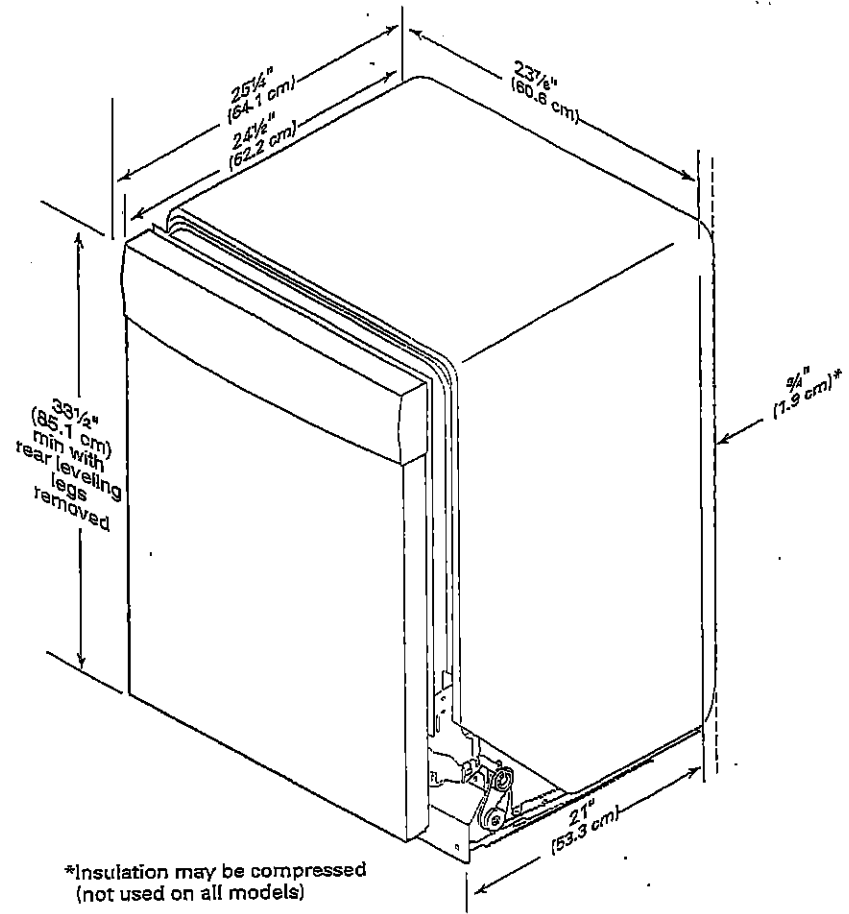

Because Whirlpool Corporation policy includes a continuous commitment to improve our products, we reserve the right to change materials and specifications without notice.

Dimensions are for planning purposes only. For complete details, see Installation Instructions packed with product. Specifications subject to change without notice.

42

C2 COUNTRY LANE
LOT 49-6
20-2447 EN ELEV B
THE BARRINGTON

36 of 42

CABINET CUTOUT DIMENSIONS

WDF320Pn

NOTE: Shaded areas of cabinet walls show where utility connections may be installed.

*Measure from the lowest point on the underside of the countertop. May be reduced to 33½" (85.1 cm) by removing the rear leveling legs from dishwasher.

**Minimum, measured from narrowest point of opening.

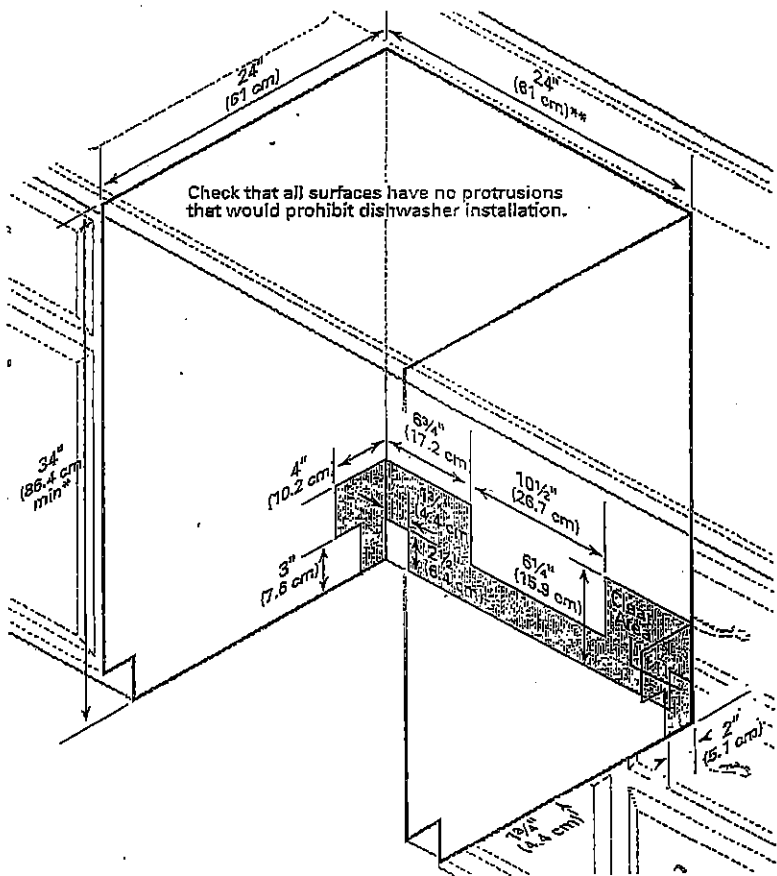

418

C2 COUNTRY LANE
LOT 49-6
20-2447 EN ELEV B
THE BARRINGTON

37 of 42

WHIRLPOOL WASHER Model #: WFW5620HW

Whirlpool Brand Canada English | Washer and Dryers | Washers | Front Load Washers | WFW5620HW

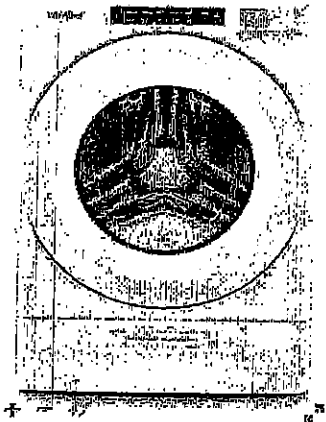

5.2 cu. ft. I.E.C. Closet-Depth
Front Load Washer with
Load & Go™ Dispenser



Whirlpool 5.2 cu. ft. I.E.C. Closet-Depth Front Load Washer with Load & Go™
Dispenser
Model #: WFW5620HW

Dimensions

Depth	80.17 cm, 31-9/16 in
Depth With Door Open 90 Degree	143.51 cm, 56-1/2 in
Minimum Height	98.11 cm, 38-5/8 in
Width	68.58 cm, 27.0 in

Appearance

LCD Touch Screen	No
Window	Yes

Details

Drum Material	Stainless Steel
---------------	-----------------

Cycles and Options

Number of Wash Cycles	37
-----------------------	----

Electrical

Hz	60
Power Cord Included	Yes

36

C2 COUNTRY LANE
 LOT 49-6
 20-2447 EN ELEV B
 THE BARRINGTON

38 of 42

WHIRLPOOL WASHER Model #: WFW5620HW

LOCATION REQUIREMENTS

Proper installation is your responsibility.

You will need:

- A water heater set to 120°F (49°C).
- A grounded electrical outlet located within 6 ft (1.8 m) of power cord on back of washer.
- Hot and cold water faucets located within 4 ft (1.2 m) of hot and cold water fill valves on washer, and water pressure of 20–100 psi (137.9–689.6 kPa).
- A level floor with maximum slope of 1" (25 mm) under entire washer. Installing on carpet or surfaces with foam backing is not recommended.
- Floor must support washer's total weight (with water and load) of 315 lbs (143 kgs).

IMPORTANT: Do not install, store, or operate washer where it will be exposed to weather or in temperatures below 32°F (0°C). Water remaining in washer after use may cause damage in low temperatures. See "Washer Care" in your Use and Care Guide for winterizing information.

Whirlpool Models*

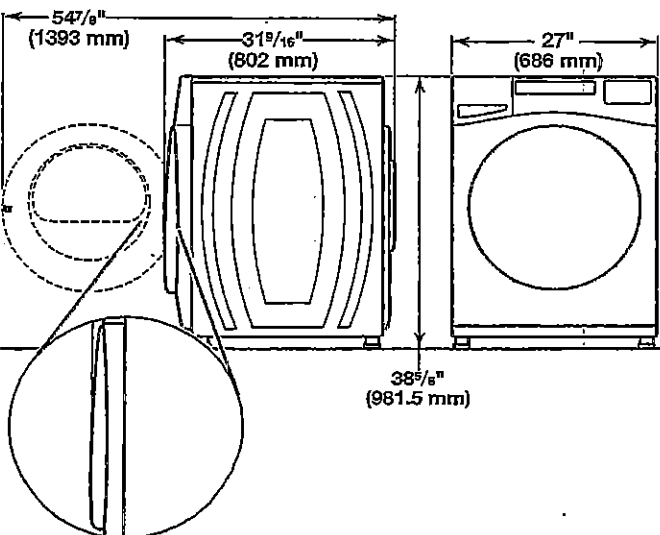
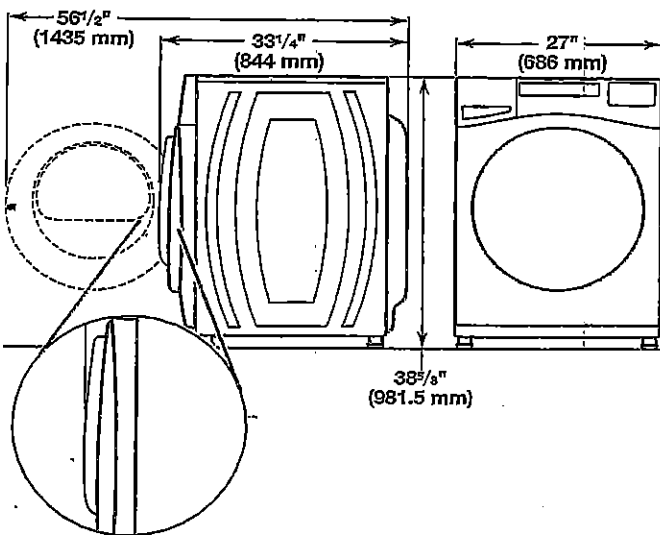

*For additional details (or information) specific to your model, refer to the 'Dimensions' listed for your model at www.whirlpool.com.

Maytag Models

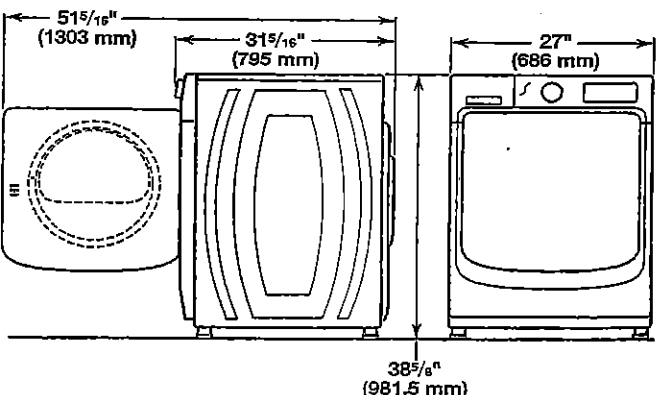
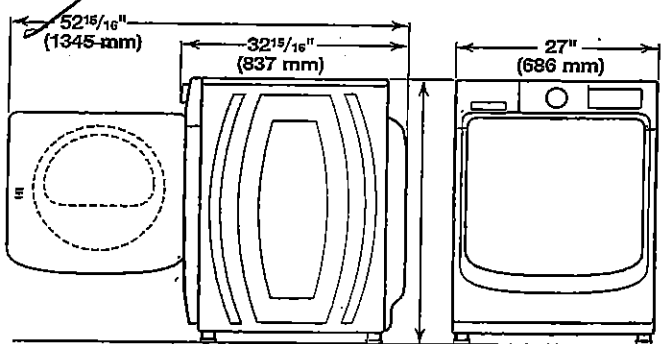

All dimensions show minimum spacing allowed. For each arrangement, consider allowing more space for ease of installation and servicing, and spacing for companion appliances and clearances for walls, doors, and floor moldings.

Space must be large enough to allow door to fully open. Add spacing of 1" (25 mm) on all sides of washer to reduce noise transfer. If a closet door or louvered door is installed, top and bottom air openings in door are required.

Recessed area or closet installation (stacked washer and dryer):

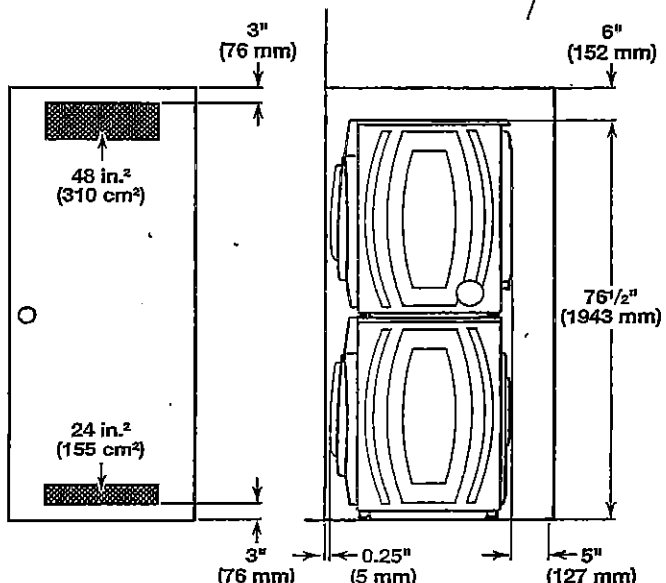

C2 COUNTRY LANE
LOT 49-6
20-2447 EN ELEV B
THE BARRINGTON

39 of 42

WHIRLPOOL WASHER Model #: WFW5620HW

Custom under-counter installation:

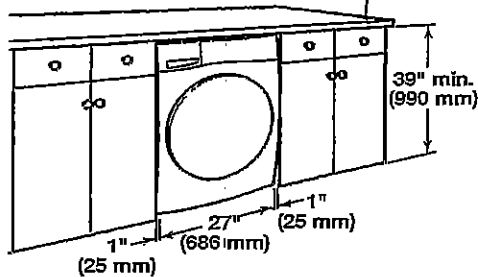

Recessed area or closet installation:

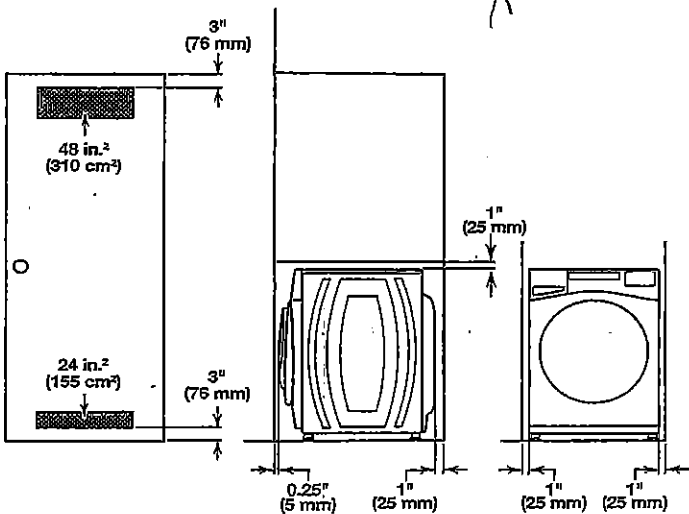

Custom cabinet installation:

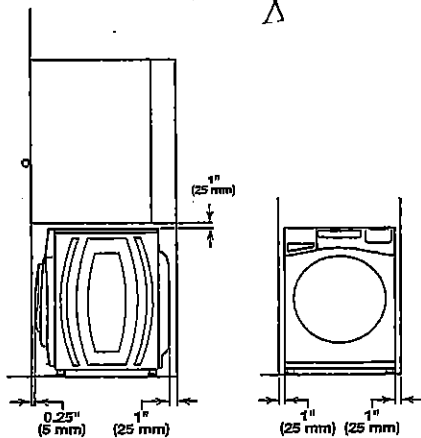

DRAIN SYSTEM

The drain system can be installed using a floor drain, wall standpipe, floor standpipe, or laundry tub. Select the method you need.

IMPORTANT: To avoid siphoning, only 4.5" (114 mm) of drain hose should be inside standpipe. Always secure drain hose with cable tie.

Floor standpipe drain system

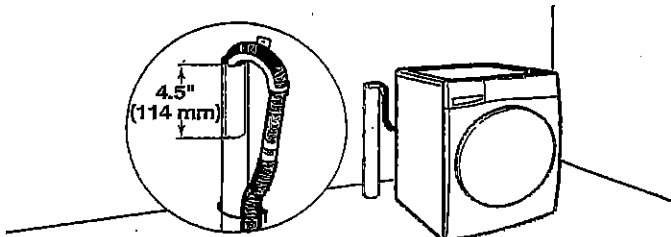

Minimum diameter for a standpipe drain: 2" (51 mm). Minimum carry-away capacity: 17 gal. (64 L) per minute. A 1/4" (6 mm) diameter to 1" (25 mm) diameter Standpipe Adapter Kit is available (Part Number 3363920). Top of standpipe must be at least 30" (762 mm) high; install no higher than 96" (2.44 m) from bottom of washer. If you have an overhead sewer and need to pump higher than 96" (2.44 m), a sump pump and associated hardware are needed. See "Alternate parts."

Wall standpipe drain system

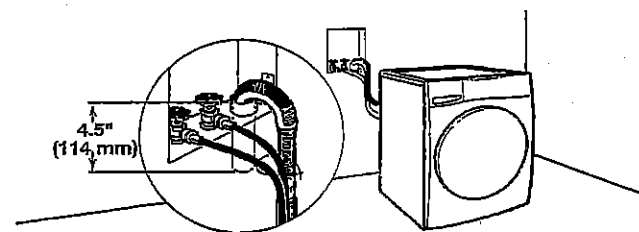

See requirements for floor standpipe drain system.

Laundry tub drain system

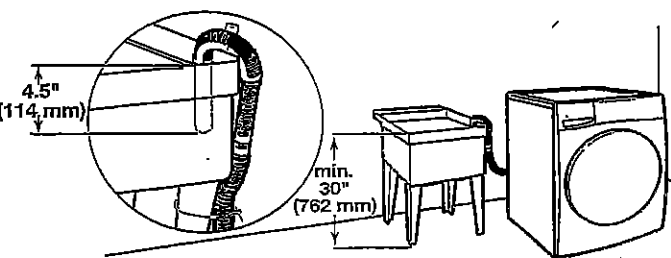

Minimum capacity: 20 gal. (76 L). Top of laundry tub must be at least 30" (762 mm) above floor; install no higher than 96" (2.44 m) from bottom of washer.

B.2

C2 COUNTRY LANE
LOT 49-6
20-2447 EN ELEV B
THE BARRINGTON

40 of 42

WHIRLPOOL DRYER Model #: YWED5620HW

Whirlpool Brand Canada English | Washer and Dryers | Dryers | Electric Dryers | YWED5620HW

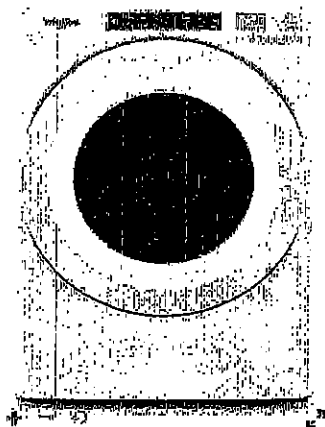

7.4 cu. ft. Front Load Electric
Dryer with Intuitive Touch
Controls



Whirlpool 7.4 cu. ft. Front Load Electric Dryer with Intuitive Touch Controls
Model #: YWED5620HW

Dimensions

Depth	78.74 cm, 31.0 in
Depth With Door Open 90 Degree	138.43 cm, 54-1/2 in
Height	98.42 cm, 38-3/4 in
Width	68.58 cm, 27.0 in

Configuration and Overview

Fuel Type	Electric
-----------	----------

Cycles and Options

Cycle Time Remaining	Yes
Last Filter Indicator	No
Number of Dryer Cycles	36
Number of Dryness Levels	3

Ventilation System

Long Vent	No
Maximum Vent Length	64
Venting Direction	Left, Right, Bottom, Rear

Electrical

Hz	60
Power Cord Included	Yes

58

C2 COUNTRY LANE
LOT 49-6
20-2447 EN ELEV B
THE BARRINGTON

41 of 42

WHIRLPOOL DRYER Model #: YWED5620HW

Back view:

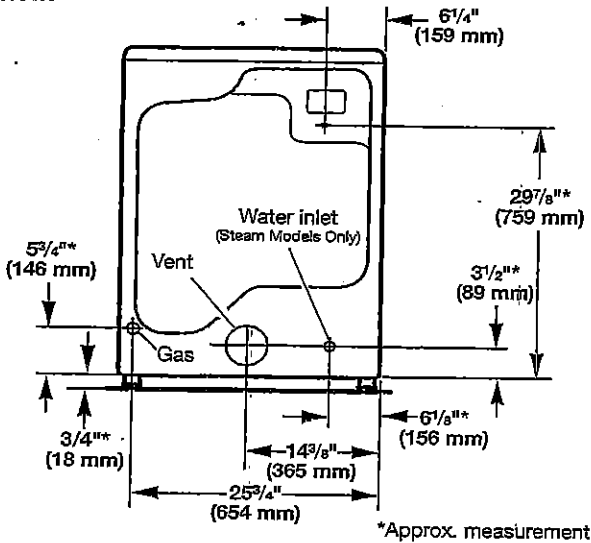

NOTE: Most installations require a minimum of 5" (127 mm) clearance behind dryer for exhaust vent with elbow. See "Venting Requirements."

Installation Clearances

For each arrangement, consider allowing more space for ease of installation and servicing, spacing for companion appliances, and clearances for walls, doors, and floor moldings. Space must be large enough to allow door to fully open. Add spacing on all sides of dryer to reduce noise transfer. If a closet door or louvered door is installed, top and bottom air openings in door are required.

Check code requirements. Some codes limit, or do not permit, installation of the dryer in garages, closets, mobile homes, or sleeping quarters. Contact your local building inspector.

NOTE: No other fuel-burning appliance can be installed in the same closet as a dryer.

Installation spacing for recessed area or closet installation

All dimensions show recommended and minimum spacing allowed.

- Additional spacing should be considered for ease of installation and servicing.
- Additional clearances might be required for wall, door, floor moldings, dryer venting, and gas line.
- Additional spacing should be considered on all sides of the dryer to reduce noise transfer.
- For closet installation with a door, minimum ventilation openings in the top and bottom of the door are required. Louvered doors with equivalent ventilation openings are acceptable.
- Companion appliance spacing should also be considered.

Recommended installation clearances (dryer only):

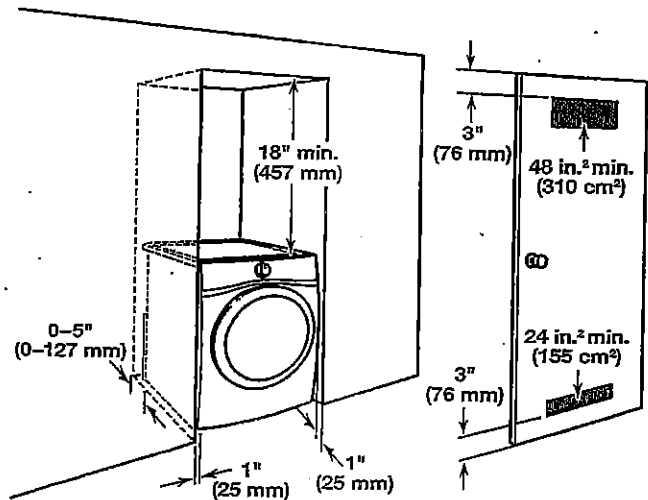

0" (0 mm) rear spacing is allowed for straight back venting only. For steam models only, inlet hose must not be kinked.

Custom under-counter installation:

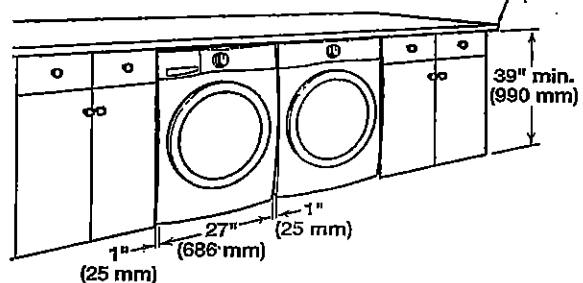

Mobile home – Additional installation requirements:

This dryer is suitable for mobile home installations. The installation must conform to the Manufactured Home Construction and Safety Standard, Title 24 CFR, Part 3280 (formerly the Federal Standard for Mobile home construction and Safety, Title 24, HUD Part 280) or Standard CAN/CSA-Z240 MH.

Mobile home installations require:

- Metal exhaust system hardware, available for purchase from your dealer. For further information, see "Assistance or Service" in your Use and Care Guide.
- Special provisions must be made in mobile homes to introduce outside air into dryer. Openings (such as a nearby window) should be at least twice as large as dryer exhaust opening.

For mobile home installation of gas dryers:

- Mobile Home Installation Hold-down Kit Part Number 346764 is available to order. For further information, see "Assistance or Service" in your Use and Care Guide.

C2 COUNTRY LANE
LOT 49-6
20-2447 EN ELEV B
THE BARRINGTON

42 of 42

WHIRLPOOL DRYER Model #: YWED5620HW

Additional parts may be required, depending on your installation. Check local codes. Check existing electrical supply and venting. Read "Electrical Requirements" and "Venting Requirements" before purchasing parts.

If using a power supply cord:

Use a UL Listed power supply cord kit marked for use with clothes dryers. The kit should contain:

- A UL Listed 30 amp power supply cord, rated 120/240 volt minimum. The cord should be type SRD or SRDT and be at least 4 ft. (1.22 m) long. The wires that connect to the dryer must end in ring terminals or spade terminals with upturned ends.
- A UL Listed strain relief.

Optional Equipment (not supplied with dryer):

Refer to your Use and Care Guide for information about accessories available for your dryer.

LOCATION REQUIREMENTS

Check code requirements. Some codes limit, or do not permit, installing dryer in garages, closets, mobile homes, or sleeping quarters. Contact your local building inspector.

⚠ WARNING



Explosion Hazard

Keep flammable materials and vapors, such as gasoline, away from dryer.

Place dryer at least 18 inches (460 mm) above the floor for a garage installation.

Failure to do so can result in death, explosion, or fire.

You will need:

- A location allowing for proper exhaust installation. See "Venting Requirements."
- A separate 15 or 20 amp circuit for a gas dryer or 30 amp circuit for an electric dryer.
- If using power supply cord, a grounded electrical outlet located within 2 ft. (610 mm) of either side of dryer. See "Electrical Requirements."
- Floor must support dryer weight of 200 lbs. (90.7 kg). Also consider weight of companion appliance.
- Cold water faucets located within 4 ft. (1.2 m) of the water fill valves, and water pressure of 20–120 psi (138–827 kPa). You may use your washer's water supply by purchasing the necessary parts noted in "Parts needed."
- Level floor with maximum slope of 1" (25 mm) under entire dryer. If slope is greater than 1" (25 mm), install Extended Dryer Feet Kit, Part Number 279810. If not level, clothes may not tumble properly and automatic sensor cycles may not operate correctly.
- For garage installation, place dryer at least 18" (460 mm) above floor. If using a pedestal, you will need 18" (460 mm) to bottom of dryer.
- The dryer must not be installed or stored in an area where it will be exposed to water and/or weather.

IMPORTANT: Do not operate, install, or store dryer where it will be exposed to water, weather, or at temperatures below 40°F (4°C). Lower temperatures may cause dryer not to shut off at end of automatic sensor cycles, resulting in longer drying times.

DRYER DIMENSIONS

Front view:

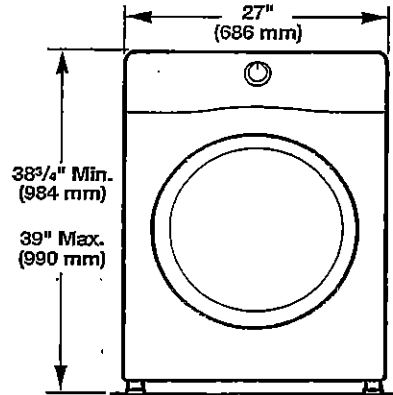

Side view:

Whirlpool Models

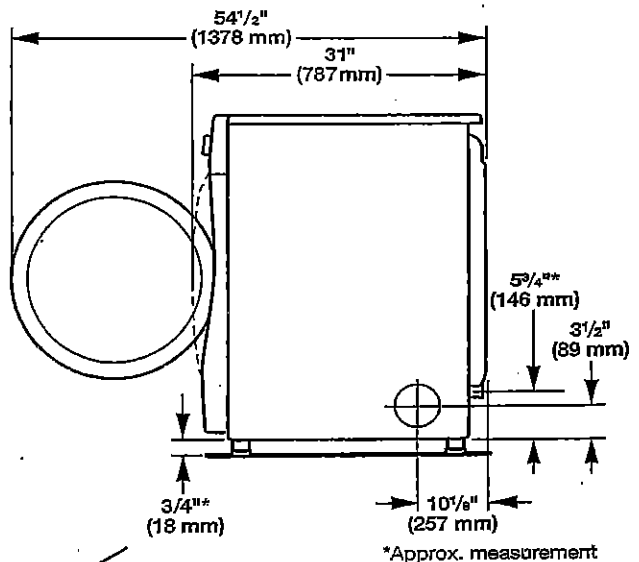

Maytag Models

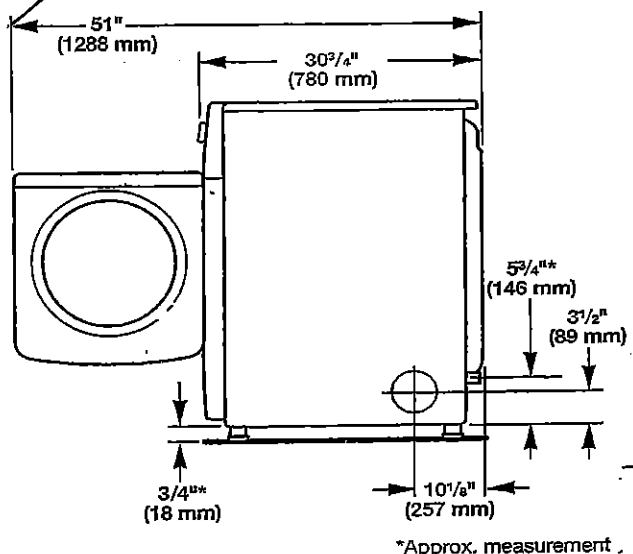

*Approx. measurement

RF