

Sales Selection Sheet
Checklist

1 of 28

LOT 243 Model: 27-2587 CRN ELEV B THE MAXWELL
PURCHASERS: FREDY, ALEXANDER FONSECA CASTANEDA AND
LIRESKY ZIRANLLY CARRENO BOLIVAR
VENDOR: Heathwood Homes (Huron) Limited

DELETE GREAT ROOM GAS FIREPLACE
MASTER ENSUITE- OPTIONAL DOUBLE SINKS

- ☒ FINISHED BASEMENT
☐ COLD CELLAR

UPGRADED / MODIFIED ELEVATION

- ☒ CORNER UPGRADE
☐ REAR UPGRADE

CEILING UPGRADE - SMOOTH

- ☐ MAIN FLOOR
☐ SECOND FLOOR
☐ BASEMENT

ADDITIONAL ROUGH-INS

- ☒ 200 AMP SERVICE
☐ WET BAR ROUGH-IN
☐ HUMIDIFIER
☒ AIR CONDITIONING

GAS ROUGH-IN

- ☐ STOVE
☐ DRYER
☐ BBQ
☐ ADDITIONAL FIREPLACE

KITCHEN: HOODFAN VENTING SIZE

- ☒ 6 IN ROUND DUCT
☐ 7 IN ROUND DUCT

FULL BASEMENT STAIRS:	Carpet Grade
UPPER BASEMENT STAIRS:	N/A
LOWER BASEMENT STAIRS:	N/A
MAIN STAIRS:	All Oak
MEDIA STAIRS (if applicable):	N/A
LOFT STAIRS (if applicable):	N/A

Aug 6/20
Date Purchaser: *Signatures*

Aug 6/20
Date Decor Consultant: *BRENDA LUICKER*

on file

- APPROVED -

Date Purchaser:

-08- 0 6 2020

Date Heathwood Homes (Huron) Limited

Locked Date:

Approved

M. Rosen



Sales Selection Sheet

Wallaceton
SCHEDULE 'E'

2 of 28

PURCHASERS: FREDY, ALEXANDER FONSECA CASTANEDA and LIRESKY,
ZIRANILLY CARRENO BOLIVAR

TEL:

LOT / UNIT	PHASE	MODEL	
243	2	27-2587 CRN B The Maxwell	

It is herein understood and agreed between the undersigned parties hereto that the following changes shall be made to the above mentioned Agreement of Purchase and Sale in accordance with the agreement and except for such changes noted below, all other terms and conditions in the Agreement of Purchase and Sale shall remain as stated herein: It is further understood that and agreed that all changes and additions shall be installed as per builder's specifications, location and available selections. The Purchaser hereby agrees to purchase the following extras:

MISC.

1	SCHEDULE E- TEN THOUSAND DOLLARS (\$10,000) AT DECOR (NO CASH VALUE) SINGLES As per Revised Schedule E from original 5 Appliances Dated July 13/20	Qty: 1	
30,505	Note:		

Sub Total

HST

Total

1. This Sales Selection Sheet when properly executed forms part of our Agreement of Purchase and Sale.
2. All extras and upgrades listed above are subject to Construction Progress and Architectural and Municipal requirements.
3. In the event the Vendor is unable to incorporate the work approved above in the construction of the house for any reason whatsoever, the Vendor will not be liable to the Purchaser in any way. The monies paid for any changes or optional extras not proceeded with shall be returned to the Purchaser, without interest. The cost of options or extras is non-refundable in all other circumstances. If for any reason whatsoever the Agreement of Purchase and Sale is not completed, the total cost of work approved above will be retained by the Vendor.
4. The Vendor reserves the right to substitute above materials and equipment with that of equal or better quality.
5. Purchaser acknowledges that items may not be exactly as shown. Variations from the Vendor's samples may occur in finished materials due to normal production processes. Vendor is not responsible for shade difference which may occur from different dye lots or wood grains. Variations from the Vendor's samples will occur with natural materials such as wood, marble, granite, hardwood and brick.
6. The Vendor reserves the right to select Grout & Thresholds that best suits the Tile selected.
7. Selections will not be processed unless signed by Heathwood Homes Head Office.
8. The selections made on this schedule are final and cannot be changed once submitted.
9. The Purchaser has checked and acknowledges the accuracy of this schedule.

Payment Summary

Paid By Amount

Total Payment:

PURCHASER:

Signatures on
FREDY, ALEXANDER FONSECA CASTA

04-Aug-20

DATE

Brenda Huber
Decor Consultant

04-Aug-20

DATE

PURCHASER:

file
LIRESKY, ZIRANILLY CARRENO BOLIVAR

04-Aug-20

DATE

-08-06 2020

Date Approved Heathwood Homes (Huron) Limited

TAX#:1

PREPARED BY: Marilyn Rosen

PE 376-1

S:\invoice.rpt 28may19

FREDY, ALEXANDER FONSECA CASTANEDA/LIRESKY, ZIRANLLY CARRENO
BOLIVAR
Project: Wallaceton
Unit: 243, Phase: 2
Model: 27-2587 CRN B The Maxwell

Created: 6/25/2020 09:15:48
Locked:
Closed:

3 of 28

Kitchen

Cabinet Colour/Style	9203	Classic II-MANCHESTER-ORCHID-PAINT MDF ***UPG***
Countertop	8897	Group 4-Quartz-Caesarstone-ORGANIC WHITE # 4600-3/4 inch with built-up edge ***4***
Countertop Edge	4005	DOUBLE MITRE 1 1/2 INCH ***UPG*** 
Cabinet Hardware	7667	12881-HARDWARE ***STD***
Island Cabinet Colour/Style	9203	Classic II-MANCHESTER-ORCHID-PAINT MDF ***UPG***
Island Countertop	8897	Group 4-Quartz-Caesarstone-ORGANIC WHITE # 4600-3/4 inch with built-up edge ***4***
Backsplash	1111	N/A *****
Backsplash Grout	1111	N/A *****
Backsplash Tile Pattern	1111	N/A *****
HoodFan	8896	SCB51436-CYCLONE 36 inch STAINLESS CANOPY CHIMNEY HOODFAN-STAINLESS STEEL ***Upg*** PAGE 24
Appliances	8896	Purchasers have been advised: standard fridge opening is a minimum 37 3/8 x 73 3/8". Ice Waterline Rough-In is included.
Appliances	8896	Standard stove opening is 30" and standard dishwasher opening is 24". Any gas stove will require backsplash or stainless steel backing to avoid fire hazards.
Appliances	8896	Purchasers acknowledge: Heathwood Homes and its contractors will not be responsible for any kitchen cabinet changes due to appliances dimension changes after
Flooring	7502	Red Oak Pearl-Vintage Engineered-ECLIPSE-3/4 inch x 3 1/4 inch ***g***
Floor Tile Grout	1111	N/A *****
Floor Tile Pattern	1111	N/A *****

FoyeComment	
Flooring	9115 OV.ET.MGR.1224.PL Eterna Series Medium Grey 12x24 Polished See Tile Direction

AF

FREDY, ALEXANDER FONSECA CASTANEDA/LIRESKY, ZIRANLLY CARRENO
BOLIVAR
Project: Wallaceton
Unit: 243, Phase: 2
Model: 27-2587 CRN B The Maxwell

Created: 6/25/2020 09:15:48
Locked:
Closed:

4 of 28

Polished See Tile Direction
SKETCH # 2 PAGE 18

Floor Tile Grout	7704	Grout-(19) Pearl Gray ***STD***
Floor Tile Pattern	3050	SIDE TO SIDE ***STD***

Comment 90572225

Laundry Room

Flooring	5494	GE.NA.GRY.1313-New Albion-Grey-13 x 13 ***STD***
Floor Tile Grout	2225	Grout-(27) Silver ***STD***
Floor Tile Pattern	3000	STANDARD SQUARE ***STD***

Comment

Laundry Room Opt.

Cabinet - Uppers	1111	N/A *****
Cabinet Hardware	1111	N/A *****
Comment		

Mud Room

Flooring	9115	OV.ET.MGR.1224.PL Eterna Series Medium Grey 12x24 Polished See Tile Direction SKETCH # 2 PAGE 18
Floor Tile Grout	7704	Grout-(19) Pearl Gray ***STD***
Floor Tile Pattern	3050	SIDE TO SIDE ***STD***

Comment

FFF

FREDY, ALEXANDER FONSECA CASTANEDA/LIRESKY, ZIRANLLY CARRENO
BOLIVAR
Project: Wallaceton
Unit: 243, Phase: 2
Model: 27-2587 CRN B The Maxwell

Created: 6/25/2020 09:15:48
Locked:
Closed:

5 of 28

Powder Room

Flooring	9115	OV.ET.MGR.1224.PL Eterna Series Medium Grey 12x24 Polished See Tile Direction SKETCH # 2 PAGE 18
Floor Tile Grout	7704	Grout-(19) Pearl Gray ***STD***
Floor Tile Pattern	3050	SIDE TO SIDE ***STD***

Plumbing Fixture (Colour)	1737	Plumbing Fixtures-WHITE ***STD***
Comment		

Dining Room

Flooring	7502	Red Oak Pearl-Vintage Engineered-ECLIPSE-3/4 inch x 3 1/4 inch ***STD***
Comment		

Great Room

Flooring	7502	Red Oak Pearl-Vintage Engineered-ECLIPSE-3/4 inch x 3 1/4 inch ***STD***
Comment		

Upper Hall

Flooring	7630	T-04-Dynasty Tex-T-04-40 oz Poly ***STD***
Comment		

Study

Flooring	7502	Red Oak Pearl-Vintage Engineered-ECLIPSE-3/4 inch x 3 1/4 inch ***STD***
Comment		

RFF

FREDY, ALEXANDER FONSECA CASTANEDA/LIRESKY, ZIRANLLY CARRENO
BOLIVAR
Project: Wallaceton
Unit: 243, Phase: 2
Model: 27-2587 CRN B The Maxwell

Created: 6/25/2020 09:15:48
Locked:
Closed:

6 of 28

Opt. Finished Basement (Rec) Room/Hall

Flooring 7630 T-04-Dynasty Tex-T-04-40 oz Poly ***STD***

Comment

Master Bedroom

Flooring 7630 T-04-Dynasty Tex-T-04-40 oz Poly ***STD***

Comment

Bedroom 2

Flooring 7630 T-04-Dynasty Tex-T-04-40 oz Poly ***STD***

Comment

Bedroom 3

Flooring 7630 T-04-Dynasty Tex-T-04-40 oz Poly ***STD***

Comment

Bedroom 4

Flooring 7630 T-04-Dynasty Tex-T-04-40 oz Poly ***STD***

Comment

Ensuite 4

Cabinet Colour/Style 9111 VIKING III SIMCOE ORCHID 3DL ***STD***

Countertop 8796 6698-46-Countertop-PALOMA POLAR ETCHINGS
FINISH-Formica ***STD***

FF

FREDY, ALEXANDER FONSECA CASTANEDA/LIRESKY, ZIRANLLY CARRENO
BOLIVAR
Project: Wallaceston
Unit: 243, Phase: 2
Model: 27-2587 CRN B The Maxwell

Created: 6/25/2020 09:15:48
Locked:
Closed:

7 of 28

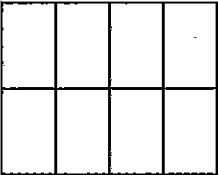
Countertop Edge	1111	N/A *****
Cabinet Hardware	7672	135-HARDWARE ***STD***
Floor Tile	7672	GE.BY.AZR.1313 New Byzantine Azzuro 13
Floor Tile Grout	2225	Grout-(27) Silver ***STD***
Floor Tile Pattern	3000	STANDARD SQUARE ***STD***
Plumbing Fixture (colour)	1737	Plumbing Fixtures-WHITE ***STD***
Wall Tile	9020	QT.WV.WHT.0810-Weave-White-8 x 10 ***STD***
Wall Tile Grout	2226	Grout-(00) White ***STD***
Wall Tile Pattern	3090	VERTICAL STACKED ***STD*** 
Comment		

Master Ensuite

Cabinet Colour/Style	9111	VIKING III SIMCOE ORCHID 3DL ***STD***
Countertop	9121	MSI Quartz GROUP 1 ICED WHITE 3/4 inch with double mitre edge ***1***
Countertop Edge	4006	GROUP 1 - DOUBLE MITRE 1 1/2 INCH ***2*** 
Cabinet Hardware	7672	135-HARDWARE ***STD***
Floor Tile	9115	OV.ET.MGR.1224.PL Eterna Series Medium Grey 12x24 Polished See Tile Direction SKETCH #4 PAGE 20
Floor Tile Grout	7704	Grout-(19) Pearl Gray ***STD***
Floor Tile Pattern	3050	SIDE TO SIDE ***STD***

Handwritten signature or initials.

FREDY, ALEXANDER FONSECA CASTANEDA/LIRESKY, ZIRANLLY CARRENO
BOLIVAR
Project: Wallaceton
Unit: 243, Phase: 2
Model: 27-2587 CRN B The Maxwell

Created: 6/25/2020 09:15:48
Locked:
Closed:

8 of 28

Shower Floor Tile	8661	OD.ON.SWT.0202.MT.N-Ontario Series Mosaic-Snow White Matte-2 x 2 ***STD***								
Shower Floor Tile Grout	2226	Grout-(00) White ***STD***								
Shower Floor Tile Pattern	3000	STANDARD SQUARE ***STD***								
Shower Wall Tile	9115	OV.ET.MGR.1224.PL Eterna Series Medium Grey 12x24 Polished See Tile Direction SKETCH # 4 PAGE 20								
Shower Wall Tile Grout	7704	Grout-(19) Pearl Gray ***UPG***								
Shower Wall Tile Pattern	3070	HORIZONTAL STACKED ***STD*** <table><tr><td></td><td></td></tr><tr><td></td><td></td></tr><tr><td></td><td></td></tr><tr><td></td><td></td></tr></table>								
Shower Jamb(s) and Sill(s)	8923	Shower Jamb / Sill-Thassos White ***STD***								
Plumbing Fixture (colour)	1737	Plumbing Fixtures-WHITE ***STD***								
Comment										

Shared Bathroom

Cabinet Colour/Style	9111	VIKING III SIMCOE ORCHID 3DL ***STD***
Countertop	8796	6698-46-Countertop-PALOMA POLAR ETCHINGS FINISH-Formica ***STD***
Countertop Edge	1111	N/A *****
Cabinet Hardware	7672	135-HARDWARE ***STD***
Flooring	7672	GE.BY.AZR.1313 New Byzantine Azzuro 13
Floor Tile Grout	2225	Grout-(27) Silver ***STD***
Floor Tile Pattern	3000	STANDARD SQUARE ***STD***
Wall Tile	9020	QT.WV.WHT.0810-Weave-White-8 x 10 ***STD***

FF
20

FREDY, ALEXANDER FONSECA CASTANEDA/LIRESKY, ZIRANLLY CARRENO
BOLIVAR
Project: Wallaceton
Unit: 243, Phase: 2
Model: 27-2587 CRN B The Maxwell

Created: 6/25/2020 09:15:48
Locked:
Closed:

9 of 28

Wall Tile Grout 2226 Grout-(00) White ***STD***

Shared Bathroom Floor Tile Pattern 3000 STANDARD SQUARE ***STD***

Plumbing Fixture (Colour) 1737 Plumbing Fixtures-WHITE ***STD***

Shower Floor Tile 8661 OD.ON.SWT.0202.MT.N-Ontario Series Mosaic-Snow White Matte-2 x 2 ***STD***

Shower Floor Tile Grout 2226 Grout-(00) White ***STD***

Shower Floor Tile Pattern 3000 STANDARD SQUARE ***STD***

Shower Jamb(s) 8923 Shower Jamb / Sill-Thassos White ***STD***

Comment

Opt. Finished Basement Bathroom

Shower Floor Tile Grout 2226 Grout-(00) White ***STD***

Shower Floor Tile Pattern 3000 STANDARD SQUARE ***STD***

Shower Wall Tile 9020 QT.WV.WHT.0810-Weave-White-8 x 10 ***STD***

Shower Wall Tile Grout 2226 Grout-(00) White ***STD***

Shower Wall Tile Pattern 3090 VERTICAL STACKED ***STD***

Shower Jamb(s) 8923 Shower Jamb / Sill-Thassos White ***STD***

Cabinet Colour/Style 9158 Viking III-SIMCOE-NAVY BLUE-3DL ***STD***

Countertop 8796 6698-46-Countertop-PALOMA POLAR ETCHINGS FINISH-Formica ***STD***

FF

FREDY, ALEXANDER FONSECA CASTANEDA/LIRESKY, ZIRANLLY CARRENO
BOLIVAR
Project: Wallaceton
Unit: 243, Phase: 2
Model: 27-2587 CRN B The Maxwell

Created: 6/25/2020 09:15:48
Locked:
Closed:

10 of 28

Countertop Edge	1111	N/A *****
Cabinet Hardware	7672	135-HARDWARE ***STD***
Flooring	7672	GE.BY.AZR.1313 New Byzantine Azzuro 13
Floor Tile Grout	2225	Grout-(27) Silver ***STD***
Floor Tile Pattern	3000	STANDARD SQUARE ***STD***
Plumbing Fixture (Colour)	1737	Plumbing Fixtures-WHITE ***STD***
Comment		

Great Room Fireplace

Type	1111	N/A *****
Mantle	1111	N/A *****
Surround Opt.	1111	N/A *****
Note	1111	Purchasers have been advised: heat from the FP can damage TV above a FP and items placed on mantle.
Note	1111	Heathwood and its contractors will not be liable for any damage on items placed/installed above a FP after closing.
Comment		

Basement Stairs

Type	1714	Carpet Grade Stairs ***STD BASEMENT STAIRS***
Colour	7922	Eclipse (Pewter) STAIN TO COMPLIMENT HARDWOOD AND WILL VARY FROM FLOORING ***99***
Carpet Runner	1111	N/A *****
Handrail/Pickets/Post Type	9119	Handrail only on closed walls (one or two sides per building code) ***STD***
Handrail/Pickets/Post Colours	1729	Carpet Grade-Stain handrail, pickets, stringers, nosing_pos
Carpet	7630	T-04-Dynasty Tex-T-04-40 oz Poly ***STD***

FF

FREDY, ALEXANDER FONSECA CASTANEDA/LIRESKY, ZIRANLLY CARRENO
BOLIVAR
Project: Wallacetown
Unit: 243, Phase: 2
Model: 27-2587 CRN B The Maxwell

Created: 6/25/2020 09:15:48
Locked:
Closed:

11 of 28

Custom Stain/Paint	1111	N/A *****
Comment		

Main Stairs

Type	1712	Oak Stairs ***STD MAIN STAIRS***
Colour	7922	Eclipse (Pewter) STAIN TO COMPLIMENT HARDWOOD AND WILL VARY FROM FLOORING ***99***
Carpet Runner	1111	N/A *****
Handrail/Pickets/Posts Type	8148	Single Collar Alt. Plain w/ Shoes with 3 1/2" Square/Cap Post(s)-BLACK ***2***
Handrail/Pickets/Posts Colour	1728	Oak Grade-Stain handrail,oak pickets,stringers,treads,risers
Custom Stain/Paint	1111	N/A *****
Comment		

Throughout

Walls - Paint Colour	1717	22-Wall-WARM GREY ***STD***
Underpad	1079	500 Series-Underpad ***STD***
Thresholds	2232	Metal Thresholds ***STD***
Switches and Plug	5796	Decora White Switches and Plugs ***STD***
Trim Size	8705	4 1/4 Baseboard and 2 3/4 Casings ***STD***
Trim - Paint Colour	1716	Trim-WHITE ***STD***
Comment		

	- APPROVED -		- APPROVED -
	-08-04 2020	Brenda Huber	-08-04 2020
Purchaser:	FREDY, ALEXANDER FONSECA	Decor Consultant	
	Date		Date

FF
le

FREDY, ALEXANDER FONSECA CASTANEDA/LIRESKY, ZIRANLLY CARRENO
BOLIVAR
Project: Wallaceton
Unit: 243, Phase: 2
Model: 27-2587 CRN B The Maxwell

Created: 6/25/2020 09:15:48
Locked:
Closed:

12 of 28

			
Purchaser:	LIRESKY, ZIRANLLY CARREN	Date	Wallaceton
			Date Approved



Sales Selection Sheet

Wallaceton

13 of 28

PURCHASERS: FREDY, ALEXANDER FONSECA CASTANEDA and LIRESKY, ZIRANILLY CARRENO BOLIVAR

TEL:

LOT / UNIT	PHASE	MODEL	
243	2	27-2587 CRN B The Maxwell	

It is herein understood and agreed between the undersigned parties hereto that the following changes shall be made to the above mentioned Agreement of Purchase and Sale in accordance with the agreement and except for such changes noted below, all other terms and conditions in the Agreement of Purchase and Sale shall remain as stated herein: It is further understood that and agreed that all changes and additions shall be installed as per builder's specifications, location and available selections. The Purchaser hereby agrees to purchase the following extras:

APPLIANCES

1	CYCLONE 36" WALLMOUNT CHIMNEY HD SS MODEL SCB51436	Qty: 1
28,854	Note: SPEC PAGE 29	

Cabinetry

2	CABINETRY - CLASSIC II - KITCHEN - UPGRADE 3	Qty: 1
187,436		
28,715	Note:	
3	CABINETRY - CLASSIC II KITCHEN BUILT IN - KITCHEN - UPGRADE 3	Qty: 1
189,295		
30,239	Note: SKETCH # 3 PAGE 19 SPECS PAGES 25-28	

Ceramics

4	CERAMICS - FLOOR - FOYER - UPGRADE 5	Qty: 1
187,716		
28,848	Note:	
5	CERAMICS - FLOOR - POWDER ROOM - UPGRADE 5	Qty: 1
187,724		
28,849	Note:	
6	CERAMICS - FLOOR - GARAGE ENTRY / MUD ROOM - UPGRADE 5	Qty: 1
187,732		
28,850	Note:	
7	CERAMICS - FLOOR - ENSUITE MASTER - UPGRADE 5	Qty: 1
187,764		
28,856	Note:	
8	CERAMICS - SHOWER WALL AND CEILING - INSTALL FLOOR TILE ON WALL AND CEILING - ENSUITE MASTER - UPGRADE 5	Qty: 1
187,675		
28,857	Note:	
9	CERAMICS - SHOWER WALL AND CEILING GROUT - ENSUITE MASTER - GROUT	Qty: 1
187,503		
30,246	Note:	

Electrical

10	ELECTRICAL - RELOCATION OF SWITCHES/LIGHTS (MUST SPECIFY LOCATION) - NOTE: PLUGS CANNOT BE RELOCATED- MUST PURCHASE ADDITIONAL OUTLET.	Qty: 3
189,417		
28,710	Note: RELOCATE TWO KITCHEN LIGHTS TO OVER ISLAND SKETCH # 2 PAGE 18 RELOCATE MASTER ENSUITE CEILING LIGHT TO OVER TUB SKETCH # 4 PAGE 20	

Initials:

TAX#:1

PREPARED BY: Brenda Luker

PE 344-1



Sales Selection Sheet

Wallaceton

14 of 28

PURCHASERS: FREDY, ALEXANDER FONSECA CASTANEDA and LIRESKY,
ZIRANILLY CARRENO BOLIVAR

TEL:

LOT / UNIT 243	PHASE 2	MODEL 27-2587 CRN B The Maxwell	
-------------------	------------	------------------------------------	--

Electrical

11 189,450 28,711	ELECTRICAL - CEILING ROUGH-IN (CAPPED) Note: INSTALL OVER ISLAND - SEE SKETCH# 2 PAGE# 18	Qty: 1
12 189,449 28,712	ELECTRICAL - EXTRA WALL INTERIOR OUTLET ON EXISTING CIRCUIT (DOES NOT INCLUDE KITCHEN OUTLETS) Note: GREAT ROOM APPROX 66" FF - SEE SKETCH# 2 PAGE 18	Qty: 1
*13 189,434 30,248	ELECTRICAL - ADDITIONAL 30AMP /240V OUTLET, PLEASE SPECIFY LOCATION FOR BUILT-IN OVEN/MICROWAVE TO BE CONFIRMED 40 amp Note: FOR BUILT IN OVEN/MICROWAVE SKETCH #3 PAGE 18 SPECS PAGE 28	Qty: 1
*14 189,432 30,855	ELECTRICAL - UPGRADE TO 50AMP/240V FROM 40AMP/240V FOR 36" INDUCTION COOKTOP SEE SPECS PAGES 26 - 27 SKETCH # 3 PAGE 19 Note:	Qty: 1

FIREPLACE

15 28,714	DELETE FIREPLACE IN GREAT ROOM AS PER PURCHASER REQUEST Note: SKETCH # 2 PAGE 18	Qty: 1
--------------	---	--------

Granite

16 187,821 30,242	GRANITE - COUNTERTOP - 3/4" GROUP 4 WITH MITRE EDGE - KITCHEN / ISLAND - UPGRADE 4 Note:	Qty: 1
17 189,464 30,243	GRANITE - GRANITE CUTOUT W/ STRAIGHT EDGE POLISH TO ACCOMMODATE COOK TOP Note: COOKTOP SPECS PAGES 26-27	Qty: 1
18 187,832 30,247	GRANITE - COUNTERTOP WITH 4" BACKSPLASH - 3/4" GROUP 1 WITH MITRE EDGE - ENSUITE MASTER - UPGRADE 1 Note:	Qty: 1

Hardwood

19 187,894 28,847	HARDWOOD - VINTAGE - 3-1/4" RED OAK ENGINEERED - KITCHEN - STANDARD SERIES Note:	Qty: 1
-------------------------	---	--------

Interior Railing

*20 187,901 28,859	INTERIOR RAILING - BLACK METAL - SINGLE COLLAR ALT. PLAIN W/ SHOES WITH 3 1/2" SQUARE/CAP POST(S) ASPER PLAN - THOUGHOUT - UPGRADE 2 Note:	Qty: 1
--------------------------	---	--------

Mirrors/Glass Pro

Initials:

TAX#:1

PREPARED BY: Brenda Luker

PE 344-2



Sales Selection Sheet
Wallaceton

15 of 28
TEL:

PURCHASERS: FREDY, ALEXANDER FONSECA CASTANEDA and LIRESKY,
ZIRANILLY CARRENO BOLIVAR

LOT / UNIT	PHASE	MODEL	
243	2	27-2587 CRN B The Maxwell	

Mirrors/Glass Pro

21 187,903 28,858	MIRRORS/GLASS PRODUCTS - UPGRADE TO FRAMELESS CLEAR GLASS WITH D-RING HANDLE IN CHROME - ENSUITE MASTER Note: SKETCH # 4 PAGE 20	Qty: 1
-------------------------	--	--------

MISC.

22 28,846	BONUS DECOR DOLLARS TEN THOUSAND (\$10,000) Note:	Qty: 1
------------------	--	--------

Plumbing

*23 189,694 28,851	PLUMBING - OPTION FROM ONE SINK TO DOUBLE SINKS INCLUDING STD CHATEAU FAUCET AND UNDERMOUNT OVALYN SINK INCLUDING CABINET CONVERSION 2D VIKING, ONE EXTRA CUTOUT AND ONE EXTRA VANITY LIGHT Note:	Qty: 1
--------------------------	--	--------

Sub Total

HST

Total

1. This Sales Selection Sheet when properly executed forms part of our Agreement of Purchase and Sale.
2. All extras and upgrades listed above are subject to Construction Progress and Architectural and Municipal requirements.
3. In the event the Vendor is unable to incorporate the work approved above in the construction of the house for any reason whatsoever, the Vendor will not be liable to the Purchaser in any way. The monies paid for any changes or optional extras not proceeded with shall be returned to the Purchaser, without interest. The cost of options or extras is non-refundable in all other circumstances. If for any reason whatsoever the Agreement of Purchase and Sale is not completed, the total cost of work approved above will be retained by the Vendor.
4. The Vendor reserves the right to substitute above materials and equipment with that of equal or better quality.
5. Purchaser acknowledges that items may not be exactly as shown. Variations from the Vendor's samples may occur in finished materials due to normal production processes. Vendor is not responsible for shade difference which may occur from different dye lots or wood grains. Variations from the Vendor's samples will occur with natural materials such as wood, marble, granite, hardwood and brick.
6. The Vendor reserves the right to select Grout & Thresholds that best suits the Tile selected.
7. Selections will not be processed unless signed by Heathwood Homes Head Office.
8. The selections made on this schedule are final and cannot be changed once submitted.
9. The Purchaser has checked and acknowledges the accuracy of this schedule.

Payment Summary

Paid By Amount

Total Payment:

Initials: mk

TAX#:1

PREPARED BY: Brenda Luker

PE 344-3

S\invoice.rpt 28may19



Sales Selection Sheet

Wallaceton

16 of 28

PURCHASERS: FREDY, ALEXANDER FONSECA CASTANEDA and LIRESKY, ZIRANLLY CARRENO BOLIVAR

TEL:

LOT / UNIT 243	PHASE 2	MODEL 27-2587 CRN B The Maxwell	
-------------------	------------	------------------------------------	--

PURCHASER:

Signatures
FREDY, ALEXANDER FONSECA CASTA

06-Aug-20
DATE

BRENDA LUKER
Decor Consultant

06-Aug-20
DATE

PURCHASER:

on file
LIRESKY, ZIRANLLY CARRENO BOLIVAR

06-Aug-20
DATE

APPROVE!

-08-06-2020

Date Approved Heathwood Homes (Huron) Limited

m Rosen

TAX#:1

PREPARED BY: Brenda Luker

PE 344-4

SInvoice.rpt 28may19

UK-75 WALLACETON
LOT 243
27-2587 CRN B
THE MAXWELL

17 of 28
THE MAXWELL
ELEVATION B | 2,593 SQ. FT.
735 sq. ft. of opt. finished Lower Level

27-2587 ELEV. B

Sketch #1

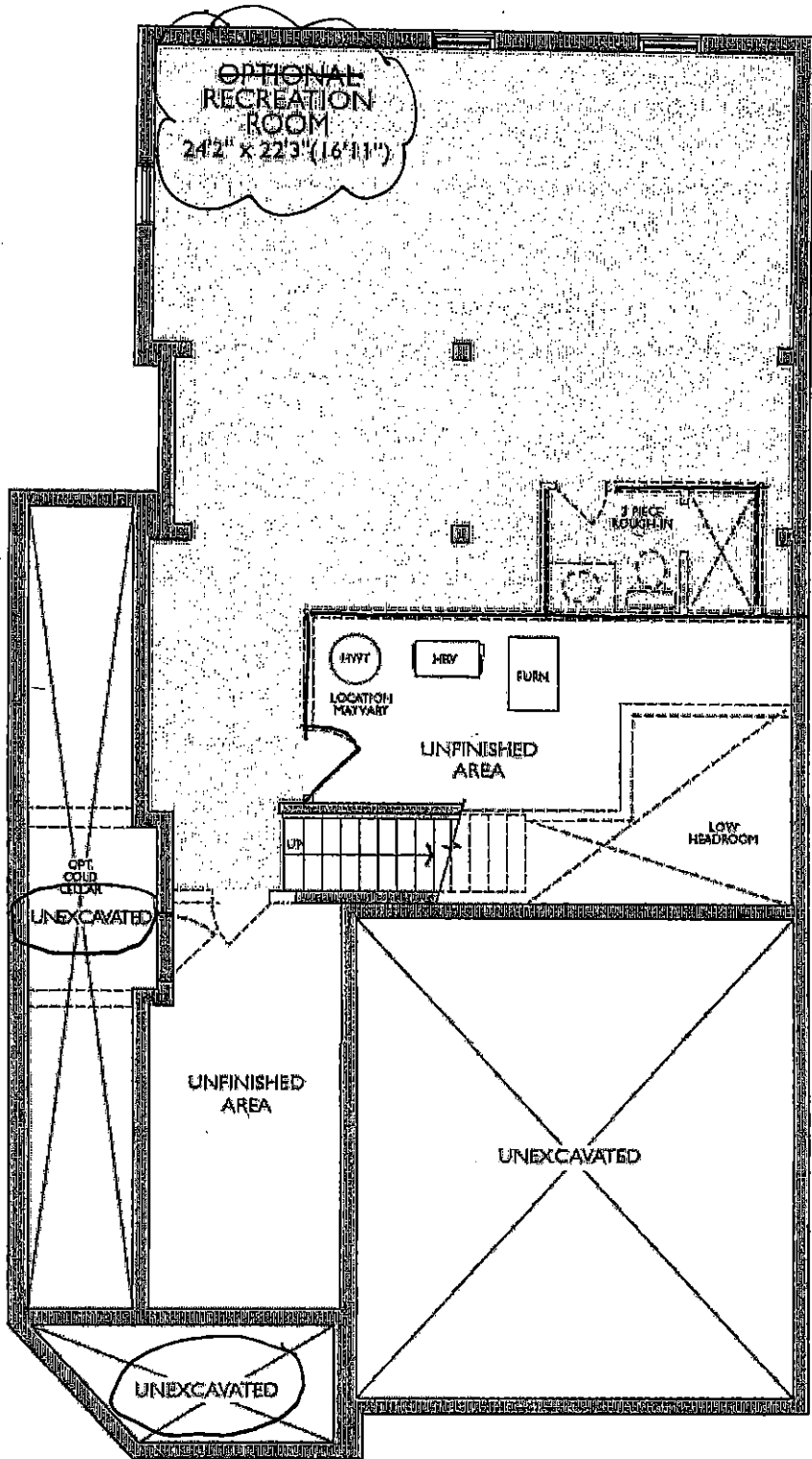

LOWER LEVEL
ELEVATION B

UK-75 WALLACETON
LOT 243
27-2587 CRN B
THE MAXWELL

18 of 28

THE MAXWELL

ELEVATION B | 2,593 SQ. FT.

735 sq. ft. of opt. finished Lower Level

27-2587 ELEV. B

Sketch #2

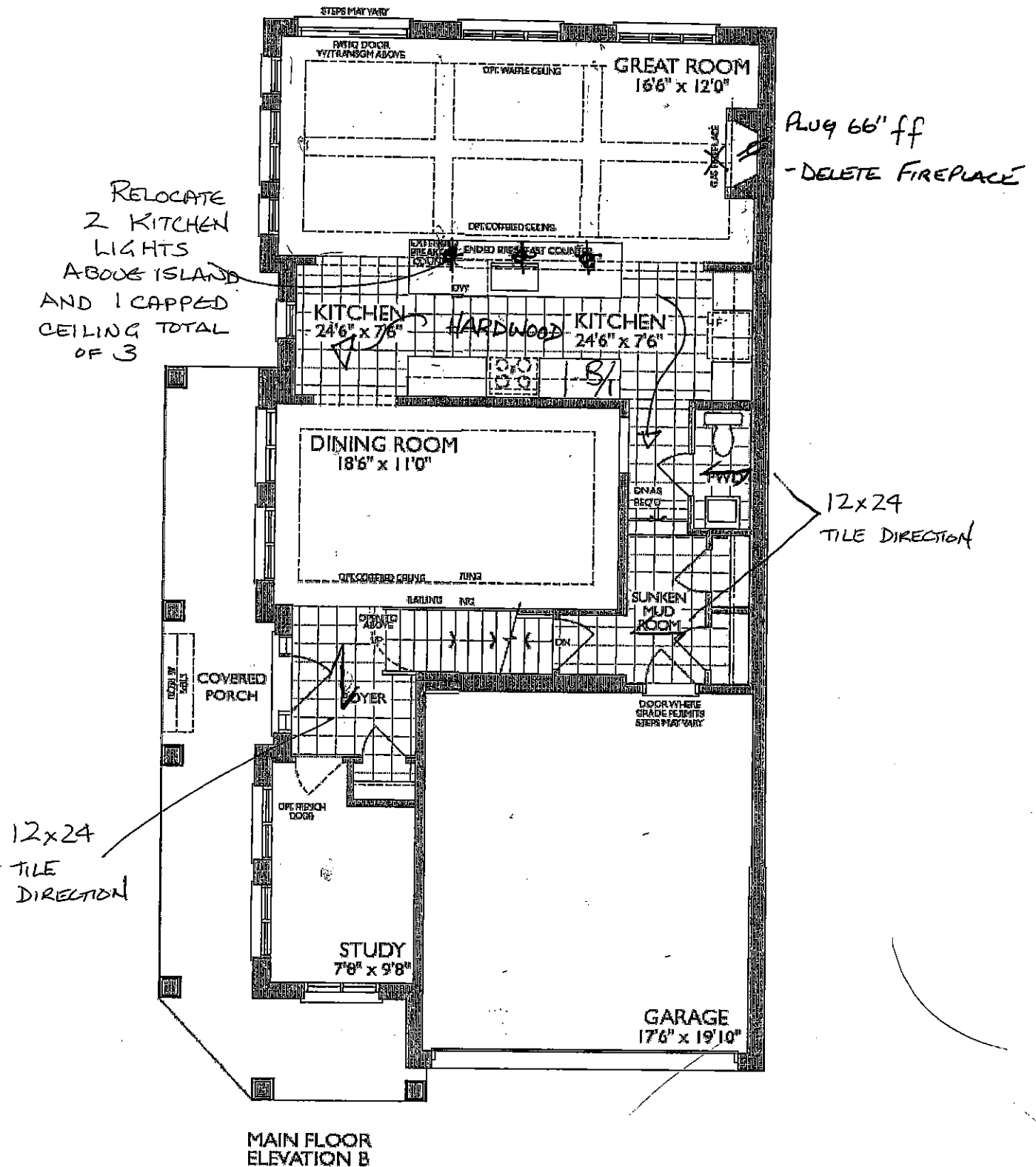

FF



F R E N D L E
K I T C H E N S L I M I T E D
1250 Shawson Drive, Mississauga, ON L4W 1C5

HEATHWOOD HOMES
WALLACETON, KITCHENER ON
MODEL: 27-2587 CRN (3106)

STANDARD CONTRACT INCLUDES:

Appliance Openings

- Hood Opening: 30"W Chimney hood
- Fridge Opening: 37 3/8 "W X 73 3/8"
- Fridge cabinet & gables: 66cm Deep
- Stove Opening: 30" Freestanding
- Dishwasher Opening: 24"

Standard Kitchens Scope:

- 100cm H wall cabinets
- Std. Blumotion Hinges- **soft close doors**
- Std. Metabox Drawers- **not soft close**
- Min 40cm W drawer
- Base pie cut corner cabinets
- Backing on all cabinets
- Countertop by others
- Upgrade applied paneled fridge & dishwashers supply only (appliance hardware by others)

Standard Vanity & Laundry Scope:

- Powder by others, pedestal
- Master Ens. - Top by others
- Remaining vanities inc. laminate top
- Std. Blumotion Hinges- **not soft close**
- Std. Metabox Drawers- **not soft close**
- Master Ens: Top drawers(Sink Full height)
- Mains: Full height doors (top drawers added if Masters can't accommodate)
- Optional laundry base & wall cabinets

THIS DRAWING IS FOR DESIGN PURPOSES ONLY.
IT IS NOT AN EXACT RENDITION.

19 of 28

KITCHEN
(GROUND FLOOR)

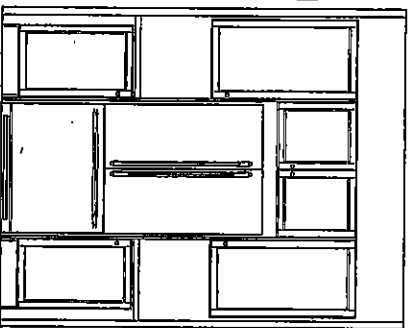

Sketch #3

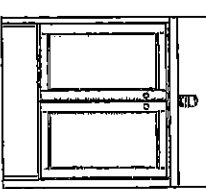
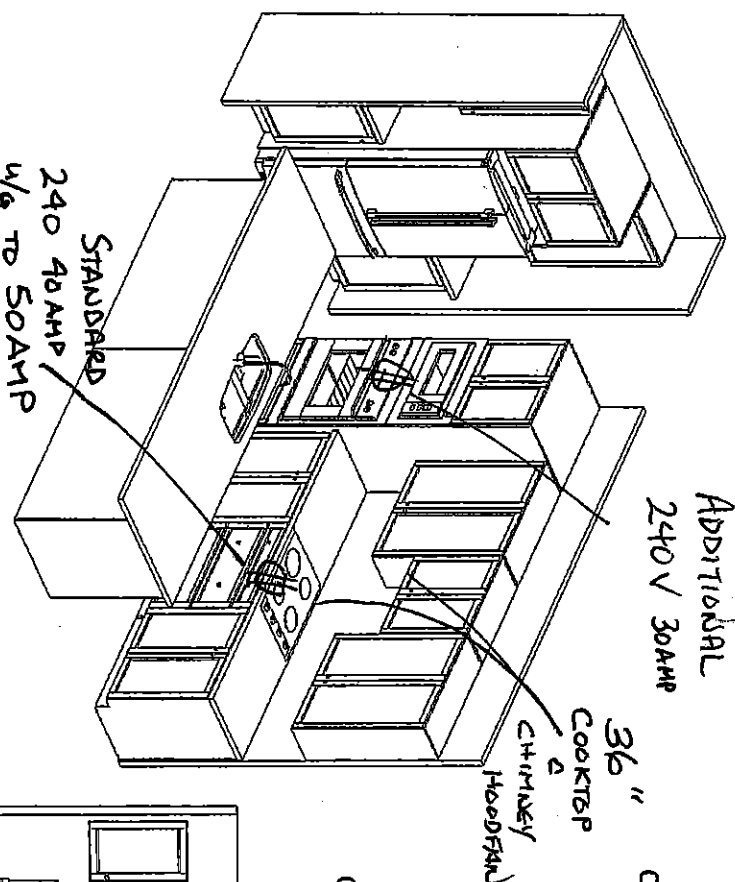
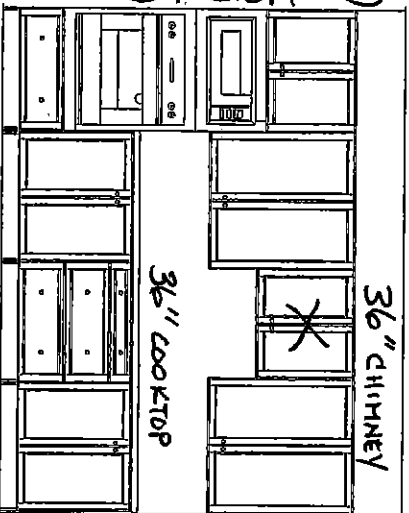

OPT. BASEMENT BATH

OPT. LAUNDRY UPpers
OPT. LAUNDRY BASE
(2ND FLR)

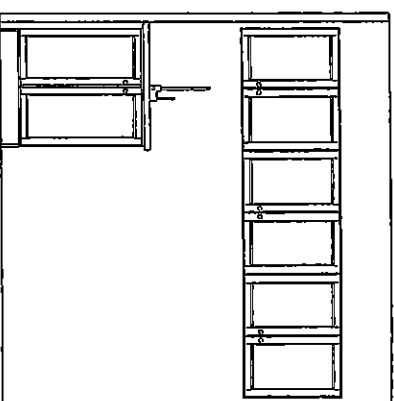

MASTER ENSUITE
(2ND FLR)

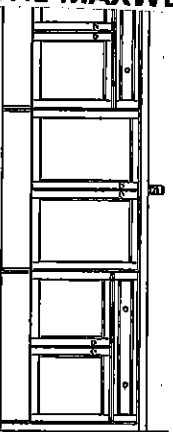

BED 4 BATH
(2ND FLR)

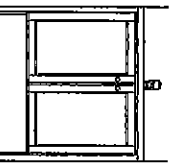

SHARED BATH A
(2ND FLR - ELEV. A)

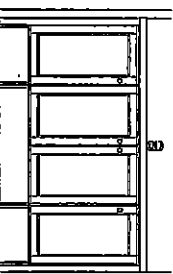

OR
ALT. SHARED BATH B
(2ND FLR - ELEV. B)

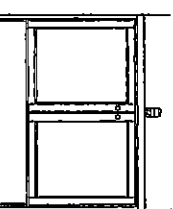

ALT. SHARED BATH C & D
(2ND FLR - ELEV. C)

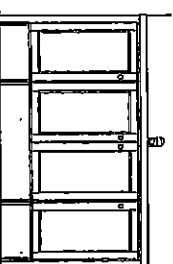

UK-75 WALLACETON
LOT 243
27-2587 CRN B
THE MAXWELL

(OPT. DBL SINK V90+VT90+V90)

10/23/2019

AT

UK-75 WALLACETON
LOT 243
27-2587 CRN B
THE MAXWELL

20 of 28
THE MAXWELL
ELEVATION B | 2,593 SQ. FT.
735 sq. ft. of opt. finished Lower Level

27-2587 ELEV. B

Sketch #4

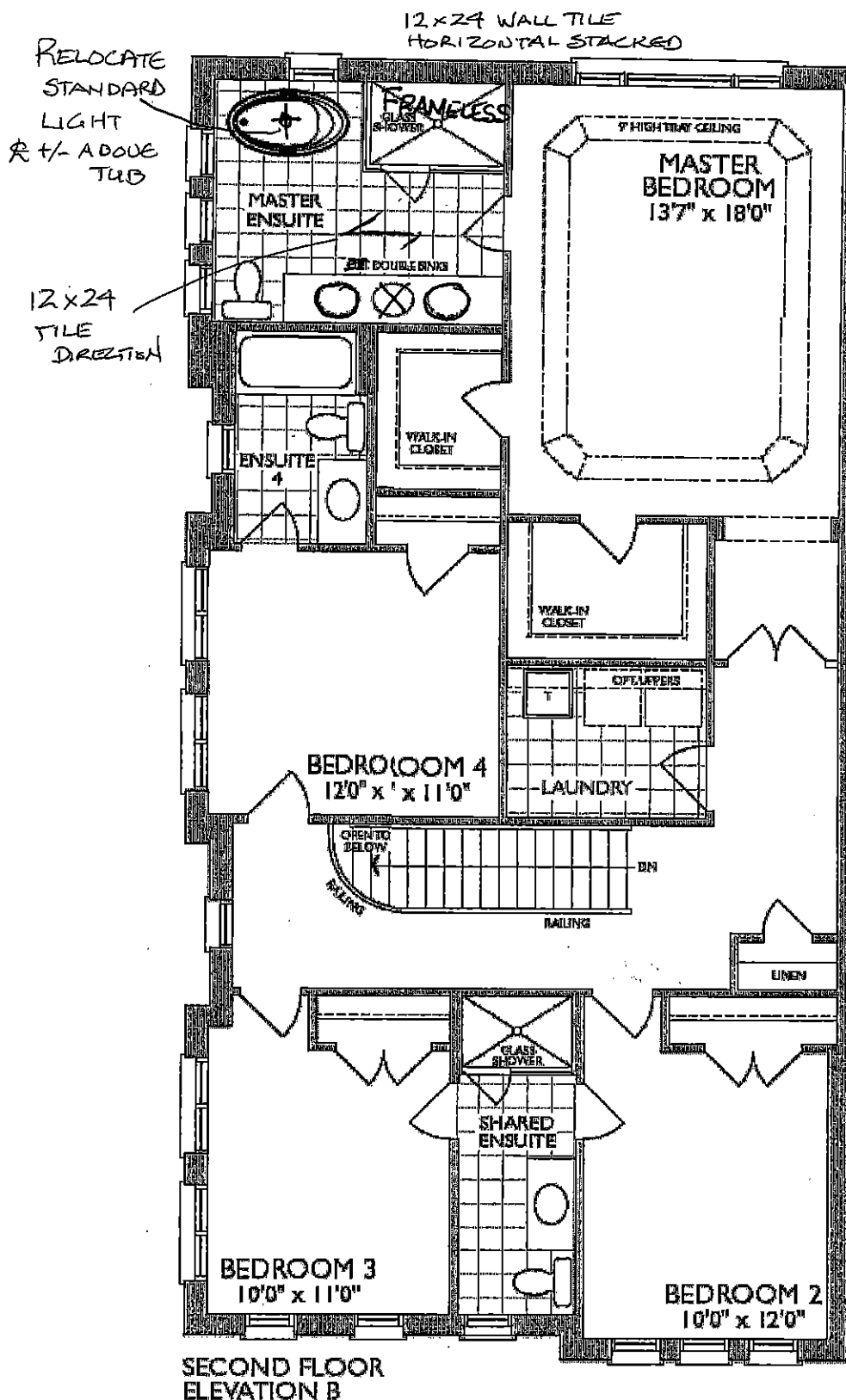

ok F.F.

UK-75 WALLACETON
 LOT 243
 27-2587 CRN B
 THE MAXWELL

21 of 28

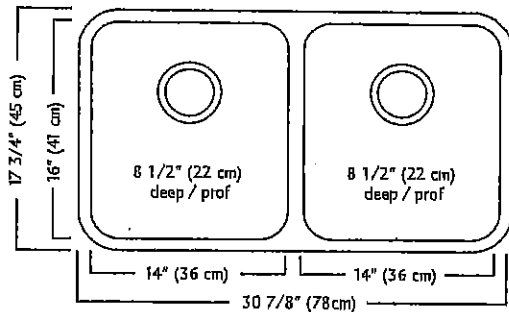

ND1831UA/9 SPECIFICATION

Model ND1831UA/9 is a double (two equal size) bowl undermount sink manufactured by Franke Kindred Canada Limited from 18 gauge stainless steel. Product has silk finished rims and linear brush finished bowls. Sink is fully undercoated. Basket strainer waste fittings (3 1/2", 89 mm) are included. Sink is backed with a limited lifetime warranty.

- O.D. 17 3/4" x 30 7/8" x 8 1/2" (45 x 78 x 22 cm)
- Recommended for minimum 36" cabinet

Franke Kindred Canada Limited
 P.O. Box 190, 1000 Franke Kindred Road, Midland, Ontario, Canada, L4R 4K9 Phone: 866-687-7465 Fax: 800-361-8408

[Handwritten signature] *[Handwritten initials]*

UK-75 WALLACETON
LOT 243
27-2587 CRN B
THE MAXWELL

22 of 28

STANDARD KITCHEN FAUCET

Align
Modern

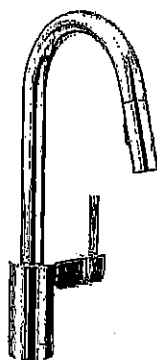

Single Handle Pull-Down Kitchen
Faucet*

Model 7565†

FF

UK-75 WALLACETON
LOT 243
27-2587 CRN B
THE MAXWELL

Chateau

Transitional

23 of 28

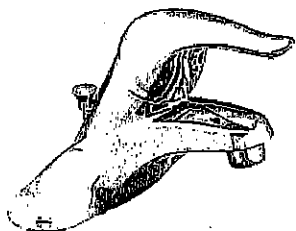

Lavatory Faucet with Pop-Up Drain
Model L4621+

VANITY SINKS AND PEDESTAL

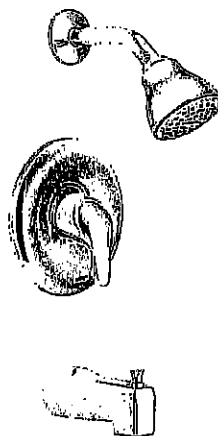

Posi-Temp® Pressure Balancing Tub/Shower
Model 62320 / TL183+

OR

Posi-Temp Valve and Tub/Shower Trim
with Eco-Performance Easy Clean® XL
Model 62320 / TL183EP+
(TL183EP not available in BC)

SHOWER AND 5' TUB FAUCETS



2 Handle Roman Tub with 9" Spout
Model 4796 / T990+

FREESTANDING TUB FAUCETS

Handwritten signature or mark.

Handwritten mark.

UK-75 WALLACETON
LOT 243
27-2587 CRN B
THE MAXWELL

Cyclone®

SCB51436 Canopy Hood

Alito Collection

Makes a statement of strength and power as the stainless steel frame gleams under your kitchen lights. It features baffle filters, tow bright LED lights in each corner, a three speed control panel, and a quiet, powerful motor. The bold design and strong stainless steel frame encasing the fan will make this machine the focus of your kitchen. Fitted with time-delay "OFF" options up to nine minutes.

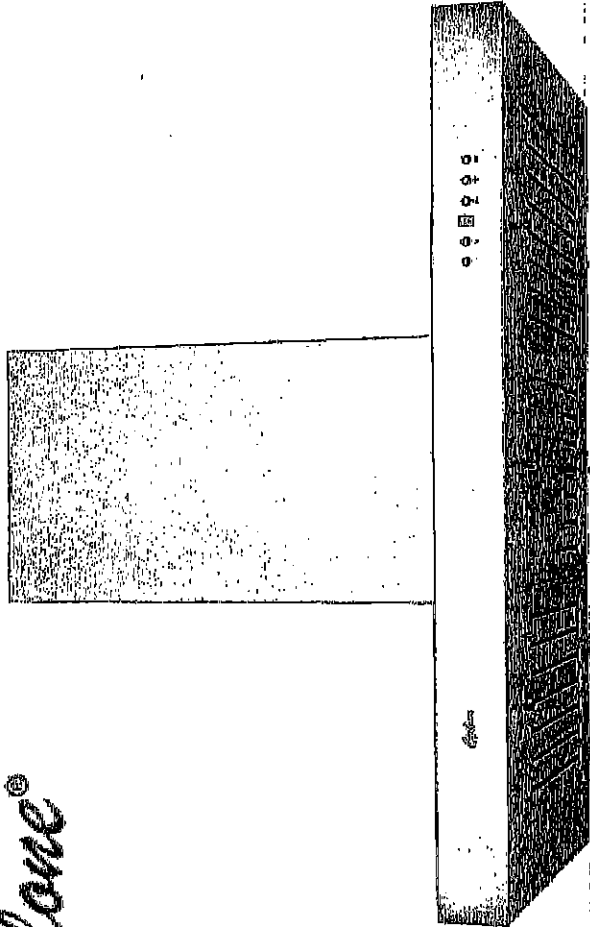

Specifications

Air Flow Volume: 550 CFM
Colours: Stainless Steel
Dimensions: W:36" H:44.5" D:19.5"
Electrical Connection: 120V/60Hz
Electrical Consumption: 200 watts
Fan Speed: 1254 RPM
Sones: Min. at 2 and Max at 6
Venting: 6" Round (Top Only)

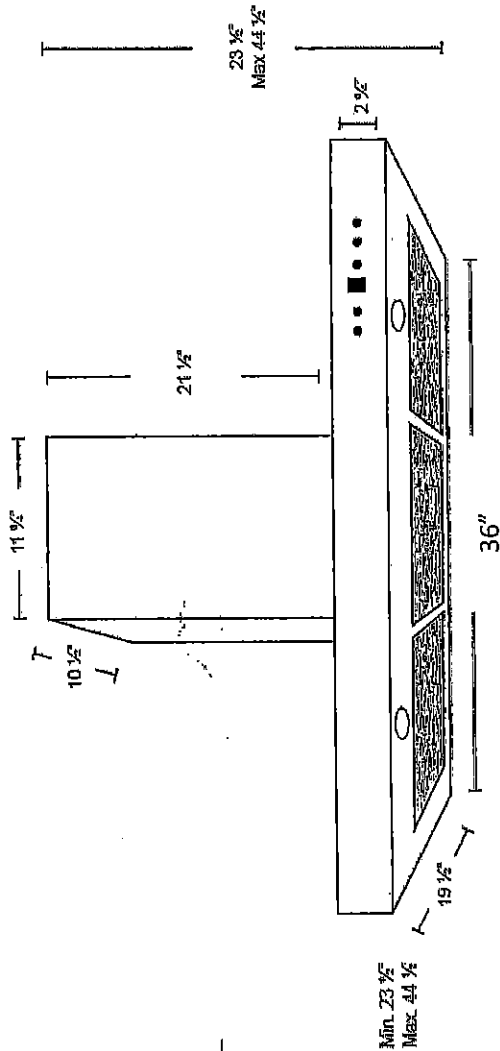
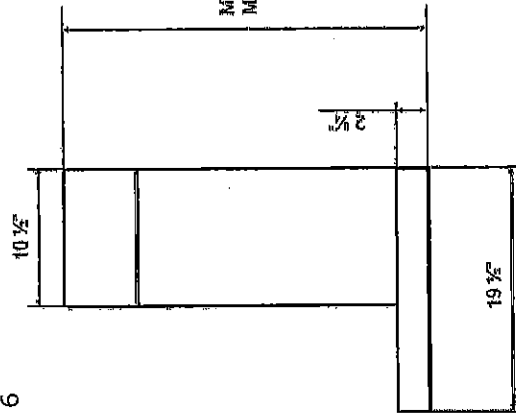
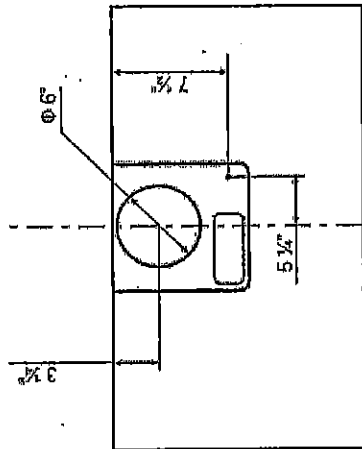

24 of 28

UK-75 WALLACETON
LOT 243
27-2587 CRN B
THE MAXWELL

25 of 28

KitchenAid®
FOR THE WAY IT'S MADE.®

PRODUCT MODEL NUMBERS

KRFC302E

Electrical: A 115 volt, 60 Hz, AC only 15- or 20-amp fused, grounded electrical supply is required. It is recommended that a separate circuit serving only your refrigerator and approved accessories be provided. Use an outlet that cannot be turned off by a switch. Do not use an extension cord.

Water: A cold water supply with water pressure of between 35 and 120 psi (241 and 827 kPa) is required to operate the water dispenser and ice maker. If you have questions about your water pressure, call a licensed, qualified plumber.

Reverse Osmosis Water Supply:
IMPORTANT: The pressure of the water supply coming out of a reverse osmosis system going to the water inlet valve of the refrigerator needs to be between 35 and 120 psi (241 and 827 kPa).

Bottom Mount Refrigerator

PRODUCT DIMENSIONS

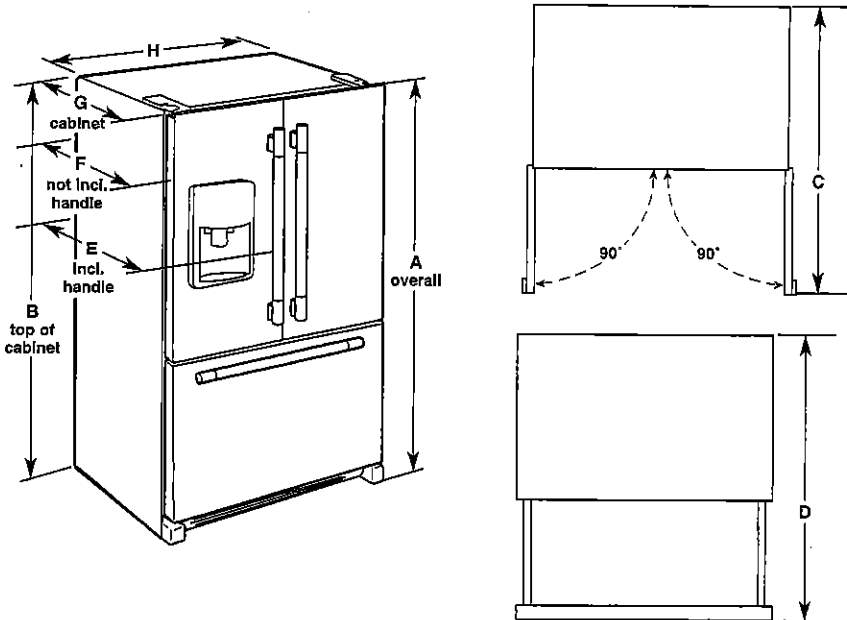

Model Size	Height - Overall "A"	Height - Top of Cabinet "B"	Depth - Doors Open 90° "C"	Depth - Drawer Open "D"	Depth - With Handles "E"	Depth - Without Handles "F"	Depth - Cabinet Only "G"	Width - Cabinet "H"
21.9	72" (182.9 cm)	71¾" (181.3 cm)	44½" (112.1 cm)	45¼" (114.9 cm)	30¼" (76.8 cm)	27¾" (70.5 cm)	24¾" (62.5 cm)	35¾" (90.8 cm)

LOCATION REQUIREMENTS

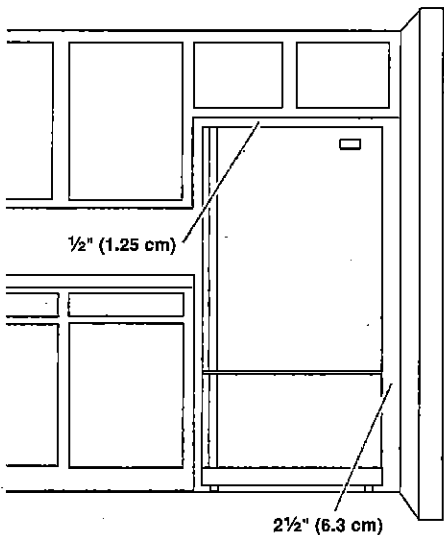

IMPORTANT: This refrigerator is designed for indoor, household use only.

To ensure proper ventilation for your refrigerator, allow for ½" (1.25 cm) of space on each side and at the top. Allow for 1" (2.54 cm) of space behind the refrigerator. If your refrigerator has an ice maker, allow extra space at the back for the water line connections. When installing your refrigerator next to a fixed wall, leave 2½" (6.3 cm) minimum on the hinge side (some models require more) to allow for the door to swing open.

NOTE: This refrigerator is intended for use in a location where the temperature ranges from a minimum of 55°F (13°C) to a maximum of 110°F (43°C). The preferred room temperature range for optimum performance, which reduces electricity usage and provides superior cooling, is between 60°F (15°C) and 90°F (32°C). It is recommended that you do not install the refrigerator near a heat source, such as an oven or radiator.

UK-75 WALLACETON
LOT 243
27-2587 CRN B
THE MAXWELL

26 of 28

Café™ 36" Built-In Touch Control
Induction Cooktop

CHP95362MSS

C A F É

DISTINCT BY DESIGN™



FEATURES & BENEFITS

- Gourmet results without any guesswork - Take culinary skills to the next level with Gourmet Guided Cooking, which combines video-guided recipes from chefs with a system that automatically adjusts the time, temperature and cooking pace for perfect results
- Precise temperature control for reliably amazing results - Maintain a set temperature within one degree, thanks to a precise Control Mode that makes temperature-sensitive cooking methods simple
- Control at your fingertips - Make your cooking process as stylish as the food itself with touch controls that let you control heat with just one swipe
- The cooktop just got smarter - Always have peace of mind in the kitchen, with cooktop technology that senses the presence of cookware and turns off the burners when cookware is removed
- Boil water in a flash - Save time with a large 3,700-watt induction element that boils one quart of water in just 101 seconds and melts butter with exact temperatures for amazing efficiency
- Safety controls add peace of mind - Maintain a worry-free environment in your kitchen with a control lock capability that prevents unintended burner activation
- More heat for more space - Evenly heat large cookware like griddles by controlling two 7" synchronized elements with just the touch of a button
- Guaranteed to fit your space - When you're updating your kitchen, attention to detail is a priority. That's why Café cooktops are guaranteed for an exact fit or Café Appliances will pay up to \$100 toward modifications.
- Multitasking now has a timer - Make multitasking look easy with a multi-element timer that lets you manage up to five pans at once
- Induction technology that helps you cook better - Prep like a pro with rapid, precise heat control that stays cool to the touch using five induction elements

APPEARANCE

Color Appearance	Flagstone Gray
Frameless	Yes

FEATURES

Cooktop Surface	Gray Ceramic Glass with Beveled-Edge
Cooktop Burner Type	5 Induction Elements
Element - Left Front	7" 2500W
Element - Left Rear	7" 2500W
Element - Right Front	8" 3200W
Element - Right Rear	6" 1800W
Element - Center	11" 3700W
Control Location	Front Center
Control Type	Glide Touch
Element - Right Rear	6" 1800W
Control Location	Front Center
Control Type	Glide Touch
Cooktop Control Features	Control Lock Capability; Custom Settings; Kitchen timer; Melt Setting; Sync-Burners Capability
Melt Setting	Yes
Indicator Lights	5 Hot Surface, Surface Element "ON"; Setting Level Indicators; White/Red
Timer	Yes
Optional Accessories	JXPROBE1 - Precision cooking probe JXGRIDL1 - Griddle

WEIGHTS & DIMENSIONS

Approximate Shipping Weight	57 lb
Cabinet Width	36 in
Cooktop Size	36 in
Cutout Dimensions (Width x Depth) (in.)	33-7/8 x 19-1/8
Net Weight	50 lb
Overall Depth	20 3/8 in
Overall Height	4 5/8 in
Overall Width	36 in

POWER/RATINGS

Amp Rating at 208V	50
Amp Rating at 240V	50
KW Rating at 208V	9.6
KW Rating at 240V	11.1

ACCESSORIES

11" Gourmet Guided Cooking Pan	Included
--------------------------------	----------

UK-75 WALLACETON
LOT 243
27-2587 CRN B
THE MAXWELL

27 of 28

Café™ 36" Built-In Touch Control
Induction Cooktop

CHP95362MSS



WARRANTY

Parts warranty	Limited 1-year entire appliance
Labor warranty	Limited 1-year entire appliance

DIMENSIONS AND INSTALLATION

Important: Requires a 3" free area between the bottom of the cooktop to any combustible material, i.e., shelving. Free area not required when installing wall oven underneath cooktop. Refer to installation instructions. Requires a 15" minimum from cooktop to adjacent overhead cabinets. Units are furnished with a 48" flexible armored cable.

Note: 36" induction cooktops are approved for use over select Café 30" Single Wall Ovens and Warming Drawers. Refer to cooktop and wall oven/warming drawer installation instructions packed with product for current dimensional data. If installed with a Café Telescopic Downdraft System, consult both the cooktop and downdraft installation instructions packed with product before installing. Cooktop gas/electric supply may need to be re-routed to install downdraft. The countertop cutout requires 23-1/2" minimum flat countertop surface and 25" minimum total countertop depth. In addition, other clearances to front edge of the countertop must be considered.

Before installing, consult installation instructions packed with product for current dimensional data.

KW RATING

240V	11.1
208V	9.6

AMPERAGE

240V	50 Amps*
208V	50 Amps*

*Note: Check local codes for required breaker size.

Approximate Cooking Dimensions

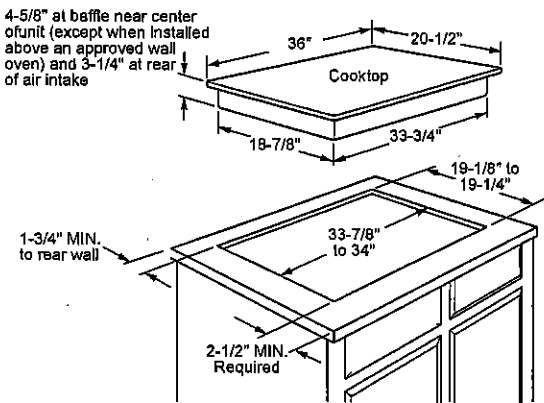

To insure accuracy, it is best to make a template when cutting the opening in the counter

Installation above a wall oven

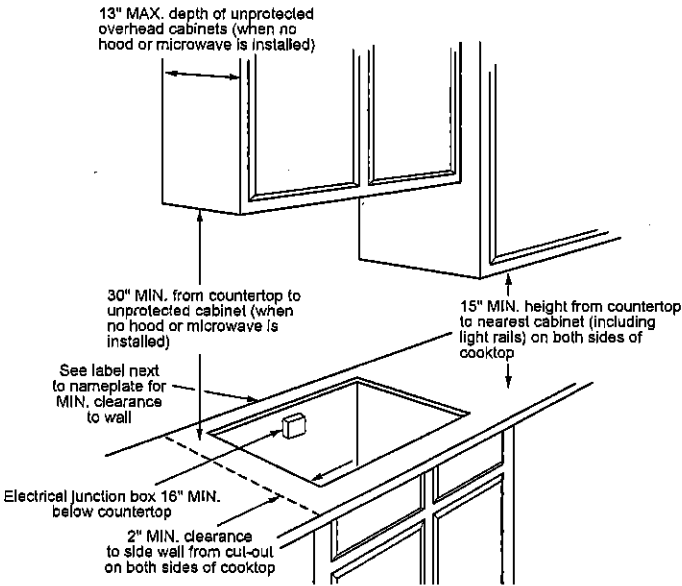
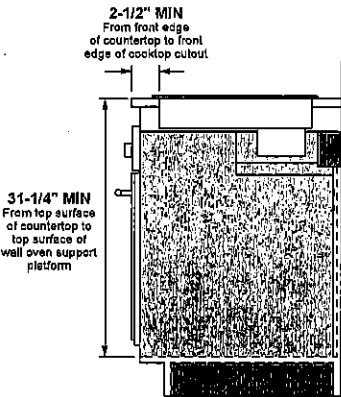

KitchenAid® 27" (68.6 cm) and 30" (76.2 cm) Electric Built-In Microwave/Oven Combination

PRODUCT MODEL NUMBERS

KEMS309E KOCE500E KOCE507E

ELECTRICAL CONNECTION

If codes permit and a separate ground wire is used, it is recommended that a qualified electrical installer determine that the ground path and the wire gauge are in accordance with local codes. Check with a qualified electrical installer if you are not sure the oven is properly grounded.

This oven must be connected to a grounded metal, permanent wiring system.

Be sure that the electrical connection and wire size are adequate and in conformance with the National Electrical Code, ANSI/NFPA 70-latest edition or CSA Standards C22.1-94, Canadian Electrical Code, Part 1 and C22.2 No. 0-M91-latest edition, and all local codes and ordinances.

To properly install your oven, you must determine the type of electrical connection you will be using and follow the instructions provided for it here.

- Oven must be connected to the proper electrical voltage and frequency as specified on the model/serial/rating plate. See the following illustration.

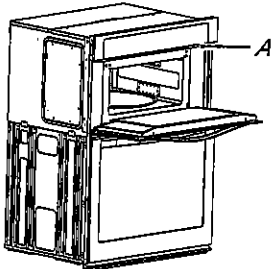

A. Model/serial/rating plate

- Models rated from 7.3 to 9.6 kW at 240 volts (5.4 to 7.4 kW at 208 volts) require a separate 40-amp circuit. Models rated at 4.8 kW and below at 240 volts (3.6 kW and below at 208 volts) require a separate 30-amp circuit.
- A circuit breaker is recommended.
- Connect directly to the fused disconnect (or circuit breaker box) through flexible, armored or nonmetallic sheathed, copper cable (with grounding wire). See "Make Electrical Connection" section.
- Flexible conduit from the oven should be connected directly to the junction box.
- Do not cut the conduit. The length of conduit provided is for serviceability of the oven.
- A UL listed or CSA approved conduit connector must be provided.
- If the house has aluminum wiring, follow the procedure below:
 - Connect a section of solid copper wire to the pigtail leads.
 - Connect the aluminum wiring to the added section of copper wire using special connectors and/or tools designed and UL listed for joining copper to aluminum.

Follow the electrical connector manufacturer's recommended procedure. Aluminum/copper connection must conform with local codes and industry accepted wiring practices.

For power requirements, refer to the following table.

Model	Voltage	Amperage (L1)*	Amperage (L2)*	Rating (W)
KOCE507E/KOCE500E	120/240	32	30	8000
KOCE507E/KOCE500E	120/208	30	28	6600

*Amperage values noted above are for information purposes only: the units are rated in watts.

PRODUCT DIMENSIONS

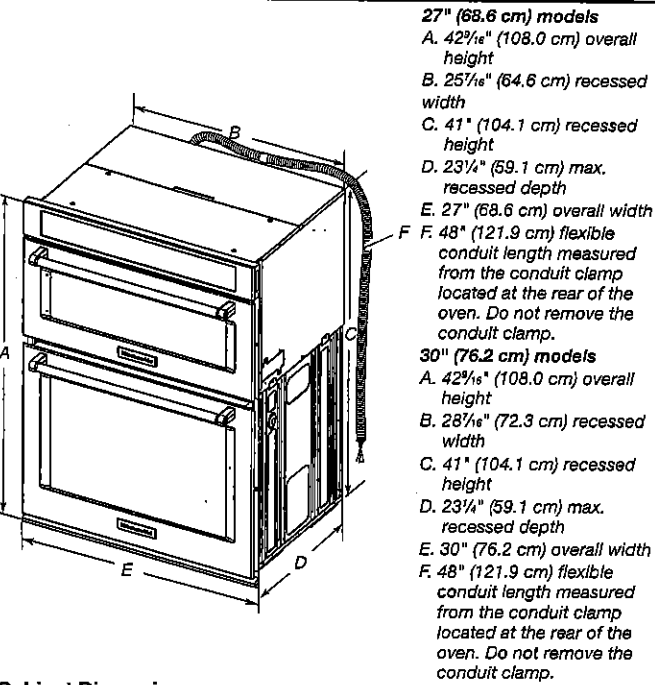

Cabinet Dimensions

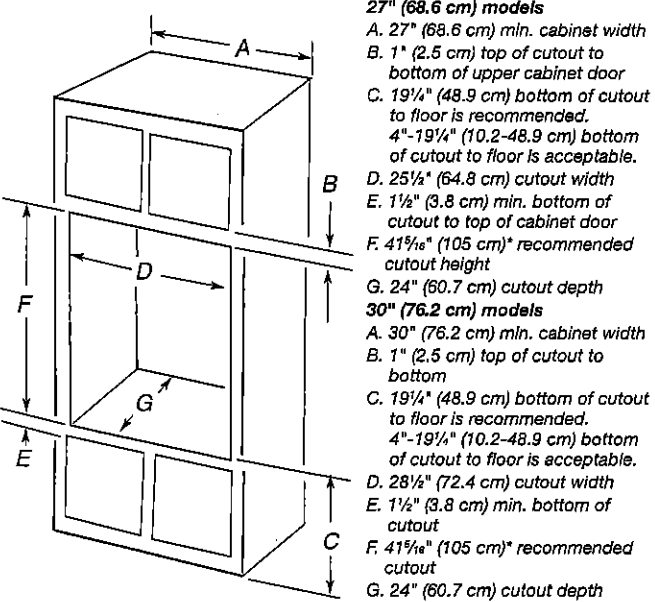

* NOTE: The cabinet height can be between 41" (104.1 cm) and 41¹/₂" (105.6 cm) for microwave/oven combination.