

PRE-Sales Selection Sheet
Checklist

1 of 43

LOT 267 Model: 25-2269 A The Walden

PURCHASERS: JIMIT, VIJAYKUMAR SUKHADIYA/DHARINIBAHEN RAJNIKANT SHA

VENDOR: Heathwood Homes (Huron) Limited

- ☒ FINISHED BASEMENT
- ☐ COLD CELLAR

UPGRADED / MODIFIED ELEVATION

- ☐ CORNER UPGRADE
- ☐ REAR UPGRADE

CEILING UPGRADE - SMOOTH

- ☐ MAIN FLOOR
- ☐ SECOND FLOOR
- ☐ BASEMENT

ADDITIONAL ROUGH-INS

- ☒ 200 AMP SERVICE
- ☐ WET BAR ROUGH-IN
- ☐ HUMIDIFIER
- ☒ AIR CONDITIONING

GAS ROUGH-IN

- ☒ STOVE
- ☐ DRYER
- ☐ BBQ
- ☐ ADDITIONAL FIREPLACE

KITCHEN: HOODFAN VENTING SIZE

- ☒ 6 IN ROUND DUCT
- ☐ 7 IN ROUND DUCT

FULL BASEMENT STAIRS:	N/A
UPPER BASEMENT STAIRS:	All Oak No Upper Bsmt Stairs - the entire Bsmt Stair is CARPET GRADE
LOWER BASEMENT STAIRS:	Carpet Grade
MAIN STAIRS:	All Oak
MEDIA STAIRS (if applicable):	N/A
LOFT STAIRS (if applicable):	N/A

Aug 13/20 Signatures on
Date Purchaser: file

Aug. 13/20 IRIT SALEH
Date Decor Consultant:

Date Purchaser:

- APPROVED -
-08- 21 2020 M. Rosen
Date Heathwood Homes (Huron) Limited
Approved

Locked Date:



Sales Selection Sheet

Wallaceton
"SCHEDULE E"

2 of 43

PURCHASERS: JIMIT, VIJAYKUMAR SUKHADIYA and DHARINIBAHEN
RAJNIKANT SHAH

TEL:

LOT / UNIT	PHASE	MODEL	
267	2	25-2269 A The Walden	

It is herein understood and agreed between the undersigned parties hereto that the following changes shall be made to the above mentioned Agreement of Purchase and Sale in accordance with the agreement and except for such changes noted below, all other terms and conditions in the Agreement of Purchase and Sale shall remain as stated herein: It is further understood that and agreed that all changes and additions shall be installed as per builder's specifications, location and available selections. The Purchaser hereby agrees to purchase the following extras:

MISC.

1	SCEDULE "E" TEN THOUSAND DOLLAR (10,000.00) IN UPGRADES AT THE DECOR STORE (NO CASH VALUE)	Qty: 1	
31,486	Note:		

Sub Total
HST
Total

1. This Sales Selection Sheet when properly executed forms part of our Agreement of Purchase and Sale.
2. All extras and upgrades listed above are subject to Construction Progress and Architectural and Municipal requirements.
3. In the event the Vendor is unable to incorporate the work approved above in the construction of the house for any reason whatsoever, the Vendor will not be liable to the Purchaser in any way. The monies paid for any changes or optional extras not proceeded with shall be returned to the Purchaser, without interest. The cost of options or extras is non-refundable in all other circumstances. If for any reason whatsoever the Agreement of Purchase and Sale is not completed, the total cost of work approved above will be retained by the Vendor.
4. The Vendor reserves the right to substitute above materials and equipment with that of equal or better quality.
5. Purchaser acknowledges that items may not be exactly as shown. Variations from the Vendor's samples may occur in finished materials due to normal production processes. Vendor is not responsible for shade difference which may occur from different dye lots or wood grains. Variations from the Vendor's samples will occur with natural materials such as wood, marble, granite, hardwood and brick.
6. The Vendor reserves the right to select Grout & Thresholds that best suits the Tile selected.
7. Selections will not be processed unless signed by Heathwood Homes Head Office.
8. The selections made on this schedule are final and cannot be changed once submitted.
9. The Purchaser has checked and acknowledges the accuracy of this schedule.

Payment Summary

<u>Paid By</u>	<u>Amount</u>
----------------	---------------

Total Payment:

PURCHASER:

Signature on file
JIMIT, VIJAYKUMAR SUKHADIYA

17-Aug-20
DATE

IRIT SALEM
Decor Consultant

17-Aug-20
DATE

PURCHASER:

Signature on file
DHARINIBAHEN RAJNIKANT SHAH

17-Aug-20
DATE

APPROVED
-08- 21 2020

Date Approved Heathwood Homes (Huron) Limited

TAX#:1

PREPARED BY: Irit Salem

PE 370-1

SInvoice.rpt 28may19

JIMIT, VIJAYKUMAR SUKHADIYA/DHARINIBAHEN RAJNIKANT SHAH
Project: Wallaceton
Unit: 267, Phase: 2
Model: 25-2269 A The Walden

Created: 6/29/2020 12:57:00
Locked:
Closed:

3 OF 43

Kitchen

Cabinet Colour/Style	9182	Classic Plus-ANNEX DHGL-TORMENTA GLOSS ***UPG***
Countertop	9121	MSI Quartz GROUP 1 ICED WHITE 3/4 inch with double mitre edge ***1***
Countertop Edge	4005	DOUBLE MITRE 1 1/2 INCH ***UPG*** 
Cabinet Hardware	1111	N/A *****
Island Cabinet Colour/Style	9182	Classic Plus-ANNEX DHGL-TORMENTA GLOSS ***UPG***
Island Countertop	9121	MSI Quartz GROUP 1 ICED WHITE 3/4 inch with double mitre edge ***1***
Backsplash	1111	N/A *****
Backsplash Grout	1111	N/A *****
Backsplash Tile Pattern	1111	N/A *****

HoodFan	1111	N/A ***** DUPLICATE
HoodFan	1111	Upgrade to Cyclone 36 inch Chimney Hoodfan Model SCB 50136 SS P2728
Appliances	1111	Purchasers have been advised: standard fridge opening is a minimum 37 3/8 x 73 3/8". Ice Waterline Rough-In is included.
Appliances	1111	Standard stove opening is 30" and standard dishwasher opening is 24". Any gas stove will require backsplash or stainless steel backing to avoid fire hazards.
Appliances	1111	Purchasers acknowledge: Heathwood Homes and its contractors will not be responsible for any kitchen cabinet changes due to appliances dimension changes after
Kitchen Floor	1111	12 x 24 CARRARA X WHITE POLISHED OV.CX.WHT.1224.PL. UPG 5 S2P17
Kitchen Floor Grout	1111	Grout- (27) Silver STD
Kitchen Floor Pattern		

Comment

MR

JIMIT, VIJAYKUMAR SUKHADIYA/DHARINIBAHEN RAJNIKANT SHAH
Project: Wallaceton
Unit: 267, Phase: 2
Model: 25-2269 A The Walden

Created: 6/29/2020 12:57:00
Locked:
Closed:

4 of 43

Foyer

Flooring	8913	UN.BL.BIA.1224-Biel-Bianco (White)-12 x 24 See Tile Direction on Sketch Page ***2***	S2P17
Floor Tile Grout	2225	Grout-(27) Silver ***STD***	
Floor Tile Pattern	3040	FRONT TO BACK ***STD***	

Comment

Laundry Room

Flooring	8261	TR.ST.BYZ.1313-Serpentine-Beyaz/White-13x13 See Tile Line Pattern on Sketch Page ***STD***	S3P18
Floor Tile Grout	2222	Grout-(105) Driftwood ***STD***	
Floor Tile Pattern	3000	STANDARD SQUARE ***STD***	

Comment

Laundry Room Opt.

Cabinet	1111	N/A *****	
Cabinet Hardware	1111	N/A *****	
Comment	1		

Mud Room

Flooring	8913	UN.BL.BIA.1224-Biel-Bianco (White)-12 x 24 See Tile Direction on Sketch Page ***2***	S2P17
Floor Tile Grout	2225	Grout-(27) Silver ***STD***	
Floor Tile Pattern	3040	FRONT TO BACK ***STD***	

mf

JIMIT, VIJAYKUMAR SUKHADIYA/DHARINIBAHEN RAJNIKANT SHAH
Project: Wallaceton
Unit: 267, Phase: 2
Model: 25-2269 A The Walden

Created: 6/29/2020 12:57:00
Locked:
Closed:

5 of 43

Comment ??

Powder Room

Flooring 8913 UN.BL.BIA.1224-Biel-Bianco (White)-12 x 24 See Tile S2P17
Direction on Sketch Page ***2***
Floor Tile Grout 2225 Grout-(27) Silver ***STD***
Floor Tile Pattern 3040 FRONT TO BACK ***STD***

Plumbing Fixture (Colour) 1737 Plumbing Fixtures-WHITE ***STD***
Comment

Dining Room

Flooring 7498 Red Oak Pearl-Vintage Engineered-IRONGATE-3/4 inch x 3 1/4 inch ***STD***
Comment

Great Room/Breakfast

Flooring 7498 Red Oak Pearl-Vintage Engineered-IRONGATE-3/4 inch x 3 1/4 inch ***STD***
Comment

Upper Hall

Flooring 7498 Red Oak Pearl-Vintage Engineered-IRONGATE-3/4 inch x 3 1/4 inch ***3***
Comment

Finished Basement (Rec) Room/Hall

Flooring 9252 DY 16787 -Dynasty Tex-MYSTIC BEIGE-40 oz
Del.***STD***

mf

JIMIT, VIJAYKUMAR SUKHADIYA/DHARINIBAHEN RAJNIKANT SHAH
Project: Wallaceton
Unit: 267, Phase: 2
Model: 25-2269 A The Walden

Created: 6/29/2020 12:57:00
Locked:
Closed:

6 of 43

Poly STD

Comment

Master Bedroom

Flooring 9252 DY 16787 -Dynasty Tex-MYSTIC BEIGE-40 oz
Poly***STD***

Comment

Bedroom 2

Flooring 9252 DY 16787 -Dynasty Tex-MYSTIC BEIGE-40 oz
Poly***STD***

Comment

Bedroom 3

Flooring 9252 DY 16787 -Dynasty Tex-MYSTIC BEIGE-40 oz
Poly***STD***

Comment

Bedroom 4

Flooring 9252 DY 16787 -Dynasty Tex-MYSTIC BEIGE-40 oz
Poly***STD***

Comment 5

Ensuite 4

Cabinet Colour/Style 9157 Viking III-SIMCOE-MOONLIGHT-3DL ***STD***

Countertop 8796 6698-46-Countertop-PALOMA POLAR ETCHINGS
FINISH-Formica ***STD***

Countertop Edge 1111 N/A *****

Cabinet Hardware 7672 135-HARDWARE ***STD***

mf

JIMIT, VIJAYKUMAR SUKHADIYA/DHARINIBAHEN RAJNIKANT SHAH
Project: Wallaceton
Unit: 267, Phase: 2
Model: 25-2269 A The Walden

Created: 6/29/2020 12:57:00
Locked:
Closed:

7 of 43

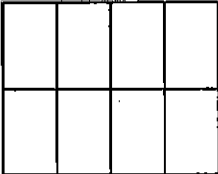
Floor Tile	7672	GE.SU.ATR.1313 Sauble Anthracite (Black) 13
Floor Tile Grout	7704	Grout-(19) Pearl Gray ***STD***
Floor Tile Pattern	3000	STANDARD SQUARE ***STD***
Wall Tile	9020	QT.WV.WHT.0810-Weave-White-8 x 10 ***STD***
Wall Tile Grout	2226	Grout-(00) White ***STD***
Wall Tile Pattern	3090	VERTICAL STACKED ***STD*** 
Plumbing Fixture (colour)	1737	Plumbing Fixtures-WHITE ***STD***
Comment		

Master Ensuite

Cabinet Colour/Style	9111	VIKING III SIMCOE ORCHID 3DL ***STD***
Countertop	9070	MSI Quartz GROUP 1 ICED GREY ***STD***
Countertop Edge	4010	GROUP 1 - SINGLE POLISHED STRAIGHT EDGE 3/4 INCH ***1*** 
Cabinet Hardware	2093	9671-HARDWARE ***STD***
Floor Tile	5494	GE.NA.GRY.1313-New Albion-Grey-13 x 13 ***STD***
Floor Tile Grout	2225	Grout-(27) Silver ***STD***
Floor Tile Pattern	3000	STANDARD SQUARE ***STD***
Shower Floor Tile	8661	OD.ON.SWT.0202.MT.N-Ontario Series Mosaic-Snow White Matte-2 x 2 ***STD***
Shower Floor Tile Grout	2226	Grout-(00) White ***STD***

MP

JIMIT, VIJAYKUMAR SUKHADIYA/DHARINIBAHEN RAJNIKANT SHAH
Project: Wallaceton
Unit: 267, Phase: 2
Model: 25-2269 A The Walden

Created: 6/29/2020 12:57:00
Locked:
Closed:

8 of 43

Shower Floor Tile Pattern	3000	STANDARD SQUARE ***STD***								
Shower Wall Tile	9020	QT.WV.WHT.0810-Weave-White-8 x 10 ***STD***								
Shower Wall Tile Grout	2226	Grout-(00) White ***STD***								
Shower Wall Tile Pattern	3090	VERTICAL STACKED ***STD*** <table><tr><td></td><td></td><td></td><td></td></tr><tr><td></td><td></td><td></td><td></td></tr></table>								
Shower Jamb(s) and Sill(s)	8925	Shower Jamb / Sill-Sky Grey (Light Grey) ***STD***								
Plumbing Fixture (colour)	1737	Plumbing Fixtures-WHITE ***STD***								
Comment										

Main Bathroom

Cabinet Colour/Style	6245	Viking III-CAMDEN-PORCINI CL-MAPLE ***STD***				
Countertop	8825	4588K-07-Countertop-KALAHARI TOPAZ-Wilsonart ***STD***				
Countertop Edge	1111	N/A *****				
Cabinet Hardware	7676	12843-HARDWARE ***STD***				
Floor Tile	8074	GE.RF.BON.1313-Reflex-Bone-13 x 13 See Tile Line Pattern on Sketch Page ***STD***				
Floor Tile Grout	2224	Grout-(44) Pale Umber ***STD***				
Floor Tile Pattern	3000	STANDARD SQUARE ***STD***				
Wall Tile	9021	QT.WV.IVO.0810-Weave-Ivory-8 x 10 ***STD***				
Wall Tile Grout	2226	Grout-(00) White ***STD***				
Wall Tile Pattern	3090	VERTICAL STACKED ***STD*** <table><tr><td></td><td></td><td></td><td></td></tr></table>				

MP

JIMIT, VIJAYKUMAR SUKHADIYA/DHARINIBAHEN RAJNIKANT SHAH
Project: Wallaceton
Unit: 267, Phase: 2
Model: 25-2269 A The Walden

Created: 6/29/2020 12:57:00
Locked:
Closed:

9 of 43

Plumbing Fixture (Colour) 1737 Plumbing Fixtures-WHITE ***STD***

Comment

Opt. Finished Basement Bathroom

Cabinet Colour/Style 9174 Viking III-TRINITY VIVA-SUNSET CRUISE ***STD***

Countertop 8822 4924-38-Countertop-WHITE CARRARA-Wilsonart ***STD***

Countertop Edge 1111 N/A *****

Cabinet Hardware 2080 113B-HARDWARE ***STD***

Floor Tile 2080 GE.SU.GRY.1313 Sauble Grey 13

Floor Tile Grout 7704 Grout-(19) Pearl Gray ***STD***

Floor Tile Pattern 3000 STANDARD SQUARE ***STD***

Shower Floor Tile 8661 OD.ON.SWT.0202.MT.N-Ontario Series Mosaic-Snow White Matte-2 x 2 ***STD***

Shower Floor Tile Grout 2226 Grout-(00) White ***STD***

Shower Floor Tile Pattern 3000 STANDARD SQUARE ***STD***

Shower Wall Tile 9022 QT.WV.TGR.0810-Weave-Tender Grey-8 x 10 ***STD***

Shower Wall Tile Grout 2226 Grout-(00) White ***STD***

Shower Wall Tile Pattern 3090 VERTICAL STACKED ***STD***

Shower Jamb(s) 8923 Shower Jamb / Sill-Thassos White ***STD***

mf

JIMIT, VIJAYKUMAR SUKHADIYA/DHARINIBAHEN RAJNIKANT SHAH
Project: Wallaceton
Unit: 267, Phase: 2
Model: 25-2269 A The Walden

Created: 6/29/2020 12:57:00
Locked:
Closed:

1043

Plumbing Fixture (Colour) 1737 Plumbing Fixtures-WHITE ***STD***

Comment

Great Room Fireplace

Type 8869 Majestic MERC32 ***STD***

Mantle 1439 NF 17-Paint Grade Mantle-Flat Wall-WHITE ***STD***

P 21

Surround 1111 N/A *****

Note 1111 Purchasers have been advised: heat from the FP can damage TV above a FP and items placed on mantle.

Note 1111 Heathwood and its contractors will not be liable for any damage on items placed/installed above a FP after closing.

Comment

Basement Stairs

Type 1714 Carpet Grade Stairs ***STD BASEMENT STAIRS***

Carpet 9252 DY 16787 -Dynasty Tex-MYSTIC BEIGE-40 oz Poly***STD***

Carpet Runner 1111 N/A *****

Handrail/Pickets/Post Type 9119 Handrail only on closed walls (one or two sides per building code) ***STD***

Handrail/Pickets/Post Colour 7912 Irongate (Gryphon) STAIN TO COMPLIMENT HARDWOOD AND WILL VARY FROM FLOORING

Handrail/Pickets/Post Locations 1111 N/A *****

Custom Stain/Paint 1111 N/A *****

Comment

Main Stairs

Type 1712 Oak Stairs ***STD MAIN STAIRS***

Carpet Runner 1111 N/A *****

WR

JIMIT, VIJAYKUMAR SUKHADIYA/DHARINIBAHEN RAJNIKANT SHAH
Project: Wallaceton
Unit: 267, Phase: 2
Model: 25-2269 A The Walden

Created: 6/29/2020 12:57:00
Locked:
Closed:

11 of 43

Handrail/Pickets/Posts Type	8148	Single Collar Alt. Plain w/ Shoes with 3 1/2" Square/Cap Post(s)-BLACK ***2***
Handrail/Pickets/Posts Colour	7912	Irongate (Gryphon) STAIN TO COMPLIMENT HARDWOOD AND WILL VARY FROM FLOORING
Handrail/Pickets/Posts Locations	7761	Oak Grade-Stain handrail,stringers,treads,risers,nosingpost
Custom Stain/Paint	1111	N/A *****
Comment		

Main Stairs Landing(s)

Flooring	7498	Red Oak Pearl-Vintage Engineered-IRONGATE-3/4 inch x 3 1/4 inch ***3***
Comment		

Throughout

Walls - Paint Colour	1717	22-Wall-WARM GREY ***STD***
Underpad	1079	500 Series-Underpad ***STD***
Thresholds	2232	Metal Thresholds ***STD***
Switches and Plug	5796	Decora White Switches and Plugs ***STD***
Trim Size	8705	4 1/4 Baseboard and 2 3/4 Casings ***STD***
Trim - Paint Colour	1716	Trim-WHITE ***STD***
Comment		

Purchaser: Signatures Aug 19/20 IRIT SALEM Aug 19/20

JIMIT, VIJAYKUMAR SUKHADI Date Decor Consultant Date

on file

Purchaser: my Rosen -08-21-2020

DHARINIBAHEN RAJNIKANT : Date Wallaceton Date Approved

APPROVED



Sales Selection Sheet
Wallaceton

12 of 43

PURCHASERS: JIMIT, VIJAYKUMAR SUKHADIYA and DHARINIBAHEN
RAJNIKANT SHAH

TEL:

LOT / UNIT 267	PHASE 2	MODEL 25-2269 A The Walden	
-------------------	------------	-------------------------------	--

It is herein understood and agreed between the undersigned parties hereto that the following changes shall be made to the above mentioned Agreement of Purchase and Sale in accordance with the agreement and except for such changes noted below, all other terms and conditions in the Agreement of Purchase and Sale shall remain as stated herein: It is further understood that and agreed that all changes and additions shall be installed as per builder's specifications, location and available selections. The Purchaser hereby agrees to purchase the following extras:

ADMIN FEE

1		Qty: 1
27,931	Note:	

APPLIANCES

2	36" CYCLONE SCB501 ALITO COLLECTION CHIMNEY HOOD FAN SEE SPECS PAGES 27-28	Qty: 1
31,413	Note:	

Cabinetry

3 189,001	CABINETRY - 11B-BANK OF DRAWERS (MAX. WIDTH 55CM) (SIZE SUBJECT TO FLOOR PLAN) - UPGRADE 2	Qty: 1
29,322	Note: TO BE INSTALLED IN THE KITCHEN ISLAND SEE SKETCH #'S 2 AND 4 PAGE 17 AND 19	
*4 189,306	CABINETRY - CLASSIC PLUS - KITCHEN - UPGRADE 3	Qty: 1
29,326	Note:	
*5 189,316	CABINETRY - 12J- VALANCE (PER 8 foot LENGTH PRICE) (FOR CLARIFICATION OF STYLES SEE MOULDING MATRIX) (LIGHT VALANCE IS NOW APPROXIMATELY 2" [50MM] HIGH. PLEASE ENSURE LIGHT FIXTURES USED WILL BE CONCEALED BY THE VALANCE.);	Qty: 3
30,439	Note: PRICE ALL THE SAME FOR ALL LINES - KITCHEN	
*6 189,344	CABINETRY - 11A-UPPER ANGLE CORNER PER UNIT - UPGRADE 2 SKETCH #'S 2 AND 4 PAGES 17 AND 19	Qty: 1
31,414	Note:	
*7 189,186	CABINETRY - 18H-BUILT-IN TALL APPLIANCE CABINET WITH DRAWER(S) BELOW FOR PANEL-MOUNT, PROUD, OR TRIMKIT INSTALLATIONS (TRIM KIT REQUIRED, SUPPLY ALL SPECS AND INSTALLATION GUIDES) (COUNTER DEPTH) - UPGRADE 2 SKETCH #'S 2 AND 4 PAGES 17 AND 19	Qty: 1
31,415	Note: SEE SPECS PAGES 37 - 43	
8	DO NOT DRILL OR INSTALL HARDWARE IN THE KITCHEN	Qty: 1
31,424	Note:	

CERAMIC

9		Qty: 1
26,603	Note: MUD ROOM CERAMIC FLOOR UPG/2	

Initials:



Sales Selection Sheet
Wallaceton

13 of 43
TEL:

PURCHASERS: JIMIT, VIJAYKUMAR SUKHADIYA and DHARINIBAHEN
RAJNIKANT SHAH

LOT / UNIT 267	PHASE 2	MODEL 25-2269 A The Walden	
-------------------	------------	-------------------------------	--

CERAMIC

10		Qty: 1
26,604	Note: POWDER ROOM CERAMIC FLOOR	

Ceramics

*11 189,400 29,323	CERAMICS -FOYER- UPGRADE Note: UPG 2	Qty: 1
*12 189,412 29,325	CERAMICS -KITCHEN UPG. 5 Note:	Qty: 1

Electrical

13 189,451 31,416	ELECTRICAL - ADDITIONAL SWITCH Note: KITCHEN FOR THE NEW R/I CAP LIGHT ABOVE THE ISLAND SEE SKETCH # 2 PAGE 17	Qty: 1
14 189,450 31,417	ELECTRICAL - CEILING ROUGH-IN (CAPPED) Note: 1-TO BE USED FOR THE CAP LIGHT ABOVE THE BREAKFAST BAR -USE SEAPARATE SWITCH 1- TO BE INSTALLED IN THE CENTRE OF THE GREAT ROOM- USE EXISTING SWITCH PLUG SEE SKETCH # 2 PAGE 17	Qty: 2
15 189,417 31,418	ELECTRICAL - RELOCATION OF SWITCHES/LIGHTS (MUST SPECIFY LOCATION) - NOTE: PLUGS CANNOT BE RELOCATED- MUST PURCHASE ADDITIONAL OUTLET. Note: RELOCATE STD. 240V 40 AMP STOVE ELECTRICAL PLUG TO THE BUILT IN OVEN LOCATION SEE SKETCH # 4 PAGE 19	Qty: 1
16 189,449 31,423	ELECTRICAL - EXTRA WALL INTERIOR OUTLET ON EXISTING CIRCUIT (DOES NOT INCLUDE KITCHEN OUTLETS) Note: GREAT ROOM TO BE INSTALL IN THE CENTRE OF THE GREATROOM APPROX. 70" FROM FLOOR SKETCH # 2 PAGE 17	Qty: 1
17 189,440 31,485	ELECTRICAL - EXTRA WALL INTERIOR OUTLET (120V/15A) ON A SEPARATE CIRCUIT (ON ARCAULT) Note: TO BE USED FOR THE MICROWAVE IN THE BUILT IN APPLIANCES SKETCH 3 4 PAGE 19 SEE SPEC.PAGES 37 - 39	Qty: 1

Granite

*18 189,464 26,600	GRANITE - GRANITE CUTOUT W/ STRAIGHT EDGE POLISH TO ACCOMMODATE COOK TOP SPECS PAGES 29 - 36 Note:	Qty: 1
--------------------------	---	--------

Initials:



Sales Selection Sheet
Wallaceton

14 OF 43
TEL:

PURCHASERS: JIMIT, VIJAYKUMAR SUKHADIYA and DHARINIBAHEN
RAJNIKANT SHAH

LOT / UNIT 267	PHASE 2	MODEL 25-2269 A The Walden	
-------------------	------------	-------------------------------	--

GRANITE

19	COUNTERTOP 3/4" GROUP 1 WITH MITRE EDGE - KITCHEN / ISLAND	Qty: 1	
29,491	Note: KITCHEN MITRE EDGE - KITCHEN AND ISLAND		

HARDWOOD

20		Qty: 1	
26,615	Note: UPPER HALLWAY: 3-1/4" RED OAK ENGINEERED		

Heating/Air

*21 189,474	HEATING/AIR - ROUGH-IN GAS LINE FOR GAS STOVE AT MAIN FLOOR (SEE SPECS) (HOOK-UP NOT INCLUDED) LEAVE STANDARD 120 VOLT ELECTRICAL OUTLET ON A SEPARATE CIRCUIT. * SPECIFY IF STANDARD 240V TO BE RELOCATED TO BUILT IN OVEN LOCATION SKETCH # 4 PAGE 19	Qty: 1	
31,419	Note: GAS COOKTOP SPECS PAGES 29 - 36		

INTERIOR RAILIN

22		Qty: 1	
26,616	Note: BLACK METAL - SINGLE COLLAR ALT W/SHOES WITH 3-1/2" SQUARE CAP/POST AS PER PLAN- MAIN STAIRS UPG. 2		

INTERIOR TRIM

23	FRENCH DOORS PAGE 20	Qty: 1	
26,620	Note: FOYER CLOSET DOORS: 6' 8" FRENCH FULL SINGLE PANEL GLASS 2 DOORS IN STD. DOORS - DO NOT INSTALL ROD OR SHELF IN FOYER CLOSET SEE SKETCH # 2 PAGE 17		

Mirrors/Glass Pro

24 183,371	MIRRORS/GLASS PRODUCTS - UPGRADE TO FRAMELESS CLEAR GLASS WITH D-RING HANDLE IN CHROME - ENSUITE MASTER	Qty: 1	
31,425	Note:		

Plumbing

25 189,509	PLUMBING - MOEN -SOAP DISPENSERS - CHROME (MODEL: 3944) -	Qty: 1	
26,588	Note: CHROME LOCATION ON SINK PAGE 22 SEE SPEC PAGE 24		
26 189,694	PLUMBING - OPTION FROM ONE SINK TO DOUBLE SINKS, INCLUDING STD CHATEAU FAUCET AND UNDERMOUNT OVALYN INCLUDING STD CHATEAU FAUCET AND UNDERMOUNT OVALYN SINK INCLUDING CABINET CONVERSION 2D VIKING, ONE EXTRA CUTOUT AND ONE EXTRA VANITY LIGHT	Qty: 1	
31,421	Note: MASTER BATHROOM		

Structured Wiring

Initials:



Sales Selection Sheet

Wallaceton

15 of 43

PURCHASERS: JIMIT, VIJAYKUMAR SUKHADIYA and DHARINIBAHEN
RAJNIKANT SHAH

TEL:

LOT / UNIT	PHASE	MODEL	
267	2	25-2269 A The Walden	

Structured Wiring

27 189,787	STRUCTURED WIRING - CONDUIT PIPE TO ABOVE FIREPLACE ROUGH-IN	Qty: 1
31,422	Note: GREAT ROOM; TO BE INSTALLED ABOVE THE CENTRE OF THE FIRE PLACE SEE SKETCH # 2 PAGE 17	

Sub Total

HST

Total

1. This Sales Selection Sheet when properly executed forms part of our Agreement of Purchase and Sale.
2. All extras and upgrades listed above are subject to Construction Progress and Architectural and Municipal requirements.
3. In the event the Vendor is unable to incorporate the work approved above in the construction of the house for any reason whatsoever, the Vendor will not be liable to the Purchaser in any way. The monies paid for any changes or optional extras not proceeded with shall be returned to the Purchaser, without interest. The cost of options or extras is non-refundable in all other circumstances. If for any reason whatsoever the Agreement of Purchase and Sale is not completed, the total cost of work approved above will be retained by the Vendor.
4. The Vendor reserves the right to substitute above materials and equipment with that of equal or better quality.
5. Purchaser acknowledges that items may not be exactly as shown. Variations from the Vendor's samples may occur in finished materials due to normal production processes. Vendor is not responsible for shade difference which may occur from different dye lots or wood grains. Variations from the Vendor's samples will occur with natural materials such as wood, marble, granite, hardwood and brick.
6. The Vendor reserves the right to select Grout & Thresholds that best suits the Tile selected.
7. Selections will not be processed unless signed by Heathwood Homes Head Office.
8. The selections made on this schedule are final and cannot be changed once submitted.
9. The Purchaser has checked and acknowledges the accuracy of this schedule.

Payment Summary

<u>Paid By</u>	<u>Amount</u>
----------------	---------------

Total Payment:

PURCHASER:

Signatures on
JIMIT, VIJAYKUMAR SUKHADIYA

21-Aug-20

DATE

IRIT SALEM
Decor Consultant

21-Aug-20

DATE

PURCHASER:

file
DHARINIBAHEN RAJNIKANT SHAH

21-Aug-20

DATE

M. Rosen
Date Approved Heathwood Homes (Huron) Limited

TAX#:1

PREPARED BY: Bei Liu

PE 328-4

S\invoice.rpt 28may19

UK-75 WALLACETON
LOT 267
25-2269 ELE A
THE WALDEN

16 of 43

THE WALDEN

25-2269 ELEV.A

ELEVATION A | 2,269 SQ. FT.
695 sq. ft. of opt. finished Lower Level

WALLACETON
B.S.T. 1870

Sketch #1

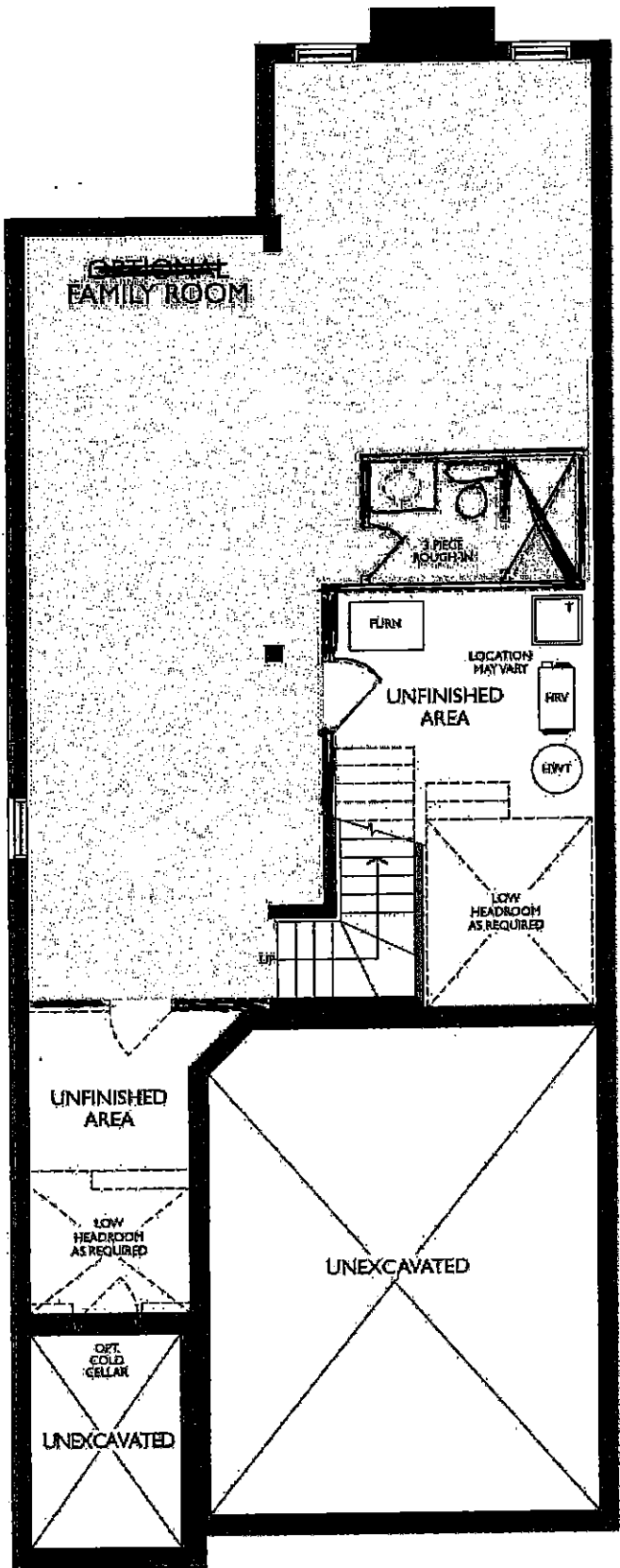

LOWER LEVEL
ELEVATION A, B, C & D

[Handwritten signature]

[Handwritten initials]

UK-75 WALLACETON
LOT 267
25-2269 ELE A
THE WALDEN

17 of 43

THE WALDEN

25-2269 ELEV.A

ELEVATION A | 2,269 SQ. FT.
695 sq. ft. of opt. finished Lower Level

Sketch #2

WALLACETON

#ST. 1870

ELECTRICAL OUTLET

CONDUIT PIPE & CHASE

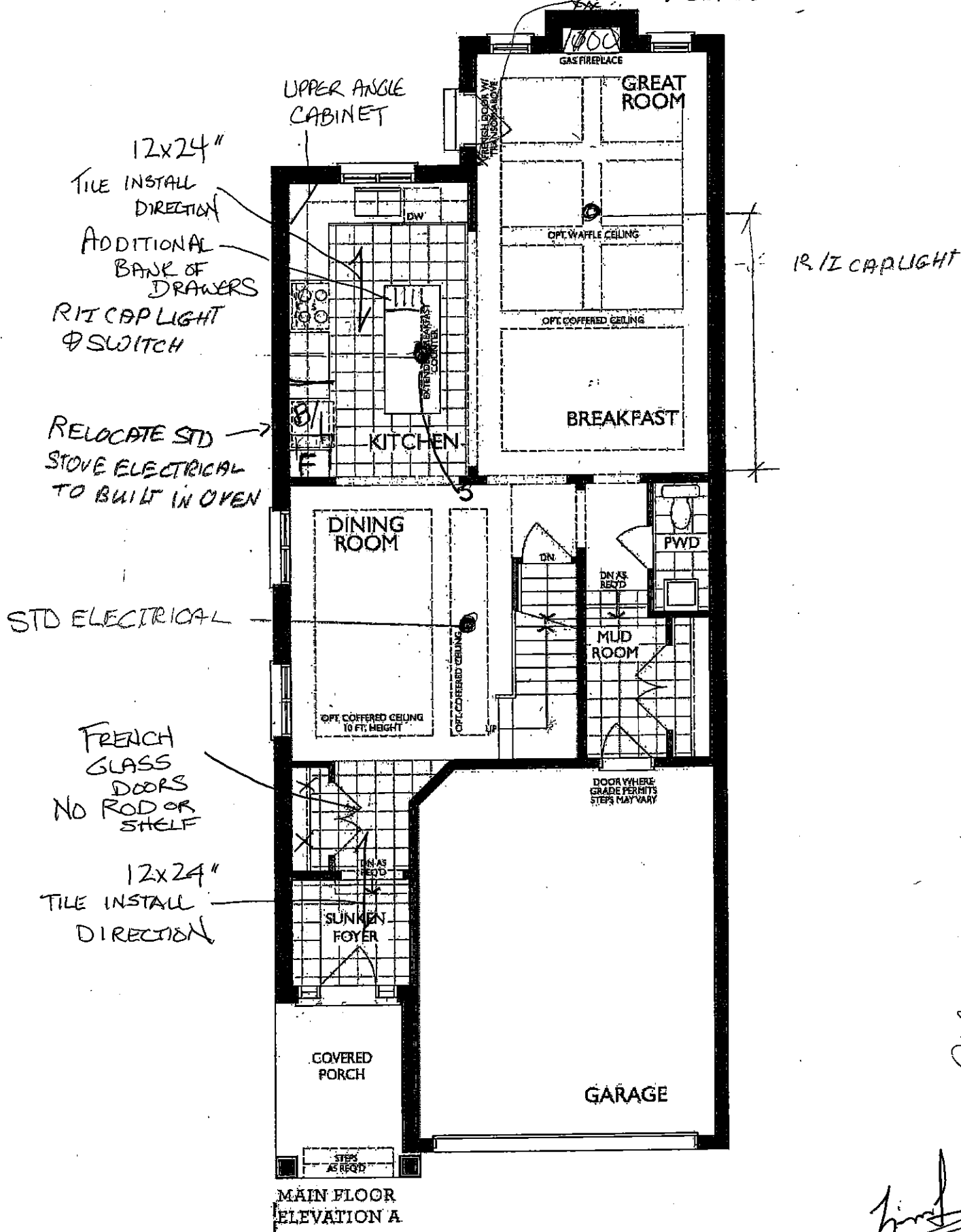

July 14, 2020

UK-75 WALLACETON
LOT 267
25-2269 ELE A
THE WALDEN

18 of 43

THE WALDEN

25-2269 ELEV.A

ELEVATION A | 2,269 SQ. FT.
695 sq. ft. of opt. finished Lower Level

Sketch #3

WALLACETON
EST. 1870

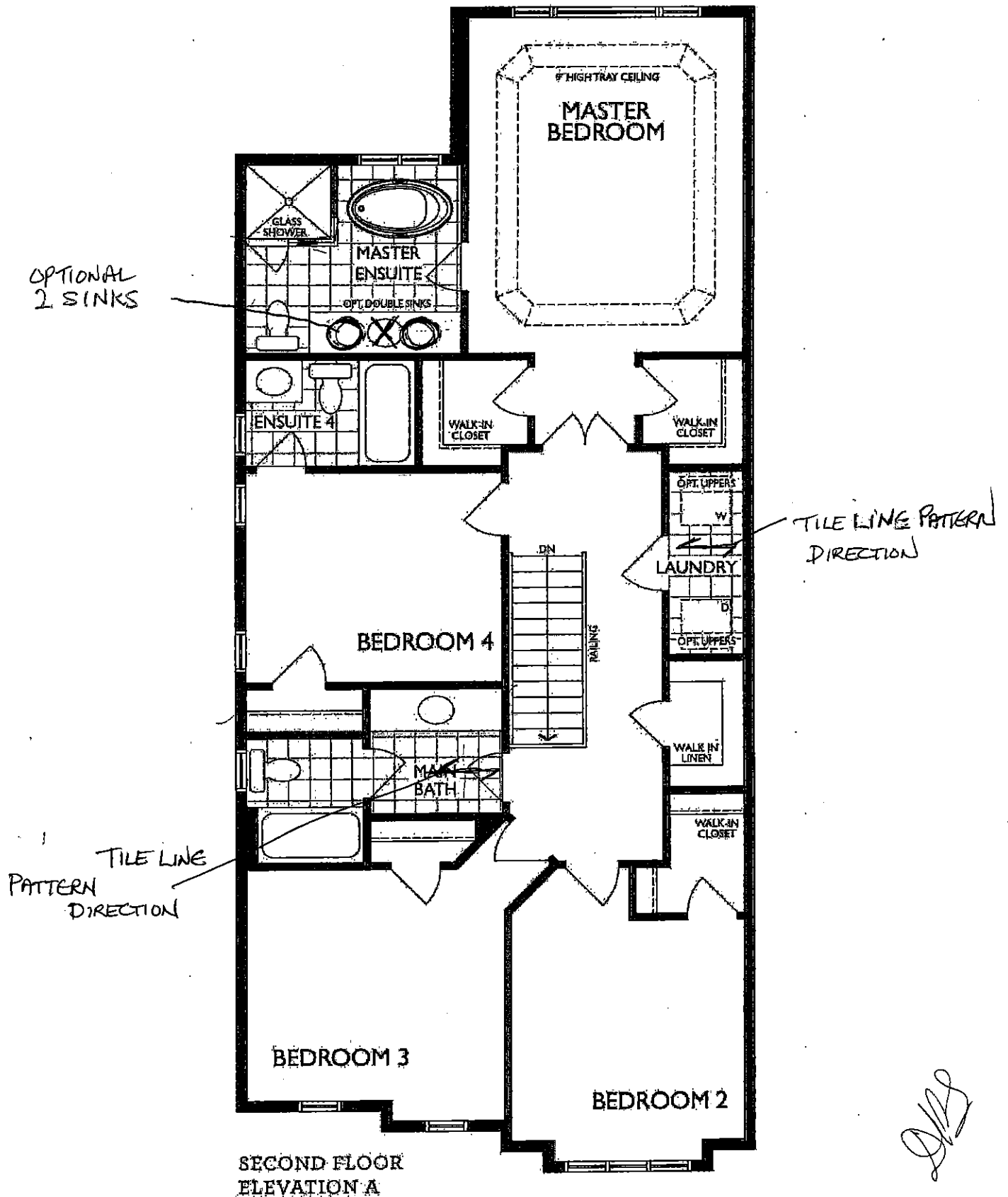

DLB

h:



F R E N D I
 K I T C H E N S L I M I T E D
 100 Shawson Drive, Mississauga, ON L4W 4G1

HEATHWOOD HOMI
 WALLACETON, KITCHENE
 MODEL: 25-2269 (3105)

STANDARD CONTRACT INCLUDES:

Appliance Openings

- Hood Opening: 30"W Chimney
- Fridge Opening: 37 3/8 "W X 73
- Fridge cabinet & gables: 66cm
- Stove Opening: 30" Freestanding
- Dishwasher Opening: 24"

Standard Kitchens Scope:

- 100cm H wall cabinets
- Std. Blumotion Hinges- **soft close doors**
- Std. Metabox Drawers- **not soft close**
- Min 40cm W drawer
- Base pie cut corner cabinets
- Backing on all cabinets
- Countertop by others
- Upgrade applied paneled fridge & dishwashers supply only (appliance hardware by others)

Standard Vanity & Laundry Scope:

- Powder by others, pedestal
- Master Ens. - Top by others
- Remaining vanities inc. laminate top
- Std. Blumotion Hinges- **not soft close**
- Std. Metabox Drawers- **not soft close**
- Master Ens: Top drawers (Sink Full Height)
- Mains: Full height doors (top drawers added if Masters can't accommodate)
- Optional laundry base & wall cabinets

THIS DRAWING IS FOR DESIGN PURPOSES ONLY.
 IT IS NOT AN EXACT RENDERING.

OPT. BASEMENT BATH

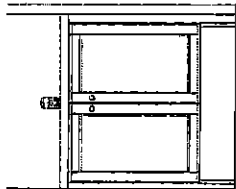

OPT. LAUNDRY UPPERS
 (2ND FLR)

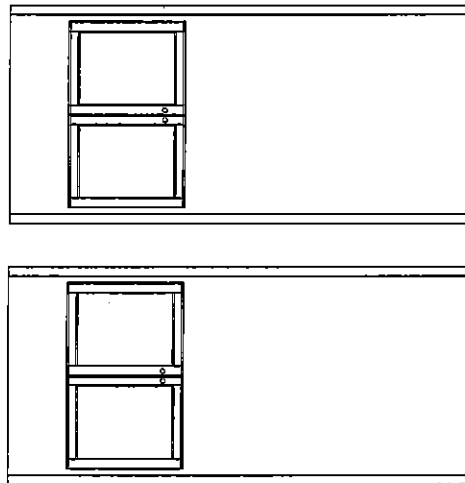

ENSUITE 4
 (2ND FLR)

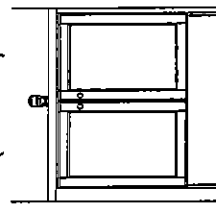

MAIN BATH
 (2ND FLR)

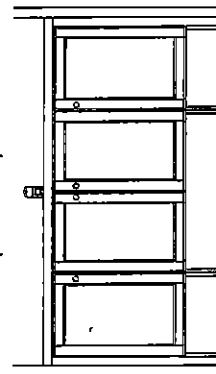

MASTER ENSUITE
 (2ND FLR)

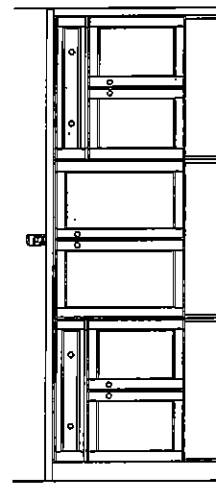

KITCHEN
 (GROUND FLOOR)

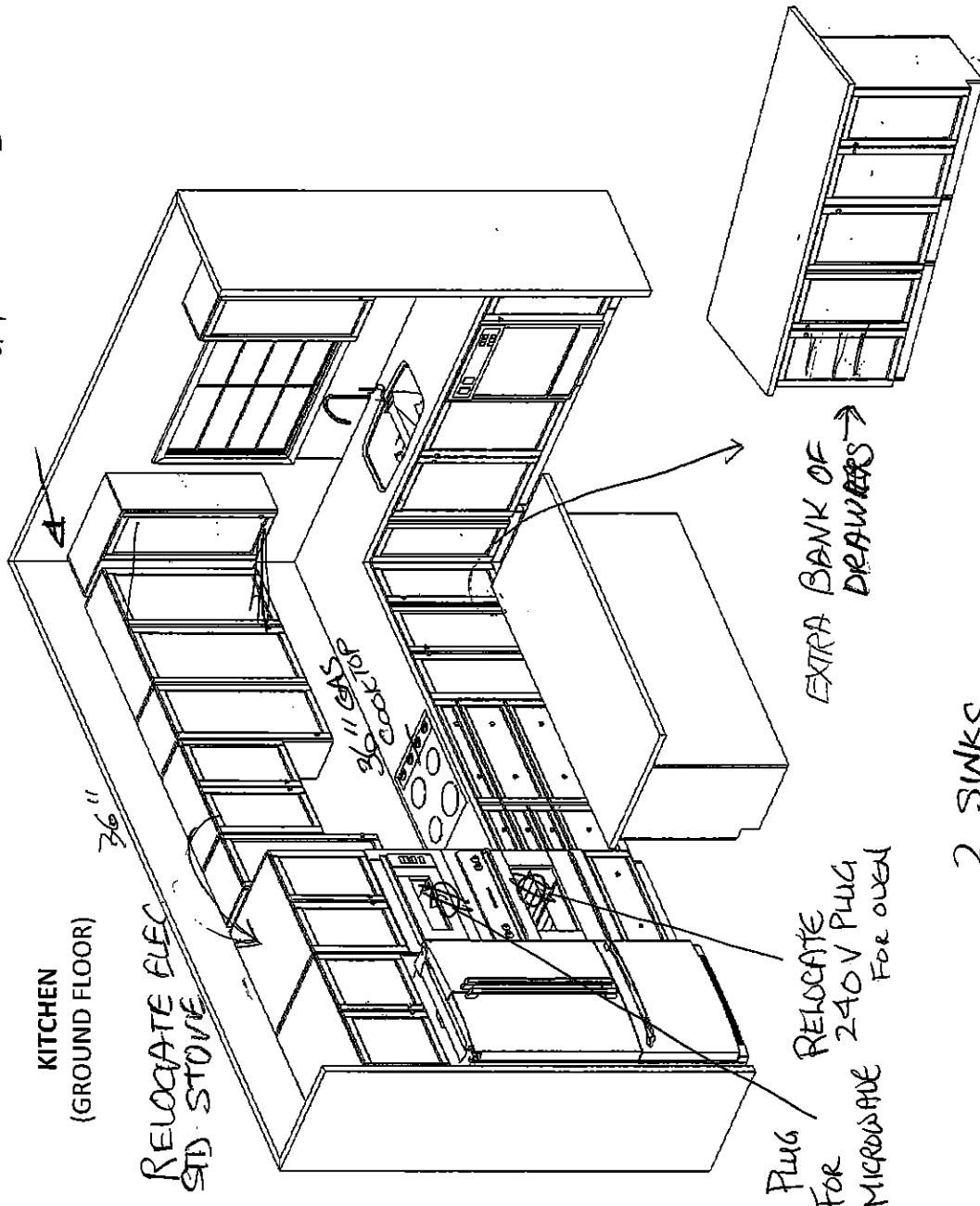

2 SINKS

[Handwritten signatures]

UK- 75 WALLACETON
LOT 267
25-2269 ELEV. A
THE WALDEN

OPTION A

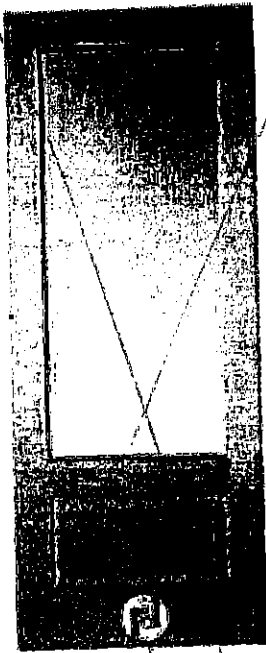

Single Pane Tempered
Glass with a 12" Panel and
an overall 24" bottom panel

OPTION B

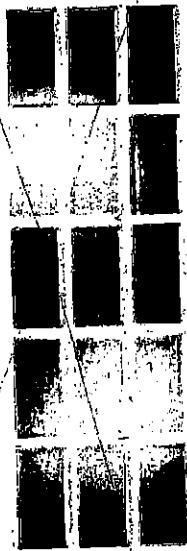

15 panes French
door with wood mullions

OPTION C



Full Single Pane
glass door with a
bottom rail of approx. 9"

X 2

Option A – Supply and install additional 1 – single 6'8" Type A door package including hardware

- a. Flat Glass Retail \$874 (code A1)
- b. Beveled Glass Add Retail \$512 (Code A1+A5) Total of \$1386
- c. Frosted Glass Add Retail \$406 (Code A1+A6) Total of \$1280

Option B – Supply and install additional 1 – single 6'8" Type B door package including hardware

- a. Flat Glass Retail \$756 (code B1)
- b. Beveled Glass Add Retail \$498 (Code B1+B5) Total of \$1254
- c. Frosted Glass Add Retail \$185 (Code B1+B6) Total of \$941

Option C – Supply and install additional 1 – single 6'8" Type C door package including hardware

- a. Flat Glass Retail \$781 (code B1) ✓
- b. Beveled Glass Add Retail \$680 (Code B1+B5) Total of \$1461
- c. Laminated Glass Add Retail \$434 (Code B1+B6) Total of \$1215

1.
h.
DMS

UK-75 WALLACETON
LOT 267
25-2269 ELE A
THE WALDEN

21 of 43

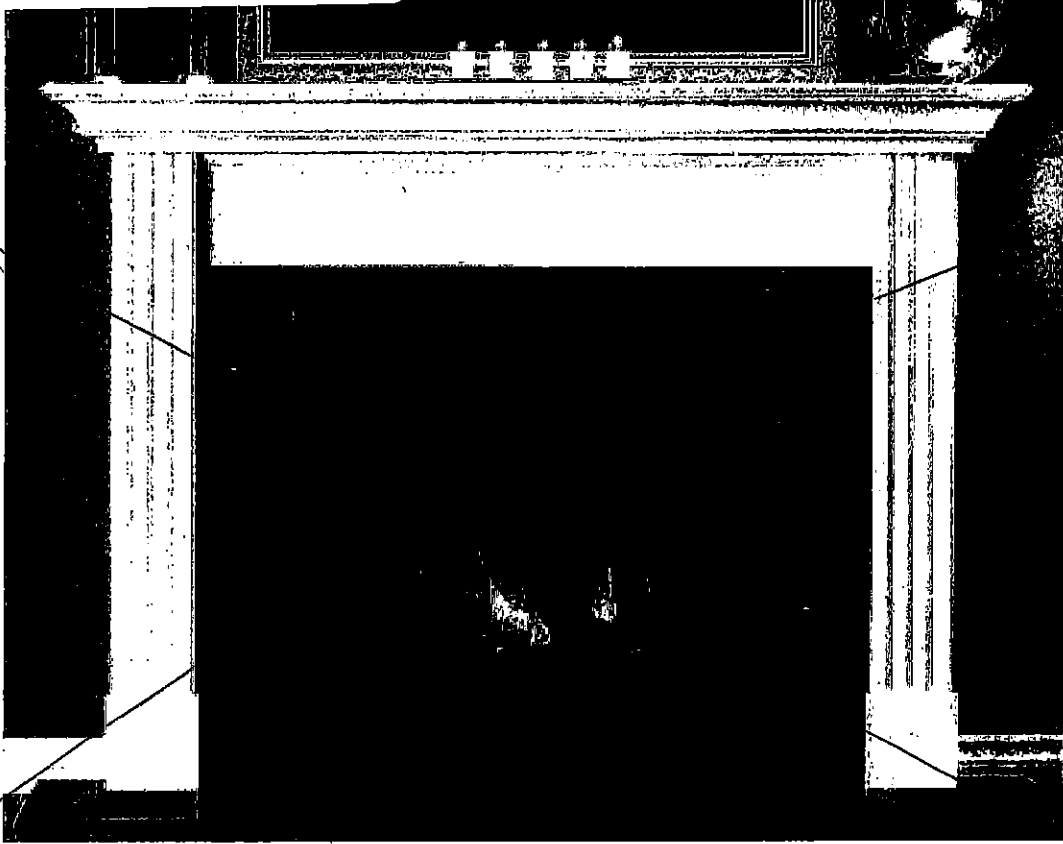

STANDARD NF 15 Mantel

Clean apron finish with fluted legs

WHITE PAINT GRADE FINISH

(PICTURE SHOWN WITH UPGRADE SURROUND AND HEARTH -PRICED SEPARATELY)

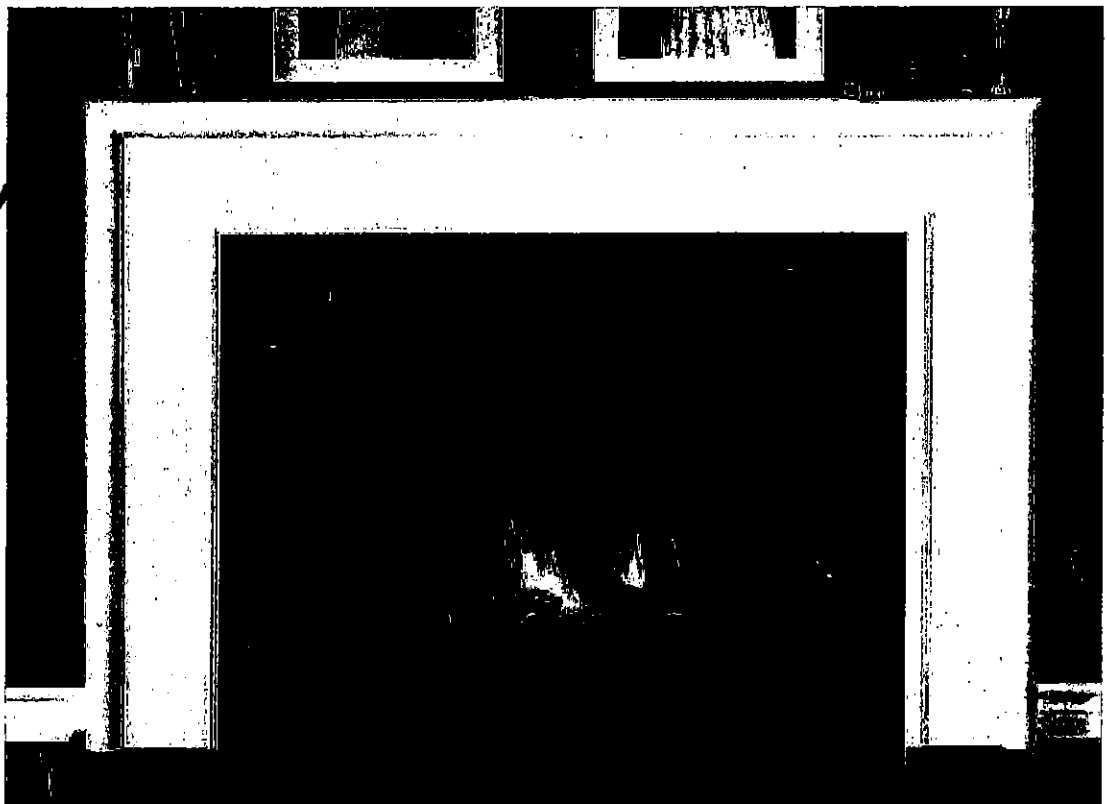

STANDARD NF 17 Mantel ✓

WHITE PAINT GRADE FINISH

(PICTURE SHOWN WITH UPGRADE SURROUND AND HEARTH -PRICED SEPARATELY)

DR

UK- 75 WALLACETON
LOT 267
25-2269 ELEV. A
THE WALDEN

22 of 43



STANDARD KITCHEN SINK

ND1831UA/9

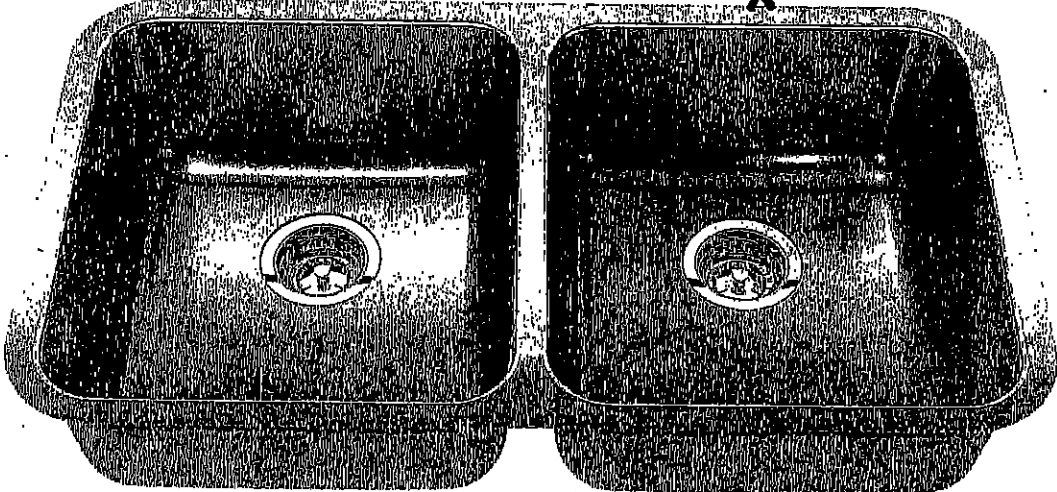

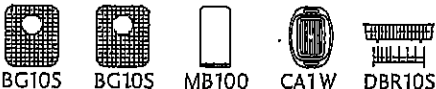



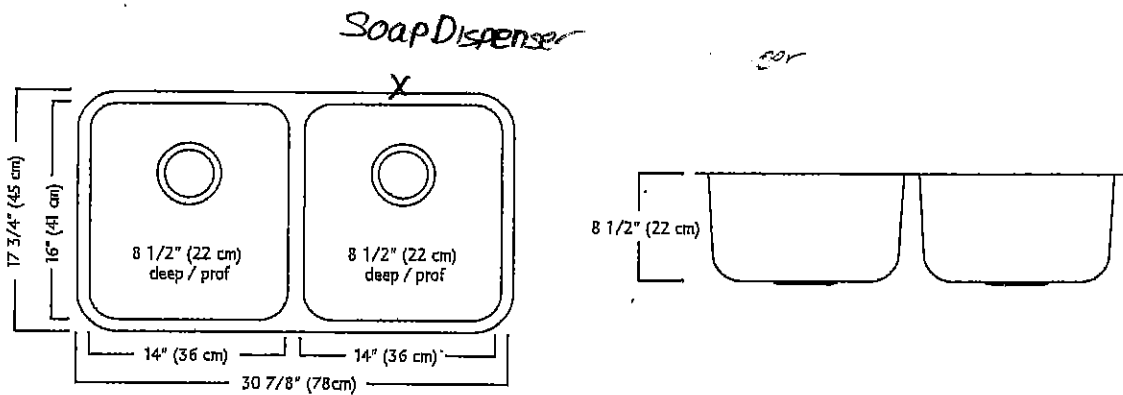

ND1831UA/9 SPECIFICATION

Model ND1831UA/9 is a double (two equal size) bowl undermount sink manufactured by Franke Kindred Canada Limited from 18 gauge stainless steel. Product has silk finished rims and linear brush finished bowls. Sink is fully undercoated. Basket strainer waste fittings (3 1/2", 89 mm) are included. Sink is backed with a limited lifetime warranty.

- O.D. 17 3/4" x 30 7/8" x 8 1/2" (45 x 78 x 22 cm)
- Recommended for minimum 36" cabinet

Franke Kindred Canada Limited
P.O. Box 190, 1000 Franke Kindred Road, Midland, Ontario, Canada, L4R 4K9 Phone: 866-687-7465 Fax: 800-361-8408

Handwritten initials/signature.

UK-75 WALLACETON
LOT 267
25-2269 ELE A
THE WALDEN

23 of 43

STANDARD KITCHEN FAUCET

Align

Modern

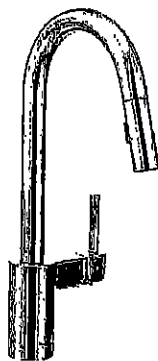

Single Handle Pull-Down Kitchen
Faucet*

Model 7565†

SS

21



UK- 75 WALLACE ION
LOT 267
25-2269 ELEV. A
THE WALDEN

Buy it for looks. Buy it for life.®

24 of 43
Specifications

DESCRIPTION

- Available in various finishes identified by suffix

OPERATION

- Press down, pump action

STANDARDS

- Designed and manufactured to comply with the requirements of: CSA B15.1 and ASME A112.18.1 and all requirements referenced therein

WARRANTY

- Lifetime limited warranty against manufacturing and finish defects to the original consumer purchaser
- 5 year warranty if used in commercial installations

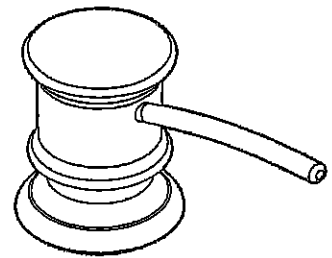

LIQUID DISPENSER

Model: 3944 series

CHROME

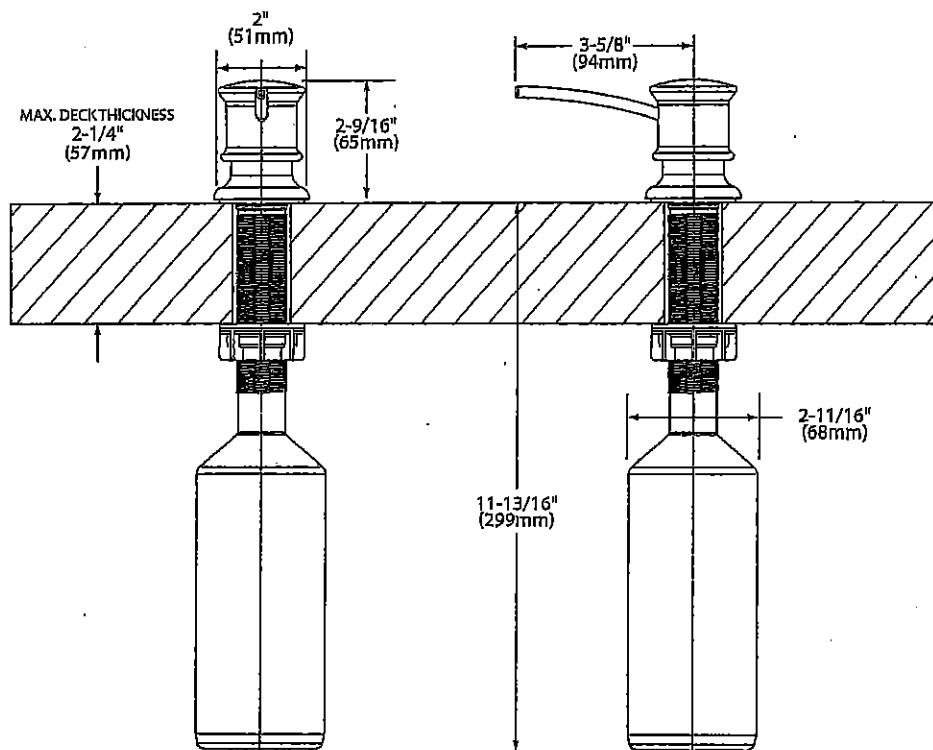

NOTE: DESIGNED TO BE INSTALLED THROUGH 1 HOLE 1-1/8" DIAMETER

CRITICAL DIMENSIONS

(DO NOT SCALE)

L.
[Signature]

UK-75 WALLACETON
LOT 267
25-2269 ELE A
THE WALDEN

25 of 43

American Standard

Style That Works Better

BARRIER FREE

Master Bathroom x 2

OVALYN™ UNDERCOUNTER SINK
VITREOUS CHINA

OVALYN™ UNDERCOUNTER SINK

- Classic oval undermount sink
- Made from vitreous china
- Front overflow
- Supplied with mounting kit (047194-0070A) and template

0496.221 Unglazed rim
489 x 413mm
(19-1/4" x 16-1/4")

Bowl size:
432mm (17") wide
356mm (14") front to back
140mm (5-1/2") deep

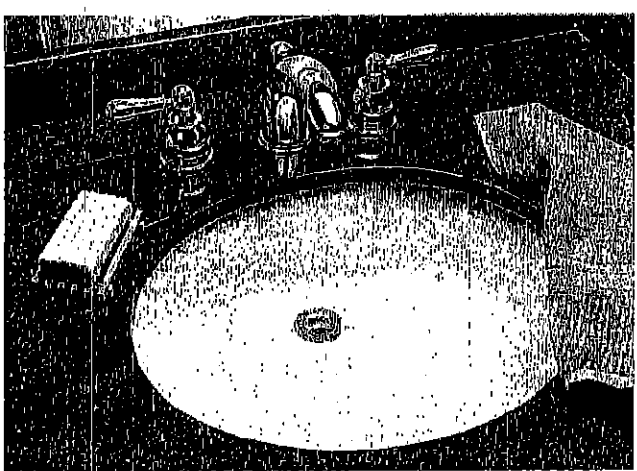

Compliance Certifications -
Meets or Exceeds the Following Specifications:
• ASME A112.19.2M for Vitreous China Fixtures
• CAN/CSA B45 series

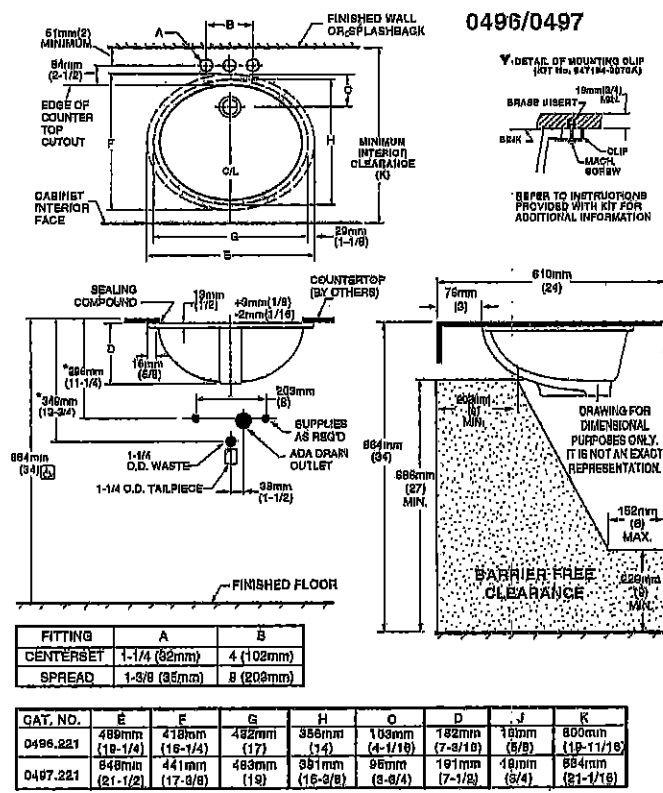

NOTES:
* DIMENSIONS SHOWN FOR LOCATION OF SUPPLIED AND "P" TRAP ARE SUGGESTED.
▼ UNDERCOUNTER MOUNTING KIT SUPPLIED WITH SINK. PLEASE NOTE MINIMUM INTERIOR CLEARANCE DIMENSION (K). FITTINGS NOT INCLUDED AND MUST BE ORDERED SEPARATELY. USE ENCLOSED TEMPLATE FOR COUNTERTOP CUTOUT SEALING COMPOUND SUPPLIED BY OTHERS.
IMPORTANT: Dimensions of fixtures are nominal and may vary within the range of tolerances established by ANSI Standard A112.19.2. These measurements are subject to change or cancellation. No responsibility is assumed for use of superseded or voided pages.

MEETS THE AMERICANS WITH DISABILITIES ACT GUIDELINES AND ANSI A117.1 ACCESSIBLE AND USEABLE BUILDINGS AND FACILITIES - CHECK LOCAL CODES.
Countertop 864mm (34") from finished floor. Lavatory Installed 76mm (3") from front edge of countertop. Countertop thickness to be 25mm (1") maximum.

Handwritten signature or initials.

Handwritten mark or signature.

UK-75 WALLACETON
LOT 267
25-2269 ELEV A
THE WALDEN

26 of 43

Chateau

Transitional

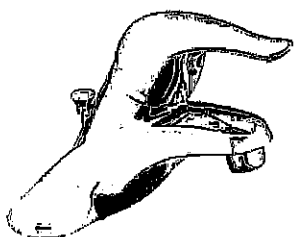

Lavatory Faucet with Pop-Up Drain
Model L4621†

VANITY SINKS AND PEDESTAL

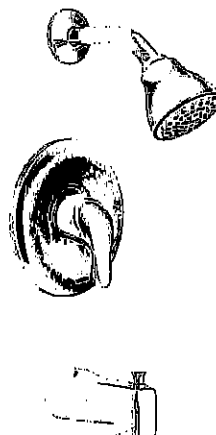

Posi-Temp® Pressure Balancing Tub/Shower
Model 62320 / TL183†

OR

Posi-Temp Valve and Tub/Shower Trim
with Eco-Performance Easy Clean® XL

Model 62320 / TL183EP†

(TL183EP not available in BC)

SHOWER AND 5' TUB FAUCETS



2 Handle Roman Tub with 9" Spout
Model 4796 / T990†

FREESTANDING TUB FAUCETS

UK- 75 WALLACETON
LOT 267
25-2269 ELEV. A
THE WALDEN

27 of 43

SC(B)501 | ALITO Collection

Cyclone®
Breathe Better

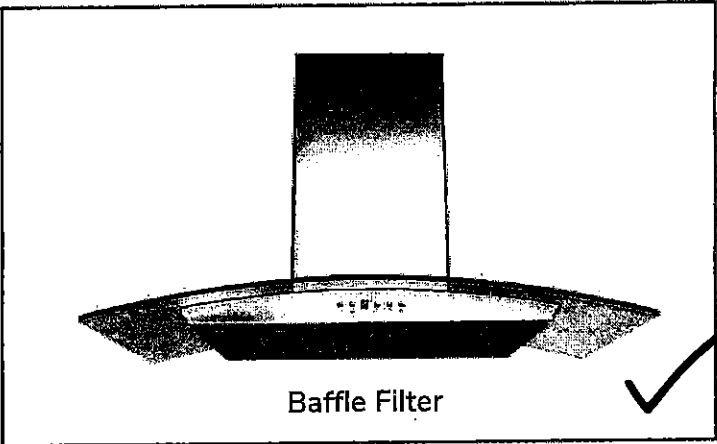
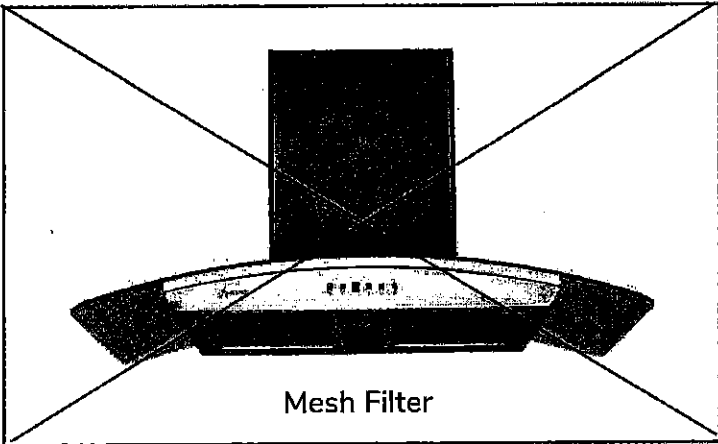

Wall Mount

A very attractive exhaust fan, the SC(B)501 is the perfect balance of substance and style. The arched glass canopy frames a classic design giving it a modern appeal. The hood features a three-speed digital control panel. Two LED lights, two mesh or baffle filters and a quiet, efficient motor. Fitted with a time-delay OFF feature up to nine minutes.

Green Features



3 Speed Push Button
Control Panel



Long-Lasting
LED Lights



Time-Delay
OFF Feature



Grease Cup

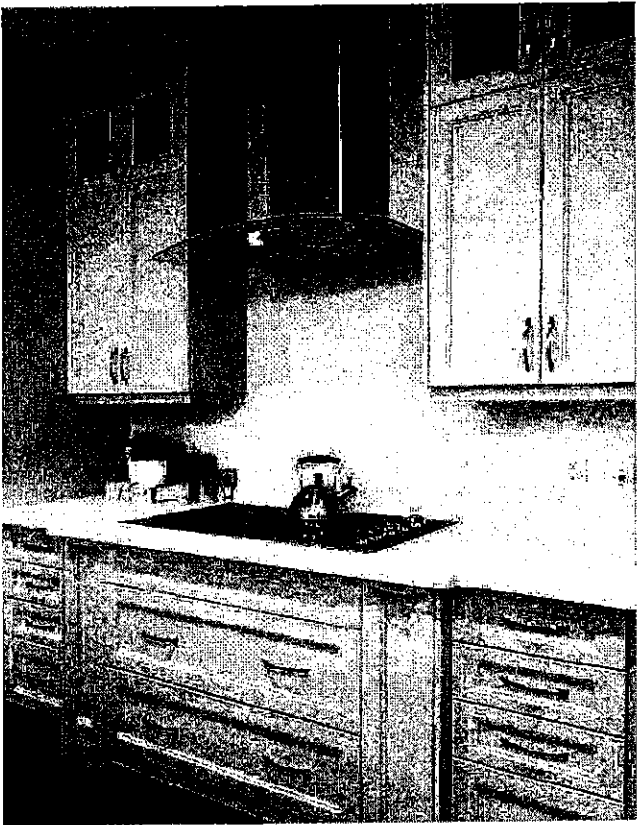

Model	Colour	Ducting	Filters	Size	CFM
SC50130	Stainless Steel	6"	Mesh	30"	550
SC50136	Stainless Steel	6"	Mesh	36"	550
SCB50130	Stainless Steel	6"	Baffle	30"	550
SCB50136	Stainless Steel	6"	Baffle	36"	550

Cyclone Range Hoods Inc.

1361 Huntingwood Drive, Unit 16, Toronto, ON, M1S 3J1, Canada.

Toll Free: 1-888-293-5662 Tel: (416) 293-0933 Fax: (416) 293-4793 Website: www.CycloneRangeHoods.com

Handwritten signatures and initials.

UK- 75 WALLACETON
LOT 267
25-2269 ELEV. A
THE WALDEN

28 of 43

SC(B)501 | ALITO Collection



Features

- Wall mount range hood
- 6" round duct adapter
- Non-stick aluminum fan blades
- 3 speed push button control
- 2 LED lights (2 x 1.4W, 4000K)
- Quick release aluminum mesh filters
- Standard chimney fits up to 9 ft. ceiling
- Up to 9 minute time-delay OFF feature
- Plug-in connection

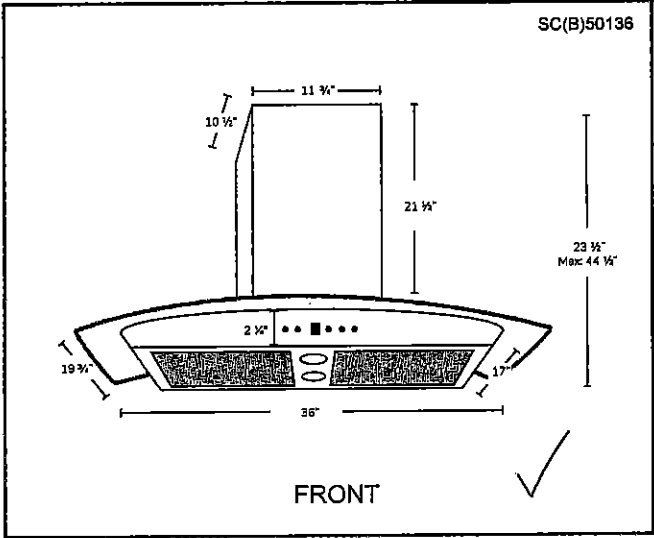
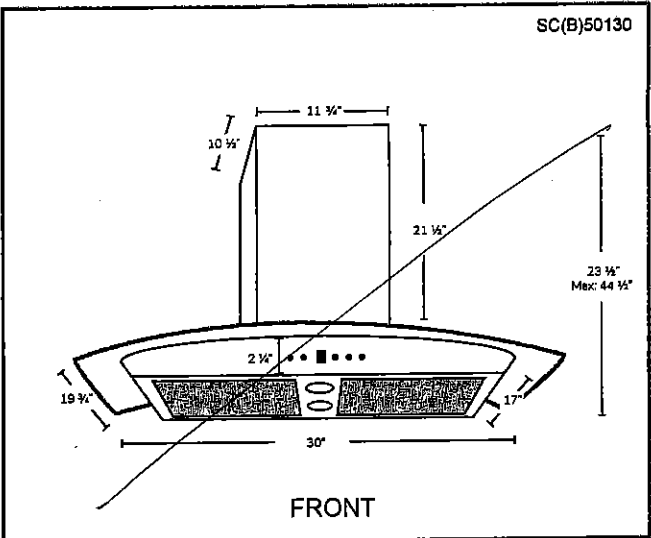

Options

- Filters:
 - SC501 - Quick Release Aluminum Mesh Filters
 - SCB501 - Quick Release Stainless Steel Baffle Filters
- Chimney Flues:
 - B1.CH16 - short (7'-8' ceilings)
 - B1.CH22 - standard (8'-9' ceilings)
 - B1.CH32 - extended (9'-11' ceilings)
- Widths: 30" 36"

Specifications

- | | | |
|---|---|--|
| <ul style="list-style-type: none">▪ Air Flow Volume: 550 CFM▪ Electrical Connection: 120V/60Hz▪ Power Consumption: 240 Watts▪ Current: 2.0 Amps▪ Fan Speed: 1599 RPM▪ Fan Type: Centrifugal Blower | <ul style="list-style-type: none">▪ Finishes: Stainless Steel▪ Ducting: 6" Round▪ Dimensions: Width: 30" 36" Height: 44 1/2" Depth: 19 3/4" | <ul style="list-style-type: none">▪ Noise Level: Min. 2 Sones Max. 6 Sones |
|---|---|--|



Toronto • Vancouver • Boston
www.CycloneRangeHoods.com

Handwritten signature and initials

29 of 43

Product Dimensions

KCGS550ESS and KCGS950ESS Models

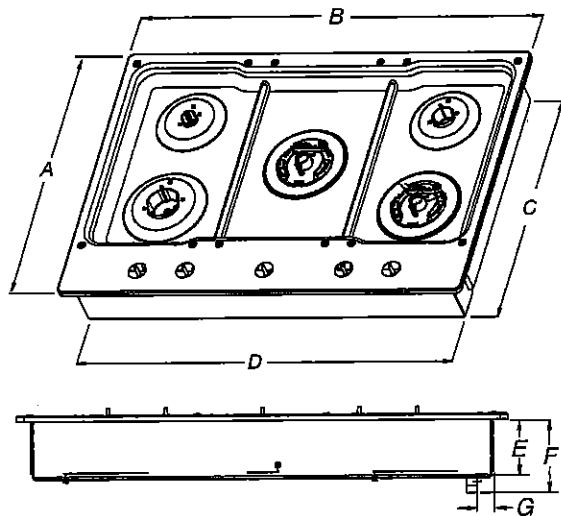

- | | |
|----------------------|---------------------|
| A. 21" (53.3 cm) | E. 3 3/8" (9.2 cm) |
| B. 30" (76.2 cm) | F. 4 1/8" (11.6 cm) |
| C. 19 3/8" (49.2 cm) | G. 1 3/8" (3.4 cm) |
| D. 28 3/8" (72.1 cm) | |

KCGS556ESS and KCGS956ESS Models

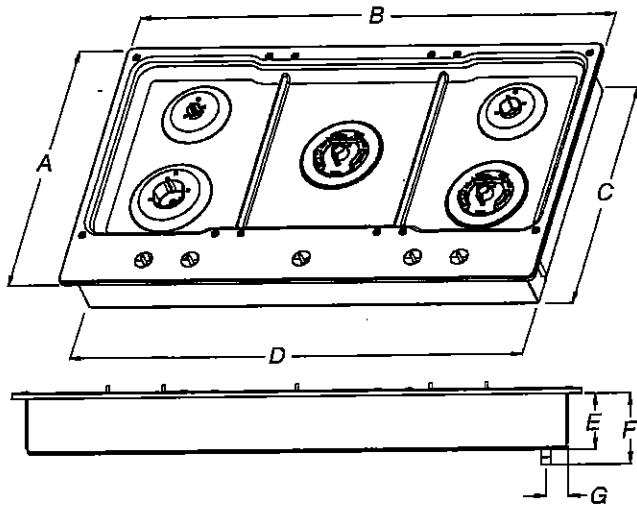

- | | |
|----------------------|---------------------|
| A. 21" (53.3 cm) | E. 3 3/8" (9.2 cm) |
| B. 36 1/4" (92.0 cm) | F. 4 1/8" (11.6 cm) |
| C. 19 3/8" (49.2 cm) | G. 1 7/8" (3.6 cm) |
| D. 34 3/8" (88.1 cm) | |

All Other 30" (76.2 cm) Models

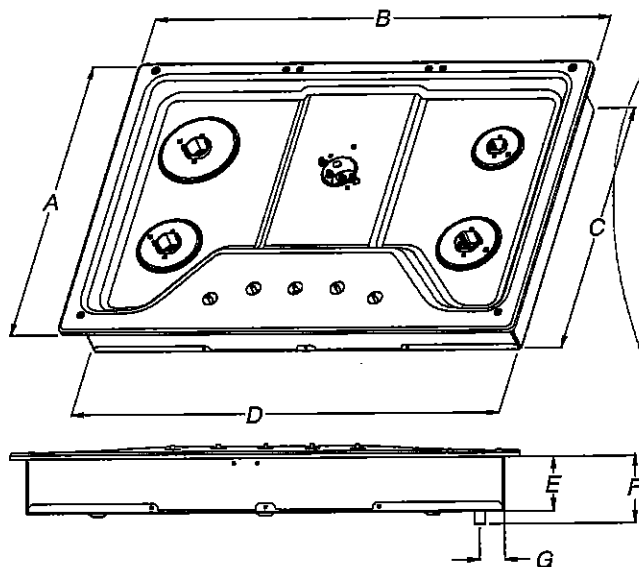

- | | |
|----------------------|---------------------|
| A. 21" (53.3 cm) | E. 3 3/8" (8.6 cm) |
| B. 30" (76.2 cm) | F. 4 1/8" (10.5 cm) |
| C. 18 7/8" (48.0 cm) | G. 1 1/2" (3.8 cm) |
| D. 28 3/8" (72.1 cm) | |

All Other 36" (91.4 cm) Models

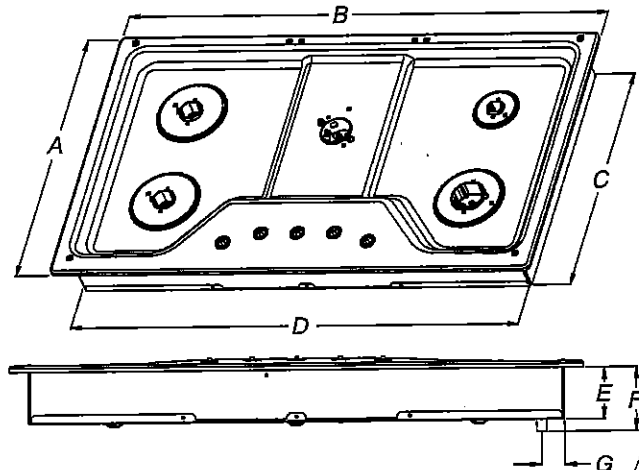

- | | |
|----------------------|---------------------|
| A. 21" (53.3 cm) | E. 3 3/8" (8.6 cm) |
| B. 36" (91.4 cm) | F. 4 1/8" (10.5 cm) |
| C. 18 7/8" (48.0 cm) | G. 1 1/2" (3.8 cm) |
| D. 33 3/4" (85.7 cm) | |

UK- 75 WALLACETON
LOT 267
25-2269 ELEV. A
THE WALDEN

30 or 43

Cabinet Clearances

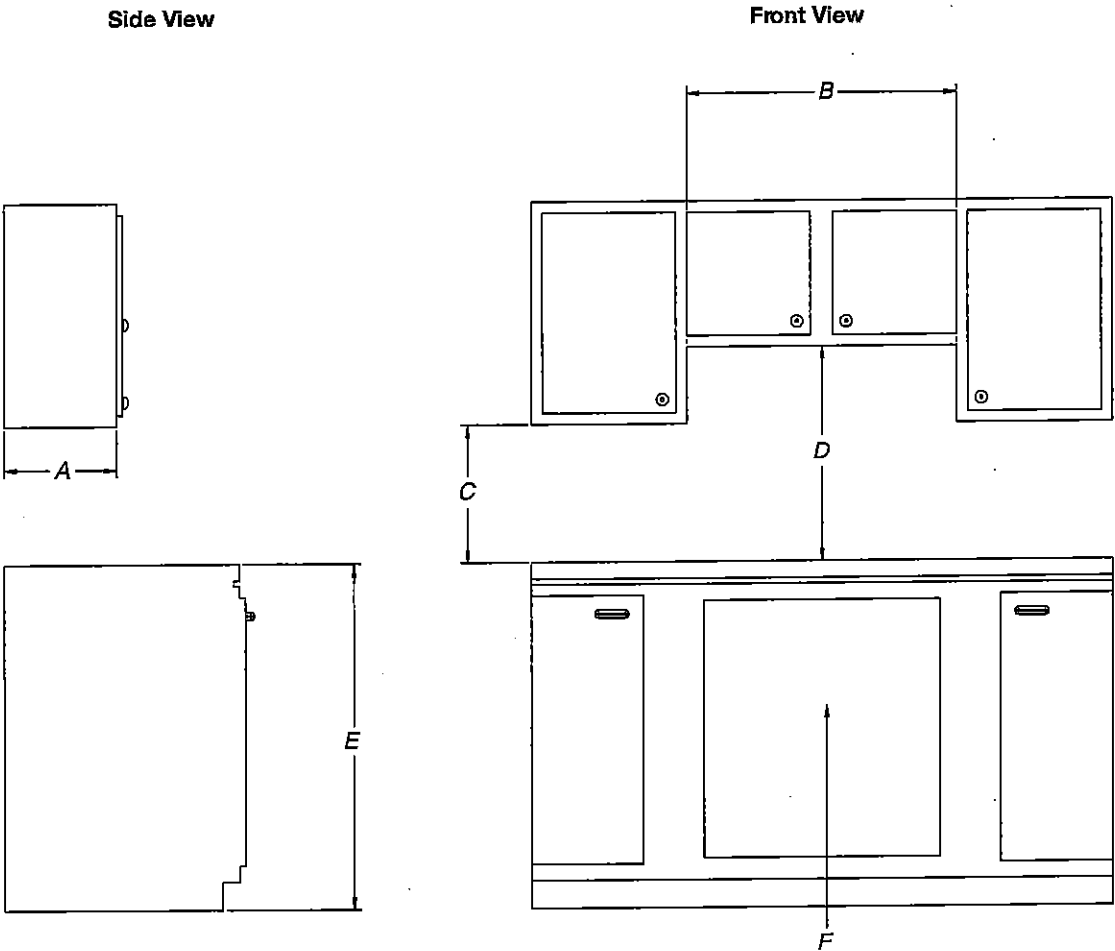

- A. 13" (33.0 cm) recommended upper cabinet depth.
- B. 30" (76.2 cm) for 30" models; 36" (91.4 cm) for 36" models.
- C. 18" (45.7 cm) minimum clearance from upper cabinet to countertop within minimum horizontal clearances to cooktop.
- D. 30" (76.2 cm) minimum clearance between top of cooktop platform and bottom of uncovered wood or metal cabinet.
24" (61 cm) minimum clearance if bottom of wood or metal cabinet is covered by not less than 1/4" (0.6 cm) flame retardant millboard covered with not less than No. 28 MSG sheet steel, 0.015" (0.04 cm) stainless steel, or 0.024" (0.06 cm) aluminum or 0.020" (0.05 cm) copper.
- E. 36" (91.4 cm) top of countertop to floor.
- F. Gas line opening - Wall: anywhere 5" (12.7 cm) below underside of countertop. Cabinet floor: anywhere within 6" (15.2 cm) of rear wall is recommended.

SPS

1

31 of 43

Cutout Dimensions - Top View

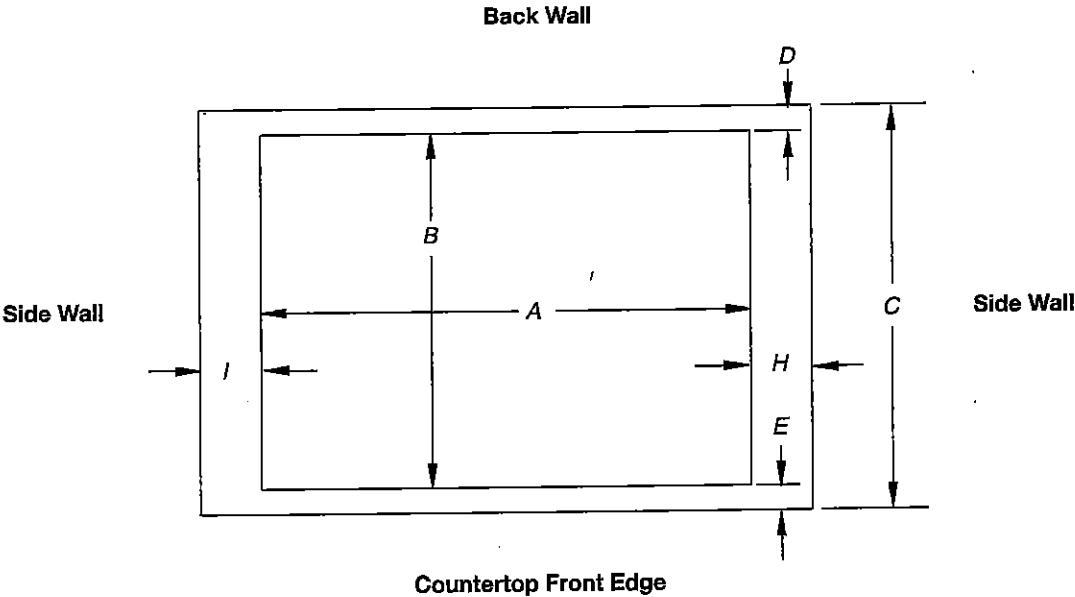

Cutout (Product Opening) Dimensions						
30" (76.2 cm) Models						
Models	A			B		
	Min	Recommended	Max	Min	Recommended	Max
KCGS550 and KCGS950 All Other 30" (76.2 cm) Models	28 1/2" (72.4 cm) 28 1/2" (72.4 cm)	28 7/8" (73.4 cm) 28 7/8" (73.4 cm)	29 3/8" (74.3 cm) 29 3/8" (74.3 cm)	19 1/2" (49.5 cm) 19" (48.3 cm)	19 19/32" (50.2 cm) 19 1/2" (49.5 cm)	20" (50.8 cm) 20" (50.8 cm)
36" (91.4 cm) Models						
KCGS556 and KCGS956 All Other 36" (91.4 cm) Models	34 7/8" (88.4 cm) 33 7/8" (86.0 cm)	35 3/8" (89.4 cm) 34 3/8" (87.0 cm)	35 3/8" (90.3 cm) 35 1/4" (89.5 cm)	19 1/2" (49.5 cm) 19" (48.3 cm)	19 19/32" (50.2 cm) 19 1/2" (49.5 cm)	20" (50.8 cm) 20" (50.8 cm)

Side Walls (Combustible Surfaces)	
Models	H and I
KCGS5 and KCGS9	H and I added together must be at least 48" (122.0 cm), with each side individually being at least 8" (20.3 cm).
KCGS350, KCGS356, MGC9536, WCG97US0, WCG97US6	H and I added together must be at least 48" (122.0 cm), with each side individually being at least 12" (30.5 cm).
All Other Models	Both have to be 8" (20.3 cm) or more.

Back Wall and Countertop Front Dimensions			
Models	C	D	E
KCGS550 and KCGS950	26" (63.5 cm)	2 7/8" (7.3 cm)	2 3/4" (6.9 cm)
All Other Models			3 3/8" (7.9 cm)

NOTES: After making the countertop cutout, some installations may require notching down the base cabinet side walls to clear the cooktop base. To avoid this modification, use a base cabinet with sidewalls wider than the cutout.

If cabinet has a drawer, a 4" (10.2 cm) depth clearance from the countertop to the top of the drawer (or other obstruction) in base cabinet is required. The drawer depth may need to be shortened to avoid interfering with the regulator.

IMPORTANT: If a built-in wall oven is to be installed below this cooktop, the grounded outlet and gas supply piping must be located in an adjacent cabinet. If installing a range hood or microwave hood combination above the cooking surface, follow the range hood or microwave hood combination installation instructions for dimensional clearances above the cooktop surface.

This cooktop and its gas and electrical supply sources must be installed before the undercounter built-in wall oven is installed.

DN2

h

UK-75 WALLACETON
LOT 267
25-2269 ELEV A
THE WALDEN

32 of 43

Electrical Requirements

⚠ WARNING



Electrical Shock Hazard

- Plug into a grounded 3 prong outlet.
- Do not remove ground prong.
- Do not use an adapter.
- Do not use an extension cord.
- Failure to follow these instructions can result in death, fire, or electrical shock.

IMPORTANT: The cooktop must be electrically grounded in accordance with local codes and ordinances, or in the absence of local codes, with the National Electrical Code, ANSI/NFPA 70 or Canadian Electrical Code, CSA C22.1.

If codes permit and a separate ground wire is used, it is recommended that a qualified electrical installer determine that the ground path is adequate.

A copy of the above code standards can be obtained from:

National Fire Protection Association
One Batterymarch Park
Quincy, MA 02269
CSA International
8501 East Pleasant Valley Road
Cleveland, Ohio 44131-5575

- A 120-volt, 60 Hz, AC-only, 15-amp, fused electrical circuit is required. A time-delay fuse or circuit breaker is also recommended. It is recommended that a separate circuit serving only this cooktop be provided.
- Electronic ignition systems operate within wide voltage limits, but proper grounding and polarity are necessary. Check that the outlet provides 120-volt power and is correctly grounded.
- The wiring diagrams are provided with this cooktop. See "Wiring Diagrams" on a separate sheet. The wiring diagrams are located on the left underside of the cooktop base.

Gas Supply Requirements

⚠ WARNING



Explosion Hazard

- Use a new CSA International approved gas supply line.
- Install a shut-off valve.
- Securely tighten all gas connections.
- If connected to propane, have a qualified person make sure gas pressure does not exceed 14" (36 cm) water column.
- Examples of a qualified person include:
licensed heating personnel,
authorized gas company personnel, and
authorized service personnel.
- Failure to do so can result in death, explosion, or fire.

Observe all governing codes and ordinances.

IMPORTANT: This installation must conform with all local codes and ordinances. In the absence of local codes, installation must conform with American National Standard, National Fuel Gas Code ANSI Z223.1 - latest edition or CAN/CGA B149 - latest edition.

IMPORTANT: Leak testing of the cooktop must be conducted according to the manufacturer's instructions.

Type of Gas

Natural Gas:

- This cooktop is factory set for use with Natural gas. If converting to propane gas, see the "Propane Gas Conversion" instructions provided in the package containing literature. The model/serial rating plate located on the underside of the cooktop base has information on the types of gas that can be used. If the types of gas listed do not include the type of gas available, check with the local gas supplier.

Propane Gas Conversion:

Conversion must be done by a qualified service technician. No attempt shall be made to convert the cooktop from the gas specified on the model/serial rating plate for use with a different gas without consulting the serving gas supplier. See the Gas Conversion instructions provided in the package containing literature.

h
SMT

33 of 43

Gas Supply Line

- Provide a gas supply line of $\frac{3}{4}$ " (1.9 cm) rigid pipe to the cooktop location. A smaller size pipe on longer runs may result in insufficient gas supply. Pipe-joint compounds that resist the action of propane gas must be used. Do not use TEFLON[†] tape. With propane gas, piping or tubing size should be $\frac{1}{2}$ " (1.3 cm) minimum. Usually, propane gas suppliers determine the size and materials used in the system.

Flexible metal appliance connector:

- If local codes permit, use a $\frac{1}{2}$ " (1.3 cm) or $\frac{3}{4}$ " (1.9 cm) I.D. flexible stainless steel tubing gas connector, designed by CSA to connect the cooktop to the rigid gas supply line.



- A $\frac{1}{2}$ " (1.3 cm) male pipe thread is needed for connection to the female pipe threads of the inlet to the cooktop pressure regulator.
- Do not kink or damage the flexible metal tubing when moving the cooktop.
- Must include a shut-off valve:
Install a manual gas line shut-off valve in an easily accessible location. Do not block access to shut-off valve. The valve is for turning on or shutting off gas to the cooktop.

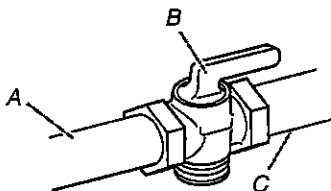

A. Gas supply line
B. Shut-off valve open position
C. To cooktop

Gas Pressure Regulator

The gas pressure regulator supplied with this cooktop must be used. The inlet pressure to the regulator should be as follows for proper operation:

Natural Gas:

Minimum pressure: 5" (12.7 cm) WCP

Maximum pressure: 7" to 14" (17.8 cm to 35.5 cm) WCP

Propane Gas:

Minimum pressure: 10" (25.4 cm) WCP

Maximum pressure: 14" (35.5 cm) WCP

Contact local gas supplier if you are not sure about the inlet pressure.

Burner Input Requirements

Input ratings shown on the model/serial rating plate are for elevations up to 2,000 ft (609.6 m).

For elevations above 2,000 ft (609.6 m), ratings should be reduced at a rate of 4% for each 1,000 ft (304.8 m) above sea level (not applicable for Canada).

Gas Supply Pressure Testing

Gas supply pressure for testing regulator must be at least 1" (2.5 cm) water column pressure above the manifold pressure shown on the model/serial rating plate.

Line pressure testing above $\frac{1}{2}$ psi (3.5 kPa) gauge 14" (35.5 cm) WCP

The cooktop and its individual shutoff valve must be disconnected from the gas supply piping system during any pressure testing of that system at test pressures in excess of $\frac{1}{2}$ psi (3.5 kPa).

Line pressure testing at $\frac{1}{2}$ psi (3.5 kPa) gauge 14" (35.5 cm) WCP or lower

The cooktop must be isolated from the gas supply piping system by closing its individual manual shut-off valve during any pressure testing of the gas supply piping system at test pressures equal to or less than $\frac{1}{2}$ psi (3.5 kPa).

[†]TEFLON is a registered trademark of Chemours.

DPB

h

UK- 75 WALLACETON
LOT 267
25-2269 ELEV. A
THE WALDEN

34 of 43

INSTALLATION INSTRUCTIONS

Install Cooktop

⚠ WARNING

Excessive Weight Hazard

Use two or more people to move and install cooktop.
Failure to do so can result in back or other injury.

Decide on the final location for the cooktop. Avoid drilling into or severing existing wiring during installation.

1. Determine whether your cabinet construction provides clearance for installing clamping brackets at cooktop base ends. This is the recommended location. Clamping brackets can be installed on the front and back of cooktop base bottom, if necessary.

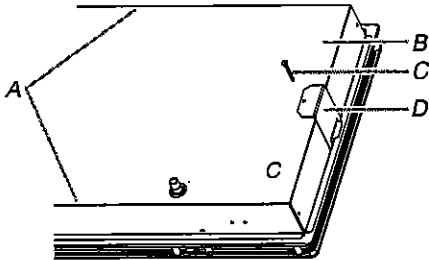

- A. Attachment screw holes for optional front and back location
- B. Cooktop base bottom
- C. Attachment screw
- D. Clamping bracket (end locations recommended)

2. Using 2 or more people, place cooktop right side up into the cutout.

NOTE: Make sure that the front edge of the cooktop is parallel to the front edge of the countertop. If repositioning is needed, lift entire cooktop up from cutout to avoid scratching the countertop.

3. Remove the attachment screws for the selected bracket locations from the bottom of the cooktop base.

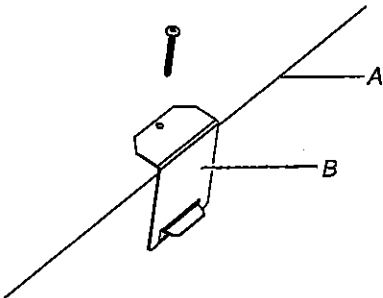

- A. Edge of cooktop base bottom
- B. Clamping bracket

4. Attach brackets to cooktop base bottom with bracket attachment screws. Securely tighten screws.

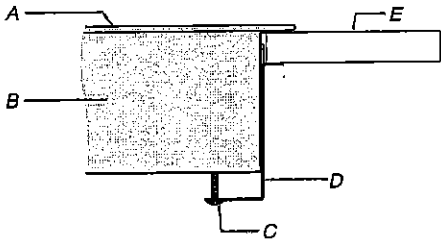

- A. Cooktop
- B. Cooktop base
- C. 2" (5.1 cm) bracket attachment screw
- D. Clamping bracket (extends far enough beyond cooktop base to allow installation of clamping screws)
- E. Countertop

Make Gas Connection

⚠ WARNING



Explosion Hazard

Use a new CSA International approved gas supply line.
Install a shut-off valve.

Securely tighten all gas connections.

If connected to propane, have a qualified person make sure gas pressure does not exceed 14" (36 cm) water column.

Examples of a qualified person include:

licensed heating personnel,
authorized gas company personnel, and
authorized service personnel.

Failure to do so can result in death, explosion, or fire.

Typical flexible connection

1. Apply pipe-joint compound made for use with Natural and propane gas to the smaller thread ends of the flexible connector adapters (see C and G in the following illustration).
2. Attach one adapter to the gas pressure regulator and the other adapter to the gas shutoff valve. Tighten both adapters.

DPZ
h.

35 of 43

3. Use a 15/16" (2.4 cm) combination wrench and channel lock pliers to attach the flexible connector to the adapters. Check that connector is not kinked.

IMPORTANT: All connections must be wrench-tightened. Do not make connections to the gas regulator too tight. Making the connections too tight may crack the regulator and cause a gas leak. Do not allow the regulator to turn when tightening fittings.

No appliance/obstructions below cooktop

Suggested installation to avoid interference below cooktop

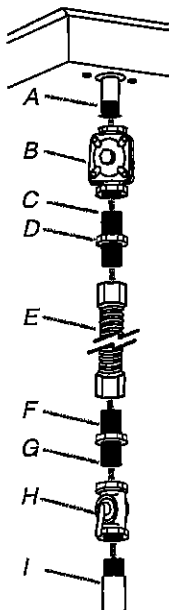

- A. Manifold entrance
- B. Gas pressure regulator
- C. Use pipe-joint compound.
- D. Adapter (must have 1/2" (1.3 cm) male pipe thread)
- E. Flexible connector
- F. Adapter
- G. Use pipe-joint compound.
- H. Manual gas shutoff valve
- I. 1/2" (1.3 cm) or 3/4" (1.9 cm) gas pipe

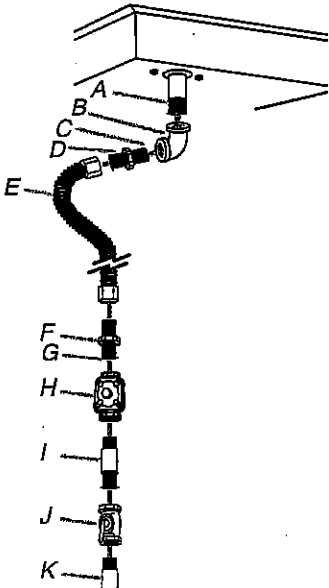

- A. Manifold entrance
- B. 3/4" (1.9 cm) elbow
- C. Use pipe-joint compound.
- D. Adapter (must have 3/8" (9.5 mm) male pipe thread)
- E. Flexible connector (pass through wall between cabinets)
- F. Adapter (must have 3/8" (9.5 mm) male pipe thread)
- G. Use pipe-joint compound.
- H. Appliance pressure regulator (supplied)
- I. 1/2" (1.3 cm) or 3/4" (1.9 cm) gas pipe
- J. Manual gas shutoff valve
- K. 1/2" (1.3 cm) or 3/4" (1.9 cm) gas pipe

4. Install the pressure regulator with the arrow pointing in the direction toward the bottom of the cooktop base and in a position where you can reach the regulator access cap.

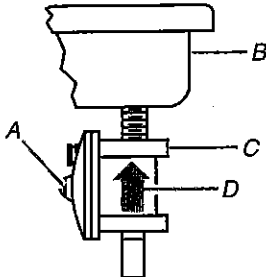

- A. Access cap
- B. Rear of cooktop
- C. Gas pressure regulator
- D. Up arrow. The regulator must be installed with the arrow pointing toward the cooktop bottom.

Use only pipe-joint compound made for use with natural and propane gas.

Do not use TEFLON[®] tape. You will need to determine the fittings required depending on your installation.

Complete Connection

1. Open the manual shutoff valve in the gas supply line. The valve is open when the handle is parallel to the gas pipe.

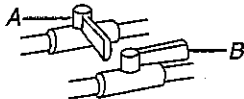

- A. Closed valve
- B. Open valve

2. Test all connections by brushing on an approved noncorrosive leak-detection solution. Bubbles will show a leak. Correct any leak found.

3. Remove surface burner caps, burner base and grates from parts package. Align notches in burner caps with pins in burner base

Align orifice holder in burner base with igniter electrode. Burner caps should be level when properly positioned. If burner caps are not properly positioned, surface burners will not light. Place burner grates over burners and caps.

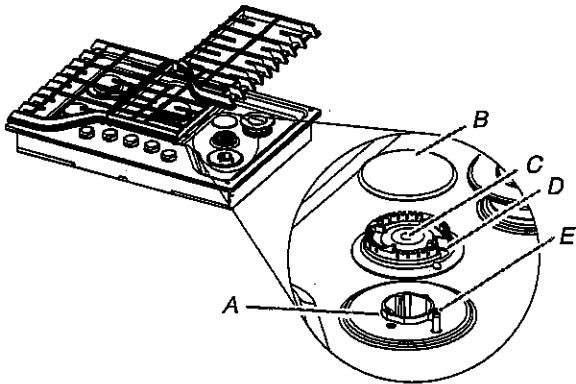

- A. Orifice holder
- B. Burner cap
- C. Gas tube opening
- D. Burner base
- E. Igniter electrode

†TEFLON is a registered trademark of Chemours.

SS

h

UK- 75 WALLACETON
LOT 267
25-2269 ELEV. A
THE WALDEN

36 of 43

⚠ WARNING



Electrical Shock Hazard
Plug into a grounded 3 prong outlet.
Do not remove ground prong.
Do not use an adapter.
Do not use an extension cord.
Failure to follow these instructions can result in death, fire, or electrical shock.

4. Plug into a grounded 3 prong outlet.

Complete Installation

Electronic Ignition System

Initial lighting and gas flame adjustments

Surface burners use electronic igniters in place of standing pilots. When the cooktop control knob is turned to the "IGNITE" position, the system creates a spark to light the burner. This sparking continues, as long as the control knob is turned to "IGNITE".

Check Operation of Surface Burners

Push in and turn the surface burners control knobs to light. The surface burner flame should light within 4 seconds. The first time a surface burner is lit, it may take longer than 4 seconds to light because of air in the gas line.

Check the flame on "HIGH" for a blue color. It should be clean and soft in character. No yellow tip, blowing or lifting of flame should occur. Occasional orange flashes are normal and reflect different elements in the air or gas.

After verifying the proper burner operation, turn the control knobs to "OFF."

If burners do not light properly:

- Turn surface burner control knob to the "OFF" position.
- Check that the power supply cord is plugged in and the circuit breaker has not tripped or the fuse blown.
- Check that the gas shutoff valve is set to the "open" position.
- Check that burner caps are properly positioned on burner bases.

Recheck operation of surface burners. If a burner does not light at this point, contact your dealer or authorized service company for assistance.

Check Flame Height

Adjust the height of surface burner flames. The surface burner low flame should be a steady blue flame approximately 1/4" (6.4 mm) high.

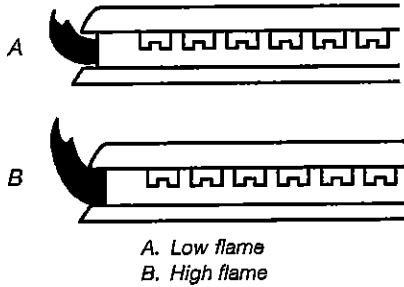

Adjustment for Single Valve:

1. Set the burner flame to LO.
2. Remove the control knob.
3. Hold knob stem with a pair of pliers. Use a 3/32" (#0 [2 mm]) flat-blade screwdriver to turn the screw located within the shaft of the control knob stem until the flame is the proper size.

Turn adjustment screw "C" to the right to reduce flame height, turn adjustment screw to the left to increase flame height.

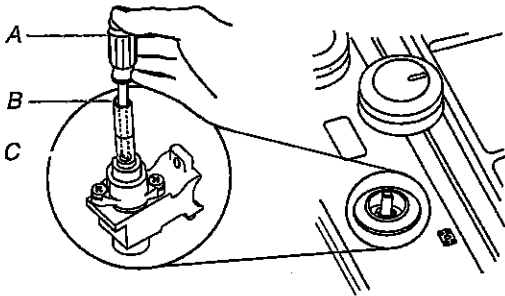

A. 3/32" (#0 [2.0 mm]) flat-blade screwdriver (screwdriver shaft must be a minimum of 2" [5.1 cm] long)
B. Control knob stem opening.
C. Adjustment screw location

4. Replace the control knob.
5. Test the flame by turning the control from LO to HI, checking the flame at each setting.

IMPORTANT: Dual valve adjustments must be performed by a qualified installer or service agency.

DB

h.

37 of 43

BUILT IN MICROWAVE ABOVE OVEN

BUILT-IN MICROWAVE INSTALLATION INSTRUCTIONS

3. Cabinet Installation

- 1. Unpack the microwave oven.
- 2. Find the two mounting screws included in the literature package.
- 3. Insert the oven into the cabinet opening.
- 4. Push the oven in and against the cabinet.

NOTES:

- 1. The base must be capable of supporting 155 pounds (70 kg).
- 2. Allow at least 21" (53.3 cm) clearance in front of the oven for door depth when it is open.
- 3. Dimension G (cutout depth) is critical to the proper installation of the built-in oven. If the oven decorative trim does not lie flush against the cabinet, or if noise is heard on models, verify dimension G to assure that it is the required depth.

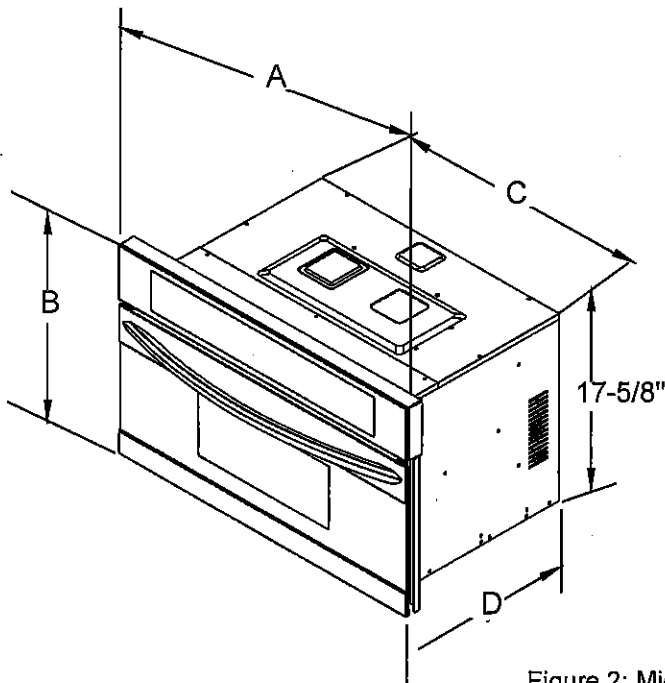

⚠ WARNING

Do not lift or manipulate the oven door handle or the control panel.

⚠ WARNING

Heavy Weight Hazard

- Use two or more people to move and install the microwave oven.
- Failure to follow this instruction can result in injury or damage to the unit.

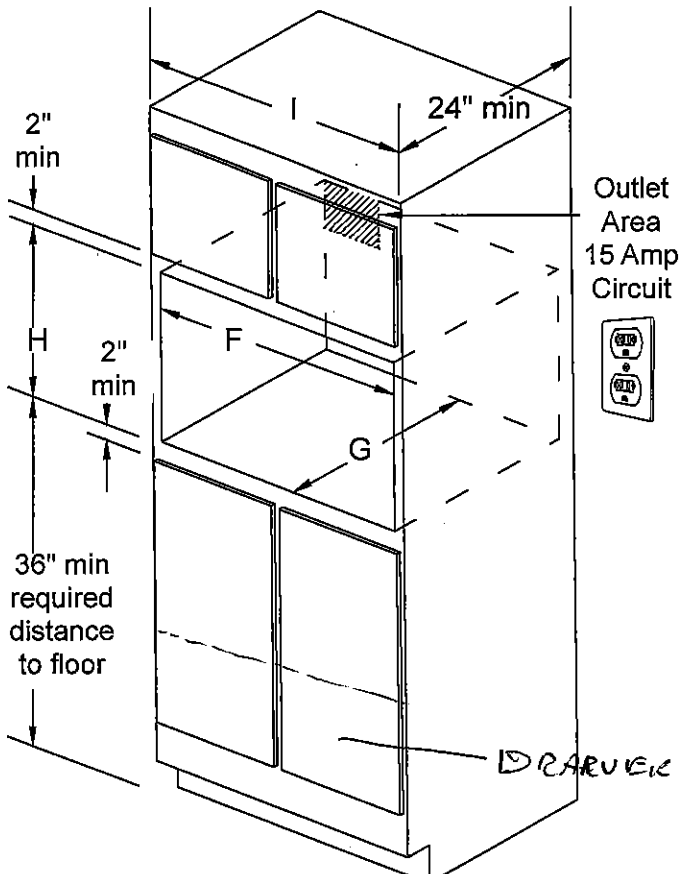

Figure 2: Microwave Only

PRODUCT DIMENSIONS						
MODEL	A		B	C		D
Microwave Oven	30		19-1/4	24-5/8		19-3/4
CUTOUT DIMENSIONS AND CABINET WIDTH						
MODEL	F		G	H		I
	Min.	Max.	Min	Min.	Max.	Min.
Microwave Oven	28	28-3/8	22	17-3/4	18	30-1/8

All dimensions are in inches (cm).

BUILT-IN MICROWAVE INSTALLATION INSTRUCTIONS

- NOTES:
- 1. The base must be capable of supporting 155 pounds (70 kg).
 - 2. Allow at least 21" (53.3 cm) clearance in front of the oven for door depth when it is open.
 - 3. Dimension G (cutout depth) is critical to the proper installation of the built-in oven. If the oven decorative trim does not lie flush against the cabinet, or if noise is heard on models, verify dimension G to assure that it is the required depth.

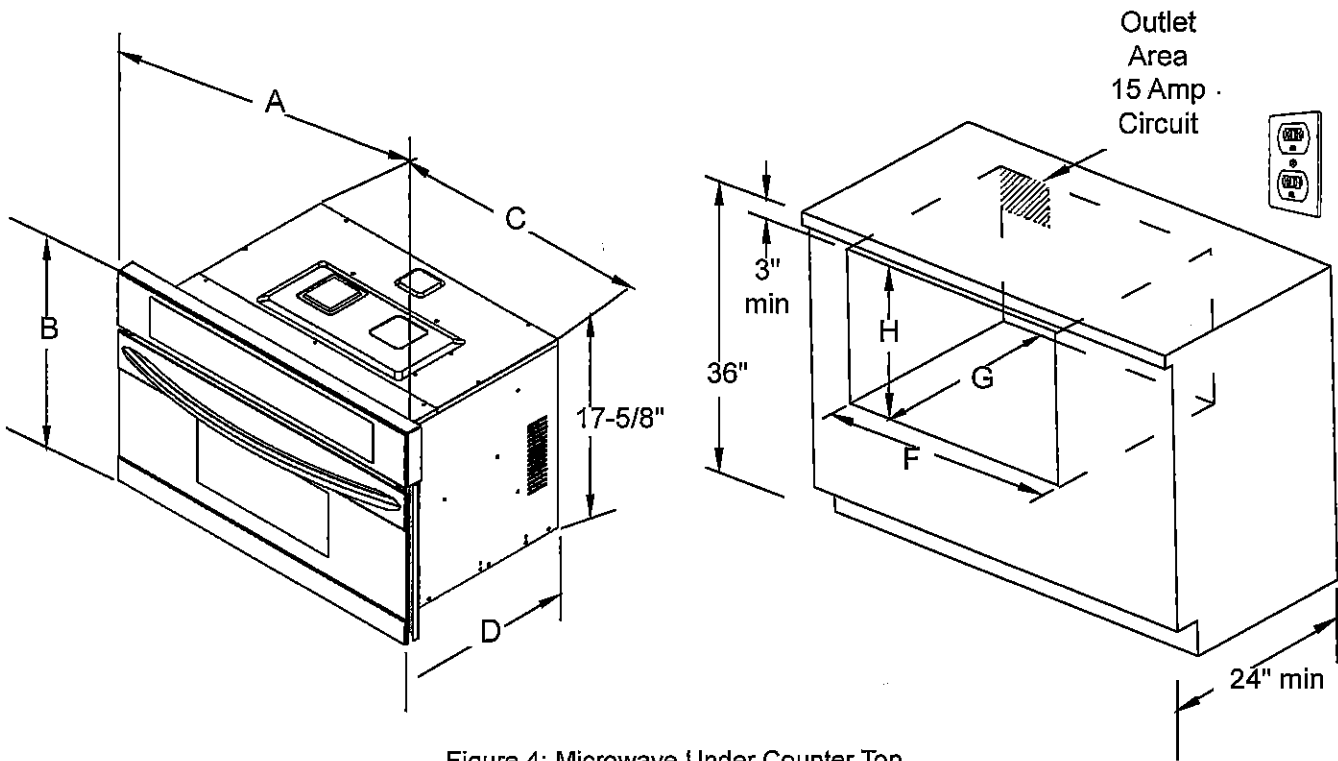

Figure 4: Microwave Under Counter Top

PRODUCT DIMENSIONS						
MODEL	A		B	C		D
Microwave Oven	30		19-1/4	24-5/8		19-3/4
CUTOUT DIMENSIONS AND CABINET WIDTH						
MODEL	F		G	H		
	Min.	Max.	Min	Min.	Max.	
Microwave Oven	28	28-3/8	22	17-3/4	18	

All dimensions are in inches (cm).

BUILT-IN MICROWAVE INSTALLATION INSTRUCTIONS

4. Install Mounting Screws

! WARNING The microwave oven can tip when the door is open. The mounting screws supplied with the microwave oven must be installed to prevent tipping of the microwave oven and injury to persons.

- 1. The mounting holes in the side trims may be used as a template to locate the appliance mounting screw holes (see figure 5).
- 2. Use the two screws supplied to fix the appliance to the cabinet.

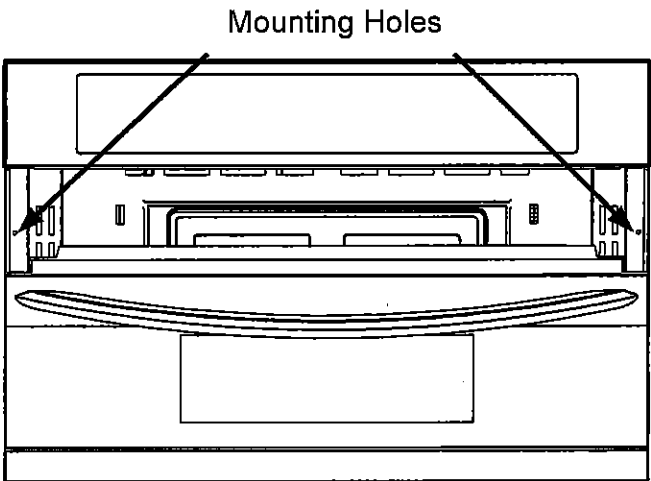

Figure 5: Mounting Screw Holes

6. Model and Serial Number Location

The serial plate is located along the interior side trim of the oven and visible when the door is open.

When ordering parts for or making inquiries about your microwave oven, always be sure to include the model and serial numbers and a lot number or letter from the serial plate.

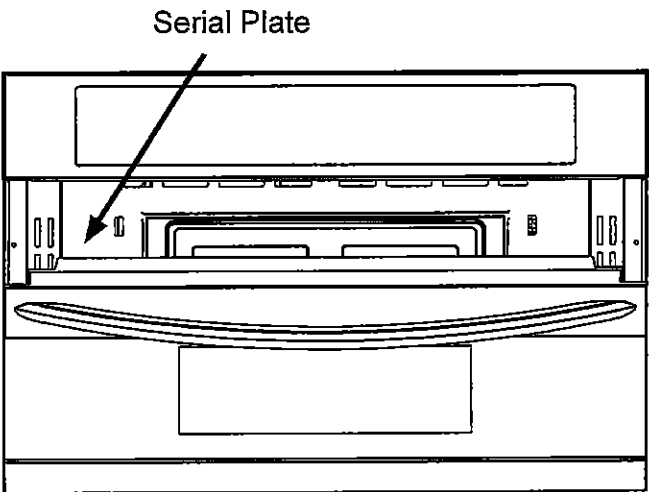

Figure 6: Serial Plate Location

5. Minimum Cutout Overlap

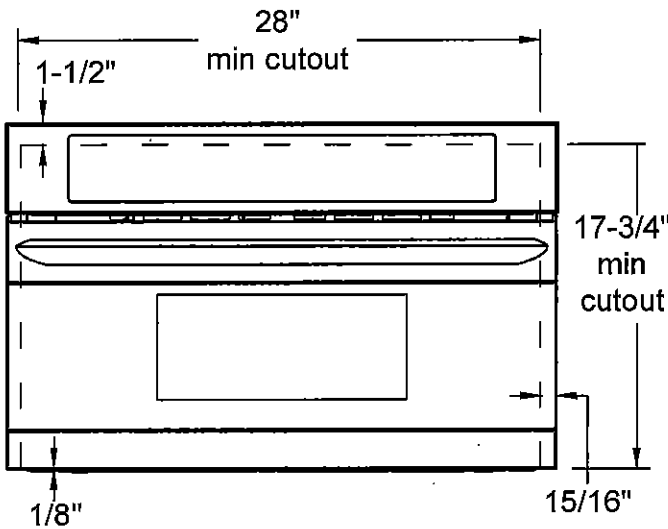

Figure 7: Minimum cutout overlap

Before You Call for Service

Read the "Before You Call for Service Checklist" and the "Operating Instructions" in your *Use and Care Guide*: it may save you time and expense. The list includes common occurrences that are not the result of defective workmanship or materials in this appliance.

Refer to your *Use and Care Guide* for service phone numbers.

40 OF 43

WALL OVEN BELOW MICROWAVE 30"

ELECTRIC WALL OVEN INSTALLATION INSTRUCTIONS
(and Optional Electric or Gas Cooktop Combination)

INSTALLATION AND SERVICE MUST BE PERFORMED BY A QUALIFIED INSTALLER.
IMPORTANT: SAVE FOR LOCAL ELECTRICAL INSPECTOR'S USE.
READ AND SAVE THESE INSTRUCTIONS FOR FUTURE REFERENCE.



WARNING FOR YOUR SAFETY: Do not store or use gasoline or other flammable vapors and liquids in the vicinity of this or any other appliance.

Your new wall oven has been designed to fit a limited variety of cutout sizes to make the job of installing easier. The first step of your installation should be to measure your current cutout dimensions and compare them to the cutout dimensions chart below for your model. You may find little or no cabinet work being necessary.

WARNING Do not remove spacers (if equipped) on the side walls of the built-in oven. These spacers center the oven in the space provided. The oven must be centered to prevent excess heat buildup that may result in heat damage or fire.

NOTES:

1. Base must be capable of supporting 150 pounds (68 kg) for 27" models and 200 pounds (90 kg) for 30" models.
2. Allow at least 21" (53.3 cm) clearance in front of oven for door depth when it is open.
3. Dimension G (cutout depth) is critical to the proper installation of the built-in oven. If the oven decorative trim does not butt against the cabinet, or if noise is heard on convection models, verify dimension G to assure it is the required depth.
4. For a cutout height greater than 28 1/4" (71.8 cm) add one 2" (5 cm) wide wood shim of appropriate height to each side of the opening under the appliance side rails.
5. For a cutout height (H) greater than 28 1/4" (71.8 cm) you can order a larger bottom trim through a Service Center.

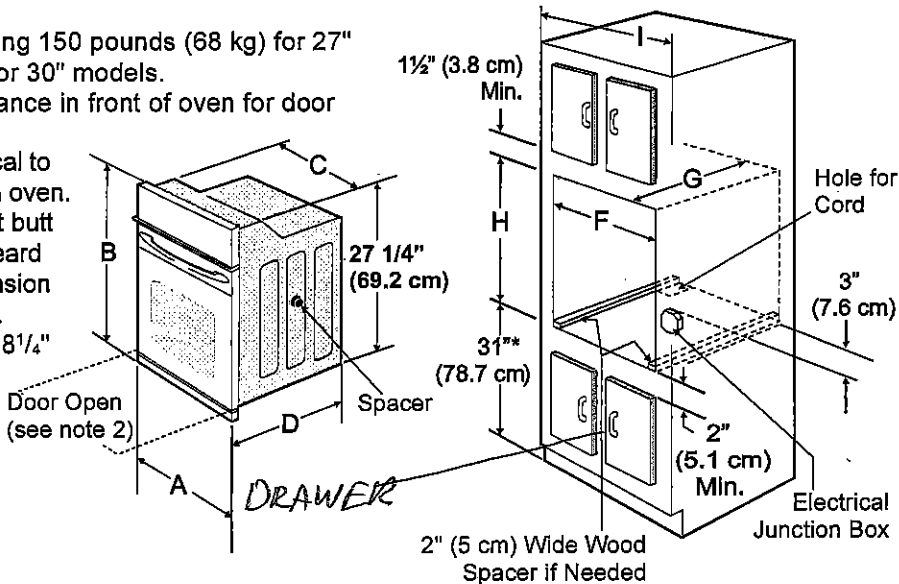

* Suggested distance from floor is 31" (78.7cm).
Minimum required distance is 4 1/2" (11.4cm).

Figure 1
27" and 30" Single Wall Ovens (Double ovens see Figure 2)

PRODUCT DIMENSIONS						
MODEL	A		B	C		D
27" (68.6 cm) Wall Oven	27 (68.6)		29 (73.7)	24 ⁵ / ₈ (62.5)		24 ³ / ₄ (62.9)
30" (76.2 cm) Wall Oven	30 (76.2)		29 (73.7)	28 ¹ / ₄ (71.8)		24 ³ / ₄ (62.9)
CUTOUT DIMENSIONS AND CABINET WIDTH						
MODEL	F		G (Min.)	H. Standard Height (**Others, see notes 4 & 5)		I
	Min.	Max.		Min.	Max.	
27" (68.6 cm) Wall Oven	24 ⁷ / ₈ (63.2)	25 ¹ / ₄ (64.1)	24 (61.0)	27 ¹ / ₄ (69.2)	28 ¹ / ₄ (71.8)	27 ¹ / ₈ (68.9) Min
30" (76.2 cm) Wall Oven	28 ¹ / ₂ (72.4)	29 (73.7)	24 (61.0)	27 ¹ / ₄ (69.2)	28 ¹ / ₄ (71.8)	30 ¹ / ₈ (76.5) Min

41 of 43

ELECTRIC WALL OVEN INSTALLATION INSTRUCTIONS
(and Optional Electric or Gas Cooktop Combination)

⚠ WARNING Do not remove spacers (if equipped) on the side walls of the built-in oven. These spacers center the oven in the space provided. The oven must be centered to prevent excess heat buildup that may result in heat damage or fire.

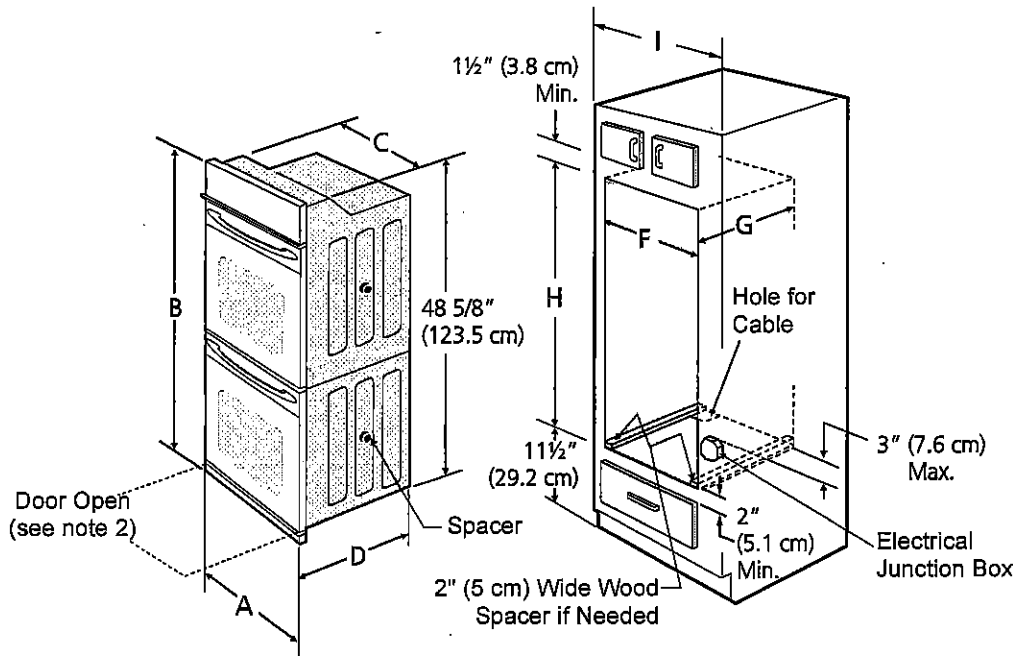

- NOTES:
- 1. Base must be capable of supporting 300 pounds (136 kg) for 27" models and 375 pounds (170 kg) for 30" models.
 - 2. Allow at least 21" (53.3 cm) clearance in front of oven for door depth when it is open.
 - 3. Dimension G (cutout depth) is critical to the proper installation of the built-in oven. If the oven decorative trim does not butt against the cabinet, or if noise is heard on convection models, verify dimension G to assure it is according to the required dimension.
 - 4. For a cutout height greater than 49⁵/₈" (126 cm) add a 2" (5 cm) wide wood shim of appropriate height to each side of the opening under the appliance side rails.
 - 5. For a cutout height (H) greater than 49⁵/₈" (126 cm) you can order a larger bottom trim through a Service Center.

Figure 2
27" AND 30" DOUBLE OVENS (Single Ovens see Figure 1) + MICROWAVE

PRODUCT DIMENSIONS						
MODEL	A		B	C		D
27" (68.6 cm) Wall Oven	27 (68.6)		50 ⁷ / ₁₆ (128.1)	24 ⁵ / ₈ (62.5)		24 ³ / ₄ (62.9)
30" (76.2 cm) Wall Oven	30 (76.2)		50 ⁷ / ₁₆ (128.1)	28 ¹ / ₄ (71.8)		24 ³ / ₄ (62.9)
CUTOUT DIMENSIONS AND CABINET WIDTH						
MODEL	F		G (Min.)	H. Standard Height (**Others, see notes 4 & 5)		I
	Min.	Max.		Min.	Max.	
27" (68.6 cm) Wall Oven	24 ⁷ / ₈ (63.2)	25 ¹ / ₄ (64.1)	24 (61.0)	48 ⁷ / ₈ (124.1)	49 ⁵ / ₈ (126)	27 ¹ / ₈ (68.9) Min
30" (76.2 cm) Wall Oven	28 ¹ / ₂ (72.4)	29 (73.7)	24 (61.0)	48 ⁷ / ₈ (124.1)	49 ⁵ / ₈ (126)	30 ¹ / ₈ (76.5) Min

All dimensions are in inches (cm).

42 of 43

ELECTRIC WALL OVEN INSTALLATION INSTRUCTIONS

(and Optional Electric or Gas Cooktop Combination)

⚠ WARNING

Electrical Shock Hazard

- Electrical ground is required on this appliance.
- Do not connect to the electrical supply until appliance is permanently grounded.
- Disconnect power to the junction box before making the electrical connection.
- This appliance must be connected to a grounded, metallic, permanent wiring system, or a grounding connector should be connected to the grounding terminal or wire lead on the appliance.
- Do not use a gas supply line for grounding the appliance.

Failure to do any of the above could result in a fire, personal injury or electrical shock.

⚠ CAUTION In cold weather shipping and storage conditions, make sure that oven is in final location at least three (3) hours before switching on power. Switching on power while oven is still cold may damage the oven controls.

4. Electrical connection

It is the responsibility and obligation of the consumer to contact a qualified installer to assure that the electrical installation is adequate and is in conformance with the National Electrical Code ANSI/NFPA No. 70-latest edition, or with CSA Standard C22.1, Canadian Electrical Code, Part 1, and local codes and ordinances.

⚠ WARNING Risk of electrical shock (Failure to heed this warning may result in electrocution or other serious injury.) This appliance is equipped with copper lead wire. If connection is made to aluminum house wiring, use only connectors that are approved for joining copper and aluminum wire in accordance with the National Electrical Code and local code and ordinances. When installing connectors having screws which bear directly on the steel and/or aluminum flexible conduit, do not tighten screws sufficiently to damage the flexible conduit. Do not over bend or excessively distort flexible conduit to avoid separation of convolutions en exposure of internal wires.

DO NOT ground to a gas supply pipe. DO NOT connect to electrical power supply until appliance is permanently grounded. Connect the ground wire before turning on the power.

⚠ WARNING (If your appliance is equipped with a white neutral conductor.)

This appliance is manufactured with a white neutral power supply and a frame connected copper wire. The frame is grounded by connection of grounding lead to neutral lead at the termination of the conduit, if used in USA, in a new branch circuit installation (1996 NEC), mobile home, recreational vehicles, where local code do not permit grounding through the neutral (white) wire or in Canada, disconnect the white and green lead from each other and use ground lead to ground unit in accordance with local codes, connect neutral lead to branch circuit-neutral conductor in usual manner see Figure 4. If your appliance is to be connected to a 3 wire grounded junction box (US only), where local code permit connecting the appliance-grounding conductor to the neutral (white) see Figure 3.

NOTE TO ELECTRICIAN: The armored cable leads supplied with the appliance are UL-recognized for connection to larger gauge household wiring. The insulation of the leads is rated at temperatures much higher than temperature rating of household wiring. The current carrying capacity of the conductor is governed by the temperature rating of the insulation around the wire, rather than the wire gauge alone.

Where local codes permit connecting the appliance-grounding conductor to the neutral (white) wire (US Only) (see figure 3):

1. Disconnect the power supply.
2. In the junction box:
connect appliance and power supply cable wires as shown in Figure 3.

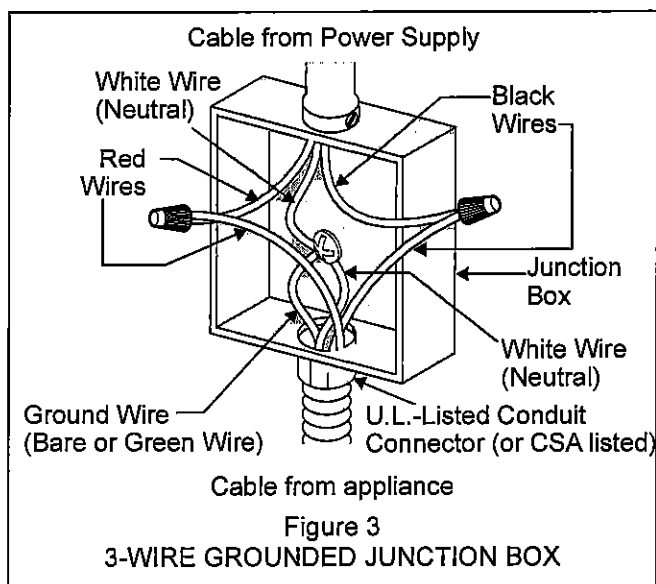

43 of 43

MICROWAVE OVEN TECH SHEET

CAUTION

Disconnect from Electrical Supply Before Servicing Unit

PRECAUTIONS TO BE OBSERVED BEFORE AND DURING SERVICING TO AVOID POSSIBLE EXPOSURE TO EXCESSIVE MICROWAVE ENERGY

- A. Do not operate or allow the oven to be operated with the door open.
- B. Make the following safety checks on all ovens to be serviced before activating the Magnetron or other microwave source, and make repairs as necessary:
1. Interlock operating.
 2. Proper door closing.
 3. Seal and sealing surfaces (Arcing, wear and other damage).
 4. Damage to or loosening of hinges and latch.
 5. Evidence of drooping or abuse.
- C. Before turning on microwave power for any service test or inspection within the microwave generating components,
- check the magnetron. Wavguide or transmission line. And cavity for proper alignment, integrity and connection.
- D. Any defective or mis-adjusted components in the interlock, monitor, door seal, and microwave generation and transmission systems shall be repaired, replaced, or adjusted by procedures, described in this manual before the oven is released to the owner.
- E. A microwave leakage check to verify compliance with the Federal performance Standard should be performed on each oven prior to release to the owner.
- F. Do not attempt to operate the oven if the door glass is broken.

Parts Layout

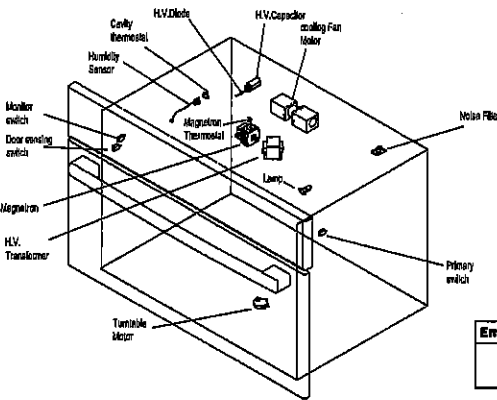

Schematic Diagram

Warning : Power must be disconnected before servicing this appliance

MODEL NO. : FGMO3067UF/ FGMO3067UD

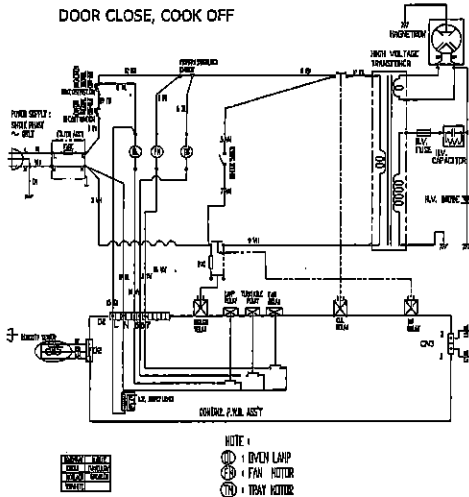

NOTE: Door is closed

Error code	Error item	Error description	Judge moment
E04	humidity sensor being abnormal.	start the sensor menu without plinking the humidity sensor correctly.	Judge on the 20 sec after the sensor menu start.

Wiring Diagram

Warning : Power must be disconnected before servicing this appliance

MODEL NO. : FGMO3067UF/ FGMO3067UD

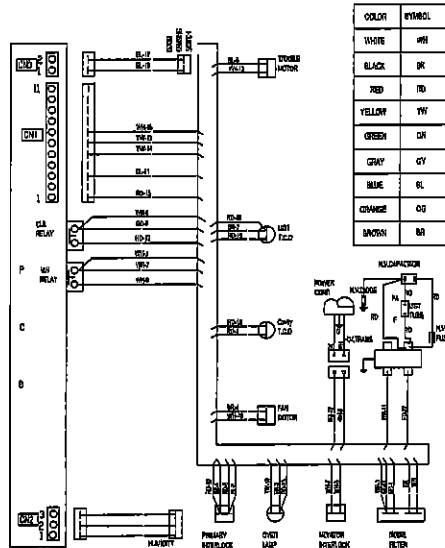

NOTE: For servicing replacement use 16GA, 105°C thermoplastic covered wire except for high voltage leads or as noted on special leads.

Switch Chart

SWITCH	CHECK BY	DOOR	DOOR CLOSE
Primary Interlock	Disconnect the wires at the Primary Interlock Switch. Check from the common terminal to the normally opened terminal.	-	+
Door sensing Interlock	Disconnect the wires at the sensing Interlock Switch. Check from the common terminal and Normally closed terminal.	-	+
Monitor Interlock	Disconnect the wires at the Monitor Switch. Check from the common terminal and Normally closed terminal.	+	-

(+) CONTINUITY
(-) NO CONTINUITY

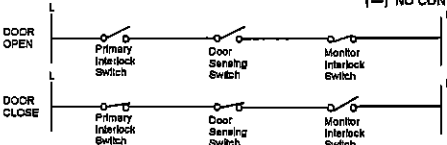

Notes: These Diagrams are not intended to show a complete circuit, they represent the position of switches during "DOOR OPEN" and "DOOR CLOSED". (continuity checks only)

OUTPUT POWER OF MAGNETRON

CAUTION MICROWAVE RADIATION
PERSONNEL SHOULD NOT ALLOW EXPOSURE TO MICROWAVE RADIATION FROM MICROWAVE GENERATOR OTHER PARTS CONDUCTING MICROWAVE ENERGY.

The output power of the magnetron can be measured by performing a water temperature rise test.

- Equipment needed:
- * Two 1-lit glass cylindrical borosilicate glass vessels (Outside diameter: 180 mm)
 - * One glass thermometer with mercury column
- NOTE: Check line voltage under load. Low voltage will lower the magnetron output. Make all temperature and time tests with accurate equipment.
1. Fill the one liter glass vessel with water.
 2. Stir water in glass vessel with thermometer, and record glass vessels temperature ("T1"; 10± 1°C).
 3. After moving the water into another glass vessel, place it in the center of the cooking tray.
 4. Set the oven to high power and operate for 60 seconds exactly. (3 seconds included as a holding time of magnetron oscillation)
 5. When heating is finished, stir the water again with the thermometer and measure the temperature ("T2").
 6. Subtract T1 from T2. This will give you the water temperature rise. (ΔT)
 7. The output power is obtained by the following formula:

$$\text{Output} = \frac{4.187 \times 1000 \times \Delta T \times 999.89 \times 10^3}{\Delta T}$$

48: Heating Times (sec)
(3 seconds included as a holding time of magnetron oscillation.)
4.187: Coefficient for water
1000: Water (cc)
ΔT: Temperature Rise (T2-T1)
TD: Room Temperature
Mg: Cylindrical borosilicate glass weight

NOTE 1: Variations or errors in the test procedure will cause a variance in the temperature rise. Additional power test should be made if temperature rise is marginal.
NOTE 2: Output power in watts is computed by multiplying the temperature rise (step 6) by a factor of 51 times the cc of glass weight.

Component tests

WARNING

- Personal Injury/Product Hazard
- ❑ Disconnect the power supply cord from the outlet before removing the outer cabinet from the unit.
 - ❑ Discharge the high voltage capacitor and remove the lead wires from the magnetron before conducting any of the following tests.
 - ❑ Conduct all operation tests with 1 liter of water in the oven.
 - ❑ Conduct a microwave energy test after performing any test or repair to the microwave.
 - ❑ Check that all wire leads are in the correct position before operating the microwave oven.
 - ❑ Grasp wire connectors when servicing the wire leads from microwave parts.
- Failure to follow these instructions may result in electrical shock or other Personal injury or in product damage.

High voltage components

Transformer	1. Remove wire leads. 2. Measure resistance (ohm meter scale: Rx1) 3. Measure resistance (ohm meter scale: Rx1000) 4. Measure resistance (ohm meter scale: Rx10000) 5. Measure resistance (ohm meter scale: Rx100000)	Approx. 0.2 ± 5% ohm. Approx. 97.4 ± 5% ohm. 0 ohm. Normal: Infinite. Normal: Infinite.
Magnetron	1. Remove wire leads, hold the magnetron seal to the normal position. Check that the seal is in good condition. 2. Measure resistance (ohm meter scale: Rx1) 3. Measure resistance (ohm meter scale: Rx1000) 4. Measure resistance (ohm meter scale: Rx10000) 5. Measure resistance (ohm meter scale: Rx100000)	Normal: Less than 1 ohm Normal: Infinite.
Capacitor	1. Remove wire leads. 2. Measure resistance (ohm meter scale: Rx10000) 3. Measure resistance (ohm meter scale: Rx100000) 4. Measure resistance (ohm meter scale: Rx1000000) 5. Measure resistance (ohm meter scale: Rx10000000)	Normal: Momentarily indicates several ohms, and then gradually returns to infinite. Normal: Infinite. Normal: Infinite.
Diode	1. Measure continuity. Forward (ohm meter scale: Rx1000) 2. Measure continuity. Reverse (ohm meter scale: Rx10000)	Normal: Continuity. Abnormal: Infinite. Normal: Infinite. Abnormal: Continuity.
Cooking Fan	1. Remove wire leads. 2. Measure resistance (ohm meter scale: Rx1) 3. Measure resistance (ohm meter scale: Rx1000) 4. Measure resistance (ohm meter scale: Rx10000) 5. Measure resistance (ohm meter scale: Rx100000)	Approximately 10 to 20 ohms Abnormal: Infinite.

Other component tests

Components	Test	Results
Wettable Motor	1. Remove wire leads. 2. Measure resistance (ohm meter scale: Rx1000)	Normal: Approximately 1.5 to 2.5 ohms Abnormal: Infinite or several
Humidity Sensor	1. Disconnect sensor capacitor from micro computer board. 2. Measure resistance terminal to terminal (ohm meter scale: Rx1000)	Normal: Approximately 0.5K to 1.5K ohms Abnormal: Infinite or several Normal: Infinite or approx. 0 ohm