

PRE-Sales Selection Sheet
Checklist

1 of 36

LOT 201 Model: 27-2587 CRN B The Maxwell

PURCHASERS: AMITA TAKHTAR/

VENDOR: Heathwood Homes (Huron) Limited

- ☒ FINISHED BASEMENT
☐ COLD CELLAR

UPGRADED / MODIFIED ELEVATION

- ☐ CORNER UPGRADE
☐ REAR UPGRADE

CEILING UPGRADE - SMOOTH

- ☒ MAIN FLOOR
☐ SECOND FLOOR
☐ BASEMENT

ADDITIONAL ROUGH-INS

- ☒ 200 AMP SERVICE
☐ WET BAR ROUGH-IN
☐ HUMIDIFIER
☒ AIR CONDITIONING

GAS ROUGH-IN

- ☒ STOVE
☐ DRYER
☐ BBQ
☐ ADDITIONAL FIREPLACE

KITCHEN: HOODFAN VENTING SIZE

- ☒ 6 IN ROUND DUCT
☐ 7 IN ROUND DUCT

FULL BASEMENT STAIRS:	Carpet Grade
UPPER BASEMENT STAIRS:	N/A
LOWER BASEMENT STAIRS:	N/A
MAIN STAIRS:	All Oak
MEDIA STAIRS (if applicable):	N/A
LOFT STAIRS (if applicable):	N/A

Nov 5/20 *Signature on file*
Date Purchaser:

Oct 29, 2020 *Signature*
Date Decor Consultant:

Date Purchaser:

APPROVED
-11- 05 2020 *m. Roen*
Date Heathwood Homes (Huron) Limited
Approved

Locked Date:



Sales Selection Sheet
Wallaceton

2 of 36

PURCHASER: AMITA TAKHTAR

TEL:

LOT / UNIT 201	PHASE 2	MODEL 27-2587 CRN B The Maxwell	
-------------------	------------	------------------------------------	--

It is herein understood and agreed between the undersigned parties hereto that the following changes shall be made to the above mentioned Agreement of Purchase and Sale in accordance with the agreement and except for such changes noted below, all other terms and conditions in the Agreement of Purchase and Sale shall remain as stated herein: It is further understood that and agreed that all changes and additions shall be installed as per builder's specifications, location and available selections. The Purchaser hereby agrees to purchase the following extras:

MISC.

1 42,507	SCHEDULE "E" FINISHED LOWER LEVEL WITH FINISHED BATHROOM 735 SQ FT (THE MAXWELL) Note:	Qty: 1	
2 42,508	TEN THOUSAND DOLLARS (\$10,000.00) AT DECOR (NO CASH VALUE) - SINGLES Note:	Qty: 1	

Sub Total
HST
Total

- 1. This Sales Selection Sheet when properly executed forms part of our Agreement of Purchase and Sale.
- 2. All extras and upgrades listed above are subject to Construction Progress and Architectural and Municipal requirements.
- 3. In the event the Vendor is unable to incorporate the work approved above in the construction of the house for any reason whatsoever, the Vendor will not be liable to the Purchaser in any way. The monies paid for any changes or optional extras not proceeded with shall be returned to the Purchaser, without interest. The cost of options or extras is non-refundable in all other circumstances. If for any reason whatsoever the Agreement of Purchase and Sale is not completed, the total cost of work approved above will be retained by the Vendor.
- 4. The Vendor reserves the right to substitute above materials and equipment with that of equal or better quality.
- 5. Purchaser acknowledges that items may not be exactly as shown. Variations from the Vendor's samples may occur in finished materials due to normal production processes. Vendor is not responsible for shade difference which may occur from different dye lots or wood grains. Variations from the Vendor's samples will occur with natural materials such as wood, marble, granite, hardwood and brick.
- 6. The Vendor reserves the right to select Grout & Thresholds that best suits the Tile selected.
- 7. Selections will not be processed unless signed by Heathwood Homes Head Office.
- 8. The selections made on this schedule are final and cannot be changed once submitted.
- 9. The Purchaser has checked and acknowledges the accuracy of this schedule.

Payment Summary	
Paid By	Amount
Total Payment:	

PURCHASER: Signature on file
AMITA TAKHTAR

02-Nov-20
DATE

Decor Consultant
DATE

02-Nov-20
DATE

- APPROVED -
-11- 05 2020
Date Approved

M. Rosen
Heathwood Homes (Huron) Limited

AMITA TAKHTAR/
Project: Wallaceton
Unit: 201, Phase: 2
Model: 27-2587 CRN B The Maxwell

Created: 10/4/2020 09:43:22
Locked:
Closed:

3 of 36

Kitchen

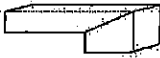
Cabinet Colour/Style	6823	Classic Plus-BOSTON-MACADEMIA-PAINT MDF ***UPG***
Countertop	7888	Group 6-Quartz- Caesarstone-ALPINE MIST # 5110-3/4 inch with built-up edge ***6***
Countertop Edge	4005	DOUBLE MITRE 1 1/2 INCH ***UPG*** 
Cabinet Hardware	7667	12881-HARDWARE ***STD***
Island Cabinet Colour/Style	6823	Classic Plus-BOSTON-MACADEMIA-PAINT MDF ***UPG***
Island Countertop	7888	Group 6-Quartz- Caesarstone-ALPINE MIST # 5110-3/4 inch with built-up edge ***6***
Backsplash	1111	N/A *****
Backsplash Grout	1111	N/A *****
Backsplash Tile Pattern	1111	N/A *****
HoodFan	8909	KVWB600DSS-KITCHEN AID 30 inch STAINLESS CHIMNEY HOOD-STAINLESS STEEL-30 inch ***Upg*** PAGE 28
Appliance	8909	Purchasers have been advised: standard fridge opening is a minimum 37 3/8 x 73 3/8". Ice Waterline Rough-In is included.
Appliance	8909	Standard stove opening is 30" and standard dishwasher opening is 24". Any gas stove will require backsplash or stainless steel backing to avoid fire hazards.
Appliance	8909	Purchasers acknowledge: Heathwood Homes and its contractors will not be responsible for any kitchen cabinet changes due to appliances dimension changes after
Flooring	9064	White Oak UVF-Vintage Northern Solid Sawn : White Oak : Sculpted UVF-APOLLO-3/4 inch x 5 inch ***10***
Floor Tile Grout	1111	N/A *****
Floor Tile Pattern	1111	N/A *****

AT

FoyerComment

Flooring	8291	OV.CD.BGE.1224.PL-Concorde-Beige Polished-12x24 See Tile Direction on Sketch of Page 18 ***5***
----------	------	--

AMITA TAKHTAR/
Project: Wallaceton
Unit: 201, Phase: 2
Model: 27-2587 CRN B The Maxwell

Created: 10/4/2020 09:43:22
Locked:
Closed:

4 of 36

Tile Direction on Sketch 2 Page 18

Floor Tile Grout	2222	Grout-(105) Driftwood ***STD***
Floor Tile Pattern	3040	FRONT TO BACK ***STD***

Comment

Laundry Room

Flooring	3040	GE.BY.AZR.1313 New Byzantine Azzuro 13
Floor Tile Grout	2225	Grout-(27) Silver ***STD***
Floor Tile Pattern	3000	STANDARD SQUARE ***STD***

Comment

Laundry Room Opt.

Cabinet - Uppers	9166	Viking III-CHARLESTON-ORCHID-3DL ***STD***
Cabinet Hardware	7667	12881-HARDWARE ***STD***
Comment		

Mud Room

Flooring	8291	OV.CD.BGE.1224.PL-Concorde-Beige Polished-12x24 See Tile Direction on Sketch 2 Page 18 ***5***
Floor Tile Grout	2222	Grout-(105) Driftwood ***STD***
Floor Tile Pattern	3050	SIDE TO SIDE ***STD***

AT

Comment POWDER ROOM LANDING AREA-HARDWOOD APOLLO

AMITA TAKHTAR/
Project: Wallaceton
Unit: 201, Phase: 2
Model: 27-2587 CRN B The Maxwell

Created: 10/4/2020 09:43:22
Locked:
Closed:

5 of 36

Powder Room

Flooring	8291	OV.CD.BGE.1224.PL-Concorde-Beige Polished-12x24 See Tile Direction on Sketch 2 Page 18 ***5***
Floor Tile Grout	2222	Grout-(105) Driftwood ***STD***
Floor Tile Pattern	3050	SIDE TO SIDE ***STD***

Plumbing Fixture (Colour)	1737	Plumbing Fixtures-WHITE ***STD***
Comment		

Dining Room

Flooring	9064	White Oak UVF-Vintage Northern Solid Sawn : White Oak : Sculpted UVF-APOLLO-3/4 inch x 5 inch ***2***
Comment		

Great Room

Flooring	9064	White Oak UVF-Vintage Northern Solid Sawn : White Oak : Sculpted UVF-APOLLO-3/4 inch x 5 inch ***2***
Comment		

Upper Hall

Flooring	9252	DY 16787 -Dynasty Tex-MYSTIC BEIGE-40 oz Poly***STD***
Comment		

Study

Flooring	9064	White Oak UVF-Vintage Northern Solid Sawn : White Oak : Sculpted UVF-APOLLO-3/4 inch x 5 inch ***2***
Comment		

AT

AMITA TAKHTAR/
Project: Wallaceton
Unit: 201, Phase: 2
Model: 27-2587 CRN B The Maxwell

Created: 10/4/2020 09:43:22
Locked:
Closed:

6 of 36

Opt. Finished Basement (Rec) Room/Hall

Flooring	9252	DY 16787 -Dynasty Tex-MYSTIC BEIGE-40 oz Poly***STD***
Comment		

Master Bedroom

Flooring	9252	DY 16787 -Dynasty Tex-MYSTIC BEIGE-40 oz Poly***STD***
Comment		

Bedroom 2

Flooring	9252	DY 16787 -Dynasty Tex-MYSTIC BEIGE-40 oz Poly***STD***
Comment		

Bedroom 3

Flooring	9252	DY 16787 -Dynasty Tex-MYSTIC BEIGE-40 oz Poly***STD***
Comment		

Bedroom 4

Flooring	9252	DY 16787 -Dynasty Tex-MYSTIC BEIGE-40 oz Poly***STD***
Comment		

Ensuite 4

Cabinet Colour/Style	9168	Viking III-CHARLESTON-MOONLIGHT-3DL ***STD***
Countertop	8822	4924-38-Countertop-WHITE CARRARA-Wilsonart ***STD***

AT

AMITA TAKHTAR/
Project: Wallace-ton
Unit: 201, Phase: 2
Model: 27-2587 CRN B The Maxwell

Created: 10/4/2020 09:43:22
Locked:
Closed:

7 of 36

Countertop Edge	1111	N/A *****								
Cabinet Hardware	7667	12881-HARDWARE ***STD***								
Floor Tile	7667	GE.BY.AZR.1313 New Byzantine Azzuro 13								
Floor Tile Grout	2225	Grout-(27) Silver ***STD***								
Floor Tile Pattern	3000	STANDARD SQUARE ***STD***								
Plumbing Fixture (colour)	1737	Plumbing Fixtures-WHITE ***STD***								
Wall Tile	5411	QT.SP.WHT.0810-Splendour-White-8 inch x 10 inch ***STD***								
Wall Tile Grout	2226	Grout-(00) White ***STD***								
Wall Tile Pattern	3090	VERTICAL STACKED ***STD*** <table><tr><td></td><td></td><td></td><td></td></tr><tr><td></td><td></td><td></td><td></td></tr></table>								
Comment										

Master Ensuite

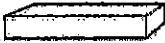
Cabinet Colour/Style	9166	Viking III-CHARLESTON-ORCHID-3DL ***STD***
Countertop	9069	MSI Quartz GROUP 1 ICED WHITE ***STD***
Countertop Edge	4010	GROUP 1 - SINGLE POLISHED STRAIGHT EDGE 3/4 INCH ***1*** 
Cabinet Hardware	7667	12881-HARDWARE ***STD***
Floor Tile	5494	GE.NA.GRY.1313-New Albion-Grey-13 x 13 ***STD***
Floor Tile Grout	7705	Grout-(01) Alabaster ***UPG***
Floor Tile Pattern	3000	STANDARD SQUARE ***STD***

AT

AMITA TAKHTAR/
Project: Wallaceton
Unit: 201, Phase: 2
Model: 27-2587 CRN B The Maxwell

Created: 10/4/2020 09:43:22
Locked:
Closed:

8 of 36



Shower Floor Tile	8661	OD.ON.SWT.0202.MT.N-Ontario Series Mosaic-Snow White Matte-2 x 2 ***STD***
Shower Floor Tile Grout	2225	Grout-(27) Silver ***STD***
Shower Floor Tile Pattern	3000	STANDARD SQUARE ***STD***
Shower Wall Tile	5420	QT.SP.DGR.0810-Splendour-Dark Grey-8 inch x 10 inch ***STD***
Shower Wall Tile Grout	2225	Grout-(27) Silver ***UPG***
Shower Wall Tile Pattern	3090	VERTICAL STACKED ***STD*** <div><div></div></div>
Shower Jamb(s) and Sill(s)	8923	Shower Jamb / Sill-Thassos White ***STD***
Plumbing Fixture (colour)	1737	Plumbing Fixtures-WHITE ***STD***
Comment		

Shared Bathroom

Cabinet Colour/Style	9168	Viking III-CHARLESTON-MOONLIGHT-3DL ***STD***
Countertop	8822	4924-38-Countertop-WHITE CARRARA-Wilsonart ***STD***
Countertop Edge	1111	N/A *****
Cabinet Hardware	7667	12881-HARDWARE ***STD***
Flooring	7667	GE.BY.AZR.1313 New Byzantine Azzuro 13
Floor Tile Grout	2225	Grout-(27) Silver ***STD***
Floor Tile Pattern	3000	STANDARD SQUARE ***STD***
Wall Tile	5420	QT.SP.DGR.0810-Splendour-Dark Grey-8 inch x 10 inch ***STD***



AT

AMITA TAKHTAR/
Project: Wallaceton
Unit: 201, Phase: 2
Model: 27-2587 CRN B The Maxwell

Created: 10/4/2020 09:43:22
Locked:
Closed:

9 of 36



Wall Tile Grout 2225 Grout-(27) Silver ***UPG***

Shared Bathroom Floor Tile Pattern 3090 VERTICAL STACKED ***STD***

Plumbing Fixture (Colour) 1737 Plumbing Fixtures-WHITE ***STD***

Shower Floor Tile 8661 OD.ON.SWT.0202.MT.N-Ontario Series Mosaic-Snow White Matte-2 x 2 ***STD***

Shower Floor Tile Grout 2225 Grout-(27) Silver ***STD***

Shower Floor Tile Pattern 3000 STANDARD SQUARE ***STD***

Shower Jamb(s) 8923 Shower Jamb / Sill-Thassos White ***STD***

Comment

Opt. Shower Floor Tile 8661 OD.ON.SWT.0202.MT.N-Ontario Series Mosaic-Snow White Matte-2 x 2 ***STD***

Shower Floor Tile Grout 2225 Grout-(27) Silver ***STD***

Shower Floor Tile Pattern 3000 STANDARD SQUARE ***STD***

Shower Wall Tile 5420 QT.SP.DGR.0810-Splendour-Dark Grey-8 inch x 10 inch ***STD***

Shower Wall Tile Grout 2225 Grout-(27) Silver ***UPG***

Shower Wall Tile Pattern 3090 VERTICAL STACKED ***STD***

Shower Jamb(s) 8923 Shower Jamb / Sill-Thassos White ***STD***

Cabinet Colour/Style 9168 Viking III-CHARLESTON-MOONLIGHT-3DL ***STD***

Countertop 8822 4924-38-Countertop-WHITE CARRARA-Wilsonart ***STD***

AT



AMITA TAKHTAR/
Project: Wallaceton
Unit: 201, Phase: 2
Model: 27-2587 CRN B The Maxwell

Created: 10/4/2020 09:43:22
Locked:
Closed:

10 of 36

Countertop Edge	1111	N/A *****
Cabinet Hardware	7667	12881-HARDWARE ***STD***
Flooring	7667	GE.BY.AZR.1313 New Byzantine Azzuro 13
Floor Tile Grout	2225	Grout-(27) Silver ***STD***
Floor Tile Pattern	3000	STANDARD SQUARE ***STD***
Plumbing Fixture (Colour)	1737	Plumbing Fixtures-WHITE ***STD***
Comment		

Great Room Fireplace

Type	8869	Majestic MERC32 ***STD***
Mantle	1439	NF 17-Paint Grade Mantle-Flat Wall-WHITE ***STD*** PAGE 21
Surround Opt.	1111	N/A *****
Note	1111	Purchasers have been advised: heat from the FP can damage TV above a FP and items placed on mantle.
Note	1111	Heathwood and its contractors will not be liable for any damage on items placed/installed above a FP after closing.
Comment		

Basement Stairs

Type	1714	Carpet Grade Stairs ***STD BASEMENT STAIRS***
Colour	7940	Sambucca STAIN TO COMPLIMENT HARDWOOD AND WILL VARY FROM FLOORING ***99***
Carpet Runner	1111	N/A *****
Handrail/Pickets/Post Type	9119	Handrail only on closed walls (one or two sides per building code) ***STD***
Handrail/Pickets/Post Colours	1729	Carpet Grade-Stain handrail, pickets, stringers, nosing_pos
Carpet	9252	DY 16787 -Dynasty Tex-MYSTIC BEIGE-40 oz Poly***STD***

MR

AMITA TAKHTAR/
Project: Wallaceton
Unit: 201, Phase: 2
Model: 27-2587 CRN B The Maxwell

Created: 10/4/2020 09:43:22
Locked:
Closed:

11 of 36

Custom Stain/Paint	1111	N/A *****
Comment		

Main Stairs

Type	1712	Oak Stairs ***STD MAIN STAIRS***
Colour	7940	Sambucca STAIN TO COMPLIMENT HARDWOOD AND WILL VARY FROM FLOORING ***99***
Carpet Runner	1111	N/A *****
Handrail/Pickets/Posts Type	8148	Single Collar Alt. Plain w/ Shoes with 3 1/2" Square/Cap Post(s)-BLACK ***2***
Handrail/Pickets/Posts Colour	7761	Oak Grade-Stain handrail,stringers,treads,risers,nosingpost
Custom Stain/Paint	1111	N/A *****
Comment		

Throughout

Walls - Paint Colour	1717	22-Wall-WARM GREY ***STD***
Underpad	1079	500 Series-Underpad ***STD***
Thresholds	2232	Metal Thresholds ***STD***
Switches and Plug	5796	Decora White Switches and Plugs ***STD***
Trim Size	8705	4 ¼ Baseboard and 2 ¾ Casings ***STD***
Trim - Paint Colour	1716	Trim-WHITE ***STD***
Comment		

Purchaser:	<u>Amita Takhtar</u>	<u>Oct 29, 2020</u>	<u>[Signature]</u>	<u>Oct 29, 2020</u>
	AMITA TAKHTAR	Date	Decor Consultant	Date

AMITA TAKHTAR/
Project: Wallaceton
Unit: 201, Phase: 2
Model: 27-2587 CRN B The Maxwell

Created: 10/4/2020 09:43:22

Locked:

Closed:

12 of 36

Purchaser:

Amrita Takhtar

Oct 29, 2020

Date

Wallaceton

[Signature]

Date Approved

-11- 05 2020



Sales Selection Sheet

Wallaceton

13 of 36

PURCHASER: AMITA TAKHTAR

TEL:

LOT / UNIT	PHASE	MODEL	
201	2	27-2587 CRN B The Maxwell	

It is herein understood and agreed between the undersigned parties hereto that the following changes shall be made to the above mentioned Agreement of Purchase and Sale in accordance with the agreement and except for such changes noted below, all other terms and conditions in the Agreement of Purchase and Sale shall remain as stated herein: It is further understood that and agreed that all changes and additions shall be installed as per builder's specifications, location and available selections. The Purchaser hereby agrees to purchase the following extras:

APPLIANCES

1	KITCHENAID KVWB600DS PAGE 28	Qty: 1
42,480	Note: KITCHENAID WALL MOUNT CANOPY HOOD FAN 30" SS	

Cabinetry

2	CABINETRY - 12J-LIGHT VALANCE (PER 8 foot LENGTH PRICE) (FOR CLARIFICATION OF STYLES SEE MOULDING MATRIX) (LIGHT VALANCE IS NOW APPROXIMATELY 2" [50MM] HIGH. PLEASE ENSURE LIGHT FIXTURES USED WILL BE CONCEALED BY THE VALANCE.);	Qty: 3
189,316		
38,954	Note: PRICE ALL THE SAME FOR ALL LINES - KITCHEN	
3	CABINETRY - VIKING I/II/III - OPT. LAUNDRY ROOM UPPERS - STANDARD SERIES	Qty: 1
187,485		
38,956	Note:	
4	CABINETRY - CLASSIC PLUS - KITCHEN - UPGRADE 4	Qty: 1
187,437		
42,481	Note:	
5	CABINETRY - CLASSIC PLUS KITCHEN BUILT IN - KITCHEN - UPGRADE 4	Qty: 1
189,306		
42,492	Note: SKETCH # 3 PAGE 19 SPECS PAGES 29-36	

Ceramics

6	CERAMICS - FLOOR GROUT - ENSUITE MASTER - GROUT	Qty: 1
187,512		
38,944	Note:	
7	CERAMICS - FLOOR - FOYER - UPGRADE 5	Qty: 1
187,716		
42,484	Note:	
*8	CERAMICS - FLOOR - GARAGE ENTRY / MUD ROOM - UPGRADE 5	Qty: 1
187,732		
42,485	Note: UP TO POWDER ROOM STEP SEE SKETCH # 2 PAGE# 18	
9	CERAMICS - FLOOR - POWDER ROOM - UPGRADE 5	Qty: 1
187,724		
42,487	Note:	
10	CERAMICS - SHOWER WALL AND CEILING GROUT - ENSUITE MASTER - GROUT	Qty: 1
187,503		
42,502	Note:	

Initials: AT

TAX#:1

PREPARED BY: Irit Salem

PE 534-1



Sales Selection Sheet
Wallaceton

14 of 36

PURCHASER: AMITA TAKHTAR

TEL:

LOT / UNIT	PHASE	MODEL	
201	2	27-2587 CRN B The Maxwell	

CERAMICS

11 187,502 42,504	CERAMICS - TUB WALL GROUT - SHARED ENSUITE - GROUT Note:	Qty: 1
12 187,501 42,505	CERAMICS - TUB WALL GROUT - ENSUITE 4 - GROUT Note:	Qty: 1
13 187,515 42,506	CERAMICS - SHOWER WALL AND CEILING GROUT - OPTIONAL BASEMENT BATHROOM - GROUT Note:	Qty: 1

Drywall

14 187,817 38,938	DRYWALL - SMOOTH CEILING IN MAIN FLOOR Note:	Qty: 1
-------------------------	---	--------

Electrical

15 189,450 38,935	ELECTRICAL - CEILING ROUGH-IN (CAPPED) Note: 1 ABOVE THE BRAKFAST BAR - USE SEPARATE SWITCH 1- IN THE CENTRE OF GREAT ROOM - USE EXISTING SWITCH PLUG SEE SKETCH # 2 PAGE# 18	Qty: 2
16 189,449 38,936	ELECTRICAL - EXTRA WALL INTERIOR OUTLET ON EXISTING CIRCUIT (DOES NOT INCLUDE KITCHEN OUTLETS) Note: GREAT ROOM' TO BE INSTALL ABOVE THE CENTRE OF THE FIRE PLACE 65" FROM FLOOR SKETCH # 2 PAGE 18	Qty: 1
*17 189,417 38,937	ELECTRICAL - RELOCATION OF SWITCHES Note: KITCHEN: RELOCATE STD. STOVE ELECTRICAL TO WALL OVEN LOCATION SEE SKETCH# 2 AND 3 PAGE# 18 AND 19	Qty: 1
18 189,449 42,500	ELECTRICAL - EXTRA WALL INTERIOR OUTLET ON EXISTING CIRCUIT (DOES NOT INCLUDE KITCHEN OUTLETS) Note: FAMILY ROOM IN THE BASEMENT INSTALL 5' FROM WALL AND 5' FROM FLOOR SEE SKETCH # 1 PAGE# 17	Qty: 1
19 189,451 42,501	ELECTRICAL - ADDITIONAL SWITCH Note: KITCHEN TO BE USED FOR THERM/ CAP LIGHT SKETCH # 2 PAGE 18	Qty: 1

Granite

20 189,464 38,946	GRANITE - GRANITE CUTOUT W/ STRAIGHT EDGE POLISH TO ACCOMMODATE COOK TOP SKETCH # 2 AND 3 PAGES 18 AND 19 Note: COOKTOP SPECS PAGES 31-32	Qty: 1
-------------------------	---	--------

Initials: AT

TAX#:1

PREPARED BY: Irit Salem

PE 534-2

S\invoice.rpt 26may19



Sales Selection Sheet
Wallaceton

15 of 36

PURCHASER: AMITA TAKHTAR

TEL:

LOT / UNIT	PHASE	MODEL	
201	2	27-2587 CRN B The Maxwell	

GRANITE

*21 189,466 42,483	GRANITE - DRILL ADDITIONAL HOLE ON COUNTERTOP FOR FUTURE SOAP DISPENSER DISPENSER SPEC PAGE 24 Note: KITCHEN SEE SKETCH # 3 PAGE# 19 AND PAGE 22	Qty: 1
22 187,823 43,340	GRANITE - COUNTERTOP - 3/4" GROUP 6 WITH MITRE EDGE - KITCHEN / ISLAND - UPGRADE 6 Note:	Qty: 1

HARDWOOD

*23 187,86C 42,494	HARDWOOD - VINTAGE - 5" WHITE OAK UVF OIL - GREAT ROOM - UPGRADE 4 Note:	Qty: 1
24 187,86E 42,495	HARDWOOD - VINTAGE - 5" WHITE OAK UVF OIL - STUDY - UPGRADE 2 Note:	Qty: 1
25 187,89E 42,496	HARDWOOD - VINTAGE - 5" WHITE OAK UVF OIL - KITCHEN - UPGRADE 2 Note:	Qty: 1
26 187,862 42,498	HARDWOOD - VINTAGE - 5" WHITE OAK UVF OIL - DINING ROOM - UPGRADE 2 Note:	Qty: 1
*27 187,862 42,499	HARDWOOD - VINTAGE - 5" WHITE OAK UVF OIL - POWDER ROOM LANDING - UPGRADE 2 Note:	Qty: 1

Heating/Air

28 189,474 38,931	HEATING/AIR - ROUGH-IN GAS LINE FOR GAS STOVE AT MAIN FLOOR (SEE SPECS) (HOOK-UP NOT INCLUDED) LEAVE STANDARD 120 VOLT ELECTRICAL OUTLET ON A SEPARATE CIRCUIT. * SPECIFY IF STANDARD 220V WILL STAY OR BE RELOCATED Note: STANDARD RELOCATED FOR B/I OVEN/MICRO SPEC SKETCH # 3 PAGE 19 PAGES 33-34	Qty: 1
-------------------------	--	--------

Interior Railing

29 187,901 38,945	INTERIOR RAILING - BLACK METAL - SINGLE COLLAR ALT. PLAIN W/ SHOES WITH 3 1/2" SQUARE/CAP POST(S) AS PER PLAN - THOUGHOUT - UPGRADE 2 Note:	Qty: 1
-------------------------	---	--------

MISC.

30 38,939	PROMO Note:	Qty: (1)
--------------	--------------------	----------



Sales Selection Sheet

Wallaceton

16 of 36

PURCHASER: AMITA TAKHTAR

TEL:

LOT / UNIT	PHASE	MODEL	
201	2	27-2587 CRN B The Maxwell	

1. This Sales Selection Sheet when properly executed forms part of our Agreement of Purchase and Sale.
2. All extras and upgrades listed above are subject to Construction Progress and Architectural and Municipal requirements.
3. In the event the Vendor is unable to incorporate the work approved above in the construction of the house for any reason whatsoever, the Vendor will not be liable to the Purchaser in any way. The monies paid for any changes or optional extras not proceeded with shall be returned to the Purchaser, without interest. The cost of options or extras is non-refundable in all other circumstances. If for any reason whatsoever the Agreement of Purchase and Sale is not completed, the total cost of work approved above will be retained by the Vendor.
4. The Vendor reserves the right to substitute above materials and equipment with that of equal or better quality.
5. Purchaser acknowledges that items may not be exactly as shown. Variations from the Vendor's samples may occur in finished materials due to normal production processes. Vendor is not responsible for shade difference which may occur from different dye lots or wood grains. Variations from the Vendor's samples will occur with natural materials such as wood, marble, granite, hardwood and brick.
6. The Vendor reserves the right to select Grout & Thresholds that best suits the Tile selected.
7. Selections will not be processed unless signed by Heathwood Homes Head Office.
8. The selections made on this schedule are final and cannot be changed once submitted.
9. The Purchaser has checked and acknowledges the accuracy of this schedule.

Payment Summary

<u>Paid By</u>	<u>Amount</u>
----------------	---------------

<u>Total Payment:</u>	
-----------------------	--

PURCHASER:

Amita Takhtar
AMITA TAKHTAR

29-Oct-20
DATE

[Signature]
Decor Consultant

29-Oct-20
DATE

APPROVED

-11- 05 2020

Date Approved Heathwood Homes (Huron) Limited

TAX#:1

PREPARED BY: Irit Salem

PE 534-4

S\invoice.rpt 28may19

UK -75 WALLACETON
LOT 201
27-2587 CRN ELEV B
THE MAXWELL

17 of 36

THE MAXWELL

ELEVATION B | 2,593 SQ. FT.

735 sq. ft. of opt. finished Lower Level

27-2587 CRN ELEV. B

Sketch #1

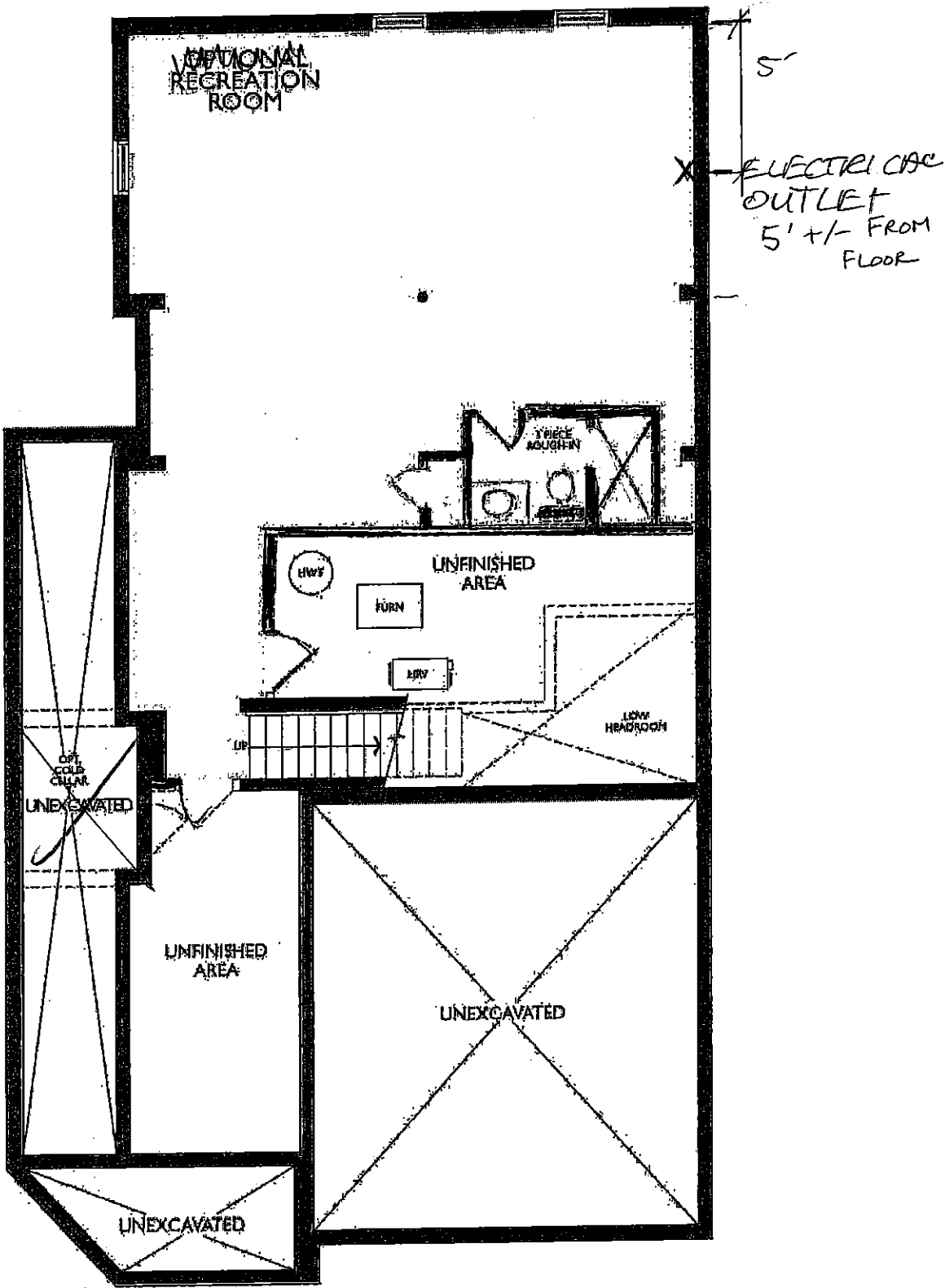

LOWER LEVEL
ELEVATION B

UK-75 WALLACETON
LOT 201
27-2587 CRN ELEV B
THE MAXWELL

18 of 36

THE MAXWELL

ELEVATION B | 2,593 SQ. FT.

735 sq. ft. of opt. finished Lower Level

27-2587 CRN ELEV. B

Sketch #2

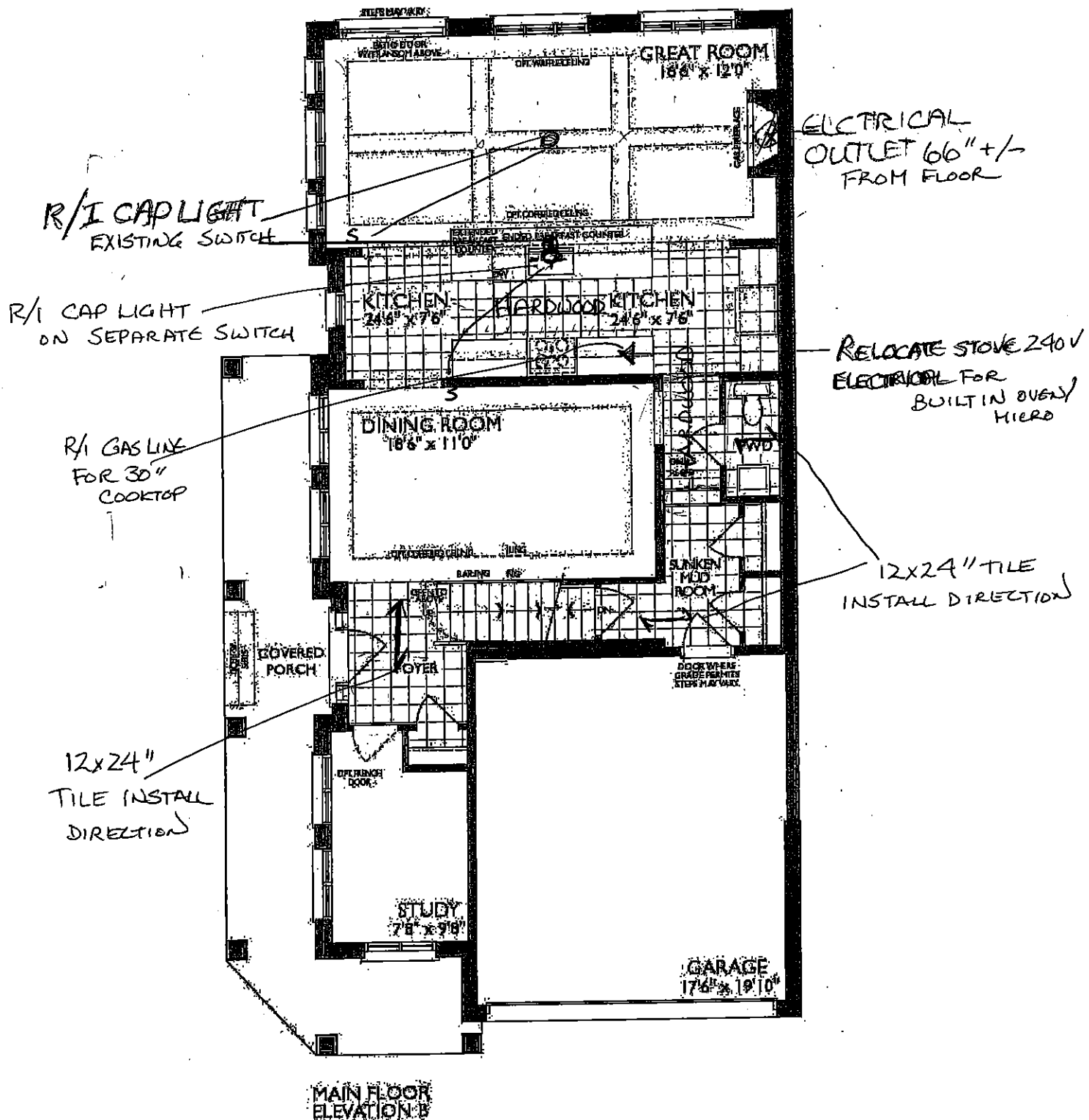

✓

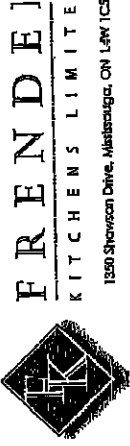

HEATHWOOD HOMES
 WALLACETON, KITCHENER
 MODEL: 27-2587 CRN (310)

STANDARD CONTRACT INCLUDES:

Appliance Openings

- Hood Opening: 30"W Chimney h/c
- Fridge Opening: 37 3/8 "W X 73 3/4"
- Fridge cabinet & gables: 66cm D/c
- Stove Opening: 30" Freestanding
- Dishwasher Opening: 24"

Standard Kitchens Scope:

- 100cm H wall cabinets
- Std. Blumotion Hinges- soft close doors
- Std. Metabox Drawers- not soft close
- Min 40cm W drawer
- Base pie cut corner cabinets
- Backing on all cabinets
- Countertop by others
- Upgrade applied paneled fridge & dishwashers supply only (appliance hardware by others)

Standard Vanity & Laundry Scope:

- Powder by others, pedestal
- Master Ens. - Top by others
- Remaining vanities inc. laminate top
- Std. Blumotion Hinges- not soft close
- Std. Metabox Drawers- not soft close
- Master Ens: Top drawers (Sink Full height)
- Mains: Full height doors (top drawers added if Masters can't accommodate)
- Optional laundry base & wall cabinets

THIS DRAWING IS FOR DESIGN PURPOSES ONLY.
 IT IS NOT AN EXACT REPRESENTATION.

Sketch #3

19 of 36

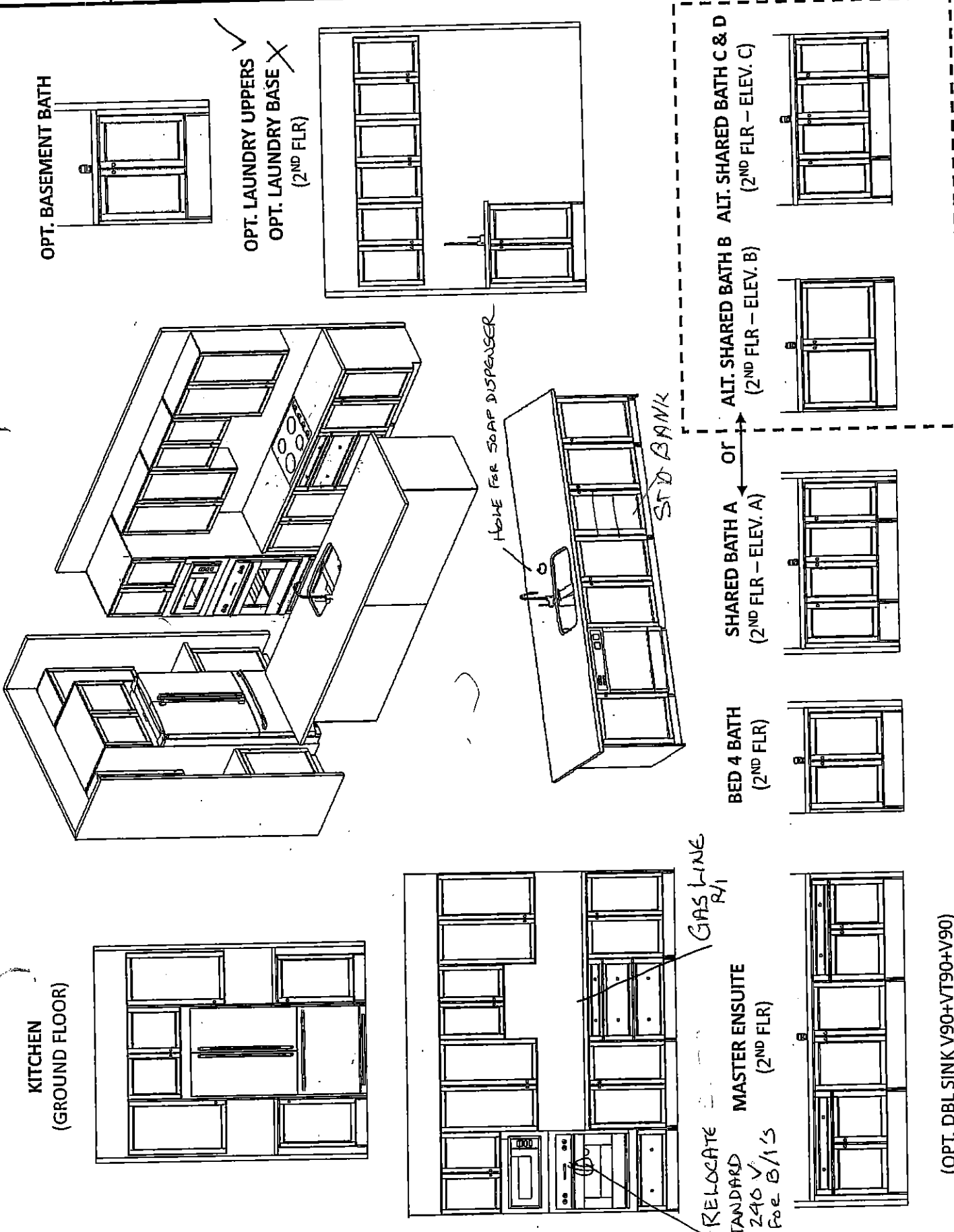

(OPT. DBL SINK V90+VT90+V90)

10/23/2019

UK -75 WALLACETON
LOT 201
27-2587 CRN ELEV B
THE MAXWELL

20 of 36

THE MAXWELL

ELEVATION B | 2,593 SQ. FT.

735 sq. ft. of opt. finished Lower Level

27-2587 CRN ELEV. B

Sketch #4

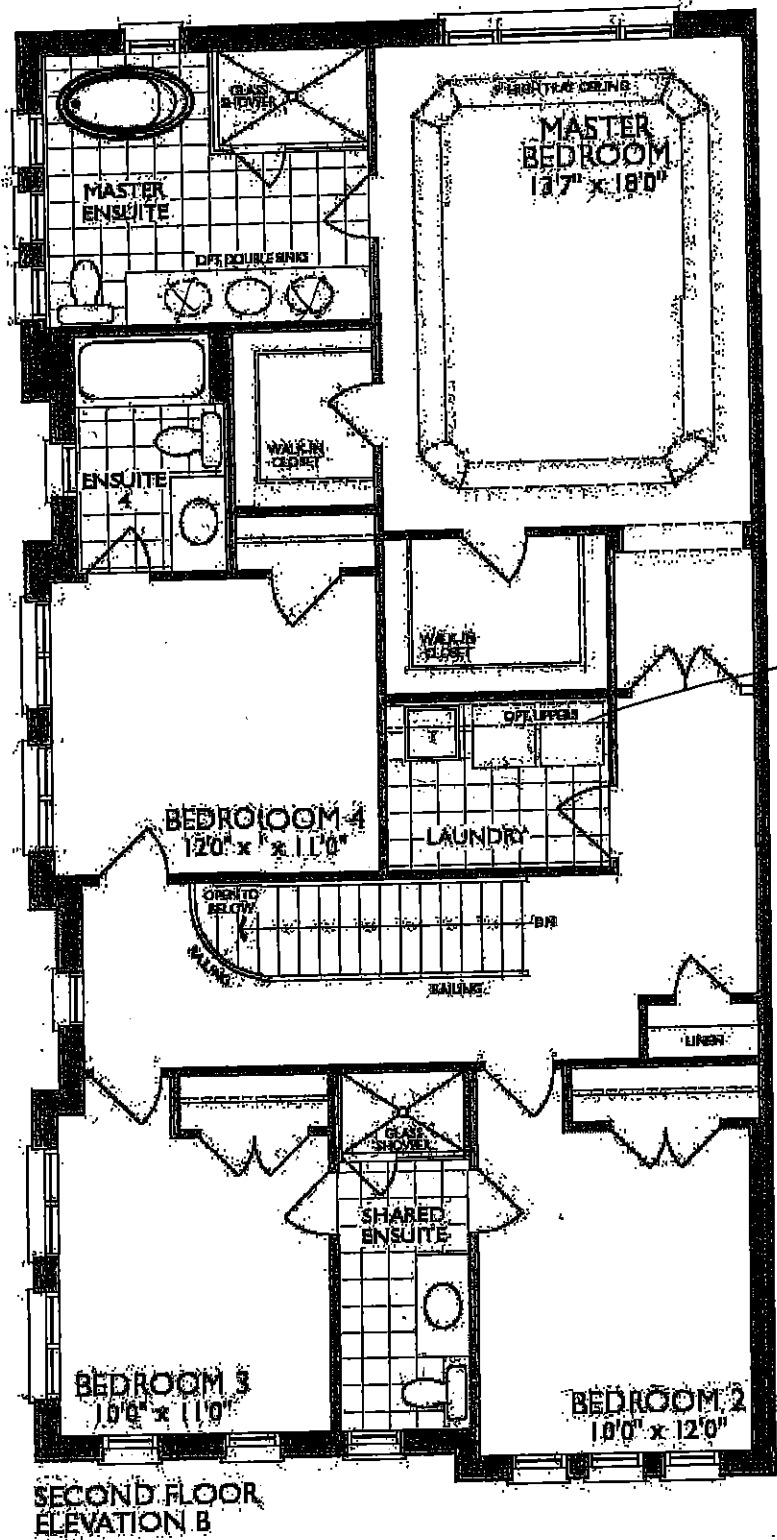

UK-75 WALLACETON
LOT 201
27-2587 CRN ELEV B
THE MAXWELL

21 of 36

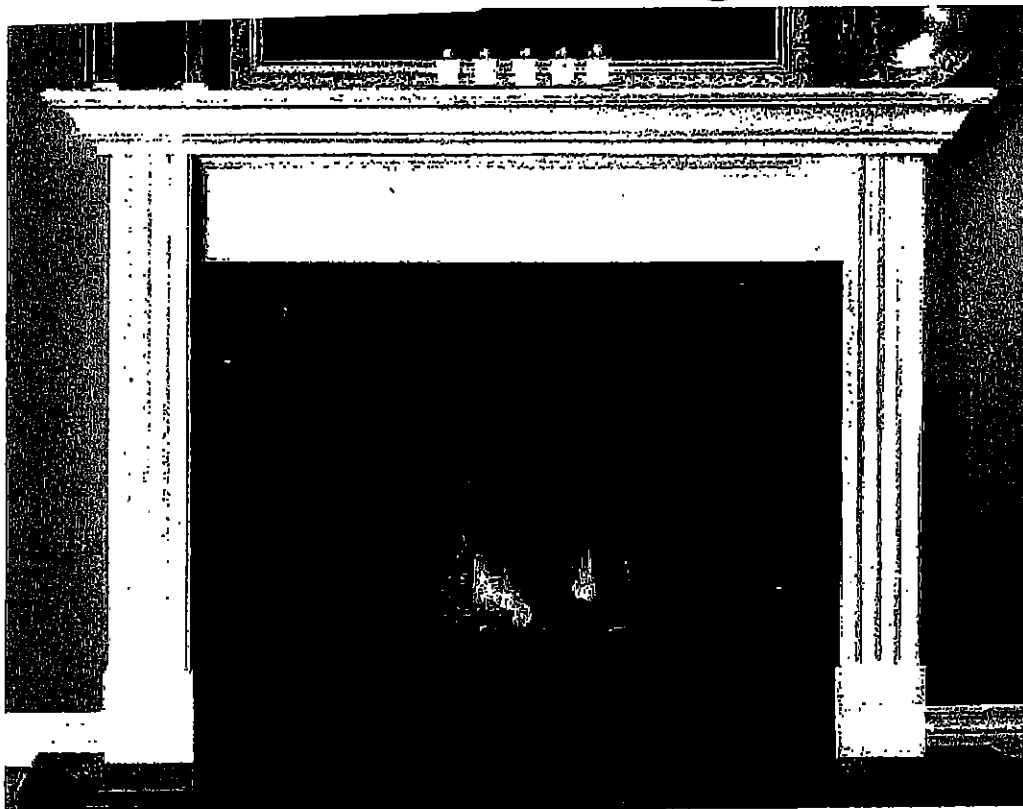

STANDARD NF 15 Mantel

Clean apron finish with fluted legs

WHITE PAINT GRADE FINISH

(PICTURE SHOWN WITH UPGRADE SURROUND AND HEARTH -PRICED SEPARATELY)

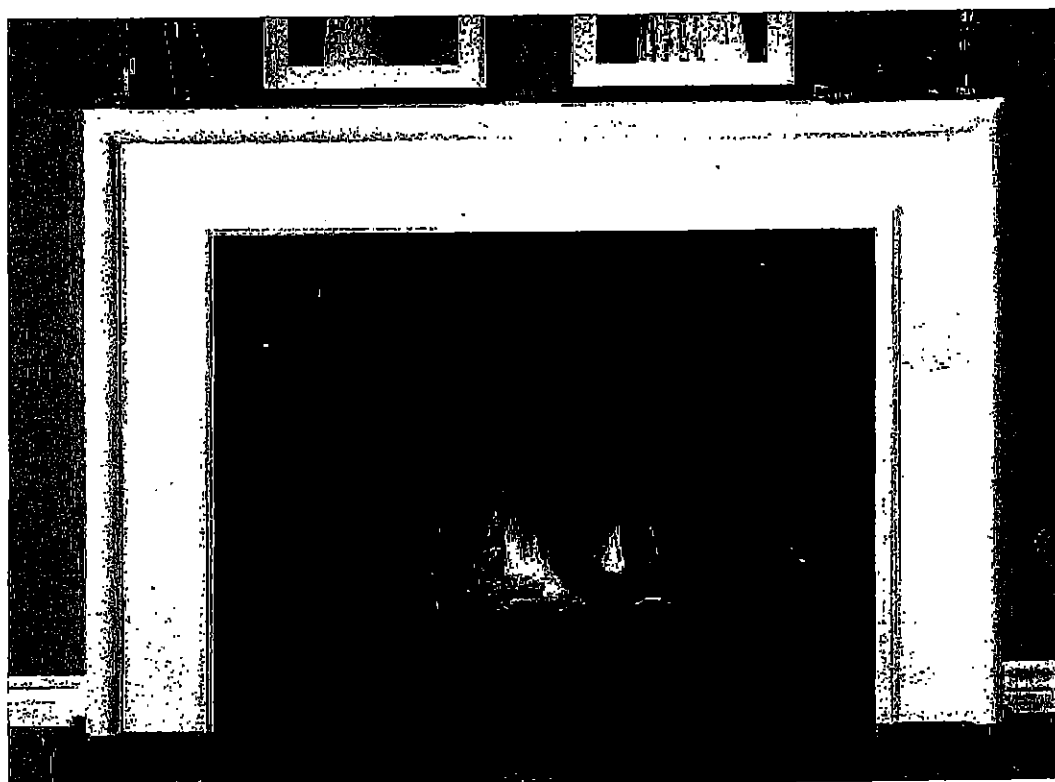

STANDARD NF 17 Mantel

WHITE PAINT GRADE FINISH

(PICTURE SHOWN WITH UPGRADE SURROUND AND HEARTH -PRICED SEPARATELY)

AD

UK-75 WALLACETON
 LOT 201
 27-2587 CRN ELEV B
 THE MAXWELL

22 of 36

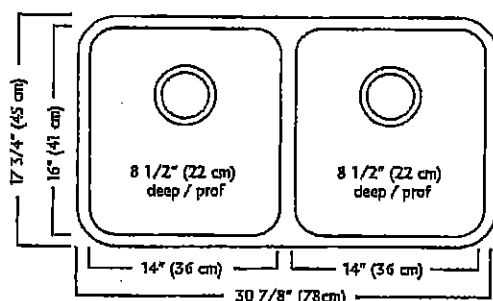
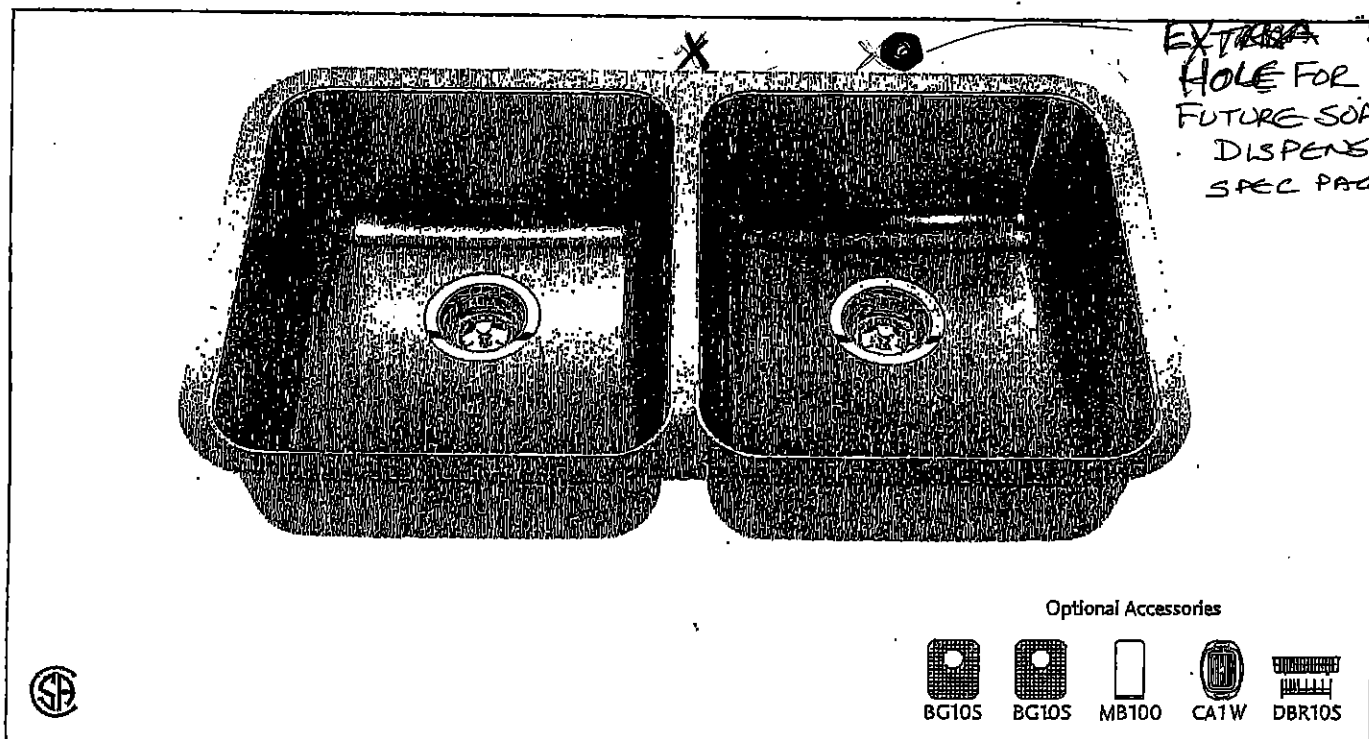

ND1831UA/9 SPECIFICATION

Model ND1831UA/9 is a double (two equal size) bowl undermount sink manufactured by Franke Kindred Canada Limited from 18 gauge stainless steel. Product has silk finished rims and linear brush finished bowls. Sink is fully undercoated. Basket strainer waste fittings (3 1/2\", 89 mm) are included. Sink is backed with a limited lifetime warranty.

- O.D. 17 3/4\" x 30 7/8\" x 8 1/2\" (45 x 78 x 22 cm)
- Recommended for minimum 36\" cabinet

Franke Kindred Canada Limited
 P.O. Box 190, 1000 Franke Kindred Road, Midland, Ontario, Canada, L4R 4K9 Phone: 866-687-7465 Fax: 800-361-8408

AT

UK-75 WALLACETON
LOT 201
27-2587 CRN ELEV B
THE MAXWELL

23 of 36

STANDARD KITCHEN FAUCET

Align

Modern

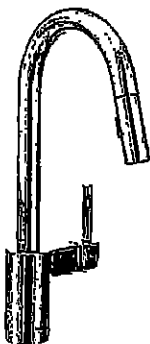

Single Handle Pull-Down Kitchen
Faucet*

Model 7565†

AT

UK-75 WALLACETON
LOT 201
27-2587 CRN ELEV B
THE MAXWELL

24 of 36



Buy it for looks. Buy it for life.®

Specifications

DESCRIPTION

- Available in various finishes identified by suffix

OPERATION

- Press down, pump action

WARRANTY

- Limited lifetime warranty against manufacturing and finish defects to the original consumer purchaser
- 5 year warranty if used in commercial installations

SPEC FOR FUTURE
SOAP DISPENSER TO BE
INSTALLED BY
PURCHASER AFTER
CLOSING

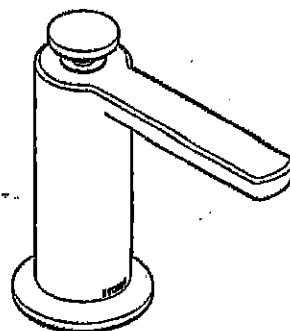

MODERN
SOAP/LOTION DISPENSER

Model: S3947 series

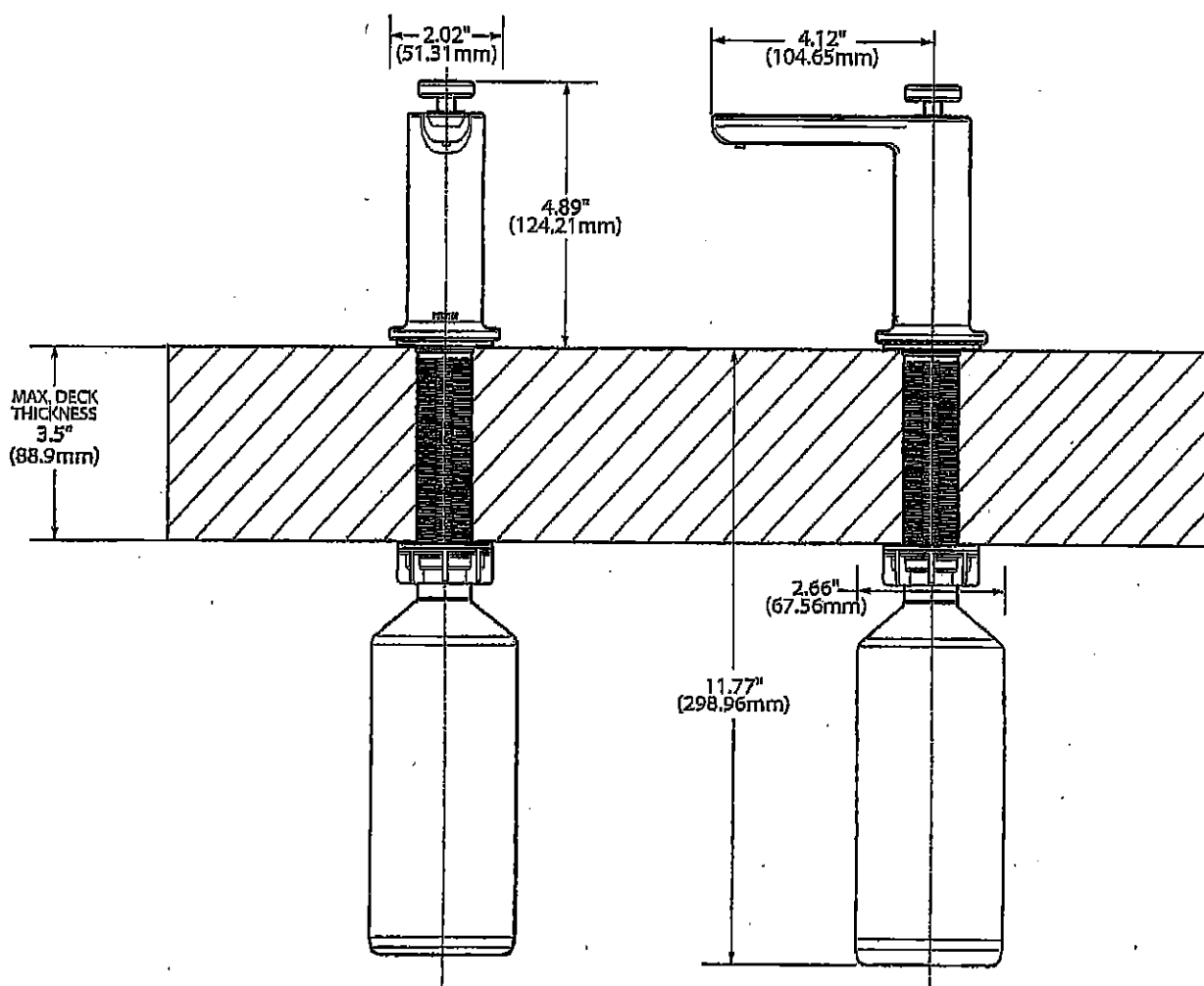

NOTE: DESIGNED TO BE INSTALLED THROUGH 1 HOLE 1-1/8" DIAMETER

CRITICAL DIMENSIONS

(DO NOT SCALE)

UK-75 WALLACETON
LOT 201
27-2587 CRN ELEV B
THE MAXWELL

25 of 36

Chateau

Transitional

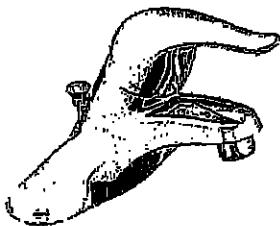

Lavatory Faucet with Pop-Up Drain
Model L4621†

VANITY SINKS AND PEDESTAL

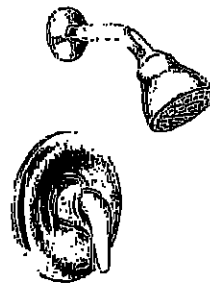

Posi-Temp® Pressure Balancing Tub/Shower
Model 62320 / TL183†

OR

Posi-Temp Valve and Tub/Shower Trim
with Eco-Performance Easy Clean® XL

Model 62320 / TL183EP†

(TL183EP not available in BC)

SHOWER AND 5" TUB FAUCETS



2 Handle Roman Tub with 9" Spout
Model 4796 / T990†

FREESTANDING TUB FAUCETS

AT

UK-75 WALLACETON
 LOT 201
 27-2587 CRN ELEV B
 THE MAXWELL

26 of 36



Buy it for looks. Buy it for life.®

There is more than 1 version of this model.
 Page down to identify the version you have.

DESCRIPTION

- Metal construction with various finishes identified by suffix
- 1/2" IPS connections
- Includes metal or 50/50 pop-up type waste assembly where noted

OPERATION

- Pivot action lever style handle
- Temperature controlled through 100° degree arc of handle travel

FLOW

- Water usage is limited to these maximum flow rates as indicated by the corresponding product markings
 - 1.2 gpm max (4.5L/min) at 60 psi
 - 1.5 gpm max (5.7L/min) at 60 psi

CARTRIDGE

- 1255™ Duralast™ cartridge
- Nonmetallic/nonferrous and stainless steel material

STANDARDS

- Third party certified to WaterSense®, ASME A112.18.1/CSA B125.1 and all applicable requirements referenced therein
- Certified to NSF 61/9 & 372
- Products marked with 1.2 gpm are compliant with California water efficiency regulations
- Complies with California Proposition 65 and with the Federal Safe Drinking Water Act

- ADA ♿ for lever handle

WARRANTY

- Lifetime limited warranty against leaks, drips and finish defects to the original consumer purchaser
- 5 year warranty if used in commercial installations

Specifications

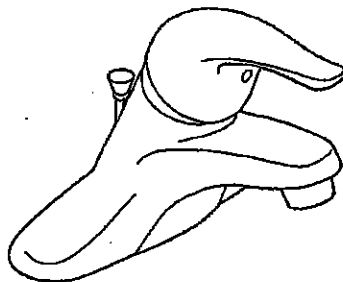

CHATEAU® Single-Handle Lavatory Faucet

with Metal Waste Assembly
 Models: L4621 series

Bulk Pack Models (12 Per Carton):
 L64620 series

with 50/50 Waste Assembly
 Bulk Pack Model (12 Per Carton): L64621 series

Less Waste
 Model: L4601 series

Bulk Pack Model (12 Per Carton):
 L64601 series

NOTE: THIS FAUCET IS DESIGNED TO BE
 INSTALLED THRU 3-1" DIA. HOLES, 2" ON CENTER

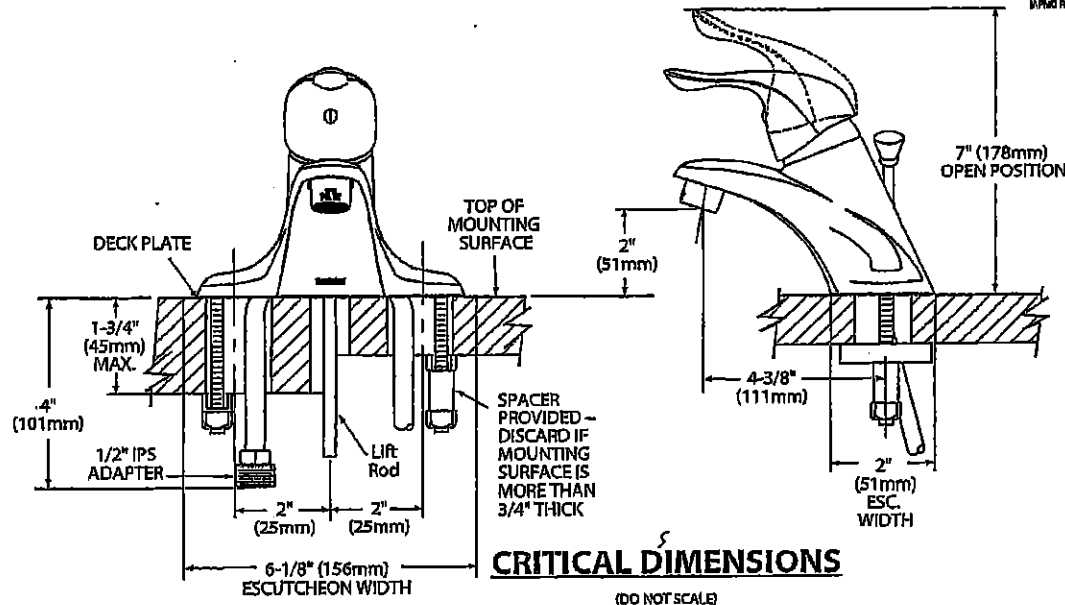

Rev. 1/16

FOR MORE INFORMATION CALL: 1-800-BUY-MOEN
www.moen.com

45

UK-75 WALLACETON
LOT 201
27-2587 CRN ELEV B
THE MAXWELL

27 of 36

MASTER ENSUITE BATHROOM

American Standard

Style That Works Better

BARRIER FREE

OVALYN™ UNDERCOUNTER SINK

- Classic oval undermount sink
- Made from vitreous china
- Front overflow
- Supplied with mounting kit (047194-0070A) and template

0496.221 Unglazed rim
489 x 413mm
(19-1/4" x 16-1/4")

Bowl size:
432mm (17") wide
356mm (14") front to back
140mm (5-1/2") deep

Compliance Certifications -
Meets or Exceeds the Following Specifications:
• ASME A112.19.2M for Vitreous China Fixtures
• CAN/CSA B45 series

OVALYN™
UNDERCOUNTER SINK
VITREOUS CHINA

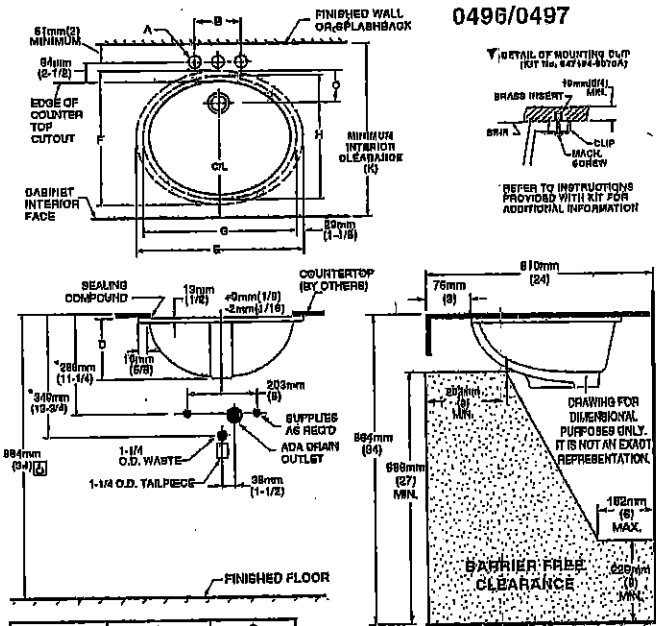
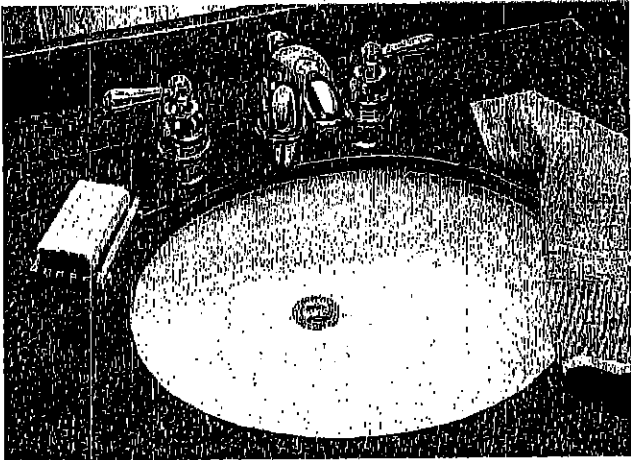

0496/0497

NOTES:
* DIMENSIONS SHOWN FOR LOCATION OF SUPPLIED AND "P" TRAP ARE SUGGESTED.
▼ UNDERCOUNTER MOUNTING KIT SUPPLIED WITH SINK. PLEASE NOTE MINIMUM INTERIOR CLEARANCE DIMENSION (K). FITTINGS NOT INCLUDED AND MUST BE ORDERED SEPARATELY. USE ENCLOSED TEMPLATE FOR COUNTERTOP CUTOUT SEALING COMPOUND SUPPLIED BY OTHERS.

IMPORTANT: Dimensions of fixtures are nominal and may vary within the range of tolerances established by ANSI Standard A112.19.2. These measurements are subject to change or cancellation. No responsibility is assumed for use of superseded or voided pages.

MEETS THE AMERICANS WITH DISABILITIES ACT GUIDELINES AND ANSI A117.1 ACCESSIBLE AND USEABLE BUILDINGS AND FACILITIES - CHECK LOCAL CODES.
Countertop 864mm (34") from finished floor. Lavatory installed 78mm (3") from front edge of countertop. Countertop thickness to be 25mm (1") maximum.

FITTING	A	B
CENTERSET	1-1/4 (32mm)	4 (102mm)
SPREAD	1-3/8 (38mm)	9 (229mm)

GAT. NO.	E	F	G	H	O	D	J	K
0496.221	406mm (16-1/8)	418mm (16-5/16)	432mm (17)	95mm (3 7/8)	108mm (4-1/4)	182mm (7-1/8)	18mm (3/4)	806mm (31-3/4)
0497.221	846mm (33-1/4)	441mm (17-3/8)	466mm (18-3/8)	261mm (10-3/8)	96mm (3-3/4)	191mm (7-5/8)	18mm (3/4)	884mm (34-7/8)

AT

28 of 36

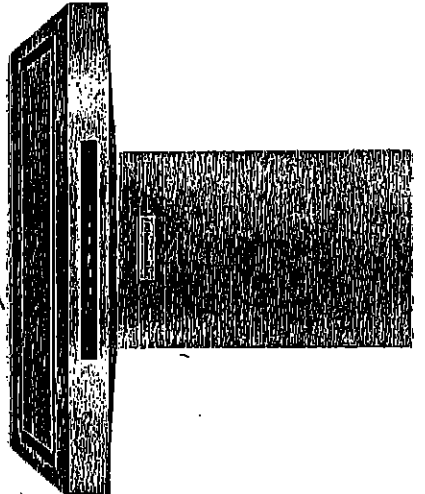

FOR THE WAY IT'S MADE®
FOR THE MAXIMUM IN VALUE

MODEL: KQWB600DSS

30-in. Width | Wall-Mount Canopy | 600 CFM Motor

This 3-speed vent hood has power to effectively vent an output of up to 65K BTUs. Auto speed sensing keeps the vent at the proper fan speed by sensing the amount of heat coming from the cooktop. This 30-inch wall-mount canopy hood has both LED and halogen lights to brighten almost any work area.

PRODUCT FEATURES

- 600 CFM/65K BTU Threshold
- Allows installation over any KitchenAid regular 30-inch range or cooktop, and some commercial-style cooking surfaces with outputs up to 65K BTU
- Perimeter Ventilation
- Increases ventilation system efficiency by pulling air from the edges of the hood and speeding up the movement of air at the center, allowing it to efficiently handle up to a 65K BTU total output
- Auto Speed Setting
- Takes the guesswork out of protecting cabinets from steam, grease, and moisture by automatically adjusting fan speed to ventilation needs depending on the heat being produced
- LED Task Lights
- Provide extra lighting over the cooking surface to help in the cooking process
- Halogen Night Lights
- Enhances the style-of the ventilation system by providing soft, accent lighting in the kitchen

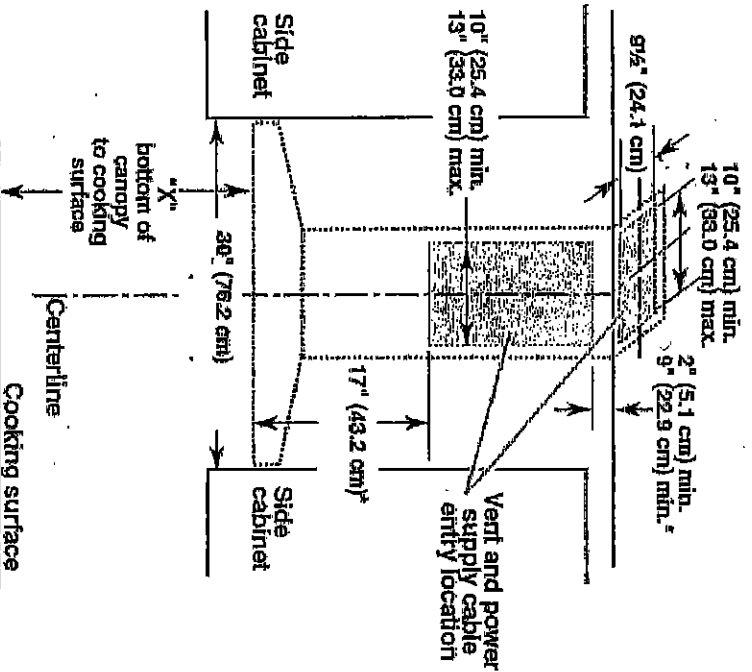

*For non-vented (recirculating) installations

IMPORTANT:
Minimum distance "X": 24" (61.0 cm) from electric cooking surface.
Minimum distance "X": 27" (68.6 cm) from gas cooking surfaces.
Suggested maximum distance "X": 36" (91.4 cm)

Duct Outlet Type
Duct Outlet Size

PERFORMANCE
Round
6"

15amp, 60 Hz, 120 V.

ELECTRICAL

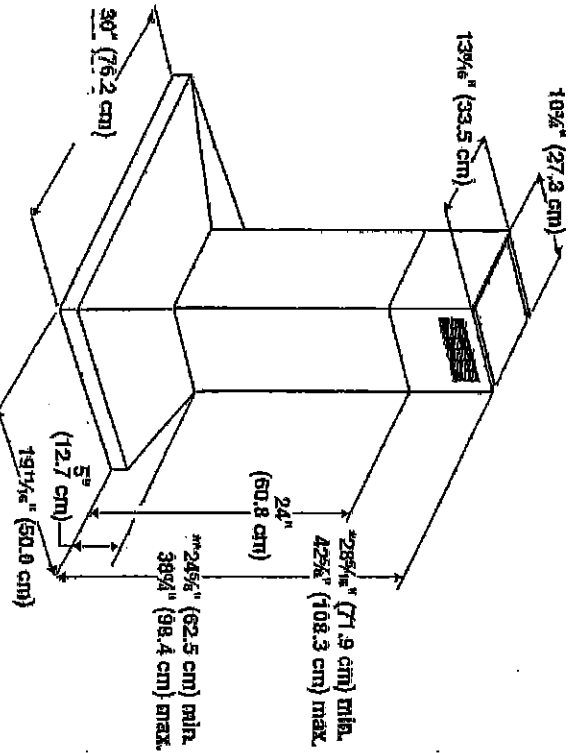

*For non-vented (recirculating) installations
**For vented installations

47

UK-75 WALLACETON
LOT 201
27-2587 CRN ELEV B
THE MAXWELL

29 of 36

RF22M9581SR

SAMSUNG

Samsung Counter-Depth, 4-Door Flex™ with Family Hub™

22 cu. ft. Capacity

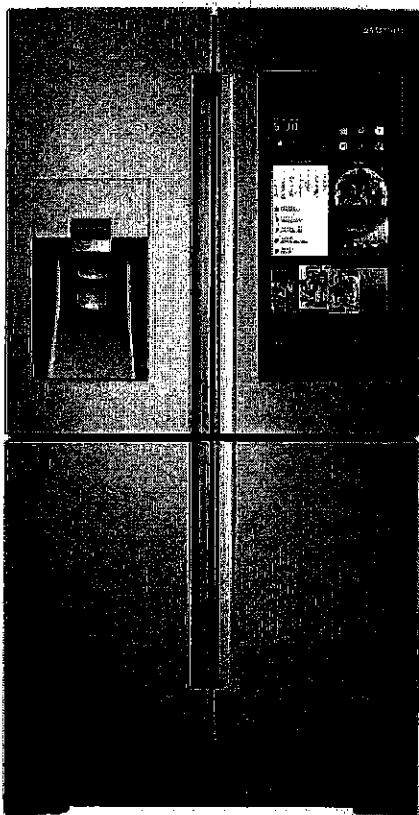

Signature Features

Food

- Use your voice to add items to your shopping lists.
- See inside from anywhere with 3 built-in cameras.

Family

- Sync calendars for all family activities and events.
- Remotely share photos, notes and memos.

Fun

- Stream music, mirror your Samsung TV or Samsung phone directly on your Family Hub™ screen.

Connect

- Simplify your life through the SmartThings app by controlling smart devices and appliances: set lights, adjust the thermostat or monitor your baby's room.

Available Colors



Stainless Steel (shown)



Black Stainless Steel

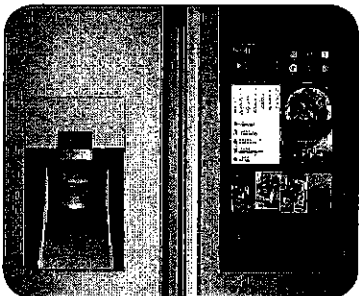

Family Hub™



FlexZone™

Features

- Profile Base Communication Apps
- S-Voice – Integrated Voice-Activated Features
- One Family Hub™ Experience Integrated Mobile App
- FlexZone™
- Triple and Metal Cooling
- Large Capacity – 22 cu. ft.
- External Filtered Water and Ice Dispenser
- Ice Master Ice Maker in the Refrigerator
- High-Efficiency LED Lighting
- Wine Rack
- Fingerprint-Proof Coating
- ENERGY STAR® Compliant
- EZ Slide-Out Shelves in Freezer and FlexZone™
- Counter-Depth

Convenience

- Tempered Glass Spill-Proof Shelves
- Gallon Door Bins
- Flip-Up Shelf
- Door Alarm
- Water Filter Indicator

Rating



ENERGY STAR®-rated:
709 kWh/yr

AT

UK-75 WALLACETON
LOT 201
27-2587 CRN ELEV B
THE MAXWELL

30 of 36

RF22M9581SR

SAMSUNG

Samsung Counter-Depth, 4-Door Flex™ with Family Hub™

22 cu. ft. Capacity

Installation Specifications

- 1. Measure the height, width and depth of the opening, making sure to include baseboards, molding tile, countertop overhang, etc. Check to be sure there is enough room to open the door (consider walls, islands or other obstacles when measuring).
- 2. Refer to illustration below to determine dimensions.
- 3. Allow 2.5" of clearance on hinge side of refrigerator when installing next to a wall where handle may make contact.
- 4. Allow 1" minimum clearance at rear for proper air circulation and water/electrical connections. Allow a 3/8" minimum clearance at sides and top for ease of installation.
- 5. Ensure each door and entryway in the home is wide enough for the refrigerator to be moved through easily.

For optimal usage and to be able to open refrigerator doors completely, do not install next to a wall.

Please note: The following dimension and cutout information is for planning purposes only. For complete installation details, consult manual packed with product, or download manual online at samsung.com.

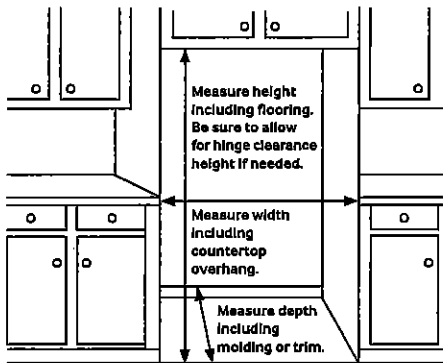

Dimensions

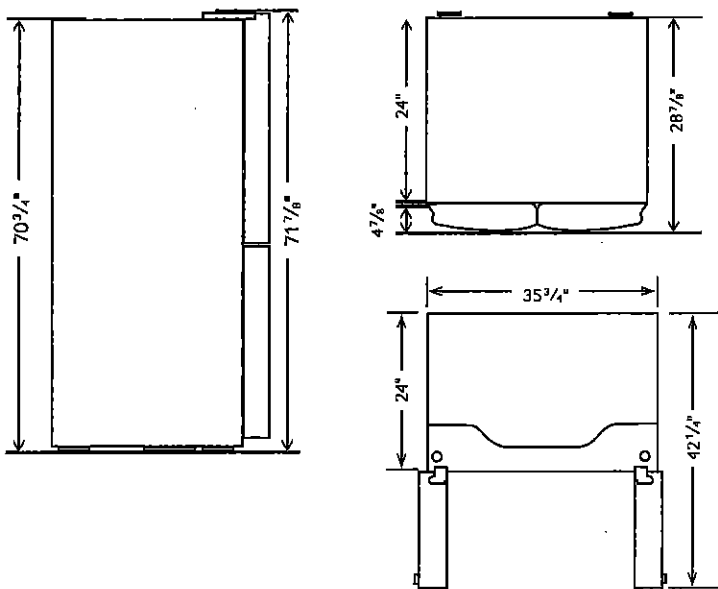

Total Capacity: 22 cu. ft.

Refrigerator: 13.2 cu. ft.

- Premium External Filtered Water and Ice Dispenser (Crushed or Cubed Ice)
- Ice Master Ice Maker
- 2 Humidity-Controlled Crispers
- Gallon Door Bins
- 5 Tempered Glass Spill-Proof Shelves
 - 1 Slide-In
 - 1 Flip-Up
 - 3 Fixed
- Wine Rack
- High-Efficiency LED Lighting

FlexZone™: 4.4 cu. ft.

- 1 EZ Slide-Out Shelf
- 2 Drawers
- 5 Temperature Zones:
 - 41°F
 - 35°F
 - 30°F
 - 23°F
 - -8°F – 5°F
- High-Efficiency LED Lighting

Freezer: 4.4 cu. ft.

- 1 EZ Slide-Out Shelf
- 2 Freezer Drawers
- High-Efficiency LED Lighting

Warranty

One (1) Year Parts and Labor on Refrigerator
Five (5) Years Parts and Labor on Sealed Refrigeration System Only*
Ten (10) Years Parts and Five (5) Years Labor on Digital Inverter Compressor

*Compressor, evaporator, condenser, drier and connecting tubing.

Product Dimensions & Weight

Dimensions (WxHxD with hinges, handles and doors):
35 3/4" x 71 7/8" x 28 7/8"

Dimensions (WxHxD without hinges and door):
35 3/4" x 70 3/4" x 24"

Dimensions (WxHxD with hinge and door, no handle):
35 3/4" x 71 7/8" x 28 7/8"

Weight: 350.5 lbs.

Shipping Dimensions & Weight (WxHxD)

Dimensions: 38 5/16" x 78" x 31 5/16"

Weight: 374.7 lbs.

Color	Model #	UPC Code
Stainless Steel	RF22M9581SR	887276197999
Black Stainless Steel	RF22M9581SG	887276197982

Actual color may vary. Design, specifications, and color availability are subject to change without notice. Non-metric weights and measurements are approximate.
©2018 Samsung Electronics America, Inc. 85 Challenger Road, Ridgefield Park, NJ 07660. Tel: 800-SAMSUNG. samsung.com. Samsung is a registered trademark of Samsung Electronics Co., Ltd.

AT

UK-75 WALLACETON
LOT 201
27-2587 CRN ELEV B
THE MAXWELL

31 of 36

NA30N7755TS

SAMSUNG

30" Gas Cooktop

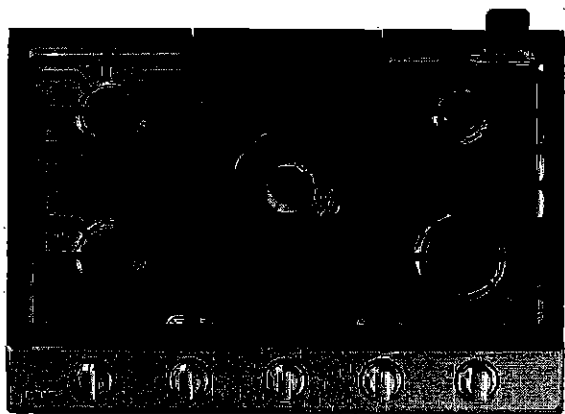

Signature Features

22K True Dual-Power Burner

- Two independent heating burners offer intense heat and precise control to quickly boil water or temper chocolate.

Analog Controls with Digital Wi-Fi and Bluetooth® Technology

- The ultimate combination of analog comfort and digital technology delivers exceptional cooking performance.

Cast Iron Griddle

- Cook breakfast, grill sandwiches, or sauté vegetables on the removable griddle.

Available Colors



Stainless Steel (shown)



Fingerprint Resistant
Black Stainless Steel



22K True Dual-Power Burner

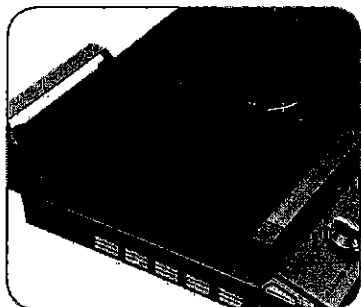

Cast Iron Griddle

Features

- Bluetooth® Connected to Hood
- Blue LED Lights
- Wi-Fi Connectivity
- Powerful Cooktop
 - Right Front: 13K BTU
 - Left Front: 9.5K BTU
 - Right Rear: 5K BTU
 - Left Rear: 9.5K BTU
 - Center: True Dual, 22K BTU (Brass)

- Cast Iron 3-Piece Grates
- Sealed Burners
- Burner On/Off Monitoring
- ADA Compliant

Convenience

- Wok Grate
- LP Conversion Kit



ADA Compliant

AT

UK-75 WALLACETON
LOT 201
27-2587 CRN ELEV B
THE MAXWELL

32 of 36

NA30N7755TS

30" Gas Cooktop

SAMSUNG

Installation Requirements

Countertop cut-out and minimum clearance dimensions:

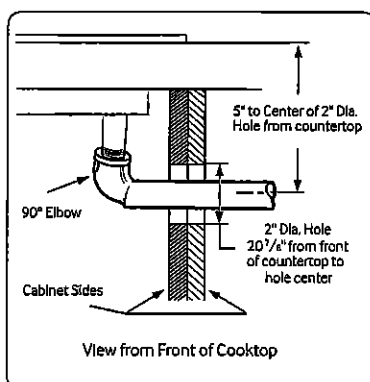
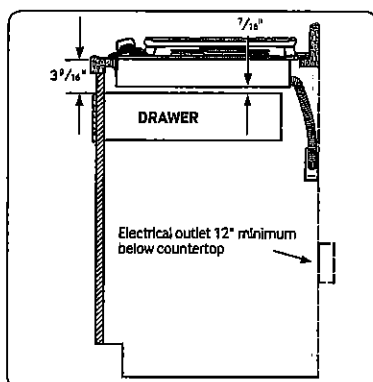
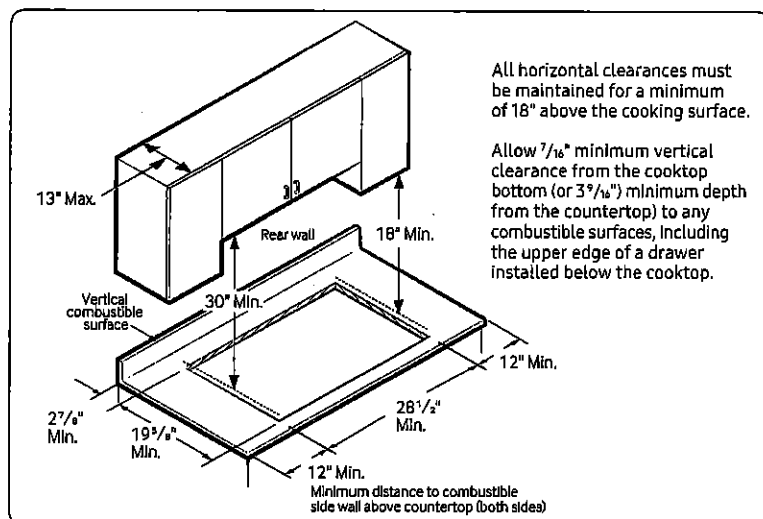
**Total Power (BTU)**

59K

Power Source

120V / 60 Hz / 1A

Gas Cooktop (BTU)

- Right Front: 13K
- Left Front: 9.5K
- Right Rear: 5K Simmer
- Left Rear: 9.5K
- Center: 22K (True Dual)

Warranty

One (1) Year All Parts and Labor

Product Dimensions & Weight (WxHxD)

Outside (Max) Cooktop Dimensions:

30" x 5⁴¹/₇₂" x 22¹/₃"

Cooktop Cut-Out Dimensions:

28¹/₂" x 3¹/₈" x 19⁵/₈"

Weight: 75.8 lbs. (76.3 lbs. Fingerprint Resistant Black Stainless Steel)

Shipping Dimensions & Weight (WxHxD)

Dimensions: 34^{11/16"} x 10^{5/8"} x 25^{5/8"}

Weight: 84.0 lbs. (84.9 lbs. Fingerprint Resistant Black Stainless Steel)

Color

Stainless Steel

Model #

NA30N7755TS

UPC Code

887276281704

Fingerprint Resistant

Black Stainless Steel NA30N7755TG 887276281698

Installing Over a Single Oven

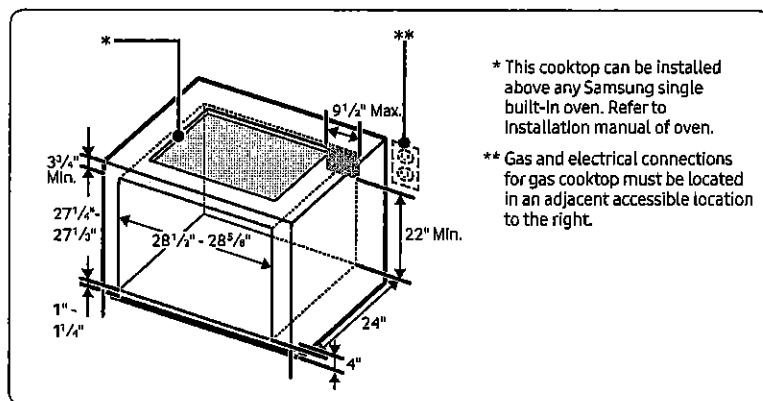

Cooktop Dimensions

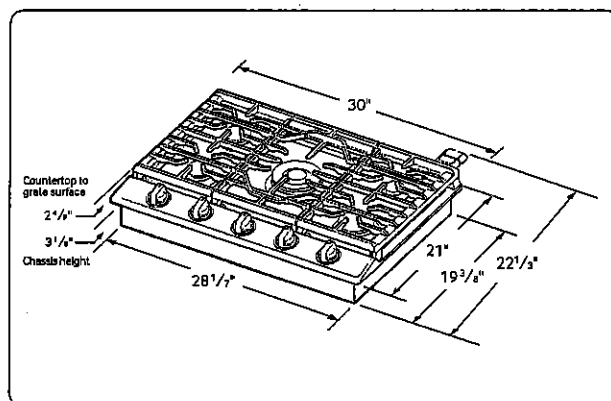

A

UK-75 WALLACETON
LOT 201
27-2587 CRN ELEV B
THE MAXWELL

33 of 36

NQ70M7770DS

SAMSUNG

30" Microwave Combination Wall Oven

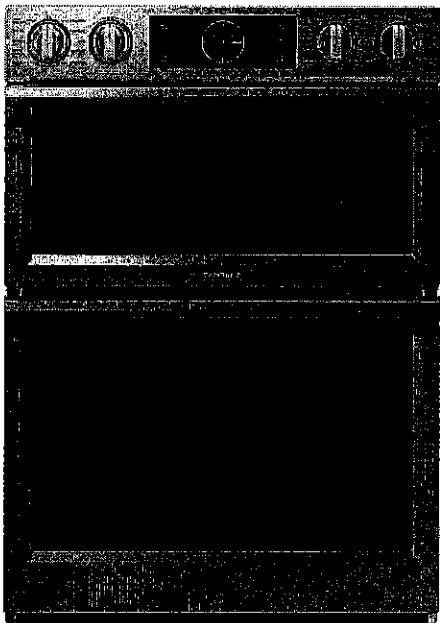

Signature Features

Steam Cook (Oven)

- Delivers moisture at precise times for a crisp, browned outside and tender inside.

Speed Cook (Microwave)

- Cook food faster and more evenly by using power convection.

Flex Duo™ (Oven)

- Cook two dishes at different temperatures simultaneously with the Smart Divider.

Available Colors



Stainless Steel (shown)



Black Stainless Steel

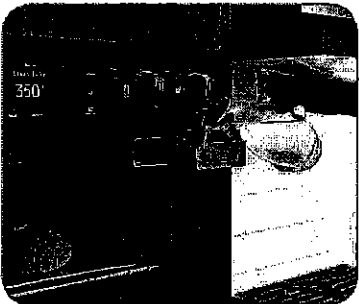

Steam Cook

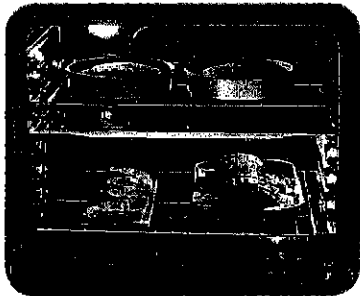

Flex Duo™

Features

- Digital-Analog Controls
- 1.9/5.1 cu. ft. Capacity
- Hybrid Clean and Self-Clean (Oven)
- Gourmet Cook (Oven)
- Dual Convection (Oven)
- Wi-Fi Connectivity
- Wi-Fi Enabled Temperature Probe (Oven)
- LED Spotlights (Oven)
- Easy View Window
- 3 Heavy-Duty Racks including a Gliding Rack (Oven)
- Soft-Close Door (Oven)
- Ceramic Plate (Microwave)
- Rapid Preheat (Oven)
- Auto Latch Microwave Door
- 6 Oven Modes including Steam Bake and Steam Roast
- Blue LED Illuminated Knobs
- Broil Element
- Smart Control Key (Oven)
- 6 Rack Positions (Oven)
- Drop-Down Door Design
- LCD Display

Convenience

- Hidden Heating Element (Oven)
- Sabbath Mode (Oven)
- Delay Start (Oven)
- Proofing (Oven)
- Warming Mode (Oven)
- Kitchen Timer
- Child Safety Lock
- Convection Conversion

AT

UK-75 WALLACETON
LOT 201
27-2587 CRN ELEV B
THE MAXWELL

34 of 36

NQ70M7770DS

SAMSUNG

30" Microwave Combination Wall Oven

Cabinet Dimensions

Combination Oven Installed in Cabinet

* Junction Box

**Allow a minimum of 22" for clearance to adjacent corners, drawers, walls, etc. when door is open.

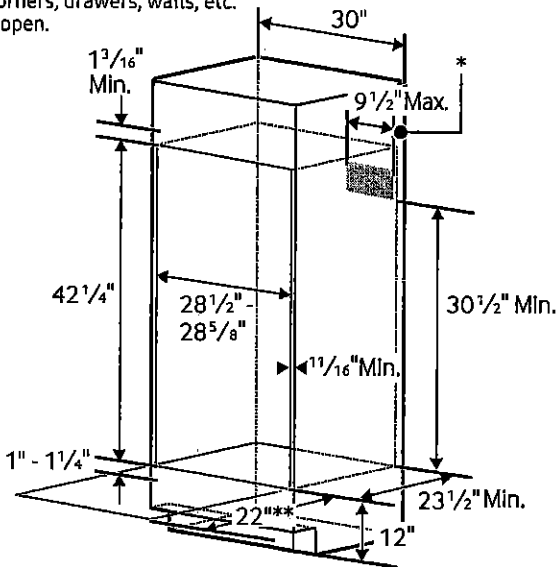

Product Dimensions

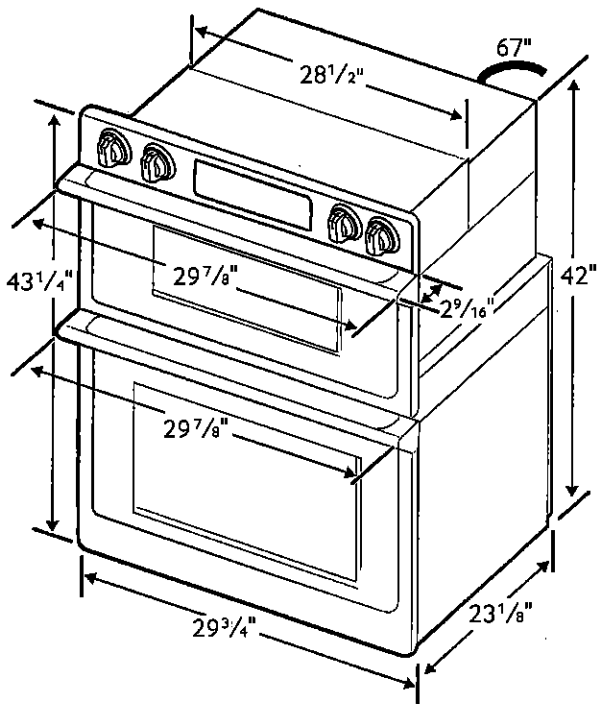

Total Capacity: 1.9/5.1 cu. ft.

- Microwave: 1.9 cu. ft.
- Wall Oven: 5.1 cu. ft. total, 2.8/2.2 cu. ft.
- Hidden Bake Element
- Bake: 175°F–550°F
- Convection Bake: 175°F–550°F
- Convection Roast: 175°F–550°F
- Broil: Low-High
- Steam Bake: 230°F–550°F
- Steam Roast: 230°F–550°F
- Proofing
- Sabbath Mode

Warranty

One (1) Year All Parts and Labor
Ten (10) Years Parts Warranty for Magnetron

Product Dimensions & Weight (WxHxD)

Outside (Max) Combination Oven Dimensions:
29 7/8" x 43 1/4" x 25 11/16"

Combination Oven Cut-Out Dimensions:
28 1/2" x 42 1/4" x 23 1/2"

Weight: 262.4 lbs.

Shipping Dimensions & Weight (WxHxD)

Dimensions:
33 5/8" x 48 3/16" x 29 51/64"

Weight: 291.1 lbs.

Color

Stainless Steel
Black Stainless Steel

Model #

NQ70M7770DS
NQ70M7770DG

UPC Code

887276195186
887276195162

RATING	
240V	9.5 kW
208V	7.2 kW
BREAKER SIZE	
240V	40 Amps
208V	40 Amps

AT

UK-75 WALLACETON
LOT 201
27-2587 CRN ELEV B
THE MAXWELL

35 of

DW80R9950

SAMSUNG

Samsung Linear Wash 39 dBA Dishwasher

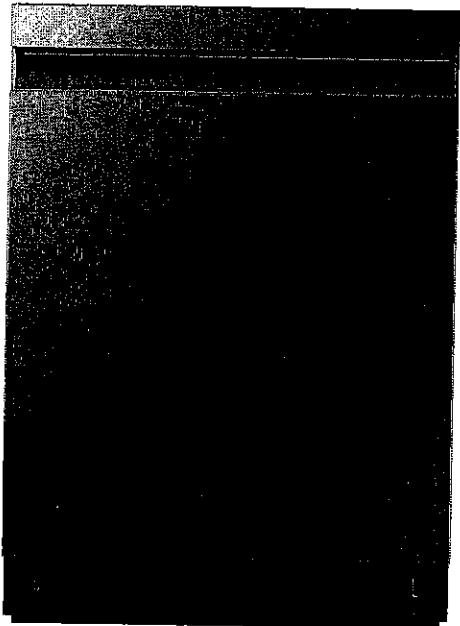

Signature Features

Linear Wash System

- AquaBlast™ jets provide corner to corner coverage for superior cleaning.

Whisper Quiet Cleaning

- Less noise and less disturbance with virtually silent wash cycles at 39 dBA.

AutoRelease™ Door

- At the end of a cycle, the door automatically opens to circulate air and improve drying performance.

Available Colors



Fingerprint Resistant
Stainless Steel (shown)



Fingerprint Resistant
Black Stainless Steel



Fingerprint Resistant
Tuscan Stainless Steel

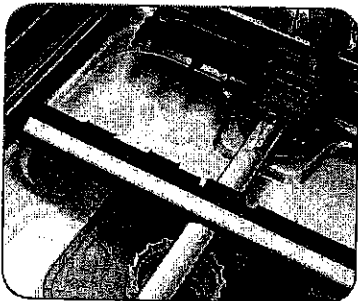

Linear Wash System

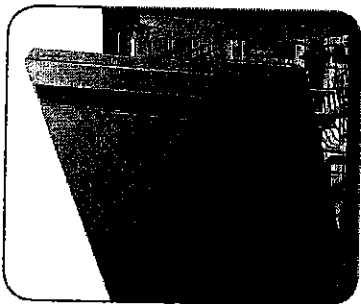

AutoRelease™ Door

Features

- Flexible 3rd Rack
- Fingerprint Resistant Stainless Finish
- Zone Booster™
- Touch Control
- Quiet Operation: 39 dBA
- Wi-Fi Connectivity
- 7 Wash Cycles
- 8 Options
- Half-Load Cycle
- Express Cycle: 60 Minutes
- One-Touch Adjustable Racking System
- Full Stainless Steel Interior
- 15 Place Settings
- 3 Spray Wash Arms
(Upper, Middle, Lower)

Convenience

- LED Time Display
- Control Lock
- Delay Start
- Digital Leak Sensor

Rating

ENERGY STAR®-rated:
239 kWh/yr

AT

UK-75 WALLACETON
LOT 201
27-2587 CRN ELEV B
THE MAXWELL

36 of 36

DW80R9950

SAMSUNG

Samsung Linear Wash 39 dBA Dishwasher

Installation Specifications

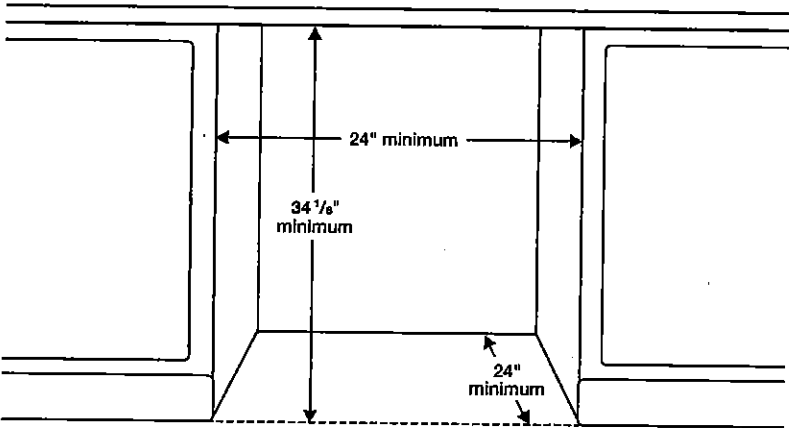

Features

- 7 Wash Cycles: Auto, Normal, Heavy, Delicate, Express 60, Rinse Only, Self Clean
- 8 Options: Half-Load Wash (Lower Rack), Zone Booster™ (Left), Speed Booster, Hi-Temp Wash, Sanitize (Anti-bacterial – NSF), Delay Start, Control Lock, Smart Control (Wi-Fi App)
- AutoRelease™ Door
- Hidden Heat Element
- Stainless Steel Interior Tub

Convenience

- Control Lock
- Digital Water Leakage Sensor
- Flexible Third Rack
- One-Touch Adjustable Racking System
- Silverware Basket
- Upper Rack: Foldable Cup Shelves, 2 Adjustable Tines
- Lower Rack: Fold-Down Tines

Warranty

One (1) Year All Parts and Labor
Five (5) Year Limited on Printed Circuit Board and Interior Nylon Racks

Dimensions

Side View

Rear View

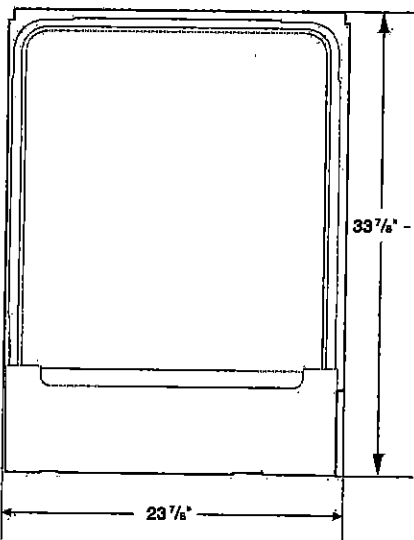
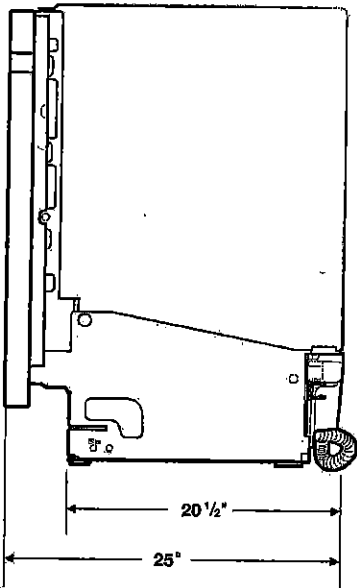

Product Dimensions & Weight (WxHxD)

Dimensions (height is adjustable):
23 7/8" x 33 7/8" – 35" x 25"

Weight: 95 lbs

Shipping Dimensions & Weight (WxHxD)

Dimensions:
26" x 34 3/4" x 29 3/4"

Weight: 101 lbs

Color	Model #	UPC Code
Fingerprint Resistant Stainless Steel	DW80R9950US	887276296647
Fingerprint Resistant Black Stainless Steel	DW80R9950UG	887276296623
Fingerprint Resistant Tuscan Stainless Steel	DW80R9950UT	887276320137

AT