

PRE-Sales Selection Sheet  
Checklist

1 of 25

LOT 284C-15 Model: 20-1606 A The Grassfield

PURCHASERS: NAVNEET KUMAR/KIRTI NAGPAL

VENDOR: Heathwood Homes (Huron) Limited

- ☒ FINISHED BASEMENT  
☐ COLD CELLAR

UPGRADED / MODIFIED ELEVATION

- ☐ CORNER UPGRADE  
☐ REAR UPGRADE

CEILING UPGRADE - SMOOTH

- ☐ MAIN FLOOR  
☐ SECOND FLOOR  
☐ BASEMENT

ADDITIONAL ROUGH-INS

- ☐ 200 AMP SERVICE  
☐ WET BAR ROUGH-IN  
☐ HUMIDIFIER  
☒ AIR CONDITIONING

GAS ROUGH-IN

- ☒ STOVE  
☐ DRYER  
☐ BBQ  
☐ ADDITIONAL FIREPLACE

KITCHEN: HOODFAN VENTING SIZE

- ☒ 6 IN ROUND DUCT  
☐ 7 IN ROUND DUCT

FULL BASEMENT STAIRS:  
UPPER BASEMENT STAIRS:  
LOWER BASEMENT STAIRS:  
MAIN STAIRS:  
MEDIA STAIRS (if applicable):  
LOFT STAIRS (if applicable):

N/A  
All Oak  
Carpet Grade  
All Oak  
N/A  
N/A

20 Oct, 2020 Kirti  
Date Purchaser:

OCT 20, 2020  
Date Decor Consultant:

OCT 20, 2020 Navneet Kumar  
Date Purchaser:

- APPROVED -

-10- 29 2020

Date  
Approved

Heathwood Homes (Huron) Limited

Locked Date:



Sales Selection Sheet

Wallaceton

' SCHEDULE E '

2 of 25

PURCHASERS: NAVNEET KUMAR and KIRTI NAGPAL

TEL:

LOT / UNIT	PHASE	MODEL	
284C-15	2	20-1606 A The Grassfield	

It is herein understood and agreed between the undersigned parties hereto that the following changes shall be made to the above mentioned Agreement of Purchase and Sale in accordance with the agreement and except for such changes noted below, all other terms and conditions in the Agreement of Purchase and Sale shall remain as stated herein: It is further understood that and agreed that all changes and additions shall be installed as per builder's specifications, location and available selections. The Purchaser hereby agrees to purchase the following extras:

MISC.

1	SCHEDULE E- FIVE THOUSAND DOLLARS (\$5,000.00) - TOWNHOMES AS PER AMENDMENT TO SCHEDULE E DATED OCTOBER 20, 2020	Qty: 1	
40,548	Note:		

Sub Total

HST

Total

1. This Sales Selection Sheet when properly executed forms part of our Agreement of Purchase and Sale.
2. All extras and upgrades listed above are subject to Construction Progress and Architectural and Municipal requirements.
3. In the event the Vendor is unable to incorporate the work approved above in the construction of the house for any reason whatsoever, the Vendor will not be liable to the Purchaser in any way. The monies paid for any changes or optional extras not proceeded with shall be returned to the Purchaser, without interest. The cost of options or extras is non-refundable in all other circumstances. If for any reason whatsoever the Agreement of Purchase and Sale is not completed, the total cost of work approved above will be retained by the Vendor.
4. The Vendor reserves the right to substitute above materials and equipment with that of equal or better quality.
5. Purchaser acknowledges that items may not be exactly as shown. Variations from the Vendor's samples may occur in finished materials due to normal production processes. Vendor is not responsible for shade difference which may occur from different dye lots or wood grains. Variations from the Vendor's samples will occur with natural materials such as wood, marble, granite, hardwood and brick.
6. The Vendor reserves the right to select Grout & Thresholds that best suits the Tile selected.
7. Selections will not be processed unless signed by Heathwood Homes Head Office.
8. The selections made on this schedule are final and cannot be changed once submitted.
9. The Purchaser has checked and acknowledges the accuracy of this schedule.

Payment Summary

Paid By Amount

Total Payment:

PURCHASER:

NAVNEET KUMAR

26-Oct-20

DATE

IRIT SALEM

Decor Consultant

26-Oct-20

DATE

PURCHASER:

KIRTI NAGPAL

26-Oct-20

DATE

- APPROVED -

-10- 29 2020

Date Approved Heathwood Homes (Huron) Limited

TAX#:1

PREPARED BY: Irit Salem

PE 557-1

SInvoice.rpt 28may19

Customer Colours

3 of 25

NAVNEET KUMAR/KIRTI NAGPAL  
Project: Wallaceton  
Unit: 284C-15, Phase: 2  
Model: 20-1606 A The Grassfield

Created: 10/9/2020 15:53:54  
Locked:  
Closed:

Kitchen

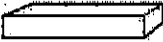
Cabinet Colour/Style	9111	VIKING III SIMCOE ORCHID 3DL ***STD***
Countertop	9069	MSI Quartz GROUP 1 ICED WHITE ***STD***
Countertop Edge	4010	SINGLE POLISHED STRAIGHT EDGE 3/4 INCH ***STD*** 
Cabinet Hardware	7667	12881-HARDWARE ***STD***
Island Cabinet Colour/Style	9111	VIKING III SIMCOE ORCHID 3DL ***STD***
Island Countertop	9069	MSI Quartz GROUP 1 ICED WHITE ***STD***
Backsplash	1111	N/A *****
Backsplash Grout	1111	N/A *****
Backsplash Tile Pattern	1111	N/A *****

HoodFan	8909	KVWB600DSS-KITCHEN AID 30 inch STAINLESS CHIMNEY HOOD-STAINLESS STEEL-30 inch ***Upg*** PAGE 22
Appliance	8909	Purchasers have been advised: standard fridge opening is a minimum 37 3/8 x 73 3/8". Ice Waterline Rough-In is included.
Appliance	8909	Standard stove opening is 30" and standard dishwasher opening is 24". Any gas stove will require backsplash or stainless steel backing to avoid fire hazards.
Appliance	8909	Purchasers acknowledge: Heathwood Homes and its contractors will not be responsible for any kitchen cabinet changes due to appliances dimension changes after
Comment		

Kitchen/Breakfast

Flooring	9106	GE.MD.WHT.1818.MT Madison Series White Matte 18
Floor Tile Grout	2225	Grout-(27) Silver ***STD***
Floor Tile Pattern	3000	STANDARD SQUARE ***STD***

Kr  
M

NAVNEET KUMAR/KIRTI NAGPAL  
Project: Wallaceton  
Unit: 284C-15, Phase: 2  
Model: 20-1606 A The Grassfield

Created: 10/9/2020 15:53:54  
Locked:  
Closed:

4 of 25

Comment

Foyer

Flooring

9106

GE.MD.WHT.1818.MT Madison Series White Matte 18

Floor Tile Grout

2225

Grout-(27) Silver \*\*\*STD\*\*\*

Floor Tile Pattern

3000

STANDARD SQUARE \*\*\*STD\*\*\*

Comment

Laundry Room

Flooring

8627

TR.AD.BLK.1313-Andes-Black-13 x 13 \*\*\*STD\*\*\*

Floor Tile Grout

7704

Grout-(19) Pearl Gray \*\*\*STD\*\*\*

Floor Tile Pattern

3000

STANDARD SQUARE \*\*\*STD\*\*\*

Comment

Mud Room

Flooring

9106

GE.MD.WHT.1818.MT Madison Series White Matte 18

Floor Tile Grout

2225

Grout-(27) Silver \*\*\*STD\*\*\*

Floor Tile Pattern

3000

STANDARD SQUARE \*\*\*STD\*\*\*

Comment

KW  
MR

NAVNEET KUMAR/KIRTI NAGPAL  
Project: Wallaceon  
Unit: 284C-15, Phase: 2  
Model: 20-1606 A The Grassfield

Created: 10/9/2020 15:53:54  
Locked:  
Closed:

5 OF 25

Powder Room

Flooring	9103	GE.MD.LGR.1818.MT Madison Series Light Grey Matte 18
Floor Tile Grout	2225	Grout-(27) Silver ***STD***
Floor Tile Pattern	3000	STANDARD SQUARE ***STD***

Plumbing Fixture (Colour)	1737	Plumbing Fixtures-WHITE ***STD***
Comment		

Hall

Flooring	9106	GE.MD.WHT.1818.MT Madison Series White Matte 18
Grout	2225	Grout-(27) Silver ***STD***
Floor Tile Pattern	3000	STANDARD SQUARE ***STD***

Comment		
---------	--	--

Great Room

Flooring	7498	Red Oak Pearl-Vintage Engineered-IRONGATE-3/4 inch x 3 1/4 inch ***STD***
Comment		

Upper Hall

Flooring	9248	DY 89418 -Dynasty Tex-BLACK ICE-40 oz Poly***STD***
Comment		

KW  
HK

NAVNEET KUMAR/KIRTI NAGPAL  
Project: Wallaceton  
Unit: 284C-15, Phase: 2  
Model: 20-1606 A The Grassfield

Created: 10/9/2020 15:53:54  
Locked:  
Closed:

6 of 25

Finished Basement (Rec) Room/Hall

Flooring	9248	DY 89418 -Dynasty Tex-BLACK ICE-40 oz Poly***STD***
Comment		

Master Bedroom

Flooring	9248	DY 89418 -Dynasty Tex-BLACK ICE-40 oz Poly***STD***
Comment		

Bedroom 2

Flooring	9248	DY 89418 -Dynasty Tex-BLACK ICE-40 oz Poly***STD***
Comment		

Bedroom 3

Flooring	9248	DY 89418 -Dynasty Tex-BLACK ICE-40 oz Poly***STD***
Comment		

Master Ensuite

Cabinet Colour/Style	9111	VIKING III SIMCOE ORCHID 3DL ***STD***
Countertop	8827	4925K-07-Countertop-CALCUTTA MARBLE-Wilsonart ***STD***
Countertop Edge	1111	N/A *****
Cabinet Hardware	7667	12881-HARDWARE ***STD***
Floor Tile	8627	TR.AD.BLK.1313-Andes-Black-13 x 13 ***STD***
Floor Tile Grout	7704	Grout-(19) Pearl Gray ***STD***

KN  
14

NAVNEET KUMAR/KIRTI NAGPAL  
Project: Wallaceton  
Unit: 284C-15, Phase: 2  
Model: 20-1606 A The Grassfield

Created: 10/9/2020 15:53:54  
Locked:  
Closed:

7 of 25

Floor Tile Pattern	3000	STANDARD SQUARE ***STD***
Shower Floor Tile	8661	OD.ON.SWT.0202.MT.N-Ontario Series Mosaic-Snow White Matte-2 x 2 ***STD***
Shower Floor Tile Grout	2226	Grout-(00) White ***STD***
Shower Floor Tile Pattern	3000	STANDARD SQUARE ***STD***
Shower Wall Tile	9020	QT.WV.WHT.0810-Weave-White-8 x 10 ***STD***
Shower Wall Tile Grout	2226	Grout-(00) White ***STD***
Shower Wall Tile Pattern	3090	VERTICAL STACKED ***STD*** <div><div></div><div></div><div></div><div></div><div></div><div></div><div></div><div></div></div>
Shower Jamb(s) and Sill(s)	8923	Shower Jamb / Sill-Thassos White ***STD***
Plumbing Fixture (colour)	1737	Plumbing Fixtures-WHITE ***STD***
Comment		

Main Bathroom

Cabinet Colour/Style	9111	VIKING III SIMCOE ORCHID 3DL ***STD***
Countertop	8822	4924-38-Countertop-WHITE CARRARA-Wilsonart ***STD***
Countertop Edge	1111	N/A *****
Cabinet Hardware	7667	12881-HARDWARE ***STD***
Flooring	8627	TR.AD.BLK.1313-Andes-Black-13 x 13 ***STD***
Floor Tile Grout	7704	Grout-(19) Pearl Gray ***STD***
Floor Tile Pattern	3000	STANDARD SQUARE ***STD***

12/11

NAVNEET KUMAR/KIRTI NAGPAL  
Project: Wallaceon  
Unit: 284C-15, Phase: 2  
Model: 20-1606 A The Grassfield

Created: 10/9/2020 15:53:54  
Locked:  
Closed:

8 of 25

Wall Tile	9020	QT.WV.WHT.0810-Weave-White-8 x 10 ***STD***								
Wall Tile Grout	2226	Grout-(00) White ***STD***								
Main Bathroom Tile Pattern	3090	VERTICAL STACKED ***STD*** <table><tr><td></td><td></td><td></td><td></td></tr><tr><td></td><td></td><td></td><td></td></tr></table>								
Plumbing Fixture (Colour)	1737	Plumbing Fixtures-WHITE ***STD***								
Comment										

Finished Basement Bathroom

Cabinet Colour/Style	9111	VIKING III SIMCOE ORCHID 3DL ***STD***
Countertop	8826	4926K-07-Countertop-BLACK ALICANTE-Wilsonart ***STD***
Countertop Edge	1111	N/A *****
Cabinet Hardware	7667	12881-HARDWARE ***STD***
Flooring	9071	GE.BY.AZR.1313 New Byzantine Azzuro 13
Floor Tile Grout	2225	Grout-(27) Silver ***STD***
Floor Tile Pattern	3000	STANDARD SQUARE ***STD***
Shower Floor Tile	8661	OD.ON.SWT.0202.MT.N-Ontario Series Mosaic-Snow White Matte-2 x 2 ***STD***
Shower Floor Tile Grout	2226	Grout-(00) White ***STD***
Shower Floor Tile Pattern	3000	STANDARD SQUARE ***STD***
Shower Wall Tile	9020	QT.WV.WHT.0810-Weave-White-8 x 10 ***STD***

KN  
N/A



NAVNEET KUMAR/KIRTI NAGPAL  
Project: Wallaceton  
Unit: 284C-15, Phase: 2  
Model: 20-1606 A The Grassfield

Created: 10/9/2020 15:53:54  
Locked:  
Closed:

9.25

Shower Wall Tile Grout	2226	Grout-(00) White ***STD***								
Shower Wall Tile Pattern	3090	VERTICAL STACKED ***STD*** <table><tr><td></td><td></td><td></td><td></td></tr><tr><td></td><td></td><td></td><td></td></tr></table>								
Shower Jamb(s)	8923	Shower Jamb / Sill-Thassos White ***STD***								
Plumbing Fixture (Colour)	1737	Plumbing Fixtures-WHITE ***STD***								
Comment										

Great Room Fireplace

Type	8865	Dimplex-Electric Fireplace-PF3033HL ***STD***
Mantle	8891	NF-17-Paint Grade Mantle- Cabinet (Per Plan)-WHITE ***STD*** PAGE 18
Surround Opt.	1111	N/A *****
Note	1111	Purchasers have been advised: heat from the FP can damage TV above a FP and items placed on mantle.
Note	1111	Heathwood and its contractors will not be liable for any damage on items placed/installed above a FP after closing.
Comment		

Basement Stairs

Type	1714	Carpet Grade Stairs ***STD BASEMENT STAIRS***
Colour	7912	Irongate (Gryphon) STAIN TO COMPLIMENT HARDWOOD AND WILL VARY FROM FLOORING
Carpet Runner	1111	N/A *****
Handrail/Pickets/Post Type	9119	Handrail only on closed walls (one or two sides per building code) ***STD***
Handrail/Pickets/Post Colours	1729	Carpet Grade-Stain handrail, pickets, stringers, nosing_pos
Carpet	9248	DY 89418 -Dynasty Tex-BLACK ICE-40 oz Poly***STD***
Custom Stain/Paint	1111	N/A *****

Comment		
---------	--	--

KW  
MK

NAVNEET KUMAR/KIRTI NAGPAL  
Project: Wallaceton  
Unit: 284C-15, Phase: 2  
Model: 20-1606 A The Grassfield

Created: 10/9/2020 15:53:54  
Locked:  
Closed:

10 of 25

Comment

Basement Stairs Landings (Upper and Lower)

Flooring

7498

Red Oak Pearl-Vintage Engineered-IRONGATE-3/4 inch x 3 1/4 inch \*\*\*3\*\*\*

Comment

Main Stairs

Type

1712

Oak Stairs \*\*\*STD MAIN STAIRS\*\*\*

Colour

7912

Irongate (Gryphon) STAIN TO COMPLIMENT HARDWOOD AND WILL VARY FROM FLOORING

Carpet Runner

1111

N/A \*\*\*\*\*

Handrail/Pickets/Posts Type

7652

1 5/16 inch Square pickets with 3 1/2" Square/Cap Post(s)-ALL OAK \*\*\*STD\*\*\*

Handrail/Pickets/Posts Colour

1728

Oak Grade-Stain handrail,oak pickets,stringers,treads,risers

Custom Stain/Paint

1111

N/A \*\*\*\*\*

Comment

Main Stairs Landing(s)

Flooring

7498

Red Oak Pearl-Vintage Engineered-IRONGATE-3/4 inch x 3 1/4 inch \*\*\*STD\*\*\*

Comment

Throughout

Walls - Paint Colour

1717

22-Wall-WARM GREY \*\*\*STD\*\*\*

Underpad

1079

500 Series-Underpad \*\*\*STD\*\*\*

Thresholds

2232

Metal Thresholds \*\*\*STD\*\*\*

Switches and Plug

5796

Decora White Switches and Plugs \*\*\*STD\*\*\*

Trim Size

8705

4 1/4 Baseboard and 2 3/4 Casings \*\*\*STD\*\*\*

Trim Paint Colour

1717

22-Wall-WARM GREY \*\*\*STD\*\*\*

KN  
MT

NAVNEET KUMAR/KIRTI NAGPAL  
Project: Wallace-ton  
Unit: 284C-15, Phase: 2  
Model: 20-1606 A The Grassfield

Created: 10/9/2020 15:53:54  
Locked:  
Closed:

11 OF 25

Trim - Paint Colour		1716	Trim-WHITE ***STD***
Comment	9071		

Purchaser:	<u>Nav Kumar</u>	<u>Oct 20, 2020</u>	<u>[Signature]</u>	<u>Oct 20, 2020</u>
	NAVNEET KUMAR	Date	Decor Consultant	Date

Purchaser:	<u>Kirti</u>	<u>Oct 20, 2020</u>	<u>[Signature]</u>	<u>-10- 29 2020</u>
	KIRTI NAGPAL	Date	Wallaceton	Date Approved

APPROVED

KN  
MR



Sales Selection Sheet

Wallaceton

12 of 25

PURCHASERS: NAVNEET KUMAR and KIRTI NAGPAL

TEL:

LOT / UNIT	PHASE	MODEL	
284C-15	2	20-1606 A The Grassfield	

It is herein understood and agreed between the undersigned parties hereto that the following changes shall be made to the above mentioned Agreement of Purchase and Sale in accordance with the agreement and except for such changes noted below, all other terms and conditions in the Agreement of Purchase and Sale shall remain as stated herein: It is further understood that and agreed that all changes and additions shall be installed as per builder's specifications, location and available selections. The Purchaser hereby agrees to purchase the following extras:

APPLIANCES

1	HOOD FAN KVV 600 DSS KITCHENAID HOOD FAN 30"	Qty: 1
41,581	Note: PAGE 22	

Cabinetry

2	CABINETRY - 31H-WALL CABINET FOR BUILT-IN MICROWAVE/SMALL APPLIANCE WITH TRIM KIT (SUPPLY SPECS) - UPGRADE 1	Qty: 1
189,211	SPECS PAGES 23-25	
40,550	Note: SEE SKETCH B# 2 PAGE# 16	

CERAMICS

3	CERAMICS - FLOOR - FOYER - UPGRADE 1	Qty: 1
176,556		
41,585	Note:	
4	CERAMICS - FLOOR - KITCHEN - UPGRADE 1	Qty: 1
176,596		
41,586	Note:	
5	CERAMICS - FLOOR - MAIN HALL - UPGRADE 1	Qty: 1
176,572		
41,587	Note:	
6	CERAMICS - FLOOR - MUD ROOM - UPGRADE 1	Qty: 1
176,58C		
41,588	Note:	
7	CERAMICS - FLOOR - POWDER ROOM - UPGRADE 1	Qty: 1
176,564		
41,589	Note:	

Electrical

8	ELECTRICAL - EXTRA WALL INTERIOR OUTLET ON EXISTING CIRCUIT (DOES NOT INCLUDE KITCHEN OUTLETS)	Qty: 1
189,449		
40,543	Note: TO BE INSTALLED ABOVE THE CENTRE OF TEHFIRE PLACE 70" FROM FLOOR SEE SKETCH # 2 PAGE# 16	
9	ELECTRICAL - CEILING ROUGH-IN (CAPPED)	Qty: 2
189,45C		
40,544	Note: KITCHEN :ONE TO BE INSTALLED ABOVE THE BREAKFAST BAR - USE SEPARATE SWITCH GREAT ROOM: ONE TO BE INSTALLED IN TH ECENTRE OF THE ROOM- USE EXISTING WITCH PLUG SEE SKETCH # 2 PAGE# 16	

Initials: KM NM

TAX#:1

PREPARED BY: Irit Salem

PE 556-1

Sinvoice.rpt 28may19



Sales Selection Sheet

Wallaceton

13 of 25

PURCHASERS: NAVNEET KUMAR and KIRTI NAGPAL

TEL:

LOT / UNIT	PHASE	MODEL	
284C-15	2	20-1606 A The Grassfield	

Electrical

10 189,451	ELECTRICAL - ADDITIONAL SWITCH	Qty: 1
40,545	Note: KITCHEN- TO BE USED FOR THE R/I CAP LIGHT SEE SKETCH # 2 PAGE# 16	
11 189,44C	ELECTRICAL - EXTRA WALL INTERIOR OUTLET (120V/15A) ON A SEPARATE CIRCUIT (ON ARCFAULT)	Qty: 1
40,549	Note: KITCHEN TO BE USED FOR THE MICROWAVE SEE SKETCH # 2 PAGE# 16	

HEATING/AIR

12 189,474	HEATING/AIR - ROUGH-IN GAS LINE FOR GAS STOVE AT MAIN FLOOR (SEE SPECS) (HOOK-UP NOT INCLUDED) LEAVE STANDARD 120 VOLT ELECTRICAL OUTLET ON A SEPARATE CIRCUIT. * SPECIFY IF STANDARD 220V WILL STAY OR BE RELOCATED-	Qty: 1
41,582	Note: STANDARD 220 /240 WILL STAY	

MISC.

13 41,583	SCHEDULE E PROMO	Qty: (1)
	Note:	

Sub Total
HST
Total

1. This Sales Selection Sheet when properly executed forms part of our Agreement of Purchase and Sale.
2. All extras and upgrades listed above are subject to Construction Progress and Architectural and Municipal requirements.
3. In the event the Vendor is unable to incorporate the work approved above in the construction of the house for any reason whatsoever, the Vendor will not be liable to the Purchaser in any way. The monies paid for any changes or optional extras not proceeded with shall be returned to the Purchaser, without interest. The cost of options or extras is non-refundable in all other circumstances. If for any reason whatsoever the Agreement of Purchase and Sale is not completed, the total cost of work approved above will be retained by the Vendor.
4. The Vendor reserves the right to substitute above materials and equipment with that of equal or better quality.
5. Purchaser acknowledges that items may not be exactly as shown. Variations from the Vendor's samples may occur in finished materials due to normal production processes. Vendor is not responsible for shade difference which may occur from different dye lots or wood grains. Variations from the Vendor's samples will occur with natural materials such as wood, marble, granite, hardwood and brick.
6. The Vendor reserves the right to select Grout & Thresholds that best suits the Tile selected.
7. Selections will not be processed unless signed by Heathwood Homes Head Office.
8. The selections made on this schedule are final and cannot be changed once submitted.
9. The Purchaser has checked and acknowledges the accuracy of this schedule.

Payment Summary	
<u>Paid By</u>	<u>Amount</u>
Total Payment:	

Initials: KN NI

TAX#:1

PREPARED BY: Irit Salem

PE 556-2

Sinvoice.rpt 28may19



Sales Selection Sheet

Wallaceton

14 of 25

PURCHASERS: NAVNEET KUMAR and KIRTI NAGPAL

TEL:

LOT / UNIT 284C-15	PHASE 2	MODEL 20-1606 A The Grassfield	
-----------------------	------------	-----------------------------------	--

PURCHASER:

Nav Kumar  
NAVNEET KUMAR

20-Oct-20  
DATE

*[Signature]*  
Decor Consultant

20-Oct-20  
DATE

PURCHASER:

Kirti  
KIRTI NAGPAL

20-Oct-20  
DATE

**- APPROVED -**  
-10- 29 2020

*[Signature]*

Date Approved Heathwood Homes (Huron) Limited

TAX#:1

PREPARED BY: Irit Salem

PE 556-3

Slinvoice.rpt 28may19

UK-75 WALLACETON  
LOT 284C-15  
20-1606 ELEV A  
THE GRASSFIELD

15 of 25

THE GRASSFIELD

ELEVATION A | 1,986 SQ. FT.  
Includes 380 square feet of finished lower level

20-1606 ELEV. A

WALLACETON  
B.B.T. 1470

Sketch #1

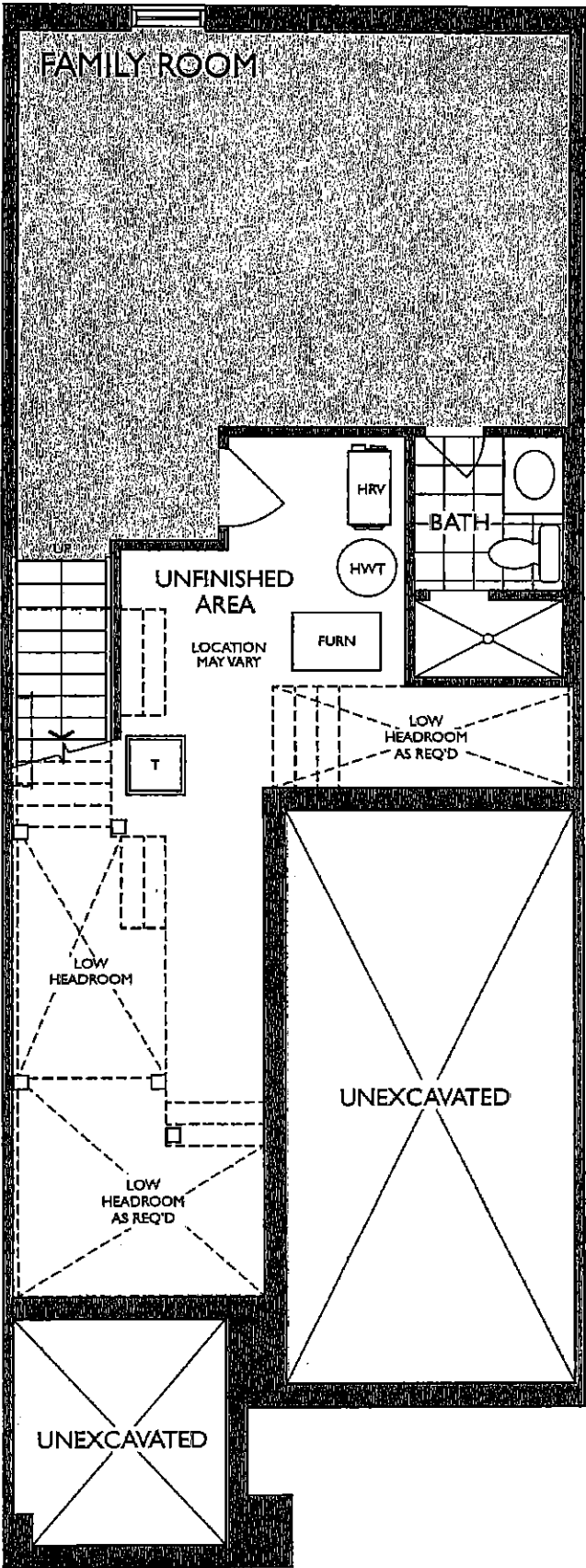

LOWER LEVEL  
ELEVATION A & B

14-  
kr

July 7, 2020

UK-75 WALLACETON  
LOT 284C-15  
20-1606 ELEV A  
THE GRASSFIELD

16 of 25

THE GRASSFIELD

ELEVATION A | 1,986 SQ. FT.

Includes 380 square feet of finished lower level

20-1606 ELEV. A

WALLACETON  
EST. 1870

Sketch # 2

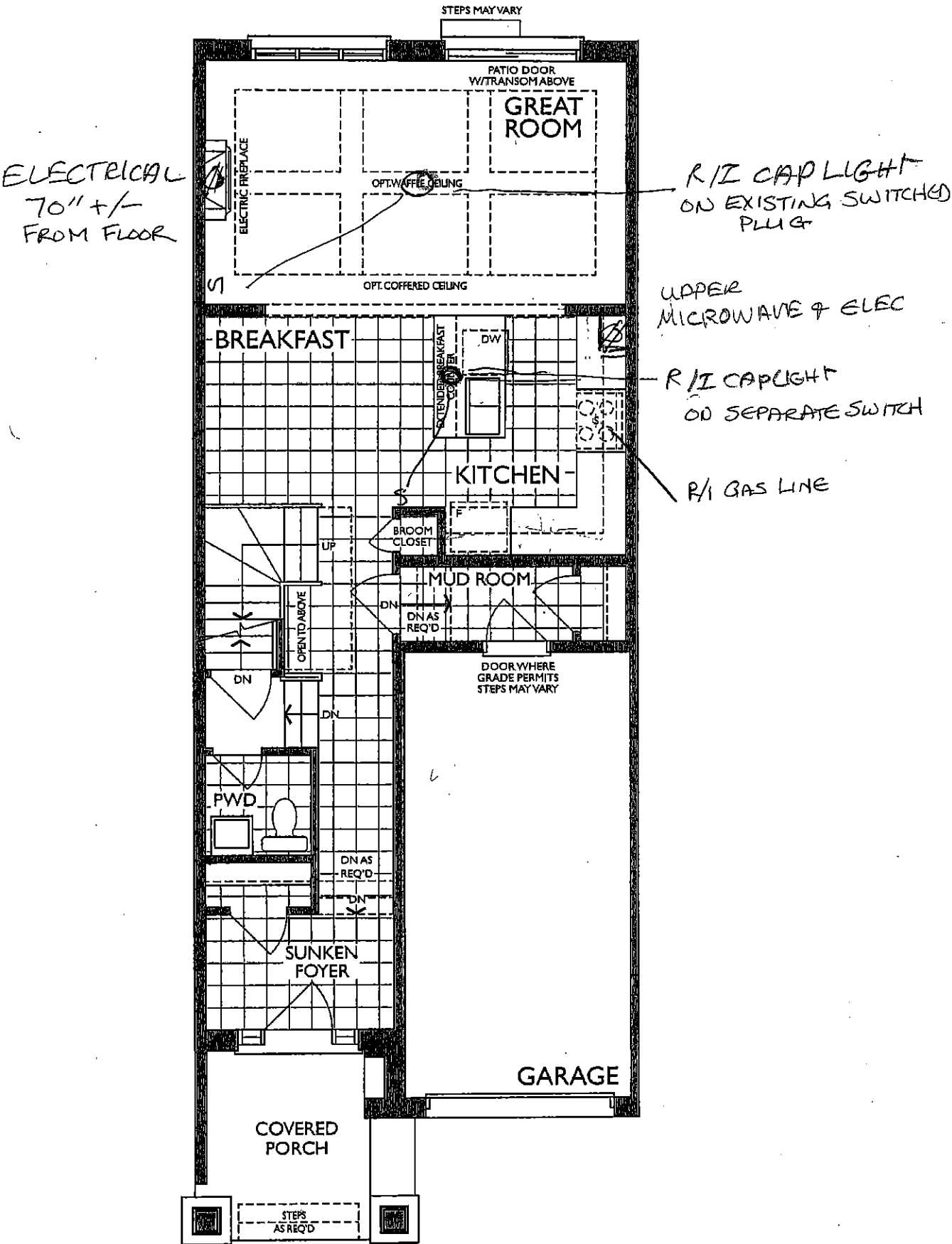

MAIN FLOOR  
ELEVATION A

N/C  
KN

July 7, 2020



UK-75 WALLACETON  
LOT 284C-15  
20-1606 ELEV A  
THE GRASSFIELD

17 of 25

THE GRASSFIELD

ELEVATION A | 1,986 SQ. FT.  
Includes 380 square feet of finished lower level

WALLACETON  
EST. 1870

20-1606 ELEV. A

Sketch #3

TILE PATTERN  
DIRECTION

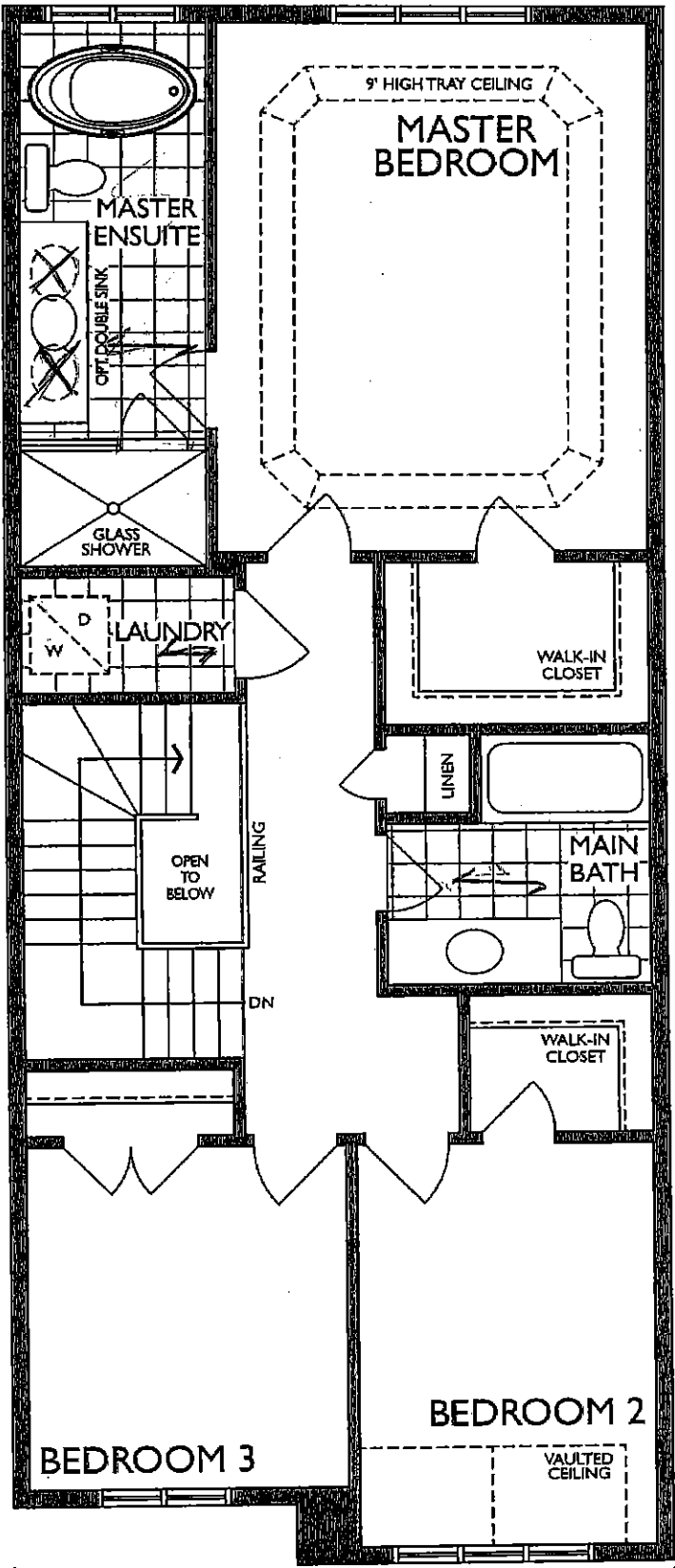

TILE PATTERN  
DIRECTION

SECOND FLOOR  
ELEVATION A

UK-75 WALLACETON  
LOT 284C-15  
20-1606 ELEV A  
THE GRASSFIELD

18 of 25



## STANDARD NF 15 Mantel

Clean apron finish with fluted legs

**WHITE PAINT GRADE FINISH**

(PICTURE SHOWN WITH UPGRADE SURROUND AND HEARTH -PRICED SEPARATELY)



'CABINET'

## STANDARD NF 17 Mantel

**WHITE PAINT GRADE FINISH**

(PICTURE SHOWN WITH UPGRADE SURROUND AND HEARTH -PRICED SEPARATELY)

22

UK-75 WALLACETON  
 LOT 284C-15  
 20-1606 ELEV A  
 THE GRASSFIELD

19 of 25

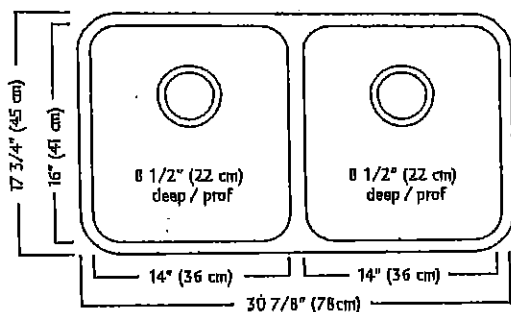
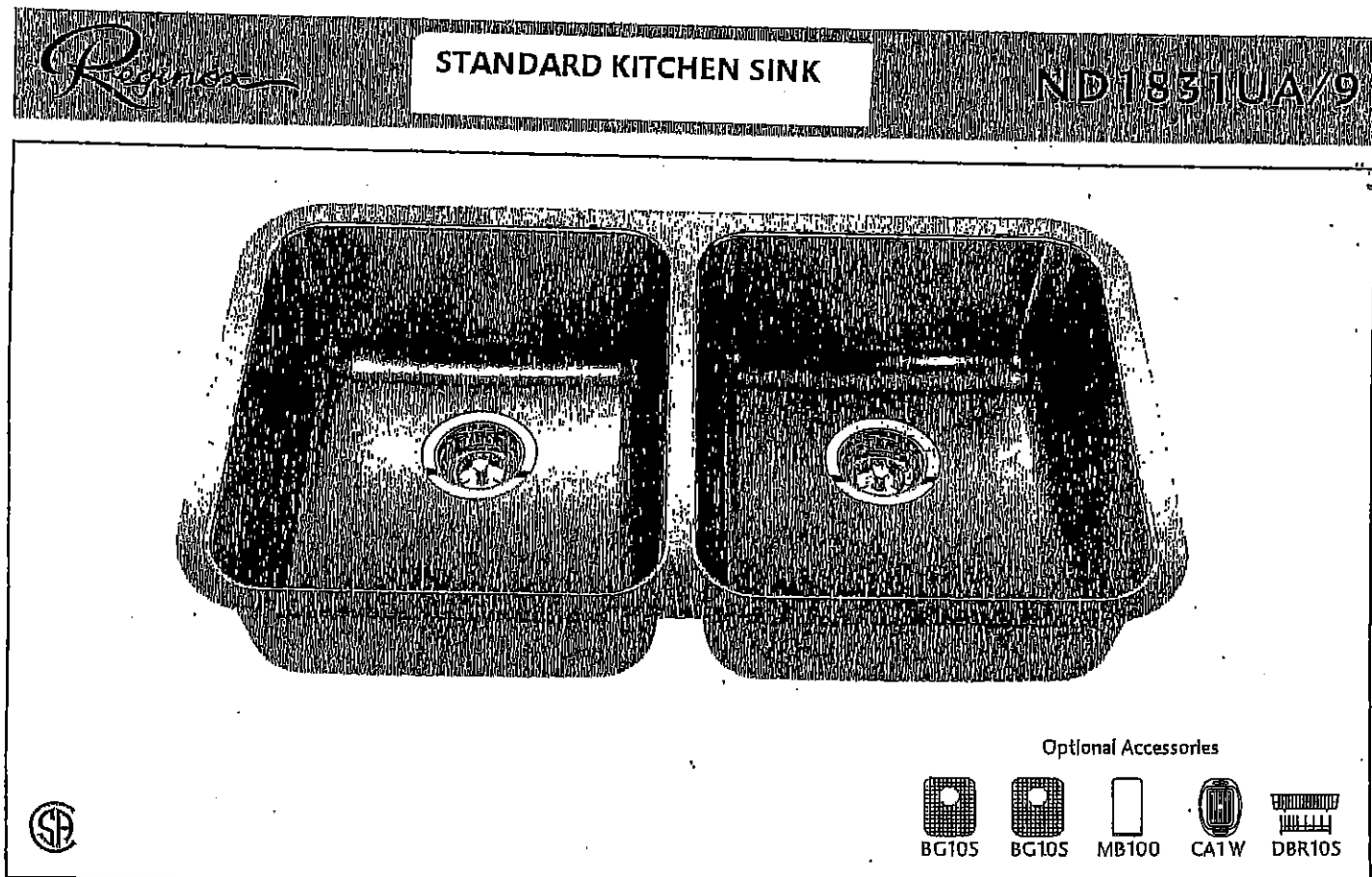

### ND1831UA/9 SPECIFICATION

Model ND1831UA/9 is a double (two equal size) bowl undermount sink manufactured by Franke Kindred Canada Limited from 18 gauge stainless steel. Product has silk finished rims and linear brush finished bowls. Sink is fully undercoated. Basket strainer waste fittings (3 1/2", 89 mm) are included. Sink is backed with a limited lifetime warranty.

- O.D. 17 3/4" x 30 7/8" x 8 1/2" (45 x 78 x 22 cm)
- Recommended for minimum 36" cabinet

Franke Kindred Canada Limited  
 P.O. Box 190, 1000 Franke Kindred Road, Midland, Ontario, Canada, L4R 4K9 Phone: 866-687-7465 Fax: 800-361-8408

25

UK-75 WALLACETON  
LOT 284C-15  
20-1606 ELEV A  
THE GRASSFIELD

20 OF 25

STANDARD KITCHEN FAUCET

Align

Modern

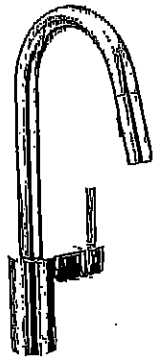

Single Handle Pull-Down Kitchen  
Faucet\*

Model 7565†

MT  
KN

UK-75 WALLACETON  
LOT 284C-15  
20-1606 ELEV A  
THE GRASSFIELD

21 of 25

# Chateau

Transitional

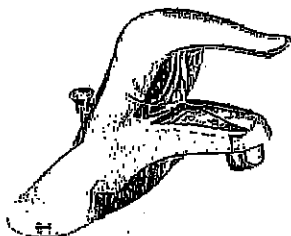

Lavatory Faucet with Pop-Up Drain  
Model L4621†

VANITY SINKS AND PEDESTAL

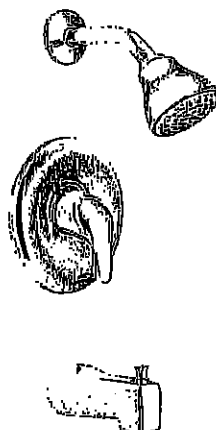

Posi-Temp® Pressure Balancing Tub/Shower  
Model 62320 / TL183†

OR

Posi-Temp Valve and Tub/Shower Trim  
with Eco-Performance Easy Clean® XL  
Model 62320 / TL183EP†  
(TL183EP not available in BC)

SHOWER AND 5' TUB FAUCETS



2 Handle Roman Tub with 9" Spout  
Model 4796 / T990†

FREESTANDING TUB FAUCETS

AK  
JAN

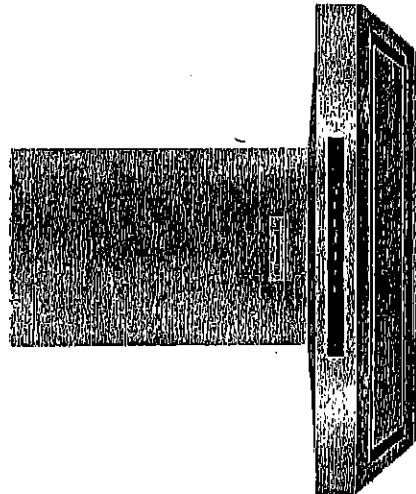

**MODEL: K1WB600DSS**

30-In. Width | Wall-Mount Canopy | 600 CFM Motor

This 3-speed vent hood has power to effectively vent an output of up to 65K BTUs. Auto speed sensing keeps the vent at the proper fan speed by sensing the amount of heat coming from the cooktop. This 30-inch wall-mount canopy hood has both LED and halogen lights to brighten almost any work area.

## 600 CFM/65K BTU Threshold

Allows installation over any KitchenAid regular 30-inch range or cooktop, and some commercial-style cooking surfaces with outputs up to 65K BTU

## Perimeter Ventilation

Increases ventilation system efficiency by pulling air from the edges of the hood and speeding up the movement of air at the center, allowing it to efficiently handle up to a 65K BTU total output

### Auto Speed Setting

Takes the guesswork out of protecting cabinets from steam, grease, and moisture by automatically adjusting fan speed to ventilation needs depending on the heat being produced

## LED Task Lights

Provide extra lighting over the cooking surface to help in the cooking process

## Halogen Night Lights

Enhances the style-of the ventilation system by providing soft, accent lighting in the kitchen

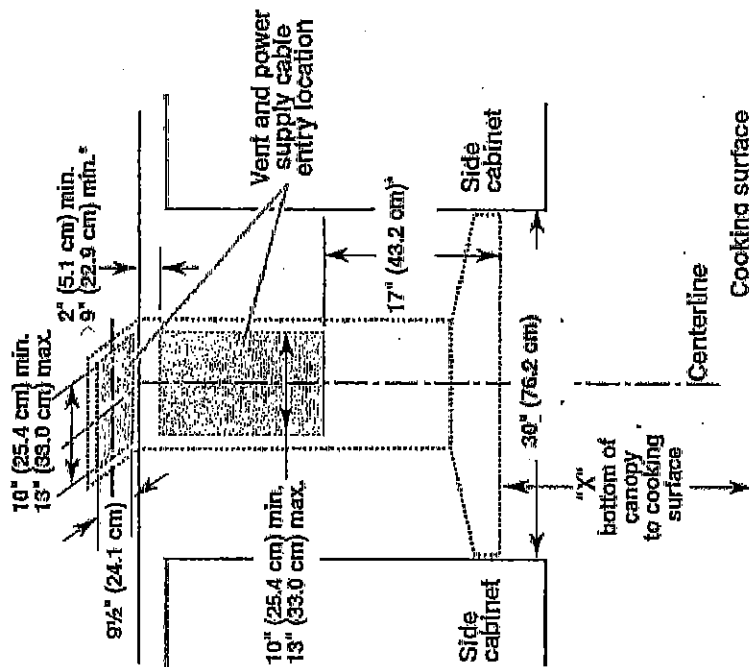

<sup>a</sup>For non-vented (recirculating) installations

## IMPORTANT:

Minimum distance  $\alpha^*$ : 24" (61.0 cm) from electric cooking surface.  
Minimum distance  $\alpha^*$ : 27" (68.6 cm) from gas cooking surfaces.  
Suggested maximum distance  $\alpha^*$ : 36" (91.4 cm)

Duct Outlet Type  
Duct Outlet Size

Round  
6"

## ELECTRICAL

15amp, 60 Hz, 120 V.

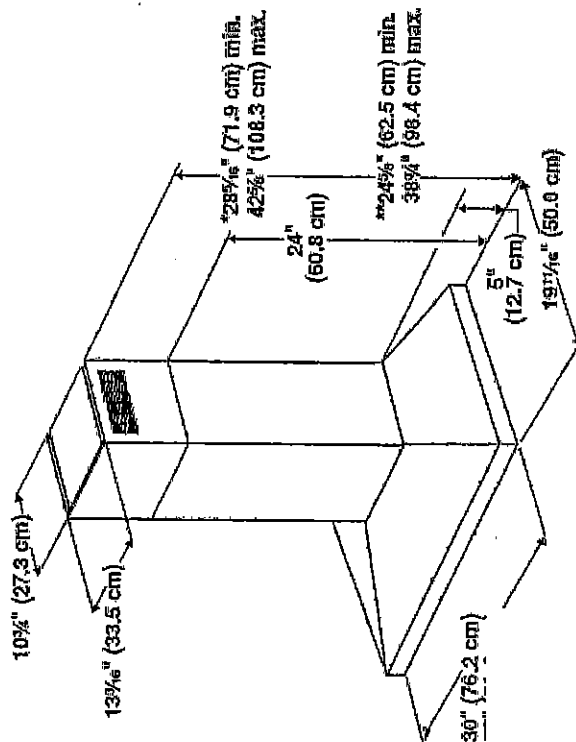

\*For non-vented (recirculating) installations

\*\*\* For vented installations

UK-75 WALLACETON  
 LOT 284C-15  
 20-1606 ELEV A  
 THE GRASSFIELD

23 of 25

### Trim Kit Frame Dimensions

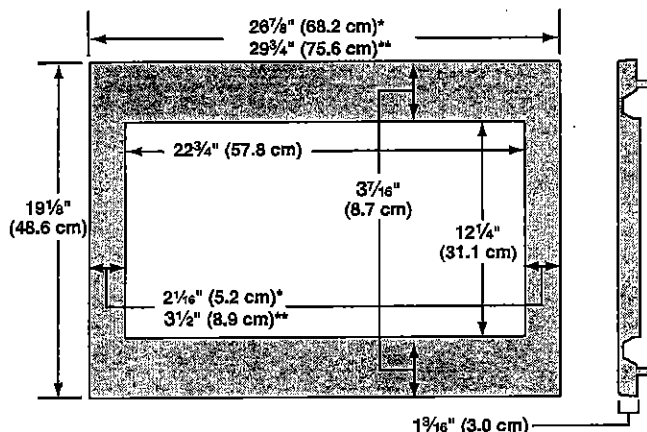

\*27" (68.6 cm) trim kit

\*\*30" (76.2 cm) trim kit

### Electrical Requirements

#### ⚠ WARNING



#### Electrical Shock Hazard

Plug into a grounded 3 prong outlet.

Do not remove ground prong.

Do not use an adapter.

Do not use an extension cord.

Failure to follow these instructions can result in death, fire, or electrical shock.

Observe all governing codes and ordinances.

#### Required:

- A 120 volt, 60 Hz, AC only, 15- or 20-amp electrical supply with a fuse or circuit breaker.

#### Recommended:

- A time-delay fuse or time-delay circuit breaker.
- A separate circuit serving only this microwave oven.

### GROUNDING INSTRUCTIONS

#### ■ For all cord connected appliances:

The microwave oven must be grounded. In the event of an electrical short circuit, grounding reduces the risk of electric shock by providing an escape wire for the electric current. The microwave oven is equipped with a cord having a grounding wire with a grounding plug. The plug must be plugged into an outlet that is properly installed and grounded.

**WARNING:** Improper use of the grounding plug can result in a risk of electric shock. Consult a qualified electrician or serviceman if the grounding instructions are not completely understood, or if doubt exists as to whether the microwave oven is properly grounded.

Do not use an extension cord. If the power supply cord is too short, have a qualified electrician or serviceman install an outlet near the microwave oven.

### SAVE THESE INSTRUCTIONS

### Prepare Microwave Oven

1. Unplug microwave oven before proceeding with installation.
2. Remove any loose items inside microwave oven.
3. Gently turn microwave oven onto its top, with the door facing forward (toward installer).
4. Align the two rails on the microwave oven bottom, as shown, making sure the flanges are forward and pointing up.

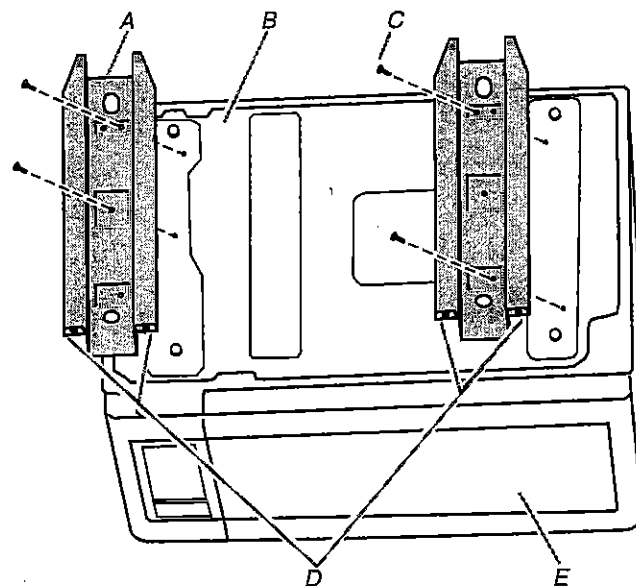

A. Rails (2)

B. Microwave oven bottom

C. Short screws (4)

D. Flanges

E. Door

5. Secure the rails to the microwave oven bottom using four short screws.

24 of 25

INSTALLATION INSTRUCTIONS



Tools and Parts

Tools Needed

Gather the required tools and parts before starting installation. Read and follow the instructions provided with any tools listed here.

- Measuring tape
- Drill
- Pencil
- 7/64" drill bit
- Phillips screwdriver

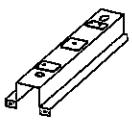
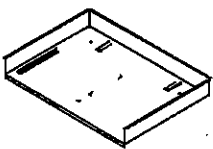
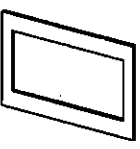
Parts Supplied (not shown to scale)

		
Rails (2)	Bottom duct	Trim kit frame
		
Short screws (14) (11 + 3 extra)	Long wood screws (6 - painted) (4 + 2 extra)	

Location Requirements

The microwave oven may be installed over a built-in oven. If installing over a built-in oven, make sure there is a minimum of 3" (7.6 cm) between the top of the lower oven cutout and the microwave oven cutout floor.

The microwave oven may also be installed in a cabinet by itself (without a built-in oven below). For best usability, we recommend a minimum distance of 36" (91.4 cm) from the floor to the cutout floor.

Make sure the surrounding cabinetry has clearance to open and close freely. Allow a clearance of at least 1 1/8" (4.0 cm) below the cutout floor (3" [7.6 cm] for installation above a built-in oven), and a clearance of at least 2" (5.1 cm) above the cutout opening.

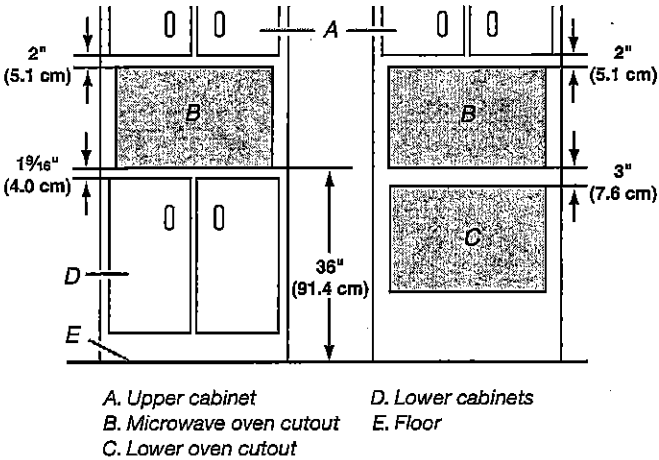

Required Cutout Dimensions

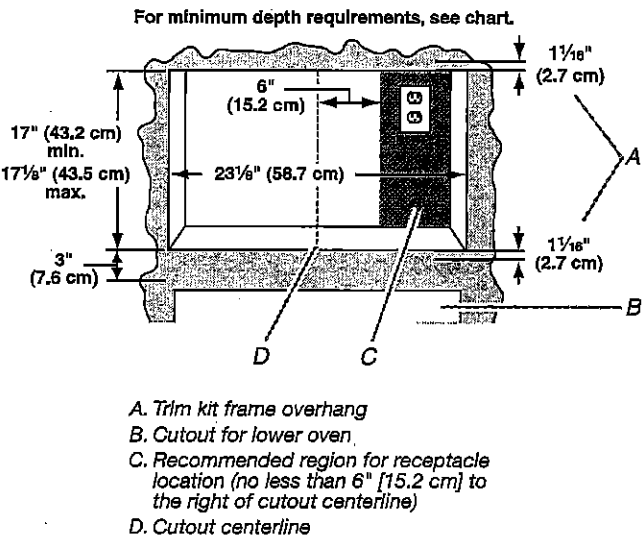

Receptacle Location	Minimum Depth
Within recommended region	18" (45.7 cm) with flush receptacle; 21" (53.2 cm) with non-flush receptacle
Outside recommended region	19 1/2" (49.5 cm) with flush receptacle; 22 1/2" (57.2 cm) with non-flush receptacle

NOTES:

- Depth requirements depend upon receptacle and its location within or outside of recommended region. See illustration and chart above.
- Height dimension is critical: 17" (43.2 cm) minimum, 17 1/8" (43.5 cm) maximum.
- Width measurement has  $\pm 1/16$ " (2 mm) tolerance.
- 3" (7.6 cm) minimum dimension is from lower oven cutout ceiling to microwave oven cutout floor.
- Trim kit frame extends 1 1/8" (2.7 cm) above and below the cutout opening.



## Prepare Cutout/Cabinet Opening

1. On the cutout floor, find and mark the centerline.
2. Place the bottom duct in the opening, with the flange resting against the bottom front facing of the opening.

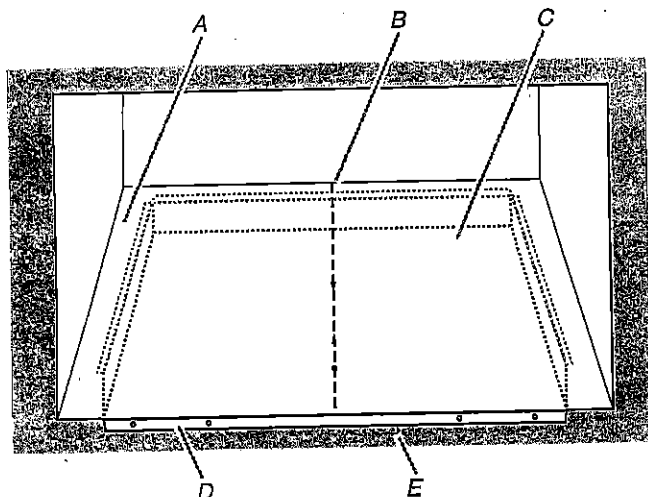

A. Cutout floor  
 B. Centerline  
 C. Bottom duct  
 D. Bottom duct flange  
 E. Front facing

3. Align the center arrows on the bottom duct with the centerline drawn in Step 1 above.

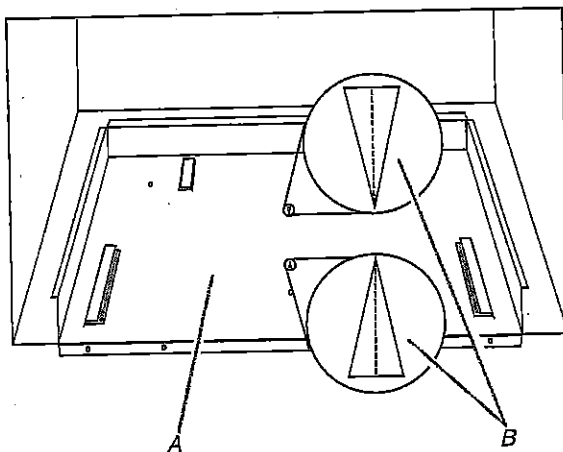

A. Bottom duct  
 B. Center arrows, aligned with centerline

4. Mark the three mounting holes through the bottom duct onto the cutout floor.

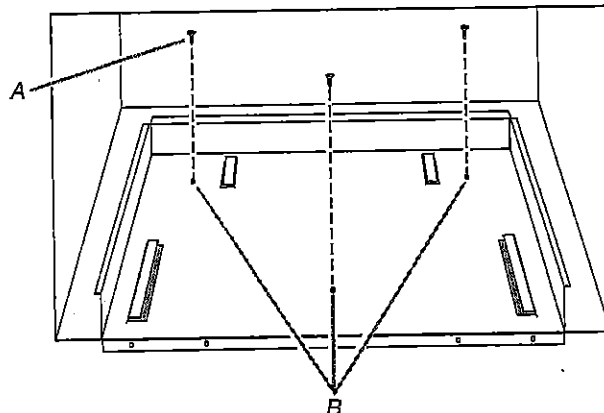

A. Short screws (3)  
 B. Bottom duct mounting holes

5. Using 7/64" drill, drill pilot holes into the three holes marked in Step 4.
6. Realign and install the bottom duct with three short screws.
7. Using 7/64" drill, drill pilot holes through the four mounting holes of the bottom duct flange into the bottom front facing of the cutout/cabinet opening.

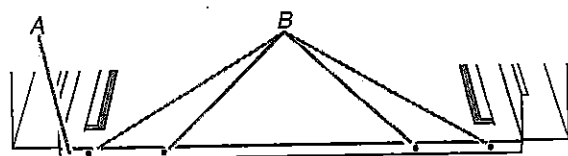

A. Bottom duct flange  
 B. Mounting holes