

PRE-Sales Selection Sheet
Checklist

1 of 23

LOT 286C-23 Model: 20-1790 B The Dunmore

PURCHASERS: Parvinder, Singh Kadwal/

VENDOR: Heathwood Homes (Huron) Limited

- ☒ FINISHED BASEMENT
☐ COLD CELLAR

UPGRADED / MODIFIED ELEVATION

- ☐ CORNER UPGRADE
☐ REAR UPGRADE

CEILING UPGRADE - SMOOTH

- ☐ MAIN FLOOR
☐ SECOND FLOOR
☐ BASEMENT

ADDITIONAL ROUGH-INS

- ☐ 200 AMP SERVICE
☐ WET BAR ROUGH-IN
☐ HUMIDIFIER
☒ AIR CONDITIONING

GAS ROUGH-IN

- ☒ STOVE
☐ DRYER
☐ BBQ
☐ ADDITIONAL FIREPLACE

KITCHEN: HOODFAN VENTING SIZE

- ☒ 6 IN ROUND DUCT
☐ 7 IN ROUND DUCT

FULL BASEMENT STAIRS:

N/A

UPPER BASEMENT STAIRS:

All Oak

LOWER BASEMENT STAIRS:

Carpet Grade

MAIN STAIRS:

All Oak

MEDIA STAIRS (if applicable):

N/A

LOFT STAIRS (if applicable):

N/A

Oct 9/20
Date

Purchaser:

Signature
on file

Oct 9, 2020
Date

Decor Consultant:

- APPROVED -

-10- 16 2020

Date

Purchaser:

Date

Heathwood Homes (Huron) Limited

Locked Date:

Approved

M. Rosen



Sales Selection Sheet

Wallaceton

2 of 23

PURCHASER: Parvinder, Singh Kadwal

TEL:

LOT / UNIT	PHASE	MODEL	
286C-23	2	20-1790 B The Dunmore	

It is herein understood and agreed between the undersigned parties hereto that the following changes shall be made to the above mentioned Agreement of Purchase and Sale in accordance with the agreement and except for such changes noted below, all other terms and conditions in the Agreement of Purchase and Sale shall remain as stated herein: It is further understood that and agreed that all changes and additions shall be installed as per builder's specifications, location and available selections. The Purchaser hereby agrees to purchase the following extras:

MISC.

1	SCHEDULE "E" FIVE THOUSAND DOLLARS (\$5,000.00) AT DECOR (NO CASHE VALUE) -TOWNHOMES	Qty: 1	
39,172	Note:		

Sub Total

HST

Total

1. This Sales Selection Sheet when properly executed forms part of our Agreement of Purchase and Sale.
2. All extras and upgrades listed above are subject to Construction Progress and Architectural and Municipal requirements.
3. In the event the Vendor is unable to incorporate the work approved above in the construction of the house for any reason whatsoever, the Vendor will not be liable to the Purchaser in any way. The monies paid for any changes or optional extras not proceeded with shall be returned to the Purchaser, without interest. The cost of options or extras is non-refundable in all other circumstances. If for any reason whatsoever the Agreement of Purchase and Sale is not completed, the total cost of work approved above will be retained by the Vendor.
4. The Vendor reserves the right to substitute above materials and equipment with that of equal or better quality.
5. Purchaser acknowledges that items may not be exactly as shown. Variations from the Vendor's samples may occur in finished materials due to normal production processes. Vendor is not responsible for shade difference which may occur from different dye lots or wood grains. Variations from the Vendor's samples will occur with natural materials such as wood, marble, granite, hardwood and brick.
6. The Vendor reserves the right to select Grout & Thresholds that best suits the Tile selected.
7. Selections will not be processed unless signed by Heathwood Homes Head Office.
8. The selections made on this schedule are final and cannot be changed once submitted.
9. The Purchaser has checked and acknowledges the accuracy of this schedule.

Payment Summary

<u>Paid By</u>	<u>Amount</u>
----------------	---------------

Total Payment:

PURCHASER:

Signature on file
Parvinder, Singh Kadwal

09-Oct-20

DATE

Decor Consultant

09-Oct-20

DATE

- APPROVED -

-10- 16 2020

Date Approved Heathwood Homes (Huron) Limited

TAX#:1

PREPARED BY: Irit Salem

PE 542-1

SInvoice.rpt 28may19

Parvinder, Singh Kadwal/
Project: Wallaceeton
Unit: 286C-23, Phase: 2
Model: 20-1790 B The Dunmore

Created: 10/5/2020 11:38:01
Locked:
Closed:

3 of 23

Kitchen

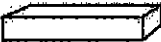
Cabinet Colour/Style	6239	Viking III-CAMDEN-EXPRESSO CL-MAPLE ***STD***
Countertop	7821	Group 1-Granite-GRIGIO SARDO-3/4 inch ***STD***
Countertop Edge	4010	SINGLE POLISHED STRAIGHT EDGE 3/4 INCH ***STD*** 
Cabinet Hardware	2093	9671-HARDWARE ***STD***
Island Cabinet Colour/Style	6239	Viking III-CAMDEN-EXPRESSO CL-MAPLE ***STD***
Island Countertop	7821	Group 1-Granite-GRIGIO SARDO-3/4 inch ***STD***
Backsplash	1111	N/A *****
Backsplash Grout	1111	N/A *****
Backsplash Tile Pattern	1111	N/A *****

HoodFan	9117	SCB50030-CYCLONE 30 inch CANOPY CHIMNEY HOODFAN-SS PAGES 22-23
Appliance	9117	Purchasers have been advised: standard fridge opening is a minimum 37 3/8 x 73 3/8". Ice Waterline Rough-In is included.
Appliance	9117	Standard stove opening is 30" and standard dishwasher opening is 24". Any gas stove will require backsplash or stainless steel backing to avoid fire hazards.
Appliance	9117	Purchasers acknowledge: Heathwood Homes and its contractors will not be responsible for any kitchen cabinet changes due to appliances dimension changes after
Comment		

Kitchen/Breakfast

Flooring	9117	GE.MD.WHT.1818.MT Madison Series White Matte 18
Floor Tile Grout	2225	Grout-(27) Silver ***STD***
Floor Tile Pattern	3000	STANDARD SQUARE ***STD***

Handwritten signature

Parvinder, Singh Kadwal/
Project: Wallaceton
Unit: 286C-23, Phase: 2
Model: 20-1790 B The Dunmore

Created: 10/5/2020 11:38:01
Locked:
Closed:

4 of 23

Comment

Foyer

Flooring

3000 GE.MD.WHT.1818.MT Madison Series White Matte 18

Floor Tile Grout

2225 Grout-(27) Silver ***STD***

Floor Tile Pattern

3000 STANDARD SQUARE ***STD***

Comment

Laundry Room

Flooring

3000 GE.BY.AZR.1313 New Byzantine Azzuro 13

Floor Tile Grout

2225 Grout-(27) Silver ***STD***

Floor Tile Pattern

3000 STANDARD SQUARE ***STD***

Comment

Laundry Room Opt.

Cabinet - Uppers

1111 N/A *****

Cabinet Hardware

1111 N/A *****

Comment

Mud Room

Flooring

1111 GE.MD.WHT.1818.MT Madison Series White Matte 18

[Handwritten signature]

Parvinder, Singh Kadwal/
Project: Wallaceton
Unit: 286C-23, Phase: 2
Model: 20-1790 B The Dunmore

Created: 10/5/2020 11:38:01
Locked:
Closed:

5 of 23

Floor Tile Grout 2225 Grout-(27) Silver ***STD***

Floor Tile Pattern 3000 STANDARD SQUARE ***STD***

Comment

Powder Room

Flooring 3000 GE.MD.WHT.1818.MT Madison Series White Matte 18

Floor Tile Grout 2225 Grout-(27) Silver ***STD***

Floor Tile Pattern 3000 STANDARD SQUARE ***STD***

Plumbing Fixture (Colour) 1737 Plumbing Fixtures-WHITE ***STD***

Comment

Hall

Flooring 7497 Red Oak Pearl-Vintage Engineered-AURORA -3/4 inch x 3 1/4 inch ***STD***

Comment

Dining Room

Flooring 7497 Red Oak Pearl-Vintage Engineered-AURORA -3/4 inch x 3 1/4 inch ***STD***

Comment

Great Room

Flooring 7497 Red Oak Pearl-Vintage Engineered-AURORA -3/4 inch x 3 1/4 inch ***STD***

Comment

Handwritten signature

Parvinder, Singh Kadwal/
Project: Wallaceton
Unit: 286C-23, Phase: 2
Model: 20-1790 B The Dunmore

Created: 10/5/2020 11:38:01
Locked:
Closed:

6 of 23

Upper Hall

Flooring 9252 DY 16787 -Dynasty Tex-MYSTIC BEIGE-40 oz
Poly***STD***

Comment

Finished Basement (Rec) Room/Hall

Flooring 9252 DY 16787 -Dynasty Tex-MYSTIC BEIGE-40 oz
Poly***STD***

Comment

Master Bedroom

Flooring 9252 DY 16787 -Dynasty Tex-MYSTIC BEIGE-40 oz
Poly***STD***

Comment

Bedroom 2

Flooring 9252 DY 16787 -Dynasty Tex-MYSTIC BEIGE-40 oz
Poly***STD***

Comment

Bedroom 3

Flooring 9252 DY 16787 -Dynasty Tex-MYSTIC BEIGE-40 oz
Poly***STD***

Comment

Master Ensuite

Cabinet Colour/Style 6247 Viking III-CAMDEN-SHALE GREY CL-MAPLE ***STD***

Countertop 8827 4925K-07-Countertop-CALCUTTA MARBLE-Wilsonart
STD

[Handwritten signature]

Parvinder, Singh Kadwal/
Project: Wallaceton
Unit: 286C-23, Phase: 2
Model: 20-1790 B The Dunmore

Created: 10/5/2020 11:38:01
Locked:
Closed:

7 or 23

Countertop Edge	1111	N/A *****								
Cabinet Hardware	2076	181-HARDWARE ***STD***								
Floor Tile	2076	GE.BY.AZR.1313 New Byzantine Azzuro 13								
Floor Tile Grout	2225	Grout-(27) Silver ***STD***								
Floor Tile Pattern	3000	STANDARD SQUARE ***STD***								
Shower Floor Tile	8661	OD.ON.SWT.0202.MT.N-Ontario Series Mosaic-Snow White Matte-2 x 2 ***STD***								
Shower Floor Tile Grout	2226	Grout-(00) White ***STD***								
Shower Floor Tile Pattern	3000	STANDARD SQUARE ***STD***								
Shower Wall Tile	9020	QT.WV.WHT.0810-Weave-White-8 x 10 ***STD***								
Shower Wall Tile Grout	2226	Grout-(00) White ***STD***								
Shower Wall Tile Pattern	3070	HORIZONTAL STACKED ***STD*** <table><tr><td></td><td></td></tr><tr><td></td><td></td></tr><tr><td></td><td></td></tr><tr><td></td><td></td></tr></table>								
Shower Jamb(s) and Sill(s)	8923	Shower Jamb / Sill-Thassos White ***STD***								
Plumbing Fixture (colour)	1737	Plumbing Fixtures-WHITE ***STD***								
Comment										

Main Bathroom

Cabinet Colour/Style	6247	Viking III-CAMDEN-SHALE GREY CL-MAPLE ***STD***
Countertop	8797	6697-46-Countertop-ARGENTO ROMANO ETCHINGS FINISH-Formica ***STD***
Countertop Edge	1111	N/A *****

Handwritten signature

Parvinder, Singh Kadwal/
Project: Wallaceton
Unit: 286C-23, Phase: 2
Model: 20-1790 B The Dunmore

Created: 10/5/2020 11:38:01
Locked:
Closed:

8 of 23

Cabinet Hardware	2076	181-HARDWARE ***STD***								
Flooring	2076	GE.BY.AZR.1313 New Byzantine Azzuro 13								
Floor Tile Grout	2225	Grout-(27) Silver ***STD***								
Floor Tile Pattern	3000	STANDARD SQUARE ***STD***								
Wall Tile	9020	QT.WV.WHT.0810-Weave-White-8 x 10 ***STD***								
Wall Tile Grout	2226	Grout-(00) White ***STD***								
Main Bathroom Tile Pattern	3070	HORIZONTAL STACKED ***STD*** <table><tr><td></td><td></td></tr><tr><td></td><td></td></tr><tr><td></td><td></td></tr><tr><td></td><td></td></tr></table>								
Plumbing Fixture (Colour)	1737	Plumbing Fixtures-WHITE ***STD***								
Comment										

Finished Basement Bathroom

Cabinet Colour/Style	6247	Viking III-CAMDEN-SHALE GREY CL-MAPLE ***STD***
Countertop	8827	4925K-07-Countertop-CALCUTTA MARBLE-Wilsonart ***STD***
Countertop Edge	1111	N/A *****
Cabinet Hardware	2076	181-HARDWARE ***STD***
Flooring	1111	GE.BY.AZR.1313 New Byzantine Azzuro 13
Floor Tile Grout	2225	Grout-(27) Silver ***STD***
Floor Tile Pattern	3000	STANDARD SQUARE ***STD***
Shower Floor Tile	8661	OD.ON.SWT.0202.MT.N-Ontario Series Mosaic-Snow White Matte-2 x 2 ***STD***

8 of 23

Parvinder, Singh Kadwal/
Project: Wallaceton
Unit: 286C-23, Phase: 2
Model: 20-1790 B The Dunmore

Created: 10/5/2020 11:38:01
Locked:
Closed:

9 of 23

Shower Floor Tile Grout	2226	Grout-(00) White ***STD***								
Shower Floor Tile Pattern	3000	STANDARD SQUARE ***STD***								
Shower Wall Tile	9020	QT.WV.WHT.0810-Weave-White-8 x 10 ***STD***								
Shower Wall Tile Grout	2226	Grout-(00) White ***STD***								
Shower Wall Tile Pattern	3070	HORIZONTAL STACKED ***STD*** <table><tr><td></td><td></td></tr><tr><td></td><td></td></tr><tr><td></td><td></td></tr><tr><td></td><td></td></tr></table>								
Shower Jamb(s)	8923	Shower Jamb / Sill-Thassos White ***STD***								
Plumbing Fixture (Colour)	1737	Plumbing Fixtures-WHITE ***STD***								
Comment										

Great Room Fireplace

Type	8865	Dimplex-Electric Fireplace-PF3033HL ***STD***
Mantle	8891	NF-17-Paint Grade Mantle- Cabinet (Per Plan)-WHITE ***STD*** PAGE 18
Surround Opt.	1111	N/A *****
Note	1111	Purchasers have been advised: heat from the FP can damage TV above a FP and items placed on mantle.
Note	1111	Heathwood and its contractors will not be liable for any damage on items placed/installed above a FP after closing.
Comment		

Basement Stairs

Type	1714	Carpet Grade Stairs ***STD BASEMENT STAIRS***
Colour	7920	Aurora (Carob) STAIN TO COMPLIMENT HARDWOOD AND WILL VARY FROM FLOORING ***99***
Carpet Runner	1111	N/A *****
Handrail/Pickets/Post Type	9119	Handrail only on closed walls (one or two sides per building code) ***STD***

Hand

Parvinder, Singh Kadwal/
Project: Wallaceton
Unit: 286C-23, Phase: 2
Model: 20-1790 B The Dunmore

Created: 10/5/2020 11:38:01
Locked:
Closed:

10 of 23

	code)	STD
Handrail/Pickets/Post Colours	7762	Carpet Grade-Stain handrail, stringers, nosing _post(s). (Me
Carpet	9252	DY 16787 -Dynasty Tex-MYSTIC BEIGE-40 oz Poly***STD***
Custom Stain/Paint	1111	N/A *****
Comment		

Basement Stairs Landings (Upper and Lo

Flooring	7497	Red Oak Pearl-Vintage Engineered-AURORA -3/4 inch x 3 1/4 inch ***3***
Comment		

Main Stairs

Type	1712	Oak Stairs ***STD MAIN STAIRS***
Colour	7920	Aurora (Carob) STAIN TO COMPLIMENT HARDWOOD AND WILL VARY FROM FLOORING ***99***
Carpet Runner	1111	N/A *****
Handrail/Pickets/Posts Type	7651	1 5/16 inch Turned pickets with 3 1/2" Turned Post(s)-ALL OAK***STD***
Handrail/Pickets/Posts Colour	1728	Oak Grade-Stain handrail,oak pickets,stringers,treads,risers
Custom Stain/Paint	1111	N/A *****
Comment		

Main Stairs Landing(s)

Flooring	7497	Red Oak Pearl-Vintage Engineered-AURORA -3/4 inch x 3 1/4 inch ***STD***
Comment		

Throughout

Handwritten signature

Parvinder, Singh Kadwal/
Project: Wallaceton
Unit: 286C-23, Phase: 2
Model: 20-1790 B The Dunmore

Created: 10/5/2020 11:38:01
Locked:
Closed:

11 of 23

Walls - Paint Colour	1717	22-Wall-WARM GREY ***STD***
Underpad	1080	600 Series-Underpad ***UPG***
Thresholds	2232	Metal Thresholds ***STD***
Switches and Plug	5796	Decora White Switches and Plugs ***STD***
Trim Size	8705	4 1/4 Baseboard and 2 1/4 Casings ***STD***
Trim - Paint Colour	1716	Trim-WHITE ***STD***
Comment		

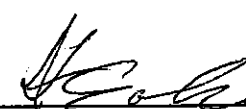
Purchaser:		OCT- 9 th 2020		OCT 9 2020
	Parvinder, Singh Kadwal	Date	Decor Consultant	Date

Purchaser:				-10- 1 6 2020
		Date	Wallaceton	Date Approved

- APPROVED -



Sales Selection Sheet

Wallaceton

12 of 23

PURCHASER: Parvinder, Singh Kadwal

TEL:

LOT / UNIT 286C-23	PHASE 2	MODEL 20-1790 B The Dunmore	
-----------------------	------------	--------------------------------	--

It is herein understood and agreed between the undersigned parties hereto that the following changes shall be made to the above mentioned Agreement of Purchase and Sale in accordance with the agreement and except for such changes noted below, all other terms and conditions in the Agreement of Purchase and Sale shall remain as stated herein: It is further understood that and agreed that all changes and additions shall be installed as per builder's specifications, location and available selections. The Purchaser hereby agrees to purchase the following extras:

APPLIANCES

1	SCB500030 CYCLONE HOOD FAN	Qty: 1	
39,169	Note: CYCLONE CHIMNY HOOD FAN	PAGES 22-23	

Carpet

2	CARPET - 600 SERIES UNDERPAD - BEDROOM 2 - UPGRADE 4	Qty: 1	
177,592			
39,163	Note:		
3	CARPET - 600 SERIES UNDERPAD - BEDROOM 3 - UPGRADE 4	Qty: 1	
177,595			
39,164	Note:		
4	CARPET - 600 SERIES UNDERPAD - MASTER BEDROOM - UPGRADE 4	Qty: 1	
177,589			
39,165	Note:		
5	CARPET - 600 SERIES UNDERPAD - RECREATION ROOM AND BASEMENT STAIRS - UPGRADE 4	Qty: 1	
177,601			
39,166	Note:		
6	CARPET - 600 SERIES UNDERPAD - UPPER HALL - UPGRADE 4	Qty: 1	
177,598			
39,167	Note:		

Ceramics

7	CERAMICS - FLOOR - FOYER - UPGRADE 1	Qty: 1	
177,571			
39,159	Note:		
8	CERAMICS - FLOOR - KITCHEN - UPGRADE 1	Qty: 1	
177,438			
39,160	Note:		
9	CERAMICS - FLOOR - MUD ROOM - UPGRADE 1	Qty: 1	
177,422			
39,161	Note:		
10	CERAMICS - FLOOR - POWDER ROOM - UPGRADE 1	Qty: 1	
177,579			
39,162	Note:		

Electrical

Initials:

TAX#:1

PREPARED BY: Marilyn Rosen

PE 541-1



Sales Selection Sheet

Wallaceton

13 of 23

PURCHASER: Parvinder, Singh Kadwal

TEL:

LOT / UNIT 286C-23	PHASE 2	MODEL 20-1790 B The Dunmore	
-----------------------	------------	--------------------------------	--

Electrical

11 189,45C 39,170	ELECTRICAL - CEILING ROUGH-IN (CAPPED) Note: GREAT ROOM TO BE INSTALLED IN THE CENTRE OF THE ROOM- USE EXISTING SWITCH PLUG SEE SKETCH # 2 PAGE# 16	Qty: 1
12 189,44C 39,171	ELECTRICAL - EXTRA WALL INTERIOR OUTLET ON EXISTING CIRCUIT (DOES NOT INCLUDE KITCHEN OUTLETS) Note: GREAT ROOM- TO BE INSTALLED IN THE CENTRE OF THE FIRE PLACE 70" -+ FROM FLOOR SEE SKETCH # 2 PAGE# 16	Qty: 1

Heating/Air

13 189,474 39,157	HEATING/AIR - ROUGH-IN GAS LINE FOR GAS STOVE AT MAIN FLOOR (SEE SPECS) (HOOK-UP NOT INCLUDED) LEAVE STANDARD 120 VOLT ELECTRICAL OUTLET ON A SEPARATE CIRCUIT. * SPECIFY IF STANDARD 220V WILL STAY OR BE RELOCATED Note: SKETCH # 2 PAGE 16	Qty: 1
-------------------------	------------------------------------------------------------------------------------------------------------------------------------------------------------------------------------------------------------------------------------------------------------------------	--------

MISC.

14 39,168	 Note:	Qty: (1)
------------------	----------------------	----------

Sub Total

HST

Total

1. This Sales Selection Sheet when properly executed forms part of our Agreement of Purchase and Sale.
2. All extras and upgrades listed above are subject to Construction Progress and Architectural and Municipal requirements.
3. In the event the Vendor is unable to incorporate the work approved above in the construction of the house for any reason whatsoever, the Vendor will not be liable to the Purchaser in any way. The monies paid for any changes or optional extras not proceeded with shall be returned to the Purchaser, without interest. The cost of options or extras is non-refundable in all other circumstances. If for any reason whatsoever the Agreement of Purchase and Sale is not completed, the total cost of work approved above will be retained by the Vendor.
4. The Vendor reserves the right to substitute above materials and equipment with that of equal or better quality.
5. Purchaser acknowledges that items may not be exactly as shown. Variations from the Vendor's samples may occur in finished materials due to normal production processes. Vendor is not responsible for shade difference which may occur from different dye lots or wood grains. Variations from the Vendor's samples will occur with natural materials such as wood, marble, granite, hardwood and brick.
6. The Vendor reserves the right to select Grout & Thresholds that best suits the Tile selected.
7. Selections will not be processed unless signed by Heathwood Homes Head Office.
8. The selections made on this schedule are final and cannot be changed once submitted.
9. The Purchaser has checked and acknowledges the accuracy of this schedule.

Payment Summary

Paid By Amount

Total Payment:

Initials: PS

TAX#:1

PREPARED BY: Marilyn Rosen

PE 541-2

S\invoice.rpt 28may19



Sales Selection Sheet

Wallaceton

14.23

PURCHASER: Parvinder, Singh Kadwal

TEL:

LOT / UNIT	PHASE	MODEL	
286C-23	2	20-1790 B The Dunmore	

PURCHASER:

Parvinder, Singh Kadwal

09-Oct-20
DATE

Decor Consultant

09-Oct-20
DATE

- APPROVED -

-10-16-2020
Date Approved Heathwood Homes (Huron) Limited

TAX#:1

PREPARED BY: Marilyn Rosen

PE 541-3

8Invoice.rpt 28may19

UK-75 WALLACETON
LOT 286C-23
20-1790 ELEV B
THE DUNMORE

15 of 23

THE DUNMORE

Sketch # 1

ELEVATION B | 2,263 SQ. FT.

Includes 443 square feet of finished lower level

20-1790 ELEV. B

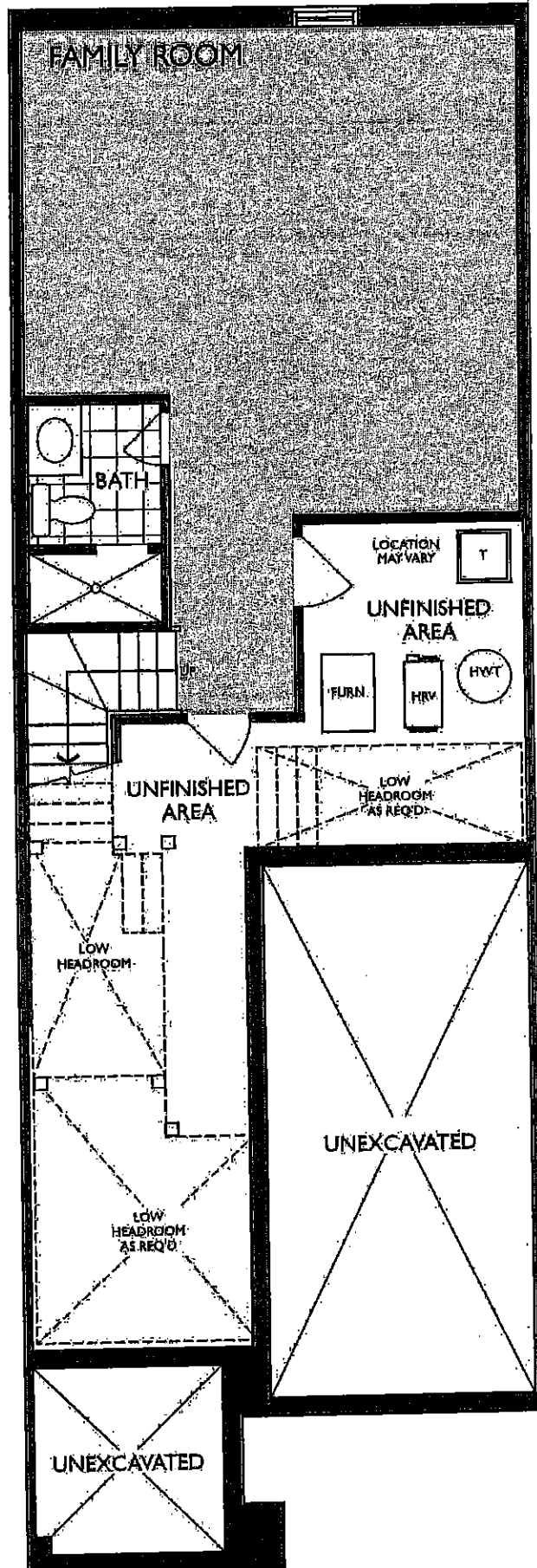

LOWER LEVEL
ELEVATION B

Handwritten signature

10/06/20

UK-75 WALLACETON
LOT 286C-23
20-1790 ELEV B
THE DUNMORE

16 of 23

THE DUNMORE

Sketch # 2

ELEVATION B | 2,263 SQ. FT.

Includes 443 square feet of finished lower level

20-1790 ELEV. B

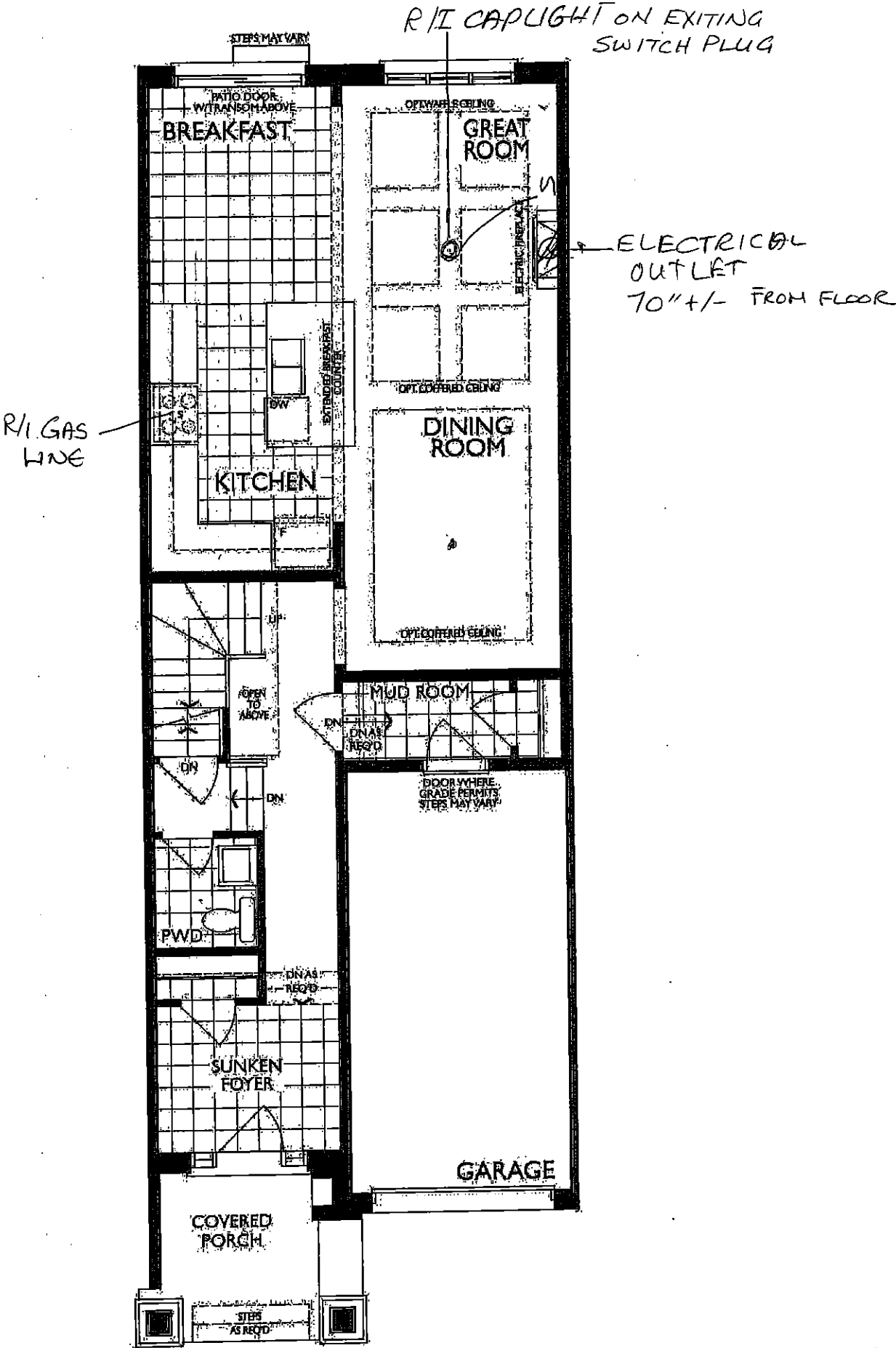

MAIN FLOOR
ELEVATION B

Handwritten signature

UK-75 WALLACETON
LOT 286C-23
20-1790 ELEV B
THE DUNMORE

17 OF 23

THE DUNMORE

Sketch #3

ELEVATION B | 2,263 SQ. FT.

Includes 443 square feet of finished lower level

20-1790 ELEV. B

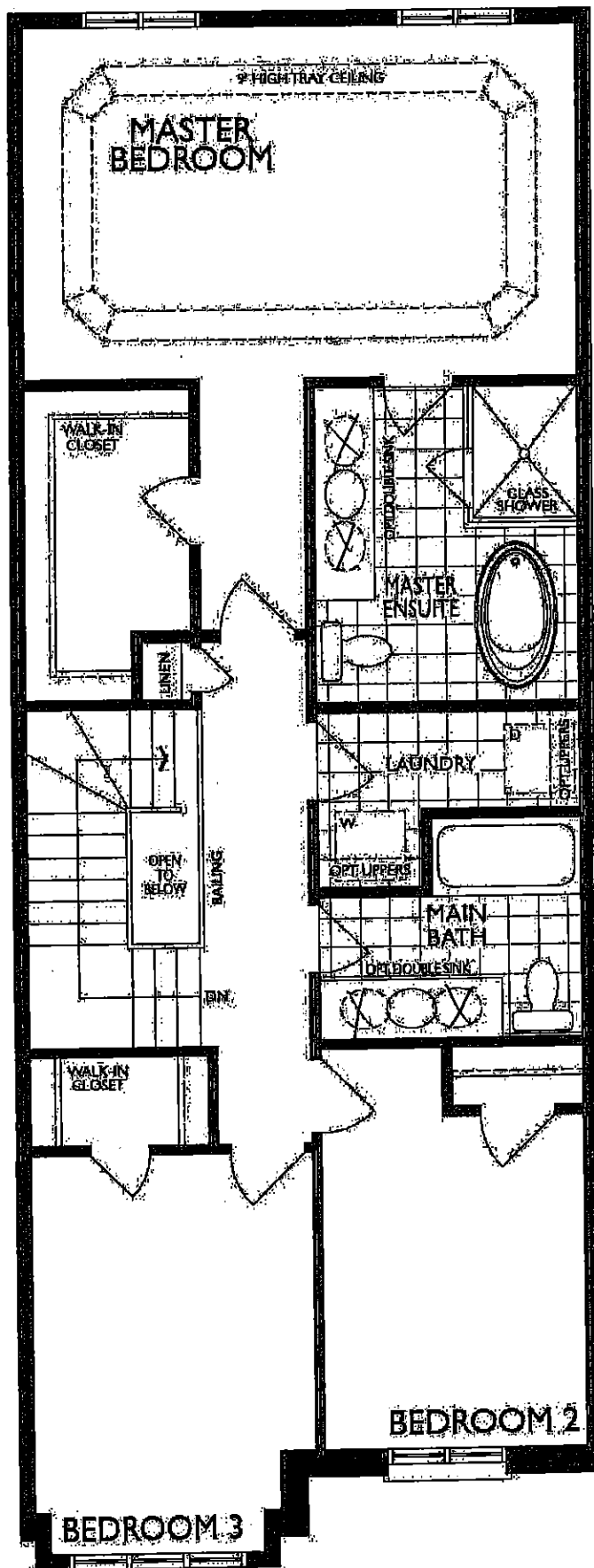

SECOND FLOOR
ELEVATION B

Jim

UK-75 WALLACETON
LOT 286C-23
20-1790 ELEV B
THE DUNMORE

18 of 23

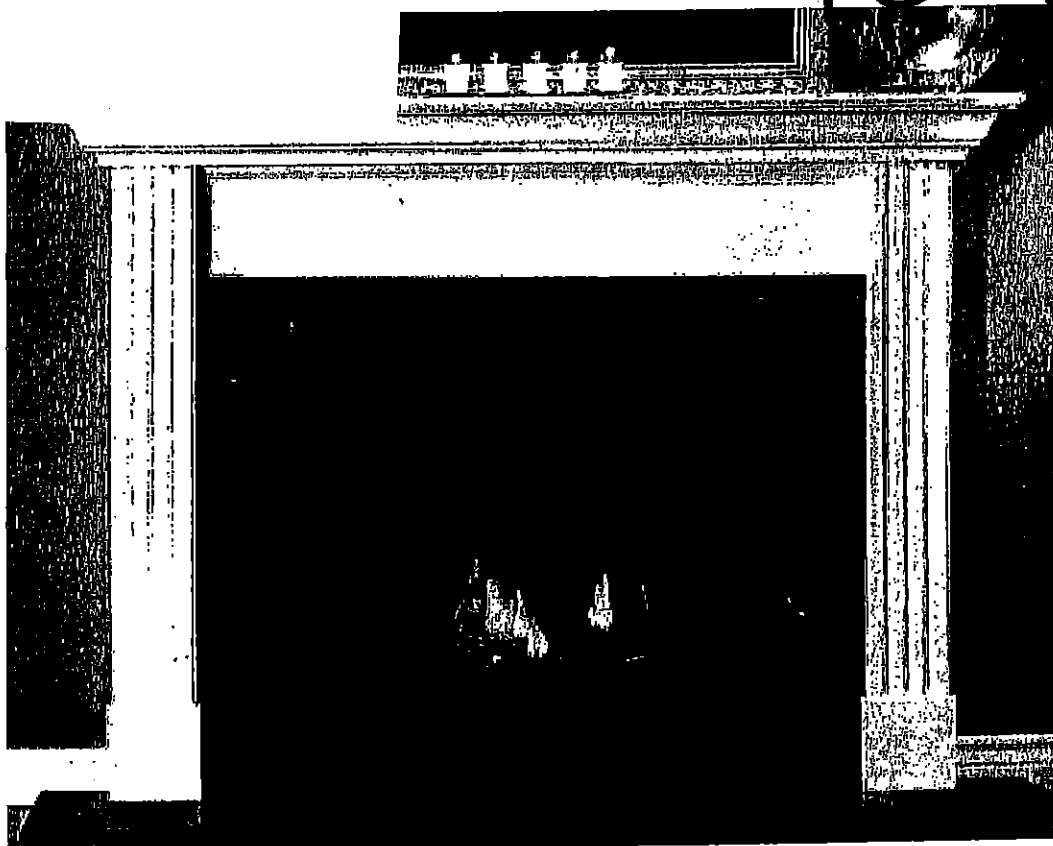

STANDARD NF 15 Mantel

Clean apron finish with fluted legs

WHITE PAINT GRADE FINISH

(PICTURE SHOWN WITH UPGRADE SURROUND AND HEARTH -PRICED SEPARATELY)



STANDARD NF 17 Mantel

WHITE PAINT GRADE FINISH

(PICTURE SHOWN WITH UPGRADE SURROUND AND HEARTH -PRICED SEPARATELY)

UK-75 WALLACETON
LOT 286C-23
20-1790 ELEV B
THE DUNMORE

19 of 23



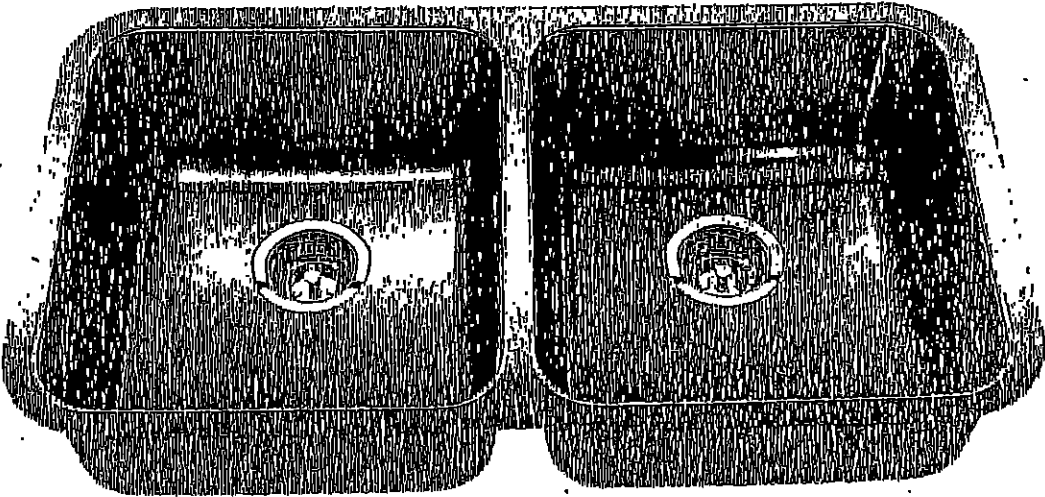

STANDARD KITCHEN SINK

ND1831UA/9





Optional Accessories

 BG105

 BG105

 MB100

 CATW

 DBR105



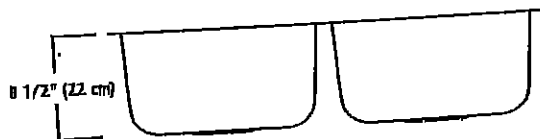
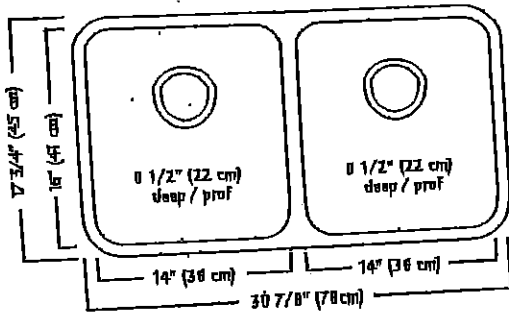

ND1831UA/9 SPECIFICATION

Model ND1831UA/9 is a double (two equal size) bowl undermount sink manufactured by Franke Kindred Canada Limited from 18 gauge stainless steel. Product has silk finished rims and linear brush finished bowls. Sink is fully undercoated. Basket strainer waste fittings (3 1/2", 89 mm) are included. Sink is backed with a limited lifetime warranty.

- O.D. 17 3/4" x 30 7/8" x 8 1/2" (45 x 78 x 22 cm)
- Recommended for minimum 36" cabinet

Franke Kindred Canada Limited
P.O. Box 190, 1000 Franke Kindred Road, Midland, Ontario, Canada, L4R 4K9 Phone: 866-687-7465 Fax: 800-361-8408

Franke Kindred Canada Limited Printed in Canada

1117

K.Y

UK-75 WALLACETON
LOT 286C-23
20-1790 ELEV B
THE DUNMORE

20 of 23

STANDARD KITCHEN FAUCET

Align

Modern

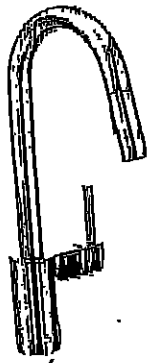

Single Handle Pull-Down Kitchen
Faucet*

Model 7565†

K12

UK-75 WALLACETON
LOT 286C-23
20-1790 ELEV B
THE DUNMORE

21 of 23

Chateau

Transitional

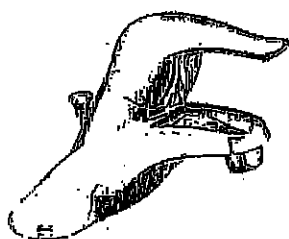

Lavatory Faucet with Pop-Up Drain
Model L4621†

VANITY SINKS AND PEDESTAL

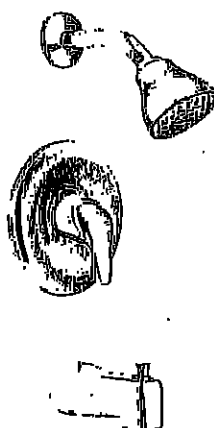

Posi-Temp® Pressure Balancing Tub/Shower
Model 62320 / TL183†
OR

Posi-Temp Valve and Tub/Shower Trim
with Eco-Performance Easy Clean® XL
Model 62320 / TL183EP†
(TL183EP not available in BC)

SHOWER AND 5' TUB FAUCETS

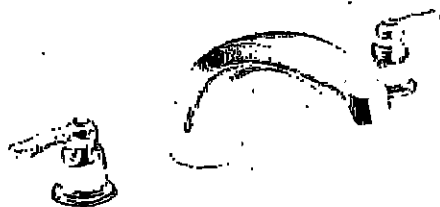

2 Handle Roman Tub with 9" Spout
Model 4796 / T990†

FREESTANDING TUB FAUCETS

UK-75 WALLACETON
LOT 286C-23
20-1790 ELEV B
THE DUNMORE

22 of 23

SC(B)500 | ALITO Collection

Cyclone®
Breathe Better

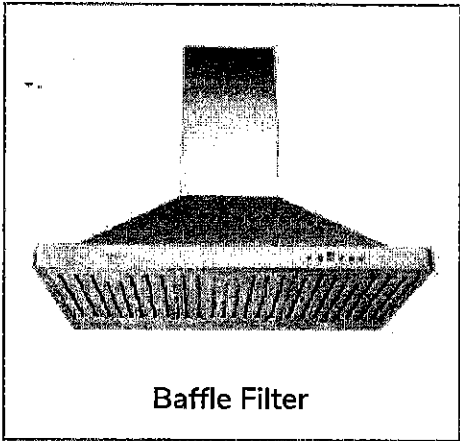

Wall Mount

Strong and sturdy with attractive lines and an imposing frame, the SC(B)500 is fitted with time-delay OFF feature up to nine minutes, 550 CFM fan, bright LED lights and a digital three-speed push button control panel.

Green Features



3 Speed Push Button
Control Panel



Dishwasher
Safe Filters



Long-Lasting
LED Light



Time-Delay
OFF Feature



Model	Colour	Ducting	Filters	Size	CFM
SC50024	Stainless Steel	6"	Mesh	24"	550
SC50030	Stainless Steel	6"	Mesh	30"	550
SC50036	Stainless Steel	6"	Mesh	36"	550
SCB50024	Stainless Steel	6"	Baffle	24"	550
SCB50030	Stainless Steel	6"	Baffle	30"	550
SCB50036	Stainless Steel	6"	Baffle	36"	550

Cyclone Range Hoods Inc.

1361 Huntingwood Drive, Unit 16, Toronto, ON, M1S 3J1, Canada.

Toll Free: 1-888-293-5662 Tel: (416) 293-0933 Fax: (416) 293-4793 Website: www.CycloneRangeHoods.com

SC(B)500 | ALITO Collection

1225
Cyclone®
 Breathe Better

Features

- Wall mount range hood
- 6" round duct adapter
- Non-stick aluminum fan blades
- 3 speed push button control
- 2 LED lights (2 x 1.4W)
- Dishwasher-safe mesh or baffle filters
- Standard chimney fits up to 9 ft. ceiling
- Up to 9 minute time-delay OFF feature
- Plug-in connection

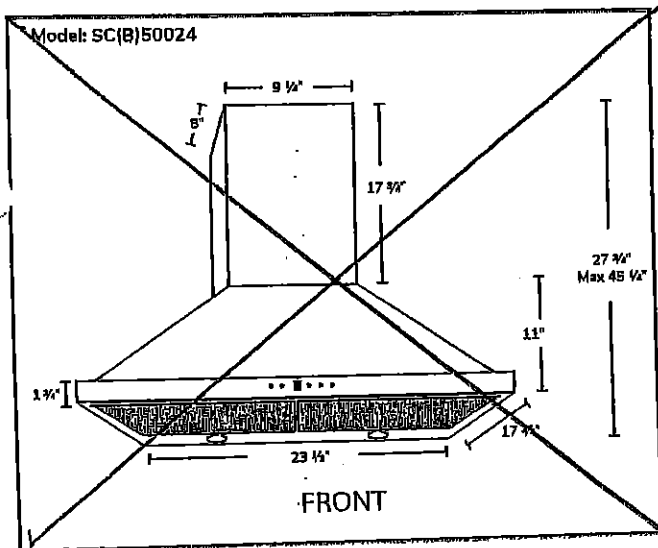
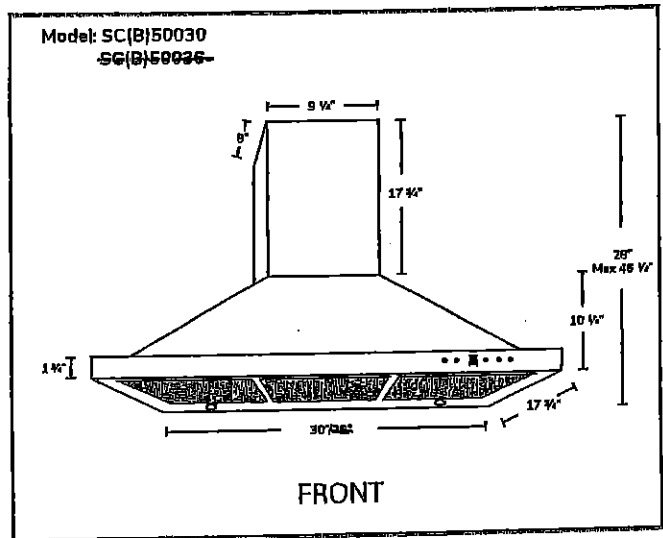

Options

- Filters: ~~SC500~~ - Quick Release Aluminum Mesh Filters
 SCB500 - Quick Release Stainless Steel Baffle Filters
- Available Chimney Flues:
 Short (7 ft. - 8 ft.. A1.CH10)
 Standard (8 ft. - 9 ft.. A1.CH18)
 Extended (9 ft. - 11 ft. A1.CH30)
- Widths: 24", 30", 36"

Specifications

- Air Flow Volume: 550 CFM
- Electrical Connection: 120V/60Hz
- Power Consumption: 210 Watts
- Current: 2.5 Amps
- Fan Speed: 1600RPM
- Fan Type: Centrifugal Blower

- Finishes: Stainless Steel
- Ducting: 6" Round
- Dimensions: Width: 24", 30", 36"
 Height: 46"
 Depth: 18"

- Noise Level: Min. 2 Sones
 Max. 6 Sones

