

PRE-Sales Selection Sheet
Checklist

1 OF 22

LOT 204 Model: 25-2500 ALT C The Bridgeport

PURCHASERS: GURJARMAN, SINGH SANDHU/

VENDOR: Heathwood Homes (Huron) Limited

☒ OPTIONAL SERVERY SINK

☐ FINISHED BASEMENT

☐ COLD CELLAR

UPGRADED / MODIFIED ELEVATION

☐ CORNER UPGRADE

☐ REAR UPGRADE

CEILING UPGRADE - SMOOTH

☒ MAIN FLOOR

☐ SECOND FLOOR

☐ BASEMENT

ADDITIONAL ROUGH-INS

☒ 200 AMP SERVICE

☐ WET BAR ROUGH-IN

☐ HUMIDIFIER

☒ AIR CONDITIONING

GAS ROUGH-IN

☒ STOVE

☐ DRYER

☐ BBQ

☐ ADDITIONAL FIREPLACE

KITCHEN: HOODFAN VENTING SIZE

☐ 6 IN ROUND DUCT

☒ 7 IN ROUND DUCT

FULL BASEMENT STAIRS:

Carpet Grade

UPPER BASEMENT STAIRS:

N/A

LOWER BASEMENT STAIRS:

N/A

MAIN STAIRS:

All Oak

MEDIA STAIRS (if applicable):

N/A

LOFT STAIRS (if applicable):

N/A

OCT/8/2020 *Je*
Date Purchaser:

OCT 8 2020 *df*
Date Decor Consultant:

Date Purchaser:

Locked Date:

APPROVED

-10- 16 2020

Date
Approved

Heathwood Homes (Huron) Limited



Sales Selection Sheet
Wallaceton

2 of 22

PURCHASER: GURJARMAN, SINGH SANDHU

TEL:

LOT / UNIT 204	PHASE 2	MODEL 25-2500 ALT C The Bridgeport	
-------------------	------------	---------------------------------------	--

It is herein understood and agreed between the undersigned parties hereto that the following changes shall be made to the above mentioned Agreement of Purchase and Sale in accordance with the agreement and except for such changes noted below, all other terms and conditions in the Agreement of Purchase and Sale shall remain as stated herein: It is further understood that and agreed that all changes and additions shall be installed as per builder's specifications, location and available selections. The Purchaser hereby agrees to purchase the following extras:

MISC.

1	SCHEDULE "E" TEN THOUSAND DOLLARS (\$10,000.00) AT DECOR (NO CASHE VALUE) -SINGLES	Qty: 1	
39,173	Note:		

Sub Total
HST
Total

1. This Sales Selection Sheet when properly executed forms part of our Agreement of Purchase and Sale.
2. All extras and upgrades listed above are subject to Construction Progress and Architectural and Municipal requirements.
3. In the event the Vendor is unable to incorporate the work approved above in the construction of the house for any reason whatsoever, the Vendor will not be liable to the Purchaser in any way. The monies paid for any changes or optional extras not proceeded with shall be returned to the Purchaser, without interest. The cost of options or extras is non-refundable in all other circumstances. If for any reason whatsoever the Agreement of Purchase and Sale is not completed, the total cost of work approved above will be retained by the Vendor.
4. The Vendor reserves the right to substitute above materials and equipment with that of equal or better quality.
5. Purchaser acknowledges that items may not be exactly as shown. Variations from the Vendor's samples may occur in finished materials due to normal production processes. Vendor is not responsible for shade difference which may occur from different dye lots or wood grains. Variations from the Vendor's samples will occur with natural materials such as wood, marble, granite, hardwood and brick.
6. The Vendor reserves the right to select Grout & Thresholds that best suits the Tile selected.
7. Selections will not be processed unless signed by Heathwood Homes Head Office.
8. The selections made on this schedule are final and cannot be changed once submitted.
9. The Purchaser has checked and acknowledges the accuracy of this schedule.

Payment Summary	
<u>Paid By</u>	<u>Amount</u>
<u>Total Payment:</u>	

PURCHASER:

Signature on file
GURJARMAN SINGH SANDHU

09-Oct-20
DATE

Decor Consultant
DATE

09-Oct-20
DATE

- APPROVED -

-10- 16 2020

Date Approved Heathwood Homes (Huron) Limited

TAX#:1

PREPARED BY: Irit Salem

PE 543-1

S\invoice.rpt 26may19

GURJARMAN, SINGH SANDHU/
Project: Wallaceton
Unit: 204, Phase: 2
Model: 25-2500 ALT C The Bridgeport

Created: 10/5/2020 11:33:04
Locked:
Closed:

3 of 22

Kitchen/Servery

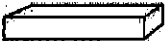
Cabinet Colour/Style	9156	Viking III-SIMCOE-RAIN CLOUD-3DL ***STD***
Countertop	9069	MSI Quartz GROUP 1 ICED WHITE ***STD***
Countertop Edge	4010	SINGLE POLISHED STRAIGHT EDGE 3/4 INCH ***STD*** 
Cabinet Hardware	7667	12881-HARDWARE ***STD***
Island Cabinet Colour/Style	9156	Viking III-SIMCOE-RAIN CLOUD-3DL ***STD***
Island Countertop	9069	MSI Quartz GROUP 1 ICED WHITE ***STD***
Backsplash	1111	N/A *****
Backsplash Grout	1111	N/A *****
Backsplash Tile Pattern	1111	N/A *****

HoodFan	1111	AV1308 Air King 30 PAGE 22
---------	------	-----------------------------------

Comment	
---------	--

Opt. Servery Upper

Cabinet - Uppers	9156	Viking III-SIMCOE-RAIN CLOUD-3DL ***STD***
Cabinet Hardware	7667	12881-HARDWARE ***STD***
Comment		

Kitchen/Breakfast/Servery

Flooring	9156	GE.MD.WHT.1818.MT Madison Series White Matte 18
Floor Tile Grout	2225	Grout-(27) Silver ***STD***
Floor Tile Pattern	3000	STANDARD SQUARE ***STD***

G.S

GURJARMAN, SINGH SANDHU/
Project: Wallaceton
Unit: 204, Phase: 2
Model: 25-2500 ALT C The Bridgeport

Created: 10/5/2020 11:33:04
Locked:
Closed:

4 of 22



Comment

Foyer

Flooring

9106GE.MD.WHT.1818.MT Madison Series White Matte 18

Floor Tile Grout

2225Grout-(27) Silver ***STD***

Floor Tile Pattern

3000STANDARD SQUARE ***STD***

Comment

Laundry Room

Flooring

9106GE.MD.WHT.1818.MT Madison Series White Matte 18

Floor Tile Grout

2225Grout-(27) Silver ***STD***

Floor Tile Pattern

3000STANDARD SQUARE ***STD***

Comment

Laundry Room Opt.

Cabinet - Uppers

1111N/A *****

Cabinet Hardware

1111N/A *****

Comment

G.S

Mud Room



GURJARMAN, SINGH SANDHU/
Project: Wallaceton
Unit: 204, Phase: 2
Model: 25-2500 ALT C The Bridgeport

Created: 10/5/2020 11:33:04
Locked:
Closed:

5 of 22

Flooring	9106	GE.MD.WHT.1818.MT Madison Series White Matte 18
Floor Tile Grout	2225	Grout-(27) Silver ***STD***
Floor Tile Pattern	3000	STANDARD SQUARE ***STD***

Comment

Powder Room

Flooring	9106	GE.MD.WHT.1818.MT Madison Series White Matte 18
Floor Tile Grout	2225	Grout-(27) Silver ***STD***
Floor Tile Pattern	3000	STANDARD SQUARE ***STD***

Plumbing Fixture (Colour)

1737	Plumbing Fixtures-WHITE ***STD***
------	-----------------------------------

Comment

0

Dining Room/Hall

Flooring	7502	Red Oak Pearl-Vintage Engineered-ECLIPSE-3/4 inch x 3 1/4 inch ***STD***
Comment	7502	

Great Room

Flooring	7502	Red Oak Pearl-Vintage Engineered-ECLIPSE-3/4 inch x 3 1/4 inch ***STD***
Comment		

Upper Hall

Flooring	9248	DY 89418 -Dynasty Tex-BLACK ICE-40 oz Poly***STD***
----------	------	---

G.S

GURJARMAN, SINGH SANDHU/
Project: Wallaceton
Unit: 204, Phase: 2
Model: 25-2500 ALT C The Bridgeport

Created: 10/5/2020 11:33:04
Locked:
Closed:

6 of 22

Comment

Finished Basement Foyer

Flooring

9248

DY 89418 -Dynasty Tex-BLACK ICE-40 oz Poly***STD***

Comment

Opt. Finished Basement (Rec) Room/Hall

Flooring

1111

N/A *****

Comment

Master Bedroom

Flooring

9248

DY 89418 -Dynasty Tex-BLACK ICE-40 oz Poly***STD***

Comment

Bedroom 2

Flooring

9248

DY 89418 -Dynasty Tex-BLACK ICE-40 oz Poly***STD***

Comment

Bedroom 3

Flooring

9248

DY 89418 -Dynasty Tex-BLACK ICE-40 oz Poly***STD***

Comment

Bedroom 4

Flooring

9248

DY 89418 -Dynasty Tex-BLACK ICE-40 oz Poly***STD***

G.S

GURJARMAN, SINGH SANDHU/
Project: Wallaceton
Unit: 204, Phase: 2
Model: 25-2500 ALT C The Bridgeport

Created: 10/5/2020 11:33:04
Locked:
Closed:

7 of 22

Comment

Ensuite 4

Cabinet Colour/Style	9157	Viking III-SIMCOE-MOONLIGHT-3DL ***STD***
Countertop	8827	4925K-07-Countertop-CALCUTTA MARBLE-Wilsonart ***STD***
Countertop Edge	1111	N/A *****
Cabinet Hardware	7667	12881-HARDWARE ***STD***
Floor Tile	7667	GE.MD.WHT.1818.MT Madison Series White Matte 18
Floor Tile Grout	2225	Grout-(27) Silver ***STD***
Floor Tile Pattern	3000	STANDARD SQUARE ***STD***

Plumbing Fixture (colour)	1737	Plumbing Fixtures-WHITE ***STD***
Wall Tile	5420	QT.SP.DGR.0810-Splendour-Dark Grey-8 inch x 10 inch ***STD***
Wall Tile Grout	2226	Grout-(00) White ***STD***
Wall Tile Pattern	3090	VERTICAL STACKED ***STD***

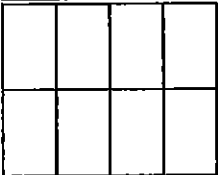

Comment

Master Ensuite

Cabinet Colour/Style	9156	Viking III-SIMCOE-RAIN CLOUD-3DL ***STD***
Countertop	9069	MSI Quartz GROUP 1 ICED WHITE ***STD***
Countertop Edge	4010	GROUP 1 - SINGLE POLISHED STRAIGHT EDGE 3/4 INCH ***1***

G.S

GURJARMAN, SINGH SANDHU/
Project: Wallaceeton
Unit: 204, Phase: 2
Model: 25-2500 ALT C The Bridgeport

Created: 10/5/2020 11:33:04
Locked:
Closed:

8 of 22

Cabinet Hardware	<div>7667</div> <div>12881-HARDWARE ***STD***</div>
Floor Tile	<div>7667</div> <div>GE.MD.WHT.1818.MT Madison Series White Matte 18</div>
Floor Tile Grout	<div>2225</div> <div>Grout-(27) Silver ***STD***</div>
Floor Tile Pattern	<div>3000</div> <div>STANDARD SQUARE ***STD***</div>
Shower Floor Tile	<div>8661</div> <div>OD.ON.SWT.0202.MT.N-Ontario Series Mosaic-Snow White Matte-2 x 2 ***STD***</div>
Shower Floor Tile Grout	<div>2226</div> <div>Grout-(00) White ***STD***</div>
Shower Floor Tile Pattern	<div>3000</div> <div>STANDARD SQUARE ***STD***</div>
Shower Wall Tile	<div>5411</div> <div>QT.SP.WHT.0810-Splendour-White-8 inch x 10 inch ***STD***</div>
Shower Wall Tile Grout	<div>2226</div> <div>Grout-(00) White ***STD***</div>
Shower Wall Tile Pattern	<div>3090</div> <div>VERTICAL STACKED ***STD***<div><div></div><div></div><div></div><div></div><div></div><div></div><div></div><div></div></div></div>
Shower Jamb(s) and Sill(s)	<div>8923</div> <div>Shower Jamb / Sill-Thassos White ***STD***</div>
Plumbing Fixture (colour)	<div>1737</div> <div>Plumbing Fixtures-WHITE ***STD***</div>
Comment	<div></div>

Shared Bathroom

Cabinet Colour/Style	<div>9157</div> <div>Viking III-SIMCOE-MOONLIGHT-3DL ***STD***</div>
Countertop	<div>8827</div> <div>4925K-07-Countertop-CALCUTTA MARBLE-Wilsonart ***STD***</div>
Countertop Edge	<div>1111</div> <div>N/A *****</div>
Cabinet Hardware	<div>7667</div> <div>12881-HARDWARE ***STD***</div>

G.S

GURJARMAN, SINGH SANDHU/
Project: Wallaceton
Unit: 204, Phase: 2
Model: 25-2500 ALT C The Bridgeport

Created: 10/5/2020 11:33:04
Locked:
Closed:

9 of 22

Flooring	7667	GE.MD.WHT.1818.MT Madison Series White Matte 18								
Floor Tile Grout	2225	Grout-(27) Silver ***STD***								
Floor Tile Pattern	3000	STANDARD SQUARE ***STD***								
Wall Tile	5420	QT.SP.DGR.0810-Splendour-Dark Grey-8 inch x 10 inch ***STD***								
Wall Tile Grout	2226	Grout-(00) White ***STD***								
Shared Bathroom Floor Tile Pattern	3090	VERTICAL STACKED ***STD*** <table><tr><td></td><td></td><td></td><td></td></tr><tr><td></td><td></td><td></td><td></td></tr></table>								
Plumbing Fixture (Colour)	1737	Plumbing Fixtures-WHITE ***STD***								
Comment										

Opt. Finished Basement Bathroom	11	N/A *****
Shower Floor Tile Grout	1111	N/A *****
Shower Floor Tile Pattern	1111	N/A *****
Shower Wall Tile	1111	N/A *****
Shower Wall Tile Grout	1111	N/A *****
Shower Wall Tile Pattern	1111	N/A *****
Shower Jamb(s)	1111	N/A *****
Cabinet Colour/Style	1111	N/A *****
Countertop	1111	N/A *****

G.S

GURJARMAN, SINGH SANDHU/
Project: Wallaceton
Unit: 204, Phase: 2
Model: 25-2500 ALT C The Bridgeport

Created: 10/5/2020 11:33:04
Locked:
Closed: 10 of 22



Countertop Edge	1111	N/A *****
Cabinet Hardware	1111	N/A *****
Flooring	1111	N/A *****
Floor Tile Grout	1111	N/A *****
Floor Tile Pattern	1111	N/A *****
Plumbing Fixture (Colour)	1111	N/A *****
Comment		

Great Room Fireplace

Type	8869	Majestic MERC32 ***STD***
Mantle	8891	NF-17-Paint Grade Mantle- Cabinet (Per Plan)-WHITE ***STD*** PAGE 18
Surround Opt.	1111	N/A *****
Comment		

Basement Stairs

Type	1713	Paint Grade Stairs ***STD BASEMENT STAIR ***
Colour	7922	Eclipse (Pewter) STAIN TO COMPLIMENT HARDWOOD AND WILL VARY FROM FLOORING ***99***
Carpet Runner	1111	N/A *****
Handrail/Pickets/Post Type	7652	1 5/16 inch Square pickets with 3 1/2" Square/Cap Post(s)-ALL OAK ***STD***
Handrail/Pickets/Post Colours	1729	Carpet Grade-Stain handrail, pickets, stringers, nosing_pos
Carpet	9248	DY 89418 -Dynasty Tex-BLACK ICE-40 oz Poly***STD***
Custom Stain/Paint	1111	N/A *****

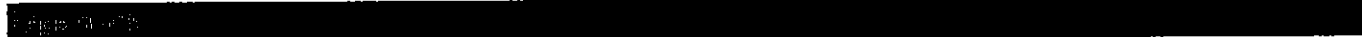

MR

GURJARMAN, SINGH SANDHU/
Project: Wallaceton
Unit: 204, Phase: 2
Model: 25-2500 ALT C The Bridgeport

Created: 10/5/2020 11:33:04
Locked:
Closed:

11 of 22

Comment

Main Stairs

Type	1712	Oak Stairs ***STD MAIN STAIRS***
Colour	7922	Eclipse (Pewter) STAIN TO COMPLIMENT HARDWOOD AND WILL VARY FROM FLOORING ***99***
Carpet Runner	1111	N/A *****
Handrail/Pickets/Posts Type	7652	1 5/16 inch Square pickets with 3 1/2" Square/Cap Post(s)-ALL OAK ***STD***
Handrail/Pickets/Posts Colour	1728	Oak Grade-Stain handrail,oak pickets,stringers,treads,risers
Custom Stain/Paint	1111	N/A *****

Comment

Throughout

Walls - Paint Colour	1717	22-Wall-WARM GREY ***STD***
Underpad	1079	500 Series-Underpad ***STD***
Thresholds	2232	Metal Thresholds ***STD***
Switches and Plug	5796	Decora White Switches and Plugs ***STD***
Trim Size	8705	4 ¼ Baseboard and 2 ¾ Casings ***STD***
Trim - Paint Colour	1716	Trim-WHITE ***STD***

Comment

Purchaser:

GURJARMAN, SINGH SANDHI

Date

Oct 8 / 2020

Decor Consultant

Date

Oct 8, 2020

Purchaser:

Date

Wallaceton

-10- 1 6 2020

Date Approved

APPROVED



Sales Selection Sheet

Wallaceton

12 of 22

PURCHASER: GURJARMAN, SINGH SANDHU

TEL:

LOT / UNIT	PHASE	MODEL	
204	2	25-2500 ALT C The Bridgeport	

It is herein understood and agreed between the undersigned parties hereto that the following changes shall be made to the above mentioned Agreement of Purchase and Sale in accordance with the agreement and except for such changes noted below, all other terms and conditions in the Agreement of Purchase and Sale shall remain as stated herein: It is further understood that and agreed that all changes and additions shall be installed as per builder's specifications, location and available selections. The Purchaser hereby agrees to purchase the following extras:

Cabinetry

1	OPT. SERVERY UPPERS UPG 1 - VIKING III	Qty: 1
39,151	Note: OPT. SERVERY UPPERS-UPG.1 SKETCH # 2 PAGE 16	

CERAMIC

2	MASTER ENSUITE CERAMIC FLOOR UPG.1	Qty: 1
39,001	Note: MASTER ENSUITE FLOOR UPG.1	
3	MAIN BATHROOM CERAMIC FLOOR UPG.1	Qty: 1
39,002	Note: MAIN FLOOR UPG 1 FLOOR	
4	ENSUITE 4 CERAMIC FLOOR UPG 1	Qty: 1
39,003	Note: ENSUITE 4 CERAMIC FLOOR UPG 1	
5	LAUNDRY ROOM CERAMIC FLOOR	Qty: 1
39,004	Note: LAUNDRY ROOM UPG 1 CERAMIC FLOOR	
6	KITCHEN FLOOR UPG 1	Qty: 1
39,005	Note: KITCHEN FLOOR UPG 1	
7	POWDER ROOM FLOOR UPG 1	Qty: 1
39,006	Note: POWDER ROOM FLOOR UPG 1	
8	MAIN HALL CERAMIC FLOOR UPG 1	Qty: 1
39,007	Note: MAIN HALL CERAMIC FLOOR UPG 1	
9	CERAMIC FLOOR UPG 1 MUDROOM AND GARAGE DOOR ENTRY	Qty: 1
39,008	Note: CERAMIC FLOOR UPG 1 MUDROOM AND GARAGE DOOR ENTRY	
10	FOYER CERAMIC FLOOR UPG. 1	Qty: 1
39,011	Note: FOYER CERAMIC FLOOR UPG. 1	

DRYWALL

TAX#:1

PREPARED BY: Irit Salem

PE 537-1

\$Invoice.rpt 28May18



Sales Selection Sheet
Wallaceton

13 of 22

PURCHASER: GURJARMAN, SINGH SANDHU

TEL:

LOT / UNIT 204	PHASE 2	MODEL 25-2500 ALT C The Bridgeport	
-------------------	------------	---------------------------------------	--

DRYWALL

11	SMOOTH CEILING - MAIN FLOOR	Qty: 1
39,012	Note: SMOOTH CEILING - MAIN FLOOR	

Electrical

12 189,45C 38,998	ELECTRICAL - CEILING ROUGH-IN (CAPPED) Note: GREAT ROOM, TO BE INSTALLED IN THE CENTRE OF THE ROOM- USE EXSITING SWITCH PLUG KITCHEN, TO BE INSTALL ABOVE THE BREAKFAST BAR - USE KITCHEN SWITCH SEE SKETCH # 2 PAGE# 16	Qty: 2
13 189,44C 38,999	ELECTRICAL - EXTRA WALL INTERIOR OUTLET ON EXISTING CIRCUIT (DOES NOT INCLUDE KITCHEN OUTLETS) Note: GREAT ROOM - TO BE USED ABOVE THE CENTRE OF FIRE PLACE 70" FROM FLOOR SEE SKETCH # 2 PAGE# 16	Qty: 1

Heating/Air

14 189,474 39,009	HEATING/AIR - ROUGH-IN GAS LINE FOR GAS STOVE AT MAIN FLOOR (SEE SPECS) (HOOK-UP NOT INCLUDED) LEAVE STANDARD 120 VOLT ELECTRICAL OUTLET ON A SEPARATE CIRCUIT. * SPECIFY IF STANDARD 220V WILL STAY OR BE RELOCATED- Note: FOR FUTURE USE SKETCH # 2 PAGE 16	Qty: 1
-------------------------	--	--------

Mirrors/Glass Pro

*15 189,478 39,000	MIRRORS/GLASS PRODUCTS -FRAMLESS SHOWER S DOORS Note: MASTER ENSUITE	Qty: 1
--------------------------	---	--------

MISC.

16 39,010	PROMO Note:	Qty: (1)
--------------	--------------------	----------

Plumbing

17 189,613 38,997	PLUMBING - BAR SINK - COMPLETE BAR SINK FOR SERVERY INCLUDES PLUMBING ROUGH-IN AND MOEN ALIGN BAR PR EP FAUCET (MODEL: 5965) AND REGINOX NS1813U/7 UNDERMOUNT SINK (INCLUDING GRANITE SINK CUTOUT/POLISH) - Note: SKETCH # 2 PAGE 16	Qty: 1
-------------------------	---	--------

Sub Total
HST
Total

Initials: G.S



Sales Selection Sheet

Wallaceton

14 of 22
TEL:

PURCHASER: GURJARMAN, SINGH SANDHU

LOT / UNIT	PHASE	MODEL	
204	2	25-2500 ALT C The Bridgeport	

1. This Sales Selection Sheet when properly executed forms part of our Agreement of Purchase and Sale.
2. All extras and upgrades listed above are subject to Construction Progress and Architectural and Municipal requirements.
3. In the event the Vendor is unable to incorporate the work approved above in the construction of the house for any reason whatsoever, the Vendor will not be liable to the Purchaser in any way. The monies paid for any changes or optional extras not proceeded with shall be returned to the Purchaser, without interest. The cost of options or extras is non-refundable in all other circumstances. If for any reason whatsoever the Agreement of Purchase and Sale is not completed, the total cost of work approved above will be retained by the Vendor.
4. The Vendor reserves the right to substitute above materials and equipment with that of equal or better quality.
5. Purchaser acknowledges that items may not be exactly as shown. Variations from the Vendor's samples may occur in finished materials due to normal production processes. Vendor is not responsible for shade difference which may occur from different dye lots or wood grains. Variations from the Vendor's samples will occur with natural materials such as wood, marble, granite, hardwood and brick.
6. The Vendor reserves the right to select Grout & Thresholds that best suits the Tile selected.
7. Selections will not be processed unless signed by Heathwood Homes Head Office.
8. The selections made on this schedule are final and cannot be changed once submitted.
9. The Purchaser has checked and acknowledges the accuracy of this schedule.

Payment Summary

Paid By Amount

Total Payment:

PURCHASER:

GURJARMAN, SINGH SANDHU

08-Oct-20
DATE

Decor Consultant

08-Oct-20
DATE

APPROVED

-10-16-2020

Date Approved Heathwood Homes (Huron) Limited

TAX#:1

PREPARED BY: Irit Salem

PE 537-3

SlInvoice.rpt 28may19

UK-75 WALLACETON
LOT 204
25-2500 ALT ELEV C
THE BRIDGEPORT

15 of 22

THE BRIDGEPORT

With finished Lower Level

ELEVATION C & D | 2,484 SQ. FT.
With 120 sq. ft. of finished Lower Level
792 sq. ft. of opt. finished Lower Level

25-2500 ELEV. C & D ALT

WALLACETON
EST. 1870

Sketch # 1

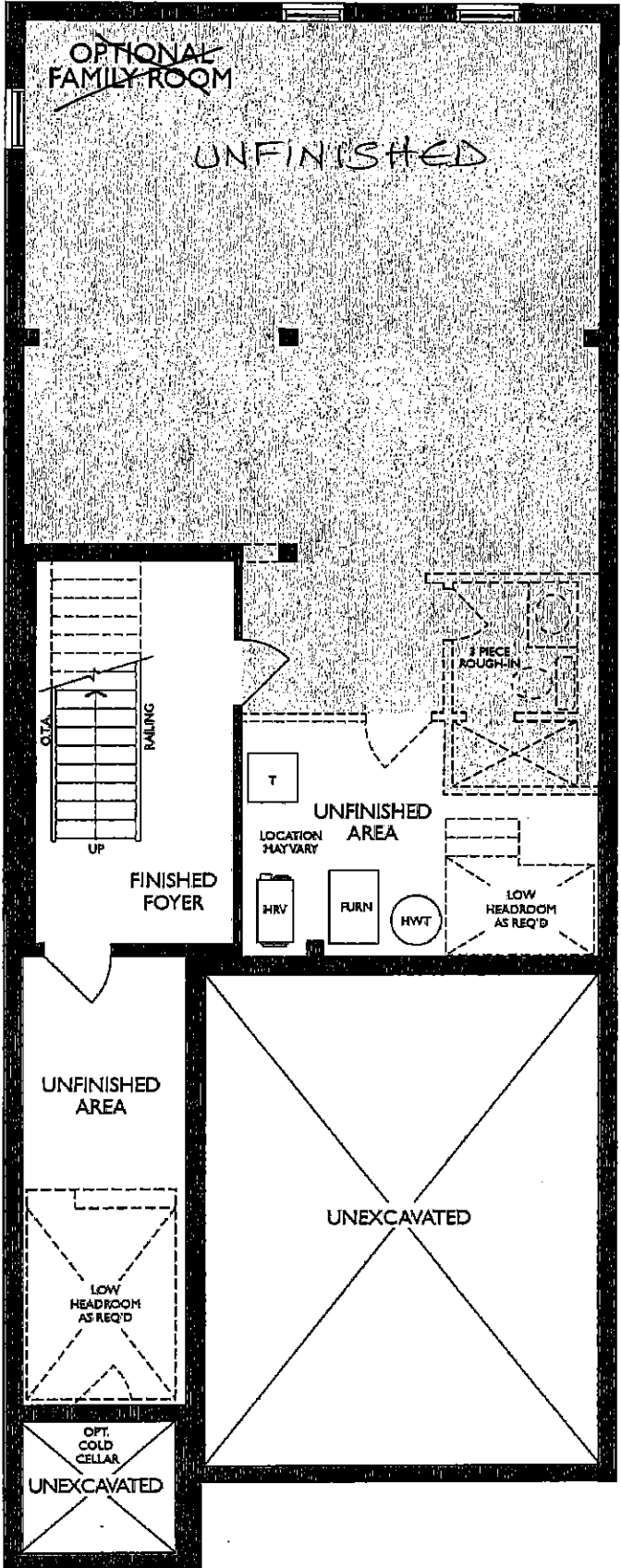

LOWER LEVEL
ELEVATION A, B, C & D

MR

UK-75 WALLACETON
LOT 204
25-2500 ALT ELEV C
THE BRIDGEPORT

16 of 22

THE BRIDGEPORT

With finished Lower Level

ELEVATION C & D | 2,484 SQ. FT.
With 120 sq. ft. of finished Lower Level

792 sq. ft. of opt. finished Lower Level

WALLACETON
EST. 1870

25-2500 ELEV. C & D ALT

Sketch #2

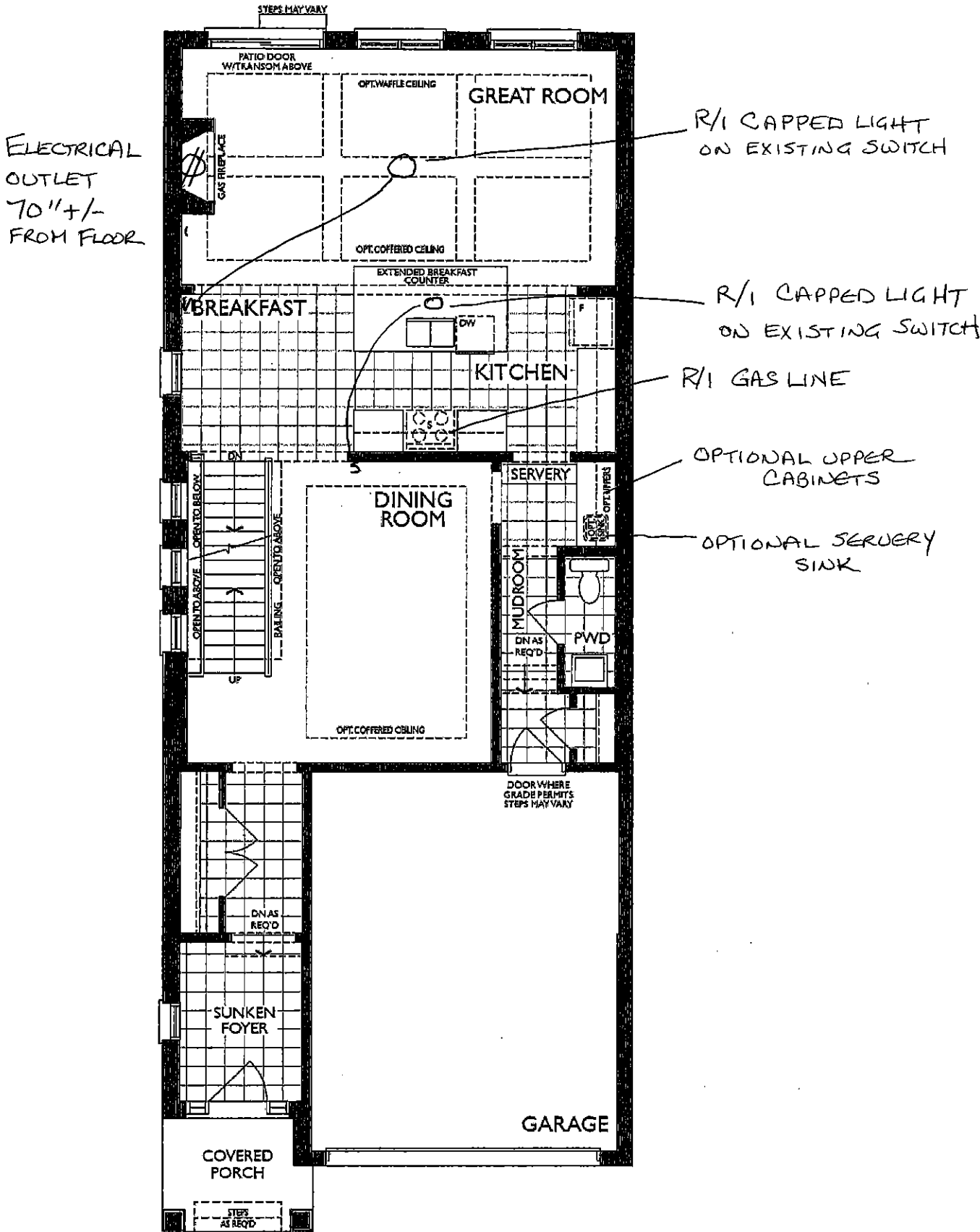

MAIN FLOOR
ELEVATION C & D

UK-75 WALLACETON
LOT 204
25-2500 ALT ELEV C
THE BRIDGEPORT

17 of 22

THE BRIDGEPORT

With finished Lower Level

ELEVATION C & D | 2,484 SQ. FT.
With 120 sq. ft. of finished Lower Level

792 sq. ft. of opt. finished Lower Level

25-2500 ELEV. C & D ALT

WALLACETON
EST. 1870

Sketch #3

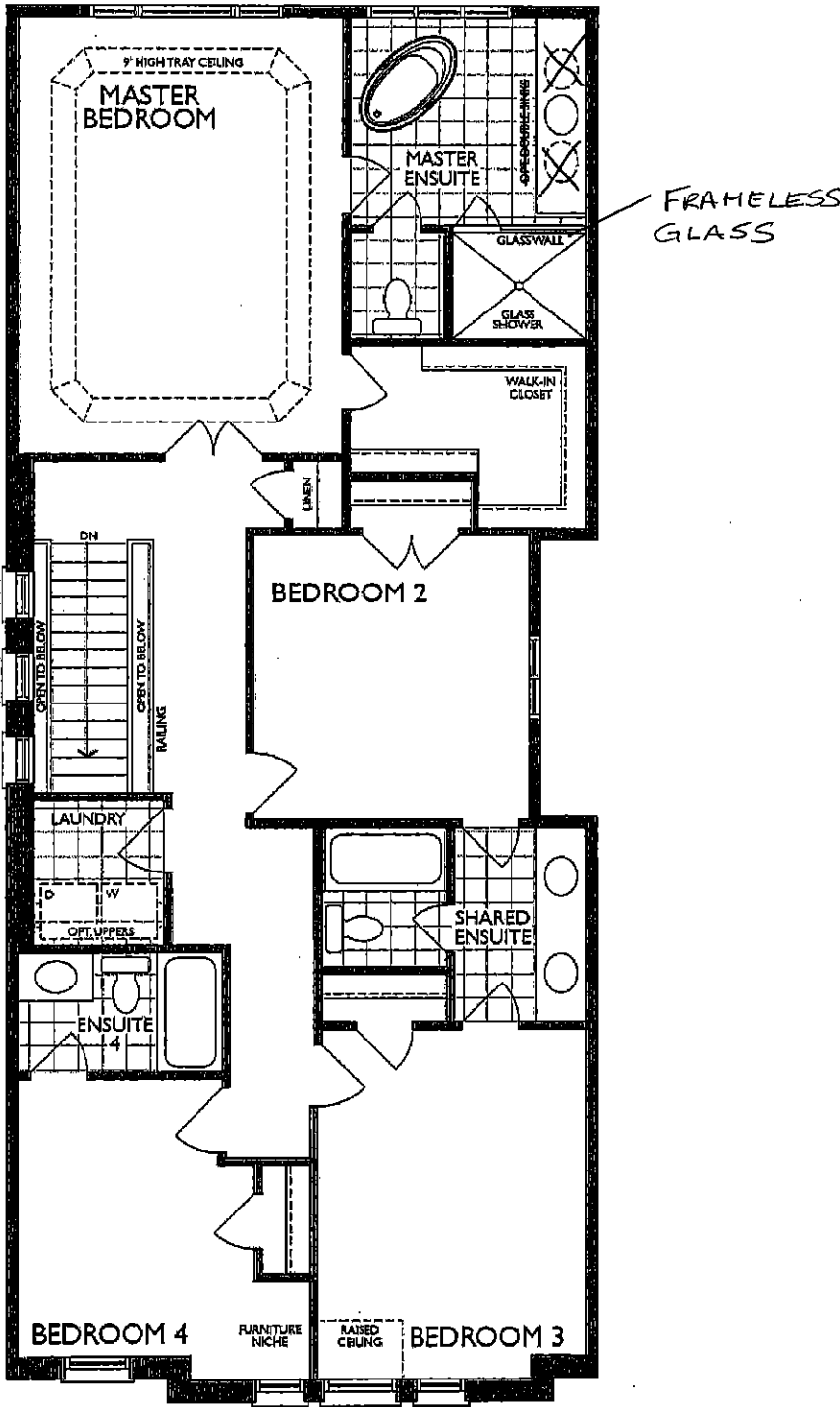

SECOND FLOOR
ELEVATION C & D

MR

UK-75 WALLACETON
LOT 204
25-2500 ALT ELEV C
THE BRIDGEPORT

18 of 22

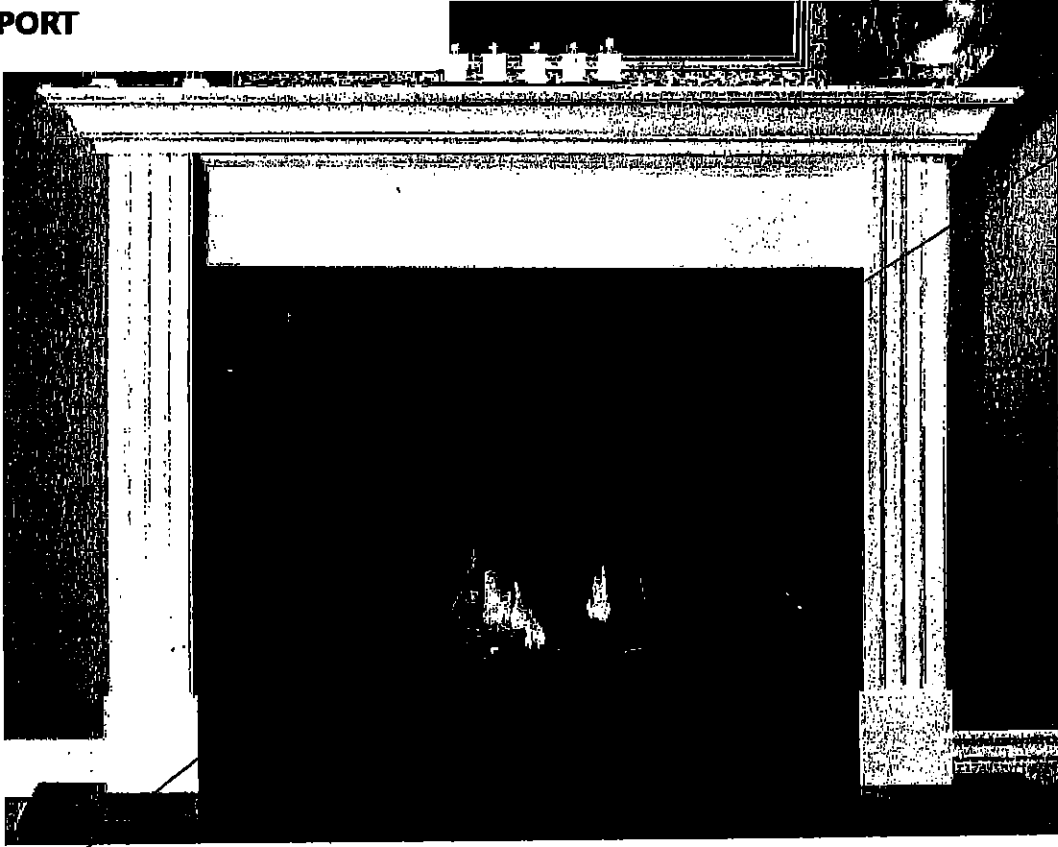

STANDARD NF 15 Mantel

Clean apron finish with fluted legs

WHITE PAINT GRADE FINISH

(PICTURE SHOWN WITH UPGRADE SURROUND AND HEARTH -PRICED SEPARATELY)

X

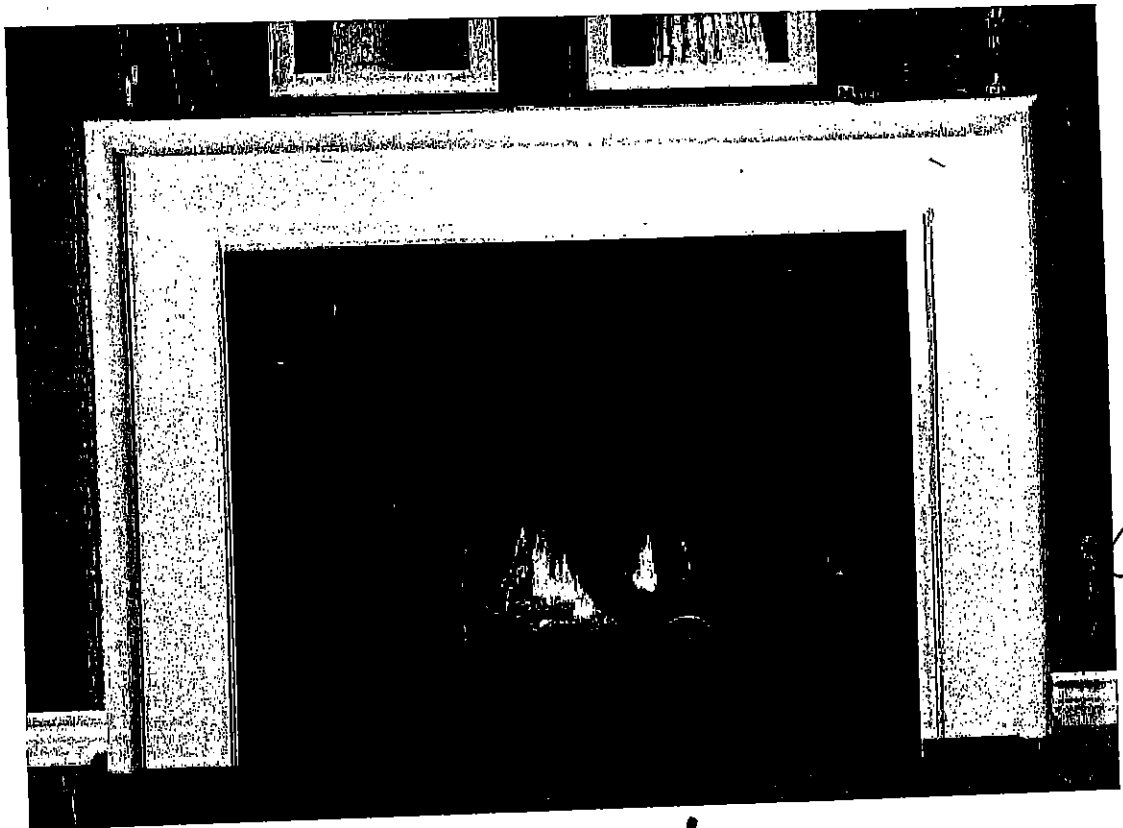

'CABINET'

STANDARD NF 17 Mantel

WHITE PAINT GRADE FINISH

(PICTURE SHOWN WITH UPGRADE SURROUND AND HEARTH -PRICED SEPARATELY)

✓

✓

G.S







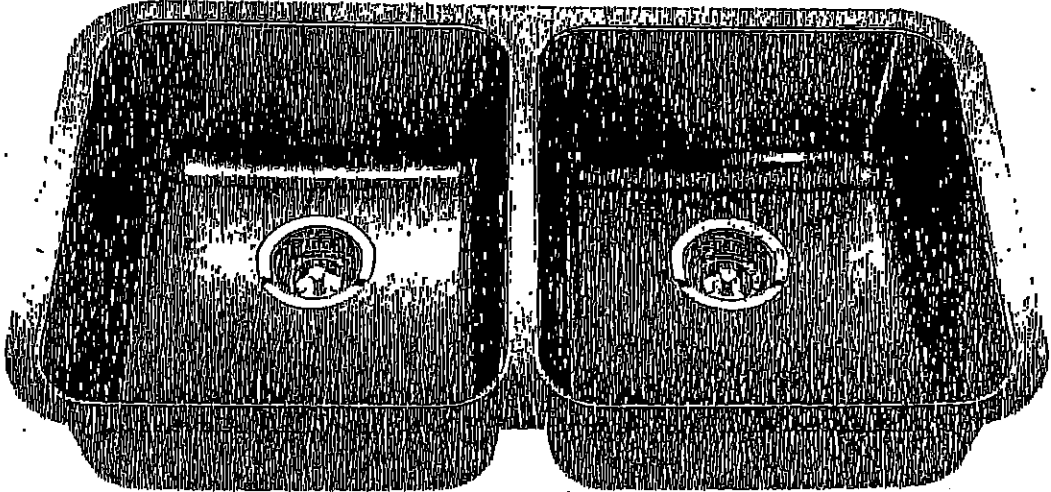

STANDARD KITCHEN SINK

ND1831UA/9



Optional Accessories

 BG105
  BG105
  MB100
  CA1W
  DBR105



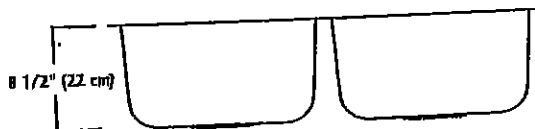
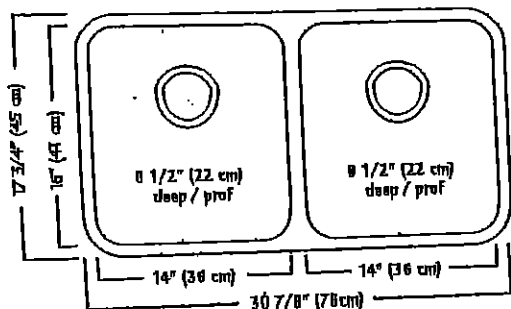

ND1831UA/9 SPECIFICATION

Model ND1831UA/9 is a double (two equal size) bowl undermount sink manufactured by Franke Kindred Canada Limited from 18 gauge stainless steel. Product has silk finished rims and linear brush finished bowls. Sink is fully undercoated. Basket strainer waste fittings (3 1/2", 89 mm) are included. Sink is backed with a limited lifetime warranty.

- O.D. 17 3/4" x 30 7/8" x 14 1/2" (45 x 78 x 22 cm)
- Recommended for minimum 36" cabinet

Franke Kindred Canada Limited
 P.O. Box 190, 1000 Franke Kindred Road, Midland, Ontario, Canada, L4R 4K9 Phone: 866-687-7465 Fax: 800-361-8408

K.Y. 6.5

UK-75 WALLACETON
LOT 204
25-2500 ALT ELEV C
THE BRIDGEPORT

20 of 22

STANDARD KITCHEN FAUCET

Align

Modern

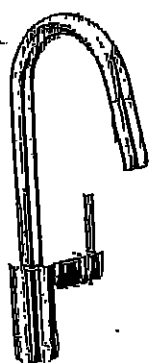

Single Handle Pull-Down Kitchen
Faucet*

Model 7565†

G.S

Kip

UK-75 WALLACETON
LOT 204
25-2500 ALT ELEV C
THE BRIDGEPORT

21 of 22

Chateau

Transitional

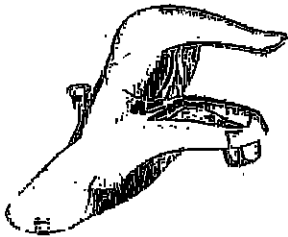

Lavatory Faucet with Pop-Up Drain
Model L4621+

VANITY SINKS AND PEDESTAL



Posi-Temp® Pressure Balancing Tub/Shower
Model 62320 / TL183+

OR

Posi-Temp Valve and Tub/Shower Trim
with Eco-Performance Easy Clean® XL

Model 62320 / TL183EP+

(TL183EP not available in BC)

SHOWER AND 5' TUB FAUCETS

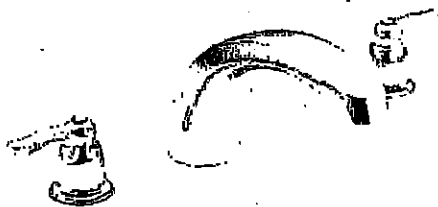

2 Handle Roman Tub with 9" Spout
Model 4796 / T990+

FREESTANDING TUB FAUCETS

G.S

UK-75 WALLACETON
LOT 204
25-2500 ALT ELEV C
THE BRIDGEPORT

STANDARD HOODFAN FOR
WALLACETON TOWNS AND SINGLES

22 of 22



SPECIFICATIONS
AV SERIES
RANGE HOODS



180 CFM/7.0 Sones @ 0.10" SP. Horizontal
180 CFM/7.5 Sones @ 0.10" SP. Vertical

• **Dimensions**

Overall bottom projection - 18 3/8"
Overall top projection - 12"
Height - 6"
Available widths: 21", 24", 30", 36" & 42"

• **Hood Body**

Stainless Steel: 24 gauge, grade 430 stainless steel.
Painted: 23 gauge cold rolled commercial grade (CRCC) steel, auto welded, coated with a baked enamel finish.

• **Motor**

2 speed, single coil, thermally protected, permanently lubricated.
Rated 120 volts, 60 hz. Complete with 200°C lead wires

• **Lighting**

Single 60 watt cook light capacity (bulb not included).

• **Ducting Options**

Horizontal ducting: 3 1/4" x 10" (duct adapter and damper included).
Vertical ducting: 3 1/4" x 10" (duct adapter and damper included).
Vertical ducting: 7" round (duct adapter and damper not included).
Ductless; removable front vent (charcoal filter not included).

• **Fan Blade**

One piece polymeric, electronically balanced blade. 6 5/8" diameter with 5 paddles.

• **Electrical connection**

Hood top - 7/8" knockout hole for use with 1/2" cable clamp
Hood back - 7/8" knockout hole for use with 1/2" cable clamp

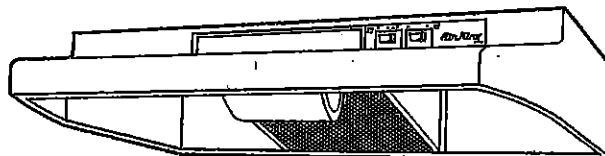

AV SERIES

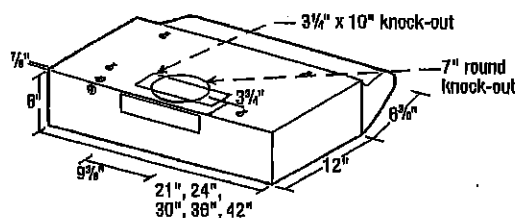

• **Filters**

UL rated, class 2 filter.
Grease Filter: RF35 - 8 7/8" x 10 3/8" (included).
Charcoal Filter: RF34 (not included).
Combo Grease/Charcoal: RF55 (not included).

• **Available Finishes**

White, Biscuit, Almond, Black & Stainless Steel.

EXPANDED PERFORMANCE

Air Flow - CFM	Static Pressure (inches of w.g.)						Sones @ .1 SP	Fan Speed RPM	Power Watts	Amps
	0	0.05	0.1	0.15	0.2	0.25				
Vertical Ducting High	248	232	218	203	181	147	7.5	2973	87.0	2.1
Horizontal Ducting High	225	210	180	176	155	120	7.0	3024	87.0	2.1

PROJECT							ARCHITECT			
LOCATION							ENGINEER			
CONTRACTOR							SUBMITTED BY		DATE	
FAN NUMBER	MODEL NUMBER	CFM	IN W.G.	RPM	WATTS	AMPS	SONES	QTY	OPTIONAL EQUIPMENT & REMARKS	



Air King: 820 Lincoln Avenue
West Chester, Pennsylvania 19380-4466
Tel: (610) 692-7400 • 877-304-3785
Fax: (610) 696-8048

Canada:
Brampton, Ontario
Tel: 905-456-2033
Fax: (905) 456-1015

Specifications subject to change without notice.

Updated 2-10

G.5