

PRE-Sales Selection Sheet
Checklist

1 of 28

LOT 211 Model: 25-2140 ALT B The Wallace

PURCHASERS: THU, PHUONG TRAN/

VENDOR: Heathwood Homes (Huron) Limited

OPTIONAL DOUBLE SINKS IN MASTER ENSUITE BATHROOM

- ☐ FINISHED BASEMENT
☒ COLD CELLAR

UPGRADED / MODIFIED ELEVATION

- ☐ CORNER UPGRADE
☐ REAR UPGRADE

CEILING UPGRADE - SMOOTH

- ☐ MAIN FLOOR
☐ SECOND FLOOR
☐ BASEMENT

ADDITIONAL ROUGH-INS

- ☒ 200 AMP SERVICE
☐ WET BAR ROUGH-IN
☐ HUMIDIFIER
☒ AIR CONDITIONING

GAS ROUGH-IN

- ☐ STOVE
☐ DRYER
☐ BBQ
☐ ADDITIONAL FIREPLACE

KITCHEN: HOODFAN VENTING SIZE

- ☒ 6 IN ROUND DUCT
☐ 7 IN ROUND DUCT

FULL BASEMENT STAIRS:

Carpet Grade

UPPER BASEMENT STAIRS:

N/A

LOWER BASEMENT STAIRS:

N/A

MAIN STAIRS:

All Oak

MEDIA STAIRS (if applicable):

N/A

LOFT STAIRS (if applicable):

N/A

Oct 19/20 Signature on
Date Purchaser:

file

Oct 19/20 Brenda hukers
Date Decor Consultant:

APPROVED

-10- 27 2020

Date Purchaser:

Date

Heathwood Homes (Huron) Limited

Locked Date:

Approved



Sales Selection Sheet

Wallaceton

2 of 28

PURCHASER: THU, PHUONG TRAN

TEL:

LOT / UNIT	PHASE	MODEL	
211	2	25-2140 ALT B The Wallace	

It is herein understood and agreed between the undersigned parties hereto that the following changes shall be made to the above mentioned Agreement of Purchase and Sale in accordance with the agreement and except for such changes noted below, all other terms and conditions in the Agreement of Purchase and Sale shall remain as stated herein: It is further understood that and agreed that all changes and additions shall be installed as per builder's specifications, location and available selections. The Purchaser hereby agrees to purchase the following extras:

FRAMING

1	ALTERNATE MAIN FLOOR WITH MODIFIED ACCES TO MUDROOM	Qty: 1	
43,213	Note:		

MISC.

2	TEN THOUSAND DOLLARS (\$10,000) AT DECOR (NO CASH VALUE) As per Revised Schedule E dated October 14/20	Qty: 1	
43,212	Note:		

Sub Total

HST

Total

1. This Sales Selection Sheet when properly executed forms part of our Agreement of Purchase and Sale.
2. All extras and upgrades listed above are subject to Construction Progress and Architectural and Municipal requirements.
3. In the event the Vendor is unable to incorporate the work approved above in the construction of the house for any reason whatsoever, the Vendor will not be liable to the Purchaser in any way. The monies paid for any changes or optional extras not proceeded with shall be returned to the Purchaser, without interest. The cost of options or extras is non-refundable in all other circumstances. If for any reason whatsoever the Agreement of Purchase and Sale is not completed, the total cost of work approved above will be retained by the Vendor.
4. The Vendor reserves the right to substitute above materials and equipment with that of equal or better quality.
5. Purchaser acknowledges that items may not be exactly as shown. Variations from the Vendor's samples may occur in finished materials due to normal production processes. Vendor is not responsible for shade difference which may occur from different dye lots or wood grains. Variations from the Vendor's samples will occur with natural materials such as wood, marble, granite, hardwood and brick.
6. The Vendor reserves the right to select Grout & Thresholds that best suits the Tile selected.
7. Selections will not be processed unless signed by Heathwood Homes Head Office.
8. The selections made on this schedule are final and cannot be changed once submitted.
9. The Purchaser has checked and acknowledges the accuracy of this schedule.

Payment Summary	
<u>Paid By</u>	<u>Amount</u>
<u>Total Payment:</u>	

PURCHASER:

Signature on file
THU, PHUONG TRAN

27-Oct-20
DATE

BRENDA LUKER
Decor Consultant

27-Oct-20
DATE

APPROVED

-10- 27 2020

Date Approved Heathwood Homes (Huron) Limited

TAX#:1

PREPARED BY: Marilyn Rosen

PE 582-1

S\invoice.rpt 28may19

THU, PHUONG TRAN/
Project: Wallaceton
Unit: 211, Phase: 2
Model: 25-2140 ALT B The Wallace

Created: 10/9/2020 15:36:00
Locked:
Closed:

3 of 28

Kitchen

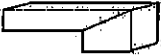
Cabinet Colour/Style	9111	VIKING III SIMCOE ORCHID 3DL ***STD***
Countertop	7885	Group 6-Quartz- Caesarstone-FROSTY CARRINA # 5141-3/4 inch with built-up edge ***6***
Countertop Edge	4005	DOUBLE MITRE 1 1/2 INCH ***UPG*** 
Cabinet Hardware	7667	12881-HARDWARE ***STD***
Island Cabinet Colour/Style	9111	VIKING III SIMCOE ORCHID 3DL ***STD***
Island Countertop	7885	Group 6-Quartz- Caesarstone-FROSTY CARRINA # 5141-3/4 inch with built-up edge ***6***
Backsplash	1111	N/A
Backsplash Grout	1111	N/A
Backsplash Tile Pattern	1111	N/A

HoodFan	9117	SCB50030-CYCLONE 30 inch CANOPY CHIMNEY HOODFAN-SS PAGES 25-26
Appliance	9117	Purchasers have been advised: standard fridge opening is a minimum 37 3/8 x 73 3/8". Ice Waterline Rough-In is included.
Appliance	9117	Standard stove opening is 30" and standard dishwasher opening is 24". Any gas stove will require backsplash or stainless steel backing to avoid fire hazards.
Appliance	9117	Purchasers acknowledge: Heathwood Homes and its contractors will not be responsible for any kitchen cabinet changes due to appliances dimension changes after
Comment		

Kitchen/Breakfast

Flooring	8913	UN.BL.BIA.1224-Biel-Bianco (White)-12 x 24 See Tile Direction on Sketch 2 Page 18 ***2***
Floor Tile Grout	7705	Grout-(01) Alabaster ***UPG***
Floor Tile Pattern	3040	FRONT TO BACK ***STD***

P7

THU, PHUONG TRAN/
Project: Wallaceton
Unit: 211, Phase: 2
Model: 25-2140 ALT B The Wallace

Created: 10/9/2020 15:36:00
Locked:
Closed:

4 of 28

Comment

Foyer

Flooring

8913

UN.BL.BIA.1224-Biel-Bianco (White)-12 x 24 See Tile
Direction on Sketch 2 Page 18 ***2***

Floor Tile Grout

7705

Grout-(01) Alabaster ***UPG***

Floor Tile Pattern

3050

SIDE TO SIDE ***STD***

Comment

Laundry Room

Flooring

3050

GE.BY.AZR.1313 New Byzantine Azzuro 13

Floor Tile Grout

2225

Grout-(27) Silver ***STD***

Floor Tile Pattern

3000

STANDARD SQUARE ***STD***

Comment

Laundry Room Opt.

Cabinet - Uppers

1111

N/A *****

Cabinet Hardware

1111

N/A *****

Comment

Mud Room

Flooring

8913

UN.BL.BIA.1224-Biel-Bianco (White)-12 x 24 See Tile
Direction on Sketch 2 Page 18 ***2***

PO

THU, PHUONG TRAN/
Project: Wallaceton
Unit: 211, Phase: 2
Model: 25-2140 ALT B The Wallace

Created: 10/9/2020 15:36:00
Locked:
Closed:

5 of 28

Floor Tile Grout 7705 Grout-(01) Alabaster ***UPG***
Floor Tile Pattern 3050 SIDE TO SIDE ***STD***

Comment

Powder Room

Flooring 8913 UN.BL.BIA.1224-Biel-Bianco (White)-12 x 24 See Tile
Direction on Sketch 2 Page 18 ***2***
Floor Tile Grout 7705 Grout-(01) Alabaster ***UPG***
Floor Tile Pattern 3050 SIDE TO SIDE ***STD***

Plumbing Fixture (Colour) 1737 Plumbing Fixtures-WHITE ***STD***
Comment

Dining Room/Hall

Flooring 7498 Red Oak Pearl-Vintage Engineered-IRONGATE-3/4 inch x
3 1/4 inch ***STD***
Comment

Dining Room/Hall

Flooring 7498 Red Oak Pearl-Vintage Engineered-IRONGATE-3/4 inch x
3 1/4 inch ***STD***
Comment
DUPLICATE

Great Room

Flooring 7498 Red Oak Pearl-Vintage Engineered-IRONGATE-3/4 inch x
3 1/4 inch ***STD***
Comment

PD

THU, PHUONG TRAN/
Project: Wallaceton
Unit: 211, Phase: 2
Model: 25-2140 ALT B The Wallace

Created: 10/9/2020 15:36:00
Locked:
Closed:

6 of 28

Upper Hall

Flooring 7498 Red Oak Pearl-Vintage Engineered-IRONGATE-3/4 inch x 3 1/4 inch ***3***

Comment

Opt. Finished Basement (Rec) Room/Hall

Flooring 1111 N/A *****

Comment

Master Bedroom

Flooring 9246 DY 84558 -Dynasty Tex-BEACH SHELL-40 oz Poly***STD***

Comment

Bedroom 2

Flooring 9246 DY 84558 -Dynasty Tex-BEACH SHELL-40 oz Poly***STD***

Comment

Bedroom 3

Flooring 9246 DY 84558 -Dynasty Tex-BEACH SHELL-40 oz Poly***STD***

Comment

Bedroom 4

Flooring 9246 DY 84558 -Dynasty Tex-BEACH SHELL-40 oz Poly***STD***

Comment

121

THU, PHUONG TRAN/
Project: Wallaceton
Unit: 211, Phase: 2
Model: 25-2140 ALT B The Wallace

Created: 10/9/2020 15:36:00

Locked:

Closed:

7 of 28

Master Ensuite

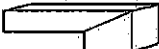
Cabinet Colour/Style	9111	VIKING III SIMCOE ORCHID 3DL ***STD***
Countertop	8595	Group 2-Quartz-Caesarstone-OCEAN FOAM #6141-3/4 inch with built-up edge ***2***
Countertop Edge	4007	GROUP 2 TO 7 - DOUBLE MITRE 1 1/2 INCH ***3***
Cabinet Hardware	7672	135-HARDWARE ***STD*** 
Floor Tile	8913	UN.BL.BIA.1224-Biel-Bianco (White)-12 x 24 See Tile Direction on Sketch 3 Page 19 ***2***
Floor Tile Grout	7705	Grout-(01) Alabaster ***UPG***
Floor Tile Pattern	3050	SIDE TO SIDE ***STD***

Shower Floor Tile	8661	OD.ON.SWT.0202.MT.N-Ontario Series Mosaic-Snow White Matte-2 x 2 ***STD***
Shower Floor Tile Grout	2226	Grout-(00) White ***STD***
Shower Floor Tile Pattern	3000	STANDARD SQUARE ***STD***

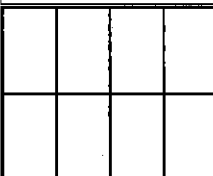
Shower Wall Tile	9020	QT.WV.WHT.0810-Weave-White-8 x 10 ***STD*** 
Shower Wall Tile Grout	2226	Grout-(00) White ***STD***
Shower Wall Tile Pattern	3090	VERTICAL STACKED ***STD*** 
Shower Jamb(s) and Sill(s)	8923	Shower Jamb / Sill-Thassos White ***STD***
Plumbing Fixture (colour)	1737	Plumbing Fixtures-WHITE ***STD***

Comment

THU, PHUONG TRAN/
Project: Wallaceton
Unit: 211, Phase: 2
Model: 25-2140 ALT B The Wallace

Created: 10/9/2020 15:36:00

Locked:

Closed:

8 of 28

Main Bathroom

Cabinet Colour/Style	9111	VIKING III SIMCOE ORCHID 3DL ***STD***
Countertop	8595	Group 2-Quartz-Caesarstone-OCEAN FOAM #6141-3/4 inch with built-up edge ***3***
Countertop Edge	4007	GROUP 2 TO 7 - DOUBLE MITRE 1 1/2 INCH ***3***
Cabinet Hardware	7672	135-HARDWARE ***STD***
Flooring	8913	UN.BL.BIA.1224-Biel-Bianco (White)-12 x 24 See Tile Direction on Sketch 3 Page 19 ***2***
Floor Tile Grout	7705	Grout-(01) Alabaster ***UPG***
Floor Tile Pattern	3050	SIDE TO SIDE ***STD***

Wall Tile	9020	QT.WV.WHT.0810-Weave-White-8 x 10 ***STD***
Wall Tile Grout	2226	Grout-(00) White ***STD***
Main Bathroom Tile Pattern	3090	VERTICAL STACKED ***STD***
Plumbing Fixture (Colour)	1737	Plumbing Fixtures-WHITE ***STD***

Comment

Opt. Shower Floor Tile

Shower Floor Tile Grout	1111	N/A *****
Shower Floor Tile Pattern	1111	N/A *****
Shower Wall Tile	1111	N/A *****
Shower Wall Tile Grout	1111	N/A *****

MR

THU, PHUONG TRAN/
Project: Wallaceton
Unit: 211, Phase: 2
Model: 25-2140 ALT B The Wallace

Created: 10/9/2020 15:36:00

Locked:

Closed:

9 of 28

Shower Wall Tile Pattern1111N/A *****

Shower Jamb(s)1111N/A *****

Cabinet Colour/Style1111N/A *****

Countertop1111N/A *****

Countertop Edge1111N/A *****

Cabinet Hardware1111N/A *****

Flooring1111N/A *****

Floor Tile Grout1111N/A *****

Floor Tile Pattern1111N/A *****

Plumbing Fixture (Colour)1111N/A *****

Comment

Great Room Fireplace

Type8869Majestic MERC32 ***STD***

Mantle8891NF-17-Paint Grade Mantle- Cabinet (Per Plan)-WHITE
STDPAGE 20

Surround Opt.1111N/A *****

Note

Note1111Heathwood and its contractors will not be liable for any
damage on items placed/installed above a FP after closing.

Comment

Basement Stairs

Type1713Paint Grade Stairs ***STD BASEMENT STAIR ***

Handwritten signature

THU, PHUONG TRAN/
Project: Wallaceton
Unit: 211, Phase: 2
Model: 25-2140 ALT B The Wallace

Created: 10/9/2020 15:36:00
Locked:
Closed:

10 of 28

Colour	1111	N/A *****
Carpet Runner	1111	N/A *****
Handrail/Pickets/Post Type	1111	N/A *****
Handrail/Pickets/Post Colours	1111	N/A *****
Carpet	1111	N/A *****
Custom Stain/Paint	1111	N/A *****
Comment		

Landing to Basement

Flooring	7498	Red Oak Pearl-Vintage Engineered-IRONGATE-3/4 inch x 3 1/4 inch ***STD***
Comment		

Main Stairs

Type	1712	Oak Stairs ***STD MAIN STAIRS***
Colour	7912	Irongate (Gryphon) STAIN TO COMPLIMENT HARDWOOD AND WILL VARY FROM FLOORING
Carpet Runner	1111	N/A *****
Handrail/Pickets/Posts Type	8148	Single Collar Alt. Plain w/ Shoes with 3 1/2" Square/Cap Post(s)-BLACK ***2***
Handrail/Pickets/Posts Colour	7761	Oak Grade-Stain handrail,stringers,treads,risers,nosingpost
Custom Stain/Paint	1111	N/A *****
Comment		

Hall

Flooring	1111	N/A *****
----------	------	-----------

12

THU, PHUONG TRAN/
Project: Wallaceton
Unit: 211, Phase: 2
Model: 25-2140 ALT B The Wallace

Created: 10/9/2020 15:36:00
Locked:
Closed:

11 of 28

Comment

Throughout

Walls - Paint Colour	1717	22-Wall-WARM GREY ***STD***
Underpad	1079	500 Series-Underpad ***STD***
Thresholds	2232	Metal Thresholds ***STD***
Switches and Plug	5796	Decora White Switches and Plugs ***STD***
Trim Size	8705	4 1/4 Baseboard and 2 1/4 Casings ***STD***
Trim - Paint Colour	1716	Trim-WHITE ***STD***

Comment

Purchaser:

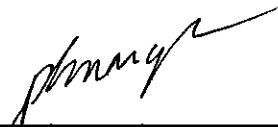

THU, PHUONG TRAN

Date

Oct. 19. 20



Decor Consultant

Date

Oct. 19. 20

Purchaser:

Date



Wallaceton

Date Approved

-10- 27 2020

- APPROVED -



Sales Selection Sheet

Wallaceton

12 of 28

PURCHASER: THU, PHUONG TRAN

TEL:

LOT / UNIT 211	PHASE 2	MODEL 25-2140 ALT B The Wallace	
-------------------	------------	------------------------------------	--

It is herein understood and agreed between the undersigned parties hereto that the following changes shall be made to the above mentioned Agreement of Purchase and Sale in accordance with the agreement and except for such changes noted below, all other terms and conditions in the Agreement of Purchase and Sale shall remain as stated herein: It is further understood that and agreed that all changes and additions shall be installed as per builder's specifications, location and available selections. The Purchaser hereby agrees to purchase the following extras:

APPLIANCES

1	CYCLONE SC B 500 ALITO COLLECTION HOOD FAN 30"	Qty: 1
40,338	Note: SPECS PAGES 25-26	

Cabinetry

2	CABINETRY - 11A-UPPER ANGLE CORNER PER UNIT - UPGRADE 1	Qty: 1
189,343		
40,335	Note: SKETCH # 2 PAGE 18	
3	CABINETRY - 33H-BASE CABINET FOR UNDER-COUNTER MICROWAVE/SMALL APPLIANCE WITH TRIM KIT WITH DRAWER BELOW (SUPPLY SPECS) - UPGRADE 1	Qty: 1
189,220		
40,337	Note: INSTALL BESIDE FRIDGE SKETCH # 2 PAGE 18 SPECS PAGES 27-28	

Ceramics

4	CERAMICS - FLOOR - FOYER - UPGRADE 2	Qty: 1
193,352		
40,343	Note:	
5	CERAMICS - FLOOR - GARAGE ENTRY / MUD ROOM - UPGRADE 2	Qty: 1
193,475		
40,344	Note:	
6	CERAMICS - FLOOR - POWDER ROOM - UPGRADE 2	Qty: 1
193,456		
40,345	Note:	
7	CERAMICS - FLOOR - KITCHEN - UPGRADE 2	Qty: 1
193,376		
40,346	Note:	
8	CERAMICS - FLOOR GROUT - FOYER - GROUT	Qty: 1
193,282		
40,350	Note:	
9	CERAMICS - FLOOR GROUT - GARAGE ENTRY / MUD ROOM - GROUT	Qty: 1
193,285		
40,351	Note:	
10	CERAMICS - FLOOR GROUT - KITCHEN - GROUT	Qty: 1
193,287		
40,352	Note:	

Initials: PT

TAX#:1

PREPARED BY: Brenda Luker

PE 548-1

\$Invoice.rpt 28may19



Sales Selection Sheet

Wallaceton

13 of 28

PURCHASER: THU, PHUONG TRAN

TEL:

LOT / UNIT 211	PHASE 2	MODEL 25-2140 ALT B The Wallace	
-------------------	------------	------------------------------------	--

Ceramics

11 193,283 40,353	CERAMICS - FLOOR GROUT - POWDER ROOM - GROUT Note:	Qty: 1
12 193,515 40,358	CERAMICS - FLOOR - ENSUITE MASTER - UPGRADE 2 Note:	Qty: 1
13 193,290 40,360	CERAMICS - FLOOR GROUT - ENSUITE MASTER - GROUT Note:	Qty: 1
14 193,289 40,361	CERAMICS - FLOOR GROUT - MAIN BATHROOM - GROUT Note:	Qty: 1
15 193,507 40,363	CERAMICS - FLOOR - MAIN BATHROOM - UPGRADE 2 Note:	Qty: 1

Cold Cellar

16 193,278 40,367	COLD CELLAR - UPGRADE 1 Note: SKETCH #1 PAGE 17	Qty: 1
-------------------------	--	--------

Electrical

17 189,440 40,339	ELECTRICAL - EXTRA WALL INTERIOR OUTLET (120V/15A) ON A SEPARATE CIRCUIT (ON ARCAULT) Note: FOR BUILT IN MICRO SKETCH #2 PAGE 16 SPECS PAGES 27-28	Qty: 1
18 189,417 40,369	ELECTRICAL - RELOCATION OF SWITCHES/LIGHTS (MUST SPECIFY LOCATION) - NOTE: PLUGS CANNOT BE RELOCATED- MUST PURCHASE ADDITIONAL OUTLET. Note: RELOCATE STD KITCHEN LIGHT TO OVER ISLAND SKETCH #2 PAGE 18	Qty: 1
19 189,449 40,370	ELECTRICAL - EXTRA WALL INTERIOR OUTLET ON EXISTING CIRCUIT (DOES NOT INCLUDE KITCHEN OUTLETS) Note: GREAT ROOM OVER FIREPLACE APPROX 66" FF SKETCH #2 PAGE 18	Qty: 1

Granite

20 189,463 40,365	GRANITE - GRANITE CUTOUT W/ STRAIGHT EDGE POLISH TO ACCOMMODATE UNDER MOUNT VANITY SINK Note: FOR MAIN BATH SINK SPEC PAGE 23	Qty: 1
21 193,570 41,068	GRANITE - COUNTERTOP - 3/4" GROUP 6 WITH MITRE EDGE - KITCHEN / ISLAND - UPGRADE 6 Note:	Qty: 1

Initials: PT

TAX#:1

PREPARED BY: Brenda Luker

PE 548-2

Sinvoice.rpt 26may19



Sales Selection Sheet

Wallaceton

14 of 28

PURCHASER: THU, PHUONG TRAN

TEL:

LOT / UNIT 211	PHASE 2	MODEL 25-2140 ALT B The Wallace	
-------------------	------------	------------------------------------	--

Granite

22 193,581 41,069	GRANITE - COUNTERTOP WITH 4" BACKSPLASH - 3/4" GROUP 2 WITH MITRE EDGE - MAIN BATHROOM - UPGRADE 3 Note:	Qty: 1
-------------------------	---	--------

Hardwood

23 193,632 40,355	HARDWOOD - VINTAGE - 3-1/4" RED OAK ENGINEERED - UPPER HALL - STANDARD SERIES Note:	Qty: 1
-------------------------	--	--------

Interior Railing

24 193,189 40,356	INTERIOR RAILING - BLACK METAL - SINGLE COLLAR ALT. PLAIN W/ SHOES WITH 3 1/2" SQUARE/CAP POST(S) AS PER PLAN - THOUGHOUT - UPGRADE 2 Note:	Qty: 1
-------------------------	--	--------

Mirrors/Glass Pro

25 193,191 40,368	MIRRORS/GLASS PRODUCTS - UPGRADE TO FRAMELESS CLEAR GLASS WITH D-RING HANDLE IN CHROME - ENSUITE MASTER Note:	Qty: 1
-------------------------	--	--------

MISC.

26 40,334	TEN THOUSAND DOLLARS TO BE USED AT DECOR (\$10,000) Note:	Qty: 1
------------------	--	--------

Plumbing

27 189,722 40,342	PLUMBING - KITCHEN SINK UPGRADE - BLANCO KITCHEN SINK QUATRUS U 1 MAXI #401248 (32 INCH X 18 INCH) Note: SPEC PAGE 21	Qty: 1
28 189,694 40,359	PLUMBING - OPTION FROM ONE SINK TO DOUBLE SINKS, INCLUDING STD CHATEAU FAUCET AND UNDERMOUNT OVALYN INCLUDING STD CHATEAU FAUCET AND UNDERMOUNT OVALYN SINK INCLUDING CABINET CONVERSION 2D VIKING, ONE EXTRA CUTOUT AND ONE EXTRA VANITY LIGHT Note: MASTER ENSUITE SKETCH # 3 PAGE 19	Qty: 1
29 189,535 40,366	PLUMBING - AMERICAN STANDARD - SINK OPTIONS - UNDERMOUNT SINK - OVALYN MODEL 0496 221 020 (19 1/4" X Note: MAIN BATH SPEC PAGE 23	Qty: 1

Sub Total
HST
Total

Initials: PT

TAX#:1

PREPARED BY: Brenda Luker

PE 548-3

S\invoice.rpt 28may19



Sales Selection Sheet

Wallaceton

REVISED

15 of 28

PURCHASER: THU, PHUONG TRAN

TEL:

LOT / UNIT	PHASE	MODEL	
211	2	25-2140 ALT B The Wallace	

It is herein understood and agreed between the undersigned parties hereto that the following changes shall be made to the above mentioned Agreement of Purchase and Sale in accordance with the agreement and except for such changes noted below, all other terms and conditions in the Agreement of Purchase and Sale shall remain as stated herein; It is further understood that and agreed that all changes and additions shall be installed as per builder's specifications, location and available selections. The Purchaser hereby agrees to purchase the following extras:

Granite

1	GRANITE - COUNTERTOP WITH 4" BACKSPLASH - 3/4" GROUP 2 WITH MITRE EDGE - ENSUITE MASTER - UPGRADE 2	Qty: 1
193,573		
41,098	Note: CHARGE FOR GR2 'OCEAN FOAM' MISSED ON ORIGINAL SSS	

Sub Total

HST

Total

1. This Sales Selection Sheet when properly executed forms part of our Agreement of Purchase and Sale.
2. All extras and upgrades listed above are subject to Construction Progress and Architectural and Municipal requirements.
3. In the event the Vendor is unable to incorporate the work approved above in the construction of the house for any reason whatsoever, the Vendor will not be liable to the Purchaser in any way. The monies paid for any changes or optional extras not proceeded with shall be returned to the Purchaser, without interest. The cost of options or extras is non-refundable in all other circumstances. If for any reason whatsoever the Agreement of Purchase and Sale is not completed, the total cost of work approved above will be retained by the Vendor.
4. The Vendor reserves the right to substitute above materials and equipment with that of equal or better quality.
5. Purchaser acknowledges that items may not be exactly as shown. Variations from the Vendor's samples may occur in finished materials due to normal production processes. Vendor is not responsible for shade difference which may occur from different dye lots or wood grains. Variations from the Vendor's samples will occur with natural materials such as wood, marble, granite, hardwood and brick.
6. The Vendor reserves the right to select Grout & Thresholds that best suits the Tile selected.
7. Selections will not be processed unless signed by Heathwood Homes Head Office.
8. The selections made on this schedule are final and cannot be changed once submitted.
9. The Purchaser has checked and acknowledges the accuracy of this schedule.

Payment Summary

Paid By

Amount

Total Payment:

PURCHASER:

THU, PHUONG TRAN

19-Oct-20

DATE

BRENDA LUKER

Decor Consultant

19-Oct-20

DATE

APPROVED

-10- 23 2020

Date Approved Heathwood Homes (Huron) Limited

TAX#:1

PREPARED BY: Brenda Luker

PE 563-1

Strinvoice.rpt 28may19



Sales Selection Sheet

Wallaceton

16 of 28

PURCHASER: THU, PHUONG TRAN

TEL:

LOT / UNIT	PHASE	MODEL	
211	2	25-2140 ALT B The Wallace	

1. This Sales Selection Sheet when properly executed forms part of our Agreement of Purchase and Sale.
2. All extras and upgrades listed above are subject to Construction Progress and Architectural and Municipal requirements.
3. In the event the Vendor is unable to incorporate the work approved above in the construction of the house for any reason whatsoever, the Vendor will not be liable to the Purchaser in any way. The monies paid for any changes or optional extras not proceeded with shall be returned to the Purchaser, without interest. The cost of options or extras is non-refundable in all other circumstances. If for any reason whatsoever the Agreement of Purchase and Sale is not completed, the total cost of work approved above will be retained by the Vendor.
4. The Vendor reserves the right to substitute above materials and equipment with that of equal or better quality.
5. Purchaser acknowledges that items may not be exactly as shown. Variations from the Vendor's samples may occur in finished materials due to normal production processes. Vendor is not responsible for shade difference which may occur from different dye lots or wood grains. Variations from the Vendor's samples will occur with natural materials such as wood, marble, granite, hardwood and brick.
6. The Vendor reserves the right to select Grout & Thresholds that best suits the Tile selected.
7. Selections will not be processed unless signed by Heathwood Homes Head Office.
8. The selections made on this schedule are final and cannot be changed once submitted.
9. The Purchaser has checked and acknowledges the accuracy of this schedule.

Payment Summary	
<u>Paid By</u>	<u>Amount</u>
<u>Total Payment:</u>	

PURCHASER:

PT phuonng
THU, PHUONG TRAN

19-Oct-20
DATE

[Signature]
Decor Consultant

19-Oct-20
DATE

- APPROVED -

-10- 27 2020

mRosen

Date Approved Heathwood Homes (Huron) Limited

TAX#:1

PREPARED BY: Brenda Luker

PE 548-4

SInvoice.rpt 28may19

UK - 75 WALLACETON
LOT 211
25-2140 ALT B
THE WALLACE

17 of 28

THE WALLACE
ELEVATION B, C D & E | 2,133 SQ. FT.
589 sq. ft. of opt. finished lower level

WALLACETON
EST. 1879

25-2140 ALT ELEV.B

Sketch #1

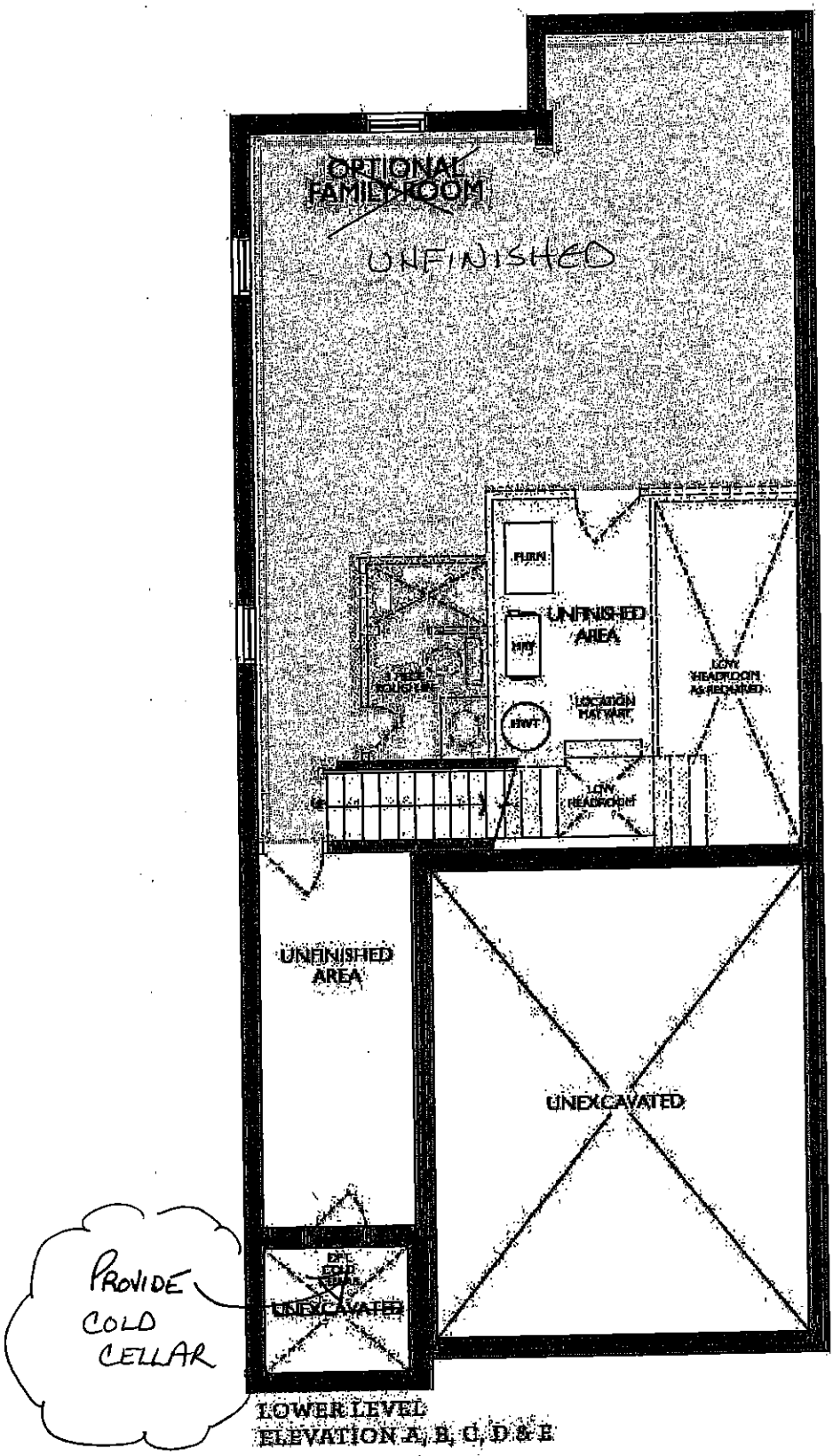

PT

UK - 75 WALLACETON
LOT 211
25-2140 ALT B
THE WALLACE

18 of 28

THE WALLACE
ELEVATION B, C D & E | 2,133 SQ. FT.
500 sq. ft. of opt. finished lower level
WALLACETON
EST. 1930

25-2140 ALT ELEV.B

Sketch #2

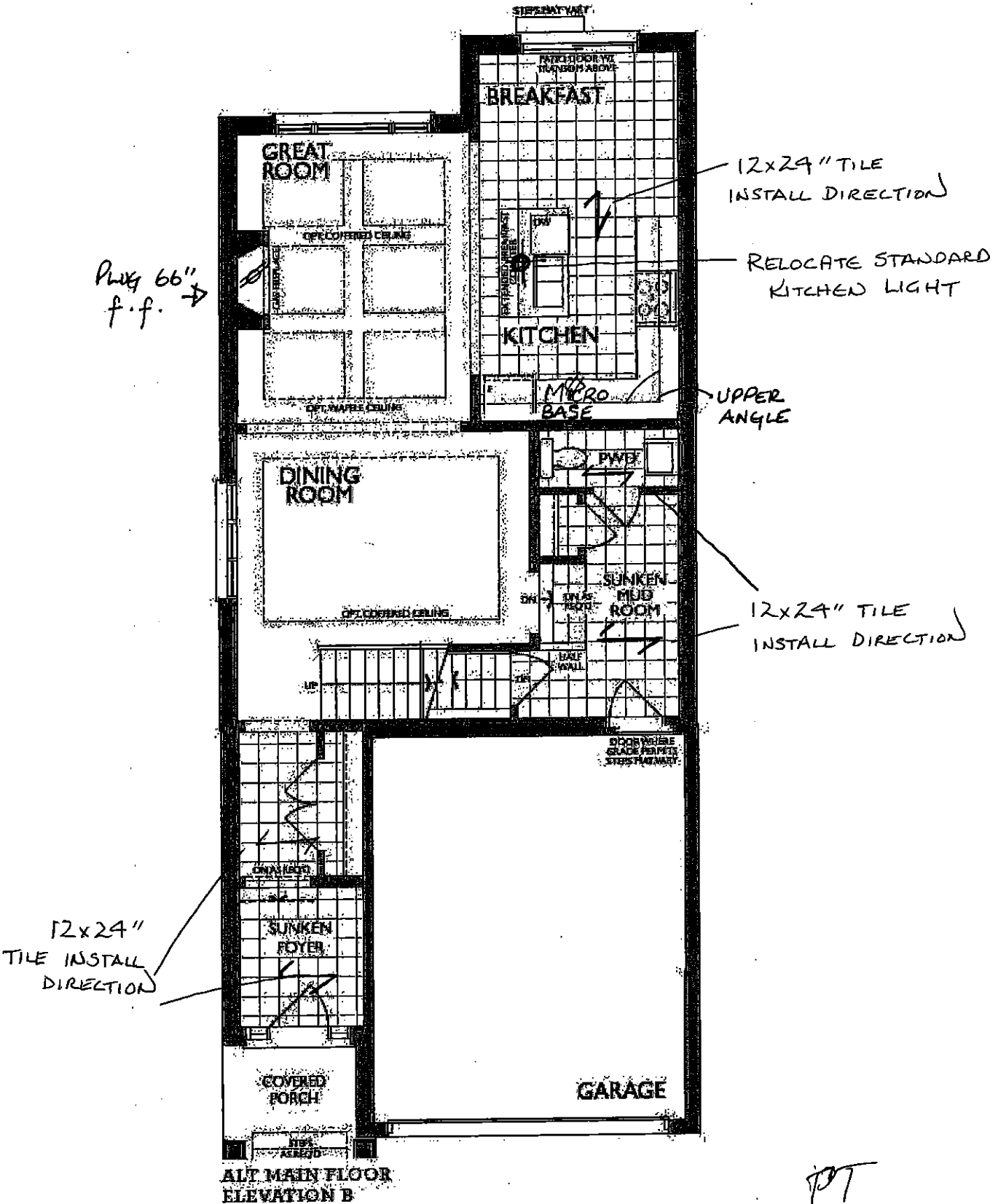

UK - 75 WALLACETON
LOT 211
25-2140 ALT B
THE WALLACE

19 of 28

THE WALLACE
ELEVATION B, C D & E | 2,133 SQ. FT.
389 sq. ft. of opt. finished lower level
WALLACETON
EST. 1979

25-2140 ALT ELEV.B

Sketch #3

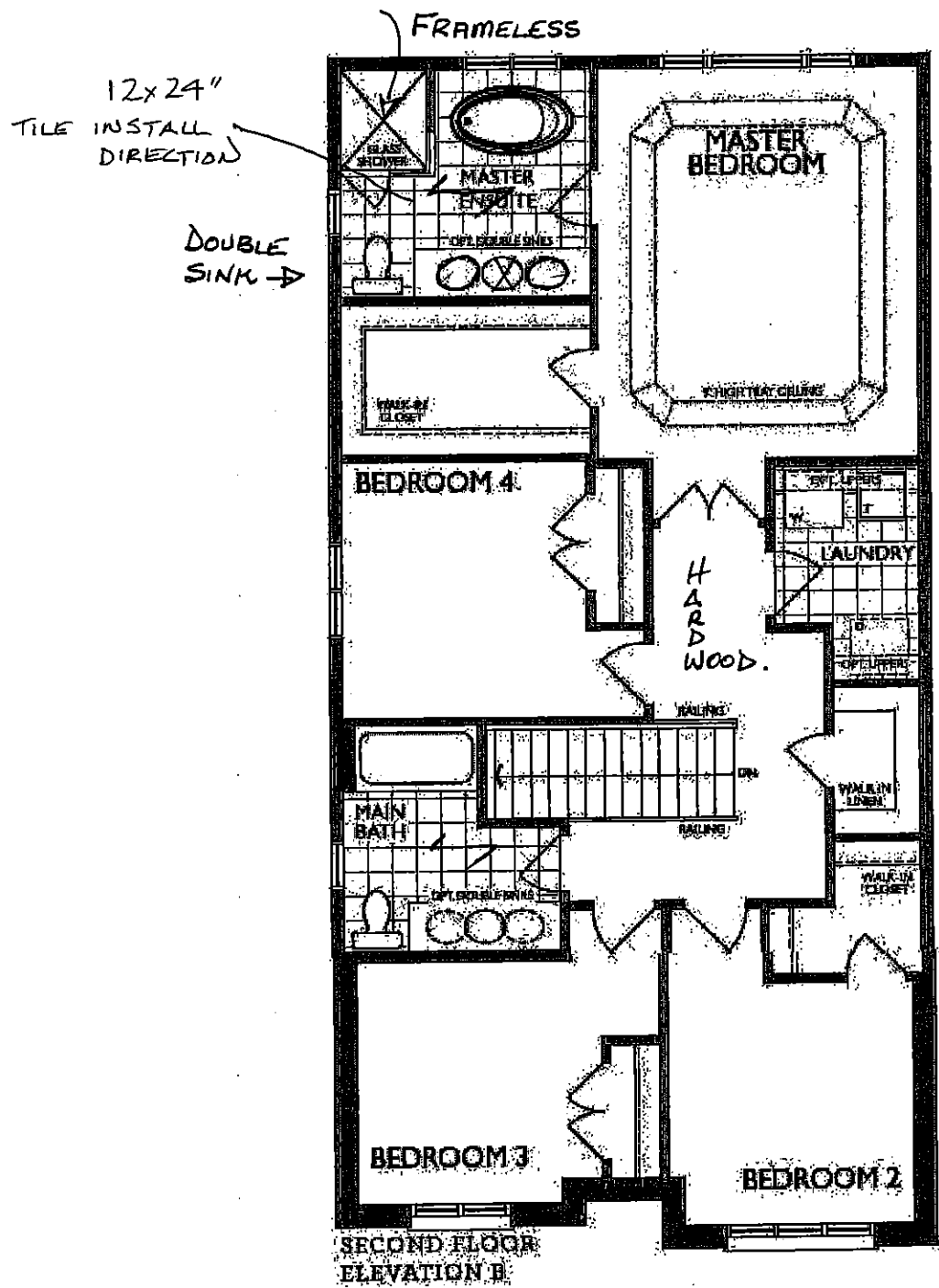

UK - 75 WALLACETON
LOT 211
25-2140 ALT B
THE WALLACE

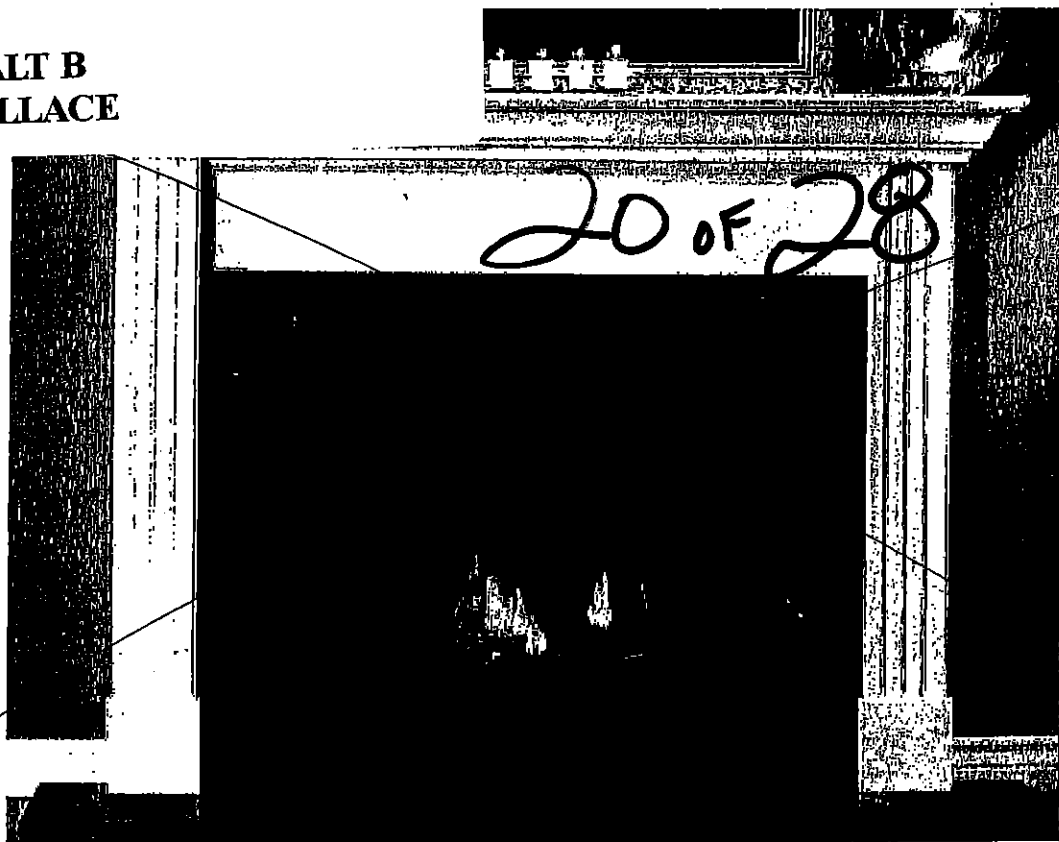

STANDARD NF 15 Mantel X

Clean apron finish with fluted legs

WHITE PAINT GRADE FINISH

(PICTURE SHOWN WITH UPGRADE SURROUND AND HEARTH -PRICED SEPARATELY)



CABINET

STANDARD NF 17 Mantel ✓

WHITE PAINT GRADE FINISH

(PICTURE SHOWN WITH UPGRADE SURROUND AND HEARTH -PRICED SEPARATELY)

PT

UK - 75 WALLACETON
LOT 211
25-2140 ALT B
THE WALLACE

21 of 28

BLANCO

BLANCO QUATRUS U Maxi
Stainless Steel
Undermount Sink

This new German-engineered sink from BLANCO features a 9-inch bowl depth and zero-radius bowl corners. Made of durable 18 gauge stainless steel.

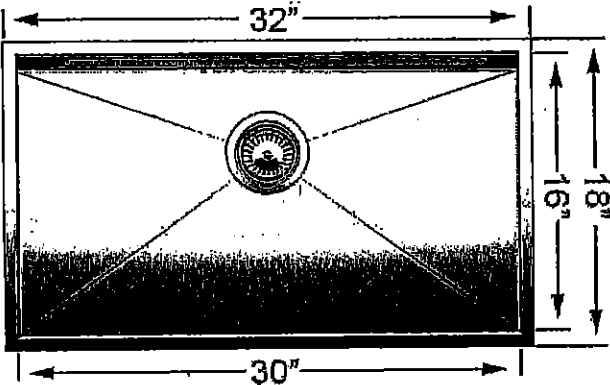
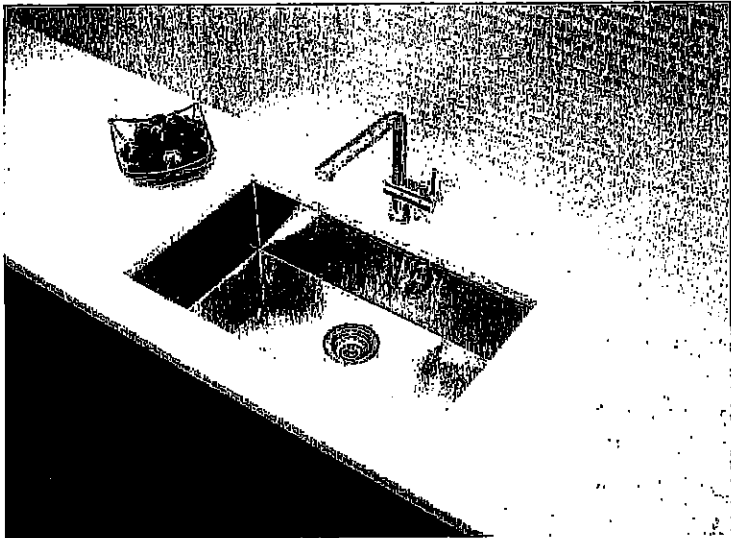

Model No.	Bowl Depth	
	Main	Secondary
401248	9" (230 mm)	

Material

Durable 18 gauge stainless steel
Brushed finish

Specifications

- Minimum Cabinet Size: 33" (840 mm)
- Undermount Installation
- Rear positioned drain hole for maximum usable bowl and cabinet storage space
- Zero-radius corners and x-pattern drain grooves
- Sound deadening system included
- Template included
- 3 1/2" stainless steel strainer included
- Limited Lifetime Warranty

Accessories

Stainless Steel Grid	223192
----------------------	--------

UK - 75 WALLACETON
LOT 211
25-2140 ALT B
THE WALLACE

22 of 28

STANDARD KITCHEN FAUCET

Align

Modern

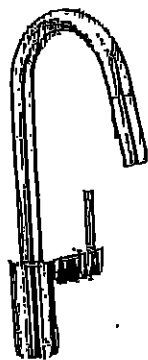

Single Handle Pull-Down Kitchen
Faucet*
Model 7565+

Kip

RD

UK - 75 WALLACETON
LOT 211
25-2140 ALT B
THE WALLACE

23 of 28

2x MASTER ENSUITE BATHROOM
1x MAIN BATHROOM

American Standard

Style That Works Better

 BARRIER FREE

OVALYN™ UNDERCOUNTER SINK

- Classic oval undermount sink
- Made from vitreous china
- Front overflow
- Supplied with mounting kit (047194-0070A) and template

☐ 0496.221 Unglazed rim
489 x 413mm
(19-1/4" x 16-1/4")

Bowl size:

432mm (17") wide
356mm (14") front to back
140mm (5-1/2") deep

Compliance Certifications -
Meets or Exceeds the Following Specifications:
• ASME A112.19.2M for Vitreous China Fixtures
• CAN/CSA B45 series

OVALYN™
UNDERCOUNTER SINK
VITREOUS CHINA

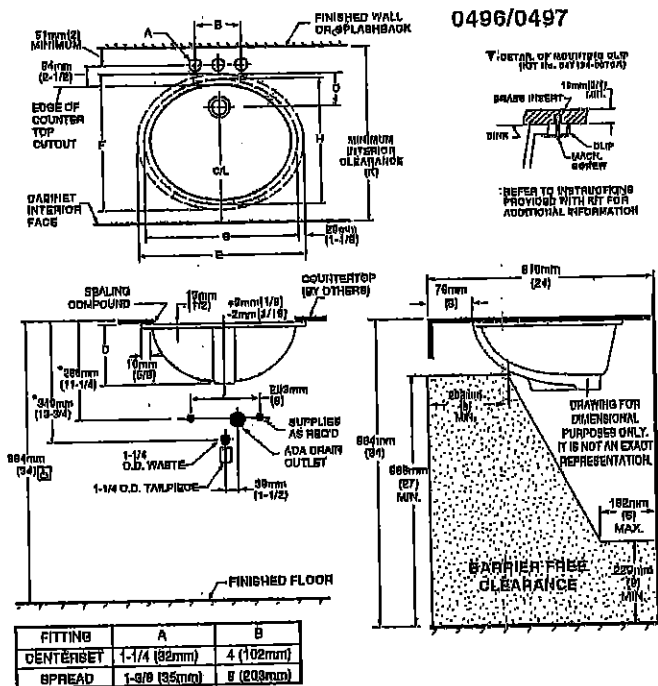
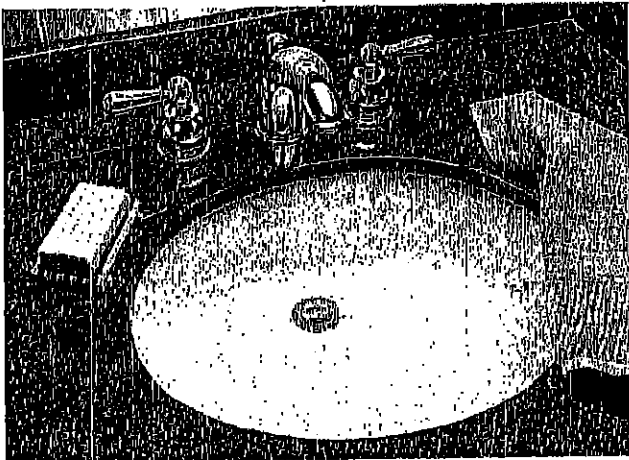

NOTES:
* DIMENSIONS SHOWN FOR LOCATION OF SUPPLIED AND "P" TRAP ARE SUGGESTED.
† UNDERCOUNTER MOUNTING KIT SUPPLIED WITH SINK. PLEASE NOTE MINIMUM INTERIOR CLEARANCE DIMENSION (K). FITTINGS NOT INCLUDED AND MUST BE ORDERED SEPARATELY. USE ENCLOSED TEMPLATE FOR COUNTERTOP CUTOUT SEALING COMPOUND SUPPLIED BY OTHERS.

IMPORTANT: Dimensions of fixtures are nominal and may vary within the range of tolerances established by ANSI Standard A112.19.2. These measurements are subject to change or cancellation. No responsibility is assumed for use of superseded or voided pages.



MEETS THE AMERICANS WITH DISABILITIES ACT GUIDELINES AND ANSI A117.1 ACCESSIBLE AND USEABLE BUILDINGS AND FACILITIES - CHECK LOCAL CODES.
Countertop 864mm (34") from finished floor. Lavatory installed 78mm (3") from front edge of countertop. Countertop thickness to be 25mm (1") maximum.

FITTING	A	B
CENTERSET	1-1/4 (32mm)	4 (102mm)
SPREAD	1-3/8 (35mm)	8 (203mm)

OAT. NO.	E	F	G	H	D	D	J	R
0488.221	489mm (19-1/4)	418mm (16-1/4)	492mm (19-3/8)	385mm (15-1/8)	165mm (6-1/2)	182mm (7-1/8)	18mm (3/4)	200mm (7-7/8)
0497.221	489mm (19-1/4)	418mm (16-1/4)	492mm (19-3/8)	385mm (15-1/8)	165mm (6-1/2)	182mm (7-1/8)	18mm (3/4)	200mm (7-7/8)

UK - 75 WALLACETON
LOT 211
25-2140 ALT B
THE WALLACE

24 of 28

Chateau

Transitional

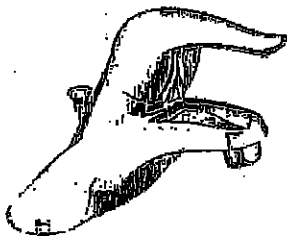

Lavatory Faucet with Pop-Up Drain
Model L4621+

VANITY SINKS AND PEDESTAL



Posi-Temp® Pressure Balancing Tub/Shower
Model 62320 / TL183+

OR

Posi-Temp Valve and Tub/Shower Trim
with Eco-Performance Easy Clean® XL
Model 62320 / TL183EP+
(TL183EP not available in BC)

SHOWER AND 5' TUB FAUCETS



2 Handle Roman Tub with 9" Spout
Model 4796 / T990+

FREESTANDING TUB FAUCETS

PT

UK-75 WALLACETON
LOT 211
25-2140 ALT B
THE WALLACE

25 of 28

SC(B)500 | ALITO Collection

Cyclone®
Breathe Better

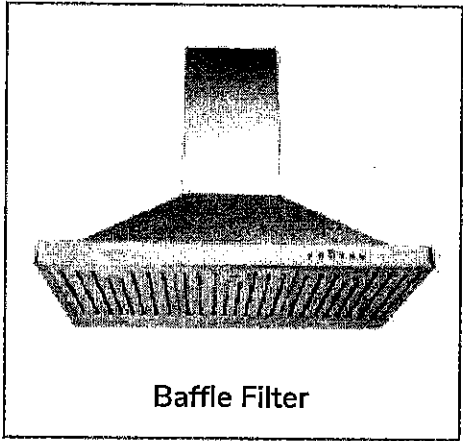

Wall Mount

Strong and sturdy with attractive lines and an imposing frame, the SC(B)500 is fitted with time-delay OFF feature up to nine minutes, 550 CFM fan, bright LED lights and a digital three-speed push button control panel.

Green Features



3 Speed Push Button
Control Panel



Dishwasher
Safe Filters



Long-Lasting
LED Light



Time-Delay
OFF Feature



Model	Colour	Ducting	Filters	Size	CFM
SC50024	Stainless Steel	6"	Mesh	24"	550
SC50030	Stainless Steel	6"	Mesh	30"	550
SC50036	Stainless Steel	6"	Mesh	36"	550
SCB50024	Stainless Steel	6"	Baffle	24"	550
SCB50030	Stainless Steel	6"	Baffle	30"	550
SCB50036	Stainless Steel	6"	Baffle	36"	550

Cyclone Range Hoods Inc.

1361 Huntingwood Drive, Unit 16, Toronto, ON, M1S 3J1, Canada

Toll Free: 1-888-293-5662 Tel: (416) 293-0933 Fax: (416) 293-4793 Website: www.CycloneRangeHoods.com

UK - 75 WALLACETON
LOT 211
25-2140 ALT B
THE WALLACE

26 of 28

1225

SC(B)500 | ALITO Collection

Cyclone®
Breathe Better

Features

- Wall mount range hood
- 6" round duct adapter
- Non-stick aluminum fan blades
- 3 speed push button control
- 2 LED lights (2 x 1.4W)
- Dishwasher-safe mesh or baffle filters
- Standard chimney fits up to 9 ft. ceiling
- Up to 9 minute time-delay OFF feature
- Plug-in connection

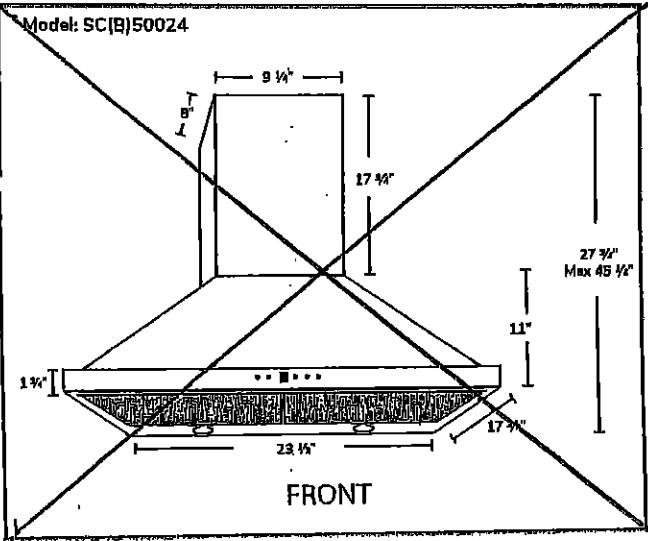
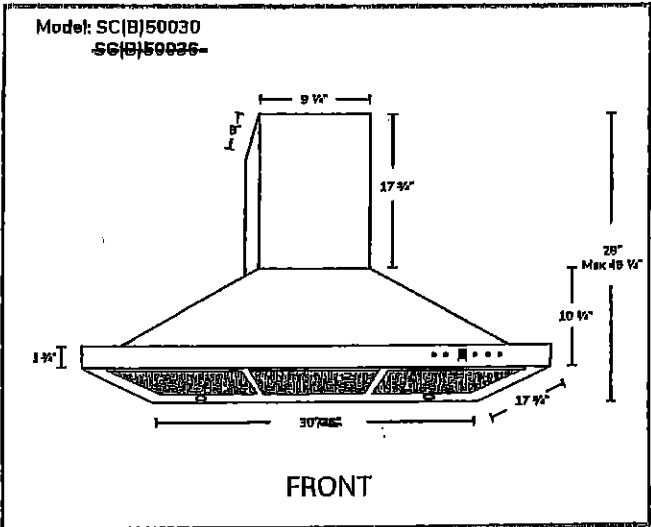

Options

- Filters: SC500 - Quick Release Aluminum Mesh Filters
SCB500 - Quick Release Stainless Steel Baffle Filters
- Available Chimney Flues:
Short (7 ft. - 8 ft.. A1.CH10)
Standard (8 ft. - 9 ft. A1.CH18)
Extended (9 ft. - 11 ft. A1.CH30)
- Widths: 24", 30", 36"

Specifications

- Air Flow Volume: 550 CFM
- Electrical Connection: 120V/60Hz
- Power Consumption: 210 Watts
- Current: 2.5 Amps
- Fan Speed: 1600RPM
- Fan Type: Centrifugal Blower

- Finishes: Stainless Steel
- Ducting: 6" Round
- Dimensions: Width: 24", 30", 36"
Height: 46"
Depth: 18"

- Noise Level: Min. 2 Sones
Max. 6 Sones



Toronto Vancouver Boston
www.cyclonerangehoods.com

PT

27 OF 28

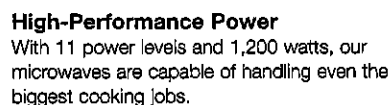
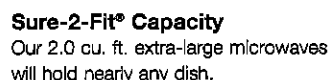
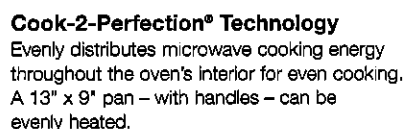
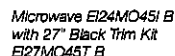
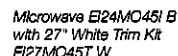
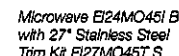
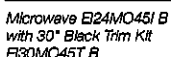
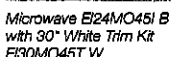
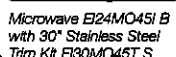

Wall Ovens

Warmer Drawers

Cooktops

Built-In Ranges

Understanding

Microwaves

Spout Hoods

Dishwashers /

Refrigerators

Freezers

Under Counter

Washers / Dryers

Built-In Microwave

EI24MO45I B

Electrolux

* BUILT-IN UNDER COUNTER INSTALLATION *

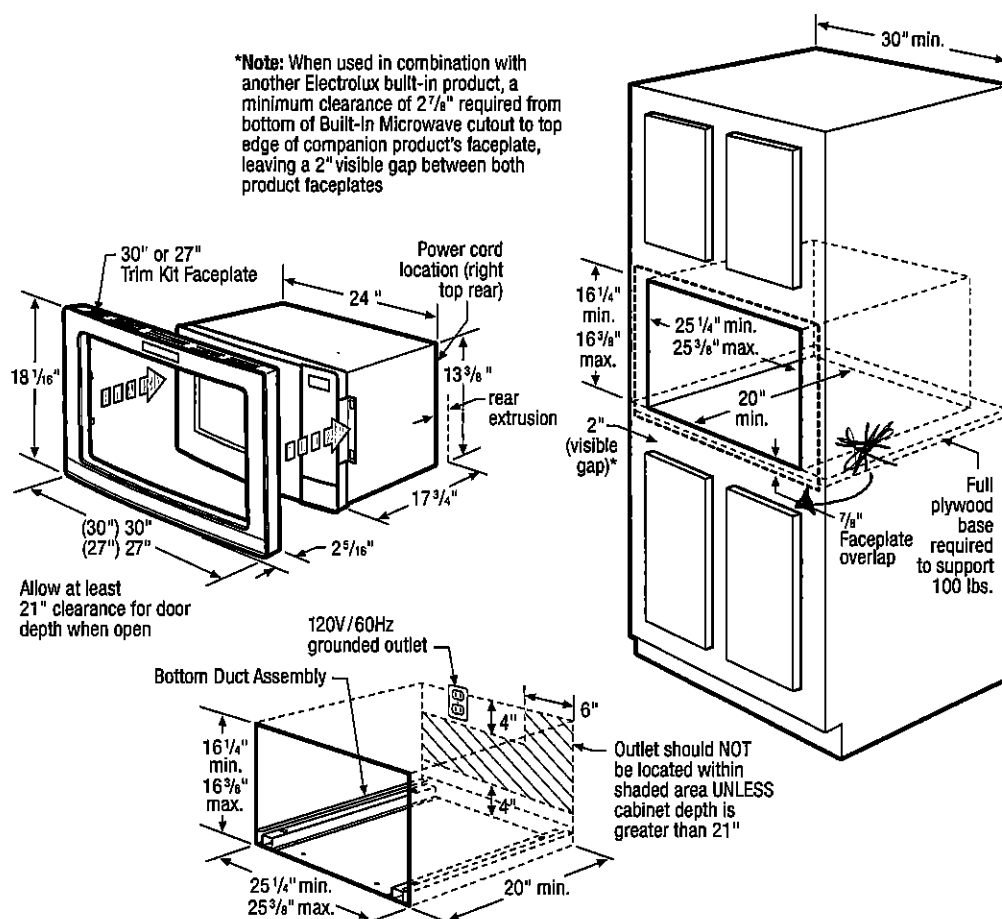

Built-In Microwave Specifications

- Product Weight (Microwave with Trim Kit) – 51 Lbs.
- Voltage Rating – 120V/60Hz/15 or 20 Amps
- Connected Load (kW Rating) @ 120 Volts = 1.5kW (For use on adequately wired 120V, dedicated circuit having 2-wire service with a separate ground wire. Appliance must be grounded for safe operation.)
- Amps @ 120 Volts = 13 Amps
- Always consult local and national electric codes.
- Allow 21" minimum clearance for 90° door swing.
- Installation requires use of 30" or 27" Trim Kit (ordered by individual part number and shipped separate). Includes Bottom Duct Assembly.
- Minimum 20" deep oven cutout dimension is critical for proper installation for oven and faceplate to fit flush against cabinet front.
- Consult local building code, in the event that cutout opening may be required to be enclosed with sides, ceiling and rear partition.
- Full oven base of solid plywood or similar material required, capable of supporting 100 Lbs.

- Base must be level and front of cabinet square for proper operation.
- Grounded outlet should NOT be located in shaded area, as indicated, unless cabinet depth is greater than 21".
- Can NOT be installed above any gas wall oven.
- Built-In Convection Microwave can be built in alone or is approved to be used in combination with any Electrolux Electric Single Wall Oven and/or Warmer Drawer. (Refer to model-specific Combination Installation Specification pages on web.)
- When used in combination with another Electrolux built-in product, a minimum clearance of 2-7/8" required from bottom of Built-In Microwave cutout to top edge of companion product's faceplate, leaving a 2" visible gap between both product faceplates.

Note: For planning purposes only. Refer to Product Installation Guide on the web at electroluxappliances.com for detailed instructions.

Electrolux Major Appliances, N.A.

USA • 10200 David Taylor Drive • Charlotte, NC 28262 • 1-877-4electrolux (1-877-435-3287) • electroluxappliances.com
 CANADA • 5855 Terry Fox Way • Mississauga, ON L5V 3E4 • 1-800-265-8352 • electroluxappliances.ca



High standards of quality at Electrolux Home Products, Inc. mean we are constantly working to improve our products. We reserve the right to change specifications or discontinue models without notice.

© 2011 Electrolux Home Products, Inc.

Printed in the U.S.A.