

PRE-Sales Selection Sheet
Checklist

1 of 21

LOT 260 Model: 25-2140 ALT E The Wallace
PURCHASERS: HASAN FAHAD/
VENDOR: Heathwood Homes (Huron) Limited

- ☐ FINISHED BASEMENT
- ☐ COLD CELLAR

UPGRADED / MODIFIED ELEVATION

- ☐ CORNER UPGRADE
- ☐ REAR UPGRADE

CEILING UPGRADE - SMOOTH

- ☐ MAIN FLOOR
- ☐ SECOND FLOOR
- ☐ BASEMENT

ADDITIONAL ROUGH-INS

- ☒ 200 AMP SERVICE
- ☐ WET BAR ROUGH-IN
- ☐ HUMIDIFIER
- ☒ AIR CONDITIONING

GAS ROUGH-IN

- ☐ STOVE
- ☐ DRYER
- ☐ BBQ
- ☐ ADDITIONAL FIREPLACE

KITCHEN: HOODFAN VENTING SIZE

- ☐ 6 IN ROUND DUCT
- ☒ 7 IN ROUND DUCT

FULL BASEMENT STAIRS:	Paint Grade
UPPER BASEMENT STAIRS:	N/A
LOWER BASEMENT STAIRS:	N/A
MAIN STAIRS:	All Oak
MEDIA STAIRS (if applicable):	N/A
LOFT STAIRS (if applicable):	N/A

SEPT. 30/20

Date

Signature on

Purchaser:

file

SEPT 30/20

Date

BRENDA LUKER

Decor Consultant:

APPROVED

-10- 05 2020

Date

M. Rosen

Heathwood Homes (Huron) Limited

Approved

Locked Date:



Sales Selection Sheet
Wallaceton

2 of 21

PURCHASER: HASAN FAHAD

TEL: RES.: 647-274-6110

LOT / UNIT 260	PHASE 2	MODEL 25-2140 ALT E The Wallace	
-------------------	------------	------------------------------------	--

It is herein understood and agreed between the undersigned parties hereto that the following changes shall be made to the above mentioned Agreement of Purchase and Sale in accordance with the agreement and except for such changes noted below, all other terms and conditions in the Agreement of Purchase and Sale shall remain as stated herein: It is further understood that and agreed that all changes and additions shall be installed as per builder's specifications, location and available selections. The Purchaser hereby agrees to purchase the following extras:

MISC.

1 38,490	SCHEDULE E- TEN THOUSAND DOLLARS (\$10,000) AT DECOR (NO CASH VALUE) - SINGLES Note:	Qty: 1	
2 38,491	SCHEDULE E- Schedule X: Item # 5 Adjustments (e) and (f) Combined to be Capped at \$5,000. Note:	Qty: 1	

Sub Total
HST
Total

- 1. This Sales Selection Sheet when properly executed forms part of our Agreement of Purchase and Sale.
- 2. All extras and upgrades listed above are subject to Construction Progress and Architectural and Municipal requirements.
- 3. In the event the Vendor is unable to incorporate the work approved above in the construction of the house for any reason whatsoever, the Vendor will not be liable to the Purchaser in any way. The monies paid for any changes or optional extras not proceeded with shall be returned to the Purchaser, without interest. The cost of options or extras is non-refundable in all other circumstances. If for any reason whatsoever the Agreement of Purchase and Sale is not completed, the total cost of work approved above will be retained by the Vendor.
- 4. The Vendor reserves the right to substitute above materials and equipment with that of equal or better quality.
- 5. Purchaser acknowledges that items may not be exactly as shown. Variations from the Vendor's samples may occur in finished materials due to normal production processes. Vendor is not responsible for shade difference which may occur from different dye lots or wood grains. Variations from the Vendor's samples will occur with natural materials such as wood, marble, granite, hardwood and brick.
- 6. The Vendor reserves the right to select Grout & Thresholds that best suits the Tile selected.
- 7. Selections will not be processed unless signed by Heathwood Homes Head Office.
- 8. The selections made on this schedule are final and cannot be changed once submitted.
- 9. The Purchaser has checked and acknowledges the accuracy of this schedule.

Payment Summary	
<u>Paid By</u>	<u>Amount</u>
<u>Total Payment:</u>	

PURCHASER: Signature on file
HASAN FAHAD

05-Oct-20
DATE

BRENDA LUKER
Decor Consultant

05-Oct-20
DATE

APPROVED

-10- 05 2020
Date Approved

M. Rosen
Heathwood Homes (Huron) Limited

HASAN FAHAD/~~RESHMA~~ RESHMA
Project: Wallaceton
Unit: 260, Phase: 2
Model: 25-2140 ALT E The Wallace

Created: 9/29/2020 14:16:43
Locked:
Closed:

3 of 21

Kitchen

Cabinet Colour/Style	9167	Viking III-CHARLESTON-RAIN CLOUD-3DL ***STD***
Countertop	9121	MSI Quartz GROUP 1 ICED WHITE 3/4 inch with double mitre edge ***1***
Countertop Edge	4005	DOUBLE MITRE 1 1/2 INCH ***UPG*** 
Cabinet Hardware	7667	12881-HARDWARE ***STD***
Island Cabinet Colour/Style	9167	Viking III-CHARLESTON-RAIN CLOUD-3DL ***STD***
Island Countertop	9121	MSI Quartz GROUP 1 ICED WHITE 3/4 inch with double mitre edge ***1***
Backsplash	1111	N/A *****
Backsplash Grout	1111	N/A *****
Backsplash Tile Pattern	1111	N/A *****
HoodFan	1111	AV1308 Air King 30 PAGE 21
Appliance	1111	Purchasers have been advised: standard fridge opening is a minimum 37 3/8 x 73 3/8". Ice Waterline Rough-In is included.
Appliance	1111	Standard stove opening is 30" and standard dishwasher opening is 24". Any gas stove will require backsplash or stainless steel backing to avoid fire hazards.
Appliance	1111	Purchasers acknowledge: Heathwood Homes and its contractors will not be responsible for any kitchen cabinet changes due to appliances dimension changes after
Comment		

Kitchen/Breakfast

Flooring	8244	OV.CX.WHT.1224.PL-Carrara X-White Polished-12 x 24 See Tile Direction on Sketch 2 Page 15 ***5***
Floor Tile Grout	2225	Grout-(27) Silver ***STD***
Floor Tile Pattern	3000	STANDARD SQUARE ***STD***

MF

HASAN FAHAD/RESHMA RESHMA
Project: Wallaceton
Unit: 260, Phase: 2
Model: 25-2140 ALT E The Wallace

Created: 9/29/2020 14:16:43
Locked:
Closed:

4 of 21

Comment

Foyer

Flooring

3000GE.BY.AZR.1313 New Byzantine Azzuro 13

Floor Tile Grout

2225Grout-(27) Silver ***STD***

Floor Tile Pattern

3000STANDARD SQUARE ***STD***

Comment

Laundry Room

Flooring

8262TR.ST.GRY.1313-Serpentine-Grey-13x13 See Tile Line
Pattern on Sketch 3 Page 16 ***STD***

Floor Tile Grout

2225Grout-(27) Silver ***STD***

Floor Tile Pattern

3000STANDARD SQUARE ***STD***

Comment

Laundry Room Opt.

Cabinet - Uppers

1111N/A *****

Cabinet Hardware

1111N/A *****

Comment

Mud Room

Flooring

1111GE.BY.AZR.1313 New Byzantine Azzuro 13

MF

HASAN FAHAD/~~RESHMA~~ RESHMA
Project: Wallaceton
Unit: 260, Phase: 2
Model: 25-2140 ALT E The Wallace

Created: 9/29/2020 14:16:43
Locked:
Closed:

5 of 21

Floor Tile Grout 2225 Grout-(27) Silver ***STD***
Floor Tile Pattern 3000 STANDARD SQUARE ***STD***

Comment

Powder Room

Flooring 3000 GE.BY.AZR.1313 New Byzantine Azzuro 13
Floor Tile Grout 2225 Grout-(27) Silver ***STD***
Floor Tile Pattern 3000 STANDARD SQUARE ***STD***

Plumbing Fixture (Colour) 1737 Plumbing Fixtures-WHITE ***STD***
Comment

Dining Room/Hall

Flooring 7498 Red Oak Pearl-Vintage Engineered-IRONGATE-3/4 inch x 3 1/4 inch ***STD***
Comment

Dining Room/Hall

Flooring 7498 Red Oak Pearl-Vintage Engineered-IRONGATE-3/4 inch x 3 1/4 inch ***STD***
Comment * DUPLICATE *

Great Room

Flooring 7498 Red Oak Pearl-Vintage Engineered-IRONGATE-3/4 inch x 3 1/4 inch ***STD***
Comment

MF

HASAN FAHAD/~~BESHMA~~ RESHMA
Project: Wallaceton
Unit: 260, Phase: 2
Model: 25-2140 ALT E The Wallace

Created: 9/29/2020 14:16:43
Locked:
Closed:

6 of 21

Upper Hall

Flooring 7498 Red Oak Pearl-Vintage Engineered-IRONGATE-3/4 inch x 3 1/4 inch ***3***

Comment

Opt. Finished Basement (Rec) Room/Hall

Flooring 1111 N/A *****

Comment

Master Bedroom

Flooring 9245 DY 87354-Dynasty Tex-OVERCAST-40 oz Poly***STD***

Comment

Bedroom 2

Flooring 9245 DY 87354-Dynasty Tex-OVERCAST-40 oz Poly***STD***

Comment

Bedroom 3

Flooring 9245 DY 87354-Dynasty Tex-OVERCAST-40 oz Poly***STD***

Comment

Bedroom 4

Flooring 9245 DY 87354-Dynasty Tex-OVERCAST-40 oz Poly***STD***

Comment

MF

HASAN FAHAD/RESHMA/RESHMA
Project: Wallaceton
Unit: 260, Phase: 2
Model: 25-2140 ALT E The Wallace

Created: 9/29/2020 14:16:43
Locked:
Closed:

7 of 21

Master Ensuite

Cabinet Colour/Style	9166	Viking III-CHARLESTON-ORCHID-3DL ***STD***
Countertop	9070	MSI Quartz GROUP 1 ICED GREY ***STD***
Countertop Edge	4010	GROUP 1 - SINGLE POLISHED STRAIGHT EDGE 3/4 INCH ***1***
Cabinet Hardware	7672	135-HARDWARE ***STD***
Floor Tile	5494	GE.NA.GRY.1313-New Albion-Grey-13 x 13 ***STD***
Floor Tile Grout	2225	Grout-(27) Silver ***STD***
Floor Tile Pattern	3000	STANDARD SQUARE ***STD***

Shower Floor Tile	8661	OD.ON.SWT.0202.MT.N-Ontario Series Mosaic-Snow White Matte-2 x 2 ***STD***
Shower Floor Tile Grout	2226	Grout-(00) White ***STD***
Shower Floor Tile Pattern	3000	STANDARD SQUARE ***STD***

Shower Wall Tile	9020	QT.WV.WHT.0810-Weave-White-8 x 10 ***STD***
Shower Wall Tile Grout	2226	Grout-(00) White ***STD***
Shower Wall Tile Pattern	3090	VERTICAL STACKED ***STD***

Shower Jamb(s) and Sill(s)	8925	Shower Jamb / Sill-Sky Grey (Light Grey) ***STD***
Plumbing Fixture (colour)	1737	Plumbing Fixtures-WHITE ***STD***

Comment	
---------	--

HF

HASAN FAHAD/RESHMA RESHMA
Project: Wallaceton
Unit: 260, Phase: 2
Model: 25-2140 ALT E The Wallace

Created: 9/29/2020 14:16:43
Locked:
Closed:

8 of 21

Main Bathroom

Cabinet Colour/Style	6261	Viking III-MANCHESTER-OYSTER CL-MAPLE ***STD***
Countertop	8819	1876K-52-Countertop-SPRING CARNIVAL-Wilsonart ***STD***
Countertop Edge	1111	N/A *****
Cabinet Hardware	2076	181-HARDWARE ***STD***
Flooring	8073	GE.RF.WHT.1313-Reflex-White-13 x 13 See Tile Line Pattern on Sketch 3 Page 16 ***STD***
Floor Tile Grout	2222	Grout-(105) Driftwood ***STD***
Floor Tile Pattern	3000	STANDARD SQUARE ***STD***

Wall Tile	9021	QT.WV.IVO.0810-Weave-Ivory-8 x 10 ***STD***
Wall Tile Grout	2226	Grout-(00) White ***STD***
Main Bathroom Tile Pattern	3090	VERTICAL STACKED ***STD*** <div><div></div><div></div><div></div><div></div><div></div><div></div><div></div><div></div></div>
Plumbing Fixture (Colour)	1737	Plumbing Fixtures-WHITE ***STD***
Comment		

Opt. Shower Floor Tile

im

Shower Floor Tile Grout	1111	N/A *****
Shower Floor Tile Pattern	1111	N/A *****
Shower Wall Tile	1111	N/A *****
Shower Wall Tile Grout	1111	N/A *****

HF

HASAN FAHAD/~~RESHMA~~ RESHMA
Project: Wallaceton
Unit: 260, Phase: 2
Model: 25-2140 ALT E The Wallace

Created: 9/29/2020 14:16:43
Locked:
Closed:

9 of 21

Shower Wall Tile Pattern	1111	N/A *****
Shower Jamb(s)	1111	N/A *****
Cabinet Colour/Style	1111	N/A *****
Countertop	1111	N/A *****
Countertop Edge	1111	N/A *****
Cabinet Hardware	1111	N/A *****
Flooring	1111	N/A *****
Floor Tile Grout	1111	N/A *****
Floor Tile Pattern	1111	N/A *****
Plumbing Fixture (Colour)	1111	N/A *****
Comment		

Great Room Fireplace

Type	8869	MAJESTIC MERC32
Mantle	8891	NF-17-Paint Grade Mantle- Cabinet (Per Plan)-WHITE ***STD*** PAGE 17
Surround Opt.	1111	N/A *****
Note	1111	Purchasers have been advised: heat from the FP can damage TV above a FP and items placed on mantle.
Note	1111	Heathwood and its contractors will not be liable for any damage on items placed/installed above a FP after closing.
Comment		

Basement Stairs

Type	1713	Paint Grade Stairs ***STD BASEMENT STAIR ***
------	------	--

MF

HASAN FAHAD/RESHMA-RESHMA
Project: Wallaceton
Unit: 260, Phase: 2
Model: 25-2140 ALT E The Wallace

Created: 9/29/2020 14:16:43
Locked:
Closed:

10 of 21

Colour	1111	N/A *****
Carpet Runner	1111	N/A *****
Handrail/Pickets/Post Type	1111	N/A *****
Handrail/Pickets/Post Colours	1111	N/A *****
Carpet	1111	N/A *****
Custom Stain/Paint	1111	N/A *****
Comment		

Landing to Basement

Flooring	1111	N/A *****
Comment		

Main Stairs

Type	1712	Oak Stairs ***STD MAIN STAIRS***
Colour	7912	Irongate (Gryphon) STAIN TO COMPLIMENT HARDWOOD AND WILL VARY FROM FLOORING
Carpet Runner	1111	N/A *****
Handrail/Pickets/Posts Type	7651	1 5/16 inch Turned pickets with 3 1/2" Turned Post(s)-ALL OAK***STD***
Handrail/Pickets/Posts Colour	1728	Oak Grade-Stain handrail,oak pickets,stringers,treads,risers
Custom Stain/Paint	1111	N/A *****
Comment		

Hall

Flooring	1111	N/A *****
----------	------	-----------

MF

HASAN FAHAD/~~RESHMA~~ RESHMA
Project: Wallaceton
Unit: 260, Phase: 2
Model: 25-2140 ALT E The Wallace

Created: 9/29/2020 14:16:43
Locked:
Closed:

11 of 21

Comment

Throughout

Walls - Paint Colour	1717	22-Wall-WARM GREY ***STD***
Underpad	1079	500 Series-Underpad ***STD***
Thresholds	2232	Metal Thresholds ***STD***
Switches and Plug	5796	Decora White Switches and Plugs ***STD***
Trim Size	8705	4 1/4 Baseboard and 2 3/4 Casings ***STD***
Trim - Paint Colour	1716	Trim-WHITE ***STD***

Comment

Purchaser: Hasan Fahad Sept 29, 20 Decor Consultant Sept 30/20
HASAN FAHAD Date Date

Purchaser: RESHMA RESHMA Wallaceton -10- 05 2020
~~RESHMA RESHMA~~ Date Approved

APPROVED

HF



Sales Selection Sheet

Wallaceton

12 of 21

PURCHASERS: HASAN FAHAD and ~~RESHMA~~ RESHMA

TEL: RES.: 647-274-6110

LOT / UNIT	PHASE	MODEL	
260	2	25-2140 ALT E The Wallace	

It is herein understood and agreed between the undersigned parties hereto that the following changes shall be made to the above mentioned Agreement of Purchase and Sale in accordance with the agreement and except for such changes noted below, all other terms and conditions in the Agreement of Purchase and Sale shall remain as stated herein: It is further understood that and agreed that all changes and additions shall be installed as per builder's specifications, location and available selections. The Purchaser hereby agrees to purchase the following extras:

Cabinetry

1 189,343 37,943	CABINETRY - 11A-UPPER ANGLE CORNER PER UNIT - UPGRADE 1 Note: SKETCH # 2 PAGE 15	Qty: 1
2 198,115 37,961	CABINETRY - OPT LIGHT VALANCE - KITCHEN Note:	Qty: 1

Ceramics

3 198,356 37,962	CERAMICS - FLOOR - KITCHEN - UPGRADE 5 Note:	Qty: 1
------------------------	---	--------

Electrical

4 189,450 37,944	ELECTRICAL - CEILING ROUGH-IN (CAPPED) SKETCH # 2 PAGE 15 Note: 1 X GREAT RM USE EXISTING SWITCH 1 X OVER ISLAND - SEPARATE SWITCH	Qty: 2
5 189,451 37,963	ELECTRICAL - ADDITIONAL SWITCH Note: FOR LIGHT OVER ISLAND	Qty: 1

Granite

6 198,437 37,949	GRANITE - COUNTERTOP - 3/4" GROUP 1 WITH MITRE EDGE - KITCHEN / ISLAND - UPGRADE 1 Note:	Qty: 1
------------------------	---	--------

Hardwood

7 198,497 37,950	HARDWOOD - VINTAGE - 3-1/4" RED OAK ENGINEERED - UPPER HALL - STANDARD SERIES Note:	Qty: 1
------------------------	--	--------

MISC.

8 37,941	TEN THOUSAND DOLLARS - DECOR BONUS. Note:	Qty: 1
-------------	--	--------

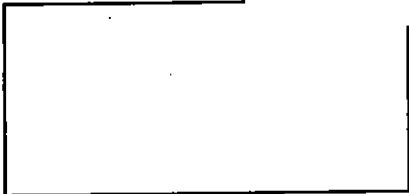

Initials: H F

TAX#:1

PREPARED BY: Bei Liu

PE 517-1

Invoice.rpt 28may19



Sales Selection Sheet
Wallaceton

13 of 21

PURCHASERS: HASAN FAHAD and RESHMA RESHMA

TEL: RES.: 647-274-6110

LOT / UNIT 260	PHASE 2	MODEL 25-2140 ALT E The Wallace	
-------------------	------------	------------------------------------	--

Sub Total
HST
Total

- 1. This Sales Selection Sheet when properly executed forms part of our Agreement of Purchase and Sale.
- 2. All extras and upgrades listed above are subject to Construction Progress and Architectural and Municipal requirements.
- 3. In the event the Vendor is unable to incorporate the work approved above in the construction of the house for any reason whatsoever, the Vendor will not be liable to the Purchaser in any way. The monies paid for any changes or optional extras not proceeded with shall be returned to the Purchaser, without interest. The cost of options or extras is non-refundable in all other circumstances. If for any reason whatsoever the Agreement of Purchase and Sale is not completed, the total cost of work approved above will be retained by the Vendor.
- 4. The Vendor reserves the right to substitute above materials and equipment with that of equal or better quality.
- 5. Purchaser acknowledges that items may not be exactly as shown. Variations from the Vendor's samples may occur in finished materials due to normal production processes. Vendor is not responsible for shade difference which may occur from different dye lots or wood grains. Variations from the Vendor's samples will occur with natural materials such as wood, marble, granite, hardwood and brick.
- 6. The Vendor reserves the right to select Grout & Thresholds that best suits the Tile selected.
- 7. Selections will not be processed unless signed by Heathwood Homes Head Office.
- 8. The selections made on this schedule are final and cannot be changed once submitted.
- 9. The Purchaser has checked and acknowledges the accuracy of this schedule.

Payment Summary	
Paid By	Amount
Total Payment:	

PURCHASER: 
HASAN FAHAD

30-Sep-20
DATE



Decor Consultant

30-Sep-20
DATE

PURCHASER: 
RESHMA RESHMA

30-Sep-20
DATE

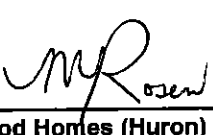
- APPROVED -
-10- 05 2020
Date Approved

Heathwood Homes (Huron) Limited

UK 75 WALLACETON
LOT 260
25-2140 ALT E
THE WALLANCE

14 of 21

THE WALLACE
ELEVATION B, C D & E | 2,133 SQ. FT.
589 sq. ft. of opt. finished lower level

WALLACETON
EST. 1939

25-2140 ALT ELEV.E

Sketch # 1

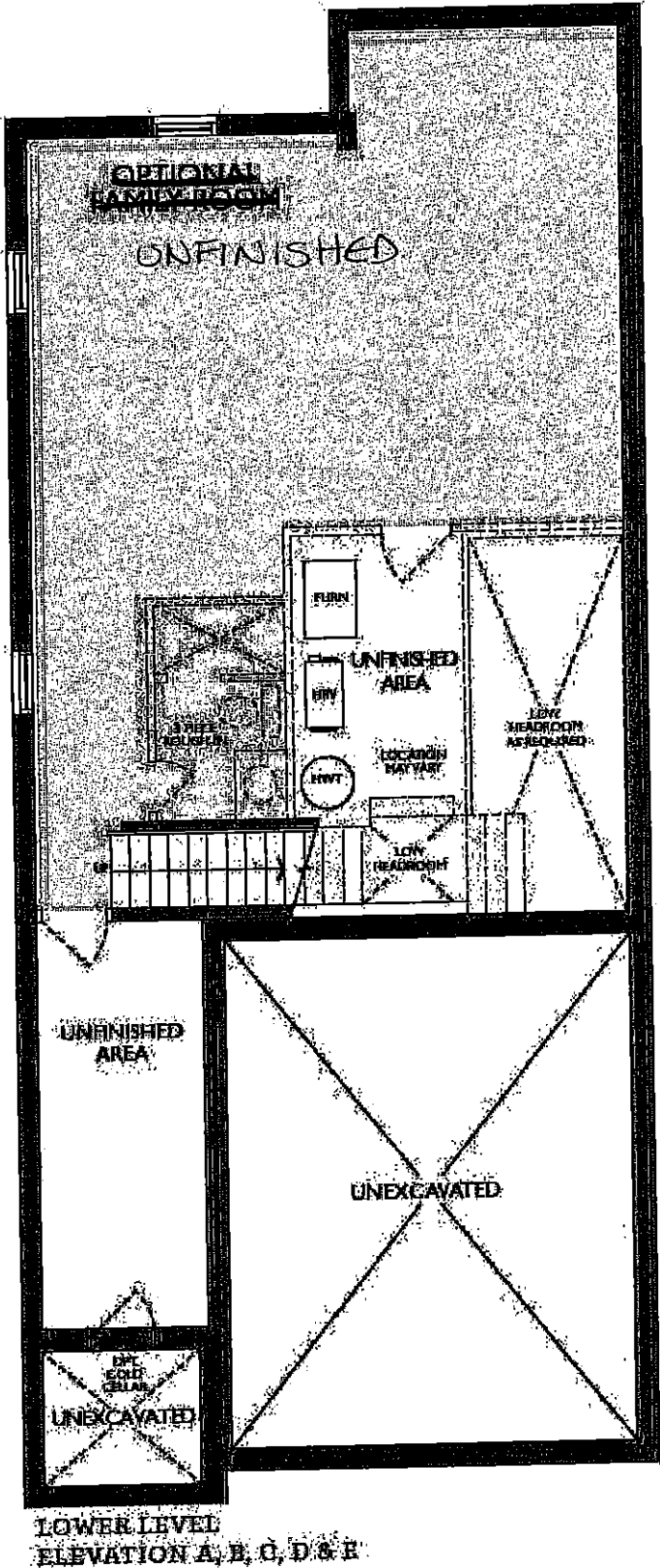

UK 75 WALLACETON
LOT 260
25-2140 ALT E
THE WALLANCE

15 of 21

THE WALLACE
ELEVATION B, C D & E | 2,133 SQ. FT.
(88 sq. ft. of opt. Finished Lower Level)
WALLACETON
EST. 1939

25-2140 ALT ELEV.E

Sketch #2

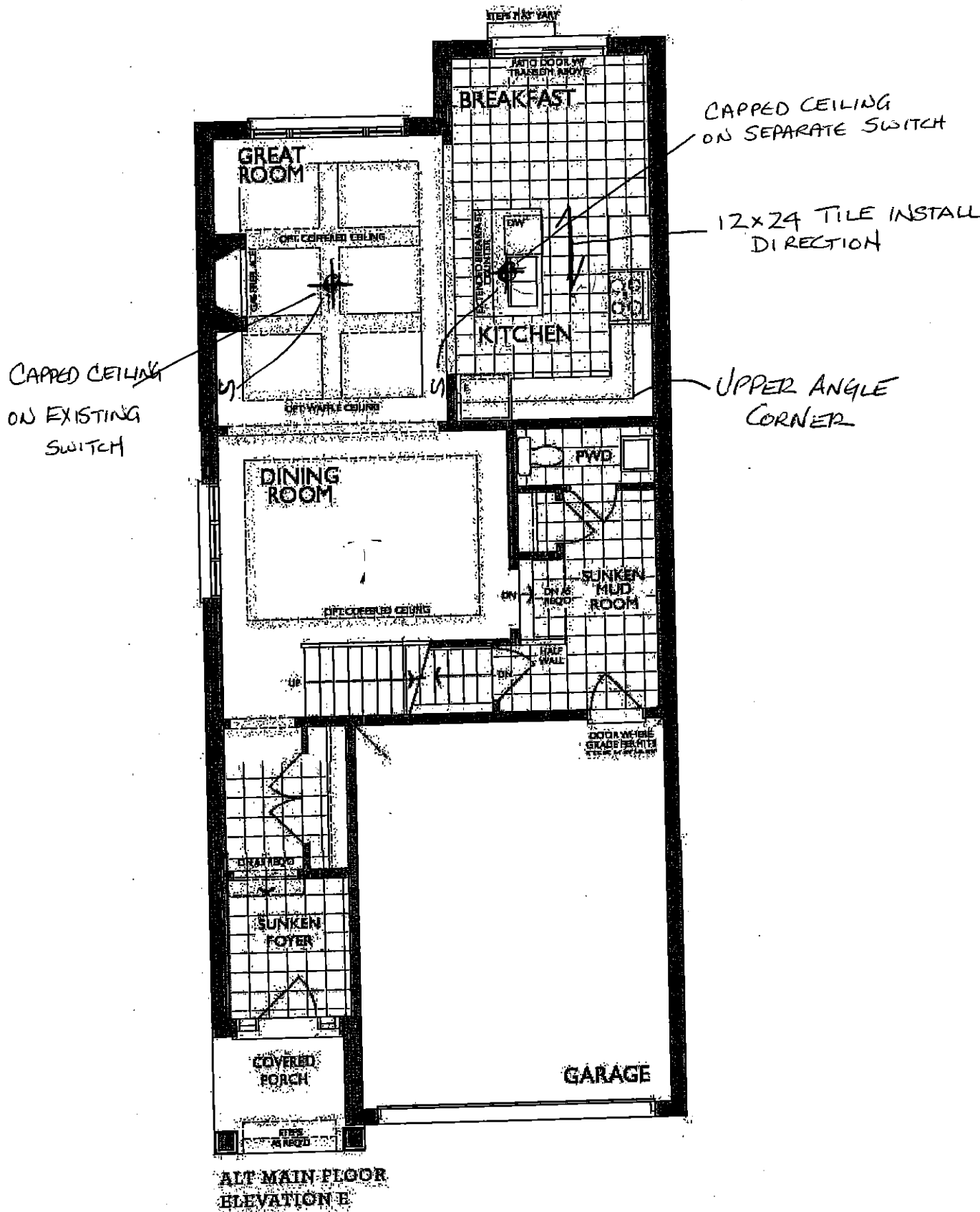

UK 75 WALLACETON
LOT 260
25-2140 ALT E
THE WALLANCE

16 of 21

THE WALLACE
ELEVATION B, C D & E | 2,133 SQ. FT.

589 sq. ft. of opt. finished lower level

25-2140 ALT ELEV.E

WALLACETON
EST. 1979

Sketch # 3

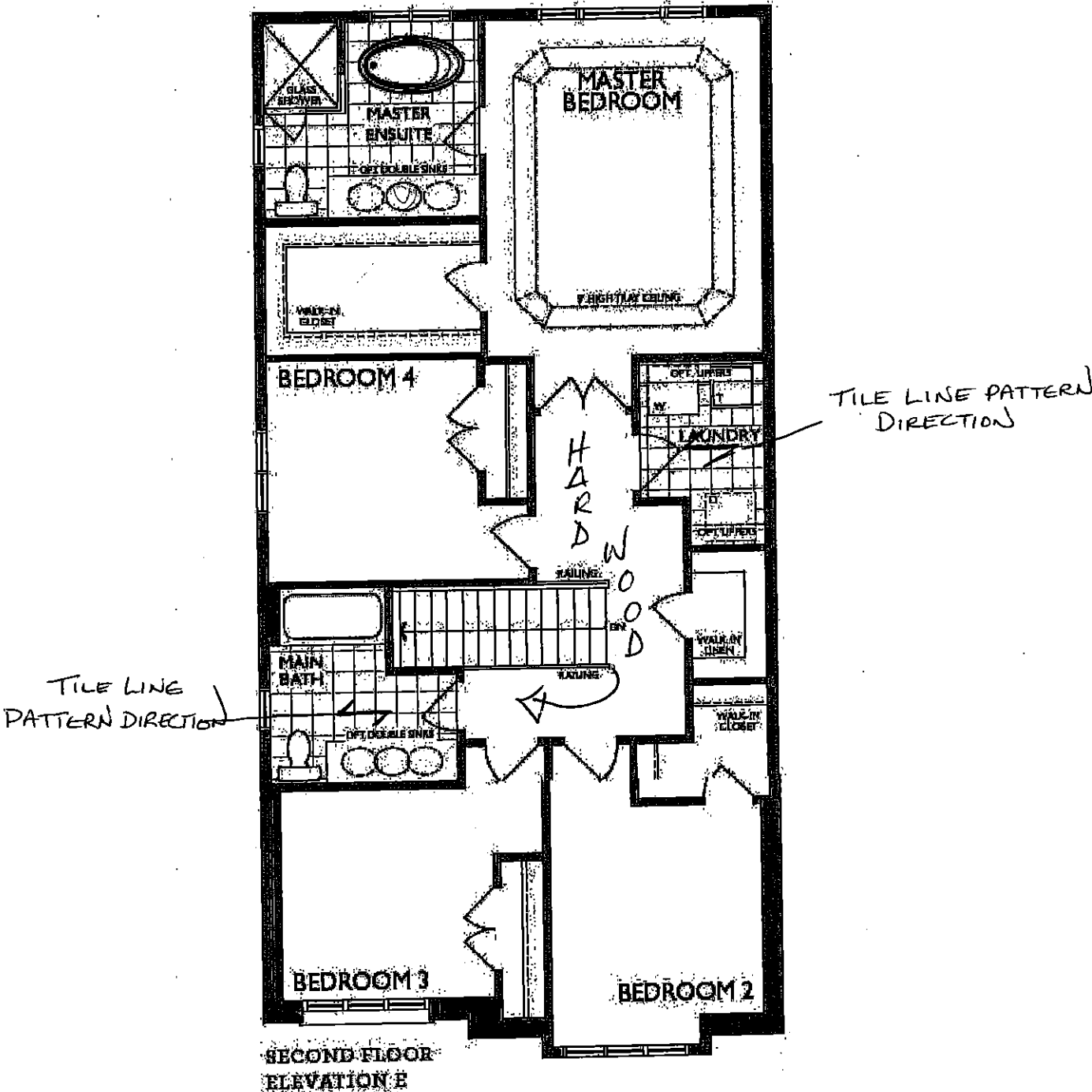

UK 75 WALLACETON
LOT 260
25-2140 ALT E
THE WALLANCE

17 of 21

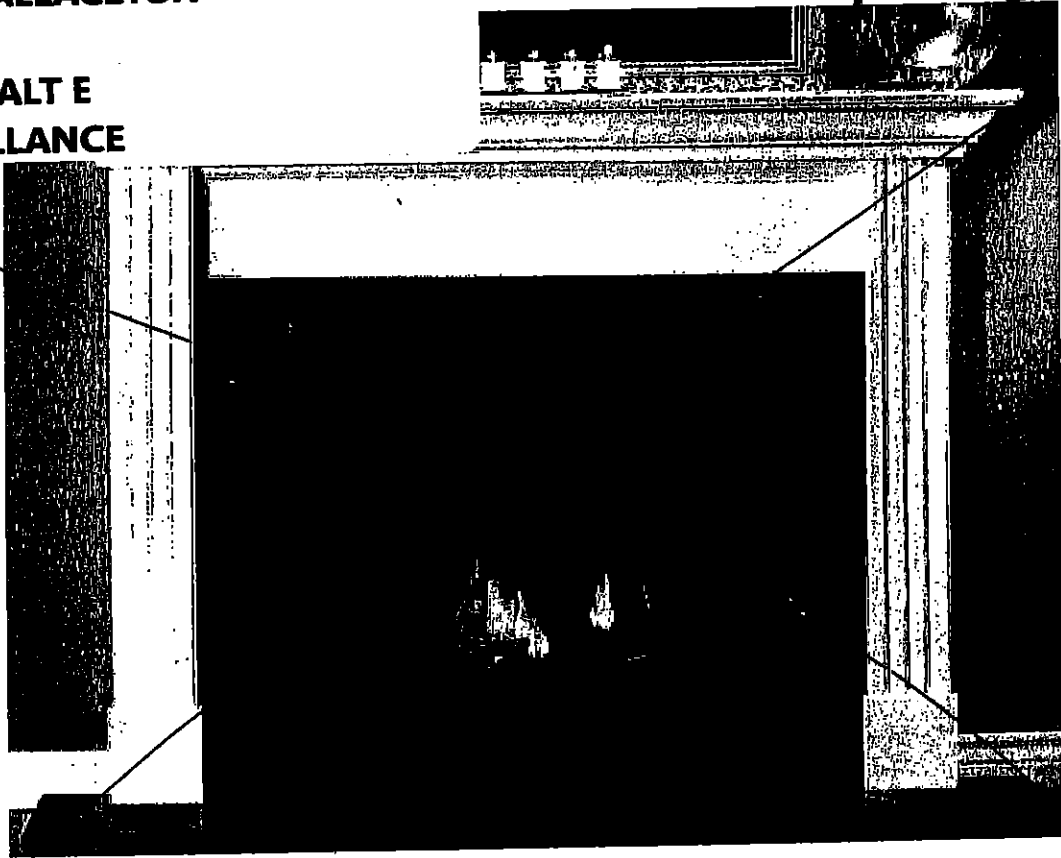

STANDARD NF 15 Mantel

Clean apron finish with fluted legs

WHITE PAINT GRADE FINISH

(PICTURE SHOWN WITH UPGRADE SURROUND AND HEARTH -PRICED SEPARATELY)

X

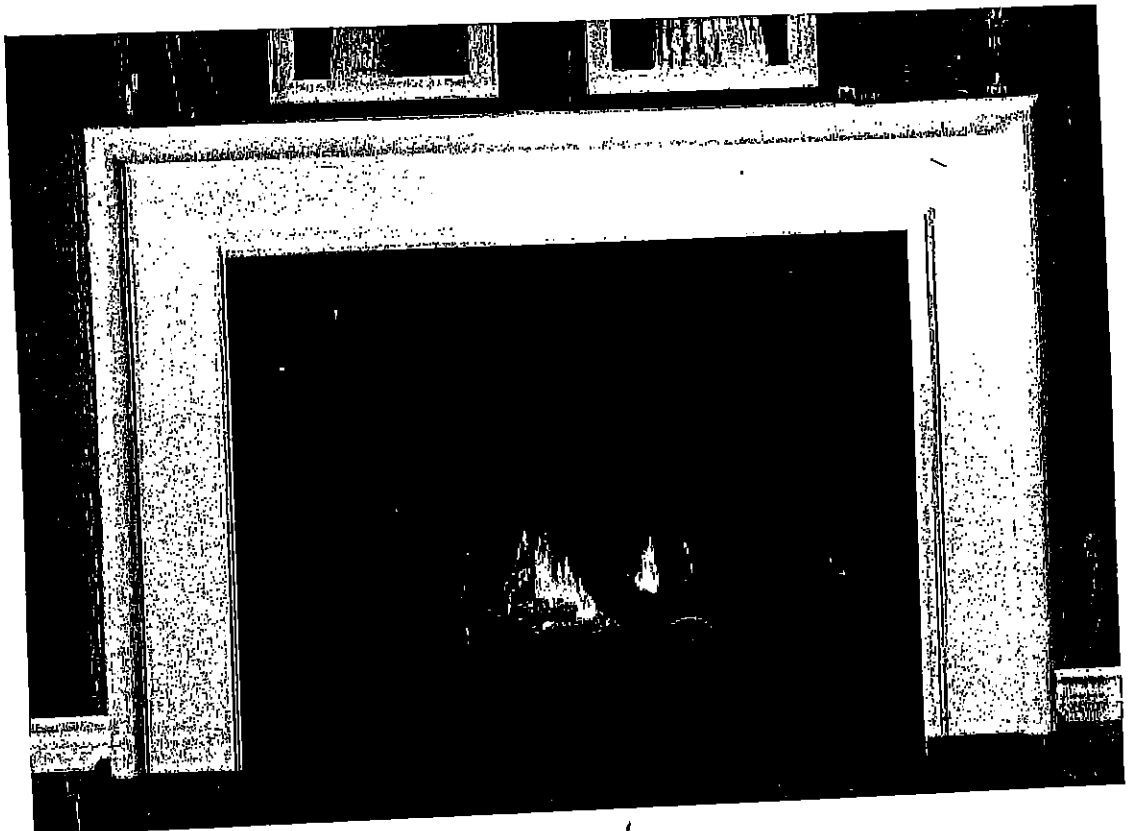

CABINET

STANDARD NF 17 Mantel

WHITE PAINT GRADE FINISH

(PICTURE SHOWN WITH UPGRADE SURROUND AND HEARTH -PRICED SEPARATELY)

HF

UK 75 WALLACETON
LOT 260
25-2140 ALT E
THE WALLANCE

18 of 21



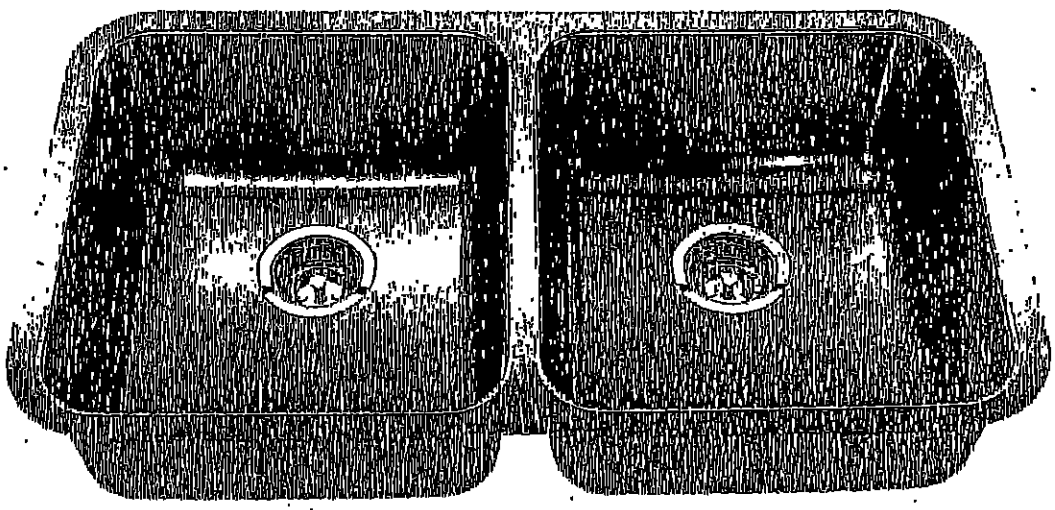

STANDARD KITCHEN SINK

ND1831UA/9





Optional Accessories

 BG105

 BG105

 MB100

 CATW

 DBR105



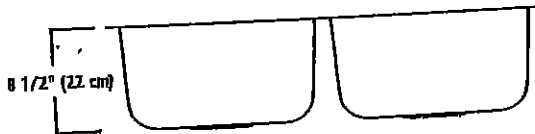
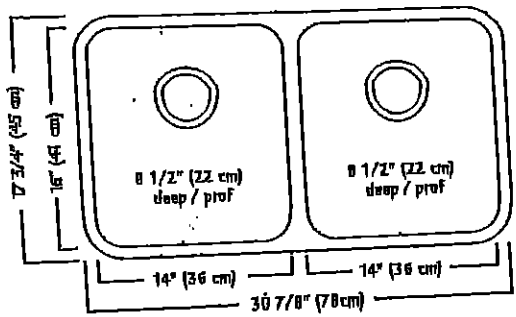

ND1831UA/9 SPECIFICATION

Model ND1831UA/9 is a double (two equal size) bowl undermount sink manufactured by Franke Kindred Canada Limited from 18 gauge stainless steel. Product has silk finished rims and linear brush finished bowls. Sink is fully undercoated. Basket strainer waste fittings (3 1/2", 89 mm) are included. Sink is backed with a limited lifetime warranty.

- O.D. 17 3/4" x 30 7/8" x 8 1/2" (45 x 78 x 22 cm)
- Recommended for minimum 36" cabinet

Franke Kindred Canada Limited
P.O. Box 190, 1000 Franke Kindred Road, Midland, Ontario, Canada, L4R 4K9 Phone: 866-687-7465 Fax: 800-361-8408

Kiy

Franke Kindred Canada Limited Printed in Canada 1117

UK 75 WALLACETON
LOT 260
25-2140 ALT E
THE WALLANCE

19 OF 21

STANDARD KITCHEN FAUCET

Align

Modern

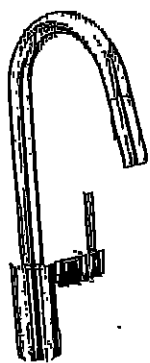

Single Handle Pull-Down Kitchen
Faucet*
Model 7565+

HF

HF

UK 75 WALLACETON
LOT 260
25-2140 ALT E
THE WALLANCE

20 of 21

Chateau

Transitional

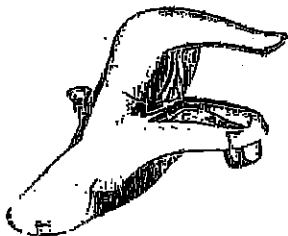

Lavatory Faucet with Pop-Up Drain
Model L4621+

VANITY SINKS AND PEDESTAL



Posi-Temp® Pressure Balancing Tub/Shower
Model 62320 / TL183+

OR

Posi-Temp Valve and Tub/Shower Trim
with Eco-Performance Easy Clean® XL
Model 62320 / TL183EP+
(TL183EP not available in BC)

SHOWER AND 5' TUB FAUCETS



2 Handle Roman Tub with 9" Spout
Model 4796 / T990+

FREESTANDING TUB FAUCETS

HF

UK 75 WALLACETON
LOT 260
25-2140 ALT E
THE WALLANCE

RD HOODFAN FOR
N TOWNS AND SINGLES

21 of 21



SPECIFICATIONS
AV SERIES
RANGE HOODS

	180 CFM/7.0 Sones @ 0.10" SP. Horizontal
	180 CFM/7.5 Sones @ 0.10" SP. Vertical

- Dimensions**
Overall bottom projection - 18 3/8"
Overall top projection - 12"
Height - 8"
Available widths: 21", 24", 30", 36" & 42"
- Hood Body**
Stainless Steel: 24 gauge, grade 430 stainless steel.
Painted: 23 gauge cold rolled commercial grade (CRCC) steel, auto welded, coated with a baked enamel finish.
- Motor**
2 speed, single coil, thermally protected, permanently lubricated.
Rated 120 volts, 60 hz. Complete with 200°C lead wires!
- Lighting**
Single 60 watt cook light capacity (bulb not included).
- Ducting Options**
Horizontal ducting: 3 1/4"x10" (duet adapter and damper included).
Vertical ducting: 3 1/4"x10" (duet adapter and damper included).
Vertical ducting: 7" round (duet adapter and damper not included).
Ductless: removable front vent (charcoal filter not included).
- Fan Blade**
One piece polymeric, electronically balanced blade, 8 5/8" diameter with 5 paddles.
- Electrical connection**
Hood top - 7/8" knockout hole for use with 1/2" cable clamp
Hood back - 7/8" knockout hole for use with 1/2" cable clamp

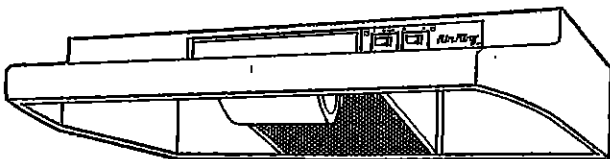

AV SERIES

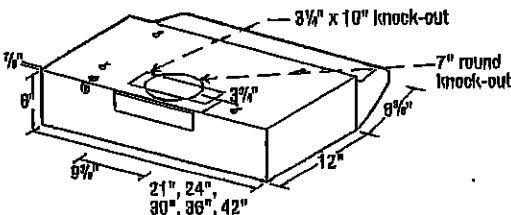

- Filters**
UL rated, class 2 filter.
Grease Filter: RF35 - 8 7/8"x10 3/8" (included).
Charcoal Filter: RF34 (not included).
Combo Grease/Charcoal: RF55 (not included).
- Available Finishes**
White, Bisquit, Almond, Black & Stainless Steel.

EXPANDED PERFORMANCE										
Air Flow - CFM	Static Pressure (Inches of w.g.)						Sones @ .1 SP	Fan Speed RPM	Power Watts	Amps
	0	0.05	0.1	0.15	0.2	0.25				
Vertical Ducting High	248	292	218	203	181	147	7.5	2873	87.0	2.1
Horizontal Ducting High	225	210	180	175	165	120	7.0	3024	87.0	2.1

PROJECT				ARCHITECT						
LOCATION				ENGINEER						
CONTRACTOR				SUBMITTED BY		DATE				
FAN NUMBER	MODEL NUMBER	CFM	IN W.G.	RPM	WATTS	AMPS	SONES	QTY	OPTIONAL EQUIPMENT & REMARKS	



Air King: 820 Lincoln Avenue
West Chester, Pennsylvania 19380-4468
Tel: (610) 692-7400 • 877-304-3785
Fax: (610) 696-8048

Canada:
Brampton, Ontario
Tel: 905-456-2033
Fax: (905) 456-1015

Specifications subject to change without notice.

Updated 2-10

HF