

PRE-Sales Selection Sheet  
Checklist

OF 22

LOT 188B-10    Model: 20-1790 A The Dunmore  
PURCHASERS: SEZER, RECEP KUTUK/  
VENDOR:        Heathwood Homes (Huron) Limited

RELOCATE LAUNDRY TUB TO SECOND FLOOR AND PROVIDE FOR STACKABLE WASHER/DRYER  
OPTIONAL COFFERED CEILING IN DINING ROOM  
OPTIONAL DOUBLE SINKS IN MASTER ENSUITE AND MAIN BATHROOMS

- ☒ FINISHED BASEMENT
- ☐ COLD CELLAR

UPGRADED / MODIFIED ELEVATION

- ☐ CORNER UPGRADE
- ☐ REAR UPGRADE

CEILING UPGRADE - SMOOTH

- ☐ MAIN FLOOR
- ☐ SECOND FLOOR
- ☐ BASEMENT

ADDITIONAL ROUGH-INS

- ☐ 200 AMP SERVICE
- ☐ WET BAR ROUGH-IN
- ☐ HUMIDIFIER
- ☒ AIR CONDITIONING

GAS ROUGH-IN

- ☐ STOVE
- ☐ DRYER
- ☐ BBQ
- ☐ ADDITIONAL FIREPLACE

KITCHEN: HOODFAN VENTING SIZE

- ☐ 6 IN ROUND DUCT
- ☒ 7 IN ROUND DUCT

FULL BASEMENT STAIRS:	N/A
UPPER BASEMENT STAIRS:	All Oak
LOWER BASEMENT STAIRS:	Carpet Grade
MAIN STAIRS:	All Oak
MEDIA STAIRS (if applicable):	N/A
LOFT STAIRS (if applicable):	N/A

Sept 24/20    *Signature*  
Date    Purchaser: *on file*

\_\_\_\_\_  
Date    Purchaser:

SEPT 24/20    IRIT SALEM  
Date    Decor Consultant:

**APPROVE**  
-09- 24 2020    *Signature*  
Date    Heathwood Homes (Huron) Limited  
**Approved**

Locked Date:



Sales Selection Sheet

Wallaceton

2 of 22

PURCHASER: SEZER, RECEP KUTUK

TEL:

LOT / UNIT	PHASE	MODEL	
188B-10	1	20-1790 A The Dunmore	

It is herein understood and agreed between the undersigned parties hereto that the following changes shall be made to the above mentioned Agreement of Purchase and Sale in accordance with the agreement and except for such changes noted below, all other terms and conditions in the Agreement of Purchase and Sale shall remain as stated herein: It is further understood that and agreed that all changes and additions shall be installed as per builder's specifications, location and available selections. The Purchaser hereby agrees to purchase the following extras:

MISC.

1	SCHEDULE 'E' : FIVE THOUSAND DOLLARS (\$5,000.00) AT DECOR (NO CASH VALUE) - TOWNHOME	Qty: 1	
36,448	Note:		

Sub Total

HST

Total

1. This Sales Selection Sheet when properly executed forms part of our Agreement of Purchase and Sale.
2. All extras and upgrades listed above are subject to Construction Progress and Architectural and Municipal requirements.
3. In the event the Vendor is unable to incorporate the work approved above in the construction of the house for any reason whatsoever, the Vendor will not be liable to the Purchaser in any way. The monies paid for any changes or optional extras not proceeded with shall be returned to the Purchaser, without interest. The cost of options or extras is non-refundable in all other circumstances. If for any reason whatsoever the Agreement of Purchase and Sale is not completed, the total cost of work approved above will be retained by the Vendor.
4. The Vendor reserves the right to substitute above materials and equipment with that of equal or better quality.
5. Purchaser acknowledges that items may not be exactly as shown. Variations from the Vendor's samples may occur in finished materials due to normal production processes. Vendor is not responsible for shade difference which may occur from different dye lots or wood grains. Variations from the Vendor's samples will occur with natural materials such as wood, marble, granite, hardwood and brick.
6. The Vendor reserves the right to select Grout & Thresholds that best suits the Tile selected.
7. Selections will not be processed unless signed by Heathwood Homes Head Office.
8. The selections made on this schedule are final and cannot be changed once submitted.
9. The Purchaser has checked and acknowledges the accuracy of this schedule.

Payment Summary

Paid By Amount

Total Payment:

PURCHASER:

SEZER, RECEP KUTUK

16-Sep-20

DATE

Decor Consultant

16-Sep-20

DATE

APPROVED

-09- 24 2020

Date Approved Heathwood Homes (Huron) Limited

TAX#:1

PREPARED BY: Irit Salem

PE 496-1

S\invoice.rpt 28may19

SEZER, RECEP KUTUK/  
Project: Wallaceton  
Unit: 188B-10, Phase: 1  
Model: 20-1790 A The Dunmore

Created: 6/2/2020 08:52:14  
Locked:  
Closed:

3 of 22

Kitchen

Cabinet Colour/Style	9167	Viking III-CHARLESTON-RAIN CLOUD-3DL ***STD***
Countertop	9069	MSI Quartz GROUP 1 ICED WHITE ***STD***
Countertop Edge	4005	DOUBLE MITRE 1 1/2 INCH ***UPG*** 
Cabinet Hardware	2093	9671-HARDWARE ***STD***
Island Cabinet Colour/Style	9166	Viking III-CHARLESTON-ORCHID-3DL ***STD***
Island Countertop	9069	MSI Quartz GROUP 1 ICED WHITE ***STD***
Backsplash	1111	N/A *****
Backsplash Grout	1111	N/A *****
Backsplash Tile Pattern	1111	N/A *****

HoodFan	1111	AV1308 Air King 30  PAGE 22
Appliances	1111	Purchasers have been advised: standard fridge opening is a minimum 37 3/8 x 73 3/8". Ice Waterline Rough-In is included.
Appliances	1111	Standard stove opening is 30" and standard dishwasher opening is 24". Any gas stove will require backsplash or stainless steel backing to avoid fire hazards.
Appliances	1111	Purchasers acknowledge: Heathwood Homes and its contractors will not be responsible for any kitchen cabinet changes due to appliances dimension changes after
Comment		

Kitchen/Breakfast

Flooring	1111	GE.BY.AZR.1313 New Byzantine Azzuro 13
Floor Tile Grout	2225	Grout-(27) Silver ***STD***
Floor Tile Pattern	3000	STANDARD SQUARE ***STD***

S.K

SEZER, RECEP KUTUK/  
Project: Wallaceton  
Unit: 188B-10, Phase: 1  
Model: 20-1790 A The Dunmore

Created: 6/2/2020 08:52:14  
Locked:  
Closed:

4 of 22

Comment

Foyer

Flooring	3000	GE.BY.AZR.1313 New Byzantine Azzuro 13
Floor Tile Grout	2225	Grout-(27) Silver ***STD***
Floor Tile Pattern	3000	STANDARD SQUARE ***STD***

Comment

Laundry Room

Flooring	3000	GE.BY.AZR.1313 New Byzantine Azzuro 13
Floor Tile Grout	2225	Grout-(27) Silver ***STD***
Floor Tile Pattern	3000	STANDARD SQUARE ***STD***

Comment

Laundry Room Opt.

Cabinet - Uppers	1111	N/A *****
Cabinet Hardware	1111	N/A *****

Comment

Mud Room

Flooring	1111	GE.BY.AZR.1313 New Byzantine Azzuro 13
----------	------	--

S.k

SEZER, RECEP KUTUK/  
Project: Wallaceton  
Unit: 188B-10, Phase: 1  
Model: 20-1790 A The Dunmore

Created: 6/2/2020 08:52:14  
Locked:  
Closed:

5 of 22

Floor Tile Grout	2225	Grout-(27) Silver ***STD***
Floor Tile Pattern	3000	STANDARD SQUARE ***STD***

Comment

Powder Room

Flooring	3000	GE.BY.AZR.1313 New Byzantine Azzuro 13
Floor Tile Grout	2225	Grout-(27) Silver ***STD***
Floor Tile Pattern	3000	STANDARD SQUARE ***STD***

Plumbing Fixture (Colour)	1737	Plumbing Fixtures-WHITE ***STD***
Comment		

Hall

Flooring	7498	Red Oak Pearl-Vintage Engineered-IRONGATE-3/4 inch x 3 1/4 inch ***STD***
Comment		

Dining Room

Flooring	7498	Red Oak Pearl-Vintage Engineered-IRONGATE-3/4 inch x 3 1/4 inch ***STD***
Comment		

Great Room

S.K

Flooring	7498	Red Oak Pearl-Vintage Engineered-IRONGATE-3/4 inch x 3 1/4 inch ***STD***
Comment		

SEZER, RECEP KUTUK/  
Project: Wallaceton  
Unit: 188B-10, Phase: 1  
Model: 20-1790 A The Dunmore

Created: 6/2/2020 08:52:14  
Locked:  
Closed:

6 of 22

Upper Hall

Flooring 9248 DY 89418 -Dynasty Tex-BLACK ICE-40 oz Poly\*\*\*STD\*\*\*

Comment

Finished Basement (Rec) Room/Hall

Flooring 9248 DY 89418 -Dynasty Tex-BLACK ICE-40 oz Poly\*\*\*STD\*\*\*

Comment

Master Bedroom

Flooring 9248 DY 89418 -Dynasty Tex-BLACK ICE-40 oz Poly\*\*\*STD\*\*\*

Comment

Bedroom 2

Flooring 9248 DY 89418 -Dynasty Tex-BLACK ICE-40 oz Poly\*\*\*STD\*\*\*

Comment

Bedroom 3

Flooring 9248 DY 89418 -Dynasty Tex-BLACK ICE-40 oz Poly\*\*\*STD\*\*\*

Comment

Master Ensuite

S.K

Cabinet Colour/Style 9166 Viking III-CHARLESTON-ORCHID-3DL \*\*\*STD\*\*\*

Countertop 8796 6698-46-Countertop-PALOMA POLAR ETCHINGS  
FINISH-Formica \*\*\*STD\*\*\*

SEZER, RECEP KUTUK/  
Project: Wallaceton  
Unit: 188B-10, Phase: 1  
Model: 20-1790 A The Dunmore

Created: 6/2/2020 08:52:14  
Locked:  
Closed:

7 of 22

Countertop Edge	1111	N/A *****
Cabinet Hardware	2093	9671-HARDWARE ***STD***
Floor Tile	2093	GE.BY.AZR.1313 New Byzantine Azzuro 13
Floor Tile Grout	2225	Grout-(27) Silver ***STD***
Floor Tile Pattern	3000	STANDARD SQUARE ***STD***
Shower Floor Tile	8661	OD.ON.SWT.0202.MT.N-Ontario Series Mosaic-Snow White Matte-2 x 2 ***STD***
Shower Floor Tile Grout	2226	Grout-(00) White ***STD***
Shower Floor Tile Pattern	3000	STANDARD SQUARE ***STD***
Shower Wall Tile	9020	QT.WV.WHT.0810-Weave-White-8 x 10 ***STD***
Shower Wall Tile Grout	2226	Grout-(00) White ***STD***
Shower Wall Tile Pattern	3090	VERTICAL STACKED ***STD*** <div><div></div><div></div><div></div><div></div><div></div><div></div><div></div><div></div></div>
Shower Jamb(s) and Sill(s)	8923	Shower Jamb / Sill-Thassos White ***STD***
Plumbing Fixture (colour)	1737	Plumbing Fixtures-WHITE ***STD***
Comment		

Main Bathroom

Cabinet Colour/Style	9166	Viking III-CHARLESTON-ORCHID-3DL ***STD***
Countertop	8796	6698-46-Countertop-PALOMA POLAR ETCHINGS FINISH-Formica ***STD***
Countertop Edge	1111	N/A *****

S. IC

SEZER, RECEP KUTUK/  
Project: Wallaceton  
Unit: 188B-10, Phase: 1  
Model: 20-1790 A The Dunmore

Created: 6/2/2020 08:52:14  
Locked:  
Closed:

8 of 22

Cabinet Hardware	2093	9671-HARDWARE ***STD***
Flooring	2093	GE.BY.AZR.1313 New Byzantine Azzuro 13
Floor Tile Grout	2225	Grout-(27) Silver ***STD***
Floor Tile Pattern	3000	STANDARD SQUARE ***STD***
Wall Tile	9020	QT.WV.WHT.0810-Weave-White-8 x 10 ***STD***
Wall Tile Grout	2226	Grout-(00) White ***STD***
Main Bathroom Tile Pattern	3090	VERTICAL STACKED ***STD*** <div><div></div><div></div><div></div><div></div><div></div><div></div><div></div><div></div></div>
Plumbing Fixture (Colour)	1737	Plumbing Fixtures-WHITE ***STD***
Comment		

Finished Basement Bathroom

Cabinet Colour/Style	9166	Viking III-CHARLESTON-ORCHID-3DL ***STD***
Countertop	8796	6698-46-Countertop-PALOMA POLAR ETCHINGS FINISH-Formica ***STD***
Countertop Edge	1111	N/A *****
Cabinet Hardware	2093	9671-HARDWARE ***STD***
Flooring	2093	GE.BY.AZR.1313 New Byzantine Azzuro 13
Floor Tile Grout	2225	Grout-(27) Silver ***STD***
Floor Tile Pattern	3000	STANDARD SQUARE ***STD***
Shower Floor Tile	8661	OD.ON.SWT.0202.MT.N-Ontario Series Mosaic-Snow White Matte-2 x 2 ***STD***

S.K



SEZER, RECEP KUTUK/  
Project: Wallaceton  
Unit: 188B-10, Phase: 1  
Model: 20-1790 A The Dunmore

Created: 6/2/2020 08:52:14  
Locked:  
Closed:

9 of 22

Shower Floor Tile Grout 2226 Grout-(00) White \*\*\*STD\*\*\*

Shower Floor Tile Pattern 3000 STANDARD SQUARE \*\*\*STD\*\*\*

Shower Wall Tile 9020 QT.WV.WHT.0810-Weave-White-8 x 10 \*\*\*STD\*\*\*

Shower Wall Tile Grout 2226 Grout-(00) White \*\*\*STD\*\*\*

Shower Wall Tile Pattern 3090 VERTICAL STACKED \*\*\*STD\*\*\*

Shower Jamb(s) 8923 Shower Jamb / Sill-Thassos White \*\*\*STD\*\*\*

Plumbing Fixture (Colour) 1737 Plumbing Fixtures-WHITE \*\*\*STD\*\*\*

Comment

Great Room Fireplace

Type 8865 Dimplex-Electric Fireplace-PF3033HL \*\*\*STD\*\*\*

Mantle 8891 NF-17-Paint Grade Mantle- Cabinet (Per Plan)-WHITE \*\*\*STD\*\*\*

Surround Opt. 1111 N/A \*\*\*\*\*

Note 1111 Purchasers have been advised: heat from the FP can damage TV above a FP and items placed on mantle.

Note 1111 Heathwood and its contractors will not be liable for any damage on items placed/installed above a FP after closing.

Comment RELOCATE STD. FIRE PLACE TO FAMILY ROOM SEE SKETCH# PAGE# 18

Basement Stairs

Type 1714 Carpet Grade Stairs \*\*\*STD BASEMENT STAIRS\*\*\*

Colour 7912 Irongate (Gryphon) STAIN TO COMPLIMENT HARDWOOD AND WILL VARY FROM FLOORING

Carpet Runner 1111 N/A \*\*\*\*\*

Handrail/Pickets/Post Type 9119 Handrail only on closed walls (one or two sides per building code) \*\*\*STD\*\*\*

S-K

SEZER, RECEP KUTUK/  
Project: Wallaceton  
Unit: 188B-10, Phase: 1  
Model: 20-1790 A The Dunmore

Created: 6/2/2020 08:52:14  
Locked:  
Closed:

10 of 22

code) STD

Handrail/Pickets/Post Colours1729Carpet Grade-Stain handrail, pickets, stringers, nosing\_pos

Carpet9248DY 89418 -Dynasty Tex-BLACK ICE-40 oz Poly\*\*\*STD\*\*\*

Custom Stain/Paint1111N/A \*\*\*\*\*

Comment

Basement Stairs Landings (Upper and Lo

Flooring7498Red Oak Pearl-Vintage Engineered-IRONGATE-3/4 inch x 3 1/4 inch \*\*\*3\*\*\*

Comment

Main Stairs

Type1712Oak Stairs \*\*\*STD MAIN STAIRS\*\*\*

Colour7912Irongate (Gryphon) STAIN TO COMPLIMENT HARDWOOD AND WILL VARY FROM FLOORING

Carpet Runner1111N/A \*\*\*\*\*

Handrail/Pickets/Posts Type76521 5/16 inch Square pickets with 3 1/2" Square/Cap Post(s)-ALL OAK \*\*\*STD\*\*\*

Handrail/Pickets/Posts Colour

Custom Stain/Paint1111N/A \*\*\*\*\*

Comment

Main Stairs Landing(s)

Flooring7498Red Oak Pearl-Vintage Engineered-IRONGATE-3/4 inch x 3 1/4 inch \*\*\*STD\*\*\*

Comment

S.K

Throughout

SEZER, RECEP KUTUK/  
Project: Wallaceton  
Unit: 188B-10, Phase: 1  
Model: 20-1790 A The Dunmore

Created: 6/2/2020 08:52:14  
Locked:  
Closed:

11 of 22

Walls - Paint Colour	1717	22-Wall-WARM GREY ***STD***
Underpad	1079	500 Series-Underpad ***STD***
Thresholds	2232	Metal Thresholds ***STD***
Switches and Plug	5796	Decora White Switches and Plugs ***STD***
Trim Size	8705	4 1/4 Baseboard and 2 1/4 Casings ***STD***
Trim - Paint Colour	1716	Trim-WHITE ***STD***
Comment		

Purchaser: SEZER, RECEP KUTUK Sep 11 2020 Date Decor Consultant Sep 11 2020 Date

Purchaser: \_\_\_\_\_ Date \_\_\_\_\_ Wallaceton M. Rosen -09- 24 2020 Date Approved - APPROVED -



## Sales Selection Sheet

Wallaceton

12 of 22

PURCHASER: SEZER, RECEP KUTUK

TEL:

LOT / UNIT	PHASE	MODEL	
188B-10	1	20-1790 A The Dunmore	

It is herein understood and agreed between the undersigned parties hereto that the following changes shall be made to the above mentioned Agreement of Purchase and Sale in accordance with the agreement and except for such changes noted below, all other terms and conditions in the Agreement of Purchase and Sale shall remain as stated herein: It is further understood that and agreed that all changes and additions shall be installed as per builder's specifications, location and available selections. The Purchaser hereby agrees to purchase the following extras:

## Cabinetry

1 189,005 35,249	CABINETY - 12B-POTS AND PANS DRAWERS (WIDTH MIN. 60CM/MAX. 90CM) (SIZE SUBJECT TO FLOOR PLAN) - UPGRADE 1  Note: KITCHEN SEE SKETCH # 2 PAGE# 16	Qty: 1
2 189,308 35,250	CABINETY - 04H-66CM DEEP FRIDGE ENCLOSURE (COUNTER DEPTH) WITH (1) WALL ([1] 66CM DEEP GABLE AND [1] 66CM DEEP CABINET) (THIS IS NOT A ZERO CLEARANCE ENCLOSURE. STANDARD HEIGHTS AND WIDTHS WILL BE USED.) ; PRICE ALL THE SAME FOR ALL LINES - KITCHEN  Note: SKETCH # 2 PAGE 16	Qty: 1
3 189,051 35,251	CABINETY - 28B-BASE PIE-CUT CORNER LAZY-SUSAN HARDWARE ONLY (BPC MUST BE PART OF CONTRACT) (INCLUDES [2] WHITE 270-DEGREE PLASTIC TRAYS) - UPGRADE 1  Note: KITCHEN SEE SKETCH # 2 PAGE# 16	Qty: 1
4 189,343 35,252	CABINETY - 11A-UPPER ANGLE CORNER PER UNIT - UPGRADE 1  Note: KITCHEN SEE SKETCH # 2 PAGE# 16	Qty: 1
5 189,316 35,267	CABINETY - 12J-LIGHT VALANCE (PER 8 foot LENGTH PRICE) (FOR CLARIFICATION OF STYLES SEE MOULDING MATRIX) (LIGHT VALANCE IS NOW APPROXIMATELY 2" [50MM] HIGH. PLEASE ENSURE LIGHT FIXTURES USED WILL BE CONCEALED BY THE VALANCE.) ;  Note: PRICE ALL THE SAME FOR ALL LINES - KITCHEN	Qty: 2

## Coffered Ceiling

6 177,262 35,268	COFFERED CEILING - OPT. COFFERED CEILING - DINING ROOM  Note:	Qty: 1
------------------------	---	--------

## Electrical

7 189,450 35,256	ELECTRICAL - CEILING ROUGH-IN (CAPPED)  Note: GREAT ROOM SEE SKETCH# 2 PAGE# 16	Qty: 1
8 189,448 35,259	ELECTRICAL - EXTRA WALL INTERIOR OUTLET ON EXISTING CIRCUIT (DOES NOT INCLUDE KITCHEN OUTLETS)  Note: FAMILY ROOM TO BE INSTALL ABOVE THE CENTRE OF THE FIRE PLAVE 70" FROM FLOOR SEE SKETCH # 1 PAGE # 15	Qty: 1
9 189,417 35,264	ELECTRICAL - RELOCATION OF SWITCHES/LIGHTS (MUST SPECIFY LOCATION) - NOTE: PLUGS CANNOT BE RELOCATED- MUST PURCHASE ADDITIONAL OUTLET.  Note: LAUNDRY ROOM- RELOCATE STD. WASHER PLUG SEE SKETCH # 3 PAGE# 17	Qty: 1

Page 1 of 3

Initials: SIK

TAX#:1

PREPARED BY: Irif Salem

PE 479-1

SInvoice.rpt 28may19



Sales Selection Sheet

Wallaceton

13 of 22

PURCHASER: SEZER, RECEP KUTUK

TEL:

LOT / UNIT	PHASE	MODEL	
188B-10	1	20-1790 A The Dunmore	

Electrical

10	ELECTRICAL - ADDITIONAL SWITCH	Qty: 1
189,451		
35,265	Note: GREAT ROOM- TO BE USED FOR THE R/I CAP LIGHT SEE SKETCH # 2 PAGE# 16	

FIREPLACE

11		Qty: 1
35,262	Note: RELOCATE FIRE PLACE TO FAMILY ROOM LOCATION SEE SKETCH # 1 PAGE# 15	

Granite

12	GRANITE - COUNTERTOP - 3/4" GROUP 1 WITH MITRE EDGE - KITCHEN / ISLAND - UPGRADE 1	Qty: 1
177,291		
35,253	Note:	

MISC.

13	PROMO	Qty: (1)
35,270	Note: PROMO	

Plumbing

14	PLUMBING - OPTION FROM ONE SINK TO DOUBLE SINKS INCLUDING STD CHATEAU FAUCET, STD COLONY SINK, INCLU INCLUDING CABINET CONVERSION 2D VIKING AND ONE EXTRA VANITY LIGHT	Qty: 1
189,689		
35,254	Note: MAIN BATHROOM SKETCH # 3 PAGE 17	
15	PLUMBING - OPTION FROM ONE SINK TO DOUBLE SINKS INCLUDING STD CHATEAU FAUCET, STD COLONY SINK, INCLU INCLUDING CABINET CONVERSION 2D VIKING AND ONE EXTRA VANITY LIGHT	Qty: 1
189,689		
35,255	Note: MASTER BATHROOM SKETCH # 3 PAGE 17	
16	SKETCH # 3 PAGE 17	Qty: 1
35,261	Note: RELOCATE LAUNDRY TUB ( AT THE WASHER LOCATION)	
17		Qty: 1
35,263	Note: STACKABLE WASHER AND DRYER - RELOCATE WASHER IN TO DRYER LOCATION- providing homeowner to provide and install stackable kit. SEE SKETCH # 3 PAGE 17	

Structured Wiring

*18	STRUCTURED WIRING - RELOCATION OF TV	Qty: 1
189,775		
35,266	Note: FAMILY ROOM RELOCATE R/I CABLE TO BE 70" ABOVE THE FLOOR IN THE CENTRE OF FIRE PLACE ABOVE THE FIRE PLACE SEE SKETCH # 1 PAGE# 15	

TAX#:1

PREPARED BY: Irit Salem

PE 479-2



# Sales Selection Sheet

Wallaceton

14 of 22

PURCHASER: SEZER, RECEP KUTUK

TEL:

LOT / UNIT	PHASE	MODEL	
188B-10	1	20-1790 A The Dunmore	

Sub Total

HST

Total

1. This Sales Selection Sheet when properly executed forms part of our Agreement of Purchase and Sale.
2. All extras and upgrades listed above are subject to Construction Progress and Architectural and Municipal requirements.
3. In the event the Vendor is unable to incorporate the work approved above in the construction of the house for any reason whatsoever, the Vendor will not be liable to the Purchaser in any way. The monies paid for any changes or optional extras not proceeded with shall be returned to the Purchaser, without interest. The cost of options or extras is non-refundable in all other circumstances. If for any reason whatsoever the Agreement of Purchase and Sale is not completed, the total cost of work approved above will be retained by the Vendor.
4. The Vendor reserves the right to substitute above materials and equipment with that of equal or better quality.
5. Purchaser acknowledges that items may not be exactly as shown. Variations from the Vendor's samples may occur in finished materials due to normal production processes. Vendor is not responsible for shade difference which may occur from different dye lots or wood grains. Variations from the Vendor's samples will occur with natural materials such as wood, marble, granite, hardwood and brick.
6. The Vendor reserves the right to select Grout & Thresholds that best suits the Tile selected.
7. Selections will not be processed unless signed by Heathwood Homes Head Office.
8. The selections made on this schedule are final and cannot be changed once submitted.
9. The Purchaser has checked and acknowledges the accuracy of this schedule.

## Payment Summary

Paid By Amount

Total Payment:

PURCHASER:

P. l. Kutuk  
SEZER, RECEP KUTUK

11-Sep-20  
DATE

[Signature]  
Decor Consultant

11-Sep-20  
DATE

APPROVED

-09- 24 2020

[Signature]

Date Approved Heathwood Homes (Huron) Limited

TAX#:1

PREPARED BY: Irit Salem

PE 479-3

Invoice.rpt 28may19

UK-75 WALLACETON  
LOT 188B-10  
20-1790 ELEV. A  
THE DUNMORE

15 of 22  
THE DUNMORE

ELEVATION A | 2,233 SQ. FT.

20-1790 ELEV. A

Includes 448 square feet of finished lower level

Sketch # 1

RELOCATE  
ELECTRIC  
FIREPLAC

Relocate  
R/I cable &  
Fireplace  
Elec outlet  
70" +/-  
FROM FLOOR

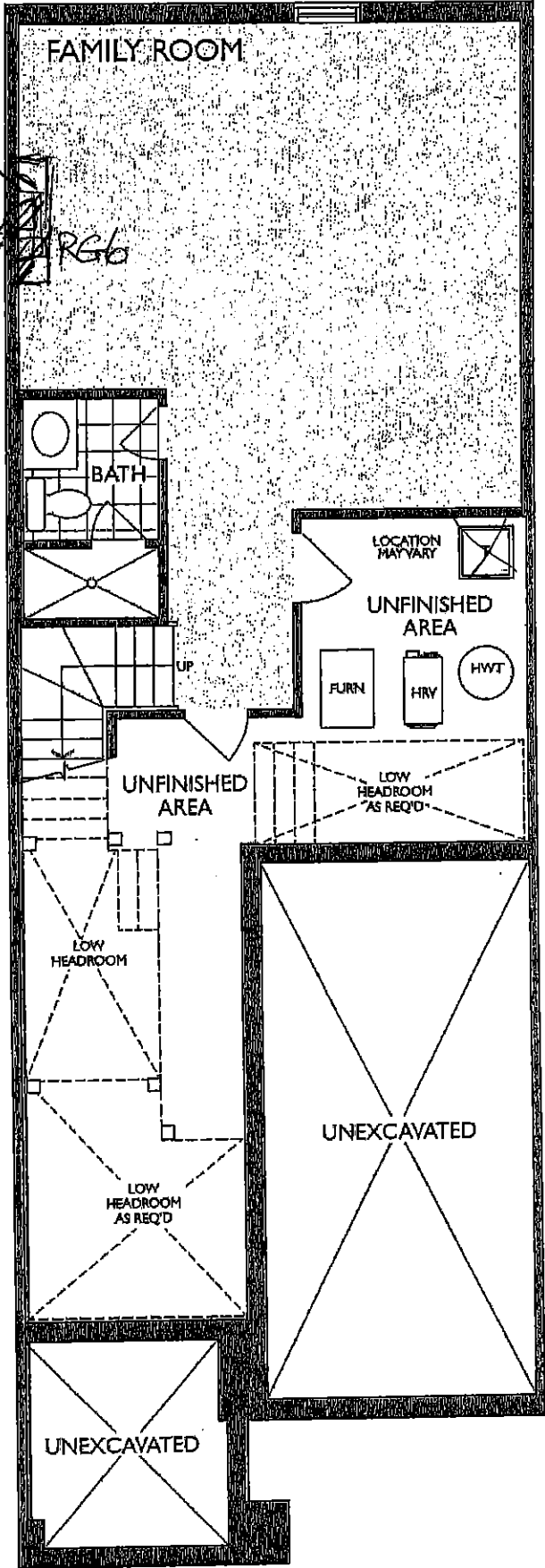

LOWER LEVEL  
ELEVATION A

UK-75 WALLACETON  
LOT 188B-10  
20-1790 ELEV. A  
THE DUNMORE

16 of 22  
THE DUNMORE

ELEVATION A | 2,233 SQ. FT.

20-1790 ELEV. A

Includes 443 square feet of finished lower level  
Sketch # 2

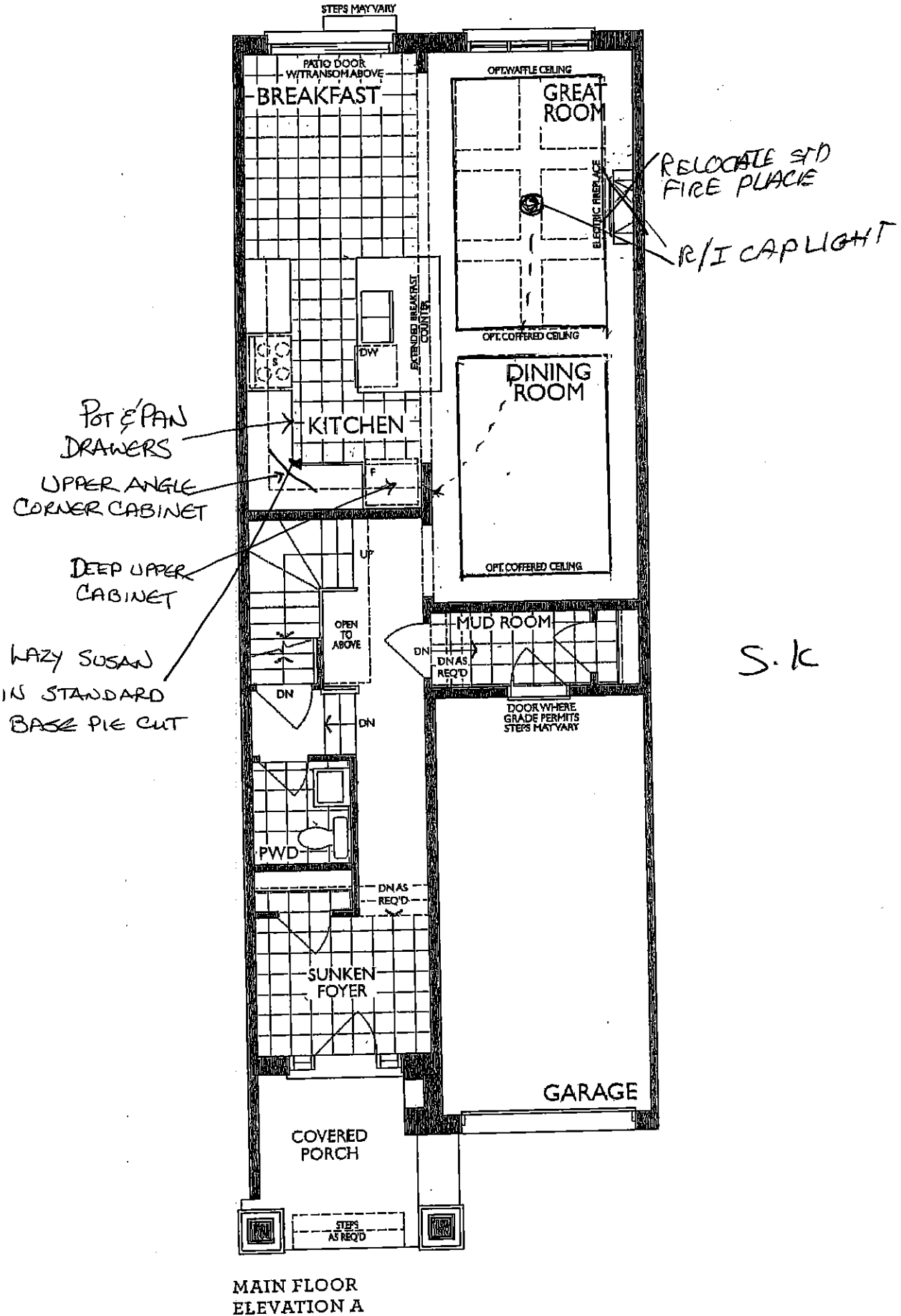



UK-75 WALLACETON  
LOT 188B-10  
20-1790 ELEV. A  
THE DUNMORE

17 of 22

THE DUNMORE

ELEVATION A | 2,233 SQ. FT.

20-1790 ELEV. A

Includes 443 square feet of finished lower level  
Sketch #3

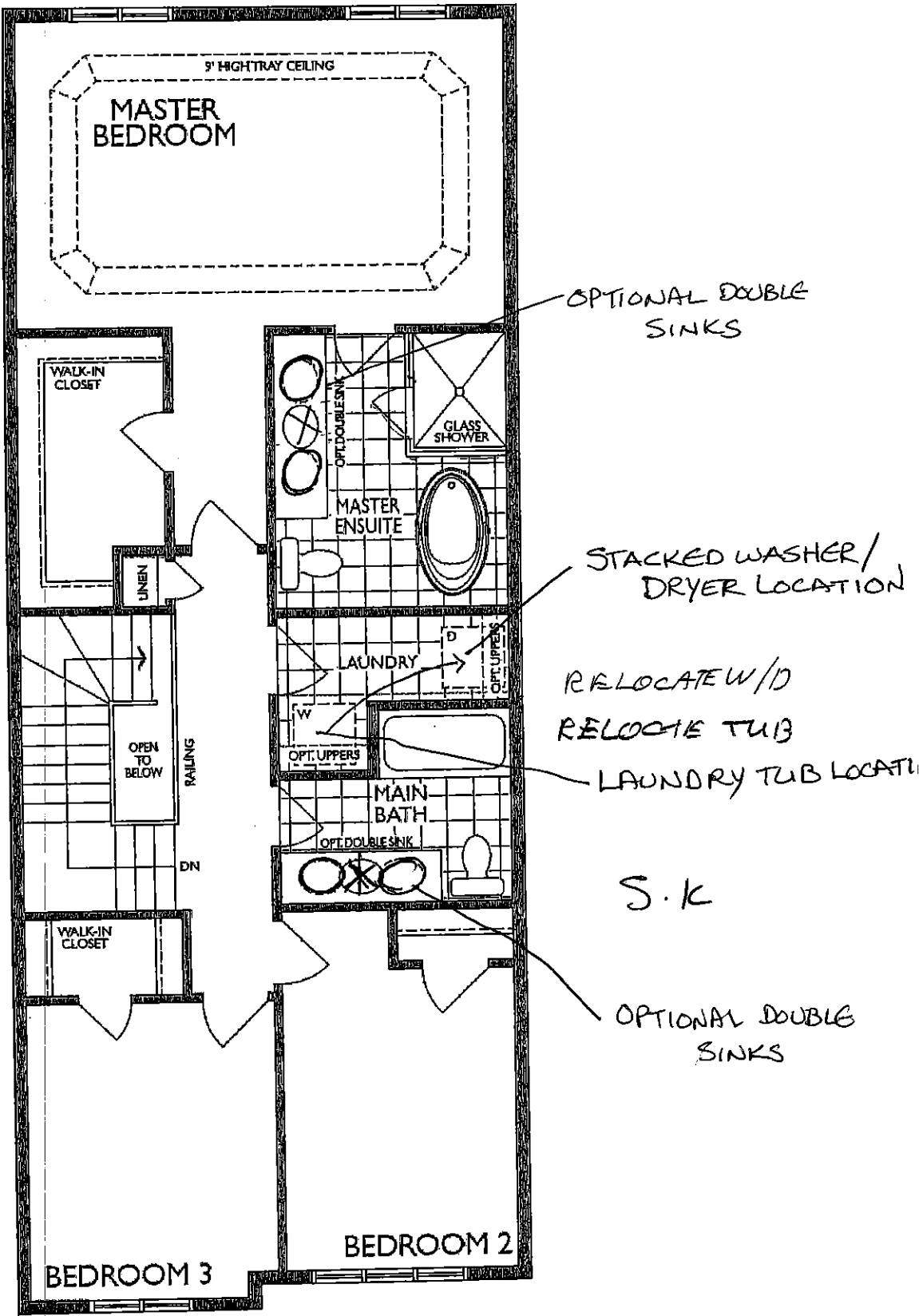

SECOND FLOOR  
ELEVATION A

UK-75 WALLACETON  
LOT 188B-10  
20-1790 ELEV. A  
THE DUNMORE

18 of 22

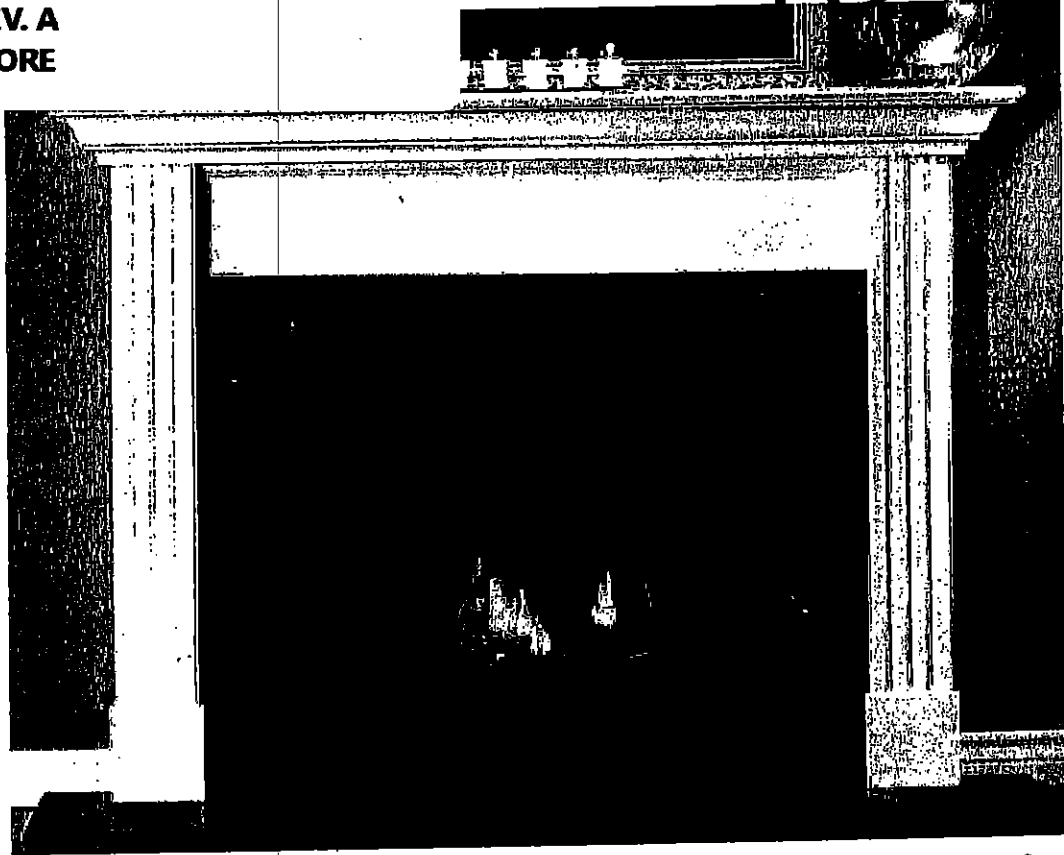

## STANDARD NF 15 Mantel

Clean apron finish with fluted legs

**WHITE PAINT GRADE FINISH**

(PICTURE SHOWN WITH UPGRADE SURROUND AND HEARTH -PRICED SEPARATELY)

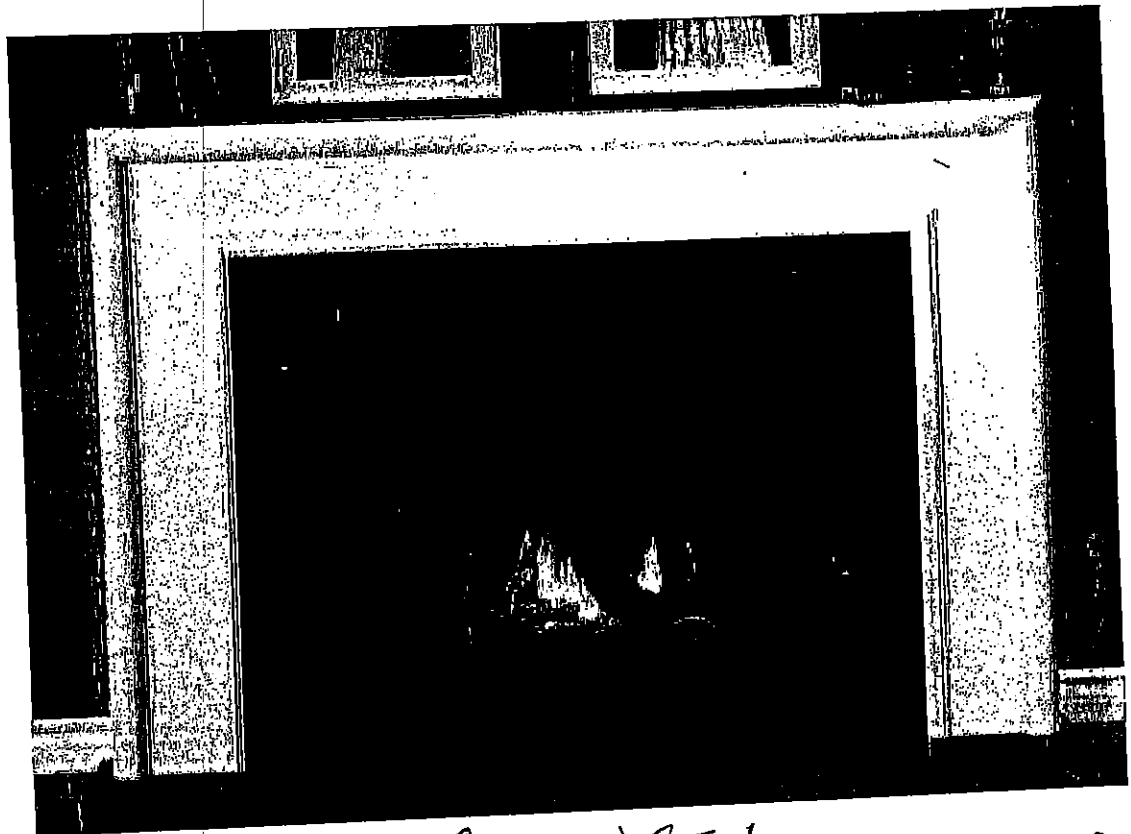

1 CABINET

## STANDARD NF 17 Mantel

**WHITE PAINT GRADE FINISH**

(PICTURE SHOWN WITH UPGRADE SURROUND AND HEARTH -PRICED SEPARATELY)

S.K

UK-75 WALLACETON  
LOT 188B-10  
20-1790 ELEV. A  
THE DUNMORE

19 of 22



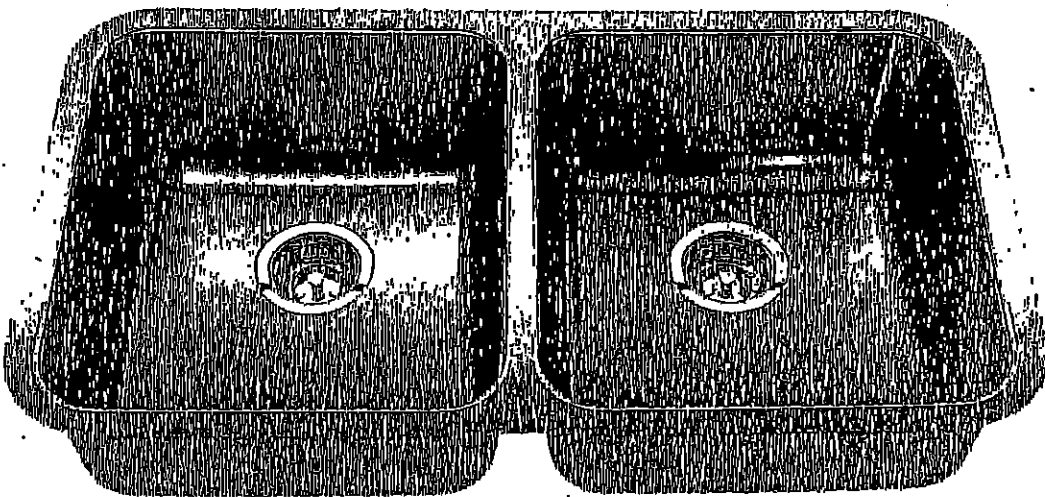

STANDARD KITCHEN SINK

ND1831UA/9





Optional Accessories

 BG105

 BG105

 MB100

 CA1W

 DBR105



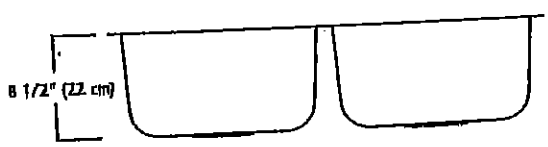
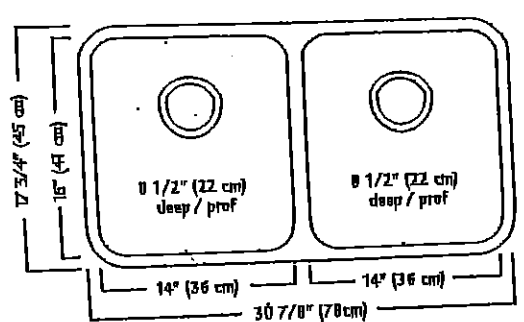

ND1831UA/9 SPECIFICATION

Model ND1831UA/9 is a double (two equal size) bowl undermount sink manufactured by Franke Kindred Canada Limited from 18 gauge stainless steel. Product has silk finished rims and linear brush finished bowls. Sink is fully undercoated. Basket strainer waste fittings (3 1/2", 89 mm) are included. Sink is backed with a limited lifetime warranty.

- O.D. 17 3/4" x 30 7/8" x 8 1/2" (45 x 78 x 22 cm)
- Recommended for minimum 36" cabinet

Franke Kindred Canada Limited  
P.O. Box 190, 1000 Franke Kindred Road, Midland, Ontario, Canada, L4R 4K9 Phone: 866-687-7465 Fax: 800-361-8408

Franke Kindred Canada Limited Printed in Canada 1117

K.Y.  
S.K.

UK-75 WALLACETON  
LOT 188B-10  
20-1790 ELEV. A  
THE DUNMORE

20 OF 22

STANDARD KITCHEN FAUCET

Align

Modern

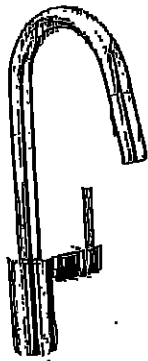

Single Handle Pull-Down Kitchen  
Faucet\*

Model 7565†

K.P.

S.K.

UK-75 WALLACETON  
LOT 188B-10  
20-1790 ELEV. A  
THE DUNMORE

21 of 22

## Chateau

Transitional

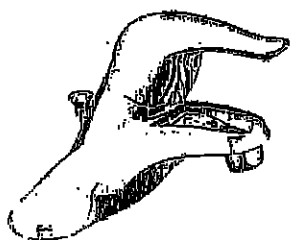

Lavatory Faucet with Pop-Up Drain  
Model L4621+

VANITY SINKS AND PEDESTAL



Posi-Temp® Pressure Balancing Tub/Shower  
Model 62320 / TL183+

OR

Posi-Temp Valve and Tub/Shower Trim  
with Eco-Performance Easy Clean® XL  
Model 62320 / TL183EP+  
(TL183EP not available in BC)

SHOWER AND 5' TUB FAUCETS

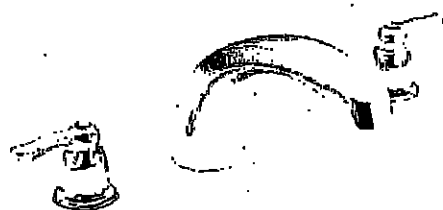

2 Handle Roman Tub with 9" Spout  
Model 4796 / T990+

FREESTANDING TUB FAUCETS

S.K

UK-75 WALLACETON  
LOT 188B-10  
20-1790 ELEV. A  
THE DUNMORE

HOODFAN FOR  
WALLACETON TOWNS AND SINGLES

22 of 22



SPECIFICATIONS  
**AV SERIES**  
RANGE HOODS



180 CFM/7.0 Sones @ 0.10" SP. Horizontal  
180 CFM/7.5 Sones @ 0.10" SP. Vertical

- Dimensions**  
Overall bottom projection - 18 3/8"  
Overall top projection - 12"  
Height - 6"  
Available widths: 21", 24", 30", 36" & 42"
- Hood Body**  
Stainless Steel: 24 gauge, grade 430 stainless steel.  
Painted: 23 gauge cold rolled commercial grade (CRCC) steel, auto welded, coated with a baked enamel finish.
- Motor**  
2 speed, single coil, thermally protected, permanently lubricated.  
Rated 120 volts, 60 hz. Complete with 200°C lead wires!
- Lighting**  
Single 60 watt cook light capacity (bulb not included).
- Ducting Options**  
Horizontal ducting: 3 1/4"x10" (duct adapter and damper included).  
Vertical ducting: 3 1/4"x10" (duct adapter and damper included).  
Vertical ducting: 7" round (duct adapter and damper not included).  
Ductless: removable front vent (charcoal filter: not included).
- Fan Blade**  
One piece polymeric, electronically balanced blade. 6 5/8" diameter with 5 paddles.
- Electrical connection**  
Hood top - 7/8" knockout hole for use with 1/2" cable clamp  
Hood back - 7/8" knockout hole for use with 1/2" cable clamp

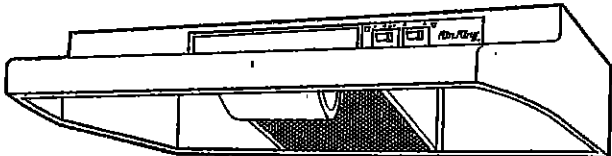

AV SERIES

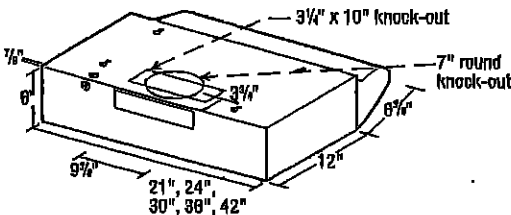

- Filters**  
UL rated, class 2 filter.  
Grease Filter: RF35 - 8 7/8"x10 3/8" (included).  
Charcoal Filter: RF34 (not included).  
Combo Grease/Charcoal: RF55 (not included).
- Available Finishes**  
White, Blacult, Almond, Black & Stainless Steel.

EXPANDED PERFORMANCE										
Air Flow - CFM	Static Pressure (inches of w.g.)						Sones @ .1 SP	Fan Speed RPM	Power Watts	Amps
	0	0.05	0.1	0.15	0.2	0.25				
Vertical Ducting High	246	232	218	203	181	147	7.5	2973	87.0	2.1
Horizontal Ducting High	225	210	180	176	155	120	7.0	3024	87.0	2.1

PROJECT				ARCHITECT						
LOCATION				ENGINEER						
CONTRACTOR				SUBMITTED BY					DATE	
FAN NUMBER	MODEL NUMBER	CFM	IN W.G.	RPM	WATTS	AMPS	SONES	QTY	OPTIONAL EQUIPMENT & REMARKS	



Air King: 820 Lincoln Avenue  
West Chester, Pennsylvania 19380-4486  
Tel: (610) 692-7400 • 877-304-3785  
Fax: (610) 696-8048

Canada:  
Brampton, Ontario  
Tel: 905-456-2033  
Fax: (905) 456-1015

Specifications subject to change without notice.

Updated 2-11

S.K