

PRE-Sales Selection Sheet  
Checklist

OF 21

LOT 4 Model: 25-2140-Alt B The Wallace

PURCHASERS: DINESH THAKUR/JASPREET SINGH

VENDOR: Heathwood Homes (Huron) Limited

- ☐ FINISHED BASEMENT  
☐ COLD CELLAR

UPGRADED / MODIFIED ELEVATION

- ☐ CORNER UPGRADE  
☐ REAR UPGRADE

CEILING UPGRADE - SMOOTH

- ☐ MAIN FLOOR  
☐ SECOND FLOOR  
☐ BASEMENT

ADDITIONAL ROUGH-INS

- ☒ 200 AMP SERVICE  
☐ WET BAR ROUGH-IN  
☐ HUMIDIFIER  
☒ AIR CONDITIONING

GAS ROUGH-IN

- ☐ STOVE  
☐ DRYER  
☐ BBQ  
☐ ADDITIONAL FIREPLACE

KITCHEN: HOODFAN VENTING SIZE

- ☐ 6 IN ROUND DUCT  
☒ 7 IN ROUND DUCT

FULL BASEMENT STAIRS:

Paint Grade

UPPER BASEMENT STAIRS:

N/A

LOWER BASEMENT STAIRS:

N/A

MAIN STAIRS:

All Oak

MEDIA STAIRS (if applicable):

N/A

LOFT STAIRS (if applicable):

N/A

Sept 4/20  
Date Purchaser: *file*

Sept 4/20  
Date Decor Consultant: IRIT SALEM

APPROVED

Date Purchaser:

-09- 14 2020

*mRosen*

Locked Date:

Approved

Heathwood Homes (Huron) Limited



## Sales Selection Sheet

Wallaceton

2 OF 21

PURCHASERS: DINESH THAKUR and JASPREET SINGH

TEL: RES.: 647-226-7935

LOT / UNIT	PHASE	MODEL	
4	1	25-2140-Alt B The Wallace	

It is herein understood and agreed between the undersigned parties hereto that the following changes shall be made to the above mentioned Agreement of Purchase and Sale in accordance with the agreement and except for such changes noted below, all other terms and conditions in the Agreement of Purchase and Sale shall remain as stated herein: It is further understood that and agreed that all changes and additions shall be installed as per builder's specifications, location and available selections. The Purchaser hereby agrees to purchase the following extras:

## MISC.

1	SCHEDULE 'E' TEN THOUSAND DOLLARS (\$10,000.00) IN DECOR NO CASH VALUE - SINGLES	Qty: 1	
34,865	Note: BY AMENDMENT SEPTEMBER 4/20 FROM ORIGINAL SCHEDULE E- APPLIANCE PACKAGE -SINGLES		

Sub Total

HST

Total

1. This Sales Selection Sheet when properly executed forms part of our Agreement of Purchase and Sale.
2. All extras and upgrades listed above are subject to Construction Progress and Architectural and Municipal requirements.
3. In the event the Vendor is unable to incorporate the work approved above in the construction of the house for any reason whatsoever, the Vendor will not be liable to the Purchaser in any way. The monies paid for any changes or optional extras not proceeded with shall be returned to the Purchaser, without interest. The cost of options or extras is non-refundable in all other circumstances. If for any reason whatsoever the Agreement of Purchase and Sale is not completed, the total cost of work approved above will be retained by the Vendor.
4. The Vendor reserves the right to substitute above materials and equipment with that of equal or better quality.
5. Purchaser acknowledges that items may not be exactly as shown. Variations from the Vendor's samples may occur in finished materials due to normal production processes. Vendor is not responsible for shade difference which may occur from different dye lots or wood grains. Variations from the Vendor's samples will occur with natural materials such as wood, marble, granite, hardwood and brick.
6. The Vendor reserves the right to select Grout & Thresholds that best suits the Tile selected.
7. Selections will not be processed unless signed by Heathwood Homes Head Office.
8. The selections made on this schedule are final and cannot be changed once submitted.
9. The Purchaser has checked and acknowledges the accuracy of this schedule.

## Payment Summary

Paid By	Amount
---------	--------

Total Payment:

PURCHASER:

DINESH THAKUR

14-Sep-20

DATE

IRIT SALEM  
Decor Consultant

14-Sep-20

DATE

PURCHASER:

JASPREET SINGH

14-Sep-20

DATE

APPROVED  
-09- 14 2020

Date Approved Heathwood Homes (Huron) Limited

TAX#:1

PREPARED BY: Irit Salem

PE 464-1

Sinvoice.rpt 28may19

DINESH THAKUR/JASPREET SINGH  
Project: Wallaceton  
Unit: 4, Phase: 1  
Model: 25-2140-Alt B The Wallace

Created: 8/31/2020 11:07:40  
Locked:  
Closed:

3 OF 21

Kitchen

Cabinet Colour/Style	9167	Viking III-CHARLESTON-RAIN CLOUD-3DL ***STD***
Countertop	9069	MSI Quartz GROUP 1 ICED WHITE ***STD***
Countertop Edge	4005	DOUBLE MITRE 1 1/2 INCH ***UPG*** 
Cabinet Hardware	7667	12881-HARDWARE ***STD***
Island Cabinet Colour/Style	9167	Viking III-CHARLESTON-RAIN CLOUD-3DL ***STD***
Island Countertop	9069	MSI Quartz GROUP 1 ICED WHITE ***STD***
Backsplash	1111	N/A *****
Backsplash Grout	1111	N/A *****
Backsplash Tile Pattern	1111	N/A *****

HoodFan	1111	AV1308 Air King 30  PAGE 21
Appliances	1111	Purchasers have been advised: standard fridge opening is a minimum 37 3/8 x 73 3/8". Ice Waterline Rough-In is included.
Appliances	1111	Standard stove opening is 30" and standard dishwasher opening is 24". Any gas stove will require backsplash or stainless steel backing to avoid fire hazards.
Appliances	1111	Purchasers acknowledge: Heathwood Homes and its contractors will not be responsible for any kitchen cabinet changes due to appliances dimension changes after
Comment		

Kitchen/Breakfast

Flooring	8244	OV.CX.WHT.1224.PL-Carrara X-White Polished-12 x 24 See Tile Direction on Sketch 2 Page 15 ***5***
Floor Tile Grout	7704	Grout-(19) Pearl Gray ***STD***
Floor Tile Pattern	3040	FRONT TO BACK ***STD***

DINESH THAKUR/JASPREET SINGH  
Project: Wallaceton  
Unit: 4, Phase: 1  
Model: 25-2140-Alt B The Wallace

Created: 8/31/2020 11:07:40  
Locked:  
Closed:

4 of 21

Comment

Foyer

Flooring	8244	OV.CX.WHT.1224.PL-Carrara X-White Polished-12 x 24 See Tile Direction on Sketch 2 Page 15 ***5***
Floor Tile Grout	7704	Grout-(19) Pearl Gray ***STD***
Floor Tile Pattern	3040	FRONT TO BACK ***STD***

Comment

Laundry Room

Flooring	3040	GE.BY.AZR.1313 New Byzantine Azzuro 13
Floor Tile Grout	2225	Grout-(27) Silver ***STD***
Floor Tile Pattern	3000	STANDARD SQUARE ***STD***

Comment

JS  
DT

Laundry Room Opt.

Cabinet - Uppers	1111	N/A *****
Cabinet Hardware	1111	N/A *****

Comment

Mud Room

Flooring	8244	OV.CX.WHT.1224.PL-Carrara X-White Polished-12 x 24 See Tile Direction on Sketch 2 Page 15 ***5***
----------	------	------------------------------------------------------------------------------------------------------

DINESH THAKUR/JASPREET SINGH  
Project: Wallaceton  
Unit: 4, Phase: 1  
Model: 25-2140-Alt B The Wallace

Created: 8/31/2020 11:07:40  
Locked:  
Closed:

5 of 21



Floor Tile Grout 7704 Grout-(19) Pearl Gray \*\*\*STD\*\*\*  
Floor Tile Pattern 3040 FRONT TO BACK \*\*\*STD\*\*\*

Comment

Powder Room

Flooring 8244 OV.CX.WHT.1224.PL-Carrara X-White Polished-12 x 24  
See Tile Direction on Sketch 2 Page 15 \*\*\*5\*\*\*  
Floor Tile Grout 7704 Grout-(19) Pearl Gray \*\*\*STD\*\*\*  
Floor Tile Pattern 3040 FRONT TO BACK \*\*\*STD\*\*\*

Plumbing Fixture (Colour) 1737 Plumbing Fixtures-WHITE \*\*\*STD\*\*\*  
Comment

Dining Room/Hall

Flooring 9061 White Oak UVF-Vintage Northern Solid Sawn : White Oak :  
Sculpted UVF-BAROQUE-3/4 inch x 5 inch \*\*\*2\*\*\*  
Comment

Dining Room/Hall

Duplicate  
Flooring 9061 White Oak UVF-Vintage Northern Solid Sawn : White Oak :  
Sculpted UVF-BAROQUE-3/4 inch x 5 inch \*\*\*2\*\*\*  
Comment

IS  
DT

Great Room

Flooring 9061 White Oak UVF-Vintage Northern Solid Sawn : White Oak :  
Sculpted UVF-BAROQUE-3/4 inch x 5 inch \*\*\*2\*\*\*  
Comment



DINESH THAKUR/JASPREET SINGH  
Project: Wallaceton  
Unit: 4, Phase: 1  
Model: 25-2140-Alt B The Wallace

Created: 8/31/2020 11:07:40  
Locked:  
Closed:

b of 21

Upper Hall

Flooring 9248 DY 89418 -Dynasty Tex-BLACK ICE-40 oz Poly\*\*\*STD\*\*\*

Comment

Opt. Finished Basement (Rec) Room/Hall

Flooring 1111 N/A \*\*\*\*\*

Comment

Master Bedroom

Flooring 9248 DY 89418 -Dynasty Tex-BLACK ICE-40 oz Poly\*\*\*STD\*\*\*

Comment

Bedroom 2

Flooring 9248 DY 89418 -Dynasty Tex-BLACK ICE-40 oz Poly\*\*\*STD\*\*\*

Comment

Bedroom 3

Flooring 9248 DY 89418 -Dynasty Tex-BLACK ICE-40 oz Poly\*\*\*STD\*\*\*

Comment

B  
BT

Bedroom 4

Flooring 9248 DY 89418 -Dynasty Tex-BLACK ICE-40 oz Poly\*\*\*STD\*\*\*

Comment

DINESH THAKUR/JASPREET SINGH  
Project: Wallaceton  
Unit: 4, Phase: 1  
Model: 25-2140-Alt B The Wallace

Created: 8/31/2020 11:07:40  
Locked:  
Closed:

7 of 21

Master Ensuite

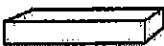
Cabinet Colour/Style	9166	Viking III-CHARLESTON-ORCHID-3DL ***STD***
Countertop	9069	MSI Quartz GROUP 1 ICED WHITE ***STD***
Countertop Edge	4010	GROUP 1 - SINGLE POLISHED STRAIGHT EDGE 3/4 INCH ***1***
Cabinet Hardware	2093	 9671-HARDWARE ***STD***
Floor Tile	2093	GE.BY.AZR.1313 New Byzantine Azzuro 13
Floor Tile Grout	2225	Grout-(27) Silver ***STD***
Floor Tile Pattern	3000	STANDARD SQUARE ***STD***

Shower Floor Tile	8661	OD.ON.SWT.0202.MT.N-Ontario Series Mosaic-Snow White Matte-2 x 2 ***STD***
Shower Floor Tile Grout	2226	Grout-(00) White ***STD***
Shower Floor Tile Pattern	3000	STANDARD SQUARE ***STD***

IS  
27

Shower Wall Tile	9020	QT.WV.WHT.0810-Weave-White-8 x 10 ***STD***
Shower Wall Tile Grout	2226	Grout-(00) White ***STD***
Shower Wall Tile Pattern	3090	VERTICAL STACKED ***STD*** 
Shower Jamb(s) and Sill(s)	8923	Shower Jamb / Sill-Thassos White ***STD***
Plumbing Fixture (colour)	1737	Plumbing Fixtures-WHITE ***STD***

Comment	
---------	--

DINESH THAKUR/JASPREET SINGH  
Project: Wallaceton  
Unit: 4, Phase: 1  
Model: 25-2140-Alt B The Wallace

Created: 8/31/2020 11:07:40  
Locked:  
Closed:

8 of 21

Main Bathroom

Cabinet Colour/Style	9166	Viking III-CHARLESTON-ORCHID-3DL ***STD***
Countertop	8827	4925K-07-Countertop-CALCUTTA MARBLE-Wilsonart ***STD***
Countertop Edge	1111	N/A *****
Cabinet Hardware	2093	9671-HARDWARE ***STD***
Flooring	2093	GE.BY.AZR.1313 New Byzantine Azzuro 13
Floor Tile Grout	2225	Grout-(27) Silver ***STD***
Floor Tile Pattern	3000	STANDARD SQUARE ***STD***

Wall Tile	9020	QT.WV.WHT.0810-Weave-White-8 x 10 ***STD***								
Wall Tile Grout	2226	Grout-(00) White ***STD***								
Main Bathroom Tile Pattern	3090	VERTICAL STACKED ***STD*** <table><tr><td></td><td></td><td></td><td></td></tr><tr><td></td><td></td><td></td><td></td></tr></table>								
Plumbing Fixture (Colour)	1737	Plumbing Fixtures-WHITE ***STD***								

JS  
DT

Comment	
---------	--

Opt. Shower Floor Tile

Shower Floor Tile Grout	1111	N/A *****
Shower Floor Tile Pattern	1111	N/A *****
Shower Wall Tile	1111	N/A *****
Shower Wall Tile Grout	1111	N/A *****



DINESH THAKUR/JASPREET SINGH  
Project: Wallaceton  
Unit: 4, Phase: 1  
Model: 25-2140-Alt B The Wallace

Created: 8/31/2020 11:07:40  
Locked:  
Closed:

9 of 21

Shower Wall Tile Pattern 1111 N/A \*\*\*\*\*

Shower Jamb(s) 1111 N/A \*\*\*\*\*

Cabinet Colour/Style 1111 N/A \*\*\*\*\*

Countertop 1111 N/A \*\*\*\*\*

Countertop Edge 1111 N/A \*\*\*\*\*

Cabinet Hardware 1111 N/A \*\*\*\*\*

Flooring 1111 N/A \*\*\*\*\*

Floor Tile Grout 1111 N/A \*\*\*\*\*

Floor Tile Pattern 1111 N/A \*\*\*\*\*

Plumbing Fixture (Colour) 1111 N/A \*\*\*\*\*

Comment

Great Room Fireplace

JS  
DT

Type 8869 Majestic MERC32 \*\*\*STD\*\*\*

Mantle 8891 NF-17-Paint Grade Mantle- Cabinet (Per Plan)-WHITE  
\*\*\*STD\*\*\*

PAGE 17

Surround Opt. 1111 N/A \*\*\*\*\*

Note 1111 Purchasers have been advised: heat from the FP can damage TV above a FP and items placed on mantle.

Note 1111 Heathwood and its contractors will not be liable for any damage on items placed/installed above a FP after closing.

Comment

Basement Stairs

Type 1713 Paint Grade Stairs \*\*\*STD BASEMENT STAIR \*\*\*

Customer Colours

170

DINESH THAKUR/JASPREET SINGH  
Project: Wallaceton  
Unit: 4, Phase: 1  
Model: 25-2140-Alt B The Wallace

Created: 8/31/2020 11:07:40  
Locked:  
Closed:

10 of 21

Colour	1111	N/A *****
Carpet Runner	1111	N/A *****
Handrail/Pickets/Post Type	1111	N/A *****
Handrail/Pickets/Post Colours	1111	N/A *****
Carpet	1111	N/A *****
Custom Stain/Paint	1111	N/A *****
Comment		

Landing to Basement

Flooring	1111	N/A *****
Comment		

Main Stairs

Type	1712	Oak Stairs ***STD MAIN STAIRS***
Colour	7934	Baroque STAIN TO COMPLIMENT HARDWOOD AND WILL VARY FROM FLOORING ***99***
Carpet Runner	1111	N/A *****
Handrail/Pickets/Posts Type	7651	1 5/16 inch Turned pickets with 3 1/2" Turned Post(s)-ALL OAK***STD***
Handrail/Pickets/Posts Colour	1728	Oak Grade-Stain handrail,oak pickets,stringers,treads,risers
Custom Stain/Paint	1111	N/A *****
Comment		

Hall

Flooring	9061	White Oak UVF-Vintage Northern Solid Sawn : White Oak :
----------	------	---------------------------------------------------------

DINESH THAKUR/JASPREET SINGH  
Project: Wallaceton  
Unit: 4, Phase: 1  
Model: 25-2140-Alt B The Wallace

Created: 8/31/2020 11:07:40  
Locked:  
Closed:

11 of 21

Sculpted UVF-BAROQUE-3/4 inch x 5 inch \*\*\*2\*\*\*

Comment

Throughout

Walls - Paint Colour	1717	22-Wall-WARM GREY ***STD***
Underpad	1079	500 Series-Underpad ***STD***
Thresholds	2232	Metal Thresholds ***STD***
Switches and Plug	5796	Decora White Switches and Plugs ***STD***
Trim Size	8705	4 1/4 Baseboard and 2 3/4 Casings ***STD***
Trim - Paint Colour	1716	Trim-WHITE ***STD***

Comment

Purchaser:



DINESH THAKUR

Sep 04 / 2020

Date

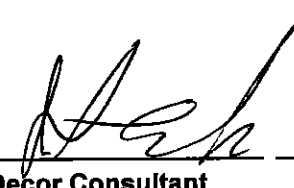

Decor Consultant

Sep 4 2020

Date

Purchaser:

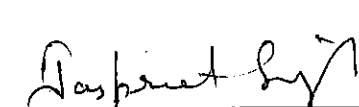

JASPREET SINGH

Sep-4-2020

Date



Wallaceton

APPROVED

-09-14 2020

Date Approved



## Sales Selection Sheet

Wallaceton

12 of 21

PURCHASERS: DINESH THAKUR and JASPREET SINGH

TEL: RES.: 647-226-7935

LOT / UNIT	PHASE	MODEL	
4	1	25-2140-Alt B The Wallace	

It is herein understood and agreed between the undersigned parties hereto that the following changes shall be made to the above mentioned Agreement of Purchase and Sale in accordance with the agreement and except for such changes noted below, all other terms and conditions in the Agreement of Purchase and Sale shall remain as stated herein: It is further understood that and agreed that all changes and additions shall be installed as per builder's specifications, location and available selections. The Purchaser hereby agrees to purchase the following extras:

## Ceramics

1 197,427 34,858	CERAMICS - FLOOR - FOYER - UPGRADE 5  Note:	Qty: 1
2 197,451 34,859	CERAMICS - FLOOR - GARAGE ENTRY / MUD ROOM - UPGRADE 5  Note:	Qty: 1
3 197,467 34,860	CERAMICS - FLOOR - KITCHEN - UPGRADE 5  Note:	Qty: 1
4 197,336 34,861	CERAMICS - FLOOR - POWDER ROOM - UPGRADE 5  Note:	Qty: 1

## Electrical

5 189,450 34,862	ELECTRICAL - CEILING ROUGH-IN (CAPPED)  Note: GREAT ROOM: TO BE INSTALL IN THE CENTRE OF THE ROOM- USE EXISTING SWITCH PLUG SEE SKETCH# 2 PAGE# 15	Qty: 1
------------------------	-------------------------------------------------------------------------------------------------------------------------------------------------------------	--------

## Granite

6 197,545 34,863	GRANITE - COUNTERTOP - 3/4" GROUP 1 WITH MITRE EDGE - KITCHEN / ISLAND - UPGRADE 1  Note:	Qty: 1
------------------------	-------------------------------------------------------------------------------------------------	--------

## Hardwood

7 197,574 34,850	HARDWOOD - VINTAGE - 5" WHITE OAK UVF OIL - DINING ROOM - UPGRADE 2  Note:	Qty: 1
8 197,570 34,851	HARDWOOD - VINTAGE - 5" WHITE OAK UVF OIL - GREAT ROOM - UPGRADE 2  Note:	Qty: 1
9 197,582 34,852	HARDWOOD - VINTAGE - 5" WHITE OAK UVF OIL - LANDING(S) TO BSMT - UPGRADE 2  Note: DELETE AND CREDIT ON CLOSING AS PER REVISED SSS PAGE 22 OF 22 THE ALTERNATE PLAN DOES NOT HAVE A HARDWOOD LANDING TO BASEMENT	Qty: 1
10 197,578 34,853	HARDWOOD - VINTAGE - 5" WHITE OAK UVF OIL - MAIN HALL - UPGRADE 2  Note:	Qty: 1

Page 1 of 2

Initials: DT JS

TAX#:1

PREPARED BY: Brenda Luker

PE 443-1

Sinvoice.rpt 28may19



Sales Selection Sheet

Wallaceton

13 of 21

PURCHASERS: DINESH THAKUR and JASPREET SINGH

TEL: RES.: 647-226-7935

LOT / UNIT	PHASE	MODEL	
4	1	25-2140-Alt B The Wallace	

MISC.

11	promo	Qty: (1)
34,849	Note:	

Sub Total  
HST  
Total

- 1. This Sales Selection Sheet when properly executed forms part of our Agreement of Purchase and Sale.
- 2. All extras and upgrades listed above are subject to Construction Progress and Architectural and Municipal requirements.
- 3. In the event the Vendor is unable to incorporate the work approved above in the construction of the house for any reason whatsoever, the Vendor will not be liable to the Purchaser in any way. The monies paid for any changes or optional extras not proceeded with shall be returned to the Purchaser, without interest. The cost of options or extras is non-refundable in all other circumstances. If for any reason whatsoever the Agreement of Purchase and Sale is not completed, the total cost of work approved above will be retained by the Vendor.
- 4. The Vendor reserves the right to substitute above materials and equipment with that of equal or better quality.
- 5. Purchaser acknowledges that items may not be exactly as shown. Variations from the Vendor's samples may occur in finished materials due to normal production processes. Vendor is not responsible for shade difference which may occur from different dye lots or wood grains. Variations from the Vendor's samples will occur with natural materials such as wood, marble, granite, hardwood and brick.
- 6. The Vendor reserves the right to select Grout & Thresholds that best suits the Tile selected.
- 7. Selections will not be processed unless signed by Heathwood Homes Head Office.
- 8. The selections made on this schedule are final and cannot be changed once submitted.
- 9. The Purchaser has checked and acknowledges the accuracy of this schedule.

Payment Summary	
<u>Paid By</u>	<u>Amount</u>
<u>Total Payment:</u>	

PURCHASER:

04-Sep-20  
DATE

DINESH THAKUR

04-Sep-20  
DATE

Decor Consultant

PURCHASER:

04-Sep-20  
DATE

JASPREET SINGH

09-14-2020  
Date Approved

HEATHWOOD HOMES (HURON) LIMITED

PAID w/ VISA

14 of 21

sq. ft. of opt. finished Lower Level

25-2140 ALT ELEV.B

## Sketch #1

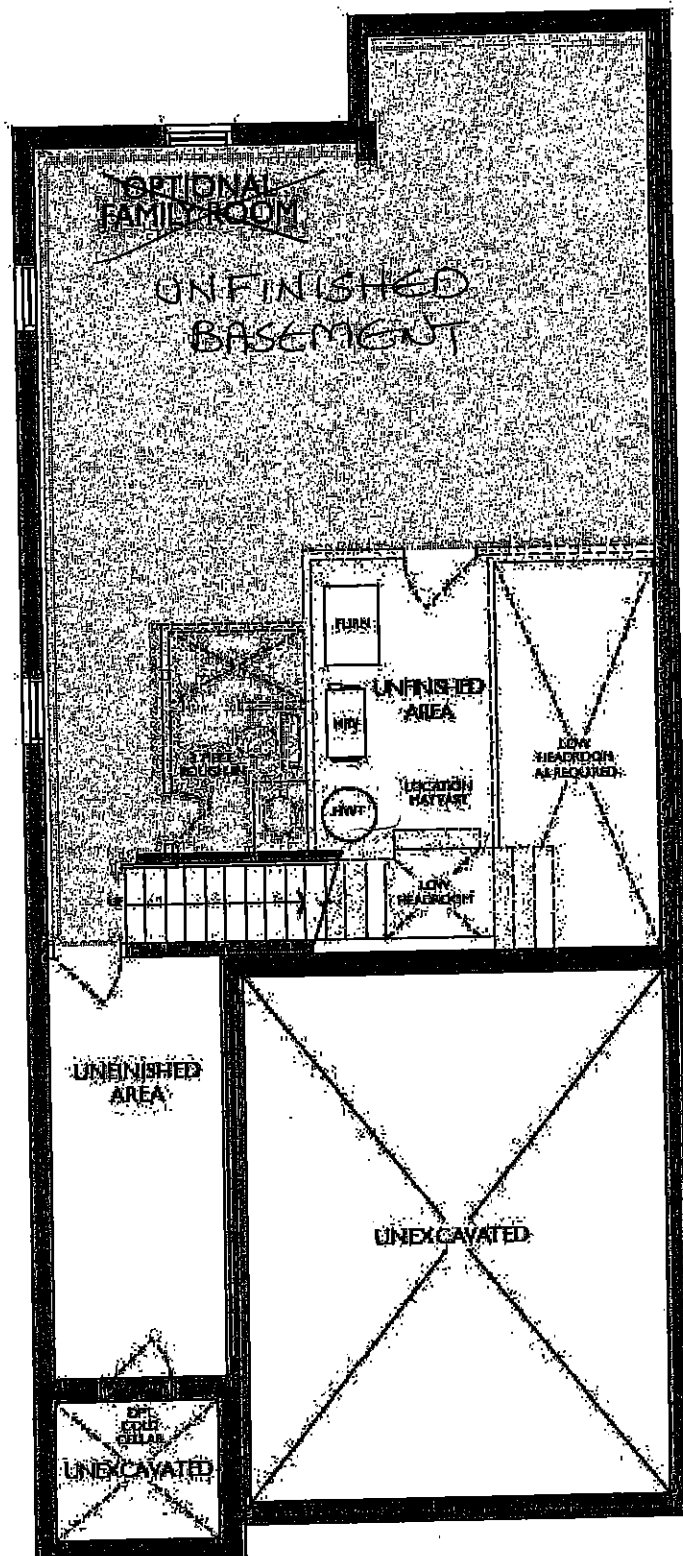

LOWER LEVEL  
ELEVATION A, B, C, D & E

AS  
DT

15 of 21

580 sq. ft. of opt. finished lower level

25-2140 ALT ELEV.B

## Sketch #2

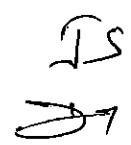

UK-75 WALLACETON  
LOT 4  
25-2140 ALT ELEV B  
THE WALLACE

16 of 21

THE WALLACE  
ELEVATION B, C D & E | 2,133 SQ. FT.  
585 sq. ft. of opt. finished lower level  
WALLACETON  
EST. 1975

25-2140 ALT ELEV.B

Sketch #3

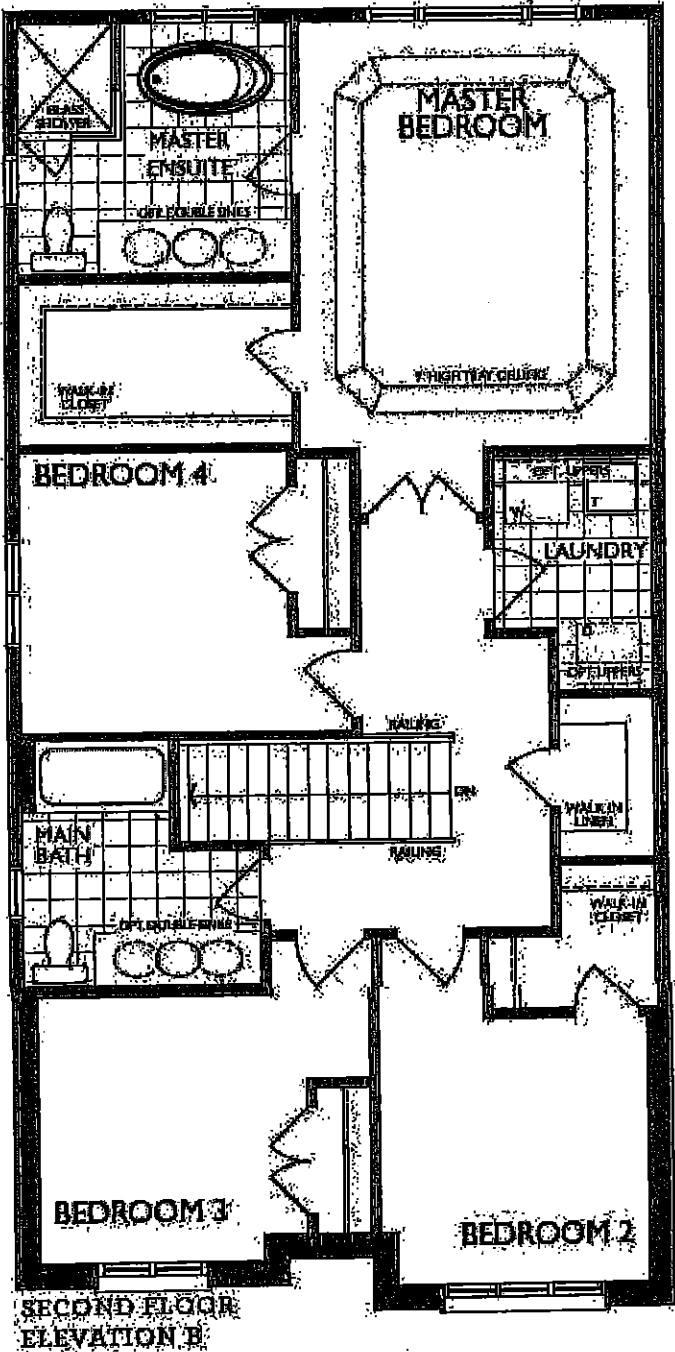

B  
BT



UK-75 WALLACETON  
LOT 4  
25-2140 ALT ELEV B  
THE WALLACE

17 of 21

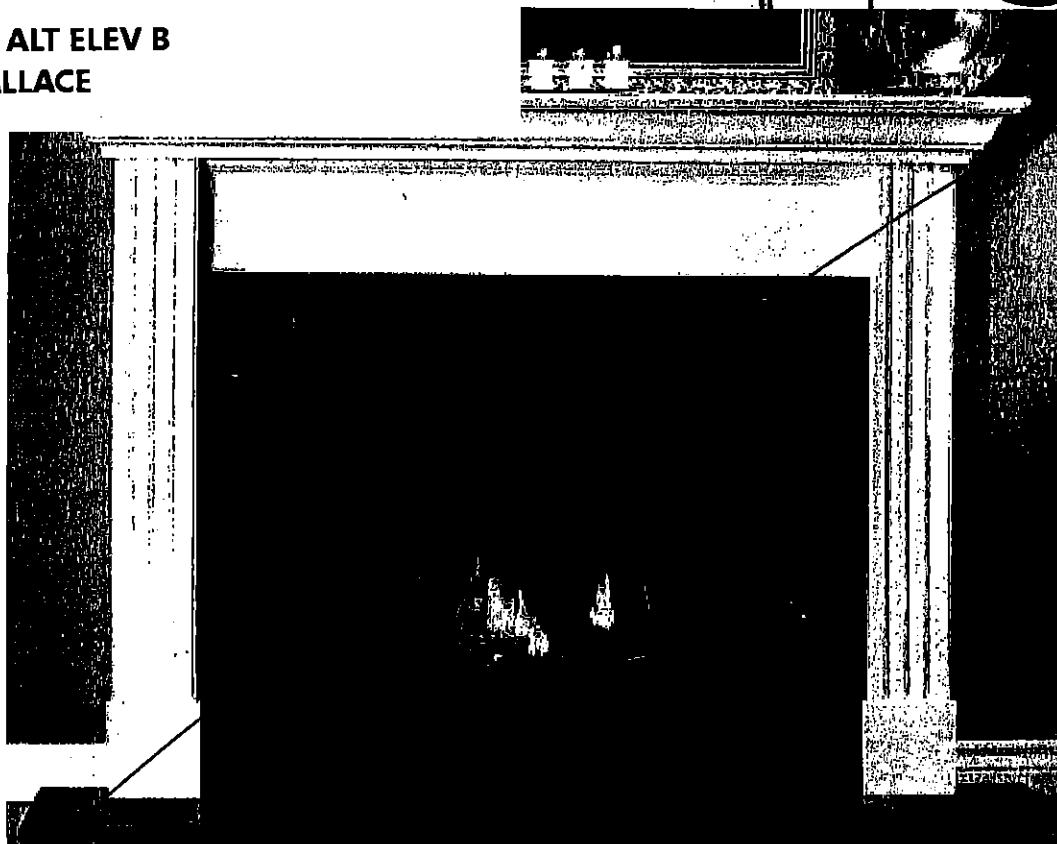

## STANDARD NF 15 Mantel

Clean apron finish with fluted legs

**WHITE PAINT GRADE FINISH**

(PICTURE SHOWN WITH UPGRADE SURROUND AND HEARTH -PRICED SEPARATELY)

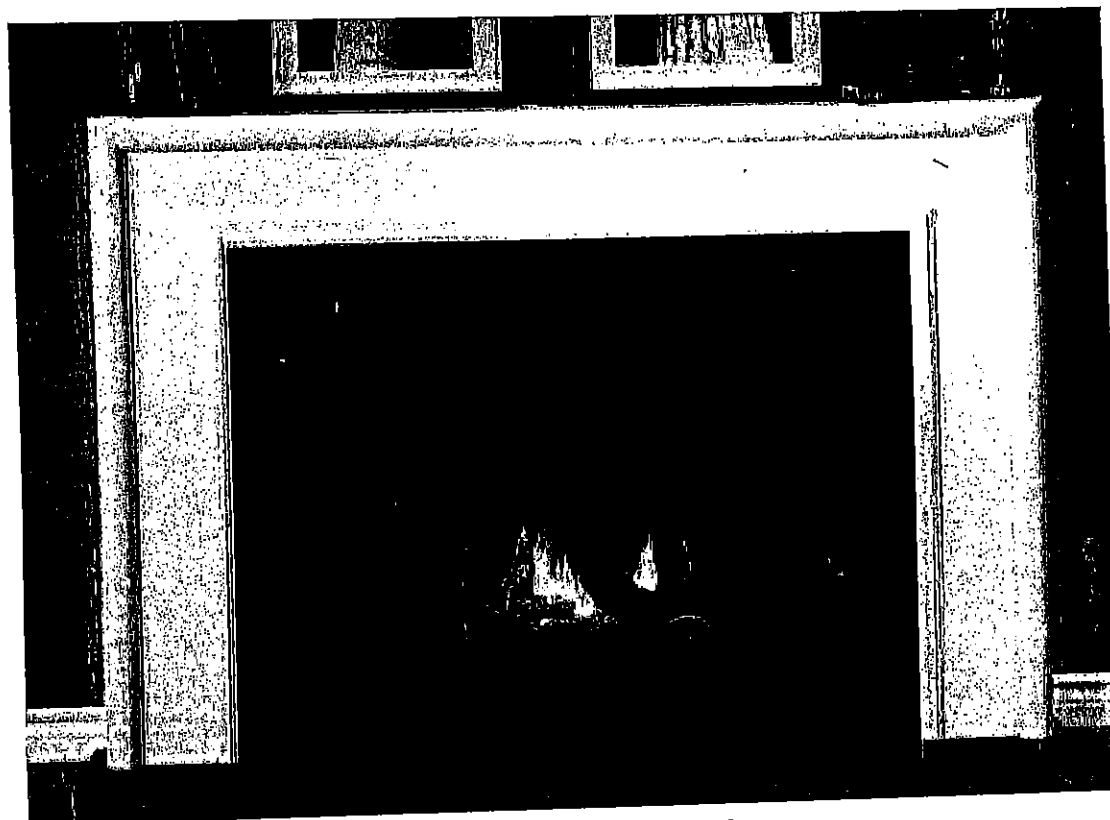

' CABINET '

## STANDARD NF 17 Mantel

**WHITE PAINT GRADE FINISH**

(PICTURE SHOWN WITH UPGRADE SURROUND AND HEARTH -PRICED SEPARATELY)

IS  
DT

UK-75 WALLACETON  
 LOT 4  
 25-2140 ALT ELEV B  
 THE WALLACE

18 of 21

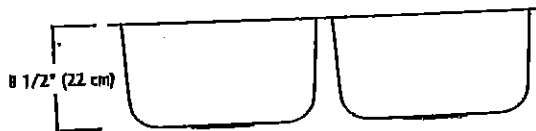
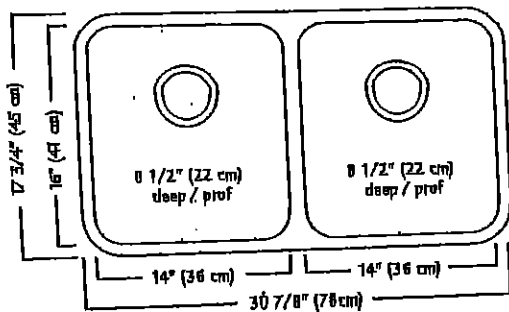
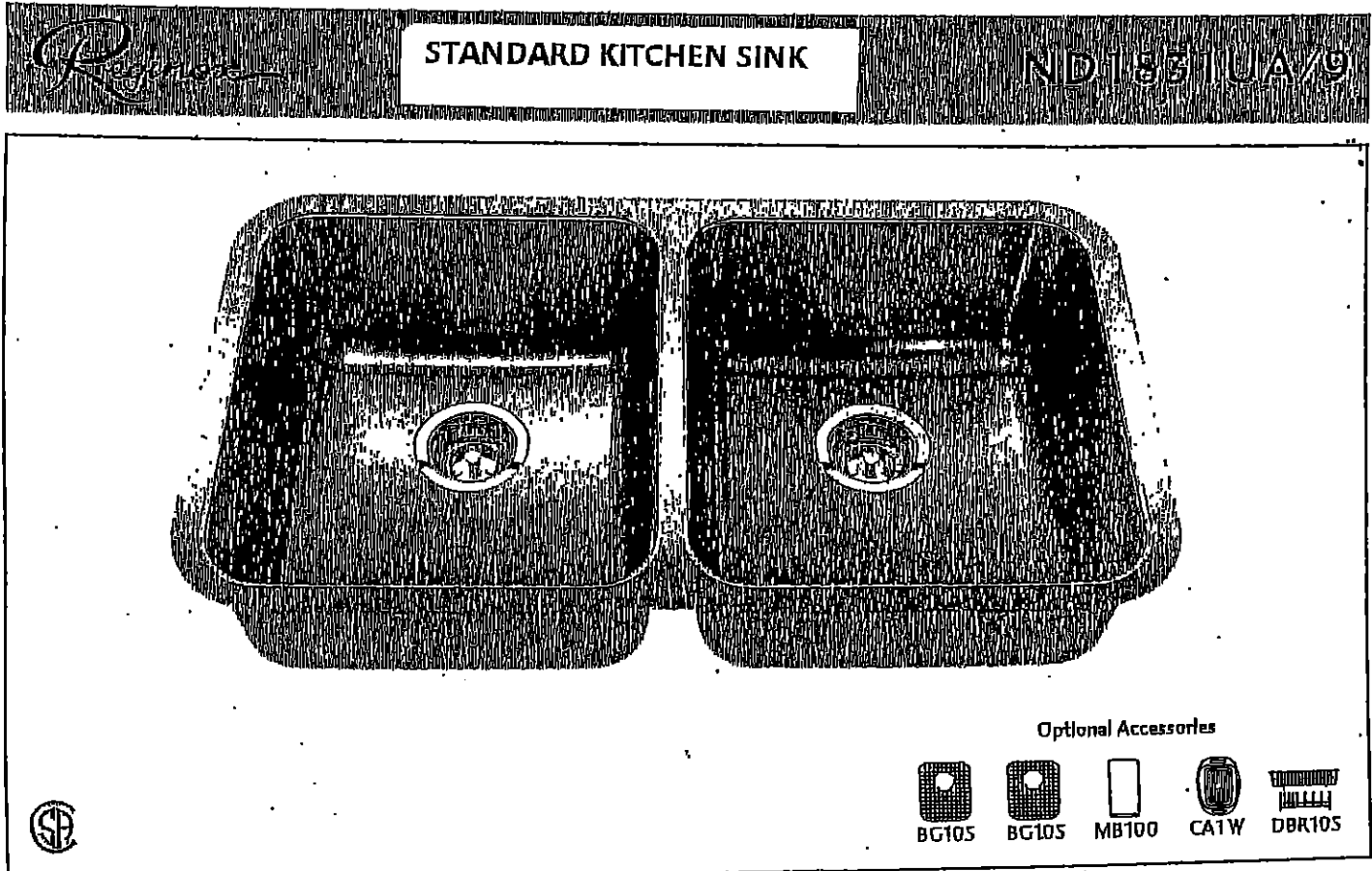

### ND1831UA/9 SPECIFICATION

Model ND1831UA/9 is a double (two equal size) bowl undermount sink manufactured by Franke Kindred Canada Limited from 18 gauge stainless steel. Product has silk finished rims and linear brush finished bowls. Sink is fully undercoated. Basket strainer waste fittings (3 1/2", 89 mm) are included. Sink is backed with a limited lifetime warranty.

- O.D. 17 3/4" x 30 7/8" x 8 1/2" (45 x 78 x 22 cm)
- Recommended for minimum 36" cabinet

Franke Kindred Canada Limited  
 P.O. Box 190, 1000 Franke Kindred Road, Midland, Ontario, Canada, L4R 4K9 Phone: 866-687-7465 Fax: 800-361-8408

Franke Kindred Canada Limited

Printed in Canada

1117

Handwritten notes: "AS", "K.Y.", and "2T" are visible at the bottom right of the page.

19 of 21

UK-75 WALLACETON  
LOT 4  
25-2140 ALT ELEV B  
THE WALLACE

STANDARD KITCHEN FAUCET

Align

Modern

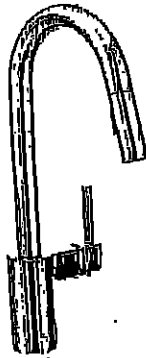

Single Handle Pull-Down Kitchen  
Faucet\*  
Model 7565†

TS  
OT

Ky

UK-75 WALLACETON  
LOT 4  
25-2140 ALT ELEV B  
THE WALLACE

20 of 21

## Chateau

Transitional

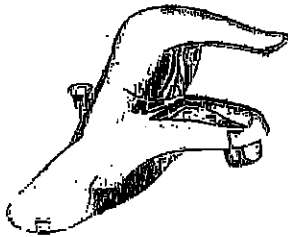

Lavatory Faucet with Pop-Up Drain  
Model L4621+

VANITY SINKS AND PEDESTAL



Posi-Temp® Pressure Balancing Tub/Shower  
Model 62320 / TL183+

OR

Posi-Temp Valve and Tub/Shower Trim  
with Eco-Performance Easy Clean® XL

Model 62320 / TL183EP+

(TL183EP not available in BC)

SHOWER AND 5' TUB FAUCETS



2 Handle Roman Tub with 9" Spout  
Model 4796 / T990+

FREESTANDING TUB FAUCETS

JS  
DT

UK-75 WALLACETON  
LOT 4  
25-2140 ALT ELEV B  
THE WALLACE

STANDARD HOODFAN FOR  
WALLACETON TOWNS AND SINGLES

21 of 21



SPECIFICATIONS  
**AV SERIES**  
RANGE HOODS

180 CFM/7.0 Sones @ 0.10" SP. Horizontal

180 CFM/7.5 Sones @ 0.10" SP. Vertical

- Dimensions**  
Overall bottom projection - 18 3/8"  
Overall top projection - 12"  
Height - 6"  
Available widths: 21", 24", 30", 36" & 42"
- Hood Body**  
Stainless Steel: 24 gauge, grade 430 stainless steel.  
Painted: 23 gauge cold rolled commercial grade (CRCQ) steel, auto welded, coated with a baked enamel finish.
- Motor**  
2 speed, single coil, thermally protected, permanently lubricated.  
Rated 120 volts, 60 hz. Complete with 200°C lead wires.
- Lighting**  
Single 60 watt cook light capacity (bulb not included).
- Ducting Options**  
Horizontal ducting: 3 1/4"x10" (duct adapter and damper included).  
Vertical ducting: 3 1/4"x10" (duct adapter and damper included).  
Vertical ducting: 7" round (duct adapter and damper not included).  
Ductless: removable front vent (charcoal filter not included).
- Fan Blade**  
One piece polymeric, electronically balanced blade, 6 5/8" diameter with 5 paddles.
- Electrical connection**  
Hood top - 7/8" knockout hole for use with 1/2" cable clamp  
Hood back - 7/8" knockout hole for use with 1/2" cable clamp

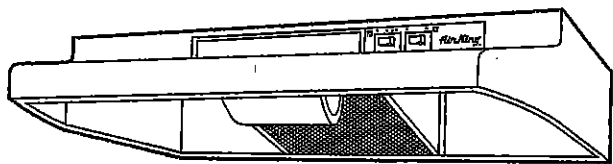

AV SERIES

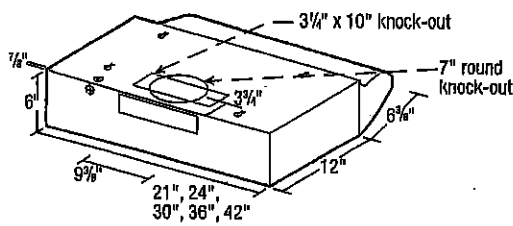

- Filters**  
UL rated, class 2 filter.  
Grease Filter: RF35 - 8 7/8"x10 3/8" (included).  
Charcoal Filter: RF34 (not included).  
Combo Grease/Charcoal: RF55 (not included).
- Available Finishes**  
White, Biscuit, Almond, Black & Stainless Steel.

EXPANDED PERFORMANCE										
Air Flow - CFM	Static Pressure (inches of w.g.)						Sones @ .1 SP	Fan Speed RPM	Power Watts	Amps
	0	0.05	0.1	0.15	0.2	0.25				
Vertical Ducting High	246	232	218	203	181	147	7.5	2973	87.0	2.1
Horizontal Ducting High	225	210	180	175	155	120	7.0	3024	87.0	2.1

PROJECT							ARCHITECT			
LOCATION							ENGINEER			
CONTRACTOR							SUBMITTED BY		DATE	
FAN NUMBER	MODEL NUMBER	CFM	IN W.G.	RPM	WATTS	AMPS	SONES	QTY	OPTIONAL EQUIPMENT & REMARKS	



Air King: 820 Lincoln Avenue  
West Chester, Pennsylvania 19380-4466  
Tel: (610) 692-7400 • 877-304-3785  
Fax: (610) 696-8048

Canada:  
Brampton, Ontario  
Tel: 905-456-2033  
Fax: (905) 456-1015



# Sales Selection Sheet

Wallaceton

22 OF 22

PURCHASERS: DINESH THAKUR and JASPREET SINGH

TEL: RES.: 647-226-7935

LOT / UNIT	PHASE	MODEL	
4	1	25-2140-Alt B The Wallace	

It is herein understood and agreed between the undersigned parties hereto that the following changes shall be made to the above mentioned Agreement of Purchase and Sale in accordance with the agreement and except for such changes noted below, all other terms and conditions in the Agreement of Purchase and Sale shall remain as stated herein: It is further understood that and agreed that all changes and additions shall be installed as per builder's specifications, location and available selections. The Purchaser hereby agrees to purchase the following extras:

## HARDWOOD

1	DELETE AND CREDIT ON CLOSING AMOUNT PAID FOR UPGRADE 2 HARDWOOD - LANDING TO BASEMENT AS PER PAGE 12 OF 21 THE ALTERNATE PLAN DOES NOT HAVE A HARDWOOD LANDING TO BASEMENT	Qty: 1
35,818	Note:	

Sub Total  
HST  
Total

1. This Sales Selection Sheet when properly executed forms part of our Agreement of Purchase and Sale.
2. All extras and upgrades listed above are subject to Construction Progress and Architectural and Municipal requirements.
3. In the event the Vendor is unable to incorporate the work approved above in the construction of the house for any reason whatsoever, the Vendor will not be liable to the Purchaser in any way. The monies paid for any changes or optional extras not proceeded with shall be returned to the Purchaser, without interest. The cost of options or extras is non-refundable in all other circumstances. If for any reason whatsoever the Agreement of Purchase and Sale is not completed, the total cost of work approved above will be retained by the Vendor.
4. The Vendor reserves the right to substitute above materials and equipment with that of equal or better quality.
5. Purchaser acknowledges that items may not be exactly as shown. Variations from the Vendor's samples may occur in finished materials due to normal production processes. Vendor is not responsible for shade difference which may occur from different dye lots or wood grains. Variations from the Vendor's samples will occur with natural materials such as wood, marble, granite, hardwood and brick.
6. The Vendor reserves the right to select Grout & Thresholds that best suits the Tile selected.
7. Selections will not be processed unless signed by Heathwood Homes Head Office.
8. The selections made on this schedule are final and cannot be changed once submitted.
9. The Purchaser has checked and acknowledges the accuracy of this schedule.

## Payment Summary

Paid By	Amount
---------	--------

Total Payment:

PURCHASER:

Signatures on  
DINESH THAKUR 14-Sep-20  
DATE

IRIT SALEM 14-Sep-20  
Decor Consultant DATE

PURCHASER:

file by e-mail  
JASPREET SINGH 14-Sep-20  
DATE

APPROVED

-09- 14 2020

Date Approved Heathwood Homes (Huron) Limited

TAX#:1

PREPARED BY: Marilyn Rosen

PE 487-1

Siinvoice.rpt 28may19