

PRE-Sales Selection Sheet  
Checklist

1 of 39

LOT 285A-1    Model: 20-2146 CRN ALT A The Upton  
PURCHASERS: MANHAR KAPOOR/KAUR PRITPAL  
VENDOR:        Heathwood Homes (Huron) Limited

R/I WET BAR IN LOWER LEVEL RECREATION ROOM  
OPTIONAL DOUBLE SINKS IN MASTER ENSUITE BATHROOM

- ☒ FINISHED BASEMENT  
☐ COLD CELLAR

UPGRADED / MODIFIED ELEVATION

- ☐ CORNER UPGRADE  
☐ REAR UPGRADE

CEILING UPGRADE - SMOOTH

- ☐ MAIN FLOOR  
☐ SECOND FLOOR  
☐ BASEMENT

ADDITIONAL ROUGH-INS

- ☐ 200 AMP SERVICE  
☐ WET BAR ROUGH-IN  
☐ HUMIDIFIER  
☒ AIR CONDITIONING

GAS ROUGH-IN

- ☒ STOVE  
☐ DRYER  
☐ BBQ  
☐ ADDITIONAL FIREPLACE

KITCHEN: HOODFAN VENTING SIZE

- ☒ 6 IN ROUND DUCT  
☐ 7 IN ROUND DUCT

FULL BASEMENT STAIRS:  
UPPER BASEMENT STAIRS:  
LOWER BASEMENT STAIRS:  
MAIN STAIRS:  
MEDIA STAIRS (if applicable):  
LOFT STAIRS (if applicable):

Carpet Grade
N/A
N/A
All Oak
N/A
N/A

Sept. 14/20	Signature	Sept 14/20	IRIT SALEM
Date	Purchaser:	Date	Decor Consultant:
on file by		APPROVED	
		-09- 14 2020	M. Rosen
Date	Purchaser:	Date	Heathwood Homes (Huron) Limited
Locked Date:		Approved	



# Sales Selection Sheet

Wallaceton

2 of 39

PURCHASERS: MANHAR KAPOOR and KAUR PRITPAL

TEL: RES.: 416-587-9363

LOT / UNIT	PHASE	MODEL	
285A-1	2	20-2146 CRN ALT A The Upton	

It is herein understood and agreed between the undersigned parties hereto that the following changes shall be made to the above mentioned Agreement of Purchase and Sale in accordance with the agreement and except for such changes noted below, all other terms and conditions in the Agreement of Purchase and Sale shall remain as stated herein: It is further understood that and agreed that all changes and additions shall be installed as per builder's specifications, location and available selections. The Purchaser hereby agrees to purchase the following extras:

## MISC.

1	FIVE APPLIANCES: SS FRIDGE, STOVE, DISHWASHER, WHITE FRONT LOADER WASHER AND DRYER-TOWN HOME	Qty: 1	
34,820	Note: SPECS PAGES 26-39		

Sub Total

HST

Total

1. This Sales Selection Sheet when properly executed forms part of our Agreement of Purchase and Sale.
2. All extras and upgrades listed above are subject to Construction Progress and Architectural and Municipal requirements.
3. In the event the Vendor is unable to incorporate the work approved above in the construction of the house for any reason whatsoever, the Vendor will not be liable to the Purchaser in any way. The monies paid for any changes or optional extras not proceeded with shall be returned to the Purchaser, without interest. The cost of options or extras is non-refundable in all other circumstances. If for any reason whatsoever the Agreement of Purchase and Sale is not completed, the total cost of work approved above will be retained by the Vendor.
4. The Vendor reserves the right to substitute above materials and equipment with that of equal or better quality.
5. Purchaser acknowledges that items may not be exactly as shown. Variations from the Vendor's samples may occur in finished materials due to normal production processes. Vendor is not responsible for shade difference which may occur from different dye lots or wood grains. Variations from the Vendor's samples will occur with natural materials such as wood, marble, granite, hardwood and brick.
6. The Vendor reserves the right to select Grout & Thresholds that best suits the Tile selected.
7. Selections will not be processed unless signed by Heathwood Homes Head Office.
8. The selections made on this schedule are final and cannot be changed once submitted.
9. The Purchaser has checked and acknowledges the accuracy of this schedule.

## Payment Summary

Paid By	Amount
---------	--------

Total Payment:

PURCHASER:

*Signatures on file*  
MANHAR KAPOOR

03-Sep-20  
DATE

IRIT SALEM  
Decor Consultant  
03-Sep-20  
DATE

PURCHASER:

KAUR PRITPAL

03-Sep-20  
DATE

**APPROVED**  
-09-09-2020  
Date Approved Heathwood Homes (Huron) Limited

TAX#:1

PREPARED BY: Irit Salem

PE 459-1

Stnvoice.rpt 28may19

MANHAR KAPOOR/KAUR PRITPAL  
Project: Wallaceton  
Unit: 285A-1, Phase: 2  
Model: 20-2146 CRN ALT A The Upton

Created: 8/31/2020 11:35:33  
Locked:  
Closed:

3 of 39

Kitchen

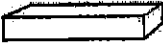
Cabinet Colour/Style	6279	Viking III-TORONTO-ESPRESSO CL-MAPLE ***STD***
Countertop	7820	Group 1-Granite-NEW CALEDONIA-3/4 inch ***STD***
Countertop Edge	4010	SINGLE POLISHED STRAIGHT EDGE 3/4 INCH ***STD*** 
Cabinet Hardware	7667	12881-HARDWARE ***STD***
Island Cabinet Colour/Style	6279	Viking III-TORONTO-ESPRESSO CL-MAPLE ***STD***
Island Countertop	7820	Group 1-Granite-NEW CALEDONIA-3/4 inch ***STD***
Backsplash	1111	N/A *****
Backsplash Grout	1111	N/A *****
Backsplash Tile Pattern	1111	N/A *****

HoodFan	8894	SCB51430-CYCLONE 30 inch CANOPY CHIMNEY HOODFAN-STAINLESS STEEL ***** PAGE 25
Appliance	8894	Purchasers have been advised: standard fridge opening is a minimum 37 3/8 x 73 3/8". Ice Waterline Rough-In is included.
Appliance	8894	Standard stove opening is 30" and standard dishwasher opening is 24". Any gas stove will require backsplash or stainless steel backing to avoid fire hazards.
Appliance	8894	Purchasers acknowledge: Heathwood Homes and its contractors will not be responsible for any kitchen cabinet changes due to appliances dimension changes after
Flooring	8894	GE.MD.WHT.1818.MT Madison Series White Matte 18

Floor Tile Grout	7705	Grout-(01) Alabaster ***UPG***
Dining Room		
Floor Tile Pattern	3000	STANDARD SQUARE ***STD***
Flooring	7497	Red Oak Pearl-Vintage Engineered-AURORA -3/4 inch x 3 1/4 inch ***STD***

Comment

Foyer

PK  
MK

Customer Colours

171

MANHAR KAPOOR/KAUR PRITPAL  
Project: Wallaceton  
Unit: 285A-1, Phase: 2  
Model: 20-2146 CRN ALT A The Upton

Created: 8/31/2020 11:35:33  
Locked:  
Closed:

4 of 39

Flooring	7705	GE.MD.WHT.1818.MT Madison Series White Matte 18
Floor Tile Grout	7705	Grout-(01) Alabaster ***UPG***
Floor Tile Pattern	3000	STANDARD SQUARE **STD**

Comment

Laundry Room

Flooring	7705	GE.BY.AZR.1313 New Byzantine Azzuro 13
Floor Tile Grout	7705	Grout-(01) Alabaster ***UPG***
Floor Tile Pattern	3000	STANDARD SQUARE ***STD***

Comment

Laundry Room Opt.

Cabinet - Uppers	9166	Viking III-CHARLESTON-ORCHID-3DL ***STD***
Cabinet Hardware	2093	9671-HARDWARE ***STD***
Comment		

Mud Room

Flooring	2093	GE.MD.WHT.1818.MT Madison Series White Matte 18
Floor Tile Grout	7705	Grout-(01) Alabaster ***UPG***
Floor Tile Pattern	3000	STANDARD SQUARE ***STD***

PIC  
OK

MANHAR KAPOOR/KAUR PRITPAL  
Project: Wallaceton  
Unit: 285A-1, Phase: 2  
Model: 20-2146 CRN ALT A The Upton

Created: 8/31/2020 11:35:33  
Locked:  
Closed:

5 of 39

Comment

0

Powder Room

Flooring

3000

GE.MD.WHT.1818.MT Madison Series White Matte 18

Floor Tile Grout

7705

Grout-(01) Alabaster \*\*\*UPG\*\*\*

Floor Tile Pattern

3000

STANDARD SQUARE \*\*\*STD\*\*\*

Plumbing Fixture (Colour)

1737

Plumbing Fixtures-WHITE \*\*\*STD\*\*\*

Comment

Hall

Flooring

7497

Red Oak Pearl-Vintage Engineered-AURORA -3/4 inch x 3 1/4 inch \*\*\*STD\*\*\*

Comment

Great Room

Flooring

7497

Red Oak Pearl-Vintage Engineered-AURORA -3/4 inch x 3 1/4 inch \*\*\*STD\*\*\*

Comment

Library

Flooring

7497

Red Oak Pearl-Vintage Engineered-AURORA -3/4 inch x 3 1/4 inch \*\*\*STD\*\*\*

Comment

Upper Hall

Flooring

9245

DY 87354-Dynasty Tex-OVERCAST-40 oz Poly\*\*\*STD\*\*\*

Comment

PIC  
H/K

MANHAR KAPOOR/KAUR PRITPAL  
Project: Wallaceton  
Unit: 285A-1, Phase: 2  
Model: 20-2146 CRN ALT A The Upton

Created: 8/31/2020 11:35:33  
Locked:  
Closed:

6 of 39

Finished Basement (Rec) Room/Hall

Flooring	9248	DY 89418 -Dynasty Tex-BLACK ICE-40 oz Poly***STD***
Comment		

Master Bedroom

Flooring	9245	DY 87354-Dynasty Tex-OVERCAST-40 oz Poly***STD***
Comment		

Bedroom 2

Flooring	9245	DY 87354-Dynasty Tex-OVERCAST-40 oz Poly***STD***
Comment		

Bedroom 3

Flooring	9245	DY 87354-Dynasty Tex-OVERCAST-40 oz Poly***STD***
Comment		

Bedroom 4

Flooring	9245	DY 87354-Dynasty Tex-OVERCAST-40 oz Poly***STD***
Comment		

Opt. Ensuite 2

Cabinet Colour/Style	1111	N/A *****
Countertop	1111	N/A *****

PIC  
MK

MANHAR KAPOOR/KAUR PRITPAL  
Project: Wallaceton  
Unit: 285A-1, Phase: 2  
Model: 20-2146 CRN ALT A The Upton

Created: 8/31/2020 11:35:33  
Locked:  
Closed:

7 of 39

Countertop Edge 1111 N/A \*\*\*\*\*

Cabinet Hardware 1111 N/A \*\*\*\*\*

Floor Tile 1111 N/A \*\*\*\*\*

Floor Tile Grout 1111 N/A \*\*\*\*\*

Ensuite 2 Tile Pattern 1111 N/A \*\*\*\*\*

Plumbing Fixture (colour) 1111 N/A \*\*\*\*\*

Shower Floor Tile 1111 N/A \*\*\*\*\*

Shower Floor Tile Grout 1111 N/A \*\*\*\*\*

Ensuite 2 Tile Pattern 1111 N/A \*\*\*\*\*

Tub Wall Tile 1111 N/A \*\*\*\*\*

Tub Wall Tile Grout 1111 N/A \*\*\*\*\*

Ensuite 2 Tile Pattern 1111 N/A \*\*\*\*\*

Shower Jamb(s) and Sill(s) 1111 N/A \*\*\*\*\*

Comment

Master Ensuite

Cabinet Colour/Style 9166 Viking III-CHARLESTON-ORCHID-3DL \*\*\*STD\*\*\*

Countertop 7820 Group 1-Granite-NEW CALEDONIA-3/4 inch \*\*\*1\*\*\*

Countertop Edge 4010 GROUP 1 - SINGLE POLISHED STRAIGHT EDGE 3/4 INCH \*\*\*1\*\*\*

P/K  
W/K

MANHAR KAPOOR/KAUR PRITPAL  
Project: Wallaceton  
Unit: 285A-1, Phase: 2  
Model: 20-2146 CRN ALT A The Upton

Created: 8/31/2020 11:35:33  
Locked:  
Closed:

8 of 39

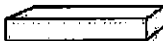
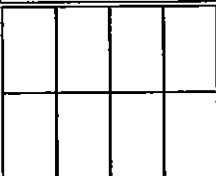
			
Cabinet Hardware	2093	9671-HARDWARE ***STD***	
Floor Tile	8627	TR.AD.BLK.1313-Andes-Black-13 x 13 ***STD***	
Floor Tile Grout	7704	Grout-(19) Pearl Gray ***STD***	
Floor Tile Pattern	3000	STANDARD SQUARE ***STD***	
Shower Floor Tile	8661	OD.ON.SWT.0202.MT.N-Ontario Series Mosaic-Snow White Matte-2 x 2 ***STD***	
Shower Floor Tile Grout	2226	Grout-(00) White ***STD***	
Shower Floor Tile Pattern	3000	STANDARD SQUARE ***STD***	
Shower Wall Tile	9020	QT.WV.WHT.0810-Weave-White-8 x 10 ***STD***	
Shower Wall Tile Grout	2226	Grout-(00) White ***STD***	
Shower Wall Tile Pattern	3090	VERTICAL STACKED ***STD***	
			
Shower Jamb(s) and Sill(s)	8923	Shower Jamb / Sill-Thassos White ***STD***	
Plumbing Fixture (colour)	1737	Plumbing Fixtures-WHITE ***STD***	
Comment			

Main Bathroom

Cabinet Colour/Style	9166	Viking III-CHARLESTON-ORCHID-3DL ***STD***	
Countertop	7821	Group 1-Granite-GRIGIO SARDO-3/4 inch ***1***	
Countertop Edge	4010	GROUP 1 - SINGLE POLISHED STRAIGHT EDGE 3/4 INCH ***1***	
			
Cabinet Hardware	2093	9671-HARDWARE ***STD***	

PK  
MK



Customer Colours

171

MANHAR KAPOOR/KAUR PRITPAL  
Project: Wallaceton  
Unit: 285A-1, Phase: 2  
Model: 20-2146 CRN ALT A The Upton

Created: 8/31/2020 11:35:33  
Locked:  
Closed:

9 of 39

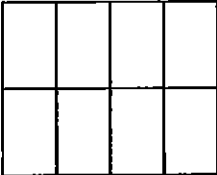
Flooring	8623	GE.CM.GRY.1313-Corte Milla-Grey-13 x 13 ***STD***
Floor Tile Grout	2225	Grout-(27) Silver ***STD***
Floor Tile Pattern	3000	STANDARD SQUARE ***STD***
Wall Tile	9020	QT.WV.WHT.0810-Weave-White-8 x 10 ***STD***
Wall Tile Grout	2226	Grout-(00) White ***STD***
Main Bathroom Tile Pattern	3090	VERTICAL STACKED ***STD*** 
Plumbing Fixture (Colour)	1737	Plumbing Fixtures-WHITE ***STD***
Comment		

Finished Basement Bathroom

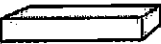
Cabinet Colour/Style	9166	Viking III-CHARLESTON-ORCHID-3DL ***STD***
Countertop	7821	Group 1-Granite-GRIGIO SARDO-3/4 inch ***1***
Countertop Edge	4010	GROUP 1 - SINGLE POLISHED STRAIGHT EDGE 3/4 INCH ***1*** 
Cabinet Hardware	2093	9671-HARDWARE ***STD***
Flooring	2093	GE.BY.AZR.1313 New Byzantine Azzuro 13
Floor Tile Grout	7705	Grout-(01) Alabaster ***UPG***
Floor Tile Pattern	3000	STANDARD SQUARE ***STD***
Shower Floor Tile	8661	OD.ON.SWT.0202.MT.N-Ontario Series Mosaic-Snow White Matte-2 x 2 ***STD***
Shower Floor Tile Grout	2226	Grout-(00) White ***STD***

PK  
MK

MANHAR KAPOOR/KAUR PRITPAL  
Project: Wallaceton  
Unit: 285A-1, Phase: 2  
Model: 20-2146 CRN ALT A The Upton

Created: 8/31/2020 11:35:33  
Locked:  
Closed:

10 of 39

Shower Floor Tile Pattern	3000	STANDARD SQUARE ***STD***								
Shower Wall Tile	5411	QT.SP.WHT.0810-Splendour-White-8 inch x 10 inch ***STD***								
Shower Wall Tile Grout	2226	Grout-(00) White ***STD***								
Shower Wall Tile Pattern	3090	VERTICAL STACKED ***STD*** <table><tr><td></td><td></td><td></td><td></td></tr><tr><td></td><td></td><td></td><td></td></tr></table>								
Shower Jamb(s)	8923	Shower Jamb / Sill-Thassos White ***STD***								
Plumbing Fixture (Colour)	1737	Plumbing Fixtures-WHITE ***STD***								
Comment										

Great Room Fireplace

Type	8865	Dimplex-Electric Fireplace-PF3033HL ***STD***
Mantle	9114	NF 15-Paint Grade Mantle- Cabinet (Per Plan)-WHITE ***STD*** PAGE 20
Surround Opt.	1111	N/A *****
Note	1111	Purchasers have been advised: heat from the FP can damage TV above a FP and items placed on mantle.
Note	1111	Heathwood and its contractors will not be liable for any damage on items placed/installed above a FP after closing.
Comment		

Basement Stairs

Type	1714	Carpet Grade Stairs ***STD BASEMENT STAIRS***
Colour	7920	Aurora (Carob) STAIN TO COMPLEMENT HARDWOOD AND WILL VARY FROM FLOORING ***99***
Carpet Runner	1111	N/A *****
Handrail/Pickets/Post Type	9119	Handrail only on closed walls (one or two sides per building code) ***STD***

PK  
W/K

Customer Colours

171

MANHAR KAPOOR/KAUR PRITPAL  
Project: Wallaceton  
Unit: 285A-1, Phase: 2  
Model: 20-2146 CRN ALT A The Upton

Created: 8/31/2020 11:35:33  
Locked:  
Closed:

1 of 39

Handrail/Pickets/Post Colours	1729	Carpet Grade-Stain handrail, pickets, stringers, nosing_pos
Carpet	9248	DY 89418 -Dynasty Tex-BLACK ICE-40 oz Poly***STD***
Custom Stain/Paint	1111	N/A *****
Comment	1	

Main Stairs

Type	1712	Oak Stairs ***STD MAIN STAIRS***
Colour	7920	Aurora (Carob) STAIN TO COMPLIMENT HARDWOOD AND WILL VARY FROM FLOORING ***99***
Carpet Runner	1111	N/A *****
Handrail/Pickets/Posts Type	7651	1 5/16 inch Turned pickets with 3 1/2" Turned Post(s)-ALL OAK***STD***
Handrail/Pickets/Posts Colour	1728	Oak Grade-Stain handrail,oak pickets,stringers,treads,risers
Custom Stain/Paint	1111	N/A *****
Comment		

Main Stairs Landing(s) (Lower)

Flooring	7497	Red Oak Pearl-Vintage Engineered-AURORA -3/4 inch x 3 1/4 inch ***STD***
Comment		

Throughout

Walls - Paint Colour	1717	22-Wall-WARM GREY ***STD***
Underpad	1079	500 Series-Underpad ***STD***
Thresholds	2232	Metal Thresholds ***STD***
Switches and Plug	5796	Decora White Switches and Plugs ***STD***
Trim Size	8705	4 1/4 Baseboard and 2 1/4 Casings ***STD***
Trim - Paint Colour	1716	Trim-WHITE ***STD***

PK  
dk

MANHAR KAPOOR/KAUR PRITPAL  
Project: Wallaceton  
Unit: 285A-1, Phase: 2  
Model: 20-2146 CRN ALT A The Upton

Created: 8/31/2020 11:35:33  
Locked:  
Closed:

12 of 39

Comment

Purchaser: Manhar Kapoor  
MANHAR KAPOOR

Date

ASL  
Decor Consultant

Sep 1 2020  
Date

Purchaser: Pritpal  
KAUR PRITPAL

Date

M. Rosen  
Wallaceton

APPROVED

-09- 14 2020

Date Approved



Sales Selection Sheet

Wallaceton

13 of 39

PURCHASERS: MANHAR KAPOOR and KAUR PRITPAL

TEL: RES.: 416-587-9363

LOT / UNIT	PHASE	MODEL	
285A-1	2	20-2146 CRN ALT A The Upton	

It is herein understood and agreed between the undersigned parties hereto that the following changes shall be made to the above mentioned agreement of Purchase and Sale in accordance with the agreement and except for such changes noted below, all other terms and conditions in the Agreement of Purchase and Sale shall remain as stated herein: It is further understood that and agreed that all changes and additions shall be installed as per builder's specifications, location and available selections. The Purchaser hereby agrees to purchase the following extras:

APPLIANCES

1	SCB51436 CYCLONE 30" WALLMOUNT HOOD SS	Qty: 1
33,996	Note: CYCLONE 30" WALLMOUNT HOOD SS	PAGE 25

Cabinetry

2	CABINETRY - 11A-UPPER ANGLE CORNER PER UNIT - UPGRADE 1	Qty: 1
189,343		
33,992	Note: SKETCH # 2 PAGE 18	
3	CABINETRY - VIKING IV - OPT. LAUNDRY ROOM UPPERS - UPGRADE 1	Qty: 1
179,840		
33,993	Note: SKETCH # 3 PAGE 19	

CARPET

4	DIFFERENT COLOUR CARPET IN BASEMENT	Qty: 1
34,003	Note: DIFFERENT COLOUR CARPET IN BASEMENT	

CERAMIC

5	GROUT	Qty: 1
33,997	Note: KITCHEN GROUT	
6	GROUT	Qty: 1
33,998	Note: MUDROOM GROUT - GARAGE DOOR	
7	GROUT	Qty: 1
33,999	Note: POWDER ROOM GROUT	
8	GROUT	Qty: 1
34,000	Note: FOYER GROUT	
9	GROUT	Qty: 1
34,001	Note: LAUNDRY ROOM GROUT	
10	GROUT	Qty: 1
34,002	Note: BASEMENT FLOOR GROUT	

Ceramics

Initials: MK PIC

TAX#:1

PREPARED BY: Bei Liu

PE 445-1

S\invoice.rpt 28may19



# Sales Selection Sheet

Wallaceton

14 of 39

PURCHASERS: MANHAR KAPOOR and KAUR PRITPAL

TEL: RES.: 416-587-9363

LOT / UNIT	PHASE	MODEL	
285A-1	2	20-2146 CRN ALT A The Upton	

## Ceramics

11 180,024 33,977	CERAMICS - FLOOR - KITCHEN - UPGRADE 1  Note:	Qty: 1
12 180,000 33,978	CERAMICS - FLOOR - FOYER - UPGRADE 1  Note:	Qty: 1
13 180,016 33,979	CERAMICS - FLOOR - GARAGE ENTRY - UPGRADE 1  Note:	Qty: 1
14 180,008 33,981	CERAMICS - FLOOR - POWDER ROOM - UPGRADE 1  Note:	Qty: 1

## Electrical

15 189,450 33,989	ELECTRICAL - CEILING ROUGH-IN (CAPPED)  Note: ONE TO BE INSTALLED IN THE KITCHEN ABOVE THE BREAKFAST BAR - USE SEPARATE SWITCH TWO TO BE INSTALLED IN THE GREAT ROOM- USE EXISTING SWITCH PLUG SEE SKETCH # 2 PAGE# 18	Qty: 3
16 189,449 33,990	ELECTRICAL - EXTRA WALL INTERIOR OUTLET ON EXISTING CIRCUIT (DOES NOT INCLUDE KITCHEN OUTLETS)  Note: GREAT ROOM TO BE INSTALLED IN THE CENTRE OF THE FIRE PLACE APROX. 70" FEOM FLOOR SEE SKETCH# 2 PAGE# 18	Qty: 1
17 189,451 33,995	ELECTRICAL - ADDITIONAL SWITCH  Note: KITCHEN: TO BE USED FOR A N EXTRA CAP LIGHT SEE SKETCH# 2 PAGE# 18	Qty: 1

## Granite

18 180,138 33,982	GRANITE - COUNTERTOP WITH 4" BACKSPLASH - 3/4" GROUP 1 - BASEMENT BATHROOM - UPGRADE 1  Note:	Qty: 1
19 180,114 33,983	GRANITE - COUNTERTOP WITH 4" BACKSPLASH - 3/4" GROUP 1 - ENSUITE MASTER - UPGRADE 1  Note:	Qty: 1
20 180,122 33,984	GRANITE - COUNTERTOP WITH 4" BACKSPLASH - 3/4" GROUP 1 - MAIN BATHROOM - UPGRADE 1  Note:	Qty: 1

Initials: M/K BK

TAX#:1

PREPARED BY: Bei Liu

PE 445-2

SI\invoice.rpt 28may19



Sales Selection Sheet  
Wallaceton

15 of 39

PURCHASERS: MANHAR KAPOOR and KAUR PRITPAL

TEL: RES.: 416-587-9363

LOT / UNIT 285A-1	PHASE 2	MODEL 20-2146 CRN ALT A The Upton	
----------------------	------------	--------------------------------------	--

Granite

21 189,463  33,985	GRANITE - GRANITE CUTOUT W/ STRAIGHT EDGE POLISH TO ACCOMMODATE UNDER MOUNT VANITY SINK  <b>Note:</b> 2 IN THE MASTER BATHROOM ONE IN MAIN BATHROOM ONE IN BASMENT BATHROOM  OVALYN SINK SPEC PAGE 24	Qty: 4
-----------------------------	---	--------

Heating/Air

22 189,474  33,994	HEATING/AIR - ROUGH-IN GAS LINE FOR GAS STOVE AT MAIN FLOOR (SEE SPECS) (HOOK-UP NOT INCLUDED) LEAVE STANDARD 120 VOLT ELECTRICAL OUTLET ON A SEPARATE CIRCUIT. * SPECIFY IF STANDARD 220V WILL STAY OR BE RELOCATED  <b>Note:</b> SKETCH # 2 PAGE 18	Qty: 1
-----------------------------	---	--------

Plumbing

23 189,543  33,976	PLUMBING - OPTIONAL EXTRA - ROUGH- IN FOR FUTURE WET BAR -  <b>Note:</b> SKETCH # 1 PAGE 17	Qty: 1
24 189,535  33,986	PLUMBING - AMERICAN STANDARD - SINK OPTIONS - UNDERMOUNT SINK - OVALYN MODEL 0496 221 020 (19 1/2" X  <b>Note:</b> 2 IN THE MASTER BATHROOM ONE IN MAIN BATHROOM ONE IN BASMENT BATHROOM  SPEC PAGE 24	Qty: 4
25 189,686  33,988	PLUMBING - OPTION FROM ONE SINK TO DOUBLE SINKS INCLUDING STD CHATEAU FAUCET, STD COLONY SINK, INCLU INCLUDING CABINET CONVERSION 2D VIKING AND ONE EXTRA VANITY LIGHT  <b>Note:</b> MASTER BATHROOM SKETCH # 3 PAGE 19	Qty: 1

Structured Wiring

26 189,785  33,991	STRUCTURED WIRING - HDMI TO ABOVE FIREPLACE ROUGH-IN  <b>Note:</b> GREAT ROOM TO BE INSTALLED IN THE CENTRE OF THE FIRE PLACE APROX. 70" FEOM FLOOR SEE SKETCH# 2 PAGE# 18	Qty: 1
-----------------------------	---	--------

Sub Total  
HST  
Total

Initials: MK PK



Sales Selection Sheet  
Wallaceton

16 of 39

PURCHASERS: MANHAR KAPOOR and KAUR PRITPAL

TEL: RES.: 416-587-9363

LOT / UNIT  
285A-1

PHASE  
2

MODEL  
20-2146 CRN ALT A The Upton

1. This Sales Selection Sheet when properly executed forms part of our Agreement of Purchase and Sale.
2. All extras and upgrades listed above are subject to Construction Progress and Architectural and Municipal requirements.
3. In the event the Vendor is unable to incorporate the work approved above in the construction of the house for any reason whatsoever, the Vendor will not be liable to the Purchaser in any way. The monies paid for any changes or optional extras not proceeded with shall be returned to the Purchaser, without interest. The cost of options or extras is non-refundable in all other circumstances. If for any reason whatsoever the Agreement of Purchase and Sale is not completed, the total cost of work approved above will be retained by the Vendor.
4. The Vendor reserves the right to substitute above materials and equipment with that of equal or better quality.
5. Purchaser acknowledges that items may not be exactly as shown. Variations from the Vendor's samples may occur in finished materials due to normal production processes. Vendor is not responsible for shade difference which may occur from different dye lots or wood grains. Variations from the Vendor's samples will occur with natural materials such as wood, marble, granite, hardwood and brick.
6. The Vendor reserves the right to select Grout & Thresholds that best suits the Tile selected.
7. Selections will not be processed unless signed by Heathwood Homes Head Office.
8. The selections made on this schedule are final and cannot be changed once submitted.
9. The Purchaser has checked and acknowledges the accuracy of this schedule.

Payment Summary

Paid By Amount

Total Payment:

PURCHASER:

Manhar Kapoor  
MANHAR KAPOOR

01-Sep-20  
DATE

Decor Consultant

01-Sep-20  
DATE

PURCHASER:

Pritpal  
KAUR PRITPAL

01-Sep-20  
DATE

**APPROVED**

-09- 14 2020

Date Approved Heathwood Homes (Huron) Limited

TAX#:1

PREPARED BY: Bei Liu

PE 445-4

S:\invoice.rpt 28may19



UK-75 WALLACETON  
LOT 285A-1  
20-2046 CRN ALT A  
THE UPTON

17 of 39

# THE UPTON

ELEVATION A | 2,689 SQ. FT.

Sketch # 1

20-2146 CRN ALT ELEV. A

Includes 543 square feet of finished lower level

R/I  
WET BAR

UK  
DK

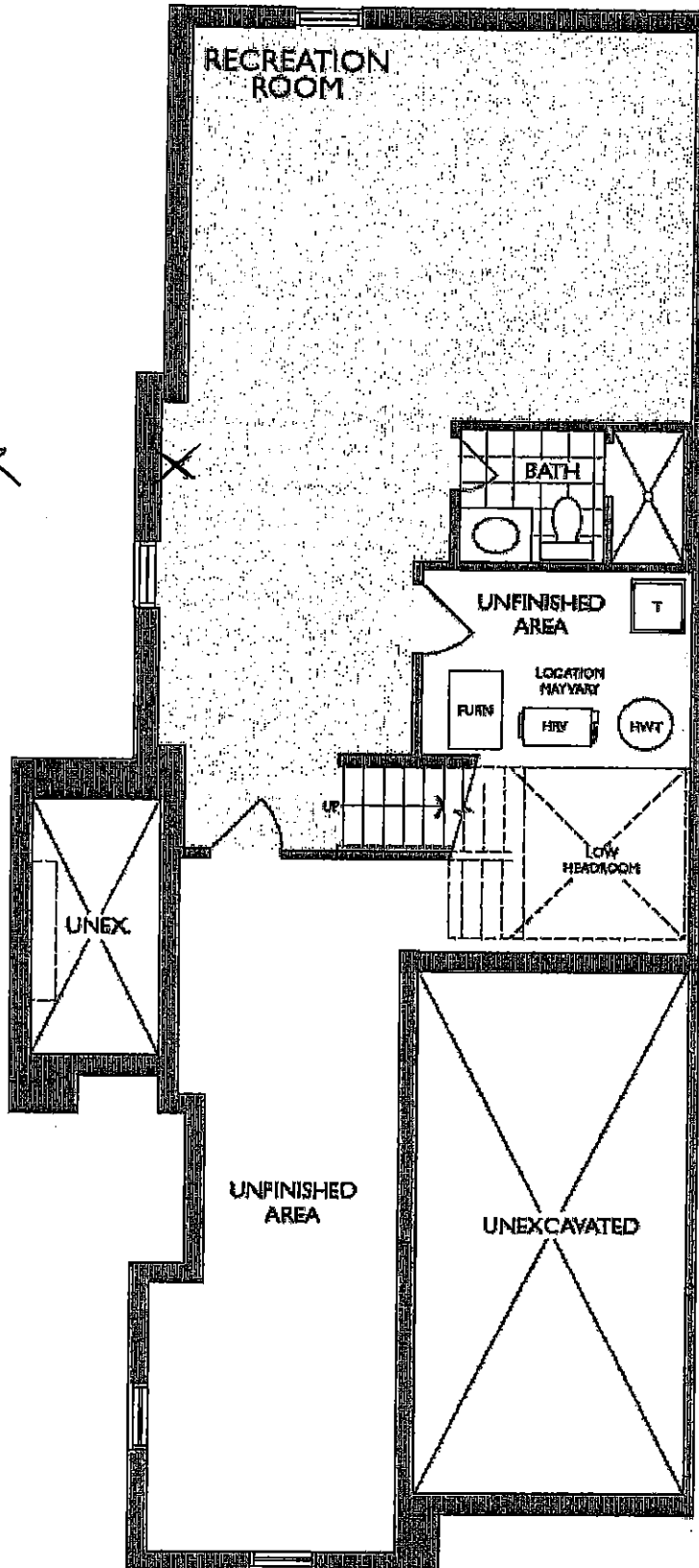

LOWER LEVEL  
ELEVATION A

UK-75 WALLACETON  
LOT 285A-1  
20-2046 CRN ALT A  
THE UPTON

18 of 39

Sketch #2

THE UPTON

ELEVATION A | 2,689 SQ. FT.

20-2146 CRN ALT ELEV. A

Includes 543 square feet of finished lower level

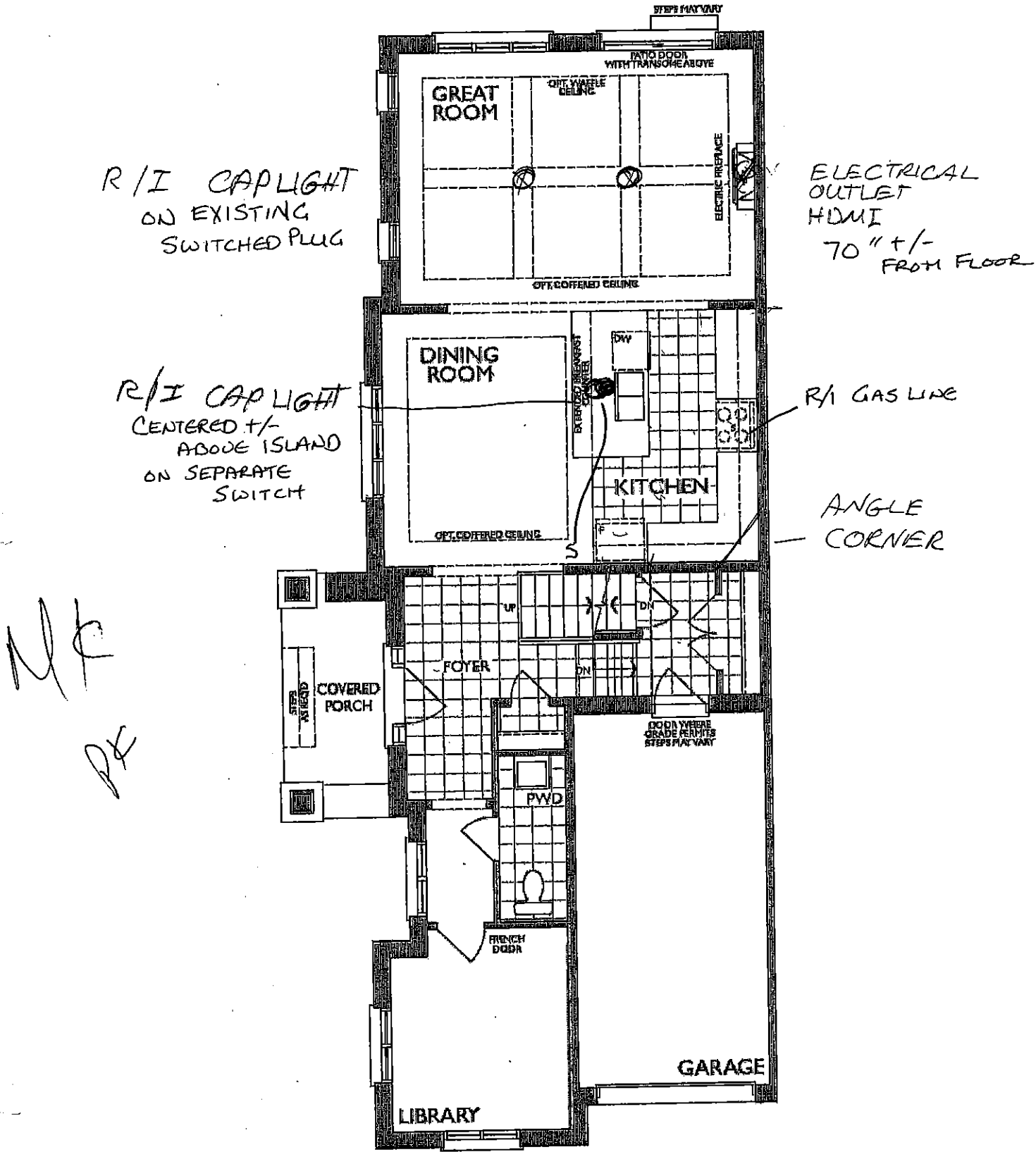

MAIN FLOOR  
ELEVATION A

UK-75 WALLACETON  
LOT 285A-1  
20-2046 CRN ALT A  
THE UPTON

19 of 39

Sketch #3

THE UPTON

ELEVATION A | 2,689 SQ. FT.

20-2146 CRN ALT ELEV. A

Includes 543 square feet of finished lower level

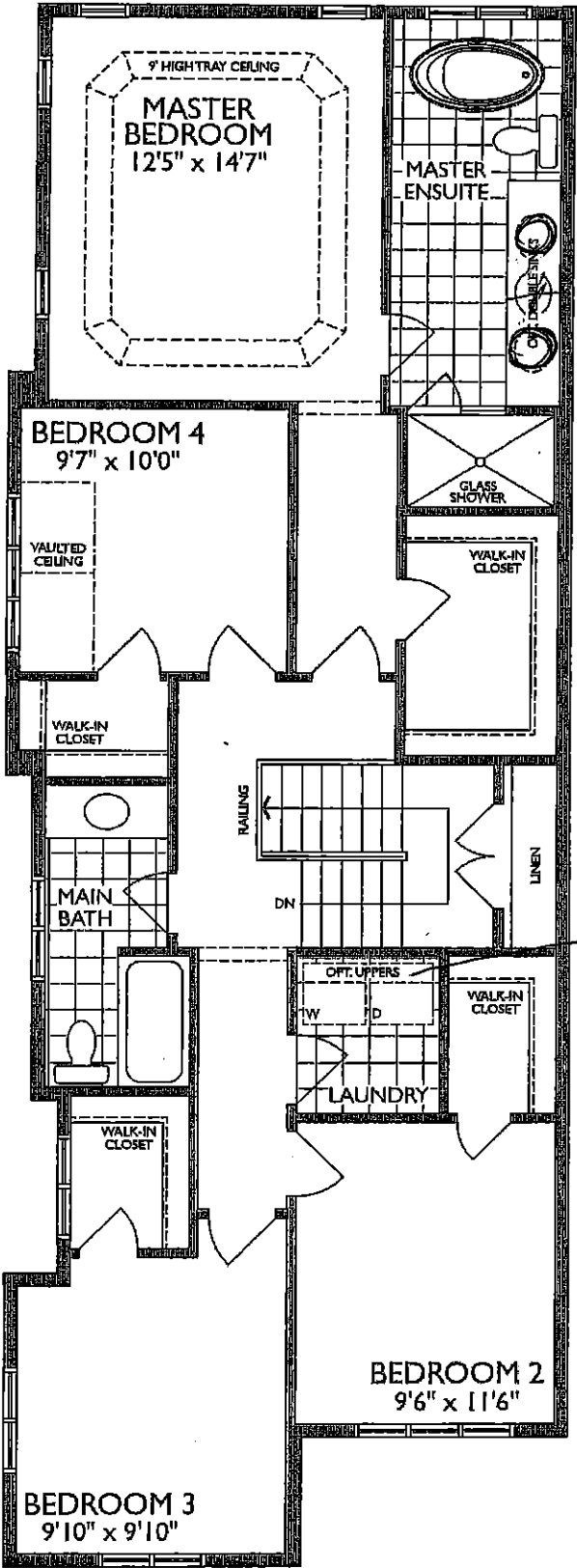

M/K  
D/C

ALT. SECOND FLOOR  
4 BEDROOMS  
ELEVATION A

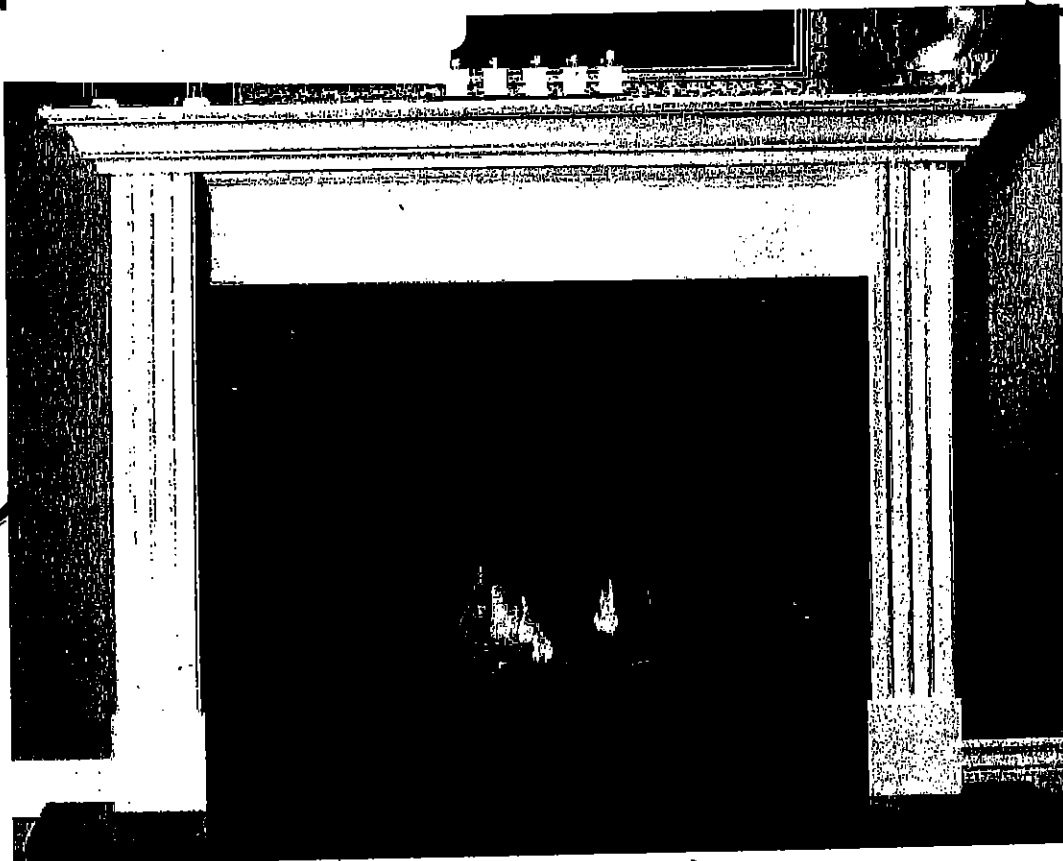

**' CABINET '**  
**STANDARD NF 15 Mantel**

Clean apron finish with fluted legs

**WHITE PAINT GRADE FINISH**

(PICTURE SHOWN WITH UPGRADE SURROUND AND HEARTH -PRICED SEPARATELY)

MC



**STANDARD NF 17 Mantel**

**WHITE PAINT GRADE FINISH**

(PICTURE SHOWN WITH UPGRADE SURROUND AND HEARTH -PRICED SEPARATELY)

IF

UK-75 WALLACETON  
 LOT 285A-1  
 20-2046 CRN ALT A  
 THE UPTON

21 of 39

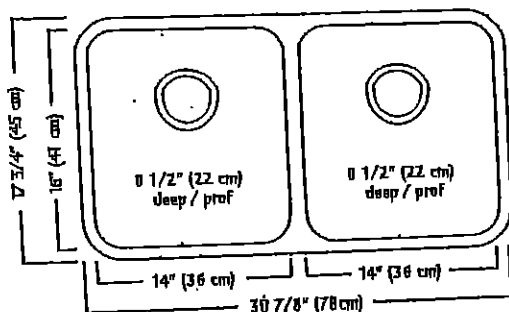
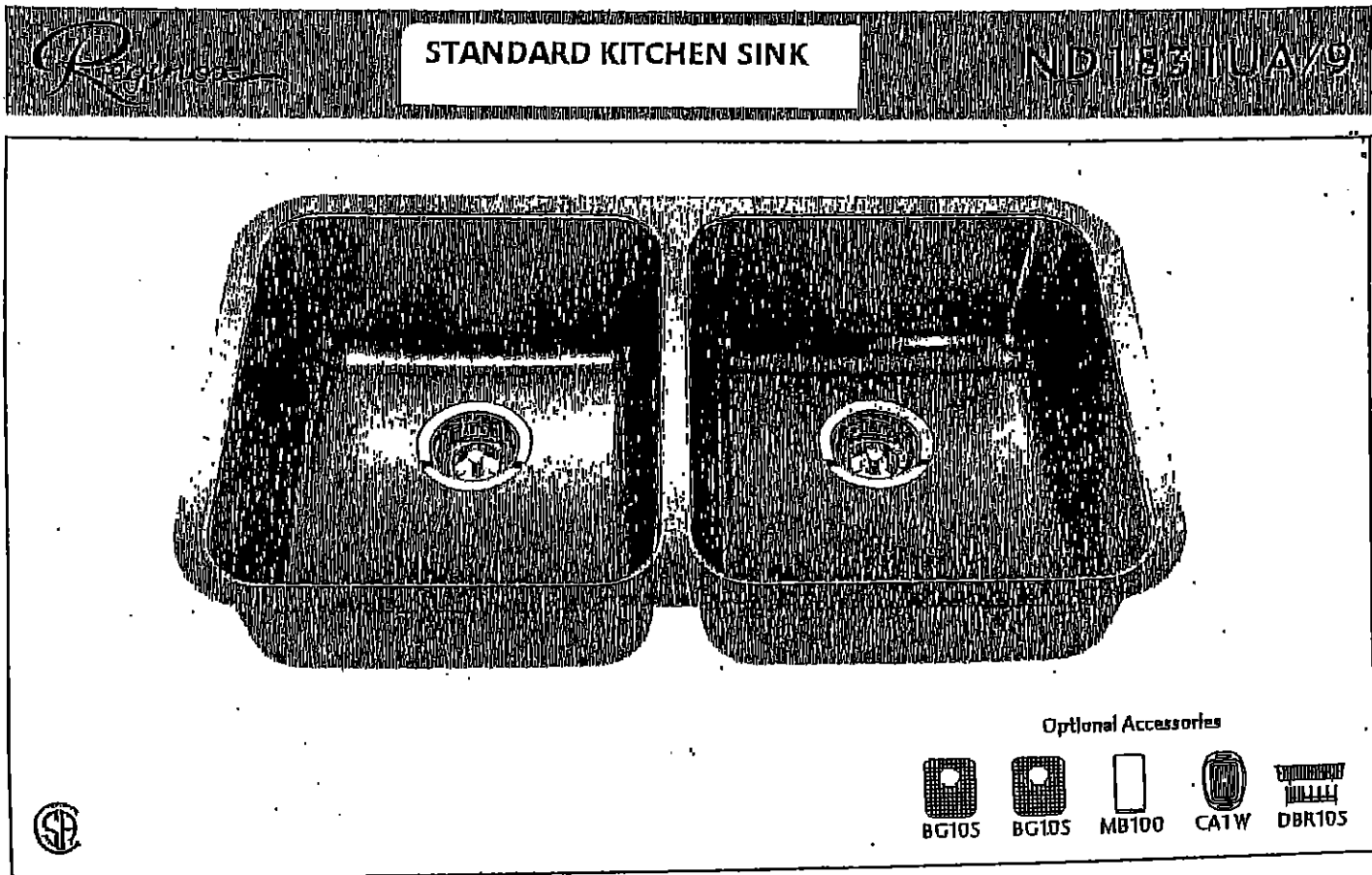

### ND1831UA/9 SPECIFICATION

Model ND1831UA/9 is a double (two equal size) bowl undermount sink manufactured by Franke Kindred Canada Limited from 18 gauge stainless steel. Product has silk finished rims and linear brush finished bowls. Sink is fully undercoated. Basket strainer waste fittings (3 1/2\", 89 mm) are included. Sink is backed with a limited lifetime warranty.

- O.D. 17 3/4\" x 30 7/8\" x 8 1/2\" (45 x 78 x 22 cm)
- Recommended for minimum 36\" cabinet

Franke Kindred Canada Limited  
 P.O. Box 190, 1000 Franke Kindred Road, Midland, Ontario, Canada, L4R 4K9 Phone: 866-687-7465 Fax: 800-361-8408

K.Y.  
 PK MK

UK-75 WALLACETON  
LOT 285A-1  
20-2046 CRN ALT A  
THE UPTON

22 of 39

STANDARD KITCHEN FAUCET

Align  
Modern

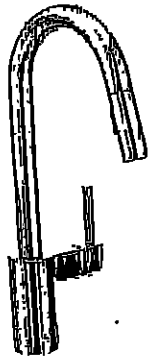

Single Handle Pull-Down Kitchen  
Faucet\*  
Model 7565†

Ky

PK H/C

UK-75 WALLACETON  
LOT 285A-1  
20-2046 CRN ALT A  
THE UPTON

23 of 39

## Chateau

Transitional

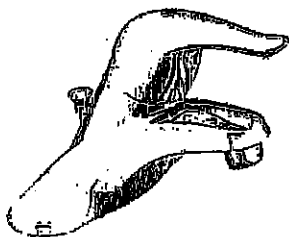

Lavatory Faucet with Pop-Up Drain  
Model L4621†

VANITY SINKS AND PEDESTAL



Posi-Temp® Pressure Balancing Tub/Shower  
Model 62320 / TL183†

OR

Posi-Temp Valve and Tub/Shower Trim  
with Eco-Performance Easy Clean® XL

Model 62320 / TL183EP†

(TL183EP not available in BC)

SHOWER AND 5' TUB FAUCETS



2 Handle Roman Tub with 9" Spout  
Model 4796 / T990†

FREESTANDING TUB FAUCETS

M/K  
B/K

24 of 39

American Standard  
Style That Works Better  
BARRIER FREE

OVALYN™  
UNDERCOUNTER SINK  
VITREOUS CHINA

OVALYN™ UNDERCOUNTER SINK

- Classic oval undermount sink
- Made from vitreous china
- Front overflow
- Supplied with mounting kit (047194-0070A) and template

0496.221 Unglazed rim  
489 x 413mm  
(19-1/4" x 16-1/4")

Bowl size:  
432mm (17") wide  
356mm (14") front to back  
140mm (5-1/2") deep

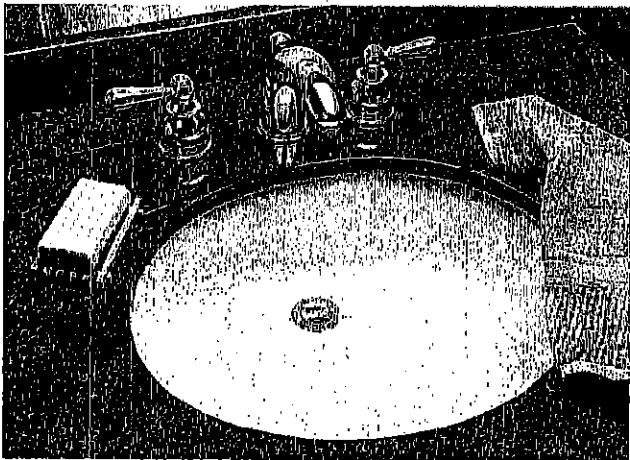

Compliance Certifications -  
Meets or Exceeds the Following Specifications:  
• ASME A112.19.2M for Vitreous China Fixtures  
• CAN/CSA B45 series

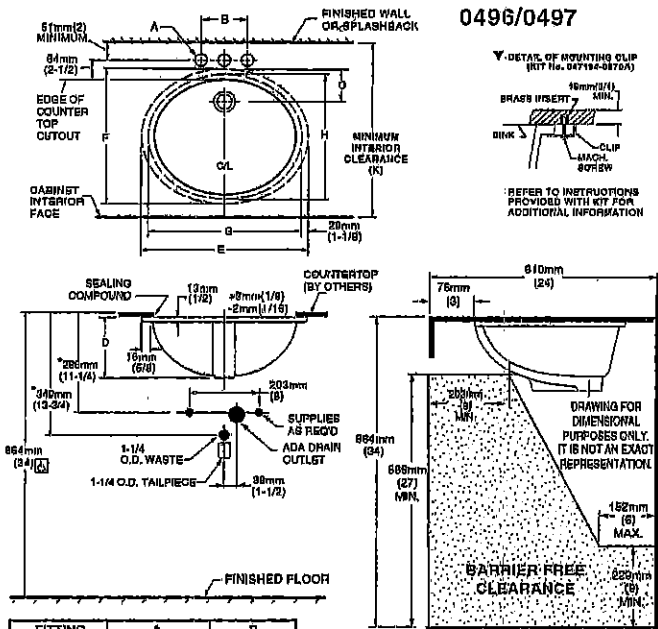

0496/0497

NOTES:  
\* DIMENSIONS SHOWN FOR LOCATION OF SUPPLIED AND "P" TRAP ARE SUGGESTED.  
▼ UNDERCOUNTER MOUNTING KIT SUPPLIED WITH SINK. PLEASE NOTE MINIMUM INTERIOR CLEARANCE DIMENSION (K). FITTINGS NOT INCLUDED AND MUST BE ORDERED SEPARATELY. USE ENCLOSED TEMPLATE FOR COUNTERTOP CUTOUT SEALING COMPOUND SUPPLIED BY OTHERS.

IMPORTANT: Dimensions of fixtures are nominal and may vary within the range of tolerances established by ANSI Standard A112.19.2. These measurements are subject to change or cancellation. No responsibility is assumed for use of superseded or voided pages.

MEETS THE AMERICANS WITH DISABILITIES ACT GUIDELINES AND ANSI A117.1 ACCESSIBLE AND USEABLE BUILDINGS AND FACILITIES - CHECK LOCAL CODES.  
Countertop 864mm (34") from finished floor. Lavatory installed 78mm (3") from front edge of countertop. Countertop thickness to be 25mm (1") maximum.

FITTING	A	B
CENTERSET	1-1/4 (32mm)	4 (102mm)
SPREAD	1-3/8 (35mm)	8 (203mm)

CAT. NO.	E	F	G	H	C	D	J	K
0496.221	489mm (19-1/4)	413mm (16-1/4)	432mm (17)	356mm (14)	168mm (4-1/8)	182mm (7-3/16)	18mm (3/8)	600mm (19-11/16)
0497.221	540mm (21-1/2)	441mm (17-3/8)	483mm (19)	381mm (15-3/8)	95mm (3-3/4)	181mm (7-1/2)	19mm (3/4)	584mm (23-1/16)



Cyclone®

## SCB51430 Canopy Hood

### Alito Collection

Makes a statement of strength and power as the stainless steel frame gleams under your kitchen lights. It features baffle filters, tow bright LED lights in each corner, a three speed control panel, and a quiet, powerful motor. The bold design and strong stainless steel frame encasing the fan will make this machine the focus of your kitchen. Fitted with time-delay "OFF" options up to nine minutes.

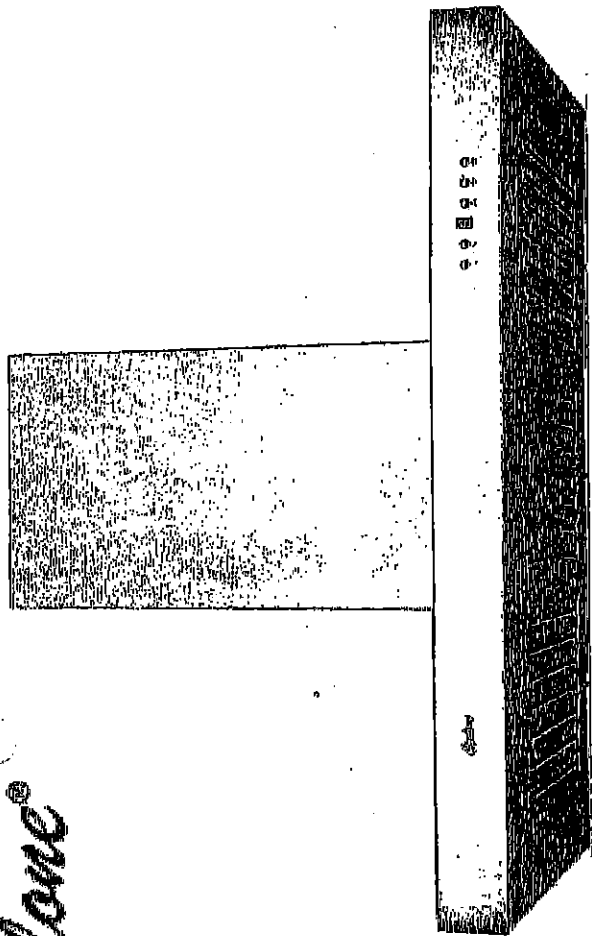

#### Specifications

**Air Flow Volume:** 550 CFM  
**Colours:** Stainless Steel  
**Dimensions:** W:30" H:44.5" D:19.5"  
**Electrical Connection:** 120V/60Hz  
**Electrical Consumption:** 200 watts  
**Fan Speed:** 1254 RPM  
**Sones:** Min. at 2 and Max at 6  
**Venting:** 6" Round (Top Only)

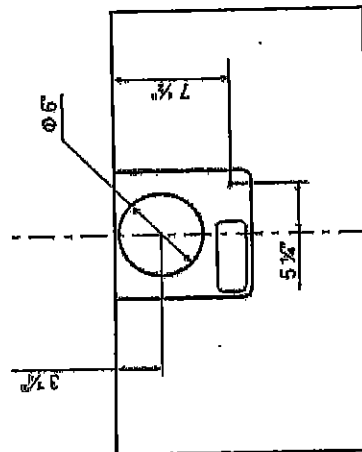

TOP

PK UK

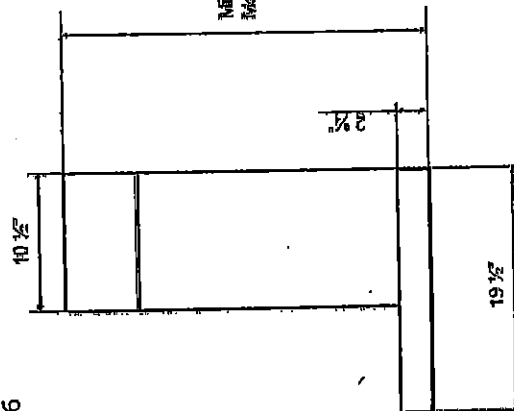

SIDE

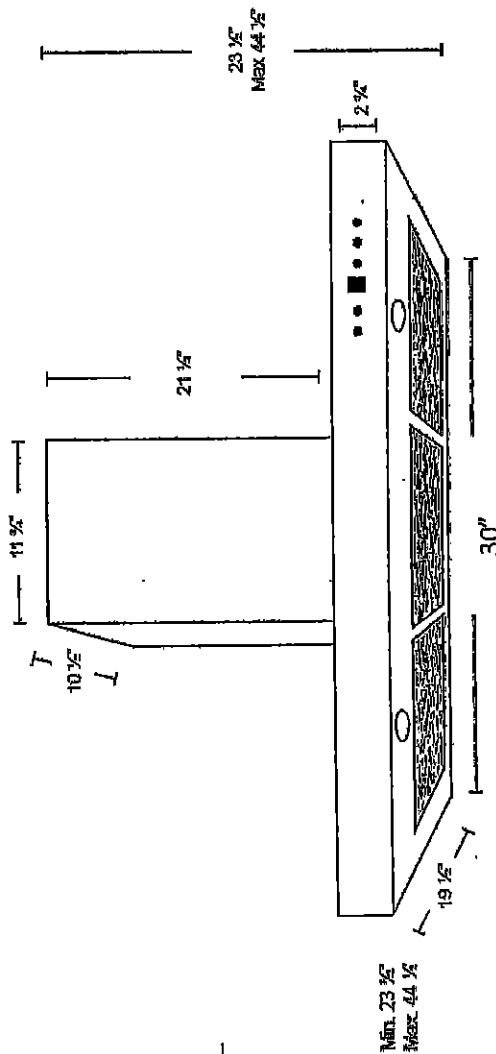

25 of 39

34  
26 OF 39

Whirlpool® Top Mount Refrigerator

PRODUCT MODEL NUMBERS

WRT311FZD      WRT641SZD  
WRT611SZD

**Electrical:** A 115-volt, 60-Hz, AC-only, 15- or 20-amp fused, grounded electrical supply is required. It is recommended that a separate circuit serving only your refrigerator be provided. Use an outlet that cannot be turned off by a switch. Do not use an extension cord.

**NOTE:** Before performing any type of installation, cleaning, or removing a light bulb, turn the control (Thermostat, Refrigerator or Freezer Control depending on the model) to OFF and then disconnect the refrigerator from the electrical source. When you are finished, reconnect the refrigerator to the electrical source and reset the control (Thermostat, Refrigerator or Freezer Control depending on the model) to the desired setting. See "Using the Controls."

**Water:** A cold water supply with water pressure between 30 and 120 psi (207 and 827 kPa) is required to operate ice maker and water dispenser. If you have questions about your water pressure, call a licensed, qualified plumber.

**IMPORTANT:** The pressure of the water coming out of a reverse osmosis system going to the water inlet valve of the refrigerator needs to be between 30 and 120 psi (207 and 827 kPa).

**Reverse Osmosis Water Supply:** If a reverse osmosis water filtration system is connected to your cold water supply, the water pressure to the reverse osmosis system needs to be a minimum of 40 to 60 psi (276 to 414 kPa).

PRODUCT DIMENSIONS

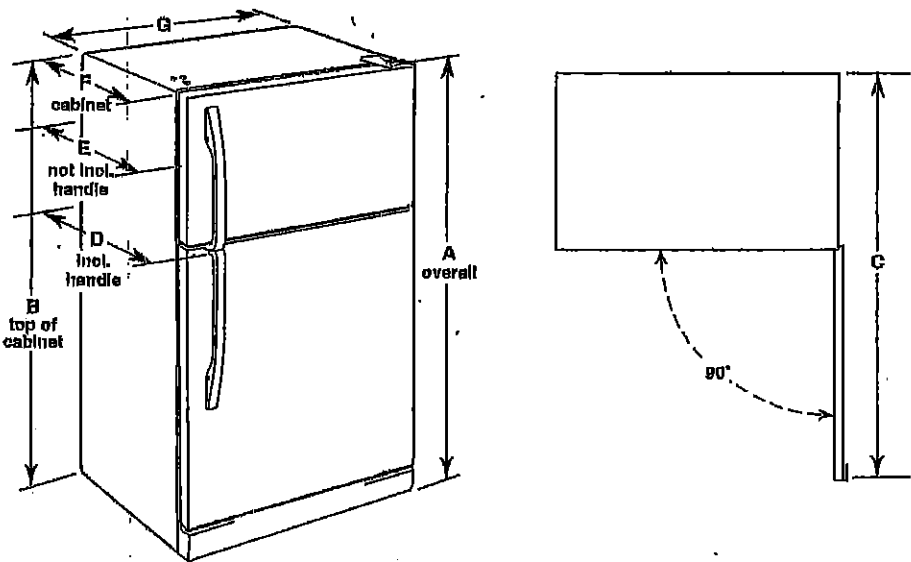

Model Number	Model Size	Reversible Door	Height - Overall "A"	Height - Top of Cabinet "B"	Depth - Door Open 90° "C"	Depth - With Handles "D"	Depth - Without Handles "E"	Depth - Cabinet Only "F"	Width - Cabinet "G"
WRT311FZD	20.5 cu. ft.	Yes	66 1/4" (168.3 cm)	65 1/2" (166.4 cm)	62 1/4" (158.1 cm)	32 1/4" (83.5 cm)	30 1/4" (77.8 cm)	28 1/4" (72.4 cm)	32 3/4" (83.2 cm)
WRT611SZD WRT641SZD	21.3 cu. ft.	Yes	66 1/4" (168.3 cm)	65 1/2" (166.4 cm)	62 1/4" (158.1 cm)	34" (86.4 cm)	32 1/4" (82.3 cm)	28 1/4" (72.4 cm)	32 3/4" (83.2 cm)

LOCATION REQUIREMENTS

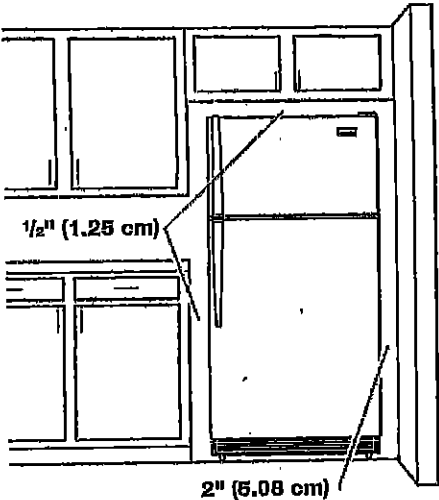

To ensure proper ventilation for your refrigerator, allow for a 1/2" (1.25 cm) space on each and between overhead cabinets and refrigerator top. Allow at least 1" (2.5 cm) between back of cabinet and the wall. If your refrigerator has an ice maker, make sure you leave some extra space at the back for the water line connections.

If you are installing your refrigerator next to a fixed wall, leave 2" (5 cm) minimum on the hinge side (depending on your model) to allow for the door to swing open.

**NOTE:** This refrigerator is intended for use in a location where the temperature ranges from a minimum of 55°F (13°C) to a maximum of 110°F (43°C). The preferred room temperature range for optimum performance, which reduces electricity usage and provides superior cooling, is between 60°F (15°C) and 90°F (32°C). It is recommended that you do not install the refrigerator near a heat source, such as an oven or radiator.

Because Whirlpool Corporation policy includes a continuous commitment to improve our products, we reserve the right to change materials and specifications without notice.

Dimensions are for planning purposes only. For complete details, see Installation Instructions packed with product. Specifications subject to change without notice.

Ref. W10874109  
10/29/14

UK  
PK

UK-75 WALLACETON  
LOT 285A-1  
20-2046 CRN ALT A  
THE UPTON

27 of 39

Refrigerator Door Swing Verification

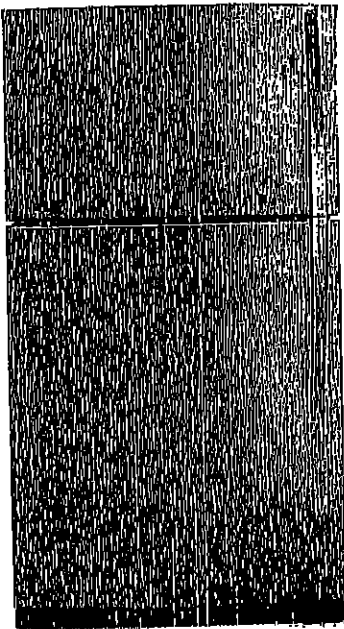
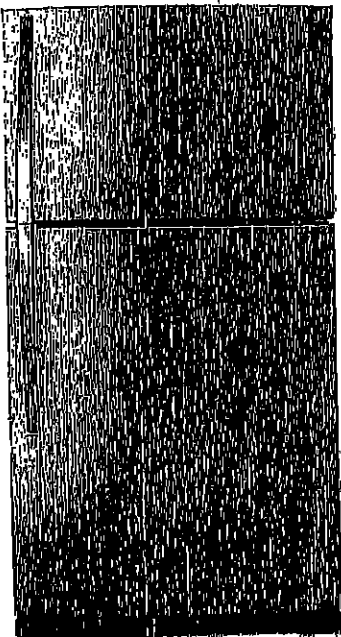
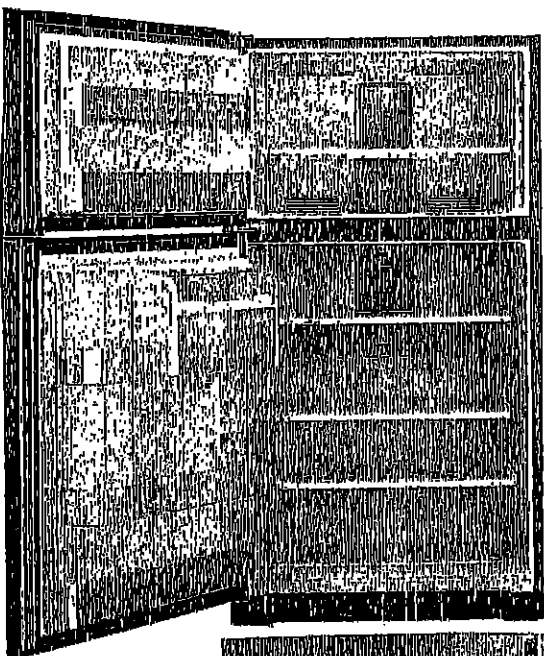
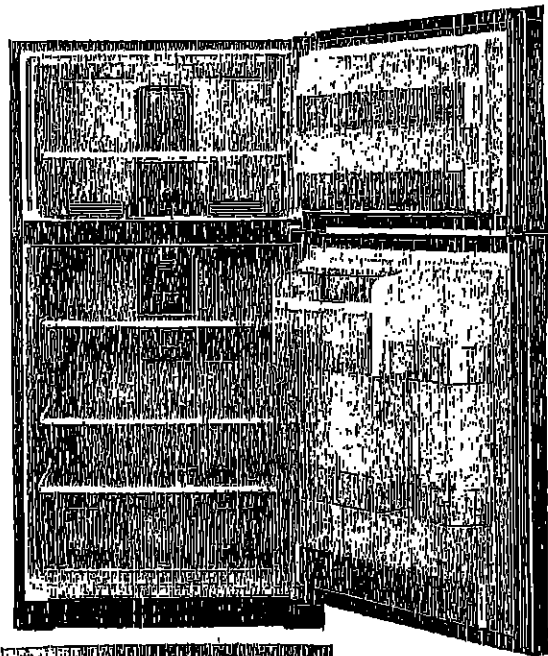

When facing the refrigerator



RIGHT HAND  
DOOR OPENING

- Hinges on right
- Handle on left

*mk*  
INITIAL

LEFT HAND  
DOOR OPENING

- Hinges on left
- Handle on right



\_\_\_\_\_  
INITIAL

Please check and INITIAL your door swing selection.

*mk*  
*pk*

UK-75 WALLACETON  
LOT 285A-1  
20-2046 CRN ALT A  
THE UPTON

28 of 39

**WHIRLPOOL 30" (76.0 CM) FREESTANDING ELECTRIC RANGES**  
**Model YWFE515S0JS**

**5.3 cu. ft. Whirlpool® electric range with Frozen  
Bake™ technology**

YWFE515S0JS

**Whirlpool®**

---

Home > Kitchen Appliances > Cooking Appliances > Ranges > Single Oven Ranges > YWFE515S0JS

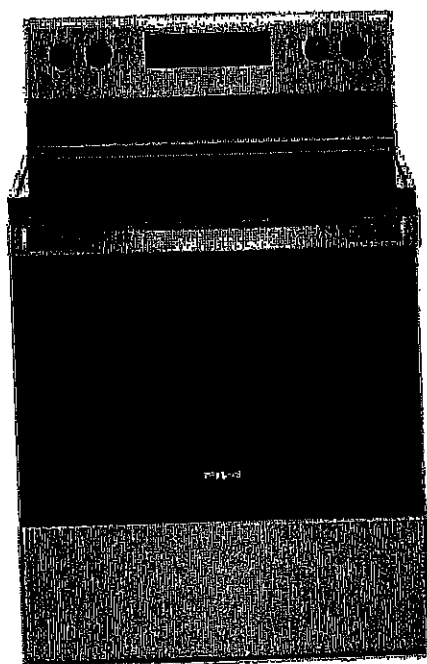

M/K  
PK

29 of 39

WHIRLPOOL 30" (76.0 CM) FREESTANDING ELECTRIC RANGES  
Model YWFE515S0JS

Product Dimensions

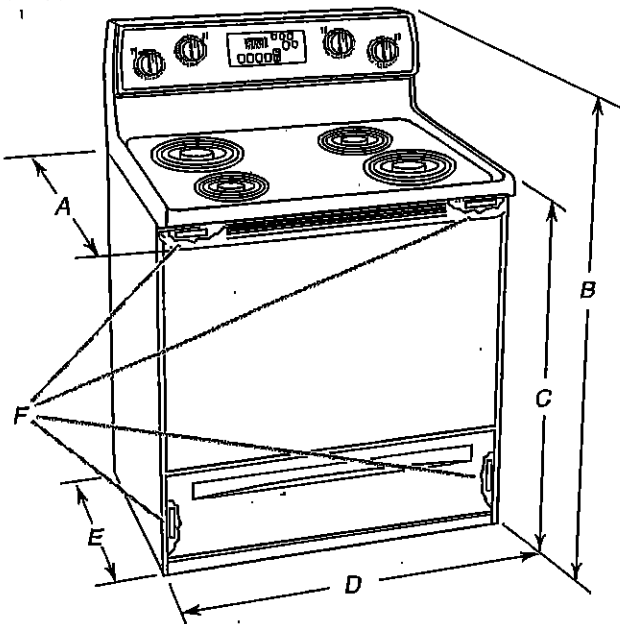

- A. 27<sup>3</sup>/<sub>4</sub>" (70.5 cm) max. depth with handle
- B. 46<sup>7</sup>/<sub>8</sub>" (119.1 cm) overall height (max.) with leveling legs screwed all the way in\*
- C. 36" (91.4 cm) cooktop height (max.) with leveling legs screwed all the way in\*
- D. 29<sup>7</sup>/<sub>8</sub>" (75.9 cm) width
- E. 25<sup>5</sup>/<sub>8</sub>" (64.3 cm) depth - back of range to front of cooktop\*\*
- F. Model/serial/rating plate (located on the frame behind a top corner of the door or either side of the drawer)

**IMPORTANT:** Range must be level after installation. Follow the instructions in the "Level Range" section. Using the cooktop as a reference for leveling the range is not recommended.

\*Range can be raised approximately 1" (2.5 cm) by adjusting the leveling legs.

\*\*Front of door and drawer may extend further forward depending on styling.

Cabinet Dimensions

Cabinet opening dimensions shown are for 25" (64.0 cm) countertop depth, 24" (61.0 cm) base cabinet depth and 36" (91.4 cm) countertop height.

**IMPORTANT:** If installing a range hood or microwave hood combination above the cooking surface, follow the range hood or microwave hood combination installation instructions for dimensional clearances above the cooktop surface.

A freestanding range may be installed next to combustible walls with zero clearance.

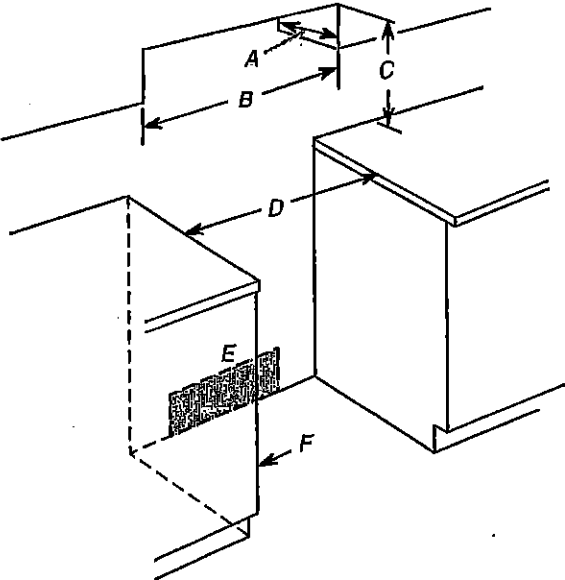

- A. 13" (33.0 cm) max. upper cabinet depth
- B. 30" (76.2 cm) min. opening width
- C. For minimum clearance to top of cooktop, see NOTE\*
- D. 30" (76.2 cm) min. opening width
- E. Outlet - 8" (20.3 cm) to 22" (55.9 cm) from either cabinet, 7" (17.8 cm) max. from floor.
- F. Cabinet door or hinges should not extend into the cutout.

**\*NOTE:** 24" (61.0 cm) minimum when bottom of wood or metal cabinet is covered by not less than 1/4" (6.4 mm) flame retardant millboard covered with not less than No. 28 MSG sheet steel, 0.015" (0.4 mm) stainless steel, 0.024" (0.6 mm) aluminum or 0.020" (0.5 mm) copper.

30" (76.2 cm) minimum clearance between the top of the cooking platform and the bottom of an uncovered wood or metal cabinet.

M/K  
JK

30 of 39

WHIRLPOOL 30" (76.0 CM) FREESTANDING ELECTRIC RANGES  
Model YWFE515S0JS

Install Anti-Tip Bracket

**⚠ WARNING**

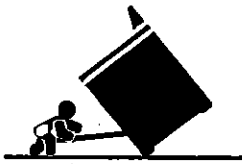

**Tip Over Hazard**

A child or adult can tip the range and be killed.  
Install anti-tip bracket to floor or wall per Installation instructions.  
Slide range back so rear range foot is engaged in the slot of the anti-tip bracket.  
Re-engage anti-tip bracket if range is moved.  
Do not operate range without anti-tip bracket installed and engaged.  
Failure to follow these instructions can result in death or serious burns to children and adults.

1. Remove the anti-tip bracket from where it is taped inside the storage drawer or warming drawer.
2. Determine which mounting method to use: floor or wall.  
If you have a stone or masonry floor, you can use the wall mounting method. If you are installing the range in a mobile home, you must secure the range to the floor.
3. Determine and mark centerline of the cutout space. The mounting can be installed on either the left-side or right-side of the cutout. Position mounting bracket against the wall in the cutout so that the V-notch of the bracket is 12<sup>9</sup>/<sub>16</sub>" (31.9 cm) from centerline as shown.

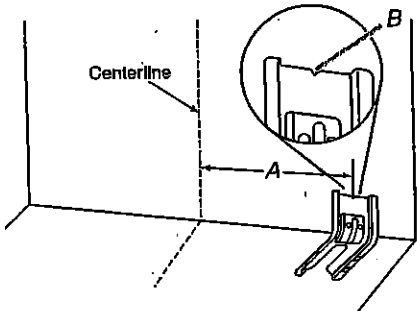

A. 12<sup>9</sup>/<sub>16</sub>" (31.9 cm)  
B. Bracket V-notch

4. Drill two 1/8" (3 mm) holes that correspond to the bracket holes of the determined mounting method. See the following illustrations.

**Floor Mounting**

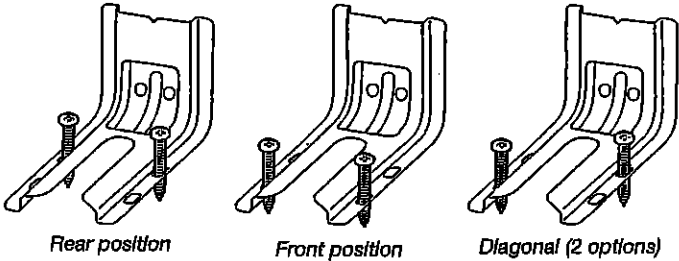

**Wall Mounting**

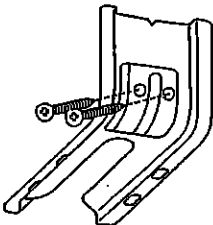

5. Using the Phillips screwdriver, mount anti-tip bracket to the wall or floor with the two #12 x 1<sup>5</sup>/<sub>8</sub>" (4.1 cm) screws provided.
6. Move range close enough to opening to allow for final electrical connections. Remove shipping base, cardboard or hardboard from under range.
7. Move range into its final location, making sure rear levelling leg slides into anti-tip bracket.
8. Move range forward onto shipping base, cardboard or hardboard to continue installing the range using the following installation instructions.

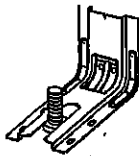

MK  
PK

Whirlpool® Dishwasher with ENERGY STAR® qualification



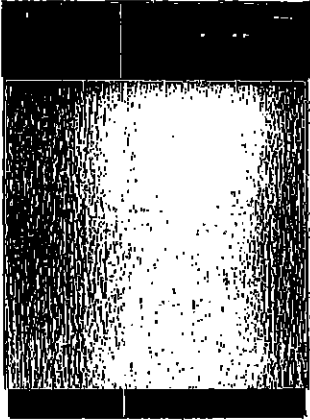



**WDF310PAAS**  
**Black-on-Stainless**

**OTHER AVAILABLE COLORS**

Black  
Model: WDF310PAAB

Black-on-Black  
Model: WDF310PAAT

White  
Model: WDF310PAAW

Universal Silver  
Model: WDF310PAAD



DIMENSIONS		KEY FEATURES
Maximum Height	34 1/2 Inches	
Minimum Height	33 1/2 Inches	
Height	34 1/2 Inches	
Depth	24 1/2 Inches	
Width	23 7/8 Inches	
Dimensions shown are for planning purposes only. For complete information, see installation instructions packaged with product.		
ELECTRICAL		
15 Amps. 60 Hz. 120 V. 16,		
Before purchasing this appliance, read important information about its estimated annual energy consumption or energy efficiency rating that is available from your dealer.		

ENERGY STAR® Qualified

No One Has Fewer Repairs 17 Years In A Row

Resource - Efficient Wash System

CEE Tier 1 qualified

Tall Tub Design

White Plastic Interior

Quiet Partner(TM) I Sound Package

Auto Soil Sensor

Electronic Controls

3 Automatic Cycles

1-Hour Wash Cycle

Heavy Wash Cycle

Normal Cycle

4 Options

High Temperature Wash System

Heated Dry Option

4 Hour Delay Wash Option

4-Tier SheerClean® Direct Feed Wash System

Control Lock

Vinyl Racks

In-Rack Silverware Basket

MX

PIC

32 of 39

# Whirlpool® Undercounter Dishwasher

## PRODUCT MODEL NUMBERS

WDF110PAB	WDE310PLA	WDF530P8Y
WDF111PAB	WDF320PAD	WDF540PAD
WDF120PAF	WDF510PAY	WDF730PAY
WDF121PAF	WDF520PAD	WDT710PAY
WDF310PAA	WDF530PAY	WDT720PAD
WDF310PCA	WDF530PLY	WDT770PAY

**Electrical Requirements:** 120-volt, 60-Hz, AC only, 15- or 20-amp. fused electrical supply. Copper wire only. A time delay fuse or circuit breaker and separate circuit is recommended.

**If direct wiring dishwasher:** Use flexible, armored, or nonmetallic, sheathed copper wire with grounding wire that meets the wiring requirements for your home and local codes and ordinances. Use a UL listed or CSA approved conduit connector.

**If connecting dishwasher with a power supply cord:** Use Power Supply Cord Kit (Part No. 4317824) marked for use with dishwashers. Follow the kit instructions for installing the power supply cord.

Power supply cord must plug into a grounded 3 prong, outlet, located in the cabinet next to the dishwasher opening. Outlet must meet all local codes and ordinances.

**Water Supply Requirements:** A hot water line with 20 to 120 psi (138 to 862 kPa) water pressure. Water temperature must be 120°F (49°C) water at dishwasher. Use 3/8" O.D. copper tubing with compression fitting or flexible braided water supply line (1/2" minimum plastic tubing is not recommended). Use a 90° elbow with 1/4"N.P.T. external pipe threads on one end. Do not solder within 6" (15.2 cm) from water inlet valve.

**Drain Requirements:** A new drain hose is supplied with your dishwasher. If this is not long enough, use a new drain hose with a maximum length of 12' (3.7 m) (Part No. 3385566) that meets all current AHAM/IAPMO test standards, is resistant to heat and detergent, and fits the 1" (2.5 cm) drain connector of the dishwasher.

Make sure to connect the drain hose to waste tee or disposer inlet above drain trap in house plumbing and 20" (50.8 cm) minimum above the floor. It is recommended

that the drain hose either be looped up and securely fastened to the underside of the counter or be connected to an air gap.

Make sure to use an air gap if the drain hose is connected to house plumbing lower than 20" (50.8 cm) above subfloor or floor.

Use 1/2" (1.3 cm) minimum I.D. drain line fittings.

If required, the air gap should be installed in accordance with the air gap installation instructions. When connecting the air gap, a rubber hose (not provided) will be needed to connect to the waste tee or disposer inlet.

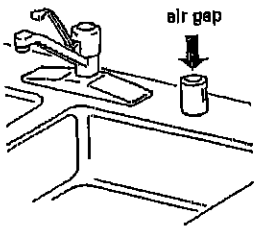

## PRODUCT DIMENSIONS

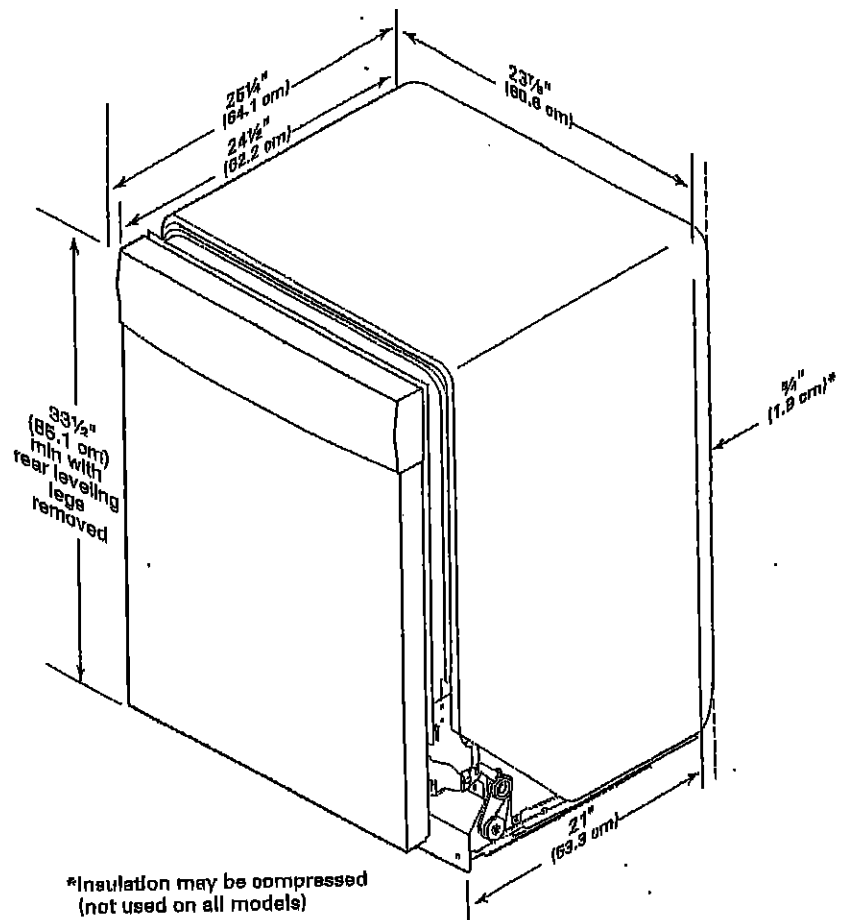

ALL  
pic



33 of 39

CABINET CUTOUT DIMENSIONS

WDF320PAB

NOTE: Shaded areas of cabinet walls show where utility connections may be installed.

\*Measure from the lowest point on the underside of the countertop. May be reduced to 33½" (85.1 cm) by removing the rear leveling legs from dishwasher.

\*Minimum, measured from narrowest point of opening.

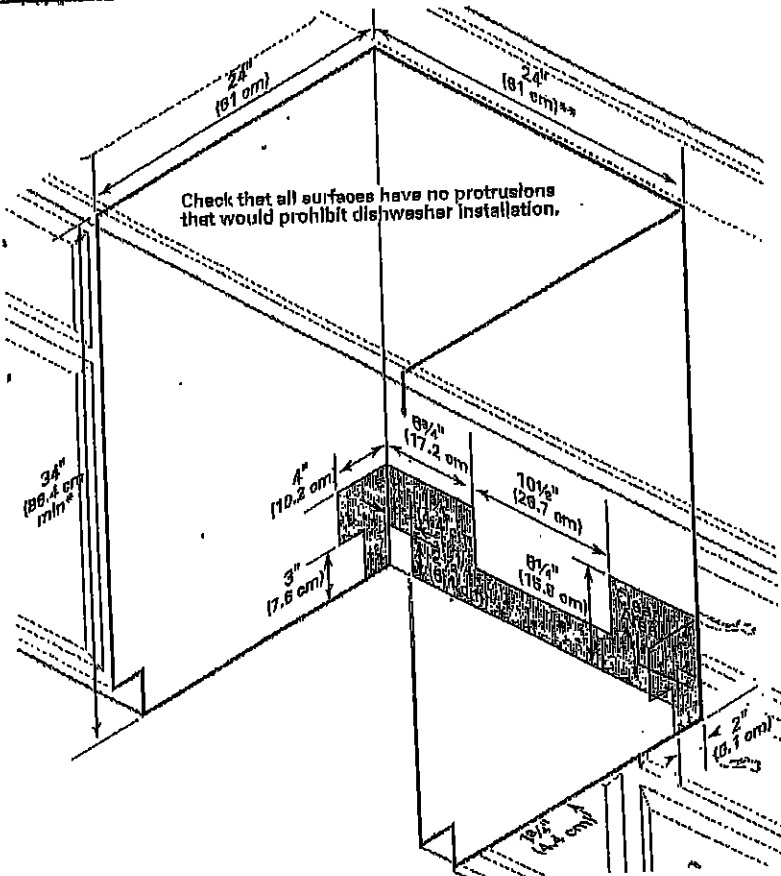

M/K  
P/K

UK-75 WALLACETON  
LOT 285A-1  
20-2046 CRN ALT A  
THE UPTON

34 of 39

WHIRLPOOL WASHER Model #: WFW5620HW

Whirlpool Brand Canada English | Washer and Dryers | Washers | Front Load Washers | WFW5620HW

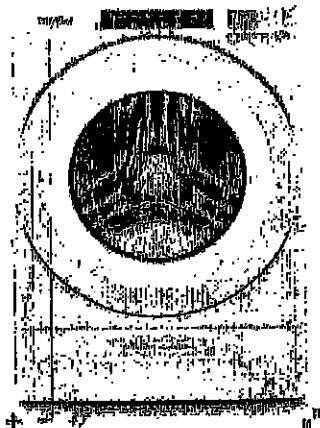

5.2 cu. ft. I.E.C. Closet-Depth  
Front Load Washer with  
Load & Go™ Dispenser



5.2 cu. ft. I.E.C. Closet-Depth Front Load Washer with Load & Go™  
Dispenser  
Model #: WFW5620HW

Dimensions

Depth	80.17 cm, 31-9/16 in
Depth With Door Open 90 Degree	143.51 cm, 56-1/2 in
Minimum Height	96.11 cm, 38-5/8 in
Width	68.58 cm, 27.0 in

Appearance

LCD Touch Screen	No
Window	Yes

W/C

Details

Drum Material	Stainless Steel
---------------	-----------------

PIC

Cycles and Options

Number of Wash Cycles	37
-----------------------	----

Electrical

Hz	60
Power Cord Included	Yes

UK-75 WALLACETON  
 LOT 285A-1  
 20-2046 CRN ALT A  
 THE UPTON

35 or 39

WHIRLPOOL WASHER Model #: WFW5620HW

## LOCATION REQUIREMENTS

Proper installation is your responsibility.

You will need:

- A water heater set to 120°F (49°C).
- A grounded electrical outlet located within 6 ft (1.8 m) of power cord on back of washer.
- Hot and cold water faucets located within 4 ft (1.2 m) of hot and cold water fill valves on washer, and water pressure of 20–100 psi (137.9–689.6 kPa).
- A level floor with maximum slope of 1" (25 mm) under entire washer. Installing on carpet or surfaces with foam backing is not recommended.
- Floor must support washer's total weight (with water and load) of 315 lbs (143 kgs).

**IMPORTANT:** Do not install, store, or operate washer where it will be exposed to weather or in temperatures below 32°F (0°C). Water remaining in washer after use may cause damage in low temperatures. See "Washer Care" in your Use and Care Guide for winterizing information.

Whirlpool Models\*

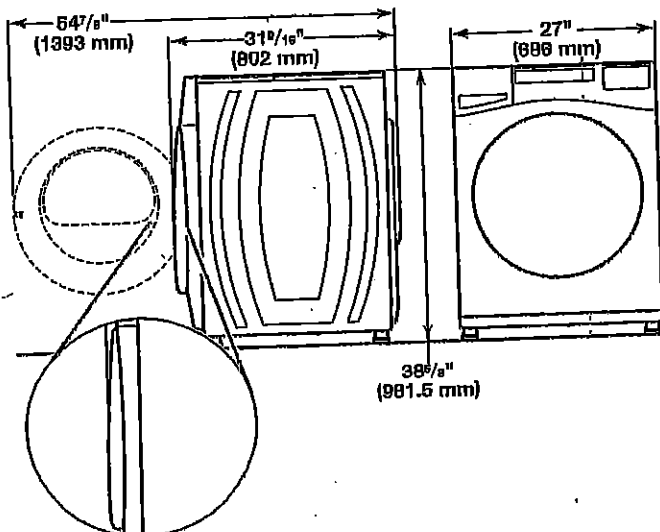
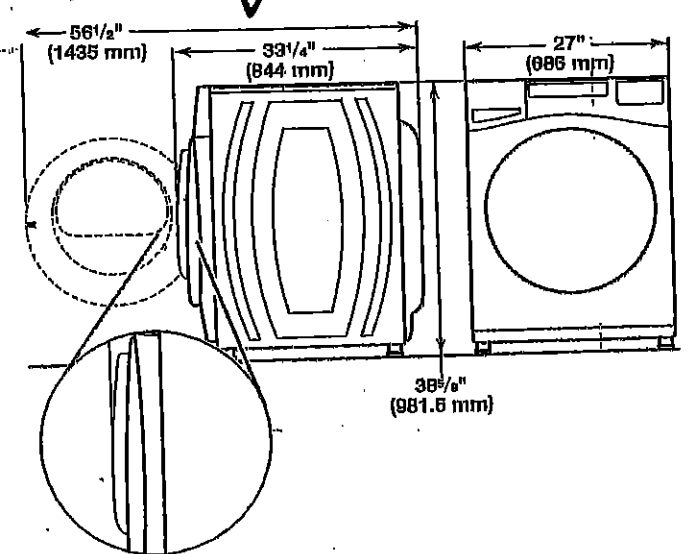

\*For additional details (or information) specific to your model, refer to the 'Dimensions' listed for your model at [www.whirlpool.com](http://www.whirlpool.com).

Maytag Models

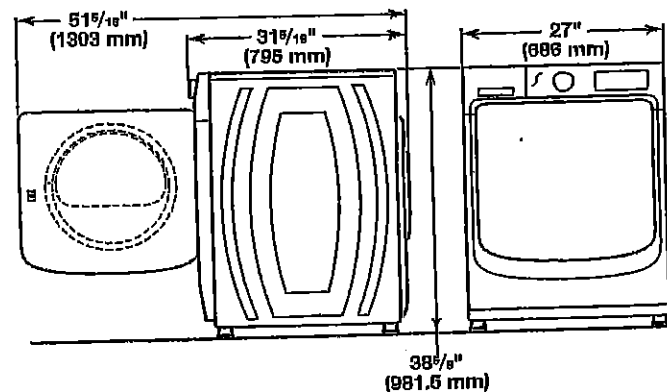
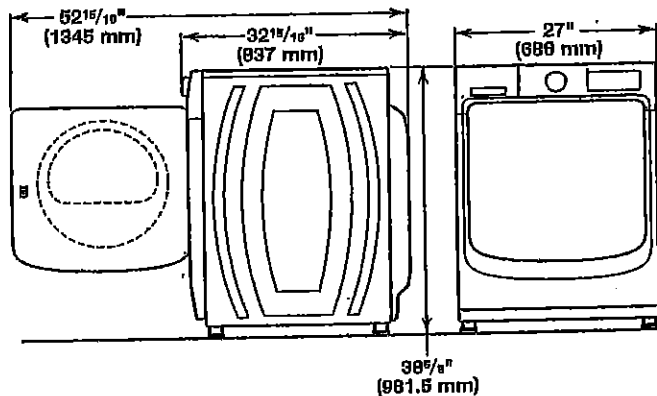

All dimensions show minimum spacing allowed. For each arrangement, consider allowing more space for ease of installation and servicing, and spacing for companion appliances and clearances for walls, doors, and floor moldings.

Space must be large enough to allow door to fully open. Add spacing of 1" (25 mm) on all sides of washer to reduce noise transfer. If a closet door or louvered door is installed, top and bottom air openings in door are required.

Recessed area or closet installation (stacked washer and dryer):

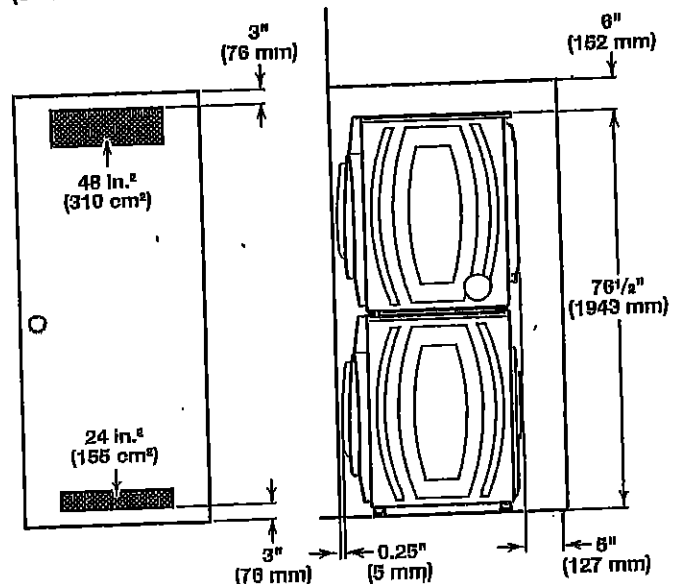

UK-75 WALLACETON  
LOT 285A-1  
20-2046 CRN ALT A  
THE UPTON

36 of 39

WHIRLPOOL WASHER Model #: WFW5620HW

Custom under-counter installation:

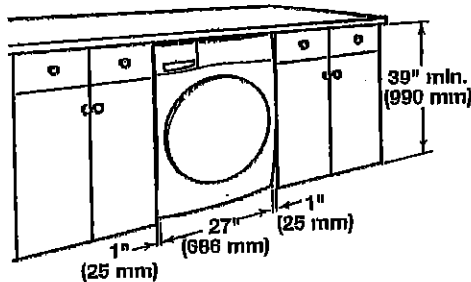

Recessed area or closet installation:

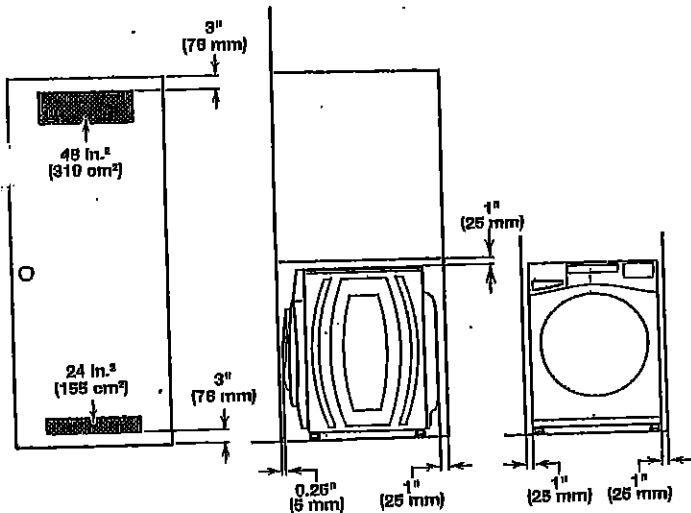

Custom cabinet installation:

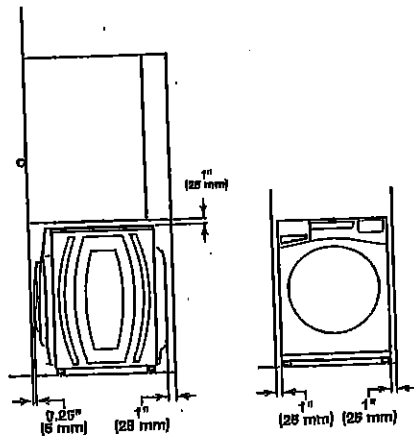

DRAIN SYSTEM

The drain system can be installed using a floor drain, wall standpipe, floor standpipe, or laundry tub. Select the method you need.

**IMPORTANT:** To avoid siphoning, only 4.5" (114 mm) of drain hose should be inside standpipe. Always secure drain hose with cable tie.

Floor standpipe drain system

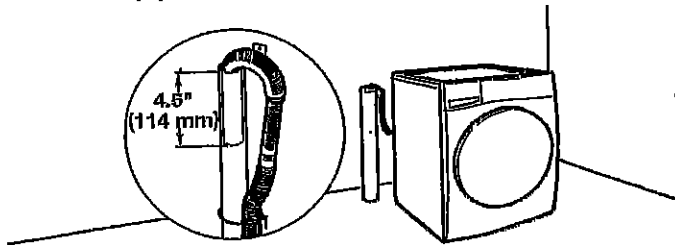

Minimum diameter for a standpipe drain: 2" (51 mm). Minimum carry-away capacity: 17 gal. (64 L) per minute. A 1/4" (6 mm) diameter to 1" (25 mm) diameter Standpipe Adapter Kit is available (Part Number 3363920). Top of standpipe must be at least 30" (762 mm) high; install no higher than 96" (2.44 m) from bottom of washer. If you have an overhead sewer and need to pump higher than 96" (2.44 m), a sump pump and associated hardware are needed. See "Alternate parts."

Wall standpipe drain system

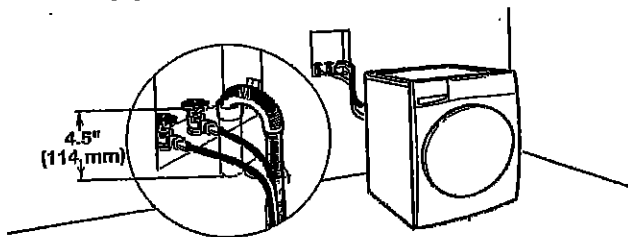

See requirements for floor standpipe drain system.

Laundry tub drain system

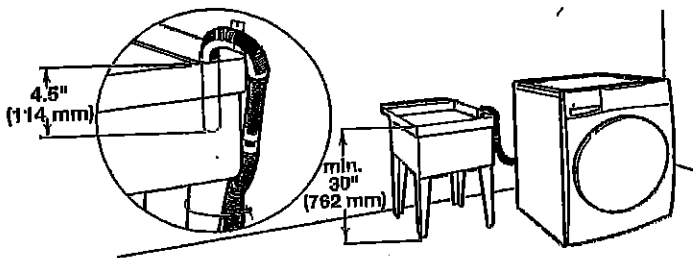

Minimum capacity: 20 gal. (76 L). Top of laundry tub must be at least 30" (762 mm) above floor; install no higher than 96" (2.44 m) from bottom of washer.

M/K  
PK

UK-75 WALLACETON  
LOT 285A-1  
20-2046 CRN ALT A  
THE UPTON

37 of 39

WHIRLPOOL DRYER Model #: YWED5620HW

Whirlpool Brand Canada English | Washer and Dryers | Dryers | Electric Dryers | YWED5620HW

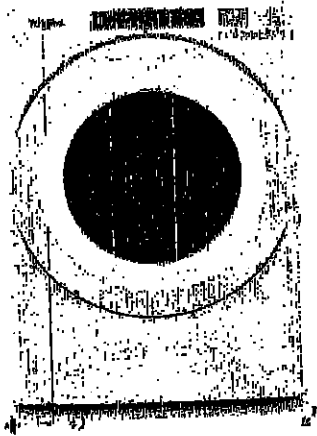

7.4 cu. ft. Front Load Electric  
Dryer with Intuitive Touch  
Controls



Whirlpool 7.4 cu. ft. Front Load Electric Dryer with Intuitive Touch Controls  
Model #: YWED5620HW

M/C

P/C

Dimensions

Depth	78.74 cm, 31.0 in
Depth With Door Open 90 Degrees	138.43 cm, 54 1/2 in
Height	98.42 cm, 38 9/16 in
Width	68.58 cm, 27.0 in

Configuration and Overview

Fuel Type	Electric
-----------	----------

Cycles and Options

Cycle Time Remaining	Yes
Lint Filter Indicator	No
Number of Dryer Cycles	30
Number of Dryness Levels	3

Ventilation System

Long Vent	No
Maximum Vent Length	84
Venting Direction	Left, Right, Bottom, Rear

Electrical

Hz	60
Power Cord Included	Yes

UK-75 WALLACETON  
 LOT 285A-1  
 20-2046 CRN ALT A  
 THE UPTON

38.39

WHIRLPOOL DRYER Model #: YWED5620HW

Back view:

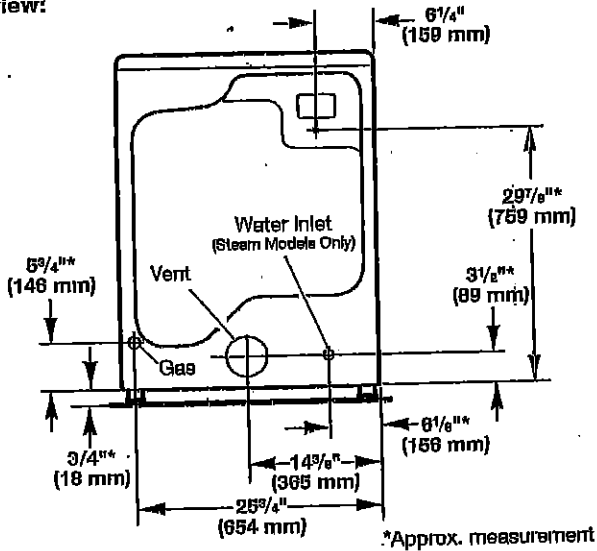

Recommended installation clearances (dryer only):

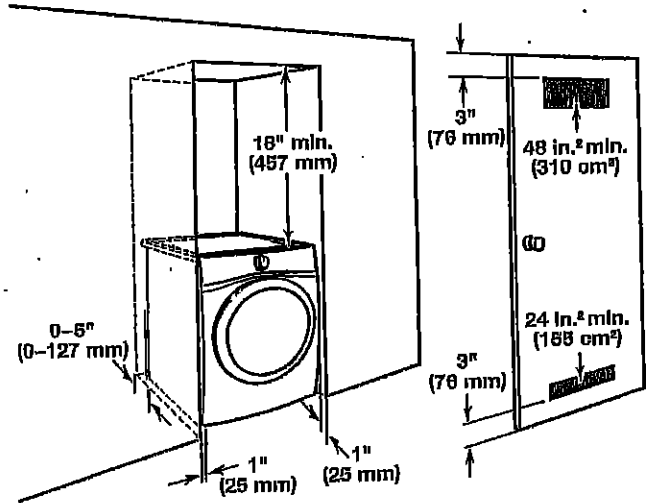

NOTE: Most installations require a minimum of 5" (127 mm) clearance behind dryer for exhaust vent with elbow. See "Venting Requirements."

0" (0 mm) rear spacing is allowed for straight back venting only. For steam models only, Inlet hose must not be kinked.

#### Installation Clearances

For each arrangement, consider allowing more space for ease of installation and servicing, spacing for companion appliances, and clearances for walls, doors, and floor moldings. Space must be large enough to allow door to fully open. Add spacing on all sides of dryer to reduce noise transfer. If a closet door or louvered door is installed, top and bottom air openings in door are required.

Check code requirements. Some codes limit, or do not permit, installation of the dryer in garages, closets, mobile homes, or sleeping quarters. Contact your local building inspector.

NOTE: No other fuel-burning appliance can be installed in the same closet as a dryer.

#### Installation spacing for recessed area or closet installation

All dimensions show recommended and minimum spacing allowed.

- Additional spacing should be considered for ease of installation and servicing.
- Additional clearances might be required for wall, door, floor moldings, dryer venting, and gas line.
- Additional spacing should be considered on all sides of the dryer to reduce noise transfer.
- For closet installation with a door, minimum ventilation openings in the top and bottom of the door are required. Louvered doors with equivalent ventilation openings are acceptable.
- Companion appliance spacing should also be considered.

#### Custom under-counter installation:

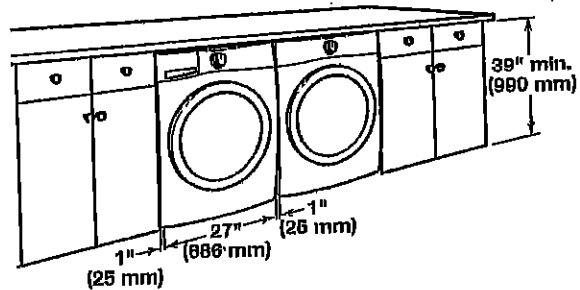

#### Mobile home - Additional installation requirements:

This dryer is suitable for mobile home installations. The installation must conform to the Manufactured Home Construction and Safety Standard, Title 24 CFR, Part 3280 (formerly the Federal Standard for Mobile home construction and Safety, Title 24, HUD Part 280) or Standard CAN/CSA-Z240 MH.

#### Mobile home installations require:

- Metal exhaust system hardware, available for purchase from your dealer. For further information, see "Assistance or Service" in your Use and Care Guide.
- Special provisions must be made in mobile homes to introduce outside air into dryer. Openings (such as a nearby window) should be at least twice as large as dryer exhaust opening.

#### For mobile home installation of gas dryers:

- Mobile Home Installation Hold-down Kit Part Number 346764 is available to order. For further information, see "Assistance or Service" in your Use and Care Guide.

MY

PK

UK-75 WALLACETON  
LOT 285A-1  
20-2046 CRN ALT A  
THE UPTON

39" 39

WHIRLPOOL DRYER Model #: YWED5620HW

Additional parts may be required, depending on your installation. Check local codes. Check existing electrical supply and venting. Read "Electrical Requirements" and "Venting Requirements" before purchasing parts.

If using a power supply cord:

Use a UL Listed power supply cord kit marked for use with clothes dryers. The kit should contain:

- A UL Listed 30 amp power supply cord, rated 120/240 volt minimum. The cord should be type SRD or SRDT and be at least 4 ft. (1.22 m) long. The wires that connect to the dryer must end in ring terminals or spade terminals with upturned ends.
- A UL Listed strain relief.

Optional Equipment (not supplied with dryer):

Refer to your Use and Care Guide for information about accessories available for your dryer.

LOCATION REQUIREMENTS

Check code requirements. Some codes limit, or do not permit, installing dryer in garages, closets, mobile homes, or sleeping quarters. Contact your local building inspector.

⚠ WARNING



Explosion Hazard

Keep flammable materials and vapors, such as gasoline, away from dryer.

Place dryer at least 18 inches (460 mm) above the floor for a garage installation.

Failure to do so can result in death, explosion, or fire.

You will need:

- A location allowing for proper exhaust installation. See "Venting Requirements."
- A separate 15 or 20 amp circuit for a gas dryer or 30 amp circuit for an electric dryer.
- If using power supply cord, a grounded electrical outlet located within 2 ft. (610 mm) of either side of dryer. See "Electrical Requirements."
- Floor must support dryer weight of 200 lbs. (90.7 kg). Also consider weight of companion appliance.
- Cold water faucets located within 4 ft. (1.2 m) of the water fill valves, and water pressure of 20–120 psi (138–827 kPa). You may use your washer's water supply by purchasing the necessary parts noted in "Parts needed."
- Level floor with maximum slope of 1" (25 mm) under entire dryer. If slope is greater than 1" (25 mm), install Extended Dryer Feet Kit, Part Number 279810. If not level, clothes may not tumble properly and automatic sensor cycles may not operate correctly.
- For garage installation, place dryer at least 18" (460 mm) above floor. If using a pedestal, you will need 18" (460 mm) to bottom of dryer.
- The dryer must not be installed or stored in an area where it will be exposed to water and/or weather.

**IMPORTANT:** Do not operate, install, or store dryer where it will be exposed to water, weather, or at temperatures below 40°F (4°C). Lower temperatures may cause dryer not to shut off at end of automatic sensor cycles, resulting in longer drying times.

DRYER DIMENSIONS

Front view:

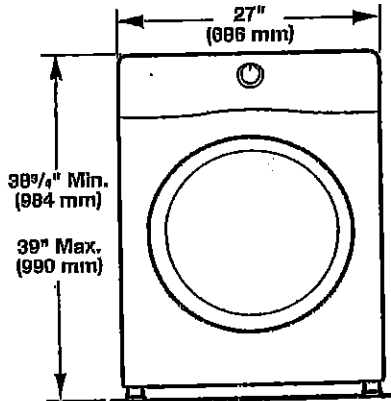

Side view:

Whirlpool Models

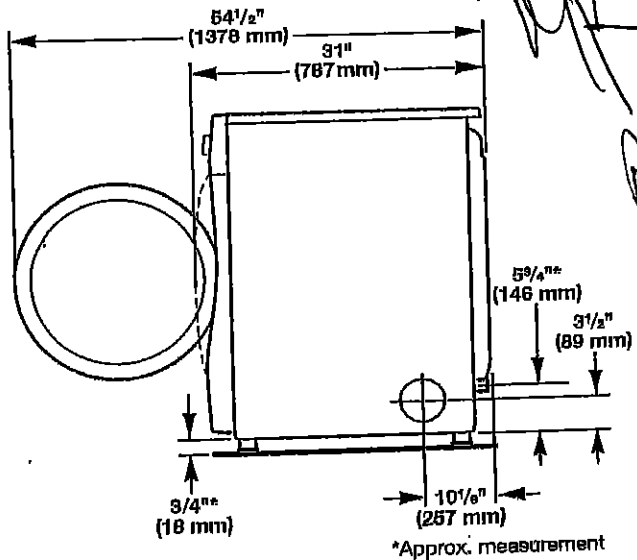

Maytag Models

