

Customer Colours

148

MANPREET, SINGH JOHAL/KAVITHA, KAUR JOHAL
Project: Wallaceton
Unit: 251, Phase: 2
Model: 25-2500 B The Bridgeport ALT

Created: 7/17/2020 11:44:12
Locked:
Closed:

9 of 39

Kitchen/Servery

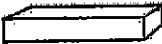
Cabinet Colour/Style	9166	Viking III-CHARLESTON-ORCHID-3DL ***STD***
Countertop	9069	MSI Quartz GROUP 1 ICED WHITE ***STD***
Countertop Edge	4010	SINGLE POLISHED STRAIGHT EDGE 3/4 INCH ***STD*** 
Cabinet Hardware	2076	181-HARDWARE ***STD***
Island Cabinet Colour/Style	9166	Viking III-CHARLESTON-ORCHID-3DL ***STD***
Island Countertop	9069	MSI Quartz GROUP 1 ICED WHITE ***STD***
Backsplash	1111	N/A *****
Backsplash Grout	1111	N/A *****
Backsplash Tile Pattern	1111	N/A *****
HoodFan	1111	AV1308 Air King 30 PRE SSS PAGE 8
Appliances	1111	Purchasers have been advised: standard fridge opening is a minimum 37 3/8 x 73 3/8". Ice Waterline Rough-In is included.
Appliances	1111	Standard stove opening is 30" and standard dishwasher opening is 24". Any gas stove will require backsplash or stainless steel backing to avoid fire hazards.
Appliances	1111	Purchasers acknowledge: Heathwood Homes and its contractors will not be responsible for any kitchen cabinet changes due to appliances dimension changes after
Comment		

Opt. Servery Upper

Cabinet - Uppers	9166	Viking III-CHARLESTON-ORCHID-3DL ***STD***
Cabinet Hardware	2076	181-HARDWARE ***STD***
Comment		

Handwritten initials "MJ" and "B" with a flourish.

MANPREET, SINGH JOHAL/KAVITHA, KAUR JOHAL
Project: Wallaceton
Unit: 251, Phase: 2
Model: 25-2500 B The Bridgeport **ALT**

Created: 7/17/2020 11:44:12
Locked:
Closed:

10 of 39

Kitchen/Breakfast/Servery

Flooring	7502	Red Oak Pearl-Vintage Engineered-ECLIPSE-3/4 inch x 3 1/4 inch ***8***
Floor Tile Grout	1111	N/A *****
Floor Tile Pattern	1111	N/A *****

Comment

Foyer

Flooring	8295	OV.CD.BGE.2424.PL-Concorde-Beige Polished-24x24 ***6***
Floor Tile Grout	7705	Grout-(01) Alabaster ***UPG***
Floor Tile Pattern	3050	SIDE TO SIDE ***STD***

Comment

Laundry Room

Flooring	8073	GE.RF.WHT.1313-Reflex-White-13 x 13 See Tile Line Pattern on Sketch 7 Page 26 ***STD***
Floor Tile Grout	7706	Grout-(49) Light Almond ***UPG***
Floor Tile Pattern	3000	STANDARD SQUARE ***STD***

Comment

Laundry Room Opt.

Cabinet - Uppers	1111	N/A *****
------------------	------	-----------

10/17/20
by

Customer Colours

MANPREET, SINGH JOHAL/KAVITHA, KAUR JOHAL
Project: Wallaceton
Unit: 251, Phase: 2
Model: 25-2500 B The Bridgeport ALT

Created: 7/17/2020 11:44:12
Locked:
Closed:

11 of 39

Cabinet Hardware1111N/A *****

Comment

Mud Room

Flooring8291OV.CD.BGE.1224.PL-Concorde-Beige Polished-12x24 See Tile Direction on Sketch 5 Page 24 ***5***

Floor Tile Grout7705Grout-(01) Alabaster ***UPG***

Floor Tile Pattern3050SIDE TO SIDE ***STD***

Comment

Powder Room

Flooring8291OV.CD.BGE.1224.PL-Concorde-Beige Polished-12x24 See Tile Direction on Sketch 5 Page 24 ***5***

Floor Tile Grout7705Grout-(01) Alabaster ***UPG***

Floor Tile Pattern3050SIDE TO SIDE ***STD***

Plumbing Fixture (Colour)1737Plumbing Fixtures-WHITE ***STD***

Comment

Dining Room/Hall

Flooring7502Red Oak Pearl-Vintage Engineered-ECLIPSE-3/4 inch x 3 1/4 inch ***STD***

CommentINCL. PARK OF FOYER AND SERVERY/ POWDER ROOM LANDING
SEE SKETCH# 5 PAGE# 24

Great Room

Flooring7502Red Oak Pearl-Vintage Engineered-ECLIPSE-3/4 inch x 3 1/4 inch ***STD***

Handwritten signature

Customer Colours

MANPREET, SINGH JOHAL/KAVITHA, KAUR JOHAL
Project: Wallaceton
Unit: 251, Phase: 2
Model: 25-2500 B The Bridgeport ALT

Created: 7/17/2020 11:44:12
Locked:
Closed:

12 of 39

Comment

Upper Hall

Flooring

9247

DY 16611-Dynasty Tex-SANDY BEIGE-40 oz
Poly***STD***

Comment

Finished Basement Foyer

Flooring

9247

DY 16611-Dynasty Tex-SANDY BEIGE-40 oz
Poly***STD***

Comment

Opt. Finished Basement (Rec) Room/Hall

Flooring

1111

N/A *****

Comment

Master Bedroom

Flooring

9247

DY 16611-Dynasty Tex-SANDY BEIGE-40 oz
Poly***STD***

Comment

Bedroom 2

Flooring

9247

DY 16611-Dynasty Tex-SANDY BEIGE-40 oz
Poly***STD***

Comment

Bedroom 3

Flooring

9247

DY 16611-Dynasty Tex-SANDY BEIGE-40 oz
Poly***STD***

Handwritten signature

Customer Colours

148

MANPREET, SINGH JOHAL/KAVITHA, KAUR JOHAL
Project: Wallaceton
Unit: 251, Phase: 2
Model: 25-2500 B The Bridgeport ALT

Created: 7/17/2020 11:44:12
Locked:
Closed:

3 of 39

Comment

Bedroom 4

Flooring

9247

DY 16611-Dynasty Tex-SANDY BEIGE-40 oz
Poly***STD***

Comment

Ensuite 4

Cabinet Colour/Style

6261

Viking III-MANCHESTER-OYSTER CL-MAPLE ***STD***

Countertop

8817

1881K-52-Countertop-CIPOLLINO BIANCO-Wilsonart
STD

Countertop Edge

1111

N/A *****

Cabinet Hardware

7672

135-HARDWARE ***STD***

Floor Tile

8916

OV.CH.WHT.1224-Chambray-White-12 x 24 See Tile
Direction on Sketch 7 Page 26 ***2***

Floor Tile Grout

7705

Grout-(01) Alabaster ***UPG***

Floor Tile Pattern

3050

SIDE TO SIDE ***STD***

Plumbing Fixture (colour)

1737

Plumbing Fixtures-WHITE ***STD***

Wall Tile

8833

QT.UW.WHT.0810-Uniwall-White-8 x 10 ***STD***

Wall Tile Grout

2226

Grout-(00) White ***STD***

Wall Tile Pattern

3070

HORIZONTAL STACKED ***STD***

Comment

Handwritten signature

Master Ensuite

Customer Colours

MANPREET, SINGH JOHAL/KAVITHA, KAUR JOHAL
Project: Wallaceton
Unit: 251, Phase: 2
Model: 25-2500 B The Bridgeport *ALT*

Created: 7/17/2020 11:44:12
Locked:
Closed:

14 of 39

Cabinet Colour/Style	9166	Viking III-CHARLESTON-ORCHID-3DL ***STD***
Countertop	9069	MSI Quartz GROUP 1 ICED WHITE ***STD***
Countertop Edge	4010	GROUP 1 - SINGLE POLISHED STRAIGHT EDGE 3/4 INCH ***1***
Cabinet Hardware	7672	135-HARDWARE ***STD***
Floor Tile	8669	MZ.ME.TFU.2424.PL-Marmi Evoluzione-Tafu (Light Grey)Polished-24 x 24 ***6***
Floor Tile Grout	2220	Grout-(11) Sahara Beige ***UPG***
Floor Tile Pattern	3000	STANDARD SQUARE ***STD***
Shower Floor Tile	8643	WB.PR.TPE.1212.GL-Penny Rounds-Taupe Glossy-12 x 12 ***6***
Shower Floor Tile Grout	2220	Grout-(11) Sahara Beige ***UPG***
Shower Floor Tile Pattern	1111	N/A *****
Shower Wall Tile	9025	QT.UW.TGR.0810-Uniwall-Tender Grey-8 x 10 ***STD***
Shower Wall Tile Grout	2220	Grout-(11) Sahara Beige ***UPG***
Shower Wall Tile Pattern	3070	HORIZONTAL STACKED ***STD***
Shower Jamb(s) and Sill(s)	8923	Shower Jamb / Sill-Thassos White ***STD***
Plumbing Fixture (colour)	1737	Plumbing Fixtures-WHITE ***STD***
Comment	SHOWER BACK WALL: WB.PR.TPE.1212 GL PENNY ROUND 8643 -TAUPE GLOSSY 12X12 UPG GROUT 2220SHARA BEIGE. CEILING STD. QT. UW TGR 0810 UNIWALL TENDER GREY 8X10 UPG. GROUT DO NOT SUPPLY OR INSTALL SOWDER INCLOSURE	

Shared Bathroom

Cabinet Colour/Style	9167	Viking III-CHARLESTON-RAIN CLOUD-3DL ***STD***
----------------------	------	--

mj
bg

Customer Colours

MANPREET, SINGH JOHAL/KAVITHA, KAUR JOHAL
Project: Wallaceton
Unit: 251, Phase: 2
Model: 25-2500 B The Bridgeport

Created: 7/17/2020 11:44:12
Locked:
Closed:

ALT

5 of 39

Countertop	8796	6698-46-Countertop-PALOMA POLAR ETCHINGS FINISH-Formica ***STD***								
Countertop Edge	1111	N/A *****								
Cabinet Hardware	2076	181-HARDWARE ***STD***								
Flooring	8913	UN.BL.BIA.1224-Biel-Bianco (White)-12 x 24 See Tile Direction on Sketch 7 Page 26 ***2***								
Floor Tile Grout	2225	Grout-(27) Silver ***STD***								
Floor Tile Pattern	3040	FRONT TO BACK ***STD***								
Wall Tile	8833	QT.UW.WHT.0810-Uniwall-White-8 x 10 ***STD***								
Wall Tile Grout	2226	Grout-(00) White ***STD***								
Shared Bathroom Floor Tile Pattern	3070	HORIZONTAL STACKED ***STD*** <table><tr><td></td><td></td></tr><tr><td></td><td></td></tr><tr><td></td><td></td></tr><tr><td></td><td></td></tr></table>								
Plumbing Fixture (Colour)	1737	Plumbing Fixtures-WHITE ***STD***								
Comment										

Finished Basement Shower

Shower Floor Tile	1111	N/A *****
Shower Floor Tile Grout	1111	N/A *****
Shower Floor Tile Pattern	1111	N/A *****
Shower Wall Tile	1111	N/A *****
Shower Wall Tile Grout	1111	N/A *****
Shower Wall Tile Pattern	1111	N/A *****

mf

MANPREET, SINGH JOHAL/KAVITHA, KAUR JOHAL
Project: Wallaceton
Unit: 251, Phase: 2
Model: 25-2500 B The Bridgeport ALT

Created: 7/17/2020 11:44:12
Locked:
Closed:

16 of 39

Shower Jamb(s)	1111	N/A *****
Comment	1	

Opt. Finished Basement Bathroom

Cabinet Colour/Style	1111	N/A *****
Countertop	1111	N/A *****
Countertop Edge	1111	N/A *****
Cabinet Hardware	1111	N/A *****
Flooring	1111	N/A *****
Floor Tile Grout	1111	N/A *****
Floor Tile Pattern	1111	N/A *****

Plumbing Fixture (Colour)	1111	N/A *****
Comment		

Great Room Fireplace

Type	8869	Majestic MERC32 ***STD***
Mantle	8891	NF-17-Paint Grade Mantle- Cabinet (Per Plan)-WHITE ***STD*** PAGE 31
Surround Opt.	1111	N/A *****
Note	1111	Purchasers have been advised: heat from the FP can damage TV above a FP and items placed on mantle.
Note	1111	Heathwood and its contractors will not be liable for any damage on items placed/installed above a FP after closing.
Comment		

16 of 39

Customer Colours

148

MANPREET, SINGH JOHAL/KAVITHA, KAUR JOHAL
Project: Wallaceton
Unit: 251, Phase: 2
Model: 25-2500 B The Bridgeport ALT

Created: 7/17/2020 11:44:12

Locked:

Closed:

7 OF 39

Basement Stairs

Type	1712	Oak Stairs ***STD MAIN STAIRS***
Colour	7922	Eclipse (Pewter) STAIN TO COMPLIMENT HARDWOOD AND WILL VARY FROM FLOORING ***99***
Carpet Runner	1111	N/A *****
Handrail/Pickets/Post Type	7652	1 5/16 inch Square pickets with 3 1/2" Square/Cap Post(s)-ALL OAK ***STD***
Handrail/Pickets/Post Colours	1728	Oak Grade-Stain handrail,oak pickets,stringers,treads,risers
Carpet	1111	N/A *****
Custom Stain/Paint	1111	N/A *****
Comment		

Main Stairs

Type	1712	Oak Stairs ***STD MAIN STAIRS***
Colour	7922	Eclipse (Pewter) STAIN TO COMPLIMENT HARDWOOD AND WILL VARY FROM FLOORING ***99***
Carpet Runner	1111	N/A *****
Handrail/Pickets/Posts Type	7652	1 5/16 inch Square pickets with 3 1/2" Square/Cap Post(s)-ALL OAK ***STD***
Handrail/Pickets/Posts Colour	1728	Oak Grade-Stain handrail,oak pickets,stringers,treads,risers
Custom Stain/Paint	1111	N/A *****
Comment		

Throughout

Walls - Paint Colour	1717	22-Wall-WARM GREY ***STD***
Underpad	1079	500 Series-Underpad ***STD***
Thresholds	2232	Metal Thresholds ***STD***
Switches and Plug	5796	Decora White Switches and Plugs ***STD***

mj
B

Customer Colours

148

MANPREET, SINGH JOHAL/KAVITHA, KAUR JOHAL
Project: Wallaceton
Unit: 251, Phase: 2
Model: 25-2500 B The Bridgeport ALT



Created: 7/17/2020 11:44:12
Locked:
Closed:

18 of 39



Trim Size 8705 4 1/4 Baseboard and 2 3/4 Casings ***STD***

Trim - Paint Colour 1716 Trim-WHITE ***STD***

Comment

Purchaser:  Aug 27/20 Date Decor Consultant  Aug 26.2020 Date

MANPREET, SINGH JOHAL

Purchaser:  Aug 27/20 Date Wallaceton  -09- 0 9 2020 Date Approved

KAVITHA, KAUR JOHAL

APPROVED

-09- 0 9 2020

Date Approved



Sales Selection Sheet

Wallaceton

19 of 39

PURCHASERS: MANPREET, SINGH JOHAL and KAVITHA, KAUR JOHAL

TEL:

LOT / UNIT	PHASE	MODEL	
251	2	25-2500 Alt B The Bridgeport	ALT

It is herein understood and agreed between the undersigned parties hereto that the following changes shall be made to the above mentioned Agreement of Purchase and Sale in accordance with the agreement and except for such changes noted below, all other terms and conditions in the Agreement of Purchase and Sale shall remain as stated herein: It is further understood that and agreed that all changes and additions shall be installed as per builder's specifications, location and available selections. The Purchaser hereby agrees to purchase the following extras:

Cabinetry

1 183,939 30,261	CABINETRY - VIKING IV - OPT SERVERY UPPER - UPGRADE 1 Note: SKETCH # 6 PAGE 25	Qty: 1
2 189,124 30,266	CABINETRY - 11D-VANITY BANK OF DRAWERS (MAX. WIDTH 55CM) - UPGRADE 1 Note: MASTER BATHROOM (MAKE IT AS WIDE AS CAN) SKETCH # 7 PAGE 26	Qty: 1
3 189,316 30,275	CABINETRY - 12J-LIGHT VALANCE (PER 8 foot LENGTH PRICE) (FOR CLARIFICATION OF STYLES SEE MOULDING MATRIX) (LIGHT VALANCE IS NOW APPROXIMATELY 2" [50MM] HIGH. PLEASE ENSURE LIGHT FIXTURES USED WILL BE CONCEALED BY THE VALANCE.); Note: PRICE ALL THE SAME FOR ALL LINES - KITCHEN AND SERVEY	Qty: 3
*4 189,315 30,822	CABINETRY - 09J-CROWN MOULDING (PER 8' LENGTH PRICE) (FOR CLARIFICATION OF STYLES, SEE MOULDING MATRIX); PRICE ALL THE SAME FOR ALL LINES - KITCHEN Note: INCL. SERVERY	Qty: 1
5 189,047 35,088	CABINETRY - VIKING I/III/III KITCHEN BUILT IN - KITCHEN - STANDARD SERIES SKETCH # 5 AND 6 PAGES 24 AND 25 Note: APPLIANCE SPECS PAGES 32-39	Qty: 1

CERAMIC

6 32,965	CERAMICS - SHOWER BACK WALL - ENSUITE MASTER UPG. 4 Note: MASTER SHOWER BACK WALL UPG 4 PENNY ROUND SEE SKETCH # 7 PAGE# 26	Qty: 1
-------------	---	--------

Ceramics

7 184,057 30,313	CERAMICS - FLOOR - FOYER - UPGRADE 6 Note:	Qty: 1
8 183,967 30,314	CERAMICS - FLOOR GROUT - FOYER - GROUT Note:	Qty: 1
9 183,969 30,315	CERAMICS - FLOOR GROUT - GARAGE ENTRY / MUD ROOM - GROUT Note:	Qty: 1
*10 184,177 30,316	CERAMICS - FLOOR - GARAGE ENTRY- UPGRADE 5 Note:	Qty: 1

Initials:

TAX#:1

PREPARED BY: Irit Salem

PE 350-1

S\invoice.rpt 28may19



Sales Selection Sheet

Wallaceton

PURCHASERS: MANPREET, SINGH JOHAL and KAVITHA, KAUR JOHAL

20 of 39
TEL:

LOT / UNIT 251	PHASE 2	MODEL 25-2500 Alt B The Bridgeport	ALT
-------------------	------------	---------------------------------------	-----

Ceramics

11 184,169 30,317	CERAMICS - FLOOR - POWDER ROOM - UPGRADE 5 Note:	Qty: 1
12 183,968 30,318	CERAMICS - FLOOR GROUT - POWDER ROOM - GROUT Note:	Qty: 1
13 184,222 30,328	CERAMICS - FLOOR - ENSUITE 4 - UPGRADE 2 Note:	Qty: 1
14 184,147 30,329	CERAMICS - SHOWER FLOOR - ENSUITE MASTER - UPGRADE 4 Note:	Qty: 1
15 183,966 30,330	CERAMICS - SHOWER FLOOR GROUT - ENSUITE MASTER - GROUT Note:	Qty: 1
16 184,218 30,331	CERAMICS - FLOOR - ENSUITE MASTER - UPGRADE 6 Note:	Qty: 1
17 184,206 32,957	CERAMICS - FLOOR - MAIN BATHROOM - UPGRADE 2 Note:	Qty: 1
18 183,974 32,961	CERAMICS - FLOOR GROUT - ENSUITE MASTER - GROUT Note:	Qty: 1
19 183,965 32,964	CERAMICS - SHOWER WALL AND CEILING GROUT - ENSUITE MASTER - GROUT Note:	Qty: 1
20 183,975 32,966	CERAMICS - FLOOR GROUT - ENSUITE 4 - GROUT Note:	Qty: 1

Electrical

21 189,435 32,962	ELECTRICAL - ADDITIONAL 40AMP/240V OUTLET, PLEASE SPECIFY LOCATION. SKETCH # 5 AND 6 PAGES 24 AND 25 Note: FOR MICRO/OVEN SPECS PAGES 35-39	Qty: 1
-------------------------	---	--------

Granite

22 189,464 35,087	GRANITE - GRANITE CUTOUT W/ STRAIGHT EDGE POLISH TO ACCOMMODATE COOK TOP SKETCH # 6 PAGE 25 Note: COOKTOP SPECS PAGES 33-34	Qty: 1
-------------------------	---	--------

Initials:

TAX#:1

PREPARED BY: Irit Salem

PE 350-2

S\invoice.rpt 28may19



Sales Selection Sheet
Wallaceton

21 of 39
TEL:

PURCHASERS: MANPREET, SINGH JOHAL and KAVITHA, KAUR JOHAL

LOT / UNIT 251	PHASE 2	MODEL 25-2500 Alt B The Bridgeport -ALT	
-------------------	------------	--	--

Hardwood

23 184,357 30,258	HARDWOOD - VINTAGE - 3-1/4" RED OAK ENGINEERED - KITCHEN / BREAKFAST - STANDARD SERIES Note:	Qty: 1
24 32,958	HARDWOOD - VINTAGE - 3-1/4" RED OAK ENGINEERED - SERVERY AND POWDERROOM LANDING - STANDARD SERIES Note:	Qty: 1
25 32,967	HARDWOOD - VINTAGE - 3-1/4" RED OAK ENGINEERED - PART OF FOYER IN FRONT OF THE CLOSET - STANDARD SERIES Note: PART OF FOYER SEE SKETCH # 5 PAGE# 24	Qty: 1

MIRRORS/GLASS

26 35,097	MASTER ENSUITE BATHROOM- DO NOT SUPPLY OR INSTALL GLASS SHOWER ENCLOSURE PURCHASER WILL BE DOING HIS OWN AFTER CLOSING Note: SKETCH # 7 PAGE 26	Qty: 1
------------------	---	--------

MISC.

27 32,968	PROMO - SCHEDULE E - TEN THOUSAND IN UPGRADES AT DECOR Note:	Qty: (1)
------------------	---	----------

Sub Total
HST
Total

1. This Sales Selection Sheet when properly executed forms part of our Agreement of Purchase and Sale.
2. All extras and upgrades listed above are subject to Construction Progress and Architectural and Municipal requirements.
3. In the event the Vendor is unable to incorporate the work approved above in the construction of the house for any reason whatsoever, the Vendor will not be liable to the Purchaser in any way. The monies paid for any changes or optional extras not proceeded with shall be returned to the Purchaser, without interest. The cost of options or extras is non-refundable in all other circumstances. If for any reason whatsoever the Agreement of Purchase and Sale is not completed, the total cost of work approved above will be retained by the Vendor.
4. The Vendor reserves the right to substitute above materials and equipment with that of equal or better quality.
5. Purchaser acknowledges that items may not be exactly as shown. Variations from the Vendor's samples may occur in finished materials due to normal production processes. Vendor is not responsible for shade difference which may occur from different dye lots or wood grains. Variations from the Vendor's samples will occur with natural materials such as wood, marble, granite, hardwood and brick.
6. The Vendor reserves the right to select Grout & Thresholds that best suits the Tile selected.
7. Selections will not be processed unless signed by Heathwood Homes Head Office.
8. The selections made on this schedule are final and cannot be changed once submitted.
9. The Purchaser has checked and acknowledges the accuracy of this schedule.

Initials:



Sales Selection Sheet
Wallaceton

22 of 39

PURCHASERS: MANPREET, SINGH JOHAL and KAVITHA, KAUR JOHAL

TEL:

LOT / UNIT 251	PHASE 2	MODEL 25-2500 Alt B The Bridgeport	Alt
-------------------	------------	---------------------------------------	-----

PURCHASER:

Signature on

MANPREET, SINGH JOHAL

file

09-Sep-20

DATE

Irit Salem

Decor Consultant

09-Sep-20

DATE

PURCHASER:

Signature on

KAVITHA, KAUR JOHAL

09-Sep-20

DATE

- APPROVED -

-09- 0 9 2020

Date Approved

Heathwood Homes (Huron) Limited

UK 75- WALLACETON
25-2500 ELEV. B
THE BRIDGEPORT
LOT 251

23 of 39

THE BRIDGEPORT

With finished Lower Level

ELEVATION B | 2,451 SQ. FT.

With 120 sq. ft. of finished Lower Level

792 sq. ft. of opt. finished Lower Level

WALLACETON

EST. 1878

25-2500 ELEV. B ALT

Sketch # 4

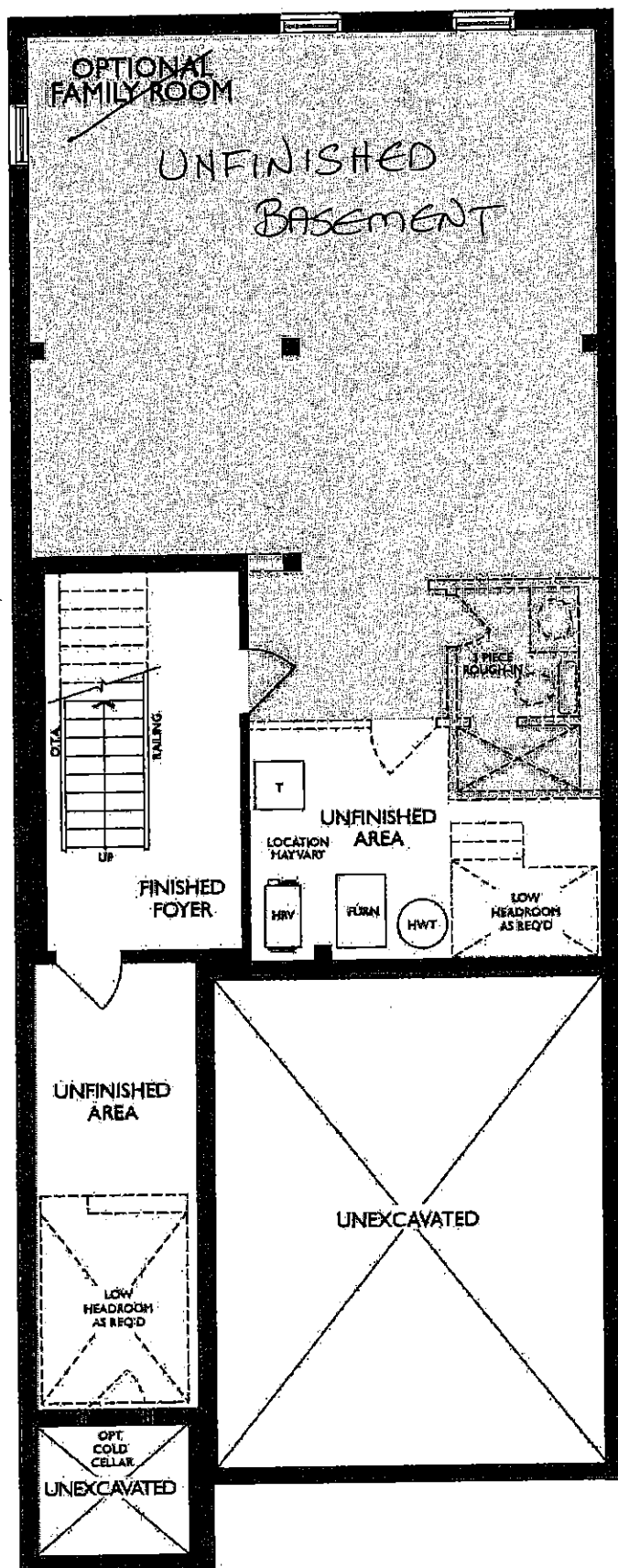

LOWER LEVEL
ELEVATION A, B, C & D

UK 75- WALLACETON
25-2500 ELEV. B
THE BRIDGEPORT
LOT 251

24 of 39

THE BRIDGEPORT

With finished Lower Level

ELEVATION B | 2,451 SQ. FT.

With 120 sq. ft. of finished Lower Level

792 sq. ft. of opt. finished Lower Level

WALLACETON
EST. 1878

25-2500 ELEV. B ALT

Sketch #5

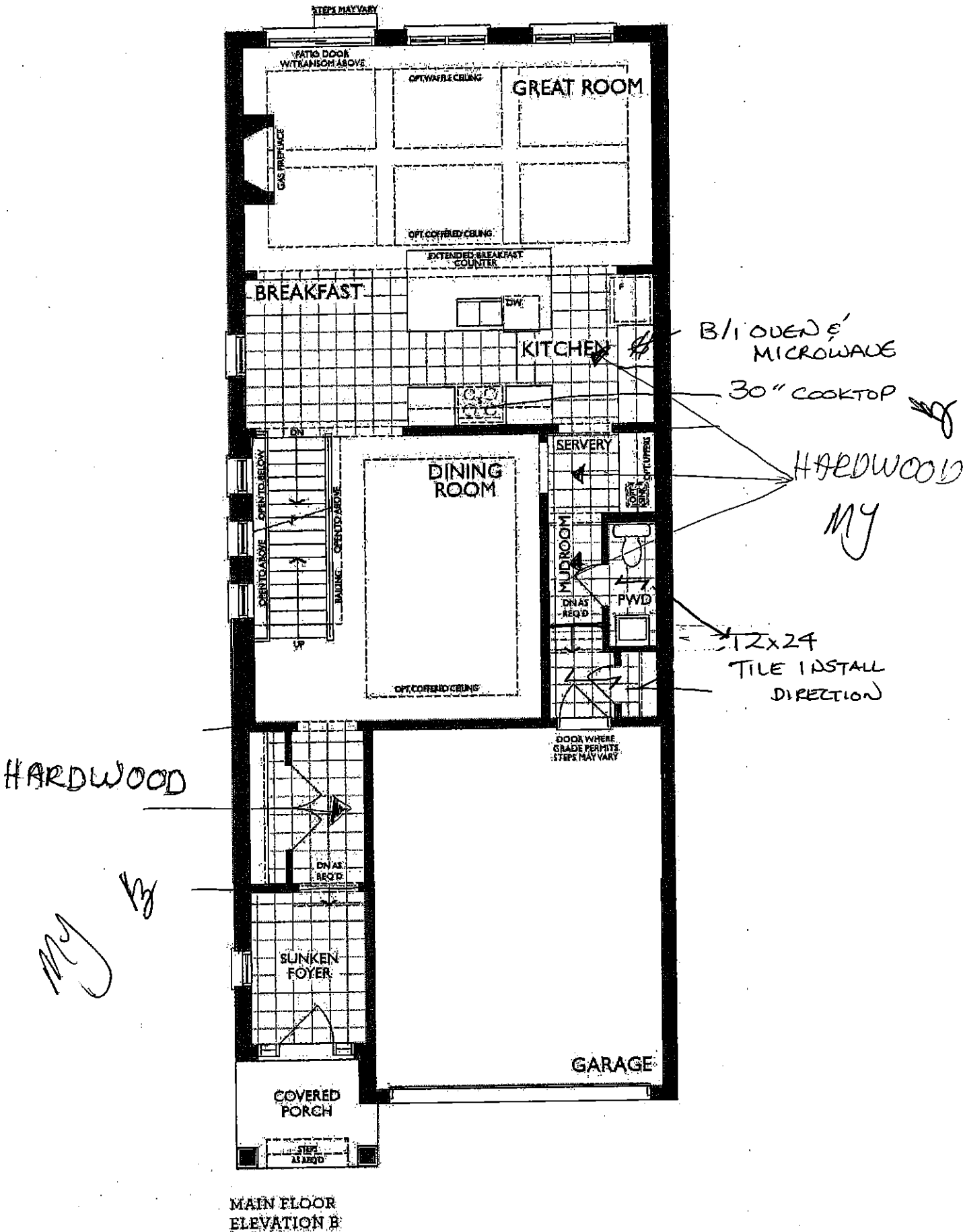

KITCHEN

(GROUND FLOOR)

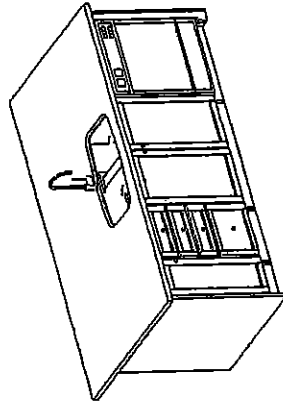
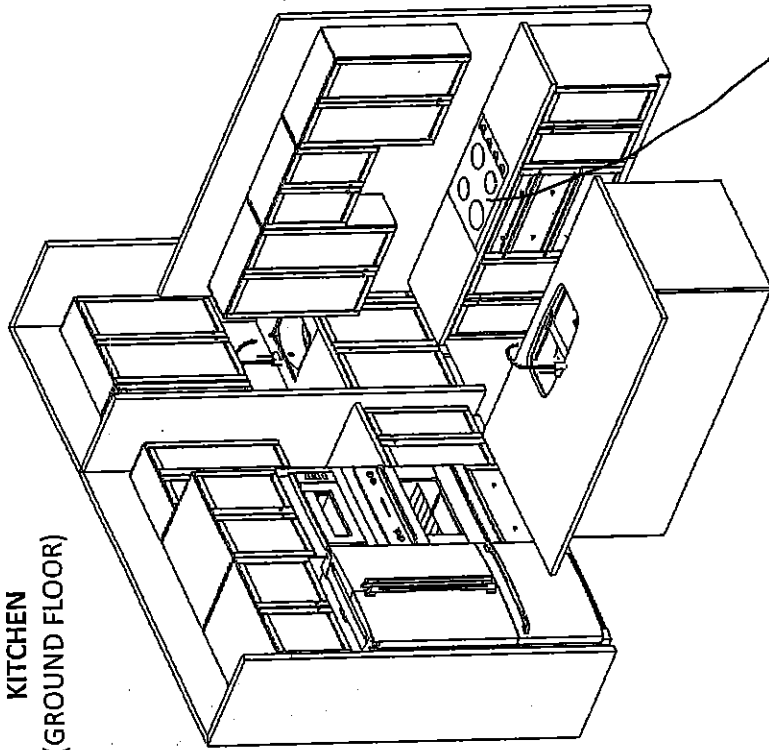

MASTER ENSUITE

(2ND FLR)

2 SINKS
BANK OF
DRAWER
make as wide
possible

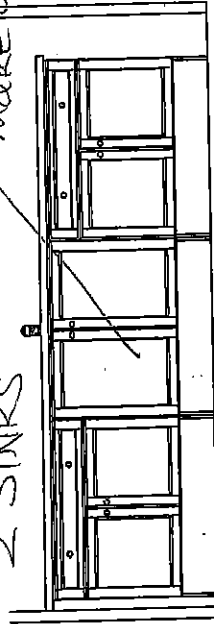

(OPT. DBL SINK V90+VT90+V90)

10/23/2019

SERVERY

*STD. BASE CABINETS

*OPT. BAR SINK

*OPT. WALL CABINETS

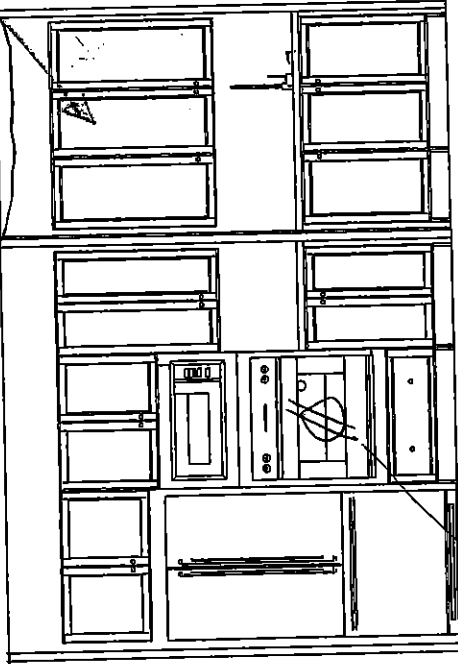

246
40 AMP
PLUG

30"

COOKTOP

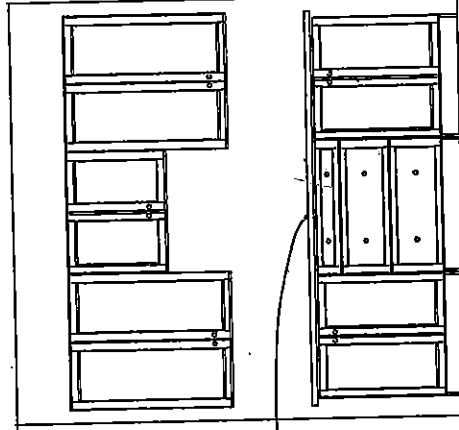

MAIN BATH

(2ND FLR)

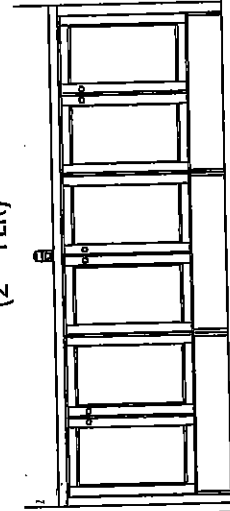

(OPT. DBL SINK V80+VT80+V80)

OPT. BASEMENT BATH

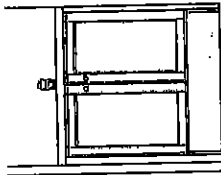

OPT. LAUNDRY UPPERS
(2ND FLR)

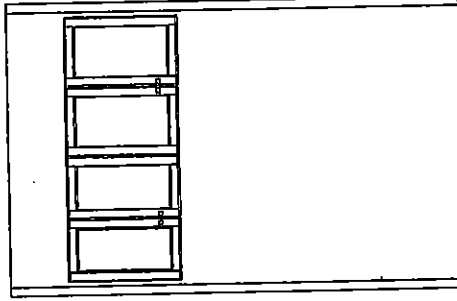

ENSUITE 4

(2ND FLR)

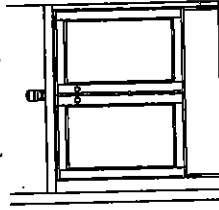

FRIEND

KITCHENS

1350 Shawan Drive, Mississauga, ON L4W

HEATHWOOD HOME
WALLACETON, KITCHENE
MODEL: 25-2500 (3105)

STANDARD CONTRACT INCLUDES:

Appliance Openings

- Hood Opening: 30"W Chimney h
- Fridge Opening: 37 3/8 "W X 73 3
- Fridge cabinet & gables: 66cm D
- Stove Opening: 30" Freestanding
- Dishwasher Opening: 24"

Standard Kitchens Scope:

- 100cm H wall cabinets
- Std. Blumotion Hinges- soft close doors
- Std. Metabox Drawers- not soft close
- Min 40cm W drawer
- Base pie cut corner cabinets
- Backing on all cabinets
- Countertop by others
- Upgrade applied paneled fridge & dishwashers supply only (appliance hardware by others)

Standard Vanity & Laundry Scope:

- Powder by others, pedestal
- Master Ens. - Top by others
- Remaining vanities inc. laminate top
- Std. Blumotion Hinges- not soft close
- Std. Metabox Drawers- not soft close
- Master Ens: Top drawers (Sink Full height)
- Mains: Full height doors (top drawers added if Masters can't accommodate)
- Optional laundry base & wall cabinets

Sketch # 6

25 of 39

THIS DRAWING IS FOR DESIGN PURPOSES ONLY.
IT IS NOT AN EXACT RENDITION.

26 of 39

With finished Lower Level

With 120 sq. ft. of finished Lower Level

792 sq. ft. of opt. finished Lower Level

WALLACETON

1857. 1858

Sketch # 7



Aug 24, 2020

UK 75- WALLACETON
25-2500 ELEV. B
THE BRIDGEPORT
LOT 251

27 of 39



STANDARD KITCHEN SINK

ND1831UA/9

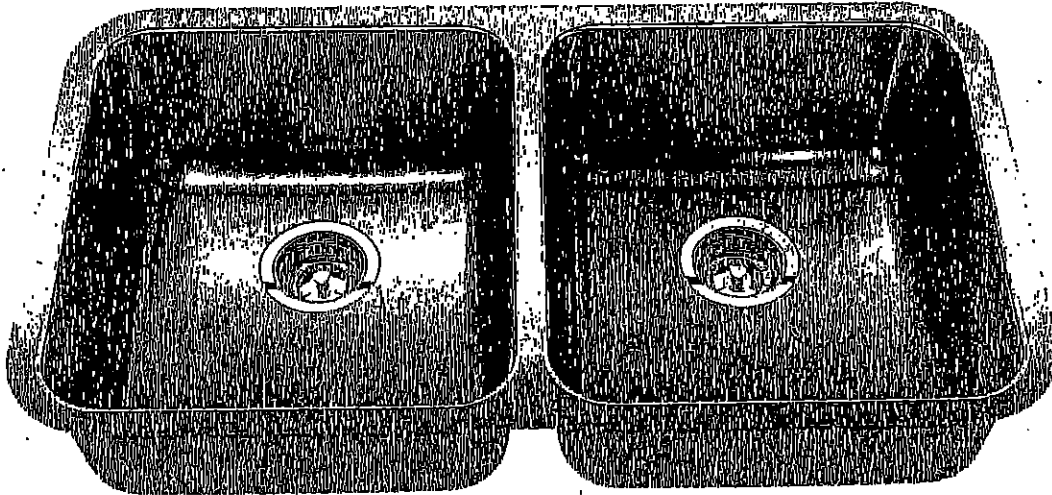

Optional Accessories



BG105



BG10S



MB100



CA1W



DBR10S

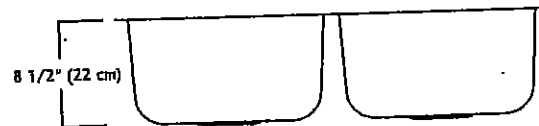
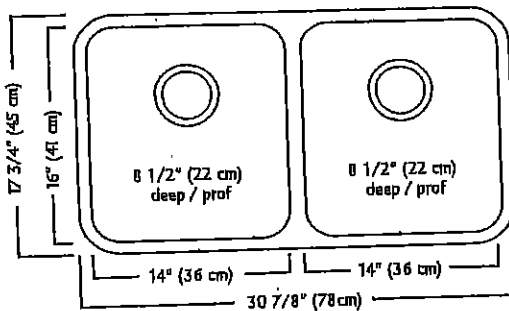

ND1831UA/9 SPECIFICATION

Model ND1831UA/9 is a double (two equal size) bowl undermount sink manufactured by Franke Kindred Canada Limited from 18 gauge stainless steel. Product has silk finished rims and linear brush finished bowls. Sink is fully undercoated. Basket strainer waste fittings (3 1/2", 89 mm) are included. Sink is backed with a limited lifetime warranty.

- O.D. 17 3/4" x 30 7/8" x 8 1/2" (45 x 78 x 22 cm)
- Recommended for minimum 36" cabinet

Franke Kindred Canada Limited
P.O. Box 190, 1000 Franke Kindred Road, Midland, Ontario, Canada, L4R 4K9 Phone: 866-687-7465 Fax: 800-361-8408

ND

UK 75- WALLACETON
25-2500 ELEV. B
THE BRIDGEPORT
LOT 251

28 of 39

STANDARD KITCHEN FAUCET

Align

Modern

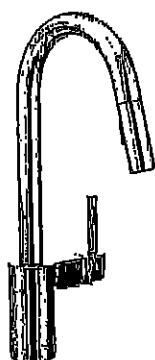

Single Handle Pull-Down Kitchen
Faucet*

Model 7565†

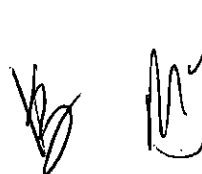

UK 75- WALLACETON
25-2500 ELEV. B
THE BRIDGEPORT
LOT 251

29 of 39

Chateau

Transitional

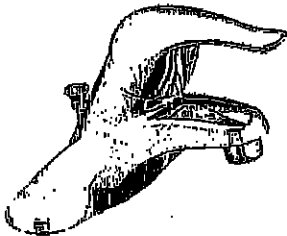

Lavatory Faucet with Pop-Up Drain
Model L4621†

VANITY SINKS AND PEDESTAL



Posi-Temp® Pressure Balancing Tub/Shower
Model 62320 / TL183†

OR

Posi-Temp Valve and Tub/Shower Trim
with Eco-Performance Easy Clean® XL

Model 62320 / TL183EP†

(TL183EP not available in BC)

SHOWER AND 5' TUB FAUCETS



2 Handle Roman Tub with 9" Spout
Model 4796 / T990†

FREESTANDING TUB FAUCETS

Handwritten initials "B" and "M" with a signature.

UK 75- WALLACETON
25-2500 ELEV. B
THE BRIDGEPORT
LOT 251

30 of 39

American Standard

Style That Works Better

 **BARrier FREE**

OVALYN™ UNDERCOUNTER SINK

- Classic oval undermount sink
- Made from vitreous china
- Front overflow
- Supplied with mounting kit (047194-0070A) and template

☐ **0496.221 Unglazed rim**
489 x 413mm
(19-1/4" x 16-1/4")

Bowl size:

432mm (17") wide
356mm (14") front to back
140mm (5-1/2") deep

Compliance Certifications -

Meets or Exceeds the Following Specifications:

- ASME A112.19.2M for Vitreous China Fixtures
- CAN/CSA B45 series

MASTER BATHROOM
OVALYN™
UNDERCOUNTER SINK
VITREOUS CHINA

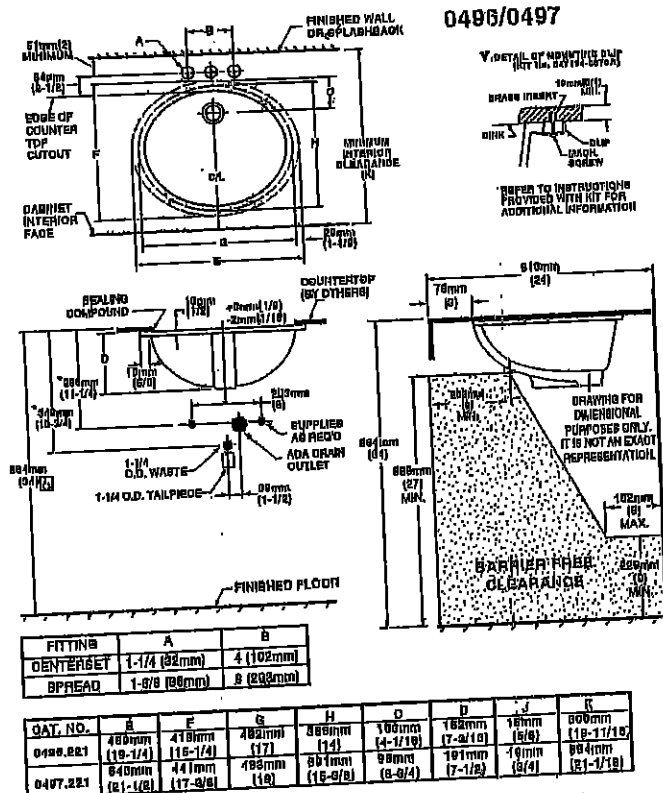
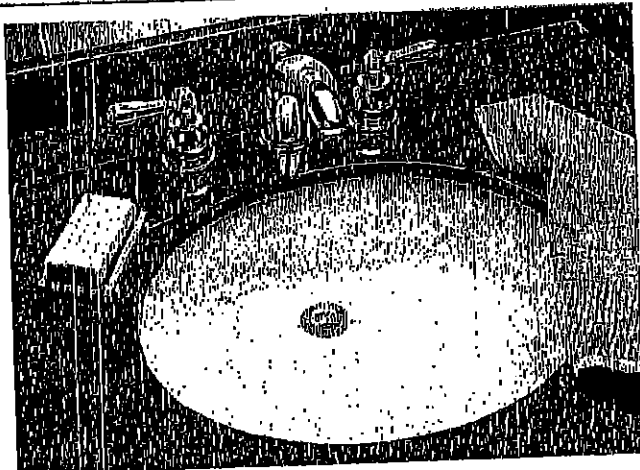

NOTES:
* DIMENSIONS SHOWN FOR LOCATION OF SUPPLIED AND "P" TRAP ARE SUGGESTED.
† UNDERCOUNTER MOUNTING KIT SUPPLIED WITH SINK.
PLEASE NOTE MINIMUM INTERIOR CLEARANCE DIMENSION (K).
FITTINGS NOT INCLUDED AND MUST BE ORDERED SEPARATELY.
USE ENCLOSED TEMPLATE FOR COUNTERTOP CUTOUT
SEALING COMPOUND SUPPLIED BY OTHERS.

IMPORTANT: Dimensions of fixtures are nominal and may vary within the range of tolerances established by ANSI Standard A112.19.2. These measurements are subject to change or cancellation. No responsibility is assumed for use of superseded or voided pages.

 **MEETS THE AMERICANS WITH DISABILITIES ACT GUIDELINES AND ANSI A117.1 ACCESSIBLE AND USEABLE BUILDINGS AND FACILITIES - CHECK LOCAL CODES.**
Countertop 894mm (34") from finished floor. Lavatory installed 78mm (3") from front edge of countertop. Countertop thickness to be 25mm (1") maximum.

my

UK 75- WALLACETON
25-2500 ELEV. B
THE BRIDGEPORT
LOT 251

31. of 39

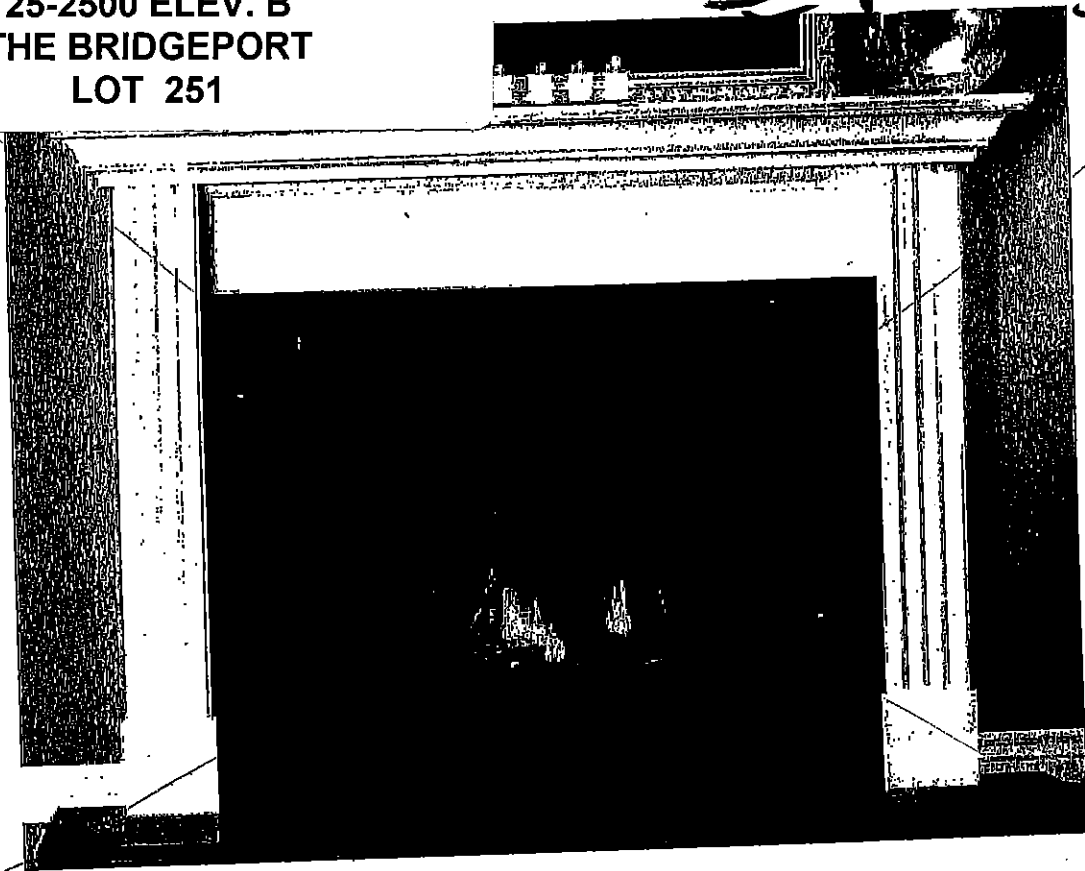

STANDARD NF 15 Mantel

Clean apron finish with fluted legs

WHITE PAINT GRADE FINISH

(PICTURE SHOWN WITH UPGRADE SURROUND AND HEARTH -PRICED SEPARATELY)



'CABINET'

STANDARD NF 17 Mantel

WHITE PAINT GRADE FINISH

(PICTURE SHOWN WITH UPGRADE SURROUND AND HEARTH -PRICED SEPARATELY)

mg by

UK -75 WALLACETON
LOT 251
25- 2500 ELEV B
THE BRIDGEPORT

32 of 39

MSRP
\$2,899.00

Frigidaire 27.2 Cu. Ft.
French Door
Refrigerator

36" W x 33-3/8" D x 69-7/8" H
FFHB2750TS

★★★★★ 4.5 (3541) Write a review

WHERE TO BUY

SUPPORT (/OWNER-
CENTER/PRODUCT-SUPPORT-
-MANUALS/?
PRODUCTCODE=FFHB2750TS)

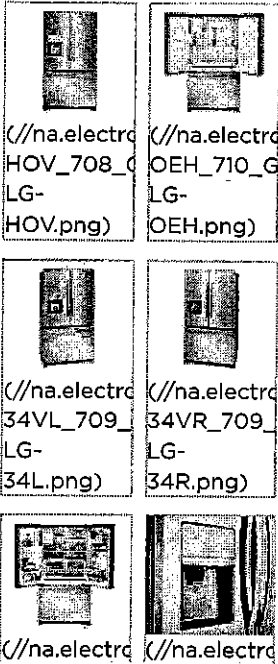
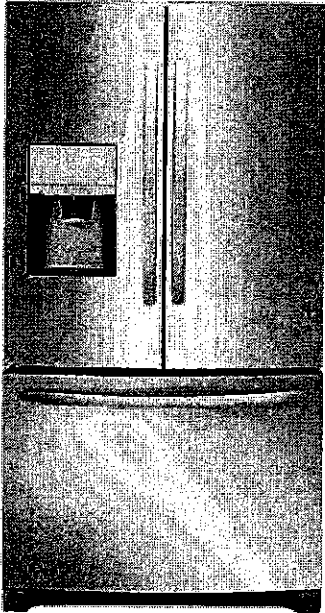

9/9/2020

Frigidaire 27.2 Cu. Ft. French Door Refrigerator Stainless Steel-FFHB2750TS

Sound Package: Quiet Pack
Water Inlet Location: Left Rear Bottom
Power Type: Electric
Size: 27 Cu. Ft.
Installation Type: Free-Standing
Collection: Frigidaire

Weight and Dimensions

Shipping Weight (lbs): 365
Product Weight (lbs): 352

Dispenser

Dispenser Type: Flush Single Paddle
Crushed Ice: Yes
Cube Ice: Yes
Water: Yes
Dispenser Light: Yes
Display On/Off: Yes

Exterior Dimensions

Height: 69-7/8"
Width: 36"
Depth: 33-3/8"
Cabinet Height: 68-5/8"
Cabinet Height (w/Covers): 69-7/8"
Case Width: 35-7/8"
Cabinet Depth: 28-3/4"
Cabinet Depth (w/ Door): 33-3/8"
Cabinet Depth (w/Handle): 35-7/8"
Depth(w/ 90° Door Open): 47-3/8"

CSA Certified: Yes
ADA Compliant - All Brands: No

Capacities

Total Capacity - Cu. Ft.: 26.9
Fresh Food Capacity (Cu. Ft.): 18.1
Freezer Capacity (Cu. Ft.): 8.7
Total Shelf Area (Sq. Ft.): 29
Fresh Food Shelf Area (Sq. Ft.): 22.9
Freezer Shelf Area (Sq. Ft.): 6.1

Ice Maker

Ice Maker: Yes 2nd Ice Maker Optional
Ice Maker On/Off: Yes

Minimum Circuit Required (Amps): 15A
Connected Load @ 120V: 1.02
Connection Location: Right Rear
Bottom

Exterior Specifications

Counter-Depth: No
Door Design: Tall
Door Style: Soft-Arc
Door Finish: Stainless Steel
Name Badge: Frigidaire
Door and Handle Design: Frigidaire
Door Hinge Covers: Hidden
Front Rollers: Adjustable
Rear Rollers: Yes
Door Stops: Yes
Door Closers: Yes

Freezer Specifications

Ice Maker Location: Fresh Food Section

Water Filter: PureSource® Ultra 2
Water Filter Location: Top-Right Fresh
Food Section
Cantilever Shelves: Yes
Sliding Shelves: 3 Half-Width 1 Quarter-
Width SpillSafe®
Crispers: 2 Smooth-Glide®
Humidity Controls: 2
Meat / Deli Drawer: Full-Width Full-
Extension Cool Drawer
1-Gallon Adjustable Door Bins: 2 Clear 2
White (bottom bins)
Dispenser Bin: Clear Left Door
Dairy Compartment: No
Bottle Retainers: 1 on Dispenser Bin

Controls

Control Type: Express-Select®
Control Location: Dispenser
Control Buttons: 11
Water Filter Change Indicator Light:
Yes

Freezer Specifications

Freezer Lighting: LED
Drawer: Yes
Lower Basket Design: Deep Plastic
Basket with Adjustable Divider
Lower Adjustable Basket Dividers:
White
Upper Basket Design: Full-Width
Upper Basket Construction: Powder-
Coated Wire

INDUCTION COOKTOP INSTALLATION INSTRUCTIONS

INSTALLATION AND SERVICE MUST BE PERFORMED BY A QUALIFIED INSTALLER.

IMPORTANT: SAVE FOR LOCAL ELECTRICAL INSPECTOR'S USE.
READ AND SAVE THESE INSTRUCTIONS FOR FUTURE REFERENCE.

WARNING FOR YOUR SAFETY: Do not store or use gasoline or other flammable vapors and liquids in the vicinity of this or any other appliance.



IMPORTANT INSTALLATION INFORMATION

- All electric cooktops run off a single phase, three-wire or four-wire cable, 240/208 volt, 60 hertz, AC only electrical supply with ground.
- Minimum distance between cooktop and overhead cabinetry is 30" (76.2 cm).

* 30" (76.2 cm) min. for unprotected cabinet and 24" (61 cm) min. for cabinet with protected bottom surface.

DO NOT apply any sealant along the perimeter. The cooktop must breath freely.

Cooktop Dimensions

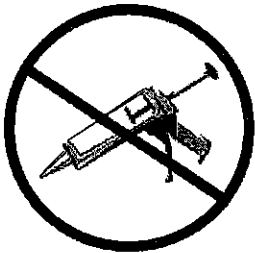
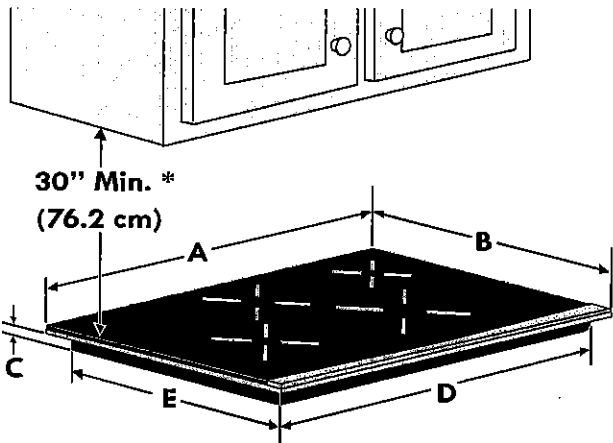

Cooktop Cutout Dimensions

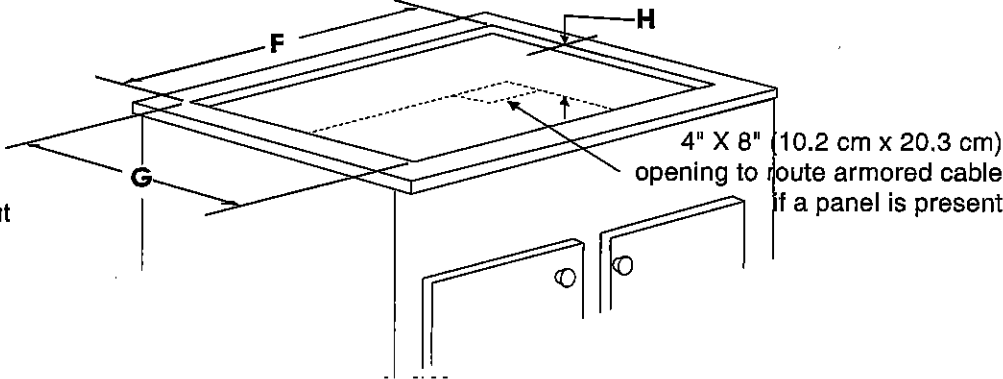

Figure 1

COOKTOP DIMENSIONS					CUTOUT DIMENSIONS				
A. WIDTH	B. DEPTH	C. HEIGHT	D. WIDTH	E. DEPTH	F. WIDTH		G. DEPTH		H. HEIGHT
					Min.	Max.	Min.	Max.	
✓ 30 (76.2)	20 ⁵ / ₈ (52.4)	2 ⁷ / ₈ (7.3)	28 ¹ / ₄ (71.8)	19 ³ / ₈ (49.2)	28 ¹ / ₂ (72.4)	28 ⁵ / ₈ (72.7)	19 ⁵ / ₈ (49.8)	19 ³ / ₄ (50.2)	3 ⁵ / ₈ (9.2)
X 36 (91.4)	20 ¹ / ₈ (51.1)	2 ⁷ / ₈ (7.3)	33 ⁵ / ₈ (85.4)	18 ⁷ / ₈ (47.9)	33 ⁷ / ₈ (86)	34 (86.4)	19 ¹ / ₈ (48.6)	19 ¹ / ₄ (48.9)	3 ⁵ / ₈ (9.2)

All dimensions are stated in inches and (cm).
Allow 2" (5 cm) space below the armored cable opening to clear the electric cable and allow space for installation of the junction box on the wall at the back of the cooktop.

P/N A01705202 (1603) Rev. B
English – pages 1-8
Spanish – pages 9-16
Francais – pages 17-24

INDUCTION COOKTOP INSTALLATION INSTRUCTIONS

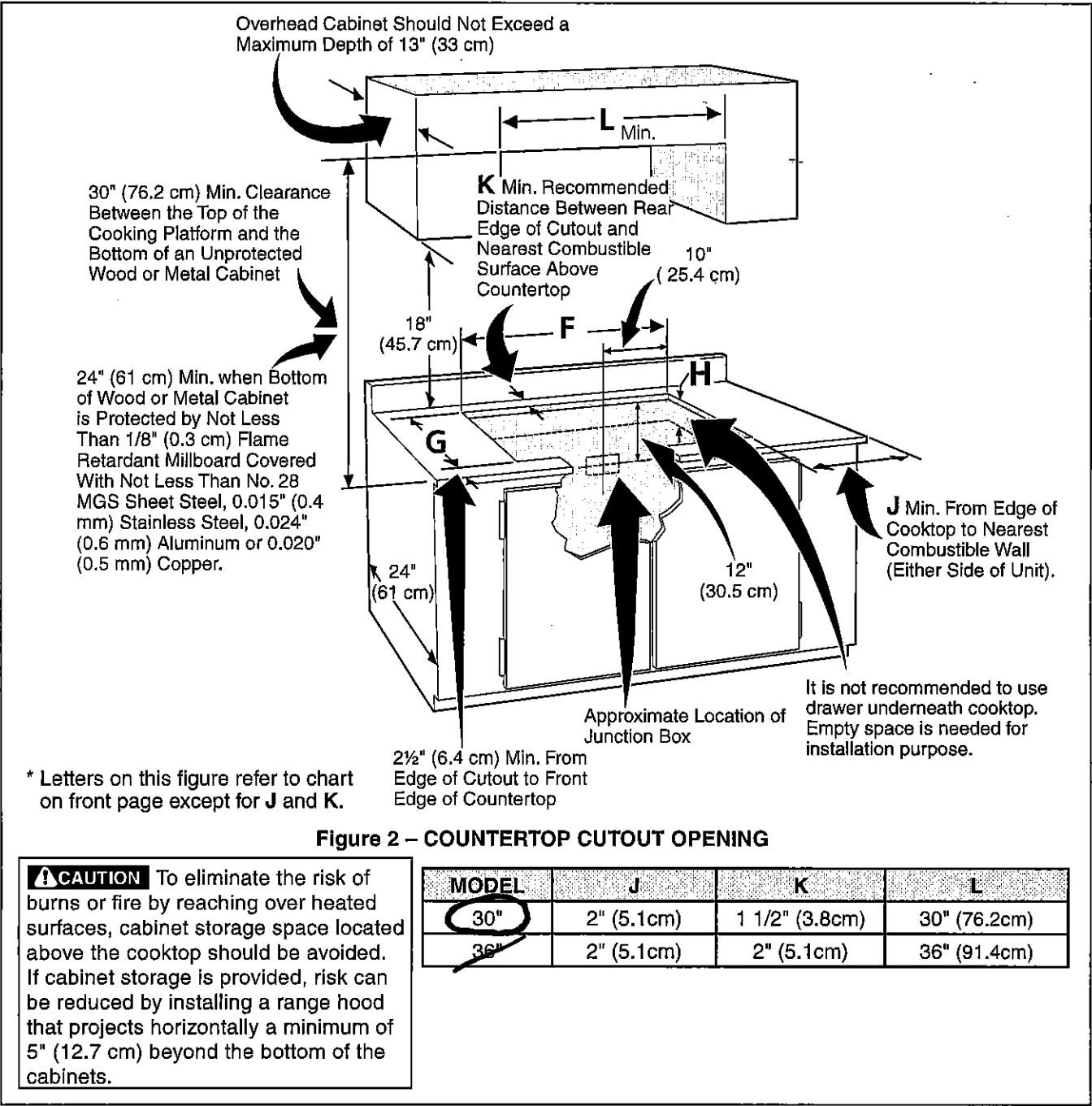

Model and Serial Number Location

The serial plate is located under the cooktop.

When ordering parts for or making inquiries about your cooktop, always be sure to include the model and serial numbers and a lot number or letter from the serial plate on your cooktop.

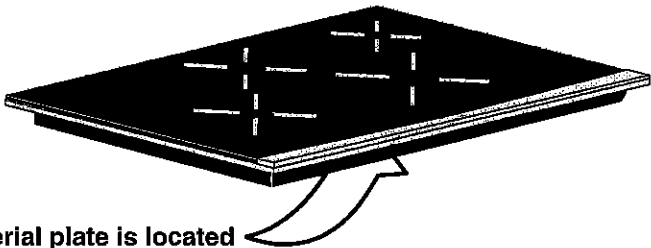

Serial plate is located under the burner box of cooktop.

UK -75 WALLACETON
LOT 251
25- 2500 ELEV B
THE BRIDGEPORT

r customers and team members is a top priority. [LEARN MORE](#)

35 of 39

By closing this message, you consent to our cookies on this device in accordance with our Privacy Notice unless you have disabled them. [CLOSE](#)



WHAT CAN WE HELP YOU FIND [Sign In](#)

Maytag Brand Canada English | Kitchen | Cooking Appliances | Wall Ovens | Combination Microwave Wall Ovens

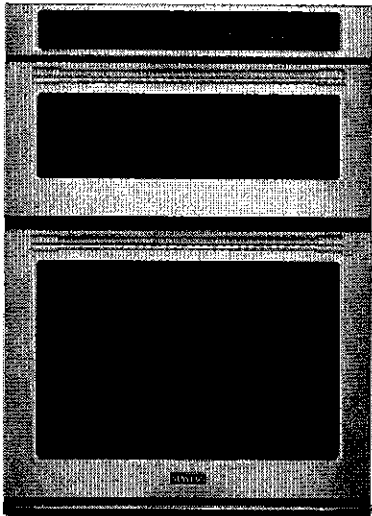

30-INCH WIDE COMBINATION WALL OVEN WITH TRUE CONVECTION - 6.4 CU. FT.

MMW9730FZ

Colour: **Fingerprint Resistant Stainless Steel**



WHERE TO BUY

WishList

☐ Compare

FEATURES REVIEWS SPECS & MANUALS WHERE TO BUY MANUALS & GUIDES

PRODUCT OVERVIEW

30-INCH WIDE COMBINATION WALL OVEN WITH TRUE CONVECTION - 6.4 CU. FT.

Enjoy two cooking systems in one with this 30-inch combination wall oven in fingerprint resistant stainless steel. Sensor cooking in the 1.4 cu. ft. upper microwave adjusts to your dinner with ideal time and power settings, while true convection with a third heating element in the 5.0 cu. ft. lower oven bakes and roasts faster.* This oven microwave combo also features the Precision Cooking™ system for evenly cooked meals, and a heavy-duty roll-out rack that supports a 30-lb turkey. Best of all, this wall



30-INCH WIDE COMBINATION WALL OVEN WI...
Model: MMW9730FZ

MSRP: ~~\$8,799.99~~

36 of 39

 CALIFORNIA
RESIDENTS ONLY -
WARNING: Cancer
and Reproductive Harm -
www.P65Warnings.ca.gov

ELECTRICAL

Power Cord Included No

CONTROLS

Display Color Amber

CONFIGURATION

Oven Configuration Microwave Combination

ENDECAPROPS

ProductOutletCategories Cooking

FEATURES

Oven Selections Clock, Control Lock, Convect
Modes, Delay Start, Keep
Warm Setting, Time Bake,
Sabbath Mode, Cook and
Hold

MICROWAVE

Microwave Selections Cook, Defrost, Popcorn,
Reheat, Add 30 Seconds

MANUALS & GUIDES +

WHERE TO BUY —





1710 of 31 reviews

Helpful? Yes - 0 No - 3 Report

30-INCH WIDE COMBINATION WALL OVEN WI...

Model: MMW9730FZ

MSRP: ~~\$2,799.99~~

37 of 39

SPECIFICATIONS

EXTERIOR

Door Release	Handle	Oven Window Size	Extra Large
--------------	--------	------------------	-------------

DIMENSIONS

Capacity	5.00	Cutout Depth	60.96 cm, 24.0 in
Cutout Height	104.93 cm, 41-5/16 in	Cutout Width	72.39 cm, 28-1/2 in
Depth	68.26 cm, 26-7/8 in	Depth Closed Excluding Handles	62.23 cm, 24-1/2 in
Depth Closed Including Handles	68.26 cm, 26-7/8 in	Depth With Door Open 90 Degree	115.57 cm, 45-1/2 in
Height	108.11 cm, 42-9/16 in	Microwave Capacity	39.62 l, 1.4 cu. ft.
Oven Capacity	141.50 l, 5.0 cu. ft.	Width	76.20 cm, 30.0 in

CONFIGURATION AND OVERVIEW

Fuel Type	Electric	Oven Type	Combination
Size	76.20 cm, 30 in		

OVEN DETAILS

Automatic Shut-Off	Yes	Broiler Location	Top of Oven
Convection Functions	Bake, Broil, Roast	Door Broil Position	Closed
Door Lock	Yes	Door Removable	Yes
Hidden Bake Element	Yes	Interior Color	Grey
Language Conversion	English/French (Both)	Oven Cooking System	Convection
Self-Cleaning Oven Racks	No	Temperature Conversion	No

APPEARANCE

Flush Installation Approved	No	Handle Material	Metal
-----------------------------	----	-----------------	-------

MICROWAVE DETAILS

Convection	No	Cooking Power	900 W, 900 W, 900 W, 900 W
Door Swing	Drop Down	Grill	No
Interior Light	Halogen	Scrolling Electronic Display	Yes
Sensor Cooking	Yes	Turntable Diameter Size	35.88 cm, 14-1/8 in

DETAILS

Bake Element Power	2800W	Broiler Element Power	3600W
Convection Element Power	2500	Convection Element Type	True Conve

38 of 39

Product Dimensions

27" (68.6 cm) and 30" (76.2 cm) Ovens

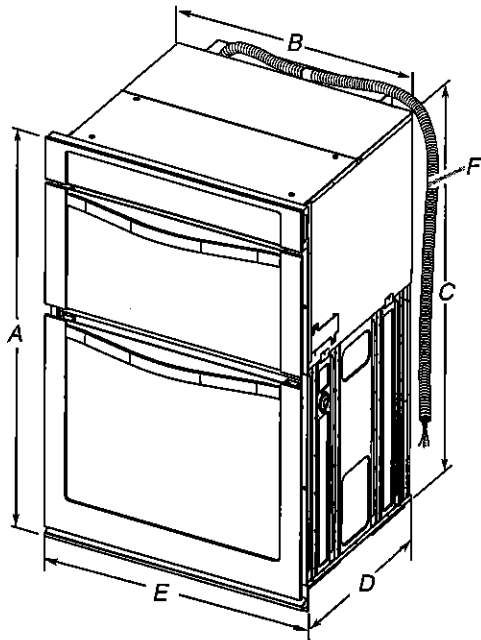

- 27" (68.6 cm) models**
- A. 42³/₁₆" (108.0 cm) overall height
 - B. 25⁷/₁₆" (64.6 cm) recessed width
 - C. 41" (104.1 cm) recessed height
 - D. 23¹/₄" (59.1 cm) max. recessed depth
 - E. 27" (68.6 cm) overall width
 - F. 48" (121.9 cm) Flexible conduit length measured from the conduit clamp located at the rear of the oven. Do not remove the conduit clamp.

- 30" (76.2 cm) models**
- A. 42³/₁₆" (108.0 cm) overall height
 - B. 28¹/₂" (72.3 cm) recessed width
 - C. 41" (104.1 cm) recessed height
 - D. 23¹/₄" (59.1 cm) max. recessed depth
 - E. 30" (76.2 cm) overall width
 - F. 48" (121.9 cm) Flexible conduit length measured from the conduit clamp located at the rear of the oven. Do not remove the conduit clamp.

Cabinet Dimensions

27" (68.6 cm) and 30" (76.2 cm) Ovens

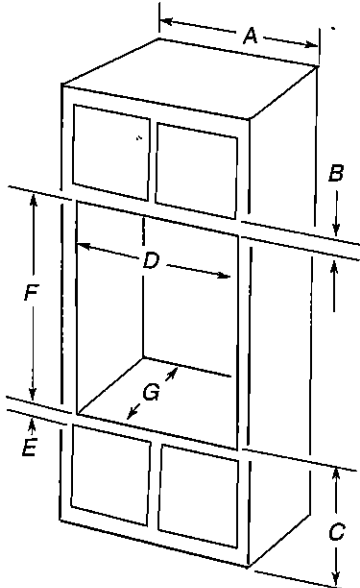

- | | |
|--|--|
| <p>27" (68.6 cm) models</p> <ul style="list-style-type: none">A. 27" (68.6 cm) min. cabinet widthB. 1" (2.5 cm) top of cutout to bottom of upper cabinet doorC. 19¹/₄" (48.9 cm) bottom of cutout to floor is recommended. 4"-19¹/₄" (10.2-48.9 cm) bottom of cutout to floor is acceptable.D. 25¹/₂" (64.8 cm) cutout widthE. 1¹/₂" (3.8 cm) min. bottom of cutout to top of cabinet doorF. 41³/₁₆" (105 cm)* recommended cutout heightG. 24" (60.7 cm) cutout depth | <p>30" (76.2 cm) models</p> <ul style="list-style-type: none">A. 30" (76.2 cm) min. cabinet widthB. 1" (2.5 cm) top of cutout to bottom of upper cabinet doorC. 19¹/₄" (48.9 cm) bottom of cutout to floor is recommended. 4"-19¹/₄" (10.2-48.9 cm) bottom of cutout to floor is acceptable.D. 28¹/₂" (72.4 cm) cutout widthE. 1¹/₂" (3.8 cm) min. bottom of cutout to top of cabinet doorF. 41³/₁₆" (105 cm)* recommended cutout heightG. 24" (60.7 cm) cutout depth |
|--|--|

***NOTE:** The cutout height can be between 41" (104.1 cm) and 41¹/₂" (105.6 cm) for microwave/oven combination.

39 of 39

BUILT-IN MICROWAVE/OVEN COMBINATION SAFETY

Your safety and the safety of others are very important.

We have provided many important safety messages in this manual and on your appliance. Always read and obey all safety messages.



This is the safety alert symbol.

This symbol alerts you to potential hazards that can kill or hurt you and others.

All safety messages will follow the safety alert symbol and either the word "DANGER" or "WARNING."

These words mean:

⚠ DANGER

You can be killed or seriously injured if you don't immediately follow instructions.

⚠ WARNING

You can be killed or seriously injured if you don't follow instructions.

All safety messages will tell you what the potential hazard is, tell you how to reduce the chance of injury, and tell you what can happen if the instructions are not followed.

INSTALLATION REQUIREMENTS

Tools and Parts

Gather the required tools and parts before starting installation. Read and follow the instructions provided with any tools listed here.

Tools needed

- Phillips screwdriver
- Measuring tape
- Drill (for wall cabinet installations)
- 1" (25 mm) drill bit (for wall cabinet installations)
- Level
- Flat-blade screwdriver

Parts needed

- UL listed or CSA approved conduit connector
- UL listed wire connectors
- Warming Drawer Deflector Kit (for ovens installed above a warming drawer)

Order Part Number W10489566B for white 27" (68.6 cm) kit
Order Part Number W10489564B for black 27" (68.6 cm) kit
Order Part Number W10489568A for stainless steel 27" (68.6 cm) kit
Order Part Number W10489567B for white 30" (76.2 cm) kit
Order Part Number W10489565B for black 30" (76.2 cm) kit
Order Part Number W10489569A for stainless steel 30" (76.2 cm) kit

To order, see the "Assistance or Service" section of the Use and Care Guide.

Parts supplied

- Four #8-14 x 3/4" screws
- Bottom vent
- Two #8-18 x 5/8" screws - bottom vent
- Four grommets*

Check local codes. Check existing electrical supply. See "Electrical Requirements."

It is recommended that all electrical connections be made by a licensed, qualified electrical installer.

*Grommets are not included with models KEMS309B and KEMS379B.

Built-In Microwave/Oven Combination Location Requirements

IMPORTANT: Observe all governing codes and ordinances.

- Cabinet opening dimensions that are shown must be used. Given dimensions provide minimum clearance with oven.
- Recessed installation area must provide complete enclosure around the recessed portion of the oven.
- Grounded electrical supply is required. See "Electrical Requirements" section.
- Electrical supply junction box should be located 3" (7.6 cm) maximum below the support surface when the oven is installed in a wall cabinet. A 1" (2.5 cm) minimum diameter hole should have been drilled in the left rear corner of the support surface to pass the appliance cable through to the junction box.
- Oven support surface must be solid, level and flush with bottom of cabinet cutout. Floor must be able to support a total weight (microwave and built-in oven) of 208 lbs (95 kg) for 27" (68.6 cm) models or 249 lbs (113 kg) for 30" (76.2 cm) models.

IMPORTANT: To avoid damage to your cabinets, check with your builder or cabinet supplier to make sure that the materials used will not discolor, delaminate or sustain other damage. This oven has been designed in accordance with the requirements of UL and CSA International and complies with the maximum allowable wood cabinet temperatures of 194°F (90°C).