

PRE-Sales Selection Sheet
Checklist

1 OF 37

LOT 285A-7 Model: 20-1790 A The Dunmore

PURCHASERS: ADNAN, M KHAN/ATIYA KHAN

VENDOR: Heathwood Homes (Huron) Limited

- ☒ FINISHED BASEMENT
☐ COLD CELLAR

UPGRADED / MODIFIED ELEVATION

- ☐ CORNER UPGRADE
☐ REAR UPGRADE

CEILING UPGRADE - SMOOTH

- ☐ MAIN FLOOR
☐ SECOND FLOOR
☐ BASEMENT

ADDITIONAL ROUGH-INS

- ☐ 200 AMP SERVICE
☐ WET BAR ROUGH-IN
☐ HUMIDIFIER
☒ AIR CONDITIONING

GAS ROUGH-IN

- ☒ STOVE
☐ DRYER
☐ BBQ
☐ ADDITIONAL FIREPLACE

KITCHEN: HOODFAN VENTING SIZE

- ☒ 6 IN ROUND DUCT
☐ 7 IN ROUND DUCT

FULL BASEMENT STAIRS:	N/A
UPPER BASEMENT STAIRS:	All Oak
LOWER BASEMENT STAIRS:	Carpet Grade
MAIN STAIRS:	All Oak
MEDIA STAIRS (if applicable):	N/A
LOFT STAIRS (if applicable):	N/A

Sept 4/20
Date Purchaser: *Signature*
on file

Aug 19, 2020
Date Decor Consultant: *Signature*

- APPROVE! -

Date Purchaser:

-09- 04 2020

Date

Heathwood Homes (Huron) Limited

Locked Date:

Approved

M. Rosen



Sales Selection Sheet

Wallaceton

2 of 37
TEL:

PURCHASERS: ADNAN, M KHAN and ATIYA KHAN

LOT / UNIT	PHASE	MODEL	
285A-7	2	20-1790 A The Dunmore	

It is herein understood and agreed between the undersigned parties hereto that the following changes shall be made to the above mentioned Agreement of Purchase and Sale in accordance with the agreement and except for such changes noted below, all other terms and conditions in the Agreement of Purchase and Sale shall remain as stated herein: It is further understood that and agreed that all changes and additions shall be installed as per builder's specifications, location and available selections. The Purchaser hereby agrees to purchase the following extras:

MISC.

1	SCHEDULE "E" FIVE APPLIANCES: DD FRIDGE, STOVE, DISHWASHER, WHITE FRONT LOADER WASHER AND DRYER -TOWNHOMES <i>SEE SPECS PAGES 25-37</i>	Qty: 1	
31,484	<i>Note: * SOME UPGRADED AT APPLIANCE CANADA</i>		

Sub Total

HST

Total

1. This Sales Selection Sheet when properly executed forms part of our Agreement of Purchase and Sale.
2. All extras and upgrades listed above are subject to Construction Progress and Architectural and Municipal requirements.
3. In the event the Vendor is unable to incorporate the work approved above in the construction of the house for any reason whatsoever, the Vendor will not be liable to the Purchaser in any way. The monies paid for any changes or optional extras not proceeded with shall be returned to the Purchaser, without interest. The cost of options or extras is non-refundable in all other circumstances. If for any reason whatsoever the Agreement of Purchase and Sale is not completed, the total cost of work approved above will be retained by the Vendor.
4. The Vendor reserves the right to substitute above materials and equipment with that of equal or better quality.
5. Purchaser acknowledges that items may not be exactly as shown. Variations from the Vendor's samples may occur in finished materials due to normal production processes. Vendor is not responsible for shade difference which may occur from different dye lots or wood grains. Variations from the Vendor's samples will occur with natural materials such as wood, marble, granite, hardwood and brick.
6. The Vendor reserves the right to select Grout & Thresholds that best suits the Tile selected.
7. Selections will not be processed unless signed by Heathwood Homes Head Office.
8. The selections made on this schedule are final and cannot be changed once submitted.
9. The Purchaser has checked and acknowledges the accuracy of this schedule.

Payment Summary

Paid By Amount

Total Payment:

PURCHASER:

Signatures
ADNAN, M KHAN

04-Sep-20

DATE

IRIT SALEM
Decor Consultant

04-Sep-20

DATE

PURCHASER:

on file
ATIYA KHAN

04-Sep-20

DATE

- APPROVED -

-09- 04 2020

M. Rosen
Date Approved Heathwood Homes (Huron) Limited

TAX#:1

PREPARED BY: Irit Salem

PE 397-1

S\invoice.rpt 28may19

ADNAN, M KHAN/ATIYA KHAN
Project: Wallaceton
Unit: 285A-7, Phase: 2
Model: 20-1790 A The Dunmore

Created: 7/20/2020 17:11:56
Locked:
Closed:

3 of 37

Kitchen

Cabinet Colour/Style	9111	VIKING III SIMCOE ORCHID 3DL ***STD***
Countertop	9121	MSI Quartz GROUP 1 ICED WHITE 3/4 inch with double mitre edge ***1***
Countertop Edge	4005	DOUBLE MITRE 1 1/2 INCH ***UPG*** 
Cabinet Hardware	7667	12881-HARDWARE ***STD***
Island Cabinet Colour/Style	9111	VIKING III SIMCOE ORCHID 3DL ***STD***
Island Countertop	9121	MSI Quartz GROUP 1 ICED WHITE 3/4 inch with double mitre edge ***1***
Backsplash	1111	N/A *****
Backsplash Grout	1111	N/A *****
Backsplash Tile Pattern	1111	N/A *****

HoodFan	9117	SCB50030-CYCLONE 30 inch CANOPY CHIMNEY HOODFAN-SS PAGES 23-24
Appliances	9117	Purchasers have been advised: standard fridge opening is a minimum 37 3/8 x 73 3/8". Ice Waterline Rough-In is included.
Appliances	9117	Standard stove opening is 30" and standard dishwasher opening is 24". Any gas stove will require backsplash or stainless steel backing to avoid fire hazards.
Appliances	9117	Purchasers acknowledge: Heathwood Homes and its contractors will not be responsible for any kitchen cabinet changes due to appliances dimension changes after
Comment	APPLIANCE: SEE SPECS	

Kitchen/Breakfast

Flooring	9117	GE.MD.WHT.1818.MT Madison Series White Matte 18
Floor Tile Grout	2225	Grout-(27) Silver ***STD***
Floor Tile Pattern	3000	STANDARD SQUARE ***STD***

ADNAN, M KHAN/ATIYA KHAN
Project: Wallaceton
Unit: 285A-7, Phase: 2
Model: 20-1790 A The Dunmore

Created: 7/20/2020 17:11:56
Locked:
Closed:

4 of 37

Comment

Foyer

Flooring	8913	UN.BL.BIA.1224-Biel-Bianco (White)-12 x 24 See Tile Direction on Sketch 2 Page 16 ***2***
Floor Tile Grout	2225	Grout-(27) Silver ***STD***
Floor Tile Pattern	3050	SIDE TO SIDE ***STD***

Comment

????

Laundry Room

Flooring	3050	GE.MD.WHT.1818.MT Madison Series White Matte 18
Floor Tile Grout	2225	Grout-(27) Silver ***STD***
Floor Tile Pattern	3000	STANDARD SQUARE ***STD***

Comment

Laundry Room Opt.

Cabinet - Uppers	1111	N/A *****
Cabinet Hardware	1111	N/A *****

Comment

Mud Room

Flooring	1111	GE.MD.WHT.1818.MT Madison Series White Matte 18
----------	------	---

ADNAN, M KHAN/ATIYA KHAN
Project: Wallaceton
Unit: 285A-7, Phase: 2
Model: 20-1790 A The Dunmore

Created: 7/20/2020 17:11:56
Locked:
Closed:

5 of 37

Floor Tile Grout 2225 Grout-(27) Silver ***STD***

Floor Tile Pattern 3000 STANDARD SQUARE ***STD***

Comment

Powder Room

Flooring 8913 UN.BL.BIA.1224-Biel-Bianco (White)-12 x 24 See Tile Direction on Sketch 2 Page 16 ***2***

Floor Tile Grout 2225 Grout-(27) Silver ***STD***

Floor Tile Pattern 3040 FRONT TO BACK ***STD***

Plumbing Fixture (Colour) 1737 Plumbing Fixtures-WHITE ***STD***

Comment ???

Hall

Flooring 7502 Red Oak Pearl-Vintage Engineered-ECLIPSE-3/4 inch x 3 1/4 inch ***STD***

Comment

Dining Room

Flooring 7502 Red Oak Pearl-Vintage Engineered-ECLIPSE-3/4 inch x 3 1/4 inch ***STD***

Comment

Great Room

Flooring 7502 Red Oak Pearl-Vintage Engineered-ECLIPSE-3/4 inch x 3 1/4 inch ***STD***

Comment

ADNAN, M KHAN/ATIYA KHAN
Project: Wallaceton
Unit: 285A-7, Phase: 2
Model: 20-1790 A The Dunmore

Created: 7/20/2020 17:11:56
Locked:
Closed:

6 OF 37

Upper Hall

Flooring 9248 DY 89418 -Dynasty Tex-BLACK ICE-40 oz Poly***STD***

Comment HARD WOOD?

Finished Basement (Rec) Room/Hall

Flooring 9248 DY 89418 -Dynasty Tex-BLACK ICE-40 oz Poly***STD***

Comment

Master Bedroom

Flooring 9248 DY 89418 -Dynasty Tex-BLACK ICE-40 oz Poly***STD***

Comment

Bedroom 2

Flooring 9248 DY 89418 -Dynasty Tex-BLACK ICE-40 oz Poly***STD***

Comment

Bedroom 3

Flooring 9248 DY 89418 -Dynasty Tex-BLACK ICE-40 oz Poly***STD***

Comment

Master Ensuite

Cabinet Colour/Style 8714 Viking III-SOHO-STAINLESS-LPL ***STD***

Countertop 8796 6698-46-Countertop-PALOMA POLAR ETCHINGS
FINISH-Formica ***STD***

ADNAN, M KHAN/ATIYA KHAN
Project: Wallaceeton
Unit: 285A-7, Phase: 2
Model: 20-1790 A The Dunmore

Created: 7/20/2020 17:11:56
Locked:
Closed:

7 of 37



Countertop Edge

1111

N/A *****

Cabinet Hardware

7667

12881-HARDWARE ***STD***

Floor Tile

8913

UN.BL.BIA.1224-Biel-Bianco (White)-12 x 24 See Tile Direction on Sketch 4 Page 18 ***2***

Floor Tile Grout

2225

Grout-(27) Silver ***STD***

Floor Tile Pattern

3040

FRONT TO BACK ***STD***

Shower Floor Tile

8661

OD.ON.SWT.0202.MT.N-Ontario Series Mosaic-Snow White Matte-2 x 2 ***STD***

Shower Floor Tile Grout

2226

Grout-(00) White ***STD***

Shower Floor Tile Pattern

3000

STANDARD SQUARE ***STD***

Shower Wall Tile

5411

QT.SP.WHT.0810-Splendour-White-8 inch x 10 inch ***STD***

Shower Wall Tile Grout

2226

Grout-(00) White ***STD***

Shower Wall Tile Pattern

3090

VERTICAL STACKED ***STD***

Shower Jamb(s) and Sill(s)

8923

Shower Jamb / Sill-Thassos White ***STD***

Plumbing Fixture (colour)

1737

Plumbing Fixtures-WHITE ***STD***

Comment

Main Bathroom

Cabinet Colour/Style

9172

Viking III-SILK TOUCH-TWILIGHT GREY-3DL ***STD***

Countertop

8796

6698-46-Countertop-PALOMA POLAR ETCHINGS FINISH-Formica ***STD***

Countertop Edge

1111

N/A *****



ADNAN, M KHAN/ATIYA KHAN
Project: Wallaceston
Unit: 285A-7, Phase: 2
Model: 20-1790 A The Dunmore

Created: 7/20/2020 17:11:56
Locked:
Closed:

8 of 37

Cabinet Hardware	7667	12881-HARDWARE ***STD***
Flooring	8913	UN.BL.BIA.1224-Biel-Bianco (White)-12 x 24 See Tile Direction on Sketch 4 Page 18 ***2***
Floor Tile Grout	2225	Grout-(27) Silver ***STD***
Floor Tile Pattern	3050	SIDE TO SIDE ***STD***
Wall Tile	5411	QT.SP.WHT.0810-Splendour-White-8 inch x 10 inch ***STD***
Wall Tile Grout	2226	Grout-(00) White ***STD***
Main Bathroom Tile Pattern	3090	VERTICAL STACKED ***STD*** <div><div></div><div></div><div></div><div></div><div></div><div></div><div></div><div></div></div>
Plumbing Fixture (Colour)	1737	Plumbing Fixtures-WHITE ***STD***
Comment	9120	

Finished Basement Bathroom

Cabinet Colour/Style	9120	VIKING III-GEORGIAN-ORCHID 3DL ***STD***
Countertop	8799	P-346 LM-Countertop-INUKSHUK CARBON-Arborite ***STD***
Countertop Edge	1111	N/A *****
Cabinet Hardware	7667	12881-HARDWARE ***STD***
Flooring	8915	UN.BL.ATR.1224-Biel-Antracita (Dark Grey)-12 x 24 See Tile Direction on Sketch 1 Page 15 ***2***
Floor Tile Grout	7704	Grout-(19) Pearl Gray ***STD***
Floor Tile Pattern	3040	FRONT TO BACK ***STD***
Shower Floor Tile	8661	OD.ON.SWT.0202.MT.N-Ontario Series Mosaic-Snow White Matte-2 x 2 ***STD***

ADNAN, M KHAN/ATIYA KHAN
Project: Wallaceton
Unit: 285A-7, Phase: 2
Model: 20-1790 A The Dunmore

Created: 7/20/2020 17:11:56
Locked:
Closed:

9 of 37



Shower Floor Tile Grout	2226	Grout-(00) White ***STD***
Shower Floor Tile Pattern	3000	STANDARD SQUARE ***STD***

Shower Wall Tile	5411	QT.SP.WHT.0810-Splendour-White-8 inch x 10 inch ***STD***
------------------	------	--

Shower Wall Tile Grout	2226	Grout-(00) White ***STD***
------------------------	------	----------------------------

Shower Wall Tile Pattern	3090	VERTICAL STACKED ***STD***
--------------------------	------	----------------------------

Shower Jamb(s)	8923	Shower Jamb / Sill-Thassos White ***STD***
----------------	------	--

Plumbing Fixture (Colour)	1737	Plumbing Fixtures-WHITE ***STD***
---------------------------	------	-----------------------------------

Comment		
---------	--	--

Great Room Fireplace

Type	8865	Dimplex-Electric Fireplace-PF3033HL ***STD***
------	------	---

Mantle	8891	NF-17-Paint Grade Mantle- Cabinet (Per Plan)-WHITE ***STD*** PAGE 19
--------	------	--

Surround Opt.	1111	N/A *****
---------------	------	-----------

Note	1111	Purchasers have been advised: heat from the FP can damage TV above a FP and items placed on mantle.
------	------	---

Note	1111	Heathwood and its contractors will not be liable for any damage on items placed/installed above a FP after closing.
------	------	---

Comment		
---------	--	--

Basement Stairs

Type	1714	Carpet Grade Stairs ***STD BASEMENT STAIRS***
------	------	---

Colour	7922	Eclipse (Pewter) STAIN TO COMPLIMENT HARDWOOD AND WILL VARY FROM FLOORING ***99***
--------	------	--

Carpet Runner	1111	N/A *****
---------------	------	-----------

Handrail/Pickets/Post Type	9119	Handrail only on closed walls (one or two sides per building code) ***STD***
----------------------------	------	--



Customer Colours

ADNAN, M KHAN/ATIYA KHAN
Project: Wallaceton
Unit: 285A-7, Phase: 2
Model: 20-1790 A The Dunmore

Created: 7/20/2020 17:11:56
Locked:
Closed:

10 of 37

	code/	STD
Handrail/Pickets/Post Colours	1729	Carpet Grade-Stain handrail, pickets, stringers, nosing_pos
Carpet	9248	DY 89418 -Dynasty Tex-BLACK ICE-40 oz Poly***STD***
Custom Stain/Paint	1111	N/A *****
Comment		

Basement Stairs Landings (Upper and Lower)

Flooring	7502	Red Oak Pearl-Vintage Engineered-ECLIPSE-3/4 inch x 3 1/4 inch ***3***
Comment		

Main Stairs

Type	1712	Oak Stairs ***STD MAIN STAIRS***
Colour	7922	Eclipse (Pewter) STAIN TO COMPLIMENT HARDWOOD AND WILL VARY FROM FLOORING ***99***
Carpet Runner	1111	N/A *****
Handrail/Pickets/Posts Type	7652	1 5/16 inch Square pickets with 3 1/2" Square/Cap Post(s)-ALL OAK ***STD***
Handrail/Pickets/Posts Colour	1728	Oak Grade-Stain handrail,oak pickets,stringers,treads,risers
Custom Stain/Paint	1111	N/A *****
Comment		

Main Stairs Landing(s)

Flooring	7502	Red Oak Pearl-Vintage Engineered-ECLIPSE-3/4 inch x 3 1/4 inch ***STD***
Comment		

Throughout

--	--	--

Customer Colours

151

ADNAN, M KHAN/ATIYA KHAN
Project: Wallaceton
Unit: 285A-7, Phase: 2
Model: 20-1790 A The Dunmore

Created: 7/20/2020 17:11:56
Locked:
Closed:

11 OF 37

Walls - Paint Colour	1717	22-Wall-WARM GREY ***STD***
Underpad	1079	500 Series-Underpad ***STD***
Thresholds	2232	Metal Thresholds ***STD***
Switches and Plug	5796	Decora White Switches and Plugs ***STD***
Trim Size	8705	4 1/4 Baseboard and 2 3/4 Casings ***STD***
Trim - Paint Colour	1716	Trim-WHITE ***STD***
Comment		

Purchaser:	<u>Signatures on</u> ADNAN M KHAN file	<u>Sept 4/20</u> Date	<u>RIT SALEM</u> Decor Consultant	<u>SEPT 4/20</u> Date
Purchaser:	<u>ATIYA KHAN</u>	<u> </u> Date	<u>M. Rozen</u> Wallaceton	<u>-09- 04 2020</u> Date Approved

APPROVED



Sales Selection Sheet

Wallaceton

12 of 37
TEL:

PURCHASERS: ADNAN, M KHAN and ATIYA KHAN

LOT / UNIT	PHASE	MODEL	
285A-7	2	20-1790 A The Dunmore	

It is herein understood and agreed between the undersigned parties hereto that the following changes shall be made to the above mentioned Agreement of Purchase and Sale in accordance with the agreement and except for such changes noted below, all other terms and conditions in the Agreement of Purchase and Sale shall remain as stated herein: It is further understood that and agreed that all changes and additions shall be installed as per builder's specifications, location and available selections. The Purchaser hereby agrees to purchase the following extras:

APPLIANCES

1	SCB50030 CYCLON 30" WALLMOUNT CHMNY HD SS	Qty: 1
30,466	Note: SPEC PAGES 23-24	
2		Qty: 1
31,933	Note: SEE SPEC. PAGE# 25-37	

Cabinetry

*3	CABINETRY - 22A-GLASS DOOR (EACH) (FROSTED, GLASS) (UNFINISHED CABINET INTERIOR) ; PRICE ALL THE SAME FOR ALL LINES - KITCHEN	Qty: 1
189,070		
30,443	Note: TO BE INSTALLED IN THE CORNER CABINET : FROSTED GLASS SEE SKETCH # 3 PAGE# 17	
4	CABINETRY - 12B-POTS AND PANS DRAWERS (WIDTH MIN. 60CM/MAX. 90CM) (SIZE SUBJECT TO FLOOR PLAN) - UPGRADE 1	Qty: 1
189,005		
30,445	Note: SEE SKETCH # 3 PAGE# 17	
*5	CABINETRY - 12J-VALANCE (PER 8 foot LENGTH PRICE) (FOR CLARIFICATION OF STYLES SEE MOULDING MATRIX) (LIGHT VALANCE IS NOW APPROXIMATELY 2" [50MM] HIGH. PLEASE ENSURE LIGHT FIXTURES USED WILL BE CONCEALED BY THE VALANCE.);	Qty: 2
189,316		
30,446	Note:	
6	CABINETRY - 04H-66CM DEEP FRIDGE ENCLOSURE (COUNTER DEPTH) WITH (1) WALL ([1] 66CM DEEP GABLE AND [1] 66CM DEEP CABINET) (THIS IS NOT A ZERO CLEARANCE ENCLOSURE. STANDARD HEIGHTS AND WIDTHS WILL BE USED.); PRICE ALL THE SAME FOR ALL LINES - KITCHEN	Qty: 1
189,308		
30,447	Note: SKETCH # 3 PAGE 17	
7	CABINETRY - 11A-UPPER ANGLE CORNER PER UNIT - UPGRADE 1	Qty: 1
189,343		
30,463	Note: SEE SKETCH # 3 PAGE# 17	

Ceramics

8	CERAMICS - FLOOR - KITCHEN - UPGRADE 1	Qty: 1
177,221		
30,453	Note:	
9	CERAMICS - FLOOR - FOYER - UPGRADE 2	Qty: 1
177,190		
30,454	Note:	
10	CERAMICS - FLOOR - MUD ROOM - UPGRADE 1	Qty: 1
177,205		
30,455	Note:	

Initials:

TAX#:1

PREPARED BY: Irit Salem

PE 372-1

S\invoice.rpt 28may19



Sales Selection Sheet
Wallaceton

13 of 37

PURCHASERS: ADNAN, M KHAN and ATIYA KHAN

TEL:

LOT / UNIT 285A-7	PHASE 2	MODEL 20-1790 A The Dunmore	
----------------------	------------	--------------------------------	--

Ceramics

11 177,198 30,456	CERAMICS - FLOOR - POWDER ROOM - UPGRADE 2 Note:	Qty: 1
12 177,230 30,457	CERAMICS - FLOOR - MAIN BATHROOM - UPGRADE 2 Note:	Qty: 1
13 177,246 30,459	CERAMICS - FLOOR - BASEMENT BATHROOM - UPGRADE 2 Note:	Qty: 1
14 177,213 30,872	CERAMICS - FLOOR - LAUNDRY ROOM - UPGRADE 1 Note:	Qty: 1
15 177,238 30,875	CERAMICS - FLOOR - ENSUITE MASTER - UPGRADE 2 Note:	Qty: 1

Electrical

16 189,450 30,448	ELECTRICAL - CEILING ROUGH-IN (CAPPED) Note: 1- ABOVE THE BREAKFAST BAR- USE SEPARATE SWITCH 1 IN THE CENTRE OF THE GREAT ROOM, USE EXISTING SWITCH PLYUG SEE SKETCH # <u>2</u> PAGE# <u>16</u>	Qty: 2
17 189,451 30,449	ELECTRICAL - ADDITIONAL SWITCH Note: KITCHEN TO BE USED FOR THE R/ CAP LIGHT ABOVE THE BREAKST BAR SEE SKETCH # <u>2</u> PAGE# <u>16</u>	Qty: 1
18 189,449 30,450	ELECTRICAL - EXTRA WALL INTERIOR OUTLET ON EXISTING CIRCUIT (DOES NOT INCLUDE KITCHEN OUTLETS) Note: GREAT ROOM; TO BE INSTALLED 70" ABOVE THE CENTRE OF THE FIRE PLACE SEE SKETCH # <u>2</u> PAGE# <u>16</u>	Qty: 1

Granite

19 177,291 30,460	GRANITE - COUNTERTOP - 3/4" GROUP 1 WITH MITRE EDGE - KITCHEN / ISLAND - UPGRADE 1 Note:	Qty: 1
-------------------------	---	--------

Heating/Air

20 189,474 31,932	HEATING/AIR - ROUGH-IN GAS LINE FOR GAS STOVE AT MAIN FLOOR (SEE SPECS) (HOOK-UP NOT INCLUDED) LEAVE STANDARD 120 VOLT ELECTRICAL OUTLET ON A SEPARATE CIRCUIT. * SPECIFY IF STANDARD 220V WILL STAY OR BE RELOCATED Note:	Qty: 1
-------------------------	---	--------

INTERIOR TRIM

Initials: MS

TAX#:1

PREPARED BY: Irit Salem

PE 372-2

14 of 37

 <div style="text-align: center;"> Sales Selection Sheet Wallaceston </div>			
PURCHASERS: ADNAN, M KHAN and ATIYA KHAN			TEL:
LOT / UNIT 285A-7	PHASE 2	MODEL 20-1790 A The Dunmore	



INTERIOR TRIM

21	1-3/8"X96" HC MOULDED DOORS	MAIN FLOOR SKETCH # 2 PAGE 16	Qty: 4
30,452	Note: UPGRADE AN 1-3/8"X80" MOULDED DOOR TO AN 1-3/8"X96" HC MOULDED DOOR (IF BS BASEMENT DOORS AND POWDER ROOM CAN NOT BE INSTALLED DUE TO CONSTRUCTION, THE PRICE FOR THE DOORS UPG WILL BE CREDIT ON CLOSING) SEE SKETCH# 2 PAGE# 16		

Sub Total
HST
Total

1. This Sales Selection Sheet when properly executed forms part of our Agreement of Purchase and Sale.
2. All extras and upgrades listed above are subject to Construction Progress and Architectural and Municipal requirements.
3. In the event the Vendor is unable to incorporate the work approved above in the construction of the house for any reason whatsoever, the Vendor will not be liable to the Purchaser in any way. The monies paid for any changes or optional extras not proceeded with shall be returned to the Purchaser, without interest. The cost of options or extras is non-refundable in all other circumstances. If for any reason whatsoever the Agreement of Purchase and Sale is not completed, the total cost of work approved above will be retained by the Vendor.
4. The Vendor reserves the right to substitute above materials and equipment with that of equal or better quality.
5. Purchaser acknowledges that items may not be exactly as shown. Variations from the Vendor's samples may occur in finished materials due to normal production processes. Vendor is not responsible for shade difference which may occur from different dye lots or wood grains. Variations from the Vendor's samples will occur with natural materials such as wood, marble, granite, hardwood and brick.
6. The Vendor reserves the right to select Grout & Thresholds that best suits the Tile selected.
7. Selections will not be processed unless signed by Heathwood Homes Head Office.
8. The selections made on this schedule are final and cannot be changed once submitted.
9. The Purchaser has checked and acknowledges the accuracy of this schedule.

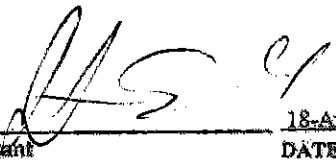
Payment Summary	
Paid By	Amount
Total Payment:	

PURCHASER:		18-Aug-20		18-Aug-20
	ADNAN, M KHAN	DATE	Decor Consultant	DATE
PURCHASER:		18-Aug-20	APPROVED - 	
	ATIYA KHAN	DATE		
		09-04-2020	Date Approved: Heathwood Homes (Huron) Limited	

TAX#1

PREPARED BY: Int Salem

PE 372-3

Invoice.rpt 28May19

UK 75 WALLACETON
20-1790 ELEV. A
THE DUNMORE
LOT 285A-7

15 of 37

THE DUNMORE

ELEVATION A | 2,233 SQ. FT.

20-1790 ELEV. A

Includes 443 square feet of finished lower level
Sketch # 1

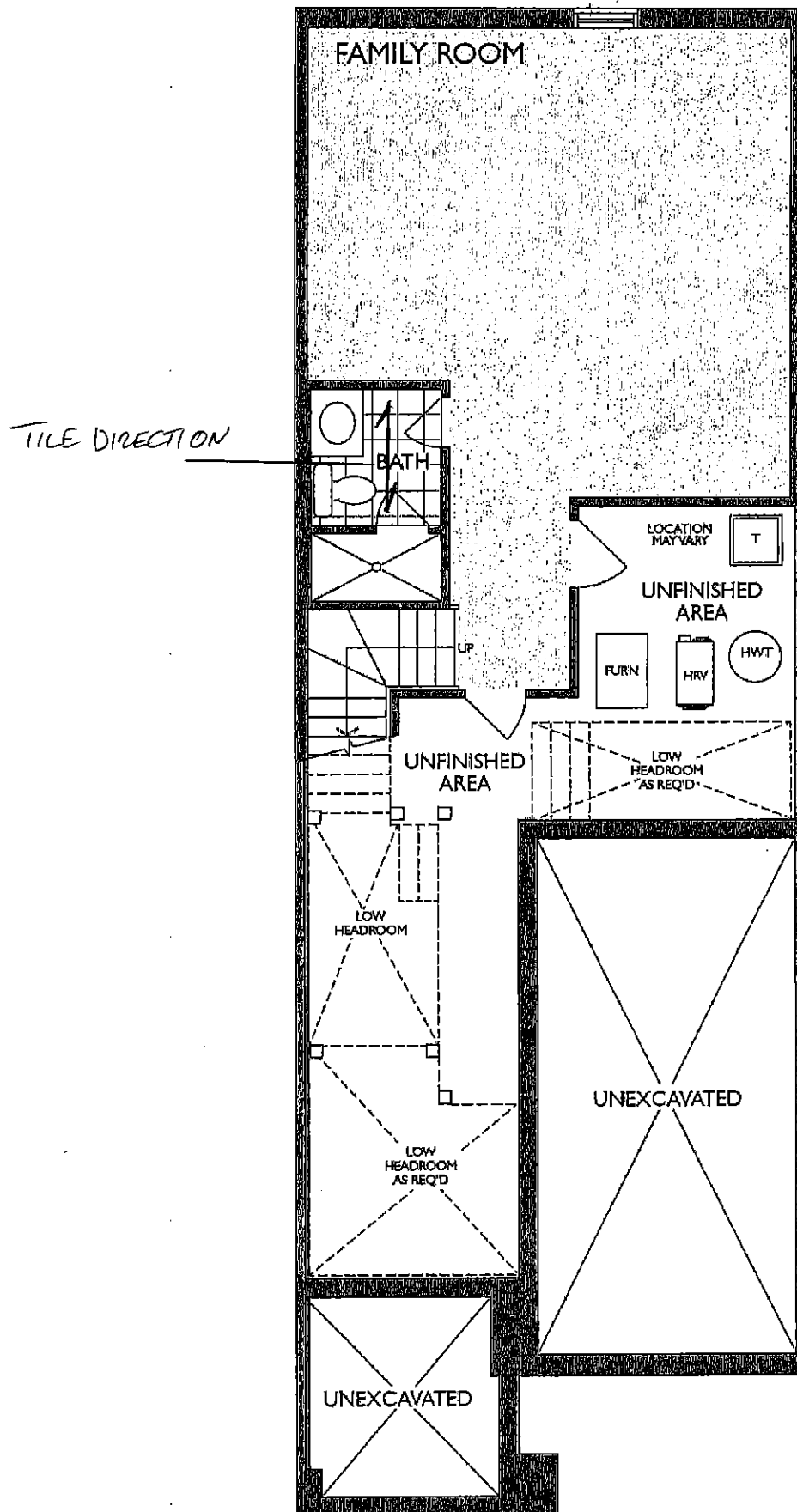

LOWER LEVEL
ELEVATION A



July 7, 2020

UK 75 WALLACETON
20-1790 ELEV. A
THE DUNMORE
LOT 285A-7

16 of 37

THE DUNMORE

Sketch #2 ELEVATION A | 2,233 SQ. FT.

20-1790 ELEV. A

Includes 443 square feet of finished lower level

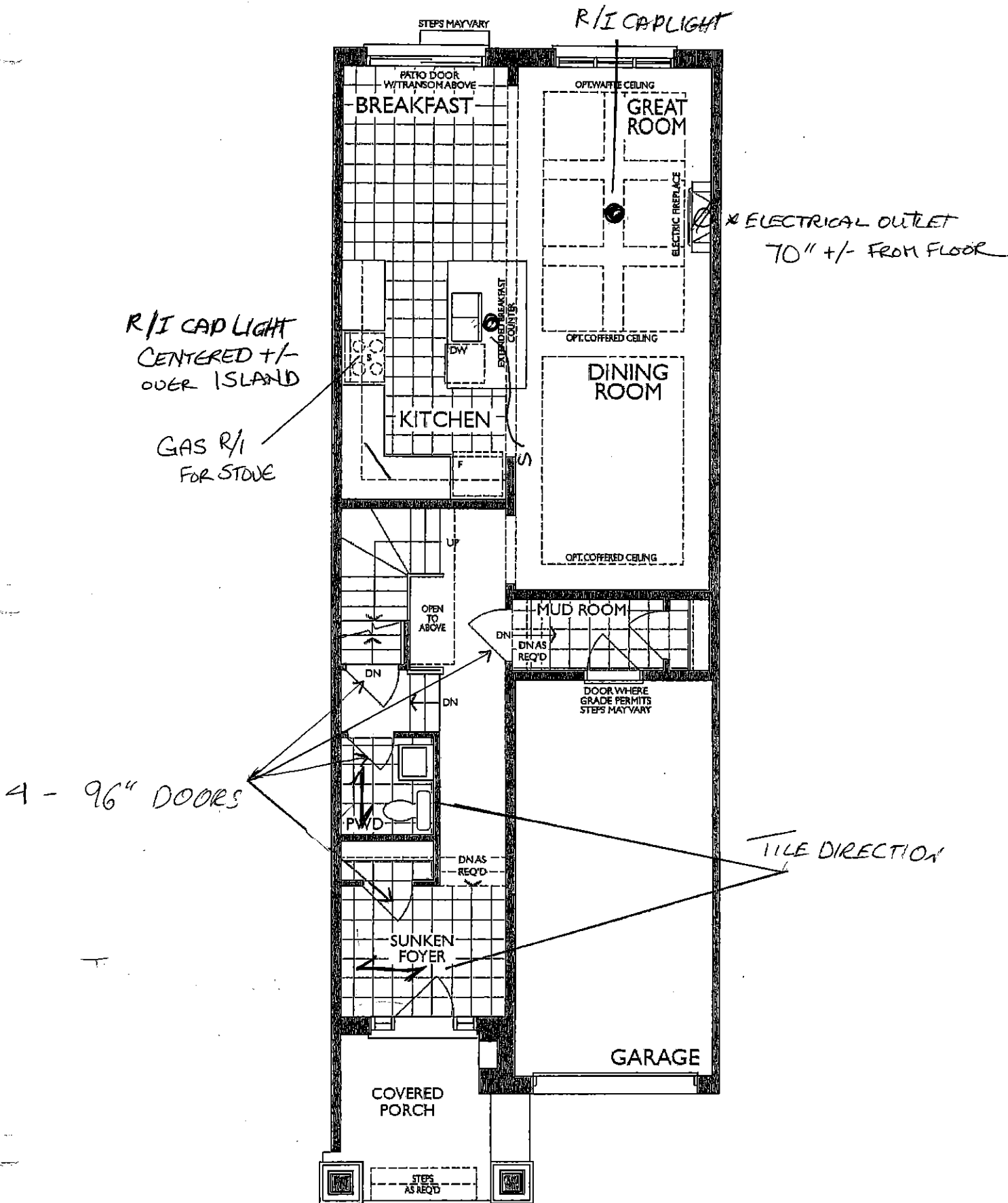

MAIN FLOOR
ELEVATION A

KITCHEN

(GROUND FLOOR)

CORNER CABINET W/
GLASS (FROSTED)

DEEP
UPPER

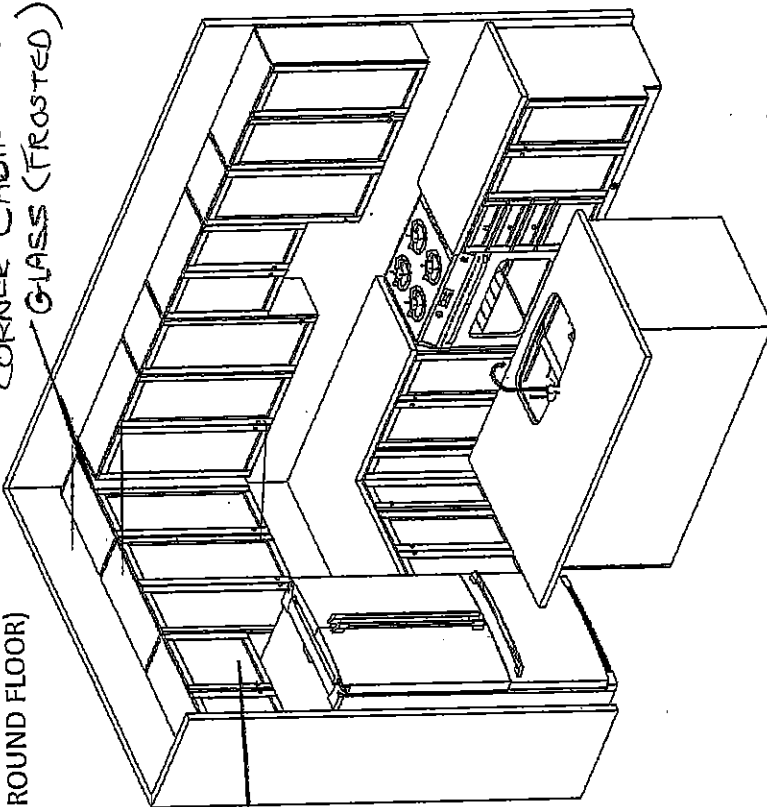

MASTER ENSUITE

(2ND FLR)

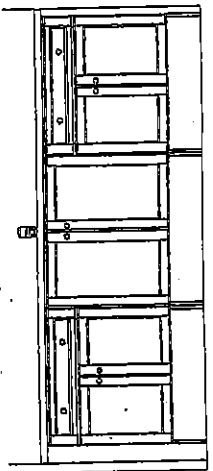

MAIN BATH

(2ND FLR)

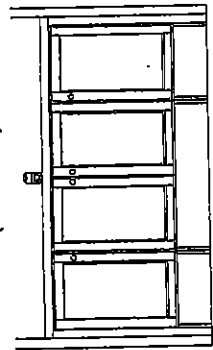

OPT. LAUNDRY UPPERS

(2ND FLR)

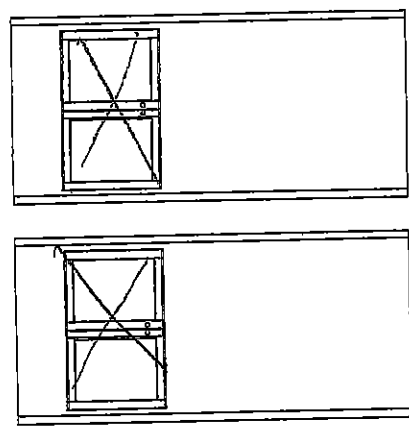

STD. BASEMENT BATH

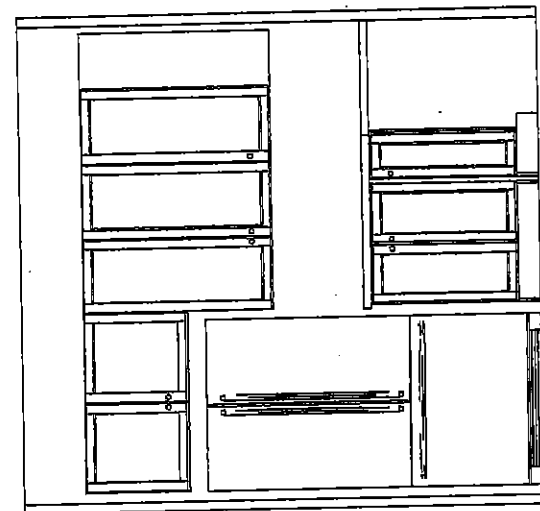
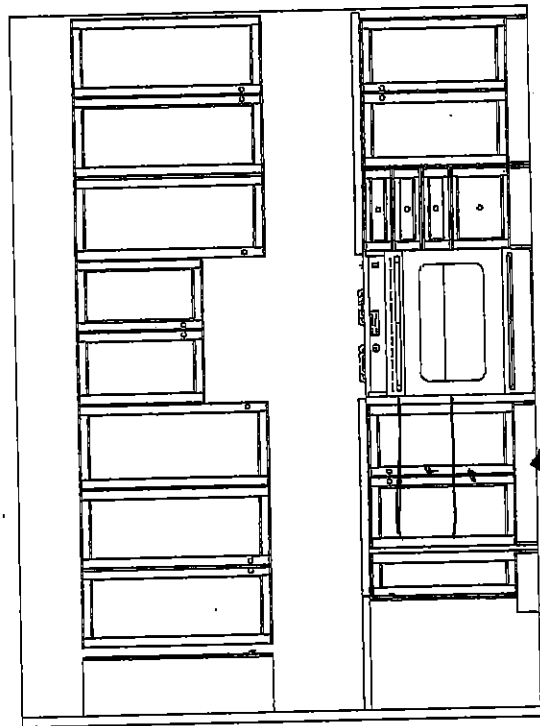
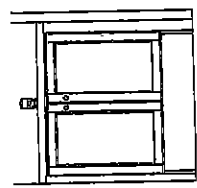

POT & PAN DRAWERS

UK 75 WALLACETON
20-1790 ELEV. A
THE DUNMORE
LOT 285A-7

Sketch #3



HEATHWOOD
WALLACETON, KIT
MODEL: 20-17

STANDARD CONTRACT IN

Appliance Openings

- Hood Opening: 30" W
- Fridge Opening: 37 3/8"
- 30cm deep cabinet o
- Stove Opening: 30" Fre
- Dishwasher Opening: 2

Standard Kitchens Scope:

- 100cm H wall cabinets
- Std. Blumotion Hinges- soft close doors
- Std. Metabox Drawers- not soft close
- Min 40cm W drawer
- Base pie cut corner cabinets
- Backing on all cabinets
- Countertop by others
- Upgrade applied paneled fridge &
- dishwashers supply only (appliance hardware by others)

Standard Vanity & Laundry Scope:

- Powder by others, pedestal
- All vanities include laminate counter
- Std. Blumotion Hinges- not soft close
- Tandem Box Drawers- soft close
- Master Ensuite: Top drawers (Full height doors at sink)
- Mains: Full height doors (top drawers added if Masters can't accommodate)
- Optional laundry base & wall cabinets

17 of 37

UK 75 WALLACETON
20-1790 ELEV. A
THE DUNMORE
LOT 285A-7

18 of 37

THE DUNMORE

ELEVATION A | 2,233 SQ. FT.

Includes 443 square feet of finished lower level

Sketch #4

20-1790 ELEV. A

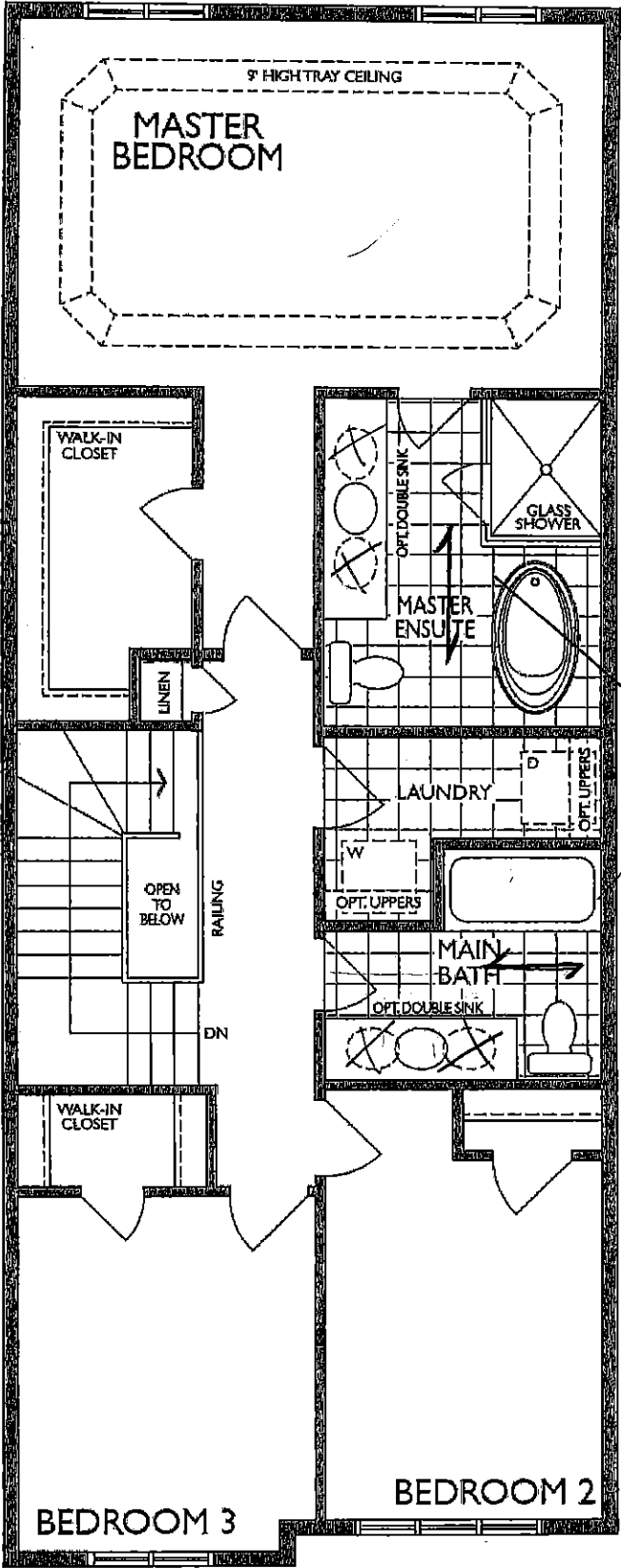

TILE DIRECTION

SECOND FLOOR
ELEVATION A



July 7, 2020

UK 75 WALLACETON
20-1790 ELEV. A
THE DUNMORE
LOT 285A-7

19 of 37

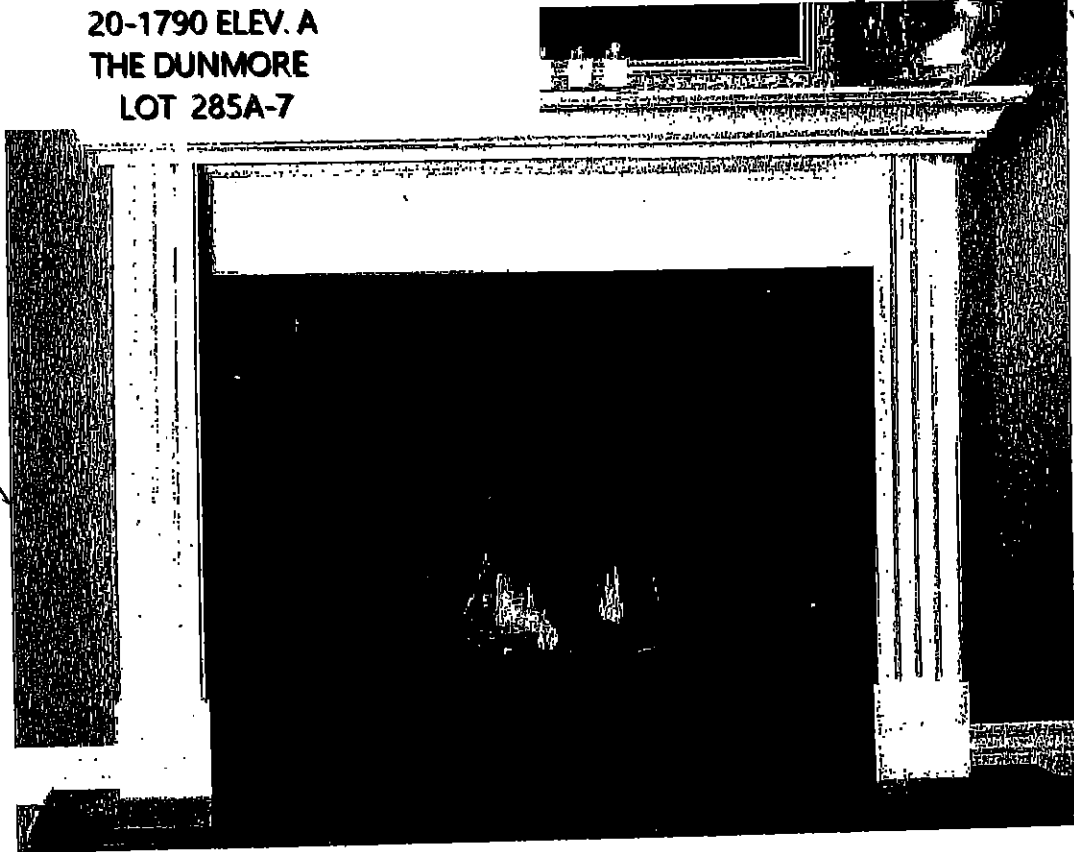

~~STANDARD NF 15 Mantel~~

~~Clean apron finish with fluted legs~~

~~WHITE PAINT GRADE FINISH~~

~~(PICTURE SHOWN WITH UPGRADE SURROUND AND HEARTH -PRICED SEPARATELY)~~



' CABINET '

STANDARD NF 17 Mantel

WHITE PAINT GRADE FINISH

(PICTURE SHOWN WITH UPGRADE SURROUND AND HEARTH -PRICED SEPARATELY)

A

UK 75 WALLACETON
20-1790 ELEV. A
THE DUNMORE
LOT 285A-7

20 of 37

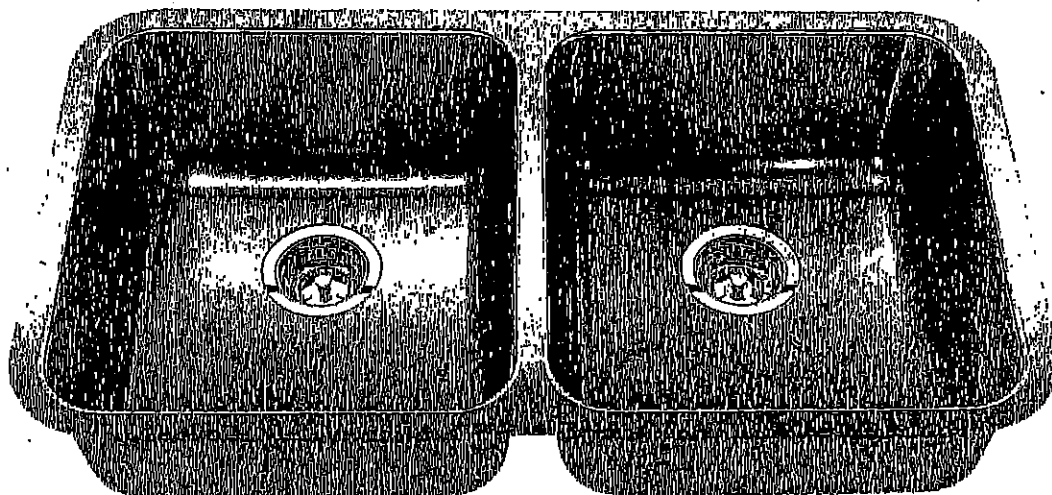

Optional Accessories

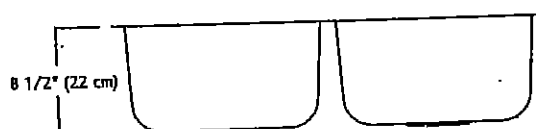
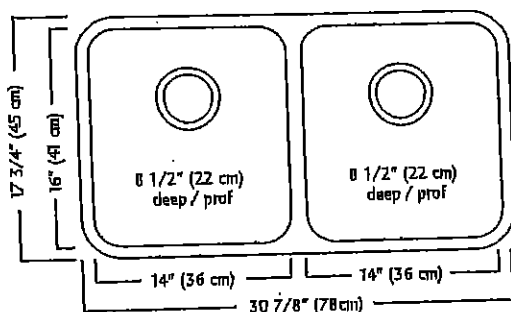

ND1831UA/9 SPECIFICATION

Model ND1831UA/9 is a double (two equal size) bowl undermount sink manufactured by Franke Kindred Canada Limited from 18 gauge stainless steel. Product has silk finished rims and linear brush finished bowls. Sink is fully undercoated. Basket strainer waste fittings (3 1/2", 89 mm) are included. Sink is backed with a limited lifetime warranty.

- O.D. 17 3/4" x 30 7/8" x 8 1/2" (45 x 78 x 22 cm)
- Recommended for minimum 36" cabinet

Franke Kindred Canada Limited
P.O. Box 190, 1000 Franke Kindred Road, Midland, Ontario, Canada, L4R 4K9 Phone: 866-687-7465 Fax: 800-361-8408

A

UK 75 WALLACETON
20-1790 ELEV. A
THE DUNMORE
LOT 285A-7

21 of 37

STANDARD KITCHEN FAUCET

Align

Modern

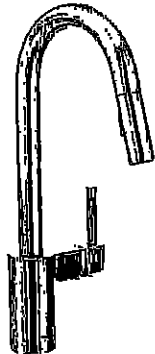

Single Handle Pull-Down Kitchen
Faucet*

Model 7565†

A

UK 75 WALLACETON
20-1790 ELEV. A
THE DUNMORE
LOT 285A-7

22 of 37

Chateau

Transitional

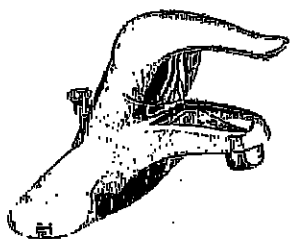

Lavatory Faucet with Pop-Up Drain
Model L4621†

VANITY SINKS AND PEDESTAL



Posi-Temp® Pressure Balancing Tub/Shower
Model 62320 / TL183†
OR

Posi-Temp Valve and Tub/Shower Trim
with Eco-Performance Easy Clean® XL
Model 62320 / TL183EP†
(TL183EP not available in BC)

SHOWER AND 5" TUB FAUCETS

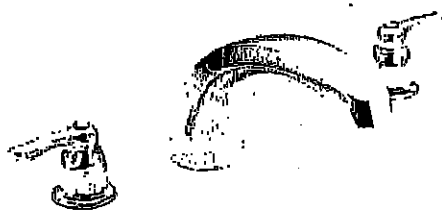

2 Handle Roman Tub with 9" Spout
Model 4796 / T990†

FREESTANDING TUB FAUCETS

A

UK 75 WALLACETON
20-1790 ELEV. A
THE DUNMORE
LOT 285A-7

23 OF 37

SC(B)500 | ALITO Collection

Cyclone®
Breathe Better

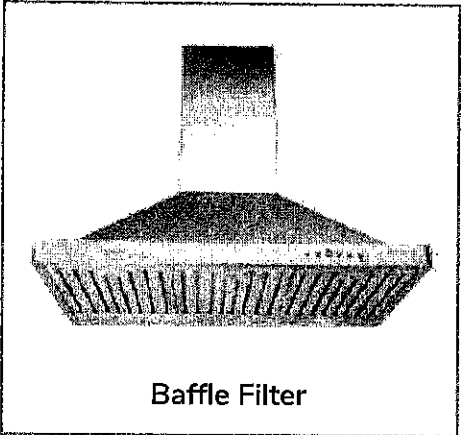

Wall Mount

Strong and sturdy with attractive lines and an imposing frame, the SC(B)500 is fitted with time-delay OFF feature up to nine minutes, 550 CFM fan, bright LED lights and a digital three-speed push button control panel.

Green Features



3 Speed Push Button
Control Panel



Dishwasher
Safe Filters



Long-Lasting
LED Light



Time-Delay
OFF Feature



Model	Colour	Ducting	Filters	Size	CFM
SC50024	Stainless Steel	6"	Mesh	24"	550
SC50030	Stainless Steel	6"	Mesh	30"	550
SC50036	Stainless Steel	6"	Mesh	36"	550
SCB50024	Stainless Steel	6"	Baffle	24"	550
SCB50030	Stainless Steel	6"	Baffle	30"	550
SCB50036	Stainless Steel	6"	Baffle	36"	550

Cyclone Range Hoods Inc.

1361 Huntingwood Drive, Unit 16, Toronto, ON, M1S 3J1, Canada

Toll Free: 1-888-293-5662 Tel: (416) 293-0933 Fax: (416) 293-4793 Website: www.CycloneRangeHoods.com

UK 75 WALLACETON
20-1790 ELEV. A
THE DUNMORE
LOT 285A-7

24 of 37

SC(B)500 | ALITO Collection

Cyclone®
Breathe Better

Features

- Wall mount range hood
- 6" round duct adapter
- Non-stick aluminum fan blades
- 3 speed push button control
- 2 LED lights (2 x 1.4W)
- Dishwasher-safe mesh or baffle filters
- Standard chimney fits up to 9 ft. ceiling
- Up to 9 minute time-delay OFF feature
- Plug-in connection

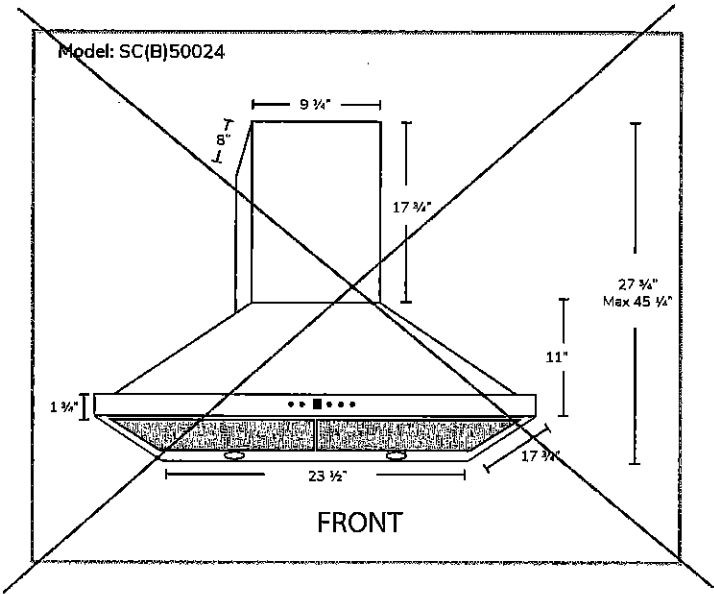
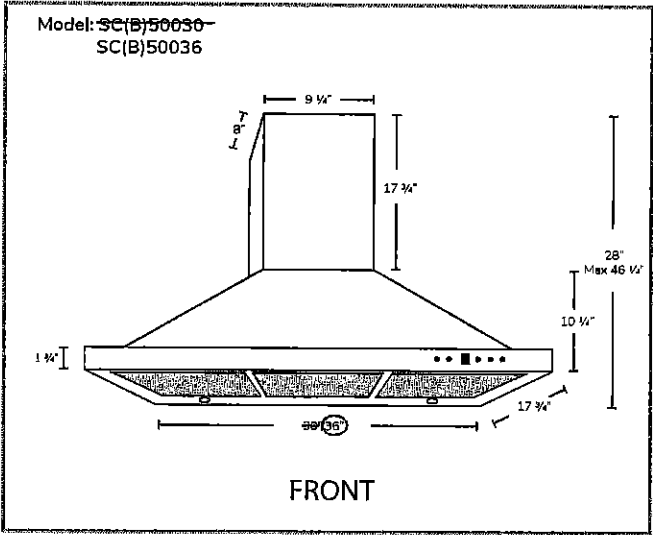

Options

- Filters: SC500 - Quick Release Aluminum Mesh Filters
SCB500 - Quick Release Stainless Steel Baffle Filters
- Available Chimney Flues:
Short (7 ft. - 8 ft., A1.CH10)
Standard (8 ft. - 9 ft., A1.CH18)
Extended (9 ft. - 11 ft., A1.CH30)
- Widths: 24", 30", 36"

Specifications

- | | | |
|------------------------------------|------------------------------------|-----------------------------|
| ▪ Air Flow Volume: 550 CFM | ▪ Finishes: Stainless Steel | ▪ Noise Level: Min. 2 Sones |
| ▪ Electrical Connection: 120V/60Hz | ▪ Ducting: 6" Round | Max. 6 Sones |
| ▪ Power Consumption: 210 Watts | ▪ Dimensions: Width: 24", 30", 36" | |
| ▪ Current: 2.5 Amps | Height: 46" | |
| ▪ Fan Speed: 1600RPM | Depth: 18" | |
| ▪ Fan Type: Centrifugal Blower | | |



Toronto • Vancouver • Boston
www.CycloneRangeHoods.com



Whirlpool® Bottom Mount Refrigerator

PRODUCT MODEL NUMBERS

WRF532SMB
WRF535SMB

WRF535SWB
WRF540CWB

Electrical: A 115-volt, 60-Hz, AC-only, 15- or 20-amp fused, grounded electrical supply is required. It is recommended that a separate circuit serving only your refrigerator be provided. Use an outlet that cannot be turned off by a switch. Do not use an extension cord.

NOTE: Before performing any type of installation, cleaning, or removing a light bulb, turn the control (Thermostat, Refrigerator or Freezer Control depending on the model) to OFF and then disconnect the refrigerator from the electrical source. When you are finished, reconnect the refrigerator to the electrical source and reset the control (Thermostat, Refrigerator or Freezer Control depending on the model) to the desired setting. See "Using the Controls."

Water: A cold water supply with water pressure between 30 and 120 psi (207 and 827 kPa) is required to operate the ice maker and water dispenser. If you have questions about your water pressure, call a licensed, qualified plumber.

IMPORTANT: The pressure of the water coming out of a reverse osmosis system going to the water inlet valve of the refrigerator needs to be between 35 and 120 psi (241 and 827 kPa).

Reverse Osmosis Water Supply: If a reverse osmosis water filtration system is connected to your cold water supply, the water pressure to the reverse osmosis system needs to be a minimum of 40 to 60 psi (276 to 414 kPa).

PRODUCT DIMENSIONS

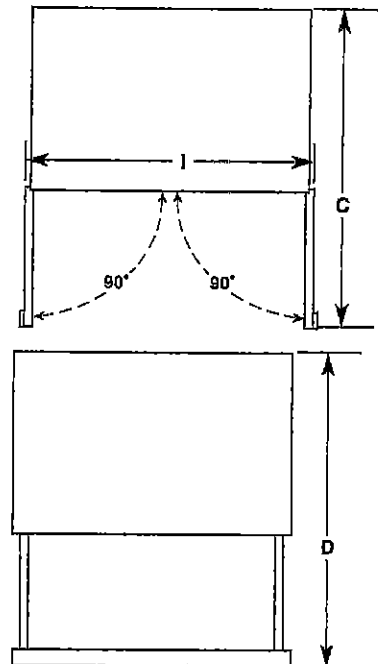
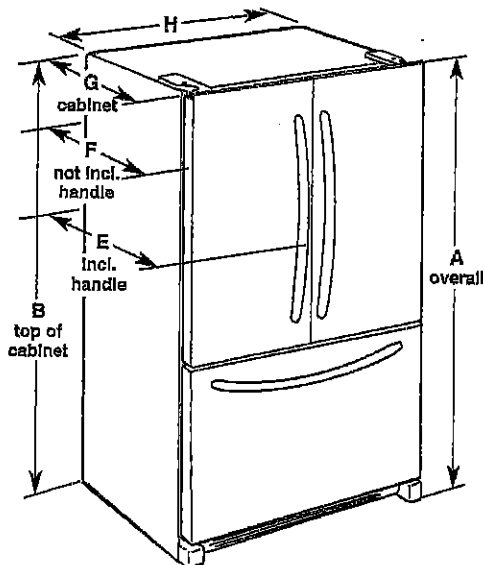

Model Number/Size	Height - Overall "A"	Height - Top of Cabinet "B"	Depth - Doors Open 90° "C"	Depth - Drawer Open "D"	Depth - With Handles "E"	Depth - Without Handles "F"	Depth - Cabinet Only "G"	Width - Cabinet "H"	Width - Door Open 90° "I"
WRF535SWB 25.2 cu. ft.	70 1/8" (178.1 cm)	68 1/8" (174.8 cm)	48 1/8" (122.1 cm)	53 1/8" (135 cm)	35 1/8" (90 cm)	32 1/8" (83.7 cm)	29 1/8" (74 cm)	35 1/8" (90.5 cm)	43 1/8" (110.2 cm)
WRF535SMB 25.2 cu. ft.	70 1/8" (178.1 cm)	68 1/8" (174.8 cm)	48 1/8" (122.1 cm)	53 1/8" (135 cm)	35 1/8" (90 cm)	32 1/8" (83.7 cm)	29 1/8" (74 cm)	35 1/8" (90.5 cm)	43 1/8" (110.2 cm)
WRF532SMB 22.1 cu. ft.	70 1/8" (178.1 cm)	68 1/8" (174.8 cm)	47 1/8" (119.5 cm)	52 1/8" (132.4 cm)	34 1/8" (87.5 cm)	31 1/8" (81.1 cm)	28 1/8" (74.4 cm)	32 1/8" (82.9 cm)	42 1/8" (107.6 cm)
WRF540CWB 20 cu. ft.	70 1/8" (178.1 cm)	68 1/8" (174.8 cm)	48" (121.9 cm)	44 1/8" (113.0 cm)	29 1/8" (74.6 cm)	28" (71.1 cm)	24 1/8" (61.3 cm)	35 1/8" (90.5 cm)	39 1/8" (100.0 cm)

LOCATION REQUIREMENTS

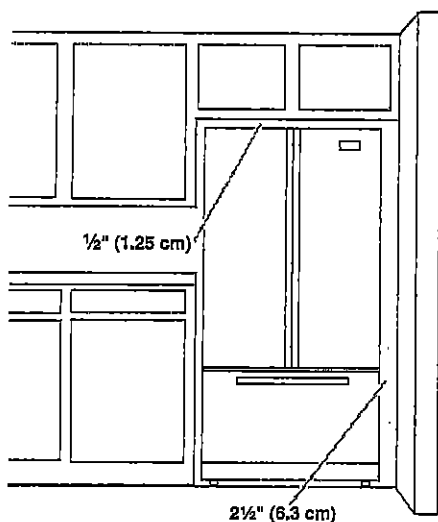

To ensure proper ventilation for your refrigerator, allow for a 1/2" (1.25 cm) space on each side and at the top. Allow for 1" (2.54 cm) of space behind the refrigerator. If your refrigerator has an ice maker, make sure you leave some extra space at the back for the water line connections.

If you are installing your refrigerator next to a fixed wall, leave 2 1/2" (6.3 cm) minimum on the hinge side (some models require more) to allow for the door to swing open.

NOTE: This refrigerator is intended for use in a location where the temperature ranges from a minimum of 55°F (13°C) to a maximum of 110°F (43°C). The preferred room temperature range for optimum performance, which reduces electricity usage and provides superior cooling, is between 60°F (15°C) and 90°F (32°C). It is recommended that you do not install the refrigerator near a heat source, such as an oven or radiator.

UK 75 WALLACETON
20-1790 ELEV. A
THE DUNMORE
LOT 285A-7

26 of 37

FRIDGE (WRF540CWH2)

Specifications

Dimensions	
Cabinet Width	90.49 cm, 35-5/8 in
Depth Closed Excluding Handles	68.26 cm, 26-7/8 in
Depth Closed Including Handles	74.61 cm, 29-3/8 in
Depth Excluding Doors	61.28 cm, 24-1/8 in
Depth With Door Open 90 Degree	33.02 cm, 13.0 in
Freezer Volume	159.05 l, 5.62 cu. ft.
Height	178.12 cm, 70-1/8 in
Height To Top Of Cabinet	174.94 cm, 68-7/8 in
Height To Top Of Door Hinge	178.12 cm, 70-1/8 in
Refrigerator Volume	406.95 l, 14.38 cu. ft.
Width	90.49 cm, 35-5/8 in
Configuration and Overview	
Advance Foam Insulation	99.9% lower Global Warming Potential and Better Energy Performance
Counter Depth	Yes
Energy Star® Qualified	ENERGY STAR® Qualified
Number of Doors	3
Appearance	
Cabinet Finish	Textured
Door Finish	Smooth
Door Style	Contour
Handle Material	Metal
Handle Type	Reach-Through Handle
Hidden Hinge	Yes
LCD Touch Screen	No
Reversible Door	No
Controls	
Air Filter Indicator/Reset	No
Automatic Defrost	Yes
Control Location	Interior Up Front
Control Type	Electronic
Door Ajar/Open Alarm	Yes
Max Cool/Fast Cool	Yes
Verrouillage des commandes	No

UK 75 WALLACETON
20-1790 ELEV. A
THE DUNMORE
LOT 285A-7

27 of 37

Freezer Details

Door Type	Pull-Out
Freezer Drawer/Basket	1 Full Width Upper Plastic, 1 Full Width Lower Wire

Refrigerator Details

Door Bins	2 Fixed Full-Width Gallon, 4 Adjustable Full-Width
Humidity-Controlled Drawers	2 Half-Width
Lighting	LED
Number of Interior Shelves	5
Pantry Drawer	Yes

Filter Details

Fresh Flow Air Filter	No
Produce Preserver	Yes
Water Filter Indicator/Reset	Yes
Water Filter Location	Interior

Dispenser Details

Dispenser Options	Filtered Water
Dispenser Type	Interior Water Only
Types of Ice	Cubed

Icemaker Details

Icemaker	Factory Installed
Icemaker Location	Freezer

Electrical

Volts	115
-------	-----

UK 75 WALLACETON
20-1790 ELEV. A
THE DUNMORE
LOT 285A-7

28 of 37

Whirlpool® 30" (76.2 cm) Slide-in Gas Range

PRODUCT MODEL NUMBERS

WEG745H0F

WEG745H0F

WEG745H0F

GAS SUPPLY REQUIREMENTS

Gas supply line:

- Provide a gas supply line of $\frac{1}{2}$ " (1.3 cm) rigid pipe to the range location. A smaller size pipe on longer runs may result in insufficient gas supply. With LP gas, piping or tubing size can be $\frac{1}{2}$ " (1.3 cm) minimum. Usually, LP gas suppliers determine the size and materials used in the system.

NOTE: Pipe-joint compounds that resist the action of LP gas must be used. Do not use TEFLON® tape.

Flexible metal appliance connector:

- If local codes permit, a new CSA design-certified, 4 to 5 ft (122 to 152.4 cm) long, $\frac{1}{2}$ " (1.3 cm) or $\frac{3}{4}$ " (1.9 cm) I.D., flexible metal appliance connector may be used for connecting range to the gas supply line.



- A $\frac{1}{2}$ " (1.3 cm) male pipe thread is needed for connection to the female pipe threads of the inlet to the appliance pressure regulator.
- Do not kink or damage the flexible metal tubing when moving the range.
- Must include a shutoff valve:
The supply line must be equipped with a manual shutoff valve. This valve should be located in the same room but external to the range opening, such as an adjacent cabinet. It should be in a location that allows ease of opening and closing. Do not block access to shutoff valve. The valve is for turning on or shutting off gas to the range.

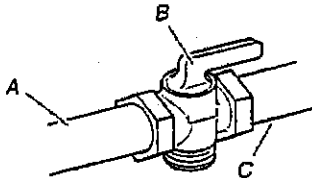

A. Gas supply line
B. Shutoff valve "open" position
C. To range

Gas Pressure Regulator

The gas pressure regulator supplied with this range must be used. The inlet pressure to the regulator should be as follows for proper operation:

Natural gas:

Minimum pressure: 5" WCP
Maximum pressure: 14" WCP

LP gas:

Minimum pressure: 11" WCP
Maximum pressure: 14" WCP

Contact local gas supplier if you are not sure about the inlet pressure.

PRODUCT DIMENSIONS

This manual covers several models. Your model may appear different from the models depicted. Dimensions given are maximum dimensions across all models.

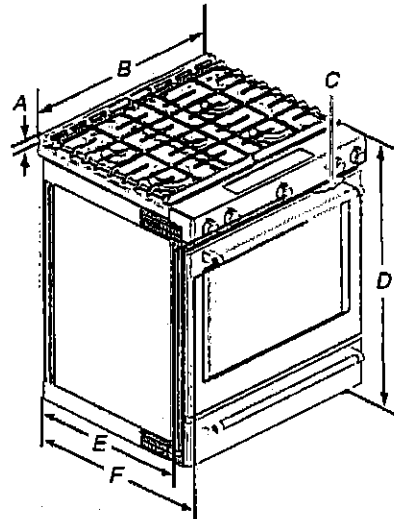

- A. 1 $\frac{1}{4}$ " (3.0 cm) height from cooktop to top of vent
- B. 29 $\frac{1}{2}$ " (75.9 cm)
- C. Model/serial number plate (located behind the oven door on the top right-hand side of the oven frame)
- D. 36" (91.4 cm) height to top of cooktop edge with leveling legs screwed all the way in*
- E. 28 $\frac{3}{8}$ " (71.9 cm) max. depth from front of console to back of range.
- F. 28 $\frac{1}{2}$ " (73.3 cm) max. depth from handle to back of range.

IMPORTANT: Range must be level after installation. Follow the instructions in the "Level Range" section. Using the cooktop as a reference for leveling the range is not recommended.

* Range can be raised approximately 1" (2.5 cm) by adjusting the leveling legs.

Type of Gas

Natural gas:

- This range is factory set for use with Natural gas. See "Gas Conversions" section. The model/serial rating plate located behind the control panel has information on the types of gas that can be used. If the types of gas listed do not include the type of gas available, check with the local gas supplier.

LP gas conversion:

Conversion must be done by a qualified service technician. No attempt shall be made to convert the appliance from the gas specified on the model/serial rating plate for use with a different gas without consulting the serving gas supplier. See "Gas Conversions" section.

*TEFLON is a registered trademark of Chemours.

29 of 37

ELECTRICAL REQUIREMENTS

IMPORTANT: The range must be electrically grounded in accordance with local codes and ordinances, or in the absence of local codes, with the National Electrical Code, ANSI/NFPA 70 or Canadian Electrical Code, CSA C22.1.

If codes permit and a separate ground wire is used, it is recommended that a qualified electrical installer determine that the ground path is adequate.

- A 120 volt, 60 Hz., AC only, 15-amp fused, electrical circuit is required. A time-delay fuse or circuit breaker is also recommended. It is recommended that a separate circuit serving only this range be provided.
- Electronic ignition systems operate within wide voltage limits, but proper grounding and polarity are necessary. Check that the outlet provides 120-volt power and is correctly grounded.

CABINET OPENING DIMENSIONS

Cabinet opening dimensions shown are for 25" (64.0 cm) countertop depth, 24" (61.0 cm) base cabinet depth and 36" (91.4 cm) countertop height.

IMPORTANT: If installing a range hood or microwave hood combination above the range, follow the range hood or microwave hood combination installation instructions for dimensional clearances above the cooktop surface.

Range may be installed next to combustible walls with zero clearance.

NOTE: When installed in a slide-in cutout, the front of oven door may protrude beyond the base cabinet.

- A. 18" (45.7 cm) upper side cabinet to countertop
- B. 13" (33 cm) max. upper cabinet depth
- C. 30" (76.2 cm) min. opening width
- D. For minimum clearance to top of cooktop, see NOTE*.
- E. 30" (76.2 cm) min. opening width
- F. 3" (7.6 cm) min. clearance from both sides of range to side wall or other combustible material.
- G. The shaded area is recommended for installation of rigid gas pipe and grounded outlet.
- H. 13 1/2" (33.3 cm)
- I. 7 1/8" (19.5 cm)
- J. 4 1/4" (12.2 cm)
- K. 3 1/4" (9.4 cm) or measurement of N, whichever is greater
- L. 12" (30.5 cm)
- M. Cabinet door or hinges should not extend into the cutout.
- N. Remaining counter depth should not exceed 2 1/4" (5.7 cm)

*NOTE: 24" (61.0 cm) minimum when bottom of wood or metal cabinet is shielded by not less than 1/4" (0.64 cm) flame retardant milboard covered with not less than No. 28 MSG sheet steel, 0.015" (0.4 mm) stainless steel, 0.024" (0.6 mm) aluminum or 0.020" (0.5 mm) copper.

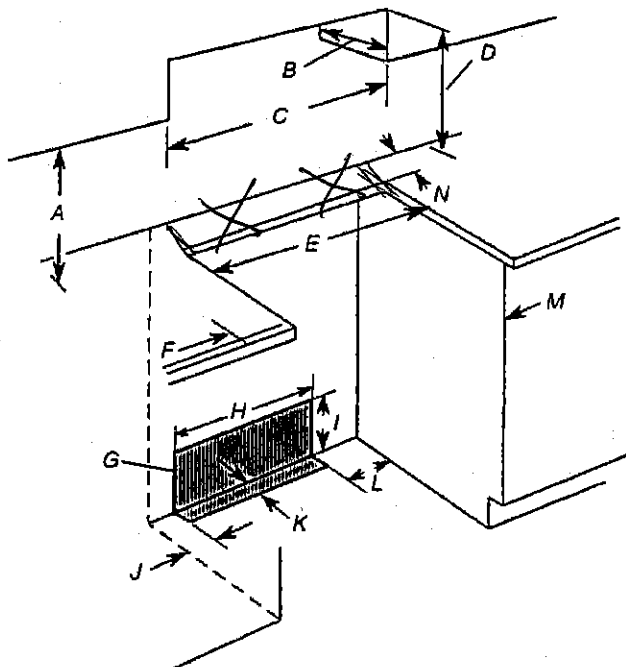

UK 75 WALLACETON
20-1790 ELEV. A
THE DUNMORE
LOT 285A-7

30 of 37

WDT730PAHZ



Undercounter Dishwasher

PRODUCT MODEL NUMBERS

WDF110PAB
WDF111PAB
WDF120PAF
WDF121PAF
WDF30PAH
WDF131PAH

WDF320PAD
WDF330PAH
WDF331PAH
WDF520PAD
WDF540PAD
WDF545PAF

WDT710PAH
WDT720PAD
WDT730PAH
WDT735PAG
WDT735PAH

DRAIN REQUIREMENTS

- A new drain hose is supplied with your dishwasher. If drain hose is not long enough, use a new drain hose with a maximum length of 12 ft (3.7 m) that meets all current AHAM/IAPMO test standards, is resistant to heat and detergent, and fits the 1" (25 mm) drain connector of the dishwasher. See the "Tools and Parts" section at the front of the guide for part details and orders.
- Make sure to connect drain hose to waste tee or disposer inlet above drain trap in house plumbing and 20" (508 mm) minimum above the floor. It is recommended that the drain hose either be looped up and securely fastened to the underside of the counter or be connected to an air gap.
- Make sure to use an air gap if the drain hose is connected to house plumbing lower than 20" (508 mm) above subfloor or floor.

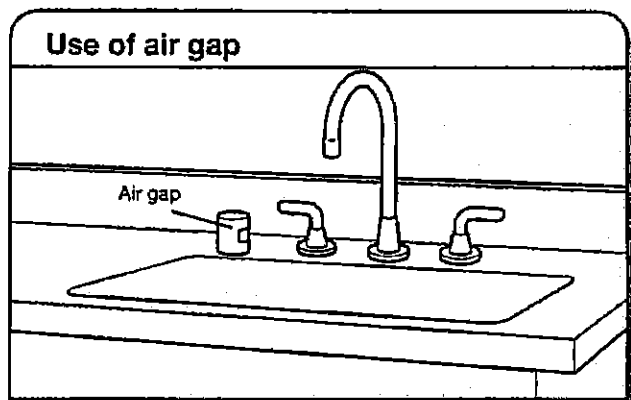

- If required, the air gap should be installed in accordance with the air gap installation instructions. When you are connecting the air gap, a rubber hose (not provided) will be needed to connect to the waste tee or disposer inlet.
- Use 1/2" minimum I.D. drain line fittings.

WATER SUPPLY REQUIREMENTS

- This dishwasher has a water heating feature and also requires a connection to a hot water supply line.
- A hot water line with 20 to 120 psi (138 to 862 kPa) water pressure can be verified by a licensed plumber.
- 120°F (49°C) water at dishwasher
- 3/8" O.D. copper tubing with compression fitting or flexible braided water supply line. See the "Tools and Parts" section at the front of the guide for part details and orders.

NOTE: 1/2" minimum plastic tubing is not recommended.

- A 90° elbow with 3/4" hose connection with rubber washer. See the "Tools and Parts" section at the front of the guide for part details and orders.
- Do not solder within 6" (152 mm) of the water inlet valve.
- If installed in new construction, make sure the house water supply lines have been flushed prior to connecting the dishwasher to remove any debris that may exist in the supply line.

NOTE: If replacing an existing dishwasher, it is recommended to install a new water line (see the "Tools and Parts" section at the front of the guide for part details) and drain hose (supplied) with the new dishwasher.

ELECTRICAL REQUIREMENTS

You Must Have:

- 120-volt, 60 Hz, AC-only, 15- or 20-amp, fused electrical supply
- Copper wire only
- A maximum of 2 field wiring supply conductors (12 AWG largest size) plus 1 grounding conductor are permitted in the terminal box.

We Recommend:

- A time-delay fuse or circuit breaker
- A separate circuit

If Connecting Dishwasher with a Power Cord:

- Use a UL Listed power cord kit marked for use with dishwasher. See the "Tools and Parts" section at the front of the guide for part details and orders.
- Plug into a grounded 3 prong outlet. Outlet must meet all local codes and ordinances.

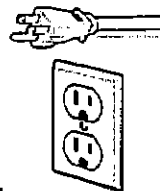

If Connecting Dishwasher with Direct Wiring:

- Use flexible, armored, or nonmetallic sheathed copper wire with grounding wire that meets the wiring requirements for your home and local codes and ordinances.
- Use a UL Listed/CSA Approved metallic strain relief.



Because Whirlpool Corporation policy includes a continuous commitment to improve our products, we reserve the right to change materials and specifications without notice.

Dimensions are for planning purposes only. For complete details, see Installation Instructions packed with product. Specifications subject to change without notice.

Page 1 of 2
W10806908-D-WH
12/16

31 of 37

PRODUCT AND CABINET OPENING DIMENSIONS

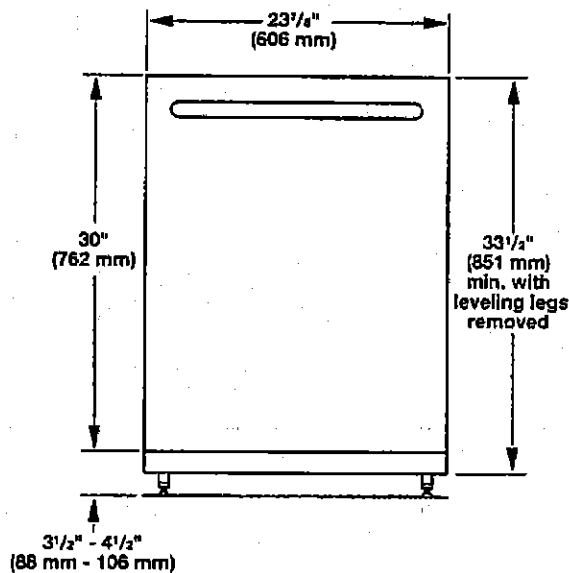

For 4" (100 mm) toe kick, height of cabinet opening is 34 1/2" (863 mm).

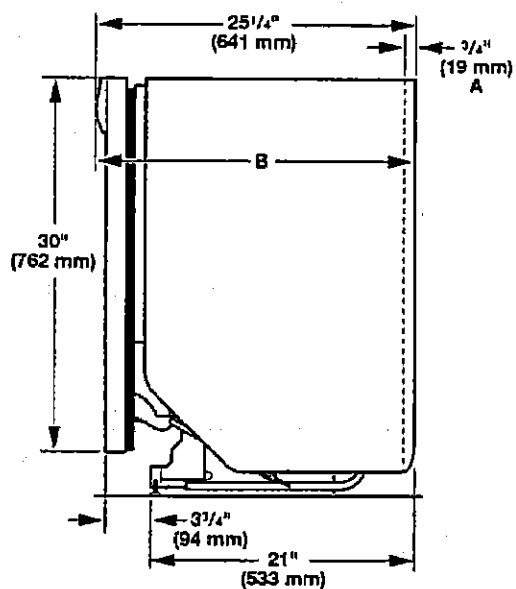

A. Insulation may be compressed (not used on all models).
B. Door handles may protrude forward of the face of the dishwasher, (varies by model).

Check that all surfaces have no protrusions that would prohibit dishwasher installation.

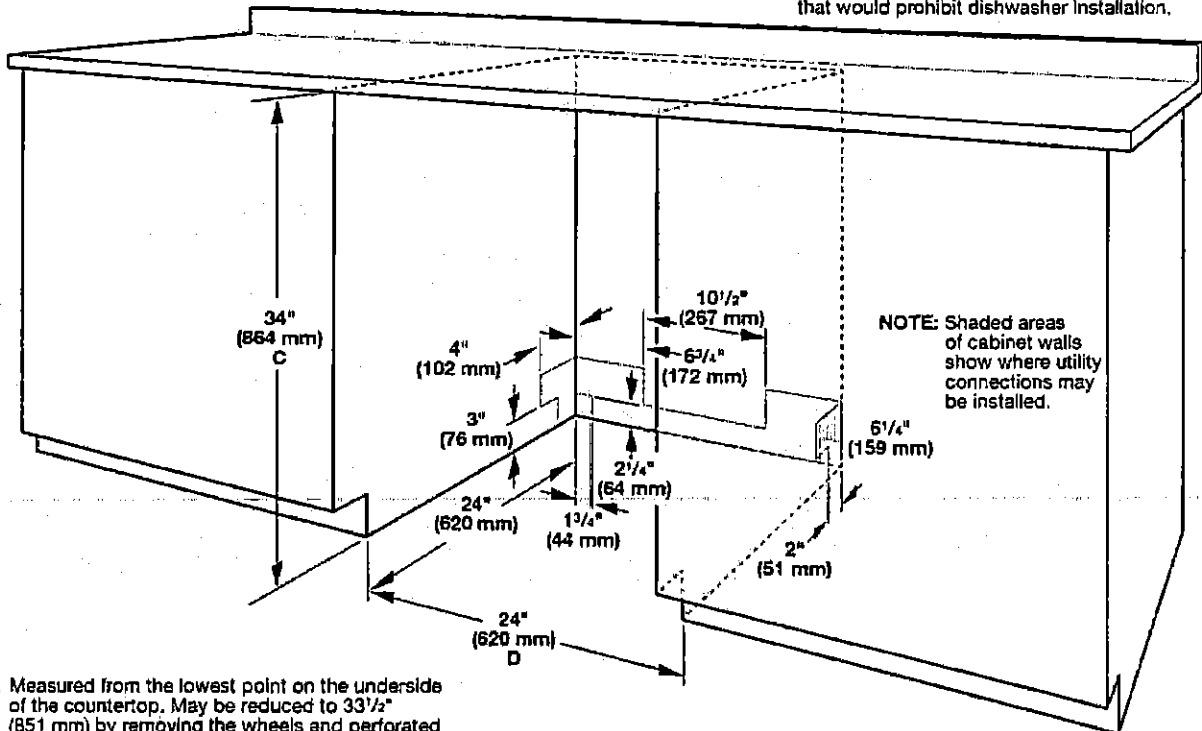

C. Measured from the lowest point on the underside of the countertop. May be reduced to 33 1/2" (851 mm) by removing the wheels and perforated area of insulation (blanket) on dishwasher.
D. Minimum, measured from narrowest point of opening.

UK 75 WALLACETON
20-1790 ELEV. A
THE DUNMORE
LOT 285A-7

32 of 37

WHIRLPOOL WASHER Model #: WFW5620HW

Whirlpool Brand Canada English | Washers and Dryers | Washers | Front-Load Washers | WFW5620HW

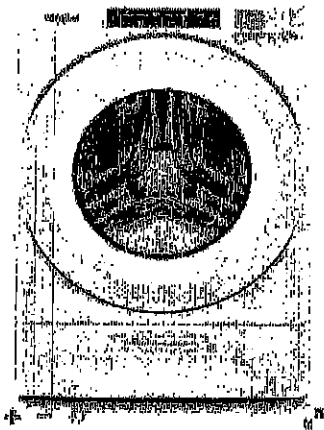

5.2 cu. ft. I.E.C. Closet-Depth
Front Load Washer with
Load & Go™ Dispenser



Whirlpool 5.2 cu. ft. I.E.C. Closet-Depth Front Load Washer with Load & Go™
Dispenser
Model #: WFW5620HW

Dimensions

Depth	80.17 cm, 31-9/16 in.
Depth With Door Open 90 Degrees	143.51 cm, 56-1/2 in.
Minimum Height	88.11 cm, 34-5/8 in.
Width	68.58 cm, 27.0 in.

Appearance

LCD Touch Screen	No
Window	Yes

Details

Drum Material	Stainless Steel
---------------	-----------------

Cycles and Options

Number of Wash Cycles	37
-----------------------	----

Electrical

Hz	60
Power Cord Included	Yes

33 of 37

WHIRLPOOL WASHER Model #: WFW5620HW

LOCATION REQUIREMENTS

Proper installation is your responsibility.

You will need:

- A water heater set to 120°F (49°C).
- A grounded electrical outlet located within 6 ft (1.8 m) of power cord on back of washer.
- Hot and cold water faucets located within 4 ft (1.2 m) of hot and cold water fill valves on washer, and water pressure of 20–100 psi (137.9–689.6 kPa).
- A level floor with maximum slope of 1" (25 mm) under entire washer. Installing on carpet or surfaces with foam backing is not recommended.
- Floor must support washer's total weight (with water and load) of 315 lbs (143 kgs).

IMPORTANT: Do not install, store, or operate washer where it will be exposed to weather or in temperatures below 32°F (0°C). Water remaining in washer after use may cause damage in low temperatures. See "Washer Care" in your Use and Care Guide for winterizing information.

Whirlpool Models*

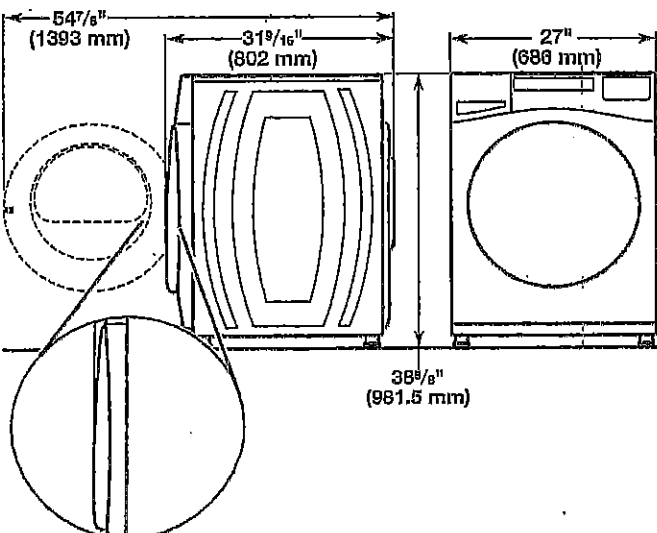
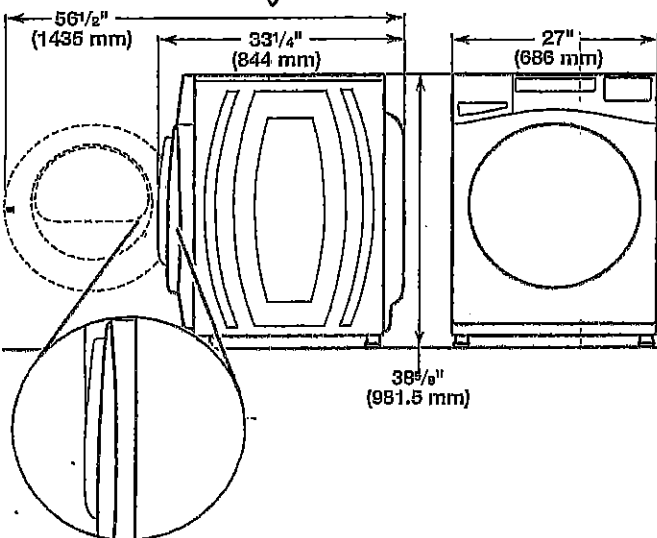

*For additional details (or information) specific to your model, refer to the 'Dimensions' listed for your model at www.whirlpool.com.

Maytag Models

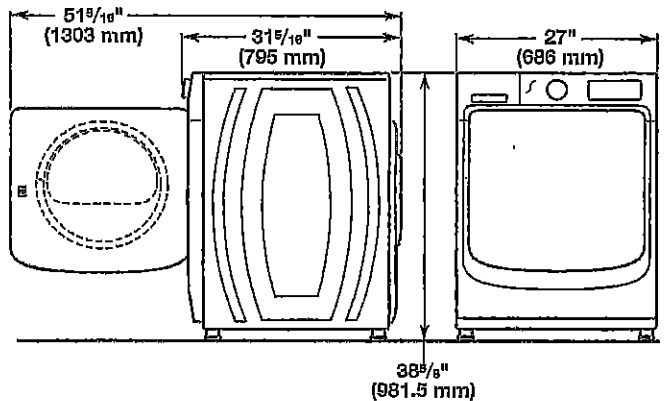
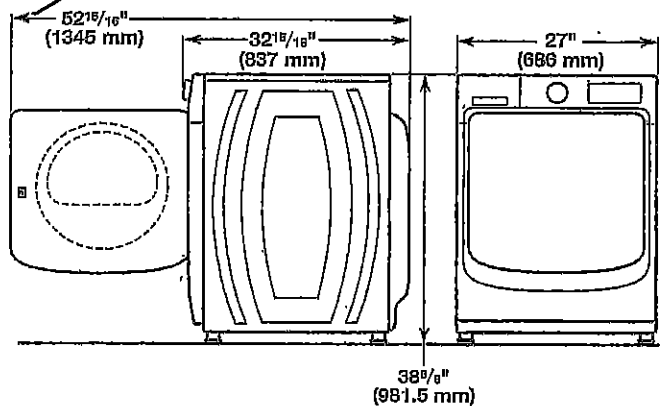

All dimensions show minimum spacing allowed. For each arrangement, consider allowing more space for ease of installation and servicing, and spacing for companion appliances and clearances for walls, doors, and floor moldings.

Space must be large enough to allow door to fully open. Add spacing of 1" (25 mm) on all sides of washer to reduce noise transfer. If a closet door or louvered door is installed, top and bottom air openings in door are required.

Recessed area or closet installation (stacked washer and dryer):

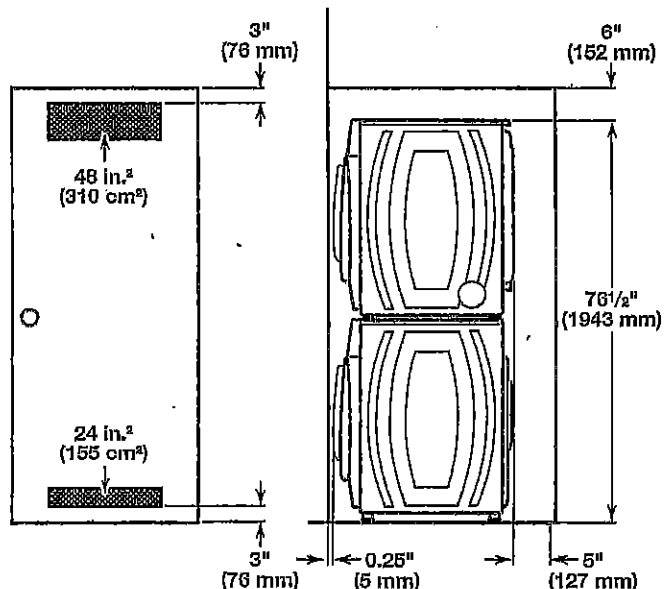

UK 75 WALLACETON
20-1790 ELEV. A
THE DUNMORE
LOT 285A-7

34 of 37

WHIRLPOOL WASHER Model #: WFW5620HW

Custom under-counter installation:

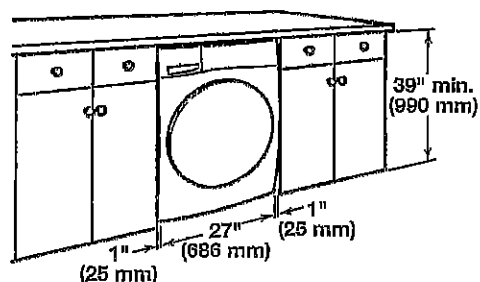

Recessed area or closet installation:

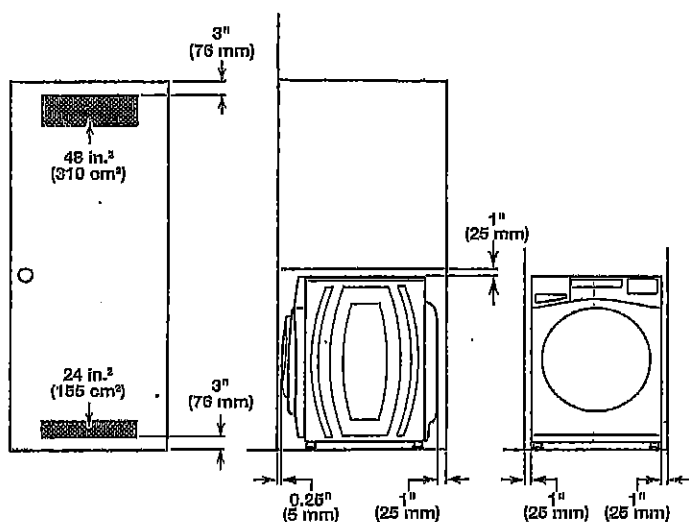

Custom cabinet installation:

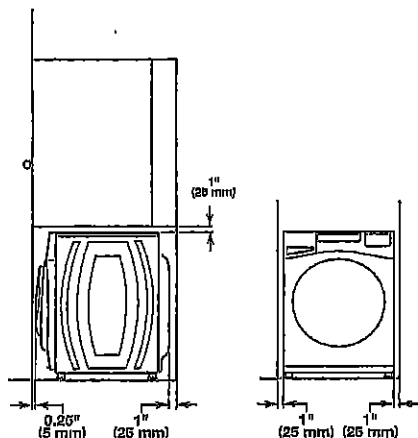

DRAIN SYSTEM

The drain system can be installed using a floor drain, wall standpipe, floor standpipe, or laundry tub. Select the method you need.

IMPORTANT: To avoid siphoning, only 4.5" (114 mm) of drain hose should be inside standpipe. Always secure drain hose with cable tie.

Floor standpipe drain system

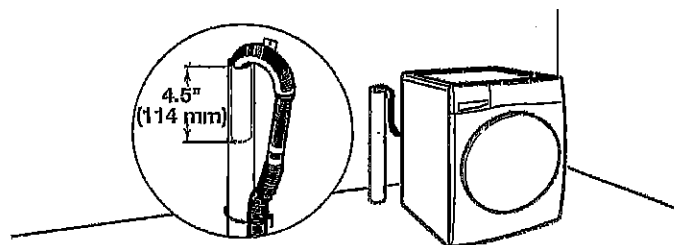

Minimum diameter for a standpipe drain: 2" (51 mm). Minimum carry-away capacity: 17 gal. (64 L) per minute. A 1/4" (6 mm) diameter to 1" (25 mm) diameter Standpipe Adapter Kit is available (Part Number 3363920). Top of standpipe must be at least 30" (762 mm) high; install no higher than 96" (2.44 m) from bottom of washer. If you have an overhead sewer and need to pump higher than 96" (2.44 m), a sump pump and associated hardware are needed. See "Alternate parts."

Wall standpipe drain system

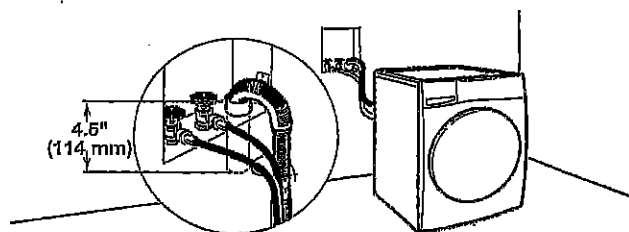

See requirements for floor standpipe drain system.

Laundry tub drain system

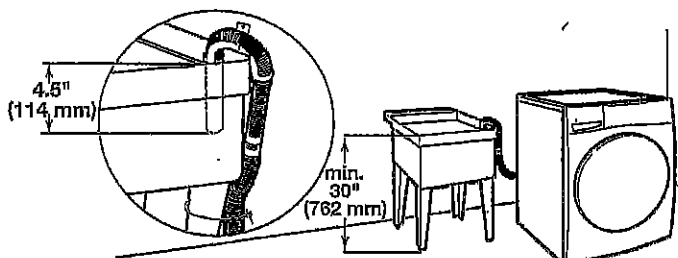

Minimum capacity: 20 gal. (76 L). Top of laundry tub must be at least 30" (762 mm) above floor; install no higher than 96" (2.44 m) from bottom of washer.

UK 75 WALLACETON
20-1790 ELEV. A
THE DUNMORE
LOT 285A-7

35 of 37

WHIRLPOOL DRYER Model #: YWED5620HW

Whirlpool Brand Canada English | Washer and Dryer | Dryer | Electric Dryer | YWED5620HW

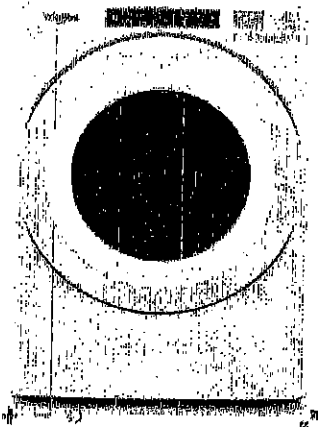

7.4 cu. ft. Front Load Electric
Dryer with Intuitive Touch
Controls



Whirlpool 7.4 cu. ft. Front Load Electric Dryer with Intuitive Touch Controls

Model #: YWED5620HW

Dimensions

Depth	78.74 cm, 31.0 in
Depth With Door Open 90 Degree	138.43 cm, 54-1/2 in
Height	98.42 cm, 38-9/16 in
Width	68.58 cm, 27.0 in

Configuration and Overview

Fuel Type	Electric
-----------	----------

Cycles and Options

Cycle Time Remaining	Yes
Lint Filter Indicator	No
Number of Dryer Cycles	36
Number of Dryness Levels	3

Ventilation System

Long Vent	No
Maximum Vent Length	64
Venting Direction	Left, Right, Bottom, Rear

Electrical

Hz	60
Power Cord Included	Yes

UK 75 WALLACETON
20-1790 ELEV. A
THE DUNMORE
LOT 285A-7

36 of 37

WHIRLPOOL DRYER Model #: YWED5620HW

Back view:

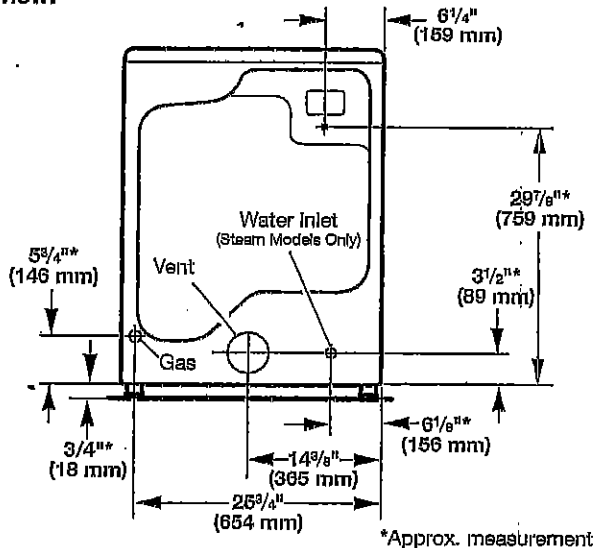

NOTE: Most installations require a minimum of 5" (127 mm) clearance behind dryer for exhaust vent with elbow. See "Venting Requirements."

Installation Clearances

For each arrangement, consider allowing more space for ease of installation and servicing, spacing for companion appliances, and clearances for walls, doors, and floor moldings. Space must be large enough to allow door to fully open. Add spacing on all sides of dryer to reduce noise transfer. If a closet door or louvered door is installed, top and bottom air openings in door are required.

Check code requirements. Some codes limit, or do not permit, installation of the dryer in garages, closets, mobile homes, or sleeping quarters. Contact your local building inspector.

NOTE: No other fuel-burning appliance can be installed in the same closet as a dryer.

Installation spacing for recessed area or closet installation

All dimensions show recommended and minimum spacing allowed.

- Additional spacing should be considered for ease of installation and servicing.
- Additional clearances might be required for wall, door, floor moldings, dryer venting, and gas line.
- Additional spacing should be considered on all sides of the dryer to reduce noise transfer.
- For closet installation with a door, minimum ventilation openings in the top and bottom of the door are required. Louvered doors with equivalent ventilation openings are acceptable.
- Companion appliance spacing should also be considered.

Recommended installation clearances (dryer only):

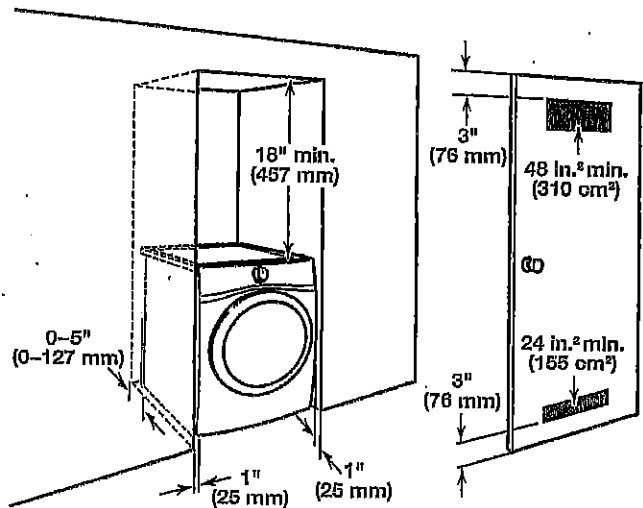

0" (0 mm) rear spacing is allowed for straight back venting only. For steam models only, inlet hose must not be kinked.

Custom under-counter installation:

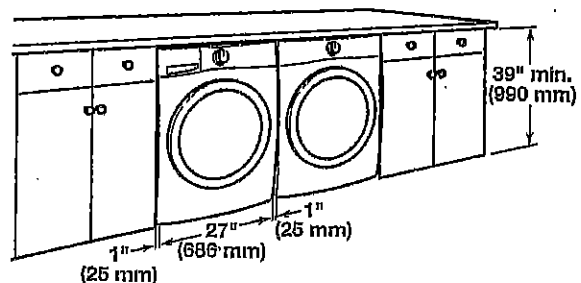

Mobile home - Additional installation requirements:

This dryer is suitable for mobile home installations. The installation must conform to the Manufactured Home Construction and Safety Standard, Title 24 CFR, Part 3280 (formerly the Federal Standard for Mobile home construction and Safety, Title 24, HUD Part 280) or Standard CAN/CSA-Z240 MH.

Mobile home installations require:

- Metal exhaust system hardware, available for purchase from your dealer. For further information, see "Assistance or Service" in your Use and Care Guide.
- Special provisions must be made in mobile homes to introduce outside air into dryer. Openings (such as a nearby window) should be at least twice as large as dryer exhaust opening.

For mobile home installation of gas dryers:

- Mobile Home Installation Hold-down Kit Part Number 346764 is available to order. For further information, see "Assistance or Service" in your Use and Care Guide.

UK 75 WALLACETON
20-1790 ELEV. A
THE DUNMORE
LOT 285A-7

37 of 37

WHIRLPOOL DRYER Model #: YWED5620HW

Additional parts may be required, depending on your installation. Check local codes. Check existing electrical supply and venting. Read "Electrical Requirements" and "Venting Requirements" before purchasing parts.

If using a power supply cord:

Use a UL Listed power supply cord kit marked for use with clothes dryers. The kit should contain:

- A UL Listed 30 amp power supply cord, rated 120/240 volt minimum. The cord should be type SRD or SRDT and be at least 4 ft. (1.22 m) long. The wires that connect to the dryer must end in ring terminals or spade terminals with upturned ends.
- A UL Listed strain relief.

Optional Equipment (not supplied with dryer):

Refer to your Use and Care Guide for information about accessories available for your dryer.

LOCATION REQUIREMENTS

Check code requirements. Some codes limit, or do not permit, installing dryer in garages, closets, mobile homes, or sleeping quarters. Contact your local building inspector.

⚠ WARNING



Explosion Hazard

Keep flammable materials and vapors, such as gasoline, away from dryer.

Place dryer at least 18 inches (460 mm) above the floor for a garage installation.

Failure to do so can result in death, explosion, or fire.

You will need:

- A location allowing for proper exhaust installation. See "Venting Requirements."
- A separate 15 or 20 amp circuit for a gas dryer or 30 amp circuit for an electric dryer.
- If using power supply cord, a grounded electrical outlet located within 2 ft. (610 mm) of either side of dryer. See "Electrical Requirements."
- Floor must support dryer weight of 200 lbs. (90.7 kg). Also consider weight of companion appliance.
- Cold water faucets located within 4 ft. (1.2 m) of the water fill valves, and water pressure of 20-120 psi (138-827 kPa). You may use your washer's water supply by purchasing the necessary parts noted in "Parts needed."
- Level floor with maximum slope of 1" (25 mm) under entire dryer. If slope is greater than 1" (25 mm), install Extended Dryer Feet Kit, Part Number 279810. If not level, clothes may not tumble properly and automatic sensor cycles may not operate correctly.
- For garage installation, place dryer at least 18" (460 mm) above floor. If using a pedestal, you will need 18" (460 mm) to bottom of dryer.
- The dryer must not be installed or stored in an area where it will be exposed to water and/or weather.

IMPORTANT: Do not operate, install, or store dryer where it will be exposed to water, weather, or at temperatures below 40°F (4°C). Lower temperatures may cause dryer not to shut off at end of automatic sensor cycles, resulting in longer drying times.

DRYER DIMENSIONS

Front view:

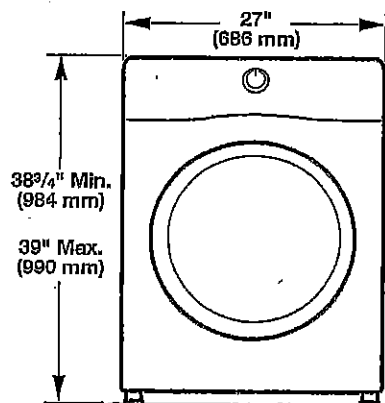

Side view:

Whirlpool Models ✓

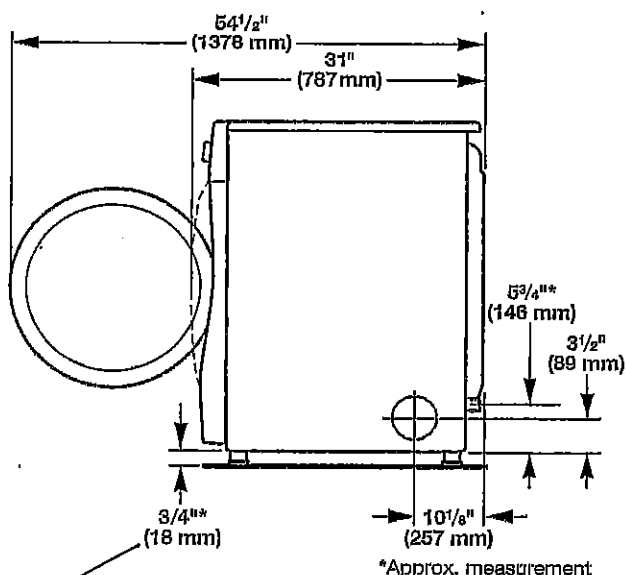

*Approx. measurement

Maytag Models

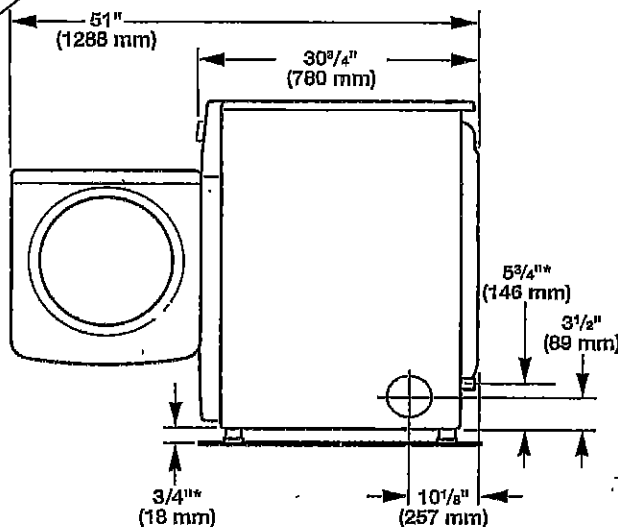

*Approx. measurement