

PRE-Sales Selection Sheet
Checklist

1 OF 24

LOT 254 Model: 25-2140 B The Wallace

PURCHASERS: PAWANDEEP SINGH/

VENDOR: Heathwood Homes (Huron) Limited

OPTIONAL DOUBLE SINKS IN MASTER ENSUITE BATH

- ☐ FINISHED BASEMENT
- ☐ COLD CELLAR

UPGRADED / MODIFIED ELEVATION

- ☐ CORNER UPGRADE
- ☐ REAR UPGRADE

CEILING UPGRADE - SMOOTH

- ☐ MAIN FLOOR
- ☐ SECOND FLOOR
- ☐ BASEMENT

ADDITIONAL ROUGH-INS

- ☒ 200 AMP SERVICE
- ☐ WET BAR ROUGH-IN
- ☐ HUMIDIFIER
- ☒ AIR CONDITIONING

GAS ROUGH-IN

- ☐ STOVE
- ☐ DRYER
- ☐ BBQ
- ☐ ADDITIONAL FIREPLACE

KITCHEN: HOODFAN VENTING SIZE

- ☐ 6 IN ROUND DUCT
- ☒ 7 IN ROUND DUCT

FULL BASEMENT STAIRS:	Paint Grade
UPPER BASEMENT STAIRS:	N/A
LOWER BASEMENT STAIRS:	N/A
MAIN STAIRS:	All Oak
MEDIA STAIRS (if applicable):	N/A
LOFT STAIRS (if applicable):	N/A

Aua 19/20

Date

Signature

on file

Purchaser:

Aua 19/20

Date

Decor Consultant:

APPROVED

-08- 2 8 2020

Date

Heathwood Homes (Huron) Limited

Date

Purchaser:

Approved

Locked Date:



Sales Selection Sheet

Wallaceton

'SCHEDULE E'

2 of 24

PURCHASER: PAWANDEEP SINGH

TEL:

LOT / UNIT	PHASE	MODEL	
254	2	25-2140 B The Wallace	

It is herein understood and agreed between the undersigned parties hereto that the following changes shall be made to the above mentioned Agreement of Purchase and Sale in accordance with the agreement and except for such changes noted below, all other terms and conditions in the Agreement of Purchase and Sale shall remain as stated herein: It is further understood that and agreed that all changes and additions shall be installed as per builder's specifications, location and available selections. The Purchaser hereby agrees to purchase the following extras:

MISC.

1	SCHEDULE "E" TEN THOUSAND DOLLARS (\$10,000.00) AT DECOR (NO CASH VALUE) SINGLES	Qty: 1	
32,388	Note:		

MODIFICATION

2	ALTERNATE MAIN FLOOR WITH MODIFIED ACCESS TO MUDROOM \$500.00	Qty: 1	
32,389	Note: SKETCH # 2 PAGE 17		

Sub Total

HST

Total

1. This Sales Selection Sheet when properly executed forms part of our Agreement of Purchase and Sale.
2. All extras and upgrades listed above are subject to Construction Progress and Architectural and Municipal requirements.
3. In the event the Vendor is unable to incorporate the work approved above in the construction of the house for any reason whatsoever, the Vendor will not be liable to the Purchaser in any way. The monies paid for any changes or optional extras not proceeded with shall be returned to the Purchaser, without interest. The cost of options or extras is non-refundable in all other circumstances. If for any reason whatsoever the Agreement of Purchase and Sale is not completed, the total cost of work approved above will be retained by the Vendor.
4. The Vendor reserves the right to substitute above materials and equipment with that of equal or better quality.
5. Purchaser acknowledges that items may not be exactly as shown. Variations from the Vendor's samples may occur in finished materials due to normal production processes. Vendor is not responsible for shade difference which may occur from different dye lots or wood grains. Variations from the Vendor's samples will occur with natural materials such as wood, marble, granite, hardwood and brick.
6. The Vendor reserves the right to select Grout & Thresholds that best suits the Tile selected.
7. Selections will not be processed unless signed by Heathwood Homes Head Office.
8. The selections made on this schedule are final and cannot be changed once submitted.
9. The Purchaser has checked and acknowledges the accuracy of this schedule.

Payment Summary

Paid By Amount

Total Payment:

PURCHASER:

PAWANDEEP SINGH

19-Aug-20
DATE

Decor Consultant

19-Aug-20
DATE

APPROVED -

-08- 28 2020

Date Approved Heathwood Homes (Huron) Limited

TAX#:1

PREPARED BY: Irit Salem

PE 423-1

Siinvoice.rpt 28may19



Sales Selection Sheet
Wallaceton

3 of 24
TEL:

PURCHASER: PAWANDEEP SINGH

LOT / UNIT 254	PHASE 2	MODEL 25-2140 B The Wallace	
-------------------	------------	--------------------------------	--

PURCHASER: 
PAWANDEEP SINGH

19-Aug-20 DATE Decor Consultant 19-Aug-20 DATE

- APPROVED -

-08- 2 8 2020 

Date Approved Heathwood Homes (Huron) Limited

PAWANDEEP SINGH/
Project: Wallaceton
Unit: 254, Phase: 2
Model: 25-2140 B The Wallace

Created: 8/18/2020 09:06:54
Locked:
Closed:

4 of 24

Kitchen

Cabinet Colour/Style	9188	Classic II-CAMDEN-RAIN CLOUD-PAINT MDF ***UPG***
Countertop	8595	Group 2-Quartz-Caesarstone-OCEAN FOAM #6141-3/4 inch with built-up edge ***2***
Countertop Edge	4005	DOUBLE MITRE 1 1/2 INCH ***UPG*** 
Cabinet Hardware	7667	12881-HARDWARE ***STD***
Island Cabinet Colour/Style	9188	Classic II-CAMDEN-RAIN CLOUD-PAINT MDF ***UPG***
Island Countertop	8595	Group 2-Quartz-Caesarstone-OCEAN FOAM #6141-3/4 inch with built-up edge ***2***
Backsplash	8103	OD.ON.SWT.02.HEX.MT-ONTARIO HEXAGON MATTE-SNOW WHITE ***2***
Backsplash Grout	2226	Grout-(00) White ***STD***
Backsplash Tile Pattern	3110	HORIZONTAL HEX ***STD***

HoodFan	3110	AV1308 Air King 30 PAGE 24
Appliance	3110	Purchasers have been advised: standard fridge opening is a minimum 37 3/8 x 73 3/8". Ice Waterline Rough-In is included.
Appliance	3110	Standard stove opening is 30" and standard dishwasher opening is 24". Any gas stove will require backsplash or stainless steel backing to avoid fire hazards.
Appliance	3110	Purchasers acknowledge: Heathwood Homes and its contractors will not be responsible for any kitchen cabinet changes due to appliances dimension changes after

Comment

Kitchen/Breakfast

Flooring	8913	UN.BL.BIA.1224-Biel-Bianco (White)-12 x 24 See Tile Direction on Sketch 2 Page 17 ***2***
Floor Tile Grout	2225	Grout-(27) Silver ***STD***
Floor Tile Pattern	3040	FRONT TO BACK ***STD***

Handwritten mark

PAWANDEEP SINGH/
Project: Wallaceton
Unit: 254, Phase: 2
Model: 25-2140 B The Wallace

Created: 8/18/2020 09:06:54
Locked:
Closed:

5 of 24

Comment

Foyer

Flooring

8913UN.BL.BIA.1224-Biel-Bianco (White)-12 x 24 See Tile
Direction on Sketch 2 Page 17***2***

Floor Tile Grout

2225Grout-(27) Silver ***STD***

Floor Tile Pattern

3040FRONT TO BACK ***STD***

Comment

Laundry Room

Flooring

3040GE.BY.AZR.1313 New Byzantine Azzuro 13

Floor Tile Grout

2225Grout-(27) Silver ***STD***

Floor Tile Pattern

3000STANDARD SQUARE ***STD***

Comment

Laundry Room Opt.

Cabinet - Uppers

1111N/A *****

Cabinet Hardware

1111N/A *****

Comment

Mud Room

Flooring

8913UN.BL.BIA.1224-Biel-Bianco (White)-12 x 24 See Tile
Direction on Sketch 2 Page 17***2***

M

PAWANDEEP SINGH/
Project: Wallaceton
Unit: 254, Phase: 2
Model: 25-2140 B The Wallace

Created: 8/18/2020 09:06:54
Locked:
Closed:

6 of 24

Floor Tile Grout 2225 Grout-(27) Silver ***STD***
Floor Tile Pattern 3040 FRONT TO BACK ***STD***

Comment

Powder Room

Flooring 8913 UN.BL.BIA.1224-Biel-Bianco (White)-12 x 24 See Tile Direction on Sketch 2 Page 17 ***2***
Floor Tile Grout 2225 Grout-(27) Silver ***STD***
Floor Tile Pattern 3040 FRONT TO BACK ***STD***

Plumbing Fixture (Colour) 1737 Plumbing Fixtures-WHITE ***STD***
Comment

Dining Room/Hall

Flooring 7502 Red Oak Pearl-Vintage Engineered-ECLIPSE-3/4 inch x 3 1/4 inch ***STD***
Comment

Dining Room/Hall

Flooring 1111 N/A *****
Comment DUPLICATE

Great Room

Flooring 7502 Red Oak Pearl-Vintage Engineered-ECLIPSE-3/4 inch x 3 1/4 inch ***STD***
Comment

Handwritten signature

PAWANDEEP SINGH/
Project: Wallaceton
Unit: 254, Phase: 2
Model: 25-2140 B The Wallace

Created: 8/18/2020 09:06:54
Locked:
Closed:

7 of 24

Upper Hall

Flooring	9248	DY 89418 -Dynasty Tex-BLACK ICE-40 oz Poly***STD***
Comment		

Opt. Finished Basement (Rec) Room/Hall

Flooring	1111	N/A *****
Comment		

Master Bedroom

Flooring	9248	DY 89418 -Dynasty Tex-BLACK ICE-40 oz Poly***STD***
Comment		

Bedroom 2

Flooring	9248	DY 89418 -Dynasty Tex-BLACK ICE-40 oz Poly***STD***
Comment		

Bedroom 3

Flooring	9248	DY 89418 -Dynasty Tex-BLACK ICE-40 oz Poly***STD***
Comment		

Bedroom 4

Flooring	9248	DY 89418 -Dynasty Tex-BLACK ICE-40 oz Poly***STD***
Comment		

PA

PAWANDEEP SINGH/
Project: Wallaceton
Unit: 254, Phase: 2
Model: 25-2140 B The Wallace

Created: 8/18/2020 09:06:54
Locked:
Closed:

8 of 24

Master Ensuite

Cabinet Colour/Style	9168	Viking III-CHARLESTON-MOONLIGHT-3DL ***STD***
Countertop	9069	MSI Quartz GROUP 1 ICED WHITE ***STD***
Countertop Edge	4010	GROUP 1 - SINGLE POLISHED STRAIGHT EDGE 3/4 INCH ***1***
Cabinet Hardware	7667	 12881-HARDWARE ***STD***
Floor Tile	5494	GE.NA.GRY.1313-New Albion-Grey-13 x 13 ***STD***
Floor Tile Grout	2225	Grout-(27) Silver ***STD***
Floor Tile Pattern	3000	STANDARD SQUARE ***STD***

Shower Floor Tile	8661	OD.ON.SWT.0202.MT.N-Ontario Series Mosaic-Snow White Matte-2 x 2 ***STD***
Shower Floor Tile Grout	2226	Grout-(00) White ***STD***
Shower Floor Tile Pattern	3000	STANDARD SQUARE ***STD***

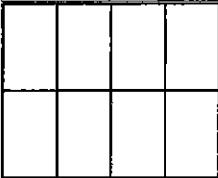
Shower Wall Tile	9022	QT.WV.TGR.0810-Weave-Tender Grey-8 x 10 ***STD***
Shower Wall Tile Grout	2226	Grout-(00) White ***STD***
Shower Wall Tile Pattern	3090	VERTICAL STACKED ***STD*** 

Shower Jamb(s) and Sill(s)	8923	Shower Jamb / Sill-Thassos White ***STD***
Plumbing Fixture (colour)	1737	Plumbing Fixtures-WHITE ***STD***

Comment

PAWANDEEP SINGH/
Project: Wallaceton
Unit: 254, Phase: 2
Model: 25-2140 B The Wallace

Created: 8/18/2020 09:06:54
Locked:
Closed:

9 of 24

Main Bathroom

Cabinet Colour/Style	6283	Viking III-TORONTO-OYSTER CL-MAPLE ***STD***								
Countertop	8829	4954K-22-Countertop-ITALIAN WHITE DI PESCO-Wilsonart ***STD***								
Countertop Edge	1111	N/A *****								
Cabinet Hardware	2076	181-HARDWARE ***STD***								
Flooring	8261	TR.ST.BYZ.1313-Serpentine-Beyaz/White-13x13 See Tile Line Pattern on Sketch 3 Page 18 ***STD***								
Floor Tile Grout	7705	Grout-(01) Alabaster ***UPG***								
Floor Tile Pattern	3000	STANDARD SQUARE ***STD***								
Wall Tile	8257	TR.ST.BYZ.0810-Serpentine-Beyaz/White-8 x 10 ***STD***								
Wall Tile Grout	2226	Grout-(00) White ***STD***								
Main Bathroom Tile Pattern	3090	VERTICAL STACKED ***STD*** <table><tr><td></td><td></td><td></td><td></td></tr><tr><td></td><td></td><td></td><td></td></tr></table>								
Plumbing Fixture (Colour)	1737	Plumbing Fixtures-WHITE ***STD***								
Comment										
Opt. Shower Floor Tile	im 1111	N/A *****								
Shower Floor Tile Grout	1111	N/A *****								
Shower Floor Tile Pattern	1111	N/A *****								
Shower Wall Tile	1111	N/A *****								
Shower Wall Tile Grout	1111	N/A *****								

Handwritten signature

Customer Colours

PAWANDEEP SINGH/
Project: Wallaceton
Unit: 254, Phase: 2
Model: 25-2140 B The Wallace

Created: 8/18/2020 09:06:54
Locked:
Closed:

10 of 24

Shower Wall Tile Pattern	1111	N/A *****
Shower Jamb(s)	1111	N/A *****
Cabinet Colour/Style	1111	N/A *****
Countertop	1111	N/A *****
Countertop Edge	1111	N/A *****
Cabinet Hardware	1111	N/A *****
Flooring	1111	N/A *****
Floor Tile Grout	1111	N/A *****
Floor Tile Pattern	1111	N/A *****
Plumbing Fixture (Colour)	1111	N/A *****
Comment		

Great Room Fireplace

Type	8869	Majestic MERC32 ***STD***
Mantle	8891	NF-17-Paint Grade Mantle- Cabinet (Per Plan)-WHITE ***STD*** PAGE 19
Surround Opt.	1111	N/A *****
Note	1111	Purchasers have been advised: heat from the FP can damage TV above a FP and items placed on mantle.
Note	1111	Heathwood and its contractors will not be liable for any damage on items placed/installed above a FP after closing.
Comment		

Handwritten signature

Basement Stairs

Type	1713	Paint Grade Stairs ***STD BASEMENT STAIR ***
------	------	--

Customer Colours

161

PAWANDEEP SINGH/
Project: Wallaceton
Unit: 254, Phase: 2
Model: 25-2140 B The Wallace

Created: 8/18/2020 09:06:54
Locked:
Closed:

11 of 24

Colour	1111	N/A *****
Carpet Runner	1111	N/A *****
Handrail/Pickets/Post Type	9119	Handrail only on closed walls (one or two sides per building code) ***STD***
Handrail/Pickets/Post Colours	1111	N/A *****
Carpet	1111	N/A *****
Custom Stain/Paint	1111	N/A *****
Comment		

Landing to Basement

Flooring	1111	N/A *****
Comment		

Main Stairs

Type	1712	Oak Stairs ***STD MAIN STAIRS***
Colour	7922	Eclipse (Pewter) STAIN TO COMPLIMENT HARDWOOD AND WILL VARY FROM FLOORING ***99***
Carpet Runner	1111	N/A *****
Handrail/Pickets/Posts Type	7652	1 5/16 inch Square pickets with 3 1/2" Square/Cap Post(s)-ALL OAK ***STD***
Handrail/Pickets/Posts Colour	1728	Oak Grade-Stain handrail,oak pickets,stringers,treads,risers
Custom Stain/Paint	1111	N/A *****
Comment		

PK

Hall

Flooring	7502	Red Oak Pearl-Vintage Engineered-ECLIPSE-3/4 inch x 3
----------	------	---

PAWANDEEP SINGH/
Project: Wallaceton
Unit: 254, Phase: 2
Model: 25-2140 B The Wallace

Created: 8/18/2020 09:06:54
Locked:
Closed:

12 of 24

1/4 inch ***STD***

Comment

Throughout

Walls - Paint Colour	1717	22-Wall-WARM GREY ***STD***
Underpad	1079	500 Series-Underpad ***STD***
Thresholds	2232	Metal Thresholds ***STD***
Switches and Plug	5796	Decora White Switches and Plugs ***STD***
Trim Size	8705	4 1/4 Baseboard and 2 3/4 Casings ***STD***
Trim - Paint Colour	1716	Trim-WHITE ***STD***

Comment

Purchaser: PAWANDEEP SINGH Aug 19, 2020 Date [Signature] Aug 19, 2020 Date Decor Consultant

Purchaser: _____ Date _____ [Signature] -08- 28 2020 Date Approved WALLACETON - APPROVED -



Sales Selection Sheet
Wallaceton

13 of 24
TEL:

PURCHASER: PAWANDEEP SINGH

LOT / UNIT	PHASE	MODEL	
254	2	25-2140 B The Wallace	

It is herein understood and agreed between the undersigned parties hereto that the following changes shall be made to the above mentioned Agreement of Purchase and Sale in accordance with the agreement and except for such changes noted below, all other terms and conditions in the Agreement of Purchase and Sale shall remain as stated herein: It is further understood that and agreed that all changes and additions shall be installed as per builder's specifications, location and available selections. The Purchaser hereby agrees to purchase the following extras:

Cabinetry

1 181,942 32,379	CABINETRY - CLASSIC II - KITCHEN - UPGRADE 3 Note:	Qty: 1
------------------------	---	--------

Ceramics

*2 182,206 32,380	CERAMICS - FLOOR - POWDER ROOM - UPGRADE 2 (ALT- Dining Room Layout) Note:	Qty: 1
3 182,070 32,381	CERAMICS - FLOOR - FOYER - UPGRADE 2 Note:	Qty: 1
4 182,238 32,382	CERAMICS - FLOOR - KITCHEN - UPGRADE 2 Note:	Qty: 1
5 182,278 32,383	CERAMICS - BACKSPLASH - KITCHEN - UPGRADE 2 Note:	Qty: 1
6 182,007 32,384	CERAMICS - FLOOR GROUT - MAIN BATHROOM - GROUT Note:	Qty: 1
*7 182,222 32,385	CERAMICS - FLOOR - GARAGE ENTRY / MUD ROOM - UPGRADE 2 (ALT- Dining Room Layout) Note:	Qty: 1

Electrical

8 189,450 32,376	ELECTRICAL - CEILING ROUGH-IN (CAPPED) Note: ONE TO BE INSTALLED IN THE KITCHEN- USE SEPARATE SWITCH ONE TO BE INSTALLED IN THE GREAT ROOM- USE EXISTING SWITCH PLUG SEE SKETCH# 2 PAGE# 17	Qty: 2
9 189,449 32,377	ELECTRICAL - EXTRA WALL INTERIOR OUTLET ON EXISTING CIRCUIT (DOES NOT INCLUDE KITCHEN OUTLETS) Note: GREAT ROOM : TO BE INSTALLED 70" ABOVE THE FLOOR IN THE CENTRE OF THE FIRE PLACE SEE SKETCH# 2 PAGE# 17	Qty: 1
10 189,451 32,378	ELECTRICAL - ADDITIONAL SWITCH Note: KITCHEN- TO BE USED FOR THE R/I CAP LIGHT SEE SKETCH# 2 PAGE# 17	Qty: 1

Initials:

TAX#:1

PREPARED BY: Irit Salem

PE 421-1

SlInvoice.rpt 28may19



Sales Selection Sheet
Wallaceton

14 of 24
TEL:

PURCHASER: PAWANDEEP SINGH

LOT / UNIT 254	PHASE 2	MODEL 25-2140 B The Wallace	
-------------------	------------	--------------------------------	--

Granite

11 182,313 32,386	GRANITE - COUNTERTOP - 3/4" GROUP 2 WITH MITRE EDGE - KITCHEN / ISLAND - UPGRADE 2 Note:	Qty: 1	
-------------------------	---	--------	--

MISC.

12 32,387	TEN THOUSAND DOLLARS (\$10,000) IN UPGRADE AT DECOR AS PER SCHEDULE E Note:	Qty: 1	
--------------	--	--------	--

Plumbing

13 189,695 32,375	PLUMBING - OPTION FROM ONE SINK TO DOUBLE SINKS, INCLUDING STD CHATEAU FAUCET AND UNDERMOUNT OVALYN INCLUDING STD CHATEAU FAUCET AND UNDERMOUNT OVALYN SINK INCLUDING CABINET CONVERSION 2D CLASSIC, ONE EXTRA CUTOUT AND ONE EXTRA VANITY LIGHT Note: SKETCH # 3 PAGE 18 SINK SPEC PAGE 23	Qty: 1	
-------------------------	--	--------	--

Sub Total
HST
Total

- 1. This Sales Selection Sheet when properly executed forms part of our Agreement of Purchase and Sale.
- 2. All extras and upgrades listed above are subject to Construction Progress and Architectural and Municipal requirements.
- 3. In the event the Vendor is unable to incorporate the work approved above in the construction of the house for any reason whatsoever, the Vendor will not be liable to the Purchaser in any way. The monies paid for any changes or optional extras not proceeded with shall be returned to the Purchaser, without interest. The cost of options or extras is non-refundable in all other circumstances. If for any reason whatsoever the Agreement of Purchase and Sale is not completed, the total cost of work approved above will be retained by the Vendor.
- 4. The Vendor reserves the right to substitute above materials and equipment with that of equal or better quality.
- 5. Purchaser acknowledges that items may not be exactly as shown. Variations from the Vendor's samples may occur in finished materials due to normal production processes. Vendor is not responsible for shade difference which may occur from different dye lots or wood grains. Variations from the Vendor's samples will occur with natural materials such as wood, marble, granite, hardwood and brick.
- 6. The Vendor reserves the right to select Grout & Thresholds that best suits the Tile selected.
- 7. Selections will not be processed unless signed by Heathwood Homes Head Office.
- 8. The selections made on this schedule are final and cannot be changed once submitted.
- 9. The Purchaser has checked and acknowledges the accuracy of this schedule.

Payment Summary	
<u>Paid By</u>	<u>Amount</u>
<u>Total Payment:</u>	

Initials:

LOT / UNIT 254	PHASE 2	MODEL 25-2140 B The Wallace	
-------------------	------------	--------------------------------	--

PURCHASER:

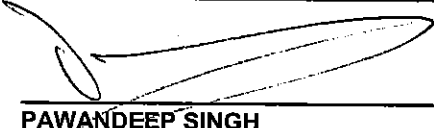
PAWANDEEP SINGH

19-Aug-20

DATE

Decor Consultant

19-Aug-20

DATE

- APPROVED -

-08- 28 2020

Date Approved

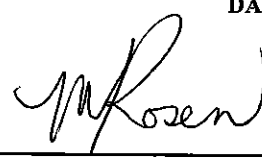
Heathwood Homes (Huron) Limited

UK-75 WALLACETON
LOT 254
25-2140 ALT ELEV B
THE WALLACE

16 of 24

THE WALLACE
ELEVATION B, C D & E | 2,133 SQ. FT.
589 sq. ft. of opt. Finished Lower Level
WALLACETON
EST. 1870

25-2140 ALT ELEV.B

Sketch # 1

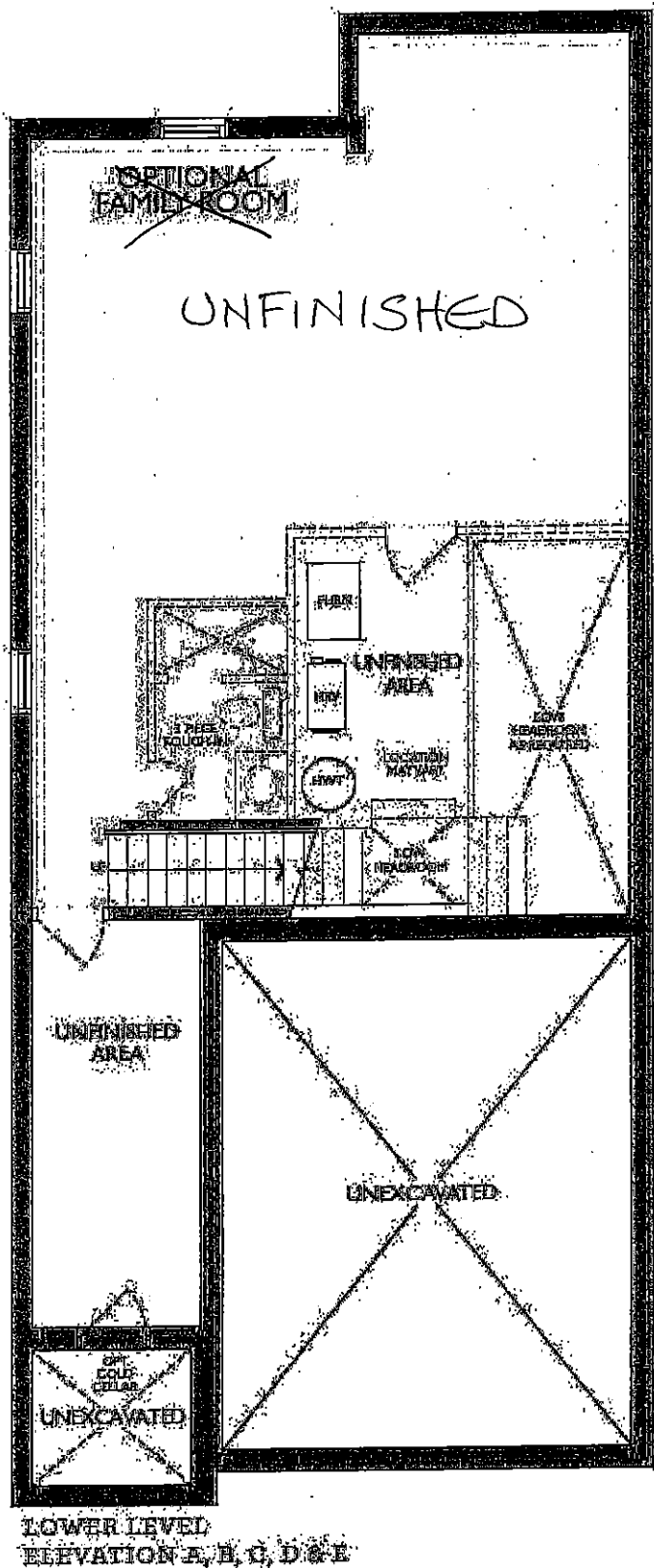

Handwritten signature or initials.

UK-75 WALLACETON
LOT 254
25-2140 ALT ELEV B
THE WALLACE

17 of 24

THE WALLACE
ELEVATION B, C D & E | 2,133 SQ. FT.

500 sq. ft. of opt. Finished Lower Level

WALLACETON
EST. 1939

25-2140 ALT ELEV.B

Sketch #2

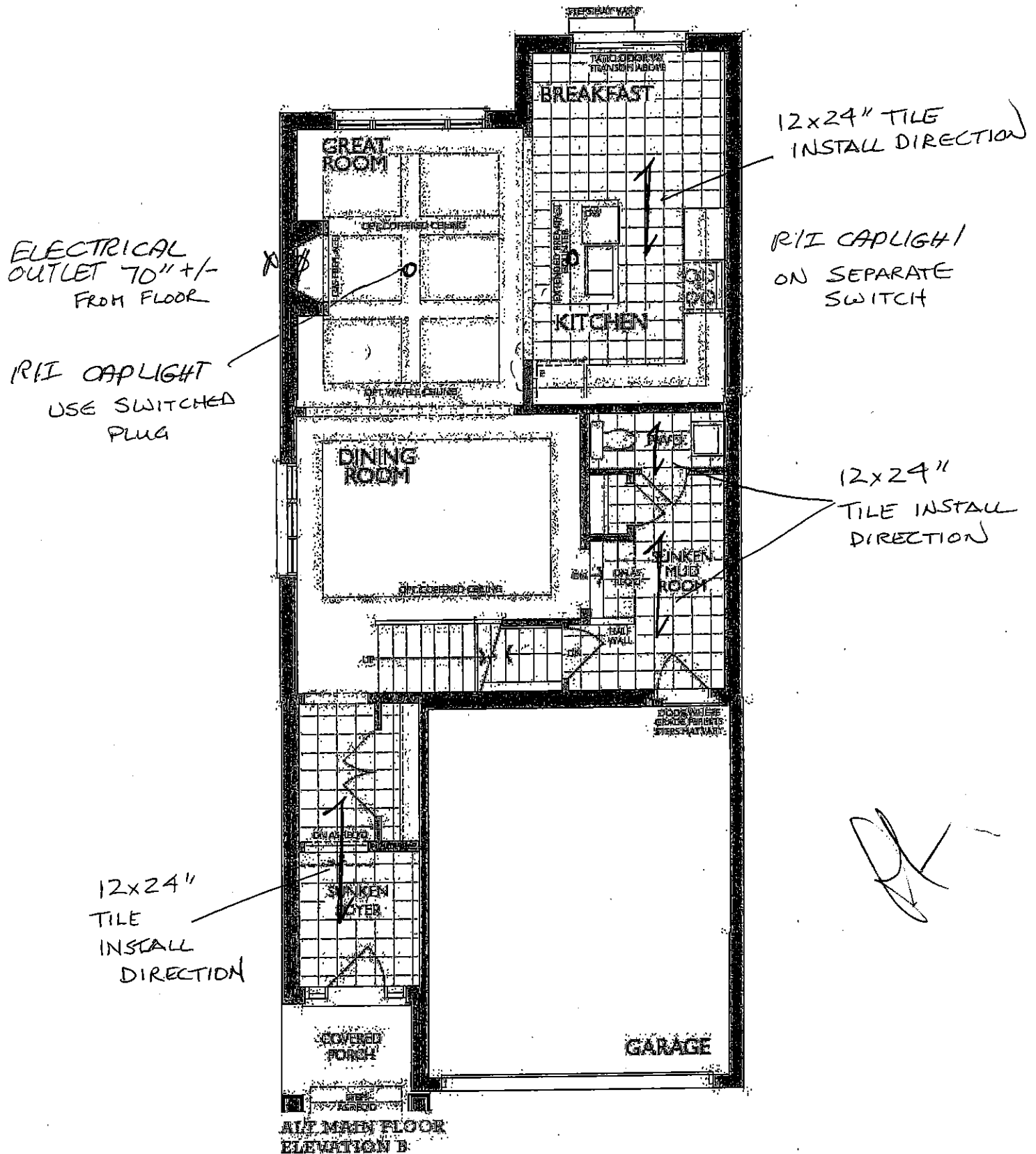

UK-75 WALLACETON
LOT 254
25-2140 ALT ELEV B
THE WALLACE

18 of 24

THE WALLACE
ELEVATION B, C D & E | 2,133 SQ. FT.

500 sq. ft. of opt. finished lower level

WALLACETON
EST. 1870

25-2140 ALT ELEV.B

SKETCH #3

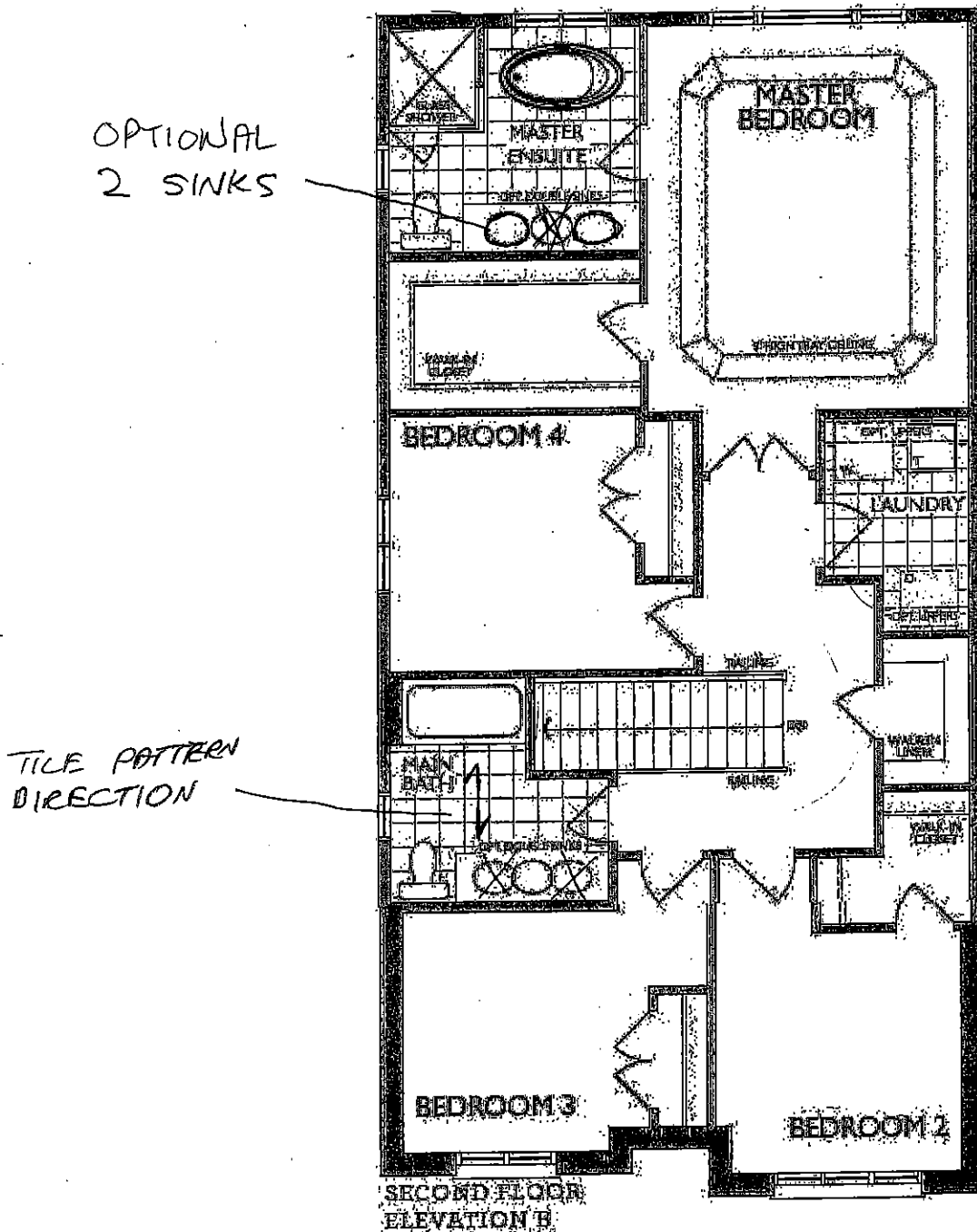

UK-75 WALLACETON
LOT 254
25-2140 ALT ELEV B
THE WALLACE

19 of 24

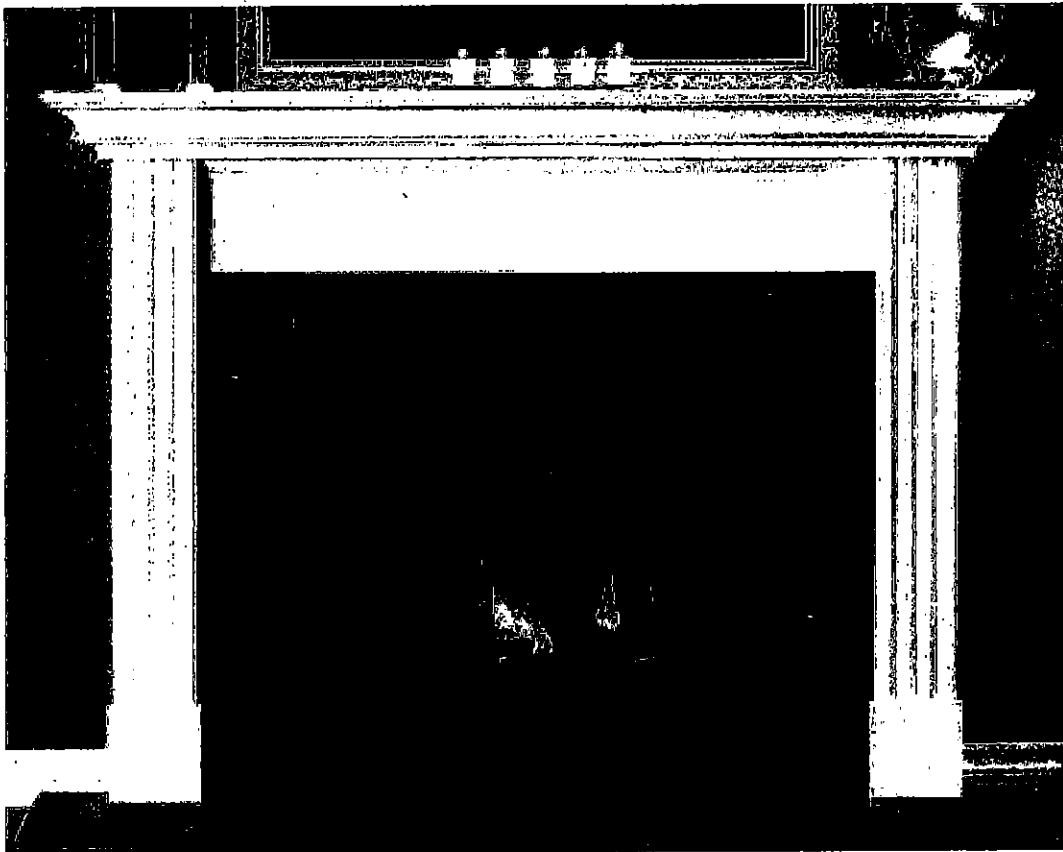

STANDARD NF 15 Mantel

Clean apron finish with fluted legs

WHITE PAINT GRADE FINISH

(PICTURE SHOWN WITH UPGRADE SURROUND AND HEARTH -PRICED SEPARATELY)

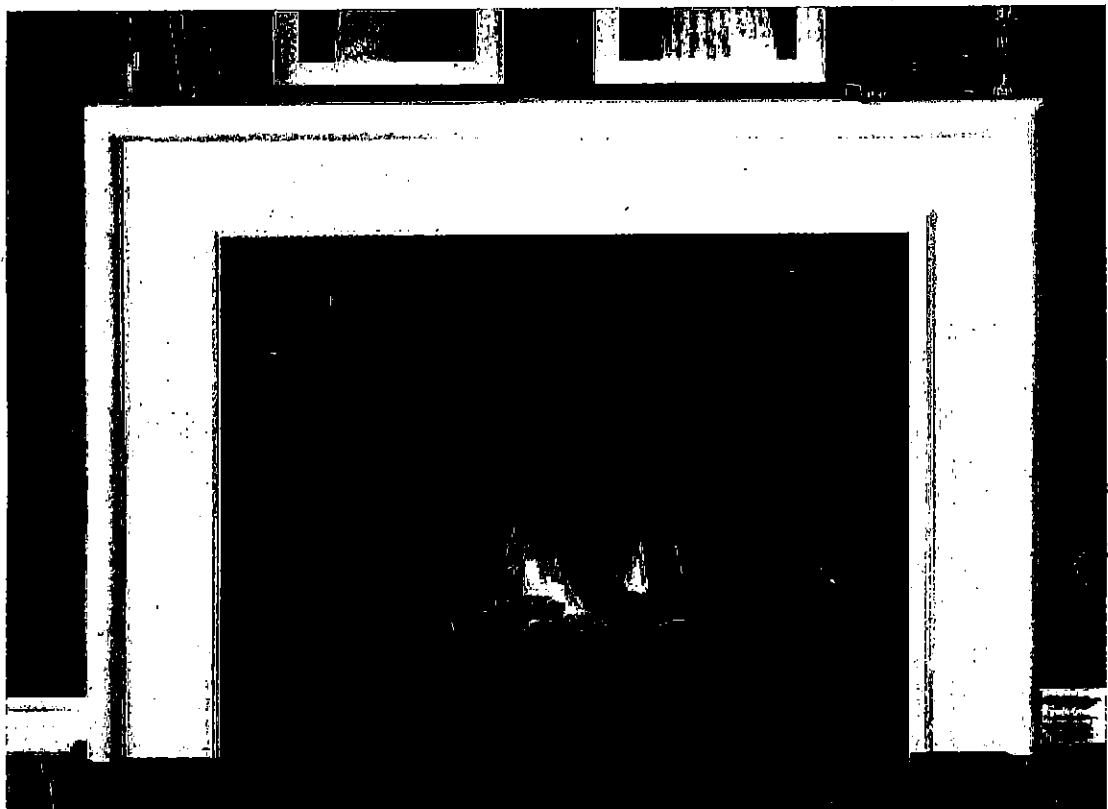

CABINET

STANDARD NF 17 Mantel

WHITE PAINT GRADE FINISH

(PICTURE SHOWN WITH UPGRADE SURROUND AND HEARTH -PRICED SEPARATELY)

UK-75 WALLACETON
LOT 254
25-2140 ALT ELEV B
THE WALLACE

20 of 24

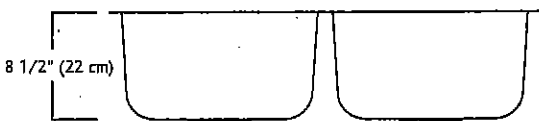
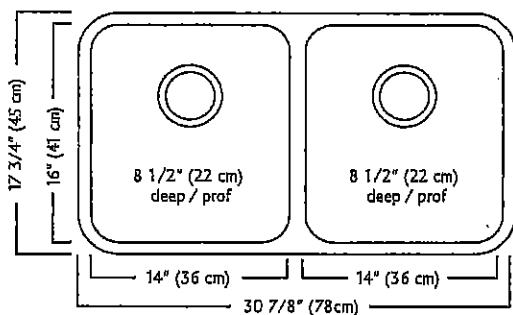

ND1831UA/9 SPECIFICATION

Model ND1831UA/9 is a double (two equal size) bowl undermount sink manufactured by Franke Kindred Canada Limited from 18 gauge stainless steel. Product has silk finished rims and linear brush finished bowls. Sink is fully undercoated. Basket strainer waste fittings (3 1/2", 89 mm) are included. Sink is backed with a limited lifetime warranty.

- O.D. 17 3/4" x 30 7/8" x 8 1/2" (45 x 78 x 22 cm)
- Recommended for minimum 36" cabinet

Franke Kindred Canada Limited
P.O. Box 190, 1000 Franke Kindred Road, Midland, Ontario, Canada, L4R 4K9 Phone: 866-687-7465 Fax: 800-361-8408

UK-75 WALLACETON
LOT 254
25-2140 ALT ELEV B
THE WALLACE

21 of 24

STANDARD KITCHEN FAUCET

Align

Modern



Single Handle Pull-Down Kitchen
Faucet*

Model 7565†

RK

UK-75 WALLACETON
LOT 254
25-2140 ALT ELEV B
THE WALLACE

22 of 24

Chateau

Transitional

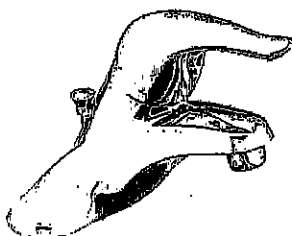

Lavatory Faucet with Pop-Up Drain
Model L4621†

VANITY SINKS AND PEDESTAL

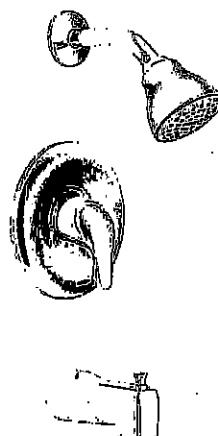

Posi-Temp® Pressure Balancing Tub/Shower
Model 62320 / TL183†

OR

Posi-Temp Valve and Tub/Shower Trim
with Eco-Performance Easy Clean® XL

Model 62320 / TL183EP†
(TL183EP not available in BC)

SHOWER AND 5" TUB FAUCETS



2 Handle Roman Tub with 9" Spout
Model 4796 / T990†

FREESTANDING TUB FAUCETS

UK-75 WALLACETON
LOT 254
25-2140 ALT ELEV B
THE WALLACE

23 of 24

American Standard

Style That Works Better

BARRIER FREE

OVALYN™ UNDERCOUNTER SINK

- Classic oval undermount sink
- Made from vitreous china
- Front overflow
- Supplied with mounting kit (047194-0070A) and template

0496.221 Unglazed rim
489 x 413mm
(19-1/4" x 16-1/4")

Bowl size:
432mm (17") wide
356mm (14") front to back
140mm (5-1/2") deep

Compliance Certifications -
Meets or Exceeds the Following Specifications:
• ASME A112.19.2M for Vitreous China Fixtures
• CAN/CSA B45 series

OVALYN™
UNDERCOUNTER SINK
VITREOUS CHINA

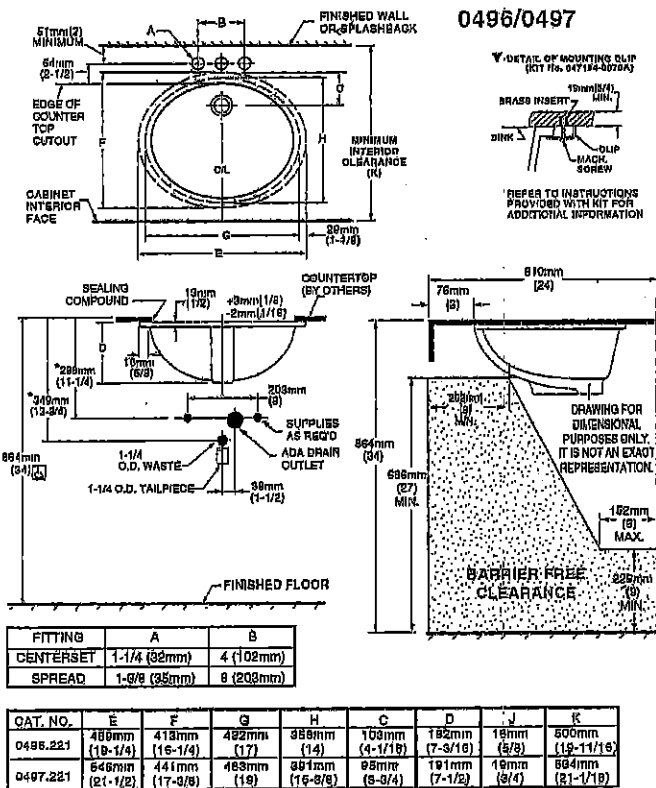
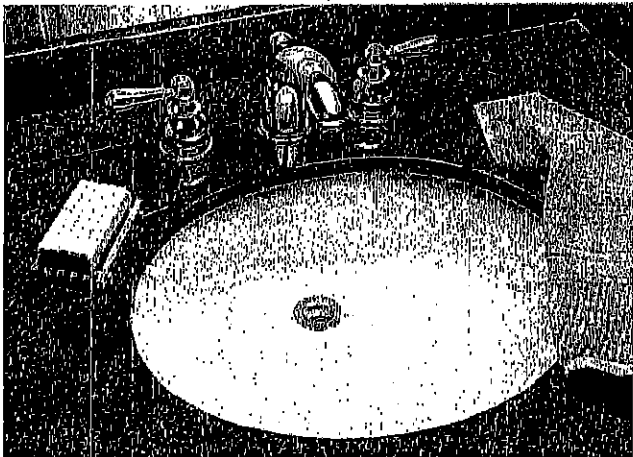

UK-75 WALLACETON
LOT 254
25-2140 ALT ELEV B
THE WALLACE

24 of 24

STANDARD HOOD FAN
WALLACETON TOWNHOMES



SPECIFICATIONS
AV SERIES
RANGE HOODS



180 CFM/7.0 Sones @ 0.10" SP. Horizontal
180 CFM/7.5 Sones @ 0.10" SP. Vertical

- Dimensions**
Overall bottom projection - 18 3/8"
Overall top projection - 12"
Height - 6"
Available widths: 21", 24", 30", 36" & 42"
- Hood Body**
Stainless Steel: 24 gauge, grade 430 stainless steel.
Painted: 23 gauge cold rolled commercial grade (CRCC) steel, auto welded, coated with a baked enamel finish.
- Motor**
2 speed, single coil, thermally protected, permanently lubricated.
Rated 120 volts, 60 hz. Complete with 200°C lead wires!
- Lighting**
Single 60 watt cook light capacity (bulb not included).
- Ducting Options**
Horizontal ducting: 3 1/4"x10" (duct adapter and damper included).
Vertical ducting: 3 1/4"x10" (duct adapter and damper included).
Vertical ducting: 7" round (duct adapter and damper not included).
Ductless: removable front vent (charcoal filter not included).
- Fan Blade**
One piece polymeric, electronically balanced blade, 6 5/8" diameter with 5 paddles.
- Electrical connection**
Hood top - 7/8" knockout hole for use with 1/2" cable clamp
Hood back - 7/8" knockout hole for use with 1/2" cable clamp

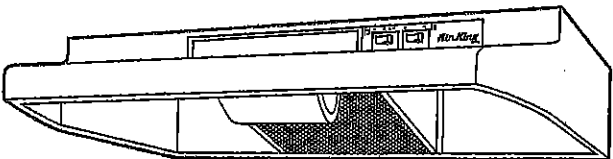

AV SERIES

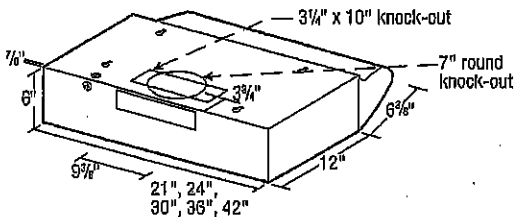

- Filters**
UL rated, class 2 filter.
Grease Filter: RF35 - 8 7/8"x10 3/8" (included).
Charcoal Filter: RF34 (not included).
Combo Grease/Charcoal: RF55 (not included).
- Available Finishes**
White, Biscuit, Almond, Black & Stainless Steel.

EXPANDED PERFORMANCE										
Air Flow - CFM	Static Pressure (inches of w.g.)						Sones @ .1 SP	Fan Speed RPM	Power Watts	Amps
	0	0.05	0.1	0.15	0.2	0.25				
Vertical Ducting High	246	232	218	203	181	147	7.5	2973	87.0	2.1
Horizontal Ducting High	225	210	180	175	155	120	7.0	3024	87.0	2.1

PROJECT							ARCHITECT			
LOCATION							ENGINEER			
CONTRACTOR							SUBMITTED BY		DATE	
FAN NUMBER	MODEL NUMBER	CFM	IN W.G.	RPM	WATTS	AMPS	SONES	QTY	OPTIONAL EQUIPMENT & REMARKS	



Air King: 820 Lincoln Avenue
West Chester, Pennsylvania 19380-4466
Tel: (610) 692-7400 • 877-304-3785
Fax: (610) 696-8048

Canada:
Brampton, Ontario
Tel: 905-456-2033
Fax: (905) 456-1015

Specifications subject to change without notice.

Updated 2-18

[Handwritten signature]