

Sales Selection Sheet  
Checklist

1 of 29

LOT 246 Model: 25-2140 B The Wallace

PURCHASERS: OSCAR, ADOLFO MENJIVAR MADRID AND NATALIA BAGAN

VENDOR: Heathwood Homes (Huron) Limited

COFFERED CELINGS IN GREAT ROOM AND DINING ROOM  
MASTER ENSUITE- OPTIONAL DOUBLE SINKS

- ☒ FINISHED BASEMENT  
☐ COLD CELLAR

UPGRADED / MODIFIED ELEVATION

- ☐ CORNER UPGRADE  
☒ REAR UPGRADE

CEILING UPGRADE - SMOOTH

- ☐ MAIN FLOOR  
☐ SECOND FLOOR  
☐ BASEMENT

ADDITIONAL ROUGH-INS

- ☒ 200 AMP SERVICE  
☐ WET BAR ROUGH-IN  
☐ HUMIDIFIER  
☒ AIR CONDITIONING

GAS ROUGH-IN

- ☒ STOVE  
☐ DRYER  
☐ BBQ  
☐ ADDITIONAL FIREPLACE

KITCHEN: HOODFAN VENTING SIZE

- ☒ 6 IN ROUND DUCT  
☐ 7 IN ROUND DUCT

FULL BASEMENT STAIRS:	Carpet Grade
UPPER BASEMENT STAIRS:	N/A
LOWER BASEMENT STAIRS:	N/A
MAIN STAIRS:	All Oak
MEDIA STAIRS (if applicable):	N/A
LOFT STAIRS (if applicable):	N/A

July 7/20  
Date Purchaser: *Signature*  
*on file*

July 7/20  
Date Decor Consultant: *TINA LEFUR*

- APPROVED -  
-07- 31 2020  
Date Approved  
Heathwood Homes (Huron) Limited  
*M. Rosen*

Locked Date:



Sales Selection Sheet  
Wallaceton

2 of 29  
TEL:

PURCHASERS: OSCAR, ADOLFO MENJIVAR MADRID and NATALIA BAGAN

LOT / UNIT 246	PHASE 2	MODEL 25-2140 B The Wallace	
-------------------	------------	--------------------------------	--

It is herein understood and agreed between the undersigned parties hereto that the following changes shall be made to the above mentioned Agreement of Purchase and Sale in accordance with the agreement and except for such changes noted below, all other terms and conditions in the Agreement of Purchase and Sale shall remain as stated herein: It is further understood that and agreed that all changes and additions shall be installed as per builder's specifications, location and available selections. The Purchaser hereby agrees to purchase the following extras:

MISC.

1  26,275	SCHEDULE E: FINISHED LOWER LEVEL-589 SQ FT ( THE WALLACE)  Note:	Qty: 1	
2  26,276	SCHEDULE E: TEN THOUSAND DOLLARS ( \$10,000) AT DECOR (NO CASH VALUE) - SINGLES  Note:	Qty: 1	
3  26,277	SCHEDULE E: SCHEDULE X: ITEM #5 ADJUSTMENTS (e) AND (f) COMBINED TO BE CAPPED AT \$5,000  Note:	Qty: 1	

Sub Total
HST
Total

1. This Sales Selection Sheet when properly executed forms part of our Agreement of Purchase and Sale.
2. All extras and upgrades listed above are subject to Construction Progress and Architectural and Municipal requirements.
3. In the event the Vendor is unable to incorporate the work approved above in the construction of the house for any reason whatsoever, the Vendor will not be liable to the Purchaser in any way. The monies paid for any changes or optional extras not proceeded with shall be returned to the Purchaser, without interest. The cost of options or extras is non-refundable in all other circumstances. If for any reason whatsoever the Agreement of Purchase and Sale is not completed, the total cost of work approved above will be retained by the Vendor.
4. The Vendor reserves the right to substitute above materials and equipment with that of equal or better quality.
5. Purchaser acknowledges that items may not be exactly as shown. Variations from the Vendor's samples may occur in finished materials due to normal production processes. Vendor is not responsible for shade difference which may occur from different dye lots or wood grains. Variations from the Vendor's samples will occur with natural materials such as wood, marble, granite, hardwood and brick.
6. The Vendor reserves the right to select Grout & Thresholds that best suits the Tile selected.
7. Selections will not be processed unless signed by Heathwood Homes Head Office.
8. The selections made on this schedule are final and cannot be changed once submitted.
9. The Purchaser has checked and acknowledges the accuracy of this schedule.

Payment Summary	
<u>Paid By</u>	<u>Amount</u>
Total Payment: _____	

Initials: mf



Sales Selection Sheet  
Wallaceton

3 of 29

PURCHASERS: OSCAR, ADOLFO MENJIVAR MADRID and NATALIA BAGAN

TEL:

LOT / UNIT 246	PHASE 2	MODEL 25-2140 B The Wallace	
-------------------	------------	--------------------------------	--

PURCHASER:

Signatures

OSCAR, ADOLFO MENJIVAR MADRID

13-Jul-20

DATE

on file

NATALIA BAGAN

13-Jul-20

DATE

TINA LEFUR

Decor Consultant

13-Jul-20

DATE

APPROVED

-07- 31 2020

mRoew

Date Approved

Heathwood Homes (Huron) Limited

OSCAR, ADOLFO MENJIVAR MADRID/NATALIA BAGAN  
Project: Wallaceton  
Unit: 246, Phase: 2  
Model: 25-2140 B The Wallace

Created: 4/23/2020 09:59:51  
Locked:  
Closed:

4 of 29

Kitchen

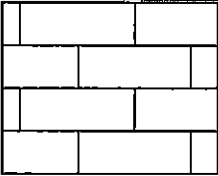
Cabinet Colour/Style	9111	VIKING III SIMCOE ORCHID 3DL ***STD***
Countertop	8897	Group 4-Quartz-Caesarstone-ORGANIC WHITE # 4600-3/4 inch with built-up edge ***4***
Countertop Edge	4005	DOUBLE MITRE 1 1/2 INCH ***UPG*** 
Cabinet Hardware	7667	12881-HARDWARE ***STD***
Island Cabinet Colour/Style	9111	VIKING III SIMCOE ORCHID 3DL ***STD***
Island Countertop	8897	Group 4-Quartz-Caesarstone-ORGANIC WHITE # 4600-3/4 inch with built-up edge ***4***
Backsplash	8114	QT.CH.TGR.0306.BR-Chess Bevelled Gloss-TENDER GREY-3 x 6 ***3***
Backsplash Grout	2226	Grout-(00) White ***STD***
Backsplash Tile Pattern	3060	HORIZONTAL BRICK ***STD*** 
HoodFan	8894	SCB51430-CYCLONE 30 inch CANOPY CHIMNEY HOODFAN-STAINLESS STEEL ***** PAGES 28/29
Appliance	8894	Purchasers have been advised: standard fridge opening is a minimum 37 3/8 x 73 3/8". Ice Waterline Rough-In is included.
Appliance	8894	Standard stove opening is 30" and standard dishwasher opening is 24". Any gas stove will require backsplash or stainless steel backing to avoid fire hazards.
Appliance	8894	Purchasers acknowledge: Heathwood Homes and its contractors will not be responsible for any kitchen cabinet changes due to appliances dimension changes after
Comment		

Kitchen/Breakfast

Flooring	9008	Red Oak PEARL-Vintage Red Oak Solid Sculpted Character PEARL-SAND DUNE-3/4 inch X 5 inch ***9***
Floor Tile Grout	1111	N/A *****
Floor Tile Pattern	1111	N/A *****

## 109

Closed:

4/23/2020 09:59:51  
5 of 29

--

## Foyer

UN.BL.ATR.1224-Biel-Antracita (Dark Grey)-12 x 24 See  
Tile Direction on Sketch **2** Page **19** \*\*\*2\*\*\*

Grout-(19) Pearl Gray \*\*\*STD\*\*\*

OFF SET 1/3 X 2/3 BRICK PATTERN \*\*\*UPG\*\*\*

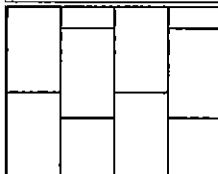

--

## Laundry Room

GE.SU.ATR.1313 Sauble Anthracite (Black) 13

Grout-(19) Pearl Gray \*\*\*STD\*\*\*

STANDARD SQUARE \*\*\*STD\*\*\*

--

**Laundry Room Opt.**

N/A *****
-----------

N/A	*****
-----	-------

\_\_\_\_\_

## Mud Room

UN.BL.ATR.1224-Biel-Antracita (Dark Grey)-12 x 24 See  
Tile Direction on Sketch **2** Page **19** \*\*\*2\*\*\*

OSCAR, ADOLFO MENJIVAR MADRID/NATALIA BAGAN  
Project: Wallaceton  
Unit: 246, Phase: 2  
Model: 25-2140 B The Wallace

Created: 4/23/2020 09:59:51  
Locked:  
Closed:

6 of 29

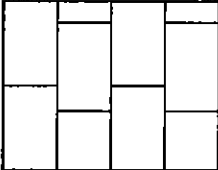
Floor Tile Grout	7704	Grout-(19) Pearl Gray ***STD***
Floor Tile Pattern	3020	OFF SET 1/3 X 2/3 BRICK PATTERN ***UPG***
		

Comment

Powder Room

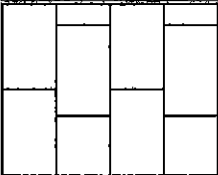
Flooring	8915	UN.BL.ATR.1224-Biel-Antracita (Dark Grey)-12 x 24 See Tile Direction on Sketch 2 Page 19**2***
Floor Tile Grout	7704	Grout-(19) Pearl Gray ***STD***
Floor Tile Pattern	3020	OFF SET 1/3 X 2/3 BRICK PATTERN ***UPG***
		
Plumbing Fixture (Colour)	1737	Plumbing Fixtures-WHITE ***STD***
Comment		

Dining Room/Hall

Flooring	9008	Red Oak PEARL-Vintage Red Oak Solid Sculpted Character PEARL-SAND DUNE-3/4 inch X 5 inch ***1***
Comment		

Dining Room/Hall

Flooring	9008	Red Oak PEARL-Vintage Red Oak Solid Sculpted Character PEARL-SAND DUNE-3/4 inch X 5 inch ***1***
Comment		

Great Room

Flooring	9008	Red Oak PEARL-Vintage Red Oak Solid Sculpted Character PEARL-SAND DUNE-3/4 inch X 5 inch ***1***
Comment		

OSCAR, ADOLFO MENJIVAR MADRID/NATALIA BAGAN  
Project: Wallaceton  
Unit: 246, Phase: 2  
Model: 25-2140 B The Wallace

Created: 4/23/2020 09:59:51  
Locked:  
Closed:

7 of 29

Upper Hall

Flooring 9008 Red Oak PEARL-Vintage Red Oak Solid Sculpted  
Character PEARL-SAND DUNE-3/4 inch X 5 inch \*\*\*4\*\*\*

Comment

Opt. Finished Basement (Rec) Room/Hall

Flooring 9008 T-15-Dynasty Tex-T-15-40 oz Poly \*\*\*STD\*\*\*

Comment

Master Bedroom

Flooring 9008 T-15-Dynasty Tex-T-15-40 oz Poly \*\*\*STD\*\*\*

Comment

Bedroom 2

Flooring 9008 T-15-Dynasty Tex-T-15-40 oz Poly \*\*\*STD\*\*\*

Comment

Bedroom 3

Flooring 9008 T-15-Dynasty Tex-T-15-40 oz Poly \*\*\*STD\*\*\*

Comment

Bedroom 4

Flooring 9008 T-15-Dynasty Tex-T-15-40 oz Poly \*\*\*STD\*\*\*

Comment

OSCAR, ADOLFO MENJIVAR MADRID/NATALIA BAGAN  
Project: Wallaceton  
Unit: 246, Phase: 2  
Model: 25-2140 B The Wallace

Created: 4/23/2020 09:59:51  
Locked:  
Closed:

8 of 29

Master Ensuite

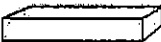
Cabinet Colour/Style	9169	Viking III-CHARLESTON-NAVY BLUE-3DL ***STD***
Countertop	9069	MSI Quartz GROUP 1 ICED WHITE ***STD***
Countertop Edge	4010	GROUP 1 - SINGLE POLISHED STRAIGHT EDGE 3/4 INCH ***1***
Cabinet Hardware	7667	 12881-HARDWARE ***STD***
Floor Tile	8691	NY.RG.SLW.1224.MT-Regal Matte-Shell White Matte-12 x 24 See Tile Direction on Sketch <b>3</b> Page <b>26</b> ***4***
Floor Tile Grout	7705	Grout-(01) Alabaster ***UPG***
Floor Tile Pattern	3040	FRONT TO BACK ***STD***

Shower Floor Tile	8108	OD.ON.DGR.02.HEX.MT-ONTARIO HEXAGON MATTE-DARK GREY ***2***
Shower Floor Tile Grout	7704	Grout-(19) Pearl Gray ***STD***
Shower Floor Tile Pattern	3000	STANDARD SQUARE ***STD***

Shower Wall Tile	5730	QT.CD.ARW.0306MT-Colour and Dimension Matte-Arctic White-3 x 6 ***1***
Shower Wall Tile Grout	2226	Grout-(00) White ***STD***
Shower Wall Tile Pattern	3060	HORIZONTAL BRICK ***UPG*** 
Shower Jamb(s) and Sill(s)	8923	Shower Jamb / Sill-Thassos White ***STD***
Plumbing Fixture (colour)	1737	Plumbing Fixtures-WHITE ***STD***

Comment

OSCAR, ADOLFO MENJIVAR MADRID/NATALIA BAGAN  
Project: Wallaceton  
Unit: 246, Phase: 2  
Model: 25-2140 B The Wallace

Created: 4/23/2020 09:59:51  
Locked:  
Closed:

9 of 29

Main Bathroom

Cabinet Colour/Style	6318	Viking III-CAMDEN-CAVIAR CL-MAPLE ***STD***								
Countertop	8796	6698-46-Countertop-PALOMA POLAR ETCHINGS FINISH-Formica ***STD***								
Countertop Edge	1111	N/A *****								
Cabinet Hardware	2076	181-HARDWARE ***STD***								
Flooring	2076	GE.MD.WHT.1818.MT Madison Series White Matte 18								
Floor Tile Grout	2225	Grout-(27) Silver ***STD***								
Floor Tile Pattern	3000	STANDARD SQUARE ***STD***								
Wall Tile	5737	QT.CD.STG.0306.MT-Colour and Dimension Matte-Sterling Grey-3 x 6 ***2***								
Wall Tile Grout	2225	Grout-(27) Silver ***UPG***								
Main Bathroom Tile Pattern	3070	HORIZONTAL STACKED ***STD*** <table><tr><td></td><td></td></tr><tr><td></td><td></td></tr><tr><td></td><td></td></tr><tr><td></td><td></td></tr></table>								
Plumbing Fixture (Colour)	1737	Plumbing Fixtures-WHITE ***STD***								
Comment										

Opt. Shower Floor Tile	im 8106	OD.ON.TGR.02.HEX.MT-ONTARIO HEXAGON MATTE-TENDER GREY ***2***
Shower Floor Tile Grout	2226	Grout-(00) White ***STD***
Shower Floor Tile Pattern	3000	STANDARD SQUARE ***STD***
Shower Wall Tile	8833	QT.UW.WHT.0810-Uniwall-White-8 x 10 ***STD***
Shower Wall Tile Grout	2226	Grout-(00) White ***STD***

OSCAR, ADOLFO MENJIVAR MADRID/NATALIA BAGAN  
Project: Wallaceton  
Unit: 246, Phase: 2  
Model: 25-2140 B The Wallace

Created: 4/23/2020 09:59:51  
Locked:  
Closed:

10 of 29

Shower Wall Tile Pattern	3070	HORIZONTAL STACKED ***STD*** <table><tr><td></td><td></td></tr><tr><td></td><td></td></tr><tr><td></td><td></td></tr><tr><td></td><td></td></tr></table>								
Shower Jamb(s)	8923	Shower Jamb / Sill-Thassos White ***STD***								
Cabinet Colour/Style	9156	Viking III-SIMCOE-RAIN CLOUD-3DL ***STD***								
Countertop	8796	6698-46-Countertop-PALOMA POLAR ETCHINGS FINISH-Formica ***STD***								
Countertop Edge	1111	N/A *****								
Cabinet Hardware	2076	181-HARDWARE ***STD***								
Flooring	8913	UN.BL.BIA.1224-Biel-Bianco (White)-12 x 24 See Tile Direction on Sketch   Page 18 ***2***								
Floor Tile Grout	2225	Grout-(27) Silver ***STD***								
Floor Tile Pattern	3040	FRONT TO BACK ***STD***								
Plumbing Fixture (Colour)	1737	Plumbing Fixtures-WHITE ***STD***								
Comment										

Great Room Fireplace

Type	8869	Majestic MERC32 ***STD***
Mantle	9114	NF 15-Paint Grade Mantle- Cabinet (Per Plan)-WHITE ***STD*** PAGE 22
Surround Opt.	1111	N/A *****
Note	1111	Purchasers have been advised: heat from the FP can damage TV above a FP and items placed on mantle.
Note	1111	Heathwood and its contractors will not be liable for any damage on items placed/installed above a FP after closing.
Comment		

Basement Stairs

Type	1714	Carpet Grade Stairs ***STD BASEMENT STAIRS***
------	------	---

OSCAR, ADOLFO MENJIVAR MADRID/NATALIA BAGAN  
Project: Wallaceton  
Unit: 246, Phase: 2  
Model: 25-2140 B The Wallace

Created: 4/23/2020 09:59:51  
Locked:  
Closed:

11 of 29

Colour	7940	Sambucca STAIN TO COMPLIMENT HARDWOOD AND WILL VARY FROM FLOORING ***99***
Carpet Runner	1111	N/A *****
Handrail/Pickets/Post Type	9119	Handrail only on closed walls (one or two sides per building code) ***STD***
Handrail/Pickets/Post Colours	1111	N/A *****
Carpet	1111	T-15-Dynasty Tex-T-15-40 oz Poly ***STD***
Custom Stain/Paint	1111	N/A *****
Comment		

Landing to Basement

Flooring	8906	Red Oak-Vintage 5 inch Pre-Sanded Smooth Unfinished Red Oak-Unfinished-3/4 inch x 5 inch ***1***
Comment	STAINED SAMBUCA	

Main Stairs

Type	1712	Oak Stairs ***STD MAIN STAIRS***
Colour	7940	Sambucca STAIN TO COMPLIMENT HARDWOOD AND WILL VARY FROM FLOORING ***99***
Carpet Runner	1111	N/A *****
Handrail/Pickets/Posts Type	7652	1 5/16 inch Square pickets with 3 1/2" Square/Cap Post(s)-ALL OAK ***STD***
Handrail/Pickets/Posts Colour	1728	Oak Grade-Stain handrail,oak pickets,stringers,treads,risers
Custom Stain/Paint	1725	Paint Poplar Pickets /Risers/Stringer in White - Stain All - Oak Grade ***99***
Comment		

Hall

Flooring	9008	Red Oak PEARL-Vintage Red Oak Solid Sculpted
----------	------	--

OSCAR, ADOLFO MENJIVAR MADRID/NATALIA BAGAN  
Project: Wallaceton  
Unit: 246, Phase: 2  
Model: 25-2140 B The Wallace

Created: 4/23/2020 09:59:51  
Locked:  
Closed:

12 of 29

Character PEARL-SAND DUNE-3/4 inch X 5 inch \*\*\*1\*\*\*

Comment

Throughout

- Walls - Paint Colour 1717 22-Wall-WARM GREY \*\*\*STD\*\*\*
- Underpad 1079 500 Series-Underpad \*\*\*STD\*\*\*
- Thresholds 2232 Metal Thresholds \*\*\*STD\*\*\*
- Switches and Plug 5796 Decora White Switches and Plugs \*\*\*STD\*\*\*
- Trim Size 8705 4 1/4 Baseboard and 2 3/4 Casings \*\*\*STD\*\*\*
- Trim - Paint Colour 1716 Trim-WHITE \*\*\*STD\*\*\*

Comment

Purchaser: Signatures on July 7/20 TINA LEFUR July 7/20  
OSCAR, ADOLFO MENJIVAR I Date Decor Consultant Date

file

Purchaser: July 7/20 M. Rosen -07- 31 2020  
NATALIA BAGAN Date Wallaceton Date Approved

- APPROVED -



# Sales Selection Sheet

Wallaceton

13 of 29

PURCHASERS: OSCAR, ADOLFO MENJIVAR MADRID and NATALIA BAGAN

TEL:

LOT / UNIT  
246

PHASE  
2

MODEL  
25-2140 B The Wallace

It is herein understood and agreed between the undersigned parties hereto that the following changes shall be made to the above mentioned Agreement of Purchase and Sale in accordance with the agreement and except for such changes noted below, all other terms and conditions in the Agreement of Purchase and Sale shall remain as stated herein: It is further understood that and agreed that all changes and additions shall be installed as per builder's specifications, location and available selections. The Purchaser hereby agrees to purchase the following extras:

## APPLIANCES

1	CYCLONE STAINLESS 30" CHIMNEY HOOD FAN MODEL SCB50030	Qty: 1
26,302	Note: PAGE 28-29	

## Cabinetry

2	CABINETRY - 11A-UPPER ANGLE CORNER PER UNIT - UPGRADE 1	Qty: 1
189,343		
26,285	Note: SKETCH # 2 AND 4 PAGES 19 AND 21	
*3	CABINETRY - 12B-POTS AND PANS DRAWERS (WIDTH MIN. 60CM/MAX. 90CM) (SIZE SUBJECT TO FLOOR PLAN) - UPGRADE 1 SEE SKETCH # PAGE	Qty: 1
189,005		
26,286	Note: SKETCH # 2 AND 4 PAGES 19 AND 21	
4	CABINETRY - 02B-RAISE KITCHEN CABINETS FOR HARDWOOD/POST-INSTALL FLOORING (SAMPLE TO BE PROVIDED TO	Qty: 1
189,203		
26,291	Note:	
5	CABINETRY - 30H-WALL CABINET WITH SHELF FOR MICROWAVE (FINISHED INTERIOR) (OPENING 24"W X 13 3/4"H X 17"D) - UPGRADE 1	Qty: 1
189,207		
26,292	Note: SKETCH # 2 AND 4 PAGES 19 AND 21	
6	CABINETRY - 11D-VANITY BANK OF DRAWERS (MAX. WIDTH 55CM) - UPGRADE 1	Qty: 1
189,124		
28,655	Note: TO BE CENTRED ON VANITY BETWEEN DOUBLE SINKS IN MASTER ENSUITE. SEE SKETCH # 3 PAGE 20	

## Ceramics

7	CERAMICS - ADDITIONAL BACKSPLASH DUE TO INSTALL CHIMENEY HOODFAN IN KITCHEN - KITCHEN - UPGRADE 3	Qty: 1
189,361		
26,303	Note:	
8	CERAMICS - BACKSPLASH - KITCHEN - UPGRADE 3	Qty: 1
182,279		
26,304	Note:	
9	CERAMICS - FLOOR - INSTALL IN SPECIFIC PATTERN - FOYER - PATTERN	Qty: 1
182,204		
26,308	Note:	
10	CERAMICS - FLOOR - INSTALL IN SPECIFIC PATTERN - GARAGE ENTRY / MUD ROOM - PATTERN	Qty: 1
182,228		
26,309	Note:	

Initials: O.M. MB

TAX#:1

PREPARED BY: Tina LeFur

PE 326-1

S\invoice.rpt 28may19



## Sales Selection Sheet

Wallaceton

14 of 29

PURCHASERS: OSCAR, ADOLFO MENJIVAR MADRID and NATALIA BAGAN

TEL:

LOT / UNIT  
246PHASE  
2MODEL  
25-2140 B The Wallace

## Ceramics

11 182,212 26,310	CERAMICS - FLOOR - INSTALL IN SPECIFIC PATTERN - POWDER ROOM - PATTERN  Note:	Qty: 1
12 182,264 26,313	CERAMICS - FLOOR - ENSUITE MASTER - UPGRADE 4  Note: SEE SKETCH # 3 PAGE 20 FOR TILE DIRECTION	Qty: 1
13 182,253 26,316	CERAMICS - FLOOR - MAIN BATHROOM - UPGRADE 1  Note:	Qty: 1
14 182,186 26,582	CERAMICS - SHOWER FLOOR - ENSUITE MASTER - UPGRADE 2  Note:	Qty: 1
15 182,155 26,583	CERAMICS - SHOWER WALL AND CEILING - ENSUITE MASTER - UPGRADE 1  Note:	Qty: 1
16 182,270 26,585	CERAMICS - FLOOR - OPTIONAL BASEMENT BATHROOM - UPGRADE 2  Note: SEE SKETCH # 1 PAGE 18 FOR TILE DIRECTION	Qty: 1
17 182,140 28,657	CERAMICS - TUB WALL - MAIN BATHROOM - UPGRADE 1  Note:	Qty: 1
18 182,033 28,658	CERAMICS - SHOWER WALL AND CEILING - INSTALL IN SPECIFIC PATTERN - ENSUITE MASTER - PATTERN  Note:	Qty: 1
19 182,070 28,659	CERAMICS - FLOOR - FOYER - UPGRADE 2  Note: SEE SKETCH # 2 PAGE 19 PAGE FOR TILE DIRECTION	Qty: 1
20 182,222 28,660	CERAMICS - FLOOR - GARAGE ENTRY / MUD ROOM - UPGRADE 2  Note: SEE SKETCH # 2 PAGE 19 FOR TILE DIRECTION	Qty: 1
21 182,206 28,661	CERAMICS - FLOOR - POWDER ROOM - UPGRADE 2  Note: SEE SKETCH # 2 PAGE 19 FOR TILE DIRECTION	Qty: 1

## Coffered Ceiling

22 182,286 26,281	COFFERED CEILING - OPT. COFFERED CEILING - DINING ROOM  Note:	Qty: 1
-------------------------	---	--------

Page 2 of 5

Initials: OM MB

TAX#:1

PREPARED BY: Tina LeFur

PE 326-2

Sinvoice.rpt 28may19



## Sales Selection Sheet

Wallaceton

15 of 29

TEL:

PURCHASERS: OSCAR, ADOLFO MENJIVAR MADRID and NATALIA BAGAN

LOT / UNIT	PHASE	MODEL
246	2	25-2140 B The Wallace

## Coffered Ceiling

23	COFFERED CEILING - OPT. COFFERED CEILING - GREAT ROOM	Qty: 1
182,285		
26,282	Note:	

## Electrical

24	ELECTRICAL - POTLIGHT BUNDLE - 8 X T477GR-W 4 INCH LINE VOLTAGE POTLIGHTS INCLUDES 2 SWITCHESMAIN FLOOR (SEE SLIM LINE FOR BASEMENT)	Qty: 1
189,445		
26,283	Note: 4X IN GREAT ROOM ON 1 SWITCH; 4X IN KITCHEN ON 1 SWITCH. SEE SKETCH # 2 PAGE 19	
25	ELECTRICAL - RELOCATION OF SWITCHES/LIGHTS (MUST SPECIFY LOCATION) - NOTE: PLUGS CANNOT BE RELOCATED- MUST PURCHASE ADDITIONAL OUTLET.	Qty: 1
189,417		
26,284	Note: KITCHEN STANDARD LIGHT TO ISLAND SKETCH # 2 PAGE 19	
*26	ELECTRICAL - EXTRA WALL INTERIOR OUTLET (120V/15A) ON A SEPARATE CIRCUIT (ON ARCAULT) FOR MICROWAVE SHELF SEE SKETCH # 2 PAGE 19	Qty: 1
189,440		
26,294	Note: AND SKETCH # 4 PAGE 21	
27	ELECTRICAL - CEILING ROUGH-IN (CAPPED)	Qty: 2
189,450		
26,320	Note: 1) TO BE CENTRED ON ISLAND WITH RELOCATED ELECTRICAL BEHIND FLUSH BREAKFAST BAR 2) TO BE CENTRED ON GREAT ROOM CEILING	
28	ELECTRICAL - EXTRA WALL INTERIOR OUTLET ON EXISTING CIRCUIT (DOES NOT INCLUDE KITCHEN OUTLETS)	Qty: 1
189,445		
26,322	Note: TO BE LOCATED 70" +/- FROM THE FLOOR ABOVE THE FIREPALCE AND BESDIE THE CONDUIT. SKETCH # 2 PAGE 19	

## Granite

29	GRANITE - COUNTERTOP - 3/4" GROUP 4 WITH MITRE EDGE - KITCHEN / ISLAND - UPGRADE 4	Qty: 1
182,315		
26,300	Note:	

## Hardwood

30	HARDWOOD - VINTAGE - 5" RED OAK SCULPTED - KITCHEN / BREAKFAST - UPGRADE 3	Qty: 1
182,387		
26,295	Note:	
31	HARDWOOD - VINTAGE - 5" RED OAK SCULPTED - DINING ROOM - UPGRADE 3	Qty: 1
182,345		
26,296	Note:	
32	HARDWOOD - VINTAGE - 5" RED OAK SCULPTED - GREAT ROOM - UPGRADE 3	Qty: 1
182,345		
26,297	Note:	
33	HARDWOOD - VINTAGE - 5" RED OAK SCULPTED - LANDING(S) TO BSMT - UPGRADE 3	Qty: 1
182,357		
26,298	Note:	

Page 3 of 5

Initials: OM MB

TAX#:1

PREPARED BY: Tina LeFur

PE 326-3

SInvoice.rpt 28may19



Sales Selection Sheet

Wallaceton

PURCHASERS: OSCAR, ADOLFO MENJIVAR MADRID and NATALIA BAGAN

16 of 29  
TEL:

LOT / UNIT	PHASE	MODEL	
246	2	25-2140 B The Wallace	

hardwood

34	HARDWOOD - VINTAGE - 5" RED OAK SCULPTED - UPPER HALL - UPGRADE 3	Qty: 1	
182,382			
26,299	Note:		

heating/Air

35	HEATING/AIR - ROUGH-IN GAS LINE FOR GAS STOVE AT MAIN FLOOR (SEE SPECS) (HOOK-UP NOT INCLUDED) LEAVE STANDARD 120 VOLT ELECTRICAL OUTLET ON A SEPARATE CIRCUIT. * SPECIFY IF STANDARD 220V WILL STAY OR BE RELOCATED	Qty: 1	
189,474			
26,293	Note:		

Mirrors/Glass Pro

36	MIRRORS/GLASS PRODUCTS - UPGRADE TO FRAMELESS CLEAR GLASS WITH D-RING HANDLE IN CHROME - ENSUITE MASTER	Qty: 1	
182,393			
26,579	Note:		
37	DELETE ALL MIRRORS THROUGHOUT. DO NOT SUPPLY OR INSTALL.	Qty: 1	
28,656	Note:		

MISC.

38	SCHEDULE E - DECOR BONUS \$ 10,000 AT DECOR	Qty: 1	
28,662	Note:		

PAINTING

39	STAIN UPPER BASEMENT LANDING- (UNDER 25 SQ.ST.) SAMBUCCA	Qty: 1	
26,312	Note:		

Plumbing

40	PLUMBING - OPTION FROM ONE SINK TO DOUBLE SINKS INCLUDING STD CHATEAU FAUCET AND UNDERMOUNT OVALYN SINK INCLUDING CABINET CONVERSION 2D VIKING, ONE EXTRA CUTOUT AND ONE EXTRA VANITY LIGHT	Qty: 1	
189,694			
26,301	Note: MASTER ENSUITE SKETCH 3 ADD 4 PAGES 20 AND 21		
41	PLUMBING - MOEN -SOAP DISPENSERS - CHROME (MODEL: 3942) -	Qty: 1	
189,508			
26,581	Note: SEE SKETCH # 4 PAGE 21 FOR SPECS PAGES 25 AND 26		

Structured Wiring

42	STRUCTURED WIRING - CONDUIT PIPE TO ABOVE FIREPLACE ROUGH-IN	Qty: 1	
189,787			
26,321	Note: TO BE LOCATED 70" +/- ABOVE THE FIREPLACE. SKETCH # 2 PAGE 19		

Initials: OM MB

TAX#:1

PREPARED BY: Tina LeFur

PE 326-4

SInvoice.rpt 28may19



Sales Selection Sheet

Wallaceton

17.29  
TEL:

PURCHASERS: OSCAR, ADOLFO MENJIVAR MADRID and NATALIA BAGAN

LOT / UNIT 246	PHASE 2	MODEL 25-2140 B The Wallace	
-------------------	------------	--------------------------------	--

Sub Total  
HST  
Total

1. This Sales Selection Sheet when properly executed forms part of our Agreement of Purchase and Sale.
2. All extras and upgrades listed above are subject to Construction Progress and Architectural and Municipal requirements.
3. In the event the Vendor is unable to incorporate the work approved above in the construction of the house for any reason whatsoever, the Vendor will not be liable to the Purchaser in any way. The monies paid for any changes or optional extras not proceeded with shall be returned to the Purchaser, without interest. The cost of options or extras is non-refundable in all other circumstances. If for any reason whatsoever the Agreement of Purchase and Sale is not completed, the total cost of work approved above will be retained by the Vendor.
4. The Vendor reserves the right to substitute above materials and equipment with that of equal or better quality.
5. Purchaser acknowledges that items may not be exactly as shown. Variations from the Vendor's samples may occur in finished materials due to normal production processes. Vendor is not responsible for shade difference which may occur from different dye lots or wood grains. Variations from the Vendor's samples will occur with natural materials such as wood, marble, granite, hardwood and brick.
6. The Vendor reserves the right to select Grout & Thresholds that best suits the Tile selected.
7. Selections will not be processed unless signed by Heathwood Homes Head Office.
8. The selections made on this schedule are final and cannot be changed once submitted.
9. The Purchaser has checked and acknowledges the accuracy of this schedule.

Payment Summary	
<u>Paid By</u>	<u>Amount</u>
<u>Total Payment:</u>	

PURCHASER: [Signature]  
OSCAR, ADOLFO MENJIVAR MADRID

07-Jul-20 [Signature] 07-Jul-20  
DATE Decor Consultant DATE

PURCHASER: Natalia Bagan  
NATALIA BAGAN

07-Jul-20 **APPROVED** [Signature]  
DATE -07-10-2020  
Date Approved Heathwood Homes (Huron) Limited

UK-75 WALLACETON  
LOT 246  
25-2140 ELEV B  
THE WALLACE

18-29  
THE WALLACE

25-2140 ELEV. B

ELEVATION B | 2,133 SQ. FT.  
589 sq. ft. of opt. finished Lower Level

Sketch #1

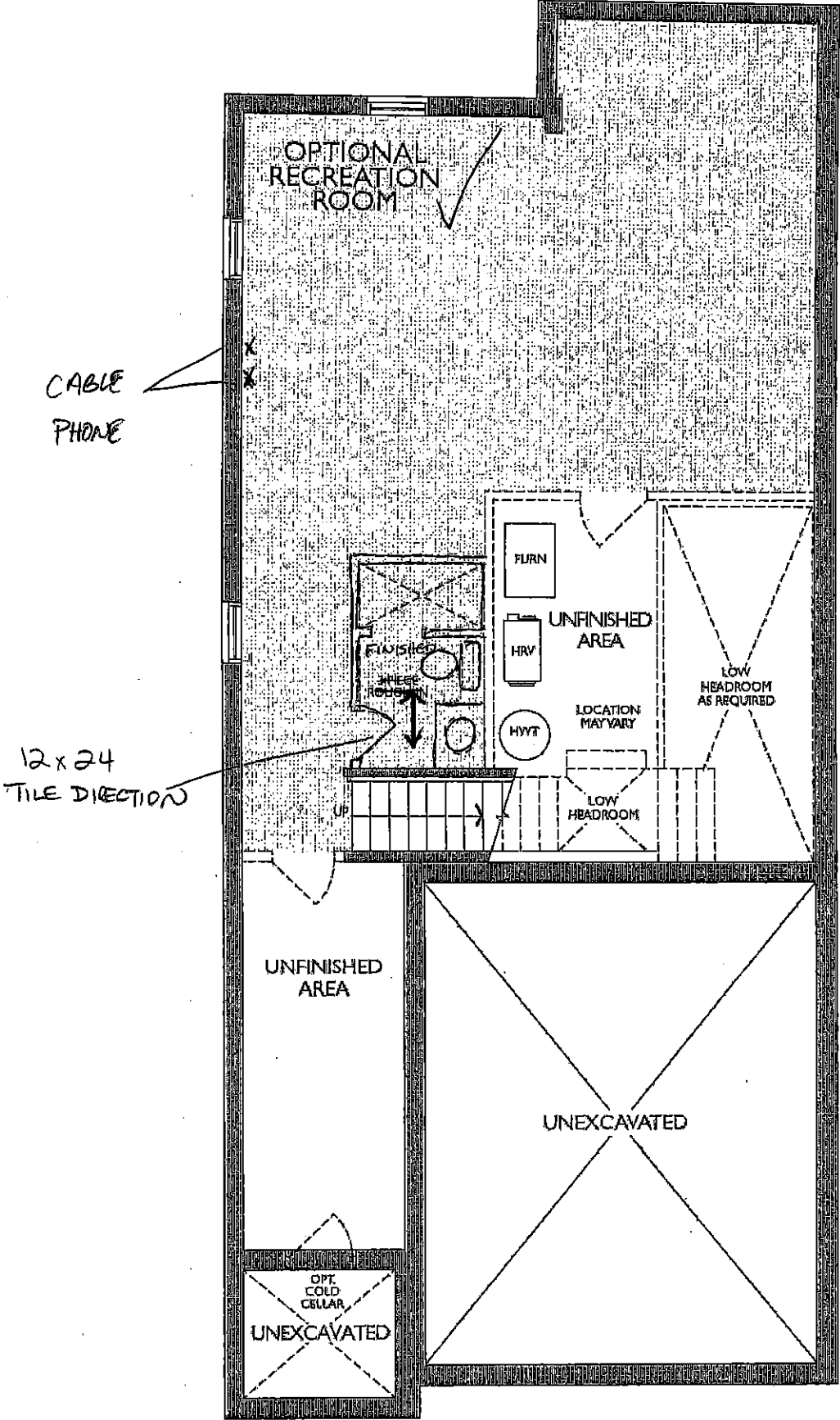

LOWER LEVEL  
ELEVATION. B

OM MB

19 of 29  
THE WALLACE

ELEVATION B | 2,133 SQ. FT.  
589 sq. ft. of opt. finished Lower Level

Sketch # 2



UK-75 WALLACETON  
LOT 246  
25-2140 ELEV B  
THE WALLACE

20 of 29  
THE WALLACE

25-2140 ELEV. B

ELEVATION B | 2,133 SQ. FT.  
589 sq. ft. of opt. finished Lower Level

Sketch #3

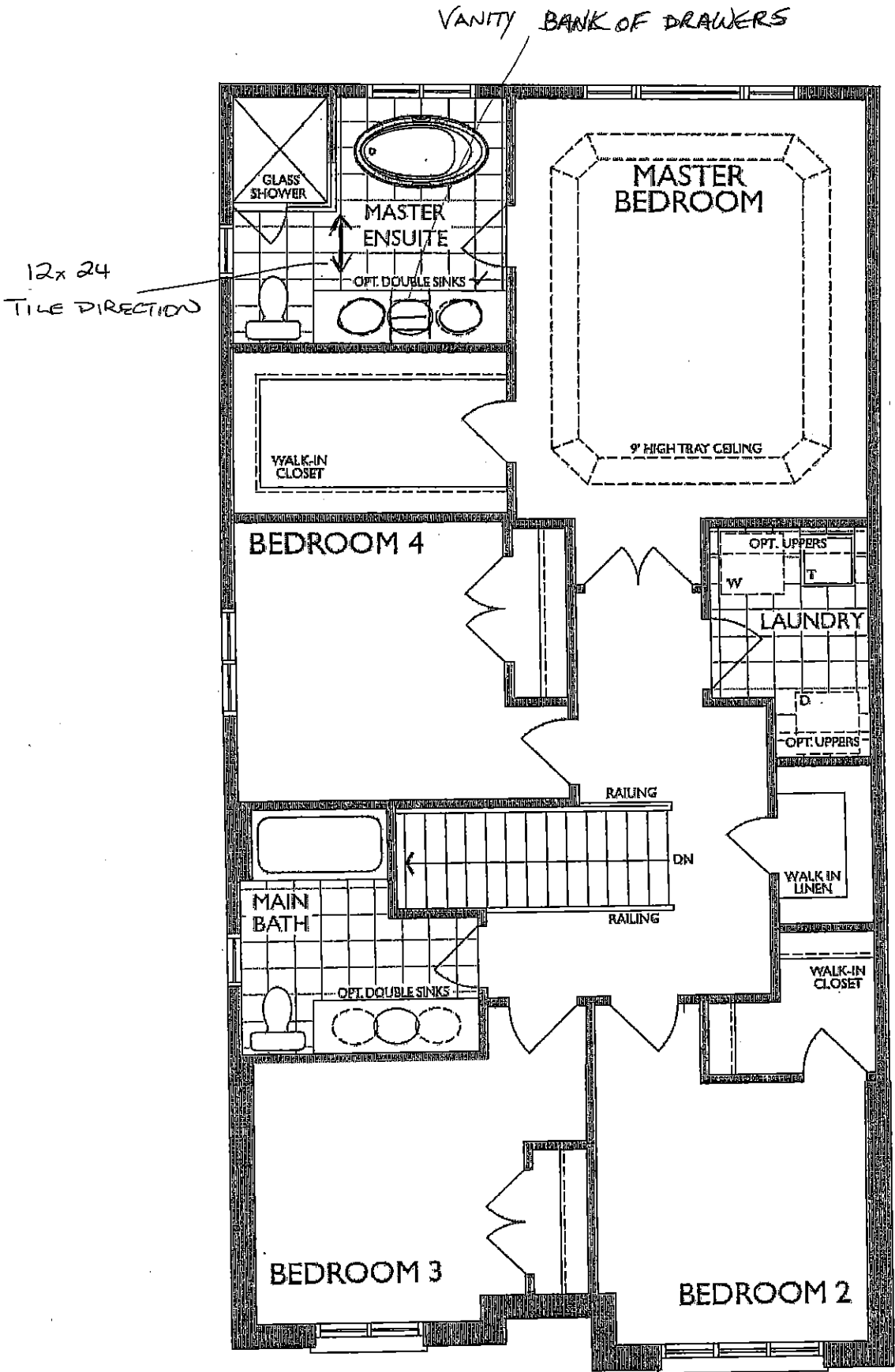

SECOND FLOOR  
ELEVATION B

OM RWB

10/23/2019

21 of 29

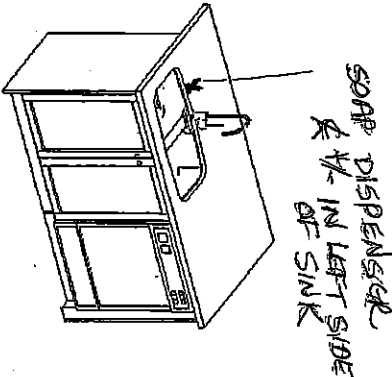
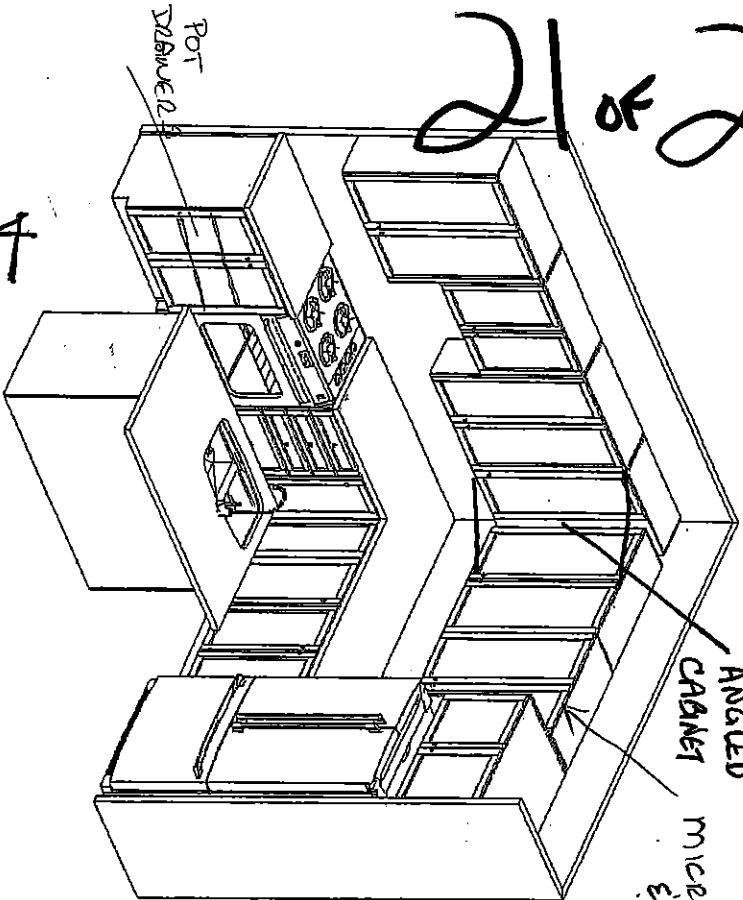

Sketch # 4

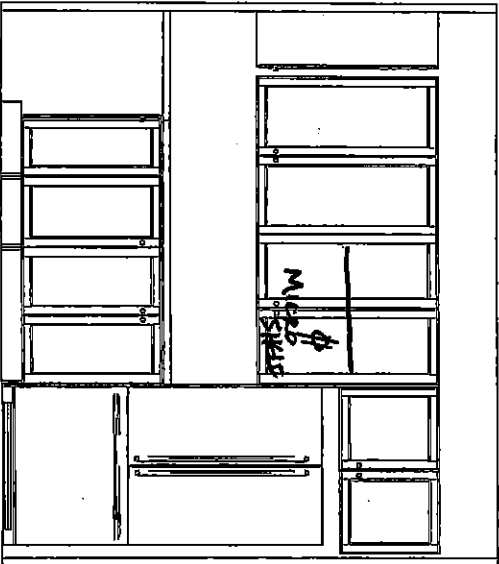
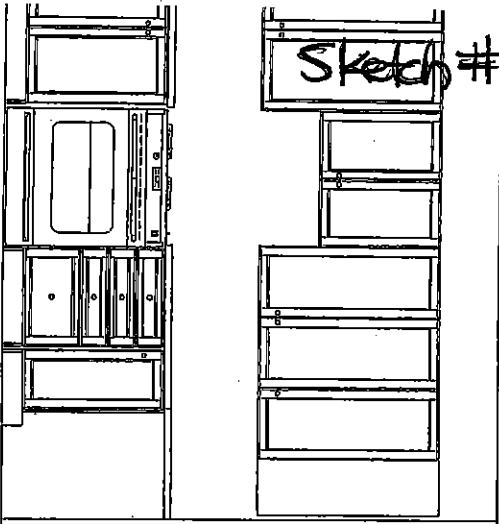

(OPT. DBL SINK V70+V77+V70)

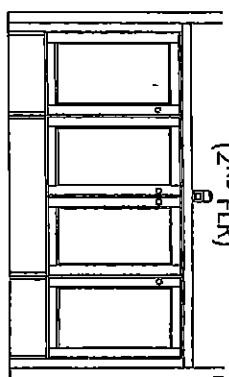

(OPT. DBL SINK V70+V40+V70)

OPT. LAUNDRY UPERS  
 OPT. LAUNDRY BASE  
 (2ND FLR)

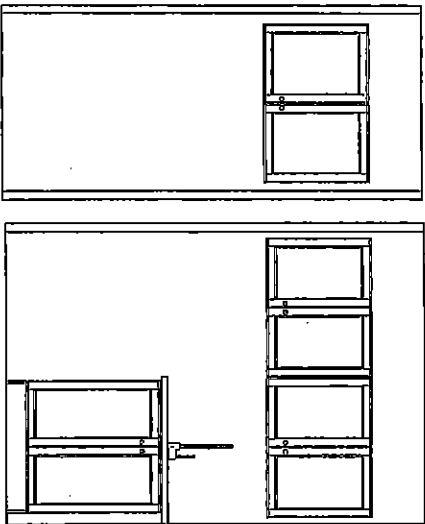

OPT. BASEMENT BATH



F R E N D L E  
 K I T C H E N S L I M I T E D  
 1350 SHIMMON DRIVE, MISSISSAUGA, ON L4W 1C5

HEATHWOOD HOMES  
 WALLACETON, KITCHENER ON  
 MODEL: 25-2140 (3108)

STANDARD CONTRACT INCLUDES:

- Appliance Openings**
- Hood Opening: 30"W Chimney hood
  - Fridge Opening: 37 3/8 "W X 73 3/8"
  - Fridge cabinet & gables: 66cm Deep
  - Stove Opening: 30" Freestanding
  - Dishwasher Opening: 24"

- Standard Kitchens Scope:**
- 100cm H wall cabinets
  - Std. Blumotion Hinges- **soft close doors**
  - Std. Metabox Drawers- **not soft close**
  - Min 40cm W drawer
  - Base pie cut corner cabinets
  - Backing on all cabinets
  - Countertop by others
  - Upgrade applied paneled fridge & dishwashers supply only (appliance hardware by others)

- Standard Vanity & Laundry Scope:**
- Powder by others, pedestal
  - Master Ens. - Top by others
  - Remaining vanities inc. laminate top
  - Std. Blumotion Hinges- **not soft close**
  - Std. Metabox Drawers- **not soft close**
  - Master Ens: Top drawers(Sink Full height)
  - Mains: Full height doors (top drawers added if Masters can't accommodate)
  - Optional laundry base & wall cabinets

OM

UK-75 WALLACETON  
LOT 246  
25-2140 ELEV B  
THE WALLACE

22 of 29

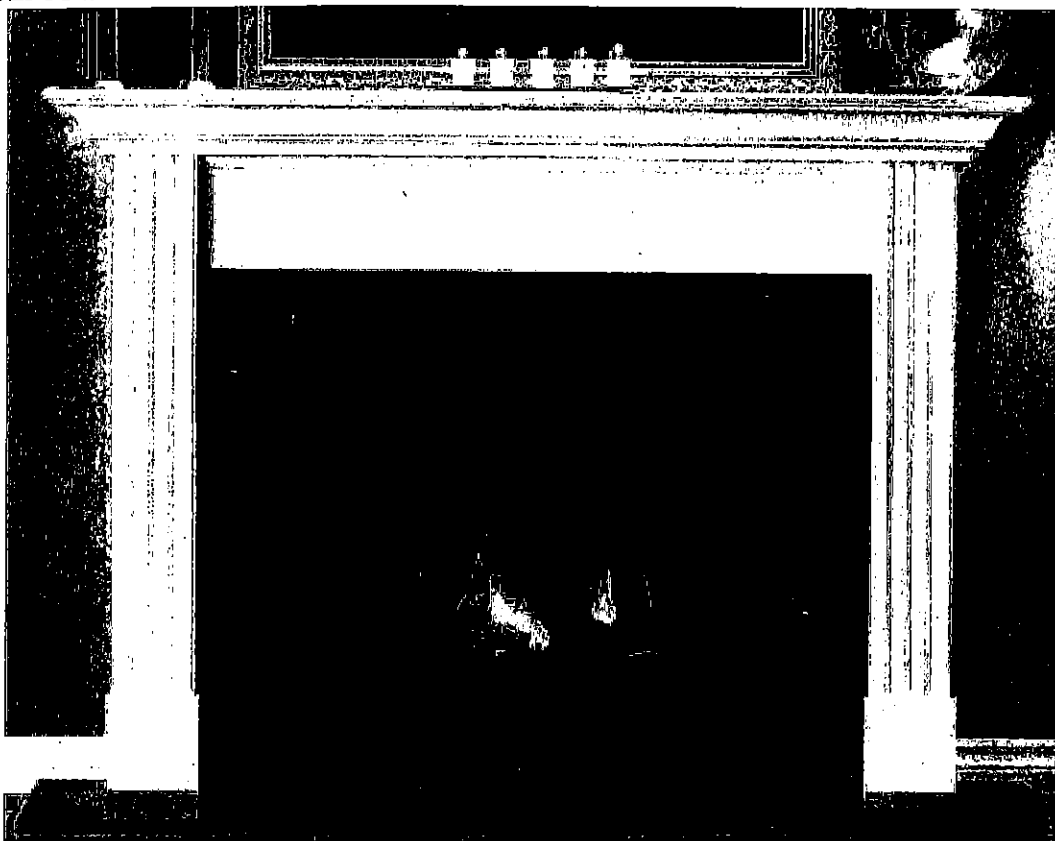

" CABINET DESIGN "

## **STANDARD NF 15 Mantel**

**Clean apron finish with fluted legs**

**WHITE PAINT GRADE FINISH**

*(PICTURE SHOWN WITH UPGRADE SURROUND AND HEARTH -PRICED SEPARATELY)*

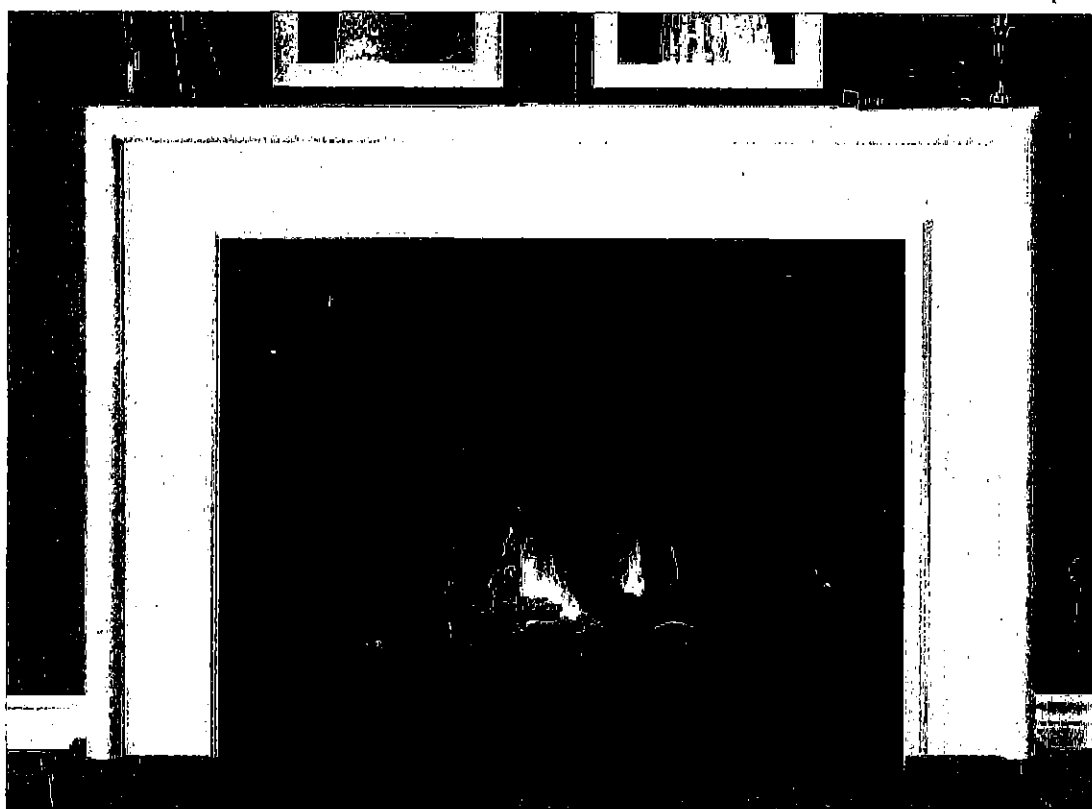

## **STANDARD NF 17 Mantel**

**WHITE PAINT GRADE FINISH**

*(PICTURE SHOWN WITH UPGRADE SURROUND AND HEARTH -PRICED SEPARATELY)*

UK-75 WALLACETON  
LOT 246  
25-2140 ELEV B  
THE WALLACE

23 of 29

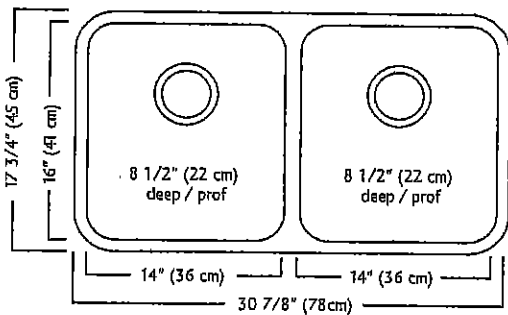

### ND1831UA/9 SPECIFICATION

Model ND1831UA/9 is a double (two equal size) bowl undermount sink manufactured by Franke Kindred Canada Limited from 18 gauge stainless steel. Product has silk finished rims and linear brush finished bowls. Sink is fully undercoated. Basket strainer waste fittings (3 1/2", 89 mm) are included. Sink is backed with a limited lifetime warranty.

- O.D. 17 3/4" x 30 7/8" x 8 1/2" (45 x 78 x 22 cm)
- Recommended for minimum 36" cabinet

Franke Kindred Canada Limited  
P.O. Box 190, 1000 Franke Kindred Road, Midland, Ontario, Canada, L4R 4K9 Phone: 866-687-7465 Fax: 800-361-8408

UK-75 WALLACETON  
LOT 246  
25-2140 ELEV B  
THE WALLACE

24 of 29

STANDARD KITCHEN FAUCET

Align

Modern

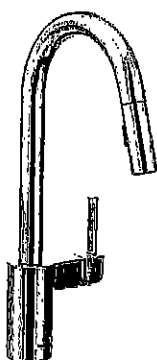

Single Handle Pull-Down Kitchen  
Faucet\*

Model 7565†

UK-75 WALLACETON  
LOT 246  
25-2140 ELEV B  
THE WALLACE

25 of 29

# Soap or Lotion Dispensers

Traditional | Transitional | Modern  
*However you define your faucet's style,  
you can assure a coordinated look with Moen soap dispensers.*

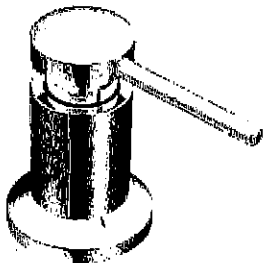

Soap or Lotion  
Dispenser

Model 3942  
Not available in ORB

Chrome  
Other

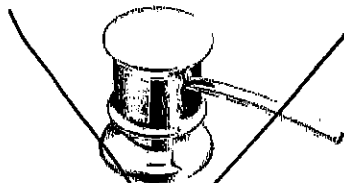

Soap or Lotion  
Dispenser

Model 3944  
Available in BL  
Not available in W

Chrome  
Other

FINISH OPTIONS:

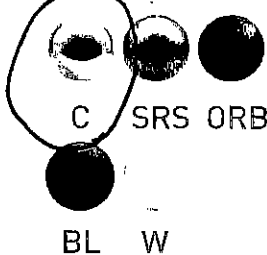

To order, combine the model number with one of these finish letter(s):  
LifeShine® Classic Stainless (CSL), Spot Resist™ Stainless (SRS),  
Oil Rubbed Bronze (ORB), Matte Black (BL) & Glacier (W).  
To order Chrome (C) model, use model number only.

UK-75 WALLACETON  
LOT 246  
25-2140 ELEV B  
THE WALLACE



Buy it for looks. Buy it for life.®

26 of 29

Specifications

DESCRIPTION

- Available in various finishes identified by suffix

OPERATION

- Press down, pump action

STANDARDS

- Designed and manufactured to comply with the requirements of: CSA B15.1 and ASME A112.18.1 and all requirements referenced therein

WARRANTY

- Lifetime limited warranty against manufacturing and finish defects to the original consumer purchaser
- 5 year warranty if used in commercial installations

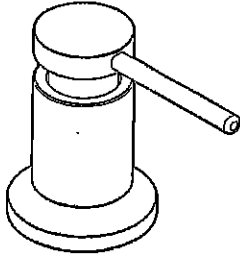

LIQUID DISPENSER

Model: 3942 series

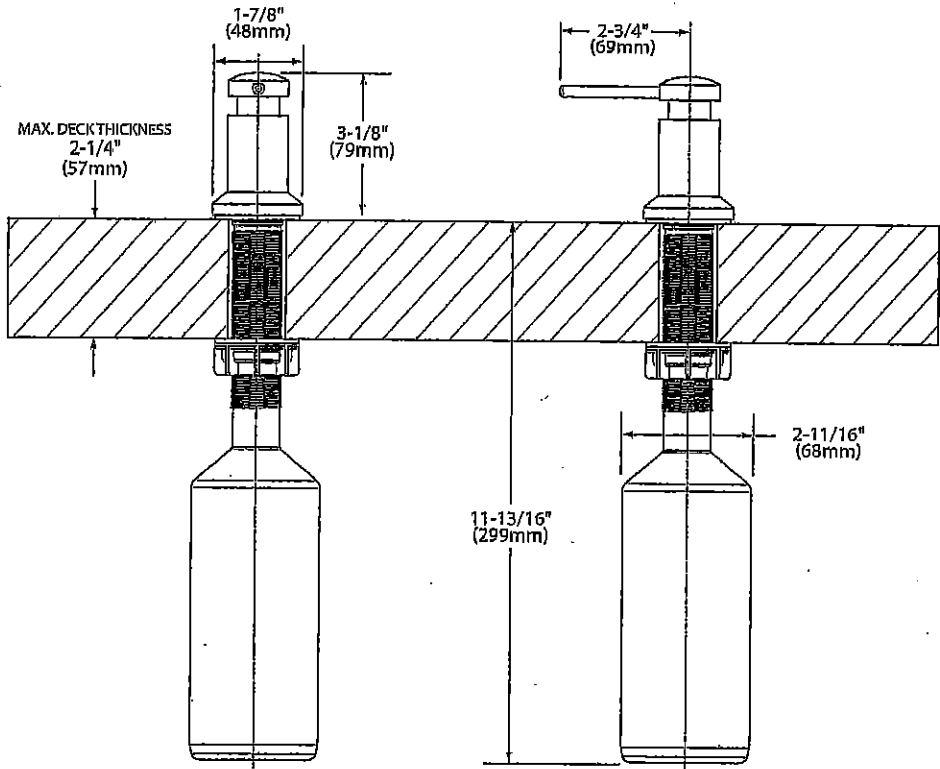

NOTE: DESIGNED TO BE INSTALLED THROUGH 1 HOLE 1-1/8" DIAMETER

CRITICAL DIMENSIONS

(DO NOT SCALE)

UK-75 WALLACETON  
LOT 246  
25-2140 ELEV B  
THE WALLACE

27<sup>th</sup> 29

## Chateau

Transitional

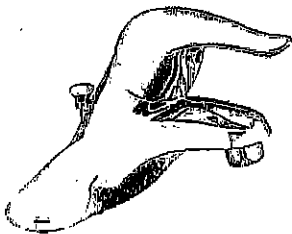

Lavatory Faucet with Pop-Up Drain  
Model L4621†

### VANITY SINKS AND PEDESTAL

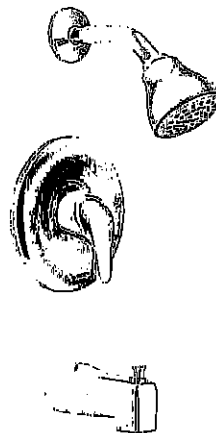

Posi-Temp® Pressure Balancing Tub/Shower  
Model 62320 / TL183†

OR

Posi-Temp Valve and Tub/Shower Trim  
with Eco-Performance Easy Clean® XL

Model 62320 / TL183EP†

(TL183EP not available in BC)

### SHOWER AND 5' TUB FAUCETS



2 Handle Roman Tub with 9" Spout  
Model 4796 / T990†

### FREESTANDING TUB FAUCETS

UK-75 WALLACETON  
LOT 246  
25-2140 ELEV B  
THE WALLACE

28 of 29

SC(B)500 | ALITO Collection

Cyclone®  
Breathe Better

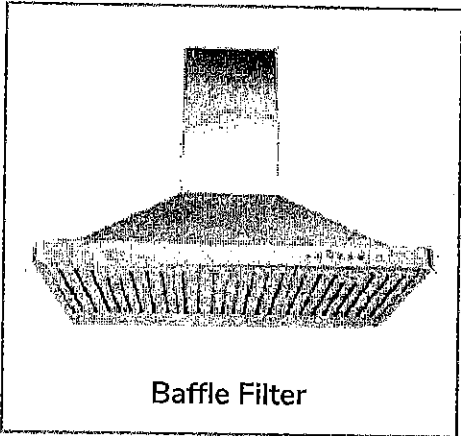

Wall Mount

Strong and sturdy with attractive lines and an imposing frame, the SC(B)500 is fitted with time-delay OFF feature up to nine minutes, 550 CFM fan, bright LED lights and a digital three-speed push button control panel.

Green Features



3 Speed Push Button  
Control Panel



Dishwasher  
Safe Filters



Long-Lasting  
LED Light



Time-Delay  
OFF Feature



Model	Colour	Ducting	Filters	Size	CFM
SC50024	Stainless Steel	6"	Mesh	24"	550
SC50030	Stainless Steel	6"	Mesh	30"	550
SC50036	Stainless Steel	6"	Mesh	36"	550
SCB50024	Stainless Steel	6"	Baffle	24"	550
SCB50030	Stainless Steel	6"	Baffle	30"	550
SCB50036	Stainless Steel	6"	Baffle	36"	550

Cyclone Range Hoods Inc.

1361 Huntingwood Drive, Unit 16, Toronto, ON, M1S 3J1, Canada.

Toll Free: 1-888-293-5662 Tel: (416) 293-0933 Fax: (416) 293-4793 Website: [www.CycloneRangeHoods.com](http://www.CycloneRangeHoods.com)

UK-75 WALLACETON  
LOT 246  
25-2140 ELEV B  
THE WALLACE

29 of 29

SC(B)500 | ALITO Collection



Features

- Wall mount range hood
- 6" round duct adapter
- Non-stick aluminum fan blades
- 3 speed push button control
- 2 LED lights (2 x 1.4W)
- Dishwasher-safe mesh or baffle filters
- Standard chimney fits up to 9 ft. ceiling
- Up to 9 minute time-delay OFF feature
- Plug-in connection

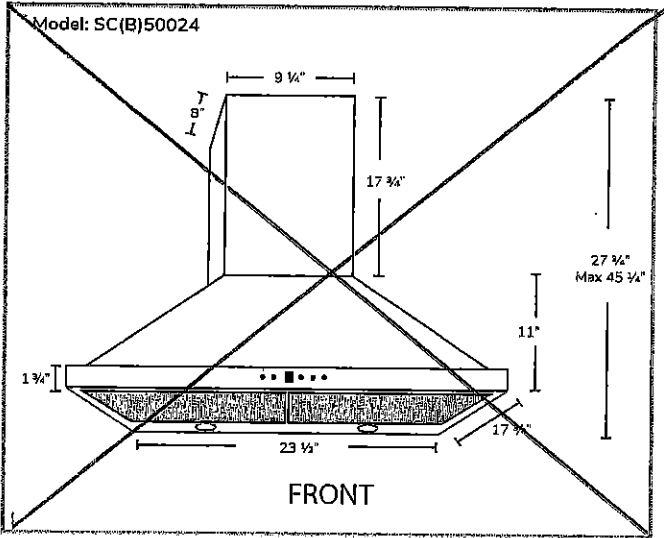
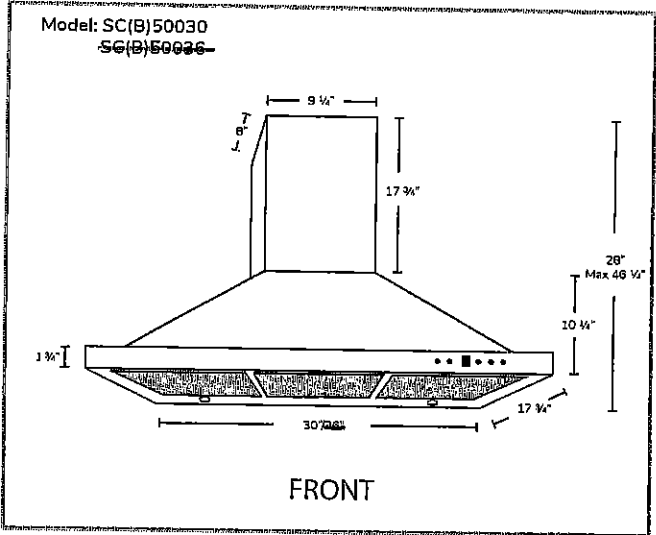

Options

- Filters: SC500 - Quick Release Aluminum Mesh Filters  
SCB500 - Quick Release Stainless Steel Baffle Filters
- Available Chimney Flues:  
Short (7 ft. - 8 ft.. A1.CH10)  
Standard (8 ft. - 9 ft.. A1.CH18)  
Extended (9 ft. - 11 ft. A1.CH30)
- Widths: 24", 30", 36"

Specifications

- |                                    |                                    |                             |
|------------------------------------|------------------------------------|-----------------------------|
| ▪ Air Flow Volume: 550 CFM         | ▪ Finishes: Stainless Steel        | ▪ Noise Level: Min. 2 Sones |
| ▪ Electrical Connection: 120V/60Hz | ▪ Ducting: 6" Round                | Max. 6 Sones                |
| ▪ Power Consumption: 210 Watts     | ▪ Dimensions: Width: 24", 30", 36" |                             |
| ▪ Current: 2.5 Amps                | Height: 46"                        |                             |
| ▪ Fan Speed: 1600RPM               | Depth: 18"                         |                             |
| ▪ Fan Type: Centrifugal Blower     |                                    |                             |



Toronto • Vancouver • Boston  
[www.CycloneRangeHoods.com](http://www.CycloneRangeHoods.com)