

PRE-Sales Selection Sheet
Checklist

1 of 30

LOT 244 Model: 25-2140 C The Wallace ALT

PURCHASERS: JULIAN, A ARCILA AND CRISTINA FRANCO

VENDOR: Heathwood Homes (Huron) Limited

Exterior Pot Lights
Master Ensuite - Optional Double Sink

- ☒ FINISHED BASEMENT
- ☐ COLD CELLAR

UPGRADED / MODIFIED ELEVATION

- ☐ CORNER UPGRADE
- ☒ REAR UPGRADE

CEILING UPGRADE - SMOOTH

- ☒ MAIN FLOOR
- ☐ SECOND FLOOR
- ☐ BASEMENT

ADDITIONAL ROUGH-INS

- ☒ 200 AMP SERVICE
- ☐ WET BAR ROUGH-IN
- ☐ HUMIDIFIER
- ☒ AIR CONDITIONING

GAS ROUGH-IN

- ☐ STOVE
- ☐ DRYER
- ☐ BBQ
- ☐ ADDITIONAL FIREPLACE

KITCHEN: HOODFAN VENTING SIZE

- ☒ 6 IN ROUND DUCT
- ☐ 7 IN ROUND DUCT

| | |
|-------------------------------|--------------|
| FULL BASEMENT STAIRS: | Carpet Grade |
| UPPER BASEMENT STAIRS: | N/A |
| LOWER BASEMENT STAIRS: | N/A |
| MAIN STAIRS: | All Oak |
| MEDIA STAIRS (if applicable): | N/A |
| LOFT STAIRS (if applicable): | N/A |

July 31/20

Signatures

Date

Purchaser:

on file

July 31/20

TINA LEFUR

Date

Decor Consultant:

- APPROVED -

Date

Purchaser:

-07- 31 2020

Date

Heathwood Homes (Huron) Limited

Approved

Locked Date:





Sales Selection Sheet

Wallaceton

SCHEDULE 'E'

2 of 30

TEL: BUS.: 519-635-1209

PURCHASERS: JULIAN, A ARCILA and CRISTINA FRANCO

| | | | |
|-------------------|------------|------------------------------------|--|
| LOT / UNIT 244 | PHASE 2 | MODEL 25-2140 C The Wallace ALT | |
|-------------------|------------|------------------------------------|--|

It is herein understood and agreed between the undersigned parties hereto that the following changes shall be made to the above mentioned Agreement of Purchase and Sale in accordance with the agreement and except for such changes noted below, all other terms and conditions in the Agreement of Purchase and Sale shall remain as stated herein: It is further understood that and agreed that all changes and additions shall be installed as per builder's specifications, location and available selections. The Purchaser hereby agrees to purchase the following extras:

Cabinetry

| | | | |
|--------|--|--------|--|
| 1 | DEEP FRIDGE UPPERS IN KITCHEN (SINGLES) | Qty: 1 | |
| 30,373 | Note: | | |

MISC.

| | | | |
|--------|---|--------|--|
| 2 | FINISHED LOWER LEVEL- 589 SQ F (THE WALLACE) | Qty: 1 | |
| 30,370 | Note: | | |
| 3 | THIS IS AN ALT PLAN AS PER AMENDMENT DATED JULY 14/20 AND RELEASE HAS BEEN MODIFIED | Qty: 1 | |
| 30,371 | Note: | | |
| 4 | TEN THOUSAND DOLLARS (\$10,000.00) AT DECOR (NO CASH VALUE) - SINGLES | Qty: 1 | |
| 30,372 | Note: | | |
| 5 | VENDOR TO UPGRADE THE REAR OF THE HOME SINCE IT IS BACKING PARQUETTE AND IS A REQUIREMENT, SKETCH TO FOLLOW | Qty: 1 | |
| 30,374 | Note: | | |

Sub Total

HST

Total

1. This Sales Selection Sheet when properly executed forms part of our Agreement of Purchase and Sale.

2. All extras and upgrades listed above are subject to Construction Progress and Architectural and Municipal requirements.

3. In the event the Vendor is unable to incorporate the work approved above in the construction of the house for any reason whatsoever, the Vendor will not be liable to the Purchaser in any way. The monies paid for any changes or optional extras not proceeded with shall be returned to the Purchaser, without interest. The cost of options or extras is non-refundable in all other circumstances. If for any reason whatsoever the Agreement of Purchase and Sale is not completed, the total cost of work approved above will be retained by the Vendor.

4. The Vendor reserves the right to substitute above materials and equipment with that of equal or better quality.

5. Purchaser acknowledges that items may not be exactly as shown. Variations from the Vendor's samples may occur in finished materials due to normal production processes. Vendor is not responsible for shade difference which may occur from different dye lots or wood grains. Variations from the Vendor's samples will occur with natural materials such as wood, marble, granite, hardwood and brick.

6. The Vendor reserves the right to select Grout & Thresholds that best suits the Tile selected.

7. Selections will not be processed unless signed by Heathwood Homes Head Office.

8. The selections made on this schedule are final and cannot be changed once submitted.

9. The Purchaser has checked and acknowledges the accuracy of this schedule.

Page 1 of 2

Initials: 

TAX#:1

PREPARED BY: Marilyn Rosen

PE 367-1

Invoice.rpt 28may19



Sales Selection Sheet
Wallaceton

3 of 30

PURCHASERS: JULIAN, A ARCILA and CRISTINA FRANCO

TEL: BUS.: 519-635-1209

| | | | |
|-------------------|------------|--------------------------------|--|
| LOT / UNIT 244 | PHASE 2 | MODEL 25-2140 C The Wallace | |
|-------------------|------------|--------------------------------|--|

| | |
|-----------------------|---------------|
| Payment Summary | |
| <u>Paid By</u> | <u>Amount</u> |
| <u>Total Payment:</u> | |

| | | | | |
|---|-------------------|------------------|---------------------|------------------|
| PURCHASER: | <u>signatures</u> | <u>29-Jul-20</u> | <u>TINA LEFUR</u> | <u>29-Jul-20</u> |
| | JULIAN, A ARCILA | DATE | Decor Consultant | DATE |
| PURCHASER: | <u>on file</u> | <u>29-Jul-20</u> | - APPROVED - | |
| | CRISTINA FRANCO | DATE | -07- 29 2020 | <u>M. Rosen</u> |
| <u>Date Approved Heathwood Homes (Huron) Limited</u> | | | | |

JULIAN, A ARCILA/CRISTINA FRANCO
Project: Wallaceton
Unit: 244, Phase: 2
Model: 25-2140 C The Wallace *ALT PLAN*

Created: 7/14/2020 09:21:52
Locked:
Closed:

4 of 30

Kitchen

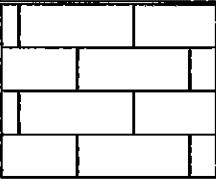
| | | |
|-----------------------------|------|---|
| Cabinet Colour/Style | 9111 | VIKING III SIMCOE ORCHID 3DL ***STD*** |
| Countertop | 8613 | Group 6-Quartz-Caesarstone-WHITE ATTICA # 5143-3/4 inch with built-up edge ***6*** |
| Countertop Edge | 4005 | DOUBLE MITRE 1 1/2 INCH ***UPG***  |
| Cabinet Hardware | 9144 | 12877 BN NICKEL-HARDWARE ***2*** |
| Island Cabinet Colour/Style | 9158 | Viking III-SIMCOE-NAVY BLUE-3DL ***STD*** |
| Island Countertop | 8613 | Group 6-Quartz-Caesarstone-WHITE ATTICA # 5143-3/4 inch with built-up edge ***6*** |
| Backsplash | 5730 | QT.CD.ARW.0306MT-Colour and Dimension Matte-Arctic White-3 x 6 ***STD*** |
| Backsplash Grout | 2226 | Grout-(00) White ***STD*** |
| Backsplash Tile Pattern | 3060 | HORIZONTAL BRICK ***STD***  |
| HoodFan | 9904 | YWMH31017HZ-Whirlpool Over-The-Range Microwave Hood Combination-SS-30 inch <i>SPECS PAGES 27-30</i> |
| Appliances | 9904 | Purchasers have been advised: standard fridge opening is a minimum 37 3/8 x 73 3/8". Ice Waterline Rough-In is included. |
| Appliances | 9904 | Standard stove opening is 30" and standard dishwasher opening is 24". Any gas stove will require backsplash or stainless steel backing to avoid fire hazards. |
| Appliances | 9904 | Purchasers acknowledge: Heathwood Homes and its contractors will not be responsible for any kitchen cabinet changes due to appliances dimension changes after |
| Comment | | |

Kitchen/Breakfast

| | | |
|--------------------|------|--|
| Flooring | 9060 | White Oak PEARL-Vintage Northern Solid Sawn : White Oak : Sculpted Pearl-APOLLO-3/4 inch x 5 inch ***10*** |
| Floor Tile Grout | 1111 | N/A ***** |
| Floor Tile Pattern | 1111 | N/A ***** |

JULIAN, A ARCILA/CRISTINA FRANCO
Project: Wallaceton
Unit: 244, Phase: 2
Model: 25-2140 C The Wallace

ALT PLAN

Created: 7/14/2020 09:21:52
Locked:
Closed:

5 of 30

Comment

Foyer

| | | |
|--------------------|------|---|
| Flooring | 1111 | GE.MD.WHT.1818.MT Madison Series White Matte 18 |
| Floor Tile Grout | 2225 | Grout-(27) Silver ***STD*** |
| Floor Tile Pattern | 3000 | STANDARD SQUARE ***STD*** |

Comment

Laundry Room

| | | |
|--------------------|------|--|
| Flooring | 3000 | GE.BY.AZR.1313 New Byzantine Azzuro 13 |
| Floor Tile Grout | 2225 | Grout-(27) Silver ***STD*** |
| Floor Tile Pattern | 3000 | STANDARD SQUARE ***STD*** |

Comment

Laundry Room Opt.

| | | |
|------------------|------|--|
| Cabinet - Uppers | 9120 | VIKING III-GEORGIAN-ORCHID 3DL ***STD*** |
| Cabinet Hardware | 2093 | 9671-HARDWARE ***STD*** |

Comment

Mud Room

| | | |
|----------|------|---|
| Flooring | 2093 | GE.MD.WHT.1818.MT Madison Series White Matte 18 |
|----------|------|---|

JULIAN, A ARCILA/CRISTINA FRANCO
Project: Wallaceton
Unit: 244, Phase: 2
Model: 25-2140 C The Wallace ALT PLAN

Created: 7/14/2020 09:21:52
Locked:
Closed:

6 of 30

| | | |
|--------------------|------|-----------------------------|
| Floor Tile Grout | 2225 | Grout-(27) Silver ***STD*** |
| Floor Tile Pattern | 3000 | STANDARD SQUARE ***STD*** |

Comment

Powder Room

| | | |
|--------------------|------|---|
| Flooring | 3000 | GE.MD.WHT.1818.MT Madison Series White Matte 18 |
| Floor Tile Grout | 2225 | Grout-(27) Silver ***STD*** |
| Floor Tile Pattern | 3000 | STANDARD SQUARE ***STD*** |

| | | |
|---------------------------|------|-----------------------------------|
| Plumbing Fixture (Colour) | 1737 | Plumbing Fixtures-WHITE ***STD*** |
| Comment | | |

Dining Room/Hall

| | | |
|----------|------|---|
| Flooring | 9060 | White Oak PEARL-Vintage Northern Solid Sawn : White Oak : Sculpted Pearl-APOLLO-3/4 inch x 5 inch ***2*** |
| Comment | | |

Dining Room/Hall

| | | |
|----------|------|---|
| Flooring | 9060 | White Oak PEARL-Vintage Northern Solid Sawn : White Oak : Sculpted Pearl-APOLLO-3/4 inch x 5 inch ***2*** |
| Comment | 1 | |

Great Room

| | | |
|----------|------|---|
| Flooring | 9060 | White Oak PEARL-Vintage Northern Solid Sawn : White Oak : Sculpted Pearl-APOLLO-3/4 inch x 5 inch ***2*** |
| Comment | | |

JULIAN, A ARCILA/CRISTINA FRANCO
Project: Wallaceton
Unit: 244, Phase: 2
Model: 25-2140 C The Wallace ALT PLAN

Created: 7/14/2020 09:21:52
Locked:
Closed:

7 of 30

Upper Hall

| | | |
|----------|------|---|
| Flooring | 9060 | White Oak PEARL-Vintage Northern Solid Sawn : White Oak : Sculpted Pearl-APOLLO-3/4 inch x 5 inch ***5*** |
| Comment | | |

Opt. Finished Basement (Rec) Room/Hall

| | | |
|----------|------|--|
| Flooring | 7625 | T-15-Dynasty Tex-T-15-40 oz Poly ***STD*** |
| Comment | | |

Master Bedroom

| | | |
|----------|------|--|
| Flooring | 7625 | T-15-Dynasty Tex-T-15-40 oz Poly ***STD*** |
| Comment | | |

Bedroom 2

| | | |
|----------|------|--|
| Flooring | 7625 | T-15-Dynasty Tex-T-15-40 oz Poly ***STD*** |
| Comment | | |

Bedroom 3

| | | |
|----------|------|--|
| Flooring | 7625 | T-15-Dynasty Tex-T-15-40 oz Poly ***STD*** |
| Comment | | |

Bedroom 4

| | | |
|----------|------|--|
| Flooring | 7625 | T-15-Dynasty Tex-T-15-40 oz Poly ***STD*** |
| Comment | | |

JULIAN, A ARCILA/CRISTINA FRANCO
Project: Wallaceton
Unit: 244, Phase: 2
Model: 25-2140 C The Wallace *ALT PLAN*

Created: 7/14/2020 09:21:52
Locked:
Closed:

8 OF 30

Master Ensuite

| | | |
|----------------------|------|--|
| Cabinet Colour/Style | 9156 | Viking III-SIMCOE-RAIN CLOUD-3DL ***STD*** |
| Countertop | 9069 | MSI Quartz GROUP 1 ICED WHITE ***STD*** |
| Countertop Edge | 4010 | GROUP 1 - SINGLE POLISHED STRAIGHT EDGE 3/4 INCH ***1*** |
| Cabinet Hardware | 7672 |  135-HARDWARE ***STD*** |
| Floor Tile | 8913 | UN.BL.BIA.1224-Biel-Bianco (White)-12 x 24 See Tile Direction on Sketch <i>3</i> Page <i>20</i> ***2*** |
| Floor Tile Grout | 2225 | Grout-(27) Silver ***STD*** |
| Floor Tile Pattern | 3050 | SIDE TO SIDE ***STD*** |

| | | |
|---------------------------|------|--|
| Shower Floor Tile | 8661 | OD.ON.SWT.0202.MT.N-Ontario Series Mosaic-Snow White Matte-2 x 2 ***STD*** |
| Shower Floor Tile Grout | 2226 | Grout-(00) White ***STD*** |
| Shower Floor Tile Pattern | 1111 | N/A ***** |

| | | |
|--------------------------|------|---|
| Shower Wall Tile | 8913 | UN.BL.BIA.1224-Biel-Bianco (White)-12 x 24 See Tile Direction on Sketch <i>3</i> Page <i>20</i> ***3*** |
| Shower Wall Tile Grout | 2226 | Grout-(00) White ***STD*** |
| Shower Wall Tile Pattern | 3090 | VERTICAL STACKED ***STD***  |

| | | |
|----------------------------|------|--|
| Shower Jamb(s) and Sill(s) | 8923 | Shower Jamb / Sill-Thassos White ***STD*** |
| Plumbing Fixture (colour) | 1737 | Plumbing Fixtures-WHITE ***STD*** |

Comment

JULIAN, A ARCILA/CRISTINA FRANCO
Project: Wallaceton
Unit: 244, Phase: 2
Model: 25-2140 C The Wallace. *ALT PLAN*

Created: 7/14/2020 09:21:52
Locked:
Closed: *9 of 30*

Main Bathroom

| | | |
|----------------------|------|--|
| Cabinet Colour/Style | 9111 | VIKING III SIMCOE ORCHID 3DL ***STD*** |
| Countertop | 8801 | P-344 LM-Countertop-INUKSHUK GREY-Arborite ***STD*** |
| Countertop Edge | 1111 | N/A ***** |
| Cabinet Hardware | 7672 | 135-HARDWARE ***STD*** |
| Flooring | 7672 | GE.BY.AZR.1313 New Byzantine Azzuro 13 |
| Floor Tile Grout | 2225 | Grout-(27) Silver ***STD*** |
| Floor Tile Pattern | 3000 | STANDARD SQUARE ***STD*** |

| | | |
|----------------------------|------|--|
| Wall Tile | 3000 | GE.BY.AZR.1313 New Byzantine Azzuro 13 |
| Wall Tile Grout | 2226 | Grout-(00) White ***STD*** |
| Main Bathroom Tile Pattern | 3000 | STANDARD SQUARE ***STD*** |

| | | |
|---------------------------|------|-----------------------------------|
| Plumbing Fixture (Colour) | 1737 | Plumbing Fixtures-WHITE ***STD*** |
| Comment | | |

| | | |
|---------------------------|------|--|
| Opt. Shower Floor Tile | 8061 | OD.ON.SWT.0202.MT.N-Ontario Series Mosaic-Snow White Matte-2 x 2 ***STD*** |
| Shower Floor Tile Grout | 2226 | Grout-(00) White ***STD*** |
| Shower Floor Tile Pattern | 3000 | STANDARD SQUARE ***STD*** |
| Shower Wall Tile | 9020 | QT.WV.WHT.0810-Weave-White-8 x 10 ***STD*** |
| Shower Wall Tile Grout | 2226 | Grout-(00) White ***STD*** |

JULIAN, A ARCILA/CRISTINA FRANCO
Project: Wallaceton
Unit: 244, Phase: 2
Model: 25-2140 C The Wallace *ALT PLAN*

Created: 7/14/2020 09:21:52
Locked:
Closed:

10 of 30

| | | |
|--------------------------|------|--|
| Shower Wall Tile Pattern | 3070 | HORIZONTAL STACKED ***STD*** <div><div></div><div></div><div></div><div></div></div> |
| Shower Jamb(s) | 8923 | Shower Jamb / Sill-Thassos White ***STD*** |
| Cabinet Colour/Style | 9165 | Viking II-GEORGIAN-NAVY BLUE-3DL ***STD*** |
| Countertop | 8796 | 6698-46-Countertop-PALOMA POLAR ETCHINGS FINISH-Formica ***STD*** |
| Countertop Edge | 1111 | N/A ***** |
| Cabinet Hardware | 7672 | 135-HARDWARE ***STD*** |
| Flooring | 7672 | GE.BY.AZR.1313 New Byzantine Azzuro 13 |
| Floor Tile Grout | 2225 | Grout-(27) Silver ***STD*** |
| Floor Tile Pattern | 3000 | STANDARD SQUARE ***STD*** |

| | | |
|---------------------------|------|-----------------------------------|
| Plumbing Fixture (Colour) | 1737 | Plumbing Fixtures-WHITE ***STD*** |
| Comment | | |

Great Room Fireplace

| | | |
|---------------|------|---|
| Type | 1111 | N/A ***** |
| Mantle | 1111 | N/A ***** |
| Surround Opt. | 1111 | N/A ***** |
| Note | 1111 | Purchasers have been advised: heat from the FP can damage TV above a FP and items placed on mantle. |
| Note | 1111 | Heathwood and its contractors will not be liable for any damage on items placed/installed above a FP after closing. |
| Comment | | |

Basement Stairs

| | | |
|------|------|---|
| Type | 1714 | Carpet Grade Stairs ***STD BASEMENT STAIRS*** |
|------|------|---|

JULIAN, A ARCILA/CRISTINA FRANCO
Project: Wallaceton
Unit: 244, Phase: 2
Model: 25-2140 C The Wallace ALT PLAN

Created: 7/14/2020 09:21:52
Locked:
Closed: 11 of 30

| | | |
|-------------------------------|----------------------------------|--|
| Colour | 7940 | Sambucca STAIN TO COMPLIMENT HARDWOOD AND WILL VARY FROM FLOORING ***99*** |
| Carpet Runner | 1111 | N/A ***** |
| Handrail/Pickets/Post Type | 7652 | 1 5/16 inch Square pickets with 3 1/2" Square/Cap Post(s)-ALL OAK ***STD*** |
| Handrail/Pickets/Post Colours | 1729 | Carpet Grade-Stain handrail, pickets, stringers, nosing_pos |
| Carpet | 7625 | T-15-Dynasty Tex-T-15-40 oz Poly ***STD*** |
| Custom Stain/Paint | 1727 | Stain treads,risers, and nosing. Paint handrail, pickets, stringers and posts ***99*** |
| Comment | CARPET GRADE STAIRS RAILING ONLY | |

Landing to Basement

| | | |
|----------|------|-----------|
| Flooring | 1111 | N/A ***** |
| Comment | | |

Main Stairs

| | | |
|-------------------------------|------|--|
| Type | 1712 | Oak Stairs ***STD MAIN STAIRS*** |
| Colour | 7940 | Sambucca STAIN TO COMPLIMENT HARDWOOD AND WILL VARY FROM FLOORING ***99*** |
| Carpet Runner | 1111 | N/A ***** |
| Handrail/Pickets/Posts Type | 7652 | 1 5/16 inch Square pickets with 3 1/2" Square/Cap Post(s)-ALL OAK ***STD*** |
| Handrail/Pickets/Posts Colour | 1728 | Oak Grade-Stain handrail,oak pickets,stringers,treads,risers |
| Custom Stain/Paint | 1727 | Stain treads,risers, and nosing. Paint handrail, pickets, stringers and posts ***99*** |
| Comment | | |

Hall

| | | |
|----------|------|-----------|
| Flooring | 1111 | N/A ***** |
|----------|------|-----------|

JULIAN, A ARCILA/CRISTINA FRANCO
Project: Wallaceton
Unit: 244, Phase: 2
Model: 25-2140 C The Wallace

ALT PLAN

Created: 7/14/2020 09:21:52
Locked:
Closed:

12 of 30

Comment

Throughout

| | | |
|----------------------|------|---|
| Walls - Paint Colour | 1717 | 22-Wall-WARM GREY ***STD*** |
| Underpad | 1079 | 500 Series-Underpad ***STD*** |
| Thresholds | 2232 | Metal Thresholds ***STD*** |
| Switches and Plug | 5796 | Decora White Switches and Plugs ***STD*** |
| Trim Size | 8705 | 4 ¼ Baseboard and 2 ¾ Casings ***STD*** |
| Trim - Paint Colour | 1716 | Trim-WHITE ***STD*** |

Comment

Purchaser:

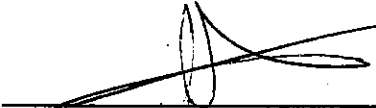
JULIAN, A ARCILA
Date July 28/20

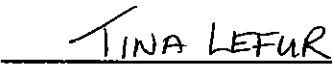
TINA LEFUR
Decor Consultant
Date July 28/20

Purchaser:

CRISTINA FRANCO
Date July 28/20

Wallaceton
-07- 31 2020
Date Approved

APPROVED



Sales Selection Sheet

Wallaceton

3 of 30
TEL: BUS.: 519-635-1209

PURCHASERS: JULIAN, A ARCILA and CRISTINA FRANCO

| LOT / UNIT | PHASE | MODEL | |
|------------|-------|-----------------------|----------|
| 244 | 2 | 25-2140 C The Wallace | ALT PLAN |

It is herein understood and agreed between the undersigned parties hereto that the following changes shall be made to the above mentioned Agreement of Purchase and Sale in accordance with the agreement and except for such changes noted below, all other terms and conditions in the Agreement of Purchase and Sale shall remain as stated herein: It is further understood that and agreed that all changes and additions shall be installed as per builder's specifications, location and available selections. The Purchaser hereby agrees to purchase the following extras:

APPLIANCES

| | | |
|--------|---|--------|
| 1 | SUPPLY AND INSTALL WHIRLPOOL YWMH31017HZ STAINLESS MICROWAVE/FAN COMBO SEE SPECS PAGES 27-30 | Qty: 1 |
| 29,244 | Note: | |

Cabinetry

| | | |
|---------|--|--------|
| 2 | CABINETRY - 12B-POTS AND PANS DRAWERS (WIDTH MIN. 60CM/MAX. 90CM) (SIZE SUBJECT TO FLOOR PLAN) - UPGRADE 1 | Qty: 1 |
| 189,005 | | |
| 29,116 | Note: SKETCH #'S 2 AND 4 PAGES 19 AND 21 | |
| 3 | CABINETRY - 10B-UPGRADE LEVELS 1-4, 5-7 DRAWERS FROM METABOX TO TANDEMBOX PER DRAWER. BD X 4, BPP X | Qty: 1 |
| 188,998 | | |
| 29,265 | Note: | |
| 4 | CABINETRY - 11A-UPPER ANGLE CORNER PER UNIT - UPGRADE 1 | Qty: 1 |
| 189,343 | | |
| 29,266 | Note: SKETCH #'S 2 AND 4 PAGES 19 AND 21 | |
| 5 | CABINETRY - 11D-VANITY BANK OF DRAWERS (MAX. WIDTH 55CM) - UPGRADE 1 | Qty: 1 |
| 189,124 | | |
| 29,275 | Note: MASTER ENSUITE - BETWEEN DOUBLE SINKS SKETCH # 3 AND 4 PAGES 20 AND 21 | |
| 6 | CABINETRY - OPT LIGHT VALANCE - KITCHEN | Qty: 1 |
| 182,447 | | |
| 29,276 | Note: | |

Ceramics

| | | |
|---------|--|--------|
| 7 | CERAMICS - FLOOR - FOYER - UPGRADE 1 | Qty: 1 |
| 182,647 | | |
| 29,251 | Note: | |
| 8 | CERAMICS - FLOOR - GARAGE ENTRY / MUD ROOM - UPGRADE 1 | Qty: 1 |
| 182,671 | | |
| 29,252 | Note: | |
| 9 | CERAMICS - FLOOR - POWDER ROOM - UPGRADE 1 | Qty: 1 |
| 182,655 | | |
| 29,253 | Note: | |
| 10 | CERAMICS - FLOOR - ENSUITE MASTER - UPGRADE 2 | Qty: 1 |
| 182,712 | | |
| 29,259 | Note: | |

Initials: CF JA

TAX#:1

PREPARED BY: Tina LeFur

PE 346-1

SlInvoice.rpt 28may19



Sales Selection Sheet

Wallaceton

PURCHASERS: JULIAN, A ARCILA and CRISTINA FRANCO

TEL: BUS.: 519-635-1209

14 of 30

| LOT / UNIT 244 | PHASE 2 | MODEL 25-2140 C The Wallace | ALT PLAN |
|-------------------|------------|--------------------------------|----------|
|-------------------|------------|--------------------------------|----------|

Ceramics

| | | |
|-------------------------|---|--------|
| 11 182,613 29,260 | CERAMICS - SHOWER WALL AND CEILING - INSTALL FLOOR TILE ON WALL AND CEILING - ENSUITE MASTER - UPGRADE 2 Note: | Qty: 1 |
| 12 182,727 30,339 | CERAMICS - BACKSPLASH - KITCHEN - UPGRADE 1 Note: | Qty: 1 |
| 13 182,469 30,340 | CERAMICS - TUB WALL - INSTALL FLOOR TILE ON WALL - MAIN BATHROOM - STANDARD SERIES Note: | Qty: 1 |

Drywall

| | | |
|-------------------------|---|--------|
| 14 182,761 29,264 | DRYWALL - SMOOTH CEILING IN MAIN FLOOR Note: | Qty: 1 |
|-------------------------|---|--------|

Electrical

| | | |
|--------------------------|---|--------|
| *15 189,445 29,262 | ELECTRICAL - POTLIGHT BUNDLE - 8 X T477GR-W 4 INCH LINE VOLTAGE POTLIGHTS INCLUDES 2 SWITCHES MAIN FLOOR (SEE SLIM LINE FOR BASEMENT) Note: 4 X KITCHEN AND 4 X GREAT ROOM SKETCH # 2 PAGE 19 | Qty: 1 |
| *16 189,450 29,269 | ELECTRICAL - CEILING ROUGH-IN (CAPPED) CENTERED ABOVE ISLAND +/- WITH RELOCATED STANDARD KITCHEN LIGHT (CAPPED) Note: SEE SKETCH #2 PAGE 19 | Qty: 1 |
| *17 189,417 29,270 | ELECTRICAL - RELOCATION OF SWITCHES/LIGHTS (MUST SPECIFY LOCATION) - NOTE: PLUGS CANNOT BE RELOCATED- MUST PURCHASE ADDITIONAL OUTLET. RELOCATE STANDARD KITCHEN LIGHT TO ABOVE ISLAND (CAPPED) ALONG WITH SECOND CAPPED FOR A TOTAL OF 2. Note: SEE SKETCH #2 PAGE 19 | Qty: 1 |
| *18 189,449 29,273 | FAMILY ROOM - ELECTRICAL - EXTRA WALL INTERIOR OUTLET ON EXISTING CIRCUIT (DOES NOT INCLUDE KITCHEN OUTLETS) INSTALL 70" +/- FROM FLOOR BESIDE CONDUIT Note: SEE SKETCH # 1 PAGE 18 | Qty: 1 |
| *19 189,449 29,274 | MASTER BEDROOM ELECTRICAL - EXTRA WALL INTERIOR OUTLET ON EXISTING CIRCUIT (DOES NOT INCLUDE KITCHEN OUTLETS) INSTALL ON WALL 70" +/- FROM FLOOR BESIDE CONDUIT Note: SEE SKETCH #3 PAGE 20 | Qty: 1 |
| *20 189,426 30,336 | ELECTRICAL - 4" EXTERIOR POTLIGHT IN SOFFIT (120 VOLT NON-INSULATED) MODEL #2550WH TWO INSTALLED UNDER ROOF ON EACH SIDE OF FRONT ELEVATION AND ONE CENTERED ABOVE GARAGE WITH RELOCATED STANDARD EXTERIOR POT LIGHT ON THE OTHER SIDE Note: SEE SKETCH # 5 PAGE 22 | Qty: 3 |

Initials: CF JA

TAX#:1

PREPARED BY: Tina LeFur

PE 346-2

SInvoice.rpt 28may19



Sales Selection Sheet

Wallaceton

15 of 30

PURCHASERS: JULIAN, A ARCILA and CRISTINA FRANCO

TEL: BUS.: 519-635-1209

| LOT / UNIT 244 | PHASE 2 | MODEL 25-2140 C The Wallace | ALT PLAN |
|-------------------|------------|--------------------------------|----------|
|-------------------|------------|--------------------------------|----------|

Electrical

| | | |
|----------------|--|--------|
| *21 189,417 | ELECTRICAL - RELOCATION OF SWITCHES/LIGHTS (MUST SPECIFY LOCATION) - NOTE: PLUGS CANNOT BE RELOCATED- MUST PURCHASE ADDITIONAL OUTLET. RELOCATE EXTERIOR POT LIGHT CENTERED ABOVE GARAGE ALONG WITH SECOND EXTERIOR POT LIGHT- | Qty: 1 |
| 30,338 | Note: USE EXISTING SWITCH FOR ALL EXTERIOR POT LIGHTS SEE SKETCH #5 PAGE 22 | |

FIREPLACE AND I

| | | |
|--------------|---|--------|
| 22 29,261 | GREAT ROOM- DELETE AND CREDIT STANDARD GAS FIREPLACE AND STANDARD MANTEL - DO NOT SUPPLY OR INSTALL | Qty: 1 |
| | Note: | |

Granite

| | | |
|---------------|--|--------|
| 23 182,785 | GRANITE - COUNTERTOP - 3/4" GROUP 6 WITH MITRE EDGE - KITCHEN / ISLAND - UPGRADE 6 | Qty: 1 |
| 29,243 | Note: | |

Hardwood

| | | |
|-------------------------|--|--------|
| 24 182,80C 29,246 | HARDWOOD - VINTAGE - 5" WHITE OAK SCULPTED - DINING ROOM - UPGRADE 4 | Qty: 1 |
| | Note: | |
| 25 182,796 29,247 | HARDWOOD - VINTAGE - 5" WHITE OAK SCULPTED - GREAT ROOM - UPGRADE 4 | Qty: 1 |
| | Note: | |
| 26 182,838 29,248 | HARDWOOD - VINTAGE - 5" WHITE OAK SCULPTED - KITCHEN / BREAKFAST - UPGRADE 4 | Qty: 1 |
| | Note: | |
| 27 182,804 29,249 | HARDWOOD - VINTAGE - 5" WHITE OAK SCULPTED - MAIN HALL - UPGRADE 4 | Qty: 1 |
| | Note: | |
| 28 182,833 29,250 | HARDWOOD - VINTAGE - 5" WHITE OAK SCULPTED - UPPER HALL - UPGRADE 4 | Qty: 1 |
| | Note: | |

Mirrors/Glass Pro

| | | |
|-------------------------|---|--------|
| 29 182,843 29,268 | MIRRORS/GLASS PRODUCTS - UPGRADE TO FRAMELESS CLEAR GLASS WITH D-RING HANDLE IN CHROME - ENSUITE MASTER | Qty: 1 |
| | Note: | |

MISC.

| | | |
|--------------|--|--------|
| 30 29,280 | SCHEDULE E- \$10,000.00 AT DECOR (NO CASH VALUE) | Qty: 1 |
| | Note: | |

Plumbing

Initials: CF JA

TAX#:1

PREPARED BY: Tina LeFur

PE 346-3

SInvoice.rpt 28may19



Sales Selection Sheet
Wallaceton

16 of 30
TEL: BUS.: 519-635-1209

PURCHASERS: JULIAN, A ARCILA and CRISTINA FRANCO

| | | | |
|-------------------|------------|---|--|
| LOT / UNIT 244 | PHASE 2 | MODEL 25-2140 C The Wallace ALT PLAN | |
|-------------------|------------|---|--|

Plumbing

| | | |
|--------------------------|--|--------|
| 31 189,694 29,267 | PLUMBING - OPTION FROM ONE SINK TO DOUBLE SINKSINCLUDING STD CHATEAU FAUCET AND UNDERMOUNT OVALYN SINKINCLUDING CABINET CONVERSION 2D VIKING, ONE EXTRA CUTOUT AND ONE EXTRA VANITY LIGHT Note: SKETCH # 3, 4 PAGES 20 AND 21 | Qty: 1 |
| *32 189,654 30,335 | PLUMBING - MASTER ENSUITE BATHROOM-MOEN -VICHY - LAV SINGLE HANDLE FAUCET WITH LIFT ROD DRAIN - CHROME (MODEL: 6710) LESS 20 % DISCOUNT FOR TWO Note: SPEC PAGE 25 | Qty: 2 |
| 33 189,720 30,341 | PLUMBING - KITCHEN SINK UPGRADE - BLANCO KITCHEN SINK PRECIS U SUPER SINGLE (32 INCH X 19 INCH) UNDERMOUNT 1 LARGE BOWL 9-1/2 INCH DEEP - COLOUR: WHITE MODEL#401820 Note: SPEC PAGE 23 | Qty: 1 |

Structured Wiring

| | | |
|--------------------------|--|--------|
| *34 189,788 29,271 | FAMILY ROOM- STRUCTURED WIRING - CONDUIT PIPE ROUGH-IN; SHORT - WHEN USED WITHIN SAME ROOM (MAX 10FT) 70" +/- FROM FLOOR BESIDE PLUG Note: SEE SKETCH # 1 PAGE 18 | Qty: 1 |
| *35 189,788 29,272 | MASTER BEDROOM- STRUCTURED WIRING - CONDUIT PIPE ROUGH-IN; SHORT - WHEN USED WITHIN SAME ROOM (MAX 10FT) 70" +/- FROM FLOOR BESIDE ELECTRICAL PLUG Note: SEE SKETCH # 2 PAGE 20 | Qty: 1 |

Sub Total
HST
Total

- 1. This Sales Selection Sheet when properly executed forms part of our Agreement of Purchase and Sale.
- 2. All extras and upgrades listed above are subject to Construction Progress and Architectural and Municipal requirements.
- 3. In the event the Vendor is unable to incorporate the work approved above in the construction of the house for any reason whatsoever, the Vendor will not be liable to the Purchaser in any way. The monies paid for any changes or optional extras not proceeded with shall be returned to the Purchaser, without interest. The cost of options or extras is non-refundable in all other circumstances. If for any reason whatsoever the Agreement of Purchase and Sale is not completed, the total cost of work approved above will be retained by the Vendor.
- 4. The Vendor reserves the right to substitute above materials and equipment with that of equal or better quality.
- 5. Purchaser acknowledges that items may not be exactly as shown. Variations from the Vendor's samples may occur in finished materials due to normal production processes. Vendor is not responsible for shade difference which may occur from different dye lots or wood grains. Variations from the Vendor's samples will occur with natural materials such as wood, marble, granite, hardwood and brick.
- 6. The Vendor reserves the right to select Grout & Thresholds that best suits the Tile selected.
- 7. Selections will not be processed unless signed by Heathwood Homes Head Office.
- 8. The selections made on this schedule are final and cannot be changed once submitted.
- 9. The Purchaser has checked and acknowledges the accuracy of this schedule.

| | |
|-----------------|--------|
| Payment Summary | |
| Paid By | Amount |
| Total Payment: | |

Initials: CF JA



Sales Selection Sheet

Wallaceton

17 of 30

PURCHASERS: JULIAN, A ARCILA and CRISTINA FRANCO

TEL: BUS.: 519-635-1209

| LOT / UNIT | PHASE | MODEL | |
|------------|-------|-----------------------|----------|
| 244 | 2 | 25-2140 C The Wallace | ALT PLAN |

PURCHASER:

JULIAN, A ARCILA

28-Jul-20

DATE

TINA LEFUR
Decor Consultant

28-Jul-20

DATE

PURCHASER:

CRISTINA FRANCO

28-Jul-20

DATE

APPROVED

07-29-2020
Date Approved Heathwood Homes (Huron) Limited

TAX#:1

PREPARED BY: Tina LeFur

PE 346-5

SInvoice.rpt 28may19

UK-75 WALLACETON
LOT 244
25-2140 ALT ELEV C
THE WALLACE

18 of 30
THE WALLACE
ELEVATION B, C D & E | 2,133 SQ. FT.
589 sq. ft. of opt. finished Lower Level
WALLACETON
EST. 1870

25-2140 ALT ELEV.C

Sketch # 1

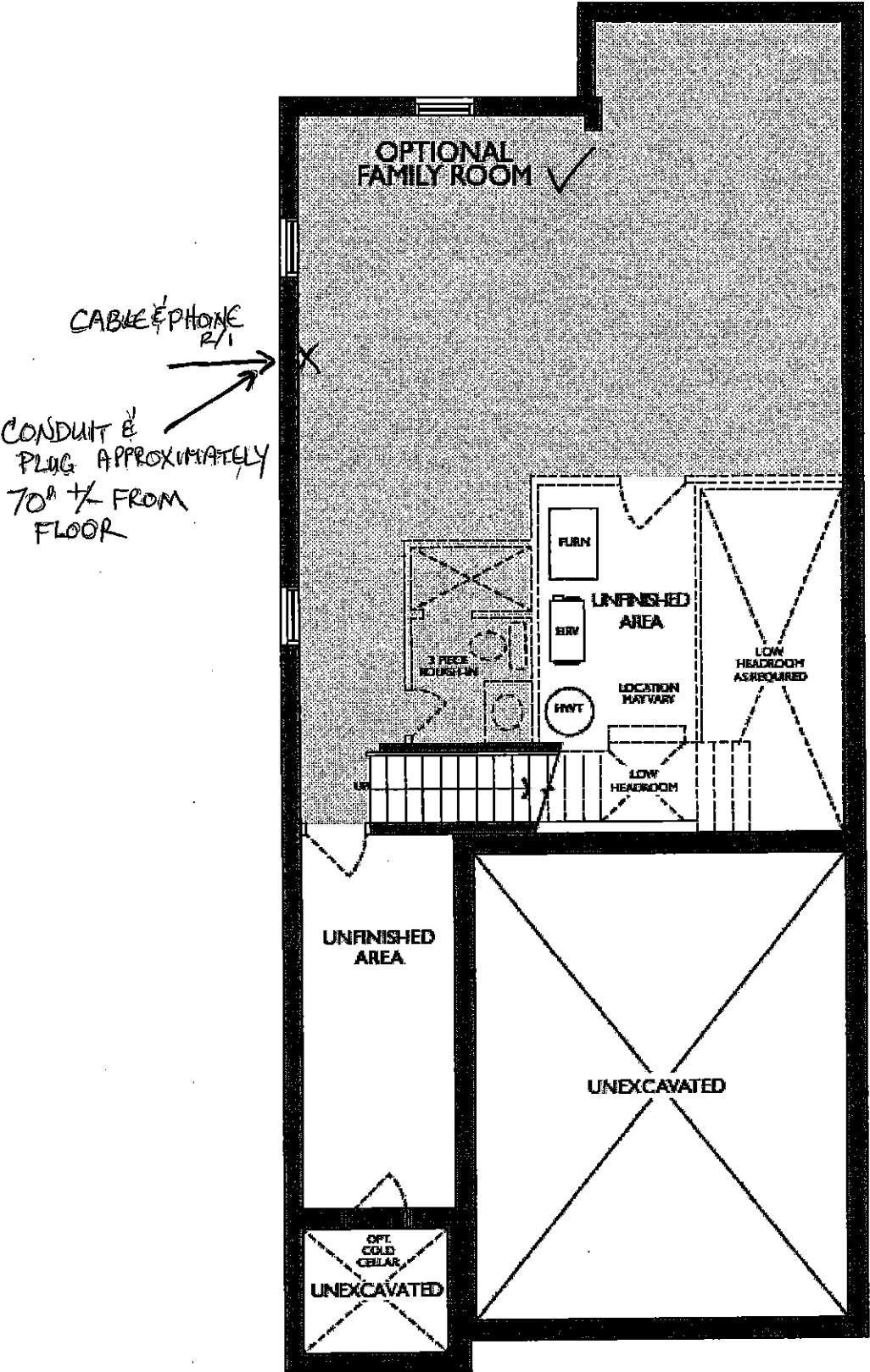

LOWER LEVEL
ELEVATION A, B, C, D & E

JA CF
July 7, 2020

UK-75 WALLACETON
LOT 244
25-2140 ALT ELEV C
THE WALLACE

19 of 30
THE WALLACE

ELEVATION B, C D & E | 2,133 SQ. FT.

589 sq. ft. of opt. finished Lower Level

25-2140 ALT ELEV.C

WALLACETON
EST. 1870

Sketch # 2

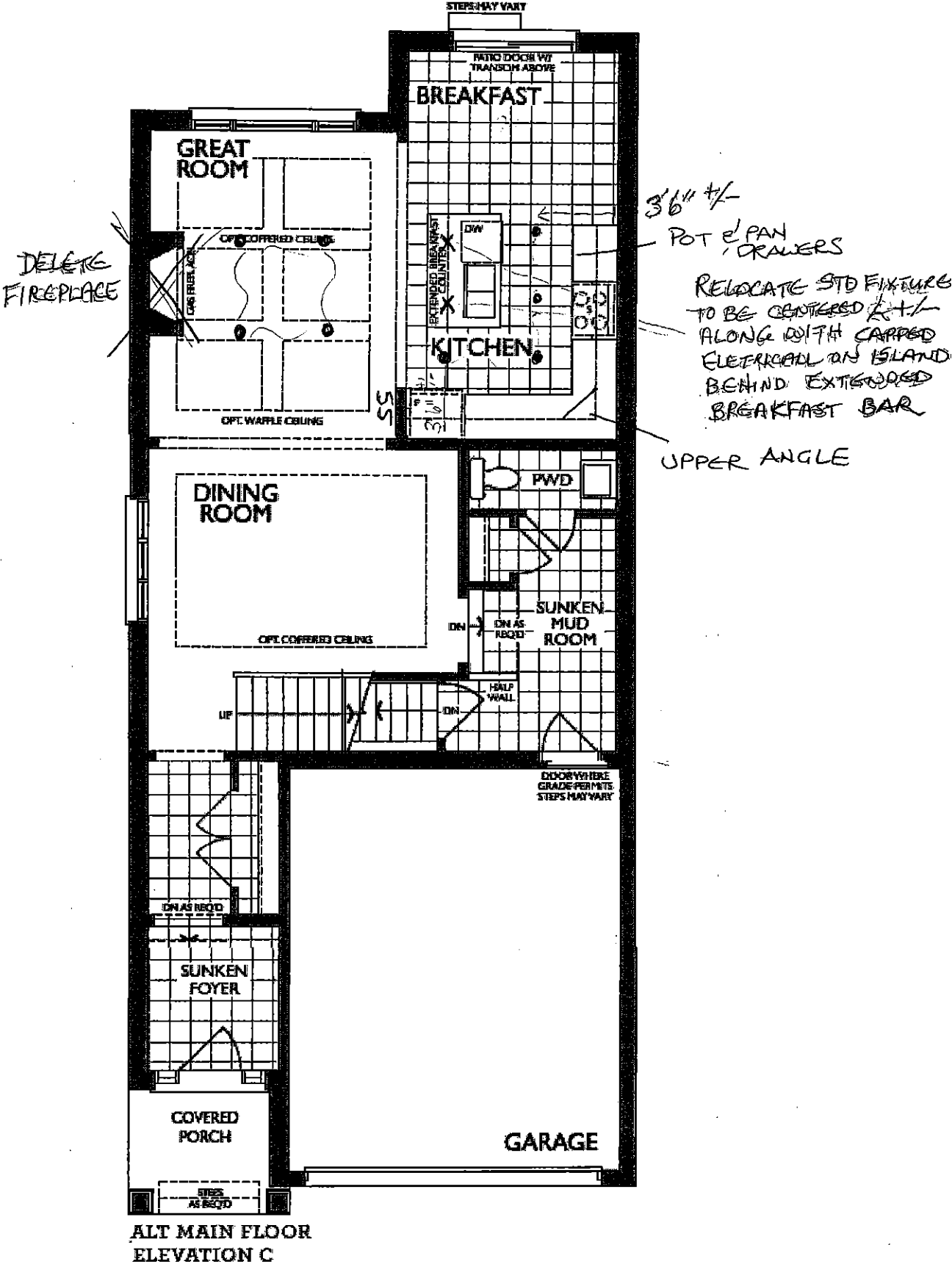

JA CF

UK-75 WALLACETON
LOT 244
25-2140 ALT ELEV C
THE WALLACE

20 of 30
THE WALLACE
ELEVATION B, C D & E | 2,133 SQ. FT.
589 sq. ft. of opt. finished Lower Level
WALLACETON
EST. 1870

25-2140 ALT ELEV.C

Sketch #3

FLOOR TILE ON WALL
& CEILING STACKED

VERTICALLY

12x24
TILE INSTALL
DIRECTION

CONDUIT
& PLUG
70" +/-

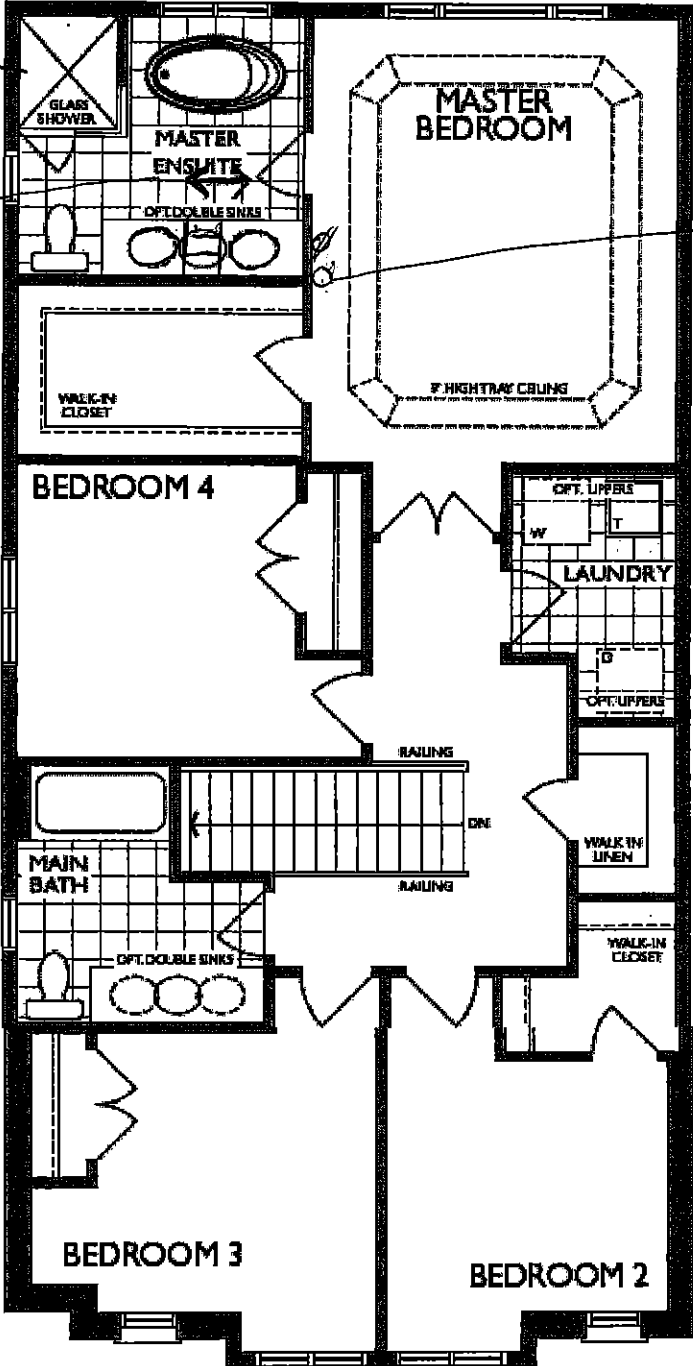

SECOND FLOOR
ELEVATION C

SA
CF

0/23/2019

21 of 30

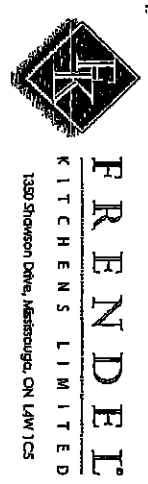
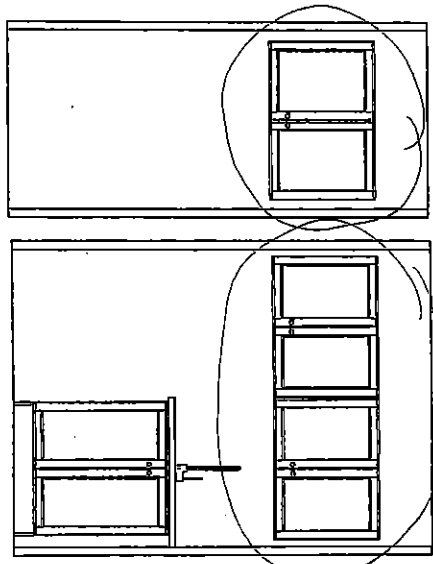
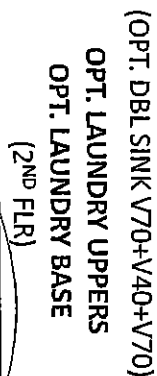
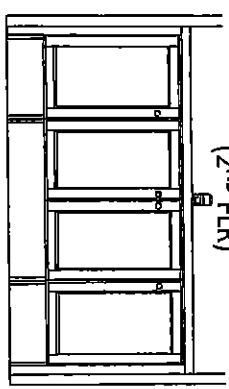
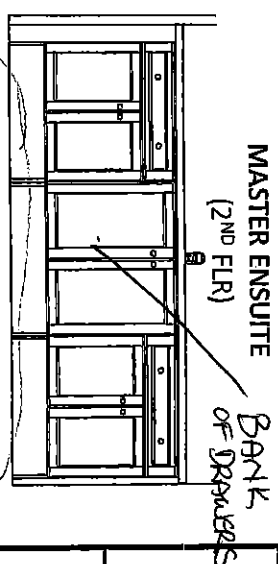
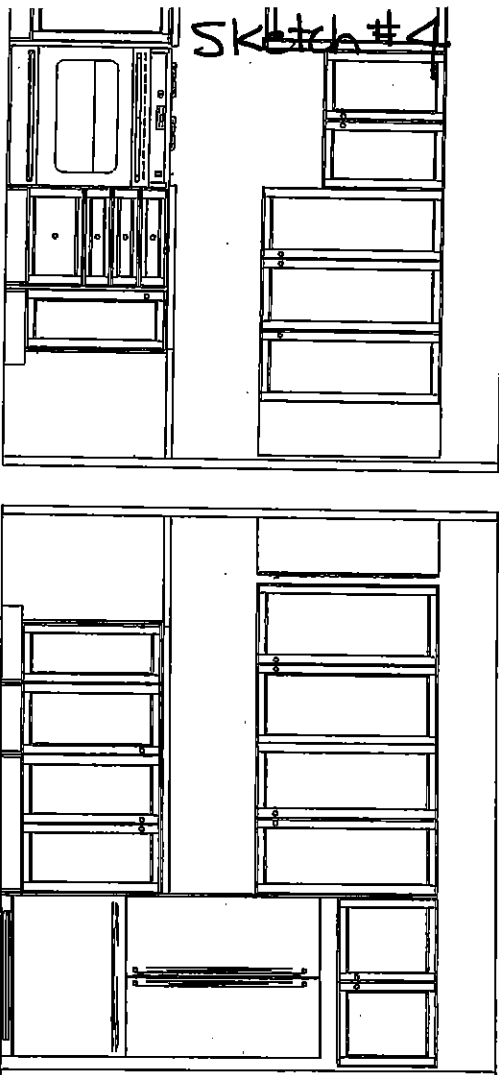
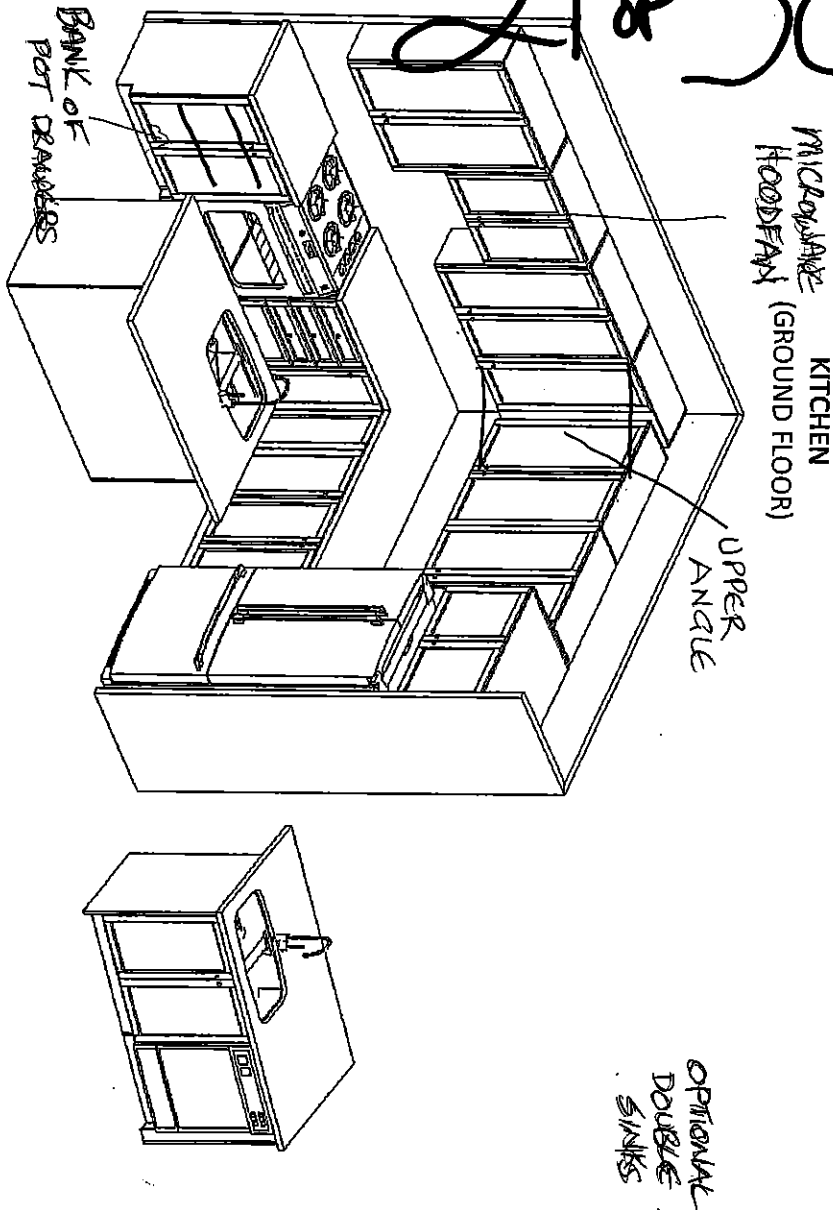

HEATHWOOD HOMES
WALLACETON, KITCHENER ON
MODEL: 25-2140 (3108)

STANDARD CONTRACT INCLUDES:

- Appliance Openings**
- Hood Opening: 30"W Chimney hood
 - Fridge Opening: 37 3/8 "W X 73 3/8"
 - Fridge cabinet & gables: 66cm Deep
 - Stove Opening: 30" Freestanding
 - Dishwasher Opening: 24"

- Standard Kitchens Scope:**
- 100cm H wall cabinets
 - Std. Blumotion Hinges- soft close doors
 - Std. Metabox Drawers- not soft close
 - Min 40cm W drawer
 - Base pie cut corner cabinets
 - Backing on all cabinets
 - Countertop by others
 - Upgrade applied paneled fridge & dishwashers supply only (appliance hardware by others)

- Standard Vanity & Laundry Scope:**
- Powder by others, pedestal
 - Master Ens. - Top by others
 - Remaining vanities inc. laminate top
 - Std. Blumotion Hinges- not soft close
 - Std. Metabox Drawers- not soft close
 - Master Ens: Top drawers(sink Full height)
 - Mains: Full height doors (top drawers added if Masters can't accommodate)
 - Optional laundry base & wall cabinets

THIS DRAWING IS FOR DESIGN PURPOSES ONLY.
IT IS NOT AN EXACT REPRESENTATION.

CF
5A

UK-75 WALLACETON
LOT 244
25-2140 ALT ELEV C
THE WALLACE

22 of 30

Sketch #5

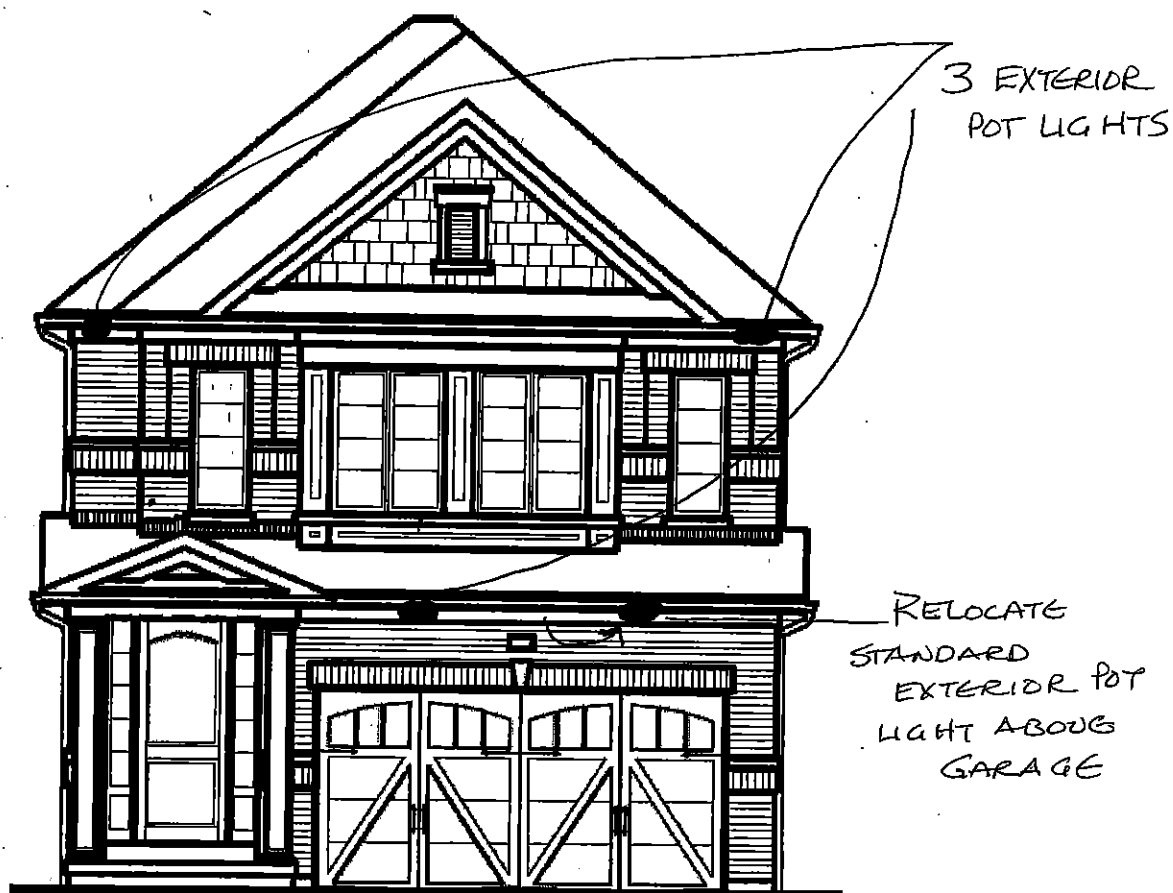

ELEVATION C & D

4 EXTERIOR POT LIGHTS
2 ON EACH CORNER GABLE
2 ABOVE GARAGE

UK-75 WALLACETON
LOT 244
25-2140 ALT ELEV C
THE WALLACE

23 of 30

Product Specification Sheet

PRECIS U SUPER SINGLE



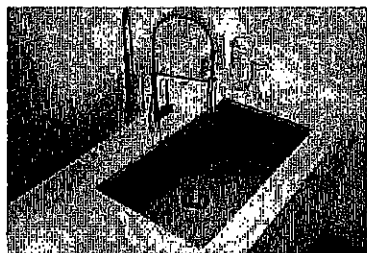



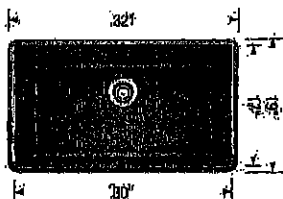

SILGRANIT®



KITCHEN SINK

PRODUCT DIMENSIONS



| PRECIS U SUPER SINGLE | Colour/Finish | Model No. | FEATURES / SPECIFICATIONS |
|---|---------------|-----------|---|
| ✓  | White | 401820 | <ul style="list-style-type: none">Precis kitchen sinks are made in Canada and GermanyExtra-large bowl size is ideal for busy familiesMade of SILGRANIT, a high-quality granite compositeHeat, scratch and stain resistantNon-porous surface is anti-bacterial and easy to clean <p>DESIGN AND PLANNING TIPS</p> <p>Cabinet Size: 36" (915 mm) Bowl depth: 9 1/2" (240 mm) To protect from damage, this model should be shipped on a pallet</p> |
|  | Truffle | 401143 | |
|  | Metallic Gray | 401863 | |
|  | Concrete Gray | 402266 | |
|  | Cinder | 401397 | |
|  | Café | 400889 | |
|  | Biscuit | 401819 | |
|  | Anthracite | 400890 | |

WARRANTY

Limited Lifetime warranty

Code/Standards Compliance

BLANCO sinks and faucets are third-party tested and certified to CSA, cUPC, ANSI/ASME and NSF standards and listed by applicable certification bodies. For more information on individual product listings, contact our office or listing organization.

BLANCO CANADA
100 Corporation Drive
Brampton, ON L6S 6B5

Tel: 905 494 2400
Fax: 905 494 2425
www.blancocanada.com

Toll Free: 1 877 425 2626
Toll Free: 1 877 825 2626

© 2016 BLANCO CANADA

JA
CF

UK-75 WALLACETON
LOT 244
25-2140 ALT ELEV C
THE WALLACE

24 of 30

STANDARD KITCHEN FAUCET

Align

Modern

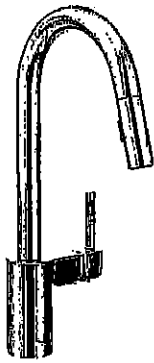

Single Handle Pull-Down Kitchen
Faucet*

Model 7565†

JA
CF

UK-75 WALLACETON
LOT 244
25-2140 ALT ELEV C
THE WALLACE

25 of 30

NEW! Vichy™

Traditional | Transitional | Modern
*With its cylindrical shapes, contoured edges and slim handle,
Vichy gives modern style a soft touch.*

X 2 MASTER ENSUITE BATHROOM

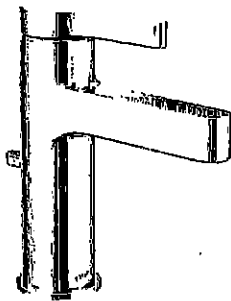

**Single Handle
Lav Faucet
with Lift Rod Drain**

Model 6710

Chrome

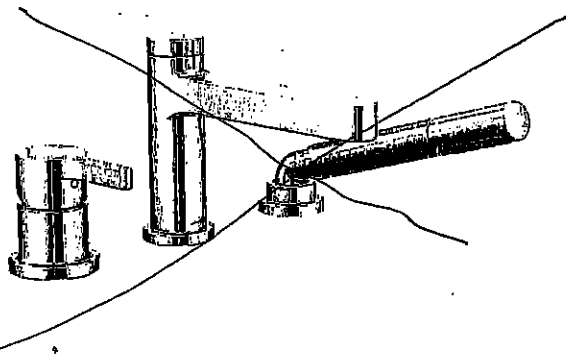

**One Handle Roman Tub Faucet
with Hand Shower**

Model T967 / 4791

Chrome



Tub Drain Half Kit Available**
Chrome

FINISH OPTIONS:



C

To order, use model number only
** T90331 / 140680

JA
CF.

UK-75 WALLACETON
LOT 244
25-2140 ALT ELEV C
THE WALLACE

Chateau

Transitional

26 of 30

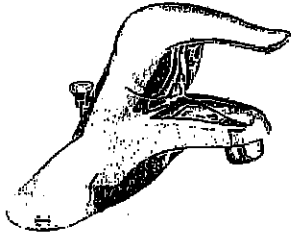

Lavatory Faucet with Pop-Up Drain
Model L4621†

VANITY SINKS AND PEDESTAL

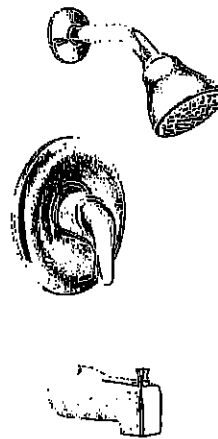

Posi-Temp® Pressure Balancing Tub/Shower
Model 62320 / TL183†

OR

Posi-Temp Valve and Tub/Shower Trim
with Eco-Performance Easy Clean® XL
Model 62320 / TL183EP†

(TL183EP not available in BC)

SHOWER AND 5" TUB FAUCETS



2 Handle Roman Tub with 9" Spout
Model 4796 / T990†

FREESTANDING TUB FAUCETS

JA
CF

UK-75 WALLACETON
LOT 244
25-2140 ALT ELEV C
THE WALLACE

27 OF 30

WMH31017H
OVER-THE-RANGE MICROWAVE



DISHWASHER-SAFE TURNTABLE PLATE

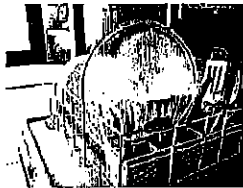

Clean up spills on the turntable by simply putting it in the dishwasher.

2-SPEED 600 CFM MOTOR/CLASS



Match the right amount of ventilation to the dish being prepared and quickly get rid of cooking odors with two different fan speed settings.

MICROWAVE PRESETS



Get just the right amount of heat and time, whether you're cooking or defrosting, with specific preset options.

OTHER FEATURES

- Add 30 seconds option
- Electronic touch controls
- Adjustable cooktop lighting

| | White (W) | Black (B) | Fingerprint Resistant Stainless Steel (Z) | Silver (S) |
|-----------------|--------------|--------------|--|---------------|
| MODEL | WMH31017HW | WMH31017HB | WMH31017HZ | WMH31017HS |
| Max height (in) | 17-1/8" | 17-1/8" | 17-1/8" | 17-1/8" |
| Width (in) | 29-15/16" | 29-15/16" | 29-15/16" | 29-15/16" |
| Depth (in) | 15-9/16" | 15-9/16" | 15-9/16" | 15-9/16" |

Whirlpool®

*Performance varies based on installation.

©/™ ©2018 Whirlpool. All rights reserved. 1/18. WC170107A

JA
CF

28 of 30

Whirlpool® MICROWAVE HOOD INSTALLATION INSTRUCTIONS

PRODUCT MODEL NUMBERS

WMH31017H

LOCATION REQUIREMENTS

Installation Dimensions

NOTE: The grounded 3 prong outlet must be inside the upper cabinet.
See the "Electrical Requirements" section.

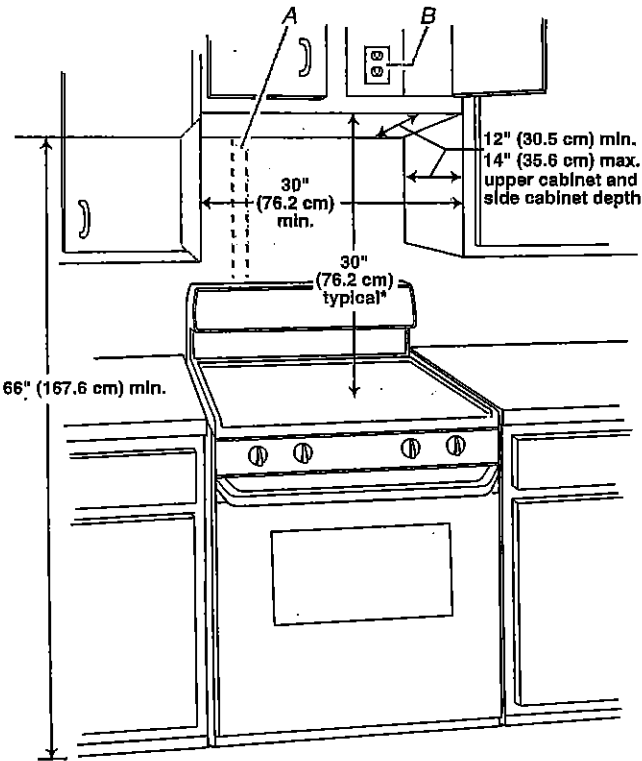

A. 2" x 4" wall stud
B. Grounded 3 prong outlet

*30" (76.2 cm) is typical for 66" (167.6 cm) installation height. Exact dimensions may vary depending on type of range/cooktop below.

PRODUCT DIMENSIONS

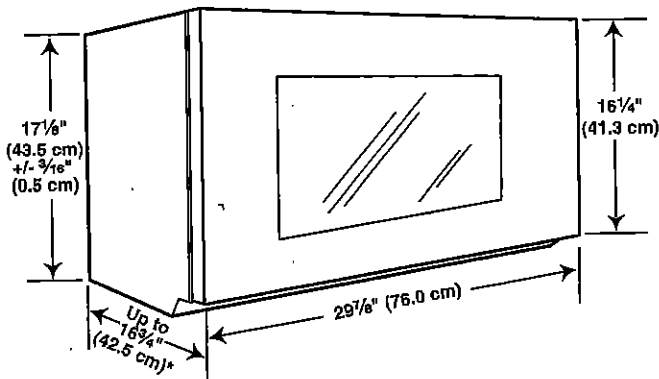

*Overall depth of product will vary slightly depending on door design.

PRODUCT DIMENSIONS

ELECTRICAL REQUIREMENTS

⚠ WARNING



Electrical Shock Hazard

- Plug into a grounded 3 prong outlet.
- Do not remove ground prong.
- Do not use an adapter.
- Do not use an extension cord.
- Failure to follow these instructions can result in death, fire, or electrical shock.

Observe all governing codes and ordinances.

Required:

- A 120-volt, 60 Hz, AC-only, 15- or 20-amp electrical supply with a fuse or circuit breaker

Recommended:

- A time-delay fuse or time-delay circuit breaker
- A separate circuit serving only this microwave oven

Because Whirlpool Corporation includes a continuous commitment to improve our products, we reserve the right to change materials and specifications without notice.

Dimensions are for planning purposes only. For complete details, see installation instructions packed with product. Specifications subject to change without notice.

JA
CF

29 of 30

VENTING DESIGN SPECIFICATIONS

- This section is intended for architectural designer and builder/ contractor reference only.

NOTES:

- Vent materials needed for installation are not provided with microwave hood combination.
- We do not recommend using a flexible metal vent.
- To avoid possible product damage, be sure to vent air outside, unless using recirculation installation. Do not vent exhaust air into concealed spaces, such as spaces within walls or ceilings, attics, crawl spaces, or garages.

For optimal venting installation, we recommend:

- Using roof or wall caps that have back draft dampers
 - Using a rigid metal vent
 - Using the most direct route by minimizing the length of the vent and number of elbows to provide efficient performance
 - Using uniformly sized vents
 - Using duct tape to seal all joints in the vent system
 - Using caulking compound to seal exterior wall or roof opening around cap
 - Not installing 2 elbows together for optimal hood performance
- If venting through the wall, be sure that there is proper clearance within the wall for the damper to open fully.
- If venting through the roof, and rectangular-to-round transition is used, be sure there are at least 3" (7.6 cm) of clearance between the top of the microwave oven and the transition piece. See "Rectangular-to-Round Transition" illustration.

Rectangular-to-Round Transition

NOTE: The minimum 3" (7.6 cm) clearance must exist between the top of the microwave oven and the rectangular to round transition piece so that the damper can open freely and fully.

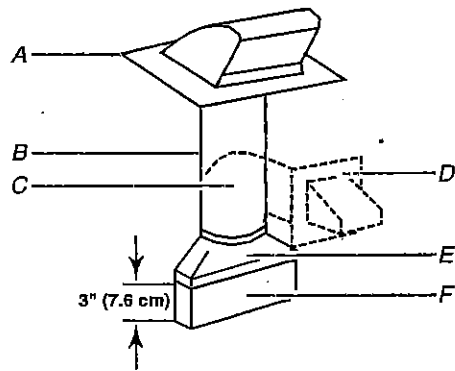

- A. Roof cap
- B. 6" (15.2 cm) min. diameter round vent
- C. Elbow (for wall venting only)
- D. Wall cap
- E. 3 1/4" x 10" to 6" (8.3 x 25.4 cm to 15.2 cm) rectangular to round transition piece
- F. Vent extension piece, at least 3" (7.6 cm) high

Recommended Standard Fittings

The following length equivalents are for use when figuring vent length. See the examples in "Recommended Vent Length."

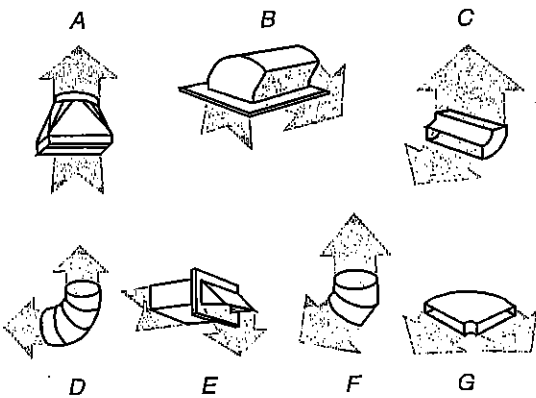
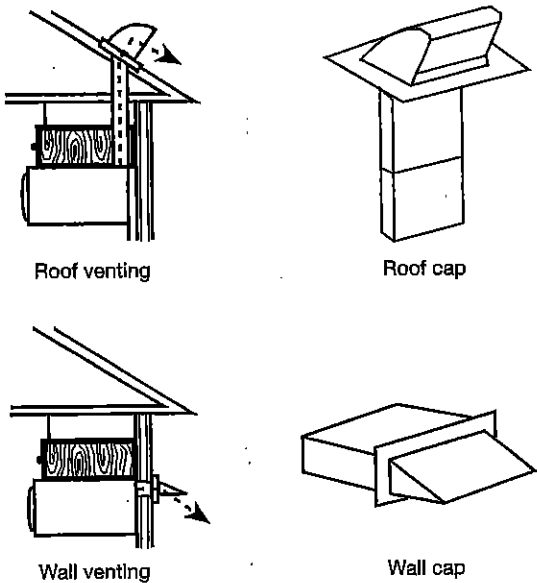

- A. Rectangular-to-round transition piece: 3 1/4" x 10" to 6" = 5 ft (8.3 x 25.4 cm to 15.2 cm = 1.5 m)
- B. Roof cap: 3 1/4" x 10" = 24 ft (8.3 x 25.4 cm = 7.3 m)
- C. 90° elbow: 3 1/4" x 10" = 25 ft (8.3 x 25.4 cm = 7.6 m)
- D. 90° elbow: 6" = 10 ft (15.2 cm = 3 m)
- E. Wall cap: 3 1/4" x 10" = 40 ft (8.3 x 25.4 cm = 12.2 m)
- F. 45° elbow: 6" = 5 ft (15.2 cm = 1.5 m)
- G. 90° flat elbow: 3 1/4" x 10" = 10 ft (8.3 x 25.4 cm = 3 m)

JA
CF

30 OF 30

Recommended Vent Length

3¼" x 10" (8.3 x 25.4 cm) rectangular or 6" (15.2 cm) round vent should be used.

The total length of the vent system including straight vent, elbow(s), transitions, and wall or roof caps must not exceed the equivalent of 140 ft (42.7 m) for either type of vent. See the "Recommended Standard Fittings" section for equivalent lengths.

For best performance, use no more than three 90° elbows.

To calculate the length of the system you need, add the equivalent lengths of each vent piece used in the system.

See the following examples:

3¼" x 10" (8.3 x 25.4 cm) vent system = 73 ft (22.2 m) total

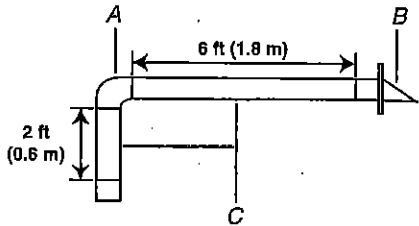

- A. One 3¼" x 10" (8.3 x 25.4 cm) 90° elbow = 25 ft (7.6 m)
- B. 1 wall cap = 40 ft (12.2 m)
- C. 2 ft (0.6 m) + 6 ft (1.8 m) straight = 8 ft (2.4 m)

6" (15.2 cm) vent system = 73 ft (22.2 m) total

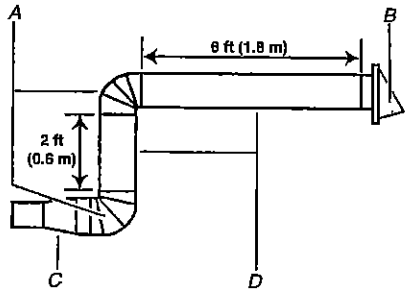

- A. Two 90° elbows = 20 ft (6.1 m)
- B. 1 wall cap = 40 ft (12.2 m)
- C. 1 rectangular-to-round transition piece = 5 ft (1.5 m)
- D. 2 ft (0.6 m) + 6 ft (1.8 m) straight = 8 ft (2.4 m)

If the existing vent is round, a rectangular-to-round transition piece must be used. In addition, a rectangular 3" (7.6 cm) extension vent between the damper assembly and rectangular-to-round transition piece must be installed to keep the damper from sticking.

JA
CF