

PRE-Sales Selection Sheet
Checklist

1 OF 1

LOT 188A-5 Model: 20-1606 B The Grassfield

PURCHASERS: ALOK SAHI/KIRAN ARORA

VENDOR: Heathwood Homes (Huron) Limited

- ☒ FINISHED BASEMENT
☐ COLD CELLAR

UPGRADED / MODIFIED ELEVATION

- ☐ CORNER UPGRADE
☐ REAR UPGRADE

CEILING UPGRADE - SMOOTH

- ☐ MAIN FLOOR
☐ SECOND FLOOR
☐ BASEMENT

ADDITIONAL ROUGH-INS

- ☐ 200 AMP SERVICE
☐ WET BAR ROUGH-IN
☐ HUMIDIFIER
☒ AIR CONDITIONING

GAS ROUGH-IN

- ☐ STOVE
☐ DRYER
☐ BBQ
☐ ADDITIONAL FIREPLACE

KITCHEN: HOODFAN VENTING SIZE

- ☒ 6 IN ROUND DUCT
☐ 7 IN ROUND DUCT

FULL BASEMENT STAIRS:	N/A
UPPER BASEMENT STAIRS:	All Oak
LOWER BASEMENT STAIRS:	Carpet Grade
MAIN STAIRS:	All Oak
MEDIA STAIRS (if applicable):	N/A
LOFT STAIRS (if applicable):	N/A

June 17/20
Date
Signatures
Purchaser:
on file by
e-mail

June 17/20
Date
TINA LEFUR
Decor Consultant:
- APPROVED -
-06- 17 2020

Date
Purchaser:
Locked Date:

Date
Heathwood Homes (Huron) Limited
Approved



Sales Selection Sheet

Wallaceton

2 of 11

PURCHASERS: ALOK SAHI and KIRAN ARORA

TEL:

LOT / UNIT	PHASE	MODEL	
188A-5	1	20-1606 B The Grassfield	

It is herein understood and agreed between the undersigned parties hereto that the following changes shall be made to the above mentioned Agreement of Purchase and Sale in accordance with the agreement and except for such changes noted below, all other terms and conditions in the Agreement of Purchase and Sale shall remain as stated herein: It is further understood that and agreed that all changes and additions shall be installed as per builder's specifications, location and available selections. The Purchaser hereby agrees to purchase the following extras:

APPLIANCES

1	SCHEDULE E: FIVE APPLIANCES: SS FRIDGE, STOVE, DISHWASHER; WHITE FRONT LOADER WASHER/DRYER - TOWNHOMES	Qty: 1	
25,121	Note:		

MISC.

2	SCHEDULE E: SCHEDULE X: ITEM # 5 ADJUSTMENTS (e) and (f) COMBINED TO BE CAPPED AT \$5000.00	Qty: 1	
25,122	Note:		

Sub Total

HST

Total

1. This Sales Selection Sheet when properly executed forms part of our Agreement of Purchase and Sale.
2. All extras and upgrades listed above are subject to Construction Progress and Architectural and Municipal requirements.
3. In the event the Vendor is unable to incorporate the work approved above in the construction of the house for any reason whatsoever, the Vendor will not be liable to the Purchaser in any way. The monies paid for any changes or optional extras not proceeded with shall be returned to the Purchaser, without interest. The cost of options or extras is non-refundable in all other circumstances. If for any reason whatsoever the Agreement of Purchase and Sale is not completed, the total cost of work approved above will be retained by the Vendor.
4. The Vendor reserves the right to substitute above materials and equipment with that of equal or better quality.
5. Purchaser acknowledges that items may not be exactly as shown. Variations from the Vendor's samples may occur in finished materials due to normal production processes. Vendor is not responsible for shade difference which may occur from different dye lots or wood grains. Variations from the Vendor's samples will occur with natural materials such as wood, marble, granite, hardwood and brick.
6. The Vendor reserves the right to select Grout & Thresholds that best suits the Tile selected.
7. Selections will not be processed unless signed by Heathwood Homes Head Office.
8. The selections made on this schedule are final and cannot be changed once submitted.
9. The Purchaser has checked and acknowledges the accuracy of this schedule.

Payment Summary

Paid By Amount

Total Payment:

PURCHASER:

Signatures on file
ALOK SAHI

10-Jun-20
DATE

TINA LEFUR
Decor Consultant

10-Jun-20
DATE

PURCHASER:

by e-mail
KIRAN ARORA

10-Jun-20
DATE

- APPROVED -

-06- 17 2020

M. Rosen
Date Approved Heathwood Homes (Huron) Limited

TAX#:1

PREPARED BY: Marilyn Rosen

PE 290-1

SlInvoice.rpt 28may19



Sales Selection Sheet
Wallaceton

3 of 11
TEL:

PURCHASERS: ALOK SAHI and KIRAN ARORA

LOT / UNIT 188A-5	PHASE 1	MODEL 20-1606 B The Grassfield	
----------------------	------------	-----------------------------------	--

It is herein understood and agreed between the undersigned parties hereto that the following changes shall be made to the above mentioned Agreement of Purchase and Sale in accordance with the agreement and except for such changes noted below, all other terms and conditions in the Agreement of Purchase and Sale shall remain as stated herein: It is further understood that and agreed that all changes and additions shall be installed as per builder's specifications, location and available selections. The Purchaser hereby agrees to purchase the following extras:

APPLIANCES

1	SUPPLY AND INSTALL WHIRLPOOL OVER-THE RANGE MICROWAVE MODEL WMH31017H IN LIEU OF STANDARD HOOD FAN	Qty: 1
25,123	Note: SEES SPECS PAGES 8-11	

Cabinetry

2	CABINETRY - 11A-UPPER ANGLE CORNER PER UNIT - UPGRADE 1	Qty: 1
189,343		
25,124	Note: SKETCH # 2 PAGE 6	

Electrical

3	ELECTRICAL - CEILING ROUGH-IN (CAPPED) <i>CENTERED ABOVE KITCHEN ISLAND +/-</i>	Qty: 1
189,450		
25,125	Note: SKETCH # 2 PAGE 6	
*4	ELECTRICAL - ADDITIONAL SWITCH FOR CAPPED CEILING ABOVE ISLAND LOCATE WITH STANDARD KITCHEN SWITCH	Qty: 1
189,451		
25,126	Note: SKETCH # 2 PAGE 6	

Sub Total
HST
Total

- 1. This Sales Selection Sheet when properly executed forms part of our Agreement of Purchase and Sale.
- 2. All extras and upgrades listed above are subject to Construction Progress and Architectural and Municipal requirements.
- 3. In the event the Vendor is unable to incorporate the work approved above in the construction of the house for any reason whatsoever, the Vendor will not be liable to the Purchaser in any way. The monies paid for any changes or optional extras not proceeded with shall be returned to the Purchaser, without interest. The cost of options or extras is non-refundable in all other circumstances. If for any reason whatsoever the Agreement of Purchase and Sale is not completed, the total cost of work approved above will be retained by the Vendor.
- 4. The Vendor reserves the right to substitute above materials and equipment with that of equal or better quality.
- 5. Purchaser acknowledges that items may not be exactly as shown. Variations from the Vendor's samples may occur in finished materials due to normal production processes. Vendor is not responsible for shade difference which may occur from different dye lots or wood grains. Variations from the Vendor's samples will occur with natural materials such as wood, marble, granite, hardwood and brick.
- 6. The Vendor reserves the right to select Grout & Thresholds that best suits the Tile selected.
- 7. Selections will not be processed unless signed by Heathwood Homes Head Office.
- 8. The selections made on this schedule are final and cannot be changed once submitted.
- 9. The Purchaser has checked and acknowledges the accuracy of this schedule.

Payment Summary	
<u>Paid By</u>	<u>Amount</u>
<u>Total Payment:</u>	

Initials: *mf*



PURCHASERS: ALOK SAHI and KIRAN ARORA

Sales Selection Sheet
Wallaceton

4 of 11

TEL:

LOT / UNIT 188A-5	PHASE 1	MODEL 20-1606 B The Grassfield	
----------------------	------------	-----------------------------------	--

PURCHASER:

Signatures

ALO K SAHI

11-Jun-20

DATE

on file by email

KIRAN ARORA

11-Jun-20

DATE

TINA LEFUR

Decor Consultant

11-Jun-20

DATE

- APPROVED -

-06- 17 2020

Date Approved

M Rosen

Heathwood Homes (Huron) Limited

UK - 75 WALLACETON
LOT 188A-5
20-1606 ELEV B
THE GRASSFIELD

5 of 11

THE GRASSFIELD

ELEVATION B | 1,986 SQ. FT.

Includes 380 square feet of finished lower level

20-1606 ELEV. B

WALLACETON
EST. 1870

Sketch # 1

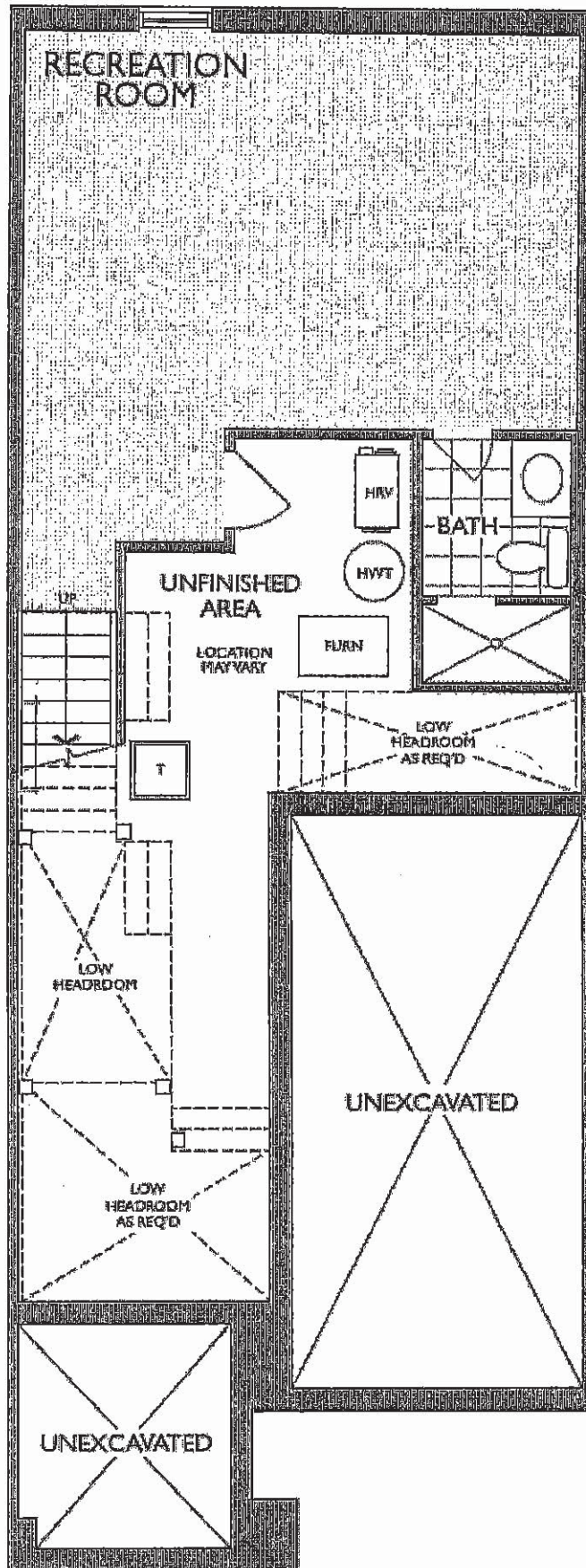

LOWER LEVEL
ELEVATION B

THE GRASSFIELD

Includes 380 square feet of finished lower level

WALLACETON
EST. 1870

Sketch #2

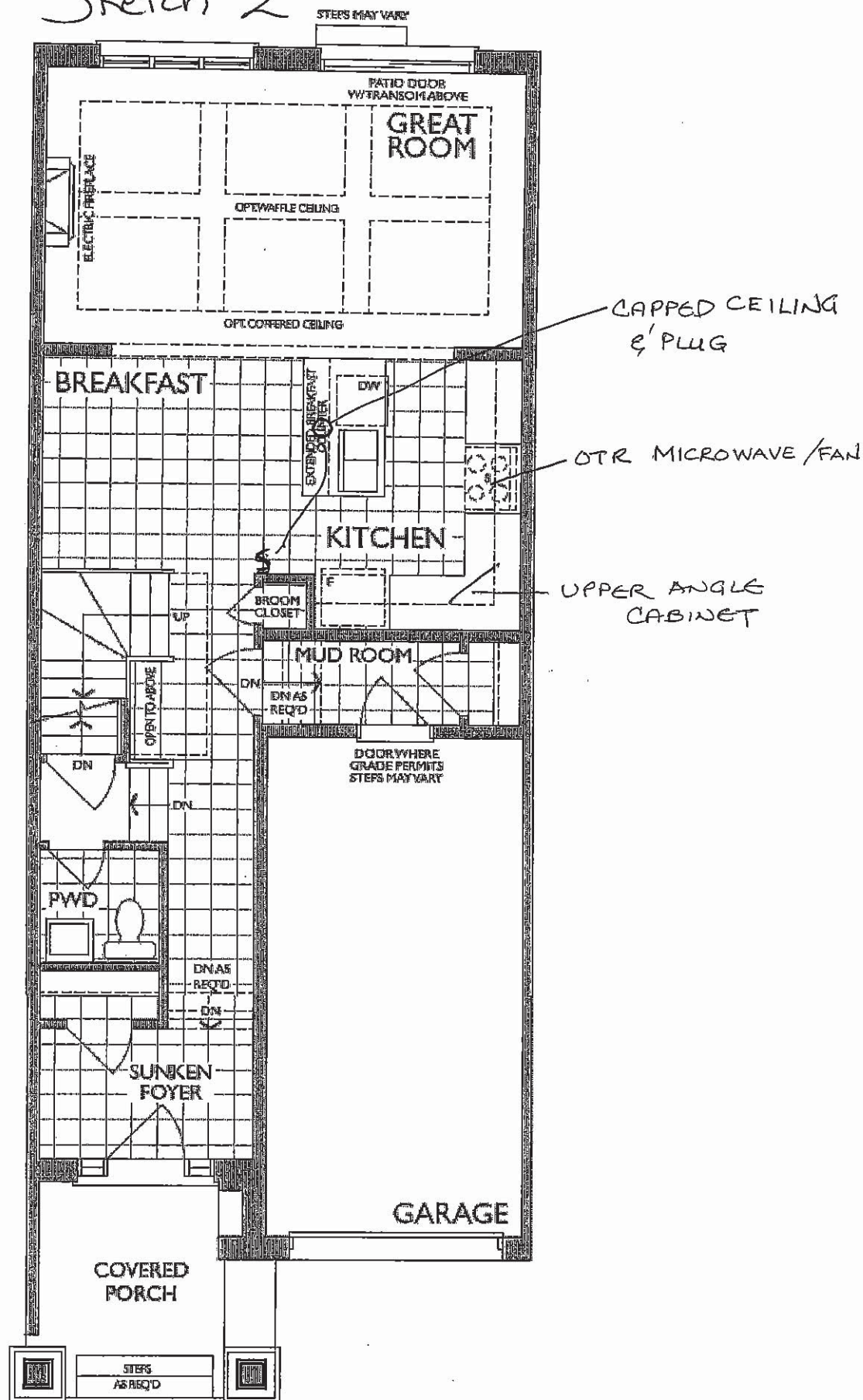

MAIN FLOOR
ELEVATION B

UK - 75 WALLACETON
LOT 188A-5
20-1606 ELEV B
THE GRASSFIELD

7 OF 11
THE GRASSFIELD

ELEVATION B | 1,986 SQ. FT.

Includes 380 square feet of finished lower level

20-1606 ELEV. B

Sketch #3 WALLACETON
BPT. 1870

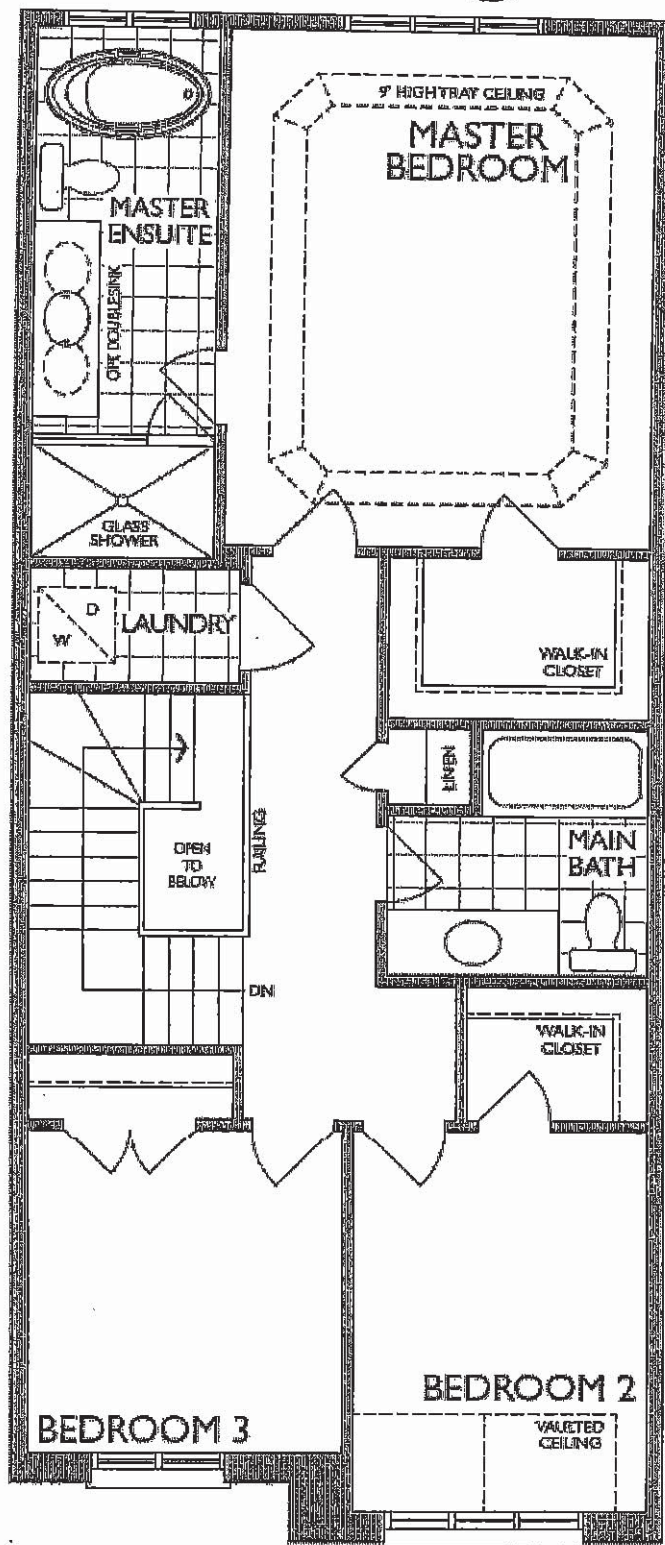

SECOND FLOOR
ELEVATION B

UK - 75 WALLACETON
LOT 188A-5
20-1606 ELEV B
THE GRASSFIELD

8 of 11

WHIRLPOOL
OVER-THE-RANGE MICROWAVE



DISHWASHER-SAFE TURNTABLE PLATE

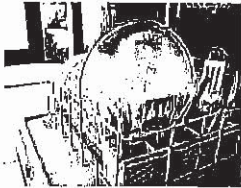

Clean up spills on the turntable by simply putting it in the dishwasher.

ADJUSTABLE SMOOTH MOTOR CLASS



Match the right amount of ventilation to the dish being prepared and quickly get rid of cooking odors with two different fan speed settings.

MICROWAVE PRESETS



Get just the right amount of heat and time, whether you're cooking or defrosting, with specific preset options.

OTHER FEATURES

- Add 30 seconds option
- Electronic touch controls
- Adjustable cooktop lighting



White (W)



Black (B)



Fingerprint Resistant Stainless Steel (Z)



Silver (S)

	WHIRLPOOL	WHIRLPOOL	WHIRLPOOL	WHIRLPOOL
Max height (in)	17-1/8"	17-1/8"	17-1/8"	17-1/8"
Width (in)	29-15/16"	29-15/16"	29-15/16"	29-15/16"
Depth (in)	15-9/16"	15-9/16"	15-9/16"	15-9/16"

Whirlpool®

*Performance varies based on installation.
©/™ ©2018 Whirlpool. All rights reserved. 1/18. WC170107A

UK - 75 WALLACETON
LOT 188A-5
20-1606 ELEV B
THE GRASSFIELD

9 of 11

Whirlpool® MICROWAVE HOOD INSTALLATION INSTRUCTIONS

PRODUCT MODEL NUMBERS

WMH31017H

LOCATION REQUIREMENTS

Installation Dimensions

NOTE: The grounded 3 prong outlet must be inside the upper cabinet.
See the "Electrical Requirements" section.

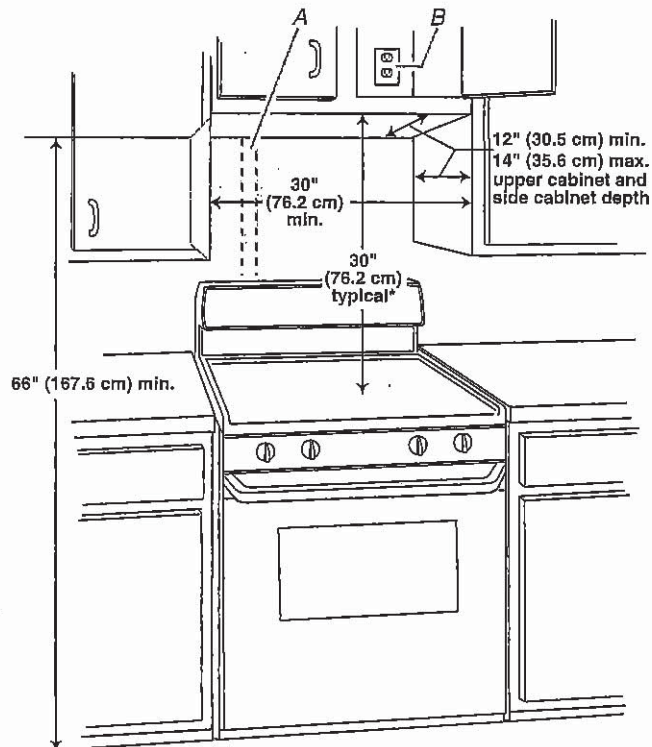

A. 2" x 4" wall stud
B. Grounded 3 prong outlet

*30" (76.2 cm) is typical for 66" (167.6 cm) installation height. Exact dimensions may vary depending on type of range/cooktop below.

PRODUCT DIMENSIONS

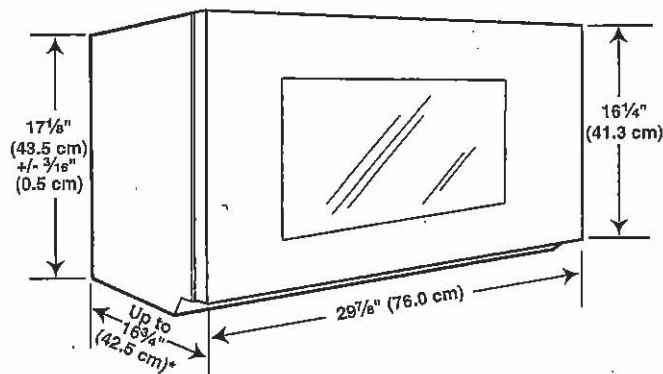

*Overall depth of product will vary slightly depending on door design.

PRODUCT DIMENSIONS

ELECTRICAL REQUIREMENTS

⚠ WARNING



Electrical Shock Hazard

Plug into a grounded 3 prong outlet.

Do not remove ground prong.

Do not use an adapter.

Do not use an extension cord.

Failure to follow these instructions can result in death, fire, or electrical shock.

Observe all governing codes and ordinances.

Required:

- A 120-volt, 60 Hz, AC-only, 15- or 20-amp electrical supply with a fuse or circuit breaker

Recommended:

- A time-delay fuse or time-delay circuit breaker
- A separate circuit serving only this microwave oven

Because Whirlpool Corporation includes a continuous commitment to improve our products, we reserve the right to change materials and specifications without notice.

Dimensions are for planning purposes only. For complete details, see Installation Instructions packed with product. Specifications subject to change without notice.

10 of 11

VENTING DESIGN SPECIFICATIONS

This section is intended for architectural designer and builder/ contractor reference only.

NOTES:

- Vent materials needed for installation are not provided with microwave hood combination.
- We do not recommend using a flexible metal vent.
- To avoid possible product damage, be sure to vent air outside, unless using recirculation installation. Do not vent exhaust air into concealed spaces, such as spaces within walls or ceilings, attics, crawl spaces, or garages.

For optimal venting installation, we recommend:

- Using roof or wall caps that have back draft dampers
- Using a rigid metal vent
- Using the most direct route by minimizing the length of the vent and number of elbows to provide efficient performance
- Using uniformly sized vents
- Using duct tape to seal all joints in the vent system
- Using caulking compound to seal exterior wall or roof opening around cap
- Not installing 2 elbows together for optimal hood performance

If venting through the wall, be sure that there is proper clearance within the wall for the damper to open fully.

If venting through the roof, and rectangular-to-round transition is used, be sure there are at least 3" (7.6 cm) of clearance between the top of the microwave oven and the transition piece. See "Rectangular-to-Round Transition" illustration.

Rectangular-to-Round Transition

NOTE: The minimum 3" (7.6 cm) clearance must exist between the top of the microwave oven and the rectangular to round transition piece so that the damper can open freely and fully.

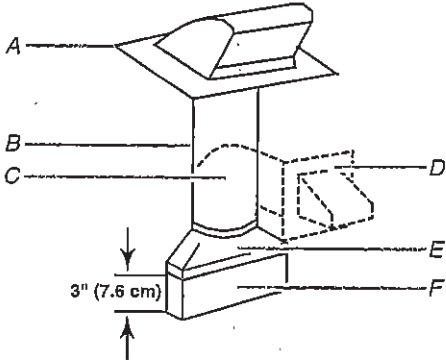

- A. Roof cap
- B. 6" (15.2 cm) min. diameter round vent
- C. Elbow (for wall venting only)
- D. Wall cap
- E. 3 1/4" x 10" to 6" (8.3 x 25.4 cm to 15.2 cm) rectangular to round transition piece
- F. Vent extension piece, at least 3" (7.6 cm) high

Recommended Standard Fittings

The following length equivalents are for use when figuring vent length. See the examples in "Recommended Vent Length."

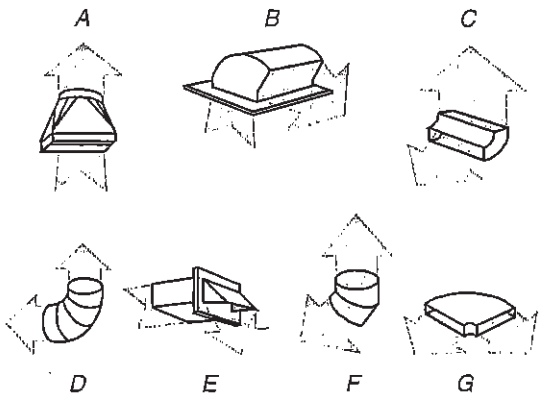

- A. Rectangular-to-round transition piece: 3 1/4" x 10" to 6" = 5 ft (8.3 x 25.4 cm to 15.2 cm = 1.5 m)
- B. Roof cap: 3 1/4" x 10" = 24 ft (8.3 x 25.4 cm = 7.3 m)
- C. 90° elbow: 3 1/4" x 10" = 25 ft (8.3 x 25.4 cm = 7.6 m)
- D. 90° elbow: 6" = 10 ft (15.2 cm = 3 m)
- E. Wall cap: 3 1/4" x 10" = 40 ft (8.3 x 25.4 cm = 12.2 m)
- F. 45° elbow: 6" = 5 ft (15.2 cm = 1.5 m)
- G. 90° flat elbow: 3 1/4" x 10" = 10 ft (8.3 x 25.4 cm = 3 m)

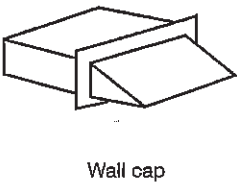
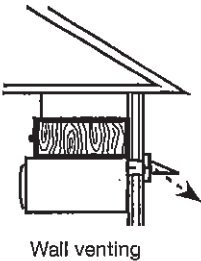
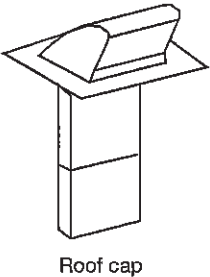
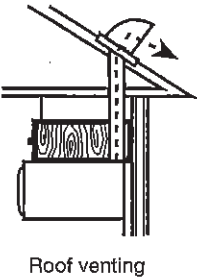

UK - 75 WALLACETON
LOT 188A-5
20-1606 ELEV B
THE GRASSFIELD

11 OF 11

Recommended Vent Length

3 1/4" x 10" (8.3 x 25.4 cm) rectangular or 6" (15.2 cm) round vent should be used.

The total length of the vent system including straight vent, elbow(s), transitions, and wall or roof caps must not exceed the equivalent of 140 ft (42.7 m) for either type of vent. See the "Recommended Standard Fittings" section for equivalent lengths.

For best performance, use no more than three 90° elbows.

To calculate the length of the system you need, add the equivalent lengths of each vent piece used in the system.

See the following examples:

3 1/4" x 10" (8.3 x 25.4 cm) vent system = 73 ft (22.2 m) total

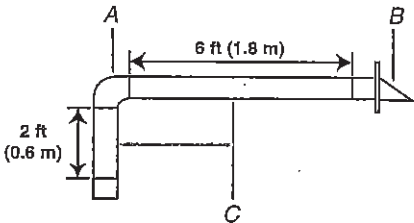

- A. One 3 1/4" x 10" (8.3 x 25.4 cm) 90° elbow = 25 ft (7.6 m)
- B. 1 wall cap = 40 ft (12.2 m)
- C. 2 ft (0.6 m) + 6 ft (1.8 m) straight = 8 ft (2.4 m)

6" (15.2 cm) vent system = 73 ft (22.2 m) total

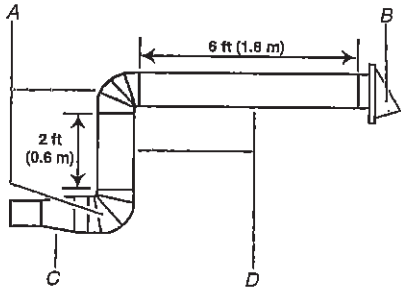

- A. Two 90° elbows = 20 ft (6.1 m)
- B. 1 wall cap = 40 ft (12.2 m)
- C. 1 rectangular-to-round transition piece = 5 ft (1.5 m)
- D. 2 ft (0.6 m) + 6 ft (1.8 m) straight = 8 ft (2.4 m)

If the existing vent is round, a rectangular-to-round transition piece must be used. In addition, a rectangular 3" (7.6 cm) extension vent between the damper assembly and rectangular-to-round transition piece must be installed to keep the damper from sticking.