

CONSTRUCTION SUMMARY

The Albas on Thorndale - Granelli Home Corporation

PURCHASERS: Sunil PESHWA and Hemaben Sunilkumar PESHWA

TEL:

| | | | | |
|------------------------------|--------------------|-------------------------------------|--|--|
| LOT / PHASE 24 / 1 | REG. PLAN # | HOUSE TYPE Liana 3 Elev 1 | | |
|------------------------------|--------------------|-------------------------------------|--|--|

CABINETRY

1 - KITCHEN - DELETE CABINETS ABOVE STOVE - VENDOR WILL SUPPLY 6 INCH VENT AS PER CONSTRUCTION SPECIFICATIONS AND VENT MAY NOT BE IN THE APPROPRIATE LOCATION FOR INSTALLATION OF PURCHASER SUPPLIED VENT - PURCHASER TO SUPPLY OWN FAN AFTER CLOSING (TEMP. FAN MA

27Mar19 Note:

CABINETRY ACCESSORIES

1 - KITCHEN CABINETRY BASE - POT/PAN DRAWERS (CABINET) - STANDARD

27Mar19 Note: INSTALLED ON ISLAND AS PER SKETCH

1 - KITCHEN CABINETRY BASE - PIE CUT CORNER CABINET - BASE CABINETRY - STANDARD

27Mar19 Note:

1 - PANTRY UNIT UPGRADE - TO GO FROM 300MM TO 600MM DEEP - PRICE IS PER FOOT - STANDARD

27Mar19 Note:

1 - KITCHEN CABINETRY UPPER - FULL DEPTH ABOVE FRIDGE - WITH GABLES - 600MM - PRICE IS EACH - STANDARD

27Mar19 Note:

2 - KITCHEN CABINETRY UPPER - ANGLED CORNER CABINET - FITS TALL UPPER CABINETS - PER UNIT - STANDARD

27Mar19 Note:

2 - KITCHEN CABINETRY UPPER - GLASS DOOR - CORD GLK340 - FINISHED INTERIOR - FITS TALL UPPER CABINETS - PRICE IS PER DOOR - STANDARD

27Mar19 Note:

1 - KITCHEN CABINETRY - BUILT-IN MICROWAVE/OVEN COMBO - STANDARD

27Mar19 Note: *Spens Attached*

1 - KITCHEN CABINETRY BASE - COOKTOP CABINET WITH POT DRAWERS (2 DRAWERS) - STANDARD - 30" cooktop

27Mar19 Note: *Spens Attached*

CERAMIC TILE

1 - TILE - UPGRADE 5 FLOOR TILE - - KITCHEN

27Mar19 Note:

1 - TILE - UPGRADE 1 FLOOR TILE - - POWDER ROOM

27Mar19 Note:

1 - TILE - UPGRADE 1 FLOOR TILE - - FOYER

27Mar19 Note:

1 - DELETE ALL CERAMIC BATHROOM ACCESSORIES - DELETE TOWEL BAR, PAPER HOLDER & SOAP DISH THROUGHOUT

27Mar19 Note:

CONSTRUCTION

1 - DELETE BULK HEADS IN KITCHEN IF CONSTRUCTION PERMITS

27Mar19 Note:

1 - BASEMENT- COMPLETE FINISHED BATHROOM IN BASEMENT- STANDARD FINISHES TO BE CHOSEN AT TIME OF COLOUR CHART SELECTIONS-

13Nov18 Note:

3 - ENLARGE BASEMENT WINDOWS (MAY REQUIRE WINDOW WELLS) - WINDOW IS 30 INCHES X 24 INCHES

13Nov18 Note:

COUNTER TOP

1 - HARD SURFACE COUNTERTOP - KITCHEN COUNTER TOP - UPGRADE - STANDARD SINIK

27Mar19 Note:

DOORS AND TRIM

RECEIVED APR 12 2019

| CONSTRUCTION SUMMARY | | | | |
|--|-------------|------------------------------|--|------|
| The Albas on Thorndale - Granelli Home Corporation | | | | |
| PURCHASERS: Sunil PESHWA and Hemaben Sunilkumar PESHWA | | | | TEL: |
| LOT / PHASE 24 / 1 | REG. PLAN # | HOUSE TYPE Liana 3 Elev 1 | | |
| 1 - TRIM - 7-¼" BASEBOARD AND 3" CASING 27Mar19 Note: | | | | |

| | | | | |
|---|--|--|--|--|
| ELECTRICAL | | | | |
| 1 - BUILT IN OVEN AND COOKTOP PROVISION - PROVISION ONLY - ELECTRICAL ONLY 27Mar19 Note: | | | | |
| 1 - PLUG - ELECTRICAL PLUG - TO BE INSTALLED OVER FIREPLACE 07Mar19 Note: | | | | |

| | | | | |
|---|--|--|--|--|
| FIREPLACE AND ACCESSORIES | | | | |
| 1 - GAS LINE ROUGH-IN FOR STOVE (INCLUDES ELECTRICAL OUTLET) - FIRST FLOOR 12Apr19 Note: | | | | |

| | | | | |
|---|--|--|--|--|
| MISCELLANEOUS | | | | |
| 1 - FURTHER DISCOUNT AS PER VENDOR 27Mar19 Note: | | | | |

| | | | | |
|---|--|--|--|--|
| PLUMBING | | | | |
| 1 - POWDER ROOM - AMERICAN STANDARD TOWN SQUARE 2PC TOILET - RIGHT HEIGHT ELONGATED WITH SLOW-CLOSE SEAT #2817-128 27Mar19 Note: | | | | |
| 1 - KITCHEN - CHROME SOAP DISPENSER - TRADITIONAL - CHROME - #RP71543 27Mar19 Note: | | | | |
| 4 - MOEN BATHROOM ACCESSORIES - MASON CHROME - TOWEL BAR 24" #YB8094/YB8000 - PRICE IS EACH 27Mar19 Note: ALL BATHROOMS | | | | |
| 4 - MOEN BATHROOM ACCESSORIES - MASON CHROME - PAPER HOLDER #YB8099/YB8000 - PRICE IS EACH 27Mar19 Note: ALL BATHROOMS | | | | |
| 1 - POWDER ROOM - VIERA PEDESTAL - 4390DHX / 4319DHX - STANDARD FAUCET 27Mar19 Note: | | | | |
| 1 - 5 FOOT SHOWER WITH SLIDING GLASS CHROME DOORS IN LIEU OF TUB 13Nov18 Note: IN MAIN BATH- | | | | |

| | | | | |
|--|--|--|--|--|
| PROMOTIONAL | | | | |
| 1 - PARTIAL REDEMPTION OF PROMOTIONAL PACKAGE \$\$\$\$\$\$ BALANCE FORWARD TO BE USED AT A LATER DATE. ORIGINAL PROMOTIONAL PACKAGE OF \$\$\$\$ AS PER SCHEDULE PE DATED MMMDDYYYY. 13Nov18 Note: | | | | |

EXTRAS AS PER OFFER

| | | | | |
|--|--|--|--|--|
| The Vendor agrees that notwithstanding any other term or provision in this Agreement included in the Purchase Price and in addition to those items detailed in Schedule GP to the Agreement of Purchase and Sale, the Purchaser is entitled to a credit of Sev Worksheet Note: | | | | |
| The Purchaser acknowledges that the Purchase Price is inclusive of all credits and promotional packages available at the time of purchase. Worksheet Note: | | | | |

This Document is Extremely Time Sensitive - Printed 12 Apr 19 at 9:54

Purchasers:

Sunil PESHWA & Hemaben Sunilkumar PESHWA

Telephone Res. / Bus:

/

Decor Advisor:

Candace Forza

Lock Date:

27-Mar-19

Property: 24

Project: Granelli Home Corporation

Model and Elevation: Liana 3 Elev 1

Plan #:

Layout Changes:

☒ Yes ☐ No

Sketch Attached:

☒ Yes ☐ No

Exterior Colour Scheme:

1. Cabinetry

| | Style and Colour | Hardware |
|-------------------------|------------------|----------|
| Kitchen / Breakfast | MONACO W823XZ4 | 2004 |
| Laundry Room | ELISSE | Standard |
| Powder Room | PEDESTAL SINK | 2004 |
| Master Ensuite Bathroom | MONACO W823XZ4 | 2004 |
| Main Bathroom | MONACO W823XZ4 | 2004 |
| BASEMENT BATHROOM | MONACO W823XZ4 | 2004 |
| | N/A | N/A |
| | N/A | N/A |
| | N/A | N/A |

Appliances:

Built In Appliances

☐ Yes ☒ No

Slide In Stove

☐ Yes ☒ No

Dishwasher Cabinet

☐ Closed ☒ Open

41" Upper Cabinets

☒ Yes ☐ No

Please NOTE: Standard Cabinet Height is 30"

Stove Opening

36"

NOTE: If not specified, opening will be set to builder's standard opening of approximately 30" width

Fridge Opening

NOTE: If not specified, opening will be set to builder's standard opening of approximately 37" width x 74" height

** Refer to Construction Summary

2. Counters

| | Counter | Edge |
|-------------------------|----------------------------------|-----------|
| Kitchen / Breakfast | QUARTZ-MOUNTAIN GREY | #360 EDGE |
| Laundry Room | N/A | |
| Powder Room | N/A | |
| Master Ensuite Bathroom | LAMINATE-BRONZITE 4971-52 | |
| Main Bathroom | LAMINATE-ARGENTO ROMANO 6697-46 | |
| BASEMENT BATHROOM | LAMINATE-BLACK ALICANTE 4926K-07 | |
| | N/A | |
| | N/A | |
| | N/A | |

** Refer to Construction Summary

Purchasers:

Telephone Res. / Bus: /

Decor Advisor:

Lock Date:

Sunil PESHW & Hemaben Sunilkumar PESHWA

Candace Forza

27-Mar-19

Property: 24

Project: Granelli Home Corporation

Model and Elevation: Liana 3 Elev 1

Plan #:

3. Ceramic Flooring

At a 45 Threshold-If App.

| | | | |
|-------------------------|------------------------------------|--------------------------|------------------------------|
| Entrance Vestibule | TILE-FM45GL001S GLOSSY WHITE-18X18 | <input type="checkbox"/> | metal strip where applicable |
| Main Hall | STRIP | <input type="checkbox"/> | |
| Kitchen / Breakfast | TILE-GOTHA PLATINUM LUX-24X24 | <input type="checkbox"/> | |
| Laundry Room | TILE-RETRO DARK GREY-12X12 | <input type="checkbox"/> | |
| Powder Room | TILE-FM45GL001S GLOSSY WHITE-18X18 | <input type="checkbox"/> | |
| Master Ensuite Bathroom | TILE-BEACH BLACK-13X13 | <input type="checkbox"/> | |
| Main Bathroom | TILE-SIENA GREY-13X13 | <input type="checkbox"/> | |
| BASEMENT BATHROOM | TILE-BEACH BLACK-13X13 | <input type="checkbox"/> | |
| | N/A | <input type="checkbox"/> | |
| | N/A | <input type="checkbox"/> | |
| | N/A | <input type="checkbox"/> | |

** Refer to Construction Summary

4. Ceramic Wall Tile

| | Selection | Describe |
|-------------------------|-----------------------------|----------|
| Master Ensuite Bathroom | | |
| Tub Deck Wall | N/A | |
| Tub Deck | N/A | |
| Tub Deck Skirt | N/A | |
| Shower Stall | TILE-LUC CONCEPT FERRO-8X16 | |
| Bathtub Enclosure Walls | N/A | |
| Main Bathroom | TILE-LUC 09 AFRICA-8X16 | |
| BASEMENT BATHROOM | TILE-LUC 09 AFRICA-8X16 | |
| | N/A | |
| | N/A | |
| | N/A | |
| Kitchen Backsplash | N/A | |

** Refer to Construction Summary - STANDARD GROUT THROUGHOUT UNLESS SPECIFIED

5. Plumbing Fixtures

All Bathrooms

White

N/A

N/A

N/A

N/A

N/A

Whirlpool

N/A

☐ Yes ☒ No

Dishwasher Rough-In

☒ Yes ☐ No

Waterline for Fridge

☐ Yes ☒ No

** Refer to Construction Summary

6. Trim Carpentry

| | |
|----------------------------|---|
| Interior Doors | CARRARA-SMOOTH |
| Interior Trim | 3" BB CASING WITH 7 1/4" BASEBOARD - COLONIAL |
| Door Handles | As Per Construction Specifications |
| Exterior Front Door Handle | As Per Construction Specifications |

** Refer to Construction Summary

Purchasers: Sunil PESHWA & Hemaben Sunilkumar PESHWA **Property:** 24
Telephone Res. / Bus: / **Project:** Granelli Home Corporation
Decor Advisor: Candace Forza **Model and Elevation:** Liana 3 Elev 1
Lock Date: 27-Mar-19 27-Mar-19 **Plan #:**

7. Other Flooring

| | |
|------------------------------|---|
| Main Hall | STRIP-NATURAL RED OAK-2 1/4" |
| Living Room | N/A |
| Dining Room | STRIP-NATURAL RED OAK-2 1/4" |
| Family Room | STRIP-NATURAL RED OAK-2 1/4" |
| Den / Library / Study | N/A |
| Basement Landing(If Applies) | N/A |
| Lower Landing (If Applies) | N/A |
| Upper Landing | N/A |
| Upper Hall | LAMINATE-MANHATTAN - RED OAK NATURAL TL-15004 |
| Master Bedroom | LAMINATE-MANHATTAN - RED OAK NATURAL TL-15004 |
| Bedroom #2 | LAMINATE-MANHATTAN - RED OAK NATURAL TL-15004 |
| Bedroom #3 | LAMINATE-MANHATTAN - RED OAK NATURAL TL-15004 |
| Bedroom #4 | LAMINATE-MANHATTAN - RED OAK NATURAL TL-15004 |
| Bedroom #5 | N/A |
| | N/A |
| | N/A |
| | N/A |
| Underpad | Type Area |
| | N/A N/A |

**** Refer to Construction Summary**

8. Railings and Pickets

| | | | |
|---------------------------------------|---------------------------|---|---------|
| Railing Type | AS PER CONSTRUCTION SPECS | Colour | NATURAL |
| Picket Type | AS PER CONSTRUCTION SPECS | Colour | BLACK |
| Stringer / Riser | AS PER CONSTRUCTION SPECS | Colour | NATURAL |
| Treads | AS PER CONSTRUCTION SPECS | Colour | NATURAL |
| Red Oak Stairs with Semi Gloss Finish | | <input checked="" type="radio"/> Yes <input type="radio"/> No | |

**** Refer to Construction Summary**

9. Wall Paint Flat Finish

| | | | |
|-----------------------|-------------|----------------|-----------|
| Main & Upper Hall | 25 OYSTER | Master Bedroom | 25 OYSTER |
| Living Room | N/A | Bedroom #2 | 25 OYSTER |
| Dining Room | 25 OYSTER | Bedroom #3 | 25 OYSTER |
| Kitchen / Breakfast | 25 OYSTER | Bedroom #4 | 25 OYSTER |
| Family Room | 25 OYSTER | Bedroom #5 | N/A |
| Powder Room | 25 OYSTER | Master Ensuite | 25 OYSTER |
| Laundry Room | 25 OYSTER | Main Bathroom | 25 OYSTER |
| Den/Library | N/A | Basement Bath | 25 OYSTER |
| Trim Paint-Semi Gloss | BIRCH WHITE | | N/A |
| | N/A | | N/A |
| | N/A | | N/A |

Smooth Ceilings First Floor ☐ Yes ☒ No

**** Refer to Construction Summary**

Initials: _____

Purchasers: Sunil PESHWA & Hemaben Sunilkumar PESHWA **Property:** 24
Telephone Res. / Bus: / **Project:** Granelli Home Corporation
Decor Advisor: Candace Forza **Model and Elevation:** Liana 3 Elev 1
Lock Date: 27-Mar-19 27-Mar-19 **Plan #:**

10. Plaster Mouldings and Medallions

| | | | | | |
|--------------------|-----|--|-------------------|-----|--|
| Entrance Vestibule | N/A | | Kitchen/Breakfast | N/A | |
| Main Hall | N/A | | Den/Library | N/A | |
| Living Room | N/A | | Lower Landing | N/A | |
| Dining Room | N/A | | | N/A | |
| Family Room | N/A | | | | |

** Refer to Construction Summary

11. Fireplace

| | Living Room | | | Family Room | | | Other Room - Specify | | |
|----------------|-----------------------|-----------------------|----------------------------------|------------------------------------|----------------------------------|-----------------------|-----------------------|-----------------------|----------------------------------|
| | Purchased | As Per Plan | N/A | Purchased | As Per Plan | N/A | Purchased | As Per Plan | N/A |
| | <input type="radio"/> | <input type="radio"/> | <input checked="" type="radio"/> | <input type="radio"/> | <input checked="" type="radio"/> | <input type="radio"/> | <input type="radio"/> | <input type="radio"/> | <input checked="" type="radio"/> |
| Fireplace Type | N/A | | | FLAT ON WALL | | | N/A | | |
| Mantle Type | N/A | | | MANTLE M2-STANDARD | | | N/A | | |
| Colour / Stain | N/A | | | AS PER CONSTRUCTION SPECIFICATIONS | | | N/A | | |
| Surround | N/A | | | BIANCO | | | N/A | | |
| Hearth | N/A | | | NO | | | N/A | | |

** Refer to Construction Summary

12. Heating and Air Conditioning

| | | | |
|----------------------|----|-------------------------|--------------------------------------|
| Air Conditioning | NO | Gas Provisions Stove | yes <input checked="" type="radio"/> |
| Gas Provisions Dryer | NO | Gas Provisions Barbecue | NO <input type="radio"/> |
| Comment | | | |

** Refer to Construction Summary

13. Electrical

| | | | | |
|---------------------|---|---|---|---|
| Plugs and Switches | <input checked="" type="radio"/> White | DECOR | Above Kitchen Cabinet Light | <input type="radio"/> Yes <input checked="" type="radio"/> No |
| Hood Fan | STANDARD WHITE TEMP. | | Below Kitchen Cabinet Light | <input type="radio"/> Yes <input checked="" type="radio"/> No |
| Appliances | Built in Cooktop | Built in Oven | Gas Stove | Microwave |
| | <input checked="" type="radio"/> Yes <input type="radio"/> No | <input checked="" type="radio"/> Yes <input type="radio"/> No | <input checked="" type="radio"/> Yes <input type="radio"/> No | <input checked="" type="radio"/> Yes <input type="radio"/> No |
| Dishwasher Rough-in | Yes <input type="radio"/> | | | |

** Refer to Construction Summary

14. General Comments

** Refer to Construction Summary

Disclaimers and Notes

- Colours of all materials are as close as possible to builder's selection, but not necessarily identical due to variances in manufacturing.
- Any extras listed above are null and void unless accompanied by a separate invoice/amendment. Said invoice must be paid in full.
- The Purchaser agrees that this colour selection is final and that no changes will be permitted, unless required by the Vendor.
- The Purchaser acknowledges reading and accepting document which contains other miscellaneous disclaimers.

Signature:  Date: _____ Signature: _____ Date: _____

Upper Angled
Corner
Cabinet
With (ORD)
Glass Door

Delete Cabinetry
Above Cooktop

Upper Angled
Corner
Cabinet
With (ORD)
Glass Door

Built-In
Oven/micro

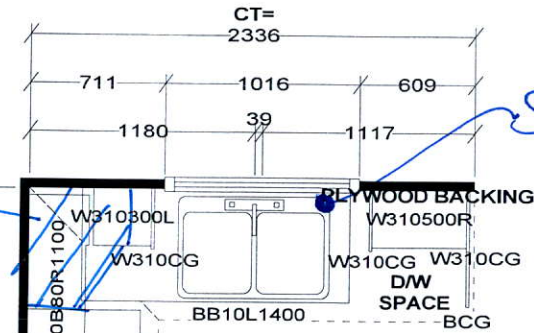

Soap Dispenser



Pot
+ Pan
Drawers



Base Pie Cut
Corner Cabinet

Full Depth
Fridge upper
(24" Deep)

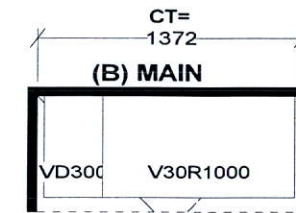
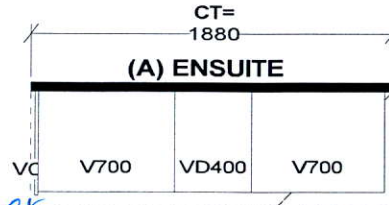
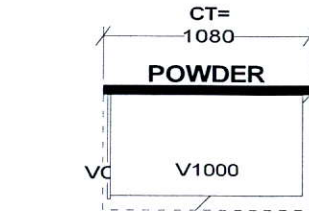

Basement
Bath Vanity

| W | WDTH | W | HGHT | W | CNT | FL | HGHT | DWY | H | ST | CENT | 2X4 | VENT BOX COVER |
|---|------|---|------|---|-----|----|------|-----|---|----|------|-----|----------------|
|---|------|---|------|---|-----|----|------|-----|---|----|------|-----|----------------|

This drawing is the intellectual property of SELBA INDUSTRIES INC. and is an original design which must not be released, copied or copied unless applicable fee has been paid or job order placed.



JOB NUMBER:
BUILDER: GREENYORK
SITE NAME: GRANELLI HOME CORP., Brampton
MODEL: LIANA 3X ELEV 1,2
LOT #:
DESIGNER: KS
DATE: AUG 23 18/REV'D JAN 8 19

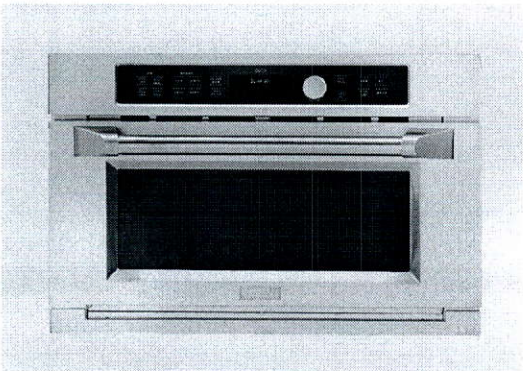

SPECIFICATIONS

| | |
|--------------------------------------|---|
| Overall Width | 29 3/4" (75.6 cm) |
| Overall Height | 19" (48.3 cm) |
| Overall Depth | 21 1/2" (54.6 cm) |
| Oven Door Clearance | 13" (33.0 cm) |
| Overall Oven Interior Capacity | 1.6 cu. ft. (.05 cu. cm) |
| Oven Interior Dimensions (W x H x D) | 20 1/16" x 8 1/2" x 17" (51 cm x 21.6 cm x 43.2 cm) |
| Minimum Cabinet Width | 30" (76.2 cm) |
| Minimum Cabinet Depth | 21 1/2" (54.6 cm) |
| Minimum Base Support | 130 lbs (59 kg) |
| Cutout Width | 25 1/4" (64.1 cm) |
| Cutout Height | 17 1/2" (44.5 cm) |
| Cutout Depth | 21 1/2" (54.6 cm) Min |
| Voltz/Hertz/Amps | 240/208V AC, 60 Hz, 30A |
| Conduit Length | 48" (121.9 cm) |
| Electrical Rating | 4.72 kW at 208V |
| Total Amps | 6.3 kW at 240V |
| Shipping Weight | 87 lbs (39.5 kg) |

ATTENTION ELECTRICIAN:

A 240/208V, 60Hz, 30 Amp circuit is required. An individual properly grounded branch circuit or circuit breaker is required. Hardware junction box is required for built-in product.

ELEVATE EVERYTHING™



OVERALL DIMENSIONS

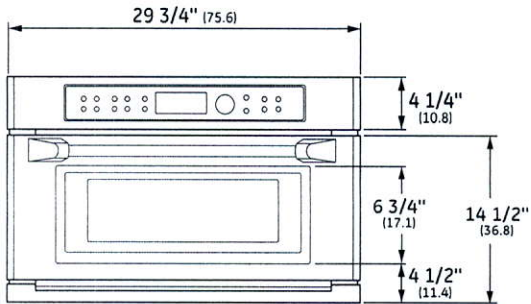

FRONT VIEW (SHOWING CUTOUT OVERLAP)

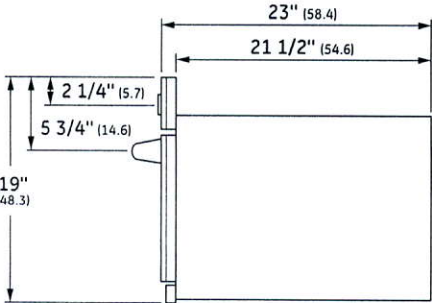

SIDE VIEW

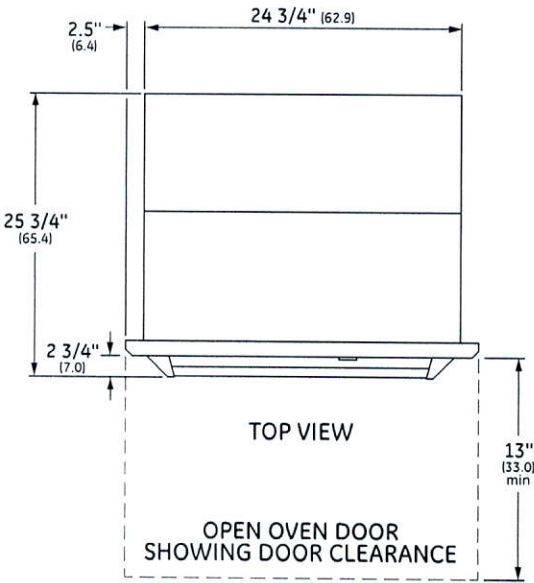

TOP VIEW

OPEN OVEN DOOR
SHOWING DOOR CLEARANCE

Dimensions in parentheses are in centimeters unless otherwise noted. Actual product dimensions may vary due to manufacturing tolerances.

WALL INSTALLATION

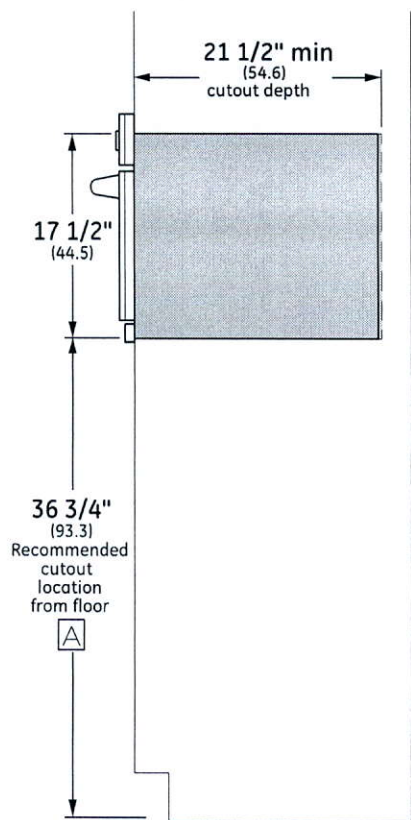

STANDARD
INSTALLATION

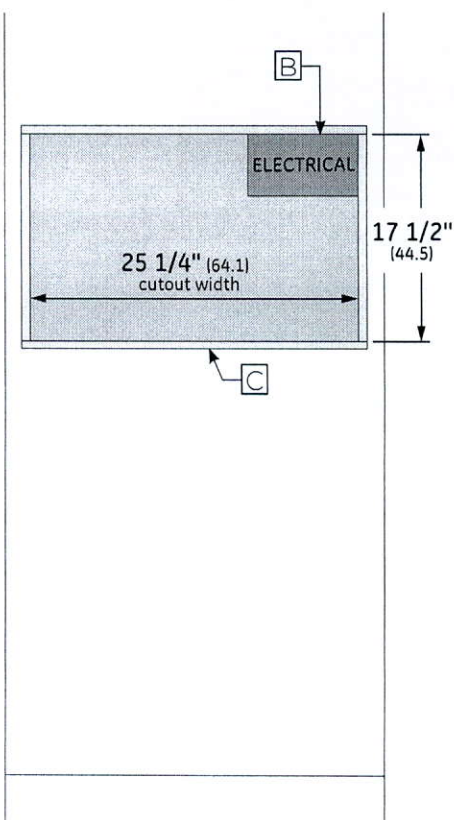

STANDARD INSTALLATION
FRONT VIEW

NOTES

- A Based on a user height of 5' 6" to 5' 10"
- B Junction box location (May also be located in adjacent cabinet.)
- C Platform must be able to support 130 lbs (59 kg)

For more details, refer to the installation instructions for this product on Monogram.com. Dimensions in parentheses are in centimeters unless otherwise noted.

ELEVATE EVERYTHING™



MONOGRAM 30" BUILT-IN FRENCH-DOOR SINGLE OVEN

ZET1FHSS

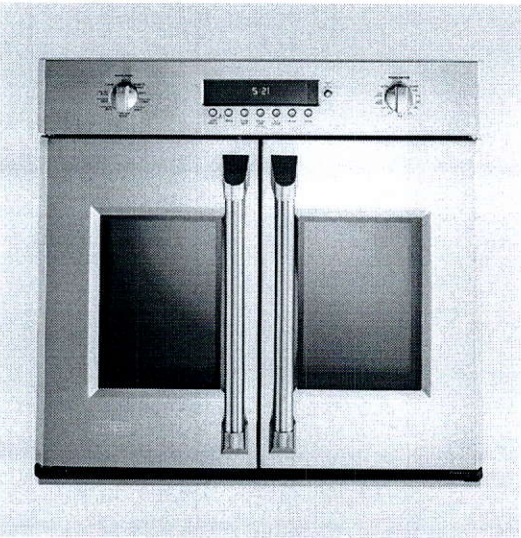

SPECIFICATIONS

| | |
|--------------------------------------|---|
| Overall Width | 29 3/4" (75.6 cm) |
| Overall Height | 28 5/8" (72.7 cm) |
| Overall Depth Including Handle | 27 15/16" (71.0 cm) |
| Oven Door Clearance | 16" (40.6 cm) |
| Overall Oven Interior Capacity | 5.0 cu. ft. (141.6 l) |
| Oven Interior Dimensions (W x H x D) | 25" x 17 3/8" x 20 1/4" (63.5 cm x 44.1 cm x 51.4 cm) |
| Minimum Cabinet Width | 30" (76.2 cm) |
| Minimum Cabinet Depth | 24" (61.0 cm) |
| Minimum Base Support | 220 lbs (98.8 kg) |
| Cutout Width | 28 1/2" (72.4 cm) Min 28 5/8" (72.7 cm) Max |
| Cutout Height | 27 1/4" (69.2 cm) Min 27 5/16" (69.4 cm) Max |
| Cutout Depth | 23 1/2" (59.7 cm) Min |
| Volts/Hertz/Amps | 240/208 V AC, 60 Hz, 20A |
| Conduit Length | 40", 72" available special order: WB18T10398 |
| Electrical Rating | 3.4 kW at 208V 4.5 kW at 240V |
| Shipping Weight | 208 lbs (95 kg) |

ATTENTION ELECTRICIAN:
A 240/208V, 60Hz, 20 Amp circuit is required. An individual properly grounded branch circuit or circuit breaker is required. Hardware junction box is required for built-in product.

ELEVATE EVERYTHING



OVERALL DIMENSIONS

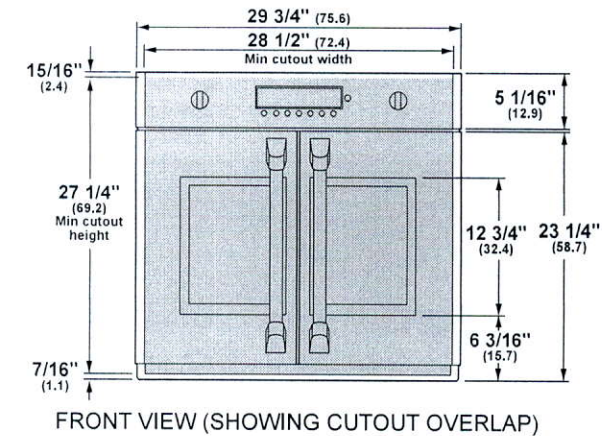

FRONT VIEW (SHOWING CUTOUT OVERLAP)

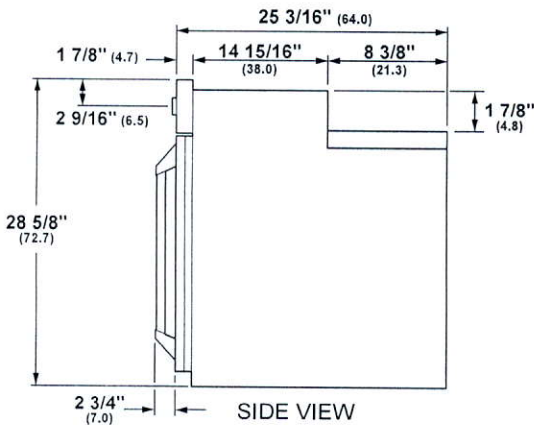

SIDE VIEW

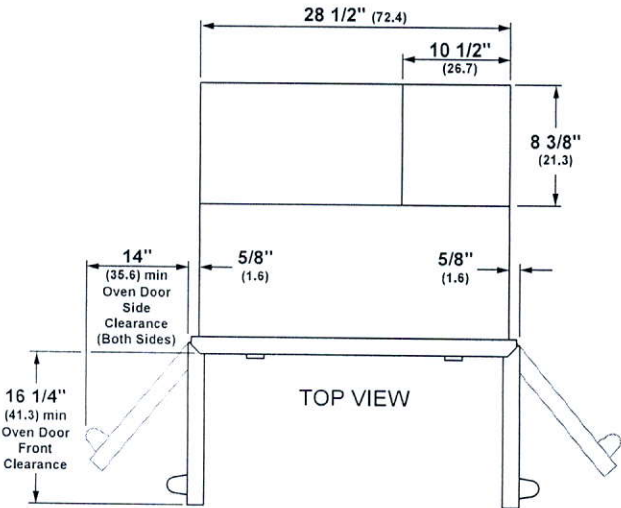

TOP VIEW

Dimensions in parentheses are in centimeters unless otherwise noted. Actual product dimensions may vary due to manufacturing tolerances.

WALL INSTALLATION

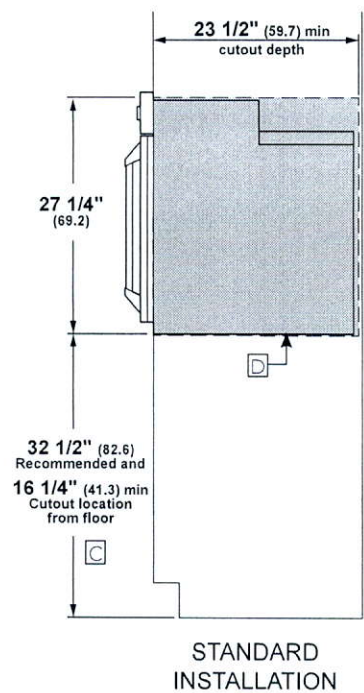

INSTALLATION WITH ADVANTIUM
AND WARMING DRAWER

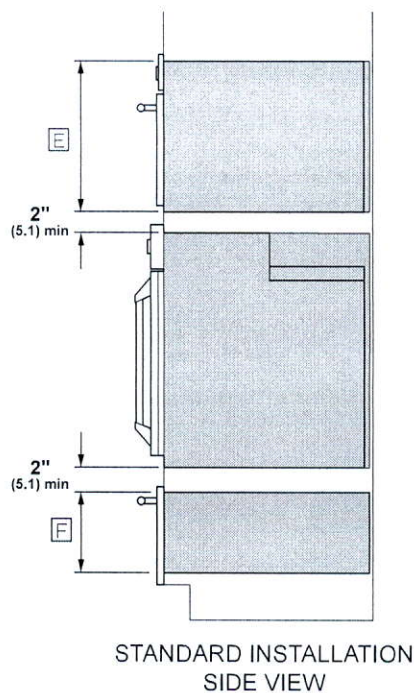

- NOTES
- A This model is not approved for installation below a countertop or in combination with a separate cooktop. The minimum installation height from the floor is 16 1/4".
 - B This model is not approved for flush-mount installation.
 - C Based on user height of 5'6" to 5'10"
 - D Platform must be able to support 220 lbs. (98.8 kg)
 - E Dimensions per Advantium or Microwave Oven requirements.
 - F Dimensions per Warming Drawer requirements.

INSTALLATION TO ADJACENT COUNTERTOP

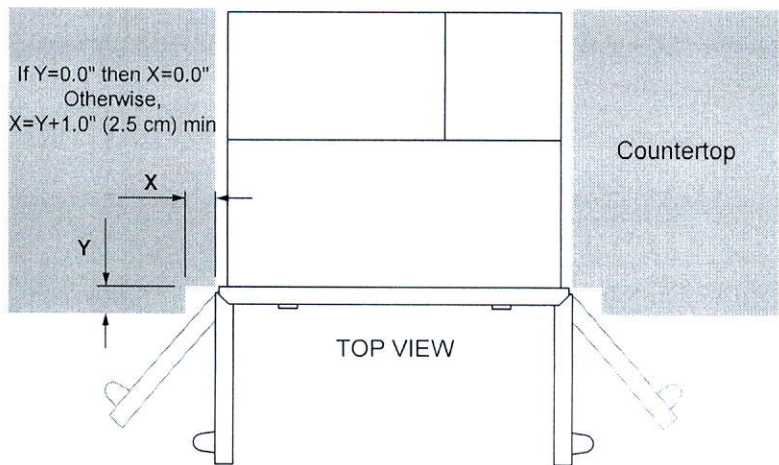

For more details, refer to the installation instructions for this product on Monogram.com. Dimensions in parentheses are in centimeters unless otherwise noted.

ELEVATE EVERYTHING™



SIDE BY SIDE INSTALLATION

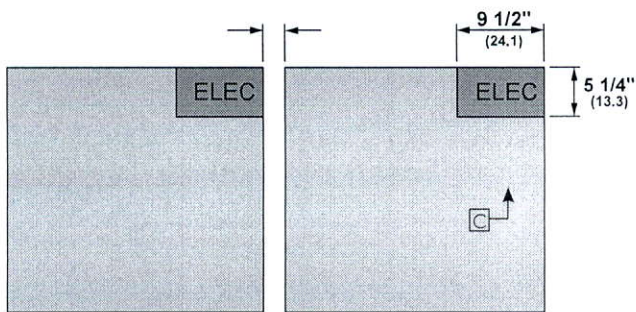

SIDE BY SIDE INSTALLATION
FRONT VIEW OF CUTOUTS

NOTES

- A** This model is not approved for installation below a countertop or in combination with a separate cooktop. The minimum installation height from the floor is 16 1/4".
- B** This model is not approved for flush-mount installation.
- C** Junction box location (may also be located in adjacent cabinet.)

For more details, refer to the installation instructions for this product on [Monogram.com](https://www.monogram.com). Dimensions in parentheses are in centimeters unless otherwise noted.

ELEVATE EVERYTHING™



MONOGRAM 30" BUILT-IN FRENCH-DOOR SINGLE OVEN

ZET1FHSS

FEATURES AND BENEFITS

FRENCH DOOR DESIGN

Inspired by commercial kitchen designs, the precision engineered chain-drive mechanism allows for one-handed opening of both oven doors at the same time

TRUE EUROPEAN CONVECTION WITH DIRECT AIR Channels heated air from the top of the oven and circulates it around food on all sides for perfectly uniform baking and roasting

5.0 CU. FT. CAPACITY

Easily accommodates even the largest meals

SELF-CLEAN WITH STEAM CLEAN OPTION

Gives you flexible options for thorough oven cleaning

EXCLUSIVE SELF-CLEAN (2 FULL-EXTENSION, 1 REGULAR) OVEN RACKS

Glide in and out smoothly on stainless steel ball bearings, and are designed to be left in the oven during the self-clean cycle

WIFI CONNECT

Allows you to control oven functions from anywhere inside or even outside your home, using your smartphone or other web-enabled mobile device

STAINLESS STEEL BACK-LIT DIGITAL CONTROL KNOBS

Rotate with smooth precision. An indicator light in each knob makes it easy to view and select heat settings

THEATRE-STYLE LED OVEN LIGHTING

Located on both sides of the oven to enhance visibility and provide a clear view of food, regardless of rack position

TEN-PASS DUAL BROIL ELEMENT

Evenly browns dishes of all types and sizes

TEN-PASS HIDDEN BAKE ELEMENT

Assures even baking, while maximizing interior capacity and allowing easy cleaning

HAND-FINISHED EDGES

Reflect the meticulous quality and craftsmanship for which Monogram products are renowned

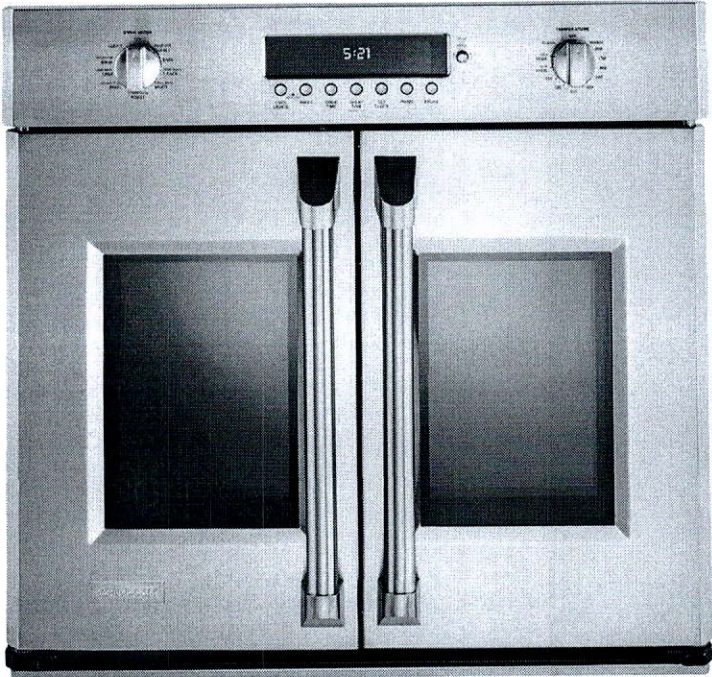

ELEVATE EVERYTHING®





36" COOKTOP SERIES

The BlueStar Cooktop Series delivers professional power and performance for the home chef with minimal kitchen space. The perfect accompaniment to a BlueStar gas or electric wall oven, the open burner cooktop has all the signature features of a BlueStar rangetop, with burner temperatures from simmer to sear.

PRODUCT FEATURES

- UltraNova™ power burner delivers 22,000 BTUs of intense heat
- Gentle 130° simmer burner
- Full motion grates
- Stainless steel knobs and available customization
- Enhanced compatibility with BlueStar Electric Wall Oven
- Includes wok ring accessory

SPECIFICATIONS

Cooktop Dimensions: 36"W x 22"D x 5"H
 Top Burner Rating: 22,000 BTUs
 Simmer Burner Rating: 9,000 BTUs
 Electrical Requirements: 120V, 60Hz, 15 AMPs, 1 PH
 (Unit must be on a Non-GFI, dedicated outlet)
 Operating Gas Pressure: NAT: 5.0" WC, LP: 10.0" WC
 Gas Line Size: 1/2"

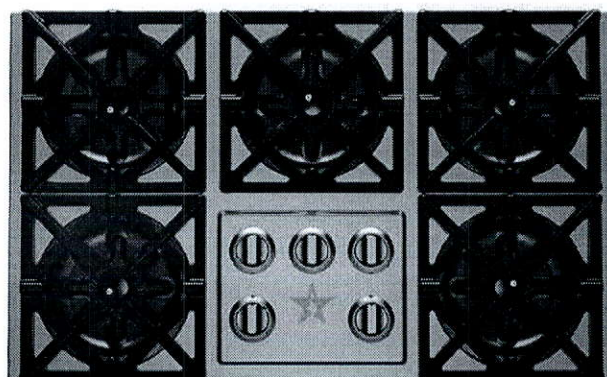

MODEL CONFIGURATION

Five Burners

RBCT365BV2

BURNER CONFIGURATION

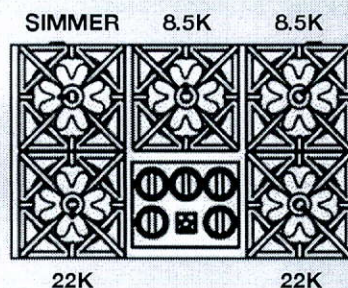

ADDITIONAL CUSTOMIZATION OPTIONS

- Knob colors
- Trim options

*All specifications subject to change without notice.
 Visit www.bluestarcooking.com prior to installation
 or site preparation.*

30" & 36" COOKTOP SERIES

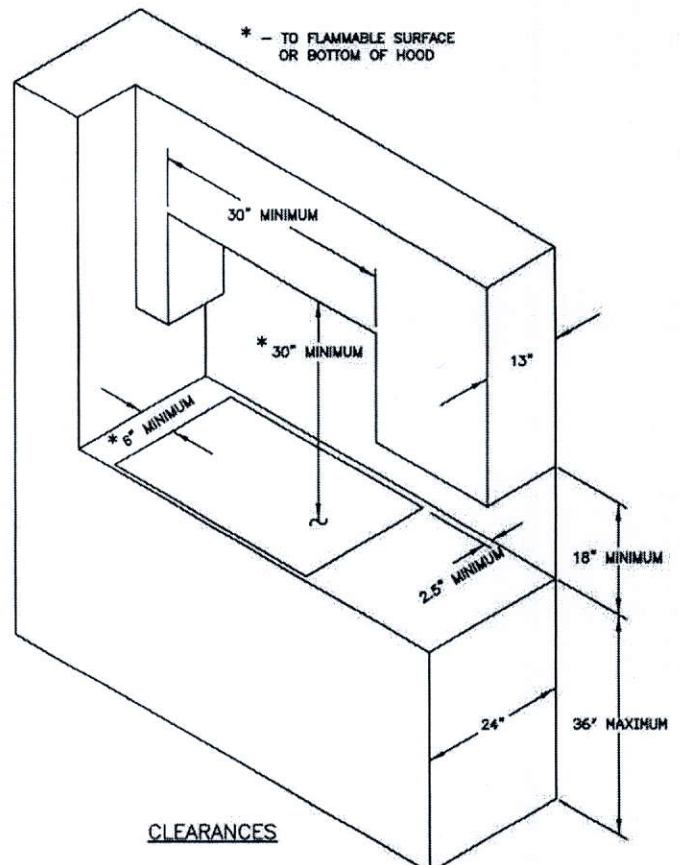
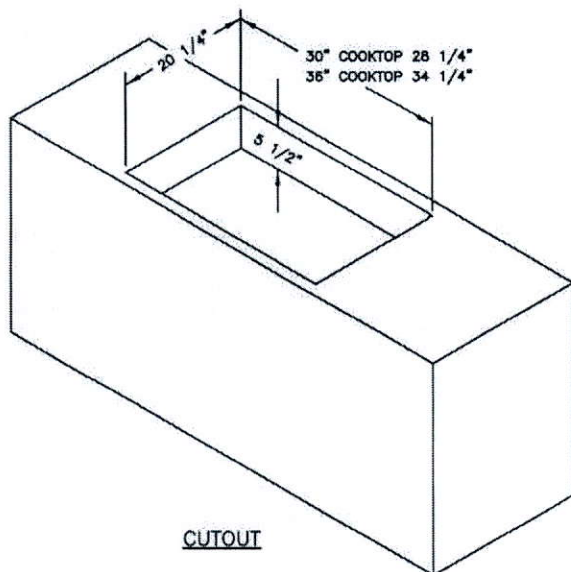
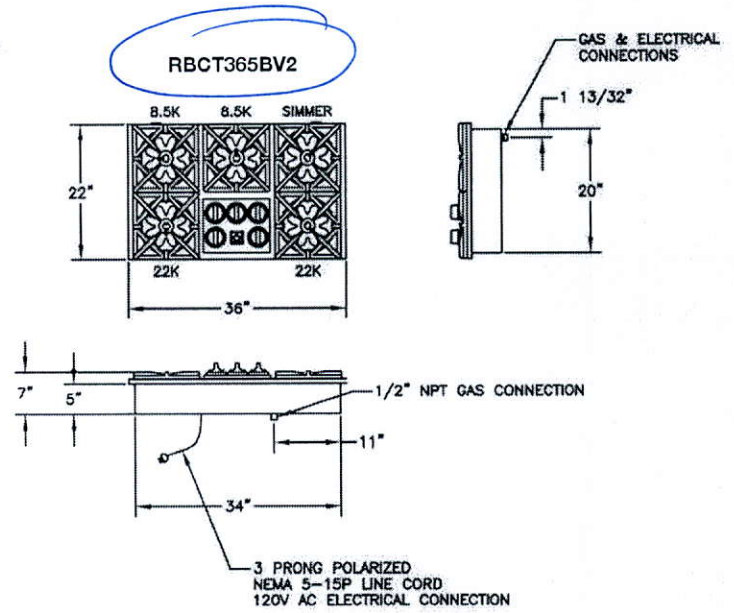
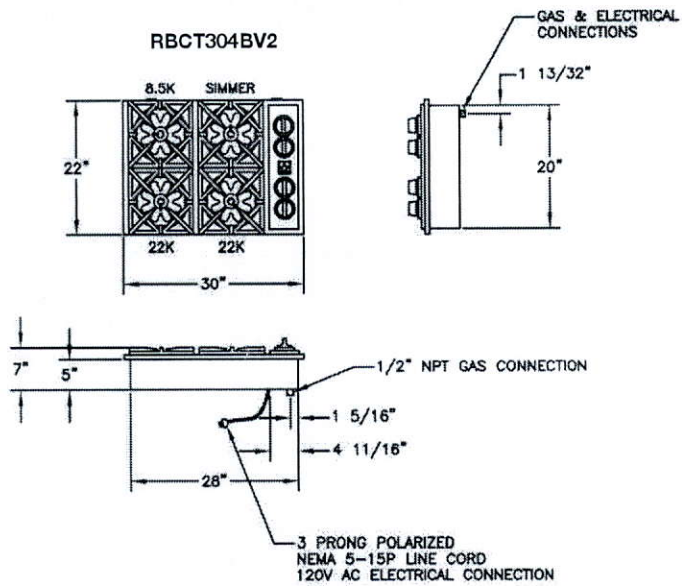

UVW8361SLSS

36" Designer Wall Mount Hood w/Dimmable LED Lighting

DIMENSIONS AND INSTALLATION INFORMATION (IN INCHES)

INSTALLATION INFORMATION:
Before installing, consult Use & Care/installation instructions packed with product for current dimensional data.

OPTIONAL ACCESSORIES

- UX10DC83SS - 10(ft.) Ceiling Duct Cover Kit
Max ceiling height installation with kit - 10'-0" (36" hood spacing)
- UX12DC93SS - 12(ft.) Ceiling Duct Cover Kit
- UX14DC93SS - 14(ft.) Ceiling Duct Cover Kit
- UXCF91 - Charcoal Filter
(needed if used in recirculation mode)

| AMP RATING | |
|------------|-----|
| 120V | TBD |

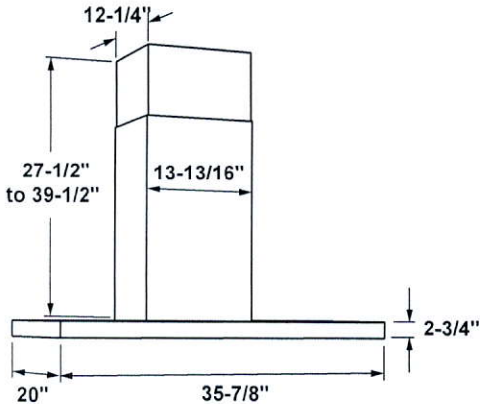
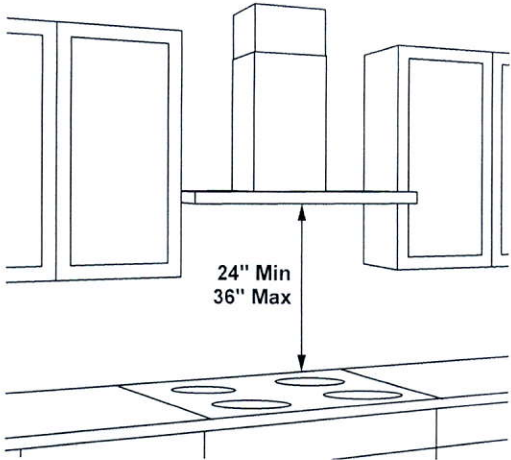

36" models require a 36"-wide opening
*The supplied duct cover fits 7'-7" to 9'-6" ceiling heights
(10' ceiling height with optional high ceiling kit UX10DC83SS)
(12' ceiling height with optional high ceiling kit UX12DC93SS)
(14' ceiling height with optional high ceiling kit UX14DC93SS)

The vent hood must be installed 24" min. above the cooking surface. For optimal performance, installing the hood more than 36" above the cooking surface is not recommended. The hood installation height above the cooking surface depends upon ceiling height. The telescopic duct cover conceals the ductwork running from the top of the hood to the ceiling.

NOTE: Installation height should be measured from the cooking surface to the lowest part of the hood. This hood may be installed onto a wall and vented to the outdoors, or it can be installed for recirculating operation. Parts for recirculating operation are supplied with the hood.



For answers to your Monogram, GE Café® Series, GE Profile® Series or GE Appliances product questions, visit our website at geappliances.com or call GE Answer Center® Service, 800.626.2000.



Specification Revised 10/18

UVW8361SLSS

36" Designer Wall Mount Hood w/Dimmable LED Lighting

FEATURES AND BENEFITS

- 350-CFM blower – Powerful blower removes smoke, grease, odor and moisture
- Dual LED dimmable lighting – bulbs included - Enjoy the right amount of bright LED lighting on the cooktop and surrounding areas
- Electronic backlit controls – Add a sophisticated look with this up-front, easy-to-use display
- Convertible venting options – Select recirculating or external venting
- 9-ft. ceiling height – Included duct cover extensions reach up to 9' ceilings and work with optional accessories to reach up to 14' ceilings
- Chef Connect – Automatically control the hood's lights and fan by syncing with the range
- Dishwasher safe filter – Filters grease and is dishwasher-safe
- Remote control included – Activate and adjust your hood functions from anywhere in the kitchen
- Model UVW8361SLSS – Stainless steel

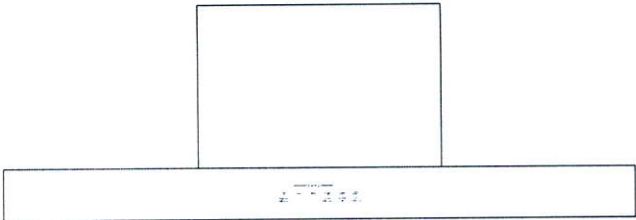

For answers to your Monogram, GE Café® Series, GE Profile® Series or GE Appliances product questions, visit our website at geappliances.com or call GE Answer Center® Service, 800.626.2000.

Specification Revised 10/18

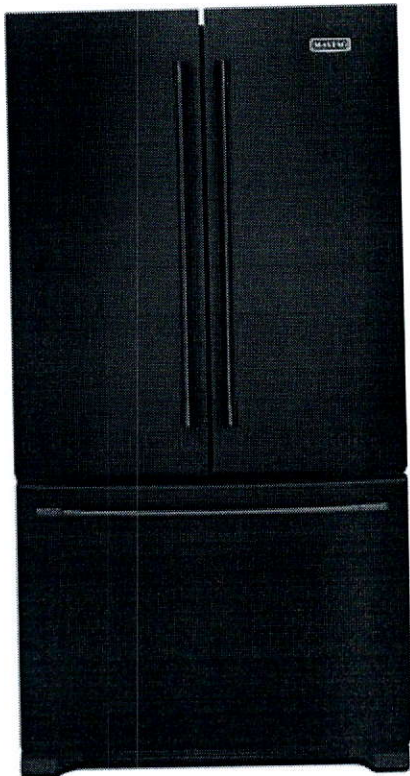

36-INCH WIDE FRENCH DOOR REFRIGERATOR - 25 CU. FT.

Maytag® 36-Inch Wide French Door Refrigerator - 25 Cu. Ft. is rated 4.7 out of 5 by 35.

Model #: MFF2558FEB



-
- Temperature-controlled Wide-N-Fresh™ deli drawer
- BrightSeries™ LED Lighting

FEATURES

ADDITIONAL FEATURES

10-YEAR LIMITED PARTS WARRANTY ON THE COMPRESSOR

Our 10-year limited parts warranty on the compressor covers the heart of the refrigerator, so you know you can count on it to keep all your food cold for years.

DESIGNED, ENGINEERED, AND ASSEMBLED IN THE U.S.A.

From Amana, Iowa to you, this Maytag® refrigerator is designed, engineered and assembled in the U.S.A.

SPECIFICATIONS

Dimensions

| | |
|--------------------------------|-------------------------|
| Cabinet Width | 90.49 cm, 35-5/8 in |
| Depth | 90.17 cm, 35-1/2 in |
| Depth Closed Excluding Handles | 83.50 cm, 32-7/8 in |
| Depth Closed Including Handles | 90.17 cm, 35-1/2 in |
| Depth Excluding Doors | 73.98 cm, 29-1/8 in |
| Depth With Door Open 90 Degree | 122.24 cm, 48-1/8 in |
| Freezer Volume | 210.55 l, 7.44 cu. ft. |
| Height | 178.12 cm, 70-1/8 in |
| Height To Top Of Cabinet | 174.62 cm, 68-3/4 in |
| Height To Top Of Door Hinge | 178.12 cm, 70-1/8 in |
| Refrigerator Volume | 502.32 l, 17.75 cu. ft. |
| Width | 90.49 cm, 35-5/8 in |

Configuration and Overview

| | |
|-------------------------|--|
| Advance Foam Insulation | 99.9% lower Global Warming Potential and Better Energy Performance |
| Counter Depth | No |
| Number of Doors | 3 |

Appearance

| | |
|----------------|----------|
| Cabinet Finish | Textured |
| Door Finish | Smooth |
| Door Style | Contour |
| Handle Color | Black |

LOT #24 GRANELLI

THE ALBAS ON THORNDALE
CITY OF BRAMPTON

LIANA 3 ELEVATION 1

REVISIONS:

1. INCREASE THREE BASEMENT WINDOWS TO 30"X24" SIZE.
2. FINISHED BATHROOM WITH 60"X32" SHOWER IN BASEMENT.

ADDS 50 SQ.FT. FINISHED AREA.

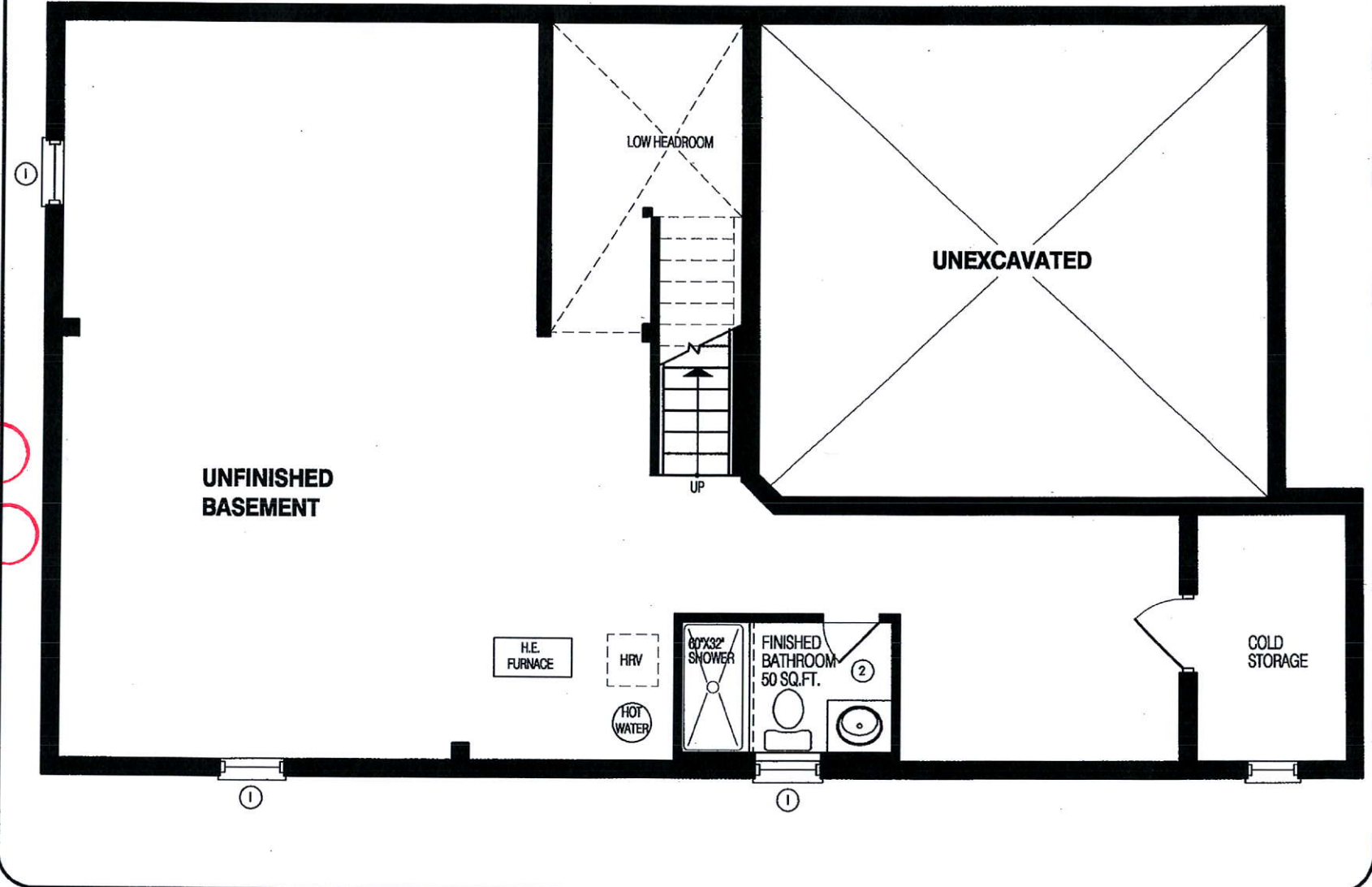

LOWER LEVEL

DISCLAIMERS: SKETCH NOT TO SCALE. DIMENSIONS, SPECIFICATIONS AND ARCHITECTURAL DETAILS SUBJECT TO MODIFICATION BY THE VENDOR. SKETCH IS ONLY FOR THE PURPOSE OF ILLUSTRATING REVISIONS REQUESTED BY THE PURCHASER AND ALL REVISIONS ARE SUBJECT TO VENDOR'S FINAL APPROVAL. ONLY REVISIONS ACCEPTED IN WRITING BY THE PURCHASER AND VENDOR ON A PURCHASER'S EXTRA SHEET WILL BE INCORPORATED INTO THE PLANS FILED WITH THE MUNICIPALITY. E. & O.E.

REGION
DESIGN
INC.

SCALE
BY MB

N.T.S.
PAGE No.
1 OF 2



GREENYORK
HOMES

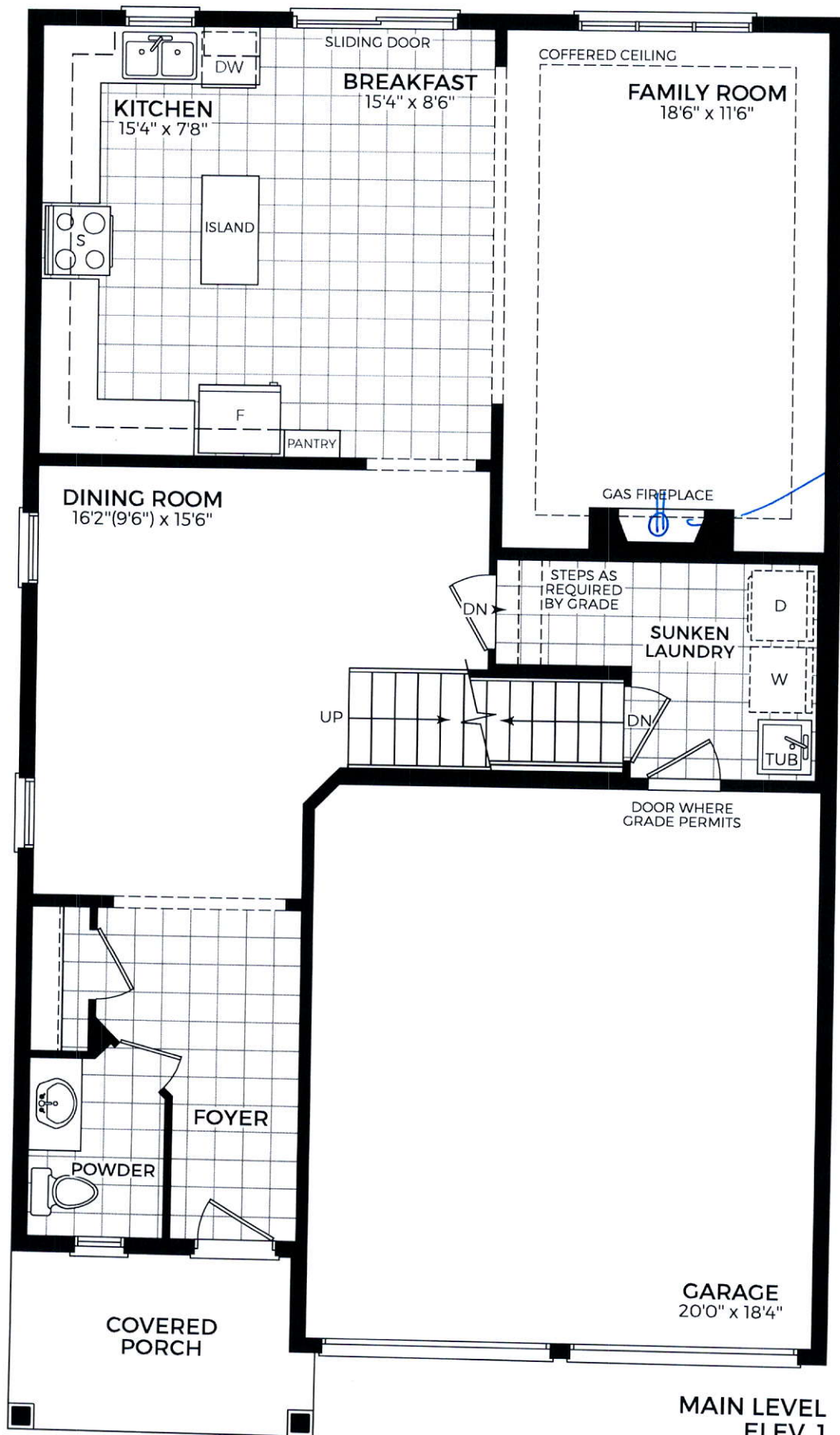

MAIN LEVEL
ELEV. 1

SP

KSP

LOT #24 GRANELLI

THE ALBAS ON THORNDALE
CITY OF BRAMPTON

LIANA 3 ELEVATION 1

REVISIONS:

1. REPLACE TUB WITH 60"X32" SHOWER IN MAIN BATHROOM.

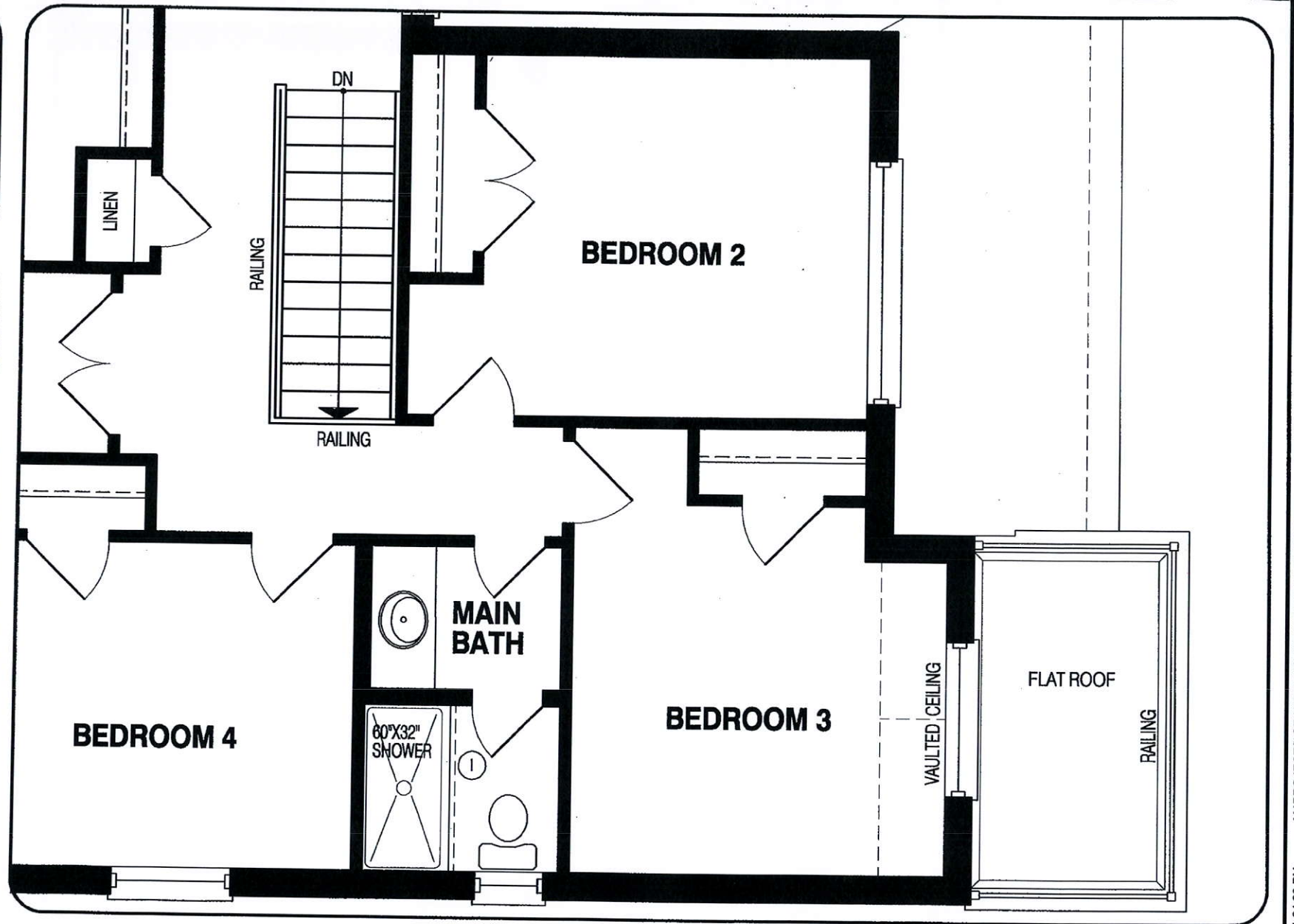

UPPER LEVEL

DISCLAIMERS: SKETCH NOT TO SCALE. DIMENSIONS, SPECIFICATIONS AND ARCHITECTURAL DETAILS SUBJECT TO MODIFICATION BY THE VENDOR. SKETCH IS ONLY FOR THE PURPOSE OF ILLUSTRATING REVISIONS REQUESTED BY THE PURCHASER AND ALL REVISIONS ARE SUBJECT TO VENDOR'S FINAL APPROVAL. ONLY REVISIONS ACCEPTED IN WRITING BY THE PURCHASER AND VENDOR ON A PURCHASER'S EXTRA SHEET WILL BE INCORPORATED INTO THE PLANS FILED WITH THE MUNICIPALITY. E. & O.E.

REGION
DESIGN
INC.

SCALE

N.T.S.

BY

PAGE No.

MB

2 OF 2



GREENYORK
HOMES

