

CONSTRUCTION SUMMARY

The Reserve At Vales Of The Humber - Ostiense Construction (Sliver) Corp.

PURCHASERS: RAJINDER SINGH SIDHU and VIRPAL KAUR SIDHU

TEL:

LOT / PHASE 53 / 1	REG. PLAN # 43M-1981	HOUSE TYPE Auburn 3 Elev 1		
-----------------------	-------------------------	-------------------------------	--	--

CABINETRY

1 - KITCHEN - DELETE CABINETS ABOVE STOVE - VENDOR WILL INSTALL UPGRADE FAN 09Apr18 Note:	
1 - KITCHEN CABINETRY ACCESSORY - UPGRADE HARDWARE LEVEL 2 09Apr18 Note:	

CABINETRY ACCESSORIES

2 - PANTRY UNIT UPGRADE - TO GO FROM 300MM TO 600MM DEEP - PRICE IS PER FOOT - UPGRADE 3 09Apr18 Note:	
1 - KITCHEN CABINETRY UPPER - FULL DEPTH ABOVE FRIDGE - WITH GABLES - 600MM - PRICE IS EACH - UPGRADE 3 09Apr18 Note: <i>Specs. Attached</i>	
1 - OVEN CABINET - BUILT-IN - MICROWAVE COMBO - PRICE IS EACH - UPGRADE 3 09Apr18 Note: <i>Specs. Attached</i>	
1 - KITCHEN CABINETRY BASE - COOKTOP CABINET FULL HEIGHT DOORS - UPGRADE 3 09Apr18 Note: <i>Specs. Attached</i>	

CERAMIC TILE

1 - UPGRADE 2 TILE - FLOOR & WALL -- BEDROOM 2/3 ENSUITE 09Apr18 Note: LAID STRAIGHT	
---	--

CONSTRUCTION

1 - FAMILY ROOM -- ADD WAFFLE CEILING 09Apr18 Note:	
--	--

COUNTER TOP

1 - MASTER ENSUITE-UPGRADED SURFACE FROM STANDARD VENDOR GRANITE 09Apr18 Note:	
1 - MAIN BATH- HARD SURFACE 09Apr18 Note:	
1 - BED 2/3 HARD SURFACE- 09Apr18 Note:	
1 - UPGRADE HARD SURFACE COUNTERTOP IN LIEU OF VENDOR STANDARD -- KITCHEN 09Apr18 Note:	
1 - HARDSURFACE COUNTER TOP -- POWDER ROOM 09Apr18 Note:	

DOORS AND TRIM

1 - LIBRARY AND MASTER BEDROOM- DOORS TO HAVE LOCKS WITH KEYS 09Apr18 Note:	
--	--

ELECTRICAL

1 - KITCHEN - CANOPY HOOD FAN - 30" CYCLONE 550 CFM #SC51330 09Apr18 Note: <i>Specs. Attached</i>	
1 - BUILT IN OVEN AND COOKTOP PROVISION - PROVISION ONLY - ELECTRICAL ONLY 09Apr18 Note:	

FIREPLACE AND ACCESSORIES

CONSTRUCTION SUMMARY

The Reserve At Vales Of The Humber - Ostiense Construction (Sliver) Corp.

PURCHASERS: RAJINDER SINGH SIDHU and VIRPAL KAUR SIDHU

TEL:

LOT / PHASE 53 / 1	REG. PLAN # 43M-1981	HOUSE TYPE Auburn 3 Elev 1		
-----------------------	-------------------------	-------------------------------	--	--

1 - GAS LINE ROUGH-IN FOR STOVE (INCLUDES ELECTRICAL OUTLET) - FIRST FLOOR 09Apr18 Note:	
1 - MANTEL - CAST STONE - AEQUALITAS I STYLE MANTEL -- FAMILY ROOM 09Apr18 Note:	

HARDWOOD FLOORING

1 - HARDWOOD - GROUP A 5" - FIRST FLOOR & UPPER HALL (NON-TILED AREAS) 09Apr18 Note:	
---	--

PLUMBING

1 - WATER LINE FOR FRIDGE - ROUGH-IN ONLY 09Apr18 Note:	
4 - SINK - UNDERMOUNT SINK - CONTRAC COLLETTE #4220CIY -- POWDER ROOM/BED2/3 AND MAIN BATH 09Apr18 Note:	

PROMOTIONAL

1 - LESS CREDIT FROM PURCHASER EXTRA SHEET IN OFFER 09Apr18 Note:	
--	--

This Document is Extremely Time Sensitive - Printed 9 Apr 18 at 15:02

Purchasers:

RAJINDER SINGH SIDHU & VIRPAL KAUR SIDI

Telephone Res. / Bus:

/

Decor Advisor:

Anne Federico

Lock Date:

9-Apr-18

Property:

53

Project:

Ostiense Construction (Sliver) Corp.

Model and Elevation:

Auburn 3 Elev 1

Plan #:

43M-1981

Layout Changes:

☐ Yes ☐ No

Sketch Attached:

☐ Yes ☐ No

Exterior Colour Scheme:

1. Cabinetry

	Style and Colour	Hardware
Kitchen / Breakfast	BANCOFT W823XZ4	722SC
Laundry Room	ELISSE	standard
Powder Room	HAMPTON W823XZ4	2004
Master Ensuite Bathroom	HAMPTON W823XZ4	2004
Ensuite Bath - Bedroom 2/3	AMALFI WHITE	2004
Main Bathroom	HAMPTON W823XZ4	2004

Appliances:

Built In Appliances

☒ Yes ☐ No

Slide In Stove

☐ Yes ☒ No

Dishwasher Cabinet

☐ Closed ☒ Open

41" Upper Cabinets

☒ Yes ☐ No

Please NOTE:

Standard Cabinet Height is 30"

Stove Opening

NOTE: If not specified, opening will be set to builder's standard opening of approximately 30" width

Fridge Opening

NOTE: If not specified, opening will be set to builder's standard opening of approximately 37" width x 74" height

** Refer to Construction -KITCHEN BANK OF DRAWERS INSTALL 167SB KNOBS ONLY

2. Counters

	Counter	Edge
Kitchen / Breakfast	QUARTZ-CALACATTA MICHELANGELO	PENCIL ROUND #320
Laundry Room	N/A	
Powder Room	QUARTZ-VIRGINIA	PENCIL ROUND #320
Master Ensuite Bathroom	QUARTZ-LYSKAMM	PENCIL ROUND #320
Ensuite Bath - Bedroom 2/3	MARBLE-EQUATOR MAMMARA	PENCIL ROUND #320
Main Bathroom	QUARTZ-MOUNTAIN GREY	PENCIL ROUND #320

** Refer to Construction Summary

Purchasers: RAJINDER SINGH SIDHU & VIRPAL KAUR SIDHU **Property:** 53
Telephone Res. / Bus: / **Project:** Ostiense Construction (Sliver) Corp.
Decor Advisor: Anne Federico **Model and Elevation:** Auburn 3 Elev 1
Lock Date: 9-Apr-18 9-Apr-18 **Plan #:** 43M-1981

3. Ceramic Flooring

		At a 45° Threshold-If App.
Entrance Vestibule	TILE-FM45GL001S GLOSSY WHITE 18X18	<input type="checkbox"/> METAL STRIP WERE APPL.
Main Hall	HARDWOOD	<input type="checkbox"/>
Kitchen / Breakfast	TILE-FM45GL001SGLOSSY WHITE 18X18	<input type="checkbox"/>
Laundry Room	TILE-FM45GL001SGLOSSY WHITE 18X18	<input type="checkbox"/>
Powder Room	TILE-FM45GL001SGLOSSY WHITE 18X18	<input type="checkbox"/>
Master Ensuite Bathroom	TILE-RAINBOW LIGHT GREY 13X13	<input type="checkbox"/>
Ensuite Bath - Bedroom 2/3	TILE-PRY250 NERO MARQUINO 10X24	<input type="checkbox"/>
Main Bathroom	TILE-SIENA GRIGIO 13X13	<input type="checkbox"/>
		<input type="checkbox"/>
		<input type="checkbox"/>
		<input type="checkbox"/>

** Refer to Construction Summary

4. Ceramic Wall Tile

Master Ensuite Bathroom	Selection	Describe
Tub Deck Wall		
Tub Deck		
Tub Deck Skirt		
Shower Stall	TILE-CONCEPT NEVE LUC 8X16	
Bathtub Enclosure Walls		
Ensuite Bath - Bedroom 2/3	TILE-PRY200 ROYAL CARRARA 10X24	
Main Bathroom	TILE-GREY EUROPE LUC 8X16	
Kitchen Backsplash		

** Refer to Construction Summary - STANDARD GROUT THROUGHOUT UNLESS SPECIFIED

5. Plumbing Fixtures

All Bathrooms	White	Whirlpool <input type="text"/> <input type="radio"/> Yes <input checked="" type="radio"/> No Dishwasher Rough-In <input checked="" type="radio"/> Yes <input type="radio"/> No Waterline for Fridge <input checked="" type="radio"/> Yes <input type="radio"/> No
	<input type="text"/>	
	<input type="text"/>	
	<input type="text"/>	
	<input type="text"/>	

** Refer to Construction Summary

6. Trim Carpentry

Interior Doors	CARRARA-SMOOTH
Interior Trim	STANDARD
Door Handles	As Per Construction Specifications
Exterior Front Door Handle	As Per Construction Specifications

** Refer to Construction Summary

Initials: RS VS

Purchasers: RAJINDER SINGH SIDHU & VIRPAL KAUR SIDI **Property:** 53
Telephone Res. / Bus: / **Project:** Ostiense Construction (Sliver) Corp.
Decor Advisor: Anne Federico **Model and Elevation:** Auburn 3 Elev 1
Lock Date: 9-Apr-18 9-Apr-18 **Plan #:** 43M-1981

7. Other Flooring

Main Hall	MIRAGE 5" CHARCOAL RED OAK CASHMERE
Living Room	MIRAGE 5" CHARCOAL RED OAK CASHMERE
Dining Room	MIRAGE 5" CHARCOAL RED OAK CASHMERE
Family Room	MIRAGE 5" CHARCOAL RED OAK CASHMERE
Den / Library / Study	MIRAGE 5" CHARCOAL RED OAK CASHMERE
Basement Landing(If Applies)	LAMINATE-PARK LANE - GREY VARNISHED OAK TL-U1305
Lower Landing (If Applies)	MIRAGE 5" CHARCOAL RED OAK CASHMERE
Upper Landing	MIRAGE 5" CHARCOAL RED OAK CASHMERE
Upper Hall	MIRAGE 5" CHARCOAL RED OAK CASHMERE
Master Bedroom	CARPET-SHAW - E0949 NEWBERN CLASSIC - ANTIQUE SILK 00131
Bedroom #2	CARPET-SHAW - E0949 NEWBERN CLASSIC - ANTIQUE SILK 00131
Bedroom #3	CARPET-SHAW - E0949 NEWBERN CLASSIC - ANTIQUE SILK 00131
Bedroom #4	CARPET-SHAW - E0949 NEWBERN CLASSIC - ANTIQUE SILK 00131
Bedroom #5	CARPET-SHAW - E0949 NEWBERN CLASSIC - ANTIQUE SILK 00131

Underpad	Type	Area

** Refer to Construction Summary

8. Railings and Pickets

Railing Type	V-GROOVE	Colour	MIRAGE CHARCOAL
Picket Type	EUROLINE 1	Colour	B LACK
Stringer / Riser	standard	Colour	MIRAGE CHARCOAL
Treads	standard	Colour	MIRAGE CHARCOAL

Red Oak Stairs with Semi Gloss Finish

☒ Yes ☐ No

** Refer to Construction Summary

9. Wall Paint Flat Finish

Main & Upper Hall	22 WARM GREY	Master Bedroom	22 WARM GREY
Living Room	22 WARM GREY	Bedroom #2	22 WARM GREY
Dining Room	22 WARM GREY	Bedroom #3	22 WARM GREY
Kitchen / Breakfast	22 WARM GREY	Bedroom #4	22 WARM GREY
Family Room	22 WARM GREY	Bedroom #5	
Powder Room	22 WARM GREY	Master Ensuite	22 WARM GREY
Laundry Room	22 WARM GREY	Ensuite Bath - Bedroom 2/3	22 WARM GREY
Den/Library	22 WARM GREY	Main Bathroom	22 WARM GREY
Trim Paint-Semi Gloss	BIRCH WHITE		

Smooth Ceilings First Floor ☒ Yes ☐ No

** Refer to Construction Summary

Initials: RS VS

Purchasers: RAJINDER SINGH SIDHU & VIRPAL KAUR SIDHU **Property:** 53
Telephone Res. / Bus: / **Project:** Ostiense Construction (Sliver) Corp.
Decor Advisor: Anne Federico **Model and Elevation:** Auburn 3 Elev 1
Lock Date: 9-Apr-18 9-Apr-18 **Plan #:** 43M-1981

10. Plaster Mouldings and Medallions

Entrance Vestibule			Kitchen/Breakfast		
Main Hall			Den/Library		
Living Room			Lower Landing		
Dining Room					
Family Room					

** Refer to Construction Summary

11. Fireplace

	Living Room			Family Room			Other Room - Specify		
	Purchased	As Per Plan	N/A	Purchased	As Per Plan	N/A	Purchased	As Per Plan	N/A
Fireplace Type	<input type="radio"/>	<input type="radio"/>	<input type="radio"/>	<input type="radio"/>	<input checked="" type="radio"/>	<input type="radio"/>	<input type="radio"/>	<input type="radio"/>	<input type="radio"/>
Mantle Type				AEQUALITAS 1-			Natural Ivory		
Colour / Stain									
Surround									
Hearth									

** Refer to Construction Summary

12. Heating and Air Conditioning

Air Conditioning	NO	Gas Provisions Stove	yes
Gas Provisions Dryer	NO	Gas Provisions Barbecue	NO
Comment			

** Refer to Construction Summary

13. Electrical

Plugs and Switches	<input checked="" type="radio"/> White	DECOR	Above Kitchen Cabinet Light	<input type="radio"/> Yes	<input checked="" type="radio"/> No
Hood Fan	STANDARD		Below Kitchen Cabinet Light	<input type="radio"/> Yes	<input checked="" type="radio"/> No
Appliances	Built in Cooktop	Built in Oven	Gas Stove	Microwave	
	<input checked="" type="radio"/> Yes <input type="radio"/> No	<input checked="" type="radio"/> Yes <input type="radio"/> No	<input checked="" type="radio"/> Yes	<input checked="" type="radio"/> Yes	<input type="radio"/> No
Dishwasher Rough-in	Yes				

** Refer to Construction Summary

14. General Comments

** Refer to Construction Summary

Disclaimers and Notes

- Colours of all materials are as close as possible to builder's selection, but not necessarily identical due to variances in manufacturing.
- Any extras listed above are null and void unless accompanied by a separate invoice/amendment. Said invoice must be paid in full.
- The Purchaser agrees that this colour selection is final and that no changes will be permitted, unless required by the Vendor.
- The Purchaser acknowledges reading and accepting document which contains other miscellaneous disclaimers.

Signature: Rajinder Singh Sidhu Date: _____ Signature: Virpal Sidhu Date: _____

mantle only.

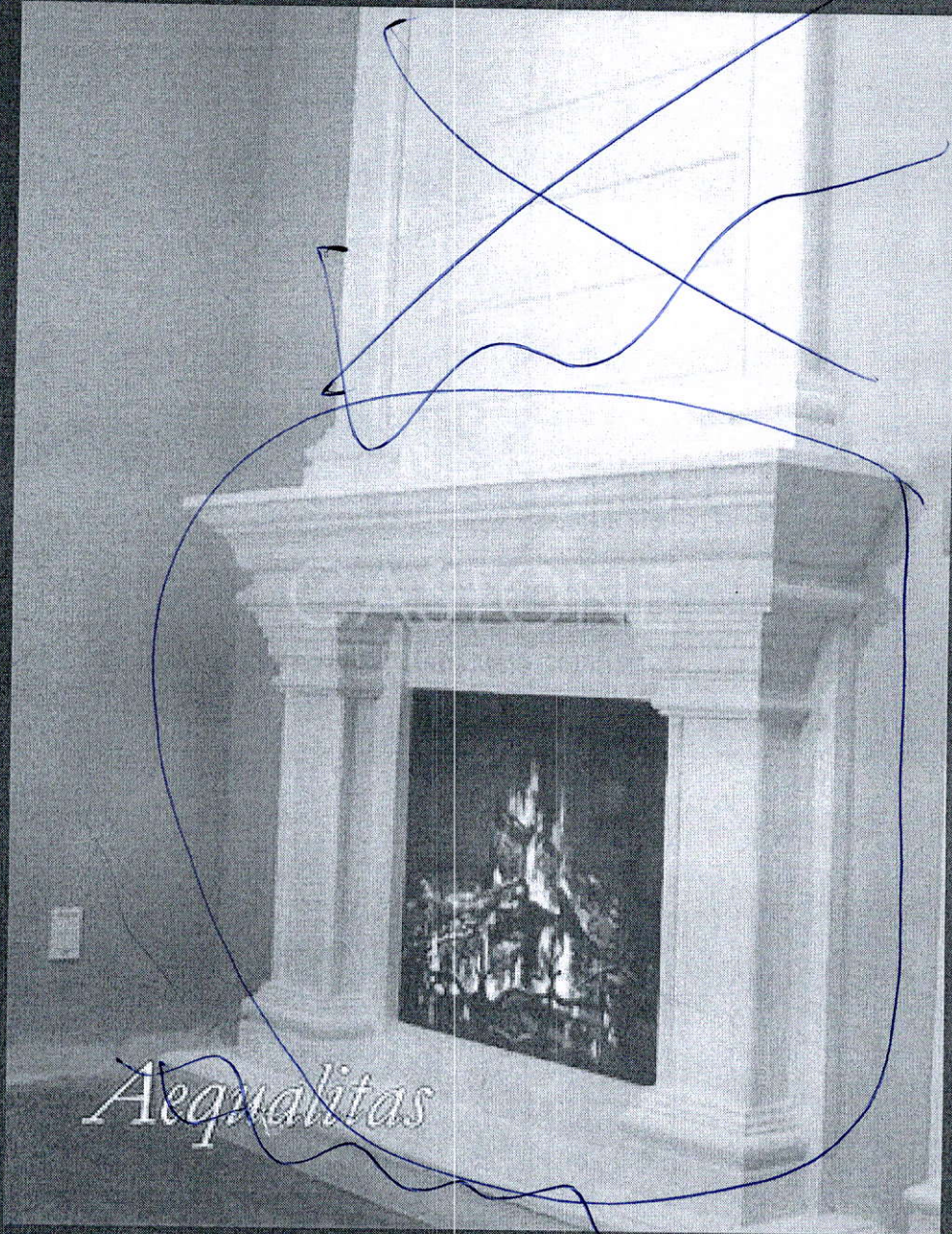

AEQUALITAS I

Specifications: Alito Collection - Wall Mount

Model: SC513

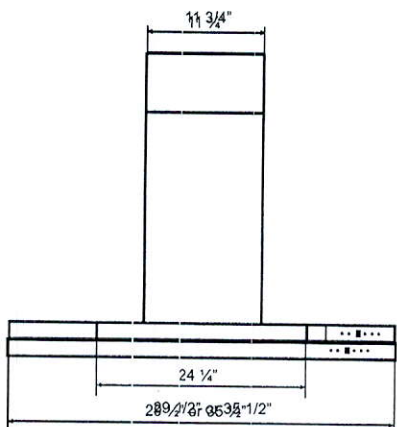
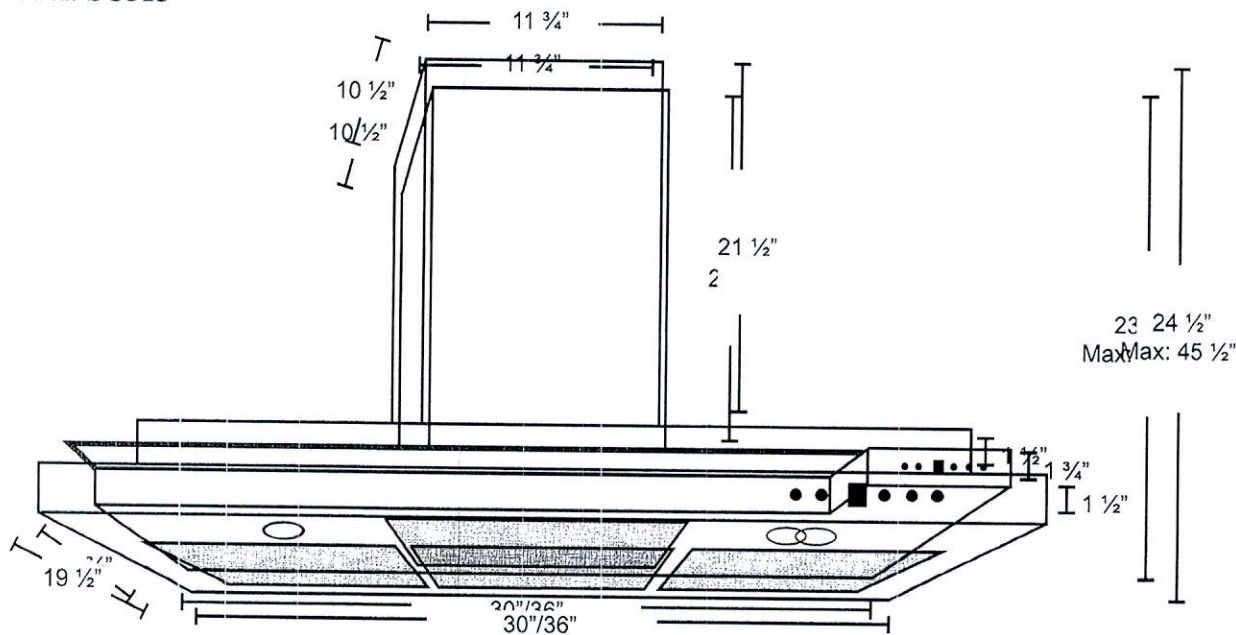

FRONT

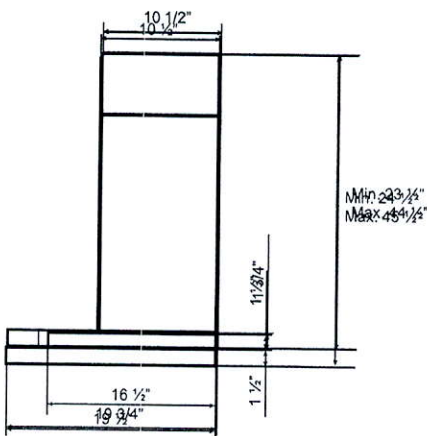

SIDE

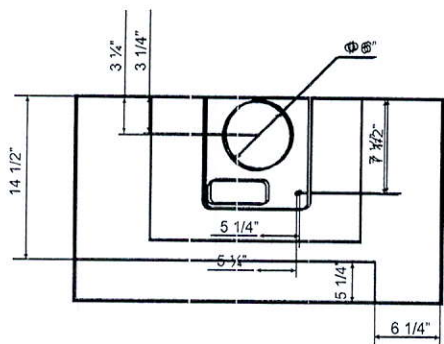

TOP

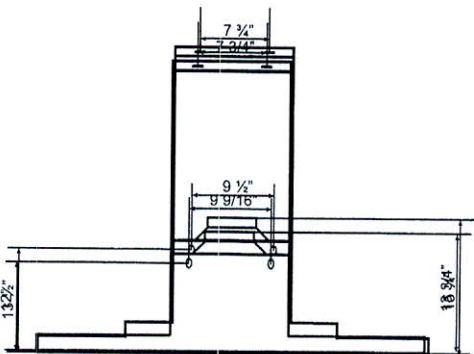

BACK

30" (76.2 CM) AND [REDACTED]

PRODUCT MODEL NUMBERS

KCGS550E	KCGS550E	KCGS550E	KCGS550E
KCGS550E	KCGS550E	KCGS550E	KCGS550E
KCGS550E	KCGS550E	KCGS550E	KCGS550E

GAS SUPPLY REQUIREMENTS

Type of Gas

Natural Gas:

• This cooktop is factory set for use with Natural gas. If converting to LP gas, see the "LP Gas Conversion" instructions provided in the package containing literature. The model/serial rating plate located on the underside of the cooktop base has information on the types of gas that can be used. If the types of gas listed do not include the type of gas available, check with the local gas supplier.

LP Gas Conversion:

Conversion must be done by a qualified service technician.

No attempt shall be made to convert the cooktop from the gas specified on the model/serial rating plate for use with a different gas without consulting the serving gas supplier. See the Gas Conversion instructions provided in the package containing literature.

Gas Supply Line

• Provide a gas supply line of 3/4" (1.9 cm) rigid pipe to the cooktop location. A smaller size pipe on longer runs may result in insufficient gas supply. Pipe-joint compounds that resist the action of LP gas must be used. Do not use TEFLON® tape. With LP gas, piping or tubing size should be 1/2" minimum. Usually, LP gas suppliers determine the size and materials used in the system.

Flexible metal appliance connector:

• If local codes permit, use a 1/2" or 3/4" I.D. flexible stainless steel tubing gas connector, designed by CSA to connect the cooktop to the rigid gas supply line.



- A 1/2" male pipe thread is needed for connection to the female pipe threads of the inlet to the cooktop pressure regulator.
- Do not kink or damage the flexible metal tubing when moving the cooktop.

• Must include a shutoff valve:
The supply line must be equipped with a manual shutoff valve. This valve should be located in the same room but external to the cooktop opening, such as an adjacent cabinet. It must be accessible without removing the cooktop, and it should be in a location that allows ease of opening and closing. Do not block access to shutoff valve. The valve is for turning on or shutting off gas to the cooktop.

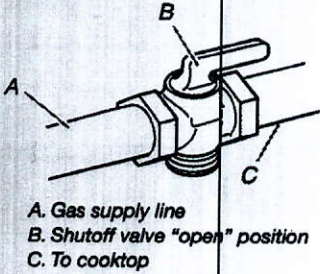

• TEFLON is a registered trademark of E.I. Du Pont De Nemours and Company.

ELECTRICAL REQUIREMENTS

- A 120 volt, 60 Hz, AC only, 15-amp, fused electrical circuit is required. A time-delay fuse or circuit breaker is also recommended. It is recommended that a separate circuit serving only this cooktop be provided.
- Electronic ignition systems operate within wide voltage limits, but proper grounding and polarity are necessary. Check that the outlet provides 120-volt power and is correctly grounded.

Lot. 53

Cooktop

PRODUCT DIMENSIONS

KCGS550ESS and KCGS950ESS Models

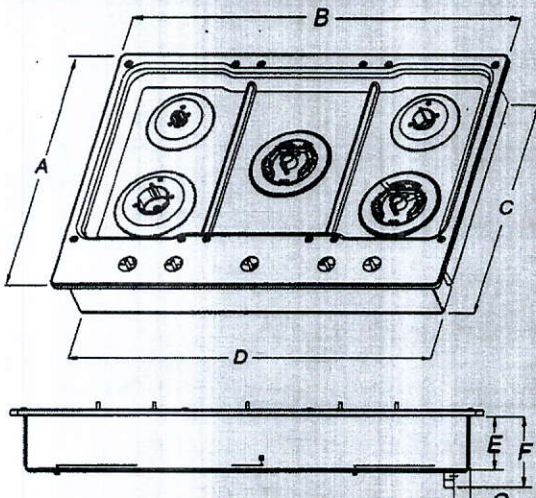

A. 21" (53.3 cm)
B. 30" (76.2 cm)
C. 19 3/8" (49.2 cm)
D. 28 3/8" (72.1 cm)
E. 3 3/8" (9.2 cm)
F. 4 1/8" (11.6 cm)
G. 1 1/8" (3.4 cm)

KCGS556ESS and KCGS956ESS Models

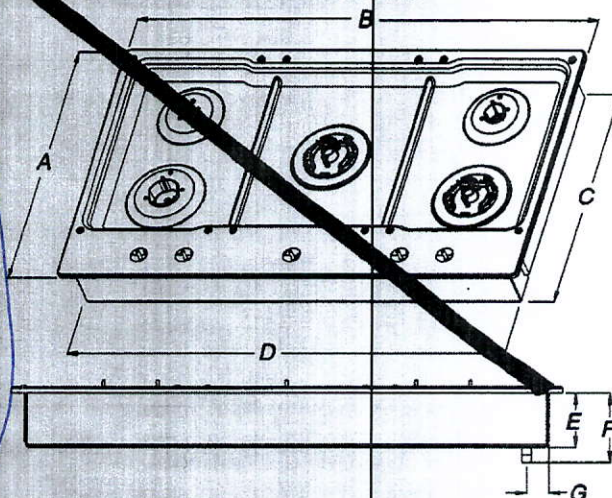

A. 21" (53.3 cm)
B. 36 1/4" (92.0 cm)
C. 19 3/8" (49.2 cm)
D. 34 3/8" (88.1 cm)
E. 3 3/8" (9.2 cm)
F. 4 1/8" (11.6 cm)
G. 1 1/8" (3.6 cm)

Other 30" (76.2 cm) Models

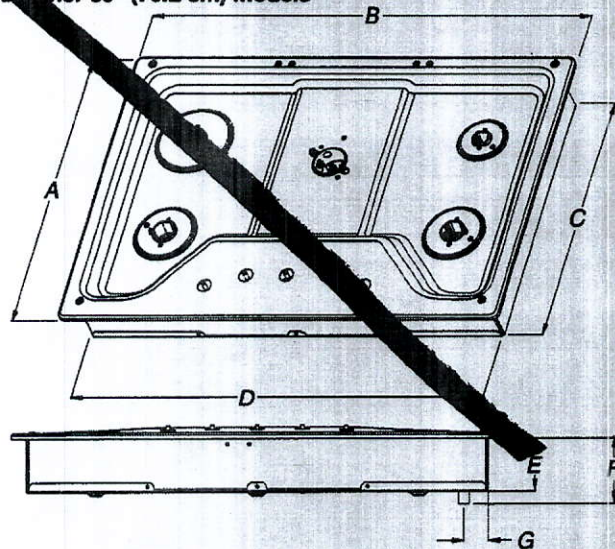

A. 21" (53.3 cm)
B. 30" (76.2 cm)
C. 18 7/8" (48.0 cm)
D. 28 3/8" (72.1 cm)
E. 3 3/8" (8.6 cm)
F. 4 1/8" (10.5 cm)
G. 1 1/2" (3.8 cm)

Other 36" (91.4 cm) Models

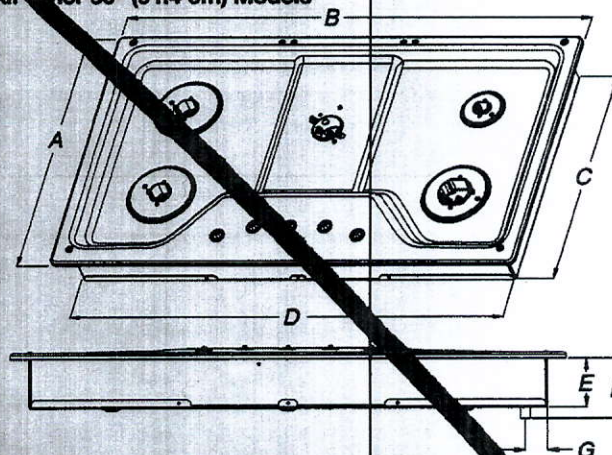

A. 21" (53.3 cm)
B. 36" (91.4 cm)
C. 18 7/8" (48.0 cm)
D. 33 3/4" (85.7 cm)
E. 3 3/8" (8.6 cm)
F. 4 1/8" (10.5 cm)
G. 1 1/2" (3.8 cm)

CABINET DIMENSIONS

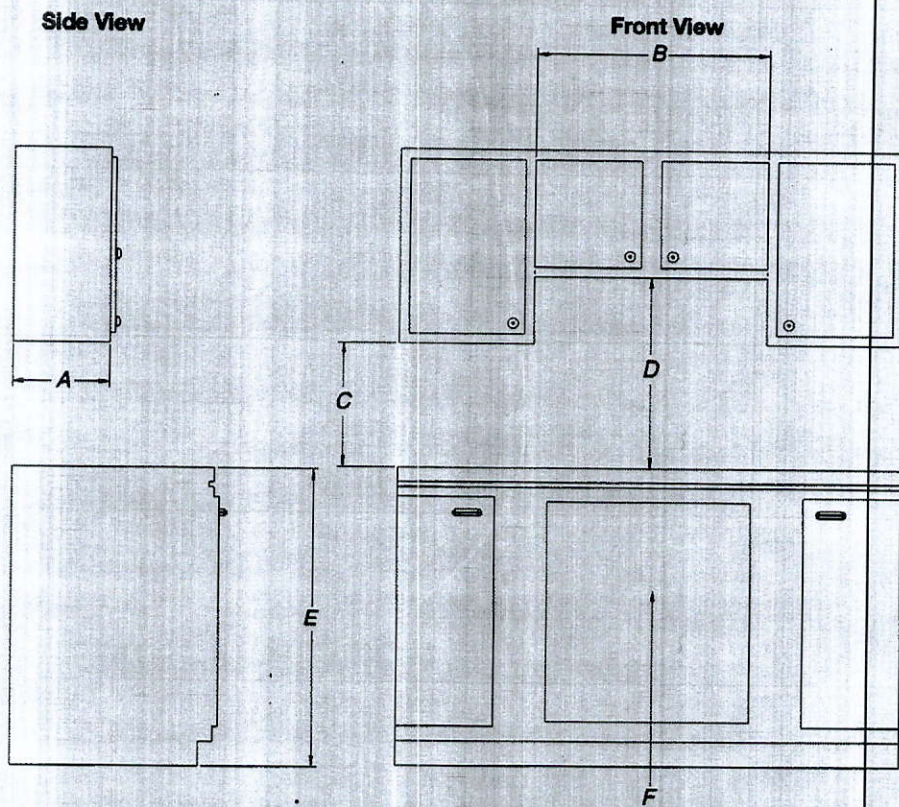

- A. 13" (33.0 cm) recommended upper cabinet depth.
- B. 30" (76.2 cm) for 30" models; [REDACTED]
- C. 18" (45.7 cm) minimum clearance from upper cabinet to countertop within minimum horizontal clearances to cooktop.
- D. 30" (76.2 cm) minimum clearance between top of cooktop platform and bottom of uncovered wood or metal cabinet. 24" (61 cm) minimum clearance if bottom of wood or metal cabinet is covered by not less than 1/4" (0.6 cm) flame retardant millboard covered with not less than No. 28 MSG sheet steel, 0.015" (0.04 cm) stainless steel, or 0.024" (0.06 cm) aluminum or 0.020" (0.05 cm) copper
- [REDACTED]
- F. Gas line opening - Wall: anywhere 5" (12.7 cm) below underside of countertop. Cabinet floor: anywhere within 6" (15.2 cm) of rear wall is recommended.

CABINET DIMENSIONS (cont.)

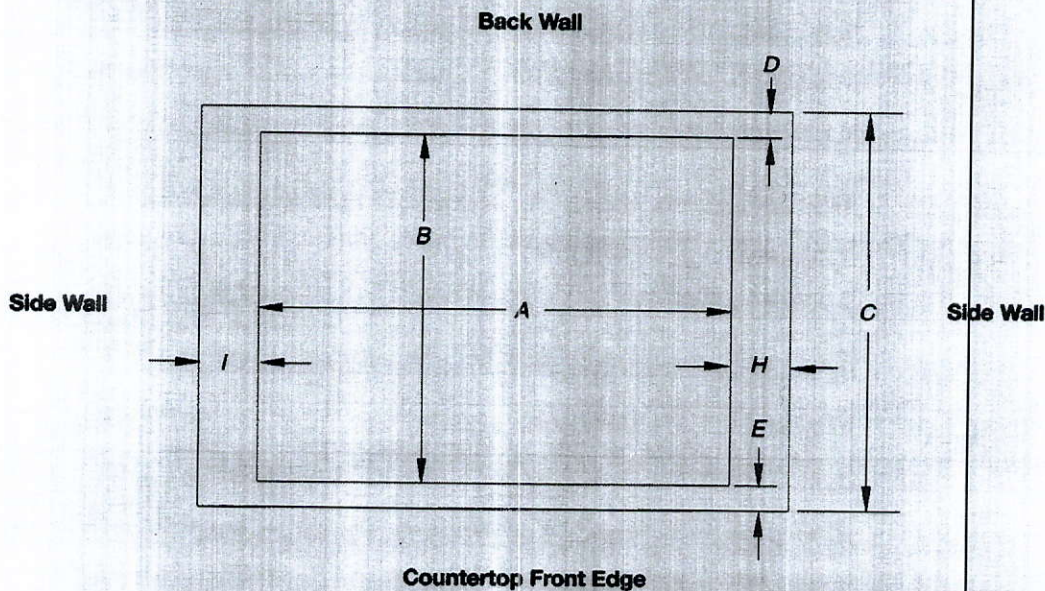

Cutout (Product Opening) Dimensions						
30" (76.2 cm) Models						
Models	A			B		
	Min	Recommended	Max	Min	Recommended	Max
KCGS550 and KCGS950 All Other 30" (76.2 cm) Models	28 1/2" (72.4 cm) 28 1/2" (72.4 cm)	28 7/8" (73.4 cm) 28 7/8" (73.4 cm)	29 9/16" (74.3 cm) 29 9/16" (74.3 cm)	19 1/2" (49.5 cm) 19" (48.3 cm)	19 13/16" (50.2 cm) 19 1/2" (49.5 cm)	20" (50.8 cm) 20" (50.8 cm)
36" (91.4 cm) Models						
KCGS556 and KCGS956 All Other 36" (91.4 cm) Models	34 1/2" (88.4 cm) 33 7/8" (86.6 cm)	35 3/8" (89.4 cm) 34 9/16" (87.0 cm)	35 5/8" (90.3 cm) 35 1/2" (89.5 cm)	19 1/2" (49.5 cm) 19" (48.3 cm)	19 13/16" (50.2 cm) 19 1/2" (49.5 cm)	20" (50.8 cm) 20" (50.8 cm)

Side Walls (Combustible Surfaces)	
Models	H and I
KCGS5 and KCGS9	H and I added together must be at least 48" (122.0 cm), with each side individually being at least 8" (20.3 cm).
KCGS350, KCGS356, MGC3600, WCG97US0, WCG97US6	H and I added together must be at least 48" (122.0 cm), with each side individually being at least 12" (30.5 cm).
All Other Models	Both have to be at least 20.3 cm or more.

Back Wall and Countertop Front Dimensions			
Models	C	D	E
KCGS550 and KCGS950	25" (63.5 cm)	2 7/8" (7.3 cm)	2 3/4" (6.9 cm)
All Other Models			2 1/2" (7.0 cm)

NOTES: After making the countertop cutout, some installations may require notching down the base cabinet side walls to clear the cooktop base. To avoid this modification, use a base cabinet with sidewalls wider than the cutout.

If cabinet has a drawer, a 4" (10.2 cm) depth clearance from the countertop to the top of the drawer (or other obstruction) in base cabinet is required. The drawer depth may need to be shortened to avoid interfering with the regulator.

IMPORTANT: If a built-in wall oven is to be installed below this cooktop, the grounded outlet and gas supply piping must be located in an adjacent cabinet.

This cooktop and its gas and electrical supply sources must be installed before the undercounter built-in wall oven is installed.

AND 30" (76.2 CM) ELECTRIC SINGLE AND BUILT-IN OVEN

PRODUCT MODEL NUMBERS

KODE30E
KODE30E
KODE50E
KODE50E

KODT100E
KODT100E
KODE50E
KODE50E

KOST100E

Electrical: To properly install your oven, you must determine the type of electrical connection you will be using and follow the instructions provided for it here.

- Oven must be connected to the proper electrical voltage and frequency as specified on the model/serial number rating plate. The model/serial number rating plate is located under the control panel on single ovens and under the control panel on the upper oven cavity on double ovens. See the following illustrations.

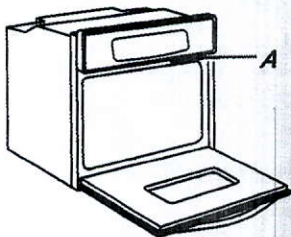

Single Oven

A. Model/serial number plate

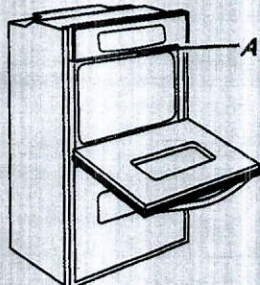

Double Oven

A. Model/serial number plate

- Models rated from 7.3 to 9.6 kW at 240 volts (5.4 to 7.4 kW at 208 volts) require a separate 40-amp circuit. Models rated at 4.8 kW and below at 240 volts (3.6 kW and below at 208 volts) require a separate 20-amp circuit.
- A circuit breaker is recommended.
- Connect directly to the circuit breaker box (or fused disconnect) through flexible, armored or nonmetallic sheathed, copper cable (with grounding wire). See "Make Electrical Connection" section.
- Flexible conduit from the oven should be connected directly to the junction box.
- Fuse both sides of the line.
- Do not cut the conduit. The length of conduit provided is for serviceability of the oven.
- A UL listed or CSA approved conduit connector must be provided.
- If the house has aluminum wiring, follow the procedure below:
 - Connect a section of solid copper wire to the ends of the flexible conduit leads.
 - Connect the aluminum wiring to the added section of copper wire using special connectors and/or tools designed and UL listed for joining copper to aluminum.

Follow the electrical connector manufacturer's recommended procedure. Aluminum/copper connection must conform with local codes and industry accepted wiring practices.

For power requirements for models KOST107E, KOST100E, KODE507E, KODE500E, KODE307E, KODE300E, KODE507E, KODE500E, KODT100E and KODT107E, refer to the following table.

Voltage	Single Thermal	Single Convector	Double Thermal	Double Convector	Double Convector/Thermal
240 VAC	4100 W	4100 W	8163 W	8300 W	8300 W
208 VAC	3100 W	3100 W	6300 W	6300 W	6300 W
240 VAC	17.2 A	17.2 A	34.2 A	34.2 A	34.2 A
208 VAC	15.0 A	15.0 A	29.9 A	29.9 A	29.9 A

PRODUCT DIMENSIONS

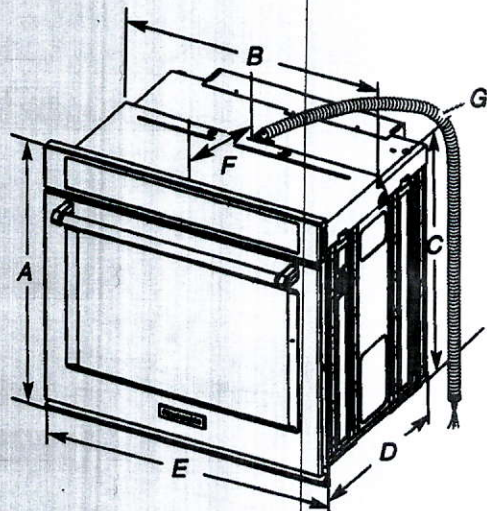

68.6 cm) models
A. 28 3/4" (72.8 cm) max. overall height
B. 28 1/2" (72.4 cm) max. recessed width
C. 26 3/4" (67.9 cm) recessed height
D. 23 1/4" (59.1 cm) max. recessed depth
E. 27" (68.6 cm) overall width
F. 12" (30.5 cm) from back of control panel to start of strain relief
G. 48" (121.9 cm) flexible conduit length

30" (76.2 cm) models
A. 28 3/4" (72.8 cm) max. overall height
B. 28 1/2" (72.4 cm) max. recessed width
C. 26 3/4" (67.9 cm) recessed height
D. 23 1/4" (59.1 cm) max. recessed depth
E. 30" (76.2 cm) overall width
F. 12" (30.5 cm) from back of control panel to start of strain relief
G. 48" (121.9 cm) flexible conduit length

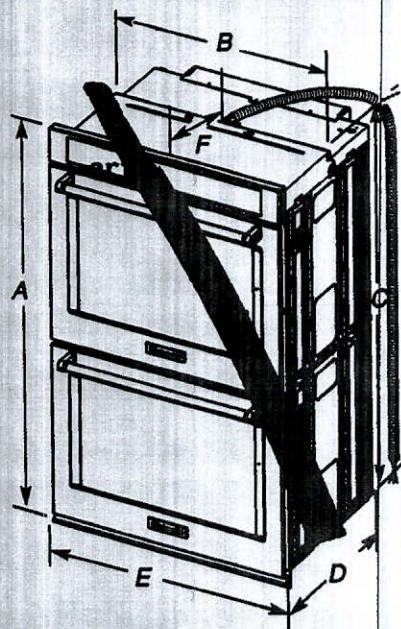

68.6 cm) models
A. 51 1/2" (130.0 cm) max. overall height
B. 28 1/2" (72.4 cm) max. recessed width
C. 48 1/2" (124.0 cm) recessed height
D. 23 1/4" (59.1 cm) max. recessed depth
E. 27" (68.6 cm) overall width
F. 12" (30.5 cm) from back of control panel to start of strain relief
G. 66" (167.6 cm) flexible conduit length

30" (76.2 cm) models
A. 51 1/2" (130.0 cm) max. overall height
B. 28 1/2" (72.4 cm) max. recessed width
C. 48 1/2" (124.0 cm) recessed height
D. 23 1/4" (59.1 cm) max. recessed depth
E. 30" (76.2 cm) overall width
F. 12" (30.5 cm) from back of control panel to start of strain relief
G. 66" (167.6 cm) flexible conduit length

MICROWAVE OVEN BUILT-IN TRIM KIT INSTALLATION INSTRUCTIONS

Built-In Trim Kit Models MK2167, MK2160

UL listed for use over any electric or gas built-in oven, up to 30" (76.2 cm) wide

INSTRUCTIONS D'INSTALLATION GARNITURE ENCASTRÉE POUR FOUR À MICRO-ONDES

Garniture encastrée pour modèles MK2167, MK2160

Homologation UL pour utilisation au-dessus de tous les fours encastrés électriques ou gaz, jusqu'à 30" (76,2 cm) de largeur

Table of Contents / Table des matières

MICROWAVE OVEN SAFETY	1	SÉCURITÉ DU FOUR À MICRO-ONDES	7
INSTALLATION INSTRUCTIONS.....	2	INSTRUCTIONS D'INSTALLATION	7
Tools and Parts	2	Outillage et pièces.....	7
Location Requirements	2	Exigences d'emplacement.....	7
Required Cutout Dimensions.....	2	Dimensions nécessaires de l'ouverture d'encastrement.....	8
Trim Kit Frame Dimensions.....	3	Dimensions du cadre de la trousse de garniture.....	8
Electrical Requirements	3	Spécifications électriques	9
Prepare Microwave Oven.....	3	Préparation du four à micro-ondes.....	9
Prepare Cutout/Cabinet Opening.....	4	Préparation de l'ouverture d'encastrement	10
Install the Microwave Oven.....	5	Installation du four à micro-ondes	11
Install Trim Kit Frame	6	Installation du cadre de la trousse de garniture	12

MICROWAVE OVEN SAFETY

Your safety and the safety of others are very important.

We have provided many important safety messages in this manual and on your appliance. Always read and obey all safety messages.



This is the safety alert symbol.
This symbol alerts you to potential hazards that can kill or hurt you and others.
All safety messages will follow the safety alert symbol and either the word "DANGER" or "WARNING."
These words mean:

⚠ DANGER

You can be killed or seriously injured if you don't immediately follow instructions.

⚠ WARNING

You can be killed or seriously injured if you don't follow instructions.

All safety messages will tell you what the potential hazard is, tell you how to reduce the chance of injury, and tell you what can happen if the instructions are not followed.

INSTALLATION INSTRUCTIONS

Tools and Parts

Tools Needed

Gather the required tools and parts before starting installation. Read and follow the instructions provided with any tools listed here.

- Measuring tape
- Drill
- Pencil
- 7/64" drill bit
- Phillips screwdriver

Parts Supplied (not shown to scale)

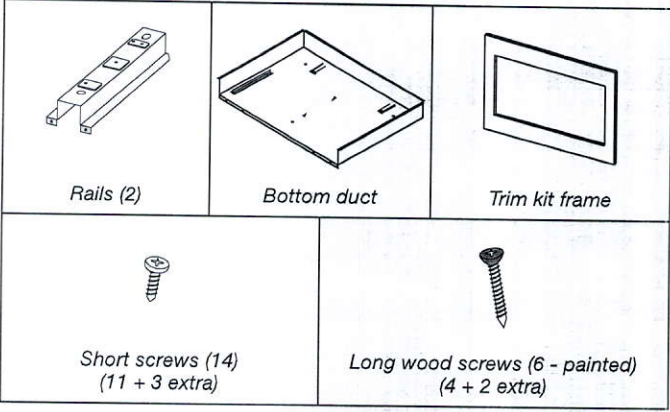

Location Requirements

The microwave oven may be installed over a built-in oven. If installing over a built-in oven, make sure there is a minimum of 3" (7.6 cm) between the top of the lower oven cutout and the microwave oven cutout floor.

The microwave oven may also be installed in a cabinet by itself (without a built-in oven below). For best usability, we recommend a minimum distance of 36" (91.4 cm) from the floor to the cutout floor.

Make sure the surrounding cabinetry has clearance to open and close freely. Allow a clearance of at least 1 1/16" (4.0 cm) below the cutout floor (3" [7.6 cm] for installation above a built-in oven), and a clearance of at least 2" (5.1 cm) above the cutout opening.

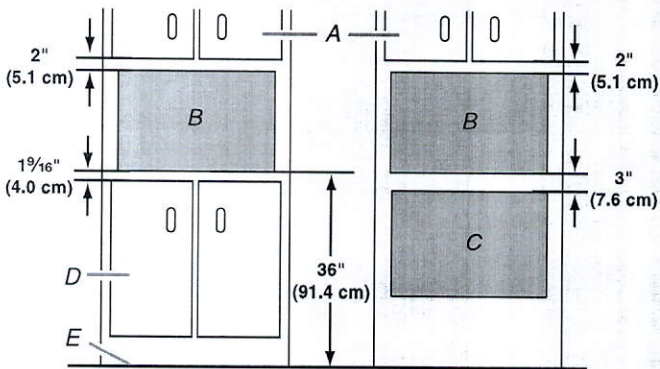

- A. Upper cabinet
- B. Microwave oven cutout
- C. Lower oven cutout
- D. Lower cabinets
- E. Floor

Required Cutout Dimensions

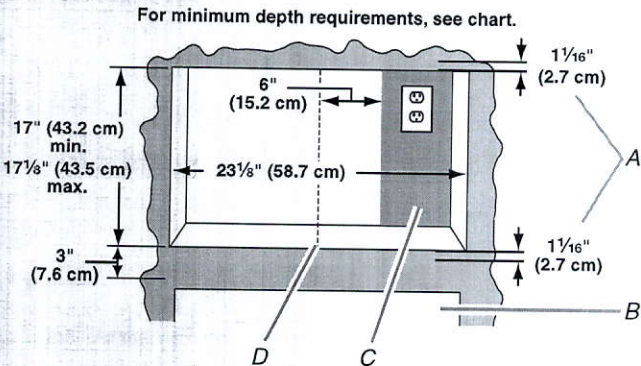

- A. Trim kit frame overhang
- B. Cutout for lower oven
- C. Recommended region for receptacle location (no less than 6" [15.2 cm] to the right of cutout centerline)
- D. Cutout centerline

Receptacle Location	Minimum Depth
Within recommended region	18" (45.7 cm) with flush receptacle; 21" (53.2 cm) with non-flush receptacle
Outside recommended region	19 1/2" (49.5 cm) with flush receptacle; 22 1/2" (57.2 cm) with non-flush receptacle

NOTES:

- Depth requirements depend upon receptacle and its location within or outside of recommended region. See illustration and chart above.
- Height dimension is critical: 17" (43.2 cm) minimum, 17 1/8" (43.5 cm) maximum.
- Width measurement has $\pm 1/16"$ (2 mm) tolerance.
- 3" (7.6 cm) minimum dimension is from lower oven cutout ceiling to microwave oven cutout floor.
- Trim kit frame extends 1 1/16" (2.7 cm) above and below the cutout opening.

Trim Kit Frame Dimensions

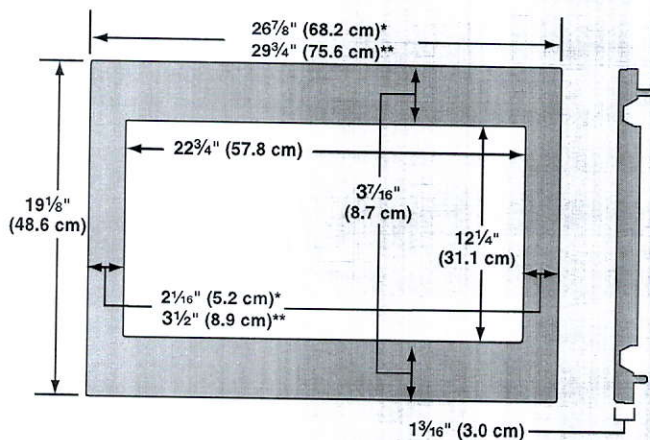

*27" (68.6 cm) trim kit

**30" (76.2 cm) trim kit

Electrical Requirements

⚠ WARNING



Electrical Shock Hazard

Plug into a grounded 3 prong outlet.

Do not remove ground prong.

Do not use an adapter.

Do not use an extension cord.

Failure to follow these instructions can result in death, fire, or electrical shock.

Observe all governing codes and ordinances.

Required:

- A 120 volt, 60 Hz, AC only, 15- or 20-amp electrical supply with a fuse or circuit breaker.

Recommended:

- A time-delay fuse or time-delay circuit breaker.
- A separate circuit serving only this microwave oven.

GROUNDING INSTRUCTIONS

■ For all cord connected appliances:

The microwave oven must be grounded. In the event of an electrical short circuit, grounding reduces the risk of electric shock by providing an escape wire for the electric current. The microwave oven is equipped with a cord having a grounding wire with a grounding plug. The plug must be plugged into an outlet that is properly installed and grounded.

WARNING: Improper use of the grounding plug can result in a risk of electric shock. Consult a qualified electrician or serviceman if the grounding instructions are not completely understood, or if doubt exists as to whether the microwave oven is properly grounded.

Do not use an extension cord. If the power supply cord is too short, have a qualified electrician or serviceman install an outlet near the microwave oven.

SAVE THESE INSTRUCTIONS

Prepare Microwave Oven

1. Unplug microwave oven before proceeding with installation.
2. Remove any loose items inside microwave oven.
3. Gently turn microwave oven onto its top, with the door facing forward (toward installer).
4. Align the two rails on the microwave oven bottom, as shown, making sure the flanges are forward and pointing up.

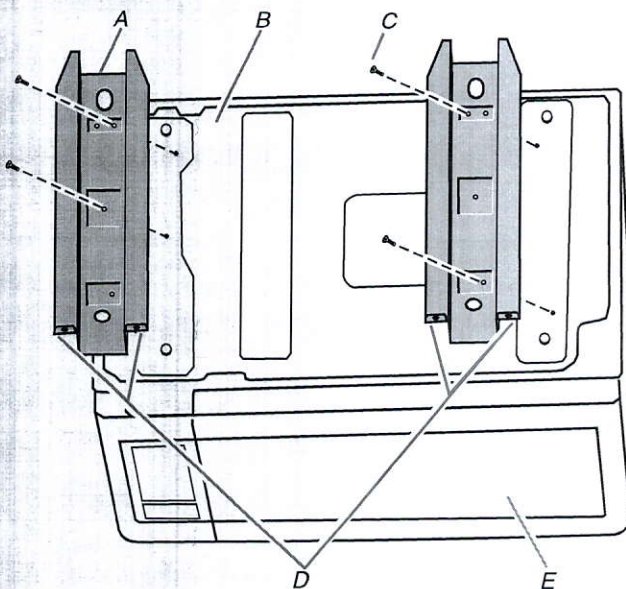

A. Rails (2)

B. Microwave oven bottom

C. Short screws (4)

D. Flanges

E. Door

5. Secure the rails to the microwave oven bottom using four short screws.

KitchenAid Countertop Microwave Use and Care Guide

PRODUCT MODEL NUMBERS

KMCC5015G

LOCATION REQUIREMENTS

IMPORTANT: The control side of the microwave oven is the heavy side. Handle the microwave oven gently. The weight of the microwave oven is over 35 lbs (15.9 kg).

- Place the microwave oven on a cart, counter, table, or shelf that is strong enough to hold the microwave oven and the food and utensils you place inside it.
- The microwave oven should be at a temperature above 50°F (10°C) for proper operation.

NOTE: Some models can be built into a wall or cabinet by using one of the trim kits listed in the “Assistance or Service” section.

- Do not block the exhaust vents or air intake openings. Allow a few inches of space at the back and side of the microwave oven where the exhaust vents are located. Blocking the exhaust vents could cause damage to the microwave oven as well as poor cooking results.
- Make sure the microwave oven legs are in place to ensure proper airflow. If vents are blocked, a sensitive thermal device may automatically turn the microwave oven off. The microwave oven should work properly once it has cooled.

ELECTRICAL REQUIREMENTS

Observe all governing codes and ordinances.

Required:

- A 120-volt, 60 Hz, AC-only, 15- or 20-amp electrical supply with a fuse or circuit breaker.

Recommended:

- A time-delay fuse or time-delay circuit breaker
- A separate circuit serving only this microwave oven

OVERALL DIMENSIONS

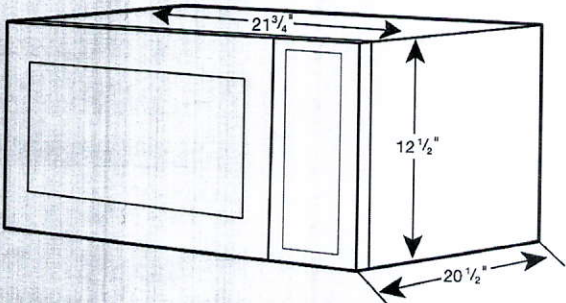

KitchenAid®
FOR THE WAY IT'S MADE®

Bottom Mount Refrigerator

PRODUCT MODEL NUMBERS

KRFF507E KRFF607E
KRFF707E

Electrical: A 115 volt, 60 Hz, AC only 15- or 20-amp fused, grounded electrical supply is required. It is recommended that a separate circuit serving only your refrigerator be provided. Use an outlet that cannot be turned off by a switch. Do not use an extension cord.

Water: A cold water supply with water pressure between 35 and 120 psi (241 and 827 kPa) is required to operate the water dispenser and ice maker. If you have questions about your water pressure, call a licensed, qualified plumber.

NOTE: If the water pressure is less than what is required, the flow of water from the water dispenser could decrease or ice cubes could be hollow or irregular shaped.

Reverse Osmosis Water Supply:

IMPORTANT: The pressure of the water supply coming out of a reverse osmosis system going to the water inlet valve of the refrigerator needs to be between 35 and 120 psi (241 and 827 kPa).

If a reverse osmosis water filtration system is connected to your cold water supply, the water pressure to the reverse osmosis system needs to be a minimum of 40 to 60 psi (276 to 414 kPa).

PRODUCT DIMENSIONS

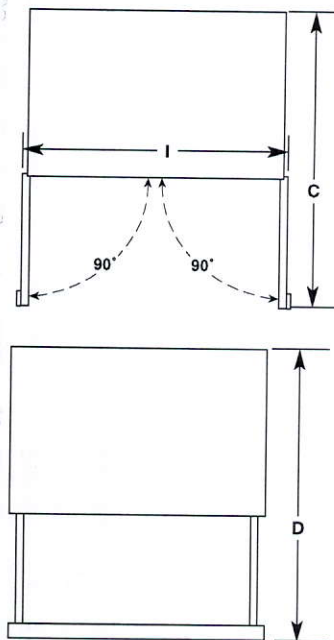
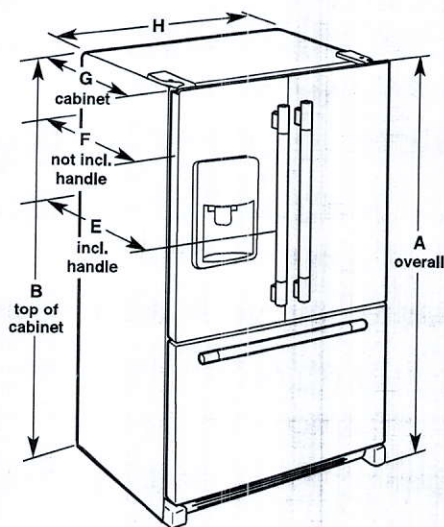

Model Size	Height - Overall "A"	Height - Top of Cabinet "B"	Depth - Doors Open 90° "C"	Depth - Drawer Open "D"	Depth - With Handles "E"	Depth - Without Handles "F"	Depth - Cabinet Only "G"	Width - Cabinet "H"	Width - Door Open 90° "I"
26.8	70¾"	68¾"	49"	54¾"	36½"	34"	297⁄8"	35½"	39½"

LOCATION REQUIREMENTS

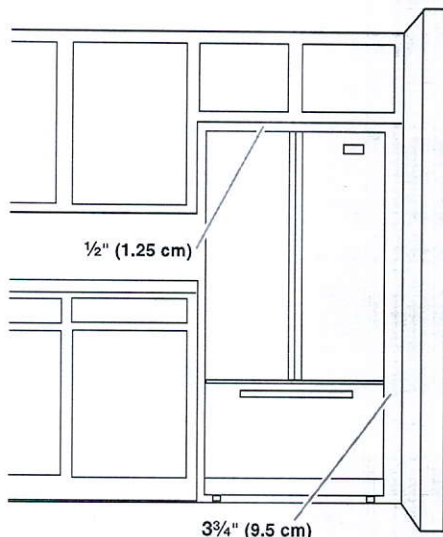

To ensure proper ventilation for your refrigerator, allow for a ½" (1.25 cm) of space on each side and at the top. Allow for a 1" (2.54 cm) space behind the refrigerator. If your refrigerator has an ice maker, allow extra space at the back for the water line connections. When installing your refrigerator next to a fixed wall, leave a 3¾" (9.5 cm) minimum space between the refrigerator and wall to allow the door to swing open.

NOTE: This refrigerator is intended for use in a location where the temperature ranges from a minimum of 55°F (13°C) to a maximum of 110°F (43°C). The preferred room temperature range for optimum performance, which reduces electricity usage and provides superior cooling, is between 60°F (15°C) and 90°F (32°C). It is recommended that you do not install the refrigerator near a heat source, such as an oven or radiator.

KitchenAid®

FOR THE WAY IT'S MADE®

Undercounter Dishwasher

PRODUCT MODEL NUMBERS

KDFE204E, KDFE454C, KDTE104E, KDTE204E,
KDTE254E, KDTM354E, KDTM384E, KDTM404E,
KDTM504E, KDTM704E, KDTM804E

Electrical Requirements: 120-volt, 60 Hz, AC-only, 15- or 20-amp. fused electrical supply. Copper wire only. A time delay fuse or circuit breaker and separate circuit is recommended.

If direct wiring dishwasher: Use flexible, armored or nonmetallic, sheathed copper wire with grounding wire that meets the wiring requirements for your home and local codes and ordinances.

Use a UL Listed or CSA Approved conduit connector.

If connecting dishwasher with a power supply cord:

Use power supply cord kit (Part Number 4317824) marked for use with dishwashers. Follow the kit instructions for installing the power supply cord.

Power supply cord must plug into a grounded 3 prong outlet located in the cabinet next to the dishwasher opening. Outlet must meet all local codes and ordinances.

Water Supply Requirements: A hot water line with 20 to 120 psi (138 to 862 kPa) water pressure. Water temperature must be 120°F (49°C) water at dishwasher. Use 3/8" O.D. copper tubing with compression fitting or flexible braided water supply line.

Note: 1/2" minimum plastic tubing is not recommended.

Use a 90° elbow with 3/4" hose connection with rubber washer (Part Number W10273460). Do not solder within 6" (15.2 cm) from water inlet valve.

Drain Requirements: A new drain hose is supplied with your dishwasher. If this is not long enough, use a new drain hose with a maximum length of 12' (3.7 m) (Part Number 3385556) that meets all current AHAM/IAPMO test standards, is resistant to heat and detergent, and fits the 1" (2.5 cm) drain connector of the dishwasher.

Make sure to connect the drain hose to waste tee or disposer inlet above drain trap in house plumbing and 20" (50.8 cm) minimum above the floor. It is recommended

that the drain hose either be looped up and securely fastened to the underside of the counter or be connected to an air gap.

Make sure to use an air gap if the drain hose is connected to house plumbing lower than 20" (50.8 cm) above subfloor or floor.

Use 1/2" (1.3 cm) minimum I.D. drain line fittings.

If required, the air gap should be installed in accordance with the air gap installation instructions. When connecting the air gap, a rubber hose (not provided) will be needed to connect to the waste tee or disposer inlet.

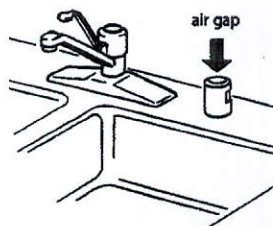

PRODUCT DIMENSIONS

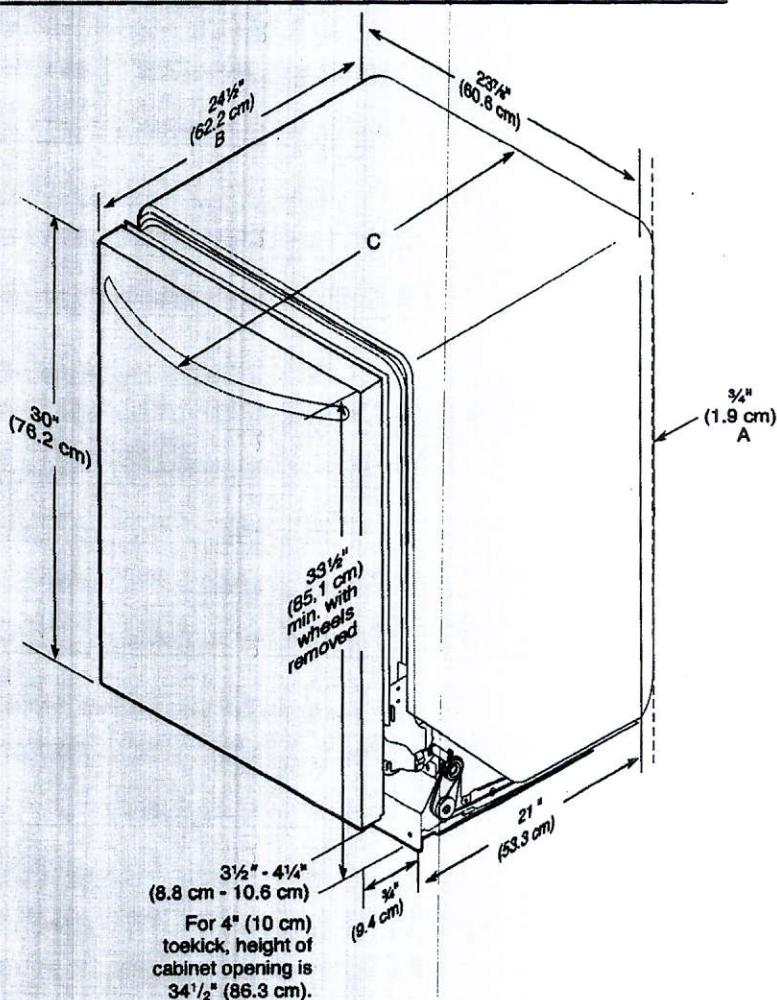

- A. Insulation may be compressed (not used on all models).
- B. For panel-ready models, dishwasher depth is 24" (60 cm) not including the 3/4" (1.9 cm) custom door panel.
- C. Door handles may protrude forward of the face of the dishwasher; varies by model.

CABINET CUTOUT DIMENSIONS

NOTE: Shaded areas of cabinet walls show where utility connections may be installed.

* Measure from the lowest point on the underside of the countertop. May be reduced to 33½" (85.1 cm) by removing the rear leveling legs from dishwasher.

** Minimum, measured from narrowest point of opening.

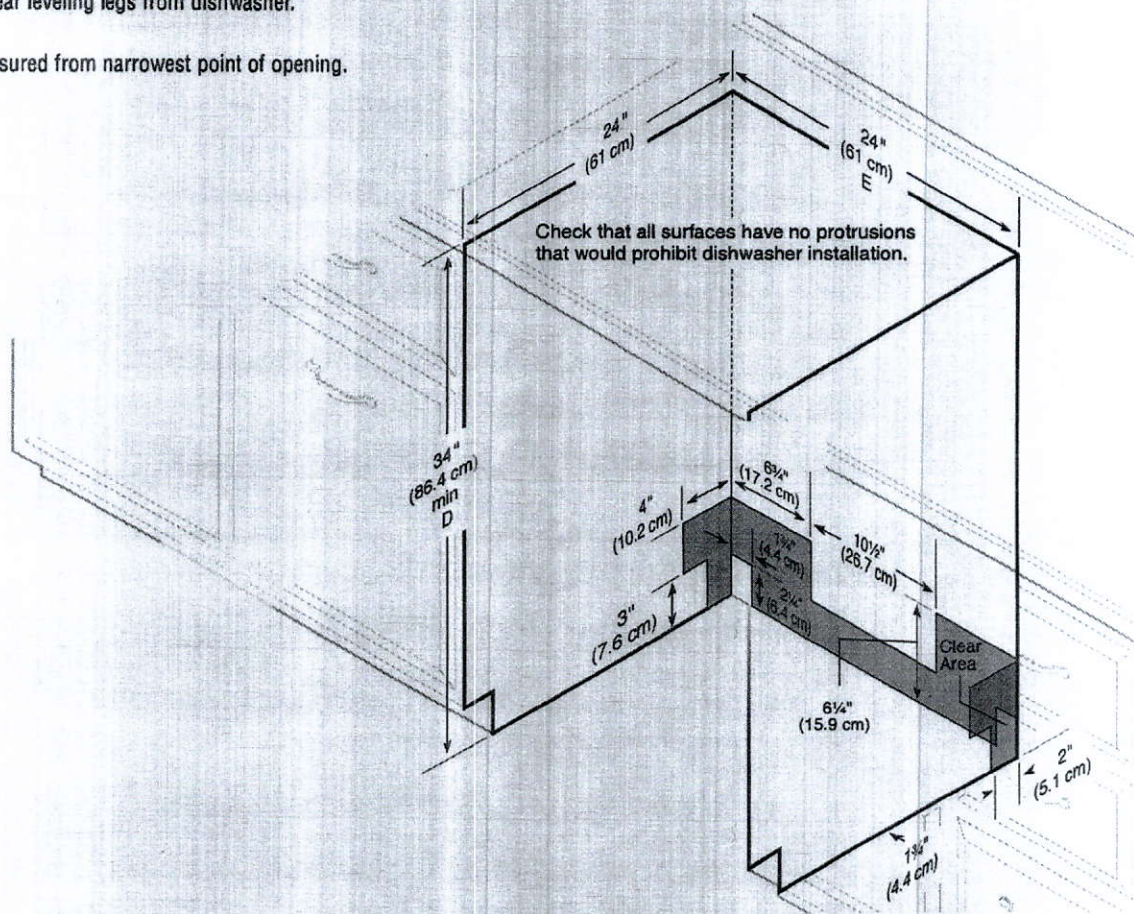

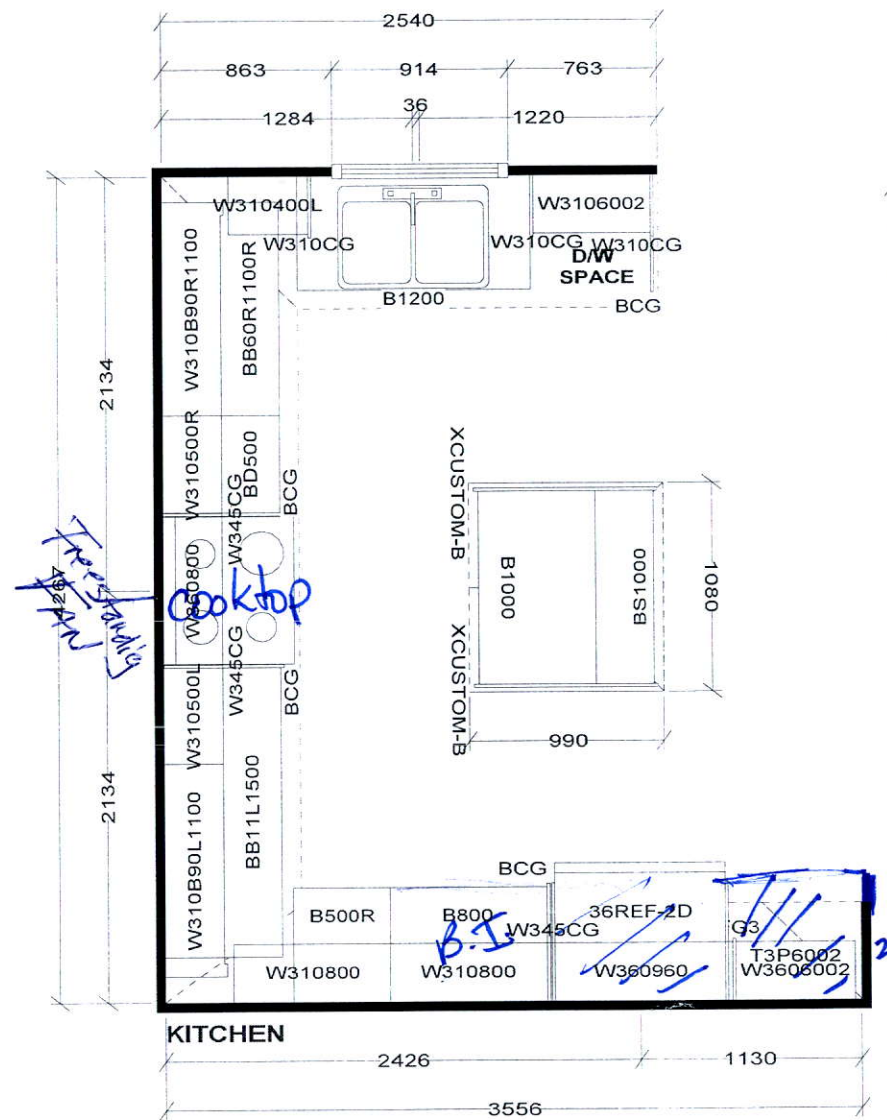

Selba Industries

1040MM HIGH UPPERS WITH CROWN MOULDING
 LIGHT VALANCE
 DISHWASHER SPACE
 GRANITE KITCHEN & ENSUITE COUNTERTOPS BY OTHERS
 CLEAN CUT LAMINATE VANITY COUNTERTOPS
 LAUNDRY BASE, UPPER AND LAMINATE COUNTERTOP

This drawing is the intellectual property of
 SELBA INDUSTRIES INC. and is an
 original design which must not be released
 or copied unless applicable fee has been
 paid or job order placed.



JOB NUMBER:
 BUILDER: GREENYORK
 SITE NAME: OSTIENSE CONST.
 MODEL: AUBURN 3X
 LOT #:
 DESIGNER: KS
 DATE: MAY 23 17

53 Ostiense

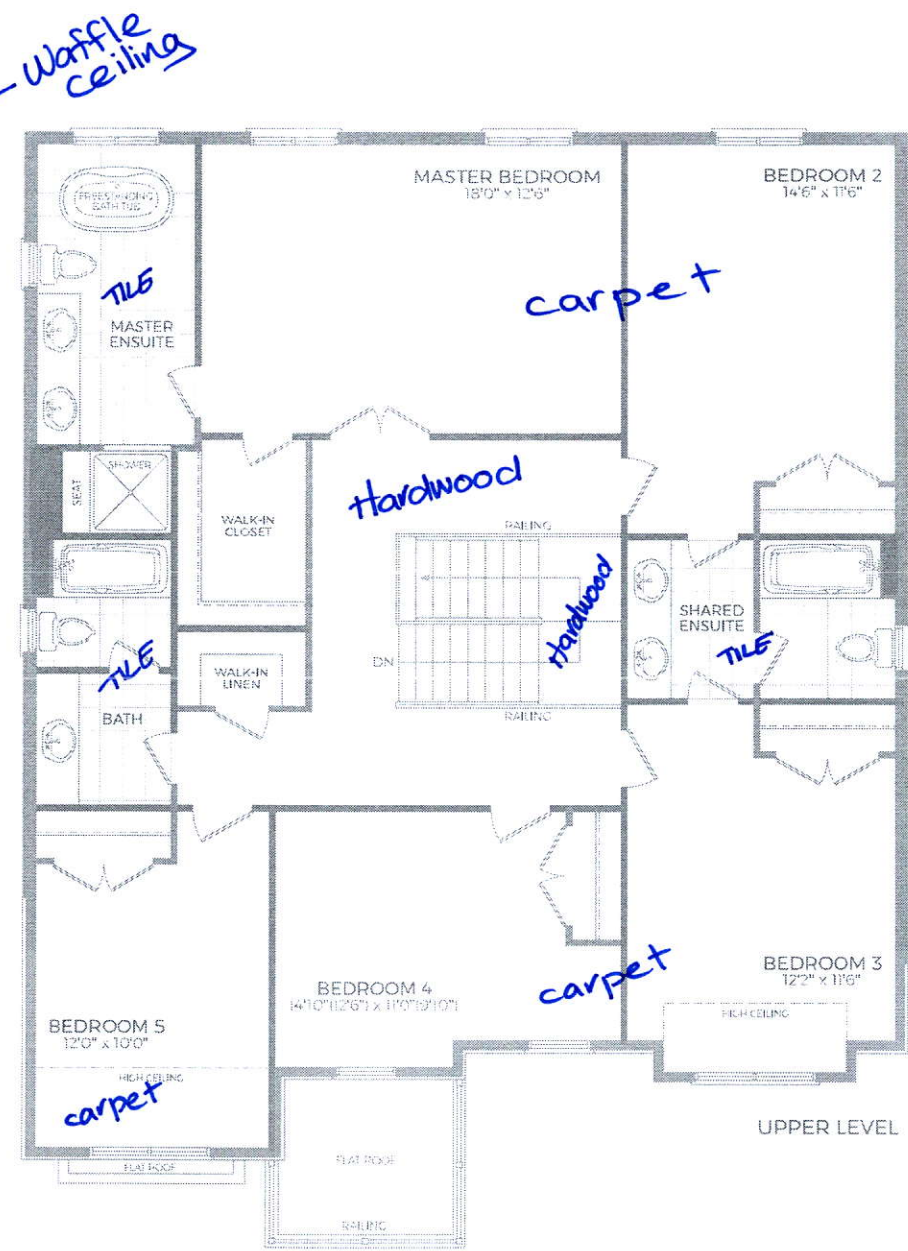
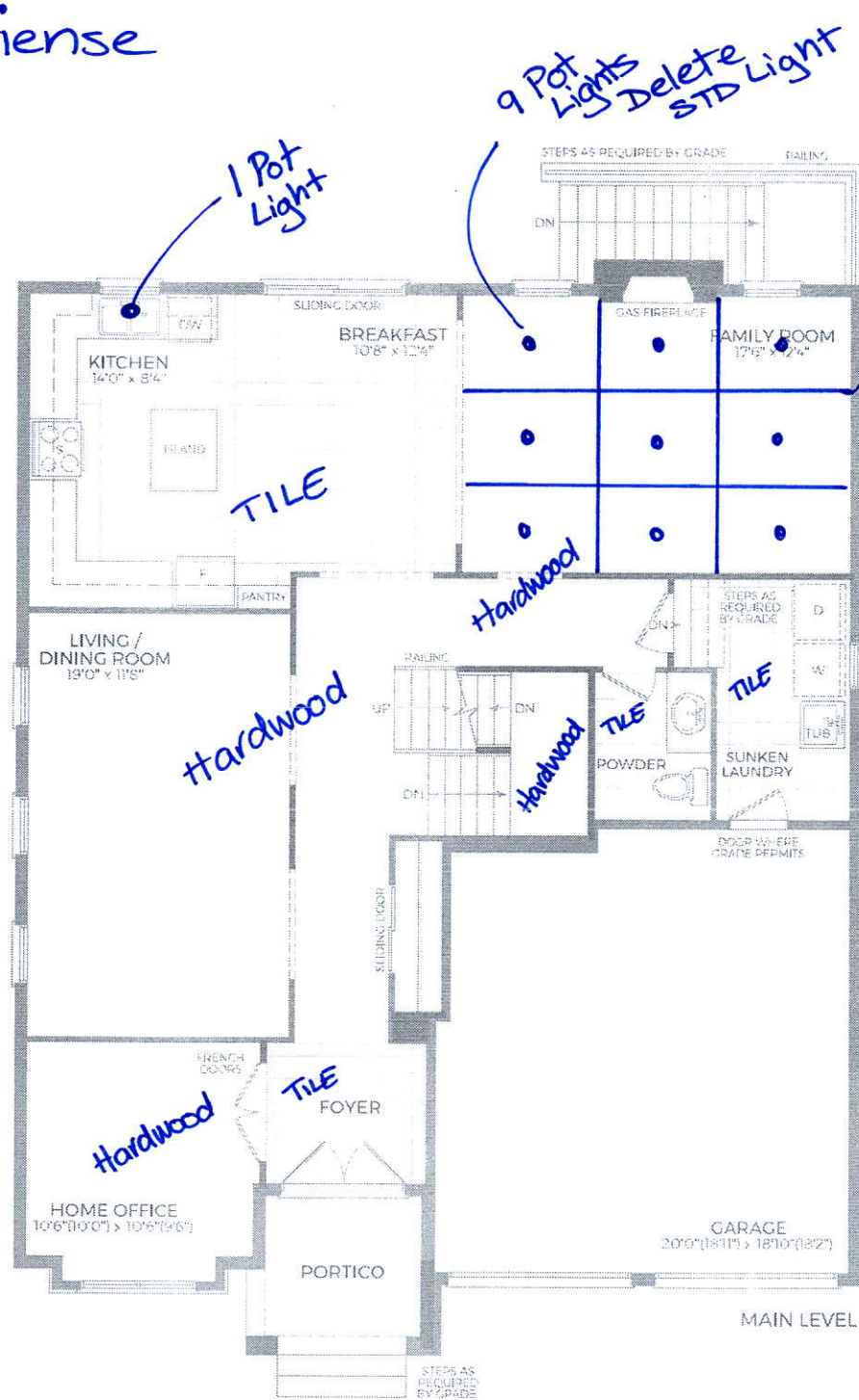

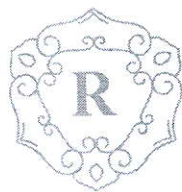

Auburn 3

3100 sq. ft.

Including 33 sq. ft. basement area

