

CONSTRUCTION SUMMARY			
Charisma Condominiums - Granerola Residences Ltd.			
PURCHASERS: Sirous AZIMI and Maryam AZIMI			TEL:
Unit 6, Level 8 (806-North)	Floor Plan A600		

RECEIVED
FEB 23 2024

CABINETRY

1 - KITCHEN - EXTENDED UPPERS 12Aug22 Note:	
--	--

COUNTER TOP

1 - KITCHEN - UPGRADE EDGE 12Aug22 Note:	
---	--

ELECTRICAL

1 - POT LIGHT – ADD SHOWER POT LIGHT TO TUB 08Jun22 Note:	
1 - LIVING ROOM - ADD LIGHT 08Jun22 Note:	

MISCELLANEOUS

1 - PACKAGE CHANGE FEE 12Aug22 Note:	
---	--

PLUMBING

1 - POWDER ROOM - MOEN BATHROOM ACCESSORIES - METHOD - PAPER HOLDER - CHROME #YB2408 12Aug22 Note:	
1 - MASTER ENSUITE - MOEN BATHROOM ACCESSORIES - METHOD - PAPER HOLDER - CHROME #YB2408 12Aug22 Note:	
1 - POWDER ROOM - MOEN BATHROOM ACCESSORIES - METHOD - 18 INCH TOWEL BAR - CHROME #YB2418 12Aug22 Note:	
1 - MASTER ENSUITE - MOEN BATHROOM ACCESSORIES - METHOD - 18 INCH TOWEL BAR - CHROME #YB2418 12Aug22 Note:	

PROMOTIONAL

1 - PROMO CREDIT BALANCE 12Aug22 Note:	
1 - LESS BALANCE OF CREDIT FROM PURCHASER EXTRA SHEET IN OFFER (NEW PROMO BALANCE - \$3,811.00) 08Jun22 Note:	

EXTRAS AS PER OFFER

The Vendor agrees that notwithstanding any other term or provision in this Agreement included in the Purchase Price and in addition to those items detailed in Schedule D to the Agreement of Purchase and Sale, the Purchaser is entitled to a credit of Five Worksheet Note:	
The Purchaser acknowledges that the Purchase Price is inclusive of all credits and promotional packages available at the time of purchase. Worksheet Note:	
1 Parking Unit - location to be selected by the Vendor at their sole discretion. Worksheet Note:	

CONSTRUCTION SUMMARY			
Charisma Condominiums - Granerola Residences Ltd.			
PURCHASERS: Sirous AZIMI and Maryam AZIMI			TEL:
Unit 6, Level 8 (806-North)	Floor Plan A600		

This Document is Extremely Time Sensitive - Printed 23 Feb 24 at 8:59

Purchasers:

Sirous AZIMI & Maryam AZIMI

Telephone Res. / Bus:

/

Decor Advisor:

Ida Viola

Lock Date:

8/12/2022 10:40:30

Const. No.:

Unit 6, Level 8

Municipal:

806

Suite Type:

A600

Project/Phase:

Granerola Residences Ltd./North

Layout Changes:

☐ Yes ☒ No

Sketch Attached:

☒ Yes ☐ No

1. Kitchen and Vanities

	Style and Colour	Hardware
Kitchen	MONACO 350 PLATINUM SILVER	428SB
Main Bathroom	N/A	
Master Ensuite Bathroom	MONACO 350 PLATINUM SILVER	428SB
Powder Room	MONACO 350 PLATINUM SILVER	428SB

Built In Appliances

☐ Yes ☒ No

Kitchen Extended Upper Cabinets

☒ Yes ☐ No

Comment

** Refer to Construction Summary

2. Counters

	Counter	Edge
Kitchen	QUARTZ- ISTRIA	#360
Main Bathroom	N/A	
Master Ensuite Bathroom	QUARTZ- ISTRIA	Straight Polished Edge
Powder Room	QUARTZ- ISTRIA	Straight Polished Edge
Kitchen Backsplash	TILE-GLOSSY WHITE 4X12	

Comment

** Refer to Construction Summary

3. Flooring

	Selection
Vestibule/Main Hall	LAMINATE-LEXINGTON ROCHEFORT OAK TL-LW1317
Kitchen	LAMINATE-LEXINGTON ROCHEFORT OAK TL-LW1317
Living Room/Dining Room	LAMINATE-LEXINGTON ROCHEFORT OAK TL-LW1317
Den/Office	N/A
Master Bedroom	LAMINATE-LEXINGTON ROCHEFORT OAK TL-LW1317
Bedroom #2	N/A
Bedroom #3	N/A
Laundry Room	TILE-WHITE MATTE 8X8
Main Bath	N/A
Master Ensuite Bathroom	TILE- STONE WHITE 12X24
Powder Room	TILE- STONE WHITE 12X24

Comment

** Refer to Construction Summary - Standard Grout throughout unless specified

4. Tile

	Selection	Describe
Main Bath	N/A	
Master Ensuite Bathroom	TILE-GLOSSY WHITE 8X16	
Kitchen Backsplash	TILE-GLOSSY WHITE 4X12	

Comment

** Refer to Construction Summary - Standard Grout throughout unless specified

Purchasers:

Sirous AZIMI & Maryam AZIMI

Telephone Res. / Bus:

/

Decor Advisor:

Ida Viola

Lock Date:

8/12/2022 10:40:30

Const. No.:

Unit 6, Level 8

Municipal:

806

Suite Type:

A600

Project/Phase:

Granerola Residences Ltd./North

5. Misc

Water Line Rough-in for Fridge

☐ Yes

☒ No

Upgrade Bathroom Accessories

☐ Yes

☒ No

Comment

** Refer to Construction Summary

6. Wall, Trim and Door Paint - Birch White Paint Throughout unless specified below.

Entrance Vestibule	<input type="text"/>	Living Room	<input type="text"/>
Main Hall	<input type="text"/>	Dining Room	<input type="text"/>
Kitchen	<input type="text"/>	Den/Library	<input type="text"/>
Laundry Room	<input type="text"/>	Master Bedroom	<input type="text"/>
Main Bathroom	<input type="text"/>	Bedroom #2	<input type="text"/>
Master Ensuite Bathroom	<input type="text"/>	Bedroom #3	<input type="text"/>
	<input type="text"/>		<input type="text"/>

Comment

** Refer to Construction Summary

7. General Comments

** Refer to Construction Summary

Disclaimers and Notes

- 1)

Colours of all materials are as close as possible to builder's selection, but not necessarily identical due to variances in manufacturing.
- 2)

The selection images are digital photographs of the Vendor's samples at its Decor Centre. Such images when displayed on your computer monitor may not match Decor Centre samples due to the hardware/software configuration of the computer.
In the event of conflict between selection images and the Décor Centre samples, Décor Centre samples shall prevail.
- 3)

Any extras listed above are null and void unless accompanied by a separate invoice/amendment. Said invoice must be paid in full.
- 4)

The Purchaser agrees that this colour selection is final and that no changes will be permitted, unless required by the Vendor.
- 5)

The Purchaser acknowledges reading and accepting document which contains other miscellaneous disclaimers.

Signature:_____

Date:_____

Signature:_____

Date:_____

Signature:_____

Date:_____

SCHEDULE 'A'

ON THE PARK

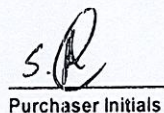
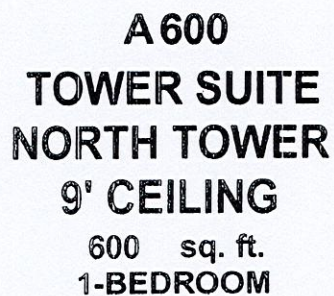

MA
Purchaser Initials

05/28/19
Date

Unit No. 6 Level No. 8 Suite No. 806

Dimensions, specifications, layouts, location of materials and fixtures, tile floor patterns and architectural detailing (including window size and location and door size, location and swing) are approximate only and are subject to change or modifications, without notice. Actual usable floor space varies from stated floor area. Ceiling height measured from top of floor slab to underside of floor slab above and excludes finishes, bulkheads and drop ceilings. Orientation of suite may be reversed and Purchaser agrees to accept same. Balconies decks and terraces are exclusive use common elements shown for display purposes only and location and size are subject to change without notice. All illustrations are artist concept only. The provisions of the Agreement of purchase and sale apply to this Schedule. E. & O.E.

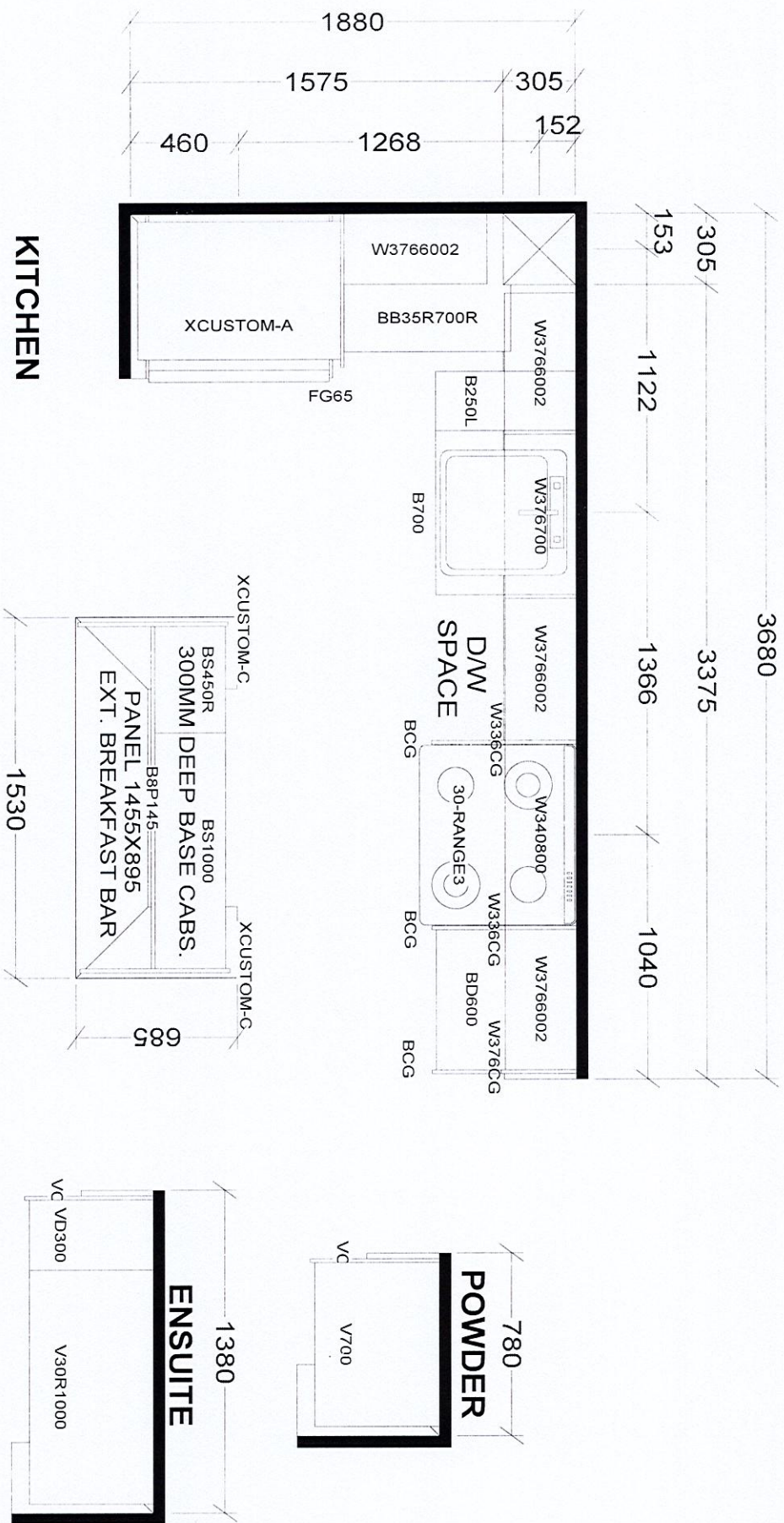

BASE & VANITY CABINETS ON ADJUSTABLE LEGS

Seiba Industries

W WDT H W HGT W CNT

W CNT

This drawing is the intellectual property of SELBA INDUSTRIES INC. and is an original design which must not be released or copied unless applicable fee has been paid or job order placed.

JOB NUMBER:

J #

FLOOR HGT

DOOR HGT

DESIGNER: KS

DATE: JAN 6 22

ST CENT

2X4

VENT BOX COVER

DATE: JAN 6 22

LOT #: 806

MODEL: A600

SITE: GRANEROLA NORTH & SOUTH

BUILDER: GREENPARK