



CONSTRUCTION SUMMARY

The Post - Silk Westerns Corporation

PURCHASER: Sean Sankar RAMSARRAN

TEL: RES.: 905-330-0503

Unit 18, Level 5 (519-1)

Floor Plan
B555

CABINETRY

1 - CABINETRY - MAIN BATH RAISE VANITY TO 36" HIGH VANITY IN LIEU OF STANDARD HEIGHT

11Dec23 Note:

1 - CABINETRY - KITCHEN - EXTENDED TALL UPPER CABINETS - STANDARD LEVEL

11Dec23 Note:

This Document is Extremely Time Sensitive - Printed 11 Dec 23 at 14:40

RECEIVED
DEC 11 2023

Purchaser:Sean Sankar RAMSARRAN

Const. No.: Unit 18, Level 5

Telephone Res. / Bus: (905) 330-0503 /

Municipal: 519

Decor Advisor: Julia L Rosa

Suite Type: B555

Lock Date: 2023-12-11 14:39:53

Project/Phase: Silk Westerns Corporation/1

1. Kitchen and Vanities

	Style and Colour	Hardware
Kitchen	DORAL W-500	Standard
Primary Ensuite Bathroom	N/A	N/A
Main Bathroom	DORAL W-500	Standard

Kitchen Extended Upper Cabinets ☒ Yes ☐ No

Comment

** Refer to Construction Summary

2. Counters

	Counter	Edge
Kitchen	QUARTZ - WHITE	Standard
Primary Ensuite Bathroom	N/A	N/A
Main Bathroom	WHITE ONE PIECE VANITY TOP WITH SINK	Standard

Kitchen BacksplashTILE - GLOSSY WHITE 4X12

Comment

** Refer to Construction Summary

3. Flooring - In all Non-Tiled Areas where Applicable

LAMINATE-LEXINGTON-LANEFFE OAK-TL-LW1311

Comment

** Refer to Construction Summary - KITCHEN LAUNDRY CABINET, FLOORING TO BE LAMINATE

4. Tile

	Floor Tile	Wall Tile
Primary Ensuite Bathroom	N/A	N/A
Main Bath	TILE - VIENNA BIANCO 12X24	TILE - GLOSSY WHITE 8X16

Kitchen BacksplashTILE - GLOSSY WHITE 4X12

Comment

** Refer to Construction Summary - STANDARD GROUT THROUGHOUT UNLESS SPECIFIED
- KITCHEN LAUNDRY CABINET, FLOORING TO BE LAMINATE

5. Wall, Trim and Door Paint - Standard paint as per constuction specificationThroughout.

Comment

** Refer to Construction Summary

Purchaser:	Sean Sankar RAMSARRAN	Const. No.:	Unit 18, Level 5
Telephone Res. / Bus:	(905) 330-0503 /	Municipal:	519
Decor Advisor:	Julia L Rosa	Suite Type:	B555
Lock Date:	2023-12-11 14:39:53	Project/Phase:	Silk Westerns Corporation/1

6. General Comments

Revision Detail



Disclaimers and Notes

The following disclaimers apply to all of the Purchaser's Extra, Purchaser's Estimate Request and all Interior Colour Selection Schedules. The Purchaser(s) acknowledges that the following items may affect matters relating to their unit:

Natural Stone
The Purchaser acknowledges that natural stone products such as granite, marble and quartz that are installed in their dwelling may vary in shading, pattern, texture, veining, pores, colour and fissures from the sample in the Vendor's Décor Centre despite having the same name. Marble is not recommended in high traffic areas, such as the kitchen, as marble is a more porous stone

Ceramic Tile
any variables affect tile colour, pattern and/or design which means that installed tiles may not be identical to the samples. As a result of the manufacturing process, tiles with the same name but of different sizes, may have different colours, pattern or and will not be an exact match to each other. Furthermore, the staggered pattern of the laid tiles will vary due to size of the tile. Purchaser accepts tiles as laid by Vendor.

Hardwood/Laminate Flooring
Cupping and shrinkage are characteristics of hardwood/laminate flooring normally appearing some time after installation, and warranty is provided by the flooring supplier with respect to such cupping and shrinkage. Purchaser acknowledges that hardwood

Appliances
All appliance openings are set to Vendor's standard width. Please advise Décor Centre at time of colour appointment if custom sizing of cabinets and openings are required for any appliance. The Purchaser is responsible for costs and fees associated with changes to standard kitchen cabinets and openings and shall provide the Vendor with appliance specifications prior to of colour chart.

If applicable, where appliances are supplied by the Vendor, the model may vary according to availability and the Purchaser acknowledges that the Vendor may substitute appliances for same or better quality as determined by the Vendor in its sole unfettered discretion.

The Purchaser(s) acknowledge that all measurements and locations are approximate only and are subject to verification on site and may be adjusted to accommodate site conditions. Purchaser acknowledges that not all of the above modifications were available or offered to the Purchaser.

- Colours of all materials are as close as possible to builder's selection, but not necessarily identical due to variances in manufacturing.
- The selection images are digital photographs of the Vendor's samples at its Decor Centre. Such images when displayed on your computer monitor may not match Decor Centre samples due to the hardware/software configuration of the computer. In the event of conflict between selection images and the Décor Centre samples, Décor Centre samples shall prevail.
- Any extras listed above are null and void unless accompanied by a separate invoice/amendment. Said invoice must be paid in full.
- The Purchaser agrees that this colour selection is final and that no changes will be permitted, unless required by the Vendor.
- The Purchaser acknowledges reading and accepting document which contains other miscellaneous disclaimers.

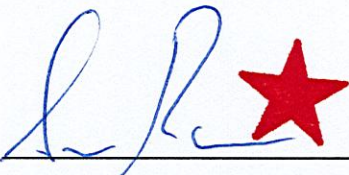
Signature: 

Date: Dec 11/23 Signature: _____ Date: _____

**RECESS FOR
WASHER/DRYER
770mm Wide X 215mm Deep**

Technical drawing of a kitchen cabinet layout. The drawing shows a side view of a cabinet with a total width of 3050 units. The layout is divided into sections with the following dimensions and specifications:

- Section 1 (Left):** Width 770 units. Contains a **WASHER/ DRYER** (XCUSTOM-C).
- Section 2:** Width 318 units. Contains a **W376600L** unit (26F).
- Section 3:** Width 603 units. Contains a **W376600L** unit (22F).
- Section 4:** Width 630 units. Contains a **MICRO/ HOOD FAN** (XCUSTOM-E).
- Section 5:** Width 1116 units. Contains a **24. DISH-IQ** (24-RANGE3) and a **BD450** unit (XCUSTOM-A).
- Section 6 (Right):** Width 384 units. Contains a **BTD600L** unit (FG65) and a **BCG** unit (FG65).

A central blacked-out area indicates a section where the cabinet is not shown in detail. The text **NO CG'S @ STOVE UPPER** is written across the middle of the drawing.

KITCHEN

**(KITCHEN AND / OR VANITY MAY BE
REVERSED DEPENDING ON MODEL
OR SITE CONDITION**

W WDTH _____	W HGHT _____	W CNT _____	This drawing is the intellectual property of SELBA INDUSTRIES INC. and is an original design which must not be released or copied unless applicable fee has been paid or job order placed.	JOB NUMBER: BUILDER: GREENPARK SITE: SILK WESTERNS, Oakville MODEL: B543, B555, B583, B591, B605, LOT #:
FLOOR HGHT _____	DOOR HGHT _____			
ST CENT _____	2X4 _____	VENT BOX COVER _____		
	DESIGNER: KS	DATE: Mar 3 23		

-increase height to 36"

extended uppers -

SCHEDULE 'A'

Agreement of Purchase and Sale



B555

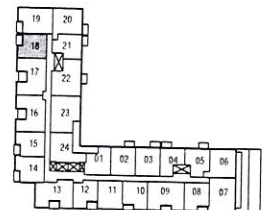

LEVEL 5

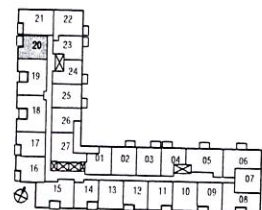

LEVEL 4

Suite **519**, Unit **18**, Level **5**

Purchaser's Initials

[Handwritten initials]

Purchaser's Initials

Date

Dec 11/23

Dimensions, specifications, layouts, location of materials and fixtures, tile floor patterns and architectural detailing (including window size and location and door size, location and swing) are approximate only and are subject to change or modifications, without notice. Actual usable floor space varies from stated floor area. Ceiling height measured from top of floor slab to underside of floor slab above and excludes finishes, bulkheads and drop ceilings. Orientation of suite may be reverse and Purchaser agrees to accept same. Balconies, terraces and patios are exclusive use common elements shown for display purposes only and location and size are subject to change without notice. All illustrations are artist concept only. The provisions of the Agreement of Purchase and Sale apply to this Schedule.

E. & O.E

Jun. 22, 2023