



CONSTRUCTION SUMMARY

RECEIVED

The Post - Silk Westerns Corporation

SEP 26 2023

PURCHASER: Marko BILIC

TEL: RES.: 647-983-4252

Unit 10, Level 2 (210-1)	Floor Plan B543		
--------------------------	--------------------	--	--

CABINetry

1 - CABINetry - KITCHEN - EXTENDED TALL UPPER CABINETS - STANDARD LEVEL 11Sep23 Note:	
---	--

MISCELLANEOUS

1 - PACKAGE CHANGE FEE 11Sep23 Note:	
--	--

This Document is Extremely Time Sensitive - Printed 20 Sep 23 at 15:04



INTERIOR COLOUR SCHEME

Purchaser:Marko BILIC

Telephone Res. / Bus: (647) 983-4252 /

Decor Advisor:Julia L Rosa

Lock Date:2023-09-20 14:43:31

Const. No.: Unit 10, Level 2

Municipal: 210

Suite Type: B543

Project/Phase: Silk Westerns Corporation/1

1. Kitchen and Vanities

	Style and Colour	Hardware
Kitchen	DORAL W- 500	Standard
Primary Ensuite Bathroom	N/A	N/A
Main Bathroom	DORAL W - 500	Standard

Kitchen Extended Upper Cabinets ☒ Yes ☐ No

Comment

** Refer to Construction Summary

2. Counters

	Counter	Edge
Kitchen	QUARTZ - BEIGE	Standard
Primary Ensuite Bathroom	N/A	N/A
Main Bathroom	WHITE ONE - PIECE VANITY TOP WITH INTEGRATED SINK	Standard

Kitchen Backsplash

TILE - GLOSSY WHITE 4X12

Comment

** Refer to Construction Summary

3. Flooring - In all Non-Tiled Areas where Applicable

LAMINATE - LEXINGTON - BRUSSELLS OAK - TL-LW1316

Comment

** Refer to Construction Summary KITCHEN LAUNDRY CABINET, FLOORING TO BE LAMINATE

4. Tile

	Floor Tile	Wall Tile
Main Bath	TILE- EXTRA WHITE 12X24	TILE - GLOSSY WHITE 8X16
Primary Ensuite Bathroom	N/A	N/A
Kitchen Backsplash		TILE - GLOSSY WHITE 4X12

Comment

** Refer to Construction Summary - STANDARD GROUT THROUGHOUT UNLESS SPECIFIED

KITCHEN LAUNDRY CABINET, FLOORING TO BE LAMINATE

Comment

5. Wall, Trim and Door Paint - Birch White Paint Throughout unless specified below.

** Refer to Construction Summary

Printed 2023-09-25 16:57:45

Initial:_____

Page 1 of 2

Purchaser:	Marko BILIC	Const. No.:	Unit 10, Level 2
Telephone Res. / Bus:	(647) 983-4252 /	Municipal:	210
Decor Advisor:	Julia L Rosa	Suite Type:	B543
Lock Date:	2023-09-20 14:43:31	Project/Phase:	Silk Westerns Corporation/1

6. General Comments

** Refer to Construction Summary

Revision Detail

Disclaimers and Notes

The following disclaimers apply to all of the Purchaser’s Extra, Purchaser’s Estimate Request and all Interior Colour Selection Schedules. The Purchaser(s) acknowledges that the following items may affect matters relating to their unit:

Natural Stone
The Purchaser acknowledges that natural stone products such as granite, marble and quartz that are installed in their dwelling may vary in shading, pattern, texture, veining, pores, colour and fissures from the sample in the Vendor’s Décor Centre despite having the same name. Marble is not recommended in high traffic areas, such as the kitchen, as marble is a more porous stone

Ceramic Tile
any variables affect tile colour, pattern and/or design which means that installed tiles may not be identical to the samples. As a result of the manufacturing process, tiles with the same name but of different sizes, may have different colours, pattern or and will not be an exact match to each other. Furthermore, the staggered pattern of the laid tiles will vary due to size of the tile. Purchaser accepts tiles as laid by Vendor.

Hardwood/Laminate Flooring
Cupping and shrinkage are characteristics of hardwood/laminate flooring normally appearing some time after installation, and warranty is provided by the flooring supplier with respect to such cupping and shrinkage. Purchaser acknowledges that hardwood

Appliances
All appliance openings are set to Vendor’s standard width. Please advise Décor Centre at time of colour appointment if custom sizing of cabinets and openings are required for any appliance. The Purchaser is responsible for costs and fees associated with changes to standard kitchen cabinets and openings and shall provide the Vendor with appliance specifications prior to of colour chart.

If applicable, where appliances are supplied by the Vendor, the model may vary according to availability and the Purchaser acknowledges that the Vendor may substitute appliances for same or better quality as determined by the Vendor in its sole unfettered discretion.

The Purchaser(s) acknowledge that all measurements and locations are approximate only and are subject to verification on site and may be adjusted to accommodate site conditions. Purchaser acknowledges that not all of the above modifications were available or offered to the Purchaser.

- 1) Colours of all materials are as close as possible to builder's selection, but not necessarily identical due to variances in manufacturing.
- 2) The selection images are digital photographs of the Vendor's samples at its Decor Centre. Such images when displayed on your computer monitor may not match Decor Centre samples due to the hardware/software configuration of the computer.
In the event of conflict between selection images and the Décor Centre samples, Décor Centre samples shall prevail.
- 3) Any extras listed above are null and void unless accompanied by a separate invoice/amendment. Said invoice must be paid in full.
- 4) The Purchaser agrees that this colour selection is final and that no changes will be permitted, unless required by the Vendor.
- 5) The Purchaser acknowledges reading and accepting document which contains other miscellaneous disclaimers.

Signature:_____ Date: _____Signature:_____ Date: _____

The Post Suite 210

RECESS FOR
WASHER/DRYER

770mm Wide X 215mm Deep

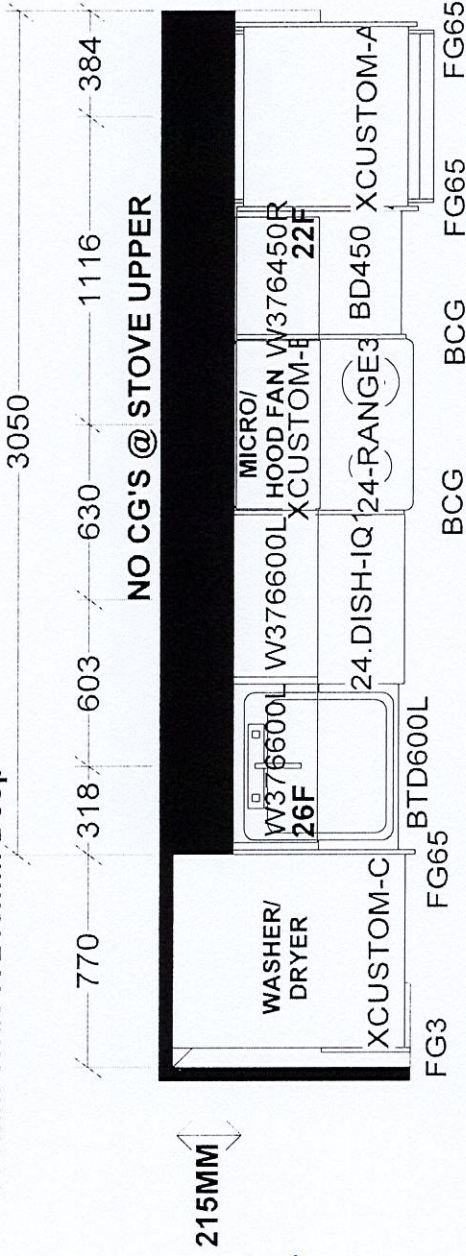

215MM

- extended uppers

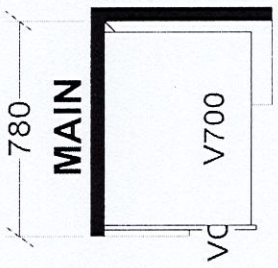

ASSEMBLE CABINET
FOR WASHER/
DRYER ON SITE

KITCHEN

KITCHEN AND / OR VANITY MAY BE
REVERSED DEPENDING ON MODEL
OR SITE CONDITION

Selba Industries				
W WIDTH	W HGHT	W CNT	JOB NUMBER:	
FLOOR HGHT	DOOR HGHT		BUILDER: GREENPARK	
ST CENT	2X4	VENT BOX COVER	SITE: SILK WESTERNS, Oakville	
			MODEL: B543, B555, B583, B591, B605, B610, B666X	
			LOT #:	
			DESIGNER: KS	
			DATE: Mar 3 23	

This drawing is the intellectual property of SELBA INDUSTRIES INC. and is an original design which must not be released or copied unless applicable fee has been paid or job order placed.

SCHEDULE "A"
Agreement of Purchase and Sale

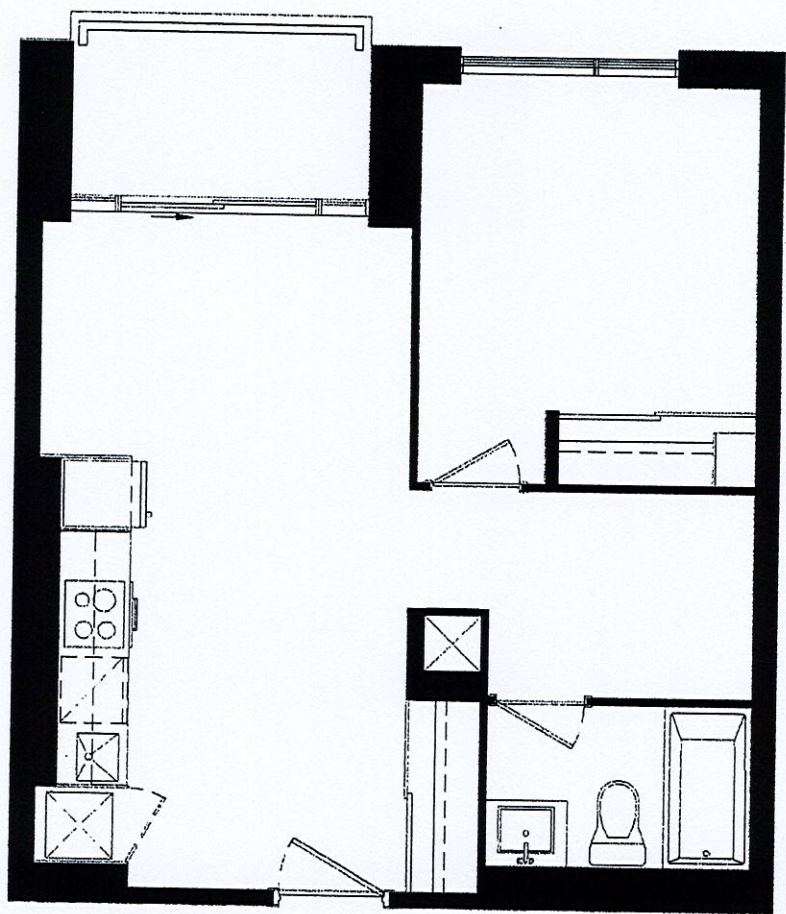

B543

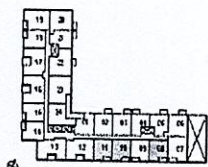

Unit 10, Level 2 Suite 210

Dimensions, specifications, layouts, location of materials and fixtures, tile floor patterns and architectural detailing (including window size and location and door size, location and swing) are approximate only and are subject to change or modifications, without notice. Actual usable floor space varies from stated floor area. Ceiling height measured from top of floor slab to underside of floor slab above and excludes finishes, bulkheads and drop ceilings. Orientation of suite may be reverse and Purchaser agrees to accept same. Balconies, terraces and patios are exclusive use common elements shown for display purposes only and location and size are subject to change without notice. All illustrations are artist concept only. The provisions of the Agreement of Purchase and Sale apply to this Schedule.

E.& O..E. Sep 30, 2022

Initials: 