

CONSTRUCTION SUMMARY

Charisma Condominiums - Granerola Residences Ltd.

RECEIVED

JAN 18 2023

TEL:

PURCHASER: Carmela ANDRIANO

Unit 8, Level 13 (1408-North)	Floor Plan B646		
-------------------------------	--------------------	--	--

CABINETS

<p>1 - CABINETS - KITCHEN - LIGHT VALENCE 13Jan23 Note:</p>	
<p>1 - KITCHEN - EXTENDED UPPER CABINETS 13Jan23 Note:</p>	
<p>1 - PROVISION - GABLE CUT OUT FOR ELECTRICAL PLUG AT KITCHEN ISLAND 13Sep22 Note:</p>	

CONSTRUCTION

<p>1 - MASTER ENSUITE - SMOOTH CEILING 13Jan23 Note:</p>	
--	--

COUNTER TOP

<p>1 - KITCHEN - UPGRADE BACKSPLASH - ISTRIA -STANDARD 13Jan23 Note:</p>	
--	--

ELECTRICAL

<p>1 - KITCHEN - ADD PLUG FOR MICROWAVE HOOD FAN 13Jan23 Note:</p>	
<p>1 - KITCHEN - ADD PLUG AT KITCHEN ISLAND - AT SIDE GABLE 13Sep22 Note:</p>	

This Document is Extremely Time Sensitive - Printed 13 Jan 23 at 12:19

Purchaser: Carmela ANDRIANO
 Telephone Res. / Bus: /
 Decor Advisor: Ida Viola
 Lock Date: 1/13/2023 11:54:47

Const. No.: Unit 8, Level 13
 Municipal: 1408
 Suite Type: B646
 Project/Phase: Granerola Residences Ltd./North

Layout Changes: Yes No

Sketch Attached: Yes No

1. Kitchen and Vanities

	Style and Colour	Hardware
Kitchen	DORAL W500	Standard
Main Bathroom	N/A	
Master Ensuite Bathroom	DORAL W500	Standard
Powder Room	DORAL W500	Standard

Built In Appliances Yes No

Kitchen Extended Upper Cabinets Yes No

Comment

** Refer to Construction Summary

2. Counters

	Counter	Edge
Kitchen	QUARTZ-ISTRIA	Straight Polished Edge
Main Bathroom	N/A	
Master Ensuite Bathroom	QUARTZ-ISTRIA	Straight Polished Edge
Powder Room	QUARTZ-ISTRIA	Straight Polished Edge
		Straight Polished Edge
Kitchen Backsplash	QUARTZ-ISTRIA	

Comment

** Refer to Construction Summary

3. Flooring

	Selection
Vestibule/Main Hall	LAMINATE-LEXINGTON LANEFFE OAK TL-LW1311
Kitchen	LAMINATE-LEXINGTON LANEFFE OAK TL-LW1311
Living Room/Dining Room	LAMINATE-LEXINGTON LANEFFE OAK TL-LW1311
Den/Office	LAMINATE-LEXINGTON LANEFFE OAK TL-LW1311
Master Bedroom	LAMINATE-LEXINGTON LANEFFE OAK TL-LW1311
Bedroom #2	N/A
Bedroom #3	N/A
Laundry Room	TILE-WHITE MATTE 8X8
Main Bath	N/A
Master Ensuite Bathroom	TILE-CITY WHITE MATTE 12X24
Powder Room	TILE-CITY WHITE MATTE 12X24

Comment

** Refer to Construction Summary - Standard Grout throughout unless specified

4. Wall Tile

	Selection	Describe
Main Bath	N/A	
Master Ensuite Bathroom	TILE-GLOSSY WHITE 8X16	
Kitchen Backsplash	QUARTZ - ISTRIA	

Comment

** Refer to Construction Summary - Standard Grout throughout unless specified

Purchaser: Carmela ANDRIANO
Telephone Res. / Bus: /
Decor Advisor: Ida Viola
Lock Date: 1/13/2023 11:54:47

Const. No.: Unit 8, Level 13
Municipal: 1408
Suite Type: B646
Project/Phase: Granerola Residences Ltd./North

5. Misc

Water Line Rough-in for Fridge Yes No
Upgrade Bathroom Accessories Yes No

Comment

** Refer to Construction Summary

6. Wall, Trim and Door Paint - Birch White Paint Throughout unless specified below.

Entrance Vestibule	<input type="text"/>	Living Room	<input type="text"/>
Main Hall	<input type="text"/>	Dining Room	<input type="text"/>
Kitchen	<input type="text"/>	Den/Library	<input type="text"/>
Laundry Room	<input type="text"/>	Master Bedroom	<input type="text"/>
Main Bathroom	<input type="text"/>	Bedroom #2	<input type="text"/>
Master Ensuite Bathroom	<input type="text"/>	Bedroom #3	<input type="text"/>
	<input type="text"/>		<input type="text"/>

Comment

** Refer to Construction Summary

7. General Comments

** Refer to Construction Summary

Disclaimers and Notes

- 1) Colours of all materials are as close as possible to builder's selection, but not necessarily identical due to variances in manufacturing.
- 2) The selection images are digital photographs of the Vendor's samples at its Decor Centre. Such images when displayed on your computer monitor may not match Decor Centre samples due to the hardware/software configuration of the In the event of conflict between selection images and the Décor Centre samples, Décor Centre samples shall prevail.
- 3) Any extras listed above are null and void unless accompanied by a separate invoice/amendment. Said invoice must be paid in full.
- 4) The Purchaser agrees that this colour selection is final and that no changes will be permitted, unless required by the Vendor.
- 5) The Purchaser acknowledges reading and accepting document which contains other miscellaneous disclaimers.

Signature: C. Anderson Date: Jan-13, 2023 Signature: _____ Date: _____

May 01, 2019

SCHEDULE 'A'

Charisma²

ON THE PARK

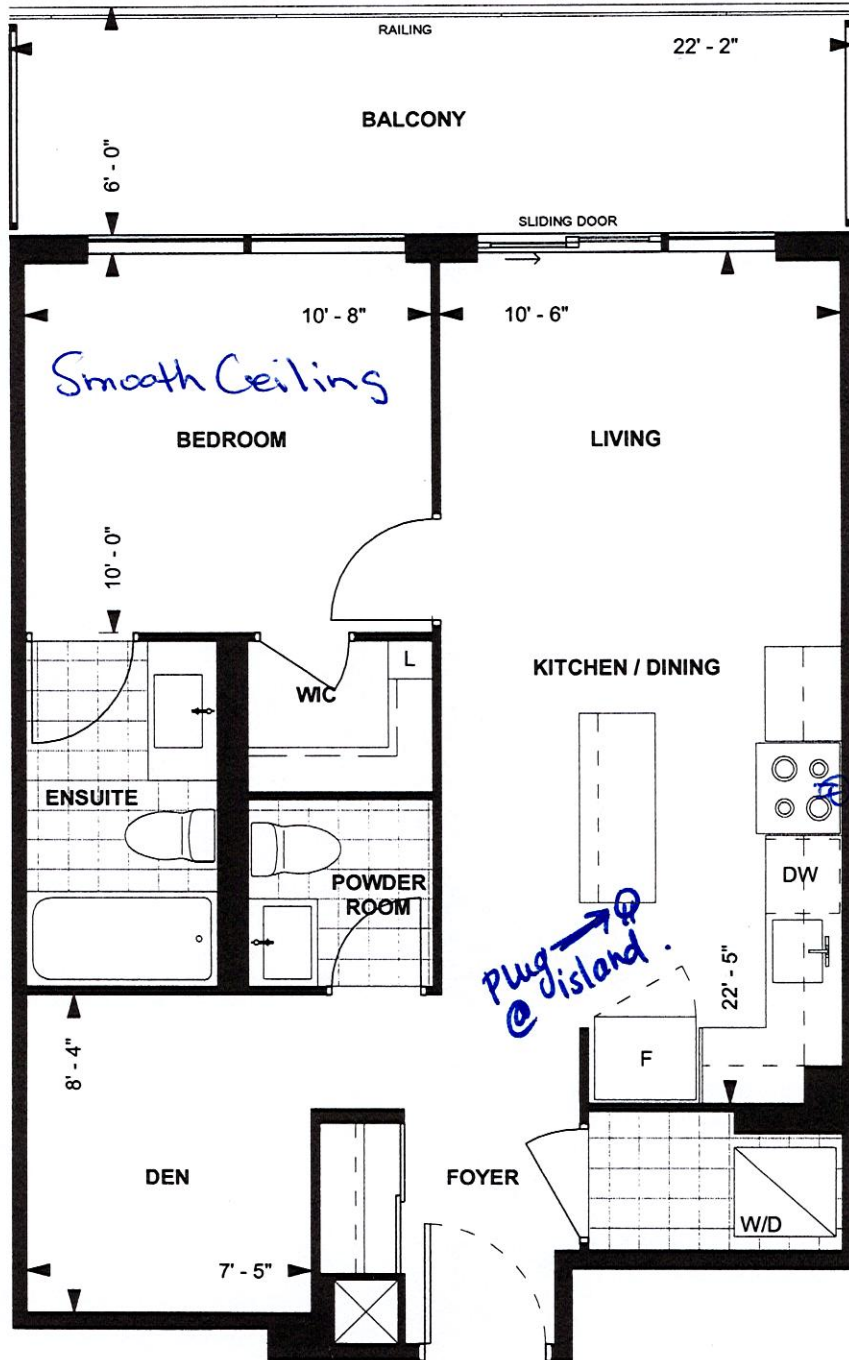

Add Plug. for Microwave Hood Fan

plug @ island.

B646
TOWER SUITE
NORTH TOWER
9' CEILING
 646 sq. ft.
1-BEDROOM+DEN

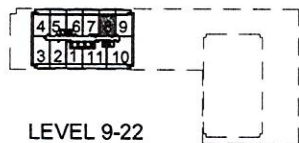

LEVEL 9-22

Purchaser Initials C.A Purchaser Initials May 15, 2019 Date
 Unit No. 8 Level No. 13 Suite No. 1408

Dimensions, specifications, layouts, location of materials and fixtures, tile floor patterns and architectural detailing (including window size and location and door size, location and swing) are approximate only and are subject to change or modifications, without notice. Actual usable floor space varies from stated floor area. Ceiling height measured from top of floor slab to underside of floor slab above and excludes finishes, bulkheads and drop ceilings. Orientation of suite may be reversed and Purchaser agrees to accept same. Balconies decks and terraces are exclusive use common elements shown for display purposes only and location and size are subject to change without notice. All illustrations are artist concept only. The provisions of the Agreement of purchase and sale apply to this Schedule. E. & O.E.

Suite 1408 Granerola North

-Extended Upper Cabinets
-Light Valence Shield

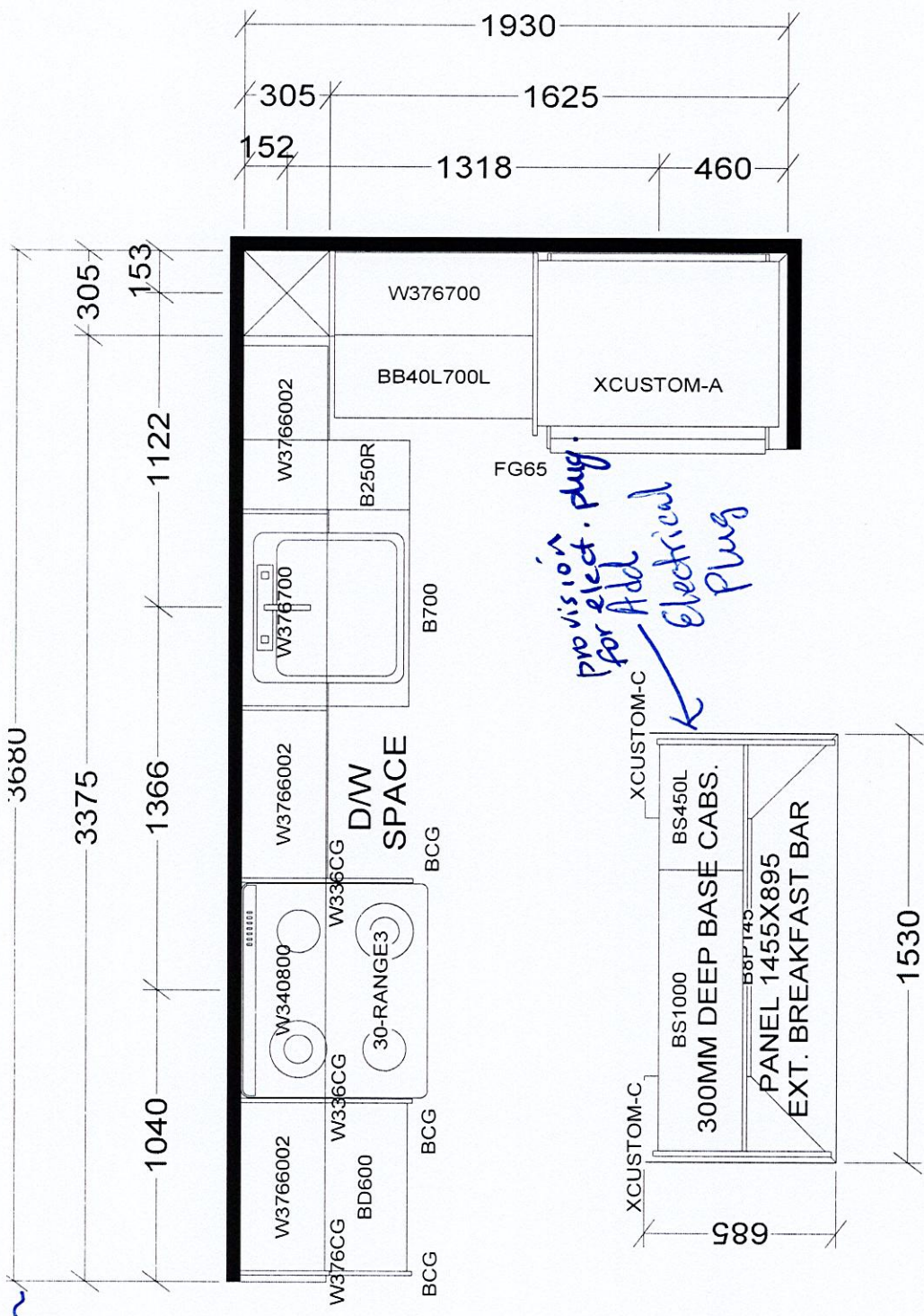

*provision for elect. plug.
for Add Electrical Plug*

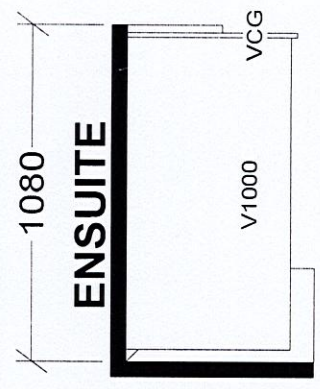
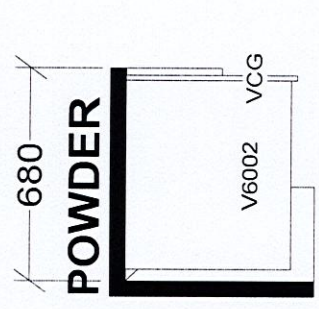

KITCHEN

BASE & VANITY CABINETS ON ADJUSTABLE LEGS

TOWER & PODIUM SUITES
NORTH TOWER X19
SOUTH TOWER X21

Selba Industries		J # _____
WWIDTH _____	WHGHT _____	WCNT _____
FLOOR HGHT _____	DOOR HGHT _____	
ST CENT _____	2X4 _____	VENT BOX COVER _____
<small>This drawing is the intellectual property of SELBA INDUSTRIES INC. and is an original design which must not be released or copied unless applicable fee has been paid or job order placed.</small>		
JOB NUMBER: _____ BUILDER: GREENPARK SITE: GRANEROLA NORTH & SOUTH MODEL: B646 LOT #: _____		DESIGNER: KS DATE: JAN 6 22