

CONSTRUCTION SUMMARY

Charisma Condominiums - Genazzano Highrises Inc.

RECEIVED

PURCHASERS: Andrew RAIMONDO and Matthew RAIMONDO

APR - 7 2022

TEL:

LOT / PHASE 1612 / East	REG. PLAN #	HOUSE TYPE Charisma Condominiums	AND APPLIANCE SPECS
----------------------------	-------------	-------------------------------------	---------------------

CABINETRY

1 - VANITY - MASTER ENSUITE - UPGRADE 2 06Apr22 Note:	
1 - VANITY - POWDER ROOM - UPGRADE 2 06Apr22 Note:	
3 - VANITY CABINETRY - RAISE VANITY TO 36" HIGH VANITY IN LIEU OF STANDARD HEIGHT - PRICE IS PER FOOT 06Apr22 Note: POWDER & MASTER ENSUITE	
1 - KITCHEN CABINETRY BASE - BUILT-IN - MICROWAVE BASE CABINET WITH SINGLE POT DRAWER - 800MM WIDE - PRICE IS EACH - UPGRADE 2 06Apr22 Note: Microwave ON ISLAND.	
2 - KITCHEN CABINETRY BASE - BASE AND STANDARD COUNTER - UPGRADE 2 06Apr22 Note: Extend Island by approx. 2 ft.	
1 - CABINETRY - BASE - ISLAND - EXTEND BASE CABINETS INCLUDES OVERHANG 06Apr22 Note: to 24" plus overhang -	
1 - CABINETRY - EXTENDED UPPERS IN KITCHEN - UPGRADE 2 06Apr22 Note:	
1 - CABINETRY - KITCHEN - UPGRADE 2 06Apr22 Note:	

CABINETRY ACCESSORIES

1 - KITCHEN CABINETRY BASE - POT/PAN DRAWERS (CABINET) - UPGRADE 2 06Apr22 Note: ON ISLAND.	
1 - CABINETRY - VALENCE 06Apr22 Note:	

CERAMIC TILE

1 - CERAMIC TILE - UPGRADE 3 - POWDER FLOOR 06Apr22 Note:	
1 - CERAMIC TILE - UPGRADE 3 - MASTER ENSUITE WALL 06Apr22 Note:	
1 - CERAMIC TILE - UPGRADE 3 - MASTER ENSUITE FLOOR 06Apr22 Note:	

CONSTRUCTION

1 - SMOOTH CEILING - MASTER BEDROOM 06Apr22 Note:	
--	--

COUNTER TOP

1 - VANITY COUNTERTOP UPGRADE COLOUR - QUARTZ MISTRAL - MASTER ENSUITE 06Apr22 Note:	
---	--



CONSTRUCTION SUMMARY				
Charisma Condominiums - Genazzano Highrises Inc.				
PURCHASERS: Andrew RAIMONDO and Matthew RAIMONDO				TEL:
LOT / PHASE	REG. PLAN #	HOUSE TYPE		
1612 / East		Charisma Condominiums		
1 - VANITY COUNTERTOP UPGRADE COLOUR - QUARTZ MISTRAL - POWDER ROOM 06Apr22 Note:				
1 - COUNTERTOP - ISLAND - EXTENSION 06Apr22 Note: See Revised Island Size				

ELECTRICAL

1 - ELECTRICAL - VALENCE - LED 06Apr22 Note:	
1 - PLUG - ELECTRICAL PLUG - FOR BUILT-IN MICROWAVE 06Apr22 Note:	

MIRRORS AND GLASS

1 - CLOSET SLIDER - FRAMELESS MIRROR SLIDING DOOR WITH MIRRORED FASCIA IN LIEU OF STANDARD 06Apr22 Note: MASTER BEDROOM	
--	--

PLUMBING

2 - MOEN BATHROOM ACCESSORIES - 90 DEGREE - PAPER HOLDER - CHROME 06Apr22 Note: POWDER & MASTER ENSUITE YB 8808 -	
2 - MOEN BATHROOM ACCESSORIES - 90 DEGREE - 24 INCH TOWEL BAR - CHROME 06Apr22 Note: POWDER & MASTER ENSUITE YB 8824 -	
1 - UPGRADE - 8 INCH FLAT/THIN RAINSHOWER MODEL S1006 CHROME & 12 INCH STRAIGHT SHOWER ARM MODEL 226651 CHROME 06Apr22 Note: MASTER ENSUITE Standard Shower System with Upgrade Shower Head & ARM.	

This Document is Extremely Time Sensitive - Printed 6 Apr 22 at 12:27



Purchasers:Andrew RAIMONDO & Matthew RAIMONDO

Const. No.:Unit 12, Level 15

Telephone Res. / Bus: /

Municipal:1612

Decor Advisor:Aly Aversa

Suite Type:Charisma Condominiums

Lock Date:4/6/2022 12:32:35

Project/Phase:Genazzano Highrises Inc./East

Layout Changes:☐ Yes☒ No

Sketch Attached:☐ Yes☒ No

1. Kitchen and Vanities

	Style and Colour	Hardware
Kitchen	SONATA - SATIN SNOW	Standard
Main Bathroom	N/A	N/A
Master Ensuite Bathroom	SONATA - SATIN SNOW	Standard
POWDER	SONATA - SATIN SNOW	Standard
Built In Appliances <input checked="" type="radio"/> Yes <input type="radio"/> No		Kitchen Extended Upper Cabinets <input checked="" type="radio"/> Yes <input type="radio"/> No

Comment

\*\* Refer to Construction Summary

2. Counters

	Counter	Edge
Kitchen	QUARTZ - FLORENCE (Q)	Straight Polished Edge
Main Bathroom	N/A	
Master Ensuite Bathroom	QUARTZ - MISTRAL (Q)	Straight Polished Edge
POWDER	QUARTZ - MISTRAL (Q)	Straight Polished Edge
Kitchen Backsplash	TILE - GLOSSY WHITE 4X12	

Comment

\*\* Refer to Construction Summary

3. Flooring

	Selection
Vestibule/Main Hall	LAMINATE-LEXINGTON-LANEFFE OAK-TL-LW1311
Kitchen	LAMINATE-LEXINGTON-LANEFFE OAK-TL-LW1311
Living Room/Dining Room	LAMINATE-LEXINGTON-LANEFFE OAK-TL-LW1311
Den/Office	N/A
Master Bedroom	LAMINATE-LEXINGTON-LANEFFE OAK-TL-LW1311
Bedroom #2	N/A
Bedroom #3	N/A
Laundry Room	TILE-WHITE 8X8
Main Bath	N/A
Master Ensuite Bathroom	TILE - RMD CALCATTA BRILL 10X30
Powder Room	TILE - RMD CALCATTA BRILL 10X30

Comment

\*\* Refer to Construction Summary - Standard Grout throughout unless specified

4. Wall Tile

	Selection	Describe
Main Bath	N/A	
Master Ensuite Bathroom	TILE - RMD CALCATTA BRILL 10X30	
Powder Room	N/A	
Kitchen Backsplash	TILE-GLOSSY WHITE 4X12	

Comment

\*\* Refer to Construction Summary - Standard Grout throughout unless specified

Initials:



5. Misc

Water Line Rough-in for Fridge

Yes

No

Upgrade Bathroom Accessories

Yes

No

Comment

\*\* Refer to Construction Summary

6. Wall, Trim and Door Paint - Birch White Paint Throughout unless specified below.

Entrance Vestibule	BIRCH WHITE	Living Room	BIRCH WHITE
Main Hall	BIRCH WHITE	Dining Room	BIRCH WHITE
Kitchen	BIRCH WHITE	Den/Library	N/A
Laundry Room	BIRCH WHITE	Master Bedroom	BIRCH WHITE
Main Bathroom	N/A	Bedroom #2	N/A
Master Ensuite Bathroom	BIRCH WHITE	Bedroom #3	N/A
Powder Room	BIRCH WHITE		

Comment

\*\* Refer to Construction Summary

7. General Comments

\*\* Refer to Construction Summary

Disclaimers and Notes

- 1) Colours of all materials are as close as possible to builder's selection, but not necessarily identical due to variances in manufacturing.

2) The selection images are digital photographs of the Vendor's samples at its Decor Centre. Such images when displayed on your computer monitor may not match Decor Centre samples due to the hardware/software configuration of the computer.  
In the event of conflict between selection images and the Décor Centre samples, Décor Centre samples shall prevail.

3) Any extras listed above are null and void unless accompanied by a separate invoice/amendment. Said invoice must be paid in full.

4) The Purchaser agrees that this colour selection is final and that no changes will be permitted, unless required by the Vendor.

5) The Purchaser acknowledges reading and accepting document which contains other miscellaneous disclaimers.

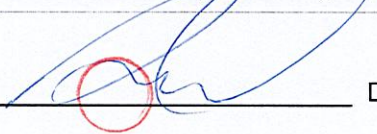
Signature: 

Date: 04/06/22

Signature: 

Date: Apr 6/22

Signature: \_\_\_\_\_

Date: \_\_\_\_\_



Aug. 23, 2017

SCHEDULE 'A'  
**Charisma**  
CONDOMINIUMS

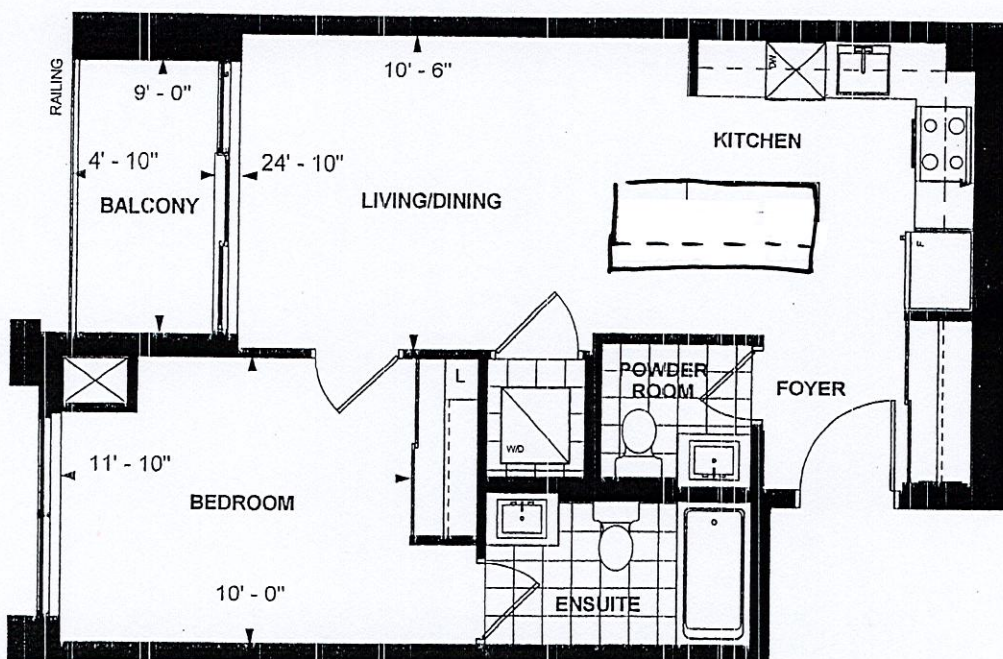

- microwave island
- Valence lighting
- smooth ceiling
- mirror - closet door in Bedroom
- Upgraded Bathroom Accessories
- Upgraded plumbing in m. Ensuite Showerhead



1/1

**A 615  
TOWER SUITE  
EAST TOWER  
9' CEILING  
615 sq. ft.  
1-BEDROOM**



LEVEL 9,14,15,17,18

Purchaser Initials H Purchaser Initials Oct 11 / 2017  
Date

Unit No. 12 Level No. 15 Suite No. 1612

Dimensions, specifications, layouts, location of materials and fixtures, tile floor patterns and architectural detailing (including window size and location and door size, location and swing) are approximate only and are subject to change or modifications, without notice. Actual usable floor space varies from stated floor area. Ceiling height measured from top of floor slab to underside of floor slab above and excludes finishes, bulkheads and drop ceilings. Orientation of suite may be reversed and Purchaser agrees to accept same. Balconies decks and terraces are exclusive use and sale apply to this Schedule. E. & O.E.



- Valence
- extended uppers
- Upgrade 2 kitchen

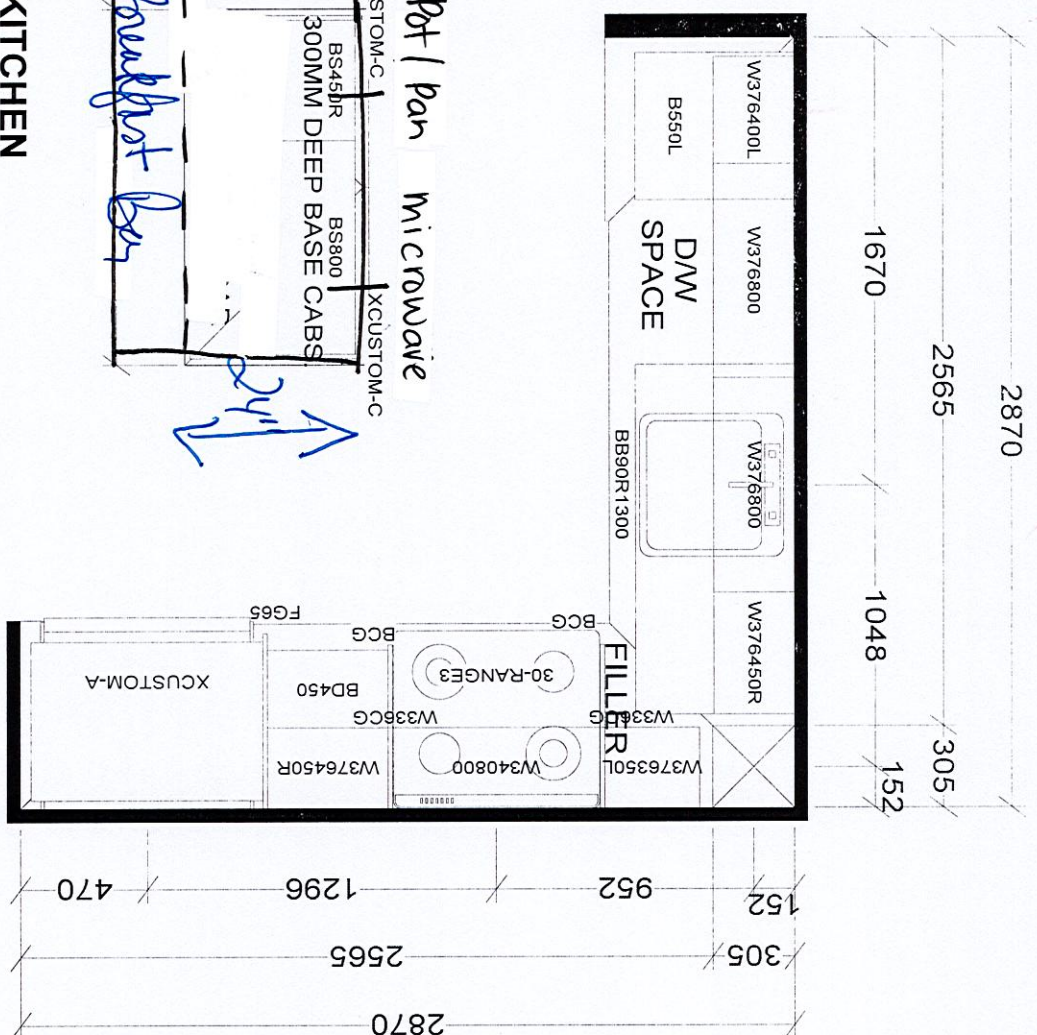

KITCHEN

BASE & VANITY CABINETS ON ADJUSTABLE LEGS

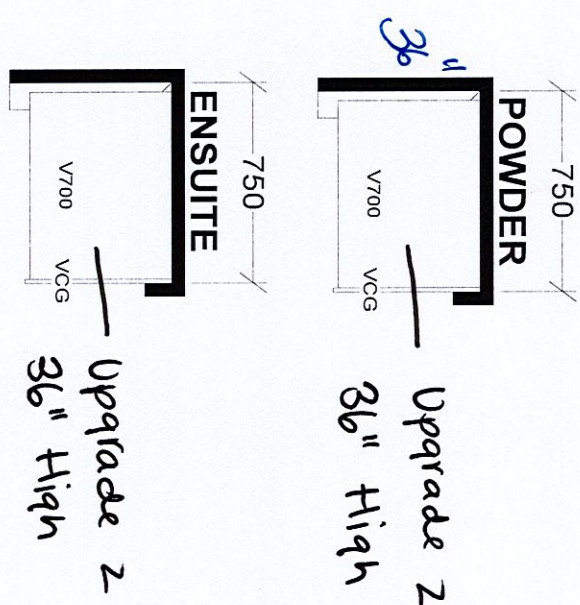

TOWER & PODIUM SUITES  
EAST TOWER X14  
WEST TOWER X20

<b>Selba Industries</b>				J # _____
W WDT	W HGT	W CNT	This drawing is the intellectual property of JOB NUMBER: _____	
FLOOR HGT	DOOR HGT	DESIGNER: KS	SELBA INDUSTRIES INC. and is an original design which must not be released or copied unless applicable fee has been paid or job order placed.	
ST CENT	2X4	VENT BOX COVER	DATE: OCT 27 20/rev'd Dec 10 20	LOT #: _____
			BUILDER: GREENPARK SITE: CHARISMA EAST & WEST MODEL: A615	



SUITE 1612 East

# Rainshowers

MASTER ENSUITE (DEC 5/22)

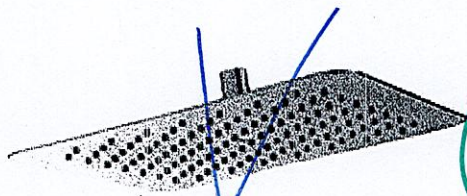

~~12" Square Flat/Thin Rainshower  
Model S1004  
Chrome~~



10" Square Flat/Thin Rainshower  
Model S1003  
Chrome

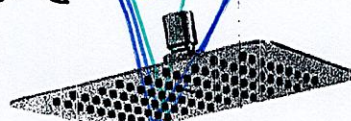

~~8" Square Flat/Thin Rainshower  
Model S1006  
Chrome~~

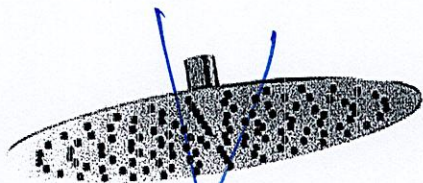

~~12" Round Flat/Thin Rainshower  
Model S1002  
Chrome~~

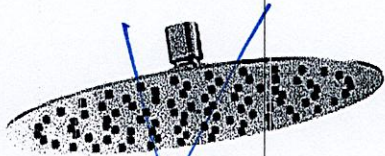

~~10" Round Flat/Thin Rainshower  
Model S1001  
Chrome~~



~~8" Round Flat/Thin Rainshower  
Model S1005  
Chrome~~



C

## FINISH OPTIONS:

Chrome (C) finish is only available on these models.

\* To order the Eco-Performance (EP) version, use EP suffix in addition to the model number



Suite 1612 East

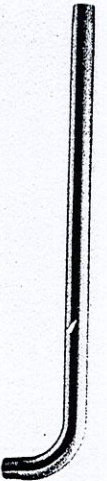

**16" Overhead Shower Arm**  
Model 151380

Chrome

Other



**12" Straight Shower Arm**  
Model 226651

Chrome

Other



**FINISH OPTIONS:**

To order, combine the model number with one of these finish letter(s):

LifeShine® Brushed Nickel (BN), Oil Rubbed Bronze (ORB), LifeShine® Polished Nickel (NL), Matte Black (BL), Brushed Gold (BG) & Wrought Iron (WR).

To order Chrome (C) model, use model number only.

\* To order the Eco-Performance (EP) version, use EP suffix in addition to finish



**8" Curved Shower Arm**  
Model 123815

Chrome

Other



**6" Straight Shower Arm**  
Model 116651

Chrome

Other





SUITE 1612 East

90°™

Traditional | Transitional | Modern

Geometric forms, squared corners and straight lines create an urban focal point for today's contemporary baths.

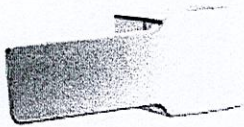

**Toilet Tank Lever**  
Model YB8801

Chrome  
Other

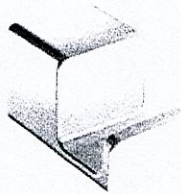

**Robe Hook**  
Model YB8803

Chrome  
Other

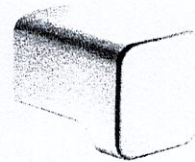

**Cabinet Knob**  
Model YB8805

Chrome  
Other



**Drawer Pull**  
Model YB8807

Chrome  
Other

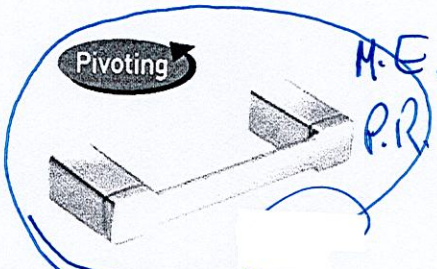

**Pivoting Paper Holder**  
Model YB8808

Chrome  
Other

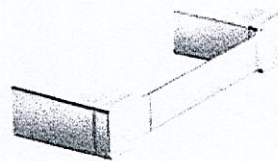

**Mini Towel Bar**  
Model YB8886

Chrome  
Other

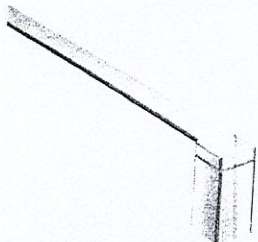

**18" Towel Bar**  
Model YB8818

Chrome  
Other

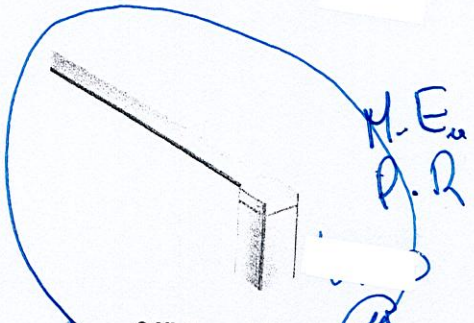

**24" Towel Bar**  
Model YB8824

Chrome  
Other



**Designer Grab Bar**

Models: Chrome Other  
12" - YG8812  
18" - YG8818  
24" - YG8824  
36" - YG8836



CH BN

**FINISH OPTIONS:**

To order, combine the model number with one of these finish letter(s):  
Chrome (CH), LifeShine® Brushed Nickel (BN).



Andrew / Matthew Raimondo

Suite 1612 / East  
Charisma Condos

SHARP

SMD2477ASC

24-INCH MICROWAVE DRAWER® OVEN

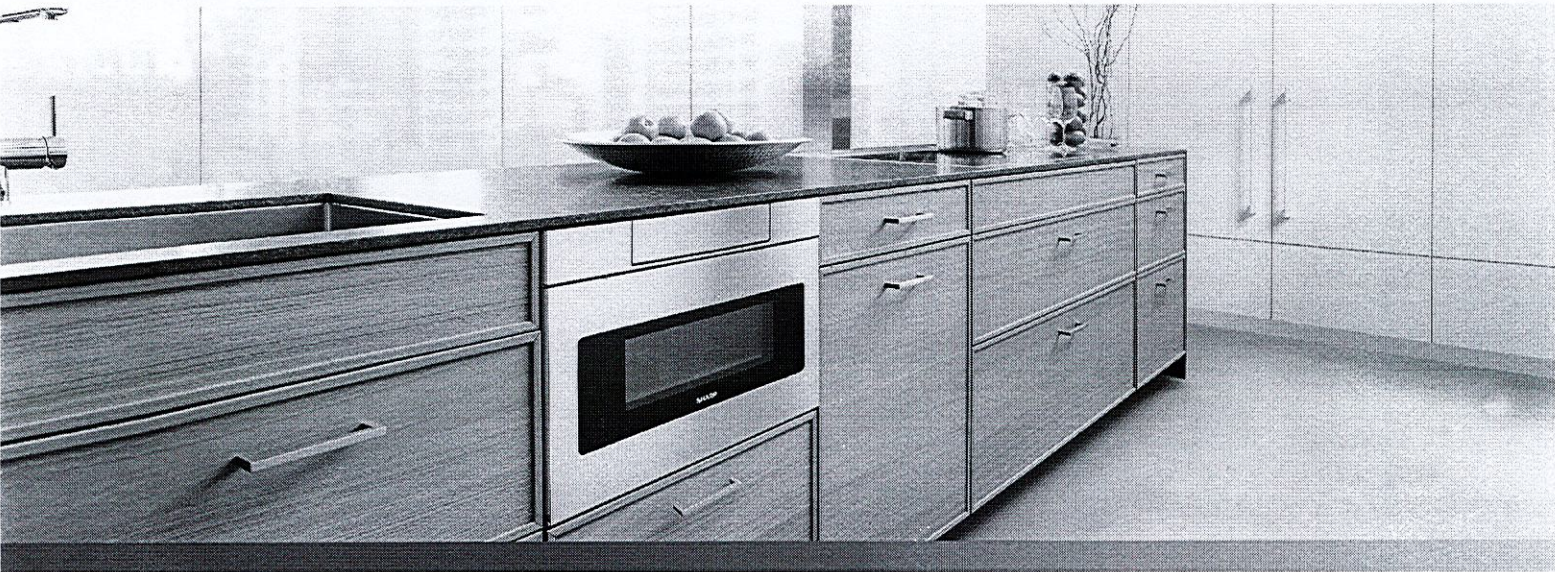

TAKE YOUR MICROWAVE TO A BETTER PLACE

It's your kitchen, your design and your lifestyle. Sharp's Microwave Drawer Oven allows you to focus on the design elements you prefer by removing the microwave from sightlines and enabling more design versatility. The Microwave Drawer offers flexible placement options below an island, peninsula, or standard cabinetry, and can also be installed adjacent to your wall oven. The Microwave Drawer allows you to showcase your design savvy and create a kitchen that flows with your lifestyle.

Sharp introduces the next generation of this successful appliance—model SMD2477ASC - a 24" microwave drawer with a simpler and a sleeker design to match more built-in appliances.

Design Flexibility

Sharp's Microwave Drawer product expands the option for microwave placement in almost any kitchen plan—it's a perfect choice for open-plan kitchens, islands, peninsulas, and a great addition to wet bars, family rooms and home theatres.

Location and Counter Space Saving

You may place the drawer under a counter, cooktop or wall oven or above a warming drawer without a built-in kit, additional trim or venting. Sharp microwave drawer provides the best solution for a cleaner, uncluttered counter space.

SHARP's Exclusive AutoTouch™ System

Sharp's exclusive AutoTouch™ system allows you to open and close the drawer automatically at one-finger operation by pressing a button on the control panel.

New Hidden Control Panel

The new SMD2477ASC model features a hidden control panel which gives a more integrated look and feel within the kitchen. The new tall control panel, angled at 45° degrees, is easy to see, easy to access and easy to use.

Specifications

TECHNICAL SPECIFICATIONS	
Size	24" wide
Microwave Capacity	1.2 cu.ft
Microwave Power	950 watts
Control Panel	Digital LCD Display
Control Type	Hidden Control Panel
Drawer Opening	AutoTouch™ System
Power Level	11
Sensor Cook, Reheat, Popcorn Settings	13
Reheat Auto Settings	2
Defrost Auto Settings	6
Keep Warm Setting	Yes, up to 30 min.
Melt / Soften / Settings	Yes
Beverage Setting	Yes
Programmable Stages	Yes, 4
Digital Clock	Yes
Kitchen Timer	Yes
Child Lock	Yes
+30 sec	Yes
Interior Oven Light	Yes

TECHNICAL SPECIFICATIONS CONTINUED	
Demonstration Mode	Yes
Built-in Ready	Yes
Available Colour	Stainless Steel
Accessory	SKMD24FOAS
DIMENSIONS/WEIGHT(inches/lbs.)	
Cut-out Dimension	22 1/8" x 15 9/16"
Product Dimension	23 7/8" x 23 1/64" x 15 7/8"
Box Dimension	29.8" w x 27.9" x 21.9"
Net Weight	74 lb.
Gross Weight	85.8 lb.
POWER/SAFETY	
Power / Ratings	120V, 60Hz
Ratings	1.67Kw, 14.5Amps
Safety Compliance	FCC, DHHS, cUL
WARRANTY/UPC	
Warranty	1 year parts & labour with in-home service; 4 additional years for magnetron tube only
UPC	074000619944



SHARP

SMD2477ASC

