

CONSTRUCTION SUMMARY			
Charisma Condominiums - Granerola Residences Ltd.		RECEIVED	
PURCHASERS: Valeria-stella D'ORAZIO and Joseph CAMPAGNA		NOV - 8 2022	
TEL:			
Unit 15, Level 12 (1216-South)	Floor Plan B646		

CABINETRY

1 - CABINETRY PROVISION - PROVISION FOR PLUG ON ISLAND 07Nov22 Note:	
1 - KITCHEN EXTENDED UPPERS 03Nov22 Note:	

CONSTRUCTION

1 - SMOOTH CEILING IN BEDROOM 03Nov22 Note:	
--	--

ELECTRICAL

1 - LIVING ROOM - ADD LIGHT 07Jul22 Note:	
1 - KITCHEN- ADD PLUG ON KITCHEN ISLAND 07Jul22 Note:	
1 - POT LIGHT – ADD SHOWER POT LIGHT TO TUB 07Jul22 Note:	

PLUMBING

1 - UPGRADE KITCHEN SINK- TECO #163 03Nov22 Note:	
--	--

EXTRAS AS PER OFFER

1 Parking Unit - location to be selected by the Vendor at their sole discretion. Worksheet Note:	
---	--

This Document is Extremely Time Sensitive - Printed 7 Nov 22 at 16:35

Purchasers:Valeria-stella D?ORAZIO & Joseph CAMPAGNA

Const. No.:Unit 15, Level 12

Telephone Res. / Bus: /

Municipal:1216

Decor Advisor:Natalie Mancuso

Suite Type:B646

Lock Date:11/3/2022 11:31:38

Project/Phase:Granerola Residences Ltd./South

Layout Changes: ☐ Yes ☒ No

Sketch Attached: ☒ Yes ☐ No

1. Kitchen and Vanities		Style and Colour	Hardware
Kitchen		DORAL W500	428SB
Main Bathroom		N/A	N/A
Master Ensuite Bathroom		DORAL W500	428SB
Powder Room		DORAL W500	428SB
		Built In Appliances	Yes <input checked="" type="radio"/> No
		Kitchen Extended Upper Cabinets	<input checked="" type="radio"/> Yes No

Comment

** Refer to Construction Summary

2. Counters		Counter	Edge
Kitchen		QUARTZ- ISTRIA	Straight Polished Edge
Main Bathroom		N/A	
Master Ensuite Bathroom		QUARTZ- ISTRIA	Straight Polished Edge
Powder Room		QUARTZ- ISTRIA	Straight Polished Edge
		Kitchen Backsplash	N/A

Comment

** Refer to Construction Summary

3. Flooring		Selection
Vestibule/Main Hall		LAMINATE-LEXINGTON-LANEFFE OAK-TL-LW1311
Kitchen		LAMINATE-LEXINGTON-LANEFFE OAK-TL-LW1311
Living Room/Dining Room		LAMINATE-LEXINGTON-LANEFFE OAK-TL-LW1311
Den/Office		LAMINATE-LEXINGTON-LANEFFE OAK-TL-LW1311
Master Bedroom		LAMINATE-LEXINGTON-LANEFFE OAK-TL-LW1311
Bedroom #2		N/A
Bedroom #3		N/A
Laundry Room		TILE-WHITE MATTE 8X8
Main Bath		N/A
Master Ensuite Bathroom		TILE-CITY WHITE 12X24
Powder Room		TILE-CITY WHITE 12X24

Comment

** Refer to Construction Summary - Standard Grout throughout unless specified

4. Wall Tile		Selection	Describe
Main Bath		N/A	
Master Ensuite Bathroom		TILE-WHITE GLOSSY 8X16	
		Kitchen Backsplash	TILE-WHITE GLOSSY 4X12

Comment

** Refer to Construction Summary - Standard Grout throughout unless specified

Purchasers:

Valeria-stella D?ORAZIO & Joseph CAMPAGNA

Const. No.: Unit 15, Level 12

Telephone Res. / Bus:

/

Municipal: 1216

Decor Advisor:

Natalie Mancuso

Suite Type: B646

Lock Date:

11/3/2022 11:31:38

Project/Phase: Granerola Residences Ltd./South

5. Misc

Water Line Rough-in for Fridge

☐ Yes

☒ No

Upgrade Bathroom Accessories

☐ Yes

☒ No

Comment

** Refer to Construction Summary

6. Wall, Trim and Door Paint - Birch White Paint Throughout unless specified below.

Entrance Vestibule	Living Room
Main Hall	Dining Room
Kitchen	Den/Library
Laundry Room	Master Bedroom
Main Bathroom	Bedroom #2
Master Ensuite Bathroom	Bedroom #3

Comment

** Refer to Construction Summary

7. General Comments

** Refer to Construction Summary

Disclaimers and Notes

- 1)

Colours of all materials are as close as possible to builder's selection, but not necessarily identical due to variances in manufacturing.
- 2)

The selection images are digital photographs of the Vendor's samples at its Decor Centre. Such images when displayed on your computer monitor may not match Decor Centre samples due to the hardware/software configuration of the computer.
In the event of conflict between selection images and the Décor Centre samples, Décor Centre samples shall prevail.
- 3)

Any extras listed above are null and void unless accompanied by a separate invoice/amendment. Said invoice must be paid in full.
- 4)

The Purchaser agrees that this colour selection is final and that no changes will be permitted, unless required by the Vendor.
- 5)

The Purchaser acknowledges reading and accepting document which contains other miscellaneous disclaimers.

Signature:

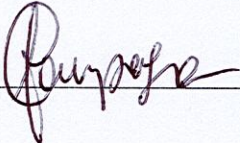

Date:

Nov 3/22

Signature:

Date:

Signature:

Date:

September 26, 2019

SCHEDULE 'A'

Charisma²
ON THE PARK



**B646
TOWER SUITE
SOUTH TOWER
9' CEILING**

646 sq. ft.
1-BEDROOM+DEN

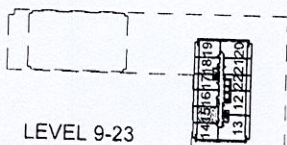

LEVEL 9-23

Purchaser Initials *[Signature]* Purchaser Initials *[Signature]* Date *Oct 7/19*

Unit No. 15 Level No. 12 Suite No. 1216

Dimensions, specifications, layouts, location of materials and fixtures, tile floor patterns and architectural detailing (including window size and location and door size, location and swing) are approximate only and are subject to change or modifications, without notice. Actual usable floor space varies from stated floor area. Ceiling height measured from top of floor slab to underside of floor slab above and excludes finishes, bulkheads and drop ceilings. Orientation of suite may be reversed and Purchaser agrees to accept same. Balconies decks and terraces are exclusive use common elements shown for display purposes only and location and size are subject to change without notice. All illustrations are artist concept only. The provisions of the Agreement of purchase and sale apply to this Schedule, E. & O.E.

Suite 1216 South

Kitchen upgrades

- extended
uppers

- add #163 Sink

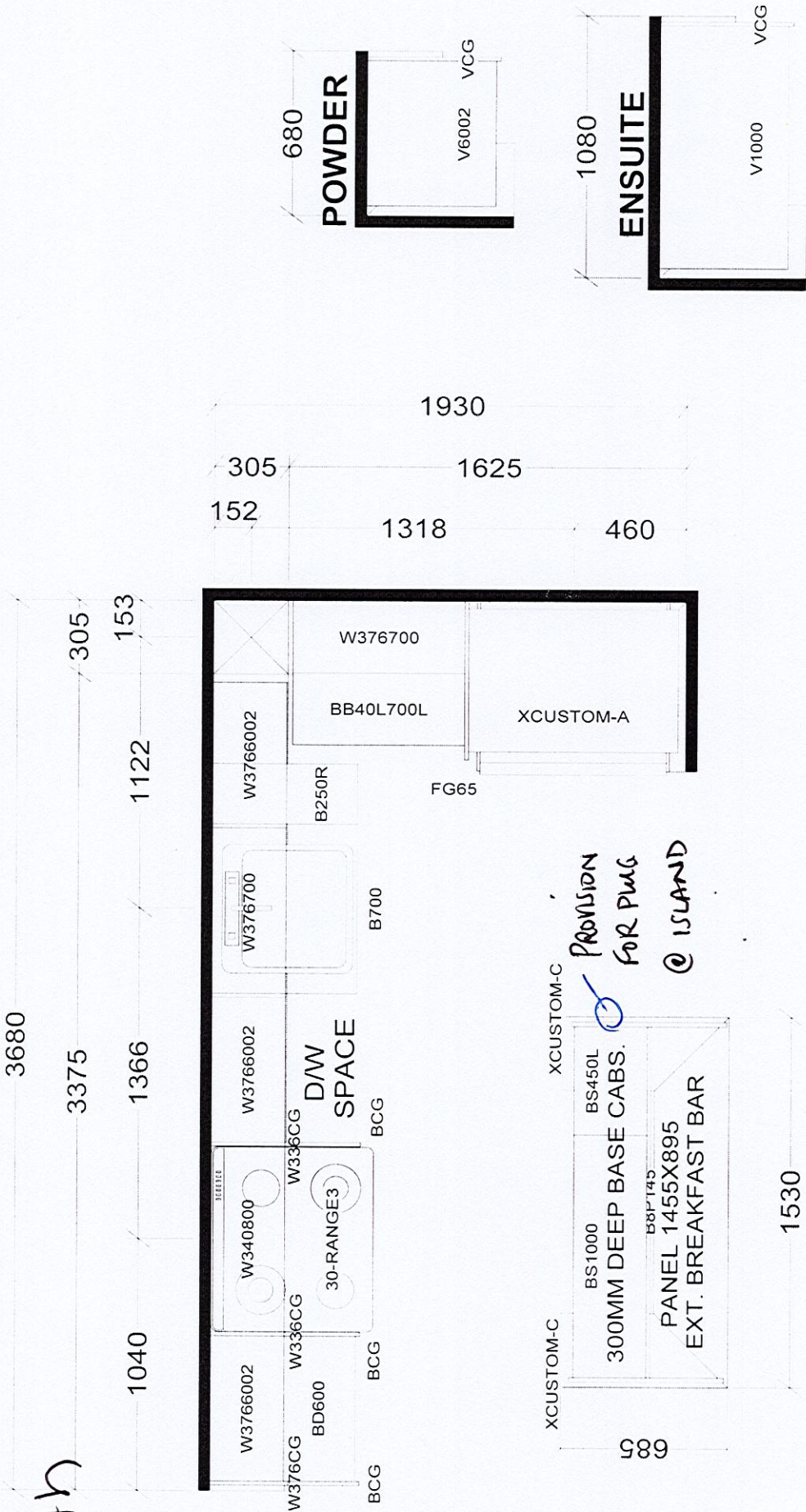

TOWER & PODIUM SUITES
NORTH TOWER X19
SOUTH TOWER X21

Selba Industries

W WDTH _____ W HGHT _____ W CNT _____ J# _____

FLOOR HGHT _____ DOOR HGHT _____

ST CENT _____ 2X4 _____ VENT BOX COVER _____

DESIGNER: KS
DATE: JAN 6 22

Model: B646
Lot #: 1216 South

This drawing is the intellectual property of JOB NUMBER: _____
SELBA INDUSTRIES INC. and is an original design which must not be released or copied unless applicable fee has been paid or job order placed.

BUILDER: GREENPARK
SITE: GRANEROLA NORTH & SOUTH
MODEL: B646
LOT #: