

CONSTRUCTION SUMMARY

DunWest Condo - Perano Residences Ltd.

RECEIVED

PURCHASERS: David James Murray BILTON and Adam James Murray BILTON

NOV - 2 2022

TEL: RES.: 365-880-1912

Unit 16, Level 5 (517-1)

Floor Plan
C930

CABINETRY

1 - FLUSH PROVISION FOR BUILT IN MICROWAVE

21Oct22 Note:

1 - KITCHEN ISLAND - EXTEND ISLAND TO 24" WITH OVERHANG

01Feb22 Note:

CABINETRY ACCESSORIES

1 - KITCHEN-CABINETRY BASE-PULL OUT RECYCLE SINGLE BIN

01Feb22 Note:

1 - KITCHEN-ADD TO ISLAND POT AND PAN DRAWERS STANDARD

01Feb22 Note:

1 - KITCHEN CABINETRY BASE-BUILT-IN-MICROWAVE BASE CABINET WITH SINGLE POT DRAWER- 800MM WIDE-PRICE IS EACH-STANDARD

01Feb22 Note:

PROVISION FOR FLUSH INSTALLATION - PRICED SEPARATELY

CONSTRUCTION

1 - SMOOTH CEILINGS THROUGHOUT-

01Feb22 Note:

ELECTRICAL

1 - PLUG-ELECTRICAL PLUG - FOR BUILT-IN MICROWAVE

01Feb22 Note:

1 - POT LIGHT – ADD SHOWER POT LIGHT TO TUB

01Feb22 Note:

1 - ADD A LIGHT TO THE LIVING ROOM - NO FIXTURE INCLUDED

01Feb22 Note:

MIRRORS AND GLASS

1 - CLOSET SLIDER - FRAMELESS MIRROR SLIDING DOOR WITH MIRRORED FASCIA IN LIEU OF STANDARD

01Feb22 Note: FOYER

This Document is Extremely Time Sensitive - Printed 24 Oct 22 at 9:58

SHARP

SMD2477ASC
24-INCH MICROWAVE DRAWER® OVEN



TAKE YOUR MICROWAVE TO A BETTER PLACE

It's your kitchen, your design and your lifestyle. Sharp's Microwave Drawer Oven allows you to focus on the design elements you prefer by removing the microwave from sightlines and enabling more design versatility. The Microwave Drawer offers flexible placement options below an island, peninsula, or standard cabinetry, and can also be installed adjacent to your wall oven. The Microwave Drawer allows you to showcase your design savvy and create a kitchen that flows with your lifestyle.

Sharp introduces the next generation of this successful appliance—model SMD2477ASC - a 24" microwave drawer with a simpler and a sleeker design to match more built-in appliances.

Design Flexibility

Sharp's Microwave Drawer product expands the option for microwave placement in almost any kitchen plan—it's a perfect choice for open-plan kitchens, islands, peninsulas, and a great addition to wet bars, family rooms and home theatres.

Location and Counter Space Saving

You may place the drawer under a counter, cooktop or wall oven or above a warming drawer without a built-in kit, additional trim or venting. Sharp microwave drawer provides the best solution for a cleaner, uncluttered counter space.

SHARP's Exclusive AutoTouch™ System

Sharp's exclusive AutoTouch™ system allows you to open and close the drawer automatically at one-finger operation by pressing a button on the control panel.

New Hidden Control Panel

The new SMD2477ASC model features a hidden control panel which gives a more integrated look and feel within the kitchen. The new tall control panel, angled at 45° degrees, is easy to see, easy to access and easy to use.

Specifications

TECHNICAL SPECIFICATIONS	
Size	24" wide
Microwave Capacity	1.2 cu.ft
Microwave Power	950 watts
Control Panel	Digital LCD Display
Control Type	Hidden Control Panel
Drawer Opening	AutoTouch™ System
Power Level	11
Sensor Cook, Reheat, Popcorn Settings	13
Reheat Auto Settings	2
Defrost Auto Settings	6
Keep Warm Setting	Yes, up to 30 min.
Melt / Soften / Settings	Yes
Beverage Setting	Yes
Programmable Stages	Yes, 4
Digital Clock	Yes
Kitchen Timer	Yes
Child Lock	Yes
+30 sec	Yes
Interior Oven Light	Yes

TECHNICAL SPECIFICATIONS CONTINUED	
Demonstration Mode	Yes
Built-in Ready	Yes
Available Colour	Stainless Steel
Accessory	SKMD24F0AS
DIMENSIONS/WEIGHT(inches/lbs.)	
Cut-out Dimension	22 1/8" x 15 9/16"
Product Dimension	23 7/8" x 23 1/64" x 15 7/8"
Box Dimension	29.8" w x 27.9" x 21.9"
Net Weight	74 lb.
Gross Weight	85.8 lb.
POWER/SAFETY	
Power / Ratings	120V, 60Hz
Ratings	1.67Kw, 14.5Amps
Safety Compliance	FCC, DHHS, cUL
WARRANTY/UPC	
Warranty	1 year parts & labour with in-home service; 4 additional years for magnetron tube only
UPC	074000619944

SHARP

SMD2477ASC

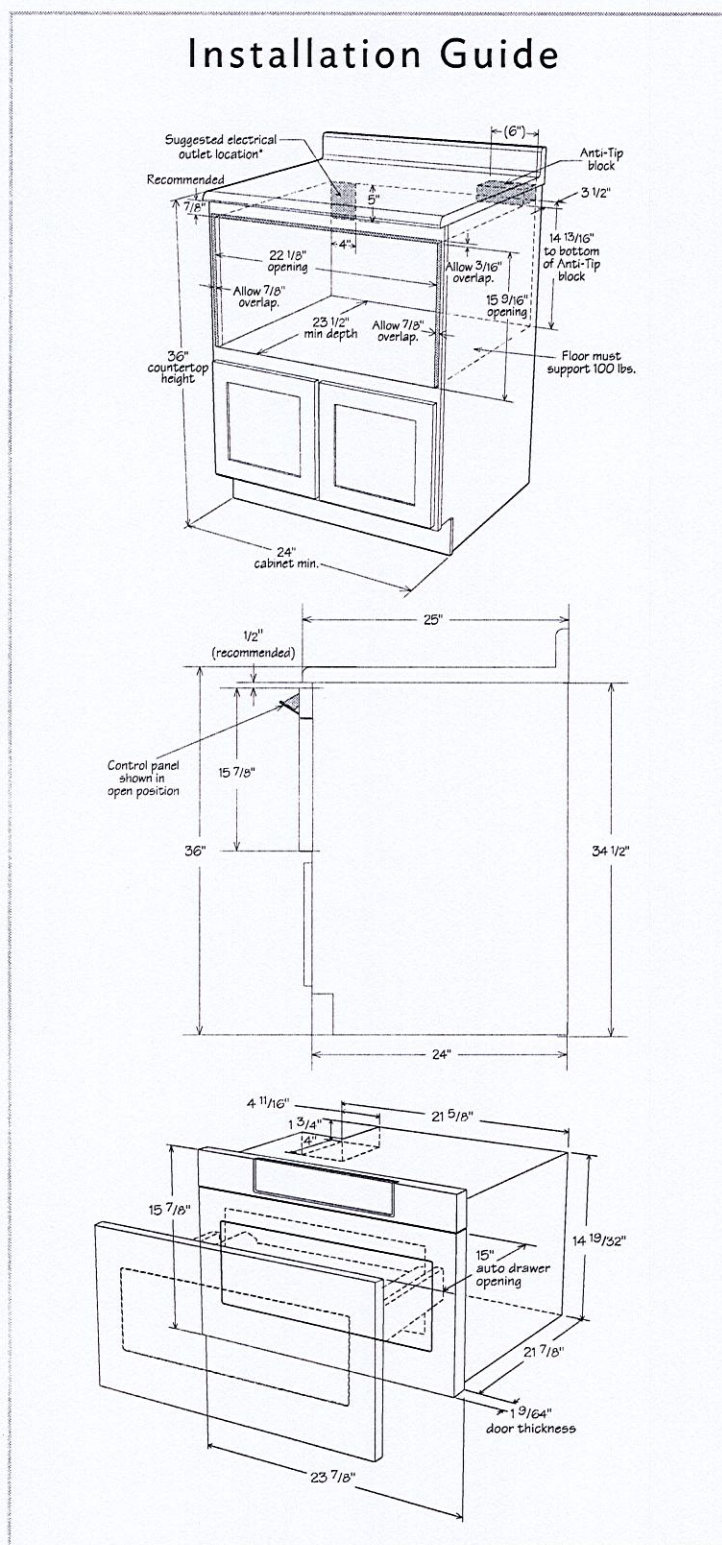

© 2016 Sharp Electronics Corporation. All rights reserved.
Product specification and design are subject to change without notice.

SHARP ELECTRONICS OF CANADA LTD.
335 Britannia Road East, MISSISSAUGA, ONTARIO, L4Z 1W9
www.sharp.ca

SHARP®

24" FLUSH MOUNT DEFLECTOR VENT: SKMD24FOAS
INSTALLATION INSTRUCTIONS

IMPORTANT NOTES TO THE INSTALLER

- Read all of the Installation Manual that is included with the Microwave Drawer before installing in the flush mount configuration.
- Observe all governing codes, ordinances, and safety instructions.
- Be sure to leave these instructions with the consumer.

Parts includes:

Qty.	Part number
1	PREF-B019MRP0 Flush Mount Deflector Vent
2	LX-CZB055MRE0 Mounting screws

1. Prepare cabinet opening as shown in Figures 1, 2A, 2B, 2C.

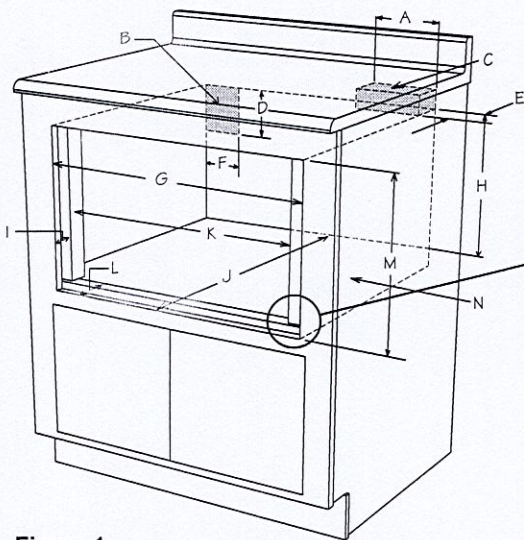
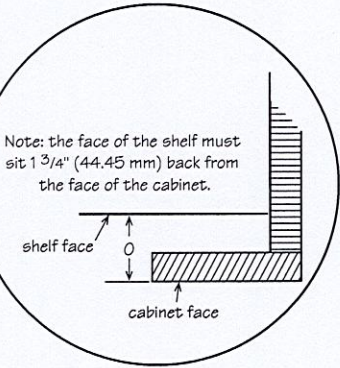

Figure 1



- A. 6" (152.40 mm)
- B. Suggested electrical outlet location
- C. Anti-Tip block
- D. 5" (127 mm)
- E. 3-1/2" (88.90 mm)
- F. 4" (101.60 mm)
- G. 24-3/16" (614.35 mm) minimum
24-1/2" (622.3 mm) maximum
- H. 14-13/16" (376.24 mm) to bottom of
Anti-Tip block
- I. 1-1/16" (26.97 mm)
- J. 23-1/2" (596.90 mm) minimum depth
- K. 22-1/8" (561.97 mm)
- L. 1-3/4" (44.45 mm)
- M. 16-7/8" (428.62 mm) opening
- N. Floor must support 100 lb (45.4 kg)
- O. 1-3/4" (44.45 mm)

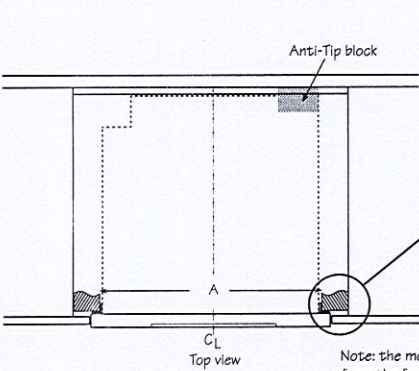
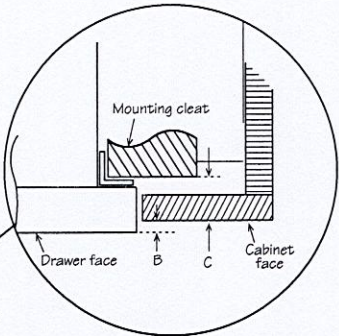

Figure 2A



- A. 22" (558.8 mm) mounting cleat opening width
- B. 1/4" (6.35 mm)
- C. 1-1/16" (26.97 mm)

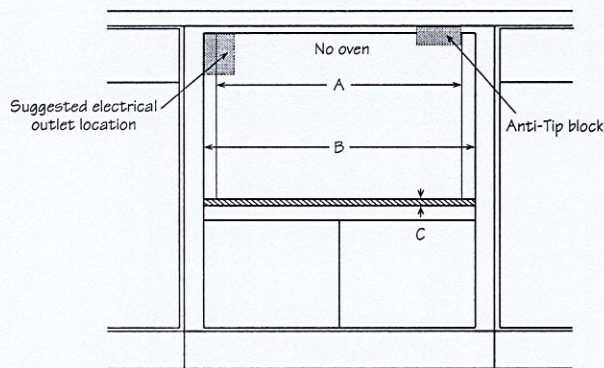

Figure 2B

Front view

- A. 22-1/8" (561.97 mm) mounting cleat opening width
- B. 24-3/16" (614.35 mm) minimum
24-1/2" (622.3 mm) maximum
flush opening width
- C. 3/4" (19.05 mm) shelf

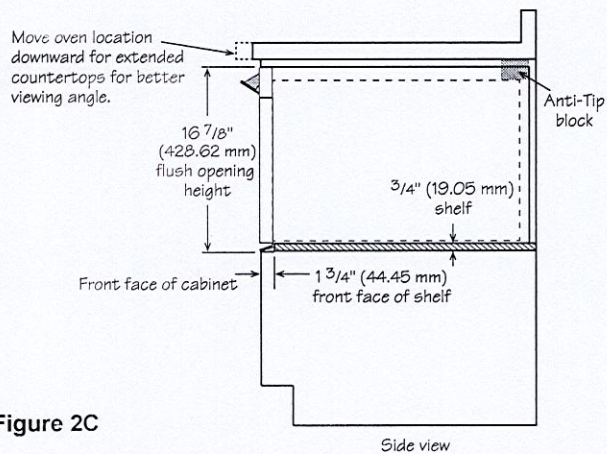

Figure 2C

Side view

2. Install deflector as shown in Figure 3A.

Shelf detail showing the deflector vent during installation.
Position deflector vent and mark holes. Pre drill using a 1/16" (1.57 mm) bit before mounting.

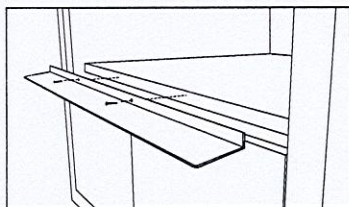

Figure 3A

Shelf detail showing the deflector vent installed.

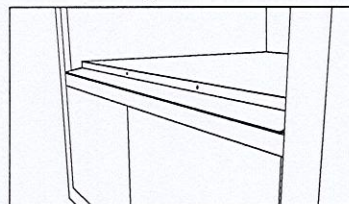

Figure 3B

3. Place the drawer adjacent to the wall or cabinet opening. Plug the power supply cord into the electrical outlet.
4. Carefully guide the drawer into the prepared opening. Avoid contact with the sides of the cutout opening and also pinching the cord between the oven and the wall.
5. Slide the drawer all the way back until the mounting flanges touch the cleats mounted in the cabinet opening.
6. Open the drawer. Using the 4 holes on the drawer as a template, pre drill the cabinet using a 1/16" (1.57 mm) bit. See Figure 4.

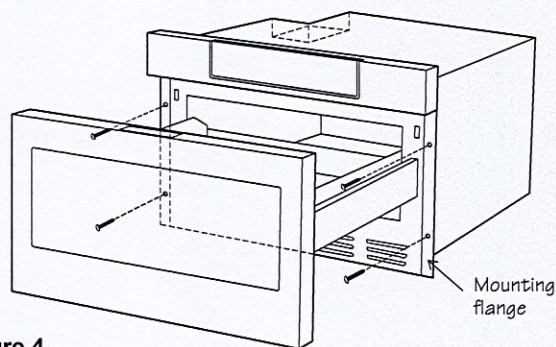
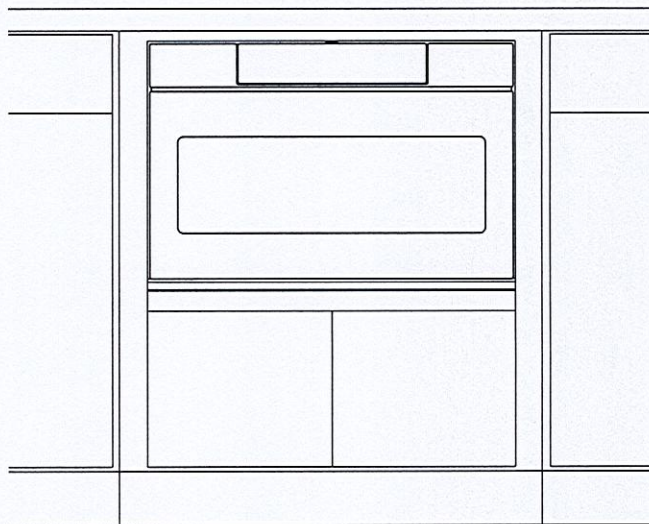

Figure 4

7. Secure the drawer with the 4 screws supplied.



GLACIER - BCSM1 SERIES

GLACIER

SIZE	WHITE	STAINLESS	GREASE FILTERS (replacement)	NON-DUCTED FILTER
30 in.	BCSM130WH	BCSM130SS	HPFAM130 (Type C2)	HPF30 (Type Xc)

FEATURES	
Control type	3-speed Pushbutton
Delay off	no
Filter Clean Reminder	no
Heat Sentry™	no
ADA Capable	yes
Lighting	2-level 50 W Halogen (bulbs included)
Grease Filters	Micro Mesh (Qty. 2)
Installation Hardware	EZ1 bracket
ENERGY STAR®	no
Recirculation	Non-ducted filters sold separately
AC INPUT	
120 V, 60 Hz - 1.4 AMPS	
OPTIONAL ACCESSORIES	
7-in. Round Damper	BP87Q
7-in. Round Adapter Plate	SR680508
Make-up Air Dampers	MD6TU, MD8TU and MD10TU
MOUNTING HEIGHT	
18 in. to 24 in. from cooktop to bottom of hood	
LIMITED WARRANTY	
1-year	
FOR INDOOR USE ONLY	

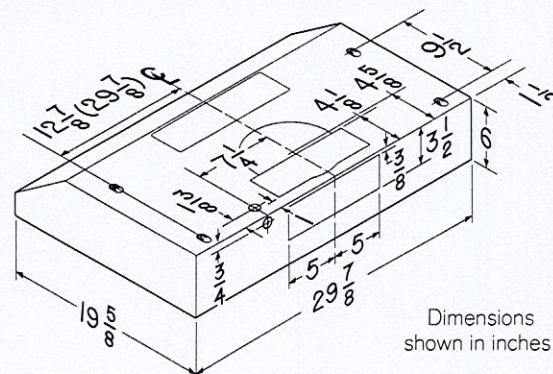
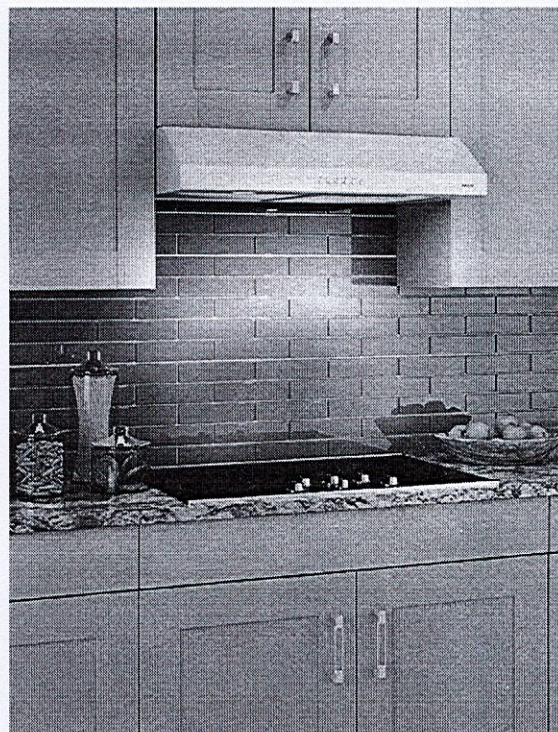
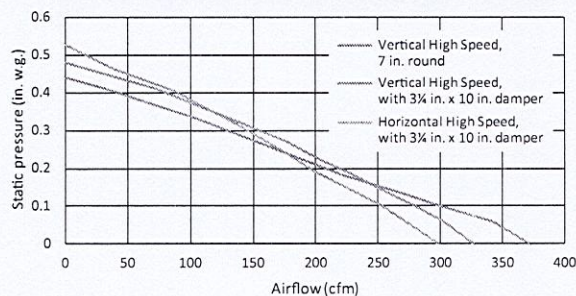

HVI-2100 CERTIFIED RATINGS comply with new testing technologies and procedures prescribed by the Home Ventilating Institute, for off-the-shelf products, as they are available to consumers. Product performance is rated at 0.1 in. static pressure, based on tests conducted in AMCA's state-of-the-art test laboratory. Sones are a measure of humanly-perceived loudness, based on laboratory measurements.

99045742C

HOME APPLIANCES

LG LAUNDRY

WKEX200HBA

LG WashTower™ with Centre Control™
5.2 cu.ft. Washer, 7.4 cu.ft. Dryer



Unitary One Body Design with Centre Control™

AIDD™ & AI Sensor Dry™

TurboWash™ 360

TurboSteam™

Wi-Fi Enabled™

Full STS Drums with STS Lifters™



Enjoy new ways to control your home with LG smart appliances

LG ThinQ™

- Start the laundry while you're out shopping
- Get alerts when the cycle is finished
- Works with the LG ThinQ® app

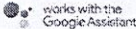

SUMMARY	Washer	Dryer
Type	Front Load Washer	Front Load Dryer
Capacity (cu.ft)	5.2	7.4
Colour	Black Steel (B)	
APPEARANCE	Washer	Dryer
Hard Buttons	No	
Full Touch Electronic Control Panel	Yes	
ENERGY	Washer	Dryer
ENERGY STAR® Qualified	Yes	
CEE Tier	Tier2	-
IMEF	2.92	-
IWF	2.9	-
CEF	-	3.94
PROGRAMS	Washer	Dryer
No. of Programs	6 Normal, Bedding, Delicates, Heavy Duty, Speed Wash, Downloaded	6 Normal, Bedding, Delicates, Heavy Duty, Speed Wash, Downloaded
OPTIONS	Washer	Dryer
No. of Options	10 TurboWash®, Steam, Extra Rinse, Pre-wash, Sanitary, Tub Clean, Drum Light, Child Lock, Signal, Wi-Fi / Remote Start	10 Wrinkle Care, TurboSteam™, Reduce Static, Energy Saver, Steam Fresh®, Drum Light*, Child Lock*, Signal*, Wi-Fi* / Remote Start
DETAILS	Washer	Dryer
No. of Wash/Rinse Temps	5 Hot, Warm/Hot, Warm, Cold/ Warm, Cold	-
No. of Spin Speeds	5 High, Medium/ High, Medium, Low, No Spin	-
Max RPM	1300	-
Water Levels	Load Sensing	-
No. of Soil Levels	5	-
Temperature Settings	-	High, Medium/ High, Medium, Low/Medium, Low

Drying Levels	-	Very, More, Normal, Less, Damp
Manual Dry Times	-	60 min, 50 min, 40 min, 30 min, 20 min.
FABRIC CARE FEATURES	Washer	Dryer
AI DD	Yes	-
TurboWash™ 360 Technology	Yes	-
TurboWash™ 2.0 Technology	No	-
Steam Technology	Yes	-
Allergiene™ Cycle	Yes	-
Sanitary Cycle	Yes	-
SenseClean™ System	Yes	-
AI Sensor Dry™	-	Yes
Sensor Dry	-	Yes
Precise Temperature Control with Variable Heater	-	Yes
Steam Technology	-	Yes (TurboSteam™)
CONVENIENCE FEATURES	Washer	Dryer
TrueBalance™ Anti-Vibration System	Yes	-
4 Tray Dispenser	-	Prewash, Main Wash (with liquid detergent cup), Bleach, Fabric Softener
LoadSense	Yes	-
Auto Suds Removal	Yes	-
3 Minute Installation Check	-	Yes
Reversible Door	-	No
FlowSense™ Duct Clogging Indicator	-	Yes
Wrinkle Care Option	-	Yes
Venting Option	-	3 Way
End of Cycle Signal	Yes	
Control Lock*	Yes	
Drum Light	Yes	
4 Adjustable Levelling Legs	Yes	
Remaining Time Display/Status Indicator(s)	Yes	

THINQ TECHNOLOGY	Washer	Dryer
SmartDiagnosis™ (v3.0)	Yes	
Wi-Fi	Yes	
Remote Start and Cycle Monitor	Yes	
Energy Monitoring	Yes	
Tub Clean Coach	Yes	-
MOTOR	Washer	Dryer
Motor Type	Inverter Direct Drive Motor	-
Axis	Horizontal	-
MATERIALS AND FINISHES	Washer	Dryer
NeveRust™ Stainless Steel Drum	Yes	
Control Panel	Plastic	
Top Plate	Steel	
Cabinet	PCM	
Door / Rim	Large Circle Chrome Rim	
Door Cover	Tinted Round Tempered Glass	
CERTIFICATION	Washer	Dryer
Asthma Canada	Yes	-
POWER SOURCE	Washer	Dryer
Ratings	CSA Listed	
Electrical Requirements	120V, 10 Amps	240V 30 Amps
Type	Electric	
DIMENSIONS	Washer	Dryer
Product (WxHxD)	27" x 74 3/8" x 30 3/8"	
Depth with Door Open	55" D with door open	
Carton (WxHxD)	30 1/16" x 79 11/32" x 32"	
Weight (Product/Carton)	326 lbs / 361 lbs	
LIMITED WARRANTY	Washer	Dryer
Parts and Labour	1 Year	1 Year
Direct Drive Motor	10 Years	-
Drum	3 Years	10 Years
UPC	Washer	Dryer
WKEX200HBA	772454073670	