

CONSTRUCTION SUMMARY

Charisma Condominiums - Granerola Residences Ltd.

PURCHASER: Aryou KHOSHIBIN

RECEIVED

SEP 13 2022

TEL:

LOT / PHASE 2519 / South	REG. PLAN #	HOUSE TYPE A600		
-----------------------------	-------------	--------------------	--	--

CABINETRY

I - MAIN BATH- MEDICINE CABINET 11Aug22 Note: <i>(MASTER ENS)</i> <i>Utility / Medicine Cabinet over the toilet tank</i>	
I - KITCHEN EXTENDED UPPERS 11Aug22 Note:	

CONSTRUCTION

I - SMOOTH CEILING IN BEDROOM 11Aug22 Note:	
--	--

ELECTRICAL

I - MAIN BATH- ADD LIGHT IN TUB CEILING 11Aug22 Note:	
I - ADD LIGHT IN LIVING ROOM 11Aug22 Note:	

MISCELLANEOUS

I - FURTHER VENDOR DISCOUNT 11Aug22 Note:	
--	--

PROMOTIONAL

I - LESS CREDIT FROM PURCHASERS EXTRA SHEET IN OFFER 11Aug22 Note:	
---	--

EXTRAS AS PER OFFER

The Purchaser acknowledges that the Purchase Price is inclusive of all credits and promotional packages available at the time of purchase. <i>Worksheet</i> Note:	
The Vendor agrees that notwithstanding any other term or provision in this Agreement included in the Purchase Price and in addition to those items detailed in Schedule D to the Agreement of Purchase and Sale, the Purchaser is entitled to a credit of Five <i>Worksheet</i> Note:	
1 Parking Unit - location to be selected by the Vendor at their sole discretion. <i>Worksheet</i> Note:	

This Document is Extremely Time Sensitive - Printed 11 Aug 22 at 13:34

Purchaser: Aryou KHOSHBIN
Telephone Res. / Bus: /
Decor Advisor: Natalie Mancuso
Lock Date: 8/11/2022 13:37:35

Const. No.: Unit 13, Level 24
Municipal: 2519
Suite Type: A600
Project/Phase: Granerola Residences Ltd./South
Sketch Attached: ☒ Yes ☐ No

Layout Changes: ☐ Yes ☒ No

1. Kitchen and Vanities

	Style and Colour	Hardware
Kitchen	DORAL W-500	428SB
Main Bathroom	DORAL W-500	428SB
Master Ensuite Bathroom	N/A	

Built In Appliances ☐ Yes ☒ No

Kitchen Extended Upper Cabinets ☒ Yes ☐ No

Comment

** Refer to Construction Summary

2. Counters

	Counter	Edge
Kitchen	QUARTZ- ISTRIA	Straight Polished Edge
Main Bathroom	QUARTZ- ISTRIA	Straight Polished Edge
Master Ensuite Bathroom	N/A	

Kitchen Backsplash N/A

Comment

** Refer to Construction Summary

3. Flooring

	Selection
Vestibule/Main Hall	LAMINATE- LEXINGTON- LANEFFE OAK TL-LW1311
Kitchen	LAMINATE- LEXINGTON- LANEFFE OAK TL-LW1311
Living Room/Dining Room	LAMINATE- LEXINGTON- LANEFFE OAK TL-LW1311
Den/Office	N/A
Master Bedroom	LAMINATE- LEXINGTON- LANEFFE OAK TL-LW1311
Bedroom #2	
Bedroom #3	
Laundry Room	TILE- WHITE 8X8
Main Bath	TILE- CITY WHITE MATTE 12X24
Master Ensuite Bathroom	N/A

Comment

** Refer to Construction Summary - Standard Grout throughout unless specified

4. Wall Tile

	Selection	Describe
Main Bath	TILE- GLOSSY WHITE 8X16	
Master Ensuite Bathroom	N/A	

Kitchen Backsplash TILE- GLOSSY WHITE 4X12

Comment

** Refer to Construction Summary - Standard Grout throughout unless specified

Initial: 

Purchaser: Aryou KHOSHBIN
Telephone Res. / Bus: /
Decor Advisor: Natalie Mancuso
Lock Date: 8/11/2022 13:37:35

Const. No.: Unit 13, Level 24
Municipal: 2519
Suite Type: A600
Project/Phase: Granerola Residences Ltd./South

5. Misc

Water Line Rough-in for Fridge ☐ Yes ☒ No
Upgrade Bathroom Accessories ☐ Yes ☒ No
Comment
** Refer to Construction Summary

6. Wall, Trim and Door Paint - Birch White Paint Throughout unless specified below.

Entrance Vestibule	Living Room
Main Hall	Dining Room
Kitchen	Den/Library
Laundry Room	Master Bedroom
Main Bathroom	Bedroom #2
Master Ensuite Bathroom	Bedroom #3





Comment
** Refer to Construction Summary

7. General Comments

** Refer to Construction Summary

Disclaimers and Notes

- Colours of all materials are as close as possible to builder's selection, but not necessarily identical due to variances in manufacturing.
- The selection images are digital photographs of the Vendor's samples at its Decor Centre. Such images when displayed on your computer monitor may not match Decor Centre samples due to the hardware/software configuration of the computer.
In the event of conflict between selection images and the Décor Centre samples, Décor Centre samples shall prevail.
- Any extras listed above are null and void unless accompanied by a separate invoice/amendment. Said invoice must be paid in full.
- The Purchaser agrees that this colour selection is final and that no changes will be permitted, unless required by the Vendor.
- The Purchaser acknowledges reading and accepting document which contains other miscellaneous disclaimers.

 Signature: <u>Ario Khoshbin</u>	 Date: <u>August 25 2022</u>	 Signature: _____	 Date: _____
--	--	---	--

September 26, 2019

SCHEDULE 'A'



A 600
TOWER SUITE
SOUTH TOWER
9' CEILING

600 sq. ft.
1-BEDROOM

10-NOV-21



LEVEL 24



Purchaser Initials Purchaser Initials Date

Unit No. 13 Level No. 24 Suite No. 2519

Dimensions, specifications, layouts, location of materials and fixtures, tile floor patterns and architectural detailing (including window size and location and door size, location and swing) are approximate only and are subject to change or modifications, without notice. Actual usable floor space varies from stated floor area. Ceiling height measured from top of floor slab to underside of floor slab above and excludes finishes, bulkheads and drop ceilings. Orientation of suite may be reversed and Purchaser agrees to accept same. Balconies decks and terraces are exclusive use common elements shown for display purposes only and location and size are subject to change without notice. All illustrations are artist concept only. The provisions of the Agreement of purchase and sale apply to this Schedule. E. & O.E.

extended uppers
main Bath - MED cab.

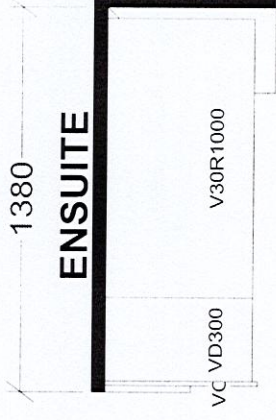

BASE & VANITY CABINETS ON ADJUSTABLE LEGS

Selba Industries

٢٠٠٠

This drawing is the intellectual property of **JOB NUMBER:**
SELBA INDUSTRIES INC. and is an

BUILDER: GREENPARK

SITE: GRANEROLA NORTH & SOUTH

MODEL: A600

LOT #:

W	WDTH	W HGT	W CNT
1	1	1	1
2	2	2	2
3	3	3	3
4	4	4	4
5	5	5	5
6	6	6	6
7	7	7	7
8	8	8	8
9	9	9	9
10	10	10	10
11	11	11	11
12	12	12	12
13	13	13	13
14	14	14	14
15	15	15	15
16	16	16	16
17	17	17	17
18	18	18	18
19	19	19	19
20	20	20	20
21	21	21	21
22	22	22	22
23	23	23	23
24	24	24	24
25	25	25	25
26	26	26	26
27	27	27	27
28	28	28	28
29	29	29	29
30	30	30	30
31	31	31	31
32	32	32	32
33	33	33	33
34	34	34	34
35	35	35	35
36	36	36	36
37	37	37	37
38	38	38	38
39	39	39	39
40	40	40	40
41	41	41	41
42	42	42	42
43	43	43	43
44	44	44	44
45	45	45	45
46	46	46	46
47	47	47	47
48	48	48	48
49	49	49	49
50	50	50	50
51	51	51	51
52	52	52	52
53	53	53	53
54	54	54	54
55	55	55	55
56	56	56	56
57	57	57	57
58	58	58	58
59	59	59	59
60	60	60	60
61	61	61	61
62	62	62	62
63	63	63	63
64	64	64	64
65	65	65	65
66	66	66	66
67	67	67	67
68	68	68	68
69	69	69	69
70	70	70	70
71	71	71	71
72	72	72	72
73	73	73	73
74	74	74	74
75	75	75	75
76	76	76	76
77	77	77	77
78	78	78	78
79	79	79	79
80	80	80	80
81	81	81	81
82	82	82	82
83	83	83	83
84	84	84	84
85	85	85	85
86	86	86	86
87	87	87	87
88	88	88	88
89	89	89	89
90	90	90	90
91	91	91	91
92	92	92	92
93	93	93	93
94	94	94	94
95	95	95	95
96	96	96	96
97	97	97	97
98	98	98	98
99	99	99	99
100	100	100	100

FLOOR HGT

ST CENT 2X4 VENT BOX COVER

DESIGNER: KS

DATE: JAN 6 22