

CONSTRUCTION SUMMARY

Charisma Condominiums - Granerola Residences Ltd.

PURCHASER: Anuoluwape AJIBADE

RECEIVED
SEP 13 2022

TEL:

LOT / PHASE 1010 / North	REG. PLAN #	HOUSE TYPE C969		
-----------------------------	-------------	--------------------	--	--

CABINETRY

1 - CABINETRY - EXTENDED UPPERS IN KITCHEN - STANDARD CABINET 29Aug22 Note:	
1 - KITCHEN ISLAND - EXTEND ISLAND TO 24" WITH OVERHANG 29Aug22 Note:	
1 - CABINETRY PROVISION- PROVISION FOR PLUG ON ISLAND (PLUG EXTRA ORDERED SEPARATELY) 20Jun22 Note:	

CABINETRY ACCESSORIES

2 - KITCHEN ISLAND - ADD POT AND PAN DRAWERS ON ISLAND **SEE SKETCH FOR LOCATION 29Aug22 Note:	
---	--

CERAMIC TILE

1 - UPGRADE SHOWER WALL TILE- SECOND BEDROOM ENSUITE 29Aug22 Note:	
1 - UPGRADE SHOWER WALL TILE - MASTER ENSUITE 29Aug22 Note:	

CONSTRUCTION

1 - SMOOTH CEILINGS - BOTH BEDROOMS 29Aug22 Note:	
1 - TUB TO SHOWER CONVERSION - INCLUDES CLEAR GLASS CHROME FRAMED SLIDING DOORS 20Jun22 Note: SECOND BEDROOM ENSUITE FURTHER UPGRADED TO FRAMELESS GLASS	

COUNTER TOP AND BACKSPLASH

1 - UPGRADE KITCHEN BACKSPLASH MATERIAL 29Aug22 Note:	
---	--

ELECTRICAL

1 - ADD ELECTRICAL PLUG FOR FUTURE OVER THE RANGE MICROWAVE/HOOD FAN 20Jun22 Note:	
1 - ADD A LIGHT IN LIVING ROOM- SEE SKETCH 20Jun22 Note:	
1 - ADD A PLUG AT KITCHEN ISLAND AT SIDE GABLE **SEE SKETCH 20Jun22 Note:	

MIRRORS AND GLASS

1 - SHOWER - FRAMELESS CLEAR GLASS SHOWER DOOR WITH SIDE PANEL TO CEILING FOR 5 FOOT SHOWER ? INCLUDES CHROME KNOB & HINGES 29Aug22 Note: MASTER ENSUITE	
1 - SHOWER ENCLOSURE – FRAMELESS CLEAR GLASS SHOWER DOOR WITH SIDE PANEL TO CEILING FOR 5 FOOT SHOWER – INCLUDES CHROME KNOB & HINGES 20Jun22 Note: SECOND BEDROOM ENSUITE	

MISCELLANEOUS

1 - ADMIN FEE FOR STANDARD CHANGE OF PACKAGE 29Aug22 Note:	
--	--



CONSTRUCTION SUMMARY				
Charisma Condominiums - Granerola Residences Ltd.				
PURCHASER: Anuoluwape AJIBADE				TEL:
LOT / PHASE 1010 / North	REG. PLAN #	HOUSE TYPE C969		

PLUMBING

1 - KITCHEN SINK - UPGRADE SINK TO TECO #163 29Aug22 Note:	
2 - TOE TESTER FOR SHOWER 20Jun22 Note: MASTER ENNSUITE & SECOND BEDROOM ENSUITE	
1 - KITCHEN – WATERLINE ROUGH-IN FOR FRIDGE 20Jun22 Note:	

This Document is Extremely Time Sensitive - Printed 30 Aug 22 at 14:01

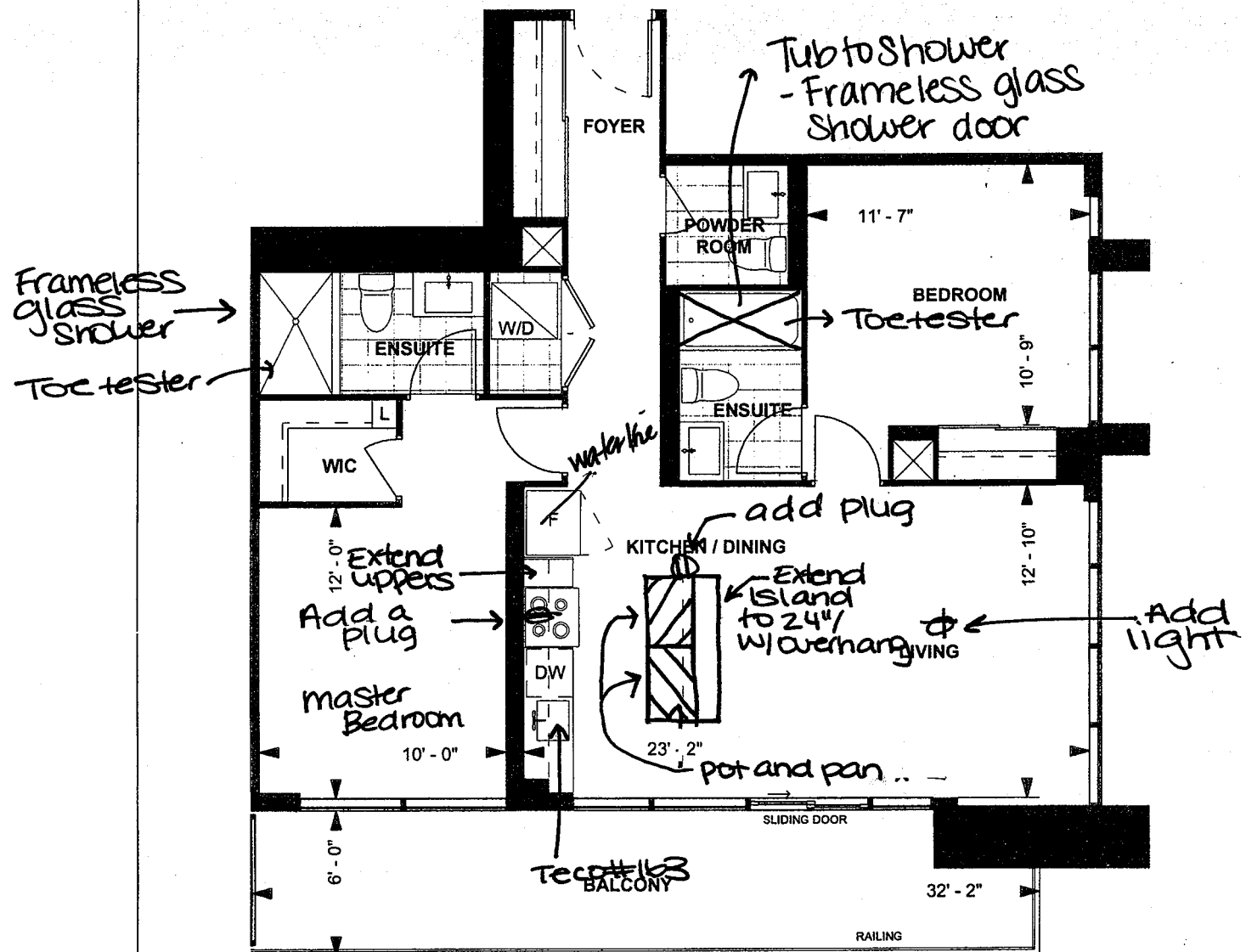

* smooth ceilings - both bedrooms
 * waterline for fridge.

C969

**TOWER SUITE
 NORTH TOWER
 9' CEILING**

969 sq. ft.
 2-BEDROOM



LEVEL 9-22



M.S

Purchaser Initials

Purchaser Initials

Date

Unit No. 10 Level No. 10 Suite No. 1010

May 15/17

Suite #1010 / North
AJ1010ae - C969

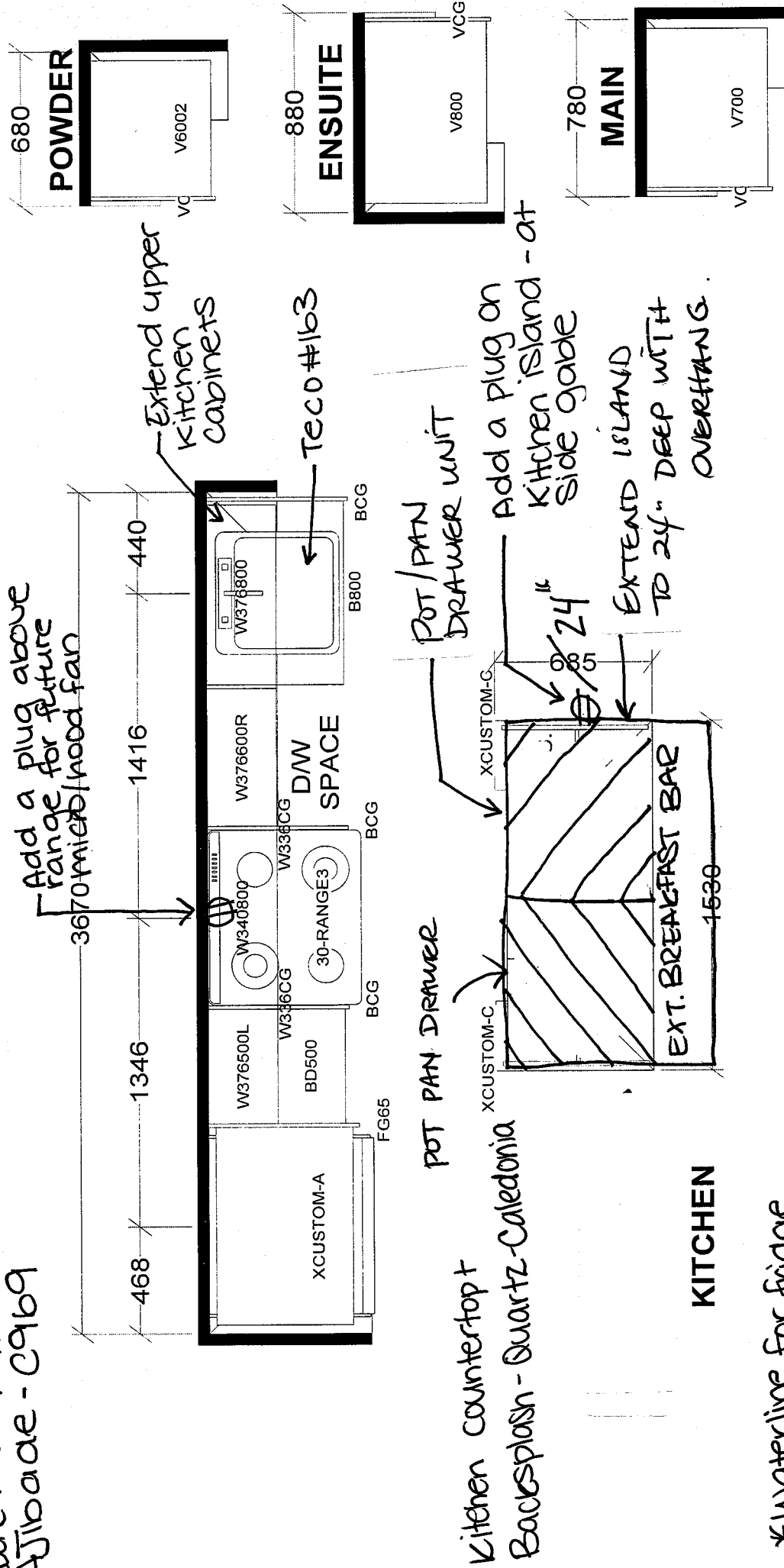

* Waterline for fridge

BASE & VANITY CABINETS ON ADJUSTABLE LEGS

TOWER & PODIUM SUITES
NORTH TOWER X14
SOUTH TOWER X18

Selba Industries				J #
W WIDTH	W HGHT	W CNT	JOB NUMBER:	
FLOOR HGHT	DOOR HGHT		BUILDER: GREENPARK	
ST CENT	2X4	VENT BOX COVER	SITE: GRANEROLA NORTH & SOUTH	
			MODEL: C969	
			LOT #: Suite #1010 / North	
			DESIGNER: KS	
			DATE: JAN 6 22	

Purchaser:

Anuoluwape AJIBADE

Telephone Res. / Bus:

/

Decor Advisor:

Giulia Di Girolamo

Lock Date:

2022-08-29 15:05:07

Const. No.:

Unit 10, Level 10

Municipal:

1010

Suite Type:

C969

Project/Phase:

Granerola Residences Ltd./North

Layout Changes:

☐ Yes ☒ No

Sketch Attached:

☒ Yes ☐ No

1. Kitchen and Vanities

	Style and Colour	Hardware
Kitchen	MONACO -350 PLATINUM SILVER	Standard
Main Bathroom	N/A	N/A
Master Ensuite Bathroom	MONACO -350 PLATINUM SILVER	Standard
Bedroom 2 Ensuite	MONACO -350 PLATINUM SILVER	Standard
Powder Room	MONACO -350 PLATINUM SILVER	Standard
Built In Appliances <input type="radio"/> Yes <input checked="" type="radio"/> No Kitchen Extended Upper Cabinets <input checked="" type="radio"/> Yes <input type="radio"/> No		

Comment

** Refer to Construction Summary

2. Counters

	Counter	Edge
Kitchen	QUARTZ- CALEDONIA	Straight Polished Edge
Main Bathroom	N/A	N/A
Master Ensuite Bathroom	QUARTZ- CALEDONIA	Straight Polished Edge
Bedroom 2 Ensuite	QUARTZ- CALEDONIA	Straight Polished Edge
Powder Room	QUARTZ- CALEDONIA	Straight Polished Edge
Kitchen Backsplash	QUARTZ- CALEDONIA	

Comment

** Refer to Construction Summary

3. Flooring

	Selection
Vestibule/Main Hall	LAMINATE-LEXINGTON-ROCHEFORT OAK-TL-LW1317
Kitchen	LAMINATE-LEXINGTON-ROCHEFORT OAK-TL-LW1317
Living Room/Dining Room	LAMINATE-LEXINGTON-ROCHEFORT OAK-TL-LW1317
Den/Office	N/A
Master Bedroom	LAMINATE-LEXINGTON-ROCHEFORT OAK-TL-LW1317
Bedroom #2	LAMINATE-LEXINGTON-ROCHEFORT OAK-TL-LW1317
Bedroom #3	N/A
Powder Room	TILE-STONE WHITE 12X24
Laundry Room	TILE-WHITE MATTE 8X8
Main Bath	N/A
Master Ensuite Bathroom	TILE-STONE WHITE 12X24
Bedroom 2 Ensuite	TILE-STONE WHITE 12X24

Comment

** Refer to Construction Summary - Standard Grout throughout unless specified

4. Wall Tile

	Selection	Describe
Main Bath	N/A	
Master Ensuite Bathroom	TILE-STONE WHITE 12X24	
Bedroom 2 Ensuite	TILE-STONE WHITE 12X24	
Powder Room	N/A	
Kitchen Backsplash	QUARTZ- CALEDONIA	

Comment

** Refer to Construction Summary - Standard Grout throughout unless specified

Purchaser:Anuoluwape AJIBADE

Telephone Res. / Bus: /

Decor Advisor:Giulia Di Girolamo

Lock Date:2022-08-29 15:05:07

Const. No.: Unit 10, Level 10

Municipal: 1010

Suite Type: C969

Project/Phase: Granerola Residences Ltd./North

5. Misc

Water Line Rough-in for Fridge

YesNo

Upgrade Bathroom Accessories

YesNo

Comment

** Refer to Construction Summary

6. Wall, Trim and Door Paint - Birch White Paint Throughout unless specified below.

Entrance Vestibule	BIRCH WHITE	Living Room	BIRCH WHITE
Main Hall	BIRCH WHITE	Dining Room	BIRCH WHITE
Kitchen	BIRCH WHITE	Den/Library	N/A
Laundry Room	BIRCH WHITE	Master Bedroom	BIRCH WHITE
Main Bathroom	N/A	Bedroom #2	BIRCH WHITE
Master Ensuite Bathroom	BIRCH WHITE	Bedroom #3	N/A
Powder Room	BIRCH WHITE	Bedroom 2 Ensuite	BIRCH WHITE

Comment

** Refer to Construction Summary

7. General Comments

** Refer to Construction Summary

Disclaimers and Notes

- 1) Colours of all materials are as close as possible to builder's selection, but not necessarily identical due to variances in manufacturing.

2) The selection images are digital photographs of the Vendor's samples at its Decor Centre. Such images when displayed on your computer monitor may not match Decor Centre samples due to the hardware/software configuration of the computer.
In the event of conflict between selection images and the Décor Centre samples, Décor Centre samples shall prevail.

3) Any extras listed above are null and void unless accompanied by a separate invoice/amendment. Said invoice must be paid in full.

4) The Purchaser agrees that this colour selection is final and that no changes will be permitted, unless required by the Vendor.

5) The Purchaser acknowledges reading and accepting document which contains other miscellaneous disclaimers.

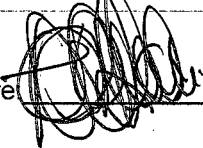
Signature: 

Date: 2022/08/29

Signature: 

Date:



COAST APPLIANCES

Specifications for Project

SUITE 1010 /North
Anuoluwape Ajibade

Location

Vaughan

905-303-6909



REMINDER:

To ensure a smooth project it is the responsibility of the homeowner / purchaser of appliances for this project to share all the attached specifications to ensure the cabinet provider, contractor, or any other tradesperson have all the information required to complete their work accurately.

Specifications are subject to change. If any tradesperson has questions regarding the attached specifications please contact our sales associate.

Powered by SteelCod

SUITE 1010 /North



Contents	Page no.
RF170BRPUX6 N Fisher & Paykel Refrigeration Freestanding Refrigerator Freezer, 32", 17.5 cu ft, Ice & Water	3-4
YKMHS120KPS KitchenAid Microwave 30" 900-Watt Microwave Hood Combination	5-6
YKSEG700ESS KitchenAid Range	7-10
KDTE204KPS KitchenAid Dishwasher	11-15
WFW560CHW Whirlpool Washer 4.3 cu. ft. Closet-Depth Front Load Washer with Intuitive Controls	16-19
YWED5620HW Whirlpool Dryer	20-26

Coast Appliances
coastappliances.com

Andrew Haidari
Commercial Sales Representative
905-303-6909

Search **20220901163549128SC**
Version 1.1

Thu, Sep 1, 2022
12:35 PM EDT

To ensure a smooth project it is the responsibility of the homeowner / purchaser of appliances for this project to share all the attached specifications to ensure the cabinet provider, contractor, or any other tradesperson have all the information required to complete their work accurately.

Specifications are subject to change. If any tradesperson has questions regarding the attached specifications please contact our sales associate.



enterprise.steelcod.com/sp/csta/WGE37MFY

Note about page numbers:
Because the original manufacturer's documents are not altered in any way, the page numbers displayed on the page may not correspond to the page number within this package.

All specifications are intended for initial planning purposes only.
Manufacturers reserve the right to change specifications at any time without notice. Always consult the installation instructions found on the manufacturer's website or included with the appliances before installation.

Suite #1010/North page 1 of 14

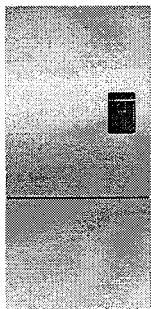

RF170BRPUX6_N

Counter Depth Refrigerator
17.5 cu ft, Ice & Water

Contemporary

This Fisher & Paykel Fridge Freezer is right hinge with large flexible storage options for a busy family and comes in a stylish stainless steel finish with ice and water.

EZKleen Stainless Steel



A PEACE OF MIND SALE
24 Hours 7 Days a Week Customer Support
T 1.888.936.7872 W fisherpaykel.com

Dimensions

Depth	27 7/8"
Height	67 3/4"
Width	31 1/8"

Features & Benefits

Clever energy
Your fridge adapts to daily use by cooling and defrosting only when needed. This means your fridge uses the energy it needs without compromising on food care.

Humidity control
Your fruit and veges need different environments. Each storage bin creates a microclimate, which helps keep them fresher for longer.

Easy cleaning
No more permanent dirty marks with our EZKleen feature for stainless steel fridges. Anti-fingerprint coating means you simply wipe clean any marks. Spill-safe secure glass shelves easily capture any drips or leaks.

Ice maker
Fresh ice is always available for you in a dedicated freezer bin. Simply turn it off to free up freezer space or during busy times, you can boost ice production by up to 30%.

Design quality
Our fridges are designed and built using quality materials. We use real stainless steel on our fridges and solid glass for shelving.

Water on tap
The slimline dispenser makes it easy to fill almost any sized jug or vessel with cool filtered water and doesn't take up any storage space in your fridge.

Internal
The internal
bin the
or similar
mode

Specifications

Accessories
Replacement
Capacity
Freezer
Refrigerator
Total volume
Consult
Energy
Energy
Design
Bottom
Concealed
Door options
EZKleen
Flat door
Premium
Sleek silver
Details
UPC Code

FISHER & PAYKEL

Freezer		
Bottle chill		•
Built-in ice maker		•
Clear plastic bins	2	
Door alarm		•
Fast freeze		•
Ice Boost		•
Ice bin and scoop		•
Large plastic bin		•
Slide Out Pastry Tray		•

Measurements		
Height - to top of cabinet	67-3/4"	
Minimum air clearance - at rear	1-3/16"	
Minimum air clearance - each side	13/16"	
Minimum air clearance - on top	2"	

Performance		
ActiveSmart™ Foodcare		•
Adaptive defrost		•
Bottle chill mode		•
External water dispenser		•
Fast freeze		•
Frost free		•
Humidity controlled crisper bin		•
Inverter controlled compressor		•
Sabbath mode		•

Refrigerator		
Adjustable door shelves	4	
Adjustable glass shelves	4	
Covered door shelves	2	
Door alarm		•
Front levelling feet		•
Fruit and vegetable bins	2	
Full extension runners		•
Full width door shelves	2	
LED lighting		•
Rear rollers		•
SmartTouch control panel		•
Stackable bottle holders	2	
Ultra slim water dispenser		•

Style And Series	
Product Style	Contemporary

Warranty		
Parts & Labor	2 years	
Sealed system parts	5 years	

SKU	25103
-----	-------

The product dimensions and specifications in this page apply to the specific product and model. Under our policy of continuous improvement, these dimensions and specifications may change at any time. You should therefore check with Fisher & Paykel's Customer Care Centre to ensure this page correctly describes the model currently available. © Fisher & Paykel Appliances Ltd 2018

Other product downloads available at fisherpaykel.com

Suite #1010 / North page 3 of 14

30" 950-Watt Microwave Hood Combination

YKMHS120KPS

Available Finishes/Colours

YKMHS120KPS
Other

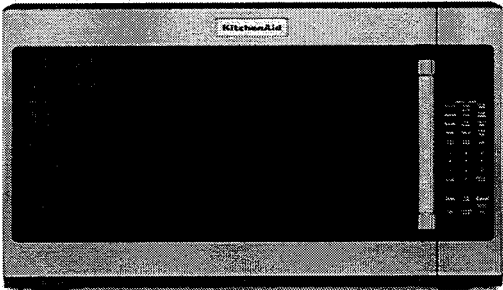

This high power, 950-watt over-the-range microwave features sensor functions to assist you in the kitchen by automatically adjusting the time needed to cook, reheat or defrost without guesswork about power levels or cooking times. A 3-speed ventilation fan helps capture smoke, grease and odors from the cooking surface below to clear the air for any culinary adventure. Stainless Steel with PrintShield™ Finish resists smudges and fingerprints.

Top Features
Sensor functions
Cookshield Finish
2.0 Cu. Ft. Capacity

Manuals & Literature:

 [Installation Guide](#)

Dimensions	
Depth	16 1/4
Height	17 1/8
Width	29 7/8

Microwave Details	
Interior Depth	14 1/8
Interior Height	10 1/16
Interior Width	21 1/16
Scrolling Electronic Display	Yes
Cavity Finish	Non-Stick
Sensor Cooking	Yes
Work Surface Light	Halogen
Turntable Diameter Size (IN,inches)	14
Turntable Diameter Size (in.)	14

Microwave Details	
Turntable	Stoppable,Recesse
Cooking Power(W,watts)	950
Cooking Power (watts)	950
Convection	No
Grill	No
Interior Light	Incandescent
Number or Racks	1

Configuration and Overview	
Microwave Type	Over-the-Range
Size (IN,inches)	30

Exterior	
Door Release	Handle
Cabinet Color	Black
Door Opening	Left

KitchenAid®

Because Whirlpool Corporation policy includes a continuous commitment to improve our products, we reserve the right to change materials and specifications without notice. Dimensions are for planning purposes only. For complete details, see Installation Instructions packed with product. Specifications subject to change without notice.

Suite #1010/North page 4 of 14

Remove Cardboard Template

The cardboard piece from the top of the microwave oven packaging is perforated. The piece inside the perforation is for use as a rear wall template.

1. Cut along the perforation to separate the template from the rest of the cardboard packaging.
2. Set the cardboard template to the side and refer to it during the "Mark Rear Wall" part of installation.

Depending on your model, skip "Remove Cardboard Template" steps if full carton box is used for packing. But use the wall template for "Mark Rear Wall" part of the installation.

Location Requirements

Check the opening where the microwave oven will be installed. The location must provide:

- Minimum installation dimensions. See the "Installation Dimensions" illustration.
- Minimum one 2" x 4" (5.1 x 10.2 cm) wood wall stud and minimum 3/8" (1 cm) thickness drywall or plaster/lath within cabinet opening.
- Support for weight of 150 lbs (68 kg) which includes microwave oven and items placed inside the microwave oven and upper cabinet.
- Grounded electrical outlet inside upper cabinet. See the "Electrical Requirements" section.

NOTES:

- If installing the microwave oven near a left sidewall, make sure there is at least 6" (15.2 cm) of clearance between the wall and the microwave oven so that the door can open fully.
- Some models have a pocket handle. If installing the microwave near a right side wall, make sure there is at least 3 inches of clearance between wall and microwave oven so you can grab the handle integrated inside the door.
- Some cabinet and building materials are not designed to withstand the heat produced by the microwave oven for cooking. Check with your builder or cabinet supplier to make sure that the materials used will not discolor, delaminate, or sustain other damages.

Special Requirements

For Wall Venting Installation Only:

- Cutout must be free of any obstructions so that the vent fit properly and the damper blade opens freely and fully.

For Roof Venting Installation Only:

- If you are using a rectangular-to-round transition piece, the 3" (7.6 cm) clearance needs to exist above the microwave oven so that the damper blade can open freely and fully. See "Rectangular to Round Transition" illustration in the "Venting Design Specifications" section.

Installation Dimensions

NOTE: The grounded 3 prong outlet must be inside the upper cabinet. See the "Electrical Requirements" section.

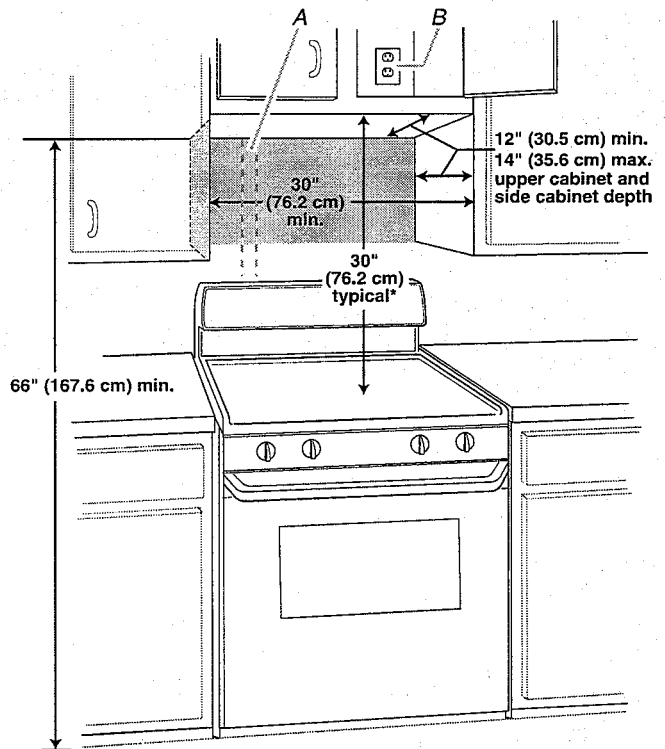

A. 2" x 4" (5.1 x 10.2 cm) wall stud
B. Grounded 3 prong outlet

*30" (76.2 cm) is typical for 66" (167.6 cm) installation height. Exact dimensions may vary depending on type of range/cooktop below.

NOTE: To ensure good performance, do not obstruct top vent airflow. If cabinets are deeper than 14" (35.6 cm) but no more than 15" (38.1 cm), use the bump out mounting kit replacing the I bar mounting plate from the wall. The bump out mounting kit (part # W11185746) is not provided but can be purchased from Whirlpool.

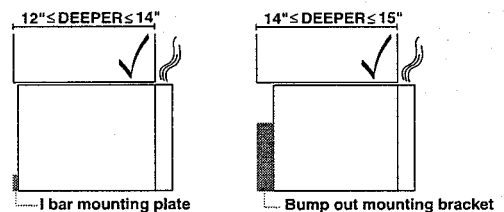

Product Dimensions

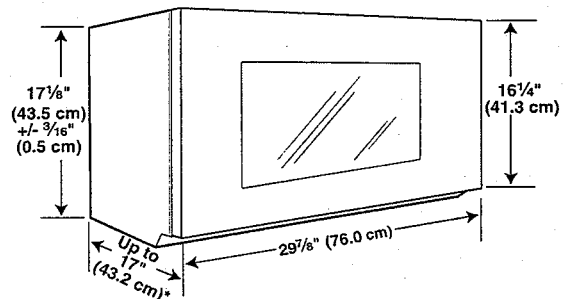

*Overall depth of product will vary slightly depending on door design.

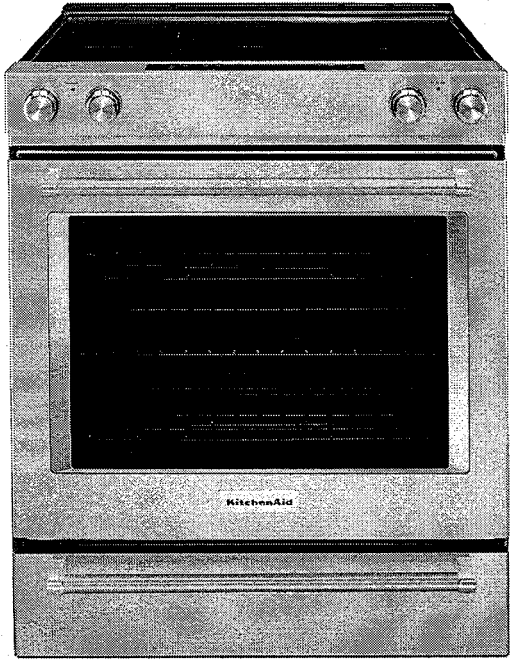

KitchenAid® 30-Inch 5-Element Electric Convection Front Control Range

YKSEG700ESS

Available Finishes/Colours

YKSEG700ESS
Other

YKSEG700EWH
White

 YKSEG700EBL
Black

Dimensions	
Height	36
Width	29 7/8

Configuration and Overview	
Fuel Type	Electric
Range Type	Slide-in



Cooktop Features	
Cooktop Element Style	Radiant
Cooktop Surface Color	Black
Cooktop Surface Material	Ceramic Glass
Number of Cooking Element-Burners	5
Center Rear Element-Burner Power	100W
Center Rear Element-Burner Size	6"
Center Rear Element-Burner Type	Warming

Cooktop Features	
Left Front Element-Burner Power	3000W/1950W/105
Left Front Element-Burner Size	12"/9"/6"
Left Front Element-Burner Type	Triple
Left Rear Element-Burner Power	1300W
Left Rear Element-Burner Size	6"
Left Rear Element-Burner Type	Hyper
Right Front Element-Burner Power	3200W
Right Front Element-Burner Size	10"

This beautiful electric range produces flawless cooking results with Even-Heat™ True Convection. The unique bow-tie design and convection fan ensure the inside of the entire oven is heated to, and stays at, the perfect temperature. This range also features a Steam Rack that adds additional moisture to the inside of the oven, enhancing cooking results. The oven is 6.4 cu ft., providing an extra-large cooking capacity that's perfect for preparing multiple dishes at once.

Top Features
Even-Heat™ True Convection
Steam Rack
6.4 cu ft Capacity

Manuals & Literature:

 [Use and Care](#)  [Warranty](#)

KitchenAid®

Because Whirlpool Corporation policy includes a continuous commitment to improve our products, we reserve the right to change materials and specifications without notice. Dimensions are for planning purposes only. For complete details, see Installation Instructions packed with product. Specifications subject to change without notice.

Suite #1010 / North page 6 of 14

- Cabinet opening dimensions that are shown must be used. Given dimensions are minimum clearances.
- The anti-tip bracket must be installed. To install the anti-tip bracket shipped with the range, see "Install Anti-Tip Bracket" section.
- Grounded electrical supply is required. See the appropriate "Electrical Requirements" section.
- Contact a qualified floor covering installer to check that the floor covering can withstand at least 200°F (93°C).
- Use an insulated pad or 1/4" (0.64 cm) plywood under range if installing range over carpeting.

IMPORTANT: To avoid damage to your cabinets, check with your builder or cabinet supplier to make sure that the materials used will not discolor, delaminate or sustain other damage. This oven has been designed in accordance with the requirements of UL and CSA International and complies with the maximum allowable wood cabinet temperatures of 194°F (90°C).

Mobile Home - Additional Installation Requirements

The installation of this range must conform to the Manufactured Home Construction and Safety Standard, Title 24 CFR, Part 3280 (formerly the Federal Standard for Mobile Home Construction and Safety, Title 24, HUD Part 280). When such standard is not applicable, use the Standard for Manufactured Home Installations, ANSI A225.1/NFPA 501A or with local codes.

In Canada, the installation of this range must conform with the current standards CAN/CSA-A240-latest edition, or with local codes.

Mobile Home Installations Require:

- When this range is installed in a mobile home, it must be secured to the floor during transit. Any method of securing the range is adequate as long as it conforms to the standards listed above.
- Four-wire power supply cord or cable must be used in a mobile home installation. The appliance wiring will need to be revised. See "Electrical Connection - U.S.A. Only" section.

Product Dimensions

This manual covers several models. Your model may appear different from the models depicted. Dimensions given are maximum dimensions across all models.

Model KSEB900

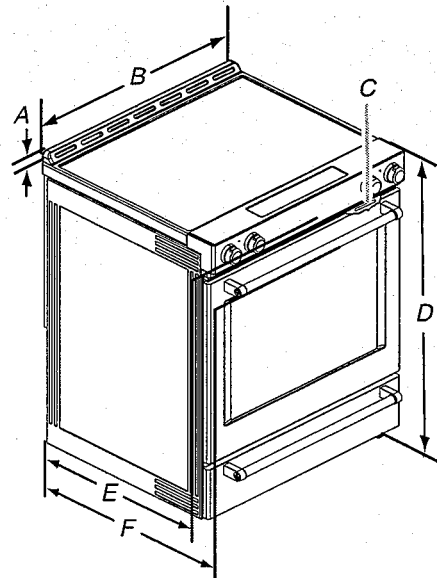

A. 1 3/16" (3.0 cm) height from cooktop to top of vent

B. 29 7/8" (75.9 cm)

C. Model/serial/rating plate (located behind the oven door on the top right-hand side of the oven frame)

D. 36" (91.4 cm) height to top of cooktop edge with leveling legs screwed all the way in*

E. 28 5/16" (71.9 cm) max. depth from front of console to back of range

F. 28 7/8" (73.3 cm) max. depth from handle to back of range

IMPORTANT: Range must be level after installation. Follow the instructions in the "Level Range" section. Using the cooktop as a reference for leveling the range is not recommended.

*Range can be raised approximately 1" (2.5 cm) by adjusting the leveling legs.

Cabinet Dimensions

Cabinet opening dimensions shown are for 25" (64.0 cm) countertop depth, 24" (61.0 cm) base cabinet depth and 36" (91.4 cm) countertop height.

IMPORTANT: If installing a range hood or microwave hood combination above the range, follow the range hood or microwave hood combination installation instructions for dimensional clearances above the cooktop surface.

Range may be installed next to combustible walls with zero clearance.

NOTE: When installed in a slide-in cutout, the front of oven door may protrude beyond the base cabinet.

Slide-In Cutout

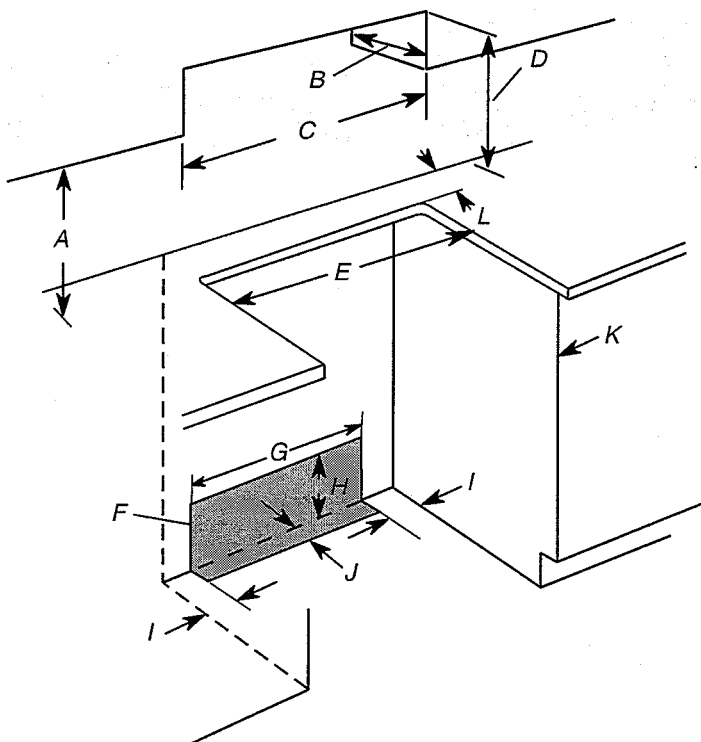

- A. 18" (45.7 cm) upper side cabinet to countertop
- B. 13" (33 cm) max. upper cabinet depth
- C. 30" (76.2 cm) min. opening width
- D. For minimum clearance to top of cooktop, see NOTE*.
- E. 30" (76.2 cm) min. opening width
- F. The shaded area is recommended for installation of grounded outlet.
- G. 13 1/8" (33.3 cm)
- H. 7 1/16" (19.5 cm)
- I. 4 13/16" (12.2 cm)
- J. 3 1/16" (9.4 cm) plus measurement of L
- K. Cabinet door or hinges should not extend into the cutout.
- L. Remaining counter depth should not exceed 2 1/4" (5.7 cm).

Freestanding Cutout

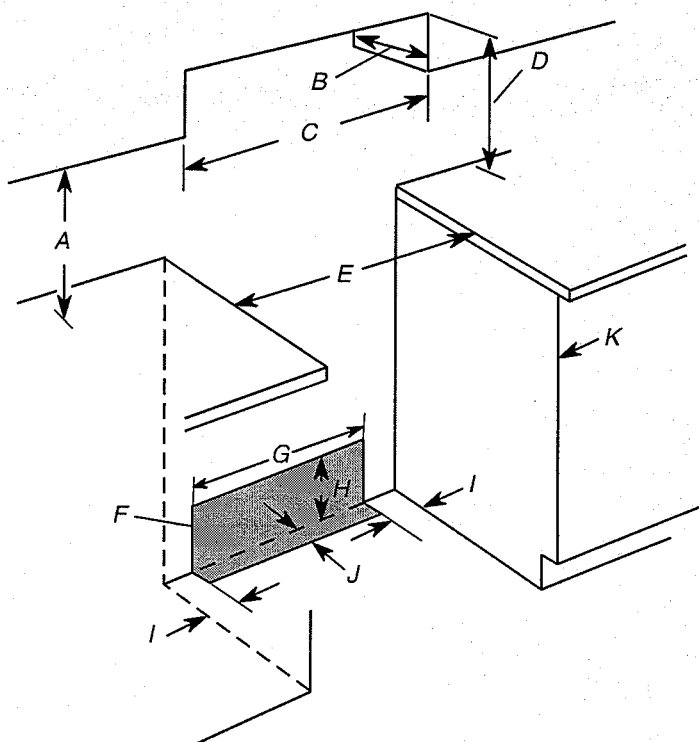

- A. 18" (45.7 cm) upper side cabinet to countertop
- B. 13" (33 cm) max. upper cabinet depth
- C. 30" (76.2 cm) min. opening width
- D. For minimum clearance to top of cooktop, see NOTE*.
- E. 30" (76.2 cm) min. opening width
- F. The shaded area is recommended for installation of grounded outlet.
- G. 13 1/8" (33.3 cm)
- H. 7 1/16" (19.5 cm)
- I. 4 13/16" (12.2 cm)
- J. 3 1/16" (9.4 cm)
- K. Cabinet door or hinges should not extend into the cutout.

***NOTE:** 24" (61.0 cm) minimum when bottom of wood or metal cabinet is shielded by not less than 1/4" (0.64 cm) flame retardant millboard covered with not less than No. 28 MSG sheet steel, 0.015" (0.4 mm) stainless steel, 0.024" (0.6 mm) aluminum or 0.020" (0.5 mm) copper.

30" (76.2 cm) minimum clearance between the top of the cooking platform and the bottom of an uncovered wood or metal cabinet.

Electrical Requirements - Canada Only

⚠️ **WARNING**



Electrical Shock Hazard

Electrically ground range.
Failure to do so can result in death, fire, or electrical shock.

If codes permit and a separate ground wire is used, it is recommended that a qualified electrical installer determine that the ground path is adequate and wire gauge are in accordance with local codes.

Be sure that the electrical connection and wire size are adequate and in conformance with CSA Standard C22.1, Canadian Electrical Code, Part 1 - latest edition, and all local codes and ordinances.

A copy of the above code standards can be obtained from:
Canadian Standards Association
178 Rexdale Blvd.
Toronto, ON M9W 1R3 CANADA

- Check with a qualified electrical installer if you are not sure the range is properly grounded.
- | Range Rating* | | Specified Rating of Power Supply Cord Kit and Circuit Protection |
|----------------|----------------|--|
| 120/240 Volts | 120/208 Volts | Amps |
| 8.8 - 16.5 KW | 7.8 - 12.5 KW | 40 or 50** |
| 16.6 - 22.5 KW | 12.6 - 18.5 KW | 50 |
- *The NEC calculated load is less than the total connected load listed on the model/serial/rating plate.
- **If connecting to a 50-amp circuit, use a 50-amp rated cord with kit. For 50-amp rated cord kits, use kits that specify use with a nominal 1 3/8" (3.5 cm) diameter connection opening.
- A circuit breaker is recommended.
 - This range is equipped with a CSA International Certified Power Cord intended to be plugged into a standard 14-50R wall receptacle. Be sure the wall receptacle is within reach of range's final location.

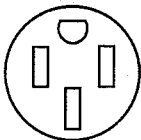

- Do not use an extension cord.
- The tech sheet and wiring diagram are located on the back of the range in a plastic bag.

39 dBA Dishwasher in PrintShield™ Finish with
Third Level Utensil Rack

<http://www.kitchenaid.com>

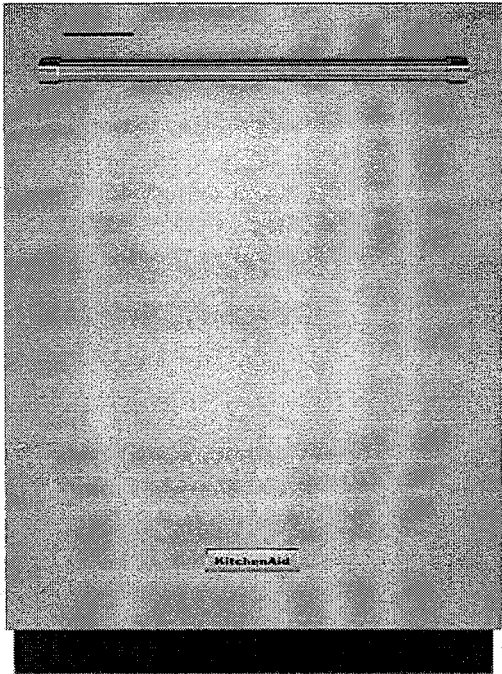

Key Features:

- 39 dBA
- ProWash™ Cycle
- Heat Dry Option
- Third Level Utensil Rack
- Extended Heat Dry Option
- Durable Stainless Steel Interior
- SatinGlide® Rails in Third and Middle Racks
- Express Wash Cycle
- Top Controls
- Adjustable Middle Rack

Product Dimensions:

Height: 34 1/2
Width: 23 7/8
Depth: 26 3/4

Additional Information:

- [Dimension Guide](#)
- [Energy Guide](#)
- [Warranty Certificate](#)

Available in:

- Black
- Black Stainless Steel with PrintShield™ Finish
- Stainless Steel with PrintShield™ Finish
- White



©Registered trademark/TM Trademark of Whirlpool, U.S.A. © 2016 Whirlpool Corporation. All Rights Reserved. All other trademarks are owned by their respective companies.
Because Whirlpool Corporation policy includes a continuous commitment to improve our products, we reserve the right to change materials and specifications without notice. We also reserve the right to discontinue or transition products without notice.
Manufacturer's Suggested Retail Price (MSRP) and Minimum Advertised Price (MAP) provided for reference purposes only. Dealer alone determines advertised and retail prices.
Created On: Tuesday, July 28, 2020 08:39:51



24" Dishwasher

DETAILED PLANNING DIMENSIONS GUIDE

Applies to all model numbers starting with;
KDFE104K, KDFE204K, KDTE204K, KDTE204LPA, KDFM404K,
KDTM404K, KDPM604K, KDTM604K, KDPM704K, KDTM704K,
KDTM704LPA, KDPM804K, KDTM804K

PRODUCT DIMENSIONS

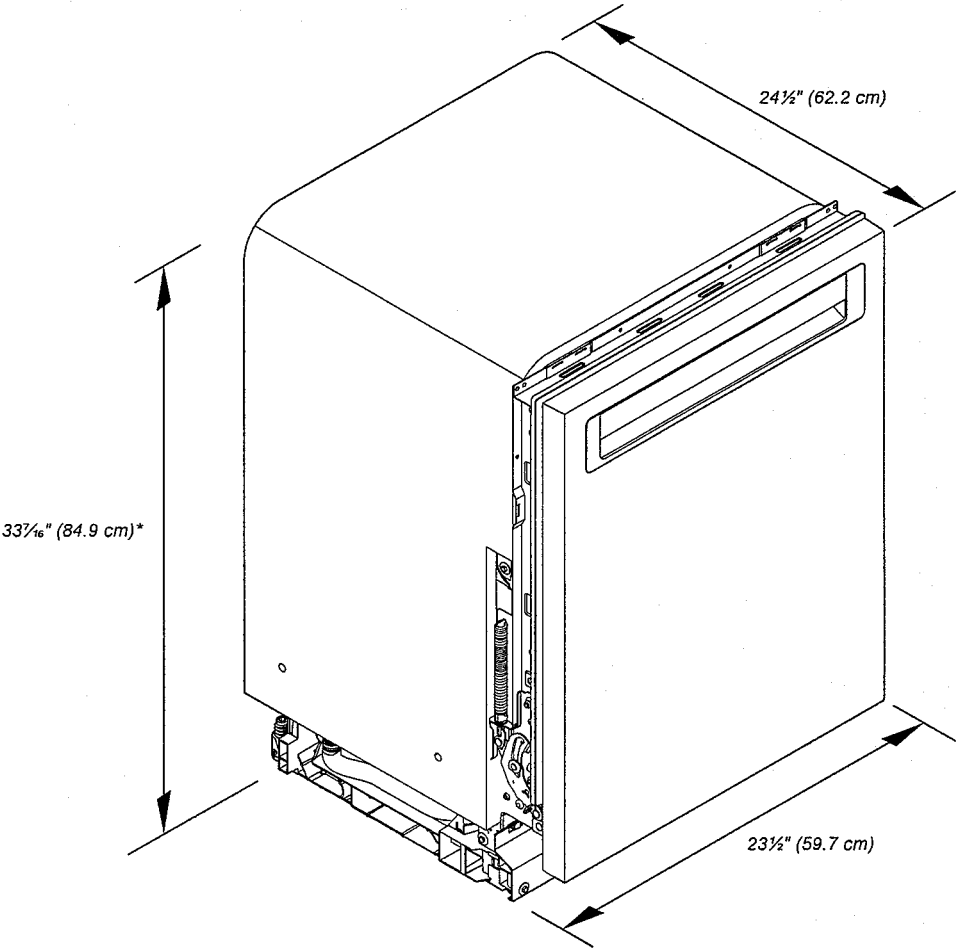

*Dishwasher can be raised 1 7/16" (3.7 cm) with feet fully extended.

Because Whirlpool Corporation policy includes a continuous commitment to improve our products, we reserve the right to change materials and specifications without notice.

Dimensions are for planning purposes only. For complete details, see Installation Instructions packed with product. Specifications subject to change without notice.

24" Dishwasher

DETAILED PLANNING DIMENSIONS GUIDE

Figure 1 is a dimensional drawing of a refrigerator, showing three views: Front View, Top View, and Side View. The dimensions are labeled as follows:

- Front View:** Width is A , Height is B^* , and Base Height is C .
- Top View:** Width is D , and Height is E^* .
- Side View:** Width is J^* , Height is H^* , Base Height is G^* , and Depth is K^* . The Side View also shows the Wall and Floor.

	DESCRIPTION	DIMENSIONS
A	Width of door	23½" (59.7 cm)
B*	Height to top of handle	30⅓½" (78.3 cm)
C	Height of adjustable toe kick	3⅝" (8.4 cm) - min. 4⅞" (11.8 cm) - max.
D	Width of recessed dishwasher	22⅝" (57.4 cm)
E†	Depth without door	22⅝" (57.5 cm)
F***	Depth with Towel Bar Handle	26⅞" (68.3 cm)
	Depth with Pocket Handle	24½" (62.6 cm)
	Depth of Panel-Ready Models	24" (61.0 cm)
G*	Height to bottom of door (min.)	3⅝" (8.4 cm)
H*	Height to top of door (min.)	33⅞" (84.9 cm)
I*	Height of recessed dishwasher (min.)	33⅝" (85.4 cm)
J†	Depth with door fully open (min.)	50⅞" (127.4 cm)
K†	Depth with toe kick (min.)	20⅓½" (52.9 cm)

****For panel-ready models, dishwasher depth is 24" (61.0 cm), not including the 3/4" (1.9 cm) custom door panel.**

Dimensions are for planning purposes only. For complete details, see Installation Instructions packed with product. Specifications subject to change without notice.

24" Dishwasher

DETAILED PLANNING DIMENSIONS GUIDE

OPENING/CLEARANCE DIMENSIONS

IMPORTANT: Check that all surfaces have no protrusions that would prohibit dishwasher installation.

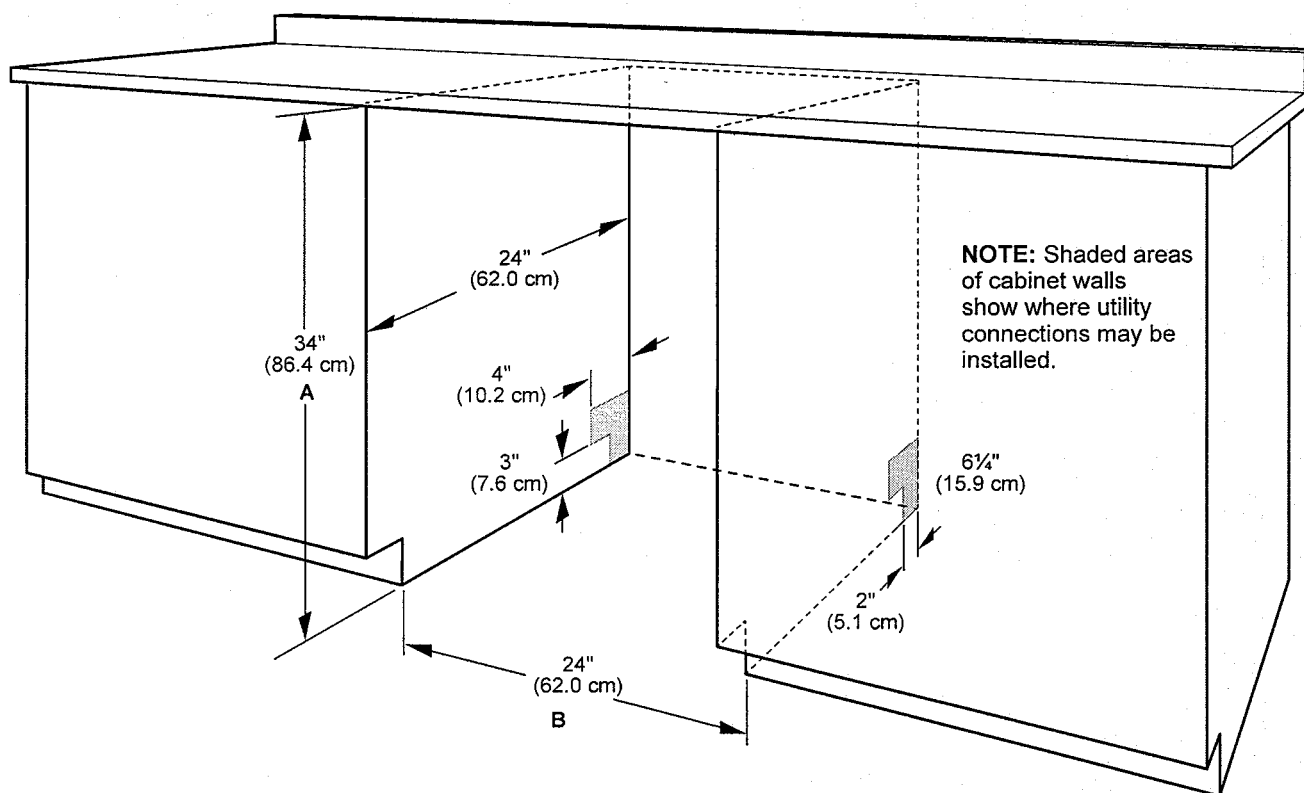

A. Measured from the lowest point on the underside of the countertop. May be reduced to 33½" (85.1 cm) by removing the wheels and perforated area of insulation (blanket) on dishwasher.

B. Minimum, measured from narrowest point of opening.

NOTE: Corner locations require a 2" (5.1 cm) minimum clearance between the side of the dishwasher door and the wall or cabinet.

Because Whirlpool Corporation policy includes a continuous commitment to improve our products, we reserve the right to change materials and specifications without notice.

Dimensions are for planning purposes only. For complete details, see Installation Instructions packed with product. Specifications subject to change without notice.

DRAIN REQUIREMENTS

- A new drain hose is supplied with your dishwasher. If drain hose is not long enough, use a new drain hose with a maximum length of 12 ft (3.7 m) that meets all current AHAM/ IAPMO test standards, is resistant to heat and detergent, and fits the 1" (2.5 cm) drain connector of the dishwasher.

NOTE: Do not connect multiple drain hoses together.

- Make sure to connect drain hose to waste tee or disposer inlet above drain trap in house plumbing and 20" (50.8 cm) minimum above the floor. It is recommended that the drain hose either be looped up and securely fastened to the underside of the counter or be connected to an air gap.
- Make sure to use an air gap if the drain hose is connected to house plumbing lower than 20" (50.8 cm) above subfloor or floor.

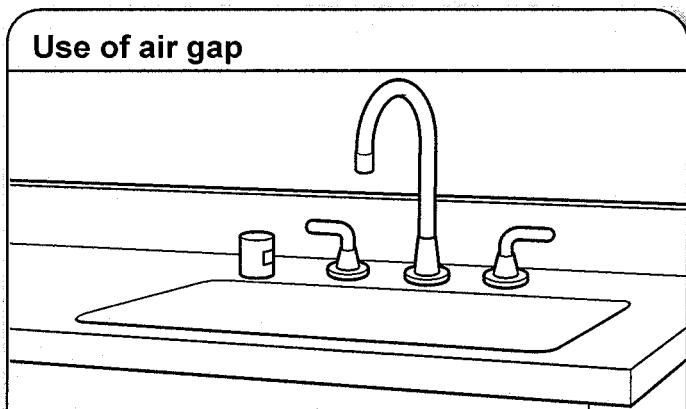

- If required, the air gap should be installed in accordance with the air gap installation instructions. When you are connecting the air gap, a rubber hose (not provided) will be needed to connect to the waste tee or disposer inlet.
- Use 1/2" (1.3 cm) minimum I.D. drain line fittings.

WATER SUPPLY REQUIREMENTS

- This dishwasher has a water heating feature and also requires a connection to a hot water supply line.
 - A hot water line with 20 psi to 120 psi (138 kPa to 862 kPa) water pressure can be verified by a licensed plumber.
 - 120°F (49°C) water at dishwasher.
 - 3/8" (0.95 cm) O.D. copper tubing with compression fitting or flexible braided water supply line.
- NOTE:** 1/2" (1.3 cm) minimum plastic tubing is not recommended.
- A 90° elbow with 3/4" (0.95 cm) hose connection with rubber washer.
 - Do not solder within 6" (15.2 cm) of the water inlet valve.
 - If installed in new construction, make sure the house water supply lines have been flushed prior to connecting the dishwasher to remove any debris that may exist in the supply line.

NOTE: If replacing an existing dishwasher, it is recommended to install a new water line and drain hose (supplied) with the new dishwasher.

ELECTRICAL REQUIREMENTS

⚠ WARNING



Electrical Shock Hazard

Plug into a grounded 3 prong outlet.

Do not remove ground prong.

Do not use an adapter.

Do not use an extension cord.

Failure to follow these instructions can result in death, fire, or electrical shock.

Be sure that the electrical connection and wire size are adequate and in conformance with the National Electrical Code, ANSI/NFPA 70 - latest edition, and all local codes and ordinances.

A copy of the above code standards can be obtained from:

National Fire Protection Association
1 Batterymarch Park
Quincy, MA 02169-7471

You Must Have:

- 120 V, 60 Hz, AC only, 15 A or 20 A, fused electrical supply
- Copper wire only
- A maximum of 2 field wiring supply conductors (12 AWG largest size) plus 1 grounding conductor are permitted in the terminal box.

We Recommend:

- A time-delay fuse or circuit breaker.

Circuit Requirements:

- The dishwasher may be installed on the same circuit as a garbage disposal providing that the branch circuit cannot exceed rated circuit load and must comply with all governing codes and regulations such as but not limited to National Electrical Code, ANSI/NFPA 70 - latest edition.
- No electrical connections other than the dishwasher power and ground connections can be made inside of the dishwasher terminal box.

If connecting dishwasher with a power supply cord:

- Use UL Listed power cord kit marked for use with dishwasher.
- Plug into a grounded 3 prong outlet. Outlet must meet all local codes and ordinances.



If connecting dishwasher with direct wiring:

- Use flexible, armored, or nonmetallic sheathed copper wire with grounding wire that meets the wiring requirements for your home and local codes and ordinances.
- Use a UL Listed/CSA Approved metallic strain relief.

