

CONSTRUCTION SUMMARY

Charisma Condominiums - Granerola Residences Ltd.

RECEIVED

JUL 20 2022

PURCHASER: George KLANA

TEL:

LOT / PHASE 527 / South	REG. PLAN #	HOUSE TYPE A462		
----------------------------	-------------	--------------------	--	--

CABINTRY

1 - KITCHEN - EXTENDED UPPER CABINETS 15Jul22 Note:	
---	--

COUNTER TOP

1 - KITCHEN - QUARTZ COUNTERTOP AND BACKSPLASH - CALEDONIA 15Jul22 Note:	
--	--

ELECTRICAL

1 - ADD LIGHT IN LIVING ROOM 21Apr22 Note:	
--	--

MISCELLANEOUS

1 - ADMIN FEE FOR STANDARD CHANGE OF PACKAGE 15Jul22 Note:	
--	--

PROMOTIONAL

1 - PROMO BALANCE AS PER OFFER 15Jul22 Note:	
1 - PROMO AS PER OFFER - NEW PROMO BALANCE 4400.00 21Apr22 Note:	

EXTRAS AS PER OFFER

The Purchaser acknowledges that the Purchase Price is inclusive of all credits and promotional packages available at the time of purchase. Worksheet Note:	
The Vendor agrees that notwithstanding any other term or provision in this Agreement included in the Purchase Price and in addition to those items detailed in Schedule D to the Agreement of Purchase and Sale, the Purchaser is entitled to a credit of Five Worksheet Note:	
1 Parking Unit - location to be selected by the Vendor at their sole discretion. Worksheet Note:	

This Document is Extremely Time Sensitive - Printed 18 Jul 22 at 9:06

Purchaser: George KLANA
Telephone Res. / Bus: /
Decor Advisor: Ida Viola
Lock Date: 7/15/2022 15:51:36

Const. No.: Unit 20, Level 5
Municipal: 527
Suite Type: A462
Project/Phase: Granerola Residences Ltd./South

Layout Changes: ☐ Yes ☒ No Sketch Attached: ☒ Yes ☐ No

1. Kitchen and Vanities

	Style and Colour	Hardware
Kitchen	MONACO - 350 PLATINUM SILVER	428SB
Main Bathroom	MONACO - 350 PLATINUM SILVER	428SB
Master Ensuite Bathroom	N/A	N/A
Built In Appliances <input type="radio"/> Yes <input checked="" type="radio"/> No		Kitchen Extended Upper Cabinets <input checked="" type="radio"/> Yes <input type="radio"/> No

Comment
** Refer to Construction Summary

2. Counters

	Counter	Edge
Kitchen	QUARTZ-CALEDONIA	#360
Main Bathroom	QUARTZ-CALEDONIA	Straight Polish Edge
Master Ensuite Bathroom	N/A	
Kitchen Backsplash	QUARTZ-CALEDONIA	

Comment
** Refer to Construction Summary

3. Flooring

	Selection
Vestibule/Main Hall	LAMINATE - LEXINGTON ROCHEFORT OAK TL-LW1317
Kitchen	LAMINATE - LEXINGTON ROCHEFORT OAK TL-LW1317
Living Room/Dining Room	LAMINATE - LEXINGTON ROCHEFORT OAK TL-LW1317
Den/Office	N/A
Master Bedroom	N/A
Bedroom #2	N/A
Bedroom #3	N/A
Laundry Room	TILE-WHITE MATTE 8X8
Main Bath	TILE-STONE WHITE 12X24
Master Ensuite Bathroom	N/A

Comment
** Refer to Construction Summary - Standard Grout throughout unless specified

4. Wall Tile

	Selection	Describe
Main Bath	TILE-GLOSSY WHITE 8X16	
Master Ensuite Bathroom	N/A	
Kitchen Backsplash	QUARTZ-CALEDONIA	

Comment
** Refer to Construction Summary - Standard Grout throughout unless specified

Purchaser: George KLANA
Telephone Res. / Bus: /
Decor Advisor: Ida Viola
Lock Date: 7/15/2022 15:51:36

Const. No.: Unit 20, Level 5
Municipal: 527
Suite Type: A462
Project/Phase: Granerola Residences Ltd./South

5. Misc

Water Line Rough-in for Fridge ☐ Yes ☒ No
Upgrade Bathroom Accessories ☐ Yes ☒ No

Comment
** Refer to Construction Summary

6. Wall, Trim and Door Paint - Birch White Paint Throughout unless specified below.

Entrance Vestibule		Living Room	
Main Hall		Dining Room	
Kitchen		Den/Library	
Laundry Room		Master Bedroom	
Main Bathroom		Bedroom #2	
Master Ensuite Bathroom		Bedroom #3	

Comment
** Refer to Construction Summary

7. General Comments

** Refer to Construction Summary

Disclaimers and Notes

- 1) Colours of all materials are as close as possible to builder's selection, but not necessarily identical due to variances in manufacturing.
- 2) The selection images are digital photographs of the Vendor's samples at its Decor Centre. Such images when displayed on your computer monitor may not match Decor Centre samples due to the hardware/software configuration of the computer. In the event of conflict between selection images and the Décor Centre samples, Décor Centre samples shall prevail.
- 3) Any extras listed above are null and void unless accompanied by a separate invoice/amendment. Said invoice must be paid in full.
- 4) The Purchaser agrees that this colour selection is final and that no changes will be permitted, unless required by the Vendor.
- 5) The Purchaser acknowledges reading and accepting document which contains other miscellaneous disclaimers.

Signature:  Date: July 15, 2022 Signature: _____ Date: _____

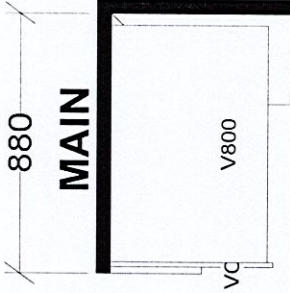
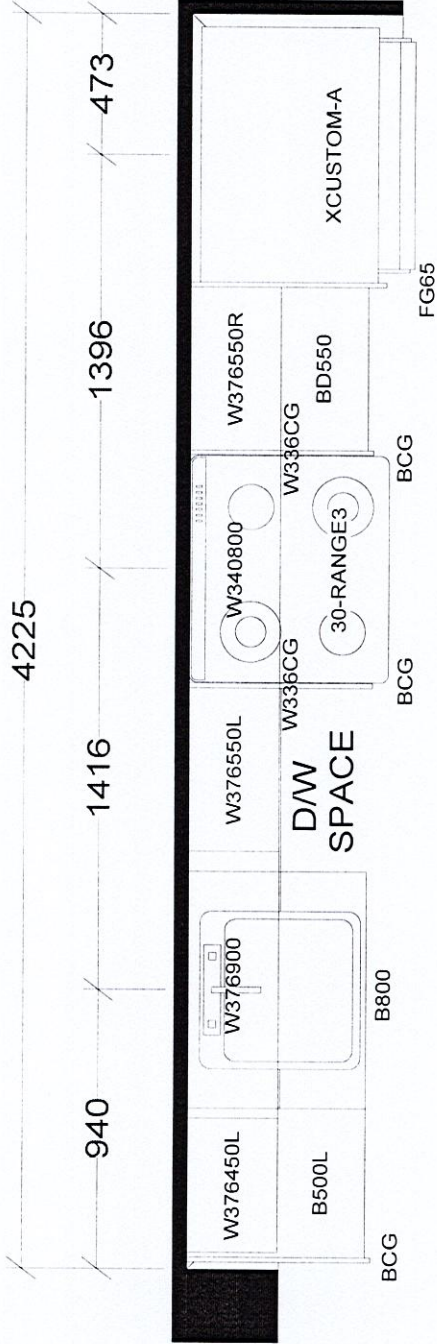

KITCHEN

BASE & VANITY CABINETS ON ADJUSTABLE LEGS

TOWER & PODIUM SUITES

SOUTH TOWER X4

Selba Industries			J #
W WDTH	W HGHT	W CNT	This drawing is the intellectual property of SELBA INDUSTRIES INC. and is an original design which must not be released or copied unless applicable fee has been paid or job order placed.
FLOOR HGHT	DOOR HGHT		
ST CNT	2X4	VENT BOX COVER	
		DESIGNER: KS DATE: JAN 6 22	
			JOB NUMBER: BUILDER: GREENPARK SITE: GRANEROLA NORTH & SOUTH MODEL: A462 LOT #:

September 18, 2019

SCHEDULE 'A'

Charisma²
ON THE PARK

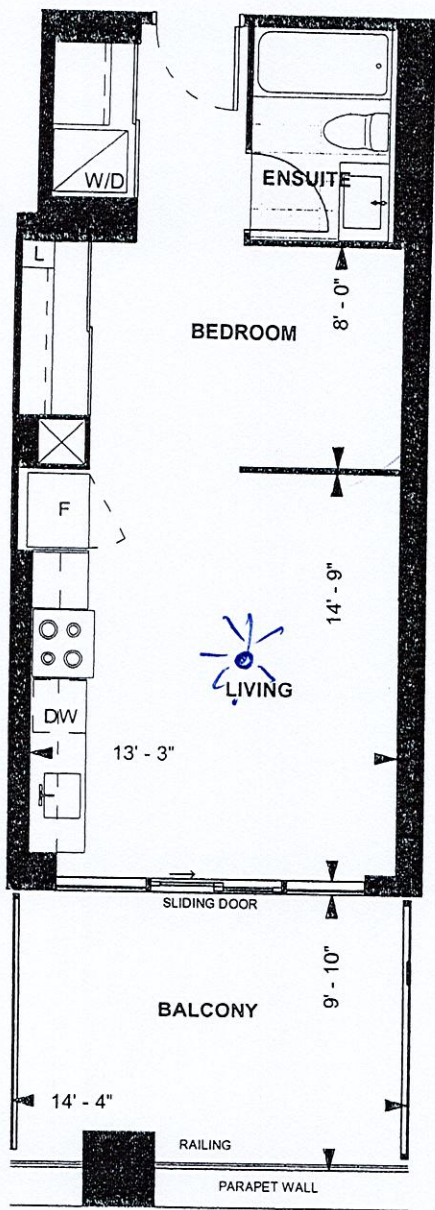

A462
TOWER SUITE
SOUTH TOWER
8'10" CEILING

462 sq. ft.
STUDIO

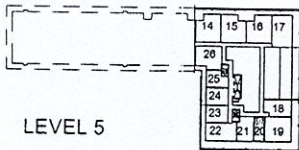

LEVEL 5

[Signature]
Purchaser Initials

[Signature]
Purchaser Initials

Apr. 6 2021
Date

Unit No. 20 Level No. 5 Suite No. 527

Dimensions, specifications, layouts, location of materials and fixtures, tile floor patterns and architectural detailing (including window size and location and door size, location and swing) are approximate only and are subject to change or modifications, without notice. Actual usable floor space varies from stated floor area. Ceiling height measured from top of floor slab to underside of floor slab above and excludes finishes, bulkheads and drop ceilings. Orientation of suite may be reversed and Purchaser agrees to accept same. Balconies decks and terraces are exclusive use common elements shown for display purposes only and location and size are subject to change without notice. All illustrations are artist concept only. The provisions of the Agreement of purchase and sale apply to this Schedule. E. & O.E