

CONSTRUCTION SUMMARY DunWest Condo - Perano Residences Ltd.		RECEIVED MAR 25 2022	TEL:
PURCHASERS: Shazia Tariq PARACHA and Tariq Siddiq PARACHA			

LOT / PHASE 802 / 1	REG. PLAN #	HOUSE TYPE F1503		
-------------------------------	--------------------	----------------------------	--	--

CABINETRY

1 - KITCHEN- BUILT IN OVEN/MICROWAVE 22Mar22 Note:	
1 - COOKTOP WITH DRAWERS UNDERNEATH 22Mar22 Note:	
1 - KITCHEN- ADD LIGHT VALANCE 28Feb22 Note:	

CABINETRY ACCESSORIES

1 - KITCEN- DELETE UPPER CABINETS ABOVE STOVE- 22Mar22 Note:	
2 - KITCHEN CABINETRY BASE-PULLOUT WIRE SPICE RACK 22Mar22 Note:	
8 - PANTRY ACCESSORY- PULLOUT SHELVES (8 PULLOUT SHELVES TOTAL, 4 PULLOUT SHELVES PER PANTRY) 28Feb22 Note: SEE SKETCH	
1 - KITCHEN CABINETRY- ADD TO ISLAND PULL OUT RECYCLE 4-BIN 28Feb22 Note:	
1 - KITCHEN CABINETRY BASE- ADD POT AND PAN DRAWERS 28Feb22 Note:	

CERAMIC TILE

1 - UPGRADE FOYER FLOOR TILE 28Feb22 Note: Main Hall Included.	
1 - UPGRADE POWDER ROOM FLOOR TILE 28Feb22 Note:	
1 - UPGRADE MASTER ENSUITE FLOOR AND WALL TILE 28Feb22 Note:	
1 - UPGRADE MAIN BATH FLOOR AND WALL TILE 28Feb22 Note:	

CONSTRUCTION

1 - SMOOTH CEILINGS THROUGHOUT- ✓ 28Feb22 Note:	
--	--

COUNTER TOP

1 - VANITY COUNTERTOP UPGRADE MATERIAL - EACH ✓ 28Feb22 Note: MASTER ENSUITE	
2 - VANITY COUNTERTOP UPGRADE MATERIAL - EACH ✓ 28Feb22 Note: MAIN BATH & POWDER ROOM	

COUNTER TOP AND BACKSPLASH

1 - KITCHEN COUNTERTOP AND BACKSPLASH - UPGRADE COLOUR - QUARTZ MISTRAL ✓ 28Feb22 Note:	
1 - KITCHEN ISLAND – ADD WATERFALL LEGS – FOR ISLANDS LEGS [REDACTED] ✓ 28Feb22 Note:	

ELECTRICAL



CONSTRUCTION SUMMARY

DunWest Condo - Perano Residences Ltd.

PURCHASERS: Shazia Tariq PARACHA and Tariq Siddiq PARACHA

TEL:

LOT / PHASE	REG. PLAN #	HOUSE TYPE		
802 / 1		F1503		
1 - ELECTRICAL ROUGH IN FOR BUILT INS- 22Mar22 Note:				
1 - ADD FLOURESENT LIGHT TO VLANCE 28Feb22 Note:				
2 - ADD TWO LIGHTS ABOVE KITCHEN ISLAND- NO FIXTURE INCLUDED 28Feb22 Note: IF CONSTRUCTION PERMITS. SEE SKETCH.				
1 - ADD A LIGHT TO THE LIVING ROOM - NO FIXTURE INCLUDED 28Feb22 Note: IF CONSTRUCTION PERMITS				
1 - POT LIGHT – ADD SHOWER POT LIGHT TO TUB 28Feb22 Note: MAIN BATH				

MIRRORS AND GLASS

1 - CLOSET SLIDER - FRAMELESS MIRROR SLIDING DOOR WITH MIRRORED FASCIA IN LIEU OF STANDARD 28Feb22 Note: BEDROOM 3	
1 - TUB ENCLOSURE - FRAMELESS GLASS TUB ENCLOSURE WITH DOOR WITH SIDE PANEL TO CEILING - INCLUDES CHROME KNOB & HINGES 28Feb22 Note: MAIN BATH	

MISCELLANEOUS

1 - ADMIN FEE FOR STANDARD CHANGE OF PACKAGE 28Feb22 Note:	
---	--

PLUMBING

1 - KITCHEN – WATERLINE ROUGH-IN FOR FRIDGE 22Mar22 Note:	
1 - KITCHEN -ISLAND RELOCATE SINK TO ISLAND 28Feb22 Note:	
3 - DELTA BATHROOM ACCESSORIES -DELTA ASHYLN 18" TOWEL BAR IN CHROME MODEL#76418 & DELTA ASHYLN TISSUE HOLDER IN CHROME MODEL#76450. TO BE PLACED IN THE POWDER ROOM, MAIN BATH & ENSUITE BATH. REFER TO SKETCH 28Feb22 Note:	
1 - KITCHEN UNDERMOUNT SINK - BLANCO QUARTUS R15 U MEDIUM #401517 28Feb22 Note:	

EXTRAS AS PER OFFER

1 Parking Unit Worksheet Note:	
-----------------------------------	--

This Document is Extremely Time Sensitive - Printed 24 Mar 22 at 13:18

Purchasers: Shazia Tariq PARACHA & Tariq Siddiq PARACHA Const. No.: Unit 2, Level 8

Telephone Res. / Bus: /

Municipal: 802

Decor Advisor: Giulia Di Girolamo

Suite Type: F1503

Lock Date: 2022-03-05 12:50:25

Project/Phase: Perano Residences Ltd./1

Layout Changes: ☐ Yes ☒ No

Sketch Attached: ☒ Yes ☐ No

1. Kitchen and Vanities

	Style and Colour	Hardware
Kitchen	DORAL WHITE W500	Standard
Main Bathroom	DORAL WHITE W500	Standard
Master Ensuite Bathroom	DORAL WHITE W500	Standard
Powder Room	DORAL WHITE W500	Standard

Built In Appliances ☐ Yes ☒ No

Kitchen Extended Upper Cabinets ☒ Yes ☐ No

Comment

** Refer to Construction Summary

2. Counters

	Counter	Edge
Kitchen	QUARTZ-MISTRAL	Straight Polished Edge
Main Bathroom	MARBLE-SILVER PORTOLO	Straight Polished Edge
Master Ensuite Bathroom	MARBLE-SILVER PORTOLO	Straight Polished Edge
Powder Room	MARBLE-NERO MARQUINO	Straight Polished Edge
Kitchen Backsplash	QUARTZ-MISTRAL	

Comment

** Refer to Construction Summary

3. Flooring

	Selection
Vestibule/Main Hall	TILE-PURITY CALACATTA LUX 24X24
Kitchen	LAMINATE-LEXINGTON-ROCHEFORT OAK-TL-LW1317
Living Room/Dining Room	LAMINATE-LEXINGTON-ROCHEFORT OAK-TL-LW1317
Den/Office	LAMINATE-LEXINGTON-ROCHEFORT OAK-TL-LW1317
Master Bedroom	LAMINATE-LEXINGTON-ROCHEFORT OAK-TL-LW1317
Bedroom #2	LAMINATE-LEXINGTON-ROCHEFORT OAK-TL-LW1317
Bedroom #3	LAMINATE-LEXINGTON-ROCHEFORT OAK-TL-LW1317
Powder Room	TILE-MISTIQ WHITE 24X24
Laundry Room	TILE-WHITE MATTE 8X8
Main Bath	TILE-PURITY STATUARIO LUX 24X24
Master Ensuite Bathroom	TILE-PURITY STATUARIO LUX 24X24

Comment

** Refer to Construction Summary - Standard Grout throughout unless specified

4. Wall Tile

	Selection	Describe
Main Bath	TILE-PURITY STATUARIO LUX 12X24	
Master Ensuite Bathroom	TILE-PURITY STATUARIO LUX 12X24	
Powder Room	N/A	
Kitchen Backsplash	QUARTZ-MISTRAL	

Comment

Purchasers:

Shazia Tariq PARACHA & Tariq Siddiq PARACHA

Const. No.:

Unit 2, Level 8

Telephone Res. / Bus:

/

Municipal:

802

Decor Advisor:

Giulia Di Girolamo

Suite Type:

F1503

Lock Date:

2022-03-05 12:50:25

Project/Phase:

Perano Residences Ltd./1

5. Misc

Water Line Rough-in for Fridge

☐ Yes

☒ No

Upgrade Bathroom Accessories

☒ Yes

☐ No

Comment

** Refer to Construction Summary

6. Wall, Trim and Door Paint - Birch White Paint Throughout unless specified below.

Entrance Vestibule	<div>BIRCH WHITE</div>	Living Room	<div>BIRCH WHITE</div>
Main Hall	<div>BIRCH WHITE</div>	Dining Room	<div>BIRCH WHITE</div>
Kitchen	<div>BIRCH WHITE</div>	Den/Library	<div>BIRCH WHITE</div>
Laundry Room	<div>BIRCH WHITE</div>	Master Bedroom	<div>BIRCH WHITE</div>
Main Bathroom	<div>BIRCH WHITE</div>	Bedroom #2	<div>BIRCH WHITE</div>
Master Ensuite Bathroom	<div>BIRCH WHITE</div>	Bedroom #3	<div>BIRCH WHITE</div>

Comment

** Refer to Construction Summary

7. General Comments

** Refer to Construction Summary

Comment

Disclaimers and Notes

- 1) Colours of all materials are as close as possible to builder's selection, but not necessarily identical due to variances in manufacturing.
- 2) The selection images are digital photographs of the Vendor's samples at its Decor Centre. Such images when displayed on your computer monitor may not match Decor Centre samples due to the hardware/software configuration of the computer.
In the event of conflict between selection images and the Décor Centre samples, Décor Centre samples shall prevail.
- 3) Any extras listed above are null and void unless accompanied by a separate invoice/amendment. Said invoice must be paid in full.
- 4) The Purchaser agrees that this colour selection is final and that no changes will be permitted, unless required by the Vendor.
- 5) The Purchaser acknowledges reading and accepting document which contains other miscellaneous disclaimers.

Signature:

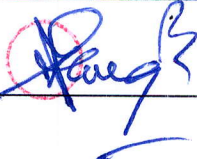

Date:

22/3/05

Signature:

Date:

Signature:

Date:

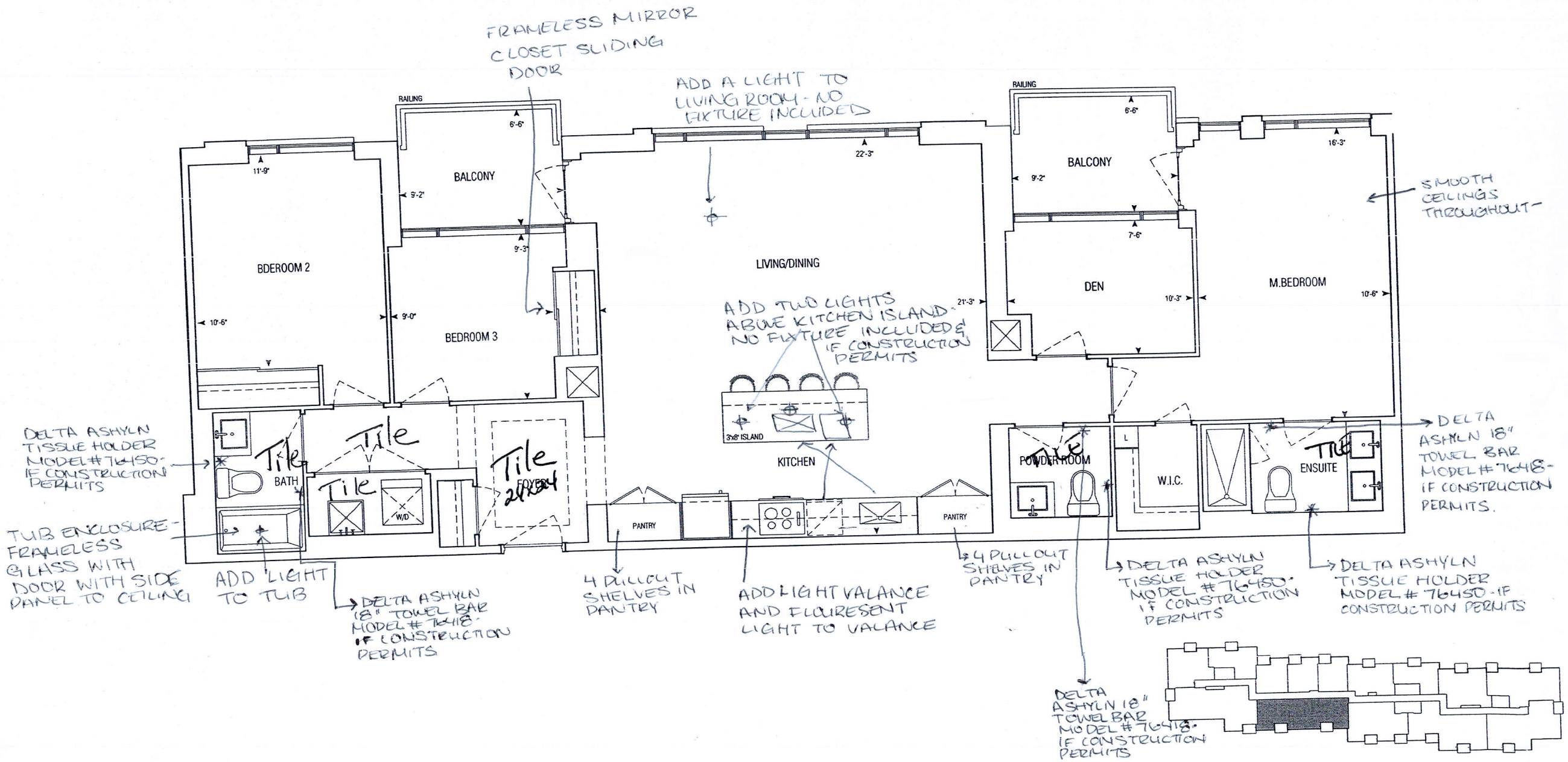

1503 sq.ft | F1503

• Greenpark • Dun West Condo • 1241.14 • Sep. 1, 2020

APPROVED: MARCH 12 2018

3 Bedroom + Den

1:75



6TH FLOOR PLAN
GRAZIANI
+ CORAZZA
ARCHITECTS INC.

FILE NAME:
DUNWEST SUITE 802

THIS LAYOUT CONTAINS EXTRAS
THAT ARE NOT PART OF CONTRACT

PROTOTYPE FOR EXTRAS

PAULINE
MAR 14 22

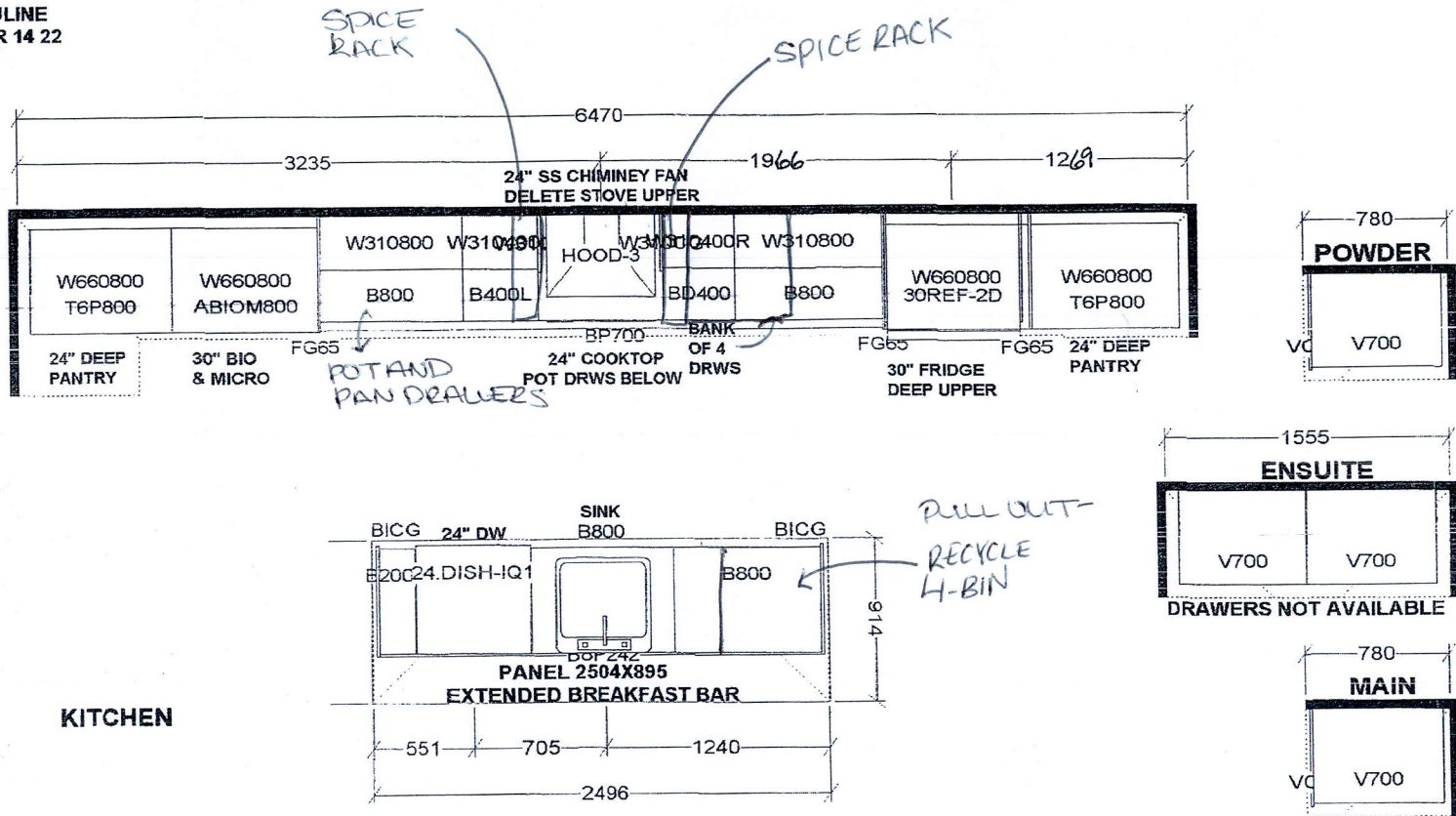

Selba Industries				
W WIDTH	W HGHT	W CNT	This drawing is the intellectual property of SELBA INDUSTRIES INC. and is an original design which must not be released or copied unless applicable fee has been paid or job order placed. DESIGNER: KS DATE: NOV 24 20/rev'd Nov 29 21	JOB NUMBER:
FLOOR HGHT	DOOR HGHT			BUILDER: GREENPARK
ST CENT	2X4	VENT BOX COVER		SITE: PERANO (Dunwest), Oakville
				MODEL: 3 BD+D-F1503
				LOT #:

Suite
802
Dunwest

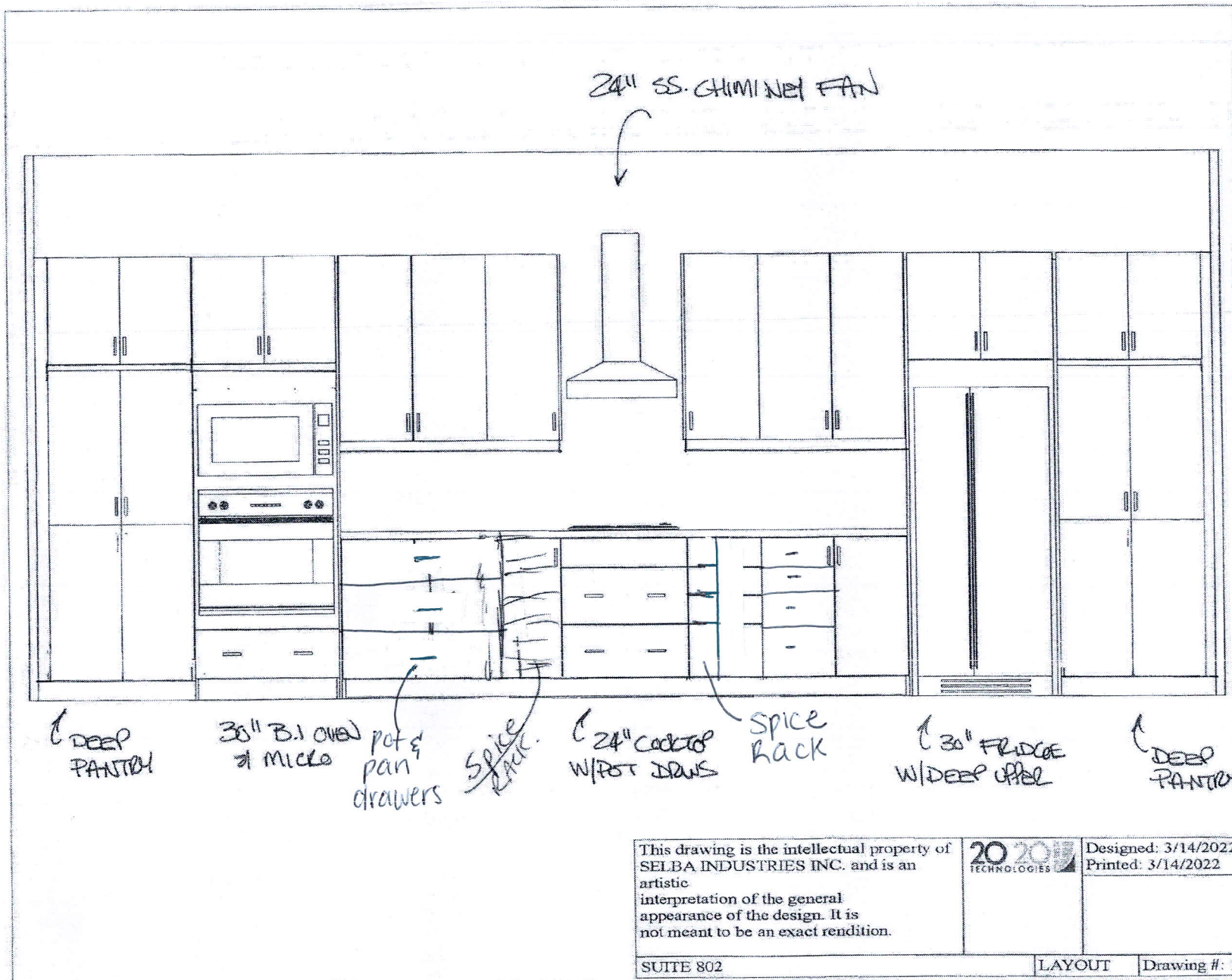

Suite
802
Dunwest

PULL
OUT
RECYCLE
BIN

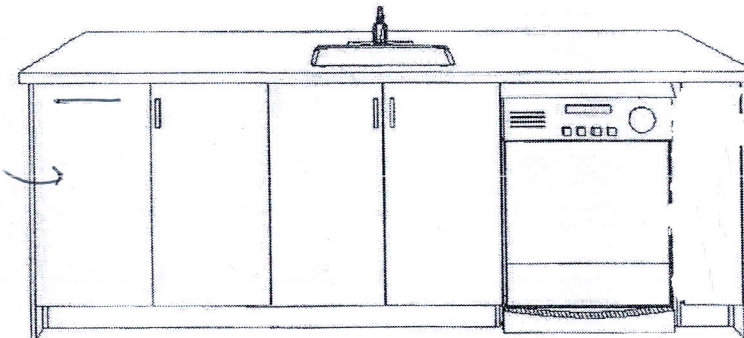

This drawing is the intellectual property of
SELBA INDUSTRIES INC. and is an
artistic
interpretation of the general
appearance of the design. It is
not meant to be an exact rendition.

2020
TECHNOLOGIES

Designed: 3/14/2022
Printed: 3/14/2022

SUITE 802

LAYOUT

Drawing #: 1

WCE55US4HB

24-inch Compact Electric Ceramic Glass Cooktop



<http://www.whirlpool.com>

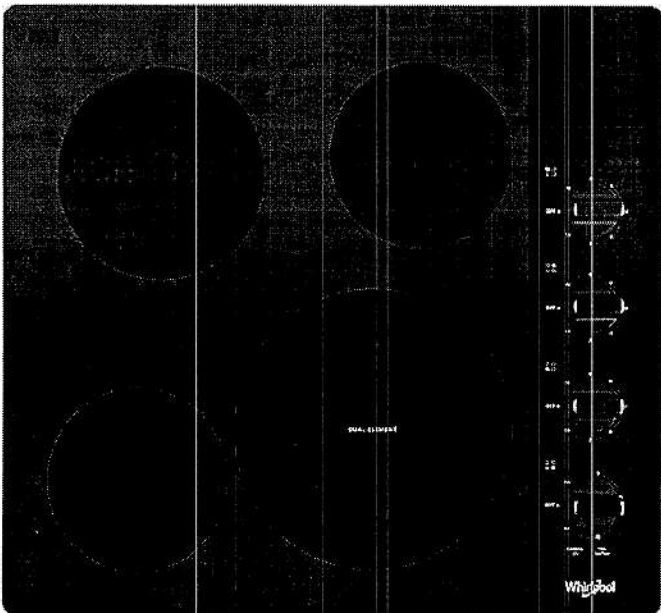

Key Features:

- Small Space Solution
- FlexHeat™ Dual Radiant Element
- Easy-Wipe Ceramic Glass Cooktop
- 30 & 40 Amp Installation
- Dishwasher-Safe Knobs
- Hot Surface Indicator Light
- Wall Oven Compatible
- 8" Extra Element
- 6" Extra Element
- #1 Selling Appliance Brand in the U.S.A.

Product Dimensions:

- Height: 5
- Width: 23 13/16
- Depth: 21 3/4

Additional Information:

- [Use And Care Guide](#)
- [Installation Guide](#)
- [Warranty Certificate](#)

Available in:

● Black



©Registered trademark/TM Trademark of Whirlpool, U.S.A. © 2016 Whirlpool Corporation. All Rights Reserved.
All other trademarks are owned by their respective companies.
Because Whirlpool Corporation policy includes a continuous commitment to improve our products, we reserve the right to change materials and specifications without notice. We also reserve the right to discontinue or transition products without notice.
Manufacturer's Suggested Retail Price (MSRP) and Minimum Advertised Price (MAP) provided for reference purposes only. Dealer alone determines advertised and retail prices.
Created On: Tuesday, January 15, 2019 18:58:20

- The cooktop should be installed away from strong draft areas, such as windows, doors, fans or strong heating vents. The cooktop should be located for convenient use in the kitchen.
- Use the countertop opening dimensions that are given with these Installation Instructions. Given dimensions are minimum clearances and provide 0" (0 cm) clearance.
- Grounded electrical supply is required. See "Electrical Requirements" section.

IMPORTANT: To avoid damage to your cabinets, check with your builder or cabinet supplier to make sure that the materials used will not discolor, delaminate, or sustain other damage.

Product Dimensions

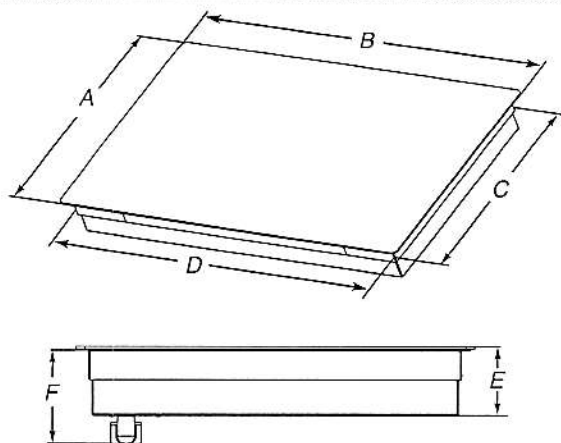

- A. Glass depth - black and white models - 21 ³/₄" (55.2 cm)
Glass depth - stainless steel models - 22 ¹/₈" (56.4 cm)
- B. Glass width - 24" (60.9 cm) models - 23 ¹³/₁₆" (60.5 cm)
Glass width - 30" (76.2 cm) models - 30 ¹³/₁₆" (78.4 cm)
Glass width - 36" (91.4 cm) models - 36 ⁵/₁₆" (92.3 cm)
- C. Frame depth - 20 ⁵/₁₆" (51.6 cm)
- D. Frame width - 24" (60.9 cm) models - 21 ⁵⁹/₆₄" (55.7 cm)
Frame width - 30" (76.2 cm) models - 29" (73.7 cm)
Frame width - 36" (91.4 cm) models - 34 ⁷/₁₆" (87.5 cm)
- E. Cooktop height with bottom heat shield - 3 ⁷/₈" (9.8 cm)
Cooktop height lighted knobs - 4 ¹⁵/₁₆" (12.55 cm)
- F. Cooktop height including conduit (located at rear of cooktop, right side) - 5" (12.7 cm)
Cooktop height lighted knobs, including conduit (located at rear of cooktop, right side) - 6 ¹/₁₆" (15.4 cm)

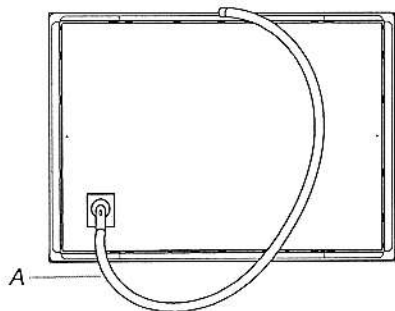

A. Location of Power Cord (length of power cord is 48" (121.9 cm), including the conduit)

Cabinet Dimensions

IMPORTANT: If installing a range hood or microwave hood combination above cooking surface, follow the range hood or microwave hood combination installation instructions for dimensional clearances above the cooktop surface.

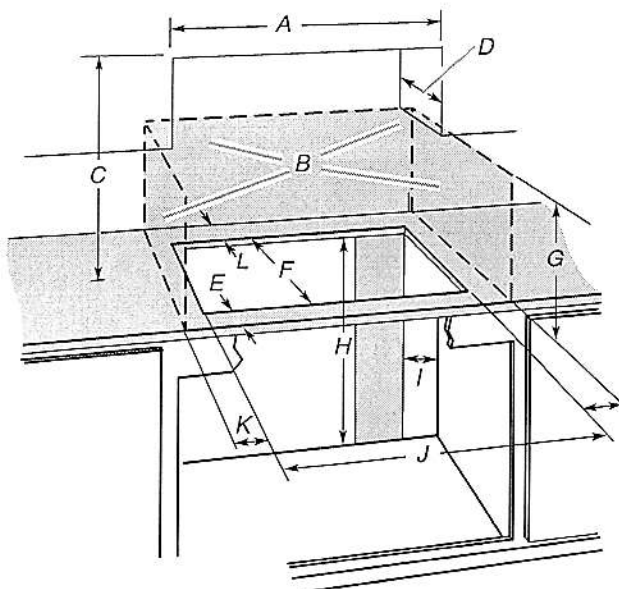

- A. 24" (60.9 cm) on 24" models; 30" (76.2 cm) on 30" models; 36" (91.4 cm) on 36" models
- B. Combustible area above countertop (shown by dashed box above)
- C. 30" (76.2 cm) minimum clearance between top of cooktop platform and bottom of uncovered wood or metal cabinet (24" [61 cm] minimum clearance if bottom of wood or metal cabinet is covered by not less than 1/4" [0.6 cm] flame retardant millboard covered with not less than No. 28 MSG sheet steel, 0.015" [0.04 cm] stainless steel, or 0.024" [0.06 cm] aluminum or 0.020" [0.05 cm] copper)
- D. 13" (33 cm) recommended upper cabinet depth
- E. 2" (5.1 cm)
- F. 20 ¹/₂" (52.0 cm) recommended cutout.
Will fit in cutout from 20 ³/₈" - 20 ⁹/₁₆" (51.8-52.2 cm).
- G. 18" (45.7 cm) minimum clearance from upper cabinet to countertop within minimum horizontal clearances to cooktop
- H. Junction box or outlet: 7" (17.8 cm) minimum from top of countertop
- I. Junction box or outlet: 9" (23.0 cm) maximum from right side of cabinet
- J. 29 ¹/₂" (74.9 cm) recommended cutout on 30" (76.2 cm) models.
Will fit in cutout from 29 ¹/₁₆" - 29 ³/₁₆" (73.8-75.1 cm) on 30" (76.2 cm) models.
35 ¹/₂" (90.2 cm) recommended cutout on 36" (91.4 cm) models.
Will fit in cutout from 34 ³/₁₆" - 35 ³/₁₆" (87.8-90.3 cm) on 36" (91.4 cm) models.
22 ⁵/₁₆" (56.67 cm) recommended cutout on 24" (61.0 cm) models.
Will fit in cutout from 22 ¹/₄" - 22 ³/₁₆" (56.4 - 57.0 cm) on 24" (61.0 cm) models.
- K. 2 ¹/₂" (6.35 cm) minimum distance to nearest left and right side combustible surface above cooktop
- L. 1 ¹/₂" (3.81 cm) minimum clearance between back wall and countertop

NOTES: After making the countertop cutout, some installations may require notching down the base cabinet side walls to clear the cooktop base. To avoid this modification, use a base cabinet with sidewalls wider than the cutout.

If cabinet has a drawer, a 5 ¹/₂" (14.0 cm) depth clearance from the top of the countertop to the top of the drawer (or other obstruction) in base cabinet is required.

Electrical Requirements

⚠ WARNING



Electrical Shock Hazard

Disconnect power before servicing.

Use 8 gauge copper wire.

Electrically ground cooktop.

Failure to follow these instructions can result in death, fire, or electrical shock.

If codes permit and a separate ground wire is used, it is recommended that a qualified electrical installer determine that the ground path and wire gauge are in accordance with local codes.

Check with a qualified electrical installer if you are not sure the cooktop is properly grounded.

Make sure that the electrical connection and wire size are adequate and in conformance with the National Electrical Code, ANSI/NFPA 70-latest edition or CSA Standards C22.1-94, Canadian Electrical Code, Part 1 and C22.2 No. 0-M91-latest edition, and all local codes and ordinances.

A copy of the above code standards can be obtained from:

National Fire Protection Association
1 Batterymarch Park
Quincy, MA 02169-7471
CSA International
8501 East Pleasant Valley Road
Cleveland, OH 44131-5575

Before You Make the Electrical Connection:

To properly install your cooktop, you must determine the type of electrical connection you will be using and follow the instructions provided for it here.

Use a 3-wire or 4-wire, single phase, 120/208 V or 120/240 V, 60 Hz, AC only. The model/serial number rating plate is located on the metal cabinet underneath the cooktop. See the following illustration.

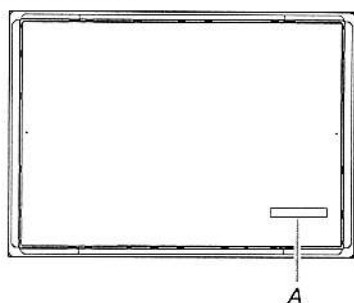

A. Model/serial number plate

- The cooktop is rated for 120/208 V or 120/240 V. Some models have a neutral (white) wire.

For power requirements, refer to the following table:

Family Model Number	Electrical Ratings at 60 Hz	
	208 V~	240 V~
WCE55US0H	5.0 kW	6.7 kW
WCE55US4H	5.0 kW	6.7 kW
WCE55US6H	6.0 kW	8.0 kW
WCE77US0H	6.4 kW	8.5 kW
WCE77US6H	6.4 kW	8.5 kW
WCE97US0H	6.8 kW	9.1 kW
WCE97US6H	6.8 kW	9.1 kW
MEC8830H	6.5 kW	8.6 kW
MEC8836H	7.4 kW	9.9 kW
KCES550H	7.9 kW	10.5 kW
KCES556H	7.9 kW	10.5 kW
KCES950H	7.2 kW	9.6 kW
KCES956H	7.2 kW	9.6 kW
JEC3430H	6.4 kW	8.5 kW
JEC3536H	7.9 kW	10.5 kW
JEC4424H	5.5kW	7.3 kW
JEC4430H	7.2 kW	9.6 kW
JEC4536H	7.2 kW	9.6 kW

- The cooktop should be connected directly to the junction box through flexible, armored or nonmetallic sheathed, copper cable. The flexible, armored cable extending from the fuse box or circuit breaker box should be connected directly to the junction box.
- Locate the junction box to allow as much slack as possible between the junction box and the cooktop so that the cooktop can be moved if servicing becomes necessary in the future.
- Do not cut the conduit. Use the length of conduit provided. A UL listed or CSA approved conduit connector must be provided at each end of the power supply cable (at the cooktop and at the junction box). A listed conduit connector is already provided at the cooktop.
- If the house has aluminum wiring follow the procedure below:
Connect the aluminum wiring using special connectors and/or tools designed and UL listed for joining copper to aluminum.

Follow the electrical connector manufacturer's recommended procedure. Aluminum/copper connection must conform with local codes and industry accepted wiring practices.

UXW7324BSS

24" Wall-Mount Canopy



<http://www.whirlpoolcorp.com>

Key Features:

- Dishwasher Safe Aluminum Mesh Grease Filter
- Halogen lights provide increased visibility of the cooking surface with brighter, more natural light

Product Dimensions:

- Height: 38
- Width: 24
- Depth: 20

Electrical Requirements:

- 15. 120 V.

Additional Information:

- [Use And Care Guide](#)
- [Dimension Guide](#)
- [Installation Guide](#)
- [Warranty Certificate](#)

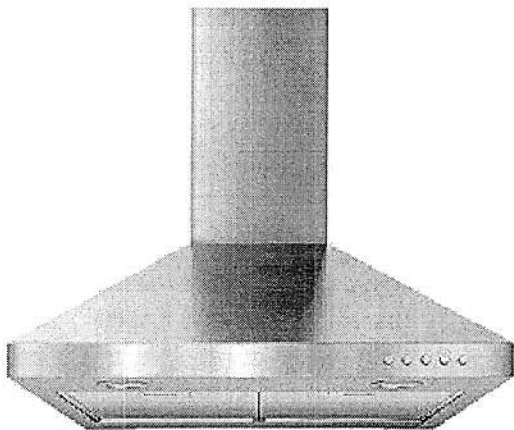

Available in:

- ☒ Stainless Steel

©Registered trademark/TM Trademark of Whirlpool, U.S.A. © 2016 Whirlpool Corporation. All Rights Reserved.
All other trademarks are owned by their respective companies.
Because Whirlpool Corporation policy includes a continuous commitment to improve our products, we reserve the right to change materials and specifications without notice. We also reserve the right to discontinue or transition products without notice.
Manufacturer's Suggested Retail Price (MSRP) and Minimum Advertised Price (MAP) provided for reference purposes only. Dealer alone determines advertised and retail prices.
Created On: Thursday, April 13, 2017 07:38:06

Range Hood – 30" (76.2 cm) and 36" (91.4 cm)

PRODUCT MODEL NUMBERS

UXW7324B

Electrical: A 120-volt, 60-Hz, AC-only, 15 amp, fused electrical circuit is required.

CABINET DIMENSIONS

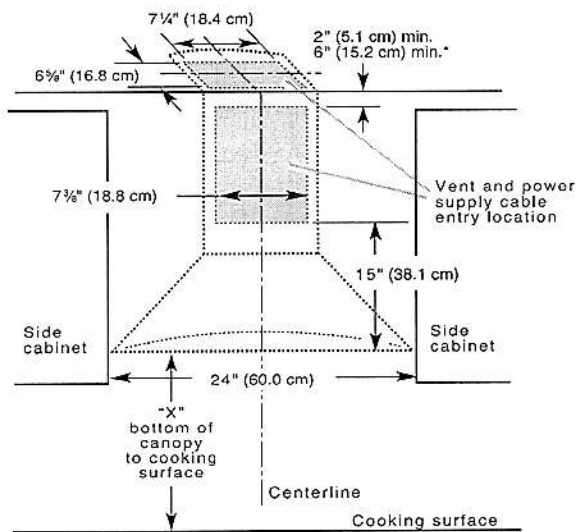

*For non-vented (recirculating) installations

IMPORTANT:

- Minimum distance "X": 24" (61.0 cm) from electric cooking surface.
- Minimum distance "X": 27" (68.6 cm) from gas cooking surface
- Suggested maximum distance "X": 36" (91.4 cm)

The chimneys can be adjusted for different ceiling heights. See the following chart.

Vented Installations		
	Min. ceiling height	Max. ceiling height
Electric cooking surface	7' 5" (2.26 m)	9' 2" (2.79 m)
Gas cooking surface	7' 8" (2.34 m)	9' 2" (2.79 m)

Non-vented (recirculating) Installations		
	Min. ceiling height	Max. ceiling height
Electric cooking surface	7' 5" (2.26 m)	9' 6" (2.9 m)
Gas cooking surface	7' 8" (2.34 m)	9' 6" (2.9 m)

***NOTE:** The range hood chimneys are adjustable and designed to meet varying ceiling or soffit heights depending on the distance "X" between the bottom of the range hood and the cooking surface. For higher ceilings, a Stainless Steel Chimney Extension Kit Part Number W10337357 is available from your dealer or an authorized parts distributor. The chimney extension replaces the upper chimney shipped with the range hood.

PRODUCT DIMENSIONS

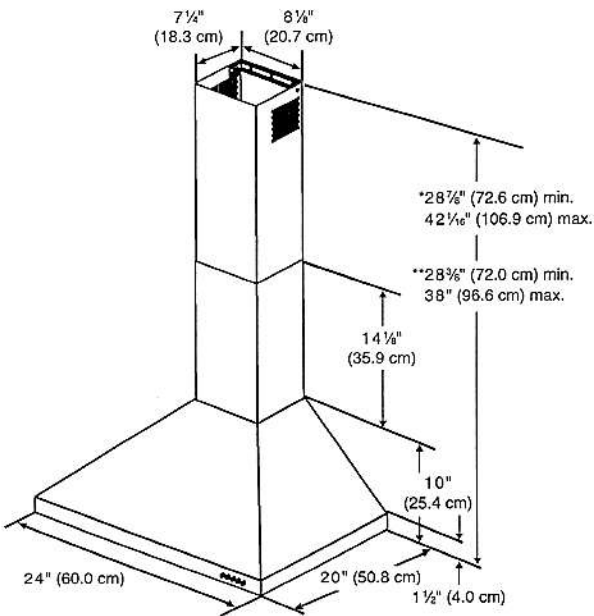

*For non-vented (recirculating) installations
**For vented installations

VENTING METHODS

- Vent system must terminate to the outdoors, except for nonvented (recirculating) installations.
 - Do not terminate the vent system in an attic or other enclosed area.
 - Do not use 4" (10.2 cm) laundry-type wall cap.
 - Use metal vent only. Rigid metal vent is recommended. Plastic or metal foil vent is not recommended.
 - The length of vent system and number of elbows should be kept to a minimum to provide efficient performance.
- For the most efficient and quiet operation:**
- Use no more than three 90° elbows.
 - Make sure there is a minimum of 24" (61 cm) of straight vent between the elbows if more than 1 elbow is used.
 - Do not install 2 elbows together.
 - Use clamps to seal all joints in the vent system.
 - The vent system must have a damper. If the roof or wall cap has a damper, do not use the damper supplied with the range hood.
 - Use caulking to seal exterior wall or roof opening around the cap.
 - The size of the vent should be uniform.

VENTING METHODS (cont.)

This canopy hood is factory set for venting through the roof or wall.

A 6" (15.2 cm) round vent system is needed for installation (not included). The hood exhaust opening is 6" (15.2 cm) round.

NOTE: Flexible vent is not recommended. Flexible vent creates back pressure and air turbulence that greatly reduce performance.

Vent system can terminate either through the roof or wall. To vent through a wall, a 90° elbow is needed.

Rear discharge



A 90° elbow may be installed immediately above the hood.

For Non-Vented (recirculating) Installations

If it is not possible to vent cooking fumes and vapors to the outside, the hood can be used in the non-vented (recirculating) version, using a Recirculation Kit (which includes charcoal filters and a deflector).

Calculating Vent System Length

To calculate the length of the system you need, add the equivalent feet (meters) for each vent piece used in the system.

Vent Piece	6" (15.2 cm) Round
45° elbow	2.5 ft (0.8 m) 
90° elbow	5.0 ft (1.5 m) 

Maximum equivalent vent length is 35 ft (10.7 m).

Roof Venting

Wall Venting

Non-vented
(recirculating)

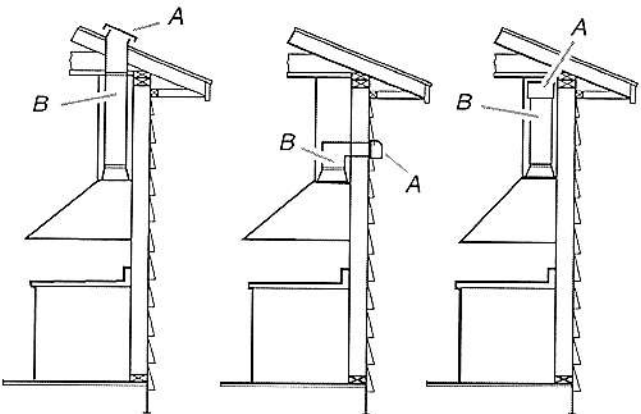

A. Roof cap
B. 6" (15.2 cm)
round vent

A. Wall cap
B. 6" (15.2 cm)
round vent

A. Deflector
B. 6" (15.2 cm)
round vent

Example vent system

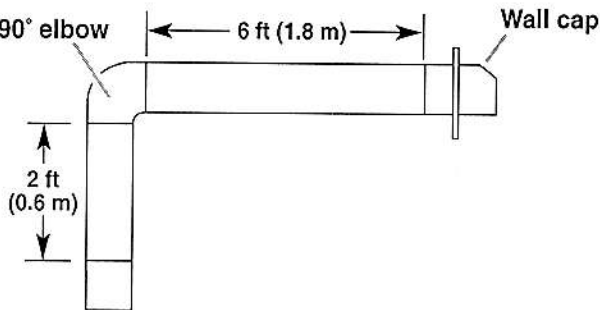

The following example falls within the maximum recommended vent length of 35 ft (10.7 m).

1 - 90° elbow	= 5.0 ft (1.5 m)
1 - wall cap	= 0.0 ft (0.0 m)
8 ft (2.4 m) straight	= 8.0 ft (2.4 m)
Length of system	= 13.0 ft (3.9 m)

WRF560SEHZ



30-inch Wide French Door Refrigerator - 20 cu. ft.

<http://www.whirlpool.com>

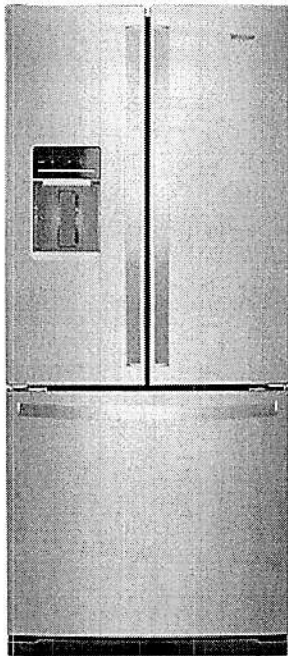

Key Features:

- Humidity-Controlled Crispers
- Adjustable Gallon Door Bins
- Tuck Shelf
- FreshFlow™ Produce Preserver
- Spillproof Glass Shelves
- LED Interior Lighting
- Fingerprint Resistant
- Compact 30" Width
- Exterior Water Dispenser with EveryDrop® Filtration
- Full-Width Pantry Drawer
- Condiment Caddy
- Adaptive Defrost

Product Dimensions:

Height: 68 3/8
Width: 30
Depth: 34 3/8

Additional Information:

- [Use And Care Guide](#)
- [Dimension Guide](#)
- [Energy Guide](#)
- [Warranty Certificate](#)

Available in:

- Black
- Fingerprint Resistant Black
- White
- Fingerprint Resistant Stainless Steel

©Registered trademark/TM Trademark of Whirlpool, U.S.A. © 2016 Whirlpool Corporation. All Rights Reserved.
All other trademarks are owned by their respective companies.
Because Whirlpool Corporation policy includes a continuous commitment to improve our products, we reserve the right to change materials and specifications without notice. We also reserve the right to discontinue or transition products without notice.
Manufacturer's Suggested Retail Price (MSRP) and Minimum Advertised Price (MAP) provided for reference purposes only. Dealer alone determines advertised and retail prices.
Created On: Friday, May 07, 2021 05:48:08

Unit 802
Tariq Paracha



Models	Pages
WRF560SEHZ Whirlpool Refrigeration	3-4
WOC54EC0HS Whirlpool Wall Oven	5-7
WCE55US4HB Whirlpool Cooktop	8-10
UXW7324BSS Whirlpool Ventilation	11-13
WDTA50SAKZ Whirlpool Dishwasher	14-18
WKEX200HBA LG Washer-Dryer	19

Coast Appliances
coastappliances.com

JERRY DOMANICO
Contract Sales
9053324264

Search 20220309201811678SC
Version 1.1

Wed, Mar 9, 2022
3:18 PM EST

To ensure a smooth project it is the responsibility of the homeowner / purchaser of appliances for this project to share all the attached specifications to ensure the cabinet provider, contractor, or any other tradesperson have all the information required to complete their work accurately.

Specifications are subject to change. If any tradesperson has questions regarding the attached specifications please contact our sales associate.



enterprise.steelcod.com/sp/csta/ZEY2MWET

Note about page numbers:
Because the original manufacturer's documents are not altered in any way, the page numbers displayed on the page may not correspond to the page number within this package.

All specifications are intended for initial planning purposes only. Manufacturers reserve the right to change specifications at any time without notice. Always consult the installation instructions found on the manufacturer's website or included with the appliances before installation.

WOC54EC0HS



<http://www.whirlpool.com>

6.4 cu. ft. Smart Combination Wall Oven with
Touchscreen

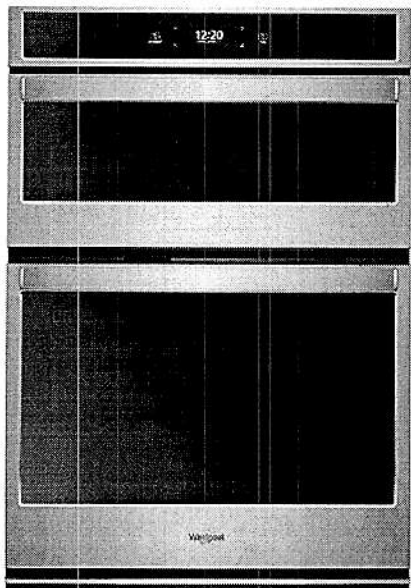

Key Features:

- Smart Appliance
- Touchscreen
- Voice Control with a Smart Voice Assistant (U.S. Only)
- Multi-Step Cooking
- Frozen Bake™ Technology
- Nest Learning Thermostat™ Integration (U.S. Only)
- Remote Start
- Keep Warm Setting
- Party Mode
- Enhanced Troubleshooting
- Guided Service
- Temperature Sensor

Product Dimensions:

Height: 42 9/16

Width: 30

Depth: 26 1/2

Additional Information:

[Use And Care Guide](#)

[Installation Guide](#)

[Warranty Certificate](#)

Available in:

- Black
- Stainless Steel
- White

INVESTED
IN
AMERICA

©Registered trademark/TM Trademark of Whirlpool, U.S.A. © 2016 Whirlpool Corporation. All Rights Reserved.
All other trademarks are owned by their respective companies.
Because Whirlpool Corporation policy includes a continuous commitment to improve our products, we reserve the right to change materials and specifications without notice. We also reserve the right to discontinue or transition products without notice.
Manufacturer's Suggested Retail Price (MSRP) and Minimum Advertised Price (MAP) provided for reference purposes only. Dealer alone determines advertised and retail prices.
Created On: Friday, September 28, 2018 11:37:38

DRAIN REQUIREMENTS

- A new drain hose is supplied with your dishwasher. If drain hose is not long enough, use a new drain hose with a maximum length of 12 ft (3.7 m) that meets all current AHAM/ IAPMO test standards, is resistant to heat and detergent, and fits the 1" (2.5 cm) drain connector of the dishwasher.

NOTE: Do not connect multiple drain hoses together.

- Make sure to connect drain hose to waste tee or disposer inlet above drain trap in house plumbing and 20" (50.8 cm) minimum above the floor. It is recommended that the drain hose either be looped up and securely fastened to the underside of the counter or be connected to an air gap.
- Make sure to use an air gap if the drain hose is connected to house plumbing lower than 20" (50.8 cm) above subfloor or floor.

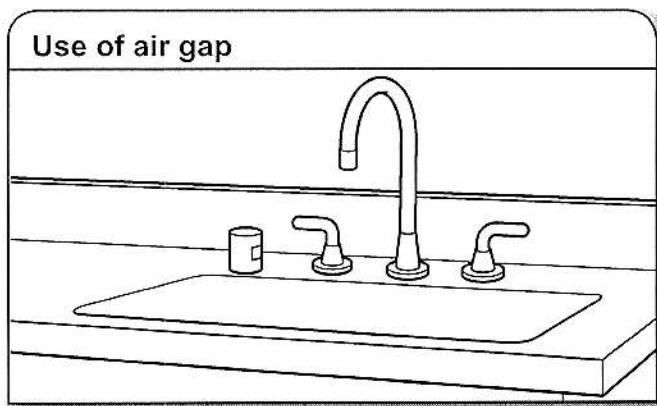

- If required, the air gap should be installed in accordance with the air gap installation instructions. When you are connecting the air gap, a rubber hose (not provided) will be needed to connect to the waste tee or disposer inlet.
- Use 1/2" (1.3 cm) minimum I.D. drain line fittings.

WATER SUPPLY REQUIREMENTS

- This dishwasher has a water heating feature and also requires a connection to a hot water supply line.
 - A hot water line with 20 psi to 120 psi (138 kPa to 862 kPa) water pressure can be verified by a licensed plumber.
 - 120°F (49°C) water at dishwasher.
 - 3/8" (0.95 cm) O.D. copper tubing with compression fitting or flexible braided water supply line.
- NOTE:** 1/2" (1.3 cm) minimum plastic tubing is not recommended.
- A 90° elbow with 3/4" (0.95 cm) hose connection with rubber washer.
 - Do not solder within 6" (15.2 cm) of the water inlet valve.
 - If installed in new construction, make sure the house water supply lines have been flushed prior to connecting the dishwasher to remove any debris that may exist in the supply line.

NOTE: If replacing an existing dishwasher, it is recommended to install a new water line and drain hose (supplied) with the new dishwasher.

ELECTRICAL REQUIREMENTS

⚠ WARNING

Electrical Shock Hazard

Plug into a grounded 3 prong outlet.

Do not remove ground prong.

Do not use an adapter.

Do not use an extension cord.

Failure to follow these instructions can result in death, fire, or electrical shock.

Be sure that the electrical connection and wire size are adequate and in conformance with the National Electrical Code, ANSI/NFPA 70 - latest edition, and all local codes and ordinances.

A copy of the above code standards can be obtained from:

National Fire Protection Association
1 Batterymarch Park
Quincy, MA 02169-7471

You Must Have:

- 120 V, 60 Hz, AC only, 15 A or 20 A, fused electrical supply
- Copper wire only
- A maximum of 2 field wiring supply conductors (12 AWG largest size) plus 1 grounding conductor are permitted in the terminal box.

We Recommend:

- A time-delay fuse or circuit breaker.

Circuit Requirements:

- The dishwasher may be installed on the same circuit as a garbage disposal providing that the branch circuit cannot exceed rated circuit load and must comply with all governing codes and regulations such as but not limited to National Electrical Code, ANSI/NFPA 70 - latest edition.
- No electrical connections other than the dishwasher power and ground connections can be made inside of the dishwasher terminal box.

If connecting dishwasher with a power supply cord:

- Use UL Listed power cord kit marked for use with dishwasher.
- Plug into a grounded 3 prong outlet. Outlet must meet all local codes and ordinances.



If connecting dishwasher with direct wiring:

- Use flexible, armored, or nonmetallic sheathed copper wire with grounding wire that meets the wiring requirements for your home and local codes and ordinances.
- Use a UL Listed/CSA Approved metallic strain relief.

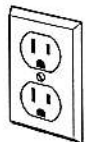

Electrical Requirements

If codes permit and a separate ground wire is used, it is recommended that a qualified electrical installer determine that the ground path and wire gauge are in accordance with local codes.

Check with a qualified electrical installer if you are not sure the oven is properly grounded.

This oven must be connected to a grounded metal, permanent wiring system.

Be sure that the electrical connection and wire size are adequate and in conformance with the National Electrical Code, ANSI/NFPA 70-latest edition or CSA Standards C22.1-94, Canadian Electrical Code, Part 1 and C22.2 No. O-M91-latest edition, and all local codes and ordinances.

A copy of the above code standards can be obtained from:

National Fire Protection Association
1 Batterymarch Park
Quincy, MA 02169-7471

CSA International
8501 East Pleasant Valley Road
Cleveland, OH 44131-5575

Electrical Connection

To properly install your oven, you must determine the type of electrical connection you will be using and follow the instructions provided for it here.

- Oven must be connected to the proper electrical voltage, amperage, and frequency as specified on the model/serial/rating plate. See the following illustration.

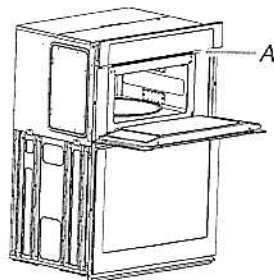

A. Model/serial/rating plate

- Models rated from 7.3 to 9.6 kW at 240 volts (6.3 to 8.3 kW at 208 volts) require a separate 40-amp circuit. Models rated from 4.9 to 7.2 kW at 240 volts (4.3 to 6.2 kW at 208 volts) require a separate 30-amp circuit. Models rated at 4.8 kW and below at 240 volts (4.2 kW and below at 208 volts) require a separate 20-amp circuit.
- A circuit breaker is recommended.
- Connect directly to the fused disconnect (or circuit breaker box) through flexible, armored or nonmetallic sheathed, copper cable (with grounding wire). See the "Make Electrical Connection" section.
- Flexible conduit from the oven should be connected directly to the junction box.
- Do not cut the conduit. The length of conduit provided is for serviceability of the oven.
- A UL Listed or CSA Approved conduit connector must be provided.
- If the house has aluminum wiring, follow the procedure below:
 - Connect the aluminum wiring using special connectors and/or tools designed and UL Listed for joining copper to aluminum.

Follow the electrical connector manufacturer's recommended procedure. Aluminum/copper connection must conform with local codes and industry accepted wiring practices.

Be sure that the electrical connection and wire size are adequate and in conformance with the National Electrical Code, ANSI/NFPA 70-latest edition or CSA Standards C22.1-94, Canadian Electrical Code, Part 1 and C22.2 No. O-M91-latest edition, and all local codes and ordinances. A copy of the above code standards can be obtained from: National Fire Protection Association 1 Batterymarch Park Quincy, MA 02169-7471 CSA International 8501 East Pleasant Valley Road Cleveland, OH 44131-5575.

For power requirements, refer to the following table.

Series	Voltage	Frequency	Rating
WOC97EC/ WOC75EC	120/240 V AC	60 Hz	7.6 kW
	120/208 V AC	60 Hz	6.2 kW
WOC75EC	120/240 V AC	60 Hz	7.5 kW
	120/208 V AC	60 Hz	6.1 kW
WOC54EC	120/240 V AC	60 Hz	7.5 kW
	120/208 V AC	60 Hz	6.1 kW

Built-In Microwave/Oven Combination Location Requirements

IMPORTANT: Observe all governing codes and ordinances.

- Cabinet opening dimensions that are shown must be used. Given dimensions provide minimum clearance with oven.
- Recessed installation area must provide complete enclosure around the recessed portion of the oven.
- Grounded electrical supply is required. See the "Electrical Requirements" section.
- Electrical supply junction box should be located 3" (7.6 cm) above the cutout 3" (7.6 cm) maximum below the support surface when the oven is installed in a wall cabinet. A 1" (2.5 cm) minimum diameter hole should have been drilled in the right rear or left rear corner of the upper or lower support surface to pass the appliance cable through to the junction box.
- Oven support surface must be solid, level and flush with bottom of cabinet cutout. Floor must be able to support a total weight (microwave and built-in oven) of 208 lbs (95 kg) for 27" (68.6 cm) models or 249 lbs (113 kg) for 30" (76.2 cm) models.

IMPORTANT: To avoid damage to your cabinets, check with your builder or cabinet supplier to make sure that the materials used will not discolor, delaminate or sustain other damage. This oven has been designed in accordance with the requirements of UL and CSA International and complies with the maximum allowable wood cabinet temperatures of 194°F (90°C).

Product Dimensions

27" (68.6 cm) and 30" (76.2 cm) Ovens

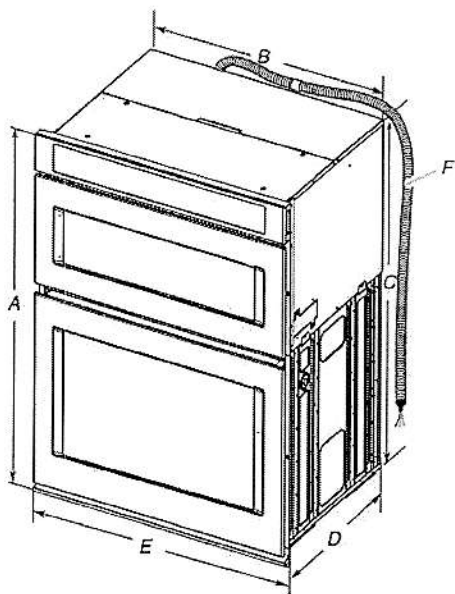

30" (76.2 cm) models

- A. 42⁹/₁₆" (108.0 cm) overall height
- B. 28¹/₂" (72.3 cm) recessed width
- C. 41" (104.1 cm) recessed height
- D. 23¹/₄" (59.1 cm) max. recessed depth
- E. 30" (76.2 cm) overall width
- F. 48" (121.9 cm) Flexible conduit length measured from the conduit clamp located at the rear of the oven. Do not remove the conduit clamp.

Cabinet Dimensions

27" (68.6 cm) and 30" (76.2 cm) Ovens

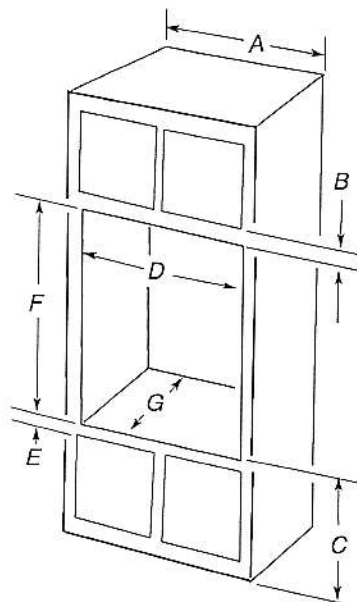

30" (76.2 cm) models

- A. 30" (76.2 cm) min. cabinet width
- B. 1" (2.5 cm) top of cutout to bottom of upper cabinet door
- C. 19¹/₄" (48.9 cm) bottom of cutout to floor is recommended. 4"-19¹/₄" (10.2-48.9 cm) bottom of cutout to floor is acceptable.
- D. 28¹/₂" (72.4 cm) cutout width
- E. 1¹/₂" (3.8 cm) min. bottom of cutout to top of cabinet door
- F. 41⁵/₁₆" (105 cm)* recommended cutout height
- G. 24" (60.7 cm) cutout depth

* **NOTE:** The cutout height can be between 41" (104.1 cm) and 41¹/₂" (105.6 cm) for microwave/oven combination.

Whirlpool®

French Door Bottom Mount Refrigerator

PRODUCT MODEL NUMBERS

WRF560SEH

Electrical: A 115 V, 60 Hz., AC only, 15 or 20 A fused, grounded electrical supply is required. It is recommended that a separate circuit serving only your freezer be provided. Use an outlet that cannot be turned off by a switch. Do not use an extension cord.

NOTE: Before performing any type of installation, cleaning, or removing a light bulb, turn the control (Thermostat, Refrigerator or Freezer Control depending on the model) to OFF and then disconnect the refrigerator from the electrical source. When you are finished, reconnect the refrigerator to the electrical source and reset the control (Thermostat, Refrigerator or Freezer Control depending on the model) to the desired setting. See "Using the Controls."

Water: A cold water supply with water pressure between 35 and 120 psi (241 and 827 kPa) is required to operate the water dispenser and ice maker. If you have questions about your water pressure, call a licensed, qualified plumber.

NOTE: If the water pressure is less than what is required, the flow of water from the water dispenser could decrease or ice cubes could be hollow or irregular shaped.

Reverse Osmosis Water Supply

IMPORTANT: The pressure of the water supply coming out of a reverse osmosis system going to the water inlet valve of the refrigerator needs to be between 35 and 120 psi (241 and 827 kPa).

If a reverse osmosis water filtration system is connected to your home cold water supply, the water pressure to the reverse osmosis system needs to be a minimum of 40 to 60 psi (276 to 414 kPa).

PRODUCT DIMENSIONS

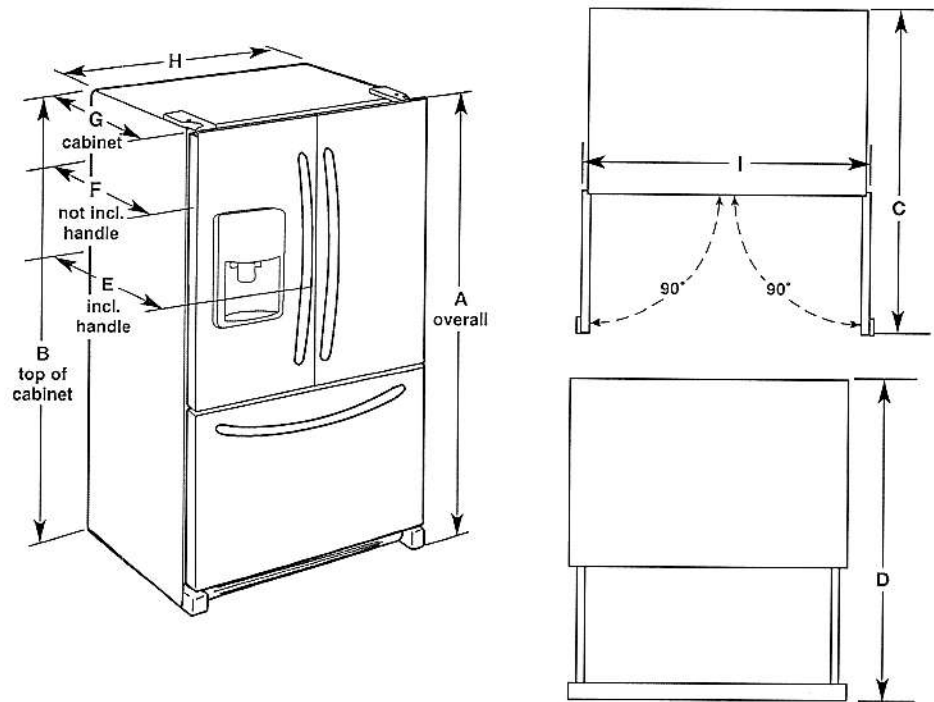

Model Number	Model Size	Height - Overall "A"	Height - Top of Cabinet "B"	Depth - Doors Open 90° "C"	Depth - Drawer Open "D"	Depth - With Handles "E"	Depth - Without Handles "F"	Depth - Cabinet Only "G"	Width - Cabinet "H"
WRF560SEH	20 cu. ft. (566.3 L)	68 3/8" (173.7 cm)	67 3/8" (171.1 cm)	51 1/8" (131.3 cm)	52 1/8" (132.4 cm)	34 3/8" (87.3 cm)	32 3/8" (82.2 cm)	27 13/16" (70.7 cm)	29 1/2" (74.9 cm)

LOCATION REQUIREMENTS

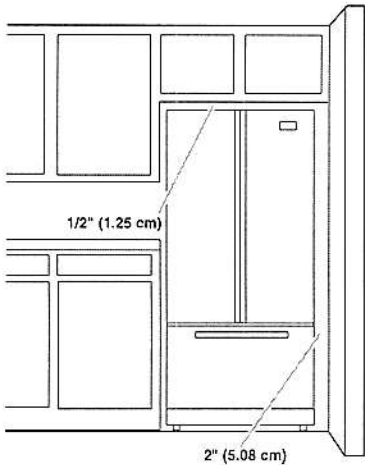

To ensure proper ventilation for your refrigerator, allow for a 1/2" (1.25 cm) of space on each side and at the top. Allow for a 1" (2.54 cm) space behind the refrigerator. If your refrigerator has an ice maker, allow extra space at the back for the water line connections. When installing your refrigerator next to a fixed wall, leave a 2" (5.08 cm) minimum space between the refrigerator and wall to allow the door to swing open.

NOTE: This refrigerator is intended for use in a location where the temperature ranges from a minimum of 55°F (13°C) to a maximum of 110°F (43°C). The preferred room temperature range for optimum performance, which reduces electricity usage and provides superior cooling, is between 60°F (15°C) and 90°F (32°C). It is recommended that you do not install the refrigerator near a heat source, such as an oven or radiator.

LG LAUNDRY

WKEX200HBA

LG WashTower™ with Centre Control™
5.2 cu.ft. Washer, 7.4 cu.ft. Dryer

Unitary One Body Design with Centre Control™

AIDD™ & AI Sensor Dry™

TurboWash™ 360

TurboSteam™

Wi-Fi Enabled™

Full STS Drums with STS Lifters™

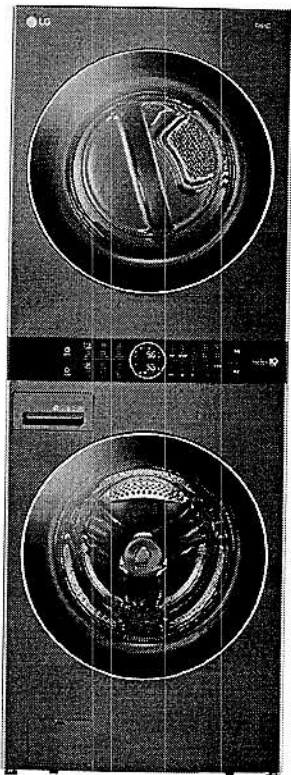

Enjoy new ways to control your home with LG smart appliances

- Start the laundry while you're out shopping
- Get alerts when the cycle is finished
- Works with the LG ThinQ® app

works with the Google Assistant

works with alexa



SUMMARY	Washer	Dryer
Type	Front Load Washer	Front Load Dryer
Capacity (cu.ft)	5.2	7.4
Colour	Black Steel (B)	
APPEARANCE	Washer	Dryer
Hard Buttons		No
Full Touch Electronic Control Panel		Yes
ENERGY	Washer	Dryer
ENERGY STAR® Qualified	Yes	
CEE Tier	Tier2	-
IMEF	2.92	-
IWF	2.9	-
CEF	-	3.94
PROGRAMS	Washer	Dryer
No. of Programs	6 Normal, Bedding, Delicates, Heavy Duty, Speed Wash, Downloaded	6 Normal, Bedding, Delicates, Heavy Duty, Speed Wash, Downloaded
OPTIONS	Washer	Dryer
No. of Options	10 TurboWash®, Steam, Extra Rinse, Pre-wash, Sanitary, Tub Clean, Drum Light, Child Lock, Signal, Wi-Fi / Remote Start	10 Wrinkle Care, TurboSteam™, Reduce Static, Energy Saver, Steam Fresh®, Drum Light®, Child Lock®, Signal®, Wi-Fi® / Remote Start
DETAILS	Washer	Dryer
No. of Wash/Rinse Temps	5 Hot, Warm/Hot, Warm, Cold/ Warm, Cold	-
No. of Spin Speeds	5 High, Medium/ High, Medium, Low, No Spin	-
Max RPM	1300	-
Water Levels	Load Sensing	-
No. of Soil Levels	5	-
Temperature Settings	-	High, Medium/ High, Medium, Low/Medium, Low

Drying Levels	-	Very, More, Normal, Less, Damp
Manual Dry Times	-	60 min., 50 min., 40 min., 30 min., 20 min.
FABRIC CARE FEATURES	Washer	Dryer
AI DD	Yes	-
TurboWash™ 360 Technology	Yes	-
TurboWash™ 2.0 Technology	No	-
Steam Technology	Yes	-
Allergiene™ Cycle	Yes	-
Sanitary Cycle	Yes	-
SenseClean™ System	Yes	-
AI Sensor Dry™	-	Yes
Sensor Dry	-	Yes
Precise Temperature Control with Variable Heater	-	Yes
Steam Technology	-	Yes (TurboSteam™)
CONVENIENCE FEATURES	Washer	Dryer
TrueBalance™ Anti-Vibration System	Yes	-
4 Tray Dispenser		Prewash, Main Wash (with liquid detergent cup), Bleach, Fabric Softener
LoadSense	Yes	-
Auto Suds Removal	Yes	-
3 Minute Installation Check	-	Yes
Reversible Door	-	No
FlowSense™ Duct Clogging Indicator	-	Yes
Wrinkle Care Option	-	Yes
Venting Option	-	3 Way
End of Cycle Signal		Yes
Control Lock*		Yes
Drum Light		Yes
4 Adjustable Leveling Legs		Yes
Remaining Time Display/Status Indicator(s)		Yes

THINQ TECHNOLOGY	Washer	Dryer
SmartDiagnosis™ (v3.0)		Yes
Wi-Fi		Yes
Remote Start and Cycle Monitor		Yes
Energy Monitoring		Yes
Tub Clean Coach	Yes	-
MOTOR	Washer	Dryer
Motor Type	Inverter Direct Drive Motor	-
Axis	Horizontal	-
MATERIALS AND FINISHES	Washer	Dryer
NeveRust™ Stainless Steel Drum		Yes
Control Panel		Plastic
Top Plate		Steel
Cabinet		PCM
Door / Rim		Large Circle Chrome Rim
Door Cover		Tinted Round Tempered Glass
CERTIFICATION	Washer	Dryer
Asthma Canada	Yes	-
POWER SOURCE	Washer	Dryer
Ratings	CSA Listed	
Electrical Requirements	120V, 10 Amps	240V 30 Amps
Type	Electric	
DIMENSIONS	Washer	Dryer
Product (WxHxD)	27" x 74 3/8" x 30 3/8"	
Depth with Door Open	55" D with door open	
Carton (WxHxD)	30 1/16" x 79 11/32" x 32"	
Weight (Product/Carton)	326 lbs / 361 lbs	
LIMITED WARRANTY	Washer	Dryer
Parts and Labour	1 Year	1 Year
Direct Drive Motor	10 Years	-
Drum	3 Years	10 Years
UPC	Washer	Dryer
WKEX200HBA	772454073670	

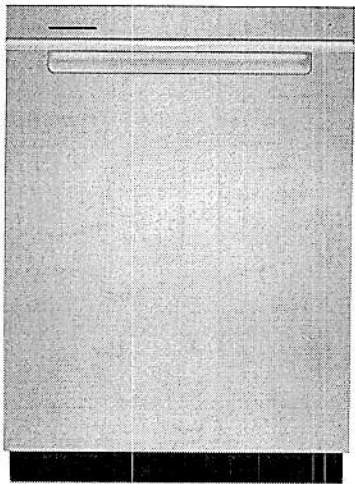

Large Capacity Dishwasher with 3rd Rack

WDTA50SAKZ

Available Finishes/Colours

-  WDTA50SAKB
Black
-  WDTA50SAKW
White

-  WDTA50SAKV
Black Stainless
-  WDTA50SAKZ
FingerPrint Resistant Stainless Steel

Dimensions	
Height	34 7/16
Width	23 7/8

Configuration and Overview	
Dishwasher Type	Built-In
Decibel Level dBA	47

Controls	
Automatic Temperature Controls	Yes
Control Location	Hidden
Control Type	Electronic Touch with Display
Sensor	Yes
Status Light	White
End of Cycle Signal	Yes



Details	
Dispenser	Detergent and Rinse Aid

Details	
Rinse Aid Dispenser Level Indicator	Yes
True Hold Door	Yes
Rack Material	Nylon
Number of Wash Levels	5
Tub Material	Stainless Steel
Wash System Type	Removable Filter
Number of Washarms	3
Leak Detect	Yes
Drying System Type	Vent Dry with Heating Element
Interior Light	No
Number of Racks	3
Tub Style	Built-in Tall Tub 24"

Load more, run less in this dishwasher with 3rd rack. Load hard-to-fit utensils or measuring spoons in the 3rd rack to free up more space for dishes below. You can even fit taller items where you want thanks to the adjustable rack. Plus, you can move or separate the flexible 3-piece silverware basket to make extra space.

Top Features	
3rd rack	
Adjustable 2nd rack	
3-piece silverware basket	

Manuals & Literature:

-  [Dimension Guide](#)
-  [Energy Guide](#)
-  [Warranty Information](#)

Whirlpool® 24" Dishwasher

DETAILED PLANNING DIMENSIONS GUIDE

OPENING/CLEARANCE DIMENSIONS

IMPORTANT: Check that all surfaces have no protrusions that would prohibit dishwasher installation.

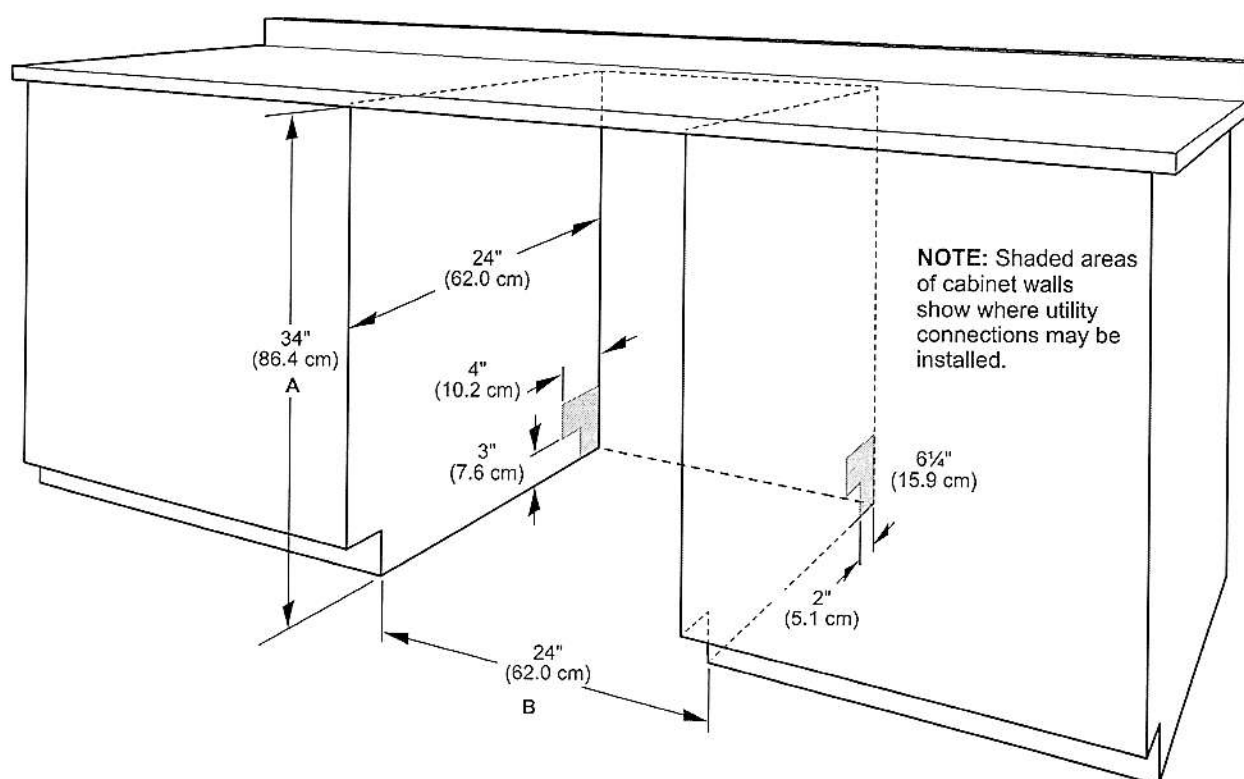

A. Measured from the lowest point on the underside of the countertop. May be reduced to 33½" (85.1 cm) by removing the wheels and perforated area of insulation (blanket) on dishwasher.

B. Minimum, measured from narrowest point of opening.

NOTE: Corner locations require a 2" (5.1 cm) minimum clearance between the side of the dishwasher door and the wall or cabinet.

Because Whirlpool Corporation policy includes a continuous commitment to improve our products, we reserve the right to change materials and specifications without notice.

Dimensions are for planning purposes only. For complete details, see Installation Instructions packed with product. Specifications subject to change without notice.

Whirlpool®

24" Dishwasher

DETAILED PLANNING DIMENSIONS GUIDE

PRODUCT DIMENSIONS (CONTD.)

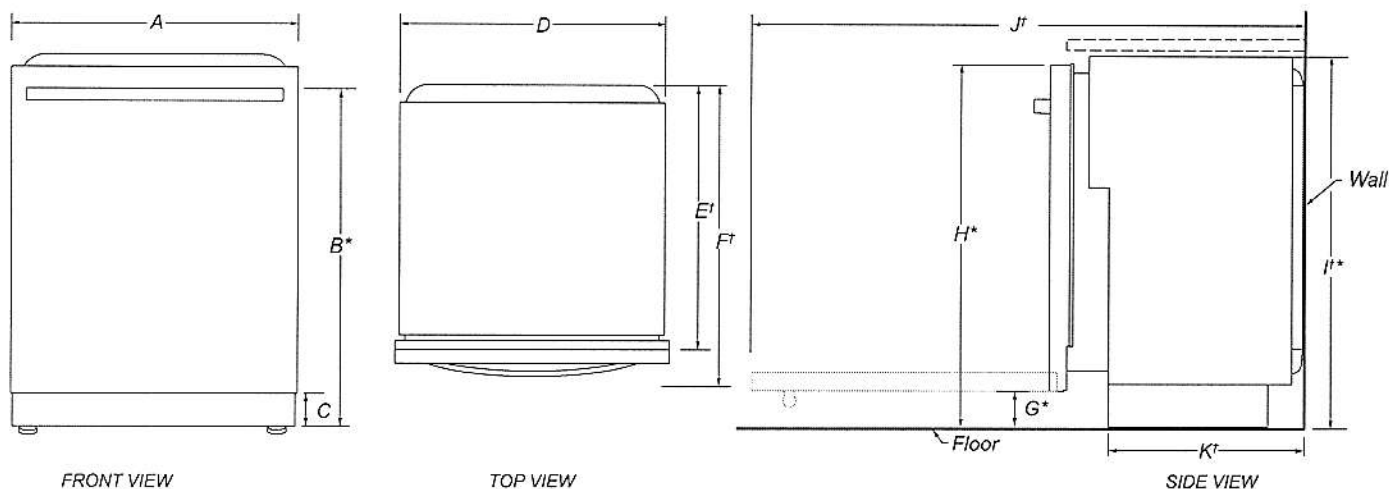

	DESCRIPTION	DIMENSIONS
A	Width of door	23⅞" (60.6 cm)
B*	Height to top of handle	31⅞" (80.1 cm)
C	Height of adjustable toe kick	3½" (8.8 cm) - min. 4¼" (10.8 cm) - max.
D	Width of recessed dishwasher	23⅞" (60.6 cm)
E†	Depth without door	22⅝" (57.5 cm)
F†	Depth with Towel Bar Handle	26½" (67.3 cm)
	Depth with Pocket Handle	24½" (62.2 cm)
G*	Height to bottom of door (min.)	3⅞" (8.4 cm)
H*	Height to top of door (min.)	33⅞" (84.9 cm)
I*	Height of recessed dishwasher (min.)	33⅝" (85.4 cm)
J†	Depth with door fully open (min.)	50⅜" (127.4 cm)
K†	Depth with toe kick (min.)	20⅜" (52.9 cm)

†Insulation blanket thickness adds up to 11/16" (1.8 cm) but can crush up to 1/8" (0.3 cm).

*Dishwasher can be raised 1⅞" (3.7 cm) with feet fully extended.

Because Whirlpool Corporation policy includes a continuous commitment to improve our products, we reserve the right to change materials and specifications without notice.

Dimensions are for planning purposes only. For complete details, see Installation Instructions packed with product. Specifications subject to change without notice.



24" Dishwasher

DETAILED PLANNING DIMENSIONS GUIDE

Applies to all model numbers starting with;
WDTA50SAK, WDT750SAKW0, WDTA80SAKZ0

PRODUCT DIMENSIONS

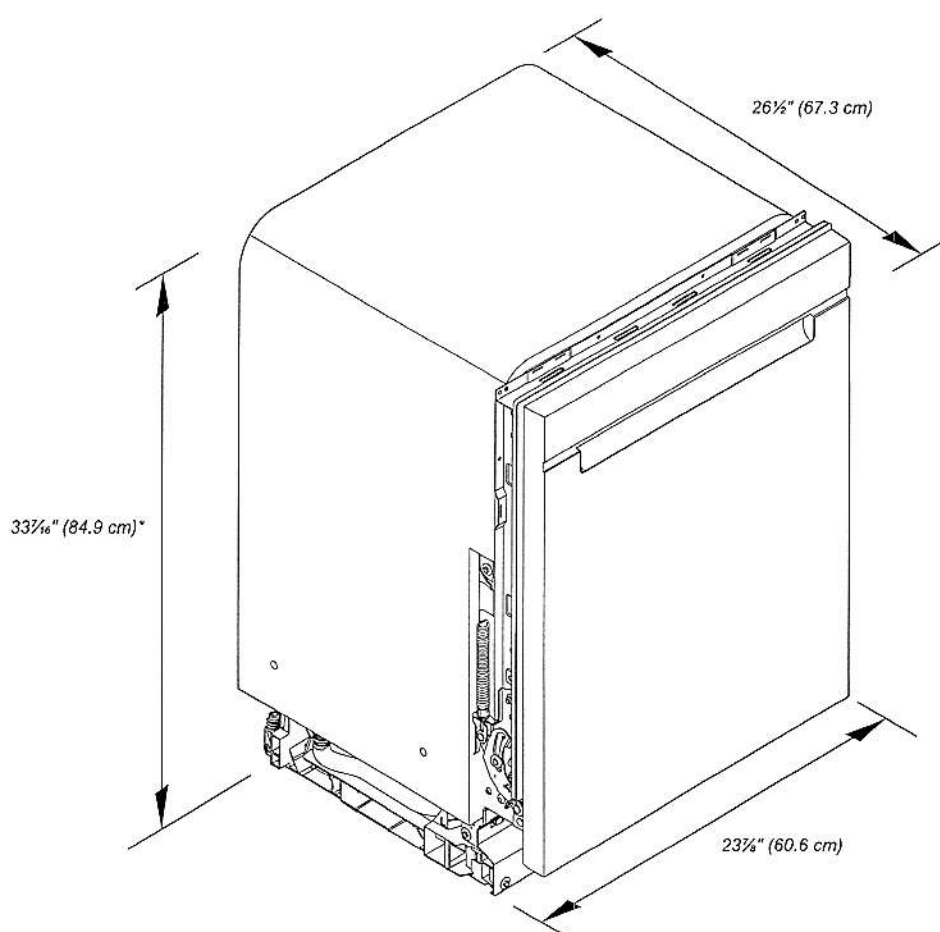

*Dishwasher can be raised 1 1/8" (3.7 cm) with feet fully extended.

Because Whirlpool Corporation policy includes a continuous commitment to improve our products, we reserve the right to change materials and specifications without notice.

Dimensions are for planning purposes only. For complete details, see Installation Instructions packed with product. Specifications subject to change without notice.