

CONSTRUCTION SUMMARY

Charisma Condominiums - Genazzano Highrises Inc.

RECEIVED

PURCHASER: Mark L. BISGROVE

DEC 22 2021

TEL:

LOT / PHASE 2519 / West	REG. PLAN #	HOUSE TYPE A615		
----------------------------	-------------	--------------------	--	--

CABINETRY

1 - KITCHEN SOFT CLOSE DRAWERS 14Dec21 Note:	
1 - KITCHEN ADD 2 FROSTED GLASS TILT UPS 14Dec21 Note:	
1 - KITCHEN ADD SOFT CLOSE DOORS 14Dec21 Note:	
1 - MASTER ENSUITE VANITY ADD BANK OF DRAWERS 14Dec21 Note:	
1 - KITCHEN ISLAND ADD POT DRAWERS 14Dec21 Note:	
1 - KITCHEN ISLAND EXTEND TO 24" WITH OVERHANG AND WATERFALL LEGS 14Dec21 Note:	
1 - CABINETRY - MINI UPPERS AND 8 TILT UP DOORS 14Dec21 Note:	
1 - CABINETRY - KITCHEN - UPGRADE 3 14Dec21 Note:	
1 - CABINETRY - KITCHEN - LIGHT VALENCE 14Dec21 Note:	
1 - KITCHEN- ADD CABINETS BASE AND UPPERS-REVISED LAYOUT 16Jun21 Note:	

CABINETRY ACCESSORIES

1 - KITCHEN- ADD 4 PUCKLIGHTS 14Dec21 Note:	
--	--

CONSTRUCTION

1 - SMOOTH CEILING - MASTER BEDROOM 14Dec21 Note:	
1 - FOYER- DECREASE CLOSET AND EXTEND KITCHEN CABINETS 16Jun21 Note:	
1 - MASTER ENSUITE-TUB TO SHOWER CONVERSION - INCLUDES CLEAR GLASS CHROME FRAMELESS DOORS 16Jun21 Note: MIRRORS	

COUNTER TOP AND BACKSPLASH

1 - KITCHEN ISLAND – ADD WATERFALL LEGS – FOR ISLANDS LEGS APPROX. 685 MM WIDE 14Dec21 Note:	
1 - KITCHEN COUNTERTOP AND BACKSPLASH - UPGRADE COLOUR - QUARTZ MISTRAL 14Dec21 Note:	

DOORS AND TRIM

1 - LIVING ROOM/DINING ROOM SHIFT BEDROOM DOOR AND EXTEND WALL- SEE SKETCH 16Jun21 Note:	
---	--

ELECTRICAL

1 - KITCHEN- ADD POT LIGHTS SEE SKETCH- 21Dec21 Note:	
--	--

CONSTRUCTION SUMMARY

Charisma Condominiums - Genazzano Highrises Inc.

PURCHASER: Mark L. BISGROVE TEL:

LOT / PHASE 2519 / West	REG. PLAN #	HOUSE TYPE A615		
----------------------------	-------------	--------------------	--	--

1 - LIVING /DINING ROOM ADD LIGHT - SEE SKETCH 21Dec21 Note:	
---	--

1 - KITCHEN ADD ELECTRICAL LIGHT VALANCE 14Dec21 Note:	
---	--

HARDWOOD FLOORING

1 - UPGRADED FLOORING TO EVERWOOD THROUGHOUT NON TILED AREAS 14Dec21 Note:	
---	--

PAINTING

1 - UPGRADE PAINT THROUGHOUT WITH FEATURE WALL IN MASTER BEDROOM WALL- SEE SKETCH 14Dec21 Note:	
--	--

This Document is Extremely Time Sensitive - Printed 21 Dec 21 at 11:55

Mirrors:  
Shower Door Frameless;





INTERIOR COLOUR SCHEME

Purchaser: Mark L. BISGROVE  
Telephone Res. / Bus: /  
Decor Advisor: Anne Federico  
Lock Date: 12/20/2021 16:54:39

Const. No.: Unit 15, Level 24  
Municipal: 2519  
Suite Type: A615  
Project/Phase: Genazzano Highrises Inc./West

Layout Changes: ☐ Yes ☐ No  
Sketch Attached: ☐ Yes ☐ No

1. Kitchen and Vanities

	Style and Colour	Hardware
Kitchen	SEE BELOW	428SB
Main Bathroom	N/A	
Master Ensuite Bathroom	MONACO DARK CHOCOLATE	428SB
Powder Room	MONACO DARK CHOCOLATE	428SB
Built In Appliances <input type="radio"/> Yes <input checked="" type="radio"/> No      Kitchen Extended Upper Cabinets <input checked="" type="radio"/> Yes <input type="radio"/> No		

Comment

\*\* Refer to Construction SummaryUPPERS AND BASE IN SENOSAN SNOW WHITE- ISLAND ONLY SENOSAN DARK GREY GLOSS-85382

2. Counters

	Counter	Edge
Kitchen	QUARTZ-MISTRAL	Straight Polished Edge
Main Bathroom		
Master Ensuite Bathroom	QUARTZ-FLORENCE	Straight Polished Edge
Powder Room	QUARTZ-FLORENCE	Straight Polished Edge
Kitchen Backsplash	QUARTZ-MISTRAL	

Comment

\*\* Refer to Construction Summary

3. Flooring

	Selection
Vestibule/Main Hall	TORLYS EVERWOOD DESIGNER-HIGHPOINT EW27004
Kitchen	TORLYS EVERWOOD DESIGNER-HIGHPOINT EW27004
Living Room/Dining Room	TORLYS EVERWOOD DESIGNER-HIGHPOINT EW27004
Den/Office	N/A
Master Bedroom	TORLYS EVERWOOD DESIGNER-HIGHPOINT EW27004
Bedroom #2	N/A
Bedroom #3	
Laundry Room	TILE-8X8 WHITE MATT
Main Bath	N/A
Master Ensuite Bathroom	TILE-STONE WHITE 12X24
Powder Room	TILE-STONE WHITE 12X24

Comment

\*\* Refer to Construction Summary - Standard Grout throughout unless specified

4. Wall Tile

	Selection	Describe
Main Bath	N/A	
Master Ensuite Bathroom	TILE-GLOSSY WHITE 8X16	
Kitchen Backsplash	QUARTZ-MISTRAL	

Comment

\*\* Refer to Construction Summary - Standard Grout throughout unless specified

Initial: MB



INTERIOR COLOUR SCHEME

Purchaser: Mark L. BISGROVE  
Telephone Res. / Bus: /  
Decor Advisor: Anne Federico  
Lock Date: 12/20/2021 16:54:39

Const. No.: Unit 15, Level 24  
Municipal: 2519  
Suite Type: A615  
Project/Phase: Genazzano Highrises Inc./West

5. Misc

Water Line Rough-in for Fridge ☐ Yes ☒ No  
Upgrade Bathroom Accessories ☐ Yes ☒ No

Comment  
\*\* Refer to Construction Summary

6. Wall, Trim and Door Paint - Birch White Paint Throughout unless specified below.

Entrance Vestibule	SEE ATTACHED UPGRADE COLOUR	Living Room	
Main Hall	BENJAMIN MOORE	Dining Room	
Kitchen		Den/Library	
Laundry Room		Master Bedroom	
Main Bathroom		Bedroom #2	
Master Ensuite Bathroom		Bedroom #3	
Powder Room			

Comment  
\*\* Refer to Construction Summary

7. General Comments

\*\* Refer to Construction Summary

Disclaimers and Notes

- Colours of all materials are as close as possible to builder's selection, but not necessarily identical due to variances in manufacturing.
- The selection images are digital photographs of the Vendor's samples at its Decor Centre. Such images when displayed on your computer monitor may not match Decor Centre samples due to the hardware/software configuration of the computer. In the event of conflict between selection images and the Décor Centre samples, Décor Centre samples shall prevail.
- Any extras listed above are null and void unless accompanied by a separate invoice/amendment. Said invoice must be paid in full.
- The Purchaser agrees that this colour selection is final and that no changes will be permitted, unless required by the Vendor.
- The Purchaser acknowledges reading and accepting document which contains other miscellaneous disclaimers.

Signature:  Date: \_\_\_\_\_ Signature: \_\_\_\_\_ Date: \_\_\_\_\_

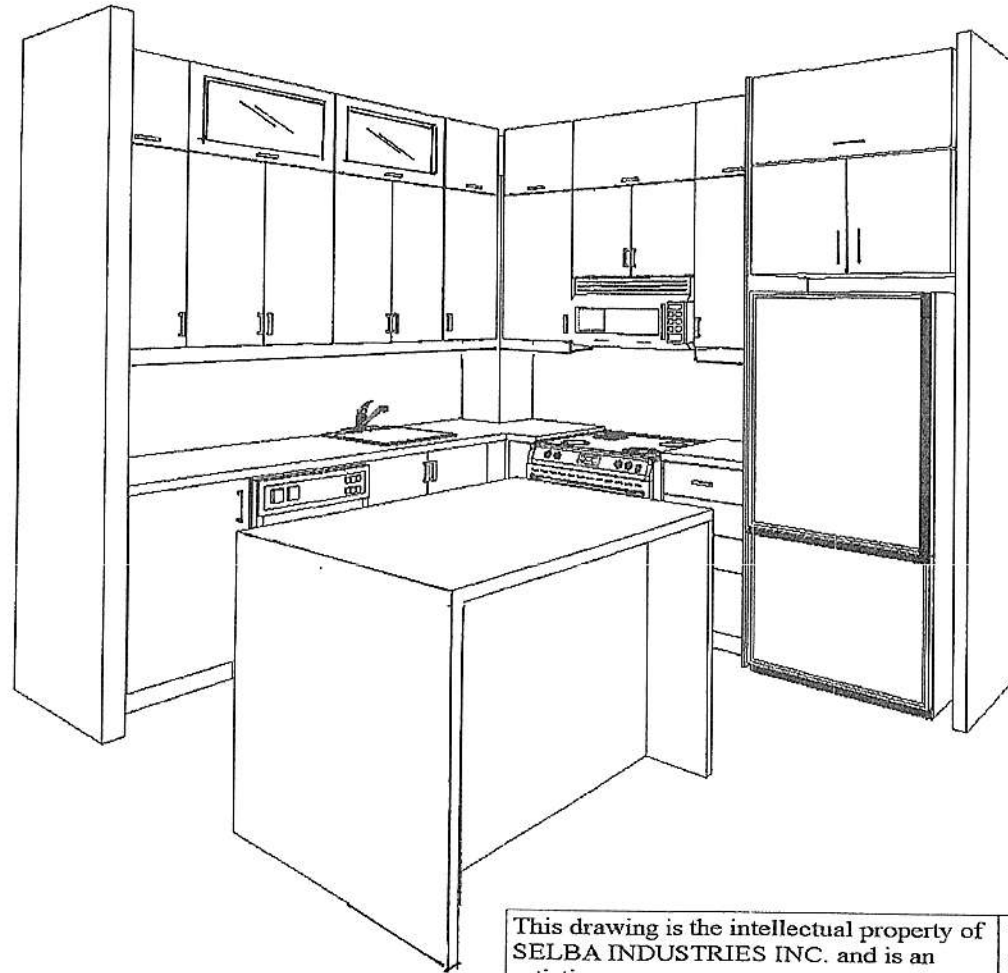

This drawing is the intellectual property of  
SELBA INDUSTRIES INC. and is an  
artistic  
interpretation of the general  
appearance of the design. It is  
not meant to be an exact rendition.



Designed: 12/10/2021  
Printed: 12/13/2021

CHARISMA SUITE 2519 WEST-DEC 10 21

LAYOUT

Drawing #: 1





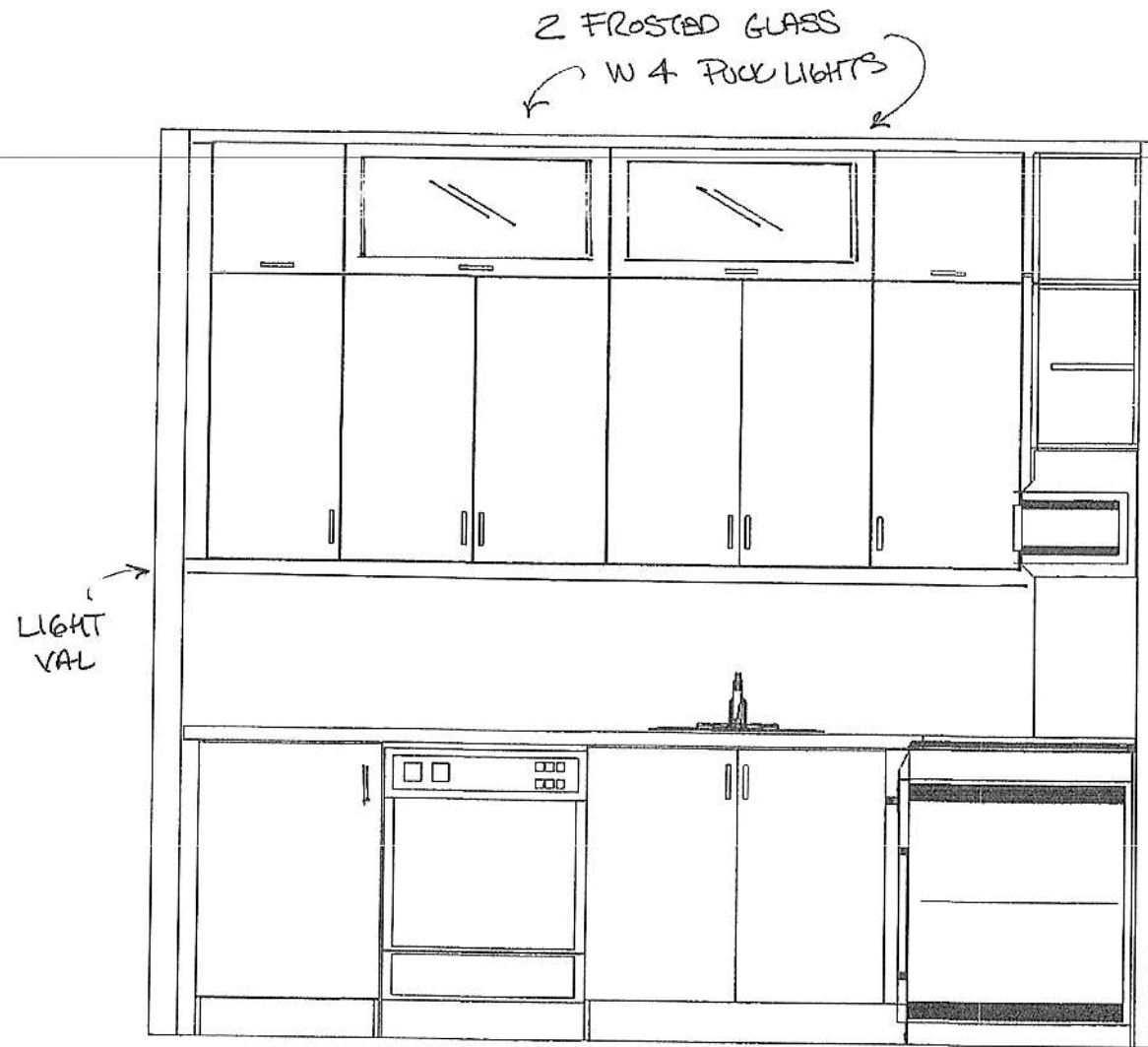

This drawing is the intellectual property of SELBA INDUSTRIES INC. and is an artistic interpretation of the general appearance of the design. It is not meant to be an exact rendition.



Designed: 12/10/2021  
Printed: 12/13/2021

CHARISMA SUITE 2519 WEST-DEC 10 21

LAYOUT

Drawing #: 1

FILE NAME:  
CHARISMA SUITE 2519 WEST

THIS LAY OUT CONTAINS EXTRAS  
THAT ARE NOT PART OF CONTRACT

PROTOTYPE FOR EXTRAS

JUNE 8 21 FB  
REV DEC 10 21 PB  
REV DEC 13 21 PB

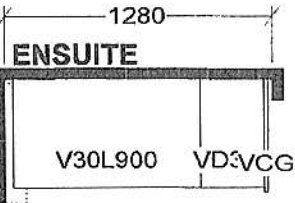
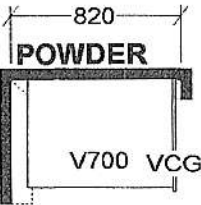
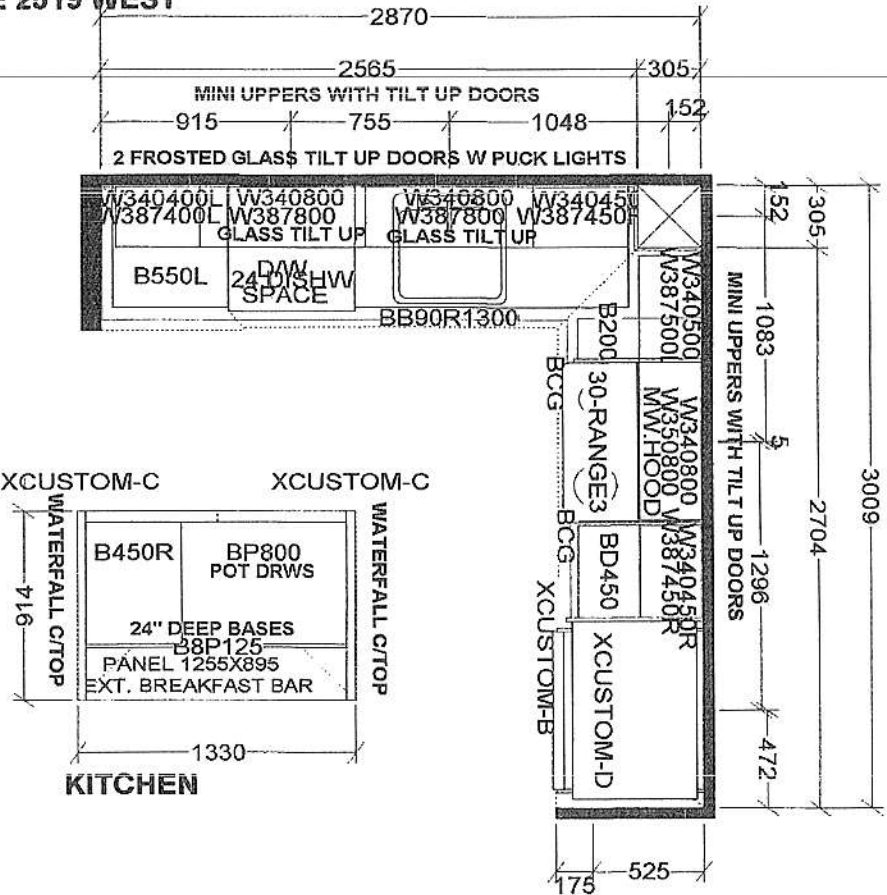

EXTEND VANITY &  
ADD BANK OF DRWS

BASE & VANITY CABINETS ON ADJUSTABLE LEGS

TOWER & PODIUM SUITES  
EAST TOWER X14  
WEST TOWER X20

Selba Industries				J #
W WIDTH	W HGHT	W CNT	This drawing is the intellectual property of SELBA INDUSTRIES INC. and is an original design which must not be released or copied unless applicable fee has been paid or job order placed.	JOB NUMBER:
FLOOR HGHT	DOOR HGHT			BUILDER: GREENPARK
ST CENT	2X4	VENT BOX COVER		SITE: CHARISMA EAST & WEST
			DESIGNER: KS	MODEL: A615
			DATE: OCT 27 20/rev'd Dec 10 20	LOT #: SUITE 2519



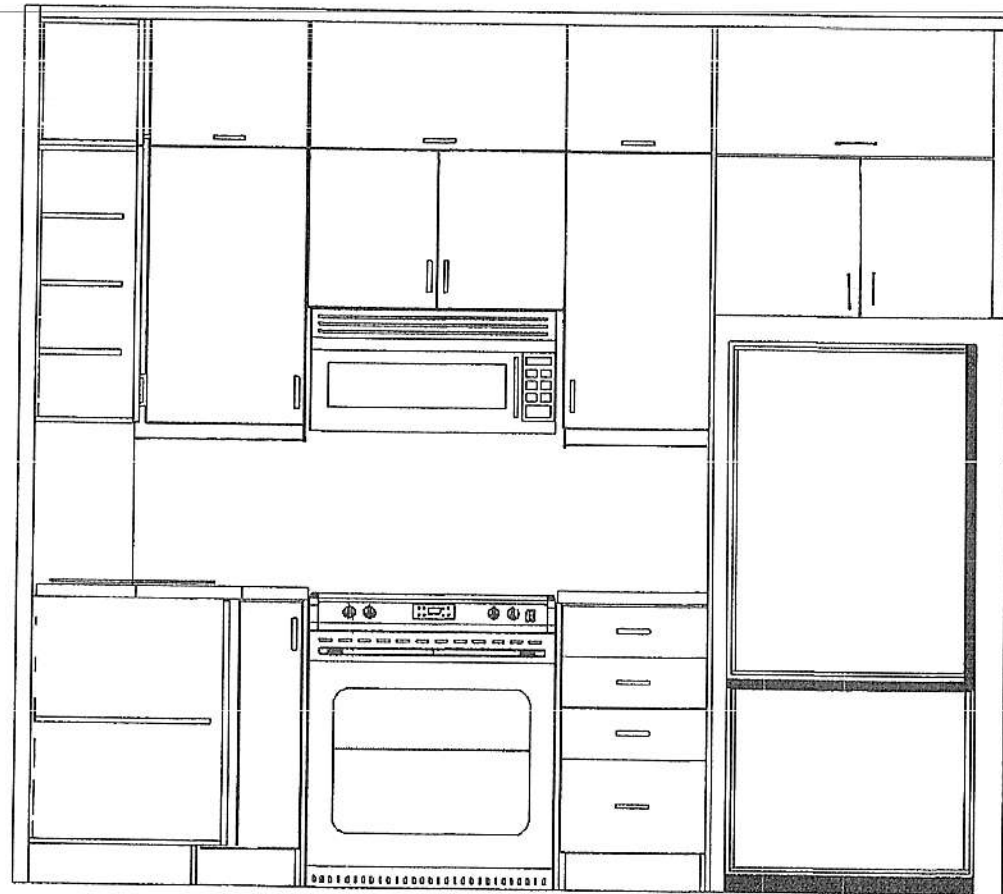

This drawing is the intellectual property of  
SELBA INDUSTRIES INC. and is an  
artistic  
interpretation of the general  
appearance of the design. It is  
not meant to be an exact rendition.



Designed: 12/10/2021  
Printed: 12/13/2021

CHARISMA SUITE 2519 WEST-DEC 10 21

LAYOUT

Drawing #: 1

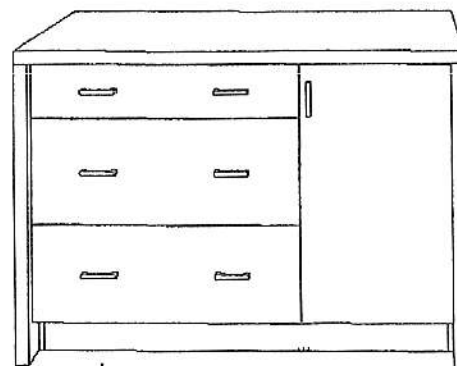
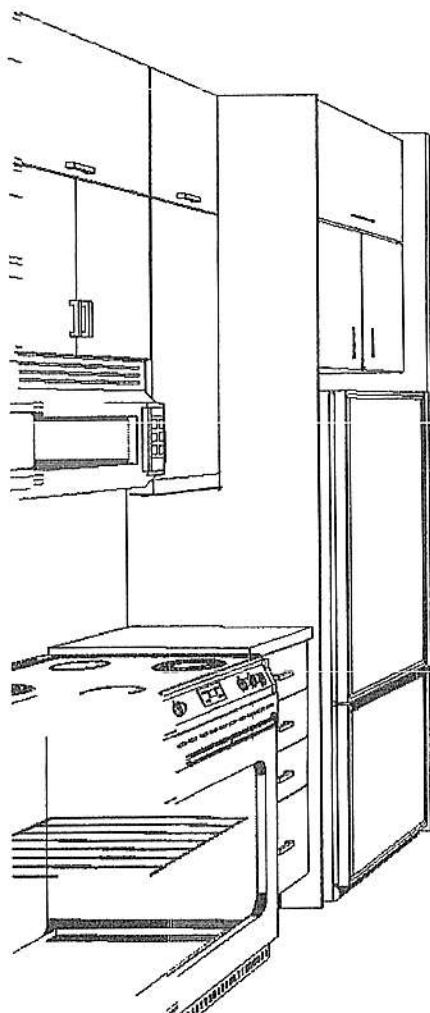

↑ POT DRWS

This drawing is the intellectual property of SELBA INDUSTRIES INC. and is an artistic interpretation of the general appearance of the design. It is not meant to be an exact rendition.



Designed: 12/10/2021  
Printed: 12/13/2021

CHARISMA SUITE 2519 WEST-DEC 10 21

LAYOUT

Drawing #: 1

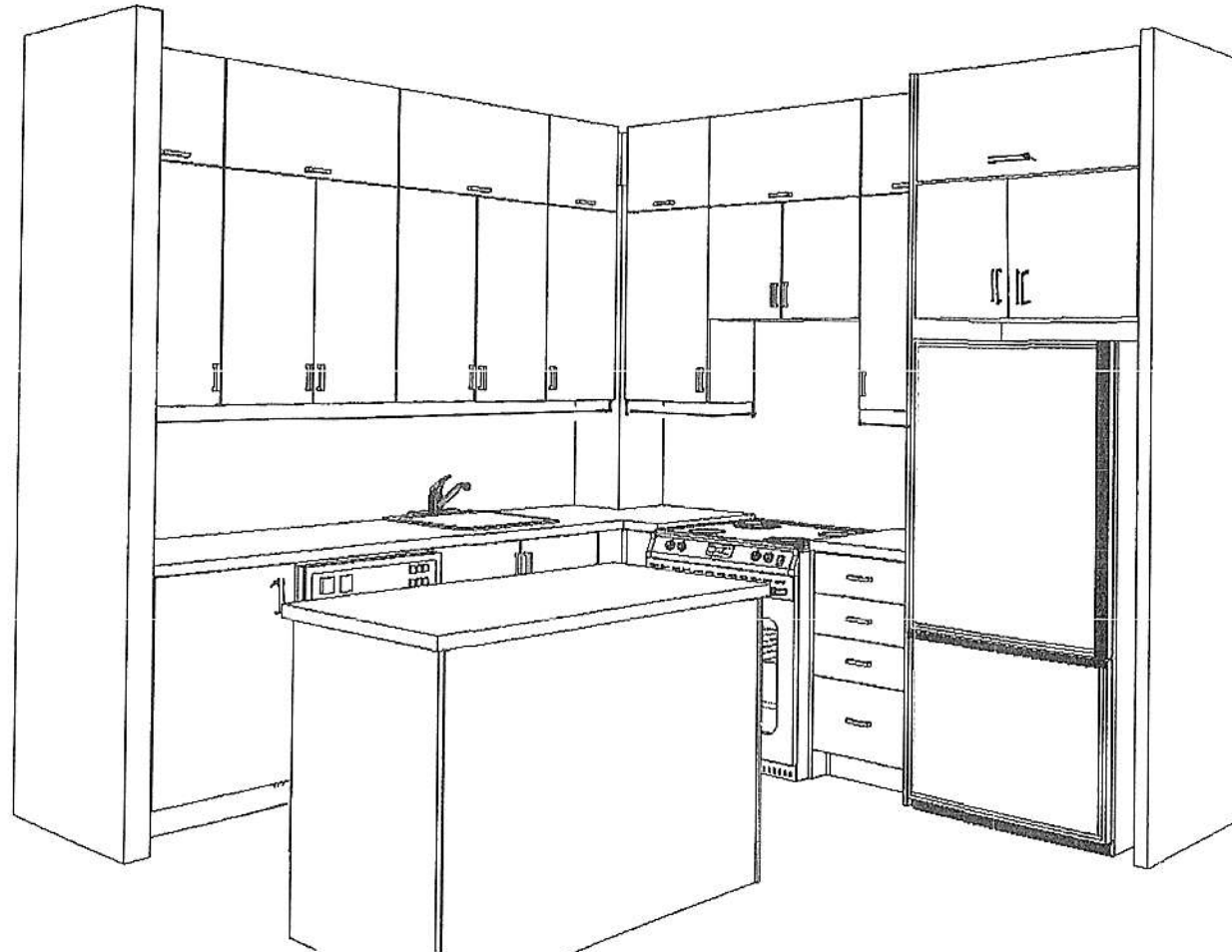

This drawing is the intellectual property of  
SELBA INDUSTRIES INC. and is an  
artistic  
interpretation of the general  
appearance of the design. It is  
not meant to be an exact rendition.



Designed: 12/10/2021  
Printed: 12/10/2021

CHARISMA SUITE 2519 WEST-DEC 10 21

LAYOUT

Drawing #: 1



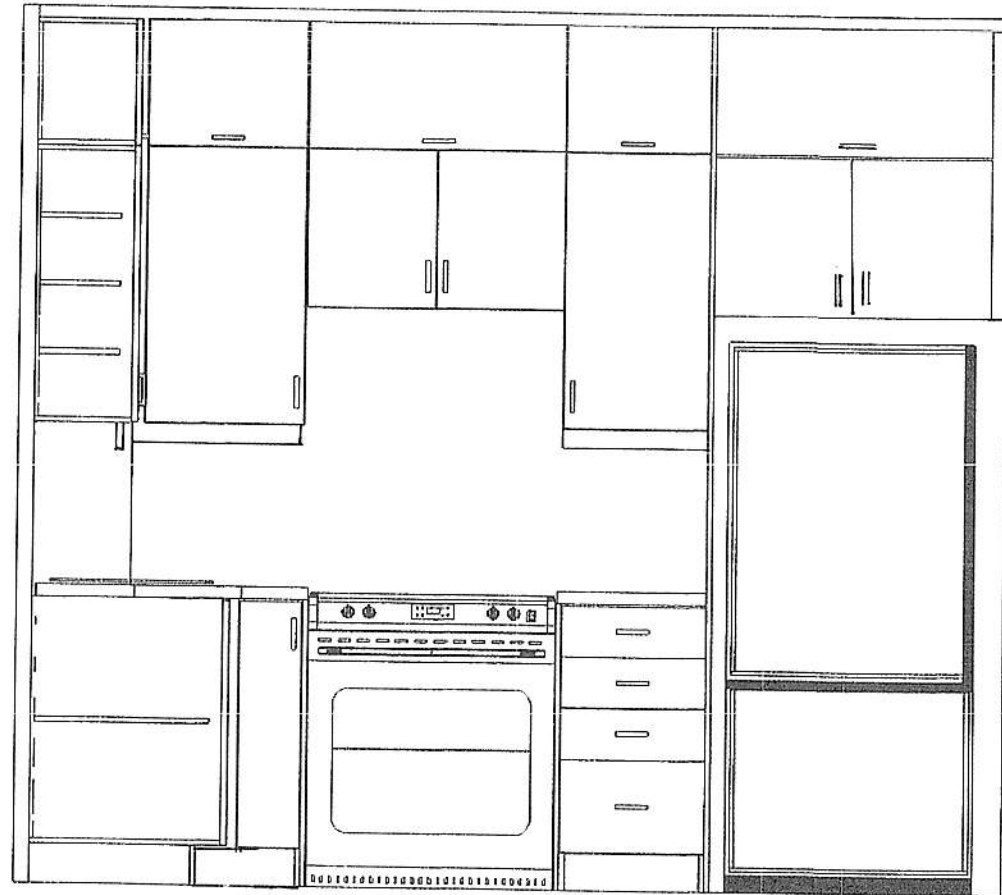

This drawing is the intellectual property of  
SELBA INDUSTRIES INC. and is an  
artistic  
interpretation of the general  
appearance of the design. It is  
not meant to be an exact rendition.



Designed: 12/10/2021  
Printed: 12/10/2021

CHARISMA SUITE 2519 WEST-DEC 10 21

LAYOUT

Drawing #: 1

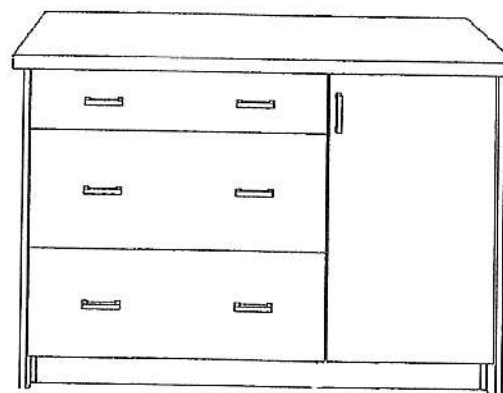
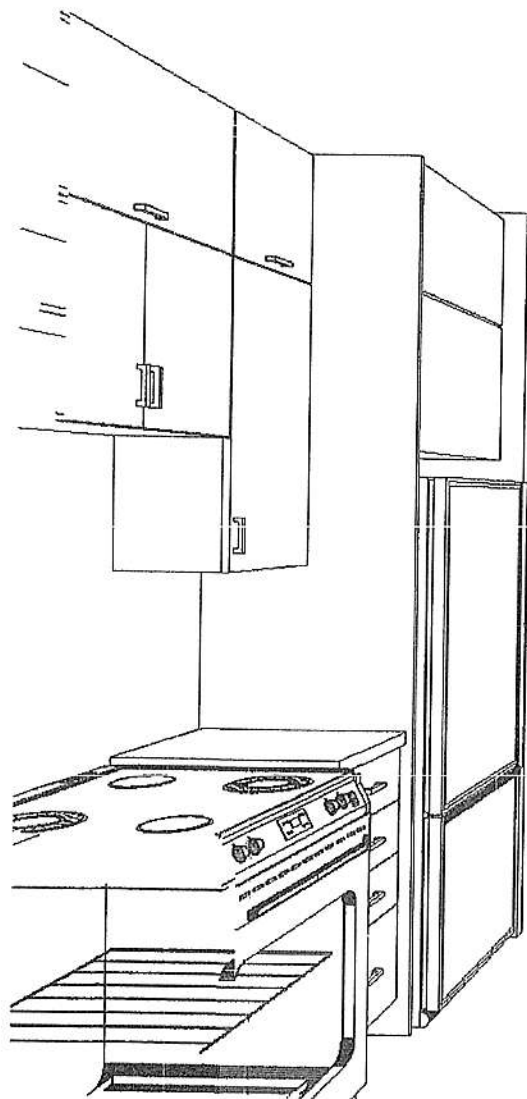

This drawing is the intellectual property of  
SELBA INDUSTRIES INC. and is an  
artistic  
interpretation of the general  
appearance of the design. It is  
not meant to be an exact rendition.





Designed: 12/10/2021  
Printed: 12/10/2021

CHARISMA SUITE 2519 WEST-DEC 10 21

LAYOUT

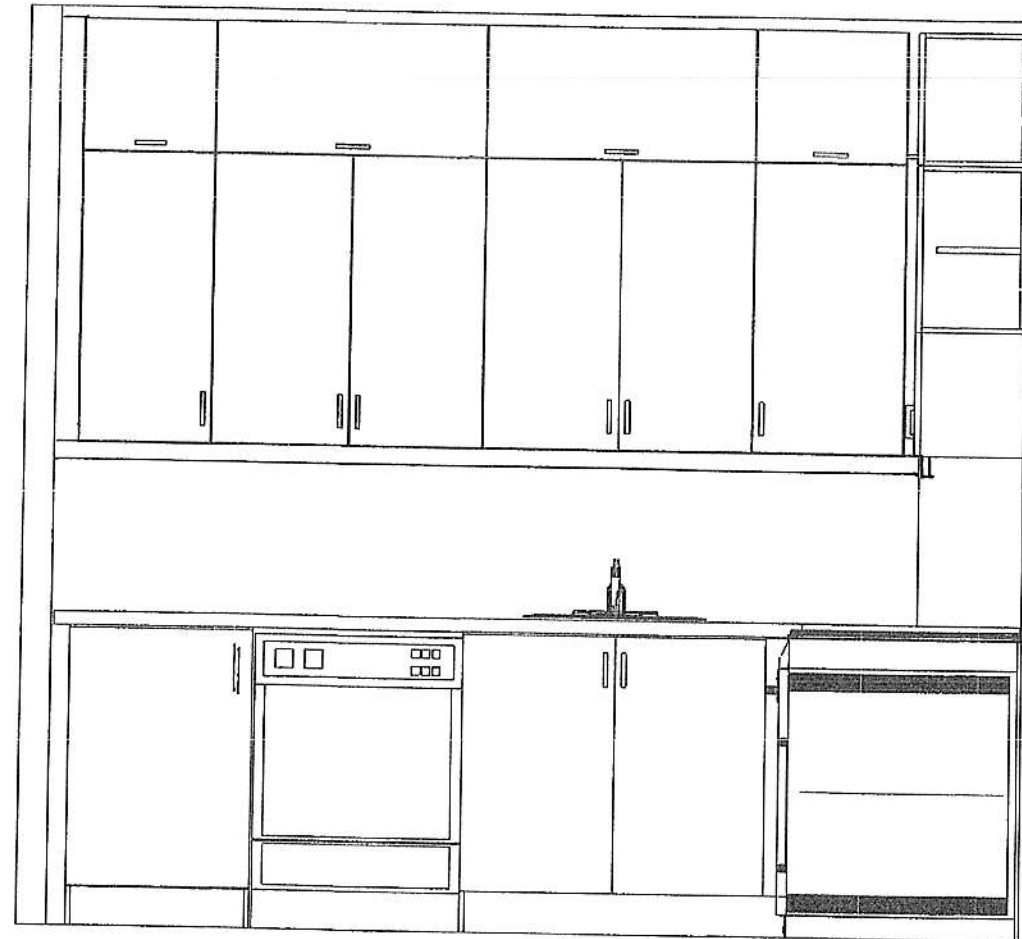
Drawing #: 1



<p>This drawing is the intellectual property of SELBA INDUSTRIES INC. and is an artistic interpretation of the general appearance of the design. It is not meant to be an exact rendition.</p>		Designed: 12/10/2021	
		Printed: 12/10/2021	
CHARISMA SUITE 2519 WEST-DEC 10 21		LAYOUT	Drawing #: 1



FILE NAME:  
CHARISMA SUITE 2519 WEST

JUNE 8 21 FB  
REV DEC 10 21 PB

THIS LAY OUT CONTAINS EXTRAS  
THAT ARE NOT PART OF CONTRACT

PROTOTYPE FOR EXTRAS

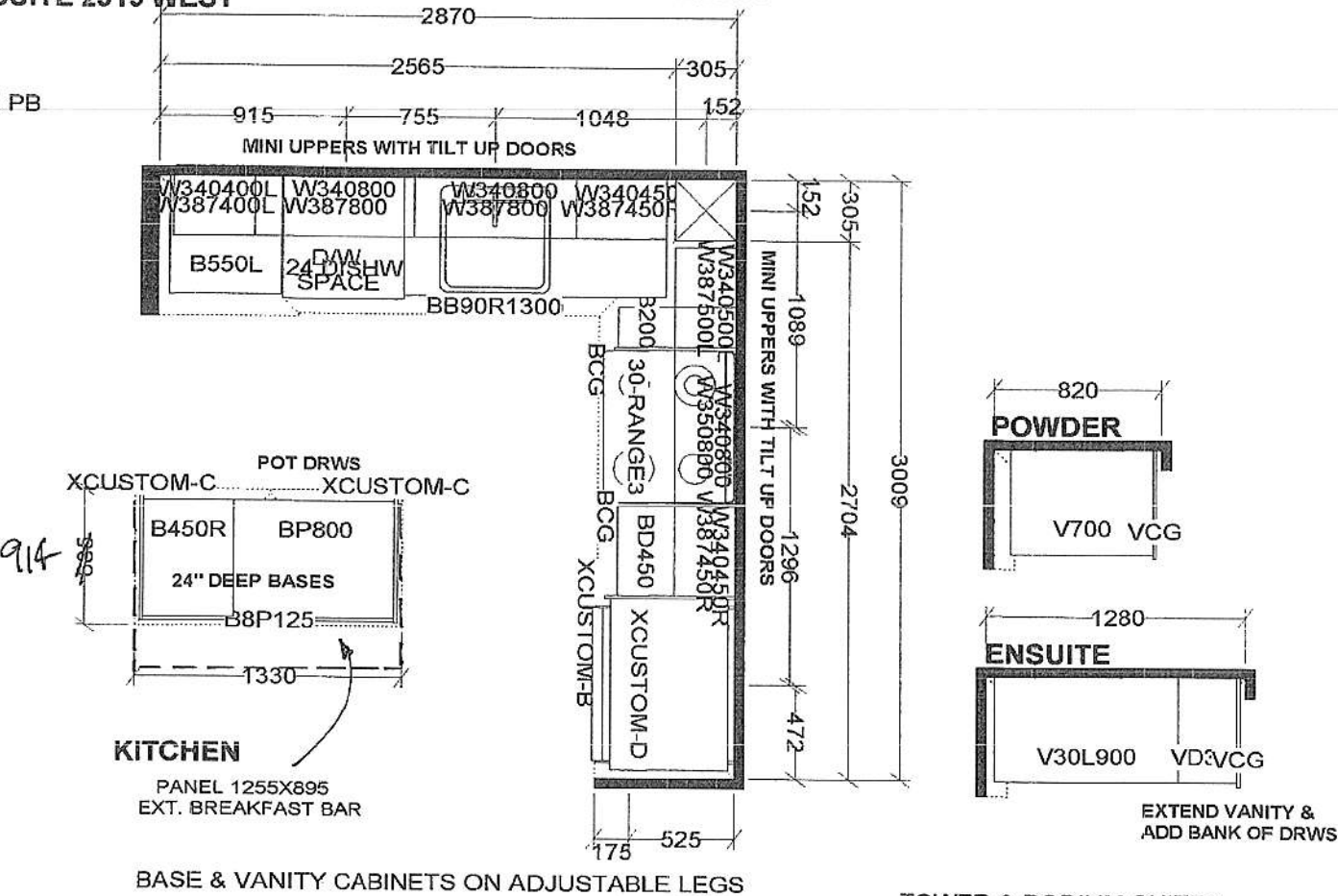

Selba Industries				J #
W WIDTH	W HGHT	W CNT	This drawing is the intellectual property of SELBA INDUSTRIES INC. and is an original design which must not be released or copied unless applicable fee has been paid or job order placed.	JOB NUMBER:
FLOOR HGHT	DOOR HGHT			BUILDER: GREENPARK
ST CENT	2X4	VENT BOX COVER		SITE: CHARISMA EAST & WEST
DATE: OCT 27 20/rev'd Dec 10 20			DESIGNER: KS	MODEL: A615
				LOT #: SUITE

1 BEDROOM | Interior 615 Sq.Ft. • Exterior 43 Sq.Ft. • Total 658 Sq.Ft.

# PAINT COLOUR



**Benjamin Moore®**

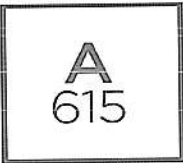

CHARISMA SERIES

10' CEILING | FLOOR 25

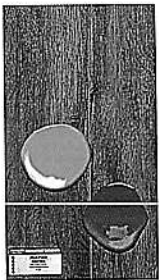
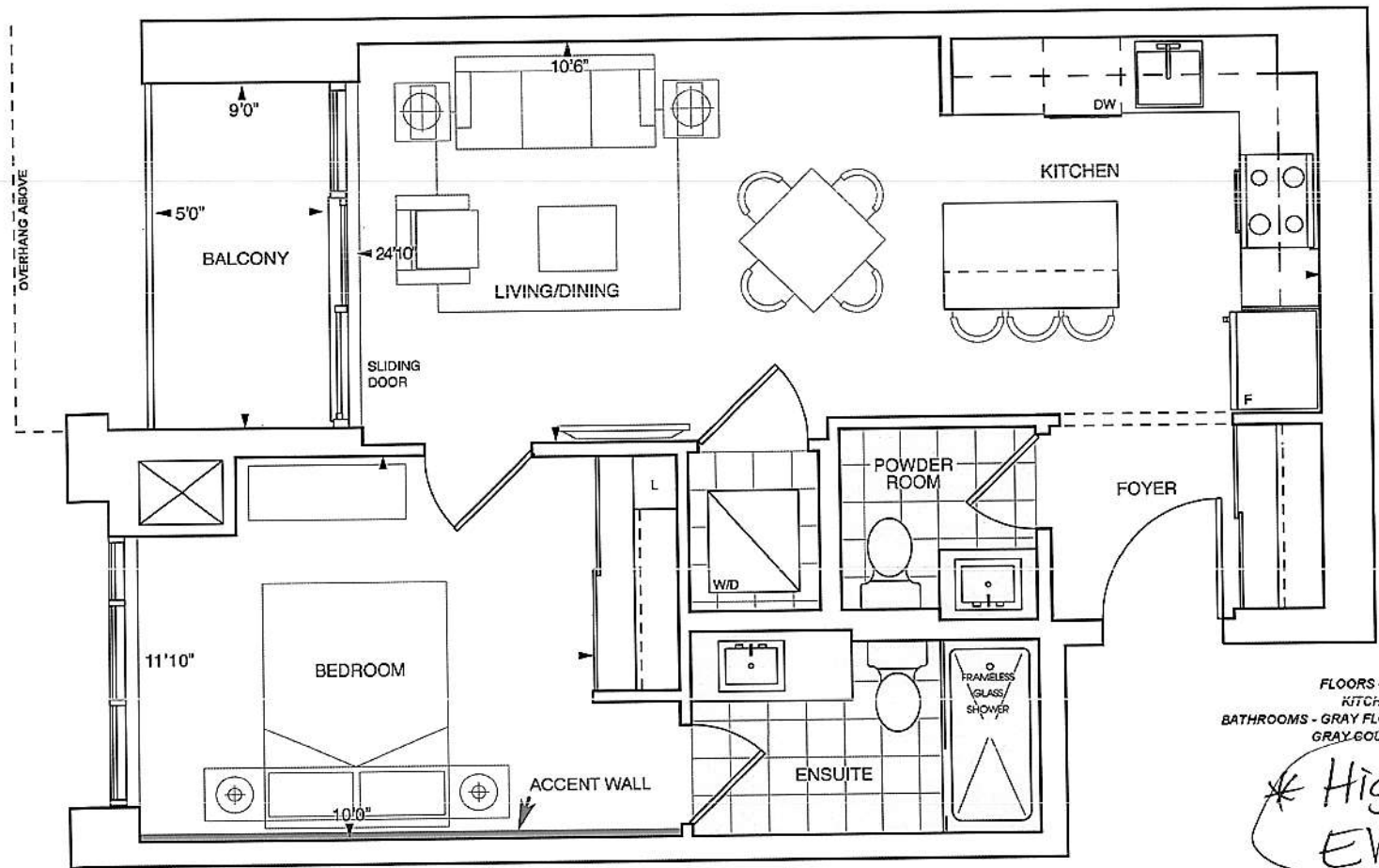

NOTES:  
FLOORS - TORLYS EVERWOOD GRAY  
KITCHEN - GLOSS WHITE & BLACK  
BATHROOMS - GRAY FLOOR TILE, BLACK CABINETS,  
GRAY COUNTER, WHITE SHOWER TILE

*\* HighPoint \*  
EW 27004*

MAIN UNIT  
**OCTOBER MIST 1495**  
EGGSHELL FINISH

BATHROOMS  
**MORNING DEW 1493**  
EGGSHELL FINISH

BEDROOM ACCENT WALL  
**GLOUCESTER SAGE HC-100**  
EGGSHELL FINISH

WHITES - CEILING, TRIM, DOORS  
**STEAM AF-15**  
SATIN TRIM & FLAT CEILING FINISH

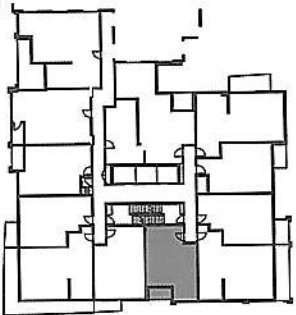
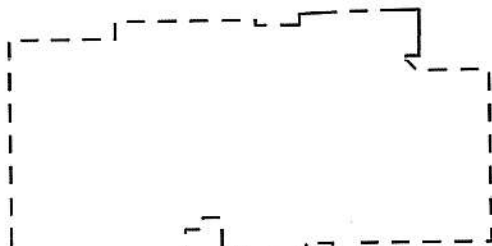

WEST TOWER



UNIT 15, LEVEL 24, SUITE 2519  
Mark Bisgrove

ALL TAKEN FROM BENJAMIN MOORE  
2022 COLORS OF THE YEAR

**Charisma**  
CONDOMINIUMS

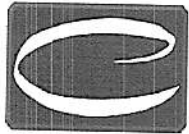

**COAST  
APPLIANCES**  
*Brands You Want, Expertise You Need*

## INVOICE

Unit #1-1748 Creditstone Road  
Vaughan, ON L4K 5V8  
PHONE: (905) 303-6909  
FAX: (905) 856-5325  
SERVICE TOLL FREE: (888) 745-0622

Invoice #	S03479056
Date	Page
Dec 08, 2021	Page 1 of 3
Ref #	PO #
CHARISMA	VIP GRNPRK EMPLO
Date Printed	Time Printed
Dec 08, 2021	8:56 am

Visit our website at [WWW.COASTAPPLIANCES.COM](http://WWW.COASTAPPLIANCES.COM)

GST# 79494 2516

Bill To:	BISGROVE, MARK UNIT 15, LEVEL 24 -2519 WEST CHARISMA VAUGHAN, ON TBA TBA (416) 736-4096
----------	---

Ship To:	Customer 199173 BISGROVE, MARK UNIT 15, LEVEL 24 -2519 WEST CHARISMA VAUGHAN, ON TBA TBA (416) 736-4096
----------	--

Invoice Type Upgrade	Ship Via 7 Suns Delivery	Payment Type COD	Salesperson Andrew Haidari	Schedule Date May 11, 2022
-------------------------	-----------------------------	---------------------	-------------------------------	-------------------------------

FROM	QTY	BRAND	MODEL / ITEM #	DESCRIPTION
513	1	KITCH	YKMHS120ES	30 OTR, 300 CFM, SS
	-1			Contr Bldrs Allow Hoodfan Base
513	1	FISHE	RF170BRPX6 N	32 BOTTOM MOUNT, SS
				CUSTOMER HAS SELECTED RIGHT HAND DOOR SWING. THE HINGES
				WILL BE ON THE RIGHT.
				HINGE TO BE CONFIRMED
	-1			Contr Bldrs Allow Fridge Base
513	1	KITCH	YKSEG700ESS	30 ELECTRIC RANGE, SS
	-1			Contr Bldrs Allow Range Base
513	1	KITCH	KDTE204KPS	24 DISHWASHER, 39 DBA, SS
	-1			Contr Bldrs Allow D/W Base
513	1	WHIRL	WFW560CHW	^27 FRONT LOAD WASHER, WH
				IMPORTANT: Washer door is hinged on the LH side and is not field
				reversible.
	-1			Contr Bldrs Allow Washer Base
513	1	WHIRL	YWED5620HW	^7.4 CU FT, FRONT LOAD DRYER, WH
513	1	WHIRL	W10869845	STACKING KIT
				IMPORTANT: Dryer door is hinged on the RH side and is field reversible.
				- to be completed by 3rd party installer or customer
				- customer to pay installer direct
513	1	EZFLO	48372	6 FEET SS BRAIDED HOSE
	-1			Contr Bldrs Allow Dryer Base
	-1			Contr Bldrs Allow Hoses
	-1			Contr Bldrs Allow Accessory
	1			Installation ANTI TIP
	-1			Contr Bldrs Allow Installation
	1			Installation DW
	-1			Contr Bldrs Allow Installation
513	1	ELECT	DW CORD	DISHWASHER CORDS
	1			Installation DW CORD
	-1			Contr Bldrs Allow Installation
	1			Installation HOOD
	-1			Contr Bldrs Allow Installation
	1			Installation LAUNDRY
	-1			Contr Bldrs Allow Installation





Specifications for Project  
unit 2519 charisma

Location  
Vaughan  
905-303-6909

**i REMINDER:** To ensure a smooth project it is the responsibility of the homeowner / purchaser of appliances for this project to share all the attached specifications to ensure the cabinet provider, contractor, or any other tradesperson have all the information required to complete their work accurately.

Specifications are subject to change. If any tradesperson has questions regarding the attached specifications please contact our sales associate.

Powered by SteelCod

Full Spec Package

unit 2519 charisma

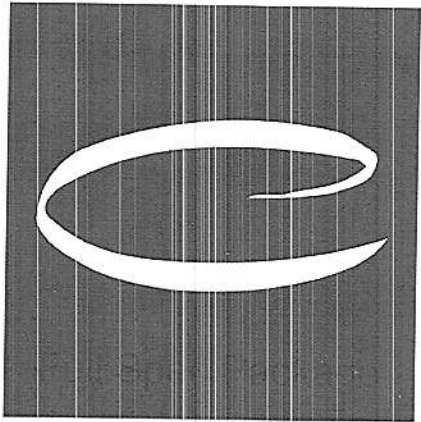

**Coast Appliances**  
coastappliances.com

**Andrew Haidari**  
Commercial Sales Representative  
905-303-6909

Search 20211208170002298SC  
Version 1.1

Wed, Dec 8, 2021  
12:00 PM EST

To ensure a smooth project it is the responsibility of the homeowner / purchaser of appliances for this project to share all the attached specifications to ensure the cabinet provider, contractor, or any other tradesperson have all the information required to complete their work accurately.

Specifications are subject to change. If any tradesperson has questions regarding the attached specifications please contact our sales associate.



[enterprise.steelcod.com/sp/csta/YQWX63Y2](https://enterprise.steelcod.com/sp/csta/YQWX63Y2)

<i>Models</i>	<i>Pages</i>
<b>YKMHS120ES</b> KitchenAid Microwave	3-4

**Note about page numbers:**  
Because the original manufacturer's documents are not altered in any way, the page numbers displayed on the page may not correspond to the page number within this package.

**All specifications are intended for initial planning purposes only.**  
Manufacturers reserve the right to change specifications at any time without notice. Always consult the installation instructions found on the manufacturer's website or included with the appliances before installation.

# YKMHS120ES

## KitchenAid®

KitchenAid® 950-Watt Microwave with 7 Sensor Functions - 30"

[www.kitchenaid.ca](http://www.kitchenaid.ca)

### Specifications

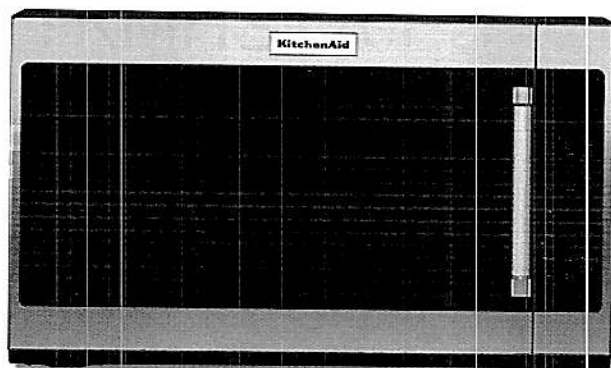

#### Configuration and Overview

Fan CFM: 300

Venting Type: Exterior or Recirculating

#### Ventilation Features

Odor Removal Filter (charcoal): Charcoal

Odor Removing Filter

#### Controls

Number of Speeds: 3

### Color

Stainless Steel

### Dimensions

Depth: 16 1/8

Height: 17 1/8

Width: 30

Product dimension, cutout and installation specifications are provided for planning purposes only. Before installing any product, be sure to verify cutout dimensions and electrical/gas connections with the installation

® Registered trademark/TM Trademark of Whirlpool, U.S.A. © Whirlpool Corporation. All Rights Reserved.

All other trademarks are owned by their respective companies.

Because Whirlpool Corporation policy includes a continuous commitment to improve our products, we reserve the right to change materials and specifications without notice. We also reserve the right to discontinue or transition products without notice.

## Installation Dimensions:

**NOTE:** The grounded 3 prong outlet must be inside the upper cabinet. See "Electrical Requirements" section.

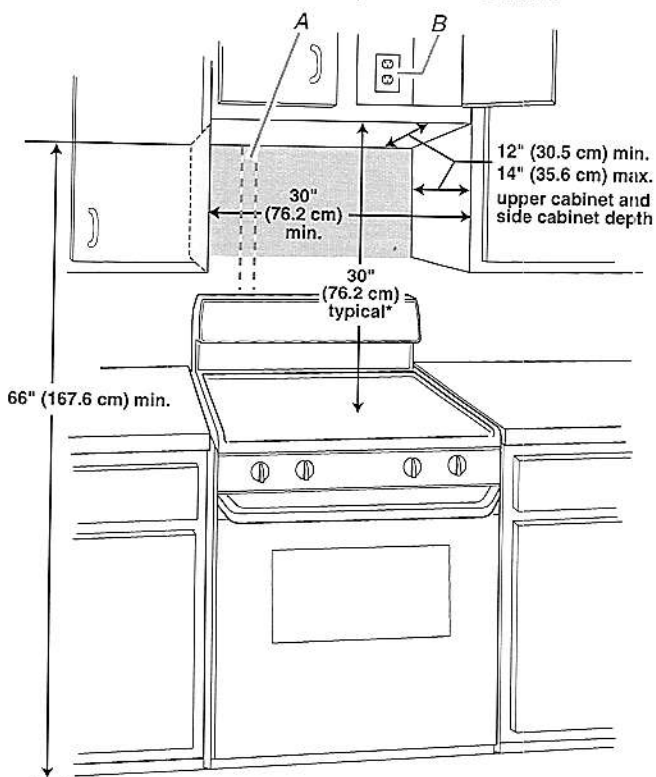

A. 2" x 4" wall stud  
B. Grounded 3 prong outlet

\*30" (76.2 cm) is typical for 66" (167.6 cm) installation height. Exact dimensions may vary depending on type of range/cooktop below.

## Product Dimensions

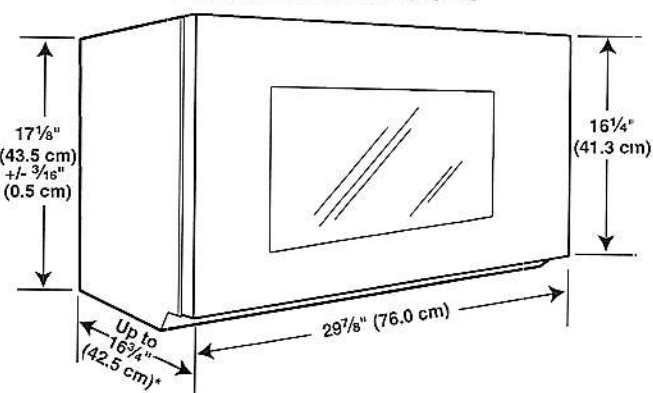

\*Overall depth of product will vary slightly depending on door design.

## Electrical Requirements

### ⚠ WARNING



#### Electrical Shock Hazard

Plug into a grounded 3 prong outlet.

Do not remove ground prong.

Do not use an adapter.

Do not use an extension cord.

Failure to follow these instructions can result in death, fire, or electrical shock.

Observe all governing codes and ordinances.

#### Required:

- A 120 volt, 60 Hz, AC only, 15- or 20-amp electrical supply with a fuse or circuit breaker.

#### Recommended:

- A time-delay fuse or time-delay circuit breaker.
- A separate circuit serving only this microwave oven.

## GROUNDING INSTRUCTIONS

#### ■ For all cord connected appliances:

The microwave oven must be grounded. In the event of an electrical short circuit, grounding reduces the risk of electric shock by providing an escape wire for the electric current. The microwave oven is equipped with a cord having a grounding wire with a grounding plug. The plug must be plugged into an outlet that is properly installed and grounded.

**WARNING:** Improper use of the grounding plug can result in a risk of electric shock. Consult a qualified electrician or serviceman if the grounding instructions are not completely understood, or if doubt exists as to whether the microwave oven is properly grounded.

Do not use an extension cord. If the power supply cord is too short, have a qualified electrician or serviceman install an outlet near the microwave oven.

## SAVE THESE INSTRUCTIONS