

CONSTRUCTION SUMMARY				
Charisma Condominiums - Genazzano Highrises Inc.				
PURCHASERS: Giuseppe DIGIUSEPPE and Mathew DI GIUSEPPE				
RECEIVED DEC 01 2021 TEL:				
LOT / PHASE 314 / East	REG. PLAN #	HOUSE TYPE D1004		

CABINETRY

2 - UTILITY/ CABINET FOR OVER THE TOILET TANK – STANDARD CABINETRY-FOR MAIN AND MASTER ENSUITE 20Oct21 Note:	
1 - CABINETRY - KITCHEN - LIGHT VALENCE 20Oct21 Note:	
1 - KITCHEN ISLAND ADD BUILT IN MICROWAVE- 20Oct21 Note:	
1 - KITCHEN- FULL DEPTH ISLAND 24" 20Oct21 Note: With Overhang:	
1 - CABINETRY - EXTENDED UPPERS IN KITCHEN - STANDARD SERIES CABINETRY 20Oct21 Note:	

CONSTRUCTION

1 - SMOOTH CEILING - BOTH BEDROOMS 20Oct21 Note:	
1 - MASTER ENSUITE -DELETE TUB AND INSERT SHOWER MAIN BATH - DELETE SHOWER AND INSERT TUB 23Apr21 Note:	

COUNTER TOP

1 - DELETE SHOWER NICHE IN ENSUITE AND MAIN BATH 29Nov21 Note:	
1 - KITCHEN ADD A HOLE FOR FUTURE WATER FILTER SYSTEM 29Nov21 Note:	

COUNTER TOP AND BACKSPLASH

1 - KITCHEN COUNTERTOP UPGRADE MATERIAL 20Oct21 Note:	
2 - SHAMPOO NICHE 14" WIDE X 20" HIGH AS PER SKETCH – MARBLE, GRANITE OR QUARTZ – IF CONSTRUCTION PERMITS. REQUIRES PROVISION FROM CONSTRUCTION 20Oct21 Note: ENSUITE AND MAIN TUB AND SHOWER Deleted	

ELECTRICAL

1 - KITCHEN ISLAND ADD A PLUG FOR FUTURE MICROWAVE- 20Oct21 Note:	
1 - KITCHEN ADD ELECTRICAL FLORESCENT LIGHT TO VALANCE 20Oct21 Note:	

FIXTURE - PAPER HOLDER

1 - MOEN BATHROOM ACCESSORIES - METHOD - PAPER HOLDER - CHROME #YB2408 - MAIN BATHROOM 20Oct21 Note:	
1 - MOEN BATHROOM ACCESSORIES - METHOD - PAPER HOLDER - CHROME #YB2408 - ENSUITE BATHROOM 20Oct21 Note:	

FIXTURE - SINK

1 - STANDARD SINK - MAIN BATHROOM 20Oct21 Note:	
1 - STANDARD SINK - ENSUITE BATHROOM 20Oct21 Note:	

CONSTRUCTION SUMMARY				
Charisma Condominiums - Genazzano Highrises Inc.				
PURCHASERS: Giuseppe DIGIUSEPPE and Mathew DI GIUSEPPE				TEL:
LOT / PHASE	REG. PLAN #	HOUSE TYPE		
314 / East		D1004		

FIXTURE - TOILET

1 - STANDARD TOILET AND TOILET SEAT - MAIN BATHROOM 20Oct21 Note:	
1 - STANDARD TOILET AND TOILET SEAT - MAIN BATHROOM 20Oct21 Note:	

FIXTURE - TOWEL BAR

1 - MOEN BATHROOM ACCESSORIES - METHOD - 18" TOWEL BAR - CHROME #YB2418 - MAIN BATHROOM 20Oct21 Note:	
1 - MOEN BATHROOM ACCESSORIES - METHOD - 18" TOWEL BAR - CHROME #YB2418 - ENSUITE BATHROOM 20Oct21 Note:	

MIRRORS AND GLASS

1 - MASTER BATH BATH ADD----- - FRAMELESS CLEAR GLASS SHOWER DOOR WITH SIDE PANEL TO CEILING 3 - INCLUDES CHROME KNOB AND HINGES - 20Oct21 Note: MASTER Ensuite:	
1 - CLOSET SLIDER - FRAMELESS MIRROR SLIDING DOOR WITH MIRRORRED FASCIA IN LIEU OF STANDARD - BEDROOM 2 20Oct21 Note: Extend Height to Bulkhead Bath Bedroom	
1 - MASTER BATH SHOWER ENCLOSURE - FRAMELESS CLEAR GLASS DOOR WITH SIDE PANEL 3 - INCLUDES KNOB & HINGES 23Apr21 Note: Main Bath:	

MISCELLANEOUS

1 - FURTHER VENDOR DISCOUNT 20Oct21 Note:	
--	--

PLUMBING

1 - DELETE ABSOLUTE ALKALINE DRINKING SYSTEM 29Nov21 Note:	
1 - KITCHEN - ADD SINK GRID TO UNDERMOUNT SINK-BLANCO SKU 406452 20Oct21 Note:	
1 - ABSOLUTE ALKALINE PLUS DRINKING SYSTEM FOR KITCHEN SINK 20Oct21 Note:	
1 - KITCHEN - WATERLINE ROUGH-IN FOR FRIDGE 20Oct21 Note:	
1 - KITCHEN UNDERMOUNT SINK - BLANCO QUARTUS R15 U MEDIUM #401517 20Oct21 Note:	

Purchasers:Giuseppe DIGIUSEPPE & Mathew DI GIUSEPPE

Const. No.: Unit 25, Level 3

Telephone Res. / Bus: /

Municipal: 314

Decor Advisor: Ida Viola

Suite Type: D1004

Lock Date: 10/26/2021 09:10:22

Project/Phase: Genazzano Highrises Inc./East

Layout Changes: ☐ Yes ☒ No

Sketch Attached: ☒ Yes ☐ No

1. Kitchen and Vanities

	Style and Colour	Hardware
Kitchen	DORAL W 500	428SB
Main Bathroom	MONACO 350 PLATINUM SILVER	428SB
Master Ensuite Bathroom	MONACO 350 PLATINUM SILVER	428SB

Built In Appliances ☐ Yes ☒ No

Kitchen Extended Upper Cabinets ☒ Yes ☐ No

Comment

** Refer to Construction Summary

2. Counters

	Counter	Edge
Kitchen	QUARTZ-MISTRAL	Straight Polished Edge
Main Bathroom	QUARTZ- AMIATA	Straight Polished Edge
Master Ensuite Bathroom	QUARTZ-AMIATA	Straight Polished Edge

Kitchen Backsplash

Comment

** Refer to Construction Summary

3. Flooring

	Selection
Vestibule/Main Hall	LEXINGTON - ROCHEFORT OAK TL-LW1317
Kitchen	LEXINGTON - ROCHEFORT OAK TL-LW1317
Living Room/Dining Room	LEXINGTON - ROCHEFORT OAK TL-LW1317
Den/Office	LEXINGTON - ROCHEFORT OAK TL-LW1317
Master Bedroom	LEXINGTON - ROCHEFORT OAK TL-LW1317
Bedroom #2	LEXINGTON - ROCHEFORT OAK TL-LW1317
Bedroom #3	N/A
Laundry Room	TILE - WHITE MATTE 8X8
Main Bath	TILE - STONE WHITE 12X24
Master Ensuite Bathroom	TILE - STONE WHITE 12X24

Comment

** Refer to Construction Summary - Standard Grout throughout unless specified

4. Wall Tile

	Selection	Describe
Main Bath	TILE - GLOSSY WHITE 8X16	
Master Ensuite Bathroom	TILE - GLOSSY WHITE 8X16	
Kitchen Backsplash	TILE - GLOSSY WHITE 4X12	

Comment

** Refer to Construction Summary - Standard Grout throughout unless specified



Initials: _____

Purchasers:Giuseppe DIGIUSEPPE & Mathew DI GIUSEPPE

Const. No.: Unit 25, Level 3

Telephone Res. / Bus: /

Municipal: 314

Decor Advisor: Ida Viola

Suite Type: D1004

Lock Date: 10/26/2021 09:10:22

Project/Phase: Genazzano Highrises Inc./East

5. Misc

Water Line Rough-in for Fridge

☒ Yes

☐ No

Upgrade Bathroom Accessories

☐ Yes

☒ No

Comment

** Refer to Construction Summary

6. Wall, Trim and Door Paint - Birch White Paint Throughout unless specified below.

Entrance Vestibule

BIRCH WHITE

Main Hall

BIRCH WHITE

Kitchen

BIRCH WHITE

Laundry Room

BIRCH WHITE

Main Bathroom

BIRCH WHITE

Master Ensuite Bathroom

BIRCH WHITE

Living Room

BIRCH WHITE

Dining Room

BIRCH WHITE

Den/Library

BIRCH WHITE

Master Bedroom

BIRCH WHITE

Bedroom #2

BIRCH WHITE

Bedroom #3

N/A

Comment

** Refer to Construction Summary

7. General Comments

** Refer to Construction Summary

Disclaimers and Notes

1) Colours of all materials are as close as possible to builder's selection, but not necessarily identical due to variances in manufacturing.

2) The selection images are digital photographs of the Vendor's samples at its Decor Centre. Such images when displayed on your computer monitor may not match Decor Centre samples due to the hardware/software configuration of the computer. In the event of conflict between selection images and the Décor Centre samples, Décor Centre samples shall prevail.

3) Any extras listed above are null and void unless accompanied by a separate invoice/amendment. Said invoice must be paid in full.

4) The Purchaser agrees that this colour selection is final and that no changes will be permitted, unless required by the Vendor.

5) The Purchaser acknowledges reading and accepting document which contains other miscellaneous disclaimers.

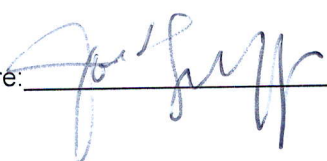
Signature: 

Date: _____

Signature: _____

Date: _____

Signature: _____

Date: _____

Aug. 23, 2017

SCHEDULE 'A'
Charisma
CONDOMINIUMS

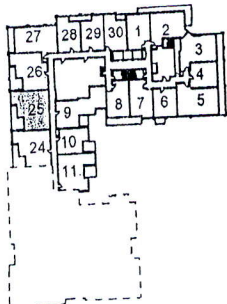
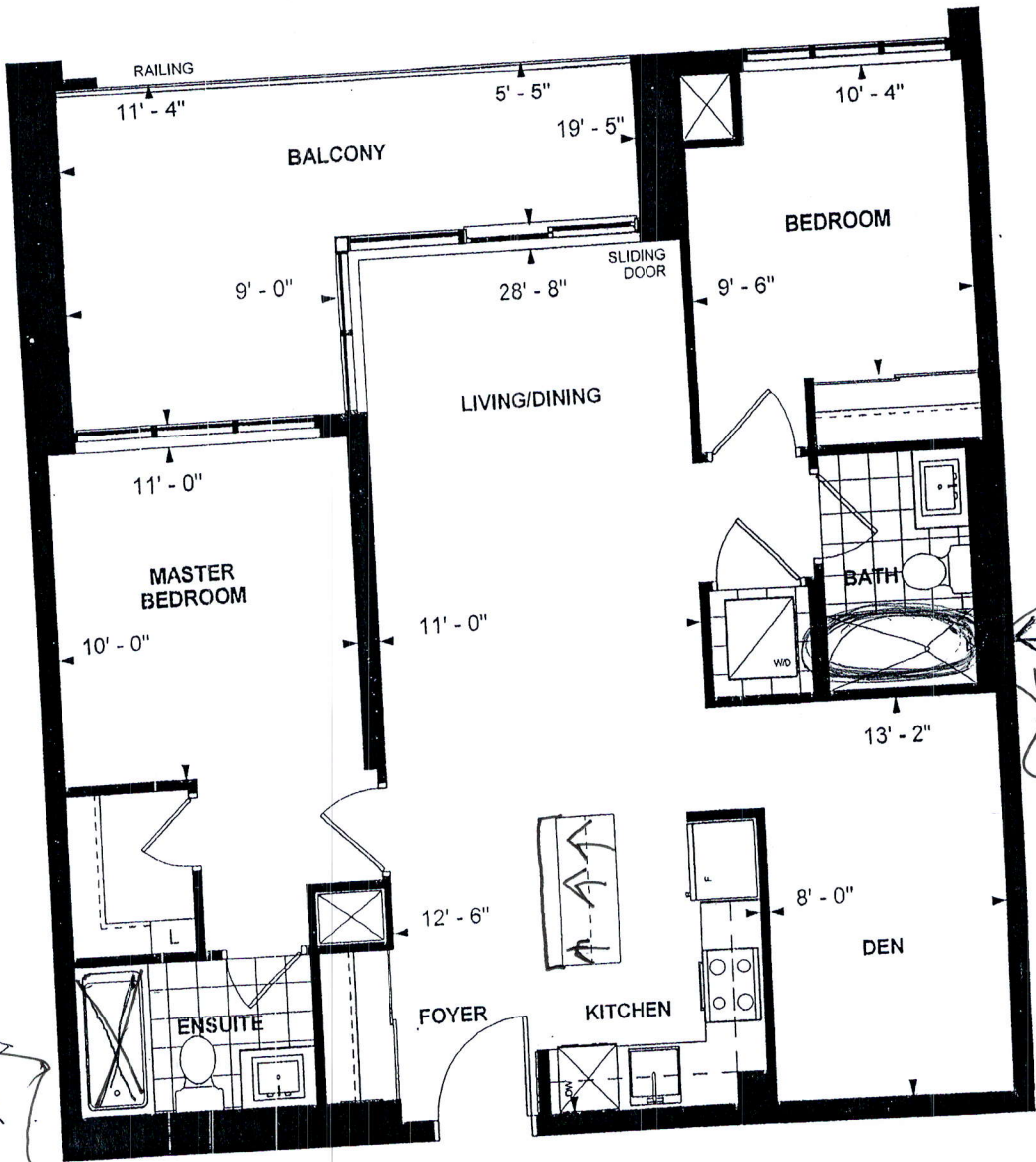

LEVEL 3-4



OPTION D 1004
TOWER SUITE
EAST TOWER
9' CEILING
1004 sq. ft.
2-BEDROOM+DEN

[Signature]
Purchaser Initials
[Signature]
Purchaser Initials
Date Sept 28/17

Unit No. 25 Level No. 3 Suite No. 314

Dimensions, specifications, layouts, location of materials and fixtures, tile floor patterns and architectural detailing (including window size and location and door size, location and swing) are approximate only and are subject to change or modifications, without notice. Actual usable floor space varies from stated floor area. Ceiling height measured from top of floor slab to underside of floor slab above and excludes finishes, bulkheads and drop ceilings. Orientation of suite may be reversed and Purchaser agrees to accept same. Balconies decks and terraces are exclusive use common elements shown for display purposes only and location and size are subject to change without notice. All illustrations are artist concept only. The provisions of the Agreement of purchase and sale apply to this Schedule. E. & O.E.

Upgraded
Kitchen Cabinets

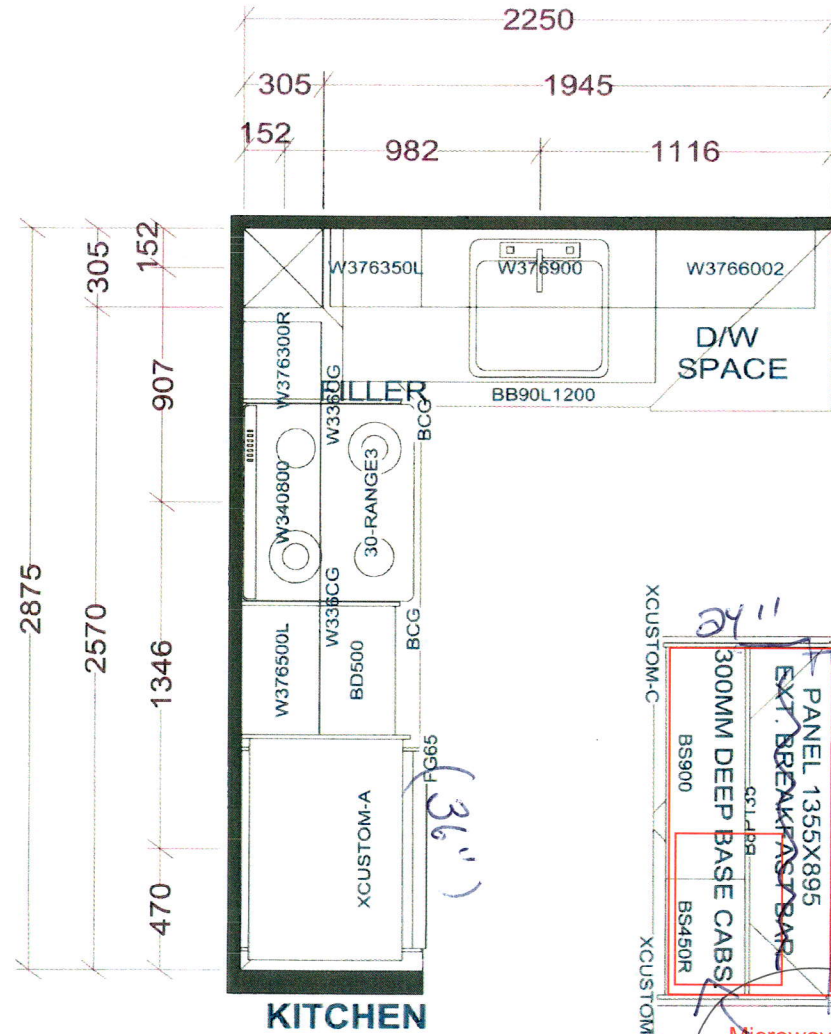

D947: UNIT #315 (EAST TOWER PODIUM)

D1004: UNIT #214, 314, 414, 514 (EAST TOWER PODIUM)

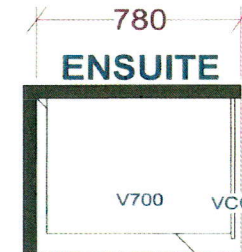

Drawers ?

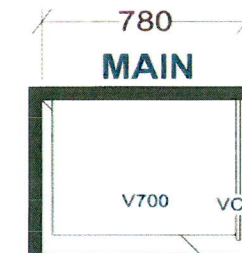

Full Depth Island

Microwave in Island

BASE & VANITY CABINETS ON ADJUSTABLE LEGS

TOWER & PODIUM SUITES
EAST TOWER-D947 X1
EAST TOWER-D1004 X2

Selba Industries

J# _____

W WDT _____ W HGHT _____ W CNT _____
FLOOR HGHT _____ DOOR HGHT _____
ST CENT _____ 2X4 _____ VENT BOX COVER _____

This drawing is the intellectual property of
SELBA INDUSTRIES INC. and is an
original design which must not be released
or copied unless applicable fee has been
paid or job order placed.

DESIGNER: KS
DATE: OCT 27 20

JOB NUMBER: _____
BUILDER: GREENPARK
SITE: CHARISMA EAST & WEST
MODEL: D947, D1004
LOT #: _____



Specifications for Project

Charisma

Di Giuseppe, Joe

Location

Vaughan

905-303-6909

i REMINDER: To ensure a smooth project it is the responsibility of the homeowner / purchaser of appliances for this project to share all the attached specifications to ensure the cabinet provider, contractor, or any other tradesperson have all the information required to complete their work accurately.

Specifications are subject to change. If any tradesperson has questions regarding the attached specifications please contact our sales associate.

Powered by SteelCod

Charisma

Di Giuseppe, Joe

Charisma
Suite 314
VAUGHAN, ON TBA TBA
TBA

Models	Pages
NNTK714SS Panasonic Trim Kit	3-7
KRFC300ESS KitchenAid Refrigeration	8-9
NNST765S Panasonic Microwave	10-11

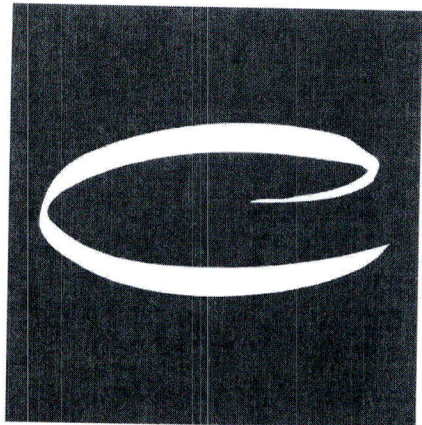

Coast Appliances
coastappliances.com

Andrew Haidari
Commercial Sales Representative
905-303-6909

Inv **S03472544**
Version 1.1

Mon, Nov 22, 2021
11:16 AM EST

To ensure a smooth project it is the responsibility of the homeowner / purchaser of appliances for this project to share all the attached specifications to ensure the cabinet provider, contractor, or any other tradesperson have all the information required to complete their work accurately.

Specifications are subject to change. If any tradesperson has questions regarding the attached specifications please contact our sales associate.



enterprise.steelcod.com/sp/csta/4UB2YI6N

Note about page numbers:
Because the original manufacturer's documents are not altered in any way, the page numbers displayed on the page may not correspond to the page number within this package.

All specifications are intended for initial planning purposes only.
Manufacturers reserve the right to change specifications at any time without notice. Always consult the installation instructions found on the manufacturer's website or included with the appliances before installation.

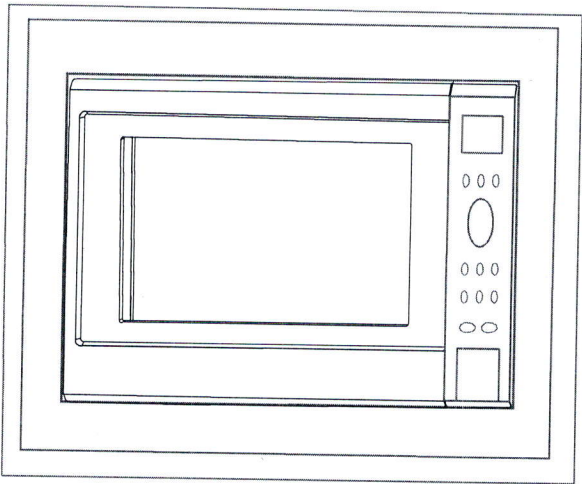
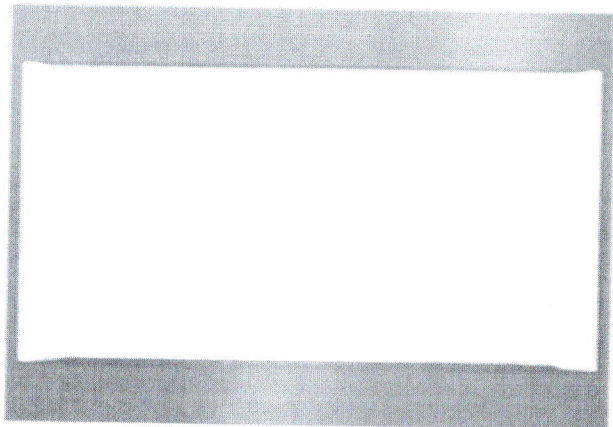

Installation Instructions

Cabinet Armoire Gabinete	Trim kit Nécessaire d'encastrement Juego de acabados
24" (596 mm) 24 po (596 mm)	NN-TK714S

Read carefully and keep these installation instructions.
Lisez attentivement et conservez cette notice d'installation.
Lea cuidadosamente y guarde este instructivo de
instalación para su referencia.

2. Installation Diagram

2. Schéma d'installation

2. Diagrama de instalación

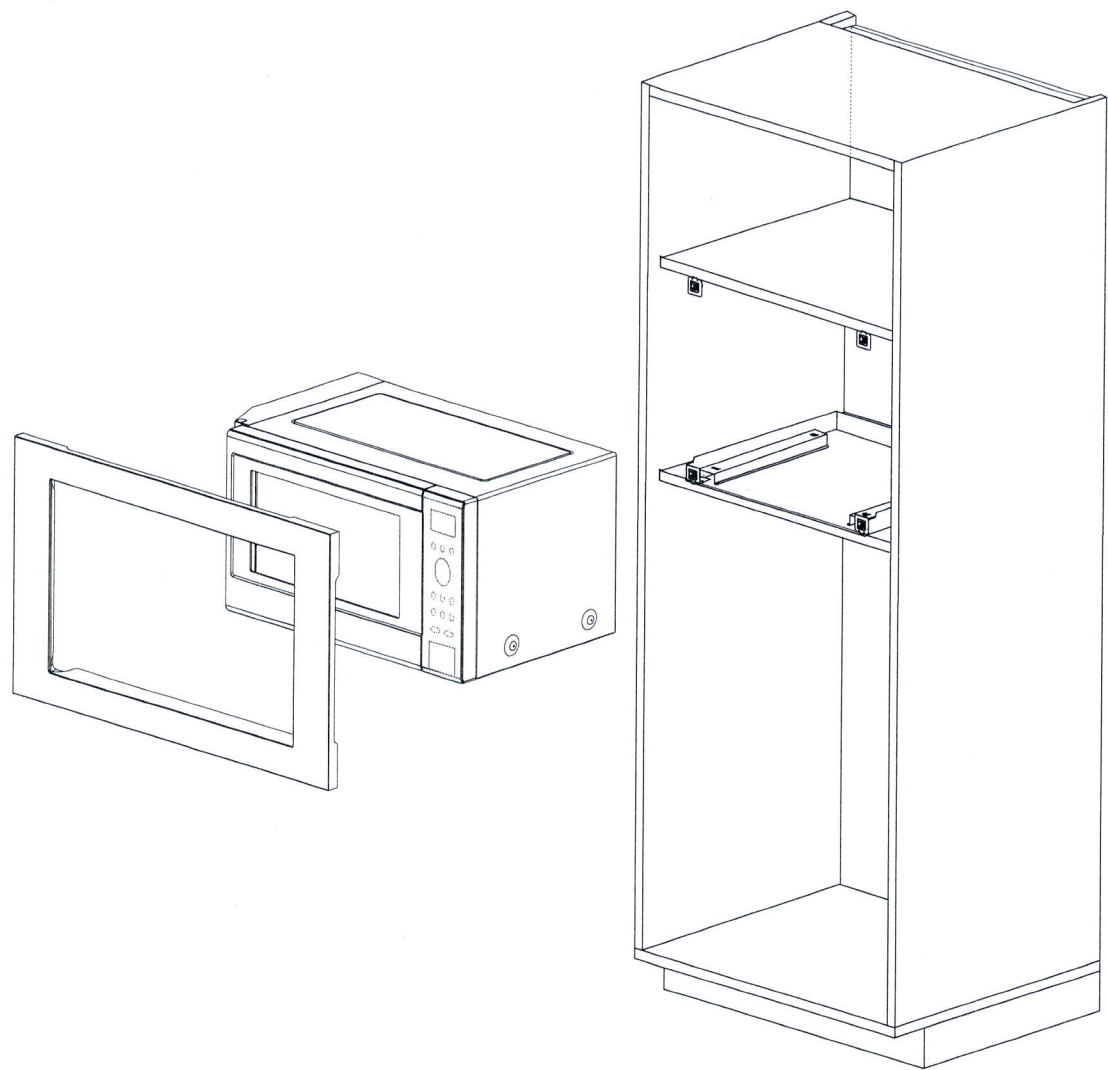

Trim Kit Dimensions	
Width	596 mm (23½")
Height	410 mm (16⅛")
Depth (Thickness)	20 mm (¾")

Dimensions du nécessaire d'encastrement	
Largeur	596 mm (23½ po)
Hauteur	410 mm (16 ⅛ po)
Profondeur (épaisseur)	20 mm (¾ po)

Dimensiones del juego de acabados	
Ancho	23½" (596 mm)
Altura	16⅛" (410 mm)
Profundidad (grosor)	¾" (20 mm)

3. Cabinet Diagram and Dimensions

3. Schéma de l'armoire et dimensions

3. Dimensiones y diagrama del gabinete

fig 1.

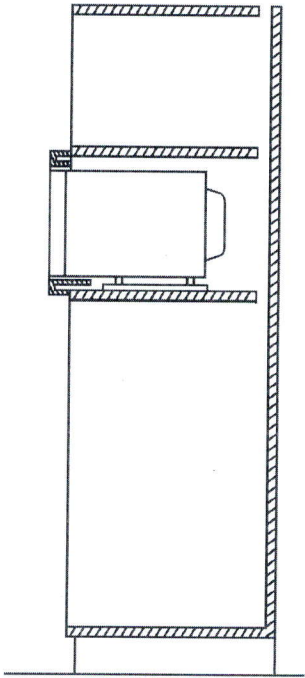
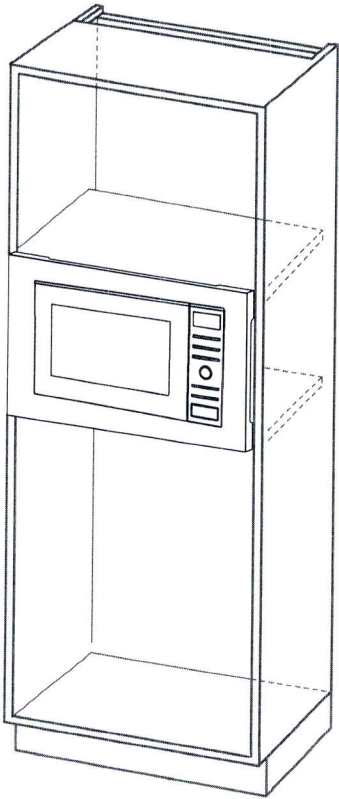
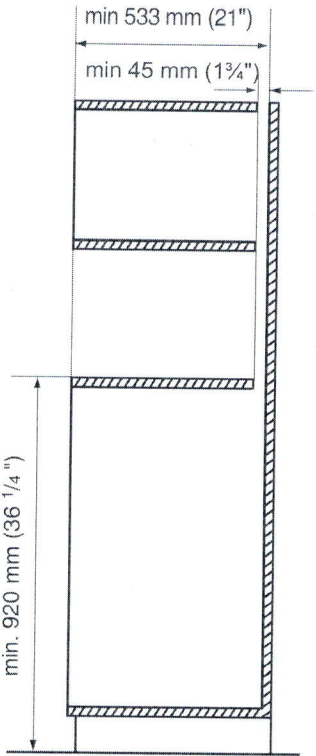
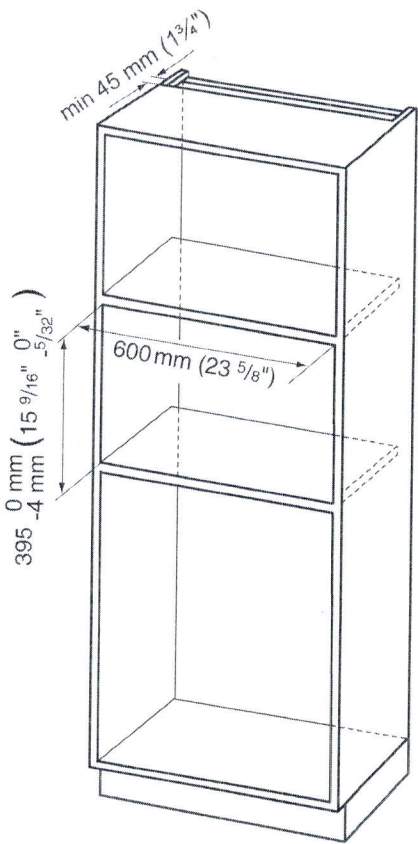

3. Cabinet Diagram and Dimensions

3. Schéma de l'armoire et dimensions

3. Dimensiones y diagrama del gabinete

fig 2.

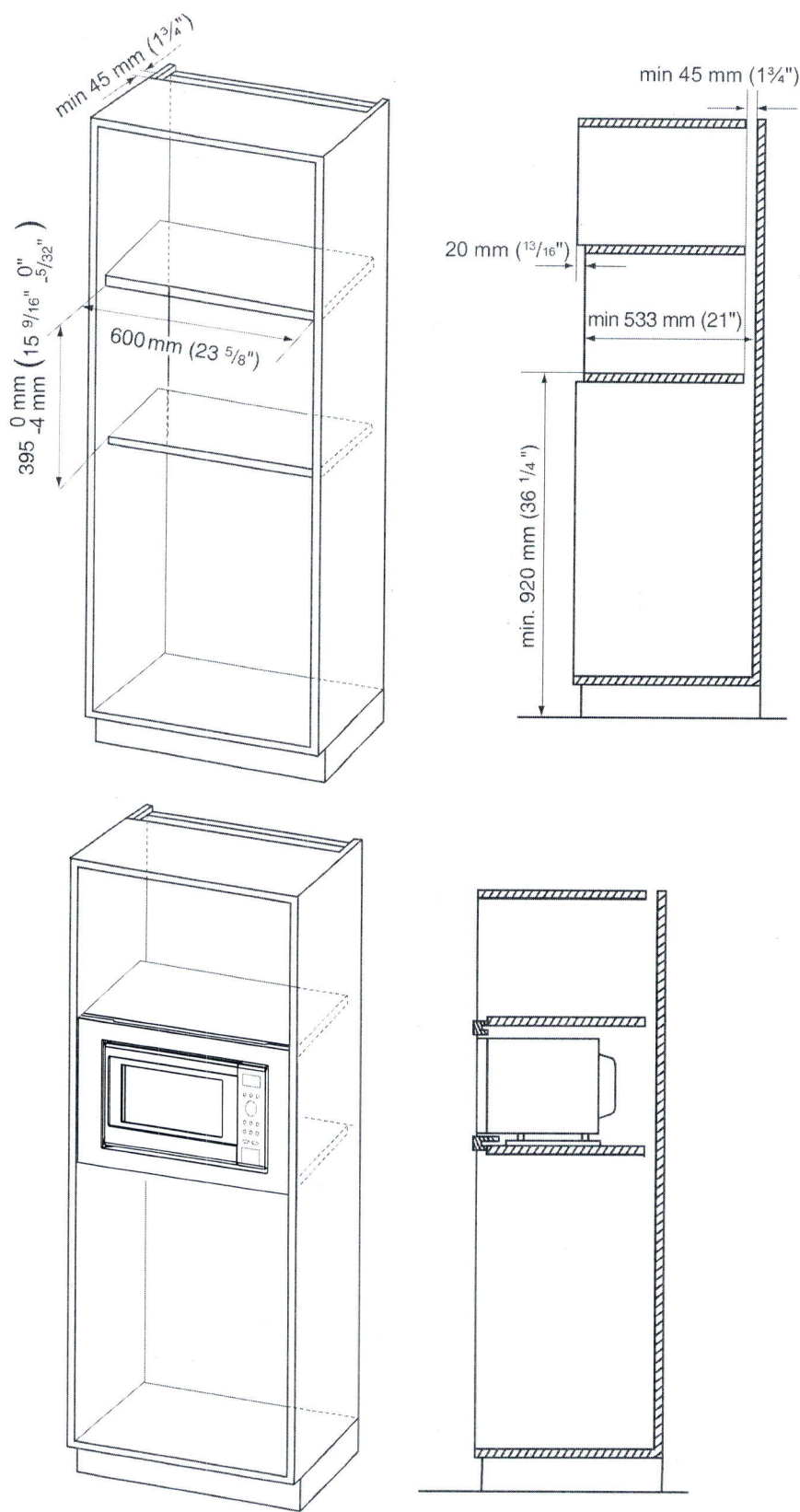

3. Cabinet Diagram and Dimensions

3. Schéma de l'armoire et dimensions

3. Dimensiones y diagrama del gabinete

fig 3.

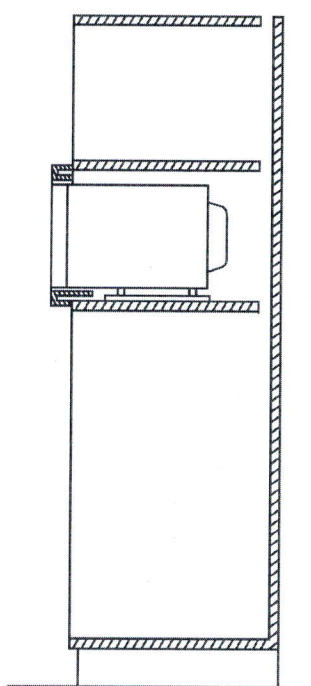
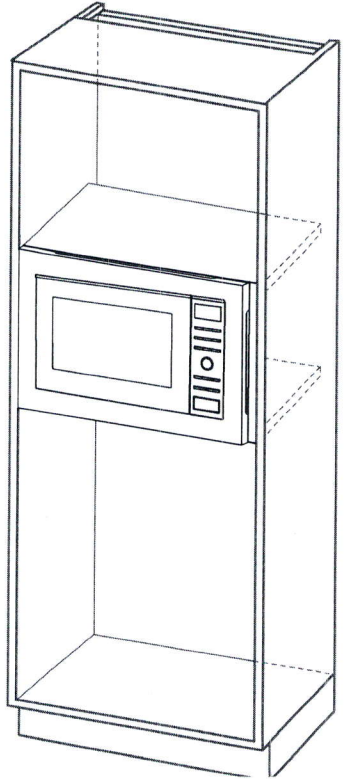
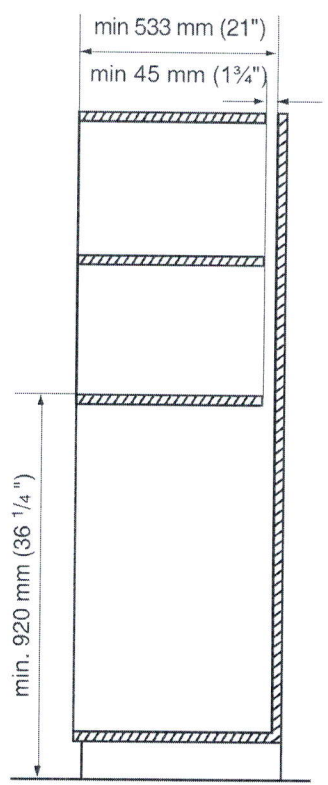
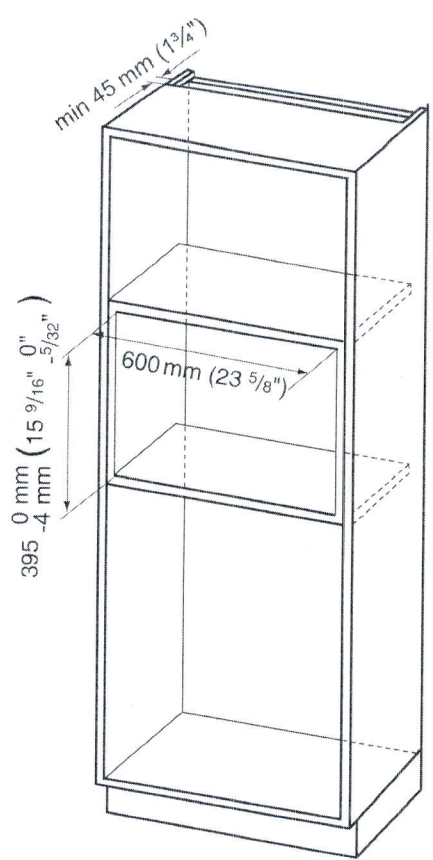

KRFC300ESS

KitchenAid®

20 cu. ft. 36-Inch Width Counter-Depth French Door Refrigerator with Interior Dispense

<http://www.kitchenaid.com>

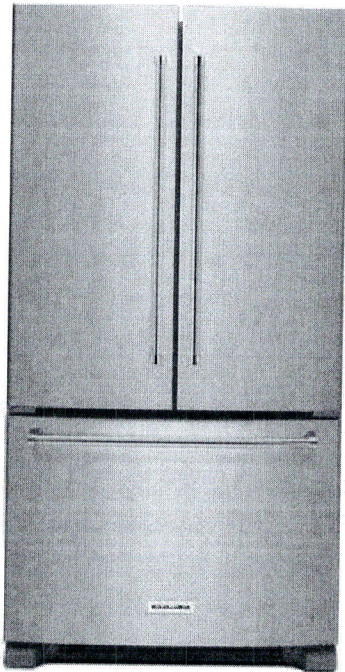

Key Features:

- ExtendFresh™ Temperature Management System
- Interior Water Dispenser
- Professionally-Inspired Design
- Produce Preserver
- Humidity-Controlled Crispers
- FreshChill™ Temperature-Controlled Full-Width Pantry
- Automatic Ice Maker
- Max Cool
- LED Lighting
- ENERGY STAR® Qualified
- Metallic Accents on Shelf Trim

Product Dimensions:

Height: 70 1/8

Width: 35 3/4

Depth: 30 1/2

Additional Information:

[Use And Care Guide](#)

[Dimension Guide](#)

[Energy Guide](#)

[Warranty Certificate](#)

Available in:

- Black
- Stainless Steel
- White

INVESTED
IN
AMERICA



©Registered trademark/TM Trademark of Whirlpool, U.S.A. © 2016 Whirlpool Corporation. All Rights Reserved.
All other trademarks are owned by their respective companies.

Because Whirlpool Corporation policy includes a continuous commitment to improve our products, we reserve the right to change materials and specifications without notice. We also reserve the right to discontinue or transition products without notice.

Manufacturer's Suggested Retail Price (MSRP) and Minimum Advertised Price (MAP) provided for reference purposes only. Dealer alone determines advertised and retail prices.

Created On: Monday, March 06, 2017 19:10:51

PRODUCT MODEL NUMBERS

KBFS20EC	KBFS25EC
KBFS22EC	KRFC300E
KRFF302E	KRFF305E

Electrical: A 115-volt, 60-Hz, AC-only, 15- or 20-amp fused, grounded electrical supply is required. It is recommended that a separate circuit serving only your refrigerator be provided. Use an outlet that cannot be turned off by a switch. Do not use an extension cord.

NOTE: Before performing any type of installation, cleaning, or removing a light bulb, turn the control (Thermostat, Refrigerator or Freezer Control depending on the model) to OFF and then disconnect the refrigerator from the electrical source. When you are finished, reconnect the refrigerator to the electrical source and reset the control (Thermostat, Refrigerator or Freezer Control depending on the model) to the desired setting. See "Using the Controls."

Water: A cold water supply with water pressure between 35 and 120 psi (241 and 827 kPa) is required to operate the ice maker and water dispenser. If you have questions about your water pressure, call a licensed, qualified plumber.

IMPORTANT: The pressure of the water coming out of a reverse osmosis system going to the water inlet valve of the refrigerator needs to be between 35 and 120 psi (241 and 827 kPa).

Reverse Osmosis Water Supply: If a reverse osmosis water filtration system is connected to your cold water supply, the water pressure to the reverse osmosis system needs to be a minimum of 40 to 60 psi (276 to 414 kPa).

Bottom Mount Refrigerator

PRODUCT DIMENSIONS

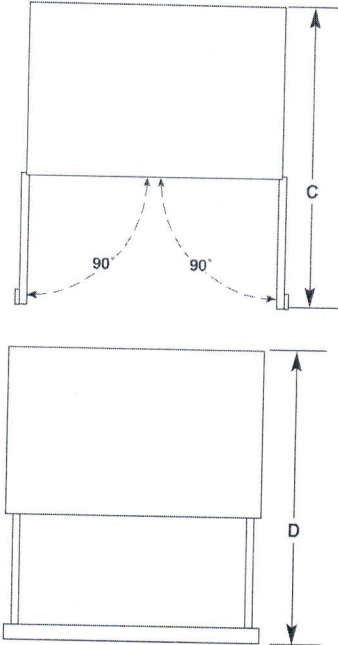
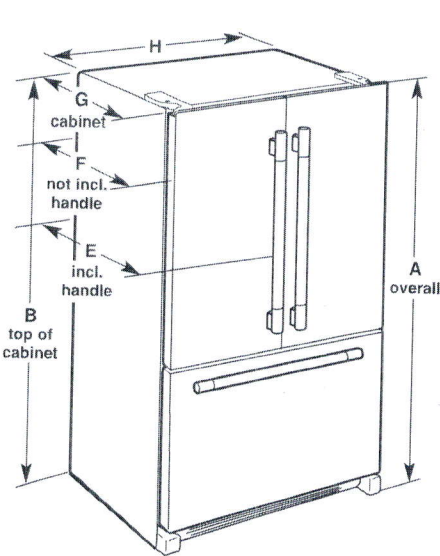

Model Number/Size	Height - Overall "A"	Height - Top of Cabinet "B"	Depth - Doors Open 90° "C"	Depth - Drawer Open "D"	Depth - With Handles "E"	Depth - Without Handles "F"	Depth - Cabinet Only "G"	Width - Cabinet "H"
KBFS20EC 20.0 cu. ft.	70 ¹ / ₈ " (178.1 cm)	68 ¹ / ₂ " (174.0 cm)	43" (109.2 cm)	44 ¹ / ₂ " (113 cm)	29 ³ / ₈ " (74.6 cm)	28" (71.1 cm)	24 ¹ / ₈ " (61.3 cm)	35 ⁵ / ₈ " (90.5 cm)
KBFS22EC (21.7 cu. ft.)	70 ¹ / ₈ " (178.1 cm)	68 ¹ / ₄ " (174.8 cm)	47 ¹ / ₁₆ " (119.5 cm)	52 ¹ / ₁₆ " (132.2 cm)	34 ⁷ / ₁₆ " (87.5 cm)	31 ¹ / ₁₆ " (81.1 cm)	28 ¹ / ₈ " (71.4 cm)	32 ⁵ / ₈ " (82.9 cm)
KBFS25EC (24.8 cu. ft.)	70 ¹ / ₈ " (178.1 cm)	68 ¹ / ₄ " (174.8 cm)	48 ¹ / ₁₆ " (122.1 cm)	53 ¹ / ₈ " (135 cm)	35 ⁷ / ₁₆ " (90 cm)	32 ¹ / ₁₆ " (83.7 cm)	29 ¹ / ₈ " (74 cm)	35 ⁵ / ₈ " (90.5 cm)
KRFC300E (20 cu. ft.)	70 ¹ / ₈ " (178.1 cm)	68 ⁷ / ₈ " (174.9 cm)	43 ¹ / ₈ " (109.5 cm)	48 ¹ / ₈ " (122.2 cm)	30 ¹ / ₂ " (77.5 cm)	28" (71.1 cm)	24 ¹ / ₈ " (61.3 cm)	35 ³ / ₄ " (90.8 cm)
KRFF302E (22.1 cu. ft.)	70 ¹ / ₈ " (178.1 cm)	68 ⁷ / ₈ " (174.9 cm)	47 ¹ / ₈ " (122.2 cm)	52 ¹ / ₈ " (134.9 cm)	34 ¹ / ₈ " (90.2 cm)	32" (83.8 cm)	28 ¹ / ₈ " (74 cm)	32 ⁷ / ₈ " (83.5 cm)
KRFF305E (25.2 cu. ft.)	70 ¹ / ₈ " (178.1 cm)	68 ⁷ / ₈ " (174.9 cm)	48 ¹ / ₈ " (122.2 cm)	53 ¹ / ₈ " (134.9 cm)	35 ¹ / ₂ " (90.2 cm)	33" (83.8 cm)	29 ¹ / ₈ " (74 cm)	35 ⁵ / ₈ " (91.1 cm)

LOCATION REQUIREMENTS

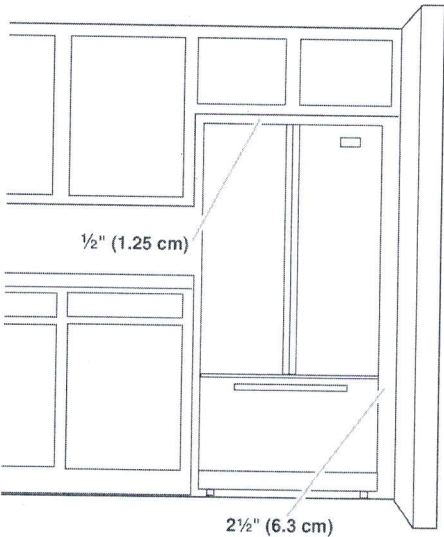

To ensure proper ventilation for your refrigerator, allow for a 1/2" (1.25 cm) space on each side and at the top. Allow for 1" (2.54 cm) of space behind the refrigerator. If your refrigerator has an ice maker, make sure you leave some extra space at the back for the water line connections.

If you are installing your refrigerator next to a fixed wall, leave 2 1/2" (6.3 cm) minimum on the hinge side (some models require more) to allow for the door to swing open.

NOTE: This refrigerator is intended for use in a location where the temperature ranges from a minimum of 55°F (13°C) to a maximum of 110°F (43°C). The preferred room temperature range for optimum performance, which reduces electricity usage and provides superior cooling, is between 60°F (15°C) and 90°F (32°C). It is recommended that you do not install the refrigerator near a heat source, such as an oven or radiator.

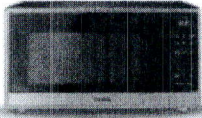

Microwave Ovens

Cyclonic Inverter™

Countertop NN-ST765S

MODEL & SIZE	Model Number	NN-ST765S
	Type	Family-size
	Installation	Countertop or built-in
	Oven Capacity	1.6 cu. ft.
	Cooking Power	1200W
	Turntable Diameter	380mm
PANASONIC TECHNOLOGY	Panasonic Inverter	Cyclonic Inverter
	Genius Sensor	Genius®
DESIGN	Color	Stainless Steel
	Control Panel	Touch pad
	Display Panel	New 4 Digit + Icon LCD / Green
STYLE	Door Window	Clear Black
	Door Release	Push Open
	Oven Interior	Paint White
PERFORMANCE	Multi-stage Cooking	3 stage
PROGRAMMABLE FEATURES	Sensor Cook	Yes
	Sensor Reheat	Yes
	Auto Cook/Reheat	Yes
	More / Less Control	Yes
	Inverter Turbo Defrost	Yes
	Keep Warm Button	Yes
	Popcorn Button	Yes
	Quick Minute	Yes
SPECIFICATIONS	Cavity Dimensions (W x D x H)	Approx. 418 x 470 x 228 mm

			15.7 x 18.5 x 8.3 inch
		Unit Dimensions (W x D x H)	555 x 493 x 304 mm 21.9 x 19.4 x 12 inch
		Carton Dimensions (W x D x H)	627 x 540 x 360 mm
ACCESSORIES	TRIM KITS	27" Model Number	NN-TK722S
		30" Model Number	NN-TK732S
	Accessory		Glass Tray