

CONSTRUCTION SUMMARY

Charisma Condominiums - Genazzano Highrises Inc.

PURCHASERS: Thi Phuong-Linh NGUYEN and Tony Ngoc-Hieu NGUYEN

TEL:

LOT / PHASE 215 / East	REG. PLAN #	HOUSE TYPE C947		
---------------------------	-------------	--------------------	--	--

BACKSPLASH - COUNTER TOP MATERIAL

1 - KITCHEN BACKSPLASH - UPGRADE COLOUR - QUARTZ MISTRAL 29Mar21 Note:	
---	--

CABINETRY

1 - TOUCH LATCH - NO HARDWARE 29Mar21 Note:	
KITCHEN - UPPERS CABINETS ONLY	
1 - ALL GLASS UPPERS 29Mar21 Note:	
IN EXTENDED UPPERS -KITCHEN	
1 - KITCHEN CABINET UPPERS 29Mar21 Note:	
EXTENDED UPPERS IN KITCHEN CABINETS	
1 - CABINETRY - KITCHEN - UPGRADE 1 29Mar21 Note:	

CONSTRUCTION

1 - SMOOTH CEILING FOR BEDROOM - PRICE IS EACH BEDROOM 29Mar21 Note:	
1 - SMOOTH CEILING FOR BEDROOM - PRICE IS EACH BEDROOM 29Mar21 Note:	
1 - MAIN BATHROOM-FRAMELESS CLEAR GLASS SHOWER DOOR INCLUDES CHROME KNOB AND HINGES 04Feb21 Note:	
1 - MASTER ENSUITE- TUB TO SHOWER CONVERSION - INCLUDES FRAMELESS CLEAR GLASS SHOWER DOOR WITH SIDE PANEL TO CEILING-INCLUDES CHROME KNOB AND HINGES 04Feb21 Note:	
INCLUDES SHOWER POT LIGHT	

COUNTER TOP

1 - KITCHEN COUNTERTOP - UPGRADE COLOUR - QUARTZ MISTRAL 29Mar21 Note:	
---	--

ELECTRICAL

1 - MASTER ENSUITE AND BEDROOM 2 ENSUITE ADD - GFI PLUGS BEHIND TOILETS - SEE SKETCH 29Mar21 Note:	
---	--

MIRRORS AND GLASS

1 - MAIN AND ENSUITE - FOR CLARIFICATION PURPOSES - FRAMELESS GLASS SHOWER DOORS 04Feb21 Note:	
---	--

PLUMBING

2 - MASTER ENSUITE AND BEDROOM 2 ENSUITE ADD - TOTO AQUIA IV CLOSE COUPLED TOILET CST446CEMG WITH WASHLET SEAT SW30747T40 29Mar21 Note:	
1 - MOEN 90 DEGREE POSI-TEMP SHOWER ONLY WITH 3 FUNCTION TRANSFER VALVE/TRIM AND SLIDE BAR WITH HAND SHOWER – CHROME #TS2712EP/U361CI/UTS4172/62320/S3879EP/A721 29Mar21 Note:	
1 - KITCHEN – WATERLINE ROUGH-IN FOR FRIDGE 29Mar21 Note: UPGRADE FRIDGE REQUIRED	
1 - MOEN 90 DEGREE POSI-TEMP SHOWER ONLY WITH 3 FUNCTION TRANSFER VALVE/TRIM AND SLIDE BAR WITH HAND SHOWER – CHROME #TS2712EP/U361CI/UTS4172/62320/S3879EP/A721 29Mar21 Note:	



CONSTRUCTION SUMMARY

Charisma Condominiums - Genazzano Highrises Inc.

PURCHASERS: Thi Phuong-Linh NGUYEN and Tony Ngoc-Hieu NGUYEN

TEL:

LOT / PHASE 215 / East	REG. PLAN #	HOUSE TYPE C947		
---------------------------	-------------	--------------------	--	--

This Document is Extremely Time Sensitive - Printed 30 Mar 21 at 14:56

Purchasers: Thi Phuong-Linh NGUYEN & Tony Ngoc-Hieu NG Const. No.: Unit 26, Level 2
Telephone Res. / Bus: / Municipal: 215
Decor Advisor: Ida Viola Suite Type: C947
Lock Date: 3/29/2021 13:23:08 Project/Phase: Genazzano Highrises Inc./East

Layout Changes: ☐ Yes ☒ NoSketch Attached: ☒ Yes ☐ No

1. Kitchen and Vanities

	Style and Colour	Hardware
Kitchen	RICHMOND 908 COLUMBIA COFFEE	428SB - Base
Main Bathroom	DORAL - W-500	428SB
Master Ensuite Bathroom	DORAL - W-500	428SB
Powder Room	DORAL - W500	428SB

Built In Appliances ☐ Yes ☒ NoKitchen Extended Upper Cabinets ☒ Yes ☐ No

Comment

** Refer to Construction Summary - Uppers - Touch Latch only *

2. Counters

	Counter	Edge
Kitchen	QUARTZ - MISTRAL	Straight Polished Edge
Main Bathroom	QUARTZ - FLORENCE	Straight Polished Edge
Master Ensuite Bathroom	QUARTZ - FLORENCE	Straight Polished Edge
Powder Room	QUARTZ - FLORENCE	Straight Polished Edge
Kitchen Backsplash	QUARTZ - MISTRAL	

Comment

** Refer to Construction Summary

3. Flooring

	Selection
Vestibule/Main Hall	LEXINGTON - LANEFFE OAK - TL-LW1311
Kitchen	LEXINGTON - LANEFFE OAK - TL-LW1311
Living Room/Dining Room	LEXINGTON - LANEFFE OAK - TL-LW1311
Den/Office	N/A
Master Bedroom	LEXINGTON - LANEFFE OAK - TL-LW1311
Bedroom #2	LEXINGTON - LANEFFE OAK - TL-LW1311
Bedroom #3	N/A
Laundry Room	WHITE MATTE 8X8
Main Bath	TILE - STONE WHITE 12X24
Master Ensuite Bathroom	TILE - STONE WHITE 12X24
Powder Room	TILE - STONE WHITE 12X24

Comment

** Refer to Construction Summary - Standard Grout throughout unless specified

4. Wall Tile

	Selection	Describe
Main Bath	TILE - GLOSSY WHITE 8X16	
Master Ensuite Bathroom	TILE - GLOSSY WHITE 8X16	
Powder Room	TILE - GLOSSY WHITE 8X16	
Kitchen Backsplash	QUARTZ - MISTRAL	

Comment

** Refer to Construction Summary - Standard Grout throughout unless specified

Initials: LN

TN

Page 1 of 2

Purchasers:Thi Phuong-Linh NGUYEN & Tony Ngoc-Hieu NGConst. No.: Unit 26, Level 2

Telephone Res. / Bus: /Municipal: 215

Decor Advisor: Ida ViolaSuite Type: C947

Lock Date: 3/29/2021 13:23:08Project/Phase: Genazzano Highrises Inc./East

5. Misc

Water Line Rough-in for Fridge☒ Yes ☐ No

Upgrade Bathroom Accessories☐ Yes ☒ No

Comment

** Refer to Construction Summary

6. Wall Paint - Birch White Paint Throughout unless specified below.

Entrance Vestibule	BIRCH WHITE	Living Room	BIRCH WHITE
Main Hall	BIRCH WHITE	Dining Room	BIRCH WHITE
Kitchen	BIRCH WHITE	Den/Library	N/A
Laundry Room	BIRCH WHITE	Master Bedroom	BIRCH WHITE
Main Bathroom	BIRCH WHITE	Bedroom #2	BIRCH WHITE
Master Ensuite Bathroom	BIRCH WHITE	Bedroom #3	N/A
Powder Room	BIRCH WHITE		

Comment



SMOOTH CEILINGS THROUGHOUT

7. General Comments

** Refer to Construction Summary

Disclaimers and Notes

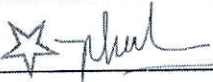
- 1) Colours of all materials are as close as possible to builder's selection, but not necessarily identical due to variances in manufacturing.
- 2) The selection images are digital photographs of the Vendor's samples at its Decor Centre. Such images when displayed on your computer monitor may not match Decor Centre samples due to the hardware/software configuration of the computer. In the event of conflict between selection images and the Décor Centre samples, Décor Centre samples shall prevail.
- 3) Any extras listed above are null and void unless accompanied by a separate invoice/amendment. Said invoice must be paid in full.
- 4) The Purchaser agrees that this colour selection is final and that no changes will be permitted, unless required by the Vendor.
- 5) The Purchaser acknowledges reading and accepting document which contains other miscellaneous disclaimers.

Signature: Date: _____Signature: Date: _____

Signature: _____Date: _____Signature: _____Date: _____

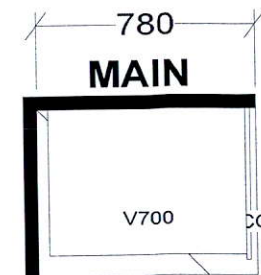
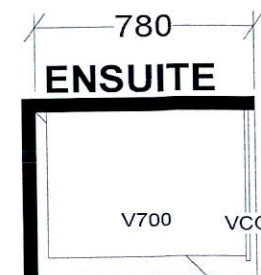
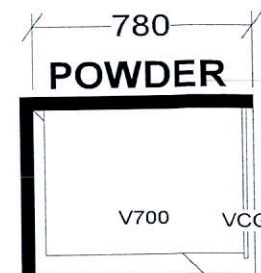
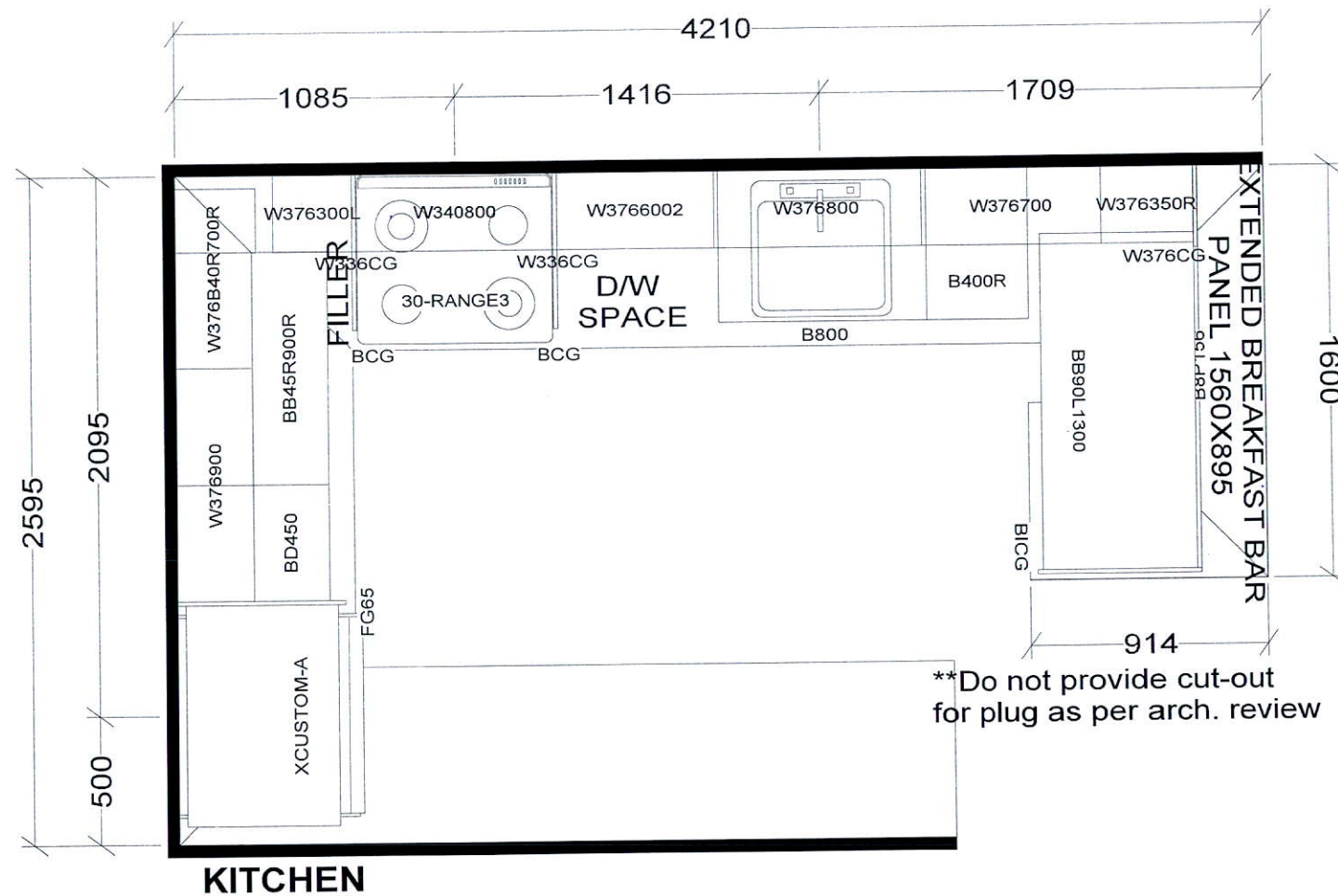



BASE & VANITY CABINETS ON ADJUSTABLE LEGS

TOWER & PODIUM SUITES
EAST TOWER X3

Selba Industries			J # _____
W WDT _____	W HGHT _____	W CNT _____	This drawing is the intellectual property of SELBA INDUSTRIES INC. and is an original design which must not be released or copied unless applicable fee has been paid or job order placed. DESIGNER: KS DATE: OCT 27 20/rev'd Dec 10 29
FLOOR HGHT _____ DOOR HGHT _____			
ST CENT _____	2X4 _____	VENT BOX COVER _____	
			JOB NUMBER: BUILDER: GREENPARK SITE: CHARISMA EAST & WEST MODEL: C947 LOT #:

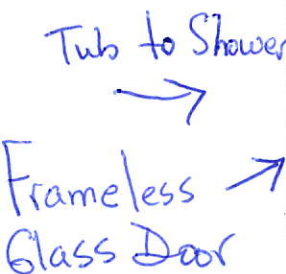
SCHEDULE 'A'
Charisma
CONDOMINIUMS



Purchaser Initials

Purchaser Initials

Date _____

Unit No. 26 Level No. 2 Suite No. 215

Dimensions, specifications, layouts, location of materials and fixtures, tile floor patterns and architectural detailing (including window size and location and door size, location and swing) are approximate only and are subject to change or modifications, without notice. Actual usable floor space varies from stated floor area. Ceiling height measured from top of floor slab to underside of floor slab above and excludes finishes, bulkheads and drop ceilings. Orientation of suite may be reversed and Purchaser agrees to accept same. Balconies decks and terraces are exclusive use common elements shown for display purposes only and location and size are subject to change without notice. All illustrations are artist concept only. The provisions of the Agreement of purchase and sale apply to this Schedule. E. & O.E.

TOTO®

CST446CEMG

Aquia® IV Close Coupled Toilet, 1.28 & 0.8 GPF

FEATURES

- DynaMax™ Tornado Flush® utilizes 360° cleaning power to reach every part of the bowl
- Ultra high-efficiency dual flush 1.28 & 0.8 GPF (4.8 & 3.0 LPF)
- CEFIONTECT® ceramic glaze prevents debris and mold from sticking to ceramic surfaces
- Design of the bowl reduces water flow resistance resulting in a quieter flushing sound
- Completely skirted design for a sleek and understated look that's easier to clean
- Elongated front bowl and tank set, less toilet seat
- Chrome push-button
- 12" Rough-in

MODELS

- CST446CEMG (#01)
With CEFIONTECT ceramic glaze

COMPONENTS

- CT446CUG
Elongated bowl with CEFIONTECT
- ST446EMA
Tank and cover only

Optional Components

- SS124
SoftClose Seat
- SS234
SoftClose Seat
- TSU08W.10
10" Unifit Rough-In
- TSU08W.14
14" Unifit Rough-In
- 9AU321-A
WASHLET® adapter
(Required for WASHLET installation)

COLORS/FINISHES

- #01 Cotton



 DynaMax
Tornado Flush

 Skirted Design

 CEFIONTECT

PRODUCT SPECIFICATION

The two-piece, ultra high-efficiency, DynaMax Tornado Flush toilet shall be dual flush 1.28 GPF/0.8 GPF. Toilet shall be coated with CEFIONTECT, elongated front bowl, high profile tank, complete skirted bowl and chrome push-button. Toilet shall be TOTO Model CST446CEMG.

CODES/STANDARDS

- Meets and exceeds ASME A112.19.2/CSA B45.1, ASME A112.19.14
- Certifications: IAPMO(cUPC®), EPA WaterSense, State of Massachusetts, and others
- Code Compliance: UPC, IPC, NSPC, NPC Canada, and others
- Legislative Compliance: California Green Building Code, City of Los Angeles Water Efficiency Ordinance, and others
- Complies with CA Prop 65 warning requirements



CST446CEMG

Aquia® IV Close Coupled Toilet, 1.28 & 0.8 GPF

SPECIFICATIONS

Water Use	1.28 & 0.8 GPF (4.8 & 3.0 LPF)
Flush System	DynaMax™ Tornado Flush®
Min. Water Pressure	8 psi (Flowing)
Water Surface	5-5/8" x 4-1/8"
Trap Diameter	2-1/2"
Rough-in	12" (10" & 14" Optional)
Trap Seal	2-1/8"
Warranty	One Year Limited Warranty
Material	Vitreous China
Shipping Weight	CT446CU(G) 85 lbs
	ST446EMA 29 lbs
Shipping Dimensions	CT446CU(G) 30-3/4" L x 17-3/8" W x 20-1/2" H
	ST446EMA 17-1/4" L x 7-7/8" W x 17-1/2" H

INSTALLATION NOTES

Back-to-Back Toilet Installations:
TOTO recommends the use of a nationally listed, double sanitary tee-wye only, in vertical waste stacks, in accordance with the stipulations noted in the majority of nationally recognized plumbing codes.

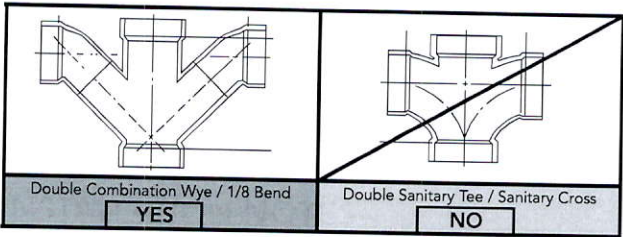

To maintain adequate wall gap between the back of the tank and wall, mount the floor flange at a nominal 12" rough-in distance.

DIMENSIONS

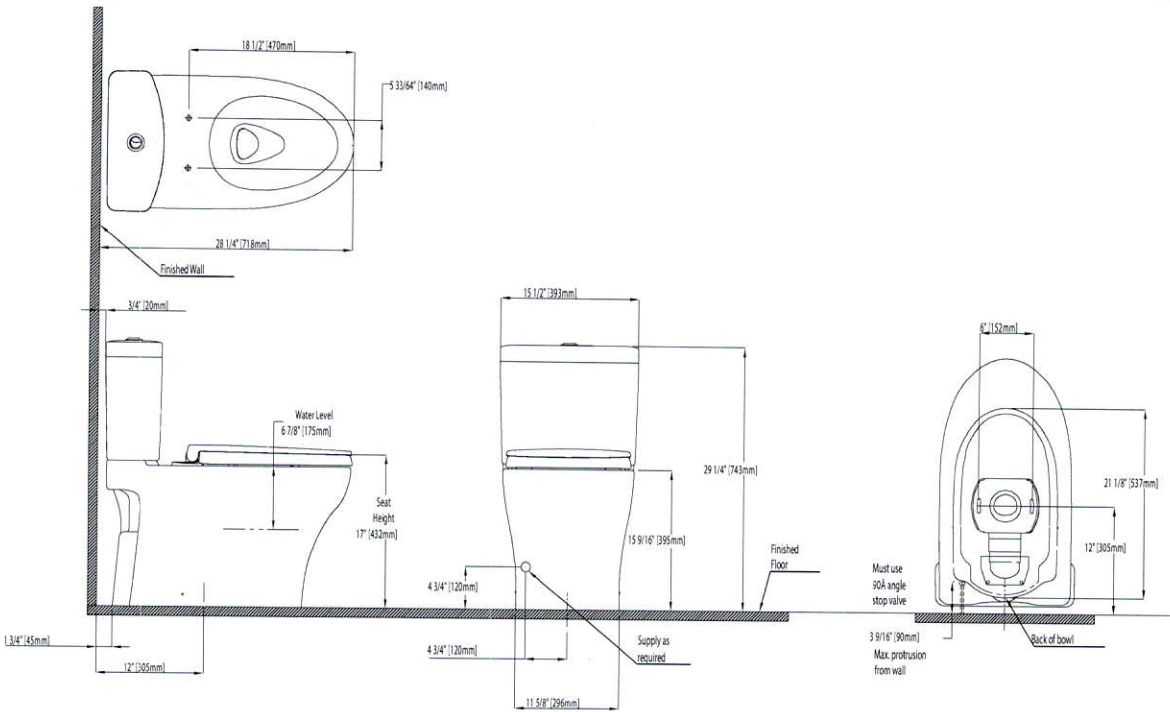

Ph: (888) 295-8134 | Fax: (800) 699-4889 | www.totousa.com | © TOTO USA

SS-01318 v.03

TOTO®

SW3074T40

WASHLET®+ C2

FEATURES

- Concealed supply connection for seamless installation
- Gentle Aerated, Warm Water, Dual Action Spray with oscillating and pulsating feature
- Adjustable water temperature and volume
- Warm air drying with three variable temperature settings
- Automatic air deodorizer
- Convenient arm control panel
- Docking station for easy cleaning and installation
- Heated seat with temperature control
- EWATER+® auto-cleans wand
- On-demand remote function cleans wand with EWATER+
- Water PREMIST® of bowl before each use

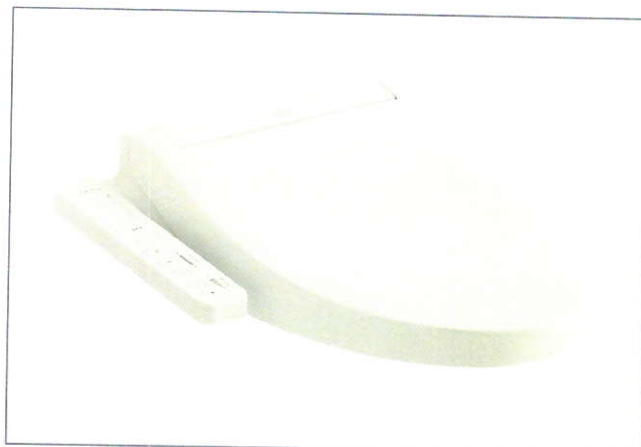

washlet®+

 EWATER+

 PREMIST

MODELS

- SW3074T40 - Contemporary Design

COLORS/FINISHES

- #01 Cotton

PRODUCT SPECIFICATION

Seat shall have gentle aerated, warm water, dual action spray with cycling movement and massage feature. Seat shall have adjustable water temperature and volume. Seat shall have warm air drying with five variable temperature settings. Seat shall have automatic air deodorizer. Seat shall include convenient arm control panel. Seat shall be solid plastic with closed front seat and cover. Seat shall include power cord, and water supply hoses. EWATER+ cleans the wand. Seat shall be model SW3074T40#_____.

CODES/STANDARDS

- Meets and exceeds ASME A112.4.2, ASME A112.18.1/CSA B125.1, UL 1431, CSA C22.2 #68
- Certifications: IAPMO(cUPC), State of Massachusetts, City of Los Angeles and others
- Code Compliance: UPC, IPC, NSPC, NPC Canada, and others
- Complies with CA Prop 65 warning requirements



SW3074T40

WASHLET®+ C2

SPECIFICATIONS

Power Rating	AC 120 V 60 Hz
Power Consumption	403W
Max Power Consumption	512W
Power Cord Length	3.93 ft (1.2 m)
Spray Volume	Rear Cleansing: 0.07 – 0.11 gal/min Rear Soft Cleansing: 0.07 – 0.11 gal/min Front Cleansing: 0.08 – 0.11 gal/min
Spray Features	Adjustable Surface Temp: 95 – 104 °F (35 – 40 °C) Safety Device: Temperature Fuse
Warm Air Dryer Features	Adjustable Air Temp: 95 – 140 °F (35 – 60 °C) Airflow Volume: 8.83 ft3/min (0.25 m3/min) Safety Device: Temperature Fuse
Heated Seat Features	Adjustable Surface Temp: 82 – 97 °F (28 – 36 °C) Safety Device: Temperature Fuse
Water Supply Pressure	Minimum: 7.25 PSI (Dynamic) Maximum: 108.75 PSI (Static)
Ambient Temp.	32 – 104 °F (0 – 40 °C)
Warranty	One Year Limited Warranty
Shipping Weight	SW3074T40: 17.0 lbs
Shipping Dimensions	SW3074T40 24-3/8" L x 20-3/4" W x 9-1/8" H

INSTALLATION NOTES

- WASHLET+ C2 may not fit certain toilet bowl designs
- If possible, with your order, please include your model number (from the underside of the tank lid).
- It is highly recommended to use a surge protector to prevent damage in the event of a power surge.
- For use with potable water only. Do not use with recycled water.

DIMENSIONS

SW3074T40

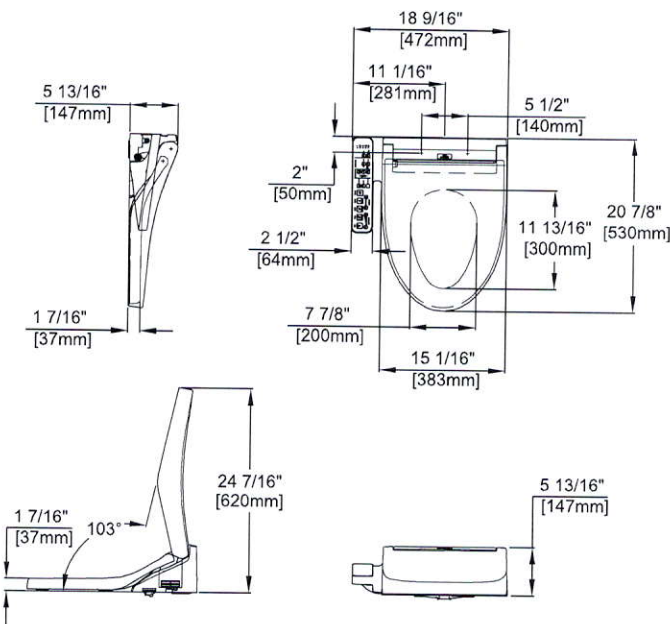

WASHLET® + RECOMMENDED MODELS

To achieve the best in comfort and hygiene, TOTO recommends these models that deliver the best performance TOTO has to offer. Clean Synergy - combining the best toilet and WASHLET® technologies working together in harmony to set the standard for everyday living.

AQUIA® IV TWO-PIECE TOILET:
MW4463056CUMFG, PAGE 62

Shuy