

<b>CONSTRUCTION SUMMARY</b>			
PURCHASER: Tribeca Property Management Group Inc.		330 Richmond - Petaluma Building Corp. DATE: <b>OCT 30 2020</b>	
Unit 8, Level 20 (2309-1)		Floor Plan E698	TEL: RES.: 416-225-6900

CABINETRY

1 - 41" UPPER CABINETS IN KITCHEN 12Jun19 Note:	
--	--

CONSTRUCTION

1 - THE PURCHASER ACKNOWLEDGES AND AGREES TO ACCEPT THE SHOWER AS INSTALLED IN THE UNIT INSTEAD OF THE BATHTUB IN THE MASTER BATHROOM AS SHOWN ON THE UNIT FLOOR PLAN. AT NO COST TO THE PURCHASER. 30Oct20 Note: THE PURCHASER ACCEPTS THE SHOWER AS INSTALLED AND AGREES THAT THE PURCHASER SHALL NOT MAKE ANY CLAIMS INCLUDING CLAIMS TO THE TARION WARRANTY CORPORATION, IN RESEPECT OF THE SHOWER INSTALLED IN PLACE OF THE BATHTUB. INCLUDING CHROME FRAMED SHOWER SLIDING DOORS	RECEIVED OCT 30 2020
1 - SMOOTH CEILINGS IN BEDROOMS 12Jun19 Note:	

PLUMBING

2 - UPGRADE BATHROOM ACCESSORIES- MOEN 90 DEGREE CHROME- IN BOTH BAHTROOMS TOILET PAPER HOLDER #YB 8886 TOWEL RING #YB8886 24" TOWEL BAR #YB8824 12Jun19 Note:	
--	--

This Document is Extremely Time Sensitive - Printed 30 Oct 20 at 14:23

Purchaser:Tribecca Property Management Group Inc.

Const. No.:Unit 8, Level 20

Telephone Res. / Bus:(416) 225-6900 /

Municipal:2309

Decor Advisor:Natalie Mancuso

Suite Type:E698

Lock Date:6/12/2019 10:47:44

Project/Phase:Petaluma Building Corp./1

Layout Changes: ☐ Yes ☒ No

Sketch Attached: ☒ Yes ☐ No

Exterior Colour Scheme:

1. Kitchen and Vanities

	Style and Colour	Counter	Hardware
Kitchen / Breakfast	SEE BELOW	QUARTZ- AMIATA- STRAIGHT POLISHED EDGE	STD
Main Bath	DORAL H3081 HACIENDA BLACK	QUARTZ- AMIATA- STRAIGHT POLISHED EDGE	STD
Master Ensuite Bathroom	DORAL H3081 HACIENDA BLACK	QUARTZ- AMIATA- STRAIGHT POLISHED EDGE	STD

Appliances:

Built In Appliances ☒ Yes ☐ No

41" Upper Cabinets ☒ Yes ☐ No

Slide In Stove ☐ Yes ☒ No

Comment

KITCHEN UPPER CABINETS- SENOSAN LIGHT GREY

KITCHEN BASE CABINETS- DORAL H3081 HACIENDA BLACK

2. Flooring

		Grout-If App.	At a 45
Entrance Vestibule	HARDWOOD- MIRAGE 4 5/16 LOCK RED OAK- GRAPHITE- CASHMERE		<input type="checkbox"/>
Main Hall	HARDWOOD- MIRAGE 4 5/16 LOCK RED OAK- GRAPHITE- CASHMERE		<input type="checkbox"/>
Kitchen / Breakfast	HARDWOOD- MIRAGE 4 5/16 LOCK RED OAK- GRAPHITE- CASHMERE		<input type="checkbox"/>
Laundry Room	TILE- MATTE WHITE 8X8	STD	<input type="checkbox"/>
Main Bath	TILE-LIFE ICE 12X24	STD	<input type="checkbox"/>
Master Ensuite Bathroom	TILE-LIFE ICE 12X24	STD	<input type="checkbox"/>
			<input type="checkbox"/>
Living Room	HARDWOOD- MIRAGE 4 5/16 LOCK RED OAK- GRAPHITE- CASHMERE		<input type="checkbox"/>
Dining Room	HARDWOOD- MIRAGE 4 5/16 LOCK RED OAK- GRAPHITE- CASHMERE		<input type="checkbox"/>
Den / Library / Study			<input type="checkbox"/>
Master Bedroom	HARDWOOD- MIRAGE 4 5/16 LOCK RED OAK- GRAPHITE- CASHMERE		<input type="checkbox"/>
Bedroom #2	HARDWOOD- MIRAGE 4 5/16 LOCK RED OAK- GRAPHITE- CASHMERE		<input type="checkbox"/>
Bedroom #3			<input type="checkbox"/>
			<input type="checkbox"/>

Comment

3. Wall Tile

	Selection	Grout	Describe
Main Bath			
Tub Deck Wall			
Shower Stall	TILE- GLOSSY WHITE 3X6	STD	
Bathtub Enclosure Walls			
Master Ensuite Bathroom			
Tub Deck Wall			
Shower Stall			
Bathtub Enclosure Walls	TILE- GLOSSY WHITE 3X6	STD	
Kitchen Backsplash	PAINTED GLASS BM #HC-170		
Backsplash Behind Fridge			

Comment

\*\* Refer to Construction Summary

4. Misc

Water Line for Fridge

NO

Interior Door Handles

STANDARD

Ceramic Bathroom Accessories

MOEN 90 DEGREE

☒ Yes ☐ No

Comment

RK



Purchaser:	Tribecca Property Management Group Inc.	Const. No.:	Unit 8, Level 20
Telephone Res. / Bus:	(416) 225-6900 /	Municipal:	2309
Decor Advisor:	Natalie Mancuso	Suite Type:	E698
Lock Date:	6/12/2019 10:47:44	Project/Phase:	Petaluma Building Corp./1

5. Plaster Mouldings and Medallions

Entrance Vestibule		Living Room	
Main Hall		Dining Room	
Kitchen/Breakfast		Den / Library /Study	
Laundry Room		Master Bedroom	
Main Bath		BedRoom #2	
Master Ensuite Bathroom		BedRoom #3	

Comment

\*\* Refer to Construction Summary

6. Wall Paint

Entrance Vestibule	BIRCH WHITE	Living Room	BIRCH WHITE
Main Hall	BIRCH WHITE	Dining Room	BIRCH WHITE
Kitchen / Breakfast	BIRCH WHITE	Den/Library	
Laundry Room	BIRCH WHITE	Master Bedroom	BIRCH WHITE
Main Bath	BIRCH WHITE	Bedroom #2	BIRCH WHITE
Master Ensuite	BIRCH WHITE	Bedroom #3	

Comment

7. General Comments

\*\* Refer to Construction Summary

Disclaimers and Notes

- Colours of all materials are as close as possible to builder's selection, but not necessarily identical due to variances in manufacturing.
- Any extras listed above are null and void unless accompanied by a separate invoice/amendment. Said invoice must be paid in full.
- The Purchaser agrees that this colour selection is final and that no changes will be permitted, unless required by the Vendor.
- The Purchaser acknowledges reading and accepting document which contains other miscellaneous disclaimers.

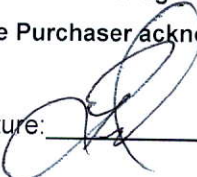
Signature:  Date: June 12/19 Signature: \_\_\_\_\_ Date: \_\_\_\_\_

Initial: 

# 90°™

Traditional | Transitional | Modern

*Geometric forms, squared corners and straight lines create an urban focal point for today's contemporary baths.*



**Toilet Tank Lever**  
Model YB8801

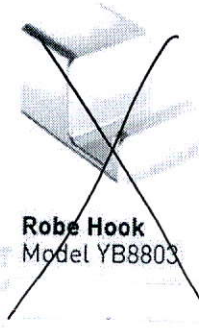

**Robe Hook**  
Model YB8803

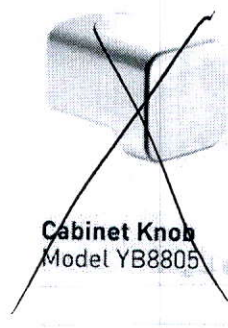

**Cabinet Knob**  
Model YB8805

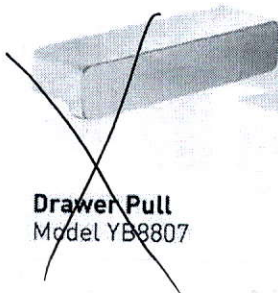

**Drawer Pull**  
Model YB8807

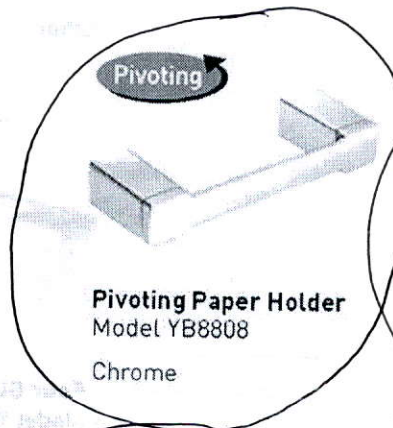

**Pivoting Paper Holder**  
Model YB8808  
Chrome



**Mini Towel Bar**  
Model YB8886  
Chrome

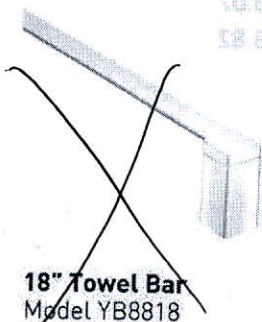

**18" Towel Bar**  
Model YB8818



**24" Towel Bar**  
Model YB8824  
Chrome

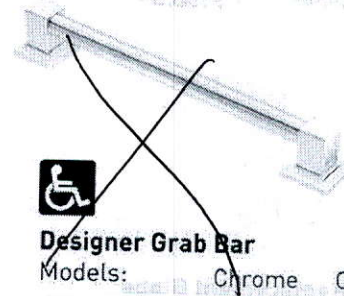

**Designer Grab Bar**  
Models: Chrome Other

## FINISH OPTIONS:

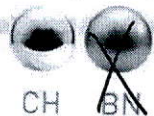

To order, combine the model number with one of these finish letter(s):  
Chrome (CH), LifeShine® Brushed Nickel (BN).



# SCHEDULE 'A'

## 330

RICHMOND

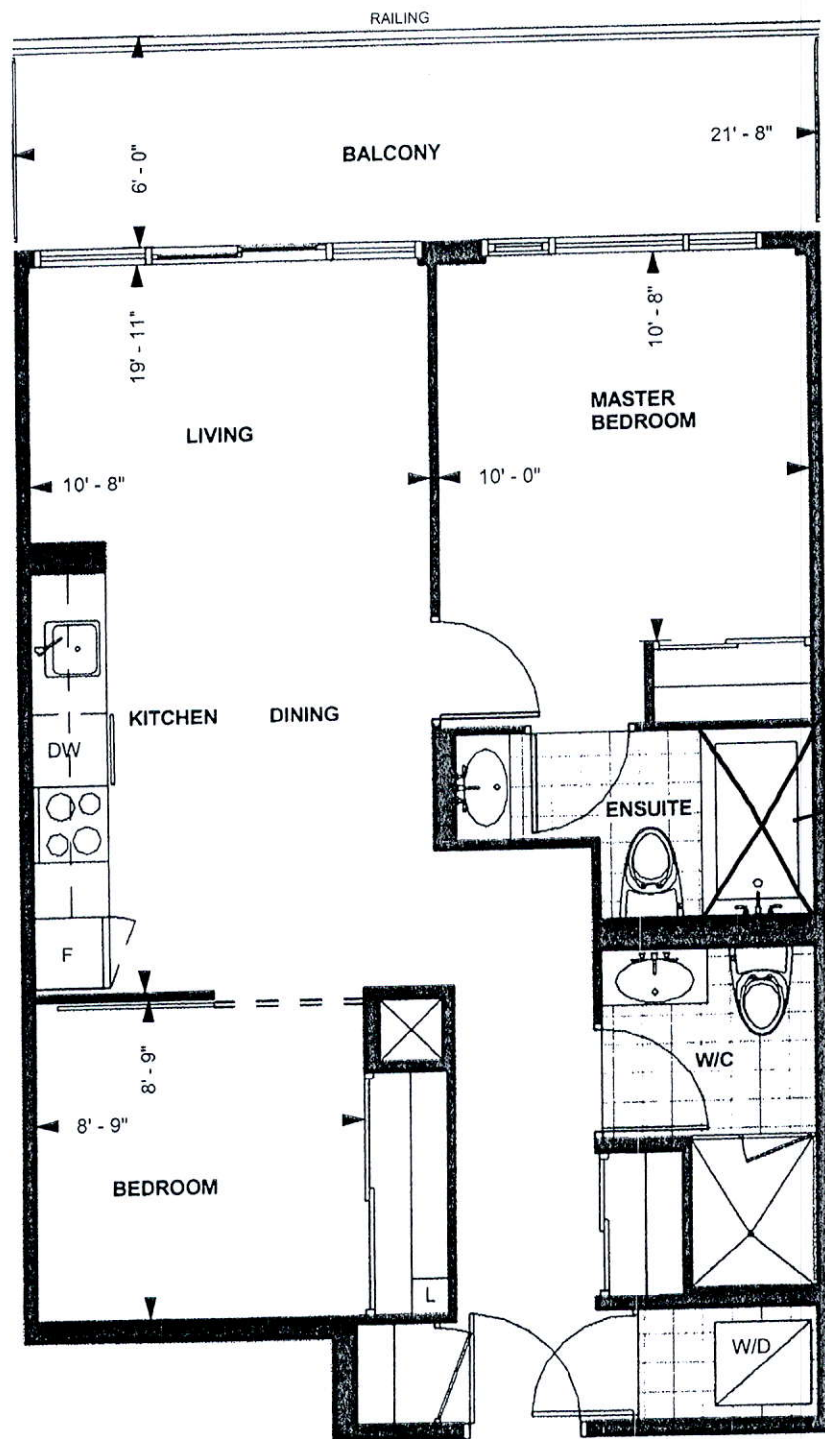

RECEIVED  
OCT 30 2020  
shower  
As per Const.

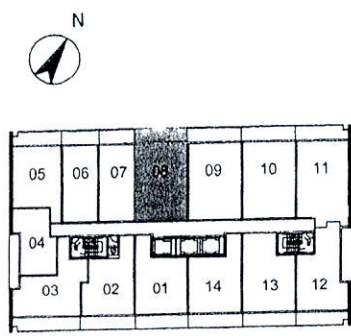

LEVEL 13-20

TOWER SUITE  
E 698  
9' CEILING \*  
698 sq. ft.  
2-BEDROOM

Purchaser Initials R.K. Date MAR 24/14  
Unit No. 8 Level No. 20 Suite No. 2309

Dimensions, specification, tile floor pattern and architectural detailing (including window size and location) are approximate and subject to modifications without notice. Orientation of suite may vary from the stated floor area.  
\*Ceiling height measured from top of floor slab to underside of slab above before finishes, and excluding bulkheads and required drop ceilings. E.&O.E.

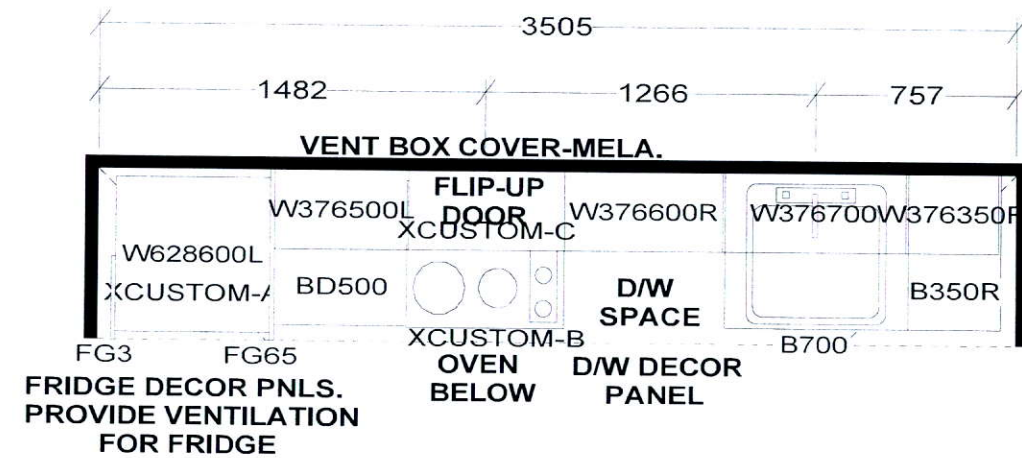

**KITCHEN**  
- 41" uppers

- APPLIANCE PACKAGE:**  
24" INTEGRATED FRIDGE W/ DECOR PNLS  
24" INTEGRATED DISHWASHER W/ DECOR PNL  
24" BUILT-IN OVEN  
24" COOKTOP  
24" MICROWAVE HOOD FAN

**KITCHEN BASES & VANITIES INSTALLED  
WITH ADJUSTABLE LEGS**

*S e l b a I n d u s t r i e s*

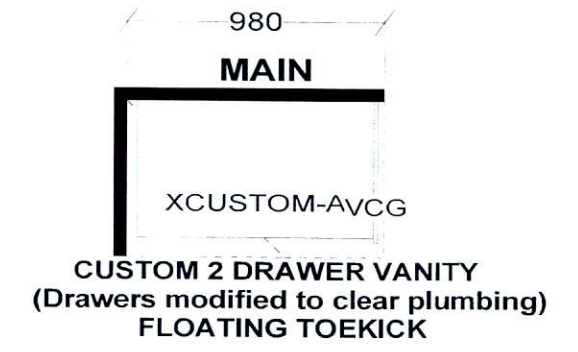
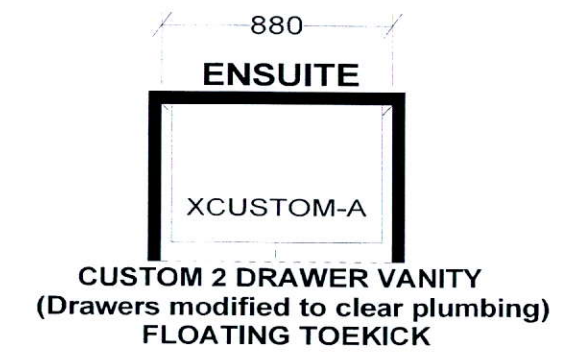

WDTH	W	HGHT	W	CNT	FL	HGHT	DWY	H	ST	CENT	2X4	VENT BOX COVER
TOWER SUITES: 760MM HIGH UPPER CABINETS WHITE STEEL DRAWER BOXES COUNTERTOPS BY OTHERS VENT BOX COVERS CUSTOM VANITIES					This drawing is the intellectual property of SELBA INDUSTRIES INC. and is an original design which must not be released or copied unless applicable fee has been paid or job order placed.					JOB NUMBER: BUILDER: GREENPARK SITE NAME: PETALUMA MODEL: 2 BEDROOM - E 698 LOT #: DESIGNER: KS DATE: JAN 8 18		