

CONSTRUCTION SUMMARY		DATE: MAR 05 2020	
330 Richmond - Petaluma Building Corp.		TEL: RES.: 416-858-0968	
PURCHASER: Daniel MEDEIROS			
Unit 6, Level 10 (1107-1)	Floor Plan B592		

CABINETRY

I - DELETE - 41" INCH UPPERS IN KITCHEN	NEW	MAR 05 2020	
** INSERT ** - 39" UPPERS IN KITCHEN			
04Mar20 Note: The Purchaser acknowledges and agrees that the kitchen cannot accommodate the 41" upper cabinet height, which was chosen by the Purchaser at the time of colour selection, as a result of site conditions. The Purchaser accepts that the kitchen upper cabinets will have a height of approximately 39" and the Purchaser shall not make any claims, including claims to Tarion Warranty Corporation, in respect of the upper kitchen cabinet height being 39".			
I - KITCHEN - 41" UPPER CABINETRY			
15Oct18 Note:	Revised		

CERAMIC TILE

3 - MOEN MASON BATHROOM ACCESSORIES - CHROME	
TISSUE HOLDER-#YB8099/YB8000	
TOWEL RING - #YB8086	
24" TOWEL BAR - #YB8094 / YB8000	
15Oct18 Note:	

CONSTRUCTION

I - BEDROOM - SMOOTH CEILING	
15Oct18 Note:	

COUNTER TOP

I - KITCHEN - FULL HEIGHT QUARTZ BACKSPLASH	
15Oct18 Note:	
I - BATHROOM - HIGH-END QUARTZ COUNTERTOP IN LIEU OF STANDARD AS PER OFFER	
15Oct18 Note:	
I - KITCHEN - HIGH-END QUARTZ COUNTERTOP IN LIEU OF STANDARD AS PER OFFER	
15Oct18 Note:	

PLUMBING

I - BATHROOM - DELETE STANDARD WHITE CERAMIC BATH ACCESSORIES - DO NOT INSTALL SOAP DISH, TOWEL RACK OR TISSUE HOLDERS	
15Oct18 Note:	

PROMOTIONAL

I - LESS CREDIT FROM PURCHASERS EXTRA SHEET IN OFFER	
15Oct18 Note:	

EXTRAS AS PER OFFER

The Vendor agrees that notwithstanding any other term or provision in this Agreement included in the Purchase Price and in addition to those items detailed in Schedule D to the Agreement of Purchase and Sale, the Purchaser is entitled to a credit of Fiv Worksheet Note:	
---	--

This Document is Extremely Time Sensitive - Printed 5 Mar 20 at 11:20

Purchaser: Daniel MEDEIROS

Telephone Res. / Bus: (416) 858-0968 /

Decor Advisor: Candace Forza

Lock Date: 10/15/2018 14:56:50

Const. No.: Unit 6, Level 10

Municipal: 1107

Suite Type: B592

Project/Phase: Petaluma Building Corp./1

Layout Changes: ☒ Yes ☐ NoSketch Attached: ☐ Yes ☒ No

Exterior Colour Scheme:

1. Kitchen and Vanities

	Style and Colour	Counter	Hardware
Kitchen / Breakfast	SEE BELOW	QUARTZ-FROSTY CARRARA-STRAIGHT POLISHED EDGE	STD
Main Bath	DORAL H3081-HACIENDA BLACK	QUARTZ-FROSTY CARRARA-STRAIGHT POLISHED EDGE	STD
Master Ensuite Bathroom	N/A	N/A	N/A

Appliances:

Built In Appliances ☒ Yes ☐ No41" Upper Cabinets ☒ Yes ☐ NoSlide In Stove ☐ Yes ☒ No

Comment

KITCHEN CABINETRY - BASE DORAL H3081-HACIENDA BLACK *** UPPERS SENOSAN LIGHT GREY

2. Flooring

		Grout-If App.	At a 45
Entrance Vestibule	STRIP-MIRAGE-LOCK-RED OAK-CASHMERE-GRAPHITE-4 5/16"		
Main Hall	STRIP-MIRAGE-LOCK-RED OAK-CASHMERE-GRAPHITE-4 5/16"		
Kitchen / Breakfast	STRIP-MIRAGE-LOCK-RED OAK-CASHMERE-GRAPHITE-4 5/16"		
Laundry Room	TILE-LIFE ICE-12X24	STANDARD	
Main Bath	TILE-LIFE ICE-12X24	STANDARD	
Master Ensuite Bathroom	N/A		
	N/A		
Living Room	STRIP-MIRAGE-LOCK-RED OAK-CASHMERE-GRAPHITE-4 5/16"		
Dining Room	STRIP-MIRAGE-LOCK-RED OAK-CASHMERE-GRAPHITE-4 5/16"		
Den / Library / Study	N/A		
Master Bedroom	STRIP-MIRAGE-LOCK-RED OAK-CASHMERE-GRAPHITE-4 5/16"		
Bedroom #2	N/A		
Bedroom #3	N/A		

Comment

3. Wall Tile

	Selection	Grout	Describe
Main Bath			
Tub Deck Wall	N/A		
Shower Stall	N/A		
Bathtub Enclosure Walls	TILE-GLOSSY WHITE-3X6	STANDARD	
Master Ensuite Bathroom			
Tub Deck Wall	N/A		
Shower Stall	N/A		
Bathtub Enclosure Walls	N/A		
Kitchen Backsplash	QUARTZ-FROSTY CARRARA		
Backsplash Behind Fridge	N/A		

Comment

** Refer to Construction Summary

4. Misc

Water Line for Fridge

N/A

Interior Door Handles

AS PER CONSTRUCTION SPECS

Ceramic Bathroom Accessories

NO - MOEN MASON UPGRADE

Comment

☐ Yes ☒ No

Purchaser: Daniel MEDEIROS
Telephone Res. / Bus: (416) 858-0968 /
Decor Advisor: Candace Forza
Lock Date: 10/15/2018 14:56:50

Const. No.: Unit 6, Level 10
Municipal: 1107
Suite Type: B592
Project/Phase: Petaluma Building Corp./1

5. Plaster Mouldings and Medallions

Entrance Vestibule	N/A	Living Room	N/A
Main Hall	N/A	Dining Room	N/A
Kitchen/Breakfast	N/A	Den / Library /Study	N/A
Laundry Room	N/A	Master BedRoom	N/A
Main Bath	N/A	BedRoom #2	N/A
Master Ensuite Bathroom	N/A	BedRoom #3	N/A

Comment

** Refer to Construction Summary

6. Wall Paint

Entrance Vestibule	43- BIRCH WHITE	Living Room	43- BIRCH WHITE
Main Hall	43- BIRCH WHITE	Dining Room	43- BIRCH WHITE
Kitchen / Breakfast	43- BIRCH WHITE	Den/Library	N/A
Laundry Room	43- BIRCH WHITE	Master Bedroom	43- BIRCH WHITE
Main Bath	43- BIRCH WHITE	Bedroom #2	N/A
Master Ensuite	N/A	Bedroom #3	N/A

Comment

7. General Comments

** Refer to Construction Summary

Disclaimers and Notes

- Colours of all materials are as close as possible to builder's selection, but not necessarily identical due to variances in manufacturing.
- Any extras listed above are null and void unless accompanied by a separate invoice/amendment. Said invoice must be paid in full.
- The Purchaser agrees that this colour selection is final and that no changes will be permitted, unless required by the Vendor.
- The Purchaser acknowledges reading and accepting document which contains other miscellaneous disclaimers.

Signature: 

Date: 10/15/18

Signature: _____

Date: _____

Initial: _____

Page 2 of 2

Mason™

Traditional | Transitional | Modern

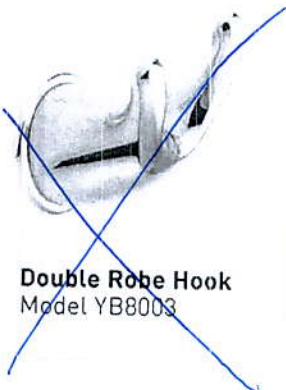

Double Robe Hook
Model YB8003



Paper Holder
Model YB8099 / YB8000
Chrome

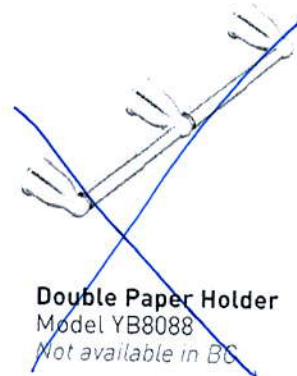

Double Paper Holder
Model YB8088
Not available in BC



Towel Ring
Model YB8086
Chrome



18" Towel Bar
Model YB8098 / YB8000



24" Towel Bar
Model YB8094 / YB8000
Chrome

PRO+FIT™
INSTALLATION SYSTEM

FINISH OPTIONS:

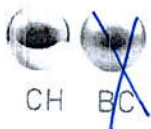

To order, combine the model number with one of these finish letter(s):
Chrome (CH) & Brushed Chrome (BC).

SCHEDULE 'A'

330

RICHMOND

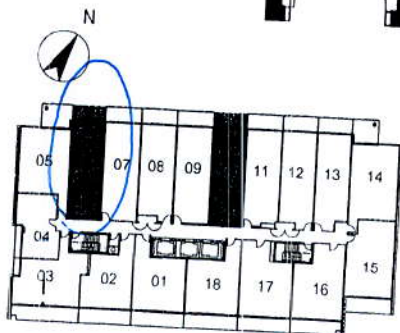
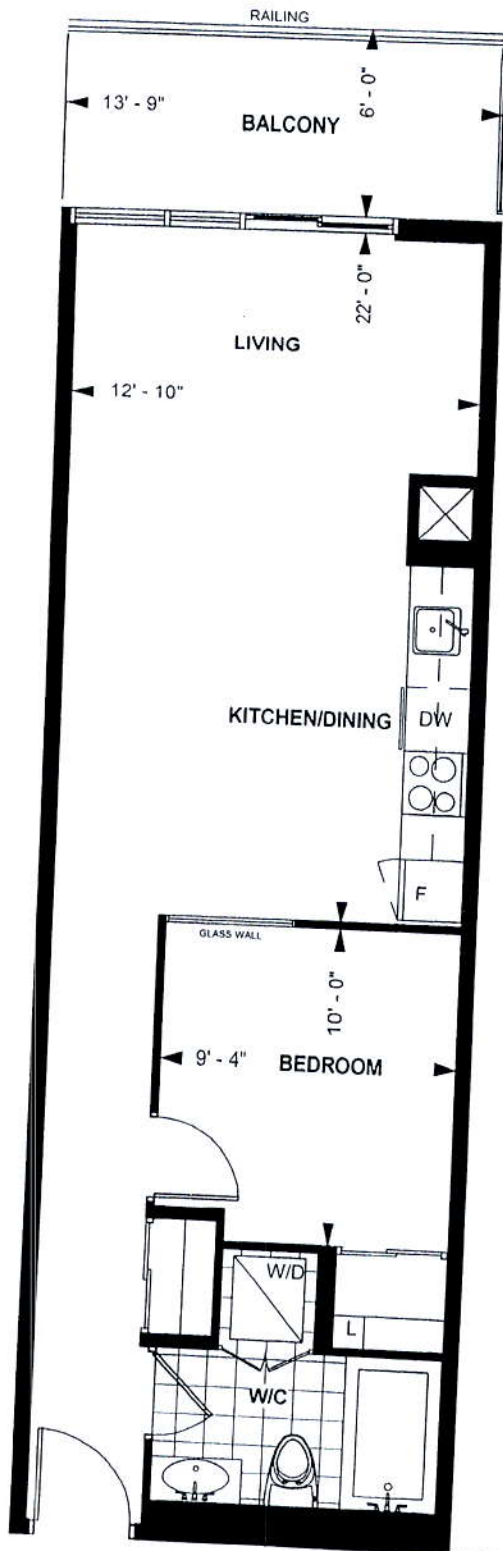

LEVEL 10

TOWER SUITE

B 592

9' CEILING *

592 sq. ft.

1-BEDROOM

Purchaser Initials _____ Purchaser Initials _____

Date _____

Unit No. 6 Level No. 10 Suite No. 1107

Dimensions, specification, tile floor pattern and architectural detailing (including window size and location) are approximate and subject to modifications without notice. Orientation of suite may vary from the stated floor area.
*Ceiling height measured from top of floor slab to underside of slab above before finishes, and excluding bulkheads and required drop ceilings. E.&O.E.

REVISED

DATE: MAR 05 2020

39" uppers
~~41" uppers~~

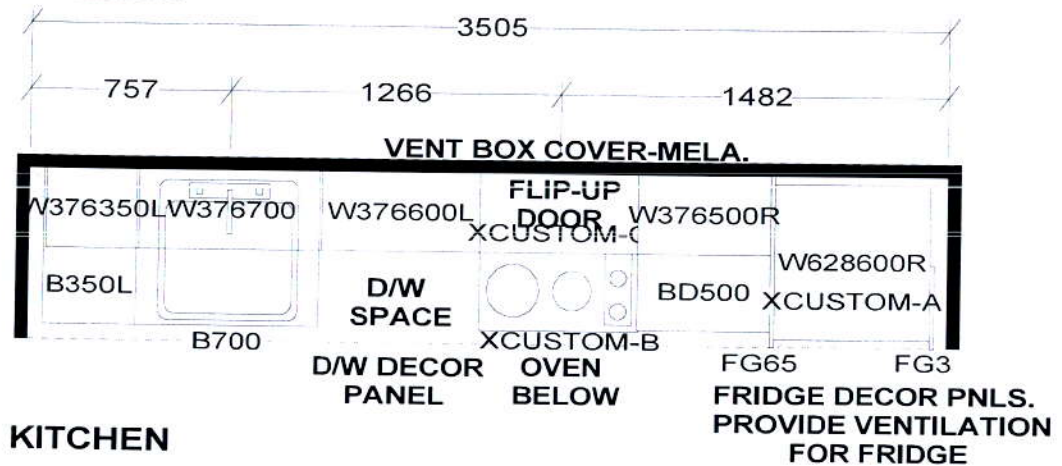

KITCHEN

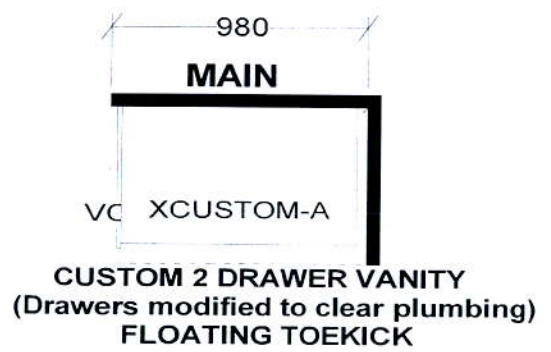

KITCHEN BASES & VANITIES INSTALLED WITH ADJUSTABLE LEGS

- APPLIANCE PACKAGE:
24" INTEGRATED FRIDGE W/ DECOR PNLS
24" INTEGRATED DISHWASHER W/ DECOR PNL
24" BUILT-IN OVEN
24" COOKTOP
24" MICROWAVE HOOD FAN

Selba Industries

WDTH _____ W HGHT _____ W CNT _____ FL HGHT _____ DWY H _____ ST CENT _____ 2X4 _____ VENT BOX COVER _____

- TOWER SUITES:
760MM HIGH UPPER CABINETS
WHITE STEEL DRAWER BOXES
COUNTERTOPS BY OTHERS
VENT BOX COVERS
CUSTOM VANITIES

This drawing is the intellectual property of SELBA INDUSTRIES INC. and is an original design which must not be released or copied unless applicable fee has been paid or job order placed.



JOB NUMBER:
BUILDER: GREENPARK
SITE NAME: PETALUMA
MODEL: 1 BEDROOM-B 592, B 609, B 635
LOT #:
DESIGNER: KS
DATE: JAN 8 18