

CONSTRUCTION SUMMARY
330 Richmond - Petaluma Building Corp.

DATE: NOV 19 2019

PURCHASER: Bijan TOUFIGHI TEL: RES.: 647-633-9141

Unit 5, Level 9 (1006-1)	Floor Plan C702		
--------------------------	--------------------	--	--

CABINETRY

1 - KITCHEN - 41" UPPER CABINETRY 08Nov18 Note:	
----------------------------------------------------	--

CABINETRY ACCESSORIES

1 - KITCHEN - ISLAND DEPTH REDUCED - SEE SKETCH FOR UPDATED ISLAND DESIGN 29Oct19 Note:	RECEIVED NOV 19 2019 NEW
1 - KITCHEN - ADD APPROX 5' ISLAND WITH OVERHANG 08Nov18 Note:	

CERAMIC TILE

1 - BATHROOM - DELETE STANDARD WHITE CERAMIC ACCESSORIES - DO NOT INSTALL SOAP DISH, TOWEL RACK OR TISSUE HOLDER 08Nov18 Note:	
-----------------------------------------------------------------------------------------------------------------------------------	--

CONSTRUCTION

1 - BEDROOM - SMOOTH CEILING 08Nov18 Note:	
-----------------------------------------------	--

COUNTER TOP

1 - BATHROOM - HIGH-END QUARTZ COUNTERTOP IN LIEU OF STANDARD AS PER OFFER 08Nov18 Note:	
1 - KITCHEN - HIGH-END QUARTZ COUNTERTOP IN LIEU OF STANDARD AS PER OFFER 08Nov18 Note:	

HARDWOOD FLOORING

1 - THROUGHOUT - STANDARD NON-TILED AREAS - UPGRADE 2 HARDWOOD FLOORING 08Nov18 Note:	
------------------------------------------------------------------------------------------	--

PLUMBING

3 - BATHROOM - MOEN MASON BATHROOM ACCESSORIES - CHROME TISSUE HOLDER-#YB8099/YB8000 TOWEL RING - #YB8086 24" TOWEL BAR - #YB8094 / YB8000 08Nov18 Note:	
----------------------------------------------------------------------------------------------------------------------------------------------------------------------	--

PROMOTIONAL

1 - FURTHER DISCOUNT AS PER VENDOR 08Nov18 Note:	
1 - LESS CREDIT FROM PURCHASERS EXTRA SHEET IN OFFER 08Nov18 Note:	

EXTRAS AS PER OFFER

The Vendor agrees that notwithstanding any other term or provision in this Agreement included in the Purchase Price and in addition to those items detailed in Schedule D to the Agreement of Purchase and Sale, the Purchaser is entitled to a credit of Five Worksheet Note:	
-----------------------------------------------------------------------------------------------------------------------------------------------------------------------------------------------------------------------------------------------------------------------------------	--

Purchaser:

Telephone Res. / Bus:

Decor Advisor:

Lock Date:

~~Mario Anthony ILARI~~

~~(647) 404-8872~~

Candace Forza

11/8/2018 16:25:04

Const. No.:

Municipal:

Suite Type:

Project/Phase:

Unit 5, Level 9

1006

C702

Petaluma Building Corp./1

Layout Changes:

Sketch Attached:

Exterior Colour Scheme:

☐ Yes ☒ No

☒ Yes ☐ No

1. Kitchen and Vanities	Style and Colour	Counter	Hardware
Kitchen / Breakfast	SEE BELOW	QUARTZ-FROSTY CARRARA-STRAIGHT POLISHED	STD
Main Bath	DORAL H3078-HACIENDA WHITE	QUARTZ-FROSTY CARRARA-STRAIGHT POLISHED	STD
Master Ensuite Bathroom	N/A	N/A	N/A

Appliances:

Built In Appliances

41" Upper Cabinets

Slide In Stove

☒ Yes ☐ No

☒ Yes ☐ No

☐ Yes ☒ No

Comment

KITCHEN - CABINETRY - BASE DORAL H3078-HACIENDA WHITE *** UPPERS - SENOSAN WHITE

2. Flooring		Grout-If App.	At a 45
Entrance Vestibule	STRIP-MIRAGE-LOCK-SWEET MEMORIES--RED OAK-CASHMERE-GELATO-4 5/16"		
Main Hall	STRIP-MIRAGE-LOCK-SWEET MEMORIES--RED OAK-CASHMERE-GELATO-4 5/16"		
Kitchen / Breakfast	STRIP-MIRAGE-LOCK-SWEET MEMORIES--RED OAK-CASHMERE-GELATO-4 5/16"		
Laundry Room	TILE-WHITE-8X8	STANDARD	
Main Bath	TILE-LIFE SILVER-12X24	STANDARD	
Master Ensuite Bathroom	N/A		
	N/A		
Living Room	STRIP-MIRAGE-LOCK-SWEET MEMORIES--RED OAK-CASHMERE-GELATO-4 5/16"		
Dining Room	STRIP-MIRAGE-LOCK-SWEET MEMORIES--RED OAK-CASHMERE-GELATO-4 5/16"		
Den / Library / Study	STRIP-MIRAGE-LOCK-SWEET MEMORIES--RED OAK-CASHMERE-GELATO-4 5/16"		
Master Bedroom	STRIP-MIRAGE-LOCK-SWEET MEMORIES--RED OAK-CASHMERE-GELATO-4 5/16"		
Bedroom #2	N/A		
Bedroom #3	N/A		

Comment

3. Wall Tile	Selection	Grout	Describe
Main Bath			
	Tub Deck Wall N/A		
	Shower Stall N/A		
Bathtub Enclosure Walls	TILE-GLOSSY WHITE-3X6	STANDARD	
Master Ensuite Bathroom			
	Tub Deck Wall N/A		
	Shower Stall N/A		
Bathtub Enclosure Walls	N/A		
Kitchen Backsplash	BACK PAINTED GLASS-BM-#OC-16	STANDARD	
Backsplash Behind Fridge	N/A		

Comment

** Refer to Construction Summary

4. Misc	
Water Line for Fridge	N/A
Interior Door Handles	AS PER CONSTRUCTION SPECS
Ceramic Bathroom Accessories	NO - UPGRADED -MOEN MASON
Comment	

Purchaser:

Telephone Res. / Bus:

Decor Advisor:

Lock Date:

Marie Anthony ILART

~~(647) 404-8872 /~~

Candace Forza

11/8/2018 16:25:04

Const. No.: Unit 5, Level 9

Municipal: 1006

Suite Type: C702

Project/Phase: Petaluma Building Corp./1

5. Plaster Mouldings and Medallions

Entrance Vestibule	N/A	Living Room	N/A
Main Hall	N/A	Dining Room	N/A
Kitchen/Breakfast	N/A	Den / Library /Study	N/A
Laundry Room	N/A	Master BedRoom	N/A
Main Bath	N/A	BedRoom #2	N/A
Master Ensuite Bathroom	N/A	BedRoom #3	N/A

Comment

** Refer to Construction Summary

6. Wall Paint

Entrance Vestibule	43 - BIRCH WHITE	Living Room	43 - BIRCH WHITE
Main Hall	43 - BIRCH WHITE	Dining Room	43 - BIRCH WHITE
Kitchen / Breakfast	43 - BIRCH WHITE	Den/Library	43 - BIRCH WHITE
Laundry Room	43 - BIRCH WHITE	Master Bedroom	43 - BIRCH WHITE
Main Bath	43 - BIRCH WHITE	Bedroom #2	N/A
Master Ensuite	N/A	Bedroom #3	N/A
	N/A		

Comment

7. General Comments

** Refer to Construction Summary

Disclaimers and Notes

- 1)

Colours of all materials are as close as possible to builder's selection, but not necessarily identical due to variances in manufacturing.
- 2)

Any extras listed above are null and void unless accompanied by a separate invoice/amendment. Said invoice must be paid in full.
- 3)

The Purchaser agrees that this colour selection is final and that no changes will be permitted, unless required by the Vendor.
- 4)

The Purchaser acknowledges reading and accepting document which contains other miscellaneous disclaimers.

Signature:

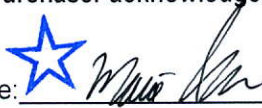

Date: Nov. 8/18

Signature:

Date:

Initial:

Page 2 of 2

Mason™

Traditional | Transitional | Modern

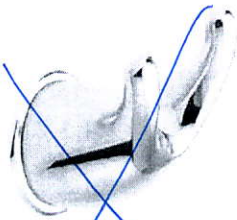

Double Robe Hook
Model YB8003

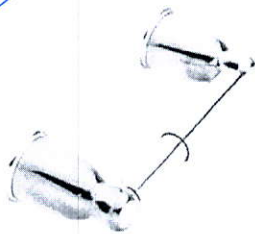

Paper Holder
Model YB8099 / YB8000
Chrome

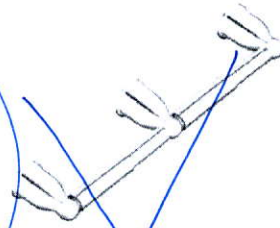

Double Paper Holder
Model YB8088
Not available in BC



Towel Ring
Model YB8086
Chrome



18" Towel Bar
Model YB8098 / YB8000

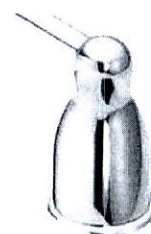

24" Towel Bar
Model YB8094 / YB8000
Chrome

PRO+FIT™
INSTALLATION SYSTEM

FINISH OPTIONS:

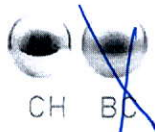

To order, combine the model number with one of these finish letter(s):
Chrome (CH) & Brushed Chrome (BC).

SCHEDULE 'A'

330

RICHMOND

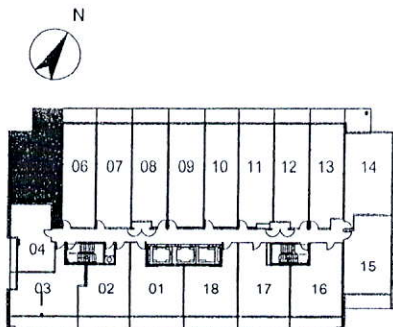
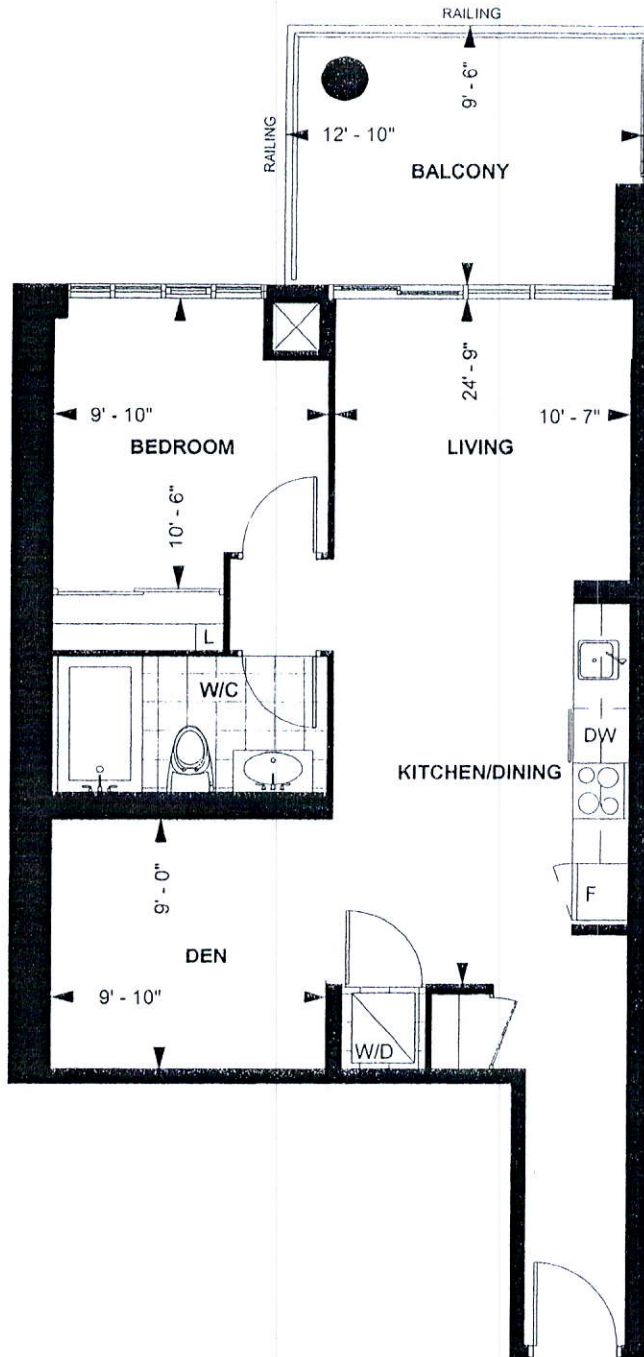

LEVEL 5-9

TOWER SUITE
C 702
9' CEILING *

702 sq. ft.

1-BEDROOM PLUS DEN

Purchaser Initials Purchaser Initials

Date

Unit No. 5 Level No. 9 Suite No. 1006

Dimensions, specification, tile floor pattern and architectural detailing (including window size and location) are approximate and subject to modifications without notice. Orientation of suite may vary from the stated floor area.

*Ceiling height measured from top of floor slab to underside of slab above before finishes, and excluding bulkheads and required drop ceilings. E.&O.E.

FILE NAME
GLOSS CONDO 1006 Y

THIS LAYOUT CONTAINS EXTRAS
THAT ARE NOT PART OF CONTRACT

PROTOTYPE
FOR EXTRAS

PAULINE
OCT 21 19

REVISED
DATE: NOV 19 2019

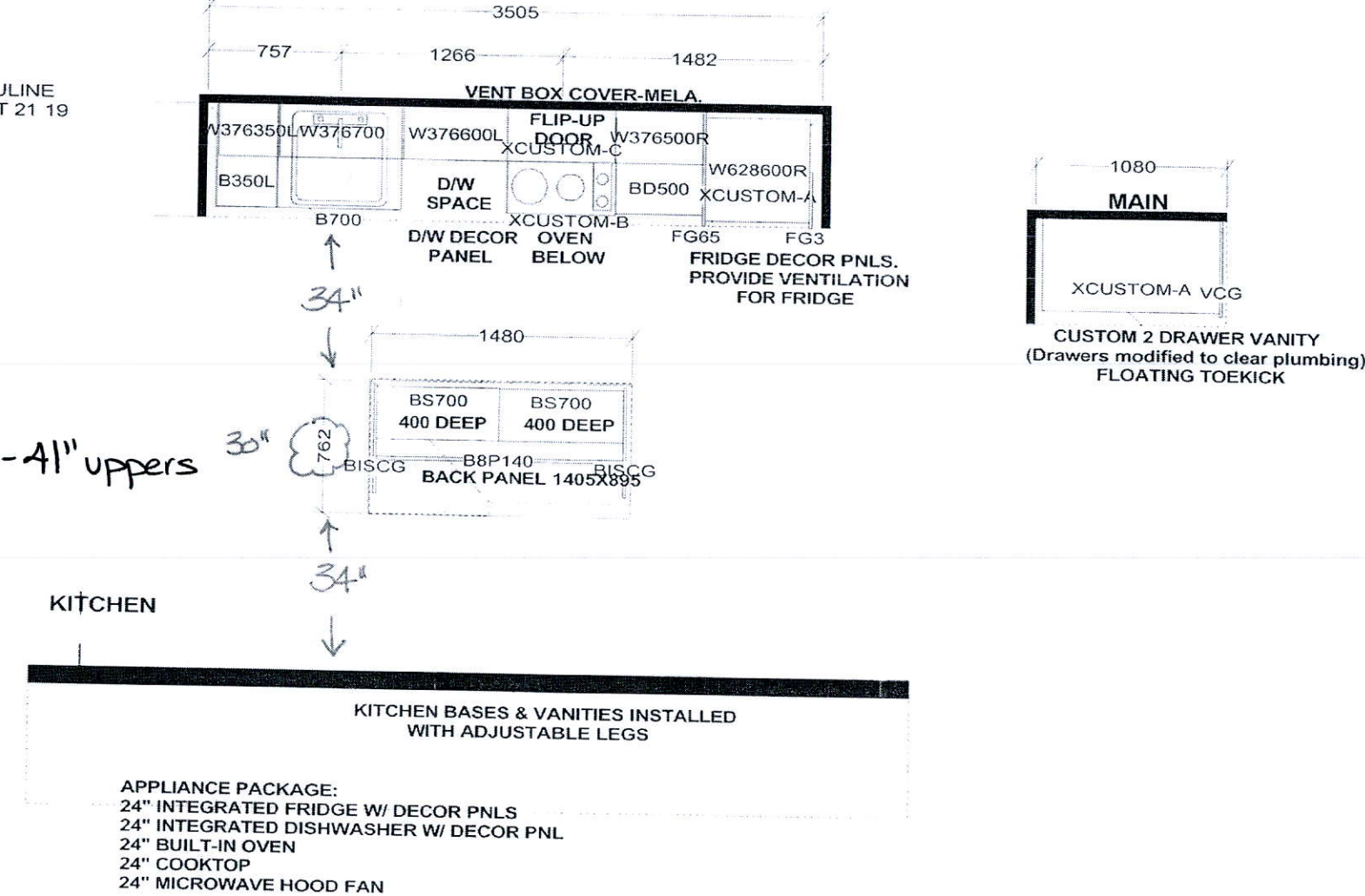

Selba Industries						
W W D T H	W H G H T	W C N T	FL H G H T	D W Y H	S T C E N T	2 X 4 V E N T B O X C O V E R
TOWER SUITES: 760MM HIGH UPPER CABINETS WHITE STEEL DRAWER BOXES COUNTERTOPS BY OTHERS VENT BOX COVERS CUSTOM VANITIES			This drawing is the intellectual property of SELBA INDUSTRIES INC. and is an original design which must not be released or copied unless applicable fee has been paid or job order placed.			
			JAN 8 18			

REVISED RECEIVED

DATE: NOV 19 2019

1480

Approx.

762

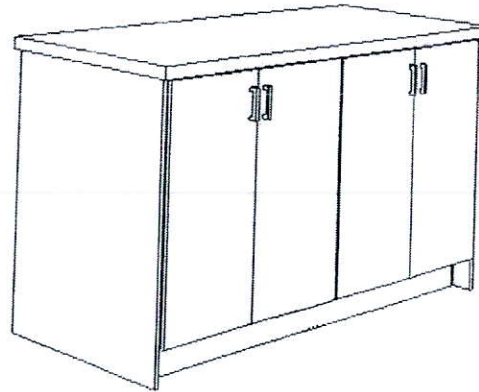

ISLAND
FRONT VIEW

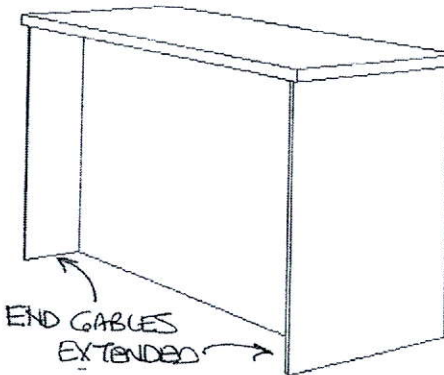

ISLAND
BACK VIEW

This drawing is the intellectual property of SELBA INDUSTRIES INC. and is an artistic interpretation of the general appearance of the design. It is not meant to be an exact rendition.

Selba

Kitchen - Bath Designs

762X1480 Drawing #: 1