

CONSTRUCTION SUMMARY

330 Richmond - Petaluma Building Corp.

DATE: NOV 05 2019

PURCHASER: Lori A. BENNETT

TEL: RES.: 416-357-1485 BUS.: 416-357-1485

Unit 14, Level 12 (1517-1)

Floor Plan
B597

CABINETRY

1 - BATHROOM - UTILITY CABINET ABOVE TOILET - DORAL CABINETRY

01Apr19 Note:

1 - KITCHEN - 41" UPPER CABINETRY

01Apr19 Note:

CABINETRY ACCESSORIES

1 - KITCHEN - BLU MOTION DRAWERS

01Apr19 Note: INCLUDES BANK OF DRAWERS AND 2 SETS OF POT AND PAN DRAWERS ON ISLAND

1 - KITCHEN - SOFT CLOSING CABINETRY

01Apr19 Note:

2 - KITCHEN - ADD POT AND PAN DRAWERS TO ISLAND

01Apr19 Note:

1 - KITCHEN - ADD APPROX 5' ISLAND - STANDARD CABINETRY & COUNTERTOP WITH FLUSH OVERHANG - UPGRADED EDGE

01Apr19 Note:

CERAMIC TILE

1 - BATHROOM - DELETE STANDARD WHITE CERAMIC BATHROOM ACCESSORIES- DO NOT INSTALL SOAP DISH, TOWEL RACK OR TISSUE HOLDER

01Apr19 Note:

1 - KITCHEN - MOSAIC BACKSPLASH

01Apr19 Note:

CONSTRUCTION

1 - BEDROOM - SMOOTH CEILING

01Apr19 Note:

COUNTER TOP

1 - BATHROOM - UPGRADED EDGE ON COUNTERTOP

01Apr19 Note:

1 - KITCHEN - UPGRADED EDGE ON COUNTERTOP

01Apr19 Note:

HARDWOOD FLOORING

1 - THROUGHOUT - STANDARD NON-TILED AREAS - UPGRADE 2 HARDWOOD IN LIEU OF STANDARD AS PER OFFER

01Apr19 Note:

MIRRORS AND GLASS

2 - FOYER & BEDROOM - FRAMELESS MIRROR SLIDING CLOSET DOORS WITH MIRROR FASCIA

01Apr19 Note:

PLUMBING

1 - BATHROOM - MOEN 90 DEGREE BATHROOM ACCESSORIES - CHROME

TOILET PAPER HOLDER #YB8808

TOWEL RING #YB8886

TOWEL BAR #YB8824

01Apr19 Note:

This Document is Extremely Time Sensitive - Printed 1 Apr 19 at 13:46

RECEIVED APR 08 2019

Purchaser: Lori A. BENNETT
Telephone Res. / Bus: (416) 357-1485 / (416) 357-1485
Decor Advisor: Candace Forza
Lock Date: 4/1/2019 01:46:16

Const. No.: Unit 14, Level 12
Municipal: 1517
Suite Type: B597
Project/Phase: Petaluma Building Corp./1

Layout Changes: ☐ Yes ☒ NoSketch Attached: ☒ Yes ☐ No

Exterior Colour Scheme:

1. Kitchen and Vanities

	Style and Colour	Counter	Hardware
Kitchen / Breakfast	SEE BELOW	QUARTZ-AMIATA-#360 EDGE	STD
Main Bath	DORAL H3081-HACIENDA BLACK	QUARTZ-AMIATA-#360 EDGE	STD
Master Ensuite Bathroom	N/A	N/A	N/A

Appliances:

Built In Appliances ☒ Yes ☐ No41" Upper Cabinets ☒ Yes ☐ NoSlide In Stove ☐ Yes ☒ No

Comment

KITCHEN - CABINETRY - BASE DORAL H3081-HACIENDA BLACK *** UPPERS - SENOSAN LIGHT GREY

2. Flooring

		Grout-If App.	At a 45
Entrance Vestibule	STRIP-MIRAGE-LOCK-MAPLE-CASHMERE-PEPPERMINT-4 5/16"		
Main Hall	STRIP-MIRAGE-LOCK-MAPLE-CASHMERE-PEPPERMINT-4 5/16"		
Kitchen / Breakfast	STRIP-MIRAGE-LOCK-MAPLE-CASHMERE-PEPPERMINT-4 5/16"		
Laundry Room	TILE-WHITE-8X8	STANDARD	
Main Bath	TILE-LIFE ICE-12X24	STANDARD	
Master Ensuite Bathroom	N/A		
	N/A		
Living Room	STRIP-MIRAGE-LOCK-MAPLE-CASHMERE-PEPPERMINT-4 5/16"		
Dining Room	STRIP-MIRAGE-LOCK-MAPLE-CASHMERE-PEPPERMINT-4 5/16"		
Den / Library / Study	N/A		
Master Bedroom	STRIP-MIRAGE-LOCK-MAPLE-CASHMERE-PEPPERMINT-4 5/16"		
Bedroom #2	N/A		
Bedroom #3	N/A		

Comment

REVISED

NOV 05 2019

DATE: _____

3. Wall Tile

	Selection	Grout	Describe
Main Bath			
Tub Deck Wall	N/A		
Shower Stall	N/A		
Bathtub Enclosure Walls	TILE-GLOSSY WHITE-3X6	STANDARD	
Master Ensuite Bathroom			
Tub Deck Wall	N/A		
Shower Stall	N/A		
Bathtub Enclosure Walls	N/A		
Kitchen Backsplash	TILE-ARISTONE WHITE(MB067B3-BP) 2"	STANDARD	13X13 SHEET
Backsplash Behind Fridge	N/A		

Comment

** Refer to Construction Summary

4. Misc

Water Line for Fridge N/A

Interior Door Handles AS PER CONSTRUCTION SPECS

Ceramic Bathroom Accessories NO - UPGRADED- MOEN 90 DEGREE ☐ Yes ☒ No

Comment

Purchaser: Lori A. BENNETT
Telephone Res. / Bus: (416) 357-1485 / (416) 357-1485
Decor Advisor: Candace Forza
Lock Date: 4/1/2019 13:46:16

Const. No.: Unit 14, Level 12
Municipal: 1517
Suite Type: B597
Project/Phase: Petaluma Building Corp./1

5. Plaster Mouldings and Medallions

Entrance Vestibule	N/A		Living Room	N/A	
Main Hall	N/A		Dining Room	N/A	
Kitchen/Breakfast	N/A		Den / Library /Study	N/A	
Laundry Room	N/A		Master BedRoom	N/A	
Main Bath	N/A		BedRoom #2	N/A	
Master Ensuite Bathroom	N/A		BedRoom #3	N/A	
	N/A				

Comment

** Refer to Construction Summary

6. Wall Paint

Entrance Vestibule	43 - BIRCH WHITE	Living Room	43 - BIRCH WHITE
Main Hall	43 - BIRCH WHITE	Dining Room	43 - BIRCH WHITE
Kitchen / Breakfast	43 - BIRCH WHITE	Den/Library	N/A
Laundry Room	43 - BIRCH WHITE	Master Bedroom	43 - BIRCH WHITE
Main Bath	43 - BIRCH WHITE	Bedroom #2	N/A
Master Ensuite	N/A	Bedroom #3	N/A
	N/A		

Comment

7. General Comments

** Refer to Construction Summary

Disclaimers and Notes

- Colours of all materials are as close as possible to builder's selection, but not necessarily identical due to variances in manufacturing.
- Any extras listed above are null and void unless accompanied by a separate invoice/amendment. Said invoice must be paid in full.
- The Purchaser agrees that this colour selection is final and that no changes will be permitted, unless required by the Vendor.
- The Purchaser acknowledges reading and accepting document which contains other miscellaneous disclaimers.

Signature:  _____ Date: _____ Signature: _____ Date: _____

Initial: _____

90°™

Traditional | Transitional | Modern

Geometric forms, squared corners and straight lines create an urban focal point for today's contemporary baths.

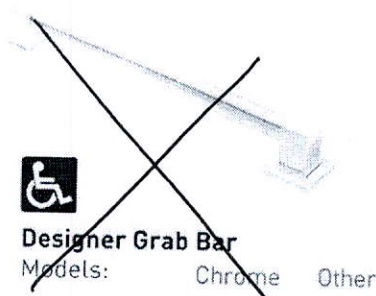
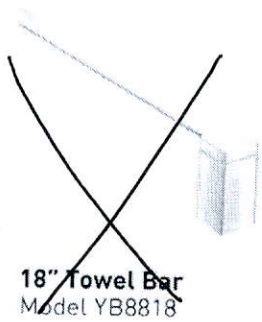
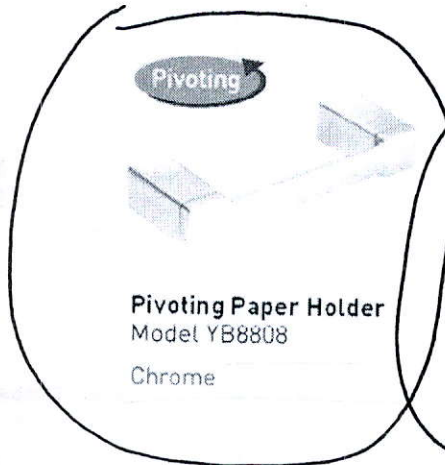
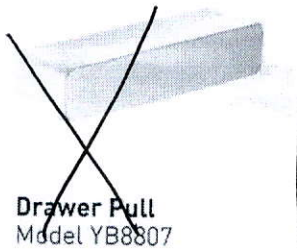
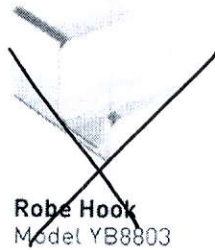

FINISH OPTIONS:



To order, combine the model number with one of these finish letter(s):
Chrome (CH), LifeShine® Brushed Nickel (BN).

SCHEDULE 'A'

330

RICHMOND

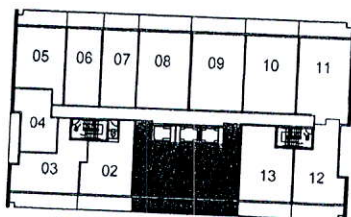
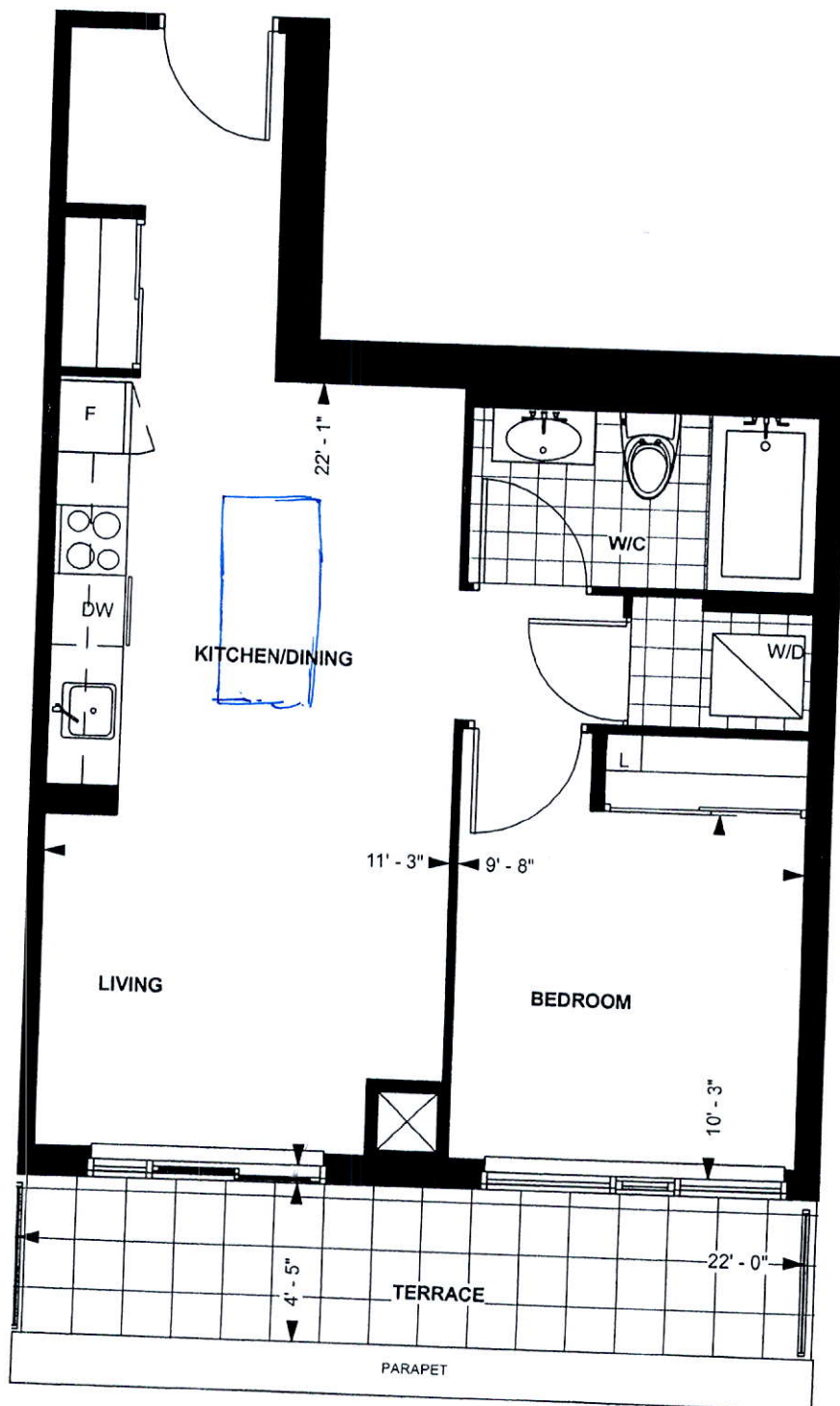

LEVEL 12

TOWER SUITE

B 597

9' CEILING *

597 sq. ft.

1-BEDROOM

JB

Purchaser Initials Purchaser Initials

Feb 17, 2016

Date

Unit No. 14 Level No. 12 Suite No. 1517

Dimensions, specification, tile floor pattern and architectural detailing (including window size and location) are approximate and subject to modifications without notice. Orientation of suite may vary from the stated floor area.
*Ceiling height measured from top of floor slab to underside of slab above before finishes, and excluding bulkheads and required drop ceilings. E.&O.E.

Island

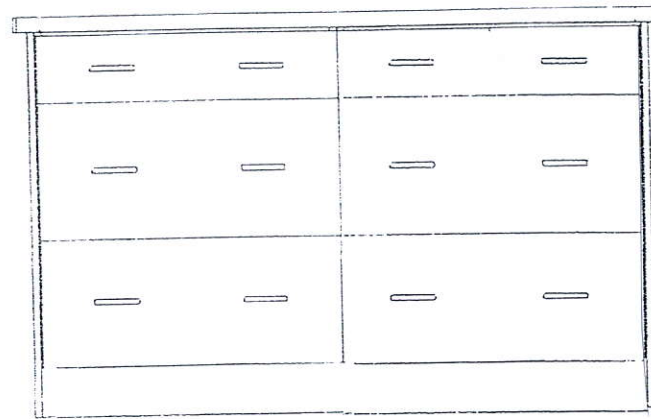

This drawing is the intellectual property of SELBA INDUSTRIES INC. and is an artistic interpretation of the general appearance of the design. It is not meant to be an exact rendition.

Selba
Kitchen + Bath Designs

Designed: 9/4/2018
Printed: 9/4/2018

ISLAND -
330 RICHMOND UNIT 516.kit 330 RICHMOND UNIT 516.kit Drawing #. 1

FILE NAME:
GLOSS CONDO ~~17/18~~

*Up. countertop Edge in
Kitchen + Bath

PROTOTYPE FOR EXTRAS

SEP 4 18 FB

THIS LAYOUT CONTAINS EXTRA
THAT ARE NOT PART OF CONTRACT

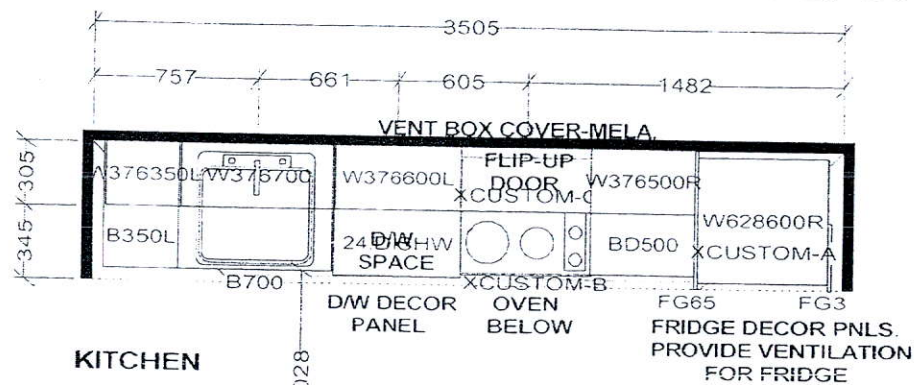

KITCHEN

- 41" uppers
- Soft close
- Blu Motion

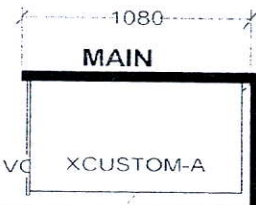
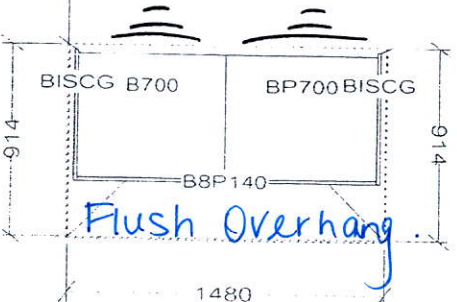

* Utility Cabinet

CUSTOM 2 DRAWER VANITY
(Drawers modified to clear plumbing)
FLOATING TOEKICK

APPLIANCE PACKAGE:
24" INTEGRATED FRIDGE W/ DECOR PNLS
24" INTEGRATED DISHWASHER W/ DECOR PNL
24" BUILT-IN OVEN
24" COOKTOP
24" MICROWAVE HOOD FAN

KITCHEN BASES & VANITIES INSTALLED
WITH ADJUSTABLE LEGS

Selba Industries

W W DTH	W H GHT	W C N T	FL H GHT	D W Y H	S T C E N T	2 X 4	V E N T B O X C O V E R
TOWER SUITES: 760MM HIGH UPPER CABINETS WHITE STEEL DRAWER BOXES COUNTERTOPS BY OTHERS VENT BOX COVERS CUSTOM VANITIES			This drawing is the intellectual property of SELBA INDUSTRIES INC. and is an original design which must not be released or copied unless applicable fee has been paid or job order placed.				JOB NUMBER: BUILDER: GREENPARK SITE NAME: PETALUMA MODEL: 1 BEDROOM - B 583, B 597 LOT #: 17/18 DESIGNER: KS DATE: JAN 8 18

