

CONSTRUCTION SUMMARY  
330 Richmond - Petaluma Building Corp.

DATE: NOV 04 2019

TEL: RES.: 647-393-9545

PURCHASERS: Houssam GHANDOUR and Lana Feisal CAPTAN

Unit 5, Level 8 (906-1)

Floor Plan  
C702

CABINETRY

1 - KITCHEN - 41" UPPER CABINETRY  
08Nov18 Note:

CABINETRY ACCESSORIES

1 - KITCHEN - ISLAND DEPTH REDUCED - SEE SKETCH FOR UPDATED ISLAND DESIGN  
29Oct19 Note:

NEW

RECEIVED  
NOV 04 2019

1 - KITCHEN - ADD APPROX 5' ISLAND - STANDARD CABINETRY AND COUNTERTOP WITH OVERHANG  
08Nov18 Note:

CERAMIC TILE

1 - DELETE STANDARD WHITE CERAMIC BATHROOM ACCESSORIES - DO NOT INSTALL SOAP DISH, TOWEL RACK OR TISSUE HOLDER  
08Nov18 Note:

CONSTRUCTION

1 - MAIN BATH - 5 FOOT SHOWER WITH SLIDING CHROME FRAMED GLASS DOORS IN LIEU OF TUB  
13Dec17 Note:

DOORS AND TRIM

1 - BEDROOM - FRAMELESS MIRROR SLIDING CLOSET DOORS WITH MIRROR FASCIA  
08Nov18 Note:

MISCELLANEOUS

1 - COLOUR CHANGE ADMINISTRATION FEE  
08Nov18 Note:

PLUMBING

3 - BATHROOM - MOEN MASON BATHROOM ACCESSORIES - CHROME  
TISSUE HOLDER-#YB8099/YB8000  
TOWEL RING - #YB8086  
24" TOWEL BAR - #YB8094 / YB8000  
08Nov18 Note:

This Document is Extremely Time Sensitive - Printed 29 Oct 19 at 16:35

Purchasers: Houssam GHANDOUR & Lana Feisal CAPTAN

Const. No.: Unit 5, Level 8

Telephone Res. / Bus: (647) 393-9545 /

Municipal: 906

Decor Advisor: Candace Forza

Suite Type: C702

Lock Date: 11/8/2018 14:09:54

Project/Phase: Petaluma Building Corp./1

Layout Changes: ☐ Yes ☒ No

Sketch Attached: ☒ Yes ☐ No

Exterior Colour Scheme:

1. Kitchen and Vanities	Style and Colour	Counter	Hardware
Kitchen / Breakfast	SEE BELOW	QUARTZ-AMIATA-STRAIGHT POLISHED EDGE	STD
Main Bath	DORAL H3081-HACIENDA BLACK	QUARTZ-AMIATA-STRAIGHT POLISHED EDGE	STD
Master Ensuite Bathroom	N/A	N/A	N/A

Appliances:

Built In Appliances ☒ Yes ☐ No

41" Upper Cabinets ☒ Yes ☐ No

Slide In Stove ☐ Yes ☒ No

Comment

KITCHEN - CABINETRY - BASE DORAL H3081-HACIENDA BLACK \*\*\* UPPERS SENOSAN LIGHT GREY

2. Flooring		Grout-If App.	At a 45
Entrance Vestibule	STRIP-MIRAGE-LOCK-RED OAK-CASHMERE-GRAPHITE-4 5/16"		
Main Hall	STRIP-MIRAGE-LOCK-RED OAK-CASHMERE-GRAPHITE-4 5/16"		
Kitchen / Breakfast	STRIP-MIRAGE-LOCK-RED OAK-CASHMERE-GRAPHITE-4 5/16"		
Laundry Room	TILE-WHITE-8X8	STANDARD	
Main Bath	TILE-ASPEN BIANCO-12X24	STANDARD	
Master Ensuite Bathroom	N/A		
	N/A		
Living Room	STRIP-MIRAGE-LOCK-RED OAK-CASHMERE-GRAPHITE-4 5/16"		
Dining Room	STRIP-MIRAGE-LOCK-RED OAK-CASHMERE-GRAPHITE-4 5/16"		
Den / Library / Study	STRIP-MIRAGE-LOCK-RED OAK-CASHMERE-GRAPHITE-4 5/16"		
Master Bedroom	STRIP-MIRAGE-LOCK-RED OAK-CASHMERE-GRAPHITE-4 5/16"		
Bedroom #2	N/A		
Bedroom #3	N/A		

Comment

3. Wall Tile	Selection	Grout	Describe
Main Bath			
Tub Deck Wall	N/A		
Shower Stall	TILE-GLOSSY WHITE-3X6	STANDARD	
Bathtub Enclosure Walls	N/A		
Master Ensuite Bathroom			
Tub Deck Wall	N/A		
Shower Stall	N/A		
Bathtub Enclosure Walls	N/A		
Kitchen Backsplash	BACK PAINTED GLASS-BM #HC-170	STANDARD	
Backsplash Behind Fridge	N/A		

Comment

\*\* Refer to Construction Summary

4. Misc

Water Line for Fridge N/A

Interior Door Handles AS PER CONSTRUCTION SPECS

Ceramic Bathroom Accessories NO - UPGRADED- MOEN MASON ☐ Yes ☒ No

Comment



Purchasers:

Telephone Res. / Bus:

Decor Advisor:

Lock Date:

Houssam GHANDOUR & Lana Feisal CAPTAN

(647) 393-9545 /

Candace Forza

11/8/2018 14:09:54

Const. No.:

Municipal:

Suite Type:

Project/Phase:

Unit 5, Level 8

906

C702

Petaluma Building Corp./1

5. Plaster Mouldings and Medallions

Entrance Vestibule	N/A	Living Room	N/A
Main Hall	N/A	Dining Room	N/A
Kitchen/Breakfast	N/A	Den / Library /Study	N/A
Laundry Room	N/A	Master BedRoom	N/A
Main Bath	N/A	BedRoom #2	N/A
Master Ensuite Bathroom	N/A	BedRoom #3	N/A

Comment

\*\* Refer to Construction Summary

6. Wall Paint

Entrance Vestibule	43 - BIRCH WHITE	Living Room	43 - BIRCH WHITE
Main Hall	43 - BIRCH WHITE	Dining Room	43 - BIRCH WHITE
Kitchen / Breakfast	43 - BIRCH WHITE	Den/Library	43 - BIRCH WHITE
Laundry Room	43 - BIRCH WHITE	Master Bedroom	43 - BIRCH WHITE
Main Bath	43 - BIRCH WHITE	Bedroom #2	N/A
Master Ensuite	N/A	Bedroom #3	N/A
	N/A		

Comment

7. General Comments

\*\* Refer to Construction Summary

Disclaimers and Notes

- 1) Colours of all materials are as close as possible to builder's selection, but not necessarily identical due to variances in manufacturing.
- 2) Any extras listed above are null and void unless accompanied by a separate invoice/amendment. Said invoice must be paid in full.
- 3) The Purchaser agrees that this colour selection is final and that no changes will be permitted, unless required by the Vendor.
- 4) The Purchaser acknowledges reading and accepting document which contains other miscellaneous disclaimers.



Signature: \_\_\_\_\_

Date: \_\_\_\_\_

Signature: \_\_\_\_\_

Date: \_\_\_\_\_

Signature: \_\_\_\_\_

Initials: \_\_\_\_\_

Page 2 of 2

# Mason™

Traditional | Transitional | Modern

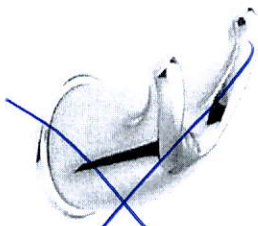

**Double Robe Hook**  
Model YB8003

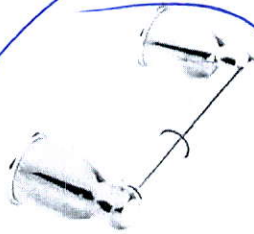

**Paper Holder**  
Model YB8099 / YB8000

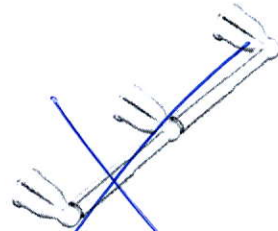

**Double Paper Holder**  
Model YB8088  
*Not available in BC*



**Towel Ring**  
Model YB8086

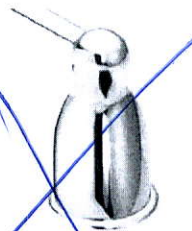

**18" Towel Bar**  
Model YB8098 / YB8000

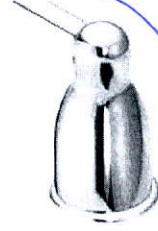

**24" Towel Bar**  
Model YB8094 / YB8000

**PRO-FIT™**  
INSTALLATION SYSTEM

## FINISH OPTIONS:

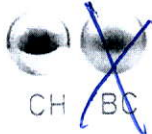

To order, combine the model number with one of these finish letter(s):  
Chrome (CH) & Brushed Chrome (BC).

# SCHEDULE 'A'

## 330

RICHMOND

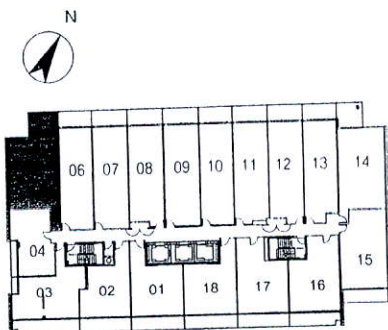
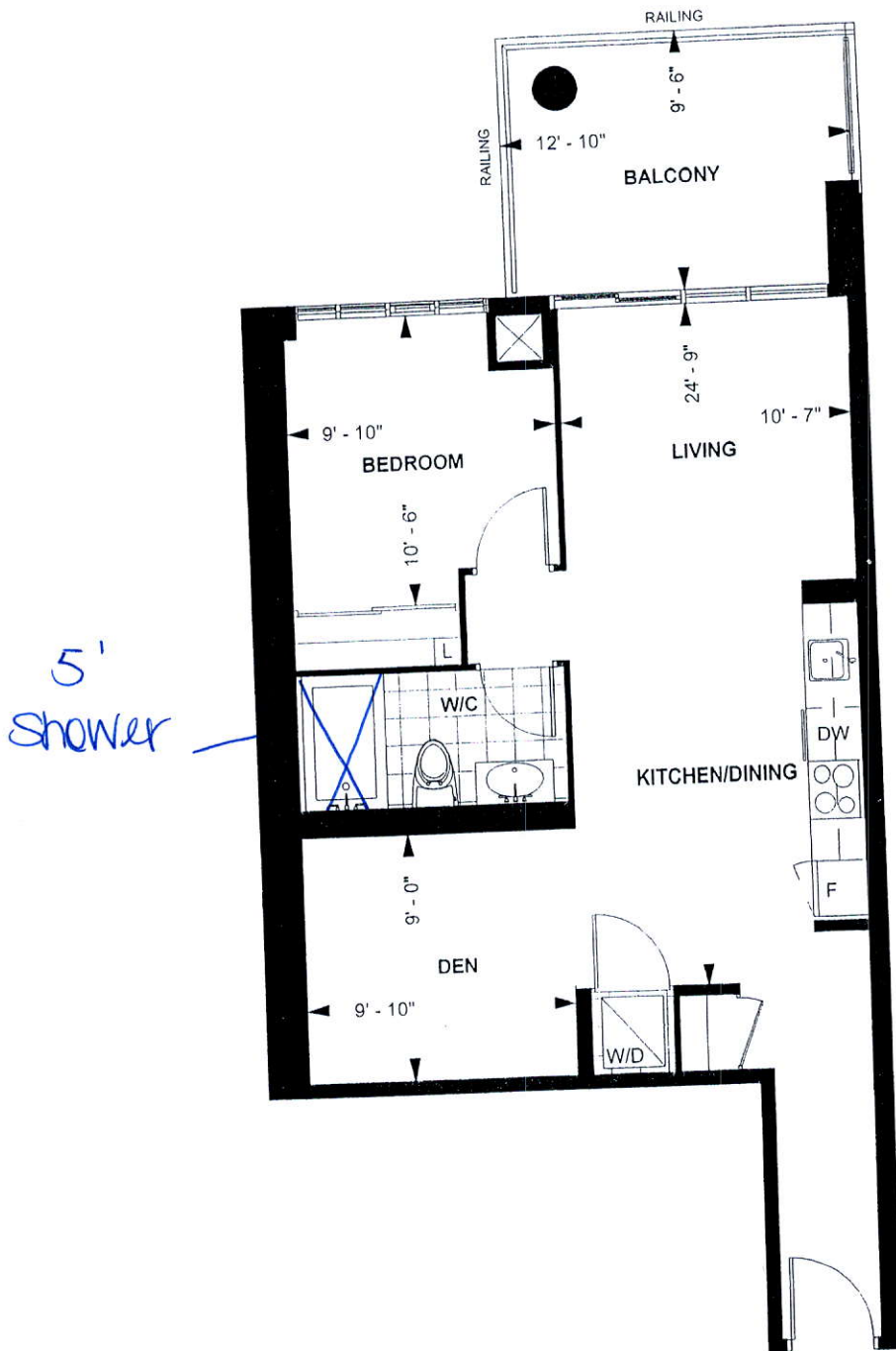

LEVEL 5 - 9

TOWER SUITE

C 702

9' CEILING \*

702 sq. ft.

1-BEDROOM PLUS DEN

Purchaser Initials Purchaser Initials

Date

Unit No. 5 Level No. 8 Suite No. 906

Dimensions, specification, tile floor pattern and architectural detailing (including window size and location) are approximate and subject to modifications without notice. Orientation of suite may vary from the stated floor area.

\*Ceiling height measured from top of floor slab to underside of slab above before finishes, and excluding bulkheads and required drop ceilings. E.&O.E.



FILE NAME  
GLOSS CONDO 906 Y

THIS LAYOUT CONTAINS EXTRAS  
THAT ARE NOT PART OF CONTRACT

PROTOTYPE  
FOR EXTRAS

PAULINE  
OCT 21 19

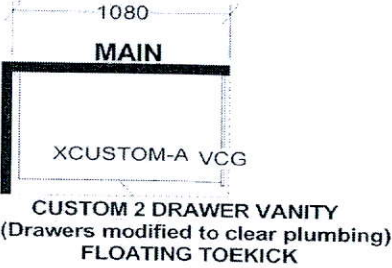
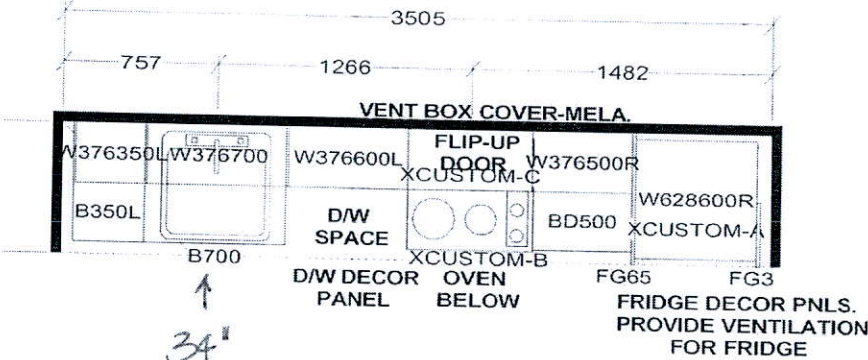

REVISED  
RECEIVED

DATE: NOV 04 2019

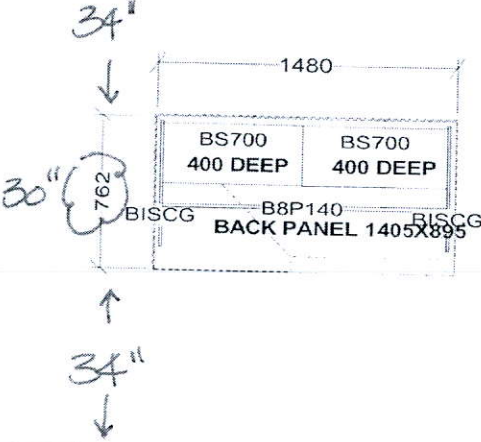

KITCHEN  
- 41" uppers

KITCHEN BASES & VANITIES INSTALLED  
WITH ADJUSTABLE LEGS

APPLIANCE PACKAGE:  
24" INTEGRATED FRIDGE W/ DECOR PNLS  
24" INTEGRATED DISHWASHER W/ DECOR PNL  
24" BUILT-IN OVEN  
24" COOKTOP  
24" MICROWAVE HOOD FAN

Selba Industries

W WDT	W HGHT	W CNT	FL HGHT	DWY H	ST CENT	2X4	VENT BOX COVER
TOWER SUITES: 760MM HIGH UPPER CABINETS WHITE STEEL DRAWER BOXES COUNTERTOPS BY OTHERS VENT BOX COVERS CUSTOM VANITIES				This drawing is the intellectual property of SELBA INDUSTRIES INC. and is an original design which must not be released or copied unless applicable fee has been paid or job order placed.		JOB NUMBER: BUILDER: GREENPARK SITE NAME: PETALUMA MODEL: 1 BEDROOM + DEN - C 683, C 702 LOT #: DESIGNER: KS DATE: JAN 8 18	

1480

Approx.

762

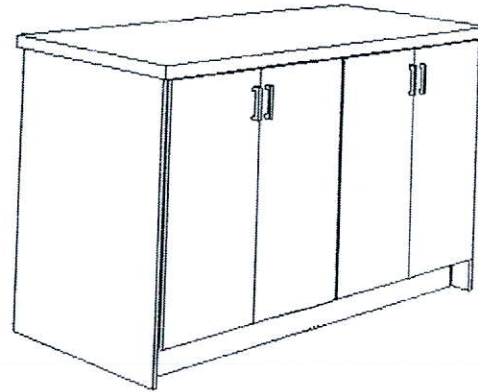

ISLAND  
FRONT VIEW

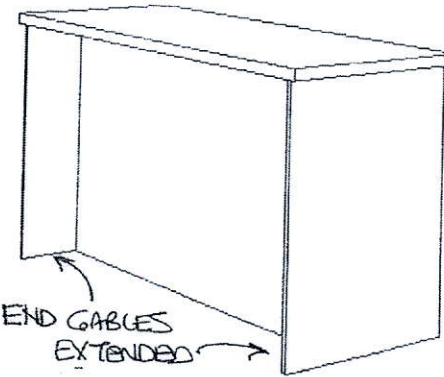

END CABLES  
EXTENDED

ISLAND  
BACK VIEW

RECEIVED  
NOV 04 2019

This drawing is the intellectual property of  
SELBA INDUSTRIES INC. and is an  
artistic interpretation of the general  
appearance of the design. It is not meant to  
be an exact rendition.

**Selba**  
Kitchen - Bath Designs

ISLAND 762X1480 Drawing #: 1

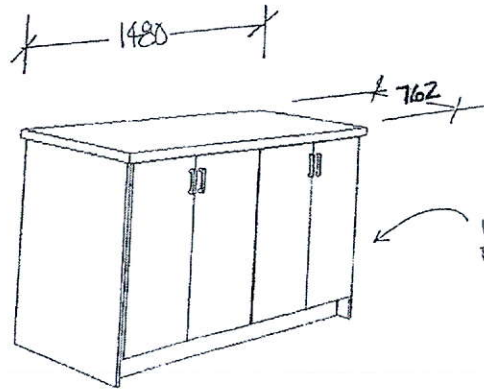

Approx.

ISLAND  
FRONT VIEW

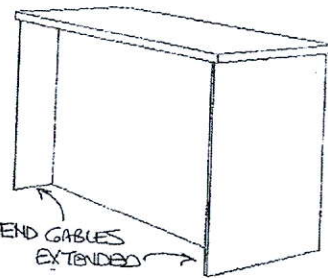

ISLAND  
BACK VIEW

RECEIVED  
NOV 04 2019

This drawing is the intellectual property of  
SELBA INDUSTRIES INC. and is an  
artistic interpretation of the general  
appearance of the design. It is not meant to  
be an exact rendition.

**Selba**  
Kitchen - Bath Designs

ISLAND 762X1480 Drawing #: 1



